



**DEPARTMENT OF NATURAL RESOURCES  
STATE OF MICHIGAN**

**TIMBER SALE PROSPECTUS #5573**

**REVISION NOTICE #2 - January 22, 2016**

**SCHEDULED SALE DATE AND TIME: 10:00 a.m. (local time) on Friday, February 12, 2016**

**LOCATION: GRAYLING MGMT UNIT, 1955 HARTWICK PINES ROAD, GRAYLING, MI 49738**

This prospectus whose original bid date, time and location are Friday, January 29, 2016 at 10:00 a.m. (local time) in the Grayling Office has been modified with the following changes.

All timber sales in this batch have received the following modifications to the specifications:

Specification 2.2.2 was modified to provide exceptions for chipping mandated by the military if the unit is able to obtain a written exception from the military. This is to provide flexibility with harvesting as long as lack of chipping does not negatively impact military operations.

Specification 8.3.1 was added to all sales specifying "In addition to cutting, all chipping must be completed by the contract expiration date. If chipping has not been completed, an extension fee or damages may be charged per General Condition & Requirement 7.2 and 8.3".

For Tank Trail Oak Sale we removed specification 2.2.2 as chipping is no longer required for this sale. We added specification 5.2.1 to manage slash if sale is not chipped.

The sale map for the TANK TRAIL OAK timber sale (72-617-14-01) has been updated. Please use the attached sale map when bidding on this sale and disregard the original sale map sent with the prospectus.

Bids for this prospectus are currently scheduled to be opened on Friday, February 12, 2016 at 10:00 a.m. (local time) in the Grayling Office.

We apologize for any inconvenience this may have caused. If you need assistance, please contact Susan Thiel at 989-348-6371 ext. 7440.



Sale Number	Year
72 - 617	14

### TIMBER SALE MAP

This information provided by authority of Part 525, 1994 PA 451, as amended.

Forest Management Unit	County	Mapped By	Date	Page	of
Grayling	Crawford	Scott Shooltz	09/30/2014	1	1
Cruised By					
Shooltz & Bartzen					

Township	Range	Section(s) and Subdivision(s)	Scale
27N	02W & 03W	Sec 31: S 1/2 NW Sec 36: SENE, NWSW	1:15,840

Cover Type				Density	
A = Aspen	H = Hemlock	N = Marsh	U = Upland Brush	0 = Non Stocked	5 = Pole Timber Medium
B = Paper Birch	J = Jack Pine	O = Oak	UM = Upland Mixed	1 = Seedling Sapling Poor	6 = Pole Timber Well
C = Cedar	L = Lowland Brush	P = Lowland Poplar	V = Bog or Marsh	2 = Seedling Sapling Medium	7 = Saw Timber Poor
D = Tread Bog	LM = Lowland Mkd	Q = Mixed Swamp Conifer	W = White Pine	3 = Seedling Sapling Well	8 = Saw Timber Medium
E = Swamp Hcwoods	M = Mpl. Bch, Brch	R = Red Pine	X = Non Stocked	4 = Pole Timber Poor	9 = Saw Timber Well
F = Spruce Fir	MC = Mixed Conifer	S = Black Spruce	Z = Water		
G = Grass	MD = Mixed Deciduous	T = Tamarack			

#### PU Stand Acres

2	4 & 27	19
1	30	5

## Tank Trail Oak

Compartment 257

24 Acres

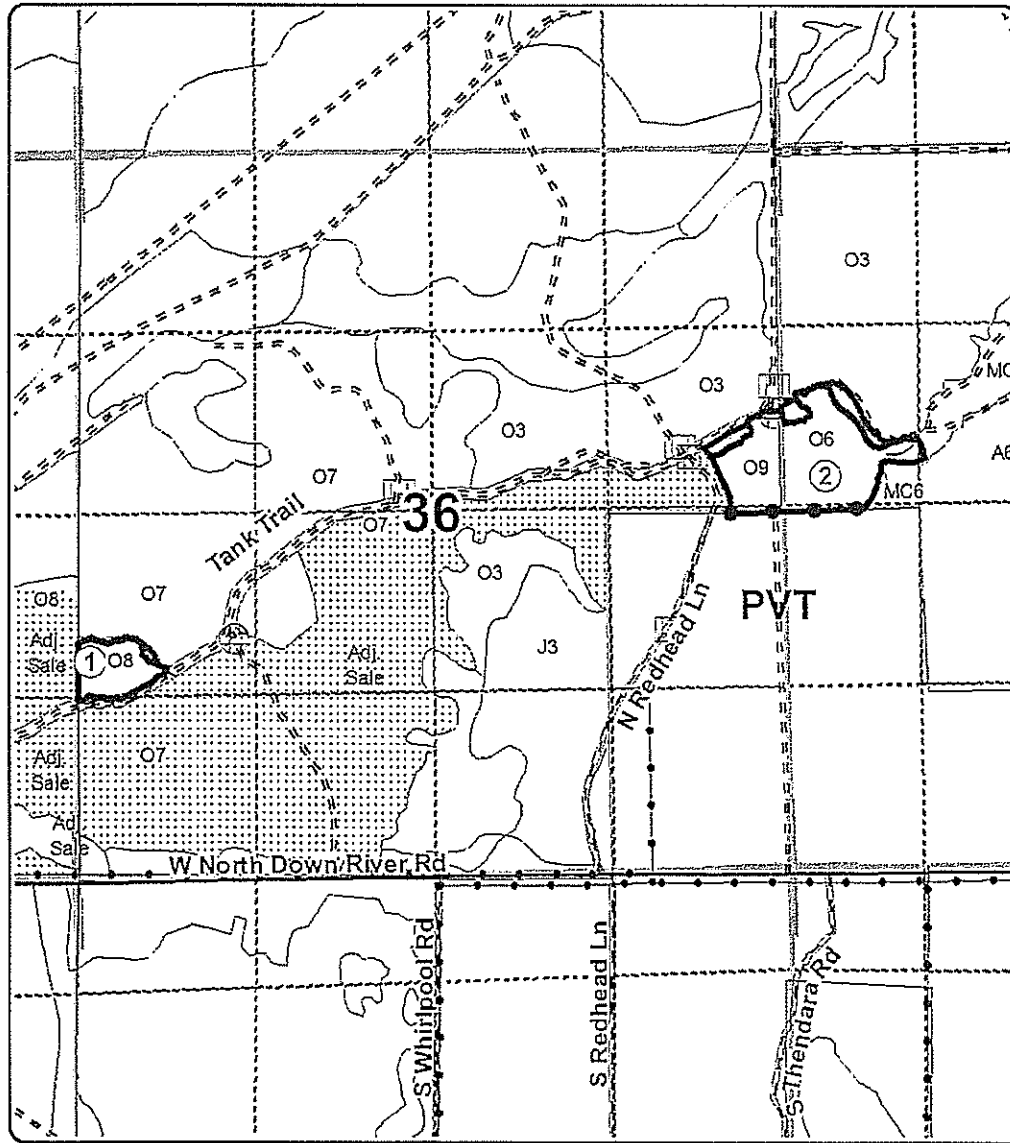

#### Legend

- Sale Boundary - State (Red)
- Private Line (Blue)
- Boundary Excluded Retention
- Payment Unit Label
- Adjacent Timber Sale
- Adjacent Stand Boundaries
- Paved
- Gravel
- Poor Dirt
- Section Corners
- Sections
- Quarter Quarter Sections
- Gates and Berms
- Type
- Gate
- Berms

