



**DEPARTMENT OF NATURAL RESOURCES
STATE OF MICHIGAN**

TIMBER SALE PROSPECTUS #5820

SCHEDULED SALE DATE AND TIME: 10:00 a.m. (local time) on July 11, 2017.

LOCATION: ATLANTA MGMT UNIT, 13501 M-33, ATLANTA, MI 49709.

PROSPECTUS NOTE: The bidder is advised to inspect the sale area and review the location, estimated volumes, operating costs and contract terms of proposed sales. Please be aware that some landowners may request 60 days or more notice for access across their land.

Notice is hereby given that bids will be received by the Unit Manager, ATLANTA MANAGEMENT UNIT, for certain timber on the following described lands:

Horsey Sauce Oak (54-007-16)

Montmorency County, Advertised Price \$89,128.10, 161.5 Acres, Aspen, Red Oak.

SALE NOTE: A recreation site such as a trail, pathway, or campground is within the sale area or the vicinity. Certain restrictions/specifications may be applicable including time restrictions.

Mark It Zero Mix (54-008-16)

Montmorency County, Advertised Price \$134,639.65, 173.3 Acres, Hardwood, Red Oak.

SALE NOTE: A recreation site such as a trail, pathway, or campground is within the sale area or the vicinity. Certain restrictions/specifications may be applicable including time restrictions.

SBW-15 (54-015-16)

Montmorency County, Advertised Price \$15,141.05, 37.0 Acres, Aspen, Spruce/Fir/Tamarack.

Maplecatation (54-042-16)

Montmorency County, Advertised Price \$231,903.50, 210.0 Acres, Aspen, Red Oak.

BID INSTRUCTIONS (VER. 09/02/2016):

1. Scheduled Bid Location, Date, and Time (2/11)

Bids must be received by the Unit Manager, ATLANTA OFFICE, 13501 M-33, ATLANTA, MI 49709, no later than 10:00 a.m. (local time) on July 11, 2017. For further information concerning this sale, contact Cody Stevens at 989-785-4251 extension 5240.

2. Bidder's Qualifications (5/16)

Purchaser shall obtain workers compensation insurance to cover claims under Michigan's Worker's Disability Compensation Act of 1969 or similar employee benefit act of any other state applicable to an employee. If all or part of a timber sale was prepared by a private contractor, the contractor and that contractor's company are not permitted to bid on the timber sale contract. Bids will not be accepted from individuals or companies appearing on the DNR/FRD No-Bid List. This list contains the names of purchasers who previously failed to execute a contract within 21-days or who have a history of poor performance.

3. Preparation of Sealed Bids (5/16)

Bid Forms may be completed online thru Michigan DNR Timber Sale Online Bidding (OLB) at www.michigan.gov/timberbidding or by completing the hardcopy Bid Form found in the Timber Sale Prospectus. Hardcopy Bid Forms shall be manually signed in ink. Registration in OLB is considered your 'signature' for all bids submitted thru that system. Bid prices must be entered for each species and product in the Bid Price column for all material subject to bidding and all fill-in blanks must be completed. If erasures or other changes appear on the hardcopy Bid Form, each erasure or change must be initialed by the person signing the bid.

4. Submission of Sealed Bids (5/16)

Bid forms may be obtained from the Unit Manager or thru OLB. Bids may be submitted hardcopy or thru OLB. All hardcopy bids must be submitted on the bid form and in an envelope clearly identified as described in this section. NOTE: Only one bid form per bid envelope. Sealed bids must be submitted to the Unit office designated in the prospectus and must be submitted at or prior to the time established in the prospectus. The envelope should show on the outside (a) the sale name or number and (b) the date and time of bid opening, as shown in the prospectus. Bids received after the time specified in the sale prospectus are late bids and will be rejected.

It is possible for a bidder to submit multiple bids on a single sale. For example, a bid may be submitted hardcopy and a bid may be submitted thru OLB. Or, two bidders from the same company could both submit bids on the same sale. If this were to happen, the State would accept all bids received and award the contract accordingly. All bidding and contractual requirements would apply to all bids received.

5. Public Opening of Sealed Bids (7/16)

If conditions permit, the sealed bids will be publicly opened and posted at the time and place set in the prospectus.

If a bidder, present at a bid opening, has submitted bids on more than one sale, that bidder may withdraw their unopened bid envelopes or announce the withdrawal of their online bid after being declared the successful bidder on one sale.

6. Award of Contract (1/11)

Award of the contract will be made to the Bidder whose bid, conforming to the prospectus, is most advantageous to the State of Michigan on the basis of total value at rates bid for the estimated quantities. The State reserves the right to reject any bid or waive any minor irregularity in bids received. A written award mailed (or otherwise furnished) to the successful Bidder shall be deemed to result in a binding contract without further action by either party.

7. Down Payment (1/11)

The Bidder to whom award is made must make a down payment within 21 days of the sale award. The amount of the down payment will be calculated as shown in the Bond and Payment Schedule of this prospectus. Only cash may be used to meet this requirement.

8. Performance Security (1/11)

As guarantee of faithful performance, a cash bond, certificate of deposit, surety bond or irrevocable letter of credit (LOC) is required within 21 days of the sale award. The amount of the performance security is shown in the Bond and

Payment Schedule of this prospectus. If an LOC or surety is used, the coverage must extend for at least 6 months beyond the contract expiration.

9. Timber Sale Contract (9/14)

Additional conditions and requirements common to all timber sales are listed on the timber sale contract (R4031) and are available on line at www.michigan.gov/timber. Contact the Unit Manager for additional information or a sample contract. Within 21 days of the date of the award letter, the bidder must sign the contract and provide the required down payment, performance security, and verification of worker's disability compensation. The down payment and performance security shall be in accordance with the provisions of the timber sale contract, in the sums stated in this prospectus. If these actions are not taken, then the Bidder, the Bidder's corporation, and the corporation's principals may not be permitted to bid on State timber sales for a period of 1 year. In addition, the Bidder certifies that if awarded this contract, the Bidder will complete the timber sale contract in accordance with its terms and any modifications thereof including requirements to purchase, cut, and remove the included timber by the expiration date.

10. Disclaimer of Estimates and Bidder's Warranty of Inspection (7/16)

Before submitting this bid, the Bidder is advised and cautioned to inspect the sale area, review the requirements of the sale contract, and take other steps as may be reasonably necessary to ascertain the location, estimated volumes, construction estimates, and operating costs of the proposed sale. Failure to do so will not relieve the Bidder from responsibility for completing the contract.

The Bidder warrants that this bid is submitted solely on the basis of the Bidder's examination and inspection of the quality and quantity of the timber offered for sale and the Bidder's opinion of the value thereof and the costs of recovery. No reliance should be placed on the State of Michigan's estimates of timber quality, quantity or costs of recovery. Bidder further acknowledges that the State of Michigan: (i) expressly disclaims any warranty of fitness of timber for any purpose; (ii) offers this timber as is without any warranty of quality (merchantability) or quantity and (iii) expressly disclaims any warranty as to the quantity or quality of timber sold.

11. Certification and Chain-of-Custody (10/14)

Unless otherwise indicated in the contract under section 7 – Other Conditions of the Sale Specific Conditions & Requirements, the area encompassed by this timber sale is certified to the standards of the Forest Stewardship Council (FSC) - Certificate #SCS-FM/COC-00090N and the Sustainable Forestry Initiative (SFI) - Certificate # NSF-SFIS-5Y031-SF5. Forest products from this sale may be delivered to the mill as "FSC 100% and / or SFI certified" as long as the contractor hauling the forest products is chain-of-custody (COC) certified or covered under a COC certificate from the destination mill. The purchaser is responsible for maintaining COC after leaving the sale area.

12. Good Neighbor Authority (GNA) Requirements (7/16)

If the name of this timber sales contains the acronym GNA, it is authorized by the Good Neighbor Authority (GNA) and covered by various agreements between the U.S. Forest Service and the State. The timber sale occurs on federal land and the following conditions apply:

GNA contracts on US Forest Service land will not be awarded to purchasers on the Federal list of excluded parties. The System for Award Management (SAM) will be checked for active excluded parties prior to award of contract. In addition, the Bidder to whom award is made must complete an Assurance Regarding Felony Conviction or Tax Delinquent Status for Corporate Applicants (AD-3031).

13. Good Neighbor Authority (GNA) Requirements, con't (9/16)

Bidder certifies, by signing this bid form, that to the best of Bidder's knowledge that the following representations are accurate and complete.

- a. That the Bidder and its principals are not presently debarred, suspended, proposed for debarment, declared ineligible, or voluntary excluded from timber sales (covered transactions) by any Federal department or agency.
- b. That the Bidder and its principals have not within a 3-year period preceding this bid been convicted of or had a civil judgment rendered against them for commission of fraud or a criminal offense in connection with obtaining, attempting to obtain, or performing a public (Federal, State, or local) transaction or contract under a public transaction; violation of Federal or State antitrust statutes or commission of embezzlement, theft, forgery, bribery, falsification or destruction of records, making false statements, or receiving stolen property.

c. That the Bidder and its principals are not presently indicted for or otherwise criminally or civilly charged by a governmental entity (Federal, State, or local) with commission of any of the offenses enumerated in paragraph b of this certification.

d. That the Bidder and its principals have not within a 3-year period preceding this bid had one or more public transactions (Federal, State, or local) terminated for breach or default of a timber or forest product contract.

Bidders that cannot certify this requirement, in whole or in part, shall submit an explanation with their bid.

KEITH CREAGH

Director

TIMBER SALE INFORMATION

Horsey Sauce Oak (54-007-16)

Montmorency County (Advertised Price \$89,128.10)

SALE NOTE: A recreation site such as a trail, pathway, or campground is within the sale area or the vicinity. Certain restrictions/specifications may be applicable including time restrictions.

A timber sale contract for this lump sum, sealed bid timber sale will be awarded to the responsible bidder offering the highest sealed bid price. Bids must be at or above the following advertised price for each species:

<u>PRODUCTS & SPECIES</u>	<u>ESTIMATED UNITS*</u>		<u>ADVERTISED PRICE</u>
Sawtimber			
B. T. Aspen	296.70	MBF	\$ 78.00 / MBF
Basswood	5.00	MBF	\$ 77.00 / MBF
Red Maple	21.30	MBF	\$ 123.00 / MBF
Red Oak	257.90	MBF	\$ 145.00 / MBF
Red Pine	1.20	MBF	\$ 128.00 / MBF
Sugar Maple	5.60	MBF	\$ 392.00 / MBF
Pulpwood			
B. T. Aspen	342.00	Cords	\$ 20.95 / Cord
Balsam Fir	3.00	Cords	\$ 28.25 / Cord
Basswood	4.00	Cords	\$ 12.80 / Cord
Misc. Species 1	41.00	Cords	\$ 4.45 / Cord
Mixed Hardwood	414.00	Cords	\$ 18.90 / Cord
Red Oak	427.00	Cords	\$ 18.45 / Cord
Red Pine	1.00	Cords	\$ 50.25 / Cord

* The total volume is statistically estimated within plus (+) or minus (-) 14.10 percent. The estimated units are final and not subject to adjustment. Prospective bidders are urged to examine this timber and to make their own estimates of quantity and quality.

BOND AND PAYMENT SCHEDULE:

1. A bond in the amount of \$4,456.00 to insure faithful performance of the conditions of the contract will be deposited by the successful bidder within 21 days of the sale award.
2. Cutting in any sale or unit without the required advance payment would be considered a trespass.
3. Total payment must be paid in advance or according to the following schedule:
 - (a) Ten percent (10%) of the sale value must be paid within 21 days of the sale award.
 - (b) The 10% down payment will be credited towards the first unit cut.
4. If no cutting takes place, the 10% down payment will not be refunded.
5. Operations on the contract issued will terminate on 06/30/2020.

Description of Timber by Payment Unit (PU)

PU	MARKET GROUP	PRODUCT	QUANTITY	UNIT	ACRES	ADVERTISE PRICE
1	B. T. Aspen Basswood Red Maple Red Oak Sugar Maple B. T. Aspen Basswood Misc. Species 1 Mixed Hardwood <i>Red Maple</i> <i>Sugar Maple</i> Red Oak	Sawtimber	7.9	MBF	31.7	\$15,929.60
			2.3	MBF		
			0.8	MBF		
			76.3	MBF		
			2.4	MBF		
			6.0	Cords		
		Pulpwood	2.0	Cords		
			17.0	Cords		
			46.0	Cords		
			26.0	<i>Cords</i>		
			20.0	<i>Cords</i>		
			105.0	Cords		
2	B. T. Aspen Basswood Red Maple Red Oak Sugar Maple B. T. Aspen Basswood Misc. Species 1 Mixed Hardwood <i>Red Maple</i> <i>Sugar Maple</i> Red Oak	Sawtimber	9.0	MBF	35.8	\$18,017.35
			2.7	MBF		
			0.9	MBF		
			86.1	MBF		
			2.8	MBF		
			6.0	Cords		
		Pulpwood	2.0	Cords		
			19.0	Cords		
			53.0	Cords		
			30.0	<i>Cords</i>		
			23.0	<i>Cords</i>		
			118.0	Cords		
3	B. T. Aspen Red Maple Red Oak B. T. Aspen Mixed Hardwood <i>Red Maple</i> Red Oak	Sawtimber	14.0	MBF	30.1	\$15,444.45
			6.4	MBF		
			55.6	MBF		
		Pulpwood	116.0	Cords		
			64.0	Cords		
			64.0	<i>Cords</i>		
			101.0	Cords		
4	B. T. Aspen Red Maple Red Oak B. T. Aspen Balsam Fir Misc. Species 1 Mixed Hardwood <i>Red Maple</i> Red Oak	Sawtimber	225.2	MBF	39.1	\$31,039.80
			12.6	MBF		
			29.2	MBF		
		Pulpwood	162.0	Cords		
			3.0	Cords		
			5.0	Cords		
			167.0	Cords		
			167.0	<i>Cords</i>		
			56.0	Cords		
5	B. T. Aspen Red Maple Red Oak Red Pine Sugar Maple B. T. Aspen Mixed Hardwood <i>Red Maple</i> <i>Sugar Maple</i> Red Oak Red Pine	Sawtimber	40.6	MBF	24.8	\$8,696.90
			0.6	MBF		
			10.7	MBF		
			1.2	MBF		
			0.4	MBF		
			52.0	Cords		
		Pulpwood	84.0	Cords		
			73.0	<i>Cords</i>		
			11.0	<i>Cords</i>		
			47.0	Cords		
			1.0	Cords		
			TOTAL:			
TOTAL:			1,232.0	Cords		

Sale Specific Conditions & Requirements

Sale Name: Horsey Sauce Oak

Sale Number: 54-007-16 Seq#: 1

1 - Sale Area

1.2 - Boundaries

1.2.1 - Painted boundaries (1/14)

The sale boundary and Payment Unit boundaries are marked and identified by red and yellow paint. Exterior sale boundary lines against state are marked with red paint. Interior Payment Unit boundaries are marked with yellow paint. The painted boundary line trees are not Included Timber and are to be protected unless marked with orange paint. Yellow painted trees designating an interior Payment Unit boundary are not to be cut unless marked with orange paint and after all surrounding Payment Units have been paid.

2 - Timber Specifications

2.1 - Included Timber

2.1.3 - Cut tree marked unit(s) (12/08)

Within Payment Unit(s) 1-5, all trees are designated for cutting when marked with orange paint above and below stump height, regardless of merchantability. Also, standing dead ash are designated for cutting.

2.1.11 - Description of timber note (2/04)

Note that Misc. Species 1 = dead ash.

2.2 - Utilization

2.2.6 - Roundwood operation required (5/07)

The skidding of whole trees or tree segments with limbs attached is prohibited. All products must be produced as roundwood and forwarded to existing roads or landing areas in final product length.

2.2.8 - Utilization and removal (5/14)

All products not meeting standards set forth in General Condition and Requirement 2.2 - Utilization may not be removed from the sale area, e.g. tops. This is because of an objective to reduce potential damage to soil and residual stand.

3 - Payments

3.4 - Damaged Timber

3.4.1 - Damaged timber (6/14)

General Condition and Requirement 3.4 Damaged Timber, defines liquidated damages for undesignated live merchantable trees which are cut or injured. No damage is acceptable to merchantable trees. Within the sale area, if more than 5% of trees (> 4.5" DBH) within a specified area of the sale are damaged, liquidated damages will be assessed for all trees damaged. Rates will be in accordance with General Condition and Requirement 3.4 Damaged Timber.

3.6 - Payment Unit Cutting Schedule

3.6.3 - Operating schedule (12/08)

Unless changed by written agreement, only 2 Payment Unit(s) may be operated at any one time. All contractual requirements on a Payment Unit shall be completed and accepted by the Unit Manager or his/her representative prior to the opening of an additional Payment Unit.

4 - Transportation

4.1 - Construction

4.1.6 - Road construction (1/09)

Improvements of existing roads shall be done in such a way as to minimize the environmental and visual impacts. Merchantable trees shall be cut and utilized unless otherwise directed. Non-merchantable trees shall be severed and laid flat on the ground. Slash shall be scattered, and not left in windrows and kept a minimum of 10 feet back from the road edge. Stumps shall be set upright, not left on edge, and be moved at least 10 feet away from the road edge. Disturbed soil shall be

feathered into the woods and not left in berms or windrows.

4.1.7 - Road closure (10/11)

Overgrown roads that are reopened into the sale must be blocked to vehicle traffic upon completion of the sale. In general, this will require constructing a four (4') foot high berm of stumps and logs covered with earth. Stumps and brush must be placed along the remainder of the trail. These roads must be rendered impassable to cars and trucks. All stumps from road work and landing construction must be reserved to block any newly constructed roads upon completion of the sale. These stumps must be scattered along the road system to prohibit vehicular movement. Temporary berms may be required if no sale activity occurs for 30 or more consecutive days.

4.1.12 - No new roads (1/12)

No new roads will be permitted in any Payment Unit. Skid trails only will be allowed.

4.2 - Maintenance

4.2.5 - Two wheel drive condition (2/04)

All existing trail roads on and adjacent to the sale area must be passable by two-wheel drive traffic for the duration of the sale.

5 - Operations

5.1 - Notification

5.1.1 - Pre-sale conference (10/11)

A pre-sale conference on site between the Purchaser and sale administrator is required prior to beginning any operations. The Unit Manager or his/her representative must be contacted at least 10 days in advance to schedule the conference.

5.1.3 - Well heads and natural gas pipelines (11/15)

The Purchaser is responsible for contacting the appropriate gas or pipeline company 30 days prior to operating equipment in the vicinity of well heads or natural gas pipelines. Well sites will NOT be utilized as landings or for decking.

5.1.4 - Post-sale conference (6/11)

A post-sale conference on site between the Purchaser and sale administrator is required 5 days prior to the completion of active logging operations to determine clean-up and repair of landings, road edges, and the fulfillment of other contract specifications.

5.2 - Conduct of Operations

5.2.3 - Operating Restrictions

5.2.3.1 - Operating restrictions (9/11)

Within Payment Unit(s) 1-5, unless changed by written agreement, cutting, skidding, and hauling are limited to the period of July 15 through February 28. This restriction is due to oak wilt, slippery bark and soil conditions.

5.2.31 - Landing locations (9/13)

Landing areas are marked on the Timber Sale Map, as shown in the legend. Landings must be confined to these designated sites unless otherwise authorized by the Unit Manager or his/her representative. In general, landings are limited to a "T" turnaround which will accommodate a truck with a 53 foot trailer.

5.2.32 - Decking/landing restoration (9/13)

All decking and landing areas must have the surface area restored to a condition equal to or better than before. This is to ensure the proper regeneration of the stand. Wood debris, chips and "cookies" from trimmings must be removed or scattered away from landing and loading areas and may not be windrowed on the edge.

5.2.38 - No decking against live trees (2/04)

Cut products may not be decked against unmarked or designated leave trees.

5.2.40 - Pathway protection (10/10)

A horse trail is shown on the Timber Sale Map. Do not cut trees or damage posts with equestrian pathway markers. Maintain a 20-foot wide slash, debris, and rut free zone daily, using the pathway as the centerline.

5.2.41 - Snowmobile trail protection (9/11)

A snowmobile trail is shown on the Timber Sale Map. Do not cut or damage posts with orange trail markers or traffic control signs. If the trail is used, it must be maintained and restored to a condition equal to or better than before the sale. The road maintenance/restoration must be done prior to November 15. If the trail road is to be used for hauling during the snowmobile season, then a snow covered base must be left on the trail. Maintain a 20 foot wide slash, debris, and rut free zone daily using the snowmobile trail as the centerline.

5.4 - Soil Protection

5.4.1 - Rutting restriction, general (7/16)

Operations are to cease immediately if equipment and weather conditions result in rutting of roads and/or skid trails which is 12 inches or greater in depth and 50 feet in length. The Unit Manager or his/her representative may restrict hauling and/or skidding if ruts exceed the specified depth. With the Unit Manager or his/her representative's approval, the Purchaser may return to the area when the risk of rutting has decreased.

5.4.2 - Skid trails (2/04)

Skid trails up and down slopes should be avoided. If however this is unavoidable, these trails will be left in a non-erodible condition using water bars, logs, and slash. Placing of slash on these skid trails while logging is ongoing may alleviate need for any further action. At the direction of the sale administrator, seed, fertilizer, and mulch may also be required.

5.4.6 - Wet area protection (5/10)

No harvesting operations, including skidding and felling, are to take place within vernal pond areas or drainages. When harvesting occurs, there should be no disturbance to the vernal pond depression. All equipment, trees and tops should be kept out of this area. Within 100 feet of the pond, equipment should only be used when the soil is in a dry or frozen condition. Care must be taken by the Purchaser to identify and avoid operating in these areas of the timber sale.

6 - Safety and Fire Prevention

6.2 - Signing

6.2.2 - Snowmobile trail posting (8/09)

The Purchaser is responsible for posting and maintaining caution signs on snowmobile trail prior to beginning operations during the snowmobile season (approximately December 1 to March 31). The trail must be posted at appropriate distances from the sale area to warn of logging activity and truck traffic. Signs must be removed when harvest operations are suspended or completed. The Purchaser will provide these signs.

6.2.3 - Recreational trail posting (2/10)

The Purchaser is responsible for posting and maintaining caution signs on the equestrian pathway prior to beginning operations. The trail must be posted at appropriate distances from the sale area to warn of logging activity and truck traffic at both ends of the trail. Signs must be removed when harvest operations are suspended or completed. The Purchaser will provide these signs.

7 - Other Conditions

7.3 - Contract Modifications

7.3.2 - Modification for oak wilt (2/05)

Within the sale area, there may be patches of oak wilt. If oak wilt is identified within the sale area, this contract may be modified. The following modifications could occur: time of cutting, species to cut, volume to harvest, or various others dealing with the treatment of oak wilt. If a species is not specified in this contract, it shall be paid for at the average price received for that species and product.



TIMBER SALE MAP

This information provided by authority of Part 525, 1994 PA 451, as amended.

Sale Number	Year
54-007	16

Forest Management Unit Atlanta		County Montmorency	Mapped By Barber	Date 09/06/2016	Page 1	of 2
Township 29N	Range 02E	Section(s) and Subdivision(s) Various in Sections 10, 11 & 15		Scale 1:15,840		

Cover Type				Density			
A = Aspen	H = Hemlock	N = Marsh	U = Upland Brush	0 = Non Stocked	5 = Pole Timber Medium		
B = Paper Birch	J = Jack Pine	O = Oak	UM = Upland Mixed	1 = Seedling Sapling Poor	6 = Pole Timber Well		
C = Cedar	L = Lowland Brush	P = Lowland Poplar	V = Bog or Marsh	2 = Seedling Sapling Medium	7 = Saw Timber Poor		
D = Tread Bog	LM = Lowland Mixed	Q = Mixed Swamp Conifer	W = White Pine	3 = Seedling Sapling Well	8 = Saw Timber Medium		
E = Swamp Hdwoods	M = Mpl, Bch, Brch	R = Red Pine	X = Non Stocked	4 = Pole Timber Poor	9 = Saw Timber Well		
F = Spruce Fir	MC = Mixed Conifer	S = Black Spruce	Z = Water				
G = Grass	MD = Mixed Deciduous	T = Tamarack					

PU	Acres	PU	Acres
1	31.7	4	39.1
2	35.8	5	24.8
3	30.1		

Horsey Sauce Oak

Compartment 006

161.5 Acres

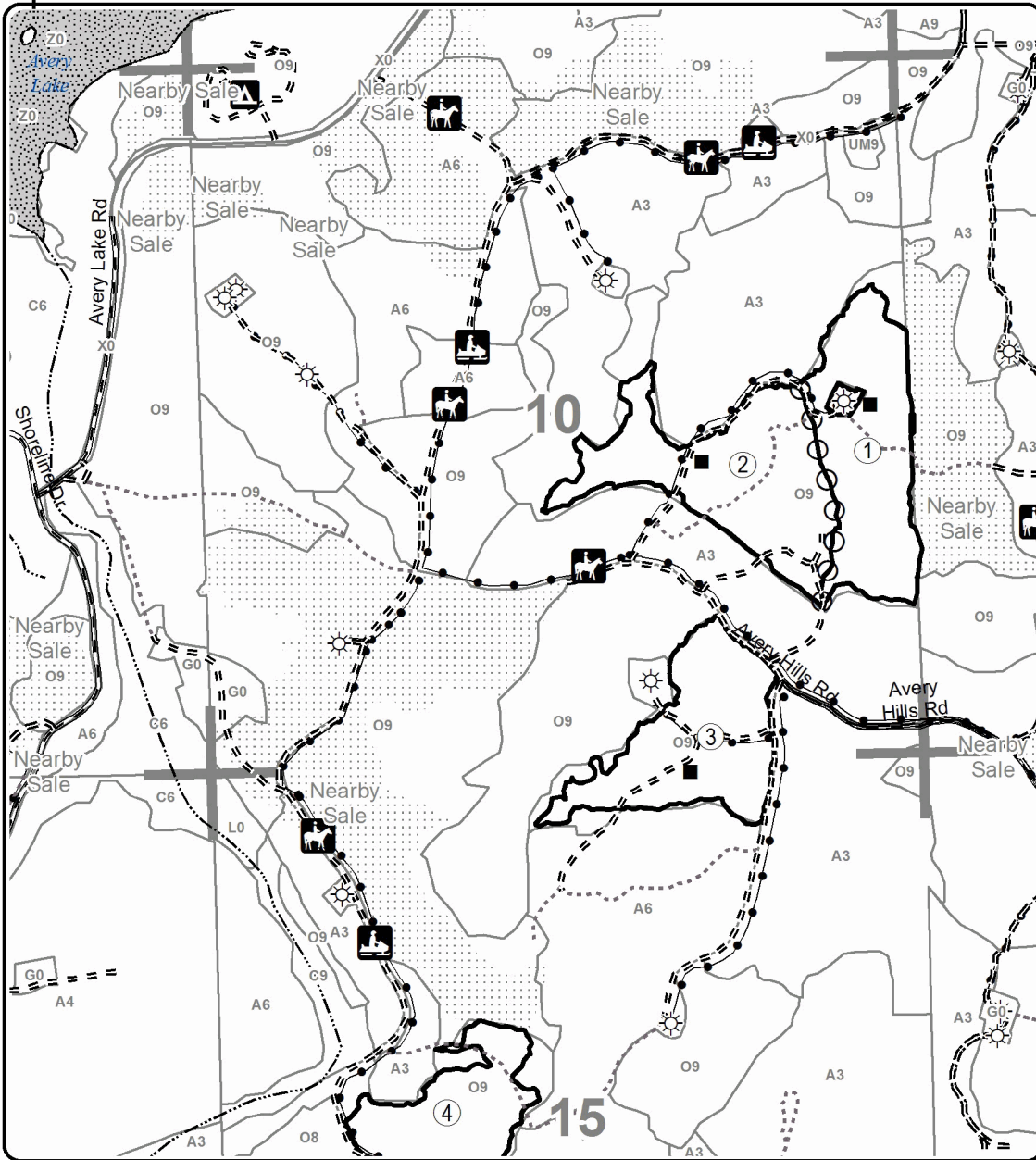
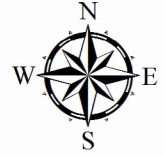

Legend

- Against State (Red)
- Payment Unit (Yellow)
- Payment Unit
- Landing
- Paved Roads
- Gravel Roads
- Poor Dirt Roads
- Closed Roads
- Horse Trails
- Snowmobile Trails
- Oil & Gas Wells
- Pipeline; Powerline
- Stand Boundaries
- Section Corners
- Nearby Sales
- Streams

Locator Map
1:200,000

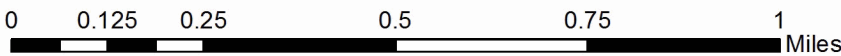
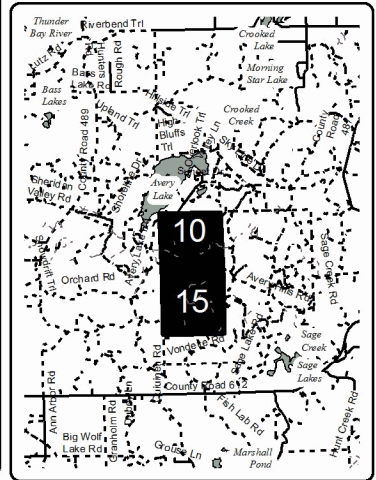



TIMBER SALE MAP

This information provided by authority of Part 525, 1994 PA 451, as amended.

Sale Number	Year
54-007	16

Forest Management Unit Atlanta		County Montmorency	Mapped By Barber	Date 09/06/2016	Page 2	of 2
Township 29N	Range 02E	Section(s) and Subdivision(s) Various in Sections 10, 11 & 15		Scale 1:15,840		

Cover Type				Density			
A = Aspen	H = Hemlock	N = Marsh	U = Upland Brush	0 = Non Stocked	5 = Pole Timber Medium		
B = Paper Birch	J = Jack Pine	O = Oak	UM = Upland Mixed	1 = Seedling Sapling Poor	6 = Pole Timber Well		
C = Cedar	L = Lowland Brush	P = Lowland Poplar	V = Bog or Marsh	2 = Seedling Sapling Medium	7 = Saw Timber Poor		
D = Tread Bog	LM = Lowland Mixed	Q = Mixed Swamp Conifer	W = White Pine	3 = Seedling Sapling Well	8 = Saw Timber Medium		
E = Swamp Hdwoods	M = Mpl, Bch, Brch	R = Red Pine	X = Non Stocked	4 = Pole Timber Poor	9 = Saw Timber Well		
F = Spruce Fir	MC = Mixed Conifer	S = Black Spruce	Z = Water				
G = Grass	MD = Mixed Deciduous	T = Tamarack					

PU	Acres	PU	Acres
1	31.7	4	39.1
2	35.8	5	24.8
3	30.1		

Horsey Sauce Oak Compartment 006 161.5 Acres

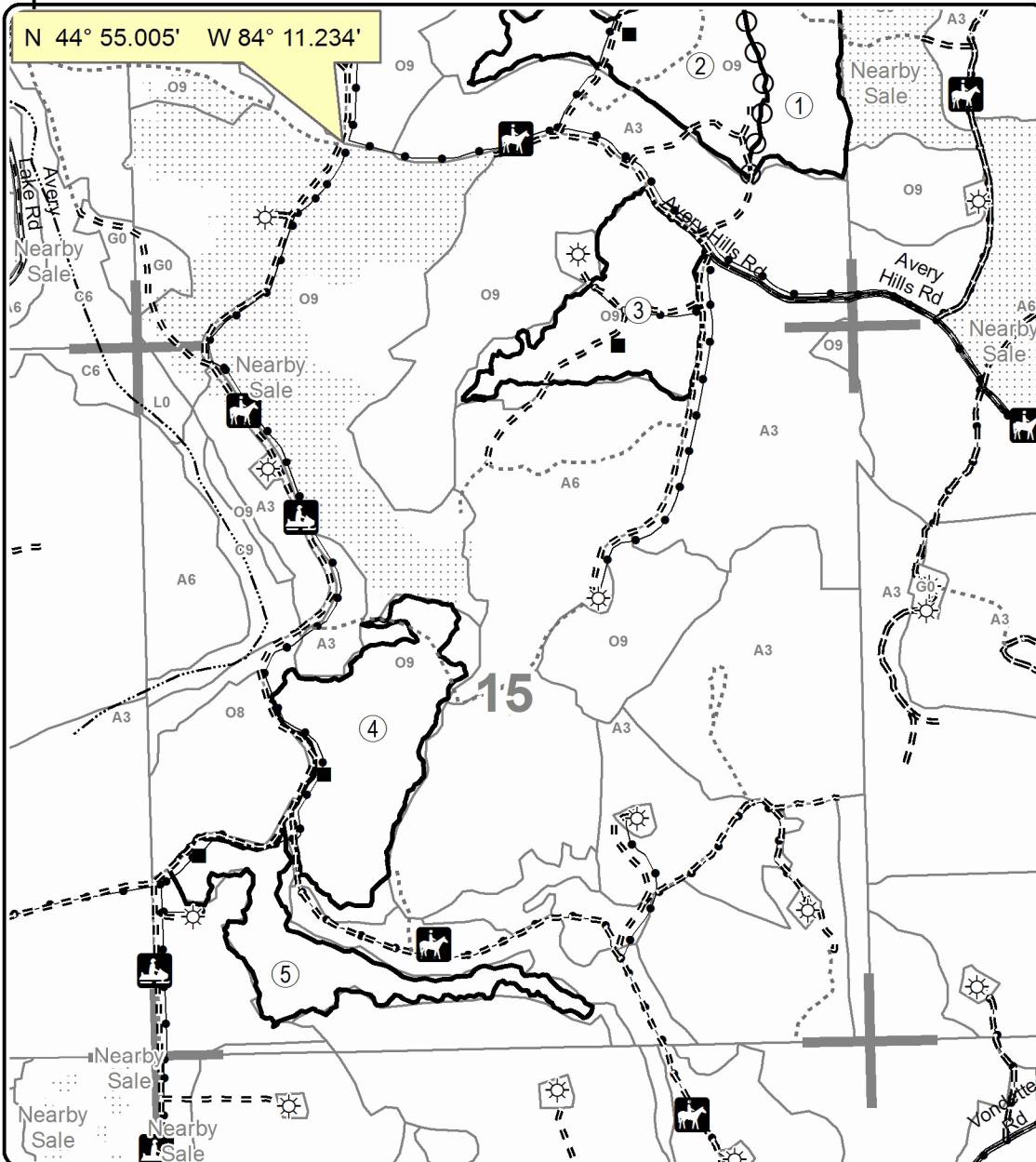

Legend	
	Against State (Red)
	Payment Unit (Yellow)
	Payment Unit
	Landing
	Paved Roads
	Gravel Roads
	Poor Dirt Roads
	Closed Roads
	Horse Trails
	Snowmobile Trails
	Oil & Gas Wells
	Pipeline; Powerline
	Stand Boundaries
	Section Corners
	Nearby Sales
	Streams

Locator Map
1:200,000

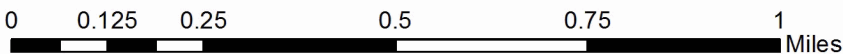
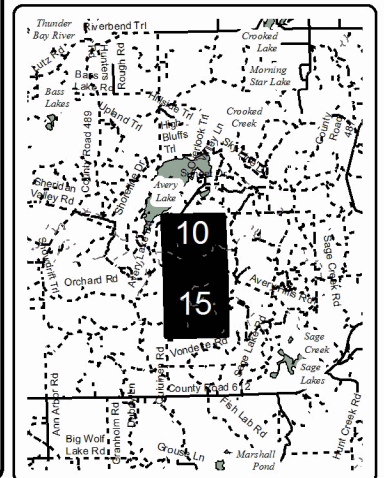

TIMBER SALE INFORMATION

Mark It Zero Mix (54-008-16)

Montmorency County (Advertised Price \$134,639.65)

SALE NOTE: A recreation site such as a trail, pathway, or campground is within the sale area or the vicinity. Certain restrictions/specifications may be applicable including time restrictions.

A timber sale contract for this lump sum, sealed bid timber sale will be awarded to the responsible bidder offering the highest sealed bid price. Bids must be at or above the following advertised price for each species:

<u>PRODUCTS & SPECIES</u>	<u>ESTIMATED UNITS*</u>		<u>ADVERTISED PRICE</u>
Sawtimber			
Basswood	185.30	MBF	\$ 77.00 / MBF
Beech	59.40	MBF	\$ 84.00 / MBF
Mixed Aspen	51.40	MBF	\$ 78.00 / MBF
Paper Birch	8.20	MBF	\$ 56.00 / MBF
Red Maple	22.40	MBF	\$ 123.00 / MBF
Red Oak	169.60	MBF	\$ 145.00 / MBF
Red Pine	27.30	MBF	\$ 128.00 / MBF
Sugar Maple	73.40	MBF	\$ 392.00 / MBF
Pulpwood			
Balsam Fir	6.00	Cords	\$ 28.25 / Cord
Basswood	552.00	Cords	\$ 12.80 / Cord
Misc. Species 1	438.00	Cords	\$ 4.45 / Cord
Mixed Aspen	501.00	Cords	\$ 20.95 / Cord
Mixed Hardwood	1,122.00	Cords	\$ 18.90 / Cord
Paper Birch	41.00	Cords	\$ 21.65 / Cord
Red Oak	386.00	Cords	\$ 18.45 / Cord
Red Pine	45.00	Cords	\$ 50.25 / Cord
White Pine	4.00	Cords	\$ 35.65 / Cord

* The total volume is statistically estimated within plus (+) or minus (-) 9.25 percent. The estimated units are final and not subject to adjustment. Prospective bidders are urged to examine this timber and to make their own estimates of quantity and quality.

BOND AND PAYMENT SCHEDULE:

1. A bond in the amount of \$6,732.00 to insure faithful performance of the conditions of the contract will be deposited by the successful bidder within 21 days of the sale award.
2. Cutting in any sale or unit without the required advance payment would be considered a trespass.
3. Total payment must be paid in advance or according to the following schedule:
 - (a) Ten percent (10%) of the sale value must be paid within 21 days of the sale award.
 - (b) The 10% down payment will be credited towards the first unit cut.
4. If no cutting takes place, the 10% down payment will not be refunded.
5. Operations on the contract issued will terminate on 12/31/2020.

Description of Timber by Payment Unit (PU)

PU	MARKET GROUP	PRODUCT	QUANTITY	UNIT	ACRES	ADVERTISE PRICE
1	Basswood Beech Mixed Aspen <i>Quaking Aspen</i> Red Oak Sugar Maple	Sawtimber	17.5	MBF	18.5	\$16,822.05
			2.0	MBF		
			1.6	MBF		
			1.6	<i>MBF</i>		
			17.2	MBF		
			10.7	MBF		
		Pulpwood	128.0	Cords		
			19.0	Cords		
			47.0	Cords		
			47.0	<i>Cords</i>		
			215.0	Cords		
			22.0	<i>Cords</i>		
			193.0	<i>Cords</i>		
			2.0	Cords		
			91.0	Cords		
2	Basswood Beech Mixed Aspen <i>Quaking Aspen</i> Red Oak Sugar Maple	Sawtimber	14.8	MBF	15.7	\$14,263.20
			1.7	MBF		
			1.4	MBF		
			1.4	<i>MBF</i>		
			14.6	MBF		
			9.0	MBF		
		Pulpwood	109.0	Cords		
			16.0	Cords		
			40.0	Cords		
			40.0	<i>Cords</i>		
			182.0	Cords		
			19.0	<i>Cords</i>		
			163.0	<i>Cords</i>		
			2.0	Cords		
			78.0	Cords		
3	Basswood Mixed Aspen <i>B. T. Aspen</i> Red Oak Sugar Maple	Sawtimber	1.0	MBF	4.5	\$4,195.50
			4.8	MBF		
			4.8	<i>MBF</i>		
			7.9	MBF		
			1.7	MBF		
		Pulpwood	3.0	Cords		
			37.0	Cords		
			37.0	<i>Cords</i>		
			28.0	Cords		
			28.0	<i>Cords</i>		
4	Basswood Mixed Aspen <i>B. T. Aspen</i> Red Oak Red Pine Sugar Maple	Sawtimber	2.3	MBF	11.6	\$13,868.20
			18.2	MBF		
			18.2	<i>MBF</i>		
			13.7	MBF		
			5.2	MBF		
		Pulpwood	4.8	MBF		
			12.0	Cords		
			6.0	Cords		
			236.0	Cords		
			236.0	<i>Cords</i>		
Mixed Hardwood	55.0	Cords				
	13.0	<i>Cords</i>				
	3.0	<i>Cords</i>				
	39.0	<i>Cords</i>				

Description of Timber by Payment Unit (PU), con't

PU	MARKET GROUP	PRODUCT	QUANTITY	UNIT	ACRES	ADVERTISE PRICE
4 con't	Red Oak	Pulpwood	39.0	Cords		
	Red Pine		17.0	Cords		
5	Mixed Aspen	Sawtimber	25.4	MBF	9.1	\$12,897.90
	<i>B. T. Aspen</i>		25.4	<i>MBF</i>		
	Red Maple		4.1	MBF		
	Red Oak		5.0	MBF		
	Red Pine		22.1	MBF		
	Sugar Maple		1.8	MBF		
	Balsam Fir	Pulpwood	6.0	Cords		
	<i>Balsam Fir</i>		4.0	<i>Cords</i>		
	<i>White Spruce</i>		2.0	<i>Cords</i>		
	Misc. Species 1		11.0	Cords		
	Mixed Aspen		141.0	Cords		
	<i>B. T. Aspen</i>		141.0	<i>Cords</i>		
	Mixed Hardwood		64.0	Cords		
	<i>Beech</i>		8.0	<i>Cords</i>		
	<i>Red Maple</i>		31.0	<i>Cords</i>		
	<i>Sugar Maple</i>		25.0	<i>Cords</i>		
	Red Oak		12.0	Cords		
	Red Pine		28.0	Cords		
	White Pine		4.0	Cords		
	<i>White Pine</i>	<i>Sawtimber</i>	0.8	<i>MBF</i>		
<i>White Pine</i>	<i>Pulpwood</i>	2.0	<i>Cords</i>			
6	Basswood	Sawtimber	29.5	MBF	38.0	\$23,680.80
	Beech		16.1	MBF		
	Paper Birch		1.1	MBF		
	Red Maple		2.2	MBF		
	Red Oak		69.0	MBF		
	Sugar Maple		6.4	MBF		
	Basswood	Pulpwood	96.0	Cords		
	Misc. Species 1		177.0	Cords		
	Mixed Hardwood		172.0	Cords		
	<i>White Ash</i>	<i>Sawtimber</i>	1.4	<i>MBF</i>		
	<i>Beech</i>	<i>Pulpwood</i>	56.0	<i>Cords</i>		
	<i>Ironwood</i>		1.0	<i>Cords</i>		
	<i>Red Maple</i>		4.0	<i>Cords</i>		
	<i>Sugar Maple</i>		70.0	<i>Cords</i>		
	<i>White Ash</i>		38.0	<i>Cords</i>		
	Paper Birch		2.0	Cords		
	Red Oak		103.0	Cords		
7	Basswood	Sawtimber	21.5	MBF	16.0	\$10,949.30
	Beech		7.4	MBF		
	Paper Birch		0.8	MBF		
	Red Oak		15.2	MBF		
	Sugar Maple		9.2	MBF		
	Basswood	Pulpwood	49.0	Cords		
	Misc. Species 1		55.0	Cords		
	Mixed Hardwood		78.0	Cords		
	<i>White Ash</i>	<i>Sawtimber</i>	1.0	<i>MBF</i>		
	<i>Beech</i>	<i>Pulpwood</i>	26.0	<i>Cords</i>		
	<i>Sugar Maple</i>		44.0	<i>Cords</i>		
	<i>White Ash</i>		6.0	<i>Cords</i>		
	Paper Birch		3.0	Cords		
	Red Oak		22.0	Cords		
8	Basswood	Sawtimber	34.6	MBF	27.3	\$17,433.00
	Beech		19.8	MBF		

Description of Timber by Payment Unit (PU), con't

PU	MARKET GROUP	PRODUCT	QUANTITY	UNIT	ACRES	ADVERTISE PRICE
8 con't	Paper Birch	Sawtimber	2.9	MBF		
	Red Maple		2.0	MBF		
	Red Oak		7.0	MBF		
	Sugar Maple		17.4	MBF		
	Basswood	Pulpwood	65.0	Cords		
	Misc. Species 1		49.0	Cords		
	Mixed Hardwood		186.0	Cords		
	<i>White Ash</i>	<i>Sawtimber</i>	1.5	<i>MBF</i>		
	<i>Beech</i>	<i>Pulpwood</i>	70.0	<i>Cords</i>		
	<i>Ironwood</i>		8.0	<i>Cords</i>		
	<i>Red Maple</i>		3.0	<i>Cords</i>		
	<i>Sugar Maple</i>		99.0	<i>Cords</i>		
	<i>White Ash</i>		3.0	<i>Cords</i>		
	Paper Birch		6.0	Cords		
	Red Oak		9.0	Cords		
	9	Basswood	Sawtimber	64.1	MBF	32.6
Beech			12.4	MBF		
Paper Birch			3.4	MBF		
Red Maple			14.1	MBF		
Red Oak			20.0	MBF		
Sugar Maple			12.4	MBF		
Basswood		Pulpwood	90.0	Cords		
Misc. Species 1			105.0	Cords		
Mixed Hardwood			142.0	Cords		
<i>Beech</i>			39.0	<i>Cords</i>		
<i>Ironwood</i>			1.0	<i>Cords</i>		
<i>Red Maple</i>			13.0	<i>Cords</i>		
<i>Sugar Maple</i>			89.0	<i>Cords</i>		
Paper Birch			9.0	Cords		
Red Oak			20.0	Cords		
TOTAL:			597.0	MBF		
TOTAL:			3,095.0	Cords		

Sale Specific Conditions & Requirements

Sale Name: Mark It Zero Mix

Sale Number: 54-008-16 Seq#: 2

1 - Sale Area

1.2 - Boundaries

1.2.1 - Painted boundaries (1/14)

The sale boundary and Payment Unit boundaries are marked and identified by blue, red and yellow paint. Exterior sale boundary lines against private property are marked with blue paint. Exterior sale boundary lines against state are marked with red paint. Interior retention areas are marked with red paint and are not to be entered. Interior Payment Unit boundaries are marked with yellow paint. The painted boundary line trees are not Included Timber and are to be protected, unless marked with orange paint. Yellow painted trees designating an interior Payment Unit boundary are only to be cut when all surrounding Payment Units have been paid.

2 - Timber Specifications

2.1 - Included Timber

2.1.1 - Clearcut unit(s) with unmerchantable trees (6/14)

Within Payment Unit(s) 1-5, cut all trees that are two (2) inches or more at DBH except trees marked with pink paint within Payment Units 1, 2, 4, and 5.

2.1.3 - Cut tree marked unit(s) (12/08)

Within Payment Unit(s) 6-9, all trees are designated for cutting when marked with orange paint above and below stump height, regardless of merchantability. In addition, all ash and beech trees are designated to be cut, except do not cut trees that are marked with pink paint.

2.1.11 - Description of timber note (2/04)

Note that mixed aspen includes quaking and bigtooth aspen. Mixed hardwood pulp includes sugar maple, ironwood, white ash, beech, and red maple. Misc. Species 1 includes dead white ash, which is designated for cutting.

2.2 - Utilization

2.2.2 - Chipping required (5/14)

Payment Units 1-2 must be chip harvested to facilitate future silvicultural activities. The Purchaser has the option to produce sawlogs or pulpwood bolts, but the remaining portion of the trees must be chipped and hauled. Do not chip 1/6 to 1/3 of the slash from harvested trees (tree tops and limbs less than four inches in diameter).

2.2.3 - Stump heights (4/07)

Stump heights within Payment Units 1 and 2 shall not exceed 6 inches for all trees. This is in order to facilitate post-harvest follow-up operations and planting.

2.2.4 - Skidding length (2/14)

Tree length skidding is required within Payment Units 1-2.

2.2.6 - Roundwood operation required (5/07)

The skidding of whole trees or tree segments with limbs attached is prohibited within Payment Units 3-5 and 6-9. All products must be produced as roundwood and forwarded to existing roads or landing areas in final product length.

3 - Payments

3.4 - Damaged Timber

3.4.1 - Damaged timber (6/14)

General Condition and Requirement 3.4 Damaged Timber, defines liquidated damages for undesignated live merchantable trees which are cut or injured. No damage is acceptable to merchantable trees. Within the sale area, if more than 5% of trees (> 4.5" DBH) within a specified area of the sale are damaged, liquidated damages will be assessed for all trees damaged. Rates will be in accordance with General Condition and Requirement 3.4 Damaged Timber.

4 - Transportation

4.1 - Construction

4.1.3 - Slash and earthen piles (8/04)

Piles or windrows of earth along roads and landings that have been widened or constructed shall be leveled. Slash from road maintenance or construction, including stumps, shall be dispersed throughout the sale.

4.1.6 - Road construction (1/09)

Construction or improvements of existing roads shall be done in such a way as to minimize the environmental and visual impacts. Merchantable trees shall be cut and utilized unless otherwise directed. Non-merchantable trees shall be severed and laid flat on the ground. Slash shall be scattered, and not left in windrows and kept a minimum of 10 feet back from the road edge. Stumps shall be set upright, not left on edge, and be moved at least 10 feet away from the road edge. Disturbed soil shall be feathered into the woods and not left in berms or windrows.

4.1.7 - Road closure (10/11)

All new roads built into the sale must be blocked to vehicle traffic upon completion of the sale. Overgrown roads that are reopened shall be considered new roads. In general, this will require constructing a four (4') foot high berm of stumps and logs covered with earth. These roads must be rendered impassable to cars and trucks. Contact the sale administrator for specific details of design and placement.

4.2 - Maintenance

4.2.5 - Two wheel drive condition (2/04)

All existing trail roads on and adjacent to the sale area must be passable by two-wheel drive traffic for the duration of the sale.

5 - Operations

5.1 - Notification

5.1.1 - Pre-sale conference (10/11)

A pre-sale conference on site between the Purchaser and sale administrator is required prior to beginning any operations to determine landing and road locations. The Unit Manager or his/her representative must be contacted at least 10 days in advance to schedule the conference.

5.1.3 - Well heads and natural gas pipelines (11/15)

The Purchaser is responsible for contacting the MP LLC and Merit Energy gas companies within 30 days prior to operating equipment in the vicinity of well heads or natural gas pipelines.

5.1.4 - Post-sale conference (6/11)

A post-sale conference on site between the Purchaser and sale administrator is required 5 days prior to the completion of active logging operations to determine clean-up and repair of landings, road edges, and the fulfillment of other contract specifications.

5.2 - Conduct of Operations

5.2.1 - Slash

5.2.1.10 - No slash in openings (5/10)

No brush or logging debris is to be left in the maintained wildlife opening which is indicated by G on the Timber Sale Map. Any damage to the opening shall be repaired according to specifications of the Unit Manager or his/her representative.

5.2.2 - Hazard Trees/Snags

5.2.2.1 - Den trees (2/04)

Obvious hollow and/or den trees shall be protected and left standing unless they are a safety hazard.

5.2.3 - Operating Restrictions

5.2.3.1 - Operating restrictions (9/11)

Within Payment Unit(s) 6-9, unless changed by written agreement, cutting, skidding, and hauling are limited to the period of 7/16-12/1 with snow off and unfrozen ground. This restriction is to scarify soil, reduce undesirable ironwood, spread of oak wilt, and bark slip.

5.2.3.2 - Operating restrictions (9/11)

Within Payment Unit(s) 1 and 2, unless changed by written agreement, cutting and skidding is limited to the period of 3/15-12/1 with snow off and unfrozen ground. This restriction is to scarify soil and reduce undesirable ironwood.

5.2.3.11 - Coppice regeneration protection (4/10)

Timber harvesting in any Payment Unit must be completed before significant deciduous seedling sprouting occurs in that Payment Unit so as to minimize damage to the new regeneration.

5.2.31 - Landing locations (9/13)

Recommended landing areas are marked on the timber sale map with the letter "L". Landings must be confined to these designated sites unless otherwise authorized by the Unit Manager or his/her representative. In general, landings are limited to a "T" turnaround which will accommodate a truck with a 53 foot trailer.

5.2.32 - Decking/landing restoration (9/13)

All decking and landing areas must have the surface area restored to a condition equal to or better than before. This is to ensure the proper regeneration of the stand. Wood debris, chips and "cookies" from trimmings must be removed or scattered away from landing and loading areas and may not be windrowed on the edge.

5.2.33 - Gas well re-vegetation (12/08)

In the event that the gas well is utilized for a landing, the site must be re-vegetated with a seeding mixture specified by the Unit Manager or his/her representative.

5.2.38 - No decking against live trees (2/04)

Cut products may not be decked against unmarked or designated leave trees.

5.2.39 - ORV trail/route protection (12/12)

The Hunt Creek motorcycle trail is shown on the Timber Sale Map. Do not cut trees or damage posts with orange ORV markers. All stumps within 5 feet of the trail must be cut flush with the ground. Maintain a 20 foot wide slash, debris, and rut free zone daily using the ORV trail or route as the centerline. Do not run equipment down the ORV trail or route. Skidding across the trail or route may only occur in locations approved by the sale administrator.

5.4 - Soil Protection

5.4.1 - Rutting restriction, general (7/16)

Operations are to cease immediately if equipment and weather conditions result in rutting of roads and/or skid trails which is 12 inches or greater in depth and 50 feet in length. The Unit Manager or his/her representative may restrict hauling and/or skidding if ruts exceed the specified depth. With the Unit Manager or his/her representative's approval, the Purchaser may return to the area when the risk of rutting has decreased.

5.4.2 - Skid trails (2/04)

Skid trails up and down slopes should be avoided. If however this is unavoidable, these trails will be left in a non-erodible condition using water bars, logs, and slash. Placing of slash on these skid trails while logging is ongoing may alleviate need for any further action. At the direction of the sale administrator, seed, fertilizer, and mulch may also be required.

5.8 - Protection of Endangered Species

5.8.5 - Protection of raptor nests (3/13)

All trees with raptor nests will be protected if found during harvesting operations. Notification will be made to the Unit Manager or his/her representative who will notify the Wildlife Biologist so an on-site evaluation and recommendation can be made, if necessary.

6 - Safety and Fire Prevention

6.2 - Signing

6.2.3 - Recreational trail posting (2/10)

The Purchaser is responsible for posting and maintaining caution signs on Hunt Creek motorcycle trails prior to beginning operations. The trail must be posted at appropriate distances from the sale area to warn of logging activity and truck traffic at both ends of the trail. Signs must be removed when harvest operations are suspended or completed. The Purchaser will provide these signs.

7 - Other Conditions

7.3 - Contract Modifications

7.3.1 - Emerald Ash Borer

7.3.1.2 - Emerald ash borer, ash or firewood on sale (2/05)

There is ash and/or "firewood" in this sale and it is located within an emerald ash borer quarantined area. The Director of the Michigan Department of Agriculture (MDA) by the authority of Act No. 72 of the Public Acts of 1945, as amended, and Quarantine Regulation No. 620, has promulgated this quarantine to prevent the further spread of this pest and sets forth: definitions, regulated articles, regulated areas, conditions of movement, violations and penalties, and special exemptions. The Purchaser must comply with this quarantine. Contact the MDA for further information.

7.5 - Loss

7.5.1 - Deteriorating timber (7/09)

The sale area has received damage from emerald ash borer. The Purchaser should harvest the wood as soon as possible. The Department of Natural Resources is held free of responsibility of any further damage or deterioration due to delay in harvesting.



TIMBER SALE MAP

This information provided by authority of Part 525, 1994 PA 451, as amended.

Sale Number	Year
54 - 008	16

Forest Management Unit	County	Mapped By	Date	Page	of
Atlanta Management Unit	Montmorency	D. Coy	08/10/2016	1	2
Township	Range	Section(s) and Subdivision(s)	Scale		
29N	02E & 03E	31- NE4, SWSE, SESW, & NENW 32- E2SW & W2NW	1:15,840		

Cover Type				Density			
A = Aspen	H = Hemlock	N = Marsh	U = Upland Brush	0 = Non Stocked	5 = Pole Timber Medium		
B = Paper Birch	J = Jack Pine	O = Oak	UM = Upland Mixed	1 = Seedling Sapling Poor	6 = Pole Timber Well		
C = Cedar	L = Lowland Brush	P = Lowland Poplar	V = Bog or Marsh	2 = Seedling Sapling Medium	7 = Saw Timber Poor		
D = Tread Bog	LM = Lowland Mixed	Q = Mixed Swamp Conifer	W = White Pine	3 = Seedling Sapling Well	8 = Saw Timber Medium		
E = Swamp Hdwoods	M = Mpl, Bch, Brch	R = Red Pine	X = Non Stocked	4 = Pole Timber Poor	9 = Saw Timber Well		
F = Spruce Fir	MC = Mixed Conifer	S = Black Spruce	Z = Water				
G = Grass	MD = Mixed Deciduous	T = Tamarack					

PU	Acres	PU	Acres	PU	Acres
1	18.5	5	9.1	9	32.6
2	15.7	6	38.0		
3	4.5	7	16.0		
4	11.6	8	27.3		

Mark It Zero Mix
Compartment 17
173.3 Acres

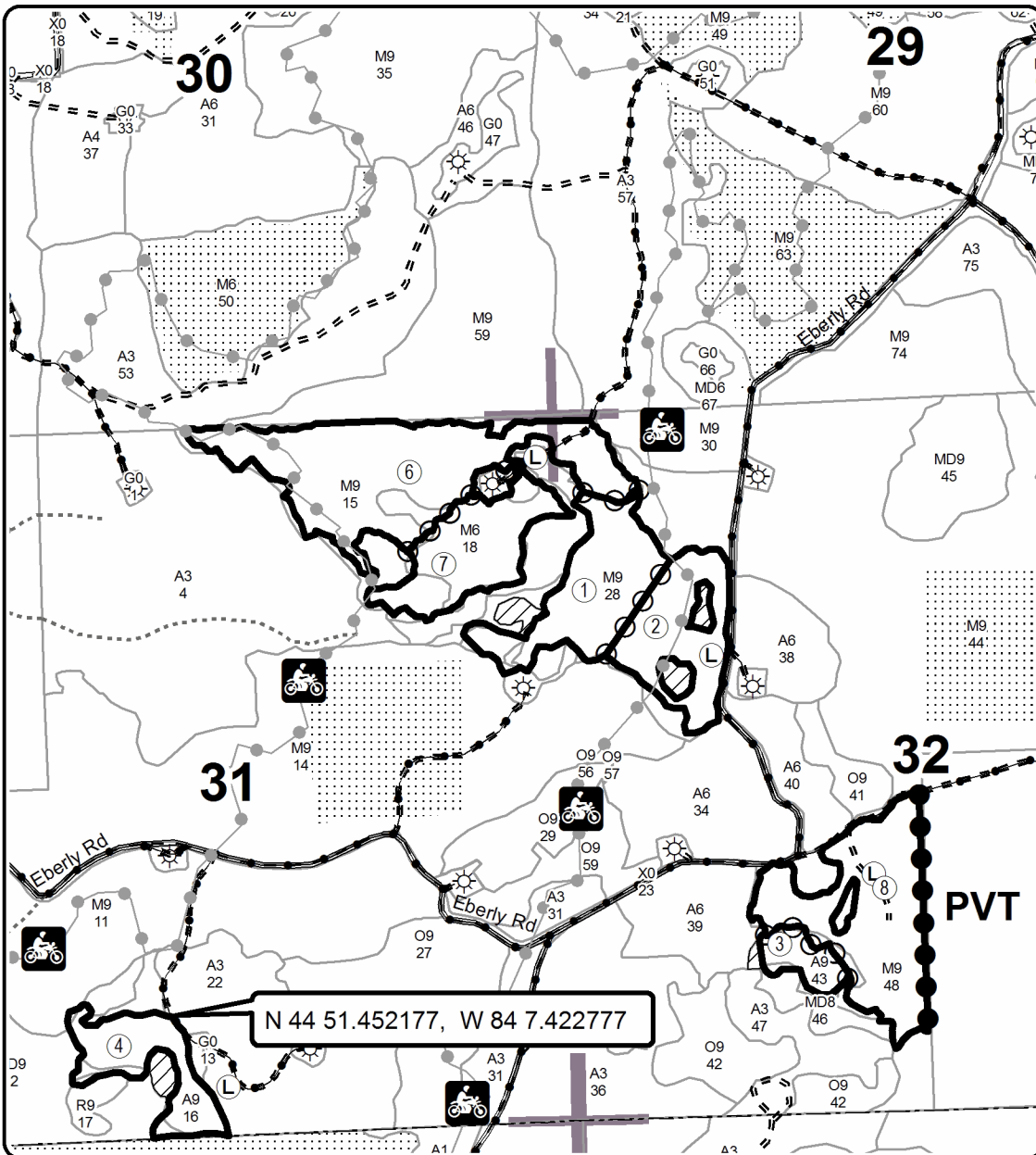
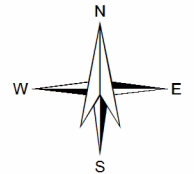

Legend

- Against State (Red)
- Private Line (Blue)
- Payment Unit (Yellow)
- Retention Area (Red)
- Nearby Timber Sale
- Stand Boundaries
- Payment Unit
- Landing
- Gas Well
- Section Corners
- Recreational Trail
- Pipeline; Powerline
- Gravel Roads
- Poor Dirt Roads
- Closed Roads

Locator Map
1:150,000

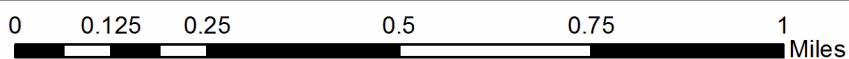
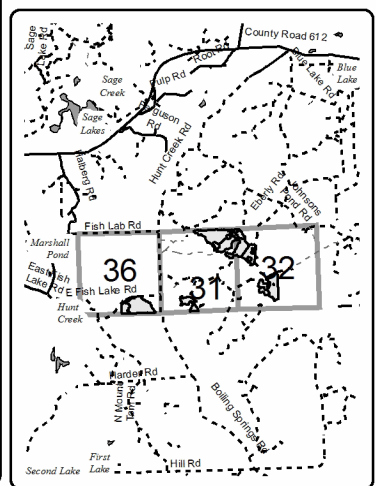



TIMBER SALE MAP

This information provided by authority of Part 525, 1994 PA 451, as amended.

Sale Number	Year
54 - 008	16

Forest Management Unit Atlanta Management Unit	County Montmorency	Mapped By D. Coy	Date 08/10/2016	Page 2	of 2
Township 29N	Range 02E & 03E	Section(s) and Subdivision(s) 31- NE4, SWSE, SESW, & NENW 32- E2SW & W2NW	Scale 1:15,840		

Cover Type				Density			
A = Aspen	H = Hemlock	N = Marsh	U = Upland Brush	0 = Non Stocked	5 = Pole Timber Medium		
B = Paper Birch	J = Jack Pine	O = Oak	UM = Upland Mixed	1 = Seedling Sapling Poor	6 = Pole Timber Well		
C = Cedar	L = Lowland Brush	P = Lowland Poplar	V = Bog or Marsh	2 = Seedling Sapling Medium	7 = Saw Timber Poor		
D = Tread Bog	LM = Lowland Mixed	Q = Mixed Swamp Conifer	W = White Pine	3 = Seedling Sapling Well	8 = Saw Timber Medium		
E = Swamp Hdwoods	M = Mpl, Bch, Brch	R = Red Pine	X = Non Stocked	4 = Pole Timber Poor	9 = Saw Timber Well		
F = Spruce Fir	MC = Mixed Conifer	S = Black Spruce	Z = Water				
G = Grass	MD = Mixed Deciduous	T = Tamarack					

PU	Acres	PU	Acres	PU	Acres
1	18.5	5	9.1	9	32.6
2	15.7	6	38.0		
3	4.5	7	16.0		
4	11.6	8	27.3		

Mark It Zero Mix Compartment 17 173.3 Acres

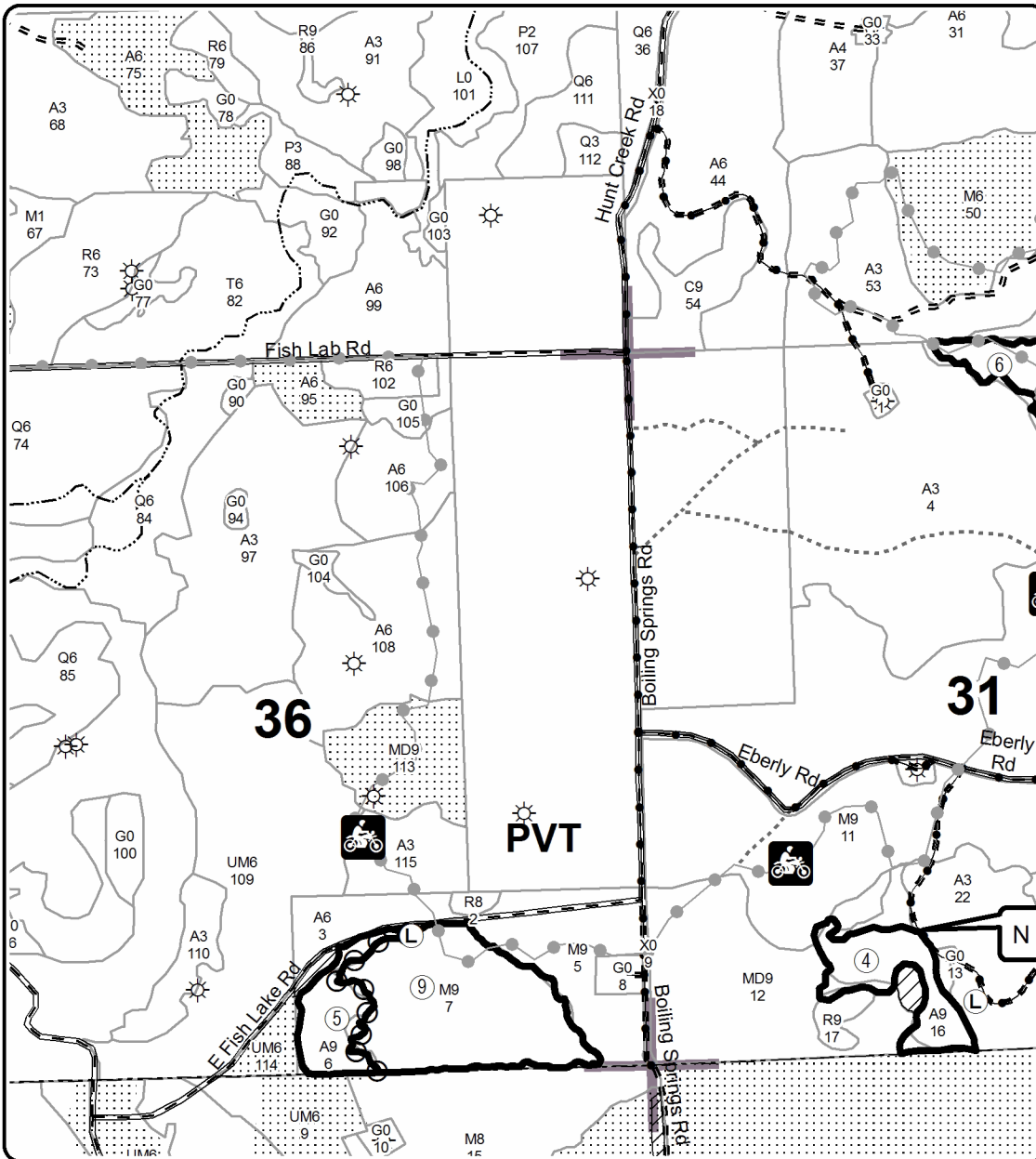
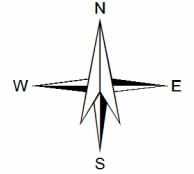

Legend	
	Against State (Red)
	Private Line (Blue)
	Payment Unit (Yellow)
	Retention Area (Red)
	Nearby Timber Sale
	Stand Boundaries
	Payment Unit
	Landing
	Gas Well
	Section Corners
	Recreational Trail
	Pipeline; Powerline
	Gravel Roads
	Poor Dirt Roads
	Closed Roads

Locator Map
1:150,000

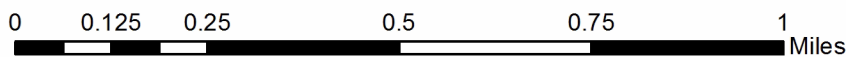
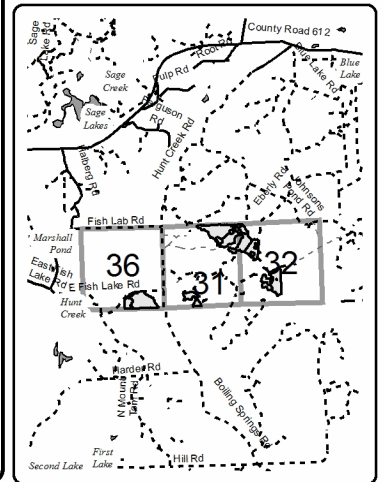

TIMBER SALE INFORMATION

SBW-15 (54-015-16)

Montmorency County (Advertised Price \$15,141.05)

A timber sale contract for this lump sum, sealed bid timber sale will be awarded to the responsible bidder offering the highest sealed bid price. Bids must be at or above the following advertised price for each species:

<u>PRODUCTS & SPECIES</u>	<u>ESTIMATED UNITS*</u>	<u>ADVERTISED PRICE</u>
Sawtimber		
Paper Birch	1.50 MBF	\$ 49.00 / MBF
Quaking Aspen	48.10 MBF	\$ 68.00 / MBF
Red Maple	14.10 MBF	\$ 107.00 / MBF
Red Oak	0.40 MBF	\$ 125.00 / MBF
Red Pine	4.60 MBF	\$ 111.00 / MBF
Pulpwood		
Balsam Fir	151.00 Cords	\$ 24.50 / Cord
Black Spruce	25.00 Cords	\$ 35.25 / Cord
Mixed Aspen	207.00 Cords	\$ 18.15 / Cord
Paper Birch	10.00 Cords	\$ 18.80 / Cord
Red Maple	59.00 Cords	\$ 16.35 / Cord
Red Oak	2.00 Cords	\$ 15.95 / Cord
Red Pine	4.00 Cords	\$ 43.55 / Cord
White Pine	1.00 Cords	\$ 30.90 / Cord

* The total volume is statistically estimated within plus (+) or minus (-) 12.50 percent. The estimated units are final and not subject to adjustment. Prospective bidders are urged to examine this timber and to make their own estimates of quantity and quality.

BOND AND PAYMENT SCHEDULE:

1. A bond in the amount of \$757.00 to insure faithful performance of the conditions of the contract will be deposited by the successful bidder within 21 days of the sale award.
2. Cutting in any sale or unit without the required advance payment would be considered a trespass.
3. Total payment must be paid in advance or according to the following schedule:
 - (a) Ten percent (10%) of the sale value must be paid within 21 days of the sale award.
 - (b) The remainder is due before cutting begins.
4. If no cutting takes place, the 10% down payment will not be refunded.
5. Operations on the contract issued will terminate on 12/31/2019.

Description of Timber by Payment Unit (PU)

PU	MARKET GROUP	PRODUCT	QUANTITY	UNIT	ACRES	ADVERTISE PRICE
1	Paper Birch	Sawtimber	1.5	MBF	37.0	\$15,116.55
	Quaking Aspen		48.1	MBF		
	Red Maple		14.1	MBF		
	Red Oak		0.4	MBF		
	Red Pine		4.6	MBF		
	Balsam Fir	Pulpwood	150.0	Cords		
	<i>Balsam Fir</i>	<i>Sawtimber</i>	19.7	<i>MBF</i>		
	<i>Balsam Fir</i>	<i>Pulpwood</i>	111.0	<i>Cords</i>		
	Black Spruce		25.0	Cords		
	<i>Black Spruce</i>	<i>Sawtimber</i>	2.1	<i>MBF</i>		
	<i>Black Spruce</i>	<i>Pulpwood</i>	21.0	<i>Cords</i>		
	Mixed Aspen		207.0	Cords		
	<i>Balsam Poplar</i>	<i>Sawtimber</i>	1.3	<i>MBF</i>		
	<i>Balsam Poplar</i>	<i>Pulpwood</i>	5.0	<i>Cords</i>		
	<i>Quaking Aspen</i>		199.0	<i>Cords</i>		
	Paper Birch		10.0	Cords		
	Red Maple		59.0	Cords		
	Red Oak		2.0	Cords		
	Red Pine		4.0	Cords		
	White Pine		1.0	Cords		
TOTAL:			68.7	MBF		
TOTAL:			458.0	Cords		

Sale Specific Conditions & Requirements

Sale Name: SBW-15

Sale Number: 54-015-16 Seq#: 2

1 - Sale Area

1.2 - Boundaries

1.2.1 - Painted boundaries (1/14)

The sale boundary is marked and identified red paint. Exterior sale boundary lines against state are marked with red paint. The painted boundary line trees are not Included Timber and are to be protected.

2 - Timber Specifications

2.1 - Included Timber

2.1.1 - Clearcut unit(s) with unmerchantable trees (6/14)

Within Payment Unit(s) 1, cut all trees that are two (2) inches or more at DBH except do not cut northern white cedar.

3 - Payments

3.4 - Damaged Timber

3.4.1 - Damaged timber (6/14)

General Condition and Requirement 3.4 Damaged Timber, defines liquidated damages for undesignated live merchantable trees which are cut or injured. No damage is acceptable to undesignated merchantable trees. Within the sale area, if more than 5% of trees (> 4.5" DBH) within a specified area of the sale are damaged, liquidated damages will be assessed for all trees damaged. Rates will be in accordance with General Condition and Requirement 3.4 Damaged Timber.

4 - Transportation

4.1 - Construction

4.1.5 - Culverts (5/14)

Roads may require the installation of culverts for cross drainage or at natural drainage-ways. If culverts are needed in these locations, their placement will be specified by the sale administrator and they shall be installed prior to hauling. The culverts shall be new, corrugated metal or plastic gauge. Culverts will be a minimum of 12 inches in diameter and 24 feet in length. If culverts are removed, fill shall be removed from wetland soils as specified. Soils shall be maintained and left in a non-erodible condition, with water bars, seed, fertilizer, mulch, and slash installed as directed by the sale administrator and as specified in the BMP manual.

4.1.12 - No new roads (1/12)

No new roads will be permitted. Skid trails only will be allowed.

4.2 - Maintenance

4.2.5 - Two wheel drive condition (2/04)

All existing trail roads on and adjacent to the sale area must be passable by two-wheel drive traffic for the duration of the sale.

5 - Operations

5.1 - Notification

5.1.1 - Pre-sale conference (10/11)

A pre-sale conference between the Purchaser and sale administrator is required prior to beginning any operations to determine landing and road locations. The Unit Manager or his/her representative must be contacted at least 10 days in advance to schedule the conference.

5.1.3 - Well heads and natural gas pipelines (11/15)

The Purchaser is responsible for contacting the gas or pipeline company 30 days prior to operating equipment in the vicinity of well heads or natural gas pipelines.

5.1.4 - Post-sale conference (6/11)

A post-sale conference on site between the Purchaser and sale administrator is required 5 days prior to the completion of active logging operations to determine clean-up and repair of landings, road edges, and the fulfillment of other contract specifications.

5.2 - Conduct of Operations

5.2.1 - Slash

5.2.1.10 - No slash in openings (5/10)

No brush or logging debris is to be left in the maintained wildlife opening which is indicated by G0 on the Timber Sale Map. Any damage to the opening shall be repaired according to specifications of the Unit Manager or his/her representative.

5.2.2 - Hazard Trees/Snags

5.2.2.1 - Den trees (2/04)

Obvious hollow and/or den trees shall be protected and left standing unless they are a safety hazard.

5.2.4 - Dead and Down Creation

5.2.4.4 - Dead and down creation, grouse (8/13)

To encourage grouse and other wildlife, in Payment Unit(s) 1, leave one, 12" diameter or larger log-length (8 foot minimum) piece on the ground for every 2 acres. These will be evenly scattered throughout the unit. This can be an unmerchantable piece or a full tree.

5.2.17 - Crane Mats/Timber Mats (10/14)

Some roads or skid trails may require extra protection such as that afforded by Crane Mats/Timber Mats. If available, Crane Mats/Timber Mats may be borrowed from the DNR and are located at the Marquette ICC and the Grayling Field Office. Contact the sale administrator for specific details. A Timber Sale Contract Supplement will be used to document the Purchaser's use of the DNR's Crane Mats/Timber Mats. It is the responsibility of the Purchaser to contact the sale administrator to schedule pick up and drop off. In addition, all mats must be cleaned prior to drop off. A charge of \$350.00 NLP will be assessed for all damaged or non-returned mats. Damage is defined as misuse resulting in three or more broken cants.

5.2.22 - Operating Caution

5.2.22.1 - Operating caution (6/11)

It is recommended, but not required, that within Payment Unit(s) 1, cutting, skidding, and hauling occur during dry summer or frozen winter conditions. The reason for the recommendation is because poor drainage soils.

5.4 - Soil Protection

5.4.1 - Rutting restriction, general (1/09)

Operations are to cease immediately if equipment and/or weather conditions result in rutting of roads and skid trails which is 12 inches or greater in depth and 50 feet in length. The Unit Manager or his/her representative may restrict hauling and/or skidding if ruts exceed the specified depth. With the Unit Manager or his/her representative's approval, the Purchaser may return to the area when the risk of rutting has decreased.

5.8 - Protection of Endangered Species

5.8.5 - Protection of raptor nests (3/13)

All trees with raptor nests will be protected if found during harvesting operations. Notification will be made to the Unit Manager or his/her representative who will notify the Wildlife Biologist so an on-site evaluation and recommendation can be made, if necessary.



TIMBER SALE MAP

This information provided by authority of Part 525, 1994 PA 451, as amended.

Sale Number	Year
54-015	16

Forest Management Unit	County	Mapped By	Date	Page	of
Atlanta Management Unit	Montmorency	A Krugh	05/04/2016	1	1
Township	Range	Section(s) and Subdivision(s)	Scale		
29N 30N	03E	Sec 5 NWNE, NENW, SENW, Sec. 32 SWSE	1:15,840		

Cover Type				Density			
A = Aspen	H = Hemlock	N = Marsh	U = Upland Brush	0 = Non Stocked	5 = Pole Timber Medium		
B = Paper Birch	J = Jack Pine	O = Oak	UM = Upland Mixed	1 = Seedling Sapling Poor	6 = Pole Timber Well		
C = Cedar	L = Lowland Brush	P = Lowland Poplar	V = Bog or Marsh	2 = Seedling Sapling Medium	7 = Saw Timber Poor		
D = Treed Bog	LM = Lowland Mixed	Q = Mixed Swamp Conifer	W = White Pine	3 = Seedling Sapling Well	8 = Saw Timber Medium		
E = Swamp Hdwoods	M = Mpl, Bch, Brch	R = Red Pine	X = Non Stocked	4 = Pole Timber Poor	9 = Saw Timber Well		
F = Spruce Fir	MC = Mixed Conifer	S = Black Spruce	Z = Water				
G = Grass	MD = Mixed Deciduous	T = Tamarack					



SBW-15

Compartment 15

37 Acres

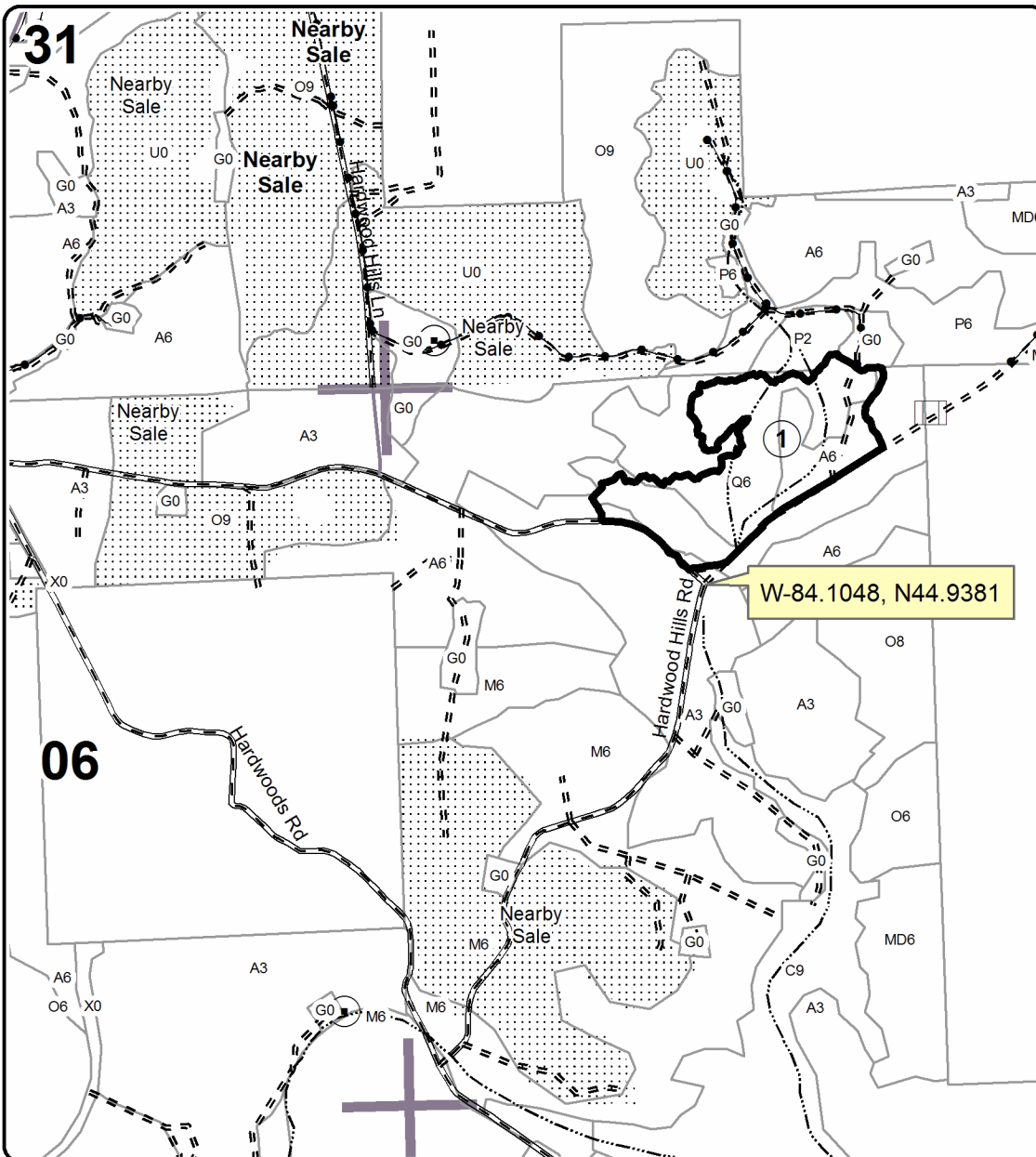

Legend

- Sale Boundary**
 - Against State (Red)
- Payment Units
- Adjacent Timber Sale
- Section Corners
- Adjacent Stand Boundaries
- Paved Roads
- Gravel Roads
- Poor Dirt Roads
- Streams
- Pipeline; Powerline
- Oil & Gas Well Sites
- Gate

Locator Map
1:200,000

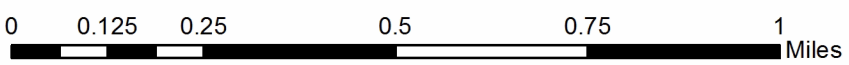
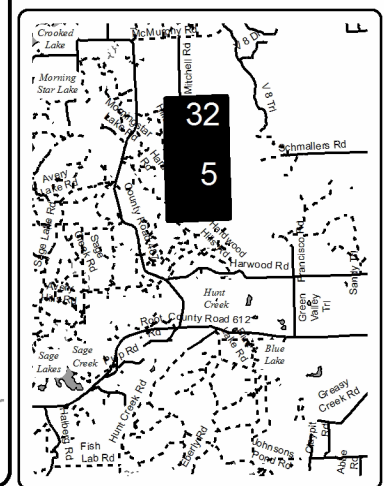

TIMBER SALE INFORMATION

Maplecatation (54-042-16)

Montmorency County (Advertised Price \$231,903.50)

A timber sale contract for this lump sum, sealed bid timber sale will be awarded to the responsible bidder offering the highest sealed bid price. Bids must be at or above the following advertised price for each species:

<u>PRODUCTS & SPECIES</u>	<u>ESTIMATED UNITS*</u>		<u>ADVERTISED PRICE</u>
Sawtimber			
Mixed Aspen	171.50	MBF	\$ 78.00 / MBF
Red Maple	60.40	MBF	\$ 123.00 / MBF
Red Oak	921.20	MBF	\$ 145.00 / MBF
Red Pine	28.80	MBF	\$ 128.00 / MBF
White Oak	45.80	MBF	\$ 72.00 / MBF
Pulpwood			
Balsam Fir	38.00	Cords	\$ 28.25 / Cord
Mixed Aspen	855.00	Cords	\$ 20.95 / Cord
Mixed Hardwood	627.00	Cords	\$ 18.90 / Cord
Red Oak	1,891.00	Cords	\$ 18.45 / Cord
Red Pine	38.00	Cords	\$ 50.25 / Cord
White Oak	113.00	Cords	\$ 18.45 / Cord
White Pine	23.00	Cords	\$ 35.65 / Cord

* The total volume is statistically estimated within plus (+) or minus (-) 9.00 percent. The estimated units are final and not subject to adjustment. Prospective bidders are urged to examine this timber and to make their own estimates of quantity and quality.

BOND AND PAYMENT SCHEDULE:

1. A bond in the amount of \$11,595.00 to insure faithful performance of the conditions of the contract will be deposited by the successful bidder within 21 days of the sale award.
2. Cutting in any sale or unit without the required advance payment would be considered a trespass.
3. Total payment must be paid in advance or according to the following schedule:
 - (a) Ten percent (10%) of the sale value must be paid within 21 days of the sale award.
 - (b) The 10% down payment will be credited towards the first unit cut.
4. If no cutting takes place, the 10% down payment will not be refunded.
5. Operations on the contract issued will terminate on 12/31/2019.

Description of Timber by Payment Unit (PU)

PU	MARKET GROUP	PRODUCT	QUANTITY	UNIT	ACRES	ADVERTISE PRICE	
1	Mixed Aspen	Sawtimber	13.9	MBF	29.0	\$31,041.00	
	<i>B. T. Aspen</i>		9.9	<i>MBF</i>			
	<i>Quaking Aspen</i>		4.0	<i>MBF</i>			
	Red Maple		11.5	MBF			
	Red Oak		101.9	MBF			
	Red Pine		21.0	MBF			
	White Oak		7.4	MBF			
	Mixed Aspen		Pulpwood	115.0			Cords
	<i>B. T. Aspen</i>			103.0			<i>Cords</i>
	<i>Quaking Aspen</i>			12.0			<i>Cords</i>
	Mixed Hardwood			97.0			Cords
	<i>Paper Birch</i>			3.0			<i>Cords</i>
	<i>Red Maple</i>			94.0			<i>Cords</i>
	Red Oak			225.0			Cords
	Red Pine			28.0			Cords
	White Oak	23.0		Cords			
	White Pine	9.0		Cords			
	<i>White Pine</i>	<i>Sawtimber</i>	1.1	<i>MBF</i>			
	<i>White Pine</i>	<i>Pulpwood</i>	7.0	<i>Cords</i>			
	2	Mixed Aspen	Sawtimber	67.0			MBF
<i>B. T. Aspen</i>		60.4		<i>MBF</i>			
<i>Quaking Aspen</i>		6.6		<i>MBF</i>			
Red Maple		8.8		MBF			
Red Oak		45.3		MBF			
Red Pine		4.3		MBF			
White Oak		1.5		MBF			
Mixed Aspen		Pulpwood		305.0	Cords		
<i>B. T. Aspen</i>				250.0	<i>Cords</i>		
<i>Quaking Aspen</i>				55.0	<i>Cords</i>		
Mixed Hardwood				115.0	Cords		
<i>Paper Birch</i>				1.0	<i>Cords</i>		
<i>Red Maple</i>				114.0	<i>Cords</i>		
Red Oak				128.0	Cords		
Red Pine				6.0	Cords		
White Oak			6.0	Cords			
White Pine			1.0	Cords			
<i>White Pine</i>		<i>Sawtimber</i>	0.2	<i>MBF</i>			
<i>White Pine</i>		<i>Pulpwood</i>	1.0	<i>Cords</i>			
3		Mixed Aspen	Sawtimber	44.5	MBF	37.2	\$38,937.25
	<i>B. T. Aspen</i>	41.9		<i>MBF</i>			
	<i>Quaking Aspen</i>	2.6		<i>MBF</i>			
	Red Maple	9.0		MBF			
	Red Oak	126.3		MBF			
	Red Pine	1.0		MBF			
	White Oak	0.4		MBF			
	Mixed Aspen	Pulpwood		220.0	Cords		
	<i>B. T. Aspen</i>			198.0	<i>Cords</i>		
	<i>Quaking Aspen</i>			22.0	<i>Cords</i>		
	Mixed Hardwood		202.0	Cords			
	<i>Red Maple</i>		202.0	<i>Cords</i>			
	Red Oak		389.0	Cords			
	Red Pine	1.0	Cords				
	White Oak	5.0	Cords				
	White Pine	4.0	Cords				
<i>White Pine</i>	4.0	<i>Cords</i>					
4	Mixed Aspen	Sawtimber	11.5	MBF	9.5	\$8,307.30	

Description of Timber by Payment Unit (PU), con't

PU	MARKET GROUP	PRODUCT	QUANTITY	UNIT	ACRES	ADVERTISE PRICE
4 con't	<i>B. T. Aspen</i>	<i>Sawtimber</i>	11.5	<i>MBF</i>		
	Red Maple		1.1	MBF		
	Red Oak		24.8	MBF		
	Mixed Aspen	Pulpwood	127.0	Cords		
	<i>B. T. Aspen</i>		127.0	<i>Cords</i>		
	Mixed Hardwood		8.0	Cords		
	<i>Red Maple</i>		8.0	<i>Cords</i>		
	Red Oak		47.0	Cords		
5	Mixed Aspen	Sawtimber	2.6	MBF	12.6	\$9,252.25
	<i>B. T. Aspen</i>		1.2	<i>MBF</i>		
	<i>Quaking Aspen</i>		1.4	<i>MBF</i>		
	Red Maple		4.7	MBF		
	Red Oak		24.0	MBF		
	Red Pine		2.5	MBF		
	White Oak		19.7	MBF		
	Balsam Fir	Pulpwood	8.0	Cords		
	<i>Balsam Fir</i>	<i>Sawtimber</i>	1.0	<i>MBF</i>		
	<i>Balsam Fir</i>	<i>Pulpwood</i>	6.0	<i>Cords</i>		
	Mixed Aspen		24.0	Cords		
	<i>B. T. Aspen</i>		12.0	<i>Cords</i>		
	<i>Quaking Aspen</i>		12.0	<i>Cords</i>		
	Mixed Hardwood		29.0	Cords		
	<i>Paper Birch</i>		3.0	<i>Cords</i>		
	<i>Red Maple</i>		26.0	<i>Cords</i>		
	Red Oak		62.0	Cords		
	Red Pine		3.0	Cords		
	White Oak		35.0	Cords		
	White Pine		1.0	Cords		
	<i>White Pine</i>	<i>Sawtimber</i>	0.1	<i>MBF</i>		
<i>White Pine</i>	<i>Pulpwood</i>	1.0	<i>Cords</i>			
6	Mixed Aspen	Sawtimber	21.4	MBF	64.1	\$79,579.15
	<i>B. T. Aspen</i>		16.7	<i>MBF</i>		
	<i>Quaking Aspen</i>		4.7	<i>MBF</i>		
	Red Maple		16.9	MBF		
	Red Oak		399.1	MBF		
	White Oak		11.2	MBF		
	Balsam Fir	Pulpwood	20.0	Cords		
	<i>Balsam Fir</i>		20.0	<i>Cords</i>		
	Mixed Aspen		42.0	Cords		
	<i>B. T. Aspen</i>		15.0	<i>Cords</i>		
	<i>Quaking Aspen</i>		27.0	<i>Cords</i>		
	Mixed Hardwood		117.0	Cords		
	<i>Beech</i>		3.0	<i>Cords</i>		
	<i>Red Maple</i>		114.0	<i>Cords</i>		
	Red Oak		693.0	Cords		
	White Oak		29.0	Cords		
	White Pine		5.0	Cords		
<i>White Pine</i>		5.0	<i>Cords</i>			
7	Mixed Aspen	Sawtimber	10.6	MBF	32.1	\$39,842.90
	<i>B. T. Aspen</i>		8.3	<i>MBF</i>		
	<i>Quaking Aspen</i>		2.3	<i>MBF</i>		
	Red Maple		8.4	MBF		
	Red Oak		199.8	MBF		
	White Oak		5.6	MBF		
	Balsam Fir	Pulpwood	10.0	Cords		
	<i>Balsam Fir</i>		10.0	<i>Cords</i>		

Description of Timber by Payment Unit (PU), con't

PU	MARKET GROUP	PRODUCT	QUANTITY	UNIT	ACRES	ADVERTISE PRICE
7 con't	Mixed Aspen	Pulpwood	22.0	Cords		
	<i>B. T. Aspen</i>		8.0	<i>Cords</i>		
	<i>Quaking Aspen</i>		14.0	<i>Cords</i>		
	Mixed Hardwood		59.0	Cords		
	<i>Beech</i>		2.0	<i>Cords</i>		
	<i>Red Maple</i>		57.0	<i>Cords</i>		
	Red Oak		347.0	Cords		
	White Oak		15.0	Cords		
	White Pine		2.0	Cords		
	<i>White Pine</i>		2.0	<i>Cords</i>		
TOTAL:			1,227.7	MBF		
TOTAL:			3,584.0	Cords		

Sale Specific Conditions & Requirements

Sale Name: Maplection

Sale Number: 54-042-16 Seq#: 1

1 - Sale Area

1.2 - Boundaries

1.2.1 - Painted boundaries (1/14)

The sale boundary and Payment Unit boundaries are marked and identified red and yellow paint. Exterior sale boundary lines against state are marked with red paint. Interior Payment Unit boundaries are marked with yellow paint. Yellow painted trees designating an interior Payment Unit boundary are only to be cut when all surrounding Payment Units have been paid.

2 - Timber Specifications

2.1 - Included Timber

2.1.1 - Clearcut unit(s) with unmerchantable trees (6/14)

Within Payment Unit(s) 1-7, cut all trees that are two (2) inches or more at DBH except do not cut any red or white pine in Payment Units 6 & 7.

2.1.15 - Hazard trees near roads (7/13)

Cut and remove all standing dead trees within 100 feet of the cleared portion of designated county roads. These trees may be utilized or must be scattered back into the sale area.

2.2 - Utilization

2.2.6 - Roundwood operation required (5/07)

The skidding of whole trees or tree segments with limbs attached is prohibited within Payment Unit(s) 2-4. All products must be produced as roundwood and forwarded to existing roads or landing areas in final product length.

2.2.10 - No chipping tops and limbs (8/16)

Within Payment Unit(s) 2-5, chipping of limbs or tops is not permitted. Limbs and the remaining top must be left on site and scattered.

3 - Payments

3.3 - Pre-measured Sales

3.3.4 - Dividing payment units (7/14)

Payment Unit(s) 1-3, 6, and 7 may be divided at the request of the Purchaser and upon approval of the Unit Manager. Dividing Payment Units is a contract modification which requires a Timber Sale Contract Supplement. There may be more than one division per Payment Unit in order to get units to \$20,000 or less.

3.4 - Damaged Timber

3.4.1 - Damaged timber (6/14)

General Condition and Requirement 3.4 Damaged Timber, defines liquidated damages for undesignated live merchantable trees which are cut or injured.

Within the sale area, if more than 25% of the white pine seedlings or saplings (1/4" to 4.5" DBH) within Payment Unit 5 are damaged, liquidated damages will be assessed at \$150 per acre for all acreage within that specified portion of the sale area that was damaged.

4 - Transportation

4.1 - Construction

4.1.6 - Road construction (1/09)

Improvements of existing roads shall be done in such a way as to minimize the environmental and visual impacts. Merchantable trees shall be cut and utilized unless otherwise directed. Non-merchantable trees shall be severed and laid flat on the ground. Slash shall be scattered, and not left in windrows and kept a minimum of 10 feet back from the road edge.

Stumps shall be set upright, not left on edge, and be moved at least 10 feet away from the road edge. Disturbed soil shall be feathered into the woods and not left in berms or windrows.

4.1.12 - No new roads (1/12)

No new roads will be permitted in any Payment Unit. All operations are limited to existing roads. Skid trails only will be allowed.

4.2 - Maintenance

4.2.5 - Two wheel drive condition (2/04)

All existing trail roads on and adjacent to the sale area must be passable by two-wheel drive traffic for the duration of the sale.

5 - Operations

5.1 - Notification

5.1.1 - Pre-sale conference (10/11)

A pre-sale conference on site between the Purchaser and sale administrator is required prior to beginning any operations to determine landing and road locations. The Unit Manager or his/her representative must be contacted at least 10 days in advance to schedule the conference.

5.1.3 - Well heads and natural gas pipelines (11/15)

The Purchaser is responsible for contacting the gas or pipeline company 30 days prior to operating equipment in the vicinity of well heads or natural gas pipelines.

5.1.4 - Post-sale conference (6/11)

A post-sale conference on site between the Purchaser and sale administrator is required 5 days prior to the completion of active logging operations to determine clean-up and repair of landings, road edges, and the fulfillment of other contract specifications.

5.2 - Conduct of Operations

5.2.2 - Hazard Trees/Snags

5.2.2.1 - Den trees (2/04)

Obvious hollow and/or den trees shall be protected and left standing unless they are a safety hazard.

5.2.3 - Operating Restrictions

5.2.3.1 - Operating restrictions (9/11)

Within Payment Unit(s) 5, unless changed by written agreement, cutting, skidding, and hauling are limited to the period of October 1 through April 30. This restriction is because of a state forest campground nearby.

5.2.3.1.1 - Coppice regeneration protection (4/10)

Timber harvesting in any Payment Unit must be completed before significant deciduous sprouting occurs in that Payment Unit so as to minimize damage to the new regeneration. Any post harvest operations, such as chipping, must be completed before sprouting of regeneration occurs. If it is anticipated that chipping will be delayed, then tops shall be carried to one central location or left unchipped. The Unit Manager or his/her representative may cease such operations if sprouting occurs before the operation is complete.

5.2.4 - Dead and Down Creation

5.2.4.2 - Dead and down creation, hare and grouse (1/14)

To improve habitat for snowshoe hare, grouse, and other species, the Purchaser is to leave 1 tree, nine (9) inches or larger in diameter on the ground for every 1 acre. They should be scattered throughout the sale or positioned per the sale administrators instructions. If possible, the logs or trees should be felled so they overlap. Note these pieces should have a minimum length of twenty feet. They can be of any tree species and can be an un-merchantable piece of wood or a full tree.

5.2.32 - Decking/landing restoration (9/13)

All decking and landing areas must have the surface area restored to a condition equal to or better than before. This is to

ensure the proper regeneration of the stand. Wood debris, chips and "cookies" from trimmings must be removed or scattered away from landing and loading areas and may not be windrowed on the edge.

5.2.38 - No decking against live trees (2/04)

Cut products may not be decked against unmarked or designated leave trees.

5.2.40 - Pathway protection (10/10)

The horse trail is shown on the Timber Sale Map. Do not cut trees or damage posts with blue pathway markers. Maintain a 20-foot wide slash, debris, and rut free zone daily, using the pathway as the centerline. Skidding across the trail may only occur in locations approved by the sale administrator. In addition, if a permitted event is scheduled, operations are to halt or be restricted to 330 feet or more from trails while event takes place.

5.2.41 - Snowmobile trail protection (9/11)

The snowmobile trail is shown on the Timber Sale Map. Do not cut or damage posts with orange trail markers or traffic control signs. If the trail is used, it must be maintained and restored to a condition equal to or better than before the sale. The road maintenance/restoration must be done prior to December 1. If the trail is used for hauling, it must be graded to the satisfaction of the Unit Manager or his/her representative prior to December 1st. If the trail road is to be used for hauling during the snowmobile season, then a snow covered base must be left on the trail. The snowmobile trail may only be crossed at right angles. Maintain a 20 foot wide slash, debris, and rut free zone daily using the snowmobile trail as the centerline. All stumps within 20 feet of the snowmobile trail must be cut at ground level.

5.4 - Soil Protection

5.4.1 - Rutting restriction, general (7/16)

Operations are to cease immediately if equipment and weather conditions result in rutting of roads and/or skid trails which is 12 inches or greater in depth and 50 feet in length. The Unit Manager or his/her representative may restrict hauling and/or skidding if ruts exceed the specified depth. With the Unit Manager or his/her representative's approval, the Purchaser may return to the area when the risk of rutting has decreased.

5.4.2 - Skid trails (2/04)

Skid trails up and down slopes should be avoided. If however this is unavoidable, these trails will be left in a non-erodible condition using water bars, logs, and slash. Placing of slash on these skid trails while logging is ongoing may alleviate need for any further action. At the direction of the sale administrator, seed, fertilizer, and mulch may also be required.

5.4.4 - Slope protection (5/15)

Skid trails and roads on slopes shall be water barred with slash, stumps, and/or clean straw bales native to the area as soon as use is complete to prevent erosion.

5.8 - Protection of Endangered Species

5.8.5 - Protection of raptor nests (3/13)

All trees with raptor nests will be protected if found during harvesting operations. Notification will be made to the Unit Manager or his/her representative who will notify the Wildlife Biologist so an on-site evaluation and recommendation can be made, if necessary.

6 - Safety and Fire Prevention

6.2 - Signing

6.2.1 - Road posting (9/09)

The Purchaser is responsible for posting and maintaining caution signs on Avery Lake road prior to beginning operations. The road must be posted at appropriate distances from the sale area to warn of logging activity and truck traffic. Signs must be removed when harvest operations are suspended or completed. The Purchaser will provide these signs.

6.2.2 - Snowmobile trail posting (8/09)

The Purchaser is responsible for posting and maintaining caution signs on snowmobile trail prior to beginning operations during the snowmobile season (approximately December 1 to March 31). The trail must be posted at appropriate distances from the sale area to warn of logging activity and truck traffic. Signs must be removed when harvest operations are suspended or completed. The Purchaser will provide these signs.

6.2.3 - Recreational trail posting (2/10)

The Purchaser is responsible for posting and maintaining caution signs on the horse trail prior to beginning operations. The trail must be posted at appropriate distances from the sale area to warn of logging activity and truck traffic at both ends of the trail. Signs must be removed when harvest operations are suspended or completed. The Purchaser will provide these signs.



TIMBER SALE MAP

This information provided by authority of Part 525, 1994 PA 451, as amended.

Sale Number	Year
54 - 042	16

Forest Management Unit	County	Mapped By	Krugh	Date	Page	of
Atlanta	Montmorency	Cruised By	Krugh/Natzke	09/19/2016	1	2
Township	Range	Section(s) and Subdivision(s)		Scale		
29N	02E	10 N2NE N2NW SENW SW W2SE, 15 NW, 3 N2SE E2SW SENE, 9 NENE NESE		1:15,840		

Cover Type				Density				
A = Aspen	H = Hemlock	N = Marsh	U = Upland Brush	0 = Non Stocked	5 = Pole Timber Medium			
B = Paper Birch	J = Jack Pine	O = Oak	UM = Upland Mixed	1 = Seedling Sapling Poor	6 = Pole Timber Well			
C = Cedar	L = Lowland Brush	P = Lowland Poplar	V = Bog or Marsh	2 = Seedling Sapling Medium	7 = Saw Timber Poor			
D = Tread Bog	LM = Lowland Mixed	Q = Mixed Swamp Conifer	W = White Pine	3 = Seedling Sapling Well	8 = Saw Timber Medium			
E = Swamp Hdwoods	M = Mpl, Bch, Brch	R = Red Pine	X = Non Stocked	4 = Pole Timber Poor	9 = Saw Timber Well			
F = Spruce Fir	MC = Mixed Conifer	S = Black Spruce	Z = Water					
G = Grass	MD = Mixed Deciduous	T = Tamarack						

PU	Acres	PU	Acres
1	29	4	9.5
2	25.5	5	12.6
3	37.2	6	64.1

Maplecion Compartment 006 210 Acres

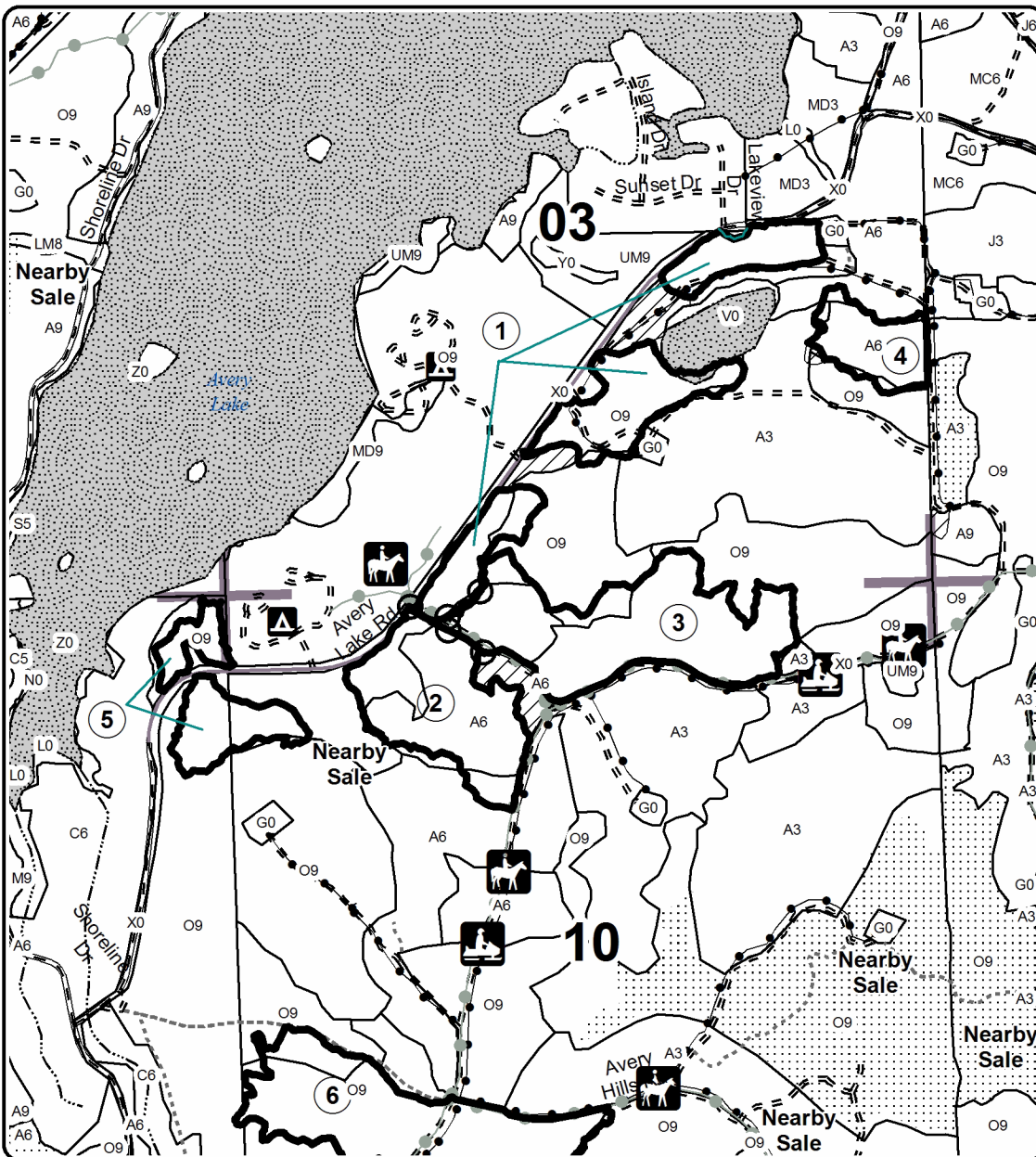
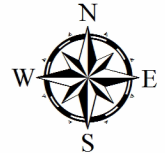

Legend

- Against State (Red)
- Payment Unit (Yellow)
- Retention Area
- Payment Units
- Recreational Trail
- Pipeline; Powerline
- Adjacent Timber Sale
- Paved Roads
- Gravel Roads
- Poor Dirt Roads
- Closed Roads
- Lakes and Rivers
- All
- Recreational Trail

Locator Map
1:200,000

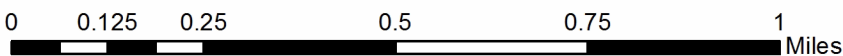
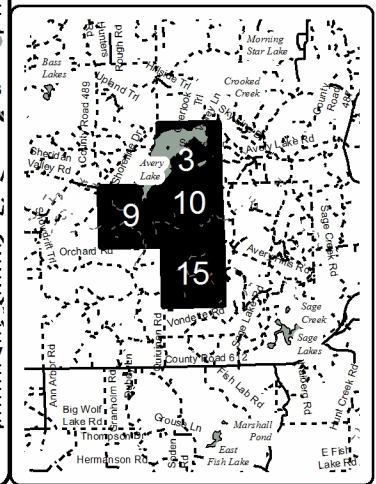



TIMBER SALE MAP

This information provided by authority of Part 525, 1994 PA 451, as amended.

Sale Number	Year
54 - 042	16

Forest Management Unit	County	Mapped By	Date	Page	of
Altanta	Montmorency	Krugh	09/19/2016	2	2
		Cruised By			
		Krugh/Natzke			

Township	Range	Section(s) and Subdivision(s)	Scale
29N	02E	10 N2NE N2NW SENW SW W2SE, 15 NW, 3 N2SE E2SW SENE, 9 NENE NESE	1:15,840

Cover Type				Density			
A = Aspen	H = Hemlock	N = Marsh	U = Upland Brush	0 = Non Stocked	5 = Pole Timber Medium		
B = Paper Birch	J = Jack Pine	O = Oak	UM = Upland Mixed	1 = Seedling Sapling Poor	6 = Pole Timber Well		
C = Cedar	L = Lowland Brush	P = Lowland Poplar	V = Bog or Marsh	2 = Seedling Sapling Medium	7 = Saw Timber Poor		
D = Treed Bog	LM = Lowland Mixed	Q = Mixed Swamp Conifer	W = White Pine	3 = Seedling Sapling Well	8 = Saw Timber Medium		
E = Swamp Hdwoods	M = Mpl, Bch, Brch	R = Red Pine	X = Non Stocked	4 = Pole Timber Poor	9 = Saw Timber Well		
F = Spruce Fir	MC = Mixed Conifer	S = Black Spruce	Z = Water				
G = Grass	MD = Mixed Deciduous	T = Tamarack					

PU Acres

6	64.1
7	32.1

Maplection Compartment 006 210 Acres

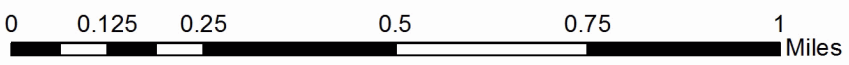
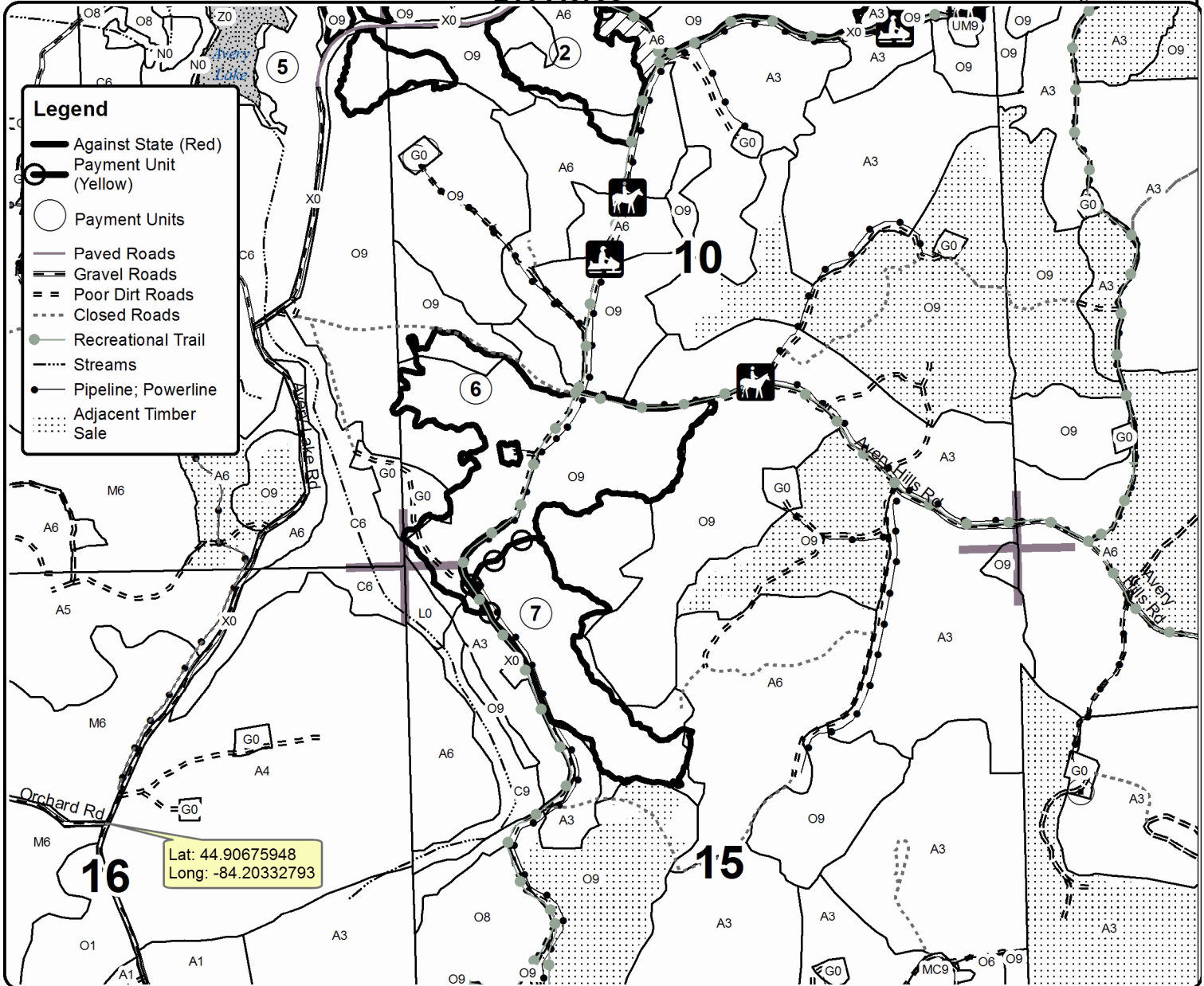

Horsey Sauce Oak (54-007-16)
 ; Montmorency COUNTY

In response to the notice of sale to be held 10:00 a.m. (local time) on July 11, 2017, I am hereby submitting my sealed bid (firm offer) for the following forest products to be cut. Bids for individual species must be at or above the advertised price. All non-responsive bid forms may be rejected.

<u>PRODUCTS & SPECIES</u>	<u>ESTIMATED VOLUME*</u>	<u>ADVERTISED PRICE</u>	<u>BID PRICE</u>
Sawtimber			
B. T. Aspen	296.70 MBF	\$ 78.00/MBF	\$ _____
Basswood	5.00 MBF	\$ 77.00/MBF	\$ _____
Red Maple	21.30 MBF	\$ 123.00/MBF	\$ _____
Red Oak	257.90 MBF	\$ 145.00/MBF	\$ _____
Red Pine	1.20 MBF	\$ 128.00/MBF	\$ _____
Sugar Maple	5.60 MBF	\$ 392.00/MBF	\$ _____
Pulpwood			
B. T. Aspen	342.00 Cords	\$ 20.95/Cord	\$ _____
Balsam Fir	3.00 Cords	\$ 28.25/Cord	\$ _____
Basswood	4.00 Cords	\$ 12.80/Cord	\$ _____
Misc. Species 1	41.00 Cords	\$ 4.45/Cord	\$ _____
Mixed Hardwood	414.00 Cords	\$ 18.90/Cord	\$ _____
Red Oak	427.00 Cords	\$ 18.45/Cord	\$ _____
Red Pine	1.00 Cords	\$ 50.25/Cord	\$ _____

*The volumes are statistically estimated within plus (+) or minus (-) 14.10 percent. These estimated volumes are final and not subject to adjustment. Prospective bidders are urged to examine this timber and to make their own estimates of quantity and quality.

I understand that any or all bids may be rejected. All bids must be signed and all bid items must be bid or the bid form may be rejected. I also understand that consideration and awarding a contract will be based upon my past performance and ability to complete the contract based upon equipment and staffing subject to my control.

FEDERAL ID: _____ or SOCIAL SECURITY NUMBER: _____
 Company or individual bidding: _____
 Company representative's name: _____
 Address: _____
 City: _____ State: _____ Zip: _____

IF AVAILABLE, PLEASE PLACE THE PERSONALIZED LABEL FROM YOUR PROSPECTUS IN THE ABOVE BOX.

Individual or company representative's signature: _____ Date: _____

Phone number : _____ Email (optional): _____

THE WINNING BIDDER MUST COMPLETE THE VERIFICATION OF WORKER'S DISABILITY COMPENSATION ACT COMPLIANCE (ON REVERSE SIDE IF DOUBLE SIDED) WITHIN 21 DAYS OF SALE AWARD DATE



FOR DEPARTMENT USE ONLY
Sale Number (XX - XXX - XX - XX)
Forest Management Unit:

TIMBER SALE VERIFICATION OF WORKER'S DISABILITY COMPENSATION ACT COMPLIANCE

*As required by Act 317, P.A. 1969 (Worker's Compensation) and
Part 5 of Act 451 of 1994, as amended.*

VERIFICATION OF WORKER'S DISABILITY COMPENSATION ACT COMPLIANCE

- This verification must be completed and submitted within 21 days of contract award and prior to the issuance of the timber sale contract.
- In addition, if boxes 2B or 2C are checked, then Notice of Exclusion or Certificate of Insurance must be submitted within twenty-one (21) days of the contract award and prior to the issuance of the timber sale contract.
- All information must be typed or printed except for written signatures.

Please Check Appropriate Categories:

1. My business is organized as (you **must** check one of the boxes below):
 - A. Sole Proprietorship (individual)
 - B. Partnership
 - C. Corporation

2. You **must** check one of the boxes below:
 - A. I certify my business is a sole proprietorship and it has no employees but the sole proprietor. I am not subject to the Worker's Compensation Laws.
 - B. I certify my business has satisfied its obligation to the Worker's Compensation Act through the use of an approved Notice of Exclusion (BWC-337, Rev. 5/96). I will provide a copy of the Notice of Exclusion within 21 days of the contract award. (For questions or a copy of the BWC-337, please call the Worker's Compensation Bureau at 517-322-1195).
 - C. I certify my business has a Worker's Compensation Policy. I will provide an original Certificate of Insurance within twenty-one (21) days of the contract award.

3. If you have checked item 2(A) or 2(B), you **must** indicate the number of **both** full-time and part-time employees, other than yourself, including family members and active partners (if none, you must enter "0").

_____ Full-time Employees

_____ Part-time Employees

Name of Business		Federal ID (or) Social Security No.	
Address		Telephone ()	
City	State	ZIP	

I hereby certify that the above information is true and correct. I agree to notify the Michigan DNR of any changes that occur in factors affecting my coverage during any of my present and future operations.

Signature of Owner or Authorized Representative

Title

Date

Please complete the "SEALED BID" information on the next page

Maplecatation (54-042-16)
 ; Montmorency COUNTY

In response to the notice of sale to be held 10:00 a.m. (local time) on July 11, 2017, I am hereby submitting my sealed bid (firm offer) for the following forest products to be cut. Bids for individual species must be at or above the advertised price. All non-responsive bid forms may be rejected.

<u>PRODUCTS & SPECIES</u>	<u>ESTIMATED VOLUME*</u>	<u>ADVERTISED PRICE</u>	<u>BID PRICE</u>
Sawtimber			
Mixed Aspen	171.50 MBF	\$ 78.00/MBF	\$ _____
Red Maple	60.40 MBF	\$ 123.00/MBF	\$ _____
Red Oak	921.20 MBF	\$ 145.00/MBF	\$ _____
Red Pine	28.80 MBF	\$ 128.00/MBF	\$ _____
White Oak	45.80 MBF	\$ 72.00/MBF	\$ _____
Pulpwood			
Balsam Fir	38.00 Cords	\$ 28.25/Cord	\$ _____
Mixed Aspen	855.00 Cords	\$ 20.95/Cord	\$ _____
Mixed Hardwood	627.00 Cords	\$ 18.90/Cord	\$ _____
Red Oak	1,891.00 Cords	\$ 18.45/Cord	\$ _____
Red Pine	38.00 Cords	\$ 50.25/Cord	\$ _____
White Oak	113.00 Cords	\$ 18.45/Cord	\$ _____
White Pine	23.00 Cords	\$ 35.65/Cord	\$ _____

*The volumes are statistically estimated within plus (+) or minus (-) 9.00 percent. These estimated volumes are final and not subject to adjustment. Prospective bidders are urged to examine this timber and to make their own estimates of quantity and quality.

I understand that any or all bids may be rejected. All bids must be signed and all bid items must be bid or the bid form may be rejected. I also understand that consideration and awarding a contract will be based upon my past performance and ability to complete the contract based upon equipment and staffing subject to my control.

FEDERAL ID: _____ or SOCIAL SECURITY NUMBER: _____

Company or individual bidding: _____

Company representative's name: _____

Address: _____

City: _____ State: _____ Zip: _____

IF AVAILABLE, PLEASE PLACE THE PERSONALIZED LABEL FROM YOUR PROSPECTUS IN THE ABOVE BOX.

Individual or company representative's signature: _____ Date: _____

Phone number : _____ Email (optional): _____

THE WINNING BIDDER MUST COMPLETE THE VERIFICATION OF WORKER'S DISABILITY COMPENSATION ACT COMPLIANCE (ON REVERSE SIDE IF DOUBLE SIDED) WITHIN 21 DAYS OF SALE AWARD DATE



FOR DEPARTMENT USE ONLY
Sale Number (XX – XXX – XX – XX)
Forest Management Unit:

TIMBER SALE VERIFICATION OF WORKER'S DISABILITY COMPENSATION ACT COMPLIANCE

*As required by Act 317, P.A. 1969 (Worker's Compensation) and
Part 5 of Act 451 of 1994, as amended.*

VERIFICATION OF WORKER'S DISABILITY COMPENSATION ACT COMPLIANCE

- This verification must be completed and submitted within 21 days of contract award and prior to the issuance of the timber sale contract.
- In addition, if boxes 2B or 2C are checked, then Notice of Exclusion or Certificate of Insurance must be submitted within twenty-one (21) days of the contract award and prior to the issuance of the timber sale contract.
- All information must be typed or printed except for written signatures.

Please Check Appropriate Categories:

1. My business is organized as (you **must** check one of the boxes below):
 - A. Sole Proprietorship (individual)
 - B. Partnership
 - C. Corporation

2. You **must** check one of the boxes below:
 - A. I certify my business is a sole proprietorship and it has no employees but the sole proprietor. I am not subject to the Worker's Compensation Laws.
 - B. I certify my business has satisfied its obligation to the Worker's Compensation Act through the use of an approved Notice of Exclusion (BWC-337, Rev. 5/96). I will provide a copy of the Notice of Exclusion within 21 days of the contract award. (For questions or a copy of the BWC-337, please call the Worker's Compensation Bureau at 517-322-1195).
 - C. I certify my business has a Worker's Compensation Policy. I will provide an original Certificate of Insurance within twenty-one (21) days of the contract award.

3. If you have checked item 2(A) or 2(B), you **must** indicate the number of **both** full-time and part-time employees, other than yourself, including family members and active partners (if none, you must enter "0").

_____ Full-time Employees

_____ Part-time Employees

Name of Business		Federal ID (or) Social Security No.	
Address		Telephone ()	
City	State	ZIP	

I hereby certify that the above information is true and correct. I agree to notify the Michigan DNR of any changes that occur in factors affecting my coverage during any of my present and future operations.

Signature of Owner or Authorized Representative

Title

Date

Please complete the "SEALED BID" information on the next page

SBW-15 (54-015-16)
 ; Montmorency COUNTY

In response to the notice of sale to be held 10:00 a.m. (local time) on July 11, 2017, I am hereby submitting my sealed bid (firm offer) for the following forest products to be cut. Bids for individual species must be at or above the advertised price. All non-responsive bid forms may be rejected.

<u>PRODUCTS & SPECIES</u>	<u>ESTIMATED VOLUME*</u>	<u>ADVERTISED PRICE</u>	<u>BID PRICE</u>
Sawtimber			
Paper Birch	1.50 MBF	\$ 49.00/MBF	\$ _____
Quaking Aspen	48.10 MBF	\$ 68.00/MBF	\$ _____
Red Maple	14.10 MBF	\$ 107.00/MBF	\$ _____
Red Oak	0.40 MBF	\$ 125.00/MBF	\$ _____
Red Pine	4.60 MBF	\$ 111.00/MBF	\$ _____
Pulpwood			
Balsam Fir	151.00 Cords	\$ 24.50/Cord	\$ _____
Black Spruce	25.00 Cords	\$ 35.25/Cord	\$ _____
Mixed Aspen	207.00 Cords	\$ 18.15/Cord	\$ _____
Paper Birch	10.00 Cords	\$ 18.80/Cord	\$ _____
Red Maple	59.00 Cords	\$ 16.35/Cord	\$ _____
Red Oak	2.00 Cords	\$ 15.95/Cord	\$ _____
Red Pine	4.00 Cords	\$ 43.55/Cord	\$ _____
White Pine	1.00 Cords	\$ 30.90/Cord	\$ _____

*The volumes are statistically estimated within plus (+) or minus (-) 12.50 percent. These estimated volumes are final and not subject to adjustment. Prospective bidders are urged to examine this timber and to make their own estimates of quantity and quality.

I understand that any or all bids may be rejected. All bids must be signed and all bid items must be bid or the bid form may be rejected. I also understand that consideration and awarding a contract will be based upon my past performance and ability to complete the contract based upon equipment and staffing subject to my control.

FEDERAL ID: _____ or SOCIAL SECURITY NUMBER: _____
 Company or individual bidding: _____
 Company representative's name: _____
 Address: _____
 City: _____ State: _____ Zip: _____

IF AVAILABLE, PLEASE PLACE THE PERSONALIZED LABEL FROM YOUR PROSPECTUS IN THE ABOVE BOX.

Individual or company representative's signature: _____ Date: _____

Phone number : _____ Email (optional): _____

THE WINNING BIDDER MUST COMPLETE THE VERIFICATION OF WORKER'S DISABILITY COMPENSATION ACT COMPLIANCE (ON REVERSE SIDE IF DOUBLE SIDED) WITHIN 21 DAYS OF SALE AWARD DATE



FOR DEPARTMENT USE ONLY
Sale Number (XX – XXX – XX – XX)
Forest Management Unit:

TIMBER SALE VERIFICATION OF WORKER'S DISABILITY COMPENSATION ACT COMPLIANCE

*As required by Act 317, P.A. 1969 (Worker's Compensation) and
Part 5 of Act 451 of 1994, as amended.*

VERIFICATION OF WORKER'S DISABILITY COMPENSATION ACT COMPLIANCE

- This verification must be completed and submitted within 21 days of contract award and prior to the issuance of the timber sale contract.
- In addition, if boxes 2B or 2C are checked, then Notice of Exclusion or Certificate of Insurance must be submitted within twenty-one (21) days of the contract award and prior to the issuance of the timber sale contract.
- All information must be typed or printed except for written signatures.

Please Check Appropriate Categories:

1. My business is organized as (you **must** check one of the boxes below):
 - A. Sole Proprietorship (individual)
 - B. Partnership
 - C. Corporation

2. You **must** check one of the boxes below:
 - A. I certify my business is a sole proprietorship and it has no employees but the sole proprietor. I am not subject to the Worker's Compensation Laws.
 - B. I certify my business has satisfied its obligation to the Worker's Compensation Act through the use of an approved Notice of Exclusion (BWC-337, Rev. 5/96). I will provide a copy of the Notice of Exclusion within 21 days of the contract award. (For questions or a copy of the BWC-337, please call the Worker's Compensation Bureau at 517-322-1195).
 - C. I certify my business has a Worker's Compensation Policy. I will provide an original Certificate of Insurance within twenty-one (21) days of the contract award.

3. If you have checked item 2(A) or 2(B), you **must** indicate the number of **both** full-time and part-time employees, other than yourself, including family members and active partners (if none, you must enter "0").

_____ Full-time Employees

_____ Part-time Employees

Name of Business		Federal ID (or) Social Security No.	
Address		Telephone ()	
City	State	ZIP	

I hereby certify that the above information is true and correct. I agree to notify the Michigan DNR of any changes that occur in factors affecting my coverage during any of my present and future operations.

Signature of Owner or Authorized Representative

Title

Date

Please complete the "SEALED BID" information on the next page

Mark It Zero Mix (54-008-16)
 ; Montmorency COUNTY

In response to the notice of sale to be held 10:00 a.m. (local time) on July 11, 2017, I am hereby submitting my sealed bid (firm offer) for the following forest products to be cut. Bids for individual species must be at or above the advertised price. All non-responsive bid forms may be rejected.

<u>PRODUCTS & SPECIES</u>	<u>ESTIMATED VOLUME*</u>	<u>ADVERTISED PRICE</u>	<u>BID PRICE</u>
Sawtimber			
Basswood	185.30 MBF	\$ 77.00/MBF	\$ _____
Beech	59.40 MBF	\$ 84.00/MBF	\$ _____
Mixed Aspen	51.40 MBF	\$ 78.00/MBF	\$ _____
Paper Birch	8.20 MBF	\$ 56.00/MBF	\$ _____
Red Maple	22.40 MBF	\$ 123.00/MBF	\$ _____
Red Oak	169.60 MBF	\$ 145.00/MBF	\$ _____
Red Pine	27.30 MBF	\$ 128.00/MBF	\$ _____
Sugar Maple	73.40 MBF	\$ 392.00/MBF	\$ _____
Pulpwood			
Balsam Fir	6.00 Cords	\$ 28.25/Cord	\$ _____
Basswood	552.00 Cords	\$ 12.80/Cord	\$ _____
Misc. Species 1	438.00 Cords	\$ 4.45/Cord	\$ _____
Mixed Aspen	501.00 Cords	\$ 20.95/Cord	\$ _____
Mixed Hardwood	1,122.00 Cords	\$ 18.90/Cord	\$ _____
Paper Birch	41.00 Cords	\$ 21.65/Cord	\$ _____
Red Oak	386.00 Cords	\$ 18.45/Cord	\$ _____
Red Pine	45.00 Cords	\$ 50.25/Cord	\$ _____
White Pine	4.00 Cords	\$ 35.65/Cord	\$ _____

*The volumes are statistically estimated within plus (+) or minus (-) 9.25 percent. These estimated volumes are final and not subject to adjustment. Prospective bidders are urged to examine this timber and to make their own estimates of quantity and quality.

I understand that any or all bids may be rejected. All bids must be signed and all bid items must be bid or the bid form may be rejected. I also understand that consideration and awarding a contract will be based upon my past performance and ability to complete the contract based upon equipment and staffing subject to my control.

FEDERAL ID: _____ or SOCIAL SECURITY NUMBER: _____

Company or individual bidding: _____

Company representative's name: _____

Address: _____

City: _____ State: _____ Zip: _____

IF AVAILABLE, PLEASE PLACE THE PERSONALIZED LABEL FROM YOUR PROSPECTUS IN THE ABOVE BOX.

Individual or company representative's signature: _____ Date: _____

Phone number : _____ Email (optional): _____

THE WINNING BIDDER MUST COMPLETE THE VERIFICATION OF WORKER'S DISABILITY COMPENSATION ACT COMPLIANCE (ON REVERSE SIDE IF DOUBLE SIDED) WITHIN 21 DAYS OF SALE AWARD DATE



FOR DEPARTMENT USE ONLY
Sale Number (XX - XXX - XX - XX)
Forest Management Unit:

TIMBER SALE VERIFICATION OF WORKER'S DISABILITY COMPENSATION ACT COMPLIANCE

*As required by Act 317, P.A. 1969 (Worker's Compensation) and
Part 5 of Act 451 of 1994, as amended.*

VERIFICATION OF WORKER'S DISABILITY COMPENSATION ACT COMPLIANCE

- This verification must be completed and submitted within 21 days of contract award and prior to the issuance of the timber sale contract.
- In addition, if boxes 2B or 2C are checked, then Notice of Exclusion or Certificate of Insurance must be submitted within twenty-one (21) days of the contract award and prior to the issuance of the timber sale contract.
- All information must be typed or printed except for written signatures.

Please Check Appropriate Categories:

1. My business is organized as (you **must** check one of the boxes below):
 - A. Sole Proprietorship (individual)
 - B. Partnership
 - C. Corporation
2. You **must** check one of the boxes below:
 - A. I certify my business is a sole proprietorship and it has no employees but the sole proprietor. I am not subject to the Worker's Compensation Laws.
 - B. I certify my business has satisfied its obligation to the Worker's Compensation Act through the use of an approved Notice of Exclusion (BWC-337, Rev. 5/96). I will provide a copy of the Notice of Exclusion within 21 days of the contract award. (For questions or a copy of the BWC-337, please call the Worker's Compensation Bureau at 517-322-1195).
 - C. I certify my business has a Worker's Compensation Policy. I will provide an original Certificate of Insurance within twenty-one (21) days of the contract award.
3. If you have checked item 2(A) or 2(B), you **must** indicate the number of **both** full-time and part-time employees, other than yourself, including family members and active partners (if none, you must enter "0").

_____ Full-time Employees

_____ Part-time Employees

Name of Business		Federal ID (or) Social Security No.	
Address		Telephone ()	
City	State	ZIP	

I hereby certify that the above information is true and correct. I agree to notify the Michigan DNR of any changes that occur in factors affecting my coverage during any of my present and future operations.

Signature of Owner or Authorized Representative

Title

Date

Please complete the "SEALED BID" information on the next page