



**DEPARTMENT OF NATURAL RESOURCES
STATE OF MICHIGAN**

TIMBER SALE PROSPECTUS #5999

SCHEDULED SALE DATE AND TIME: 9:00 a.m. (local time) on September 7, 2017.

LOCATION: BARAGA MGMT UNIT, 427 US 41 NORTH, BARAGA, MI 49908.

PROSPECTUS NOTE: The bidder is advised to inspect the sale area and review the location, estimated volumes, operating costs and contract terms of proposed sales. Please be aware that some landowners may request 60 days or more notice for access across their land.

Notice is hereby given that bids will be received by the Unit Manager, BARAGA MANAGEMENT UNIT, for certain timber on the following described lands:

Waterways Mix (11-002-17)

Baraga County, Advertised Price \$9,012.35, 21.0 Acres, Aspen, Hardwood.

Two Lakes (11-013-17)

Houghton County, Advertised Price \$74,470.90, 106.7 Acres, Hardwood, Sugar Maple.

SALE NOTE: Access may be through private land.

Skeleton Hardwoods (11-019-17)

Ontonagon County, Advertised Price \$254,485.05, 428.0 Acres, Hardwood, Sugar Maple.

SALE NOTE: Access may be through private land.

BID INSTRUCTIONS (VER. 09/02/2016):

1. Scheduled Bid Location, Date, and Time (2/11)

Bids must be received by the Unit Manager, BARAGA OFFICE, 427 US 41 NORTH, BARAGA, MI 49908, no later than 9:00 a.m. (local time) on September 7, 2017. For further information concerning this sale, contact Brad Carlson at 906-353-6651.

2. Bidder's Qualifications (5/16)

Purchaser shall obtain workers compensation insurance to cover claims under Michigan's Worker's Disability Compensation Act of 1969 or similar employee benefit act of any other state applicable to an employee. If all or part of a timber sale was prepared by a private contractor, the contractor and that contractor's company are not permitted to bid on the timber sale contract. Bids will not be accepted from individuals or companies appearing on the DNR/FRD No-Bid List. This list contains the names of purchasers who previously failed to execute a contract within 21-days or who have a history of poor performance.

3. Preparation of Sealed Bids (5/16)

Bid Forms may be completed online thru Michigan DNR Timber Sale Online Bidding (OLB) at www.michigan.gov/timberbidding or by completing the hardcopy Bid Form found in the Timber Sale Prospectus. Hardcopy Bid Forms shall be manually signed in ink. Registration in OLB is considered your 'signature' for all bids submitted thru that system. Bid prices must be entered for each species and product in the Bid Price column for all material subject to bidding and all fill-in blanks must be completed. If erasures or other changes appear on the hardcopy Bid Form, each erasure or change must be initialed by the person signing the bid.

4. Submission of Sealed Bids (5/16)

Bid forms may be obtained from the Unit Manager or thru OLB. Bids may be submitted hardcopy or thru OLB. All hardcopy bids must be submitted on the bid form and in an envelope clearly identified as described in this section. NOTE: Only one bid form per bid envelope. Sealed bids must be submitted to the Unit office designated in the prospectus and must be submitted at or prior to the time established in the prospectus. The envelope should show on the outside (a) the sale name or number and (b) the date and time of bid opening, as shown in the prospectus. Bids received after the time specified in the sale prospectus are late bids and will be rejected.

It is possible for a bidder to submit multiple bids on a single sale. For example, a bid may be submitted hardcopy and a bid may be submitted thru OLB. Or, two bidders from the same company could both submit bids on the same sale. If this were to happen, the State would accept all bids received and award the contract accordingly. All bidding and contractual requirements would apply to all bids received.

5. Public Opening of Sealed Bids (7/16)

If conditions permit, the sealed bids will be publicly opened and posted at the time and place set in the prospectus.

If a bidder, present at a bid opening, has submitted bids on more than one sale, that bidder may withdraw their unopened bid envelopes or announce the withdrawal of their online bid after being declared the successful bidder on one sale.

6. Award of Contract (1/11)

Award of the contract will be made to the Bidder whose bid, conforming to the prospectus, is most advantageous to the State of Michigan on the basis of total value at rates bid for the estimated quantities. The State reserves the right to reject any bid or waive any minor irregularity in bids received. A written award mailed (or otherwise furnished) to the successful Bidder shall be deemed to result in a binding contract without further action by either party.

7. Down Payment (1/11)

The Bidder to whom award is made must make a down payment within 21 days of the sale award. The amount of the down payment will be calculated as shown in the Bond and Payment Schedule of this prospectus. Only cash may be used to meet this requirement.

8. Performance Security (1/11)

As guarantee of faithful performance, a cash bond, certificate of deposit, surety bond or irrevocable letter of credit (LOC) is required within 21 days of the sale award. The amount of the performance security is shown in the Bond and

Payment Schedule of this prospectus. If an LOC or surety is used, the coverage must extend for at least 6 months beyond the contract expiration.

9. Timber Sale Contract (9/14)

Additional conditions and requirements common to all timber sales are listed on the timber sale contract (R4031) and are available on line at www.michigan.gov/timber. Contact the Unit Manager for additional information or a sample contract. Within 21 days of the date of the award letter, the bidder must sign the contract and provide the required down payment, performance security, and verification of worker's disability compensation. The down payment and performance security shall be in accordance with the provisions of the timber sale contract, in the sums stated in this prospectus. If these actions are not taken, then the Bidder, the Bidder's corporation, and the corporation's principals may not be permitted to bid on State timber sales for a period of 1 year. In addition, the Bidder certifies that if awarded this contract, the Bidder will complete the timber sale contract in accordance with its terms and any modifications thereof including requirements to purchase, cut, and remove the included timber by the expiration date.

10. Disclaimer of Estimates and Bidder's Warranty of Inspection (7/16)

Before submitting this bid, the Bidder is advised and cautioned to inspect the sale area, review the requirements of the sale contract, and take other steps as may be reasonably necessary to ascertain the location, estimated volumes, construction estimates, and operating costs of the proposed sale. Failure to do so will not relieve the Bidder from responsibility for completing the contract.

The Bidder warrants that this bid is submitted solely on the basis of the Bidder's examination and inspection of the quality and quantity of the timber offered for sale and the Bidder's opinion of the value thereof and the costs of recovery. No reliance should be placed on the State of Michigan's estimates of timber quality, quantity or costs of recovery. Bidder further acknowledges that the State of Michigan: (i) expressly disclaims any warranty of fitness of timber for any purpose; (ii) offers this timber as is without any warranty of quality (merchantability) or quantity and (iii) expressly disclaims any warranty as to the quantity or quality of timber sold.

11. Certification and Chain-of-Custody (10/14)

Unless otherwise indicated in the contract under section 7 – Other Conditions of the Sale Specific Conditions & Requirements, the area encompassed by this timber sale is certified to the standards of the Forest Stewardship Council (FSC) - Certificate #SCS-FM/COC-00090N and the Sustainable Forestry Initiative (SFI) - Certificate # NSF-SFIS-5Y031-SF5. Forest products from this sale may be delivered to the mill as "FSC 100% and / or SFI certified" as long as the contractor hauling the forest products is chain-of-custody (COC) certified or covered under a COC certificate from the destination mill. The purchaser is responsible for maintaining COC after leaving the sale area.

12. Good Neighbor Authority (GNA) Requirements (7/16)

If the name of this timber sales contains the acronym GNA, it is authorized by the Good Neighbor Authority (GNA) and covered by various agreements between the U.S. Forest Service and the State. The timber sale occurs on federal land and the following conditions apply:

GNA contracts on US Forest Service land will not be awarded to purchasers on the Federal list of excluded parties. The System for Award Management (SAM) will be checked for active excluded parties prior to award of contract. In addition, the Bidder to whom award is made must complete an Assurance Regarding Felony Conviction or Tax Delinquent Status for Corporate Applicants (AD-3031).

13. Good Neighbor Authority (GNA) Requirements, con't (9/16)

Bidder certifies, by signing this bid form, that to the best of Bidder's knowledge that the following representations are accurate and complete.

- a. That the Bidder and its principals are not presently debarred, suspended, proposed for debarment, declared ineligible, or voluntary excluded from timber sales (covered transactions) by any Federal department or agency.
- b. That the Bidder and its principals have not within a 3-year period preceding this bid been convicted of or had a civil judgment rendered against them for commission of fraud or a criminal offense in connection with obtaining, attempting to obtain, or performing a public (Federal, State, or local) transaction or contract under a public transaction; violation of Federal or State antitrust statutes or commission of embezzlement, theft, forgery, bribery, falsification or destruction of records, making false statements, or receiving stolen property.

c. That the Bidder and its principals are not presently indicted for or otherwise criminally or civilly charged by a governmental entity (Federal, State, or local) with commission of any of the offenses enumerated in paragraph b of this certification.

d. That the Bidder and its principals have not within a 3-year period preceding this bid had one or more public transactions (Federal, State, or local) terminated for breach or default of a timber or forest product contract.

Bidders that cannot certify this requirement, in whole or in part, shall submit an explanation with their bid.

KEITH CREAGH

Director

TIMBER SALE INFORMATION

Waterways Mix (11-002-17)

Baraga County (Advertised Price \$9,012.35)

A timber sale contract for this lump sum, sealed bid timber sale will be awarded to the responsible bidder offering the highest sealed bid price. Bids must be at or above the following advertised price for each species:

<u>PRODUCTS & SPECIES</u>	<u>ESTIMATED UNITS*</u>	<u>ADVERTISED PRICE</u>
Sawtimber		
Red Maple	6.20 MBF	\$ 221.00 / MBF
White Spruce	9.40 MBF	\$ 47.00 / MBF
Pulpwood		
Balsam Fir	45.00 Cords	\$ 10.95 / Cord
Mixed Hardwood	191.00 Cords	\$ 18.25 / Cord
Quaking Aspen	132.00 Cords	\$ 15.50 / Cord
White Spruce	67.00 Cords	\$ 17.55 / Cord

* The total volume is statistically estimated within plus (+) or minus (-) 20.77 percent. The estimated units are final and not subject to adjustment. Prospective bidders are urged to examine this timber and to make their own estimates of quantity and quality.

BOND AND PAYMENT SCHEDULE:

1. A bond in the amount of \$900.00 to insure faithful performance of the conditions of the contract will be deposited by the successful bidder within 21 days of the sale award.
2. Cutting in any sale or unit without the required advance payment would be considered a trespass.
3. Total payment must be paid in advance or according to the following schedule:
 - (a) Ten percent (10%) of the sale value must be paid within 21 days of the sale award.
 - (b) The remainder is due before cutting begins.
4. If no cutting takes place, the 10% down payment will not be refunded.
5. Operations on the contract issued will terminate on 06/30/2018.

Description of Timber by Payment Unit (PU)

PU	MARKET GROUP	PRODUCT	QUANTITY	UNIT	ACRES	ADVERTISE PRICE
1	Red Maple	Sawtimber	6.2	MBF	21.0	\$9,012.35
	White Spruce		9.4	MBF		
	Balsam Fir	Pulpwood	45.0	Cords		
	Mixed Hardwood		191.0	Cords		
	<i>Black Ash</i>		5.0	<i>Cords</i>		
	<i>Red Maple</i>		175.0	<i>Cords</i>		
	<i>Sugar Maple</i>		4.0	<i>Cords</i>		
	<i>Yellow Birch</i>		7.0	<i>Cords</i>		
	Quaking Aspen		132.0	Cords		
	White Spruce		67.0	Cords		
TOTAL:			15.6	MBF		
TOTAL:			435.0	Cords		

Sale Specific Conditions & Requirements

Sale Name: Waterways Mix

Sale Number: 11-002-17 Seq#: 1

1 - Sale Area

1.2 - Boundaries

1.2.1 - Painted boundaries (1/14)

The sale boundary is marked and identified by blue and red paint. Exterior sale boundary lines against private property are marked with blue paint. Exterior sale boundary lines against state are marked with red paint. The painted boundary line trees are not Included Timber and are to be protected, unless otherwise directed by the sale administrator.

2 - Timber Specifications

2.1 - Included Timber

2.1.2 - Clearcut unit(s) w/o unmerchantable trees (8/11)

Within Payment Unit(s) 1, cut all trees which meet minimum piece specifications in 2.2 Utilization except leave all hemlock, pine, cedar, apple and oak.

2.1.11 - Description of timber note (2/04)

Note that Mixed Hardwood pulp consists of red maple, sugar maple, black ash and yellow birch. Also, special care should be taken to inspect trees for metal. Several trees were noticed to have coffee cans nailed to them left over from a maple syrup collection operation.

2.2 - Utilization

2.2.1 - Utilization (2/04)

All listed board foot volumes of sawlog size products in this contract have been determined using a top diameter inside bark of 8 inches.

2.2.8 - Utilization and removal (5/14)

All products meeting standards set forth in General Condition and Requirement 2.2 - Utilization must be removed from the sale area. Chips are considered a product and cannot be stockpiled on site. This is because chip piles inhibit regeneration.

3 - Payments

3.4 - Damaged Timber

3.4.1 - Damaged timber (6/14)

General Condition and Requirement 3.4 Damaged Timber, defines liquidated damages for undesignated live merchantable trees which are cut or injured. In addition, extreme care should be taken to avoid damage to tree seedlings and saplings. No damage is acceptable to merchantable trees. Within the sale area, if more than 10% of trees (> 4.5" DBH) within a specified area of the sale are damaged, liquidated damages will be assessed for all trees damaged. Rates will be in accordance with General Condition and Requirement 3.4 Damaged Timber.

4 - Transportation

4.1 - Construction

4.1.3 - Slash and earthen piles (8/04)

Piles or windrows of earth along roads and landings that have been widened or constructed shall be leveled. Slash from road maintenance or construction, including stumps, shall be dispersed throughout the sale, or chipped, utilized or otherwise removed from the sale.

4.1.5 - Culverts (5/14)

Roads may require the installation of culverts for cross drainage or at natural drainage-ways. The culverts shall be new, corrugated metal or plastic gauge. Culverts will be a minimum of 12 inches in diameter and 24 feet in length. If culverts are removed, fill shall be removed from wetland soils as specified. Soils shall be maintained and left in a non-erodible condition, with water bars, seed, fertilizer, mulch, and slash installed as directed by the sale administrator and as specified in the BMP manual. Stream crossing permits on state land, if needed, will be obtained by the DNR.

4.1.6 - Road construction (1/09)

Improvements of existing roads shall be done in such a way as to minimize the environmental and visual impacts.

Merchantable trees shall be cut and utilized unless otherwise directed. Non-merchantable trees shall be severed and laid flat on the ground. Slash shall be scattered, and not left in windrows and kept a minimum of 10 feet back from the road edge, or be chipped, utilized or otherwise removed from the sale. Stumps shall be set upright, not left on edge, and be moved at least 10 feet away from the road edge. Disturbed soil shall be feathered into the woods and not left in berms or windrows.

4.1.7 - Road closure (10/11)

All new roads built into the sale must be blocked to vehicle traffic upon completion of the sale. Overgrown roads that are reopened shall be considered new roads. In general, this will require constructing a four (4') foot high berm of stumps and logs covered with earth. Temporary berms may be required if no sale activity occurs for 30 or more consecutive days. Contact the sale administrator for specific details of design and placement.

4.1.12 - No new roads (1/12)

No new roads will be permitted in Payment Unit 1. All operations are limited to existing roads. Skid trails only will be allowed.

4.2 - Maintenance

4.2.2 - Fill material (4/07)

To maintain roads, fill material may be needed in areas where "holes" exist or may be expected to develop. This fill material should be placed before trucking begins. The sale administrator reserves the right to halt harvest activities if haul roads are not properly filled and shaped to his/her specifications.

4.4 - Access

4.4.3 - Access gate (12/08)

The access gate must be locked at the completion of each day unless otherwise approved by the Unit Manager or his/her representative.

5 - Operations

5.1 - Notification

5.1.6 - Utility R.O.W. (1/15)

It is the responsibility of the Purchaser to obtain permission from the utility company to utilize the power line R.O.W. for operations. There is also a buried fiber optic cable along the east side of Main Street.

5.2 - Conduct of Operations

5.2.1 - Slash

5.2.1.8 - Slash height (12/08)

No slash or tree tops may exceed 36 inches in height.

5.2.1.11 - Slash for reforestation (5/07)

To facilitate reforestation, the sale area shall be left with slash evenly distributed. Bunched tops within the cutting area shall be broken up and scattered. Stumps shall be cut low to the ground. Processing sites shall not be left with a compacted layer of slash; tops from these sites shall be hauled back into the cut area and scattered.

5.2.2 - Hazard Trees/Snags

5.2.2.1 - Den trees (10/16)

Obvious hollow and/or den trees shall be protected and left standing unless they are a safety hazard.

5.2.3 - Operating Restrictions

5.2.3.1 - Operating restrictions (9/11)

Within Payment Unit(s) 1, unless changed by written agreement, cutting, skidding, and hauling are limited to the period of 12/1 to 3/31. This restriction is because the majority of the sale will require frozen ground conditions.

5.2.3.2 - Operating restrictions (9/11)

Within Payment Unit(s) 1, unless changed by written agreement, clean up and seeding activities on landings, decking areas, new roads, berms used for road closures and major skid trails must be completed by July 15 following harvest completion. This restriction is to allow these areas to re-vegetate before the dry season.

5.2.22 - Operating Caution

5.2.22.1 - Operating caution (6/11)

It is recommended, but not required, that within Payment Unit(s) 1, cutting, skidding, and hauling occur during frozen winter conditions. The reason for the recommendation is because the majority of the sale will require frozen ground condition and the potential for equipment damage from scrap material located on site will be reduced due to snow cover.

5.2.30 - Landing/road top soil protection (2/15)

Top soil on landings and new roads must be removed, stockpiled and saved. Upon completion of the timber sale, soil must be evenly distributed back over the area for revegetation. In addition, the area must be seeded and mulched per instructions of the sale administrator.

5.2.32 - Decking/landing restoration (9/13)

All decking and landing areas must have the surface area restored to a condition equal to or better than before. This is to ensure the proper regeneration of the stand. Wood debris, chips and "cookies" from trimmings must be removed or scattered away from landing and loading areas and may not be windrowed on the edge.

5.2.38 - No decking against live trees (2/04)

Cut products may not be decked against unmarked or designated leave trees.

5.2.41 - Snowmobile trail protection (9/11)

The Trail 15 snowmobile trail is shown on the Timber Sale Map. Do not cut or damage posts with orange trail markers or traffic control signs. The trail may not be used for any hauling or harvesting operations. Maintain a 20 foot wide slash, debris, and rut free zone daily using the snowmobile trail as the centerline. No decking of forest products will be permitted along the snowmobile trail. All stumps within 20 feet of the snowmobile trail must be cut at ground level. The trail is groomed by the Baraga County Tourist and Recreation Snowmobile club, they can be contacted at (906) 524-7444.

5.4 - Soil Protection

5.4.1 - Rutting restriction, general (7/16)

Operations are to cease immediately if equipment and weather conditions result in rutting of roads and/or skid trails which is 12 inches or greater in depth and 50 feet in length. The Unit Manager or his/her representative may restrict hauling and/or skidding if ruts exceed the specified depth. With the Unit Manager or his/her representative's approval, the Purchaser may return to the area when the risk of rutting has decreased.

5.8 - Protection of Endangered Species

5.8.5 - Protection of raptor nests (3/13)

All trees with raptor nests will be protected if found during harvesting operations. Notification will be made to the Unit Manager or his/her representative who will notify the Wildlife Biologist so an on-site evaluation and recommendation can be made, if necessary.

6 - Safety and Fire Prevention

6.2 - Signing

6.2.2 - Snowmobile trail posting (8/09)

The Purchaser is responsible for posting and maintaining caution signs on the snowmobile trail prior to beginning operations during the snowmobile season (approximately December 1 to March 31). The trail must be posted at appropriate distances from the sale area to warn of logging activity and truck traffic. Signs must be removed when harvest operations are suspended or completed. The Purchaser will provide these signs.

7 - Other Conditions

7.3 - Contract Modifications

7.3.1 - Emerald Ash Borer

7.3.1.2 - Emerald ash borer, ash or firewood on sale (2/05)

There is ash and/or "firewood" in this sale and it is located within an emerald ash borer quarantined area. The Director of the Michigan Department of Agriculture (MDA) by the authority of Act No. 72 of the Public Acts of 1945, as amended, and Quarantine Regulation No. 620, has promulgated this quarantine to prevent the further spread of this pest and sets forth: definitions, regulated articles, regulated areas, conditions of movement, violations and penalties, and special exemptions. The Purchaser must comply with this quarantine. Contact the MDA for further information.

7.5 - Loss

7.5.1 - Deteriorating timber (7/09)

The sale area has received damage from spruce budworm. The Purchaser should harvest the wood as soon as possible. The Department of Natural Resources is held free of responsibility of any further damage or deterioration due to delay in harvesting.



TIMBER SALE MAP

This information provided by authority of Par 525, 1994 PA 451, as amended.

Sale Number	Year
11-002	17

Forest Management Unit Baraga	County Baraga	Mapped By T. Adams	Date 06/29/2017	Page 1	of 1
Township 51N	Range 33W	Section(s) and Subdivision(s) Sect. 27 NWSW	Scale 1:7,920		

Cover Type				Density			
A = Aspen	H = Hemlock	N = Marsh	U = Upland Brush	0 = Non Stocked	5 = Pole Timber Medium		
B = Paper Birch	J = Jack Pine	O = Oak	UM = Upland Mixed	1 = Seeding Sapling Poor	6 = Pole Timber Well		
C = Cedar	L = Lowland Brush	P = Lowland Poplar	V = Bog or Marsh	2 = Seeding Sapling Medium	7 = Saw Timber Poor		
D = Tread Bog	LM = Lowland Mixed	Q = Mixed Swamp Conifer	W = White Pine	3 = Seeding Sapling Well	8 = Saw Timber Medium		
E = Swamp Hdwoods	M = Mpl. Bch. Bch	R = Red Pine	X = Non Stocked	4 = Pole Timber Poor	9 = Saw Timber Well		
F = Spruce Fir	MC = Mixed Conifer	S = Black Spruce	Z = Water				
G = Grass	MD = Mixed Deciduous	T = Tamarack					

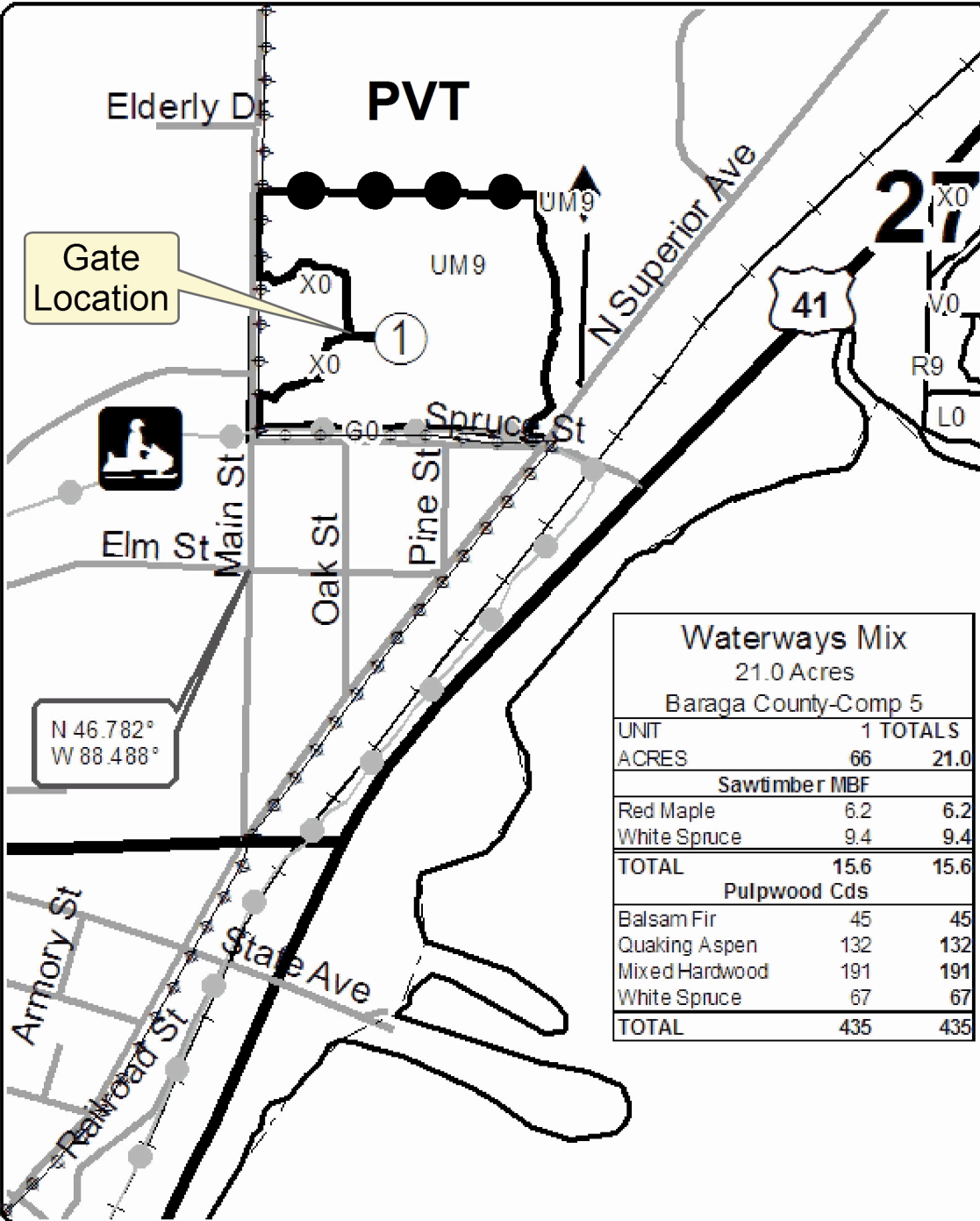

Legend

- Against State (Red)
- Private Line (Blue)
- Stand Boundaries
- Survey Corner
- Highway
- Paved Roads
- Gravel Roads
- Poor Dirt Roads
- Closed Roads
- Pipeline
- Powerline
- Railroad
- Recreation Trail
- Snowmobile Trails

Waterways Mix

21.0 Acres
Baraga County-Comp 5

UNIT	1	TOTALS
ACRES	66	21.0
Sawtimber MBF		
Red Maple	6.2	6.2
White Spruce	9.4	9.4
TOTAL	15.6	15.6
Pulpwood Cds		
Balsam Fir	45	45
Quaking Aspen	132	132
Mixed Hardwood	191	191
White Spruce	67	67
TOTAL	435	435

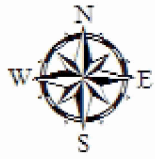

Locator Map
1:200,000

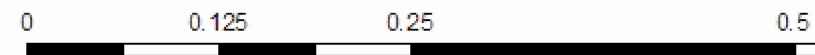
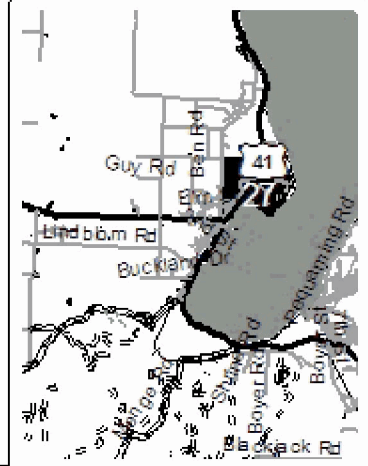

TIMBER SALE INFORMATION

Two Lakes (11-013-17)

Houghton County (Advertised Price \$74,470.90)

SALE NOTE: Access may be through private land.

A timber sale contract for this lump sum, sealed bid timber sale will be awarded to the responsible bidder offering the highest sealed bid price. Bids must be at or above the following advertised price for each species:

<u>PRODUCTS & SPECIES</u>	<u>ESTIMATED UNITS*</u>	<u>ADVERTISED PRICE</u>
Sawtimber		
Basswood	1.70 MBF	\$ 128.00 / MBF
Black Cherry	0.80 MBF	\$ 131.00 / MBF
Mixed Spruce	26.10 MBF	\$ 38.00 / MBF
Red Maple	33.30 MBF	\$ 221.00 / MBF
Sugar Maple	113.40 MBF	\$ 431.00 / MBF
Tamarack	1.90 MBF	\$ 38.00 / MBF
Yellow Birch	5.00 MBF	\$ 176.00 / MBF
Pulpwood		
Balsam Fir	42.00 Cords	\$ 10.95 / Cord
Mixed Hardwood	732.00 Cords	\$ 18.25 / Cord
Mixed Spruce	106.00 Cords	\$ 17.55 / Cord
Quaking Aspen	14.00 Cords	\$ 15.50 / Cord
Tamarack	4.00 Cords	\$ 18.40 / Cord

* The total volume is statistically estimated within plus (+) or minus (-) 21.05 percent. The estimated units are final and not subject to adjustment. Prospective bidders are urged to examine this timber and to make their own estimates of quantity and quality.

BOND AND PAYMENT SCHEDULE:

1. A bond in the amount of \$7,500.00 to insure faithful performance of the conditions of the contract will be deposited by the successful bidder within 21 days of the sale award.
2. Cutting in any sale or unit without the required advance payment would be considered a trespass.
3. Total payment must be paid in advance or according to the following schedule:
 - (a) Ten percent (10%) of the sale value must be paid within 21 days of the sale award.
 - (b) The 10% down payment will be credited towards the first unit cut.
4. If no cutting takes place, the 10% down payment will not be refunded.
5. Operations on the contract issued will terminate on 06/30/2021.

Description of Timber by Payment Unit (PU)

PU	MARKET GROUP	PRODUCT	QUANTITY	UNIT	ACRES	ADVERTISE PRICE	
1	Basswood Red Maple Sugar Maple Yellow Birch Mixed Hardwood <i>Basswood</i> <i>Red Maple</i> <i>Sugar Maple</i> <i>Yellow Birch</i>	Sawtimber	1.7	MBF	25.9	\$23,945.35	
			6.5	MBF			
			42.2	MBF			
		3.3	MBF				
		193.0	Cords				
		3.0	<i>Cords</i>				
		40.0	<i>Cords</i>				
		145.0	<i>Cords</i>				
		5.0	<i>Cords</i>				
2	Red Maple Sugar Maple Balsam Fir Mixed Hardwood <i>Ironwood</i> <i>Red Maple</i> <i>Sugar Maple</i> <i>Yellow Birch</i>	Sawtimber	11.5	MBF	32.3	\$17,067.45	
			25.7	MBF			
			10.0	Cords			
		183.0	Cords				
		2.0	<i>Cords</i>				
		69.0	<i>Cords</i>				
		110.0	<i>Cords</i>				
		2.0	<i>Cords</i>				
		3	Red Maple Sugar Maple Mixed Hardwood <i>Red Maple</i> <i>Sugar Maple</i>	Sawtimber			3.0
41.8	MBF						
Pulpwood	99.0			Cords			
	13.0			<i>Cords</i>			
	86.0			<i>Cords</i>			
4	Black Cherry Mixed Spruce <i>Black Spruce</i> <i>White Spruce</i> Red Maple Sugar Maple Tamarack Yellow Birch Balsam Fir Mixed Hardwood <i>Black Cherry</i> <i>Red Maple</i> <i>Sugar Maple</i> <i>Yellow Birch</i> Mixed Spruce <i>Black Spruce</i> <i>White Spruce</i> Quaking Aspen Tamarack	Sawtimber	0.8	MBF	15.5	\$8,517.85	
			26.1	MBF			
			2.1	<i>MBF</i>			
			24.0	<i>MBF</i>			
			5.4	MBF			
			1.3	MBF			
			1.9	MBF			
			1.3	MBF			
			Pulpwood	17.0			Cords
				166.0			Cords
		7.0		<i>Cords</i>			
		137.0		<i>Cords</i>			
		15.0		<i>Cords</i>			
		7.0		<i>Cords</i>			
		106.0		Cords			
		46.0		<i>Cords</i>			
		60.0		<i>Cords</i>			
		14.0		Cords			
		4.0	Cords				
		5	Red Maple Sugar Maple Yellow Birch Balsam Fir Mixed Hardwood <i>Red Maple</i> <i>Sugar Maple</i> <i>Yellow Birch</i>	Sawtimber			6.9
2.4	MBF						
0.4	MBF						
Pulpwood	15.0			Cords			
	91.0			Cords			
	70.0			<i>Cords</i>			
	19.0			<i>Cords</i>			
	2.0			<i>Cords</i>			
TOTAL:			182.2	MBF			
TOTAL:			898.0	Cords			

Sale Specific Conditions & Requirements

Sale Name: Two Lakes

Sale Number: 11-013-17 Seq#: 1

1 - Sale Area

1.2 - Boundaries

1.2.1 - Painted boundaries (1/14)

The sale boundary and Payment Unit boundaries are marked and identified by blue and red paint. Exterior sale boundary lines against private property are marked with blue paint. Exterior sale boundary lines against state are marked with red paint. Interior Payment Unit boundaries are marked with red paint. The painted boundary line trees are not Included Timber and are to be protected, unless otherwise directed by the sale administrator.

2 - Timber Specifications

2.1 - Included Timber

2.1.2 - Clearcut unit(s) w/o unmerchantable trees (8/11)

Within Payment Unit(s) 4, cut all trees which meet minimum piece specifications in 2.2 Utilization except white pine, hemlock and cedar. Also, retain red oak if present.

2.1.3 - Cut tree marked unit(s) (12/08)

Within Payment Unit(s) 1, 2, 3 and 5, all trees are designated for cutting when marked with orange paint above and below stump height, regardless of merchantability.

2.2 - Utilization

2.2.1 - Utilization (2/04)

All listed board foot volumes of sawlog size products in this contract have been determined using a top diameter inside bark of 8 inches.

2.2.4 - Skidding length (2/14)

Skidding of unlimbed tops or lengths over 26 feet is not permissible, unless approved by the Unit Manager or his/her representative.

2.2.7 - Uncut designated trees (2/04)

Liquidated damages of \$10.00 per tree will be assessed for every marked tree not cut.

2.2.8 - Utilization and removal (5/14)

All products meeting standards set forth in General Condition and Requirement 2.2 - Utilization must be removed from the sale area. Chips are considered a product and cannot be stockpiled on site. This is because chip piles inhibit regeneration.

3 - Payments

3.4 - Damaged Timber

3.4.1 - Damaged timber (6/14)

General Condition and Requirement 3.4 Damaged Timber, defines liquidated damages for undesignated live merchantable trees which are cut or injured. In addition, extreme care should be taken to avoid damage to tree seedlings and saplings. No damage is acceptable to merchantable trees. Within the sale area, if more than 10% of trees (> 4.5" DBH) within a specified area of the sale are damaged, liquidated damages will be assessed for all trees damaged. Rates will be in accordance with General Condition and Requirement 3.4 Damaged Timber.

4 - Transportation

4.1 - Construction

4.1.3 - Slash and earthen piles (8/04)

Piles or windrows of earth along roads and landings that have been widened or constructed shall be leveled. Slash from road maintenance or construction, including stumps, shall be dispersed throughout the sale or chipped, utilized or otherwise removed from the sale.

4.1.5 - Culverts (5/14)

Roads may require the installation of culverts for cross drainage or at natural drainage-ways. If culverts are needed in these locations, their placement will be specified by the sale administrator and they shall be installed prior to hauling. The culverts shall be new, corrugated metal or plastic gauge. Culverts will be a minimum of 12 inches in diameter and 24 feet in length. If culverts are removed, fill shall be removed from wetland soils as specified. Soils shall be maintained and left in a non-erodible condition, with water bars, seed, fertilizer, mulch, and slash installed as directed by the sale administrator and as specified in the BMP manual. Stream crossing permits, if needed, will be obtained by the DNR.

4.1.6 - Road construction (1/09)

Construction of new roads or improvements of existing roads shall be done in such a way as to minimize the environmental and visual impacts. Merchantable trees shall be cut and utilized unless otherwise directed. Non-merchantable trees shall be severed and laid flat on the ground. Slash shall be scattered, and not left in windrows and kept a minimum of 10 feet back from the road edge or be chipped, utilized or otherwise removed from the sale. Stumps shall be set upright, not left on edge, and be moved at least 10 feet away from the road edge. Disturbed soil shall be feathered into the woods and not left in berms or windrows.

4.1.7 - Road closure (10/11)

All new roads built into the sale must be blocked to vehicle traffic upon completion of the sale. Overgrown roads that are reopened shall be considered new roads. In general, this will require constructing a four (4') foot high berm of stumps and logs covered with earth. These roads must be rendered impassable to cars and trucks. Temporary berms may be required if no sale activity occurs for 30 or more consecutive days. Contact the sale administrator for specific details of design and placement.

4.2 - Maintenance

4.2.2 - Fill material (4/07)

To maintain roads, fill material may be needed in areas where "holes" exist or may be expected to develop. This fill material should be placed before trucking begins. The sale administrator reserves the right to halt harvest activities if haul roads are not properly filled and shaped to his/her specifications.

4.2.4 - Grading (10/16)

For completion of the sale, state forest roads must be graded. In general, this will require a road grader or bull dozer to shape up the roads after forest products have been hauled off site. This includes cleaning of drainage areas, grading, crowning and filling with gravel, if necessary. The grading equipment to be used must be approved by the Unit Manager or his/her representative.

4.4 - Access

4.4.1 - Private property access (3/11)

Permission for access across private land is the responsibility of the Purchaser. Should the Purchaser desire to cross private land, a copy of the written permission from the private land-owner may be required by the DNR.

5 - Operations

5.1 - Notification

5.1.1 - Pre-sale conference (10/16)

A pre-sale conference between the Purchaser and sale administrator is required prior to beginning any operations to determine landing and road locations. The Unit Manager or his/her representative must be contacted at least 10 days in advance to schedule the conference.

5.1.4 - Post-sale conference (10/16)

A post-sale conference on site between the Purchaser and sale administrator is required 5 days prior to the completion of active logging operations to determine clean-up and repair of landings, road edges, and the fulfillment of other contract specifications.

5.2 - Conduct of Operations

5.2.1 - Slash

5.2.1.8 - Slash height (12/08)

No slash or tree tops may exceed 36 inches in height.

5.2.1.11 - Slash for reforestation (5/07)

To facilitate reforestation, the sale area shall be left with slash evenly distributed. Bunched tops within the cutting area shall be broken up and scattered. Stumps shall be cut low to the ground. Processing sites shall not be left with a compacted layer of slash; tops from these sites shall be hauled back into the cut area and scattered.

5.2.2 - Hazard Trees/Snags

5.2.2.1 - Den trees (10/16)

Obvious hollow and/or den trees shall be protected and left standing unless they are a safety hazard.

5.2.3 - Operating Restrictions

5.2.3.2 - Operating restrictions (9/11)

Within Payment Unit(s) 1, 2, 3, 4 and 5, unless changed by written agreement, clean up and seeding activities on landings, decking areas, new roads, berms used for road closures and major skid trails must be completed by July 15 following harvest completion. This restriction is to allow these areas to re-vegetate before the dry season.

5.2.3.3 - Bark slippage restriction (3/09)

Within Payment Unit(s) 1, 2, 3, and 5, unless changed by written agreement, cutting, skidding, and hauling are not permitted during the period of April 1 to July 15. This restriction is because of bark slippage.

5.2.30 - Landing/road top soil protection (2/15)

Top soil on landings and new roads must be removed, stockpiled and saved. Upon completion of the timber sale, soil must be evenly distributed back over the area for revegetation. In addition, the area must be seeded and mulched per instructions of the sale administrator.

5.2.32 - Decking/landing restoration (9/13)

All decking and landing areas must have the surface area restored to a condition equal to or better than before. This is to ensure the proper regeneration of the stand. Wood debris, chips and "cookies" from trimmings must be removed or scattered away from landing and loading areas and may not be windrowed on the edge.

5.2.38 - No decking against live trees (2/04)

Cut products may not be decked against unmarked or designated leave trees.

5.2.41 - Snowmobile trail protection (9/11)

The Alston trail is a snowmobile trail and is shown on the Timber Sale Map. Do not cut or damage posts with orange trail markers or traffic control signs. If the trail is used, it must be maintained and restored to a condition equal to or better than before the sale. This maintenance/restoration must be done to the satisfaction of the Unit Manager or his/her representative prior to December 1st. Any trucking of forest products shall only occur from Monday to Thursday during daylight hours. If the trail road is to be used for hauling during the snowmobile season, then a snow covered base must be left on the trail. Maintain a 20 foot wide slash, debris, and rut free zone daily using the snowmobile trail as the centerline. No decking of forest products will be permitted along the snowmobile trail. All stumps within 20 feet of the snowmobile trail must be cut at ground level.

5.4 - Soil Protection

5.4.1 - Rutting restriction, general (7/16)

Operations are to cease immediately if equipment and weather conditions result in rutting of roads and/or skid trails which is 12 inches or greater in depth and 50 feet in length. The Unit Manager or his/her representative may restrict hauling and/or skidding if ruts exceed the specified depth. With the Unit Manager or his/her representative's approval, the Purchaser may return to the area when the risk of rutting has decreased.

5.8 - Protection of Endangered Species

5.8.5 - Protection of raptor nests (3/13)

All trees with raptor nests will be protected if found during harvesting operations. Notification will be made to the Unit Manager or his/her representative who will notify the Wildlife Biologist so an on-site evaluation and recommendation can be made, if necessary.

6 - Safety and Fire Prevention

6.2 - Signing

6.2.2 - Snowmobile trail posting (8/09)

The Purchaser is responsible for posting and maintaining caution signs on the snowmobile trail prior to beginning operations during the snowmobile season (approximately December 1 to March 31). The trail must be posted at appropriate distances from the sale area to warn of logging activity and truck traffic. Signs must be removed when harvest operations are suspended or completed. The Purchaser will provide these signs. The trail is groomed by the Superior Snowmobile club; they can be contacted at (906) 288-3025 with questions about signage.

7 - Other Conditions

7.3 - Contract Modifications

7.3.1 - Emerald Ash Borer

7.3.1.2 - Emerald ash borer, ash or firewood on sale (2/05)

There is ash and/or "firewood" in this sale and it is located within an emerald ash borer quarantined area. The Director of the Michigan Department of Agriculture (MDA) by the authority of Act No. 72 of the Public Acts of 1945, as amended, and Quarantine Regulation No. 620, has promulgated this quarantine to prevent the further spread of this pest and sets forth: definitions, regulated articles, regulated areas, conditions of movement, violations and penalties, and special exemptions. The Purchaser must comply with this quarantine. Contact the MDA for further information.



TIMBER SALE MAP

This information provided by authority of Part 525, 1994 PA 451, as amended.

Sale Number	Year
11-013	17

Forest Management Unit Baraga	County Houghton	Mapped By Carlson	Date 6/28/2017	Page 1	of 1
Township 52N	Range 36W	Section(s) and Subdivision(s) Section 35 - NW1/4, N1/2NE	Scale 1:15,840		

Cover Type				Density			
A = Aspen	H = Hemlock	N = Marsh	U = Upland Brush	0 = Non Stocked	5 = Pole Timber Medium		
B = Paper Birch	J = Jack Pine	O = Oak	UM = Upland Mixed	1 = Seeding Sapling Poor	6 = Pole Timber Well		
C = Cedar	L = Lowland Brush	P = Lowland Poplar	V = Bog or Marsh	2 = Seeding Sapling Medium	7 = Saw Timber Poor		
D = Treed Bog	LM = Lowland Mixed	Q = Mixed Swamp Conifer	W = White Pine	3 = Seeding Sapling Well	8 = Saw Timber Medium		
E = Swamp Hdwoods	M = Mpl, Boh, Bich	R = Red Pine	X = Non Stocked	4 = Pole Timber Poor	9 = Saw Timber Well		
F = Spruce Fir	MC = Mixed Conifer	S = Black Spruce	Z = Water				
G = Grass	MD = Mixed Deciduous	T = Tamarack					

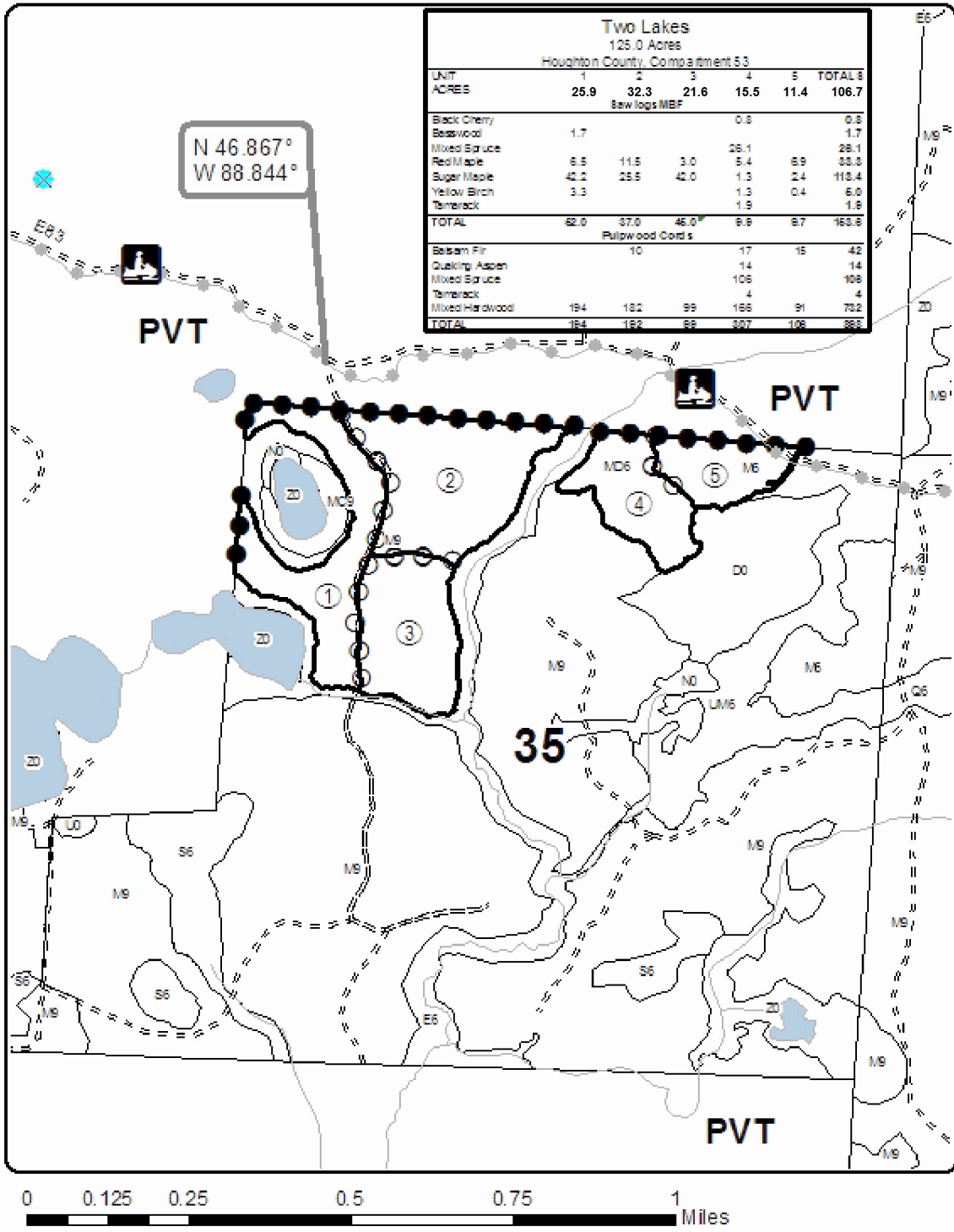

Legend

- Against State (Red)
- ○ Payment Unit (Red)
- ● Private Line (Blue)
- Stand Boundaries
- Recreational Trail
- Lakes and Rivers
- All
- Highway
- Gravel Roads
- - - Poor Dirt Roads
- ... Closed Roads

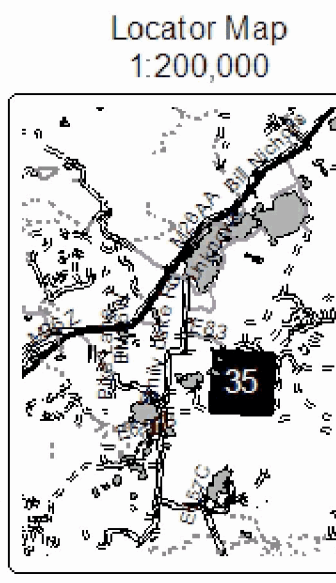

TIMBER SALE INFORMATION

Skeleton Hardwoods (11-019-17)

Ontonagon County (Advertised Price \$254,485.05)

SALE NOTE: Access may be through private land.

A timber sale contract for this lump sum, sealed bid timber sale will be awarded to the responsible bidder offering the highest sealed bid price. Bids must be at or above the following advertised price for each species:

<u>PRODUCTS & SPECIES</u>	<u>ESTIMATED UNITS*</u>	<u>ADVERTISED PRICE</u>
Sawtimber		
Basswood	88.00 MBF	\$ 128.00 / MBF
Red Maple	193.40 MBF	\$ 221.00 / MBF
Sugar Maple	235.90 MBF	\$ 431.00 / MBF
White Ash	232.40 MBF	\$ 87.00 / MBF
Yellow Birch	2.50 MBF	\$ 176.00 / MBF
Pulpwood		
Balsam Fir	11.00 Cords	\$ 10.95 / Cord
Basswood	331.00 Cords	\$ 16.75 / Cord
Mixed Hardwood	3,115.00 Cords	\$ 18.25 / Cord
Quaking Aspen	168.00 Cords	\$ 15.50 / Cord
White Ash	714.00 Cords	\$ 18.25 / Cord

* The estimated units are final and not subject to adjustment. Prospective bidders are urged to examine this timber and to make their own estimates of quantity and quality.

BOND AND PAYMENT SCHEDULE:

1. A bond in the amount of \$25,000.00 to insure faithful performance of the conditions of the contract will be deposited by the successful bidder within 21 days of the sale award.
2. Cutting in any sale or unit without the required advance payment would be considered a trespass.
3. Total payment must be paid in advance or according to the following schedule:
 - (a) Ten percent (10%) of the sale value must be paid within 21 days of the sale award.
 - (b) The 10% down payment will be credited towards the first unit cut.
4. If no cutting takes place, the 10% down payment will not be refunded.
5. Operations on the contract issued will terminate on 06/30/2021.

Description of Timber by Payment Unit (PU)

PU	MARKET GROUP	PRODUCT	QUANTITY	UNIT	ACRES	ADVERTISE PRICE
1	Basswood Red Maple Sugar Maple White Ash Basswood Mixed Hardwood <i>Ironwood</i> <i>Red Maple</i> <i>Sugar Maple</i> <i>Yellow Birch</i> White Ash	Sawtimber	17.5	MBF	37.0	\$30,624.40
			24.1	MBF		
			27.0	MBF		
			26.9	MBF		
			78.0	Cords		
		Pulpwood	333.0	Cords		
			5.0	<i>Cords</i>		
			112.0	<i>Cords</i>		
			204.0	<i>Cords</i>		
			12.0	<i>Cords</i>		
			93.0	Cords		
2	Basswood Red Maple Sugar Maple White Ash Yellow Birch Basswood Mixed Hardwood <i>American Elm</i> <i>Ironwood</i> <i>Red Maple</i> <i>Sugar Maple</i> <i>Yellow Birch</i> Quaking Aspen White Ash	Sawtimber	19.5	MBF	72.5	\$40,903.25
			6.3	MBF		
			53.4	MBF		
			32.9	MBF		
			2.5	MBF		
		Pulpwood	60.0	Cords		
			356.0	Cords		
			4.0	<i>Cords</i>		
			14.0	<i>Cords</i>		
			79.0	<i>Cords</i>		
			228.0	<i>Cords</i>		
			31.0	<i>Cords</i>		
			99.0	Cords		
			91.0	Cords		
3	Basswood Red Maple Sugar Maple White Ash Mixed Hardwood <i>Red Maple</i> <i>Sugar Maple</i> White Ash	Sawtimber	0.1	MBF	21.6	\$12,389.45
			25.4	MBF		
			3.8	MBF		
			7.1	MBF		
		Pulpwood	230.0	Cords		
			176.0	<i>Cords</i>		
			54.0	<i>Cords</i>		
			17.0	Cords		
4	Basswood Red Maple Sugar Maple White Ash Basswood Mixed Hardwood <i>Red Maple</i> <i>Sugar Maple</i> <i>Yellow Birch</i> White Ash	Sawtimber	2.4	MBF	36.9	\$19,529.15
			0.1	MBF		
			32.2	MBF		
			5.7	MBF		
		Pulpwood	7.0	Cords		
			251.0	Cords		
			27.0	<i>Cords</i>		
			211.0	<i>Cords</i>		
			13.0	<i>Cords</i>		
			7.0	Cords		
5	Basswood Red Maple Sugar Maple White Ash Basswood Mixed Hardwood <i>Ironwood</i> <i>Red Maple</i> <i>Sugar Maple</i> <i>Yellow Birch</i> White Ash	Sawtimber	13.5	MBF	49.4	\$39,593.05
			11.2	MBF		
			53.5	MBF		
			39.8	MBF		
			37.0	Cords		
		Pulpwood	329.0	Cords		
			10.0	<i>Cords</i>		
			78.0	<i>Cords</i>		
			237.0	<i>Cords</i>		
			4.0	<i>Cords</i>		
			123.0	Cords		
6	Basswood Red Maple	Sawtimber	23.9	MBF	49.9	\$28,119.75
			3.2	MBF		

Description of Timber by Payment Unit (PU), con't

PU	MARKET GROUP	PRODUCT	QUANTITY	UNIT	ACRES	ADVERTISE PRICE
6 con't	Sugar Maple	Sawtimber	27.6	MBF		
	White Ash		59.0	MBF		
	Basswood	Pulpwood	93.0	Cords		
	Mixed Hardwood		192.0	Cords		
	<i>Ironwood</i>		12.0	<i>Cords</i>		
	<i>Red Maple</i>		27.0	<i>Cords</i>		
	<i>Sugar Maple</i>		148.0	<i>Cords</i>		
	<i>Yellow Birch</i>		5.0	<i>Cords</i>		
	White Ash		124.0	Cords		
7	Basswood	Sawtimber	2.0	MBF	36.8	\$15,898.90
	Red Maple		15.0	MBF		
	Sugar Maple		5.1	MBF		
	White Ash		22.9	MBF		
	Basswood	Pulpwood	3.0	Cords		
	Mixed Hardwood		337.0	Cords		
	<i>Red Maple</i>		231.0	<i>Cords</i>		
	<i>Sugar Maple</i>		89.0	<i>Cords</i>		
	<i>Yellow Birch</i>		17.0	<i>Cords</i>		
	Quaking Aspen		19.0	Cords		
	White Ash		90.0	Cords		
	8	Basswood	Sawtimber	2.5		
Red Maple			29.0	MBF		
Sugar Maple			11.0	MBF		
White Ash			14.2	MBF		
Balsam Fir		Pulpwood	5.0	Cords		
Basswood			21.0	Cords		
Mixed Hardwood			365.0	Cords		
<i>Ironwood</i>			11.0	<i>Cords</i>		
<i>Red Maple</i>			200.0	<i>Cords</i>		
<i>Sugar Maple</i>			152.0	<i>Cords</i>		
<i>Yellow Birch</i>			2.0	<i>Cords</i>		
Quaking Aspen			17.0	Cords		
White Ash			64.0	Cords		
9		Basswood	Sawtimber	1.3	MBF	25.1
	Red Maple		45.9	MBF		
	Sugar Maple		7.8	MBF		
	White Ash		7.0	MBF		
	Basswood	Pulpwood	4.0	Cords		
	Mixed Hardwood		288.0	Cords		
	<i>Red Maple</i>		193.0	<i>Cords</i>		
	<i>Sugar Maple</i>		95.0	<i>Cords</i>		
	White Ash		23.0	Cords		
	10	Red Maple	Sawtimber	13.2	MBF	
Sugar Maple			7.1	MBF		
White Ash			12.2	MBF		
Balsam Fir		Pulpwood	6.0	Cords		
Basswood			2.0	Cords		
Mixed Hardwood			159.0	Cords		
<i>American Elm</i>			1.0	<i>Cords</i>		
<i>Ironwood</i>			2.0	<i>Cords</i>		
<i>Red Maple</i>			75.0	<i>Cords</i>		
<i>Sugar Maple</i>			79.0	<i>Cords</i>		
<i>Yellow Birch</i>			2.0	<i>Cords</i>		
Quaking Aspen			7.0	Cords		
White Ash			59.0	Cords		
11		Basswood	Sawtimber	5.3	MBF	32.5

Description of Timber by Payment Unit (PU), con't

PU	MARKET GROUP	PRODUCT	QUANTITY	UNIT	ACRES	ADVERTISE PRICE
11 con't	Red Maple	Sawtimber	20.0	MBF		
	Sugar Maple		7.4	MBF		
	White Ash		4.7	MBF		
	Basswood	Pulpwood	26.0	Cords		
	Mixed Hardwood		275.0	Cords		
	<i>Black Cherry</i>		2.0	<i>Cords</i>		
	<i>Ironwood</i>		7.0	<i>Cords</i>		
	<i>Red Maple</i>		165.0	<i>Cords</i>		
	<i>Sugar Maple</i>		89.0	<i>Cords</i>		
	<i>Yellow Birch</i>		12.0	<i>Cords</i>		
	Quaking Aspen		26.0	Cords		
	White Ash	23.0	Cords			
	TOTAL:			752.2	MBF	
TOTAL:			4,339.0	Cords		

Sale Specific Conditions & Requirements

Sale Name: Skeleton Hardwoods

Sale Number: 11-019-17 Seq#: 1

1 - Sale Area

1.2 - Boundaries

1.2.1 - Painted boundaries (1/14)

The sale boundary and Payment Unit boundaries are marked and identified by blue and red paint. Exterior sale boundary lines against private property are marked with blue paint. Exterior sale boundary lines against state are marked with red paint. Interior Payment Unit boundaries are marked with red paint. The painted boundary line trees are not Included Timber and are to be protected, unless otherwise directed by the sale administrator.

2 - Timber Specifications

2.1 - Included Timber

2.1.3 - Cut tree marked unit(s) (12/08)

Within Payment Unit(s) 1, 2, 3, 4, 5, 6, 7, 8, 9, 10, and 11, all trees are designated for cutting when marked with orange paint above and below stump height, regardless of merchantability.

2.2 - Utilization

2.2.1 - Utilization (2/04)

All listed board foot volumes of sawlog size products in this contract have been determined using a top diameter inside bark of 8 inches.

2.2.4 - Skidding length (2/14)

Skidding of unlimbed tops or lengths over 26 feet is not permissible, unless approved by the Unit Manager or his/her representative.

2.2.7 - Uncut designated trees (2/04)

Liquidated damages of \$10.00 per tree will be assessed for every marked tree not cut.

2.2.8 - Utilization and removal (5/14)

All products meeting standards set forth in General Condition and Requirement 2.2 - Utilization must be removed from the sale area. Chips are considered a product and cannot be stockpiled on site. This is because chip piles inhibit regeneration.

3 - Payments

3.4 - Damaged Timber

3.4.1 - Damaged timber (6/14)

General Condition and Requirement 3.4 Damaged Timber, defines liquidated damages for undesigned live merchantable trees which are cut or injured. In addition, extreme care should be taken to avoid damage to tree seedlings and saplings. No damage is acceptable to merchantable trees. Within the sale area, if more than 10% of trees (> 4.5" DBH) within a specified area of the sale are damaged, liquidated damages will be assessed for all trees damaged. Rates will be in accordance with General Condition and Requirement 3.4 Damaged Timber.

4 - Transportation

4.1 - Construction

4.1.3 - Slash and earthen piles (8/04)

Piles or windrows of earth along roads and landings that have been widened or constructed shall be leveled. Slash from road maintenance or construction, including stumps, shall be dispersed throughout the sale or chipped, utilized or otherwise removed from the sale.

4.1.5 - Culverts (5/14)

Roads may require the installation of culverts for cross drainage or at natural drainage-ways. If culverts are needed in these locations, their placement will be specified by the sale administrator and they shall be installed prior to hauling. The culverts

shall be new, corrugated metal or plastic gauge. Culverts will be a minimum of 12 inches in diameter and 24 feet in length. If culverts are removed, fill shall be removed from wetland soils as specified. Soils shall be maintained and left in a non-erodible condition, with water bars, seed, fertilizer, mulch, and slash installed as directed by the sale administrator and as specified in the BMP manual. Stream crossing permits, if needed, will be obtained by the DNR.

4.1.6 - Road construction (1/09)

Construction of new roads or improvements of existing roads shall be done in such a way as to minimize the environmental and visual impacts. Merchantable trees shall be cut and utilized unless otherwise directed. Non-merchantable trees shall be severed and laid flat on the ground. Slash shall be scattered, and not left in windrows and kept a minimum of 10 feet back from the road edge or be chipped, utilized or otherwise removed from the sale. Stumps shall be set upright, not left on edge, and be moved at least 10 feet away from the road edge. Disturbed soil shall be feathered into the woods and not left in berms or windrows.

4.1.7 - Road closure (10/11)

All new roads built into the sale must be blocked to vehicle traffic upon completion of the sale. Overgrown roads that are reopened shall be considered new roads. In general, this will require constructing a four (4') foot high berm of stumps and logs covered with earth. These roads must be rendered impassable to cars and trucks. Temporary berms may be required if no sale activity occurs for 30 or more consecutive days. Contact the sale administrator for specific details of design and placement.

4.2 - Maintenance

4.2.2 - Fill material (4/07)

To maintain roads, fill material may be needed in areas where "holes" exist or may be expected to develop. This fill material should be placed before trucking begins. The sale administrator reserves the right to halt harvest activities if haul roads are not properly filled and shaped to his/her specifications.

4.2.4 - Grading (10/16)

For completion of the sale, state forest roads must be graded. In general, this will require a road grader or bull dozer to shape up the roads after forest products have been hauled off site. This includes cleaning of drainage areas, grading, crowning and filling with gravel, if necessary. The grading equipment to be used must be approved by the Unit Manager or his/her representative.

4.4 - Access

4.4.5 - Federal property access (3/11)

Permission for access across federal land is the responsibility of the Purchaser.

5 - Operations

5.1 - Notification

5.1.1 - Pre-sale conference (10/16)

A pre-sale conference between the Purchaser and sale administrator is required prior to beginning any operations to determine landing and road locations. The Unit Manager or his/her representative must be contacted at least 10 days in advance to schedule the conference.

5.1.4 - Post-sale conference (10/16)

A post-sale conference on site between the Purchaser and sale administrator is required 5 days prior to the completion of active logging operations to determine clean-up and repair of landings, road edges, and the fulfillment of other contract specifications.

5.2 - Conduct of Operations

5.2.1 - Slash

5.2.1.8 - Slash height (12/08)

No slash or tree tops may exceed 36 inches in height.

5.2.1.11 - Slash for reforestation (5/07)

To facilitate reforestation, the sale area shall be left with slash evenly distributed. Bunched tops within the cutting area

shall be broken up and scattered. Stumps shall be cut low to the ground. Processing sites shall not be left with a compacted layer of slash; tops from these sites shall be hauled back into the cut area and scattered.

5.2.2 - Hazard Trees/Snags

5.2.2.1 - Den trees (10/16)

Obvious hollow and/or den trees shall be protected and left standing unless they are a safety hazard.

5.2.3 - Operating Restrictions

5.2.3.1 - Operating restrictions (9/11)

Within Payment Unit(s) 9, cutting, skidding, and hauling are not permitted during the period of January 1 to March 31. This restriction is because of spring breakup.

5.2.3.2 - Operating restrictions (9/11)

Within Payment Unit(s) 1-11, unless changed by written agreement, clean up and seeding activities on landings, decking areas, new roads, berms used for road closures and major skid trails must be completed by July 15 following harvest completion. This restriction is to allow these areas to re-vegetate before the dry season.

5.2.3.3 - Bark slippage restriction (3/09)

Within Payment Unit(s) 1-8 and 10-11, unless changed by written agreement, cutting, skidding, and hauling are not permitted during the period of April 1 to July 15. This restriction is because of bark slippage.

5.2.30 - Landing/road top soil protection (2/15)

Top soil on landings and new roads must be removed, stockpiled and saved. Upon completion of the timber sale, soil must be evenly distributed back over the area for revegetation. In addition, the area must be seeded and mulched per instructions of the sale administrator.

5.2.32 - Decking/landing restoration (9/13)

All decking and landing areas must have the surface area restored to a condition equal to or better than before. This is to ensure the proper regeneration of the stand. Wood debris, chips and "cookies" from trimmings must be removed or scattered away from landing and loading areas and may not be windrowed on the edge.

5.2.38 - No decking against live trees (2/04)

Cut products may not be decked against unmarked or designated leave trees.

5.4 - Soil Protection

5.4.1 - Rutting restriction, general (7/16)

Operations are to cease immediately if equipment and weather conditions result in rutting of roads and/or skid trails which is 12 inches or greater in depth and 50 feet in length. The Unit Manager or his/her representative may restrict hauling and/or skidding if ruts exceed the specified depth. With the Unit Manager or his/her representative's approval, the Purchaser may return to the area when the risk of rutting has decreased.

5.8 - Protection of Endangered Species

5.8.5 - Protection of raptor nests (3/13)

All trees with raptor nests will be protected if found during harvesting operations. Notification will be made to the Unit Manager or his/her representative who will notify the Wildlife Biologist so an on-site evaluation and recommendation can be made, if necessary.

7 - Other Conditions

7.3 - Contract Modifications

7.3.1 - Emerald Ash Borer

7.3.1.2 - Emerald ash borer, ash or firewood on sale (2/05)

There is ash and/or "firewood" in this sale and it is located within an emerald ash borer quarantined area. The Director of the Michigan Department of Agriculture (MDA) by the authority of Act No. 72 of the Public Acts of 1945, as amended, and Quarantine Regulation No. 620, has promulgated this quarantine to prevent the further spread of this pest and sets forth: definitions, regulated articles, regulated areas, conditions of movement, violations and penalties, and special

exemptions. The Purchaser must comply with this quarantine. Contact the MDA for further information.



TIMBER SALE MAP

This information provided by authority of Part 525, 1994 PA 451, as amended.

Forest Management Unit Baraga		County Ontonagon	Mapped By Ryan Mattila		Date 6/12/2017	Page 1	of 1
Township 51N	Range 39 & 40W	Section(s) and Subdivision(s) 51N 39W-Sec 30; S1/2NW, N1/2SW, SWSW, Sec 31; NWNW, 51N 40W- Sec 25; E1/2W1/2, W1/2E1/2, E1/2SE, SENE, Sec 36; E1/2, NENW.			Scale 1:15,840		

Cover Type				Density			
A = Aspen	H = Hemlock	N = Marsh	U = Upland Brush	0 = Non Stocked	5 = Pole Timber Medium		
B = Paper Birch	J = Jack Pine	O = Oak	UM = Upland Mixed	1 = Seedling Sapling Poor	6 = Pole Timber Well		
C = Cedar	L = Lowland Brush	P = Lowland Poplar	V = Bog or Marsh	2 = Seedling Sapling Medium	7 = Saw Timber Poor		
D = Tread Bog	LM = Lowland Mixed	Q = Mixed Swamp Conifer	W = White Pine	3 = Seedling Sapling Well	8 = Saw Timber Medium		
E = Swamp Hdwoods	M = Mpl. Bch, Brch	R = Red Pine	X = Non Stocked	4 = Pole Timber Poor	9 = Saw Timber Well		
F = Spruce Fir	MC = Mixed Conifer	S = Black Spruce	Z = Water				
G = Grass	MD = Mixed Deciduous	T = Tamarack					



Legend

- Against State (Red)
- Payment Unit (Red)
- Private Line (Blue)
- Poor Dirt Roads
- Closed Roads
- Streams
- Lakes and Rivers
- PU Label
- Survey Corners

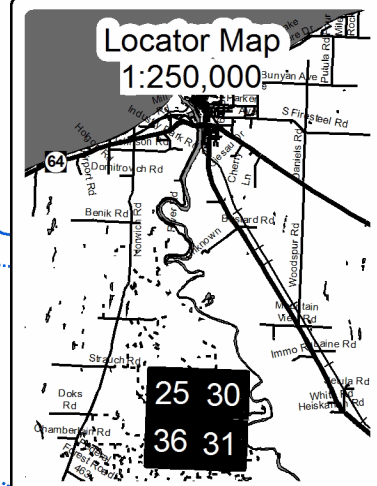
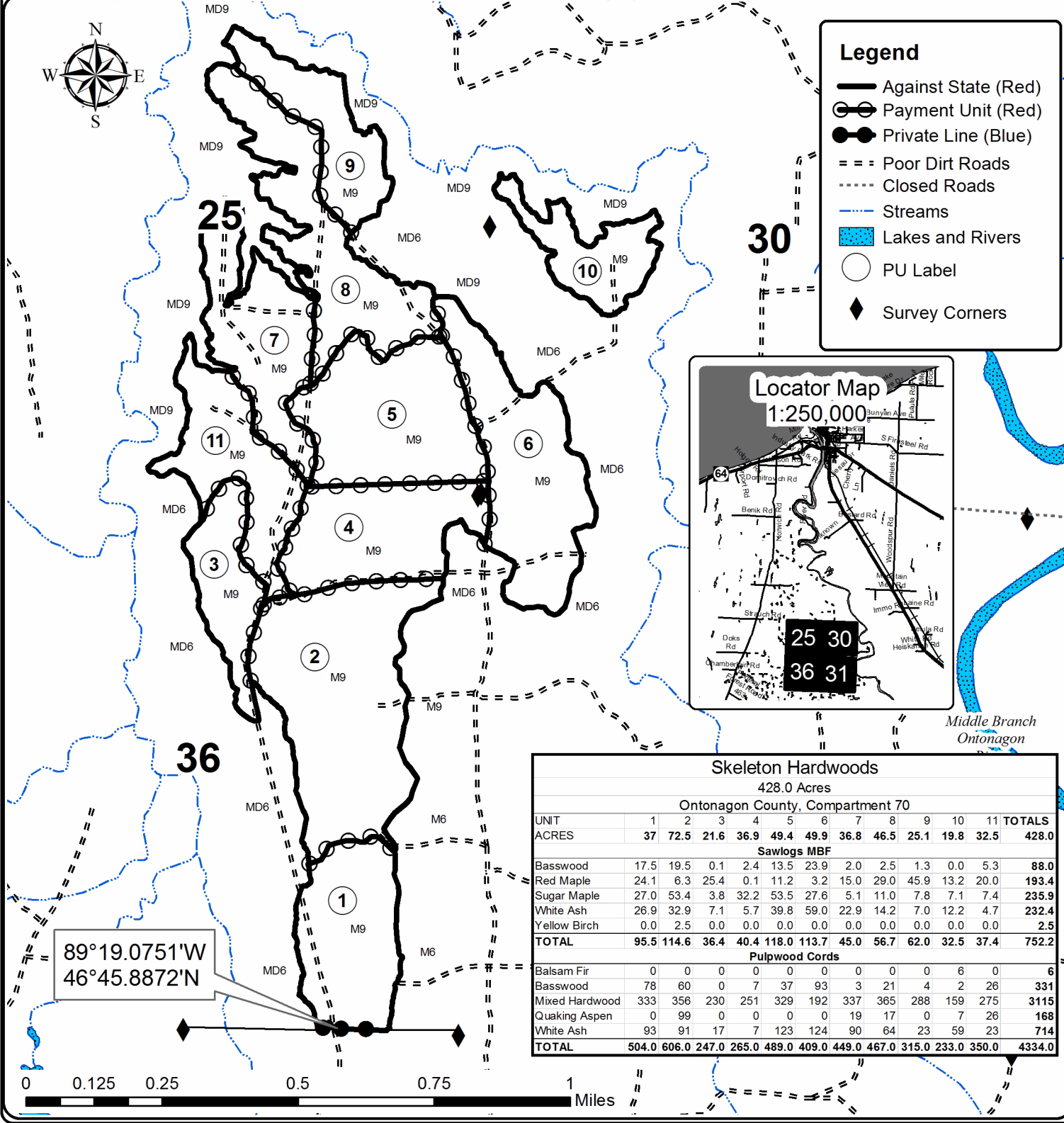

89°19.0751'W
46°45.8872'N

Skeleton Hardwoods												
428.0 Acres												
Ontonagon County, Compartment 70												
UNIT	1	2	3	4	5	6	7	8	9	10	11	TOTALS
ACRES	37	72.5	21.6	36.9	49.4	49.9	36.8	46.5	25.1	19.8	32.5	428.0
Sawlogs MBF												
Basswood	17.5	19.5	0.1	2.4	13.5	23.9	2.0	2.5	1.3	0.0	5.3	88.0
Red Maple	24.1	6.3	25.4	0.1	11.2	3.2	15.0	29.0	45.9	13.2	20.0	193.4
Sugar Maple	27.0	53.4	3.8	32.2	53.5	27.6	5.1	11.0	7.8	7.1	7.4	235.9
White Ash	26.9	32.9	7.1	5.7	39.8	59.0	22.9	14.2	7.0	12.2	4.7	232.4
Yellow Birch	0.0	2.5	0.0	0.0	0.0	0.0	0.0	0.0	0.0	0.0	0.0	2.5
TOTAL	95.5	114.6	36.4	40.4	118.0	113.7	45.0	56.7	62.0	32.5	37.4	752.2
Pulpwood Cords												
Balsam Fir	0	0	0	0	0	0	0	0	0	6	0	6
Basswood	78	60	0	7	37	93	3	21	4	2	26	331
Mixed Hardwood	333	356	230	251	329	192	337	365	288	159	275	3115
Quaking Aspen	0	99	0	0	0	0	19	17	0	7	26	168
White Ash	93	91	17	7	123	124	90	64	23	59	23	714
TOTAL	504.0	606.0	247.0	265.0	489.0	409.0	449.0	467.0	315.0	233.0	350.0	4334.0

Skeleton Hardwoods (11-019-17)
 ; Ontonagon COUNTY

In response to the notice of sale to be held 9:00 a.m. (local time) on September 7, 2017, I am hereby submitting my sealed bid (firm offer) for the following forest products to be cut. Bids for individual species must be at or above the advertised price. All non-responsive bid forms may be rejected.

<u>PRODUCTS & SPECIES</u>	<u>ESTIMATED VOLUME*</u>	<u>ADVERTISED PRICE</u>	<u>BID PRICE</u>
Sawtimber			
Basswood	88.00 MBF	\$ 128.00/MBF	\$ _____
Red Maple	193.40 MBF	\$ 221.00/MBF	\$ _____
Sugar Maple	235.90 MBF	\$ 431.00/MBF	\$ _____
White Ash	232.40 MBF	\$ 87.00/MBF	\$ _____
Yellow Birch	2.50 MBF	\$ 176.00/MBF	\$ _____
Pulpwood			
Balsam Fir	11.00 Cords	\$ 10.95/Cord	\$ _____
Basswood	331.00 Cords	\$ 16.75/Cord	\$ _____
Mixed Hardwood	3,115.00 Cords	\$ 18.25/Cord	\$ _____
Quaking Aspen	168.00 Cords	\$ 15.50/Cord	\$ _____
White Ash	714.00 Cords	\$ 18.25/Cord	\$ _____

*These estimated volumes are final and not subject to adjustment. Prospective bidders are urged to examine this timber and to make their own estimates of quantity and quality.

I understand that any or all bids may be rejected. All bids must be signed and all bid items must be bid or the bid form may be rejected. I also understand that consideration and awarding a contract will be based upon my past performance and ability to complete the contract based upon equipment and staffing subject to my control.

FEDERAL ID: _____ or SOCIAL SECURITY NUMBER: _____

Company or individual bidding: _____

Company representative's name: _____

Address: _____

City: _____ State: _____ Zip: _____

IF AVAILABLE, PLEASE PLACE THE PERSONALIZED LABEL FROM YOUR PROSPECTUS IN THE ABOVE BOX.

Individual or company representative's signature: _____ Date: _____

Phone number : _____ Email (optional): _____

THE WINNING BIDDER MUST COMPLETE THE VERIFICATION OF WORKER'S DISABILITY COMPENSATION ACT COMPLIANCE (ON REVERSE SIDE IF DOUBLE SIDED) WITHIN 21 DAYS OF SALE AWARD DATE



FOR DEPARTMENT USE ONLY	
Sale Number (XX - XXX - XX - XX)	
Forest Management Unit:	

TIMBER SALE VERIFICATION OF WORKER'S DISABILITY COMPENSATION ACT COMPLIANCE

As required by Act 317, P.A. 1969 (Worker's Compensation) and
Part 5 of Act 451 of 1994, as amended.

VERIFICATION OF WORKER'S DISABILITY COMPENSATION ACT COMPLIANCE

- This verification must be completed and submitted within 21 days of contract award and prior to the issuance of the timber sale contract.
- In addition, if boxes 2B or 2C are checked, then Notice of Exclusion or Certificate of Insurance must be submitted within twenty-one (21) days of the contract award and prior to the issuance of the timber sale contract.
- All information must be typed or printed except for written signatures.

Please Check Appropriate Categories:

1. My business is organized as (you **must** check one of the boxes below):
 - A. Sole Proprietorship (individual)
 - B. Partnership
 - C. Corporation
2. You **must** check one of the boxes below:
 - A. I certify my business is a sole proprietorship and it has no employees but the sole proprietor. I am not subject to the Worker's Compensation Laws.
 - B. I certify my business has satisfied its obligation to the Worker's Compensation Act through the use of an approved Notice of Exclusion (BWC-337, Rev. 5/96). I will provide a copy of the Notice of Exclusion within 21 days of the contract award. (For questions or a copy of the BWC-337, please call the Worker's Compensation Bureau at 517-322-1195).
 - C. I certify my business has a Worker's Compensation Policy. I will provide an original Certificate of Insurance within twenty-one (21) days of the contract award.
3. If you have checked item 2(A) or 2(B), you **must** indicate the number of **both** full-time and part-time employees, other than yourself, including family members and active partners (if none, you must enter "0").

_____ Full-time Employees

_____ Part-time Employees

Name of Business		Federal ID (or) Social Security No.	
Address		Telephone ()	
City	State	ZIP	

I hereby certify that the above information is true and correct. I agree to notify the Michigan DNR of any changes that occur in factors affecting my coverage during any of my present and future operations.

Signature of Owner or Authorized Representative

Title

Date

Please complete the "SEALED BID" information on the next page

Two Lakes (11-013-17)
 ; Houghton COUNTY

In response to the notice of sale to be held 9:00 a.m. (local time) on September 7, 2017, I am hereby submitting my sealed bid (firm offer) for the following forest products to be cut. Bids for individual species must be at or above the advertised price. All non-responsive bid forms may be rejected.

<u>PRODUCTS & SPECIES</u>	<u>ESTIMATED VOLUME*</u>	<u>ADVERTISED PRICE</u>	<u>BID PRICE</u>
Sawtimber			
Basswood	1.70 MBF	\$ 128.00/MBF	\$ _____
Black Cherry	0.80 MBF	\$ 131.00/MBF	\$ _____
Mixed Spruce	26.10 MBF	\$ 38.00/MBF	\$ _____
Red Maple	33.30 MBF	\$ 221.00/MBF	\$ _____
Sugar Maple	113.40 MBF	\$ 431.00/MBF	\$ _____
Tamarack	1.90 MBF	\$ 38.00/MBF	\$ _____
Yellow Birch	5.00 MBF	\$ 176.00/MBF	\$ _____
Pulpwood			
Balsam Fir	42.00 Cords	\$ 10.95/Cord	\$ _____
Mixed Hardwood	732.00 Cords	\$ 18.25/Cord	\$ _____
Mixed Spruce	106.00 Cords	\$ 17.55/Cord	\$ _____
Quaking Aspen	14.00 Cords	\$ 15.50/Cord	\$ _____
Tamarack	4.00 Cords	\$ 18.40/Cord	\$ _____

*The volumes are statistically estimated within plus (+) or minus (-) 21.05 percent. These estimated volumes are final and not subject to adjustment. Prospective bidders are urged to examine this timber and to make their own estimates of quantity and quality.

I understand that any or all bids may be rejected. All bids must be signed and all bid items must be bid or the bid form may be rejected. I also understand that consideration and awarding a contract will be based upon my past performance and ability to complete the contract based upon equipment and staffing subject to my control.

FEDERAL ID: ____ - ____ - ____ or SOCIAL SECURITY NUMBER: ____ - ____ - ____
 Company or individual bidding: _____
 Company representative's name: _____
 Address: _____
 City: _____ State: _____ Zip: _____

IF AVAILABLE, PLEASE PLACE THE PERSONALIZED LABEL FROM YOUR PROSPECTUS IN THE ABOVE BOX.

Individual or company representative's signature: _____ Date: _____

Phone number : _____ Email (optional): _____

THE WINNING BIDDER MUST COMPLETE THE VERIFICATION OF WORKER'S DISABILITY COMPENSATION ACT COMPLIANCE (ON REVERSE SIDE IF DOUBLE SIDED) WITHIN 21 DAYS OF SALE AWARD DATE

Waterways Mix (11-002-17)
; Baraga COUNTY

In response to the notice of sale to be held 9:00 a.m. (local time) on September 7, 2017, I am hereby submitting my sealed bid (firm offer) for the following forest products to be cut. Bids for individual species must be at or above the advertised price. All non-responsive bid forms may be rejected.

<u>PRODUCTS & SPECIES</u>	<u>ESTIMATED VOLUME*</u>	<u>ADVERTISED PRICE</u>	<u>BID PRICE</u>
Sawtimber			
Red Maple	6.20 MBF	\$ 221.00/MBF	\$ _____
White Spruce	9.40 MBF	\$ 47.00/MBF	\$ _____
Pulpwood			
Balsam Fir	45.00 Cords	\$ 10.95/Cord	\$ _____
Mixed Hardwood	191.00 Cords	\$ 18.25/Cord	\$ _____
Quaking Aspen	132.00 Cords	\$ 15.50/Cord	\$ _____
White Spruce	67.00 Cords	\$ 17.55/Cord	\$ _____

*The volumes are statistically estimated within plus (+) or minus (-) 20.77 percent. These estimated volumes are final and not subject to adjustment. Prospective bidders are urged to examine this timber and to make their own estimates of quantity and quality.

I understand that any or all bids may be rejected. All bids must be signed and all bid items must be bid or the bid form may be rejected. I also understand that consideration and awarding a contract will be based upon my past performance and ability to complete the contract based upon equipment and staffing subject to my control.

FEDERAL ID: _____ or SOCIAL SECURITY NUMBER: _____

Company or individual bidding: _____

Company representative's name: _____

Address: _____

City: _____ State: _____ Zip: _____

IF AVAILABLE, PLEASE PLACE THE PERSONALIZED LABEL FROM YOUR PROSPECTUS IN THE ABOVE BOX.

Individual or company representative's signature: _____ Date: _____

Phone number : _____ Email (optional): _____

THE WINNING BIDDER MUST COMPLETE THE VERIFICATION OF WORKER'S DISABILITY COMPENSATION ACT COMPLIANCE (ON REVERSE SIDE IF DOUBLE SIDED) WITHIN 21 DAYS OF SALE AWARD DATE

