



**DEPARTMENT OF NATURAL RESOURCES
STATE OF MICHIGAN**

TIMBER SALE PROSPECTUS #5766

SCHEDULED SALE DATE AND TIME: 8:30 a.m. (local time) on June 7, 2017.

LOCATION: CRYSTAL FALLS MGT UNIT, 1420 US-2 WEST, CRYSTAL FALLS, MI 49920.

PROSPECTUS NOTE: ***PLEASE NOTE - BID OPENINGS ARE NOW HELD AT 8:30 A.M. (LOCAL TIME)***

The bidder is advised to inspect the sale area and review the location, estimated volumes, operating costs and contract terms of proposed sales. Please be aware that some landowners may request 60 days or more notice for access across their land.

Notice is hereby given that bids will be received by the Unit Manager, CRYSTAL FALLS MANAGEMENT UNIT, for certain timber on the following described lands:

Troutman Aspen SBW (12-009-16)

Dickinson County, Advertised Price \$11,487.65, 14.7 Acres, Aspen, Spruce/Fir/Tamarack.

SALE NOTE: Sale accessed through private. Recommend dry summer or frozen ground conditions for operations.

Access may be through private land.

Hiline Hardwoods (12-010-16)

Dickinson County, Advertised Price \$164,870.10, 206.0 Acres, Aspen, Hardwood.

SALE NOTE: Best access is through private landowners. It is the responsibility of the purchaser to obtain private property permissions. If snowmobile trail is used for hauling from Dec 1 to Mar 31, no hauling on Fridays, Saturdays, or Sundays, trucks must haul during daylight hours and have flashers on at all times. Also, no decking is permitted on the trail during this time period.

A recreation site such as a trail, pathway, or campground is within the sale area or the vicinity. Certain restrictions/specifications may be applicable including time restrictions. Access may be through private land.

Split Rock Mix SBW (12-011-16)

Dickinson County, Advertised Price \$116,840.75, 132.4 Acres, Aspen, Hardwood.

SALE NOTE: Be advised Unit 1 is rugged and there is a power line between M69 and Unit 2. All culverts will be permanent. If choosing to haul across "DEQ permit required" locations on the sale map, the purchaser is responsible for obtaining permits and the culverts. DNR will provide culverts as needed for accessing other portions of sale. Purchaser is responsible for installing all culverts. If hauling during the snowmobile season (Dec 1 - Mar 31); no decking on trail, no hauling on Fridays, Saturdays, or Sundays, trucking during daylight hours only, and trucks must have flashers on at all times. Unit 4 must be cut in frozen or dry ground conditions. In Units 3 and 5, no cutting April 30 - July 15.

A recreation site such as a trail, pathway, or campground is within the sale area or the vicinity. Certain restrictions/specifications may be applicable including time restrictions.

GG Miss Molly SBW (12-012-16)

Dickinson County, Advertised Price \$171,175.30, 145.7 Acres, Aspen, Spruce/Fir/Tamarack.

SALE NOTE: Softwood volume is deteriorating quickly due to Spruce Budworm. No operations from December 1 - March 31 due to snowmobile trail conflict.

A recreation site such as a trail, pathway, or campground is within the sale area or the vicinity. Certain restrictions/specifications may be applicable including time restrictions.

Little Brook Aspen SBW (12-014-16)

Dickinson County, Advertised Price \$275,039.00, 212.2 Acres, Aspen, Spruce/Fir/Tamarack.

SALE NOTE: White Spruce and Balsam volumes are in decline due to Spruce Budworm outbreak. No operations from December 1 to March 31 due to snowmobile trail restrictions. All culverts needed on Little Brook Road will be supplied by DNR. Transportation and installation of culverts will be the responsibility of the purchaser. 2 brush piles per Payment Unit must be constructed for hare and grouse habitat.

A recreation site such as a trail, pathway, or campground is within the sale area or the vicinity. Certain restrictions/specifications may be applicable including time restrictions.

BID INSTRUCTIONS (VER. 09/02/2016):

1. Scheduled Bid Location, Date, and Time (2/11)

Bids must be received by the Unit Manager, CRYSTAL FALLS OFFICE, 1420 US-2 WEST, CRYSTAL FALLS, MI 49920, no later than 8:30 a.m. (local time) on June 7, 2017. For further information concerning this sale, contact Dan McNamee at 906-875-6622 extension 105.

2. Bidder's Qualifications (5/16)

Purchaser shall obtain workers compensation insurance to cover claims under Michigan's Worker's Disability Compensation Act of 1969 or similar employee benefit act of any other state applicable to an employee. If all or part of a timber sale was prepared by a private contractor, the contractor and that contractor's company are not permitted to bid on the timber sale contract. Bids will not be accepted from individuals or companies appearing on the DNR/FRD No-Bid List. This list contains the names of purchasers who previously failed to execute a contract within 21-days or who have a history of poor performance.

3. Preparation of Sealed Bids (5/16)

Bid Forms may be completed online thru Michigan DNR Timber Sale Online Bidding (OLB) at www.michigan.gov/timberbidding or by completing the hardcopy Bid Form found in the Timber Sale Prospectus. Hardcopy Bid Forms shall be manually signed in ink. Registration in OLB is considered your 'signature' for all bids submitted thru that system. Bid prices must be entered for each species and product in the Bid Price column for all material subject to bidding and all fill-in blanks must be completed. If erasures or other changes appear on the hardcopy Bid Form, each erasure or change must be initialed by the person signing the bid.

4. Submission of Sealed Bids (5/16)

Bid forms may be obtained from the Unit Manager or thru OLB. Bids may be submitted hardcopy or thru OLB. All hardcopy bids must be submitted on the bid form and in an envelope clearly identified as described in this section. NOTE: Only one bid form per bid envelope. Sealed bids must be submitted to the Unit office designated in the prospectus and must be submitted at or prior to the time established in the prospectus. The envelope should show on the outside (a) the sale name or number and (b) the date and time of bid opening, as shown in the prospectus. Bids received after the time specified in the sale prospectus are late bids and will be rejected.

It is possible for a bidder to submit multiple bids on a single sale. For example, a bid may be submitted hardcopy and a bid may be submitted thru OLB. Or, two bidders from the same company could both submit bids on the same sale. If this were to happen, the State would accept all bids received and award the contract accordingly. All bidding and contractual requirements would apply to all bids received.

5. Public Opening of Sealed Bids (7/16)

If conditions permit, the sealed bids will be publicly opened and posted at the time and place set in the prospectus.

If a bidder, present at a bid opening, has submitted bids on more than one sale, that bidder may withdraw their unopened bid envelopes or announce the withdrawal of their online bid after being declared the successful bidder on one sale.

6. Award of Contract (1/11)

Award of the contract will be made to the Bidder whose bid, conforming to the prospectus, is most advantageous to the State of Michigan on the basis of total value at rates bid for the estimated quantities. The State reserves the right to reject any bid or waive any minor irregularity in bids received. A written award mailed (or otherwise furnished) to the successful Bidder shall be deemed to result in a binding contract without further action by either party.

7. Down Payment (1/11)

The Bidder to whom award is made must make a down payment within 21 days of the sale award. The amount of the down payment will be calculated as shown in the Bond and Payment Schedule of this prospectus. Only cash may be used to meet this requirement.

8. Performance Security (1/11)

As guarantee of faithful performance, a cash bond, certificate of deposit, surety bond or irrevocable letter of credit (LOC) is required within 21 days of the sale award. The amount of the performance security is shown in the Bond and

Payment Schedule of this prospectus. If an LOC or surety is used, the coverage must extend for at least 6 months beyond the contract expiration.

9. Timber Sale Contract (9/14)

Additional conditions and requirements common to all timber sales are listed on the timber sale contract (R4031) and are available on line at www.michigan.gov/timber. Contact the Unit Manager for additional information or a sample contract. Within 21 days of the date of the award letter, the bidder must sign the contract and provide the required down payment, performance security, and verification of worker's disability compensation. The down payment and performance security shall be in accordance with the provisions of the timber sale contract, in the sums stated in this prospectus. If these actions are not taken, then the Bidder, the Bidder's corporation, and the corporation's principals may not be permitted to bid on State timber sales for a period of 1 year. In addition, the Bidder certifies that if awarded this contract, the Bidder will complete the timber sale contract in accordance with its terms and any modifications thereof including requirements to purchase, cut, and remove the included timber by the expiration date.

10. Disclaimer of Estimates and Bidder's Warranty of Inspection (7/16)

Before submitting this bid, the Bidder is advised and cautioned to inspect the sale area, review the requirements of the sale contract, and take other steps as may be reasonably necessary to ascertain the location, estimated volumes, construction estimates, and operating costs of the proposed sale. Failure to do so will not relieve the Bidder from responsibility for completing the contract.

The Bidder warrants that this bid is submitted solely on the basis of the Bidder's examination and inspection of the quality and quantity of the timber offered for sale and the Bidder's opinion of the value thereof and the costs of recovery. No reliance should be placed on the State of Michigan's estimates of timber quality, quantity or costs of recovery. Bidder further acknowledges that the State of Michigan: (i) expressly disclaims any warranty of fitness of timber for any purpose; (ii) offers this timber as is without any warranty of quality (merchantability) or quantity and (iii) expressly disclaims any warranty as to the quantity or quality of timber sold.

11. Certification and Chain-of-Custody (10/14)

Unless otherwise indicated in the contract under section 7 – Other Conditions of the Sale Specific Conditions & Requirements, the area encompassed by this timber sale is certified to the standards of the Forest Stewardship Council (FSC) - Certificate #SCS-FM/COC-00090N and the Sustainable Forestry Initiative (SFI) - Certificate # NSF-SFIS-5Y031-SF5. Forest products from this sale may be delivered to the mill as "FSC 100% and / or SFI certified" as long as the contractor hauling the forest products is chain-of-custody (COC) certified or covered under a COC certificate from the destination mill. The purchaser is responsible for maintaining COC after leaving the sale area.

12. Good Neighbor Authority (GNA) Requirements (7/16)

If the name of this timber sales contains the acronym GNA, it is authorized by the Good Neighbor Authority (GNA) and covered by various agreements between the U.S. Forest Service and the State. The timber sale occurs on federal land and the following conditions apply:

GNA contracts on US Forest Service land will not be awarded to purchasers on the Federal list of excluded parties. The System for Award Management (SAM) will be checked for active excluded parties prior to award of contract. In addition, the Bidder to whom award is made must complete an Assurance Regarding Felony Conviction or Tax Delinquent Status for Corporate Applicants (AD-3031).

13. Good Neighbor Authority (GNA) Requirements, con't (9/16)

Bidder certifies, by signing this bid form, that to the best of Bidder's knowledge that the following representations are accurate and complete.

- a. That the Bidder and its principals are not presently debarred, suspended, proposed for debarment, declared ineligible, or voluntary excluded from timber sales (covered transactions) by any Federal department or agency.
- b. That the Bidder and its principals have not within a 3-year period preceding this bid been convicted of or had a civil judgment rendered against them for commission of fraud or a criminal offense in connection with obtaining, attempting to obtain, or performing a public (Federal, State, or local) transaction or contract under a public transaction; violation of Federal or State antitrust statutes or commission of embezzlement, theft, forgery, bribery, falsification or destruction of records, making false statements, or receiving stolen property.

c. That the Bidder and its principals are not presently indicted for or otherwise criminally or civilly charged by a governmental entity (Federal, State, or local) with commission of any of the offenses enumerated in paragraph b of this certification.

d. That the Bidder and its principals have not within a 3-year period preceding this bid had one or more public transactions (Federal, State, or local) terminated for breach or default of a timber or forest product contract.

Bidders that cannot certify this requirement, in whole or in part, shall submit an explanation with their bid.

KEITH CREAGH

Director

TIMBER SALE INFORMATION

Troutman Aspen SBW (12-009-16)

Dickinson County (Advertised Price \$11,487.65)

SALE NOTE: Sale accessed through private. Recommend dry summer or frozen ground conditions for operations.

Access may be through private land.

A timber sale contract for this lump sum, sealed bid timber sale will be awarded to the responsible bidder offering the highest sealed bid price. Bids must be at or above the following advertised price for each species:

<u>PRODUCTS & SPECIES</u>	<u>ESTIMATED UNITS*</u>	<u>ADVERTISED PRICE</u>
Pulpwood		
Balsam Fir	120.00 Cords	\$ 12.80 / Cord
Mixed Hardwood	69.00 Cords	\$ 24.40 / Cord
Quaking Aspen	261.00 Cords	\$ 30.40 / Cord
Tamarack	7.00 Cords	\$ 13.25 / Cord
White Spruce	11.00 Cords	\$ 21.90 / Cord

* The total volume is statistically estimated within plus (+) or minus (-) 15.58 percent. The estimated units are final and not subject to adjustment. Prospective bidders are urged to examine this timber and to make their own estimates of quantity and quality.

BOND AND PAYMENT SCHEDULE:

1. A bond in the amount of \$574.00 to insure faithful performance of the conditions of the contract will be deposited by the successful bidder within 21 days of the sale award.
2. Cutting in any sale or unit without the required advance payment would be considered a trespass.
3. Total payment must be paid in advance or according to the following schedule:
 - (a) Ten percent (10%) of the sale value must be paid within 21 days of the sale award.
 - (b) The remainder is due before cutting begins.
4. If no cutting takes place, the 10% down payment will not be refunded.
5. Operations on the contract issued will terminate on 06/30/2018.

Description of Timber by Payment Unit (PU)

PU	MARKET GROUP	PRODUCT	QUANTITY	UNIT	ACRES	ADVERTISE PRICE
1	Balsam Fir	Pulpwood	120.0	Cords	14.7	\$11,487.65
	Mixed Hardwood		69.0	Cords		
	<i>Balsam Poplar</i>		60.0	<i>Cords</i>		
	<i>Black Cherry</i>		2.0	<i>Cords</i>		
	<i>Red Maple</i>		6.0	<i>Cords</i>		
	<i>Sugar Maple</i>		1.0	<i>Cords</i>		
	Quaking Aspen		261.0	Cords		
	Tamarack		7.0	Cords		
	White Spruce		11.0	Cords		
TOTAL:			468.0	Cords		

Sale Specific Conditions & Requirements

Sale Name: Troutman Aspen SBW

Sale Number: 12-009-16 Seq#: 1

1 - Sale Area

1.2 - Boundaries

1.2.1 - Painted boundaries (1/14)

The sale boundary and Payment Unit boundaries are marked and identified by BLUE and RED paint. Exterior sale boundary lines against private property are marked with BLUE paint. Exterior sale boundary lines against state are marked with RED paint. The painted boundary line trees are not Included Timber and are to be protected.

2 - Timber Specifications

2.1 - Included Timber

2.1.1 - Clearcut unit(s) with unmerchantable trees (6/14)

Within Payment Unit(s) #1, cut all trees that are two (2) inches or more at DBH EXCEPT Cedar.

2.1.11 - Description of timber note (2/04)

Note that Mixed Hardwood includes BAM, Maple, and Cherry.

4 - Transportation

4.1 - Construction

4.1.6 - Road construction (1/09)

Construction of new roads or improvements of existing roads shall be done in such a way as to minimize the environmental and visual impacts. Merchantable trees shall be cut and utilized unless otherwise directed. Non-merchantable trees shall be severed and laid flat on the ground. Slash shall be chipped, utilized or otherwise removed from the sale. Stumps shall be set upright, not left on edge, and be moved at least 10 feet away from the road edge. Disturbed soil shall be feathered into the woods and not left in berms or windrows.

4.1.7 - Road closure (10/11)

All new roads built into the sale must be blocked to vehicle traffic upon completion of the sale. In general, this will require constructing a four (4') foot high berm of stumps and logs covered with earth.

4.4 - Access

4.4.1 - Private property access (3/11)

Permission for access across private land is the responsibility of the Purchaser.

5 - Operations

5.1 - Notification

5.1.1 - Pre-sale conference (10/11)

A pre-sale conference between the Purchaser and sale administrator is required prior to beginning any operations to determine landing and road locations. The Unit Manager or his/her representative must be contacted at least 10 days in advance to schedule the conference.

5.1.4 - Post-sale conference (6/11)

A post-sale conference on site between the Purchaser and sale administrator is required 5 days prior to the completion of active logging operations to determine clean-up and repair of landings, road edges, and the fulfillment of other contract specifications.

5.2 - Conduct of Operations

5.2.1 - Slash

5.2.1.13 - Dispose of slash as directed (12/05)

Slash is to be disposed of as directed by the Sale Administrator.

5.2.2 - Hazard Trees/Snags

5.2.2.1 - Den trees (2/04)

Obvious hollow and/or den trees shall be protected and left standing unless they are a safety hazard.

5.2.22 - Operating Caution

5.2.22.1 - Operating caution (6/11)

It is recommended, but not required, that within Payment Unit(s) #1, cutting and skidding occur during dry summer or frozen winter conditions. The reason for the recommendation is due to saturated soil.

5.3 - Stream Protection

5.3.1 - Operating near stream (7/04)

No tracked or wheeled vehicles shall be operated within 300 feet of the West Branch of Sturgeon River. No crossings will be approved.

5.4 - Soil Protection

5.4.1 - Rutting restriction, general (1/09)

Operations are to cease immediately if equipment and weather conditions result in rutting of roads and skid trails which is 12 inches or greater in depth and 50 feet in length. The Unit Manager or his/her representative may restrict hauling and/or skidding if ruts exceed the specified depth. With the Unit Manager or his/her representative's approval, the Purchaser may return to the area when the risk of rutting has decreased.

7 - Other Conditions

7.5 - Loss

7.5.1 - Deteriorating timber (7/09)

The sale area has received damage from windthrow and Spruce Budworm. The Purchaser should harvest the wood as soon as possible. The Department of Natural Resources is held free of responsibility of any further damage or deterioration due to delay in harvesting.



TIMBER SALE MAP

This information provided by authority of Part 525, 1994 PA 451, as amended.

Sale Number	Year
12-009	16

Forest Management Unit Crystal Falls	County Dickinson	Mapped By Church	Date 07/08/2016	Page 1	of 1
Township 42N	Range 29W	Section(s) and Subdivision(s) SWNW Section 29	Scale 1:15,840		

Cover Type				Density	
A = Aspen	H = Hemlock	N = Marsh	U = Upland Brush	0 = Non Stocked	5 = Pole Timber Medium
B = Paper Birch	J = Jack Pine	O = Oak	UM = Upland Mixed	1 = Seedling Sapling Poor	6 = Pole Timber Well
C = Cedar	L = Lowland Brush	P = Lowland Poplar	V = Bog or Marsh	2 = Seedling Sapling Medium	7 = Saw Timber Poor
D = Treed Bog	LM = Lowland Mixed	Q = Mixed Swamp Conifer	W = White Pine	3 = Seedling Sapling Well	8 = Saw Timber Medium
E = Swamp Hdwoods	M = Mpl, Bch, Brch	R = Red Pine	X = Non Stocked	4 = Pole Timber Poor	9 = Saw Timber Well
F = Spruce Fir	MC = Mixed Conifer	S = Black Spruce	Z = Water		
G = Grass	MD = Mixed Deciduous	T = Tamarack			

PU	Acres
1	14.7

Troutman Aspen SBW

Compartment 56

14.7 Acres

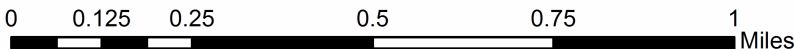
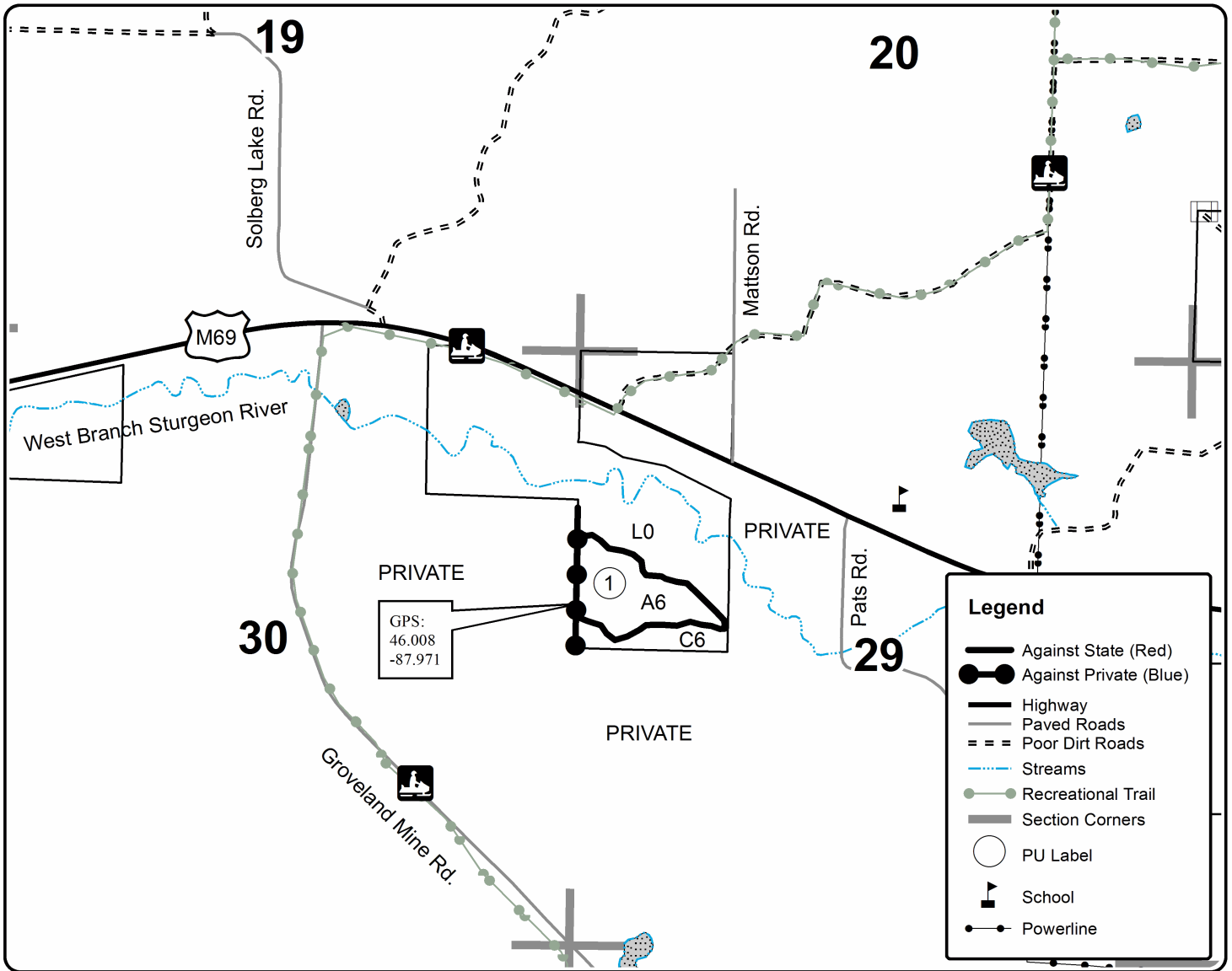
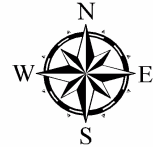

TIMBER SALE INFORMATION

Hiline Hardwoods (12-010-16)

Dickinson County (Advertised Price \$164,870.10)

SALE NOTE: Best access is through private landowners. It is the responsibility of the purchaser to obtain private property permissions. If snowmobile trail is used for hauling from Dec 1 to Mar 31, no hauling on Fridays, Saturdays, or Sundays, trucks must haul during daylight hours and have flashers on at all times. Also, no decking is permitted on the trail during this time period.

A recreation site such as a trail, pathway, or campground is within the sale area or the vicinity. Certain restrictions/specifications may be applicable including time restrictions. Access may be through private land.

A timber sale contract for this lump sum, sealed bid timber sale will be awarded to the responsible bidder offering the highest sealed bid price. Bids must be at or above the following advertised price for each species:

<u>PRODUCTS & SPECIES</u>	<u>ESTIMATED UNITS*</u>	<u>ADVERTISED PRICE</u>
Sawtimber		
Basswood	269.50 MBF	\$ 198.00 / MBF
Sugar Maple	77.60 MBF	\$ 532.00 / MBF
Pulpwood		
Balsam Fir	121.00 Cords	\$ 17.50 / Cord
Basswood	519.00 Cords	\$ 13.45 / Cord
Mixed Hardwood	1,462.00 Cords	\$ 33.25 / Cord
Mixed Spruce	18.00 Cords	\$ 29.85 / Cord
Quaking Aspen	289.00 Cords	\$ 41.45 / Cord

* The total volume is statistically estimated within plus (+) or minus (-) 10.31 percent. The estimated units are final and not subject to adjustment. Prospective bidders are urged to examine this timber and to make their own estimates of quantity and quality.

BOND AND PAYMENT SCHEDULE:

1. A bond in the amount of \$8,244.00 to insure faithful performance of the conditions of the contract will be deposited by the successful bidder within 21 days of the sale award.
2. Cutting in any sale or unit without the required advance payment would be considered a trespass.
3. Total payment must be paid in advance or according to the following schedule:
 - (a) Ten percent (10%) of the sale value must be paid within 21 days of the sale award.
 - (b) The 10% down payment will be credited towards the first unit cut.
4. If no cutting takes place, the 10% down payment will not be refunded.
5. Operations on the contract issued will terminate on 06/30/2019.

Description of Timber by Payment Unit (PU)

PU	MARKET GROUP	PRODUCT	QUANTITY	UNIT	ACRES	ADVERTISE PRICE			
1	Balsam Fir	Pulpwood	81.0	Cords	8.3	\$10,147.75			
	Mixed Hardwood		27.0	Cords					
	<i>Red Maple</i>		18.0	<i>Cords</i>					
	<i>Sugar Maple</i>		9.0	<i>Cords</i>					
	Mixed Spruce		18.0	Cords					
	<i>Black Spruce</i>		8.0	<i>Cords</i>					
	<i>White Spruce</i>		10.0	<i>Cords</i>					
	Quaking Aspen		176.0	Cords					
	2		Basswood	Sawtimber			0.3	MBF	6.7
Sugar Maple			0.9	MBF					
Basswood		Pulpwood	1.0	Cords					
Mixed Hardwood			46.0	Cords					
<i>Sugar Maple</i>			46.0	<i>Cords</i>					
Quaking Aspen			44.0	Cords					
3	Sugar Maple	Sawtimber	1.1	MBF	3.9	\$3,145.45			
	Mixed Hardwood	Pulpwood	77.0	Cords					
	<i>Red Maple</i>	<i>Sawtimber</i>	0.6	<i>MBF</i>					
	<i>Red Maple</i>	<i>Pulpwood</i>	1.0	<i>Cords</i>					
	<i>Sugar Maple</i>		75.0	<i>Cords</i>					
4	Basswood	Sawtimber	35.9	MBF	33.0	\$28,600.85			
	Sugar Maple		19.3	MBF					
	Balsam Fir	Pulpwood	8.0	Cords					
	Basswood		53.0	Cords					
	Mixed Hardwood		292.0	Cords					
	<i>Red Maple</i>		<i>Sawtimber</i>	1.4			<i>MBF</i>		
	<i>Red Maple</i>		<i>Pulpwood</i>	2.0			<i>Cords</i>		
	<i>Sugar Maple</i>		284.0	<i>Cords</i>					
	<i>Yellow Birch</i>		3.0	<i>Cords</i>					
	Quaking Aspen		16.0	Cords					
	5	Basswood	Sawtimber	38.3			MBF	35.3	\$30,611.90
Sugar Maple			20.6	MBF					
Balsam Fir		Pulpwood	9.0	Cords					
Basswood			57.0	Cords					
Mixed Hardwood			314.0	Cords					
<i>Red Maple</i>			<i>Sawtimber</i>	1.5	<i>MBF</i>				
<i>Yellow Birch</i>			<i>MBF</i>	0.1	<i>MBF</i>				
<i>Red Maple</i>		<i>Pulpwood</i>	3.0	<i>Cords</i>					
<i>Sugar Maple</i>			304.0	<i>Cords</i>					
<i>Yellow Birch</i>			4.0	<i>Cords</i>					
Quaking Aspen			17.0	Cords					
6		Basswood	Sawtimber	75.4	MBF	45.9	\$34,197.50		
		Sugar Maple		13.8	MBF				
	Balsam Fir	Pulpwood	9.0	Cords					
	Basswood		157.0	Cords					
	Mixed Hardwood		273.0	Cords					
	<i>Red Maple</i>		<i>Sawtimber</i>	0.8	<i>MBF</i>				
	<i>Yellow Birch</i>		<i>MBF</i>	0.5	<i>MBF</i>				
	<i>Red Maple</i>	<i>Pulpwood</i>	1.0	<i>Cords</i>					
	<i>Sugar Maple</i>		248.0	<i>Cords</i>					
	<i>Yellow Birch</i>		21.0	<i>Cords</i>					
	Quaking Aspen		14.0	Cords					
	7	Basswood	Sawtimber	75.3	MBF			45.9	\$34,191.15
		Sugar Maple		13.8	MBF				
Balsam Fir		Pulpwood	9.0	Cords					
Basswood			158.0	Cords					
Mixed Hardwood			273.0	Cords					

Description of Timber by Payment Unit (PU), con't

PU	MARKET GROUP	PRODUCT	QUANTITY	UNIT	ACRES	ADVERTISE PRICE
	<i>Red Maple</i>	<i>Sawtimber</i>	0.8	<i>MBF</i>		
	<i>Yellow Birch</i>		0.5	<i>MBF</i>		
	<i>Red Maple</i>	<i>Pulpwood</i>	1.0	<i>Cords</i>		
	<i>Sugar Maple</i>		248.0	<i>Cords</i>		
	<i>Yellow Birch</i>		21.0	<i>Cords</i>		
	Quaking Aspen		14.0	Cords		
8	Basswood	Sawtimber	44.3	MBF	27.0	\$20,103.80
	Sugar Maple		8.1	MBF		
	Balsam Fir	Pulpwood	5.0	Cords		
	Basswood		93.0	Cords		
	Mixed Hardwood		161.0	Cords		
	<i>Red Maple</i>	<i>Sawtimber</i>	0.5	<i>MBF</i>		
	<i>Yellow Birch</i>		0.3	<i>MBF</i>		
	<i>Red Maple</i>	<i>Pulpwood</i>	1.0	<i>Cords</i>		
	<i>Sugar Maple</i>		146.0	<i>Cords</i>		
	<i>Yellow Birch</i>		12.0	<i>Cords</i>		
	Quaking Aspen		8.0	Cords		
TOTAL:			347.1	MBF		
TOTAL:			2,410.0	Cords		

Sale Specific Conditions & Requirements

Sale Name: Hiline Hardwoods

Sale Number: 12-010-16 Seq#: 1

1 - Sale Area

1.2 - Boundaries

1.2.1 - Painted boundaries (1/14)

The sale boundary and Payment Unit boundaries are marked and identified by BLUE, RED, and YELLOW paint. Exterior sale boundary lines against private property are marked with BLUE paint. Exterior sale boundary lines against state are marked with RED paint. Interior Payment Unit boundaries are marked with YELLOW paint. Note that the boundary between Payment Units 1 and 2 is marked with RED paint. The painted boundary line trees are not Included Timber and are to be protected unless marked with orange paint.

2 - Timber Specifications

2.1 - Included Timber

2.1.1 - Clearcut unit(s) with unmerchantable trees (6/14)

Within Payment Unit(s) #1, cut all trees that are two (2) inches or more at DBH except Cedar. Also leave sub-merchantable conifers

2.1.3 - Cut tree marked unit(s) (12/08)

Within Payment Unit(s) #'s 2-8, all trees are designated for cutting when marked with ORANGE paint above and below stump height, regardless of merchantability.

2.1.11 - Description of timber note (2/04)

Note that Mixed Hardwood includes Maple, Birch, Ash, Elm, Ironwood, and Cherry. Mixed Spruce includes Black Spruce and White Spruce.

3 - Payments

3.3 - Pre-measured Sales

3.3.4 - Dividing payment units (7/14)

Payment Unit(s) #'s 4-8 may be divided at the request of the Purchaser and upon approval of the Unit Manager. Dividing Payment Units is a contract modification which requires a Timber Sale Contract Supplement. There will be only one division per Payment Unit.

3.4 - Damaged Timber

3.4.1 - Damaged timber (6/14)

General Condition and Requirement 3.4 Damaged Timber, defines liquidated damages for undesignated live merchantable trees which are cut or injured.

No damage is acceptable to merchantable trees. Within the sale area, if more than 10% of trees (> 4.5" DBH) within a specified area of the sale are damaged, liquidated damages will be assessed for all trees damaged. Rates will be in accordance with General Condition and Requirement 3.4 Damaged Timber.

4 - Transportation

4.1 - Construction

4.1.6 - Road construction (1/09)

Construction of new roads or improvements of existing roads shall be done in such a way as to minimize the environmental and visual impacts. Merchantable trees shall be cut and utilized unless otherwise directed. Non-merchantable trees shall be severed and laid flat on the ground. Slash shall be scattered, and not left in windrows and kept a minimum of 10 feet back from the road edge. Stumps shall be set upright, not left on edge, and be moved at least 10 feet away from the road edge. Disturbed soil shall be feathered into the woods and not left in berms or windrows.

4.1.7 - Road closure (10/11)

All new roads built into the sale must be blocked to vehicle traffic upon completion of the sale. In general, this will require constructing a four (4') foot high berm of stumps and logs covered with earth.

4.1.11 - Permits (2/12)

The Purchaser will secure any necessary highway and stream crossing permits that may be required.

4.2 - Maintenance

4.2.1 - Hauling restriction (12/08)

Hauling is restricted on the snowmobile trail from December 1 to March 31. The restriction is aimed to decrease truck and snowmobile interactions. No hauling will be permitted on Fridays, Saturdays, or Sundays. In addition, hauling is only permitted during daylight hours and trucks must have flashers on at all times.

4.2.5 - Two wheel drive condition (2/04)

All existing trail roads on and adjacent to the sale area must be passable by two-wheel drive traffic for the duration of the sale.

4.4 - Access

4.4.1 - Private property access (3/11)

Permission for access across private land is the responsibility of the Purchaser.

5 - Operations

5.1 - Notification

5.1.1 - Pre-sale conference (10/11)

A pre-sale conference between the Purchaser and sale administrator is required prior to beginning any operations. The Unit Manager or his/her representative must be contacted at least 10 days in advance to schedule the conference.

5.1.4 - Post-sale conference (6/11)

A post-sale conference on site between the Purchaser and sale administrator is required 5 days prior to the completion of active logging operations to determine clean-up and repair of landings, road edges, and the fulfillment of other contract specifications.

5.2 - Conduct of Operations

5.2.1 - Slash

5.2.1.13 - Dispose of slash as directed (12/05)

Slash is to be disposed of as directed by the sale administrator.

5.2.2 - Hazard Trees/Snags

5.2.2.1 - Den trees (2/04)

Obvious hollow and/or den trees shall be protected and left standing unless they are a safety hazard.

5.2.3 - Operating Restrictions

5.2.3.3 - Bark slippage restriction (3/09)

Within Payment Unit(s) #'s 2-8, unless changed by written agreement, cutting and skidding are not permitted during the period of April 15 to July 15. This restriction is because of bark slippage.

5.2.41 - Snowmobile trail protection (9/11)

The snowmobile trail is shown on the Timber Sale Map. Do not cut or damage posts with orange trail markers or traffic control signs.

If the trail is used, it must be maintained and restored to a condition equal to or better than before the sale.

The road maintenance/restoration must be done prior to December 1.

If the trail is used for hauling from December 1 to March 31, no decking of forest products will be permitted along the

snowmobile trail, and no hauling is permitted on Fridays, Saturdays, or Sundays. In addition, trucks must haul during daylight hours and have flashers on at all times.

If the trail road is to be used for hauling during the snowmobile season, then a snow covered base must be left on the trail. Maintain a 20 foot wide slash, debris, and rut free zone daily using the snowmobile trail as the centerline. All stumps within 20 feet of the snowmobile trail must be cut at ground level.

5.4 - Soil Protection

5.4.1 - Rutting restriction, general (7/16)

Operations are to cease immediately if equipment and weather conditions result in rutting of roads and/or skid trails which is 12 inches or greater in depth and 50 feet in length. The Unit Manager or his/her representative may restrict hauling and/or skidding if ruts exceed the specified depth. With the Unit Manager or his/her representative's approval, the Purchaser may return to the area when the risk of rutting has decreased.

5.4.6 - Wet area protection (5/10)

No harvesting operations, including skidding and felling, are to take place within the vernal pond areas. These are identified as Exclusion Areas on the Timber Sale map. When harvesting occurs, there should be no disturbance to the vernal pond depression. All equipment, trees and tops should be kept out of this area. Within 100 feet of the pond, equipment should only be used when the soil is in a dry or frozen condition. Care must be taken by the Purchaser to identify and avoid operating in these areas of the timber sale.

5.8 - Protection of Endangered Species

5.8.5 - Protection of raptor nests (3/13)

All trees with raptor nests will be protected if found during harvesting operations. Notification will be made to the Unit Manager or his/her representative who will notify the Wildlife Biologist so an on-site evaluation and recommendation can be made, if necessary.

6 - Safety and Fire Prevention

6.2 - Signing

6.2.2 - Snowmobile trail posting (8/09)

The Purchaser is responsible for posting and maintaining caution signs on the snowmobile trail prior to beginning operations during the snowmobile season (approximately December 1 to March 31). The trail must be posted at appropriate distances from the sale area to warn of logging activity and truck traffic. Signs must be removed when harvest operations are suspended or completed. The Purchaser will provide these signs.



TIMBER SALE MAP

This information provided by authority of Part 525, 1994 PA 451, as amended.

Forest Management Unit Crystal Falls	County Dickinson	Mapped By Church	Date 07/22/2016	Page 1	of 1
Township 42N	Range 29W	Section(s) and Subdivision(s) Sec 16: SWSE Sec17: S1/2SE Sec 21:N1/2NW,SENW,SWNE,E1/2SW,SWSW,SWSE	Scale 1:15,840		

Cover Type				Density			
A = Aspen	H = Hemlock	N = Marsh	U = Upland Brush	0 = Non Stocked	5 = Pole Timber Medium		
B = Paper Birch	J = Jack Pine	O = Oak	UM = Upland Mixed	1 = Seedling Sapling Poor	6 = Pole Timber Well		
C = Cedar	L = Lowland Brush	P = Lowland Poplar	V = Bog or Marsh	2 = Seedling Sapling Medium	7 = Saw Timber Poor		
D = Treed Bog	LM = Lowland Mixed	Q = Mixed Swamp Conifer	W = White Pine	3 = Seedling Sapling Well	8 = Saw Timber Medium		
E = Swamp Hdwoods	M = Mpl, Bch, Brch	R = Red Pine	X = Non Stocked	4 = Pole Timber Poor	9 = Saw Timber Well		
F = Spruce Fir	MC = Mixed Conifer	S = Black Spruce	Z = Water				
G = Grass	MD = Mixed Deciduous	T = Tamarack					

PU	Acres	PU	Acres
1	8.3	5	35.3
2	6.7	6	45.9
3	3.9	7	45.9
4	33.0	8	27.0

Hiline Hardwoods

Compartment 56

206.0 Acres

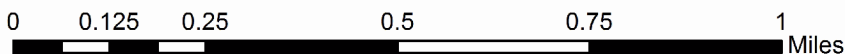
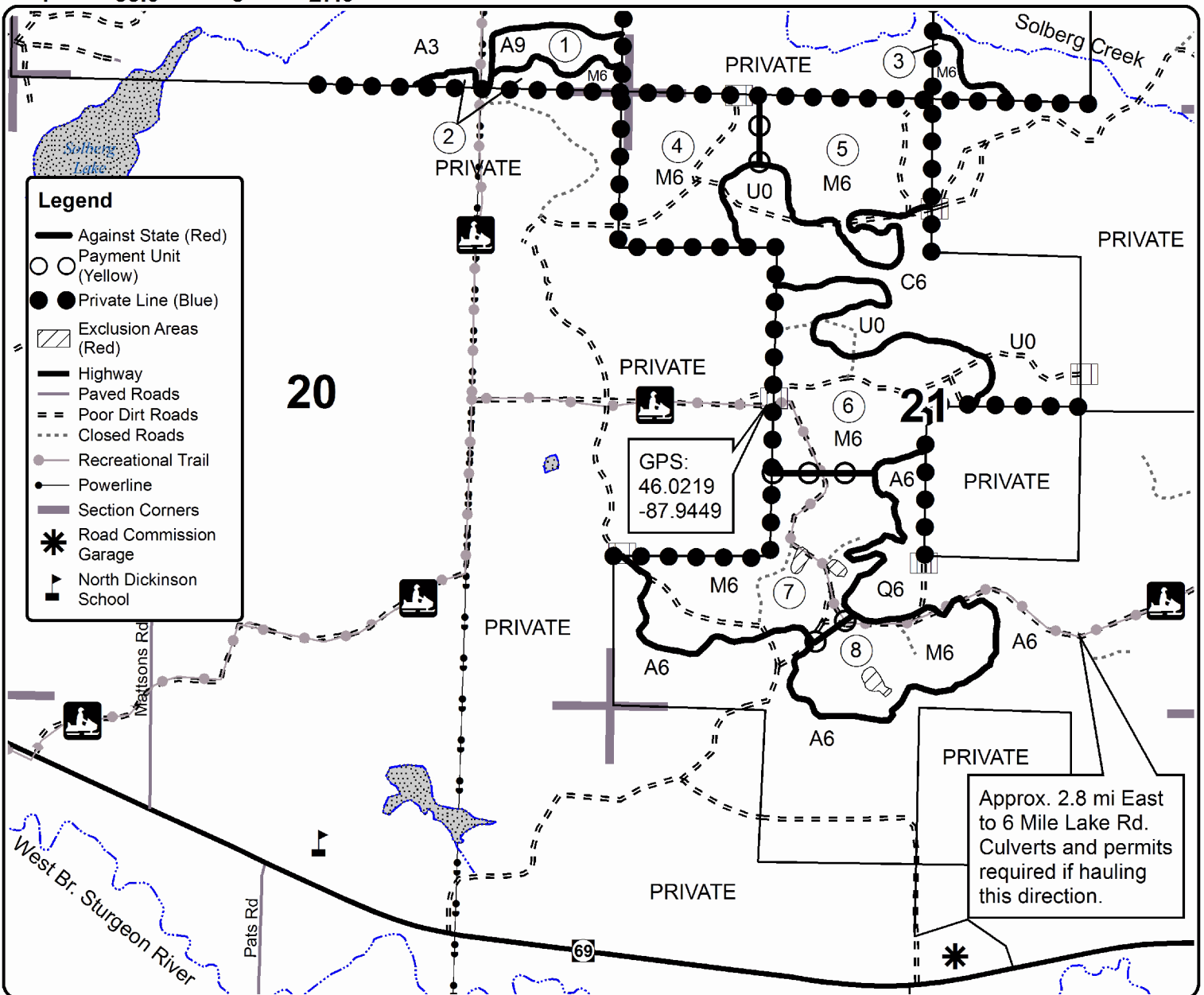
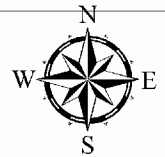

TIMBER SALE INFORMATION

Split Rock Mix SBW (12-011-16)

Dickinson County (Advertised Price \$116,840.75)

SALE NOTE: Be advised Unit 1 is rugged and there is a power line between M69 and Unit 2. All culverts will be permanent. If choosing to haul across "DEQ permit required" locations on the sale map, the purchaser is responsible for obtaining permits and the culverts. DNR will provide culverts as needed for accessing other portions of sale. Purchaser is responsible for installing all culverts. If hauling during the snowmobile season (Dec 1 - Mar 31); no decking on trail, no hauling on Fridays, Saturdays, or Sundays, trucking during daylight hours only, and trucks must have flashers on at all times. Unit 4 must be cut in frozen or dry ground conditions. In Units 3 and 5, no cutting April 30 - July 15.

A recreation site such as a trail, pathway, or campground is within the sale area or the vicinity. Certain restrictions/specifications may be applicable including time restrictions.

A timber sale contract for this lump sum, sealed bid timber sale will be awarded to the responsible bidder offering the highest sealed bid price. Bids must be at or above the following advertised price for each species:

<u>PRODUCTS & SPECIES</u>	<u>ESTIMATED UNITS*</u>		<u>ADVERTISED PRICE</u>
Sawtimber			
Basswood	41.10	MBF	\$ 172.00 / MBF
Red Maple	15.80	MBF	\$ 261.00 / MBF
Sugar Maple	31.20	MBF	\$ 461.00 / MBF
White Ash	17.20	MBF	\$ 58.00 / MBF
Pulpwood			
Balsam Fir	121.00	Cords	\$ 15.15 / Cord
Basswood	258.00	Cords	\$ 11.65 / Cord
Mixed Hardwood	1,640.00	Cords	\$ 28.80 / Cord
Quaking Aspen	1,025.00	Cords	\$ 35.90 / Cord
White Spruce	54.00	Cords	\$ 25.90 / Cord

* The total volume is statistically estimated within plus (+) or minus (-) 8.43 percent. The estimated units are final and not subject to adjustment. Prospective bidders are urged to examine this timber and to make their own estimates of quantity and quality.

BOND AND PAYMENT SCHEDULE:

1. A bond in the amount of \$5,842.00 to insure faithful performance of the conditions of the contract will be deposited by the successful bidder within 21 days of the sale award.
2. Cutting in any sale or unit without the required advance payment would be considered a trespass.
3. Total payment must be paid in advance or according to the following schedule:
 - (a) Ten percent (10%) of the sale value must be paid within 21 days of the sale award.
 - (b) The 10% down payment will be credited towards the first unit cut.
4. If no cutting takes place, the 10% down payment will not be refunded.
5. Operations on the contract issued will terminate on 06/30/2019.

Description of Timber by Payment Unit (PU)

PU	MARKET GROUP	PRODUCT	QUANTITY	UNIT	ACRES	ADVERTISE PRICE
1	Basswood	Sawtimber	1.3	MBF	54.9	\$42,175.50
	Red Maple		9.9	MBF		
	Sugar Maple		9.0	MBF		
	Balsam Fir	Pulpwood	97.0	Cords		
	Basswood		31.0	Cords		
	Mixed Hardwood		702.0	Cords		
	<i>Black Ash</i>	<i>Sawtimber</i>	1.0	<i>MBF</i>		
	<i>Yellow Birch</i>		1.3	<i>MBF</i>		
	<i>Black Ash</i>	<i>Pulpwood</i>	23.0	<i>Cords</i>		
	<i>Black Cherry</i>		3.0	<i>Cords</i>		
	<i>Paper Birch</i>		5.0	<i>Cords</i>		
	<i>Red Maple</i>		395.0	<i>Cords</i>		
	<i>Sugar Maple</i>		237.0	<i>Cords</i>		
	<i>White Ash</i>		19.0	<i>Cords</i>		
	<i>Yellow Birch</i>		15.0	<i>Cords</i>		
	Quaking Aspen		351.0	Cords		
	White Spruce		22.0	Cords		
2	Red Maple	Sawtimber	2.0	MBF	8.1	\$7,065.55
	Sugar Maple		0.4	MBF		
	Balsam Fir	Pulpwood	23.0	Cords		
	Mixed Hardwood		64.0	Cords		
	<i>Balsam Poplar</i>		7.0	<i>Cords</i>		
	<i>Black Cherry</i>		1.0	<i>Cords</i>		
	<i>Red Maple</i>		50.0	<i>Cords</i>		
	<i>Sugar Maple</i>		6.0	<i>Cords</i>		
	Quaking Aspen		93.0	Cords		
	White Spruce		32.0	Cords		
	3	Basswood	Sawtimber	19.3		
Red Maple			0.8	MBF		
Sugar Maple			4.6	MBF		
White Ash			0.6	MBF		
Basswood		Pulpwood	78.0	Cords		
Mixed Hardwood			135.0	Cords		
<i>Yellow Birch</i>		<i>Sawtimber</i>	0.4	<i>MBF</i>		
<i>Red Maple</i>		<i>Pulpwood</i>	1.0	<i>Cords</i>		
<i>Sugar Maple</i>			104.0	<i>Cords</i>		
<i>White Ash</i>			28.0	<i>Cords</i>		
<i>Yellow Birch</i>			1.0	<i>Cords</i>		
Quaking Aspen			34.0	Cords		
4	Basswood	Sawtimber	19.0	MBF	37.8	\$49,551.05
	Red Maple		1.6	MBF		
	Sugar Maple		15.8	MBF		
	White Ash		9.1	MBF		
	Balsam Fir	Pulpwood	1.0	Cords		
	Basswood		148.0	Cords		
	Mixed Hardwood		604.0	Cords		
	<i>Paper Birch</i>	<i>Sawtimber</i>	0.8	<i>MBF</i>		
	<i>American Elm</i>	<i>Pulpwood</i>	4.0	<i>Cords</i>		
	<i>Balsam Poplar</i>		18.0	<i>Cords</i>		
	<i>Black Ash</i>		18.0	<i>Cords</i>		
	<i>Black Cherry</i>		2.0	<i>Cords</i>		
	<i>Ironwood</i>		4.0	<i>Cords</i>		
	<i>Paper Birch</i>		10.0	<i>Cords</i>		
	<i>Red Maple</i>		107.0	<i>Cords</i>		
	<i>Sugar Maple</i>		349.0	<i>Cords</i>		
	<i>White Ash</i>		79.0	<i>Cords</i>		

Description of Timber by Payment Unit (PU), con't

PU	MARKET GROUP	PRODUCT	QUANTITY	UNIT	ACRES	ADVERTISE PRICE
4 con't	<i>Yellow Birch</i>	<i>Pulpwood</i>	11.0	<i>Cords</i>		
	Quaking Aspen		527.0	Cords		
5	Basswood	Sawtimber	1.5	MBF	14.1	\$6,347.55
	Red Maple		1.5	MBF		
	Sugar Maple		1.4	MBF		
	White Ash		7.5	MBF		
	Basswood	Pulpwood	1.0	Cords		
	Mixed Hardwood		135.0	Cords		
	<i>Black Cherry</i>		2.0	<i>Cords</i>		
	<i>Paper Birch</i>		2.0	<i>Cords</i>		
	<i>Red Maple</i>		49.0	<i>Cords</i>		
	<i>Sugar Maple</i>		70.0	<i>Cords</i>		
	<i>White Ash</i>		12.0	<i>Cords</i>		
	Quaking Aspen		20.0	Cords		
TOTAL:			105.3	MBF		
TOTAL:			3,098.0	Cords		

Sale Specific Conditions & Requirements

Sale Name: Split Rock Mix SBW

Sale Number: 12-011-16 Seq#: 1

1 - Sale Area

1.2 - Boundaries

1.2.1 - Painted boundaries (1/14)

The sale boundary and Payment Unit boundaries are marked and identified by BLUE and RED paint. Exterior sale boundary lines against private property are marked with BLUE paint. Exterior sale boundary lines against state are marked with RED paint. Interior Payment Unit boundaries are marked with RED paint. The painted boundary line trees are not Included Timber and are to be protected unless marked with orange paint. RED painted trees designating an interior Payment Unit boundary are not to be cut.

2 - Timber Specifications

2.1 - Included Timber

2.1.1 - Clearcut unit(s) with unmerchantable trees (6/14)

Within Payment Unit(s) #'s 1, 2, and 4, cut all trees that are two (2) inches or more at DBH except Cedar, Hemlock, Oak or Pine.

2.1.3 - Cut tree marked unit(s) (12/08)

Within Payment Unit(s) #'s 3 and 5, all trees are designated for cutting when marked with ORANGE paint above and below stump height, regardless of merchantability.

3 - Payments

3.3 - Pre-measured Sales

3.3.4 - Dividing payment units (7/14)

Payment Unit(s) #'s 1 and 4 may be divided at the request of the Purchaser and upon approval of the Unit Manager. Dividing Payment Units is a contract modification which requires a Timber Sale Contract Supplement.

3.4 - Damaged Timber

3.4.1 - Damaged timber (6/14)

General Condition and Requirement 3.4 Damaged Timber, defines liquidated damages for undesignated live merchantable trees which are cut or injured.

No damage is acceptable to merchantable trees. Within Payment Unit #'s 3 and 5, if more than 10% of trees (> 4.5" DBH) within a specified area of the sale are damaged, liquidated damages will be assessed for all trees damaged. Rates will be in accordance with General Condition and Requirement 3.4 Damaged Timber.

4 - Transportation

4.1 - Construction

4.1.5 - Culverts (5/14)

Depending on preferred haul route, roads may require the installation of culverts. If culverts are needed, their placement will be specified by the sale administrator and they shall be installed prior to hauling. The culverts shall be new, corrugated metal or plastic gauge. DEQ will specify culvert dimensions if the haul route crosses the "DEQ permit required" points on Timbersale Map. Purchaser is to supply culverts for these 2 DEQ crossings. DNR will provide all other needed culverts for this sale. Installation of all culverts is the responsibility of the purchaser. All culverts will be permanent. Soils shall be maintained and left in a non-erodible condition, with water bars, seed, fertilizer, mulch, and slash installed as directed by the sale administrator and as specified in the BMP manual. Stream crossing permits, if needed, will be obtained by the PURCHASER.

4.1.6 - Road construction (1/09)

Construction of new roads or improvements of existing roads shall be done in such a way as to minimize the environmental

and visual impacts. Merchantable trees shall be cut and utilized unless otherwise directed. Non-merchantable trees shall be severed and laid flat on the ground. Slash shall be scattered, and not left in windrows and kept a minimum of 10 feet back from the road edge. Stumps shall be set upright, not left on edge, and be moved at least 10 feet away from the road edge. Disturbed soil shall be feathered into the woods and not left in berms or windrows.

4.1.7 - Road closure (10/11)

All new roads built into the sale must be blocked to vehicle traffic upon completion of the sale. Overgrown roads that are reopened shall be considered new roads. In general, this will require constructing a four (4') foot high berm of stumps and logs covered with earth.

4.1.11 - Permits (2/12)

The Purchaser will secure any necessary highway and stream crossing permits that may be required.

4.2 - Maintenance

4.2.1 - Hauling restriction (12/08)

Hauling is restricted on the snowmobile trail from December 1 to March 31. The restriction is aimed to decrease truck and snowmobile interactions. No hauling will be permitted on Fridays, Saturdays, or Sundays during this period. In addition, hauling is only permitted during daylight hours and trucks must have flashers on at all times during this period.

4.4 - Access

4.4.2 - Alternate route on private property (2/04)

It is the Purchaser's responsibility to obtain access across private land for any routes other than the route shown on the sale map.

5 - Operations

5.1 - Notification

5.1.1 - Pre-sale conference (10/11)

A pre-sale conference between the Purchaser and sale administrator is required prior to beginning any operations. The Unit Manager or his/her representative must be contacted at least 10 days in advance to schedule the conference.

5.1.4 - Post-sale conference (6/11)

A post-sale conference on site between the Purchaser and sale administrator is required 5 days prior to the completion of active logging operations to determine clean-up and repair of landings, road edges, and the fulfillment of other contract specifications.

5.1.6 - Utility R.O.W. (1/15)

It is the responsibility of the Purchaser to obtain permission from the utility company to utilize the power line R.O.W. for operations. This refers to Payment Unit #2.

5.2 - Conduct of Operations

5.2.1 - Slash

5.2.1.13 - Dispose of slash as directed (12/05)

Slash is to be disposed of as directed by the sale administrator.

5.2.2 - Hazard Trees/Snags

5.2.2.1 - Den trees (2/04)

Obvious hollow and/or den trees shall be protected and left standing unless they are a safety hazard.

5.2.3 - Operating Restrictions

5.2.3.1 - Operating restrictions (9/11)

Within Payment Unit(s) #4, cutting and skidding operations must take place during frozen or dry ground conditions. Hauling is not restricted. This restriction is due to the saturated soil.

5.2.3.3 - Bark slippage restriction (3/09)

Within Payment Unit(s) #'s 3 and 5, unless changed by written agreement, cutting and skidding are not permitted during

the period of April 30 to July 15. This restriction is because of bark slippage.

5.2.41 - Snowmobile trail protection (9/11)

The snowmobile trail is shown on the Timber Sale Map. Do not cut or damage posts with orange trail markers or traffic control signs. If the trail is used, it must be maintained and restored to a condition equal to or better than before the sale. The road maintenance/restoration must be done prior to December 1.

If the trail is used for hauling from December 1 to March 31, no decking of forest products will be permitted along the snowmobile trail, and no hauling is permitted on Fridays, Saturdays, or Sundays.

If the trail road is to be used for hauling during the snowmobile season, then a snow covered base must be left on the trail. The snowmobile trail may only be crossed at right angles. Maintain a 20 foot wide slash, debris, and rut free zone daily using the snowmobile trail as the centerline. All stumps within 20 feet of the snowmobile trail must be cut at ground level.

5.4 - Soil Protection

5.4.1 - Rutting restriction, general (7/16)

Operations are to cease immediately if equipment and weather conditions result in rutting of roads and/or skid trails which is 12 inches or greater in depth and 50 feet in length. The Unit Manager or his/her representative may restrict hauling and/or skidding if ruts exceed the specified depth. With the Unit Manager or his/her representative's approval, the Purchaser may return to the area when the risk of rutting has decreased.

5.4.2 - Skid trails (2/04)

Skid trails up and down slopes should be avoided. If however this is unavoidable, these trails will be left in a non-erodible condition using water bars, logs, and slash. Placing of slash on these skid trails while logging is ongoing may alleviate need for any further action. At the direction of the sale administrator, seed, fertilizer, and mulch may also be required.

6 - Safety and Fire Prevention

6.2 - Signing

6.2.2 - Snowmobile trail posting (8/09)

The Purchaser is responsible for posting and maintaining caution signs on the snowmobile trail prior to beginning operations during the snowmobile season (approximately December 1 to March 31). The trail must be posted at appropriate distances along the haul route to warn of logging activity and truck traffic. Signs must be removed when harvest operations are suspended or completed. The Purchaser will provide these signs.

7 - Other Conditions

7.5 - Loss

7.5.1 - Deteriorating timber (7/09)

The sale area has received damage from Spruce Budworm. The Purchaser should harvest the wood as soon as possible. The Department of Natural Resources is held free of responsibility of any further damage or deterioration due to delay in harvesting.



TIMBER SALE MAP

This information provided by authority of Part 525, 1994 PA 451, as amended.

Sale Number	Year
12 - 11	16

Forest Management Unit Crystal Falls	County Dickinson	Mapped By Church	Date 08/03/2016	Page 1	of 1
Township 42N		Range 29W		Section(s) and Subdivision(s) Sec 22:SESW, Sec 26: S1/2N1/2, Sec 27:N1/2N1/2, NWSE, SENE	

Cruised By	Contractor	Scale
		1:15,840

Cover Type				Density			
A = Aspen	H = Hemlock	N = Marsh	U = Upland Brush	0 = Non Stocked	5 = Pole Timber Medium		
B = Paper Birch	J = Jack Pine	O = Oak	UM = Upland Mixed	1 = Seedling Sapling Poor	6 = Pole Timber Well		
C = Cedar	L = Lowland Brush	P = Lowland Poplar	V = Bog or Marsh	2 = Seedling Sapling Medium	7 = Saw Timber Poor		
D = Treed Bog	LM = Lowland Mixed	Q = Mixed Swamp Conifer	W = White Pine	3 = Seedling Sapling Well	8 = Saw Timber Medium		
E = Swamp Hdwoods	M = Mpl, Bch, Brch	R = Red Pine	X = Non Stocked	4 = Pole Timber Poor	9 = Saw Timber Well		
F = Spruce Fir	MC = Mixed Conifer	S = Black Spruce	Z = Water				
G = Grass	MD = Mixed Deciduous	T = Tamarack					

PU	Acres	PU	Acres
1	54.9	4	37.8
2	8.1	5	14.1
3	17.5		

Split Rock Mix SBW

Compartment 56

132.4 Acres

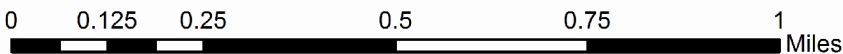
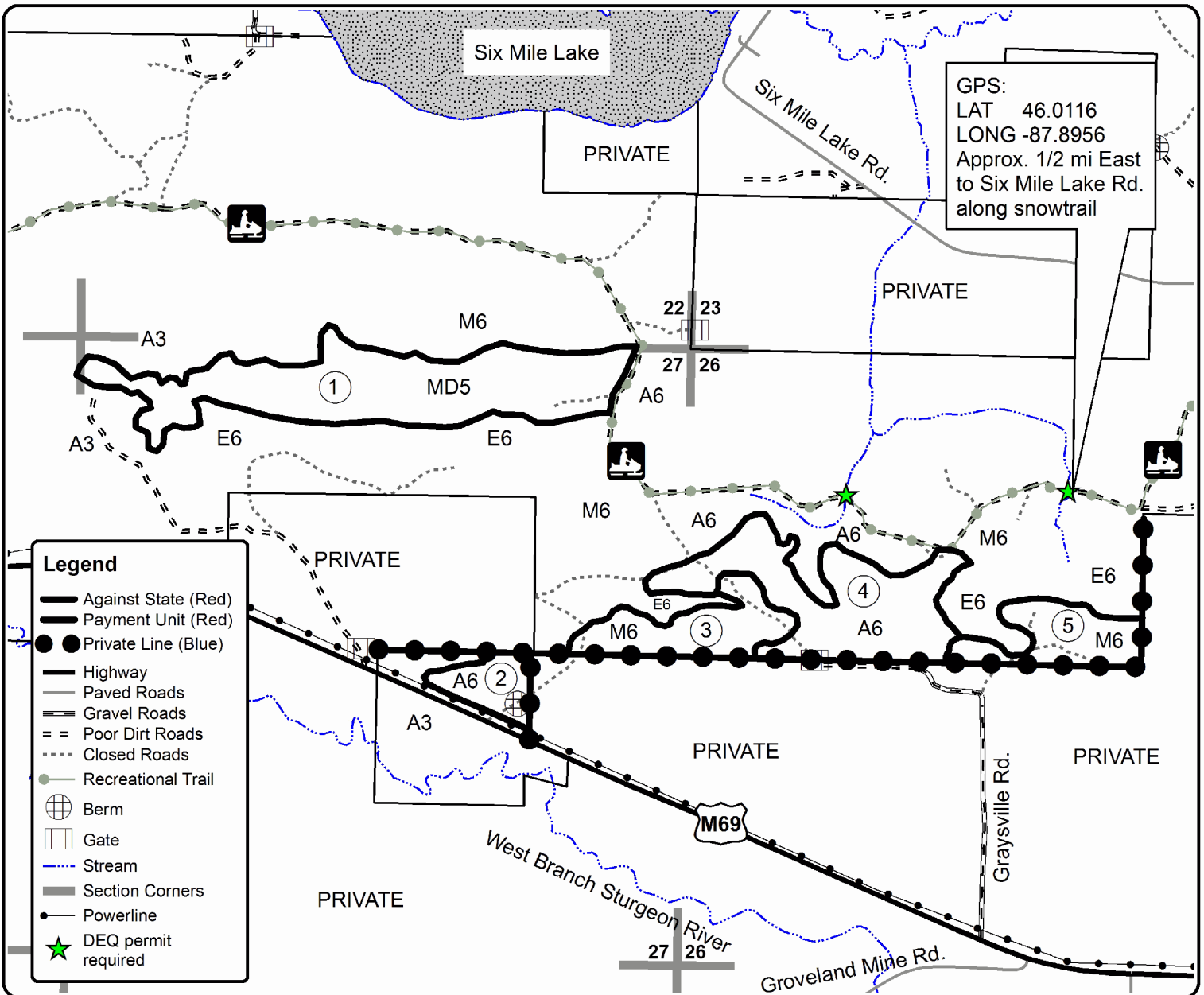
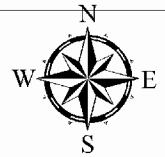

TIMBER SALE INFORMATION

GG Miss Molly SBW (12-012-16)

Dickinson County (Advertised Price \$171,175.30)

SALE NOTE: Softwood volume is deteriorating quickly due to Spruce Budworm. No operations from December 1 - March 31 due to snowmobile trail conflict.

A recreation site such as a trail, pathway, or campground is within the sale area or the vicinity. Certain restrictions/specifications may be applicable including time restrictions.

A timber sale contract for this lump sum, sealed bid timber sale will be awarded to the responsible bidder offering the highest sealed bid price. Bids must be at or above the following advertised price for each species:

<u>PRODUCTS & SPECIES</u>	<u>ESTIMATED UNITS*</u>	<u>ADVERTISED PRICE</u>
Pulpwood		
Balsam Fir	634.00 Cords	\$ 17.50 / Cord
Basswood	110.00 Cords	\$ 13.45 / Cord
Black Spruce	88.00 Cords	\$ 29.85 / Cord
Mixed Hardwood	229.00 Cords	\$ 33.25 / Cord
Quaking Aspen	3,468.00 Cords	\$ 41.45 / Cord
White Pine	8.00 Cords	\$ 27.90 / Cord
White Spruce	147.00 Cords	\$ 29.85 / Cord

* The total volume is statistically estimated within plus (+) or minus (-) 8.45 percent. The estimated units are final and not subject to adjustment. Prospective bidders are urged to examine this timber and to make their own estimates of quantity and quality.

BOND AND PAYMENT SCHEDULE:

1. A bond in the amount of \$8,559.00 to insure faithful performance of the conditions of the contract will be deposited by the successful bidder within 21 days of the sale award.
2. Cutting in any sale or unit without the required advance payment would be considered a trespass.
3. Total payment must be paid in advance or according to the following schedule:
 - (a) Ten percent (10%) of the sale value must be paid within 21 days of the sale award.
 - (b) The 10% down payment will be credited towards the first unit cut.
4. If no cutting takes place, the 10% down payment will not be refunded.
5. Operations on the contract issued will terminate on 06/30/2019.

Description of Timber by Payment Unit (PU)

PU	MARKET GROUP	PRODUCT	QUANTITY	UNIT	ACRES	ADVERTISE PRICE
1	Balsam Fir	Pulpwood	92.0	Cords	23.5	\$28,761.25
	Basswood		9.0	Cords		
	<i>Basswood</i>		9.0	<i>Cords</i>		
	Black Spruce		21.0	Cords		
	Mixed Hardwood		38.0	Cords		
	<i>Balsam Poplar</i>		4.0	<i>Cords</i>		
	<i>Black Cherry</i>		6.0	<i>Cords</i>		
	<i>Paper Birch</i>		3.0	<i>Cords</i>		
	<i>Red Maple</i>		22.0	<i>Cords</i>		
	<i>Sugar Maple</i>		3.0	<i>Cords</i>		
	Quaking Aspen		585.0	Cords		
	White Pine		2.0	Cords		
	<i>White Pine</i>	<i>Sawtimber</i>	0.6	<i>MBF</i>		
	<i>White Pine</i>	<i>Pulpwood</i>	1.0	<i>Cords</i>		
	White Spruce		28.0	Cords		
2	Balsam Fir	Pulpwood	89.0	Cords	22.7	\$27,753.55
	Basswood		9.0	Cords		
	<i>Basswood</i>		9.0	<i>Cords</i>		
	Black Spruce		19.0	Cords		
	Mixed Hardwood		36.0	Cords		
	<i>Balsam Poplar</i>		4.0	<i>Cords</i>		
	<i>Black Cherry</i>		5.0	<i>Cords</i>		
	<i>Ironwood</i>		1.0	<i>Cords</i>		
	<i>Paper Birch</i>		3.0	<i>Cords</i>		
	<i>Red Maple</i>		20.0	<i>Cords</i>		
	<i>Sugar Maple</i>		3.0	<i>Cords</i>		
	Quaking Aspen		565.0	Cords		
	White Pine		2.0	Cords		
	<i>White Pine</i>	<i>Sawtimber</i>	0.5	<i>MBF</i>		
	<i>White Pine</i>	<i>Pulpwood</i>	1.0	<i>Cords</i>		
White Spruce		28.0	Cords			
3	Balsam Fir	Pulpwood	98.0	Cords	18.9	\$20,523.15
	Basswood		29.0	Cords		
	<i>Basswood</i>	<i>Sawtimber</i>	2.3	<i>MBF</i>		
	<i>Basswood</i>	<i>Pulpwood</i>	24.0	<i>Cords</i>		
	Black Spruce		2.0	Cords		
	Mixed Hardwood		29.0	Cords		
	<i>Paper Birch</i>	<i>Sawtimber</i>	0.8	<i>MBF</i>		
	<i>Black Cherry</i>	<i>Pulpwood</i>	4.0	<i>Cords</i>		
	<i>Ironwood</i>		1.0	<i>Cords</i>		
	<i>Paper Birch</i>		7.0	<i>Cords</i>		
	<i>Red Maple</i>		7.0	<i>Cords</i>		
	<i>Sugar Maple</i>		8.0	<i>Cords</i>		
	Quaking Aspen		411.0	Cords		
	White Spruce		12.0	Cords		
	4	Balsam Fir	Pulpwood	99.0		
Basswood			25.0	Cords		
<i>Basswood</i>		<i>Sawtimber</i>	2.1	<i>MBF</i>		
<i>Basswood</i>		<i>Pulpwood</i>	21.0	<i>Cords</i>		
Black Spruce			5.0	Cords		
Mixed Hardwood			32.0	Cords		
<i>Paper Birch</i>		<i>Sawtimber</i>	0.8	<i>MBF</i>		
<i>Balsam Poplar</i>		<i>Pulpwood</i>	1.0	<i>Cords</i>		
<i>Black Cherry</i>			4.0	<i>Cords</i>		
<i>Ironwood</i>			1.0	<i>Cords</i>		
<i>Paper Birch</i>			7.0	<i>Cords</i>		

Description of Timber by Payment Unit (PU), con't

PU	MARKET GROUP	PRODUCT	QUANTITY	UNIT	ACRES	ADVERTISE PRICE			
4 con't	<i>Red Maple</i>	<i>Pulpwood</i>	9.0	<i>Cords</i>					
	<i>Sugar Maple</i>		8.0	<i>Cords</i>					
	Quaking Aspen		443.0	Cords					
	White Spruce		14.0	Cords					
5	Balsam Fir	Pulpwood	77.0	Cords	19.6	\$23,979.65			
	Basswood		7.0	Cords					
	<i>Basswood</i>		7.0	<i>Cords</i>					
	Black Spruce		17.0	Cords					
	Mixed Hardwood		31.0	Cords					
	<i>Balsam Poplar</i>		3.0	<i>Cords</i>					
	<i>Black Cherry</i>		4.0	<i>Cords</i>					
	<i>Ironwood</i>		1.0	<i>Cords</i>					
	<i>Paper Birch</i>		3.0	<i>Cords</i>					
	<i>Red Maple</i>		18.0	<i>Cords</i>					
	<i>Sugar Maple</i>		2.0	<i>Cords</i>					
	Quaking Aspen		488.0	Cords					
	White Pine		2.0	Cords					
	<i>White Pine</i>	<i>Sawtimber</i>	0.4	<i>MBF</i>					
	<i>White Pine</i>	<i>Pulpwood</i>	1.0	<i>Cords</i>					
	White Spruce		24.0	Cords					
	6	Balsam Fir	Pulpwood	101.0			Cords	21.2	\$23,808.15
Basswood			24.0	Cords					
<i>Basswood</i>		<i>Sawtimber</i>	1.9	<i>MBF</i>					
<i>Basswood</i>		<i>Pulpwood</i>	20.0	<i>Cords</i>					
Black Spruce			7.0	Cords					
Mixed Hardwood			32.0	Cords					
<i>Paper Birch</i>		<i>Sawtimber</i>	0.7	<i>MBF</i>					
<i>Balsam Poplar</i>		<i>Pulpwood</i>	1.0	<i>Cords</i>					
<i>Black Cherry</i>			4.0	<i>Cords</i>					
<i>Ironwood</i>			1.0	<i>Cords</i>					
<i>Paper Birch</i>			6.0	<i>Cords</i>					
<i>Red Maple</i>			11.0	<i>Cords</i>					
<i>Sugar Maple</i>			8.0	<i>Cords</i>					
Quaking Aspen			481.0	Cords					
White Spruce			17.0	Cords					
7		Balsam Fir	Pulpwood	78.0	Cords	19.9	\$24,287.30		
		Basswood		7.0	Cords				
	<i>Basswood</i>		7.0	<i>Cords</i>					
	Black Spruce		17.0	Cords					
	Mixed Hardwood		31.0	Cords					
	<i>Balsam Poplar</i>		3.0	<i>Cords</i>					
	<i>Black Cherry</i>		4.0	<i>Cords</i>					
	<i>Ironwood</i>		1.0	<i>Cords</i>					
	<i>Paper Birch</i>		3.0	<i>Cords</i>					
	<i>Red Maple</i>		18.0	<i>Cords</i>					
	<i>Sugar Maple</i>		2.0	<i>Cords</i>					
	Quaking Aspen		495.0	Cords					
	White Pine		2.0	Cords					
	<i>White Pine</i>	<i>Sawtimber</i>	0.4	<i>MBF</i>					
	<i>White Pine</i>	<i>Pulpwood</i>	1.0	<i>Cords</i>					
	White Spruce		24.0	Cords					
	TOTAL:			4,684.0	Cords				

Sale Specific Conditions & Requirements

Sale Name: GG Miss Molly SBW

Sale Number: 12-012-16 Seq#: 1

1 - Sale Area

1.2 - Boundaries

1.2.1 - Painted boundaries (1/14)

The sale boundary and Payment Unit boundaries are marked and identified by red and yellow paint. Exterior sale boundary lines against state are marked with red paint. Interior Payment Unit boundaries are marked with yellow paint. The painted boundary line trees are not Included Timber and are to be protected. Yellow painted trees designating an interior Payment Unit boundary are only to be cut when all surrounding Payment Units have been paid.

2 - Timber Specifications

2.1 - Included Timber

2.1.1 - Clearcut unit(s) with unmerchantable trees (6/14)

Within Payment Unit(s) #'s 1-7, cut all trees that are two (2) inches or more at DBH EXCEPT Cedar and Hemlock if found. In addition, within Payment Units 3, 4, and 6, leave all Pine and sub-merchantable conifers (less than 6" diameter stump).

2.1.11 - Description of timber note (2/04)

Note that Mixed Hardwood includes Maple, Birch, BAM, Cherry, Elm, and Ironwood.

4 - Transportation

4.1 - Construction

4.1.5 - Culverts (5/14)

Roads may require the installation of culverts for cross drainage or at natural drainage-ways. If culverts are needed in these locations, their placement will be specified by the sale administrator and they shall be installed prior to hauling. The culverts will be supplied by the DNR for use on the Cady Creek and Little Brook Roads. Purchaser is responsible for installation.

4.1.6 - Road construction (1/09)

Construction of new roads or improvements of existing roads shall be done in such a way as to minimize the environmental and visual impacts. Merchantable trees shall be cut and utilized unless otherwise directed. Non-merchantable trees shall be severed and laid flat on the ground. Slash shall be scattered, and not left in windrows and kept a minimum of 10 feet back from the road edge. Stumps shall be set upright, not left on edge, and be moved at least 10 feet away from the road edge. Disturbed soil shall be feathered into the woods and not left in berms or windrows.

5 - Operations

5.1 - Notification

5.1.1 - Pre-sale conference (10/11)

A pre-sale conference between the Purchaser and sale administrator is required prior to beginning any operations to determine landing and road locations. The Unit Manager or his/her representative must be contacted at least 5 working days in advance to schedule the conference.

5.1.4 - Post-sale conference (6/11)

A post-sale conference on site between the Purchaser and sale administrator is required 5 days prior to the completion of active logging operations to determine clean-up and repair of landings, road edges, and the fulfillment of other contract specifications.

5.2 - Conduct of Operations

5.2.1 - Slash

5.2.1.13 - Dispose of slash as directed (12/05)

Slash is to be disposed of as directed by the Sale Administrator.

5.2.2 - Hazard Trees/Snags

5.2.2.1 - Den trees (2/04)

Obvious hollow and/or den trees shall be protected and left standing unless they are a safety hazard.

5.2.3 - Operating Restrictions

5.2.3.1 - Operating restrictions (9/11)

Within Payment Unit(s) #'s 1-7, cutting, skidding, and hauling are NOT PERMITTED during the period of December 1 to March 31. This restriction is because of the snowmobile trail.

5.2.3.11 - Coppice regeneration protection (4/10)

Any post harvest operations, such as chipping, must be completed before sprouting of regeneration occurs. If it is anticipated that chipping will be delayed, then tops shall be carried to one central location or left unchipped. The Unit Manager or his/her representative may cease such operations if sprouting occurs before the operation is complete.

5.2.4 - Dead and Down Creation

5.2.4.2 - Dead and down creation, hare and grouse (1/14)

To improve habitat for snowshoe hare, grouse, and other species, the Purchaser is to leave 2 piles of slash 6 feet tall by 6 feet in diameter on the ground for every Payment Unit. The piles can be of any tree species and can be an un-merchantable piece of wood or a full tree.

5.2.41 - Snowmobile trail protection (9/11)

Little Brook Road is the snowmobile trail and is shown on the Timber Sale Map. Do not cut or damage posts with orange trail markers or traffic control signs. The snowmobile trail may not be used for any timber sale operations from December 1 to March 31. In addition, any trees cut within 5 feet of the trail must be cut flush with the ground.

5.4 - Soil Protection

5.4.1 - Rutting restriction, general (1/09)

Operations are to cease immediately if equipment and weather conditions result in rutting of roads and skid trails which is 12 inches or greater in depth and 50 feet in length. The Unit Manager or his/her representative may restrict hauling and/or skidding if ruts exceed the specified depth. With the Unit Manager or his/her representative's approval, the Purchaser may return to the area when the risk of rutting has decreased.

7 - Other Conditions

7.5 - Loss

7.5.1 - Deteriorating timber (7/09)

The sale area has received damage from windthrow and Spruce budworm. The Purchaser should harvest the wood as soon as possible. The Department of Natural Resources is held free of responsibility of any further damage or deterioration due to delay in harvesting.



TIMBER SALE MAP

This information provided by authority of Part 525, 1994 PA 451, as amended.

Sale Number	Year
12-012-16-01	16

Forest Management Unit Crystal Falls	County Dickinson	Mapped By Church	Date 06/26/2016	Page 1	of 1
Township 44N	Range 27W	Section(s) and Subdivision(s) SE, E1/2SW, SENE Sec. 15 S1/2NW, NWSW Sec 14	Scale 1:15,840		

Cover Type				Density			
A = Aspen	H = Hemlock	N = Marsh	U = Upland Brush	0 = Non Stocked	5 = Pole Timber Medium		
B = Paper Birch	J = Jack Pine	O = Oak	UM = Upland Mixed	1 = Seedling Sapling Poor	6 = Pole Timber Well		
C = Cedar	L = Lowland Brush	P = Lowland Poplar	V = Bog or Marsh	2 = Seedling Sapling Medium	7 = Saw Timber Poor		
D = Treed Bog	LM = Lowland Mixed	Q = Mixed Swamp Conifer	W = White Pine	3 = Seedling Sapling Well	8 = Saw Timber Medium		
E = Swamp Hdwoods	M = Mpl, Bch, Brch	R = Red Pine	X = Non Stocked	4 = Pole Timber Poor	9 = Saw Timber Well		
F = Spruce Fir	MC = Mixed Conifer	S = Black Spruce	Z = Water				
G = Grass	MD = Mixed Deciduous	T = Tamarack					

PU	Acres	PU	Acres
1	23.5	5	19.6
2	22.7	6	21.2
3	18.9	7	19.9
4	19.9		

GG Miss Molly SBW Compartment 23 145.7 Acres

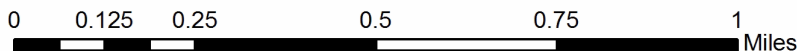
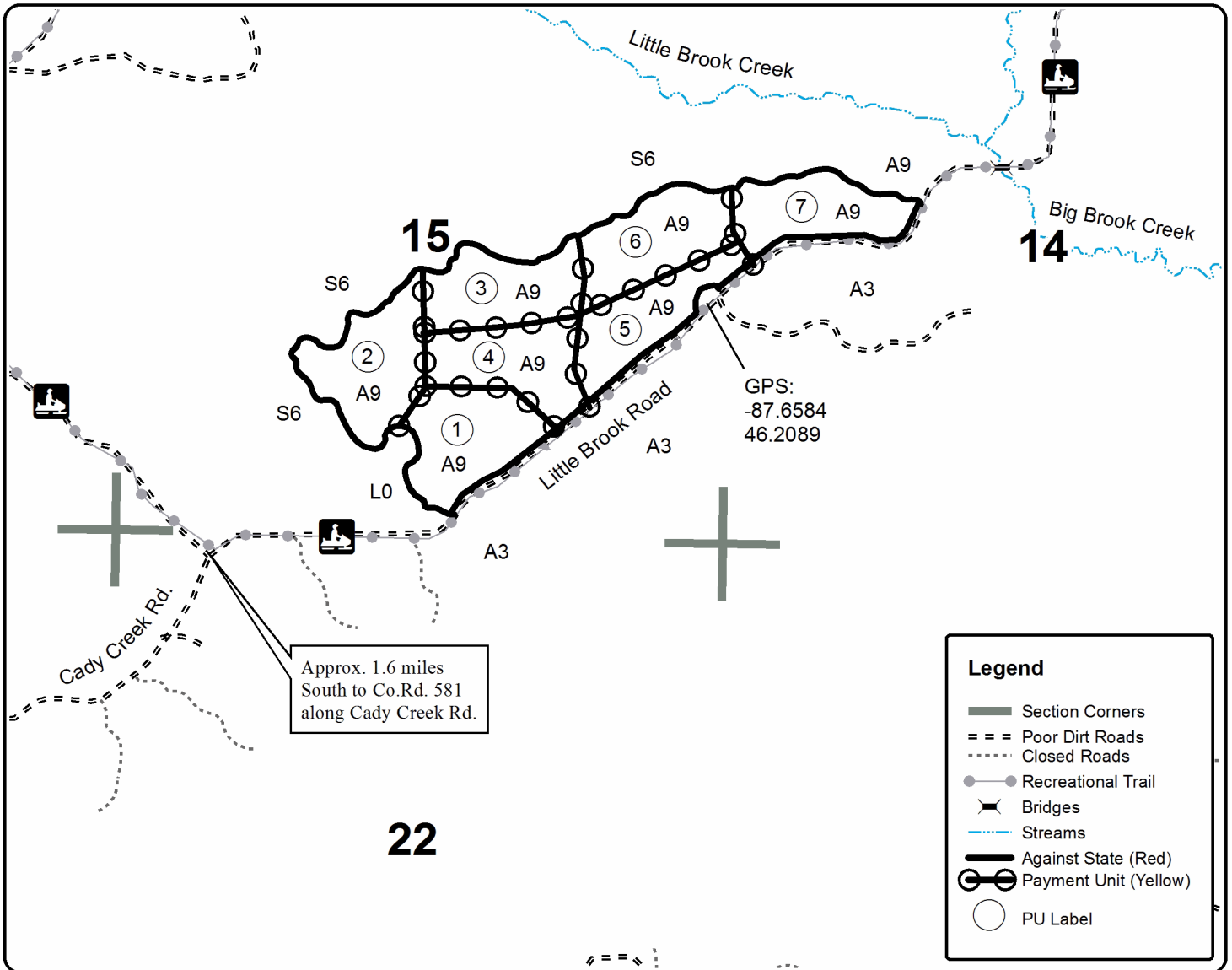
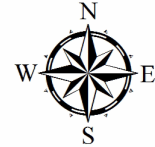

TIMBER SALE INFORMATION

Little Brook Aspen SBW (12-014-16)

Dickinson County (Advertised Price \$275,039.00)

SALE NOTE: White Spruce and Balsam volumes are in decline due to Spruce Budworm outbreak. No operations from December 1 to March 31 due to snowmobile trail restrictions. All culverts needed on Little Brook Road will be supplied by DNR. Transportation and installation of culverts will be the responsibility of the purchaser. 2 brush piles per Payment Unit must be constructed for hare and grouse habitat.

A recreation site such as a trail, pathway, or campground is within the sale area or the vicinity. Certain restrictions/specifications may be applicable including time restrictions.

A timber sale contract for this lump sum, sealed bid timber sale will be awarded to the responsible bidder offering the highest sealed bid price. Bids must be at or above the following advertised price for each species:

<u>PRODUCTS & SPECIES</u>	<u>ESTIMATED UNITS*</u>	<u>ADVERTISED PRICE</u>
Sawtimber		
Red Maple	6.00 MBF	\$ 301.00 / MBF
Pulpwood		
Balsam Fir	1,167.00 Cords	\$ 17.50 / Cord
Black Spruce	114.00 Cords	\$ 29.85 / Cord
Mixed Hardwood	366.00 Cords	\$ 33.25 / Cord
Quaking Aspen	5,542.00 Cords	\$ 41.45 / Cord
White Spruce	252.00 Cords	\$ 29.85 / Cord

* The total volume is statistically estimated within plus (+) or minus (-) 7.17 percent. The estimated units are final and not subject to adjustment. Prospective bidders are urged to examine this timber and to make their own estimates of quantity and quality.

BOND AND PAYMENT SCHEDULE:

1. A bond in the amount of \$13,752.00 to insure faithful performance of the conditions of the contract will be deposited by the successful bidder within 21 days of the sale award.
2. Cutting in any sale or unit without the required advance payment would be considered a trespass.
3. Total payment must be paid in advance or according to the following schedule:
 - (a) Ten percent (10%) of the sale value must be paid within 21 days of the sale award.
 - (b) The 10% down payment will be credited towards the first unit cut.
4. If no cutting takes place, the 10% down payment will not be refunded.
5. Operations on the contract issued will terminate on 06/30/2019.

Description of Timber by Payment Unit (PU)

PU	MARKET GROUP	PRODUCT	QUANTITY	UNIT	ACRES	ADVERTISE PRICE			
1	Red Maple	Sawtimber	2.5	MBF	29.4	\$30,723.10			
	Balsam Fir	Pulpwood	128.0	Cords					
	Black Spruce		7.0	Cords					
	Mixed Hardwood		78.0	Cords					
	<i>Sugar Maple</i>	<i>Sawtimber</i>	1.6	<i>MBF</i>					
	<i>Balsam Poplar</i>	<i>Pulpwood</i>	12.0	<i>Cords</i>					
	<i>Paper Birch</i>		19.0	<i>Cords</i>					
	<i>Red Maple</i>		40.0	<i>Cords</i>					
	<i>Sugar Maple</i>		4.0	<i>Cords</i>					
	Quaking Aspen		587.0	Cords					
	White Spruce		20.0	Cords					
	2	Red Maple	Sawtimber	0.9			MBF	27.3	\$39,168.60
Balsam Fir		Pulpwood	147.0	Cords					
Black Spruce			16.0	Cords					
Mixed Hardwood			54.0	Cords					
<i>Paper Birch</i>		<i>Sawtimber</i>	2.2	<i>MBF</i>					
<i>Balsam Poplar</i>		<i>Pulpwood</i>	7.0	<i>Cords</i>					
<i>Paper Birch</i>			7.0	<i>Cords</i>					
<i>Red Maple</i>			36.0	<i>Cords</i>					
Quaking Aspen			810.0	Cords					
White Spruce			16.0	Cords					
3		Red Maple	Sawtimber	2.6	MBF	22.1	\$26,356.80		
		Balsam Fir	Pulpwood	123.0	Cords				
	Black Spruce		2.0	Cords					
	Mixed Hardwood		63.0	Cords					
	<i>Paper Birch</i>	<i>Sawtimber</i>	1.9	<i>MBF</i>					
	<i>Balsam Poplar</i>	<i>Pulpwood</i>	1.0	<i>Cords</i>					
	<i>Paper Birch</i>		18.0	<i>Cords</i>					
	<i>Red Maple</i>		33.0	<i>Cords</i>					
	<i>Sugar Maple</i>		7.0	<i>Cords</i>					
	Quaking Aspen		503.0	Cords					
	White Spruce		14.0	Cords					
	4	Balsam Fir	Pulpwood	89.0	Cords			17.8	\$23,346.05
Black Spruce			8.0	Cords					
Mixed Hardwood			25.0	Cords					
<i>Balsam Poplar</i>			14.0	<i>Cords</i>					
<i>Ironwood</i>			2.0	<i>Cords</i>					
<i>Red Maple</i>			9.0	<i>Cords</i>					
Quaking Aspen			484.0	Cords					
White Spruce			22.0	Cords					
5		Balsam Fir	Pulpwood	191.0	Cords	38.7	\$49,929.05		
	Black Spruce		24.0	Cords					
	Mixed Hardwood		51.0	Cords					
	<i>Balsam Poplar</i>		28.0	<i>Cords</i>					
	<i>Ironwood</i>		3.0	<i>Cords</i>					
	<i>Red Maple</i>		20.0	<i>Cords</i>					
	Quaking Aspen		1,029.0	Cords					
	White Spruce		51.0	Cords					
6	Balsam Fir	Pulpwood	35.0	Cords	9.7	\$7,914.00			
	Black Spruce		41.0	Cords					
	Mixed Hardwood		10.0	Cords					
	<i>Red Maple</i>		10.0	<i>Cords</i>					
	Quaking Aspen		117.0	Cords					
	White Spruce		30.0	Cords					
7	Balsam Fir	Pulpwood	266.0	Cords	39.4	\$57,187.00			
	Black Spruce		9.0	Cords					

Description of Timber by Payment Unit (PU), con't

PU	MARKET GROUP	PRODUCT	QUANTITY	UNIT	ACRES	ADVERTISE PRICE
	Mixed Hardwood		50.0	Cords		
	<i>Balsam Poplar</i>		21.0	<i>Cords</i>		
	<i>Black Cherry</i>		4.0	<i>Cords</i>		
	<i>Paper Birch</i>		14.0	<i>Cords</i>		
	<i>Red Maple</i>		11.0	<i>Cords</i>		
	Quaking Aspen		1,179.0	Cords		
	White Spruce		58.0	Cords		
8	Balsam Fir	Pulpwood	188.0	Cords	27.8	\$40,414.40
	Black Spruce		7.0	Cords		
	Mixed Hardwood		35.0	Cords		
	<i>Balsam Poplar</i>		15.0	<i>Cords</i>		
	<i>Black Cherry</i>		2.0	<i>Cords</i>		
	<i>Paper Birch</i>		10.0	<i>Cords</i>		
	<i>Red Maple</i>		8.0	<i>Cords</i>		
	Quaking Aspen		833.0	Cords		
	White Spruce		41.0	Cords		
TOTAL:			6.0	MBF		
TOTAL:			7,441.0	Cords		

Sale Specific Conditions & Requirements

Sale Name: Little Brook Aspen SBW

Sale Number: 12-014-16 Seq#: 1

1 - Sale Area

1.2 - Boundaries

1.2.1 - Painted boundaries (1/14)

The sale boundary and Payment Unit boundaries are marked and identified by RED and YELLOW paint. Exterior sale boundary lines against state are marked with RED paint. Interior Payment Unit boundaries are marked with YELLOW paint. The painted boundary line trees are not Included Timber and are to be protected. Yellow painted trees designating an interior Payment Unit boundary are only to be cut when all surrounding Payment Units have been paid.

2 - Timber Specifications

2.1 - Included Timber

2.1.1 - Clearcut unit(s) with unmerchantable trees (6/14)

Within Payment Unit(s) #'s 1-8, cut all trees that are two (2) inches or more at DBH except CEDAR and PINE. In addition, leave all submerchantable conifers.

2.1.11 - Description of timber note (2/04)

Note that Mixed Hardwood includes Maple, Birch, Ironwood, Cherry, Elm, and BAM.

3 - Payments

3.3 - Pre-measured Sales

3.3.4 - Dividing payment units (7/14)

Payment Unit(s) may be divided at the request of the Purchaser and upon approval of the Unit Manager. Dividing Payment Units is a contract modification which requires a Timber Sale Contract Supplement. There will be only one division per Payment Unit.

4 - Transportation

4.1 - Construction

4.1.5 - Culverts (5/14)

Roads may require the installation of culverts for cross drainage or at natural drainage-ways. If culverts are needed in these locations, their placement will be specified by the sale administrator and they shall be installed prior to hauling. Culverts on the Little Brook Road shall be provided by the DNR. Transportation and installation of culverts will be the responsibility of the purchaser.

4.1.6 - Road construction (1/09)

Construction of new roads or improvements of existing roads shall be done in such a way as to minimize the environmental and visual impacts. Merchantable trees shall be cut and utilized unless otherwise directed. Non-merchantable trees shall be severed and laid flat on the ground. Slash shall be scattered, and not left in windrows and kept a minimum of 10 feet back from the road edge. Stumps shall be set upright, not left on edge, and be moved at least 10 feet away from the road edge. Disturbed soil shall be feathered into the woods and not left in berms or windrows.

4.1.7 - Road closure (10/11)

All new roads built into the sale must be blocked to vehicle traffic upon completion of the sale. In general, this will require constructing a four (4') foot high berm of stumps and logs covered with earth.

5 - Operations

5.1 - Notification

5.1.1 - Pre-sale conference (10/11)

A pre-sale conference between the Purchaser and sale administrator is required prior to beginning any operations. The Unit Manager or his/her representative must be contacted at least 10 days in advance to schedule the conference.

5.2 - Conduct of Operations

5.2.1 - Slash

5.2.1.13 - Dispose of slash as directed (12/05)

Slash is to be disposed of as directed by the Sale Administrator.

5.2.2 - Hazard Trees/Snags

5.2.2.1 - Den trees (2/04)

Obvious hollow and/or den trees shall be protected and left standing unless they are a safety hazard.

5.2.3 - Operating Restrictions

5.2.3.1 - Operating restrictions (9/11)

Within Payment Unit(s) #'s 1-8, cutting, skidding, and hauling are not permitted during the snowmobile season from December 1 to March 31. This restriction is because of the snowmobile trail.

5.2.4 - Dead and Down Creation

5.2.4.2 - Dead and down creation, hare and grouse (1/14)

To improve habitat for snowshoe hare, grouse, and other species, the Purchaser is to leave 2 slash piles 6 feet tall by 6 feet wide on the ground for every Payment Unit. They should be scattered throughout the Units. The piles can be of any tree species and can be an un-merchantable pieces of wood or a full tree.

5.2.4.1 - Snowmobile trail protection (9/11)

The Little Brook Road is a snowmobile trail and is shown on the Timber Sale Map. Do not cut or damage posts with orange trail markers or traffic control signs. The road maintenance/restoration must be done prior to December 1. The snowmobile trail may not be used for any timber sale operations from December 1 to March 31. All stumps within 20 feet of the snowmobile trail must be cut at ground level.

5.4 - Soil Protection

5.4.1 - Rutting restriction, general (7/16)

Operations are to cease immediately if equipment and weather conditions result in rutting of roads and/or skid trails which is 12 inches or greater in depth and 50 feet in length. The Unit Manager or his/her representative may restrict hauling and/or skidding if ruts exceed the specified depth. With the Unit Manager or his/her representative's approval, the Purchaser may return to the area when the risk of rutting has decreased.

7 - Other Conditions

7.5 - Loss

7.5.1 - Deteriorating timber (7/09)

The sale area has received damage from Spruce Budworm. The Purchaser should harvest the wood as soon as possible. The Department of Natural Resources is held free of responsibility of any further damage or deterioration due to delay in harvesting.



TIMBER SALE MAP

This information provided by authority of Part 525, 1994 PA 451, as amended.

Forest Management Unit		County	Mapped By	Date	Page	of
Crystal Falls		Dickinson	Church	08/01/2016	1	2
Township	Range	Section(s) and Subdivision(s)		Scale		
44N	27W	Sec8:S1/2, Sec9:S1/2, Sec10:W1/2SW, Sec15:W1/2NW, Sec16:N1/2, Sec17:N1/2		1:15,840		

Cover Type				Density			
A = Aspen	H = Hemlock	N = Marsh	U = Upland Brush	0 = Non Stocked	5 = Pole Timber Medium		
B = Paper Birch	J = Jack Pine	O = Oak	UM = Upland Mixed	1 = Seedling Sapling Poor	6 = Pole Timber Well		
C = Cedar	L = Lowland Brush	P = Lowland Poplar	V = Bog or Marsh	2 = Seedling Sapling Medium	7 = Saw Timber Poor		
D = Treed Bog	LM = Lowland Mixed	Q = Mixed Swamp Conifer	W = White Pine	3 = Seedling Sapling Well	8 = Saw Timber Medium		
E = Swamp Hdwoods	M = Mpl, Bch, Brch	R = Red Pine	X = Non Stocked	4 = Pole Timber Poor	9 = Saw Timber Well		
F = Spruce Fir	MC = Mixed Conifer	S = Black Spruce	Z = Water				
G = Grass	MD = Mixed Deciduous	T = Tamarack					

PU	Acres	PU	Acres
1	29.4	5	38.7
2	27.1	6	9.7
3	22.2	7	39.5
4	17.8	8	27.8

Little Brook Aspen SBW

Compartment 23

212.2 Acres

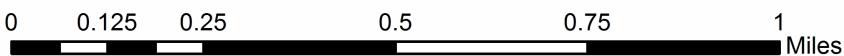
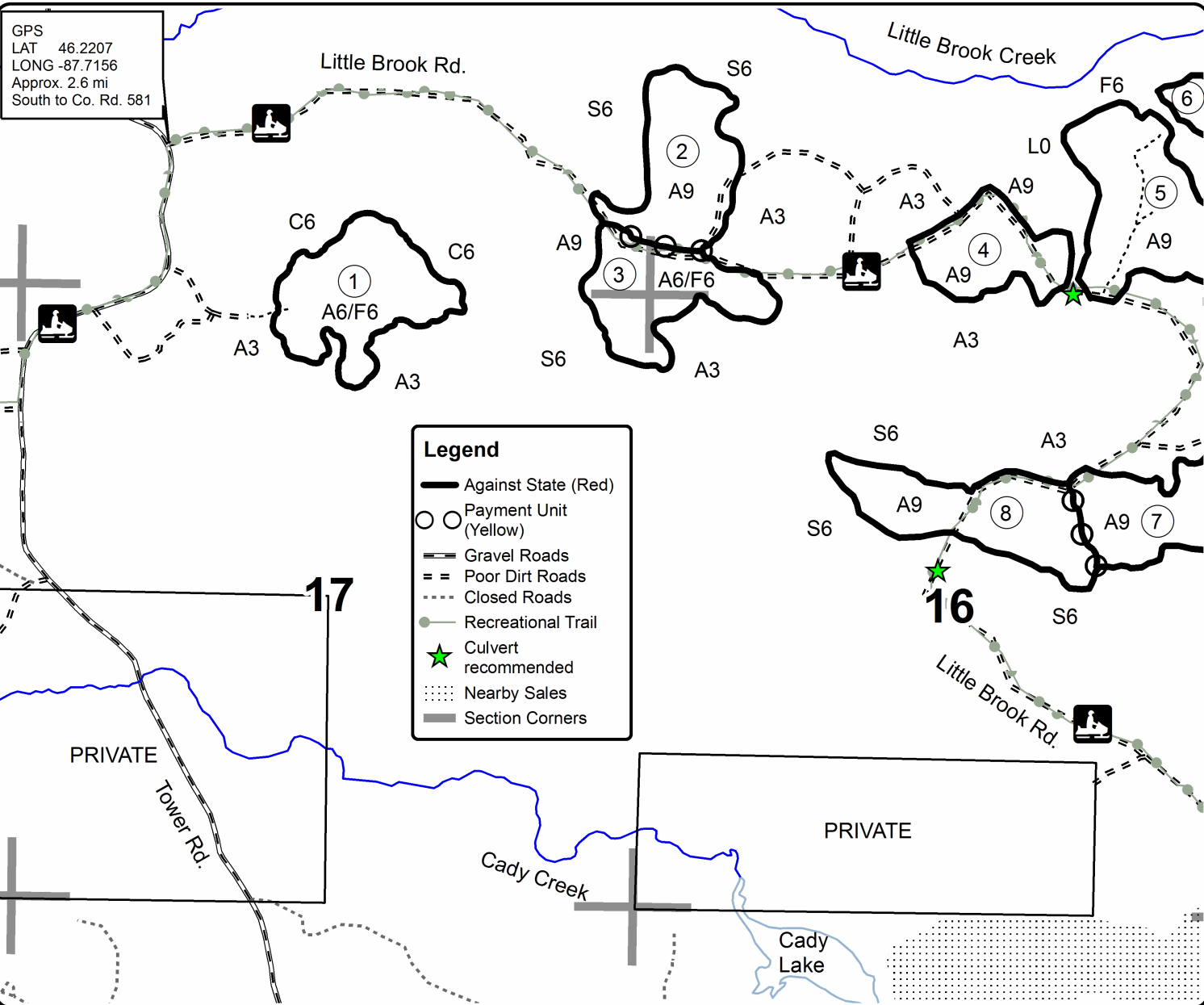
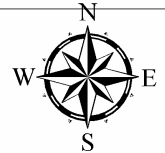



TIMBER SALE MAP

This information provided by authority of Part 525, 1994 PA 451, as amended.

Forest Management Unit Crystal Falls	County Dickinson	Mapped By Church	Date 08/01/2016	Page 2	of 2
Township 44N	Range 27W	Section(s) and Subdivision(s) Sec8:S1/2, Sec9:S1/2, Sec10:W1/2SW, Sec15:W1/2NW, Sec16:N1/2, Sec17:N1/2	Scale 1:15,840		

Cover Type				Density			
A = Aspen	H = Hemlock	N = Marsh	U = Upland Brush	0 = Non Stocked	5 = Pole Timber Medium		
B = Paper Birch	J = Jack Pine	O = Oak	UM = Upland Mixed	1 = Seedling Sapling Poor	6 = Pole Timber Well		
C = Cedar	L = Lowland Brush	P = Lowland Poplar	V = Bog or Marsh	2 = Seedling Sapling Medium	7 = Saw Timber Poor		
D = Treed Bog	LM = Lowland Mixed	Q = Mixed Swamp Conifer	W = White Pine	3 = Seedling Sapling Well	8 = Saw Timber Medium		
E = Swamp Hdwoods	M = Mpl, Bch, Brch	R = Red Pine	X = Non Stocked	4 = Pole Timber Poor	9 = Saw Timber Well		
F = Spruce Fir	MC = Mixed Conifer	S = Black Spruce	Z = Water				
G = Grass	MD = Mixed Deciduous	T = Tamarack					

PU	Acres	PU	Acres
1	29.4	5	38.7
2	27.1	6	9.7
3	22.2	7	39.5
4	17.8	8	27.8

Little Brook Aspen SBW

Compartment 23

212.2 Acres

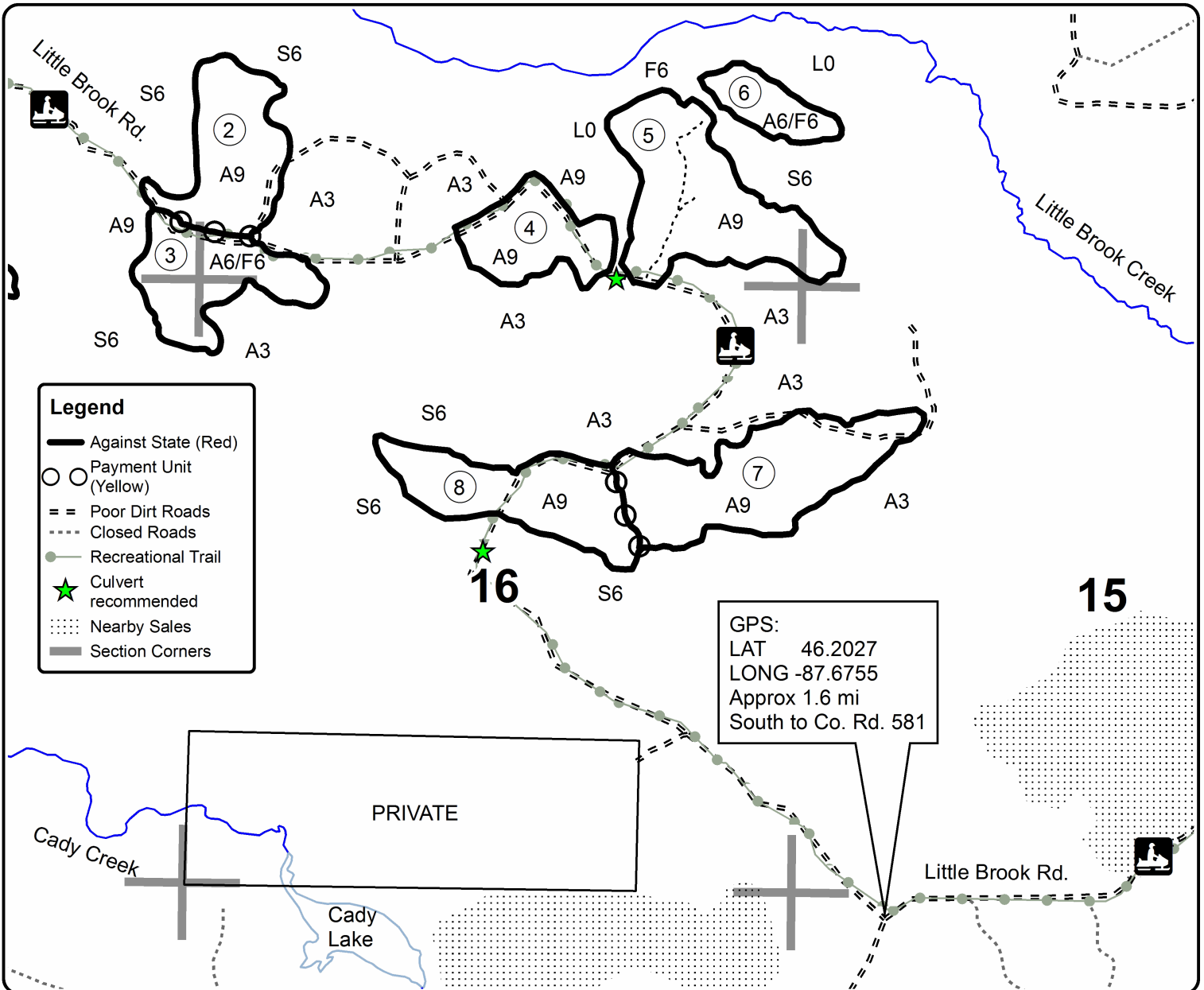
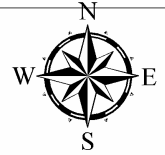

Legend	
	Against State (Red)
	Payment Unit (Yellow)
	Poor Dirt Roads
	Closed Roads
	Recreational Trail
	Culvert recommended
	Nearby Sales
	Section Corners

GPS:
 LAT 46.2027
 LONG -87.6755
 Approx 1.6 mi
 South to Co. Rd. 581

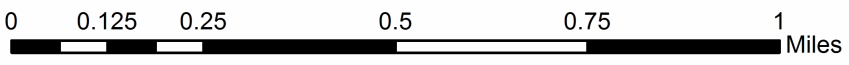

GG Miss Molly SBW (12-012-16)
; Dickinson COUNTY

In response to the notice of sale to be held 8:30 a.m. (local time) on June 7, 2017, I am hereby submitting my sealed bid (firm offer) for the following forest products to be cut. Bids for individual species must be at or above the advertised price. All non-responsive bid forms may be rejected.

<u>PRODUCTS & SPECIES</u>	<u>ESTIMATED VOLUME*</u>	<u>ADVERTISED PRICE</u>	<u>BID PRICE</u>
Pulpwood			
Balsam Fir	634.00 Cords	\$ 17.50/Cord	\$ _____
Basswood	110.00 Cords	\$ 13.45/Cord	\$ _____
Black Spruce	88.00 Cords	\$ 29.85/Cord	\$ _____
Mixed Hardwood	229.00 Cords	\$ 33.25/Cord	\$ _____
Quaking Aspen	3,468.00 Cords	\$ 41.45/Cord	\$ _____
White Pine	8.00 Cords	\$ 27.90/Cord	\$ _____
White Spruce	147.00 Cords	\$ 29.85/Cord	\$ _____

*The volumes are statistically estimated within plus (+) or minus (-) 8.45 percent. These estimated volumes are final and not subject to adjustment. Prospective bidders are urged to examine this timber and to make their own estimates of quantity and quality.

I understand that any or all bids may be rejected. All bids must be signed and all bid items must be bid or the bid form may be rejected. I also understand that consideration and awarding a contract will be based upon my past performance and ability to complete the contract based upon equipment and staffing subject to my control.

FEDERAL ID: ___ - ___ - ___ or SOCIAL SECURITY NUMBER: ___ - ___ - ___

Company or individual bidding: _____

Company representative's name: _____

Address: _____

City: _____ State: _____ Zip: _____

IF AVAILABLE, PLEASE PLACE THE PERSONALIZED LABEL FROM YOUR PROSPECTUS IN THE ABOVE BOX.

Individual or company representative's signature: _____ Date: _____

Phone number : _____ Email (optional): _____

THE WINNING BIDDER MUST COMPLETE THE VERIFICATION OF WORKER'S DISABILITY COMPENSATION ACT COMPLIANCE (ON REVERSE SIDE IF DOUBLE SIDED) WITHIN 21 DAYS OF SALE AWARD DATE



FOR DEPARTMENT USE ONLY
Sale Number (XX - XXX - XX - XX)
Forest Management Unit:

TIMBER SALE VERIFICATION OF WORKER'S DISABILITY COMPENSATION ACT COMPLIANCE

*As required by Act 317, P.A. 1969 (Worker's Compensation) and
Part 5 of Act 451 of 1994, as amended.*

VERIFICATION OF WORKER'S DISABILITY COMPENSATION ACT COMPLIANCE

- This verification must be completed and submitted within 21 days of contract award and prior to the issuance of the timber sale contract.
- In addition, if boxes 2B or 2C are checked, then Notice of Exclusion or Certificate of Insurance must be submitted within twenty-one (21) days of the contract award and prior to the issuance of the timber sale contract.
- All information must be typed or printed except for written signatures.

Please Check Appropriate Categories:

1. My business is organized as (you **must** check one of the boxes below):
 - A. Sole Proprietorship (individual)
 - B. Partnership
 - C. Corporation
2. You **must** check one of the boxes below:
 - A. I certify my business is a sole proprietorship and it has no employees but the sole proprietor. I am not subject to the Worker's Compensation Laws.
 - B. I certify my business has satisfied its obligation to the Worker's Compensation Act through the use of an approved Notice of Exclusion (BWC-337, Rev. 5/96). I will provide a copy of the Notice of Exclusion within 21 days of the contract award. (For questions or a copy of the BWC-337, please call the Worker's Compensation Bureau at 517-322-1195).
 - C. I certify my business has a Worker's Compensation Policy. I will provide an original Certificate of Insurance within twenty-one (21) days of the contract award.
3. If you have checked item 2(A) or 2(B), you **must** indicate the number of **both** full-time and part-time employees, other than yourself, including family members and active partners (if none, you must enter "0").

_____ Full-time Employees

_____ Part-time Employees

Name of Business		Federal ID (or) Social Security No.	
Address		Telephone ()	
City	State	ZIP	

I hereby certify that the above information is true and correct. I agree to notify the Michigan DNR of any changes that occur in factors affecting my coverage during any of my present and future operations.

Signature of Owner or Authorized Representative

Title

Date

Please complete the "SEALED BID" information on the next page

Troutman Aspen SBW (12-009-16)
 ; Dickinson COUNTY

In response to the notice of sale to be held 8:30 a.m. (local time) on June 7, 2017, I am hereby submitting my sealed bid (firm offer) for the following forest products to be cut. Bids for individual species must be at or above the advertised price. All non-responsive bid forms may be rejected.

<u>PRODUCTS & SPECIES</u>	<u>ESTIMATED VOLUME*</u>	<u>ADVERTISED PRICE</u>	<u>BID PRICE</u>
Pulpwood			
Balsam Fir	120.00 Cords	\$ 12.80/Cord	\$ _____
Mixed Hardwood	69.00 Cords	\$ 24.40/Cord	\$ _____
Quaking Aspen	261.00 Cords	\$ 30.40/Cord	\$ _____
Tamarack	7.00 Cords	\$ 13.25/Cord	\$ _____
White Spruce	11.00 Cords	\$ 21.90/Cord	\$ _____

*The volumes are statistically estimated within plus (+) or minus (-) 15.58 percent. These estimated volumes are final and not subject to adjustment. Prospective bidders are urged to examine this timber and to make their own estimates of quantity and quality.

I understand that any or all bids may be rejected. All bids must be signed and all bid items must be bid or the bid form may be rejected. I also understand that consideration and awarding a contract will be based upon my past performance and ability to complete the contract based upon equipment and staffing subject to my control.

FEDERAL ID: _____ or SOCIAL SECURITY NUMBER: _____
 Company or individual bidding: _____
 Company representative's name: _____
 Address: _____
 City: _____ State: _____ Zip: _____

IF AVAILABLE, PLEASE PLACE THE PERSONALIZED LABEL FROM YOUR PROSPECTUS IN THE ABOVE BOX.

Individual or company representative's signature: _____ Date: _____

Phone number : _____ Email (optional): _____

THE WINNING BIDDER MUST COMPLETE THE VERIFICATION OF WORKER'S DISABILITY COMPENSATION ACT COMPLIANCE (ON REVERSE SIDE IF DOUBLE SIDED) WITHIN 21 DAYS OF SALE AWARD DATE



FOR DEPARTMENT USE ONLY
Sale Number (XX - XXX - XX - XX)
Forest Management Unit:

TIMBER SALE VERIFICATION OF WORKER'S DISABILITY COMPENSATION ACT COMPLIANCE

*As required by Act 317, P.A. 1969 (Worker's Compensation) and
Part 5 of Act 451 of 1994, as amended.*

VERIFICATION OF WORKER'S DISABILITY COMPENSATION ACT COMPLIANCE

- This verification must be completed and submitted within 21 days of contract award and prior to the issuance of the timber sale contract.
- In addition, if boxes 2B or 2C are checked, then Notice of Exclusion or Certificate of Insurance must be submitted within twenty-one (21) days of the contract award and prior to the issuance of the timber sale contract.
- All information must be typed or printed except for written signatures.

Please Check Appropriate Categories:

1. My business is organized as (you **must** check one of the boxes below):
 - A. Sole Proprietorship (individual)
 - B. Partnership
 - C. Corporation

2. You **must** check one of the boxes below:
 - A. I certify my business is a sole proprietorship and it has no employees but the sole proprietor. I am not subject to the Worker's Compensation Laws.
 - B. I certify my business has satisfied its obligation to the Worker's Compensation Act through the use of an approved Notice of Exclusion (BWC-337, Rev. 5/96). I will provide a copy of the Notice of Exclusion within 21 days of the contract award. (For questions or a copy of the BWC-337, please call the Worker's Compensation Bureau at 517-322-1195).
 - C. I certify my business has a Worker's Compensation Policy. I will provide an original Certificate of Insurance within twenty-one (21) days of the contract award.

3. If you have checked item 2(A) or 2(B), you **must** indicate the number of **both** full-time and part-time employees, other than yourself, including family members and active partners (if none, you must enter "0").

_____ Full-time Employees

_____ Part-time Employees

Name of Business		Federal ID (or) Social Security No.	
Address		Telephone ()	
City	State	ZIP	

I hereby certify that the above information is true and correct. I agree to notify the Michigan DNR of any changes that occur in factors affecting my coverage during any of my present and future operations.

Signature of Owner or Authorized Representative

Title

Date

Please complete the "SEALED BID" information on the next page

Hiline Hardwoods (12-010-16)
 ; Dickinson COUNTY

In response to the notice of sale to be held 8:30 a.m. (local time) on June 7, 2017, I am hereby submitting my sealed bid (firm offer) for the following forest products to be cut. Bids for individual species must be at or above the advertised price. All non-responsive bid forms may be rejected.

<u>PRODUCTS & SPECIES</u>	<u>ESTIMATED VOLUME*</u>	<u>ADVERTISED PRICE</u>	<u>BID PRICE</u>
Sawtimber			
Basswood	269.50 MBF	\$ 198.00/MBF	\$ _____
Sugar Maple	77.60 MBF	\$ 532.00/MBF	\$ _____
Pulpwood			
Balsam Fir	121.00 Cords	\$ 17.50/Cord	\$ _____
Basswood	519.00 Cords	\$ 13.45/Cord	\$ _____
Mixed Hardwood	1,462.00 Cords	\$ 33.25/Cord	\$ _____
Mixed Spruce	18.00 Cords	\$ 29.85/Cord	\$ _____
Quaking Aspen	289.00 Cords	\$ 41.45/Cord	\$ _____

*The volumes are statistically estimated within plus (+) or minus (-) 10.31 percent. These estimated volumes are final and not subject to adjustment. Prospective bidders are urged to examine this timber and to make their own estimates of quantity and quality.

I understand that any or all bids may be rejected. All bids must be signed and all bid items must be bid or the bid form may be rejected. I also understand that consideration and awarding a contract will be based upon my past performance and ability to complete the contract based upon equipment and staffing subject to my control.

FEDERAL ID: _____ or SOCIAL SECURITY NUMBER: _____
 Company or individual bidding: _____
 Company representative's name: _____
 Address: _____
 City: _____ State: _____ Zip: _____

IF AVAILABLE, PLEASE PLACE THE PERSONALIZED LABEL FROM YOUR PROSPECTUS IN THE ABOVE BOX.

Individual or company representative's signature: _____ Date: _____

Phone number : _____ Email (optional): _____

THE WINNING BIDDER MUST COMPLETE THE VERIFICATION OF WORKER'S DISABILITY COMPENSATION ACT COMPLIANCE (ON REVERSE SIDE IF DOUBLE SIDED) WITHIN 21 DAYS OF SALE AWARD DATE



FOR DEPARTMENT USE ONLY
Sale Number (XX - XXX - XX - XX)
Forest Management Unit:

TIMBER SALE VERIFICATION OF WORKER'S DISABILITY COMPENSATION ACT COMPLIANCE

*As required by Act 317, P.A. 1969 (Worker's Compensation) and
Part 5 of Act 451 of 1994, as amended.*

VERIFICATION OF WORKER'S DISABILITY COMPENSATION ACT COMPLIANCE

- This verification must be completed and submitted within 21 days of contract award and prior to the issuance of the timber sale contract.
- In addition, if boxes 2B or 2C are checked, then Notice of Exclusion or Certificate of Insurance must be submitted within twenty-one (21) days of the contract award and prior to the issuance of the timber sale contract.
- All information must be typed or printed except for written signatures.

Please Check Appropriate Categories:

1. My business is organized as (you **must** check one of the boxes below):
 - A. Sole Proprietorship (individual)
 - B. Partnership
 - C. Corporation

2. You **must** check one of the boxes below:
 - A. I certify my business is a sole proprietorship and it has no employees but the sole proprietor. I am not subject to the Worker's Compensation Laws.
 - B. I certify my business has satisfied its obligation to the Worker's Compensation Act through the use of an approved Notice of Exclusion (BWC-337, Rev. 5/96). I will provide a copy of the Notice of Exclusion within 21 days of the contract award. (For questions or a copy of the BWC-337, please call the Worker's Compensation Bureau at 517-322-1195).
 - C. I certify my business has a Worker's Compensation Policy. I will provide an original Certificate of Insurance within twenty-one (21) days of the contract award.

3. If you have checked item 2(A) or 2(B), you **must** indicate the number of **both** full-time and part-time employees, other than yourself, including family members and active partners (if none, you must enter "0").

_____ Full-time Employees

_____ Part-time Employees

Name of Business		Federal ID (or) Social Security No.	
Address		Telephone ()	
City	State	ZIP	

I hereby certify that the above information is true and correct. I agree to notify the Michigan DNR of any changes that occur in factors affecting my coverage during any of my present and future operations.

Signature of Owner or Authorized Representative

Title

Date

Please complete the "SEALED BID" information on the next page

Split Rock Mix SBW (12-011-16)
 ; Dickinson COUNTY

In response to the notice of sale to be held 8:30 a.m. (local time) on June 7, 2017, I am hereby submitting my sealed bid (firm offer) for the following forest products to be cut. Bids for individual species must be at or above the advertised price. All non-responsive bid forms may be rejected.

<u>PRODUCTS & SPECIES</u>	<u>ESTIMATED VOLUME*</u>	<u>ADVERTISED PRICE</u>	<u>BID PRICE</u>
Sawtimber			
Basswood	41.10 MBF	\$ 172.00/MBF	\$ _____
Red Maple	15.80 MBF	\$ 261.00/MBF	\$ _____
Sugar Maple	31.20 MBF	\$ 461.00/MBF	\$ _____
White Ash	17.20 MBF	\$ 58.00/MBF	\$ _____
Pulpwood			
Balsam Fir	121.00 Cords	\$ 15.15/Cord	\$ _____
Basswood	258.00 Cords	\$ 11.65/Cord	\$ _____
Mixed Hardwood	1,640.00 Cords	\$ 28.80/Cord	\$ _____
Quaking Aspen	1,025.00 Cords	\$ 35.90/Cord	\$ _____
White Spruce	54.00 Cords	\$ 25.90/Cord	\$ _____

*The volumes are statistically estimated within plus (+) or minus (-) 8.43 percent. These estimated volumes are final and not subject to adjustment. Prospective bidders are urged to examine this timber and to make their own estimates of quantity and quality.

I understand that any or all bids may be rejected. All bids must be signed and all bid items must be bid or the bid form may be rejected. I also understand that consideration and awarding a contract will be based upon my past performance and ability to complete the contract based upon equipment and staffing subject to my control.

FEDERAL ID: ____ - ____ - ____ or SOCIAL SECURITY NUMBER: ____ - ____ - ____

Company or individual bidding: _____

Company representative's name: _____

Address: _____

City: _____ State: _____ Zip: _____

IF AVAILABLE, PLEASE PLACE THE PERSONALIZED LABEL FROM YOUR PROSPECTUS IN THE ABOVE BOX.

Individual or company representative's signature: _____ Date: _____

Phone number : _____ Email (optional): _____

THE WINNING BIDDER MUST COMPLETE THE VERIFICATION OF WORKER'S DISABILITY COMPENSATION ACT COMPLIANCE (ON REVERSE SIDE IF DOUBLE SIDED) WITHIN 21 DAYS OF SALE AWARD DATE



FOR DEPARTMENT USE ONLY
Sale Number (XX - XXX - XX - XX)
Forest Management Unit:

TIMBER SALE VERIFICATION OF WORKER'S DISABILITY COMPENSATION ACT COMPLIANCE

*As required by Act 317, P.A. 1969 (Worker's Compensation) and
Part 5 of Act 451 of 1994, as amended.*

VERIFICATION OF WORKER'S DISABILITY COMPENSATION ACT COMPLIANCE

- This verification must be completed and submitted within 21 days of contract award and prior to the issuance of the timber sale contract.
- In addition, if boxes 2B or 2C are checked, then Notice of Exclusion or Certificate of Insurance must be submitted within twenty-one (21) days of the contract award and prior to the issuance of the timber sale contract.
- All information must be typed or printed except for written signatures.

Please Check Appropriate Categories:

1. My business is organized as (you **must** check one of the boxes below):
 - A. Sole Proprietorship (individual)
 - B. Partnership
 - C. Corporation
2. You **must** check one of the boxes below:
 - A. I certify my business is a sole proprietorship and it has no employees but the sole proprietor. I am not subject to the Worker's Compensation Laws.
 - B. I certify my business has satisfied its obligation to the Worker's Compensation Act through the use of an approved Notice of Exclusion (BWC-337, Rev. 5/96). I will provide a copy of the Notice of Exclusion within 21 days of the contract award. (For questions or a copy of the BWC-337, please call the Worker's Compensation Bureau at 517-322-1195).
 - C. I certify my business has a Worker's Compensation Policy. I will provide an original Certificate of Insurance within twenty-one (21) days of the contract award.
3. If you have checked item 2(A) or 2(B), you **must** indicate the number of **both** full-time and part-time employees, other than yourself, including family members and active partners (if none, you must enter "0").

_____ Full-time Employees

_____ Part-time Employees

Name of Business		Federal ID (or) Social Security No.	
Address		Telephone ()	
City	State	ZIP	

I hereby certify that the above information is true and correct. I agree to notify the Michigan DNR of any changes that occur in factors affecting my coverage during any of my present and future operations.

Signature of Owner or Authorized Representative

Title

Date

Please complete the "SEALED BID" information on the next page

Little Brook Aspen SBW (12-014-16)
; Dickinson COUNTY

In response to the notice of sale to be held 8:30 a.m. (local time) on June 7, 2017, I am hereby submitting my sealed bid (firm offer) for the following forest products to be cut. Bids for individual species must be at or above the advertised price. All non-responsive bid forms may be rejected.

<u>PRODUCTS & SPECIES</u>	<u>ESTIMATED VOLUME*</u>	<u>ADVERTISED PRICE</u>	<u>BID PRICE</u>
Sawtimber			
Red Maple	6.00 MBF	\$ 301.00/MBF	\$ _____
Pulpwood			
Balsam Fir	1,167.00 Cords	\$ 17.50/Cord	\$ _____
Black Spruce	114.00 Cords	\$ 29.85/Cord	\$ _____
Mixed Hardwood	366.00 Cords	\$ 33.25/Cord	\$ _____
Quaking Aspen	5,542.00 Cords	\$ 41.45/Cord	\$ _____
White Spruce	252.00 Cords	\$ 29.85/Cord	\$ _____

*The volumes are statistically estimated within plus (+) or minus (-) 7.17 percent. These estimated volumes are final and not subject to adjustment. Prospective bidders are urged to examine this timber and to make their own estimates of quantity and quality.

I understand that any or all bids may be rejected. All bids must be signed and all bid items must be bid or the bid form may be rejected. I also understand that consideration and awarding a contract will be based upon my past performance and ability to complete the contract based upon equipment and staffing subject to my control.

FEDERAL ID: ____ - ____ - ____ or SOCIAL SECURITY NUMBER: ____ - ____ - ____

Company or individual bidding: _____

Company representative's name: _____

Address: _____

City: _____ State: _____ Zip: _____

IF AVAILABLE, PLEASE PLACE THE PERSONALIZED LABEL FROM YOUR PROSPECTUS IN THE ABOVE BOX.

Individual or company representative's signature: _____ Date: _____

Phone number : _____ Email (optional): _____

THE WINNING BIDDER MUST COMPLETE THE VERIFICATION OF WORKER'S DISABILITY COMPENSATION ACT COMPLIANCE (ON REVERSE SIDE IF DOUBLE SIDED) WITHIN 21 DAYS OF SALE AWARD DATE



FOR DEPARTMENT USE ONLY	
Sale Number (XX - XXX - XX - XX)	
Forest Management Unit:	

TIMBER SALE VERIFICATION OF WORKER'S DISABILITY COMPENSATION ACT COMPLIANCE

As required by Act 317, P.A. 1969 (Worker's Compensation) and
Part 5 of Act 451 of 1994, as amended.

VERIFICATION OF WORKER'S DISABILITY COMPENSATION ACT COMPLIANCE

- This verification must be completed and submitted within 21 days of contract award and prior to the issuance of the timber sale contract.
- In addition, if boxes 2B or 2C are checked, then Notice of Exclusion or Certificate of Insurance must be submitted within twenty-one (21) days of the contract award and prior to the issuance of the timber sale contract.
- All information must be typed or printed except for written signatures.

Please Check Appropriate Categories:

1. My business is organized as (you **must** check one of the boxes below):
 - A. Sole Proprietorship (individual)
 - B. Partnership
 - C. Corporation
2. You **must** check one of the boxes below:
 - A. I certify my business is a sole proprietorship and it has no employees but the sole proprietor. I am not subject to the Worker's Compensation Laws.
 - B. I certify my business has satisfied its obligation to the Worker's Compensation Act through the use of an approved Notice of Exclusion (BWC-337, Rev. 5/96). I will provide a copy of the Notice of Exclusion within 21 days of the contract award. (For questions or a copy of the BWC-337, please call the Worker's Compensation Bureau at 517-322-1195).
 - C. I certify my business has a Worker's Compensation Policy. I will provide an original Certificate of Insurance within twenty-one (21) days of the contract award.
3. If you have checked item 2(A) or 2(B), you **must** indicate the number of **both** full-time and part-time employees, other than yourself, including family members and active partners (if none, you must enter "0").

_____ Full-time Employees

_____ Part-time Employees

Name of Business		Federal ID (or) Social Security No.	
Address		Telephone ()	
City	State	ZIP	

I hereby certify that the above information is true and correct. I agree to notify the Michigan DNR of any changes that occur in factors affecting my coverage during any of my present and future operations.

Signature of Owner or Authorized Representative

Title

Date

Please complete the "SEALED BID" information on the next page