



**DEPARTMENT OF NATURAL RESOURCES
STATE OF MICHIGAN**

TIMBER SALE PROSPECTUS #5691

SCHEDULED SALE DATE AND TIME: 11:00 a.m. (local time) on January 24, 2017.

LOCATION: ROSCOMMON MGMT UNIT, PO BOX 218, ROSCOMMON, MI 48653.

PROSPECTUS NOTE: The bidder is advised to inspect the sale area and review the location, estimated volumes, operating costs and contract terms of proposed sales. Please be aware that some landowners may request 60 days or more notice for access across their land.

Notice is hereby given that bids will be received by the Unit Manager, ROSCOMMON MANAGEMENT UNIT, for certain timber on the following described lands:

Knoch Road Aspen-Jack (71-007-16)

Ogemaw County, Advertised Price \$202,316.30, 256.3 Acres, Aspen, Hardwood.

SALE NOTE: A recreation site such as a trail, pathway, or campground is within the sale area or the vicinity. Certain restrictions/specifications may be applicable including time restrictions.

Neighborhood Mix (71-020-16)

Roscommon County, Advertised Price \$103,656.10, 159.0 Acres, Aspen, Hardwood.

SALE NOTE: Two units within the sale contain multiple cross-country ski trails that will require extra attention during operations to limit impacts physically to the trail bed and future visual concerns, i.e. slash heights. These two units can not be harvested during winter months.

A road construction project with slightly more than normal "road" work will need to be done to access Payment Unit 1. Contact will need to be made to the Roscommon County Road Commission to find out about site distance requirements for a drive coming out on the leeward side of a hill on a county road. Also a buried fiber optic line is located where the access drive will need to be constructed.

A recreation site such as a trail, pathway, or campground is within the sale area or the vicinity. Certain restrictions/specifications may be applicable including time restrictions.

Louies Pine (71-030-16)

Roscommon County, Advertised Price \$32,208.90, 95.8 Acres, Hardwood, Jack Pine.

SALE NOTE: A recreation site such as a trail, pathway, or campground is within the sale area or the vicinity. Certain restrictions/specifications may be applicable including time restrictions.

BID INSTRUCTIONS (VER. 09/02/2016):

1. Scheduled Bid Location, Date, and Time (2/11)

Bids must be received by the Unit Manager, ROSCOMMON OFFICE, PO BOX 218, ROSCOMMON, MI 48653, no later than 11:00 a.m. (local time) on January 24, 2017. For further information concerning this sale, contact Steve Anderson at 989-275-4622 extension 2740.

2. Bidder's Qualifications (5/16)

Purchaser shall obtain workers compensation insurance to cover claims under Michigan's Worker's Disability Compensation Act of 1969 or similar employee benefit act of any other state applicable to an employee. If all or part of a timber sale was prepared by a private contractor, the contractor and that contractor's company are not permitted to bid on the timber sale contract. Bids will not be accepted from individuals or companies appearing on the DNR/FRD No-Bid List. This list contains the names of purchasers who previously failed to execute a contract within 21-days or who have a history of poor performance.

3. Preparation of Sealed Bids (5/16)

Bid Forms may be completed online thru Michigan DNR Timber Sale Online Bidding (OLB) at www.michigan.gov/timberbidding or by completing the hardcopy Bid Form found in the Timber Sale Prospectus. Hardcopy Bid Forms shall be manually signed in ink. Registration in OLB is considered your 'signature' for all bids submitted thru that system. Bid prices must be entered for each species and product in the Bid Price column for all material subject to bidding and all fill-in blanks must be completed. If erasures or other changes appear on the hardcopy Bid Form, each erasure or change must be initialed by the person signing the bid.

4. Submission of Sealed Bids (5/16)

Bid forms may be obtained from the Unit Manager or thru OLB. Bids may be submitted hardcopy or thru OLB. All hardcopy bids must be submitted on the bid form and in an envelope clearly identified as described in this section. NOTE: Only one bid form per bid envelope. Sealed bids must be submitted to the Unit office designated in the prospectus and must be submitted at or prior to the time established in the prospectus. The envelope should show on the outside (a) the sale name or number and (b) the date and time of bid opening, as shown in the prospectus. Bids received after the time specified in the sale prospectus are late bids and will be rejected.

It is possible for a bidder to submit multiple bids on a single sale. For example, a bid may be submitted hardcopy and a bid may be submitted thru OLB. Or, two bidders from the same company could both submit bids on the same sale. If this were to happen, the State would accept all bids received and award the contract accordingly. All bidding and contractual requirements would apply to all bids received.

5. Public Opening of Sealed Bids (7/16)

If conditions permit, the sealed bids will be publicly opened and posted at the time and place set in the prospectus.

If a bidder, present at a bid opening, has submitted bids on more than one sale, that bidder may withdraw their unopened bid envelopes or announce the withdrawal of their online bid after being declared the successful bidder on one sale.

6. Award of Contract (1/11)

Award of the contract will be made to the Bidder whose bid, conforming to the prospectus, is most advantageous to the State of Michigan on the basis of total value at rates bid for the estimated quantities. The State reserves the right to reject any bid or waive any minor irregularity in bids received. A written award mailed (or otherwise furnished) to the successful Bidder shall be deemed to result in a binding contract without further action by either party.

7. Down Payment (1/11)

The Bidder to whom award is made must make a down payment within 21 days of the sale award. The amount of the down payment will be calculated as shown in the Bond and Payment Schedule of this prospectus. Only cash may be used to meet this requirement.

8. Performance Security (1/11)

As guarantee of faithful performance, a cash bond, certificate of deposit, surety bond or irrevocable letter of credit (LOC) is required within 21 days of the sale award. The amount of the performance security is shown in the Bond and

Payment Schedule of this prospectus. If an LOC or surety is used, the coverage must extend for at least 6 months beyond the contract expiration.

9. Timber Sale Contract (9/14)

Additional conditions and requirements common to all timber sales are listed on the timber sale contract (R4031) and are available on line at www.michigan.gov/timber. Contact the Unit Manager for additional information or a sample contract. Within 21 days of the date of the award letter, the bidder must sign the contract and provide the required down payment, performance security, and verification of worker's disability compensation. The down payment and performance security shall be in accordance with the provisions of the timber sale contract, in the sums stated in this prospectus. If these actions are not taken, then the Bidder, the Bidder's corporation, and the corporation's principals may not be permitted to bid on State timber sales for a period of 1 year. In addition, the Bidder certifies that if awarded this contract, the Bidder will complete the timber sale contract in accordance with its terms and any modifications thereof including requirements to purchase, cut, and remove the included timber by the expiration date.

10. Disclaimer of Estimates and Bidder's Warranty of Inspection (7/16)

Before submitting this bid, the Bidder is advised and cautioned to inspect the sale area, review the requirements of the sale contract, and take other steps as may be reasonably necessary to ascertain the location, estimated volumes, construction estimates, and operating costs of the proposed sale. Failure to do so will not relieve the Bidder from responsibility for completing the contract.

The Bidder warrants that this bid is submitted solely on the basis of the Bidder's examination and inspection of the quality and quantity of the timber offered for sale and the Bidder's opinion of the value thereof and the costs of recovery. No reliance should be placed on the State of Michigan's estimates of timber quality, quantity or costs of recovery. Bidder further acknowledges that the State of Michigan: (i) expressly disclaims any warranty of fitness of timber for any purpose; (ii) offers this timber as is without any warranty of quality (merchantability) or quantity and (iii) expressly disclaims any warranty as to the quantity or quality of timber sold.

11. Certification and Chain-of-Custody (10/14)

Unless otherwise indicated in the contract under section 7 – Other Conditions of the Sale Specific Conditions & Requirements, the area encompassed by this timber sale is certified to the standards of the Forest Stewardship Council (FSC) - Certificate #SCS-FM/COC-00090N and the Sustainable Forestry Initiative (SFI) - Certificate # NSF-SFIS-5Y031-SF5. Forest products from this sale may be delivered to the mill as "FSC 100% and / or SFI certified" as long as the contractor hauling the forest products is chain-of-custody (COC) certified or covered under a COC certificate from the destination mill. The purchaser is responsible for maintaining COC after leaving the sale area.

12. Good Neighbor Authority (GNA) Requirements (7/16)

If the name of this timber sales contains the acronym GNA, it is authorized by the Good Neighbor Authority (GNA) and covered by various agreements between the U.S. Forest Service and the State. The timber sale occurs on federal land and the following conditions apply:

GNA contracts on US Forest Service land will not be awarded to purchasers on the Federal list of excluded parties. The System for Award Management (SAM) will be checked for active excluded parties prior to award of contract. In addition, the Bidder to whom award is made must complete an Assurance Regarding Felony Conviction or Tax Delinquent Status for Corporate Applicants (AD-3031).

13. Good Neighbor Authority (GNA) Requirements, con't (9/16)

Bidder certifies, by signing this bid form, that to the best of Bidder's knowledge that the following representations are accurate and complete.

- a. That the Bidder and its principals are not presently debarred, suspended, proposed for debarment, declared ineligible, or voluntary excluded from timber sales (covered transactions) by any Federal department or agency.
- b. That the Bidder and its principals have not within a 3-year period preceding this bid been convicted of or had a civil judgment rendered against them for commission of fraud or a criminal offense in connection with obtaining, attempting to obtain, or performing a public (Federal, State, or local) transaction or contract under a public transaction; violation of Federal or State antitrust statutes or commission of embezzlement, theft, forgery, bribery, falsification or destruction of records, making false statements, or receiving stolen property.

c. That the Bidder and its principals are not presently indicted for or otherwise criminally or civilly charged by a governmental entity (Federal, State, or local) with commission of any of the offenses enumerated in paragraph b of this certification.

d. That the Bidder and its principals have not within a 3-year period preceding this bid had one or more public transactions (Federal, State, or local) terminated for breach or default of a timber or forest product contract.

Bidders that cannot certify this requirement, in whole or in part, shall submit an explanation with their bid.

KEITH CREAGH

Director

TIMBER SALE INFORMATION

Knoch Road Aspen-Jack (71-007-16)

Ogemaw County (Advertised Price \$202,316.30)

SALE NOTE: A recreation site such as a trail, pathway, or campground is within the sale area or the vicinity. Certain restrictions/specifications may be applicable including time restrictions.

A timber sale contract for this lump sum, sealed bid timber sale will be awarded to the responsible bidder offering the highest sealed bid price. Bids must be at or above the following advertised price for each species:

<u>PRODUCTS & SPECIES</u>	<u>ESTIMATED UNITS*</u>		<u>ADVERTISED PRICE</u>
Sawtimber			
BI/R/Hybrid Oak	17.30	MBF	\$ 114.00 / MBF
Quaking Aspen	800.10	MBF	\$ 81.00 / MBF
Red Maple	62.10	MBF	\$ 43.00 / MBF
Red Pine	74.20	MBF	\$ 152.00 / MBF
Pulpwood			
BI/R/Hybrid Oak	131.00	Cords	\$ 14.60 / Cord
Jack Pine	710.00	Cords	\$ 16.15 / Cord
Mixed Hardwood	47.00	Cords	\$ 18.95 / Cord
Quaking Aspen	2,484.00	Cords	\$ 37.95 / Cord
Red Maple	409.00	Cords	\$ 18.95 / Cord
Red Pine	108.00	Cords	\$ 48.55 / Cord
White Pine	3.00	Cords	\$ 18.60 / Cord

* The total volume is statistically estimated within plus (+) or minus (-) 8.19 percent. The estimated units are final and not subject to adjustment. Prospective bidders are urged to examine this timber and to make their own estimates of quantity and quality.

BOND AND PAYMENT SCHEDULE:

1. A bond in the amount of \$10,116.00 to insure faithful performance of the conditions of the contract will be deposited by the successful bidder within 21 days of the sale award.
2. Cutting in any sale or unit without the required advance payment would be considered a trespass.
3. Total payment must be paid in advance or according to the following schedule:
 - (a) Ten percent (10%) of the sale value must be paid within 21 days of the sale award.
 - (b) The 10% down payment will be credited towards the first unit cut.
4. If no cutting takes place, the 10% down payment will not be refunded.
5. Operations on the contract issued will terminate on 12/31/2019.

Description of Timber by Payment Unit (PU)

PU	MARKET GROUP	PRODUCT	QUANTITY	UNIT	ACRES	ADVERTISE PRICE			
1	BI/R/Hybrid Oak	Sawtimber	5.5	MBF	8.6	\$5,092.05			
	Quaking Aspen		2.2	MBF					
	Red Pine		11.9	MBF					
	BI/R/Hybrid Oak	Pulpwood	15.0	Cords					
	Jack Pine		82.0	Cords					
	<i>Jack Pine</i>	<i>Sawtimber</i>	8.9	<i>MBF</i>					
	<i>Jack Pine</i>	<i>Pulpwood</i>	64.0	<i>Cords</i>					
	Quaking Aspen		8.0	Cords					
	Red Pine		13.0	Cords					
	2	BI/R/Hybrid Oak	Sawtimber	5.0			MBF	23.8	\$10,813.10
Quaking Aspen			10.9	MBF					
Red Pine			12.2	MBF					
BI/R/Hybrid Oak		Pulpwood	50.0	Cords					
Jack Pine			173.0	Cords					
<i>Jack Pine</i>		<i>Sawtimber</i>	7.5	<i>MBF</i>					
<i>Jack Pine</i>		<i>Pulpwood</i>	158.0	<i>Cords</i>					
Quaking Aspen			60.0	Cords					
Red Maple			7.0	Cords					
Red Pine			32.0	Cords					
White Pine			1.0	Cords					
3		BI/R/Hybrid Oak	Sawtimber	4.3	MBF	18.6	\$7,797.55		
		Quaking Aspen		0.8	MBF				
	Red Pine		9.4	MBF					
	BI/R/Hybrid Oak	Pulpwood	40.0	Cords					
	Jack Pine		147.0	Cords					
	<i>Jack Pine</i>	<i>Sawtimber</i>	6.4	<i>MBF</i>					
	<i>Jack Pine</i>	<i>Pulpwood</i>	134.0	<i>Cords</i>					
	Quaking Aspen		39.0	Cords					
	Red Maple		5.0	Cords					
	Red Pine		26.0	Cords					
	White Pine		1.0	Cords					
	4	BI/R/Hybrid Oak	Sawtimber	2.5	MBF			13.7	\$6,970.75
Quaking Aspen			15.2	MBF					
Red Pine			7.1	MBF					
BI/R/Hybrid Oak		Pulpwood	27.0	Cords					
Jack Pine			88.0	Cords					
<i>Jack Pine</i>		<i>Sawtimber</i>	3.8	<i>MBF</i>					
<i>Jack Pine</i>		<i>Pulpwood</i>	80.0	<i>Cords</i>					
Quaking Aspen			44.0	Cords					
Red Maple			5.0	Cords					
Red Pine			16.0	Cords					
White Pine			1.0	Cords					
5		Quaking Aspen	Sawtimber	137.9	MBF	30.9	\$24,144.95		
	Red Maple		8.8	MBF					
	Jack Pine	Pulpwood	155.0	Cords					
	<i>Jack Pine</i>	<i>Sawtimber</i>	19.5	<i>MBF</i>					
	<i>Jack Pine</i>	<i>Pulpwood</i>	116.0	<i>Cords</i>					
	Quaking Aspen		240.0	Cords					
	Red Maple		52.0	Cords					
6	Quaking Aspen	Sawtimber	170.8	MBF	22.0	\$24,562.40			
	Red Maple		5.6	MBF					
	Jack Pine	Pulpwood	42.0	Cords					
	<i>Jack Pine</i>	<i>Sawtimber</i>	3.9	<i>MBF</i>					
	<i>Jack Pine</i>	<i>Pulpwood</i>	34.0	<i>Cords</i>					
	Quaking Aspen		227.0	Cords					
	Red Maple		63.0	Cords					

Description of Timber by Payment Unit (PU), con't

PU	MARKET GROUP	PRODUCT	QUANTITY	UNIT	ACRES	ADVERTISE PRICE
7	Quaking Aspen	Sawtimber	130.0	MBF	39.0	\$34,587.55
	Red Maple		13.4	MBF		
	Red Pine		9.4	MBF		
	Jack Pine	Pulpwood	7.0	Cords		
	<i>Jack Pine</i>		7.0	<i>Cords</i>		
	Mixed Hardwood		13.0	Cords		
	<i>Black Cherry</i>	<i>Sawtimber</i>	1.0	<i>MBF</i>		
	<i>Black Cherry</i>	<i>Pulpwood</i>	11.0	<i>Cords</i>		
	Quaking Aspen		525.0	Cords		
	Red Maple		78.0	Cords		
	Red Pine		6.0	Cords		
8	Quaking Aspen	Sawtimber	82.3	MBF	24.7	\$21,882.15
	Red Maple		8.5	MBF		
	Red Pine		6.0	MBF		
	Jack Pine	Pulpwood	4.0	Cords		
	<i>Jack Pine</i>		4.0	<i>Cords</i>		
	Mixed Hardwood		8.0	Cords		
	<i>Black Cherry</i>	<i>Sawtimber</i>	0.6	<i>MBF</i>		
	<i>Black Cherry</i>	<i>Pulpwood</i>	7.0	<i>Cords</i>		
	Quaking Aspen		332.0	Cords		
	Red Maple		49.0	Cords		
	Red Pine		4.0	Cords		
9	Quaking Aspen	Sawtimber	85.0	MBF	25.5	\$22,599.50
	Red Maple		8.8	MBF		
	Red Pine		6.2	MBF		
	Jack Pine	Pulpwood	4.0	Cords		
	<i>Jack Pine</i>		4.0	<i>Cords</i>		
	Mixed Hardwood		8.0	Cords		
	<i>Black Cherry</i>	<i>Sawtimber</i>	0.6	<i>MBF</i>		
	<i>Black Cherry</i>	<i>Pulpwood</i>	7.0	<i>Cords</i>		
	Quaking Aspen		343.0	Cords		
	Red Maple		51.0	Cords		
	Red Pine		4.0	Cords		
10	Quaking Aspen	Sawtimber	165.0	MBF	49.5	\$43,897.05
	Red Maple		17.0	MBF		
	Red Pine		12.0	MBF		
	Jack Pine	Pulpwood	9.0	Cords		
	<i>Jack Pine</i>		9.0	<i>Cords</i>		
	Mixed Hardwood		18.0	Cords		
	<i>Black Cherry</i>	<i>Sawtimber</i>	1.3	<i>MBF</i>		
	<i>Black Cherry</i>	<i>Pulpwood</i>	15.0	<i>Cords</i>		
	Quaking Aspen		666.0	Cords		
	Red Maple		99.0	Cords		
	Red Pine		7.0	Cords		
TOTAL:			953.7	MBF		
TOTAL:			3,894.0	Cords		

Sale Specific Conditions & Requirements

Sale Name: Knoch Road Aspen-Jack

Sale Number: 71-007-16 Seq#: 1

1 - Sale Area

1.2 - Boundaries

1.2.1 - Painted boundaries (1/14)

The sale boundary and Payment Unit boundaries are marked and identified by blue, red and yellow paint. Exterior sale boundary lines against private property are marked with blue paint. Exterior sale boundary lines against state are marked with red paint. Retention areas are marked with red paint. Interior Payment Unit boundaries are marked with yellow paint. The painted boundary line trees are not Included Timber and are to be protected. Yellow painted trees designating an interior Payment Unit boundary are only to be cut when all surrounding Payment Units have been paid.

2 - Timber Specifications

2.1 - Included Timber

2.1.1 - Clearcut unit(s) with unmerchantable trees (6/14)

Within Payment Unit(s) 1 - 10, cut all trees that are two (2) inches or more at DBH, with the following exceptions:

Within Payment Units 2 - 4, do not cut or damage any trees marked above and below stump height with green paint.

Within Payment Units 5-10, do not cut or damage any oak trees.

3 - Payments

3.3 - Pre-measured Sales

3.3.4 - Dividing payment units (7/14)

Payment Unit(s) may be divided at the request of the Purchaser and upon approval of the Unit Manager. Dividing Payment Units is a contract modification which requires a Timber Sale Contract Supplement.

3.4 - Damaged Timber

3.4.1 - Damaged timber (6/14)

General Condition and Requirement 3.4 Damaged Timber, defines liquidated damages for undesignated live merchantable trees which are cut or injured.

No damage is acceptable to merchantable trees. Within the sale area, if more than 5% of the green painted residual trees (> 4.5" DBH) within a specified area of the sale are damaged, liquidated damages will be assessed for all trees damaged. Rates will be in accordance with General Condition and Requirement 3.4 Damaged Timber.

3.6 - Payment Unit Cutting Schedule

3.6.2 - One active unit (12/08)

Each Payment Unit must be completed to the satisfaction of the Unit Manager or his/her representative before the next unit may be opened.

4 - Transportation

4.1 - Construction

4.1.6 - Road construction (1/09)

Construction of new roads or improvements of existing roads shall be done in such a way as to minimize the environmental and visual impacts. Merchantable trees shall be cut and utilized unless otherwise directed. Non-merchantable trees shall be severed and laid flat on the ground. Slash shall be scattered, and not left in windrows and kept a minimum of 10 feet back from the road edge or be chipped, utilized or otherwise removed from the sale. Stumps shall be set upright, not left on edge, and be moved at least 10 feet away from the road edge. Disturbed soil shall be feathered into the woods and not left in berms or windrows.

4.1.7 - Road closure (10/11)

All new roads built into the sale must be blocked to vehicle traffic within 30 days of completion of hauling. Overgrown roads that are reopened shall be considered new roads. In general, this will require constructing a four (4') foot high berm of stumps and logs covered with earth. Stumps and brush must be placed along the remainder of the trail. These roads must be rendered impassable to cars and trucks. Contact the sale administrator for specific details of design and placement.

4.2 - Maintenance

4.2.1 - Hauling restriction (12/08)

Hauling may be restricted on forest roads by the Unit Manager or his/her representative. The restriction may occur during spring breakup or during wet weather conditions.

4.2.2 - Fill material (4/07)

To maintain roads, fill material may be needed in areas where "holes" exist or may be expected to develop. This fill material should be placed before trucking begins. Contact the sale administrator regarding the availability of onsite sand or gravel from adjacent State-owned lands.

4.2.3 - Road maintenance (8/13)

The following road maintenance may be needed: Within 60 days of completion of hauling, or if no hauling occurs for 60 days, the road must be maintained and graded. This includes cleaning of drainage areas, grading, crowning and filling with gravel, if necessary. Damages will be assessed if grading/repair does not occur.

5 - Operations

5.2 - Conduct of Operations

5.2.1 - Slash

5.2.1.8 - Slash height (12/08)

No slash or tree tops may exceed 24 inches in height.

5.2.2 - Hazard Trees/Snags

5.2.2.1 - Den trees (2/04)

Obvious hollow and/or den trees shall be protected and left standing unless they are a safety hazard.

5.2.3 - Operating Restrictions

5.2.3.11 - Coppice regeneration protection (4/10)

To promote aspen regeneration, harvesting is limited to July 15th through March 31st. Timber harvesting in any Payment Unit must be completed before significant aspen sprouting occurs in that Payment Unit so as to minimize damage to the new regeneration. Any post harvest operations, such as chipping, must be completed before sprouting of regeneration occurs. If it is anticipated that chipping will be delayed, then tops shall be carried to one central location or left unchipped. The Unit Manager or his/her representative may cease such operations if sprouting occurs before the operation is complete.

5.2.4 - Dead and Down Creation

5.2.4.2 - Dead and down creation, hare and grouse (1/14)

To improve habitat for snowshoe hare, grouse, and other species, the Purchaser is to leave two trees or sections of trees or tree tops on the ground for every two acres. They should be scattered throughout the sale or positioned per the sale administrators instructions. If possible, the logs or trees should be felled so they overlap. Note these pieces should have a minimum length of five feet. They can be of any tree species and can be an un-merchantable piece of wood or a full tree.

5.2.4.3 - Dead and down creation, dead trees (6/07)

Except as provided for in General Condition and Requirement 5.2.2, no dead trees, standing or down, are to be cut, skidded, or processed.

5.2.4.6 - Dead and down creation, other (9/09)

To create grouse habitat/drumming logs, within Payment Unit(s) 5 - 10, one tree per acre (maple where available) must

be cut at least 4.5' (feet) above ground level and left on site and not utilized. These trees must have a DBH over 7" (inches) and are to be felled and left within 3'(feet) of the stump.

5.2.29 - Shrub protection (9/07)

Do not cut or damage hawthorn, witch-hazel, dogwood or juneberry. These woody-shrub plants are highly beneficial to various wildlife species.

5.2.32 - Decking/landing restoration (9/13)

All decking and landing areas must have the surface area restored to a condition equal to or better than before. This is to ensure the proper regeneration of the stand. Wood debris, chips and "cookies" from trimmings must be removed or scattered away from landing and loading areas and may not be windrowed on the edge.

5.2.38 - No decking against live trees (2/04)

Cut products may not be decked against unmarked or designated leave trees.

5.2.40 - Pathway protection (10/10)

The Midland-to-Mackinac Boy Scout Trail is a hiking trail as shown on the Timber Sale Map. Do not cut trees or damage posts with blue pathway markers. Maintain a 10-foot wide slash, debris, and rut free zone daily, using the pathway as the centerline. Do not run equipment down the pathway. Skidding across the trail may only occur at right angles to the trail and in locations approved by the sale administrator.

5.2.41 - Snowmobile trail protection (9/11)

Marl Lake Road/Berry Trail and Meridian Road are also snowmobile trails as shown on the Timber Sale Map. Do not cut or damage posts with orange trail markers or traffic control signs. If the trail is used, it must be maintained and restored to a condition equal to or better than before the sale. If the trail is used for hauling, it must be graded to the satisfaction of the Unit Manager or his/her representative prior to December 1st. If the trail road is to be used for hauling during the snowmobile season (Approximately December 1 to March 31), then a snow covered base must be left on the trail. Maintain a 20 foot wide slash, debris, and rut free zone daily using the snowmobile trail as the centerline. No decking of forest products will be permitted along the snowmobile trail. All stumps within 20 feet of the snowmobile trail must be cut as close to ground level as possible.

5.4 - Soil Protection

5.4.1 - Rutting restriction, general (7/16)

Operations are to cease immediately if equipment and weather conditions result in rutting of roads and/or skid trails which is 12 inches or greater in depth and 50 feet in length. The Unit Manager or his/her representative may restrict hauling and/or skidding if ruts exceed the specified depth. With the Unit Manager or his/her representative's approval, the Purchaser may return to the area when the risk of rutting has decreased.

5.4.3 - Erosion control (12/08)

Skid trails or haul roads may require erosion control structures or berms per direction of the Unit Manager or his/her representative.

6 - Safety and Fire Prevention

6.2 - Signing

6.2.2 - Snowmobile trail posting (8/09)

The Purchaser is responsible for posting and maintaining caution signs on the snowmobile trail prior to beginning operations during the snowmobile season (approximately December 1 to March 31). The trail must be posted at appropriate distances from the sale area to warn of logging activity and truck traffic. Signs must be removed when harvest operations are suspended or completed.

6.2.3 - Recreational trail posting (2/10)

The Purchaser is responsible for posting and maintaining caution signs on the Midland-to-Mackinac trail prior to beginning operations. The trail must be posted at appropriate distances from the sale area to warn of logging activity and truck traffic at both ends of the trail. Signs must be removed when harvest operations are suspended or completed.



TIMBER SALE MAP

This information provided by authority of Part 525, 1994 PA 451, as amended.

Forest Management Unit	County	Mapped By	Ekdrom	Date	Page	of
Roscommon	Roscommon	Cruised By	Ekdrom	08/05/2016	1	1
Township	Range	Section(s) and Subdivision(s)		Scale		
24N	01W	25 - 36 -		1:15,840		

Cover Type				Density			
A = Aspen	H = Hemlock	N = Marsh	U = Upland Brush	0 = Non Stocked	5 = Pole Timber Medium		
B = Paper Birch	J = Jack Pine	O = Oak	UM = Upland Mixed	1 = Seedling Sapling Poor	6 = Pole Timber Well		
C = Cedar	L = Lowland Brush	P = Lowland Poplar	V = Bog or Marsh	2 = Seedling Sapling Medium	7 = Saw Timber Poor		
D = Treed Bog	LM = Lowland Mixed	Q = Mixed Swamp Conifer	W = White Pine	3 = Seedling Sapling Well	8 = Saw Timber Medium		
E = Swamp Hdwoods	M = Mpl, Bch, Brch	R = Red Pine	X = Non Stocked	4 = Pole Timber Poor	9 = Saw Timber Well		
F = Spruce Fir	MC = Mixed Conifer	S = Black Spruce	Z = Water				
G = Grass	MD = Mixed Deciduous	T = Tamarack					

PU	Acres	PU	Acres
1	8.6	6	22.0
2	23.8	7	39.0
3	18.6	8	24.7
4	13.7	9	25.5
5	30.9	10	49.5

Knoch Road Aspen-Jack

Compartment 50

256.3 Acres

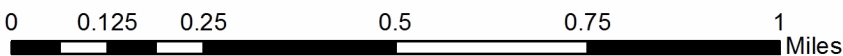
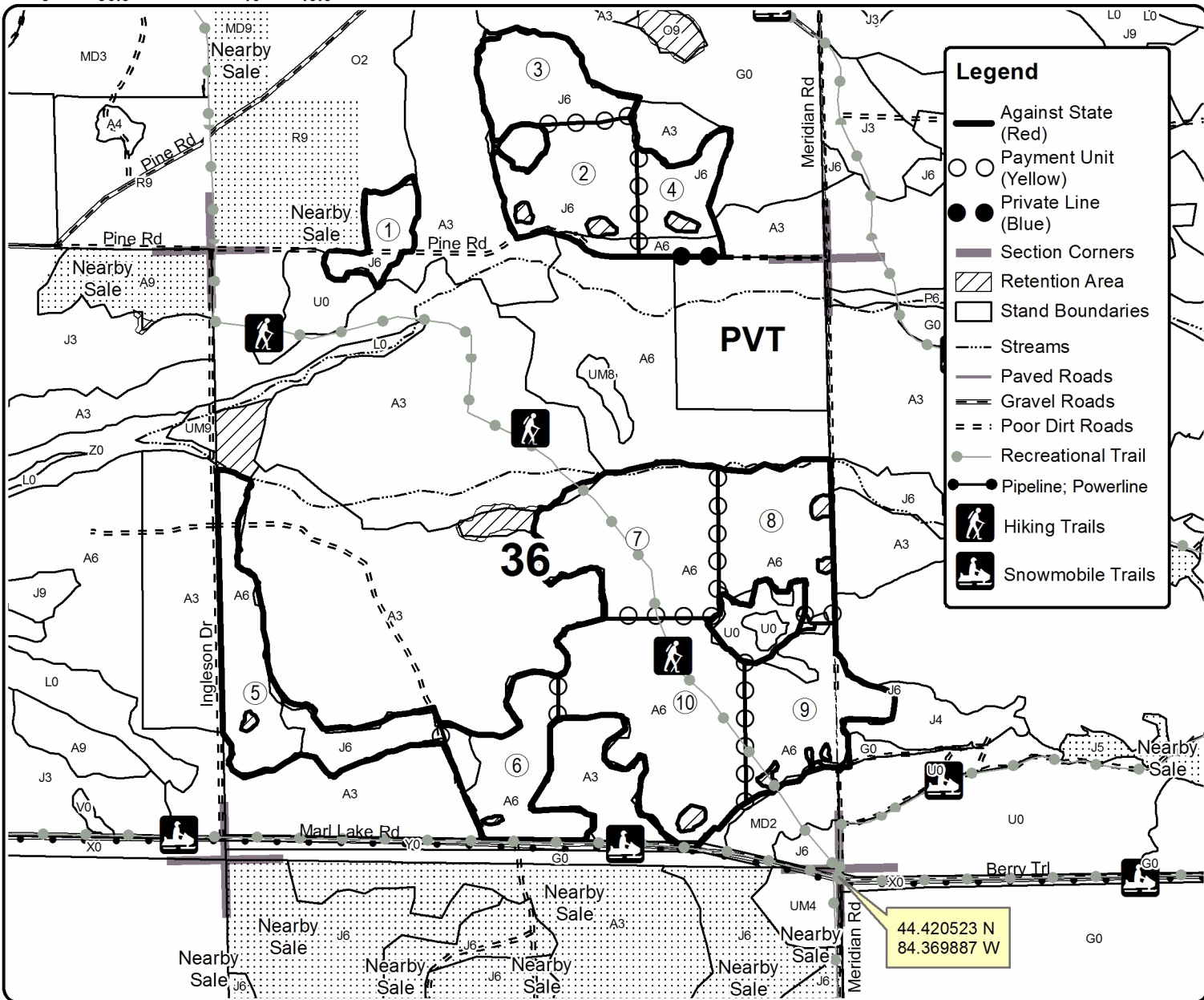

TIMBER SALE INFORMATION

Neighborhood Mix (71-020-16)

Roscommon County (Advertised Price \$103,656.10)

SALE NOTE: Two units within the sale contain multiple cross-country ski trails that will require extra attention during operations to limit impacts physically to the trail bed and future visual concerns, i.e. slash heights. These two units can not be harvested during winter months.

A road construction project with slightly more than normal "road" work will need to be done to access Payment Unit 1. Contact will need to be made to the Roscommon County Road Commission to find out about site distance requirements for a drive coming out on the leeward side of a hill on a county road. Also a buried fiber optic line is located where the access drive will need to be constructed.

A recreation site such as a trail, pathway, or campground is within the sale area or the vicinity. Certain restrictions/specifications may be applicable including time restrictions.

A timber sale contract for this lump sum, sealed bid timber sale will be awarded to the responsible bidder offering the highest sealed bid price. Bids must be at or above the following advertised price for each species:

<u>PRODUCTS & SPECIES</u>	<u>ESTIMATED UNITS*</u>		<u>ADVERTISED PRICE</u>
Sawtimber			
Mixed Aspen	16.90	MBF	\$ 80.00 / MBF
Mixed Oak	54.70	MBF	\$ 111.00 / MBF
Red Maple	14.70	MBF	\$ 42.00 / MBF
Red Oak	117.50	MBF	\$ 192.00 / MBF
Red Pine	108.10	MBF	\$ 148.00 / MBF
White Pine	31.80	MBF	\$ 213.00 / MBF
Pulpwood			
B. T. Aspen	376.00	Cords	\$ 35.35 / Cord
BI/R/Hybrid Oak	195.00	Cords	\$ 14.20 / Cord
Jack Pine	204.00	Cords	\$ 15.75 / Cord
Mixed Oak	158.00	Cords	\$ 14.20 / Cord
Quaking Aspen	283.00	Cords	\$ 35.35 / Cord
Red Maple	206.00	Cords	\$ 18.45 / Cord
Red Oak	257.00	Cords	\$ 14.20 / Cord
Red Pine	185.00	Cords	\$ 47.25 / Cord
White Pine	142.00	Cords	\$ 18.10 / Cord

* The total volume is statistically estimated within plus (+) or minus (-) 7.95 percent. The estimated units are final and not subject to adjustment. Prospective bidders are urged to examine this timber and to make their own estimates of quantity and quality.

BOND AND PAYMENT SCHEDULE:

1. A bond in the amount of \$5,183.00 to insure faithful performance of the conditions of the contract will be deposited by the successful bidder within 21 days of the sale award.
2. Cutting in any sale or unit without the required advance payment would be considered a trespass.
3. Total payment must be paid in advance or according to the following schedule:
 - (a) Ten percent (10%) of the sale value must be paid within 21 days of the sale award.
 - (b) The 10% down payment will be credited towards the first unit cut.
4. If no cutting takes place, the 10% down payment will not be refunded.
5. Operations on the contract issued will terminate on 03/31/2019.

Description of Timber by Payment Unit (PU)

PU	MARKET GROUP	PRODUCT	QUANTITY	UNIT	ACRES	ADVERTISE PRICE	
1	Mixed Aspen	Sawtimber	1.1	MBF	20.0	\$7,999.35	
	<i>B. T. Aspen</i>		1.1	<i>MBF</i>			
	Mixed Oak		18.0	MBF			
	<i>BI/R/Hybrid Oak</i>		16.6	<i>MBF</i>			
	<i>White Oak</i>		1.4	<i>MBF</i>			
	Red Maple		3.9	MBF			
	White Pine		2.4	MBF			
	B. T. Aspen		Pulpwood	90.0			Cords
	<i>BI/R/Hybrid Oak</i>			70.0			Cords
	Mixed Oak			13.0			Cords
	<i>White Oak</i>	13.0		<i>Cords</i>			
	Red Maple	27.0		Cords			
	White Pine	21.0	Cords				
2	Mixed Oak	Sawtimber	8.8	MBF	30.7	\$22,579.55	
	<i>White Oak</i>		8.8	<i>MBF</i>			
	Red Oak		88.9	MBF			
	Red Pine		0.7	MBF			
	White Pine		1.0	MBF			
	Mixed Oak		Pulpwood	33.0			Cords
	<i>White Oak</i>			33.0			<i>Cords</i>
	Red Maple			21.0			Cords
	Red Oak			204.0			Cords
	Red Pine			6.0			Cords
White Pine	10.0	Cords					
3	Jack Pine	Pulpwood	184.0	Cords	15.8	\$3,210.15	
	Mixed Oak		12.0	Cords			
	<i>Northern Pin Oak</i>		12.0	<i>Cords</i>			
	Red Pine		3.0	Cords			
4	Mixed Oak	Sawtimber	18.1	MBF	27.4	\$18,467.85	
	<i>BI/R/Hybrid Oak</i>		14.7	<i>MBF</i>			
	<i>White Oak</i>		3.4	<i>MBF</i>			
	Red Maple		0.7	MBF			
	Red Pine		24.6	MBF			
	White Pine		27.6	MBF			
	B. T. Aspen		Pulpwood	11.0			Cords
	<i>BI/R/Hybrid Oak</i>			125.0			Cords
	Jack Pine			20.0			Cords
	Mixed Oak			29.0			Cords
	<i>White Oak</i>			29.0			<i>Cords</i>
	Quaking Aspen			5.0			Cords
	Red Maple			30.0			Cords
	Red Pine			29.0			Cords
White Pine	106.0	Cords					
5	Mixed Oak	Sawtimber	0.9	MBF	9.9	\$8,139.35	
	<i>White Oak</i>		0.9	<i>MBF</i>			
	Red Maple		7.4	MBF			
	Red Oak		28.6	MBF			
	B. T. Aspen		Pulpwood	9.0			Cords
	Mixed Oak			12.0			Cords
	<i>White Oak</i>			12.0			<i>Cords</i>
	Red Maple			54.0			Cords
Red Oak	53.0	Cords					
6	Red Pine	Sawtimber	37.6	MBF	9.8	\$8,801.25	
	Quaking Aspen	Pulpwood	2.0	Cords			
	Red Pine	67.0	Cords				
7	Red Pine	Sawtimber	42.6	MBF	11.1	\$9,919.25	

Description of Timber by Payment Unit (PU), con't

PU	MARKET GROUP	PRODUCT	QUANTITY	UNIT	ACRES	ADVERTISE PRICE
	Quaking Aspen	Pulpwood	2.0	Cords		
	Red Pine		75.0	Cords		
8	Mixed Aspen	Sawtimber	6.9	MBF	14.9	\$10,659.55
	<i>B. T. Aspen</i>		2.7	<i>MBF</i>		
	<i>Quaking Aspen</i>		4.2	<i>MBF</i>		
	Mixed Oak		3.9	MBF		
	<i>Northern Pin Oak</i>		3.3	<i>MBF</i>		
	<i>White Oak</i>		0.6	<i>MBF</i>		
	Red Maple		1.2	MBF		
	Red Pine		1.1	MBF		
	White Pine		0.3	MBF		
	B. T. Aspen	Pulpwood	116.0	Cords		
	Mixed Oak		26.0	Cords		
	<i>Northern Pin Oak</i>		23.0	<i>Cords</i>		
	<i>White Oak</i>		3.0	<i>Cords</i>		
	Quaking Aspen		119.0	Cords		
	Red Maple		32.0	Cords		
	Red Pine		2.0	Cords		
	White Pine		2.0	Cords		
9	Mixed Aspen	Sawtimber	8.9	MBF	19.4	\$13,879.80
	<i>B. T. Aspen</i>		3.5	<i>MBF</i>		
	<i>Quaking Aspen</i>		5.4	<i>MBF</i>		
	Mixed Oak		5.0	MBF		
	<i>Northern Pin Oak</i>		4.2	<i>MBF</i>		
	<i>White Oak</i>		0.8	<i>MBF</i>		
	Red Maple		1.5	MBF		
	Red Pine		1.5	MBF		
	White Pine		0.5	MBF		
	B. T. Aspen	Pulpwood	150.0	Cords		
	Mixed Oak		33.0	Cords		
	<i>Northern Pin Oak</i>		29.0	<i>Cords</i>		
	<i>White Oak</i>		4.0	<i>Cords</i>		
	Quaking Aspen		155.0	Cords		
	Red Maple		42.0	Cords		
	Red Pine		3.0	Cords		
	White Pine		3.0	Cords		
TOTAL:			343.7	MBF		
TOTAL:			2,006.0	Cords		

Sale Specific Conditions & Requirements

Sale Name: Neighborhood Mix

Sale Number: 71-020-16 Seq#: 1

1 - Sale Area

1.2 - Boundaries

1.2.1 - Painted boundaries (1/14)

The sale boundary and Payment Unit boundaries are marked and identified by blue, red, and yellow paint. Exterior sale boundary lines against private property are marked with blue paint. Exterior sale boundary lines against state are marked with red paint. Interior Payment Unit boundaries are marked with yellow paint. The painted boundary line trees are not Included Timber and are to be protected unless marked with orange paint. Yellow painted trees designating an interior Payment Unit boundary are only to be cut when all surrounding Payment Units have been paid.

2 - Timber Specifications

2.1 - Included Timber

2.1.1 - Clearcut unit(s) with unmerchantable trees (6/14)

Within Payment Unit(s) 3, 8, and 9, cut all trees that are two (2) inches or more at DBH.

EXCEPTION: Within Payment Units 8 and 9, do not cut any green marked trees or any white pine trees 14 inches in diameter and greater.

2.1.3 - Cut tree marked unit(s) (12/08)

Within Payment Unit(s) 1, 6 and 7, all trees are designated for cutting when marked with orange paint above and below stump height, regardless of merchantability. In addition, within Payment Unit 1, cut all aspen and multi-stemmed red maple to a 2 inch DBH.

2.1.7 - Leave tree marked unit(s) (6/14)

Within Payment Unit(s) 2, 4 and 5, all trees, which meet minimum piece specifications in 2.2 Utilization, are designated for cutting except trees marked with green paint above and below stump height. In addition, within Payment Unit 4, do not cut any red and white pines with a DBH of 16 inches and greater.

2.2 - Utilization

2.2.2 - Chipping required (5/14)

Payment Unit 3 must be chip harvested to facilitate subsequent planting operations. The Purchaser has the option to produce sawlogs or pulpwood bolts, but the remaining portion of the trees must be chipped and hauled. The requirement to retain approximately 1/6 to 1/3 of tree tops and limbs less than four inches in diameter does not apply (G. C. & R. 2.2) for trenching purposes.

2.2.3 - Stump heights (4/07)

Stump heights within the Sale Area shall not exceed 6 inches for all trees.

2.2.4 - Skidding length (2/14)

Within payment units 6 and 7, skidding of lengths over 17 feet is permissible as long as the timber sale administrator approves the method and machinery used. If at any point damage exceeds specification 3.4.1, all of the remaining wood must be skid in lengths less than 17 feet.

3 - Payments

3.3 - Pre-measured Sales

3.3.4 - Dividing payment units (7/14)

Payment Unit(s) may be divided at the request of the Purchaser and upon approval of the Unit Manager. Dividing Payment Units is a contract modification which requires a Timber Sale Contract Supplement. There will be only one division per Payment Unit.

3.4 - Damaged Timber

3.4.1 - Damaged timber (6/14)

General Condition and Requirement 3.4 Damaged Timber, defines liquidated damages for undesignated live merchantable trees which are cut or injured. In addition, extreme care should be taken to avoid damage to tree seedlings and saplings. Within Payment Units 1, 2, 4, and 5, if more than 30% of the tree seedlings or saplings (1/4" to 4.5" DBH) within a specified portion of the sale area are damaged, liquidated damages will be assessed at \$300 per acre for all acreage within that specified portion of the sale area that was damaged.

No damage is acceptable to merchantable trees. Within all Payment Units, if more than 5% of trees (> 4.5" DBH) within a specified area of the sale are damaged, liquidated damages will be assessed for all trees damaged. Rates will be in accordance with General Condition and Requirement 3.4 Damaged Timber.

4 - Transportation

4.1 - Construction

4.1.3 - Slash and earthen piles (8/04)

Piles or windrows of earth along roads and landings that have been widened or constructed shall be leveled. Slash from road maintenance or construction, including stumps, shall be chipped, utilized or dispersed throughout the sale.

4.1.6 - Road construction (1/09)

Reopening of the overgrown forest road leading into Payment Units 8 and 9 from the north shall be done in such a way as to minimize the environmental and visual impacts. Merchantable trees shall be cut and utilized unless otherwise directed.

Non-merchantable trees shall be severed and laid flat on the ground. Slash shall be chipped, utilized or otherwise scattered about the sale. Stumps shall be set upright, not left on edge, and be moved at least 10 feet away from the road edge.

Disturbed soil shall be feathered into the woods and not left in berms or windrows.

4.1.7 - Road closure (10/11)

All new roads built into the sale must be blocked to vehicle traffic upon completion of the sale. Overgrown roads that are reopened shall be considered new roads. This applies to the haul road south off Burdell Road into Payment Units 8 and 9. In general, this will require constructing a four (4') foot high berm of stumps and logs covered with earth. Stumps and brush must be placed along the remainder of the trail. These roads must be rendered impassable to cars and trucks. All stumps from road building and landing construction must be reserved to block any newly constructed roads upon completion of the sale. These stumps must be scattered along the road system to prohibit vehicular movement. Contact the sale administrator for specific details of design and placement.

4.1.8 - Road work (1) (8/07)

The following road work is required within Payment Unit 1: Approximately 40 yards of fill will need to be brought in and covered by a suitable substrate to create a ramp on an incline from within the sale area up onto Sunset Drive. This material will need to be brought in and not "borrowed" from site. Upon sale completion, this road will need to be blocked off with stumps/brush. The site will need to be west of the current two-track which lies on an old pipeline ROW. It will need to be close to the west boundary line. This is to help comply with possible site distance issues for entering out onto a county road as the result of the hill on Sunset Drive.

4.1.10 - Oversight (12/08)

The Unit Manager, or his/her representative, must be present when the road improvement project is initiated.

4.1.12 - No new roads (1/12)

No new roads will be permitted in any Payment Unit except for Payment Units 1, 8 and 9. All operations are limited to existing roads. Skid trails only will be allowed.

4.2 - Maintenance

4.2.3 - Road maintenance (8/13)

The following road maintenance is required: Within 60 days of completion of hauling, or if no hauling occurs for 60 days, the road must be maintained and graded. This includes cleaning of drainage areas, grading, crowning and filling with gravel, if necessary. Damages will be assessed if grading/repair does not occur.

5 - Operations

5.1 - Notification

5.1.1 - Pre-sale conference (10/16)

A pre-sale conference on site between the Purchaser and sale administrator is required prior to beginning any operations to determine landing and road locations.

5.1.4 - Post-sale conference (6/11)

A post-sale conference on site between the Purchaser and sale administrator is required 5 days prior to the completion of active logging operations to determine clean-up and repair of landings, road edges, and the fulfillment of other contract specifications.

5.2 - Conduct of Operations

5.2.1 - Slash

5.2.1.2 - Slash Removal

5.2.1.2.1 - Slash removal, right-of-way (9/16)

All slash must be removed at least 10 feet from the cleared right-of-way of overhead powerlines.

5.2.1.8 - Slash height (12/08)

No slash or tree tops may exceed 24 inches in height.

5.2.2 - Hazard Trees/Snags

5.2.2.1 - Den trees (2/04)

Obvious hollow and/or den trees shall be protected and left standing unless they are a safety hazard.

5.2.3 - Operating Restrictions

5.2.3.1 - Operating restrictions (9/11)

Within Payment Unit(s) 8 and 9, unless changed by written agreement, cutting, skidding, and hauling are not permitted during the period of December 1 to March 31. This restriction is because of the cross-country ski trails within the sale units.

5.2.3.3 - Bark slippage restriction (3/09)

Within Payment Unit(s) 6 and 7, unless changed by written agreement, cutting and skidding are not permitted during the period of April 15 to July 15. This restriction is because of bark slippage.

5.2.3.4 - Oak wilt restriction (6/10)

Within Payment Unit(s) 1, 2, 4 and 5, unless changed by written agreement, cutting and skidding are not permitted during the period of April 15 to July 15. This is necessary to reduce the spread of oak wilt. For more information, contact the Unit Manager or his/her representative.

5.2.3.6 - Bark beetle restriction (12/08)

In the event drought creates a high risk of pine bark beetle infestation, pine is not to be cut during the period March 1 through July 1, unless all portions of trees greater than two inches in diameter are removed from the sale area, reduced to chips, or treated to the satisfaction of the Unit Manager or his/her representative, within fifteen days of being severed from the stump. Pine log decks, pulpwood piles and treetops that are piled for chipping in the fall or winter within a 1/4 mile of susceptible sites must be removed before March 15. Residual slash must not be placed in piles or rows and must be spread over the site for quick drying. The Department of Natural Resources will exercise this specification if the risk of damage warrants.

5.2.32 - Decking/landing restoration (9/13)

All decking and landing areas must have the surface area restored to a condition equal to or better than before. This is to ensure the proper regeneration of the stand. Wood debris, chips and "cookies" from trimmings must be removed or scattered away from landing and loading areas and may not be windrowed on the edge. Wood chip accumulation shall not exceed 6 inches in depth.

5.2.38 - No decking against live trees (2/04)

Cut products may not be decked against unmarked or designated leave trees.

5.2.40 - Pathway protection (10/10)

There are cross-country ski trails within Payment Units 8 and 9, and are shown on the Timber Sale Map. Maintain a 20-foot wide slash, debris, and rut free zone daily, using the pathway as the centerline. Do not run equipment down the pathway.

Skidding across the trail may only occur in locations approved by the sale administrator.

5.4 - Soil Protection

5.4.1 - Rutting restriction, general (7/16)

Operations are to cease immediately if equipment and weather conditions result in rutting of roads and/or skid trails which is 12 inches or greater in depth and 50 feet in length. The Unit Manager or his/her representative may restrict hauling and/or skidding if ruts exceed the specified depth. With the Unit Manager or his/her representative's approval, the Purchaser may return to the area when the risk of rutting has decreased.

5.7 - Protection of Historical Sites

5.7.1 - Historical sites (7/12)

The Purchaser shall not cut live or dead trees or operate equipment within historical sites. Historical sites are to be identified to the purchaser onsite by the sale administrator. The Purchaser shall protect historical sites from damage by the Purchaser's operations. If Purchaser's operations have cut or damaged historical sites through carelessness, the Purchaser shall pay \$500 as fixed, agreed and liquidated damages for each acre or part thereof cut or damaged.

6 - Safety and Fire Prevention

6.2 - Signing

6.2.3 - Recreational trail posting (2/10)

The Purchaser is responsible for posting and maintaining caution signs on the information station of the cross-country ski trail prior to beginning operations. The trail must be posted here to warn of logging activity and truck traffic at both ends of the trail. Signs must be removed when harvest operations are suspended or completed. The Purchaser will provide these signs.

7 - Other Conditions

7.3 - Contract Modifications

7.3.2 - Modification for oak wilt (2/05)

Within the sale area, there may be patches of oak wilt. If oak wilt is identified within the sale area, this contract may be modified. The following modifications could occur: time of cutting, species to cut, volume to harvest, or various others dealing with the treatment of oak wilt. If a species is not specified in this contract, it shall be paid for at the average price received for that species and product.

7.3.3 - Modification for reforestation (8/05)

When contractual work of Purchaser has been accepted for any Payment Unit identified on Sale Area Map, Payment Unit will be eliminated from the Sale Area on written notice so that reforestation operations can begin.



Sale Number	Year
71-020	16

TIMBER SALE MAP

This information provided by authority of Part 525, 1994 PA 451, as amended.

Forest Management Unit	County	Mapped By	Bates	Date	Page	of
Roscommon	Roscommon	Cruised By	Bates	10/04/2016	2	2
Township	Range	Section(s) and Subdivision(s)			Scale	
24N	03W	9 - SESE 10 - SESE;SWSW 15 - SWNE;NWSE 16 - SENE;NESE			1:19,131	

Cover Type				Density			
A = Aspen	H = Hemlock	N = Marsh	U = Upland Brush	0 = Non Stocked	5 = Pole Timber Medium		
B = Paper Birch	J = Jack Pine	O = Oak	UM = Upland Mixed	1 = Seedling Sapling Poor	6 = Pole Timber Well		
C = Cedar	L = Lowland Brush	P = Lowland Poplar	V = Bog or Marsh	2 = Seedling Sapling Medium	7 = Saw Timber Poor		
D = Treed Bog	LM = Lowland Mixed	Q = Mixed Swamp Conifer	W = White Pine	3 = Seedling Sapling Well	8 = Saw Timber Medium		
E = Swamp Hdwoods	M = Mpl, Bch, Brch	R = Red Pine	X = Non Stocked	4 = Pole Timber Poor	9 = Saw Timber Well		
F = Spruce Fir	MC = Mixed Conifer	S = Black Spruce	Z = Water				
G = Grass	MD = Mixed Deciduous	T = Tamarack					

PU	Acres	PU	Acres
2	30.7	6	9.8
3	15.8	7	11.1
4	27.4	8	14.9
5	9.9	9	19.4

Neighborhood Mix

Compartment 17

159.0 Acres

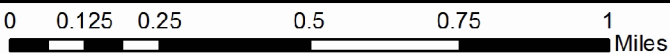
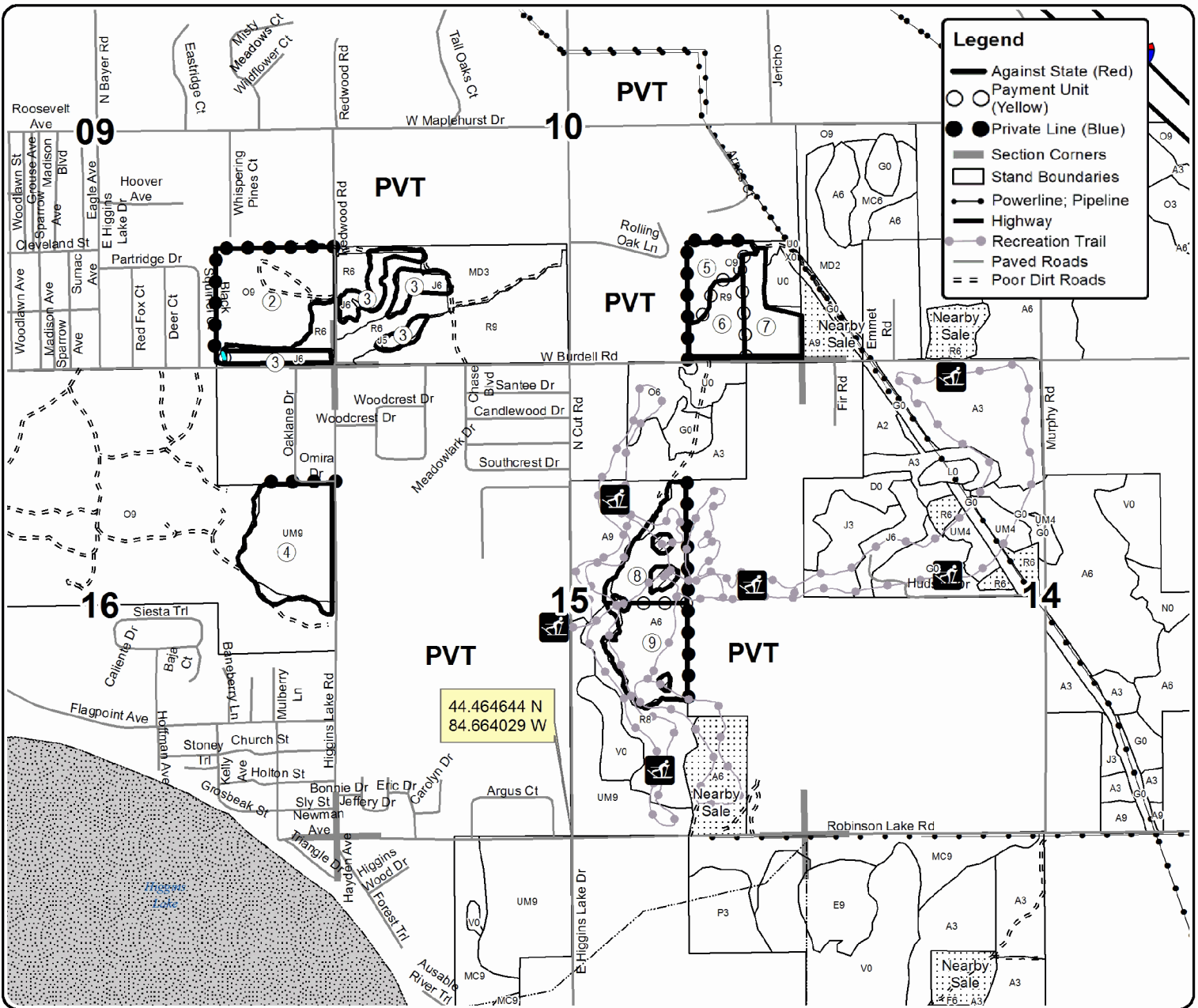

TIMBER SALE INFORMATION

Louies Pine (71-030-16)

Roscommon County (Advertised Price \$32,208.90)

SALE NOTE: A recreation site such as a trail, pathway, or campground is within the sale area or the vicinity. Certain restrictions/specifications may be applicable including time restrictions.

A timber sale contract for this lump sum, sealed bid timber sale will be awarded to the responsible bidder offering the highest sealed bid price. Bids must be at or above the following advertised price for each species:

<u>PRODUCTS & SPECIES</u>	<u>ESTIMATED UNITS*</u>	<u>ADVERTISED PRICE</u>
Sawtimber		
B. T. Aspen	18.00 MBF	\$ 83.00 / MBF
Bl/R/Hybrid Oak	53.00 MBF	\$ 114.00 / MBF
Jack Pine	58.40 MBF	\$ 34.00 / MBF
Red Pine	14.60 MBF	\$ 152.00 / MBF
Pulpwood		
B. T. Aspen	51.00 Cords	\$ 36.35 / Cord
Bl/R/Hybrid Oak	280.00 Cords	\$ 14.60 / Cord
Jack Pine	497.00 Cords	\$ 16.15 / Cord
Red Pine	122.00 Cords	\$ 48.55 / Cord
White Pine	31.00 Cords	\$ 18.60 / Cord

* The total volume is statistically estimated within plus (+) or minus (-) 12.11 percent. The estimated units are final and not subject to adjustment. Prospective bidders are urged to examine this timber and to make their own estimates of quantity and quality.

BOND AND PAYMENT SCHEDULE:

1. A bond in the amount of \$1,610.00 to insure faithful performance of the conditions of the contract will be deposited by the successful bidder within 21 days of the sale award.
2. Cutting in any sale or unit without the required advance payment would be considered a trespass.
3. Total payment must be paid in advance or according to the following schedule:
 - (a) Ten percent (10%) of the sale value must be paid within 21 days of the sale award.
 - (b) The 10% down payment will be credited towards the first unit cut.
4. If no cutting takes place, the 10% down payment will not be refunded.
5. Operations on the contract issued will terminate on 12/31/2018.

Description of Timber by Payment Unit (PU)

PU	MARKET GROUP	PRODUCT	QUANTITY	UNIT	ACRES	ADVERTISE PRICE	
1	B. T. Aspen	Sawtimber	18.0	MBF	38.6	\$15,584.80	
	BI/R/Hybrid Oak		26.2	MBF			
	Jack Pine		21.8	MBF			
	Red Pine		6.3	MBF			
	B. T. Aspen	Pulpwood	51.0	Cords			
	BI/R/Hybrid Oak		142.0	Cords			
	Jack Pine		240.0	Cords			
	Red Pine		33.0	Cords			
2	BI/R/Hybrid Oak	Sawtimber	11.2	MBF	15.3	\$6,126.20	
	Jack Pine		16.3	MBF			
	Red Pine		1.4	MBF			
	BI/R/Hybrid Oak	Pulpwood	56.0	Cords			
	Jack Pine		127.0	Cords			
	Red Pine		25.0	Cords			
3	BI/R/Hybrid Oak	Sawtimber	7.2	MBF	17.5	\$5,306.85	
	Jack Pine		12.2	MBF			
	Red Pine		2.5	MBF			
	BI/R/Hybrid Oak	Pulpwood	38.0	Cords			
	Jack Pine		65.0	Cords			
	Red Pine		38.0	Cords			
	White Pine		13.0	Cords			
	<i>White Pine</i>		13.0	<i>Cords</i>			
4	BI/R/Hybrid Oak	Sawtimber	8.4	MBF	24.4	\$5,191.05	
	Jack Pine		8.1	MBF			
	Red Pine		4.4	MBF			
	BI/R/Hybrid Oak	Pulpwood	44.0	Cords			
	Jack Pine		65.0	Cords			
	Red Pine		26.0	Cords			
	White Pine		18.0	Cords			
	<i>White Pine</i>		<i>Sawtimber</i>	0.5			<i>MBF</i>
	<i>White Pine</i>		<i>Pulpwood</i>	17.0			<i>Cords</i>
TOTAL:			144.0	MBF			
TOTAL:			981.0	Cords			

Sale Specific Conditions & Requirements

Sale Name: Louies Pine

Sale Number: 71-030-16 Seq#: 1

1 - Sale Area

1.2 - Boundaries

1.2.1 - Painted boundaries (1/14)

The sale boundary and Payment Unit boundaries are marked and identified by blue, red and yellow paint. Exterior sale boundary lines against private property are marked with blue paint. Exterior sale boundary lines against state are marked with red paint. Interior Payment Unit boundaries are marked with yellow paint. The painted boundary line trees are not Included Timber and are to be protected. Yellow painted trees designating an interior Payment Unit boundary are only to be cut when all surrounding Payment Units have been paid.

2 - Timber Specifications

2.1 - Included Timber

2.1.1 - Clearcut unit(s) with unmerchantable trees (6/14)

Within Payment Unit(s) #'s 1 and 2, cut all trees that are two (2) inches or more at DBH except trees marked with Green paint.

2.1.3 - Cut tree marked unit(s) (12/08)

Within Payment Unit(s) #'s 3 and 4, all trees are designated for cutting when marked with orange paint above and below stump height, regardless of merchantability. In addition, all jack pine is designated for cutting.

2.2 - Utilization

2.2.3 - Stump heights (4/07)

Stump heights within the Sale Area shall not exceed 12 inches for trees greater than 10 inches DBH and 4 inches for trees smaller than 10 inches DBH.

2.2.6 - Roundwood operation required (5/07)

The skidding of whole trees or tree segments with limbs attached is prohibited within Payment Unit(s) #'s 3 and 4. All products must be produced as roundwood and forwarded to existing roads or landing areas in final product length.

3 - Payments

3.3 - Pre-measured Sales

3.3.4 - Dividing payment units (7/14)

Payment Unit(s) may be divided at the request of the Purchaser and upon approval of the Unit Manager. Dividing Payment Units is a contract modification which requires a Timber Sale Contract Supplement.

3.4 - Damaged Timber

3.4.1 - Damaged timber (6/14)

General Condition and Requirement 3.4 Damaged Timber, defines liquidated damages for undesignated live merchantable trees which are cut or injured. In addition, extreme care should be taken to avoid damage to tree seedlings and saplings.

Within Payment Unit #'s 3 and 4, if more than 20% of the tree seedlings or saplings (1/4" to 4.5" DBH) within a specified portion of the sale area are damaged, liquidated damages will be assessed at \$300 per acre for all acreage within that specified portion of the sale area that was damaged.

No damage is acceptable to merchantable trees. Within the sale area, if more than 5% of trees (> 4.5" DBH) within a specified area of the sale are damaged, liquidated damages will be assessed for all trees damaged. Rates will be in accordance with General Condition and Requirement 3.4 Damaged Timber.

4 - Transportation

4.1 - Construction

4.1.3 - Slash and earthen piles (8/04)

Piles or windrows of earth along roads and landings that have been widened or constructed shall be leveled. Slash from road maintenance or construction, including stumps, shall be dispersed throughout the sale.

4.1.6 - Road construction (1/09)

Construction of new roads or improvements of existing roads shall be done in such a way as to minimize the environmental and visual impacts. Merchantable trees shall be cut and utilized unless otherwise directed. Non-merchantable trees shall be severed and laid flat on the ground. Slash shall be scattered, and not left in windrows and kept a minimum of 10 feet back from the road edge. Stumps shall be set upright, not left on edge, and be moved at least 10 feet away from the road edge. Disturbed soil shall be feathered into the woods and not left in berms or windrows.

4.1.7 - Road closure (10/11)

All new roads built into the sale must be blocked to vehicle traffic upon completion of the sale. In general, this will require constructing a four (4') foot high berm of stumps and logs covered with earth. Stumps and brush must be placed along the remainder of the trail. These roads must be rendered impassable to cars and trucks. Contact the sale administrator for specific details of design and placement.

4.2 - Maintenance

4.2.1 - Hauling restriction (12/08)

Hauling may be restricted on forest roads by the Unit Manager or his/her representative. The restriction may occur during wet weather conditions.

4.2.3 - Road maintenance (8/13)

The following road maintenance is required: Within 60 days of completion of hauling, or if no hauling occurs for 60 days, the road must be maintained and graded. This includes cleaning of drainage areas, grading, crowning and filling with gravel, if necessary. Damages will be assessed if grading/repair does not occur.

4.2.5 - Two wheel drive condition (2/04)

All existing trail roads on and adjacent to the sale area must be passable by two-wheel drive traffic for the duration of the sale.

5 - Operations

5.1 - Notification

5.1.1 - Pre-sale conference (10/16)

A pre-sale conference between the Purchaser and sale administrator is required prior to beginning any operations to determine landing and road locations.

5.1.4 - Post-sale conference (6/11)

A post-sale conference on site between the Purchaser and sale administrator is required prior to the completion of active logging operations to determine clean-up and repair of landings, road edges, and the fulfillment of other contract specifications.

5.2 - Conduct of Operations

5.2.1 - Slash

5.2.1.8 - Slash height (12/08)

No slash or tree tops may exceed 24 inches in height.

5.2.2 - Hazard Trees/Snags

5.2.2.1 - Den trees (2/04)

Obvious hollow and/or den trees shall be protected and left standing unless they are a safety hazard.

5.2.3 - Operating Restrictions

5.2.3.3 - Bark slippage restriction (3/09)

Within Payment Unit(s) #'s 3 and 4, cutting and skidding are not permitted during the period of April 15 to July 15. This restriction is because of bark slippage.

5.2.30 - Landing/road top soil protection (2/15)

Top soil on landings and new roads must be removed, stockpiled and saved. Upon completion of the timber sale, soil must be evenly distributed back over the area for revegetation.

5.2.39 - ORV trail/route protection (12/12)

The ORV trail is shown on the Timber Sale Map. Do not cut trees or damage posts with orange ORV markers. Trees with orange ORV markers shall be cut off above the markers and at least 5 feet above ground. All stumps within 5 feet of the trail must be cut flush with the ground. Maintain a 20 foot wide slash, debris, and rut free zone daily using the ORV trail or route as the centerline. Do not run equipment down the ORV trail or route. Skidding across the trail or route may only occur in locations approved by the sale administrator.

6 - Safety and Fire Prevention

6.2 - Signing

6.2.3 - Recreational trail posting (2/10)

The Purchaser is responsible for posting and maintaining caution signs on the ORV trail prior to beginning operations. The trail must be posted at appropriate distances from the sale area to warn of logging activity and truck traffic at both ends of the trail. Signs must be removed when harvest operations are suspended or completed. The Purchaser will provide these signs.



TIMBER SALE MAP

This information provided by authority of Part 525, 1994 PA 451, as amended.

Sale Number	Year
71 - 030	16

Forest Management Unit	County	Mapped By	LEWICKI	Date	Page	of
Roscommon Management Unit	Roscommon Name	Cruised By	LEWICKI	09/28/2016	1	1
Township	Range	Section(s) and Subdivision(s)	Scale			
23N	01W	S.34 NW: NE	1:15,840			

Cover Type				Density			
A = Aspen	H = Hemlock	N = Marsh	U = Upland Brush	0 = Non Stocked	5 = Pole Timber Medium		
B = Paper Birch	J = Jack Pine	O = Oak	UM = Upland Mixed	1 = Seedling Sapling Poor	6 = Pole Timber Well		
C = Cedar	L = Lowland Brush	P = Lowland Poplar	V = Bog or Marsh	2 = Seedling Sapling Medium	7 = Saw Timber Poor		
D = Tread Bog	LM = Lowland Mixed	Q = Mixed Swamp Conifer	W = White Pine	3 = Seedling Sapling Well	8 = Saw Timber Medium		
E = Swamp Hdwoods	M = Mpl, Bch, Brch	R = Red Pine	X = Non Stocked	4 = Pole Timber Poor	9 = Saw Timber Well		
F = Spruce Fir	MC = Mixed Conifer	S = Black Spruce	Z = Water				
G = Grass	MD = Mixed Deciduous	T = Tamarack					

PU	Acres	PU	Acres
1	38.6	4	24.4
2	15.3		
3	17.5		

LOUIES PINE

Compartment 91

95.8 Acres

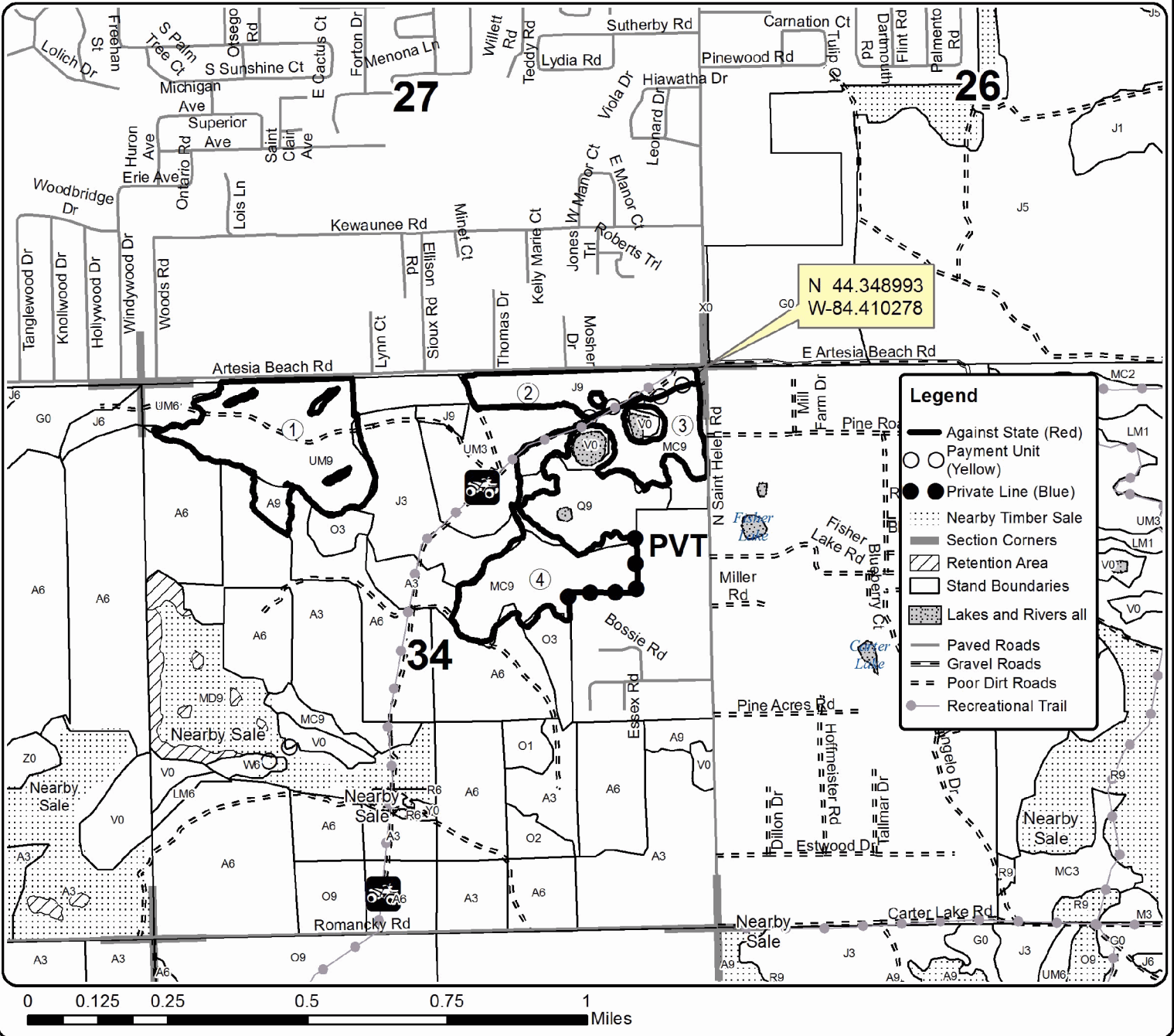
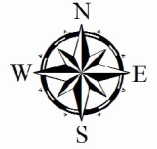

Knoch Road Aspen-Jack (71-007-16)
 ; Ogemaw COUNTY

In response to the notice of sale to be held 11:00 a.m. (local time) on January 24, 2017, I am hereby submitting my sealed bid (firm offer) for the following forest products to be cut. Bids for individual species must be at or above the advertised price. All non-responsive bid forms may be rejected.

<u>PRODUCTS & SPECIES</u>	<u>ESTIMATED VOLUME*</u>	<u>ADVERTISED PRICE</u>	<u>BID PRICE</u>
Sawtimber			
BI/R/Hybrid Oak	17.30 MBF	\$ 114.00/MBF	\$ _____
Quaking Aspen	800.10 MBF	\$ 81.00/MBF	\$ _____
Red Maple	62.10 MBF	\$ 43.00/MBF	\$ _____
Red Pine	74.20 MBF	\$ 152.00/MBF	\$ _____
Pulpwood			
BI/R/Hybrid Oak	131.00 Cords	\$ 14.60/Cord	\$ _____
Jack Pine	710.00 Cords	\$ 16.15/Cord	\$ _____
Mixed Hardwood	47.00 Cords	\$ 18.95/Cord	\$ _____
Quaking Aspen	2,484.00 Cords	\$ 37.95/Cord	\$ _____
Red Maple	409.00 Cords	\$ 18.95/Cord	\$ _____
Red Pine	108.00 Cords	\$ 48.55/Cord	\$ _____
White Pine	3.00 Cords	\$ 18.60/Cord	\$ _____

*The volumes are statistically estimated within plus (+) or minus (-) 8.19 percent. These estimated volumes are final and not subject to adjustment. Prospective bidders are urged to examine this timber and to make their own estimates of quantity and quality.

I understand that any or all bids may be rejected. All bids must be signed and all bid items must be bid or the bid form may be rejected. I also understand that consideration and awarding a contract will be based upon my past performance and ability to complete the contract based upon equipment and staffing subject to my control.

FEDERAL ID: _____ or SOCIAL SECURITY NUMBER: _____

Company or individual bidding: _____

Company representative's name: _____

Address: _____

City: _____ State: _____ Zip: _____

IF AVAILABLE, PLEASE PLACE THE PERSONALIZED LABEL FROM YOUR PROSPECTUS IN THE ABOVE BOX.

Individual or company representative's signature: _____ Date: _____

Phone number : _____ Email (optional): _____

THE WINNING BIDDER MUST COMPLETE THE VERIFICATION OF WORKER'S DISABILITY COMPENSATION ACT COMPLIANCE (ON REVERSE SIDE IF DOUBLE SIDED) WITHIN 21 DAYS OF SALE AWARD DATE



FOR DEPARTMENT USE ONLY	
Sale Number (XX - XXX - XX - XX)	
Forest Management Unit:	

TIMBER SALE VERIFICATION OF WORKER'S DISABILITY COMPENSATION ACT COMPLIANCE

As required by Act 317, P.A. 1969 (Worker's Compensation) and
Part 5 of Act 451 of 1994, as amended.

VERIFICATION OF WORKER'S DISABILITY COMPENSATION ACT COMPLIANCE

- This verification must be completed and submitted within 21 days of contract award and prior to the issuance of the timber sale contract.
- In addition, if boxes 2B or 2C are checked, then Notice of Exclusion or Certificate of Insurance must be submitted within twenty-one (21) days of the contract award and prior to the issuance of the timber sale contract.
- All information must be typed or printed except for written signatures.

Please Check Appropriate Categories:

1. My business is organized as (you **must** check one of the boxes below):
 - A. Sole Proprietorship (individual)
 - B. Partnership
 - C. Corporation
2. You **must** check one of the boxes below:
 - A. I certify my business is a sole proprietorship and it has no employees but the sole proprietor. I am not subject to the Worker's Compensation Laws.
 - B. I certify my business has satisfied its obligation to the Worker's Compensation Act through the use of an approved Notice of Exclusion (BWC-337, Rev. 5/96). I will provide a copy of the Notice of Exclusion within 21 days of the contract award. (For questions or a copy of the BWC-337, please call the Worker's Compensation Bureau at 517-322-1195).
 - C. I certify my business has a Worker's Compensation Policy. I will provide an original Certificate of Insurance within twenty-one (21) days of the contract award.
3. If you have checked item 2(A) or 2(B), you **must** indicate the number of **both** full-time and part-time employees, other than yourself, including family members and active partners (if none, you must enter "0").

_____ Full-time Employees

_____ Part-time Employees

Name of Business		Federal ID (or) Social Security No.	
Address		Telephone ()	
City	State	ZIP	

I hereby certify that the above information is true and correct. I agree to notify the Michigan DNR of any changes that occur in factors affecting my coverage during any of my present and future operations.

Signature of Owner or Authorized Representative

Title

Date

Please complete the "SEALED BID" information on the next page

Neighborhood Mix (71-020-16)
 ; Roscommon COUNTY

In response to the notice of sale to be held 11:00 a.m. (local time) on January 24, 2017, I am hereby submitting my sealed bid (firm offer) for the following forest products to be cut. Bids for individual species must be at or above the advertised price. All non-responsive bid forms may be rejected.

<u>PRODUCTS & SPECIES</u>	<u>ESTIMATED VOLUME*</u>	<u>ADVERTISED PRICE</u>	<u>BID PRICE</u>
Sawtimber			
Mixed Aspen	16.90 MBF	\$ 80.00/MBF	\$ _____
Mixed Oak	54.70 MBF	\$ 111.00/MBF	\$ _____
Red Maple	14.70 MBF	\$ 42.00/MBF	\$ _____
Red Oak	117.50 MBF	\$ 192.00/MBF	\$ _____
Red Pine	108.10 MBF	\$ 148.00/MBF	\$ _____
White Pine	31.80 MBF	\$ 213.00/MBF	\$ _____
Pulpwood			
B. T. Aspen	376.00 Cords	\$ 35.35/Cord	\$ _____
Bl/R/Hybrid Oak	195.00 Cords	\$ 14.20/Cord	\$ _____
Jack Pine	204.00 Cords	\$ 15.75/Cord	\$ _____
Mixed Oak	158.00 Cords	\$ 14.20/Cord	\$ _____
Quaking Aspen	283.00 Cords	\$ 35.35/Cord	\$ _____
Red Maple	206.00 Cords	\$ 18.45/Cord	\$ _____
Red Oak	257.00 Cords	\$ 14.20/Cord	\$ _____
Red Pine	185.00 Cords	\$ 47.25/Cord	\$ _____
White Pine	142.00 Cords	\$ 18.10/Cord	\$ _____

*The volumes are statistically estimated within plus (+) or minus (-) 7.95 percent. These estimated volumes are final and not subject to adjustment. Prospective bidders are urged to examine this timber and to make their own estimates of quantity and quality.

I understand that any or all bids may be rejected. All bids must be signed and all bid items must be bid or the bid form may be rejected. I also understand that consideration and awarding a contract will be based upon my past performance and ability to complete the contract based upon equipment and staffing subject to my control.

FEDERAL ID: _____ or SOCIAL SECURITY NUMBER: _____

Company or individual bidding: _____

Company representative's name: _____

Address: _____

City: _____ State: _____ Zip: _____

IF AVAILABLE, PLEASE PLACE THE PERSONALIZED LABEL FROM YOUR PROSPECTUS IN THE ABOVE BOX.

Individual or company representative's signature: _____ Date: _____

Phone number : _____ Email (optional): _____

THE WINNING BIDDER MUST COMPLETE THE VERIFICATION OF WORKER'S DISABILITY COMPENSATION ACT COMPLIANCE (ON REVERSE SIDE IF DOUBLE SIDED) WITHIN 21 DAYS OF SALE AWARD DATE



FOR DEPARTMENT USE ONLY
Sale Number (XX - XXX - XX - XX)
Forest Management Unit:

TIMBER SALE VERIFICATION OF WORKER'S DISABILITY COMPENSATION ACT COMPLIANCE

*As required by Act 317, P.A. 1969 (Worker's Compensation) and
Part 5 of Act 451 of 1994, as amended.*

VERIFICATION OF WORKER'S DISABILITY COMPENSATION ACT COMPLIANCE

- This verification must be completed and submitted within 21 days of contract award and prior to the issuance of the timber sale contract.
- In addition, if boxes 2B or 2C are checked, then Notice of Exclusion or Certificate of Insurance must be submitted within twenty-one (21) days of the contract award and prior to the issuance of the timber sale contract.
- All information must be typed or printed except for written signatures.

Please Check Appropriate Categories:

1. My business is organized as (you **must** check one of the boxes below):
 - A. Sole Proprietorship (individual)
 - B. Partnership
 - C. Corporation
2. You **must** check one of the boxes below:
 - A. I certify my business is a sole proprietorship and it has no employees but the sole proprietor. I am not subject to the Worker's Compensation Laws.
 - B. I certify my business has satisfied its obligation to the Worker's Compensation Act through the use of an approved Notice of Exclusion (BWC-337, Rev. 5/96). I will provide a copy of the Notice of Exclusion within 21 days of the contract award. (For questions or a copy of the BWC-337, please call the Worker's Compensation Bureau at 517-322-1195).
 - C. I certify my business has a Worker's Compensation Policy. I will provide an original Certificate of Insurance within twenty-one (21) days of the contract award.
3. If you have checked item 2(A) or 2(B), you **must** indicate the number of **both** full-time and part-time employees, other than yourself, including family members and active partners (if none, you must enter "0").

_____ Full-time Employees

_____ Part-time Employees

Name of Business		Federal ID (or) Social Security No.	
Address		Telephone ()	
City	State	ZIP	

I hereby certify that the above information is true and correct. I agree to notify the Michigan DNR of any changes that occur in factors affecting my coverage during any of my present and future operations.

Signature of Owner or Authorized Representative

Title

Date

Please complete the "SEALED BID" information on the next page

Louies Pine (71-030-16)
 ; Roscommon COUNTY

In response to the notice of sale to be held 11:00 a.m. (local time) on January 24, 2017, I am hereby submitting my sealed bid (firm offer) for the following forest products to be cut. Bids for individual species must be at or above the advertised price. All non-responsive bid forms may be rejected.

<u>PRODUCTS & SPECIES</u>	<u>ESTIMATED VOLUME*</u>	<u>ADVERTISED PRICE</u>	<u>BID PRICE</u>
Sawtimber			
B. T. Aspen	18.00 MBF	\$ 83.00/MBF	\$ _____
Bl/R/Hybrid Oak	53.00 MBF	\$ 114.00/MBF	\$ _____
Jack Pine	58.40 MBF	\$ 34.00/MBF	\$ _____
Red Pine	14.60 MBF	\$ 152.00/MBF	\$ _____
Pulpwood			
B. T. Aspen	51.00 Cords	\$ 36.35/Cord	\$ _____
Bl/R/Hybrid Oak	280.00 Cords	\$ 14.60/Cord	\$ _____
Jack Pine	497.00 Cords	\$ 16.15/Cord	\$ _____
Red Pine	122.00 Cords	\$ 48.55/Cord	\$ _____
White Pine	31.00 Cords	\$ 18.60/Cord	\$ _____

*The volumes are statistically estimated within plus (+) or minus (-) 12.11 percent. These estimated volumes are final and not subject to adjustment. Prospective bidders are urged to examine this timber and to make their own estimates of quantity and quality.

I understand that any or all bids may be rejected. All bids must be signed and all bid items must be bid or the bid form may be rejected. I also understand that consideration and awarding a contract will be based upon my past performance and ability to complete the contract based upon equipment and staffing subject to my control.

FEDERAL ID: ____ - ____ - ____ or SOCIAL SECURITY NUMBER: ____ - ____ - ____

Company or individual bidding: _____

Company representative's name: _____

Address: _____

City: _____ State: _____ Zip: _____

IF AVAILABLE, PLEASE PLACE THE PERSONALIZED LABEL FROM YOUR PROSPECTUS IN THE ABOVE BOX.

Individual or company representative's signature: _____ Date: _____

Phone number : _____ Email (optional): _____

THE WINNING BIDDER MUST COMPLETE THE VERIFICATION OF WORKER'S DISABILITY COMPENSATION ACT COMPLIANCE (ON REVERSE SIDE IF DOUBLE SIDED) WITHIN 21 DAYS OF SALE AWARD DATE



FOR DEPARTMENT USE ONLY	
Sale Number (XX - XXX - XX - XX)	
Forest Management Unit:	

TIMBER SALE VERIFICATION OF WORKER'S DISABILITY COMPENSATION ACT COMPLIANCE

As required by Act 317, P.A. 1969 (Worker's Compensation) and
Part 5 of Act 451 of 1994, as amended.

VERIFICATION OF WORKER'S DISABILITY COMPENSATION ACT COMPLIANCE

- This verification must be completed and submitted within 21 days of contract award and prior to the issuance of the timber sale contract.
- In addition, if boxes 2B or 2C are checked, then Notice of Exclusion or Certificate of Insurance must be submitted within twenty-one (21) days of the contract award and prior to the issuance of the timber sale contract.
- All information must be typed or printed except for written signatures.

Please Check Appropriate Categories:

1. My business is organized as (you **must** check one of the boxes below):
 - A. Sole Proprietorship (individual)
 - B. Partnership
 - C. Corporation
2. You **must** check one of the boxes below:
 - A. I certify my business is a sole proprietorship and it has no employees but the sole proprietor. I am not subject to the Worker's Compensation Laws.
 - B. I certify my business has satisfied its obligation to the Worker's Compensation Act through the use of an approved Notice of Exclusion (BWC-337, Rev. 5/96). I will provide a copy of the Notice of Exclusion within 21 days of the contract award. (For questions or a copy of the BWC-337, please call the Worker's Compensation Bureau at 517-322-1195).
 - C. I certify my business has a Worker's Compensation Policy. I will provide an original Certificate of Insurance within twenty-one (21) days of the contract award.
3. If you have checked item 2(A) or 2(B), you **must** indicate the number of **both** full-time and part-time employees, other than yourself, including family members and active partners (if none, you must enter "0").

_____ Full-time Employees

_____ Part-time Employees

Name of Business		Federal ID (or) Social Security No.	
Address		Telephone ()	
City	State	ZIP	

I hereby certify that the above information is true and correct. I agree to notify the Michigan DNR of any changes that occur in factors affecting my coverage during any of my present and future operations.

Signature of Owner or Authorized Representative

Title

Date

Please complete the "SEALED BID" information on the next page