



**DEPARTMENT OF NATURAL RESOURCES
STATE OF MICHIGAN**

TIMBER SALE PROSPECTUS #5725

SCHEDULED SALE DATE AND TIME: 4:00 p.m. (local time) on October 3, 2016.

LOCATION: KALKASKA FIELD OFFICE, 2089 N BIRCH ST, KALKASKA, MI 49646.

PROSPECTUS NOTE: The bidder is advised to inspect the sale area and review the location, estimated volumes, operating costs and contract terms of proposed sales. Please be aware that some landowners may request 60 days or more notice for access across their land.

Notice is hereby given that bids will be received by the Unit Manager, TRAVERSE CITY MANAGEMENT UNIT, for certain timber on the following described lands:

No Red Pine Left Behind (61-133-16)

Kalkaska County, Advertised Price \$174,695.70, 100.5 Acres, Hardwood, Red Pine.

SALE NOTE: Note that some units of this sale must be chip harvested to facilitate future planting operations.

A recreation site such as a trail, pathway, or campground is within the sale area or the vicinity. Certain restrictions/specifications may be applicable including time restrictions.

Bruin Pond RP (61-134-16)

Kalkaska County, Advertised Price \$56,807.20, 86.8 Acres, Red Pine, White Pine.

SALE NOTE: A recreation site such as a trail, pathway, or campground is within the sale area or the vicinity. Certain restrictions/specifications may be applicable including time restrictions.

Culicidae Pine (61-141-16)

Kalkaska County, Advertised Price \$149,976.60, 127.1 Acres, Red Pine, White Pine.

Honeymoon Cabin Mix (61-147-16)

Kalkaska County, Advertised Price \$39,370.80, 42.8 Acres, Red Pine, White Pine.

SALE NOTE: This sale must be cut during frozen winter conditions, due to poor condition of the seasonal county road and wet areas within the sale.

Obata Oak (61-152-16)

Kalkaska County, Advertised Price \$108,138.80, 54.5 Acres, Hardwood, Red Oak.

BID INSTRUCTIONS (VER. 09/02/2016):

1. Scheduled Bid Location, Date, and Time (2/11)

Bids must be received by the Unit Manager, KALKASKA OFFICE, 2089 N BIRCH ST, KALKASKA, MI 49646, no later than 4:00 p.m. (local time) on October 3, 2016. For further information concerning this sale, contact David Lemmien at 231-922-5280 extension 6840.

2. Bidder's Qualifications (5/16)

Purchaser shall obtain workers compensation insurance to cover claims under Michigan's Worker's Disability Compensation Act of 1969 or similar employee benefit act of any other state applicable to an employee. If all or part of a timber sale was prepared by a private contractor, the contractor and that contractor's company are not permitted to bid on the timber sale contract. Bids will not be accepted from individuals or companies appearing on the DNR/FRD No-Bid List. This list contains the names of purchasers who previously failed to execute a contract within 21-days or who have a history of poor performance.

3. Preparation of Sealed Bids (5/16)

Bid Forms may be completed online thru Michigan DNR Timber Sale Online Bidding (OLB) at www.michigan.gov/timberbidding or by completing the hardcopy Bid Form found in the Timber Sale Prospectus. Hardcopy Bid Forms shall be manually signed in ink. Registration in OLB is considered your 'signature' for all bids submitted thru that system. Bid prices must be entered for each species and product in the Bid Price column for all material subject to bidding and all fill-in blanks must be completed. If erasures or other changes appear on the hardcopy Bid Form, each erasure or change must be initialed by the person signing the bid.

4. Submission of Sealed Bids (5/16)

Bid forms may be obtained from the Unit Manager or thru OLB. Bids may be submitted hardcopy or thru OLB. All hardcopy bids must be submitted on the bid form and in an envelope clearly identified as described in this section. NOTE: Only one bid form per bid envelope. Sealed bids must be submitted to the Unit office designated in the prospectus and must be submitted at or prior to the time established in the prospectus. The envelope should show on the outside (a) the sale name or number and (b) the date and time of bid opening, as shown in the prospectus. Bids received after the time specified in the sale prospectus are late bids and will be rejected.

It is possible for a bidder to submit multiple bids on a single sale. For example, a bid may be submitted hardcopy and a bid may be submitted thru OLB. Or, two bidders from the same company could both submit bids on the same sale. If this were to happen, the State would accept all bids received and award the contract accordingly. All bidding and contractual requirements would apply to all bids received.

5. Public Opening of Sealed Bids (7/16)

If conditions permit, the sealed bids will be publicly opened and posted at the time and place set in the prospectus.

If a bidder, present at a bid opening, has submitted bids on more than one sale, that bidder may withdraw their unopened bid envelopes or announce the withdrawal of their online bid after being declared the successful bidder on one sale.

6. Award of Contract (1/11)

Award of the contract will be made to the Bidder whose bid, conforming to the prospectus, is most advantageous to the State of Michigan on the basis of total value at rates bid for the estimated quantities. The State reserves the right to reject any bid or waive any minor irregularity in bids received. A written award mailed (or otherwise furnished) to the successful Bidder shall be deemed to result in a binding contract without further action by either party.

7. Down Payment (1/11)

The Bidder to whom award is made must make a down payment within 21 days of the sale award. The amount of the down payment will be calculated as shown in the Bond and Payment Schedule of this prospectus. Only cash may be used to meet this requirement.

8. Performance Security (1/11)

As guarantee of faithful performance, a cash bond, certificate of deposit, surety bond or irrevocable letter of credit (LOC) is required within 21 days of the sale award. The amount of the performance security is shown in the Bond and

Payment Schedule of this prospectus. If an LOC or surety is used, the coverage must extend for at least 6 months beyond the contract expiration.

9. Timber Sale Contract (9/14)

Additional conditions and requirements common to all timber sales are listed on the timber sale contract (R4031) and are available on line at www.michigan.gov/timber. Contact the Unit Manager for additional information or a sample contract. Within 21 days of the date of the award letter, the bidder must sign the contract and provide the required down payment, performance security, and verification of worker's disability compensation. The down payment and performance security shall be in accordance with the provisions of the timber sale contract, in the sums stated in this prospectus. If these actions are not taken, then the Bidder, the Bidder's corporation, and the corporation's principals may not be permitted to bid on State timber sales for a period of 1 year. In addition, the Bidder certifies that if awarded this contract, the Bidder will complete the timber sale contract in accordance with its terms and any modifications thereof including requirements to purchase, cut, and remove the included timber by the expiration date.

10. Disclaimer of Estimates and Bidder's Warranty of Inspection (7/16)

Before submitting this bid, the Bidder is advised and cautioned to inspect the sale area, review the requirements of the sale contract, and take other steps as may be reasonably necessary to ascertain the location, estimated volumes, construction estimates, and operating costs of the proposed sale. Failure to do so will not relieve the Bidder from responsibility for completing the contract.

The Bidder warrants that this bid is submitted solely on the basis of the Bidder's examination and inspection of the quality and quantity of the timber offered for sale and the Bidder's opinion of the value thereof and the costs of recovery. No reliance should be placed on the State of Michigan's estimates of timber quality, quantity or costs of recovery. Bidder further acknowledges that the State of Michigan: (i) expressly disclaims any warranty of fitness of timber for any purpose; (ii) offers this timber as is without any warranty of quality (merchantability) or quantity and (iii) expressly disclaims any warranty as to the quantity or quality of timber sold.

11. Certification and Chain-of-Custody (10/14)

Unless otherwise indicated in the contract under section 7 – Other Conditions of the Sale Specific Conditions & Requirements, the area encompassed by this timber sale is certified to the standards of the Forest Stewardship Council (FSC) - Certificate #SCS-FM/COC-00090N and the Sustainable Forestry Initiative (SFI) - Certificate # NSF-SFIS-5Y031-SF5. Forest products from this sale may be delivered to the mill as "FSC 100% and / or SFI certified" as long as the contractor hauling the forest products is chain-of-custody (COC) certified or covered under a COC certificate from the destination mill. The purchaser is responsible for maintaining COC after leaving the sale area.

12. Good Neighbor Authority (GNA) Requirements (7/16)

If the name of this timber sales contains the acronym GNA, it is authorized by the Good Neighbor Authority (GNA) and covered by various agreements between the U.S. Forest Service and the State. The timber sale occurs on federal land and the following conditions apply:

GNA contracts on US Forest Service land will not be awarded to purchasers on the Federal list of excluded parties. The System for Award Management (SAM) will be checked for active excluded parties prior to award of contract. In addition, the Bidder to whom award is made must complete an Assurance Regarding Felony Conviction or Tax Delinquent Status for Corporate Applicants (AD-3031).

13. Good Neighbor Authority (GNA) Requirements, con't (9/16)

Bidder certifies, by signing this bid form, that to the best of Bidder's knowledge that the following representations are accurate and complete.

- a. That the Bidder and its principals are not presently debarred, suspended, proposed for debarment, declared ineligible, or voluntary excluded from timber sales (covered transactions) by any Federal department or agency.
- b. That the Bidder and its principals have not within a 3-year period preceding this bid been convicted of or had a civil judgment rendered against them for commission of fraud or a criminal offense in connection with obtaining, attempting to obtain, or performing a public (Federal, State, or local) transaction or contract under a public transaction; violation of Federal or State antitrust statutes or commission of embezzlement, theft, forgery, bribery, falsification or destruction of records, making false statements, or receiving stolen property.

c. That the Bidder and its principals are not presently indicted for or otherwise criminally or civilly charged by a governmental entity (Federal, State, or local) with commission of any of the offenses enumerated in paragraph b of this certification.

d. That the Bidder and its principals have not within a 3-year period preceding this bid had one or more public transactions (Federal, State, or local) terminated for breach or default of a timber or forest product contract.

Bidders that cannot certify this requirement, in whole or in part, shall submit an explanation with their bid.

KEITH CREAGH

Director

TIMBER SALE INFORMATION

No Red Pine Left Behind (61-133-16)

Kalkaska County (Advertised Price \$174,695.70)

SALE NOTE: Note that some units of this sale must be chip harvested to facilitate future planting operations.

A recreation site such as a trail, pathway, or campground is within the sale area or the vicinity. Certain restrictions/specifications may be applicable including time restrictions.

A timber sale contract for this lump sum, sealed bid timber sale will be awarded to the responsible bidder offering the highest sealed bid price. Bids must be at or above the following advertised price for each species:

<u>PRODUCTS & SPECIES</u>	<u>ESTIMATED UNITS*</u>	<u>ADVERTISED PRICE</u>
Sawtimber		
Mixed Aspen	9.70 MBF	\$ 113.00 / MBF
Red Maple	40.90 MBF	\$ 180.00 / MBF
Red Pine	830.20 MBF	\$ 142.00 / MBF
White Pine	67.10 MBF	\$ 98.00 / MBF
Pulpwood		
Beech	136.00 Cords	\$ 22.65 / Cord
Jack Pine	18.00 Cords	\$ 12.85 / Cord
Mixed Aspen	151.00 Cords	\$ 24.25 / Cord
Mixed Hardwood	353.00 Cords	\$ 22.65 / Cord
Red Pine	494.00 Cords	\$ 47.75 / Cord
White Pine	160.00 Cords	\$ 20.10 / Cord

* The total volume is statistically estimated within plus (+) or minus (-) 10.10 percent. The estimated units are final and not subject to adjustment. Prospective bidders are urged to examine this timber and to make their own estimates of quantity and quality.

BOND AND PAYMENT SCHEDULE:

1. A bond in the amount of \$8,735.00 to insure faithful performance of the conditions of the contract will be deposited by the successful bidder within 21 days of the sale award.
2. Cutting in any sale or unit without the required advance payment would be considered a trespass.
3. Total payment must be paid in advance or according to the following schedule:
 - (a) Ten percent (10%) of the sale value must be paid within 21 days of the sale award.
 - (b) The 10% down payment will be credited towards the first unit cut.
4. If no cutting takes place, the 10% down payment will not be refunded.
5. Operations on the contract issued will terminate on 12/31/2018.

Description of Timber by Payment Unit (PU)

PU	MARKET GROUP	PRODUCT	QUANTITY	UNIT	ACRES	ADVERTISE PRICE		
1	Mixed Aspen	Sawtimber	9.7	MBF	13.0	\$17,332.55		
	<i>B. T. Aspen</i>		3.6	<i>MBF</i>				
	<i>Quaking Aspen</i>		6.1	<i>MBF</i>				
	Red Maple		11.2	MBF				
	Red Pine		47.7	MBF				
	White Pine		15.2	MBF				
	Jack Pine		Pulpwood	2.0			Cords	
	Mixed Aspen			78.0			Cords	
	<i>B. T. Aspen</i>			27.0			<i>Cords</i>	
	<i>Quaking Aspen</i>			51.0			<i>Cords</i>	
	Mixed Hardwood	60.0		Cords				
	<i>Black Cherry</i>	Sawtimber		0.7			<i>MBF</i>	
	<i>Red Oak</i>			0.4			<i>MBF</i>	
	<i>Black Cherry</i>			Pulpwood			2.0	<i>Cords</i>
	<i>Red Maple</i>						51.0	<i>Cords</i>
	<i>Red Oak</i>						4.0	<i>Cords</i>
	<i>Sugar Maple</i>	1.0	<i>Cords</i>					
	Red Pine		33.0	Cords				
	White Pine		55.0	Cords				
	2	Red Pine	Sawtimber	169.5			MBF	15.8
White Pine		1.5		MBF				
Jack Pine		Pulpwood	6.0	Cords				
Mixed Aspen			4.0	Cords				
<i>B. T. Aspen</i>			4.0	<i>Cords</i>				
Red Pine			107.0	Cords				
White Pine			9.0	Cords				
3	Red Maple	Sawtimber	14.9	MBF	14.2	\$10,852.40		
	Red Pine		5.1	MBF				
	White Pine		1.0	MBF				
	Beech	Pulpwood	115.0	Cords				
	Mixed Aspen		41.0	Cords				
	<i>Quaking Aspen</i>		41.0	<i>Cords</i>				
	Mixed Hardwood		146.0	Cords				
	<i>Red Maple</i>		143.0	<i>Cords</i>				
	<i>Red Oak</i>		3.0	<i>Cords</i>				
	Red Pine		8.0	Cords				
	White Pine		3.0	Cords				
4	Red Pine	Sawtimber	295.8	MBF	16.8	\$48,947.55		
	Mixed Hardwood	Pulpwood	3.0	Cords				
	<i>Red Maple</i>		3.0	<i>Cords</i>				
	Red Pine		144.0	Cords				
5	Red Maple	Sawtimber	13.4	MBF	21.7	\$35,509.55		
	Red Pine		131.5	MBF				
	White Pine		48.9	MBF				
	Beech	Pulpwood	21.0	Cords				
	Jack Pine		2.0	Cords				
	Mixed Aspen		18.0	Cords				
	<i>Quaking Aspen</i>		18.0	<i>Cords</i>				
	Mixed Hardwood		141.0	Cords				
	<i>Red Maple</i>		133.0	<i>Cords</i>				
	<i>Red Oak</i>		1.0	<i>Cords</i>				
	<i>Sugar Maple</i>		7.0	<i>Cords</i>				
	Red Pine		79.0	Cords				
	White Pine		86.0	Cords				
6	Red Maple	Sawtimber	1.4	MBF	19.0	\$32,373.40		
	Red Pine		180.6	MBF				

Description of Timber by Payment Unit (PU), con't

PU	MARKET GROUP	PRODUCT	QUANTITY	UNIT	ACRES	ADVERTISE PRICE
6 con't	White Pine	Sawtimber	0.5	MBF		
	Jack Pine	Pulpwood	8.0	Cords		
	Mixed Aspen		10.0	Cords		
	<i>Quaking Aspen</i>		10.0	<i>Cords</i>		
	Mixed Hardwood		3.0	Cords		
	<i>Red Maple</i>		3.0	<i>Cords</i>		
	Red Pine		123.0	Cords		
	White Pine		7.0	Cords		
TOTAL:			958.7	MBF		
TOTAL:			1,814.0	Cords		

Sale Specific Conditions & Requirements

Sale Name: No Red Pine Left Behind

Sale Number: 61-133-16 Seq#: 1

1 - Sale Area

1.2 - Boundaries

1.2.1 - Painted boundaries (1/14)

The sale boundary and Payment Unit boundaries are marked and identified by red and yellow paint. Exterior sale boundary lines against state are marked with red paint. Interior Payment Unit boundaries are marked with yellow paint. Yellow painted trees designating an interior Payment Unit boundary may be cut when all surrounding Payment Units have been paid and they are designated for removal.

2 - Timber Specifications

2.1 - Included Timber

2.1.1 - Clearcut unit(s) with unmerchantable trees (6/14)

Within Payment Unit(s) 2, 4a, 4b, 4c, 4d, and 6, cut all trees that are two (2) inches or more at DBH.

2.1.7 - Leave tree marked unit(s) (6/14)

Within Payment Unit(s) 1, 3, and 5, all trees which meet minimum piece specifications in 2.2 Utilization are designated for cutting except trees marked with green paint above and below stump height. Also, leave all white pine less than 4" DBH.

2.1.11 - Description of timber note (2/04)

Note that Mixed Hardwood Pulpwood includes mostly red maple pulpwood plus 0.7 mbf and 2 cords black cherry, 0.4 mbf and 8 cords red oak, and 8 cords sugar maple.

2.2 - Utilization

2.2.2 - Chipping required (5/14)

Payment Units 2, 4a, 4b, 4c, 4d, and 6 must be chip harvested to facilitate subsequent planting operations. The Purchaser has the option to produce sawlogs or pulpwood bolts, but the remaining portion of the trees must be chipped and hauled. Do not chip 1/6 to 1/3 of the slash from harvested trees (tree tops and limbs less than four inches in diameter).

2.2.3 - Stump heights (4/07)

Stump heights within Payment Units 2, 4a, 4b, 4c, 4d, and 6 shall not exceed 8 inches for trees greater than 10 inches DBH and 4 inches for trees smaller than 10 inches DBH. This is in order to facilitate planting operations.

3 - Payments

3.3 - Pre-measured Sales

3.3.4 - Dividing payment units (7/14)

Payment Unit(s) greater than \$15,000 may be divided at the request of the Purchaser and upon approval of the Unit Manager. Dividing Payment Units is a contract modification which requires a Timber Sale Contract Supplement. There will be only one division per Payment Unit.

3.4 - Damaged Timber

3.4.1 - Damaged timber (6/14)

General Condition and Requirement 3.4 Damaged Timber, defines liquidated damages for undesignated live merchantable trees which are cut or injured. In addition, extreme care should be taken to avoid damage to tree seedlings and saplings.

Within Payment Units 1, 3, and 5, if more than 25% of the tree seedlings or saplings (1/4" to 4.5" DBH) within a specified portion of the sale area are damaged, liquidated damages will be assessed at \$300 per acre for all acreage within that specified portion of the sale area that was damaged.

4 - Transportation

4.1 - Construction

4.1.6 - Road construction (1/09)

Construction of new roads or improvements of existing roads shall be done in such a way as to minimize the environmental and visual impacts. Merchantable trees shall be cut and utilized unless otherwise directed. Non-merchantable trees shall be severed and laid flat on the ground. Slash shall be scattered, and not left in windrows and kept a minimum of 10 feet back from the road edge. Stumps shall be set upright, not left on edge, and be moved at least 10 feet away from the road edge. Disturbed soil shall be feathered into the woods and not left in berms or windrows.

4.1.7 - Road closure (10/11)

All new roads built into the sale must be blocked to vehicle traffic within 30 days of completion of hauling. Overgrown roads that are reopened shall be considered new roads. As noted on the Timber Sale Map, a berm will need to be replaced south of Payment Units 1 and 2. In general, this will require constructing a four (4') foot high berm of stumps and logs covered with earth. All stumps from road building and landing construction should be reserved to construct berms upon completion of the sale. Temporary berms may be required if no sale activity occurs for 30 or more consecutive days. Contact the sale administrator for specific details of design and placement.

4.1.11 - Permits (2/12)

The Purchaser will secure any necessary Kaskaska County Road Commission driveway permits that may be required.

5 - Operations

5.1 - Notification

5.1.1 - Pre-sale conference (10/11)

A pre-sale conference on site between the Purchaser and sale administrator is required prior to beginning any operations to determine landing and road locations. The sale administrator must be contacted at least 5 days in advance to schedule the conference.

5.1.4 - Post-sale conference (6/11)

A post-sale conference on site between the Purchaser and sale administrator is required 3 days prior to the completion of active logging operations to determine clean-up and repair of landings, road edges, and the fulfillment of other contract specifications.

5.2 - Conduct of Operations

5.2.1 - Slash

5.2.1.2 - Slash Removal

5.2.1.2.1 - Slash removal, right-of-way (12/04)

All slash must be removed at least 10 feet from the cleared right-of-way of forest roads.

5.2.1.8 - Slash height (12/08)

No slash or tree tops may exceed 24 inches in height.

5.2.2 - Hazard Trees/Snags

5.2.2.1 - Den trees (2/04)

Obvious hollow and/or den trees shall be protected and left standing unless they are a safety hazard.

5.2.3 - Operating Restrictions

5.2.3.6 - Bark beetle restriction (12/08)

In the event drought creates a high risk of pine bark beetle infestation, pine is not to be cut during the period March 1 through July 1, unless all portions of trees greater than two inches in diameter are removed from the sale area, reduced to chips, or treated to the satisfaction of the Unit Manager or his/her representative, within fifteen days of being severed from the stump. Pine log decks, pulpwood piles and treetops that are piled for chipping in the fall or winter within a 1/4 mile of susceptible sites must be removed before March 15. Residual slash must not be placed in piles or rows and must be spread over the site for quick drying. The Department of Natural Resources will exercise this specification if the risk of damage warrants.

5.2.29 - Shrub protection (9/07)

Do not cut or damage hawthorn, witch hazel, or juneberry within Payment Units 1, 3, or 5. These woody-shrub plants are

highly beneficial to various wildlife species. In areas where these shrubs are dense, some damage is inevitable but should be minimized.

5.2.32 - Decking/landing restoration (9/13)

All decking and landing areas must have the surface area restored to a condition equal to or better than before. This is to ensure the proper regeneration of the stand. Wood debris, chips and "cookies" from trimmings must be removed or scattered away from landing and loading areas and may not be windrowed on the edge.

5.2.38 - No decking against live trees (2/04)

Cut products may not be decked against unmarked or designated leave trees.

5.2.39 - ORV trail/route protection (12/12)

There is an ORV trail shown on the Timber Sale Map. Do not cut trees or damage posts with orange ORV markers. At the end of each day, all slash and debris must be removed from the trail and the area 10 feet on either side of it. Do not run equipment down the ORV trail. Skidding across the trail should be minimized and may only occur in locations approved by the sale administrator.

5.4 - Soil Protection

5.4.1 - Rutting restriction, general (7/16)

Operations are to cease immediately if equipment and weather conditions result in rutting of roads and/or skid trails which is 12 inches or greater in depth and 50 feet in length. The Unit Manager or his/her representative may restrict hauling and/or skidding if ruts exceed the specified depth. With the Unit Manager or his/her representative's approval, the Purchaser may return to the area when the risk of rutting has decreased.

5.4.2 - Skid trails (2/04)

Skid trails up and down slopes should be avoided. If however this is unavoidable, these trails will be left in a non-erodible condition using water bars, logs, and slash. Placing of slash on these skid trails while logging is ongoing may alleviate need for any further action. At the direction of the sale administrator, seed, fertilizer, and mulch may also be required.

6 - Safety and Fire Prevention

6.2 - Signing

6.2.1 - Road posting (9/09)

The Purchaser is responsible for posting and maintaining caution signs on haul roads prior to beginning operations. The road must be posted 200 feet from both ends of the sale area to warn of logging activity and truck traffic. Signs must be removed when harvest operations are suspended or completed. The Purchaser will provide these signs.

6.2.3 - Recreational trail posting (2/10)

The Purchaser is responsible for posting and maintaining caution signs on the ORV trail prior to beginning operations. The trail must be posted 200 feet from both ends of the sale area (i.e. south of Payment Units 1 and 2 and north of Payment Unit 4a) to warn of logging activity and truck traffic at both ends of the trail. Signs must be removed when harvest operations are suspended or completed. The Purchaser will provide these signs.

7 - Other Conditions

7.3 - Contract Modifications

7.3.3 - Modification for reforestation (8/05)

When contractual work of Purchaser has been accepted for any Payment Unit identified on Sale Area Map, Payment Unit will be eliminated from the Sale Area on written notice so that reforestation operations can begin.

7.5 - Loss

7.5.1 - Deteriorating timber (7/09)

The sale area has received damage from beech bark disease. The Purchaser should harvest the wood as soon as possible. The Department of Natural Resources is held free of responsibility of any further damage or deterioration due to delay in harvesting.



TIMBER SALE MAP

This information provided by authority of Part 525, 1994 PA 451, as amended.

Forest Management Unit Traverse City FMU		County Kalkaska	Mapped By Armstrong		Date 7/14/2016	Page 1	of 1
Township 27N	Range 5W	Section(s) and Subdivision(s) Sec. 22: NE1/4, SENW, SWNW, NESE, NWSE, SWSE, NESW, NWSW, SESW		Scale 1:15,840			

Cover Type				Density			
A = Aspen	H = Hemlock	N = Marsh	U = Upland Brush	0 = Non Stocked	5 = Pole Timber Medium		
B = Paper Birch	J = Jack Pine	O = Oak	UM = Upland Mixed	1 = Seedling Sapling Poor	6 = Pole Timber Well		
C = Cedar	L = Lowland Brush	P = Lowland Poplar	V = Bog or Marsh	2 = Seedling Sapling Medium	7 = Saw Timber Poor		
D = Treed Bog	LM = Lowland Mixed	Q = Mixed Swamp Conifer	W = White Pine	3 = Seedling Sapling Well	8 = Saw Timber Medium		
E = Swamp Hdwoods	M = Mpl, Bch, Brch	R = Red Pine	X = Non Stocked	4 = Pole Timber Poor	9 = Saw Timber Well		
F = Spruce Fir	MC = Mixed Conifer	S = Black Spruce	Z = Water				
G = Grass	MD = Mixed Deciduous	T = Tamarack					

P. Unit	Acres	P. Unit	Acres
1	13.0	4c	2.9
2	15.8	4d	4.1
3	14.2	5	21.7
4a	8.1	6	19.0
4b	1.7		

No Red Pine Left Behind

Compartment 116

100.5 acres

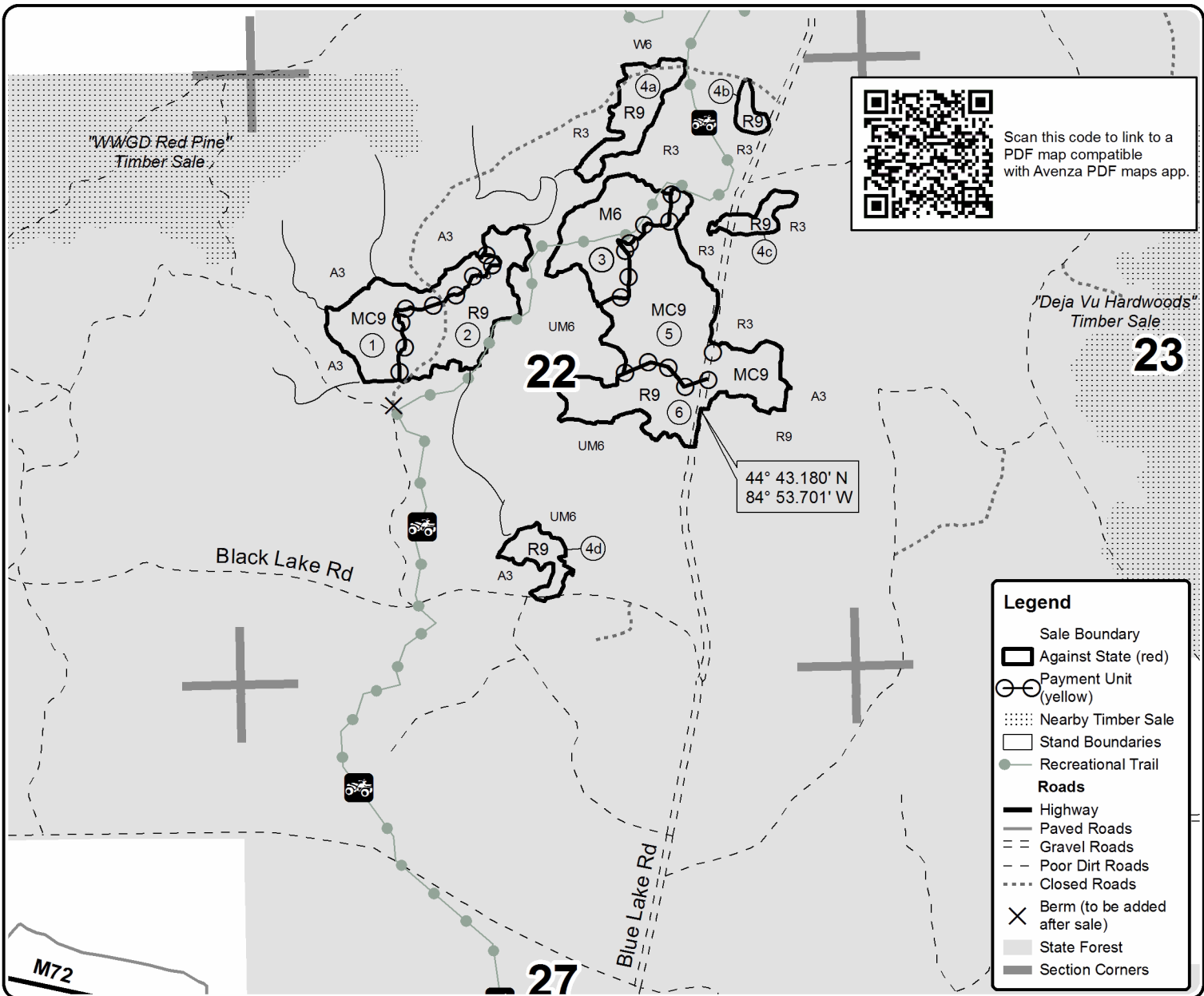

Scan this code to link to a PDF map compatible with Avenza PDF maps app.

Legend

- Sale Boundary
- Against State (red)
- Payment Unit (yellow)
- Nearby Timber Sale
- Stand Boundaries
- Recreational Trail
- Roads
 - Highway
 - Paved Roads
 - Gravel Roads
 - Poor Dirt Roads
 - Closed Roads
- Berm (to be added after sale)
- State Forest
- Section Corners

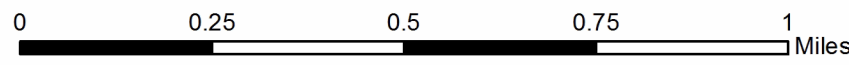

TIMBER SALE INFORMATION

Bruin Pond RP (61-134-16)

Kalkaska County (Advertised Price \$56,807.20)

SALE NOTE: A recreation site such as a trail, pathway, or campground is within the sale area or the vicinity. Certain restrictions/specifications may be applicable including time restrictions.

A timber sale contract for this lump sum, sealed bid timber sale will be awarded to the responsible bidder offering the highest sealed bid price. Bids must be at or above the following advertised price for each species:

<u>PRODUCTS & SPECIES</u>	<u>ESTIMATED UNITS*</u>		<u>ADVERTISED PRICE</u>
Sawtimber			
B. T. Aspen	1.30	MBF	\$ 113.00 / MBF
Red Pine	112.60	MBF	\$ 142.00 / MBF
White Pine	14.20	MBF	\$ 98.00 / MBF
Pulpwood			
B. T. Aspen	7.00	Cords	\$ 24.25 / Cord
Balsam Fir	2.00	Cords	\$ 16.45 / Cord
Jack Pine	11.00	Cords	\$ 12.85 / Cord
Mixed Aspen	41.00	Cords	\$ 24.25 / Cord
Mixed Hardwood	19.00	Cords	\$ 22.65 / Cord
Red Pine	746.00	Cords	\$ 47.75 / Cord
White Pine	94.00	Cords	\$ 20.10 / Cord

* The total volume is statistically estimated within plus (+) or minus (-) 15.12 percent. The estimated units are final and not subject to adjustment. Prospective bidders are urged to examine this timber and to make their own estimates of quantity and quality.

BOND AND PAYMENT SCHEDULE:

1. A bond in the amount of \$5,113.00 to insure faithful performance of the conditions of the contract will be deposited by the successful bidder within 21 days of the sale award.
2. Cutting in any sale or unit without the required advance payment would be considered a trespass.
3. Total payment must be paid in advance or according to the following schedule:
 - (a) Ten percent (10%) of the sale value must be paid within 21 days of the sale award.
 - (b) The 10% down payment will be credited towards the first unit cut.
4. If no cutting takes place, the 10% down payment will not be refunded.
5. Operations on the contract issued will terminate on 12/31/2019.

Description of Timber by Payment Unit (PU)

PU	MARKET GROUP	PRODUCT	QUANTITY	UNIT	ACRES	ADVERTISE PRICE			
1	Red Pine	Sawtimber	58.6	MBF	49.8	\$30,850.00			
	Jack Pine	Pulpwood	3.0	Cords					
	Red Pine		471.0	Cords					
2	Red Pine	Sawtimber	6.0	MBF	14.6	\$8,969.50			
	Red Pine	Pulpwood	170.0	Cords					
3	Red Pine	Sawtimber	6.5	MBF	5.0	\$2,642.00			
	Red Pine	Pulpwood	36.0	Cords					
4	Red Pine	Sawtimber	38.5	MBF	7.7	\$9,735.80			
	White Pine		2.8	MBF					
	B. T. Aspen	Pulpwood	7.0	Cords					
	Jack Pine		8.0	Cords					
	Red Pine		67.0	Cords					
	White Pine		26.0	Cords					
5	B. T. Aspen	Sawtimber	1.3	MBF	9.7	\$4,609.90			
	Red Pine		3.0	MBF					
	White Pine		11.4	MBF					
	Balsam Fir	Pulpwood	2.0	Cords					
	Mixed Aspen		41.0	Cords					
	<i>B. T. Aspen</i>		35.0	<i>Cords</i>					
	<i>Quaking Aspen</i>		6.0	<i>Cords</i>					
	Mixed Hardwood		19.0	Cords					
	<i>Black Cherry</i>		3.0	<i>Cords</i>					
	<i>Red Maple</i>		16.0	<i>Cords</i>					
	Red Pine		2.0	Cords					
	White Pine		68.0	Cords					
	TOTAL:			128.1			MBF		
	TOTAL:			980.0			Cords		

Sale Specific Conditions & Requirements

Sale Name: Bruin Pond RP

Sale Number: 61-134-16 Seq#: 1

1 - Sale Area

1.2 - Boundaries

1.2.1 - Painted boundaries (1/14)

The sale boundary and Payment Unit boundaries are marked and identified by red and yellow paint. Exterior sale boundary lines against state are marked with red paint. Interior Payment Unit boundaries are marked with yellow paint. Yellow painted trees designating an interior Payment Unit boundary are only to be cut when all surrounding Payment Units have been paid.

2 - Timber Specifications

2.1 - Included Timber

2.1.1 - Clearcut unit(s) with unmerchantable trees (6/14)

Within Payment Unit(s) 5, cut all trees that are two (2) inches or more at DBH except cut all balsam and white pine four (4) inches and larger. In addition, leave all trees marked with green paint.

2.1.3 - Cut tree marked unit(s) (12/08)

Within Payment Unit(s) 4 and 3b, all trees are designated for cutting when marked with orange paint above and below stump height, regardless of merchantability. In addition, within Payment Unit 4, cut all aspen, red maple, and jack pine.

2.1.8 - Designated plantation row unit(s) (12/08)

Within Payment Unit(s) 1, 2 and 3a, all trees which meet minimum piece specifications in 2.2 Utilization, within designated plantation rows are designated for cutting. Designated plantation rows begin with the third row in from the outside of the plantation, then continue every third row. Because of the variability of row direction, it shall be the responsibility of the producer to maintain the third row sequence.

3 - Payments

3.3 - Pre-measured Sales

3.3.4 - Dividing payment units (7/14)

Payment Unit(s) 1 may be divided at the request of the Purchaser and upon approval of the Unit Manager. Dividing Payment Units is a contract modification which requires a Timber Sale Contract Supplement.

4 - Transportation

4.1 - Construction

4.1.6 - Road construction (1/09)

Construction of new roads or improvements of existing roads shall be done in such a way as to minimize the environmental and visual impacts. Merchantable trees shall be cut and utilized unless otherwise directed. Non-merchantable trees shall be severed and laid flat on the ground. Slash shall be scattered, and not left in windrows and kept a minimum of 10 feet back from the road edge. Stumps shall be set upright, not left on edge, and be moved at least 10 feet away from the road edge. Disturbed soil shall be feathered into the woods and not left in berms or windrows.

4.2 - Maintenance

4.2.5 - Two wheel drive condition (2/04)

All existing trail roads on and adjacent to the sale area must be passable by two-wheel drive traffic for the duration of the sale.

5 - Operations

5.1 - Notification

5.1.1 - Pre-sale conference (10/11)

A pre-sale conference between the Purchaser and sale administrator is required prior to beginning any operations to

determine landing and road locations. The Unit Manager or his/her representative must be contacted at least 3 days in advance to schedule the conference.

5.1.4 - Post-sale conference (6/11)

A post-sale conference on site between the Purchaser and sale administrator is required 3 days prior to the completion of active logging operations to determine clean-up and repair of landings, road edges, and the fulfillment of other contract specifications.

5.2 - Conduct of Operations

5.2.3 - Operating Restrictions

5.2.3.6 - Bark beetle restriction (12/08)

In the event drought creates a high risk of pine bark beetle infestation, pine is not to be cut during the period March 1 through July 1, unless all portions of trees greater than two inches in diameter are removed from the sale area, reduced to chips, or treated to the satisfaction of the Unit Manager or his/her representative, within fifteen days of being severed from the stump. Pine log decks, pulpwood piles and treetops that are piled for chipping in the fall or winter within a 1/4 mile of susceptible sites must be removed before March 15. Residual slash must not be placed in piles or rows and must be spread over the site for quick drying. The Department of Natural Resources will exercise this specification if the risk of damage warrants.

5.2.39 - ORV trail/route protection (12/12)

The motorcycle trail and ORV route are shown on the Timber Sale Map. The ORV route is the two track which is the access for the sale. Do not cut trees or damage posts with orange ORV markers. All stumps within 5 feet of the trail must be cut flush with the ground. Maintain a 20 foot wide slash, debris, and rut free zone daily using the ORV trail or route as the centerline. Skidding across the Motorcycle trail may only occur in locations approved by the sale administrator.

5.2.40 - Pathway protection (10/10)

The horse trail is shown on the Timber Sale Map and it runs through Payment Unit 1. There will not be any landings or roads allowed on or near the horse trail. Do not cut trees or damage posts with blue pathway markers. Maintain a 20-foot wide slash, debris, and rut free zone daily, using the pathway as the centerline. Do not run equipment down the pathway. Skidding across the trail may only occur in locations approved by the sale administrator.

5.2.41 - Snowmobile trail protection (9/11)

The snowmobile trail is shown on the Timber Sale Map. Do not cut or damage posts with orange trail markers or traffic control signs. If the trail is used, it must be maintained and restored to a condition equal to or better than before the sale. The road maintenance/restoration must be done prior to December 1. The snowmobile trail may not be used for any timber sale operations from December 1 to March 31. Maintain a 20 foot wide slash, debris, and rut free zone daily using the snowmobile trail as the centerline. No decking of forest products will be permitted along the snowmobile trail. All stumps within 20 feet of the snowmobile trail must be cut at ground level.

5.4 - Soil Protection

5.4.1 - Rutting restriction, general (1/09)

Operations are to cease immediately if equipment and weather conditions result in rutting of roads and skid trails which is 12 inches or greater in depth and 50 feet in length. The Unit Manager or his/her representative may restrict hauling and/or skidding if ruts exceed the specified depth. With the Unit Manager or his/her representative's approval, the Purchaser may return to the area when the risk of rutting has decreased.

5.8 - Protection of Endangered Species

5.8.5 - Protection of raptor nests (3/13)

All trees with raptor nests will be protected if found during harvesting operations. Notification will be made to the Unit Manager or his/her representative who will notify the Wildlife Biologist so an on-site evaluation and recommendation can be made, if necessary.

6 - Safety and Fire Prevention

6.2 - Signing

6.2.3 - Recreational trail posting (2/10)

The Purchaser is responsible for posting and maintaining caution signs on the ORV Route, Motorcycle Trail and Snowmobile Trail prior to beginning operations. The trail must be posted at appropriate distances from the sale area to warn of logging activity and truck traffic at both ends of the trail. Signs must be removed when harvest operations are suspended or completed. The Purchaser will provide these signs.



TIMBER SALE MAP

This information provided by authority of Part 525, 1994 PA 451, as amended.

Forest Management Unit Traverse City	County Kalkaska	Mapped By Roell	Date 06/16/2016	Page 1	of 1
Township 27N	Range 05W	Section(s) and Subdivision(s) Sec 7: S1/2; S1/2NW	Scale 1:15,840		

Cover Type				Density	
A = Aspen	H = Hemlock	N = Marsh	U = Upland Brush	0 = Non Stocked	5 = Pole Timber Medium
B = Paper Birch	J = Jack Pine	O = Oak	UM = Upland Mixed	1 = Seedling Sapling Poor	6 = Pole Timber Well
C = Cedar	L = Lowland Brush	P = Lowland Poplar	V = Bog or Marsh	2 = Seedling Sapling Medium	7 = Saw Timber Poor
D = Tread Bog	LM = Lowland Mixed	Q = Mixed Swamp Conifer	W = White Pine	3 = Seedling Sapling Well	8 = Saw Timber Medium
E = Swamp Hdwoods	M = Mpl, Bch, Brch	R = Red Pine	X = Non Stocked	4 = Pole Timber Poor	9 = Saw Timber Well
F = Spruce Fir	MC = Mixed Conifer	S = Black Spruce	Z = Water		
G = Grass	MD = Mixed Deciduous	T = Tamarack			

PU	Acres	PU	Acres
1	49.8	4	7.7
2	14.6	5	9.7
3	5		

Bruin Pond RP

Compartment 109

86.8 Acres

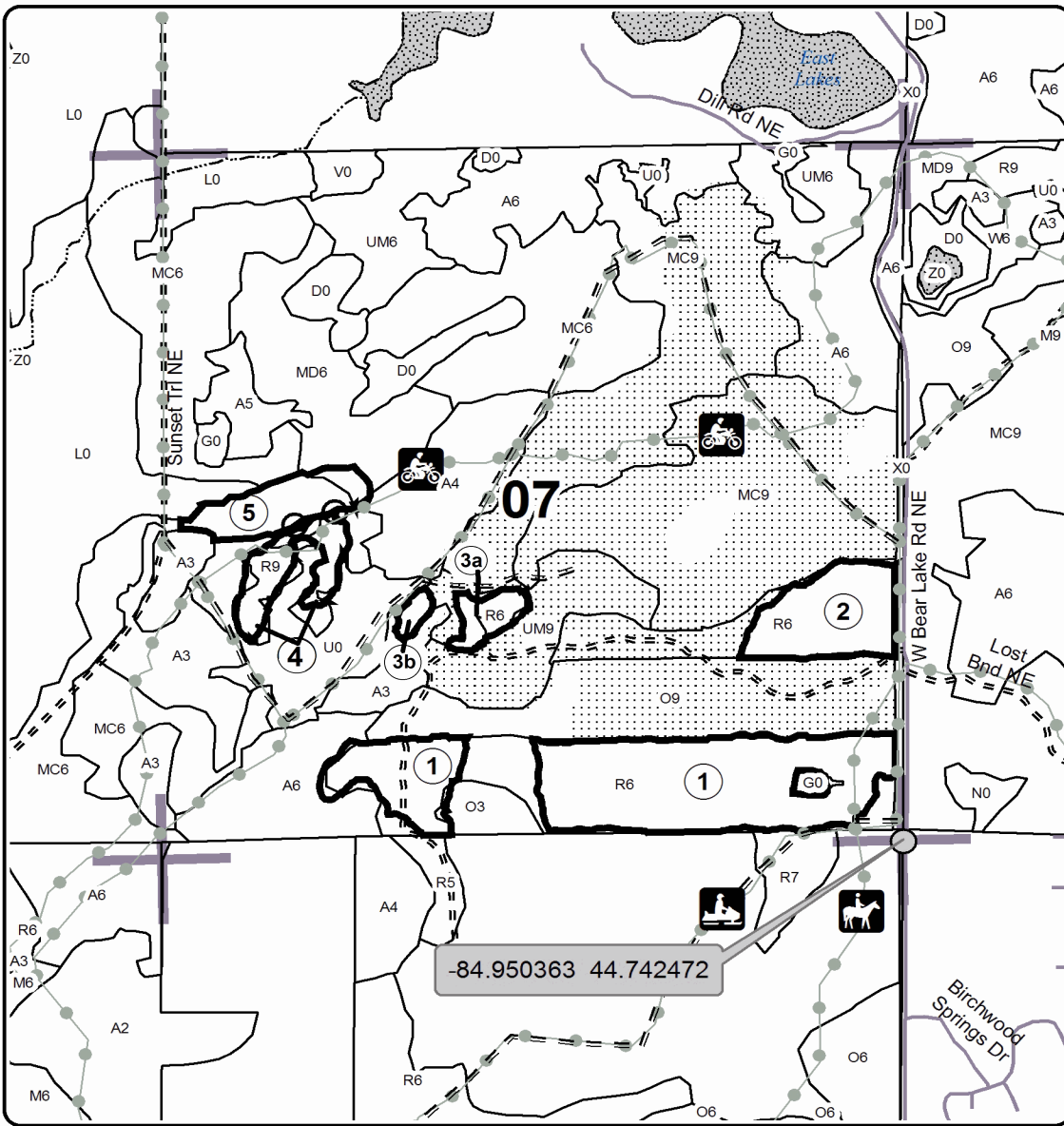
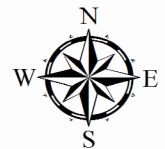

Legend

- Payment Unit (Yellow)
- Against State (Red)
- Adjacent Timber Sales
- Adjacent Stand Boundaries
- Section Corners
- Paved Roads
- Poor Dirt Roads
- Recreational Trail
- Lakes
- Streams

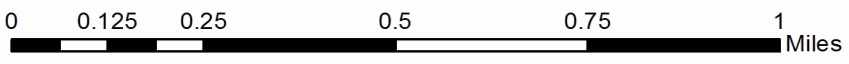
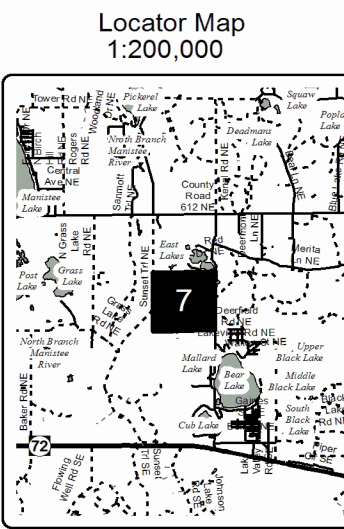

TIMBER SALE INFORMATION

Culicidae Pine (61-141-16)

Kalkaska County (Advertised Price \$149,976.60)

A timber sale contract for this lump sum, sealed bid timber sale will be awarded to the responsible bidder offering the highest sealed bid price. Bids must be at or above the following advertised price for each species:

<u>PRODUCTS & SPECIES</u>	<u>ESTIMATED UNITS*</u>	<u>ADVERTISED PRICE</u>
Sawtimber		
Basswood	35.80 MBF	\$ 100.00 / MBF
Black Cherry	3.40 MBF	\$ 293.00 / MBF
Mixed Aspen	3.90 MBF	\$ 113.00 / MBF
Paper Birch	0.30 MBF	\$ 43.00 / MBF
Red Maple	13.30 MBF	\$ 180.00 / MBF
Red Pine	635.10 MBF	\$ 142.00 / MBF
Sugar Maple	25.80 MBF	\$ 305.00 / MBF
White Pine	104.70 MBF	\$ 98.00 / MBF
Pulpwood		
Balsam Fir	6.00 Cords	\$ 16.45 / Cord
Basswood	134.00 Cords	\$ 17.25 / Cord
Mixed Aspen	36.00 Cords	\$ 24.25 / Cord
Mixed Hardwood	151.00 Cords	\$ 22.65 / Cord
Red Pine	495.00 Cords	\$ 47.75 / Cord
White Pine	194.00 Cords	\$ 20.10 / Cord

* The total volume is statistically estimated within plus (+) or minus (-) 13.19 percent. The estimated units are final and not subject to adjustment. Prospective bidders are urged to examine this timber and to make their own estimates of quantity and quality.

BOND AND PAYMENT SCHEDULE:

1. A bond in the amount of \$7,499.00 to insure faithful performance of the conditions of the contract will be deposited by the successful bidder within 21 days of the sale award.
2. Cutting in any sale or unit without the required advance payment would be considered a trespass.
3. Total payment must be paid in advance or according to the following schedule:
 - (a) Ten percent (10%) of the sale value must be paid within 21 days of the sale award.
 - (b) The 10% down payment will be credited towards the first unit cut.
4. If no cutting takes place, the 10% down payment will not be refunded.
5. Operations on the contract issued will terminate on 12/31/2019.

Description of Timber by Payment Unit (PU)

PU	MARKET GROUP	PRODUCT	QUANTITY	UNIT	ACRES	ADVERTISE PRICE
1	Mixed Aspen	Sawtimber	1.0	MBF	18.0	\$26,877.10
	<i>Quaking Aspen</i>		1.0	<i>MBF</i>		
	Red Pine	137.6	MBF			
	White Pine	6.3	MBF			
	Mixed Aspen	Pulpwood	8.0	Cords		
	<i>Quaking Aspen</i>		8.0	<i>Cords</i>		
	Red Pine		128.0	Cords		
	White Pine		15.0	Cords		
2	Red Maple	Sawtimber	13.3	MBF	29.7	\$44,026.85
	Red Pine		223.3	MBF		
	White Pine	0.2	MBF			
	Mixed Hardwood	Pulpwood	10.0	Cords		
	<i>Red Maple</i>		10.0	<i>Cords</i>		
	Red Pine		201.0	Cords		
	White Pine		4.0	Cords		
3	Red Pine	Sawtimber	142.9	MBF	24.1	\$37,868.40
	White Pine		97.3	MBF		
	Red Pine	Pulpwood	96.0	Cords		
	White Pine		172.0	Cords		
4	Basswood	Sawtimber	35.8	MBF	55.3	\$41,204.25
	Black Cherry		3.4	MBF		
	Mixed Aspen	2.9	MBF			
	<i>B. T. Aspen</i>	2.9	<i>MBF</i>			
	Paper Birch	0.3	MBF			
	Red Pine	131.3	MBF			
	Sugar Maple	25.8	MBF			
	White Pine	0.9	MBF			
	Balsam Fir	Pulpwood	6.0	Cords		
	Basswood		134.0	Cords		
	Mixed Aspen		28.0	Cords		
	<i>B. T. Aspen</i>		28.0	<i>Cords</i>		
	Mixed Hardwood		141.0	Cords		
	<i>Black Cherry</i>		46.0	<i>Cords</i>		
	<i>Ironwood</i>		2.0	<i>Cords</i>		
	<i>Paper Birch</i>		1.0	<i>Cords</i>		
	<i>Red Maple</i>		5.0	<i>Cords</i>		
	<i>Sugar Maple</i>		87.0	<i>Cords</i>		
	Red Pine		70.0	Cords		
	White Pine		3.0	Cords		
TOTAL:			826.2	MBF		
TOTAL:			1,203.0	Cords		

Sale Specific Conditions & Requirements

Sale Name: Culicidae Pine

Sale Number: 61-141-16 Seq#: 1

1 - Sale Area

1.2 - Boundaries

1.2.1 - Painted boundaries (1/14)

The sale boundary and Payment Unit boundaries are marked and identified by red and yellow paint. Exterior sale boundary lines against state are marked with red paint. Interior Payment Unit boundaries are marked with yellow paint. Yellow painted trees designating an interior Payment Unit boundary are only to be cut when all surrounding Payment Units have been paid.

2 - Timber Specifications

2.1 - Included Timber

2.1.1 - Clearcut unit(s) with unmerchantable trees (6/14)

Within Payment Unit(s) 1, 2, 3, and 4, cut all trees that are TWO (2) inches or more at DBH.

2.2 - Utilization

2.2.2 - Chipping required (5/14)

This sale must be chip harvested to facilitate subsequent planting operations. The Purchaser has the option to produce sawlogs or pulpwood bolts, but the remaining portion of the trees must be chipped and hauled. Do not chip 1/6 to 1/3 of the slash from harvested trees (tree tops and limbs less than four inches in diameter).

2.2.3 - Stump heights (4/07)

Stump heights within the Sale Area shall not exceed 6 inches for all trees. This is in order to facilitate planting operations.

4 - Transportation

4.1 - Construction

4.1.6 - Road construction (1/09)

Construction of new roads or improvements of existing roads shall be done in such a way as to minimize the environmental and visual impacts. Merchantable trees shall be cut and utilized unless otherwise directed. Non-merchantable trees shall be severed and laid flat on the ground. Slash shall be scattered, and not left in windrows and kept a minimum of 10 feet back from the road edge. Stumps shall be set upright, not left on edge, and be moved at least 10 feet away from the road edge. Disturbed soil shall be feathered into the woods and not left in berms or windrows.

4.2 - Maintenance

4.2.5 - Two wheel drive condition (2/04)

All existing trail roads on and adjacent to the sale area must be passable by two-wheel drive traffic for the duration of the sale.

5 - Operations

5.1 - Notification

5.1.1 - Pre-sale conference (10/11)

A pre-sale conference between the Purchaser and sale administrator is required prior to beginning any operations to determine landing and road locations. The Unit Manager or his/her representative must be contacted at least 3 days in advance to schedule the conference.

5.1.4 - Post-sale conference (6/11)

A post-sale conference on site between the Purchaser and sale administrator is required 3 days prior to the completion of active logging operations to determine clean-up and repair of landings, road edges, and the fulfillment of other contract specifications.

5.4 - Soil Protection

5.4.1 - Rutting restriction, general (7/16)

Operations are to cease immediately if equipment and weather conditions result in rutting of roads and/or skid trails which is 12 inches or greater in depth and 50 feet in length. The Unit Manager or his/her representative may restrict hauling and/or skidding if ruts exceed the specified depth. With the Unit Manager or his/her representative's approval, the Purchaser may return to the area when the risk of rutting has decreased.

5.7 - Protection of Historical Sites

5.7.1 - Historical sites (7/12)

The Purchaser shall not cut live or dead trees or operate equipment within historical sites. Historical sites are adjacent to the sale and must be protected. The Purchaser shall protect historical sites from damage by the Purchaser's operations. If Purchaser's operations have cut or damaged historical sites through carelessness, the Purchaser shall pay \$1,000 as fixed, agreed and liquidated damages for each acre or part thereof cut or damaged.

5.8 - Protection of Endangered Species

5.8.5 - Protection of raptor nests (3/13)

All trees with raptor nests will be protected if found during harvesting operations. Notification will be made to the Unit Manager or his/her representative who will notify the Wildlife Biologist so an on-site evaluation and recommendation can be made, if necessary.

6 - Safety and Fire Prevention

6.2 - Signing

6.2.1 - Road posting (9/09)

The Purchaser is responsible for posting and maintaining caution signs on Grass Lake Rd and CO 612 prior to beginning operations. The road must be posted at appropriate distances from the sale area to warn of logging activity and truck traffic. Signs must be removed when harvest operations are suspended or completed. The Purchaser will provide these signs.



Sale Number	Year
61-141	16

TIMBER SALE MAP

This information provided by authority of Part 525, 1994 PA 451, as amended.

Forest Management Unit		County	Mapped By	Date	Page	of
Traverse City		Kalkaska	Roell	07/13/2016	1	1
Township	Range	Section(s) and Subdivision(s)		Scale		
27N	06W	See Prospectus for Sec 1; N1/2NW, NWNE Sec 12		1:15,840		

Cover Type				Density			
A = Aspen	H = Hemlock	N = Marsh	U = Upland Brush	0 = Non Stocked	5 = Pole Timber Medium		
B = Paper Birch	J = Jack Pine	O = Oak	UM = Upland Mixed	1 = Seedling Sapling Poor	6 = Pole Timber Well		
C = Cedar	L = Lowland Brush	P = Lowland Poplar	V = Bog or Marsh	2 = Seedling Sapling Medium	7 = Saw Timber Poor		
D = Tread Bog	LM = Lowland Mixed	Q = Mixed Swamp Conifer	W = White Pine	3 = Seedling Sapling Well	8 = Saw Timber Medium		
E = Swamp Hdwoods	M = Mpl, Bch, Brch	R = Red Pine	X = Non Stocked	4 = Pole Timber Poor	9 = Saw Timber Well		
F = Spruce Fir	MC = Mixed Conifer	S = Black Spruce	Z = Water				
G = Grass	MD = Mixed Deciduous	T = Tamarack					

PU	Acres	PU	Acres
1	18	4	55.3
2	29.7		
3	24.1		

Culicidae Pine

Compartment 109

127.1 Acres

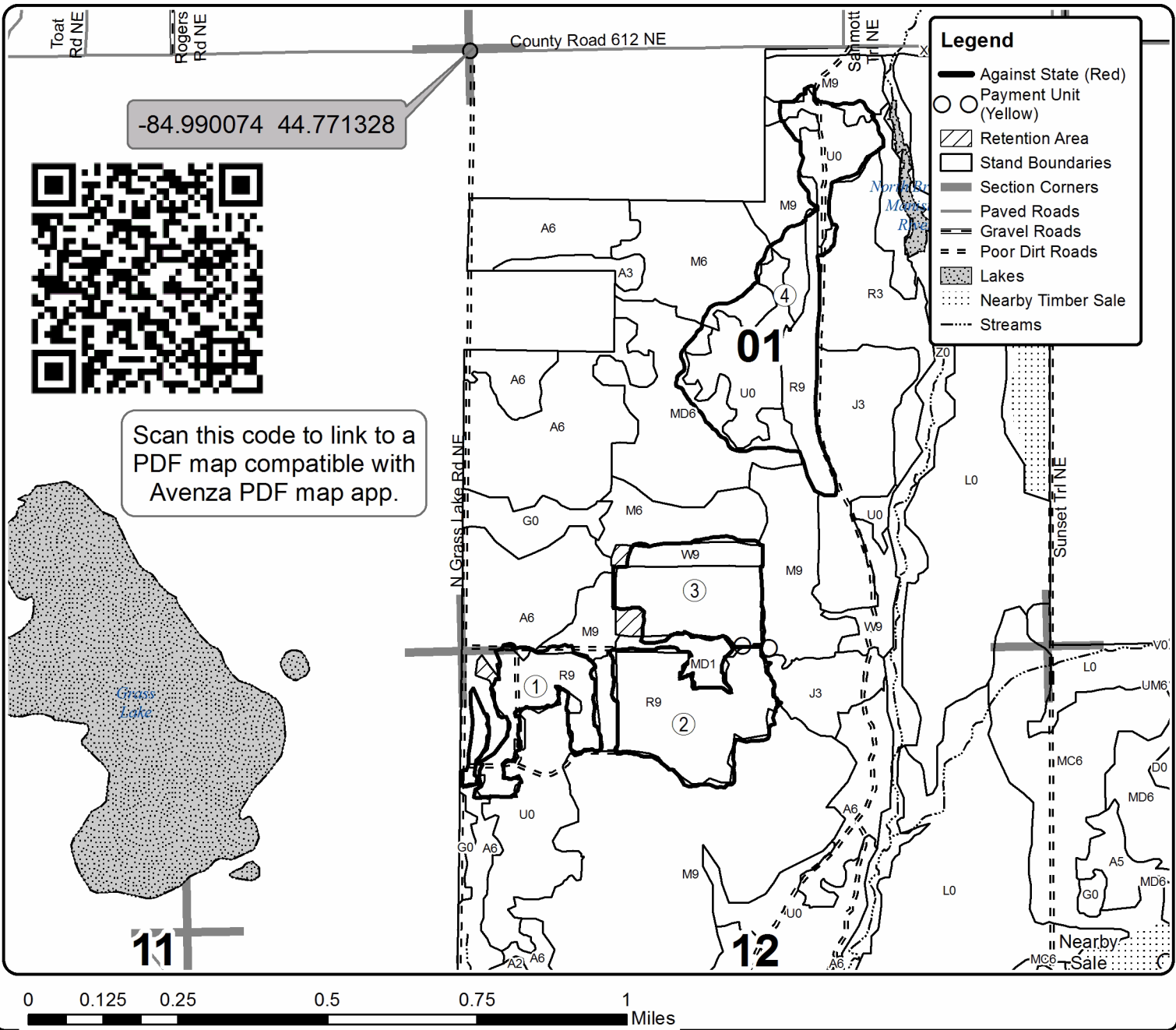
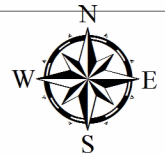

TIMBER SALE INFORMATION

Honeymoon Cabin Mix (61-147-16)

Kalkaska County (Advertised Price \$39,370.80)

SALE NOTE: This sale must be cut during frozen winter conditions, due to poor condition of the seasonal county road and wet areas within the sale.

A timber sale contract for this lump sum, sealed bid timber sale will be awarded to the responsible bidder offering the highest sealed bid price. Bids must be at or above the following advertised price for each species:

<u>PRODUCTS & SPECIES</u>	<u>ESTIMATED UNITS*</u>		<u>ADVERTISED PRICE</u>
Sawtimber			
Mixed Aspen	10.60	MBF	\$ 107.00 / MBF
Red Oak	30.30	MBF	\$ 254.00 / MBF
Red Pine	86.20	MBF	\$ 134.00 / MBF
White Pine	43.10	MBF	\$ 92.00 / MBF
Pulpwood			
Jack Pine	12.00	Cords	\$ 12.05 / Cord
Mixed Aspen	130.00	Cords	\$ 22.80 / Cord
Mixed Hardwood	89.00	Cords	\$ 21.35 / Cord
Red Oak	141.00	Cords	\$ 17.70 / Cord
Red Pine	97.00	Cords	\$ 44.90 / Cord
White Pine	167.00	Cords	\$ 18.95 / Cord

* The total volume is statistically estimated within plus (+) or minus (-) 12.53 percent. The estimated units are final and not subject to adjustment. Prospective bidders are urged to examine this timber and to make their own estimates of quantity and quality.

BOND AND PAYMENT SCHEDULE:

1. A bond in the amount of \$1,969.00 to insure faithful performance of the conditions of the contract will be deposited by the successful bidder within 21 days of the sale award.
2. Cutting in any sale or unit without the required advance payment would be considered a trespass.
3. Total payment must be paid in advance or according to the following schedule:
 - (a) Ten percent (10%) of the sale value must be paid within 21 days of the sale award.
 - (b) The 10% down payment will be credited towards the first unit cut.
4. If no cutting takes place, the 10% down payment will not be refunded.
5. Operations on the contract issued will terminate on 12/31/2019.

Description of Timber by Payment Unit (PU)

PU	MARKET GROUP	PRODUCT	QUANTITY	UNIT	ACRES	ADVERTISE PRICE
1	Red Oak	Sawtimber	2.0	MBF	7.0	\$6,051.05
	Red Pine		11.8	MBF		
	White Pine		15.2	MBF		
	Jack Pine	Pulpwood	4.0	Cords		
	<i>Balsam Fir</i>		2.0	<i>Cords</i>		
	<i>Black Spruce</i>		2.0	<i>Cords</i>		
	Mixed Aspen		18.0	Cords		
	<i>Quaking Aspen</i>		18.0	<i>Cords</i>		
	Mixed Hardwood		12.0	Cords		
	<i>Black Cherry</i>		1.0	<i>Cords</i>		
	<i>Paper Birch</i>		2.0	<i>Cords</i>		
	<i>Red Maple</i>		9.0	<i>Cords</i>		
	Red Oak		11.0	Cords		
	<i>Red Oak</i>		11.0	<i>Cords</i>		
	Red Pine		17.0	Cords		
	White Pine		47.0	Cords		
2	Mixed Aspen	Sawtimber	3.1	MBF	15.0	\$16,093.45
	<i>B. T. Aspen</i>		2.3	<i>MBF</i>		
	<i>Quaking Aspen</i>		0.8	<i>MBF</i>		
	Red Oak		8.4	MBF		
	Red Pine		50.8	MBF		
	White Pine		16.6	MBF		
	Jack Pine	Pulpwood	6.0	Cords		
	<i>Jack Pine</i>	<i>Sawtimber</i>	0.4	<i>MBF</i>		
	<i>Balsam Fir</i>	<i>Pulpwood</i>	1.0	<i>Cords</i>		
	<i>Jack Pine</i>		4.0	<i>Cords</i>		
	Mixed Aspen		38.0	Cords		
	<i>B. T. Aspen</i>		37.0	<i>Cords</i>		
	<i>Quaking Aspen</i>		1.0	<i>Cords</i>		
	Mixed Hardwood		26.0	Cords		
	<i>Red Maple</i>	<i>Sawtimber</i>	0.4	<i>MBF</i>		
	<i>Black Cherry</i>	<i>Pulpwood</i>	1.0	<i>Cords</i>		
	<i>Paper Birch</i>		1.0	<i>Cords</i>		
	<i>Red Maple</i>		23.0	<i>Cords</i>		
	Red Oak		43.0	Cords		
	<i>Misc. Species 2</i>		12.0	<i>Cords</i>		
	<i>Red Oak</i>		31.0	<i>Cords</i>		
	Red Pine		47.0	Cords		
	White Pine		49.0	Cords		
3	Mixed Aspen	Sawtimber	7.5	MBF	20.8	\$17,226.30
	<i>B. T. Aspen</i>		7.2	<i>MBF</i>		
	<i>Quaking Aspen</i>		0.3	<i>MBF</i>		
	Red Oak		19.9	MBF		
	Red Pine		23.6	MBF		
	White Pine		11.3	MBF		
	Jack Pine	Pulpwood	2.0	Cords		
	<i>Jack Pine</i>	<i>Sawtimber</i>	0.2	<i>MBF</i>		
	<i>Jack Pine</i>	<i>Pulpwood</i>	2.0	<i>Cords</i>		
	Mixed Aspen		74.0	Cords		
	<i>B. T. Aspen</i>		73.0	<i>Cords</i>		
	<i>Quaking Aspen</i>		1.0	<i>Cords</i>		
	Mixed Hardwood		51.0	Cords		
	<i>Red Maple</i>	<i>Sawtimber</i>	1.4	<i>MBF</i>		
	<i>Black Cherry</i>	<i>Pulpwood</i>	1.0	<i>Cords</i>		
	<i>Red Maple</i>		47.0	<i>Cords</i>		
Red Oak		87.0	Cords			

Description of Timber by Payment Unit (PU), con't

PU	MARKET GROUP	PRODUCT	QUANTITY	UNIT	ACRES	ADVERTISE PRICE
3 con't	Misc. Species 2	<i>Pulpwood</i>	24.0	<i>Cords</i>		
	Red Oak		63.0	<i>Cords</i>		
	Red Pine		33.0	Cords		
	White Pine		71.0	Cords		
TOTAL:			183.2	MBF		
TOTAL:			1,003.0	Cords		

Sale Specific Conditions & Requirements

Sale Name: Honeymoon Cabin Mix

Sale Number: 61-147-16 Seq#: 1

1 - Sale Area

1.2 - Boundaries

1.2.1 - Painted boundaries (1/14)

The sale boundaries are marked and identified by blue and red paint. Exterior sale boundary lines against private property are marked with blue paint. Exterior sale boundary lines against state are marked with red paint. The painted boundary line trees are not Included Timber and are to be protected. Black Lake Road defines the boundary between Payment Units 2 and 3.

2 - Timber Specifications

2.1 - Included Timber

2.1.7 - Leave tree marked unit(s) (6/14)

Within Payment Unit(s) 1, 2, and 3, cut all trees that are four (4) inches or more at DBH except cedar, hemlock and trees marked with green paint above and below stump height.

2.1.11 - Description of timber note (2/04)

Note that Jack Pine Pulpwood includes approximately 0.6 mbf sawlogs, 3 cords balsam fir, 2 cords black spruce, and 6 cords jack pine. Mixed Hardwood Pulpwood includes approximately 1.8 mbf and 79 cords red maple, 3 cords black cherry, and 3 cords paper birch. Red oak pulp includes approximately 36 cords of dead oak which may be cut.

3 - Payments

3.3 - Pre-measured Sales

3.3.4 - Dividing payment units (7/14)

Payment Unit(s) greater than \$15,000 may be divided at the request of the Purchaser and upon approval of the Unit Manager. Dividing Payment Units is a contract modification which requires a Timber Sale Contract Supplement. There will be only one division per Payment Unit.

3.4 - Damaged Timber

3.4.1 - Damaged timber (6/14)

General Condition and Requirement 3.4 Damaged Timber, defines liquidated damages for undesignated live merchantable trees which are cut or injured. In addition, extreme care should be taken to avoid damage to tree seedlings and saplings. Within the sale area, if more than 25% of the tree seedlings or saplings (1/4" to 4.5" DBH) within a specified portion of the sale area are damaged, liquidated damages will be assessed at \$300 per acre for all acreage within that specified portion of the sale area that was damaged.

4 - Transportation

4.1 - Construction

4.1.6 - Road construction (1/09)

Improvements of existing roads shall be done in such a way as to minimize the environmental and visual impacts. Merchantable trees shall be cut and utilized unless otherwise directed. Non-merchantable trees shall be severed and laid flat on the ground. Slash shall be scattered, and not left in windrows and kept a minimum of 10 feet back from the road edge. Stumps shall be set upright, not left on edge, and be moved at least 10 feet away from the road edge. Disturbed soil shall be feathered into the woods and not left in berms or windrows.

4.1.7 - Road closure (10/11)

Formerly closed roads that have been opened must be blocked to vehicle traffic within 30 days of completion of hauling. Please see the Timber Sale Map for two berm locations. In general, this will require constructing a four (4') foot high berm of stumps and logs covered with earth. Contact the sale administrator for specific details of design and placement.

4.1.12 - No new roads (1/12)

No new roads will be permitted. Skid trails only will be allowed.

5 - Operations

5.1 - Notification

5.1.1 - Pre-sale conference (10/11)

A pre-sale conference on site between the Purchaser and sale administrator is required prior to beginning any operations to determine landing and road locations. The sale administrator must be contacted at least 3 days in advance to schedule the conference.

5.1.3 - Well heads and natural gas pipelines (11/15)

The Purchaser is responsible for contacting the pipeline company prior to operating equipment in the vicinity of well heads or natural gas pipelines. There is a pipeline along the north side of the poor dirt road leading to the southern end of Payment Unit 3. Contact Consumers Energy at 517-789-6811.

5.1.4 - Post-sale conference (6/11)

A post-sale conference on site between the Purchaser and sale administrator is required 3 days prior to the completion of active logging operations to determine clean-up and repair of landings, road edges, and the fulfillment of other contract specifications.

5.2 - Conduct of Operations

5.2.1 - Slash

5.2.1.1 - Slash within sale area (2/04)

No trees are to be felled outside the sale area and all slash is to be kept at least 10 feet back from the blue paint line.

5.2.1.8 - Slash height (12/08)

No slash or tree tops may exceed 36 inches in height.

5.2.1.10 - No slash in openings (5/10)

No brush or logging debris is to be left in the maintained wildlife opening which is indicated by G0 on the Timber Sale Map south of Payment Unit 1. Any damage to the opening shall be repaired according to specifications of the Unit Manager or his/her representative.

5.2.2 - Hazard Trees/Snags

5.2.2.1 - Den trees (2/04)

Obvious hollow and/or den trees shall be protected and left standing unless they are a safety hazard.

5.2.3 - Operating Restrictions

5.2.3.2 - Operating restrictions (9/11)

Within Payment Unit(s) 1, 2, and 3, unless changed by written agreement, cutting, skidding, and hauling are limited to frozen winter conditions. This restriction is because of the poor condition of Black Lake Road and wet areas within the sale.

5.2.3.4 - Oak wilt restriction (6/10)

Within Payment Unit(s) 1, 2, and 3, unless changed by written agreement, cutting, and skidding are not permitted during the period of April 15 to July 15. This is necessary to reduce the spread of oak wilt. For more information, contact the Unit Manager or his/her representative.

5.2.32 - Decking/landing restoration (9/13)

All decking and landing areas must have the surface area restored to a condition equal to or better than before. This is to ensure the proper regeneration of the stand. Wood debris, chips and "cookies" from trimmings must be removed or scattered away from landing and loading areas and may not be windrowed on the edge.

5.2.38 - No decking against live trees (2/04)

Cut products may not be decked against unmarked or designated leave trees.

5.4 - Soil Protection

5.4.1 - Rutting restriction, general (7/16)

Operations are to cease immediately if equipment and weather conditions result in rutting of roads and/or skid trails which is 12 inches or greater in depth and 50 feet in length. The Unit Manager or his/her representative may restrict hauling and/or skidding if ruts exceed the specified depth. With the Unit Manager or his/her representative's approval, the Purchaser may return to the area when the risk of rutting has decreased.

5.8 - Protection of Endangered Species

5.8.5 - Protection of raptor nests (3/13)

All trees with raptor nests will be protected if found during harvesting operations. Notification will be made to the Unit Manager or his/her representative who will notify the Wildlife Biologist so an on-site evaluation and recommendation can be made, if necessary.

6 - Safety and Fire Prevention

6.2 - Signing

6.2.1 - Road posting (9/09)

The Purchaser is responsible for posting and maintaining caution signs on Black Lake Road prior to beginning operations. The road must be posted at appropriate distances from both ends of the sale area to warn of logging activity and truck traffic. Signs must be removed when harvest operations are suspended or completed. The Purchaser will provide these signs.



TIMBER SALE MAP

This information provided by authority of Part 525, 1994 PA 451, as amended.

Forest Management Unit Traverse City FMU		County Kalkaska	Mapped By Armstrong Cruised By Armstrong, Crigier, Roell		Date 7/14/2016	Page 1	of 1
Township 27N	Range 5W	Section(s) and Subdivision(s) Sec 21: SWSE, NESW, SESW; Sec 28: NWNE			Scale 1:15,840		

Cover Type				Density				
A = Aspen	H = Hemlock	N = Marsh	U = Upland Brush	0 = Non Stocked	5 = Pole Timber Medium			
B = Paper Birch	J = Jack Pine	O = Oak	UM = Upland Mixed	1 = Seedling Sapling Poor	6 = Pole Timber Well			
C = Cedar	L = Lowland Brush	P = Lowland Poplar	V = Bog or Marsh	2 = Seedling Sapling Medium	7 = Saw Timber Poor			
D = Treed Bog	LM = Lowland Mixed	Q = Mixed Swamp Conifer	W = White Pine	3 = Seedling Sapling Well	8 = Saw Timber Medium			
E = Swamp Hdwoods	M = Mpl, Bch, Brch	R = Red Pine	X = Non Stocked	4 = Pole Timber Poor	9 = Saw Timber Well			
F = Spruce Fir	MC = Mixed Conifer	S = Black Spruce	Z = Water					
G = Grass	MD = Mixed Deciduous	T = Tamarack						

Payment Unit	Acres
1	7.0
2	15.0
3	20.8

Honeymoon Cabin Mix

Compartment 116

42.8 acres

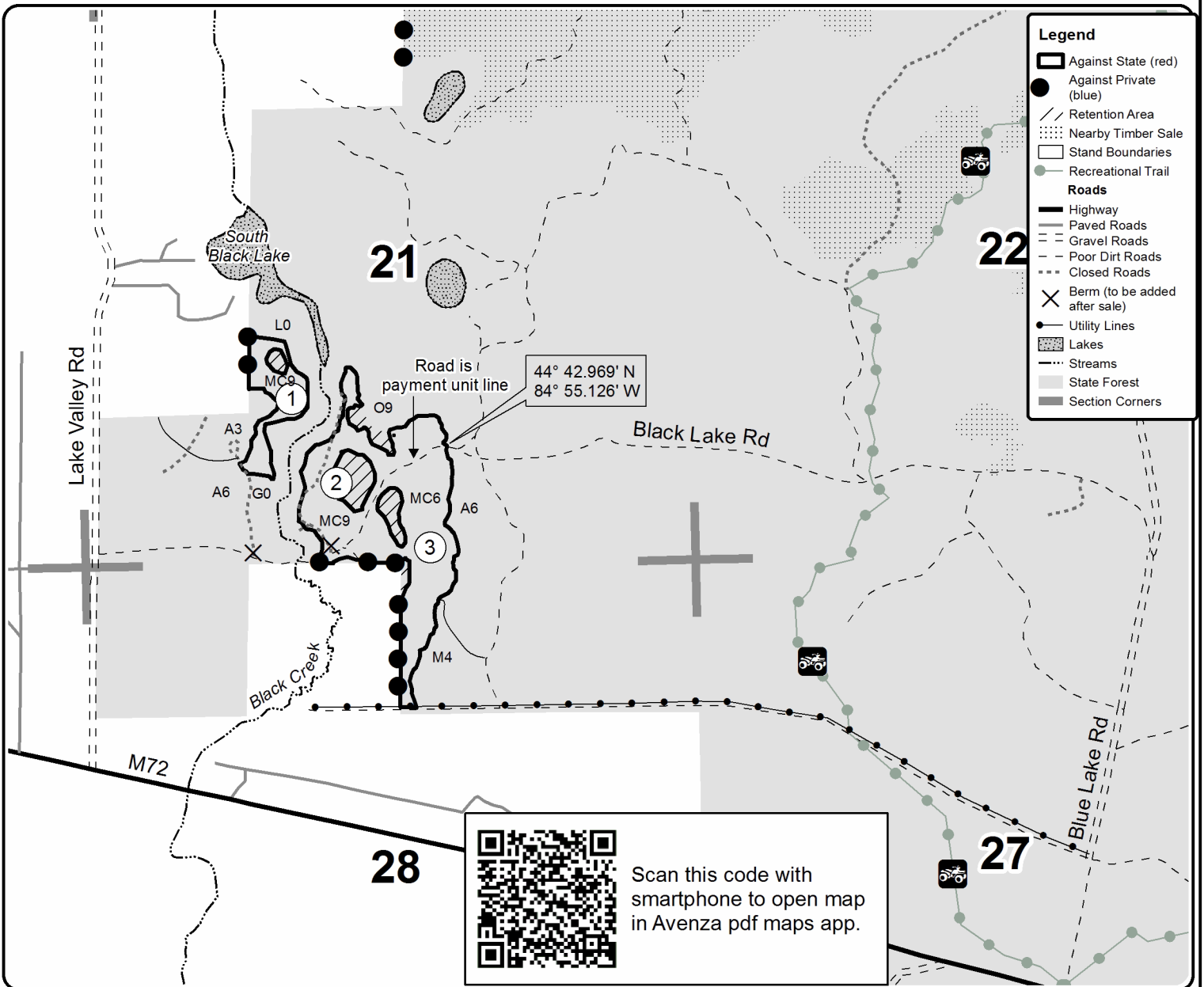

Scan this code with smartphone to open map in Avenza pdf maps app.

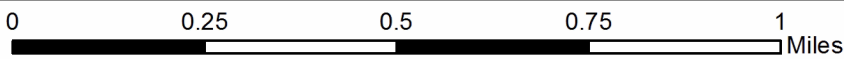

TIMBER SALE INFORMATION

Obata Oak (61-152-16)

Kalkaska County (Advertised Price \$108,138.80)

A timber sale contract for this lump sum, sealed bid timber sale will be awarded to the responsible bidder offering the highest sealed bid price. Bids must be at or above the following advertised price for each species:

<u>PRODUCTS & SPECIES</u>	<u>ESTIMATED UNITS*</u>	<u>ADVERTISED PRICE</u>
Sawtimber		
B. T. Aspen	2.30 MBF	\$ 120.00 / MBF
Red Maple	1.20 MBF	\$ 190.00 / MBF
Red Oak	295.50 MBF	\$ 285.00 / MBF
Red Pine	4.80 MBF	\$ 151.00 / MBF
White Oak	49.40 MBF	\$ 74.00 / MBF
Pulpwood		
B. T. Aspen	47.00 Cords	\$ 25.70 / Cord
Misc. Species 2	21.00 Cords	\$ 4.50 / Cord
Mixed Hardwood	24.00 Cords	\$ 24.00 / Cord
Red Oak	674.00 Cords	\$ 19.95 / Cord
Red Pine	3.00 Cords	\$ 50.55 / Cord
White Oak	171.00 Cords	\$ 19.95 / Cord
White Pine	7.00 Cords	\$ 21.30 / Cord

* The total volume is statistically estimated within plus (+) or minus (-) 8.27 percent. The estimated units are final and not subject to adjustment. Prospective bidders are urged to examine this timber and to make their own estimates of quantity and quality.

BOND AND PAYMENT SCHEDULE:

1. A bond in the amount of \$5,407.00 to insure faithful performance of the conditions of the contract will be deposited by the successful bidder within 21 days of the sale award.
2. Cutting in any sale or unit without the required advance payment would be considered a trespass.
3. Total payment must be paid in advance or according to the following schedule:
 - (a) Ten percent (10%) of the sale value must be paid within 21 days of the sale award.
 - (b) The 10% down payment will be credited towards the first unit cut.
4. If no cutting takes place, the 10% down payment will not be refunded.
5. Operations on the contract issued will terminate on 12/31/2018.

Description of Timber by Payment Unit (PU)

PU	MARKET GROUP	PRODUCT	QUANTITY	UNIT	ACRES	ADVERTISE PRICE
1	Red Oak	Sawtimber	74.0	MBF	13.3	\$25,797.05
	Red Pine		0.5	MBF		
	White Oak		8.7	MBF		
	Misc. Species 2	Pulpwood	6.0	Cords		
	Red Oak		173.0	Cords		
	Red Pine		1.0	Cords		
	White Oak		23.0	Cords		
	2	Red Maple	Sawtimber	0.7		
Red Oak			114.1	MBF		
White Oak			21.2	MBF		
B. T. Aspen		Pulpwood	15.0	Cords		
Mixed Hardwood			4.0	Cords		
<i>Red Maple</i>			4.0	<i>Cords</i>		
Red Oak			212.0	Cords		
White Oak			51.0	Cords		
3	B. T. Aspen	Sawtimber	2.3	MBF	23.5	\$42,393.10
	Red Maple		0.5	MBF		
	Red Oak		107.4	MBF		
	Red Pine		4.3	MBF		
	White Oak		19.5	MBF		
	B. T. Aspen	Pulpwood	32.0	Cords		
	Misc. Species 2		15.0	Cords		
	Mixed Hardwood		20.0	Cords		
	<i>Black Cherry</i>		2.0	<i>Cords</i>		
	<i>Red Maple</i>		18.0	<i>Cords</i>		
	Red Oak		289.0	Cords		
	Red Pine		2.0	Cords		
	White Oak		97.0	Cords		
	White Pine		7.0	Cords		
TOTAL:			353.2	MBF		
TOTAL:			971.0	Cords		

Sale Specific Conditions & Requirements

Sale Name: Obata Oak

Sale Number: 61-152-16 Seq#: 1

1 - Sale Area

1.2 - Boundaries

1.2.1 - Painted boundaries (1/14)

The sale boundary and Payment Unit boundaries are marked and identified by red and yellow paint. Exterior sale boundary lines against state are marked with red paint. Interior Payment Unit boundaries are marked with yellow paint. The painted boundary line trees are not Included Timber and are to be protected. Yellow painted trees designating an interior Payment Unit boundary are only to be cut when all surrounding Payment Units have been paid.

2 - Timber Specifications

2.1 - Included Timber

2.1.7 - Leave tree marked unit(s) (6/14)

Within Payment Unit(s) 1, 2, and 3, cut all trees that are two (2) inches or more at DBH except trees marked with green paint above and below stump height. Also, leave all white pine and oak trees less than four (4) inches at DBH.

2.1.11 - Description of timber note (2/04)

Note that Misc Species 2 is dead oak, which may be cut throughout the sale.

3 - Payments

3.3 - Pre-measured Sales

3.3.4 - Dividing payment units (7/14)

Payment Unit(s) greater than \$15,000 may be divided at the request of the Purchaser and upon approval of the Unit Manager. Dividing Payment Units is a contract modification which requires a Timber Sale Contract Supplement. There will be only one division per Payment Unit.

3.4 - Damaged Timber

3.4.1 - Damaged timber (6/14)

General Condition and Requirement 3.4 Damaged Timber, defines liquidated damages for undesignated live merchantable trees which are cut or injured. In addition, extreme care should be taken to avoid damage to tree seedlings and saplings. Within the sale area, if more than 25% of the tree seedlings or saplings (1/4" to 4.5" DBH) within a specified portion of the sale area are damaged, liquidated damages will be assessed at \$300 per acre for all acreage within that specified portion of the sale area that was damaged.

4 - Transportation

4.1 - Construction

4.1.3 - Slash and earthen piles (8/04)

Piles or windrows of earth along roads and landings that have been widened or constructed shall be leveled. Slash from road maintenance or construction, including stumps, shall be dispersed throughout the sale.

4.1.6 - Road construction (1/09)

Construction of new roads or improvements of existing roads shall be done in such a way as to minimize the environmental and visual impacts. Merchantable trees shall be cut and utilized unless otherwise directed. Non-merchantable trees shall be severed and laid flat on the ground. Slash shall be scattered, and not left in windrows and kept a minimum of 10 feet back from the road edge. Stumps shall be set upright, not left on edge, and be moved at least 10 feet away from the road edge. Disturbed soil shall be feathered into the woods and not left in berms or windrows.

4.1.7 - Road closure (10/11)

All new roads built into the sale must be blocked to vehicle traffic within 30 days of completion of hauling. Overgrown roads that are reopened shall be considered new roads. In general, this will require constructing a four (4') foot high berm of stumps and logs covered with earth. Contact the sale administrator for specific details of design and placement.

5 - Operations

5.1 - Notification

5.1.1 - Pre-sale conference (10/11)

A pre-sale conference on site between the Purchaser and sale administrator is required prior to beginning any operations to determine landing and road locations. The sale administrator must be contacted at least 3 days in advance to schedule the conference.

5.1.4 - Post-sale conference (6/11)

A post-sale conference on site between the Purchaser and sale administrator is required 3 days prior to the completion of active logging operations to determine clean-up and repair of landings, road edges, and the fulfillment of other contract specifications.

5.2 - Conduct of Operations

5.2.1 - Slash

5.2.1.8 - Slash height (12/08)

No slash or tree tops may exceed 36 inches in height.

5.2.2 - Hazard Trees/Snags

5.2.2.1 - Den trees (2/04)

Obvious hollow and/or den trees shall be protected and left standing unless they are a safety hazard.

5.2.3 - Operating Restrictions

5.2.3.4 - Oak wilt restriction (6/10)

Within Payment Unit(s) 1, 2, and 3, unless changed by written agreement, cutting, and skidding are not permitted during the period of April 15 to July 15. This is necessary to reduce the spread of oak wilt. For more information, contact the Unit Manager or his/her representative.

5.2.32 - Decking/landing restoration (9/13)

All decking and landing areas must have the surface area restored to a condition equal to or better than before. This is to ensure the proper regeneration of the stand. Wood debris, chips and "cookies" from trimmings must be removed or scattered away from landing and loading areas and may not be windrowed on the edge.

5.2.38 - No decking against live trees (2/04)

Cut products may not be decked against unmarked or designated leave trees.

5.4 - Soil Protection

5.4.1 - Rutting restriction, general (1/09)

Operations are to cease immediately if equipment and weather conditions result in rutting of roads and skid trails which is 12 inches or greater in depth and 50 feet in length. The Unit Manager or his/her representative may restrict hauling and/or skidding if ruts exceed the specified depth. With the Unit Manager or his/her representative's approval, the Purchaser may return to the area when the risk of rutting has decreased.

5.4.4 - Slope protection (5/15)

Skid trails and roads on slopes shall be water barred with slash, stumps, and/or clean straw bales native to the area as soon as use is complete to prevent erosion.

6 - Safety and Fire Prevention

6.2 - Signing

6.2.1 - Road posting (9/09)

The Purchaser is responsible for posting and maintaining caution signs on haul road(s) prior to beginning operations. The road must be posted at appropriate distances from the sale area to warn of logging activity and truck traffic. Signs must be removed when harvest operations are suspended or completed. The Purchaser will provide these signs.



TIMBER SALE MAP

This information provided by authority of Part 525, 1994 PA 451, as amended.

Forest Management Unit Traverse City FMU	County Kalkaska	Mapped By Armstrong	Date 7/12/2016	Page 1	of 1
Township 27N	Range 5W	Section(s) and Subdivision(s) Sec 24: NESW, NWSE, SESW, SWSE; Sec 25: NENW, NWNE	Scale 1:15,840		

Cover Type				Density	
A = Aspen	H = Hemlock	N = Marsh	U = Upland Brush	0 = Non Stocked	5 = Pole Timber Medium
B = Paper Birch	J = Jack Pine	O = Oak	UM = Upland Mixed	1 = Seedling Sapling Poor	6 = Pole Timber Well
C = Cedar	L = Lowland Brush	P = Lowland Poplar	V = Bog or Marsh	2 = Seedling Sapling Medium	7 = Saw Timber Poor
D = Tread Bog	LM = Lowland Mixed	Q = Mixed Swamp Conifer	W = White Pine	3 = Seedling Sapling Well	8 = Saw Timber Medium
E = Swamp Hdwoods	M = Mpl, Bch, Brch	R = Red Pine	X = Non Stocked	4 = Pole Timber Poor	9 = Saw Timber Well
F = Spruce Fir	MC = Mixed Conifer	S = Black Spruce	Z = Water		
G = Grass	MD = Mixed Deciduous	T = Tamarack			

Payment Unit	Acres
1	13.3
2	17.7
3	23.5

Obata Oak
Compartment 116
54.5 acres

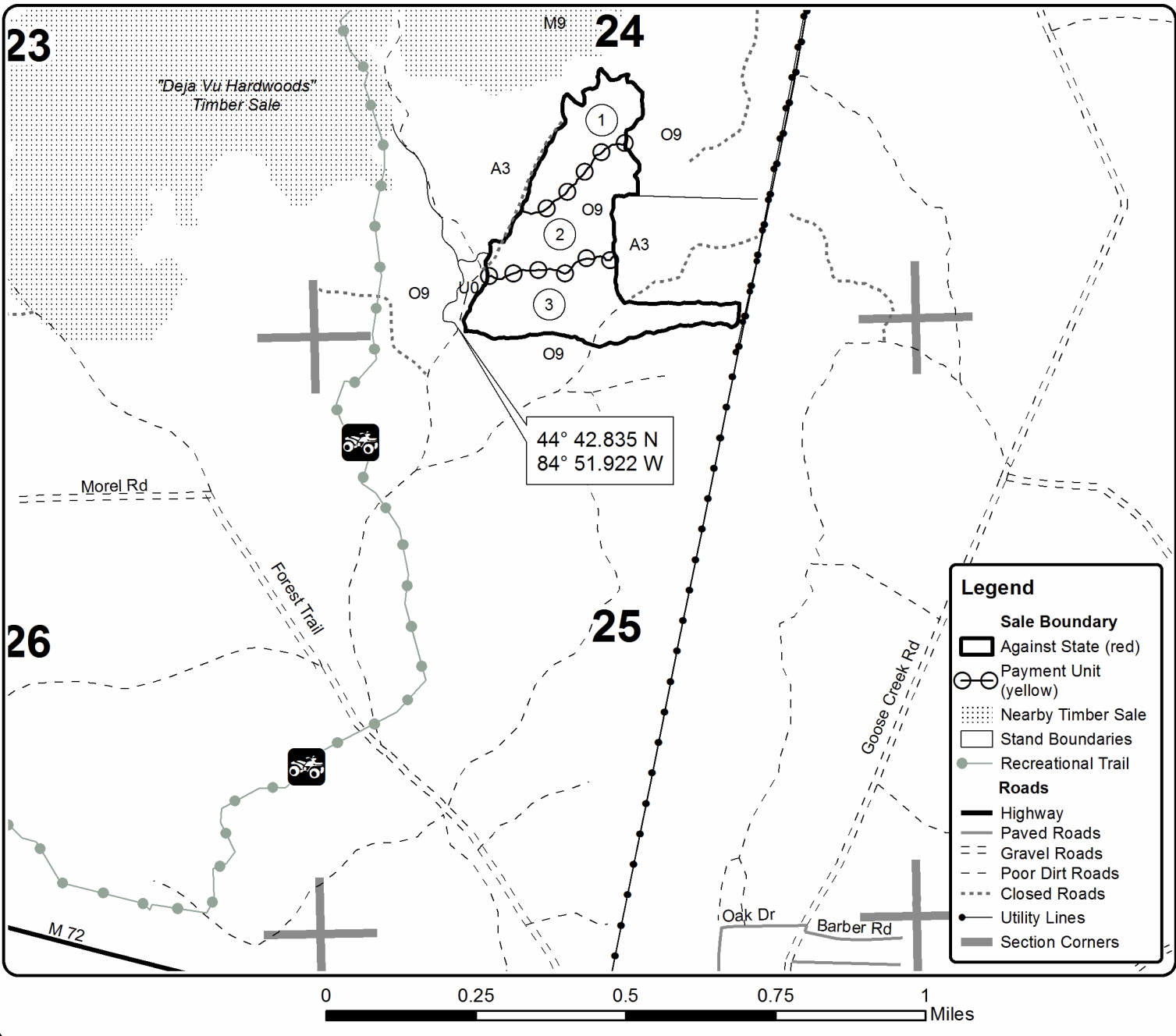

Bruin Pond RP (61-134-16)
 ; Kalkaska COUNTY

In response to the notice of sale to be held 4:00 p.m. (local time) on October 3, 2016, I am hereby submitting my sealed bid (firm offer) for the following forest products to be cut. Bids for individual species must be at or above the advertised price. All non-responsive bid forms may be rejected.

<u>PRODUCTS & SPECIES</u>	<u>ESTIMATED VOLUME*</u>	<u>ADVERTISED PRICE</u>	<u>BID PRICE</u>
Sawtimber			
B. T. Aspen	1.30 MBF	\$ 113.00/MBF	\$ _____
Red Pine	112.60 MBF	\$ 142.00/MBF	\$ _____
White Pine	14.20 MBF	\$ 98.00/MBF	\$ _____
Pulpwood			
B. T. Aspen	7.00 Cords	\$ 24.25/Cord	\$ _____
Balsam Fir	2.00 Cords	\$ 16.45/Cord	\$ _____
Jack Pine	11.00 Cords	\$ 12.85/Cord	\$ _____
Mixed Aspen	41.00 Cords	\$ 24.25/Cord	\$ _____
Mixed Hardwood	19.00 Cords	\$ 22.65/Cord	\$ _____
Red Pine	746.00 Cords	\$ 47.75/Cord	\$ _____
White Pine	94.00 Cords	\$ 20.10/Cord	\$ _____

*The volumes are statistically estimated within plus (+) or minus (-) 15.12 percent. These estimated volumes are final and not subject to adjustment. Prospective bidders are urged to examine this timber and to make their own estimates of quantity and quality.

I understand that any or all bids may be rejected. All bids must be signed and all bid items must be bid or the bid form may be rejected. I also understand that consideration and awarding a contract will be based upon my past performance and ability to complete the contract based upon equipment and staffing subject to my control.

FEDERAL ID: _____ or SOCIAL SECURITY NUMBER: _____

Company or individual bidding: _____

Company representative's name: _____

Address: _____

City: _____ State: _____ Zip: _____

IF AVAILABLE, PLEASE PLACE THE PERSONALIZED LABEL FROM YOUR PROSPECTUS IN THE ABOVE BOX.

Individual or company representative's signature: _____ Date: _____

Phone number : _____ Email (optional): _____

THE WINNING BIDDER MUST COMPLETE THE VERIFICATION OF WORKER'S DISABILITY COMPENSATION ACT COMPLIANCE (ON REVERSE SIDE IF DOUBLE SIDED) WITHIN 21 DAYS OF SALE AWARD DATE



FOR DEPARTMENT USE ONLY	
Sale Number (XX - XXX - XX - XX)	
Forest Management Unit:	

TIMBER SALE VERIFICATION OF WORKER'S DISABILITY COMPENSATION ACT COMPLIANCE

As required by Act 317, P.A. 1969 (Worker's Compensation) and
Part 5 of Act 451 of 1994, as amended.

VERIFICATION OF WORKER'S DISABILITY COMPENSATION ACT COMPLIANCE

- This verification must be completed and submitted within 21 days of contract award and prior to the issuance of the timber sale contract.
- In addition, if boxes 2B or 2C are checked, then Notice of Exclusion or Certificate of Insurance must be submitted within twenty-one (21) days of the contract award and prior to the issuance of the timber sale contract.
- All information must be typed or printed except for written signatures.

Please Check Appropriate Categories:

1. My business is organized as (you **must** check one of the boxes below):
 - A. Sole Proprietorship (individual)
 - B. Partnership
 - C. Corporation
2. You **must** check one of the boxes below:
 - A. I certify my business is a sole proprietorship and it has no employees but the sole proprietor. I am not subject to the Worker's Compensation Laws.
 - B. I certify my business has satisfied its obligation to the Worker's Compensation Act through the use of an approved Notice of Exclusion (BWC-337, Rev. 5/96). I will provide a copy of the Notice of Exclusion within 21 days of the contract award. (For questions or a copy of the BWC-337, please call the Worker's Compensation Bureau at 517-322-1195).
 - C. I certify my business has a Worker's Compensation Policy. I will provide an original Certificate of Insurance within twenty-one (21) days of the contract award.
3. If you have checked item 2(A) or 2(B), you **must** indicate the number of **both** full-time and part-time employees, other than yourself, including family members and active partners (if none, you must enter "0").

_____ Full-time Employees

_____ Part-time Employees

Name of Business		Federal ID (or) Social Security No.	
Address		Telephone ()	
City	State	ZIP	

I hereby certify that the above information is true and correct. I agree to notify the Michigan DNR of any changes that occur in factors affecting my coverage during any of my present and future operations.

Signature of Owner or Authorized Representative

Title

Date

Please complete the "SEALED BID" information on the next page

Obata Oak (61-152-16)
 ; Kalkaska COUNTY

In response to the notice of sale to be held 4:00 p.m. (local time) on October 3, 2016, I am hereby submitting my sealed bid (firm offer) for the following forest products to be cut. Bids for individual species must be at or above the advertised price. All non-responsive bid forms may be rejected.

<u>PRODUCTS & SPECIES</u>	<u>ESTIMATED VOLUME*</u>	<u>ADVERTISED PRICE</u>	<u>BID PRICE</u>
Sawtimber			
B. T. Aspen	2.30 MBF	\$ 120.00/MBF	\$ _____
Red Maple	1.20 MBF	\$ 190.00/MBF	\$ _____
Red Oak	295.50 MBF	\$ 285.00/MBF	\$ _____
Red Pine	4.80 MBF	\$ 151.00/MBF	\$ _____
White Oak	49.40 MBF	\$ 74.00/MBF	\$ _____
Pulpwood			
B. T. Aspen	47.00 Cords	\$ 25.70/Cord	\$ _____
Misc. Species 2	21.00 Cords	\$ 4.50/Cord	\$ _____
Mixed Hardwood	24.00 Cords	\$ 24.00/Cord	\$ _____
Red Oak	674.00 Cords	\$ 19.95/Cord	\$ _____
Red Pine	3.00 Cords	\$ 50.55/Cord	\$ _____
White Oak	171.00 Cords	\$ 19.95/Cord	\$ _____
White Pine	7.00 Cords	\$ 21.30/Cord	\$ _____

*The volumes are statistically estimated within plus (+) or minus (-) 8.27 percent. These estimated volumes are final and not subject to adjustment. Prospective bidders are urged to examine this timber and to make their own estimates of quantity and quality.

I understand that any or all bids may be rejected. All bids must be signed and all bid items must be bid or the bid form may be rejected. I also understand that consideration and awarding a contract will be based upon my past performance and ability to complete the contract based upon equipment and staffing subject to my control.

FEDERAL ID: _____ or SOCIAL SECURITY NUMBER: _____
 Company or individual bidding: _____
 Company representative's name: _____
 Address: _____
 City: _____ State: _____ Zip: _____

IF AVAILABLE, PLEASE PLACE THE PERSONALIZED LABEL FROM YOUR PROSPECTUS IN THE ABOVE BOX.

Individual or company representative's signature: _____ Date: _____

Phone number : _____ Email (optional): _____

THE WINNING BIDDER MUST COMPLETE THE VERIFICATION OF WORKER'S DISABILITY COMPENSATION ACT COMPLIANCE (ON REVERSE SIDE IF DOUBLE SIDED) WITHIN 21 DAYS OF SALE AWARD DATE



TIMBER SALE VERIFICATION OF WORKER'S DISABILITY COMPENSATION ACT COMPLIANCE

As required by Act 317, P.A. 1969 (Worker's Compensation) and
Part 5 of Act 451 of 1994, as amended.

FOR DEPARTMENT USE ONLY
Sale Number (XX - XXX - XX - XX)
Forest Management Unit:

VERIFICATION OF WORKER'S DISABILITY COMPENSATION ACT COMPLIANCE

- This verification must be completed and submitted within 21 days of contract award and prior to the issuance of the timber sale contract.
- In addition, if boxes 2B or 2C are checked, then Notice of Exclusion or Certificate of Insurance must be submitted within twenty-one (21) days of the contract award and prior to the issuance of the timber sale contract.
- All information must be typed or printed except for written signatures.

Please Check Appropriate Categories:

- My business is organized as (you **must** check one of the boxes below):
 - A. Sole Proprietorship (individual)
 - B. Partnership
 - C. Corporation
- You **must** check one of the boxes below:
 - A. I certify my business is a sole proprietorship and it has no employees but the sole proprietor. I am not subject to the Worker's Compensation Laws.
 - B. I certify my business has satisfied its obligation to the Worker's Compensation Act through the use of an approved Notice of Exclusion (BWC-337, Rev. 5/96). I will provide a copy of the Notice of Exclusion within 21 days of the contract award. (For questions or a copy of the BWC-337, please call the Worker's Compensation Bureau at 517-322-1195).
 - C. I certify my business has a Worker's Compensation Policy. I will provide an original Certificate of Insurance within twenty-one (21) days of the contract award.
- If you have checked item 2(A) or 2(B), you **must** indicate the number of **both** full-time and part-time employees, other than yourself, including family members and active partners (if none, you must enter "0").

_____ Full-time Employees

_____ Part-time Employees

Name of Business		Federal ID (or) Social Security No.	
Address		Telephone ()	
City	State	ZIP	

I hereby certify that the above information is true and correct. I agree to notify the Michigan DNR of any changes that occur in factors affecting my coverage during any of my present and future operations.

Signature of Owner or Authorized Representative

Title

Date

Please complete the "SEALED BID" information on the next page

Culicidae Pine (61-141-16)
 ; Kalkaska COUNTY

In response to the notice of sale to be held 4:00 p.m. (local time) on October 3, 2016, I am hereby submitting my sealed bid (firm offer) for the following forest products to be cut. Bids for individual species must be at or above the advertised price. All non-responsive bid forms may be rejected.

<u>PRODUCTS & SPECIES</u>	<u>ESTIMATED VOLUME*</u>	<u>ADVERTISED PRICE</u>	<u>BID PRICE</u>
Sawtimber			
Basswood	35.80 MBF	\$ 100.00/MBF	\$ _____
Black Cherry	3.40 MBF	\$ 293.00/MBF	\$ _____
Mixed Aspen	3.90 MBF	\$ 113.00/MBF	\$ _____
Paper Birch	0.30 MBF	\$ 43.00/MBF	\$ _____
Red Maple	13.30 MBF	\$ 180.00/MBF	\$ _____
Red Pine	635.10 MBF	\$ 142.00/MBF	\$ _____
Sugar Maple	25.80 MBF	\$ 305.00/MBF	\$ _____
White Pine	104.70 MBF	\$ 98.00/MBF	\$ _____
Pulpwood			
Balsam Fir	6.00 Cords	\$ 16.45/Cord	\$ _____
Basswood	134.00 Cords	\$ 17.25/Cord	\$ _____
Mixed Aspen	36.00 Cords	\$ 24.25/Cord	\$ _____
Mixed Hardwood	151.00 Cords	\$ 22.65/Cord	\$ _____
Red Pine	495.00 Cords	\$ 47.75/Cord	\$ _____
White Pine	194.00 Cords	\$ 20.10/Cord	\$ _____

*The volumes are statistically estimated within plus (+) or minus (-) 13.19 percent. These estimated volumes are final and not subject to adjustment. Prospective bidders are urged to examine this timber and to make their own estimates of quantity and quality.

I understand that any or all bids may be rejected. All bids must be signed and all bid items must be bid or the bid form may be rejected. I also understand that consideration and awarding a contract will be based upon my past performance and ability to complete the contract based upon equipment and staffing subject to my control.

FEDERAL ID: ____ - ____ - ____ or SOCIAL SECURITY NUMBER: ____ - ____ - ____
 Company or individual bidding: _____
 Company representative's name: _____
 Address: _____
 City: _____ State: _____ Zip: _____

IF AVAILABLE, PLEASE PLACE THE PERSONALIZED LABEL FROM YOUR PROSPECTUS IN THE ABOVE BOX.

Individual or company representative's signature: _____ Date: _____

Phone number : _____ Email (optional): _____

THE WINNING BIDDER MUST COMPLETE THE VERIFICATION OF WORKER'S DISABILITY COMPENSATION ACT COMPLIANCE (ON REVERSE SIDE IF DOUBLE SIDED) WITHIN 21 DAYS OF SALE AWARD DATE



FOR DEPARTMENT USE ONLY
Sale Number (XX - XXX - XX - XX)
Forest Management Unit:

TIMBER SALE VERIFICATION OF WORKER'S DISABILITY COMPENSATION ACT COMPLIANCE

*As required by Act 317, P.A. 1969 (Worker's Compensation) and
Part 5 of Act 451 of 1994, as amended.*

VERIFICATION OF WORKER'S DISABILITY COMPENSATION ACT COMPLIANCE

- This verification must be completed and submitted within 21 days of contract award and prior to the issuance of the timber sale contract.
- In addition, if boxes 2B or 2C are checked, then Notice of Exclusion or Certificate of Insurance must be submitted within twenty-one (21) days of the contract award and prior to the issuance of the timber sale contract.
- All information must be typed or printed except for written signatures.

Please Check Appropriate Categories:

1. My business is organized as (you **must** check one of the boxes below):
 - A. Sole Proprietorship (individual)
 - B. Partnership
 - C. Corporation

2. You **must** check one of the boxes below:
 - A. I certify my business is a sole proprietorship and it has no employees but the sole proprietor. I am not subject to the Worker's Compensation Laws.
 - B. I certify my business has satisfied its obligation to the Worker's Compensation Act through the use of an approved Notice of Exclusion (BWC-337, Rev. 5/96). I will provide a copy of the Notice of Exclusion within 21 days of the contract award. (For questions or a copy of the BWC-337, please call the Worker's Compensation Bureau at 517-322-1195).
 - C. I certify my business has a Worker's Compensation Policy. I will provide an original Certificate of Insurance within twenty-one (21) days of the contract award.

3. If you have checked item 2(A) or 2(B), you **must** indicate the number of **both** full-time and part-time employees, other than yourself, including family members and active partners (if none, you must enter "0").

_____ Full-time Employees

_____ Part-time Employees

Name of Business		Federal ID (or) Social Security No.	
Address		Telephone ()	
City	State	ZIP	

I hereby certify that the above information is true and correct. I agree to notify the Michigan DNR of any changes that occur in factors affecting my coverage during any of my present and future operations.

Signature of Owner or Authorized Representative

Title

Date

Please complete the "SEALED BID" information on the next page

Honeymoon Cabin Mix (61-147-16)
 ; Kalkaska COUNTY

In response to the notice of sale to be held 4:00 p.m. (local time) on October 3, 2016, I am hereby submitting my sealed bid (firm offer) for the following forest products to be cut. Bids for individual species must be at or above the advertised price. All non-responsive bid forms may be rejected.

<u>PRODUCTS & SPECIES</u>	<u>ESTIMATED VOLUME*</u>	<u>ADVERTISED PRICE</u>	<u>BID PRICE</u>
Sawtimber			
Mixed Aspen	10.60 MBF	\$ 107.00/MBF	\$ _____
Red Oak	30.30 MBF	\$ 254.00/MBF	\$ _____
Red Pine	86.20 MBF	\$ 134.00/MBF	\$ _____
White Pine	43.10 MBF	\$ 92.00/MBF	\$ _____
Pulpwood			
Jack Pine	12.00 Cords	\$ 12.05/Cord	\$ _____
Mixed Aspen	130.00 Cords	\$ 22.80/Cord	\$ _____
Mixed Hardwood	89.00 Cords	\$ 21.35/Cord	\$ _____
Red Oak	141.00 Cords	\$ 17.70/Cord	\$ _____
Red Pine	97.00 Cords	\$ 44.90/Cord	\$ _____
White Pine	167.00 Cords	\$ 18.95/Cord	\$ _____

*The volumes are statistically estimated within plus (+) or minus (-) 12.53 percent. These estimated volumes are final and not subject to adjustment. Prospective bidders are urged to examine this timber and to make their own estimates of quantity and quality.

I understand that any or all bids may be rejected. All bids must be signed and all bid items must be bid or the bid form may be rejected. I also understand that consideration and awarding a contract will be based upon my past performance and ability to complete the contract based upon equipment and staffing subject to my control.

FEDERAL ID: _____ or SOCIAL SECURITY NUMBER: _____

Company or individual bidding: _____

Company representative's name: _____

Address: _____

City: _____ State: _____ Zip: _____

IF AVAILABLE, PLEASE PLACE THE PERSONALIZED LABEL FROM YOUR PROSPECTUS IN THE ABOVE BOX.

Individual or company representative's signature: _____ Date: _____

Phone number : _____ Email (optional): _____

THE WINNING BIDDER MUST COMPLETE THE VERIFICATION OF WORKER'S DISABILITY COMPENSATION ACT COMPLIANCE (ON REVERSE SIDE IF DOUBLE SIDED) WITHIN 21 DAYS OF SALE AWARD DATE



FOR DEPARTMENT USE ONLY	
Sale Number (XX - XXX - XX - XX)	
Forest Management Unit:	

TIMBER SALE VERIFICATION OF WORKER'S DISABILITY COMPENSATION ACT COMPLIANCE

As required by Act 317, P.A. 1969 (Worker's Compensation) and
Part 5 of Act 451 of 1994, as amended.

VERIFICATION OF WORKER'S DISABILITY COMPENSATION ACT COMPLIANCE

- This verification must be completed and submitted within 21 days of contract award and prior to the issuance of the timber sale contract.
- In addition, if boxes 2B or 2C are checked, then Notice of Exclusion or Certificate of Insurance must be submitted within twenty-one (21) days of the contract award and prior to the issuance of the timber sale contract.
- All information must be typed or printed except for written signatures.

Please Check Appropriate Categories:

1. My business is organized as (you **must** check one of the boxes below):
 - A. Sole Proprietorship (individual)
 - B. Partnership
 - C. Corporation
2. You **must** check one of the boxes below:
 - A. I certify my business is a sole proprietorship and it has no employees but the sole proprietor. I am not subject to the Worker's Compensation Laws.
 - B. I certify my business has satisfied its obligation to the Worker's Compensation Act through the use of an approved Notice of Exclusion (BWC-337, Rev. 5/96). I will provide a copy of the Notice of Exclusion within 21 days of the contract award. (For questions or a copy of the BWC-337, please call the Worker's Compensation Bureau at 517-322-1195).
 - C. I certify my business has a Worker's Compensation Policy. I will provide an original Certificate of Insurance within twenty-one (21) days of the contract award.
3. If you have checked item 2(A) or 2(B), you **must** indicate the number of **both** full-time and part-time employees, other than yourself, including family members and active partners (if none, you must enter "0").

_____ Full-time Employees

_____ Part-time Employees

Name of Business		Federal ID (or) Social Security No.	
Address		Telephone ()	
City	State	ZIP	

I hereby certify that the above information is true and correct. I agree to notify the Michigan DNR of any changes that occur in factors affecting my coverage during any of my present and future operations.

Signature of Owner or Authorized Representative

Title

Date

Please complete the "SEALED BID" information on the next page

No Red Pine Left Behind (61-133-16)
 ; Kalkaska COUNTY

In response to the notice of sale to be held 4:00 p.m. (local time) on October 3, 2016, I am hereby submitting my sealed bid (firm offer) for the following forest products to be cut. Bids for individual species must be at or above the advertised price. All non-responsive bid forms may be rejected.

<u>PRODUCTS & SPECIES</u>	<u>ESTIMATED VOLUME*</u>	<u>ADVERTISED PRICE</u>	<u>BID PRICE</u>
Sawtimber			
Mixed Aspen	9.70 MBF	\$ 113.00/MBF	\$ _____
Red Maple	40.90 MBF	\$ 180.00/MBF	\$ _____
Red Pine	830.20 MBF	\$ 142.00/MBF	\$ _____
White Pine	67.10 MBF	\$ 98.00/MBF	\$ _____
Pulpwood			
Beech	136.00 Cords	\$ 22.65/Cord	\$ _____
Jack Pine	18.00 Cords	\$ 12.85/Cord	\$ _____
Mixed Aspen	151.00 Cords	\$ 24.25/Cord	\$ _____
Mixed Hardwood	353.00 Cords	\$ 22.65/Cord	\$ _____
Red Pine	494.00 Cords	\$ 47.75/Cord	\$ _____
White Pine	160.00 Cords	\$ 20.10/Cord	\$ _____

*The volumes are statistically estimated within plus (+) or minus (-) 10.10 percent. These estimated volumes are final and not subject to adjustment. Prospective bidders are urged to examine this timber and to make their own estimates of quantity and quality.

I understand that any or all bids may be rejected. All bids must be signed and all bid items must be bid or the bid form may be rejected. I also understand that consideration and awarding a contract will be based upon my past performance and ability to complete the contract based upon equipment and staffing subject to my control.

FEDERAL ID: _____ or SOCIAL SECURITY NUMBER: _____
 Company or individual bidding: _____
 Company representative's name: _____
 Address: _____
 City: _____ State: _____ Zip: _____

IF AVAILABLE, PLEASE PLACE THE PERSONALIZED LABEL FROM YOUR PROSPECTUS IN THE ABOVE BOX.

Individual or company representative's signature: _____ Date: _____

Phone number : _____ Email (optional): _____

THE WINNING BIDDER MUST COMPLETE THE VERIFICATION OF WORKER'S DISABILITY COMPENSATION ACT COMPLIANCE (ON REVERSE SIDE IF DOUBLE SIDED) WITHIN 21 DAYS OF SALE AWARD DATE



FOR DEPARTMENT USE ONLY
Sale Number (XX - XXX - XX - XX)
Forest Management Unit:

TIMBER SALE VERIFICATION OF WORKER'S DISABILITY COMPENSATION ACT COMPLIANCE

*As required by Act 317, P.A. 1969 (Worker's Compensation) and
Part 5 of Act 451 of 1994, as amended.*

VERIFICATION OF WORKER'S DISABILITY COMPENSATION ACT COMPLIANCE

- This verification must be completed and submitted within 21 days of contract award and prior to the issuance of the timber sale contract.
- In addition, if boxes 2B or 2C are checked, then Notice of Exclusion or Certificate of Insurance must be submitted within twenty-one (21) days of the contract award and prior to the issuance of the timber sale contract.
- All information must be typed or printed except for written signatures.

Please Check Appropriate Categories:

1. My business is organized as (you **must** check one of the boxes below):
 - A. Sole Proprietorship (individual)
 - B. Partnership
 - C. Corporation
2. You **must** check one of the boxes below:
 - A. I certify my business is a sole proprietorship and it has no employees but the sole proprietor. I am not subject to the Worker's Compensation Laws.
 - B. I certify my business has satisfied its obligation to the Worker's Compensation Act through the use of an approved Notice of Exclusion (BWC-337, Rev. 5/96). I will provide a copy of the Notice of Exclusion within 21 days of the contract award. (For questions or a copy of the BWC-337, please call the Worker's Compensation Bureau at 517-322-1195).
 - C. I certify my business has a Worker's Compensation Policy. I will provide an original Certificate of Insurance within twenty-one (21) days of the contract award.
3. If you have checked item 2(A) or 2(B), you **must** indicate the number of **both** full-time and part-time employees, other than yourself, including family members and active partners (if none, you must enter "0").

_____ Full-time Employees

_____ Part-time Employees

Name of Business		Federal ID (or) Social Security No.	
Address		Telephone ()	
City	State	ZIP	

I hereby certify that the above information is true and correct. I agree to notify the Michigan DNR of any changes that occur in factors affecting my coverage during any of my present and future operations.

Signature of Owner or Authorized Representative

Title

Date

Please complete the "SEALED BID" information on the next page