



**DEPARTMENT OF NATURAL RESOURCES
STATE OF MICHIGAN**

TIMBER SALE PROSPECTUS #5832

SCHEDULED SALE DATE AND TIME: 3:00 p.m. (local time) on February 16, 2017.

LOCATION: NEWBERRY MGMT UNIT, PO BOX 428, 5666 STATE HWY M-123, NEWBERRY, MI 49868.

PROSPECTUS NOTE: The bidder is advised to inspect the sale area and review the location, estimated volumes, operating costs and contract terms of proposed sales. Please be aware that some landowners may request 60 days or more notice for access across their land.

Notice is hereby given that bids will be received by the Unit Manager, NEWBERRY MANAGEMENT UNIT, for certain timber on the following described lands:

Out of Gas Lowlands (42-005-16)

Luce County, Advertised Price \$63,345.95, 137.7 Acres, Spruce/Fir/Tamarack, White Pine.

SALE NOTE: A snowmobile trail (Charcoal Grade) is shown on the Timber Sale Map. See sale spec 5.2.41 for restrictions.

Access will be needed across private property to gain access to sale area. Contact Newberry Field Office for details.

A recreation site such as a trail, pathway, or campground is within the sale area or the vicinity. Certain restrictions/specifications may be applicable including time restrictions. Access may be through private land.

Comp 78 North (42-015-16)

Luce County, Advertised Price \$116,610.30, 222.4 Acres, Hardwood, Spruce/Fir/Tamarack.

SALE NOTE: No new roads will be permitted in Payment Units 1, 2, 3 and 5.

Within Payment Unit(s) 6, 8 and 9, harvesting is limited to the period of December 15 to April 1 due to low ground nature of the sale area.

Within Payment Unit(s) 3, 4 and 7, harvesting is not permitted during the period of April 15 to July 15 due to bark slippage.

Within Payment Unit(s) 1-5 and 7, it is recommended that harvesting occur during summer or frozen winter conditions due to potential for rutting during wet season conditions.

The Charcoal Grade is a snowmobile trail and is shown on the Timber Sale Map. See Sale Spec 5.2.41 for restrictions.

A recreation site such as a trail, pathway, or campground is within the sale area or the vicinity. Certain restrictions/specifications may be applicable including time restrictions.

Buckies SBW (42-020-16)

Luce County, Advertised Price \$28,660.30, 51.8 Acres, Spruce/Fir/Tamarack, White Pine.

SALE NOTE: No new roads will be permitted in any Payment Unit.

This sale has received damage from spruce budworm. Purchaser should harvest the sale as soon as possible.

BID INSTRUCTIONS (VER. 09/02/2016):

1. Scheduled Bid Location, Date, and Time (2/11)

Bids must be received by the Unit Manager, NEWBERRY OFFICE, PO BOX 428 5666 STATE HWY M-123, NEWBERRY, MI 49868, no later than 3:00 p.m. (local time) on February 16, 2017. For further information concerning this sale, contact Keith Magnusson at 906-293-3293 extension 4740.

2. Bidder's Qualifications (5/16)

Purchaser shall obtain workers compensation insurance to cover claims under Michigan's Worker's Disability Compensation Act of 1969 or similar employee benefit act of any other state applicable to an employee. If all or part of a timber sale was prepared by a private contractor, the contractor and that contractor's company are not permitted to bid on the timber sale contract. Bids will not be accepted from individuals or companies appearing on the DNR/FRD No-Bid List. This list contains the names of purchasers who previously failed to execute a contract within 21-days or who have a history of poor performance.

3. Preparation of Sealed Bids (5/16)

Bid Forms may be completed online thru Michigan DNR Timber Sale Online Bidding (OLB) at www.michigan.gov/timberbidding or by completing the hardcopy Bid Form found in the Timber Sale Prospectus. Hardcopy Bid Forms shall be manually signed in ink. Registration in OLB is considered your 'signature' for all bids submitted thru that system. Bid prices must be entered for each species and product in the Bid Price column for all material subject to bidding and all fill-in blanks must be completed. If erasures or other changes appear on the hardcopy Bid Form, each erasure or change must be initialed by the person signing the bid.

4. Submission of Sealed Bids (5/16)

Bid forms may be obtained from the Unit Manager or thru OLB. Bids may be submitted hardcopy or thru OLB. All hardcopy bids must be submitted on the bid form and in an envelope clearly identified as described in this section. NOTE: Only one bid form per bid envelope. Sealed bids must be submitted to the Unit office designated in the prospectus and must be submitted at or prior to the time established in the prospectus. The envelope should show on the outside (a) the sale name or number and (b) the date and time of bid opening, as shown in the prospectus. Bids received after the time specified in the sale prospectus are late bids and will be rejected.

It is possible for a bidder to submit multiple bids on a single sale. For example, a bid may be submitted hardcopy and a bid may be submitted thru OLB. Or, two bidders from the same company could both submit bids on the same sale. If this were to happen, the State would accept all bids received and award the contract accordingly. All bidding and contractual requirements would apply to all bids received.

5. Public Opening of Sealed Bids (7/16)

If conditions permit, the sealed bids will be publicly opened and posted at the time and place set in the prospectus.

If a bidder, present at a bid opening, has submitted bids on more than one sale, that bidder may withdraw their unopened bid envelopes or announce the withdrawal of their online bid after being declared the successful bidder on one sale.

6. Award of Contract (1/11)

Award of the contract will be made to the Bidder whose bid, conforming to the prospectus, is most advantageous to the State of Michigan on the basis of total value at rates bid for the estimated quantities. The State reserves the right to reject any bid or waive any minor irregularity in bids received. A written award mailed (or otherwise furnished) to the successful Bidder shall be deemed to result in a binding contract without further action by either party.

7. Down Payment (1/11)

The Bidder to whom award is made must make a down payment within 21 days of the sale award. The amount of the down payment will be calculated as shown in the Bond and Payment Schedule of this prospectus. Only cash may be used to meet this requirement.

8. Performance Security (1/11)

As guarantee of faithful performance, a cash bond, certificate of deposit, surety bond or irrevocable letter of credit (LOC) is required within 21 days of the sale award. The amount of the performance security is shown in the Bond and

Payment Schedule of this prospectus. If an LOC or surety is used, the coverage must extend for at least 6 months beyond the contract expiration.

9. Timber Sale Contract (9/14)

Additional conditions and requirements common to all timber sales are listed on the timber sale contract (R4031) and are available on line at www.michigan.gov/timber. Contact the Unit Manager for additional information or a sample contract. Within 21 days of the date of the award letter, the bidder must sign the contract and provide the required down payment, performance security, and verification of worker's disability compensation. The down payment and performance security shall be in accordance with the provisions of the timber sale contract, in the sums stated in this prospectus. If these actions are not taken, then the Bidder, the Bidder's corporation, and the corporation's principals may not be permitted to bid on State timber sales for a period of 1 year. In addition, the Bidder certifies that if awarded this contract, the Bidder will complete the timber sale contract in accordance with its terms and any modifications thereof including requirements to purchase, cut, and remove the included timber by the expiration date.

10. Disclaimer of Estimates and Bidder's Warranty of Inspection (7/16)

Before submitting this bid, the Bidder is advised and cautioned to inspect the sale area, review the requirements of the sale contract, and take other steps as may be reasonably necessary to ascertain the location, estimated volumes, construction estimates, and operating costs of the proposed sale. Failure to do so will not relieve the Bidder from responsibility for completing the contract.

The Bidder warrants that this bid is submitted solely on the basis of the Bidder's examination and inspection of the quality and quantity of the timber offered for sale and the Bidder's opinion of the value thereof and the costs of recovery. No reliance should be placed on the State of Michigan's estimates of timber quality, quantity or costs of recovery. Bidder further acknowledges that the State of Michigan: (i) expressly disclaims any warranty of fitness of timber for any purpose; (ii) offers this timber as is without any warranty of quality (merchantability) or quantity and (iii) expressly disclaims any warranty as to the quantity or quality of timber sold.

11. Certification and Chain-of-Custody (10/14)

Unless otherwise indicated in the contract under section 7 – Other Conditions of the Sale Specific Conditions & Requirements, the area encompassed by this timber sale is certified to the standards of the Forest Stewardship Council (FSC) - Certificate #SCS-FM/COC-00090N and the Sustainable Forestry Initiative (SFI) - Certificate # NSF-SFIS-5Y031-SF5. Forest products from this sale may be delivered to the mill as "FSC 100% and / or SFI certified" as long as the contractor hauling the forest products is chain-of-custody (COC) certified or covered under a COC certificate from the destination mill. The purchaser is responsible for maintaining COC after leaving the sale area.

12. Good Neighbor Authority (GNA) Requirements (7/16)

If the name of this timber sales contains the acronym GNA, it is authorized by the Good Neighbor Authority (GNA) and covered by various agreements between the U.S. Forest Service and the State. The timber sale occurs on federal land and the following conditions apply:

GNA contracts on US Forest Service land will not be awarded to purchasers on the Federal list of excluded parties. The System for Award Management (SAM) will be checked for active excluded parties prior to award of contract. In addition, the Bidder to whom award is made must complete an Assurance Regarding Felony Conviction or Tax Delinquent Status for Corporate Applicants (AD-3031).

13. Good Neighbor Authority (GNA) Requirements, con't (9/16)

Bidder certifies, by signing this bid form, that to the best of Bidder's knowledge that the following representations are accurate and complete.

- a. That the Bidder and its principals are not presently debarred, suspended, proposed for debarment, declared ineligible, or voluntary excluded from timber sales (covered transactions) by any Federal department or agency.
- b. That the Bidder and its principals have not within a 3-year period preceding this bid been convicted of or had a civil judgment rendered against them for commission of fraud or a criminal offense in connection with obtaining, attempting to obtain, or performing a public (Federal, State, or local) transaction or contract under a public transaction; violation of Federal or State antitrust statutes or commission of embezzlement, theft, forgery, bribery, falsification or destruction of records, making false statements, or receiving stolen property.

c. That the Bidder and its principals are not presently indicted for or otherwise criminally or civilly charged by a governmental entity (Federal, State, or local) with commission of any of the offenses enumerated in paragraph b of this certification.

d. That the Bidder and its principals have not within a 3-year period preceding this bid had one or more public transactions (Federal, State, or local) terminated for breach or default of a timber or forest product contract.

Bidders that cannot certify this requirement, in whole or in part, shall submit an explanation with their bid.

KEITH CREAGH

Director

TIMBER SALE INFORMATION

Out of Gas Lowlands (42-005-16)

Luce County (Advertised Price \$63,345.95)

SALE NOTE: A snowmobile trail (Charcoal Grade) is shown on the Timber Sale Map. See sale spec 5.2.41 for restrictions.

Access will be needed across private property to gain access to sale area. Contact Newberry Field Office for details.

A recreation site such as a trail, pathway, or campground is within the sale area or the vicinity. Certain restrictions/specifications may be applicable including time restrictions. Access may be through private land.

A timber sale contract for this lump sum, sealed bid timber sale will be awarded to the responsible bidder offering the highest sealed bid price. Bids must be at or above the following advertised price for each species:

<u>PRODUCTS & SPECIES</u>	<u>ESTIMATED UNITS*</u>	<u>ADVERTISED PRICE</u>
Pulpwood		
American Elm	1.00 Cords	\$ 30.60 / Cord
Balsam Fir	72.00 Cords	\$ 19.15 / Cord
Black Spruce	760.00 Cords	\$ 33.95 / Cord
Jack Pine	86.00 Cords	\$ 42.45 / Cord
N. White Cedar	144.00 Cords	\$ 28.30 / Cord
Paper Birch	59.00 Cords	\$ 24.15 / Cord
Quaking Aspen	21.00 Cords	\$ 38.20 / Cord
Red Maple	50.00 Cords	\$ 30.60 / Cord
Red Pine	75.00 Cords	\$ 78.50 / Cord
Tamarack	831.00 Cords	\$ 18.25 / Cord
White Pine	149.00 Cords	\$ 24.15 / Cord

* The total volume is statistically estimated within plus (+) or minus (-) 13.59 percent. The estimated units are final and not subject to adjustment. Prospective bidders are urged to examine this timber and to make their own estimates of quantity and quality.

BOND AND PAYMENT SCHEDULE:

1. A bond in the amount of \$3,800.00 to insure faithful performance of the conditions of the contract will be deposited by the successful bidder within 21 days of the sale award.
2. Cutting in any sale or unit without the required advance payment would be considered a trespass.
3. Total payment must be paid in advance or according to the following schedule:
 - (a) Ten percent (10%) of the sale value must be paid within 21 days of the sale award.
 - (b) The 10% down payment will be credited towards the first unit cut.
4. If no cutting takes place, the 10% down payment will not be refunded.
5. Operations on the contract issued will terminate on 12/31/2019.

Description of Timber by Payment Unit (PU)

PU	MARKET GROUP	PRODUCT	QUANTITY	UNIT	ACRES	ADVERTISE PRICE
1	American Elm Balsam Fir Black Spruce Jack Pine N. White Cedar Paper Birch Quaking Aspen Red Maple Tamarack	Pulpwood	1.0 20.0 119.0 27.0 40.0 19.0 3.0 14.0 226.0	Cords Cords Cords Cords Cords Cords Cords Cords Cords	32.7	\$11,858.15
2	Balsam Fir Black Spruce Jack Pine N. White Cedar Paper Birch Quaking Aspen Red Maple Tamarack	Pulpwood	18.0 102.0 24.0 35.0 15.0 2.0 11.0 192.0	Cords Cords Cords Cords Cords Cords Cords Cords	27.8	\$10,096.15
3	Balsam Fir Black Spruce Jack Pine N. White Cedar Paper Birch Quaking Aspen Red Maple Tamarack	Pulpwood	9.0 55.0 13.0 19.0 8.0 1.0 6.0 103.0	Cords Cords Cords Cords Cords Cords Cords Cords	14.9	\$5,423.90
4	Balsam Fir Black Spruce Jack Pine N. White Cedar Paper Birch Quaking Aspen Red Maple Red Pine Tamarack White Pine	Pulpwood	18.0 148.0 22.0 35.0 15.0 5.0 11.0 11.0 205.0 9.0	Cords Cords Cords Cords Cords Cords Cords Cords Cords Cords	31.6	\$13,005.65
5	Balsam Fir Black Spruce N. White Cedar Quaking Aspen Red Maple Red Pine Tamarack White Pine	Pulpwood	2.0 163.0 6.0 1.0 7.0 26.0 14.0 113.0	Cords Cords Cords Cords Cords Cords Cords Cords	11.4	\$11,019.80
6	Balsam Fir Black Spruce N. White Cedar Paper Birch Quaking Aspen Red Maple Red Pine Tamarack White Pine	Pulpwood	5.0 173.0 9.0 2.0 9.0 1.0 38.0 91.0 27.0	Cords Cords Cords Cords Cords Cords Cords Cords Cords	19.3	\$11,942.30
TOTAL:			2,248.0	Cords		

Sale Specific Conditions & Requirements

Sale Name: Out of Gas Lowlands

Sale Number: 42-005-16 Seq#: 1

1 - Sale Area

1.2 - Boundaries

1.2.1 - Painted boundaries (1/14)

The sale boundary and Payment Unit boundaries are marked and identified by red and yellow paint. Exterior sale boundary lines against state are marked with red paint. Interior Payment Unit boundaries are marked with yellow paint. The painted boundary line trees are not Included Timber and are to be protected. Yellow painted trees designating an interior Payment Unit boundary are only to be cut when all surrounding Payment Units have been paid.

2 - Timber Specifications

2.1 - Included Timber

2.1.2 - Clearcut unit(s) w/o unmerchantable trees (8/11)

Within Payment Unit(s) 4, 5, 6, cut all trees which meet minimum piece specifications in 2.2 Utilization. DO NOT CUT any hemlock in any unit. DO NOT CUT any red pine or white pine in Payment Units 1-3. Sub-merchantable trees shall be left and are not to be cut unless needed for harvesting operations.

3 - Payments

3.3 - Pre-measured Sales

3.3.4 - Dividing payment units (7/14)

Payment Unit(s) #'s 1, 2 and 4 may be divided at the request of the Purchaser and upon approval of the Unit Manager.

Dividing Payment Units is a contract modification which requires a Timber Sale Contract Supplement. There will be only one division per Payment Unit.

4 - Transportation

4.1 - Construction

4.1.6 - Road construction (1/09)

Construction of new roads or improvements of existing roads shall be done in such a way as to minimize the environmental and visual impacts. Merchantable trees shall be cut and utilized unless otherwise directed. Non-merchantable trees shall be severed and laid flat on the ground. Slash shall be scattered, and not left in windrows and kept a minimum of 10 feet back from the road edge. Stumps shall be set upright, not left on edge, and be moved at least 10 feet away from the road edge. Disturbed soil shall be feathered into the woods and not left in berms or windrows.

4.1.7 - Road closure (10/11)

All new roads built into the sale must be blocked to vehicle traffic upon completion of the sale. All new roads built into the sale must be blocked to vehicle traffic within 30 days of completion of hauling. Overgrown roads that are reopened shall be considered new roads. In general, this will require constructing a four (4') foot high berm of stumps and logs covered with earth. Stumps and brush must be placed along the remainder of the trail. These roads must be rendered impassable to cars and trucks. All stumps from road building and landing construction must be reserved to block any newly constructed roads upon completion of the sale. These stumps must be scattered along the road system to prohibit vehicular movement. Contact the sale administrator for specific details of design and placement.

4.4 - Access

4.4.1 - Private property access (3/11)

Permission for access across private land is the responsibility of the Purchaser.

5 - Operations

5.1 - Notification

5.1.1 - Pre-sale conference (10/11)

A pre-sale conference on site between the Purchaser and sale administrator is required prior to beginning any operations a Payment Unit to determine landing and road locations. The Unit Manager or his/her representative must be contacted at least 5 days in advance to schedule the conference.

5.1.4 - Post-sale conference (6/11)

A post-sale conference on site between the Purchaser and sale administrator is required 5 days prior to the completion of active logging operations to determine clean-up and repair of landings, road edges, and the fulfillment of other contract specifications. It is recommended to contact sale Administrator prior to removing equipment from the site to ensure proper road work and closures have been completed successfully.

5.2 - Conduct of Operations

5.2.1 - Slash

5.2.1.8 - Slash height (12/08)

No slash or tree tops may exceed 24 inches in height.

5.2.2 - Hazard Trees/Snags

5.2.2.1 - Den trees (2/04)

Obvious hollow and/or den trees shall be protected and left standing unless they are a safety hazard.

5.2.3 - Operating Restrictions

5.2.3.1 - Operating restrictions (9/11)

Within Payment Unit(s) #'s 1-6, unless changed by written agreement, cutting, skidding and hauling are limited to the period of December 15 to March 15. This restriction is because of the low wet ground the sale is located on to prevent rutting or damage to existing roads.

5.2.38 - No decking against live trees (2/04)

Cut products may not be decked against unmarked or designated leave trees.

5.2.41 - Snowmobile trail protection (9/11)

The snowmobile is shown on the Timber Sale Map. Do not cut or damage posts with orange trail markers or traffic control signs. If the trail is used, it must be maintained and restored to a condition equal to or better than before the sale. The road maintenance/restoration must be done prior to December 1. If the trail is used for hauling, it must be graded to the satisfaction of the Unit Manager or his/her representative prior to December 1. If the trail road is to be used for hauling during the snowmobile season, then a snow covered base must be left on the trail.

5.4 - Soil Protection

5.4.1 - Rutting restriction, general (1/09)

Operations are to cease immediately if equipment and weather conditions result in rutting of roads and skid trails which is 12 inches or greater in depth and 50 feet in length. The Unit Manager or his/her representative may restrict hauling and/or skidding if ruts exceed the specified depth. With the Unit Manager or his/her representative's approval, the Purchaser may return to the area when the risk of rutting has decreased.

5.4.5 - Soil caution (11/04)

Care must be taken to minimize soil damage within the sale area. The sale area is mostly wet/low soil types.

5.8 - Protection of Endangered Species

5.8.5 - Protection of raptor nests (3/13)

All trees with raptor nests will be protected if found during harvesting operations. Notification will be made to the Unit Manager or his/her representative who will notify the Wildlife Biologist so an on-site evaluation and recommendation can be made, if necessary.

6 - Safety and Fire Prevention

6.2 - Signing

6.2.2 - Snowmobile trail posting (8/09)

The Purchaser is responsible for posting and maintaining caution signs on Charcoal Grade / Falls Snowmobile Trail prior to beginning operations during the snowmobile season (approximately December 1 to March 31). The trail must be posted at appropriate distances from the sale area to warn of logging activity and truck traffic. Signs must be removed when harvest operations are suspended or completed. The Purchaser will provide these signs.

7 - Other Conditions

7.2 - Extensions

7.2.5 - Weather related extension (1/13)

If weather conditions during the operating period of this contract prevent harvesting, this sale may qualify for a weather related extension. If approved, the normal extension fee would be waived. To qualify, there must be a documented attempt each year to harvest in the difficult portion of the sale.



TIMBER SALE MAP

This information provided by authority of Part 525, 1994 PA 451, as amended.

Sale Number	Year
42-005	16

Forest Management Unit	County	Mapped By	Date	Page	of
Newberry Management Unit	Luce	Payment	6/2/2016	1	1
Township	Range	Section(s) and Subdivision(s)	Scale		
46N	9W	Sec. 2: SWNE, NWNW, SENW, SWNW, NWSE, NESW, NWSW. Sec. 3: NENE, NWNE, SENE, NESE	1:15,840		

Cover Type				Density	
A = Aspen	H = Hemlock	N = Marsh	U = Upland Brush	0 = Non Stocked	5 = Pole Timber Medium
R = Paper Birch	J = Jack Pine	O = Oak	UM = Upland Mixed	1 = Seedling Sapling Poor	6 = Pole Timber Well
C = Cedar	L = Lowland Brush	P = Lowland Poplar	V = Bog or Marsh	2 = Seedling Sapling Medium	7 = Saw Timber Poor
D = Tread Bog	LM = Lowland Mixed	Q = Mixed Swamp Conifer	W = White Pine	3 = Seedling Sapling Well	8 = Saw Timber Medium
E = Swamp Hdwoods	M = Mpl. Bch, Birch	R = Red Pine	X = Non Stocked	4 = Pole Timber Poor	9 = Saw Timber Well
F = Spruce Fir	MC = Mixed Conifer	S = Black Spruce	Z = Water		
G = Grass	MD = Mixed Deciduous	T = Tamarack			

PU	Acres	PU	Acres
1	32.7	4	31.6
2	27.8	5	11.4
3	14.9	6	19.3

Out of Gas Lowlands
Compartment 116
137.7 Acres



Legend

- Against State (Red)
- Private Property
- Payment Unit (Yellow)
- Payment Unit
- Gravel Roads
- Poor Dirt Roads
- Closed Roads
- Streams
- Gate
- Lakes
- 02 Section Numbers
- Section Corners
- Survey Corner

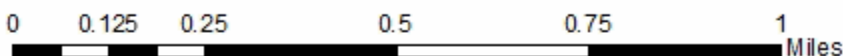
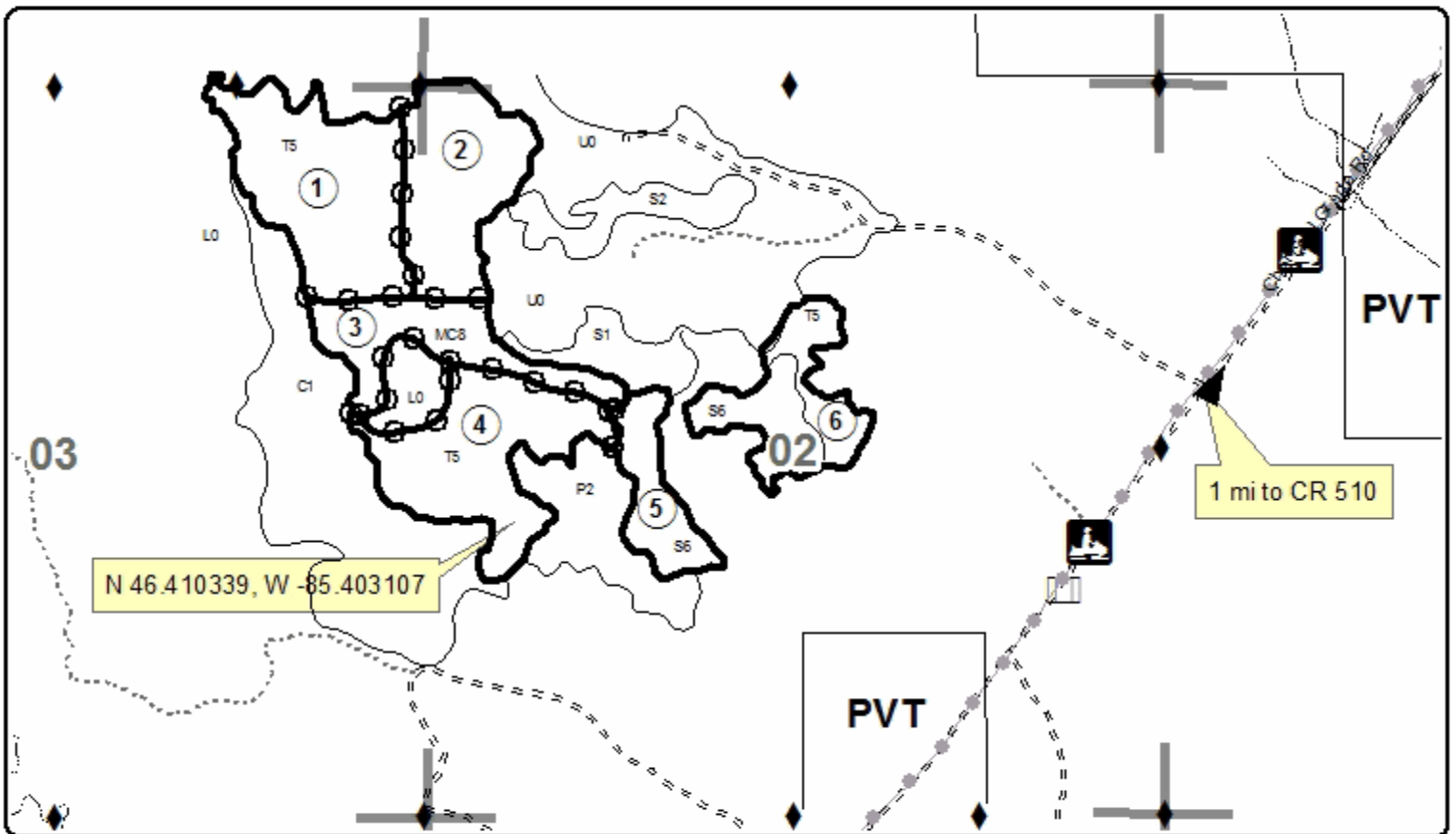

TIMBER SALE INFORMATION

Comp 78 North (42-015-16)

Luce County (Advertised Price \$116,610.30)

SALE NOTE: No new roads will be permitted in Payment Units 1, 2, 3 and 5.

Within Payment Unit(s) 6, 8 and 9, harvesting is limited to the period of December 15 to April 1 due to low ground nature of the sale area.

Within Payment Unit(s) 3, 4 and 7, harvesting is not permitted during the period of April 15 to July 15 due to bark slippage.

Within Payment Unit(s) 1-5 and 7, it is recommended that harvesting occur during summer or frozen winter conditions due to potential for rutting during wet season conditions.

The Charcoal Grade is a snowmobile trail and is shown on the Timber Sale Map. See Sale Spec 5.2.41 for restrictions.

A recreation site such as a trail, pathway, or campground is within the sale area or the vicinity. Certain restrictions/specifications may be applicable including time restrictions.

A timber sale contract for this lump sum, sealed bid timber sale will be awarded to the responsible bidder offering the highest sealed bid price. Bids must be at or above the following advertised price for each species:

<u>PRODUCTS & SPECIES</u>	<u>ESTIMATED UNITS*</u>	<u>ADVERTISED PRICE</u>
Sawtimber		
Red Maple	67.60 MBF	\$ 161.00 / MBF
Sugar Maple	9.90 MBF	\$ 636.00 / MBF
White Pine	27.60 MBF	\$ 48.00 / MBF
Pulpwood		
Balsam Fir	598.00 Cords	\$ 19.15 / Cord
Mixed Aspen	135.00 Cords	\$ 38.20 / Cord
Mixed Hardwood	1,630.00 Cords	\$ 30.60 / Cord
Mixed Spruce	647.00 Cords	\$ 33.95 / Cord
N. White Cedar	159.00 Cords	\$ 28.30 / Cord
Paper Birch	65.00 Cords	\$ 24.15 / Cord
Red Pine	13.00 Cords	\$ 78.50 / Cord
Tamarack	24.00 Cords	\$ 18.25 / Cord
White Pine	88.00 Cords	\$ 24.15 / Cord

* The total volume is statistically estimated within plus (+) or minus (-) 9.15 percent. The estimated units are final and not subject to adjustment. Prospective bidders are urged to examine this timber and to make their own estimates of quantity and quality.

BOND AND PAYMENT SCHEDULE:

1. A bond in the amount of \$5,831.00 to insure faithful performance of the conditions of the contract will be deposited by the successful bidder within 21 days of the sale award.
2. Cutting in any sale or unit without the required advance payment would be considered a trespass.
3. Total payment must be paid in advance or according to the following schedule:
 - (a) Ten percent (10%) of the sale value must be paid within 21 days of the sale award.
 - (b) The 10% down payment will be credited towards the first unit cut.
4. If no cutting takes place, the 10% down payment will not be refunded.
5. Operations on the contract issued will terminate on 06/30/2020.

Description of Timber by Payment Unit (PU)

PU	MARKET GROUP	PRODUCT	QUANTITY	UNIT	ACRES	ADVERTISE PRICE
1	Red Maple	Sawtimber	28.3	MBF	24.1	\$16,195.05
	Sugar Maple		1.5	MBF		
	Balsam Fir	Pulpwood	70.0	Cords		
	Mixed Aspen		1.0	Cords		
	<i>Quaking Aspen</i>		1.0	<i>Cords</i>		
	Mixed Hardwood		253.0	Cords		
	<i>Ironwood</i>		2.0	<i>Cords</i>		
	<i>Red Maple</i>		190.0	<i>Cords</i>		
	<i>Sugar Maple</i>		54.0	<i>Cords</i>		
	<i>Yellow Birch</i>		7.0	<i>Cords</i>		
	Mixed Spruce		45.0	Cords		
	<i>Black Spruce</i>		12.0	<i>Cords</i>		
	<i>White Spruce</i>		33.0	<i>Cords</i>		
	Tamarack		2.0	Cords		
	2	Red Maple	Sawtimber	17.5		
Sugar Maple			0.9	MBF		
Balsam Fir		Pulpwood	44.0	Cords		
Mixed Aspen			1.0	Cords		
<i>Quaking Aspen</i>			1.0	<i>Cords</i>		
Mixed Hardwood			155.0	Cords		
<i>Ironwood</i>			1.0	<i>Cords</i>		
<i>Red Maple</i>			117.0	<i>Cords</i>		
<i>Sugar Maple</i>			33.0	<i>Cords</i>		
<i>Yellow Birch</i>			4.0	<i>Cords</i>		
Mixed Spruce			27.0	Cords		
<i>Black Spruce</i>			7.0	<i>Cords</i>		
<i>White Spruce</i>			20.0	<i>Cords</i>		
Tamarack			2.0	Cords		
3		Balsam Fir	Pulpwood	20.0	Cords	16.8
	Mixed Aspen		3.0	Cords		
	<i>Quaking Aspen</i>		3.0	<i>Cords</i>		
	Mixed Hardwood		141.0	Cords		
	<i>Basswood</i>		3.0	<i>Cords</i>		
	<i>Ironwood</i>		1.0	<i>Cords</i>		
	<i>Red Maple</i>		60.0	<i>Cords</i>		
	<i>Sugar Maple</i>		77.0	<i>Cords</i>		
	4	Balsam Fir	Pulpwood	29.0	Cords	
Mixed Aspen			4.0	Cords		
<i>Quaking Aspen</i>			4.0	<i>Cords</i>		
Mixed Hardwood			211.0	Cords		
<i>Basswood</i>			5.0	<i>Cords</i>		
<i>Ironwood</i>			1.0	<i>Cords</i>		
<i>Red Maple</i>			90.0	<i>Cords</i>		
<i>Sugar Maple</i>			115.0	<i>Cords</i>		
5	Sugar Maple	Sawtimber	7.5	MBF	29.4	\$23,012.65
	Balsam Fir	Pulpwood	221.0	Cords		
	Mixed Aspen		105.0	Cords		
	<i>Quaking Aspen</i>		105.0	<i>Cords</i>		
	Mixed Hardwood		131.0	Cords		
	<i>Black Ash</i>		1.0	<i>Cords</i>		
	<i>Red Maple</i>		8.0	<i>Cords</i>		
	<i>Sugar Maple</i>		106.0	<i>Cords</i>		
	<i>Yellow Birch</i>		16.0	<i>Cords</i>		
	Mixed Spruce		155.0	Cords		
	<i>White Spruce</i>		155.0	<i>Cords</i>		
	N. White Cedar		1.0	Cords		

Description of Timber by Payment Unit (PU), con't

PU	MARKET GROUP	PRODUCT	QUANTITY	UNIT	ACRES	ADVERTISE PRICE
5 con't	Paper Birch	Pulpwood	25.0	Cords		
	<i>Paper Birch</i>		25.0	<i>Cords</i>		
	White Pine		4.0	Cords		
6	Red Maple	Sawtimber	19.3	MBF	30.1	\$19,406.60
	Balsam Fir	Pulpwood	95.0	Cords		
	Mixed Hardwood		338.0	Cords		
	<i>Black Ash</i>		19.0	<i>Cords</i>		
	<i>Red Maple</i>		297.0	<i>Cords</i>		
	<i>Sugar Maple</i>		3.0	<i>Cords</i>		
	<i>Yellow Birch</i>		19.0	<i>Cords</i>		
	Mixed Spruce		21.0	Cords		
	<i>Black Spruce</i>		8.0	<i>Cords</i>		
	<i>White Spruce</i>		13.0	<i>Cords</i>		
	N. White Cedar		121.0	Cords		
7	Balsam Fir	Pulpwood	112.0	Cords	23.9	\$6,734.80
	Mixed Hardwood		150.0	Cords		
	<i>Red Maple</i>		120.0	<i>Cords</i>		
	<i>Sugar Maple</i>		30.0	<i>Cords</i>		
8	Red Maple	Sawtimber	0.9	MBF	26.2	\$17,148.10
	White Pine		24.6	MBF		
	Balsam Fir	Pulpwood	4.0	Cords		
	Mixed Aspen		12.0	Cords		
	<i>Quaking Aspen</i>		12.0	<i>Cords</i>		
	Mixed Hardwood		25.0	Cords		
	<i>Red Maple</i>		25.0	<i>Cords</i>		
	Mixed Spruce		359.0	Cords		
	<i>Black Spruce</i>		359.0	<i>Cords</i>		
	N. White Cedar		9.0	Cords		
	Paper Birch		13.0	Cords		
	<i>Paper Birch</i>	<i>Sawtimber</i>	1.5	<i>MBF</i>		
	<i>Paper Birch</i>	<i>Pulpwood</i>	10.0	<i>Cords</i>		
Tamarack		20.0	Cords			
White Pine		58.0	Cords			
9	Red Maple	Sawtimber	1.6	MBF	32.0	\$12,169.30
	White Pine		3.0	MBF		
	Balsam Fir	Pulpwood	3.0	Cords		
	Mixed Aspen		9.0	Cords		
	<i>Quaking Aspen</i>		9.0	<i>Cords</i>		
	Mixed Hardwood		226.0	Cords		
	<i>Red Maple</i>		213.0	<i>Cords</i>		
	<i>Yellow Birch</i>		13.0	<i>Cords</i>		
	Mixed Spruce		40.0	Cords		
	<i>Black Spruce</i>		15.0	<i>Cords</i>		
	<i>White Spruce</i>		25.0	<i>Cords</i>		
	N. White Cedar		28.0	Cords		
	Paper Birch		27.0	Cords		
	<i>Paper Birch</i>	<i>Sawtimber</i>	0.5	<i>MBF</i>		
	<i>Paper Birch</i>	<i>Pulpwood</i>	26.0	<i>Cords</i>		
	Red Pine		13.0	Cords		
	<i>Red Pine</i>	<i>Sawtimber</i>	3.0	<i>MBF</i>		
<i>Red Pine</i>	<i>Pulpwood</i>	7.0	<i>Cords</i>			
White Pine		26.0	Cords			
TOTAL:			105.1	MBF		
TOTAL:			3,359.0	Cords		

Sale Specific Conditions & Requirements

Sale Name: Comp 78 North

Sale Number: 42-015-16 Seq#: 2

1 - Sale Area

1.2 - Boundaries

1.2.1 - Painted boundaries (1/14)

The sale boundary and Payment Unit boundaries are marked and identified by blue, red and yellow paint. Exterior sale boundary lines against private property are marked in blue paint. Exterior sale boundary lines against state are marked with red paint. Interior Retention Areas are also marked with red paint (Payment Unit 6). Interior Payment Unit boundaries are marked with yellow paint, with the exception of the boundaries between Payment Units 3 & 5 and 4 & 5, which are painted red.

2 - Timber Specifications

2.1 - Included Timber

2.1.2 - Clearcut unit(s) w/o unmerchantable trees (8/11)

Within Payment Unit(s) 5, cut all trees which meet minimum piece specifications in 2.2 Utilization. DO NOT CUT any yellow birch, white pine or elm.

Within Payment Unit 6, cut all trees which meet minimum piece specifications in 2.2 Utilization. DO NOT CUT any white pine or hemlock.

Within Payment Units 8 and 9, cut all trees which meet minimum piece specifications in 2.2 Utilization. DO NOT CUT any hemlock, or any white pine greater than 24 inches at diameter breast height (DBH). Also, in Payment Unit 9, DO NOT CUT any yellow birch.

2.1.3 - Cut tree marked unit(s) (12/08)

Within Payment Unit(s) 3, 4 and 7, all trees are designated for cutting when marked with orange paint above and below stump height, regardless of merchantability. In addition, cut all balsam which meet minimum piece specifications in 2.2 Utilization.

2.1.7 - Leave tree marked unit(s) (6/14)

Within Payment Unit(s) 1 and 2, cut all trees which meet minimum piece specifications in 2.2 Utilization. DO NOT CUT any cedar, hemlock, trees marked in GREEN paint, or any white pine over 24 inches at diameter breast height (DBH).

2.1.11 - Description of timber note (2/04)

Note that mixed hardwood pulp consists of red maple, sugar maple, yellow birch, black ash, basswood and ironwood. Mixed aspen consists of both bigtooth and quaking aspen. Mixed spruce consists of both black spruce and white spruce.

2.2 - Utilization

2.2.4 - Skidding length (2/14)

Within Payment Units 3, 4 and 6, skidding of unlimbed tops or lengths over 17 feet is not permissible unless approved by the Unit Manager or his/her representative.

3 - Payments

3.3 - Pre-measured Sales

3.3.4 - Dividing payment units (7/14)

Payment Unit(s) may be divided at the request of the Purchaser and upon approval of the Unit Manager. Dividing Payment Units is a contract modification which requires a Timber Sale Contract Supplement. There will be only one division per Payment Unit.

4 - Transportation

4.1 - Construction

4.1.5 - Culverts (5/14)

Roads may require the installation of temporary culverts for cross drainage or at natural drainage-ways. If culverts are needed in these locations, their placement will be specified by the sale administrator and they shall be installed prior to hauling. The culverts shall be a minimum of 12 inches in diameter and 24 feet in length. When culverts are removed, fill shall be removed from any impacted wetland soils as specified by sale administrator.

4.1.6 - Road construction (1/09)

Construction of new roads or improvements of existing roads shall be done in such a way as to minimize the environmental and visual impacts. Merchantable trees shall be cut and utilized unless otherwise directed. Non-merchantable trees shall be severed and laid flat on the ground. Slash shall be scattered, and not left in windrows and kept a minimum of 10 feet back from the road edge. Stumps shall be set upright, not left on edge, and be moved at least 10 feet away from the road edge. Disturbed soil shall be feathered into the woods and not left in berms or windrows.

The access road into Payment Units 8 and 9 is designated by trees marked with orange paint, following an old road from the east of the units. The location of the road is shown on the attached timber sale map.

4.1.7 - Road closure (10/11)

All new roads built into the sale must be blocked to vehicle traffic within 30 days of completion of hauling. Overgrown and/or abandoned roads that are reopened shall be considered new roads. In general, this will require constructing a four (4') foot high berm of stumps and logs covered with earth at the beginning of any new road course. Stumps and slash must be placed along the road course for a minimum of 200 feet, effectively obliterating it. These roads must be rendered impassable to cars, trucks and ORV's. Stumps from road building and landing construction can be reserved to meet the above road closure specifications. Temporary berms may be required if no sale activity occurs for 30 or more consecutive days. Contact the sale administrator for specific details of design and placement.

4.1.12 - No new roads (1/12)

No new roads will be permitted in Payment Units 1, 2, 3 and 5. All operations are limited to existing roads. Skid trails only will be allowed.

4.2 - Maintenance

4.2.1 - Hauling restriction (12/08)

Hauling may be restricted on the Charcoal Grade and other forest roads by the Unit Manager or his/her representative. The restriction may occur during periods of wet weather conditions, or at any time that the damage to the roads is deemed excessive.

4.2.4 - Grading (12/14)

For completion of the sale, state forest roads must be graded. In general, this will require a road grader or bull dozer to shape up the roads after forest products have been hauled off site. This includes cleaning of drainage areas, grading, crowning and filling with gravel, if necessary. The grading equipment to be used must be approved by the Unit Manager or his/her representative.

4.2.5 - Two wheel drive condition (2/04)

All existing trail roads on and adjacent to the sale area must be passable by two-wheel drive traffic for the duration of the sale.

5 - Operations

5.1 - Notification

5.1.1 - Pre-sale conference (10/16)

A pre-sale conference between the Purchaser and sale administrator is required prior to beginning any sale operations. The Unit Manager or his/her representative must be contacted at least 5 days in advance to schedule the conference.

5.1.4 - Post-sale conference (10/16)

A post-sale conference on site between the Purchaser and sale administrator is required 5 days prior to the completion of active logging operations to determine clean-up and repair of landings, road edges, and the fulfillment of other contract specifications. It is recommended that this conference take place prior to equipment being moved off site.

5.2 - Conduct of Operations

5.2.1 - Slash

5.2.1.8 - Slash height (12/08)

No slash or tree tops may exceed 36 inches in height.

5.2.2 - Hazard Trees/Snags

5.2.2.1 - Den trees (10/16)

Obvious hollow and/or den trees shall be protected and left standing unless they are a safety hazard.

5.2.3 - Operating Restrictions

5.2.3.1 - Operating restrictions (9/11)

Within Payment Unit(s) 6, 8 and 9, unless changed by written agreement, cutting, skidding and hauling are limited to the period of December 15 to April 1. This restriction is due to the low ground nature of the Payment Units and access to the Payment Units.

5.2.3.3 - Bark slippage restriction (3/09)

Within Payment Unit(s) 3, 4 and 7, unless changed by written agreement, cutting and skidding are not permitted during the period of April 15 to July 15. This restriction is because of bark slippage.

5.2.22 - Operating Caution

5.2.22.1 - Operating caution (6/11)

It is recommended, but not required, that within Payment Unit(s) 1, 2, 3, 4, 5, and 7, cutting, skidding and hauling occur during dry summer or frozen winter conditions. The reason for the recommendation to avoid the potential for rutting in wetter times of the year.

5.2.32 - Decking/landing restoration (9/13)

All decking and landing areas must have the surface area restored to a condition equal to or better than before. This is to ensure the proper regeneration of the stand. Wood debris, chips and "cookies" from trimmings must be removed or scattered away from landing and loading areas and may not be windrowed on the edge.

5.2.38 - No decking against live trees (2/04)

Cut products may not be decked against unmarked or designated leave trees.

5.2.41 - Snowmobile trail protection (9/11)

The Charcoal Grade is a snowmobile trail and is shown on the Timber Sale Map. If harvesting operations occur during the snowmobile season, a snow covered base must be left on the trail for the duration of the snowmobile season. No decking of forest products will be permitted along the snowmobile trail. All stumps within 20 feet of the snowmobile trail must be cut at ground level. Do not cut or damage posts with orange trail markers or traffic control signs.

The Charcoal Grade must be maintained and restored to a condition equal to or better than before the sale. It must be graded to the satisfaction of the Unit Manager or his/her representative prior to December 1st of the year following completion of harvest operations.

5.4 - Soil Protection

5.4.1 - Rutting restriction, general (7/16)

Operations are to cease immediately if equipment and weather conditions result in rutting of roads and/or skid trails which is 12 inches or greater in depth and 50 feet in length. The Unit Manager or his/her representative may restrict hauling and/or skidding if ruts exceed the specified depth. With the Unit Manager or his/her representative's approval, the Purchaser may return to the area when the risk of rutting has decreased.

5.8 - Protection of Endangered Species

5.8.5 - Protection of raptor nests (3/13)

All trees with raptor nests will be protected if found during harvesting operations. Notification will be made to the Unit Manager or his/her representative who will notify the Wildlife Biologist so an on-site evaluation and recommendation can be made, if necessary.

6 - Safety and Fire Prevention

6.2 - Signing

6.2.2 - Snowmobile trail posting (8/09)

The Purchaser is responsible for posting and maintaining caution signs on the snowmobile trail (Charcoal Grade) prior to beginning operations during the snowmobile season (approximately December 1 to March 31). The trail must be posted at appropriate distances from the sale area to warn of logging activity and truck traffic. Signs must be removed when harvest operations are suspended or completed. The Purchaser will provide these signs.



TIMBER SALE MAP

This information provided by authority of Part 525, 1984 P.A. 151, as amended.

Forest Management Unit Newberry	County Luce	Mapper By Grossman Forestry / Unit Staff	Date 10/13/2016	Page 1	Year 16
Township T47N	Section(s) and Subdivision(s) NE3W, S1W, NE3E, S1E, SW1/4, NW1/4, NW1/2, S1W, S1E, S1E, SW1/4, NW1/4, NW1/2	Scale 1:15,840	Density		

Cover Type	
H = Hemlock	N = Marsh
J = Jack Pine	O = Oak
L = Lowland Spruce	P = Loblolly Pine
LM = Lowland Mixed	Q = Mixed Swamp Conifer
M = Mp. Soft. Birch	K = Red Pine
MC = Mixed Conifer	S = Black Spruce
MD = Mixed Deciduous	T = Tamarack
A = Aspen	
B = Poplar/Birch	
C = Cedar	
D = Tremble Pine	
E = Redwood-Hickories	
F = Spruce Fir	
G = Grass	

PU	Acres	PU	Acres
1	24.1	6	30.1
2	14.9	7	23.9
3	16.8	8	26.2
4	25.0	9	32.0
5	29.4		

Compartment 78 North

Compartment 78
222.4 Acres

Legend

- Against State (Red)
- Payment Unit (See Sale Specs.)
- Private Line (Blue)
- Access
- Section Corners
- ▨ Retention Area
- ▭ Stand Boundaries
- PVT/Private Property
- Gravel Roads
- Poor Dirt Roads
- Closed Roads
- ◆ Survey Corners
- Recreational Trail
- ▨ Lakes and Rivers
- Streams
- Payment Units

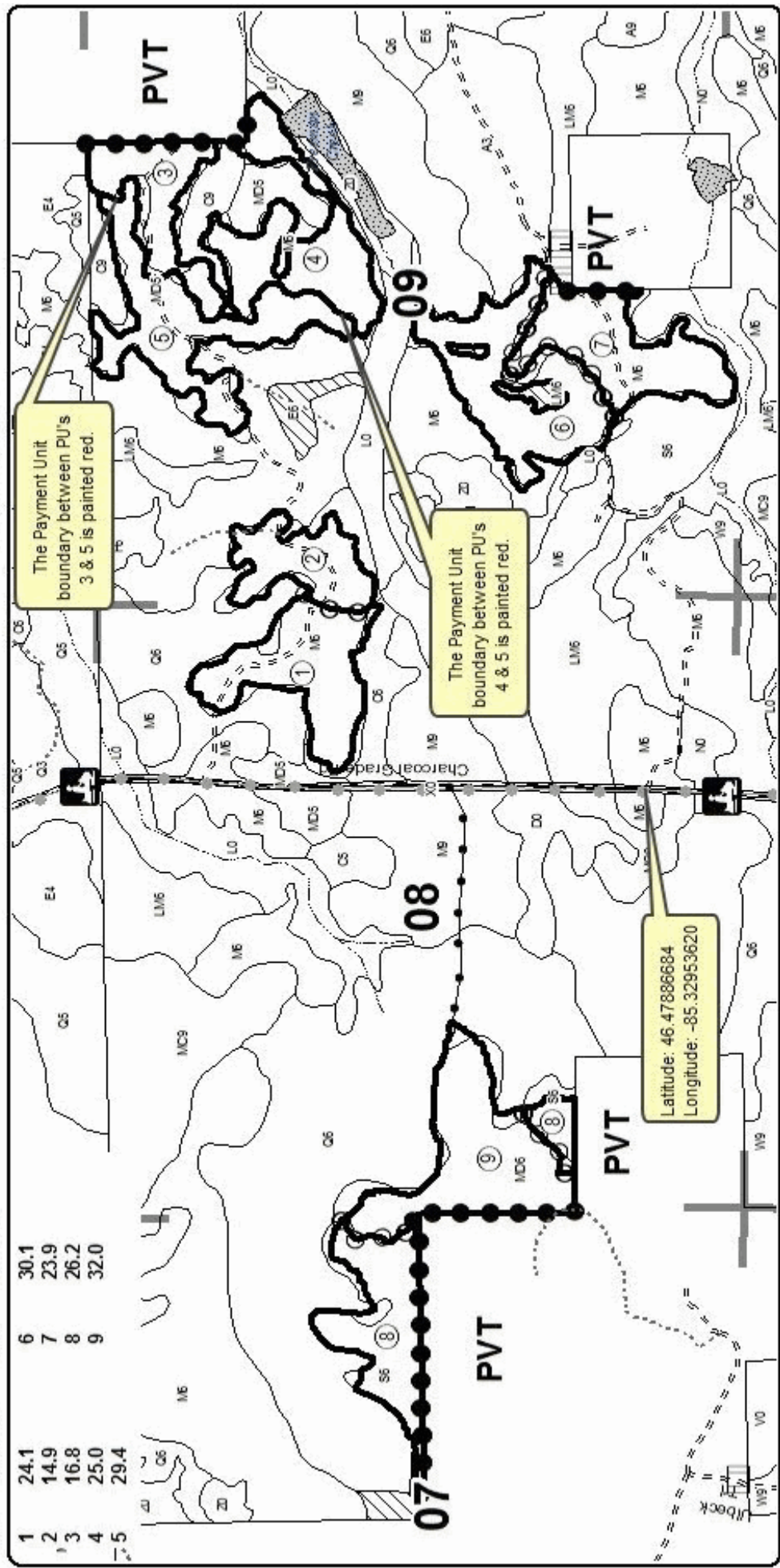

TIMBER SALE INFORMATION

Buckies SBW (42-020-16)

Luce County (Advertised Price \$28,660.30)

SALE NOTE: No new roads will be permitted in any Payment Unit.

This sale has received damage from spruce budworm. Purchaser should harvest the sale as soon as possible.

A timber sale contract for this lump sum, sealed bid timber sale will be awarded to the responsible bidder offering the highest sealed bid price. Bids must be at or above the following advertised price for each species:

<u>PRODUCTS & SPECIES</u>	<u>ESTIMATED UNITS*</u>	<u>ADVERTISED PRICE</u>
Pulpwood		
Balsam Fir	46.00 Cords	\$ 17.85 / Cord
Mixed Aspen	82.00 Cords	\$ 35.65 / Cord
Mixed Hardwood	273.00 Cords	\$ 28.55 / Cord
White Pine	301.00 Cords	\$ 22.55 / Cord
White Spruce	326.00 Cords	\$ 31.70 / Cord

* The total volume is statistically estimated within plus (+) or minus (-) 12.47 percent. The estimated units are final and not subject to adjustment. Prospective bidders are urged to examine this timber and to make their own estimates of quantity and quality.

BOND AND PAYMENT SCHEDULE:

1. A bond in the amount of \$1,433.00 to insure faithful performance of the conditions of the contract will be deposited by the successful bidder within 21 days of the sale award.
2. Cutting in any sale or unit without the required advance payment would be considered a trespass.
3. Total payment must be paid in advance or according to the following schedule:
 - (a) Ten percent (10%) of the sale value must be paid within 21 days of the sale award.
 - (b) The remainder is due before cutting begins.
4. If no cutting takes place, the 10% down payment will not be refunded.
5. Operations on the contract issued will terminate on 12/31/2017.

Description of Timber by Payment Unit (PU)

PU	MARKET GROUP	PRODUCT	QUANTITY	UNIT	ACRES	ADVERTISE PRICE
1	Balsam Fir	Pulpwood	46.0	Cords	51.8	\$28,660.30
	Mixed Aspen		82.0	Cords		
	Mixed Hardwood		273.0	Cords		
	White Pine		301.0	Cords		
	White Spruce		326.0	Cords		
TOTAL:			1,028.0	Cords		

Sale Specific Conditions & Requirements

Sale Name: Buckies SBW

Sale Number: 42-020-16 Seq#: 2

1 - Sale Area

1.2 - Boundaries

1.2.1 - Painted boundaries (1/14)

The sale boundary is marked and identified by red paint.

2 - Timber Specifications

2.1 - Included Timber

2.1.2 - Clearcut unit(s) w/o unmerchantable trees (8/11)

Within Payment Unit(s) # 1, cut all trees which meet minimum piece specifications in 2.2 Utilization except leave one (1) large white pine per acre. Further instructions for these white pine are noted in condition 5.2.4.6.

2.1.11 - Description of timber note (2/04)

Note that mixed hardwood is primarily red maple with small amounts of white birch and black cherry.

3 - Payments

3.3 - Pre-measured Sales

3.3.4 - Dividing payment units (7/14)

Payment Unit(s) # 1 may be divided at the request of the Purchaser and upon approval of the Unit Manager. Dividing Payment Units is a contract modification which requires a Timber Sale Contract Supplement. There will be only one division per Payment Unit.

4 - Transportation

4.1 - Construction

4.1.12 - No new roads (1/12)

No new roads will be permitted in any Payment Unit. All operations are limited to existing roads.

4.2 - Maintenance

4.2.1 - Hauling restriction (12/08)

Hauling may be restricted on forest roads by the Unit Manager or his/her representative. The restriction may occur during wet weather conditions.

4.2.4 - Grading (12/14)

For completion of the sale, state forest roads must be graded. In general, this will require a road grader or bull dozer to shape up the roads after forest products have been hauled off site. This includes cleaning of drainage areas, grading, crowning and filling with gravel, if necessary. The grading equipment to be used must be approved by the Unit Manager or his/her representative.

5 - Operations

5.1 - Notification

5.1.1 - Pre-sale conference (10/11)

A pre-sale conference between the Purchaser and sale administrator is required prior to beginning any operations. The Unit Manager or his/her representative must be contacted at least 5 days in advance to schedule the conference.

5.1.4 - Post-sale conference (6/11)

A post-sale conference on site between the Purchaser and sale administrator is required at least 5 days prior to the completion of active logging operations to determine clean-up and repair of landings, road edges, and the fulfillment of other contract specifications. It is recommended that this take place prior to equipment being moved from the site.

5.2 - Conduct of Operations

5.2.2 - Hazard Trees/Snags

5.2.2.1 - Den trees (2/04)

Obvious hollow and/or den trees shall be protected and left standing unless they are a safety hazard.

5.2.4 - Dead and Down Creation

5.2.4.6 - Dead and down creation, other (9/09)

To improve habitat for snowshoe hare, grouse, and other species, within Payment Unit(s) # 1, 15 - 20 of the large diameter white pine left standing should be felled by hinge cut, per snowshoe hare guidelines. These should be located especially in the south and east portions of the sale. Also, construct 2 - 3 linear brush piles along the west side river buffer and the south aspen edge of the sale. Brush piles should be 6 - 9 feet tall and at least one tree length. It is ideal if the brush pile extends into the adjacent stand slightly.

5.4 - Soil Protection

5.4.1 - Rutting restriction, general (7/16)

Operations are to cease immediately if equipment and weather conditions result in rutting of roads and/or skid trails which is 12 inches or greater in depth and 50 feet in length. The Unit Manager or his/her representative may restrict hauling and/or skidding if ruts exceed the specified depth. With the Unit Manager or his/her representative's approval, the Purchaser may return to the area when the risk of rutting has decreased.

5.8 - Protection of Endangered Species

5.8.5 - Protection of raptor nests (3/13)

All trees with raptor nests will be protected if found during harvesting operations. Notification will be made to the Unit Manager or his/her representative who will notify the Wildlife Biologist so an on-site evaluation and recommendation can be made, if necessary.

7 - Other Conditions

7.2 - Extensions

7.2.6 - Forest health extension (6/13)

This sale contains trees infected with spruce budworm. It is considered at high risk for mortality and/or loss of timber value. The sale must be harvested promptly. One (1), twelve (12) month extension can be applied to one (1) other State Forest Timber Sale Contract owned by the purchaser or owned by one (1) designated sub-contractor of the Purchaser that works this contract. To qualify, the contract expiration date of the contract to be extended must be within twelve (12) months from the issue date of this contract. If this is the first extension on the other State Forest Timber Sale Contract, then the 5% extension fee will be waived. If this is an additional extension, the 10% fee will be reduced to 5%. The forest health extension must be used before this contract is closed-out. This specification does not alleviate the purchaser from any contractual obligations of the extended State Forest Timber Sale Contract. Per General Condition & Requirement 7.2, extensions are at the sole discretion of the DNR.

7.5 - Loss

7.5.1 - Deteriorating timber (7/09)

The sale area has received damage from spruce budworm. The Purchaser should harvest the wood as soon as possible. The Department of Natural Resources is held free of responsibility of any further damage or deterioration due to delay in harvesting.



TIMBER SALE MAP

This information provided by authority of Part 525, 1994 PA 451, as amended.

Sale Number	Year
42 - 020	16

Forest Management Unit	County	Mapped By	Date	Page	of
Newberry	Luce	Douglass	09/26/2016	1	1
Crused By					
Douglass					

Township	Range	Section(s) and Subdivision(s)	Scale
46N	11W	1 - SWNW, SENW, SW1/4, NWSE	1:15,840

Cover Type				Density	
A = Aspen	H = Hemlock	N = Marsh	U = Upland Brush	0 = Non Stocked	5 = Pole Timber Medium
B = Paper Birch	J = Jack Pine	O = Oak	UM = Upland Mixed	1 = Seedling Sapling Poor	6 = Pole Timber Well
C = Cedar	L = Lowland Brush	P = Lowland Poplar	V = Bog or Marsh	2 = Seedling Sapling Medium	7 = Saw Timber Poor
D = Treed Bog	LM = Lowland Mixed	Q = Mixed Swamp Conifer	W = White Pine	3 = Seedling Sapling Well	8 = Saw Timber Medium
E = Swamp Hdwoods	M = Mpl, Bch, Brch	R = Red Pine	X = Non Stocked	4 = Pole Timber Poor	9 = Saw Timber Well
F = Spruce Fir	MC = Mixed Conifer	S = Black Spruce	Z = Water		
G = Grass	MD = Mixed Deciduous	T = Tamarack			

PU Acres
1 51.8

Buckies SBW

Compartment 102

51.8 Acres

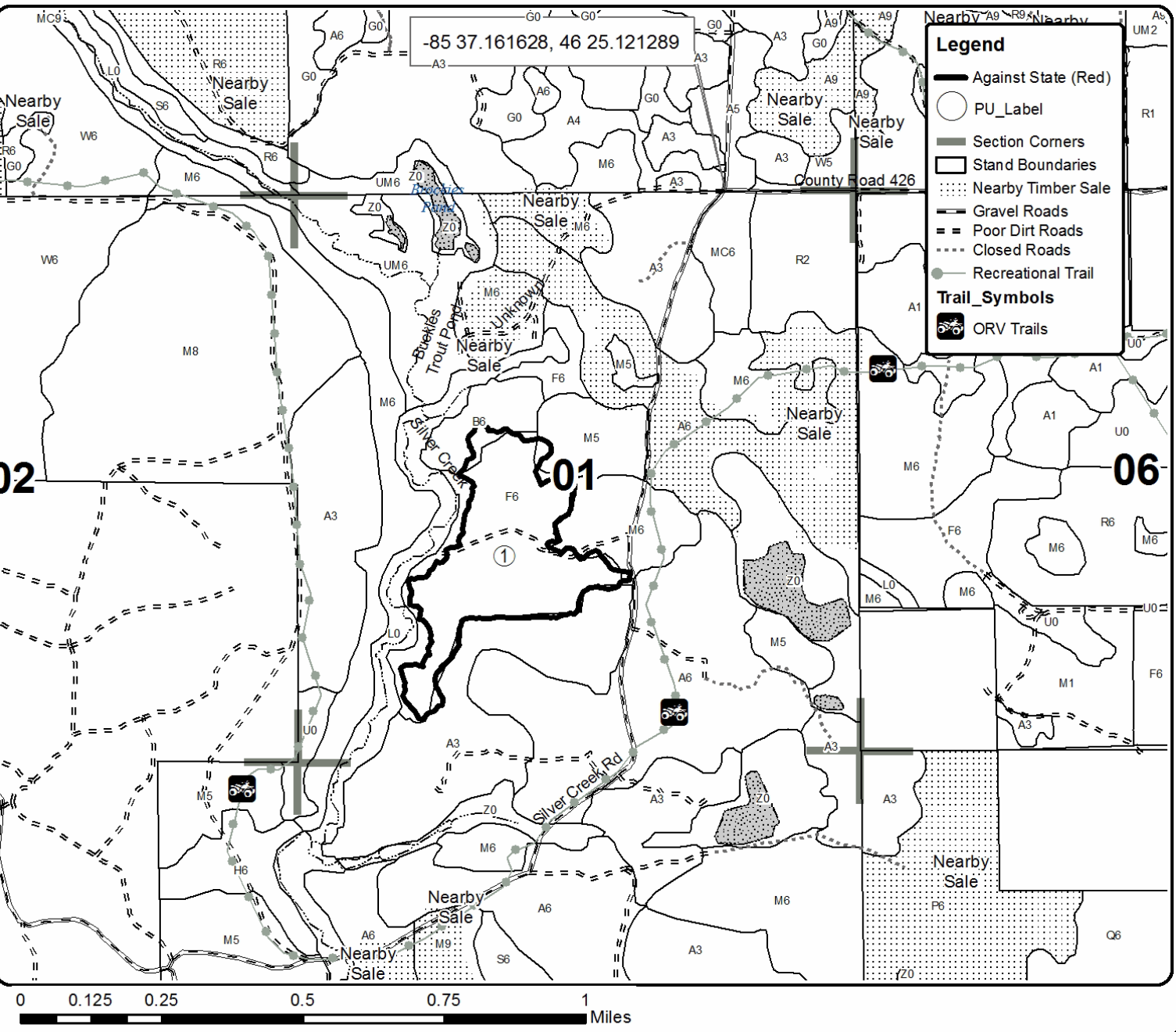

Out of Gas Lowlands (42-005-16)
 ; Luce COUNTY

In response to the notice of sale to be held 3:00 p.m. (local time) on February 16, 2017, I am hereby submitting my sealed bid (firm offer) for the following forest products to be cut. Bids for individual species must be at or above the advertised price. All non-responsive bid forms may be rejected.

<u>PRODUCTS & SPECIES</u>	<u>ESTIMATED VOLUME*</u>	<u>ADVERTISED PRICE</u>	<u>BID PRICE</u>
Pulpwood			
American Elm	1.00 Cords	\$ 30.60/Cord	\$ _____
Balsam Fir	72.00 Cords	\$ 19.15/Cord	\$ _____
Black Spruce	760.00 Cords	\$ 33.95/Cord	\$ _____
Jack Pine	86.00 Cords	\$ 42.45/Cord	\$ _____
N. White Cedar	144.00 Cords	\$ 28.30/Cord	\$ _____
Paper Birch	59.00 Cords	\$ 24.15/Cord	\$ _____
Quaking Aspen	21.00 Cords	\$ 38.20/Cord	\$ _____
Red Maple	50.00 Cords	\$ 30.60/Cord	\$ _____
Red Pine	75.00 Cords	\$ 78.50/Cord	\$ _____
Tamarack	831.00 Cords	\$ 18.25/Cord	\$ _____
White Pine	149.00 Cords	\$ 24.15/Cord	\$ _____

*The volumes are statistically estimated within plus (+) or minus (-) 13.59 percent. These estimated volumes are final and not subject to adjustment. Prospective bidders are urged to examine this timber and to make their own estimates of quantity and quality.

I understand that any or all bids may be rejected. All bids must be signed and all bid items must be bid or the bid form may be rejected. I also understand that consideration and awarding a contract will be based upon my past performance and ability to complete the contract based upon equipment and staffing subject to my control.

FEDERAL ID: _____ - _____ or SOCIAL SECURITY NUMBER: _____ - _____ - _____
 Company or individual bidding: _____
 Company representative's name: _____
 Address: _____
 City: _____ State: _____ Zip: _____

IF AVAILABLE, PLEASE PLACE THE PERSONALIZED LABEL FROM YOUR PROSPECTUS IN THE ABOVE BOX.

Individual or company representative's signature: _____ Date: _____

Phone number : _____ Email (optional): _____

THE WINNING BIDDER MUST COMPLETE THE VERIFICATION OF WORKER'S DISABILITY COMPENSATION ACT COMPLIANCE (ON REVERSE SIDE IF DOUBLE SIDED) WITHIN 21 DAYS OF SALE AWARD DATE



FOR DEPARTMENT USE ONLY	
Sale Number (XX - XXX - XX - XX)	
Forest Management Unit:	

TIMBER SALE VERIFICATION OF WORKER'S DISABILITY COMPENSATION ACT COMPLIANCE

As required by Act 317, P.A. 1969 (Worker's Compensation) and
Part 5 of Act 451 of 1994, as amended.

VERIFICATION OF WORKER'S DISABILITY COMPENSATION ACT COMPLIANCE

- This verification must be completed and submitted within 21 days of contract award and prior to the issuance of the timber sale contract.
- In addition, if boxes 2B or 2C are checked, then Notice of Exclusion or Certificate of Insurance must be submitted within twenty-one (21) days of the contract award and prior to the issuance of the timber sale contract.
- All information must be typed or printed except for written signatures.

Please Check Appropriate Categories:

1. My business is organized as (you **must** check one of the boxes below):
 - A. Sole Proprietorship (individual)
 - B. Partnership
 - C. Corporation
2. You **must** check one of the boxes below:
 - A. I certify my business is a sole proprietorship and it has no employees but the sole proprietor. I am not subject to the Worker's Compensation Laws.
 - B. I certify my business has satisfied its obligation to the Worker's Compensation Act through the use of an approved Notice of Exclusion (BWC-337, Rev. 5/96). I will provide a copy of the Notice of Exclusion within 21 days of the contract award. (For questions or a copy of the BWC-337, please call the Worker's Compensation Bureau at 517-322-1195).
 - C. I certify my business has a Worker's Compensation Policy. I will provide an original Certificate of Insurance within twenty-one (21) days of the contract award.
3. If you have checked item 2(A) or 2(B), you **must** indicate the number of **both** full-time and part-time employees, other than yourself, including family members and active partners (if none, you must enter "0").

_____ Full-time Employees

_____ Part-time Employees

Name of Business		Federal ID (or) Social Security No.	
Address		Telephone ()	
City	State	ZIP	

I hereby certify that the above information is true and correct. I agree to notify the Michigan DNR of any changes that occur in factors affecting my coverage during any of my present and future operations.

Signature of Owner or Authorized Representative

Title

Date

Please complete the "SEALED BID" information on the next page

Comp 78 North (42-015-16)
 ; Luce COUNTY

In response to the notice of sale to be held 3:00 p.m. (local time) on February 16, 2017, I am hereby submitting my sealed bid (firm offer) for the following forest products to be cut. Bids for individual species must be at or above the advertised price. All non-responsive bid forms may be rejected.

<u>PRODUCTS & SPECIES</u>	<u>ESTIMATED VOLUME*</u>	<u>ADVERTISED PRICE</u>	<u>BID PRICE</u>
Sawtimber			
Red Maple	67.60 MBF	\$ 161.00/MBF	\$ _____
Sugar Maple	9.90 MBF	\$ 636.00/MBF	\$ _____
White Pine	27.60 MBF	\$ 48.00/MBF	\$ _____
Pulpwood			
Balsam Fir	598.00 Cords	\$ 19.15/Cord	\$ _____
Mixed Aspen	135.00 Cords	\$ 38.20/Cord	\$ _____
Mixed Hardwood	1,630.00 Cords	\$ 30.60/Cord	\$ _____
Mixed Spruce	647.00 Cords	\$ 33.95/Cord	\$ _____
N. White Cedar	159.00 Cords	\$ 28.30/Cord	\$ _____
Paper Birch	65.00 Cords	\$ 24.15/Cord	\$ _____
Red Pine	13.00 Cords	\$ 78.50/Cord	\$ _____
Tamarack	24.00 Cords	\$ 18.25/Cord	\$ _____
White Pine	88.00 Cords	\$ 24.15/Cord	\$ _____

*The volumes are statistically estimated within plus (+) or minus (-) 9.15 percent. These estimated volumes are final and not subject to adjustment. Prospective bidders are urged to examine this timber and to make their own estimates of quantity and quality.

I understand that any or all bids may be rejected. All bids must be signed and all bid items must be bid or the bid form may be rejected. I also understand that consideration and awarding a contract will be based upon my past performance and ability to complete the contract based upon equipment and staffing subject to my control.

FEDERAL ID: _____ or SOCIAL SECURITY NUMBER: _____

Company or individual bidding: _____

Company representative's name: _____

Address: _____

City: _____ State: _____ Zip: _____

IF AVAILABLE, PLEASE PLACE THE PERSONALIZED LABEL FROM YOUR PROSPECTUS IN THE ABOVE BOX.

Individual or company representative's signature: _____ Date: _____

Phone number : _____ Email (optional): _____

THE WINNING BIDDER MUST COMPLETE THE VERIFICATION OF WORKER'S DISABILITY COMPENSATION ACT COMPLIANCE (ON REVERSE SIDE IF DOUBLE SIDED) WITHIN 21 DAYS OF SALE AWARD DATE



FOR DEPARTMENT USE ONLY
Sale Number (XX – XXX – XX – XX)
Forest Management Unit:

TIMBER SALE VERIFICATION OF WORKER'S DISABILITY COMPENSATION ACT COMPLIANCE

*As required by Act 317, P.A. 1969 (Worker's Compensation) and
Part 5 of Act 451 of 1994, as amended.*

VERIFICATION OF WORKER'S DISABILITY COMPENSATION ACT COMPLIANCE

- This verification must be completed and submitted within 21 days of contract award and prior to the issuance of the timber sale contract.
- In addition, if boxes 2B or 2C are checked, then Notice of Exclusion or Certificate of Insurance must be submitted within twenty-one (21) days of the contract award and prior to the issuance of the timber sale contract.
- All information must be typed or printed except for written signatures.

Please Check Appropriate Categories:

1. My business is organized as (you **must** check one of the boxes below):
 - A. Sole Proprietorship (individual)
 - B. Partnership
 - C. Corporation

2. You **must** check one of the boxes below:
 - A. I certify my business is a sole proprietorship and it has no employees but the sole proprietor. I am not subject to the Worker's Compensation Laws.
 - B. I certify my business has satisfied its obligation to the Worker's Compensation Act through the use of an approved Notice of Exclusion (BWC-337, Rev. 5/96). I will provide a copy of the Notice of Exclusion within 21 days of the contract award. (For questions or a copy of the BWC-337, please call the Worker's Compensation Bureau at 517-322-1195).
 - C. I certify my business has a Worker's Compensation Policy. I will provide an original Certificate of Insurance within twenty-one (21) days of the contract award.

3. If you have checked item 2(A) or 2(B), you **must** indicate the number of **both** full-time and part-time employees, other than yourself, including family members and active partners (if none, you must enter "0").

_____ Full-time Employees

_____ Part-time Employees

Name of Business		Federal ID (or) Social Security No.	
Address		Telephone ()	
City	State	ZIP	

I hereby certify that the above information is true and correct. I agree to notify the Michigan DNR of any changes that occur in factors affecting my coverage during any of my present and future operations.

Signature of Owner or Authorized Representative

Title

Date

Please complete the "SEALED BID" information on the next page

Buckies SBW (42-020-16)
 ; Luce COUNTY

In response to the notice of sale to be held 3:00 p.m. (local time) on February 16, 2017, I am hereby submitting my sealed bid (firm offer) for the following forest products to be cut. Bids for individual species must be at or above the advertised price. All non-responsive bid forms may be rejected.

<u>PRODUCTS & SPECIES</u>	<u>ESTIMATED VOLUME*</u>	<u>ADVERTISED PRICE</u>	<u>BID PRICE</u>
Pulpwood			
Balsam Fir	46.00 Cords	\$ 17.85/Cord	\$ _____
Mixed Aspen	82.00 Cords	\$ 35.65/Cord	\$ _____
Mixed Hardwood	273.00 Cords	\$ 28.55/Cord	\$ _____
White Pine	301.00 Cords	\$ 22.55/Cord	\$ _____
White Spruce	326.00 Cords	\$ 31.70/Cord	\$ _____

*The volumes are statistically estimated within plus (+) or minus (-) 12.47 percent. These estimated volumes are final and not subject to adjustment. Prospective bidders are urged to examine this timber and to make their own estimates of quantity and quality.

I understand that any or all bids may be rejected. All bids must be signed and all bid items must be bid or the bid form may be rejected. I also understand that consideration and awarding a contract will be based upon my past performance and ability to complete the contract based upon equipment and staffing subject to my control.

FEDERAL ID: _____ - _____ or SOCIAL SECURITY NUMBER: _____ - _____ - _____
 Company or individual bidding: _____
 Company representative's name: _____
 Address: _____
 City: _____ State: _____ Zip: _____

IF AVAILABLE, PLEASE PLACE THE PERSONALIZED LABEL FROM YOUR PROSPECTUS IN THE ABOVE BOX.

Individual or company representative's signature: _____ Date: _____

Phone number : _____ Email (optional): _____

THE WINNING BIDDER MUST COMPLETE THE VERIFICATION OF WORKER'S DISABILITY COMPENSATION ACT COMPLIANCE (ON REVERSE SIDE IF DOUBLE SIDED) WITHIN 21 DAYS OF SALE AWARD DATE



FOR DEPARTMENT USE ONLY
Sale Number (XX - XXX - XX - XX)
Forest Management Unit:

TIMBER SALE VERIFICATION OF WORKER'S DISABILITY COMPENSATION ACT COMPLIANCE

*As required by Act 317, P.A. 1969 (Worker's Compensation) and
Part 5 of Act 451 of 1994, as amended.*

VERIFICATION OF WORKER'S DISABILITY COMPENSATION ACT COMPLIANCE

- This verification must be completed and submitted within 21 days of contract award and prior to the issuance of the timber sale contract.
- In addition, if boxes 2B or 2C are checked, then Notice of Exclusion or Certificate of Insurance must be submitted within twenty-one (21) days of the contract award and prior to the issuance of the timber sale contract.
- All information must be typed or printed except for written signatures.

Please Check Appropriate Categories:

1. My business is organized as (you **must** check one of the boxes below):
 - A. Sole Proprietorship (individual)
 - B. Partnership
 - C. Corporation

2. You **must** check one of the boxes below:
 - A. I certify my business is a sole proprietorship and it has no employees but the sole proprietor. I am not subject to the Worker's Compensation Laws.
 - B. I certify my business has satisfied its obligation to the Worker's Compensation Act through the use of an approved Notice of Exclusion (BWC-337, Rev. 5/96). I will provide a copy of the Notice of Exclusion within 21 days of the contract award. (For questions or a copy of the BWC-337, please call the Worker's Compensation Bureau at 517-322-1195).
 - C. I certify my business has a Worker's Compensation Policy. I will provide an original Certificate of Insurance within twenty-one (21) days of the contract award.

3. If you have checked item 2(A) or 2(B), you **must** indicate the number of **both** full-time and part-time employees, other than yourself, including family members and active partners (if none, you must enter "0").

_____ Full-time Employees

_____ Part-time Employees

Name of Business		Federal ID (or) Social Security No.	
Address		Telephone ()	
City	State	ZIP	

I hereby certify that the above information is true and correct. I agree to notify the Michigan DNR of any changes that occur in factors affecting my coverage during any of my present and future operations.

Signature of Owner or Authorized Representative

Title

Date

Please complete the "SEALED BID" information on the next page