



**DEPARTMENT OF NATURAL RESOURCES  
STATE OF MICHIGAN**

**TIMBER SALE PROSPECTUS #5818**

SCHEDULED SALE DATE AND TIME: 10:00 a.m. (local time) on May 23, 2017.

LOCATION: ATLANTA MGMT UNIT, 13501 M-33, ATLANTA, MI 49709.

PROSPECTUS NOTE: The bidder is advised to inspect the sale area and review the location, estimated volumes, operating costs and contract terms of proposed sales. Please be aware that some landowners may request 60 days or more notice for access across their land.

Notice is hereby given that bids will be received by the Unit Manager, ATLANTA MANAGEMENT UNIT, for certain timber on the following described lands:

Spray Here Plz MWR (54-012-17)

Montmorency County, Advertised Price \$32,114.10, 60.6 Acres, Hardwood, Sugar Maple.

SALE NOTE: This is research sale with a short contract length. Cutting and skidding is limited to the period of 8/15/17 to 3/15/18. Payments units must begin by 12/1/17 at the latest. No extensions will be allowed on this sale. However, with stipulations (see spec 7.2.7), a free 1 year extension can be applied to another State Forest Timber Sale Contract. Chipping of tops is required in PU 2. Chipping of tops is highly recommended in PU1.

A recreation site such as a trail, pathway, or campground is within the sale area or the vicinity. Certain restrictions/specifications may be applicable including time restrictions. Access may be through private or other public land.

I 4 C Pine Mix (54-021-16)

Montmorency County, Advertised Price \$112,555.75, 154.2 Acres, Aspen, Red Oak.

SALE NOTE: 5.2.3.1 - Operating restrictions  
-Within Payment Unit(s) 1, 2, and 4-7, unless changed by written agreement, cutting skidding, and hauling is limited to the period of 12/01 to 3/15.

A recreation site such as a trail, pathway, or campground is within the sale area or the vicinity. Certain restrictions/specifications may be applicable including time restrictions.

Uge Winter Aspen (54-022-16)

Montmorency County, Advertised Price \$217,434.45, 340.5 Acres, Aspen, Hardwood.

SALE NOTE: 5.2.3.1 - Operating restrictions (9/11)  
Within Payment Unit(s) 1-9, unless changed by written agreement, cutting, skidding, and hauling is limited to the period of 12/01 to 3/15. This restriction is to protect a potential species of concern, reduce impact with trail users, limit browse, and increase vigor in regeneration.

A recreation site such as a trail, pathway, or campground is within the sale area or the vicinity. Certain restrictions/specifications may be applicable including time restrictions.

628 Jabba the Toad SBW Mix (54-047-16)

Montmorency County, Advertised Price \$11,990.55, 19.1 Acres, Aspen, Spruce/Fir/Tamarack.

## BID INSTRUCTIONS (VER. 09/02/2016):

### 1. Scheduled Bid Location, Date, and Time (2/11)

Bids must be received by the Unit Manager, ATLANTA OFFICE, 13501 M-33, ATLANTA, MI 49709, no later than 10:00 a.m. (local time) on May 23, 2017. For further information concerning this sale, contact Cody Stevens at 989-785-4251 extension 5240.

### 2. Bidder's Qualifications (5/16)

Purchaser shall obtain workers compensation insurance to cover claims under Michigan's Worker's Disability Compensation Act of 1969 or similar employee benefit act of any other state applicable to an employee. If all or part of a timber sale was prepared by a private contractor, the contractor and that contractor's company are not permitted to bid on the timber sale contract. Bids will not be accepted from individuals or companies appearing on the DNR/FRD No-Bid List. This list contains the names of purchasers who previously failed to execute a contract within 21-days or who have a history of poor performance.

### 3. Preparation of Sealed Bids (5/16)

Bid Forms may be completed online thru Michigan DNR Timber Sale Online Bidding (OLB) at [www.michigan.gov/timberbidding](http://www.michigan.gov/timberbidding) or by completing the hardcopy Bid Form found in the Timber Sale Prospectus. Hardcopy Bid Forms shall be manually signed in ink. Registration in OLB is considered your 'signature' for all bids submitted thru that system. Bid prices must be entered for each species and product in the Bid Price column for all material subject to bidding and all fill-in blanks must be completed. If erasures or other changes appear on the hardcopy Bid Form, each erasure or change must be initialed by the person signing the bid.

### 4. Submission of Sealed Bids (5/16)

Bid forms may be obtained from the Unit Manager or thru OLB. Bids may be submitted hardcopy or thru OLB. All hardcopy bids must be submitted on the bid form and in an envelope clearly identified as described in this section. NOTE: Only one bid form per bid envelope. Sealed bids must be submitted to the Unit office designated in the prospectus and must be submitted at or prior to the time established in the prospectus. The envelope should show on the outside (a) the sale name or number and (b) the date and time of bid opening, as shown in the prospectus. Bids received after the time specified in the sale prospectus are late bids and will be rejected.

It is possible for a bidder to submit multiple bids on a single sale. For example, a bid may be submitted hardcopy and a bid may be submitted thru OLB. Or, two bidders from the same company could both submit bids on the same sale. If this were to happen, the State would accept all bids received and award the contract accordingly. All bidding and contractual requirements would apply to all bids received.

### 5. Public Opening of Sealed Bids (7/16)

If conditions permit, the sealed bids will be publicly opened and posted at the time and place set in the prospectus.

If a bidder, present at a bid opening, has submitted bids on more than one sale, that bidder may withdraw their unopened bid envelopes or announce the withdrawal of their online bid after being declared the successful bidder on one sale.

### 6. Award of Contract (1/11)

Award of the contract will be made to the Bidder whose bid, conforming to the prospectus, is most advantageous to the State of Michigan on the basis of total value at rates bid for the estimated quantities. The State reserves the right to reject any bid or waive any minor irregularity in bids received. A written award mailed (or otherwise furnished) to the successful Bidder shall be deemed to result in a binding contract without further action by either party.

### 7. Down Payment (1/11)

The Bidder to whom award is made must make a down payment within 21 days of the sale award. The amount of the down payment will be calculated as shown in the Bond and Payment Schedule of this prospectus. Only cash may be used to meet this requirement.

### 8. Performance Security (1/11)

As guarantee of faithful performance, a cash bond, certificate of deposit, surety bond or irrevocable letter of credit (LOC) is required within 21 days of the sale award. The amount of the performance security is shown in the Bond and

Payment Schedule of this prospectus. If an LOC or surety is used, the coverage must extend for at least 6 months beyond the contract expiration.

#### 9. Timber Sale Contract (9/14)

Additional conditions and requirements common to all timber sales are listed on the timber sale contract (R4031) and are available on line at [www.michigan.gov/timber](http://www.michigan.gov/timber). Contact the Unit Manager for additional information or a sample contract. Within 21 days of the date of the award letter, the bidder must sign the contract and provide the required down payment, performance security, and verification of worker's disability compensation. The down payment and performance security shall be in accordance with the provisions of the timber sale contract, in the sums stated in this prospectus. If these actions are not taken, then the Bidder, the Bidder's corporation, and the corporation's principals may not be permitted to bid on State timber sales for a period of 1 year. In addition, the Bidder certifies that if awarded this contract, the Bidder will complete the timber sale contract in accordance with its terms and any modifications thereof including requirements to purchase, cut, and remove the included timber by the expiration date.

#### 10. Disclaimer of Estimates and Bidder's Warranty of Inspection (7/16)

Before submitting this bid, the Bidder is advised and cautioned to inspect the sale area, review the requirements of the sale contract, and take other steps as may be reasonably necessary to ascertain the location, estimated volumes, construction estimates, and operating costs of the proposed sale. Failure to do so will not relieve the Bidder from responsibility for completing the contract.

The Bidder warrants that this bid is submitted solely on the basis of the Bidder's examination and inspection of the quality and quantity of the timber offered for sale and the Bidder's opinion of the value thereof and the costs of recovery. No reliance should be placed on the State of Michigan's estimates of timber quality, quantity or costs of recovery. Bidder further acknowledges that the State of Michigan: (i) expressly disclaims any warranty of fitness of timber for any purpose; (ii) offers this timber as is without any warranty of quality (merchantability) or quantity and (iii) expressly disclaims any warranty as to the quantity or quality of timber sold.

#### 11. Certification and Chain-of-Custody (10/14)

Unless otherwise indicated in the contract under section 7 – Other Conditions of the Sale Specific Conditions & Requirements, the area encompassed by this timber sale is certified to the standards of the Forest Stewardship Council (FSC) - Certificate #SCS-FM/COC-00090N and the Sustainable Forestry Initiative (SFI) - Certificate #NSF-SFIS-5Y031-SF5. Forest products from this sale may be delivered to the mill as "FSC 100% and / or SFI certified" as long as the contractor hauling the forest products is chain-of-custody (COC) certified or covered under a COC certificate from the destination mill. The purchaser is responsible for maintaining COC after leaving the sale area.

#### 12. Good Neighbor Authority (GNA) Requirements (7/16)

If the name of this timber sales contains the acronym GNA, it is authorized by the Good Neighbor Authority (GNA) and covered by various agreements between the U.S. Forest Service and the State. The timber sale occurs on federal land and the following conditions apply:

GNA contracts on US Forest Service land will not be awarded to purchasers on the Federal list of excluded parties. The System for Award Management (SAM) will be checked for active excluded parties prior to award of contract. In addition, the Bidder to whom award is made must complete an Assurance Regarding Felony Conviction or Tax Delinquent Status for Corporate Applicants (AD-3031).

#### 13. Good Neighbor Authority (GNA) Requirements, con't (9/16)

Bidder certifies, by signing this bid form, that to the best of Bidder's knowledge that the following representations are accurate and complete.

- a. That the Bidder and its principals are not presently debarred, suspended, proposed for debarment, declared ineligible, or voluntary excluded from timber sales (covered transactions) by any Federal department or agency.
- b. That the Bidder and its principals have not within a 3-year period preceding this bid been convicted of or had a civil judgment rendered against them for commission of fraud or a criminal offense in connection with obtaining, attempting to obtain, or performing a public (Federal, State, or local) transaction or contract under a public transaction; violation of Federal or State antitrust statutes or commission of embezzlement, theft, forgery, bribery, falsification or destruction of records, making false statements, or receiving stolen property.

c. That the Bidder and its principals are not presently indicted for or otherwise criminally or civilly charged by a governmental entity (Federal, State, or local) with commission of any of the offenses enumerated in paragraph b of this certification.

d. That the Bidder and its principals have not within a 3-year period preceding this bid had one or more public transactions (Federal, State, or local) terminated for breach or default of a timber or forest product contract.

Bidders that cannot certify this requirement, in whole or in part, shall submit an explanation with their bid.

KEITH CREAGH

Director

## TIMBER SALE INFORMATION

Spray Here Plz MWR (54-012-17)

Montmorency County (Advertised Price \$32,114.10)

SALE NOTE: This is research sale with a short contract length. Cutting and skidding is limited to the period of 8/15/17 to 3/15/18. Payments units must begin by 12/1/17 at the latest. No extensions will be allowed on this sale. However, with stipulations (see spec 7.2.7), a free 1 year extension can be applied to another State Forest Timber Sale Contract. Chipping of tops is required in PU 2. Chipping of tops is highly recommended in PU1.

A recreation site such as a trail, pathway, or campground is within the sale area or the vicinity. Certain restrictions/specifications may be applicable including time restrictions. Access may be through private or other public land.

A timber sale contract for this lump sum, sealed bid timber sale will be awarded to the responsible bidder offering the highest sealed bid price. Bids must be at or above the following advertised price for each species:

<u>PRODUCTS &amp; SPECIES</u>	<u>ESTIMATED UNITS*</u>	<u>ADVERTISED PRICE</u>
Sawtimber		
Basswood	36.40 MBF	\$ 77.00 / MBF
Beech	5.20 MBF	\$ 84.00 / MBF
Red Maple	12.10 MBF	\$ 122.00 / MBF
Red Oak	5.50 MBF	\$ 141.00 / MBF
Sugar Maple	57.60 MBF	\$ 361.00 / MBF
Pulpwood		
Basswood	87.00 Cords	\$ 9.00 / Cord
Beech	28.00 Cords	\$ 17.40 / Cord
Misc. Species 1	37.00 Cords	\$ 5.00 / Cord
Mixed Aspen	39.00 Cords	\$ 18.45 / Cord
Mixed Hardwood	192.00 Cords	\$ 17.40 / Cord
Red Oak	17.00 Cords	\$ 18.45 / Cord

\* The total volume is statistically estimated within plus (+) or minus (-) 14.83 percent. The estimated units are final and not subject to adjustment. Prospective bidders are urged to examine this timber and to make their own estimates of quantity and quality.

**BOND AND PAYMENT SCHEDULE:**

1. A bond in the amount of \$1,606.00 to insure faithful performance of the conditions of the contract will be deposited by the successful bidder within 21 days of the sale award.
2. Cutting in any sale or unit without the required advance payment would be considered a trespass.
3. Total payment must be paid in advance or according to the following schedule:
  - (a) Ten percent (10%) of the sale value must be paid within 21 days of the sale award.
  - (b) The 10% down payment will be credited towards the first unit cut.
4. If no cutting takes place, the 10% down payment will not be refunded.
5. Operations on the contract issued will terminate on 06/30/2018.

**Description of Timber by Payment Unit (PU)**

PU	MARKET GROUP	PRODUCT	QUANTITY	UNIT	ACRES	ADVERTISE PRICE			
1	Basswood	Sawtimber	3.3	MBF	30.2	\$16,802.05			
	Beech		3.8	MBF					
	Red Maple		12.1	MBF					
	Red Oak		4.9	MBF					
	Sugar Maple		33.0	MBF					
	Basswood	Pulpwood	5.0	Cords					
	Beech		14.0	Cords					
	Misc. Species 1		10.0	Cords					
	<i>White Ash</i>	<i>Sawtimber</i>	2.7	<i>MBF</i>					
	<i>White Ash</i>	<i>Pulpwood</i>	5.0	<i>Cords</i>					
	Mixed Aspen		8.0	Cords					
	<i>B. T. Aspen</i>	<i>Sawtimber</i>	1.4	<i>MBF</i>					
	<i>B. T. Aspen</i>	<i>Pulpwood</i>	5.0	<i>Cords</i>					
	Mixed Hardwood		86.0	Cords					
	<i>Ironwood</i>		5.0	<i>Cords</i>					
	<i>Red Maple</i>		16.0	<i>Cords</i>					
	<i>Sugar Maple</i>		65.0	<i>Cords</i>					
	Red Oak		9.0	Cords					
	2	Basswood	Sawtimber	33.1			MBF	30.4	\$15,312.05
		Beech		1.4			MBF		
Red Oak			0.6	MBF					
Sugar Maple			24.6	MBF					
Basswood		Pulpwood	82.0	Cords					
Beech			14.0	Cords					
Misc. Species 1			27.0	Cords					
<i>White Ash</i>			27.0	<i>Cords</i>					
Mixed Aspen			31.0	Cords					
<i>B. T. Aspen</i>			31.0	<i>Cords</i>					
Mixed Hardwood			106.0	Cords					
<i>Ironwood</i>			8.0	<i>Cords</i>					
<i>Red Maple</i>			1.0	<i>Cords</i>					
<i>Sugar Maple</i>			97.0	<i>Cords</i>					
Red Oak			8.0	Cords					
TOTAL:			116.8	MBF					
TOTAL:			400.0	Cords					

## Sale Specific Conditions & Requirements

**Sale Name: Spray Here Plz MWR**

**Sale Number: 54-012-17 Seq#: 1**

### 1 - Sale Area

#### 1.2 - Boundaries

##### 1.2.1 - Painted boundaries (1/14)

The Sale Boundary is marked and identified by Red paint. Exterior sale boundary lines against state are marked with Red paint. Interior sale boundaries are marked with Yellow paint, designating patch cuts. Red painted and Yellow painted boundary line trees are not Included Timber and are to be protected unless marked with Orange paint.

### 2 - Timber Specifications

#### 2.1 - Included Timber

##### 2.1.1 - Clearcut unit(s) with unmerchantable trees (6/14)

Within Payment Unit(s) 2, cut all trees that are two (2) inches or more at DBH within designated patch-cut areas (bounded by yellow paint). Yellow painted boundary trees are not to be harvested. The total area of the patch cuts is 12.5 acres with patches ranging from 1/3 acre to 1 acre. The 20 patch cut areas are located within a 30.4 acre treatment area bounded by red paint. A detailed map showing individual patch cut locations and sizes within the cut boundary may be provided upon request.

##### 2.1.3 - Cut tree marked unit(s) (12/08)

Within Payment Unit(s) 1, all trees are designated for cutting when marked with orange paint above and below stump height, regardless of merchantability. ALSO, within Payment Units 1, cut all trees that are two (2) inches or more at DBH within designated patch cut areas (bounded by yellow paint). Yellow painted boundary trees are not to be harvested. The total area of the patch cuts is 1.95 acres with each patch being 0.15 acres in size. The 13 patch cut areas are located within a 30.2 acre treatment area bounded by red paint.

##### 2.1.11 - Description of timber note (2/04)

Note that Misc. Species 1 = dead ash, which is designated for cutting.

#### 2.2 - Utilization

##### 2.2.2 - Chipping required (5/14)

Payment Unit 2 must be chip harvested to facilitate follow-up scarification. Payment Unit(s) 1 & 2 must have all slash removed from designated patch cut areas (bounded by yellow paint). Chip harvesting in Payment Unit 1 is recommended, but not mandatory. If market conditions limit the practicality of chipping, the producer may skid all topwood out of the designated patch cut areas within Payment Unit 1, and scatter in locations approved by the sale administrator. Products may be produced as roundwood and forwarded to decking areas in final product length, but the tops must be left intact and skidded to the landing for chipping. Chipping or slash removal must be completed by March 15th 2018. If this deadline is not met, damages will be collected at a rate determined by the cost for the Department to hire a contractor to complete this specification. The requirement to retain approximately 1/6 to 1/3 of tree tops and limbs less than four inches in diameter does not apply (G. C. & R. 2.2). This is due to the research nature of these units.

##### 2.2.3 - Stump heights (4/07)

Stump heights within Payment Unit(s) 1 & 2 shall not exceed 12 inches for trees greater than 10 inches DBH and 4 inches for trees smaller than 10 inches DBH. A written waiver of this requirement may be obtained if snow levels make these heights unobtainable.

##### 2.2.8 - Utilization and removal (5/14)

Payment Units 1 & 2 are part of a research project. All slash and all forest products meeting standards set forth in General Condition and Requirement 2.2 - Utilization must be removed from the sale area. The slash must be chipped (Payment Unit 2) unless another option is negotiated with the Unit Manager or their representative to reduce, eliminate, and/or disperse the slash into the surrounding area (Payment Unit 1). Chipping or slash removal must be completed by March 15th 2018. This is because of the research nature of this project.

### 3 - Payments

### 3.4 - Damaged Timber

#### 3.4.1 - Damaged timber (6/14)

General Condition and Requirement 3.4 Damaged Timber, defines liquidated damages for undesignated live merchantable trees which are cut or injured. No damage is acceptable to residual merchantable trees. Within the sale area, if more than 5% of trees (> 4.5" DBH) within a specified area of the sale are damaged, liquidated damages will be assessed for all trees damaged. Rates will be in accordance with General Condition and Requirement 3.4 Damaged Timber, or at a rate of \$50 per sawtimber tree and \$5 per pole sized tree, whichever is greater.

## 4 - Transportation

### 4.1 - Construction

#### 4.1.3 - Slash and earthen piles (8/04)

Piles or windrows of earth along roads and landings that have been widened or constructed shall be leveled. Slash from road maintenance or construction, including stumps, shall be dispersed throughout the sale. The sale administrator may require this slash to be chipped, utilized or otherwise removed from the sale area(s) if it impedes planned post-harvest treatments.

#### 4.1.4 - Timber removed for construction (12/09)

Trees cut or damaged in the process of pre-approved road, landing or skid trail construction will be decked in an area separate from other Designated Timber and not removed until measured by the sale administrator. Payment will be made at the specified Purchase Unit Price.

#### 4.1.6 - Road construction (1/09)

Construction of new roads or improvements of existing roads shall be done in such a way as to minimize the environmental and visual impacts. Merchantable trees shall be cut and utilized unless otherwise directed. Non-merchantable trees shall be severed and laid flat on the ground. Slash shall be scattered, and not left in windrows and kept a minimum of 10 feet back from the road edge. Stumps shall be set upright, not left on edge, and be moved at least 10 feet away from the road edge. Disturbed soil shall be feathered into the woods and not left in berms or windrows.

#### 4.1.7 - Road closure (10/11)

All new roads built into the sale must be blocked to vehicle traffic upon completion of the sale. Overgrown roads that are reopened shall be considered new roads. In general, this will require constructing a four (4') foot high berm of stumps and logs covered with earth. These roads must be rendered impassable to cars and trucks. All stumps from road building and landing construction must be reserved to block any newly constructed roads upon completion of the sale. These stumps must be scattered along the road system to prohibit vehicular movement. Contact the sale administrator for specific details of design and placement.

### 4.2 - Maintenance

#### 4.2.5 - Two wheel drive condition (2/04)

All existing trail roads on and adjacent to the sale area must be passable by two-wheel drive traffic for the duration of the sale.

### 4.4 - Access

#### 4.4.1 - Private property access (3/11)

Permission for access across private land is the responsibility of the Purchaser for accessing Payment Unit 2, if it is used. A copy of the written permission from the private landowner must be given to the Unit Manager prior to the beginning of operations.

## 5 - Operations

### 5.1 - Notification

#### 5.1.1 - Pre-sale conference (10/16)

A pre-sale conference on site between the Purchaser and sale administrator is required prior to beginning any operations in a Payment Unit to determine landing and road locations. The Unit Manager or his/her representative must be contacted at least 10 days in advance to schedule the conference.

#### 5.1.4 - Post-sale conference (10/16)



A post-sale conference on site between the Purchaser and sale administrator is required 5 days prior to the completion of active logging operations to determine clean-up and repair of landings, road edges, and the fulfillment of other contract specifications.

## 5.2 - Conduct of Operations

### 5.2.2 - Hazard Trees/Snags

#### 5.2.2.1 - Den trees (10/16)

Obvious hollow and/or den trees shall be protected and left standing unless they are a safety hazard.

### 5.2.3 - Operating Restrictions

#### 5.2.3.1 - Operating restrictions (9/11)

Within Payment Unit(s) 1 and 2, unless changed by written agreement, cutting and skidding is limited to the period from August 15th 2017 to March 15th 2018. Payments must be completed and operations must begin no later than December 1st 2017. This restriction is due to the necessity of assuring that all operations are on schedule for timely completion of the research project.

#### 5.2.3.2 - Operating restrictions (9/11)

Within Payment Unit(s) 1 and 2, unless changed by written agreement, cutting and skidding is limited to the period from August 15th 2017 to March 15th 2018. This restriction is to meet the requirements of a silviculture research project.

#### 5.2.31 - Landing locations (9/13)

Recommended landing areas are marked on the Timber Sale Map with the letter "L". Landings must be confined to these designated sites unless otherwise authorized by the Unit Manager or his/her representative. In general, landings are limited to a "T" turnaround which will accommodate a truck with a 50 foot trailer.

#### 5.2.32 - Decking/landing restoration (9/13)

All decking and landing areas must have the surface area restored to a condition equal to or better than before. This is to ensure the proper regeneration of the stand. Wood debris, chips and "cookies" from trimmings must be removed or scattered away from landing and loading areas and may not be windrowed on the edge.

#### 5.2.38 - No decking against live trees (2/04)

Cut products may not be decked against unmarked or designated leave trees.

#### 5.2.39 - ORV trail/route protection (12/12)

The Hunt Creek motorcycle trail travels near the vicinity of Payment Unit 1, and is shown on the Timber Sale Map. Do not cut trees or damage posts with orange ORV markers. All stumps within 5 feet of the trail must be cut flush with the ground. Maintain a 10 foot wide slash, debris, and rut free zone daily using the ORV trail or route as the centerline. Do not run equipment down the motorcycle trail.

## 5.4 - Soil Protection

### 5.4.1 - Rutting restriction, general (7/16)

Operations are to cease immediately if equipment and weather conditions result in rutting of roads and/or skid trails which is 12 inches or greater in depth and 50 feet in length. The Unit Manager or his/her representative may restrict hauling and/or skidding if ruts exceed the specified depth. With the Unit Manager or his/her representative's approval, the Purchaser may return to the area when the risk of rutting has decreased.

### 5.4.2 - Skid trails (2/04)

Skid trails up and down slopes should be avoided. If however this is unavoidable, these trails will be left in a non-erodible condition using water bars, logs, and slash. Placing of slash on these skid trails while logging is ongoing may alleviate need for any further action. At the direction of the sale administrator, seed, fertilizer, and mulch may also be required.

## 5.8 - Protection of Endangered Species

### 5.8.5 - Protection of raptor nests (3/13)

All trees with raptor nests will be protected if found during harvesting operations. Notification will be made to the Unit Manager or his/her representative who will notify the Wildlife Biologist so an on-site evaluation and recommendation can be made, if necessary.

## **6 - Safety and Fire Prevention**

### 6.2 - Signing

#### 6.2.3 - Recreational trail posting (2/10)

The Purchaser is responsible for posting and maintaining caution signs on the Hunt Creek motorcycle trail prior to beginning operations. The trail must be posted at appropriate distances from the sale area to warn of logging activity and truck traffic at both ends of the trail. Signs must be removed when harvest operations are suspended or completed. The Purchaser will provide these signs.

## **7 - Other Conditions**

### 7.2 - Extensions

#### 7.2.7 - Research extension (12/16)

This is a research sale with a short contract length. The sale must be harvested promptly. One (1), twelve (12) month extension can be applied to one (1) other State Forest Timber Sale Contract owned by the purchaser or owned by one (1) designated sub-contractor of the Purchaser that works this contract. To qualify, the contract expiration date of the contract to be extended must be within twelve (12) months from the issue date of this contract. If this is the first extension on the other State Forest Timber Sale Contract, then the 5% extension fee will be waived. If this is an additional extension, the 10% fee will be reduced to 5%. The salvage extension must be used before this contract is closed-out. This specification does not alleviate the purchaser from any contractual obligations of the extended State Forest Timber Sale Contract. Per General Condition & Requirement 7.2, extensions are at the sole discretion of the DNR.



# TIMBER SALE MAP

This information provided by authority of Part 525, 1994 PA 451, as amended.

Sale Number	Year
54 - 012	17

Forest Management Unit Atlanta Management Unit	County Montmorency	Mapped By A Krugh	Date 3/14/2017	Page 1	of 1
		Cruised By A Krugh, D Coy			

Township 29N	Range 03E	Section(s) and Subdivision(s) Sec 31 S2NE N2SE Sec 32 W2NE E2NW	Scale 1:15,840
-----------------	--------------	--------------------------------------------------------------------	-------------------

Cover Type				Density	
A = Aspen	H = Hemlock	N = Marsh	U = Upland Brush	0 = Non Stocked	5 = Pole Timber Medium
B = Paper Birch	J = Jack Pine	O = Oak	UM = Upland Mixed	1 = Seedling Sapling Poor	6 = Pole Timber Well
C = Cedar	L = Lowland Brush	P = Lowland Poplar	V = Bog or Marsh	2 = Seedling Sapling Medium	7 = Saw Timber Poor
D = Treed Bog	LM = Lowland Mixed	Q = Mixed Swamp Conifer	W = White Pine	3 = Seedling Sapling Well	8 = Saw Timber Medium
E = Swamp Hdwoods	M = Mpl, Bch, Brch	R = Red Pine	X = Non Stocked	4 = Pole Timber Poor	9 = Saw Timber Well
F = Spruce Fir	MC = Mixed Conifer	S = Black Spruce	Z = Water		
G = Grass	MD = Mixed Deciduous	T = Tamarack			

PU	Acres
1	30.2
2	30.4

## Spray Here PLZ MWR

### Compartment 017

### 60.6 Acres

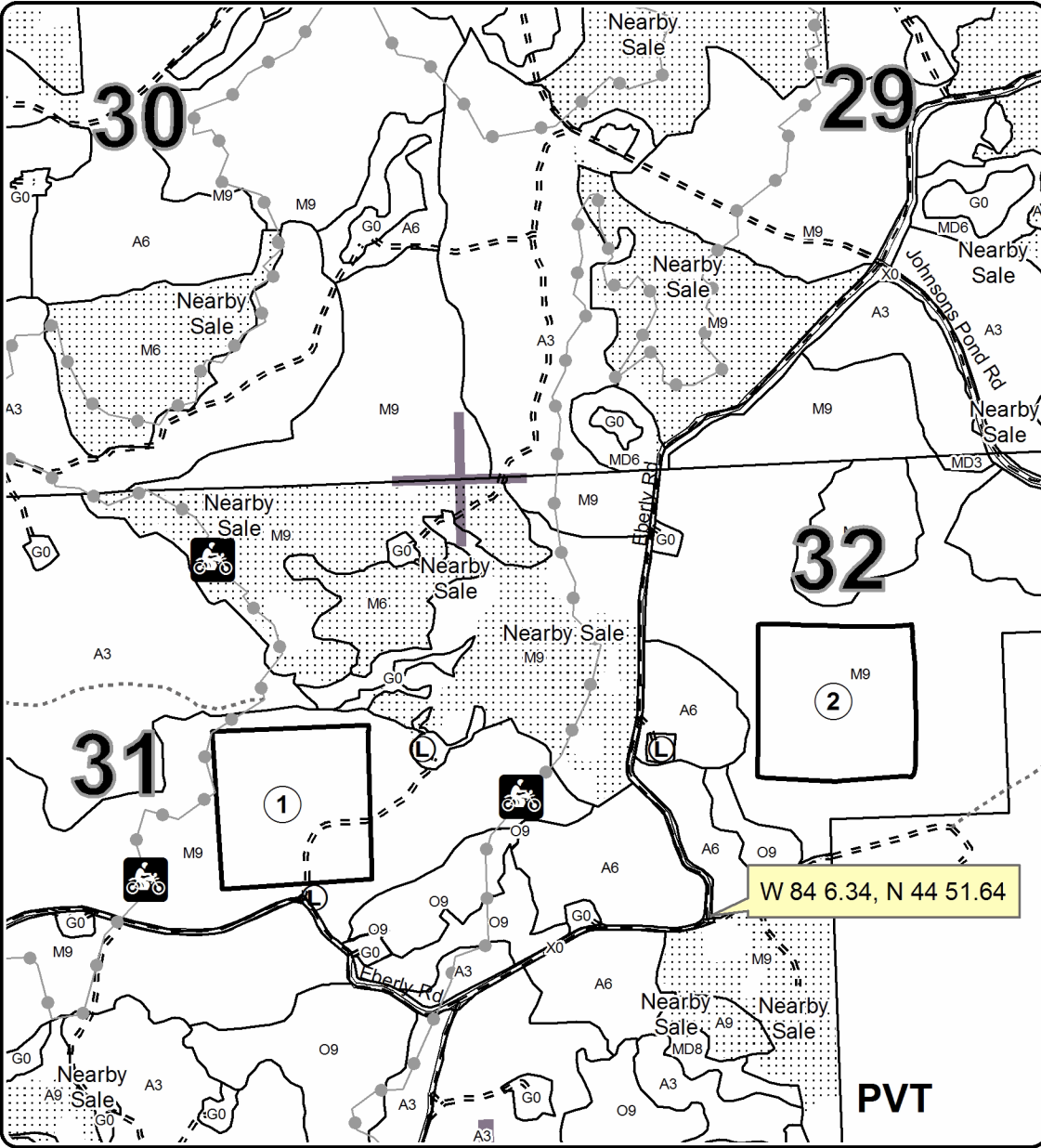
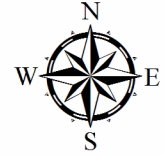

**Legend**

- Against State (Red)
- Payment Unit
- Stand Boundaries
- L Landings
- Gravel Roads
- Poor Dirt Roads
- Closed Roads
- Recreational Trail
- Section Corners



Locator Map  
1:100,000

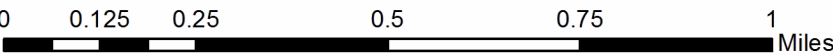
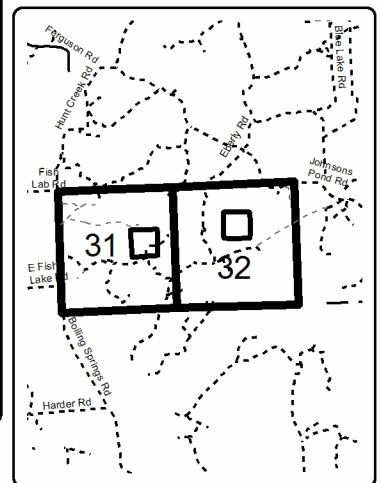



## TIMBER SALE INFORMATION

### I 4 C Pine Mix (54-021-16)

Montmorency County (Advertised Price \$112,555.75)

**SALE NOTE: 5.2.3.1 - Operating restrictions**

-Within Payment Unit(s) 1, 2, and 4-7, unless changed by written agreement, cutting skidding, and hauling is limited to the period of 12/01 to 3/15.

A recreation site such as a trail, pathway, or campground is within the sale area or the vicinity. Certain restrictions/specifications may be applicable including time restrictions.

A timber sale contract for this lump sum, sealed bid timber sale will be awarded to the responsible bidder offering the highest sealed bid price. Bids must be at or above the following advertised price for each species:

<u>PRODUCTS &amp; SPECIES</u>	<u>ESTIMATED UNITS*</u>		<u>ADVERTISED PRICE</u>
<b>Sawtimber</b>			
Mixed Aspen	36.90	MBF	\$ 70.00 / MBF
Red Oak	348.20	MBF	\$ 141.00 / MBF
Red Pine	69.80	MBF	\$ 131.00 / MBF
White Oak	4.10	MBF	\$ 71.00 / MBF
White Pine	8.60	MBF	\$ 88.00 / MBF
<b>Pulpwood</b>			
Balsam Fir	37.00	Cords	\$ 22.10 / Cord
Jack Pine	7.00	Cords	\$ 24.30 / Cord
Mixed Aspen	1,029.00	Cords	\$ 18.45 / Cord
Mixed Hardwood	404.00	Cords	\$ 17.40 / Cord
Red Oak	895.00	Cords	\$ 18.45 / Cord
Red Pine	70.00	Cords	\$ 50.80 / Cord
White Oak	61.00	Cords	\$ 18.45 / Cord
White Pine	62.00	Cords	\$ 36.60 / Cord
White Spruce	6.00	Cords	\$ 36.50 / Cord

\* The total volume is statistically estimated within plus (+) or minus (-) 11.01 percent. The estimated units are final and not subject to adjustment. Prospective bidders are urged to examine this timber and to make their own estimates of quantity and quality.

**BOND AND PAYMENT SCHEDULE:**

1. A bond in the amount of \$5,628.00 to insure faithful performance of the conditions of the contract will be deposited by the successful bidder within 21 days of the sale award.
2. Cutting in any sale or unit without the required advance payment would be considered a trespass.
3. Total payment must be paid in advance or according to the following schedule:
  - (a) Ten percent (10%) of the sale value must be paid within 21 days of the sale award.
  - (b) The 10% down payment will be credited towards the first unit cut.
4. If no cutting takes place, the 10% down payment will not be refunded.
5. Operations on the contract issued will terminate on 06/30/2020.

**Description of Timber by Payment Unit (PU)**

PU	MARKET GROUP	PRODUCT	QUANTITY	UNIT	ACRES	ADVERTISE PRICE
1	Mixed Aspen	Sawtimber	21.2	MBF	34.7	\$20,153.15
	<i>B. T. Aspen</i>		16.1	<i>MBF</i>		
	<i>Quaking Aspen</i>		5.1	<i>MBF</i>		
	Red Oak		17.9	MBF		
	Red Pine		6.9	MBF		
	White Pine		1.2	MBF		
	Balsam Fir	Pulpwood	7.0	Cords		
	Mixed Aspen		556.0	Cords		
	<i>B. T. Aspen</i>		285.0	<i>Cords</i>		
	<i>Quaking Aspen</i>		271.0	<i>Cords</i>		
	Mixed Hardwood		87.0	Cords		
	<i>Red Maple</i>	<i>Sawtimber</i>	2.3	<i>MBF</i>		
	<i>Black Cherry</i>	<i>Pulpwood</i>	2.0	<i>Cords</i>		
	<i>Red Maple</i>		80.0	<i>Cords</i>		
	Red Oak		75.0	Cords		
	Red Pine		10.0	Cords		
	White Pine		33.0	Cords		
	White Spruce		3.0	Cords		
	2	Mixed Aspen	Sawtimber	6.0		
<i>B. T. Aspen</i>			4.5	<i>MBF</i>		
<i>Quaking Aspen</i>			1.5	<i>MBF</i>		
Red Oak			5.0	MBF		
Red Pine			2.0	MBF		
White Pine			0.4	MBF		
Balsam Fir		Pulpwood	2.0	Cords		
Mixed Aspen			157.0	Cords		
<i>B. T. Aspen</i>			80.0	<i>Cords</i>		
<i>Quaking Aspen</i>			77.0	<i>Cords</i>		
Mixed Hardwood			24.0	Cords		
<i>Red Maple</i>		<i>Sawtimber</i>	0.6	<i>MBF</i>		
<i>Black Cherry</i>		<i>Pulpwood</i>	1.0	<i>Cords</i>		
<i>Red Maple</i>			22.0	<i>Cords</i>		
Red Oak			21.0	Cords		
Red Pine			3.0	Cords		
White Pine			9.0	Cords		
White Spruce		1.0	Cords			
3	Red Oak	Sawtimber	16.4	MBF	40.1	\$6,241.00
	White Oak		3.5	MBF		
	Mixed Aspen	Pulpwood	7.0	Cords		
	<i>B. T. Aspen</i>		7.0	<i>Cords</i>		
	Mixed Hardwood		27.0	Cords		
	<i>Red Maple</i>		27.0	<i>Cords</i>		
	Red Oak		111.0	Cords		
	White Oak		56.0	Cords		
4	Mixed Aspen	Sawtimber	3.3	MBF	18.5	\$25,748.65
	<i>B. T. Aspen</i>		3.3	<i>MBF</i>		
	Red Oak		131.3	MBF		
	Red Pine		0.6	MBF		
	White Oak		0.3	MBF		
	Mixed Aspen	Pulpwood	18.0	Cords		
	<i>B. T. Aspen</i>		16.0	<i>Cords</i>		
	<i>Quaking Aspen</i>		2.0	<i>Cords</i>		
	Mixed Hardwood		62.0	Cords		
	<i>Red Maple</i>	<i>Sawtimber</i>	2.3	<i>MBF</i>		
	<i>Red Maple</i>	<i>Pulpwood</i>	57.0	<i>Cords</i>		
	Red Oak		293.0	Cords		

**Description of Timber by Payment Unit (PU), con't**

PU	MARKET GROUP	PRODUCT	QUANTITY	UNIT	ACRES	ADVERTISE PRICE		
4 con't	Red Pine	Pulpwood	1.0	Cords				
	White Oak		2.0	Cords				
5	Mixed Aspen	Sawtimber	4.4	MBF	24.3	\$33,849.75		
	<i>B. T. Aspen</i>		4.4	<i>MBF</i>				
	Red Oak		172.5	MBF				
	Red Pine	0.9	MBF					
	White Oak	0.3	MBF					
	Mixed Aspen	Pulpwood	24.0	Cords				
	<i>B. T. Aspen</i>		22.0	<i>Cords</i>				
	<i>Quaking Aspen</i>		2.0	<i>Cords</i>				
	Mixed Hardwood		81.0	Cords				
	<i>Red Maple</i>		<i>Sawtimber</i>	3.0			<i>MBF</i>	
	<i>Red Maple</i>			<i>Pulpwood</i>			75.0	<i>Cords</i>
	Red Oak		386.0				Cords	
	Red Pine		1.0	Cords				
	White Oak		3.0	Cords				
6	Red Oak		Sawtimber	1.5	MBF	12.0	\$12,057.70	
	Red Pine	43.3		MBF				
	White Pine	6.3		MBF				
	Balsam Fir	Pulpwood		24.0	Cords			
	Mixed Aspen			44.0	Cords			
	<i>B. T. Aspen</i>			5.0	<i>Cords</i>			
	<i>Quaking Aspen</i>			39.0	<i>Cords</i>			
	Mixed Hardwood			74.0	Cords			
	<i>Red Maple</i>			74.0	<i>Cords</i>			
	Red Oak			2.0	Cords			
	Red Pine			43.0	Cords			
	White Pine			19.0	Cords			
	White Spruce			2.0	Cords			
	7	Mixed Aspen		Sawtimber	2.0			MBF
<i>B. T. Aspen</i>		2.0	<i>MBF</i>					
Red Oak		3.6	MBF					
Red Pine		16.1	MBF					
White Pine		0.7	MBF					
Balsam Fir		Pulpwood	4.0		Cords			
Jack Pine			7.0		Cords			
Mixed Aspen			223.0		Cords			
<i>B. T. Aspen</i>			108.0		<i>Cords</i>			
<i>Quaking Aspen</i>			115.0		<i>Cords</i>			
Mixed Hardwood			49.0		Cords			
<i>Red Maple</i>			<i>Sawtimber</i>		1.1	<i>MBF</i>		
<i>Red Maple</i>					<i>Pulpwood</i>	47.0	<i>Cords</i>	
Red Oak			7.0			Cords		
Red Pine	12.0		Cords					
White Pine	1.0	Cords						
TOTAL:			467.6	MBF				
TOTAL:			2,571.0	Cords				

## Sale Specific Conditions & Requirements

Sale Name: I 4 C Pine Mix

Sale Number: 54-021-16 Seq#: 1

### 1 - Sale Area

#### 1.2 - Boundaries

##### 1.2.1 - Painted boundaries (1/14)

The sale, retention, and Payment Unit boundaries are marked and identified by blue, red, and yellow paint. Exterior sale boundary lines against State are marked with red paint. Exterior sale boundary lines against private are marked with blue paint. Interior retention boundaries are marked with red paint. Interior Payment Unit boundaries are marked with yellow paint. The painted boundary line trees are not Included Timber and are to be protected. Yellow painted trees designating an interior Payment Unit boundary are only to be cut when all surrounding Payment Units have been paid.

### 2 - Timber Specifications

#### 2.1 - Included Timber

##### 2.1.1 - Clearcut unit(s) with unmerchantable trees (6/14)

Within Payment Unit(s) 1, 2, and 4-7, cut all trees that are two (2) inches or more at DBH except, do not cut trees marked with green paint above and below stump height. Special protection trees identified in accordance with condition 3.4.2, within clearcutting unit boundaries, are not Included Timber and are to be protected.

##### 2.1.3 - Cut tree marked unit(s) (12/08)

Within Payment Unit(s) 3, all trees are designated for cutting when marked with orange paint above and below stump height, regardless of merchantability. In addition, cut all aspen and red maple.

#### 2.2 - Utilization

##### 2.2.2 - Chipping required (5/14)

Payment Units 4 and 5 must be chip harvested to facilitate planting operations. The Purchaser has the option to produce sawlogs or pulpwood bolts, but the remaining portion of the trees must be chipped and hauled. Do not chip 1/6 to 1/3 of the slash from harvested trees (tree tops and limbs less than four inches in diameter).

##### 2.2.3 - Stump heights (4/07)

Stump heights within Payment Unit(s) 4 and 5 shall not exceed 6 inches for all trees. This is in order to facilitate future follow-up activities.

##### 2.2.6 - Roundwood operation required (5/07)

The skidding of whole trees or tree segments with limbs attached is prohibited within Payment Unit 3. All products must be produced as roundwood and forwarded to existing roads or landing areas in final product length.

### 3 - Payments

#### 3.4 - Damaged Timber

##### 3.4.1 - Damaged timber (6/14)

General Condition and Requirement 3.4 Damaged Timber, defines liquidated damages for undesignated live merchantable trees which are cut or injured. No damage is acceptable to merchantable trees. Within the sale area, if more than 5% of the trees (> 4.5" DBH) within a specified area of the sale are damaged, liquidated damages will be assessed for all trees damaged. Rates will be in accordance with General Condition and Requirement 3.4 Damaged Timber.

##### 3.4.2 - Special Protection Trees (4/14)

The Purchaser shall not cut live or dead special protection trees within cutting units or clearings. Special protection trees are marked with green paint or trees greater than 26 inches in DBH. If the Purchaser's operations have cut or damaged special protection trees through carelessness, the Purchaser shall pay \$150 as fixed, agreed and liquidated damages for each special protection tree cut or damaged. Such payment does not constitute ownership of the undesignated timber.

### 4 - Transportation

#### 4.1 - Construction



#### 4.1.3 - Slash and earthen piles (8/04)

Piles or windrows of earth along roads and landings that have been widened or constructed shall be leveled. Slash from road maintenance or construction, including stumps, shall be chipped, utilized or otherwise removed from the sale.

#### 4.1.5 - Culverts (5/14)

Access to Payment Unit 1 and 2 requires the protection of two existing culverts for an existing intermittent natural drainage-way. If any of the existing culverts are damaged, they must be replaced. Culverts shall be new, corrugated metal or plastic gauge and overlaid with crushed limestone to a depth of 12"-18". Culvert installation locations must be approved by the sale administrator. The culverts will be a minimum of 12 inches in diameter and 18 feet in length. Soils shall be maintained and left in a non-erodible condition, with water bars, seed, fertilizer, mulch, and slash installed as directed by the sale administrator and as specified in the BMP manual.

#### 4.1.6 - Road construction (1/09)

Construction or improvements of existing roads shall be done in such a way as to minimize the environmental and visual impacts. Merchantable trees shall be cut and utilized unless otherwise directed. Non-merchantable trees shall be severed and laid flat on the ground. Slash shall be scattered, and not left in windrows and kept a minimum of 10 feet back from the road edge. Stumps shall be set upright, not left on edge, and be moved at least 10 feet away from the road edge. Disturbed soil shall be feathered into the woods and not left in berms or windrows.

Access to Payment Units 1 and 2 will need to be improved, per sale administrator's request, along the distance shown on the Timber Sale Map. Improvements needed include ditching, crowning, reshaping, widening, installation of additional culverts, and protection of existing culverts (see spec 4.1.5). The new landing access route into Payment Unit 4 (as shown on the Timber Sale Map), if used, will need to be designated/flagged in by the sale administrator before use begins. Any road construction or improvement activities must be pre-authorized by the sale administrator before work begins.

#### 4.1.7 - Road closure (10/11)

All new roads and/or road segments built into the sale must be blocked to vehicle traffic upon completion of the sale. Overgrown roads that are reopened shall be considered new roads. In general, this will require constructing a four (4') foot high berm of stumps and logs covered with earth. These roads must be rendered impassable to cars and trucks. Contact the sale administrator for specific details of design and placement.

### 4.2 - Maintenance

#### 4.2.5 - Two wheel drive condition (2/04)

All existing trail roads on and adjacent to the sale area must be passable by two-wheel drive traffic for the duration of the sale.

## 5 - Operations

### 5.1 - Notification

#### 5.1.1 - Pre-sale conference (10/11)

A pre-sale conference between the Purchaser and sale administrator is required prior to beginning any operations to determine landing and road locations. The Unit Manager or his/her representative must be contacted at least 10 days in advance to schedule the conference.

#### 5.1.4 - Post-sale conference (6/11)

A post-sale conference on site between the Purchaser and sale administrator is required 5 days prior to the completion of active logging operations to determine clean-up and repair of landings, road edges, and the fulfillment of other contract specifications.

### 5.2 - Conduct of Operations

#### 5.2.2 - Hazard Trees/Snags

##### 5.2.2.1 - Den trees (2/04)

Obvious hollow and/or den trees shall be protected and left standing unless they are a safety hazard.

#### 5.2.3 - Operating Restrictions

#### 5.2.3.1 - Operating restrictions (9/11)

Within Payment Unit(s) 1, 2, and 4-7, unless changed by written agreement, cutting, skidding, and hauling is limited to the period of 12/01 to 3/15. This restriction is to protect a potential species of concern, reduce impact with trail users, limit browse, and increase stump sprout vigor.

#### 5.2.3.3 - Bark slippage restriction (3/09)

Within Payment Unit(s) 3, unless changed by written agreement cutting, skidding, and hauling are not permitted during the period of April 15 to July 15. This restriction is because of bark slippage.

#### 5.2.3.4 - Oak wilt restriction (4/17)

Within Payment Unit(s) 3, unless changed by written agreement, cutting, skidding, and hauling are not permitted during the period of April 15 to July 15. This is necessary to reduce the spread of oak wilt. For more information, contact the Unit Manager or his/her representative.

#### 5.2.3.11 - Coppice regeneration protection (4/10)

Timber harvesting in Payment Units 1, 2, and 4-7 must be completed before significant deciduous seedling sprouting occurs so as to minimize damage to the new regeneration.

### 5.2.4 - Dead and Down Creation

#### 5.2.4.4 - Dead and down creation, grouse (8/13)

To encourage grouse and other wildlife, in Payment Unit(s) 1, 2, 6, and 7, leave one, 12" diameter or larger log-length (8 foot minimum) piece on the ground for every 2 acres. These will be evenly scattered throughout the unit. This can be an unmerchantable piece or a full tree.

#### 5.2.4.6 - Dead and down creation, other (9/09)

Within Payment Units 1 and 2 leave one brush pile every 3-5 acres along lowland edge to provide habitat for reptiles and hare. The piles should be a minimum of 8 feet in diameter, consist of 3-5 trees >5" at the base, and covered with tops. A pinwheel structure, meeting minimum dimensions listed above, overlaid with tops is also acceptable.

#### 5.2.31 - Landing locations (9/13)

Recommended landing areas are marked on the Timber Sale Map with the letter "L". Landings must be confined to these designated sites unless otherwise authorized by the Unit Manager or his/her representative.

#### 5.2.32 - Decking/landing restoration (9/13)

All decking and landing areas must have the surface area restored to a condition equal to or better than before. This is to ensure the proper regeneration of the stand. Wood debris, chips and "cookies" from trimmings must be removed or scattered away from landing and loading areas and may not be windrowed on the edge.

#### 5.2.38 - No decking against live trees (2/04)

Cut products may not be decked against unmarked or designated leave trees.

#### 5.2.39 - ORV trail/route protection (12/12)

The Atlanta ORV trails and routes are shown on the Timber Sale Map. Do not cut trees or damage posts with orange ORV markers. All stumps within 5 feet of the trail must be cut flush with the ground. Maintain a 20 foot wide slash, debris, and rut free zone daily using the ORV trail or route as the centerline. Do not run equipment down the ORV trail or route. Skidding across the trail or route may only occur in locations approved by the sale administrator.

### 5.4 - Soil Protection

#### 5.4.1 - Rutting restriction, general (7/16)

Operations are to cease immediately if equipment and weather conditions result in rutting of roads and/or skid trails which is 12 inches or greater in depth and 50 feet in length. The Unit Manager or his/her representative may restrict hauling and/or skidding if ruts exceed the specified depth. With the Unit Manager or his/her representative's approval, the Purchaser may return to the area when the risk of rutting has decreased.

#### 5.4.2 - Skid trails (2/04)

Skid trails up and down slopes should be avoided. If however this is unavoidable, these trails will be left in a non-erodible condition using water bars, logs, and slash. Placing of slash on these skid trails while logging is ongoing may alleviate need for any further action. At the direction of the sale administrator, seed, fertilizer, and mulch may also be required.

## 5.8 - Protection of Endangered Species

### 5.8.5 - Protection of raptor nests (3/13)

All trees with raptor nests will be protected if found during harvesting operations. Notification will be made to the Unit Manager or his/her representative who will notify the Wildlife Biologist so an on-site evaluation and recommendation can be made, if necessary.

## 6 - Safety and Fire Prevention

### 6.2 - Signing

#### 6.2.3 - Recreational trail posting (2/10)

The Purchaser is responsible for posting and maintaining caution signs on the Atlanta ORV trails and routes prior to beginning operations. The trail must be posted at appropriate distances from the sale area to warn of logging activity and truck traffic at both ends of the trail. Signs must be removed when harvest operations are suspended or completed. The Purchaser will provide these signs.



# TIMBER SALE MAP

This information provided by authority of Part 525, 1994 PA 451, as amended.

Sale Number	Year
54 - 021	16

Forest Management Unit	County	Mapped By	Date	Page	of
Atlanta Management Unit	Montmorency	D. Coy	07/08/2016	1	1
Township	Range	Section(s) and Subdivision(s)	Scale		
32N	03E	4- SWNW 5- NE4 & SW4 6- S2NE, N2SE, & SESE 8- NWNE & NENW	1:15,840		

Cover Type				Density			
A = Aspen	H = Hemlock	N = Marsh	U = Upland Brush	0 = Non Stocked	5 = Pole Timber Medium		
B = Paper Birch	J = Jack Pine	O = Oak	UM = Upland Mixed	1 = Seedling Sapling Poor	6 = Pole Timber Well		
C = Cedar	L = Lowland Brush	P = Lowland Poplar	V = Bog or Marsh	2 = Seedling Sapling Medium	7 = Saw Timber Poor		
D = Tread Bog	LM = Lowland Mixed	Q = Mixed Swamp Conifer	W = White Pine	3 = Seedling Sapling Well	8 = Saw Timber Medium		
E = Swamp Hdwoods	M = Mpl, Bch, Brch	R = Red Pine	X = Non Stocked	4 = Pole Timber Poor	9 = Saw Timber Well		
F = Spruce Fir	MC = Mixed Conifer	S = Black Spruce	Z = Water				
G = Grass	MD = Mixed Deciduous	T = Tamarack					

PU	Acres	PU	Acres
1	34.7	5	24.3
2	9.8	6	12.0
3	40.1	7	14.8
4	18.5		

## I 4 C Pine Mix

### Compartments 69 and 70

#### 154.2 Acres

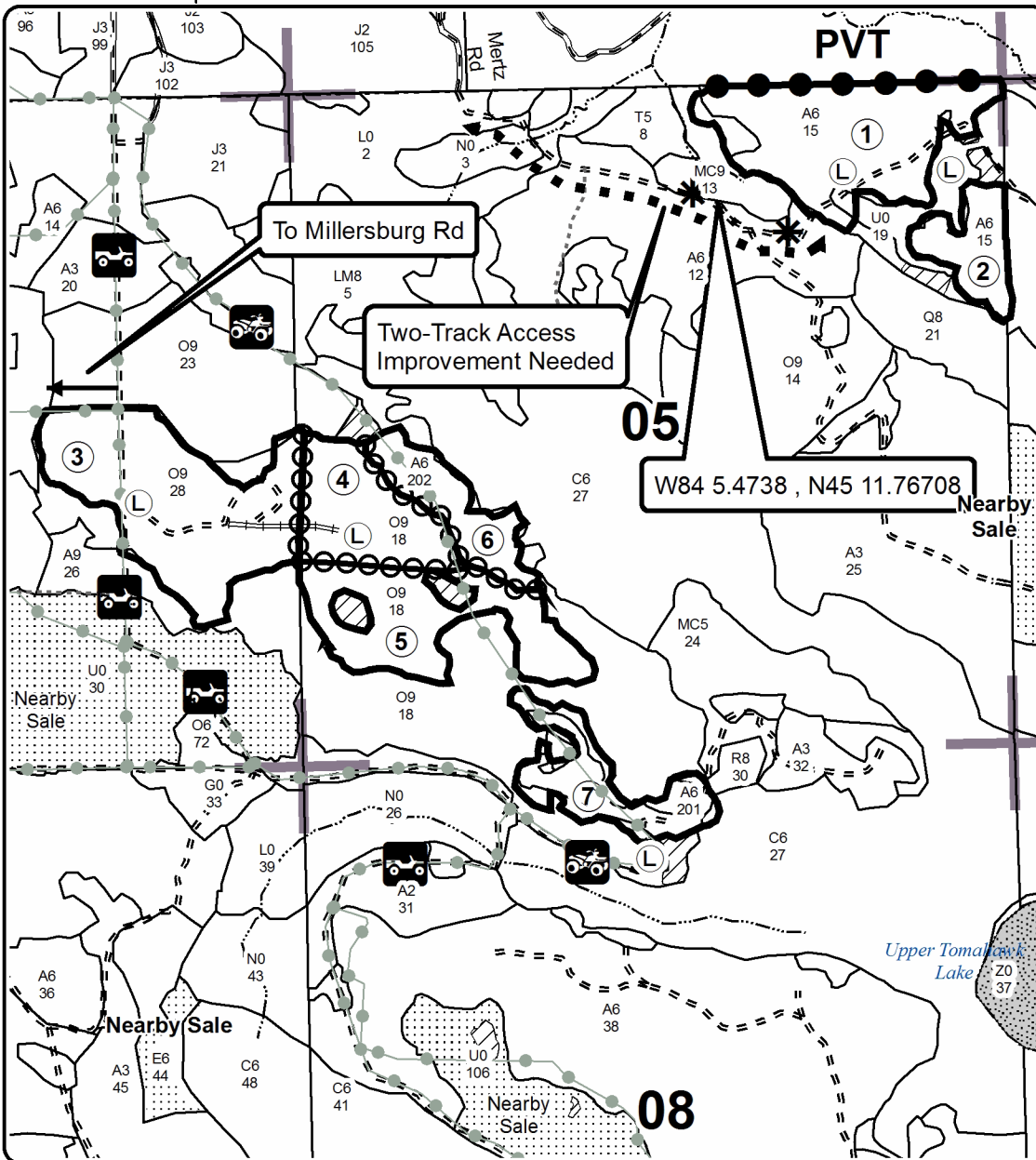
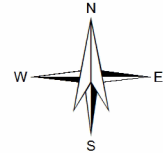

### Legend

**Sale Boundary**

- Against State (Red)
- Payment Unit (Yellow)
- Private Line (Blue)

**Retention Area (Red)**

- Adjacent Timber Sale
- Adjacent Stand Boundaries
- Section Corners
- Flagged Access
- Recreational Trail
- Gravel Roads
- Poor Dirt Roads
- Closed Roads
- Streams

**Other Symbols:**

- Payment Unit
- Existing Culvert
- Landing

Locator Map  
1:150,000

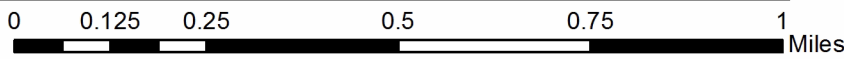
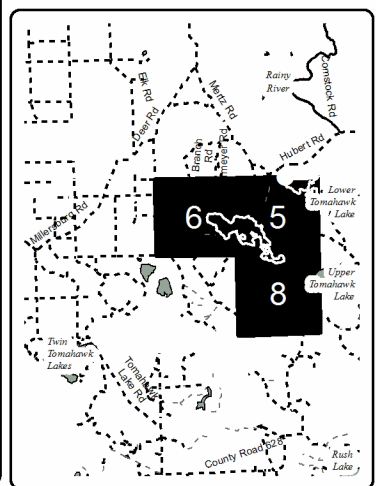

## TIMBER SALE INFORMATION

### Uge Winter Aspen (54-022-16)

Montmorency County (Advertised Price \$217,434.45)

**SALE NOTE: 5.2.3.1 - Operating restrictions (9/11)**

Within Payment Unit(s) 1-9, unless changed by written agreement, cutting, skidding, and hauling is limited to the period of 12/01 to 3/15. This restriction is to protect a potential species of concern, reduce impact with trail users, limit browse, and increase vigor in regeneration.

A recreation site such as a trail, pathway, or campground is within the sale area or the vicinity. Certain restrictions/specifications may be applicable including time restrictions.

A timber sale contract for this lump sum, sealed bid timber sale will be awarded to the responsible bidder offering the highest sealed bid price. Bids must be at or above the following advertised price for each species:

<u>PRODUCTS &amp; SPECIES</u>	<u>ESTIMATED UNITS*</u>		<u>ADVERTISED PRICE</u>
<b>Sawtimber</b>			
Basswood	50.50	MBF	\$ 87.00 / MBF
Mixed Aspen	242.50	MBF	\$ 79.00 / MBF
Paper Birch	2.40	MBF	\$ 61.00 / MBF
Red Maple	22.90	MBF	\$ 138.00 / MBF
Red Oak	47.50	MBF	\$ 160.00 / MBF
Sugar Maple	40.60	MBF	\$ 409.00 / MBF
<b>Pulpwood</b>			
Balsam Fir	713.00	Cords	\$ 25.00 / Cord
Basswood	168.00	Cords	\$ 10.20 / Cord
Beech	72.00	Cords	\$ 19.75 / Cord
Black Spruce	33.00	Cords	\$ 41.35 / Cord
Mixed Aspen	4,888.00	Cords	\$ 20.90 / Cord
Mixed Hardwood	1,242.00	Cords	\$ 19.75 / Cord
Paper Birch	87.00	Cords	\$ 18.15 / Cord
Red Oak	111.00	Cords	\$ 20.90 / Cord
Tamarack	10.00	Cords	\$ 34.80 / Cord
White Pine	18.00	Cords	\$ 41.50 / Cord
White Spruce	299.00	Cords	\$ 41.35 / Cord

\* The estimated units are final and not subject to adjustment. Prospective bidders are urged to examine this timber and to make their own estimates of quantity and quality.

**BOND AND PAYMENT SCHEDULE:**

1. A bond in the amount of \$10,872.00 to insure faithful performance of the conditions of the contract will be deposited by the successful bidder within 21 days of the sale award.
2. Cutting in any sale or unit without the required advance payment would be considered a trespass.
3. Total payment must be paid in advance or according to the following schedule:
  - (a) Ten percent (10%) of the sale value must be paid within 21 days of the sale award.
  - (b) The 10% down payment will be credited towards the first unit cut.
4. If no cutting takes place, the 10% down payment will not be refunded.
5. Operations on the contract issued will terminate on 06/30/2020.

**Description of Timber by Payment Unit (PU)**

PU	MARKET GROUP	PRODUCT	QUANTITY	UNIT	ACRES	ADVERTISE PRICE
1	Mixed Aspen	Sawtimber	23.4	MBF	57.7	\$28,730.40
	<i>B. T. Aspen</i>		23.4	<i>MBF</i>		
	Balsam Fir	Pulpwood	207.0	Cords		
	<i>Balsam Fir</i>		207.0	<i>Cords</i>		
	Black Spruce		18.0	Cords		
	Mixed Aspen		797.0	Cords		
	<i>B. T. Aspen</i>		797.0	<i>Cords</i>		
	Mixed Hardwood		57.0	Cords		
	<i>Red Maple</i>		57.0	<i>Cords</i>		
	Tamarack		7.0	Cords		
White Spruce		71.0	Cords			
2	Basswood	Sawtimber	34.1	MBF	31.2	\$34,619.80
	Mixed Aspen		39.5	MBF		
	<i>B. T. Aspen</i>		36.7	<i>MBF</i>		
	<i>Quaking Aspen</i>		2.8	<i>MBF</i>		
	Paper Birch		2.0	MBF		
	Red Maple		5.5	MBF		
	Sugar Maple		30.1	MBF		
	Balsam Fir	Pulpwood	32.0	Cords		
	<i>Balsam Fir</i>		32.0	<i>Cords</i>		
	Basswood		98.0	Cords		
	Beech		29.0	Cords		
	Mixed Aspen		296.0	Cords		
	<i>B. T. Aspen</i>		247.0	<i>Cords</i>		
	<i>Quaking Aspen</i>		49.0	<i>Cords</i>		
	Mixed Hardwood		327.0	Cords		
	<i>Red Maple</i>		64.0	<i>Cords</i>		
	<i>Sugar Maple</i>		263.0	<i>Cords</i>		
	Paper Birch		11.0	Cords		
	White Spruce		3.0	Cords		
	3	Basswood	Sawtimber	16.4		
Mixed Aspen			29.7	MBF		
<i>B. T. Aspen</i>			15.1	<i>MBF</i>		
<i>Quaking Aspen</i>			14.6	<i>MBF</i>		
Paper Birch			0.4	MBF		
Red Maple			13.9	MBF		
Sugar Maple			8.0	MBF		
Balsam Fir		Pulpwood	231.0	Cords		
<i>Balsam Fir</i>		<i>Sawtimber</i>	0.6	<i>MBF</i>		
<i>Balsam Fir</i>		<i>Pulpwood</i>	230.0	<i>Cords</i>		
Basswood			61.0	Cords		
Beech			7.0	Cords		
Mixed Aspen			485.0	Cords		
<i>B. T. Aspen</i>			101.0	<i>Cords</i>		
<i>Quaking Aspen</i>			384.0	<i>Cords</i>		
Mixed Hardwood			339.0	Cords		
<i>Red Maple</i>			269.0	<i>Cords</i>		
<i>Sugar Maple</i>			70.0	<i>Cords</i>		
Paper Birch			47.0	Cords		
White Spruce			35.0	Cords		
4	Mixed Aspen	Sawtimber	40.7	MBF	47.1	\$33,791.25
	<i>B. T. Aspen</i>		38.9	<i>MBF</i>		
	<i>Quaking Aspen</i>		1.8	<i>MBF</i>		
	Red Maple		2.3	MBF		
	Red Oak		45.9	MBF		
	Sugar Maple		2.3	MBF		

Description of Timber by Payment Unit (PU), con't

PU	MARKET GROUP	PRODUCT	QUANTITY	UNIT	ACRES	ADVERTISE PRICE		
4 con't	Balsam Fir	Pulpwood	19.0	Cords				
	<i>Balsam Fir</i>		19.0	<i>Cords</i>				
	Basswood		1.0	Cords				
	Beech		34.0	Cords				
	Mixed Aspen		807.0	Cords				
	<i>B. T. Aspen</i>		654.0	<i>Cords</i>				
	<i>Quaking Aspen</i>		153.0	<i>Cords</i>				
	Mixed Hardwood		174.0	Cords				
	<i>Red Maple</i>		114.0	<i>Cords</i>				
	<i>Sugar Maple</i>		60.0	<i>Cords</i>				
	Paper Birch		1.0	Cords				
	White Spruce		12.0	Cords				
5	Mixed Aspen	Sawtimber	26.1	MBF	32.3	\$18,735.95		
	<i>B. T. Aspen</i>		21.2	<i>MBF</i>				
	<i>Quaking Aspen</i>		4.9	<i>MBF</i>				
	Red Maple		0.4	MBF				
	Red Oak		1.6	MBF				
	Sugar Maple		0.2	MBF				
	Balsam Fir		Pulpwood	53.0			Cords	
	<i>Balsam Fir</i>			53.0			<i>Cords</i>	
	Basswood			2.0			Cords	
	Beech			2.0			Cords	
	Mixed Aspen			572.0			Cords	
	<i>B. T. Aspen</i>			305.0			<i>Cords</i>	
	<i>Quaking Aspen</i>			267.0			<i>Cords</i>	
	Mixed Hardwood			78.0			Cords	
	<i>Red Maple</i>			58.0			<i>Cords</i>	
	<i>Sugar Maple</i>			20.0			<i>Cords</i>	
	Paper Birch			2.0			Cords	
	White Spruce			33.0			Cords	
	6			Mixed Aspen			Sawtimber	50.5
<i>B. T. Aspen</i>		40.9		<i>MBF</i>				
<i>Quaking Aspen</i>		9.6		<i>MBF</i>				
Red Maple		0.5		MBF				
Balsam Fir		Pulpwood		103.0	Cords			
<i>Balsam Fir</i>				103.0	<i>Cords</i>			
Basswood				4.0	Cords			
Black Spruce			15.0	Cords				
Mixed Aspen			1,122.0	Cords				
<i>B. T. Aspen</i>			601.0	<i>Cords</i>				
<i>Quaking Aspen</i>			521.0	<i>Cords</i>				
Mixed Hardwood			144.0	Cords				
<i>Red Maple</i>			110.0	<i>Cords</i>				
<i>Sugar Maple</i>			34.0	<i>Cords</i>				
Paper Birch			5.0	Cords				
White Spruce			64.0	Cords				
7	Mixed Aspen		Sawtimber	29.1	MBF	35.5	\$20,336.55	
	<i>B. T. Aspen</i>			23.5	<i>MBF</i>			
	<i>Quaking Aspen</i>			5.6	<i>MBF</i>			
	Red Maple			0.3	MBF			
	Balsam Fir	Pulpwood		60.0	Cords			
	<i>Balsam Fir</i>			60.0	<i>Cords</i>			
	Basswood			2.0	Cords			
	Mixed Aspen			634.0	Cords			
	<i>B. T. Aspen</i>			332.0	<i>Cords</i>			
	<i>Quaking Aspen</i>			302.0	<i>Cords</i>			

**Description of Timber by Payment Unit (PU), con't**

PU	MARKET GROUP	PRODUCT	QUANTITY	UNIT	ACRES	ADVERTISE PRICE
7 con't	Mixed Hardwood	Pulpwood	84.0	Cords		
	<i>Red Maple</i>		64.0	<i>Cords</i>		
	<i>Sugar Maple</i>		20.0	<i>Cords</i>		
	Paper Birch		2.0	Cords		
	White Spruce		37.0	Cords		
8	Mixed Aspen	Sawtimber	3.0	MBF	5.5	\$2,544.75
	<i>B. T. Aspen</i>		3.0	<i>MBF</i>		
	Balsam Fir	Pulpwood	8.0	Cords		
	<i>Balsam Fir</i>		8.0	<i>Cords</i>		
	Mixed Aspen		58.0	Cords		
	<i>B. T. Aspen</i>		48.0	<i>Cords</i>		
	<i>Quaking Aspen</i>		10.0	<i>Cords</i>		
	Mixed Hardwood		6.0	Cords		
	<i>Red Maple</i>		6.0	<i>Cords</i>		
	Paper Birch		12.0	Cords		
	Tamarack		3.0	Cords		
	White Spruce		11.0	Cords		
9	Mixed Aspen	Sawtimber	0.5	MBF	13.0	\$4,628.15
	<i>Quaking Aspen</i>		0.5	<i>MBF</i>		
	Mixed Aspen	Pulpwood	117.0	Cords		
	<i>Quaking Aspen</i>		117.0	<i>Cords</i>		
	Mixed Hardwood		33.0	Cords		
	<i>Black Cherry</i>		2.0	<i>Cords</i>		
	<i>Red Maple</i>		31.0	<i>Cords</i>		
	Paper Birch		7.0	Cords		
White Spruce	33.0	Cords				
TOTAL:			406.4	MBF		
TOTAL:			7,512.0	Cords		



# Sale Specific Conditions & Requirements

**Sale Name: Uge Winter Aspen**

**Sale Number: 54-022-16 Seq#: 1**

## 1 - Sale Area

### 1.2 - Boundaries

#### 1.2.1 - Painted boundaries (1/14)

The sale, retention, and Payment Unit boundaries are marked and identified by blue, red, and green paint. Exterior sale boundary lines against State are marked with red paint. Exterior sale boundary lines against private are marked with blue paint. Interior retention boundaries are marked with red paint. Interior Payment Unit boundaries are marked with green paint. The painted boundary line trees are not Included Timber and are to be protected. Green painted trees designating an interior Payment Unit boundary are only to be cut when all surrounding Payment Units have been paid.

## 2 - Timber Specifications

### 2.1 - Included Timber

#### 2.1.1 - Clearcut unit(s) with unmerchantable trees (6/14)

Within Payment Unit(s) 1-9, cut all trees that are two (2) inches or more at DBH except, do not cut trees marked with yellow paint above and below stump height within Payment Unit 4. Also, do not cut any red pine, white pine, oak, or cedar within Payment Units 1-3 and 5-9. Special protection trees identified in accordance with condition 3.4.2, within clearcutting unit boundaries, are not Included Timber and are to be protected.

## 3 - Payments

### 3.3 - Pre-measured Sales

#### 3.3.4 - Dividing payment units (7/14)

Payment Unit(s) 1-7 may be divided at the request of the Purchaser and upon approval of the Unit Manager. Dividing Payment Units is a contract modification which requires a Timber Sale Contract Supplement. There will be only one division per Payment Unit.

### 3.4 - Damaged Timber

#### 3.4.1 - Damaged timber (6/14)

General Condition and Requirement 3.4 Damaged Timber, defines liquidated damages for undesignated live merchantable trees which are cut or injured. No damage is acceptable to merchantable trees. Within the sale area, if more than 5% of the trees (> 4.5" DBH) within a specified area of the sale are damaged, liquidated damages will be assessed for all trees damaged. Rates will be in accordance with General Condition and Requirement 3.4 Damaged Timber.

#### 3.4.2 - Special Protection Trees (4/14)

The Purchaser shall not cut live or dead special protection trees within cutting units or clearings. Special protection trees are UNDESIGNATED TREES greater than 26 inches in DBH and all other trees marked with yellow paint. If the Purchaser's operations have cut or damaged special protection trees through carelessness, the Purchaser shall pay \$150 as fixed, agreed and liquidated damages for each special protection tree cut or damaged. Such payment does not constitute ownership of the undesignated timber.

## 4 - Transportation

### 4.1 - Construction

#### 4.1.3 - Slash and earthen piles (8/04)

Piles or windrows of earth along roads and landings that have been widened or constructed shall be leveled. Slash from road maintenance or construction, including stumps, shall be chipped, utilized or otherwise removed from the sale.

#### 4.1.5 - Culverts (5/14)

If any of the existing culverts are damaged, they must be repaired or replaced. If replaced or additional culverts are needed, they shall be new, corrugated metal or plastic gauge and overlaid with crushed limestone to a depth of 12"-18". Culvert installation locations must be approved by the sale administrator. The culverts will be a minimum of 12 inches in diameter and

18 feet in length. Additional culverts installed must be removed before the sale is considered complete. Soils shall be maintained and left in a non-erodible condition, with water bars, seed, fertilizer, mulch, and slash installed as directed by the sale administrator and as specified in the BMP manual.

#### 4.1.6 - Road construction (1/09)

Construction or improvements of existing roads shall be done in such a way as to minimize the environmental and visual impacts. Merchantable trees shall be cut and utilized unless otherwise directed. Non-merchantable trees shall be severed and laid flat on the ground. Slash shall be scattered, and not left in windrows and kept a minimum of 10 feet back from the road edge. Stumps shall be set upright, not left on edge, and be moved at least 10 feet away from the road edge. Disturbed soil shall be feathered into the woods and not left in berms or windrows. Any road construction or improvement activities must be pre-authorized by the sale administrator before work begins.

#### 4.1.7 - Road closure (10/11)

All new roads and/or road segments built into the sale must be blocked to vehicle traffic upon completion of the sale. Overgrown roads that are reopened shall be considered new roads. In general, this will require constructing a four (4') foot high berm of stumps and logs covered with earth. These roads must be rendered impassable to cars and trucks. Contact the sale administrator for specific details of design and placement.

### 4.2 - Maintenance

#### 4.2.5 - Two wheel drive condition (2/04)

All existing trail roads on and adjacent to the sale area must be passable by two-wheel drive traffic for the duration of the sale.

## 5 - Operations

### 5.1 - Notification

#### 5.1.1 - Pre-sale conference (10/11)

A pre-sale conference between the Purchaser and sale administrator is required prior to beginning any operations to determine landing and road locations. The Unit Manager or his/her representative must be contacted at least 10 days in advance to schedule the conference.

#### 5.1.4 - Post-sale conference (6/11)

A post-sale conference on site between the Purchaser and sale administrator is required 5 days prior to the completion of active logging operations to determine clean-up and repair of landings, road edges, and the fulfillment of other contract specifications.

### 5.2 - Conduct of Operations

#### 5.2.2 - Hazard Trees/Snags

##### 5.2.2.1 - Den trees (2/04)

Obvious hollow and/or den trees shall be protected and left standing unless they are a safety hazard.

#### 5.2.3 - Operating Restrictions

##### 5.2.3.1 - Operating restrictions (9/11)

Within Payment Unit(s) 1-9, unless changed by written agreement, cutting, skidding, and hauling is limited to the period of 12/01 to 3/15. This restriction is to protect a potential species of concern, reduce impact with trail users, limit browse, and increase vigor in regeneration.

##### 5.2.3.11 - Coppice regeneration protection (4/10)

Timber harvesting in Payment Units 1-9 must be completed before significant deciduous seedling sprouting occurs so as to minimize damage to the new regeneration.

#### 5.2.4 - Dead and Down Creation

##### 5.2.4.4 - Dead and down creation, grouse (8/13)

To encourage grouse and other wildlife, in Payment Unit(s) 1-9 leave one, 12" diameter or larger log-length (8 foot minimum) piece on the ground for every 2 acres. These will be evenly scattered throughout the unit. This can be an unmerchantable piece or a full tree.

#### 5.2.4.6 - Dead and down creation, other (9/09)

Within Payment Units 1-9, leave one brush pile every 3-5 acres along lowland edge to provide habitat for reptiles and hare. The piles should be a minimum of 8 feet in diameter, consist of 3-5 trees > 5" in diameter at the base, and covered with tops. A pinwheel structure, meeting minimum dimensions list above, overlaid with tops is also acceptable.

#### 5.2.31 - Landing locations (9/13)

Landing areas are marked on the Timber Sale Map with the letter "L". Landings must be confined to these designated sites unless otherwise authorized by the Unit Manager or his/her representative.

#### 5.2.32 - Decking/landing restoration (9/13)

All decking and landing areas must have the surface area restored to a condition equal to or better than before. This is to ensure the proper regeneration of the stand. Wood debris, chips and "cookies" from trimmings must be removed or scattered away from landing and loading areas and may not be windrowed on the edge.

#### 5.2.38 - No decking against live trees (2/04)

Cut products may not be decked against unmarked or designated leave trees.

#### 5.2.39 - ORV trail/route protection (12/12)

The Atlanta ORV trails and routes are shown on the Timber Sale Map. Do not cut trees or damage posts with orange ORV markers. All stumps within 5 feet of the trail must be cut flush with the ground. Maintain a 20 foot wide slash, debris, and rut free zone daily using the ORV trail or route as the centerline. Do not run equipment down the ORV trail or route. Skidding across the trail or route may only occur in locations approved by the sale administrator.

### 5.4 - Soil Protection

#### 5.4.1 - Rutting restriction, general (7/16)

Operations are to cease immediately if equipment and weather conditions result in rutting of roads and/or skid trails which is 12 inches or greater in depth and 50 feet in length. The Unit Manager or his/her representative may restrict hauling and/or skidding if ruts exceed the specified depth. With the Unit Manager or his/her representative's approval, the Purchaser may return to the area when the risk of rutting has decreased.

### 5.8 - Protection of Endangered Species

#### 5.8.5 - Protection of raptor nests (3/13)

All trees with raptor nests will be protected if found during harvesting operations. Notification will be made to the Unit Manager or his/her representative who will notify the Wildlife Biologist so an on-site evaluation and recommendation can be made, if necessary.

## 6 - Safety and Fire Prevention

### 6.2 - Signing

#### 6.2.3 - Recreational trail posting (2/10)

The Purchaser is responsible for posting and maintaining caution signs on the Atlanta ORV trails and routes prior to beginning operations. The trail must be posted at appropriate distances from the sale area to warn of logging activity and truck traffic at both ends of the trail. Signs must be removed when harvest operations are suspended or completed. The Purchaser will provide these signs.



# TIMBER SALE MAP

This information provided by authority of Part 525, 1994 PA 451, as amended.

Forest Management Unit Atlanta Management Unit	County Montmorency	Mapped By Coy	Date 09/22/2016	Page 1	of 1
---------------------------------------------------	-----------------------	------------------	--------------------	-----------	---------

Township 32N	Range 03E	Section(s) and Subdivision(s) 8- SESE 9- S2SW & SWSE 16- N2 & N2S2 15-NWSW & SWNW 17-NENE, S2N2, & N2S2 18- SENE & NESE	Scale 1:15,840
-----------------	--------------	-------------------------------------------------------------------------------------------------------------------------------	-------------------

Cover Type				Density	
A = Aspen	H = Hemlock	N = Marsh	U = Upland Brush	0 = Non Stocked	5 = Pole Timber Medium
B = Paper Birch	J = Jack Pine	O = Oak	UM = Upland Mixed	1 = Seedling Sapling Poor	6 = Pole Timber Well
C = Cedar	L = Lowland Brush	P = Lowland Poplar	V = Bog or Marsh	2 = Seedling Sapling Medium	7 = Saw Timber Poor
D = Tread Bog	LM = Lowland Mixed	Q = Mixed Swamp Conifer	W = White Pine	3 = Seedling Sapling Well	8 = Saw Timber Medium
E = Swamp Hdwoods	M = Mpl, Bch, Brch	R = Red Pine	X = Non Stocked	4 = Pole Timber Poor	9 = Saw Timber Well
F = Spruce Fir	MC = Mixed Conifer	S = Black Spruce	Z = Water		
G = Grass	MD = Mixed Deciduous	T = Tamarack			

PU	Acres	PU	Acres
1	57.7	8	5.5
2	31.2	9	13.0
3	55.6		
4	47.1		
5	32.3		
6	62.6		
7	35.5		

## Uge Winter Aspen

### Compartments 68 & 69

340.5 Acres

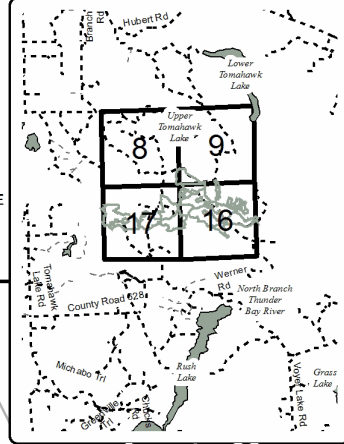
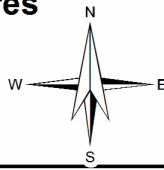

### Legend

- Against State (Red)
- Payment Unit (Green)
- Private Line (Blue)
- ▨ Retention Area (Red)
- Stand Boundaries
- ⋯ Nearby Timber Sale
- Ⓛ Landing
- Section Corners
- Recreational Trail
- - - Poor Dirt Roads
- ⋯ Closed Roads

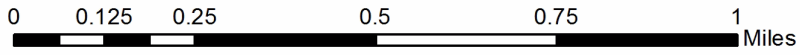
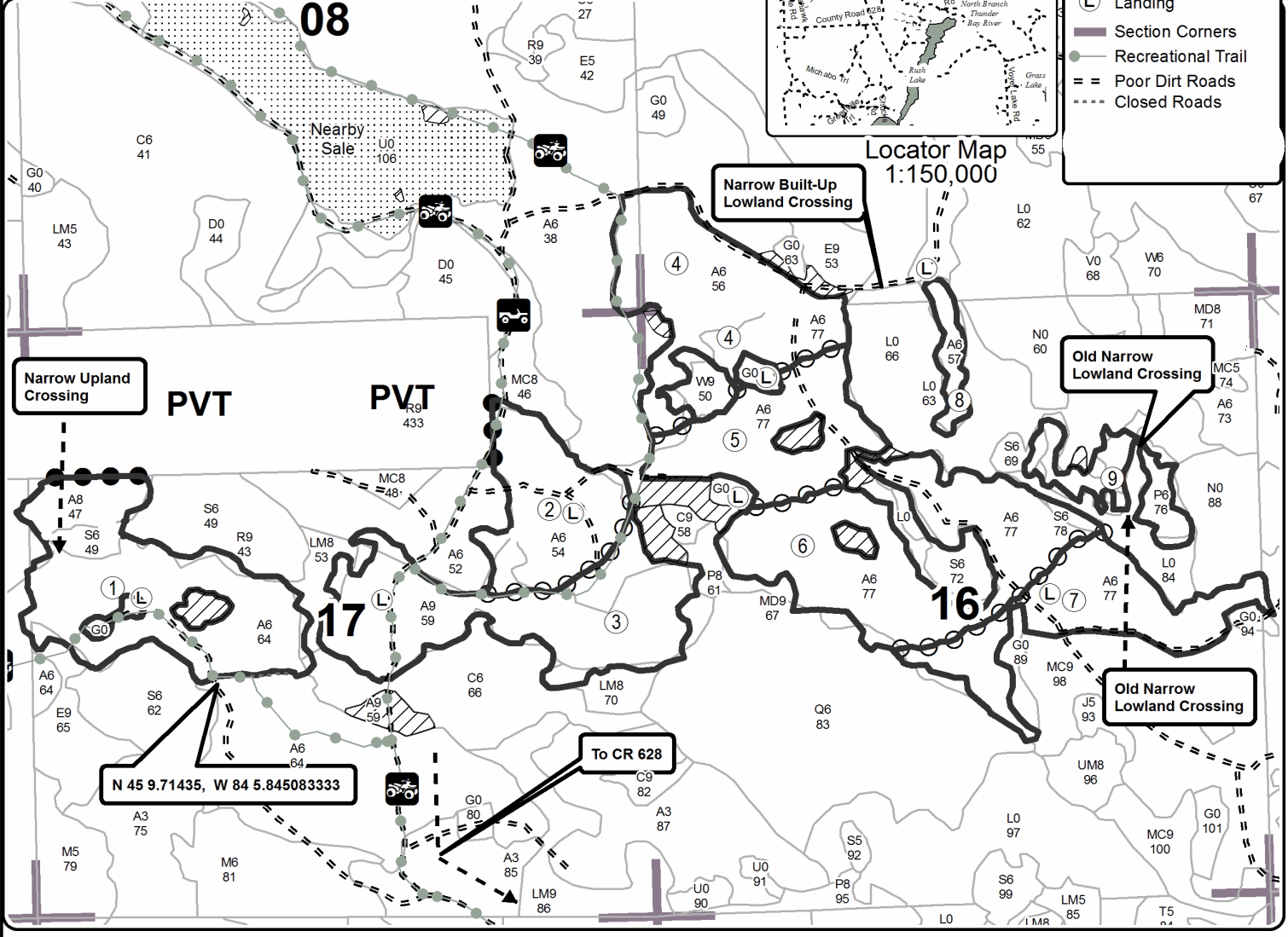

# TIMBER SALE INFORMATION

628 Jabba the Toad SBW Mix (54-047-16)

Montmorency County (Advertised Price \$11,990.55)

A timber sale contract for this lump sum, sealed bid timber sale will be awarded to the responsible bidder offering the highest sealed bid price. Bids must be at or above the following advertised price for each species:

<u>PRODUCTS &amp; SPECIES</u>	<u>ESTIMATED UNITS*</u>	<u>ADVERTISED PRICE</u>
Sawtimber		
Basswood	4.10 MBF	\$ 77.00 / MBF
Red Maple	3.10 MBF	\$ 122.00 / MBF
Red Pine	4.40 MBF	\$ 131.00 / MBF
White Spruce	2.60 MBF	\$ 73.00 / MBF
Pulpwood		
Balsam Fir	127.00 Cords	\$ 22.10 / Cord
Basswood	17.00 Cords	\$ 9.00 / Cord
Mixed Aspen	205.00 Cords	\$ 18.45 / Cord
Mixed Hardwood	84.00 Cords	\$ 17.40 / Cord
Paper Birch	25.00 Cords	\$ 16.00 / Cord
Red Oak	8.00 Cords	\$ 18.45 / Cord
Red Pine	7.00 Cords	\$ 50.80 / Cord
White Pine	2.00 Cords	\$ 36.60 / Cord
White Spruce	37.00 Cords	\$ 36.50 / Cord

\* The total volume is statistically estimated within plus (+) or minus (-) 15.58 percent. The estimated units are final and not subject to adjustment. Prospective bidders are urged to examine this timber and to make their own estimates of quantity and quality.

## **BOND AND PAYMENT SCHEDULE:**

1. A bond in the amount of \$800.00 to insure faithful performance of the conditions of the contract will be deposited by the successful bidder within 21 days of the sale award.
2. Cutting in any sale or unit without the required advance payment would be considered a trespass.
3. Total payment must be paid in advance or according to the following schedule:
  - (a) Ten percent (10%) of the sale value must be paid within 21 days of the sale award.
  - (b) The remainder is due before cutting begins.
4. If no cutting takes place, the 10% down payment will not be refunded.
5. Operations on the contract issued will terminate on 12/31/2019.

**Description of Timber by Payment Unit (PU)**

PU	MARKET GROUP	PRODUCT	QUANTITY	UNIT	ACRES	ADVERTISE PRICE			
1	Basswood	Sawtimber	4.1	MBF	19.1	\$11,990.55			
	Red Maple		3.1	MBF					
	Red Pine		4.4	MBF					
	White Spruce		2.6	MBF					
	Balsam Fir	Pulpwood	127.0	Cords					
	<i>Balsam Fir</i>	<i>Sawtimber</i>	5.0	<i>MBF</i>					
	<i>Balsam Fir</i>	<i>Pulpwood</i>	117.0	<i>Cords</i>					
	Basswood		17.0	Cords					
	Mixed Aspen		205.0	Cords					
	<i>Balsam Poplar</i>	<i>Sawtimber</i>	1.3	<i>MBF</i>					
	<i>Quaking Aspen</i>		1.5	<i>MBF</i>					
	<i>Balsam Poplar</i>	<i>Pulpwood</i>	10.0	<i>Cords</i>					
	<i>Quaking Aspen</i>		189.0	<i>Cords</i>					
	Mixed Hardwood		84.0	Cords					
	<i>Black Cherry</i>		1.0	<i>Cords</i>					
	<i>Red Maple</i>		83.0	<i>Cords</i>					
	Paper Birch		25.0	Cords					
	<i>Paper Birch</i>	<i>Sawtimber</i>	1.2	<i>MBF</i>					
	<i>Paper Birch</i>	<i>Pulpwood</i>	23.0	<i>Cords</i>					
	Red Oak		8.0	Cords					
	<i>Red Oak</i>	<i>Sawtimber</i>	0.9	<i>MBF</i>					
	<i>Red Oak</i>	<i>Pulpwood</i>	6.0	<i>Cords</i>					
	Red Pine		7.0	Cords					
	White Pine		2.0	Cords					
	White Spruce		37.0	Cords					
	TOTAL:			14.2			MBF		
	TOTAL:			512.0			Cords		

## Sale Specific Conditions & Requirements

Sale Name: 628 Jabba the Toad SBW Mix

Sale Number: 54-047-16 Seq#: 1

### 1 - Sale Area

#### 1.2 - Boundaries

##### 1.2.1 - Painted boundaries (1/14)

The sale boundaries are marked and identified by red paint. Exterior sale boundary lines against state are marked with red paint. Retention pockets are marked with red paint and are not to be entered. The painted boundary line trees are not Included Timber and are to be protected.

### 2 - Timber Specifications

#### 2.1 - Included Timber

##### 2.1.1 - Clearcut unit(s) with unmerchantable trees (6/14)

Within Payment Unit(s) 1, cut all trees that are two (2) inches or more at DBH, except do not cut any cedar or hemlock.

##### 2.1.11 - Description of timber note (2/04)

Note that Mixed Aspen pulpwood includes quaking aspen and balsam poplar. Mixed Hardwood pulpwood includes red maple with a trace amount of black cherry.

### 3 - Payments

#### 3.4 - Damaged Timber

##### 3.4.1 - Damaged timber (6/14)

General Condition and Requirement 3.4 Damaged Timber, defines liquidated damages for undesignated live merchantable trees which are cut or injured.

No damage is acceptable to undesignated merchantable trees. Within the sale area, if more than 5% of trees (> 4.5" DBH) within a specified area of the sale are damaged, liquidated damages will be assessed for all trees damaged. Rates will be in accordance with General Condition and Requirement 3.4 Damaged Timber.

### 4 - Transportation

#### 4.1 - Construction

##### 4.1.3 - Slash and earthen piles (8/04)

Piles or windrows of earth along roads and landings that have been widened or constructed shall be leveled. Slash from road maintenance or construction, including stumps, shall be dispersed throughout the sale.

##### 4.1.6 - Road construction (1/09)

Improvements of existing roads shall be done in such a way as to minimize the environmental and visual impacts. Merchantable trees shall be cut and utilized unless otherwise directed. Non-merchantable trees shall be severed and laid flat on the ground. Slash shall be scattered, and not left in windrows and kept a minimum of 10 feet back from the road edge. Stumps shall be set upright, not left on edge, and be moved at least 10 feet away from the road edge. Disturbed soil shall be feathered into the woods and not left in berms or windrows.

##### 4.1.12 - No new roads (1/12)

No new roads will be permitted. All operations are limited to existing roads. Skid trails only will be allowed.

#### 4.2 - Maintenance

##### 4.2.5 - Two wheel drive condition (2/04)

All existing trail roads on and adjacent to the sale area must be passable by two-wheel drive traffic for the duration of the sale.

### 5 - Operations

## 5.1 - Notification

### 5.1.1 - Pre-sale conference (10/11)

A pre-sale conference on site between the Purchaser and sale administrator is required prior to beginning any operations to determine landing and road locations. The Unit Manager or his/her representative must be contacted at least 10 days in advance to schedule the conference.

### 5.1.4 - Post-sale conference (6/11)

A post-sale conference on site between the Purchaser and sale administrator is required 5 days prior to the completion of active logging operations to determine clean-up and repair of landings, road edges, and the fulfillment of other contract specifications.

## 5.2 - Conduct of Operations

### 5.2.1 - Slash

#### 5.2.1.10 - No slash in openings (5/10)

No brush or logging debris is to be left in the maintained wildlife opening which is indicated by G0 on the Timber Sale Map. Any damage to the opening shall be repaired according to specifications of the Unit Manager or his/her representative.

### 5.2.2 - Hazard Trees/Snags

#### 5.2.2.1 - Den trees (2/04)

Obvious hollow and/or den trees shall be protected and left standing unless they are a safety hazard.

### 5.2.3 - Operating Restrictions

#### 5.2.3.11 - Coppice regeneration protection (4/10)

Timber harvesting in any Payment Unit must be completed before significant sprouting occurs in that Payment Unit so as to minimize damage to the new regeneration. Any post harvest operations, such as chipping, must be completed before sprouting of regeneration occurs. If it is anticipated that chipping will be delayed, then tops shall be carried to one central location or left unchipped. The Unit Manager or his/her representative may cease such operations if sprouting occurs before the operation is complete.

### 5.2.4 - Dead and Down Creation

#### 5.2.4.4 - Dead and down creation, grouse (8/13)

To encourage grouse and other wildlife, in Payment Unit(s) 1, leave one, 12" diameter or larger log-length (8 foot minimum) piece on the ground for every 2 acres. These will be evenly scattered throughout the unit. This can be an unmerchantable piece or a full tree. Each log must be clearly identified by a piece of blue flagging.

#### 5.2.32 - Decking/landing restoration (9/13)

All decking and landing areas must have the surface area restored to a condition equal to or better than before. This is to ensure the proper regeneration of the stand. Wood debris, chips and "cookies" from trimmings must be removed or scattered away from landing and loading areas and may not be windrowed on the edge.

#### 5.2.38 - No decking against live trees (2/04)

Cut products may not be decked against unmarked or designated leave trees.

## 5.4 - Soil Protection

### 5.4.1 - Rutting restriction, general (7/16)

Operations are to cease immediately if equipment and weather conditions result in rutting of roads and/or skid trails which is 12 inches or greater in depth and 50 feet in length. The Unit Manager or his/her representative may restrict hauling and/or skidding if ruts exceed the specified depth. With the Unit Manager or his/her representative's approval, the Purchaser may return to the area when the risk of rutting has decreased.

## 5.8 - Protection of Endangered Species

### 5.8.5 - Protection of raptor nests (3/13)

All trees with raptor nests will be protected if found during harvesting operations. Notification will be made to the Unit



Manager or his/her representative who will notify the Wildlife Biologist so an on-site evaluation and recommendation can be made, if necessary.

## **6 - Safety and Fire Prevention**

### 6.2 - Signing

#### 6.2.1 - Road posting (9/09)

The Purchaser is responsible for posting and maintaining caution signs on County Road 628 prior to beginning operations. The road must be posted at appropriate distances from the sale area to warn of logging activity and truck traffic. Signs must be removed when harvest operations are suspended or completed. The Purchaser will provide these signs.



# TIMBER SALE MAP

This information provided by authority of Part 525, 1994 PA 451, as amended.

Sale Number	Year
54-047	16

Forest Management Unit	County	Mapped By	Date	Page	of
Atlanta	Montmorency	D. Parris	9/20/2016	1	1
Township	Range	Section(s) and Subdivision(s)	Scale		
32N	03E	Sec 30 NWNW, SWNW, SENW, NWSW, NESW	1:15,840		

Cover Type				Density	
A = Aspen	H = Hemlock	N = Marsh	U = Upland Brush	0 = Non Stocked	5 = Pole Timber Medium
B = Paper Birch	J = Jack Pine	O = Oak	UM = Upland Mixed	1 = Seedling Sapling Poor	6 = Pole Timber Well
C = Cedar	L = Lowland Brush	P = Lowland Poplar	V = Bog or Marsh	2 = Seedling Sapling Medium	7 = Saw Timber Poor
D = Tread Bog	LM = Lowland Mixed	Q = Mixed Swamp Conifer	W = White Pine	3 = Seedling Sapling Well	8 = Saw Timber Medium
E = Swamp Hdwoods	M = Mpl, Bch, Brch	R = Red Pine	X = Non Stocked	4 = Pole Timber Poor	9 = Saw Timber Well
F = Spruce Fir	MC = Mixed Conifer	S = Black Spruce	Z = Water		
G = Grass	MD = Mixed Deciduous	T = Tamarack			

PU	Stand	Acres
1	4	19.1

## 628 Jabba the Toad SBW Mix

Compartment 72  
19.1 Acres

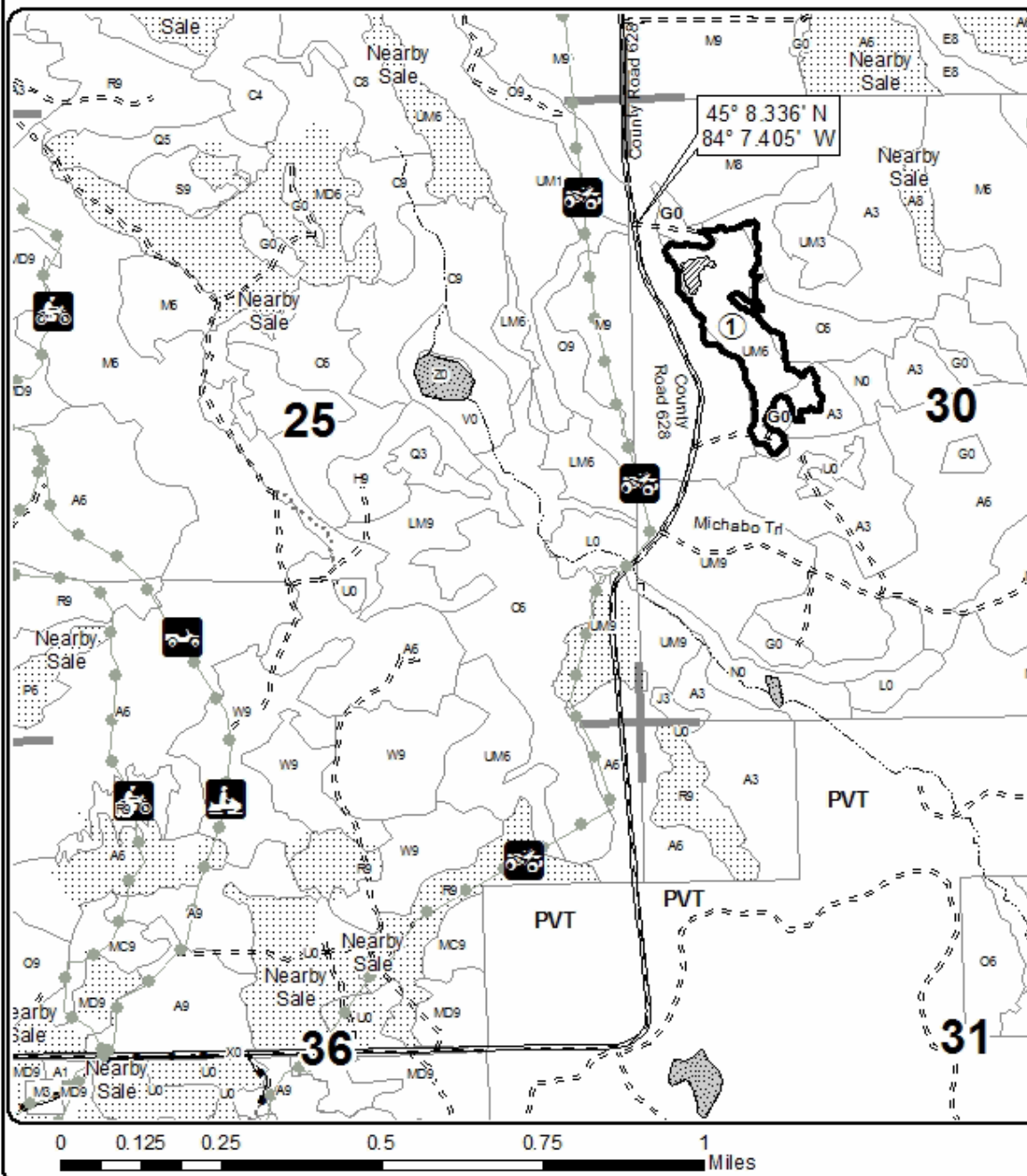

Legend	
	Against State (Red)
	Payment Unit
	Retention (Red)
	Stand Boundaries
	Nearby Timber Sale
	Recreational Trail
	Gravel Roads
	Poor Dirt Roads
	Closed Roads
	Pipeline; Powerline
	Lakes and Rivers
	Streams
	Section Corners

Locator Map  
1:150,000

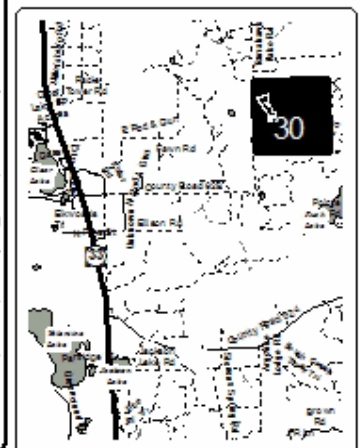

14 C Pine Mix (54-021-16)  
 ; Montmorency COUNTY

In response to the notice of sale to be held 10:00 a.m. (local time) on May 23, 2017, I am hereby submitting my sealed bid (firm offer) for the following forest products to be cut. Bids for individual species must be at or above the advertised price. All non-responsive bid forms may be rejected.

<u>PRODUCTS &amp; SPECIES</u>	<u>ESTIMATED VOLUME*</u>	<u>ADVERTISED PRICE</u>	<u>BID PRICE</u>
<b>Sawtimber</b>			
Mixed Aspen	36.90 MBF	\$ 70.00/MBF	\$ _____
Red Oak	348.20 MBF	\$ 141.00/MBF	\$ _____
Red Pine	69.80 MBF	\$ 131.00/MBF	\$ _____
White Oak	4.10 MBF	\$ 71.00/MBF	\$ _____
White Pine	8.60 MBF	\$ 88.00/MBF	\$ _____
<b>Pulpwood</b>			
Balsam Fir	37.00 Cords	\$ 22.10/Cord	\$ _____
Jack Pine	7.00 Cords	\$ 24.30/Cord	\$ _____
Mixed Aspen	1,029.00 Cords	\$ 18.45/Cord	\$ _____
Mixed Hardwood	404.00 Cords	\$ 17.40/Cord	\$ _____
Red Oak	895.00 Cords	\$ 18.45/Cord	\$ _____
Red Pine	70.00 Cords	\$ 50.80/Cord	\$ _____
White Oak	61.00 Cords	\$ 18.45/Cord	\$ _____
White Pine	62.00 Cords	\$ 36.60/Cord	\$ _____
White Spruce	6.00 Cords	\$ 36.50/Cord	\$ _____

\*The volumes are statistically estimated within plus (+) or minus (-) 11.01 percent. These estimated volumes are final and not subject to adjustment. Prospective bidders are urged to examine this timber and to make their own estimates of quantity and quality.

I understand that any or all bids may be rejected. All bids must be signed and all bid items must be bid or the bid form may be rejected. I also understand that consideration and awarding a contract will be based upon my past performance and ability to complete the contract based upon equipment and staffing subject to my control.

FEDERAL ID: \_\_\_\_\_ or SOCIAL SECURITY NUMBER: \_\_\_\_\_

Company or individual bidding: \_\_\_\_\_

Company representative's name: \_\_\_\_\_

Address: \_\_\_\_\_

City: \_\_\_\_\_ State: \_\_\_\_\_ Zip: \_\_\_\_\_

IF AVAILABLE, PLEASE PLACE THE PERSONALIZED LABEL FROM YOUR PROSPECTUS IN THE ABOVE BOX.

Individual or company representative's signature: \_\_\_\_\_ Date: \_\_\_\_\_

Phone number : \_\_\_\_\_ Email (optional): \_\_\_\_\_

**THE WINNING BIDDER MUST COMPLETE THE VERIFICATION OF WORKER'S DISABILITY COMPENSATION ACT COMPLIANCE (ON REVERSE SIDE IF DOUBLE SIDED) WITHIN 21 DAYS OF SALE AWARD DATE**



<b>FOR DEPARTMENT USE ONLY</b>	
Sale Number (XX - XXX - XX - XX)	
Forest Management Unit:	

## TIMBER SALE VERIFICATION OF WORKER'S DISABILITY COMPENSATION ACT COMPLIANCE

As required by Act 317, P.A. 1969 (Worker's Compensation) and  
Part 5 of Act 451 of 1994, as amended.

### VERIFICATION OF WORKER'S DISABILITY COMPENSATION ACT COMPLIANCE

- This verification must be completed and submitted within 21 days of contract award and prior to the issuance of the timber sale contract.
- In addition, if boxes 2B or 2C are checked, then Notice of Exclusion or Certificate of Insurance must be submitted within twenty-one (21) days of the contract award and prior to the issuance of the timber sale contract.
- All information must be typed or printed except for written signatures.

Please Check Appropriate Categories:

1. My business is organized as (you **must** check one of the boxes below):
  - A.  Sole Proprietorship (individual)
  - B.  Partnership
  - C.  Corporation
2. You **must** check one of the boxes below:
  - A.  I certify my business is a sole proprietorship and it has no employees but the sole proprietor. I am not subject to the Worker's Compensation Laws.
  - B.  I certify my business has satisfied its obligation to the Worker's Compensation Act through the use of an approved Notice of Exclusion (BWC-337, Rev. 5/96). I will provide a copy of the Notice of Exclusion within 21 days of the contract award. (For questions or a copy of the BWC-337, please call the Worker's Compensation Bureau at 517-322-1195).
  - C.  I certify my business has a Worker's Compensation Policy. I will provide an original Certificate of Insurance within twenty-one (21) days of the contract award.
3. If you have checked item 2(A) or 2(B), you **must** indicate the number of **both** full-time and part-time employees, other than yourself, including family members and active partners (if none, you must enter "0").

\_\_\_\_\_ Full-time Employees

\_\_\_\_\_ Part-time Employees

Name of Business		Federal ID (or) Social Security No.	
Address		Telephone (       )	
City	State	ZIP	

*I hereby certify that the above information is true and correct. I agree to notify the Michigan DNR of any changes that occur in factors affecting my coverage during any of my present and future operations.*

\_\_\_\_\_  
Signature of Owner or Authorized Representative

\_\_\_\_\_  
Title

\_\_\_\_\_  
Date

Please complete the "SEALED BID" information on the next page

Uge Winter Aspen (54-022-16)  
 ; Montmorency COUNTY

In response to the notice of sale to be held 10:00 a.m. (local time) on May 23, 2017, I am hereby submitting my sealed bid (firm offer) for the following forest products to be cut. Bids for individual species must be at or above the advertised price. All non-responsive bid forms may be rejected.

<u>PRODUCTS &amp; SPECIES</u>	<u>ESTIMATED VOLUME*</u>	<u>ADVERTISED PRICE</u>	<u>BID PRICE</u>
<b>Sawtimber</b>			
Basswood	50.50 MBF	\$ 87.00/MBF	\$ _____
Mixed Aspen	242.50 MBF	\$ 79.00/MBF	\$ _____
Paper Birch	2.40 MBF	\$ 61.00/MBF	\$ _____
Red Maple	22.90 MBF	\$ 138.00/MBF	\$ _____
Red Oak	47.50 MBF	\$ 160.00/MBF	\$ _____
Sugar Maple	40.60 MBF	\$ 409.00/MBF	\$ _____
<b>Pulpwood</b>			
Balsam Fir	713.00 Cords	\$ 25.00/Cord	\$ _____
Basswood	168.00 Cords	\$ 10.20/Cord	\$ _____
Beech	72.00 Cords	\$ 19.75/Cord	\$ _____
Black Spruce	33.00 Cords	\$ 41.35/Cord	\$ _____
Mixed Aspen	4,888.00 Cords	\$ 20.90/Cord	\$ _____
Mixed Hardwood	1,242.00 Cords	\$ 19.75/Cord	\$ _____
Paper Birch	87.00 Cords	\$ 18.15/Cord	\$ _____
Red Oak	111.00 Cords	\$ 20.90/Cord	\$ _____
Tamarack	10.00 Cords	\$ 34.80/Cord	\$ _____
White Pine	18.00 Cords	\$ 41.50/Cord	\$ _____
White Spruce	299.00 Cords	\$ 41.35/Cord	\$ _____

\*These estimated volumes are final and not subject to adjustment. Prospective bidders are urged to examine this timber and to make their own estimates of quantity and quality.

I understand that any or all bids may be rejected. All bids must be signed and all bid items must be bid or the bid form may be rejected. I also understand that consideration and awarding a contract will be based upon my past performance and ability to complete the contract based upon equipment and staffing subject to my control.

FEDERAL ID: \_\_\_\_\_ or SOCIAL SECURITY NUMBER: \_\_\_\_\_

Company or individual bidding: \_\_\_\_\_

Company representative's name: \_\_\_\_\_

Address: \_\_\_\_\_

City: \_\_\_\_\_ State: \_\_\_\_\_ Zip: \_\_\_\_\_

IF AVAILABLE, PLEASE PLACE THE PERSONALIZED LABEL FROM YOUR PROSPECTUS IN THE ABOVE BOX.

Individual or company representative's signature: \_\_\_\_\_ Date: \_\_\_\_\_

Phone number : \_\_\_\_\_ Email (optional): \_\_\_\_\_

**THE WINNING BIDDER MUST COMPLETE THE VERIFICATION OF WORKER'S DISABILITY COMPENSATION ACT COMPLIANCE (ON REVERSE SIDE IF DOUBLE SIDED) WITHIN 21 DAYS OF SALE AWARD DATE**



<b>FOR DEPARTMENT USE ONLY</b>
Sale Number (XX - XXX - XX - XX)
Forest Management Unit:

## TIMBER SALE VERIFICATION OF WORKER'S DISABILITY COMPENSATION ACT COMPLIANCE

*As required by Act 317, P.A. 1969 (Worker's Compensation) and  
Part 5 of Act 451 of 1994, as amended.*

### VERIFICATION OF WORKER'S DISABILITY COMPENSATION ACT COMPLIANCE

- This verification must be completed and submitted within 21 days of contract award and prior to the issuance of the timber sale contract.
- In addition, if boxes 2B or 2C are checked, then Notice of Exclusion or Certificate of Insurance must be submitted within twenty-one (21) days of the contract award and prior to the issuance of the timber sale contract.
- All information must be typed or printed except for written signatures.

Please Check Appropriate Categories:

1. My business is organized as (you **must** check one of the boxes below):
  - A.  Sole Proprietorship (individual)
  - B.  Partnership
  - C.  Corporation
  
2. You **must** check one of the boxes below:
  - A.  I certify my business is a sole proprietorship and it has no employees but the sole proprietor. I am not subject to the Worker's Compensation Laws.
  - B.  I certify my business has satisfied its obligation to the Worker's Compensation Act through the use of an approved Notice of Exclusion (BWC-337, Rev. 5/96). I will provide a copy of the Notice of Exclusion within 21 days of the contract award. (For questions or a copy of the BWC-337, please call the Worker's Compensation Bureau at 517-322-1195).
  - C.  I certify my business has a Worker's Compensation Policy. I will provide an original Certificate of Insurance within twenty-one (21) days of the contract award.
  
3. If you have checked item 2(A) or 2(B), you **must** indicate the number of **both** full-time and part-time employees, other than yourself, including family members and active partners (if none, you must enter "0").

\_\_\_\_\_ Full-time Employees

\_\_\_\_\_ Part-time Employees

Name of Business		Federal ID (or) Social Security No.	
Address		Telephone (       )	
City	State	ZIP	

*I hereby certify that the above information is true and correct. I agree to notify the Michigan DNR of any changes that occur in factors affecting my coverage during any of my present and future operations.*

\_\_\_\_\_  
Signature of Owner or Authorized Representative

\_\_\_\_\_  
Title

\_\_\_\_\_  
Date

**Please complete the "SEALED BID" information on the next page**

628 Jabba the Toad SBW Mix (54-047-16)  
 ; Montmorency COUNTY

In response to the notice of sale to be held 10:00 a.m. (local time) on May 23, 2017, I am hereby submitting my sealed bid (firm offer) for the following forest products to be cut. Bids for individual species must be at or above the advertised price. All non-responsive bid forms may be rejected.

<u>PRODUCTS &amp; SPECIES</u>	<u>ESTIMATED VOLUME*</u>	<u>ADVERTISED PRICE</u>	<u>BID PRICE</u>
<b>Sawtimber</b>			
Basswood	4.10 MBF	\$ 77.00/MBF	\$ _____
Red Maple	3.10 MBF	\$ 122.00/MBF	\$ _____
Red Pine	4.40 MBF	\$ 131.00/MBF	\$ _____
White Spruce	2.60 MBF	\$ 73.00/MBF	\$ _____
<b>Pulpwood</b>			
Balsam Fir	127.00 Cords	\$ 22.10/Cord	\$ _____
Basswood	17.00 Cords	\$ 9.00/Cord	\$ _____
Mixed Aspen	205.00 Cords	\$ 18.45/Cord	\$ _____
Mixed Hardwood	84.00 Cords	\$ 17.40/Cord	\$ _____
Paper Birch	25.00 Cords	\$ 16.00/Cord	\$ _____
Red Oak	8.00 Cords	\$ 18.45/Cord	\$ _____
Red Pine	7.00 Cords	\$ 50.80/Cord	\$ _____
White Pine	2.00 Cords	\$ 36.60/Cord	\$ _____
White Spruce	37.00 Cords	\$ 36.50/Cord	\$ _____

\*The volumes are statistically estimated within plus (+) or minus (-) 15.58 percent. These estimated volumes are final and not subject to adjustment. Prospective bidders are urged to examine this timber and to make their own estimates of quantity and quality.

I understand that any or all bids may be rejected. All bids must be signed and all bid items must be bid or the bid form may be rejected. I also understand that consideration and awarding a contract will be based upon my past performance and ability to complete the contract based upon equipment and staffing subject to my control.

FEDERAL ID: \_\_\_\_\_ or SOCIAL SECURITY NUMBER: \_\_\_\_\_  
 Company or individual bidding: \_\_\_\_\_  
 Company representative's name: \_\_\_\_\_  
 Address: \_\_\_\_\_  
 City: \_\_\_\_\_ State: \_\_\_\_\_ Zip: \_\_\_\_\_

IF AVAILABLE, PLEASE PLACE THE PERSONALIZED LABEL FROM YOUR PROSPECTUS IN THE ABOVE BOX.

Individual or company representative's signature: \_\_\_\_\_ Date: \_\_\_\_\_

Phone number : \_\_\_\_\_ Email (optional): \_\_\_\_\_

**THE WINNING BIDDER MUST COMPLETE THE VERIFICATION OF WORKER'S DISABILITY COMPENSATION ACT COMPLIANCE (ON REVERSE SIDE IF DOUBLE SIDED) WITHIN 21 DAYS OF SALE AWARD DATE**



<b>FOR DEPARTMENT USE ONLY</b>
Sale Number (XX - XXX - XX - XX)
Forest Management Unit:

## TIMBER SALE VERIFICATION OF WORKER'S DISABILITY COMPENSATION ACT COMPLIANCE

*As required by Act 317, P.A. 1969 (Worker's Compensation) and  
Part 5 of Act 451 of 1994, as amended.*

### VERIFICATION OF WORKER'S DISABILITY COMPENSATION ACT COMPLIANCE

- This verification must be completed and submitted within 21 days of contract award and prior to the issuance of the timber sale contract.
- In addition, if boxes 2B or 2C are checked, then Notice of Exclusion or Certificate of Insurance must be submitted within twenty-one (21) days of the contract award and prior to the issuance of the timber sale contract.
- All information must be typed or printed except for written signatures.

Please Check Appropriate Categories:

1. My business is organized as (you **must** check one of the boxes below):
  - A.  Sole Proprietorship (individual)
  - B.  Partnership
  - C.  Corporation
2. You **must** check one of the boxes below:
  - A.  I certify my business is a sole proprietorship and it has no employees but the sole proprietor. I am not subject to the Worker's Compensation Laws.
  - B.  I certify my business has satisfied its obligation to the Worker's Compensation Act through the use of an approved Notice of Exclusion (BWC-337, Rev. 5/96). I will provide a copy of the Notice of Exclusion within 21 days of the contract award. (For questions or a copy of the BWC-337, please call the Worker's Compensation Bureau at 517-322-1195).
  - C.  I certify my business has a Worker's Compensation Policy. I will provide an original Certificate of Insurance within twenty-one (21) days of the contract award.
3. If you have checked item 2(A) or 2(B), you **must** indicate the number of **both** full-time and part-time employees, other than yourself, including family members and active partners (if none, you must enter "0").

\_\_\_\_\_ Full-time Employees

\_\_\_\_\_ Part-time Employees

Name of Business		Federal ID (or) Social Security No.	
Address		Telephone (       )	
City	State	ZIP	

*I hereby certify that the above information is true and correct. I agree to notify the Michigan DNR of any changes that occur in factors affecting my coverage during any of my present and future operations.*

\_\_\_\_\_  
Signature of Owner or Authorized Representative

\_\_\_\_\_  
Title

\_\_\_\_\_  
Date

**Please complete the "SEALED BID" information on the next page**



Spray Here Plz MWR (54-012-17)  
 ; Montmorency COUNTY

In response to the notice of sale to be held 10:00 a.m. (local time) on May 23, 2017, I am hereby submitting my sealed bid (firm offer) for the following forest products to be cut. Bids for individual species must be at or above the advertised price. All non-responsive bid forms may be rejected.

<u>PRODUCTS &amp; SPECIES</u>	<u>ESTIMATED VOLUME*</u>	<u>ADVERTISED PRICE</u>	<u>BID PRICE</u>
<b>Sawtimber</b>			
Basswood	36.40 MBF	\$ 77.00/MBF	\$ _____
Beech	5.20 MBF	\$ 84.00/MBF	\$ _____
Red Maple	12.10 MBF	\$ 122.00/MBF	\$ _____
Red Oak	5.50 MBF	\$ 141.00/MBF	\$ _____
Sugar Maple	57.60 MBF	\$ 361.00/MBF	\$ _____
<b>Pulpwood</b>			
Basswood	87.00 Cords	\$ 9.00/Cord	\$ _____
Beech	28.00 Cords	\$ 17.40/Cord	\$ _____
Misc. Species 1	37.00 Cords	\$ 5.00/Cord	\$ _____
Mixed Aspen	39.00 Cords	\$ 18.45/Cord	\$ _____
Mixed Hardwood	192.00 Cords	\$ 17.40/Cord	\$ _____
Red Oak	17.00 Cords	\$ 18.45/Cord	\$ _____

\*The volumes are statistically estimated within plus (+) or minus (-) 14.83 percent. These estimated volumes are final and not subject to adjustment. Prospective bidders are urged to examine this timber and to make their own estimates of quantity and quality.

I understand that any or all bids may be rejected. All bids must be signed and all bid items must be bid or the bid form may be rejected. I also understand that consideration and awarding a contract will be based upon my past performance and ability to complete the contract based upon equipment and staffing subject to my control.

FEDERAL ID: \_\_\_\_\_ or SOCIAL SECURITY NUMBER: \_\_\_\_\_

Company or individual bidding: \_\_\_\_\_

Company representative's name: \_\_\_\_\_

Address: \_\_\_\_\_

City: \_\_\_\_\_ State: \_\_\_\_\_ Zip: \_\_\_\_\_

IF AVAILABLE, PLEASE PLACE THE PERSONALIZED LABEL FROM YOUR PROSPECTUS IN THE ABOVE BOX.

Individual or company representative's signature: \_\_\_\_\_ Date: \_\_\_\_\_

Phone number : \_\_\_\_\_ Email (optional): \_\_\_\_\_

**THE WINNING BIDDER MUST COMPLETE THE VERIFICATION OF WORKER'S DISABILITY COMPENSATION ACT COMPLIANCE (ON REVERSE SIDE IF DOUBLE SIDED) WITHIN 21 DAYS OF SALE AWARD DATE**



<b>FOR DEPARTMENT USE ONLY</b>
Sale Number (XX - XXX - XX - XX)
Forest Management Unit:

## TIMBER SALE VERIFICATION OF WORKER'S DISABILITY COMPENSATION ACT COMPLIANCE

*As required by Act 317, P.A. 1969 (Worker's Compensation) and  
Part 5 of Act 451 of 1994, as amended.*

### VERIFICATION OF WORKER'S DISABILITY COMPENSATION ACT COMPLIANCE

- This verification must be completed and submitted within 21 days of contract award and prior to the issuance of the timber sale contract.
- In addition, if boxes 2B or 2C are checked, then Notice of Exclusion or Certificate of Insurance must be submitted within twenty-one (21) days of the contract award and prior to the issuance of the timber sale contract.
- All information must be typed or printed except for written signatures.

Please Check Appropriate Categories:

1. My business is organized as (you **must** check one of the boxes below):
  - A.  Sole Proprietorship (individual)
  - B.  Partnership
  - C.  Corporation
  
2. You **must** check one of the boxes below:
  - A.  I certify my business is a sole proprietorship and it has no employees but the sole proprietor. I am not subject to the Worker's Compensation Laws.
  - B.  I certify my business has satisfied its obligation to the Worker's Compensation Act through the use of an approved Notice of Exclusion (BWC-337, Rev. 5/96). I will provide a copy of the Notice of Exclusion within 21 days of the contract award. (For questions or a copy of the BWC-337, please call the Worker's Compensation Bureau at 517-322-1195).
  - C.  I certify my business has a Worker's Compensation Policy. I will provide an original Certificate of Insurance within twenty-one (21) days of the contract award.
  
3. If you have checked item 2(A) or 2(B), you **must** indicate the number of **both** full-time and part-time employees, other than yourself, including family members and active partners (if none, you must enter "0").

\_\_\_\_\_ Full-time Employees

\_\_\_\_\_ Part-time Employees

Name of Business		Federal ID (or) Social Security No.	
Address		Telephone (       )	
City	State	ZIP	

*I hereby certify that the above information is true and correct. I agree to notify the Michigan DNR of any changes that occur in factors affecting my coverage during any of my present and future operations.*

\_\_\_\_\_  
Signature of Owner or Authorized Representative

\_\_\_\_\_  
Title

\_\_\_\_\_  
Date

**Please complete the "SEALED BID" information on the next page**