



**DEPARTMENT OF NATURAL RESOURCES  
STATE OF MICHIGAN**

**TIMBER SALE PROSPECTUS #5939**

SCHEDULED SALE DATE AND TIME: 3:00 p.m. (local time) on June 29, 2017.

LOCATION: NEWBERRY MGMT UNIT, PO BOX 428, 5666 STATE HWY M-123, NEWBERRY, MI 49868.

PROSPECTUS NOTE: The bidder is advised to inspect the sale area and review the location, estimated volumes, operating costs and contract terms of proposed sales. Please be aware that some landowners may request 60 days or more notice for access across their land.

Notice is hereby given that bids will be received by the Unit Manager, NEWBERRY MANAGEMENT UNIT, for certain timber on the following described lands:

Ash Overhaul (42-001-17)

Luce County, Advertised Price \$20,134.30, 106.9 Acres, Hardwood, Spruce/Fir/Tamarack.

SALE NOTE: This sale was originally a 2013 sale that was returned uncut. The sale price has been reduced approximately 25% from the original proposal price.

Within Payment Units 1, 3, 4 and 5, harvesting is limited to the period of December 15 to April 1 due to wet access, soil conditions, and winter deer activity.

Some roads or skid trails may require extra protection such as that afforded by Crane Mats. See sale spec 5.2.17 for additional information.

The Purchaser will secure any necessary stream crossing permits that may be required.

The Michigan Department of Transportation (MDOT) must be contacted prior to harvesting timber within the MDOT right-of-way.

Ridgeline Pine (42-014-16)

Luce County, Advertised Price \$256,699.10, 261.2 Acres, Jack Pine, Red Pine.

SALE NOTE: No new roads will be permitted within any Payment Units, with the exception of Payment Unit 2. See Sale Spec 4.1.12 for additional information.

The Pine Ridge Trail is an ORV trail shown on the Timber Sale Map. See Sale Spec 5.2.39 for restrictions.

Within Payment Units 1, 2, 4, 5 and 6, harvesting is not permitted during the period of April 15 to July 15 due to bark slippage.

A recreation site such as a trail, pathway, or campground is within the sale area or the vicinity. Certain restrictions/specifications may be applicable including time restrictions.

Crop Circle Red Pine (42-023-16)

Luce County, Advertised Price \$210,602.75, 310.9 Acres, Jack Pine, Red Pine.

SALE NOTE: No new roads will be permitted within Payment Units 1 through 5 or 12. See Sale Spec 4.1.12 for additional information.

The ORV and snowmobile trails are shown on the Timber Sale Map. See Sale Spec 5.2.39 and 5.2.41 for restrictions.

Harvesting is limited to April 15 to December 15 due to low stump height requirement.

A recreation site such as a trail, pathway, or campground is within the sale area or the vicinity. Certain restrictions/specifications may be applicable including time restrictions.

## BID INSTRUCTIONS (VER. 09/02/2016):

### 1. Scheduled Bid Location, Date, and Time (2/11)

Bids must be received by the Unit Manager, NEWBERRY OFFICE, PO BOX 428 5666 STATE HWY M-123, NEWBERRY, MI 49868, no later than 3:00 p.m. (local time) on June 29, 2017. For further information concerning this sale, contact Keith Magnusson at 906-293-3293 extension 4740.

### 2. Bidder's Qualifications (5/16)

Purchaser shall obtain workers compensation insurance to cover claims under Michigan's Worker's Disability Compensation Act of 1969 or similar employee benefit act of any other state applicable to an employee. If all or part of a timber sale was prepared by a private contractor, the contractor and that contractor's company are not permitted to bid on the timber sale contract. Bids will not be accepted from individuals or companies appearing on the DNR/FRD No-Bid List. This list contains the names of purchasers who previously failed to execute a contract within 21-days or who have a history of poor performance.

### 3. Preparation of Sealed Bids (5/16)

Bid Forms may be completed online thru Michigan DNR Timber Sale Online Bidding (OLB) at [www.michigan.gov/timberbidding](http://www.michigan.gov/timberbidding) or by completing the hardcopy Bid Form found in the Timber Sale Prospectus. Hardcopy Bid Forms shall be manually signed in ink. Registration in OLB is considered your 'signature' for all bids submitted thru that system. Bid prices must be entered for each species and product in the Bid Price column for all material subject to bidding and all fill-in blanks must be completed. If erasures or other changes appear on the hardcopy Bid Form, each erasure or change must be initialed by the person signing the bid.

### 4. Submission of Sealed Bids (5/16)

Bid forms may be obtained from the Unit Manager or thru OLB. Bids may be submitted hardcopy or thru OLB. All hardcopy bids must be submitted on the bid form and in an envelope clearly identified as described in this section. NOTE: Only one bid form per bid envelope. Sealed bids must be submitted to the Unit office designated in the prospectus and must be submitted at or prior to the time established in the prospectus. The envelope should show on the outside (a) the sale name or number and (b) the date and time of bid opening, as shown in the prospectus. Bids received after the time specified in the sale prospectus are late bids and will be rejected.

It is possible for a bidder to submit multiple bids on a single sale. For example, a bid may be submitted hardcopy and a bid may be submitted thru OLB. Or, two bidders from the same company could both submit bids on the same sale. If this were to happen, the State would accept all bids received and award the contract accordingly. All bidding and contractual requirements would apply to all bids received.

### 5. Public Opening of Sealed Bids (7/16)

If conditions permit, the sealed bids will be publicly opened and posted at the time and place set in the prospectus.

If a bidder, present at a bid opening, has submitted bids on more than one sale, that bidder may withdraw their unopened bid envelopes or announce the withdrawal of their online bid after being declared the successful bidder on one sale.

### 6. Award of Contract (1/11)

Award of the contract will be made to the Bidder whose bid, conforming to the prospectus, is most advantageous to the State of Michigan on the basis of total value at rates bid for the estimated quantities. The State reserves the right to reject any bid or waive any minor irregularity in bids received. A written award mailed (or otherwise furnished) to the successful Bidder shall be deemed to result in a binding contract without further action by either party.

### 7. Down Payment (1/11)

The Bidder to whom award is made must make a down payment within 21 days of the sale award. The amount of the down payment will be calculated as shown in the Bond and Payment Schedule of this prospectus. Only cash may be used to meet this requirement.

### 8. Performance Security (1/11)

As guarantee of faithful performance, a cash bond, certificate of deposit, surety bond or irrevocable letter of credit (LOC) is required within 21 days of the sale award. The amount of the performance security is shown in the Bond and

Payment Schedule of this prospectus. If an LOC or surety is used, the coverage must extend for at least 6 months beyond the contract expiration.

#### 9. Timber Sale Contract (9/14)

Additional conditions and requirements common to all timber sales are listed on the timber sale contract (R4031) and are available on line at [www.michigan.gov/timber](http://www.michigan.gov/timber). Contact the Unit Manager for additional information or a sample contract. Within 21 days of the date of the award letter, the bidder must sign the contract and provide the required down payment, performance security, and verification of worker's disability compensation. The down payment and performance security shall be in accordance with the provisions of the timber sale contract, in the sums stated in this prospectus. If these actions are not taken, then the Bidder, the Bidder's corporation, and the corporation's principals may not be permitted to bid on State timber sales for a period of 1 year. In addition, the Bidder certifies that if awarded this contract, the Bidder will complete the timber sale contract in accordance with its terms and any modifications thereof including requirements to purchase, cut, and remove the included timber by the expiration date.

#### 10. Disclaimer of Estimates and Bidder's Warranty of Inspection (7/16)

Before submitting this bid, the Bidder is advised and cautioned to inspect the sale area, review the requirements of the sale contract, and take other steps as may be reasonably necessary to ascertain the location, estimated volumes, construction estimates, and operating costs of the proposed sale. Failure to do so will not relieve the Bidder from responsibility for completing the contract.

The Bidder warrants that this bid is submitted solely on the basis of the Bidder's examination and inspection of the quality and quantity of the timber offered for sale and the Bidder's opinion of the value thereof and the costs of recovery. No reliance should be placed on the State of Michigan's estimates of timber quality, quantity or costs of recovery. Bidder further acknowledges that the State of Michigan: (i) expressly disclaims any warranty of fitness of timber for any purpose; (ii) offers this timber as is without any warranty of quality (merchantability) or quantity and (iii) expressly disclaims any warranty as to the quantity or quality of timber sold.

#### 11. Certification and Chain-of-Custody (10/14)

Unless otherwise indicated in the contract under section 7 – Other Conditions of the Sale Specific Conditions & Requirements, the area encompassed by this timber sale is certified to the standards of the Forest Stewardship Council (FSC) - Certificate #SCS-FM/COC-00090N and the Sustainable Forestry Initiative (SFI) - Certificate # NSF-SFIS-5Y031-SF5. Forest products from this sale may be delivered to the mill as "FSC 100% and / or SFI certified" as long as the contractor hauling the forest products is chain-of-custody (COC) certified or covered under a COC certificate from the destination mill. The purchaser is responsible for maintaining COC after leaving the sale area.

#### 12. Good Neighbor Authority (GNA) Requirements (7/16)

If the name of this timber sales contains the acronym GNA, it is authorized by the Good Neighbor Authority (GNA) and covered by various agreements between the U.S. Forest Service and the State. The timber sale occurs on federal land and the following conditions apply:

GNA contracts on US Forest Service land will not be awarded to purchasers on the Federal list of excluded parties. The System for Award Management (SAM) will be checked for active excluded parties prior to award of contract. In addition, the Bidder to whom award is made must complete an Assurance Regarding Felony Conviction or Tax Delinquent Status for Corporate Applicants (AD-3031).

#### 13. Good Neighbor Authority (GNA) Requirements, con't (9/16)

Bidder certifies, by signing this bid form, that to the best of Bidder's knowledge that the following representations are accurate and complete.

- a. That the Bidder and its principals are not presently debarred, suspended, proposed for debarment, declared ineligible, or voluntary excluded from timber sales (covered transactions) by any Federal department or agency.
- b. That the Bidder and its principals have not within a 3-year period preceding this bid been convicted of or had a civil judgment rendered against them for commission of fraud or a criminal offense in connection with obtaining, attempting to obtain, or performing a public (Federal, State, or local) transaction or contract under a public transaction; violation of Federal or State antitrust statutes or commission of embezzlement, theft, forgery, bribery, falsification or destruction of records, making false statements, or receiving stolen property.

c. That the Bidder and its principals are not presently indicted for or otherwise criminally or civilly charged by a governmental entity (Federal, State, or local) with commission of any of the offenses enumerated in paragraph b of this certification.

d. That the Bidder and its principals have not within a 3-year period preceding this bid had one or more public transactions (Federal, State, or local) terminated for breach or default of a timber or forest product contract.

Bidders that cannot certify this requirement, in whole or in part, shall submit an explanation with their bid.

KEITH CREAGH

Director



# TIMBER SALE INFORMATION

## Ash Overhaul (42-001-17)

Luce County (Advertised Price \$20,134.30)

SALE NOTE: This sale was originally a 2013 sale that was returned uncut. The sale price has been reduced approximately 25% from the original proposal price.

Within Payment Units 1, 3, 4 and 5, harvesting is limited to the period of December 15 to April 1 due to wet access, soil conditions, and winter deer activity.

Some roads or skid trails may require extra protection such as that afforded by Crane Mats. See sale spec 5.2.17 for additional information.

The Purchaser will secure any necessary stream crossing permits that may be required.

The Michigan Department of Transportation (MDOT) must be contacted prior to harvesting timber within the MDOT right-of-way.

A timber sale contract for this lump sum, sealed bid timber sale will be awarded to the responsible bidder offering the highest sealed bid price. Bids must be at or above the following advertised price for each species:

<u>PRODUCTS &amp; SPECIES</u>	<u>ESTIMATED UNITS*</u>	<u>ADVERTISED PRICE</u>
Sawtimber		
Red Maple	14.40 MBF	\$ 83.00 / MBF
Sugar Maple	22.00 MBF	\$ 356.00 / MBF
White Ash	28.60 MBF	\$ 44.00 / MBF
Pulpwood		
Balsam Fir	29.00 Cords	\$ 6.90 / Cord
Black Ash	56.00 Cords	\$ 11.60 / Cord
Mixed Aspen	36.00 Cords	\$ 17.55 / Cord
Mixed Hardwood	289.00 Cords	\$ 11.60 / Cord
Mixed Spruce	93.00 Cords	\$ 21.45 / Cord
Tamarack	36.00 Cords	\$ 10.95 / Cord
White Ash	222.00 Cords	\$ 11.60 / Cord
White Pine	3.00 Cords	\$ 16.85 / Cord

\* The total volume is statistically estimated within plus (+) or minus (-) 19.13 percent. The estimated units are final and not subject to adjustment. Prospective bidders are urged to examine this timber and to make their own estimates of quantity and quality.

### **BOND AND PAYMENT SCHEDULE:**

1. A bond in the amount of \$1,007.00 to insure faithful performance of the conditions of the contract will be deposited by the successful bidder within 21 days of the sale award.
2. Cutting in any sale or unit without the required advance payment would be considered a trespass.
3. Total payment must be paid in advance or according to the following schedule:
  - (a) Ten percent (10%) of the sale value must be paid within 21 days of the sale award.
  - (b) The 10% down payment will be credited towards the first unit cut.
4. If no cutting takes place, the 10% down payment will not be refunded.
5. Operations on the contract issued will terminate on 06/30/2019.

**Description of Timber by Payment Unit (PU)**

PU	MARKET GROUP	PRODUCT	QUANTITY	UNIT	ACRES	ADVERTISE PRICE	
1	Balsam Fir	Pulpwood	7.0	Cords	8.9	\$2,392.35	
	Mixed Aspen		8.0	Cords			
	<i>Quaking Aspen</i>		8.0	<i>Cords</i>			
	Mixed Spruce		82.0	Cords			
	<i>Black Spruce</i>		82.0	<i>Cords</i>			
	Tamarack		36.0	Cords			
	White Pine		3.0	Cords			
	<i>White Pine</i>		1.1	<i>MBF</i>			
	<i>White Pine</i>		1.0	<i>Cords</i>			
2	Red Maple	Sawtimber	1.3	MBF	27.3	\$3,176.95	
	Sugar Maple	Pulpwood	1.4	MBF			
	White Ash		3.8	MBF			
	Balsam Fir		5.0	Cords			
	Black Ash		27.0	Cords			
	Mixed Aspen		25.0	Cords			
	<i>Quaking Aspen</i>		25.0	<i>Cords</i>			
	Mixed Hardwood		71.0	Cords			
	<i>Beech</i>		3.0	<i>Cords</i>			
	<i>Red Maple</i>		34.0	<i>Cords</i>			
	<i>Sugar Maple</i>		34.0	<i>Cords</i>			
	Mixed Spruce		4.0	Cords			
	<i>White Spruce</i>		4.0	<i>Cords</i>			
	White Ash		61.0	Cords			
	3		Red Maple	Sawtimber			3.4
Sugar Maple			Pulpwood	5.8	MBF		
White Ash		3.7		MBF			
Balsam Fir		2.0		Cords			
Black Ash		7.0		Cords			
Mixed Aspen		3.0		Cords			
<i>Quaking Aspen</i>		3.0		<i>Cords</i>			
Mixed Hardwood		68.0		Cords			
<i>Basswood</i>		0.2		<i>MBF</i>			
<i>Basswood</i>		1.0		<i>Cords</i>			
<i>Red Maple</i>		28.0		<i>Cords</i>			
<i>Sugar Maple</i>		39.0		<i>Cords</i>			
Mixed Spruce		3.0		Cords			
<i>White Spruce</i>		3.0		<i>Cords</i>			
White Ash	22.0	Cords					
4	Red Maple	Sawtimber	3.8	MBF	25.4	\$6,260.10	
	Sugar Maple	Pulpwood	9.1	MBF			
	White Ash		15.4	MBF			
	Balsam Fir		3.0	Cords			
	Black Ash		10.0	Cords			
	Mixed Hardwood		80.0	Cords			
	<i>Basswood</i>		6.0	<i>Cords</i>			
	<i>Beech</i>		3.0	<i>Cords</i>			
	<i>Red Maple</i>		25.0	<i>Cords</i>			
	<i>Sugar Maple</i>		46.0	<i>Cords</i>			
	White Ash		83.0	Cords			
	5		Red Maple	Sawtimber			5.9
Sugar Maple			Pulpwood	5.7	MBF		
White Ash		5.7		MBF			
Balsam Fir		12.0		Cords			
Black Ash		12.0		Cords			
Mixed Hardwood		70.0		Cords			
<i>Basswood</i>		0.3		<i>MBF</i>			



**Description of Timber by Payment Unit (PU), con't**

PU	MARKET GROUP	PRODUCT	QUANTITY	UNIT	ACRES	ADVERTISE PRICE
5 con't	<i>Basswood</i>	<i>Pulpwood</i>	1.0	<i>Cords</i>		
	<i>Red Maple</i>		28.0	<i>Cords</i>		
	<i>Sugar Maple</i>		40.0	<i>Cords</i>		
	Mixed Spruce		4.0	Cords		
	<i>White Spruce</i>		4.0	<i>Cords</i>		
	White Ash		56.0	Cords		
TOTAL:			65.0	MBF		
TOTAL:			764.0	Cords		

## Sale Specific Conditions & Requirements

**Sale Name: Ash Overhaul**

**Sale Number: 42-001-17 Seq#: 1**

### 1 - Sale Area

#### 1.2 - Boundaries

##### 1.2.1 - Painted boundaries (1/14)

The sale boundary and Payment Unit boundaries are marked and identified by blue and red paint. Exterior sale boundary lines against private property are marked with blue paint. Exterior sale boundary lines against state are marked with red paint. Interior Payment Unit boundaries are marked with red paint. The painted boundary line trees are not Included Timber and are to be protected unless marked with orange paint.

### 2 - Timber Specifications

#### 2.1 - Included Timber

##### 2.1.2 - Clearcut unit(s) w/o unmerchantable trees (8/11)

Within Payment Unit(s) 1, cut all trees which meet minimum piece specifications in 2.2 Utilization except cedar, hemlock and any trees marked with green paint. Note: Payment Unit 1 is optional, due to potential access issues. Removing Payment Unit 1 is a contract modification which requires a Timber Sale Contract Supplement.

##### 2.1.3 - Cut tree marked unit(s) (12/08)

Within Payment Unit(s) 2, 3, 4 and 5, all trees are designated for cutting when marked with orange paint above and below stump height, regardless of merchantability. Also, cut all ash unless marked with green paint.

##### 2.1.9 - Harvest exception (12/08)

Do not cut any cedar other than those that are necessary to remove in order to operate within the sale area. Every effort must be made to preserve the existing cedar and hemlock and to leave an intact stand upon sale completion. All cut cedar shall be piled separately by products and scaled in the woods unless other scaling arrangements are agreed to by the Unit Manager or his/her representative. No hemlock shall be cut. Stumpage price for cedar shall be the current average District price at the time of harvest.

##### 2.1.11 - Description of timber note (2/04)

Note that Mixed Hardwood pulp is mostly maple but includes basswood, beech and ironwood. Mixed Aspen may include quaking, big tooth, and balsam poplar.

#### 2.2 - Utilization

##### 2.2.4 - Skidding length (2/14)

Within Payment Unit #'s 2, 3, 4 and 5, skidding of unlimbed tops or lengths over 17 feet is not permissible unless approved by the Unit Manager or his/her representative.

### 4 - Transportation

#### 4.1 - Construction

##### 4.1.1 - Stream crossings, general (3/11)

All stream crossing structures will be temporary and therefore, shall be provided by the Purchaser, and must be removed upon completion of the sale. All permits for stream crossings will be provided by the Purchaser.

##### 4.1.4 - Timber removed for construction (12/09)

Trees cut or damaged in the process of pre-approved road, landing or skid trail construction will be decked in an area separate from other Designated Timber and not removed until measured by the sale administrator. Payment will be made at the specified Purchase Unit Price.

##### 4.1.6 - Road construction (1/09)

Construction of new roads or improvements of existing roads shall be done in such a way as to minimize the environmental and visual impacts. Merchantable trees shall be cut and utilized unless otherwise directed. Non-merchantable trees shall be severed and laid flat on the ground. Slash shall be scattered, and not left in windrows and kept a minimum of 10 feet back

from the road edge. Stumps shall be set upright, not left on edge, and be moved at least 10 feet away from the road edge. Disturbed soil shall be feathered into the woods and not left in berms or windrows.

#### 4.1.7 - Road closure (10/11)

All new roads built into the sale must be blocked to vehicle traffic within 30 days of completion of hauling. Overgrown and/or abandoned roads that are reopened shall be considered new roads. In general, this will require constructing double earthen berms at strategic locations. Stumps and brush must be placed along the road course for a minimum of 100 feet, effectively obliterating it. These roads must be rendered completely impassable to cars, trucks and ORV's. All stumps from road building and landing construction must be reserved to block any newly constructed roads upon completion of the sale. Temporary berms may be required if no sale activity occurs for 30 or more consecutive days. Contact the sale administrator for specific details of design and placement.

#### 4.1.11 - Permits (2/12)

The DNR will secure any necessary highway permits that may be required. The Purchaser will secure any necessary stream crossing permits that may be required.

### 4.2 - Maintenance

#### 4.2.1 - Hauling restriction (12/08)

Hauling may be restricted on forest roads by the Unit Manager or his/her representative. The restriction may occur during spring breakup or wet weather conditions.

#### 4.2.4 - Grading (10/16)

For completion of the sale, state forest roads must be graded. In general, this will require a road grader or bull dozer to shape up the roads after forest products have been hauled off site. This includes cleaning of drainage areas, grading, crowning and filling with gravel, if necessary. The grading equipment to be used must be approved by the Unit Manager or his/her representative.

### 4.3 - Public Right-of-Way

#### 4.3.1 - MDOT R-O-W (11/14)

The Michigan Department of Transportation (MDOT) must be contacted prior to harvesting timber within the MDOT right-of-way.

## 5 - Operations

### 5.1 - Notification

#### 5.1.1 - Pre-sale conference (10/16)

A pre-sale conference between the Purchaser and sale administrator is required prior to beginning any operations to determine landing and road locations. The Unit Manager or his/her representative must be contacted at least 5 days in advance to schedule the conference.

#### 5.1.4 - Post-sale conference (10/16)

A post-sale conference on site between the Purchaser and sale administrator is required at least 5 days prior to the completion of active logging operations to determine clean-up and repair of landings, road edges, and the fulfillment of other contract specifications.

### 5.2 - Conduct of Operations

#### 5.2.1 - Slash

##### 5.2.1.8 - Slash height (12/08)

No slash or tree tops may exceed 36 inches in height.

#### 5.2.2 - Hazard Trees/Snags

##### 5.2.2.1 - Den trees (10/16)

Obvious hollow and/or den trees shall be protected and left standing unless they are a safety hazard.

#### 5.2.3 - Operating Restrictions

#### 5.2.3.1 - Operating restrictions (9/11)

Within Payment Unit(s) 1, 3, 4 and 5, unless changed by written agreement, cutting, skidding and hauling are limited to the period of December 15 to April 1. This restriction is because of wet access, soil conditions, and winter deer activity.

#### 5.2.3.3 - Bark slippage restriction (3/09)

Within Payment Unit(s) 2, unless changed by written agreement, cutting and skidding are not permitted during the period of April 1 to July 1. This restriction is because of bark slippage.

#### 5.2.17 - Crane Mats/Timber Mats (10/14)

Some roads or skid trails may require extra protection such as that afforded by Crane Mats/Timber Mats. If available, Crane Mats/Timber Mats may be borrowed from the DNR and are located at the Marquette ICC and the Grayling Field Office. Contact the sale administrator for specific details. A Timber Sale Contract Supplement will be used to document the Purchaser's use of the DNR's Crane Mats/Timber Mats. It is the responsibility of the Purchaser to contact the sale administrator to schedule pick up and drop off. In addition, all mats must be cleaned prior to drop off. A charge of \$125.00 will be assessed for all damaged or non-returned mats. Damage is defined as misuse resulting in three or more broken cants.

#### 5.2.37 - No decking areas (12/08)

No decking is allowed within 50 feet of cleared and maintained M-28 road corridor without permission of the Unit Manager or his/her representative.

#### 5.2.38 - No decking against live trees (2/04)

Cut products may not be decked against unmarked or designated leave trees.

### 5.4 - Soil Protection

#### 5.4.1 - Rutting restriction, general (7/16)

Operations are to cease immediately if equipment and weather conditions result in rutting of roads and/or skid trails which is 12 inches or greater in depth and 50 feet in length. The Unit Manager or his/her representative may restrict hauling and/or skidding if ruts exceed the specified depth. With the Unit Manager or his/her representative's approval, the Purchaser may return to the area when the risk of rutting has decreased.

### 5.8 - Protection of Endangered Species

#### 5.8.5 - Protection of raptor nests (3/13)

All trees with raptor nests will be protected if found during harvesting operations. Notification will be made to the Unit Manager or his/her representative who will notify the Wildlife Biologist so an on-site evaluation and recommendation can be made, if necessary.

## 6 - Safety and Fire Prevention

### 6.2 - Signing

#### 6.2.1 - Road posting (9/09)

The Purchaser is responsible for posting and maintaining caution signs on M-28 prior to beginning operations. The road must be posted at appropriate distances from the sale area, it is recommended a minimum of 1/4 mile east and west of entrance onto M-28, to warn of logging activity and truck traffic. Signs must be removed when harvest operations are suspended or completed. The Purchaser will provide these signs.

## 7 - Other Conditions

### 7.3 - Contract Modifications

#### 7.3.1 - Emerald Ash Borer

##### 7.3.1.2 - Emerald ash borer, ash or firewood on sale (2/05)

There is ash and/or "firewood" in this sale and it is located within an emerald ash borer quarantined area. The Director of the Michigan Department of Agriculture (MDA) by the authority of Act No. 72 of the Public Acts of 1945, as amended, and Quarantine Regulation No. 620, has promulgated this quarantine to prevent the further spread of this pest and sets forth: definitions, regulated articles, regulated areas, conditions of movement, violations and penalties, and special exemptions. The Purchaser must comply with this quarantine. Contact the MDA for further information.





# TIMBER SALE MAP

This information provided by authority of Part 525, 1994 PA 451, as amended.

Sale Number	Year
42 - 001	17

Forest Management Unit Newberry	County Luce	Mapped By Douglass	Date 01/09/2017	Page 1	of 1
Cruised By Mattila					

Township 45N	Range 08W	Sec 15: SWNE, E1/2NW, SWNW, N1/2SW Sec 16: NWNE, SENE, NENW, NESE	Scale 1:15,840
-----------------	--------------	--	-------------------

Cover Type				Density	
A = Aspen	H = Hemlock	N = Marsh	U = Upland Brush	0 = Non Stocked	5 = Pole Timber Medium
B = Paper Birch	J = Jack Pine	O = Oak	UM = Upland Mixed	1 = Seedling Sapling Poor	6 = Pole Timber Well
C = Cedar	L = Lowland Brush	P = Lowland Poplar	V = Bog or Marsh	2 = Seedling Sapling Medium	7 = Saw Timber Poor
D = Treed Bog	LM = Lowland Mixed	Q = Mixed Swamp Conifer	W = White Pine	3 = Seedling Sapling Well	8 = Saw Timber Medium
E = Swamp Hdwoods	M = Mpl, Bch, Brch	R = Red Pine	X = Non Stocked	4 = Pole Timber Poor	9 = Saw Timber Well
F = Spruce Fir	MC = Mixed Conifer	S = Black Spruce	Z = Water		
G = Grass	MD = Mixed Deciduous	T = Tamarack			

PU	Acres	PU	Acres
1	8.9	4	25.4
2	27.3	5	26.0
3	19.3		

## Ash Overhaul Compartment 131/133 106.9 Acres

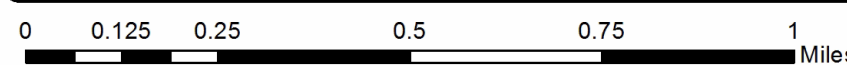
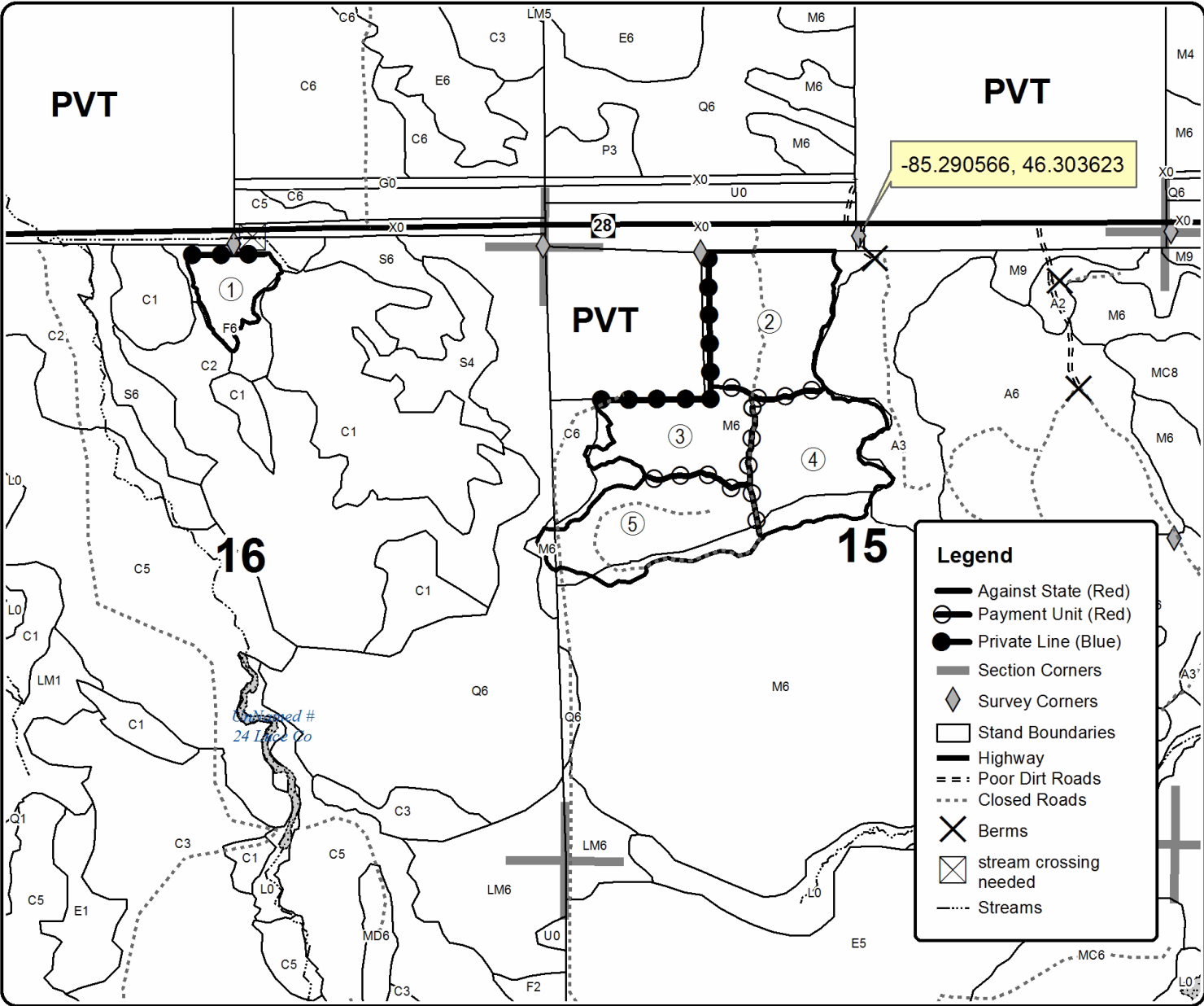

# TIMBER SALE INFORMATION

## Ridgeline Pine (42-014-16)

Luce County (Advertised Price \$256,699.10)

SALE NOTE: No new roads will be permitted within any Payment Units, with the exception of Payment Unit 2. See Sale Spec 4.1.12 for additional information.

The Pine Ridge Trail is an ORV trail shown on the Timber Sale Map. See Sale Spec 5.2.39 for restrictions.

Within Payment Units 1, 2, 4, 5 and 6, harvesting is not permitted during the period of April 15 to July 15 due to bark slippage.

A recreation site such as a trail, pathway, or campground is within the sale area or the vicinity. Certain restrictions/specifications may be applicable including time restrictions.

A timber sale contract for this lump sum, sealed bid timber sale will be awarded to the responsible bidder offering the highest sealed bid price. Bids must be at or above the following advertised price for each species:

<u>PRODUCTS &amp; SPECIES</u>	<u>ESTIMATED UNITS*</u>	<u>ADVERTISED PRICE</u>
Pulpwood		
Balsam Fir	41.00 Cords	\$ 11.05 / Cord
Jack Pine	1,235.00 Cords	\$ 44.80 / Cord
Mixed Aspen	563.00 Cords	\$ 28.05 / Cord
Mixed Hardwood	37.00 Cords	\$ 18.60 / Cord
Paper Birch	64.00 Cords	\$ 15.95 / Cord
Red Pine	1,971.00 Cords	\$ 81.75 / Cord
White Pine	827.00 Cords	\$ 26.95 / Cord

\* The total volume is statistically estimated within plus (+) or minus (-) 8.91 percent. The estimated units are final and not subject to adjustment. Prospective bidders are urged to examine this timber and to make their own estimates of quantity and quality.

### **BOND AND PAYMENT SCHEDULE:**

1. A bond in the amount of \$12,835.00 to insure faithful performance of the conditions of the contract will be deposited by the successful bidder within 21 days of the sale award.
2. Cutting in any sale or unit without the required advance payment would be considered a trespass.
3. Total payment must be paid in advance or according to the following schedule:
  - (a) Ten percent (10%) of the sale value must be paid within 21 days of the sale award.
  - (b) The 10% down payment will be credited towards the first unit cut.
4. If no cutting takes place, the 10% down payment will not be refunded.
5. Operations on the contract issued will terminate on 12/31/2020.

**Description of Timber by Payment Unit (PU)**

PU	MARKET GROUP	PRODUCT	QUANTITY	UNIT	ACRES	ADVERTISE PRICE
1	Jack Pine	Pulpwood	87.0	Cords	37.1	\$39,283.70
	Mixed Aspen		3.0	Cords		
	<i>Quaking Aspen</i>		3.0	<i>Cords</i>		
	Mixed Hardwood		2.0	Cords		
	<i>Red Maple</i>		2.0	<i>Cords</i>		
	Red Pine		405.0	Cords		
	White Pine		80.0	Cords		
	<i>White Pine</i>		80.0	<i>Cords</i>		
2	Jack Pine	Pulpwood	93.0	Cords	39.5	\$41,922.55
	Mixed Aspen		4.0	Cords		
	<i>Quaking Aspen</i>		4.0	<i>Cords</i>		
	Mixed Hardwood		2.0	Cords		
	<i>Red Maple</i>		2.0	<i>Cords</i>		
	Red Pine		432.0	Cords		
	White Pine		85.0	Cords		
	<i>White Pine</i>		85.0	<i>Cords</i>		
3	Jack Pine	Pulpwood	698.0	Cords	56.6	\$79,538.65
	Mixed Aspen		21.0	Cords		
	<i>Quaking Aspen</i>		21.0	<i>Cords</i>		
	Mixed Hardwood		3.0	Cords		
	<i>Red Maple</i>		3.0	<i>Cords</i>		
	Red Pine		572.0	Cords		
	White Pine		32.0	Cords		
	<i>White Pine</i>		32.0	<i>Cords</i>		
4	Jack Pine	Pulpwood	326.0	Cords	40.9	\$33,721.50
	Mixed Aspen		208.0	Cords		
	<i>Quaking Aspen</i>		208.0	<i>Cords</i>		
	Mixed Hardwood		6.0	Cords		
	<i>Red Maple</i>		6.0	<i>Cords</i>		
	Red Pine		141.0	Cords		
	White Pine		61.0	Cords		
	<i>White Pine</i>		61.0	<i>Cords</i>		
5	Balsam Fir	Pulpwood	22.0	Cords	58.9	\$45,968.90
	<i>Balsam Fir</i>		22.0	<i>Cords</i>		
	Jack Pine		31.0	Cords		
	Mixed Aspen		267.0	Cords		
	<i>Quaking Aspen</i>		267.0	<i>Cords</i>		
	Mixed Hardwood		24.0	Cords		
	<i>Red Maple</i>		24.0	<i>Cords</i>		
	Paper Birch		64.0	Cords		
	Red Pine		294.0	Cords		
	White Pine		421.0	Cords		
<i>White Pine</i>	421.0	<i>Cords</i>				
6	Balsam Fir	Pulpwood	19.0	Cords	28.2	\$16,263.80
	<i>Balsam Fir</i>		13.0	<i>Cords</i>		
	<i>White Spruce</i>		6.0	<i>Cords</i>		
	Mixed Aspen		60.0	Cords		
	<i>Quaking Aspen</i>		60.0	<i>Cords</i>		
	Red Pine		127.0	Cords		
	White Pine		148.0	Cords		
	<i>White Pine</i>		6.9	<i>MBF</i>		
	<i>White Pine</i>		134.0	<i>Cords</i>		
	TOTAL:			4,738.0		



## Sale Specific Conditions & Requirements

**Sale Name: Ridgeline Pine**

**Sale Number: 42-014-16 Seq#: 1**

### 1 - Sale Area

#### 1.2 - Boundaries

##### 1.2.1 - Painted boundaries (1/14)

The sale boundary and Payment Unit boundaries are marked and identified by blue, red and green paint. Exterior sale boundary lines against private property are marked with blue paint. Exterior sale boundary lines against state are marked with red paint. Interior Payment Unit boundaries are marked with green paint. The painted boundary line trees are not Included Timber and are to be protected unless marked with orange paint.

### 2 - Timber Specifications

#### 2.1 - Included Timber

##### 2.1.1 - Clearcut unit(s) with unmerchantable trees (6/14)

Within Payment Unit(s) # 3, cut all trees that are two (2) inches or more at DBH except oak, white birch and trees marked with yellow paint.

##### 2.1.3 - Cut tree marked unit(s) (12/08)

Within Payment Unit(s) #'s 1, 2, 4 and 6, all trees are designated for cutting when marked with orange paint above and below stump height, regardless of merchantability. In addition, all jack pine, red maple, aspen, spruce and balsam fir may be cut regardless of merchantability.

##### 2.1.7 - Leave tree marked unit(s) (6/14)

Within Payment Unit(s) # 5, cut all trees that are two (2) inches or more at DBH except oak, beech and trees marked with yellow paint above and below stump height.

#### 2.2 - Utilization

##### 2.2.3 - Stump heights (4/07)

Stump heights within Payment Unit(s) #'s 3 - 5 shall not exceed 12 inches for trees greater than 10 inches DBH and 4 inches for trees smaller than 10 inches DBH. This is in order to facilitate scarification operations.

##### 2.2.4 - Skidding length (2/14)

Skidding of unlimbed tops or lengths over 17 feet is not permissible unless approved by the Unit Manager or his/her representative.

### 4 - Transportation

#### 4.1 - Construction

##### 4.1.12 - No new roads (1/12)

No new roads will be permitted in any Payment Unit, except Payment Unit # 2. A spur road off the existing road may be made within Payment Unit # 2 to gain access to Payment Unit # 3. This spur road will not cross the ORV trail.

#### 4.2 - Maintenance

##### 4.2.1 - Hauling restriction (12/08)

Hauling may be restricted on forest roads by the Unit Manager or his/her representative. The restriction may occur during wet weather conditions.

##### 4.2.4 - Grading (12/14)

For completion of the sale, state forest roads must be graded. In general, this will require a road grader or bull dozer to shape up the roads after forest products have been hauled off site. The grading equipment to be used must be approved by the Unit Manager or his/her representative.

##### 4.2.5 - Two wheel drive condition (2/04)

All existing trail roads on and adjacent to the sale area must be passable by two-wheel drive traffic for the duration of the

sale.

## 5 - Operations

### 5.1 - Notification

#### 5.1.1 - Pre-sale conference (10/16)

A pre-sale conference between the Purchaser and sale administrator is required prior to beginning any operations to determine landing and road locations. The Unit Manager or his/her representative must be contacted at least 5 days in advance to schedule the conference.

#### 5.1.4 - Post-sale conference (6/11)

A post-sale conference on site between the Purchaser and sale administrator is required at least 5 days prior to the completion of active logging operations to determine clean-up and repair of landings, road edges, and the fulfillment of other contract specifications.

### 5.2 - Conduct of Operations

#### 5.2.1 - Slash

##### 5.2.1.11 - Slash for reforestation (5/07)

To facilitate reforestation, Payment Unit(s) #'s 3 - 5 shall be left with slash evenly distributed. Bunched tops within the cutting area shall be broken up and scattered. Stumps shall be cut low to the ground. Processing sites shall not be left with a compacted layer of slash; tops from these sites shall be hauled back into the cut area and scattered.

#### 5.2.2 - Hazard Trees/Snags

##### 5.2.2.1 - Den trees (2/04)

Obvious hollow and/or den trees shall be protected and left standing unless they are a safety hazard.

#### 5.2.3 - Operating Restrictions

##### 5.2.3.3 - Bark slippage restriction (3/09)

Within Payment Unit(s) #'s 1, 2, 4, 5 and 6, unless changed by written agreement, cutting and skidding are not permitted during the period of April 15 to July 15. This restriction is because of bark slippage.

##### 5.2.3.6 - Bark beetle restriction (12/08)

In the event drought creates a high risk of pine bark beetle infestation, pine is not to be cut during the period March 1 through July 1, unless all portions of trees greater than two inches in diameter are removed from the sale area, reduced to chips, or treated to the satisfaction of the Unit Manager or his/her representative, within fifteen days of being severed from the stump. Pine log decks, pulpwood piles and treetops that are piled for chipping in the fall or winter within a 1/4 mile of susceptible sites must be removed before March 15. Residual slash must not be placed in piles or rows and must be spread over the site for quick drying. The Department of Natural Resources will exercise this specification if the risk of damage warrants.

##### 5.2.38 - No decking against live trees (2/04)

Cut products may not be decked against unmarked or designated leave trees.

##### 5.2.39 - ORV trail/route protection (12/12)

The Pine Ridge Trail is an ORV trail and is shown on the Timber Sale Map. Do not cut trees or damage posts with orange ORV markers. All stumps within 5 feet of the trail must be cut flush with the ground. Maintain a 20 foot wide slash, debris, and rut free zone daily using the ORV trail as the centerline. Do not run equipment down the ORV trail. Skidding across the trail may only occur in locations approved by the sale administrator.

### 5.4 - Soil Protection

#### 5.4.1 - Rutting restriction, general (7/16)

Operations are to cease immediately if equipment and weather conditions result in rutting of roads and/or skid trails which is 12 inches or greater in depth and 50 feet in length. The Unit Manager or his/her representative may restrict hauling and/or skidding if ruts exceed the specified depth. With the Unit Manager or his/her representative's approval, the Purchaser may return to the area when the risk of rutting has decreased.

## 5.8 - Protection of Endangered Species

### 5.8.5 - Protection of raptor nests (3/13)

All trees with raptor nests will be protected if found during harvesting operations. Notification will be made to the Unit Manager or his/her representative who will notify the Wildlife Biologist so an on-site evaluation and recommendation can be made, if necessary.

## 6 - Safety and Fire Prevention

### 6.2 - Signing

#### 6.2.3 - Recreational trail posting (2/10)

The Purchaser is responsible for posting and maintaining caution signs on Pine Ridge ORV Trail prior to beginning operations. The trail must be posted at appropriate distances from the sale area to warn of logging activity and truck traffic at both ends of the trail. Signs must be removed when harvest operations are suspended or completed. The Purchaser will provide these signs.

## 7 - Other Conditions

### 7.3 - Contract Modifications

#### 7.3.3 - Modification for reforestation (8/05)

When contractual work of Purchaser has been accepted for any Payment Unit identified on Sale Area Map, Payment Unit will be eliminated from the Sale Area on written notice so that reforestation operations can begin.



Sale Number	Year
42 - 014	16

# TIMBER SALE MAP

This information provided by authority of Part 525, 1994 PA 451, as amended.

Forest Management Unit Newberry	County Luce	Mapped By Douglass	Date 09/30/2016	Page 1	of 1
Township 49N	Range 11W	Section 8 - SW1/4, W1/2 SE Section 9 - SWNE, W1/2NW, SENW, SW1/4, W1/2SE, SESE	Scale 1:15,840		

Cover Type				Density	
A = Aspen	H = Hemlock	N = Marsh	U = Upland Brush	0 = Non Stocked	5 = Pole Timber Medium
B = Paper Birch	J = Jack Pine	O = Oak	UM = Upland Mixed	1 = Seedling Sapling Poor	6 = Pole Timber Well
C = Cedar	L = Lowland Brush	P = Lowland Poplar	V = Bog or Marsh	2 = Seedling Sapling Medium	7 = Saw Timber Poor
D = Treed Bog	LM = Lowland Mixed	Q = Mixed Swamp Conifer	W = White Pine	3 = Seedling Sapling Well	8 = Saw Timber Medium
E = Swamp Hdwoods	M = Mpl, Bch, Brch	R = Red Pine	X = Non Stocked	4 = Pole Timber Poor	9 = Saw Timber Well
F = Spruce Fir	MC = Mixed Conifer	S = Black Spruce	Z = Water		
G = Grass	MD = Mixed Deciduous	T = Tamarack			

PU	Acres	PU	Acres
1	37.1	4	40.9
2	39.5	5	58.9
3	56.6	6	28.2

## Ridgeline Pine

### Compartment 12

261.2 Acres

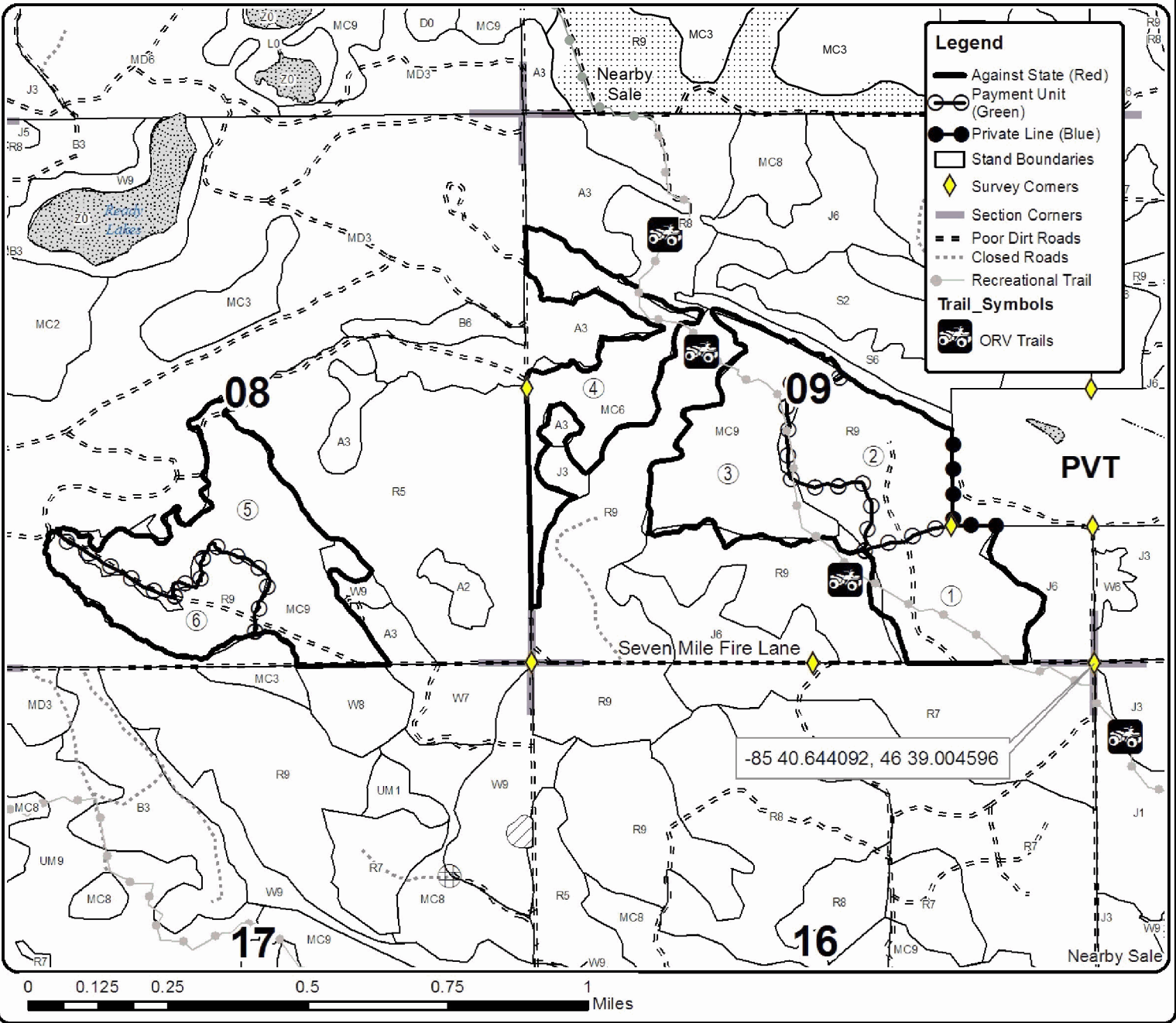

# TIMBER SALE INFORMATION

## Crop Circle Red Pine (42-023-16)

Luce County (Advertised Price \$210,602.75)

SALE NOTE: No new roads will be permitted within Payment Units 1 through 5 or 12. See Sale Spec 4.1.12 for additional information.

The ORV and snowmobile trails are shown on the Timber Sale Map. See Sale Spec 5.2.39 and 5.2.41 for restrictions.

Harvesting is limited to April 15 to December 15 due to low stump height requirement.

A recreation site such as a trail, pathway, or campground is within the sale area or the vicinity. Certain restrictions/specifications may be applicable including time restrictions.

A timber sale contract for this lump sum, sealed bid timber sale will be awarded to the responsible bidder offering the highest sealed bid price. Bids must be at or above the following advertised price for each species:

<u>PRODUCTS &amp; SPECIES</u>	<u>ESTIMATED UNITS*</u>	<u>ADVERTISED PRICE</u>
Sawtimber		
Red Pine	304.90 MBF	\$ 164.00 / MBF
White Pine	116.80 MBF	\$ 58.00 / MBF
Pulpwood		
Balsam Fir	43.00 Cords	\$ 11.05 / Cord
Jack Pine	895.00 Cords	\$ 44.80 / Cord
Mixed Aspen	440.00 Cords	\$ 28.05 / Cord
Mixed Hardwood	12.00 Cords	\$ 18.60 / Cord
Red Pine	940.00 Cords	\$ 81.75 / Cord
White Pine	620.00 Cords	\$ 26.95 / Cord
White Spruce	208.00 Cords	\$ 34.30 / Cord

\* The total volume is statistically estimated within plus (+) or minus (-) 10.30 percent. The estimated units are final and not subject to adjustment. Prospective bidders are urged to examine this timber and to make their own estimates of quantity and quality.

### **BOND AND PAYMENT SCHEDULE:**

1. A bond in the amount of \$10,530.00 to insure faithful performance of the conditions of the contract will be deposited by the successful bidder within 21 days of the sale award.
2. Cutting in any sale or unit without the required advance payment would be considered a trespass.
3. Total payment must be paid in advance or according to the following schedule:
  - (a) Ten percent (10%) of the sale value must be paid within 21 days of the sale award.
  - (b) The 10% down payment will be credited towards the first unit cut.
4. If no cutting takes place, the 10% down payment will not be refunded.
5. Operations on the contract issued will terminate on 12/31/2020.

**Description of Timber by Payment Unit (PU)**

PU	MARKET GROUP	PRODUCT	QUANTITY	UNIT	ACRES	ADVERTISE PRICE
1	Red Pine White Pine Balsam Fir Jack Pine Mixed Aspen <i>Quaking Aspen</i> Mixed Hardwood <i>Red Maple</i> Red Pine White Pine White Spruce	Sawtimber  Pulpwood	19.6	MBF	23.8	\$14,413.50
			9.5	MBF		
			2.0	Cords		
			44.0	Cords		
			36.0	Cords		
			36.0	Cords		
			1.0	Cords		
			1.0	Cords		
			73.0	Cords		
			45.0	Cords		
			13.0	Cords		
2	Red Pine White Pine Mixed Aspen <i>Quaking Aspen</i> Red Pine White Pine	Sawtimber  Pulpwood	38.2	MBF	20.4	\$14,509.60
			2.0	MBF		
			16.0	Cords		
			16.0	Cords		
			89.0	Cords		
			15.0	Cords		
3	Red Pine White Pine Jack Pine Mixed Aspen <i>Quaking Aspen</i> Red Pine White Pine	Sawtimber  Pulpwood	20.2	MBF	6.7	\$10,817.90
			2.1	MBF		
			94.0	Cords		
			18.0	Cords		
			18.0	Cords		
			29.0	Cords		
			11.0	Cords		
4	Red Pine White Pine Balsam Fir Jack Pine Mixed Aspen <i>Quaking Aspen</i> Mixed Hardwood <i>Red Maple</i> Red Pine White Pine White Spruce	Sawtimber  Pulpwood	21.9	MBF	26.6	\$16,074.55
			10.7	MBF		
			2.0	Cords		
			49.0	Cords		
			41.0	Cords		
			41.0	Cords		
			1.0	Cords		
			1.0	Cords		
			81.0	Cords		
			51.0	Cords		
14.0	Cords					
5	Red Pine White Pine Balsam Fir Jack Pine Mixed Aspen <i>Quaking Aspen</i> Mixed Hardwood <i>Red Maple</i> Red Pine White Pine White Spruce	Sawtimber  Pulpwood	11.0	MBF	13.3	\$8,042.85
			5.3	MBF		
			1.0	Cords		
			24.0	Cords		
			20.0	Cords		
			20.0	Cords		
			1.0	Cords		
			1.0	Cords		
			41.0	Cords		
			25.0	Cords		
7.0	Cords					
6	Red Pine White Pine Balsam Fir Jack Pine Mixed Aspen <i>Quaking Aspen</i> Mixed Hardwood <i>Red Maple</i> Red Pine White Pine	Sawtimber  Pulpwood	28.7	MBF	34.8	\$21,235.15
			14.1	MBF		
			3.0	Cords		
			64.0	Cords		
			53.0	Cords		
			53.0	Cords		
			2.0	Cords		
			2.0	Cords		
			108.0	Cords		
			67.0	Cords		

**Description of Timber by Payment Unit (PU), con't**

PU	MARKET GROUP	PRODUCT	QUANTITY	UNIT	ACRES	ADVERTISE PRICE
6 con't	White Spruce	Pulpwood	19.0	Cords		
7	Red Pine	Sawtimber	17.5	MBF	21.2	\$12,817.55
	White Pine		8.5	MBF		
	Balsam Fir	Pulpwood	2.0	Cords		
	Jack Pine		39.0	Cords		
	Mixed Aspen		32.0	Cords		
	<i>Quaking Aspen</i>		32.0	<i>Cords</i>		
	Mixed Hardwood		1.0	Cords		
	<i>Red Maple</i>		1.0	<i>Cords</i>		
	Red Pine		65.0	Cords		
	White Pine		40.0	Cords		
	White Spruce		11.0	Cords		
8	Red Pine	Sawtimber	12.2	MBF	14.8	\$8,935.15
	White Pine		5.9	MBF		
	Balsam Fir	Pulpwood	1.0	Cords		
	Jack Pine		27.0	Cords		
	Mixed Aspen		23.0	Cords		
	<i>Quaking Aspen</i>		23.0	<i>Cords</i>		
	Mixed Hardwood		1.0	Cords		
	<i>Red Maple</i>		1.0	<i>Cords</i>		
	Red Pine		45.0	Cords		
	White Pine		28.0	Cords		
	White Spruce		8.0	Cords		
9	Red Pine	Sawtimber	13.8	MBF	16.8	\$10,139.90
	White Pine		6.7	MBF		
	Balsam Fir	Pulpwood	1.0	Cords		
	Jack Pine		31.0	Cords		
	Mixed Aspen		26.0	Cords		
	<i>Quaking Aspen</i>		26.0	<i>Cords</i>		
	Mixed Hardwood		1.0	Cords		
	<i>Red Maple</i>		1.0	<i>Cords</i>		
	Red Pine		51.0	Cords		
	White Pine		32.0	Cords		
	White Spruce		9.0	Cords		
10	Red Pine	Sawtimber	20.1	MBF	24.4	\$14,776.20
	White Pine		9.8	MBF		
	Balsam Fir	Pulpwood	2.0	Cords		
	Jack Pine		45.0	Cords		
	Mixed Aspen		37.0	Cords		
	<i>Quaking Aspen</i>		37.0	<i>Cords</i>		
	Mixed Hardwood		1.0	Cords		
	<i>Red Maple</i>		1.0	<i>Cords</i>		
	Red Pine		75.0	Cords		
	White Pine		46.0	Cords		
	White Spruce		13.0	Cords		
11	Red Pine	Sawtimber	11.4	MBF	13.8	\$8,301.60
	White Pine		5.5	MBF		
	Balsam Fir	Pulpwood	1.0	Cords		
	Jack Pine		25.0	Cords		
	Mixed Aspen		21.0	Cords		
	<i>Quaking Aspen</i>		21.0	<i>Cords</i>		
	Mixed Hardwood		1.0	Cords		
	<i>Red Maple</i>		1.0	<i>Cords</i>		
	Red Pine		42.0	Cords		
	White Pine		26.0	Cords		
	White Spruce		7.0	Cords		

Description of Timber by Payment Unit (PU), con't

PU	MARKET GROUP	PRODUCT	QUANTITY	UNIT	ACRES	ADVERTISE PRICE
12	Red Pine White Pine Balsam Fir Jack Pine Mixed Aspen <i>Quaking Aspen</i> Red Pine White Pine White Spruce	Sawtimber	8.1	MBF	7.8	\$6,483.80
			3.0	MBF		
			3.0	Cords		
		Pulpwood	52.0	Cords		
			8.0	Cords		
			8.0	<i>Cords</i>		
			17.0	Cords		
			22.0	Cords		
			12.0	Cords		
13	Red Pine White Pine Balsam Fir Jack Pine Mixed Aspen <i>Quaking Aspen</i> Mixed Hardwood <i>Red Maple</i> Red Pine White Pine White Spruce	Sawtimber	14.2	MBF	17.2	\$10,463.40
			6.9	MBF		
			2.0	Cords		
		Pulpwood	32.0	Cords		
			26.0	Cords		
			26.0	<i>Cords</i>		
			1.0	Cords		
			1.0	<i>Cords</i>		
			53.0	Cords		
33.0	Cords					
9.0	Cords					
14	Red Pine White Pine Balsam Fir Jack Pine Mixed Aspen <i>Quaking Aspen</i> Red Pine White Pine White Spruce	Sawtimber	22.7	MBF	21.8	\$18,343.50
			8.3	MBF		
			10.0	Cords		
		Pulpwood	146.0	Cords		
			23.0	Cords		
			23.0	<i>Cords</i>		
			49.0	Cords		
			62.0	Cords		
			34.0	Cords		
15	Red Pine White Pine Balsam Fir Jack Pine Mixed Aspen <i>Quaking Aspen</i> Red Pine White Pine White Spruce	Sawtimber	9.9	MBF	9.5	\$7,904.10
			3.6	MBF		
			4.0	Cords		
		Pulpwood	63.0	Cords		
			10.0	Cords		
			10.0	<i>Cords</i>		
			21.0	Cords		
			27.0	Cords		
			14.0	Cords		
16	Red Pine White Pine Balsam Fir Jack Pine Mixed Aspen <i>Quaking Aspen</i> Red Pine White Pine White Spruce	Sawtimber	19.3	MBF	18.5	\$15,511.05
			7.1	MBF		
			7.0	Cords		
		Pulpwood	124.0	Cords		
			20.0	Cords		
			20.0	<i>Cords</i>		
			41.0	Cords		
			53.0	Cords		
			28.0	Cords		
17	Red Pine White Pine Balsam Fir Jack Pine Mixed Aspen <i>Quaking Aspen</i> Mixed Hardwood <i>Red Maple</i> Red Pine	Sawtimber	16.1	MBF	19.5	\$11,832.95
			7.8	MBF		
			2.0	Cords		
		Pulpwood	36.0	Cords		
			30.0	Cords		
			30.0	<i>Cords</i>		
			1.0	Cords		
			1.0	<i>Cords</i>		
			60.0	Cords		



**Description of Timber by Payment Unit (PU), con't**

PU	MARKET GROUP	PRODUCT	QUANTITY	UNIT	ACRES	ADVERTISE PRICE
	White Pine		37.0	Cords		
	White Spruce		10.0	Cords		
TOTAL:			421.7	MBF		
TOTAL:			3,158.0	Cords		

# Sale Specific Conditions & Requirements

**Sale Name: Crop Circle Red Pine**

**Sale Number: 42-023-16 Seq#: 1**

## 1 - Sale Area

### 1.2 - Boundaries

#### 1.2.1 - Painted boundaries (1/14)

The sale boundary and Payment Unit boundaries are marked and identified by red and yellow paint. Exterior sale boundary lines against state are marked with red paint. Interior Retention Areas are also marked with red paint (Payment Units 2 and 12). Interior Payment Unit boundaries are marked with yellow paint, with the exception of the boundary that surrounds Payment Unit 3, which is marked with red paint. The painted boundary line trees are not Included Timber and are to be protected.

## 2 - Timber Specifications

### 2.1 - Included Timber

#### 2.1.1 - Clearcut unit(s) with unmerchantable trees (6/14)

Within Payment Unit(s) 3, cut all trees that are two (2) inches or more at DBH, except oak, paper birch and trees marked with GREEN paint.

#### 2.1.3 - Cut tree marked unit(s) (12/08)

Within Payment Unit(s) 1, 2, and 4 - 17, all trees are designated for cutting when marked with orange paint above and below stump height, regardless of merchantability. In addition, within Payment Units 2 and 14 - 16, DO NOT CUT any trees marked in GREEN paint.

NOTE: Cutting of Payment Unit 12 is OPTIONAL due to raptor nest concerns. The timing of when the sale is harvested will determine whether or not this unit can be harvested. Specifics can/will be discussed with the sale administrator. Removing Payment Unit 12 is a contract modification which requires a Timber Sale Contract Supplement.

### 2.2 - Utilization

#### 2.2.3 - Stump heights (4/07)

Stump heights within Payment Unit 3 shall not exceed 6 inches for all trees. This is in order to facilitate scarification/reforestation operations.

## 3 - Payments

### 3.3 - Pre-measured Sales

#### 3.3.4 - Dividing payment units (7/14)

Payment Unit(s) may be divided at the request of the Purchaser and upon approval of the Unit Manager. Dividing Payment Units is a contract modification which requires a Timber Sale Contract Supplement.

## 4 - Transportation

### 4.1 - Construction

#### 4.1.6 - Road construction (1/09)

Construction of new roads or improvements of existing roads shall be done in such a way as to minimize the environmental and visual impacts. Merchantable trees shall be cut and utilized unless otherwise directed. Non-merchantable trees shall be severed and laid flat on the ground. Slash shall be scattered, and not left in windrows and kept a minimum of 10 feet back from the road edge. Stumps shall be set upright, not left on edge, and be moved at least 10 feet away from the road edge. Disturbed soil shall be feathered into the woods and not left in berms or windrows.

#### 4.1.7 - Road closure (10/11)

All new roads built into the sale must be blocked to vehicle traffic upon completion of the sale. Overgrown and/or abandoned roads that are reopened shall be considered new roads. In general, this will require constructing a four (4') foot high berm of stumps and logs covered with earth at the beginning of any new road course. Stumps and brush must be placed along the

road for a minimum of 200 feet, effectively obliterating it. These roads must be rendered impassable to cars, trucks, and ORV's. Stumps from road building and landing construction can be reserved to meet the above road closure specifications. Temporary berms may be required if no sale activity occurs for 30 or more consecutive days. Contact the sale administrator for specific details of design and placement.

#### 4.1.12 - No new roads (1/12)

No new roads will be permitted within Payment Units 1 - 5 or 12. All operations are limited to existing roads. Skid trails, decking areas and landing areas only will be allowed.

### 4.2 - Maintenance

#### 4.2.1 - Hauling restriction (12/08)

Hauling may be restricted on any roads by the Unit Manager or his/her representative. The restriction may occur at any time that road conditions have deteriorated to an unacceptable condition.

#### 4.2.4 - Grading (12/14)

For completion of the sale, state forest roads must be graded. In general, this will require a road grader or bull dozer to shape up the roads after forest products have been hauled off site. This includes cleaning of drainage areas, grading, crowning and filling with gravel, if necessary. The grading equipment to be used must be approved by the Unit Manager or his/her representative.

#### 4.2.5 - Two wheel drive condition (2/04)

All existing trail roads on and adjacent to the sale area must be passable by two-wheel drive traffic for the duration of the sale.

## 5 - Operations

### 5.1 - Notification

#### 5.1.1 - Pre-sale conference (10/16)

A pre-sale conference between the Purchaser and sale administrator is required prior to beginning any operations. The Unit Manager or his/her representative must be contacted at least 5 days in advance to schedule the conference.

#### 5.1.4 - Post-sale conference (10/16)

A post-sale conference on site between the Purchaser and sale administrator is required 5 days prior to the completion of active logging operations to determine clean-up and repair of landings, road edges, and the fulfillment of other contract specifications.

### 5.2 - Conduct of Operations

#### 5.2.1 - Slash

##### 5.2.1.8 - Slash height (12/08)

No slash or tree tops may exceed 24 inches in height.

##### 5.2.1.11 - Slash for reforestation (5/07)

To facilitate reforestation, Payment Unit 3 shall be left with slash evenly distributed. Bunched tops within the cutting area shall be broken up and scattered. Stumps shall be cut low to the ground. Processing sites shall not be left with a compacted layer of slash; tops from these sites shall be hauled back into the cut area and scattered.

#### 5.2.2 - Hazard Trees/Snags

##### 5.2.2.1 - Den trees (10/16)

Obvious hollow and/or den trees shall be protected and left standing unless they are a safety hazard.

#### 5.2.3 - Operating Restrictions

##### 5.2.3.1 - Operating restrictions (9/11)

Within Payment Unit(s) 1 - 17, unless changed by written agreement, cutting, skidding and hauling are limited to the period of April 15 to December 15. This restriction is due to the requirement of low stump heights for reforestation operations.

#### 5.2.3.6 - Bark beetle restriction (12/08)

In the event drought creates a high risk of pine bark beetle infestation, pine is not to be cut during the period March 1 through July 1, unless all portions of trees greater than two inches in diameter are removed from the sale area, reduced to chips, or treated to the satisfaction of the Unit Manager or his/her representative, within fifteen days of being severed from the stump. Pine log decks, pulpwood piles and treetops that are piled for chipping in the fall or winter within a 1/4 mile of susceptible sites must be removed before March 15. Residual slash must not be placed in piles or rows and must be spread over the site for quick drying. The Department of Natural Resources will exercise this specification if the risk of damage warrants.

#### 5.2.32 - Decking/landing restoration (9/13)

All decking and landing areas must have the surface area restored to a condition equal to or better than before. This is to ensure the proper regeneration of the stand. Wood debris, chips and "cookies" from trimmings must be removed or scattered away from landing and loading areas and may not be windrowed on the edge.

#### 5.2.38 - No decking against live trees (2/04)

Cut products may not be decked against unmarked or designated leave trees.

#### 5.2.39 - ORV trail/route protection (12/12)

The ORV trail is shown on the Timber Sale Map. Do not cut trees or damage posts with orange ORV markers. All stumps within 5 feet of the trail must be cut flush with the ground. Maintain a 20 foot wide slash, debris, and rut free zone daily using the ORV trail or route as the centerline. Do not run equipment down the ORV trail or route. Skidding across the trail or route may only occur in locations approved by the sale administrator.

#### 5.2.41 - Snowmobile trail protection (9/11)

The snowmobile trail is shown on the Timber Sale Map. Do not cut or damage posts with orange trail markers or traffic control signs. If the trail road is to be used for hauling during the snowmobile season, then a snow covered base must be left on the trail. No decking of forest products will be permitted along the snowmobile trail.

### 5.4 - Soil Protection

#### 5.4.5 - Soil caution (11/04)

Care must be taken to minimize soil damage due to the sandy soils.

### 5.8 - Protection of Endangered Species

#### 5.8.5 - Protection of raptor nests (3/13)

All trees with raptor nests will be protected if found during harvesting operations. Notification will be made to the Unit Manager or his/her representative who will notify the Wildlife Biologist so an on-site evaluation and recommendation can be made, if necessary.

## 6 - Safety and Fire Prevention

### 6.2 - Signing

#### 6.2.2 - Snowmobile trail posting (8/09)

The Purchaser is responsible for posting and maintaining caution signs on the snowmobile trail prior to beginning operations during the snowmobile season (approximately December 1 to March 31). The trail must be posted at appropriate distances from the sale area to warn of logging activity and truck traffic. Signs must be removed when harvest operations are suspended or completed. The Purchaser will provide these signs.

#### 6.2.3 - Recreational trail posting (2/10)

The Purchaser is responsible for posting and maintaining caution signs on the designated ORV trail prior to beginning operations. The trail must be posted at appropriate distances from the sale area to warn of logging activity and truck traffic at both ends of the trail. Signs must be removed when harvest operations are suspended or completed. The Purchaser will provide these signs.

## 7 - Other Conditions

### 7.3 - Contract Modifications

#### 7.3.3 - Modification for reforestation (8/05)

When contractual work of Purchaser has been accepted for any Payment Unit identified on Sale Area Map, Payment Unit will be eliminated from the Sale Area on written notice so that reforestation operations can begin.



# TIMBER SALE MAP

This information provided by authority of Part 525, 1994 PA 451, as amended.

Sale Number	Year
42 - 023	16

Forest Management Unit Newberry FMU	County Luce	Mapped By Tokar	Date 10/17/2016	Page 1	of 1
Township 49N	Range 10W	Section(s) and Subdivision(s) Sec 10: S1/2SW; Sec 15: W1/2 of Section, W1/2SE	Scale 1:15,840		

Cover Type				Density	
A = Aspen	H = Hemlock	N = Marsh	U = Upland Brush	0 = Non Stocked	5 = Pole Timber Medium
B = Paper Birch	J = Jack Pine	O = Oak	UM = Upland Mixed	1 = Seedling Sapling Poor	6 = Pole Timber Well
C = Cedar	L = Lowland Brush	P = Lowland Poplar	V = Bog or Marsh	2 = Seedling Sapling Medium	7 = Saw Timber Poor
D = Tread Bog	LM = Lowland Mixed	Q = Mixed Swamp Conifer	W = White Pine	3 = Seedling Sapling Well	8 = Saw Timber Medium
E = Swamp Hdwoods	M = Mpl, Bch, Brch	R = Red Pine	X = Non Stocked	4 = Pole Timber Poor	9 = Saw Timber Well
F = Spruce Fir	MC = Mixed Conifer	S = Black Spruce	Z = Water		
G = Grass	MD = Mixed Deciduous	T = Tamarack			

PU	Acres	PU	Acres	PU	Acres
1	23.8	7	21.2	13	17.2
2	20.4	8	14.8	14	21.8
3	6.7	9	16.8	15	9.5
4	26.6	10	24.4	16	18.5
5	13.3	11	13.8	17	19.5
6	34.8	12	7.8		

## Crop Circle Red Pine

### Compartment 29

### 310.9 Acres

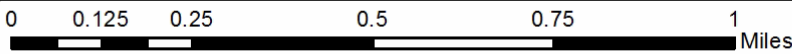
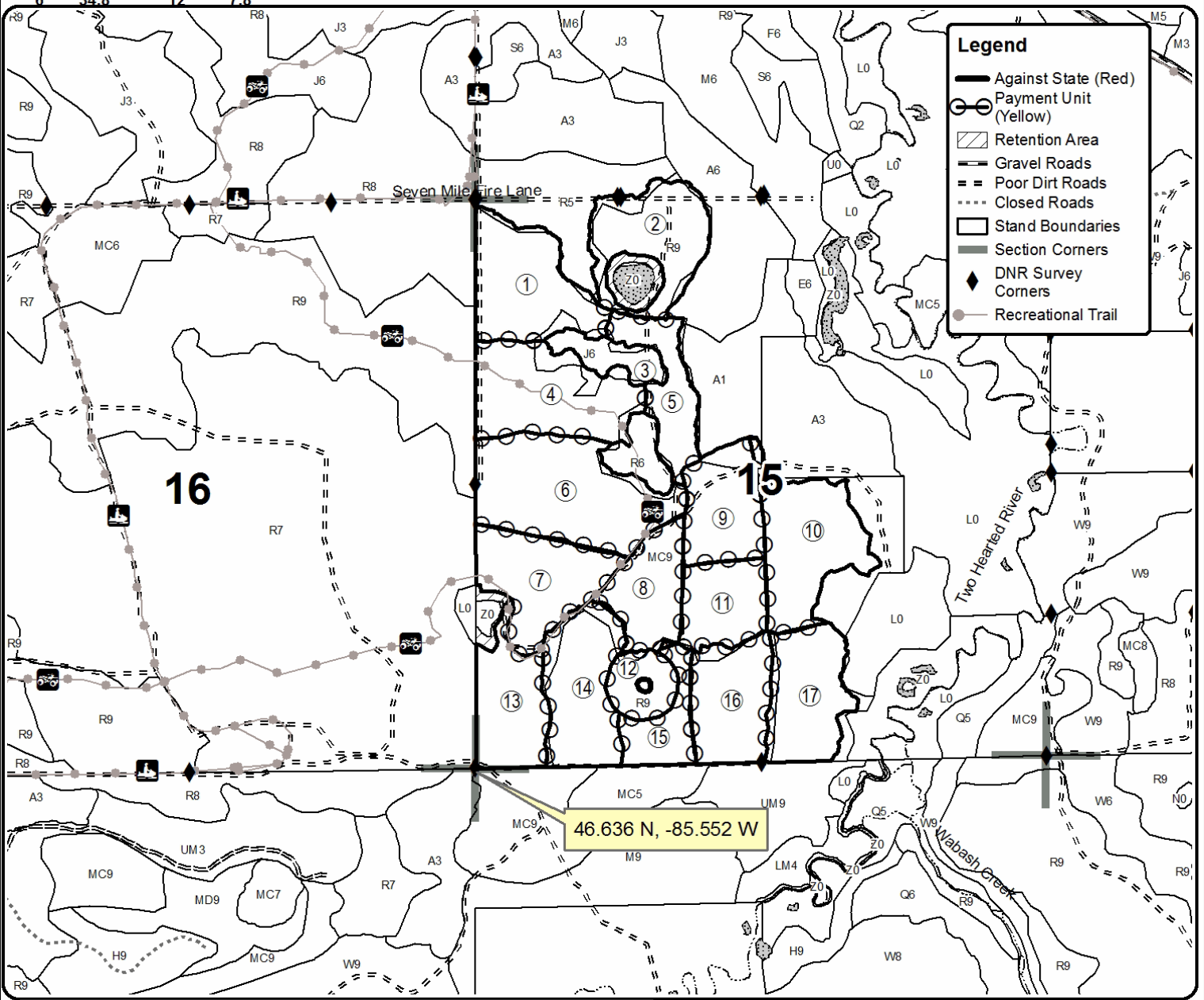

Ridgeline Pine (42-014-16)  
 ; Luce COUNTY

In response to the notice of sale to be held 3:00 p.m. (local time) on June 29, 2017, I am hereby submitting my sealed bid (firm offer) for the following forest products to be cut. Bids for individual species must be at or above the advertised price. All non-responsive bid forms may be rejected.

<u>PRODUCTS &amp; SPECIES</u>	<u>ESTIMATED VOLUME*</u>	<u>ADVERTISED PRICE</u>	<u>BID PRICE</u>
Pulpwood			
Balsam Fir	41.00 Cords	\$ 11.05/Cord	\$ _____
Jack Pine	1,235.00 Cords	\$ 44.80/Cord	\$ _____
Mixed Aspen	563.00 Cords	\$ 28.05/Cord	\$ _____
Mixed Hardwood	37.00 Cords	\$ 18.60/Cord	\$ _____
Paper Birch	64.00 Cords	\$ 15.95/Cord	\$ _____
Red Pine	1,971.00 Cords	\$ 81.75/Cord	\$ _____
White Pine	827.00 Cords	\$ 26.95/Cord	\$ _____

\*The volumes are statistically estimated within plus (+) or minus (-) 8.91 percent. These estimated volumes are final and not subject to adjustment. Prospective bidders are urged to examine this timber and to make their own estimates of quantity and quality.

I understand that any or all bids may be rejected. All bids must be signed and all bid items must be bid or the bid form may be rejected. I also understand that consideration and awarding a contract will be based upon my past performance and ability to complete the contract based upon equipment and staffing subject to my control.

FEDERAL ID: \_\_\_ - \_\_\_ - \_\_\_ or SOCIAL SECURITY NUMBER: \_\_\_ - \_\_\_ - \_\_\_

Company or individual bidding: \_\_\_\_\_

Company representative's name: \_\_\_\_\_

Address: \_\_\_\_\_

City: \_\_\_\_\_ State: \_\_\_\_\_ Zip: \_\_\_\_\_

IF AVAILABLE, PLEASE PLACE THE PERSONALIZED LABEL FROM YOUR PROSPECTUS IN THE ABOVE BOX.

Individual or company representative's signature: \_\_\_\_\_ Date: \_\_\_\_\_

Phone number : \_\_\_\_\_ Email (optional): \_\_\_\_\_

**THE WINNING BIDDER MUST COMPLETE THE VERIFICATION OF WORKER'S DISABILITY COMPENSATION ACT COMPLIANCE (ON REVERSE SIDE IF DOUBLE SIDED) WITHIN 21 DAYS OF SALE AWARD DATE**



<b>FOR DEPARTMENT USE ONLY</b>
Sale Number (XX - XXX - XX - XX)
Forest Management Unit:

## TIMBER SALE VERIFICATION OF WORKER'S DISABILITY COMPENSATION ACT COMPLIANCE

*As required by Act 317, P.A. 1969 (Worker's Compensation) and  
Part 5 of Act 451 of 1994, as amended.*

### VERIFICATION OF WORKER'S DISABILITY COMPENSATION ACT COMPLIANCE

- This verification must be completed and submitted within 21 days of contract award and prior to the issuance of the timber sale contract.
- In addition, if boxes 2B or 2C are checked, then Notice of Exclusion or Certificate of Insurance must be submitted within twenty-one (21) days of the contract award and prior to the issuance of the timber sale contract.
- All information must be typed or printed except for written signatures.

Please Check Appropriate Categories:

1. My business is organized as (you **must** check one of the boxes below):
  - A.  Sole Proprietorship (individual)
  - B.  Partnership
  - C.  Corporation
2. You **must** check one of the boxes below:
  - A.  I certify my business is a sole proprietorship and it has no employees but the sole proprietor. I am not subject to the Worker's Compensation Laws.
  - B.  I certify my business has satisfied its obligation to the Worker's Compensation Act through the use of an approved Notice of Exclusion (BWC-337, Rev. 5/96). I will provide a copy of the Notice of Exclusion within 21 days of the contract award. (For questions or a copy of the BWC-337, please call the Worker's Compensation Bureau at 517-322-1195).
  - C.  I certify my business has a Worker's Compensation Policy. I will provide an original Certificate of Insurance within twenty-one (21) days of the contract award.
3. If you have checked item 2(A) or 2(B), you **must** indicate the number of **both** full-time and part-time employees, other than yourself, including family members and active partners (if none, you must enter "0").

\_\_\_\_\_ Full-time Employees

\_\_\_\_\_ Part-time Employees

Name of Business		Federal ID (or) Social Security No.	
Address		Telephone (       )	
City	State	ZIP	

*I hereby certify that the above information is true and correct. I agree to notify the Michigan DNR of any changes that occur in factors affecting my coverage during any of my present and future operations.*

\_\_\_\_\_  
Signature of Owner or Authorized Representative

\_\_\_\_\_  
Title

\_\_\_\_\_  
Date

**Please complete the "SEALED BID" information on the next page**



Crop Circle Red Pine (42-023-16)  
 ; Luce COUNTY

In response to the notice of sale to be held 3:00 p.m. (local time) on June 29, 2017, I am hereby submitting my sealed bid (firm offer) for the following forest products to be cut. Bids for individual species must be at or above the advertised price. All non-responsive bid forms may be rejected.

<u>PRODUCTS &amp; SPECIES</u>	<u>ESTIMATED VOLUME*</u>	<u>ADVERTISED PRICE</u>	<u>BID PRICE</u>
<b>Sawtimber</b>			
Red Pine	304.90 MBF	\$ 164.00/MBF	\$ _____
White Pine	116.80 MBF	\$ 58.00/MBF	\$ _____
<b>Pulpwood</b>			
Balsam Fir	43.00 Cords	\$ 11.05/Cord	\$ _____
Jack Pine	895.00 Cords	\$ 44.80/Cord	\$ _____
Mixed Aspen	440.00 Cords	\$ 28.05/Cord	\$ _____
Mixed Hardwood	12.00 Cords	\$ 18.60/Cord	\$ _____
Red Pine	940.00 Cords	\$ 81.75/Cord	\$ _____
White Pine	620.00 Cords	\$ 26.95/Cord	\$ _____
White Spruce	208.00 Cords	\$ 34.30/Cord	\$ _____

\*The volumes are statistically estimated within plus (+) or minus (-) 10.30 percent. These estimated volumes are final and not subject to adjustment. Prospective bidders are urged to examine this timber and to make their own estimates of quantity and quality.

I understand that any or all bids may be rejected. All bids must be signed and all bid items must be bid or the bid form may be rejected. I also understand that consideration and awarding a contract will be based upon my past performance and ability to complete the contract based upon equipment and staffing subject to my control.

FEDERAL ID: \_\_\_\_ - \_\_\_\_ - \_\_\_\_ or SOCIAL SECURITY NUMBER: \_\_\_\_ - \_\_\_\_ - \_\_\_\_

Company or individual bidding: \_\_\_\_\_

Company representative's name: \_\_\_\_\_

Address: \_\_\_\_\_

City: \_\_\_\_\_ State: \_\_\_\_\_ Zip: \_\_\_\_\_

IF AVAILABLE, PLEASE PLACE THE PERSONALIZED LABEL FROM YOUR PROSPECTUS IN THE ABOVE BOX.

Individual or company representative's signature: \_\_\_\_\_ Date: \_\_\_\_\_

Phone number : \_\_\_\_\_ Email (optional): \_\_\_\_\_

**THE WINNING BIDDER MUST COMPLETE THE VERIFICATION OF WORKER'S DISABILITY COMPENSATION ACT COMPLIANCE (ON REVERSE SIDE IF DOUBLE SIDED) WITHIN 21 DAYS OF SALE AWARD DATE**



<b>FOR DEPARTMENT USE ONLY</b>
Sale Number (XX - XXX - XX - XX)
Forest Management Unit:

## TIMBER SALE VERIFICATION OF WORKER'S DISABILITY COMPENSATION ACT COMPLIANCE

*As required by Act 317, P.A. 1969 (Worker's Compensation) and  
Part 5 of Act 451 of 1994, as amended.*

### VERIFICATION OF WORKER'S DISABILITY COMPENSATION ACT COMPLIANCE

- This verification must be completed and submitted within 21 days of contract award and prior to the issuance of the timber sale contract.
- In addition, if boxes 2B or 2C are checked, then Notice of Exclusion or Certificate of Insurance must be submitted within twenty-one (21) days of the contract award and prior to the issuance of the timber sale contract.
- All information must be typed or printed except for written signatures.

Please Check Appropriate Categories:

1. My business is organized as (you **must** check one of the boxes below):
  - A.  Sole Proprietorship (individual)
  - B.  Partnership
  - C.  Corporation
2. You **must** check one of the boxes below:
  - A.  I certify my business is a sole proprietorship and it has no employees but the sole proprietor. I am not subject to the Worker's Compensation Laws.
  - B.  I certify my business has satisfied its obligation to the Worker's Compensation Act through the use of an approved Notice of Exclusion (BWC-337, Rev. 5/96). I will provide a copy of the Notice of Exclusion within 21 days of the contract award. (For questions or a copy of the BWC-337, please call the Worker's Compensation Bureau at 517-322-1195).
  - C.  I certify my business has a Worker's Compensation Policy. I will provide an original Certificate of Insurance within twenty-one (21) days of the contract award.
3. If you have checked item 2(A) or 2(B), you **must** indicate the number of **both** full-time and part-time employees, other than yourself, including family members and active partners (if none, you must enter "0").

\_\_\_\_\_ Full-time Employees

\_\_\_\_\_ Part-time Employees

Name of Business		Federal ID (or) Social Security No.	
Address		Telephone (       )	
City	State	ZIP	

*I hereby certify that the above information is true and correct. I agree to notify the Michigan DNR of any changes that occur in factors affecting my coverage during any of my present and future operations.*

\_\_\_\_\_  
Signature of Owner or Authorized Representative

\_\_\_\_\_  
Title

\_\_\_\_\_  
Date

**Please complete the "SEALED BID" information on the next page**

Ash Overhaul (42-001-17)  
 ; Luce COUNTY

In response to the notice of sale to be held 3:00 p.m. (local time) on June 29, 2017, I am hereby submitting my sealed bid (firm offer) for the following forest products to be cut. Bids for individual species must be at or above the advertised price. All non-responsive bid forms may be rejected.

<u>PRODUCTS &amp; SPECIES</u>	<u>ESTIMATED VOLUME*</u>	<u>ADVERTISED PRICE</u>	<u>BID PRICE</u>
<b>Sawtimber</b>			
Red Maple	14.40 MBF	\$ 83.00/MBF	\$ _____
Sugar Maple	22.00 MBF	\$ 356.00/MBF	\$ _____
White Ash	28.60 MBF	\$ 44.00/MBF	\$ _____
<b>Pulpwood</b>			
Balsam Fir	29.00 Cords	\$ 6.90/Cord	\$ _____
Black Ash	56.00 Cords	\$ 11.60/Cord	\$ _____
Mixed Aspen	36.00 Cords	\$ 17.55/Cord	\$ _____
Mixed Hardwood	289.00 Cords	\$ 11.60/Cord	\$ _____
Mixed Spruce	93.00 Cords	\$ 21.45/Cord	\$ _____
Tamarack	36.00 Cords	\$ 10.95/Cord	\$ _____
White Ash	222.00 Cords	\$ 11.60/Cord	\$ _____
White Pine	3.00 Cords	\$ 16.85/Cord	\$ _____

\*The volumes are statistically estimated within plus (+) or minus (-) 19.13 percent. These estimated volumes are final and not subject to adjustment. Prospective bidders are urged to examine this timber and to make their own estimates of quantity and quality.

I understand that any or all bids may be rejected. All bids must be signed and all bid items must be bid or the bid form may be rejected. I also understand that consideration and awarding a contract will be based upon my past performance and ability to complete the contract based upon equipment and staffing subject to my control.

FEDERAL ID: \_\_\_\_\_ or SOCIAL SECURITY NUMBER: \_\_\_\_\_

Company or individual bidding: \_\_\_\_\_

Company representative's name: \_\_\_\_\_

Address: \_\_\_\_\_

City: \_\_\_\_\_ State: \_\_\_\_\_ Zip: \_\_\_\_\_

IF AVAILABLE, PLEASE PLACE THE PERSONALIZED LABEL FROM YOUR PROSPECTUS IN THE ABOVE BOX.

Individual or company representative's signature: \_\_\_\_\_ Date: \_\_\_\_\_

Phone number : \_\_\_\_\_ Email (optional): \_\_\_\_\_

**THE WINNING BIDDER MUST COMPLETE THE VERIFICATION OF WORKER'S DISABILITY COMPENSATION ACT COMPLIANCE (ON REVERSE SIDE IF DOUBLE SIDED) WITHIN 21 DAYS OF SALE AWARD DATE**



<b>FOR DEPARTMENT USE ONLY</b>
Sale Number (XX – XXX – XX – XX)
Forest Management Unit:

## TIMBER SALE VERIFICATION OF WORKER'S DISABILITY COMPENSATION ACT COMPLIANCE

*As required by Act 317, P.A. 1969 (Worker's Compensation) and  
Part 5 of Act 451 of 1994, as amended.*

### VERIFICATION OF WORKER'S DISABILITY COMPENSATION ACT COMPLIANCE

- This verification must be completed and submitted within 21 days of contract award and prior to the issuance of the timber sale contract.
- In addition, if boxes 2B or 2C are checked, then Notice of Exclusion or Certificate of Insurance must be submitted within twenty-one (21) days of the contract award and prior to the issuance of the timber sale contract.
- All information must be typed or printed except for written signatures.

Please Check Appropriate Categories:

1. My business is organized as (you **must** check one of the boxes below):
  - A.  Sole Proprietorship (individual)
  - B.  Partnership
  - C.  Corporation
  
2. You **must** check one of the boxes below:
  - A.  I certify my business is a sole proprietorship and it has no employees but the sole proprietor. I am not subject to the Worker's Compensation Laws.
  - B.  I certify my business has satisfied its obligation to the Worker's Compensation Act through the use of an approved Notice of Exclusion (BWC-337, Rev. 5/96). I will provide a copy of the Notice of Exclusion within 21 days of the contract award. (For questions or a copy of the BWC-337, please call the Worker's Compensation Bureau at 517-322-1195).
  - C.  I certify my business has a Worker's Compensation Policy. I will provide an original Certificate of Insurance within twenty-one (21) days of the contract award.
  
3. If you have checked item 2(A) or 2(B), you **must** indicate the number of **both** full-time and part-time employees, other than yourself, including family members and active partners (if none, you must enter "0").

\_\_\_\_\_ Full-time Employees                      \_\_\_\_\_ Part-time Employees

Name of Business		Federal ID (or) Social Security No.	
Address		Telephone (        )	
City	State	ZIP	

*I hereby certify that the above information is true and correct. I agree to notify the Michigan DNR of any changes that occur in factors affecting my coverage during any of my present and future operations.*

\_\_\_\_\_  
Signature of Owner or Authorized Representative

\_\_\_\_\_  
Title

\_\_\_\_\_  
Date

**Please complete the "SEALED BID" information on the next page**