



**DEPARTMENT OF NATURAL RESOURCES  
STATE OF MICHIGAN**

**TIMBER SALE PROSPECTUS #6217**

SCHEDULED SALE DATE AND TIME: 10:00 a.m. (local time) on September 12, 2018.

LOCATION: GLADWIN MGMT UNIT, 801 N SILVERLEAF, GLADWIN, MI 48624.

PROSPECTUS NOTE: The bidder is advised to inspect the sale area and review the location, estimated volumes, operating costs and contract terms of proposed sales. Please be aware that some landowners may request 60 days or more notice for access across their land.

Notice is hereby given that bids will be received by the Unit Manager, GLADWIN MANAGEMENT UNIT, for certain timber on the following described lands:

High Tower Mix (73-012-18) / T13N, R02W, SEC. 10, S1/2NW,NENW.

T13N, R02W, SEC. 4 , E1/2SW.

T13N, R02W, SEC. 9 , N1/2NW,S1/2NE.

Midland County, Advertised Price \$39,981.00, 150.7 Acres, Hardwood, Aspen.

SALE NOTE: Seasonal restrictions are in place on all payment units. Roundwood operation only on Payment Unit 1 (see spec 2.2.6). Bark slippage restriction on Payment Unit 1 (see spec 5.2.3.3). Drainage crossings of Hevel Drain are required to access Payment Unit 1 (see specs 4.1.2 & 5.2.17). A DEQ permit and Midland County Drain Commission permission will be obtained by the DNR. Road building will be required to access some payment units unless permission is granted from adjoining land owners.

Access may be through private or other public land.

Magrudder Mix (73-013-17) / T13N, R01W, SEC. 18, S1/2NW,NWNW.

T13N, R01W, SEC. 7 , SWSW.

T13N, R02W, SEC. 1 , NW,NWNE,SENE,SW,S1/2SE,NESE.

T13N, R02W, SEC. 12, NW,NE,SW,NWSE.

Midland County, Advertised Price \$80,767.65, 398.9 Acres, Hardwood, Aspen.

SALE NOTE: All of the sale is seasonally restricted due to low wet ground, bark slippage and oak wilt. Roundwood operation and no chipping on three units. Sale is in an area known as the Porter Oil Field. Currently extensive rehabilitation work is being conducted under a long standing permit. This area is closed to vehicle traffic from April to November. Payment unit 10 has seasonal restrictions due to the presence of an active bald eagle nest.

45 DEGREE (73-012-15) / T16N, R01W, SEC. 26, N1/2NE.

T16N, R01W, SEC. 27, E1/2NE, NESE.

T16N, R01W, SEC. 28, SE1/4, W1/2NE, E1/2NW.

T16N, R01W, SEC. 34, SWNE, SESW, SWSE.

Midland County, Advertised Price \$27,957.80, 149.0 Acres, Hardwood, Aspen.

## BID INSTRUCTIONS (VER. 07/02/2018):

### 1. Scheduled Bid Location, Date, and Time (2/11)

Bids must be received by the Unit Manager, GLADWIN OFFICE, 801 N SILVERLEAF, GLADWIN, MI 48624, no later than 10:00 a.m. (local time) on September 12, 2018. For further information concerning this sale, contact PATRICK MOHNEY at 989-426-9205 extension 7640.

### 2. Bidder's Qualifications (5/16)

Purchaser shall obtain workers compensation insurance to cover claims under Michigan's Worker's Disability Compensation Act of 1969 or similar employee benefit act of any other state applicable to an employee. If all or part of a timber sale was prepared by a private contractor, the contractor and that contractor's company are not permitted to bid on the timber sale contract. Bids will not be accepted from individuals or companies appearing on the DNR/FRD No-Bid List. This list contains the names of purchasers who previously failed to execute a contract within 21-days or who have a history of poor performance.

### 3. Preparation of Sealed Bids (5/16)

Bid Forms may be completed online thru Michigan DNR Timber Sale Online Bidding (OLB) at [www.michigan.gov/timberbidding](http://www.michigan.gov/timberbidding) or by completing the hardcopy Bid Form found in the Timber Sale Prospectus. Hardcopy Bid Forms shall be manually signed in ink. Registration in OLB is considered your 'signature' for all bids submitted thru that system. Bid prices must be entered for each species and product in the Bid Price column for all material subject to bidding and all fill-in blanks must be completed. If erasures or other changes appear on the hardcopy Bid Form, each erasure or change must be initialed by the person signing the bid.

### 4. Submission of Sealed Bids (5/16)

Bid forms may be obtained from the Unit Manager or thru OLB. Bids may be submitted hardcopy or thru OLB. All hardcopy bids must be submitted on the bid form and in an envelope clearly identified as described in this section. NOTE: Only one bid form per bid envelope. Sealed bids must be submitted to the Unit office designated in the prospectus and must be submitted at or prior to the time established in the prospectus. The envelope should show on the outside (a) the sale name or number and (b) the date and time of bid opening, as shown in the prospectus. Bids received after the time specified in the sale prospectus are late bids and will be rejected.

It is possible for a bidder to submit multiple bids on a single sale. For example, a bid may be submitted hardcopy and a bid may be submitted thru OLB. Or, two bidders from the same company could both submit bids on the same sale. If this were to happen, the State would accept all bids received and award the contract accordingly. All bidding and contractual requirements would apply to all bids received.

### 5. Public Opening of Sealed Bids (7/16)

If conditions permit, the sealed bids will be publicly opened and posted at the time and place set in the prospectus.

If a bidder, present at a bid opening, has submitted bids on more than one sale, that bidder may withdraw their unopened bid envelopes or announce the withdrawal of their online bid after being declared the successful bidder on one sale.

### 6. Award of Contract (1/11)

Award of the contract will be made to the Bidder whose bid, conforming to the prospectus, is most advantageous to the State of Michigan on the basis of total value at rates bid for the estimated quantities. The State reserves the right to reject any bid or waive any minor irregularity in bids received. A written award mailed (or otherwise furnished) to the successful Bidder shall be deemed to result in a binding contract without further action by either party.

### 7. Down Payment (1/11)

The Bidder to whom award is made must make a down payment within 21 days of the sale award. The amount of the down payment will be calculated as shown in the Bond and Payment Schedule of this prospectus. Only cash may be used to meet this requirement.

### 8. Performance Security (1/11)

As guarantee of faithful performance, a cash bond, certificate of deposit, surety bond or irrevocable letter of credit (LOC) is required within 21 days of the sale award. The amount of the performance security is shown in the Bond and

Payment Schedule of this prospectus. If an LOC or surety is used, the coverage must extend for at least 6 months beyond the contract expiration.

#### 9. Timber Sale Contract (7/18)

Additional conditions and requirements common to all timber sales are listed on the timber sale contract (R4031) and are available on line at [www.michigan.gov/timber](http://www.michigan.gov/timber). Contact the Unit Manager for additional information or a sample contract. Within 21 days of the date of the award letter, the bidder must sign the contract and provide the required down payment, performance security, and verification of worker's disability compensation. The down payment and performance security shall be in accordance with the provisions of the timber sale contract, in the sums stated in this prospectus. If these actions are not taken, then the Bidder, the Bidder's corporation, and the corporation's principals may not be permitted to bid on State timber sales for a period of 3 months after the first offense, 6 months after the second offense, and 1 year after the third offense. An offense will only be counted against the Bidder for 5 years. In addition, the Bidder certifies that if awarded this contract, the Bidder will complete the timber sale contract in accordance with its terms and any modifications thereof including requirements to purchase, cut, and remove the included timber by the expiration date.

Payment Unit values in the State Forest Timber Sale Contract are calculated based on the advertised value of the Payment Unit as a percentage of the total advertised value of the contract. The advertised value of each Payment Unit is given in the Description of Timber by Payment Unit table on the Timber Sale Information page. For example, if the value of Payment Unit 1 is advertised as \$1,500 and the total Timber Sale value is advertised as \$10,000, the contract price for Payment Unit 1 will be 15% of the total bid price ( $\$1,500/\$10,000 * 100$ ).

#### 10. Disclaimer of Estimates and Bidder's Warranty of Inspection (7/16)

Before submitting this bid, the Bidder is advised and cautioned to inspect the sale area, review the requirements of the sale contract, and take other steps as may be reasonably necessary to ascertain the location, estimated volumes, construction estimates, and operating costs of the proposed sale. Failure to do so will not relieve the Bidder from responsibility for completing the contract.

The Bidder warrants that this bid is submitted solely on the basis of the Bidder's examination and inspection of the quality and quantity of the timber offered for sale and the Bidder's opinion of the value thereof and the costs of recovery. No reliance should be placed on the State of Michigan's estimates of timber quality, quantity or costs of recovery. Bidder further acknowledges that the State of Michigan: (i) expressly disclaims any warranty of fitness of timber for any purpose; (ii) offers this timber as is without any warranty of quality (merchantability) or quantity and (iii) expressly disclaims any warranty as to the quantity or quality of timber sold.

#### 11. Certification and Chain-of-Custody (10/14)

Unless otherwise indicated in the contract under section 7 – Other Conditions of the Sale Specific Conditions & Requirements, the area encompassed by this timber sale is certified to the standards of the Forest Stewardship Council (FSC) - Certificate #SCS-FM/COC-00090N and the Sustainable Forestry Initiative (SFI) - Certificate #NSF-SFIS-5Y031-SF5. Forest products from this sale may be delivered to the mill as "FSC 100% and / or SFI certified" as long as the contractor hauling the forest products is chain-of-custody (COC) certified or covered under a COC certificate from the destination mill. The purchaser is responsible for maintaining COC after leaving the sale area.

#### 12. Good Neighbor Authority (GNA) Requirements (7/16)

If the name of this timber sales contains the acronym GNA, it is authorized by the Good Neighbor Authority (GNA) and covered by various agreements between the U.S. Forest Service and the State. The timber sale occurs on federal land and the following conditions apply:

GNA contracts on US Forest Service land will not be awarded to purchasers on the Federal list of excluded parties. The System for Award Management (SAM) will be checked for active excluded parties prior to award of contract. In addition, the Bidder to whom award is made must complete an Assurance Regarding Felony Conviction or Tax Delinquent Status for Corporate Applicants (AD-3031).

#### 13. Good Neighbor Authority (GNA) Requirements, con't (9/16)

Bidder certifies, by signing this bid form, that to the best of Bidder's knowledge that the following representations are accurate and complete.

- a. That the Bidder and its principals are not presently debarred, suspended, proposed for debarment, declared ineligible, or voluntary excluded from timber sales (covered transactions) by any Federal department or agency.
- b. That the Bidder and its principals have not within a 3-year period preceding this bid been convicted of or had a civil judgment rendered against them for commission of fraud or a criminal offense in connection with obtaining, attempting to obtain, or performing a public (Federal, State, or local) transaction or contract under a public transaction; violation of Federal or State antitrust statutes or commission of embezzlement, theft, forgery, bribery, falsification or destruction of records, making false statements, or receiving stolen property.
- c. That the Bidder and its principals are not presently indicted for or otherwise criminally or civilly charged by a governmental entity (Federal, State, or local) with commission of any of the offenses enumerated in paragraph b of this certification.
- d. That the Bidder and its principals have not within a 3-year period preceding this bid had one or more public transactions (Federal, State, or local) terminated for breach or default of a timber or forest product contract.

Bidders that cannot certify this requirement, in whole or in part, shall submit an explanation with their bid.

KEITH CREAGH  
Director

**TIMBER SALE INFORMATION**

High Tower Mix (73-012-18)

T13N, R02W, SEC. 10; T13N, R02W, SEC. 4; T13N, R02W, SEC. 9.  
Midland County (Advertised Price \$39,981.00)

SALE NOTE: Seasonal restrictions are in place on all payment units. Roundwood operation only on Payment Unit 1 (see spec 2.2.6). Bark slippage restriction on Payment Unit 1 (see spec 5.2.3.3). Drainage crossings of Hevel Drain are required to access Payment Unit 1 (see specs 4.1.2 & 5.2.17). A DEQ permit and Midland County Drain Commission permission will be obtained by the DNR. Road building will be required to access some payment units unless permission is granted from adjoining land owners.

Access may be through private or other public land.

A timber sale contract for this lump sum, sealed bid timber sale will be awarded to the responsible bidder offering the highest sealed bid price. Bids must be at or above the following advertised price for each species:

<u>PRODUCTS &amp; SPECIES</u>	<u>ESTIMATED UNITS*</u>		<u>ADVERTISED PRICE</u>
Sawtimber			
Mixed Aspen	67.90	MBF	\$ 48.00 / MBF
Paper Birch	2.40	MBF	\$ 45.00 / MBF
Red Maple	88.50	MBF	\$ 44.00 / MBF
White Oak	7.80	MBF	\$ 67.00 / MBF
Pulpwood			
Mixed Aspen	1,049.00	Cords	\$ 17.95 / Cord
Mixed Hardwood	1,042.00	Cords	\$ 11.95 / Cord
Mixed Oak	99.00	Cords	\$ 9.25 / Cord

\* The total volume is statistically estimated within plus (+) or minus (-) 7.75 percent. The estimated units are final and not subject to adjustment. Prospective bidders are urged to examine this timber and to make their own estimates of quantity and quality.

**BOND AND PAYMENT SCHEDULE:**

1. A bond in the amount of \$1,999.00 to insure faithful performance of the conditions of the contract will be deposited by the successful bidder within 21 days of the sale award.
2. Cutting in any sale or unit without the required advance payment would be considered a trespass.
3. Total payment must be paid in advance or according to the following schedule:
  - (a) Ten percent (10%) of the sale value must be paid within 21 days of the sale award.
  - (b) The 10% down payment will be credited towards the first unit cut.
  - (c) Payment for each of the following units must be made before cutting begins in that unit:
 

<u>PAYMENT UNIT NUMBER</u>	<u>PERCENT OF TOTAL SALE VALUE</u>
01	23.9%
02	32.2%
03	43.9%

4. If no cutting takes place, the 10% down payment will not be refunded.
5. Operations on the contract issued will terminate on 09/30/2020.

**Description of Timber by Payment Unit (PU)**

PU	MARKET GROUP	PRODUCT	QUANTITY	UNIT	ACRES	ADVERTISE PRICE		
1	Mixed Aspen	Sawtimber	38.9	MBF	48.0	\$9,562.00		
	<i>B. T. Aspen</i>		37.5	<i>MBF</i>				
	<i>Quaking Aspen</i>		1.4	<i>MBF</i>				
	Red Maple		18.6	MBF				
	White Oak		1.1	MBF				
	Mixed Aspen		Pulpwood	220.0			Cords	
	<i>B. T. Aspen</i>			156.0			<i>Cords</i>	
	<i>Quaking Aspen</i>			64.0			<i>Cords</i>	
	Mixed Hardwood			221.0			Cords	
	<i>Black Cherry</i>			2.0			<i>Cords</i>	
	<i>Paper Birch</i>			4.0			<i>Cords</i>	
	<i>Red Maple</i>			215.0			<i>Cords</i>	
	Mixed Oak			23.0			Cords	
	<i>Red Oak</i>			<i>Sawtimber</i>			1.2	<i>MBF</i>
	<i>Red Oak</i>			<i>Pulpwood</i>			13.0	<i>Cords</i>
	<i>White Oak</i>			8.0			<i>Cords</i>	
2	Mixed Aspen	Sawtimber	14.9	MBF	41.3	\$12,876.95		
	<i>B. T. Aspen</i>		11.0	<i>MBF</i>				
	<i>Cottonwood</i>		1.3	<i>MBF</i>				
	<i>Quaking Aspen</i>		2.6	<i>MBF</i>				
	Paper Birch		1.5	MBF				
	Red Maple		53.6	MBF				
	White Oak		6.7	MBF				
	Mixed Aspen		Pulpwood	207.0			Cords	
	<i>B. T. Aspen</i>			86.0			<i>Cords</i>	
	<i>Cottonwood</i>			3.0			<i>Cords</i>	
	<i>Quaking Aspen</i>			118.0			<i>Cords</i>	
	Mixed Hardwood			419.0			Cords	
	<i>American Elm</i>			1.0			<i>Cords</i>	
	<i>Black Cherry</i>			2.0			<i>Cords</i>	
	<i>Paper Birch</i>			10.0			<i>Cords</i>	
	<i>Red Maple</i>			406.0			<i>Cords</i>	
Mixed Oak	61.0	Cords						
<i>Red Oak</i>	2.0	<i>Cords</i>						
<i>White Oak</i>	59.0	<i>Cords</i>						
3	Mixed Aspen	Sawtimber	14.1	MBF	61.4	\$17,532.80		
	<i>B. T. Aspen</i>		9.1	<i>MBF</i>				
	<i>Quaking Aspen</i>		5.0	<i>MBF</i>				
	Paper Birch		0.9	MBF				
	Red Maple		16.3	MBF				
	Mixed Aspen		Pulpwood	622.0			Cords	
	<i>B. T. Aspen</i>			207.0			<i>Cords</i>	
	<i>Quaking Aspen</i>			415.0			<i>Cords</i>	
	Mixed Hardwood			402.0			Cords	
	<i>American Elm</i>			<i>Sawtimber</i>			0.7	<i>MBF</i>
	<i>American Elm</i>			<i>Pulpwood</i>			4.0	<i>Cords</i>
	<i>Black Cherry</i>			4.0			<i>Cords</i>	
	<i>Paper Birch</i>			14.0			<i>Cords</i>	
	<i>Red Maple</i>			379.0			<i>Cords</i>	
	Mixed Oak			14.0			Cords	
	<i>Red Oak</i>		3.0	<i>Cords</i>				
<i>White Oak</i>	11.0	<i>Cords</i>						
TOTAL:			166.6	MBF				
TOTAL:			2,189.0	Cords				

# Sale Specific Conditions & Requirements

**Sale Name: High Tower Mix**

**Sale Number: 73-012-18 Seq#: 1**

## 1 - Sale Area

### 1.2 - Boundaries

#### 1.2.1 - Painted boundaries (1/14)

The sale boundary and Payment Unit boundaries are marked and identified by blue, red and yellow paint. Exterior sale boundary lines against private property are marked with blue paint. Exterior sale boundary lines against state are marked with red paint. Interior Payment Unit boundaries are marked with yellow paint. The painted boundary line trees are not Included Timber and are to be protected. Yellow painted trees designating an interior Payment Unit boundary are only to be cut when all surrounding Payment Units have been paid.

## 2 - Timber Specifications

### 2.1 - Included Timber

#### 2.1.1 - Clearcut unit(s) with unmerchantable trees (6/14)

Within Payment Unit(s) 2 and 3, cut all trees that are two (2) inches or more at DBH, regardless of merchantability, except do not cut trees marked with green paint above and below stump height.

#### 2.1.3 - Cut tree marked unit(s) (12/08)

Within Payment Unit(s) 1, all trees are designated for cutting when marked with orange paint above and below stump height, regardless of merchantability. In addition, cut all aspen trees two (2) inches and greater at DBH.

### 2.2 - Utilization

#### 2.2.6 - Roundwood operation required (5/07)

The skidding of whole trees or tree segments with limbs attached is prohibited within Payment Unit 1. All products must be produced as roundwood and forwarded to existing roads or landing areas in final product length.

## 3 - Payments

### 3.3 - Pre-measured Sales

#### 3.3.4 - Dividing payment units (7/14)

Payment Unit(s) 3 may be divided at the request of the Purchaser and upon approval of the Unit Manager. Dividing Payment Units is a contract modification which requires a Timber Sale Contract Supplement. There will be only one division per Payment Unit.

## 4 - Transportation

### 4.1 - Construction

#### 4.1.2 - Stream crossings, specific (3/11)

The drainage crossing will require the installation of wooden crane mats which may be borrowed from the DNR (see spec 5.2.17). This installation will be performed in accordance with the specifications on the appropriate permits which shall be provided by the DNR.

#### 4.1.3 - Slash and earthen piles (8/04)

Piles or windrows of earth along roads and landings that have been widened or constructed shall be leveled. Slash from road maintenance or construction, including stumps, shall be chipped, utilized or otherwise removed from the sale.

#### 4.1.6 - Road construction (1/09)

Construction of new roads or improvements of existing roads shall be done in such a way as to minimize the environmental and visual impacts. Merchantable trees shall be cut and utilized unless otherwise directed. Non-merchantable trees shall be severed and laid flat on the ground. Slash shall be chipped, utilized or otherwise removed from the sale. Stumps shall be set upright, not left on edge, and be moved at least 10 feet away from the road edge. Disturbed soil shall be feathered into the woods and not left in berms or windrows.

## 4.2 - Maintenance

### 4.2.1 - Hauling restriction (12/08)

Hauling may be restricted on forest roads by the Unit Manager or his/her representative. The restriction may occur during spring break up or wet weather conditions.

### 4.2.2 - Fill material (4/07)

To maintain roads, fill material may be needed in areas where "holes" exist or may be expected to develop. This fill material should be placed before trucking begins. Contact the sale administrator regarding the availability of onsite sand or gravel from adjacent State-owned lands.

## 4.3 - Public Right-of-Way

### 4.3.2 - County R-O-W (12/06)

The county must be contacted prior to harvesting in the county road R-O-W. This applies to Payment Unit 3 and Lewis Road.

## 4.4 - Access

### 4.4.3 - Access gate (12/08)

The access gate must be locked at the completion of each day unless otherwise approved by the Unit Manager or his/her representative.

## 5 - Operations

### 5.1 - Notification

#### 5.1.6 - Utility R.O.W. (1/15)

It is the responsibility of the Purchaser to obtain permission from the utility company to utilize the power line R.O.W. for operations. Contact Devon Energy Production Company.

### 5.2 - Conduct of Operations

#### 5.2.1 - Slash

##### 5.2.1.13 - Dispose of slash as directed (12/05)

Slash is to be disposed of as directed by sale administrator.

#### 5.2.3 - Operating Restrictions

##### 5.2.3.1 - Operating restrictions (9/11)

Within Payment Unit(s) 1 - 3, unless changed by written agreement, cutting, skidding, and hauling are limited to dry or frozen conditions. These conditions typically occur from January 1 to March 1, and July 1 to October 1. Approval must be obtained by the sale administrator before a payment unit can be started. This restriction is because seasonally saturated soils.

##### 5.2.3.3 - Bark slippage restriction (3/09)

Within Payment Unit(s) 1, unless changed by written agreement, cutting and skidding are not permitted during the period of April 15 to July 15. This restriction is because of bark slippage.

#### 5.2.4 - Dead and Down Creation

##### 5.2.4.4 - Dead and down creation, grouse (6/18)

To encourage grouse and other wildlife, in Payment Unit(s) 2 and 3, leave one 12" or larger diameter whole tree on the ground for every 3 acres. Trees should be scattered throughout the sale and at least two chains from any roads, two-tracks, or trails open to vehicles, or positioned per the sale administrator's instructions. Stumps must be at least 3 feet tall.

##### 5.2.17 - Timber Mats and Interlocking Composite Mats (3/18)

Timber mats will be utilized with the drainage crossing permit. These two locations are shown on the Timber Sale Map. Two crane mats will be utilized per crossing. Contact the Timber Sale Administrator for specific design and placement. If available, mats may be borrowed from the DNR. A Timber Sale Contract Supplement will be used to document the Purchaser's use of the DNR's mats. Contact the sale administrator regarding availability and pick-up. Timber mats are



available from various field offices. The Purchaser is responsible for picking up and hauling the mats to and from the site. Contact the sale administrator to schedule at least 30 days before desired install/removal date. All mats must be cleaned prior to drop off. This may include, but is not limited to, power washing and brushing to remove mud and debris. A charge of \$400.00 per timber mat will be assessed for all damaged or non-returned mats. Damage for the crane/timber mats is defined as three or more broken cants.

#### 5.2.32 - Decking/landing restoration (9/13)

All decking and landing areas must have the surface area restored to a condition equal to or better than before. This is to ensure the proper regeneration of the stand. Wood debris, chips and "cookies" from trimmings must be removed or scattered away from landing and loading areas and may not be windrowed on the edge.



# TIMBER SALE MAP

This information provided by authority of Part 525, 1994 PA 451, as amended.

Sale Number	Year
73-012	18

Forest Management Unit Gladwin Management Unit	County Midland	Mapped By Kenny Fanelli	Date 7/26/2018	Page 1	of 1
Township 13N	Range 02W	Section(s) and Subdivision(s) Section(s) 4, 9, & 10: Various	Scale 1:15,840		

Cover Type				Density	
A = Aspen	H = Hemlock	N = Marsh	U = Upland Brush	0 = Non Stocked	5 = Pole Timber Medium
B = Paper Birch	J = Jack Pine	O = Oak	UM = Upland Mixed	1 = Seedling Sapling Poor	6 = Pole Timber Well
C = Cedar	L = Lowland Brush	P = Lowland Poplar	V = Bog or Marsh	2 = Seedling Sapling Medium	7 = Saw Timber Poor
D = Treed Bog	LM = Lowland Mixed	Q = Mixed Swamp Conifer	W = White Pine	3 = Seedling Sapling Well	8 = Saw Timber Medium
E = Swamp Hdwoods	M = Mpl, Bch, Brch	R = Red Pine	X = Non Stocked	4 = Pole Timber Poor	9 = Saw Timber Well
F = Spruce Fir	MC = Mixed Conifer	S = Black Spruce	Z = Water		
G = Grass	MD = Mixed Deciduous	T = Tamarack			

PU	Acres
1	48.0
2	41.3
3	61.4

**High Tower Mix**  
**Compartment 116**  
**150.7 Acres**

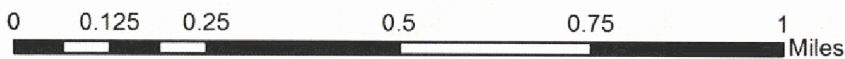
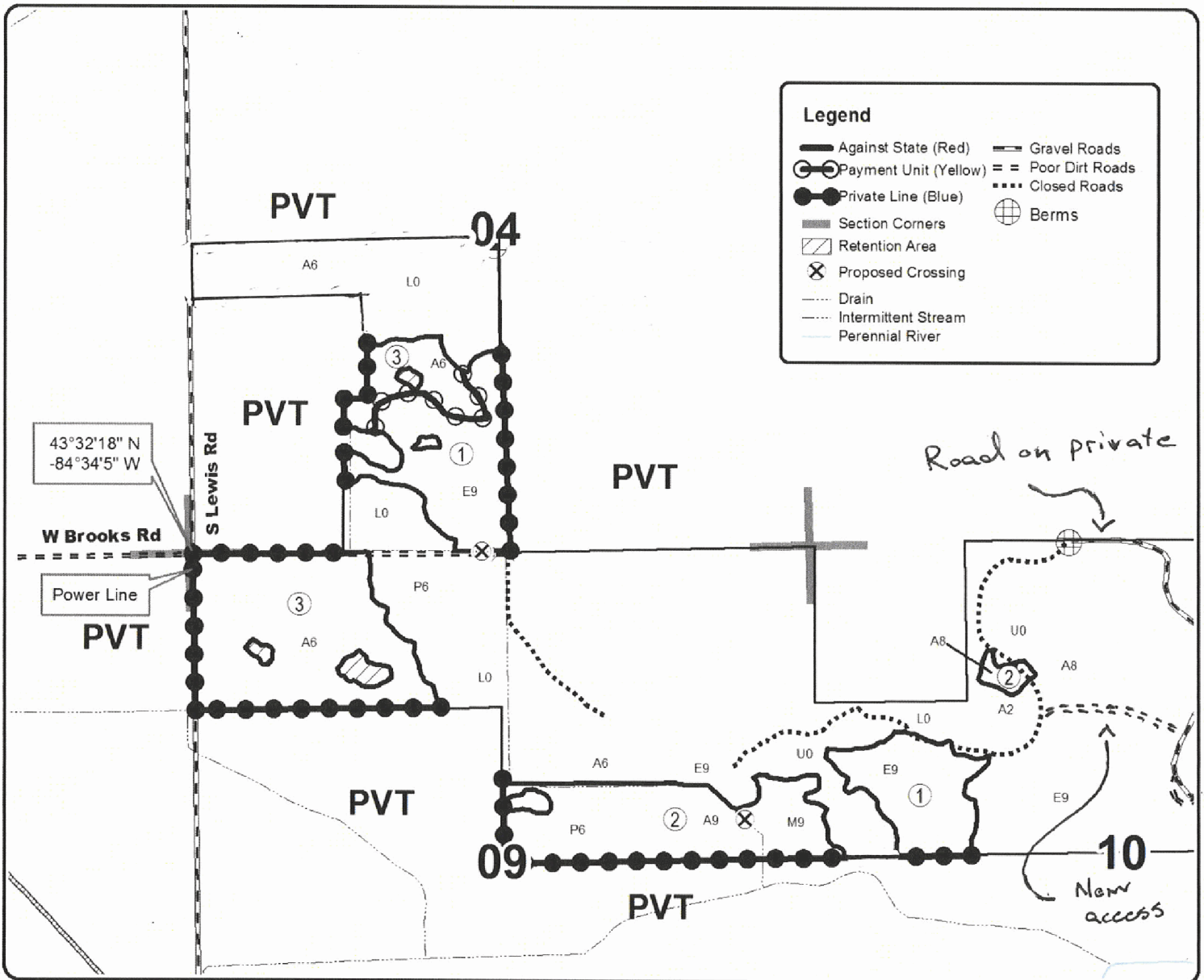

**TIMBER SALE INFORMATION**

Magruder Mix (73-013-17)

T13N, R01W, SEC. 18; T13N, R01W, SEC. 7; T13N, R02W, SEC. 1; T13N, R02W, SEC. 12.  
Midland County (Advertised Price \$80,767.65)

SALE NOTE: All of the sale is seasonally restricted due to low wet ground, bark slippage and oak wilt. Roundwood operation and no chipping on three units. Sale is in an area known as the Porter Oil Field. Currently extensive rehabilitation work is being conducted under a long standing permit. This area is closed to vehicle traffic from April to November. Payment unit 10 has seasonal restrictions due to the presence of an active bald eagle nest.

A timber sale contract for this lump sum, sealed bid timber sale will be awarded to the responsible bidder offering the highest sealed bid price. Bids must be at or above the following advertised price for each species:

<u>PRODUCTS &amp; SPECIES</u>	<u>ESTIMATED UNITS*</u>	<u>ADVERTISED PRICE</u>
Sawtimber		
Mixed Aspen	267.50 MBF	\$ 48.00 / MBF
Mixed Oak	55.10 MBF	\$ 106.00 / MBF
Red Maple	136.60 MBF	\$ 44.00 / MBF
White Oak	12.50 MBF	\$ 67.00 / MBF
Pulpwood		
Mixed Aspen	1,789.00 Cords	\$ 17.95 / Cord
Mixed Hardwood	1,508.00 Cords	\$ 11.95 / Cord
Mixed Oak	552.00 Cords	\$ 9.25 / Cord

\* The total volume is statistically estimated within plus (+) or minus (-) 8.13 percent. The estimated units are final and not subject to adjustment. Prospective bidders are urged to examine this timber and to make their own estimates of quantity and quality.

**BOND AND PAYMENT SCHEDULE:**

1. A bond in the amount of \$4,038.00 to insure faithful performance of the conditions of the contract will be deposited by the successful bidder within 21 days of the sale award.
2. Cutting in any sale or unit without the required advance payment would be considered a trespass.
3. Total payment must be paid in advance or according to the following schedule:
  - (a) Ten percent (10%) of the sale value must be paid within 21 days of the sale award.
  - (b) The 10% down payment will be credited towards the first unit cut.
  - (c) Payment for each of the following units must be made before cutting begins in that unit:

<u>PAYMENT UNIT NUMBER</u>	<u>PERCENT OF TOTAL SALE VALUE</u>
01	10.0%
02	20.3%
03	4.9%
04	18.2%
05	30.2%
06	1.4%
07	6.4%
08	1.3%
09	6.2%
10	1.1%

4. If no cutting takes place, the 10% down payment will not be refunded.
5. Operations on the contract issued will terminate on 09/30/2021.

**Description of Timber by Payment Unit (PU)**

PU	MARKET GROUP	PRODUCT	QUANTITY	UNIT	ACRES	ADVERTISE PRICE	
1	Mixed Aspen	Sawtimber	53.5	MBF	47.1	\$8,040.50	
	<i>B. T. Aspen</i>		38.9	<i>MBF</i>			
	<i>Quaking Aspen</i>		14.6	<i>MBF</i>			
	Mixed Oak		7.6	MBF			
	<i>BI/R/Hybrid Oak</i>		4.3	<i>MBF</i>			
	<i>Northern Pin Oak</i>		3.3	<i>MBF</i>			
	Red Maple		4.5	MBF			
	White Oak		3.7	MBF			
	Mixed Aspen		Pulpwood	156.0			Cords
	<i>B. T. Aspen</i>			83.0			<i>Cords</i>
	<i>Quaking Aspen</i>	73.0		<i>Cords</i>			
	Mixed Hardwood	74.0		Cords			
	<i>Basswood</i>	4.0		<i>Cords</i>			
	<i>Paper Birch</i>	4.0		<i>Cords</i>			
	<i>Red Maple</i>	66.0		<i>Cords</i>			
	Mixed Oak	58.0		Cords			
	<i>BI/R/Hybrid Oak</i>	7.0		<i>Cords</i>			
	<i>Northern Pin Oak</i>	23.0		<i>Cords</i>			
	<i>White Oak</i>	28.0	<i>Cords</i>				
	2	Mixed Aspen	Sawtimber	54.8	MBF	69.5	\$16,426.25
<i>B. T. Aspen</i>		47.9		<i>MBF</i>			
<i>Quaking Aspen</i>		6.9		<i>MBF</i>			
Mixed Oak		11.5		MBF			
<i>BI/R/Hybrid Oak</i>		1.4		<i>MBF</i>			
<i>Northern Pin Oak</i>		10.1		<i>MBF</i>			
Red Maple		15.9	MBF				
Mixed Aspen		Pulpwood	361.0	Cords			
<i>B. T. Aspen</i>			297.0	<i>Cords</i>			
<i>Quaking Aspen</i>			64.0	<i>Cords</i>			
Mixed Hardwood			334.0	Cords			
<i>Paper Birch</i>			40.0	<i>Cords</i>			
<i>Red Maple</i>			294.0	<i>Cords</i>			
Mixed Oak			152.0	Cords			
<i>BI/R/Hybrid Oak</i>			16.0	<i>Cords</i>			
<i>Northern Pin Oak</i>			136.0	<i>Cords</i>			
3	Mixed Aspen		Sawtimber	9.7	MBF	14.5	\$3,948.40
	<i>B. T. Aspen</i>	1.2		<i>MBF</i>			
	<i>Quaking Aspen</i>	8.5		<i>MBF</i>			
	Mixed Oak	12.1		MBF			
	<i>BI/R/Hybrid Oak</i>	7.4		<i>MBF</i>			
	<i>Northern Pin Oak</i>	4.7		<i>MBF</i>			
	Red Maple	0.8	MBF				
	White Oak	2.1	MBF				
	Mixed Aspen	Pulpwood	63.0	Cords			
	<i>B. T. Aspen</i>		10.0	<i>Cords</i>			
	<i>Quaking Aspen</i>		53.0	<i>Cords</i>			
	Mixed Hardwood		26.0	Cords			
	<i>American Elm</i>		2.0	<i>Cords</i>			
	<i>Paper Birch</i>		4.0	<i>Cords</i>			
	<i>Red Maple</i>		20.0	<i>Cords</i>			
	Mixed Oak		63.0	Cords			
<i>BI/R/Hybrid Oak</i>	21.0		<i>Cords</i>				
<i>Northern Pin Oak</i>	36.0		<i>Cords</i>				
<i>White Oak</i>	6.0	<i>Cords</i>					
4	Mixed Aspen	Sawtimber	18.1	MBF	76.7	\$14,681.75	
	<i>B. T. Aspen</i>		15.5	<i>MBF</i>			

Description of Timber by Payment Unit (PU), con't

PU	MARKET GROUP	PRODUCT	QUANTITY	UNIT	ACRES	ADVERTISE PRICE	
4 con't	<i>Quaking Aspen</i>	<i>Sawtimber</i>	2.6	<i>MBF</i>			
	Mixed Oak		6.9	MBF			
	<i>Northern Pin Oak</i>		6.1	<i>MBF</i>			
	<i>Red Oak</i>		0.8	<i>MBF</i>			
	Red Maple		30.1	MBF			
	White Oak		1.7	MBF			
	Mixed Aspen	Pulpwood	371.0	Cords			
	<i>B. T. Aspen</i>		264.0	<i>Cords</i>			
	<i>Quaking Aspen</i>		107.0	<i>Cords</i>			
	Mixed Hardwood		359.0	Cords			
	<i>Paper Birch</i>	<i>Sawtimber</i>	0.8	<i>MBF</i>			
	<i>Black Cherry</i>	<i>Pulpwood</i>	6.0	<i>Cords</i>			
	<i>Paper Birch</i>		23.0	<i>Cords</i>			
	<i>Red Maple</i>		328.0	<i>Cords</i>			
	Mixed Oak		75.0	Cords			
	<i>Northern Pin Oak</i>		54.0	<i>Cords</i>			
	<i>Red Oak</i>		13.0	<i>Cords</i>			
	<i>White Oak</i>		8.0	<i>Cords</i>			
	5	Mixed Aspen	Sawtimber	94.1	MBF	79.9	\$24,424.75
		<i>B. T. Aspen</i>		66.1	<i>MBF</i>		
<i>Cottonwood</i>			10.3	<i>MBF</i>			
<i>Quaking Aspen</i>			17.7	<i>MBF</i>			
Mixed Oak			2.5	MBF			
<i>Bl/R/Hybrid Oak</i>			0.4	<i>MBF</i>			
<i>Northern Pin Oak</i>			2.1	<i>MBF</i>			
Red Maple			54.2	MBF			
White Oak			1.2	MBF			
Mixed Aspen		Pulpwood	635.0	Cords			
<i>B. T. Aspen</i>			368.0	<i>Cords</i>			
<i>Cottonwood</i>			17.0	<i>Cords</i>			
<i>Quaking Aspen</i>			250.0	<i>Cords</i>			
Mixed Hardwood			455.0	Cords			
<i>Paper Birch</i>		<i>Sawtimber</i>	1.0	<i>MBF</i>			
<i>American Elm</i>		<i>Pulpwood</i>	5.0	<i>Cords</i>			
<i>Black Cherry</i>			3.0	<i>Cords</i>			
<i>Paper Birch</i>			25.0	<i>Cords</i>			
<i>Red Maple</i>			420.0	<i>Cords</i>			
Mixed Oak			37.0	Cords			
<i>Bl/R/Hybrid Oak</i>		4.0	<i>Cords</i>				
<i>Northern Pin Oak</i>		30.0	<i>Cords</i>				
<i>White Oak</i>		3.0	<i>Cords</i>				
6	Mixed Aspen	Sawtimber	0.3	MBF	9.6	\$1,099.65	
	<i>B. T. Aspen</i>		0.3	<i>MBF</i>			
	Mixed Oak		1.2	MBF			
	<i>Bl/R/Hybrid Oak</i>		1.2	<i>MBF</i>			
	Red Maple		2.0	MBF			
	Mixed Aspen	Pulpwood	18.0	Cords			
	<i>B. T. Aspen</i>		15.0	<i>Cords</i>			
	<i>Quaking Aspen</i>		3.0	<i>Cords</i>			
	Mixed Hardwood		21.0	Cords			
	<i>Black Cherry</i>		2.0	<i>Cords</i>			
	<i>Paper Birch</i>		3.0	<i>Cords</i>			
	<i>Red Maple</i>		16.0	<i>Cords</i>			
	Mixed Oak		32.0	Cords			
<i>Bl/R/Hybrid Oak</i>		32.0	<i>Cords</i>				
7	Mixed Aspen	Sawtimber	4.0	MBF	39.4	\$5,190.75	

**Description of Timber by Payment Unit (PU), con't**

PU	MARKET GROUP	PRODUCT	QUANTITY	UNIT	ACRES	ADVERTISE PRICE	
7 con't	<i>B. T. Aspen</i>	<i>Sawtimber</i>	4.0	<i>MBF</i>			
	Mixed Oak		13.3	MBF			
	<i>Northern Pin Oak</i>		13.3	<i>MBF</i>			
	Red Maple		2.3	MBF			
	Mixed Aspen		Pulpwood	80.0			Cords
	<i>B. T. Aspen</i>			64.0			<i>Cords</i>
	<i>Quaking Aspen</i>			16.0			<i>Cords</i>
	Mixed Hardwood			85.0			Cords
	<i>Black Cherry</i>			2.0			<i>Cords</i>
	<i>Paper Birch</i>			6.0			<i>Cords</i>
	<i>Red Maple</i>			77.0			<i>Cords</i>
	Mixed Oak			112.0			Cords
	<i>Northern Pin Oak</i>			112.0			<i>Cords</i>
	8			Mixed Aspen			Sawtimber
<i>B. T. Aspen</i>		0.8	<i>MBF</i>				
<i>Quaking Aspen</i>		6.2	<i>MBF</i>				
Red Maple		1.0	MBF				
Mixed Aspen		Pulpwood	27.0	Cords			
<i>B. T. Aspen</i>			7.0	<i>Cords</i>			
<i>Quaking Aspen</i>			20.0	<i>Cords</i>			
Mixed Hardwood			18.0	Cords			
<i>Red Maple</i>			18.0	<i>Cords</i>			
9			Mixed Aspen	Sawtimber	21.9	MBF	
	<i>B. T. Aspen</i>	18.7	<i>MBF</i>				
	<i>Quaking Aspen</i>	3.2	<i>MBF</i>				
	Red Maple	21.7	MBF				
	White Oak	3.2	MBF				
	Mixed Aspen	Pulpwood	66.0		Cords		
	<i>B. T. Aspen</i>		42.0		<i>Cords</i>		
	<i>Quaking Aspen</i>		24.0		<i>Cords</i>		
	Mixed Hardwood		116.0		Cords		
	<i>American Elm</i>		3.0		<i>Cords</i>		
	<i>Black Cherry</i>		2.0		<i>Cords</i>		
	<i>Paper Birch</i>		3.0		<i>Cords</i>		
	<i>Red Maple</i>		108.0		<i>Cords</i>		
	Mixed Oak		20.0		Cords		
	<i>Red Oak</i>		2.0		<i>Cords</i>		
	<i>White Oak</i>	18.0	<i>Cords</i>				
10	Mixed Aspen	Sawtimber	4.1	MBF	8.8	\$899.55	
	<i>B. T. Aspen</i>		3.5	<i>MBF</i>			
	<i>Quaking Aspen</i>		0.6	<i>MBF</i>			
	Red Maple		4.1	MBF			
	White Oak		0.6	MBF			
	Mixed Aspen		Pulpwood	12.0			Cords
	<i>B. T. Aspen</i>			8.0			<i>Cords</i>
	<i>Quaking Aspen</i>			4.0			<i>Cords</i>
	Mixed Hardwood			20.0			Cords
	<i>Red Maple</i>			20.0			<i>Cords</i>
	Mixed Oak			3.0			Cords
	<i>White Oak</i>		3.0	<i>Cords</i>			
TOTAL:			471.7	MBF			
TOTAL:			3,849.0	Cords			

## Sale Specific Conditions & Requirements

**Sale Name: Magruder Mix**

**Sale Number: 73-013-17 Seq#: 2**

### 1 - Sale Area

#### 1.2 - Boundaries

##### 1.2.1 - Painted boundaries (1/14)

The sale boundary and Payment Unit boundaries are marked and identified by blue, red and yellow paint. Exterior sale boundary lines against private property are marked with blue paint. Exterior sale boundary lines against state are marked with red paint. Interior Payment Unit boundaries are marked with yellow paint. The painted boundary line trees are not Included Timber and are to be protected unless marked with orange paint. Yellow painted trees designating an interior Payment Unit boundary are only to be cut when all surrounding Payment Units have been paid.

### 2 - Timber Specifications

#### 2.1 - Included Timber

##### 2.1.1 - Clearcut unit(s) with unmerchantable trees (6/14)

Within Payment Unit(s) 2, 3, 4, 5, & 7, cut all trees that are two (2) inches or more at DBH, except do not cut trees marked with green paint above and below stump height.

##### 2.1.3 - Cut tree marked unit(s) (12/08)

Within Payment Unit(s) 1 and 8-10, all trees are designated for cutting when marked with orange paint above and below stump height, regardless of merchantability. In addition, within Payment Unit 8, cut all aspen that are two (2) inches or more at DBH, regardless of merchantability.

##### 2.1.7 - Leave tree marked unit(s) (6/14)

Within Payment Unit(s) 6, cut all trees that are two (2) inches or more at DBH, except do not cut oak four (4) inches and under at DBH, and trees marked with green paint above and below stump height.

##### 2.1.11 - Description of timber note (2/04)

Note that red maple volumes include a minimal amount of black tupelo.

##### 2.1.16 - Timber along county or forest roads (6/14)

Cut and remove all standing trees 4.6" DBH or greater within 33 feet of the center line of S. Magruder Rd and W. Bradford Rd.

#### 2.2 - Utilization

##### 2.2.6 - Roundwood operation required (5/07)

The skidding of whole trees or tree segments with limbs attached is prohibited within Payment Unit(s) 1 and 8-10. All products must be produced as roundwood and forwarded to existing roads or landing areas in final product length.

##### 2.2.9 - No chipping permitted (12/08)

Within Payment Unit(s) 1 and 8-10, all wood must be removed by roundwood. No chipping is permitted.

### 3 - Payments

#### 3.3 - Pre-measured Sales

##### 3.3.4 - Dividing payment units (7/14)

Payment Unit(s) 2, 4, & 5 may be divided at the request of the Purchaser and upon approval of the Unit Manager. Dividing Payment Units is a contract modification which requires a Timber Sale Contract Supplement. There will be only one division per Payment Unit.

#### 3.4 - Damaged Timber

##### 3.4.1 - Damaged timber (6/14)

General Condition and Requirement 3.4 Damaged Timber, defines liquidated damages for undesignated live merchantable trees which are cut or injured. In addition extreme care should be taken to protect oak seedlings and saplings within Payment

## Unit 6.

If more than 25% of the oak seedlings or saplings (1/4" to 4.5" DBH) are damaged within Payment Unit 6, liquidated damages will be assessed at \$300 per acre for all acreage within the Payment Unit that was damaged.

## 4 - Transportation

### 4.1 - Construction

#### 4.1.7 - Road closure (10/11)

All new roads built into the sale must be blocked to vehicle traffic upon completion of the sale. Overgrown roads that are reopened shall be considered new roads. In general, this will require constructing a four (4') foot high berm of stumps and logs covered with earth. Stumps and brush must be placed along the remainder of the trail. These roads must be rendered impassable to cars and trucks. Contact the sale administrator for specific details of design and placement.

#### 4.1.11 - Permits (2/12)

The Purchaser will secure any necessary temporary driveway permits that may be required. Driveway permits can be secured from the Midland County Road Commission. Any permanent driveway permits will be secured by the DNR. See Timber Sale Map for location specifics.

### 4.2 - Maintenance

#### 4.2.4 - Grading (10/16)

For completion of the sale, gravel state forest roads may need to be graded. In general, this will require a road grader or bull dozer to shape up the roads after forest products have been hauled off site. This includes cleaning of drainage areas, grading, crowning and filling with gravel, if necessary. The grading equipment to be used must be approved by the Unit Manager or his/her representative. Areas which require grading will be determined by the sale administrator.

### 4.3 - Public Right-of-Way

#### 4.3.2 - County R-O-W (12/06)

The county must be contacted prior to harvesting in the county road R-O-W. This applies to Payment Unit(s) 1, 2, 4, & 5 and S. Magruder and W. Bradford roads.

### 4.4 - Access

#### 4.4.3 - Access gate (12/08)

The access gate must be locked at the completion of each day unless otherwise approved by the Unit Manager or his/her representative.

## 5 - Operations

### 5.1 - Notification

#### 5.1.3 - Well heads and natural gas pipelines (11/15)

The Purchaser is responsible for contacting the gas company prior to operating equipment in the vicinity of well heads or natural gas pipelines. The sale area sits on an old oil field which is in the process of being restored. Infrastructure exists which may be hazardous to equipment. For historic infrastructure locations, contact John Frary, Chevron Environmental Management Company @ 989.842.3054 x 1009.

### 5.2 - Conduct of Operations

#### 5.2.1 - Slash

##### 5.2.1.10 - No slash in openings (5/10)

No brush or logging debris is to be left in the maintained wildlife opening which is indicated by G0 on the Timber Sale Map. Any damage to the opening shall be repaired according to specifications of the Unit Manager or his/her representative.

##### 5.2.1.13 - Dispose of slash as directed (12/05)

Slash is to be disposed of as directed by the Sale Administrator.



### 5.2.3 - Operating Restrictions

#### 5.2.3.1 - Operating restrictions (9/11)

Within Payment Unit(s) 1-10, unless permission is granted by the unit manager or his/her representative, cutting & skidding are limited to dry or frozen conditions. These conditions typically occur between January 1 to March 15 for frozen, and July 1 to November 15 for dry. This restriction is because of seasonally saturated soils in parts or all of the above mentioned Payment Units.

#### 5.2.3.3 - Bark slippage restriction (3/09)

Within Payment Unit(s) 1 and 8-10, unless changed by written agreement, cutting and skidding are not permitted during the period of April 15 to July 15. This restriction is because of bark slippage.

#### 5.2.3.4 - Oak wilt restriction (9/17)

Within Payment Unit(s) 6, unless changed by written agreement, cutting, skidding, hauling and brushing of access roads are not permitted during the period of April 15 to July 15. Operations may be allowed if specific steps are taken to prevent damaging uncut oak during the high risk period. Those steps include completing all road brushing before April 15th, clearing a tree-length buffer along uncut oak cover before April 15th or leaving an uncut buffer there until after July 15th. This is necessary to reduce the spread of oak wilt. For more information, contact the Unit Manager or his/her representative.

### 5.2.4 - Dead and Down Creation

#### 5.2.4.4 - Dead and down creation, grouse (8/13)

To encourage grouse and other wildlife, in Payment Unit(s) 2, 3, 4, 5, & 7, leave at least six (6) large tops in a single pile and at least one pile per acre. These will be evenly scattered throughout the unit.

#### 5.2.17 - Crane Mats/Timber Mats (9/17)

Some roads or skid trails may require extra protection such as that afforded by Crane Mats/Timber Mats. If available, Crane Mats/Timber Mats may be borrowed from the DNR and are located at the Marquette ICC, the Newberry Field Office and the Grayling Field Office. Contact the sale administrator for specific details. A Timber Sale Contract Supplement will be used to document the Purchaser's use of the DNR's Crane Mats/Timber Mats. It is the responsibility of the Purchaser to contact the sale administrator to schedule pick up and drop off. In addition, all mats must be cleaned prior to drop off. A charge of \$350.00 will be assessed for all damaged or non-returned mats. Damage is defined as misuse resulting in three or more broken cants.

#### 5.2.38 - No decking against live trees (2/04)

Cut products may not be decked against unmarked or designated leave trees.

### 5.4 - Soil Protection

#### 5.4.1 - Rutting restriction, general (7/16)

Operations are to cease immediately if equipment and weather conditions result in rutting of roads which is 6 inches or greater in depth and 50 feet in length. In addition, operations are to cease immediately if equipment and weather conditions result in rutting on skid trails which is 12 inches or greater in depth and 50 feet in length. The Unit Manager or his/her representative may restrict hauling and/or skidding if ruts exceed the specified depth. With the Unit Manager or his/her representative's approval, the Purchaser may return to the area when the risk of rutting has decreased.

### 5.8 - Protection of Endangered Species

#### 5.8.6 - Protection of eagle nests (5/12)

To protect an active eagle's nest, all harvesting operations within Payment Unit 10 are limited to the period of September 1 through December 31. Written permission is required from the Area Biologist and the Unit Manager to operate outside of the set dates.

## 6 - Safety and Fire Prevention

### 6.2 - Signing

#### 6.2.1 - Road posting (9/09)

The Purchaser is responsible for posting and maintaining caution signs on graveled state forest roads prior to beginning

operations. The road must be posted at appropriate distances from the sale area to warn of logging activity and truck traffic. Signs must be removed when harvest operations are suspended or completed. In addition a sign must be placed at the Magruder Rd. gate when operations are occurring on the road system behind the gate. The Purchaser will provide these signs.



# TIMBER SALE MAP

This information provided by authority of Part 525, 1994 PA 451, as amended.

Sale Number	Year
73 - 013	17

Forest Management Unit Gladwin	County Midland	Mapped By Shooltz	Date 09/29/2017	Page 1	of 2
Township 13N	Range 01W/02W	Section(s) and Subdivision(s) Sections: 7 & 18/1 & 12 Subdivisions: Various	Scale 1:15,840		

Cover Type				Density			
A = Aspen	H = Hemlock	N = Marsh	U = Upland Brush	0 = Non Stocked	5 = Pole Timber Medium		
B = Paper Birch	J = Jack Pine	O = Oak	UM = Upland Mixed	1 = Seedling Sapling Poor	6 = Pole Timber Well		
C = Cedar	L = Lowland Brush	P = Lowland Poplar	V = Bog or Marsh	2 = Seedling Sapling Medium	7 = Saw Timber Poor		
D = Treed Bog	LM = Lowland Mixed	Q = Mixed Swamp Conifer	W = White Pine	3 = Seedling Sapling Well	8 = Saw Timber Medium		
E = Swamp Hdwoods	M = Mpl, Bch, Brch	R = Red Pine	X = Non Stocked	4 = Pole Timber Poor	9 = Saw Timber Well		
F = Spruce Fir	MC = Mixed Conifer	S = Black Spruce	Z = Water				
G = Grass	MD = Mixed Deciduous	T = Tamarack					

PU	Stand	Acres	PU	Stand	Acres	PU	Stand	Acres
1	60	47.1	5	49,51	79.9	9	89	46.3
2	59,62,92	69.5	6	47	9.6	10	89	8.8
3	142	14.5	7	56	39.4			
4	52,54,58	76.7	8	46	7.1			

## Magruder Mix Compartment 116 398.9 Acres

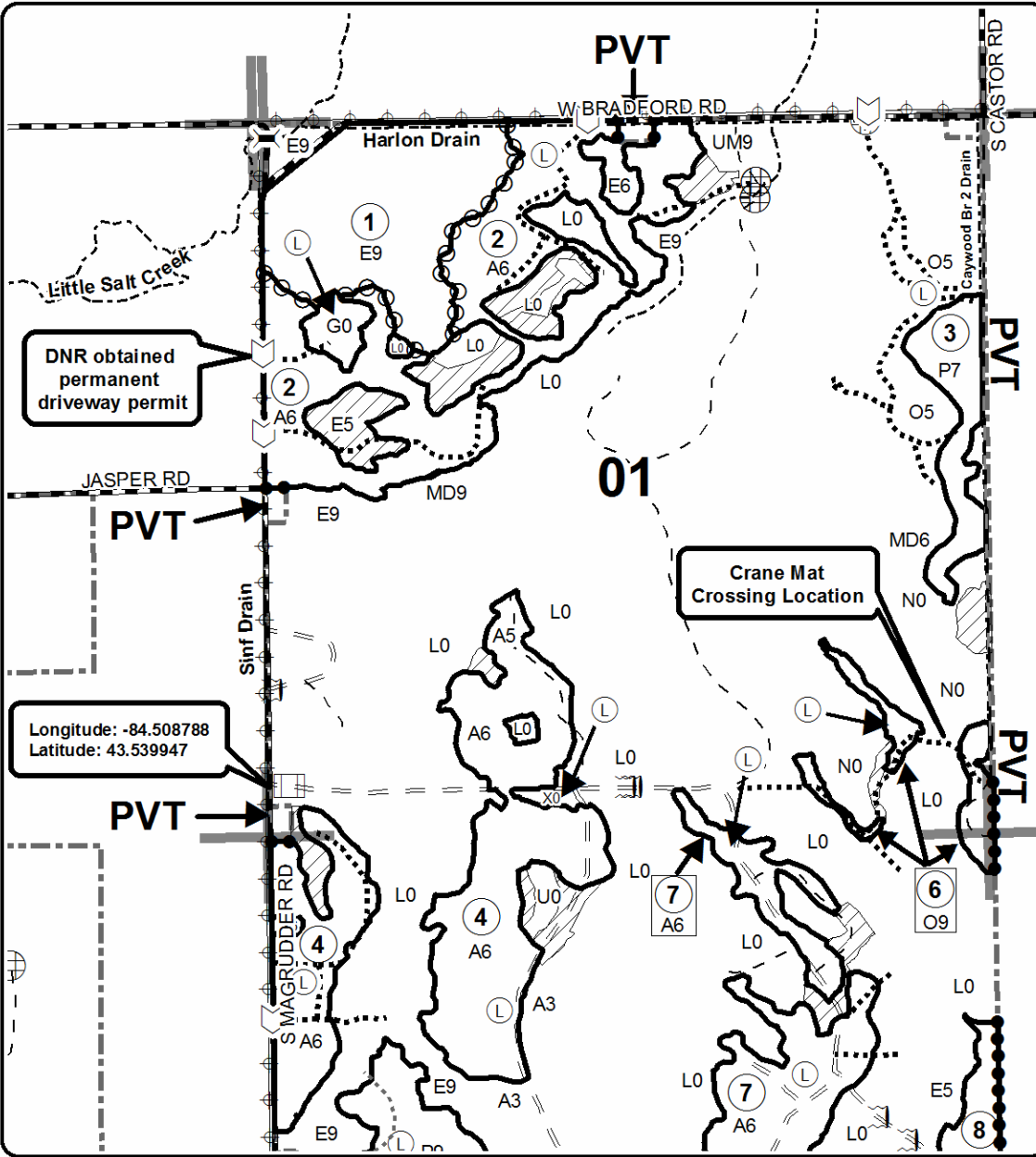

### Legend

- Sale Boundary (Red)
- Payment Unit (Yellow)
- Private Line (Blue)
- Retention Area
- Section Corners
- Driveway Permit Required
- Recommended Landing
- Gate
- Berms
- Paved Roads
- County Gravel Roads
- Gravel Roads
- County Poor Dirt Roads
- Poor Dirt Roads
- Closed
- Powerline
- Streams
- State Forests

Longitude: -84.508788  
Latitude: 43.539947

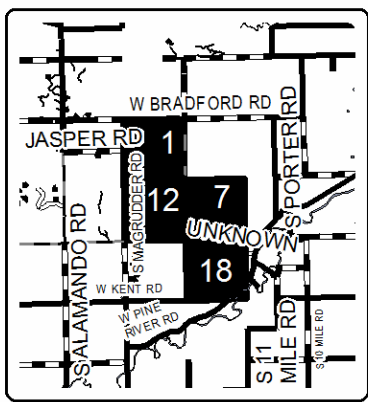

Locator Map  
1:200,000

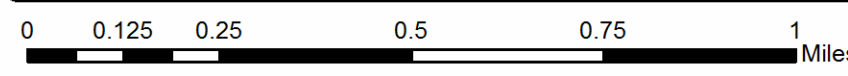



# TIMBER SALE MAP

This information provided by authority of Part 525, 1994 PA 451, as amended.

Forest Management Unit Gladwin	County Midland	Mapped By Shoottz	Date 09/29/2017	Page 2	of 2
Cruised By Shoottz					

Township 13N	Range 01W/02W	Section(s) and Subdivision(s) Sections: 7 & 18/1 & 12 Subdivisions: Various	Scale 1:15,840
-----------------	------------------	--	-------------------

Cover Type				Density			
A = Aspen	H = Hemlock	N = Marsh	U = Upland Brush	0 = Non Stocked	5 = Pole Timber Medium		
B = Paper Birch	J = Jack Pine	O = Oak	UM = Upland Mixed	1 = Seedling Sapling Poor	6 = Pole Timber Well		
C = Cedar	L = Lowland Brush	P = Lowland Poplar	V = Bog or Marsh	2 = Seedling Sapling Medium	7 = Saw Timber Poor		
D = Treed Bog	LM = Lowland Mixed	Q = Mixed Swamp Conifer	W = White Pine	3 = Seedling Sapling Well	8 = Saw Timber Medium		
E = Swamp Hdwoods	M = Mpl, Bch, Brch	R = Red Pine	X = Non Stocked	4 = Pole Timber Poor	9 = Saw Timber Well		
F = Spruce Fir	MC = Mixed Conifer	S = Black Spruce	Z = Water				
G = Grass	MD = Mixed Deciduous	T = Tamarack					

PU	Stand	Acres	PU	Stand	Acres	PU	Stand	Acres
1	60	47.1	5	49,51	79.9	9	89	46.3
2	59,62,92	69.5	6	47	9.6	10	89	8.8
3	142	14.5	7	56	39.4			
4	52,54,58	76.7	8	46	7.1			

## Magruder Mix Compartment 116 398.9 Acres

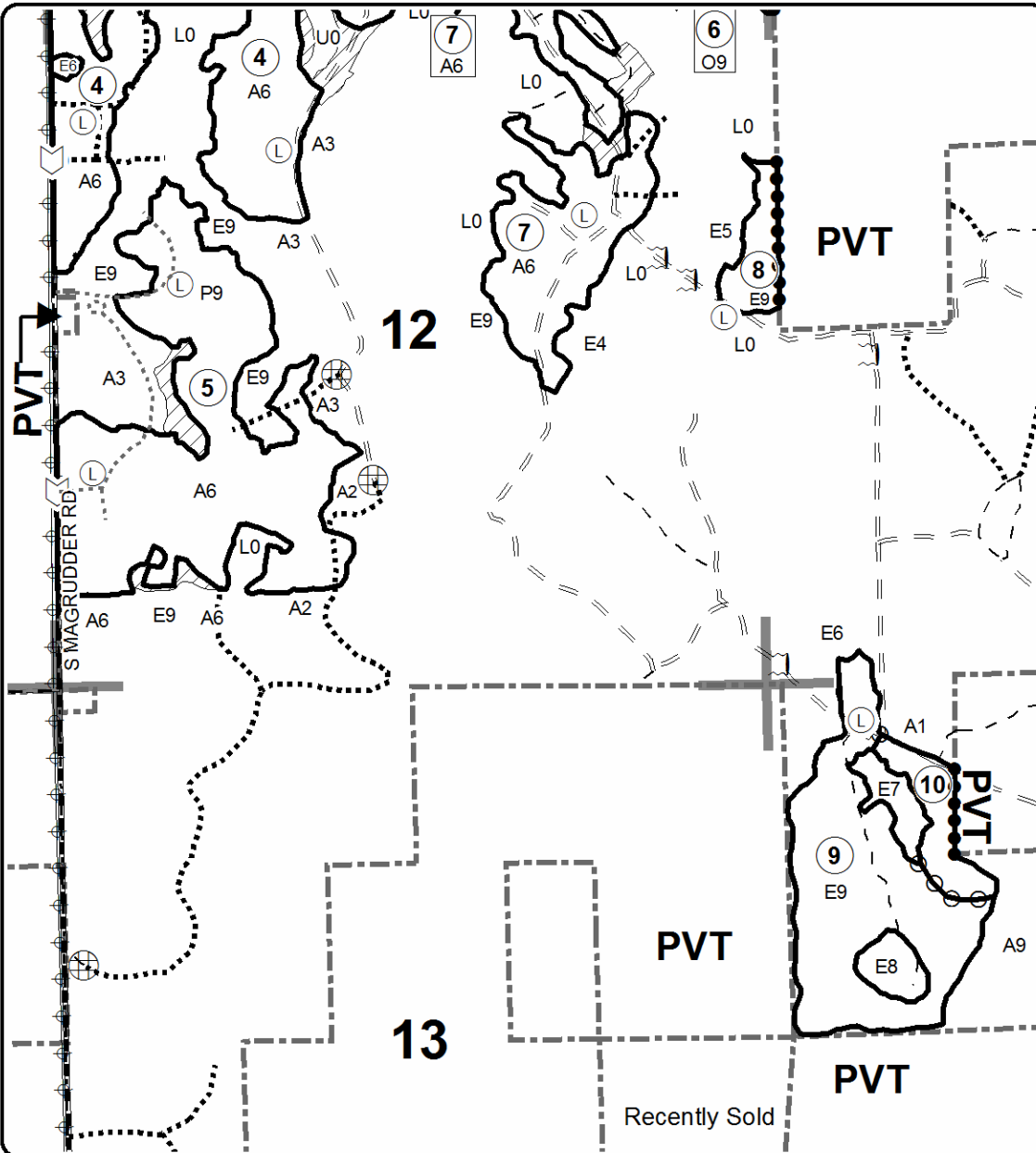

Legend	
	Sale Boundary (Red)
	Payment Unit (Yellow)
	Private Line (Blue)
	Retention Area
	Section Corners
	Driveway Permit Required
	Recommended Landing
	Berms
	County Gravel Roads
	Gravel Roads
	County Poor Dirt Roads
	Poor Dirt Roads
	Closed
	Powerline
	Streams
	State Forests

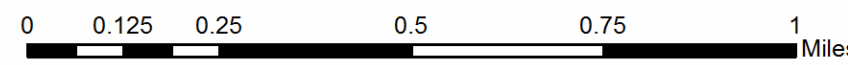
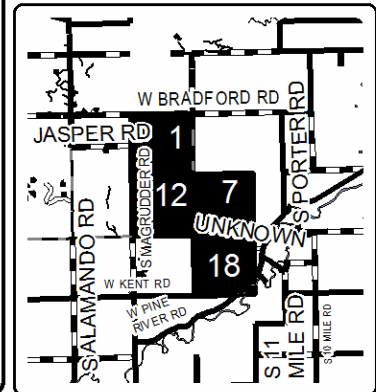

Locator Map  
1:200,000

**TIMBER SALE INFORMATION**

45 DEGREE (73-012-15)

T16N, R01W, SEC. 26; T16N, R01W, SEC. 27; T16N, R01W, SEC. 28; T16N, R01W, SEC. 34.  
Midland County (Advertised Price \$27,957.80)

A timber sale contract for this lump sum, sealed bid timber sale will be awarded to the responsible bidder offering the highest sealed bid price. Bids must be at or above the following advertised price for each species:

<u>PRODUCTS &amp; SPECIES</u>	<u>ESTIMATED UNITS*</u>	<u>ADVERTISED PRICE</u>
Sawtimber		
Mixed Aspen	17.70 MBF	\$ 77.00 / MBF
Mixed Oak	25.00 MBF	\$ 142.00 / MBF
Red Maple	80.60 MBF	\$ 56.00 / MBF
Red Oak	14.10 MBF	\$ 265.00 / MBF
Pulpwood		
Mixed Aspen	223.00 Cords	\$ 19.00 / Cord
Red Maple	503.00 Cords	\$ 10.00 / Cord
Red Oak	84.00 Cords	\$ 17.30 / Cord

In addition, the successful bidder agrees to purchase the following species at the indicated advertised price for a total value of \$4,074.60:

<u>PRODUCTS &amp; SPECIES</u>	<u>ESTIMATED UNITS*</u>	<u>ADVERTISED PRICE</u>
Sawtimber		
White Oak	13.00 MBF	\$ 62.00 / MBF
Pulpwood		
Misc. Species 2	146.00 Cords	\$ 3.70 / Cord
Mixed Hardwood	64.00 Cords	\$ 12.75 / Cord
Mixed Oak	84.00 Cords	\$ 9.00 / Cord
White Oak	38.00 Cords	\$ 17.50 / Cord
White Pine	18.00 Cords	\$ 27.30 / Cord

\* The total volume is statistically estimated within plus (+) or minus (-) 10.35 percent. The estimated units are final and not subject to adjustment. Prospective bidders are urged to examine this timber and to make their own estimates of quantity and quality.

**BOND AND PAYMENT SCHEDULE:**

1. A bond in the amount of \$2,500.00 to insure faithful performance of the conditions of the contract will be deposited by the successful bidder within 21 days of the sale award.
2. Cutting in any sale or unit without the required advance payment would be considered a trespass.
3. Total payment must be paid in advance or according to the following schedule:
  - (a) Ten percent (10%) of the sale value must be paid within 21 days of the sale award.
  - (b) The 10% down payment will be credited towards the first unit cut.
  - (c) Payment for each of the following units must be made before cutting begins in that unit:

<u>PAYMENT UNIT NUMBER</u>	<u>PERCENT OF TOTAL SALE VALUE</u>
01	19.0%
02	18.0%
03	8.0%
04	15.0%
05	7.0%
06	14.0%
07	8.0%
08	9.0%
09	2.0%

4. If no cutting takes place, the 10% down payment will not be refunded.
5. Operations on the contract issued will terminate on 09/30/2021.

## Sale Specific Conditions & Requirements

**Sale Name: 45 DEGREE**

**Sale Number: 73-012-15 Seq#: 2**

### 1 - Sale Area

#### 1.2 - Boundaries

##### 1.2.1 - Painted boundaries (1/14)

The sale boundary and Payment Unit boundaries are marked and identified by blue, red and/or yellow paint. Exterior sale boundary lines against private property are marked with blue paint. Exterior sale boundary lines against state are marked with red paint. Interior Payment Unit boundaries are marked with yellow paint. The painted boundary line trees are not Included Timber and are to be protected. Yellow painted trees designating an interior Payment Unit boundary are only to be cut when all surrounding Payment Units have been paid.

### 2 - Timber Specifications

#### 2.1 - Included Timber

##### 2.1.1 - Clearcut unit(s) with unmerchantable trees (6/14)

Within Payment Unit(s) 2, 3, and 4, cut all trees that are two (2) inches or more at DBH. Exception do not cut any trees marked with green paint above and below stump height.

##### 2.1.3 - Cut tree marked unit(s) (12/08)

Within Payment Unit(s) 1, 5, 6, 7, and 8, all trees are designated for cutting when marked with orange paint above and below stump height, regardless of merchantability. In addition, cut all aspen and ash regardless of merchantability and within units 5 and 6 also cut all the paper birch.

##### 2.1.4 - Designated timber unit(s) (6/17)

Within Payment Unit(s) 9, all aspen and birch trees are designated for cutting which meet minimum piece specifications in 2.2 - Utilization regardless of merchantability.

##### 2.1.16 - Timber along county or forest roads (6/14)

Cut and remove all standing trees 4.6" DBH or greater/trees within 33 feet of the center line of forest road from A to B as shown on the timber sale map 2 of 3. Contact Midland County Road Commission to stake R-O-W width prior to starting operations.

#### 2.2 - Utilization

##### 2.2.3 - Stump heights (4/07)

Stump heights within the Sale Area shall be cut as low to the ground as possible. Unless approved by the Unit Manager or his/her representative stump heights shall not exceed 6 inches for trees greater than 10 inches DBH and 4 inches for trees smaller than 10 inches DBH.

### 3 - Payments

#### 3.4 - Damaged Timber

##### 3.4.1 - Damaged timber (6/14)

General Condition and Requirement 3.4 Damaged Timber, defines liquidated damages for undesignated live merchantable trees which are cut or injured. In addition, extreme care should be taken to avoid damage to tree seedlings and saplings.

Within Units 1, 5, 6, 7, 8, and 9, if more than 25% of the tree seedlings or saplings (1/4" to 4.5" DBH) within a specified portion of the sale area are damaged, liquidated damages will be assessed at \$300 per acre for all acreage within that specified portion of the sale area that was damaged.

No damage is acceptable to merchantable undesignated trees. Within the sale area, if more than 5% of undesignated trees (> 4.5" DBH) within a specified area of the sale are damaged, liquidated damages will be assessed for all trees damaged. Rates will be in accordance with General Condition and Requirement 3.4 Damaged Timber.

### 4 - Transportation

## 4.1 - Construction

### 4.1.7 - Road closure (10/11)

All new roads built into the sale must be blocked to vehicle traffic upon completion of the sale. Overgrown roads that are reopened shall be considered new roads. In general, this will require the placement of stumps and slash into the road, throughout the length of routes to be closed. Contact the sale administrator for specific details of design and placement.

## 4.2 - Maintenance

### 4.2.3 - Road maintenance (8/13)

The following road maintenance is required: Within 60 days of completion of hauling, or if no hauling occurs for 60 days, the road must be maintained and graded. This includes cleaning of drainage areas, grading, crowning and filling with gravel, if necessary. Damages will be assessed if grading/repair does not occur.

### 4.2.5 - Two wheel drive condition (2/04)

All existing trail roads on and adjacent to the sale area must be passable by two-wheel drive traffic for the duration of the sale.

## 5 - Operations

### 5.1 - Notification

#### 5.1.1 - Pre-sale conference (10/11)

A pre-sale conference between the Purchaser and sale administrator is required prior to beginning a Payment Unit. This conference can occur on site or over the phone.

#### 5.1.4 - Post-sale conference (6/11)

A post-sale conference on site between the Purchaser and sale administrator is required for each payment unit 5 days prior to the completion of active logging operations to determine clean-up and repair of landings, road edges, and the fulfillment of other contract specifications. The conference can occur on site or over the phone.

### 5.2 - Conduct of Operations

#### 5.2.2 - Hazard Trees/Snags

##### 5.2.2.1 - Den trees (2/04)

Obvious hollow and/or den trees shall be protected and left standing unless they are a safety hazard.

#### 5.2.3 - Operating Restrictions

##### 5.2.3.1 - Operating restrictions (9/11)

Within Payment Unit(s) 1, 4, 6, 7, and 8, unless approved by the Unit Manager or his/her representative, cutting and skidding are limited to the period of 07/15 to 09/30 and to the period of 01/01 to 03/15. This restriction is because of seasonal wet soil conditions.

##### 5.2.3.4 - Oak wilt restriction (6/10)

Within Payment Unit(s) 1, 2, and 9, unless changed by written agreement, cutting, skidding, and hauling are not permitted during the period of April 15 to July 15. This is necessary to reduce the spread of oak wilt. For more information, contact the Unit Manager or his/her representative.

#### 5.2.4 - Dead and Down Creation

##### 5.2.4.3 - Dead and down creation, dead trees (6/07)

Except as provided for in General Condition and Requirement 5.2.2, no dead trees, standing or down, are to be cut, skidded, or processed.

### 5.4 - Soil Protection

#### 5.4.1 - Rutting restriction, general (1/09)

Operations are to cease immediately if equipment and weather conditions result in rutting of roads and skid trails which is 12 inches or greater in depth and 50 feet in length. The Unit Manager or his/her representative may restrict hauling and/or skidding if ruts exceed the specified depth. With the Unit Manager or his/her representative's approval, the Purchaser may

return to the area when the risk of rutting has decreased.





# TIMBER SALE MAP

This information provided by authority of Part 525, 1994 PA 451, as amended.

Sale Number	Year
73 - 012	15

Forest Management Unit	County	Mapped By	Date	Page	of
Gladwin Management Unit	Midland	Nyhoff	09/03/2015	1	3
Township	Range	Section(s) and Subdivision(s)	Scale		
16N	01W	Various	1:15,840		

Cover Type				Density	
A = Aspen	H = Hemlock	N = Marsh	U = Upland Brush	0 = Non Stocked	5 = Pole Timber Medium
B = Paper Birch	J = Jack Pine	O = Oak	UM = Upland Mixed	1 = Seedling Sapling Poor	6 = Pole Timber Well
C = Cedar	L = Lowland Brush	P = Lowland Poplar	V = Bog or Marsh	2 = Seedling Sapling Medium	7 = Saw Timber Poor
D = Treed Bog	LM = Lowland Mixed	Q = Mixed Swamp Conifer	W = White Pine	3 = Seedling Sapling Well	8 = Saw Timber Medium
E = Swamp Hdwoods	M = Mpl, Bch, Brch	R = Red Pine	X = Non Stocked	4 = Pole Timber Poor	9 = Saw Timber Well
F = Spruce Fir	MC = Mixed Conifer	S = Black Spruce	Z = Water		
G = Grass	MD = Mixed Deciduous	T = Tamarack			

PU	Acres	PU	Acres	PU	Acres
1	35	4	5	7	14
2	12	5	9	8	13
3	6	6	26	9	29

## 45 Degree Compartment 99 149 Acres

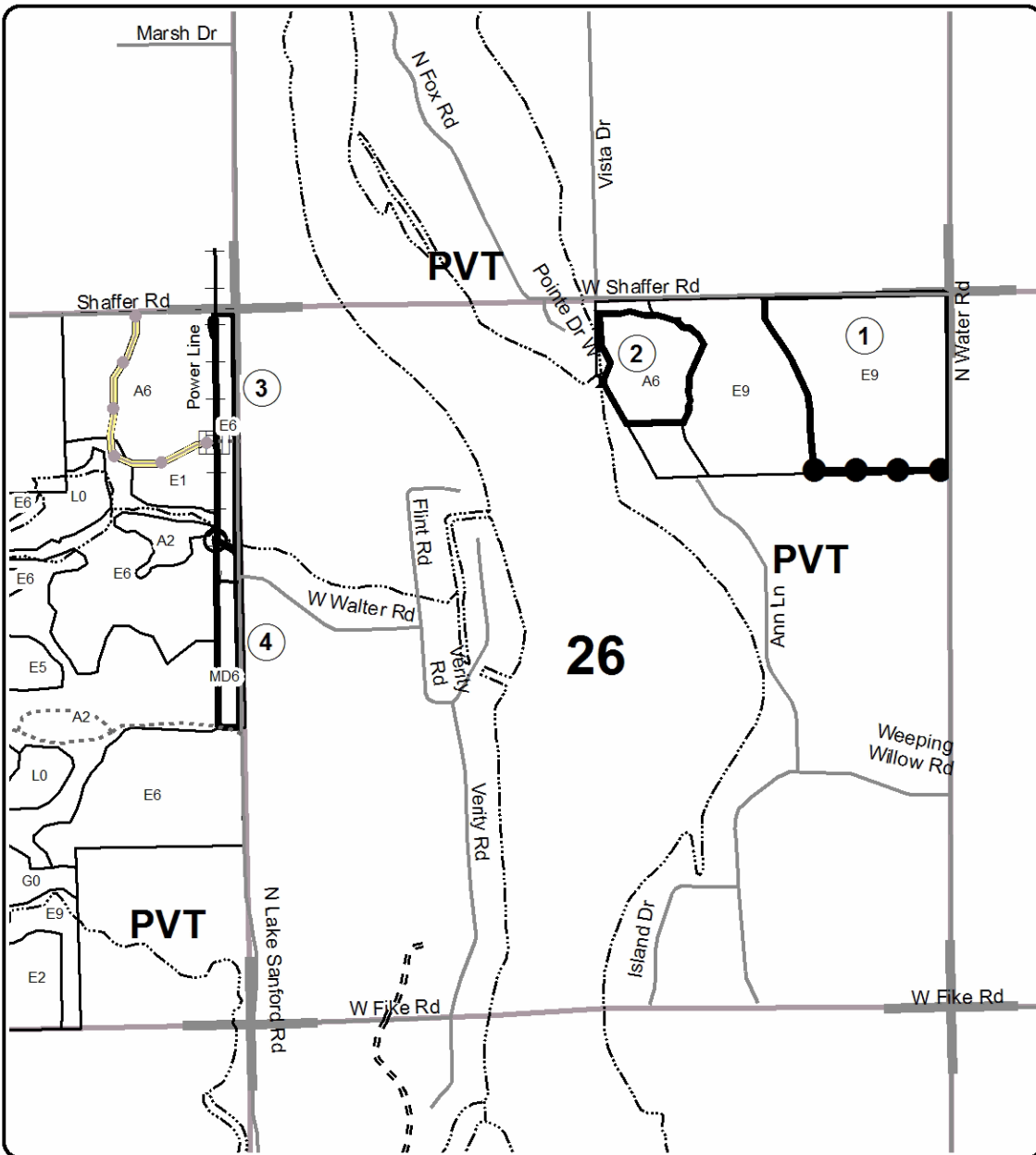

**Legend**

- Sale Boundary**
  - Against State (Red)
  - Payment Unit (Yellow)
  - Private Line (Blue)
- Section Corners
- Adjacent Stand Boundaries
- Section Corners
- Paved Roads
- Poor Dirt Roads
- Closed Roads

Locator Map  
1:200,000

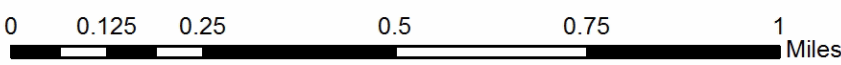
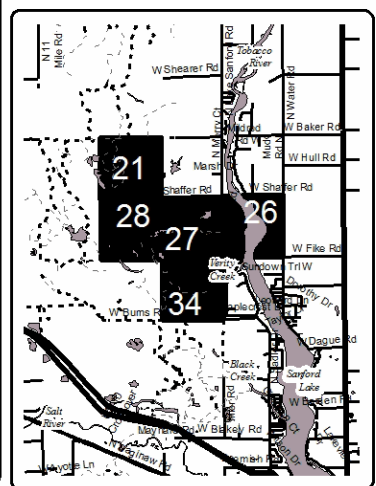



# TIMBER SALE MAP

This information provided by authority of Part 525, 1994 PA 451, as amended.

Sale Number	Year
73 - 012	15

Forest Management Unit	County	Mapped By	Nyhoff	Date	Page	of
Gladwin Management Unit	Midland	Cruised By	Metcalfe/Nyhoff	09/03/2015	2	3

Township	Range	Section(s) and Subdivision(s)	Scale
16N	01W	Various	1:15,000

Cover Type				Density			
A = Aspen	H = Hemlock	N = Marsh	U = Upland Brush	0 = Non Stocked	5 = Pole Timber Medium		
B = Paper Birch	J = Jack Pine	O = Oak	UM = Upland Mixed	1 = Seedling Sapling Poor	6 = Pole Timber Well		
C = Cedar	L = Lowland Brush	P = Lowland Poplar	V = Bog or Marsh	2 = Seedling Sapling Medium	7 = Saw Timber Poor		
D = Tread Bog	LM = Lowland Mixed	Q = Mixed Swamp Conifer	W = White Pine	3 = Seedling Sapling Well	8 = Saw Timber Medium		
E = Swamp Hdwoods	M = Mpl, Bch, Brch	R = Red Pine	X = Non Stocked	4 = Pole Timber Poor	9 = Saw Timber Well		
F = Spruce Fir	MC = Mixed Conifer	S = Black Spruce	Z = Water				
G = Grass	MD = Mixed Deciduous	T = Tamarack					

PU	Acres	PU	Acres	PU	Acres
1	35	4	5	7	14
2	12	5	9	8	13
3	6	6	26	9	29

**45 Degree**  
**Compartment 99**  
**149 Acres**

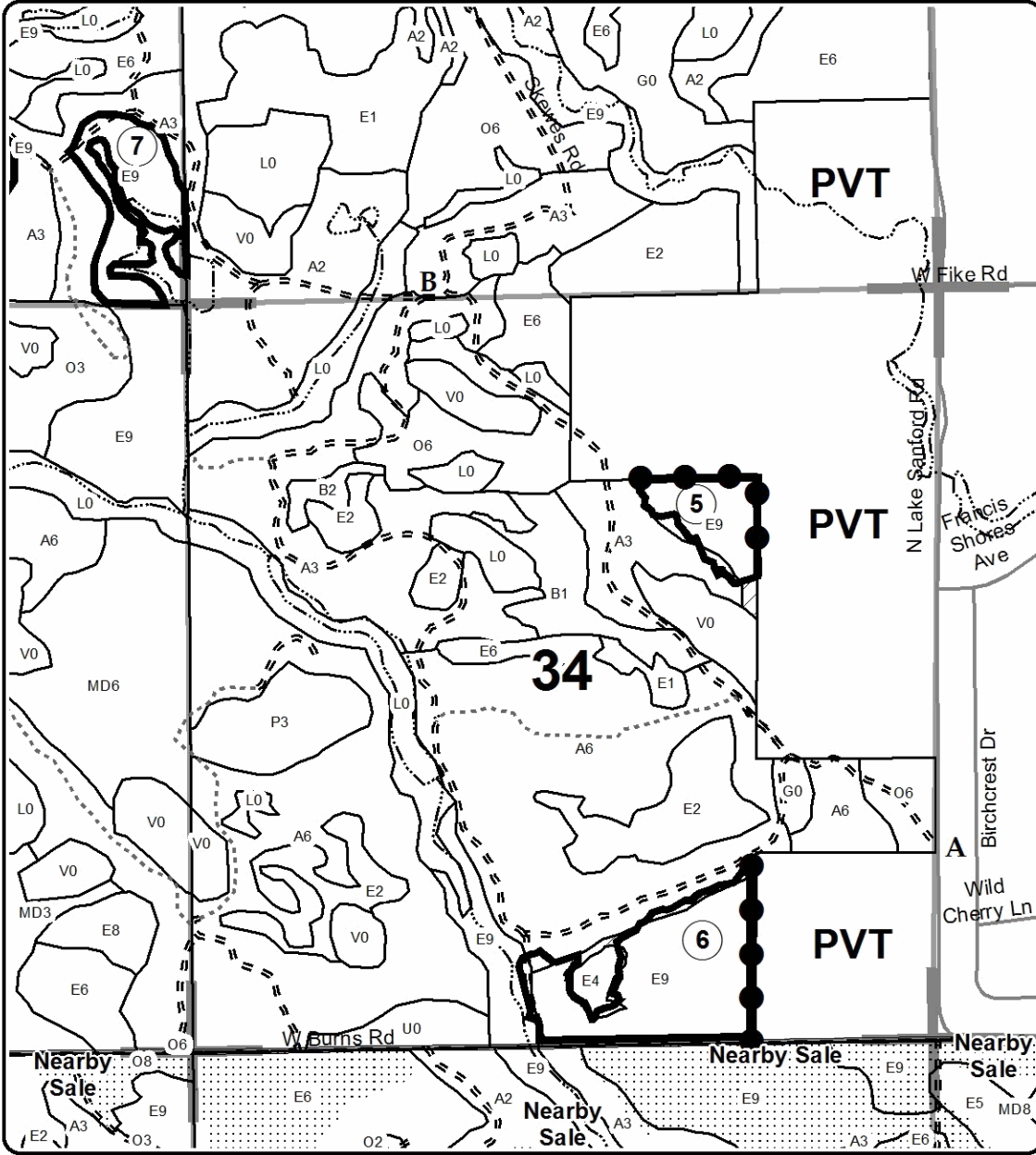

**Legend**

- Sale Boundary**
  - Against State (Red)
  - Private Line (Blue)
- Section Corners
- Retention Area
- Adjacent Stand Boundaries
- Section Corners
- Paved Roads
- Gravel Roads
- Poor Dirt Roads
- Closed Roads

Locator Map  
1:200,000

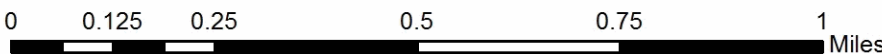
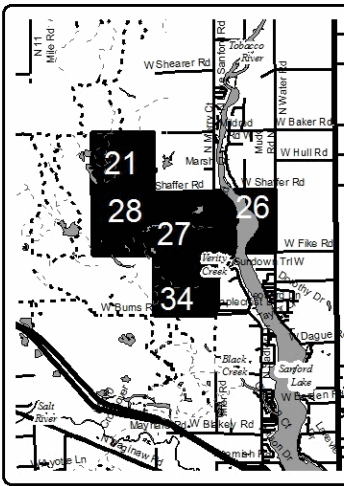



# TIMBER SALE MAP

This information provided by authority of Part 525, 1994 PA 451, as amended.

Forest Management Unit Gladwin Management Unit	County Midland	Mapped By Nyhoff	Date 09/03/2015	Page 3	of 3
Township 16N	Range 01W	Section(s) and Subdivision(s) Various	Scale 1:15,000		
Cruised By Metcalfe/Nyhoff					

Cover Type				Density			
A = Aspen	H = Hemlock	N = Marsh	U = Upland Brush	0 = Non Stocked	5 = Pole Timber Medium		
B = Paper Birch	J = Jack Pine	O = Oak	UM = Upland Mixed	1 = Seedling Sapling Poor	6 = Pole Timber Well		
C = Cedar	L = Lowland Brush	P = Lowland Poplar	V = Bog or Marsh	2 = Seedling Sapling Medium	7 = Saw Timber Poor		
D = Treed Bog	LM = Lowland Mixed	Q = Mixed Swamp Conifer	W = White Pine	3 = Seedling Sapling Well	8 = Saw Timber Medium		
E = Swamp Hdwoods	M = Mpl, Bch, Brch	R = Red Pine	X = Non Stocked	4 = Pole Timber Poor	9 = Saw Timber Well		
F = Spruce Fir	MC = Mixed Conifer	S = Black Spruce	Z = Water				
G = Grass	MD = Mixed Deciduous	T = Tamarack					

PU	Acres	PU	Acres	PU	Acres
1	35	4	5	7	14
2	12	5	9	8	13
3	6	6	26	9	29

## 45 Degree Compartment 99 149 Acres

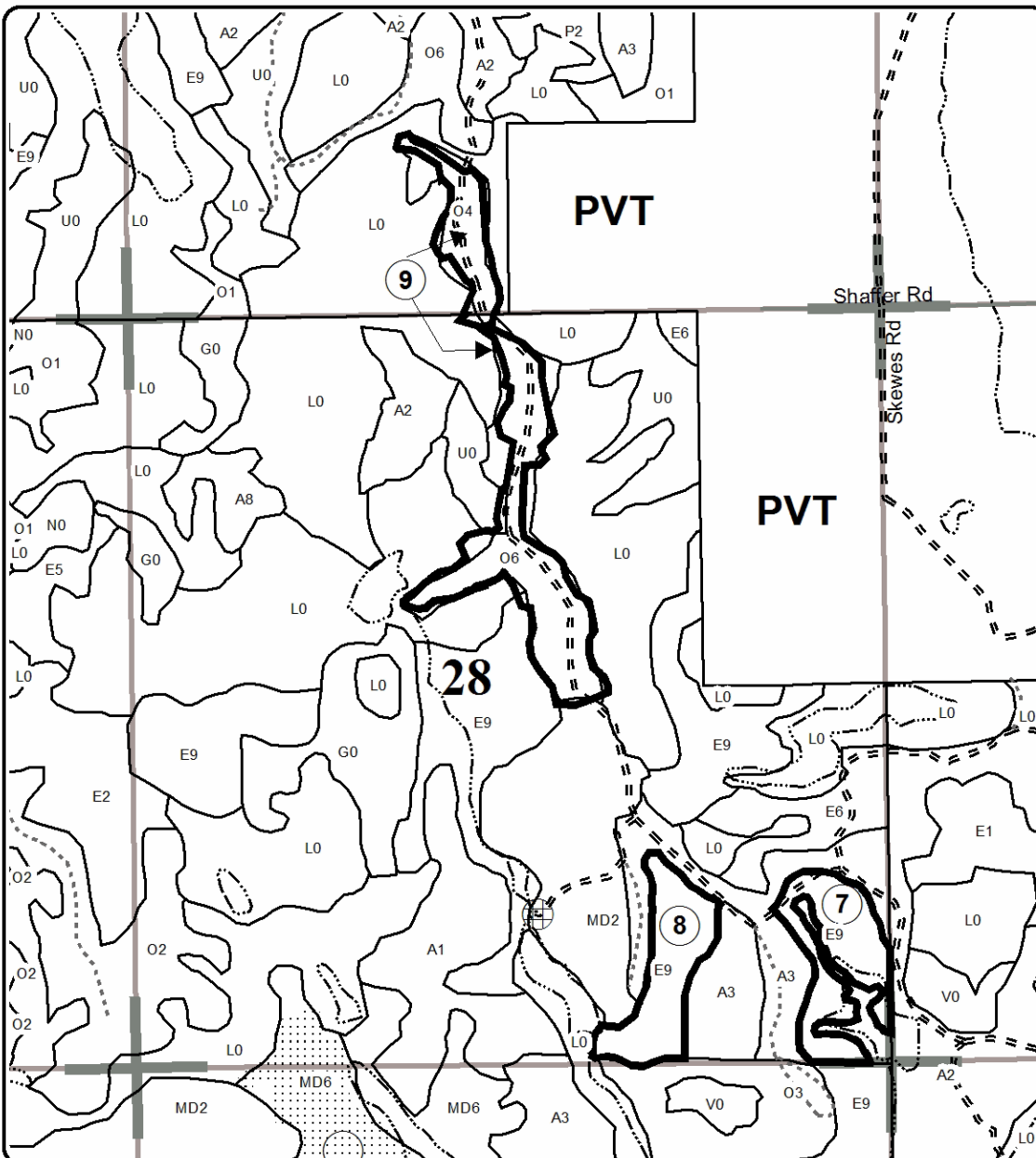

Legend	
	Sale Boundary
	Against State (Red)
	Section Corners
	Adjacent Stand Boundaries
	Section Corners
	Paved Roads
	Poor Dirt Roads
	Closed Roads

Locator Map  
1:200,000

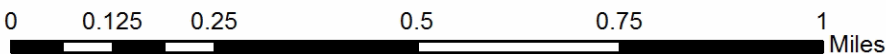
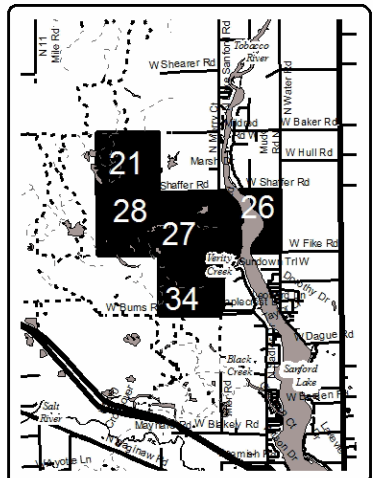



45 DEGREE (73-012-15)

T16N, R01W, SEC. 26; T16N, R01W, SEC. 27; T16N, R01W, SEC. 28; T16N,

In response to the notice of sale to be held 10:00 a.m. (local time) on September 12, 2018, I am hereby submitting my sealed bid (firm offer) for the following forest products to be cut. Bids for individual species must be at or above the advertised price. All non-responsive bid forms may be rejected.

<u>PRODUCTS &amp; SPECIES</u>	<u>ESTIMATED VOLUME*</u>	<u>ADVERTISED PRICE</u>	<u>BID PRICE/UNIT</u>
<b>Sawtimber</b>			
Mixed Aspen	17.70 MBF	\$ 77.00/MBF	\$ _____
Mixed Oak	25.00 MBF	\$ 142.00/MBF	\$ _____
Red Maple	80.60 MBF	\$ 56.00/MBF	\$ _____
Red Oak	14.10 MBF	\$ 265.00/MBF	\$ _____
<b>Pulpwood</b>			
Mixed Aspen	223.00 Cords	\$ 19.00/Cord	\$ _____
Red Maple	503.00 Cords	\$ 10.00/Cord	\$ _____
Red Oak	84.00 Cords	\$ 17.30/Cord	\$ _____

In addition, the successful bidder agrees to purchase the following species at the indicated advertised price for a total value of \$4,074.60 :

<u>PRODUCTS &amp; SPECIES</u>	<u>ESTIMATED VOLUME*</u>	<u>ADVERTISED PRICE</u>
<b>Sawtimber</b>		
White Oak	13.00 MBF	\$ 62.00/MBF
<b>Pulpwood</b>		
Misc. Species 2	146.00 Cords	\$ 3.70/Cord
Mixed Hardwood	64.00 Cords	\$ 12.75/Cord
Mixed Oak	84.00 Cords	\$ 9.00/Cord
White Oak	38.00 Cords	\$ 17.50/Cord
White Pine	18.00 Cords	\$ 27.30/Cord

\*The volumes are statistically estimated within plus (+) or minus (-) 10.35 percent. These estimated volumes are final and not subject to adjustment. Prospective bidders are urged to examine this timber and to make their own estimates of quantity and quality.

I understand that any or all bids may be rejected. All bids must be signed and all bid items must be bid or the bid form may be rejected. I also understand that consideration and awarding a contract will be based upon my past performance and ability to complete the contract based upon equipment and staffing subject to my control.

FEDERAL ID: \_\_\_\_ - \_\_\_\_ - \_\_\_\_ or SOCIAL SECURITY NUMBER: \_\_\_\_ - \_\_\_\_ - \_\_\_\_

Company or individual bidding: \_\_\_\_\_

Company representative's name: \_\_\_\_\_

Address: \_\_\_\_\_

City: \_\_\_\_\_ State: \_\_\_\_\_ Zip: \_\_\_\_\_

IF AVAILABLE, PLEASE PLACE THE PERSONALIZED LABEL FROM YOUR PROSPECTUS IN THE ABOVE BOX.

Individual or company representative's signature: \_\_\_\_\_ Date: \_\_\_\_\_

Phone number : \_\_\_\_\_ Email (optional): \_\_\_\_\_

**THE WINNING BIDDER MUST COMPLETE THE VERIFICATION OF WORKER'S DISABILITY COMPENSATION ACT COMPLIANCE (ON REVERSE SIDE IF DOUBLE SIDED) WITHIN 21 DAYS OF SALE AWARD DATE**



<b>FOR DEPARTMENT USE ONLY</b>
Sale Number (XX - XXX - XX - XX)
Forest Management Unit:

## TIMBER SALE VERIFICATION OF WORKER'S DISABILITY COMPENSATION ACT COMPLIANCE

*As required by Act 317, P.A. 1969 (Worker's Compensation) and  
Part 5 of Act 451 of 1994, as amended.*

### VERIFICATION OF WORKER'S DISABILITY COMPENSATION ACT COMPLIANCE

- This verification must be completed and submitted within 21 days of contract award and prior to the issuance of the timber sale contract.
- In addition, if boxes 2B or 2C are checked, then Notice of Exclusion or Certificate of Insurance must be submitted within twenty-one (21) days of the contract award and prior to the issuance of the timber sale contract.
- All information must be typed or printed except for written signatures.

Please Check Appropriate Categories:

1. My business is organized as (you **must** check one of the boxes below):
  - A.  Sole Proprietorship (individual)
  - B.  Partnership
  - C.  Corporation
2. You **must** check one of the boxes below:
  - A.  I certify my business is a sole proprietorship and it has no employees but the sole proprietor. I am not subject to the Worker's Compensation Laws.
  - B.  I certify my business has satisfied its obligation to the Worker's Compensation Act through the use of an approved Notice of Exclusion (BWC-337, Rev. 5/96). I will provide a copy of the Notice of Exclusion within 21 days of the contract award. (For questions or a copy of the BWC-337, please call the Worker's Compensation Bureau at 517-322-1195).
  - C.  I certify my business has a Worker's Compensation Policy. I will provide an original Certificate of Insurance within twenty-one (21) days of the contract award.
3. If you have checked item 2(A) or 2(B), you **must** indicate the number of **both** full-time and part-time employees, other than yourself, including family members and active partners (if none, you must enter "0").

\_\_\_\_\_ Full-time Employees

\_\_\_\_\_ Part-time Employees

Name of Business		Federal ID (or) Social Security No.	
Address		Telephone (       )	
City	State	ZIP	

*I hereby certify that the above information is true and correct. I agree to notify the Michigan DNR of any changes that occur in factors affecting my coverage during any of my present and future operations.*

\_\_\_\_\_  
Signature of Owner or Authorized Representative

\_\_\_\_\_  
Title

\_\_\_\_\_  
Date

**Please complete the "SEALED BID" information on the next page**

Magruder Mix (73-013-17)

T13N, R01W, SEC. 18; T13N, R01W, SEC. 7; T13N, R02W, SEC. 1; T13N, R02W,

In response to the notice of sale to be held 10:00 a.m. (local time) on September 12, 2018, I am hereby submitting my sealed bid (firm offer) for the following forest products to be cut. Bids for individual species must be at or above the advertised price. All non-responsive bid forms may be rejected.

<u>PRODUCTS &amp; SPECIES</u>	<u>ESTIMATED VOLUME*</u>	<u>ADVERTISED PRICE</u>	<u>BID PRICE/UNIT</u>
<b>Sawtimber</b>			
Mixed Aspen	267.50 MBF	\$ 48.00/MBF	\$ _____
Mixed Oak	55.10 MBF	\$ 106.00/MBF	\$ _____
Red Maple	136.60 MBF	\$ 44.00/MBF	\$ _____
White Oak	12.50 MBF	\$ 67.00/MBF	\$ _____
<b>Pulpwood</b>			
Mixed Aspen	1,789.00 Cords	\$ 17.95/Cord	\$ _____
Mixed Hardwood	1,508.00 Cords	\$ 11.95/Cord	\$ _____
Mixed Oak	552.00 Cords	\$ 9.25/Cord	\$ _____

\*The volumes are statistically estimated within plus (+) or minus (-) 8.13 percent. These estimated volumes are final and not subject to adjustment. Prospective bidders are urged to examine this timber and to make their own estimates of quantity and quality.

I understand that any or all bids may be rejected. All bids must be signed and all bid items must be bid or the bid form may be rejected. I also understand that consideration and awarding a contract will be based upon my past performance and ability to complete the contract based upon equipment and staffing subject to my control.

FEDERAL ID: \_\_\_\_\_ or SOCIAL SECURITY NUMBER: \_\_\_\_\_

Company or individual bidding: \_\_\_\_\_

Company representative's name: \_\_\_\_\_

Address: \_\_\_\_\_

City: \_\_\_\_\_ State: \_\_\_\_\_ Zip: \_\_\_\_\_

IF AVAILABLE, PLEASE PLACE THE PERSONALIZED LABEL FROM YOUR PROSPECTUS IN THE ABOVE BOX.

Individual or company representative's signature: \_\_\_\_\_ Date: \_\_\_\_\_

Phone number : \_\_\_\_\_ Email (optional): \_\_\_\_\_

**THE WINNING BIDDER MUST COMPLETE THE VERIFICATION OF WORKER'S DISABILITY COMPENSATION ACT COMPLIANCE (ON REVERSE SIDE IF DOUBLE SIDED) WITHIN 21 DAYS OF SALE AWARD DATE**



FOR DEPARTMENT USE ONLY	
Sale Number (XX - XXX - XX - XX)	
Forest Management Unit:	

## TIMBER SALE VERIFICATION OF WORKER'S DISABILITY COMPENSATION ACT COMPLIANCE

As required by Act 317, P.A. 1969 (Worker's Compensation) and  
Part 5 of Act 451 of 1994, as amended.

### VERIFICATION OF WORKER'S DISABILITY COMPENSATION ACT COMPLIANCE

- This verification must be completed and submitted within 21 days of contract award and prior to the issuance of the timber sale contract.
- In addition, if boxes 2B or 2C are checked, then Notice of Exclusion or Certificate of Insurance must be submitted within twenty-one (21) days of the contract award and prior to the issuance of the timber sale contract.
- All information must be typed or printed except for written signatures.

Please Check Appropriate Categories:

1. My business is organized as (you **must** check one of the boxes below):
  - A.  Sole Proprietorship (individual)
  - B.  Partnership
  - C.  Corporation
2. You **must** check one of the boxes below:
  - A.  I certify my business is a sole proprietorship and it has no employees but the sole proprietor. I am not subject to the Worker's Compensation Laws.
  - B.  I certify my business has satisfied its obligation to the Worker's Compensation Act through the use of an approved Notice of Exclusion (BWC-337, Rev. 5/96). I will provide a copy of the Notice of Exclusion within 21 days of the contract award. (For questions or a copy of the BWC-337, please call the Worker's Compensation Bureau at 517-322-1195).
  - C.  I certify my business has a Worker's Compensation Policy. I will provide an original Certificate of Insurance within twenty-one (21) days of the contract award.
3. If you have checked item 2(A) or 2(B), you **must** indicate the number of **both** full-time and part-time employees, other than yourself, including family members and active partners (if none, you must enter "0").

\_\_\_\_\_ Full-time Employees

\_\_\_\_\_ Part-time Employees

Name of Business		Federal ID (or) Social Security No.	
Address		Telephone (       )	
City	State	ZIP	

*I hereby certify that the above information is true and correct. I agree to notify the Michigan DNR of any changes that occur in factors affecting my coverage during any of my present and future operations.*

\_\_\_\_\_  
Signature of Owner or Authorized Representative

\_\_\_\_\_  
Title

\_\_\_\_\_  
Date

Please complete the "SEALED BID" information on the next page



High Tower Mix (73-012-18)

T13N, R02W, SEC. 10; T13N, R02W, SEC. 4; T13N, R02W, SEC. 9; Midland

In response to the notice of sale to be held 10:00 a.m. (local time) on September 12, 2018, I am hereby submitting my sealed bid (firm offer) for the following forest products to be cut. Bids for individual species must be at or above the advertised price. All non-responsive bid forms may be rejected.

<u>PRODUCTS &amp; SPECIES</u>	<u>ESTIMATED VOLUME*</u>	<u>ADVERTISED PRICE</u>	<u>BID PRICE/UNIT</u>
<b>Sawtimber</b>			
Mixed Aspen	67.90 MBF	\$ 48.00/MBF	\$ _____
Paper Birch	2.40 MBF	\$ 45.00/MBF	\$ _____
Red Maple	88.50 MBF	\$ 44.00/MBF	\$ _____
White Oak	7.80 MBF	\$ 67.00/MBF	\$ _____
<b>Pulpwood</b>			
Mixed Aspen	1,049.00 Cords	\$ 17.95/Cord	\$ _____
Mixed Hardwood	1,042.00 Cords	\$ 11.95/Cord	\$ _____
Mixed Oak	99.00 Cords	\$ 9.25/Cord	\$ _____

\*The volumes are statistically estimated within plus (+) or minus (-) 7.75 percent. These estimated volumes are final and not subject to adjustment. Prospective bidders are urged to examine this timber and to make their own estimates of quantity and quality.

I understand that any or all bids may be rejected. All bids must be signed and all bid items must be bid or the bid form may be rejected. I also understand that consideration and awarding a contract will be based upon my past performance and ability to complete the contract based upon equipment and staffing subject to my control.

FEDERAL ID: \_\_\_\_\_ or SOCIAL SECURITY NUMBER: \_\_\_\_\_

Company or individual bidding: \_\_\_\_\_

Company representative's name: \_\_\_\_\_

Address: \_\_\_\_\_

City: \_\_\_\_\_ State: \_\_\_\_\_ Zip: \_\_\_\_\_

IF AVAILABLE, PLEASE PLACE THE PERSONALIZED LABEL FROM YOUR PROSPECTUS IN THE ABOVE BOX.

Individual or company representative's signature: \_\_\_\_\_ Date: \_\_\_\_\_

Phone number : \_\_\_\_\_ Email (optional): \_\_\_\_\_

**THE WINNING BIDDER MUST COMPLETE THE VERIFICATION OF WORKER'S DISABILITY COMPENSATION ACT COMPLIANCE (ON REVERSE SIDE IF DOUBLE SIDED) WITHIN 21 DAYS OF SALE AWARD DATE**



## TIMBER SALE VERIFICATION OF WORKER'S DISABILITY COMPENSATION ACT COMPLIANCE

As required by Act 317, P.A. 1969 (Worker's Compensation) and  
Part 5 of Act 451 of 1994, as amended.

<b>FOR DEPARTMENT USE ONLY</b>
Sale Number (XX - XXX - XX - XX)
Forest Management Unit:

### VERIFICATION OF WORKER'S DISABILITY COMPENSATION ACT COMPLIANCE

- This verification must be completed and submitted within 21 days of contract award and prior to the issuance of the timber sale contract.
- In addition, if boxes 2B or 2C are checked, then Notice of Exclusion or Certificate of Insurance must be submitted within twenty-one (21) days of the contract award and prior to the issuance of the timber sale contract.
- All information must be typed or printed except for written signatures.

Please Check Appropriate Categories:

1. My business is organized as (you **must** check one of the boxes below):
  - A.  Sole Proprietorship (individual)
  - B.  Partnership
  - C.  Corporation
2. You **must** check one of the boxes below:
  - A.  I certify my business is a sole proprietorship and it has no employees but the sole proprietor. I am not subject to the Worker's Compensation Laws.
  - B.  I certify my business has satisfied its obligation to the Worker's Compensation Act through the use of an approved Notice of Exclusion (BWC-337, Rev. 5/96). I will provide a copy of the Notice of Exclusion within 21 days of the contract award. (For questions or a copy of the BWC-337, please call the Worker's Compensation Bureau at 517-322-1195).
  - C.  I certify my business has a Worker's Compensation Policy. I will provide an original Certificate of Insurance within twenty-one (21) days of the contract award.
3. If you have checked item 2(A) or 2(B), you **must** indicate the number of **both** full-time and part-time employees, other than yourself, including family members and active partners (if none, you must enter "0").

\_\_\_\_\_ Full-time Employees

\_\_\_\_\_ Part-time Employees

Name of Business		Federal ID (or) Social Security No.	
Address		Telephone ( )	
City	State	ZIP	

*I hereby certify that the above information is true and correct. I agree to notify the Michigan DNR of any changes that occur in factors affecting my coverage during any of my present and future operations.*

\_\_\_\_\_  
Signature of Owner or Authorized Representative

\_\_\_\_\_  
Title

\_\_\_\_\_  
Date

Please complete the "SEALED BID" information on the next page