



**DEPARTMENT OF NATURAL RESOURCES
STATE OF MICHIGAN**

TIMBER SALE PROSPECTUS #6212

SCHEDULED SALE DATE AND TIME: 9:00 a.m. (local time) on May 22, 2018.

LOCATION: GRAYLING MGMT UNIT, 1955 HARTWICK PINES ROAD, GRAYLING, MI 49738.

PROSPECTUS NOTE: The bidder is advised to inspect the sale area and review the location, estimated volumes, operating costs and contract terms of proposed sales. Please be aware that some landowners may request 60 days or more notice for access across their land.

Notice is hereby given that bids will be received by the Unit Manager, GRAYLING MANAGEMENT UNIT, for certain timber on the following described lands:

Duvall Creek Oak and Aspen (72-001-17)

Alcona County, Advertised Price \$50,237.85, 50.0 Acres, Aspen, Hardwood.

SALE NOTE: The sale is accessed by taking Lorenz Road north from Bissonette Road to Fawn Road, then east to Kobs Road, then north to Kings Corner Road, then east to Wilber Road, and .4 miles south to the unnamed road going into the sale area.

This sale is in an Eastern Massasauga Candidate Conservation Area. To protect this species, the sale must be harvested during dry or frozen conditions to prevent rutting which impacts snake habitat. See spec 5.2.3.1.

Roy Creek Mix (72-017-16)

Alcona County, Advertised Price \$43,327.85, 113.4 Acres, Hardwood, Jack Pine.

SALE NOTE: Payment Unit 2 of this sale must be harvested in dry summer/fall or frozen winter conditions to avoid any rutting which impacts habitat for the Massasauga, a protected species. Oak wilt restrictions also prohibit harvests from occurring April 15- July 15 unless pre-harvest operations occur to minimize the likelihood on spreading the disease.

Access may be through other public land.

BID INSTRUCTIONS (VER. 11/28/2017):

1. Scheduled Bid Location, Date, and Time (2/11)

Bids must be received by the Unit Manager, GRAYLING OFFICE, 1955 HARTWICK PINES ROAD, GRAYLING, MI 49738, no later than 9:00 a.m. (local time) on May 22, 2018. For further information concerning this sale, contact Susan Thiel at 989-348-6371 extension 7440.

2. Bidder's Qualifications (5/16)

Purchaser shall obtain workers compensation insurance to cover claims under Michigan's Worker's Disability Compensation Act of 1969 or similar employee benefit act of any other state applicable to an employee. If all or part of a timber sale was prepared by a private contractor, the contractor and that contractor's company are not permitted to bid on the timber sale contract. Bids will not be accepted from individuals or companies appearing on the DNR/FRD No-Bid List. This list contains the names of purchasers who previously failed to execute a contract within 21-days or who have a history of poor performance.

3. Preparation of Sealed Bids (5/16)

Bid Forms may be completed online thru Michigan DNR Timber Sale Online Bidding (OLB) at www.michigan.gov/timberbidding or by completing the hardcopy Bid Form found in the Timber Sale Prospectus. Hardcopy Bid Forms shall be manually signed in ink. Registration in OLB is considered your 'signature' for all bids submitted thru that system. Bid prices must be entered for each species and product in the Bid Price column for all material subject to bidding and all fill-in blanks must be completed. If erasures or other changes appear on the hardcopy Bid Form, each erasure or change must be initialed by the person signing the bid.

4. Submission of Sealed Bids (5/16)

Bid forms may be obtained from the Unit Manager or thru OLB. Bids may be submitted hardcopy or thru OLB. All hardcopy bids must be submitted on the bid form and in an envelope clearly identified as described in this section. NOTE: Only one bid form per bid envelope. Sealed bids must be submitted to the Unit office designated in the prospectus and must be submitted at or prior to the time established in the prospectus. The envelope should show on the outside (a) the sale name or number and (b) the date and time of bid opening, as shown in the prospectus. Bids received after the time specified in the sale prospectus are late bids and will be rejected.

It is possible for a bidder to submit multiple bids on a single sale. For example, a bid may be submitted hardcopy and a bid may be submitted thru OLB. Or, two bidders from the same company could both submit bids on the same sale. If this were to happen, the State would accept all bids received and award the contract accordingly. All bidding and contractual requirements would apply to all bids received.

5. Public Opening of Sealed Bids (7/16)

If conditions permit, the sealed bids will be publicly opened and posted at the time and place set in the prospectus.

If a bidder, present at a bid opening, has submitted bids on more than one sale, that bidder may withdraw their unopened bid envelopes or announce the withdrawal of their online bid after being declared the successful bidder on one sale.

6. Award of Contract (1/11)

Award of the contract will be made to the Bidder whose bid, conforming to the prospectus, is most advantageous to the State of Michigan on the basis of total value at rates bid for the estimated quantities. The State reserves the right to reject any bid or waive any minor irregularity in bids received. A written award mailed (or otherwise furnished) to the successful Bidder shall be deemed to result in a binding contract without further action by either party.

7. Down Payment (1/11)

The Bidder to whom award is made must make a down payment within 21 days of the sale award. The amount of the down payment will be calculated as shown in the Bond and Payment Schedule of this prospectus. Only cash may be used to meet this requirement.

8. Performance Security (1/11)

As guarantee of faithful performance, a cash bond, certificate of deposit, surety bond or irrevocable letter of credit (LOC) is required within 21 days of the sale award. The amount of the performance security is shown in the Bond and

Payment Schedule of this prospectus. If an LOC or surety is used, the coverage must extend for at least 6 months beyond the contract expiration.

9. Timber Sale Contract (11/17)

Additional conditions and requirements common to all timber sales are listed on the timber sale contract (R4031) and are available on line at www.michigan.gov/timber. Contact the Unit Manager for additional information or a sample contract. Within 21 days of the date of the award letter, the bidder must sign the contract and provide the required down payment, performance security, and verification of worker's disability compensation. The down payment and performance security shall be in accordance with the provisions of the timber sale contract, in the sums stated in this prospectus. If these actions are not taken, then the Bidder, the Bidder's corporation, and the corporation's principals may not be permitted to bid on State timber sales for a period of 1 year. In addition, the Bidder certifies that if awarded this contract, the Bidder will complete the timber sale contract in accordance with its terms and any modifications thereof including requirements to purchase, cut, and remove the included timber by the expiration date.

Payment Unit values in the State Forest Timber Sale Contract are calculated based on the advertised value of the Payment Unit as a percentage of the total advertised value of the contract. The advertised value of each Payment Unit is given in the Description of Timber by Payment Unit table on the Timber Sale Information page. For example, if the value of Payment Unit 1 is advertised as \$1,500 and the total Timber Sale value is advertised as \$10,000, the contract price for Payment Unit 1 will be 15% of the total bid price ($\$1,500/\$10,000 * 100$).

10. Disclaimer of Estimates and Bidder's Warranty of Inspection (7/16)

Before submitting this bid, the Bidder is advised and cautioned to inspect the sale area, review the requirements of the sale contract, and take other steps as may be reasonably necessary to ascertain the location, estimated volumes, construction estimates, and operating costs of the proposed sale. Failure to do so will not relieve the Bidder from responsibility for completing the contract.

The Bidder warrants that this bid is submitted solely on the basis of the Bidder's examination and inspection of the quality and quantity of the timber offered for sale and the Bidder's opinion of the value thereof and the costs of recovery. No reliance should be placed on the State of Michigan's estimates of timber quality, quantity or costs of recovery. Bidder further acknowledges that the State of Michigan: (i) expressly disclaims any warranty of fitness of timber for any purpose; (ii) offers this timber as is without any warranty of quality (merchantability) or quantity and (iii) expressly disclaims any warranty as to the quantity or quality of timber sold.

11. Certification and Chain-of-Custody (10/14)

Unless otherwise indicated in the contract under section 7 – Other Conditions of the Sale Specific Conditions & Requirements, the area encompassed by this timber sale is certified to the standards of the Forest Stewardship Council (FSC) - Certificate #SCS-FM/COC-00090N and the Sustainable Forestry Initiative (SFI) - Certificate # NSF-SFIS-5Y031-SF5. Forest products from this sale may be delivered to the mill as "FSC 100% and / or SFI certified" as long as the contractor hauling the forest products is chain-of-custody (COC) certified or covered under a COC certificate from the destination mill. The purchaser is responsible for maintaining COC after leaving the sale area.

12. Good Neighbor Authority (GNA) Requirements (7/16)

If the name of this timber sales contains the acronym GNA, it is authorized by the Good Neighbor Authority (GNA) and covered by various agreements between the U.S. Forest Service and the State. The timber sale occurs on federal land and the following conditions apply:

GNA contracts on US Forest Service land will not be awarded to purchasers on the Federal list of excluded parties. The System for Award Management (SAM) will be checked for active excluded parties prior to award of contract. In addition, the Bidder to whom award is made must complete an Assurance Regarding Felony Conviction or Tax Delinquent Status for Corporate Applicants (AD-3031).

13. Good Neighbor Authority (GNA) Requirements, con't (9/16)

Bidder certifies, by signing this bid form, that to the best of Bidder's knowledge that the following representations are accurate and complete.

a. That the Bidder and its principals are not presently debarred, suspended, proposed for debarment, declared ineligible, or voluntary excluded from timber sales (covered transactions) by any Federal department or agency.

b. That the Bidder and its principals have not within a 3-year period preceding this bid been convicted of or had a civil judgment rendered against them for commission of fraud or a criminal offense in connection with obtaining, attempting to obtain, or performing a public (Federal, State, or local) transaction or contract under a public transaction; violation of Federal or State antitrust statutes or commission of embezzlement, theft, forgery, bribery, falsification or destruction of records, making false statements, or receiving stolen property.

c. That the Bidder and its principals are not presently indicted for or otherwise criminally or civilly charged by a governmental entity (Federal, State, or local) with commission of any of the offenses enumerated in paragraph b of this certification.

d. That the Bidder and its principals have not within a 3-year period preceding this bid had one or more public transactions (Federal, State, or local) terminated for breach or default of a timber or forest product contract.

Bidders that cannot certify this requirement, in whole or in part, shall submit an explanation with their bid.

KEITH CREAGH

Director

TIMBER SALE INFORMATION

Duvall Creek Oak and Aspen (72-001-17)

Alcona County (Advertised Price \$50,237.85)

SALE NOTE: The sale is accessed by taking Lorenz Road north from Bissonette Road to Fawn Road, then east to Kobs Road, then north to Kings Corner Road, then east to Wilber Road, and .4 miles south to the unnamed road going into the sale area.

This sale is in an Eastern Massasauga Candidate Conservation Area. To protect this species, the sale must be harvested during dry or frozen conditions to prevent rutting which impacts snake habitat. See spec 5.2.3.1.

A timber sale contract for this lump sum, sealed bid timber sale will be awarded to the responsible bidder offering the highest sealed bid price. Bids must be at or above the following advertised price for each species:

<u>PRODUCTS & SPECIES</u>	<u>ESTIMATED UNITS*</u>	<u>ADVERTISED PRICE</u>
Sawtimber		
B. T. Aspen	55.00 MBF	\$ 86.00 / MBF
Mixed Oak	103.40 MBF	\$ 265.00 / MBF
Red Pine	6.10 MBF	\$ 132.00 / MBF
Pulpwood		
B. T. Aspen	384.00 Cords	\$ 21.65 / Cord
Balsam Fir	8.00 Cords	\$ 14.50 / Cord
Jack Pine	30.00 Cords	\$ 13.20 / Cord
Mixed Oak	324.00 Cords	\$ 13.50 / Cord
Red Maple	185.00 Cords	\$ 19.65 / Cord
Red Pine	3.00 Cords	\$ 48.60 / Cord
White Pine	15.00 Cords	\$ 21.40 / Cord

* The total volume is statistically estimated within plus (+) or minus (-) 11.52 percent. The estimated units are final and not subject to adjustment. Prospective bidders are urged to examine this timber and to make their own estimates of quantity and quality.

BOND AND PAYMENT SCHEDULE:

1. A bond in the amount of \$2,512.00 to insure faithful performance of the conditions of the contract will be deposited by the successful bidder within 21 days of the sale award.
2. Cutting in any sale or unit without the required advance payment would be considered a trespass.
3. Total payment must be paid in advance or according to the following schedule:
 - (a) Ten percent (10%) of the sale value must be paid within 21 days of the sale award.
 - (b) The 10% down payment will be credited towards the first unit cut.
 - (c) Payment for each of the following units must be made before cutting begins in that unit:

<u>PAYMENT UNIT NUMBER</u>	<u>PERCENT OF TOTAL SALE VALUE</u>
01	62.8%
02	37.2%

4. If no cutting takes place, the 10% down payment will not be refunded.
5. Operations on the contract issued will terminate on 12/31/2020.

Description of Timber by Payment Unit (PU)

PU	MARKET GROUP	PRODUCT	QUANTITY	UNIT	ACRES	ADVERTISE PRICE			
1	B. T. Aspen	Sawtimber	49.7	MBF	33.7	\$31,567.00			
	Mixed Oak		70.7	MBF					
	<i>BI/R/Hybrid Oak</i>		1.2	<i>MBF</i>					
	<i>Northern Pin Oak</i>		59.3	<i>MBF</i>					
	<i>White Oak</i>		10.2	<i>MBF</i>					
	B. T. Aspen	Pulpwood	138.0	Cords					
	Balsam Fir		7.0	Cords					
	Jack Pine		30.0	Cords					
	<i>Jack Pine</i>	<i>Sawtimber</i>	2.3	<i>MBF</i>					
	<i>Jack Pine</i>	<i>Pulpwood</i>	25.0	<i>Cords</i>					
	Mixed Oak		268.0	Cords					
	<i>BI/R/Hybrid Oak</i>		1.0	<i>Cords</i>					
	<i>Northern Pin Oak</i>		228.0	<i>Cords</i>					
	<i>White Oak</i>		39.0	<i>Cords</i>					
	Red Maple		74.0	Cords					
	<i>Red Maple</i>	<i>Sawtimber</i>	4.2	<i>MBF</i>					
	<i>Red Maple</i>	<i>Pulpwood</i>	66.0	<i>Cords</i>					
	2	B. T. Aspen	Sawtimber	5.3			MBF	16.3	\$18,670.85
		Mixed Oak		32.7			MBF		
		<i>Northern Pin Oak</i>		18.2			<i>MBF</i>		
<i>Red Oak</i>			9.5	<i>MBF</i>					
<i>White Oak</i>			5.0	<i>MBF</i>					
Red Pine			6.1	MBF					
B. T. Aspen		Pulpwood	246.0	Cords					
Balsam Fir			1.0	Cords					
Mixed Oak			56.0	Cords					
<i>Northern Pin Oak</i>			35.0	<i>Cords</i>					
<i>Red Oak</i>			10.0	<i>Cords</i>					
<i>White Oak</i>			11.0	<i>Cords</i>					
Red Maple			111.0	Cords					
<i>Red Maple</i>		<i>Sawtimber</i>	2.7	<i>MBF</i>					
<i>Red Maple</i>		<i>Pulpwood</i>	106.0	<i>Cords</i>					
Red Pine			3.0	Cords					
White Pine			15.0	Cords					
TOTAL:			164.5	MBF					
TOTAL:			949.0	Cords					

Sale Specific Conditions & Requirements

Sale Name: Duvall Creek Oak and Aspen

Sale Number: 72-001-17 Seq#: 2

1 - Sale Area

1.2 - Boundaries

1.2.1 - Painted boundaries (1/14)

The sale boundary and Payment Unit boundaries are marked and identified by red and yellow paint. Exterior sale boundary lines against state are marked with red paint. Interior Payment Unit boundaries are marked with yellow paint. The painted boundary line trees are not Included Timber and are to be protected. Yellow painted trees designating an interior Payment Unit boundary are only to be cut when all surrounding Payment Units have been paid.

2 - Timber Specifications

2.1 - Included Timber

2.1.1 - Clearcut unit(s) with unmerchantable trees (6/14)

Within Payment Unit(s) 1 and 2, cut all trees that are two (2) inches or more at DBH, with the following exceptions:

Within Payment Unit 1, do not cut red pine or white pine.

Within Payment Unit 2, do not cut red pine greater than 20" at DBH.

4 - Transportation

4.1 - Construction

4.1.3 - Slash and earthen piles (8/04)

Piles or windrows of earth along roads and landings that have been widened or constructed shall be leveled. Slash from road maintenance or construction, including stumps, shall be dispersed throughout the sale.

4.1.6 - Road construction (1/09)

Construction of new roads or improvements of existing roads shall be done in such a way as to minimize the environmental and visual impacts. Merchantable trees shall be cut and utilized unless otherwise directed. Non-merchantable trees shall be severed and laid flat on the ground. Slash shall be scattered, and not left in windrows and kept a minimum of 10 feet back from the road edge. Stumps shall be set upright, not left on edge, and be moved at least 10 feet away from the road edge. Disturbed soil shall be feathered into the woods and not left in berms or windrows.

4.1.7 - Road closure (10/11)

All new roads built into the sale must be blocked to vehicle traffic upon completion of the sale. In general, this will require constructing a four (4') foot high berm of stumps and logs covered with earth. These roads must be rendered impassable to cars and trucks. Contact the sale administrator for specific details of design and placement.

4.1.11 - Permits (2/12)

The Purchaser will secure any necessary permits that may be required.

5 - Operations

5.1 - Notification

5.1.1 - Pre-sale conference (10/16)

A pre-sale conference on site between the Purchaser and sale administrator is required prior to beginning any operations to determine landing and road locations. The Unit Manager or his/her representative must be contacted at least 10 days in advance to schedule the conference.

5.1.4 - Post-sale conference (10/16)

A post-sale conference on site between the Purchaser and sale administrator is required 5 days prior to the completion of active logging operations to determine clean-up and repair of landings, road edges, and the fulfillment of other contract specifications.

5.2 - Conduct of Operations

5.2.1 - Slash

5.2.1.8 - Slash height (12/08)

No slash or tree tops may exceed 48 inches in height.

5.2.2 - Hazard Trees/Snags

5.2.2.1 - Den trees (10/16)

Obvious hollow and/or den trees shall be protected and left standing unless they are a safety hazard.

5.2.3 - Operating Restrictions

5.2.3.1 - Operating restrictions (9/11)

Within Payment Unit(s) 1 and 2, cutting, skidding, and hauling are only permitted during dry summer or frozen winter conditions. This restriction is to prevent rutting within the harvest area in order to protect Eastern Massasauga Rattlesnake habitat.

5.2.3.5 - Oak wilt restriction (1/18)

Within Payment Unit(s) 1 and 2, unless changed by written agreement, cutting, skidding, hauling within the sale and brushing of access roads to the sale are not permitted during the period of April 15 to July 15. Operations may be allowed if specific steps are taken to prevent damaging uncut oak during the high risk period. Those steps may include completing all road brushing before April 15th and clearing a tree-length buffer along uncut oak cover before April 15th. This is necessary to reduce the spread of oak wilt. For more information, contact the Unit Manager or his/her representative.

5.2.4 - Dead and Down Creation

5.2.4.6 - Dead and down creation, other (9/09)

In order to satisfy Eastern Massasauga Rattlesnake Conservation recommendations, leave a minimum of 4 tops per acre throughout the sale area to increase fine and coarse woody debris. This is especially important in transition zones to adjacent lowland stands.

5.2.32 - Decking/landing restoration (9/13)

All decking and landing areas must have the surface area restored to a condition equal to or better than before. This is to ensure the proper regeneration of the stand. Wood debris, chips and "cookies" from trimmings must be removed or scattered away from landing and loading areas and may not be windrowed on the edge.

5.4 - Soil Protection

5.4.1 - Rutting restriction, general (7/16)

Operations are to cease immediately if equipment and weather conditions result in rutting of roads and/or skid trails which is 12 inches or greater in depth and 50 feet in length. The Unit Manager or his/her representative may restrict hauling and/or skidding if ruts exceed the specified depth. With the Unit Manager or his/her representative's approval, the Purchaser may return to the area when the risk of rutting has decreased.



TIMBER SALE MAP

This information provided by authority of Part 525, 1994 PA 451, as amended.

Forest Management Unit Grayling	County Alcona	Mapped By Ehlert	Date 11/30/2016	Page 1	of 1
Township 25N	Range 08E	Section(s) and Subdivision(s) Sec 32 - SW 1/4	Scale 1:15,840		

Cover Type				Density	
A = Aspen	H = Hemlock	N = Marsh	U = Upland Brush	0 = Non Stocked	5 = Pole Timber Medium
B = Paper Birch	J = Jack Pine	O = Oak	UM = Upland Mixed	1 = Seedling Sapling Poor	6 = Pole Timber Well
C = Cedar	L = Lowland Brush	P = Lowland Poplar	V = Bog or Marsh	2 = Seedling Sapling Medium	7 = Saw Timber Poor
D = Treed Bog	LM = Lowland Mixed	Q = Mixed Swamp Conifer	W = White Pine	3 = Seedling Sapling Well	8 = Saw Timber Medium
E = Swamp Hdwoods	M = Mpl, Bch, Brch	R = Red Pine	X = Non Stocked	4 = Pole Timber Poor	9 = Saw Timber Well
F = Spruce Fir	MC = Mixed Conifer	S = Black Spruce	Z = Water		
G = Grass	MD = Mixed Deciduous	T = Tamarack			

PU Acres

1	33.7
2	16.3

Duval Creek Oak and Aspen
Compartment 065
50 Acres

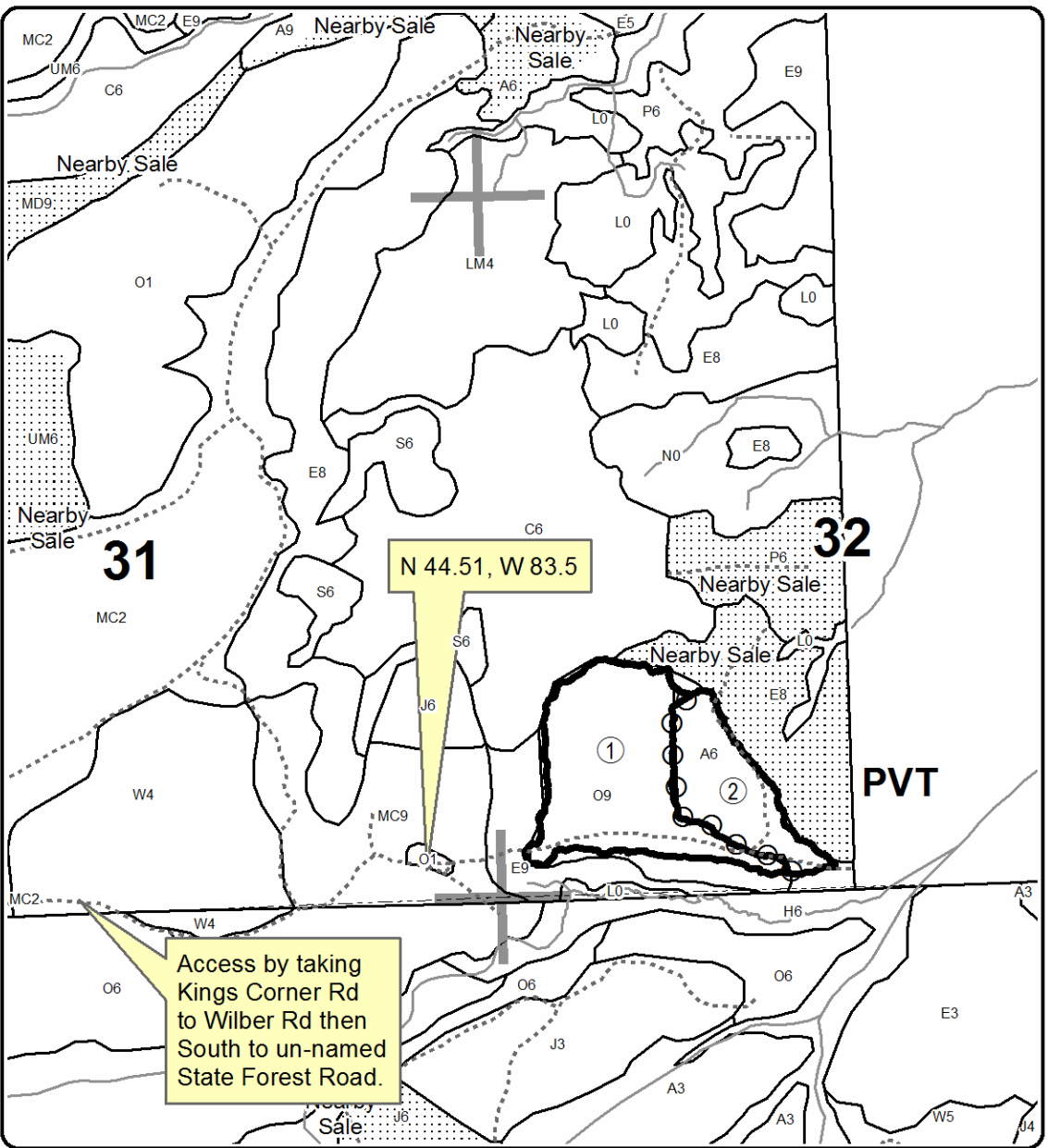

Legend

- Against State (Red)
- ⊖ Payment Unit (Yellow)
- ⋯ Nearby Timber Sale
- ▭ Stand Boundaries
- PU Label
- - - Closed Roads
- Streams
- Section Corners

Locator Map
1:200,000

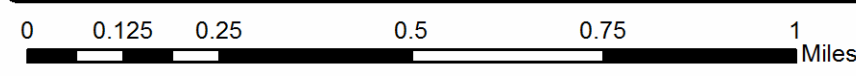
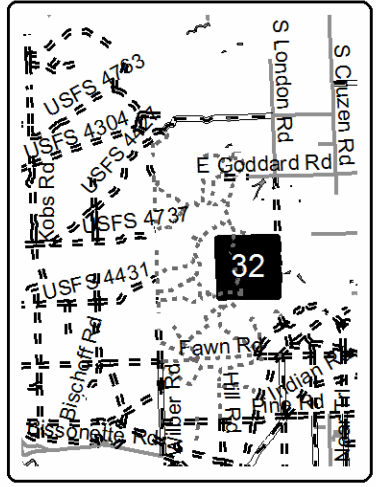

TIMBER SALE INFORMATION

Roy Creek Mix (72-017-16)

Alcona County (Advertised Price \$43,327.85)

SALE NOTE: Payment Unit 2 of this sale must be harvested in dry summer/fall or frozen winter conditions to avoid any rutting which impacts habitat for the Massasauga, a protected species. Oak wilt restrictions also prohibit harvests from occurring April 15- July 15 unless pre-harvest operations occur to minimize the likelihood on spreading the disease.

Access may be through other public land.

A timber sale contract for this lump sum, sealed bid timber sale will be awarded to the responsible bidder offering the highest sealed bid price. Bids must be at or above the following advertised price for each species:

<u>PRODUCTS & SPECIES</u>	<u>ESTIMATED UNITS*</u>	<u>ADVERTISED PRICE</u>
Sawtimber		
B. T. Aspen	112.70 MBF	\$ 80.00 / MBF
Northern Pin Oak	19.40 MBF	\$ 248.00 / MBF
Red Pine	4.10 MBF	\$ 123.00 / MBF
White Oak	1.40 MBF	\$ 62.00 / MBF
Pulpwood		
Balsam Fir	55.00 Cords	\$ 13.55 / Cord
Black Spruce	7.00 Cords	\$ 28.05 / Cord
Jack Pine	622.00 Cords	\$ 12.30 / Cord
Mixed Aspen	273.00 Cords	\$ 20.20 / Cord
Mixed Oak	614.00 Cords	\$ 12.60 / Cord
Paper Birch	23.00 Cords	\$ 9.45 / Cord
Red Maple	270.00 Cords	\$ 18.30 / Cord
Red Pine	6.00 Cords	\$ 45.35 / Cord
White Pine	82.00 Cords	\$ 19.95 / Cord

* The total volume is statistically estimated within plus (+) or minus (-) 11.71 percent. The estimated units are final and not subject to adjustment. Prospective bidders are urged to examine this timber and to make their own estimates of quantity and quality.

BOND AND PAYMENT SCHEDULE:

1. A bond in the amount of \$2,166.00 to insure faithful performance of the conditions of the contract will be deposited by the successful bidder within 21 days of the sale award.
2. Cutting in any sale or unit without the required advance payment would be considered a trespass.
3. Total payment must be paid in advance or according to the following schedule:
 - (a) Ten percent (10%) of the sale value must be paid within 21 days of the sale award.
 - (b) The 10% down payment will be credited towards the first unit cut.
 - (c) Payment for each of the following units must be made before cutting begins in that unit:

<u>PAYMENT UNIT NUMBER</u>	<u>PERCENT OF TOTAL SALE VALUE</u>
01	41.0%
02	30.8%
03	28.2%

4. If no cutting takes place, the 10% down payment will not be refunded.
5. Operations on the contract issued will terminate on 03/31/2021.

Description of Timber by Payment Unit (PU)

PU	MARKET GROUP	PRODUCT	QUANTITY	UNIT	ACRES	ADVERTISE PRICE			
1	B. T. Aspen	Sawtimber	1.2	MBF	70.9	\$17,765.75			
	Northern Pin Oak		16.4	MBF					
	Red Pine		1.7	MBF					
	Jack Pine	Pulpwood	531.0	Cords					
	<i>Jack Pine</i>	<i>Sawtimber</i>	65.2	<i>MBF</i>					
	<i>Jack Pine</i>	<i>Pulpwood</i>	401.0	<i>Cords</i>					
	Mixed Aspen		5.0	Cords					
	<i>B. T. Aspen</i>		2.0	<i>Cords</i>					
	<i>Quaking Aspen</i>		3.0	<i>Cords</i>					
	Mixed Oak		533.0	Cords					
	<i>Northern Pin Oak</i>		533.0	<i>Cords</i>					
	<i>Red Pine</i>		1.0	<i>Cords</i>					
	2	B. T. Aspen	Sawtimber	53.5			MBF	24.5	\$13,346.75
		Northern Pin Oak		0.8			MBF		
White Oak			0.5	MBF					
Balsam Fir		Pulpwood	48.0	Cords					
Black Spruce			7.0	Cords					
Jack Pine			53.0	Cords					
<i>Jack Pine</i>		<i>Sawtimber</i>	9.6	<i>MBF</i>					
<i>Jack Pine</i>		<i>Pulpwood</i>	34.0	<i>Cords</i>					
Mixed Aspen			106.0	Cords					
<i>B. T. Aspen</i>			106.0	<i>Cords</i>					
Mixed Oak			63.0	Cords					
<i>Northern Pin Oak</i>			55.0	<i>Cords</i>					
<i>White Oak</i>			8.0	<i>Cords</i>					
Paper Birch			20.0	Cords					
Red Maple			150.0	Cords					
Red Maple			4.0	Cords					
<i>Red Maple</i>		<i>Sawtimber</i>	1.9	<i>MBF</i>					
White Pine		Pulpwood	70.0	Cords					
<i>White Pine</i>		<i>Sawtimber</i>	7.3	<i>MBF</i>					
<i>White Pine</i>		<i>Pulpwood</i>	55.0	<i>Cords</i>					
3	B. T. Aspen	Sawtimber	58.0	MBF	18.0	\$12,215.35			
	Northern Pin Oak		2.2	MBF					
	Red Pine		2.4	MBF					
	White Oak		0.9	MBF					
	Balsam Fir	Pulpwood	7.0	Cords					
	Jack Pine		38.0	Cords					
	<i>Jack Pine</i>	<i>Sawtimber</i>	4.8	<i>MBF</i>					
	<i>Jack Pine</i>	<i>Pulpwood</i>	28.0	<i>Cords</i>					
	Mixed Aspen		162.0	Cords					
	<i>B. T. Aspen</i>		162.0	<i>Cords</i>					
	Mixed Oak		18.0	Cords					
	<i>Northern Pin Oak</i>		17.0	<i>Cords</i>					
	<i>White Oak</i>		1.0	<i>Cords</i>					
	Paper Birch		3.0	Cords					
	Red Maple		111.0	Cords					
	Red Maple		5.0	Cords					
	<i>Red Maple</i>	<i>Sawtimber</i>	2.3	<i>MBF</i>					
	Red Pine	Pulpwood	5.0	Cords					
	White Pine		12.0	Cords					
	<i>White Pine</i>		12.0	<i>Cords</i>					
TOTAL:			137.6	MBF					
TOTAL:			1,952.0	Cords					

Sale Specific Conditions & Requirements

Sale Name: Roy Creek Mix

Sale Number: 72-017-16 Seq#: 2

1 - Sale Area

1.2 - Boundaries

1.2.1 - Painted boundaries (1/14)

The sale boundary and Payment Unit boundaries are marked and identified by red paint, along with a utility line. Exterior sale boundary lines against state are marked with red paint, with the exception of the West boundary of Payment Unit 1, which is unpainted and identified by the utility ROW. Interior Payment Unit boundaries are marked with red paint. The painted boundary line trees are not Included Timber and are to be protected.

2 - Timber Specifications

2.1 - Included Timber

2.1.1 - Clearcut unit(s) with unmerchantable trees (6/14)

Within Payment Unit(s) 1, 2, and 3, cut all trees that are two (2) inches or more at DBH, with the following exceptions:

- Within Payment Unit 1, leave all white pine.

- Within Payment Units 2 and 3, leave all red pine and white pine greater than 18" at DBH.

2.2 - Utilization

2.2.3 - Stump heights (4/07)

Stump heights within the Sale Area shall not exceed 6 inches for all trees. A written waiver of this requirement may be obtained if wet summer weather makes winter logging necessary.

4 - Transportation

4.1 - Construction

4.1.6 - Road construction (1/09)

Construction of new roads or improvements of existing roads shall be done in such a way as to minimize the environmental and visual impacts. Merchantable trees shall be cut and utilized unless otherwise directed. Non-merchantable trees shall be severed and laid flat on the ground. Slash shall be scattered, and not left in windrows and kept a minimum of 10 feet back from the road edge. Stumps shall be set upright, not left on edge, and be moved at least 10 feet away from the road edge. Disturbed soil shall be feathered into the woods and not left in berms or windrows.

4.1.7 - Road closure (10/11)

All new roads built into the sale must be blocked to vehicle traffic upon completion of the sale. Overgrown roads that are reopened shall be considered new roads. In general, this will require constructing a four (4') foot high berm of stumps and logs covered with earth. Stumps and brush must be placed along the remainder of the trail. These roads must be rendered impassable to cars and trucks.

4.1.11 - Permits (2/12)

The Purchaser will secure any necessary highway and stream crossing permits that may be required.

4.2 - Maintenance

4.2.5 - Two wheel drive condition (2/04)

All existing trail roads on and adjacent to the sale area must be passable by two-wheel drive traffic for the duration of the sale.

5 - Operations

5.1 - Notification

5.1.1 - Pre-sale conference (10/11)

A pre-sale conference on site between the Purchaser and sale administrator is required prior to beginning a Payment Unit to determine landing and road locations. The Unit Manager or his/her representative must be contacted at least 5 days in advance to schedule the conference.

5.1.4 - Post-sale conference (6/11)

A post-sale conference on site between the Purchaser and sale administrator is required 5 days prior to the completion of active logging operations to determine clean-up and repair of landings, road edges, and the fulfillment of other contract specifications.

5.2 - Conduct of Operations

5.2.1 - Slash

5.2.1.8 - Slash height (12/08)

No slash or tree tops may exceed 24 inches in height.

5.2.2 - Hazard Trees/Snags

5.2.2.1 - Den trees (2/04)

Obvious hollow and/or den trees shall be protected and left standing unless they are a safety hazard.

5.2.3 - Operating Restrictions

5.2.3.1 - Operating restrictions (9/11)

Within Payment Unit(s) 2 and 3, unless changed by written agreement, all cutting, skidding, and hauling are limited to dry summer/fall or frozen winter conditions to avoid any soil compaction or rutting in efforts to protect Eastern Massasauga habitat. This restriction is because this area lies within a Massasauga CCA Management Area.

5.2.3.5 - Oak wilt restriction (1/18)

Within Payment Unit(s) 1, 2, and 3, unless changed by written agreement, cutting, skidding, hauling within the sale and brushing of access roads to the sale are not permitted during the period of April 15 to July 15. Operations may be allowed if specific steps are taken to prevent damaging uncut oak during the high risk period. Those steps may include completing all road brushing before April 15th and clearing a tree-length buffer along uncut oak cover before April 15th. This is necessary to reduce the spread of oak wilt. For more information, contact the Unit Manager or his/her representative.

5.2.4 - Dead and Down Creation

5.2.4.4 - Dead and down creation, grouse (8/13)

To encourage grouse and other wildlife, in Payment Unit(s) 2 and 3, leave one, 12" diameter or larger (or largest diameter trees within the stand) whole tree on the ground for every 2 acres, preferably a hardwood species such as oak or maple, or red or white pine if no hardwood species are present. These trees will be evenly scattered throughout the units, preferably at least two chains from any roads, two-tracks, or trails open to vehicles.

5.2.32 - Decking/landing restoration (9/13)

All decking and landing areas must have the surface area restored to a condition equal to or better than before. This is to ensure the proper regeneration of the stand. Wood debris, chips and "cookies" from trimmings must be removed or scattered away from landing and loading areas and may not be windrowed on the edge.

5.4 - Soil Protection

5.4.1 - Rutting restriction, general (7/16)

Operations are to cease immediately if equipment and weather conditions result in rutting of roads and/or skid trails which is 12 inches or greater in depth and 50 feet in length. The Unit Manager or his/her representative may restrict hauling and/or skidding if ruts exceed the specified depth. With the Unit Manager or his/her representative's approval, the Purchaser may return to the area when the risk of rutting has decreased.

5.4.4 - Slope protection (5/15)

Skid trails and roads on slopes shall be water barred with slash, stumps, and/or clean straw bales native to the area as soon as use is complete to prevent erosion.



TIMBER SALE MAP

This information provided by authority of Part 525, 1994 PA 451, as amended.

Forest Management Unit Gray ling	County Alcona	Mapped By K. Ehlert	Date 09/13/2016	Page 1	of 1
Township 25N	Range 08E	Section(s) and Subdivision(s) Sec 29 - SW1/4 SW; Sec 30 - S1/2; Sec 31 - NW1/4	Scale 1:15,840		

Cover Type				Density			
A = Aspen	H = Hemlock	N = Marsh	U = Upland Brush	0 = Non Stocked	5 = Pole Timber Medium		
B = Paper Birch	J = Jack Pine	O = Oak	UM = Upland Mixed	1 = Seedling Sapling Poor	6 = Pole Timber Well		
C = Cedar	L = Lowland Brush	P = Lowland Poplar	V = Bog or Marsh	2 = Seedling Sapling Medium	7 = Saw Timber Poor		
D = Treed Bog	LM = Lowland Mixed	Q = Mixed Swamp Conifer	W = White Pine	3 = Seedling Sapling Well	8 = Saw Timber Medium		
E = Swamp Hdwoods	M = Mpl. Bch. Brch	R = Red Pine	X = Non Stocked	4 = Pole Timber Poor	9 = Saw Timber Well		
F = Spruce Fir	MC = Mixed Conifer	S = Black Spruce	Z = Water				
G = Grass	MD = Mixed Deciduous	T = Tamarack					

PU	Acres
1	70.9
2	24.5
3	18

Roy Creek Mix

Compartment 065

113.4 Acres

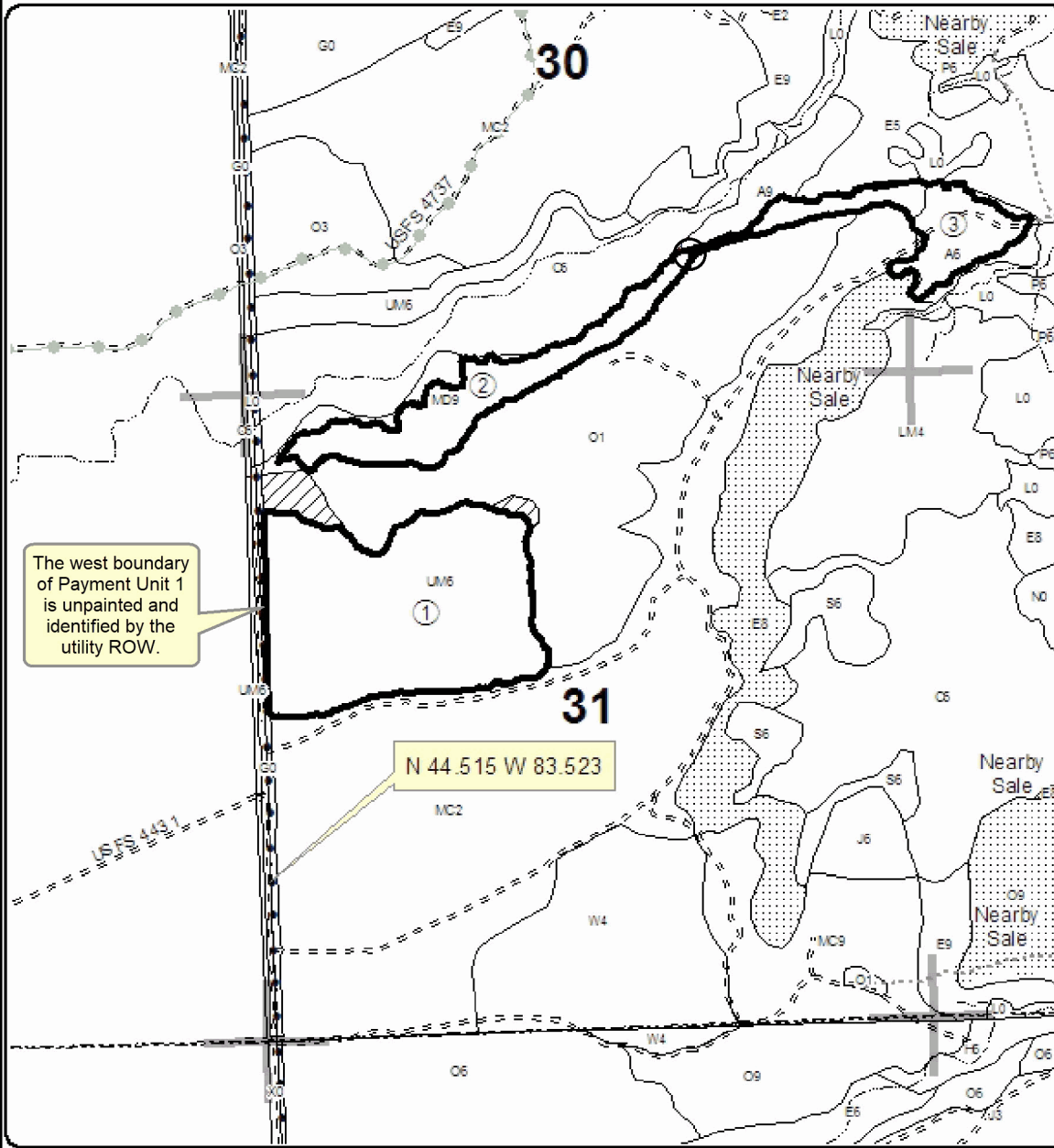

Legend

- Against State (Red)
- Payment Unit (Red)
- PU_Label
- Section Corners
- ▨ Retention Area (Red)
- Stand Boundaries
- Streams
- == Poor Dirt Roads
- Closed Roads
- Pipeline; Powerline
- Recreational Trail
- ⋯ Nearby Timber Sale



Duvall Creek Oak and Aspen (72-001-17)
; Alcona COUNTY

In response to the notice of sale to be held 9:00 a.m. (local time) on May 22, 2018, I am hereby submitting my sealed bid (firm offer) for the following forest products to be cut. Bids for individual species must be at or above the advertised price. All non-responsive bid forms may be rejected.

<u>PRODUCTS & SPECIES</u>	<u>ESTIMATED VOLUME*</u>	<u>ADVERTISED PRICE</u>	<u>BID PRICE/UNIT</u>
Sawtimber			
B. T. Aspen	55.00 MBF	\$ 86.00/MBF	\$ _____
Mixed Oak	103.40 MBF	\$ 265.00/MBF	\$ _____
Red Pine	6.10 MBF	\$ 132.00/MBF	\$ _____
Pulpwood			
B. T. Aspen	384.00 Cords	\$ 21.65/Cord	\$ _____
Balsam Fir	8.00 Cords	\$ 14.50/Cord	\$ _____
Jack Pine	30.00 Cords	\$ 13.20/Cord	\$ _____
Mixed Oak	324.00 Cords	\$ 13.50/Cord	\$ _____
Red Maple	185.00 Cords	\$ 19.65/Cord	\$ _____
Red Pine	3.00 Cords	\$ 48.60/Cord	\$ _____
White Pine	15.00 Cords	\$ 21.40/Cord	\$ _____

*The volumes are statistically estimated within plus (+) or minus (-) 11.52 percent. These estimated volumes are final and not subject to adjustment. Prospective bidders are urged to examine this timber and to make their own estimates of quantity and quality.

I understand that any or all bids may be rejected. All bids must be signed and all bid items must be bid or the bid form may be rejected. I also understand that consideration and awarding a contract will be based upon my past performance and ability to complete the contract based upon equipment and staffing subject to my control.

FEDERAL ID: _____ or SOCIAL SECURITY NUMBER: _____

Company or individual bidding: _____

Company representative's name: _____

Address: _____

City: _____ State: _____ Zip: _____

IF AVAILABLE, PLEASE PLACE THE PERSONALIZED LABEL FROM YOUR PROSPECTUS IN THE ABOVE BOX.

Individual or company representative's signature: _____ Date: _____

Phone number : _____ Email (optional): _____

THE WINNING BIDDER MUST COMPLETE THE VERIFICATION OF WORKER'S DISABILITY COMPENSATION ACT COMPLIANCE (ON REVERSE SIDE IF DOUBLE SIDED) WITHIN 21 DAYS OF SALE AWARD DATE



FOR DEPARTMENT USE ONLY
Sale Number (XX - XXX - XX - XX)
Forest Management Unit:

TIMBER SALE VERIFICATION OF WORKER'S DISABILITY COMPENSATION ACT COMPLIANCE

*As required by Act 317, P.A. 1969 (Worker's Compensation) and
Part 5 of Act 451 of 1994, as amended.*

VERIFICATION OF WORKER'S DISABILITY COMPENSATION ACT COMPLIANCE

- This verification must be completed and submitted within 21 days of contract award and prior to the issuance of the timber sale contract.
- In addition, if boxes 2B or 2C are checked, then Notice of Exclusion or Certificate of Insurance must be submitted within twenty-one (21) days of the contract award and prior to the issuance of the timber sale contract.
- All information must be typed or printed except for written signatures.

Please Check Appropriate Categories:

1. My business is organized as (you **must** check one of the boxes below):
 - A. Sole Proprietorship (individual)
 - B. Partnership
 - C. Corporation
2. You **must** check one of the boxes below:
 - A. I certify my business is a sole proprietorship and it has no employees but the sole proprietor. I am not subject to the Worker's Compensation Laws.
 - B. I certify my business has satisfied its obligation to the Worker's Compensation Act through the use of an approved Notice of Exclusion (BWC-337, Rev. 5/96). I will provide a copy of the Notice of Exclusion within 21 days of the contract award. (For questions or a copy of the BWC-337, please call the Worker's Compensation Bureau at 517-322-1195).
 - C. I certify my business has a Worker's Compensation Policy. I will provide an original Certificate of Insurance within twenty-one (21) days of the contract award.
3. If you have checked item 2(A) or 2(B), you **must** indicate the number of **both** full-time and part-time employees, other than yourself, including family members and active partners (if none, you must enter "0").

_____ Full-time Employees _____ Part-time Employees

Name of Business		Federal ID (or) Social Security No.	
Address		Telephone ()	
City	State	ZIP	

I hereby certify that the above information is true and correct. I agree to notify the Michigan DNR of any changes that occur in factors affecting my coverage during any of my present and future operations.

Signature of Owner or Authorized Representative

_____ _____
Title Date

Please complete the "SEALED BID" information on the next page

Roy Creek Mix (72-017-16)
; Alcona COUNTY

In response to the notice of sale to be held 9:00 a.m. (local time) on May 22, 2018, I am hereby submitting my sealed bid (firm offer) for the following forest products to be cut. Bids for individual species must be at or above the advertised price. All non-responsive bid forms may be rejected.

<u>PRODUCTS & SPECIES</u>	<u>ESTIMATED VOLUME*</u>	<u>ADVERTISED PRICE</u>	<u>BID PRICE/UNIT</u>
Sawtimber			
B. T. Aspen	112.70 MBF	\$ 80.00/MBF	\$ _____
Northern Pin Oak	19.40 MBF	\$ 248.00/MBF	\$ _____
Red Pine	4.10 MBF	\$ 123.00/MBF	\$ _____
White Oak	1.40 MBF	\$ 62.00/MBF	\$ _____
Pulpwood			
Balsam Fir	55.00 Cords	\$ 13.55/Cord	\$ _____
Black Spruce	7.00 Cords	\$ 28.05/Cord	\$ _____
Jack Pine	622.00 Cords	\$ 12.30/Cord	\$ _____
Mixed Aspen	273.00 Cords	\$ 20.20/Cord	\$ _____
Mixed Oak	614.00 Cords	\$ 12.60/Cord	\$ _____
Paper Birch	23.00 Cords	\$ 9.45/Cord	\$ _____
Red Maple	270.00 Cords	\$ 18.30/Cord	\$ _____
Red Pine	6.00 Cords	\$ 45.35/Cord	\$ _____
White Pine	82.00 Cords	\$ 19.95/Cord	\$ _____

*The volumes are statistically estimated within plus (+) or minus (-) 11.71 percent. These estimated volumes are final and not subject to adjustment. Prospective bidders are urged to examine this timber and to make their own estimates of quantity and quality.

I understand that any or all bids may be rejected. All bids must be signed and all bid items must be bid or the bid form may be rejected. I also understand that consideration and awarding a contract will be based upon my past performance and ability to complete the contract based upon equipment and staffing subject to my control.

FEDERAL ID: _____ or SOCIAL SECURITY NUMBER: _____

Company or individual bidding: _____

Company representative's name: _____

Address: _____

City: _____ State: _____ Zip: _____

IF AVAILABLE, PLEASE PLACE THE PERSONALIZED LABEL FROM YOUR PROSPECTUS IN THE ABOVE BOX.

Individual or company representative's signature: _____ Date: _____

Phone number : _____ Email (optional): _____

THE WINNING BIDDER MUST COMPLETE THE VERIFICATION OF WORKER'S DISABILITY COMPENSATION ACT COMPLIANCE (ON REVERSE SIDE IF DOUBLE SIDED) WITHIN 21 DAYS OF SALE AWARD DATE



FOR DEPARTMENT USE ONLY
Sale Number (XX - XXX - XX - XX)
Forest Management Unit:

TIMBER SALE VERIFICATION OF WORKER'S DISABILITY COMPENSATION ACT COMPLIANCE

*As required by Act 317, P.A. 1969 (Worker's Compensation) and
Part 5 of Act 451 of 1994, as amended.*

VERIFICATION OF WORKER'S DISABILITY COMPENSATION ACT COMPLIANCE

- This verification must be completed and submitted within 21 days of contract award and prior to the issuance of the timber sale contract.
- In addition, if boxes 2B or 2C are checked, then Notice of Exclusion or Certificate of Insurance must be submitted within twenty-one (21) days of the contract award and prior to the issuance of the timber sale contract.
- All information must be typed or printed except for written signatures.

Please Check Appropriate Categories:

1. My business is organized as (you **must** check one of the boxes below):
 - A. Sole Proprietorship (individual)
 - B. Partnership
 - C. Corporation

2. You **must** check one of the boxes below:
 - A. I certify my business is a sole proprietorship and it has no employees but the sole proprietor. I am not subject to the Worker's Compensation Laws.
 - B. I certify my business has satisfied its obligation to the Worker's Compensation Act through the use of an approved Notice of Exclusion (BWC-337, Rev. 5/96). I will provide a copy of the Notice of Exclusion within 21 days of the contract award. (For questions or a copy of the BWC-337, please call the Worker's Compensation Bureau at 517-322-1195).
 - C. I certify my business has a Worker's Compensation Policy. I will provide an original Certificate of Insurance within twenty-one (21) days of the contract award.

3. If you have checked item 2(A) or 2(B), you **must** indicate the number of **both** full-time and part-time employees, other than yourself, including family members and active partners (if none, you must enter "0").

_____ Full-time Employees

_____ Part-time Employees

Name of Business		Federal ID (or) Social Security No.	
Address		Telephone ()	
City	State	ZIP	

I hereby certify that the above information is true and correct. I agree to notify the Michigan DNR of any changes that occur in factors affecting my coverage during any of my present and future operations.

Signature of Owner or Authorized Representative

Title

Date

Please complete the "SEALED BID" information on the next page