



**DEPARTMENT OF NATURAL RESOURCES
STATE OF MICHIGAN**

TIMBER SALE PROSPECTUS #6050

SCHEDULED SALE DATE AND TIME: 4:00 p.m. (local time) on May 10, 2018.

LOCATION: TRAVERSE CITY MGMT UNIT, 2122 M 37 SOUTH, TRAVERSE CITY, MI 49685.

PROSPECTUS NOTE: The bidder is advised to inspect the sale area and review the location, estimated volumes, operating costs and contract terms of proposed sales. Please be aware that some landowners may request 60 days or more notice for access across their land.

Notice is hereby given that bids will be received by the Unit Manager, TRAVERSE CITY MANAGEMENT UNIT, for certain timber on the following described lands:

Spagetti Red (61-047-17)

Grand Traverse County, Advertised Price \$75,431.65, 31.9 Acres, Hardwood, Red Pine.

SALE NOTE: Final harvest of red pine strips. Chipping of tops required for re-planting.

Iron Age Red (61-051-17)

Grand Traverse County, Advertised Price \$90,507.85, 38.6 Acres, Red Pine, White Pine.

SALE NOTE: Red pine Final Harvest. Good quality pine. Tree length chipping job required. 1" cutting specification.

Turtle Lake Hardwoods (61-055-17)

Benzie County, Advertised Price \$39,343.10, 86.9 Acres, Aspen, Hardwood.

SALE NOTE: A recreation site such as a trail, pathway, or campground is within the sale area or the vicinity. Certain restrictions/specifications may be applicable including time restrictions.

Hermit Hardwood (61-057-17)

Benzie County, Advertised Price \$185,120.75, 220.0 Acres, Hardwood, Sugar Maple.

SALE NOTE: A recreation site such as a trail, pathway, or campground is within the sale area or the vicinity. Certain restrictions/specifications may be applicable including time restrictions.

Gradient Mix (61-072-17)

Grand Traverse County, Advertised Price \$4,631.50, 8.1 Acres, Hardwood, White Pine.

SALE NOTE: Small sale with mixed products. Good access.

Big Four Aspen (61-086-17)

Benzie County, Advertised Price \$54,763.15, 120.0 Acres, Aspen, Hardwood.

SALE NOTE: A recreation site such as a trail, pathway, or campground is within the sale area or the vicinity. Certain restrictions/specifications may be applicable including time restrictions.

BID INSTRUCTIONS (VER. 11/28/2017):

1. Scheduled Bid Location, Date, and Time (2/11)

Bids must be received by the Unit Manager, TRAVERSE CITY OFFICE, 2122 M 37 SOUTH, TRAVERSE CITY, MI 49685, no later than 4:00 p.m. (local time) on May 10, 2018. For further information concerning this sale, contact David Lemmien at 231-922-5280 extension 6840.

2. Bidder's Qualifications (5/16)

Purchaser shall obtain workers compensation insurance to cover claims under Michigan's Worker's Disability Compensation Act of 1969 or similar employee benefit act of any other state applicable to an employee. If all or part of a timber sale was prepared by a private contractor, the contractor and that contractor's company are not permitted to bid on the timber sale contract. Bids will not be accepted from individuals or companies appearing on the DNR/FRD No-Bid List. This list contains the names of purchasers who previously failed to execute a contract within 21-days or who have a history of poor performance.

3. Preparation of Sealed Bids (5/16)

Bid Forms may be completed online thru Michigan DNR Timber Sale Online Bidding (OLB) at www.michigan.gov/timberbidding or by completing the hardcopy Bid Form found in the Timber Sale Prospectus. Hardcopy Bid Forms shall be manually signed in ink. Registration in OLB is considered your 'signature' for all bids submitted thru that system. Bid prices must be entered for each species and product in the Bid Price column for all material subject to bidding and all fill-in blanks must be completed. If erasures or other changes appear on the hardcopy Bid Form, each erasure or change must be initialed by the person signing the bid.

4. Submission of Sealed Bids (5/16)

Bid forms may be obtained from the Unit Manager or thru OLB. Bids may be submitted hardcopy or thru OLB. All hardcopy bids must be submitted on the bid form and in an envelope clearly identified as described in this section. NOTE: Only one bid form per bid envelope. Sealed bids must be submitted to the Unit office designated in the prospectus and must be submitted at or prior to the time established in the prospectus. The envelope should show on the outside (a) the sale name or number and (b) the date and time of bid opening, as shown in the prospectus. Bids received after the time specified in the sale prospectus are late bids and will be rejected.

It is possible for a bidder to submit multiple bids on a single sale. For example, a bid may be submitted hardcopy and a bid may be submitted thru OLB. Or, two bidders from the same company could both submit bids on the same sale. If this were to happen, the State would accept all bids received and award the contract accordingly. All bidding and contractual requirements would apply to all bids received.

5. Public Opening of Sealed Bids (7/16)

If conditions permit, the sealed bids will be publicly opened and posted at the time and place set in the prospectus.

If a bidder, present at a bid opening, has submitted bids on more than one sale, that bidder may withdraw their unopened bid envelopes or announce the withdrawal of their online bid after being declared the successful bidder on one sale.

6. Award of Contract (1/11)

Award of the contract will be made to the Bidder whose bid, conforming to the prospectus, is most advantageous to the State of Michigan on the basis of total value at rates bid for the estimated quantities. The State reserves the right to reject any bid or waive any minor irregularity in bids received. A written award mailed (or otherwise furnished) to the successful Bidder shall be deemed to result in a binding contract without further action by either party.

7. Down Payment (1/11)

The Bidder to whom award is made must make a down payment within 21 days of the sale award. The amount of the down payment will be calculated as shown in the Bond and Payment Schedule of this prospectus. Only cash may be used to meet this requirement.

8. Performance Security (1/11)

As guarantee of faithful performance, a cash bond, certificate of deposit, surety bond or irrevocable letter of credit (LOC) is required within 21 days of the sale award. The amount of the performance security is shown in the Bond and

Payment Schedule of this prospectus. If an LOC or surety is used, the coverage must extend for at least 6 months beyond the contract expiration.

9. Timber Sale Contract (11/17)

Additional conditions and requirements common to all timber sales are listed on the timber sale contract (R4031) and are available on line at www.michigan.gov/timber. Contact the Unit Manager for additional information or a sample contract. Within 21 days of the date of the award letter, the bidder must sign the contract and provide the required down payment, performance security, and verification of worker's disability compensation. The down payment and performance security shall be in accordance with the provisions of the timber sale contract, in the sums stated in this prospectus. If these actions are not taken, then the Bidder, the Bidder's corporation, and the corporation's principals may not be permitted to bid on State timber sales for a period of 1 year. In addition, the Bidder certifies that if awarded this contract, the Bidder will complete the timber sale contract in accordance with its terms and any modifications thereof including requirements to purchase, cut, and remove the included timber by the expiration date.

Payment Unit values in the State Forest Timber Sale Contract are calculated based on the advertised value of the Payment Unit as a percentage of the total advertised value of the contract. The advertised value of each Payment Unit is given in the Description of Timber by Payment Unit table on the Timber Sale Information page. For example, if the value of Payment Unit 1 is advertised as \$1,500 and the total Timber Sale value is advertised as \$10,000, the contract price for Payment Unit 1 will be 15% of the total bid price ($\$1,500/\$10,000 * 100$).

10. Disclaimer of Estimates and Bidder's Warranty of Inspection (7/16)

Before submitting this bid, the Bidder is advised and cautioned to inspect the sale area, review the requirements of the sale contract, and take other steps as may be reasonably necessary to ascertain the location, estimated volumes, construction estimates, and operating costs of the proposed sale. Failure to do so will not relieve the Bidder from responsibility for completing the contract.

The Bidder warrants that this bid is submitted solely on the basis of the Bidder's examination and inspection of the quality and quantity of the timber offered for sale and the Bidder's opinion of the value thereof and the costs of recovery. No reliance should be placed on the State of Michigan's estimates of timber quality, quantity or costs of recovery. Bidder further acknowledges that the State of Michigan: (i) expressly disclaims any warranty of fitness of timber for any purpose; (ii) offers this timber as is without any warranty of quality (merchantability) or quantity and (iii) expressly disclaims any warranty as to the quantity or quality of timber sold.

11. Certification and Chain-of-Custody (10/14)

Unless otherwise indicated in the contract under section 7 – Other Conditions of the Sale Specific Conditions & Requirements, the area encompassed by this timber sale is certified to the standards of the Forest Stewardship Council (FSC) - Certificate #SCS-FM/COC-00090N and the Sustainable Forestry Initiative (SFI) - Certificate # NSF-SFIS-5Y031-SF5. Forest products from this sale may be delivered to the mill as "FSC 100% and / or SFI certified" as long as the contractor hauling the forest products is chain-of-custody (COC) certified or covered under a COC certificate from the destination mill. The purchaser is responsible for maintaining COC after leaving the sale area.

12. Good Neighbor Authority (GNA) Requirements (7/16)

If the name of this timber sales contains the acronym GNA, it is authorized by the Good Neighbor Authority (GNA) and covered by various agreements between the U.S. Forest Service and the State. The timber sale occurs on federal land and the following conditions apply:

GNA contracts on US Forest Service land will not be awarded to purchasers on the Federal list of excluded parties. The System for Award Management (SAM) will be checked for active excluded parties prior to award of contract. In addition, the Bidder to whom award is made must complete an Assurance Regarding Felony Conviction or Tax Delinquent Status for Corporate Applicants (AD-3031).

13. Good Neighbor Authority (GNA) Requirements, con't (9/16)

Bidder certifies, by signing this bid form, that to the best of Bidder's knowledge that the following representations are accurate and complete.

a. That the Bidder and its principals are not presently debarred, suspended, proposed for debarment, declared ineligible, or voluntary excluded from timber sales (covered transactions) by any Federal department or agency.

b. That the Bidder and its principals have not within a 3-year period preceding this bid been convicted of or had a civil judgment rendered against them for commission of fraud or a criminal offense in connection with obtaining, attempting to obtain, or performing a public (Federal, State, or local) transaction or contract under a public transaction; violation of Federal or State antitrust statutes or commission of embezzlement, theft, forgery, bribery, falsification or destruction of records, making false statements, or receiving stolen property.

c. That the Bidder and its principals are not presently indicted for or otherwise criminally or civilly charged by a governmental entity (Federal, State, or local) with commission of any of the offenses enumerated in paragraph b of this certification.

d. That the Bidder and its principals have not within a 3-year period preceding this bid had one or more public transactions (Federal, State, or local) terminated for breach or default of a timber or forest product contract.

Bidders that cannot certify this requirement, in whole or in part, shall submit an explanation with their bid.

KEITH CREAGH

Director

TIMBER SALE INFORMATION

Spagetti Red (61-047-17)

Grand Traverse County (Advertised Price \$75,431.65)

SALE NOTE: Final harvest of red pine strips. Chipping of tops required for re-planting.

A timber sale contract for this lump sum, sealed bid timber sale will be awarded to the responsible bidder offering the highest sealed bid price. Bids must be at or above the following advertised price for each species:

<u>PRODUCTS & SPECIES</u>	<u>ESTIMATED UNITS*</u>	<u>ADVERTISED PRICE</u>
Sawtimber		
Red Oak	0.70 MBF	\$ 205.00 / MBF
Red Pine	356.40 MBF	\$ 117.00 / MBF
Pulpwood		
B. T. Aspen	2.00 Cords	\$ 20.65 / Cord
Jack Pine	4.00 Cords	\$ 15.55 / Cord
Mixed Hardwood	15.00 Cords	\$ 20.05 / Cord
Red Oak	1.00 Cords	\$ 17.40 / Cord
Red Pine	807.00 Cords	\$ 41.10 / Cord

* The total volume is statistically estimated within plus (+) or minus (-) 12.00 percent. The estimated units are final and not subject to adjustment. Prospective bidders are urged to examine this timber and to make their own estimates of quantity and quality.

BOND AND PAYMENT SCHEDULE:

- A bond in the amount of \$3,772.00 to insure faithful performance of the conditions of the contract will be deposited by the successful bidder within 21 days of the sale award.
- Cutting in any sale or unit without the required advance payment would be considered a trespass.
- Total payment must be paid in advance or according to the following schedule:
 - Ten percent (10%) of the sale value must be paid within 21 days of the sale award.
 - The 10% down payment will be credited towards the first unit cut.
 - Payment for each of the following units must be made before cutting begins in that unit:

PAYMENT UNIT NUMBER	PERCENT OF TOTAL SALE VALUE
01	57.3%
02	42.7%
- If no cutting takes place, the 10% down payment will not be refunded.
- Operations on the contract issued will terminate on 06/30/2020.

Description of Timber by Payment Unit (PU)

PU	MARKET GROUP	PRODUCT	QUANTITY	UNIT	ACRES	ADVERTISE PRICE
1	Red Pine	Sawtimber	220.8	MBF	16.3	\$43,190.85
	Mixed Hardwood	Pulpwood	15.0	Cords		
	<i>Black Cherry</i>		13.0	<i>Cords</i>		
	<i>Sugar Maple</i>		2.0	<i>Cords</i>		
	Red Pine		415.0	Cords		
2	Red Oak	Sawtimber	0.7	MBF	15.6	\$32,240.80
	Red Pine		135.6	MBF		
	B. T. Aspen	Pulpwood	2.0	Cords		
	Jack Pine		4.0	Cords		
	Red Oak		1.0	Cords		
	Red Pine		392.0	Cords		
	TOTAL:			357.1		
TOTAL:			829.0	Cords		

Sale Specific Conditions & Requirements

Sale Name: Spagetti Red

Sale Number: 61-047-17 Seq#: 1

1 - Sale Area

1.2 - Boundaries

1.2.1 - Painted boundaries (1/14)

The sale boundary and Payment Unit boundaries are marked and identified red paint. Exterior sale boundary lines against state are marked with red paint. Interior Payment Unit boundaries are marked with red paint (see Timber Sale Map). The painted boundary line trees are not Included Timber and are to be protected but cut any merchantable red pine marked as boundary trees.

2 - Timber Specifications

2.1 - Included Timber

2.1.1 - Clearcut unit(s) with unmerchantable trees (6/14)

Within Payment Unit(s) 1 and 2, cut all trees that are two (2) inches or more at DBH.

2.1.11 - Description of timber note (2/04)

Note that Mixed Hardwood pulp includes black cherry and sugar maple pulpwood.

2.2 - Utilization

2.2.2 - Chipping required (5/14)

This area must be chip harvested to facilitate subsequent planting operations. The Purchaser has the option to produce sawlogs or pulpwood bolts, but the remaining portion of the trees must be chipped and hauled. Products may be produced as roundwood and forwarded to decking areas in final product length, but the tops must be left intact and skidded to the landing for chipping in order to minimize the amount of residual slash left areas. The requirement to retain approximately 1/6 to 1/3 of tree tops and limbs less than four inches in diameter does not apply (G. C. & R. 2.2). This is because slash would interfere with planting operations.

2.2.3 - Stump heights (4/07)

Stump heights within the Sale Area shall not exceed 6 inches for all trees. This is in order to facilitate planting operations.

4 - Transportation

4.1 - Construction

4.1.12 - No new roads (1/12)

No new roads will be permitted in any Payment Unit. All operations are limited to existing roads. Skid trails only will be allowed.

4.2 - Maintenance

4.2.5 - Two wheel drive condition (2/04)

All existing trail roads on and adjacent to the sale area must be passable by two-wheel drive traffic for the duration of the sale.

5 - Operations

5.1 - Notification

5.1.1 - Pre-sale conference (10/16)

A pre-sale conference on site between the Purchaser and sale administrator is required prior to beginning any operations to determine landing and road locations. The Unit Manager or his/her representative must be contacted at least 3 days in advance to schedule the conference.

5.1.4 - Post-sale conference (10/16)

A post-sale conference on site between the Purchaser and sale administrator is required 3 days prior to the completion of

active logging operations to determine clean-up and repair of landings, road edges, and the fulfillment of other contract specifications.

5.2 - Conduct of Operations

5.2.38 - No decking against live trees (2/04)

Cut products may not be decked against unmarked or designated leave trees.

5.4 - Soil Protection

5.4.1 - Rutting restriction, general (7/16)

Operations are to cease immediately if equipment and weather conditions result in rutting of roads and/or skid trails which is 12 inches or greater in depth and 50 feet in length. The Unit Manager or his/her representative may restrict hauling and/or skidding if ruts exceed the specified depth. With the Unit Manager or his/her representative's approval, the Purchaser may return to the area when the risk of rutting has decreased.

6 - Safety and Fire Prevention

6.2 - Signing

6.2.1 - Road posting (9/09)

The Purchaser is responsible for posting and maintaining caution signs on Moore Road prior to beginning operations. The road must be posted at appropriate distances from the sale area to warn of logging activity and truck traffic. Signs must be removed when harvest operations are suspended or completed. The Purchaser will provide these signs.



TIMBER SALE MAP

This information provided by authority of Part 525, 1994 PA 451, as amended.

Sale Number	Year
61-047	17

Forest Management Unit Traverse City	County Grand Traverse	Mapped By Ruppen	Date 09/14/2017	Page 1	of 1
		Cruised By Ruppen			

Township 27N	Range 9W	Section(s) and Subdivision(s) Sec 8 SE 1/4	Scale 1:7,920
-----------------	-------------	---	------------------

Cover Type				Density	
A = Aspen	H = Hemlock	N = Marsh	U = Upland Brush	0 = Non Stocked	5 = Pole Timber Medium
B = Paper Birch	J = Jack Pine	O = Oak	UM = Upland Mixed	1 = Seedling Sapling Poor	6 = Pole Timber Well
C = Cedar	L = Lowland Brush	P = Lowland Poplar	V = Bog or Marsh	2 = Seedling Sapling Medium	7 = Saw Timber Poor
D = Tread Bog	LM = Lowland Mixed	Q = Mixed Swamp Conifer	W = White Pine	3 = Seedling Sapling Well	8 = Saw Timber Medium
E = Swamp Hdwoods	M = Mpl, Bch, Brch	R = Red Pine	X = Non Stocked	4 = Pole Timber Poor	9 = Saw Timber Well
F = Spruce Fir	MC = Mixed Conifer	S = Black Spruce	Z = Water		
G = Grass	MD = Mixed Deciduous	T = Tamarack			

PU	Acres
1	16.3
2	15.6

Spagetti Red Compartment 041 31.9 Acres

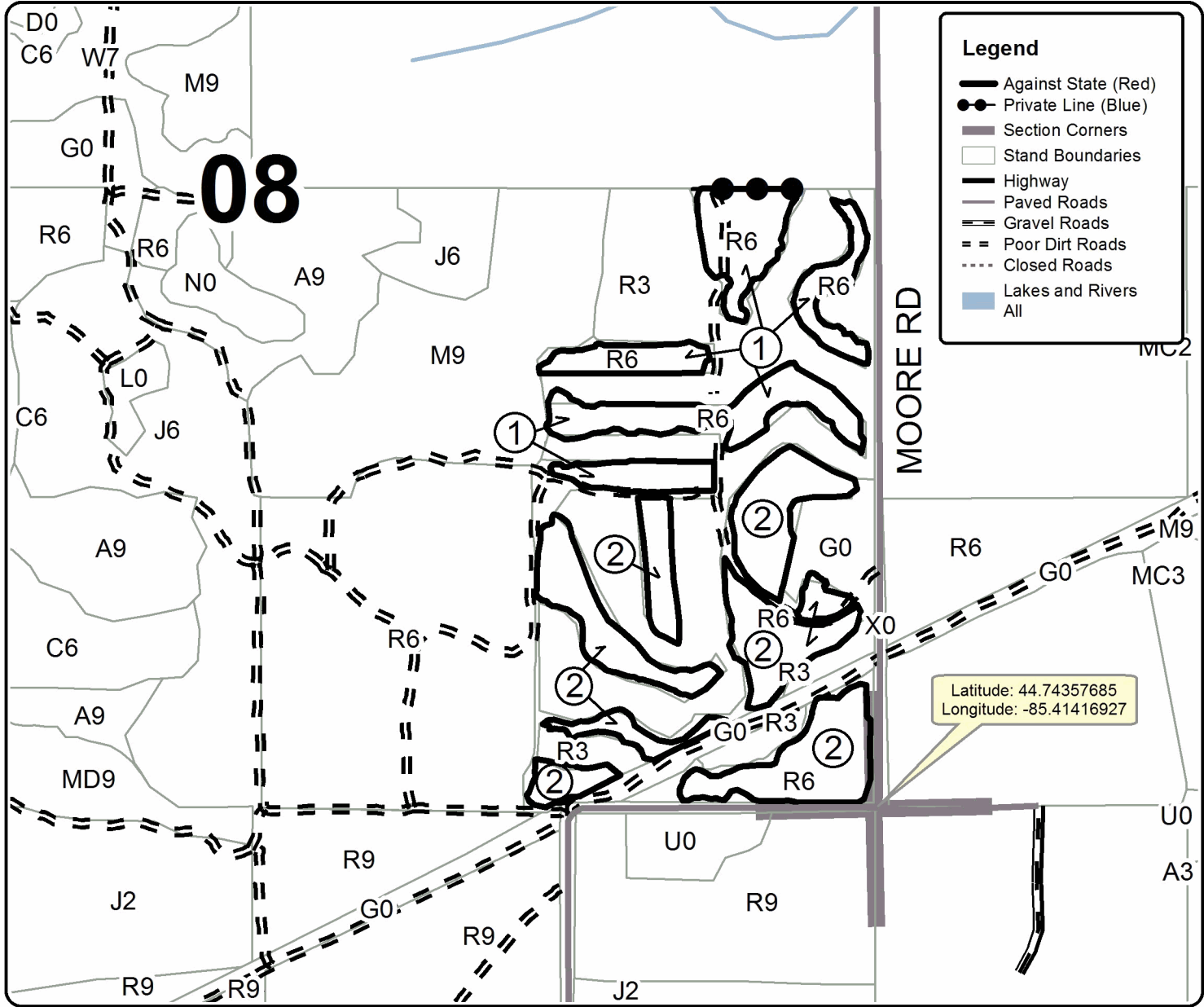
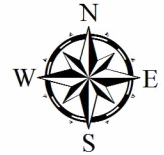

TIMBER SALE INFORMATION

Iron Age Red (61-051-17)

Grand Traverse County (Advertised Price \$90,507.85)

SALE NOTE: Red pine Final Harvest. Good quality pine. Tree length chipping job required. 1" cutting specification.

A timber sale contract for this lump sum, sealed bid timber sale will be awarded to the responsible bidder offering the highest sealed bid price. Bids must be at or above the following advertised price for each species:

<u>PRODUCTS & SPECIES</u>	<u>ESTIMATED UNITS*</u>	<u>ADVERTISED PRICE</u>
Sawtimber		
Red Oak	1.30 MBF	\$ 205.00 / MBF
Red Pine	461.50 MBF	\$ 117.00 / MBF
Sugar Maple	1.30 MBF	\$ 263.00 / MBF
White Pine	7.80 MBF	\$ 61.00 / MBF
Pulpwood		
Mixed Hardwood	18.00 Cords	\$ 20.05 / Cord
Red Oak	3.00 Cords	\$ 17.40 / Cord
Red Pine	848.00 Cords	\$ 41.10 / Cord
White Pine	11.00 Cords	\$ 14.75 / Cord

* The total volume is statistically estimated within plus (+) or minus (-) 9.80 percent. The estimated units are final and not subject to adjustment. Prospective bidders are urged to examine this timber and to make their own estimates of quantity and quality.

BOND AND PAYMENT SCHEDULE:

1. A bond in the amount of \$4,525.00 to insure faithful performance of the conditions of the contract will be deposited by the successful bidder within 21 days of the sale award.
2. Cutting in any sale or unit without the required advance payment would be considered a trespass.
3. Total payment must be paid in advance or according to the following schedule:
 - (a) Ten percent (10%) of the sale value must be paid within 21 days of the sale award.
 - (b) The 10% down payment will be credited towards the first unit cut.
 - (c) Payment for each of the following units must be made before cutting begins in that unit:

<u>PAYMENT UNIT NUMBER</u>	<u>PERCENT OF TOTAL SALE VALUE</u>
01	30.7%
02	34.8%
03	34.5%
4. If no cutting takes place, the 10% down payment will not be refunded.
5. Operations on the contract issued will terminate on 06/30/2020.

Description of Timber by Payment Unit (PU)

PU	MARKET GROUP	PRODUCT	QUANTITY	UNIT	ACRES	ADVERTISE PRICE	
1	Red Oak	Sawtimber	1.3	MBF	11.3	\$27,815.55	
	Red Pine		135.6	MBF			
	Sugar Maple		1.3	MBF			
	White Pine		4.5	MBF			
	Mixed Hardwood		Pulpwood	18.0			Cords
	<i>Black Cherry</i>			16.0			<i>Cords</i>
	<i>Sugar Maple</i>			2.0			<i>Cords</i>
	Red Oak		3.0	Cords			
	Red Pine		256.0	Cords			
	White Pine		9.0	Cords			
2	Red Pine	Sawtimber	154.2	MBF	12.9	\$31,440.00	
	Red Pine	Pulpwood	326.0	Cords			
3	Red Pine	Sawtimber	171.7	MBF	14.4	\$31,252.30	
	White Pine		3.3	MBF			
	Red Pine	Pulpwood	266.0	Cords			
	White Pine		2.0	Cords			
TOTAL:			471.9	MBF			
TOTAL:			880.0	Cords			

Sale Specific Conditions & Requirements

Sale Name: Iron Age Red

Sale Number: 61-051-17 Seq#: 1

1 - Sale Area

1.2 - Boundaries

1.2.1 - Painted boundaries (1/14)

The sale boundary and Payment Unit boundaries are marked and identified by red and yellow paint. Exterior sale boundary lines against state are marked with red paint. Interior Payment Unit boundaries are marked with yellow paint. Yellow painted trees designating an interior Payment Unit boundary are only to be cut when all surrounding Payment Units have been paid.

2 - Timber Specifications

2.1 - Included Timber

2.1.1 - Clearcut unit(s) with unmerchantable trees (6/14)

Within Payment Unit(s) 1-3, cut all trees that are one (1) inch or more at DBH.

2.1.11 - Description of timber note (2/04)

Note that Mixed Hardwood pulp includes black cherry and sugar maple pulpwood.

2.2 - Utilization

2.2.2 - Chipping required (5/14)

This area must be chip harvested to facilitate subsequent planting operations. The Purchaser has the option to produce sawlogs or pulpwood bolts, but the remaining portion of the trees must be chipped and hauled. The requirement to retain approximately 1/6 to 1/3 of tree tops and limbs less than four inches in diameter does not apply (G. C. & R. 2.2). This is because this would hinder planting operations.

2.2.3 - Stump heights (4/07)

Stump heights within the Sale Area shall not exceed 6 inches for all trees. This is in order to facilitate planting operations.

2.2.4 - Skidding length (2/14)

Tree length skidding is required.

4 - Transportation

4.1 - Construction

4.1.12 - No new roads (1/12)

No new roads will be permitted in any Payment Unit. All operations are limited to existing roads. Skid trails only will be allowed.

4.2 - Maintenance

4.2.2 - Fill material (4/07)

To maintain roads, fill material may be needed in areas where "holes" exist or may be expected to develop. This fill material should be placed before trucking begins.

4.2.4 - Grading (10/16)

For completion of the sale, state forest roads must be graded. In general, this will require a road grader or bull dozer to shape up the roads after forest products have been hauled off site. This includes cleaning of drainage areas, grading, crowning and filling with gravel, if necessary. The grading equipment to be used must be approved by the Unit Manager or his/her representative.

4.2.5 - Two wheel drive condition (2/04)

All existing trail roads on and adjacent to the sale area must be passable by two-wheel drive traffic for the duration of the sale.

5 - Operations

5.1 - Notification

5.1.1 - Pre-sale conference (10/16)

A pre-sale conference on site between the Purchaser and sale administrator is required prior to beginning any operations to determine landing and road locations. The Unit Manager or his/her representative must be contacted at least 3 days in advance to schedule the conference.

5.1.4 - Post-sale conference (10/16)

A post-sale conference on site between the Purchaser and sale administrator is required 3 days prior to the completion of active logging operations to determine clean-up and repair of landings, road edges, and the fulfillment of other contract specifications.

5.2 - Conduct of Operations

5.2.3 - Operating Restrictions

5.2.3.4 - Oak wilt restriction (9/17)

Within Payment Unit(s) 1-3, unless changed by written agreement, cutting, skidding, hauling and brushing of access roads are not permitted during the period of April 15 to July 15. Operations may be allowed if specific steps are taken to prevent damaging uncut oak during the high risk period. Those steps include completing all road brushing before April 15th, clearing a tree-length buffer along uncut oak cover before April 15th or leaving an uncut buffer there until after July 15th. This is necessary to reduce the spread of oak wilt. For more information, contact the Unit Manager or his/her representative. This requirement could be easily accomplished for this sale

5.2.38 - No decking against live trees (2/04)

Cut products may not be decked against unmarked or designated leave trees.

5.4 - Soil Protection

5.4.1 - Rutting restriction, general (7/16)

Operations are to cease immediately if equipment and weather conditions result in rutting of roads and/or skid trails which is 12 inches or greater in depth and 50 feet in length. The Unit Manager or his/her representative may restrict hauling and/or skidding if ruts exceed the specified depth. With the Unit Manager or his/her representative's approval, the Purchaser may return to the area when the risk of rutting has decreased.



TIMBER SALE MAP

This information provided by authority of Part 525, 1994 PA 451, as amended.

Forest Management Unit Traverse City	County Grand Traverse	Mapped By Ruppen	Date 09/26/2017	Page 1	of 1
Township 27N	Range 9W	Section(s) and Subdivision(s) Sec 15 N1/2NW, SWNW Sec 16 NENE	Scale 1:15,840		

Cover Type				Density	
A = Aspen	H = Hemlock	N = Marsh	U = Upland Brush	0 = Non Stocked	5 = Pole Timber Medium
B = Paper Birch	J = Jack Pine	O = Oak	UM = Upland Mixed	1 = Seedling Sapling Poor	6 = Pole Timber Well
C = Cedar	L = Lowland Brush	P = Lowland Poplar	V = Bog or Marsh	2 = Seedling Sapling Medium	7 = Saw Timber Poor
D = Treed Bog	LM = Lowland Mixed	Q = Mixed Swamp Conifer	W = White Pine	3 = Seedling Sapling Well	8 = Saw Timber Medium
E = Swamp Hdwoods	M = Mpl, Bch, Brch	R = Red Pine	X = Non Stocked	4 = Pole Timber Poor	9 = Saw Timber Well
F = Spruce Fir	MC = Mixed Conifer	S = Black Spruce	Z = Water		
G = Grass	MD = Mixed Deciduous	T = Tamarack			

PU	Acres
1	11.3
2	12.9
3	14.4

Iron Age Red Compartment 41 38.6 Acres

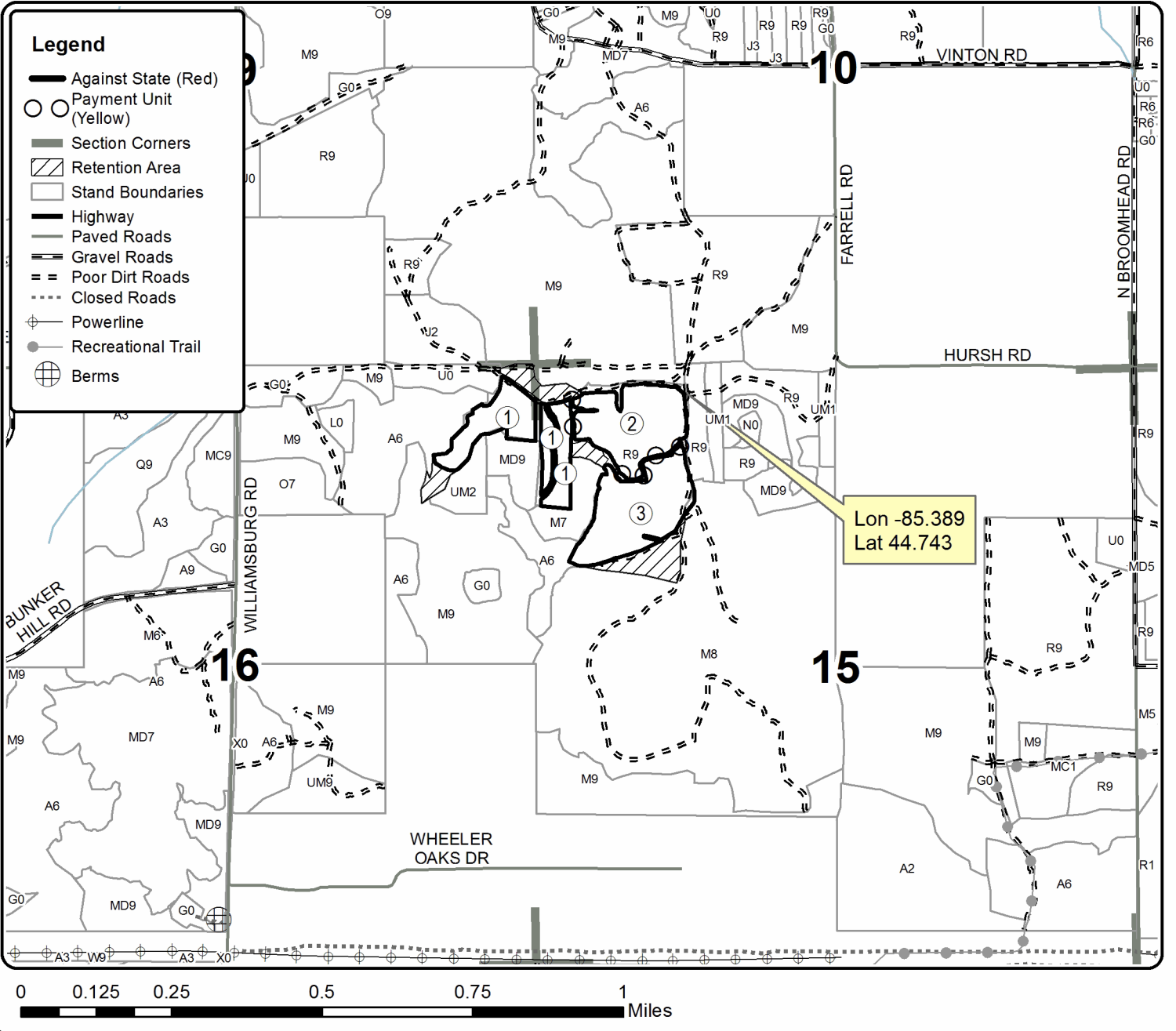
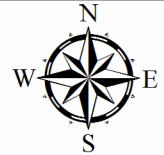

TIMBER SALE INFORMATION

Turtle Lake Hardwoods (61-055-17)

Benzie County (Advertised Price \$39,343.10)

SALE NOTE: A recreation site such as a trail, pathway, or campground is within the sale area or the vicinity. Certain restrictions/specifications may be applicable including time restrictions.

A timber sale contract for this lump sum, sealed bid timber sale will be awarded to the responsible bidder offering the highest sealed bid price. Bids must be at or above the following advertised price for each species:

<u>PRODUCTS & SPECIES</u>	<u>ESTIMATED UNITS*</u>		<u>ADVERTISED PRICE</u>
Sawtimber			
Basswood	36.20	MBF	\$ 120.00 / MBF
Beech	28.20	MBF	\$ 108.00 / MBF
Black Cherry	6.70	MBF	\$ 180.00 / MBF
Quaking Aspen	4.40	MBF	\$ 109.00 / MBF
Red Maple	82.50	MBF	\$ 115.00 / MBF
Red Oak	3.60	MBF	\$ 205.00 / MBF
Sugar Maple	21.60	MBF	\$ 263.00 / MBF
Pulpwood			
Basswood	63.00	Cords	\$ 29.80 / Cord
Mixed Hardwood	546.00	Cords	\$ 20.05 / Cord
Quaking Aspen	66.00	Cords	\$ 20.65 / Cord
Red Oak	10.00	Cords	\$ 17.40 / Cord

* The total volume is statistically estimated within plus (+) or minus (-) 17.21 percent. The estimated units are final and not subject to adjustment. Prospective bidders are urged to examine this timber and to make their own estimates of quantity and quality.

BOND AND PAYMENT SCHEDULE:

1. A bond in the amount of \$1,967.00 to insure faithful performance of the conditions of the contract will be deposited by the successful bidder within 21 days of the sale award.
2. Cutting in any sale or unit without the required advance payment would be considered a trespass.
3. Total payment must be paid in advance or according to the following schedule:
 - (a) Ten percent (10%) of the sale value must be paid within 21 days of the sale award.
 - (b) The 10% down payment will be credited towards the first unit cut.
 - (c) Payment for each of the following units must be made before cutting begins in that unit:

PAYMENT UNIT NUMBER	PERCENT OF TOTAL SALE VALUE
01	72.7%
02	27.3%
4. If no cutting takes place, the 10% down payment will not be refunded.
5. Operations on the contract issued will terminate on 06/30/2020.

Description of Timber by Payment Unit (PU)

PU	MARKET GROUP	PRODUCT	QUANTITY	UNIT	ACRES	ADVERTISE PRICE	
1	Basswood	Sawtimber	36.2	MBF	69.7	\$28,598.90	
	Beech		26.0	MBF			
	Black Cherry		3.1	MBF			
	Quaking Aspen		4.4	MBF			
	Red Maple		50.9	MBF			
	Red Oak		1.5	MBF			
	Sugar Maple		13.8	MBF			
	Basswood		Pulpwood	63.0			Cords
	Mixed Hardwood			404.0			Cords
	<i>Beech</i>	99.0		<i>Cords</i>			
	<i>Black Cherry</i>	21.0		<i>Cords</i>			
	<i>Red Maple</i>	157.0		<i>Cords</i>			
	<i>Sugar Maple</i>	127.0		<i>Cords</i>			
	Quaking Aspen		26.0	Cords			
	Red Oak		6.0	Cords			
2	Beech	Sawtimber	2.2	MBF	17.2	\$10,744.20	
	Black Cherry		3.6	MBF			
	Red Maple		31.6	MBF			
	Red Oak		2.1	MBF			
	Sugar Maple		7.8	MBF			
	Mixed Hardwood		Pulpwood	142.0			Cords
	<i>Beech</i>	13.0		<i>Cords</i>			
	<i>Black Cherry</i>	9.0		<i>Cords</i>			
	<i>Ironwood</i>	1.0		<i>Cords</i>			
	<i>Red Maple</i>	91.0		<i>Cords</i>			
	<i>Sugar Maple</i>	28.0		<i>Cords</i>			
	Quaking Aspen			40.0	Cords		
	Red Oak		4.0	Cords			
TOTAL:			183.2	MBF			
TOTAL:			685.0	Cords			

Sale Specific Conditions & Requirements

Sale Name: Turtle Lake Hardwoods

Sale Number: 61-055-17 Seq#: 1

1 - Sale Area

1.2 - Boundaries

1.2.1 - Painted boundaries (1/14)

The sale boundary and Payment Unit boundaries are marked and identified by red paint. Exterior sale boundary lines against state are marked with red paint. The painted boundary line trees are not Included Timber and are to be protected.

2 - Timber Specifications

2.1 - Included Timber

2.1.3 - Cut tree marked unit(s) (12/08)

Within Payment Unit(s) 1 and 2, all trees are designated for cutting when marked with orange paint above and below stump height, regardless of merchantability. In addition, beech and ironwood saplings (less than 4.5" at DBH) may be cut as needed to facilitate harvesting of Included Timber, but must be severed at ground level and laid flat on the ground, not just broken, bent, or pushed over.

2.2 - Utilization

2.2.4 - Skidding length (2/14)

Skidding of unlimbed tops or lengths over 17 feet is not permissible within Payment Units 1 and 2, unless approved by the Unit Manager or his/her representative.

4 - Transportation

4.1 - Construction

4.1.3 - Slash and earthen piles (8/04)

Piles or windrows of earth along roads and landings that have been widened or constructed shall be leveled. Slash from road maintenance or construction, including stumps, shall be dispersed throughout the sale, unless other arrangements are made with the sale administrator.

5 - Operations

5.2 - Conduct of Operations

5.2.1 - Slash

5.2.1.8 - Slash height (12/08)

No slash or tree tops may exceed 36 inches in height.

5.2.3 - Operating Restrictions

5.2.3.3 - Bark slippage restriction (3/09)

Within Payment Unit(s) 1 and 2, unless changed by written agreement, cutting and skidding are not permitted during the period of April 15 to July 15. This restriction is because of bark slippage.

5.2.3.4 - Oak wilt restriction (9/17)

Within Payment Unit(s) 1 and 2, unless changed by written agreement, cutting, skidding, hauling and brushing of access roads are not permitted during the period of April 15 to July 15. This is necessary to reduce the spread of oak wilt. For more information, contact the Unit Manager or his/her representative.

5.2.41 - Snowmobile trail protection (9/11)

The Betsie River trail is a snowmobile trail and is shown on the Timber Sale Map. Do not cut or damage posts with orange trail markers or traffic control signs. If the trail is used, it must be maintained and restored to a condition equal to or better than before the sale. The road maintenance/restoration must be done prior to December 1. If the trail is used for hauling, it must be graded to the satisfaction of the Unit Manager or his/her representative prior to December 1st. If the trail road is to

be used for hauling during the snowmobile season, then a snow covered base must be left on the trail. No decking of forest products will be permitted along the snowmobile trail.

6 - Safety and Fire Prevention

6.2 - Signing

6.2.2 - Snowmobile trail posting (8/09)

The Purchaser is responsible for posting and maintaining caution signs on the Betsie River trail prior to beginning operations during the snowmobile season (approximately December 1 to March 31). The trail must be posted at appropriate distances from the sale area to warn of logging activity and truck traffic. Signs must be removed when harvest operations are suspended or completed. The Purchaser will provide these signs.



TIMBER SALE MAP

This information provided by authority of Part 525, 1994 PA 451, as amended.

Forest Management Unit Traverse City	County Benzie	Mapped By Craig Allen	Date 9/25/2017	Page 1	of 1
Township 26N	Range 13W	Section(s) and Subdivision(s) Sec.28; S1/2SE, SESW, Sec.33; N1/2NE, S1/2NW, NENW, SWNE, NWSW	Scale 1:15,840		

Cover Type				Density	
A = Aspen	H = Hemlock	N = Marsh	U = Upland Brush	0 = Non Stocked	5 = Pole Timber Medium
B = Paper Birch	J = Jack Pine	O = Oak	UM = Upland Mixed	1 = Seedling Sapling Poor	6 = Pole Timber Well
C = Cedar	L = Lowland Brush	P = Lowland Poplar	V = Bog or Marsh	2 = Seedling Sapling Medium	7 = Saw Timber Poor
D = Tread Bog	LM = Lowland Mixed	Q = Mixed Swamp Conifer	W = White Pine	3 = Seedling Sapling Well	8 = Saw Timber Medium
E = Swamp Hdwoods	M = Mpl, Bch, Brch	R = Red Pine	X = Non Stocked	4 = Pole Timber Poor	9 = Saw Timber Well
F = Spruce Fir	MC = Mixed Conifer	S = Black Spruce	Z = Water		
G = Grass	MD = Mixed Deciduous	T = Tamarack			

PU	Acres
1	69.7
2	17.2

Turtle Lake Hardwoods

Compartment 17

86.9 Acres

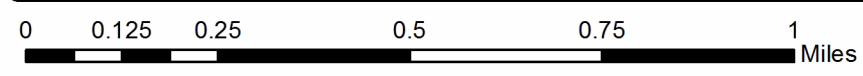
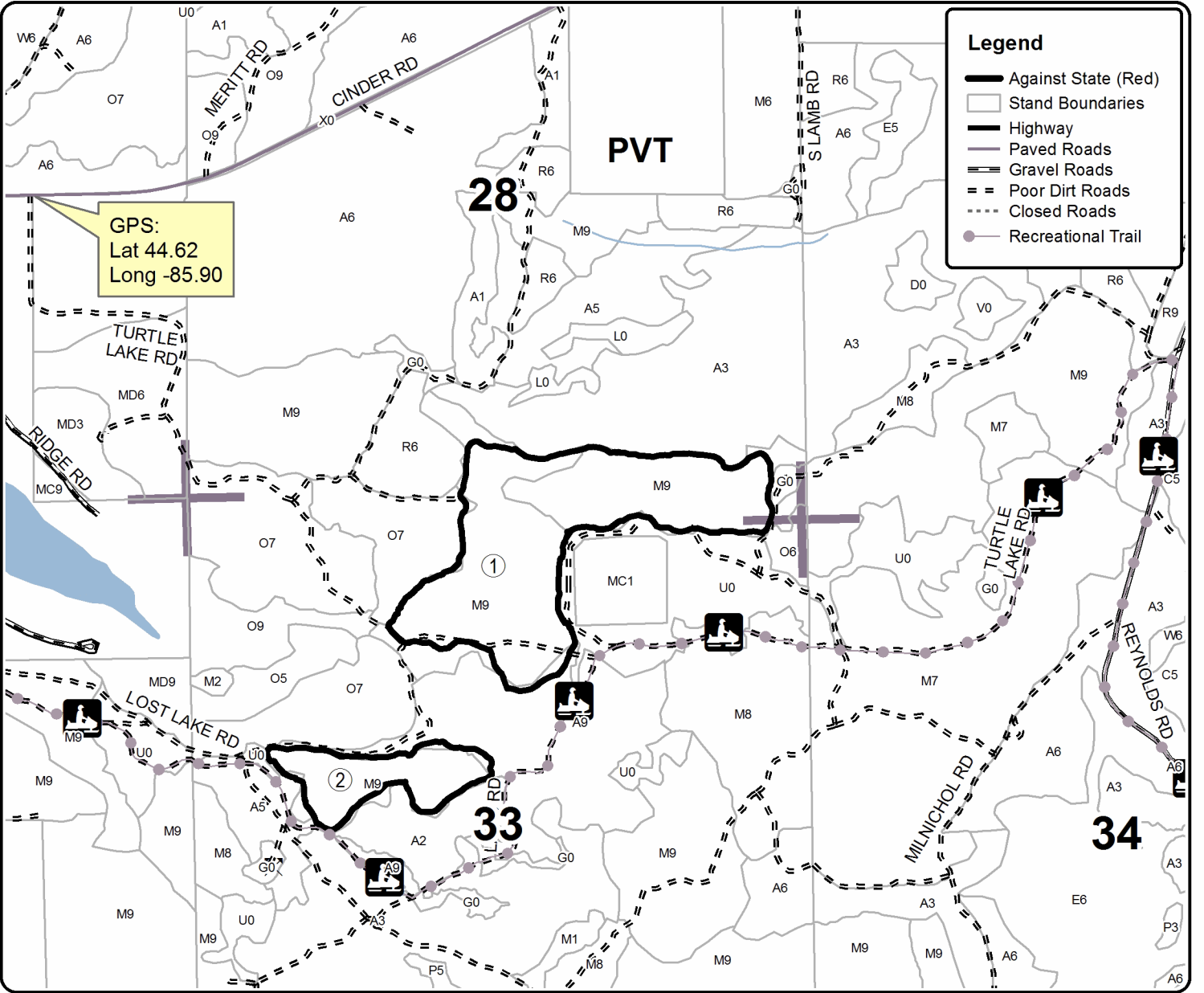

TIMBER SALE INFORMATION

Hermit Hardwood (61-057-17)

Benzie County (Advertised Price \$185,120.75)

SALE NOTE: A recreation site such as a trail, pathway, or campground is within the sale area or the vicinity. Certain restrictions/specifications may be applicable including time restrictions.

A timber sale contract for this lump sum, sealed bid timber sale will be awarded to the responsible bidder offering the highest sealed bid price. Bids must be at or above the following advertised price for each species:

<u>PRODUCTS & SPECIES</u>	<u>ESTIMATED UNITS*</u>	<u>ADVERTISED PRICE</u>
Sawtimber		
American Elm	3.80 MBF	\$ 60.00 / MBF
Basswood	282.20 MBF	\$ 104.00 / MBF
Beech	102.70 MBF	\$ 93.00 / MBF
Black Cherry	60.60 MBF	\$ 156.00 / MBF
Mixed Aspen	80.80 MBF	\$ 95.00 / MBF
Red Maple	155.30 MBF	\$ 100.00 / MBF
Sugar Maple	304.70 MBF	\$ 228.00 / MBF
Pulpwood		
Basswood	297.00 Cords	\$ 25.85 / Cord
Mixed Aspen	238.00 Cords	\$ 17.90 / Cord
Mixed Hardwood	893.00 Cords	\$ 17.35 / Cord
Sugar Maple	947.00 Cords	\$ 17.35 / Cord

* The estimated units are final and not subject to adjustment. Prospective bidders are urged to examine this timber and to make their own estimates of quantity and quality.

BOND AND PAYMENT SCHEDULE:

1. A bond in the amount of \$9,256.00 to insure faithful performance of the conditions of the contract will be deposited by the successful bidder within 21 days of the sale award.
2. Cutting in any sale or unit without the required advance payment would be considered a trespass.
3. Total payment must be paid in advance or according to the following schedule:
 - (a) Ten percent (10%) of the sale value must be paid within 21 days of the sale award.
 - (b) The 10% down payment will be credited towards the first unit cut.
 - (c) Payment for each of the following units must be made before cutting begins in that unit:

<u>PAYMENT UNIT NUMBER</u>	<u>PERCENT OF TOTAL SALE VALUE</u>
01	29.1%
02	31.2%
03	25.1%
04	14.6%
4. If no cutting takes place, the 10% down payment will not be refunded.
5. Operations on the contract issued will terminate on 06/30/2020.

Description of Timber by Payment Unit (PU)

PU	MARKET GROUP	PRODUCT	QUANTITY	UNIT	ACRES	ADVERTISE PRICE	
1	Basswood	Sawtimber	85.3	MBF	82.1	\$53,874.70	
	Beech		73.1	MBF			
	Black Cherry		4.7	MBF			
	Mixed Aspen		7.6	MBF			
	<i>Quaking Aspen</i>		7.6	<i>MBF</i>			
	Red Maple		10.7	MBF			
	Sugar Maple		87.3	MBF			
	Basswood		Pulpwood	116.0			Cords
	Mixed Aspen			45.0			Cords
	<i>B. T. Aspen</i>			7.0			<i>Cords</i>
	<i>Quaking Aspen</i>	38.0		<i>Cords</i>			
	Mixed Hardwood	301.0		Cords			
	<i>Beech</i>	213.0		<i>Cords</i>			
	<i>Black Cherry</i>	33.0		<i>Cords</i>			
	<i>Ironwood</i>	20.0	<i>Cords</i>				
	<i>Red Maple</i>	35.0	<i>Cords</i>				
	Sugar Maple	389.0	Cords				
2	Basswood	Sawtimber	91.1	MBF	48.1	\$57,878.80	
	Beech		12.8	MBF			
	Black Cherry		35.0	MBF			
	Mixed Aspen		43.4	MBF			
	<i>B. T. Aspen</i>		14.6	<i>MBF</i>			
	<i>Quaking Aspen</i>		28.8	<i>MBF</i>			
	Red Maple		2.0	MBF			
	Sugar Maple		117.4	MBF			
	Basswood		Pulpwood	82.0			Cords
	Mixed Aspen			109.0			Cords
	<i>B. T. Aspen</i>	7.0		<i>Cords</i>			
	<i>Quaking Aspen</i>	102.0		<i>Cords</i>			
	Mixed Hardwood	91.0		Cords			
	<i>Beech</i>	27.0		<i>Cords</i>			
	<i>Black Cherry</i>	61.0		<i>Cords</i>			
	<i>Red Maple</i>	3.0	<i>Cords</i>				
	Sugar Maple	289.0	Cords				
3	American Elm	Sawtimber	2.5	MBF	39.9	\$46,395.75	
	Basswood		105.8	MBF			
	Beech		15.6	MBF			
	Black Cherry		14.4	MBF			
	Mixed Aspen		17.2	MBF			
	<i>Quaking Aspen</i>		17.2	<i>MBF</i>			
	Red Maple		10.6	MBF			
	Sugar Maple		91.1	MBF			
	Basswood		Pulpwood	99.0			Cords
	Mixed Aspen			39.0			Cords
	<i>Quaking Aspen</i>	39.0		<i>Cords</i>			
	Mixed Hardwood	85.0		Cords			
	<i>American Elm</i>	2.0		<i>Cords</i>			
	<i>Beech</i>	46.0		<i>Cords</i>			
	<i>Black Cherry</i>	18.0		<i>Cords</i>			
	<i>Ironwood</i>	2.0	<i>Cords</i>				
	<i>Red Maple</i>	17.0	<i>Cords</i>				
Sugar Maple	193.0	Cords					
4	American Elm	Sawtimber	1.3	MBF	49.9	\$26,971.50	
	Beech		1.2	MBF			
	Black Cherry		6.5	MBF			
	Mixed Aspen		12.6	MBF			

Description of Timber by Payment Unit (PU), con't

PU	MARKET GROUP	PRODUCT	QUANTITY	UNIT	ACRES	ADVERTISE PRICE
4 con't	<i>Quaking Aspen</i>	<i>Sawtimber</i>	12.6	<i>MBF</i>		
	Red Maple		132.0	MBF		
	Sugar Maple		8.9	MBF		
	Mixed Aspen	Pulpwood	45.0	Cords		
	<i>Quaking Aspen</i>		45.0	<i>Cords</i>		
	Mixed Hardwood		416.0	Cords		
	<i>American Elm</i>		1.0	<i>Cords</i>		
	<i>Beech</i>		28.0	<i>Cords</i>		
	<i>Black Cherry</i>		30.0	<i>Cords</i>		
	<i>Red Maple</i>		357.0	<i>Cords</i>		
	Sugar Maple		76.0	Cords		
TOTAL:			990.1	MBF		
TOTAL:			2,375.0	Cords		

Sale Specific Conditions & Requirements

Sale Name: Hermit Hardwood

Sale Number: 61-057-17 Seq#: 1

1 - Sale Area

1.2 - Boundaries

1.2.1 - Painted boundaries (1/14)

The sale boundary and Payment Unit boundaries are marked and identified by blue, red and yellow paint. Exterior sale boundary lines against private property are marked with blue paint. Exterior sale boundary lines against state land are marked with red paint. Interior Payment Unit boundaries are marked with yellow paint. The painted boundary line trees are not Included Timber and are to be protected unless marked with orange paint.

2 - Timber Specifications

2.1 - Included Timber

2.1.3 - Cut tree marked unit(s) (12/08)

Within Payment Unit(s) 1 - 4, all trees are designated for cutting when marked with orange paint above and below stump height, regardless of merchantability. In addition, cut all beech and aspen trees greater than or equal to 5 inches at DBH, unless marked with green paint. Note that beech and ironwood trees less than 5 inches at DBH may be cut as needed to facilitate harvesting of designated timber, but must be severed at ground level and laid flat on the ground, not just broken, bent, or pushed over.

2.1.11 - Description of timber note (2/04)

Note that mixed hardwood pulpwood includes primarily red maple, beech, and cherry, with a small amount of ironwood and elm.

2.2 - Utilization

2.2.4 - Skidding length (2/14)

Skidding of unlimbed tops or lengths over 17 feet is not permissible unless approved by the Unit Manager or his/her representative.

4 - Transportation

4.1 - Construction

4.1.3 - Slash and earthen piles (8/04)

Piles or windrows of earth along roads and landings that have been widened or constructed shall be leveled. Slash from road maintenance or construction, including stumps, shall be dispersed throughout the sale.

4.1.7 - Road closure (10/11)

All new roads built into the sale must be blocked to vehicle traffic upon completion of the sale. In general, this will require constructing a four (4') foot high berm of stumps and logs covered with earth. Contact the sale administrator for specific details of design and placement.

4.4 - Access

4.4.2 - Alternate route on private property (2/04)

It is the Purchaser's responsibility to obtain access across private land for any routes other than the route shown on the sale map.

5 - Operations

5.2 - Conduct of Operations

5.2.1 - Slash

5.2.1.8 - Slash height (12/08)

No slash or tree tops may exceed 36 inches in height.

5.2.3 - Operating Restrictions

5.2.3.3 - Bark slippage restriction (3/09)

Within Payment Unit(s) 1 - 4, cutting, forwarding and skidding are not permitted during the period of April 15 to July 15. This restriction is because of bark slippage.

5.2.4 - Dead and Down Creation

5.2.4.1 - Dead and down creation, marked trees (10/13)

All trees marked with an orange "X" must be felled and left on site for wildlife.

5.2.38 - No decking against live trees (2/04)

Cut products may not be decked against unmarked or designated leave trees.

5.2.40 - Pathway protection (10/10)

The Shore to Shore riding/hiking trail is shown on the Timber Sale Map. Do not cut trees or damage posts with blue pathway markers. Maintain a 20-foot wide slash, debris, and rut free zone daily, using the pathway as the centerline.

5.2.41 - Snowmobile trail protection (9/11)

The Platte River snowmobile trail is shown on the Timber Sale Map. Do not cut or damage posts with orange trail markers or traffic control signs. If the trail is used for hauling, it must be graded to the satisfaction of the Unit Manager or his/her representative prior to December 1st. If the trail road is to be used for hauling during the snowmobile season, then a snow covered base must be left on the trail. Maintain a 20 foot wide slash, debris, and rut free zone daily using the snowmobile trail as the centerline.

5.4 - Soil Protection

5.4.3 - Erosion control (12/08)

Skid trails or haul roads may require erosion control structures or berms per direction of the Unit Manager or his/her representative.

6 - Safety and Fire Prevention

6.2 - Signing

6.2.1 - Road posting (9/09)

The Purchaser is responsible for posting and maintaining caution signs on Haze and Eliza Lake roads prior to beginning operations. The road must be posted at appropriate distances from the sale area to warn of logging activity and truck traffic. Signs must be removed when harvest operations are suspended or completed. The Purchaser will provide these signs.



TIMBER SALE MAP

This information provided by authority of Part 525, 1994 PA 451, as amended.

Forest Management Unit Traverse City FMU	County Benzie	Mapped By Tim Webb	Date 09/25/2017	Page 1	of 1
Township 27N	Range 14W, 13W	Section(s) and Subdivision(s) 27N 14W S24: SWNE, SENW, SE1/4, W1/2SW; 27N 14W S25: NWNE, S1/2NE, N1/2SE; 27N 13W S30: SWNW, NWSW	Scale 1:15,840		

Cover Type				Density	
A = Aspen	H = Hemlock	N = Marsh	U = Upland Brush	0 = Non Stocked	5 = Pole Timber Medium
B = Paper Birch	J = Jack Pine	O = Oak	UM = Upland Mixed	1 = Seedling Sapling Poor	6 = Pole Timber Well
C = Cedar	L = Lowland Brush	P = Lowland Poplar	V = Bog or Marsh	2 = Seedling Sapling Medium	7 = Saw Timber Poor
D = Tread Bog	LM = Lowland Mixed	Q = Mixed Swamp Conifer	W = White Pine	3 = Seedling Sapling Well	8 = Saw Timber Medium
E = Swamp Hdwoods	M = Mpl, Bch, Brch	R = Red Pine	X = Non Stocked	4 = Pole Timber Poor	9 = Saw Timber Well
F = Spruce Fir	MC = Mixed Conifer	S = Black Spruce	Z = Water		
G = Grass	MD = Mixed Deciduous	T = Tamarack			

PU	Acres	PU	Acres
1	82.1	4	49.9
2	48.1		
3	39.9		

Hermit Hardwood

Compartment 9

220 acres

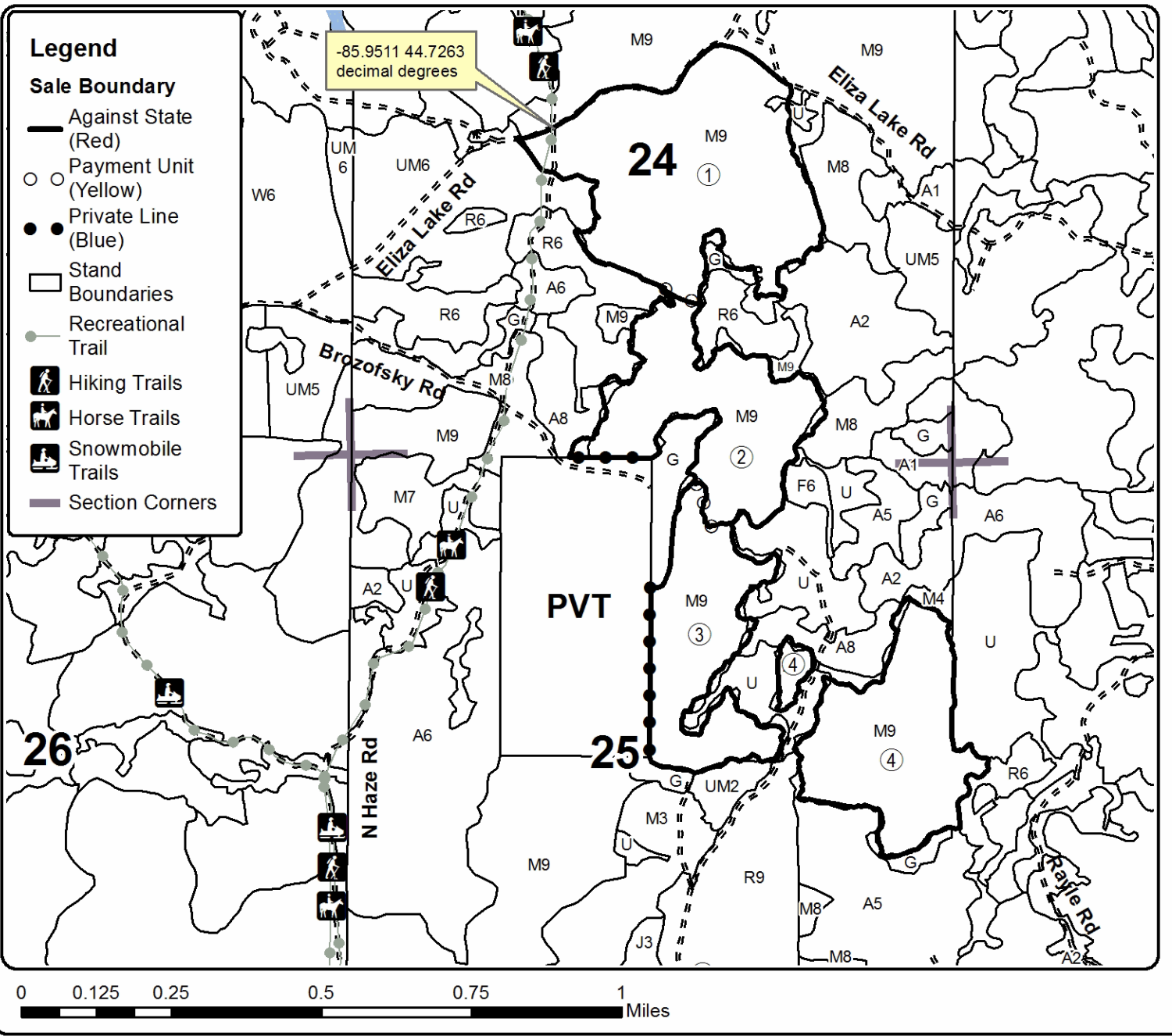

TIMBER SALE INFORMATION

Gradient Mix (61-072-17)

Grand Traverse County (Advertised Price \$4,631.50)

SALE NOTE: Small sale with mixed products. Good access.

A timber sale contract for this lump sum, sealed bid timber sale will be awarded to the responsible bidder offering the highest sealed bid price. Bids must be at or above the following advertised price for each species:

<u>PRODUCTS & SPECIES</u>	<u>ESTIMATED UNITS*</u>	<u>ADVERTISED PRICE</u>
Sawtimber		
B. T. Aspen	3.20 MBF	\$ 109.00 / MBF
Black Cherry	2.40 MBF	\$ 180.00 / MBF
Red Maple	3.20 MBF	\$ 115.00 / MBF
Red Pine	1.60 MBF	\$ 117.00 / MBF
White Pine	19.00 MBF	\$ 61.00 / MBF
Pulpwood		
Balsam Fir	2.00 Cords	\$ 13.60 / Cord
Jack Pine	15.00 Cords	\$ 15.55 / Cord
Mixed Aspen	16.00 Cords	\$ 20.65 / Cord
Mixed Hardwood	44.00 Cords	\$ 20.05 / Cord
Paper Birch	4.00 Cords	\$ 20.85 / Cord
Red Oak	3.00 Cords	\$ 17.40 / Cord
Red Pine	1.00 Cords	\$ 41.10 / Cord
White Pine	33.00 Cords	\$ 14.75 / Cord

* The total volume is statistically estimated within plus (+) or minus (-) 23.06 percent. The estimated units are final and not subject to adjustment. Prospective bidders are urged to examine this timber and to make their own estimates of quantity and quality.

BOND AND PAYMENT SCHEDULE:

1. A bond in the amount of \$500.00 to insure faithful performance of the conditions of the contract will be deposited by the successful bidder within 21 days of the sale award.
2. Cutting in any sale or unit without the required advance payment would be considered a trespass.
3. Total payment must be paid in advance or according to the following schedule:
 - (a) Ten percent (10%) of the sale value must be paid within 21 days of the sale award.
 - (b) The remainder is due before cutting begins.
 - (c) Payment for each of the following units must be made before cutting begins in that unit:

<u>PAYMENT UNIT NUMBER</u>	<u>PERCENT OF TOTAL SALE VALUE</u>
01	100.0%
4. If no cutting takes place, the 10% down payment will not be refunded.
5. Operations on the contract issued will terminate on 06/30/2020.

Description of Timber by Payment Unit (PU)

PU	MARKET GROUP	PRODUCT	QUANTITY	UNIT	ACRES	ADVERTISE PRICE
1	B. T. Aspen	Sawtimber	3.2	MBF	8.1	\$4,631.50
	Black Cherry		2.4	MBF		
	Red Maple		3.2	MBF		
	Red Pine		1.6	MBF		
	White Pine		19.0	MBF		
	Balsam Fir	Pulpwood	2.0	Cords		
	Jack Pine		15.0	Cords		
	<i>Jack Pine</i>	<i>Sawtimber</i>	2.1	<i>MBF</i>		
	<i>Jack Pine</i>	<i>Pulpwood</i>	11.0	<i>Cords</i>		
	Mixed Aspen		16.0	Cords		
	<i>B. T. Aspen</i>		8.0	<i>Cords</i>		
	<i>Quaking Aspen</i>		8.0	<i>Cords</i>		
	Mixed Hardwood		44.0	Cords		
	<i>Black Cherry</i>		5.0	<i>Cords</i>		
	<i>Red Maple</i>		39.0	<i>Cords</i>		
	Paper Birch		4.0	Cords		
	Red Oak		3.0	Cords		
	Red Pine		1.0	Cords		
	White Pine		33.0	Cords		
TOTAL:			29.4	MBF		
TOTAL:			118.0	Cords		

Sale Specific Conditions & Requirements

Sale Name: Gradient Mix

Sale Number: 61-072-17 Seq#: 1

1 - Sale Area

1.2 - Boundaries

1.2.1 - Painted boundaries (1/14)

The sale boundary is marked and identified red paint. The painted boundary line trees are not Included Timber and are to be protected

2 - Timber Specifications

2.1 - Included Timber

2.1.2 - Clearcut unit(s) w/o unmerchantable trees (8/11)

Within Payment Unit(s) 1, cut all trees which meet minimum piece specifications in 2.2 Utilization. Special protection trees identified in accordance with condition 3.4.2, within clearcutting unit boundaries, are not Included Timber and are to be protected.

2.1.11 - Description of timber note (2/04)

Note that Mixed Hardwood pulp includes black cherry and red maple pulpwood.

2.2 - Utilization

2.2.6 - Roundwood operation required (5/07)

The skidding of whole trees or tree segments with limbs attached is prohibited. All products must be produced as roundwood and forwarded to existing roads or landing areas in final product length.

3 - Payments

3.4 - Damaged Timber

3.4.1 - Damaged timber (6/14)

General Condition and Requirement 3.4 Damaged Timber, defines liquidated damages for undesignated live merchantable trees which are cut or injured. In addition, extreme care should be taken to avoid damage to tree seedlings and saplings. Some advanced white pine and balsam fir regeneration is present in the understory. This is desirable and care should be taken to protect the regeneration.

3.4.2 - Special Protection Trees (4/14)

The Purchaser shall not cut live or dead special protection trees within cutting units or clearings. Special protection trees are marked with green paint. If the Purchaser's operations have cut or damaged special protection trees through carelessness, the Purchaser shall pay \$25 as fixed, agreed and liquidated damages for each special protection tree cut or damaged. Such payment does not constitute ownership of the undesignated timber.

4 - Transportation

4.1 - Construction

4.1.12 - No new roads (1/12)

No new roads will be permitted in any Payment Unit. All operations are limited to existing roads. Skid trails only will be allowed.

4.2 - Maintenance

4.2.5 - Two wheel drive condition (2/04)

All existing trail roads on and adjacent to the sale area must be passable by two-wheel drive traffic for the duration of the sale.

5 - Operations

5.1 - Notification

5.1.1 - Pre-sale conference (10/16)

A pre-sale conference on site between the Purchaser and sale administrator is required prior to beginning any operations to determine landing and road locations. The Unit Manager or his/her representative must be contacted at least 3 days in advance to schedule the conference.

5.1.4 - Post-sale conference (10/16)

A post-sale conference on site between the Purchaser and sale administrator is required 3 days prior to the completion of active logging operations to determine clean-up and repair of landings, road edges, and the fulfillment of other contract specifications.

5.2 - Conduct of Operations

5.2.1 - Slash

5.2.1.8 - Slash height (12/08)

No slash or tree tops may exceed 30 inches in height.

5.2.2 - Hazard Trees/Snags

5.2.2.1 - Den trees (10/16)

Obvious hollow and/or den trees shall be protected and left standing unless they are a safety hazard.

5.2.3 - Operating Restrictions

5.2.3.4 - Oak wilt restriction, no exceptions (1/18)

Within Payment Unit(s) 1, cutting, skidding, hauling within the sale and brushing of access roads to the sale are not permitted during the period of April 15 to July 15. No exceptions will be granted. This is necessary to reduce the spread of oak wilt.

5.2.38 - No decking against live trees (2/04)

Cut products may not be decked against unmarked or designated leave trees.

5.4 - Soil Protection

5.4.1 - Rutting restriction, general (7/16)

Operations are to cease immediately if equipment and weather conditions result in rutting of roads and/or skid trails which is 12 inches or greater in depth and 50 feet in length. The Unit Manager or his/her representative may restrict hauling and/or skidding if ruts exceed the specified depth. With the Unit Manager or his/her representative's approval, the Purchaser may return to the area when the risk of rutting has decreased.

6 - Safety and Fire Prevention

6.2 - Signing

6.2.1 - Road posting (9/09)

The Purchaser is responsible for posting and maintaining caution signs on Boardman Road prior to beginning operations. The road must be posted at appropriate distances from the sale area to warn of logging activity and truck traffic. Signs must be removed when harvest operations are suspended or completed. The Purchaser will provide these signs.



Sale Number	Year
61-072	17

TIMBER SALE MAP

This information provided by authority of Par 525, 1994 PA 451, as amended.

Forest Management Unit Traverse City		County Grand Traverse	Mapped By Ruppen	Date 9/26/2017	Page 1	of 1
Township 26N	Range 9W	Section(s) and Subdivision(s) Sec 24 NWNE NENW		Scale 1:15,840		

Cover Type				Density	
A = Aspen	H = Hemlock	N = Marsh	U = Upland Brush	0 = Non Stocked	5 = Pole Timber Medium
B = Paper Birch	J = Jack Pine	O = Oak	UM = Upland Mixed	1 = Seeding Sapling Poor	6 = Pole Timber Well
C = Cedar	L = Lowland Brush	P = Lowland Poplar	V = Bog or Marsh	2 = Seeding Sapling Medium	7 = Saw Timber Poor
D = Tread Bog	LM = Lowland Mixed	Q = Mixed Swamp Conifer	W = White Pine	3 = Seeding Sapling Well	8 = Saw Timber Medium
E = Swamp Hdwoods	M = Mpl. Bch. Bich	R = Red Pine	X = Non Stocked	4 = Pole Timber Poor	9 = Saw Timber Well
F = Spruce Fir	MC = Mixed Conifer	S = Black Spruce	Z = Water		
G = Grass	MD = Mixed Deciduous	T = Tamarack			

PU Acres
1 8.1

Gradient Mix

Compartment 053

8.1 Acres

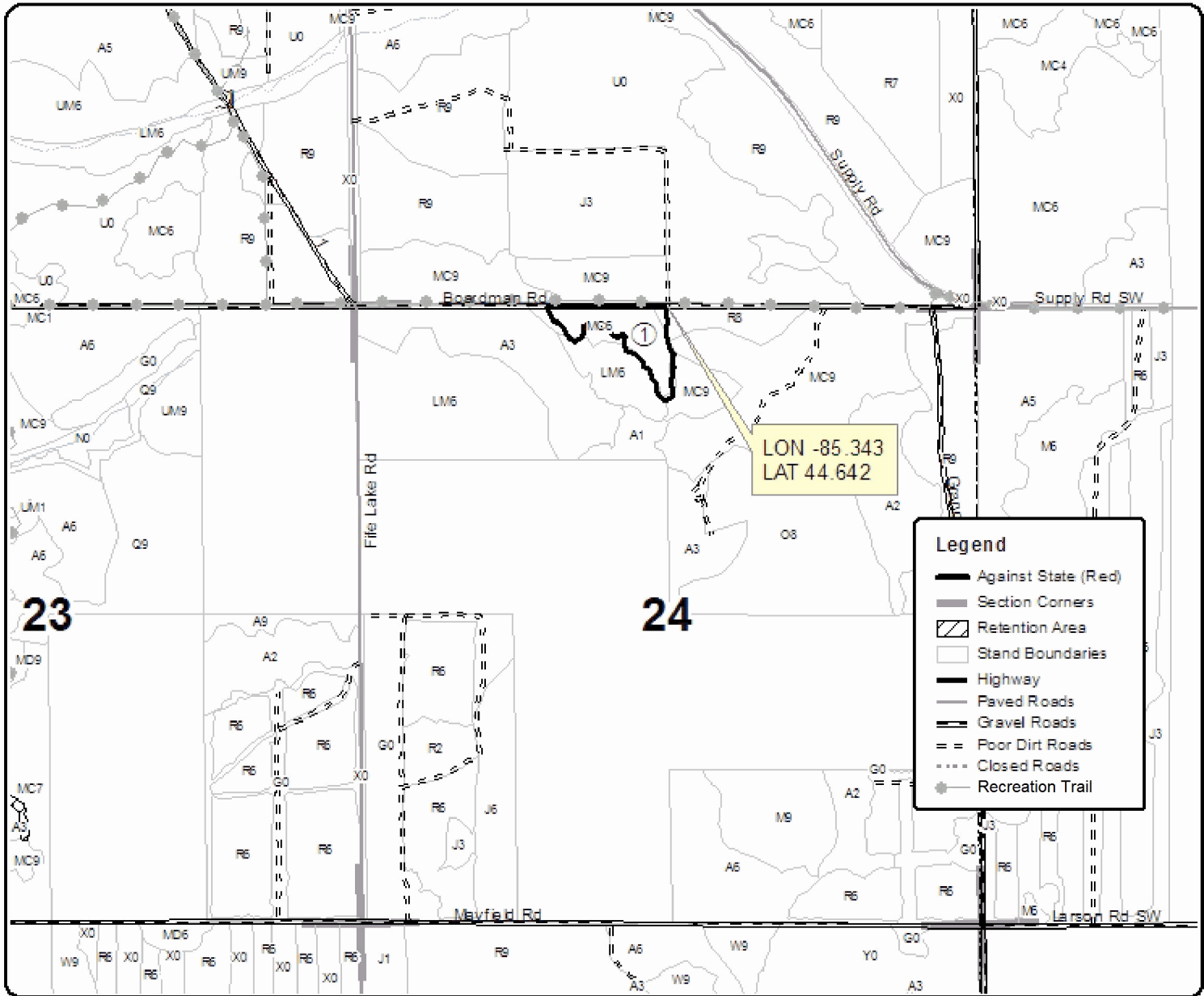
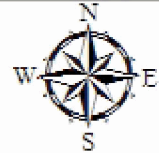

Legend	
	Against State (Red)
	Section Corners
	Retention Area
	Stand Boundaries
	Highway
	Paved Roads
	Gravel Roads
	Poor Dirt Roads
	Closed Roads
	Recreation Trail

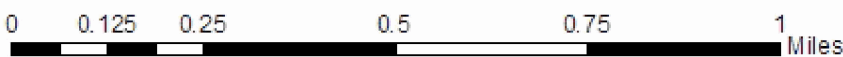

TIMBER SALE INFORMATION

Big Four Aspen (61-086-17)

Benzie County (Advertised Price \$54,763.15)

SALE NOTE: A recreation site such as a trail, pathway, or campground is within the sale area or the vicinity. Certain restrictions/specifications may be applicable including time restrictions.

A timber sale contract for this lump sum, sealed bid timber sale will be awarded to the responsible bidder offering the highest sealed bid price. Bids must be at or above the following advertised price for each species:

<u>PRODUCTS & SPECIES</u>	<u>ESTIMATED UNITS*</u>	<u>ADVERTISED PRICE</u>
Sawtimber		
B. T. Aspen	83.80 MBF	\$ 109.00 / MBF
Beech	0.90 MBF	\$ 108.00 / MBF
Red Maple	17.40 MBF	\$ 115.00 / MBF
Red Oak	36.70 MBF	\$ 205.00 / MBF
White Oak	1.40 MBF	\$ 57.00 / MBF
White Pine	18.80 MBF	\$ 61.00 / MBF
Pulpwood		
Mixed Aspen	1,206.00 Cords	\$ 20.65 / Cord
Mixed Hardwood	187.00 Cords	\$ 20.05 / Cord
Mixed Oak	186.00 Cords	\$ 17.40 / Cord
White Pine	196.00 Cords	\$ 14.75 / Cord

* The total volume is statistically estimated within plus (+) or minus (-) 10.73 percent. The estimated units are final and not subject to adjustment. Prospective bidders are urged to examine this timber and to make their own estimates of quantity and quality.

BOND AND PAYMENT SCHEDULE:

1. A bond in the amount of \$2,738.00 to insure faithful performance of the conditions of the contract will be deposited by the successful bidder within 21 days of the sale award.
2. Cutting in any sale or unit without the required advance payment would be considered a trespass.
3. Total payment must be paid in advance or according to the following schedule:
 - (a) Ten percent (10%) of the sale value must be paid within 21 days of the sale award.
 - (b) The 10% down payment will be credited towards the first unit cut.
 - (c) Payment for each of the following units must be made before cutting begins in that unit:

<u>PAYMENT UNIT NUMBER</u>	<u>PERCENT OF TOTAL SALE VALUE</u>
01	8.9%
02	2.2%
03	6.0%
04	25.1%
05	11.2%
06	12.3%
07	3.4%
08	4.7%
09	4.2%
10	6.9%
11	11.5%
12	3.6%

4. If no cutting takes place, the 10% down payment will not be refunded.
5. Operations on the contract issued will terminate on 06/30/2020.

Description of Timber by Payment Unit (PU)

PU	MARKET GROUP	PRODUCT	QUANTITY	UNIT	ACRES	ADVERTISE PRICE
1	Mixed Aspen	Pulpwood	224.0	Cords	7.4	\$4,866.20
	<i>B. T. Aspen</i>		224.0	<i>Cords</i>		
	Mixed Hardwood		12.0	Cords		
	<i>Beech</i>		1.0	<i>Cords</i>		
	<i>Black Cherry</i>		2.0	<i>Cords</i>		
	<i>Red Maple</i>		9.0	<i>Cords</i>		
2	Mixed Aspen	Pulpwood	56.0	Cords	3.2	\$1,230.15
	<i>B. T. Aspen</i>		56.0	<i>Cords</i>		
	White Pine		5.0	Cords		
3	Mixed Aspen	Pulpwood	123.0	Cords	11.0	\$3,309.00
	<i>B. T. Aspen</i>		123.0	<i>Cords</i>		
	Mixed Hardwood		25.0	Cords		
	<i>Red Maple</i>		25.0	<i>Cords</i>		
	Mixed Oak		12.0	Cords		
	<i>Red Oak</i>		12.0	<i>Cords</i>		
4	B. T. Aspen	Sawtimber	30.1	MBF	13.2	\$13,722.60
	Beech		0.9	MBF		
	Red Maple		9.3	MBF		
	Red Oak		14.3	MBF		
	White Pine		9.4	MBF		
	Mixed Aspen	Pulpwood	161.0	Cords		
	<i>B. T. Aspen</i>		152.0	<i>Cords</i>		
	<i>Quaking Aspen</i>		9.0	<i>Cords</i>		
	Mixed Hardwood		51.0	Cords		
	<i>Beech</i>		7.0	<i>Cords</i>		
	<i>Red Maple</i>		44.0	<i>Cords</i>		
	Mixed Oak		36.0	Cords		
	<i>Red Oak</i>		36.0	<i>Cords</i>		
	White Pine		54.0	Cords		
	5		B. T. Aspen	Sawtimber		
Red Maple		1.2	MBF			
Red Oak		10.3	MBF			
White Pine		5.1	MBF			
Mixed Aspen		Pulpwood	95.0	Cords		
<i>B. T. Aspen</i>			95.0	<i>Cords</i>		
Mixed Hardwood			8.0	Cords		
<i>Red Maple</i>			8.0	<i>Cords</i>		
Mixed Oak			37.0	Cords		
<i>Red Oak</i>			37.0	<i>Cords</i>		
White Pine	27.0	Cords				
6	B. T. Aspen	Sawtimber	12.1	MBF	13.7	\$6,753.65
	Red Maple		2.0	MBF		
	Red Oak		9.6	MBF		
	White Oak		1.4	MBF		
	White Pine		1.5	MBF		
	Mixed Aspen	Pulpwood	56.0	Cords		
	<i>B. T. Aspen</i>		56.0	<i>Cords</i>		
	Mixed Hardwood		19.0	Cords		
	<i>Red Maple</i>		19.0	<i>Cords</i>		
	Mixed Oak		59.0	Cords		
	<i>Red Oak</i>		38.0	<i>Cords</i>		
	<i>White Oak</i>		21.0	<i>Cords</i>		
White Pine	34.0	Cords				
7	B. T. Aspen	Sawtimber	8.3	MBF	8.9	\$1,860.10
	Red Maple		0.4	MBF		

Description of Timber by Payment Unit (PU), con't

PU	MARKET GROUP	PRODUCT	QUANTITY	UNIT	ACRES	ADVERTISE PRICE
	White Pine	Pulpwood	1.0	MBF		
	Mixed Aspen		27.0	Cords		
	<i>B. T. Aspen</i>		27.0	<i>Cords</i>		
	Mixed Hardwood		1.0	Cords		
	<i>Red Maple</i>		1.0	<i>Cords</i>		
	Mixed Oak		2.0	Cords		
	<i>Red Oak</i>		2.0	<i>Cords</i>		
	White Pine		16.0	Cords		
8	B. T. Aspen	Sawtimber	0.6	MBF	5.0	\$2,598.60
	Red Oak		2.5	MBF		
	White Pine		0.8	MBF		
	Mixed Aspen	Pulpwood	66.0	Cords		
	<i>B. T. Aspen</i>		66.0	<i>Cords</i>		
	Mixed Hardwood		8.0	Cords		
	<i>Red Maple</i>		8.0	<i>Cords</i>		
	Mixed Oak		19.0	Cords		
	<i>Red Oak</i>		17.0	<i>Cords</i>		
	<i>White Oak</i>		2.0	<i>Cords</i>		
	White Pine		8.0	Cords		
9	Red Maple	Sawtimber	0.5	MBF	20.4	\$2,315.85
	Mixed Aspen	Pulpwood	56.0	Cords		
	<i>B. T. Aspen</i>		56.0	<i>Cords</i>		
	Mixed Hardwood		44.0	Cords		
	<i>Basswood</i>		6.0	<i>Cords</i>		
	<i>Beech</i>		2.0	<i>Cords</i>		
	<i>Red Maple</i>		36.0	<i>Cords</i>		
	Mixed Oak		5.0	Cords		
	<i>Red Oak</i>		5.0	<i>Cords</i>		
	White Pine		9.0	Cords		
10	B. T. Aspen	Sawtimber	2.7	MBF	12.3	\$3,763.15
	Red Maple		2.6	MBF		
	White Pine		0.7	MBF		
	Mixed Aspen	Pulpwood	117.0	Cords		
	<i>B. T. Aspen</i>		60.0	<i>Cords</i>		
	<i>Quaking Aspen</i>		57.0	<i>Cords</i>		
	Mixed Hardwood		9.0	Cords		
	<i>Red Maple</i>		9.0	<i>Cords</i>		
	Mixed Oak		11.0	Cords		
	<i>Red Oak</i>		6.0	<i>Cords</i>		
	<i>White Oak</i>		5.0	<i>Cords</i>		
	White Pine		23.0	Cords		
11	B. T. Aspen	Sawtimber	25.1	MBF	9.9	\$6,281.15
	Mixed Aspen	Pulpwood	163.0	Cords		
	<i>B. T. Aspen</i>		163.0	<i>Cords</i>		
	Mixed Hardwood		6.0	Cords		
	<i>Beech</i>		6.0	<i>Cords</i>		
	White Pine	4.0	Cords			
12	B. T. Aspen	Sawtimber	1.4	MBF	6.5	\$1,956.40
	Red Maple		1.4	MBF		
	White Pine		0.3	MBF		
	Mixed Aspen	Pulpwood	62.0	Cords		
	<i>B. T. Aspen</i>		32.0	<i>Cords</i>		
	<i>Quaking Aspen</i>		30.0	<i>Cords</i>		
	Mixed Hardwood		4.0	Cords		
	<i>Red Maple</i>		4.0	<i>Cords</i>		
	Mixed Oak		5.0	Cords		

Description of Timber by Payment Unit (PU), con't

PU	MARKET GROUP	PRODUCT	QUANTITY	UNIT	ACRES	ADVERTISE PRICE
12 con't	<i>Red Oak</i>	<i>Pulpwood</i>	3.0	<i>Cords</i>		
	<i>White Oak</i>		2.0	<i>Cords</i>		
	White Pine		12.0	Cords		
TOTAL:			159.0	MBF		
TOTAL:			1,775.0	Cords		

Sale Specific Conditions & Requirements

Sale Name: Big Four Aspen

Sale Number: 61-086-17 Seq#: 1

1 - Sale Area

1.2 - Boundaries

1.2.1 - Painted boundaries (1/14)

The sale boundary and Payment Unit boundaries are marked and identified by blue, red and yellow paint. Exterior sale boundary lines against private property are marked with blue paint. Exterior sale boundary lines against state land are marked with red paint. Interior Payment Unit boundaries are marked with yellow paint. The painted boundary line trees are not Included Timber and are to be protected unless marked with orange paint.

2 - Timber Specifications

2.1 - Included Timber

2.1.1 - Clearcut unit(s) with unmerchantable trees (6/14)

Within Payment Unit(s) 1-6, 8, and 10-12, cut all trees that are two (2) inches or more at DBH, except trees marked with green paint and the following:

Within Payment Unit 1, do not cut sugar maple, oak, birch, or any conifers.

Within Payment Unit 2, do not cut white pine greater than 18" at DBH, or any oak.

Within Payment Unit 3, do not cut white pine greater than 18" at DBH, or oak greater than 18" at DBH.

Within Payment Unit 4, do not cut white pine greater than 18" at DBH, conifers other than white pine, or white oak.

Within Payment Unit 11, do not cut oak.

Within Payment Unit 12, white pine greater than 18" at DBH, or any oak.

2.1.3 - Cut tree marked unit(s) (12/08)

Within Payment Unit(s) 7 and 9, all trees are designated for cutting when marked with orange paint above and below stump height, regardless of merchantability. In addition, within Payment Unit 9, cut all aspen trees unless marked with green paint.

2.1.11 - Description of timber note (2/04)

Note that mixed hardwood pulpwood is mainly red maple, with small amounts of beech, basswood, and cherry.

4 - Transportation

4.1 - Construction

4.1.3 - Slash and earthen piles (8/04)

Piles or windrows of earth along roads and landings that have been widened or constructed shall be leveled. Slash from road maintenance or construction, including stumps, shall be chipped, utilized or distributed within the sale.

4.1.7 - Road closure (10/11)

All new roads built into the sale must be blocked to vehicle traffic upon completion of the sale. In general, this will require constructing a four (4') foot high berm of stumps and logs covered with earth. Contact the sale administrator for specific details of design and placement.

4.2 - Maintenance

4.2.3 - Road maintenance (8/13)

The following road maintenance is needed: the unnamed road west of Lake Ann Road, which accesses Payment Units 1-4, has two sloped portions which have loose sand and potential for erosion. These portions must be bladed and reshaped prior to the start of operations, and may require additional gravel and erosion control measures. Any needed gravel or other materials are to be provided by the Purchaser. The road must be adequately bladed and stabilized at the close of sale operations.

5 - Operations

5.1 - Notification

5.1.6 - Utility R.O.W. (1/15)

It is the responsibility of the Purchaser to obtain permission from the utility company to utilize the power line R.O.W. for operations. Note that his R.O.W. runs adjacent to the eastern edge of Payment Unit 4.

5.2 - Conduct of Operations

5.2.1 - Slash

5.2.1.8 - Slash height (12/08)

No slash or tree tops may exceed 24 inches in height.

5.2.3 - Operating Restrictions

5.2.3.4 - Oak wilt restriction (9/17)

Within Payment Units 1-12, unless changed by written agreement, cutting, skidding, hauling and brushing of access roads are not permitted during the period of April 15 to July 15. This is necessary to reduce the spread of oak wilt. For more information, contact the Unit Manager or his/her representative.

5.2.4 - Dead and Down Creation

5.2.4.1 - Dead and down creation, marked trees (10/13)

All trees marked with an orange "X" must be felled and left on site for wildlife.

5.2.17 - Crane Mats/Timber Mats (9/17)

Skidding/forwarding between the 2 portions of Payment Unit 4 may require extra protection, such as that afforded by Crane Mats/Timber Mats. If available, Crane Mats/Timber Mats may be borrowed from the DNR and are located at the Marquette ICC, the Newberry Field Office and the Grayling Field Office. Contact the sale administrator for specific details. A Timber Sale Contract Supplement will be used to document the Purchaser's use of the DNR's Crane Mats/Timber Mats. It is the responsibility of the Purchaser to contact the sale administrator to schedule pick up and drop off. In addition, all mats must be cleaned prior to drop off. A charge of \$350.00 will be assessed for all damaged or non-returned mats. Damage is defined as misuse resulting in three or more broken cants.

5.2.38 - No decking against live trees (2/04)

Cut products may not be decked against unmarked or designated leave trees.

5.2.40 - Pathway protection (10/10)

The Shore to Shore riding/hiking trail is shown on the Timber Sale Map. Do not cut trees or damage posts with blue pathway markers. Maintain a 20-foot wide slash, debris, and rut free zone daily, using the trail as the centerline. The trail lies on a forest road through part of the sale and will be used for hauling. The trail must be graded periodically during the sale. In addition, if an organized trail ride is to occur while the sale is active, the sale administrator has the authority to limit harvest and hauling activities on the day of the ride. The administrator will provide at least 1 week notice if this is to occur.

5.4 - Soil Protection

5.4.3 - Erosion control (12/08)

Skid trails or haul roads may require erosion control structures or berms per direction of the Unit Manager or his/her representative.

6 - Safety and Fire Prevention

6.2 - Signing

6.2.1 - Road posting (9/09)

The Purchaser is responsible for posting and maintaining caution signs on Buckley Road, Douglas Road, and the unnamed road accessing Payment Units 1-4 prior to beginning operations. The road must be posted at appropriate distances from the sale area to warn of logging activity and truck traffic. Signs must be removed when harvest operations are suspended or completed. The Purchaser will provide these signs.

6.2.3 - Recreational trail posting (2/10)

The Purchaser is responsible for posting and maintaining caution signs on Shore to Shore Trail prior to beginning operations. The trail must be posted at appropriate distances from the sale area to warn of logging activity and truck traffic at both ends of the trail. Signs must be removed when harvest operations are suspended or completed. The Purchaser will provide these signs.



TIMBER SALE MAP

This information provided by authority of Part 525, 1994 PA 451, as amended.

Forest Management Unit Traverse City FMU		County Benzie	Mapped By Tim Webb		Date 09/29/2017	Page 1	of 1
Township 27, 26N	Range 13W	Section(s) and Subdivision(s) 27-13-35: W1/2NE, N1/2SE, SENW; 27-13-36: S1/2NW, S1/2; 26-13-1: NWNE		Scale 1:15,840			

Cover Type				Density			
A = Aspen	H = Hemlock	N = Marsh	U = Upland Brush	0 = Non Stocked	5 = Pole Timber Medium		
B = Paper Birch	J = Jack Pine	O = Oak	UM = Upland Mixed	1 = Seedling Sapling Poor	6 = Pole Timber Well		
C = Cedar	L = Lowland Brush	P = Lowland Poplar	V = Bog or Marsh	2 = Seedling Sapling Medium	7 = Saw Timber Poor		
D = Treed Bog	LM = Lowland Mixed	Q = Mixed Swamp Conifer	W = White Pine	3 = Seedling Sapling Well	8 = Saw Timber Medium		
E = Swamp Hdwoods	M = Mpl, Bch, Brch	R = Red Pine	X = Non Stocked	4 = Pole Timber Poor	9 = Saw Timber Well		
F = Spruce Fir	MC = Mixed Conifer	S = Black Spruce	Z = Water				
G = Grass	MD = Mixed Deciduous	T = Tamarack					

PU	Acres	PU	Acres	PU	Acres	PU	Acres
1	7.4	4	13.2	7	8.9	10	12.3
2	3.2	5	8.5	8	5.0	11	9.9
3	11.0	6	13.7	9	20.4	12	6.5

Big Four Aspen

Compartment 11

120 acres

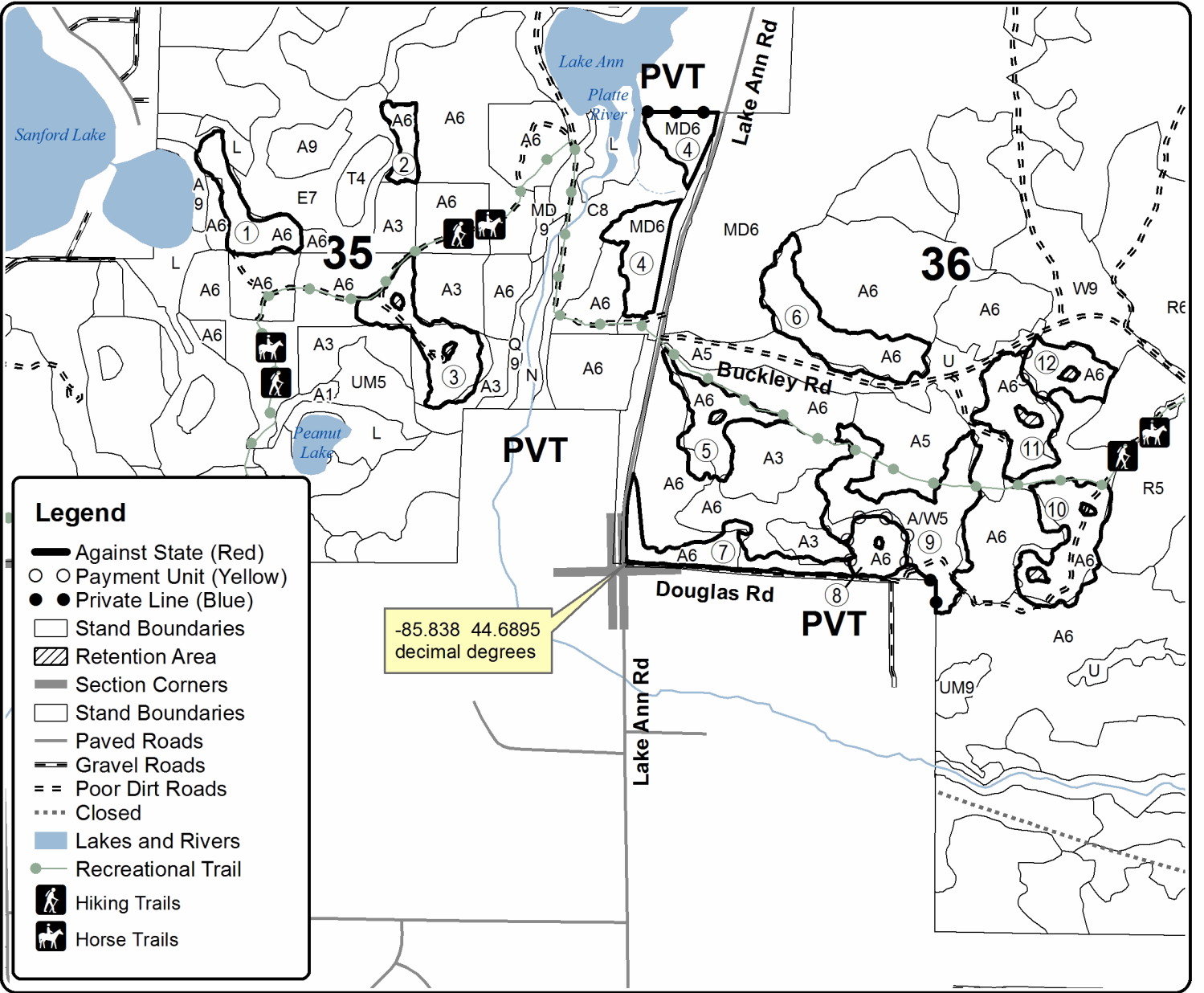
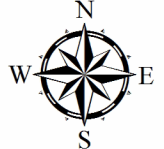

Legend

- Against State (Red)
- Payment Unit (Yellow)
- Private Line (Blue)
- Stand Boundaries
- Retention Area
- Section Corners
- Stand Boundaries
- Paved Roads
- Gravel Roads
- Poor Dirt Roads
- Closed
- Lakes and Rivers
- Recreational Trail
- Hiking Trails
- Horse Trails

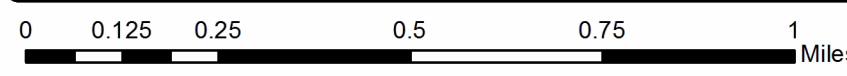

Spagetti Red (61-047-17)
; Grand Traverse COUNTY

In response to the notice of sale to be held 4:00 p.m. (local time) on May 10, 2018, I am hereby submitting my sealed bid (firm offer) for the following forest products to be cut. Bids for individual species must be at or above the advertised price. All non-responsive bid forms may be rejected.

<u>PRODUCTS & SPECIES</u>	<u>ESTIMATED VOLUME*</u>	<u>ADVERTISED PRICE</u>	<u>BID PRICE/UNIT</u>
Sawtimber			
Red Oak	0.70 MBF	\$ 205.00/MBF	\$ _____
Red Pine	356.40 MBF	\$ 117.00/MBF	\$ _____
Pulpwood			
B. T. Aspen	2.00 Cords	\$ 20.65/Cord	\$ _____
Jack Pine	4.00 Cords	\$ 15.55/Cord	\$ _____
Mixed Hardwood	15.00 Cords	\$ 20.05/Cord	\$ _____
Red Oak	1.00 Cords	\$ 17.40/Cord	\$ _____
Red Pine	807.00 Cords	\$ 41.10/Cord	\$ _____

*The volumes are statistically estimated within plus (+) or minus (-) 12.00 percent. These estimated volumes are final and not subject to adjustment. Prospective bidders are urged to examine this timber and to make their own estimates of quantity and quality.

I understand that any or all bids may be rejected. All bids must be signed and all bid items must be bid or the bid form may be rejected. I also understand that consideration and awarding a contract will be based upon my past performance and ability to complete the contract based upon equipment and staffing subject to my control.

FEDERAL ID: _____ or SOCIAL SECURITY NUMBER: _____

Company or individual bidding: _____

Company representative's name: _____

Address: _____

City: _____ State: _____ Zip: _____

IF AVAILABLE, PLEASE PLACE THE PERSONALIZED LABEL FROM YOUR PROSPECTUS IN THE ABOVE BOX.

Individual or company representative's signature: _____ Date: _____

Phone number : _____ Email (optional): _____

THE WINNING BIDDER MUST COMPLETE THE VERIFICATION OF WORKER'S DISABILITY COMPENSATION ACT COMPLIANCE (ON REVERSE SIDE IF DOUBLE SIDED) WITHIN 21 DAYS OF SALE AWARD DATE



FOR DEPARTMENT USE ONLY
Sale Number (XX - XXX - XX - XX)
Forest Management Unit:

TIMBER SALE VERIFICATION OF WORKER'S DISABILITY COMPENSATION ACT COMPLIANCE

*As required by Act 317, P.A. 1969 (Worker's Compensation) and
Part 5 of Act 451 of 1994, as amended.*

VERIFICATION OF WORKER'S DISABILITY COMPENSATION ACT COMPLIANCE

- This verification must be completed and submitted within 21 days of contract award and prior to the issuance of the timber sale contract.
- In addition, if boxes 2B or 2C are checked, then Notice of Exclusion or Certificate of Insurance must be submitted within twenty-one (21) days of the contract award and prior to the issuance of the timber sale contract.
- All information must be typed or printed except for written signatures.

Please Check Appropriate Categories:

1. My business is organized as (you **must** check one of the boxes below):
 - A. Sole Proprietorship (individual)
 - B. Partnership
 - C. Corporation
2. You **must** check one of the boxes below:
 - A. I certify my business is a sole proprietorship and it has no employees but the sole proprietor. I am not subject to the Worker's Compensation Laws.
 - B. I certify my business has satisfied its obligation to the Worker's Compensation Act through the use of an approved Notice of Exclusion (BWC-337, Rev. 5/96). I will provide a copy of the Notice of Exclusion within 21 days of the contract award. (For questions or a copy of the BWC-337, please call the Worker's Compensation Bureau at 517-322-1195).
 - C. I certify my business has a Worker's Compensation Policy. I will provide an original Certificate of Insurance within twenty-one (21) days of the contract award.
3. If you have checked item 2(A) or 2(B), you **must** indicate the number of **both** full-time and part-time employees, other than yourself, including family members and active partners (if none, you must enter "0").

_____ Full-time Employees

_____ Part-time Employees

Name of Business		Federal ID (or) Social Security No.	
Address		Telephone ()	
City	State	ZIP	

I hereby certify that the above information is true and correct. I agree to notify the Michigan DNR of any changes that occur in factors affecting my coverage during any of my present and future operations.

Signature of Owner or Authorized Representative

Title

Date

Please complete the "SEALED BID" information on the next page

Turtle Lake Hardwoods (61-055-17)
; Benzie COUNTY

In response to the notice of sale to be held 4:00 p.m. (local time) on May 10, 2018, I am hereby submitting my sealed bid (firm offer) for the following forest products to be cut. Bids for individual species must be at or above the advertised price. All non-responsive bid forms may be rejected.

<u>PRODUCTS & SPECIES</u>	<u>ESTIMATED VOLUME*</u>	<u>ADVERTISED PRICE</u>	<u>BID PRICE/UNIT</u>
Sawtimber			
Basswood	36.20 MBF	\$ 120.00/MBF	\$ _____
Beech	28.20 MBF	\$ 108.00/MBF	\$ _____
Black Cherry	6.70 MBF	\$ 180.00/MBF	\$ _____
Quaking Aspen	4.40 MBF	\$ 109.00/MBF	\$ _____
Red Maple	82.50 MBF	\$ 115.00/MBF	\$ _____
Red Oak	3.60 MBF	\$ 205.00/MBF	\$ _____
Sugar Maple	21.60 MBF	\$ 263.00/MBF	\$ _____
Pulpwood			
Basswood	63.00 Cords	\$ 29.80/Cord	\$ _____
Mixed Hardwood	546.00 Cords	\$ 20.05/Cord	\$ _____
Quaking Aspen	66.00 Cords	\$ 20.65/Cord	\$ _____
Red Oak	10.00 Cords	\$ 17.40/Cord	\$ _____

*The volumes are statistically estimated within plus (+) or minus (-) 17.21 percent. These estimated volumes are final and not subject to adjustment. Prospective bidders are urged to examine this timber and to make their own estimates of quantity and quality.

I understand that any or all bids may be rejected. All bids must be signed and all bid items must be bid or the bid form may be rejected. I also understand that consideration and awarding a contract will be based upon my past performance and ability to complete the contract based upon equipment and staffing subject to my control.

FEDERAL ID: _____ or SOCIAL SECURITY NUMBER: _____

Company or individual bidding: _____

Company representative's name: _____

Address: _____

City: _____ State: _____ Zip: _____

IF AVAILABLE, PLEASE PLACE THE PERSONALIZED LABEL FROM YOUR PROSPECTUS IN THE ABOVE BOX.

Individual or company representative's signature: _____ Date: _____

Phone number : _____ Email (optional): _____

THE WINNING BIDDER MUST COMPLETE THE VERIFICATION OF WORKER'S DISABILITY COMPENSATION ACT COMPLIANCE (ON REVERSE SIDE IF DOUBLE SIDED) WITHIN 21 DAYS OF SALE AWARD DATE



FOR DEPARTMENT USE ONLY
Sale Number (XX - XXX - XX - XX)
Forest Management Unit:

TIMBER SALE VERIFICATION OF WORKER'S DISABILITY COMPENSATION ACT COMPLIANCE

*As required by Act 317, P.A. 1969 (Worker's Compensation) and
Part 5 of Act 451 of 1994, as amended.*

VERIFICATION OF WORKER'S DISABILITY COMPENSATION ACT COMPLIANCE

- This verification must be completed and submitted within 21 days of contract award and prior to the issuance of the timber sale contract.
- In addition, if boxes 2B or 2C are checked, then Notice of Exclusion or Certificate of Insurance must be submitted within twenty-one (21) days of the contract award and prior to the issuance of the timber sale contract.
- All information must be typed or printed except for written signatures.

Please Check Appropriate Categories:

1. My business is organized as (you **must** check one of the boxes below):
 - A. Sole Proprietorship (individual)
 - B. Partnership
 - C. Corporation

2. You **must** check one of the boxes below:
 - A. I certify my business is a sole proprietorship and it has no employees but the sole proprietor. I am not subject to the Worker's Compensation Laws.
 - B. I certify my business has satisfied its obligation to the Worker's Compensation Act through the use of an approved Notice of Exclusion (BWC-337, Rev. 5/96). I will provide a copy of the Notice of Exclusion within 21 days of the contract award. (For questions or a copy of the BWC-337, please call the Worker's Compensation Bureau at 517-322-1195).
 - C. I certify my business has a Worker's Compensation Policy. I will provide an original Certificate of Insurance within twenty-one (21) days of the contract award.

3. If you have checked item 2(A) or 2(B), you **must** indicate the number of **both** full-time and part-time employees, other than yourself, including family members and active partners (if none, you must enter "0").

_____ Full-time Employees

_____ Part-time Employees

Name of Business		Federal ID (or) Social Security No.	
Address		Telephone ()	
City	State	ZIP	

I hereby certify that the above information is true and correct. I agree to notify the Michigan DNR of any changes that occur in factors affecting my coverage during any of my present and future operations.

Signature of Owner or Authorized Representative

Title

Date

Please complete the "SEALED BID" information on the next page

Iron Age Red (61-051-17)
; Grand Traverse COUNTY

In response to the notice of sale to be held 4:00 p.m. (local time) on May 10, 2018, I am hereby submitting my sealed bid (firm offer) for the following forest products to be cut. Bids for individual species must be at or above the advertised price. All non-responsive bid forms may be rejected.

<u>PRODUCTS & SPECIES</u>	<u>ESTIMATED VOLUME*</u>	<u>ADVERTISED PRICE</u>	<u>BID PRICE/UNIT</u>
Sawtimber			
Red Oak	1.30 MBF	\$ 205.00/MBF	\$ _____
Red Pine	461.50 MBF	\$ 117.00/MBF	\$ _____
Sugar Maple	1.30 MBF	\$ 263.00/MBF	\$ _____
White Pine	7.80 MBF	\$ 61.00/MBF	\$ _____
Pulpwood			
Mixed Hardwood	18.00 Cords	\$ 20.05/Cord	\$ _____
Red Oak	3.00 Cords	\$ 17.40/Cord	\$ _____
Red Pine	848.00 Cords	\$ 41.10/Cord	\$ _____
White Pine	11.00 Cords	\$ 14.75/Cord	\$ _____

*The volumes are statistically estimated within plus (+) or minus (-) 9.80 percent. These estimated volumes are final and not subject to adjustment. Prospective bidders are urged to examine this timber and to make their own estimates of quantity and quality.

I understand that any or all bids may be rejected. All bids must be signed and all bid items must be bid or the bid form may be rejected. I also understand that consideration and awarding a contract will be based upon my past performance and ability to complete the contract based upon equipment and staffing subject to my control.

FEDERAL ID: _____ or SOCIAL SECURITY NUMBER: _____

Company or individual bidding: _____

Company representative's name: _____

Address: _____

City: _____ State: _____ Zip: _____

IF AVAILABLE, PLEASE PLACE THE PERSONALIZED LABEL FROM YOUR PROSPECTUS IN THE ABOVE BOX.

Individual or company representative's signature: _____ Date: _____

Phone number : _____ Email (optional): _____

THE WINNING BIDDER MUST COMPLETE THE VERIFICATION OF WORKER'S DISABILITY COMPENSATION ACT COMPLIANCE (ON REVERSE SIDE IF DOUBLE SIDED) WITHIN 21 DAYS OF SALE AWARD DATE



FOR DEPARTMENT USE ONLY
Sale Number (XX - XXX - XX - XX)
Forest Management Unit:

TIMBER SALE VERIFICATION OF WORKER'S DISABILITY COMPENSATION ACT COMPLIANCE

*As required by Act 317, P.A. 1969 (Worker's Compensation) and
Part 5 of Act 451 of 1994, as amended.*

VERIFICATION OF WORKER'S DISABILITY COMPENSATION ACT COMPLIANCE

- This verification must be completed and submitted within 21 days of contract award and prior to the issuance of the timber sale contract.
- In addition, if boxes 2B or 2C are checked, then Notice of Exclusion or Certificate of Insurance must be submitted within twenty-one (21) days of the contract award and prior to the issuance of the timber sale contract.
- All information must be typed or printed except for written signatures.

Please Check Appropriate Categories:

1. My business is organized as (you **must** check one of the boxes below):
 - A. Sole Proprietorship (individual)
 - B. Partnership
 - C. Corporation
2. You **must** check one of the boxes below:
 - A. I certify my business is a sole proprietorship and it has no employees but the sole proprietor. I am not subject to the Worker's Compensation Laws.
 - B. I certify my business has satisfied its obligation to the Worker's Compensation Act through the use of an approved Notice of Exclusion (BWC-337, Rev. 5/96). I will provide a copy of the Notice of Exclusion within 21 days of the contract award. (For questions or a copy of the BWC-337, please call the Worker's Compensation Bureau at 517-322-1195).
 - C. I certify my business has a Worker's Compensation Policy. I will provide an original Certificate of Insurance within twenty-one (21) days of the contract award.
3. If you have checked item 2(A) or 2(B), you **must** indicate the number of **both** full-time and part-time employees, other than yourself, including family members and active partners (if none, you must enter "0").

_____ Full-time Employees

_____ Part-time Employees

Name of Business		Federal ID (or) Social Security No.	
Address		Telephone ()	
City	State	ZIP	

I hereby certify that the above information is true and correct. I agree to notify the Michigan DNR of any changes that occur in factors affecting my coverage during any of my present and future operations.

Signature of Owner or Authorized Representative

Title

Date

Please complete the "SEALED BID" information on the next page

Hermit Hardwood (61-057-17)
; Benzie COUNTY

In response to the notice of sale to be held 4:00 p.m. (local time) on May 10, 2018, I am hereby submitting my sealed bid (firm offer) for the following forest products to be cut. Bids for individual species must be at or above the advertised price. All non-responsive bid forms may be rejected.

<u>PRODUCTS & SPECIES</u>	<u>ESTIMATED VOLUME*</u>	<u>ADVERTISED PRICE</u>	<u>BID PRICE/UNIT</u>
Sawtimber			
American Elm	3.80 MBF	\$ 60.00/MBF	\$ _____
Basswood	282.20 MBF	\$ 104.00/MBF	\$ _____
Beech	102.70 MBF	\$ 93.00/MBF	\$ _____
Black Cherry	60.60 MBF	\$ 156.00/MBF	\$ _____
Mixed Aspen	80.80 MBF	\$ 95.00/MBF	\$ _____
Red Maple	155.30 MBF	\$ 100.00/MBF	\$ _____
Sugar Maple	304.70 MBF	\$ 228.00/MBF	\$ _____
Pulpwood			
Basswood	297.00 Cords	\$ 25.85/Cord	\$ _____
Mixed Aspen	238.00 Cords	\$ 17.90/Cord	\$ _____
Mixed Hardwood	893.00 Cords	\$ 17.35/Cord	\$ _____
Sugar Maple	947.00 Cords	\$ 17.35/Cord	\$ _____

*These estimated volumes are final and not subject to adjustment. Prospective bidders are urged to examine this timber and to make their own estimates of quantity and quality.

I understand that any or all bids may be rejected. All bids must be signed and all bid items must be bid or the bid form may be rejected. I also understand that consideration and awarding a contract will be based upon my past performance and ability to complete the contract based upon equipment and staffing subject to my control.

FEDERAL ID: _____ or SOCIAL SECURITY NUMBER: _____

Company or individual bidding: _____

Company representative's name: _____

Address: _____

City: _____ State: _____ Zip: _____

IF AVAILABLE, PLEASE PLACE THE PERSONALIZED LABEL FROM YOUR PROSPECTUS IN THE ABOVE BOX.

Individual or company representative's signature: _____ Date: _____

Phone number : _____ Email (optional): _____

THE WINNING BIDDER MUST COMPLETE THE VERIFICATION OF WORKER'S DISABILITY COMPENSATION ACT COMPLIANCE (ON REVERSE SIDE IF DOUBLE SIDED) WITHIN 21 DAYS OF SALE AWARD DATE



TIMBER SALE VERIFICATION OF WORKER'S DISABILITY COMPENSATION ACT COMPLIANCE

As required by Act 317, P.A. 1969 (Worker's Compensation) and
Part 5 of Act 451 of 1994, as amended.

FOR DEPARTMENT USE ONLY	
Sale Number (XX - XXX - XX - XX)	
Forest Management Unit:	

VERIFICATION OF WORKER'S DISABILITY COMPENSATION ACT COMPLIANCE

- This verification must be completed and submitted within 21 days of contract award and prior to the issuance of the timber sale contract.
- In addition, if boxes 2B or 2C are checked, then Notice of Exclusion or Certificate of Insurance must be submitted within twenty-one (21) days of the contract award and prior to the issuance of the timber sale contract.
- All information must be typed or printed except for written signatures.

Please Check Appropriate Categories:

1. My business is organized as (you **must** check one of the boxes below):
 - A. Sole Proprietorship (individual)
 - B. Partnership
 - C. Corporation
2. You **must** check one of the boxes below:
 - A. I certify my business is a sole proprietorship and it has no employees but the sole proprietor. I am not subject to the Worker's Compensation Laws.
 - B. I certify my business has satisfied its obligation to the Worker's Compensation Act through the use of an approved Notice of Exclusion (BWC-337, Rev. 5/96). I will provide a copy of the Notice of Exclusion within 21 days of the contract award. (For questions or a copy of the BWC-337, please call the Worker's Compensation Bureau at 517-322-1195).
 - C. I certify my business has a Worker's Compensation Policy. I will provide an original Certificate of Insurance within twenty-one (21) days of the contract award.
3. If you have checked item 2(A) or 2(B), you **must** indicate the number of **both** full-time and part-time employees, other than yourself, including family members and active partners (if none, you must enter "0").

_____ Full-time Employees

_____ Part-time Employees

Name of Business		Federal ID (or) Social Security No.	
Address		Telephone ()	
City	State	ZIP	

I hereby certify that the above information is true and correct. I agree to notify the Michigan DNR of any changes that occur in factors affecting my coverage during any of my present and future operations.

Signature of Owner or Authorized Representative

Title

Date

Please complete the "SEALED BID" information on the next page

Gradient Mix (61-072-17)
; Grand Traverse COUNTY

In response to the notice of sale to be held 4:00 p.m. (local time) on May 10, 2018, I am hereby submitting my sealed bid (firm offer) for the following forest products to be cut. Bids for individual species must be at or above the advertised price. All non-responsive bid forms may be rejected.

<u>PRODUCTS & SPECIES</u>	<u>ESTIMATED VOLUME*</u>	<u>ADVERTISED PRICE</u>	<u>BID PRICE/UNIT</u>
Sawtimber			
B. T. Aspen	3.20 MBF	\$ 109.00/MBF	\$ _____
Black Cherry	2.40 MBF	\$ 180.00/MBF	\$ _____
Red Maple	3.20 MBF	\$ 115.00/MBF	\$ _____
Red Pine	1.60 MBF	\$ 117.00/MBF	\$ _____
White Pine	19.00 MBF	\$ 61.00/MBF	\$ _____
Pulpwood			
Balsam Fir	2.00 Cords	\$ 13.60/Cord	\$ _____
Jack Pine	15.00 Cords	\$ 15.55/Cord	\$ _____
Mixed Aspen	16.00 Cords	\$ 20.65/Cord	\$ _____
Mixed Hardwood	44.00 Cords	\$ 20.05/Cord	\$ _____
Paper Birch	4.00 Cords	\$ 20.85/Cord	\$ _____
Red Oak	3.00 Cords	\$ 17.40/Cord	\$ _____
Red Pine	1.00 Cords	\$ 41.10/Cord	\$ _____
White Pine	33.00 Cords	\$ 14.75/Cord	\$ _____

*The volumes are statistically estimated within plus (+) or minus (-) 23.06 percent. These estimated volumes are final and not subject to adjustment. Prospective bidders are urged to examine this timber and to make their own estimates of quantity and quality.

I understand that any or all bids may be rejected. All bids must be signed and all bid items must be bid or the bid form may be rejected. I also understand that consideration and awarding a contract will be based upon my past performance and ability to complete the contract based upon equipment and staffing subject to my control.

FEDERAL ID: _____ or SOCIAL SECURITY NUMBER: _____

Company or individual bidding: _____

Company representative's name: _____

Address: _____

City: _____ State: _____ Zip: _____

IF AVAILABLE, PLEASE PLACE THE PERSONALIZED LABEL FROM YOUR PROSPECTUS IN THE ABOVE BOX.

Individual or company representative's signature: _____ Date: _____

Phone number : _____ Email (optional): _____

THE WINNING BIDDER MUST COMPLETE THE VERIFICATION OF WORKER'S DISABILITY COMPENSATION ACT COMPLIANCE (ON REVERSE SIDE IF DOUBLE SIDED) WITHIN 21 DAYS OF SALE AWARD DATE



TIMBER SALE VERIFICATION OF WORKER'S DISABILITY COMPENSATION ACT COMPLIANCE

As required by Act 317, P.A. 1969 (Worker's Compensation) and
Part 5 of Act 451 of 1994, as amended.

FOR DEPARTMENT USE ONLY

Sale Number (XX – XXX – XX – XX)

Forest Management Unit:

VERIFICATION OF WORKER'S DISABILITY COMPENSATION ACT COMPLIANCE

- This verification must be completed and submitted within 21 days of contract award and prior to the issuance of the timber sale contract.
- In addition, if boxes 2B or 2C are checked, then Notice of Exclusion or Certificate of Insurance must be submitted within twenty-one (21) days of the contract award and prior to the issuance of the timber sale contract.
- All information must be typed or printed except for written signatures.

Please Check Appropriate Categories:

1. My business is organized as (you **must** check one of the boxes below):
 - A. Sole Proprietorship (individual)
 - B. Partnership
 - C. Corporation
2. You **must** check one of the boxes below:
 - A. I certify my business is a sole proprietorship and it has no employees but the sole proprietor. I am not subject to the Worker's Compensation Laws.
 - B. I certify my business has satisfied its obligation to the Worker's Compensation Act through the use of an approved Notice of Exclusion (BWC-337, Rev. 5/96). I will provide a copy of the Notice of Exclusion within 21 days of the contract award. (For questions or a copy of the BWC-337, please call the Worker's Compensation Bureau at 517-322-1195).
 - C. I certify my business has a Worker's Compensation Policy. I will provide an original Certificate of Insurance within twenty-one (21) days of the contract award.
3. If you have checked item 2(A) or 2(B), you **must** indicate the number of **both** full-time and part-time employees, other than yourself, including family members and active partners (if none, you must enter "0").

_____ Full-time Employees

_____ Part-time Employees

Name of Business		Federal ID (or) Social Security No.
Address		Telephone ()
City	State	ZIP

I hereby certify that the above information is true and correct. I agree to notify the Michigan DNR of any changes that occur in factors affecting my coverage during any of my present and future operations.

Signature of Owner or Authorized Representative

Title

Date

Please complete the "SEALED BID" information on the next page

Big Four Aspen (61-086-17)
; Benzie COUNTY

In response to the notice of sale to be held 4:00 p.m. (local time) on May 10, 2018, I am hereby submitting my sealed bid (firm offer) for the following forest products to be cut. Bids for individual species must be at or above the advertised price. All non-responsive bid forms may be rejected.

<u>PRODUCTS & SPECIES</u>	<u>ESTIMATED VOLUME*</u>	<u>ADVERTISED PRICE</u>	<u>BID PRICE/UNIT</u>
Sawtimber			
B. T. Aspen	83.80 MBF	\$ 109.00/MBF	\$ _____
Beech	0.90 MBF	\$ 108.00/MBF	\$ _____
Red Maple	17.40 MBF	\$ 115.00/MBF	\$ _____
Red Oak	36.70 MBF	\$ 205.00/MBF	\$ _____
White Oak	1.40 MBF	\$ 57.00/MBF	\$ _____
White Pine	18.80 MBF	\$ 61.00/MBF	\$ _____
Pulpwood			
Mixed Aspen	1,206.00 Cords	\$ 20.65/Cord	\$ _____
Mixed Hardwood	187.00 Cords	\$ 20.05/Cord	\$ _____
Mixed Oak	186.00 Cords	\$ 17.40/Cord	\$ _____
White Pine	196.00 Cords	\$ 14.75/Cord	\$ _____

*The volumes are statistically estimated within plus (+) or minus (-) 10.73 percent. These estimated volumes are final and not subject to adjustment. Prospective bidders are urged to examine this timber and to make their own estimates of quantity and quality.

I understand that any or all bids may be rejected. All bids must be signed and all bid items must be bid or the bid form may be rejected. I also understand that consideration and awarding a contract will be based upon my past performance and ability to complete the contract based upon equipment and staffing subject to my control.

FEDERAL ID: _____ or SOCIAL SECURITY NUMBER: _____

Company or individual bidding: _____

Company representative's name: _____

Address: _____

City: _____ State: _____ Zip: _____

IF AVAILABLE, PLEASE PLACE THE PERSONALIZED LABEL FROM YOUR PROSPECTUS IN THE ABOVE BOX.

Individual or company representative's signature: _____ Date: _____

Phone number : _____ Email (optional): _____

THE WINNING BIDDER MUST COMPLETE THE VERIFICATION OF WORKER'S DISABILITY COMPENSATION ACT COMPLIANCE (ON REVERSE SIDE IF DOUBLE SIDED) WITHIN 21 DAYS OF SALE AWARD DATE



FOR DEPARTMENT USE ONLY
Sale Number (XX - XXX - XX - XX)
Forest Management Unit:

TIMBER SALE VERIFICATION OF WORKER'S DISABILITY COMPENSATION ACT COMPLIANCE

*As required by Act 317, P.A. 1969 (Worker's Compensation) and
Part 5 of Act 451 of 1994, as amended.*

VERIFICATION OF WORKER'S DISABILITY COMPENSATION ACT COMPLIANCE

- This verification must be completed and submitted within 21 days of contract award and prior to the issuance of the timber sale contract.
- In addition, if boxes 2B or 2C are checked, then Notice of Exclusion or Certificate of Insurance must be submitted within twenty-one (21) days of the contract award and prior to the issuance of the timber sale contract.
- All information must be typed or printed except for written signatures.

Please Check Appropriate Categories:

1. My business is organized as (you **must** check one of the boxes below):
 - A. Sole Proprietorship (individual)
 - B. Partnership
 - C. Corporation
2. You **must** check one of the boxes below:
 - A. I certify my business is a sole proprietorship and it has no employees but the sole proprietor. I am not subject to the Worker's Compensation Laws.
 - B. I certify my business has satisfied its obligation to the Worker's Compensation Act through the use of an approved Notice of Exclusion (BWC-337, Rev. 5/96). I will provide a copy of the Notice of Exclusion within 21 days of the contract award. (For questions or a copy of the BWC-337, please call the Worker's Compensation Bureau at 517-322-1195).
 - C. I certify my business has a Worker's Compensation Policy. I will provide an original Certificate of Insurance within twenty-one (21) days of the contract award.
3. If you have checked item 2(A) or 2(B), you **must** indicate the number of **both** full-time and part-time employees, other than yourself, including family members and active partners (if none, you must enter "0").

_____ Full-time Employees

_____ Part-time Employees

Name of Business		Federal ID (or) Social Security No.	
Address		Telephone ()	
City	State	ZIP	

I hereby certify that the above information is true and correct. I agree to notify the Michigan DNR of any changes that occur in factors affecting my coverage during any of my present and future operations.

Signature of Owner or Authorized Representative

Title

Date

Please complete the "SEALED BID" information on the next page