



**DEPARTMENT OF NATURAL RESOURCES
STATE OF MICHIGAN**

TIMBER SALE PROSPECTUS #6215

SCHEDULED SALE DATE AND TIME: 10:00 a.m. (local time) on June 19, 2018.

LOCATION: GLADWIN MGMT UNIT, 801 N SILVERLEAF, GLADWIN, MI 48624.

PROSPECTUS NOTE: The bidder is advised to inspect the sale area and review the location, estimated volumes, operating costs and contract terms of proposed sales. Please be aware that some landowners may request 60 days or more notice for access across their land.

Notice is hereby given that bids will be received by the Unit Manager, GLADWIN MANAGEMENT UNIT, for certain timber on the following described lands:

Bald Eagle Pine (73-003-17)

Gladwin County, Advertised Price \$28,689.60, 71.4 Acres, Red Pine, White Pine.

SALE NOTE: Payment Units 1 and 4 have a dry/frozen restriction. The sale is a three year contract to end on a quarter. The MCCCT Trail runs along the Sterling Truck Trail. There is one berm that must be removed to access Payment Unit 3.

A recreation site such as a trail, pathway, or campground is within the sale area or the vicinity. Certain restrictions/specifications may be applicable including time restrictions.

Crooks Camp Pine (73-004-17)

Gladwin County, Advertised Price \$43,422.85, 261.2 Acres, Hardwood, Jack Pine.

SALE NOTE: Access is off Secord Dam Road. Two berms will need to be removed. There are two DNR supplied culverts that will need to be placed. The sale is a three year sale to end on a quarter, due to the dry/frozen specifications that are applied to all payment units.

Spring Fawn Mix (73-010-17)

Gladwin County, Advertised Price \$27,882.60, 115.3 Acres, Aspen, Hardwood.

SALE NOTE: Access is off Wildwood Road and Secord Dam Road. There are two berms that will need to be removed to gain access to two payment units. Payment Units 1, 3, and 4 have a dry/frozen requirement (see spec 5.2.3.1). The sale has a three year contract to end on a quarter.

BID INSTRUCTIONS (VER. 11/28/2017):

1. Scheduled Bid Location, Date, and Time (2/11)

Bids must be received by the Unit Manager, GLADWIN OFFICE, 801 N SILVERLEAF, GLADWIN, MI 48624, no later than 10:00 a.m. (local time) on June 19, 2018. For further information concerning this sale, contact PATRICK MOHNEY at 989-426-9205 extension 7640.

2. Bidder's Qualifications (5/16)

Purchaser shall obtain workers compensation insurance to cover claims under Michigan's Worker's Disability Compensation Act of 1969 or similar employee benefit act of any other state applicable to an employee. If all or part of a timber sale was prepared by a private contractor, the contractor and that contractor's company are not permitted to bid on the timber sale contract. Bids will not be accepted from individuals or companies appearing on the DNR/FRD No-Bid List. This list contains the names of purchasers who previously failed to execute a contract within 21-days or who have a history of poor performance.

3. Preparation of Sealed Bids (5/16)

Bid Forms may be completed online thru Michigan DNR Timber Sale Online Bidding (OLB) at www.michigan.gov/timberbidding or by completing the hardcopy Bid Form found in the Timber Sale Prospectus. Hardcopy Bid Forms shall be manually signed in ink. Registration in OLB is considered your 'signature' for all bids submitted thru that system. Bid prices must be entered for each species and product in the Bid Price column for all material subject to bidding and all fill-in blanks must be completed. If erasures or other changes appear on the hardcopy Bid Form, each erasure or change must be initialed by the person signing the bid.

4. Submission of Sealed Bids (5/16)

Bid forms may be obtained from the Unit Manager or thru OLB. Bids may be submitted hardcopy or thru OLB. All hardcopy bids must be submitted on the bid form and in an envelope clearly identified as described in this section. NOTE: Only one bid form per bid envelope. Sealed bids must be submitted to the Unit office designated in the prospectus and must be submitted at or prior to the time established in the prospectus. The envelope should show on the outside (a) the sale name or number and (b) the date and time of bid opening, as shown in the prospectus. Bids received after the time specified in the sale prospectus are late bids and will be rejected.

It is possible for a bidder to submit multiple bids on a single sale. For example, a bid may be submitted hardcopy and a bid may be submitted thru OLB. Or, two bidders from the same company could both submit bids on the same sale. If this were to happen, the State would accept all bids received and award the contract accordingly. All bidding and contractual requirements would apply to all bids received.

5. Public Opening of Sealed Bids (7/16)

If conditions permit, the sealed bids will be publicly opened and posted at the time and place set in the prospectus.

If a bidder, present at a bid opening, has submitted bids on more than one sale, that bidder may withdraw their unopened bid envelopes or announce the withdrawal of their online bid after being declared the successful bidder on one sale.

6. Award of Contract (1/11)

Award of the contract will be made to the Bidder whose bid, conforming to the prospectus, is most advantageous to the State of Michigan on the basis of total value at rates bid for the estimated quantities. The State reserves the right to reject any bid or waive any minor irregularity in bids received. A written award mailed (or otherwise furnished) to the successful Bidder shall be deemed to result in a binding contract without further action by either party.

7. Down Payment (1/11)

The Bidder to whom award is made must make a down payment within 21 days of the sale award. The amount of the down payment will be calculated as shown in the Bond and Payment Schedule of this prospectus. Only cash may be used to meet this requirement.

8. Performance Security (1/11)

As guarantee of faithful performance, a cash bond, certificate of deposit, surety bond or irrevocable letter of credit (LOC) is required within 21 days of the sale award. The amount of the performance security is shown in the Bond and

Payment Schedule of this prospectus. If an LOC or surety is used, the coverage must extend for at least 6 months beyond the contract expiration.

9. Timber Sale Contract (11/17)

Additional conditions and requirements common to all timber sales are listed on the timber sale contract (R4031) and are available on line at www.michigan.gov/timber. Contact the Unit Manager for additional information or a sample contract. Within 21 days of the date of the award letter, the bidder must sign the contract and provide the required down payment, performance security, and verification of worker's disability compensation. The down payment and performance security shall be in accordance with the provisions of the timber sale contract, in the sums stated in this prospectus. If these actions are not taken, then the Bidder, the Bidder's corporation, and the corporation's principals may not be permitted to bid on State timber sales for a period of 1 year. In addition, the Bidder certifies that if awarded this contract, the Bidder will complete the timber sale contract in accordance with its terms and any modifications thereof including requirements to purchase, cut, and remove the included timber by the expiration date.

Payment Unit values in the State Forest Timber Sale Contract are calculated based on the advertised value of the Payment Unit as a percentage of the total advertised value of the contract. The advertised value of each Payment Unit is given in the Description of Timber by Payment Unit table on the Timber Sale Information page. For example, if the value of Payment Unit 1 is advertised as \$1,500 and the total Timber Sale value is advertised as \$10,000, the contract price for Payment Unit 1 will be 15% of the total bid price ($\$1,500/\$10,000 * 100$).

10. Disclaimer of Estimates and Bidder's Warranty of Inspection (7/16)

Before submitting this bid, the Bidder is advised and cautioned to inspect the sale area, review the requirements of the sale contract, and take other steps as may be reasonably necessary to ascertain the location, estimated volumes, construction estimates, and operating costs of the proposed sale. Failure to do so will not relieve the Bidder from responsibility for completing the contract.

The Bidder warrants that this bid is submitted solely on the basis of the Bidder's examination and inspection of the quality and quantity of the timber offered for sale and the Bidder's opinion of the value thereof and the costs of recovery. No reliance should be placed on the State of Michigan's estimates of timber quality, quantity or costs of recovery. Bidder further acknowledges that the State of Michigan: (i) expressly disclaims any warranty of fitness of timber for any purpose; (ii) offers this timber as is without any warranty of quality (merchantability) or quantity and (iii) expressly disclaims any warranty as to the quantity or quality of timber sold.

11. Certification and Chain-of-Custody (10/14)

Unless otherwise indicated in the contract under section 7 – Other Conditions of the Sale Specific Conditions & Requirements, the area encompassed by this timber sale is certified to the standards of the Forest Stewardship Council (FSC) - Certificate #SCS-FM/COC-00090N and the Sustainable Forestry Initiative (SFI) - Certificate # NSF-SFIS-5Y031-SF5. Forest products from this sale may be delivered to the mill as "FSC 100% and / or SFI certified" as long as the contractor hauling the forest products is chain-of-custody (COC) certified or covered under a COC certificate from the destination mill. The purchaser is responsible for maintaining COC after leaving the sale area.

12. Good Neighbor Authority (GNA) Requirements (7/16)

If the name of this timber sales contains the acronym GNA, it is authorized by the Good Neighbor Authority (GNA) and covered by various agreements between the U.S. Forest Service and the State. The timber sale occurs on federal land and the following conditions apply:

GNA contracts on US Forest Service land will not be awarded to purchasers on the Federal list of excluded parties. The System for Award Management (SAM) will be checked for active excluded parties prior to award of contract. In addition, the Bidder to whom award is made must complete an Assurance Regarding Felony Conviction or Tax Delinquent Status for Corporate Applicants (AD-3031).

13. Good Neighbor Authority (GNA) Requirements, con't (9/16)

Bidder certifies, by signing this bid form, that to the best of Bidder's knowledge that the following representations are accurate and complete.

a. That the Bidder and its principals are not presently debarred, suspended, proposed for debarment, declared ineligible, or voluntary excluded from timber sales (covered transactions) by any Federal department or agency.

b. That the Bidder and its principals have not within a 3-year period preceding this bid been convicted of or had a civil judgment rendered against them for commission of fraud or a criminal offense in connection with obtaining, attempting to obtain, or performing a public (Federal, State, or local) transaction or contract under a public transaction; violation of Federal or State antitrust statutes or commission of embezzlement, theft, forgery, bribery, falsification or destruction of records, making false statements, or receiving stolen property.

c. That the Bidder and its principals are not presently indicted for or otherwise criminally or civilly charged by a governmental entity (Federal, State, or local) with commission of any of the offenses enumerated in paragraph b of this certification.

d. That the Bidder and its principals have not within a 3-year period preceding this bid had one or more public transactions (Federal, State, or local) terminated for breach or default of a timber or forest product contract.

Bidders that cannot certify this requirement, in whole or in part, shall submit an explanation with their bid.

KEITH CREAGH

Director

TIMBER SALE INFORMATION

Bald Eagle Pine (73-003-17)

Gladwin County (Advertised Price \$28,689.60)

SALE NOTE: Payment Units 1 and 4 have a dry/frozen restriction. The sale is a three year contract to end on a quarter. The MCCCT Trail runs along the Sterling Truck Trail. There is one berm that must be removed to access Payment Unit 3.

A recreation site such as a trail, pathway, or campground is within the sale area or the vicinity. Certain restrictions/specifications may be applicable including time restrictions.

A timber sale contract for this lump sum, sealed bid timber sale will be awarded to the responsible bidder offering the highest sealed bid price. Bids must be at or above the following advertised price for each species:

<u>PRODUCTS & SPECIES</u>	<u>ESTIMATED UNITS*</u>		<u>ADVERTISED PRICE</u>
Sawtimber			
Red Pine	73.70	MBF	\$ 135.00 / MBF
White Pine	12.10	MBF	\$ 88.00 / MBF
Pulpwood			
Bl/R/Hybrid Oak	5.00	Cords	\$ 11.55 / Cord
Mixed Aspen	74.00	Cords	\$ 21.25 / Cord
Paper Birch	28.00	Cords	\$ 11.75 / Cord
Red Maple	100.00	Cords	\$ 15.10 / Cord
Red Pine	259.00	Cords	\$ 35.15 / Cord
White Pine	263.00	Cords	\$ 19.40 / Cord

* The total volume is statistically estimated within plus (+) or minus (-) 17.01 percent. The estimated units are final and not subject to adjustment. Prospective bidders are urged to examine this timber and to make their own estimates of quantity and quality.

BOND AND PAYMENT SCHEDULE:

1. A bond in the amount of \$1,434.00 to insure faithful performance of the conditions of the contract will be deposited by the successful bidder within 21 days of the sale award.
2. Cutting in any sale or unit without the required advance payment would be considered a trespass.
3. Total payment must be paid in advance or according to the following schedule:
 - (a) Ten percent (10%) of the sale value must be paid within 21 days of the sale award.
 - (b) The 10% down payment will be credited towards the first unit cut.
 - (c) Payment for each of the following units must be made before cutting begins in that unit:

PAYMENT UNIT NUMBER	PERCENT OF TOTAL SALE VALUE
01	14.9%
02	16.1%
03	14.9%
04	54.1%
4. If no cutting takes place, the 10% down payment will not be refunded.
5. Operations on the contract issued will terminate on 06/30/2021.

Description of Timber by Payment Unit (PU)

PU	MARKET GROUP	PRODUCT	QUANTITY	UNIT	ACRES	ADVERTISE PRICE
1	Red Pine	Sawtimber	12.7	MBF	6.0	\$4,287.10
	White Pine		4.1	MBF		
	BI/R/Hybrid Oak	Pulpwood	3.0	Cords		
	<i>BI/R/Hybrid Oak</i>	<i>Sawtimber</i>	<i>0.4</i>	<i>MBF</i>		
	<i>BI/R/Hybrid Oak</i>	<i>Pulpwood</i>	<i>2.0</i>	<i>Cords</i>		
	Mixed Aspen		11.0	Cords		
	<i>B. T. Aspen</i>		<i>11.0</i>	<i>Cords</i>		
	Paper Birch		6.0	Cords		
	Red Maple		11.0	Cords		
	<i>Red Maple</i>	<i>Sawtimber</i>	<i>0.8</i>	<i>MBF</i>		
	<i>Red Maple</i>	<i>Pulpwood</i>	<i>9.0</i>	<i>Cords</i>		
	Red Pine		32.0	Cords		
	White Pine		30.0	Cords		
2	Red Pine	Sawtimber	1.5	MBF	29.5	\$4,615.45
	White Pine		1.0	MBF		
	BI/R/Hybrid Oak	Pulpwood	2.0	Cords		
	<i>BI/R/Hybrid Oak</i>		<i>2.0</i>	<i>Cords</i>		
	Mixed Aspen		26.0	Cords		
	<i>Quaking Aspen</i>	<i>Sawtimber</i>	<i>0.9</i>	<i>MBF</i>		
	<i>B. T. Aspen</i>	<i>Pulpwood</i>	<i>19.0</i>	<i>Cords</i>		
	<i>Quaking Aspen</i>		<i>5.0</i>	<i>Cords</i>		
	Paper Birch		2.0	Cords		
	Red Maple		22.0	Cords		
	<i>Red Maple</i>		<i>22.0</i>	<i>Cords</i>		
	Red Pine		11.0	Cords		
	White Pine		155.0	Cords		
3	White Pine	Sawtimber	7.0	MBF	25.4	\$4,267.60
	Mixed Aspen	Pulpwood	37.0	Cords		
	<i>B. T. Aspen</i>	<i>Sawtimber</i>	<i>1.4</i>	<i>MBF</i>		
	<i>B. T. Aspen</i>	<i>Pulpwood</i>	<i>34.0</i>	<i>Cords</i>		
	Paper Birch		20.0	Cords		
	Red Maple		67.0	Cords		
	<i>Red Maple</i>	<i>Sawtimber</i>	<i>5.2</i>	<i>MBF</i>		
	<i>Red Maple</i>	<i>Pulpwood</i>	<i>57.0</i>	<i>Cords</i>		
	Red Pine		3.0	Cords		
	White Pine		78.0	Cords		
4	Red Pine	Sawtimber	59.5	MBF	10.5	\$15,519.45
	Red Pine	Pulpwood	213.0	Cords		
TOTAL:			85.8	MBF		
TOTAL:			729.0	Cords		

Sale Specific Conditions & Requirements

Sale Name: Bald Eagle Pine

Sale Number: 73-003-17 Seq#: 2

1 - Sale Area

1.2 - Boundaries

1.2.1 - Painted boundaries (1/14)

The sale boundary and Payment Unit boundaries are marked and identified by red paint. Exterior sale boundary lines against state are marked with red paint. The painted boundary line trees are not Included Timber and are to be protected.

2 - Timber Specifications

2.1 - Included Timber

2.1.3 - Cut tree marked unit(s) (12/08)

Within Payment Unit(s) 1 - 4, all trees are designated for cutting when marked with orange paint above and below stump height, regardless of merchantability.

2.2 - Utilization

2.2.3 - Stump heights (4/07)

Stump heights within the Sale Area shall be cut as low to the ground as possible. Unless approved by the Unit Manager or his/her representative, stump heights shall not exceed 6 inches for trees greater than 10 inches DBH and 4 inches for trees smaller than 10 inches DBH. Exception: within Payment Unit(s) 1 and 4, in order to facilitate reforestation, all stumps shall be cut at ground level.

2.2.6 - Roundwood operation required (5/07)

The skidding of whole trees or tree segments with limbs attached is prohibited within Payment Unit(s) 1 and 4. All products must be produced as roundwood and forwarded to existing roads or landing areas in final product length.

3 - Payments

3.4 - Damaged Timber

3.4.1 - Damaged timber (6/14)

General Condition and Requirement 3.4 Damaged Timber, defines liquidated damages for undesignated live merchantable trees which are cut or injured. In addition, extreme care should be taken to avoid damage to tree seedlings and saplings.

Within the sale area, if more than 25% of the tree seedlings or saplings (1/4" to 4.5" DBH) within a specified portion of the sale area are damaged, liquidated damages will be assessed at \$300 per acre for all acreage within that specified portion of the sale area that was damaged.

No damage is acceptable to merchantable undesignated trees. Within the sale area, if more than 5% of undesignated trees (> 4.5" DBH) within a specified area of the sale are damaged, liquidated damages will be assessed for all trees damaged. Rates will be in accordance with General Condition and Requirement 3.4 Damaged Timber.

4 - Transportation

4.1 - Construction

4.1.3 - Slash and earthen piles (8/04)

Piles or windrows of earth along roads and landings that have been widened or constructed shall be leveled. Slash from road maintenance or construction, including stumps, shall be dispersed throughout the sale.

4.1.12 - No new roads (1/12)

No new roads will be permitted in any Payment Unit. All operations are limited to existing roads. Skid trails only will be allowed.

4.2 - Maintenance

4.2.3 - Road maintenance (8/13)

The following road maintenance may be required: Within 60 days of completion of hauling, or if no hauling occurs for 60 days, the road must be maintained and graded. This includes cleaning of drainage areas, grading, crowning and filling with gravel, if necessary. Damages will be assessed if grading/repair does not occur.

5 - Operations

5.1 - Notification

5.1.1 - Pre-sale conference (10/16)

A pre-sale conference between the Purchaser and sale administrator is required prior to beginning a Payment Unit to determine landing locations.

5.2 - Conduct of Operations

5.2.1 - Slash

5.2.1.11 - Slash for reforestation (5/07)

To facilitate reforestation, Payment Unit(s) 1 and 4 shall be left with slash evenly distributed. Bunched tops within the cutting area shall be broken up and scattered. Stumps shall be cut low to the ground. Processing sites shall not be left with a compacted layer of slash; tops from these sites shall be hauled back into the cut area and scattered.

5.2.2 - Hazard Trees/Snags

5.2.2.1 - Den trees (10/16)

Obvious hollow and/or den trees shall be protected and left standing unless they are a safety hazard.

5.2.3 - Operating Restrictions

5.2.3.1 - Operating restrictions (9/11)

Within Payment Unit(s) 2 and 3, unless approved by the Unit Manager or his/her representative, cutting and skidding are limited to the period of 7/15 to 9/30 and 1/1 to 3/15. This restriction is because of seasonal wet soil conditions.

5.2.3.3 - Bark slippage restriction (3/09)

Within Payment Unit(s) 1 and 4, unless changed by written agreement, cutting and skidding are not permitted during the period of 4/15 to 7/15. This restriction is because of bark slippage.

5.2.39 - ORV trail/route protection (4/18)

The MCCCT Trail is an ORV trail and is shown on the Timber Sale Map. Do not cut trees or damage posts with yellow ORV markers. All stumps within 5 feet of the trail must be cut flush with the ground. Maintain a 50 foot wide slash, debris, and rut free zone daily using the ORV trail or route as the centerline. Skidding across the trail or route may only occur in locations approved by the sale administrator.

5.4 - Soil Protection

5.4.1 - Rutting restriction, general (7/16)

Operations are to cease immediately if equipment and weather conditions result in rutting of roads and/or skid trails which is 12 inches or greater in depth and 50 feet in length. The Unit Manager or his/her representative may restrict hauling and/or skidding if ruts exceed the specified depth. With the Unit Manager or his/her representative's approval, the Purchaser may return to the area when the risk of rutting has decreased.

5.8 - Protection of Endangered Species

5.8.5 - Protection of raptor nests (3/13)

All trees with raptor nests will be protected if found during harvesting operations. Notification will be made to the Unit Manager or his/her representative who will notify the Wildlife Biologist so an on-site evaluation and recommendation can be made, if necessary.

6 - Safety and Fire Prevention

6.2 - Signing

6.2.1 - Road posting (9/09)

The Purchaser is responsible for posting and maintaining caution signs on Wildwood Road and Sterling Truck Trail prior to beginning operations. The road must be posted at appropriate distances from the sale area to warn of logging activity and truck traffic. Signs must be removed when harvest operations are suspended or completed. The Purchaser will provide these signs.



TIMBER SALE MAP

This information provided by authority of Part 525, 1994 PA 451, as amended.

Forest Management Unit Gladwin Management Unit	County Gladwin	Mapped By Fanelli	Date 09/26/2017	Page 1	of 1
Township 19N	Range 02E	Section(s) and Subdivision(s) Sections 7, 8 and 9; Various	Cruised By VanOss Consulting	Scale 1:15,840	

Cover Type

A = Aspen	H = Hemlock	N = Marsh	U = Upland Brush
B = Paper Birch	J = Jack Pine	O = Oak	UM = Upland Mixed
C = Cedar	L = Lowland Brush	P = Lowland Poplar	V = Bog or Marsh
D = Treed Bog	LM = Lowland Mixed	Q = Mixed Swamp Conifer	W = White Pine
E = Swamp Hdwoods	M = Mpl, Bch, Brch	R = Red Pine	X = Non Stocked
F = Spruce Fir	MC = Mixed Conifer	S = Black Spruce	Z = Water
G = Grass	MD = Mixed Deciduous	T = Tamarack	

Density

0 = Non Stocked	5 = Pole Timber Medium
1 = Seedling Sapling Poor	6 = Pole Timber Well
2 = Seedling Sapling Medium	7 = Saw Timber Poor
3 = Seedling Sapling Well	8 = Saw Timber Medium
4 = Pole Timber Poor	9 = Saw Timber Well

PU	Acres	PU	Acres
1	6.0	3	25.4
2	29.5	4	10.5

Bald Eagle Pine

Compartment 46

71.4 Acres

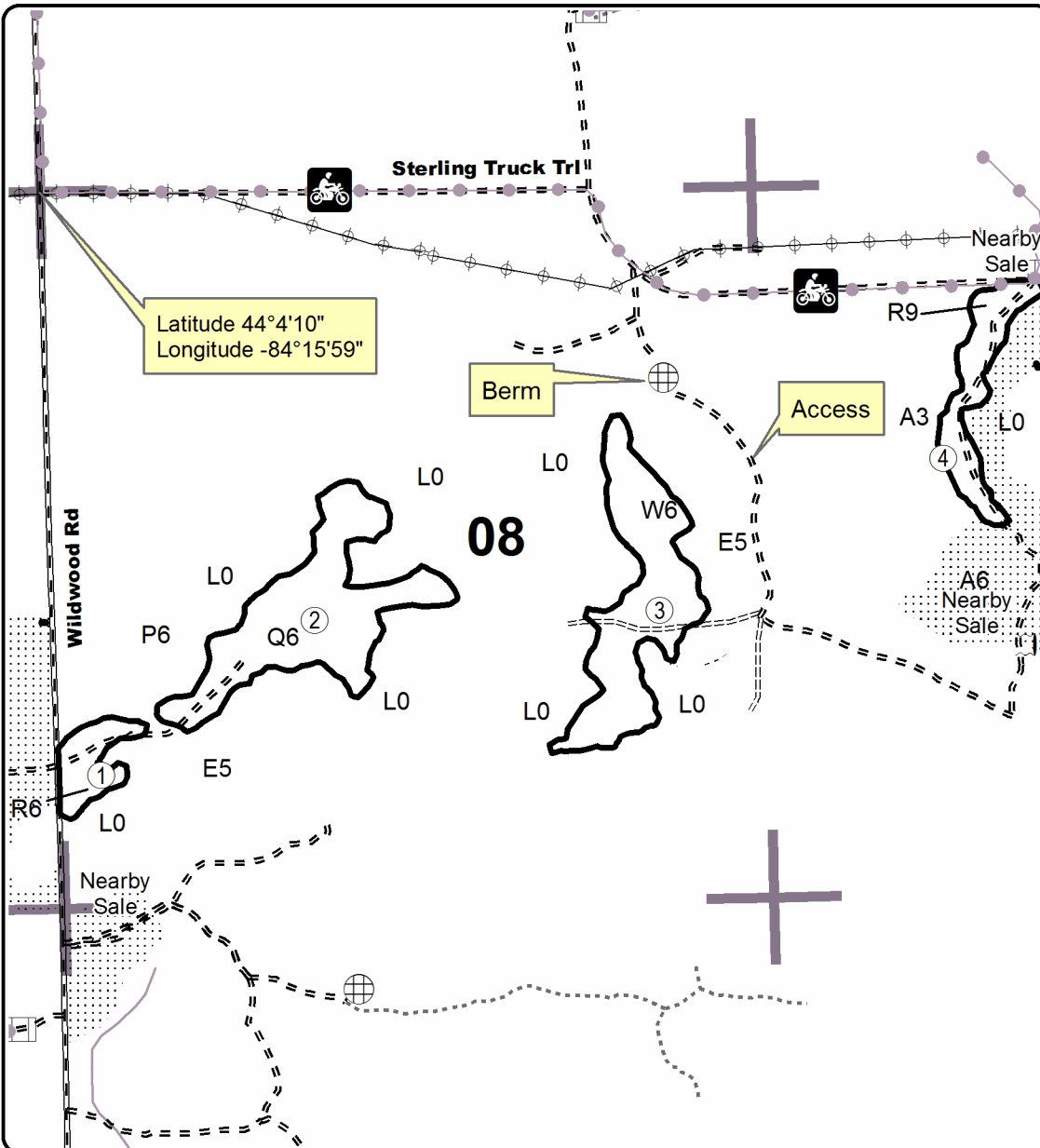

Legend

Sale Boundary

- Against State (Red)
- Section Corners
- Gravel Roads
- Poor Dirt Roads
- Closed Roads
- Recreational Trail
- Powerline
- PU Number

Locator Map
1:135,000

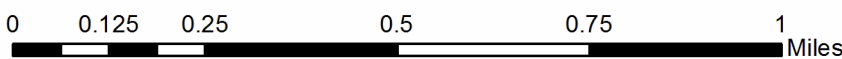
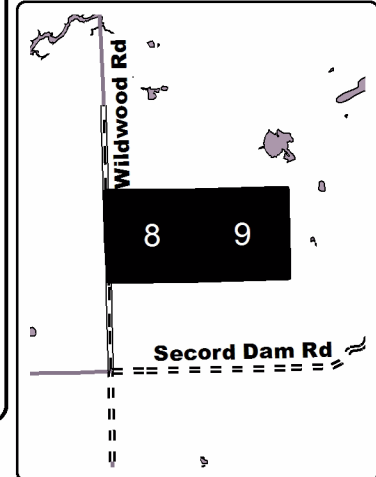

TIMBER SALE INFORMATION

Crooks Camp Pine (73-004-17)

Gladwin County (Advertised Price \$43,422.85)

SALE NOTE: Access is off Secord Dam Road. Two berms will need to be removed. There are two DNR supplied culverts that will need to be placed. The sale is a three year sale to end on a quarter, due to the dry/frozen specifications that are applied to all payment units.

A timber sale contract for this lump sum, sealed bid timber sale will be awarded to the responsible bidder offering the highest sealed bid price. Bids must be at or above the following advertised price for each species:

<u>PRODUCTS & SPECIES</u>	<u>ESTIMATED UNITS*</u>		<u>ADVERTISED PRICE</u>
Sawtimber			
BI/R/Hybrid Oak	22.60	MBF	\$ 148.00 / MBF
Mixed Aspen	46.00	MBF	\$ 52.00 / MBF
Red Maple	17.40	MBF	\$ 32.00 / MBF
Pulpwood			
BI/R/Hybrid Oak	277.00	Cords	\$ 11.55 / Cord
Jack Pine	2,061.00	Cords	\$ 12.30 / Cord
Mixed Aspen	300.00	Cords	\$ 21.25 / Cord
Mixed Hardwood	146.00	Cords	\$ 15.10 / Cord

* The total volume is statistically estimated within plus (+) or minus (-) 15.97 percent. The estimated units are final and not subject to adjustment. Prospective bidders are urged to examine this timber and to make their own estimates of quantity and quality.

BOND AND PAYMENT SCHEDULE:

1. A bond in the amount of \$2,171.00 to insure faithful performance of the conditions of the contract will be deposited by the successful bidder within 21 days of the sale award.
2. Cutting in any sale or unit without the required advance payment would be considered a trespass.
3. Total payment must be paid in advance or according to the following schedule:
 - (a) Ten percent (10%) of the sale value must be paid within 21 days of the sale award.
 - (b) The 10% down payment will be credited towards the first unit cut.
 - (c) Payment for each of the following units must be made before cutting begins in that unit:

PAYMENT UNIT NUMBER	PERCENT OF TOTAL SALE VALUE
01	19.6%
02	30.4%
03	25.3%
04	12.5%
05	1.0%
06	2.9%
07	4.7%
08	3.6%

4. If no cutting takes place, the 10% down payment will not be refunded.
5. Operations on the contract issued will terminate on 06/30/2021.

Description of Timber by Payment Unit (PU)

PU	MARKET GROUP	PRODUCT	QUANTITY	UNIT	ACRES	ADVERTISE PRICE
1	BI/R/Hybrid Oak	Sawtimber	4.8	MBF	50.6	\$8,497.25
	Mixed Aspen		12.5	MBF		
	<i>B. T. Aspen</i>		8.9	<i>MBF</i>		
	<i>Quaking Aspen</i>		3.6	<i>MBF</i>		
	Red Maple		3.6	MBF		
	BI/R/Hybrid Oak	Pulpwood	61.0	Cords		
	Jack Pine		341.0	Cords		
	<i>Jack Pine</i>	<i>Sawtimber</i>	15.7	<i>MBF</i>		
	<i>Jack Pine</i>	<i>Pulpwood</i>	310.0	<i>Cords</i>		
	Mixed Aspen		80.0	Cords		
	<i>B. T. Aspen</i>		44.0	<i>Cords</i>		
	<i>Quaking Aspen</i>		36.0	<i>Cords</i>		
	Mixed Hardwood		28.0	Cords		
	<i>Black Cherry</i>		16.0	<i>Cords</i>		
	<i>Paper Birch</i>		3.0	<i>Cords</i>		
	<i>Red Maple</i>		9.0	<i>Cords</i>		
2	BI/R/Hybrid Oak	Sawtimber	8.9	MBF	79.5	\$13,226.85
	Mixed Aspen		18.3	MBF		
	<i>B. T. Aspen</i>		13.1	<i>MBF</i>		
	<i>Quaking Aspen</i>		5.2	<i>MBF</i>		
	Red Maple		7.3	MBF		
	BI/R/Hybrid Oak	Pulpwood	101.0	Cords		
	Jack Pine		503.0	Cords		
	<i>Jack Pine</i>	<i>Sawtimber</i>	22.9	<i>MBF</i>		
	<i>Jack Pine</i>	<i>Pulpwood</i>	457.0	<i>Cords</i>		
	Mixed Aspen		116.0	Cords		
	<i>B. T. Aspen</i>		64.0	<i>Cords</i>		
	<i>Quaking Aspen</i>		52.0	<i>Cords</i>		
	Mixed Hardwood		60.0	Cords		
	<i>Black Cherry</i>		22.0	<i>Cords</i>		
	<i>Paper Birch</i>		5.0	<i>Cords</i>		
	<i>Red Maple</i>		33.0	<i>Cords</i>		
3	BI/R/Hybrid Oak	Sawtimber	7.8	MBF	66.2	\$10,990.90
	Mixed Aspen		14.8	MBF		
	<i>B. T. Aspen</i>		10.6	<i>MBF</i>		
	<i>Quaking Aspen</i>		4.2	<i>MBF</i>		
	Red Maple		6.5	MBF		
	BI/R/Hybrid Oak	Pulpwood	85.0	Cords		
	Jack Pine		410.0	Cords		
	<i>Jack Pine</i>	<i>Sawtimber</i>	18.8	<i>MBF</i>		
	<i>Jack Pine</i>	<i>Pulpwood</i>	372.0	<i>Cords</i>		
	Mixed Aspen		95.0	Cords		
	<i>B. T. Aspen</i>		52.0	<i>Cords</i>		
	<i>Quaking Aspen</i>		43.0	<i>Cords</i>		
	Mixed Hardwood		54.0	Cords		
	<i>Black Cherry</i>		19.0	<i>Cords</i>		
	<i>Paper Birch</i>		4.0	<i>Cords</i>		
	<i>Red Maple</i>		31.0	<i>Cords</i>		
4	BI/R/Hybrid Oak	Sawtimber	1.1	MBF	34.7	\$5,434.95
	BI/R/Hybrid Oak	Pulpwood	24.0	Cords		
	Jack Pine		394.0	Cords		
	<i>Jack Pine</i>	<i>Sawtimber</i>	19.4	<i>MBF</i>		
	<i>Jack Pine</i>	<i>Pulpwood</i>	355.0	<i>Cords</i>		
	Mixed Aspen		7.0	Cords		
<i>Quaking Aspen</i>		7.0	<i>Cords</i>			
5	BI/R/Hybrid Oak	Pulpwood	1.0	Cords	2.6	\$442.05

Description of Timber by Payment Unit (PU), con't

PU	MARKET GROUP	PRODUCT	QUANTITY	UNIT	ACRES	ADVERTISE PRICE
5 con't	Jack Pine	Pulpwood	35.0	Cords		
	<i>Jack Pine</i>	<i>Sawtimber</i>	1.2	<i>MBF</i>		
	<i>Jack Pine</i>	<i>Pulpwood</i>	33.0	<i>Cords</i>		
6	Mixed Aspen	Sawtimber	0.1	MBF	7.3	\$1,246.75
	<i>B. T. Aspen</i>		0.1	<i>MBF</i>		
	BI/R/Hybrid Oak	Pulpwood	1.0	Cords		
	Jack Pine		100.0	Cords		
	<i>Jack Pine</i>	<i>Sawtimber</i>	3.4	<i>MBF</i>		
	<i>Jack Pine</i>	<i>Pulpwood</i>	93.0	<i>Cords</i>		
7	Mixed Aspen	Sawtimber	0.2	MBF	11.6	\$2,040.65
	<i>B. T. Aspen</i>		0.2	<i>MBF</i>		
	BI/R/Hybrid Oak	Pulpwood	2.0	Cords		
	Jack Pine		159.0	Cords		
	<i>Jack Pine</i>	<i>Sawtimber</i>	5.5	<i>MBF</i>		
	<i>Jack Pine</i>	<i>Pulpwood</i>	148.0	<i>Cords</i>		
	Mixed Aspen		1.0	Cords		
	<i>B. T. Aspen</i>		1.0	<i>Cords</i>		
	Mixed Hardwood		2.0	Cords		
	<i>Black Cherry</i>		1.0	<i>Cords</i>		
	<i>Red Maple</i>		1.0	<i>Cords</i>		
8	Mixed Aspen	Sawtimber	0.1	MBF	8.7	\$1,543.45
	<i>B. T. Aspen</i>		0.1	<i>MBF</i>		
	BI/R/Hybrid Oak	Pulpwood	2.0	Cords		
	Jack Pine		119.0	Cords		
	<i>Jack Pine</i>	<i>Sawtimber</i>	4.1	<i>MBF</i>		
	<i>Jack Pine</i>	<i>Pulpwood</i>	111.0	<i>Cords</i>		
	Mixed Aspen		1.0	Cords		
	<i>B. T. Aspen</i>		1.0	<i>Cords</i>		
	Mixed Hardwood		2.0	Cords		
	<i>Black Cherry</i>		1.0	<i>Cords</i>		
<i>Red Maple</i>		1.0	<i>Cords</i>			
TOTAL:			86.0	MBF		
TOTAL:			2,784.0	Cords		

Sale Specific Conditions & Requirements

Sale Name: Crooks Camp Pine

Sale Number: 73-004-17 Seq#: 1

1 - Sale Area

1.2 - Boundaries

1.2.1 - Painted boundaries (1/14)

The sale boundary and Payment Unit boundaries are marked and identified by red and yellow paint. Exterior sale boundary lines against state are marked with red paint. Interior Payment Unit boundaries are marked with yellow paint. The painted boundary line trees are not Included Timber and are to be protected. Yellow painted trees designating an interior Payment Unit boundary are only to be cut when all surrounding Payment Units have been paid.

2 - Timber Specifications

2.1 - Included Timber

2.1.1 - Clearcut unit(s) with unmerchantable trees (6/14)

Within Payment Unit(s) 1, 2, and 3, cut all trees that are two (2) inches or more at DBH, except spruce, tamarack, white pine, red pine, and trees that have been marked with green paint above and below stump height.

2.1.2 - Clearcut unit(s) w/o unmerchantable trees (8/11)

Within Payment Unit(s) 4, 5, 6, 7, and 8, cut all trees which meet minimum piece specifications in 2.2 Utilization, except tamarack, white pine, red pine and trees that have been marked with green paint above and below stump height.

2.2 - Utilization

2.2.3 - Stump heights (4/07)

Stump heights within the Sale Area shall be cut as low to the ground as possible. Unless approved by the Unit Manager or his/her representative, stump heights shall not exceed 6 inches for trees greater than 10 inches DBH and 4 inches for trees smaller than 10 inches DBH.

2.2.10 - No chipping tops and limbs (8/16)

Within Payment Unit(s) 4, 5, 6, 7, and 8, chipping of jack pine limbs or tops is not permitted. Limbs and the remaining top must be left on site and scattered. This is to facilitate natural regeneration of jack pine from the cone source.

3 - Payments

3.4 - Damaged Timber

3.4.1 - Damaged timber (6/14)

General Condition and Requirement 3.4 Damaged Timber, defines liquidated damages for undesignated live merchantable trees which are cut or injured. In addition, extreme care should be taken to avoid damage to tree seedlings and saplings.

Within the sale area, if more than 25% of the tree seedlings or saplings (1/4" to 4.5" DBH) within a specified portion of the sale area are damaged, liquidated damages will be assessed at \$300 per acre for all acreage within that specified portion of the sale area that was damaged.

No damage is acceptable to merchantable undesignated trees. Within the sale area, if more than 5% of undesignated trees (> 4.5" DBH) within a specified area of the sale are damaged, liquidated damages will be assessed for all trees damaged. Rates will be in accordance with General Condition and Requirement 3.4 Damaged Timber.

4 - Transportation

4.1 - Construction

4.1.3 - Slash and earthen piles (8/04)

Piles or windrows of earth along roads and landings that have been widened or constructed shall be leveled. Slash from road maintenance or construction, including stumps, shall be dispersed throughout the sale.

4.1.5 - Culverts (5/14)

Culverts are required to be installed at two (2) locations identified on the Timber Sale Map. These culverts will be provided by the DNR and will be available for pickup at the Gladwin Field Office. Installation of the culverts must follow the guidelines established in the Sustainable Soil and Water Quality Practices on Forest Land (2009). Sand is available on site as cover for the culverts. Ten yards of 23A processed gravel must be provided by the Purchaser as a cap for each culvert.

4.1.12 - No new roads (1/12)

No new roads will be permitted in any Payment Unit. All operations are limited to existing roads. Skid trails only will be allowed.

4.2 - Maintenance

4.2.3 - Road maintenance (8/13)

The following road maintenance is required: Within 60 days of completion of hauling, or if no hauling occurs for 60 days, the road must be maintained and graded. This includes cleaning of drainage areas, grading, crowning and filling with gravel, if necessary. Damages will be assessed if grading/repair does not occur.

5 - Operations

5.1 - Notification

5.1.1 - Pre-sale conference (10/16)

A pre-sale conference between the Purchaser and sale administrator is required prior to beginning a Payment Unit to determine landing locations.

5.2 - Conduct of Operations

5.2.2 - Hazard Trees/Snags

5.2.2.1 - Den trees (10/16)

Obvious hollow and/or den trees shall be protected and left standing unless they are a safety hazard.

5.2.3 - Operating Restrictions

5.2.3.1 - Operating restrictions (9/11)

Within Payment Unit(s) 1 - 8, unless approved by the Unit Manager or his/her representative, cutting and skidding are limited to the period of 7/15 to 9/30 and 1/1 to 3/15. This restriction is because of seasonal wet soil conditions.

5.4 - Soil Protection

5.4.1 - Rutting restriction, general (7/16)

Operations are to cease immediately if equipment and weather conditions result in rutting of roads and/or skid trails which is 12 inches or greater in depth and 50 feet in length. The Unit Manager or his/her representative may restrict hauling and/or skidding if ruts exceed the specified depth. With the Unit Manager or his/her representative's approval, the Purchaser may return to the area when the risk of rutting has decreased.

6 - Safety and Fire Prevention

6.2 - Signing

6.2.1 - Road posting (9/09)

The Purchaser is responsible for posting and maintaining caution signs on Secord Dam Road prior to beginning operations. The road must be posted at appropriate distances from the sale area to warn of logging activity and truck traffic. Signs must be removed when harvest operations are suspended or completed. The Purchaser will provide these signs.



TIMBER SALE MAP

This information provided by authority of Part 525, 1994 PA 451, as amended.

Forest Management Unit Gladwin Management Unit		County Gladwin County	Mapped By R. Myrick		Date 09/30/2017	Page 1	of 1
Township 19N	Range 02E	Section(s) and Subdivision(s) Sections 10, 14, 15, and 16; Various			Scale 1:15,840		
Cruised By UMLM Consulting							

Cover Type				Density			
A = Aspen	H = Hemlock	N = Marsh	U = Upland Brush	0 = Non Stocked	5 = Pole Timber Medium		
B = Paper Birch	J = Jack Pine	O = Oak	UM = Upland Mixed	1 = Seedling Sapling Poor	6 = Pole Timber Well		
C = Cedar	L = Lowland Brush	P = Lowland Poplar	V = Bog or Marsh	2 = Seedling Sapling Medium	7 = Saw Timber Poor		
D = Treed Bog	LM = Lowland Mixed	Q = Mixed Swamp Conifer	W = White Pine	3 = Seedling Sapling Well	8 = Saw Timber Medium		
E = Swamp Hdwoods	M = Mpl, Bch, Brch	R = Red Pine	X = Non Stocked	4 = Pole Timber Poor	9 = Saw Timber Well		
F = Spruce Fir	MC = Mixed Conifer	S = Black Spruce	Z = Water				
G = Grass	MD = Mixed Deciduous	T = Tamarack					

PU	Acres	PU	Acres
1	50.6	5	2.6
2	79.5	6	7.3
3	66.2	7	11.6
4	34.7	8	8.7

Crooks Camp Pine

Compartment 46

261.2 Acres

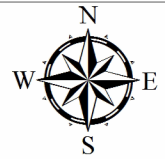

Legend

- Against State (Red)
- Payment Unit (Yellow)
- Section Corners
- Stand Boundaries
- Nearby Timber Sale
- Paved Roads
- Poor Dirt Roads
- Closed
- Streams
- Berms

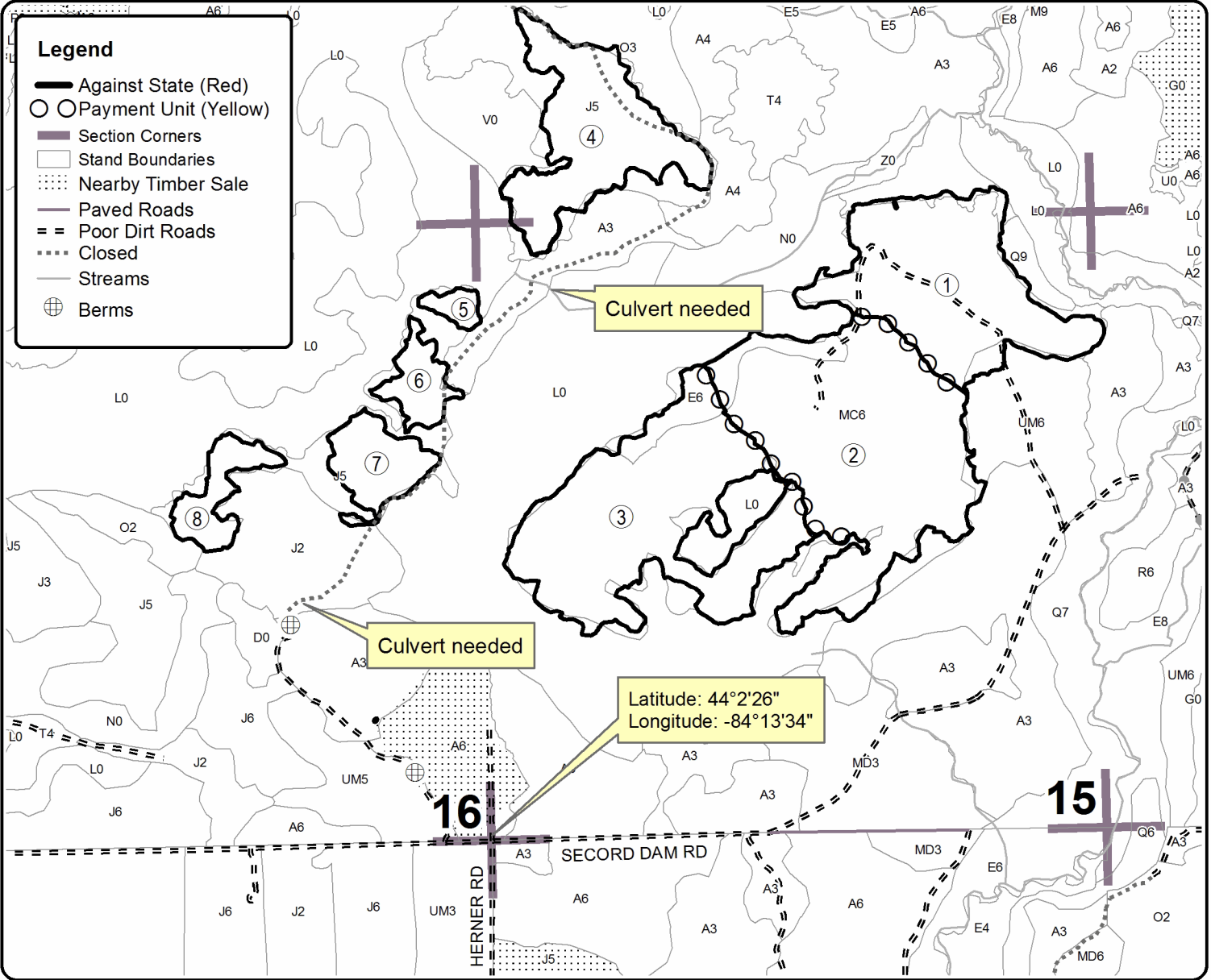

Latitude: 44°2'26"
Longitude: -84°13'34"

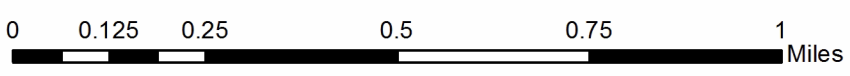

TIMBER SALE INFORMATION

Spring Fawn Mix (73-010-17)

Gladwin County (Advertised Price \$27,882.60)

SALE NOTE: Access is off Wildwood Road and Secord Dam Road. There are two berms that will need to be removed to gain access to two payment units. Payment Units 1, 3, and 4 have a dry/frozen requirement (see spec 5.2.3.1). The sale has a three year contract to end on a quarter.

A timber sale contract for this lump sum, sealed bid timber sale will be awarded to the responsible bidder offering the highest sealed bid price. Bids must be at or above the following advertised price for each species:

<u>PRODUCTS & SPECIES</u>	<u>ESTIMATED UNITS*</u>		<u>ADVERTISED PRICE</u>
Sawtimber			
Mixed Aspen	29.90	MBF	\$ 52.00 / MBF
Red Maple	11.50	MBF	\$ 32.00 / MBF
Pulpwood			
Bl/R/Hybrid Oak	137.00	Cords	\$ 11.55 / Cord
Jack Pine	15.00	Cords	\$ 12.30 / Cord
Mixed Aspen	680.00	Cords	\$ 21.25 / Cord
Mixed Hardwood	551.00	Cords	\$ 15.10 / Cord
Paper Birch	13.00	Cords	\$ 11.75 / Cord
Red Pine	5.00	Cords	\$ 35.15 / Cord
Tamarack	26.00	Cords	\$ 21.00 / Cord
White Oak	29.00	Cords	\$ 11.55 / Cord
White Pine	11.00	Cords	\$ 19.40 / Cord

* The total volume is statistically estimated within plus (+) or minus (-) 15.41 percent. The estimated units are final and not subject to adjustment. Prospective bidders are urged to examine this timber and to make their own estimates of quantity and quality.

BOND AND PAYMENT SCHEDULE:

1. A bond in the amount of \$1,394.00 to insure faithful performance of the conditions of the contract will be deposited by the successful bidder within 21 days of the sale award.
2. Cutting in any sale or unit without the required advance payment would be considered a trespass.
3. Total payment must be paid in advance or according to the following schedule:
 - (a) Ten percent (10%) of the sale value must be paid within 21 days of the sale award.
 - (b) The 10% down payment will be credited towards the first unit cut.
 - (c) Payment for each of the following units must be made before cutting begins in that unit:

PAYMENT UNIT NUMBER	PERCENT OF TOTAL SALE VALUE
01	36.5%
02	10.0%
03	4.9%
04	48.6%

4. If no cutting takes place, the 10% down payment will not be refunded.
5. Operations on the contract issued will terminate on 06/30/2021.

Description of Timber by Payment Unit (PU)

PU	MARKET GROUP	PRODUCT	QUANTITY	UNIT	ACRES	ADVERTISE PRICE
1	Mixed Aspen	Sawtimber	10.9	MBF	68.2	\$10,180.15
	<i>B. T. Aspen</i>		1.6	<i>MBF</i>		
	<i>Quaking Aspen</i>		9.3	<i>MBF</i>		
	Red Maple		1.1	MBF		
	BI/R/Hybrid Oak	Pulpwood	51.0	Cords		
	<i>BI/R/Hybrid Oak</i>	<i>Sawtimber</i>	0.5	<i>MBF</i>		
	<i>BI/R/Hybrid Oak</i>	<i>Pulpwood</i>	50.0	<i>Cords</i>		
	Mixed Aspen		264.0	Cords		
	<i>B. T. Aspen</i>		19.0	<i>Cords</i>		
	<i>Balsam Poplar</i>		4.0	<i>Cords</i>		
	<i>Quaking Aspen</i>		241.0	<i>Cords</i>		
	Mixed Hardwood		216.0	Cords		
	<i>American Elm</i>		3.0	<i>Cords</i>		
	<i>Black Cherry</i>		6.0	<i>Cords</i>		
	<i>Red Maple</i>		207.0	<i>Cords</i>		
	Paper Birch		10.0	Cords		
	2	Mixed Aspen	Sawtimber	3.7		
<i>B. T. Aspen</i>			3.7	<i>MBF</i>		
Red Maple			2.1	MBF		
BI/R/Hybrid Oak		Pulpwood	9.0	Cords		
<i>BI/R/Hybrid Oak</i>		<i>Sawtimber</i>	0.4	<i>MBF</i>		
<i>BI/R/Hybrid Oak</i>		<i>Pulpwood</i>	8.0	<i>Cords</i>		
Jack Pine			14.0	Cords		
<i>Jack Pine</i>			14.0	<i>Cords</i>		
Mixed Aspen			26.0	Cords		
<i>B. T. Aspen</i>			26.0	<i>Cords</i>		
Mixed Hardwood			56.0	Cords		
<i>Red Maple</i>			56.0	<i>Cords</i>		
Paper Birch			3.0	Cords		
Red Pine			5.0	Cords		
<i>Red Pine</i>		<i>Sawtimber</i>	0.5	<i>MBF</i>		
<i>Red Pine</i>		<i>Pulpwood</i>	4.0	<i>Cords</i>		
Tamarack			23.0	Cords		
<i>Tamarack</i>		<i>Sawtimber</i>	1.1	<i>MBF</i>		
<i>Tamarack</i>		<i>Pulpwood</i>	21.0	<i>Cords</i>		
White Pine			8.0	Cords		
<i>White Pine</i>	<i>Sawtimber</i>	1.0	<i>MBF</i>			
<i>White Pine</i>	<i>Pulpwood</i>	6.0	<i>Cords</i>			
3	Red Maple	Sawtimber	5.4	MBF	8.8	\$1,371.10
	BI/R/Hybrid Oak	Pulpwood	6.0	Cords		
	<i>BI/R/Hybrid Oak</i>	<i>Sawtimber</i>	0.7	<i>MBF</i>		
	<i>BI/R/Hybrid Oak</i>	<i>Pulpwood</i>	5.0	<i>Cords</i>		
	Jack Pine		1.0	Cords		
	<i>Jack Pine</i>		1.0	<i>Cords</i>		
	Mixed Aspen		4.0	Cords		
	<i>Quaking Aspen</i>		4.0	<i>Cords</i>		
	Mixed Hardwood		45.0	Cords		
	<i>Red Maple</i>		45.0	<i>Cords</i>		
	Tamarack		3.0	Cords		
	<i>Tamarack</i>		3.0	<i>Cords</i>		
	White Oak		20.0	Cords		
	<i>White Oak</i>	<i>Sawtimber</i>	0.4	<i>MBF</i>		
<i>White Oak</i>	<i>Pulpwood</i>	19.0	<i>Cords</i>			
White Pine		3.0	Cords			
<i>White Pine</i>		3.0	<i>Cords</i>			
4	Mixed Aspen	Sawtimber	15.3	MBF	26.7	\$13,548.30

Description of Timber by Payment Unit (PU), con't

PU	MARKET GROUP	PRODUCT	QUANTITY	UNIT	ACRES	ADVERTISE PRICE
4 con't	<i>B. T. Aspen</i>	<i>Sawtimber</i>	6.5	<i>MBF</i>		
	<i>Quaking Aspen</i>		8.8	<i>MBF</i>		
	Red Maple		2.9	MBF		
	BI/R/Hybrid Oak	Pulpwood	71.0	Cords		
	<i>BI/R/Hybrid Oak</i>	<i>Sawtimber</i>	2.7	<i>MBF</i>		
	<i>BI/R/Hybrid Oak</i>	<i>Pulpwood</i>	66.0	<i>Cords</i>		
	Mixed Aspen		386.0	Cords		
	<i>B. T. Aspen</i>		201.0	<i>Cords</i>		
	<i>Quaking Aspen</i>		185.0	<i>Cords</i>		
	Mixed Hardwood		234.0	Cords		
	<i>Red Maple</i>		234.0	<i>Cords</i>		
	White Oak		9.0	Cords		
	<i>White Oak</i>		9.0	<i>Cords</i>		
	TOTAL:			41.4	MBF	
TOTAL:			1,467.0	Cords		

Sale Specific Conditions & Requirements

Sale Name: Spring Fawn Mix

Sale Number: 73-010-17 Seq#: 1

1 - Sale Area

1.2 - Boundaries

1.2.1 - Painted boundaries (1/14)

The sale boundary and Payment Unit boundaries are marked and identified by red paint. Exterior sale boundary lines against state are marked with red paint. The painted boundary line trees are not Included Timber and are to be protected.

2 - Timber Specifications

2.1 - Included Timber

2.1.1 - Clearcut unit(s) with unmerchantable trees (6/14)

Within Payment Unit(s) 1 - 4, cut all trees that are two (2) inches or more at DBH, with the following exceptions:

Within Payment Units 1 and 4, do not cut any conifers or trees that have been marked with green paint above and below stump height.

Within Payment Unit 3, do not cut any trees that have been marked with green paint above and below stump height, or any trees that are 26" or more DBH.

2.2 - Utilization

2.2.3 - Stump heights (4/07)

Stump heights within the Sale Area shall be cut as low to the ground as possible. Unless approved by the Unit Manager or his/her representative, stump heights shall not exceed 6 inches for trees greater than 10 inches DBH and 4 inches for trees smaller than 10 inches DBH. Exception: within Payment Unit(s) 2 and 3, in order to facilitate reforestation, all stumps shall be cut at ground level.

3 - Payments

3.4 - Damaged Timber

3.4.1 - Damaged timber (6/14)

General Condition and Requirement 3.4 Damaged Timber, defines liquidated damages for undesignated live merchantable trees which are cut or injured. In addition, extreme care should be taken to avoid damage to tree seedlings and saplings.

Within Payment Units 1, 3, and 4, if more than 25% of the tree seedlings or saplings (1/4" to 4.5" DBH) within a specified portion of the sale area are damaged, liquidated damages will be assessed at \$300 per acre for all acreage within that specified portion of the sale area that was damaged.

No damage is acceptable to merchantable undesignated trees. Within Payment Units 1, 3, and 4, if more than 5% of undesignated trees (> 4.5" DBH) within a specified area of the sale are damaged, liquidated damages will be assessed for all trees damaged. Rates will be in accordance with General Condition and Requirement 3.4 Damaged Timber.

4 - Transportation

4.1 - Construction

4.1.3 - Slash and earthen piles (8/04)

Piles or windrows of earth along roads and landings that have been widened or constructed shall be leveled. Slash from road maintenance or construction, including stumps, shall be dispersed throughout the sale.

4.1.12 - No new roads (1/12)

No new roads will be permitted in any Payment Unit. All operations are limited to existing roads. Skid trails only will be allowed.

4.2 - Maintenance

4.2.3 - Road maintenance (8/13)

The following road maintenance is required: Within 60 days of completion of hauling, or if no hauling occurs for 60 days, the road must be maintained and graded. This includes cleaning of drainage areas, grading, crowning and filling with gravel, if necessary. Damages will be assessed if grading/repair does not occur.

5 - Operations

5.1 - Notification

5.1.1 - Pre-sale conference (10/16)

A pre-sale conference on site between the Purchaser and sale administrator is required prior to beginning a Payment Unit to determine landing locations.

5.2 - Conduct of Operations

5.2.1 - Slash

5.2.1.11 - Slash for reforestation (5/07)

To facilitate reforestation, Payment Unit(s) 2 and 3 shall be left with slash evenly distributed. Bunched tops within the cutting area shall be broken up and scattered. Stumps shall be cut low to the ground. Processing sites shall not be left with a compacted layer of slash; tops from these sites shall be hauled back into the cut area and scattered.

5.2.2 - Hazard Trees/Snags

5.2.2.1 - Den trees (10/16)

Obvious hollow and/or den trees shall be protected and left standing unless they are a safety hazard.

5.2.3 - Operating Restrictions

5.2.3.1 - Operating restrictions (9/11)

Within Payment Unit(s) 1, 3, and 4, unless approved by the Unit Manager or his/her representative, cutting and skidding are limited to the period of 7/15 to 9/30 and 1/1 to 3/15. This restriction is because of seasonal wet soil conditions.

5.2.4 - Dead and Down Creation

5.2.4.4 - Dead and down creation, grouse (4/18)

To encourage grouse and other wildlife, in Payment Unit(s) 1 and 4, leave one 12" or larger diameter (or largest diameter trees within stand) whole tree on the ground for every 2 acres, preferably a hardwood species such as oak or maple or if no hardwoods are present, a pine species (white or red). Stump heights shall not exceed two (2) feet. These trees will be evenly scattered throughout the unit, preferably at least two chains from any roads, two-tracks, or trails open to vehicles.

5.4 - Soil Protection

5.4.1 - Rutting restriction, general (7/16)

Operations are to cease immediately if equipment and weather conditions result in rutting of roads and/or skid trails which is 12 inches or greater in depth and 50 feet in length. The Unit Manager or his/her representative may restrict hauling and/or skidding if ruts exceed the specified depth. With the Unit Manager or his/her representative's approval, the Purchaser may return to the area when the risk of rutting has decreased.

5.8 - Protection of Endangered Species

5.8.5 - Protection of raptor nests (3/13)

All trees with raptor nests will be protected if found during harvesting operations. Notification will be made to the Unit Manager or his/her representative who will notify the Wildlife Biologist so an on-site evaluation and recommendation can be made, if necessary.

6 - Safety and Fire Prevention

6.2 - Signing

6.2.1 - Road posting (9/09)

The Purchaser is responsible for posting and maintaining caution signs on Wildwood Road and Secord Dam Road prior to beginning operations. The road must be posted at appropriate distances from the sale area to warn of logging activity and truck traffic. Signs must be removed when harvest operations are suspended or completed. The Purchaser will provide these signs.



TIMBER SALE MAP

This information provided by authority of Part 525, 1994 PA 451, as amended.

Sale Number	Year
73-010	17

Forest Management Unit Gladwin Management Unit	County Gladwin County	Mapped By R. Myrick	Date 09/30/2017	Page 1	of 2
Township 19N	Range 02E	Section(s) and Subdivision(s) Sections 7, 8, 15, 16, 17, and 18, various	Scale 1:15,840		

Cover Type

A = Aspen	H = Hemlock	N = Marsh	U = Upland Brush
B = Paper Birch	J = Jack Pine	O = Oak	UM = Upland Mixed
C = Cedar	L = Lowland Brush	P = Lowland Poplar	V = Bog or Marsh
D = Treed Bog	LM = Lowland Mixed	Q = Mixed Swamp Conifer	W = White Pine
E = Swamp Hdwoods	M = Mpl, Bch, Brch	R = Red Pine	X = Non Stocked
F = Spruce Fir	MC = Mixed Conifer	S = Black Spruce	Z = Water
G = Grass	MD = Mixed Deciduous	T = Tamarack	

Density

0 = Non Stocked	5 = Pole Timber Medium
1 = Seedling Sapling Poor	6 = Pole Timber Well
2 = Seedling Sapling Medium	7 = Saw Timber Poor
3 = Seedling Sapling Well	8 = Saw Timber Medium
4 = Pole Timber Poor	9 = Saw Timber Well

PU	Acres	PU	Acres
1	68.2	3	8.8
2	11.6	4	26.7

Spring Fawn Mix

Compartment 46

115.3 Acres

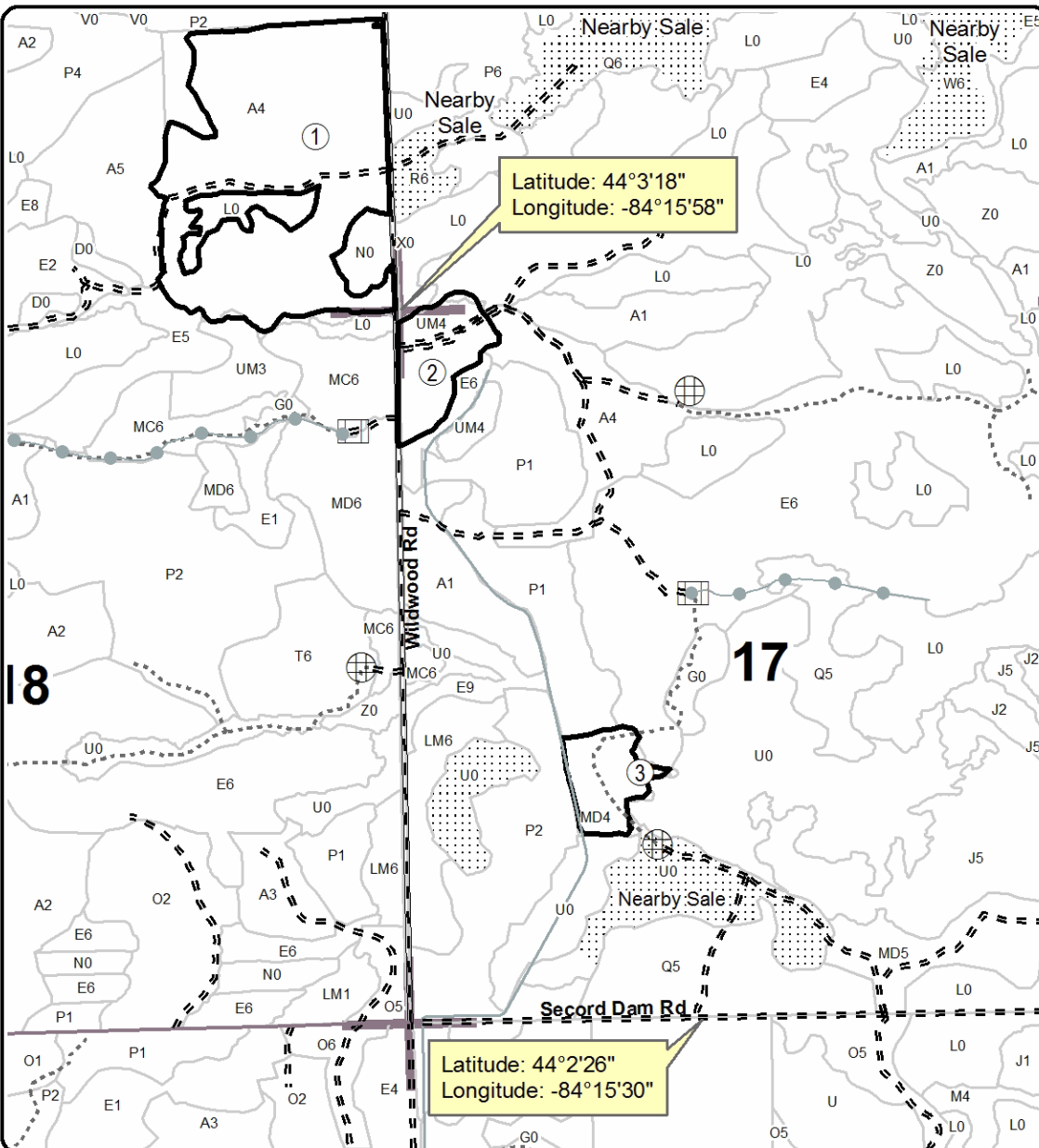

Legend

Sale Boundary

- Against State (Red)
- Section Corners
- Stand Boundaries
- Section Corners
- Gate
- Berms
- Paved Roads
- Gravel Roads
- Poor Dirt Roads
- Closed Roads
- PU Number

Locator Map

1:200,000

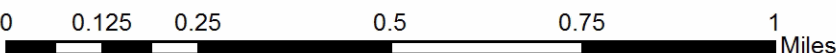
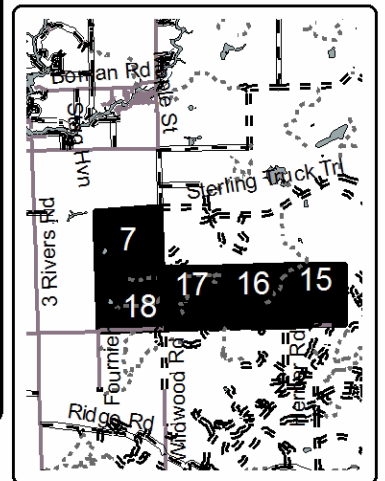



TIMBER SALE MAP

This information provided by authority of Part 525, 1994 PA 451, as amended.

Forest Management Unit Gladwin Management Unit	County Gladwin County	Mapped By R. Myrick	Date 09/30/2017	Page 2	of 2
Township 19N	Range 02E	Section(s) and Subdivision(s) Sections 7, 8, 15, 16, 17, and 18, various	Scale 1:15,840		
Cruised By R. Myrick					

Cover Type

A = Aspen	H = Hemlock	N = Marsh	U = Upland Brush
B = Paper Birch	J = Jack Pine	O = Oak	UM = Upland Mixed
C = Cedar	L = Lowland Brush	P = Lowland Poplar	V = Bog or Marsh
D = Treed Bog	LM = Lowland Mixed	Q = Mixed Swamp Conifer	W = White Pine
E = Swamp Hdwoods	M = Mpl, Bch, Brch	R = Red Pine	X = Non Stocked
F = Spruce Fir	MC = Mixed Conifer	S = Black Spruce	Z = Water
G = Grass	MD = Mixed Deciduous	T = Tamarack	

Density

0 = Non Stocked	5 = Pole Timber Medium
1 = Seedling Sapling Poor	6 = Pole Timber Well
2 = Seedling Sapling Medium	7 = Saw Timber Poor
3 = Seedling Sapling Well	8 = Saw Timber Medium
4 = Pole Timber Poor	9 = Saw Timber Well

PU	Acres	PU	Acres
1	68.2	3	8.8
2	11.6	4	26.7

Spring Fawn Mix

Compartment 46

115.3 Acres

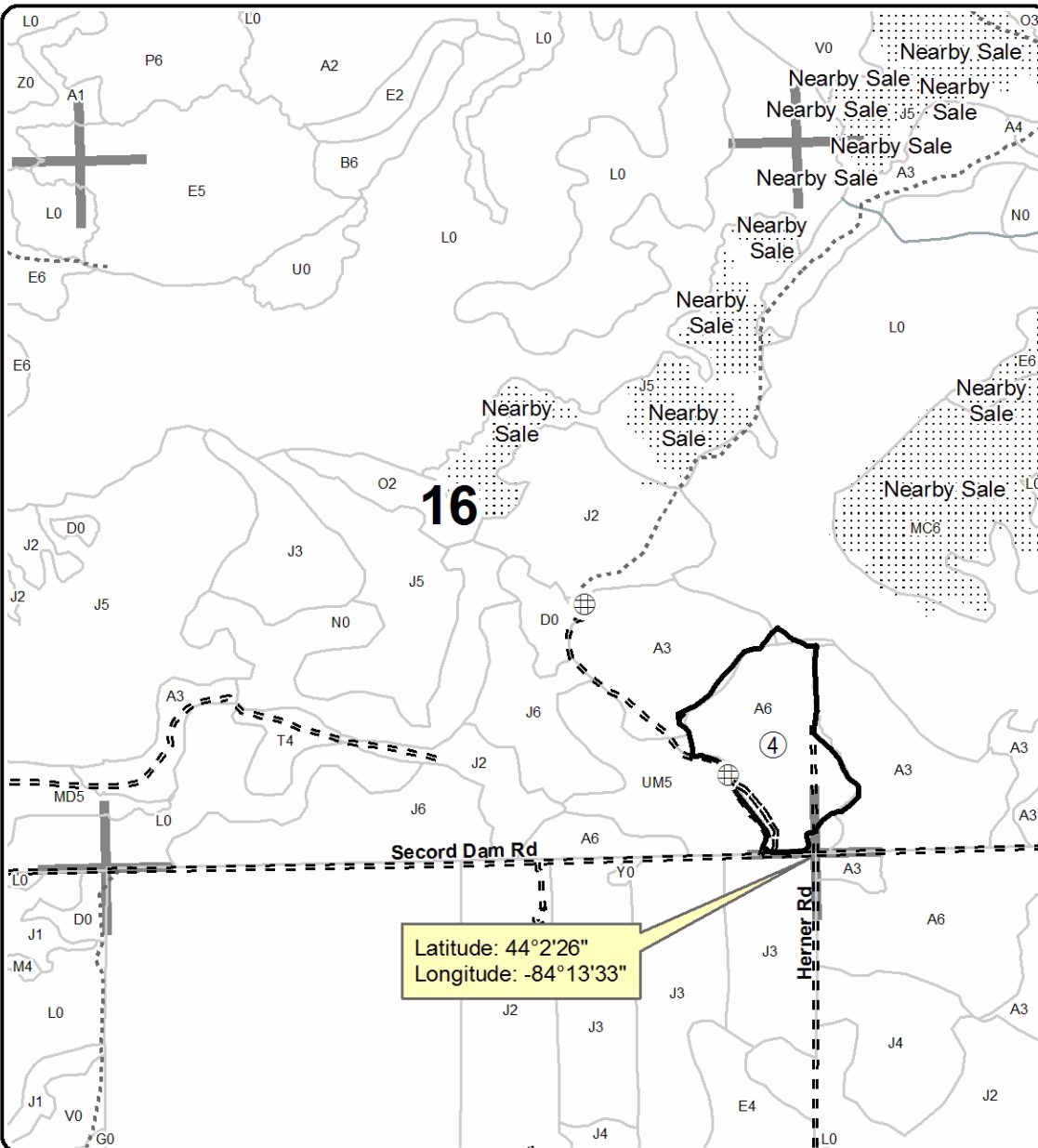

Legend

Sale Boundary

- Against State (Red)
- Section Corners
- Stand Boundaries
- Section Corners
- Poor Dirt Roads
- Closed Roads
- PU Number
- berm

Locator Map
1:200,000

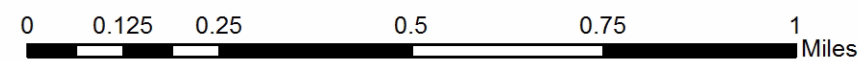
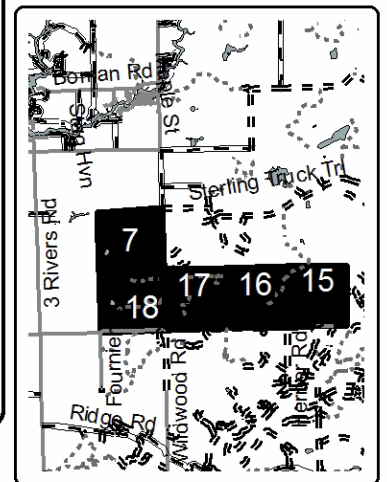

Spring Fawn Mix (73-010-17)
; Gladwin COUNTY

In response to the notice of sale to be held 10:00 a.m. (local time) on June 19, 2018, I am hereby submitting my sealed bid (firm offer) for the following forest products to be cut. Bids for individual species must be at or above the advertised price. All non-responsive bid forms may be rejected.

<u>PRODUCTS & SPECIES</u>	<u>ESTIMATED VOLUME*</u>	<u>ADVERTISED PRICE</u>	<u>BID PRICE/UNIT</u>
Sawtimber			
Mixed Aspen	29.90 MBF	\$ 52.00/MBF	\$ _____
Red Maple	11.50 MBF	\$ 32.00/MBF	\$ _____
Pulpwood			
Bl/R/Hybrid Oak	137.00 Cords	\$ 11.55/Cord	\$ _____
Jack Pine	15.00 Cords	\$ 12.30/Cord	\$ _____
Mixed Aspen	680.00 Cords	\$ 21.25/Cord	\$ _____
Mixed Hardwood	551.00 Cords	\$ 15.10/Cord	\$ _____
Paper Birch	13.00 Cords	\$ 11.75/Cord	\$ _____
Red Pine	5.00 Cords	\$ 35.15/Cord	\$ _____
Tamarack	26.00 Cords	\$ 21.00/Cord	\$ _____
White Oak	29.00 Cords	\$ 11.55/Cord	\$ _____
White Pine	11.00 Cords	\$ 19.40/Cord	\$ _____

*The volumes are statistically estimated within plus (+) or minus (-) 15.41 percent. These estimated volumes are final and not subject to adjustment. Prospective bidders are urged to examine this timber and to make their own estimates of quantity and quality.

I understand that any or all bids may be rejected. All bids must be signed and all bid items must be bid or the bid form may be rejected. I also understand that consideration and awarding a contract will be based upon my past performance and ability to complete the contract based upon equipment and staffing subject to my control.

FEDERAL ID: _____ or SOCIAL SECURITY NUMBER: _____

Company or individual bidding: _____

Company representative's name: _____

Address: _____

City: _____ State: _____ Zip: _____

IF AVAILABLE, PLEASE PLACE THE PERSONALIZED LABEL FROM YOUR PROSPECTUS IN THE ABOVE BOX.

Individual or company representative's signature: _____ Date: _____

Phone number : _____ Email (optional): _____

THE WINNING BIDDER MUST COMPLETE THE VERIFICATION OF WORKER'S DISABILITY COMPENSATION ACT COMPLIANCE (ON REVERSE SIDE IF DOUBLE SIDED) WITHIN 21 DAYS OF SALE AWARD DATE



FOR DEPARTMENT USE ONLY
Sale Number (XX - XXX - XX - XX)
Forest Management Unit:

TIMBER SALE VERIFICATION OF WORKER'S DISABILITY COMPENSATION ACT COMPLIANCE

*As required by Act 317, P.A. 1969 (Worker's Compensation) and
Part 5 of Act 451 of 1994, as amended.*

VERIFICATION OF WORKER'S DISABILITY COMPENSATION ACT COMPLIANCE

- This verification must be completed and submitted within 21 days of contract award and prior to the issuance of the timber sale contract.
- In addition, if boxes 2B or 2C are checked, then Notice of Exclusion or Certificate of Insurance must be submitted within twenty-one (21) days of the contract award and prior to the issuance of the timber sale contract.
- All information must be typed or printed except for written signatures.

Please Check Appropriate Categories:

1. My business is organized as (you **must** check one of the boxes below):
 - A. Sole Proprietorship (individual)
 - B. Partnership
 - C. Corporation

2. You **must** check one of the boxes below:
 - A. I certify my business is a sole proprietorship and it has no employees but the sole proprietor. I am not subject to the Worker's Compensation Laws.
 - B. I certify my business has satisfied its obligation to the Worker's Compensation Act through the use of an approved Notice of Exclusion (BWC-337, Rev. 5/96). I will provide a copy of the Notice of Exclusion within 21 days of the contract award. (For questions or a copy of the BWC-337, please call the Worker's Compensation Bureau at 517-322-1195).
 - C. I certify my business has a Worker's Compensation Policy. I will provide an original Certificate of Insurance within twenty-one (21) days of the contract award.

3. If you have checked item 2(A) or 2(B), you **must** indicate the number of **both** full-time and part-time employees, other than yourself, including family members and active partners (if none, you must enter "0").

_____ Full-time Employees

_____ Part-time Employees

Name of Business		Federal ID (or) Social Security No.	
Address		Telephone ()	
City	State	ZIP	

I hereby certify that the above information is true and correct. I agree to notify the Michigan DNR of any changes that occur in factors affecting my coverage during any of my present and future operations.

Signature of Owner or Authorized Representative

Title

Date

Please complete the "SEALED BID" information on the next page

Crooks Camp Pine (73-004-17)
; Gladwin COUNTY

In response to the notice of sale to be held 10:00 a.m. (local time) on June 19, 2018, I am hereby submitting my sealed bid (firm offer) for the following forest products to be cut. Bids for individual species must be at or above the advertised price. All non-responsive bid forms may be rejected.

<u>PRODUCTS & SPECIES</u>	<u>ESTIMATED VOLUME*</u>	<u>ADVERTISED PRICE</u>	<u>BID PRICE/UNIT</u>
Sawtimber			
BI/R/Hybrid Oak	22.60 MBF	\$ 148.00/MBF	\$ _____
Mixed Aspen	46.00 MBF	\$ 52.00/MBF	\$ _____
Red Maple	17.40 MBF	\$ 32.00/MBF	\$ _____
Pulpwood			
BI/R/Hybrid Oak	277.00 Cords	\$ 11.55/Cord	\$ _____
Jack Pine	2,061.00 Cords	\$ 12.30/Cord	\$ _____
Mixed Aspen	300.00 Cords	\$ 21.25/Cord	\$ _____
Mixed Hardwood	146.00 Cords	\$ 15.10/Cord	\$ _____

*The volumes are statistically estimated within plus (+) or minus (-) 15.97 percent. These estimated volumes are final and not subject to adjustment. Prospective bidders are urged to examine this timber and to make their own estimates of quantity and quality.

I understand that any or all bids may be rejected. All bids must be signed and all bid items must be bid or the bid form may be rejected. I also understand that consideration and awarding a contract will be based upon my past performance and ability to complete the contract based upon equipment and staffing subject to my control.

FEDERAL ID: _____ or SOCIAL SECURITY NUMBER: _____

Company or individual bidding: _____

Company representative's name: _____

Address: _____

City: _____ State: _____ Zip: _____

IF AVAILABLE, PLEASE PLACE THE PERSONALIZED LABEL FROM YOUR PROSPECTUS IN THE ABOVE BOX.

Individual or company representative's signature: _____ Date: _____

Phone number : _____ Email (optional): _____

THE WINNING BIDDER MUST COMPLETE THE VERIFICATION OF WORKER'S DISABILITY COMPENSATION ACT COMPLIANCE (ON REVERSE SIDE IF DOUBLE SIDED) WITHIN 21 DAYS OF SALE AWARD DATE



FOR DEPARTMENT USE ONLY
Sale Number (XX - XXX - XX - XX)
Forest Management Unit:

TIMBER SALE VERIFICATION OF WORKER'S DISABILITY COMPENSATION ACT COMPLIANCE

*As required by Act 317, P.A. 1969 (Worker's Compensation) and
Part 5 of Act 451 of 1994, as amended.*

VERIFICATION OF WORKER'S DISABILITY COMPENSATION ACT COMPLIANCE

- This verification must be completed and submitted within 21 days of contract award and prior to the issuance of the timber sale contract.
- In addition, if boxes 2B or 2C are checked, then Notice of Exclusion or Certificate of Insurance must be submitted within twenty-one (21) days of the contract award and prior to the issuance of the timber sale contract.
- All information must be typed or printed except for written signatures.

Please Check Appropriate Categories:

1. My business is organized as (you **must** check one of the boxes below):
 - A. Sole Proprietorship (individual)
 - B. Partnership
 - C. Corporation

2. You **must** check one of the boxes below:
 - A. I certify my business is a sole proprietorship and it has no employees but the sole proprietor. I am not subject to the Worker's Compensation Laws.
 - B. I certify my business has satisfied its obligation to the Worker's Compensation Act through the use of an approved Notice of Exclusion (BWC-337, Rev. 5/96). I will provide a copy of the Notice of Exclusion within 21 days of the contract award. (For questions or a copy of the BWC-337, please call the Worker's Compensation Bureau at 517-322-1195).
 - C. I certify my business has a Worker's Compensation Policy. I will provide an original Certificate of Insurance within twenty-one (21) days of the contract award.

3. If you have checked item 2(A) or 2(B), you **must** indicate the number of **both** full-time and part-time employees, other than yourself, including family members and active partners (if none, you must enter "0").

_____ Full-time Employees

_____ Part-time Employees

Name of Business		Federal ID (or) Social Security No.	
Address		Telephone ()	
City	State	ZIP	

I hereby certify that the above information is true and correct. I agree to notify the Michigan DNR of any changes that occur in factors affecting my coverage during any of my present and future operations.

Signature of Owner or Authorized Representative

Title

Date

Please complete the "SEALED BID" information on the next page

Bald Eagle Pine (73-003-17)
; Gladwin COUNTY

In response to the notice of sale to be held 10:00 a.m. (local time) on June 19, 2018, I am hereby submitting my sealed bid (firm offer) for the following forest products to be cut. Bids for individual species must be at or above the advertised price. All non-responsive bid forms may be rejected.

<u>PRODUCTS & SPECIES</u>	<u>ESTIMATED VOLUME*</u>	<u>ADVERTISED PRICE</u>	<u>BID PRICE/UNIT</u>
Sawtimber			
Red Pine	73.70 MBF	\$ 135.00/MBF	\$ _____
White Pine	12.10 MBF	\$ 88.00/MBF	\$ _____
Pulpwood			
Bl/R/Hybrid Oak	5.00 Cords	\$ 11.55/Cord	\$ _____
Mixed Aspen	74.00 Cords	\$ 21.25/Cord	\$ _____
Paper Birch	28.00 Cords	\$ 11.75/Cord	\$ _____
Red Maple	100.00 Cords	\$ 15.10/Cord	\$ _____
Red Pine	259.00 Cords	\$ 35.15/Cord	\$ _____
White Pine	263.00 Cords	\$ 19.40/Cord	\$ _____

*The volumes are statistically estimated within plus (+) or minus (-) 17.01 percent. These estimated volumes are final and not subject to adjustment. Prospective bidders are urged to examine this timber and to make their own estimates of quantity and quality.

I understand that any or all bids may be rejected. All bids must be signed and all bid items must be bid or the bid form may be rejected. I also understand that consideration and awarding a contract will be based upon my past performance and ability to complete the contract based upon equipment and staffing subject to my control.

FEDERAL ID: _____ - _____ or SOCIAL SECURITY NUMBER: _____ - _____ - _____

Company or individual bidding: _____

Company representative's name: _____

Address: _____

City: _____ State: _____ Zip: _____

IF AVAILABLE, PLEASE PLACE THE PERSONALIZED LABEL FROM YOUR PROSPECTUS IN THE ABOVE BOX.

Individual or company representative's signature: _____ Date: _____

Phone number : _____ Email (optional): _____

THE WINNING BIDDER MUST COMPLETE THE VERIFICATION OF WORKER'S DISABILITY COMPENSATION ACT COMPLIANCE (ON REVERSE SIDE IF DOUBLE SIDED) WITHIN 21 DAYS OF SALE AWARD DATE



FOR DEPARTMENT USE ONLY	
Sale Number (XX - XXX - XX - XX)	
Forest Management Unit:	

TIMBER SALE VERIFICATION OF WORKER'S DISABILITY COMPENSATION ACT COMPLIANCE

As required by Act 317, P.A. 1969 (Worker's Compensation) and
Part 5 of Act 451 of 1994, as amended.

VERIFICATION OF WORKER'S DISABILITY COMPENSATION ACT COMPLIANCE

- This verification must be completed and submitted within 21 days of contract award and prior to the issuance of the timber sale contract.
- In addition, if boxes 2B or 2C are checked, then Notice of Exclusion or Certificate of Insurance must be submitted within twenty-one (21) days of the contract award and prior to the issuance of the timber sale contract.
- All information must be typed or printed except for written signatures.

Please Check Appropriate Categories:

1. My business is organized as (you **must** check one of the boxes below):
 - A. Sole Proprietorship (individual)
 - B. Partnership
 - C. Corporation
2. You **must** check one of the boxes below:
 - A. I certify my business is a sole proprietorship and it has no employees but the sole proprietor. I am not subject to the Worker's Compensation Laws.
 - B. I certify my business has satisfied its obligation to the Worker's Compensation Act through the use of an approved Notice of Exclusion (BWC-337, Rev. 5/96). I will provide a copy of the Notice of Exclusion within 21 days of the contract award. (For questions or a copy of the BWC-337, please call the Worker's Compensation Bureau at 517-322-1195).
 - C. I certify my business has a Worker's Compensation Policy. I will provide an original Certificate of Insurance within twenty-one (21) days of the contract award.
3. If you have checked item 2(A) or 2(B), you **must** indicate the number of **both** full-time and part-time employees, other than yourself, including family members and active partners (if none, you must enter "0").

_____ Full-time Employees

_____ Part-time Employees

Name of Business		Federal ID (or) Social Security No.	
Address		Telephone ()	
City	State	ZIP	

I hereby certify that the above information is true and correct. I agree to notify the Michigan DNR of any changes that occur in factors affecting my coverage during any of my present and future operations.

Signature of Owner or Authorized Representative

Title

Date

Please complete the "SEALED BID" information on the next page