



**DEPARTMENT OF NATURAL RESOURCES
STATE OF MICHIGAN**

TIMBER SALE PROSPECTUS #6101

SCHEDULED SALE DATE AND TIME: 10:00 a.m. (local time) on August 21, 2018.

LOCATION: ATLANTA MGMT UNIT, 13501 M-33, ATLANTA, MI 49709.

PROSPECTUS NOTE: The bidder is advised to inspect the sale area and review the location, estimated volumes, operating costs and contract terms of proposed sales. Please be aware that some landowners may request 60 days or more notice for access across their land.

Notice is hereby given that bids will be received by the Unit Manager, ATLANTA MANAGEMENT UNIT, for certain timber on the following described lands:

The Flood Begins Jack Pine (54-020-17)

Montmorency County, Advertised Price \$33,342.55, 84.2 Acres, Jack Pine, Red Pine.

SALE NOTE: Sale is dry, but located along the Tomahawk Creek Flooding. Some minor rolling topography. Sale must be chip harvested and stumps must be cut low. No harvesting from May 1st to August 15th due to Kirtland's Warbler nesting habitat.

A recreation site such as a trail, pathway, or campground is within the sale area or the vicinity. Certain restrictions/specifications may be applicable including time restrictions.

Radio Tower Red Pine (54-021-17)

Montmorency County, Advertised Price \$58,636.45, 83.6 Acres, Hardwood, Red Pine.

SALE NOTE: Oak wilt restriction in place for sale boundaries and travel routes.

A recreation site such as a trail, pathway, or campground is within the sale area or the vicinity. Certain restrictions/specifications may be applicable including time restrictions.

Rocky Bottom Mix (54-023-17)

Presque Isle County, Advertised Price \$19,488.70, 41.2 Acres, Paper Birch, Spruce/Fir/Tamarack.

Are We There Yet? SBW (54-040-17)

Presque Isle County, Advertised Price \$61,961.50, 170.4 Acres, Aspen, Spruce/Fir/Tamarack.

BID INSTRUCTIONS (VER. 07/02/2018):

1. Scheduled Bid Location, Date, and Time (2/11)

Bids must be received by the Unit Manager, ATLANTA OFFICE, 13501 M-33, ATLANTA, MI 49709, no later than 10:00 a.m. (local time) on August 21, 2018. For further information concerning this sale, contact Cody Stevens at 989-785-4251 extension 5240.

2. Bidder's Qualifications (5/16)

Purchaser shall obtain workers compensation insurance to cover claims under Michigan's Worker's Disability Compensation Act of 1969 or similar employee benefit act of any other state applicable to an employee. If all or part of a timber sale was prepared by a private contractor, the contractor and that contractor's company are not permitted to bid on the timber sale contract. Bids will not be accepted from individuals or companies appearing on the DNR/FRD No-Bid List. This list contains the names of purchasers who previously failed to execute a contract within 21-days or who have a history of poor performance.

3. Preparation of Sealed Bids (5/16)

Bid Forms may be completed online thru Michigan DNR Timber Sale Online Bidding (OLB) at www.michigan.gov/timberbidding or by completing the hardcopy Bid Form found in the Timber Sale Prospectus. Hardcopy Bid Forms shall be manually signed in ink. Registration in OLB is considered your 'signature' for all bids submitted thru that system. Bid prices must be entered for each species and product in the Bid Price column for all material subject to bidding and all fill-in blanks must be completed. If erasures or other changes appear on the hardcopy Bid Form, each erasure or change must be initialed by the person signing the bid.

4. Submission of Sealed Bids (5/16)

Bid forms may be obtained from the Unit Manager or thru OLB. Bids may be submitted hardcopy or thru OLB. All hardcopy bids must be submitted on the bid form and in an envelope clearly identified as described in this section. NOTE: Only one bid form per bid envelope. Sealed bids must be submitted to the Unit office designated in the prospectus and must be submitted at or prior to the time established in the prospectus. The envelope should show on the outside (a) the sale name or number and (b) the date and time of bid opening, as shown in the prospectus. Bids received after the time specified in the sale prospectus are late bids and will be rejected.

It is possible for a bidder to submit multiple bids on a single sale. For example, a bid may be submitted hardcopy and a bid may be submitted thru OLB. Or, two bidders from the same company could both submit bids on the same sale. If this were to happen, the State would accept all bids received and award the contract accordingly. All bidding and contractual requirements would apply to all bids received.

5. Public Opening of Sealed Bids (7/16)

If conditions permit, the sealed bids will be publicly opened and posted at the time and place set in the prospectus.

If a bidder, present at a bid opening, has submitted bids on more than one sale, that bidder may withdraw their unopened bid envelopes or announce the withdrawal of their online bid after being declared the successful bidder on one sale.

6. Award of Contract (1/11)

Award of the contract will be made to the Bidder whose bid, conforming to the prospectus, is most advantageous to the State of Michigan on the basis of total value at rates bid for the estimated quantities. The State reserves the right to reject any bid or waive any minor irregularity in bids received. A written award mailed (or otherwise furnished) to the successful Bidder shall be deemed to result in a binding contract without further action by either party.

7. Down Payment (1/11)

The Bidder to whom award is made must make a down payment within 21 days of the sale award. The amount of the down payment will be calculated as shown in the Bond and Payment Schedule of this prospectus. Only cash may be used to meet this requirement.

8. Performance Security (1/11)

As guarantee of faithful performance, a cash bond, certificate of deposit, surety bond or irrevocable letter of credit (LOC) is required within 21 days of the sale award. The amount of the performance security is shown in the Bond and

Payment Schedule of this prospectus. If an LOC or surety is used, the coverage must extend for at least 6 months beyond the contract expiration.

9. Timber Sale Contract (7/18)

Additional conditions and requirements common to all timber sales are listed on the timber sale contract (R4031) and are available on line at www.michigan.gov/timber. Contact the Unit Manager for additional information or a sample contract. Within 21 days of the date of the award letter, the bidder must sign the contract and provide the required down payment, performance security, and verification of worker's disability compensation. The down payment and performance security shall be in accordance with the provisions of the timber sale contract, in the sums stated in this prospectus. If these actions are not taken, then the Bidder, the Bidder's corporation, and the corporation's principals may not be permitted to bid on State timber sales for a period of 3 months after the first offense, 6 months after the second offense, and 1 year after the third offense. An offense will only be counted against the Bidder for 5 years. In addition, the Bidder certifies that if awarded this contract, the Bidder will complete the timber sale contract in accordance with its terms and any modifications thereof including requirements to purchase, cut, and remove the included timber by the expiration date.

Payment Unit values in the State Forest Timber Sale Contract are calculated based on the advertised value of the Payment Unit as a percentage of the total advertised value of the contract. The advertised value of each Payment Unit is given in the Description of Timber by Payment Unit table on the Timber Sale Information page. For example, if the value of Payment Unit 1 is advertised as \$1,500 and the total Timber Sale value is advertised as \$10,000, the contract price for Payment Unit 1 will be 15% of the total bid price ($\$1,500/\$10,000 * 100$).

10. Disclaimer of Estimates and Bidder's Warranty of Inspection (7/16)

Before submitting this bid, the Bidder is advised and cautioned to inspect the sale area, review the requirements of the sale contract, and take other steps as may be reasonably necessary to ascertain the location, estimated volumes, construction estimates, and operating costs of the proposed sale. Failure to do so will not relieve the Bidder from responsibility for completing the contract.

The Bidder warrants that this bid is submitted solely on the basis of the Bidder's examination and inspection of the quality and quantity of the timber offered for sale and the Bidder's opinion of the value thereof and the costs of recovery. No reliance should be placed on the State of Michigan's estimates of timber quality, quantity or costs of recovery. Bidder further acknowledges that the State of Michigan: (i) expressly disclaims any warranty of fitness of timber for any purpose; (ii) offers this timber as is without any warranty of quality (merchantability) or quantity and (iii) expressly disclaims any warranty as to the quantity or quality of timber sold.

11. Certification and Chain-of-Custody (10/14)

Unless otherwise indicated in the contract under section 7 – Other Conditions of the Sale Specific Conditions & Requirements, the area encompassed by this timber sale is certified to the standards of the Forest Stewardship Council (FSC) - Certificate #SCS-FM/COC-00090N and the Sustainable Forestry Initiative (SFI) - Certificate #NSF-SFIS-5Y031-SF5. Forest products from this sale may be delivered to the mill as "FSC 100% and / or SFI certified" as long as the contractor hauling the forest products is chain-of-custody (COC) certified or covered under a COC certificate from the destination mill. The purchaser is responsible for maintaining COC after leaving the sale area.

12. Good Neighbor Authority (GNA) Requirements (7/16)

If the name of this timber sales contains the acronym GNA, it is authorized by the Good Neighbor Authority (GNA) and covered by various agreements between the U.S. Forest Service and the State. The timber sale occurs on federal land and the following conditions apply:

GNA contracts on US Forest Service land will not be awarded to purchasers on the Federal list of excluded parties. The System for Award Management (SAM) will be checked for active excluded parties prior to award of contract. In addition, the Bidder to whom award is made must complete an Assurance Regarding Felony Conviction or Tax Delinquent Status for Corporate Applicants (AD-3031).

13. Good Neighbor Authority (GNA) Requirements, con't (9/16)

Bidder certifies, by signing this bid form, that to the best of Bidder's knowledge that the following representations are accurate and complete.

- a. That the Bidder and its principals are not presently debarred, suspended, proposed for debarment, declared ineligible, or voluntary excluded from timber sales (covered transactions) by any Federal department or agency.
- b. That the Bidder and its principals have not within a 3-year period preceding this bid been convicted of or had a civil judgment rendered against them for commission of fraud or a criminal offense in connection with obtaining, attempting to obtain, or performing a public (Federal, State, or local) transaction or contract under a public transaction; violation of Federal or State antitrust statutes or commission of embezzlement, theft, forgery, bribery, falsification or destruction of records, making false statements, or receiving stolen property.
- c. That the Bidder and its principals are not presently indicted for or otherwise criminally or civilly charged by a governmental entity (Federal, State, or local) with commission of any of the offenses enumerated in paragraph b of this certification.
- d. That the Bidder and its principals have not within a 3-year period preceding this bid had one or more public transactions (Federal, State, or local) terminated for breach or default of a timber or forest product contract.

Bidders that cannot certify this requirement, in whole or in part, shall submit an explanation with their bid.

KEITH CREAGH
Director

TIMBER SALE INFORMATION

The Flood Begins Jack Pine (54-020-17)

Montmorency County (Advertised Price \$33,342.55)

SALE NOTE: Sale is dry, but located along the Tomahawk Creek Flooding. Some minor rolling topography. Sale must be chip harvested and stumps must be cut low. No harvesting from May 1st to August 15th due to Kirtland's Warbler nesting habitat.

A recreation site such as a trail, pathway, or campground is within the sale area or the vicinity. Certain restrictions/specifications may be applicable including time restrictions.

A timber sale contract for this lump sum, sealed bid timber sale will be awarded to the responsible bidder offering the highest sealed bid price. Bids must be at or above the following advertised price for each species:

<u>PRODUCTS & SPECIES</u>	<u>ESTIMATED UNITS*</u>	<u>ADVERTISED PRICE</u>
Sawtimber		
Jack Pine	24.00 MBF	\$ 48.00 / MBF
Red Pine	44.80 MBF	\$ 119.00 / MBF
Pulpwood		
Bl/R/Hybrid Oak	57.00 Cords	\$ 21.10 / Cord
Jack Pine	733.00 Cords	\$ 24.30 / Cord
Red Pine	159.00 Cords	\$ 48.65 / Cord
White Pine	2.00 Cords	\$ 54.70 / Cord

* The estimated units are final and not subject to adjustment. Prospective bidders are urged to examine this timber and to make their own estimates of quantity and quality.

BOND AND PAYMENT SCHEDULE:

1. A bond in the amount of \$1,667.00 to insure faithful performance of the conditions of the contract will be deposited by the successful bidder within 21 days of the sale award.
2. Cutting in any sale or unit without the required advance payment would be considered a trespass.
3. Total payment must be paid in advance or according to the following schedule:
 - (a) Ten percent (10%) of the sale value must be paid within 21 days of the sale award.
 - (b) The 10% down payment will be credited towards the first unit cut.
 - (c) Payment for each of the following units must be made before cutting begins in that unit:

<u>PAYMENT UNIT NUMBER</u>	<u>PERCENT OF TOTAL SALE VALUE</u>
01	19.2%
02	19.9%
03	60.9%
4. If no cutting takes place, the 10% down payment will not be refunded.
5. Operations on the contract issued will terminate on 12/31/2020.

Description of Timber by Payment Unit (PU)

PU	MARKET GROUP	PRODUCT	QUANTITY	UNIT	ACRES	ADVERTISE PRICE
1	Jack Pine	Sawtimber	10.0	MBF	23.7	\$6,387.85
	Red Pine		0.4	MBF		
	BI/R/Hybrid Oak	Pulpwood	33.0	Cords		
	<i>Northern Pin Oak</i>	<i>Sawtimber</i>	1.2	<i>MBF</i>		
	<i>Northern Pin Oak</i>	<i>Pulpwood</i>	31.0	<i>Cords</i>		
	Jack Pine		202.0	Cords		
	Red Pine		3.0	Cords		
	White Pine		2.0	Cords		
	<i>White Pine</i>	<i>Sawtimber</i>	0.4	<i>MBF</i>		
	<i>White Pine</i>	<i>Pulpwood</i>	1.0	<i>Cords</i>		
2	Jack Pine	Sawtimber	4.3	MBF	27.2	\$6,643.60
	Red Pine		2.6	MBF		
	BI/R/Hybrid Oak	Pulpwood	14.0	Cords		
	<i>Northern Pin Oak</i>		14.0	<i>Cords</i>		
	Jack Pine		224.0	Cords		
	Red Pine		8.0	Cords		
3	Jack Pine	Sawtimber	9.7	MBF	33.3	\$20,311.10
	Red Pine		41.8	MBF		
	BI/R/Hybrid Oak	Pulpwood	10.0	Cords		
	<i>Northern Pin Oak</i>		10.0	<i>Cords</i>		
	Jack Pine		307.0	Cords		
	Red Pine		148.0	Cords		
TOTAL:			68.8	MBF		
TOTAL:			951.0	Cords		

Sale Specific Conditions & Requirements

Sale Name: The Flood Begins Jack Pine

Sale Number: 54-020-17 Seq#: 1

1 - Sale Area

1.2 - Boundaries

1.2.1 - Painted boundaries (1/14)

The sale boundary and Payment Unit boundaries are marked and identified by red and yellow paint. Exterior sale boundary lines against state are marked with red paint. Interior Payment Unit boundaries are marked with yellow paint. The painted boundary line trees are not Included Timber and are to be protected. Yellow painted trees designating an interior Payment Unit boundary are only to be cut when all surrounding Payment Units have been paid.

2 - Timber Specifications

2.1 - Included Timber

2.1.1 - Clearcut unit(s) with unmerchantable trees (6/14)

Within Payment Unit(s) 1, 2, & 3, cut all trees that are two (2) inches or more at DBH.

2.2 - Utilization

2.2.2 - Chipping required (5/14)

This area must be chip harvested to facilitate subsequent planting operations. The Purchaser has the option to produce sawlogs or pulpwood bolts, but the remaining portion of the trees must be chipped and hauled. Do not chip 1/6 to 1/3 of the slash from harvested trees (tree tops and limbs less than four inches in diameter).

2.2.3 - Stump heights (4/07)

Stump heights within the Sale Area shall not exceed 6 inches for all trees. This is in order to facilitate planting operations.

2.2.11 - Chipping restriction (9/14)

If chipping occurs on this sale, then no woody debris present on the ground at the start of the sale may be chipped.

3 - Payments

3.3 - Pre-measured Sales

3.3.4 - Dividing payment units (7/14)

Payment Unit(s) 3 may be divided at the request of the Purchaser and upon approval of the Unit Manager. Dividing Payment Units is a contract modification which requires a Timber Sale Contract Supplement. There will be only one division per Payment Unit.

4 - Transportation

4.1 - Construction

4.1.3 - Slash and earthen piles (8/04)

Piles or windrows of earth along roads and landings that have been widened or constructed shall be leveled. Slash from road maintenance or construction, including stumps, shall be chipped, utilized or otherwise removed from the sale.

4.1.4 - Timber removed for construction (12/09)

Trees cut or damaged in the process of pre-approved road, landing or skid trail construction will be decked in an area separate from other Designated Timber and not removed until measured by the sale administrator. Payment will be made at the specified Purchase Unit Price.

4.1.6 - Road construction (1/09)

Construction of new roads or improvements of existing roads shall be done in such a way as to minimize the environmental and visual impacts. Merchantable trees shall be cut and utilized unless otherwise directed. Non-merchantable trees shall be severed and laid flat on the ground. Slash shall be chipped, utilized or otherwise removed from the sale. Stumps shall be set upright, not left on edge, and be moved at least 10 feet away from the road edge. Disturbed soil shall be feathered into the woods and not left in berms or windrows.

4.1.7 - Road closure (10/11)

All new roads built into the sale must be blocked to vehicle traffic upon completion of the sale. Overgrown roads that are reopened shall be considered new roads. In general, this will require constructing a four (4') foot high berm of stumps and logs covered with earth. These roads must be rendered impassable to cars and trucks. All stumps from road building and landing construction must be reserved to block any newly constructed roads upon completion of the sale. Contact the sale administrator for specific details of design and placement.

4.2 - Maintenance

4.2.5 - Two wheel drive condition (2/04)

All existing trail roads on and adjacent to the sale area must be passable by two-wheel drive traffic for the duration of the sale.

5 - Operations

5.1 - Notification

5.1.1 - Pre-sale conference (10/16)

A pre-sale conference on site between the Purchaser and sale administrator is required prior to beginning any operations to determine landing and road locations. The Unit Manager or his/her representative must be contacted at least 5 days in advance to schedule the conference.

5.1.4 - Post-sale conference (10/16)

A post-sale conference on site between the Purchaser and sale administrator is required prior to the completion of active logging operations to determine clean-up and repair of landings, road edges, and the fulfillment of other contract specifications.

5.2 - Conduct of Operations

5.2.1 - Slash

5.2.1.8 - Slash height (12/08)

No slash or tree tops remaining on the sale may exceed 24 inches in height.

5.2.1.10 - No slash in openings (5/10)

No brush or logging debris is to be left in the maintained wildlife opening which is indicated by G0 on the Timber Sale Map. Any damage to the opening shall be repaired according to specifications of the Unit Manager or his/her representative.

5.2.2 - Hazard Trees/Snags

5.2.2.1 - Den trees (10/16)

Obvious hollow and/or den trees shall be protected and left standing unless they are a safety hazard.

5.2.3 - Operating Restrictions

5.2.3.6 - Bark beetle restriction (12/08)

In the event drought creates a high risk of pine bark beetle infestation, pine is not to be cut during the period March 1 through July 1, unless all portions of trees greater than two inches in diameter are removed from the sale area, reduced to chips, or treated to the satisfaction of the Unit Manager or his/her representative, within fifteen days of being severed from the stump. Pine log decks, pulpwood piles and treetops that are piled for chipping in the fall or winter within a 1/4 mile of susceptible sites must be removed before March 15. Residual slash must not be placed in piles or rows and must be spread over the site for quick drying. The Department of Natural Resources will exercise this specification if the risk of damage warrants.

5.2.29 - Shrub protection (9/07)

Do not cut or damage hawthorn, witch-hazel, dogwood or juneberry. These woody-shrub plants are highly beneficial to various wildlife species.

5.2.32 - Decking/landing restoration (9/13)

All decking and landing areas must have the surface area restored to a condition equal to or better than before. This is to ensure the proper regeneration of the stand. Wood debris, chips and "cookies" from trimmings must be removed or scattered

away from landing and loading areas and may not be windrowed on the edge.

5.2.39 - ORV trail/route protection (12/12)

The Atlanta ORV route is shown on the Timber Sale Map. Do not cut trees or damage posts with orange ORV markers. If any trees along the trail need to be cut, all stumps within 5 feet of the trail must be cut flush with the ground. Maintain a 20 foot wide slash, debris, and rut free zone daily using the ORV trail or route as the centerline.

5.2.40 - Pathway protection (10/10)

The High Country Pathway is a hiking/biking trail and is shown on the Timber Sale Map. Do not cut trees or damage posts with blue pathway markers. Maintain a 10-foot wide slash, debris, and rut free zone daily, using the pathway as the centerline. Do not run equipment down the pathway, other than on coincident roads.

5.2.41 - Snowmobile trail protection (9/11)

The Atlanta Route is a snowmobile trail and is shown on the Timber Sale Map. Do not cut or damage posts with orange trail markers or traffic control signs. If the trail is used, it must be maintained and restored to a condition equal to or better than before the sale. The road maintenance/restoration must be done prior to December 1. If the trail is used for hauling, it must be graded to the satisfaction of the Unit Manager or his/her representative prior to December 1st. If the trail road is to be used for hauling during the snowmobile season, then a snow covered base must be left on the trail. Maintain a 20 foot wide slash, debris, and rut free zone daily using the snowmobile trail as the centerline.

5.3 - Stream Protection

5.3.1 - Operating near stream (7/04)

No tracked or wheeled vehicles shall be operated within 100 feet of Tomahawk Creek or the flooding. The red painted boundary will serve as the 100 foot buffer.

5.4 - Soil Protection

5.4.1 - Rutting restriction, general (7/16)

Operations are to cease immediately if equipment and weather conditions result in rutting of roads and/or skid trails which is 12 inches or greater in depth and 50 feet in length. The Unit Manager or his/her representative may restrict hauling and/or skidding if ruts exceed the specified depth. With the Unit Manager or his/her representative's approval, the Purchaser may return to the area when the risk of rutting has decreased.

5.8 - Protection of Endangered Species

5.8.2 - Kirtland's warbler (2) (10/12)

This sale is adjacent to a young jack pine stand which is being used by an endangered species (Kirtland's Warbler). Due to the close proximity to occupied Kirtland's Warbler habitat, all operations are confined to August 16 through May 1 for this sale. Absolutely no operations will be allowed the remainder of the year.

5.8.5 - Protection of raptor nests (3/13)

All trees with raptor nests will be protected if found during harvesting operations. Notification will be made to the Unit Manager or his/her representative who will notify the Wildlife Biologist so an on-site evaluation and recommendation can be made, if necessary.

6 - Safety and Fire Prevention

6.2 - Signing

6.2.1 - Road posting (9/09)

The Purchaser is responsible for posting and maintaining caution signs on all forest roads utilized prior to beginning operations. The road must be posted at appropriate distances from the sale area to warn of logging activity and truck traffic. Signs must be removed when harvest operations are suspended or completed. The Purchaser will provide these signs.

6.2.3 - Recreational trail posting (2/10)

The Purchaser is responsible for posting and maintaining caution signs on the Atlanta Route trail and High Country Pathway prior to beginning operations. The trail must be posted at appropriate distances from the sale area to warn of logging activity and truck traffic at both ends of the trail. Signs must be removed when harvest operations are suspended or completed. The Purchaser will provide these signs.

8 - Performance and Settlement

8.3 - Uncompleted or Terminated Contracts

8.3.1 - Completion of contract, chipping (1/16)

In addition to cutting, all chipping must be completed by the contract expiration date. If chipping has not been completed, an extension fee or damages may be charged per General Condition & Requirement 7.2 and 8.3.



TIMBER SALE MAP

This information provided by authority of Part 525, 1994 PA 451, as amended.

Sale Number	Year
54 - 020	17

Forest Management Unit Atlanta	County Montmorency	Mapped By Gilner	Date 08/03/2017	Page 1	of 1
Township 32N	Range 02E	Section(s) and Subdivision(s) Section 3: E2NW, N2SW, N2SE, W2NE, SENE	Scale 1:15,840		

Cover Type				Density	
A = Aspen	H = Hemlock	N = Marsh	U = Upland Brush	0 = Non Stocked	5 = Pole Timber Medium
B = Paper Birch	J = Jack Pine	O = Oak	UM = Upland Mixed	1 = Seedling Sapling Poor	6 = Pole Timber Well
C = Cedar	L = Lowland Brush	P = Lowland Poplar	V = Bog or Marsh	2 = Seedling Sapling Medium	7 = Saw Timber Poor
D = Treed Bog	LM = Lowland Mixed	Q = Mixed Swamp Conifer	W = White Pine	3 = Seedling Sapling Well	8 = Saw Timber Medium
E = Swamp Hdwoods	M = Mpl, Bch, Brch	R = Red Pine	X = Non Stocked	4 = Pole Timber Poor	9 = Saw Timber Well
F = Spruce Fir	MC = Mixed Conifer	S = Black Spruce	Z = Water		
G = Grass	MD = Mixed Deciduous	T = Tamarack			

PU	Acres
1	23.7
2	27.2
3	33.3

The Flood Begins Jack Pine

Compartment 063

84.2 Acres

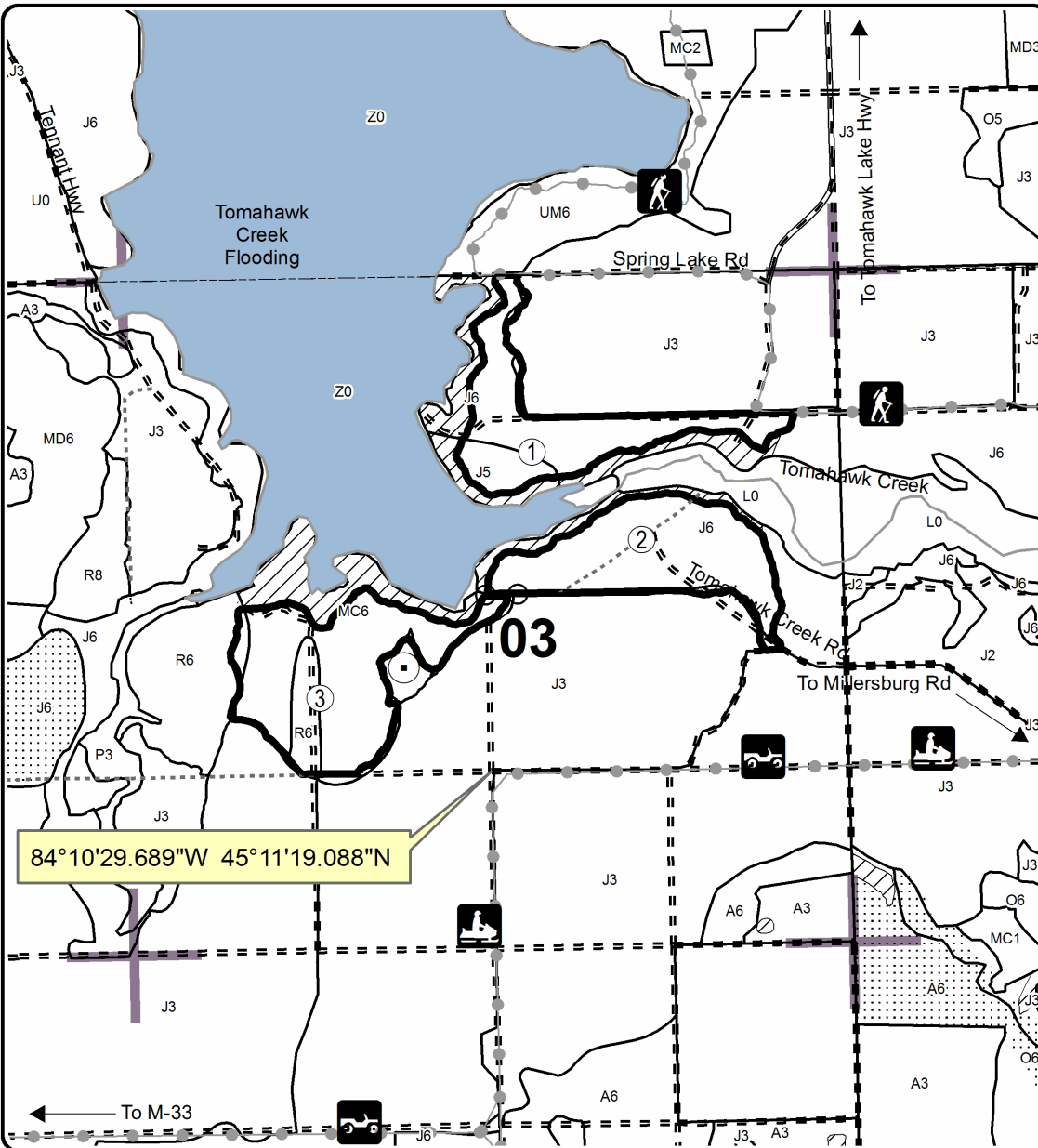

Legend

- Against State (Red)
- ⊙ Payment Unit (Yellow)
- Section Corners
- ▨ Retention Area
- ▭ Stand Boundaries
- ⋯ Nearby Timber Sale
- Lakes
- Streams/Creeks
- Recreational Trail
- Paved Roads
- Gravel Roads
- - - Poor Dirt Roads
- ⋯ Closed Roads

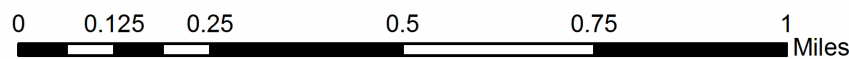
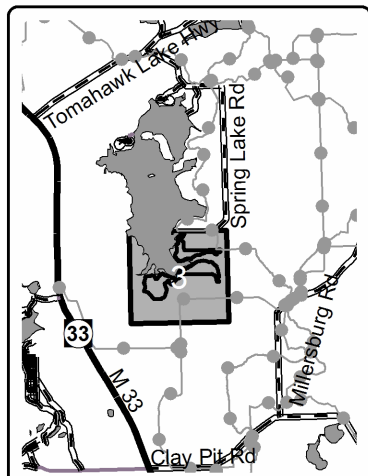

Locator Map 1:125,000

TIMBER SALE INFORMATION

Radio Tower Red Pine (54-021-17)

Montmorency County (Advertised Price \$58,636.45)

SALE NOTE: Oak wilt restriction in place for sale boundaries and travel routes.

A recreation site such as a trail, pathway, or campground is within the sale area or the vicinity. Certain restrictions/specifications may be applicable including time restrictions.

A timber sale contract for this lump sum, sealed bid timber sale will be awarded to the responsible bidder offering the highest sealed bid price. Bids must be at or above the following advertised price for each species:

<u>PRODUCTS & SPECIES</u>	<u>ESTIMATED UNITS*</u>	<u>ADVERTISED PRICE</u>
Sawtimber		
BI/R/Hybrid Oak	2.40 MBF	\$ 105.00 / MBF
Red Pine	232.40 MBF	\$ 119.00 / MBF
White Oak	18.40 MBF	\$ 87.00 / MBF
White Pine	7.10 MBF	\$ 110.00 / MBF
Pulpwood		
B. T. Aspen	13.00 Cords	\$ 23.95 / Cord
Jack Pine	8.00 Cords	\$ 24.30 / Cord
Mixed Oak	182.00 Cords	\$ 21.10 / Cord
Red Pine	436.00 Cords	\$ 48.65 / Cord
White Pine	51.00 Cords	\$ 54.70 / Cord

* The total volume is statistically estimated within plus (+) or minus (-) 13.44 percent. The estimated units are final and not subject to adjustment. Prospective bidders are urged to examine this timber and to make their own estimates of quantity and quality.

BOND AND PAYMENT SCHEDULE:

1. A bond in the amount of \$2,932.00 to insure faithful performance of the conditions of the contract will be deposited by the successful bidder within 21 days of the sale award.
2. Cutting in any sale or unit without the required advance payment would be considered a trespass.
3. Total payment must be paid in advance or according to the following schedule:
 - (a) Ten percent (10%) of the sale value must be paid within 21 days of the sale award.
 - (b) The 10% down payment will be credited towards the first unit cut.
 - (c) Payment for each of the following units must be made before cutting begins in that unit:

<u>PAYMENT UNIT NUMBER</u>	<u>PERCENT OF TOTAL SALE VALUE</u>
01	13.8%
02	30.4%
03	12.1%
04	20.3%
05	23.4%
4. If no cutting takes place, the 10% down payment will not be refunded.
5. Operations on the contract issued will terminate on 12/31/2020.

Description of Timber by Payment Unit (PU)

PU	MARKET GROUP	PRODUCT	QUANTITY	UNIT	ACRES	ADVERTISE PRICE
1	BI/R/Hybrid Oak	Sawtimber	0.3	MBF	11.5	\$8,068.60
	Red Pine		32.0	MBF		
	White Oak		2.5	MBF		
	White Pine		1.0	MBF		
	B. T. Aspen	Pulpwood	2.0	Cords		
	<i>B. T. Aspen</i>	<i>Sawtimber</i>	<i>0.1</i>	<i>MBF</i>		
	<i>B. T. Aspen</i>	<i>Pulpwood</i>	<i>2.0</i>	<i>Cords</i>		
	Jack Pine		1.0	Cords		
	Mixed Oak		25.0	Cords		
	<i>BI/R/Hybrid Oak</i>		<i>15.0</i>	<i>Cords</i>		
	<i>White Oak</i>		<i>10.0</i>	<i>Cords</i>		
	Red Pine		60.0	Cords		
	White Pine		7.0	Cords		
	2	BI/R/Hybrid Oak	Sawtimber	0.7		
Red Pine			70.5	MBF		
White Oak			5.7	MBF		
White Pine			2.1	MBF		
B. T. Aspen		Pulpwood	4.0	Cords		
<i>B. T. Aspen</i>		<i>Sawtimber</i>	<i>0.1</i>	<i>MBF</i>		
<i>B. T. Aspen</i>		<i>Pulpwood</i>	<i>4.0</i>	<i>Cords</i>		
Jack Pine			2.0	Cords		
Mixed Oak			55.0	Cords		
<i>BI/R/Hybrid Oak</i>			<i>31.0</i>	<i>Cords</i>		
<i>White Oak</i>			<i>24.0</i>	<i>Cords</i>		
Red Pine			132.0	Cords		
White Pine			16.0	Cords		
3		BI/R/Hybrid Oak	Sawtimber	0.3	MBF	10.2
	Red Pine		28.4	MBF		
	White Oak		2.2	MBF		
	White Pine		0.9	MBF		
	B. T. Aspen	Pulpwood	1.0	Cords		
	<i>B. T. Aspen</i>	<i>Sawtimber</i>	<i>0.1</i>	<i>MBF</i>		
	<i>B. T. Aspen</i>	<i>Pulpwood</i>	<i>1.0</i>	<i>Cords</i>		
	Jack Pine		1.0	Cords		
	Mixed Oak		22.0	Cords		
	<i>BI/R/Hybrid Oak</i>		<i>13.0</i>	<i>Cords</i>		
	<i>White Oak</i>		<i>9.0</i>	<i>Cords</i>		
	Red Pine		53.0	Cords		
	White Pine		6.0	Cords		
	4	BI/R/Hybrid Oak	Sawtimber	0.5	MBF	
Red Pine			47.3	MBF		
White Oak			3.7	MBF		
White Pine			1.4	MBF		
B. T. Aspen		Pulpwood	2.0	Cords		
<i>B. T. Aspen</i>		<i>Sawtimber</i>	<i>0.1</i>	<i>MBF</i>		
<i>B. T. Aspen</i>		<i>Pulpwood</i>	<i>2.0</i>	<i>Cords</i>		
Jack Pine			2.0	Cords		
Mixed Oak			37.0	Cords		
<i>BI/R/Hybrid Oak</i>			<i>22.0</i>	<i>Cords</i>		
<i>White Oak</i>			<i>15.0</i>	<i>Cords</i>		
Red Pine			89.0	Cords		
White Pine			10.0	Cords		
5		BI/R/Hybrid Oak	Sawtimber	0.6	MBF	19.5
	Red Pine		54.2	MBF		
	White Oak		4.3	MBF		
	White Pine		1.7	MBF		

Description of Timber by Payment Unit (PU), con't

PU	MARKET GROUP	PRODUCT	QUANTITY	UNIT	ACRES	ADVERTISE PRICE
5 con't	B. T. Aspen	Pulpwood	3.0	Cords		
	<i>B. T. Aspen</i>	<i>Sawtimber</i>	<i>0.1</i>	<i>MBF</i>		
	<i>B. T. Aspen</i>	<i>Pulpwood</i>	<i>3.0</i>	<i>Cords</i>		
	Jack Pine		2.0	Cords		
	Mixed Oak		43.0	Cords		
	<i>Bl/R/Hybrid Oak</i>		<i>25.0</i>	<i>Cords</i>		
	<i>White Oak</i>		<i>18.0</i>	<i>Cords</i>		
	Red Pine		102.0	Cords		
	White Pine		12.0	Cords		
	TOTAL:			260.3	MBF	
TOTAL:			689.0	Cords		

Sale Specific Conditions & Requirements

Sale Name: Radio Tower Red Pine

Sale Number: 54-021-17 Seq#: 1

1 - Sale Area

1.2 - Boundaries

1.2.1 - Painted boundaries (1/14)

The sale boundary and Payment Unit boundaries are marked and identified by red and yellow paint. Exterior sale boundary lines against state are marked with red paint. Interior Payment Unit boundaries are marked with yellow paint. The painted boundary line trees are not Included Timber and are to be protected. Yellow painted trees designating an interior Payment Unit boundary are only to be cut when all surrounding Payment Units have been paid.

2 - Timber Specifications

2.1 - Included Timber

2.1.1 - Clearcut unit(s) with unmerchantable trees (6/14)

Within Payment Unit(s) 1 - 5, cut all trees that are two (2) inches or more at DBH, except do not cut any red pine or white pine 26 inches at DBH or larger, if present.

2.1.15 - Hazard trees near roads (7/13)

Cut and remove all standing dead trees within 100 feet of the cleared portion of Radio Tower Road and the power line within the sale area. These trees may be utilized or must be scattered back into the sale area.

2.2 - Utilization

2.2.2 - Chipping required (5/14)

This sale must be chip harvested to facilitate subsequent planting operations. The Purchaser has the option to produce sawlogs or pulpwood bolts, but the remaining portion of the trees must be chipped and hauled. If chipping is delayed, all tops must be skid to the landing within 60 days of felling trees. This is to ensure that follow-up planting activities are not delayed. Do not chip 1/6 to 1/3 of the slash from harvested trees (tree tops and limbs less than four inches in diameter).

2.2.3 - Stump heights (4/07)

Stump heights within the Sale Area shall not exceed 6 inches for all trees. This is in order to facilitate planting operations.

2.2.11 - Chipping restriction (9/14)

If chipping occurs on this sale, then no woody debris present on the ground at the start of the sale may be chipped.

3 - Payments

3.3 - Pre-measured Sales

3.3.4 - Dividing payment units (7/14)

Payment Unit(s) greater than \$20,000 may be divided at the request of the Purchaser and upon approval of the Unit Manager. Dividing Payment Units is a contract modification which requires a Timber Sale Contract Supplement. There will be only one division per Payment Unit.

4 - Transportation

4.1 - Construction

4.1.3 - Slash and earthen piles (8/04)

Piles or windrows of earth along roads and landings that have been widened or constructed shall be leveled. Slash from road maintenance or construction, including stumps, shall be chipped, utilized or otherwise removed from the sale.

4.1.6 - Road construction (1/09)

Improvements of existing roads shall be done in such a way as to minimize the environmental and visual impacts. Merchantable trees shall be cut and utilized unless otherwise directed. Non-merchantable trees shall be severed and laid flat on the ground. Slash shall be chipped, utilized or otherwise removed from the sale. Stumps shall be set upright, not left on edge, and be moved at least 10 feet away from the road edge. Disturbed soil shall be feathered into the woods and not left in

berms or windrows.

4.1.7 - Road closure (10/11)

Overgrown roads that are reopened shall be closed at the entry point(s). In general, this will require constructing a four (4') foot high berm of stumps and logs covered with earth. These roads must be rendered impassable to cars and trucks. Contact the sale administrator for specific details of design and placement.

4.1.12 - No new roads (1/12)

No new roads will be permitted. All operations are limited to existing roads. Skid trails only will be allowed.

4.2 - Maintenance

4.2.5 - Two wheel drive condition (2/04)

All existing trail roads on and adjacent to the sale area must be passable by two-wheel drive traffic for the duration of the sale.

5 - Operations

5.1 - Notification

5.1.1 - Pre-sale conference (10/16)

A pre-sale conference on site between the Purchaser and sale administrator is required prior to beginning any operations to determine landing and road locations. The Unit Manager or his/her representative must be contacted at least 5 days in advance to schedule the conference.

5.1.4 - Post-sale conference (10/16)

A post-sale conference on site between the Purchaser and sale administrator is required 5 days prior to the completion of active logging operations to determine clean-up and repair of landings, road edges, and the fulfillment of other contract specifications.

5.1.6 - Utility R.O.W. (1/15)

It is the responsibility of the Purchaser to obtain permission from the utility company to utilize the power line R.O.W. for operations.

5.2 - Conduct of Operations

5.2.1 - Slash

5.2.1.8 - Slash height (12/08)

No slash or tree tops remaining on site may exceed 24 inches in height.

5.2.2 - Hazard Trees/Snags

5.2.2.1 - Den trees (10/16)

Obvious hollow and/or den trees shall be protected and left standing unless they are a safety hazard.

5.2.3 - Operating Restrictions

5.2.3.4 - Oak wilt restriction (4/17)

Within Payment Unit(s) 1 - 5, unless changed by written agreement, cutting, skidding, and hauling are not permitted during the period of April 15 to July 15. Operations may be allowed if specific steps are taken to prevent damaging uncut oak during the high risk period. Those steps include completing all road brushing before April 15th, clearing a tree-length buffer along uncut oak cover before April 15th or leaving an uncut buffer there until after July 15th. This is necessary to reduce the spread of oak wilt. For more information, contact the Unit Manager or his/her representative.

5.2.3.6 - Bark beetle restriction (12/08)

In the event drought creates a high risk of pine bark beetle infestation, pine is not to be cut during the period March 1 through July 1, unless all portions of trees greater than two inches in diameter are removed from the sale area, reduced to chips, or treated to the satisfaction of the Unit Manager or his/her representative, within fifteen days of being severed from the stump. Pine log decks, pulpwood piles and treetops that are piled for chipping in the fall or winter within a 1/4 mile of susceptible sites must be removed before March 15. Residual slash must not be placed in piles or rows and must be spread over the site for quick drying. The Department of Natural Resources will exercise this specification if the risk

of damage warrants.

5.2.31 - Landing locations (9/13)

Landing areas are marked on the Timber Sale Map with the letter "L". Landings must be confined to these designated sites unless otherwise authorized by the Unit Manager or his/her representative.

5.2.32 - Decking/landing restoration (9/13)

All decking and landing areas must have the surface area restored to a condition equal to or better than before. This is to ensure the proper regeneration of the stand. Wood debris, chips and "cookies" from trimmings must be removed or scattered away from landing and loading areas and may not be windrowed on the edge.

5.2.37 - No decking areas (12/08)

No decking is allowed within 50 feet of recreational trails without permission of the Unit Manager or his/her representative.

5.2.39 - ORV trail/route protection (12/12)

The Atlanta Route is an ORV trail or route and is shown on the Timber Sale Map. Do not damage posts with orange ORV markers. Trees with orange ORV markers shall be cut off above the markers and at least 5 feet above ground. All stumps within 5 feet of the trail must be cut flush with the ground. Maintain a 20 foot wide slash, debris, and rut free zone daily using the ORV trail or route as the centerline. Do not run equipment down the ORV trail or route. Skidding across the trail or route may only occur in locations approved by the sale administrator.

5.2.40 - Pathway protection (10/10)

The High Country Pathway is a hiking and biking trail and is shown on the Timber Sale Map. Do not cut trees or damage posts with blue pathway markers. Maintain a 20-foot wide slash, debris, and rut free zone daily, using the pathway as the centerline. Do not run equipment down the pathway. Skidding across the trail may only occur in locations approved by the sale administrator.

5.4 - Soil Protection

5.4.1 - Rutting restriction, general (7/16)

Operations are to cease immediately if equipment and weather conditions result in rutting of roads and/or skid trails which is 12 inches or greater in depth and 50 feet in length. The Unit Manager or his/her representative may restrict hauling and/or skidding if ruts exceed the specified depth. With the Unit Manager or his/her representative's approval, the Purchaser may return to the area when the risk of rutting has decreased.

5.4.2 - Skid trails (2/04)

Skid trails up and down slopes should be avoided. If however this is unavoidable, these trails will be left in a non-erodible condition using water bars, logs, and slash. Placing of slash on these skid trails while logging is ongoing may alleviate need for any further action. At the direction of the sale administrator, seed, fertilizer, and mulch may also be required.

5.8 - Protection of Endangered Species

5.8.1 - Kirtland's warbler (1) (10/12)

This sale is adjacent to a young jack pine stand which may be used by the endangered Kirtland's Warbler. The Department reserves the right to temporarily restrict all harvesting operations in a buffer zone of up to 500 feet if it is determined that Warbler territory has been established in the adjacent stand. The restricted period, if put into effect, would apply from May 1st to August 15th, within Payment Unit 1. It is advised to plan on harvesting this unit outside of this specified time period.

5.8.3 - Red shoulder hawk or goshawk (2/16)

In the event that an active red shoulder hawk or goshawk nest is found, the contract may be amended to protect the nest site until the nest is determined to be inactive. The value of the trees in this excluded area will be refunded or credited to the Purchaser. The nest will be buffered with a five-chain radius (eight acre) protection area, centered on the nest tree, in which there will be no cutting or new roads constructed. Avoid human disturbance, including loading and skidding, in the protection area.

An additional zone of five chains (ten chains centered on the active nest tree) will be established in which there is no management activity from March 15 to July 15. Limit biomass harvesting and chipping operations within this ten-chain zone, retain the maximum one-third of residues per the Woody Biomass Harvesting Guidelines (Michigan DNR 2010). Nests determined to be inactive will be protected with a one-chain no-harvest buffer.

5.8.5 - Protection of raptor nests (3/13)

All trees with raptor nests will be protected if found during harvesting operations. Notification will be made to the Unit Manager or his/her representative who will notify the Wildlife Biologist so an on-site evaluation and recommendation can be made, if necessary.

6 - Safety and Fire Prevention

6.2 - Signing

6.2.1 - Road posting (9/09)

The Purchaser is responsible for posting and maintaining caution signs on Radio Tower Road and/or Rod and Gun Road (if utilized) prior to beginning operations. The road must be posted at appropriate distances from the sale area to warn of logging activity and truck traffic. Signs must be removed when harvest operations are suspended or completed. The Purchaser will provide these signs.

6.2.3 - Recreational trail posting (2/10)

The Purchaser is responsible for posting and maintaining caution signs on the Atlanta Route and High Country Pathway prior to beginning operations. The trail must be posted at appropriate distances from the sale area to warn of logging activity and truck traffic at both ends of the trail. Signs must be removed when harvest operations are suspended or completed. The Purchaser will provide these signs.

8 - Performance and Settlement

8.3 - Uncompleted or Terminated Contracts

8.3.1 - Completion of contract, chipping (1/16)

In addition to cutting, all chipping must be completed by the contract expiration date. If chipping has not been completed, an extension fee or damages may be charged per General Condition & Requirement 7.2 and 8.3.



TIMBER SALE MAP

This information provided by authority of Part 525, 1994 PA 451, as amended.

Sale Number	Year
54-021	17

Forest Management Unit Atlanta	County Montmorency	Mapped By Gilner & Coy	Date 08/17/2017	Page 1	of 1
Township 32N	Range 02E	Section(s) and Subdivision(s) Section 27: NE 1/4, & N 1/2 of SE 1/4	Cruised By Gilner	Scale 1:15,840	

Cover Type				Density	
A = Aspen	H = Hemlock	N = Marsh	U = Upland Brush	0 = Non Stocked	5 = Pole Timber Medium
B = Paper Birch	J = Jack Pine	O = Oak	UM = Upland Mixed	1 = Seedling Sapling Poor	6 = Pole Timber Well
C = Cedar	L = Lowland Brush	P = Lowland Poplar	V = Bog or Marsh	2 = Seedling Sapling Medium	7 = Saw Timber Poor
D = Treed Bog	LM = Lowland Mixed	Q = Mixed Swamp Conifer	W = White Pine	3 = Seedling Sapling Well	8 = Saw Timber Medium
E = Swamp Hdwoods	M = Mpl, Bch, Brch	R = Red Pine	X = Non Stocked	4 = Pole Timber Poor	9 = Saw Timber Well
F = Spruce Fir	MC = Mixed Conifer	S = Black Spruce	Z = Water		
G = Grass	MD = Mixed Deciduous	T = Tamarack			



Radio Tower Red Pine

Compartment 063

83.6 Acres

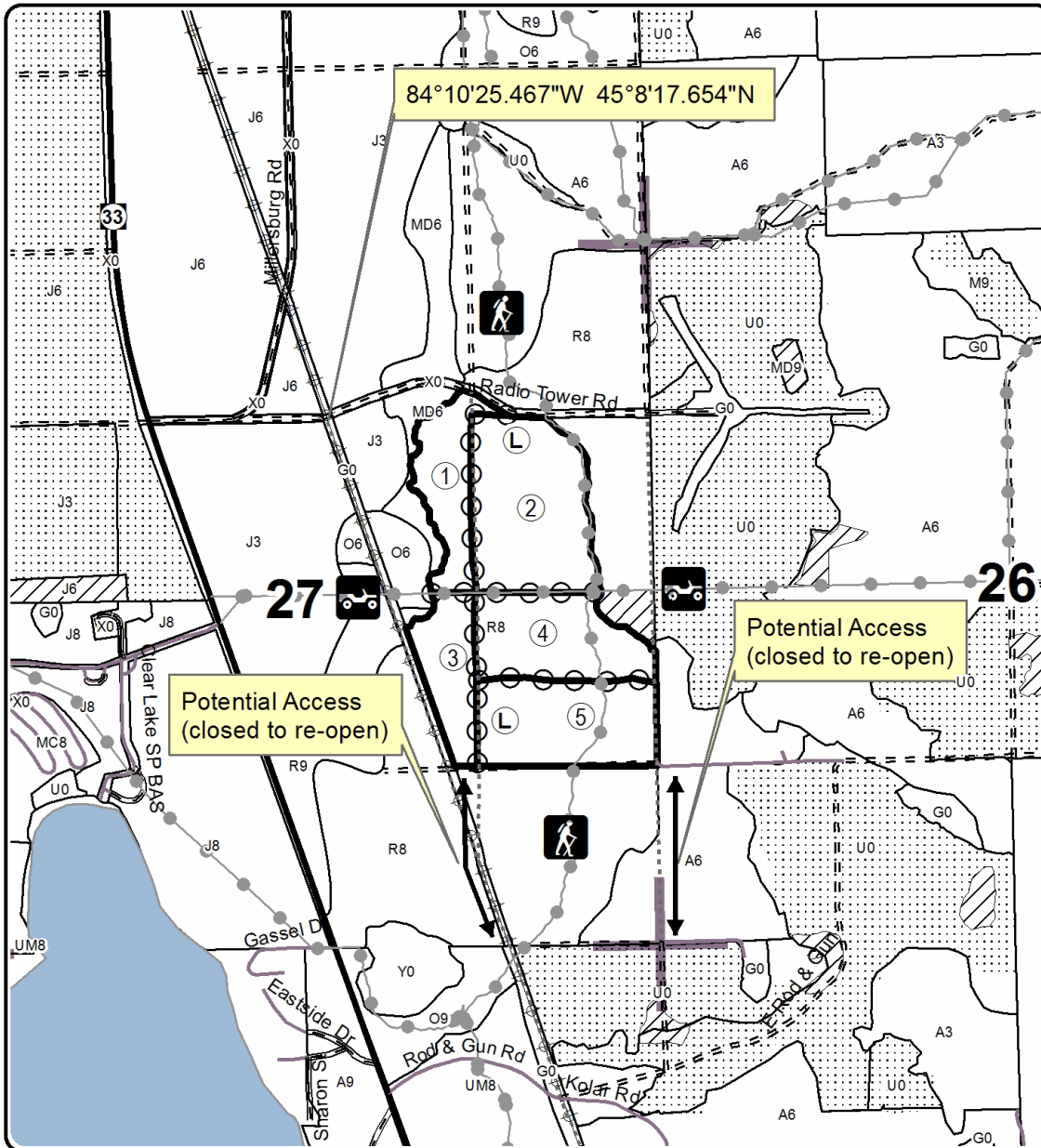

Legend

- Against State (Red)
- Payment Unit (Yellow)
- Nearby Timber Sale
- Stand Boundaries
- Retention Area
- Lakes and Rivers
- Landing
- Section Corners
- Recreational Trail
- Powerline
- Highway
- Paved Roads
- Gravel Roads
- Poor Dirt Roads
- Closed Roads

PU	Acres
1	11.5
2	25.4
3	10.2
4	17.0
5	19.5

Locator Map 1:100,000

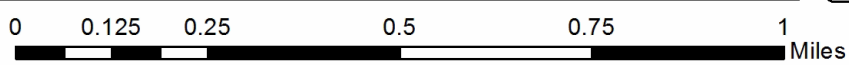
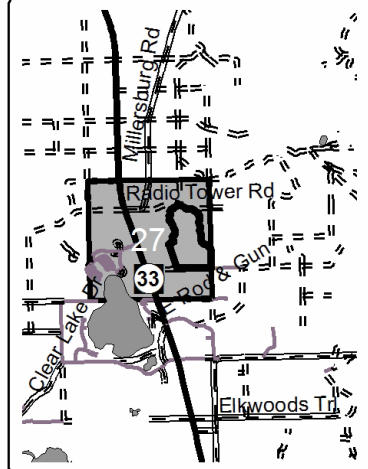

TIMBER SALE INFORMATION

Rocky Bottom Mix (54-023-17)

Presque Isle County (Advertised Price \$19,488.70)

A timber sale contract for this lump sum, sealed bid timber sale will be awarded to the responsible bidder offering the highest sealed bid price. Bids must be at or above the following advertised price for each species:

<u>PRODUCTS & SPECIES</u>	<u>ESTIMATED UNITS*</u>	<u>ADVERTISED PRICE</u>
Sawtimber		
Red Pine	3.40 MBF	\$ 119.00 / MBF
White Pine	12.90 MBF	\$ 109.00 / MBF
Pulpwood		
Balsam Fir	115.00 Cords	\$ 38.80 / Cord
Mixed Spruce	62.00 Cords	\$ 32.55 / Cord
N. White Cedar	13.00 Cords	\$ 28.70 / Cord
Paper Birch	116.00 Cords	\$ 23.15 / Cord
Quaking Aspen	98.00 Cords	\$ 23.95 / Cord
Red Pine	12.00 Cords	\$ 48.65 / Cord
Sugar Maple	18.00 Cords	\$ 18.90 / Cord
White Pine	89.00 Cords	\$ 54.70 / Cord

* The total volume is statistically estimated within plus (+) or minus (-) 19.66 percent. The estimated units are final and not subject to adjustment. Prospective bidders are urged to examine this timber and to make their own estimates of quantity and quality.

BOND AND PAYMENT SCHEDULE:

1. A bond in the amount of \$974.00 to insure faithful performance of the conditions of the contract will be deposited by the successful bidder within 21 days of the sale award.
2. Cutting in any sale or unit without the required advance payment would be considered a trespass.
3. Total payment must be paid in advance or according to the following schedule:
 - (a) Ten percent (10%) of the sale value must be paid within 21 days of the sale award.
 - (b) The 10% down payment will be credited towards the first unit cut.
 - (c) Payment for each of the following units must be made before cutting begins in that unit:

PAYMENT UNIT NUMBER	PERCENT OF TOTAL SALE VALUE
01	63.3%
02	36.7%
4. If no cutting takes place, the 10% down payment will not be refunded.
5. Operations on the contract issued will terminate on 06/30/2021.

Description of Timber by Payment Unit (PU)

PU	MARKET GROUP	PRODUCT	QUANTITY	UNIT	ACRES	ADVERTISE PRICE
1	Red Pine	Sawtimber	2.7	MBF	22.6	\$12,331.95
	White Pine		10.1	MBF		
	Balsam Fir	Pulpwood	79.0	Cords		
	Mixed Spruce		29.0	Cords		
	<i>White Spruce</i>		29.0	<i>Cords</i>		
	N. White Cedar		5.0	Cords		
	Paper Birch		40.0	Cords		
	Quaking Aspen		59.0	Cords		
	Red Pine		9.0	Cords		
	Sugar Maple		8.0	Cords		
	White Pine		70.0	Cords		
	2	Red Pine	Sawtimber	0.7		
White Pine			2.8	MBF		
Balsam Fir		Pulpwood	36.0	Cords		
Mixed Spruce			33.0	Cords		
<i>White Spruce</i>		<i>Sawtimber</i>	0.9	<i>MBF</i>		
<i>White Spruce</i>		<i>Pulpwood</i>	31.0	<i>Cords</i>		
N. White Cedar			8.0	Cords		
Paper Birch			76.0	Cords		
Quaking Aspen			39.0	Cords		
Red Pine			3.0	Cords		
Sugar Maple			10.0	Cords		
White Pine			19.0	Cords		
TOTAL:			16.3	MBF		
TOTAL:			523.0	Cords		

Sale Specific Conditions & Requirements

Sale Name: Rocky Bottom Mix

Sale Number: 54-023-17 Seq#: 1

1 - Sale Area

1.2 - Boundaries

1.2.1 - Painted boundaries (1/14)

The sale boundary and Payment Unit boundaries are marked and identified by blue, red and yellow paint. Exterior sale boundary lines against private property are marked with blue paint. Exterior sale boundary lines against state are marked with red paint. Interior Payment Unit boundaries are marked with yellow paint. The painted boundary line trees are not Included Timber and are to be protected. Yellow painted trees designating an interior Payment Unit boundary are only to be cut when all surrounding Payment Units have been paid.

2 - Timber Specifications

2.1 - Included Timber

2.1.1 - Clearcut unit(s) with unmerchantable trees (6/14)

Within Payment Unit(s) 1 and 2, cut all trees that are two (2) inches or more at DBH.

4 - Transportation

4.1 - Construction

4.1.3 - Slash and earthen piles (8/04)

Piles or windrows of earth along roads and landings that have been widened or constructed shall be leveled. Slash from road maintenance or construction, including stumps, shall be dispersed throughout the sale.

4.1.6 - Road construction (1/09)

Improvements of existing roads shall be done in such a way as to minimize the environmental and visual impacts. Merchantable trees shall be cut and utilized unless otherwise directed. Non-merchantable trees shall be severed and laid flat on the ground. Slash shall be scattered, and not left in windrows and kept a minimum of 10 feet back from the road edge. Stumps shall be set upright, not left on edge, and be moved at least 10 feet away from the road edge. Disturbed soil shall be feathered into the woods and not left in berms or windrows.

4.1.12 - No new roads (1/12)

No new roads will be permitted in any Payment Unit. All operations are limited to existing roads. Skid trails only will be allowed.

4.2 - Maintenance

4.2.5 - Two wheel drive condition (2/04)

All existing trail roads on and adjacent to the sale area must be passable by two-wheel drive traffic for the duration of the sale.

5 - Operations

5.1 - Notification

5.1.1 - Pre-sale conference (10/16)

A pre-sale conference between the Purchaser and sale administrator is required prior to beginning any operations. The Unit Manager or his/her representative must be contacted at least 10 days in advance to schedule the conference.

5.1.4 - Post-sale conference (10/16)

A post-sale conference on site between the Purchaser and sale administrator is required 5 days prior to the completion of active logging operations to determine clean-up and repair of landings, road edges, and the fulfillment of other contract specifications.

5.2 - Conduct of Operations

5.2.1 - Slash

5.2.1.8 - Slash height (12/08)

No slash or tree tops may exceed 36 inches in height.

5.2.2 - Hazard Trees/Snags

5.2.2.1 - Den trees (10/16)

Obvious hollow and/or den trees shall be protected and left standing unless they are a safety hazard.

5.2.3 - Operating Restrictions

5.2.3.1 - Operating restrictions (9/11)

Within Payment Unit(s) 1 and 2, unless changed by written agreement, cutting, skidding, and hauling are limited to dry summer or frozen winter conditions. This restriction is because of the wet soils in the sale area.

5.2.3.11 - Coppice regeneration protection (4/10)

Timber harvesting in any Payment Unit must be completed before significant aspen sprouting occurs in that Payment Unit so as to minimize damage to the new regeneration. Any post harvest operations, such as chipping, must be completed before sprouting of regeneration occurs. If it is anticipated that chipping will be delayed, then tops shall be carried to one central location or left unchipped. The Unit Manager or his/her representative may cease such operations if sprouting occurs before the operation is complete.

5.2.32 - Decking/landing restoration (9/13)

All decking and landing areas must have the surface area restored to a condition equal to or better than before. This is to ensure the proper regeneration of the stand. Wood debris, chips and "cookies" from trimmings must be removed or scattered away from landing and loading areas and may not be windrowed on the edge.

5.4 - Soil Protection

5.4.1 - Rutting restriction, general (7/16)

Operations are to cease immediately if equipment and weather conditions result in rutting of roads and/or skid trails which is 12 inches or greater in depth and 50 feet in length. The Unit Manager or his/her representative may restrict hauling and/or skidding if ruts exceed the specified depth. With the Unit Manager or his/her representative's approval, the Purchaser may return to the area when the risk of rutting has decreased.

5.8 - Protection of Endangered Species

5.8.3 - Red shoulder hawk or goshawk (2/16)

In the event that an active red shoulder hawk or goshawk nest is found, the contract may be amended to protect the nest site until the nest is determined to be inactive. The value of the trees in this excluded area will be refunded or credited to the Purchaser. The nest will be buffered with a five-chain radius (eight acre) protection area, centered on the nest tree, in which there will be no cutting or new roads constructed. Avoid human disturbance, including loading and skidding, in the protection area.

An additional zone of five chains (ten chains centered on the active nest tree) will be established in which there is no management activity from March 15 to July 15. Limit biomass harvesting and chipping operations within this ten-chain zone, retain the maximum one-third of residues per the Woody Biomass Harvesting Guidelines (Michigan DNR 2010). Nests determined to be inactive will be protected with a one-chain no-harvest buffer.

6 - Safety and Fire Prevention

6.2 - Signing

6.2.1 - Road posting (9/09)

The Purchaser is responsible for posting and maintaining caution signs on US 23 prior to beginning operations. The road must be posted at appropriate distances from the sale area to warn of logging activity and truck traffic. Signs must be removed when harvest operations are suspended or completed. The Purchaser will provide these signs.



TIMBER SALE MAP

This information provided by authority of Part 525, 1994 PA 451, as amended.

Forest Management Unit Atlanta		County Presque Isle	Mapped By Ryan Zimmerman	Date 08/18/2017	Page 1	of 1
Township 34N	Range 06E	Section(s) and Subdivision(s) Sec 23: NENE, Sec 24: NENW NWNW		Scale 1:15,840		

Cover Type				Density	
A = Aspen	H = Hemlock	N = Marsh	U = Upland Brush	0 = Non Stocked	5 = Pole Timber Medium
B = Paper Birch	J = Jack Pine	O = Oak	UM = Upland Mixed	1 = Seedling Sapling Poor	6 = Pole Timber Well
C = Cedar	L = Lowland Brush	P = Lowland Poplar	V = Bog or Marsh	2 = Seedling Sapling Medium	7 = Saw Timber Poor
D = Treed Bog	LM = Lowland Mixed	Q = Mixed Swamp Conifer	W = White Pine	3 = Seedling Sapling Well	8 = Saw Timber Medium
E = Swamp Hdwoods	M = Mpl, Bch, Brch	R = Red Pine	X = Non Stocked	4 = Pole Timber Poor	9 = Saw Timber Well
F = Spruce Fir	MC = Mixed Conifer	S = Black Spruce	Z = Water		
G = Grass	MD = Mixed Deciduous	T = Tamarack			

PU	Acres	PU	Acres
1	22.6		
2	18.6		

Rocky Bottom Mix

Compartment 139

41.2 Acres

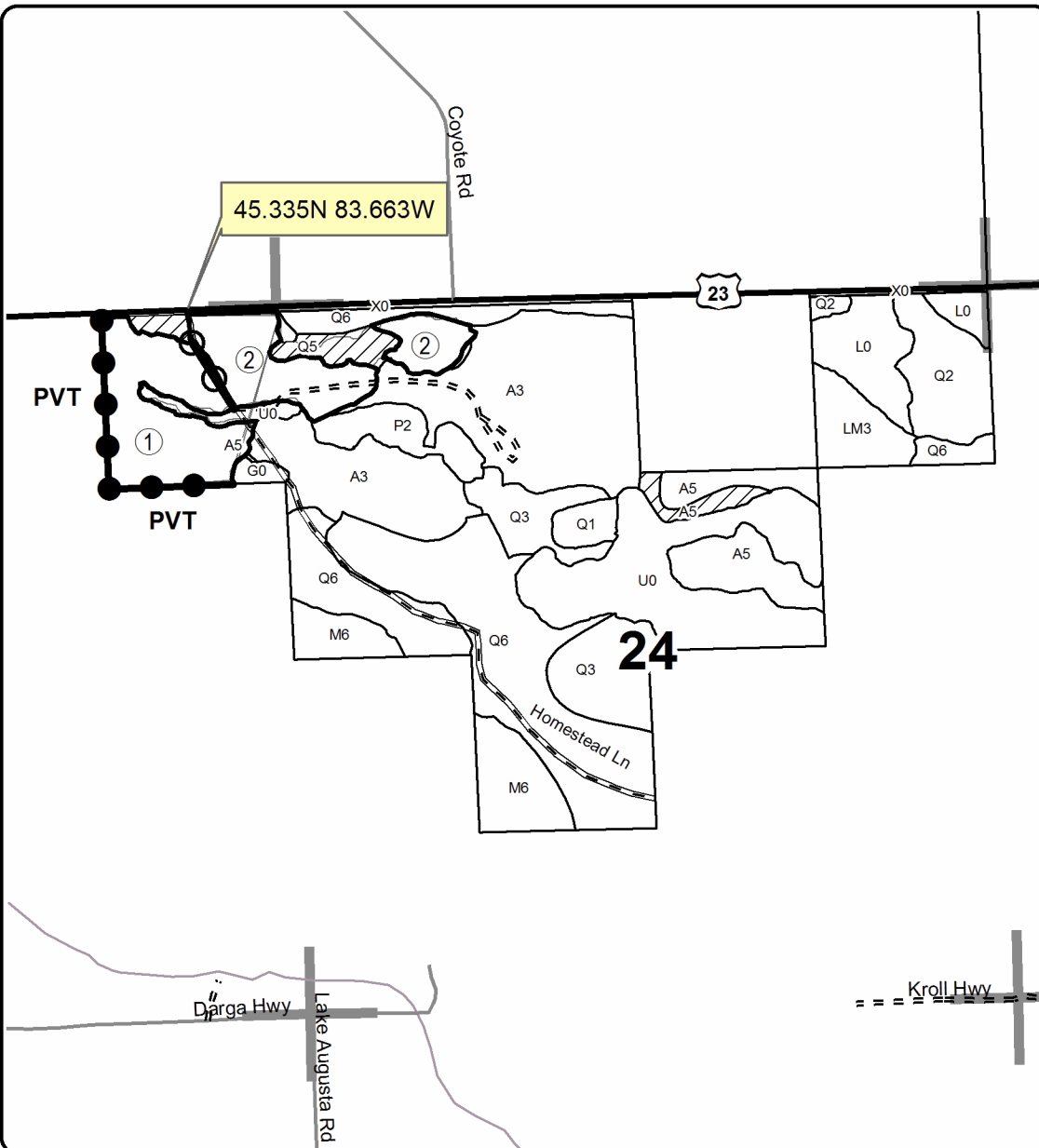

Legend

- Against State (Red)
- Payment Unit (Yellow)
- Private Line (Blue)
- ▨ Retention Area
- Payment Unit
- Stand Boundaries
- Highway
- Paved Roads
- Gravel Roads
- == Poor Dirt Roads
- Section Corners

Locator Map
1:200,000

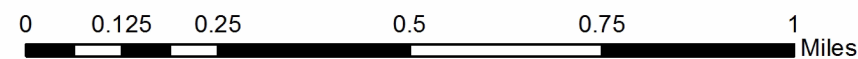
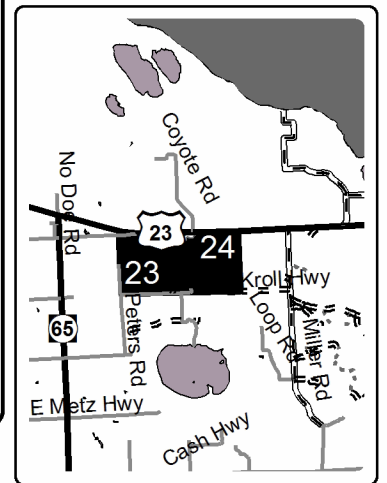

TIMBER SALE INFORMATION

Are We There Yet? SBW (54-040-17)

Presque Isle County (Advertised Price \$61,961.50)

A timber sale contract for this lump sum, sealed bid timber sale will be awarded to the responsible bidder offering the highest sealed bid price. Bids must be at or above the following advertised price for each species:

<u>PRODUCTS & SPECIES</u>	<u>ESTIMATED UNITS*</u>		<u>ADVERTISED PRICE</u>
Sawtimber			
Mixed Spruce	15.40	MBF	\$ 57.00 / MBF
N. White Cedar	16.00	MBF	\$ 50.00 / MBF
Red Maple	2.80	MBF	\$ 115.00 / MBF
Sugar Maple	0.80	MBF	\$ 393.00 / MBF
Pulpwood			
Balsam Fir	623.00	Cords	\$ 33.65 / Cord
Misc. Species 1	55.00	Cords	\$ 5.00 / Cord
Mixed Aspen	721.00	Cords	\$ 20.75 / Cord
Mixed Hardwood	182.00	Cords	\$ 16.35 / Cord
Mixed Spruce	413.00	Cords	\$ 28.25 / Cord
N. White Cedar	176.00	Cords	\$ 24.85 / Cord
Paper Birch	221.00	Cords	\$ 20.05 / Cord

* The total volume is statistically estimated within plus (+) or minus (-) 10.85 percent. The estimated units are final and not subject to adjustment. Prospective bidders are urged to examine this timber and to make their own estimates of quantity and quality.

BOND AND PAYMENT SCHEDULE:

1. A bond in the amount of \$3,098.00 to insure faithful performance of the conditions of the contract will be deposited by the successful bidder within 21 days of the sale award.
2. Cutting in any sale or unit without the required advance payment would be considered a trespass.
3. Total payment must be paid in advance or according to the following schedule:
 - (a) Ten percent (10%) of the sale value must be paid within 21 days of the sale award.
 - (b) The 10% down payment will be credited towards the first unit cut.
 - (c) Payment for each of the following units must be made before cutting begins in that unit:

PAYMENT UNIT NUMBER	PERCENT OF TOTAL SALE VALUE
01	9.4%
02	20.7%
03	10.0%
04	11.7%
05	12.1%
06	15.5%
07	12.4%
08	4.9%
09	3.3%

4. If no cutting takes place, the 10% down payment will not be refunded.
5. Operations on the contract issued will terminate on 12/31/2021.

Description of Timber by Payment Unit (PU)

PU	MARKET GROUP	PRODUCT	QUANTITY	UNIT	ACRES	ADVERTISE PRICE
1	Mixed Spruce	Sawtimber	2.0	MBF	24.5	\$5,853.05
	<i>White Spruce</i>		2.0	<i>MBF</i>		
	Sugar Maple		0.4	MBF		
	Balsam Fir	Pulpwood	81.0	Cords		
	<i>Balsam Fir</i>		81.0	<i>Cords</i>		
	Misc. Species 1		23.0	Cords		
	<i>Misc. Species 1</i>		9.0	<i>Cords</i>		
	<i>White Ash</i>		14.0	<i>Cords</i>		
	Mixed Aspen		41.0	Cords		
	<i>Quaking Aspen</i>		41.0	<i>Cords</i>		
	Mixed Hardwood		28.0	Cords		
	<i>Basswood</i>		3.0	<i>Cords</i>		
	<i>Sugar Maple</i>		25.0	<i>Cords</i>		
	Mixed Spruce		6.0	Cords		
	<i>White Spruce</i>		6.0	<i>Cords</i>		
	Paper Birch		63.0	Cords		
	<i>Paper Birch</i>	Sawtimber	0.4	<i>MBF</i>		
<i>Paper Birch</i>	Pulpwood	62.0	<i>Cords</i>			
2	Mixed Spruce	Sawtimber	2.1	MBF	25.3	\$12,726.95
	<i>White Spruce</i>		2.1	<i>MBF</i>		
	Red Maple		0.4	MBF		
	Sugar Maple		0.4	MBF		
	Balsam Fir	Pulpwood	133.0	Cords		
	<i>Balsam Fir</i>		133.0	<i>Cords</i>		
	Misc. Species 1		31.0	Cords		
	<i>Misc. Species 1</i>		12.0	<i>Cords</i>		
	<i>White Ash</i>		19.0	<i>Cords</i>		
	Mixed Aspen		198.0	Cords		
	<i>Quaking Aspen</i>		198.0	<i>Cords</i>		
	Mixed Hardwood		54.0	Cords		
	<i>Basswood</i>	Sawtimber	0.9	<i>MBF</i>		
	<i>Basswood</i>	Pulpwood	5.0	<i>Cords</i>		
	<i>Ironwood</i>		4.0	<i>Cords</i>		
	<i>Red Maple</i>		2.0	<i>Cords</i>		
	<i>Sugar Maple</i>		41.0	<i>Cords</i>		
Mixed Spruce		85.0	Cords			
<i>White Spruce</i>		85.0	<i>Cords</i>			
Paper Birch		19.0	Cords			
<i>Paper Birch</i>		19.0	<i>Cords</i>			
3	Mixed Spruce	Sawtimber	1.6	MBF	17.3	\$6,205.35
	<i>Black Spruce</i>		0.3	<i>MBF</i>		
	<i>White Spruce</i>		1.3	<i>MBF</i>		
	N. White Cedar		2.5	MBF		
	Balsam Fir	Pulpwood	60.0	Cords		
	<i>Balsam Fir</i>	Sawtimber	1.2	<i>MBF</i>		
	<i>Balsam Fir</i>	Pulpwood	58.0	<i>Cords</i>		
	Mixed Aspen		67.0	Cords		
	<i>B. T. Aspen</i>		1.0	<i>Cords</i>		
	<i>Balsam Poplar</i>		2.0	<i>Cords</i>		
	<i>Quaking Aspen</i>		64.0	<i>Cords</i>		
	Mixed Hardwood		9.0	Cords		
	<i>American Elm</i>		1.0	<i>Cords</i>		
	<i>Red Maple</i>		4.0	<i>Cords</i>		
	<i>Sugar Maple</i>		4.0	<i>Cords</i>		
	Mixed Spruce		48.0	Cords		
	<i>Black Spruce</i>		31.0	<i>Cords</i>		

Description of Timber by Payment Unit (PU), con't

PU	MARKET GROUP	PRODUCT	QUANTITY	UNIT	ACRES	ADVERTISE PRICE			
3 con't	<i>White Spruce</i>	<i>Pulpwood</i>	17.0	<i>Cords</i>					
	N. White Cedar		28.0	Cords					
	Paper Birch		19.0	Cords					
	<i>Paper Birch</i>	<i>Sawtimber</i>	0.6	<i>MBF</i>					
	<i>Paper Birch</i>	<i>Pulpwood</i>	18.0	<i>Cords</i>					
4	Mixed Spruce	Sawtimber	1.9	MBF	20.2	\$7,258.50			
	<i>Black Spruce</i>		0.4	<i>MBF</i>					
	<i>White Spruce</i>		1.5	<i>MBF</i>					
	N. White Cedar		2.9	MBF					
	Balsam Fir	Pulpwood	70.0	Cords					
	<i>Balsam Fir</i>	<i>Sawtimber</i>	1.3	<i>MBF</i>					
	<i>Balsam Fir</i>	<i>Pulpwood</i>	67.0	<i>Cords</i>					
	Mixed Aspen		78.0	Cords					
	<i>B. T. Aspen</i>		1.0	<i>Cords</i>					
	<i>Balsam Poplar</i>		2.0	<i>Cords</i>					
	<i>Quaking Aspen</i>		75.0	<i>Cords</i>					
	Mixed Hardwood		11.0	Cords					
	<i>American Elm</i>		1.0	<i>Cords</i>					
	<i>Red Maple</i>		5.0	<i>Cords</i>					
	<i>Sugar Maple</i>		5.0	<i>Cords</i>					
	Mixed Spruce		57.0	Cords					
	<i>Black Spruce</i>		37.0	<i>Cords</i>					
	<i>White Spruce</i>		20.0	<i>Cords</i>					
	N. White Cedar		33.0	Cords					
	Paper Birch		21.0	Cords					
	<i>Paper Birch</i>	<i>Sawtimber</i>	0.6	<i>MBF</i>					
	<i>Paper Birch</i>	<i>Pulpwood</i>	20.0	<i>Cords</i>					
	5	Mixed Spruce	Sawtimber	1.9			MBF	21.0	\$7,528.10
		<i>Black Spruce</i>		0.4			<i>MBF</i>		
		<i>White Spruce</i>		1.5			<i>MBF</i>		
		N. White Cedar		3.0			MBF		
		Balsam Fir	Pulpwood	73.0			Cords		
<i>Balsam Fir</i>		<i>Sawtimber</i>	1.4	<i>MBF</i>					
<i>Balsam Fir</i>		<i>Pulpwood</i>	70.0	<i>Cords</i>					
Mixed Aspen			81.0	Cords					
<i>B. T. Aspen</i>			1.0	<i>Cords</i>					
<i>Balsam Poplar</i>			2.0	<i>Cords</i>					
<i>Quaking Aspen</i>			78.0	<i>Cords</i>					
Mixed Hardwood			11.0	Cords					
<i>American Elm</i>			1.0	<i>Cords</i>					
<i>Red Maple</i>			5.0	<i>Cords</i>					
<i>Sugar Maple</i>			5.0	<i>Cords</i>					
Mixed Spruce			59.0	Cords					
<i>Black Spruce</i>			38.0	<i>Cords</i>					
<i>White Spruce</i>			21.0	<i>Cords</i>					
N. White Cedar			34.0	Cords					
Paper Birch			22.0	Cords					
<i>Paper Birch</i>		<i>Sawtimber</i>	0.7	<i>MBF</i>					
<i>Paper Birch</i>		<i>Pulpwood</i>	21.0	<i>Cords</i>					
6		Mixed Spruce	Sawtimber	2.6	MBF	26.7	\$9,613.90		
		<i>Black Spruce</i>		0.6	<i>MBF</i>				
		<i>White Spruce</i>		2.0	<i>MBF</i>				
		N. White Cedar		3.7	MBF				
		Balsam Fir	Pulpwood	93.0	Cords				
	<i>Balsam Fir</i>	<i>Sawtimber</i>	1.8	<i>MBF</i>					
	<i>Balsam Fir</i>	<i>Pulpwood</i>	89.0	<i>Cords</i>					

Description of Timber by Payment Unit (PU), con't

PU	MARKET GROUP	PRODUCT	QUANTITY	UNIT	ACRES	ADVERTISE PRICE					
6 con't	Mixed Aspen	Pulpwood	103.0	Cords							
	<i>Balsam Poplar</i>		3.0	<i>Cords</i>							
	<i>Quaking Aspen</i>		100.0	<i>Cords</i>							
	Mixed Hardwood		15.0	Cords							
	<i>American Elm</i>		1.0	<i>Cords</i>							
	<i>Red Maple</i>		7.0	<i>Cords</i>							
	<i>Sugar Maple</i>		7.0	<i>Cords</i>							
	Mixed Spruce		75.0	Cords							
	<i>Black Spruce</i>		48.0	<i>Cords</i>							
	<i>White Spruce</i>		27.0	<i>Cords</i>							
	N. White Cedar		43.0	Cords							
	Paper Birch		29.0	Cords							
	<i>Paper Birch</i>		<i>Sawtimber</i>	0.8			<i>MBF</i>				
	<i>Paper Birch</i>		<i>Pulpwood</i>	27.0			<i>Cords</i>				
7	Mixed Spruce	Sawtimber	2.0	MBF	21.3	\$7,661.35					
	<i>Black Spruce</i>		0.4	<i>MBF</i>							
	<i>White Spruce</i>		1.6	<i>MBF</i>							
	N. White Cedar		3.0	MBF							
	Balsam Fir		Pulpwood	74.0			Cords				
	<i>Balsam Fir</i>			<i>Sawtimber</i>			1.4	<i>MBF</i>			
	<i>Balsam Fir</i>			<i>Pulpwood</i>			71.0	<i>Cords</i>			
	Mixed Aspen			82.0			Cords				
	<i>B. T. Aspen</i>			1.0			<i>Cords</i>				
	<i>Balsam Poplar</i>			2.0			<i>Cords</i>				
	<i>Quaking Aspen</i>			79.0			<i>Cords</i>				
	Mixed Hardwood			11.0			Cords				
	<i>American Elm</i>			1.0			<i>Cords</i>				
	<i>Red Maple</i>			5.0			<i>Cords</i>				
	<i>Sugar Maple</i>			5.0			<i>Cords</i>				
	Mixed Spruce			60.0			Cords				
	<i>Black Spruce</i>			39.0			<i>Cords</i>				
	<i>White Spruce</i>			21.0			<i>Cords</i>				
	N. White Cedar			35.0			Cords				
	Paper Birch			23.0			Cords				
	<i>Paper Birch</i>			<i>Sawtimber</i>			0.7	<i>MBF</i>			
	<i>Paper Birch</i>			<i>Pulpwood</i>			22.0	<i>Cords</i>			
	8			Mixed Spruce			Sawtimber	1.1	MBF	9.4	\$3,056.90
				<i>White Spruce</i>				1.1	<i>MBF</i>		
N. White Cedar		0.7		MBF							
Balsam Fir		Pulpwood		25.0	Cords						
<i>Balsam Fir</i>				25.0	<i>Cords</i>						
Mixed Aspen				44.0	Cords						
<i>Quaking Aspen</i>			<i>Sawtimber</i>	0.6	<i>MBF</i>						
<i>Quaking Aspen</i>			<i>Pulpwood</i>	43.0	<i>Cords</i>						
Mixed Hardwood			18.0	Cords							
<i>Red Maple</i>			5.0	<i>Cords</i>							
<i>Sugar Maple</i>			13.0	<i>Cords</i>							
Mixed Spruce			20.0	Cords							
<i>White Spruce</i>			20.0	<i>Cords</i>							
N. White Cedar			1.0	Cords							
Paper Birch			16.0	Cords							
<i>Paper Birch</i>			16.0	<i>Cords</i>							
9	Mixed Spruce		Sawtimber	0.2	MBF	4.7	\$2,066.00				
	<i>White Spruce</i>			0.2	<i>MBF</i>						
	N. White Cedar			0.2	MBF						
	Red Maple	2.4		MBF							

Description of Timber by Payment Unit (PU), con't

PU	MARKET GROUP	PRODUCT	QUANTITY	UNIT	ACRES	ADVERTISE PRICE
9 con't	Balsam Fir	Pulpwood	15.0	Cords		
	<i>Balsam Fir</i>	<i>Sawtimber</i>	<i>0.4</i>	<i>MBF</i>		
	<i>Balsam Fir</i>	<i>Pulpwood</i>	<i>14.0</i>	<i>Cords</i>		
	Mixed Aspen		27.0	Cords		
	<i>Quaking Aspen</i>		<i>27.0</i>	<i>Cords</i>		
	Mixed Hardwood		25.0	Cords		
	<i>Red Maple</i>		<i>22.0</i>	<i>Cords</i>		
	<i>Sugar Maple</i>		<i>3.0</i>	<i>Cords</i>		
	Mixed Spruce		3.0	Cords		
	<i>White Spruce</i>		<i>3.0</i>	<i>Cords</i>		
	N. White Cedar		2.0	Cords		
	Paper Birch		8.0	Cords		
	<i>Paper Birch</i>		<i>8.0</i>	<i>Cords</i>		
	TOTAL:			35.0	MBF	
TOTAL:			2,390.0	Cords		

Sale Specific Conditions & Requirements

Sale Name: Are We There Yet? SBW

Sale Number: 54-040-17 Seq#: 1

1 - Sale Area

1.2 - Boundaries

1.2.1 - Painted boundaries (1/14)

The sale boundary and Payment Unit boundaries are marked and identified by blue, red and yellow paint. Exterior sale boundary lines against private property are marked with blue paint. Exterior sale boundary lines against state are marked with red paint. Interior retention pockets are marked with red paint. Interior Payment Unit boundaries are marked with yellow paint. The painted boundary line trees are not Included Timber and are to be protected. Yellow painted trees designating an interior Payment Unit boundary are only to be cut when all surrounding Payment Units have been paid.

2 - Timber Specifications

2.1 - Included Timber

2.1.2 - Clearcut unit(s) w/o unmerchantable trees (8/11)

Within Payment Unit(s) 1-9, cut all trees which meet minimum piece specifications in 2.2 Utilization, except do not cut oak or white pine. In addition, do not cut any cedar in Payment Unit 1.

2.1.11 - Description of timber note (2/04)

Note that Mixed Spruce Sawtimber consists of white and black spruce. Misc. Species 1 is dead ash and is designated for cutting. Mixed Aspen Pulpwood consists of quaking aspen, bigtooth aspen, and balsam poplar. Mixed Hardwood Pulpwood consists of basswood, elm, ironwood, red maple, and sugar maple. Mixed Spruce Pulpwood consists of white and black spruce.

3 - Payments

3.4 - Damaged Timber

3.4.1 - Damaged timber (6/14)

General Condition and Requirement 3.4 Damaged Timber, defines liquidated damages for undesignated live merchantable trees which are cut or injured. In addition, extreme care should be taken to avoid damage to tree seedlings and saplings.

Within the sale area, if more than 25% of the oak and/or pine seedlings or saplings (1/4" to 4.5" DBH) within a specified portion of the sale area are damaged, liquidated damages will be assessed at \$50 per acre for all acreage within that specified portion of the sale area that was damaged.

No damage is acceptable to undesignated merchantable trees. Within the sale area, if more than 5% of trees (> 4.5" DBH) within a specified area of the sale are damaged, liquidated damages will be assessed for all trees damaged. Rates will be in accordance with General Condition and Requirement 3.4 Damaged Timber.

4 - Transportation

4.1 - Construction

4.1.3 - Slash and earthen piles (8/04)

Piles or windrows of earth along roads and landings that have been widened or constructed shall be leveled. Slash from road maintenance or construction, including stumps, shall be dispersed throughout the sale.

4.1.6 - Road construction (1/09)

Construction of new roads or improvements of existing roads shall be done in such a way as to minimize the environmental and visual impacts. Merchantable trees shall be cut and utilized unless otherwise directed. Non-merchantable trees shall be severed and laid flat on the ground. Slash shall be scattered, and not left in windrows and kept a minimum of 10 feet back from the road edge. Stumps shall be set upright, not left on edge, and be moved at least 10 feet away from the road edge. Disturbed soil shall be feathered into the woods and not left in berms or windrows.

4.1.7 - Road closure (10/11)

All new roads built into the sale must be blocked to vehicle traffic upon completion of the sale. Overgrown roads that are reopened shall be considered new roads. These roads must be rendered impassable to cars and trucks. In general, this will require constructing a four (4') foot high berm of stumps and logs covered with earth at the entrance(s) to new roads. Contact the sale administrator for specific details of design and placement of berms. All stumps from road building and landing construction must be reserved to block any newly constructed roads upon completion of the sale. These stumps must be scattered along the road system to prohibit vehicular movement.

4.2 - Maintenance

4.2.1 - Hauling restriction (12/08)

Hauling is restricted on Miller Road per the request of the Presque Isle County Road Commission. The restriction will prohibit the hauling of timber on Miller Road from the beginning of spring break-up through June 1. The Presque Isle Road Commission will not bond Miller Road during this period.

4.2.2 - Fill material (4/07)

To maintain roads, fill material may be needed in areas where "holes" exist or may be expected to develop. This fill material should be placed before trucking begins. Fill may be crushed rock or cobble. Other fill material must be approved by the Unit Manager or his/her representative. Fill material may not contain clay.

4.4 - Access

4.4.1 - Private property access (3/11)

Permission for access across private land is the responsibility of the Purchaser. Permission must be received from the Presque Isle County Road Commission for access to Payment Units 8 and 9. A copy of the written permission from the Presque Isle County Road Commission must be given to the Unit Manager within 30 days of the bid opening and prior to the beginning of operations.

5 - Operations

5.2 - Conduct of Operations

5.2.1 - Slash

5.2.1.10 - No slash in openings (5/10)

No brush or logging debris is to be left in the upland brush/wildlife openings which are indicated by U0 on the Timber Sale Map. Any damage to the opening shall be repaired according to specifications of the Unit Manager or his/her representative.

5.2.2 - Hazard Trees/Snags

5.2.2.1 - Den trees (10/16)

Obvious hollow and/or den trees shall be protected and left standing unless they are a safety hazard.

5.2.3 - Operating Restrictions

5.2.3.11 - Coppice regeneration protection (4/10)

Timber harvesting in any Payment Unit must be completed before significant sprouting occurs in that Payment Unit so as to minimize damage to the new regeneration. Any post harvest operations, such as chipping, must be completed before sprouting of regeneration occurs. If it is anticipated that chipping will be delayed, then tops shall be carried to one central location or left unchipped. The Unit Manager or his/her representative may cease such operations if sprouting occurs before the operation is complete.

5.2.4 - Dead and Down Creation

5.2.4.4 - Dead and down creation, grouse (8/13)

To encourage grouse and other wildlife, in Payment Unit(s) 2-9, leave one, 10" diameter or larger log-length (8 foot minimum) piece on the ground for every 2 acres. These will be evenly scattered throughout the unit. This can be an unmerchantable piece or a full tree.

5.2.17 - Crane Mats/Timber Mats (9/17)

Some roads or skid trails may require extra protection such as that afforded by Crane Mats/Timber Mats. If available, Crane

Mats/Timber Mats may be borrowed from the DNR and are located at the Marquette ICC, the Newberry Field Office and the Grayling Field Office. Contact the sale administrator for specific details. A Timber Sale Contract Supplement will be used to document the Purchaser's use of the DNR's Crane Mats/Timber Mats. It is the responsibility of the Purchaser to contact the sale administrator to schedule pick up and drop off. In addition, all mats must be cleaned prior to drop off. A charge of \$350.00 will be assessed for all damaged or non-returned mats. Damage is defined as misuse resulting in three or more broken cants.

5.2.32 - Decking/landing restoration (9/13)

All decking and landing areas must have the surface area restored to a condition equal to or better than before. This is to ensure the proper regeneration of the stand. Wood debris, chips and "cookies" from trimmings must be removed or scattered away from landing and loading areas and may not be windrowed on the edge.

5.2.38 - No decking against live trees (2/04)

Cut products may not be decked against unmarked or designated leave trees.

5.4 - Soil Protection

5.4.1 - Rutting restriction, general (7/16)

Operations are to cease immediately if equipment and weather conditions result in rutting of roads and/or skid trails which is 12 inches or greater in depth and 50 feet in length. The Unit Manager or his/her representative may restrict hauling and/or skidding if ruts exceed the specified depth. With the Unit Manager or his/her representative's approval, the Purchaser may return to the area when the risk of rutting has decreased.

5.8 - Protection of Endangered Species

5.8.5 - Protection of raptor nests (3/13)

All trees with raptor nests will be protected if found during harvesting operations. Notification will be made to the Unit Manager or his/her representative who will notify the Wildlife Biologist so an on-site evaluation and recommendation can be made, if necessary.

6 - Safety and Fire Prevention

6.2 - Signing

6.2.1 - Road posting (9/09)

The Purchaser is responsible for posting and maintaining caution signs on forest roads prior to beginning operations. The road must be posted at appropriate distances from the sale area to warn of logging activity and truck traffic. Signs must be removed when harvest operations are suspended or completed. The Purchaser will provide these signs.



TIMBER SALE MAP

This information provided by authority of Part 525, 1994 PA 451, as amended.

Forest Management Unit Atlanta Management Unit		County Alpena	Mapped By D. Parris		Date 9/30/17	Page 1	of 2
Township 34N	Range 07E	Section(s) and Subdivision(s) Sec. 20 N2SW, SWSW; Sec. 29 E2SE Sec. 32 NE4, NESW, E2SE ; Sec. 33 SWNW, W2SW			Scale 1:15,840		

Cover Type				Density			
A = Aspen	H = Hemlock	N = Marsh	U = Upland Brush	0 = Non Stocked	5 = Pole Timber Medium		
B = Paper Birch	J = Jack Pine	O = Oak	UM = Upland Mixed	1 = Seedling Sapling Poor	6 = Pole Timber Well		
C = Cedar	L = Lowland Brush	P = Lowland Poplar	V = Bog or Marsh	2 = Seedling Sapling Medium	7 = Saw Timber Poor		
D = Treed Bog	LM = Lowland Mixed	Q = Mixed Swamp Conifer	W = White Pine	3 = Seedling Sapling Well	8 = Saw Timber Medium		
E = Swamp Hdwoods	M = Mpl, Bch, Brch	R = Red Pine	X = Non Stocked	4 = Pole Timber Poor	9 = Saw Timber Well		
F = Spruce Fir	MC = Mixed Conifer	S = Black Spruce	Z = Water				
G = Grass	MD = Mixed Deciduous	T = Tamarack					

PU	Acres	PU	Acres
1	24.5	6	26.7
2	25.3	7	21.3
3	17.3	8	9.4
4	20.2	9	4.7
5	21.0		

Are We There Yet? SBW

Compartment 142

170.4 Acres

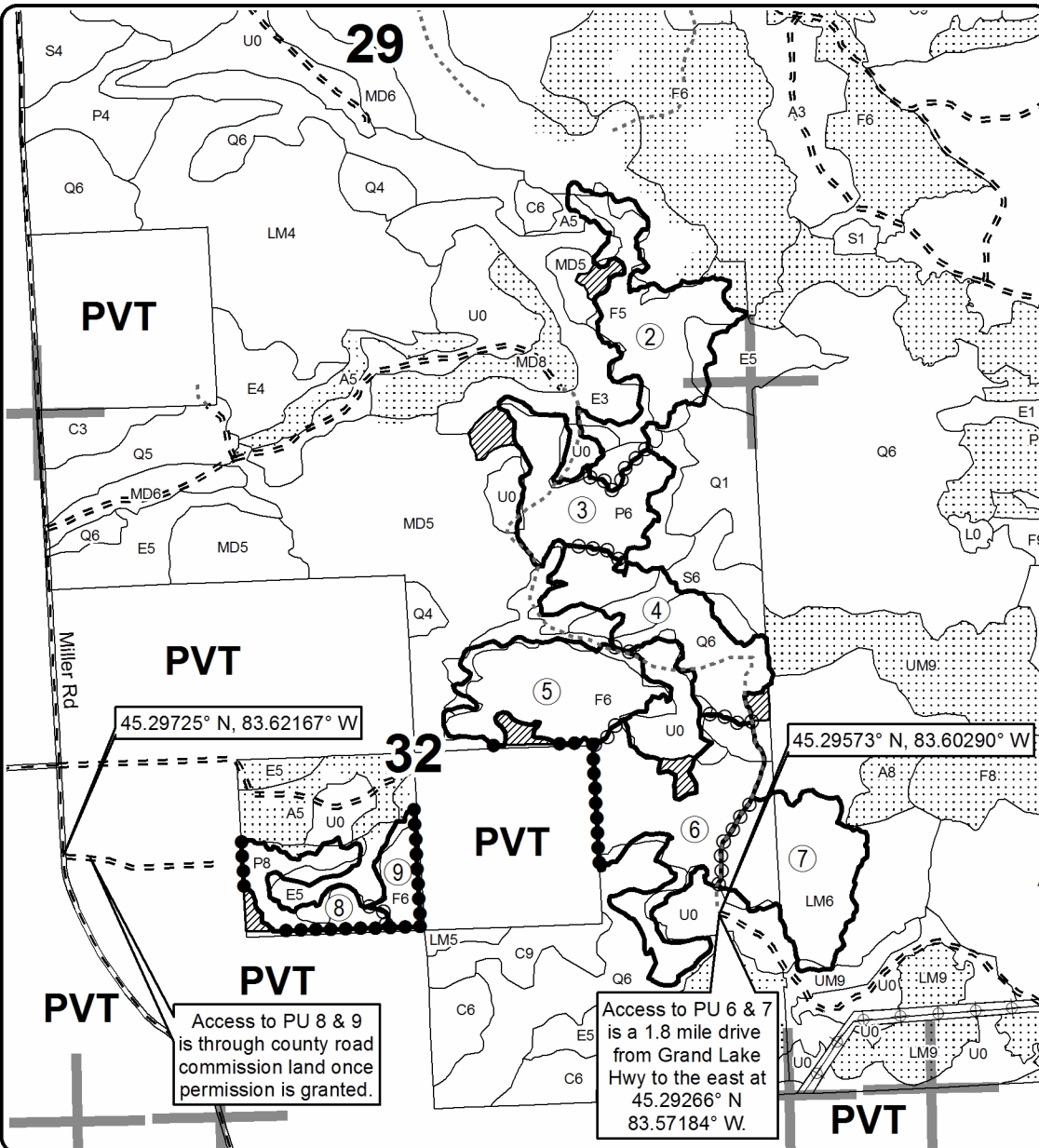

Legend

- Against State (Red)
- Payment Unit (Yellow)
- Private Line (Blue)
- ▨ Retention (Red)
- Stand Boundaries
- ⋯ Nearby Sale
- Gravel Roads
- - - Poor Dirt Roads
- ⋯ Closed Roads
- Lakes and Rivers
- ⊕ Powerline
- Section Corners



Locator Map 1:200,000

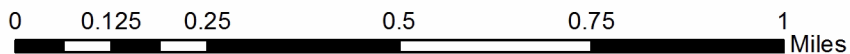
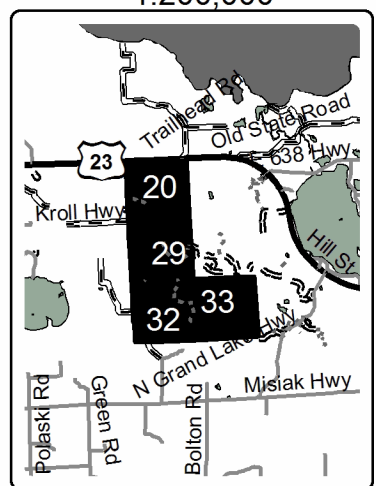



TIMBER SALE MAP

This information provided by authority of Part 525, 1994 PA 451, as amended.

Forest Management Unit Atlanta Management Unit	County Alpena	Mapped By D. Parris	Date 9/30/17	Page 2	of 2
Cruised By D. Parris					

Township 34N	Range 07E	Section(s) and Subdivision(s) Sec. 20 N2SW, SWSW; Sec. 29 E2SE Sec. 32 NE4, NESW, E2SE ; Sec. 33 SWNW, W2SW	Scale 1:15,840
-----------------	--------------	---	-------------------

Cover Type

A = Aspen	H = Hemlock	N = Marsh	U = Upland Brush
B = Paper Birch	J = Jack Pine	O = Oak	UM = Upland Mixed
C = Cedar	L = Lowland Brush	P = Lowland Poplar	V = Bog or Marsh
D = Treed Bog	LM = Lowland Mixed	Q = Mixed Swamp Conifer	W = White Pine
E = Swamp Hdwoods	M = Mpl, Bch, Brch	R = Red Pine	X = Non Stocked
F = Spruce Fir	MC = Mixed Conifer	S = Black Spruce	Z = Water
G = Grass	MD = Mixed Deciduous	T = Tamarack	

Density

0 = Non Stocked	5 = Pole Timber Medium
1 = Seedling Sapling Poor	6 = Pole Timber Well
2 = Seedling Sapling Medium	7 = Saw Timber Poor
3 = Seedling Sapling Well	8 = Saw Timber Medium
4 = Pole Timber Poor	9 = Saw Timber Well

PU	Acres	PU	Acres
1	24.5	6	26.7
2	25.3	7	21.3
3	17.3	8	9.4
4	20.2	9	4.7
5	21.0		

Are We There Yet? SBW

Compartment 142

170.4 Acres

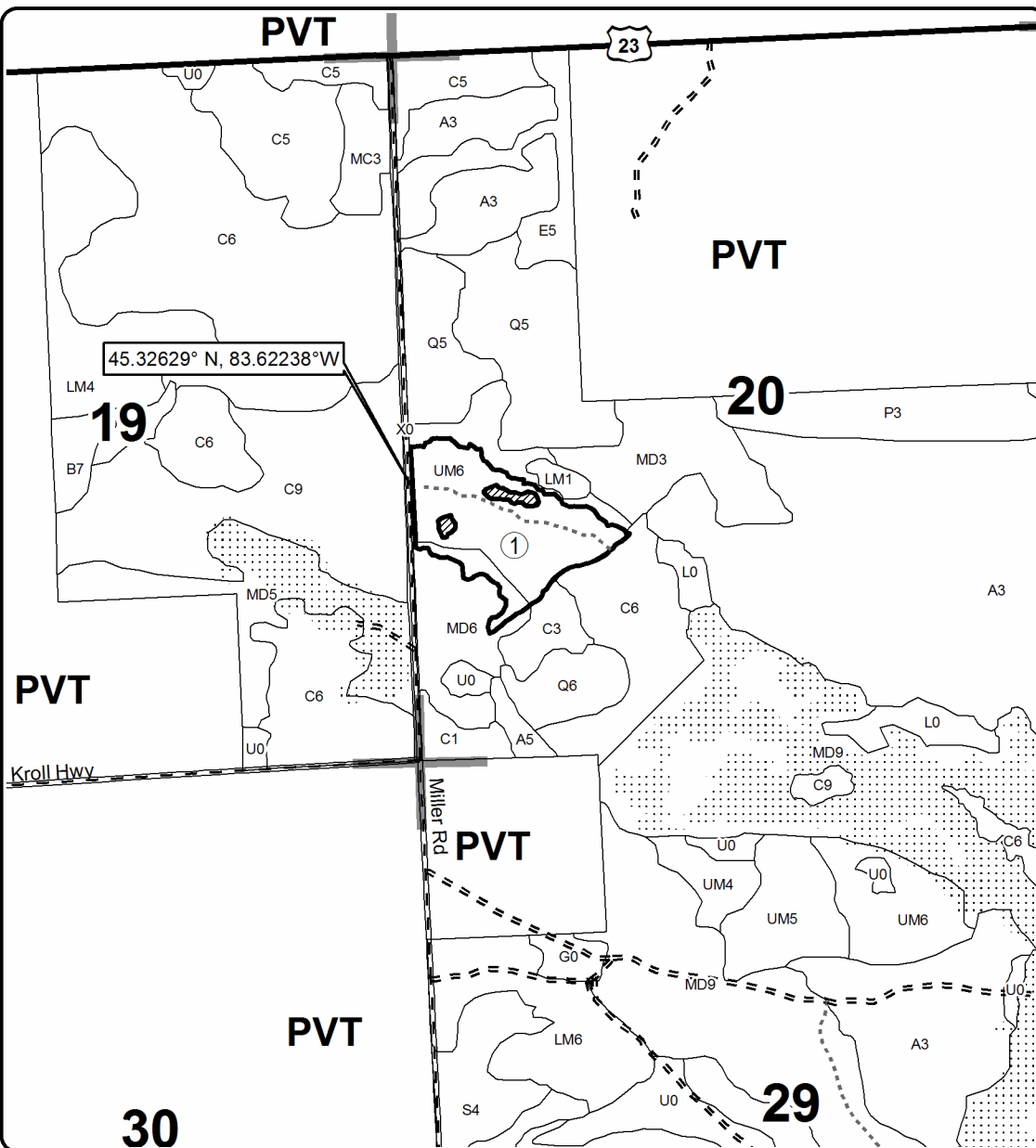

Legend

- Against State (Red)
- Retention (Red)
- Payment Unit
- Stand Boundaries
- Nearby Sales
- Highway
- Gravel Roads
- Poor Dirt Roads
- Closed Roads
- Lakes and Rivers
- All
- Section Corners



Locator Map
1:200,000

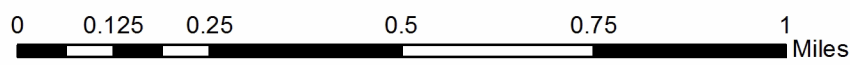
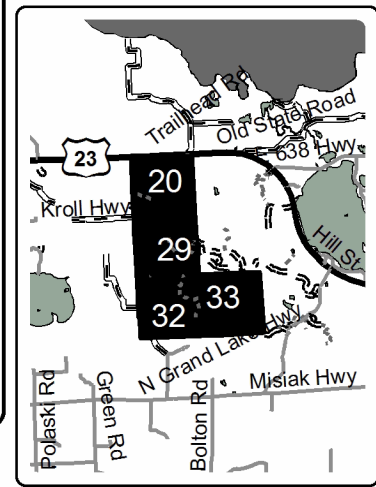

The Flood Begins Jack Pine (54-020-17)
; Montmorency COUNTY

In response to the notice of sale to be held 10:00 a.m. (local time) on August 21, 2018, I am hereby submitting my sealed bid (firm offer) for the following forest products to be cut. Bids for individual species must be at or above the advertised price. All non-responsive bid forms may be rejected.

<u>PRODUCTS & SPECIES</u>	<u>ESTIMATED VOLUME*</u>	<u>ADVERTISED PRICE</u>	<u>BID PRICE/UNIT</u>
Sawtimber			
Jack Pine	24.00 MBF	\$ 48.00/MBF	\$ _____
Red Pine	44.80 MBF	\$ 119.00/MBF	\$ _____
Pulpwood			
Bl/R/Hybrid Oak	57.00 Cords	\$ 21.10/Cord	\$ _____
Jack Pine	733.00 Cords	\$ 24.30/Cord	\$ _____
Red Pine	159.00 Cords	\$ 48.65/Cord	\$ _____
White Pine	2.00 Cords	\$ 54.70/Cord	\$ _____

*These estimated volumes are final and not subject to adjustment. Prospective bidders are urged to examine this timber and to make their own estimates of quantity and quality.

I understand that any or all bids may be rejected. All bids must be signed and all bid items must be bid or the bid form may be rejected. I also understand that consideration and awarding a contract will be based upon my past performance and ability to complete the contract based upon equipment and staffing subject to my control.

FEDERAL ID: ____ - ____ - ____ or SOCIAL SECURITY NUMBER: ____ - ____ - ____

Company or individual bidding: _____

Company representative's name: _____

Address: _____

City: _____ State: _____ Zip: _____

IF AVAILABLE, PLEASE PLACE THE PERSONALIZED LABEL FROM YOUR PROSPECTUS IN THE ABOVE BOX.

Individual or company representative's signature: _____ Date: _____

Phone number : _____ Email (optional): _____

THE WINNING BIDDER MUST COMPLETE THE VERIFICATION OF WORKER'S DISABILITY COMPENSATION ACT COMPLIANCE (ON REVERSE SIDE IF DOUBLE SIDED) WITHIN 21 DAYS OF SALE AWARD DATE



FOR DEPARTMENT USE ONLY

Sale Number (XX - XXX - XX - XX)

Forest Management Unit:

**TIMBER SALE
VERIFICATION OF WORKER'S DISABILITY
COMPENSATION ACT COMPLIANCE**

*As required by Act 317, P.A. 1969 (Worker's Compensation) and
Part 5 of Act 451 of 1994, as amended.*

VERIFICATION OF WORKER'S DISABILITY COMPENSATION ACT COMPLIANCE

- This verification must be completed and submitted within 21 days of contract award and prior to the issuance of the timber sale contract.
- In addition, if boxes 2B or 2C are checked, then Notice of Exclusion or Certificate of Insurance must be submitted within twenty-one (21) days of the contract award and prior to the issuance of the timber sale contract.
- All information must be typed or printed except for written signatures.

Please Check Appropriate Categories:

1. My business is organized as (you **must** check one of the boxes below):
 - A. Sole Proprietorship (individual)
 - B. Partnership
 - C. Corporation
2. You **must** check one of the boxes below:
 - A. I certify my business is a sole proprietorship and it has no employees but the sole proprietor. I am not subject to the Worker's Compensation Laws.
 - B. I certify my business has satisfied its obligation to the Worker's Compensation Act through the use of an approved Notice of Exclusion (BWC-337, Rev. 5/96). I will provide a copy of the Notice of Exclusion within 21 days of the contract award. (For questions or a copy of the BWC-337, please call the Worker's Compensation Bureau at 517-322-1195).
 - C. I certify my business has a Worker's Compensation Policy. I will provide an original Certificate of Insurance within twenty-one (21) days of the contract award.
3. If you have checked item 2(A) or 2(B), you **must** indicate the number of **both** full-time and part-time employees, other than yourself, including family members and active partners (if none, you must enter "0").

_____ Full-time Employees

_____ Part-time Employees

Name of Business		Federal ID (or) Social Security No.	
Address		Telephone ()	
City	State	ZIP	

I hereby certify that the above information is true and correct. I agree to notify the Michigan DNR of any changes that occur in factors affecting my coverage during any of my present and future operations.

Signature of Owner or Authorized Representative

Title

Date

Please complete the "SEALED BID" information on the next page

Rocky Bottom Mix (54-023-17)
; Presque Isle COUNTY

In response to the notice of sale to be held 10:00 a.m. (local time) on August 21, 2018, I am hereby submitting my sealed bid (firm offer) for the following forest products to be cut. Bids for individual species must be at or above the advertised price. All non-responsive bid forms may be rejected.

<u>PRODUCTS & SPECIES</u>	<u>ESTIMATED VOLUME*</u>	<u>ADVERTISED PRICE</u>	<u>BID PRICE/UNIT</u>
Sawtimber			
Red Pine	3.40 MBF	\$ 119.00/MBF	\$ _____
White Pine	12.90 MBF	\$ 109.00/MBF	\$ _____
Pulpwood			
Balsam Fir	115.00 Cords	\$ 38.80/Cord	\$ _____
Mixed Spruce	62.00 Cords	\$ 32.55/Cord	\$ _____
N. White Cedar	13.00 Cords	\$ 28.70/Cord	\$ _____
Paper Birch	116.00 Cords	\$ 23.15/Cord	\$ _____
Quaking Aspen	98.00 Cords	\$ 23.95/Cord	\$ _____
Red Pine	12.00 Cords	\$ 48.65/Cord	\$ _____
Sugar Maple	18.00 Cords	\$ 18.90/Cord	\$ _____
White Pine	89.00 Cords	\$ 54.70/Cord	\$ _____

*The volumes are statistically estimated within plus (+) or minus (-) 19.66 percent. These estimated volumes are final and not subject to adjustment. Prospective bidders are urged to examine this timber and to make their own estimates of quantity and quality.

I understand that any or all bids may be rejected. All bids must be signed and all bid items must be bid or the bid form may be rejected. I also understand that consideration and awarding a contract will be based upon my past performance and ability to complete the contract based upon equipment and staffing subject to my control.

FEDERAL ID: _____ or SOCIAL SECURITY NUMBER: _____ Company or individual bidding: _____ Company representative's name: _____ Address: _____ City: _____ State: _____ Zip: _____

IF AVAILABLE, PLEASE PLACE THE PERSONALIZED LABEL FROM YOUR PROSPECTUS IN THE ABOVE BOX.

Individual or company representative's signature: _____ Date: _____

Phone number : _____ Email (optional): _____

THE WINNING BIDDER MUST COMPLETE THE VERIFICATION OF WORKER'S DISABILITY COMPENSATION ACT COMPLIANCE (ON REVERSE SIDE IF DOUBLE SIDED) WITHIN 21 DAYS OF SALE AWARD DATE



FOR DEPARTMENT USE ONLY	
Sale Number (XX - XXX - XX - XX)	
Forest Management Unit:	

TIMBER SALE VERIFICATION OF WORKER'S DISABILITY COMPENSATION ACT COMPLIANCE

As required by Act 317, P.A. 1969 (Worker's Compensation) and
Part 5 of Act 451 of 1994, as amended.

VERIFICATION OF WORKER'S DISABILITY COMPENSATION ACT COMPLIANCE

- This verification must be completed and submitted within 21 days of contract award and prior to the issuance of the timber sale contract.
- In addition, if boxes 2B or 2C are checked, then Notice of Exclusion or Certificate of Insurance must be submitted within twenty-one (21) days of the contract award and prior to the issuance of the timber sale contract.
- All information must be typed or printed except for written signatures.

Please Check Appropriate Categories:

1. My business is organized as (you **must** check one of the boxes below):
 - A. Sole Proprietorship (individual)
 - B. Partnership
 - C. Corporation
2. You **must** check one of the boxes below:
 - A. I certify my business is a sole proprietorship and it has no employees but the sole proprietor. I am not subject to the Worker's Compensation Laws.
 - B. I certify my business has satisfied its obligation to the Worker's Compensation Act through the use of an approved Notice of Exclusion (BWC-337, Rev. 5/96). I will provide a copy of the Notice of Exclusion within 21 days of the contract award. (For questions or a copy of the BWC-337, please call the Worker's Compensation Bureau at 517-322-1195).
 - C. I certify my business has a Worker's Compensation Policy. I will provide an original Certificate of Insurance within twenty-one (21) days of the contract award.
3. If you have checked item 2(A) or 2(B), you **must** indicate the number of **both** full-time and part-time employees, other than yourself, including family members and active partners (if none, you must enter "0").

_____ Full-time Employees

_____ Part-time Employees

Name of Business		Federal ID (or) Social Security No.	
Address		Telephone ()	
City	State	ZIP	

I hereby certify that the above information is true and correct. I agree to notify the Michigan DNR of any changes that occur in factors affecting my coverage during any of my present and future operations.

Signature of Owner or Authorized Representative

Title

Date

Please complete the "SEALED BID" information on the next page

Radio Tower Red Pine (54-021-17)
; Montmorency COUNTY

In response to the notice of sale to be held 10:00 a.m. (local time) on August 21, 2018, I am hereby submitting my sealed bid (firm offer) for the following forest products to be cut. Bids for individual species must be at or above the advertised price. All non-responsive bid forms may be rejected.

<u>PRODUCTS & SPECIES</u>	<u>ESTIMATED VOLUME*</u>	<u>ADVERTISED PRICE</u>	<u>BID PRICE/UNIT</u>
Sawtimber			
BI/R/Hybrid Oak	2.40 MBF	\$ 105.00/MBF	\$ _____
Red Pine	232.40 MBF	\$ 119.00/MBF	\$ _____
White Oak	18.40 MBF	\$ 87.00/MBF	\$ _____
White Pine	7.10 MBF	\$ 110.00/MBF	\$ _____
Pulpwood			
B. T. Aspen	13.00 Cords	\$ 23.95/Cord	\$ _____
Jack Pine	8.00 Cords	\$ 24.30/Cord	\$ _____
Mixed Oak	182.00 Cords	\$ 21.10/Cord	\$ _____
Red Pine	436.00 Cords	\$ 48.65/Cord	\$ _____
White Pine	51.00 Cords	\$ 54.70/Cord	\$ _____

*The volumes are statistically estimated within plus (+) or minus (-) 13.44 percent. These estimated volumes are final and not subject to adjustment. Prospective bidders are urged to examine this timber and to make their own estimates of quantity and quality.

I understand that any or all bids may be rejected. All bids must be signed and all bid items must be bid or the bid form may be rejected. I also understand that consideration and awarding a contract will be based upon my past performance and ability to complete the contract based upon equipment and staffing subject to my control.

FEDERAL ID: ____ - ____ - ____ or SOCIAL SECURITY NUMBER: ____ - ____ - ____

Company or individual bidding: _____

Company representative's name: _____

Address: _____

City: _____ State: _____ Zip: _____

IF AVAILABLE, PLEASE PLACE THE PERSONALIZED LABEL FROM YOUR PROSPECTUS IN THE ABOVE BOX.

Individual or company representative's signature: _____ Date: _____

Phone number : _____ Email (optional): _____

THE WINNING BIDDER MUST COMPLETE THE VERIFICATION OF WORKER'S DISABILITY COMPENSATION ACT COMPLIANCE (ON REVERSE SIDE IF DOUBLE SIDED) WITHIN 21 DAYS OF SALE AWARD DATE



TIMBER SALE
VERIFICATION OF WORKER'S DISABILITY
COMPENSATION ACT COMPLIANCE

*As required by Act 317, P.A. 1969 (Worker's Compensation) and
Part 5 of Act 451 of 1994, as amended.*

FOR DEPARTMENT USE ONLY	
Sale Number (XX - XXX - XX - XX)	
Forest Management Unit:	

VERIFICATION OF WORKER'S DISABILITY COMPENSATION ACT COMPLIANCE

- This verification must be completed and submitted within 21 days of contract award and prior to the issuance of the timber sale contract.
- In addition, if boxes 2B or 2C are checked, then Notice of Exclusion or Certificate of Insurance must be submitted within twenty-one (21) days of the contract award and prior to the issuance of the timber sale contract.
- All information must be typed or printed except for written signatures.

Please Check Appropriate Categories:

1. My business is organized as (you **must** check one of the boxes below):
 - A. Sole Proprietorship (individual)
 - B. Partnership
 - C. Corporation
2. You **must** check one of the boxes below:
 - A. I certify my business is a sole proprietorship and it has no employees but the sole proprietor. I am not subject to the Worker's Compensation Laws.
 - B. I certify my business has satisfied its obligation to the Worker's Compensation Act through the use of an approved Notice of Exclusion (BWC-337, Rev. 5/96). I will provide a copy of the Notice of Exclusion within 21 days of the contract award. (For questions or a copy of the BWC-337, please call the Worker's Compensation Bureau at 517-322-1195).
 - C. I certify my business has a Worker's Compensation Policy. I will provide an original Certificate of Insurance within twenty-one (21) days of the contract award.
3. If you have checked item 2(A) or 2(B), you **must** indicate the number of **both** full-time and part-time employees, other than yourself, including family members and active partners (if none, you must enter "0").

_____ Full-time Employees

_____ Part-time Employees

Name of Business		Federal ID (or) Social Security No.	
Address		Telephone ()	
City	State	ZIP	

I hereby certify that the above information is true and correct. I agree to notify the Michigan DNR of any changes that occur in factors affecting my coverage during any of my present and future operations.

Signature of Owner or Authorized Representative

Title

Date

Please complete the "SEALED BID" information on the next page

Are We There Yet? SBW (54-040-17)
; Presque Isle COUNTY

In response to the notice of sale to be held 10:00 a.m. (local time) on August 21, 2018, I am hereby submitting my sealed bid (firm offer) for the following forest products to be cut. Bids for individual species must be at or above the advertised price. All non-responsive bid forms may be rejected.

<u>PRODUCTS & SPECIES</u>	<u>ESTIMATED VOLUME*</u>	<u>ADVERTISED PRICE</u>	<u>BID PRICE/UNIT</u>
Sawtimber			
Mixed Spruce	15.40 MBF	\$ 57.00/MBF	\$ _____
N. White Cedar	16.00 MBF	\$ 50.00/MBF	\$ _____
Red Maple	2.80 MBF	\$ 115.00/MBF	\$ _____
Sugar Maple	0.80 MBF	\$ 393.00/MBF	\$ _____
Pulpwood			
Balsam Fir	623.00 Cords	\$ 33.65/Cord	\$ _____
Misc. Species 1	55.00 Cords	\$ 5.00/Cord	\$ _____
Mixed Aspen	721.00 Cords	\$ 20.75/Cord	\$ _____
Mixed Hardwood	182.00 Cords	\$ 16.35/Cord	\$ _____
Mixed Spruce	413.00 Cords	\$ 28.25/Cord	\$ _____
N. White Cedar	176.00 Cords	\$ 24.85/Cord	\$ _____
Paper Birch	221.00 Cords	\$ 20.05/Cord	\$ _____

*The volumes are statistically estimated within plus (+) or minus (-) 10.85 percent. These estimated volumes are final and not subject to adjustment. Prospective bidders are urged to examine this timber and to make their own estimates of quantity and quality.

I understand that any or all bids may be rejected. All bids must be signed and all bid items must be bid or the bid form may be rejected. I also understand that consideration and awarding a contract will be based upon my past performance and ability to complete the contract based upon equipment and staffing subject to my control.

FEDERAL ID: _____ or SOCIAL SECURITY NUMBER: _____

Company or individual bidding: _____

Company representative's name: _____

Address: _____

City: _____ State: _____ Zip: _____

IF AVAILABLE, PLEASE PLACE THE PERSONALIZED LABEL FROM YOUR PROSPECTUS IN THE ABOVE BOX.

Individual or company representative's signature: _____ Date: _____

Phone number : _____ Email (optional): _____

THE WINNING BIDDER MUST COMPLETE THE VERIFICATION OF WORKER'S DISABILITY COMPENSATION ACT COMPLIANCE (ON REVERSE SIDE IF DOUBLE SIDED) WITHIN 21 DAYS OF SALE AWARD DATE



FOR DEPARTMENT USE ONLY	
Sale Number (XX - XXX - XX - XX)	
Forest Management Unit:	

TIMBER SALE VERIFICATION OF WORKER'S DISABILITY COMPENSATION ACT COMPLIANCE

As required by Act 317, P.A. 1969 (Worker's Compensation) and
Part 5 of Act 451 of 1994, as amended.

VERIFICATION OF WORKER'S DISABILITY COMPENSATION ACT COMPLIANCE

- This verification must be completed and submitted within 21 days of contract award and prior to the issuance of the timber sale contract.
- In addition, if boxes 2B or 2C are checked, then Notice of Exclusion or Certificate of Insurance must be submitted within twenty-one (21) days of the contract award and prior to the issuance of the timber sale contract.
- All information must be typed or printed except for written signatures.

Please Check Appropriate Categories:

1. My business is organized as (you **must** check one of the boxes below):
 - A. Sole Proprietorship (individual)
 - B. Partnership
 - C. Corporation
2. You **must** check one of the boxes below:
 - A. I certify my business is a sole proprietorship and it has no employees but the sole proprietor. I am not subject to the Worker's Compensation Laws.
 - B. I certify my business has satisfied its obligation to the Worker's Compensation Act through the use of an approved Notice of Exclusion (BWC-337, Rev. 5/96). I will provide a copy of the Notice of Exclusion within 21 days of the contract award. (For questions or a copy of the BWC-337, please call the Worker's Compensation Bureau at 517-322-1195).
 - C. I certify my business has a Worker's Compensation Policy. I will provide an original Certificate of Insurance within twenty-one (21) days of the contract award.
3. If you have checked item 2(A) or 2(B), you **must** indicate the number of **both** full-time and part-time employees, other than yourself, including family members and active partners (if none, you must enter "0").

_____ Full-time Employees

_____ Part-time Employees

Name of Business		Federal ID (or) Social Security No.	
Address		Telephone ()	
City	State	ZIP	

I hereby certify that the above information is true and correct. I agree to notify the Michigan DNR of any changes that occur in factors affecting my coverage during any of my present and future operations.

Signature of Owner or Authorized Representative

Title

Date

Please complete the "SEALED BID" information on the next page