



**DEPARTMENT OF NATURAL RESOURCES
STATE OF MICHIGAN**

TIMBER SALE PROSPECTUS #6397

SCHEDULED SALE DATE AND TIME: 8:30 a.m. (local time) on June 5, 2019.

LOCATION: CRYSTAL FALLS MGMT UNIT, 1420 US 2 WEST, CRYSTAL FALLS, MI 49920.

PROSPECTUS NOTE: The bidder is advised to inspect the sale area and review the location, estimated volumes, operating costs and contract terms of proposed sales. Please be aware that some landowners may request 60 days or more notice for access across their land.

Notice is hereby given that bids will be received by the Unit Manager, CRYSTAL FALLS MANAGEMENT UNIT, for certain timber on the following described lands:

Widen the Wells (12-007-19) / T42N, R29W, SEC. 1 , NWNW.

T42N, R29W, SEC. 10, N1/2NW,N1/2NE.

T42N, R29W, SEC. 11, N1/2NW,NWNE.

T42N, R29W, SEC. 2 , N1/2NE,SENE,N1/2SE,SWSE.

T42N, R29W, SEC. 3 , SWSW.

T42N, R29W, SEC. 4 , SESE.

T42N, R29W, SEC. 8 , S1/2NW,S1/2NE.

T42N, R29W, SEC. 9 , NENW,S1/2NW,N1/2NE.

T43N, R29W, SEC. 35, NESW,W1/2SE.

Dickinson County, Advertised Price \$425.60, 28.3 Acres, .

SALE NOTE: This short duration harvest is in preparation for road improvements. For this reason, high stumps are required. Misc. Species 1 includes all species of merchantable trees. The majority of trees to be harvested are maple. Forest products will be scaled as pulp at the specified contract price. No extensions will be granted on this sale.

A recreation site such as a trail, pathway, or campground is within the sale area or the vicinity. Certain restrictions/specifications may be applicable including time restrictions.

Weepy Hardwoods (12-001-18) / T42N, R29W, SEC. 10, NENW,N1/2NE.

T42N, R29W, SEC. 11, N1/2NW.

T42N, R29W, SEC. 2 , W1/2SW.

T42N, R29W, SEC. 3 , NESW,S1/2SW,SE.

Dickinson County, Advertised Price \$63,337.90, 218.7 Acres, Hardwood, Aspen.

Wells Drains (12-016-18) / T42N, R29W, SEC. 10, N1/2NW, SENW, SWNE.

T42N, R29W, SEC. 16, N1/2NW, SWNW, N1/2NE.

T42N, R29W, SEC. 17, NW, N1/2NE, SENE, SW.

T42N, R29W, SEC. 18, NENE.

T42N, R29W, SEC. 7, SWNE, N1/2SE, SESE.

T42N, R29W, SEC. 8, SWSW, SESE.

T42N, R29W, SEC. 9, E1/2NW, N1/2NE, SWNE, S1/2SW, SWSE.

Dickinson County, Advertised Price \$283,763.05, 282.3 Acres, Aspen, Hardwood.

SALE NOTE: Culverts must be installed before the sale is closed. The DNR will obtain the culverts and permits. The Purchaser responsible for the transportation and installation of the culverts. Due to wet soils, it is recommended operations occur during dry summer or frozen winter ground conditions.

A recreation site such as a trail, pathway, or campground is within the sale area or the vicinity. Certain restrictions/specifications may be applicable including time restrictions.

Nomadic Bear Aspen (12-017-18) / T42N, R29W, SEC. 5, W1/2NW, SW, N1/2SE, SWSE.

T42N, R29W, SEC. 6, E1/2NW, NE, E1/2SE.

Dickinson County, Advertised Price \$119,044.45, 131.5 Acres, Aspen, Hardwood.

SALE NOTE: Harvest and hauling operations are not permitted during the period of December 1 to March 31 (snowmobile season).

A recreation site such as a trail, pathway, or campground is within the sale area or the vicinity. Certain restrictions/specifications may be applicable including time restrictions.

BID INSTRUCTIONS (VER. 07/02/2018):

1. Scheduled Bid Location, Date, and Time (2/11)

Bids must be received by the Unit Manager, CRYSTAL FALLS OFFICE, 1420 US 2 West, Crystal Falls, MI 49920, no later than 8:30 a.m. (local time) on June 5, 2019. For further information concerning this sale, contact Dan McNamee at 906-875-6622.

2. Bidder's Qualifications (5/16)

Purchaser shall obtain workers compensation insurance to cover claims under Michigan's Worker's Disability Compensation Act of 1969 or similar employee benefit act of any other state applicable to an employee. If all or part of a timber sale was prepared by a private contractor, the contractor and that contractor's company are not permitted to bid on the timber sale contract. Bids will not be accepted from individuals or companies appearing on the DNR/FRD No-Bid List. This list contains the names of purchasers who previously failed to execute a contract within 21-days or who have a history of poor performance.

3. Preparation of Sealed Bids (5/16)

Bid Forms may be completed online thru Michigan DNR Timber Sale Online Bidding (OLB) at www.michigan.gov/timberbidding or by completing the hardcopy Bid Form found in the Timber Sale Prospectus. Hardcopy Bid Forms shall be manually signed in ink. Registration in OLB is considered your 'signature' for all bids submitted thru that system. Bid prices must be entered for each species and product in the Bid Price column for all material subject to bidding and all fill-in blanks must be completed. If erasures or other changes appear on the hardcopy Bid Form, each erasure or change must be initialed by the person signing the bid.

4. Submission of Sealed Bids (5/16)

Bid forms may be obtained from the Unit Manager or thru OLB. Bids may be submitted hardcopy or thru OLB. All hardcopy bids must be submitted on the bid form and in an envelope clearly identified as described in this section. NOTE: Only one bid form per bid envelope. Sealed bids must be submitted to the Unit office designated in the prospectus and must be submitted at or prior to the time established in the prospectus. The envelope should show on the outside (a) the sale name or number and (b) the date and time of bid opening, as shown in the prospectus. Bids received after the time specified in the sale prospectus are late bids and will be rejected.

It is possible for a bidder to submit multiple bids on a single sale. For example, a bid may be submitted hardcopy and a bid may be submitted thru OLB. Or, two bidders from the same company could both submit bids on the same sale. If this were to happen, the State would accept all bids received and award the contract accordingly. All bidding and contractual requirements would apply to all bids received.

5. Public Opening of Sealed Bids (7/16)

If conditions permit, the sealed bids will be publicly opened and posted at the time and place set in the prospectus.

If a bidder, present at a bid opening, has submitted bids on more than one sale, that bidder may withdraw their unopened bid envelopes or announce the withdrawal of their online bid after being declared the successful bidder on one sale.

6. Award of Contract (1/11)

Award of the contract will be made to the Bidder whose bid, conforming to the prospectus, is most advantageous to the State of Michigan on the basis of total value at rates bid for the estimated quantities. The State reserves the right to reject any bid or waive any minor irregularity in bids received. A written award mailed (or otherwise furnished) to the successful Bidder shall be deemed to result in a binding contract without further action by either party.

7. Down Payment (1/11)

The Bidder to whom award is made must make a down payment within 21 days of the sale award. The amount of the down payment will be calculated as shown in the Bond and Payment Schedule of this prospectus. Only cash may be used to meet this requirement.

8. Performance Security (1/11)

As guarantee of faithful performance, a cash bond, certificate of deposit, surety bond or irrevocable letter of credit (LOC) is required within 21 days of the sale award. The amount of the performance security is shown in the Bond and

Payment Schedule of this prospectus. If an LOC or surety is used, the coverage must extend for at least 6 months beyond the contract expiration.

9. Timber Sale Contract (7/18)

Additional conditions and requirements common to all timber sales are listed on the timber sale contract (R4031) and are available on line at www.michigan.gov/timber. Contact the Unit Manager for additional information or a sample contract. Within 21 days of the date of the award letter, the bidder must sign the contract and provide the required down payment, performance security, and verification of worker's disability compensation. The down payment and performance security shall be in accordance with the provisions of the timber sale contract, in the sums stated in this prospectus. If these actions are not taken, then the Bidder, the Bidder's corporation, and the corporation's principals may not be permitted to bid on State timber sales for a period of 3 months after the first offense, 6 months after the second offense, and 1 year after the third offense. An offense will only be counted against the Bidder for 5 years. In addition, the Bidder certifies that if awarded this contract, the Bidder will complete the timber sale contract in accordance with its terms and any modifications thereof including requirements to purchase, cut, and remove the included timber by the expiration date.

Payment Unit values in the State Forest Timber Sale Contract are calculated based on the advertised value of the Payment Unit as a percentage of the total advertised value of the contract. The advertised value of each Payment Unit is given in the Description of Timber by Payment Unit table on the Timber Sale Information page. For example, if the value of Payment Unit 1 is advertised as \$1,500 and the total Timber Sale value is advertised as \$10,000, the contract price for Payment Unit 1 will be 15% of the total bid price ($\$1,500/\$10,000 * 100$).

10. Disclaimer of Estimates and Bidder's Warranty of Inspection (7/16)

Before submitting this bid, the Bidder is advised and cautioned to inspect the sale area, review the requirements of the sale contract, and take other steps as may be reasonably necessary to ascertain the location, estimated volumes, construction estimates, and operating costs of the proposed sale. Failure to do so will not relieve the Bidder from responsibility for completing the contract.

The Bidder warrants that this bid is submitted solely on the basis of the Bidder's examination and inspection of the quality and quantity of the timber offered for sale and the Bidder's opinion of the value thereof and the costs of recovery. No reliance should be placed on the State of Michigan's estimates of timber quality, quantity or costs of recovery. Bidder further acknowledges that the State of Michigan: (i) expressly disclaims any warranty of fitness of timber for any purpose; (ii) offers this timber as is without any warranty of quality (merchantability) or quantity and (iii) expressly disclaims any warranty as to the quantity or quality of timber sold.

11. Certification and Chain-of-Custody (10/14)

Unless otherwise indicated in the contract under section 7 – Other Conditions of the Sale Specific Conditions & Requirements, the area encompassed by this timber sale is certified to the standards of the Forest Stewardship Council (FSC) - Certificate #SCS-FM/COC-00090N and the Sustainable Forestry Initiative (SFI) - Certificate #NSF-SFIS-5Y031-SF5. Forest products from this sale may be delivered to the mill as "FSC 100% and / or SFI certified" as long as the contractor hauling the forest products is chain-of-custody (COC) certified or covered under a COC certificate from the destination mill. The purchaser is responsible for maintaining COC after leaving the sale area.

12. Good Neighbor Authority (GNA) Requirements (7/16)

If the name of this timber sales contains the acronym GNA, it is authorized by the Good Neighbor Authority (GNA) and covered by various agreements between the U.S. Forest Service and the State. The timber sale occurs on federal land and the following conditions apply:

GNA contracts on US Forest Service land will not be awarded to purchasers on the Federal list of excluded parties. The System for Award Management (SAM) will be checked for active excluded parties prior to award of contract. In addition, the Bidder to whom award is made must complete an Assurance Regarding Felony Conviction or Tax Delinquent Status for Corporate Applicants (AD-3031).

13. Good Neighbor Authority (GNA) Requirements, con't (9/16)

Bidder certifies, by signing this bid form, that to the best of Bidder's knowledge that the following representations are accurate and complete.

- a. That the Bidder and its principals are not presently debarred, suspended, proposed for debarment, declared ineligible, or voluntary excluded from timber sales (covered transactions) by any Federal department or agency.
- b. That the Bidder and its principals have not within a 3-year period preceding this bid been convicted of or had a civil judgment rendered against them for commission of fraud or a criminal offense in connection with obtaining, attempting to obtain, or performing a public (Federal, State, or local) transaction or contract under a public transaction; violation of Federal or State antitrust statutes or commission of embezzlement, theft, forgery, bribery, falsification or destruction of records, making false statements, or receiving stolen property.
- c. That the Bidder and its principals are not presently indicted for or otherwise criminally or civilly charged by a governmental entity (Federal, State, or local) with commission of any of the offenses enumerated in paragraph b of this certification.
- d. That the Bidder and its principals have not within a 3-year period preceding this bid had one or more public transactions (Federal, State, or local) terminated for breach or default of a timber or forest product contract.

Bidders that cannot certify this requirement, in whole or in part, shall submit an explanation with their bid.

DAN EICHINGER
Director

TIMBER SALE INFORMATION

Widen the Wells (12-007-19)

T42N, R29W, SEC. 1; T42N, R29W, SEC. 10; T42N, R29W, SEC. 11; T42N, R29W, SEC. 2; T42N, R29W, SEC. 3; T42N, R29W, SEC. 4; T42N, R29W, SEC. 8; T42N, R29W, SEC. 9; T43N, R29W, SEC. 35.

SALE NOTE: This short duration harvest is in preparation for road improvements. For this reason, high stumps are required. Misc. Species 1 includes all species of merchantable trees. The majority of trees to be harvested are maple. Forest products will be scaled as pulp at the specified contract price. No extensions will be granted on this sale.

A recreation site such as a trail, pathway, or campground is within the sale area or the vicinity. Certain restrictions/specifications may be applicable including time restrictions.

A timber sale contract for this scaled, sealed bid timber sale will be awarded to the responsible bidder offering the highest sealed bid price. Bids must be at or above the following advertised price for each species:

<u>PRODUCTS & SPECIES</u>	<u>ESTIMATED UNITS*</u>	<u>ADVERTISED PRICE</u>
Pulpwood		
Misc. Species 1	28.00 Cords	\$ 15.20 / Cord

* The estimated units are final and not subject to adjustment. Prospective bidders are urged to examine this timber and to make their own estimates of quantity and quality.

BOND AND PAYMENT SCHEDULE:

1. A bond in the amount of \$500.00 to insure faithful performance of the conditions of the contract will be deposited by the successful bidder within 21 days of the sale award.
2. Cutting in any sale or unit without the required advance payment would be considered a trespass.
3. Total payment must be paid in advance or according to the following schedule:
 - (a) Ten percent (10%) of the sale value must be paid within 21 days of the sale award.
 - (b) The remainder is due before cutting begins.
 - (c) Payment for each of the following units must be made before cutting begins in that unit:

PAYMENT UNIT NUMBER	PERCENT OF TOTAL SALE VALUE
01	100.0%
4. If no cutting takes place, the 10% down payment will not be refunded.
5. Operations on the contract issued will terminate on 08/16/2019.

Description of Timber by Payment Unit (PU)

PU	MARKET GROUP	PRODUCT	QUANTITY	UNIT	ACRES	ADVERTISE PRICE
1	Misc. Species 1	Pulpwood	28.0	Cords	28.3	\$425.60
TOTAL:			28.0	Cords		

Sale Specific Conditions & Requirements

Sale Name: Widen the Wells

Sale Number: 12-007-19 Seq#: 1

1 - Sale Area

1.2 - Boundaries

1.2.1 - Painted boundaries (1/14)

The sale boundary is marked with pink ribbon.

2 - Timber Specifications

2.1 - Included Timber

2.1.11 - Description of timber note (2/04)

Note that Misc. Species 1 includes all species of merchantable trees to be harvested. The majority of trees to be harvested are maple. Forest products will be scaled as pulp at the specified contract price.

2.1.16 - Timber along county or forest roads (6/14)

Cut and remove all trees that are two (2) inches or greater at DBH, within 20 feet either side of the center line of the Wells Grade Road.

2.2 - Utilization

2.2.3 - Stump heights (4/07)

Stump heights within the Sale Area shall not exceed 3 feet, and must have a minimum height of 2 feet. High stumps are required to facilitate a road widening project after harvest.

4 - Transportation

4.1 - Construction

4.1.12 - No new roads (1/12)

No new roads will be permitted.

5 - Operations

5.2 - Conduct of Operations

5.2.37 - No decking areas (12/08)

No decking is allowed within 100 feet of the power line.

5.4 - Soil Protection

5.4.1 - Rutting restriction, general (7/16)

Operations are to cease immediately if equipment and weather conditions result in rutting of roads and/or skid trails which is 12 inches or greater in depth and 50 feet in length. The Unit Manager or his/her representative may restrict hauling and/or skidding if ruts exceed the specified depth. With the Unit Manager or his/her representative's approval, the Purchaser may return to the area when the risk of rutting has decreased.

6 - Safety and Fire Prevention

6.2 - Signing

6.2.1 - Road posting (9/09)

The Purchaser is responsible for posting and maintaining caution signs on the Wells Grade Road prior to beginning operations. The road must be posted at appropriate distances from the sale area to warn of logging activity and truck traffic. Signs must be removed when harvest operations are suspended or completed. The Purchaser will provide these signs.

7 - Other Conditions

7.2 - Extensions

7.2.2 - No extensions (3/09)

Due to the road improvement project, there will be no extensions granted on this contract.

Widen the Wells

approx 28.3 Acres
along 6.0 miles of
Wells Grade Road

Michigan Department of Natural Resources - Forest Resources Division

TIMBER SALE MAP

This information provided by authority of Part 525, 1994 PA 451, as amended.



Forest Management Unit Crystal Falls	County Dickinson	Maped By Church	Date 2/8/2019	Page 1	Year 19
Township 42N, 43N	Range 29W	Section(s) and Subdivision(s) T43N R29W Sec 35, T42N R29W Sec 2, 8-11	Cruised By Scaled	Scale 1:31,680	of 1

Cover Type

A = Aspen	H = Hemlock	N = Marsh	U = Upland Brush
B = Paper Birch	J = Jack Pine	O = Oak	UM = Upland Mixed
C = Cedar	L = Lowland Brush	P = Lowland Poplar	V = Bog or Marsh
D = Tread Bog	M = Mpl, Bch, Birch	Q = Mixed Swamp Conifer	W = White Pine
E = Swamp Hdwoods	MC = Mixed Conifer	R = Red Pine	X = Non Stocked
F = Spruce Fir	MD = Mixed Deciduous	S = Black Spruce	Z = Water
G = Grass	T = Tamarack		

Density

0 = Non Stocked	5 = Pole Timber Medium
1 = Seeding Sapling Poor	6 = Pole Timber Well
2 = Seeding Sapling Medium	7 = Saw Timber Poor
3 = Seeding Sapling Well	8 = Saw Timber Medium
4 = Pole Timber Poor	9 = Saw Timber Well



PU Acres
1 28.3

Legend

- Road to be widened (no paint)
- ▬ Primary Forest Road
- ▬ Secondary Forest Road
- ▬ Forest Access Route
- ▬ Paved Road
- ▬ Gravel Road
- ▬ Private
- ▬ Snowmobile Trail
- ▬ State Forests
- ▬ Nearby Timber Sale
- ▬ Section Corners
- ▬ Stream
- ▬ Powerline

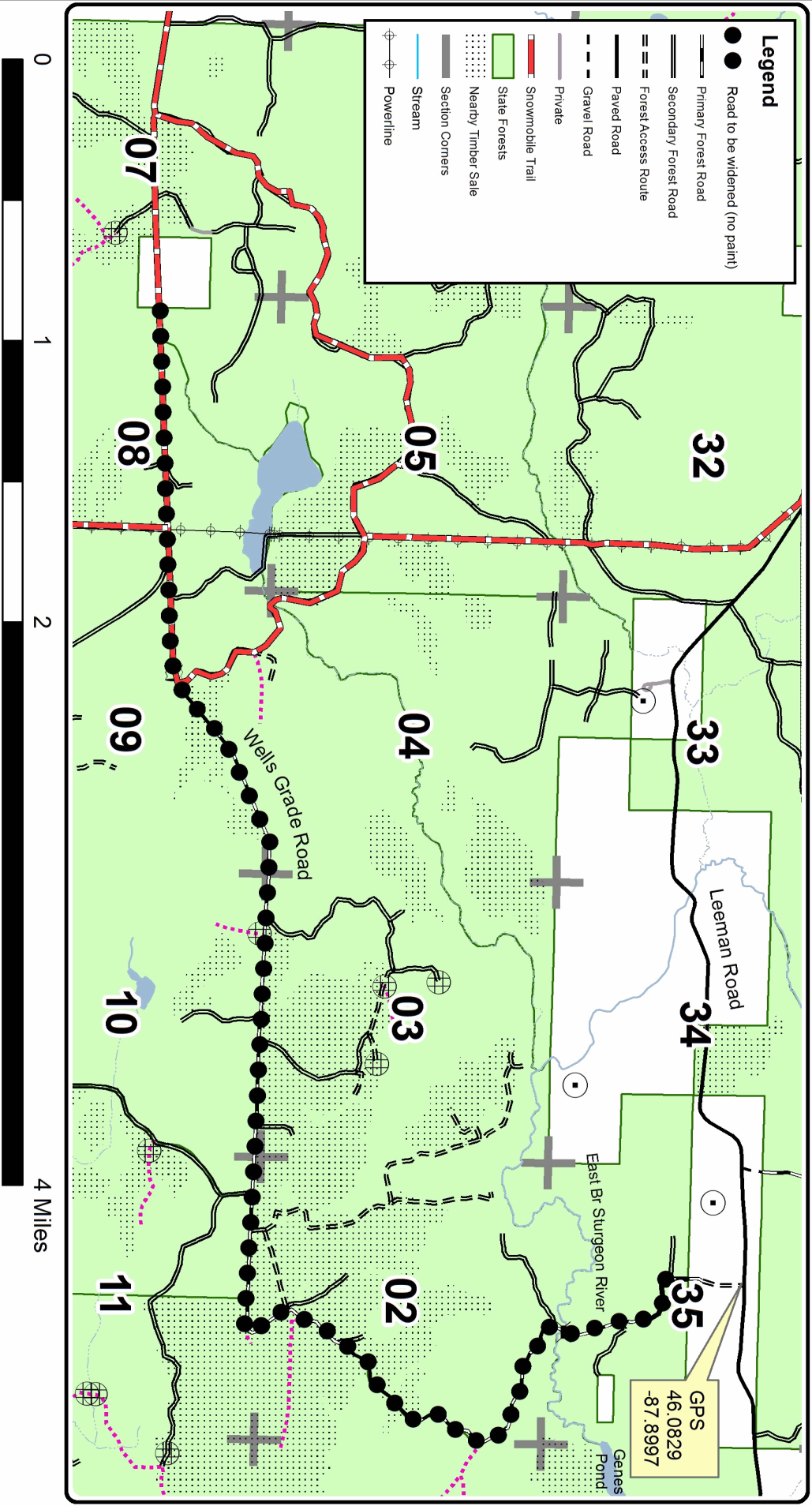

TIMBER SALE INFORMATION

Weepy Hardwoods (12-001-18)

T42N, R29W, SEC. 10; T42N, R29W, SEC. 11; T42N, R29W, SEC. 2; T42N, R29W, SEC. 3.
Dickinson County (Advertised Price \$63,337.90)

A timber sale contract for this lump sum, sealed bid timber sale will be awarded to the responsible bidder offering the highest sealed bid price. Bids must be at or above the following advertised price for each species:

<u>PRODUCTS & SPECIES</u>	<u>ESTIMATED UNITS*</u>	<u>ADVERTISED PRICE</u>
Sawtimber		
Basswood	29.70 MBF	\$ 179.00 / MBF
Sugar Maple	11.60 MBF	\$ 352.00 / MBF
Pulpwood		
Basswood	388.00 Cords	\$ 15.65 / Cord
Mixed Aspen	502.00 Cords	\$ 45.30 / Cord
Mixed Hardwood	1,102.00 Cords	\$ 22.80 / Cord

* The total volume is statistically estimated within plus (+) or minus (-) 13.01 percent. The estimated units are final and not subject to adjustment. Prospective bidders are urged to examine this timber and to make their own estimates of quantity and quality.

BOND AND PAYMENT SCHEDULE:

1. A bond in the amount of \$3,167.00 to insure faithful performance of the conditions of the contract will be deposited by the successful bidder within 21 days of the sale award.
2. Cutting in any sale or unit without the required advance payment would be considered a trespass.
3. Total payment must be paid in advance or according to the following schedule:
 - (a) Ten percent (10%) of the sale value must be paid within 21 days of the sale award.
 - (b) The 10% down payment will be credited towards the first unit cut.
 - (c) Payment for each of the following units must be made before cutting begins in that unit:

<u>PAYMENT UNIT NUMBER</u>	<u>PERCENT OF TOTAL SALE VALUE</u>
01	15.9%
02	20.7%
03	9.7%
04	16.5%
05	13.7%
06	8.5%
07	15.0%
4. If no cutting takes place, the 10% down payment will not be refunded.
5. Operations on the contract issued will terminate on 06/30/2022.

Description of Timber by Payment Unit (PU)

PU	MARKET GROUP	PRODUCT	QUANTITY	UNIT	ACRES	ADVERTISE PRICE
1	Basswood	Sawtimber	8.5	MBF	27.7	\$10,077.85
	Sugar Maple		2.0	MBF		
	Basswood	Pulpwood	21.0	Cords		
	Mixed Aspen		77.0	Cords		
	<i>Quaking Aspen</i>		77.0	<i>Cords</i>		
	Mixed Hardwood		177.0	Cords		
	<i>Paper Birch</i>	<i>Sawtimber</i>	4.3	<i>MBF</i>		
	<i>Ironwood</i>	<i>Pulpwood</i>	2.0	<i>Cords</i>		
	<i>Paper Birch</i>		67.0	<i>Cords</i>		
	<i>Sugar Maple</i>		99.0	<i>Cords</i>		
2	Basswood	Sawtimber	2.3	MBF	38.4	\$13,134.10
	Sugar Maple		1.2	MBF		
	Basswood	Pulpwood	84.0	Cords		
	Mixed Aspen		166.0	Cords		
	<i>Balsam Poplar</i>		8.0	<i>Cords</i>		
	<i>Quaking Aspen</i>		158.0	<i>Cords</i>		
	Mixed Hardwood		152.0	Cords		
	<i>Paper Birch</i>		14.0	<i>Cords</i>		
	<i>Sugar Maple</i>		138.0	<i>Cords</i>		
	3	Basswood	Pulpwood	16.0		
Mixed Aspen			45.0	Cords		
<i>Balsam Poplar</i>			22.0	<i>Cords</i>		
<i>Quaking Aspen</i>			23.0	<i>Cords</i>		
Mixed Hardwood			169.0	Cords		
<i>Red Maple</i>			14.0	<i>Cords</i>		
<i>Sugar Maple</i>			155.0	<i>Cords</i>		
4	Basswood	Sawtimber	1.1	MBF	36.8	\$10,424.50
	Sugar Maple		2.2	MBF		
	Basswood	Pulpwood	58.0	Cords		
	Mixed Aspen		91.0	Cords		
	<i>Quaking Aspen</i>		91.0	<i>Cords</i>		
	Mixed Hardwood		194.0	Cords		
	<i>Ironwood</i>		2.0	<i>Cords</i>		
	<i>Paper Birch</i>		7.0	<i>Cords</i>		
	<i>Sugar Maple</i>		185.0	<i>Cords</i>		
	5	Sugar Maple	Sawtimber	5.1		
Basswood		Pulpwood	36.0	Cords		
Mixed Aspen			50.0	Cords		
<i>Quaking Aspen</i>			50.0	<i>Cords</i>		
Mixed Hardwood			179.0	Cords		
<i>Paper Birch</i>		<i>Sawtimber</i>	2.0	<i>MBF</i>		
<i>Ironwood</i>		<i>Pulpwood</i>	5.0	<i>Cords</i>		
<i>Paper Birch</i>			10.0	<i>Cords</i>		
<i>Sugar Maple</i>			160.0	<i>Cords</i>		
6	Basswood	Pulpwood	28.0	Cords	26.2	\$5,365.70
	Mixed Aspen		67.0	Cords		
	<i>Quaking Aspen</i>		67.0	<i>Cords</i>		
	Mixed Hardwood		83.0	Cords		
	<i>Ironwood</i>		2.0	<i>Cords</i>		
	<i>Sugar Maple</i>		81.0	<i>Cords</i>		
7	Basswood	Sawtimber	17.8	MBF	29.2	\$9,488.85
	Sugar Maple		1.1	MBF		
	Basswood	Pulpwood	145.0	Cords		
	Mixed Aspen		6.0	Cords		
	<i>Balsam Poplar</i>		6.0	<i>Cords</i>		
	Mixed Hardwood		148.0	Cords		

Description of Timber by Payment Unit (PU), con't

PU	MARKET GROUP	PRODUCT	QUANTITY	UNIT	ACRES	ADVERTISE PRICE
	<i>American Elm</i>		4.0	<i>Cords</i>		
	<i>Ironwood</i>		2.0	<i>Cords</i>		
	<i>Sugar Maple</i>		142.0	<i>Cords</i>		
TOTAL:			41.3	MBF		
TOTAL:			1,992.0	Cords		

Sale Specific Conditions & Requirements

Sale Name: Weepy Hardwoods

Sale Number: 12-001-18 Seq#: 1

1 - Sale Area

1.2 - Boundaries

1.2.1 - Painted boundaries (1/14)

The sale boundary and Payment Unit boundaries are marked and identified by red and yellow paint. Exterior sale boundary lines against state are marked with red paint. Interior Payment Unit boundaries are marked with yellow paint. The painted boundary line trees are not Included Timber and are to be protected unless marked with orange paint.

2 - Timber Specifications

2.1 - Included Timber

2.1.3 - Cut tree marked unit(s) (12/08)

Within Payment Unit(s) 1-7, all trees are designated for cutting when marked with orange paint above and below stump height, regardless of merchantability.

3 - Payments

3.4 - Damaged Timber

3.4.1 - Damaged timber (6/14)

General Condition and Requirement 3.4 Damaged Timber, defines liquidated damages for undesignated live merchantable trees which are cut or injured.

No damage is acceptable to merchantable trees. Within the sale area, if more than 10% of trees (> 4.5" DBH) within a specified area of the sale are damaged, liquidated damages will be assessed for all trees damaged. Rates will be in accordance with General Condition and Requirement 3.4 Damaged Timber.

4 - Transportation

4.1 - Construction

4.1.6 - Road construction (1/09)

Construction of new roads or improvements of existing roads shall be done in such a way as to minimize the environmental and visual impacts. Merchantable trees shall be cut and utilized unless otherwise directed. Non-merchantable trees shall be severed and laid flat on the ground. Slash shall be scattered, and not left in windrows and kept a minimum of 10 feet back from the road edge. Stumps shall be set upright, not left on edge, and be moved at least 10 feet away from the road edge. Disturbed soil shall be feathered into the woods and not left in berms or windrows.

4.2 - Maintenance

4.2.4 - Grading (10/16)

If operating during non-frozen conditions, the State portion of the Wells Grade Road must be graded. In general, this will require a road grader or bull dozer to shape up the roads after forest products have been hauled off site. This includes cleaning of drainage areas, grading, crowning and filling with gravel, if necessary. The grading equipment to be used must be approved by the Unit Manager or his/her representative.

5 - Operations

5.2 - Conduct of Operations

5.2.1 - Slash

5.2.1.13 - Dispose of slash as directed (12/05)

Slash is to be disposed of as directed by the sale administrator.

5.2.3 - Operating Restrictions

5.2.3.3 - Bark slippage restriction (3/09)

Within Payment Unit(s) 1-7, unless changed by written agreement, cutting and skidding are not permitted during the period of May 1 to July 1. This restriction is because of bark slippage.

5.2.22 - Operating Caution

5.2.22.1 - Operating caution (6/11)

It is recommended, but not required, that within Payment Unit(s) 1-7, cutting, skidding, and hauling occur during dry summer or frozen winter conditions. The reason for the recommendation is due to the wet soils.

5.4 - Soil Protection

5.4.1 - Rutting restriction, general (7/16)

Operations are to cease immediately if equipment and weather conditions result in rutting of roads and/or skid trails which is 12 inches or greater in depth and 50 feet in length. The Unit Manager or his/her representative may restrict hauling and/or skidding if ruts exceed the specified depth. With the Unit Manager or his/her representative's approval, the Purchaser may return to the area when the risk of rutting has decreased.



TIMBER SALE MAP

This information provided by authority of Part 525, 1994 PA 451, as amended.

Forest Management Unit Crystal Falls	County Dickinson County	Mapped By Andy Church	Date 08/22/2018	Page 1	of 1
Township 42N	Range 29W	Section(s) and Subdivision(s) Sec 2: W1/2SW, Sec 11: N1/2NW Sec 3: NESW, S1/2SW, SE, Sec 10: NENW, N1/2NE	Cruised By Andy Church		
					Scale 1:15,840

Cover Type

A = Aspen	H = Hemlock	N = Marsh	U = Upland Brush
B = Paper Birch	J = Jack Pine	O = Oak	UM = Upland Mixed
C = Cedar	L = Lowland Brush	P = Lowland Poplar	V = Bog or Marsh
LM = Lowland Mixed	M = Mpl, Bch, Brch	Q = Mixed Swamp Conifer	W = White Pine
D = Treed Bog	MC = Mixed Conifer	R = Red Pine	X = Non Stocked
E = Swamp Hdwoods	MD = Mixed Deciduous	S = Black Spruce	Z = Water
F = Spruce Fir		T = Tamarack	
G = Grass			

Density

0 = Non Stocked	5 = Pole Timber Medium
1 = Seedling Sapling Poor	6 = Pole Timber Well
2 = Seedling Sapling Medium	7 = Saw Timber Poor
3 = Seedling Sapling Well	8 = Saw Timber Medium
4 = Pole Timber Poor	9 = Saw Timber Well

PU	Acres	PU	Acres
1	27.7	4	36.8
2	38.4	5	30.5
3	29.9	6	26.2
		7	29.2

Weepee Hardwoods

Compartment 55

218.7 Acres

QR Code for GeoRef PDF

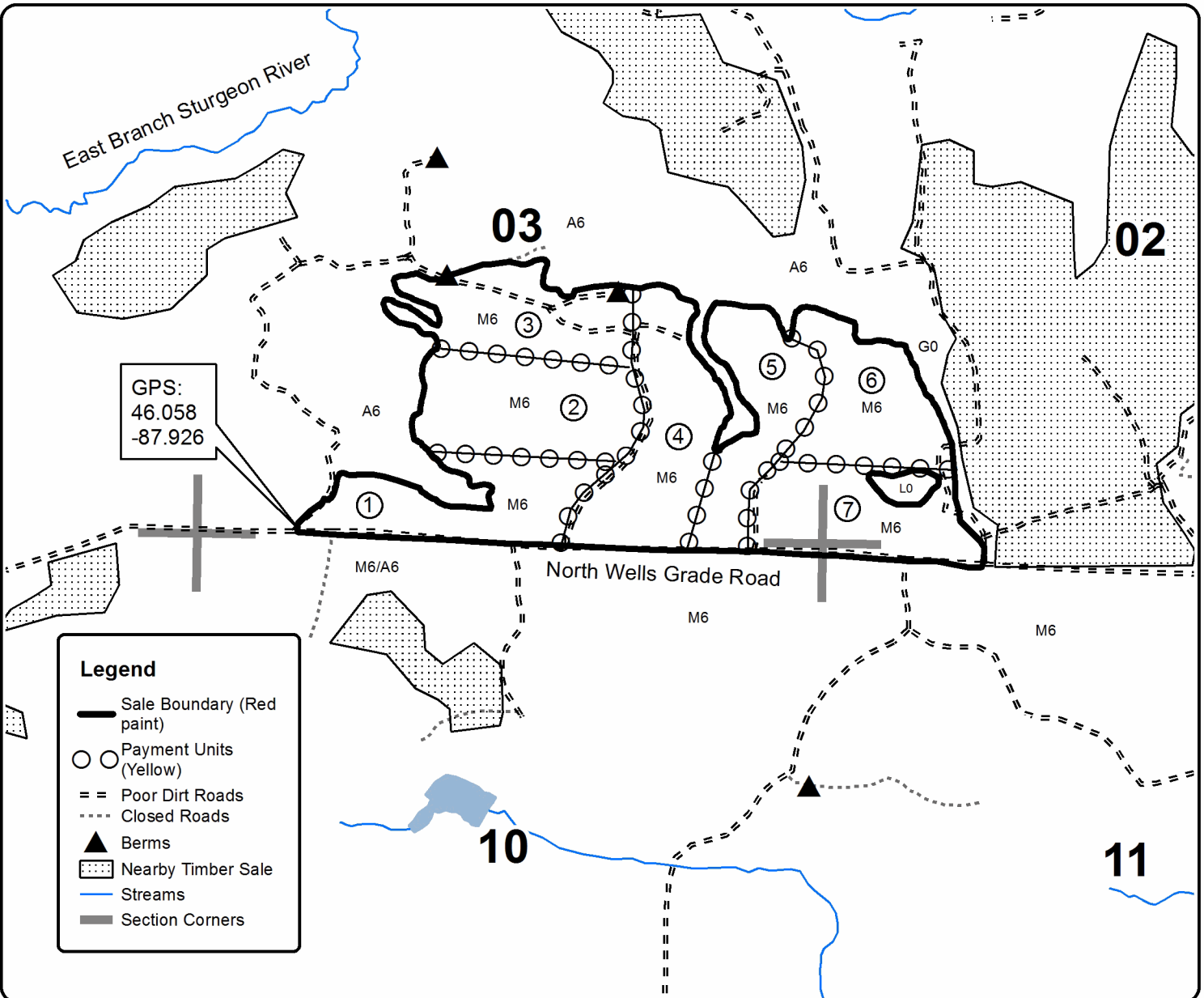

TIMBER SALE INFORMATION

Wells Drains (12-016-18)

T42N, R29W, SEC. 10; T42N, R29W, SEC. 16; T42N, R29W, SEC. 17; T42N, R29W, SEC. 18; T42N, R29W, SEC. 7; T42N, R29W, SEC. 8; T42N, R29W, SEC. 9.

SALE NOTE: Culverts must be installed before the sale is closed. The DNR will obtain the culverts and permits. The Purchaser responsible for the transportation and installation of the culverts. Due to wet soils, it is recommended operations occur during dry summer or frozen winter ground conditions.

A recreation site such as a trail, pathway, or campground is within the sale area or the vicinity. Certain restrictions/specifications may be applicable including time restrictions.

A timber sale contract for this lump sum, sealed bid timber sale will be awarded to the responsible bidder offering the highest sealed bid price. Bids must be at or above the following advertised price for each species:

<u>PRODUCTS & SPECIES</u>	<u>ESTIMATED UNITS*</u>		<u>ADVERTISED PRICE</u>
Sawtimber			
Basswood	38.70	MBF	\$ 179.00 / MBF
Black Ash	13.40	MBF	\$ 60.00 / MBF
Red Maple	10.60	MBF	\$ 138.00 / MBF
Sugar Maple	11.40	MBF	\$ 352.00 / MBF
Pulpwood			
Balsam Fir	368.00	Cords	\$ 20.35 / Cord
Basswood	347.00	Cords	\$ 15.65 / Cord
Mixed Aspen	4,704.00	Cords	\$ 45.30 / Cord
Mixed Hardwood	1,622.00	Cords	\$ 22.80 / Cord
White Spruce	248.00	Cords	\$ 30.50 / Cord

* The estimated units are final and not subject to adjustment. Prospective bidders are urged to examine this timber and to make their own estimates of quantity and quality.

BOND AND PAYMENT SCHEDULE:

1. A bond in the amount of \$14,188.00 to insure faithful performance of the conditions of the contract will be deposited by the successful bidder within 21 days of the sale award.
2. Cutting in any sale or unit without the required advance payment would be considered a trespass.
3. Total payment must be paid in advance or according to the following schedule:
 - (a) Ten percent (10%) of the sale value must be paid within 21 days of the sale award.
 - (b) The 10% down payment will be credited towards the first unit cut.
 - (c) Payment for each of the following units must be made before cutting begins in that unit:

PAYMENT UNIT NUMBER	PERCENT OF TOTAL SALE VALUE
01	10.6%
02	20.8%
03	13.3%
04	6.1%
05	4.6%
06	12.6%
07	18.9%
08	6.7%
09	6.4%

4. If no cutting takes place, the 10% down payment will not be refunded.
5. Operations on the contract issued will terminate on 06/30/2022.

Description of Timber by Payment Unit (PU)

PU	MARKET GROUP	PRODUCT	QUANTITY	UNIT	ACRES	ADVERTISE PRICE
1	Basswood	Sawtimber	3.6	MBF	25.2	\$30,009.75
	Sugar Maple		1.3	MBF		
	Balsam Fir	Pulpwood	3.0	Cords		
	Basswood		22.0	Cords		
	Mixed Aspen		601.0	Cords		
	<i>Balsam Poplar</i>		14.0	<i>Cords</i>		
	<i>Quaking Aspen</i>		587.0	<i>Cords</i>		
	Mixed Hardwood		52.0	Cords		
	<i>Black Ash</i>		4.0	<i>Cords</i>		
	<i>Paper Birch</i>		1.0	<i>Cords</i>		
	<i>Red Maple</i>		16.0	<i>Cords</i>		
	<i>Sugar Maple</i>		31.0	<i>Cords</i>		
	White Spruce		3.0	Cords		
	2	Basswood	Sawtimber	4.7		
Black Ash			3.3	MBF		
Red Maple			9.0	MBF		
Sugar Maple			2.8	MBF		
Balsam Fir		Pulpwood	26.0	Cords		
Basswood			48.0	Cords		
Mixed Aspen			977.0	Cords		
<i>Balsam Poplar</i>			386.0	<i>Cords</i>		
<i>Quaking Aspen</i>			591.0	<i>Cords</i>		
Mixed Hardwood			416.0	Cords		
<i>American Elm</i>			13.0	<i>Cords</i>		
<i>Black Ash</i>			193.0	<i>Cords</i>		
<i>Black Cherry</i>			6.0	<i>Cords</i>		
<i>Paper Birch</i>			3.0	<i>Cords</i>		
<i>Red Maple</i>			96.0	<i>Cords</i>		
<i>Sugar Maple</i>			90.0	<i>Cords</i>		
<i>White Ash</i>			5.0	<i>Cords</i>		
<i>Yellow Birch</i>			10.0	<i>Cords</i>		
White Spruce		31.0	Cords			
3	Basswood	Sawtimber	17.0	MBF	44.6	\$37,864.85
	Red Maple		0.6	MBF		
	Sugar Maple		3.2	MBF		
	Balsam Fir	Pulpwood	103.0	Cords		
	Basswood		134.0	Cords		
	Mixed Aspen		514.0	Cords		
	<i>Balsam Poplar</i>		73.0	<i>Cords</i>		
	<i>Quaking Aspen</i>		441.0	<i>Cords</i>		
	Mixed Hardwood		241.0	Cords		
	<i>Black Ash</i>		9.0	<i>Cords</i>		
	<i>Paper Birch</i>		49.0	<i>Cords</i>		
	<i>Red Maple</i>		60.0	<i>Cords</i>		
	<i>Sugar Maple</i>		121.0	<i>Cords</i>		
	<i>Yellow Birch</i>		2.0	<i>Cords</i>		
White Spruce		21.0	Cords			
4	Basswood	Sawtimber	2.9	MBF	19.5	\$17,198.60
	Sugar Maple		2.3	MBF		
	Balsam Fir	Pulpwood	37.0	Cords		
	Basswood		33.0	Cords		
	Mixed Aspen		261.0	Cords		
	<i>Balsam Poplar</i>		26.0	<i>Cords</i>		
	<i>Quaking Aspen</i>		235.0	<i>Cords</i>		
	Mixed Hardwood		79.0	Cords		
	<i>Black Ash</i>		14.0	<i>Cords</i>		

Description of Timber by Payment Unit (PU), con't

PU	MARKET GROUP	PRODUCT	QUANTITY	UNIT	ACRES	ADVERTISE PRICE
4 con't	<i>Red Maple</i>	<i>Pulpwood</i>	3.0	<i>Cords</i>		
	<i>Sugar Maple</i>		60.0	<i>Cords</i>		
	<i>Yellow Birch</i>		2.0	<i>Cords</i>		
	White Spruce		32.0	Cords		
5	Basswood	Sawtimber	3.8	MBF	20.5	\$13,087.35
	Black Ash		4.0	MBF		
	Balsam Fir	Pulpwood	12.0	Cords		
	Basswood		11.0	Cords		
	Mixed Aspen		107.0	Cords		
	<i>Balsam Poplar</i>		46.0	<i>Cords</i>		
	<i>Quaking Aspen</i>		61.0	<i>Cords</i>		
	Mixed Hardwood		264.0	Cords		
	<i>Yellow Birch</i>	<i>Sawtimber</i>	3.9	<i>MBF</i>		
	<i>American Elm</i>	<i>Pulpwood</i>	3.0	<i>Cords</i>		
	<i>Black Ash</i>		168.0	<i>Cords</i>		
	<i>Red Maple</i>		10.0	<i>Cords</i>		
	<i>Sugar Maple</i>		17.0	<i>Cords</i>		
	<i>Yellow Birch</i>		58.0	<i>Cords</i>		
	White Spruce		29.0	Cords		
	6	Balsam Fir	Pulpwood	23.0		
Basswood			10.0	Cords		
Mixed Aspen			765.0	Cords		
<i>Balsam Poplar</i>			88.0	<i>Cords</i>		
<i>Quaking Aspen</i>			677.0	<i>Cords</i>		
Mixed Hardwood			15.0	Cords		
<i>Black Cherry</i>			2.0	<i>Cords</i>		
<i>Sugar Maple</i>			13.0	<i>Cords</i>		
White Spruce			2.0	Cords		
7		Black Ash	Sawtimber	4.8	MBF	49.1
	Sugar Maple		1.8	MBF		
	Balsam Fir	Pulpwood	35.0	Cords		
	Basswood		48.0	Cords		
	Mixed Aspen		986.0	Cords		
	<i>Balsam Poplar</i>		211.0	<i>Cords</i>		
	<i>Quaking Aspen</i>		775.0	<i>Cords</i>		
	Mixed Hardwood		285.0	Cords		
	<i>Yellow Birch</i>	<i>Sawtimber</i>	1.3	<i>MBF</i>		
	<i>Black Ash</i>	<i>Pulpwood</i>	79.0	<i>Cords</i>		
	<i>Red Maple</i>		9.0	<i>Cords</i>		
	<i>Sugar Maple</i>		149.0	<i>Cords</i>		
	<i>Yellow Birch</i>		45.0	<i>Cords</i>		
8	Basswood	Sawtimber	6.7	MBF	25.3	\$19,093.15
	Black Ash		1.3	MBF		
	Red Maple		1.0	MBF		
	Balsam Fir	Pulpwood	52.0	Cords		
	Basswood		37.0	Cords		
	Mixed Aspen		228.0	Cords		
	<i>Balsam Poplar</i>		35.0	<i>Cords</i>		
	<i>Quaking Aspen</i>		193.0	<i>Cords</i>		
	Mixed Hardwood		189.0	Cords		
	<i>Paper Birch</i>	<i>Sawtimber</i>	0.8	<i>MBF</i>		
	<i>American Elm</i>	<i>Pulpwood</i>	2.0	<i>Cords</i>		
	<i>Black Ash</i>		87.0	<i>Cords</i>		
	<i>Black Cherry</i>		5.0	<i>Cords</i>		
	<i>Paper Birch</i>		3.0	<i>Cords</i>		
	<i>Red Maple</i>		65.0	<i>Cords</i>		

Description of Timber by Payment Unit (PU), con't

PU	MARKET GROUP	PRODUCT	QUANTITY	UNIT	ACRES	ADVERTISE PRICE
8 con't	<i>Sugar Maple</i>	<i>Pulpwood</i>	15.0	<i>Cords</i>		
	<i>Yellow Birch</i>		10.0	<i>Cords</i>		
	White Spruce		46.0	Cords		
9	Balsam Fir	Pulpwood	77.0	Cords	18.3	\$18,042.85
	Basswood		4.0	Cords		
	Mixed Aspen		265.0	Cords		
	<i>Balsam Poplar</i>		25.0	<i>Cords</i>		
	<i>Quaking Aspen</i>		240.0	<i>Cords</i>		
	Mixed Hardwood		81.0	Cords		
	<i>American Elm</i>		6.0	<i>Cords</i>		
	<i>Black Ash</i>		21.0	<i>Cords</i>		
	<i>Paper Birch</i>		6.0	<i>Cords</i>		
	<i>Red Maple</i>		23.0	<i>Cords</i>		
	<i>Sugar Maple</i>		5.0	<i>Cords</i>		
	<i>Yellow Birch</i>		20.0	<i>Cords</i>		
	White Spruce		84.0	Cords		
	TOTAL:			74.1		
TOTAL:			7,289.0	Cords		

Sale Specific Conditions & Requirements

Sale Name: Wells Drains

Sale Number: 12-016-18 Seq#: 1

1 - Sale Area

1.2 - Boundaries

1.2.1 - Painted boundaries (1/14)

The sale boundary and Payment Unit boundaries are marked and identified by blue, red and yellow paint. Exterior sale boundary lines against private property are marked with blue paint. Exterior sale boundary lines against state are marked with red paint. Interior Payment Unit boundaries are marked with yellow paint. The painted boundary line trees are not Included Timber and are to be protected. Yellow painted trees designating an interior Payment Unit boundary are only to be cut when all surrounding Payment Units have been paid. Note: Disregard the yellow paint in Payment Unit 7.

2 - Timber Specifications

2.1 - Included Timber

2.1.1 - Clearcut unit(s) with unmerchantable trees (6/14)

Within Payment Unit(s) 3, 4, 5, 7, 8, and 9, cut all trees that are two (2) inches or more at DBH, except do not cut cedar, hemlock, oak, and pine. In addition, the following exceptions apply:

- Within Payment Unit 3, do not cut ash.
- Within Payment Unit 4, do not cut submerchantable conifers or any cherry.
- Within Payment Units 5, 7, and 8, do not cut submerchantable ash.

2.1.2 - Clearcut unit(s) w/o unmerchantable trees (8/11)

Within Payment Unit(s) 1, 2, and 6, cut all trees which meet minimum piece specifications in 2.2 Utilization, except do not cut cedar, hemlock, oak, and pine.

3 - Payments

3.3 - Pre-measured Sales

3.3.4 - Dividing payment units (7/14)

Payment Unit(s) 2, 3, and 7 may be divided at the request of the Purchaser and upon approval of the Unit Manager. Dividing Payment Units is a contract modification which requires a Timber Sale Contract Supplement. There will be only one division per Payment Unit.

4 - Transportation

4.1 - Construction

4.1.5 - Culverts (5/14)

Roads will require the installation of 4 culverts for cross drainage. The placement of culverts are located on the Timber Sale Map and details will be specified by the sale administrator. They shall be installed prior to closing the sale. The culverts shall be new, plastic gauge and supplied by the DNR. Soils shall be maintained and left in a non-erodible condition, with water bars, seed, fertilizer, mulch, and slash installed as directed by the sale administrator and as specified in the BMP manual. Stream crossing permits, if needed, will be obtained by the DNR. Installation and transportation of culverts will be the responsibility of the Purchaser.

4.1.6 - Road construction (1/09)

Construction of new roads or improvements of existing roads shall be done in such a way as to minimize the environmental and visual impacts. Merchantable trees shall be cut and utilized unless otherwise directed. Non-merchantable trees shall be severed and laid flat on the ground. Slash shall be scattered, and not left in windrows and kept a minimum of 10 feet back from the road edge. Stumps shall be set upright, not left on edge, and be moved at least 10 feet away from the road edge. Disturbed soil shall be feathered into the woods and not left in berms or windrows.

4.1.7 - Road closure (10/11)

All new roads built into the sale must be blocked to vehicle traffic upon completion of the sale. In general, this will require constructing a four (4') foot high berm of stumps and logs covered with earth. These roads must be rendered impassable to cars and trucks. Contact the sale administrator for specific details of design and placement.

4.1.11 - Permits (2/12)

The DNR will secure any necessary stream crossing permits that may be required.

4.2 - Maintenance

4.2.4 - Grading (10/16)

For completion of the sale, state forest roads must be graded. In general, this will require a road grader or bull dozer to shape up the roads after forest products have been hauled off site. This includes cleaning of drainage areas, grading, crowning and filling with gravel, if necessary. The grading equipment to be used must be approved by the Unit Manager or his/her representative.

5 - Operations

5.2 - Conduct of Operations

5.2.1 - Slash

5.2.1.13 - Dispose of slash as directed (12/05)

Slash is to be disposed of as directed by the sale administrator.

5.2.2 - Hazard Trees/Snags

5.2.2.1 - Den trees (10/16)

Obvious hollow and/or den trees shall be protected and left standing unless they are a safety hazard.

5.2.22 - Operating Caution

5.2.22.1 - Operating caution (6/11)

It is recommended, but not required, that within Payment Unit(s) 1-9, cutting and skidding occur during dry summer or frozen winter conditions. The reason for the recommendation due to the wet soils.

5.2.41 - Snowmobile trail protection (9/11)

The snowmobile trail is shown on the Timber Sale Map. Do not cut or damage posts with orange trail markers or traffic control signs. If the trail road is to be used for hauling during the snowmobile season, then a snow covered base must be left on the trail. Maintain a 20 foot wide slash, debris, and rut free zone daily using the snowmobile trail as the centerline.

5.4 - Soil Protection

5.4.1 - Rutting restriction, general (7/16)

Operations are to cease immediately if equipment and weather conditions result in rutting of roads and/or skid trails which is 12 inches or greater in depth and 50 feet in length. The Unit Manager or his/her representative may restrict hauling and/or skidding if ruts exceed the specified depth. With the Unit Manager or his/her representative's approval, the Purchaser may return to the area when the risk of rutting has decreased.

6 - Safety and Fire Prevention

6.2 - Signing

6.2.2 - Snowmobile trail posting (8/09)

The Purchaser is responsible for posting and maintaining caution signs on the snowmobile trail prior to beginning operations during the snowmobile season (approximately December 1 to March 31). The trail must be posted at appropriate distances along the trail to warn of logging activity and truck traffic. Signs must be removed when harvest operations are suspended or completed. The Purchaser will provide these signs.

7 - Other Conditions

7.5 - Loss

7.5.1 - Deteriorating timber (7/09)

The sale area has received damage from Spruce Budworm. The Purchaser should harvest the wood as soon as possible. The Department of Natural Resources is held free of responsibility of any further damage or deterioration due to delay in harvesting.



TIMBER SALE MAP

This information provided by authority of Part 525, 1994 PA 451, as amended.

Forest Management Unit Crystal Falls	County Dickinson	Mapped By Andy Church	Date 08/28/2018	Page 1	of 2
Township 42N	Range 29W	Section(s) and Subdivision(s) Sec 7:SE,SWNE Sec 8:SWSW,SESE Sec 18:NENE Sec 9:E1/2NW,N1/2NE,SWNE,S1/2SW,SWSE Sec 10:N1/2NW,SE,SE,SWNE Sec 16:N1/2NW,SWNW,N1/2NE Sec 17:NNW,N1/2NE,SENE,SW	Scale 1:15,840		
Cruised By Church & Debbie Goupell					

Cover Type

A = Aspen	H = Hemlock	N = Marsh	U = Upland Brush
B = Paper Birch	J = Jack Pine	O = Oak	UM = Upland Mixed
C = Cedar	L = Lowland Brush	P = Lowland Poplar	V = Bog or Marsh
D = Tread Bog	LM = Lowland Mixed	Q = Mixed Swamp Conifer	W = White Pine
E = Swamp Hdwoods	M = Mpl, Bch, Brch	R = Red Pine	X = Non Stocked
F = Spruce Fir	MC = Mixed Conifer	S = Black Spruce	Z = Water
G = Grass	MD = Mixed Deciduous	T = Tamarack	

Density

0 = Non Stocked	5 = Pole Timber Medium
1 = Seedling Sapling Poor	6 = Pole Timber Well
2 = Seedling Sapling Medium	7 = Saw Timber Poor
3 = Seedling Sapling Well	8 = Saw Timber Medium
4 = Pole Timber Poor	9 = Saw Timber Well

PU	Acres	PU	Acres
1	25.2	6	22.7
2	57.1	7	49.1
3	44.6	8	25.3
4	19.5	9	18.3
5	20.5		

Wells Drains

Comp 53 & 54

282.3 Acres

QR code for GeoRef PDF

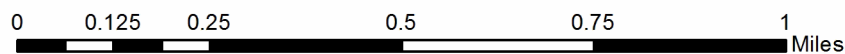
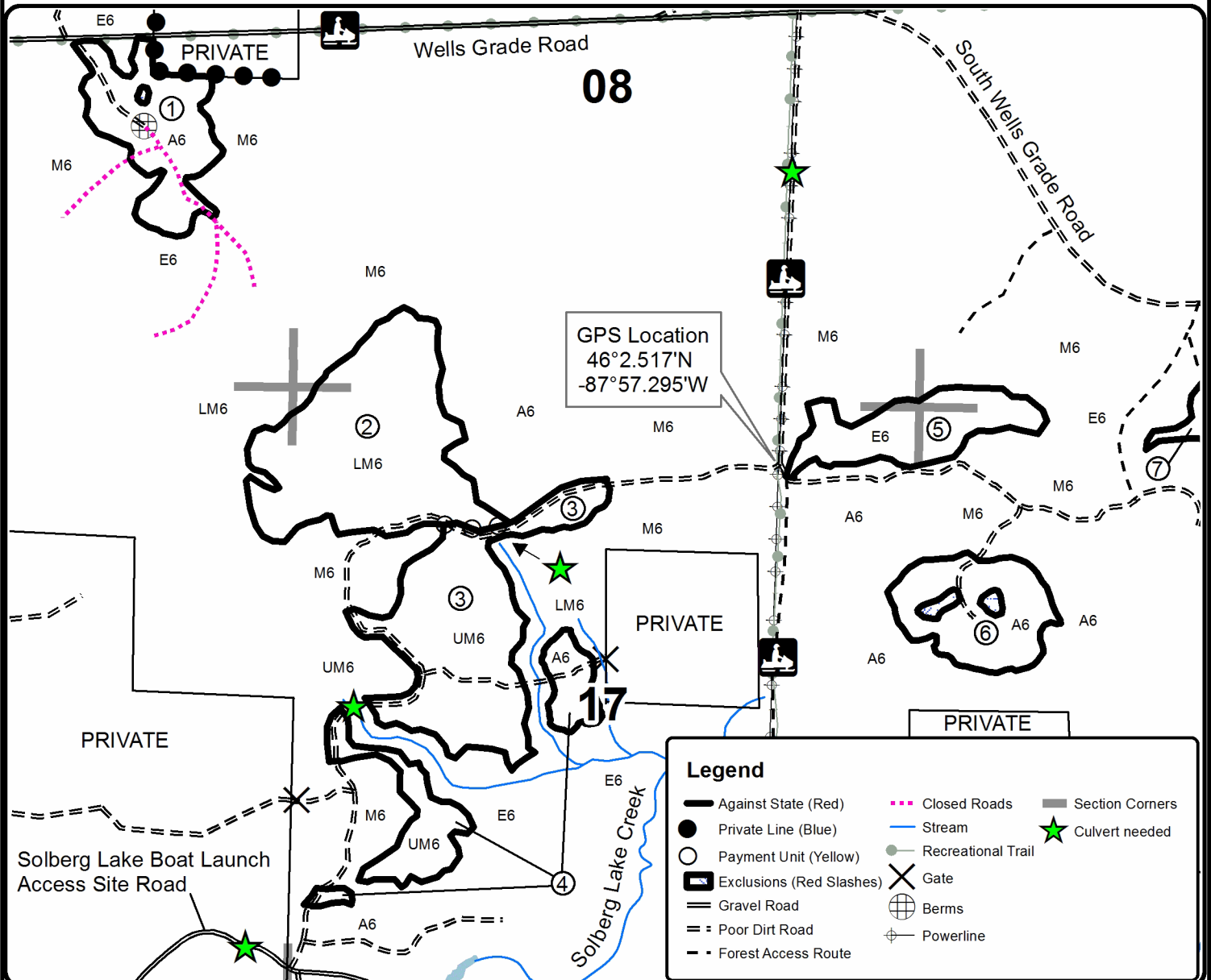



TIMBER SALE MAP

This information provided by authority of Part 525, 1994 PA 451, as amended.

Sale Number	Year
12 - 016	18

Forest Management Unit Crystal Falls	County Dickinson	Mapped By Andy Church	Date 09/23/2018	Page 2	of 2
Township 42N	Range 29W	Section(s) and Subdivision(s) Sec 7:SE,SWNE Sec 8:SWSW,SESE Sec 18:NENE Sec 9:E1/2NW,N1/2NE,SWNE,S1/2SW,SWSE Sec 10:N1/2NW,SENE,SWNE Sec 16:N1/2NW,SWNW,N1/2NE Sec 17:NW,N1/2NE,SENE,SW	Scale 1:15,840		

Cover Type				Density			
A = Aspen	H = Hemlock	N = Marsh	U = Upland Brush	0 = Non Stocked	5 = Pole Timber Medium		
B = Paper Birch	J = Jack Pine	O = Oak	UM = Upland Mixed	1 = Seedling Sapling Poor	6 = Pole Timber Well		
C = Cedar	L = Lowland Brush	P = Lowland Poplar	V = Bog or Marsh	2 = Seedling Sapling Medium	7 = Saw Timber Poor		
D = Tread Bog	LM = Lowland Mixed	Q = Mixed Swamp Conifer	W = White Pine	3 = Seedling Sapling Well	8 = Saw Timber Medium		
E = Swamp Hdwoods	M = Mpl, Bch, Brch	R = Red Pine	X = Non Stocked	4 = Pole Timber Poor	9 = Saw Timber Well		
F = Spruce Fir	MC = Mixed Conifer	S = Black Spruce	Z = Water				
G = Grass	MD = Mixed Deciduous	T = Tamarack					

PU	Acres	PU	Acres
1	25.2	6	22.7
2	57.1	7	49.1
3	44.6	8	25.3
4	19.5	9	18.3
5	20.5		

Wells Drains

Comp 53 & 54
282.3 Acres



QR code for GeoRef PDF

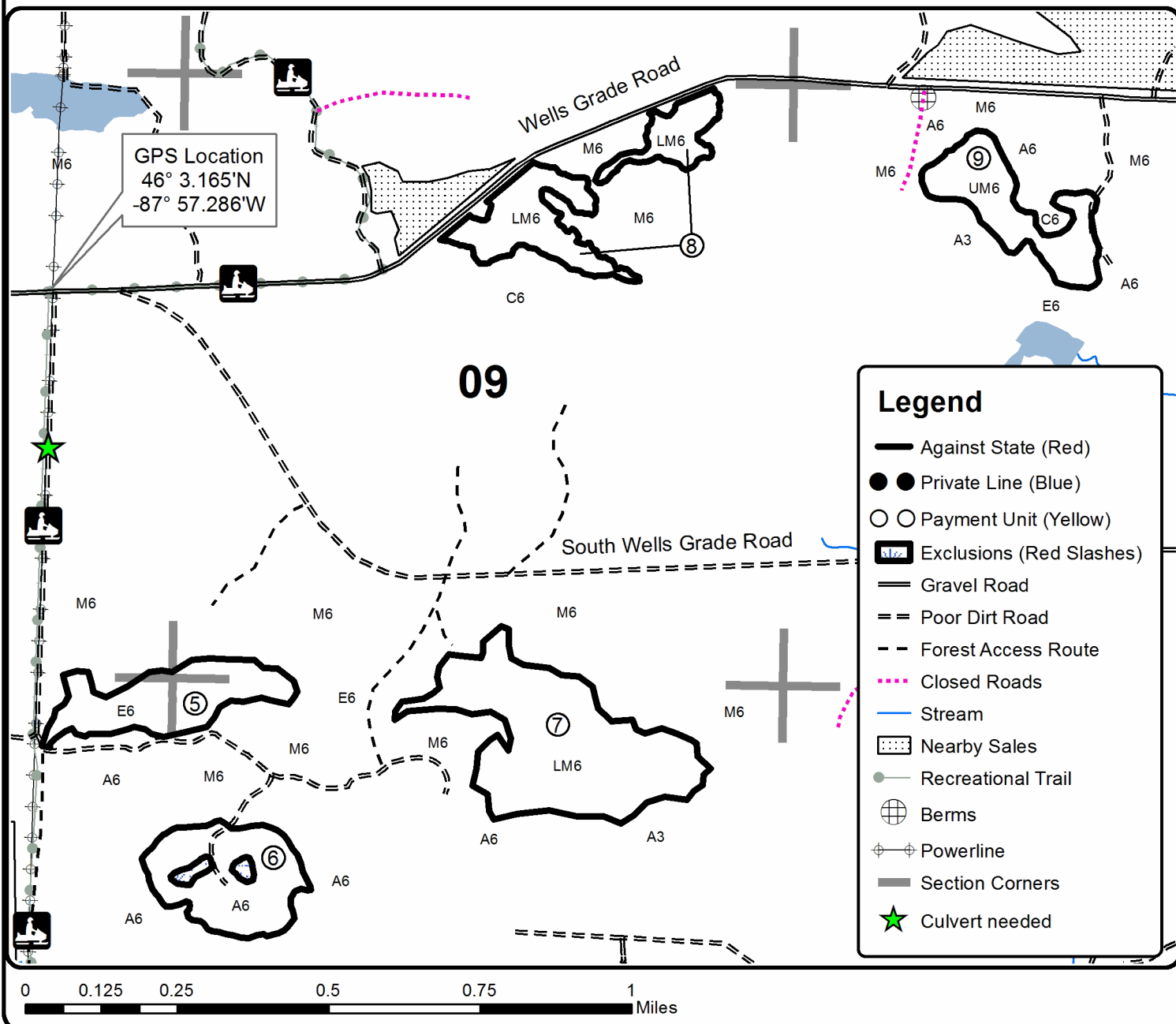
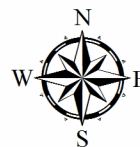

TIMBER SALE INFORMATION

Nomadic Bear Aspen (12-017-18)

T42N, R29W, SEC. 5; T42N, R29W, SEC. 6.
Dickinson County (Advertised Price \$119,044.45)

SALE NOTE: Harvest and hauling operations are not permitted during the period of December 1 to March 31 (snowmobile season).

A recreation site such as a trail, pathway, or campground is within the sale area or the vicinity. Certain restrictions/specifications may be applicable including time restrictions.

A timber sale contract for this lump sum, sealed bid timber sale will be awarded to the responsible bidder offering the highest sealed bid price. Bids must be at or above the following advertised price for each species:

<u>PRODUCTS & SPECIES</u>	<u>ESTIMATED UNITS*</u>	<u>ADVERTISED PRICE</u>
Pulpwood		
Balsam Fir	33.00 Cords	\$ 20.35 / Cord
Basswood	4.00 Cords	\$ 15.65 / Cord
Mixed Aspen	2,535.00 Cords	\$ 45.30 / Cord
Mixed Hardwood	131.00 Cords	\$ 22.80 / Cord
White Spruce	16.00 Cords	\$ 30.50 / Cord

* The total volume is statistically estimated within plus (+) or minus (-) 6.84 percent. The estimated units are final and not subject to adjustment. Prospective bidders are urged to examine this timber and to make their own estimates of quantity and quality.

BOND AND PAYMENT SCHEDULE:

1. A bond in the amount of \$9,524.00 to insure faithful performance of the conditions of the contract will be deposited by the successful bidder within 21 days of the sale award.
2. Cutting in any sale or unit without the required advance payment would be considered a trespass.
3. Total payment must be paid in advance or according to the following schedule:
 - (a) Ten percent (10%) of the sale value must be paid within 21 days of the sale award.
 - (b) The 10% down payment will be credited towards the first unit cut.
 - (c) Payment for each of the following units must be made before cutting begins in that unit:

<u>PAYMENT UNIT NUMBER</u>	<u>PERCENT OF TOTAL SALE VALUE</u>
01	20.9%
02	15.2%
03	21.8%
04	18.2%
05	23.9%
4. If no cutting takes place, the 10% down payment will not be refunded.
5. Operations on the contract issued will terminate on 06/30/2022.

Description of Timber by Payment Unit (PU)

PU	MARKET GROUP	PRODUCT	QUANTITY	UNIT	ACRES	ADVERTISE PRICE
1	Balsam Fir	Pulpwood	7.0	Cords	24.1	\$24,935.15
	Basswood		2.0	Cords		
	Mixed Aspen		531.0	Cords		
	<i>Balsam Poplar</i>		5.0	<i>Cords</i>		
	<i>Quaking Aspen</i>		526.0	<i>Cords</i>		
	Mixed Hardwood		27.0	Cords		
	<i>Red Maple</i>		20.0	<i>Cords</i>		
	<i>Sugar Maple</i>		7.0	<i>Cords</i>		
	White Spruce		3.0	Cords		
	2		Basswood	Pulpwood		
Mixed Aspen		394.0	Cords			
<i>Balsam Poplar</i>		22.0	<i>Cords</i>			
<i>Quaking Aspen</i>		372.0	<i>Cords</i>			
Mixed Hardwood		8.0	Cords			
<i>Red Maple</i>		5.0	<i>Cords</i>			
<i>Sugar Maple</i>		3.0	<i>Cords</i>			
3		Balsam Fir	Pulpwood		1.0	Cords
	Mixed Aspen	552.0		Cords		
	<i>Balsam Poplar</i>	2.0		<i>Cords</i>		
	<i>Quaking Aspen</i>	550.0		<i>Cords</i>		
	Mixed Hardwood	40.0		Cords		
	<i>Red Maple</i>	15.0		<i>Cords</i>		
	<i>Sugar Maple</i>	25.0		<i>Cords</i>		
4	Mixed Aspen	Pulpwood	456.0	Cords	25.5	\$21,713.90
	<i>Quaking Aspen</i>		456.0	<i>Cords</i>		
	Mixed Hardwood		37.0	Cords		
	<i>Red Maple</i>		21.0	<i>Cords</i>		
	<i>Sugar Maple</i>		16.0	<i>Cords</i>		
	White Spruce		7.0	Cords		
5	Balsam Fir	Pulpwood	25.0	Cords	30.2	\$28,395.55
	Mixed Aspen		602.0	Cords		
	<i>Quaking Aspen</i>		602.0	<i>Cords</i>		
	Mixed Hardwood		19.0	Cords		
	<i>Paper Birch</i>		4.0	<i>Cords</i>		
	<i>Red Maple</i>		3.0	<i>Cords</i>		
	<i>Sugar Maple</i>		12.0	<i>Cords</i>		
	White Spruce		6.0	Cords		
	TOTAL:			2,719.0		

Sale Specific Conditions & Requirements

Sale Name: Nomadic Bear Aspen

Sale Number: 12-017-18 Seq#: 1

1 - Sale Area

1.2 - Boundaries

1.2.1 - Painted boundaries (1/14)

The sale boundary and Payment Unit boundaries are marked and identified by red and yellow paint. Exterior sale boundary lines against state are marked with red paint. Interior Payment Unit boundaries are marked with yellow paint. The painted boundary line trees are not Included Timber and are to be protected. Yellow painted trees designating an interior Payment Unit boundary are only to be cut when all surrounding Payment Units have been paid.

2 - Timber Specifications

2.1 - Included Timber

2.1.1 - Clearcut unit(s) with unmerchantable trees (6/14)

Within Payment Unit(s) 1-5, cut all trees that are four (4) inches or more at DBH, except do not cut white pine, red pine, cedar, hemlock and oak.

4 - Transportation

4.1 - Construction

4.1.4 - Timber removed for construction (12/09)

Trees cut or damaged in the process of pre-approved road, landing or skid trail construction will be decked in an area separate from other Designated Timber and not removed until measured by the sale administrator. Payment will be made at the specified Purchase Unit Price.

4.1.6 - Road construction (1/09)

Construction of new roads or improvements of existing roads shall be done in such a way as to minimize the environmental and visual impacts. Merchantable trees shall be cut and utilized unless otherwise directed. Non-merchantable trees shall be severed and laid flat on the ground. Slash shall be scattered, and not left in windrows and kept a minimum of 10 feet back from the road edge. Stumps shall be set upright, not left on edge, and be moved at least 10 feet away from the road edge. Disturbed soil shall be feathered into the woods and not left in berms or windrows.

4.1.7 - Road closure (10/11)

All new roads built into the sale must be blocked to vehicle traffic upon completion of the sale. Overgrown roads that are reopened shall be considered new roads. In general, this will require constructing a four (4') foot high berm of stumps and logs covered with earth. Contact the sale administrator for specific details of design and placement.

4.2 - Maintenance

4.2.1 - Hauling restriction (12/08)

Hauling may be restricted on forest roads by the Unit Manager or his/her representative. The restriction may occur during spring breakup or prolonged wet weather conditions.

4.2.4 - Grading (10/16)

For completion of the sale, state forest roads must be graded. In general, this will require a road grader or bull dozer to shape up the roads after forest products have been hauled off site. This includes cleaning of drainage areas, grading, crowning and filling with gravel, if necessary. The grading equipment to be used must be approved by the Unit Manager or his/her representative.

4.4 - Access

4.4.2 - Alternate route on private property (2/04)

It is the Purchaser's responsibility to obtain access across private land for any routes other than the route shown on the sale map.

5 - Operations

5.2 - Conduct of Operations

5.2.1 - Slash

5.2.1.2 - Slash Removal

5.2.1.2.1 - Slash removal, right-of-way (9/16)

All slash must be removed at least 25 feet from the cleared right-of-way of forest roads.

5.2.3 - Operating Restrictions

5.2.3.1 - Operating restrictions (9/11)

Within Payment Unit(s) 1-5, unless changed by written agreement, cutting, skidding, and hauling are not permitted during the snowmobile season, which typically runs from December 1 to March 31. This restriction is to protect everyone by reducing snowmobile and logging equipment interface on the same trail system.

5.2.32 - Decking/landing restoration (9/13)

All decking and landing areas must have the surface area restored to a condition equal to or better than before. This is to ensure the proper regeneration of the stand. Wood debris, chips and "cookies" from trimmings must be removed or scattered away from landing and loading areas and may not be windrowed on the edge.

5.2.41 - Snowmobile trail protection (9/11)

The snowmobile trail is shown on the Timber Sale Map. Do not cut or damage posts with orange trail markers or traffic control signs. The snowmobile trail may not be used for any timber sale operations from December 1 to March 31. Maintain a 20 foot wide slash, debris, and rut free zone daily using the snowmobile trail as the centerline.

5.4 - Soil Protection

5.4.1 - Rutting restriction, general (7/16)

Operations are to cease immediately if equipment and weather conditions result in rutting of roads and/or skid trails which is 12 inches or greater in depth and 50 feet in length. The Unit Manager or his/her representative may restrict hauling and/or skidding if ruts exceed the specified depth. With the Unit Manager or his/her representative's approval, the Purchaser may return to the area when the risk of rutting has decreased.

6 - Safety and Fire Prevention

6.2 - Signing

6.2.1 - Road posting (9/09)

The Purchaser is responsible for posting and maintaining caution signs on the sale roads prior to beginning operations. The road must be posted at appropriate distances from the sale area to warn of logging activity and truck traffic. Signs must be removed when harvest operations are suspended or completed. The Purchaser will provide these signs.



TIMBER SALE MAP

This information provided by authority of Part 525, 1994 PA 451, as amended.

Forest Management Unit Crystal Falls Management Unit		County Dickinson Co.	Mapped By Debbie Goupell	Date 9/17/2018	Page 1	of 1
Township 42N	Range 29W	Section(s) and Subdivision(s) Sec 5: SW1/4, N1/2SE, SWSE, W1/2NW Sec 6: NE1/4, E1/2NW, E1/2SE		Scale 1:15,840		

Cover Type				Density			
A = Aspen	H = Hemlock	N = Marsh	U = Upland Brush	0 = Non Stocked	5 = Pole Timber Medium		
B = Paper Birch	J = Jack Pine	O = Oak	UM = Upland Mixed	1 = Seedling Sapling Poor	6 = Pole Timber Well		
C = Cedar	L = Lowland Brush	P = Lowland Poplar	V = Bog or Marsh	2 = Seedling Sapling Medium	7 = Saw Timber Poor		
D = Treed Bog	LM = Lowland Mixed	Q = Mixed Swamp Conifer	W = White Pine	3 = Seedling Sapling Well	8 = Saw Timber Medium		
E = Swamp Hdwoods	M = Mpl, Bch, Brch	R = Red Pine	X = Non Stocked	4 = Pole Timber Poor	9 = Saw Timber Well		
F = Spruce Fir	MC = Mixed Conifer	S = Black Spruce	Z = Water				
G = Grass	MD = Mixed Deciduous	T = Tamarack					

Nomadic Bear Aspen

Compartment 53
131.5 acres

PU	Acres	PU	Acres
1	24.1	4	25.5
2	18.1	5	30.2
3	33.6		

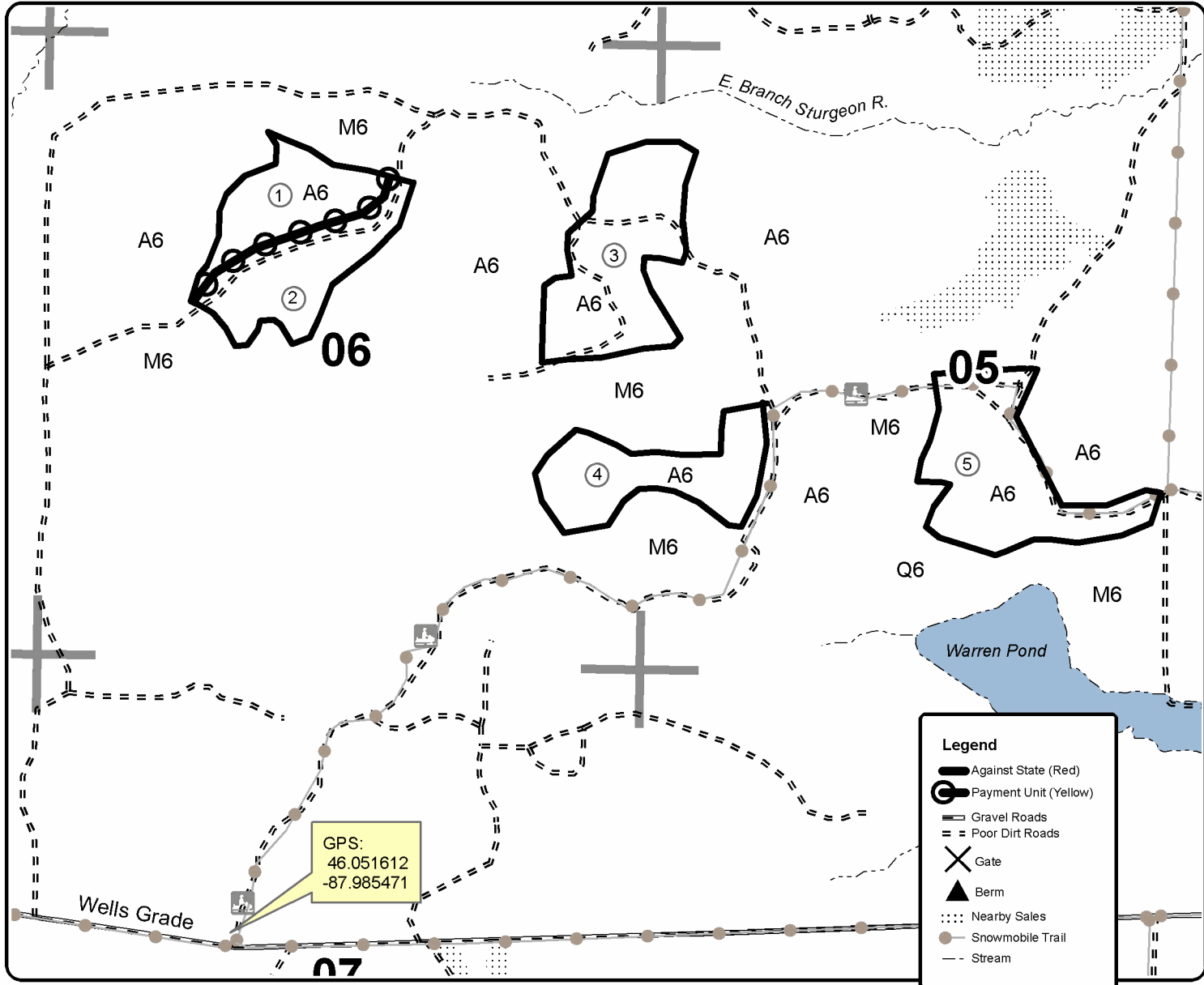

Legend

- Against State (Red)
- Payment Unit (Yellow)
- ▬ Gravel Roads
- ▬▬ Poor Dirt Roads
- ✕ Gate
- ▲ Berm
- ⋯ Nearby Sales
- Snowmobile Trail
- - - Stream

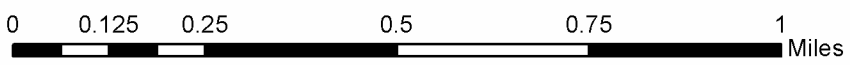

Weepy Hardwoods (12-001-18)

T42N, R29W, SEC. 10; T42N, R29W, SEC. 11; T42N, R29W, SEC. 2; T42N, R29W,

In response to the notice of sale to be held 8:30 a.m. (local time) on June 5, 2019, I am hereby submitting my sealed bid (firm offer) for the following forest products to be cut. Bids for individual species must be at or above the advertised price. All non-responsive bid forms may be rejected.

<u>PRODUCTS & SPECIES</u>	<u>ESTIMATED VOLUME*</u>	<u>ADVERTISED PRICE</u>	<u>BID PRICE/UNIT</u>
Sawtimber			
Basswood	29.70 MBF	\$ 179.00/MBF	\$ _____
Sugar Maple	11.60 MBF	\$ 352.00/MBF	\$ _____
Pulpwood			
Basswood	388.00 Cords	\$ 15.65/Cord	\$ _____
Mixed Aspen	502.00 Cords	\$ 45.30/Cord	\$ _____
Mixed Hardwood	1,102.00 Cords	\$ 22.80/Cord	\$ _____

*The volumes are statistically estimated within plus (+) or minus (-) 13.01 percent. These estimated volumes are final and not subject to adjustment. Prospective bidders are urged to examine this timber and to make their own estimates of quantity and quality.

I understand that any or all bids may be rejected. All bids must be signed and all bid items must be bid or the bid form may be rejected. I also understand that consideration and awarding a contract will be based upon my past performance and ability to complete the contract based upon equipment and staffing subject to my control.

FEDERAL ID: ____ - ____ - ____ or SOCIAL SECURITY NUMBER: ____ - ____ - ____

Company or individual bidding: _____

Company representative's name: _____

Address: _____

City: _____ State: _____ Zip: _____

IF AVAILABLE, PLEASE PLACE THE PERSONALIZED LABEL FROM YOUR PROSPECTUS IN THE ABOVE BOX.

Individual or company representative's signature: _____ Date: _____

Phone number : _____ Email (optional): _____

THE WINNING BIDDER MUST COMPLETE THE VERIFICATION OF WORKER'S DISABILITY COMPENSATION ACT COMPLIANCE (ON REVERSE SIDE IF DOUBLE SIDED) WITHIN 21 DAYS OF SALE AWARD DATE



FOR DEPARTMENT USE ONLY
Sale Number (XX - XXX - XX - XX)
Forest Management Unit:

TIMBER SALE VERIFICATION OF WORKER'S DISABILITY COMPENSATION ACT COMPLIANCE

*As required by Act 317, P.A. 1969 (Worker's Compensation) and
Part 5 of Act 451 of 1994, as amended.*

VERIFICATION OF WORKER'S DISABILITY COMPENSATION ACT COMPLIANCE

- This verification must be completed and submitted within 21 days of contract award and prior to the issuance of the timber sale contract.
- In addition, if boxes 2B or 2C are checked, then Notice of Exclusion or Certificate of Insurance must be submitted within twenty-one (21) days of the contract award and prior to the issuance of the timber sale contract.
- All information must be typed or printed except for written signatures.

Please Check Appropriate Categories:

1. My business is organized as (you **must** check one of the boxes below):
 - A. Sole Proprietorship (individual)
 - B. Partnership
 - C. Corporation
2. You **must** check one of the boxes below:
 - A. I certify my business is a sole proprietorship and it has no employees but the sole proprietor. I am not subject to the Worker's Compensation Laws.
 - B. I certify my business has satisfied its obligation to the Worker's Compensation Act through the use of an approved Notice of Exclusion (BWC-337, Rev. 5/96). I will provide a copy of the Notice of Exclusion within 21 days of the contract award. (For questions or a copy of the BWC-337, please call the Worker's Compensation Bureau at 517-322-1195).
 - C. I certify my business has a Worker's Compensation Policy. I will provide an original Certificate of Insurance within twenty-one (21) days of the contract award.
3. If you have checked item 2(A) or 2(B), you **must** indicate the number of **both** full-time and part-time employees, other than yourself, including family members and active partners (if none, you must enter "0").

_____ Full-time Employees _____ Part-time Employees

Name of Business		Federal ID (or) Social Security No.	
Address		Telephone ()	
City	State	ZIP	

I hereby certify that the above information is true and correct. I agree to notify the Michigan DNR of any changes that occur in factors affecting my coverage during any of my present and future operations.

Signature of Owner or Authorized Representative

Title

Date

Please complete the "SEALED BID" information on the next page

Nomadic Bear Aspen (12-017-18)
T42N, R29W, SEC. 5; T42N, R29W, SEC. 6; Dickinson COUNTY

In response to the notice of sale to be held 8:30 a.m. (local time) on June 5, 2019, I am hereby submitting my sealed bid (firm offer) for the following forest products to be cut. Bids for individual species must be at or above the advertised price. All non-responsive bid forms may be rejected.

<u>PRODUCTS & SPECIES</u>	<u>ESTIMATED VOLUME*</u>	<u>ADVERTISED PRICE</u>	<u>BID PRICE/UNIT</u>
Pulpwood			
Balsam Fir	33.00 Cords	\$ 20.35/Cord	\$ _____
Basswood	4.00 Cords	\$ 15.65/Cord	\$ _____
Mixed Aspen	2,535.00 Cords	\$ 45.30/Cord	\$ _____
Mixed Hardwood	131.00 Cords	\$ 22.80/Cord	\$ _____
White Spruce	16.00 Cords	\$ 30.50/Cord	\$ _____

*The volumes are statistically estimated within plus (+) or minus (-) 6.84 percent. These estimated volumes are final and not subject to adjustment. Prospective bidders are urged to examine this timber and to make their own estimates of quantity and quality.

I understand that any or all bids may be rejected. All bids must be signed and all bid items must be bid or the bid form may be rejected. I also understand that consideration and awarding a contract will be based upon my past performance and ability to complete the contract based upon equipment and staffing subject to my control.

FEDERAL ID: _____ or SOCIAL SECURITY NUMBER: _____

Company or individual bidding: _____

Company representative's name: _____

Address: _____

City: _____ State: _____ Zip: _____

IF AVAILABLE, PLEASE PLACE THE PERSONALIZED LABEL FROM YOUR PROSPECTUS IN THE ABOVE BOX.

Individual or company representative's signature: _____ Date: _____

Phone number : _____ Email (optional): _____

THE WINNING BIDDER MUST COMPLETE THE VERIFICATION OF WORKER'S DISABILITY COMPENSATION ACT COMPLIANCE (ON REVERSE SIDE IF DOUBLE SIDED) WITHIN 21 DAYS OF SALE AWARD DATE



FOR DEPARTMENT USE ONLY	
Sale Number (XX - XXX - XX - XX)	
Forest Management Unit:	

TIMBER SALE VERIFICATION OF WORKER'S DISABILITY COMPENSATION ACT COMPLIANCE

As required by Act 317, P.A. 1969 (Worker's Compensation) and
Part 5 of Act 451 of 1994, as amended.

VERIFICATION OF WORKER'S DISABILITY COMPENSATION ACT COMPLIANCE

- This verification must be completed and submitted within 21 days of contract award and prior to the issuance of the timber sale contract.
- In addition, if boxes 2B or 2C are checked, then Notice of Exclusion or Certificate of Insurance must be submitted within twenty-one (21) days of the contract award and prior to the issuance of the timber sale contract.
- All information must be typed or printed except for written signatures.

Please Check Appropriate Categories:

1. My business is organized as (you **must** check one of the boxes below):
 - A. Sole Proprietorship (individual)
 - B. Partnership
 - C. Corporation
2. You **must** check one of the boxes below:
 - A. I certify my business is a sole proprietorship and it has no employees but the sole proprietor. I am not subject to the Worker's Compensation Laws.
 - B. I certify my business has satisfied its obligation to the Worker's Compensation Act through the use of an approved Notice of Exclusion (BWC-337, Rev. 5/96). I will provide a copy of the Notice of Exclusion within 21 days of the contract award. (For questions or a copy of the BWC-337, please call the Worker's Compensation Bureau at 517-322-1195).
 - C. I certify my business has a Worker's Compensation Policy. I will provide an original Certificate of Insurance within twenty-one (21) days of the contract award.
3. If you have checked item 2(A) or 2(B), you **must** indicate the number of **both** full-time and part-time employees, other than yourself, including family members and active partners (if none, you must enter "0").

_____ Full-time Employees

_____ Part-time Employees

Name of Business		Federal ID (or) Social Security No.	
Address		Telephone ()	
City	State	ZIP	

I hereby certify that the above information is true and correct. I agree to notify the Michigan DNR of any changes that occur in factors affecting my coverage during any of my present and future operations.

Signature of Owner or Authorized Representative

Title

Date

Please complete the "SEALED BID" information on the next page

Wells Drains (12-016-18)

T42N, R29W, SEC. 10; T42N, R29W, SEC. 16; T42N, R29W, SEC. 17; T42N,

In response to the notice of sale to be held 8:30 a.m. (local time) on June 5, 2019, I am hereby submitting my sealed bid (firm offer) for the following forest products to be cut. Bids for individual species must be at or above the advertised price. All non-responsive bid forms may be rejected.

<u>PRODUCTS & SPECIES</u>	<u>ESTIMATED VOLUME*</u>	<u>ADVERTISED PRICE</u>	<u>BID PRICE/UNIT</u>
Sawtimber			
Basswood	38.70 MBF	\$ 179.00/MBF	\$ _____
Black Ash	13.40 MBF	\$ 60.00/MBF	\$ _____
Red Maple	10.60 MBF	\$ 138.00/MBF	\$ _____
Sugar Maple	11.40 MBF	\$ 352.00/MBF	\$ _____
Pulpwood			
Balsam Fir	368.00 Cords	\$ 20.35/Cord	\$ _____
Basswood	347.00 Cords	\$ 15.65/Cord	\$ _____
Mixed Aspen	4,704.00 Cords	\$ 45.30/Cord	\$ _____
Mixed Hardwood	1,622.00 Cords	\$ 22.80/Cord	\$ _____
White Spruce	248.00 Cords	\$ 30.50/Cord	\$ _____

*These estimated volumes are final and not subject to adjustment. Prospective bidders are urged to examine this timber and to make their own estimates of quantity and quality.

I understand that any or all bids may be rejected. All bids must be signed and all bid items must be bid or the bid form may be rejected. I also understand that consideration and awarding a contract will be based upon my past performance and ability to complete the contract based upon equipment and staffing subject to my control.

FEDERAL ID: ____ - ____ - ____ or SOCIAL SECURITY NUMBER: ____ - ____ - ____

Company or individual bidding: _____

Company representative's name: _____

Address: _____

City: _____ State: _____ Zip: _____

IF AVAILABLE, PLEASE PLACE THE PERSONALIZED LABEL FROM YOUR PROSPECTUS IN THE ABOVE BOX.

Individual or company representative's signature: _____ Date: _____

Phone number : _____ Email (optional): _____

THE WINNING BIDDER MUST COMPLETE THE VERIFICATION OF WORKER'S DISABILITY COMPENSATION ACT COMPLIANCE (ON REVERSE SIDE IF DOUBLE SIDED) WITHIN 21 DAYS OF SALE AWARD DATE



FOR DEPARTMENT USE ONLY
Sale Number (XX - XXX - XX - XX)
Forest Management Unit:

TIMBER SALE VERIFICATION OF WORKER'S DISABILITY COMPENSATION ACT COMPLIANCE

*As required by Act 317, P.A. 1969 (Worker's Compensation) and
Part 5 of Act 451 of 1994, as amended.*

VERIFICATION OF WORKER'S DISABILITY COMPENSATION ACT COMPLIANCE

- This verification must be completed and submitted within 21 days of contract award and prior to the issuance of the timber sale contract.
- In addition, if boxes 2B or 2C are checked, then Notice of Exclusion or Certificate of Insurance must be submitted within twenty-one (21) days of the contract award and prior to the issuance of the timber sale contract.
- All information must be typed or printed except for written signatures.

Please Check Appropriate Categories:

1. My business is organized as (you **must** check one of the boxes below):
 - A. Sole Proprietorship (individual)
 - B. Partnership
 - C. Corporation
2. You **must** check one of the boxes below:
 - A. I certify my business is a sole proprietorship and it has no employees but the sole proprietor. I am not subject to the Worker's Compensation Laws.
 - B. I certify my business has satisfied its obligation to the Worker's Compensation Act through the use of an approved Notice of Exclusion (BWC-337, Rev. 5/96). I will provide a copy of the Notice of Exclusion within 21 days of the contract award. (For questions or a copy of the BWC-337, please call the Worker's Compensation Bureau at 517-322-1195).
 - C. I certify my business has a Worker's Compensation Policy. I will provide an original Certificate of Insurance within twenty-one (21) days of the contract award.
3. If you have checked item 2(A) or 2(B), you **must** indicate the number of **both** full-time and part-time employees, other than yourself, including family members and active partners (if none, you must enter "0").

_____ Full-time Employees

_____ Part-time Employees

Name of Business		Federal ID (or) Social Security No.	
Address		Telephone ()	
City	State	ZIP	

I hereby certify that the above information is true and correct. I agree to notify the Michigan DNR of any changes that occur in factors affecting my coverage during any of my present and future operations.

Signature of Owner or Authorized Representative

Title

Date

Please complete the "SEALED BID" information on the next page

Widen the Wells (12-007-19)

T42N, R29W, SEC. 1; T42N, R29W, SEC. 10; T42N, R29W, SEC. 11; T42N, R29W,

In response to the notice of sale to be held 8:30 a.m. (local time) on June 5, 2019, I am hereby submitting my sealed bid (firm offer) for the following forest products to be cut. Bids for individual species must be at or above the advertised price. All non-responsive bid forms may be rejected.

<u>PRODUCTS & SPECIES</u>	<u>ESTIMATED VOLUME*</u>	<u>ADVERTISED PRICE</u>	<u>BID PRICE/UNIT</u>
Pulpwood Misc. Species 1	28.00 Cords	\$ 15.20/Cord	\$ _____

*These estimated volumes are final and not subject to adjustment. Prospective bidders are urged to examine this timber and to make their own estimates of quantity and quality.

I understand that any or all bids may be rejected. All bids must be signed and all bid items must be bid or the bid form may be rejected. I also understand that consideration and awarding a contract will be based upon my past performance and ability to complete the contract based upon equipment and staffing subject to my control.

FEDERAL ID: ____ - ____ - ____ or SOCIAL SECURITY NUMBER: ____ - ____ - ____

Company or individual bidding: _____

Company representative's name: _____

Address: _____

City: _____ State: _____ Zip: _____

IF AVAILABLE, PLEASE PLACE THE PERSONALIZED LABEL FROM YOUR PROSPECTUS IN THE ABOVE BOX.

Individual or company representative's signature: _____ Date: _____

Phone number : _____ Email (optional): _____

THE WINNING BIDDER MUST COMPLETE THE VERIFICATION OF WORKER'S DISABILITY COMPENSATION ACT COMPLIANCE (ON REVERSE SIDE IF DOUBLE SIDED) WITHIN 21 DAYS OF SALE AWARD DATE



FOR DEPARTMENT USE ONLY	
Sale Number (XX - XXX - XX - XX)	
Forest Management Unit:	

TIMBER SALE VERIFICATION OF WORKER'S DISABILITY COMPENSATION ACT COMPLIANCE

As required by Act 317, P.A. 1969 (Worker's Compensation) and
Part 5 of Act 451 of 1994, as amended.

VERIFICATION OF WORKER'S DISABILITY COMPENSATION ACT COMPLIANCE

- This verification must be completed and submitted within 21 days of contract award and prior to the issuance of the timber sale contract.
- In addition, if boxes 2B or 2C are checked, then Notice of Exclusion or Certificate of Insurance must be submitted within twenty-one (21) days of the contract award and prior to the issuance of the timber sale contract.
- All information must be typed or printed except for written signatures.

Please Check Appropriate Categories:

1. My business is organized as (you **must** check one of the boxes below):
 - A. Sole Proprietorship (individual)
 - B. Partnership
 - C. Corporation
2. You **must** check one of the boxes below:
 - A. I certify my business is a sole proprietorship and it has no employees but the sole proprietor. I am not subject to the Worker's Compensation Laws.
 - B. I certify my business has satisfied its obligation to the Worker's Compensation Act through the use of an approved Notice of Exclusion (BWC-337, Rev. 5/96). I will provide a copy of the Notice of Exclusion within 21 days of the contract award. (For questions or a copy of the BWC-337, please call the Worker's Compensation Bureau at 517-322-1195).
 - C. I certify my business has a Worker's Compensation Policy. I will provide an original Certificate of Insurance within twenty-one (21) days of the contract award.
3. If you have checked item 2(A) or 2(B), you **must** indicate the number of **both** full-time and part-time employees, other than yourself, including family members and active partners (if none, you must enter "0").

_____ Full-time Employees

_____ Part-time Employees

Name of Business		Federal ID (or) Social Security No.	
Address		Telephone ()	
City	State	ZIP	

I hereby certify that the above information is true and correct. I agree to notify the Michigan DNR of any changes that occur in factors affecting my coverage during any of my present and future operations.

Signature of Owner or Authorized Representative

Title

Date

Please complete the "SEALED BID" information on the next page