



**DEPARTMENT OF NATURAL RESOURCES
STATE OF MICHIGAN**

TIMBER SALE PROSPECTUS #6310

SCHEDULED SALE DATE AND TIME: 3:00 p.m. (local time) on December 18, 2018.

LOCATION: ESCANABA MGMT UNIT, 6833 HWY'S 2, 41 & M-35, GLADSTONE, MI 49837.

PROSPECTUS NOTE: The bidder is advised to inspect the sale area and review the location, estimated volumes, operating costs and contract terms of proposed sales. Please be aware that some landowners may request 60 days or more notice for access across their land.

Notice is hereby given that bids will be received by the Unit Manager, ESCANABA MANAGEMENT UNIT, for certain timber on the following described lands:

Wood Tick (33-005-18) / T41N, R23W, SEC. 11, W1/2NW.

T41N, R23W, SEC. 2, N1/2NW, SWNW, W1/2SW.

Delta County, Advertised Price \$35,097.05, 54.5 Acres, Hardwood, Aspen.

SALE NOTE: The Wood Tick Road is winter access only past the gate. The Pipeline company must be contacted prior to hauling or utilizing the Pipeline ROW with any equipment.

Pipeline (33-006-18) / T41N, R23W, SEC. 1, E1/2NW, E1/2SW.

T41N, R23W, SEC. 12, NENW.

Delta County, Advertised Price \$46,014.00, 80.8 Acres, Hardwood, Aspen.

SALE NOTE: The best time for operations within this sale area is during the winter months. The Purchaser may obtain permission through private property for alternate access. If a dry summer permits, and the rutting specifications are adhered to, the Purchaser may attempt operations outside of the winter months. The state access road will need a significant amount of fill to upgrade to a haul road. The pipeline company must be called to determine if additional fill will be required to cross.

Beaver Lane (33-007-18) / T41N, R23W, SEC. 12, SENW, SW.

Delta County, Advertised Price \$15,833.80, 32.5 Acres, N White Cedar, Spruce/Fir/Tamarack.

SALE NOTE: The access into this sale requires the improvement of an existing skid trail to a haul road on state land, as shown on the attached Timber Sale Map. The best time to access this sale is in the winter months. The amount of road work required to improve the skid trail to a haul road will depend upon the time of year of access to this sale.

North Deadhorse Mix (33-010-18) / T43N, R22W, SEC. 5, N1/2NW, SWNW, S1/2NE, SW, N1/2SE.

T43N, R22W, SEC. 5, SWSE.

T43N, R22W, SEC. 6, N1/2NW, SWNW, NE, N1/2SE, SESE.

T44N, R22W, SEC. 31, SESE.

T44N, R22W, SEC. 32, S1/2SW.

Alger County, Advertised Price \$138,973.35, 335.3 Acres, Hardwood, Spruce/Fir/Tamarack.

SALE NOTE: This sale will require work in the winter months due to low ground throughout the sale area.

BID INSTRUCTIONS (VER. 07/02/2018):

1. Scheduled Bid Location, Date, and Time (2/11)

Bids must be received by the Unit Manager, ESCANABA OFFICE, 6833 Hwy's 2, 41 & M-35, Gladstone, MI 49837, no later than 3:00 p.m. (local time) on December 18, 2018. For further information concerning this sale, contact Eric Thompson at 906-786-2354.

2. Bidder's Qualifications (5/16)

Purchaser shall obtain workers compensation insurance to cover claims under Michigan's Worker's Disability Compensation Act of 1969 or similar employee benefit act of any other state applicable to an employee. If all or part of a timber sale was prepared by a private contractor, the contractor and that contractor's company are not permitted to bid on the timber sale contract. Bids will not be accepted from individuals or companies appearing on the DNR/FRD No-Bid List. This list contains the names of purchasers who previously failed to execute a contract within 21-days or who have a history of poor performance.

3. Preparation of Sealed Bids (5/16)

Bid Forms may be completed online thru Michigan DNR Timber Sale Online Bidding (OLB) at www.michigan.gov/timberbidding or by completing the hardcopy Bid Form found in the Timber Sale Prospectus. Hardcopy Bid Forms shall be manually signed in ink. Registration in OLB is considered your 'signature' for all bids submitted thru that system. Bid prices must be entered for each species and product in the Bid Price column for all material subject to bidding and all fill-in blanks must be completed. If erasures or other changes appear on the hardcopy Bid Form, each erasure or change must be initialed by the person signing the bid.

4. Submission of Sealed Bids (5/16)

Bid forms may be obtained from the Unit Manager or thru OLB. Bids may be submitted hardcopy or thru OLB. All hardcopy bids must be submitted on the bid form and in an envelope clearly identified as described in this section. NOTE: Only one bid form per bid envelope. Sealed bids must be submitted to the Unit office designated in the prospectus and must be submitted at or prior to the time established in the prospectus. The envelope should show on the outside (a) the sale name or number and (b) the date and time of bid opening, as shown in the prospectus. Bids received after the time specified in the sale prospectus are late bids and will be rejected.

It is possible for a bidder to submit multiple bids on a single sale. For example, a bid may be submitted hardcopy and a bid may be submitted thru OLB. Or, two bidders from the same company could both submit bids on the same sale. If this were to happen, the State would accept all bids received and award the contract accordingly. All bidding and contractual requirements would apply to all bids received.

5. Public Opening of Sealed Bids (7/16)

If conditions permit, the sealed bids will be publicly opened and posted at the time and place set in the prospectus.

If a bidder, present at a bid opening, has submitted bids on more than one sale, that bidder may withdraw their unopened bid envelopes or announce the withdrawal of their online bid after being declared the successful bidder on one sale.

6. Award of Contract (1/11)

Award of the contract will be made to the Bidder whose bid, conforming to the prospectus, is most advantageous to the State of Michigan on the basis of total value at rates bid for the estimated quantities. The State reserves the right to reject any bid or waive any minor irregularity in bids received. A written award mailed (or otherwise furnished) to the successful Bidder shall be deemed to result in a binding contract without further action by either party.

7. Down Payment (1/11)

The Bidder to whom award is made must make a down payment within 21 days of the sale award. The amount of the down payment will be calculated as shown in the Bond and Payment Schedule of this prospectus. Only cash may be used to meet this requirement.

8. Performance Security (1/11)

As guarantee of faithful performance, a cash bond, certificate of deposit, surety bond or irrevocable letter of credit (LOC) is required within 21 days of the sale award. The amount of the performance security is shown in the Bond and

Payment Schedule of this prospectus. If an LOC or surety is used, the coverage must extend for at least 6 months beyond the contract expiration.

9. Timber Sale Contract (7/18)

Additional conditions and requirements common to all timber sales are listed on the timber sale contract (R4031) and are available on line at www.michigan.gov/timber. Contact the Unit Manager for additional information or a sample contract. Within 21 days of the date of the award letter, the bidder must sign the contract and provide the required down payment, performance security, and verification of worker's disability compensation. The down payment and performance security shall be in accordance with the provisions of the timber sale contract, in the sums stated in this prospectus. If these actions are not taken, then the Bidder, the Bidder's corporation, and the corporation's principals may not be permitted to bid on State timber sales for a period of 3 months after the first offense, 6 months after the second offense, and 1 year after the third offense. An offense will only be counted against the Bidder for 5 years. In addition, the Bidder certifies that if awarded this contract, the Bidder will complete the timber sale contract in accordance with its terms and any modifications thereof including requirements to purchase, cut, and remove the included timber by the expiration date.

Payment Unit values in the State Forest Timber Sale Contract are calculated based on the advertised value of the Payment Unit as a percentage of the total advertised value of the contract. The advertised value of each Payment Unit is given in the Description of Timber by Payment Unit table on the Timber Sale Information page. For example, if the value of Payment Unit 1 is advertised as \$1,500 and the total Timber Sale value is advertised as \$10,000, the contract price for Payment Unit 1 will be 15% of the total bid price ($\$1,500/\$10,000 * 100$).

10. Disclaimer of Estimates and Bidder's Warranty of Inspection (7/16)

Before submitting this bid, the Bidder is advised and cautioned to inspect the sale area, review the requirements of the sale contract, and take other steps as may be reasonably necessary to ascertain the location, estimated volumes, construction estimates, and operating costs of the proposed sale. Failure to do so will not relieve the Bidder from responsibility for completing the contract.

The Bidder warrants that this bid is submitted solely on the basis of the Bidder's examination and inspection of the quality and quantity of the timber offered for sale and the Bidder's opinion of the value thereof and the costs of recovery. No reliance should be placed on the State of Michigan's estimates of timber quality, quantity or costs of recovery. Bidder further acknowledges that the State of Michigan: (i) expressly disclaims any warranty of fitness of timber for any purpose; (ii) offers this timber as is without any warranty of quality (merchantability) or quantity and (iii) expressly disclaims any warranty as to the quantity or quality of timber sold.

11. Certification and Chain-of-Custody (10/14)

Unless otherwise indicated in the contract under section 7 – Other Conditions of the Sale Specific Conditions & Requirements, the area encompassed by this timber sale is certified to the standards of the Forest Stewardship Council (FSC) - Certificate #SCS-FM/COC-00090N and the Sustainable Forestry Initiative (SFI) - Certificate #NSF-SFIS-5Y031-SF5. Forest products from this sale may be delivered to the mill as "FSC 100% and / or SFI certified" as long as the contractor hauling the forest products is chain-of-custody (COC) certified or covered under a COC certificate from the destination mill. The purchaser is responsible for maintaining COC after leaving the sale area.

12. Good Neighbor Authority (GNA) Requirements (7/16)

If the name of this timber sales contains the acronym GNA, it is authorized by the Good Neighbor Authority (GNA) and covered by various agreements between the U.S. Forest Service and the State. The timber sale occurs on federal land and the following conditions apply:

GNA contracts on US Forest Service land will not be awarded to purchasers on the Federal list of excluded parties. The System for Award Management (SAM) will be checked for active excluded parties prior to award of contract. In addition, the Bidder to whom award is made must complete an Assurance Regarding Felony Conviction or Tax Delinquent Status for Corporate Applicants (AD-3031).

13. Good Neighbor Authority (GNA) Requirements, con't (9/16)

Bidder certifies, by signing this bid form, that to the best of Bidder's knowledge that the following representations are accurate and complete.

- a. That the Bidder and its principals are not presently debarred, suspended, proposed for debarment, declared ineligible, or voluntary excluded from timber sales (covered transactions) by any Federal department or agency.
- b. That the Bidder and its principals have not within a 3-year period preceding this bid been convicted of or had a civil judgment rendered against them for commission of fraud or a criminal offense in connection with obtaining, attempting to obtain, or performing a public (Federal, State, or local) transaction or contract under a public transaction; violation of Federal or State antitrust statutes or commission of embezzlement, theft, forgery, bribery, falsification or destruction of records, making false statements, or receiving stolen property.
- c. That the Bidder and its principals are not presently indicted for or otherwise criminally or civilly charged by a governmental entity (Federal, State, or local) with commission of any of the offenses enumerated in paragraph b of this certification.
- d. That the Bidder and its principals have not within a 3-year period preceding this bid had one or more public transactions (Federal, State, or local) terminated for breach or default of a timber or forest product contract.

Bidders that cannot certify this requirement, in whole or in part, shall submit an explanation with their bid.

KEITH CREAGH
Director

TIMBER SALE INFORMATION

Wood Tick (33-005-18)

T41N, R23W, SEC. 11; T41N, R23W, SEC. 2.
Delta County (Advertised Price \$35,097.05)

SALE NOTE: The Wood Tick Road is winter access only past the gate. The Pipeline company must be contacted prior to hauling or utilizing the Pipeline ROW with any equipment.

A timber sale contract for this lump sum, sealed bid timber sale will be awarded to the responsible bidder offering the highest sealed bid price. Bids must be at or above the following advertised price for each species:

<u>PRODUCTS & SPECIES</u>	<u>ESTIMATED UNITS*</u>	<u>ADVERTISED PRICE</u>
Sawtimber		
Basswood	5.60 MBF	\$ 106.00 / MBF
Paper Birch	0.80 MBF	\$ 82.00 / MBF
Red Maple	10.40 MBF	\$ 201.00 / MBF
Sugar Maple	13.40 MBF	\$ 281.00 / MBF
White Ash	3.50 MBF	\$ 64.00 / MBF
Pulpwood		
Balsam Fir	94.00 Cords	\$ 24.45 / Cord
Mixed Hardwood	436.00 Cords	\$ 29.15 / Cord
N. White Cedar	17.00 Cords	\$ 21.15 / Cord
Quaking Aspen	442.00 Cords	\$ 29.15 / Cord
White Spruce	5.00 Cords	\$ 21.30 / Cord

* The total volume is statistically estimated within plus (+) or minus (-) 14.22 percent. The estimated units are final and not subject to adjustment. Prospective bidders are urged to examine this timber and to make their own estimates of quantity and quality.

BOND AND PAYMENT SCHEDULE:

1. A bond in the amount of \$1,755.00 to insure faithful performance of the conditions of the contract will be deposited by the successful bidder within 21 days of the sale award.
2. Cutting in any sale or unit without the required advance payment would be considered a trespass.
3. Total payment must be paid in advance or according to the following schedule:
 - (a) Ten percent (10%) of the sale value must be paid within 21 days of the sale award.
 - (b) The 10% down payment will be credited towards the first unit cut.
 - (c) Payment for each of the following units must be made before cutting begins in that unit:

<u>PAYMENT UNIT NUMBER</u>	<u>PERCENT OF TOTAL SALE VALUE</u>
01	23.5%
02	27.3%
03	10.8%
04	7.3%
05	31.1%
4. If no cutting takes place, the 10% down payment will not be refunded.
5. Operations on the contract issued will terminate on 12/31/2021.

Description of Timber by Payment Unit (PU)

PU	MARKET GROUP	PRODUCT	QUANTITY	UNIT	ACRES	ADVERTISE PRICE
1	Basswood	Sawtimber	1.7	MBF	8.9	\$8,264.85
	Red Maple		0.8	MBF		
	Sugar Maple	5.4	MBF			
	Balsam Fir	Pulpwood	46.0	Cords		
	Mixed Hardwood		126.0	Cords		
	<i>American Elm</i>		2.0	<i>Cords</i>		
	<i>Balsam Poplar</i>		3.0	<i>Cords</i>		
	<i>Basswood</i>		25.0	<i>Cords</i>		
	<i>Black Cherry</i>		4.0	<i>Cords</i>		
	<i>Paper Birch</i>		3.0	<i>Cords</i>		
	<i>Red Maple</i>		36.0	<i>Cords</i>		
	<i>Sugar Maple</i>		52.0	<i>Cords</i>		
	<i>White Ash</i>		1.0	<i>Cords</i>		
	Quaking Aspen	53.0	Cords			
White Spruce	3.0	Cords				
2	Basswood	Sawtimber	0.7	MBF	16.8	\$9,578.90
	Red Maple		7.1	MBF		
	Sugar Maple		7.5	MBF		
	White Ash		3.1	MBF		
	Mixed Hardwood	Pulpwood	198.0	Cords		
	<i>Basswood</i>		2.0	<i>Cords</i>		
	<i>Black Ash</i>		14.0	<i>Cords</i>		
	<i>Ironwood</i>		1.0	<i>Cords</i>		
	<i>Red Maple</i>		50.0	<i>Cords</i>		
	<i>Sugar Maple</i>		95.0	<i>Cords</i>		
	<i>White Ash</i>		36.0	<i>Cords</i>		
	3		Basswood	Sawtimber		
White Ash		0.4	MBF			
Balsam Fir		Pulpwood	30.0	Cords		
Mixed Hardwood			44.0	Cords		
<i>Balsam Poplar</i>			14.0	<i>Cords</i>		
<i>Basswood</i>			5.0	<i>Cords</i>		
<i>Black Ash</i>			2.0	<i>Cords</i>		
<i>Paper Birch</i>			2.0	<i>Cords</i>		
<i>Red Maple</i>			9.0	<i>Cords</i>		
<i>Sugar Maple</i>			6.0	<i>Cords</i>		
<i>White Ash</i>			2.0	<i>Cords</i>		
<i>Yellow Birch</i>			4.0	<i>Cords</i>		
N. White Cedar			17.0	Cords		
Quaking Aspen	45.0	Cords				
4	Basswood	Sawtimber	2.5	MBF	5.3	\$2,576.85
	Paper Birch		0.8	MBF		
	Red Maple		2.5	MBF		
	Sugar Maple		0.5	MBF		
	Mixed Hardwood	Pulpwood	55.0	Cords		
	<i>Basswood</i>		11.0	<i>Cords</i>		
	<i>Paper Birch</i>		4.0	<i>Cords</i>		
	<i>Red Maple</i>		20.0	<i>Cords</i>		
	<i>Sugar Maple</i>		20.0	<i>Cords</i>		
	5		Balsam Fir	Pulpwood		
Mixed Hardwood		13.0	Cords			
<i>Black Ash</i>		9.0	<i>Cords</i>			
<i>Red Maple</i>		4.0	<i>Cords</i>			
Quaking Aspen		344.0	Cords			
White Spruce		2.0	Cords			

TOTAL:	33.7	MBF
--------	------	-----

TOTAL:	994.0	Cords
--------	-------	-------

Sale Specific Conditions & Requirements

Sale Name: Wood Tick

Sale Number: 33-005-18 Seq#: 1

1 - Sale Area

1.2 - Boundaries

1.2.1 - Painted boundaries (1/14)

The sale boundary and Payment Unit boundaries are marked and identified by blue, red and yellow paint. Exterior sale boundary lines against private property are marked with blue paint. Exterior sale boundary lines against state are marked with red paint. Interior Payment Unit boundaries are marked with yellow paint. The painted boundary line trees are not Included Timber and are to be protected unless marked with orange paint. Yellow painted trees designating an interior Payment Unit boundary are only to be cut when all surrounding Payment Units have been paid.

2 - Timber Specifications

2.1 - Included Timber

2.1.1 - Clearcut unit(s) with unmerchantable trees (6/14)

Within Payment Unit(s) 1, 3 and 5, cut all trees that are three (3) inches or more at DBH, except do not cut any green marked trees within Payment Units 1 and 3.

2.1.3 - Cut tree marked unit(s) (12/08)

Within Payment Unit(s) 2 and 4, all trees are designated for cutting when marked with orange paint above and below stump height, regardless of merchantability. In addition, within Payment Unit 2, cut all spruce, balsam fir, ash, aspen and balm which meet minimum piece specifications in 2.2 Utilization.

3 - Payments

3.4 - Damaged Timber

3.4.1 - Damaged timber (6/14)

General Condition and Requirement 3.4 Damaged Timber, defines liquidated damages for undesignated live merchantable trees which are cut or injured. In addition, extreme care should be taken to avoid damage to tree seedlings and saplings.

Within Payment Unit 2, if more than 25% of the tree seedlings or saplings (1/4" to 4.5" DBH) within a specified portion of the sale area are damaged, liquidated damages will be assessed at 100 dollars per acre for all acreage within that specified portion of the sale area that was damaged.

4 - Transportation

4.1 - Construction

4.1.5 - Culverts (5/14)

Roads may require the installation of culverts for cross drainage or at natural drainage-ways. If culverts are needed in these locations, their placement will be specified by the sale administrator and they shall be installed prior to hauling. The culverts shall be new, corrugated metal or plastic gauge. Culverts will be a minimum of 12 inches in diameter and 24 feet in length. If culverts are removed, fill shall be removed from wetland soils as specified. Soils shall be maintained and left in a non-erodible condition, with water bars, seed, fertilizer, mulch, and slash installed as directed by the sale administrator and as specified in the BMP manual. Stream crossing permits, if needed, will be obtained by the DNR.

4.1.6 - Road construction (1/09)

Construction of new roads or improvements of existing roads shall be done in such a way as to minimize the environmental and visual impacts. Merchantable trees shall be cut and utilized unless otherwise directed. Non-merchantable trees shall be severed and laid flat on the ground. Slash shall be scattered, and not left in windrows and kept a minimum of 10 feet back from the road edge. Stumps shall be set upright, not left on edge, and be moved at least 10 feet away from the road edge. Disturbed soil shall be feathered into the woods and not left in berms or windrows.

4.1.7 - Road closure (10/11)

All new roads built into the sale must be blocked to vehicle traffic upon completion of the sale. Overgrown roads that are

reopened shall be considered new roads. In general, this will require constructing a four (4') foot high berm of stumps and logs covered with earth. These roads must be rendered impassable to cars and trucks. Contact the sale administrator for specific details of design and placement.

4.2 - Maintenance

4.2.2 - Fill material (4/07)

To maintain roads, fill material may be needed in areas where "holes" exist or may be expected to develop. This fill material should be placed before trucking begins. Contact the sale administrator regarding the availability of onsite sand or gravel from adjacent State-owned lands.

4.2.4 - Grading (10/16)

For completion of the sale, state forest roads must be graded. In general, this will require a road grader or bull dozer to shape up the roads after forest products have been hauled off site. This includes cleaning of drainage areas, grading, crowning and filling with gravel, if necessary. The grading equipment to be used must be approved by the Unit Manager or his/her representative.

5 - Operations

5.1 - Notification

5.1.3 - Well heads and natural gas pipelines (11/15)

The Purchaser is responsible for contacting the gas or pipeline company 30 days prior to operating equipment in the vicinity of well heads or natural gas pipelines. Contact the Enbridge Gas Company at 906-789-1221 and Great Lakes Gas Transmission Company at 906-474-6414.

5.2 - Conduct of Operations

5.2.2 - Hazard Trees/Snags

5.2.2.1 - Den trees (10/16)

Obvious hollow and/or den trees shall be protected and left standing unless they are a safety hazard.

5.2.3 - Operating Restrictions

5.2.3.1 - Operating restrictions (9/11)

Within Payment Unit(s) 3, 4 and 5, unless changed by written agreement, cutting, skidding, and hauling are limited to the period of December 1 to March 31. This restriction is because the Wood Tick Road past the gate is low and wet.

5.2.3.3 - Bark slippage restriction (3/09)

Within Payment Unit(s) 2 and 4, unless changed by written agreement, cutting and skidding are not permitted during the period of April 15 to July 15. This restriction is because of bark slippage.

5.4 - Soil Protection

5.4.1 - Rutting restriction, general (7/16)

Operations are to cease immediately if equipment and weather conditions result in rutting of roads and/or skid trails which is 12 inches or greater in depth and 50 feet in length. The Unit Manager or his/her representative may restrict hauling and/or skidding if ruts exceed the specified depth. With the Unit Manager or his/her representative's approval, the Purchaser may return to the area when the risk of rutting has decreased.

6 - Safety and Fire Prevention

6.2 - Signing

6.2.1 - Road posting (9/09)

The Purchaser is responsible for posting and maintaining caution signs on the St. Nicholas Road prior to beginning operations. The road must be posted at appropriate distances from the sale area to warn of logging activity and truck traffic. Signs must be removed when harvest operations are suspended or completed. The Purchaser will provide these signs.

7 - Other Conditions

7.3 - Contract Modifications

7.3.1 - Emerald Ash Borer

7.3.1.2 - Emerald ash borer, ash or firewood on sale (2/05)

There is ash and/or "firewood" in this sale and it is located within an emerald ash borer quarantined area. The Director of the Michigan Department of Agriculture (MDA) by the authority of Act No. 72 of the Public Acts of 1945, as amended, and Quarantine Regulation No. 620, has promulgated this quarantine to prevent the further spread of this pest and sets forth: definitions, regulated articles, regulated areas, conditions of movement, violations and penalties, and special exemptions. The Purchaser must comply with this quarantine. Contact the MDA for further information.



TIMBER SALE MAP

This information provided by authority of Part 525, 1994 PA 451, as amended.

Forest Management Unit ESCANABA	County DELTA	Mapped By Racine	Date 8/02/2018	Page 1	of 1
Township 41N	Range 23W	Section(s) and Subdivision(s) 2) N1/2NW,SWNW,W1/2SW 11) W1/2NW	Scale 1:15,840		

Cover Type				Density			
A = Aspen	H = Hemlock	N = Marsh	U = Upland Brush	0 = Non Stocked	5 = Pole Timber Medium		
B = Paper Birch	J = Jack Pine	O = Oak	UM = Upland Mixed	1 = Seedling Sapling Poor	6 = Pole Timber Well		
C = Cedar	L = Lowland Brush	P = Lowland Poplar	V = Bog or Marsh	2 = Seedling Sapling Medium	7 = Saw Timber Poor		
D = Treed Bog	LM = Lowland Mixed	Q = Mixed Swamp Conifer	W = White Pine	3 = Seedling Sapling Well	8 = Saw Timber Medium		
E = Swamp Hdwoods	M = Mpl, Bch, Brch	R = Red Pine	X = Non Stocked	4 = Pole Timber Poor	9 = Saw Timber Well		
F = Spruce Fir	MC = Mixed Conifer	S = Black Spruce	Z = Water				
G = Grass	MD = Mixed Deciduous	T = Tamarack					

PU	Acres	PU	Acres
1	8.9	4	5.3
2	16.8	5	17.4
3	6.1		

WOOD TICK

Compartment 88
54.5 Acres

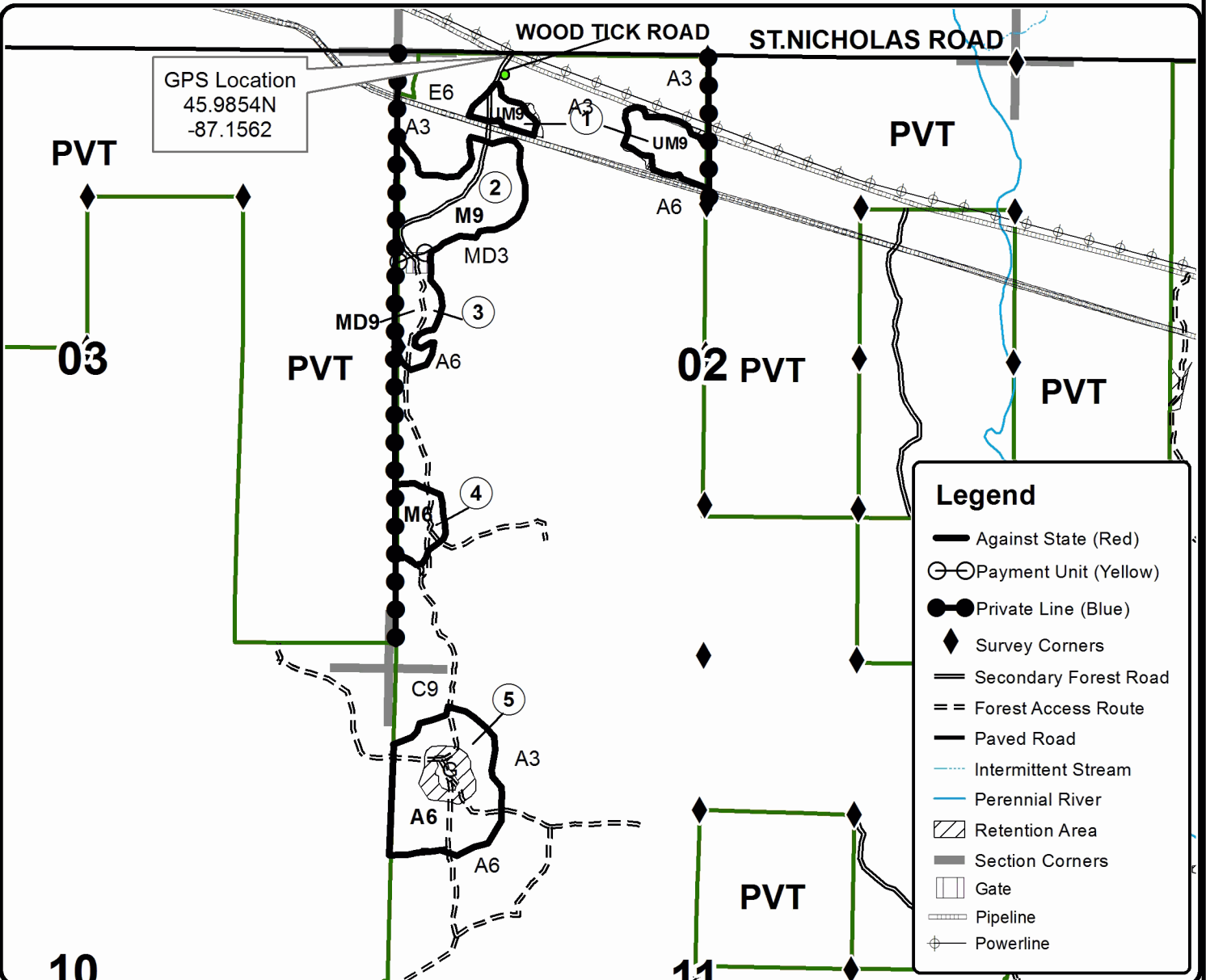
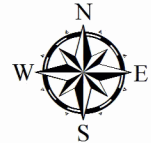

Legend

- Against State (Red)
- ⊙ Payment Unit (Yellow)
- Private Line (Blue)
- ◆ Survey Corners
- Secondary Forest Road
- == Forest Access Route
- Paved Road
- Intermittent Stream
- Perennial River
- ▨ Retention Area
- Section Corners
- Gate
- Pipeline
- ⊕ Powerline

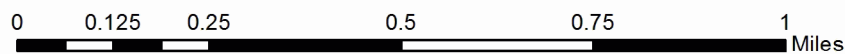

TIMBER SALE INFORMATION

Pipeline (33-006-18)

T41N, R23W, SEC. 1; T41N, R23W, SEC. 12.

Delta County (Advertised Price \$46,014.00)

SALE NOTE: The best time for operations within this sale area is during the winter months. The Purchaser may obtain permission through private property for alternate access. If a dry summer permits, and the rutting specifications are adhered to, the Purchaser may attempt operations outside of the winter months. The state access road will need a significant amount of fill to upgrade to a haul road. The pipeline company must be called to determine if additional fill will be required to cross.

A timber sale contract for this lump sum, sealed bid timber sale will be awarded to the responsible bidder offering the highest sealed bid price. Bids must be at or above the following advertised price for each species:

<u>PRODUCTS & SPECIES</u>	<u>ESTIMATED UNITS*</u>		<u>ADVERTISED PRICE</u>
Sawtimber			
Paper Birch	1.50	MBF	\$ 71.00 / MBF
Red Maple	11.10	MBF	\$ 174.00 / MBF
Sugar Maple	0.50	MBF	\$ 243.00 / MBF
White Ash	1.60	MBF	\$ 55.00 / MBF
Pulpwood			
Balsam Fir	334.00	Cords	\$ 21.20 / Cord
Mixed Hardwood	695.00	Cords	\$ 25.25 / Cord
Mixed Spruce	78.00	Cords	\$ 18.45 / Cord
N. White Cedar	273.00	Cords	\$ 18.35 / Cord
Quaking Aspen	472.00	Cords	\$ 25.25 / Cord
Tamarack	48.00	Cords	\$ 16.05 / Cord

* The total volume is statistically estimated within plus (+) or minus (-) 11.76 percent. The estimated units are final and not subject to adjustment. Prospective bidders are urged to examine this timber and to make their own estimates of quantity and quality.

BOND AND PAYMENT SCHEDULE:

1. A bond in the amount of \$2,301.00 to insure faithful performance of the conditions of the contract will be deposited by the successful bidder within 21 days of the sale award.
2. Cutting in any sale or unit without the required advance payment would be considered a trespass.
3. Total payment must be paid in advance or according to the following schedule:
 - (a) Ten percent (10%) of the sale value must be paid within 21 days of the sale award.
 - (b) The 10% down payment will be credited towards the first unit cut.
 - (c) Payment for each of the following units must be made before cutting begins in that unit:

PAYMENT UNIT NUMBER	PERCENT OF TOTAL SALE VALUE
01	35.5%
02	5.0%
03	38.8%
04	20.7%

4. If no cutting takes place, the 10% down payment will not be refunded.
5. Operations on the contract issued will terminate on 12/31/2021.

Description of Timber by Payment Unit (PU)

PU	MARKET GROUP	PRODUCT	QUANTITY	UNIT	ACRES	ADVERTISE PRICE
1	Red Maple	Sawtimber	3.5	MBF	30.4	\$16,323.15
	Balsam Fir	Pulpwood	94.0	Cords		
	Mixed Hardwood		224.0	Cords		
	<i>Balsam Poplar</i>		97.0	<i>Cords</i>		
	<i>Black Ash</i>		2.0	<i>Cords</i>		
	<i>Black Cherry</i>		8.0	<i>Cords</i>		
	<i>Paper Birch</i>		15.0	<i>Cords</i>		
	<i>Red Maple</i>		99.0	<i>Cords</i>		
	<i>Sugar Maple</i>		2.0	<i>Cords</i>		
	<i>Yellow Birch</i>		1.0	<i>Cords</i>		
	Mixed Spruce		20.0	Cords		
	<i>Black Spruce</i>		13.0	<i>Cords</i>		
	<i>White Spruce</i>		7.0	<i>Cords</i>		
	N. White Cedar		8.0	Cords		
	Quaking Aspen		292.0	Cords		
	Tamarack		11.0	Cords		
	2	Balsam Fir	Pulpwood	11.0		
Mixed Hardwood			11.0	Cords		
<i>Black Ash</i>			1.0	<i>Cords</i>		
<i>Red Maple</i>			10.0	<i>Cords</i>		
Mixed Spruce			26.0	Cords		
<i>Black Spruce</i>			26.0	<i>Cords</i>		
N. White Cedar			32.0	Cords		
Quaking Aspen			6.0	Cords		
Tamarack			37.0	Cords		
3		Paper Birch	Sawtimber	1.5	MBF	29.5
	Red Maple		4.0	MBF		
	Sugar Maple		0.5	MBF		
	White Ash		0.8	MBF		
	Balsam Fir	Pulpwood	207.0	Cords		
	Mixed Hardwood		246.0	Cords		
	<i>American Elm</i>		1.0	<i>Cords</i>		
	<i>Balsam Poplar</i>		11.0	<i>Cords</i>		
	<i>Black Ash</i>		10.0	<i>Cords</i>		
	<i>Black Cherry</i>		1.0	<i>Cords</i>		
	<i>Paper Birch</i>		14.0	<i>Cords</i>		
	<i>Red Maple</i>		199.0	<i>Cords</i>		
	<i>Sugar Maple</i>		6.0	<i>Cords</i>		
	<i>White Ash</i>		4.0	<i>Cords</i>		
	Mixed Spruce		32.0	Cords		
	<i>White Spruce</i>		32.0	<i>Cords</i>		
	N. White Cedar		87.0	Cords		
	Quaking Aspen		162.0	Cords		
	4	Red Maple	Sawtimber	3.6	MBF	
White Ash			0.8	MBF		
Balsam Fir		Pulpwood	22.0	Cords		
Mixed Hardwood			214.0	Cords		
<i>Basswood</i>			12.0	<i>Cords</i>		
<i>Black Ash</i>			59.0	<i>Cords</i>		
<i>Paper Birch</i>			5.0	<i>Cords</i>		
<i>Red Maple</i>			123.0	<i>Cords</i>		
<i>Sugar Maple</i>			7.0	<i>Cords</i>		
<i>White Ash</i>			8.0	<i>Cords</i>		
N. White Cedar			146.0	Cords		
Quaking Aspen			12.0	Cords		

TOTAL:	14.7	MBF
--------	------	-----

TOTAL:	1,900.0	Cords
--------	---------	-------

Sale Specific Conditions & Requirements

Sale Name: Pipeline

Sale Number: 33-006-18 Seq#: 1

1 - Sale Area

1.2 - Boundaries

1.2.1 - Painted boundaries (1/14)

The sale boundary and Payment Unit boundaries are marked and identified by blue, red and yellow paint. Exterior sale boundary lines against private property are marked with blue paint. Exterior sale boundary lines against state are marked with red paint. Interior Payment Unit boundaries are marked with yellow paint. Yellow painted trees designating an interior Payment Unit boundary are only to be cut when all surrounding Payment Units have been paid.

2 - Timber Specifications

2.1 - Included Timber

2.1.1 - Clearcut unit(s) with unmerchantable trees (6/14)

Within Payment Unit(s) 1-4, cut all trees that are three (3) inches or more at DBH, except do not cut any trees that are marked with green paint within Payment Unit 4.

4 - Transportation

4.1 - Construction

4.1.6 - Road construction (1/09)

Construction of new roads or improvements of existing roads shall be done in such a way as to minimize the environmental and visual impacts. Merchantable trees shall be cut and utilized unless otherwise directed. Non-merchantable trees shall be severed and laid flat on the ground. Slash shall be scattered, and not left in windrows and kept a minimum of 10 feet back from the road edge. Stumps shall be set upright, not left on edge, and be moved at least 10 feet away from the road edge. Disturbed soil shall be feathered into the woods and not left in berms or windrows.

4.2 - Maintenance

4.2.2 - Fill material (4/07)

To maintain roads, fill material may be needed in areas where "holes" exist or may be expected to develop. This fill material should be placed before trucking begins. Contact the sale administrator regarding the availability of onsite sand or gravel from adjacent State-owned lands.

4.2.4 - Grading (10/16)

For completion of the sale, state forest roads must be graded. In general, this will require a road grader or bull dozer to shape up the roads after forest products have been hauled off site. This includes cleaning of drainage areas, grading, crowning and filling with gravel, if necessary. The grading equipment to be used must be approved by the Unit Manager or his/her representative.

4.3 - Public Right-of-Way

4.3.2 - County R-O-W (12/06)

The county must be contacted prior to harvesting in the county road R-O-W. This applies to Payment Unit 1 and the St. Nicholas 31st Road.

4.4 - Access

4.4.2 - Alternate route on private property (2/04)

It is the Purchaser's responsibility to obtain access across private land for any routes other than the route shown on the sale map.

5 - Operations

5.1 - Notification

5.1.3 - Well heads and natural gas pipelines (11/15)

The Purchaser is responsible for contacting the gas or pipeline company 30 days prior to operating equipment in the vicinity of well heads or natural gas pipelines. Contact the Enbridge Gas Company at 906-789-1221 and Great Lakes Gas Transmission Company at 906-474-6414.

5.2 - Conduct of Operations

5.2.22 - Operating Caution

5.2.22.1 - Operating caution (6/11)

It is recommended, but not required, that within Payment Unit(s) 1-4, cutting, skidding, and hauling occur during dry summer or frozen winter conditions. The reason for the recommendation is because the access road through state will require a dry period and significant road work improvements to upgrade to a haul road if used outside the winter months.

5.4 - Soil Protection

5.4.1 - Rutting restriction, general (7/16)

Operations are to cease immediately if equipment and weather conditions result in rutting of roads and/or skid trails which is 12 inches or greater in depth and 50 feet in length. The Unit Manager or his/her representative may restrict hauling and/or skidding if ruts exceed the specified depth. With the Unit Manager or his/her representative's approval, the Purchaser may return to the area when the risk of rutting has decreased.

6 - Safety and Fire Prevention

6.2 - Signing

6.2.1 - Road posting (9/09)

The Purchaser is responsible for posting and maintaining caution signs on the St. Nicholas 31st Road prior to beginning operations. The road must be posted at appropriate distances from the sale area to warn of logging activity and truck traffic. Signs must be removed when harvest operations are suspended or completed. The Purchaser will provide these signs.

7 - Other Conditions

7.3 - Contract Modifications

7.3.1 - Emerald Ash Borer

7.3.1.2 - Emerald ash borer, ash or firewood on sale (2/05)

There is ash and/or "firewood" in this sale and it is located within an emerald ash borer quarantined area. The Director of the Michigan Department of Agriculture (MDA) by the authority of Act No. 72 of the Public Acts of 1945, as amended, and Quarantine Regulation No. 620, has promulgated this quarantine to prevent the further spread of this pest and sets forth: definitions, regulated articles, regulated areas, conditions of movement, violations and penalties, and special exemptions. The Purchaser must comply with this quarantine. Contact the MDA for further information.



TIMBER SALE MAP

This information provided by authority of Part 525, 1994 PA 451, as amended.

Sale Number	Year
33-006	18

Forest Management Unit Escanaba	County Delta	Mapped By Racine	Date 08/30/2018	Page 1	of 1
Township 41N	Range 23W	Section(s) and Subdivision(s) 1) E1/2NW, E1/2SW 12) NENW	Scale 1:15,840		

Cover Type				Density	
A = Aspen	H = Hemlock	N = Marsh	U = Upland Brush	0 = Non Stocked	5 = Pole Timber Medium
B = Paper Birch	J = Jack Pine	O = Oak	UM = Upland Mixed	1 = Seedling Sapling Poor	6 = Pole Timber Well
C = Cedar	L = Lowland Brush	P = Lowland Poplar	V = Bog or Marsh	2 = Seedling Sapling Medium	7 = Saw Timber Poor
D = Tread Bog	LM = Lowland Mixed	Q = Mixed Swamp Conifer	W = White Pine	3 = Seedling Sapling Well	8 = Saw Timber Medium
E = Swamp Hdwoods	M = Mpl, Bch, Brch	R = Red Pine	X = Non Stocked	4 = Pole Timber Poor	9 = Saw Timber Well
F = Spruce Fir	MC = Mixed Conifer	S = Black Spruce	Z = Water		
G = Grass	MD = Mixed Deciduous	T = Tamarack			

PU	Acres	PU	Acres
1	30.4	4	14.7
2	6.2		
3	29.5		

Pipeline
Compartment 88
80.8 Acres

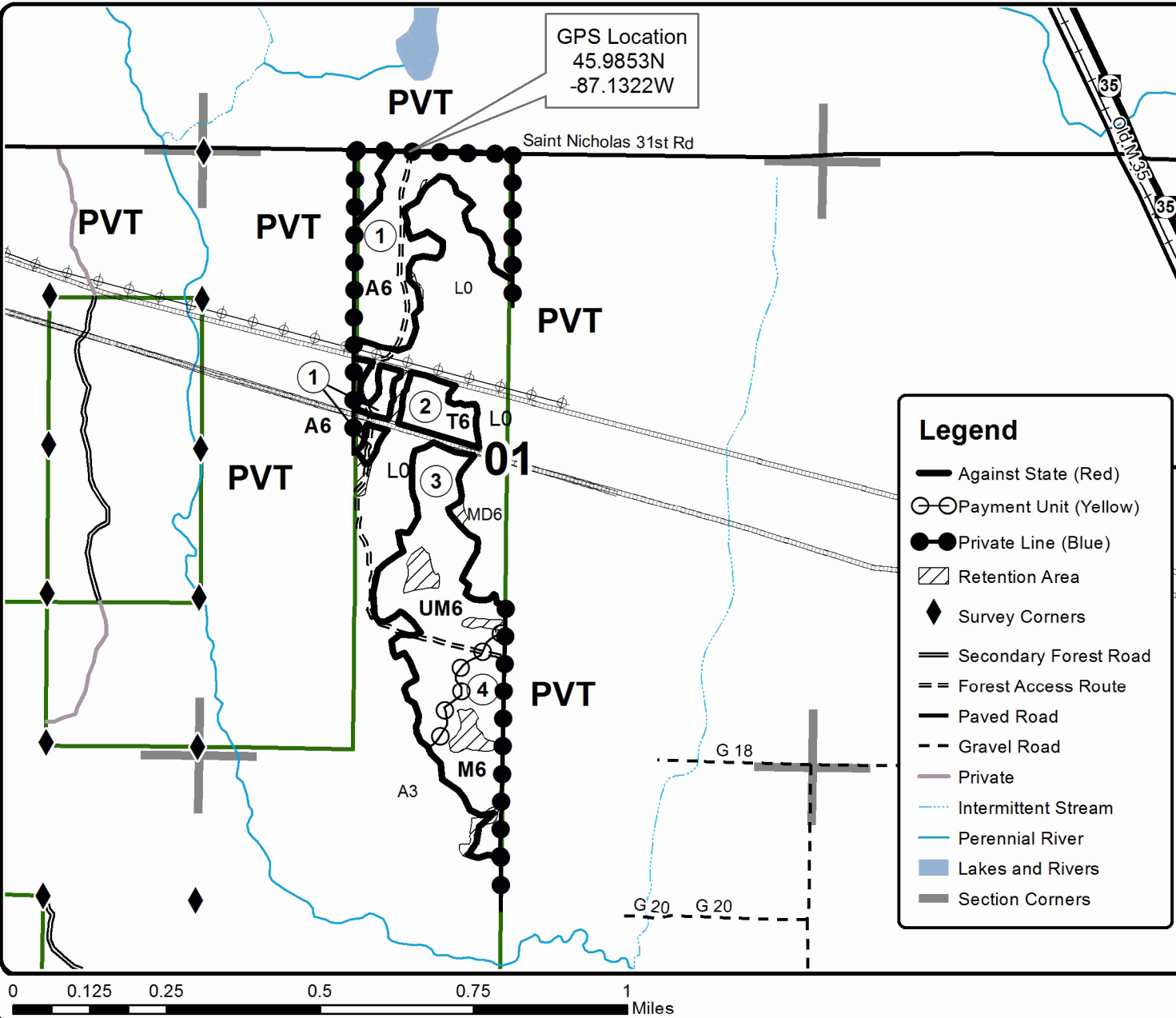
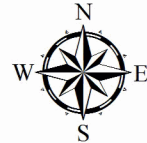

TIMBER SALE INFORMATION

Beaver Lane (33-007-18)
 T41N, R23W, SEC. 12.
 Delta County (Advertised Price \$15,833.80)

SALE NOTE: The access into this sale requires the improvement of an existing skid trail to a haul road on state land, as shown on the attached Timber Sale Map. The best time to access this sale is in the winter months. The amount of road work required to improve the skid trail to a haul road will depend upon the time of year of access to this sale.

A timber sale contract for this lump sum, sealed bid timber sale will be awarded to the responsible bidder offering the highest sealed bid price. Bids must be at or above the following advertised price for each species:

<u>PRODUCTS & SPECIES</u>	<u>ESTIMATED UNITS*</u>	<u>ADVERTISED PRICE</u>
Sawtimber		
Paper Birch	3.30 MBF	\$ 66.00 / MBF
Red Maple	1.60 MBF	\$ 160.00 / MBF
Pulpwood		
Balsam Fir	81.00 Cords	\$ 19.55 / Cord
Mixed Aspen	122.00 Cords	\$ 23.30 / Cord
Mixed Hardwood	92.00 Cords	\$ 23.35 / Cord
Mixed Spruce	24.00 Cords	\$ 17.05 / Cord
N. White Cedar	347.00 Cords	\$ 16.95 / Cord
Tamarack	168.00 Cords	\$ 14.85 / Cord

* The total volume is statistically estimated within plus (+) or minus (-) 25.53 percent. The estimated units are final and not subject to adjustment. Prospective bidders are urged to examine this timber and to make their own estimates of quantity and quality.

BOND AND PAYMENT SCHEDULE:

1. A bond in the amount of \$792.00 to insure faithful performance of the conditions of the contract will be deposited by the successful bidder within 21 days of the sale award.
2. Cutting in any sale or unit without the required advance payment would be considered a trespass.
3. Total payment must be paid in advance or according to the following schedule:
 - (a) Ten percent (10%) of the sale value must be paid within 21 days of the sale award.
 - (b) The 10% down payment will be credited towards the first unit cut.
 - (c) Payment for each of the following units must be made before cutting begins in that unit:

<u>PAYMENT UNIT NUMBER</u>	<u>PERCENT OF TOTAL SALE VALUE</u>
01	6.1%
02	12.1%
03	53.2%
04	28.6%
4. If no cutting takes place, the 10% down payment will not be refunded.
5. Operations on the contract issued will terminate on 12/31/2021.

Description of Timber by Payment Unit (PU)

PU	MARKET GROUP	PRODUCT	QUANTITY	UNIT	ACRES	ADVERTISE PRICE	
1	Balsam Fir	Pulpwood	14.0	Cords	4.2	\$969.45	
	Mixed Aspen		2.0	Cords			
	<i>Balsam Poplar</i>		2.0	<i>Cords</i>			
	Mixed Hardwood		13.0	Cords			
	<i>Black Ash</i>		10.0	<i>Cords</i>			
	<i>Paper Birch</i>		3.0	<i>Cords</i>			
	N. White Cedar		9.0	Cords			
	Tamarack		13.0	Cords			
	2		Paper Birch	Sawtimber			1.6
Red Maple			1.6	MBF			
Balsam Fir		Pulpwood	12.0	Cords			
Mixed Aspen			17.0	Cords			
<i>Quaking Aspen</i>			17.0	<i>Cords</i>			
Mixed Hardwood			34.0	Cords			
<i>Black Ash</i>			2.0	<i>Cords</i>			
<i>Paper Birch</i>			11.0	<i>Cords</i>			
<i>Red Maple</i>			21.0	<i>Cords</i>			
Mixed Spruce			8.0	Cords			
<i>Black Spruce</i>			1.0	<i>Cords</i>			
<i>White Spruce</i>			7.0	<i>Cords</i>			
3			Paper Birch	Sawtimber	1.1	MBF	13.8
	Balsam Fir		Pulpwood	36.0	Cords		
	Mixed Aspen	67.0		Cords			
	<i>Balsam Poplar</i>	35.0		<i>Cords</i>			
	<i>Quaking Aspen</i>	32.0		<i>Cords</i>			
	Mixed Hardwood	29.0		Cords			
	<i>American Elm</i>	1.0		<i>Cords</i>			
	<i>Black Ash</i>	3.0		<i>Cords</i>			
	<i>Paper Birch</i>	24.0		<i>Cords</i>			
	<i>White Ash</i>	1.0		<i>Cords</i>			
	Mixed Spruce	10.0		Cords			
	<i>Black Spruce</i>	10.0		<i>Cords</i>			
	N. White Cedar	220.0		Cords			
	Tamarack	101.0		Cords			
4	Paper Birch	Sawtimber	0.6	MBF	7.4	\$4,527.75	
	Balsam Fir	Pulpwood	19.0	Cords			
	Mixed Aspen		36.0	Cords			
	<i>Balsam Poplar</i>		19.0	<i>Cords</i>			
	<i>Quaking Aspen</i>		17.0	<i>Cords</i>			
	Mixed Hardwood		16.0	Cords			
	<i>Black Ash</i>		2.0	<i>Cords</i>			
	<i>Paper Birch</i>		13.0	<i>Cords</i>			
	<i>White Ash</i>		1.0	<i>Cords</i>			
	Mixed Spruce		6.0	Cords			
	<i>Black Spruce</i>		6.0	<i>Cords</i>			
	N. White Cedar		118.0	Cords			
	Tamarack		54.0	Cords			
	TOTAL:			4.9			MBF
TOTAL:			834.0	Cords			

Sale Specific Conditions & Requirements

Sale Name: Beaver Lane

Sale Number: 33-007-18 Seq#: 1

1 - Sale Area

1.2 - Boundaries

1.2.1 - Painted boundaries (1/14)

The sale boundary and Payment Unit boundaries are marked and identified by blue, red and yellow paint. Exterior sale boundary lines against private property are marked with blue paint. Exterior sale boundary lines against state are marked with red paint. Interior Payment Unit boundaries are marked with yellow paint. Yellow painted trees designating an interior Payment Unit boundary are only to be cut when all surrounding Payment Units have been paid.

2 - Timber Specifications

2.1 - Included Timber

2.1.1 - Clearcut unit(s) with unmerchantable trees (6/14)

Within Payment Unit(s) 1-4, cut all trees that are three (3) inches or more at DBH.

4 - Transportation

4.1 - Construction

4.1.6 - Road construction (1/09)

Construction of new roads or improvements of existing roads shall be done in such a way as to minimize the environmental and visual impacts. Merchantable trees shall be cut and utilized unless otherwise directed. Non-merchantable trees shall be severed and laid flat on the ground. Slash shall be scattered, and not left in windrows and kept a minimum of 10 feet back from the road edge. Stumps shall be set upright, not left on edge, and be moved at least 10 feet away from the road edge. Disturbed soil shall be feathered into the woods and not left in berms or windrows.

4.1.8 - Road work (1) (8/07)

The following road work is required: The improvement of the road into the sale area off Beaver Lane, as shown on the attached Timber Sale Map. The improvements will allow for the hauling of forest products from the timber sale contract. Contact the sale administrator for exact placement and improvement of the road.

4.2 - Maintenance

4.2.2 - Fill material (4/07)

To maintain roads, fill material may be needed in areas where "holes" exist or may be expected to develop. This fill material should be placed before trucking begins. Contact the sale administrator regarding the availability of onsite sand or gravel from adjacent State-owned lands.

4.2.4 - Grading (10/16)

For completion of the sale, state forest roads must be graded. In general, this will require a road grader or bull dozer to shape up the roads after forest products have been hauled off site. This includes cleaning of drainage areas, grading, crowning and filling with gravel, if necessary. The grading equipment to be used must be approved by the Unit Manager or his/her representative.

5 - Operations

5.2 - Conduct of Operations

5.2.1 - Slash

5.2.1.10 - No slash in openings (5/10)

No brush or logging debris is to be left in the maintained wildlife openings. Any damage to the opening shall be repaired according to specifications of the Unit Manager or his/her representative.

5.2.2 - Hazard Trees/Snags

5.2.2.1 - Den trees (10/16)

Obvious hollow and/or den trees shall be protected and left standing unless they are a safety hazard.

5.2.22 - Operating Caution

5.2.22.1 - Operating caution (6/11)

It is recommended, but not required, that within Payment Unit(s) 1-4, cutting, skidding, and hauling occur during dry summer or frozen winter conditions. The reason for the recommendation is because Payment Units 1, 3 and 4 are low and wet.

5.4 - Soil Protection

5.4.1 - Rutting restriction, general (7/16)

Operations are to cease immediately if equipment and weather conditions result in rutting of roads and/or skid trails which is 12 inches or greater in depth and 50 feet in length. The Unit Manager or his/her representative may restrict hauling and/or skidding if ruts exceed the specified depth. With the Unit Manager or his/her representative's approval, the Purchaser may return to the area when the risk of rutting has decreased.

7 - Other Conditions

7.3 - Contract Modifications

7.3.1 - Emerald Ash Borer

7.3.1.2 - Emerald ash borer, ash or firewood on sale (2/05)

There is ash and/or "firewood" in this sale and it is located within an emerald ash borer quarantined area. The Director of the Michigan Department of Agriculture (MDA) by the authority of Act No. 72 of the Public Acts of 1945, as amended, and Quarantine Regulation No. 620, has promulgated this quarantine to prevent the further spread of this pest and sets forth: definitions, regulated articles, regulated areas, conditions of movement, violations and penalties, and special exemptions. The Purchaser must comply with this quarantine. Contact the MDA for further information.



TIMBER SALE MAP

This information provided by authority of Part 525, 1994 PA 451, as amended.

Forest Management Unit Escanaba		County Delta	Mapped By Racine	Date 08/30/2018	Page 1	of 1
Township 41N	Range 23W	Section(s) and Subdivision(s) 12) SENW, SW		Scale 1:15,840		

Cover Type				Density	
A = Aspen	H = Hemlock	N = Marsh	U = Upland Brush	0 = Non Stocked	5 = Pole Timber Medium
B = Paper Birch	J = Jack Pine	O = Oak	UM = Upland Mixed	1 = Seedling Sapling Poor	6 = Pole Timber Well
C = Cedar	L = Lowland Brush	P = Lowland Poplar	V = Bog or Marsh	2 = Seedling Sapling Medium	7 = Saw Timber Poor
D = Treed Bog	LM = Lowland Mixed	Q = Mixed Swamp Conifer	W = White Pine	3 = Seedling Sapling Well	8 = Saw Timber Medium
E = Swamp Hdwoods	M = Mpl, Bch, Brch	R = Red Pine	X = Non Stocked	4 = Pole Timber Poor	9 = Saw Timber Well
F = Spruce Fir	MC = Mixed Conifer	S = Black Spruce	Z = Water		
G = Grass	MD = Mixed Deciduous	T = Tamarack			

PU	Acres	PU	Acres
1	4.2	4	7.4
2	7.1		
3	13.8		

Beaver Lane
Compartment 88
32.5 Acres

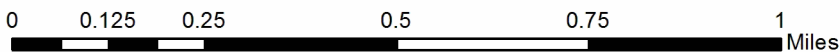
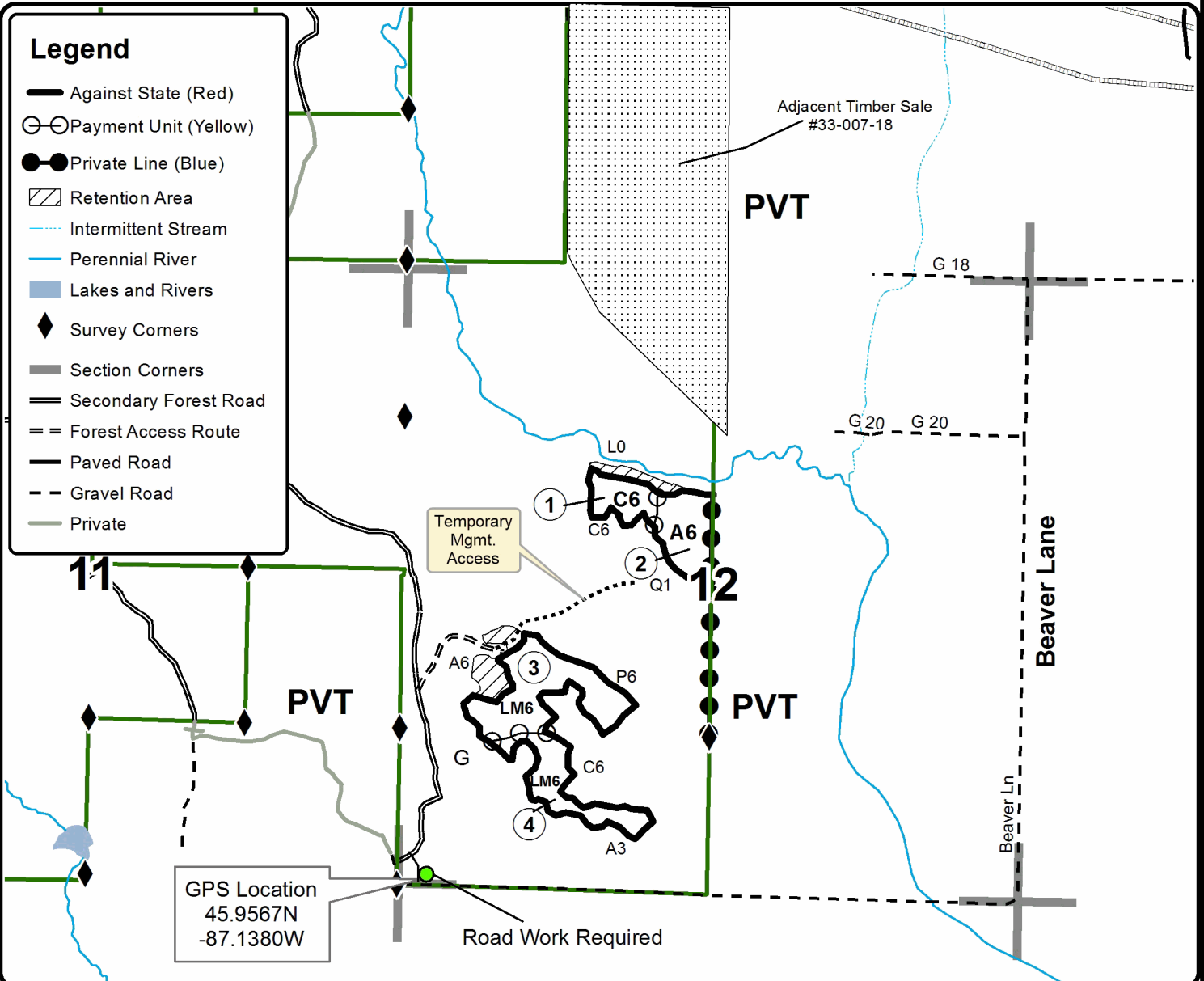
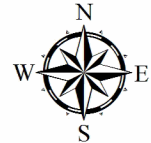

TIMBER SALE INFORMATION

North Deadhorse Mix (33-010-18)

T43N, R22W, SEC. 5; T43N, R22W, SEC. 6; T44N, R22W, SEC. 31; T44N, R22W, SEC. 32.
Alger County (Advertised Price \$138,973.35)

SALE NOTE: This sale will require work in the winter months due to low ground throughout the sale area.

A timber sale contract for this lump sum, sealed bid timber sale will be awarded to the responsible bidder offering the highest sealed bid price. Bids must be at or above the following advertised price for each species:

<u>PRODUCTS & SPECIES</u>	<u>ESTIMATED UNITS*</u>	<u>ADVERTISED PRICE</u>
Sawtimber		
Paper Birch	3.10 MBF	\$ 71.00 / MBF
Red Maple	52.60 MBF	\$ 174.00 / MBF
Sugar Maple	3.80 MBF	\$ 243.00 / MBF
Yellow Birch	5.50 MBF	\$ 103.00 / MBF
Pulpwood		
Balsam Fir	853.00 Cords	\$ 21.20 / Cord
Mixed Aspen	819.00 Cords	\$ 25.25 / Cord
Mixed Hardwood	3,431.00 Cords	\$ 25.25 / Cord
Mixed Spruce	135.00 Cords	\$ 18.45 / Cord
White Pine	9.00 Cords	\$ 24.90 / Cord

* The estimated units are final and not subject to adjustment. Prospective bidders are urged to examine this timber and to make their own estimates of quantity and quality.

BOND AND PAYMENT SCHEDULE:

1. A bond in the amount of \$6,949.00 to insure faithful performance of the conditions of the contract will be deposited by the successful bidder within 21 days of the sale award.
2. Cutting in any sale or unit without the required advance payment would be considered a trespass.
3. Total payment must be paid in advance or according to the following schedule:
 - (a) Ten percent (10%) of the sale value must be paid within 21 days of the sale award.
 - (b) The 10% down payment will be credited towards the first unit cut.
 - (c) Payment for each of the following units must be made before cutting begins in that unit:

<u>PAYMENT UNIT NUMBER</u>	<u>PERCENT OF TOTAL SALE VALUE</u>
01	11.3%
02	4.3%
03	13.6%
04	14.7%
05	8.0%
06	10.9%
07	4.7%
08	7.2%
09	1.0%
10	14.7%
11	9.6%

4. If no cutting takes place, the 10% down payment will not be refunded.
5. Operations on the contract issued will terminate on 12/31/2021.

Description of Timber by Payment Unit (PU)

PU	MARKET GROUP	PRODUCT	QUANTITY	UNIT	ACRES	ADVERTISE PRICE
1	Red Maple	Sawtimber	10.8	MBF	52.4	\$15,655.95
	Sugar Maple		0.9	MBF		
	Balsam Fir	Pulpwood	19.0	Cords		
	Mixed Aspen		10.0	Cords		
	<i>Balsam Poplar</i>		10.0	<i>Cords</i>		
	Mixed Hardwood		511.0	Cords		
	<i>American Elm</i>		3.0	<i>Cords</i>		
	<i>Black Ash</i>		41.0	<i>Cords</i>		
	<i>Red Maple</i>		419.0	<i>Cords</i>		
	<i>Sugar Maple</i>		48.0	<i>Cords</i>		
	2	Red Maple	Sawtimber	3.0		
Yellow Birch			1.1	MBF		
Balsam Fir		Pulpwood	52.0	Cords		
Mixed Aspen			1.0	Cords		
<i>Balsam Poplar</i>			1.0	<i>Cords</i>		
Mixed Hardwood			160.0	Cords		
<i>Black Ash</i>			19.0	<i>Cords</i>		
<i>Red Maple</i>			93.0	<i>Cords</i>		
<i>Sugar Maple</i>			5.0	<i>Cords</i>		
<i>Yellow Birch</i>			43.0	<i>Cords</i>		
Mixed Spruce			4.0	Cords		
<i>Black Spruce</i>			1.0	<i>Cords</i>		
<i>White Spruce</i>			3.0	<i>Cords</i>		
White Pine			2.0	Cords		
3	Red Maple	Sawtimber	9.5	MBF	54.8	\$18,855.00
	Yellow Birch		3.4	MBF		
	Balsam Fir	Pulpwood	165.0	Cords		
	Mixed Aspen		3.0	Cords		
	<i>Balsam Poplar</i>		3.0	<i>Cords</i>		
	Mixed Hardwood		508.0	Cords		
	<i>Black Ash</i>		59.0	<i>Cords</i>		
	<i>Red Maple</i>		297.0	<i>Cords</i>		
	<i>Sugar Maple</i>		15.0	<i>Cords</i>		
	<i>Yellow Birch</i>		137.0	<i>Cords</i>		
	Mixed Spruce		15.0	Cords		
	<i>Black Spruce</i>		4.0	<i>Cords</i>		
	<i>White Spruce</i>		11.0	<i>Cords</i>		
	White Pine		7.0	Cords		
4	Red Maple	Sawtimber	2.5	MBF	34.5	\$20,541.65
	Balsam Fir	Pulpwood	106.0	Cords		
	Mixed Aspen		26.0	Cords		
	<i>Balsam Poplar</i>		26.0	<i>Cords</i>		
	Mixed Hardwood		655.0	Cords		
	<i>Black Ash</i>		8.0	<i>Cords</i>		
	<i>Black Cherry</i>		3.0	<i>Cords</i>		
	<i>Paper Birch</i>		3.0	<i>Cords</i>		
	<i>Red Maple</i>		613.0	<i>Cords</i>		
	<i>Yellow Birch</i>		28.0	<i>Cords</i>		
	Mixed Spruce		36.0	Cords		
	<i>White Spruce</i>		36.0	<i>Cords</i>		
	5	Paper Birch	Sawtimber	1.5		
Red Maple			0.8	MBF		
Yellow Birch			1.0	MBF		
Balsam Fir		Pulpwood	134.0	Cords		
Mixed Aspen			92.0	Cords		
<i>Balsam Poplar</i>			89.0	<i>Cords</i>		

Description of Timber by Payment Unit (PU), con't

PU	MARKET GROUP	PRODUCT	QUANTITY	UNIT	ACRES	ADVERTISE PRICE
5 con't	<i>Quaking Aspen</i>	<i>Pulpwood</i>	3.0	<i>Cords</i>		
	Mixed Hardwood		213.0	Cords		
	<i>Paper Birch</i>		61.0	<i>Cords</i>		
	<i>Red Maple</i>		104.0	<i>Cords</i>		
	<i>Yellow Birch</i>		48.0	<i>Cords</i>		
	Mixed Spruce		12.0	Cords		
	<i>White Spruce</i>		12.0	<i>Cords</i>		
6	Paper Birch	Sawtimber	0.5	MBF	45.1	\$15,178.60
	Red Maple		5.7	MBF		
	Balsam Fir	<i>Pulpwood</i>	143.0	Cords		
	Mixed Aspen		46.0	Cords		
	<i>Balsam Poplar</i>		30.0	<i>Cords</i>		
	<i>Quaking Aspen</i>		16.0	<i>Cords</i>		
	Mixed Hardwood		390.0	Cords		
	<i>Black Ash</i>		23.0	<i>Cords</i>		
	<i>Paper Birch</i>		10.0	<i>Cords</i>		
	<i>Red Maple</i>		357.0	<i>Cords</i>		
	Mixed Spruce		6.0	Cords		
	<i>White Spruce</i>		6.0	<i>Cords</i>		
	7		Paper Birch	Sawtimber		
Red Maple			1.9	MBF		
Balsam Fir		<i>Pulpwood</i>	65.0	Cords		
Mixed Aspen			19.0	Cords		
<i>Balsam Poplar</i>			9.0	<i>Cords</i>		
<i>Quaking Aspen</i>			10.0	<i>Cords</i>		
Mixed Hardwood			166.0	Cords		
<i>Black Ash</i>			23.0	<i>Cords</i>		
<i>Paper Birch</i>			21.0	<i>Cords</i>		
<i>Red Maple</i>			99.0	<i>Cords</i>		
<i>Yellow Birch</i>			23.0	<i>Cords</i>		
Mixed Spruce			7.0	Cords		
<i>Black Spruce</i>			4.0	<i>Cords</i>		
<i>White Spruce</i>			3.0	<i>Cords</i>		
8	Paper Birch	Sawtimber	0.5	MBF	36.8	\$9,951.75
	Red Maple		2.8	MBF		
	Balsam Fir	<i>Pulpwood</i>	99.0	Cords		
	Mixed Aspen		29.0	Cords		
	<i>Balsam Poplar</i>		13.0	<i>Cords</i>		
	<i>Quaking Aspen</i>		16.0	<i>Cords</i>		
	Mixed Hardwood		254.0	Cords		
	<i>Black Ash</i>		35.0	<i>Cords</i>		
	<i>Paper Birch</i>		32.0	<i>Cords</i>		
	<i>Red Maple</i>		152.0	<i>Cords</i>		
	<i>Yellow Birch</i>		35.0	<i>Cords</i>		
	Mixed Spruce		10.0	Cords		
	<i>Black Spruce</i>		6.0	<i>Cords</i>		
<i>White Spruce</i>	4.0	<i>Cords</i>				
9	Paper Birch	Sawtimber	0.3	MBF	4.0	\$1,370.30
	Red Maple		0.3	MBF		
	Balsam Fir	<i>Pulpwood</i>	4.0	Cords		
	Mixed Hardwood		48.0	Cords		
	<i>Paper Birch</i>		2.0	<i>Cords</i>		
	<i>Red Maple</i>		45.0	<i>Cords</i>		
	<i>Yellow Birch</i>		1.0	<i>Cords</i>		
10	Red Maple	Sawtimber	9.8	MBF	28.0	\$20,477.40
	Sugar Maple		1.1	MBF		

Description of Timber by Payment Unit (PU), con't

PU	MARKET GROUP	PRODUCT	QUANTITY	UNIT	ACRES	ADVERTISE PRICE			
10 con't	Balsam Fir	Pulpwood	20.0	Cords					
	Mixed Aspen		420.0	Cords					
	<i>B. T. Aspen</i>		26.0	<i>Cords</i>					
	<i>Balsam Poplar</i>		75.0	<i>Cords</i>					
	<i>Quaking Aspen</i>		319.0	<i>Cords</i>					
	Mixed Hardwood		280.0	Cords					
	<i>American Elm</i>		4.0	<i>Cords</i>					
	<i>Black Ash</i>		35.0	<i>Cords</i>					
	<i>Paper Birch</i>		2.0	<i>Cords</i>					
	<i>Red Maple</i>		187.0	<i>Cords</i>					
	<i>Sugar Maple</i>		52.0	<i>Cords</i>					
	Mixed Spruce		22.0	Cords					
	<i>White Spruce</i>		22.0	<i>Cords</i>					
	11		Red Maple	Sawtimber			5.5	MBF	20.4
Sugar Maple			1.8	MBF					
Balsam Fir		Pulpwood	46.0	Cords					
Mixed Aspen			173.0	Cords					
<i>Balsam Poplar</i>			56.0	<i>Cords</i>					
<i>Quaking Aspen</i>			117.0	<i>Cords</i>					
Mixed Hardwood			246.0	Cords					
<i>Black Ash</i>			58.0	<i>Cords</i>					
<i>Paper Birch</i>			47.0	<i>Cords</i>					
<i>Red Maple</i>			108.0	<i>Cords</i>					
<i>Sugar Maple</i>			17.0	<i>Cords</i>					
<i>Yellow Birch</i>			16.0	<i>Cords</i>					
Mixed Spruce			23.0	Cords					
<i>Black Spruce</i>			6.0	<i>Cords</i>					
<i>White Spruce</i>			17.0	<i>Cords</i>					
TOTAL:			65.0	MBF					
TOTAL:			5,247.0	Cords					

Sale Specific Conditions & Requirements

Sale Name: North Deadhorse Mix

Sale Number: 33-010-18 Seq#: 1

1 - Sale Area

1.2 - Boundaries

1.2.1 - Painted boundaries (1/14)

The sale boundary and Payment Unit boundaries are marked and identified by blue, red and yellow paint. Exterior sale boundary lines against private property are marked with blue paint. Exterior sale boundary lines against state are marked with red paint. Interior Payment Unit boundaries are marked with yellow paint, with the exception of the boundary between Payment Units 2 and 3, which is marked with red paint. The painted boundary line trees are not Included Timber and are to be protected unless marked with orange paint. Yellow painted trees and the red painted trees between Payment Units 2 and 3, designating an interior Payment Unit boundary are only to be cut when all surrounding Payment Units have been paid.

2 - Timber Specifications

2.1 - Included Timber

2.1.2 - Clearcut unit(s) w/o unmerchantable trees (8/11)

Within Payment Unit(s) 2, 3, 4, 5, 7, 8, 10 and 11, cut all trees which meet minimum piece specifications in 2.2 Utilization, with the following exceptions:

- Within Payment Units 2, 3, 7, and 8, do not cut cedar and hemlock.
- Within Payment Unit 4, do not cut cedar, hemlock, pine, trees greater than 26 inches at DBH and trees marked with green paint.
- Within Payment Unit 5, do not cut cedar, hemlock and trees greater than 26 inches at DBH.
- Within Payment Unit 10, do not cut cedar, hemlock, yellow birch and pine.
- Within Payment Unit 11, do not cut cedar.

2.1.4 - Designated timber unit(s) (6/17)

Within Payment Unit(s) 6, all maple, spruce/fir, paper birch, aspen, balsam and ash trees are designated for cutting which meet minimum piece specifications in 2.2 - Utilization.

2.1.7 - Leave tree marked unit(s) (6/14)

Within Payment Unit(s) 1 and 9, cut all trees that are two (2) inches or more at DBH, except do not cut trees marked with green paint above and below stump height. In addition, within Payment Unit 1, do not cut cedar, hemlock and birch trees.

2.1.9 - Harvest exception (12/08)

Do not cut any cedar trees other than those that are necessary to remove in order to operate within the sale area. Every effort must be made to preserve the existing cedar and to leave an intact stand upon sale completion. All cut cedar shall be piled separately by products and scaled in the woods unless other scaling arrangements are agreed to by the Unit Manager or his/her representative. Stumpage price for cedar shall be \$50.00 per cord for posts and pulpwood, and \$100.00 per cord for bolts and sawlogs.

3 - Payments

3.3 - Pre-measured Sales

3.3.4 - Dividing payment units (7/14)

Payment Unit(s) with a contract bid value of \$20,000 or greater may be divided at the request of the Purchaser and upon approval of the Unit Manager. Dividing Payment Units is a contract modification which requires a Timber Sale Contract Supplement. There will be only one division per Payment Unit.

3.4 - Damaged Timber

3.4.1 - Damaged timber (6/14)

General Condition and Requirement 3.4 Damaged Timber, defines liquidated damages for undesignated live merchantable trees which are cut or injured. In addition, extreme care should be taken to avoid damage to tree seedlings and saplings.

Within Payment Unit 1, if more than 25% of the tree seedlings or saplings (1/4" to 4.5" DBH) within a specified portion of the sale area are damaged, liquidated damages will be assessed at \$100 per acre for all acreage within that specified portion of the sale area that was damaged.

4 - Transportation

4.1 - Construction

4.1.1 - Stream crossings, general (3/11)

All stream crossing structures will be temporary and therefore, shall be provided by the Purchaser, and must be removed upon completion of the sale. All permits for stream crossings will be provided by the DNR.

4.1.5 - Culverts (5/14)

Roads may require the installation of culverts for cross drainage or at natural drainage-ways. If culverts are needed in these locations, their placement will be specified by the sale administrator and they shall be installed prior to hauling. The culverts shall be new, corrugated metal or plastic gauge. Culverts will be a minimum of 12 inches in diameter and 24 feet in length. If culverts are removed, fill shall be removed from wetland soils as specified. Soils shall be maintained and left in a non-erodible condition, with water bars, seed, fertilizer, mulch, and slash installed as directed by the sale administrator and as specified in the BMP manual. Stream crossing permits, if needed, will be obtained by the DNR.

4.1.6 - Road construction (1/09)

Construction of new roads or improvements of existing roads shall be done in such a way as to minimize the environmental and visual impacts. Merchantable trees shall be cut and utilized unless otherwise directed. Non-merchantable trees shall be severed and laid flat on the ground. Slash shall be scattered, and not left in windrows and kept a minimum of 10 feet back from the road edge. Stumps shall be set upright, not left on edge, and be moved at least 10 feet away from the road edge. Disturbed soil shall be feathered into the woods and not left in berms or windrows.

4.1.7 - Road closure (10/11)

All new roads built into the sale must be blocked to vehicle traffic upon completion of the sale. Overgrown roads that are reopened shall be considered new roads. In general, this will require constructing a four (4') foot high berm of stumps and logs covered with earth. Contact the sale administrator for specific details of design and placement.

4.2 - Maintenance

4.2.2 - Fill material (4/07)

To maintain roads, fill material may be needed in areas where "holes" exist or may be expected to develop. This fill material should be placed before trucking begins. Contact the sale administrator regarding the availability of onsite sand or gravel from adjacent State-owned lands.

4.2.4 - Grading (10/16)

For completion of the sale, state forest roads must be graded. In general, this will require a road grader or bull dozer to shape up the roads after forest products have been hauled off site. This includes cleaning of drainage areas, grading, crowning and filling with gravel, if necessary. The grading equipment to be used must be approved by the Unit Manager or his/her representative.

5 - Operations

5.2 - Conduct of Operations

5.2.2 - Hazard Trees/Snags

5.2.2.1 - Den trees (10/16)

Obvious hollow and/or den trees shall be protected and left standing unless they are a safety hazard.

5.2.3 - Operating Restrictions

5.2.3.1 - Operating restrictions (9/11)

Within Payment Unit(s) 7, 8, 9, 10 and 11, unless changed by written agreement, cutting, skidding, and hauling are limited to the period of December 1 to March 31 or frozen ground conditions. This restriction is because these units are or contain low wet ash swales.

5.2.22 - Operating Caution

5.2.22.1 - Operating caution (6/11)

It is recommended, but not required, that within Payment Unit(s) 1, 2, 3, 4, 5 and 6, cutting, skidding, and hauling occur during dry summer or frozen winter conditions. The reason for the recommendation is because portions of these units have low wet ground and susceptible to rutting.

5.4 - Soil Protection

5.4.1 - Rutting restriction, general (7/16)

Operations are to cease immediately if equipment and weather conditions result in rutting of roads and/or skid trails which is 12 inches or greater in depth and 50 feet in length. The Unit Manager or his/her representative may restrict hauling and/or skidding if ruts exceed the specified depth. With the Unit Manager or his/her representative's approval, the Purchaser may return to the area when the risk of rutting has decreased. Note that existing ruts from previous sale activity are within Payment Unit 1.

6 - Safety and Fire Prevention

6.2 - Signing

6.2.1 - Road posting (9/09)

The Purchaser is responsible for posting and maintaining caution signs on the North Deadhorse Road prior to beginning operations. The road must be posted at appropriate distances from the sale area to warn of logging activity and truck traffic. Signs must be removed when harvest operations are suspended or completed. The Purchaser will provide these signs.

7 - Other Conditions

7.3 - Contract Modifications

7.3.1 - Emerald Ash Borer

7.3.1.2 - Emerald ash borer, ash or firewood on sale (2/05)

There is ash and/or "firewood" in this sale and it is located within an emerald ash borer quarantined area. The Director of the Michigan Department of Agriculture (MDA) by the authority of Act No. 72 of the Public Acts of 1945, as amended, and Quarantine Regulation No. 620, has promulgated this quarantine to prevent the further spread of this pest and sets forth: definitions, regulated articles, regulated areas, conditions of movement, violations and penalties, and special exemptions. The Purchaser must comply with this quarantine. Contact the MDA for further information.



TIMBER SALE MAP

This information provided by authority of Part 525, 1994 PA 451, as amended.

Sale Number	Year
33-010	18

Forest Management Unit Escanaba	County Delta	Mapped By Racine	Date 9/27/2018	Page 1	of 1
Township 44/43N	Range 22W	Section(s) and Subdivision(s) 44/22 31) SESE 32) S1/2SW	Scale 1:15,840		

Cover Type

A = Aspen	H = Hemlock	N = Marsh	U = Upland Brush
B = Paper Birch	J = Jack Pine	O = Oak	UM = Upland Mixed
C = Cedar	L = Lowland Brush	P = Lowland Poplar	V = Bog or Marsh
D = Treed Bog	LM = Lowland Mixed	Q = Mixed Swamp Conifer	W = White Pine
E = Swamp Hdwoods	M = Mpl. Bch, Brch	R = Red Pine	X = Non Stocked
F = Spruce Fir	MC = Mixed Conifer	S = Black Spruce	Z = Water
G = Grass	MD = Mixed Deciduous	T = Tamarack	

Density

0 = Non Stocked	5 = Pole Timber Medium
1 = Seedling Sapling Poor	6 = Pole Timber Well
2 = Seedling Sapling Medium	7 = Saw Timber Poor
3 = Seedling Sapling Well	8 = Saw Timber Medium
4 = Pole Timber Poor	9 = Saw Timber Well

PU Acres PU Acres

1	52.4	7	24
2	17.1	8	36.8
3	54.8	9	4
4	34.5	10	28
5	18.2	11	20.4
6	45.1		



North Deadhorse Mix

Compartment 90/91

335.3 Acres

Legend

- Against State (Red)
- Payment Unit (Yellow/Red)
- Private Line (Blue)
- Primary Forest Road
- Secondary Forest Road
- Forest Access Route
- Gravel Road
- Private
- Streams
- Survey Corners
- Section Corners
- Retention Area
- Gates and Berms**
- Gate

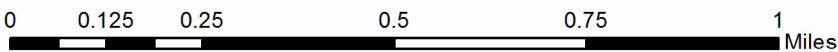
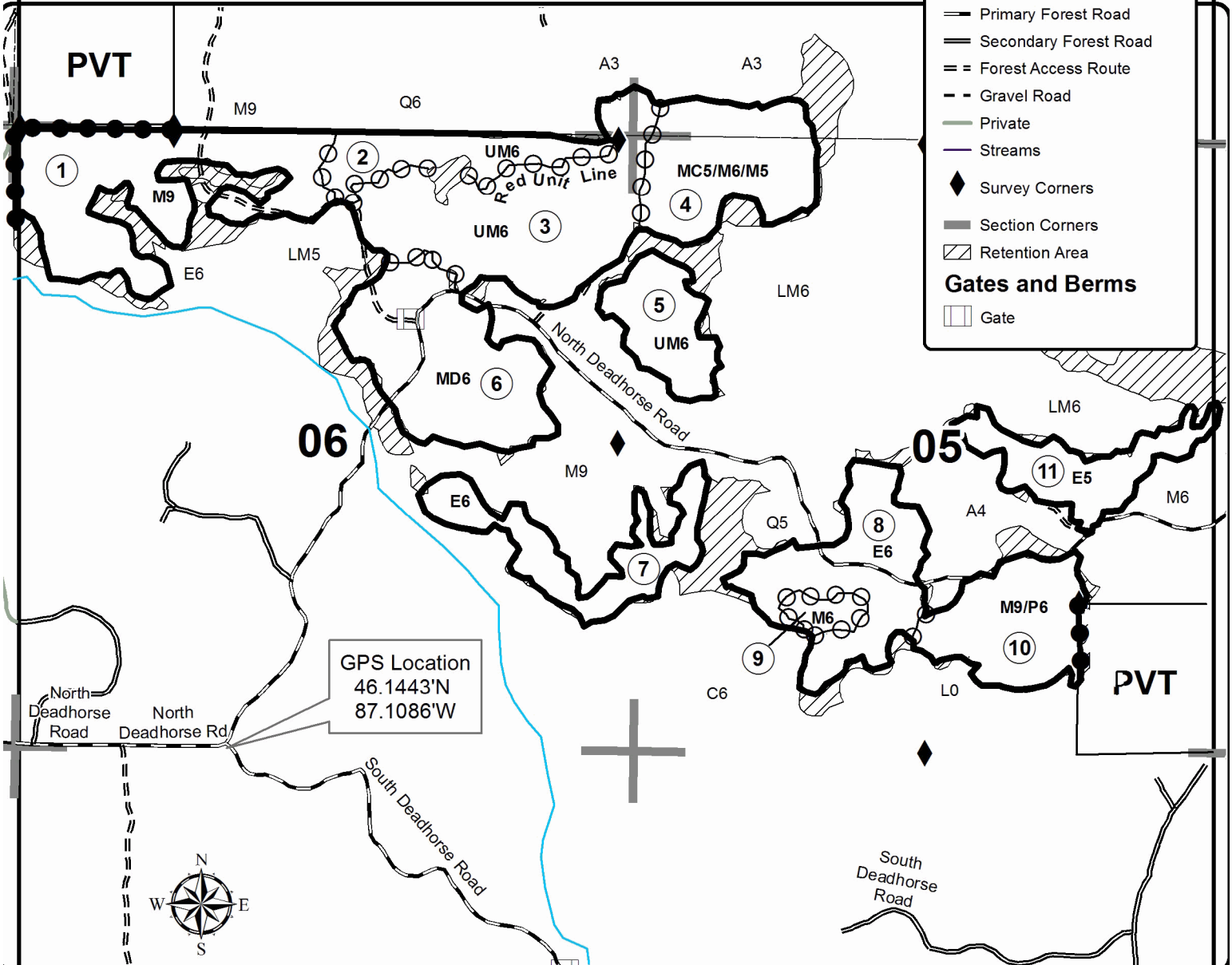

Wood Tick (33-005-18)

T41N, R23W, SEC. 11; T41N, R23W, SEC. 2; Delta COUNTY

In response to the notice of sale to be held 3:00 p.m. (local time) on December 18, 2018, I am hereby submitting my sealed bid (firm offer) for the following forest products to be cut. Bids for individual species must be at or above the advertised price. All non-responsive bid forms may be rejected.

<u>PRODUCTS & SPECIES</u>	<u>ESTIMATED VOLUME*</u>	<u>ADVERTISED PRICE</u>	<u>BID PRICE/UNIT</u>
Sawtimber			
Basswood	5.60 MBF	\$ 106.00/MBF	\$ _____
Paper Birch	0.80 MBF	\$ 82.00/MBF	\$ _____
Red Maple	10.40 MBF	\$ 201.00/MBF	\$ _____
Sugar Maple	13.40 MBF	\$ 281.00/MBF	\$ _____
White Ash	3.50 MBF	\$ 64.00/MBF	\$ _____
Pulpwood			
Balsam Fir	94.00 Cords	\$ 24.45/Cord	\$ _____
Mixed Hardwood	436.00 Cords	\$ 29.15/Cord	\$ _____
N. White Cedar	17.00 Cords	\$ 21.15/Cord	\$ _____
Quaking Aspen	442.00 Cords	\$ 29.15/Cord	\$ _____
White Spruce	5.00 Cords	\$ 21.30/Cord	\$ _____

*The volumes are statistically estimated within plus (+) or minus (-) 14.22 percent. These estimated volumes are final and not subject to adjustment. Prospective bidders are urged to examine this timber and to make their own estimates of quantity and quality.

I understand that any or all bids may be rejected. All bids must be signed and all bid items must be bid or the bid form may be rejected. I also understand that consideration and awarding a contract will be based upon my past performance and ability to complete the contract based upon equipment and staffing subject to my control.

FEDERAL ID: _____ or SOCIAL SECURITY NUMBER: _____

Company or individual bidding: _____

Company representative's name: _____

Address: _____

City: _____ State: _____ Zip: _____

IF AVAILABLE, PLEASE PLACE THE PERSONALIZED LABEL FROM YOUR PROSPECTUS IN THE ABOVE BOX.

Individual or company representative's signature: _____ Date: _____

Phone number : _____ Email (optional): _____

THE WINNING BIDDER MUST COMPLETE THE VERIFICATION OF WORKER'S DISABILITY COMPENSATION ACT COMPLIANCE (ON REVERSE SIDE IF DOUBLE SIDED) WITHIN 21 DAYS OF SALE AWARD DATE



FOR DEPARTMENT USE ONLY
Sale Number (XX - XXX - XX - XX)
Forest Management Unit:

TIMBER SALE VERIFICATION OF WORKER'S DISABILITY COMPENSATION ACT COMPLIANCE

*As required by Act 317, P.A. 1969 (Worker's Compensation) and
Part 5 of Act 451 of 1994, as amended.*

VERIFICATION OF WORKER'S DISABILITY COMPENSATION ACT COMPLIANCE

- This verification must be completed and submitted within 21 days of contract award and prior to the issuance of the timber sale contract.
- In addition, if boxes 2B or 2C are checked, then Notice of Exclusion or Certificate of Insurance must be submitted within twenty-one (21) days of the contract award and prior to the issuance of the timber sale contract.
- All information must be typed or printed except for written signatures.

Please Check Appropriate Categories:

1. My business is organized as (you **must** check one of the boxes below):
 - A. Sole Proprietorship (individual)
 - B. Partnership
 - C. Corporation

2. You **must** check one of the boxes below:
 - A. I certify my business is a sole proprietorship and it has no employees but the sole proprietor. I am not subject to the Worker's Compensation Laws.
 - B. I certify my business has satisfied its obligation to the Worker's Compensation Act through the use of an approved Notice of Exclusion (BWC-337, Rev. 5/96). I will provide a copy of the Notice of Exclusion within 21 days of the contract award. (For questions or a copy of the BWC-337, please call the Worker's Compensation Bureau at 517-322-1195).
 - C. I certify my business has a Worker's Compensation Policy. I will provide an original Certificate of Insurance within twenty-one (21) days of the contract award.

3. If you have checked item 2(A) or 2(B), you **must** indicate the number of **both** full-time and part-time employees, other than yourself, including family members and active partners (if none, you must enter "0").

_____ Full-time Employees

_____ Part-time Employees

Name of Business		Federal ID (or) Social Security No.	
Address		Telephone ()	
City	State	ZIP	

I hereby certify that the above information is true and correct. I agree to notify the Michigan DNR of any changes that occur in factors affecting my coverage during any of my present and future operations.

Signature of Owner or Authorized Representative

Title

Date

Please complete the "SEALED BID" information on the next page

Pipeline (33-006-18)

T41N, R23W, SEC. 1; T41N, R23W, SEC. 12; Delta COUNTY

In response to the notice of sale to be held 3:00 p.m. (local time) on December 18, 2018, I am hereby submitting my sealed bid (firm offer) for the following forest products to be cut. Bids for individual species must be at or above the advertised price. All non-responsive bid forms may be rejected.

<u>PRODUCTS & SPECIES</u>	<u>ESTIMATED VOLUME*</u>	<u>ADVERTISED PRICE</u>	<u>BID PRICE/UNIT</u>
Sawtimber			
Paper Birch	1.50 MBF	\$ 71.00/MBF	\$ _____
Red Maple	11.10 MBF	\$ 174.00/MBF	\$ _____
Sugar Maple	0.50 MBF	\$ 243.00/MBF	\$ _____
White Ash	1.60 MBF	\$ 55.00/MBF	\$ _____
Pulpwood			
Balsam Fir	334.00 Cords	\$ 21.20/Cord	\$ _____
Mixed Hardwood	695.00 Cords	\$ 25.25/Cord	\$ _____
Mixed Spruce	78.00 Cords	\$ 18.45/Cord	\$ _____
N. White Cedar	273.00 Cords	\$ 18.35/Cord	\$ _____
Quaking Aspen	472.00 Cords	\$ 25.25/Cord	\$ _____
Tamarack	48.00 Cords	\$ 16.05/Cord	\$ _____

*The volumes are statistically estimated within plus (+) or minus (-) 11.76 percent. These estimated volumes are final and not subject to adjustment. Prospective bidders are urged to examine this timber and to make their own estimates of quantity and quality.

I understand that any or all bids may be rejected. All bids must be signed and all bid items must be bid or the bid form may be rejected. I also understand that consideration and awarding a contract will be based upon my past performance and ability to complete the contract based upon equipment and staffing subject to my control.

FEDERAL ID: _____ or SOCIAL SECURITY NUMBER: _____

Company or individual bidding: _____

Company representative's name: _____

Address: _____

City: _____ State: _____ Zip: _____

IF AVAILABLE, PLEASE PLACE THE PERSONALIZED LABEL FROM YOUR PROSPECTUS IN THE ABOVE BOX.

Individual or company representative's signature: _____ Date: _____

Phone number : _____ Email (optional): _____

THE WINNING BIDDER MUST COMPLETE THE VERIFICATION OF WORKER'S DISABILITY COMPENSATION ACT COMPLIANCE (ON REVERSE SIDE IF DOUBLE SIDED) WITHIN 21 DAYS OF SALE AWARD DATE



FOR DEPARTMENT USE ONLY
Sale Number (XX - XXX - XX - XX)
Forest Management Unit:

TIMBER SALE VERIFICATION OF WORKER'S DISABILITY COMPENSATION ACT COMPLIANCE

*As required by Act 317, P.A. 1969 (Worker's Compensation) and
Part 5 of Act 451 of 1994, as amended.*

VERIFICATION OF WORKER'S DISABILITY COMPENSATION ACT COMPLIANCE

- This verification must be completed and submitted within 21 days of contract award and prior to the issuance of the timber sale contract.
- In addition, if boxes 2B or 2C are checked, then Notice of Exclusion or Certificate of Insurance must be submitted within twenty-one (21) days of the contract award and prior to the issuance of the timber sale contract.
- All information must be typed or printed except for written signatures.

Please Check Appropriate Categories:

1. My business is organized as (you **must** check one of the boxes below):
 - A. Sole Proprietorship (individual)
 - B. Partnership
 - C. Corporation
2. You **must** check one of the boxes below:
 - A. I certify my business is a sole proprietorship and it has no employees but the sole proprietor. I am not subject to the Worker's Compensation Laws.
 - B. I certify my business has satisfied its obligation to the Worker's Compensation Act through the use of an approved Notice of Exclusion (BWC-337, Rev. 5/96). I will provide a copy of the Notice of Exclusion within 21 days of the contract award. (For questions or a copy of the BWC-337, please call the Worker's Compensation Bureau at 517-322-1195).
 - C. I certify my business has a Worker's Compensation Policy. I will provide an original Certificate of Insurance within twenty-one (21) days of the contract award.
3. If you have checked item 2(A) or 2(B), you **must** indicate the number of **both** full-time and part-time employees, other than yourself, including family members and active partners (if none, you must enter "0").

_____ Full-time Employees

_____ Part-time Employees

Name of Business		Federal ID (or) Social Security No.	
Address		Telephone ()	
City	State	ZIP	

I hereby certify that the above information is true and correct. I agree to notify the Michigan DNR of any changes that occur in factors affecting my coverage during any of my present and future operations.

Signature of Owner or Authorized Representative

Title

Date

Please complete the "SEALED BID" information on the next page

Beaver Lane (33-007-18)
T41N, R23W, SEC. 12; Delta COUNTY

In response to the notice of sale to be held 3:00 p.m. (local time) on December 18, 2018, I am hereby submitting my sealed bid (firm offer) for the following forest products to be cut. Bids for individual species must be at or above the advertised price. All non-responsive bid forms may be rejected.

<u>PRODUCTS & SPECIES</u>	<u>ESTIMATED VOLUME*</u>	<u>ADVERTISED PRICE</u>	<u>BID PRICE/UNIT</u>
Sawtimber			
Paper Birch	3.30 MBF	\$ 66.00/MBF	\$ _____
Red Maple	1.60 MBF	\$ 160.00/MBF	\$ _____
Pulpwood			
Balsam Fir	81.00 Cords	\$ 19.55/Cord	\$ _____
Mixed Aspen	122.00 Cords	\$ 23.30/Cord	\$ _____
Mixed Hardwood	92.00 Cords	\$ 23.35/Cord	\$ _____
Mixed Spruce	24.00 Cords	\$ 17.05/Cord	\$ _____
N. White Cedar	347.00 Cords	\$ 16.95/Cord	\$ _____
Tamarack	168.00 Cords	\$ 14.85/Cord	\$ _____

*The volumes are statistically estimated within plus (+) or minus (-) 25.53 percent. These estimated volumes are final and not subject to adjustment. Prospective bidders are urged to examine this timber and to make their own estimates of quantity and quality.

I understand that any or all bids may be rejected. All bids must be signed and all bid items must be bid or the bid form may be rejected. I also understand that consideration and awarding a contract will be based upon my past performance and ability to complete the contract based upon equipment and staffing subject to my control.

FEDERAL ID: _____ or SOCIAL SECURITY NUMBER: _____

Company or individual bidding: _____

Company representative's name: _____

Address: _____

City: _____ State: _____ Zip: _____

IF AVAILABLE, PLEASE PLACE THE PERSONALIZED LABEL FROM YOUR PROSPECTUS IN THE ABOVE BOX.

Individual or company representative's signature: _____ Date: _____

Phone number : _____ Email (optional): _____

THE WINNING BIDDER MUST COMPLETE THE VERIFICATION OF WORKER'S DISABILITY COMPENSATION ACT COMPLIANCE (ON REVERSE SIDE IF DOUBLE SIDED) WITHIN 21 DAYS OF SALE AWARD DATE



FOR DEPARTMENT USE ONLY
Sale Number (XX - XXX - XX - XX)
Forest Management Unit:

TIMBER SALE VERIFICATION OF WORKER'S DISABILITY COMPENSATION ACT COMPLIANCE

*As required by Act 317, P.A. 1969 (Worker's Compensation) and
Part 5 of Act 451 of 1994, as amended.*

VERIFICATION OF WORKER'S DISABILITY COMPENSATION ACT COMPLIANCE

- This verification must be completed and submitted within 21 days of contract award and prior to the issuance of the timber sale contract.
- In addition, if boxes 2B or 2C are checked, then Notice of Exclusion or Certificate of Insurance must be submitted within twenty-one (21) days of the contract award and prior to the issuance of the timber sale contract.
- All information must be typed or printed except for written signatures.

Please Check Appropriate Categories:

1. My business is organized as (you **must** check one of the boxes below):
 - A. Sole Proprietorship (individual)
 - B. Partnership
 - C. Corporation
2. You **must** check one of the boxes below:
 - A. I certify my business is a sole proprietorship and it has no employees but the sole proprietor. I am not subject to the Worker's Compensation Laws.
 - B. I certify my business has satisfied its obligation to the Worker's Compensation Act through the use of an approved Notice of Exclusion (BWC-337, Rev. 5/96). I will provide a copy of the Notice of Exclusion within 21 days of the contract award. (For questions or a copy of the BWC-337, please call the Worker's Compensation Bureau at 517-322-1195).
 - C. I certify my business has a Worker's Compensation Policy. I will provide an original Certificate of Insurance within twenty-one (21) days of the contract award.
3. If you have checked item 2(A) or 2(B), you **must** indicate the number of **both** full-time and part-time employees, other than yourself, including family members and active partners (if none, you must enter "0").

_____ Full-time Employees

_____ Part-time Employees

Name of Business		Federal ID (or) Social Security No.	
Address		Telephone ()	
City	State	ZIP	

I hereby certify that the above information is true and correct. I agree to notify the Michigan DNR of any changes that occur in factors affecting my coverage during any of my present and future operations.

Signature of Owner or Authorized Representative

Title

Date

Please complete the "SEALED BID" information on the next page

North Deadhorse Mix (33-010-18)

T43N, R22W, SEC. 5; T43N, R22W, SEC. 6; T44N, R22W, SEC. 31; T44N, R22W,

In response to the notice of sale to be held 3:00 p.m. (local time) on December 18, 2018, I am hereby submitting my sealed bid (firm offer) for the following forest products to be cut. Bids for individual species must be at or above the advertised price. All non-responsive bid forms may be rejected.

<u>PRODUCTS & SPECIES</u>	<u>ESTIMATED VOLUME*</u>	<u>ADVERTISED PRICE</u>	<u>BID PRICE/UNIT</u>
Sawtimber			
Paper Birch	3.10 MBF	\$ 71.00/MBF	\$ _____
Red Maple	52.60 MBF	\$ 174.00/MBF	\$ _____
Sugar Maple	3.80 MBF	\$ 243.00/MBF	\$ _____
Yellow Birch	5.50 MBF	\$ 103.00/MBF	\$ _____
Pulpwood			
Balsam Fir	853.00 Cords	\$ 21.20/Cord	\$ _____
Mixed Aspen	819.00 Cords	\$ 25.25/Cord	\$ _____
Mixed Hardwood	3,431.00 Cords	\$ 25.25/Cord	\$ _____
Mixed Spruce	135.00 Cords	\$ 18.45/Cord	\$ _____
White Pine	9.00 Cords	\$ 24.90/Cord	\$ _____

*These estimated volumes are final and not subject to adjustment. Prospective bidders are urged to examine this timber and to make their own estimates of quantity and quality.

I understand that any or all bids may be rejected. All bids must be signed and all bid items must be bid or the bid form may be rejected. I also understand that consideration and awarding a contract will be based upon my past performance and ability to complete the contract based upon equipment and staffing subject to my control.

FEDERAL ID: ____ - ____ - ____ or SOCIAL SECURITY NUMBER: ____ - ____ - ____

Company or individual bidding: _____

Company representative's name: _____

Address: _____

City: _____ State: _____ Zip: _____

IF AVAILABLE, PLEASE PLACE THE PERSONALIZED LABEL FROM YOUR PROSPECTUS IN THE ABOVE BOX.

Individual or company representative's signature: _____ Date: _____

Phone number : _____ Email (optional): _____

THE WINNING BIDDER MUST COMPLETE THE VERIFICATION OF WORKER'S DISABILITY COMPENSATION ACT COMPLIANCE (ON REVERSE SIDE IF DOUBLE SIDED) WITHIN 21 DAYS OF SALE AWARD DATE



FOR DEPARTMENT USE ONLY	
Sale Number (XX - XXX - XX - XX)	
Forest Management Unit:	

TIMBER SALE VERIFICATION OF WORKER'S DISABILITY COMPENSATION ACT COMPLIANCE

As required by Act 317, P.A. 1969 (Worker's Compensation) and
Part 5 of Act 451 of 1994, as amended.

VERIFICATION OF WORKER'S DISABILITY COMPENSATION ACT COMPLIANCE

- This verification must be completed and submitted within 21 days of contract award and prior to the issuance of the timber sale contract.
- In addition, if boxes 2B or 2C are checked, then Notice of Exclusion or Certificate of Insurance must be submitted within twenty-one (21) days of the contract award and prior to the issuance of the timber sale contract.
- All information must be typed or printed except for written signatures.

Please Check Appropriate Categories:

1. My business is organized as (you **must** check one of the boxes below):
 - A. Sole Proprietorship (individual)
 - B. Partnership
 - C. Corporation
2. You **must** check one of the boxes below:
 - A. I certify my business is a sole proprietorship and it has no employees but the sole proprietor. I am not subject to the Worker's Compensation Laws.
 - B. I certify my business has satisfied its obligation to the Worker's Compensation Act through the use of an approved Notice of Exclusion (BWC-337, Rev. 5/96). I will provide a copy of the Notice of Exclusion within 21 days of the contract award. (For questions or a copy of the BWC-337, please call the Worker's Compensation Bureau at 517-322-1195).
 - C. I certify my business has a Worker's Compensation Policy. I will provide an original Certificate of Insurance within twenty-one (21) days of the contract award.
3. If you have checked item 2(A) or 2(B), you **must** indicate the number of **both** full-time and part-time employees, other than yourself, including family members and active partners (if none, you must enter "0").

_____ Full-time Employees

_____ Part-time Employees

Name of Business		Federal ID (or) Social Security No.	
Address		Telephone ()	
City	State	ZIP	

I hereby certify that the above information is true and correct. I agree to notify the Michigan DNR of any changes that occur in factors affecting my coverage during any of my present and future operations.

Signature of Owner or Authorized Representative

Title

Date

Please complete the "SEALED BID" information on the next page