



**DEPARTMENT OF NATURAL RESOURCES
STATE OF MICHIGAN**

TIMBER SALE PROSPECTUS #6333

SCHEDULED SALE DATE AND TIME: 2:00 p.m. (local time) on June 12, 2019.

LOCATION: ROSCOMMON MGMT UNIT, PO BOX 218, ROSCOMMON, MI 48653.

PROSPECTUS NOTE: The bidder is advised to inspect the sale area and review the location, estimated volumes, operating costs and contract terms of proposed sales. Please be aware that some landowners may request 60 days or more notice for access across their land.

Notice is hereby given that bids will be received by the Unit Manager, ROSCOMMON MANAGEMENT UNIT, for certain timber on the following described lands:

Stoney Heath Oak (71-005-18) / T24N, R02E, SEC. 28, SWNW,NWSW.

T24N, R02E, SEC. 29, NE,NESE,S1/2SE.

Ogemaw County, Advertised Price \$14,523.60, 67.7 Acres, Aspen, Hardwood.

SALE NOTE: A recreation site such as a trail, pathway, or campground is within the sale area or the vicinity. Certain restrictions/specifications may be applicable including time restrictions.

Boyce Lake Thin (71-013-18) / T21N, R03W, SEC. 10, SENW,SENE,E1/2SW,SE.

T21N, R03W, SEC. 15, NENW,SWNW,N1/2NE,SW,W1/2SE.

T21N, R03W, SEC. 16, NESE.

T21N, R03W, SEC. 3, N1/2NW,NENE,SW.

T22N, R03W, SEC. 34, SWSW.

Roscommon County, Advertised Price \$179,954.50, 273.0 Acres, Hardwood, Red Pine.

SALE NOTE: Large sale covering two sections that encompasses multiple recreational systems, both ORV and snowmobile, in several locations. Signage will be required to be placed in several locations by the Purchaser, warning of sale operations. Due to the areas water influences, the haul routes also have the snowmobile trails on them. With the majority of the treatments being in conifer cover types, bark slippage is a concern and thus restricts the time window down for operations. Because of this, hauling is being allowed on the snowmobile system during winter months with some restrictions. Also, an additional operating year is being placed upon the sale making it a three year contract.

A recreation site such as a trail, pathway, or campground is within the sale area or the vicinity. Certain restrictions/specifications may be applicable including time restrictions.

RGF Harvest (71-027-18) / T23N, R01E, SEC. 18, SENW,SWNE,NESW,NWSE.

T23N, R01E, SEC. 7, SW,SE.

Ogemaw County, Advertised Price \$50,654.70, 106.8 Acres, Jack Pine, Red Pine.

SALE NOTE: This sale requires construction of a haul road or skid trail to be built to access Payment Units 2 and 3. The road will require installation of a culvert or portable bridge for a stream crossing. The DNR will provide the necessary permits and portable bridge, if needed.

BID INSTRUCTIONS (VER. 07/02/2018):

1. Scheduled Bid Location, Date, and Time (2/11)

Bids must be received by the Unit Manager, ROSCOMMON OFFICE, PO BOX 218, ROSCOMMON, MI 48653, no later than 2:00 p.m. (local time) on June 12, 2019. For further information concerning this sale, contact Steve Anderson at 989-275-4622 extension 2740.

2. Bidder's Qualifications (5/16)

Purchaser shall obtain workers compensation insurance to cover claims under Michigan's Worker's Disability Compensation Act of 1969 or similar employee benefit act of any other state applicable to an employee. If all or part of a timber sale was prepared by a private contractor, the contractor and that contractor's company are not permitted to bid on the timber sale contract. Bids will not be accepted from individuals or companies appearing on the DNR/FRD No-Bid List. This list contains the names of purchasers who previously failed to execute a contract within 21-days or who have a history of poor performance.

3. Preparation of Sealed Bids (5/16)

Bid Forms may be completed online thru Michigan DNR Timber Sale Online Bidding (OLB) at www.michigan.gov/timberbidding or by completing the hardcopy Bid Form found in the Timber Sale Prospectus. Hardcopy Bid Forms shall be manually signed in ink. Registration in OLB is considered your 'signature' for all bids submitted thru that system. Bid prices must be entered for each species and product in the Bid Price column for all material subject to bidding and all fill-in blanks must be completed. If erasures or other changes appear on the hardcopy Bid Form, each erasure or change must be initialed by the person signing the bid.

4. Submission of Sealed Bids (5/16)

Bid forms may be obtained from the Unit Manager or thru OLB. Bids may be submitted hardcopy or thru OLB. All hardcopy bids must be submitted on the bid form and in an envelope clearly identified as described in this section. NOTE: Only one bid form per bid envelope. Sealed bids must be submitted to the Unit office designated in the prospectus and must be submitted at or prior to the time established in the prospectus. The envelope should show on the outside (a) the sale name or number and (b) the date and time of bid opening, as shown in the prospectus. Bids received after the time specified in the sale prospectus are late bids and will be rejected.

It is possible for a bidder to submit multiple bids on a single sale. For example, a bid may be submitted hardcopy and a bid may be submitted thru OLB. Or, two bidders from the same company could both submit bids on the same sale. If this were to happen, the State would accept all bids received and award the contract accordingly. All bidding and contractual requirements would apply to all bids received.

5. Public Opening of Sealed Bids (7/16)

If conditions permit, the sealed bids will be publicly opened and posted at the time and place set in the prospectus.

If a bidder, present at a bid opening, has submitted bids on more than one sale, that bidder may withdraw their unopened bid envelopes or announce the withdrawal of their online bid after being declared the successful bidder on one sale.

6. Award of Contract (1/11)

Award of the contract will be made to the Bidder whose bid, conforming to the prospectus, is most advantageous to the State of Michigan on the basis of total value at rates bid for the estimated quantities. The State reserves the right to reject any bid or waive any minor irregularity in bids received. A written award mailed (or otherwise furnished) to the successful Bidder shall be deemed to result in a binding contract without further action by either party.

7. Down Payment (1/11)

The Bidder to whom award is made must make a down payment within 21 days of the sale award. The amount of the down payment will be calculated as shown in the Bond and Payment Schedule of this prospectus. Only cash may be used to meet this requirement.

8. Performance Security (1/11)

As guarantee of faithful performance, a cash bond, certificate of deposit, surety bond or irrevocable letter of credit (LOC) is required within 21 days of the sale award. The amount of the performance security is shown in the Bond and

Payment Schedule of this prospectus. If an LOC or surety is used, the coverage must extend for at least 6 months beyond the contract expiration.

9. Timber Sale Contract (7/18)

Additional conditions and requirements common to all timber sales are listed on the timber sale contract (R4031) and are available on line at www.michigan.gov/timber. Contact the Unit Manager for additional information or a sample contract. Within 21 days of the date of the award letter, the bidder must sign the contract and provide the required down payment, performance security, and verification of worker's disability compensation. The down payment and performance security shall be in accordance with the provisions of the timber sale contract, in the sums stated in this prospectus. If these actions are not taken, then the Bidder, the Bidder's corporation, and the corporation's principals may not be permitted to bid on State timber sales for a period of 3 months after the first offense, 6 months after the second offense, and 1 year after the third offense. An offense will only be counted against the Bidder for 5 years. In addition, the Bidder certifies that if awarded this contract, the Bidder will complete the timber sale contract in accordance with its terms and any modifications thereof including requirements to purchase, cut, and remove the included timber by the expiration date.

Payment Unit values in the State Forest Timber Sale Contract are calculated based on the advertised value of the Payment Unit as a percentage of the total advertised value of the contract. The advertised value of each Payment Unit is given in the Description of Timber by Payment Unit table on the Timber Sale Information page. For example, if the value of Payment Unit 1 is advertised as \$1,500 and the total Timber Sale value is advertised as \$10,000, the contract price for Payment Unit 1 will be 15% of the total bid price ($\$1,500/\$10,000 * 100$).

10. Disclaimer of Estimates and Bidder's Warranty of Inspection (7/16)

Before submitting this bid, the Bidder is advised and cautioned to inspect the sale area, review the requirements of the sale contract, and take other steps as may be reasonably necessary to ascertain the location, estimated volumes, construction estimates, and operating costs of the proposed sale. Failure to do so will not relieve the Bidder from responsibility for completing the contract.

The Bidder warrants that this bid is submitted solely on the basis of the Bidder's examination and inspection of the quality and quantity of the timber offered for sale and the Bidder's opinion of the value thereof and the costs of recovery. No reliance should be placed on the State of Michigan's estimates of timber quality, quantity or costs of recovery. Bidder further acknowledges that the State of Michigan: (i) expressly disclaims any warranty of fitness of timber for any purpose; (ii) offers this timber as is without any warranty of quality (merchantability) or quantity and (iii) expressly disclaims any warranty as to the quantity or quality of timber sold.

11. Certification and Chain-of-Custody (10/14)

Unless otherwise indicated in the contract under section 7 – Other Conditions of the Sale Specific Conditions & Requirements, the area encompassed by this timber sale is certified to the standards of the Forest Stewardship Council (FSC) - Certificate #SCS-FM/COC-00090N and the Sustainable Forestry Initiative (SFI) - Certificate #NSF-SFIS-5Y031-SF5. Forest products from this sale may be delivered to the mill as "FSC 100% and / or SFI certified" as long as the contractor hauling the forest products is chain-of-custody (COC) certified or covered under a COC certificate from the destination mill. The purchaser is responsible for maintaining COC after leaving the sale area.

12. Good Neighbor Authority (GNA) Requirements (7/16)

If the name of this timber sales contains the acronym GNA, it is authorized by the Good Neighbor Authority (GNA) and covered by various agreements between the U.S. Forest Service and the State. The timber sale occurs on federal land and the following conditions apply:

GNA contracts on US Forest Service land will not be awarded to purchasers on the Federal list of excluded parties. The System for Award Management (SAM) will be checked for active excluded parties prior to award of contract. In addition, the Bidder to whom award is made must complete an Assurance Regarding Felony Conviction or Tax Delinquent Status for Corporate Applicants (AD-3031).

13. Good Neighbor Authority (GNA) Requirements, con't (9/16)

Bidder certifies, by signing this bid form, that to the best of Bidder's knowledge that the following representations are accurate and complete.

- a. That the Bidder and its principals are not presently debarred, suspended, proposed for debarment, declared ineligible, or voluntary excluded from timber sales (covered transactions) by any Federal department or agency.
- b. That the Bidder and its principals have not within a 3-year period preceding this bid been convicted of or had a civil judgment rendered against them for commission of fraud or a criminal offense in connection with obtaining, attempting to obtain, or performing a public (Federal, State, or local) transaction or contract under a public transaction; violation of Federal or State antitrust statutes or commission of embezzlement, theft, forgery, bribery, falsification or destruction of records, making false statements, or receiving stolen property.
- c. That the Bidder and its principals are not presently indicted for or otherwise criminally or civilly charged by a governmental entity (Federal, State, or local) with commission of any of the offenses enumerated in paragraph b of this certification.
- d. That the Bidder and its principals have not within a 3-year period preceding this bid had one or more public transactions (Federal, State, or local) terminated for breach or default of a timber or forest product contract.

Bidders that cannot certify this requirement, in whole or in part, shall submit an explanation with their bid.

DAN EICHINGER
Director

TIMBER SALE INFORMATION

Stoney Heath Oak (71-005-18)
 T24N, R02E, SEC. 28; T24N, R02E, SEC. 29.
 Ogemaw County (Advertised Price \$14,523.60)

SALE NOTE: A recreation site such as a trail, pathway, or campground is within the sale area or the vicinity. Certain restrictions/specifications may be applicable including time restrictions.

A timber sale contract for this lump sum, sealed bid timber sale will be awarded to the responsible bidder offering the highest sealed bid price. Bids must be at or above the following advertised price for each species:

| <u>PRODUCTS & SPECIES</u> | <u>ESTIMATED UNITS*</u> | <u>ADVERTISED PRICE</u> |
|-------------------------------|-------------------------|-------------------------|
| Sawtimber | | |
| B. T. Aspen | 63.30 MBF | \$ 43.00 / MBF |
| BI/R/Hybrid Oak | 13.60 MBF | \$ 87.00 / MBF |
| Red Pine | 18.90 MBF | \$ 80.00 / MBF |
| Pulpwood | | |
| B. T. Aspen | 252.00 Cords | \$ 19.75 / Cord |
| Jack Pine | 33.00 Cords | \$ 10.45 / Cord |
| Mixed Oak | 86.00 Cords | \$ 11.55 / Cord |
| Red Maple | 78.00 Cords | \$ 14.70 / Cord |
| Red Pine | 51.00 Cords | \$ 32.25 / Cord |

* The total volume is statistically estimated within plus (+) or minus (-) 27.06 percent. The estimated units are final and not subject to adjustment. Prospective bidders are urged to examine this timber and to make their own estimates of quantity and quality.

BOND AND PAYMENT SCHEDULE:

1. A bond in the amount of \$726.00 to insure faithful performance of the conditions of the contract will be deposited by the successful bidder within 21 days of the sale award.
2. Cutting in any sale or unit without the required advance payment would be considered a trespass.
3. Total payment must be paid in advance or according to the following schedule:
 - (a) Ten percent (10%) of the sale value must be paid within 21 days of the sale award.
 - (b) The 10% down payment will be credited towards the first unit cut.
 - (c) Payment for each of the following units must be made before cutting begins in that unit:

| <u>PAYMENT UNIT NUMBER</u> | <u>PERCENT OF TOTAL SALE VALUE</u> |
|----------------------------|------------------------------------|
| 01 | 28.9% |
| 02 | 27.8% |
| 03 | 43.3% |
4. If no cutting takes place, the 10% down payment will not be refunded.
5. Operations on the contract issued will terminate on 09/30/2021.

Description of Timber by Payment Unit (PU)

| PU | MARKET GROUP | PRODUCT | QUANTITY | UNIT | ACRES | ADVERTISE PRICE |
|------------------------|------------------------|------------------|--------------|--------------|-------|-----------------|
| 1 | B. T. Aspen | Sawtimber | 11.2 | MBF | 5.8 | \$4,194.40 |
| | BI/R/Hybrid Oak | | 0.7 | MBF | | |
| | Red Pine | | 14.0 | MBF | | |
| | B. T. Aspen | Pulpwood | 50.0 | Cords | | |
| | <i>B. T. Aspen</i> | | <i>50.0</i> | <i>Cords</i> | | |
| | Mixed Oak | | 4.0 | Cords | | |
| | <i>White Oak</i> | <i>Sawtimber</i> | <i>1.2</i> | <i>MBF</i> | | |
| | <i>BI/R/Hybrid Oak</i> | <i>Pulpwood</i> | <i>1.0</i> | <i>Cords</i> | | |
| | <i>White Oak</i> | | <i>1.0</i> | <i>Cords</i> | | |
| | Red Maple | | 1.0 | Cords | | |
| | <i>Red Maple</i> | | <i>1.0</i> | <i>Cords</i> | | |
| | Red Pine | | 46.0 | Cords | | |
| | 2 | B. T. Aspen | Sawtimber | 21.6 | | |
| BI/R/Hybrid Oak | | | 5.4 | MBF | | |
| Red Pine | | | 0.4 | MBF | | |
| B. T. Aspen | | Pulpwood | 82.0 | Cords | | |
| <i>B. T. Aspen</i> | | | <i>81.0</i> | <i>Cords</i> | | |
| <i>Balsam Poplar</i> | | | <i>1.0</i> | <i>Cords</i> | | |
| Jack Pine | | | 14.0 | Cords | | |
| <i>Jack Pine</i> | | <i>Sawtimber</i> | <i>1.4</i> | <i>MBF</i> | | |
| <i>Jack Pine</i> | | <i>Pulpwood</i> | <i>11.0</i> | <i>Cords</i> | | |
| Mixed Oak | | | 32.0 | Cords | | |
| <i>White Oak</i> | | <i>Sawtimber</i> | <i>0.7</i> | <i>MBF</i> | | |
| <i>BI/R/Hybrid Oak</i> | | <i>Pulpwood</i> | <i>23.0</i> | <i>Cords</i> | | |
| <i>White Oak</i> | | | <i>8.0</i> | <i>Cords</i> | | |
| Red Maple | | | 32.0 | Cords | | |
| <i>Red Maple</i> | | <i>Sawtimber</i> | <i>2.2</i> | <i>MBF</i> | | |
| <i>Red Maple</i> | | <i>Pulpwood</i> | <i>28.0</i> | <i>Cords</i> | | |
| 3 | | B. T. Aspen | Sawtimber | 30.5 | MBF | 37.7 |
| | BI/R/Hybrid Oak | | 7.5 | MBF | | |
| | Red Pine | | 4.5 | MBF | | |
| | B. T. Aspen | Pulpwood | 120.0 | Cords | | |
| | <i>B. T. Aspen</i> | | <i>119.0</i> | <i>Cords</i> | | |
| | <i>Balsam Poplar</i> | | <i>1.0</i> | <i>Cords</i> | | |
| | Jack Pine | | 19.0 | Cords | | |
| | <i>Jack Pine</i> | <i>Sawtimber</i> | <i>2.0</i> | <i>MBF</i> | | |
| | <i>Jack Pine</i> | <i>Pulpwood</i> | <i>15.0</i> | <i>Cords</i> | | |
| | Mixed Oak | | 50.0 | Cords | | |
| | <i>White Oak</i> | <i>Sawtimber</i> | <i>1.0</i> | <i>MBF</i> | | |
| | <i>BI/R/Hybrid Oak</i> | <i>Pulpwood</i> | <i>36.0</i> | <i>Cords</i> | | |
| | <i>White Oak</i> | | <i>12.0</i> | <i>Cords</i> | | |
| | Red Maple | | 45.0 | Cords | | |
| | <i>Red Maple</i> | <i>Sawtimber</i> | <i>3.0</i> | <i>MBF</i> | | |
| | <i>Red Maple</i> | <i>Pulpwood</i> | <i>39.0</i> | <i>Cords</i> | | |
| | Red Pine | | 5.0 | Cords | | |
| TOTAL: | | | 95.8 | MBF | | |
| TOTAL: | | | 500.0 | Cords | | |

Sale Specific Conditions & Requirements

Sale Name: Stoney Heath Oak

Sale Number: 71-005-18 Seq#: 2

1 - Sale Area

1.2 - Boundaries

1.2.1 - Painted boundaries (1/14)

The sale boundary and Payment Unit boundaries are marked and identified by red and yellow paint. Exterior sale boundary lines against state are marked with red paint. Interior Payment Unit boundaries are marked with yellow paint. The painted boundary line trees are not Included Timber and are to be protected. Yellow painted trees designating an interior Payment Unit boundary are only to be cut when all surrounding Payment Units have been paid.

2 - Timber Specifications

2.1 - Included Timber

2.1.1 - Clearcut unit(s) with unmerchantable trees (6/14)

Within Payment Unit(s) 1, cut all trees that are two (2) inches or more at DBH.

2.1.3 - Cut tree marked unit(s) (12/08)

Within Payment Unit(s) 2 and 3, all trees are designated for cutting when marked with orange paint above and below stump height, regardless of merchantability. In addition, all jack pine and aspen are designated for cutting.

2.2 - Utilization

2.2.6 - Roundwood operation required (5/07)

The skidding of whole trees or tree segments with limbs attached is prohibited within Payment Units 2 and 3. All products must be produced as roundwood and forwarded to existing roads or landing areas in final product length.

3 - Payments

3.3 - Pre-measured Sales

3.3.4 - Dividing payment units (7/14)

Payment Unit(s) may be divided at the request of the Purchaser and upon approval of the Unit Manager. Dividing Payment Units is a contract modification which requires a Timber Sale Contract Supplement.

3.4 - Damaged Timber

3.4.1 - Damaged timber (6/14)

General Condition and Requirement 3.4 Damaged Timber, defines liquidated damages for undesignated live merchantable trees which are cut or injured.

No damage is acceptable to merchantable trees. Within the sale area, if more than 5% of trees (> 4.5" DBH) within a specified area of the sale are damaged, liquidated damages will be assessed for all trees damaged. Rates will be in accordance with General Condition and Requirement 3.4 Damaged Timber.

4 - Transportation

4.1 - Construction

4.1.6 - Road construction (1/09)

Construction of new roads or improvements of existing roads shall be done in such a way as to minimize the environmental and visual impacts. Merchantable trees shall be cut and utilized unless otherwise directed. Non-merchantable trees shall be severed and laid flat on the ground. Slash shall be scattered, and not left in windrows and kept a minimum of 10 feet back from the road edge. Stumps shall be set upright, not left on edge, and be moved at least 10 feet away from the road edge. Disturbed soil shall be feathered into the woods and not left in berms or windrows.

4.1.7 - Road closure (10/11)

All new roads built into the sale must be blocked to vehicle traffic upon completion of the sale. In general, this will require

constructing a four (4') foot high berm of stumps and logs covered with earth. Stumps and brush must be placed along the remainder of the trail. These roads must be rendered impassable to cars and trucks. Contact the sale administrator for specific details of design and placement.

4.2 - Maintenance

4.2.1 - Hauling restriction (12/08)

Hauling may be restricted on forest roads by the Unit Manager or his/her representative. The restriction may occur during wet weather conditions.

4.2.3 - Road maintenance (8/13)

The following road maintenance is required: Within 60 days of completion of hauling, or if no hauling occurs for 60 days, the road must be maintained and graded. This includes cleaning of drainage areas, grading, crowning and filling with gravel, if necessary. Damages will be assessed if grading/repair does not occur.

4.2.5 - Two wheel drive condition (2/04)

All existing trail roads on and adjacent to the sale area must be passable by two-wheel drive traffic for the duration of the sale.

5 - Operations

5.1 - Notification

5.1.1 - Pre-sale conference (10/16)

A pre-sale conference between the Purchaser and sale administrator is required prior to beginning any operations to determine landing and road locations.

5.1.4 - Post-sale conference (10/16)

A post-sale conference on site between the Purchaser and sale administrator is required prior to the completion of active logging operations to determine clean-up and repair of landings, road edges, and the fulfillment of other contract specifications.

5.2 - Conduct of Operations

5.2.1 - Slash

5.2.1.8 - Slash height (12/08)

No slash or tree tops may exceed 24 inches in height.

5.2.2 - Hazard Trees/Snags

5.2.2.1 - Den trees (10/16)

Obvious hollow and/or den trees shall be protected and left standing unless they are a safety hazard.

5.2.3 - Operating Restrictions

5.2.3.4 - Oak wilt restriction, no exceptions (1/18)

Within Payment Unit 2 and 3, cutting, skidding, hauling within the sale and brushing of access roads to the sale are not permitted during the period of April 15 to July 15. No exceptions will be granted. This is necessary to reduce the spread of oak wilt.

5.2.3.11 - Coppice regeneration protection (4/10)

Timber harvesting in Payment Unit 1 must be completed before significant aspen sprouting occurs in that Payment Unit so as to minimize damage to the new regeneration. Any post harvest operations, such as chipping, must be completed before sprouting of regeneration occurs. If it is anticipated that chipping will be delayed, then tops shall be carried to one central location or left unchipped. The Unit Manager or his/her representative may cease such operations if sprouting occurs before the operation is complete.

5.2.4 - Dead and Down Creation

5.2.4.3 - Dead and down creation, dead trees (6/07)

Except as provided for in General Condition and Requirement 5.2.2, no dead trees, standing or down, are to be cut, skidded, or processed.

5.2.32 - Decking/landing restoration (9/13)

All decking and landing areas must have the surface area restored to a condition equal to or better than before. This is to ensure the proper regeneration of the stand. Wood debris, chips and "cookies" from trimmings must be removed or scattered away from landing and loading areas and may not be windrowed on the edge.

5.2.38 - No decking against live trees (2/04)

Cut products may not be decked against unmarked or designated leave trees.

5.2.39 - ORV trail/route protection (4/18)

The ORV trail is shown on the Timber Sale Map. Do not cut trees or damage posts with yellow ORV markers. All stumps within 5 feet of the trail must be cut flush with the ground. Maintain a 20 foot wide slash, debris, and rut free zone daily using the ORV trail or route as the centerline. Do not run equipment down the ORV trail or route. Skidding across the trail or route may only occur in locations approved by the sale administrator.

6 - Safety and Fire Prevention

6.2 - Signing

6.2.3 - Recreational trail posting (2/10)

The Purchaser is responsible for posting and maintaining caution signs on the ORV trail prior to beginning operations. The trail must be posted at appropriate distances from the sale area to warn of logging activity and truck traffic at both ends of the trail. Signs must be removed when harvest operations are suspended or completed.



TIMBER SALE MAP

This information provided by authority of Part 525, 1994 PA 451, as amended.

| | |
|-------------|------|
| Sale Number | Year |
| 71-005 | 18 |

| | | | | | |
|-------------------------------------|------------------|---|--------------------|-----------|---------|
| Forest Management Unit Roscommon | County Ogemaw | Mapped By LEWICKI | Date 09/28/2018 | Page 1 | of 1 |
| Township 24N | Range 02E | Section(s) and Subdivision(s) S.29NE; NESE; S1/2SE | Scale 1:15,840 | | |

| Cover Type | | | | Density | |
|-------------------|----------------------|-------------------------|-------------------|-----------------------------|------------------------|
| A = Aspen | H = Hemlock | N = Marsh | U = Upland Brush | 0 = Non Stocked | 5 = Pole Timber Medium |
| B = Paper Birch | J = Jack Pine | O = Oak | UM = Upland Mixed | 1 = Seedling Sapling Poor | 6 = Pole Timber Well |
| C = Cedar | L = Lowland Brush | P = Lowland Poplar | V = Bog or Marsh | 2 = Seedling Sapling Medium | 7 = Saw Timber Poor |
| D = Treed Bog | LM = Lowland Mixed | Q = Mixed Swamp Conifer | W = White Pine | 3 = Seedling Sapling Well | 8 = Saw Timber Medium |
| E = Swamp Hdwoods | M = Mpl, Bch, Brch | R = Red Pine | X = Non Stocked | 4 = Pole Timber Poor | 9 = Saw Timber Well |
| F = Spruce Fir | MC = Mixed Conifer | S = Black Spruce | Z = Water | | |
| G = Grass | MD = Mixed Deciduous | T = Tamarack | | | |

| PU | Acres |
|----|-------|
| 1 | 5.8 |
| 2 | 24.2 |
| 3 | 37.7 |

STONEY HEATH OAK

Compartment 86
67.7 Acres

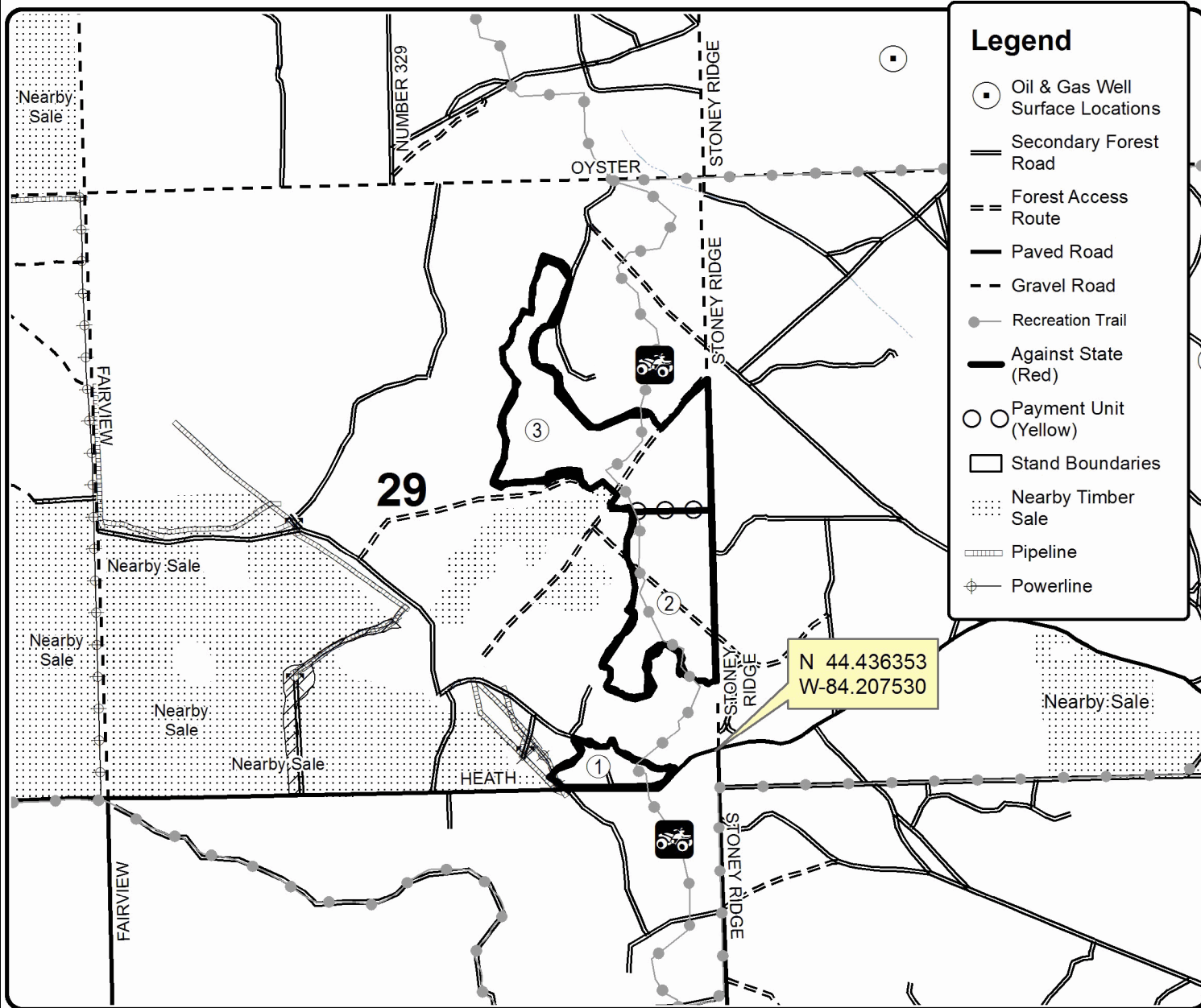
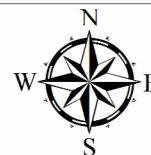

Legend

- Oil & Gas Well Surface Locations
- Secondary Forest Road
- Forest Access Route
- Paved Road
- Gravel Road
- Recreation Trail
- Against State (Red)
- Payment Unit (Yellow)
- Stand Boundaries
- Nearby Timber Sale
- Pipeline
- Powerline

TIMBER SALE INFORMATION

Boyce Lake Thin (71-013-18)

T21N, R03W, SEC. 10; T21N, R03W, SEC. 15; T21N, R03W, SEC. 16; T21N, R03W, SEC. 3; T22N, R03W, SEC. 34.
Roscommon County (Advertised Price \$179,954.50)

SALE NOTE: Large sale covering two sections that encompasses multiple recreational systems, both ORV and snowmobile, in several locations. Signage will be required to be placed in several locations by the Purchaser, warning of sale operations. Due to the areas water influences, the haul routes also have the snowmobile trails on them. With the majority of the treatments being in conifer cover types, bark slippage is a concern and thus restricts the time window down for operations. Because of this, hauling is being allowed on the snowmobile system during winter months with some restrictions. Also, an additional operating year is being placed upon the sale making it a three year contract.

A recreation site such as a trail, pathway, or campground is within the sale area or the vicinity. Certain restrictions/specifications may be applicable including time restrictions.

A timber sale contract for this lump sum, sealed bid timber sale will be awarded to the responsible bidder offering the highest sealed bid price. Bids must be at or above the following advertised price for each species:

| <u>PRODUCTS & SPECIES</u> | <u>ESTIMATED UNITS*</u> | | <u>ADVERTISED PRICE</u> |
|-------------------------------|-------------------------|-------|-------------------------|
| Sawtimber | | | |
| Jack Pine | 44.10 | MBF | \$ 31.00 / MBF |
| Mixed Aspen | 87.30 | MBF | \$ 61.00 / MBF |
| Mixed Oak | 197.50 | MBF | \$ 123.00 / MBF |
| Mixed Spruce | 14.50 | MBF | \$ 41.00 / MBF |
| Paper Birch | 1.30 | MBF | \$ 43.00 / MBF |
| Red Maple | 89.60 | MBF | \$ 62.00 / MBF |
| Red Pine | 580.80 | MBF | \$ 114.00 / MBF |
| White Pine | 178.80 | MBF | \$ 55.00 / MBF |
| Pulpwood | | | |
| Balsam Fir | 23.00 | Cords | \$ 27.15 / Cord |
| Jack Pine | 161.00 | Cords | \$ 14.85 / Cord |
| Mixed Aspen | 515.00 | Cords | \$ 28.00 / Cord |
| Mixed Hardwood | 21.00 | Cords | \$ 20.85 / Cord |
| Mixed Oak | 563.00 | Cords | \$ 16.40 / Cord |
| Mixed Spruce | 48.00 | Cords | \$ 20.30 / Cord |
| Red Maple | 596.00 | Cords | \$ 20.85 / Cord |
| Red Pine | 369.00 | Cords | \$ 45.75 / Cord |
| White Pine | 454.00 | Cords | \$ 20.55 / Cord |

* The total volume is statistically estimated within plus (+) or minus (-) 7.48 percent. The estimated units are final and not subject to adjustment. Prospective bidders are urged to examine this timber and to make their own estimates of quantity and quality.

BOND AND PAYMENT SCHEDULE:

1. A bond in the amount of \$8,998.00 to insure faithful performance of the conditions of the contract will be deposited by the successful bidder within 21 days of the sale award.
2. Cutting in any sale or unit without the required advance payment would be considered a trespass.
3. Total payment must be paid in advance or according to the following schedule:
 - (a) Ten percent (10%) of the sale value must be paid within 21 days of the sale award.
 - (b) The 10% down payment will be credited towards the first unit cut.

(c) Payment for each of the following units must be made before cutting begins in that unit:

| PAYMENT UNIT NUMBER | PERCENT OF TOTAL SALE VALUE |
|---------------------|-----------------------------|
| 01 | 6.6% |
| 02 | 10.3% |
| 03 | 3.2% |
| 04 | 2.0% |
| 05 | 6.2% |
| 06 | 16.4% |
| 07 | 2.3% |
| 08 | 13.9% |
| 09 | 7.5% |
| 10 | 0.4% |
| 11 | 12.2% |
| 12 | 8.6% |
| 13 | 10.4% |

4. If no cutting takes place, the 10% down payment will not be refunded.

5. Operations on the contract issued will terminate on 12/31/2022.

Description of Timber by Payment Unit (PU)

| PU | MARKET GROUP | PRODUCT | QUANTITY | UNIT | ACRES | ADVERTISE PRICE | |
|------------------------|-------------------------|-----------|------------------|--------------|-------|-----------------|--------------|
| 1 | Mixed Aspen | Sawtimber | 1.0 | MBF | 13.7 | \$11,922.70 | |
| | <i>Quaking Aspen</i> | | 1.0 | <i>MBF</i> | | | |
| | Mixed Oak | | 17.3 | MBF | | | |
| | <i>BI/R/Hybrid Oak</i> | | 16.9 | <i>MBF</i> | | | |
| | <i>White Oak</i> | | 0.4 | <i>MBF</i> | | | |
| | Red Pine | 51.9 | MBF | | | | |
| | Mixed Aspen | Pulpwood | 9.0 | Cords | | | |
| | <i>Quaking Aspen</i> | | 9.0 | <i>Cords</i> | | | |
| | Mixed Oak | | 45.0 | Cords | | | |
| | <i>BI/R/Hybrid Oak</i> | | 40.0 | <i>Cords</i> | | | |
| | <i>White Oak</i> | | 5.0 | <i>Cords</i> | | | |
| | Red Pine | | 60.0 | Cords | | | |
| | White Pine | | 4.0 | Cords | | | |
| | 2 | | Red Pine | Sawtimber | | | 119.5 |
| Mixed Oak | | Pulpwood | 1.0 | Cords | | | |
| <i>BI/R/Hybrid Oak</i> | | | 1.0 | <i>Cords</i> | | | |
| Red Pine | | | 108.0 | Cords | | | |
| 3 | Jack Pine | Sawtimber | 5.7 | MBF | 10.6 | \$5,743.95 | |
| | Mixed Aspen | | 0.3 | MBF | | | |
| | <i>Quaking Aspen</i> | | 0.3 | <i>MBF</i> | | | |
| | Mixed Oak | | 15.1 | MBF | | | |
| | <i>BI/R/Hybrid Oak</i> | | 6.4 | <i>MBF</i> | | | |
| | <i>Northern Pin Oak</i> | | 8.7 | <i>MBF</i> | | | |
| | Red Pine | | 12.1 | MBF | | | |
| | Balsam Fir | Pulpwood | 10.0 | Cords | | | |
| | <i>Balsam Fir</i> | | <i>Sawtimber</i> | 0.6 | | | <i>MBF</i> |
| | <i>Balsam Fir</i> | | <i>Pulpwood</i> | 9.0 | | | <i>Cords</i> |
| | Jack Pine | | 36.0 | Cords | | | |
| | Mixed Aspen | | 2.0 | Cords | | | |
| | <i>Quaking Aspen</i> | | 2.0 | <i>Cords</i> | | | |
| | Mixed Oak | | 41.0 | Cords | | | |
| | <i>BI/R/Hybrid Oak</i> | | 19.0 | <i>Cords</i> | | | |
| | <i>Northern Pin Oak</i> | | 22.0 | <i>Cords</i> | | | |
| Red Pine | 17.0 | Cords | | | | | |
| 4 | Jack Pine | Sawtimber | 2.4 | MBF | 18.6 | \$3,663.55 | |
| | Mixed Aspen | | 2.2 | MBF | | | |
| | <i>Quaking Aspen</i> | | 2.2 | <i>MBF</i> | | | |
| | Red Pine | | 3.3 | MBF | | | |
| | White Pine | 4.3 | MBF | | | | |
| | Jack Pine | Pulpwood | 38.0 | Cords | | | |
| | Mixed Aspen | | 22.0 | Cords | | | |
| | <i>Quaking Aspen</i> | | 22.0 | <i>Cords</i> | | | |
| | Mixed Oak | | 8.0 | Cords | | | |
| | <i>BI/R/Hybrid Oak</i> | | 8.0 | <i>Cords</i> | | | |
| | Red Pine | | 11.0 | Cords | | | |
| | White Pine | | 50.0 | Cords | | | |
| 5 | Jack Pine | | Sawtimber | 0.5 | MBF | 7.8 | \$11,076.65 |
| | Mixed Oak | 8.6 | | MBF | | | |
| | <i>BI/R/Hybrid Oak</i> | 8.6 | | <i>MBF</i> | | | |
| | Red Pine | 69.0 | MBF | | | | |
| | White Pine | 1.8 | MBF | | | | |
| | Jack Pine | Pulpwood | 1.0 | Cords | | | |
| | Mixed Hardwood | | 6.0 | Cords | | | |
| | <i>Misc. Species 1</i> | | 6.0 | <i>Cords</i> | | | |
| | Mixed Oak | | 27.0 | Cords | | | |
| | <i>BI/R/Hybrid Oak</i> | | 27.0 | <i>Cords</i> | | | |

Description of Timber by Payment Unit (PU), con't

| PU | MARKET GROUP | PRODUCT | QUANTITY | UNIT | ACRES | ADVERTISE PRICE | | | |
|------------------------|------------------------|--------------------|-----------|--------------|-------|-----------------|--------------|-----|------------|
| 5 con't | Red Maple | Pulpwood | 12.0 | Cords | | | | | |
| | Red Pine | | 25.0 | Cords | | | | | |
| | White Pine | | 3.0 | Cords | | | | | |
| 6 | Jack Pine | Sawtimber | 23.4 | MBF | 33.9 | \$29,546.45 | | | |
| | Mixed Aspen | | 1.4 | MBF | | | | | |
| | <i>Quaking Aspen</i> | | 1.4 | <i>MBF</i> | | | | | |
| | Mixed Oak | | 51.9 | MBF | | | | | |
| | <i>BI/R/Hybrid Oak</i> | | 49.0 | <i>MBF</i> | | | | | |
| | <i>Red Oak</i> | | 0.7 | <i>MBF</i> | | | | | |
| | <i>White Oak</i> | | 2.2 | <i>MBF</i> | | | | | |
| | Paper Birch | | 0.7 | MBF | | | | | |
| | Red Maple | | 12.7 | MBF | | | | | |
| | Red Pine | | 68.7 | MBF | | | | | |
| | White Pine | | 84.5 | MBF | | | | | |
| | Jack Pine | | Pulpwood | 35.0 | | | Cords | | |
| | Mixed Aspen | | | 15.0 | | | Cords | | |
| | <i>Quaking Aspen</i> | 15.0 | | <i>Cords</i> | | | | | |
| | Mixed Hardwood | 6.0 | | Cords | | | | | |
| | <i>Misc. Species 1</i> | 4.0 | | <i>Cords</i> | | | | | |
| | <i>Paper Birch</i> | 2.0 | | <i>Cords</i> | | | | | |
| | Mixed Oak | 119.0 | | Cords | | | | | |
| | <i>BI/R/Hybrid Oak</i> | 106.0 | | <i>Cords</i> | | | | | |
| | <i>Red Oak</i> | 2.0 | | <i>Cords</i> | | | | | |
| | <i>White Oak</i> | 11.0 | | <i>Cords</i> | | | | | |
| | Red Maple | 95.0 | | Cords | | | | | |
| | Red Pine | 33.0 | | Cords | | | | | |
| | White Pine | 124.0 | | Cords | | | | | |
| | 7 | Mixed Aspen | Sawtimber | 12.7 | | | MBF | 4.5 | \$4,064.75 |
| | | <i>B. T. Aspen</i> | | 12.7 | | | <i>MBF</i> | | |
| Red Maple | | 0.8 | | MBF | | | | | |
| White Pine | | 0.5 | MBF | | | | | | |
| Mixed Aspen | | Pulpwood | 87.0 | Cords | | | | | |
| <i>B. T. Aspen</i> | | | 51.0 | <i>Cords</i> | | | | | |
| <i>Quaking Aspen</i> | | | 36.0 | <i>Cords</i> | | | | | |
| Mixed Hardwood | | | 2.0 | Cords | | | | | |
| <i>Misc. Species 1</i> | | | 2.0 | <i>Cords</i> | | | | | |
| Mixed Oak | | | 8.0 | Cords | | | | | |
| <i>BI/R/Hybrid Oak</i> | | | 8.0 | <i>Cords</i> | | | | | |
| Red Maple | | | 27.0 | Cords | | | | | |
| White Pine | 2.0 | | Cords | | | | | | |
| 8 | Jack Pine | Sawtimber | 2.9 | MBF | 44.0 | \$25,025.80 | | | |
| | Mixed Aspen | | 1.3 | MBF | | | | | |
| | <i>Quaking Aspen</i> | | 1.3 | <i>MBF</i> | | | | | |
| | Mixed Oak | | 39.3 | MBF | | | | | |
| | <i>BI/R/Hybrid Oak</i> | | 39.3 | <i>MBF</i> | | | | | |
| | Red Maple | | 9.0 | MBF | | | | | |
| | Red Pine | | 104.4 | MBF | | | | | |
| | White Pine | | 22.6 | MBF | | | | | |
| | Jack Pine | | Pulpwood | 26.0 | | | Cords | | |
| | Mixed Aspen | | | 21.0 | | | Cords | | |
| | <i>Quaking Aspen</i> | | | 21.0 | | | <i>Cords</i> | | |
| | Mixed Hardwood | | | 3.0 | | | Cords | | |
| | <i>Misc. Species 1</i> | | | 3.0 | | | <i>Cords</i> | | |
| | Mixed Oak | | | 109.0 | | | Cords | | |
| | <i>BI/R/Hybrid Oak</i> | | | 108.0 | | | <i>Cords</i> | | |
| <i>White Oak</i> | 1.0 | <i>Cords</i> | | | | | | | |

Description of Timber by Payment Unit (PU), con't

| PU | MARKET GROUP | PRODUCT | QUANTITY | UNIT | ACRES | ADVERTISE PRICE | |
|------------|------------------------|-----------|------------|--------------|-------|-----------------|-------|
| 8 con't | Mixed Spruce | Pulpwood | 5.0 | Cords | | | |
| | <i>Black Spruce</i> | | 5.0 | <i>Cords</i> | | | |
| | Red Maple | | 55.0 | Cords | | | |
| | Red Pine | | 37.0 | Cords | | | |
| | White Pine | | 27.0 | Cords | | | |
| 9 | Jack Pine | Sawtimber | 1.6 | MBF | 23.8 | \$13,543.50 | |
| | Mixed Aspen | | 0.7 | MBF | | | |
| | <i>Quaking Aspen</i> | | 0.7 | <i>MBF</i> | | | |
| | Mixed Oak | | 21.3 | MBF | | | |
| | <i>BI/R/Hybrid Oak</i> | | 21.3 | <i>MBF</i> | | | |
| | Red Maple | | 4.8 | MBF | | | |
| | Red Pine | | 56.5 | MBF | | | |
| | White Pine | | 12.2 | MBF | | | |
| | Jack Pine | | Pulpwood | 14.0 | | | Cords |
| | Mixed Aspen | | | 12.0 | | | Cords |
| | <i>Quaking Aspen</i> | 12.0 | | <i>Cords</i> | | | |
| | Mixed Hardwood | 1.0 | | Cords | | | |
| | <i>Misc. Species 1</i> | 1.0 | | <i>Cords</i> | | | |
| | Mixed Oak | 59.0 | | Cords | | | |
| | <i>BI/R/Hybrid Oak</i> | 59.0 | | <i>Cords</i> | | | |
| | Mixed Spruce | 2.0 | | Cords | | | |
| | <i>Black Spruce</i> | 2.0 | | <i>Cords</i> | | | |
| | Red Maple | 30.0 | | Cords | | | |
| | Red Pine | 20.0 | Cords | | | | |
| | White Pine | 15.0 | Cords | | | | |
| 10 | White Pine | Sawtimber | 1.9 | MBF | 5.8 | \$658.75 | |
| | Mixed Aspen | Pulpwood | 1.0 | Cords | | | |
| | <i>Quaking Aspen</i> | | 1.0 | <i>Cords</i> | | | |
| | Mixed Oak | | 1.0 | Cords | | | |
| | <i>BI/R/Hybrid Oak</i> | | 1.0 | <i>Cords</i> | | | |
| | Red Pine | | 8.0 | Cords | | | |
| | White Pine | | 7.0 | Cords | | | |
| 11 | Mixed Aspen | Sawtimber | 29.9 | MBF | 20.0 | \$21,924.50 | |
| | <i>B. T. Aspen</i> | | 29.9 | <i>MBF</i> | | | |
| | Mixed Oak | | 13.8 | MBF | | | |
| | <i>BI/R/Hybrid Oak</i> | | 11.5 | <i>MBF</i> | | | |
| | <i>Red Oak</i> | 2.3 | <i>MBF</i> | | | | |
| | Red Maple | 34.4 | MBF | | | | |
| | Red Pine | 69.9 | MBF | | | | |
| | White Pine | 13.9 | MBF | | | | |
| | Mixed Aspen | Pulpwood | 70.0 | Cords | | | |
| | <i>B. T. Aspen</i> | | 70.0 | <i>Cords</i> | | | |
| | Mixed Oak | | 36.0 | Cords | | | |
| | <i>BI/R/Hybrid Oak</i> | | 32.0 | <i>Cords</i> | | | |
| | <i>Red Oak</i> | | 4.0 | <i>Cords</i> | | | |
| | Red Maple | | 151.0 | Cords | | | |
| Red Pine | 33.0 | | Cords | | | | |
| White Pine | 16.0 | | Cords | | | | |
| 12 | Jack Pine | Sawtimber | 3.4 | MBF | 34.2 | \$15,444.15 | |
| | Mixed Aspen | | 17.1 | MBF | | | |
| | <i>B. T. Aspen</i> | | 11.1 | <i>MBF</i> | | | |
| | <i>Quaking Aspen</i> | | 6.0 | <i>MBF</i> | | | |
| | Mixed Oak | | 13.6 | MBF | | | |
| | <i>BI/R/Hybrid Oak</i> | | 13.6 | <i>MBF</i> | | | |
| | Mixed Spruce | | 6.6 | MBF | | | |
| | <i>Black Spruce</i> | | 0.7 | <i>MBF</i> | | | |

Description of Timber by Payment Unit (PU), con't

| PU | MARKET GROUP | PRODUCT | QUANTITY | UNIT | ACRES | ADVERTISE PRICE | |
|------------|------------------------|------------------|-----------------|------------|--------------|-----------------|--------------|
| 12 con't | <i>White Spruce</i> | <i>Sawtimber</i> | 5.9 | <i>MBF</i> | | | |
| | Paper Birch | | 0.3 | MBF | | | |
| | Red Maple | | 12.6 | MBF | | | |
| | Red Pine | | 11.5 | MBF | | | |
| | White Pine | | 16.8 | MBF | | | |
| | Balsam Fir | | <i>Pulpwood</i> | 6.0 | | | Cords |
| | <i>Balsam Fir</i> | | | 6.0 | | | <i>Cords</i> |
| | Jack Pine | | | 5.0 | | | Cords |
| | Mixed Aspen | | | 124.0 | | | Cords |
| | <i>B. T. Aspen</i> | | | 61.0 | | | <i>Cords</i> |
| | <i>Quaking Aspen</i> | | | 63.0 | | | <i>Cords</i> |
| | Mixed Hardwood | | | 1.0 | | | Cords |
| | <i>Paper Birch</i> | | | 1.0 | | | <i>Cords</i> |
| | Mixed Oak | | | 49.0 | | | Cords |
| | <i>BI/R/Hybrid Oak</i> | | | 49.0 | | | <i>Cords</i> |
| | Mixed Spruce | | | 19.0 | | | Cords |
| | <i>Black Spruce</i> | | | 5.0 | | | <i>Cords</i> |
| | <i>White Spruce</i> | | | 14.0 | | | <i>Cords</i> |
| | Red Maple | | | 102.0 | | | Cords |
| | Red Pine | | | 8.0 | | | Cords |
| White Pine | 93.0 | Cords | | | | | |
| 13 | Jack Pine | <i>Sawtimber</i> | | 4.2 | MBF | 41.5 | \$18,759.35 |
| | Mixed Aspen | | | 20.7 | MBF | | |
| | <i>B. T. Aspen</i> | | | 13.4 | <i>MBF</i> | | |
| | <i>Quaking Aspen</i> | | | 7.3 | <i>MBF</i> | | |
| | Mixed Oak | | 16.6 | MBF | | | |
| | <i>BI/R/Hybrid Oak</i> | | 16.6 | <i>MBF</i> | | | |
| | Mixed Spruce | | 7.9 | MBF | | | |
| | <i>Black Spruce</i> | | 0.8 | <i>MBF</i> | | | |
| | <i>White Spruce</i> | | 7.1 | <i>MBF</i> | | | |
| | Paper Birch | | 0.3 | MBF | | | |
| | Red Maple | | 15.3 | MBF | | | |
| | Red Pine | | 14.0 | MBF | | | |
| | White Pine | | 20.3 | MBF | | | |
| | Balsam Fir | | <i>Pulpwood</i> | 7.0 | Cords | | |
| | <i>Balsam Fir</i> | | | 7.0 | <i>Cords</i> | | |
| | Jack Pine | | | 6.0 | Cords | | |
| | Mixed Aspen | | | 152.0 | Cords | | |
| | <i>B. T. Aspen</i> | | | 75.0 | <i>Cords</i> | | |
| | <i>Quaking Aspen</i> | | | 77.0 | <i>Cords</i> | | |
| | Mixed Hardwood | | | 2.0 | Cords | | |
| | <i>Paper Birch</i> | | | 2.0 | <i>Cords</i> | | |
| | Mixed Oak | | | 60.0 | Cords | | |
| | <i>BI/R/Hybrid Oak</i> | | | 60.0 | <i>Cords</i> | | |
| | Mixed Spruce | | | 22.0 | Cords | | |
| | <i>Black Spruce</i> | | | 5.0 | <i>Cords</i> | | |
| | <i>White Spruce</i> | | | 17.0 | <i>Cords</i> | | |
| | Red Maple | | | 124.0 | Cords | | |
| | Red Pine | | | 9.0 | Cords | | |
| | White Pine | | | 113.0 | Cords | | |
| | TOTAL: | | | 1,193.9 | MBF | | |
| TOTAL: | | | | 2,750.0 | Cords | | |

Sale Specific Conditions & Requirements

Sale Name: Boyce Lake Thin

Sale Number: 71-013-18 Seq#: 1

1 - Sale Area

1.2 - Boundaries

1.2.1 - Painted boundaries (1/14)

The sale boundary and Payment Unit boundaries are marked and identified by red and yellow paint. Exterior sale boundary lines against state are marked with red paint. Interior Payment Unit boundaries are marked with yellow paint. The painted boundary line trees are not Included Timber and are to be protected. Yellow painted trees designating an interior Payment Unit boundary are only to be cut when all surrounding Payment Units have been paid.

2 - Timber Specifications

2.1 - Included Timber

2.1.1 - Clearcut unit(s) with unmerchantable trees (6/14)

Within Payment Unit(s) 7 and 10, cut all trees that are two (2) inches or more at DBH, except do not cut any trees marked with green paint above and below stump height.

2.1.3 - Cut tree marked unit(s) (12/08)

Within Payment Unit(s) 1, 3, 4, 8, 9, 12, and 13, all trees are designated for cutting when marked with orange paint above and below stump height, regardless of merchantability. In addition, the following specifications apply:

- Within Payment Unit 3, cut all red oak and jack pine.
- Within Payment Unit 4, cut all aspen.
- Within Payment Units 8 and 9, cut all aspen and red maple trees that are two (2) inches or more at DBH.
- Within Payment Units 12 and 13, cut all balsam fir, black spruce, aspen, and red oak trees that are two (2) inches or more at DBH, except do not cut any oak over 24 inches at DBH.

2.1.7 - Leave tree marked unit(s) (6/14)

Within Payment Unit(s) 2, 5, 6, and 11, cut all trees that are two (2) inches or more at DBH, except do not cut trees marked with green paint above and below stump height. In addition, within Payment Unit 2, do not cut oak less than 5 inches at DBH. Also, within Payment Unit 5, do not cut oak and pine less than 5 inches at DBH.

2.1.11 - Description of timber note (2/04)

Note that Misc. Species 1 = pin cherry.

2.2 - Utilization

2.2.3 - Stump heights (4/07)

Stump heights within the Sale Area shall not exceed 6 inches for all trees.

2.2.4 - Skidding length (2/14)

Skidding of unlimbed tops is not permissible within Payment Units 2, 5, and 6 unless approved by the Unit Manager or his/her representative. Skidding of lengths over 17 feet is permissible as long as the timber sale administrator approves the method and machinery used. If at any point damage exceeds specification 3.4.1, all of the remaining wood must be skid in lengths less than 17 feet.

2.2.6 - Roundwood operation required (5/07)

The skidding of whole trees or tree segments with limbs attached is prohibited within Payment Unit(s) 1, 3, 4, 8, 9, and 11-13. All products must be produced as roundwood and forwarded to existing roads or landing areas in final product length.

3 - Payments

3.3 - Pre-measured Sales

3.3.4 - Dividing payment units (7/14)

Payment Unit(s) may be divided at the request of the Purchaser and upon approval of the Unit Manager. Dividing Payment

Units is a contract modification which requires a Timber Sale Contract Supplement. There will be only one division per Payment Unit.

3.4 - Damaged Timber

3.4.1 - Damaged timber (6/14)

General Condition and Requirement 3.4 Damaged Timber, defines liquidated damages for undesignated live merchantable trees which are cut or injured. In addition, extreme care should be taken to avoid damage to tree seedlings and saplings.

Within the sale area, if more than 35% of the tree seedlings or saplings (1/4" to 4.5" DBH) within a specified portion of the sale area are damaged, liquidated damages will be assessed at \$300 per acre for all acreage within that specified portion of the sale area that was damaged.

No damage is acceptable to merchantable trees. Within the sale area, if more than 5% of trees (> 4.5" DBH) within a specified area of the sale are damaged, liquidated damages will be assessed for all trees damaged. Rates will be in accordance with General Condition and Requirement 3.4 Damaged Timber.

4 - Transportation

4.1 - Construction

4.1.3 - Slash and earthen piles (8/04)

Piles or windrows of earth along roads and landings that have been widened or constructed shall be leveled. Slash from road maintenance or construction, including stumps, shall be dispersed throughout the sale.

4.1.7 - Road closure (10/11)

All new roads built into the sale must be blocked to vehicle traffic upon completion of the sale. Overgrown roads that are reopened shall be considered new roads. These roads must be rendered impassable to cars and trucks. Temporary berms may be required if no sale activity occurs for 30 or more consecutive days. Contact the sale administrator for specific details of design and placement.

4.1.12 - No new roads (1/12)

No new roads will be permitted in any Payment Unit other than Payment Unit 10. All operations are limited to existing roads. Skid trails only will be allowed.

4.2 - Maintenance

4.2.3 - Road maintenance (8/13)

The following road maintenance is required: Within 60 days of completion of hauling, or if no hauling occurs for 60 days, the road must be maintained and graded to the condition it was prior to use. This includes cleaning of drainage areas, grading, crowning and filling with gravel, if necessary. Damages will be assessed if grading/repair does not occur.

5 - Operations

5.1 - Notification

5.1.1 - Pre-sale conference (10/16)

A pre-sale conference on site between the Purchaser and sale administrator is required prior to beginning any operations to determine landing and road locations.

5.1.4 - Post-sale conference (10/16)

A post-sale conference on site between the Purchaser and sale administrator is required 5 days prior to the completion of active logging operations to determine clean-up and repair of landings, road edges, and the fulfillment of other contract specifications.

5.2 - Conduct of Operations

5.2.1 - Slash

5.2.1.8 - Slash height (12/08)

No slash or tree tops may exceed 24 inches in height.

5.2.2 - Hazard Trees/Snags

5.2.2.1 - Den trees (10/16)

Obvious hollow and/or den trees shall be protected and left standing unless they are a safety hazard.

5.2.3 - Operating Restrictions

5.2.3.3 - Bark slippage restriction (3/09)

Within Payment Unit(s) 1, 3, 8, 9, 12, and 13, unless changed by written agreement, cutting and skidding are not permitted during the period of April 15 to July 15. This restriction is because of bark slippage.

5.2.3.5 - Oak wilt restriction (1/18)

Within Payment Unit(s) 3, unless changed by written agreement, cutting, skidding, hauling within the sale and brushing of access roads to the sale are not permitted during the period of April 15 to July 15. Operations may be allowed if specific steps are taken to prevent damaging uncut oak during the high risk period. Those steps may include completing all road brushing before April 15th and clearing a tree-length buffer along uncut oak cover before April 15th. This is necessary to reduce the spread of oak wilt. For more information, contact the Unit Manager or his/her representative.

5.2.3.6 - Bark beetle restriction (12/08)

In the event drought creates a high risk of pine bark beetle infestation, pine is not to be cut during the period March 1 through July 1, unless all portions of trees greater than two inches in diameter are removed from the sale area, reduced to chips, or treated to the satisfaction of the Unit Manager or his/her representative, within fifteen days of being severed from the stump. Pine log decks, pulpwood piles and treetops that are piled for chipping in the fall or winter within a 1/4 mile of susceptible sites must be removed before March 15. Residual slash must not be placed in piles or rows and must be spread over the site for quick drying. The Department of Natural Resources will exercise this specification if the risk of damage warrants.

5.2.17 - Timber Mats and Interlocking Composite Mats (3/18)

Some roads or skid trails may require extra protection such as that afforded by timber mats, interlocking composite mats, or another approved system. If available, mats may be borrowed from the DNR. A Timber Sale Contract Supplement will be used to document the Purchaser's use of the DNR's mats. Contact the sale administrator regarding availability and pick-up. Timber mats are available from various field offices. Composite mats are only available from the Grayling field office. The Purchaser is responsible for picking up and hauling the mats to and from the site. The composite mats will require DNR staff onsite for installation and removal. Contact the sale administrator to schedule at least 30 days before desired install/removal date. All mats must be cleaned prior to drop off. This may include, but is not limited to, power washing and brushing to remove mud and debris. A charge of \$400.00 per timber mat and \$2,000.00 per composite mat will be assessed for all damaged or non-returned mats. Damage for the crane/timber mats is defined as three or more broken cants. Damage for the composite mats is defined as cracked or broken mats.

5.2.32 - Decking/landing restoration (9/13)

All decking and landing areas must have the surface area restored to a condition equal to or better than before. This is to ensure the proper regeneration of the stand. Wood debris, chips and "cookies" from trimmings must be removed or scattered away from landing and loading areas and may not be windrowed on the edge. Depth of debris shall not exceed six inches in depth.

5.2.38 - No decking against live trees (2/04)

Cut products may not be decked against unmarked or designated leave trees.

5.2.39 - ORV trail/route protection (4/18)

There is an ORV trail or route and is shown on the Timber Sale Map. Do not cut trees or damage posts with yellow ORV markers. All stumps within 5 feet of the trail must be cut flush with the ground. Maintain a 20 foot wide slash, debris, and rut free zone daily using the ORV trail or route as the centerline. Do not run equipment down the ORV trail or route. Skidding across the trail or route may only occur in locations approved by the sale administrator.

5.2.41 - Snowmobile trail protection (9/11)

There is a snowmobile trail and is shown on the Timber Sale Map. Do not cut or damage posts with orange trail markers or traffic control signs. If the trail is used, it must be maintained and restored to a condition equal to or better than before the sale. If the trail is used for hauling, it must be graded to the satisfaction of the Unit Manager or his/her representative prior to December 1st. If the trail road is to be used for hauling during the snowmobile season, then a snow covered base must be left

on the trail. Maintain a 20 foot wide slash, debris, and rut free zone daily using the snowmobile trail as the centerline. No decking of forest products will be permitted along the snowmobile trail. All stumps within 20 feet of the snowmobile trail must be cut at ground level.

5.4 - Soil Protection

5.4.1 - Rutting restriction, general (7/16)

Operations are to cease immediately if equipment and weather conditions result in rutting of roads and/or skid trails which is 12 inches or greater in depth and 50 feet in length. The Unit Manager or his/her representative may restrict hauling and/or skidding if ruts exceed the specified depth. With the Unit Manager or his/her representative's approval, the Purchaser may return to the area when the risk of rutting has decreased.

6 - Safety and Fire Prevention

6.2 - Signing

6.2.2 - Snowmobile trail posting (8/09)

The Purchaser is responsible for posting and maintaining caution signs on the snowmobile trails prior to beginning operations during the snowmobile season (approximately December 1 to March 31). The trail must be posted at appropriate distances from the sale area to warn of logging activity and truck traffic. Signs must be removed when harvest operations are suspended or completed. The Purchaser will provide these signs.

6.2.3 - Recreational trail posting (2/10)

The Purchaser is responsible for posting and maintaining caution signs on the ORV Trail prior to beginning operations. The trail must be posted at appropriate distances from the sale area to warn of logging activity and truck traffic at both ends of the trail. Signs must be removed when harvest operations are suspended or completed. The Purchaser will provide these signs.



TIMBER SALE MAP

This information provided by authority of Part 525, 1994 PA 451, as amended.

| | |
|-------------|------|
| Sale Number | Year |
| 71 - 013 | 18 |

| | | | | | |
|-------------------------------------|---------------------|--|-------------------|-----------|---------|
| Forest Management Unit Roscommon | County Roscommon | Mapped By Bates/Martell | Date 09/30/18 | Page 1 | of 2 |
| Township 21N | Range 03W | Section(s) and Subdivision(s) Sec. 3 - N1/2NW, NENE, SW; Sec. 10 - SENW, SENE, E1/2SW, SE | Scale 1:15,840 | | |

| Cover Type | | | | Density | |
|-------------------|----------------------|-------------------------|-------------------|-----------------------------|------------------------|
| A = Aspen | H = Hemlock | N = Marsh | U = Upland Brush | 0 = Non Stocked | 5 = Pole Timber Medium |
| B = Paper Birch | J = Jack Pine | O = Oak | UM = Upland Mixed | 1 = Seedling Sapling Poor | 6 = Pole Timber Well |
| C = Cedar | L = Lowland Brush | P = Lowland Poplar | V = Bog or Marsh | 2 = Seedling Sapling Medium | 7 = Saw Timber Poor |
| D = Treed Bog | LM = Lowland Mixed | Q = Mixed Swamp Conifer | W = White Pine | 3 = Seedling Sapling Well | 8 = Saw Timber Medium |
| E = Swamp Hdwoods | M = Mpl, Bch, Brch | R = Red Pine | X = Non Stocked | 4 = Pole Timber Poor | 9 = Saw Timber Well |
| F = Spruce Fir | MC = Mixed Conifer | S = Black Spruce | Z = Water | | |
| G = Grass | MD = Mixed Deciduous | T = Tamarack | | | |

| PU | Acres | PU | Acres |
|----|-------|----|-------|
| 1 | 13.7 | 4 | 18.6 |
| 2 | 14.6 | 5 | 7.8 |
| 3 | 10.6 | | |

Boyce Lake Thin Compartment 025 273 Acres

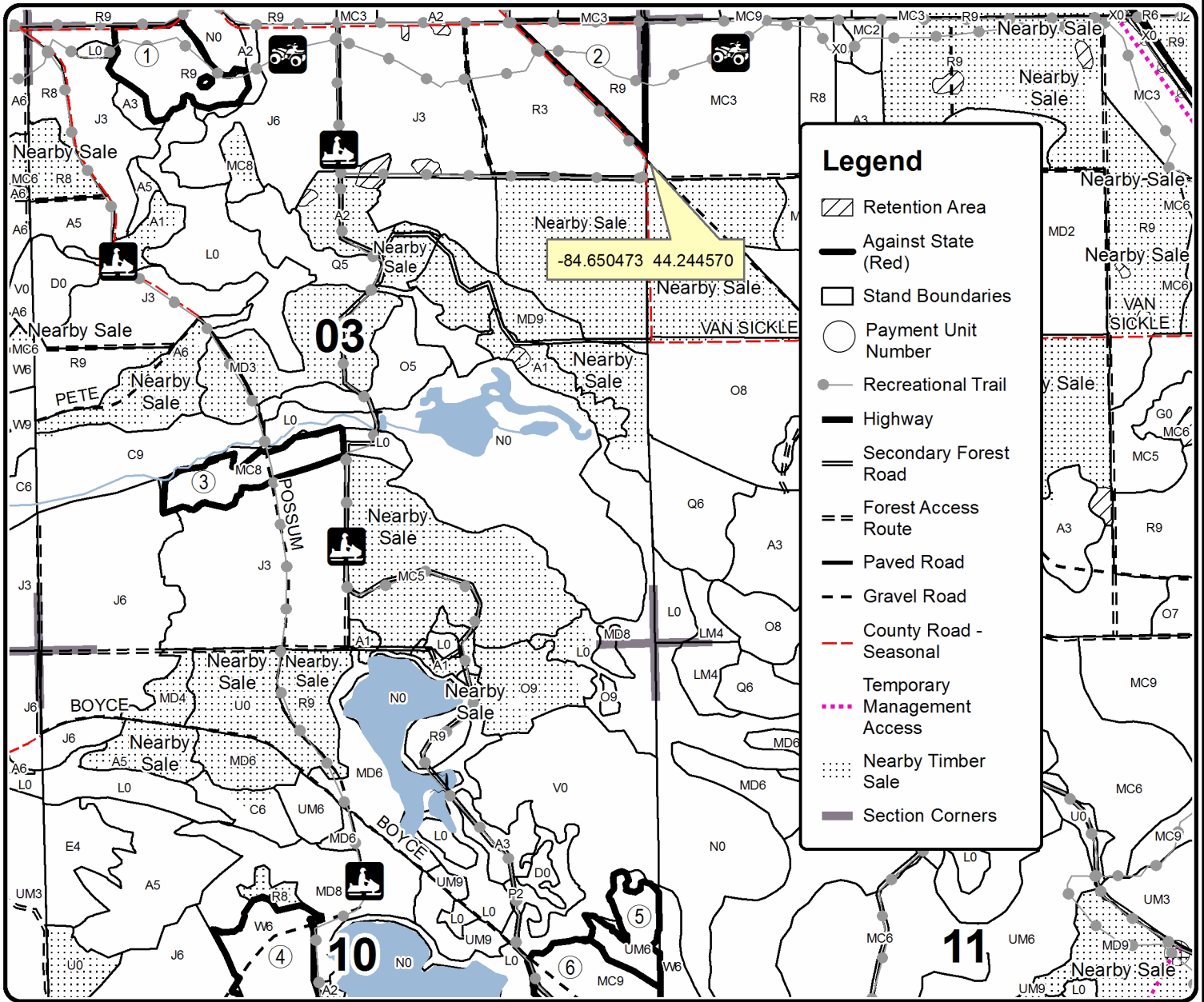
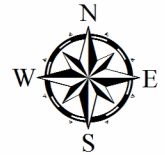

Legend

- Retention Area
- Against State (Red)
- Stand Boundaries
- Payment Unit Number
- Recreational Trail
- Highway
- Secondary Forest Road
- Forest Access Route
- Paved Road
- Gravel Road
- County Road - Seasonal
- Temporary Management Access
- Nearby Timber Sale
- Section Corners

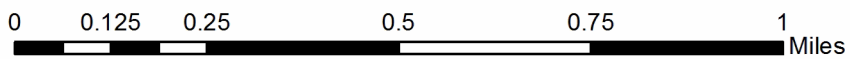



TIMBER SALE MAP

This information provided by authority of Part 525, 1994 PA 451, as amended.

| | |
|-------------|------|
| Sale Number | Year |
| 71 - 013 | 18 |

| | | | | | |
|------------------------|-----------|--|----------|------|----|
| Forest Management Unit | County | Mapped By | Date | Page | of |
| Roscommon | Roscommon | Bates/Martell | 09/30/18 | 2 | 2 |
| Township | Range | Section(s) and Subdivision(s) | Scale | | |
| 21N | 03W | Sec. 10 - SENW, SENE, E1/2SW, SE; Sec. 15 - NENW, SWNW, N1/2NE, SW, W1/2SE; Sec. 16 - NESE; Sec. 34 - SWSW | 1:15,840 | | |

Cover Type

| | | | |
|-------------------|----------------------|-------------------------|-------------------|
| A = Aspen | H = Hemlock | N = Marsh | U = Upland Brush |
| B = Paper Birch | J = Jack Pine | O = Oak | UM = Upland Mixed |
| C = Cedar | L = Lowland Brush | P = Lowland Poplar | V = Bog or Marsh |
| D = Treed Bog | LM = Lowland Mixed | Q = Mixed Swamp Conifer | W = White Pine |
| E = Swamp Hdwoods | M = Mpl. Bch, Brch | R = Red Pine | X = Non Stocked |
| F = Spruce Fir | MC = Mixed Conifer | S = Black Spruce | Z = Water |
| G = Grass | MD = Mixed Deciduous | T = Tamarack | |

Density

| | |
|-----------------------------|------------------------|
| 0 = Non Stocked | 5 = Pole Timber Medium |
| 1 = Seedling Sapling Poor | 6 = Pole Timber Well |
| 2 = Seedling Sapling Medium | 7 = Saw Timber Poor |
| 3 = Seedling Sapling Well | 8 = Saw Timber Medium |
| 4 = Pole Timber Poor | 9 = Saw Timber Well |

| PU | Acres | PU | Acres |
|----|-------|----|-------|
| 4 | 18.6 | 9 | 23.8 |
| 5 | 7.8 | 10 | 5.8 |
| 6 | 33.9 | 11 | 20.0 |
| 7 | 4.5 | 12 | 34.2 |
| 8 | 44.0 | 13 | 41.5 |

Boyce Lake Thin

Compartment 025

273 Acres

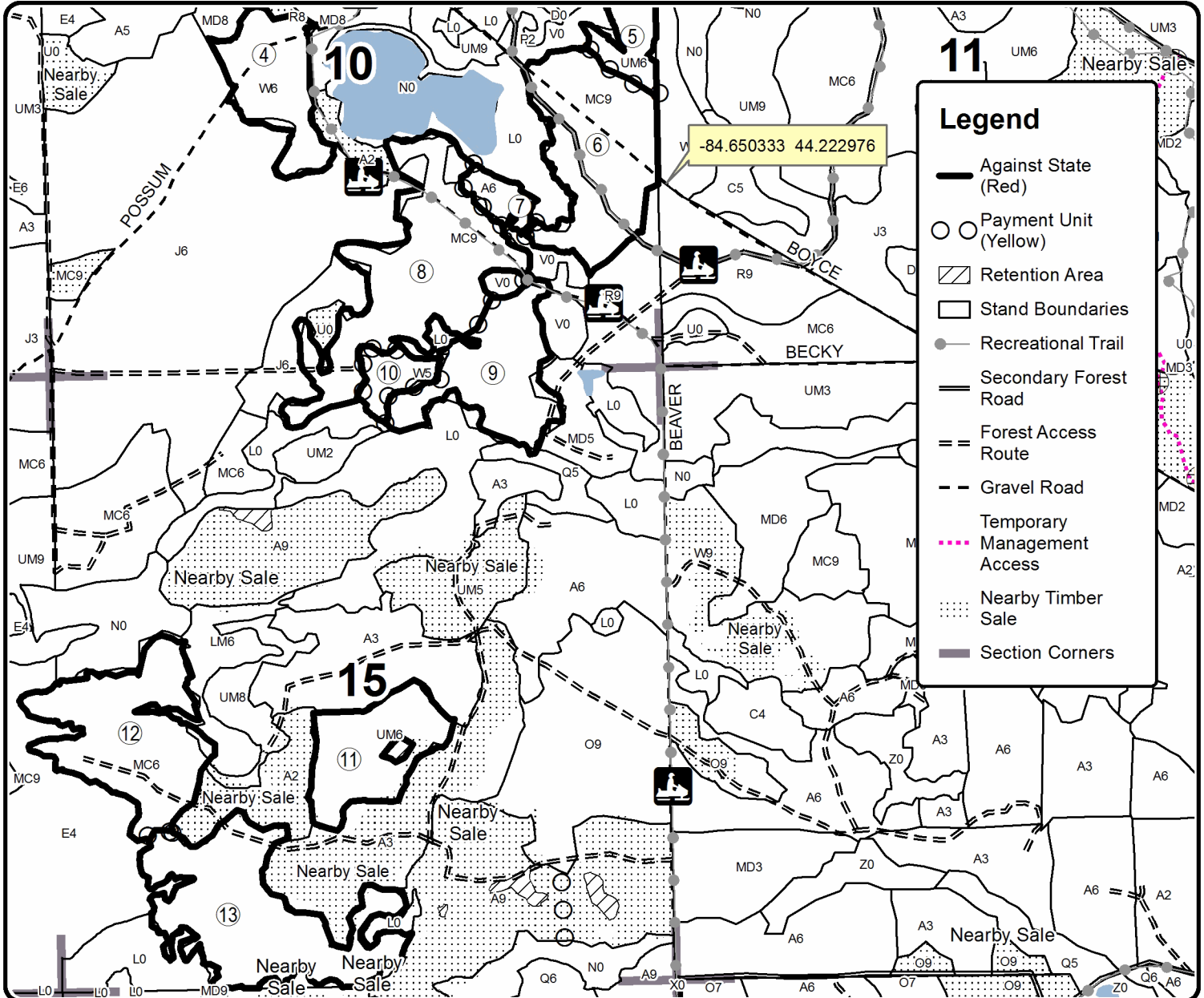

Legend

- Against State (Red)
- Payment Unit (Yellow)
- Retention Area
- Stand Boundaries
- Recreational Trail
- Secondary Forest Road
- Forest Access Route
- Gravel Road
- Temporary Management Access
- Nearby Timber Sale
- Section Corners

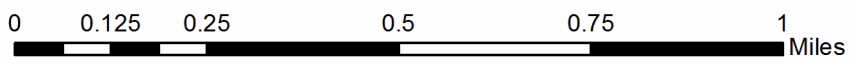

TIMBER SALE INFORMATION

RGF Harvest (71-027-18)

T23N, R01E, SEC. 18; T23N, R01E, SEC. 7.
Ogemaw County (Advertised Price \$50,654.70)

SALE NOTE: This sale requires construction of a haul road or skid trail to be built to access Payment Units 2 and 3. The road will require installation of a culvert or portable bridge for a stream crossing. The DNR will provide the necessary permits and portable bridge, if needed.

A timber sale contract for this lump sum, sealed bid timber sale will be awarded to the responsible bidder offering the highest sealed bid price. Bids must be at or above the following advertised price for each species:

| <u>PRODUCTS & SPECIES</u> | <u>ESTIMATED UNITS*</u> | | <u>ADVERTISED PRICE</u> |
|-------------------------------|-------------------------|-------|-------------------------|
| Sawtimber | | | |
| BI/R/Hybrid Oak | 36.10 | MBF | \$ 113.00 / MBF |
| Black Spruce | 10.30 | MBF | \$ 37.00 / MBF |
| Jack Pine | 95.20 | MBF | \$ 28.00 / MBF |
| Red Maple | 22.20 | MBF | \$ 56.00 / MBF |
| Red Pine | 129.00 | MBF | \$ 104.00 / MBF |
| White Pine | 30.60 | MBF | \$ 50.00 / MBF |
| Pulpwood | | | |
| Balsam Fir | 11.00 | Cords | \$ 24.85 / Cord |
| BI/R/Hybrid Oak | 108.00 | Cords | \$ 15.05 / Cord |
| Black Spruce | 101.00 | Cords | \$ 18.55 / Cord |
| Jack Pine | 342.00 | Cords | \$ 13.60 / Cord |
| Mixed Aspen | 12.00 | Cords | \$ 25.65 / Cord |
| Mixed Hardwood | 124.00 | Cords | \$ 19.10 / Cord |
| N. White Cedar | 6.00 | Cords | \$ 25.25 / Cord |
| Red Pine | 305.00 | Cords | \$ 41.90 / Cord |
| White Pine | 176.00 | Cords | \$ 18.80 / Cord |

* The total volume is statistically estimated within plus (+) or minus (-) 10.25 percent. The estimated units are final and not subject to adjustment. Prospective bidders are urged to examine this timber and to make their own estimates of quantity and quality.

BOND AND PAYMENT SCHEDULE:

1. A bond in the amount of \$2,533.00 to insure faithful performance of the conditions of the contract will be deposited by the successful bidder within 21 days of the sale award.
2. Cutting in any sale or unit without the required advance payment would be considered a trespass.
3. Total payment must be paid in advance or according to the following schedule:
 - (a) Ten percent (10%) of the sale value must be paid within 21 days of the sale award.
 - (b) The 10% down payment will be credited towards the first unit cut.
 - (c) Payment for each of the following units must be made before cutting begins in that unit:

| PAYMENT UNIT NUMBER | PERCENT OF TOTAL SALE VALUE |
|---------------------|-----------------------------|
| 01 | 10.9% |
| 02 | 59.2% |
| 03 | 10.8% |
| 04 | 9.9% |
| 05 | 9.2% |

4. If no cutting takes place, the 10% down payment will not be refunded.
5. Operations on the contract issued will terminate on 09/30/2022.

Description of Timber by Payment Unit (PU)

| PU | MARKET GROUP | PRODUCT | QUANTITY | UNIT | ACRES | ADVERTISE PRICE | | | |
|------------------|-----------------------|------------------|-----------|--------------|-------|-----------------|------------|------|-------------|
| 1 | BI/R/Hybrid Oak | Sawtimber | 7.5 | MBF | 9.6 | \$5,513.40 | | | |
| | Red Maple | | 11.1 | MBF | | | | | |
| | Red Pine | | 12.7 | MBF | | | | | |
| | White Pine | | 2.2 | MBF | | | | | |
| | Balsam Fir | Pulpwood | 3.0 | Cords | | | | | |
| | BI/R/Hybrid Oak | | 13.0 | Cords | | | | | |
| | Mixed Hardwood | | 58.0 | Cords | | | | | |
| | <i>Paper Birch</i> | <i>Sawtimber</i> | 0.8 | <i>MBF</i> | | | | | |
| | <i>Paper Birch</i> | <i>Pulpwood</i> | 7.0 | <i>Cords</i> | | | | | |
| | <i>Red Maple</i> | | 49.0 | <i>Cords</i> | | | | | |
| | N. White Cedar | | 6.0 | Cords | | | | | |
| | <i>N. White Cedar</i> | <i>Sawtimber</i> | 1.5 | <i>MBF</i> | | | | | |
| | <i>N. White Cedar</i> | <i>Pulpwood</i> | 3.0 | <i>Cords</i> | | | | | |
| | Red Pine | | 16.0 | Cords | | | | | |
| | White Pine | | 22.0 | Cords | | | | | |
| | 2 | BI/R/Hybrid Oak | Sawtimber | 27.5 | | | MBF | 50.9 | \$29,982.15 |
| Black Spruce | | | 0.8 | MBF | | | | | |
| Jack Pine | | | 89.4 | MBF | | | | | |
| Red Maple | | | 7.0 | MBF | | | | | |
| Red Pine | | | 78.4 | MBF | | | | | |
| White Pine | | | 13.5 | MBF | | | | | |
| Balsam Fir | | Pulpwood | 6.0 | Cords | | | | | |
| BI/R/Hybrid Oak | | | 85.0 | Cords | | | | | |
| Black Spruce | | | 34.0 | Cords | | | | | |
| Jack Pine | | | 294.0 | Cords | | | | | |
| Mixed Hardwood | | | 47.0 | Cords | | | | | |
| <i>Red Maple</i> | | | 47.0 | <i>Cords</i> | | | | | |
| Red Pine | | | 159.0 | Cords | | | | | |
| White Pine | | | 80.0 | Cords | | | | | |
| 3 | | BI/R/Hybrid Oak | Sawtimber | 1.1 | MBF | 17.8 | \$5,476.65 | | |
| | | Jack Pine | | 3.3 | MBF | | | | |
| | Red Maple | | 2.8 | MBF | | | | | |
| | Red Pine | | 10.6 | MBF | | | | | |
| | BI/R/Hybrid Oak | Pulpwood | 10.0 | Cords | | | | | |
| | Black Spruce | | 11.0 | Cords | | | | | |
| | Jack Pine | | 33.0 | Cords | | | | | |
| | Mixed Aspen | | 8.0 | Cords | | | | | |
| | <i>Quaking Aspen</i> | | 8.0 | <i>Cords</i> | | | | | |
| | Mixed Hardwood | | 13.0 | Cords | | | | | |
| | <i>Red Maple</i> | | 13.0 | <i>Cords</i> | | | | | |
| | Red Pine | | 61.0 | Cords | | | | | |
| | White Pine | | 10.0 | Cords | | | | | |
| 4 | Black Spruce | Sawtimber | 7.7 | MBF | 21.5 | \$5,015.20 | | | |
| | Jack Pine | | 0.4 | MBF | | | | | |
| | Red Pine | | 15.6 | MBF | | | | | |
| | White Pine | | 7.0 | MBF | | | | | |
| | Balsam Fir | Pulpwood | 2.0 | Cords | | | | | |
| | Black Spruce | | 48.0 | Cords | | | | | |
| | Jack Pine | | 7.0 | Cords | | | | | |
| | Mixed Aspen | | 4.0 | Cords | | | | | |
| | <i>B. T. Aspen</i> | | 2.0 | <i>Cords</i> | | | | | |
| | <i>Quaking Aspen</i> | | 2.0 | <i>Cords</i> | | | | | |
| | Red Pine | | 20.0 | Cords | | | | | |
| | White Pine | | 41.0 | Cords | | | | | |
| | 5 | Black Spruce | Sawtimber | 1.8 | | | MBF | 7.0 | \$4,667.30 |
| Jack Pine | | | 2.1 | MBF | | | | | |

Description of Timber by Payment Unit (PU), con't

| PU | MARKET GROUP | PRODUCT | QUANTITY | UNIT | ACRES | ADVERTISE PRICE |
|---------|------------------|-----------|----------|--------------|-------|-----------------|
| 5 con't | Red Maple | Sawtimber | 1.3 | MBF | | |
| | Red Pine | | 11.7 | MBF | | |
| | White Pine | | 7.9 | MBF | | |
| | Black Spruce | Pulpwood | 8.0 | Cords | | |
| | Jack Pine | | 8.0 | Cords | | |
| | Mixed Hardwood | | 6.0 | Cords | | |
| | <i>Red Maple</i> | | 6.0 | <i>Cords</i> | | |
| | Red Pine | | 49.0 | Cords | | |
| | White Pine | | 23.0 | Cords | | |
| TOTAL: | | | 323.4 | MBF | | |
| TOTAL: | | | 1,185.0 | Cords | | |

Sale Specific Conditions & Requirements

Sale Name: RGF Harvest

Sale Number: 71-027-18 Seq#: 1

1 - Sale Area

1.2 - Boundaries

1.2.1 - Painted boundaries (1/14)

The sale boundary and Payment Unit boundaries are marked and identified by red and yellow paint. Exterior sale boundary lines against state are marked with red paint. Interior Payment Unit boundaries are marked with yellow paint. The painted boundary line trees are not Included Timber and are to be protected unless marked with orange paint. Yellow painted trees designating an interior Payment Unit boundary are only to be cut when all surrounding Payment Units have been paid.

2 - Timber Specifications

2.1 - Included Timber

2.1.1 - Clearcut unit(s) with unmerchantable trees (6/14)

Within Payment Unit(s) 1 and 2, cut all trees that are two (2) inches or more at DBH, except do not cut trees marked with green paint.

2.1.3 - Cut tree marked unit(s) (12/08)

Within Payment Unit(s) 3, 4, and 5, all trees are designated for cutting when marked with orange paint above and below stump height, regardless of merchantability. In addition, the following specifications apply:

- Within Payment Unit 3, all other trees are designated for cutting, except do not cut red pine and white pine.

- Within Payment Unit 4, all spruce, fir, and aspen are designated for cutting.

- Within Payment Unit 5, all other trees are designated for cutting, except do not cut red pine.

2.2 - Utilization

2.2.6 - Roundwood operation required (5/07)

The skidding of whole trees or tree segments with limbs attached is prohibited within Payment Units 3, 4, and 5. All products must be produced as roundwood and forwarded to existing roads or landing areas in final product length.

2.2.9 - No chipping permitted (12/08)

Within Payment Unit(s) 2, no chipping is permitted. Tops must be spread evenly throughout the sale.

3 - Payments

3.3 - Pre-measured Sales

3.3.4 - Dividing payment units (7/14)

Payment Unit(s) may be divided at the request of the Purchaser and upon approval of the Unit Manager. Dividing Payment Units is a contract modification which requires a Timber Sale Contract Supplement.

4 - Transportation

4.1 - Construction

4.1.2 - Stream crossings, specific (3/11)

The creek crossing in Payment Unit 1 will require the installation of a culvert or portable bridge which may be borrowed from the DNR. This installation will be performed in accordance with the specifications on the appropriate permits which shall be provided by the DNR.

4.1.6 - Road construction (1/09)

Construction of new roads or improvements of existing roads shall be done in such a way as to minimize the environmental and visual impacts. Merchantable trees shall be cut and utilized unless otherwise directed. Non-merchantable trees shall be severed and laid flat on the ground. Slash shall be scattered, and not left in windrows and kept a minimum of 10 feet back

from the road edge. Stumps shall be set upright, not left on edge, and be moved at least 10 feet away from the road edge. Disturbed soil shall be feathered into the woods and not left in berms or windrows.

4.1.7 - Road closure (10/11)

All new roads built into the sale must be blocked to vehicle traffic upon completion of the sale. Overgrown roads that are reopened shall be considered new roads. In general, this will require constructing a four (4') foot high berm of stumps and logs covered with earth. These roads must be rendered impassable to cars and trucks. Contact the sale administrator for specific details of design and placement.

4.1.8 - Road work (1) (8/07)

A new haul and/or skid route will be required between Payment Units 1 and 2. There is a stream crossing within Payment Unit 1 that will need a culvert or portable bridge (provided by the DNR). Crane mats or composite mats may be needed along other portions of the route.

4.2 - Maintenance

4.2.5 - Two wheel drive condition (2/04)

All existing trail roads on and adjacent to the sale area must be passable by two-wheel drive traffic for the duration of the sale.

5 - Operations

5.1 - Notification

5.1.1 - Pre-sale conference (10/16)

A pre-sale conference on site between the Purchaser and sale administrator is required prior to beginning any operations to determine landing and road locations. The Unit Manager or his/her representative must be contacted in advance to schedule the conference.

5.2 - Conduct of Operations

5.2.1 - Slash

5.2.1.8 - Slash height (12/08)

No slash or tree tops may exceed 36 inches in height.

5.2.3 - Operating Restrictions

5.2.3.3 - Bark slippage restriction (3/09)

Within Payment Unit(s) 3, 4, and 5, unless changed by written agreement, cutting and skidding are not permitted during the period of April 15 to July 15. This restriction is because of bark slippage.

5.2.3.5 - Oak wilt restriction (1/18)

Within Payment Units 1, 2, and 3, unless changed by written agreement, cutting, skidding, hauling within the sale and brushing of access roads to the sale are not permitted during the period of April 15 to July 15. The main concern will be brushing the road leading into Payment Unit 1. Operations may be allowed if specific steps are taken to prevent damaging uncut oak during the high risk period. Those steps may include completing all road brushing before April 15th and clearing a tree-length buffer along uncut oak cover before April 15th. This is necessary to reduce the spread of oak wilt. For more information, contact the Unit Manager or his/her representative.

5.2.3.6 - Bark beetle restriction (12/08)

In the event drought creates a high risk of pine bark beetle infestation, pine is not to be cut during the period March 1 through July 1, unless all portions of trees greater than two inches in diameter are removed from the sale area, reduced to chips, or treated to the satisfaction of the Unit Manager or his/her representative, within fifteen days of being severed from the stump. Pine log decks, pulpwood piles and treetops that are piled for chipping in the fall or winter within a 1/4 mile of susceptible sites must be removed before March 15. Residual slash must not be placed in piles or rows and must be spread over the site for quick drying. The Department of Natural Resources will exercise this specification if the risk of damage warrants.

5.2.17 - Timber Mats and Interlocking Composite Mats (3/18)

Some roads or skid trails may require extra protection such as that afforded by timber mats, interlocking composite mats, or

another approved system. If available, mats may be borrowed from the DNR. A Timber Sale Contract Supplement will be used to document the Purchaser's use of the DNR's mats. Contact the sale administrator regarding availability and pick-up. Timber mats are available from various field offices. Composite mats are only available from the Grayling field office. The Purchaser is responsible for picking up and hauling the mats to and from the site. The composite mats will require DNR staff onsite for installation and removal. Contact the sale administrator to schedule at least 30 days before desired install/removal date. All mats must be cleaned prior to drop off. This may include, but is not limited to, power washing and brushing to remove mud and debris. A charge of \$400.00 per timber mat and \$2,000.00 per composite mat will be assessed for all damaged or non-returned mats. Damage for the crane/timber mats is defined as three or more broken cants. Damage for the composite mats is defined as cracked or broken mats.

5.2.22 - Operating Caution

5.2.22.2 - Operating caution (6/11)

It is recommended, but not required, that within Payment Unit(s) 1, 2, and 3, cutting, skidding, and/or hauling occur during dry summer or frozen winter conditions. The reason for the recommendation is because of areas with potentially soft ground.

5.2.32 - Decking/landing restoration (9/13)

All decking and landing areas must have the surface area restored to a condition equal to or better than before. This is to ensure the proper regeneration of the stand. Wood debris, chips and "cookies" from trimmings must be removed or scattered away from landing and loading areas and may not be windrowed on the edge.

5.2.40 - Pathway protection (10/10)

There is a hiking pathway on the road leading to Payment Unit 1 and it is shown on the Timber Sale Map. Do not cut trees or damage posts with blue pathway markers. The pathway road must be maintained on a daily basis, per direction from the sale administrator.

5.2.41 - Snowmobile trail protection (9/11)

There is a snowmobile trail that is shown on the Timber Sale Map. Do not cut or damage posts with orange trail markers or traffic control signs. If the trail is used for hauling, it must be graded to the satisfaction of the Unit Manager or his/her representative prior to December 1st. If the trail road is to be used for hauling during the snowmobile season, then a snow covered base must be left on the trail. Maintain a 20 foot wide slash, debris, and rut free zone daily using the snowmobile trail as the centerline.



TIMBER SALE MAP

This information provided by authority of Part 525, 1994 PA 451, as amended.

| | |
|-------------|------|
| Sale Number | Year |
| 71 - 027 | 18 |

| | | | | | |
|-------------------------------------|------------------|--|-------------------|-----------|---------|
| Forest Management Unit Roscommon | County Ogemaw | Mapped By Martell | Date 07/06/18 | Page 1 | of 1 |
| Township 23N | Range 01E | Section(s) and Subdivision(s) Sec. 7 - S1/2, SE1/4NW; Sec. 18 - E1/2NW, N1/2S1/2, SW1/4NE | Scale 1:15,840 | | |

| Cover Type | | | | Density | |
|-------------------|----------------------|-------------------------|-------------------|-----------------------------|------------------------|
| A = Aspen | H = Hemlock | N = Marsh | U = Upland Brush | 0 = Non Stocked | 5 = Pole Timber Medium |
| B = Paper Birch | J = Jack Pine | O = Oak | UM = Upland Mixed | 1 = Seedling Sapling Poor | 6 = Pole Timber Well |
| C = Cedar | L = Lowland Brush | P = Lowland Poplar | V = Bog or Marsh | 2 = Seedling Sapling Medium | 7 = Saw Timber Poor |
| D = Treed Bog | LM = Lowland Mixed | Q = Mixed Swamp Conifer | W = White Pine | 3 = Seedling Sapling Well | 8 = Saw Timber Medium |
| E = Swamp Hdwoods | M = Mpl, Bch, Brch | R = Red Pine | X = Non Stocked | 4 = Pole Timber Poor | 9 = Saw Timber Well |
| F = Spruce Fir | MC = Mixed Conifer | S = Black Spruce | Z = Water | | |
| G = Grass | MD = Mixed Deciduous | T = Tamarack | | | |

| PU | Acres | PU | Acres |
|----|-------|----|-------|
| 1 | 9.6 | 4 | 21.5 |
| 2 | 50.9 | 5 | 7.0 |
| 3 | 17.8 | | |

RGF Harvest

Compartment 069
106.8 Acres

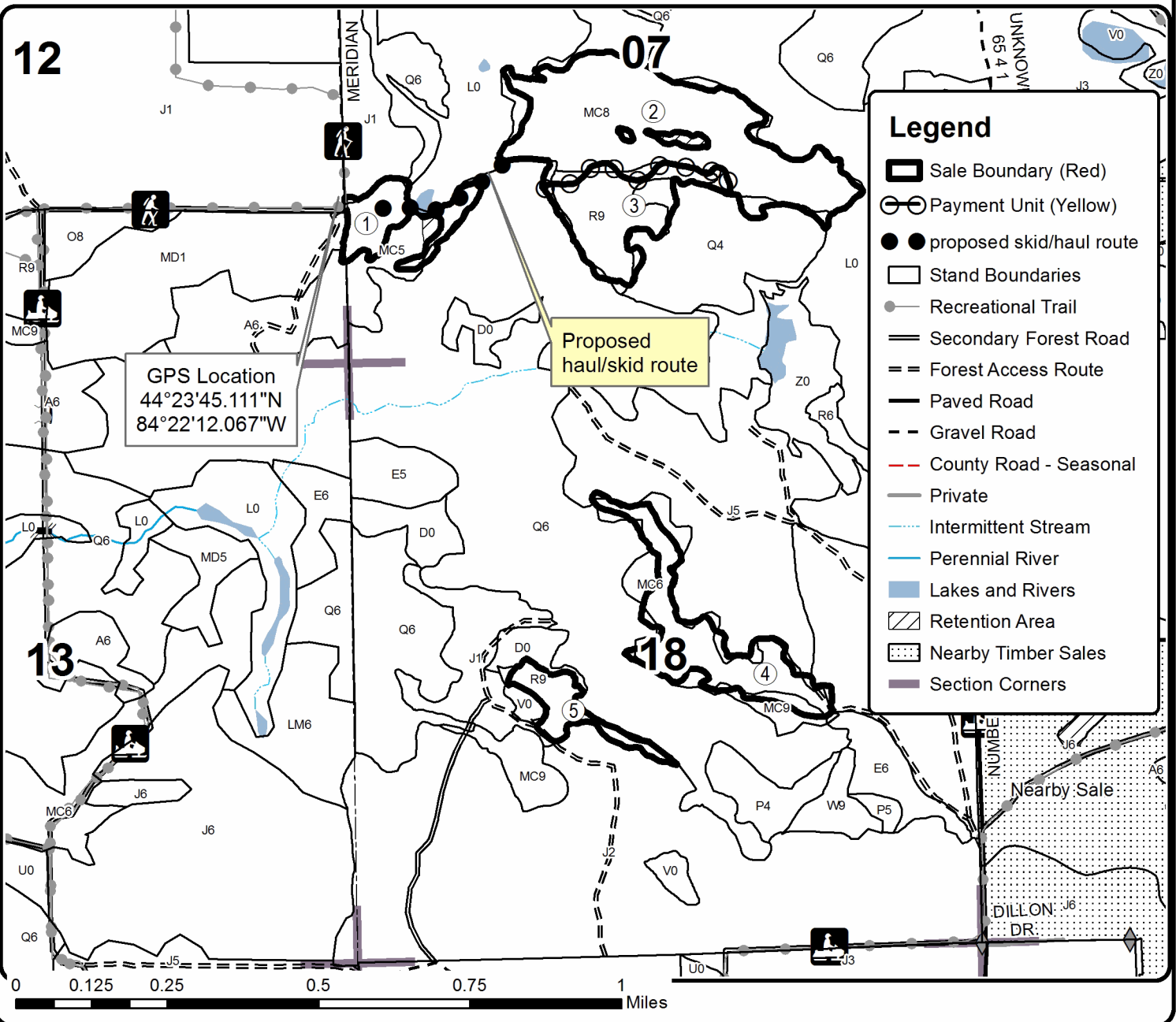
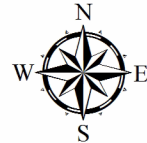

RGF Harvest (71-027-18)
T23N, R01E, SEC. 18; T23N, R01E, SEC. 7; Ogemaw COUNTY

In response to the notice of sale to be held 2:00 p.m. (local time) on June 12, 2019, I am hereby submitting my sealed bid (firm offer) for the following forest products to be cut. Bids for individual species must be at or above the advertised price. All non-responsive bid forms may be rejected.

| <u>PRODUCTS & SPECIES</u> | <u>ESTIMATED VOLUME*</u> | <u>ADVERTISED PRICE</u> | <u>BID PRICE/UNIT</u> |
|-------------------------------|--------------------------|-------------------------|-----------------------|
| Sawtimber | | | |
| BI/R/Hybrid Oak | 36.10 MBF | \$ 113.00/MBF | \$ _____ |
| Black Spruce | 10.30 MBF | \$ 37.00/MBF | \$ _____ |
| Jack Pine | 95.20 MBF | \$ 28.00/MBF | \$ _____ |
| Red Maple | 22.20 MBF | \$ 56.00/MBF | \$ _____ |
| Red Pine | 129.00 MBF | \$ 104.00/MBF | \$ _____ |
| White Pine | 30.60 MBF | \$ 50.00/MBF | \$ _____ |
| Pulpwood | | | |
| Balsam Fir | 11.00 Cords | \$ 24.85/Cord | \$ _____ |
| BI/R/Hybrid Oak | 108.00 Cords | \$ 15.05/Cord | \$ _____ |
| Black Spruce | 101.00 Cords | \$ 18.55/Cord | \$ _____ |
| Jack Pine | 342.00 Cords | \$ 13.60/Cord | \$ _____ |
| Mixed Aspen | 12.00 Cords | \$ 25.65/Cord | \$ _____ |
| Mixed Hardwood | 124.00 Cords | \$ 19.10/Cord | \$ _____ |
| N. White Cedar | 6.00 Cords | \$ 25.25/Cord | \$ _____ |
| Red Pine | 305.00 Cords | \$ 41.90/Cord | \$ _____ |
| White Pine | 176.00 Cords | \$ 18.80/Cord | \$ _____ |

*The volumes are statistically estimated within plus (+) or minus (-) 10.25 percent. These estimated volumes are final and not subject to adjustment. Prospective bidders are urged to examine this timber and to make their own estimates of quantity and quality.

I understand that any or all bids may be rejected. All bids must be signed and all bid items must be bid or the bid form may be rejected. I also understand that consideration and awarding a contract will be based upon my past performance and ability to complete the contract based upon equipment and staffing subject to my control.

FEDERAL ID: _____ or SOCIAL SECURITY NUMBER: _____

Company or individual bidding: _____

Company representative's name: _____

Address: _____

City: _____ State: _____ Zip: _____

IF AVAILABLE, PLEASE PLACE THE PERSONALIZED LABEL FROM YOUR PROSPECTUS IN THE ABOVE BOX.

Individual or company representative's signature: _____ Date: _____

Phone number : _____ Email (optional): _____

THE WINNING BIDDER MUST COMPLETE THE VERIFICATION OF WORKER'S DISABILITY COMPENSATION ACT COMPLIANCE (ON REVERSE SIDE IF DOUBLE SIDED) WITHIN 21 DAYS OF SALE AWARD DATE



| FOR DEPARTMENT USE ONLY | |
|----------------------------------|--|
| Sale Number (XX - XXX - XX - XX) | |
| Forest Management Unit: | |

TIMBER SALE VERIFICATION OF WORKER'S DISABILITY COMPENSATION ACT COMPLIANCE

As required by Act 317, P.A. 1969 (Worker's Compensation) and
Part 5 of Act 451 of 1994, as amended.

VERIFICATION OF WORKER'S DISABILITY COMPENSATION ACT COMPLIANCE

- This verification must be completed and submitted within 21 days of contract award and prior to the issuance of the timber sale contract.
- In addition, if boxes 2B or 2C are checked, then Notice of Exclusion or Certificate of Insurance must be submitted within twenty-one (21) days of the contract award and prior to the issuance of the timber sale contract.
- All information must be typed or printed except for written signatures.

Please Check Appropriate Categories:

1. My business is organized as (you **must** check one of the boxes below):
 - A. Sole Proprietorship (individual)
 - B. Partnership
 - C. Corporation
2. You **must** check one of the boxes below:
 - A. I certify my business is a sole proprietorship and it has no employees but the sole proprietor. I am not subject to the Worker's Compensation Laws.
 - B. I certify my business has satisfied its obligation to the Worker's Compensation Act through the use of an approved Notice of Exclusion (BWC-337, Rev. 5/96). I will provide a copy of the Notice of Exclusion within 21 days of the contract award. (For questions or a copy of the BWC-337, please call the Worker's Compensation Bureau at 517-322-1195).
 - C. I certify my business has a Worker's Compensation Policy. I will provide an original Certificate of Insurance within twenty-one (21) days of the contract award.
3. If you have checked item 2(A) or 2(B), you **must** indicate the number of **both** full-time and part-time employees, other than yourself, including family members and active partners (if none, you must enter "0").

_____ Full-time Employees

_____ Part-time Employees

| | | | |
|------------------|-------|-------------------------------------|--|
| Name of Business | | Federal ID (or) Social Security No. | |
| Address | | Telephone () | |
| City | State | ZIP | |

I hereby certify that the above information is true and correct. I agree to notify the Michigan DNR of any changes that occur in factors affecting my coverage during any of my present and future operations.

Signature of Owner or Authorized Representative

Title

Date

Please complete the "SEALED BID" information on the next page

Boyce Lake Thin (71-013-18)

T21N, R03W, SEC. 10; T21N, R03W, SEC. 15; T21N, R03W, SEC. 16; T21N,

In response to the notice of sale to be held 2:00 p.m. (local time) on June 12, 2019, I am hereby submitting my sealed bid (firm offer) for the following forest products to be cut. Bids for individual species must be at or above the advertised price. All non-responsive bid forms may be rejected.

| <u>PRODUCTS & SPECIES</u> | <u>ESTIMATED VOLUME*</u> | <u>ADVERTISED PRICE</u> | <u>BID PRICE/UNIT</u> |
|-------------------------------|--------------------------|-------------------------|-----------------------|
| Sawtimber | | | |
| Jack Pine | 44.10 MBF | \$ 31.00/MBF | \$ _____ |
| Mixed Aspen | 87.30 MBF | \$ 61.00/MBF | \$ _____ |
| Mixed Oak | 197.50 MBF | \$ 123.00/MBF | \$ _____ |
| Mixed Spruce | 14.50 MBF | \$ 41.00/MBF | \$ _____ |
| Paper Birch | 1.30 MBF | \$ 43.00/MBF | \$ _____ |
| Red Maple | 89.60 MBF | \$ 62.00/MBF | \$ _____ |
| Red Pine | 580.80 MBF | \$ 114.00/MBF | \$ _____ |
| White Pine | 178.80 MBF | \$ 55.00/MBF | \$ _____ |
| Pulpwood | | | |
| Balsam Fir | 23.00 Cords | \$ 27.15/Cord | \$ _____ |
| Jack Pine | 161.00 Cords | \$ 14.85/Cord | \$ _____ |
| Mixed Aspen | 515.00 Cords | \$ 28.00/Cord | \$ _____ |
| Mixed Hardwood | 21.00 Cords | \$ 20.85/Cord | \$ _____ |
| Mixed Oak | 563.00 Cords | \$ 16.40/Cord | \$ _____ |
| Mixed Spruce | 48.00 Cords | \$ 20.30/Cord | \$ _____ |
| Red Maple | 596.00 Cords | \$ 20.85/Cord | \$ _____ |
| Red Pine | 369.00 Cords | \$ 45.75/Cord | \$ _____ |
| White Pine | 454.00 Cords | \$ 20.55/Cord | \$ _____ |

*The volumes are statistically estimated within plus (+) or minus (-) 7.48 percent. These estimated volumes are final and not subject to adjustment. Prospective bidders are urged to examine this timber and to make their own estimates of quantity and quality.

I understand that any or all bids may be rejected. All bids must be signed and all bid items must be bid or the bid form may be rejected. I also understand that consideration and awarding a contract will be based upon my past performance and ability to complete the contract based upon equipment and staffing subject to my control.

FEDERAL ID: _____ or SOCIAL SECURITY NUMBER: _____

Company or individual bidding: _____

Company representative's name: _____

Address: _____

City: _____ State: _____ Zip: _____

IF AVAILABLE, PLEASE PLACE THE PERSONALIZED LABEL FROM YOUR PROSPECTUS IN THE ABOVE BOX.

Individual or company representative's signature: _____ Date: _____

Phone number : _____ Email (optional): _____

THE WINNING BIDDER MUST COMPLETE THE VERIFICATION OF WORKER'S DISABILITY COMPENSATION ACT COMPLIANCE (ON REVERSE SIDE IF DOUBLE SIDED) WITHIN 21 DAYS OF SALE AWARD DATE



| |
|----------------------------------|
| FOR DEPARTMENT USE ONLY |
| Sale Number (XX - XXX - XX - XX) |
| Forest Management Unit: |

TIMBER SALE VERIFICATION OF WORKER'S DISABILITY COMPENSATION ACT COMPLIANCE

*As required by Act 317, P.A. 1969 (Worker's Compensation) and
Part 5 of Act 451 of 1994, as amended.*

VERIFICATION OF WORKER'S DISABILITY COMPENSATION ACT COMPLIANCE

- This verification must be completed and submitted within 21 days of contract award and prior to the issuance of the timber sale contract.
- In addition, if boxes 2B or 2C are checked, then Notice of Exclusion or Certificate of Insurance must be submitted within twenty-one (21) days of the contract award and prior to the issuance of the timber sale contract.
- All information must be typed or printed except for written signatures.

Please Check Appropriate Categories:

1. My business is organized as (you **must** check one of the boxes below):
 - A. Sole Proprietorship (individual)
 - B. Partnership
 - C. Corporation

2. You **must** check one of the boxes below:
 - A. I certify my business is a sole proprietorship and it has no employees but the sole proprietor. I am not subject to the Worker's Compensation Laws.
 - B. I certify my business has satisfied its obligation to the Worker's Compensation Act through the use of an approved Notice of Exclusion (BWC-337, Rev. 5/96). I will provide a copy of the Notice of Exclusion within 21 days of the contract award. (For questions or a copy of the BWC-337, please call the Worker's Compensation Bureau at 517-322-1195).
 - C. I certify my business has a Worker's Compensation Policy. I will provide an original Certificate of Insurance within twenty-one (21) days of the contract award.

3. If you have checked item 2(A) or 2(B), you **must** indicate the number of **both** full-time and part-time employees, other than yourself, including family members and active partners (if none, you must enter "0").

_____ Full-time Employees

_____ Part-time Employees

| | | | |
|------------------|-------|-------------------------------------|--|
| Name of Business | | Federal ID (or) Social Security No. | |
| Address | | Telephone () | |
| City | State | ZIP | |

I hereby certify that the above information is true and correct. I agree to notify the Michigan DNR of any changes that occur in factors affecting my coverage during any of my present and future operations.

Signature of Owner or Authorized Representative

Title

Date

Please complete the "SEALED BID" information on the next page

Stoney Heath Oak (71-005-18)
T24N, R02E, SEC. 28; T24N, R02E, SEC. 29; Ogemaw COUNTY

In response to the notice of sale to be held 2:00 p.m. (local time) on June 12, 2019, I am hereby submitting my sealed bid (firm offer) for the following forest products to be cut. Bids for individual species must be at or above the advertised price. All non-responsive bid forms may be rejected.

| <u>PRODUCTS & SPECIES</u> | <u>ESTIMATED VOLUME*</u> | <u>ADVERTISED PRICE</u> | <u>BID PRICE/UNIT</u> |
|-------------------------------|--------------------------|-------------------------|-----------------------|
| Sawtimber | | | |
| B. T. Aspen | 63.30 MBF | \$ 43.00/MBF | \$ _____ |
| Bl/R/Hybrid Oak | 13.60 MBF | \$ 87.00/MBF | \$ _____ |
| Red Pine | 18.90 MBF | \$ 80.00/MBF | \$ _____ |
| Pulpwood | | | |
| B. T. Aspen | 252.00 Cords | \$ 19.75/Cord | \$ _____ |
| Jack Pine | 33.00 Cords | \$ 10.45/Cord | \$ _____ |
| Mixed Oak | 86.00 Cords | \$ 11.55/Cord | \$ _____ |
| Red Maple | 78.00 Cords | \$ 14.70/Cord | \$ _____ |
| Red Pine | 51.00 Cords | \$ 32.25/Cord | \$ _____ |

*The volumes are statistically estimated within plus (+) or minus (-) 27.06 percent. These estimated volumes are final and not subject to adjustment. Prospective bidders are urged to examine this timber and to make their own estimates of quantity and quality.

I understand that any or all bids may be rejected. All bids must be signed and all bid items must be bid or the bid form may be rejected. I also understand that consideration and awarding a contract will be based upon my past performance and ability to complete the contract based upon equipment and staffing subject to my control.

FEDERAL ID: _____ or SOCIAL SECURITY NUMBER: _____

Company or individual bidding: _____

Company representative's name: _____

Address: _____

City: _____ State: _____ Zip: _____

IF AVAILABLE, PLEASE PLACE THE PERSONALIZED LABEL FROM YOUR PROSPECTUS IN THE ABOVE BOX.

Individual or company representative's signature: _____ Date: _____

Phone number : _____ Email (optional): _____

THE WINNING BIDDER MUST COMPLETE THE VERIFICATION OF WORKER'S DISABILITY COMPENSATION ACT COMPLIANCE (ON REVERSE SIDE IF DOUBLE SIDED) WITHIN 21 DAYS OF SALE AWARD DATE

