



**DEPARTMENT OF NATURAL RESOURCES
STATE OF MICHIGAN**

TIMBER SALE PROSPECTUS #6417

SCHEDULED SALE DATE AND TIME: 2:00 p.m. (local time) on September 25, 2019.

LOCATION: ROSCOMMON MGMT UNIT, PO BOX 218, ROSCOMMON, MI 48653.

PROSPECTUS NOTE: The bidder is advised to inspect the sale area and review the location, estimated volumes, operating costs and contract terms of proposed sales. Please be aware that some landowners may request 60 days or more notice for access across their land.

Notice is hereby given that bids will be received by the Unit Manager, ROSCOMMON MANAGEMENT UNIT, for certain timber on the following described lands:

Crushed Concrete White Pine (71-015-19) / T22N, R02W, SEC. 31, N1/2NW,SWNW,NWSW.
Roscommon County, Advertised Price \$16,206.95, 40.1 Acres, White Pine, Hardwood.

SALE NOTE: A recreation site such as a trail, pathway, or campground is within the sale area or the vicinity. Certain restrictions/specifications may be applicable including time restrictions.

Boyce Lake Final (71-012-18) / T21N, R03W, SEC. 10, N1/2NW,SENW,N1/2NE.
T21N, R03W, SEC. 15, NENW,S1/2NW,W1/2NE,SE.
T21N, R03W, SEC. 22, N1/2NW,NWNE.
T21N, R03W, SEC. 3 , NWNW,S1/2NW,S1/2NE,N1/2SW,SE.
T21N, R03W, SEC. 4 , NENE.

Roscommon County, Advertised Price \$175,827.20, 239.2 Acres, Aspen, Hardwood.

SALE NOTE: Payment Unit 10 will require crane mat installation (approximately 100 feet) by the Purchaser, along with some minor road work and fill to access. Installation will be on the downward side of an old beaver dam. There is no water flowing, but the soils are still saturated and will not hold up equipment. Payment Unit 13 will require product to be skid to the landing for Payment Units 11 and 12; no new haul road will be allowed to be built down to it.

The sale area is fragmented by numerous water bodies, which limits the haul route options. The snowmobile trail system has limited options as well, resulting in them both being on the same roads. With seasonal restrictions on some units, hauling may be required during snowmobile season with some restrictions.

A recreation site such as a trail, pathway, or campground is within the sale area or the vicinity. Certain restrictions/specifications may be applicable including time restrictions.

BID INSTRUCTIONS (VER. 07/02/2018):

1. Scheduled Bid Location, Date, and Time (2/11)

Bids must be received by the Unit Manager, ROSCOMMON OFFICE, PO BOX 218, ROSCOMMON, MI 48653, no later than 2:00 p.m. (local time) on September 25, 2019. For further information concerning this sale, contact Steve Anderson at 989-275-4622 extension 2740.

2. Bidder's Qualifications (5/16)

Purchaser shall obtain workers compensation insurance to cover claims under Michigan's Worker's Disability Compensation Act of 1969 or similar employee benefit act of any other state applicable to an employee. If all or part of a timber sale was prepared by a private contractor, the contractor and that contractor's company are not permitted to bid on the timber sale contract. Bids will not be accepted from individuals or companies appearing on the DNR/FRD No-Bid List. This list contains the names of purchasers who previously failed to execute a contract within 21-days or who have a history of poor performance.

3. Preparation of Sealed Bids (5/16)

Bid Forms may be completed online thru Michigan DNR Timber Sale Online Bidding (OLB) at www.michigan.gov/timberbidding or by completing the hardcopy Bid Form found in the Timber Sale Prospectus. Hardcopy Bid Forms shall be manually signed in ink. Registration in OLB is considered your 'signature' for all bids submitted thru that system. Bid prices must be entered for each species and product in the Bid Price column for all material subject to bidding and all fill-in blanks must be completed. If erasures or other changes appear on the hardcopy Bid Form, each erasure or change must be initialed by the person signing the bid.

4. Submission of Sealed Bids (5/16)

Bid forms may be obtained from the Unit Manager or thru OLB. Bids may be submitted hardcopy or thru OLB. All hardcopy bids must be submitted on the bid form and in an envelope clearly identified as described in this section. NOTE: Only one bid form per bid envelope. Sealed bids must be submitted to the Unit office designated in the prospectus and must be submitted at or prior to the time established in the prospectus. The envelope should show on the outside (a) the sale name or number and (b) the date and time of bid opening, as shown in the prospectus. Bids received after the time specified in the sale prospectus are late bids and will be rejected.

It is possible for a bidder to submit multiple bids on a single sale. For example, a bid may be submitted hardcopy and a bid may be submitted thru OLB. Or, two bidders from the same company could both submit bids on the same sale. If this were to happen, the State would accept all bids received and award the contract accordingly. All bidding and contractual requirements would apply to all bids received.

5. Public Opening of Sealed Bids (7/16)

If conditions permit, the sealed bids will be publicly opened and posted at the time and place set in the prospectus.

If a bidder, present at a bid opening, has submitted bids on more than one sale, that bidder may withdraw their unopened bid envelopes or announce the withdrawal of their online bid after being declared the successful bidder on one sale.

6. Award of Contract (1/11)

Award of the contract will be made to the Bidder whose bid, conforming to the prospectus, is most advantageous to the State of Michigan on the basis of total value at rates bid for the estimated quantities. The State reserves the right to reject any bid or waive any minor irregularity in bids received. A written award mailed (or otherwise furnished) to the successful Bidder shall be deemed to result in a binding contract without further action by either party.

7. Down Payment (1/11)

The Bidder to whom award is made must make a down payment within 21 days of the sale award. The amount of the down payment will be calculated as shown in the Bond and Payment Schedule of this prospectus. Only cash may be used to meet this requirement.

8. Performance Security (1/11)

As guarantee of faithful performance, a cash bond, certificate of deposit, surety bond or irrevocable letter of credit (LOC) is required within 21 days of the sale award. The amount of the performance security is shown in the Bond and

Payment Schedule of this prospectus. If an LOC or surety is used, the coverage must extend for at least 6 months beyond the contract expiration.

9. Timber Sale Contract (7/18)

Additional conditions and requirements common to all timber sales are listed on the timber sale contract (R4031) and are available on line at www.michigan.gov/timber. Contact the Unit Manager for additional information or a sample contract. Within 21 days of the date of the award letter, the bidder must sign the contract and provide the required down payment, performance security, and verification of worker's disability compensation. The down payment and performance security shall be in accordance with the provisions of the timber sale contract, in the sums stated in this prospectus. If these actions are not taken, then the Bidder, the Bidder's corporation, and the corporation's principals may not be permitted to bid on State timber sales for a period of 3 months after the first offense, 6 months after the second offense, and 1 year after the third offense. An offense will only be counted against the Bidder for 5 years. In addition, the Bidder certifies that if awarded this contract, the Bidder will complete the timber sale contract in accordance with its terms and any modifications thereof including requirements to purchase, cut, and remove the included timber by the expiration date.

Payment Unit values in the State Forest Timber Sale Contract are calculated based on the advertised value of the Payment Unit as a percentage of the total advertised value of the contract. The advertised value of each Payment Unit is given in the Description of Timber by Payment Unit table on the Timber Sale Information page. For example, if the value of Payment Unit 1 is advertised as \$1,500 and the total Timber Sale value is advertised as \$10,000, the contract price for Payment Unit 1 will be 15% of the total bid price ($\$1,500/\$10,000 * 100$).

10. Disclaimer of Estimates and Bidder's Warranty of Inspection (7/16)

Before submitting this bid, the Bidder is advised and cautioned to inspect the sale area, review the requirements of the sale contract, and take other steps as may be reasonably necessary to ascertain the location, estimated volumes, construction estimates, and operating costs of the proposed sale. Failure to do so will not relieve the Bidder from responsibility for completing the contract.

The Bidder warrants that this bid is submitted solely on the basis of the Bidder's examination and inspection of the quality and quantity of the timber offered for sale and the Bidder's opinion of the value thereof and the costs of recovery. No reliance should be placed on the State of Michigan's estimates of timber quality, quantity or costs of recovery. Bidder further acknowledges that the State of Michigan: (i) expressly disclaims any warranty of fitness of timber for any purpose; (ii) offers this timber as is without any warranty of quality (merchantability) or quantity and (iii) expressly disclaims any warranty as to the quantity or quality of timber sold.

11. Certification and Chain-of-Custody (10/14)

Unless otherwise indicated in the contract under section 7 – Other Conditions of the Sale Specific Conditions & Requirements, the area encompassed by this timber sale is certified to the standards of the Forest Stewardship Council (FSC) - Certificate #SCS-FM/COC-00090N and the Sustainable Forestry Initiative (SFI) - Certificate #NSF-SFIS-5Y031-SF5. Forest products from this sale may be delivered to the mill as "FSC 100% and / or SFI certified" as long as the contractor hauling the forest products is chain-of-custody (COC) certified or covered under a COC certificate from the destination mill. The purchaser is responsible for maintaining COC after leaving the sale area.

12. Good Neighbor Authority (GNA) Requirements (7/16)

If the name of this timber sales contains the acronym GNA, it is authorized by the Good Neighbor Authority (GNA) and covered by various agreements between the U.S. Forest Service and the State. The timber sale occurs on federal land and the following conditions apply:

GNA contracts on US Forest Service land will not be awarded to purchasers on the Federal list of excluded parties. The System for Award Management (SAM) will be checked for active excluded parties prior to award of contract. In addition, the Bidder to whom award is made must complete an Assurance Regarding Felony Conviction or Tax Delinquent Status for Corporate Applicants (AD-3031).

13. Good Neighbor Authority (GNA) Requirements, con't (9/16)

Bidder certifies, by signing this bid form, that to the best of Bidder's knowledge that the following representations are accurate and complete.

- a. That the Bidder and its principals are not presently debarred, suspended, proposed for debarment, declared ineligible, or voluntary excluded from timber sales (covered transactions) by any Federal department or agency.
- b. That the Bidder and its principals have not within a 3-year period preceding this bid been convicted of or had a civil judgment rendered against them for commission of fraud or a criminal offense in connection with obtaining, attempting to obtain, or performing a public (Federal, State, or local) transaction or contract under a public transaction; violation of Federal or State antitrust statutes or commission of embezzlement, theft, forgery, bribery, falsification or destruction of records, making false statements, or receiving stolen property.
- c. That the Bidder and its principals are not presently indicted for or otherwise criminally or civilly charged by a governmental entity (Federal, State, or local) with commission of any of the offenses enumerated in paragraph b of this certification.
- d. That the Bidder and its principals have not within a 3-year period preceding this bid had one or more public transactions (Federal, State, or local) terminated for breach or default of a timber or forest product contract.

Bidders that cannot certify this requirement, in whole or in part, shall submit an explanation with their bid.

DAN EICHINGER
Director

TIMBER SALE INFORMATION

Crushed Concrete White Pine (71-015-19)

T22N, R02W, SEC. 31.

Roscommon County (Advertised Price \$16,206.95)

SALE NOTE: A recreation site such as a trail, pathway, or campground is within the sale area or the vicinity. Certain restrictions/specifications may be applicable including time restrictions.

A timber sale contract for this lump sum, sealed bid timber sale will be awarded to the responsible bidder offering the highest sealed bid price. Bids must be at or above the following advertised price for each species:

<u>PRODUCTS & SPECIES</u>	<u>ESTIMATED UNITS*</u>		<u>ADVERTISED PRICE</u>
Sawtimber			
BI/R/Hybrid Oak	10.40	MBF	\$ 127.00 / MBF
Red Maple	9.80	MBF	\$ 68.00 / MBF
Red Pine	11.00	MBF	\$ 119.00 / MBF
White Pine	30.20	MBF	\$ 58.00 / MBF
Pulpwood			
Balsam Fir	18.00	Cords	\$ 28.80 / Cord
Black Spruce	6.00	Cords	\$ 20.55 / Cord
Jack Pine	16.00	Cords	\$ 15.10 / Cord
Mixed Aspen	70.00	Cords	\$ 30.85 / Cord
Mixed Hardwood	85.00	Cords	\$ 21.60 / Cord
Mixed Oak	87.00	Cords	\$ 18.55 / Cord
Red Pine	15.00	Cords	\$ 43.30 / Cord
White Pine	195.00	Cords	\$ 20.60 / Cord

* The total volume is statistically estimated within plus (+) or minus (-) 14.92 percent. The estimated units are final and not subject to adjustment. Prospective bidders are urged to examine this timber and to make their own estimates of quantity and quality.

BOND AND PAYMENT SCHEDULE:

1. A bond in the amount of \$810.00 to insure faithful performance of the conditions of the contract will be deposited by the successful bidder within 21 days of the sale award.
2. Cutting in any sale or unit without the required advance payment would be considered a trespass.
3. Total payment must be paid in advance or according to the following schedule:
 - (a) Ten percent (10%) of the sale value must be paid within 21 days of the sale award.
 - (b) The 10% down payment will be credited towards the first unit cut.
 - (c) Payment for each of the following units must be made before cutting begins in that unit:

PAYMENT UNIT NUMBER	PERCENT OF TOTAL SALE VALUE
01	34.3%
02	65.7%
4. If no cutting takes place, the 10% down payment will not be refunded.
5. Operations on the contract issued will terminate on 12/31/2021.

Description of Timber by Payment Unit (PU)

PU	MARKET GROUP	PRODUCT	QUANTITY	UNIT	ACRES	ADVERTISE PRICE
1	Red Maple	Sawtimber	0.7	MBF	13.4	\$5,563.80
	Red Pine		9.7	MBF		
	White Pine		12.9	MBF		
	Balsam Fir	Pulpwood	10.0	Cords		
	<i>Balsam Fir</i>	<i>Sawtimber</i>	1.0	<i>MBF</i>		
	<i>Balsam Fir</i>	<i>Pulpwood</i>	8.0	<i>Cords</i>		
	Black Spruce		4.0	Cords		
	<i>Black Spruce</i>	<i>Sawtimber</i>	0.4	<i>MBF</i>		
	<i>Black Spruce</i>	<i>Pulpwood</i>	3.0	<i>Cords</i>		
	Jack Pine		2.0	Cords		
	<i>Jack Pine</i>	<i>Sawtimber</i>	0.7	<i>MBF</i>		
	<i>Jack Pine</i>	<i>Pulpwood</i>	1.0	<i>Cords</i>		
	Mixed Aspen		30.0	Cords		
	<i>B. T. Aspen</i>	<i>Sawtimber</i>	0.9	<i>MBF</i>		
	<i>B. T. Aspen</i>	<i>Pulpwood</i>	28.0	<i>Cords</i>		
	Mixed Hardwood		5.0	Cords		
	<i>Red Maple</i>		5.0	<i>Cords</i>		
	Red Pine		8.0	Cords		
	White Pine		89.0	Cords		
	2	Bl/R/Hybrid Oak	Sawtimber	10.4		
Red Maple			9.1	MBF		
Red Pine			1.3	MBF		
White Pine			17.3	MBF		
Balsam Fir		Pulpwood	8.0	Cords		
<i>Balsam Fir</i>			8.0	<i>Cords</i>		
Black Spruce			2.0	Cords		
<i>Black Spruce</i>			2.0	<i>Cords</i>		
Jack Pine			14.0	Cords		
<i>Jack Pine</i>			14.0	<i>Cords</i>		
Mixed Aspen			40.0	Cords		
<i>B. T. Aspen</i>		<i>Sawtimber</i>	5.6	<i>MBF</i>		
<i>B. T. Aspen</i>		<i>Pulpwood</i>	29.0	<i>Cords</i>		
Mixed Hardwood			80.0	Cords		
<i>Black Cherry</i>			2.0	<i>Cords</i>		
<i>Red Maple</i>			78.0	<i>Cords</i>		
Mixed Oak			87.0	Cords		
<i>White Oak</i>		<i>Sawtimber</i>	2.3	<i>MBF</i>		
<i>Bl/R/Hybrid Oak</i>		<i>Pulpwood</i>	69.0	<i>Cords</i>		
<i>White Oak</i>			13.0	<i>Cords</i>		
Red Pine		7.0	Cords			
White Pine		106.0	Cords			
TOTAL:			61.4	MBF		
TOTAL:			492.0	Cords		

Sale Specific Conditions & Requirements

Sale Name: Crushed Concrete White Pine

Sale Number: 71-015-19 Seq#: 1

1 - Sale Area

1.2 - Boundaries

1.2.1 - Painted boundaries (1/14)

The sale boundary is marked and identified by blue and red paint. Exterior sale boundary lines against private property are marked with blue paint. Exterior sale boundary lines against state are marked with red paint. The painted boundary line trees are not Included Timber and are to be protected unless marked with orange paint.

2 - Timber Specifications

2.1 - Included Timber

2.1.4 - Designated timber unit(s) (6/17)

Within Payment Unit(s) 1 and 2, all trees are designated for cutting, except do not cut white pine, red pine, and white oak. Also, within Payment Unit 1, do not cut any cedar or hemlock. In addition, all white pine, red pine, and white oak are designated for cutting when marked with orange paint.

2.2 - Utilization

2.2.3 - Stump heights (4/07)

Stump heights within the Sale Area shall not exceed 6 inches for all trees.

2.2.6 - Roundwood operation required (5/07)

The skidding of whole trees or tree segments with limbs attached is prohibited. All products must be produced as roundwood and forwarded to existing roads or landing areas in final product length.

3 - Payments

3.3 - Pre-measured Sales

3.3.4 - Dividing payment units (7/14)

Payment Unit(s) may be divided at the request of the Purchaser and upon approval of the Unit Manager. Dividing Payment Units is a contract modification which requires a Timber Sale Contract Supplement. There will be only one division per Payment Unit.

4 - Transportation

4.1 - Construction

4.1.12 - No new roads (1/12)

No new roads will be permitted in any Payment Unit.

4.2 - Maintenance

4.2.3 - Road maintenance (8/13)

The following road maintenance is required: Within 60 days of completion of hauling, or if no hauling occurs for 60 days, the road must be maintained and graded. This includes cleaning of drainage areas, grading, crowning and filling with gravel, if necessary. Damages will be assessed if grading/repair does not occur.

4.2.5 - Two wheel drive condition (2/04)

All existing trail roads on and adjacent to the sale area must be passable by two-wheel drive traffic for the duration of the sale.

5 - Operations

5.1 - Notification

5.1.1 - Pre-sale conference (10/16)

A pre-sale conference between the Purchaser and sale administrator is required prior to beginning any operations to determine landing and road locations. The Unit Manager or his/her representative must be contacted at least 2 days in advance to schedule the conference.

5.2 - Conduct of Operations

5.2.1 - Slash

5.2.1.8 - Slash height (12/08)

No slash or tree tops may exceed 24 inches in height.

5.2.3 - Operating Restrictions

5.2.3.3 - Bark slippage restriction (3/09)

Within Payment Unit(s) 1 and 2, unless changed by written agreement, cutting and skidding are not permitted during the period of April 15 to July 15. This restriction is because of bark slippage.

5.2.3.6 - Bark beetle restriction (12/08)

In the event drought creates a high risk of pine bark beetle infestation, pine is not to be cut during the period March 1 through July 1, unless all portions of trees greater than two inches in diameter are removed from the sale area, reduced to chips, or treated to the satisfaction of the Unit Manager or his/her representative, within fifteen days of being severed from the stump. Pine log decks, pulpwood piles and treetops that are piled for chipping in the fall or winter within a 1/4 mile of susceptible sites must be removed before March 15. Residual slash must not be placed in piles or rows and must be spread over the site for quick drying. The Department of Natural Resources will exercise this specification if the risk of damage warrants.

5.2.32 - Decking/landing restoration (9/13)

All decking and landing areas must have the surface area restored to a condition equal to or better than before. This is to ensure the proper regeneration of the stand. Wood debris, chips and "cookies" from trimmings must be removed or scattered away from landing and loading areas and may not be windrowed on the edge.

5.2.41 - Snowmobile trail protection (9/11)

There is a snowmobile trail within the sale area that is shown on the Timber Sale Map. Do not cut or damage posts with orange trail markers or traffic control signs. If the trail is used, it must be maintained and restored to a condition equal to or better than before the sale. It must be graded to the satisfaction of the Unit Manager or his/her representative prior to December 1st. If the trail road is to be used during the snowmobile season, then a snow covered base must be left on the trail. The snowmobile trail may only be crossed at right angles.

6 - Safety and Fire Prevention

6.2 - Signing

6.2.1 - Road posting (9/09)

The Purchaser is responsible for posting and maintaining caution signs on the snowmobile trail prior to beginning operations. The road must be posted at appropriate distances from the sale area to warn of logging activity and truck traffic. Signs must be removed when harvest operations are suspended or completed. The Purchaser will provide these signs.



TIMBER SALE MAP

This information provided by authority of Part 525, 1994 PA 451, as amended.

Sale Number	Year
71 - 015	19

Forest Management Unit	County	Mapped By	Date	Page	of
Roscommon	Roscommon	Martell	5/17/19	1	1
Township	Range	Section(s) and Subdivision(s)	Scale		
22N	02W	Sec. 31 - N1/2NW, SWNW, NWSW	1:7,920		

Cover Type				Density	
A = Aspen	H = Hemlock	N = Marsh	U = Upland Brush	0 = Non Stocked	5 = Pole Timber Medium
B = Paper Birch	J = Jack Pine	O = Oak	UM = Upland Mixed	1 = Seedling Sapling Poor	6 = Pole Timber Well
C = Cedar	L = Lowland Brush	P = Lowland Poplar	V = Bog or Marsh	2 = Seedling Sapling Medium	7 = Saw Timber Poor
D = Treed Bog	LM = Lowland Mixed	Q = Mixed Swamp Conifer	W = White Pine	3 = Seedling Sapling Well	8 = Saw Timber Medium
E = Swamp Hdwoods	M = Mpl, Bch, Brch	R = Red Pine	X = Non Stocked	4 = Pole Timber Poor	9 = Saw Timber Well
F = Spruce Fir	MC = Mixed Conifer	S = Black Spruce	Z = Water		
G = Grass	MD = Mixed Deciduous	T = Tamarack			

PU Acres

1	13.4
2	26.7

Crushed Concrete White Pine

Compartment 047

40.1 Acres

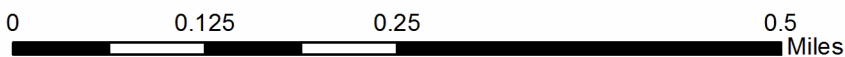
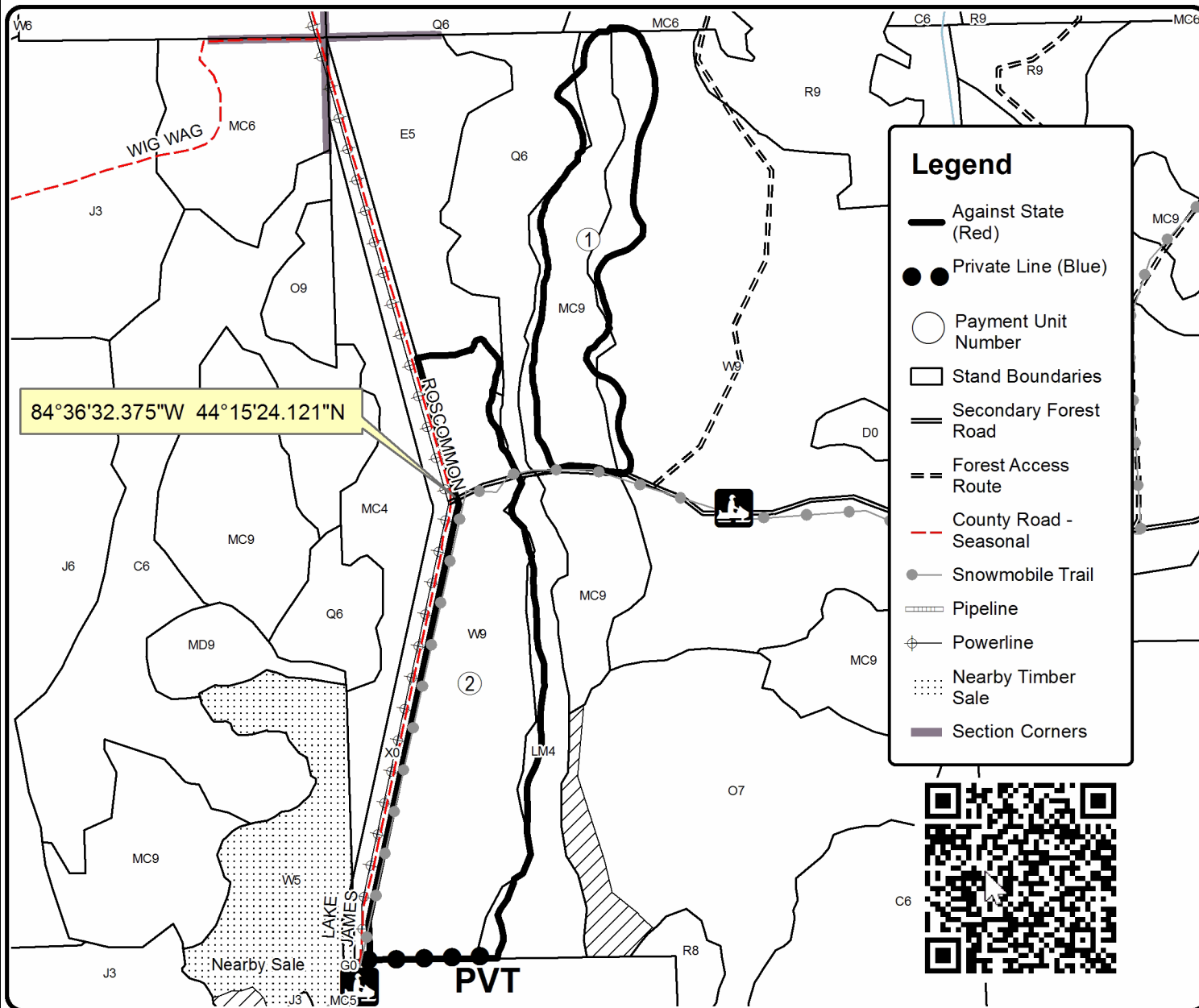
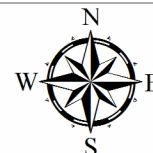

TIMBER SALE INFORMATION

Boyce Lake Final (71-012-18)

T21N, R03W, SEC. 10; T21N, R03W, SEC. 15; T21N, R03W, SEC. 22; T21N, R03W, SEC. 3; T21N, R03W, SEC. 4.
Roscommon County (Advertised Price \$175,827.20)

SALE NOTE: Payment Unit 10 will require crane mat installation (approximately 100 feet) by the Purchaser, along with some minor road work and fill to access. Installation will be on the downward side of an old beaver dam. There is no water flowing, but the soils are still saturated and will not hold up equipment. Payment Unit 13 will require product to be skid to the landing for Payment Units 11 and 12; no new haul road will be allowed to be built down to it.

The sale area is fragmented by numerous water bodies, which limits the haul route options. The snowmobile trail system has limited options as well, resulting in them both being on the same roads. With seasonal restrictions on some units, hauling may be required during snowmobile season with some restrictions.

A recreation site such as a trail, pathway, or campground is within the sale area or the vicinity. Certain restrictions/specifications may be applicable including time restrictions.

A timber sale contract for this lump sum, sealed bid timber sale will be awarded to the responsible bidder offering the highest sealed bid price. Bids must be at or above the following advertised price for each species:

<u>PRODUCTS & SPECIES</u>	<u>ESTIMATED UNITS*</u>		<u>ADVERTISED PRICE</u>
Sawtimber			
Mixed Aspen	168.00	MBF	\$ 64.00 / MBF
Mixed Oak	119.40	MBF	\$ 118.00 / MBF
Red Maple	153.00	MBF	\$ 64.00 / MBF
Red Oak	41.20	MBF	\$ 237.00 / MBF
Red Pine	292.20	MBF	\$ 111.00 / MBF
White Pine	99.10	MBF	\$ 54.00 / MBF
Pulpwood			
Balsam Fir	106.00	Cords	\$ 26.85 / Cord
Jack Pine	302.00	Cords	\$ 14.10 / Cord
Misc. Species 1	16.00	Cords	\$ 29.55 / Cord
Mixed Aspen	1,480.00	Cords	\$ 28.80 / Cord
Mixed Oak	536.00	Cords	\$ 17.30 / Cord
Paper Birch	13.00	Cords	\$ 14.35 / Cord
Red Maple	806.00	Cords	\$ 20.15 / Cord
Red Pine	280.00	Cords	\$ 40.40 / Cord
White Pine	308.00	Cords	\$ 19.20 / Cord
White Spruce	27.00	Cords	\$ 19.15 / Cord

* The total volume is statistically estimated within plus (+) or minus (-) 6.73 percent. The estimated units are final and not subject to adjustment. Prospective bidders are urged to examine this timber and to make their own estimates of quantity and quality.

BOND AND PAYMENT SCHEDULE:

1. A bond in the amount of \$8,791.00 to insure faithful performance of the conditions of the contract will be deposited by the successful bidder within 21 days of the sale award.
2. Cutting in any sale or unit without the required advance payment would be considered a trespass.
3. Total payment must be paid in advance or according to the following schedule:
 - (a) Ten percent (10%) of the sale value must be paid within 21 days of the sale award.
 - (b) The 10% down payment will be credited towards the first unit cut.

(c) Payment for each of the following units must be made before cutting begins in that unit:

PAYMENT UNIT NUMBER	PERCENT OF TOTAL SALE VALUE
01	6.5%
02	6.2%
03	3.2%
04	9.1%
05	7.3%
06	4.4%
07	2.9%
08	3.2%
09	2.2%
10	11.3%
11	11.6%
12	22.5%
13	9.6%

4. If no cutting takes place, the 10% down payment will not be refunded.

5. Operations on the contract issued will terminate on 12/31/2022.

Description of Timber by Payment Unit (PU)

PU	MARKET GROUP	PRODUCT	QUANTITY	UNIT	ACRES	ADVERTISE PRICE
1	Mixed Oak	Sawtimber	6.0	MBF	6.8	\$11,418.90
	<i>BI/R/Hybrid Oak</i>		6.0	<i>MBF</i>		
	Red Pine		82.7	MBF		
	Jack Pine	Pulpwood	3.0	Cords		
	<i>Jack Pine</i>	<i>Sawtimber</i>	0.9	<i>MBF</i>		
	<i>Jack Pine</i>	<i>Pulpwood</i>	1.0	<i>Cords</i>		
	Mixed Oak		9.0	Cords		
	<i>BI/R/Hybrid Oak</i>		9.0	<i>Cords</i>		
	Red Pine		33.0	Cords		
	2	Mixed Aspen	Sawtimber	5.6		
<i>Quaking Aspen</i>			5.6	<i>MBF</i>		
Mixed Oak			9.7	MBF		
<i>BI/R/Hybrid Oak</i>			6.3	<i>MBF</i>		
<i>White Oak</i>			3.4	<i>MBF</i>		
Red Maple			2.3	MBF		
Red Pine			8.1	MBF		
White Pine			0.9	MBF		
Balsam Fir		Pulpwood	59.0	Cords		
<i>Balsam Fir</i>		<i>Sawtimber</i>	6.3	<i>MBF</i>		
<i>Balsam Fir</i>		<i>Pulpwood</i>	46.0	<i>Cords</i>		
Jack Pine			3.0	Cords		
<i>Jack Pine</i>		<i>Sawtimber</i>	0.9	<i>MBF</i>		
<i>Jack Pine</i>		<i>Pulpwood</i>	1.0	<i>Cords</i>		
Misc. Species 1			2.0	Cords		
Mixed Aspen			144.0	Cords		
<i>Quaking Aspen</i>			144.0	<i>Cords</i>		
Mixed Oak			56.0	Cords		
<i>BI/R/Hybrid Oak</i>			39.0	<i>Cords</i>		
<i>White Oak</i>			17.0	<i>Cords</i>		
Red Maple			42.0	Cords		
Red Pine			4.0	Cords		
White Pine			1.0	Cords		
White Spruce			27.0	Cords		
<i>White Spruce</i>		<i>Sawtimber</i>	6.8	<i>MBF</i>		
<i>White Spruce</i>		<i>Pulpwood</i>	13.0	<i>Cords</i>		
3		Mixed Aspen	Sawtimber	6.4	MBF	25.4
	<i>B. T. Aspen</i>		6.4	<i>MBF</i>		
	Mixed Oak		11.1	MBF		
	<i>BI/R/Hybrid Oak</i>		9.1	<i>MBF</i>		
	<i>White Oak</i>		2.0	<i>MBF</i>		
	Red Maple		6.9	MBF		
	Red Oak		1.0	MBF		
	Red Pine		2.2	MBF		
	Balsam Fir	Pulpwood	5.0	Cords		
	<i>Balsam Fir</i>		5.0	<i>Cords</i>		
	Mixed Aspen		32.0	Cords		
	<i>B. T. Aspen</i>		32.0	<i>Cords</i>		
	Mixed Oak		66.0	Cords		
	<i>BI/R/Hybrid Oak</i>		25.0	<i>Cords</i>		
	<i>Red Oak</i>		1.0	<i>Cords</i>		
	<i>White Oak</i>		40.0	<i>Cords</i>		
	Red Maple		30.0	Cords		
Red Pine		2.0	Cords			
White Pine		5.0	Cords			
4	Mixed Aspen	Sawtimber	2.2	MBF	24.6	\$16,076.40
	<i>Quaking Aspen</i>		2.2	<i>MBF</i>		

Description of Timber by Payment Unit (PU), con't

PU	MARKET GROUP	PRODUCT	QUANTITY	UNIT	ACRES	ADVERTISE PRICE
4 con't	Mixed Oak	Sawtimber	10.5	MBF		
	<i>BI/R/Hybrid Oak</i>		10.5	<i>MBF</i>		
	Red Pine		60.4	MBF		
	White Pine		3.8	MBF		
	Balsam Fir	Pulpwood	3.0	Cords		
	<i>Balsam Fir</i>	<i>Sawtimber</i>	0.3	<i>MBF</i>		
	<i>Balsam Fir</i>	<i>Pulpwood</i>	2.0	<i>Cords</i>		
	Jack Pine		120.0	Cords		
	<i>Jack Pine</i>	<i>Sawtimber</i>	6.9	<i>MBF</i>		
	<i>Jack Pine</i>	<i>Pulpwood</i>	106.0	<i>Cords</i>		
	Misc. Species 1		1.0	Cords		
	Mixed Aspen		16.0	Cords		
	<i>B. T. Aspen</i>		6.0	<i>Cords</i>		
	<i>Quaking Aspen</i>		10.0	<i>Cords</i>		
	Mixed Oak		57.0	Cords		
	<i>BI/R/Hybrid Oak</i>		54.0	<i>Cords</i>		
	<i>White Oak</i>		3.0	<i>Cords</i>		
	Red Pine		109.0	Cords		
	White Pine		7.0	Cords		
	5	Mixed Aspen	Sawtimber	1.8		
<i>Quaking Aspen</i>			1.8	<i>MBF</i>		
Mixed Oak			8.4	MBF		
<i>BI/R/Hybrid Oak</i>			8.4	<i>MBF</i>		
Red Pine			48.6	MBF		
White Pine			3.1	MBF		
Balsam Fir		Pulpwood	1.0	Cords		
<i>Balsam Fir</i>		<i>Sawtimber</i>	0.2	<i>MBF</i>		
<i>Balsam Fir</i>		<i>Pulpwood</i>	1.0	<i>Cords</i>		
Jack Pine			97.0	Cords		
<i>Jack Pine</i>		<i>Sawtimber</i>	5.6	<i>MBF</i>		
<i>Jack Pine</i>		<i>Pulpwood</i>	86.0	<i>Cords</i>		
Misc. Species 1			1.0	Cords		
Mixed Aspen			12.0	Cords		
<i>B. T. Aspen</i>			4.0	<i>Cords</i>		
<i>Quaking Aspen</i>			8.0	<i>Cords</i>		
Mixed Oak			47.0	Cords		
<i>BI/R/Hybrid Oak</i>			44.0	<i>Cords</i>		
<i>White Oak</i>			3.0	<i>Cords</i>		
Red Pine			87.0	Cords		
White Pine		5.0	Cords			
6	Mixed Oak	Sawtimber	23.9	MBF	11.6	\$7,666.05
	<i>BI/R/Hybrid Oak</i>		21.9	<i>MBF</i>		
	<i>White Oak</i>		2.0	<i>MBF</i>		
	Red Maple		0.8	MBF		
	Red Pine		6.5	MBF		
	White Pine		10.8	MBF		
	Jack Pine	Pulpwood	31.0	Cords		
	<i>Jack Pine</i>	<i>Sawtimber</i>	3.2	<i>MBF</i>		
	<i>Jack Pine</i>	<i>Pulpwood</i>	25.0	<i>Cords</i>		
	Mixed Oak		69.0	Cords		
	<i>BI/R/Hybrid Oak</i>		57.0	<i>Cords</i>		
	<i>White Oak</i>		12.0	<i>Cords</i>		
	Red Maple		13.0	Cords		
	Red Pine		21.0	Cords		
	White Pine		39.0	Cords		
7	Red Pine	Sawtimber	41.9	MBF	15.5	\$5,012.10

Description of Timber by Payment Unit (PU), con't

PU	MARKET GROUP	PRODUCT	QUANTITY	UNIT	ACRES	ADVERTISE PRICE
7 con't	White Pine	Sawtimber	0.8	MBF		
	Jack Pine	Pulpwood	4.0	Cords		
	<i>Jack Pine</i>	<i>Sawtimber</i>	1.4	<i>MBF</i>		
	<i>Jack Pine</i>	<i>Pulpwood</i>	1.0	<i>Cords</i>		
	Red Pine		6.0	Cords		
	White Pine		1.0	Cords		
	8	Mixed Aspen	Sawtimber	6.5		
<i>B. T. Aspen</i>			6.5	<i>MBF</i>		
Mixed Oak			3.1	MBF		
<i>BI/R/Hybrid Oak</i>			1.4	<i>MBF</i>		
<i>White Oak</i>			1.7	<i>MBF</i>		
Red Pine			1.9	MBF		
White Pine			18.5	MBF		
Balsam Fir		Pulpwood	21.0	Cords		
<i>Balsam Fir</i>			21.0	<i>Cords</i>		
Jack Pine			7.0	Cords		
<i>Jack Pine</i>		<i>Sawtimber</i>	1.4	<i>MBF</i>		
<i>Jack Pine</i>		<i>Pulpwood</i>	4.0	<i>Cords</i>		
Mixed Aspen			53.0	Cords		
<i>B. T. Aspen</i>			53.0	<i>Cords</i>		
Mixed Oak			16.0	Cords		
<i>BI/R/Hybrid Oak</i>			12.0	<i>Cords</i>		
<i>White Oak</i>			4.0	<i>Cords</i>		
Red Maple			29.0	Cords		
Red Pine			1.0	Cords		
White Pine			24.0	Cords		
9	Mixed Aspen	Sawtimber	2.4	MBF	7.8	\$3,799.55
	<i>Quaking Aspen</i>		2.4	<i>MBF</i>		
	Mixed Oak		1.8	MBF		
	<i>BI/R/Hybrid Oak</i>		0.4	<i>MBF</i>		
	<i>White Oak</i>		1.4	<i>MBF</i>		
	Red Pine		1.8	MBF		
	Balsam Fir	Pulpwood	3.0	Cords		
	<i>Balsam Fir</i>		3.0	<i>Cords</i>		
	Misc. Species 1		7.0	Cords		
	Mixed Aspen		86.0	Cords		
	<i>Quaking Aspen</i>		86.0	<i>Cords</i>		
	Mixed Oak		12.0	Cords		
	<i>BI/R/Hybrid Oak</i>		11.0	<i>Cords</i>		
	<i>White Oak</i>		1.0	<i>Cords</i>		
Red Maple		13.0	Cords			
10	Mixed Aspen	Sawtimber	7.2	MBF	30.2	\$19,897.40
	<i>B. T. Aspen</i>		7.2	<i>MBF</i>		
	Mixed Oak		22.2	MBF		
	<i>BI/R/Hybrid Oak</i>		22.2	<i>MBF</i>		
	Red Maple		23.2	MBF		
	Red Pine		4.8	MBF		
	White Pine		21.7	MBF		
	Balsam Fir	Pulpwood	5.0	Cords		
	<i>Balsam Fir</i>		5.0	<i>Cords</i>		
	Jack Pine		29.0	Cords		
	<i>Jack Pine</i>	<i>Sawtimber</i>	4.9	<i>MBF</i>		
	<i>Jack Pine</i>	<i>Pulpwood</i>	19.0	<i>Cords</i>		
	Mixed Aspen		249.0	Cords		
	<i>B. T. Aspen</i>		249.0	<i>Cords</i>		
Mixed Oak		102.0	Cords			

Description of Timber by Payment Unit (PU), con't

PU	MARKET GROUP	PRODUCT	QUANTITY	UNIT	ACRES	ADVERTISE PRICE
10 con't	<i>BI/R/Hybrid Oak</i>	<i>Pulpwood</i>	102.0	<i>Cords</i>		
	Red Maple		159.0	Cords		
	Red Pine		2.0	Cords		
	White Pine		45.0	Cords		
11	Mixed Aspen	Sawtimber	42.6	MBF	19.7	\$20,380.05
	<i>B. T. Aspen</i>		35.3	<i>MBF</i>		
	<i>Quaking Aspen</i>		7.3	<i>MBF</i>		
	Mixed Oak		6.9	MBF		
	<i>BI/R/Hybrid Oak</i>		4.8	<i>MBF</i>		
	<i>White Oak</i>		2.1	<i>MBF</i>		
	Red Maple		10.8	MBF		
	Red Oak		13.6	MBF		
	Red Pine		8.1	MBF		
	White Pine		11.2	MBF		
	Balsam Fir	Pulpwood	1.0	Cords		
	<i>Balsam Fir</i>	<i>Sawtimber</i>	0.2	<i>MBF</i>		
	<i>Balsam Fir</i>	<i>Pulpwood</i>	1.0	<i>Cords</i>		
	Jack Pine		2.0	Cords		
	<i>Jack Pine</i>	<i>Sawtimber</i>	0.7	<i>MBF</i>		
	<i>Jack Pine</i>	<i>Pulpwood</i>	1.0	<i>Cords</i>		
	Misc. Species 1		1.0	Cords		
	Mixed Aspen		279.0	Cords		
	<i>B. T. Aspen</i>		217.0	<i>Cords</i>		
	<i>Quaking Aspen</i>		62.0	<i>Cords</i>		
	Mixed Oak		29.0	Cords		
	<i>BI/R/Hybrid Oak</i>		10.0	<i>Cords</i>		
	<i>Red Oak</i>		15.0	<i>Cords</i>		
	<i>White Oak</i>		4.0	<i>Cords</i>		
	Paper Birch		3.0	Cords		
	<i>Paper Birch</i>		3.0	<i>Cords</i>		
	Red Maple		84.0	Cords		
	Red Pine		4.0	Cords		
	White Pine		47.0	Cords		
12	Mixed Aspen	Sawtimber	82.8	MBF	38.4	\$39,647.00
	<i>B. T. Aspen</i>		68.7	<i>MBF</i>		
	<i>Quaking Aspen</i>		14.1	<i>MBF</i>		
	Mixed Oak		13.5	MBF		
	<i>BI/R/Hybrid Oak</i>		9.5	<i>MBF</i>		
	<i>White Oak</i>		4.0	<i>MBF</i>		
	Red Maple		21.0	MBF		
	Red Oak		26.6	MBF		
	Red Pine		15.9	MBF		
	White Pine		21.7	MBF		
	Balsam Fir	Pulpwood	2.0	Cords		
	<i>Balsam Fir</i>	<i>Sawtimber</i>	0.3	<i>MBF</i>		
	<i>Balsam Fir</i>	<i>Pulpwood</i>	1.0	<i>Cords</i>		
	Jack Pine		6.0	Cords		
	<i>Jack Pine</i>	<i>Sawtimber</i>	1.3	<i>MBF</i>		
	<i>Jack Pine</i>	<i>Pulpwood</i>	3.0	<i>Cords</i>		
	Misc. Species 1		1.0	Cords		
	Mixed Aspen		542.0	Cords		
	<i>B. T. Aspen</i>		422.0	<i>Cords</i>		
	<i>Quaking Aspen</i>		120.0	<i>Cords</i>		
	Mixed Oak		55.0	Cords		
	<i>BI/R/Hybrid Oak</i>		19.0	<i>Cords</i>		
	<i>Red Oak</i>		29.0	<i>Cords</i>		

Description of Timber by Payment Unit (PU), con't

PU	MARKET GROUP	PRODUCT	QUANTITY	UNIT	ACRES	ADVERTISE PRICE	
12 con't	<i>White Oak</i>	<i>Pulpwood</i>	7.0	<i>Cords</i>			
	Paper Birch		6.0	Cords			
	<i>Paper Birch</i>		6.0	<i>Cords</i>			
	Red Maple		163.0	Cords			
	Red Pine		8.0	Cords			
	White Pine		91.0	Cords			
	13		Mixed Aspen	Sawtimber			10.5
<i>Quaking Aspen</i>		10.5	<i>MBF</i>				
Mixed Oak		2.3	MBF				
<i>Bl/R/Hybrid Oak</i>		2.3	<i>MBF</i>				
Red Maple		88.0	MBF				
Red Pine		9.3	MBF				
White Pine		6.6	MBF				
Balsam Fir		Pulpwood	6.0		Cords		
<i>Balsam Fir</i>			6.0		<i>Cords</i>		
Misc. Species 1			3.0		Cords		
Mixed Aspen			67.0		Cords		
<i>Quaking Aspen</i>			67.0		<i>Cords</i>		
Mixed Oak			18.0		Cords		
<i>Bl/R/Hybrid Oak</i>			18.0	<i>Cords</i>			
Paper Birch			4.0	Cords			
<i>Paper Birch</i>			<i>Sawtimber</i>	0.7	<i>MBF</i>		
<i>Paper Birch</i>			<i>Pulpwood</i>	3.0	<i>Cords</i>		
Red Maple		273.0	Cords				
Red Pine		3.0	Cords				
White Pine		43.0	Cords				
TOTAL:			872.9	MBF			
TOTAL:			3,874.0	Cords			

Sale Specific Conditions & Requirements

Sale Name: Boyce Lake Final

Sale Number: 71-012-18 Seq#: 1

1 - Sale Area

1.2 - Boundaries

1.2.1 - Painted boundaries (1/14)

The sale boundary and Payment Unit boundaries are marked and identified by red and yellow paint. Exterior sale boundary lines against state are marked with red paint. Interior Payment Unit boundaries are marked with yellow paint. The painted boundary line trees are not Included Timber and are to be protected. Yellow painted trees designating an interior Payment Unit boundary are only to be cut when all surrounding Payment Units have been paid.

2 - Timber Specifications

2.1 - Included Timber

2.1.1 - Clearcut unit(s) with unmerchantable trees (6/14)

Within Payment Unit(s) 1, 2, and 4-13, cut all trees that are two (2) inches or more at DBH, except do not cut any trees marked with green paint above and below stump height, or any cedar or hemlock. In addition, the following exceptions apply:

- Within Payment Unit 6, cut red pine that are five (5) inches or more at DBH, and cut white pine that are eight (8) inches or more at DBH.
- Within Payment Unit 10, do not cut white oak.

2.1.3 - Cut tree marked unit(s) (12/08)

Within Payment Unit(s) 3, all trees are designated for cutting when marked with orange paint above and below stump height, regardless of merchantability. In addition, cut all multi-stemmed red maple trees that are two (2) inches or more at DBH.

2.1.11 - Description of timber note (2/04)

Note that Misc. Species 1 is pin cherry. Mixed oak is all species of red oak and white oak.

2.2 - Utilization

2.2.2 - Chipping required (2/18)

Payment Unit(s) 1, 4 and 5 must be chip harvested to facilitate subsequent planting operations. The Purchaser has the option to produce sawlogs or pulpwood bolts, but the remaining portion of the trees must be chipped and hauled. If market conditions limit the practicality of chipping, tops and slash must be arranged in a way that will not inhibit future planting operations, as directed by the sale administrator. A chipping exemption can be obtained if proposed operations are determined to be suitable for planting by reforestation staff. This exemption must be granted in writing. The requirement to retain approximately 1/6 of tree tops and limbs less than four inches in diameter does apply (G. C. & R. 2.2).

2.2.3 - Stump heights (4/07)

Stump heights within the Sale Area shall not exceed 6 inches for all trees.

2.2.6 - Roundwood operation required (5/07)

The skidding of whole trees or tree segments with limbs attached is prohibited within Payment Unit(s) 3. All products must be produced as roundwood and forwarded to existing roads or landing areas in final product length.

2.2.10 - No chipping tops and limbs (8/16)

Within Payment Unit(s) 10, chipping of the bole, 2-inches in diameter or greater, is allowed. Chipping of limbs or portions of the tree less than 2-inches in diameter is not permitted. Limbs and the remaining top must be left on site and scattered.

3 - Payments

3.3 - Pre-measured Sales

3.3.4 - Dividing payment units (7/14)

Payment Unit(s) may be divided at the request of the Purchaser and upon approval of the Unit Manager. Dividing Payment Units is a contract modification which requires a Timber Sale Contract Supplement. There will be only one division per Payment Unit.

3.4 - Damaged Timber

3.4.1 - Damaged timber (6/14)

General Condition and Requirement 3.4 Damaged Timber, defines liquidated damages for undesignated live merchantable trees which are cut or injured.

No damage is acceptable to merchantable trees. Within the sale area, if more than 5% of trees (> 4.5" DBH) within a specified area of the sale are damaged, liquidated damages will be assessed for all trees damaged. Rates will be in accordance with General Condition and Requirement 3.4 Damaged Timber.

4 - Transportation

4.1 - Construction

4.1.8 - Road work (1) (8/07)

The following road work is required: Within Payment Unit 10, the existing road to the south side of the unit will need to be improved and crane mats will need to be installed on the downward side of an old beaver dam. The crossing is approximately 100 feet in length. Some fill may be required and will need to be brought in. There is no onsite fill available from adjacent State-owned lands. Upon completion, the mats must be removed and any fill material can then be spread on the pre-existing road bed. The road that slopes downhill towards mat placement shall be water barred and brushed over to impede erosion immediately after mats are removed. The road will then be blocked at the hill crest to stop illegal ORV activity.

4.1.10 - Oversight (12/08)

The Unit Manager, or his/her representative, must be present when the road improvement project is initiated.

4.1.12 - No new roads (1/12)

No new roads will be permitted in any Payment Unit, except Payment Unit 10. All operations are limited to existing roads. Skid trails only will be allowed.

4.2 - Maintenance

4.2.3 - Road maintenance (8/13)

The following road maintenance is required: Within 60 days of completion of hauling, or if no hauling occurs for 60 days, the road must be maintained and graded to the condition the road was prior to use. This includes cleaning of drainage areas, grading, crowning and filling with gravel, if necessary. Damages will be assessed if grading/repair does not occur.

5 - Operations

5.1 - Notification

5.1.1 - Pre-sale conference (10/16)

A pre-sale conference on site between the Purchaser and sale administrator is required prior to beginning any operations to determine landing and road locations.

5.1.4 - Post-sale conference (10/16)

A post-sale conference on site between the Purchaser and sale administrator is required 5 days prior to the completion of active logging operations to determine clean-up and repair of landings, road edges, and the fulfillment of other contract specifications.

5.2 - Conduct of Operations

5.2.1 - Slash

5.2.1.8 - Slash height (12/08)

No slash or tree tops may exceed 24 inches in height.

5.2.2 - Hazard Trees/Snags

5.2.2.1 - Den trees (10/16)

Obvious hollow and/or den trees shall be protected and left standing unless they are a safety hazard.

5.2.3 - Operating Restrictions

5.2.3.5 - Oak wilt restriction (1/18)

Within Payment Unit(s) 3 and 6, unless changed by written agreement, cutting, skidding, hauling within the sale and brushing of access roads to the sale are not permitted during the period of April 15 to July 15. Operations may be allowed if specific steps are taken to prevent damaging uncut oak during the high risk period. Those steps may include completing all road brushing before April 15th and clearing a tree-length buffer along uncut oak cover before April 15th. This is necessary to reduce the spread of oak wilt. For more information, contact the Unit Manager or his/her representative.

5.2.3.6 - Bark beetle restriction (12/08)

In the event drought creates a high risk of pine bark beetle infestation, pine is not to be cut during the period March 1 through July 1, unless all portions of trees greater than two inches in diameter are removed from the sale area, reduced to chips, or treated to the satisfaction of the Unit Manager or his/her representative, within fifteen days of being severed from the stump. Pine log decks, pulpwood piles and treetops that are piled for chipping in the fall or winter within a 1/4 mile of susceptible sites must be removed before March 15. Residual slash must not be placed in piles or rows and must be spread over the site for quick drying. The Department of Natural Resources will exercise this specification if the risk of damage warrants.

5.2.3.11 - Coppice regeneration protection (4/10)

Timber harvesting Payment Unit(s) 2 and 8-13 must be completed before significant aspen sprouting occurs in that Payment Unit so as to minimize damage to the new regeneration. Any post harvest operations, such as chipping, must be completed before sprouting of regeneration occurs. If it is anticipated that chipping will be delayed, then tops shall be carried to one central location or left unchipped. The Unit Manager or his/her representative may cease such operations if sprouting occurs before the operation is complete.

5.2.4 - Dead and Down Creation

5.2.4.2 - Dead and down creation, hare and grouse (1/14)

To improve habitat for snowshoe hare, grouse, and other species, the Purchaser is to leave the following:

- Within Payment Unit(s) 2 and 10-13, leave two trees, eight (8) inches or larger in diameter on the ground for every two acres. They should be scattered throughout the sale or positioned per the sale administrators instructions. If possible, the logs or trees should be felled so they overlap. Note these pieces should have a minimum length of five feet. They can be of any tree species and can be an un-merchantable piece of wood or a full tree.
- Within Payment Unit(s) 7 and 8, place one pile of loosely scattered brush over two pieces of large diameter logs for every two acres along the south edge of the unit where it adjoins the swamp edge. This is to create rabbit habitat.

5.2.17 - Timber Mats and Interlocking Composite Mats (3/18)

Some roads or skid trails may require extra protection such as that afforded by timber mats, interlocking composite mats, or another approved system. Approximately 100 feet of road or trail will need extra protection at locations shown on the Timber Sale Map. If available, mats may be borrowed from the DNR. A Timber Sale Contract Supplement will be used to document the Purchaser's use of the DNR's mats. Contact the sale administrator regarding availability and pick-up. Timber mats are available from various field offices. Composite mats are only available from the Grayling field office. The Purchaser is responsible for picking up and hauling the mats to and from the site. The composite mats will require DNR staff onsite for installation and removal. Contact the sale administrator to schedule at least 30 days before desired install/removal date. All mats must be cleaned prior to drop off. This may include, but is not limited to, power washing and brushing to remove mud and debris. A charge of \$400.00 per timber mat and \$2,000.00 per composite mat will be assessed for all damaged or non-returned mats. Damage for the crane/timber mats is defined as three or more broken cants. Damage for the composite mats is defined as cracked or broken mats.

5.2.22 - Operating Caution

5.2.22.1 - Operating caution (6/11)

It is recommended, but not required, that within Payment Unit(s) 2, 8, 9, and 10, cutting and skidding occur during dry summer or frozen winter conditions. The reason for the recommendation is due to sensitive soils on the outer fringes of units.

5.2.32 - Decking/landing restoration (9/13)

All decking and landing areas must have the surface area restored to a condition equal to or better than before. This is to ensure the proper regeneration of the stand. Wood debris, chips and "cookies" from trimmings must be removed or scattered

away from landing and loading areas and may not be windrowed on the edge. Depth of debris mat shall not exceed 6 inches in depth.

5.2.38 - No decking against live trees (2/04)

Cut products may not be decked against unmarked or designated leave trees.

5.2.39 - ORV trail/route protection (4/18)

There is an ORV trail or route and is shown on the Timber Sale Map. Do not cut trees or damage posts with yellow ORV markers. All stumps within 5 feet of the trail must be cut flush with the ground. Maintain a 20 foot wide slash, debris, and rut free zone daily using the ORV trail or route as the centerline. Do not run equipment down the ORV trail or route. Skidding across the trail or route may only occur in locations approved by the sale administrator.

5.2.41 - Snowmobile trail protection (9/11)

There is a snowmobile trail and is shown on the Timber Sale Map. Do not cut or damage posts with orange trail markers or traffic control signs. If the trail is used, it must be maintained and restored to a condition equal to or better than before the sale. The road maintenance/restoration must be done prior to December 1. If the trail is used for hauling, it must be graded to the satisfaction of the Unit Manager or his/her representative prior to December 1st. If the trail road is to be used for hauling during the snowmobile season, then a snow covered base must be left on the trail. Maintain a 20 foot wide slash, debris, and rut free zone daily using the snowmobile trail as the centerline. No decking of forest products will be permitted along the snowmobile trail. All stumps within 20 feet of the snowmobile trail must be cut at ground level.

5.4 - Soil Protection

5.4.1 - Rutting restriction, general (7/16)

Operations are to cease immediately if equipment and weather conditions result in rutting of roads and/or skid trails which is 12 inches or greater in depth and 50 feet in length. The Unit Manager or his/her representative may restrict hauling and/or skidding if ruts exceed the specified depth. With the Unit Manager or his/her representative's approval, the Purchaser may return to the area when the risk of rutting has decreased.

5.4.6 - Wet area protection (5/10)

No harvesting operations, including skidding and felling, are to take place within the vernal pond(s) within Payment Units 4 and 6. The ponds are identified by a red painted boundary line. When harvesting occurs, there should be no disturbance to the vernal pond depression. All equipment, trees and tops should be kept out of this area. Within 100 feet of the pond, equipment should only be used when the soil is in a dry or frozen condition. Care must be taken by the Purchaser to identify and avoid operating in these areas of the timber sale.

6 - Safety and Fire Prevention

6.2 - Signing

6.2.2 - Snowmobile trail posting (8/09)

The Purchaser is responsible for posting and maintaining caution signs on the snowmobile trails prior to beginning operations during the snowmobile season (approximately December 1 to March 31). The trail must be posted at appropriate distances from the sale area to warn of logging activity and truck traffic. Signs must be removed when harvest operations are suspended or completed. The Purchaser will provide these signs.

6.2.3 - Recreational trail posting (2/10)

The Purchaser is responsible for posting and maintaining caution signs on the ORV trails prior to beginning operations. The trail must be posted at appropriate distances from the sale area to warn of logging activity and truck traffic at both ends of the trail. Signs must be removed when harvest operations are suspended or completed. The Purchaser will provide these signs.

7 - Other Conditions

7.3 - Contract Modifications

7.3.3 - Modification for reforestation (8/05)

When contractual work of Purchaser has been accepted for any Payment Unit identified on Sale Area Map, Payment Unit will be eliminated from the Sale Area on written notice so that reforestation operations can begin.



TIMBER SALE MAP

This information provided by authority of Part 525, 1994 PA 451, as amended.

Forest Management Unit Roscommon	County Roscommon	Mapped By Bates/Martell	Date 09/30/18	Page 1	of 2
Township 21N	Range 03W	Section(s) and Subdivision(s) Sec. 3 - NWNW, S1/2NW, S1/2NE, N1/2SW, SE; Sec. 4 - NENE; Sec. 10 - N1/2NW, SENW, N1/2NE	Scale 1:15,840		

Cover Type				Density	
A = Aspen	H = Hemlock	N = Marsh	U = Upland Brush	0 = Non Stocked	5 = Pole Timber Medium
B = Paper Birch	J = Jack Pine	O = Oak	UM = Upland Mixed	1 = Seedling Sapling Poor	6 = Pole Timber Well
C = Cedar	L = Lowland Brush	P = Lowland Poplar	V = Bog or Marsh	2 = Seedling Sapling Medium	7 = Saw Timber Poor
D = Tread Bog	LM = Lowland Mixed	Q = Mixed Swamp Conifer	W = White Pine	3 = Seedling Sapling Well	8 = Saw Timber Medium
E = Swamp Hdwoods	M = Mpl, Bch, Brch	R = Red Pine	X = Non Stocked	4 = Pole Timber Poor	9 = Saw Timber Well
F = Spruce Fir	MC = Mixed Conifer	S = Black Spruce	Z = Water		
G = Grass	MD = Mixed Deciduous	T = Tamarack			

PU	Acres	PU	Acres
1	6.8	6	11.6
2	13.4	7	15.5
3	25.4	8	8.2
4	24.6	9	7.8
5	19.8		

Boyce Lake Final Compartment 027 239.2 Acres

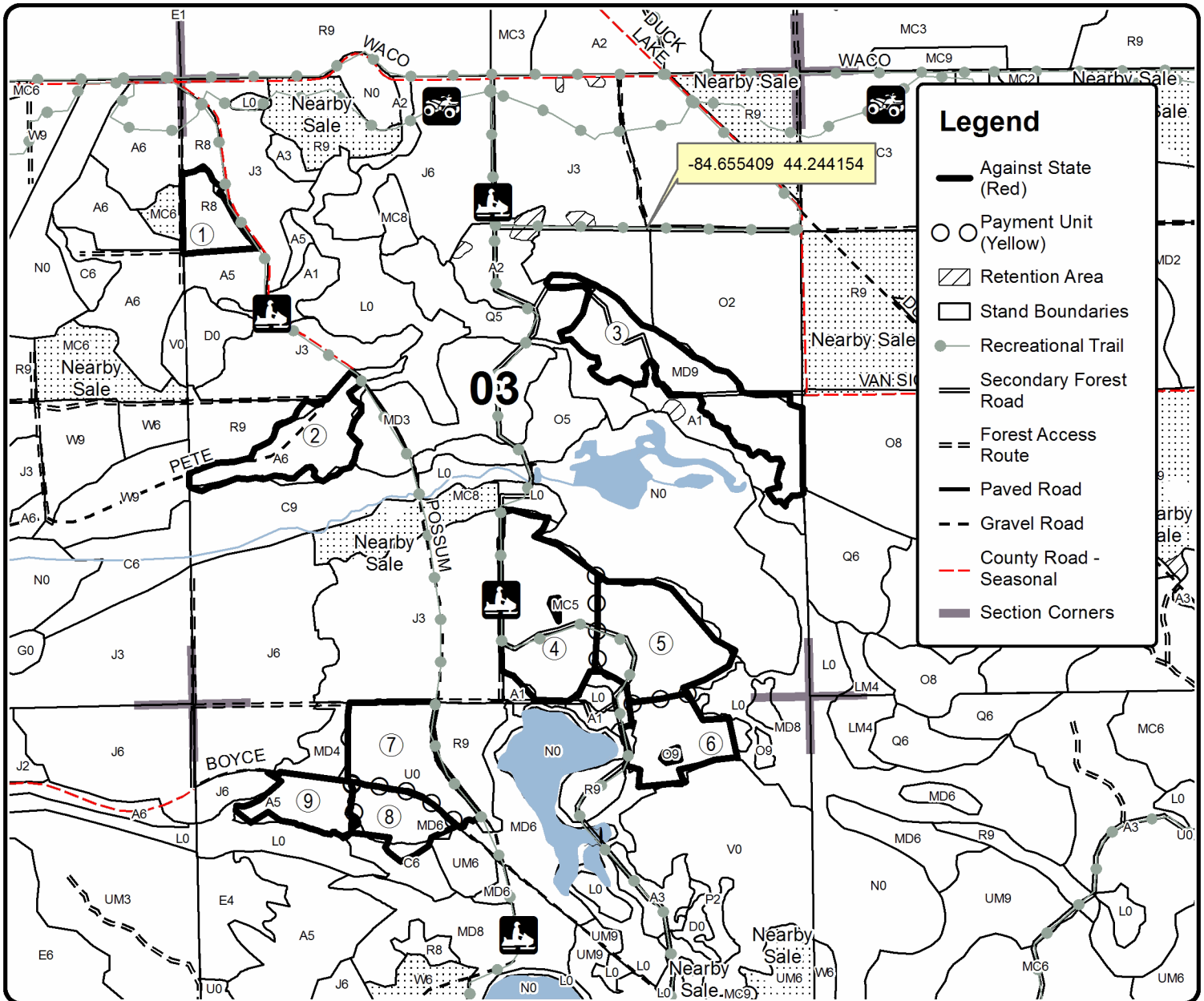
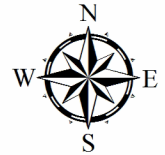

Legend

- Against State (Red)
- Payment Unit (Yellow)
- ▨ Retention Area
- ▭ Stand Boundaries
- Recreational Trail
- == Secondary Forest Road
- == Forest Access Route
- Paved Road
- - Gravel Road
- - County Road - Seasonal
- Section Corners

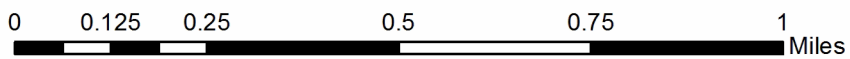



Sale Number	Year
71 - 012	18

TIMBER SALE MAP

This information provided by authority of Part 525, 1994 PA 451, as amended.

Forest Management Unit	County	Mapped By	Date	Page	of
Roscommon	Roscommon	Bates/Martell	09/30/18	2	2
Township	Range	Section(s) and Subdivision(s)	Scale		
21N	03W	Sec. 15 - NENW, S1/2NW, W1/2NE, SE; Sec. 22 - N1/2NW, NWNE	1:15,840		

Cover Type				Density	
A = Aspen	H = Hemlock	N = Marsh	U = Upland Brush	0 = Non Stocked	5 = Pole Timber Medium
B = Paper Birch	J = Jack Pine	O = Oak	UM = Upland Mixed	1 = Seedling Sapling Poor	6 = Pole Timber Well
C = Cedar	L = Lowland Brush	P = Lowland Poplar	V = Bog or Marsh	2 = Seedling Sapling Medium	7 = Saw Timber Poor
D = Treed Bog	LM = Lowland Mixed	Q = Mixed Swamp Conifer	W = White Pine	3 = Seedling Sapling Well	8 = Saw Timber Medium
E = Swamp Hdwoods	M = Mpl. Bch, Brch	R = Red Pine	X = Non Stocked	4 = Pole Timber Poor	9 = Saw Timber Well
F = Spruce Fir	MC = Mixed Conifer	S = Black Spruce	Z = Water		
G = Grass	MD = Mixed Deciduous	T = Tamarack			

PU	Acres	PU	Acres
10	30.2	13	17.8
11	19.7		
12	38.4		

Boyce Lake Final

Compartment 027

239.2 Acres

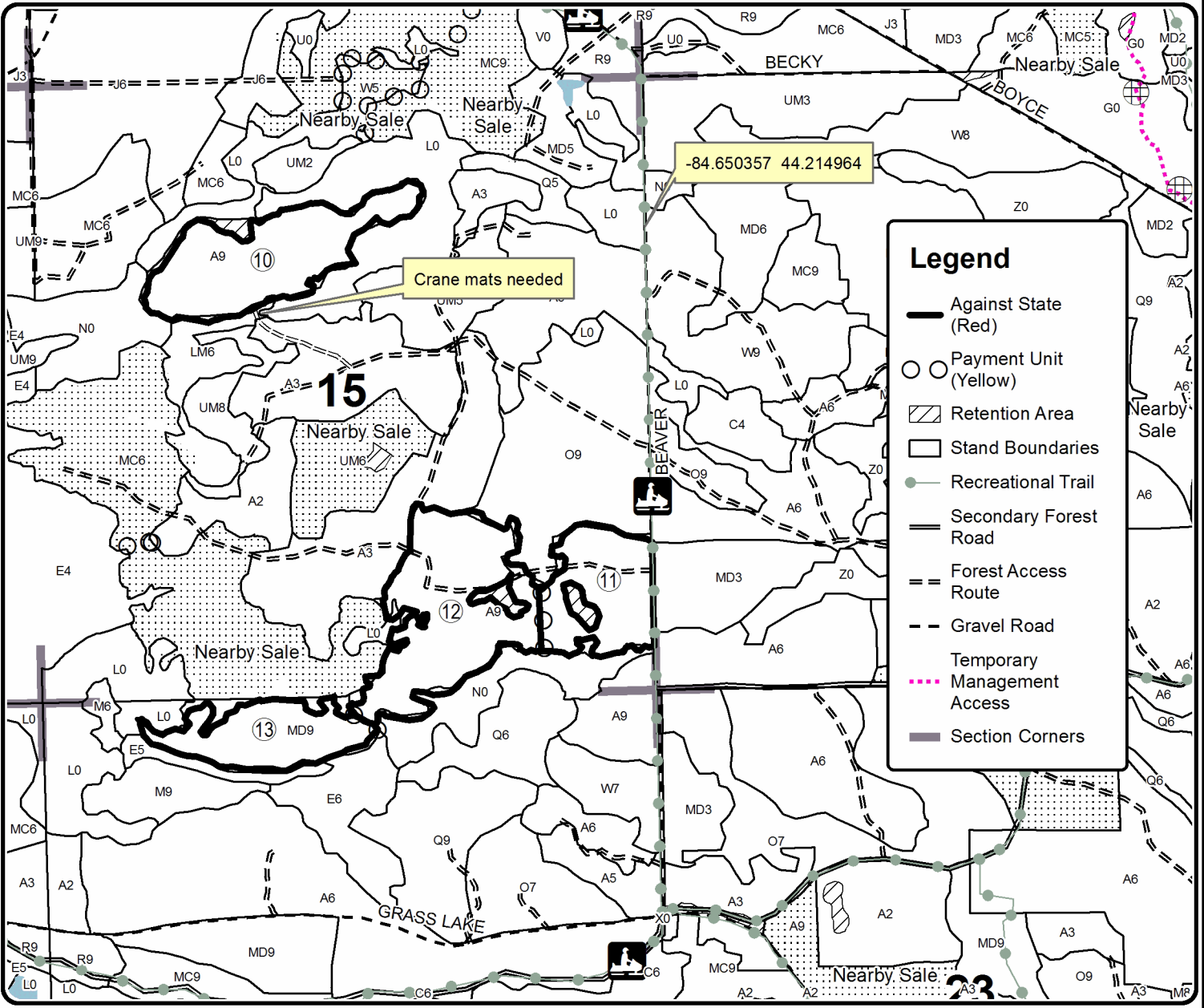

Boyce Lake Final (71-012-18)
T21N, R03W, SEC. 10; T21N, R03W, SEC. 15; T21N, R03W, SEC. 22; T21N,

In response to the notice of sale to be held 2:00 p.m. (local time) on September 25, 2019, I am hereby submitting my sealed bid (firm offer) for the following forest products to be cut. Bids for individual species must be at or above the advertised price. All non-responsive bid forms may be rejected.

<u>PRODUCTS & SPECIES</u>	<u>ESTIMATED VOLUME*</u>	<u>ADVERTISED PRICE</u>	<u>BID PRICE/UNIT</u>
Sawtimber			
Mixed Aspen	168.00 MBF	\$ 64.00/MBF	\$ _____
Mixed Oak	119.40 MBF	\$ 118.00/MBF	\$ _____
Red Maple	153.00 MBF	\$ 64.00/MBF	\$ _____
Red Oak	41.20 MBF	\$ 237.00/MBF	\$ _____
Red Pine	292.20 MBF	\$ 111.00/MBF	\$ _____
White Pine	99.10 MBF	\$ 54.00/MBF	\$ _____
Pulpwood			
Balsam Fir	106.00 Cords	\$ 26.85/Cord	\$ _____
Jack Pine	302.00 Cords	\$ 14.10/Cord	\$ _____
Misc. Species 1	16.00 Cords	\$ 29.55/Cord	\$ _____
Mixed Aspen	1,480.00 Cords	\$ 28.80/Cord	\$ _____
Mixed Oak	536.00 Cords	\$ 17.30/Cord	\$ _____
Paper Birch	13.00 Cords	\$ 14.35/Cord	\$ _____
Red Maple	806.00 Cords	\$ 20.15/Cord	\$ _____
Red Pine	280.00 Cords	\$ 40.40/Cord	\$ _____
White Pine	308.00 Cords	\$ 19.20/Cord	\$ _____
White Spruce	27.00 Cords	\$ 19.15/Cord	\$ _____

*The volumes are statistically estimated within plus (+) or minus (-) 6.73 percent. These estimated volumes are final and not subject to adjustment. Prospective bidders are urged to examine this timber and to make their own estimates of quantity and quality.

I understand that any or all bids may be rejected. All bids must be signed and all bid items must be bid or the bid form may be rejected. I also understand that consideration and awarding a contract will be based upon my past performance and ability to complete the contract based upon equipment and staffing subject to my control.

FEDERAL ID: ____ - ____ - ____ or SOCIAL SECURITY NUMBER: ____ - ____ - ____

Company or individual bidding: _____

Company representative's name: _____

Address: _____

City: _____ State: _____ Zip: _____

IF AVAILABLE, PLEASE PLACE THE PERSONALIZED LABEL FROM YOUR PROSPECTUS IN THE ABOVE BOX.

Individual or company representative's signature: _____ Date: _____

Phone number : _____ Email (optional): _____

THE WINNING BIDDER MUST COMPLETE THE VERIFICATION OF WORKER'S DISABILITY COMPENSATION ACT COMPLIANCE (ON REVERSE SIDE IF DOUBLE SIDED) WITHIN 21 DAYS OF SALE AWARD DATE



FOR DEPARTMENT USE ONLY
Sale Number (XX - XXX - XX - XX)
Forest Management Unit:

TIMBER SALE VERIFICATION OF WORKER'S DISABILITY COMPENSATION ACT COMPLIANCE

*As required by Act 317, P.A. 1969 (Worker's Compensation) and
Part 5 of Act 451 of 1994, as amended.*

VERIFICATION OF WORKER'S DISABILITY COMPENSATION ACT COMPLIANCE

- This verification must be completed and submitted within 21 days of contract award and prior to the issuance of the timber sale contract.
- In addition, if boxes 2B or 2C are checked, then Notice of Exclusion or Certificate of Insurance must be submitted within twenty-one (21) days of the contract award and prior to the issuance of the timber sale contract.
- All information must be typed or printed except for written signatures.

Please Check Appropriate Categories:

1. My business is organized as (you **must** check one of the boxes below):
 - A. Sole Proprietorship (individual)
 - B. Partnership
 - C. Corporation

2. You **must** check one of the boxes below:
 - A. I certify my business is a sole proprietorship and it has no employees but the sole proprietor. I am not subject to the Worker's Compensation Laws.
 - B. I certify my business has satisfied its obligation to the Worker's Compensation Act through the use of an approved Notice of Exclusion (BWC-337, Rev. 5/96). I will provide a copy of the Notice of Exclusion within 21 days of the contract award. (For questions or a copy of the BWC-337, please call the Worker's Compensation Bureau at 517-322-1195).
 - C. I certify my business has a Worker's Compensation Policy. I will provide an original Certificate of Insurance within twenty-one (21) days of the contract award.

3. If you have checked item 2(A) or 2(B), you **must** indicate the number of **both** full-time and part-time employees, other than yourself, including family members and active partners (if none, you must enter "0").

_____ Full-time Employees

_____ Part-time Employees

Name of Business		Federal ID (or) Social Security No.	
Address		Telephone ()	
City	State	ZIP	

I hereby certify that the above information is true and correct. I agree to notify the Michigan DNR of any changes that occur in factors affecting my coverage during any of my present and future operations.

Signature of Owner or Authorized Representative

Title

Date

Please complete the "SEALED BID" information on the next page

Crushed Concrete White Pine (71-015-19)
T22N, R02W, SEC. 31; Roscommon COUNTY

In response to the notice of sale to be held 2:00 p.m. (local time) on September 25, 2019, I am hereby submitting my sealed bid (firm offer) for the following forest products to be cut. Bids for individual species must be at or above the advertised price. All non-responsive bid forms may be rejected.

<u>PRODUCTS & SPECIES</u>	<u>ESTIMATED VOLUME*</u>	<u>ADVERTISED PRICE</u>	<u>BID PRICE/UNIT</u>
Sawtimber			
BI/R/Hybrid Oak	10.40 MBF	\$ 127.00/MBF	\$ _____
Red Maple	9.80 MBF	\$ 68.00/MBF	\$ _____
Red Pine	11.00 MBF	\$ 119.00/MBF	\$ _____
White Pine	30.20 MBF	\$ 58.00/MBF	\$ _____
Pulpwood			
Balsam Fir	18.00 Cords	\$ 28.80/Cord	\$ _____
Black Spruce	6.00 Cords	\$ 20.55/Cord	\$ _____
Jack Pine	16.00 Cords	\$ 15.10/Cord	\$ _____
Mixed Aspen	70.00 Cords	\$ 30.85/Cord	\$ _____
Mixed Hardwood	85.00 Cords	\$ 21.60/Cord	\$ _____
Mixed Oak	87.00 Cords	\$ 18.55/Cord	\$ _____
Red Pine	15.00 Cords	\$ 43.30/Cord	\$ _____
White Pine	195.00 Cords	\$ 20.60/Cord	\$ _____

*The volumes are statistically estimated within plus (+) or minus (-) 14.92 percent. These estimated volumes are final and not subject to adjustment. Prospective bidders are urged to examine this timber and to make their own estimates of quantity and quality.

I understand that any or all bids may be rejected. All bids must be signed and all bid items must be bid or the bid form may be rejected. I also understand that consideration and awarding a contract will be based upon my past performance and ability to complete the contract based upon equipment and staffing subject to my control.

FEDERAL ID: _____ or SOCIAL SECURITY NUMBER: _____

Company or individual bidding: _____

Company representative's name: _____

Address: _____

City: _____ State: _____ Zip: _____

IF AVAILABLE, PLEASE PLACE THE PERSONALIZED LABEL FROM YOUR PROSPECTUS IN THE ABOVE BOX.

Individual or company representative's signature: _____ Date: _____

Phone number : _____ Email (optional): _____

THE WINNING BIDDER MUST COMPLETE THE VERIFICATION OF WORKER'S DISABILITY COMPENSATION ACT COMPLIANCE (ON REVERSE SIDE IF DOUBLE SIDED) WITHIN 21 DAYS OF SALE AWARD DATE



FOR DEPARTMENT USE ONLY
Sale Number (XX - XXX - XX - XX)
Forest Management Unit:

TIMBER SALE VERIFICATION OF WORKER'S DISABILITY COMPENSATION ACT COMPLIANCE

*As required by Act 317, P.A. 1969 (Worker's Compensation) and
Part 5 of Act 451 of 1994, as amended.*

VERIFICATION OF WORKER'S DISABILITY COMPENSATION ACT COMPLIANCE

- This verification must be completed and submitted within 21 days of contract award and prior to the issuance of the timber sale contract.
- In addition, if boxes 2B or 2C are checked, then Notice of Exclusion or Certificate of Insurance must be submitted within twenty-one (21) days of the contract award and prior to the issuance of the timber sale contract.
- All information must be typed or printed except for written signatures.

Please Check Appropriate Categories:

1. My business is organized as (you **must** check one of the boxes below):
 - A. Sole Proprietorship (individual)
 - B. Partnership
 - C. Corporation

2. You **must** check one of the boxes below:
 - A. I certify my business is a sole proprietorship and it has no employees but the sole proprietor. I am not subject to the Worker's Compensation Laws.
 - B. I certify my business has satisfied its obligation to the Worker's Compensation Act through the use of an approved Notice of Exclusion (BWC-337, Rev. 5/96). I will provide a copy of the Notice of Exclusion within 21 days of the contract award. (For questions or a copy of the BWC-337, please call the Worker's Compensation Bureau at 517-322-1195).
 - C. I certify my business has a Worker's Compensation Policy. I will provide an original Certificate of Insurance within twenty-one (21) days of the contract award.

3. If you have checked item 2(A) or 2(B), you **must** indicate the number of **both** full-time and part-time employees, other than yourself, including family members and active partners (if none, you must enter "0").

_____ Full-time Employees

_____ Part-time Employees

Name of Business		Federal ID (or) Social Security No.	
Address		Telephone ()	
City	State	ZIP	

I hereby certify that the above information is true and correct. I agree to notify the Michigan DNR of any changes that occur in factors affecting my coverage during any of my present and future operations.

Signature of Owner or Authorized Representative

Title

Date

Please complete the "SEALED BID" information on the next page