



**DEPARTMENT OF NATURAL RESOURCES
STATE OF MICHIGAN**

TIMBER SALE PROSPECTUS #6218

SCHEDULED SALE DATE AND TIME: 4:00 p.m. (local time) on November 8, 2018.

LOCATION: TRAVERSE CITY MGMT UNIT, 2122 M 37 SOUTH, TRAVERSE CITY, MI 49685.

PROSPECTUS NOTE: The bidder is advised to inspect the sale area and review the location, estimated volumes, operating costs and contract terms of proposed sales. Please be aware that some landowners may request 60 days or more notice for access across their land.

Notice is hereby given that bids will be received by the Unit Manager, TRAVERSE CITY MANAGEMENT UNIT, for certain timber on the following described lands:

Crossfire Aspen (61-016-18) / T27N, R13W, SEC. 29, N1/2NE,SENE,S1/2SE.

Benzie County, Advertised Price \$30,293.50, 41.6 Acres, Hardwood, Aspen.

SALE NOTE: A recreation site such as a trail, pathway, or campground is within the sale area or the vicinity. Certain restrictions/specifications may be applicable including time restrictions.

April Snow Aspen (61-026-18) / T27N, R13W, SEC. 30, NW,W1/2NE,N1/2SW,SESW,NWSE.

Benzie County, Advertised Price \$42,995.85, 115.4 Acres, Hardwood, Aspen.

SALE NOTE: A recreation site such as a trail, pathway, or campground is within the sale area or the vicinity. Certain restrictions/specifications may be applicable including time restrictions.

Bear Sign Mix (61-046-18) / T24N, R14W, SEC. 25, SESW.

T24N, R14W, SEC. 36, E1/2NW,W1/2NE.

Manistee County, Advertised Price \$17,767.40, 24.5 Acres, Hardwood, Aspen.

SALE NOTE: No operations will be permitted during the period of 3/15 - 7/15 in order to avoid issues with seasonally wet soils. See 5.2.3.1 for details.

Curveball Mix (61-048-18) / T24N, R14W, SEC. 34, N1/2NE.

T24N, R14W, SEC. 35, NW,NWNE.

Manistee County, Advertised Price \$170,911.50, 93.1 Acres, Red Pine, Hardwood.

Wheelhouse Pine (61-054-18) / T24N, R14W, SEC. 34, SENE,NESE.

T24N, R14W, SEC. 35, SWNW,N1/2SW,SWSW.

Manistee County, Advertised Price \$171,821.15, 95.6 Acres, Red Pine, White Pine.

BID INSTRUCTIONS (VER. 07/02/2018):

1. Scheduled Bid Location, Date, and Time (2/11)

Bids must be received by the Unit Manager, TRAVERSE CITY OFFICE, 2122 M 37 SOUTH, TRAVERSE CITY, MI 49685, no later than 4:00 p.m. (local time) on November 8, 2018. For further information concerning this sale, contact David Lemmien at 231-922-6040.

2. Bidder's Qualifications (5/16)

Purchaser shall obtain workers compensation insurance to cover claims under Michigan's Worker's Disability Compensation Act of 1969 or similar employee benefit act of any other state applicable to an employee. If all or part of a timber sale was prepared by a private contractor, the contractor and that contractor's company are not permitted to bid on the timber sale contract. Bids will not be accepted from individuals or companies appearing on the DNR/FRD No-Bid List. This list contains the names of purchasers who previously failed to execute a contract within 21-days or who have a history of poor performance.

3. Preparation of Sealed Bids (5/16)

Bid Forms may be completed online thru Michigan DNR Timber Sale Online Bidding (OLB) at www.michigan.gov/timberbidding or by completing the hardcopy Bid Form found in the Timber Sale Prospectus. Hardcopy Bid Forms shall be manually signed in ink. Registration in OLB is considered your 'signature' for all bids submitted thru that system. Bid prices must be entered for each species and product in the Bid Price column for all material subject to bidding and all fill-in blanks must be completed. If erasures or other changes appear on the hardcopy Bid Form, each erasure or change must be initialed by the person signing the bid.

4. Submission of Sealed Bids (5/16)

Bid forms may be obtained from the Unit Manager or thru OLB. Bids may be submitted hardcopy or thru OLB. All hardcopy bids must be submitted on the bid form and in an envelope clearly identified as described in this section. NOTE: Only one bid form per bid envelope. Sealed bids must be submitted to the Unit office designated in the prospectus and must be submitted at or prior to the time established in the prospectus. The envelope should show on the outside (a) the sale name or number and (b) the date and time of bid opening, as shown in the prospectus. Bids received after the time specified in the sale prospectus are late bids and will be rejected.

It is possible for a bidder to submit multiple bids on a single sale. For example, a bid may be submitted hardcopy and a bid may be submitted thru OLB. Or, two bidders from the same company could both submit bids on the same sale. If this were to happen, the State would accept all bids received and award the contract accordingly. All bidding and contractual requirements would apply to all bids received.

5. Public Opening of Sealed Bids (7/16)

If conditions permit, the sealed bids will be publicly opened and posted at the time and place set in the prospectus.

If a bidder, present at a bid opening, has submitted bids on more than one sale, that bidder may withdraw their unopened bid envelopes or announce the withdrawal of their online bid after being declared the successful bidder on one sale.

6. Award of Contract (1/11)

Award of the contract will be made to the Bidder whose bid, conforming to the prospectus, is most advantageous to the State of Michigan on the basis of total value at rates bid for the estimated quantities. The State reserves the right to reject any bid or waive any minor irregularity in bids received. A written award mailed (or otherwise furnished) to the successful Bidder shall be deemed to result in a binding contract without further action by either party.

7. Down Payment (1/11)

The Bidder to whom award is made must make a down payment within 21 days of the sale award. The amount of the down payment will be calculated as shown in the Bond and Payment Schedule of this prospectus. Only cash may be used to meet this requirement.

8. Performance Security (1/11)

As guarantee of faithful performance, a cash bond, certificate of deposit, surety bond or irrevocable letter of credit (LOC) is required within 21 days of the sale award. The amount of the performance security is shown in the Bond and

Payment Schedule of this prospectus. If an LOC or surety is used, the coverage must extend for at least 6 months beyond the contract expiration.

9. Timber Sale Contract (7/18)

Additional conditions and requirements common to all timber sales are listed on the timber sale contract (R4031) and are available on line at www.michigan.gov/timber. Contact the Unit Manager for additional information or a sample contract. Within 21 days of the date of the award letter, the bidder must sign the contract and provide the required down payment, performance security, and verification of worker's disability compensation. The down payment and performance security shall be in accordance with the provisions of the timber sale contract, in the sums stated in this prospectus. If these actions are not taken, then the Bidder, the Bidder's corporation, and the corporation's principals may not be permitted to bid on State timber sales for a period of 3 months after the first offense, 6 months after the second offense, and 1 year after the third offense. An offense will only be counted against the Bidder for 5 years. In addition, the Bidder certifies that if awarded this contract, the Bidder will complete the timber sale contract in accordance with its terms and any modifications thereof including requirements to purchase, cut, and remove the included timber by the expiration date.

Payment Unit values in the State Forest Timber Sale Contract are calculated based on the advertised value of the Payment Unit as a percentage of the total advertised value of the contract. The advertised value of each Payment Unit is given in the Description of Timber by Payment Unit table on the Timber Sale Information page. For example, if the value of Payment Unit 1 is advertised as \$1,500 and the total Timber Sale value is advertised as \$10,000, the contract price for Payment Unit 1 will be 15% of the total bid price ($\$1,500/\$10,000 * 100$).

10. Disclaimer of Estimates and Bidder's Warranty of Inspection (7/16)

Before submitting this bid, the Bidder is advised and cautioned to inspect the sale area, review the requirements of the sale contract, and take other steps as may be reasonably necessary to ascertain the location, estimated volumes, construction estimates, and operating costs of the proposed sale. Failure to do so will not relieve the Bidder from responsibility for completing the contract.

The Bidder warrants that this bid is submitted solely on the basis of the Bidder's examination and inspection of the quality and quantity of the timber offered for sale and the Bidder's opinion of the value thereof and the costs of recovery. No reliance should be placed on the State of Michigan's estimates of timber quality, quantity or costs of recovery. Bidder further acknowledges that the State of Michigan: (i) expressly disclaims any warranty of fitness of timber for any purpose; (ii) offers this timber as is without any warranty of quality (merchantability) or quantity and (iii) expressly disclaims any warranty as to the quantity or quality of timber sold.

11. Certification and Chain-of-Custody (10/14)

Unless otherwise indicated in the contract under section 7 – Other Conditions of the Sale Specific Conditions & Requirements, the area encompassed by this timber sale is certified to the standards of the Forest Stewardship Council (FSC) - Certificate #SCS-FM/COC-00090N and the Sustainable Forestry Initiative (SFI) - Certificate #NSF-SFIS-5Y031-SF5. Forest products from this sale may be delivered to the mill as "FSC 100% and / or SFI certified" as long as the contractor hauling the forest products is chain-of-custody (COC) certified or covered under a COC certificate from the destination mill. The purchaser is responsible for maintaining COC after leaving the sale area.

12. Good Neighbor Authority (GNA) Requirements (7/16)

If the name of this timber sales contains the acronym GNA, it is authorized by the Good Neighbor Authority (GNA) and covered by various agreements between the U.S. Forest Service and the State. The timber sale occurs on federal land and the following conditions apply:

GNA contracts on US Forest Service land will not be awarded to purchasers on the Federal list of excluded parties. The System for Award Management (SAM) will be checked for active excluded parties prior to award of contract. In addition, the Bidder to whom award is made must complete an Assurance Regarding Felony Conviction or Tax Delinquent Status for Corporate Applicants (AD-3031).

13. Good Neighbor Authority (GNA) Requirements, con't (9/16)

Bidder certifies, by signing this bid form, that to the best of Bidder's knowledge that the following representations are accurate and complete.

- a. That the Bidder and its principals are not presently debarred, suspended, proposed for debarment, declared ineligible, or voluntary excluded from timber sales (covered transactions) by any Federal department or agency.
- b. That the Bidder and its principals have not within a 3-year period preceding this bid been convicted of or had a civil judgment rendered against them for commission of fraud or a criminal offense in connection with obtaining, attempting to obtain, or performing a public (Federal, State, or local) transaction or contract under a public transaction; violation of Federal or State antitrust statutes or commission of embezzlement, theft, forgery, bribery, falsification or destruction of records, making false statements, or receiving stolen property.
- c. That the Bidder and its principals are not presently indicted for or otherwise criminally or civilly charged by a governmental entity (Federal, State, or local) with commission of any of the offenses enumerated in paragraph b of this certification.
- d. That the Bidder and its principals have not within a 3-year period preceding this bid had one or more public transactions (Federal, State, or local) terminated for breach or default of a timber or forest product contract.

Bidders that cannot certify this requirement, in whole or in part, shall submit an explanation with their bid.

KEITH CREAGH
Director

TIMBER SALE INFORMATION

Crossfire Aspen (61-016-18)

T27N, R13W, SEC. 29.

Benzie County (Advertised Price \$30,293.50)

SALE NOTE: A recreation site such as a trail, pathway, or campground is within the sale area or the vicinity. Certain restrictions/specifications may be applicable including time restrictions.

A timber sale contract for this lump sum, sealed bid timber sale will be awarded to the responsible bidder offering the highest sealed bid price. Bids must be at or above the following advertised price for each species:

<u>PRODUCTS & SPECIES</u>	<u>ESTIMATED UNITS*</u>	<u>ADVERTISED PRICE</u>
Sawtimber		
B. T. Aspen	41.30 MBF	\$ 109.00 / MBF
Basswood	11.70 MBF	\$ 114.00 / MBF
Black Cherry	0.90 MBF	\$ 154.00 / MBF
Red Maple	20.20 MBF	\$ 114.00 / MBF
Red Oak	7.40 MBF	\$ 234.00 / MBF
Sugar Maple	19.20 MBF	\$ 272.00 / MBF
White Pine	1.20 MBF	\$ 59.00 / MBF
Pulpwood		
Basswood	34.00 Cords	\$ 24.55 / Cord
Mixed Aspen	334.00 Cords	\$ 20.55 / Cord
Mixed Hardwood	335.00 Cords	\$ 18.90 / Cord
Red Oak	28.00 Cords	\$ 18.30 / Cord
White Pine	31.00 Cords	\$ 14.50 / Cord

* The total volume is statistically estimated within plus (+) or minus (-) 15.76 percent. The estimated units are final and not subject to adjustment. Prospective bidders are urged to examine this timber and to make their own estimates of quantity and quality.

BOND AND PAYMENT SCHEDULE:

1. A bond in the amount of \$1,515.00 to insure faithful performance of the conditions of the contract will be deposited by the successful bidder within 21 days of the sale award.
2. Cutting in any sale or unit without the required advance payment would be considered a trespass.
3. Total payment must be paid in advance or according to the following schedule:
 - (a) Ten percent (10%) of the sale value must be paid within 21 days of the sale award.
 - (b) The 10% down payment will be credited towards the first unit cut.
 - (c) Payment for each of the following units must be made before cutting begins in that unit:

<u>PAYMENT UNIT NUMBER</u>	<u>PERCENT OF TOTAL SALE VALUE</u>
01	30.0%
02	29.8%
03	40.2%
4. If no cutting takes place, the 10% down payment will not be refunded.
5. Operations on the contract issued will terminate on 12/31/2020.

Description of Timber by Payment Unit (PU)

PU	MARKET GROUP	PRODUCT	QUANTITY	UNIT	ACRES	ADVERTISE PRICE	
1	B. T. Aspen	Sawtimber	10.7	MBF	11.7	\$9,094.15	
	<i>B. T. Aspen</i>		10.7	<i>MBF</i>			
	Basswood		5.9	MBF			
	Red Maple		3.1	MBF			
	Red Oak		3.7	MBF			
	Sugar Maple		8.0	MBF			
	White Pine		0.6	MBF			
	Basswood		Pulpwood	17.0			Cords
	Mixed Aspen			80.0			Cords
	<i>B. T. Aspen</i>			80.0			<i>Cords</i>
	Mixed Hardwood			69.0			Cords
	<i>Ironwood</i>			1.0			<i>Cords</i>
	<i>Red Maple</i>			23.0			<i>Cords</i>
	<i>Sugar Maple</i>			45.0			<i>Cords</i>
	Red Oak			14.0			Cords
White Pine	14.0	Cords					
2	B. T. Aspen	Sawtimber	10.7	MBF	11.6	\$9,019.05	
	<i>B. T. Aspen</i>		10.7	<i>MBF</i>			
	Basswood		5.8	MBF			
	Red Maple		3.0	MBF			
	Red Oak		3.7	MBF			
	Sugar Maple		8.0	MBF			
	White Pine		0.6	MBF			
	Basswood		Pulpwood	17.0			Cords
	Mixed Aspen			80.0			Cords
	<i>B. T. Aspen</i>			80.0			<i>Cords</i>
	Mixed Hardwood			67.0			Cords
	<i>Red Maple</i>			22.0			<i>Cords</i>
	<i>Sugar Maple</i>			45.0			<i>Cords</i>
	Red Oak			14.0			Cords
	White Pine			13.0			Cords
3	B. T. Aspen	Sawtimber		19.9	MBF	18.3	\$12,180.30
	<i>B. T. Aspen</i>		19.1	<i>MBF</i>			
	<i>Quaking Aspen</i>		0.8	<i>MBF</i>			
	Black Cherry		0.9	MBF			
	Red Maple		14.1	MBF			
	Sugar Maple		3.2	MBF			
	Mixed Aspen		Pulpwood	174.0	Cords		
	<i>B. T. Aspen</i>			164.0	<i>Cords</i>		
	<i>Quaking Aspen</i>			10.0	<i>Cords</i>		
	Mixed Hardwood			199.0	Cords		
	<i>Black Cherry</i>			11.0	<i>Cords</i>		
	<i>Ironwood</i>			3.0	<i>Cords</i>		
	<i>Red Maple</i>			157.0	<i>Cords</i>		
	<i>Sugar Maple</i>			28.0	<i>Cords</i>		
	White Pine			4.0	Cords		
TOTAL:			101.9	MBF			
TOTAL:			762.0	Cords			

Sale Specific Conditions & Requirements

Sale Name: Crossfire Aspen

Sale Number: 61-016-18 Seq#: 1

1 - Sale Area

1.2 - Boundaries

1.2.1 - Painted boundaries (1/14)

The sale boundaries are marked and identified by red paint. Retention areas within Payment Units 1 and 2 are marked with double red paint marks. The painted boundary line trees are not Included Timber and are to be protected unless marked with orange paint.

2 - Timber Specifications

2.1 - Included Timber

2.1.1 - Clearcut unit(s) with unmerchantable trees (6/14)

Within Payment Unit(s) 1, 2, and 3, cut all trees that are two (2) inches or more at DBH, except for the following:

- Within Payment Units 1 and 2, do not cut any elm, hemlock, or any trees marked with green paint.
- Within Payment Unit 3, do not cut any white pine greater than 18 inches at DBH, any oak, or any trees marked with green paint.

4 - Transportation

4.1 - Construction

4.1.3 - Slash and earthen piles (8/04)

Piles or windrows of earth along roads and landings that have been widened or constructed shall be leveled. Slash from road maintenance or construction, including stumps, shall be chipped, utilized or dispersed throughout the sale.

4.1.7 - Road closure (10/11)

All new roads built into the sale must be blocked to vehicle traffic upon completion of the sale. In general, this will require constructing a four (4') foot high berm of stumps and logs covered with earth. Contact the sale administrator for specific details of design and placement.

5 - Operations

5.2 - Conduct of Operations

5.2.1 - Slash

5.2.1.8 - Slash height (12/08)

No slash or tree tops may exceed 24 inches in height.

5.2.3 - Operating Restrictions

5.2.3.1 - Operating restrictions (9/11)

Within Payment Unit(s) 1 and 2, cutting, skidding, and hauling are limited to the period of October 15 to April 15. This restriction is to encourage more vigorous resprouting of aspen to outcompete autumn olive.

5.2.3.4 - Oak wilt restriction, no exceptions (1/18)

Within Payment Unit(s) 1, 2, and 3, cutting, skidding, hauling within the sale and brushing of access roads to the sale are not permitted during the period of April 15 to July 15. No exceptions will be granted. This is necessary to reduce the spread of oak wilt.

5.2.4 - Dead and Down Creation

5.2.4.1 - Dead and down creation, marked trees (10/13)

All trees marked with an orange "X" must be felled and left on site for wildlife. The felled tree must be cut at ground

level and placed on the ground with the trunk against a nearby 1-4 inch DBH sapling tree retained for this purpose, or cut at 4 feet above ground level and placed against the resulting stump.

5.2.38 - No decking against live trees (2/04)

Cut products may not be decked against unmarked or designated leave trees.

5.4 - Soil Protection

5.4.3 - Erosion control (12/08)

Skid trails or haul roads may require erosion control structures or berms per direction of the Unit Manager or his/her representative.

6 - Safety and Fire Prevention

6.2 - Signing

6.2.1 - Road posting (9/09)

The Purchaser is responsible for posting and maintaining caution signs on Fogg Road and Hulbert Road prior to beginning operations. The road must be posted at appropriate distances from the sale area to warn of logging activity and truck traffic. Signs must be removed when harvest operations are suspended or completed. The Purchaser will provide these signs.

6.2.3 - Recreational trail posting (2/10)

The Purchaser is responsible for posting and maintaining caution signs on the Shore to Shore riding/hiking trail, coincident with Hooker Road, prior to beginning operations. The trail must be posted at appropriate distances from the sale area to warn of logging activity and truck traffic at both ends of the trail. Signs must be removed when harvest operations are suspended or completed. The Purchaser will provide these signs.



TIMBER SALE MAP

This information provided by authority of Part 525, 1994 PA 451, as amended.

Forest Management Unit Traverse City		County Benzie	Mapped By Tim Webb	Date 6/15/2018	Page 1	of 1
Township 27N	Range 13W	Section(s) and Subdivision(s) Sec 28: SWSW; Sec. 29: N1/2NE, SENE, W1/2SE, SESE		Scale 1:15,840		

Cover Type				Density	
A = Aspen	H = Hemlock	N = Marsh	U = Upland Brush	0 = Non Stocked	5 = Pole Timber Medium
B = Paper Birch	J = Jack Pine	O = Oak	UM = Upland Mixed	1 = Seedling Sapling Poor	6 = Pole Timber Well
C = Cedar	L = Lowland Brush	P = Lowland Poplar	V = Bog or Marsh	2 = Seedling Sapling Medium	7 = Saw Timber Poor
D = Treed Bog	LM = Lowland Mixed	Q = Mixed Swamp Conifer	W = White Pine	3 = Seedling Sapling Well	8 = Saw Timber Medium
E = Swamp Hdwoods	M = Mpl, Bch, Brch	R = Red Pine	X = Non Stocked	4 = Pole Timber Poor	9 = Saw Timber Well
F = Spruce Fir	MC = Mixed Conifer	S = Black Spruce	Z = Water		
G = Grass	MD = Mixed Deciduous	T = Tamarack			

PU	Acres
1	11.7
2	11.6
3	18.3

Crossfire Aspen

Compartment 10

41.6 acres

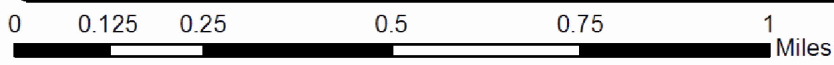
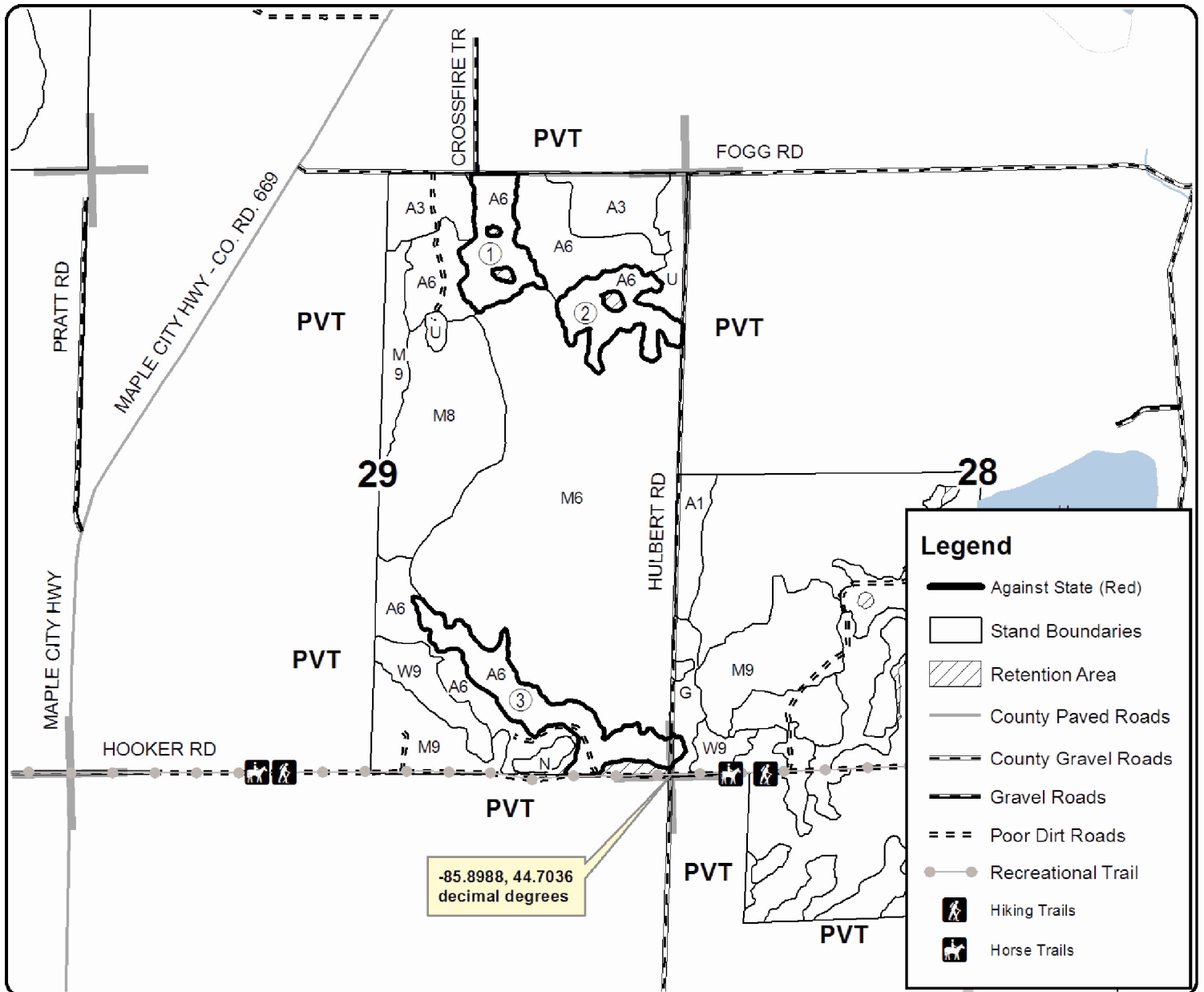

TIMBER SALE INFORMATION

April Snow Aspen (61-026-18)
 T27N, R13W, SEC. 30.
 Benzie County (Advertised Price \$42,995.85)

SALE NOTE: A recreation site such as a trail, pathway, or campground is within the sale area or the vicinity. Certain restrictions/specifications may be applicable including time restrictions.

A timber sale contract for this lump sum, sealed bid timber sale will be awarded to the responsible bidder offering the highest sealed bid price. Bids must be at or above the following advertised price for each species:

<u>PRODUCTS & SPECIES</u>	<u>ESTIMATED UNITS*</u>	<u>ADVERTISED PRICE</u>
Sawtimber		
Black Cherry	14.10 MBF	\$ 154.00 / MBF
Mixed Aspen	58.20 MBF	\$ 109.00 / MBF
Red Maple	25.50 MBF	\$ 114.00 / MBF
Sugar Maple	27.00 MBF	\$ 272.00 / MBF
Pulpwood		
Mixed Aspen	546.00 Cords	\$ 20.55 / Cord
Mixed Hardwood	682.00 Cords	\$ 18.90 / Cord
Red Pine	3.00 Cords	\$ 39.85 / Cord

* The total volume is statistically estimated within plus (+) or minus (-) 15.07 percent. The estimated units are final and not subject to adjustment. Prospective bidders are urged to examine this timber and to make their own estimates of quantity and quality.

BOND AND PAYMENT SCHEDULE:

1. A bond in the amount of \$2,150.00 to insure faithful performance of the conditions of the contract will be deposited by the successful bidder within 21 days of the sale award.
2. Cutting in any sale or unit without the required advance payment would be considered a trespass.
3. Total payment must be paid in advance or according to the following schedule:
 - (a) Ten percent (10%) of the sale value must be paid within 21 days of the sale award.
 - (b) The 10% down payment will be credited towards the first unit cut.
 - (c) Payment for each of the following units must be made before cutting begins in that unit:

<u>PAYMENT UNIT NUMBER</u>	<u>PERCENT OF TOTAL SALE VALUE</u>
01	8.2%
02	16.1%
03	6.7%
04	0.9%
05	0.3%
06	15.0%
07	3.7%
08	28.2%
09	2.0%
10	18.9%

4. If no cutting takes place, the 10% down payment will not be refunded.
5. Operations on the contract issued will terminate on 12/31/2020.

Description of Timber by Payment Unit (PU)

PU	MARKET GROUP	PRODUCT	QUANTITY	UNIT	ACRES	ADVERTISE PRICE					
1	Black Cherry	Sawtimber	1.4	MBF	31.0	\$3,540.60					
	Red Maple		0.5	MBF							
	Sugar Maple		2.9	MBF							
	Mixed Aspen		Pulpwood	2.0			Cords				
	<i>B. T. Aspen</i>			2.0			<i>Cords</i>				
	Mixed Hardwood			129.0			Cords				
	<i>Black Cherry</i>			92.0			<i>Cords</i>				
	<i>Red Maple</i>			10.0			<i>Cords</i>				
	<i>Sugar Maple</i>			27.0			<i>Cords</i>				
	2			Mixed Aspen			Sawtimber	10.9	MBF	10.1	\$6,939.35
<i>B. T. Aspen</i>		8.2		<i>MBF</i>							
<i>Quaking Aspen</i>		2.7		<i>MBF</i>							
Red Maple		2.4		MBF							
Sugar Maple		7.4	MBF								
Mixed Aspen		Pulpwood	61.0	Cords							
<i>B. T. Aspen</i>			32.0	<i>Cords</i>							
<i>Quaking Aspen</i>			29.0	<i>Cords</i>							
Mixed Hardwood			117.0	Cords							
<i>Black Cherry</i>			6.0	<i>Cords</i>							
<i>Red Maple</i>			41.0	<i>Cords</i>							
<i>Sugar Maple</i>			70.0	<i>Cords</i>							
3			Mixed Aspen	Sawtimber	3.2	MBF		5.3	\$2,862.25		
			<i>B. T. Aspen</i>		3.2	<i>MBF</i>					
	Red Maple		2.6		MBF						
	Sugar Maple	3.7	MBF								
	Mixed Aspen	Pulpwood	35.0		Cords						
	<i>B. T. Aspen</i>		26.0		<i>Cords</i>						
	<i>Quaking Aspen</i>		9.0		<i>Cords</i>						
	Mixed Hardwood		26.0		Cords						
	<i>Beech</i>		1.0		<i>Cords</i>						
	<i>Red Maple</i>		9.0		<i>Cords</i>						
	<i>Sugar Maple</i>		16.0		<i>Cords</i>						
4	Black Cherry		Sawtimber	0.2	MBF	2.5	\$392.55				
	Sugar Maple			0.2	MBF						
	Mixed Aspen			Pulpwood	3.0			Cords			
	<i>Quaking Aspen</i>	3.0			<i>Cords</i>						
	Mixed Hardwood	13.0			Cords						
	<i>Black Cherry</i>	5.0			<i>Cords</i>						
	<i>Red Maple</i>	2.0			<i>Cords</i>						
	<i>Sugar Maple</i>	6.0			<i>Cords</i>						
	5	Mixed Aspen			Pulpwood			3.0	Cords	2.5	\$137.25
<i>Quaking Aspen</i>		3.0	<i>Cords</i>								
Mixed Hardwood		4.0	Cords								
<i>Black Cherry</i>		4.0	<i>Cords</i>								
6	Black Cherry	Sawtimber	2.2	MBF	8.4	\$6,428.95					
	Mixed Aspen		7.7	MBF							
	<i>B. T. Aspen</i>		6.4	<i>MBF</i>							
	<i>Quaking Aspen</i>		1.3	<i>MBF</i>							
	Red Maple		4.9	MBF							
	Sugar Maple		6.8	MBF							
	Mixed Aspen		Pulpwood	39.0			Cords				
	<i>B. T. Aspen</i>			30.0			<i>Cords</i>				
	<i>Quaking Aspen</i>			9.0			<i>Cords</i>				
	Mixed Hardwood			108.0			Cords				
	<i>Black Cherry</i>			15.0			<i>Cords</i>				
	<i>Red Maple</i>			18.0			<i>Cords</i>				

Description of Timber by Payment Unit (PU), con't

PU	MARKET GROUP	PRODUCT	QUANTITY	UNIT	ACRES	ADVERTISE PRICE
6 con't	<i>Sugar Maple</i>	<i>Pulpwood</i>	75.0	<i>Cords</i>		
7	Mixed Aspen	Sawtimber	1.3	MBF	4.5	\$1,569.35
	<i>B. T. Aspen</i>		1.0	<i>MBF</i>		
	<i>Quaking Aspen</i>		0.3	<i>MBF</i>		
	Red Maple		0.8	MBF		
	Sugar Maple		0.8	MBF		
	Mixed Aspen	Pulpwood	10.0	Cords		
	<i>B. T. Aspen</i>		3.0	<i>Cords</i>		
	<i>Quaking Aspen</i>		7.0	<i>Cords</i>		
	Mixed Hardwood		42.0	Cords		
	<i>Black Cherry</i>		3.0	<i>Cords</i>		
	<i>Red Maple</i>		13.0	<i>Cords</i>		
	<i>Sugar Maple</i>		26.0	<i>Cords</i>		
	Red Pine		3.0	Cords		
8	Black Cherry	Sawtimber	5.3	MBF	22.4	\$12,152.80
	Mixed Aspen		27.9	MBF		
	<i>B. T. Aspen</i>		22.3	<i>MBF</i>		
	<i>Quaking Aspen</i>		5.6	<i>MBF</i>		
	Red Maple		12.1	MBF		
	Sugar Maple		2.8	MBF		
	Mixed Aspen	Pulpwood	202.0	Cords		
	<i>B. T. Aspen</i>		104.0	<i>Cords</i>		
	<i>Quaking Aspen</i>		98.0	<i>Cords</i>		
	Mixed Hardwood		106.0	Cords		
	<i>Black Cherry</i>		23.0	<i>Cords</i>		
	<i>Red Maple</i>		78.0	<i>Cords</i>		
	<i>Sugar Maple</i>		5.0	<i>Cords</i>		
9	Red Maple	Sawtimber	0.4	MBF	9.4	\$839.40
	Mixed Hardwood	Pulpwood	42.0	Cords		
	<i>Black Cherry</i>		8.0	<i>Cords</i>		
	<i>Red Maple</i>		22.0	<i>Cords</i>		
	<i>Sugar Maple</i>		12.0	<i>Cords</i>		
10	Black Cherry	Sawtimber	5.0	MBF	19.3	\$8,133.35
	Mixed Aspen		7.2	MBF		
	<i>B. T. Aspen</i>		3.6	<i>MBF</i>		
	<i>Quaking Aspen</i>		3.6	<i>MBF</i>		
	Red Maple		1.8	MBF		
	Sugar Maple		2.4	MBF		
	Mixed Aspen	Pulpwood	191.0	Cords		
	<i>B. T. Aspen</i>		93.0	<i>Cords</i>		
	<i>Quaking Aspen</i>		98.0	<i>Cords</i>		
	Mixed Hardwood		95.0	Cords		
	<i>Black Cherry</i>		43.0	<i>Cords</i>		
	<i>Ironwood</i>		6.0	<i>Cords</i>		
	<i>Red Maple</i>		39.0	<i>Cords</i>		
	<i>Sugar Maple</i>		7.0	<i>Cords</i>		
TOTAL:			124.8	MBF		
TOTAL:			1,231.0	Cords		

Sale Specific Conditions & Requirements

Sale Name: April Snow Aspen

Sale Number: 61-026-18 Seq#: 1

1 - Sale Area

1.2 - Boundaries

1.2.1 - Painted boundaries (1/14)

The sale boundary and Payment Unit boundaries are marked and identified by blue, red and yellow paint. Exterior sale boundary lines against private property are marked with blue paint. Exterior sale boundary lines against state property are marked with red paint. Retention islands are marked with double red paint marks. Interior Payment Unit boundaries are marked with yellow paint. The painted boundary line trees are not Included Timber and are to be protected.

2 - Timber Specifications

2.1 - Included Timber

2.1.1 - Clearcut unit(s) with unmerchantable trees (6/14)

Within Payment Unit(s) 2, 3, 5, 6, 7, 8, and 10, cut all trees that are two (2) inches or more at DBH, except do not cut beech greater than 20 inches at DBH, oak, elm, conifers, or any trees marked with green paint. In addition, within Payment Unit 7, cut all red pine which meet minimum piece specifications in 2.2 Utilization.

2.1.3 - Cut tree marked unit(s) (12/08)

Within Payment Unit(s) 4, all trees are designated for cutting when marked with orange paint above and below stump height, regardless of merchantability.

2.1.4 - Designated timber unit(s) (6/17)

Within Payment Unit(s) 1 and 9, all aspen, beech, maple and cherry trees greater than 5 inches at DBH are designated for cutting, regardless of merchantability, except do not cut trees marked with green paint.

4 - Transportation

4.1 - Construction

4.1.3 - Slash and earthen piles (8/04)

Piles or windrows of earth along roads and landings that have been widened or constructed shall be leveled. Slash from road maintenance or construction, including stumps, shall be chipped, utilized or dispersed throughout the sale.

4.1.7 - Road closure (10/11)

All new roads built into the sale must be blocked to vehicle traffic upon completion of the sale. In general, this will require constructing a four (4') foot high berm of stumps and logs covered with earth. Contact the sale administrator for specific details of design and placement.

5 - Operations

5.2 - Conduct of Operations

5.2.1 - Slash

5.2.1.8 - Slash height (12/08)

No slash or tree tops may exceed 24 inches in height. Note: there is an exception for the required slash piles within Payment Units 1 and 9 (see spec 5.2.4.4).

5.2.4 - Dead and Down Creation

5.2.4.1 - Dead and down creation, marked trees (10/13)

All trees marked with an orange "X" must be felled and left on site for wildlife. The felled tree must be cut at ground level and placed on the ground with the trunk against a nearby 1 to 4 inch DBH sapling tree retained for this purpose, or cut at 4 feet above ground level and placed against the resulting stump.

5.2.4.4 - Dead and down creation, grouse (6/18)

To encourage grouse and other wildlife, in Payment Unit(s) 1 and 9, leave compact piles of slash evenly scattered throughout the units. Slash piles are not to exceed 4 feet in height. Contact the sale administrator for details.

5.2.29 - Shrub protection (9/07)

Do not cut or damage hawthorn or juneberry. These woody-shrub plants are highly beneficial to various wildlife species.

5.2.38 - No decking against live trees (2/04)

Cut products may not be decked against unmarked or designated leave trees.

5.4 - Soil Protection

5.4.3 - Erosion control (12/08)

Skid trails or haul roads may require erosion control structures or berms per direction of the Unit Manager or his/her representative.

5.7 - Protection of Historical Sites

5.7.1 - Historical sites (7/12)

The Purchaser shall not cut live or dead trees or operate equipment within historical sites. Historical sites are marked with orange flagging within Payment Unit 1. The Purchaser shall protect historical sites from damage by the Purchaser's operations. If Purchaser's operations have cut or damaged historical sites through carelessness, the Purchaser shall pay \$300 as fixed, agreed and liquidated damages for each acre or part thereof cut or damaged.

6 - Safety and Fire Prevention

6.2 - Signing

6.2.1 - Road posting (9/09)

The Purchaser is responsible for posting and maintaining caution signs on Rayle Road prior to beginning operations. The road must be posted at appropriate distances from the sale area to warn of logging activity and truck traffic. Signs must be removed when harvest operations are suspended or completed. The Purchaser will provide these signs.

6.2.3 - Recreational trail posting (2/10)

The Purchaser is responsible for posting and maintaining caution signs on the Shore to Shore riding/hiking trail, coincident with Hooker Road, prior to beginning operations. The trail must be posted about 200 feet on each side of the Rayle Road intersection to warn of logging activity and truck traffic at both ends of the trail. Signs must be removed when harvest operations are suspended or completed. The Purchaser will provide these signs.



Sale Number	Year
61-026	18

TIMBER SALE MAP

This information provided by authority of Part 525, 1994 PA 451, as amended.

Forest Management Unit Traverse City	County Benzie	Mapped By Tim Webb	Date 5/18/2018	Page 1	of 1
Township 27N	Range 13W	Section(s) and Subdivision(s) Sec. 30: NW1/4, W1/2NE, NWSW, E1/2SW, NWSE	Scale 1:15,840		

Cover Type

A = Aspen	H = Hemlock	N = Marsh	U = Upland Brush
B = Paper Birch	J = Jack Pine	O = Oak	UM = Upland Mixed
C = Cedar	L = Lowland Brush	P = Lowland Poplar	V = Bog or Marsh
D = Treed Bog	LM = Lowland Mixed	Q = Mixed Swamp Conifer	W = White Pine
E = Swamp Hdwoods	M = Mpl, Bch, Brch	R = Red Pine	X = Non Stocked
F = Spruce Fir	MC = Mixed Conifer	S = Black Spruce	Z = Water
G = Grass	MD = Mixed Deciduous	T = Tamarack	

Density

0 = Non Stocked	5 = Pole Timber Medium
1 = Seedling Sapling Poor	6 = Pole Timber Well
2 = Seedling Sapling Medium	7 = Saw Timber Poor
3 = Seedling Sapling Well	8 = Saw Timber Medium
4 = Pole Timber Poor	9 = Saw Timber Well

PU	Acres	PU	Acres	PU	Acres
1	31.0	5	2.5	9	9.4
2	10.1	6	8.4	10	19.3
3	5.3	7	4.5		
4	2.5	8	22.4		

April Snow Aspen

Compartment 10

115.4 acres

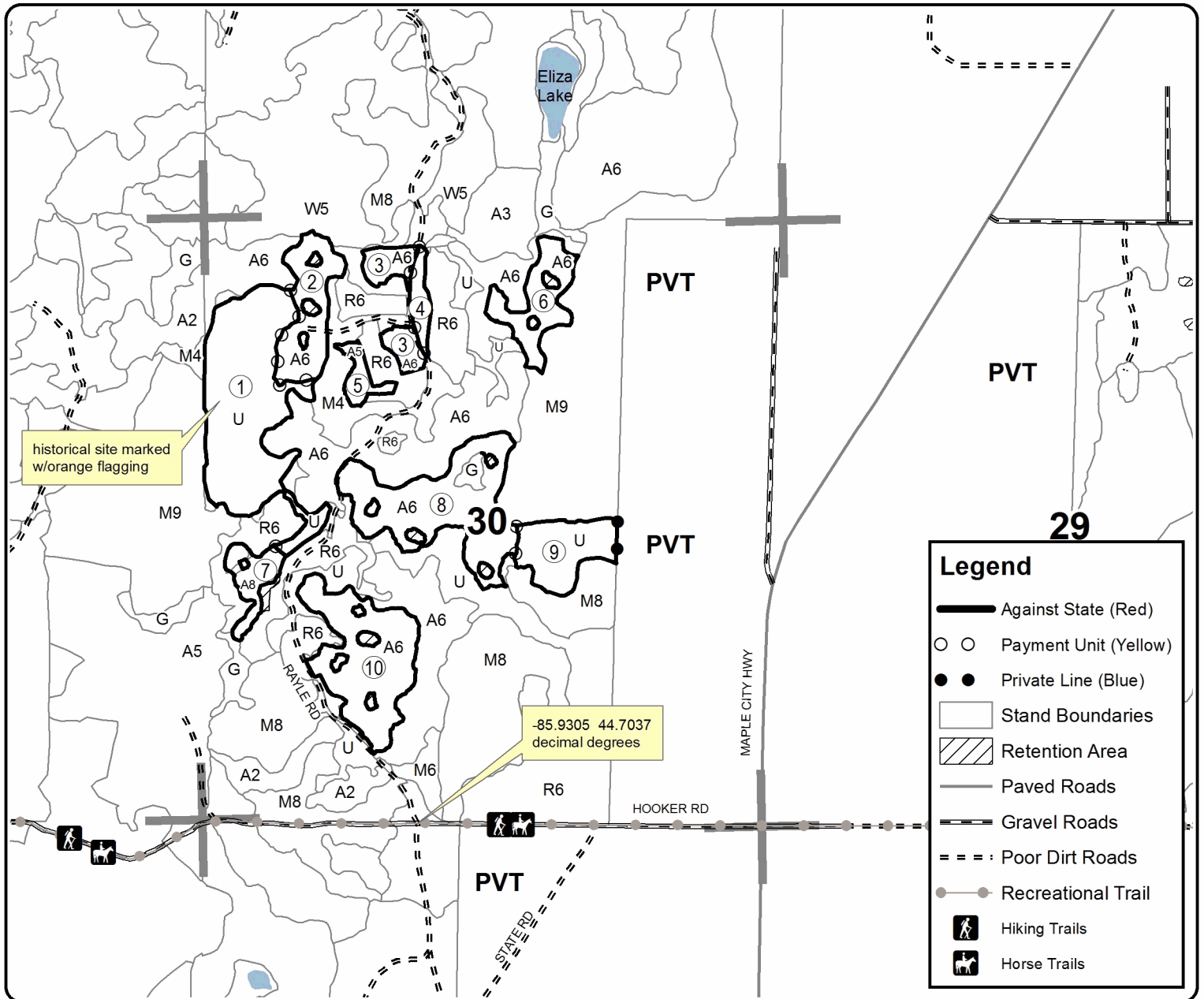

TIMBER SALE INFORMATION

Bear Sign Mix (61-046-18)
 T24N, R14W, SEC. 25; T24N, R14W, SEC. 36.
 Manistee County (Advertised Price \$17,767.40)

SALE NOTE: No operations will be permitted during the period of 3/15 - 7/15 in order to avoid issues with seasonally wet soils. See 5.2.3.1 for details.

A timber sale contract for this lump sum, sealed bid timber sale will be awarded to the responsible bidder offering the highest sealed bid price. Bids must be at or above the following advertised price for each species:

<u>PRODUCTS & SPECIES</u>	<u>ESTIMATED UNITS*</u>	<u>ADVERTISED PRICE</u>
Sawtimber		
B. T. Aspen	17.20 MBF	\$ 109.00 / MBF
Black Cherry	11.80 MBF	\$ 154.00 / MBF
Red Maple	29.20 MBF	\$ 114.00 / MBF
Pulpwood		
B. T. Aspen	236.00 Cords	\$ 20.55 / Cord
Mixed Hardwood	312.00 Cords	\$ 18.90 / Cord

* The total volume is statistically estimated within plus (+) or minus (-) 14.34 percent. The estimated units are final and not subject to adjustment. Prospective bidders are urged to examine this timber and to make their own estimates of quantity and quality.

BOND AND PAYMENT SCHEDULE:

- A bond in the amount of \$888.00 to insure faithful performance of the conditions of the contract will be deposited by the successful bidder within 21 days of the sale award.
- Cutting in any sale or unit without the required advance payment would be considered a trespass.
- Total payment must be paid in advance or according to the following schedule:
 - Ten percent (10%) of the sale value must be paid within 21 days of the sale award.
 - The remainder is due before cutting begins.
 - Payment for each of the following units must be made before cutting begins in that unit:

PAYMENT UNIT NUMBER	PERCENT OF TOTAL SALE VALUE
01	100.0%
- If no cutting takes place, the 10% down payment will not be refunded.
- Operations on the contract issued will terminate on 12/31/2020.

Description of Timber by Payment Unit (PU)

PU	MARKET GROUP	PRODUCT	QUANTITY	UNIT	ACRES	ADVERTISE PRICE
1	B. T. Aspen	Sawtimber	17.2	MBF	24.5	\$17,767.40
	Black Cherry		11.8	MBF		
	Red Maple		29.2	MBF		
	B. T. Aspen	Pulpwood	236.0	Cords		
	Mixed Hardwood		312.0	Cords		
	<i>Beech</i>		1.0	<i>Cords</i>		
	<i>Black Cherry</i>		121.0	<i>Cords</i>		
	<i>Red Maple</i>		190.0	<i>Cords</i>		
TOTAL:			58.2	MBF		
TOTAL:			548.0	Cords		

Sale Specific Conditions & Requirements

Sale Name: Bear Sign Mix

Sale Number: 61-046-18 Seq#: 1

1 - Sale Area

1.2 - Boundaries

1.2.1 - Painted boundaries (1/14)

The sale boundary is marked and identified by red paint. Exterior sale boundary lines against state are marked with red paint. The painted boundary line trees are not Included Timber and are to be protected.

2 - Timber Specifications

2.1 - Included Timber

2.1.1 - Clearcut unit(s) with unmerchantable trees (6/14)

Within Payment Unit(s) 1, cut all trees that are two (2) inches or more at DBH, except do not cut green marked trees, paper birch, or any conifer species.

2.2 - Utilization

2.2.3 - Stump heights (4/07)

Stump heights within the Sale Area shall not exceed 12 inches for trees greater than 10 inches DBH and 4 inches for trees smaller than 10 inches DBH.

3 - Payments

3.4 - Damaged Timber

3.4.1 - Damaged timber (6/14)

General Condition and Requirement 3.4 Damaged Timber, defines liquidated damages for undesignated live merchantable trees which are cut or injured.

No damage is acceptable to merchantable trees. Within the sale area, if more than 5% of trees (> 4.5" DBH) within a specified area of the sale are damaged, liquidated damages will be assessed for all trees damaged. Rates will be in accordance with General Condition and Requirement 3.4 Damaged Timber.

4 - Transportation

4.1 - Construction

4.1.11 - Permits (2/12)

The Purchaser will secure any necessary permits that may be required.

4.1.12 - No new roads (1/12)

No new roads will be permitted in any Payment Unit. All operations are limited to existing roads. Skid trails only will be allowed.

5 - Operations

5.2 - Conduct of Operations

5.2.1 - Slash

5.2.1.8 - Slash height (12/08)

No slash or tree tops may exceed 24 inches in height.

5.2.2 - Hazard Trees/Snags

5.2.2.1 - Den trees (10/16)

Obvious hollow and/or den trees shall be protected and left standing unless they are a safety hazard.

5.2.3 - Operating Restrictions

5.2.3.1 - Operating restrictions (9/11)

Within Payment Unit(s) 1, unless changed by written agreement, cutting, skidding, and hauling are not permitted during the period of March 15 to July 15. Outside of this window, operations must be approved by the sale administrator and/or the Unit Manager to ensure that soils within the sale area are not excessively wet. Ideally, this sale will be harvested in dry summer or frozen winter conditions. This restriction is because the soils within the sale area and surrounding stands are seasonally wet.

5.2.4 - Dead and Down Creation

5.2.4.2 - Dead and down creation, hare and grouse (1/14)

To improve habitat for snowshoe hare, grouse, and other species, the Purchaser is to leave two, 10 inch diameter or larger log size pieces on the ground for every two acres (20-25 pieces total). They should be scattered throughout the sale or positioned per the sale administrators instructions. If possible, the logs should be placed so they overlap. Note these pieces should have a minimum length of six feet. They can be of any tree species and can be an un-merchantable piece of wood.

5.2.29 - Shrub protection (9/07)

Do not cut or damage witch-hazel or junberry. These woody-shrub plants are highly beneficial to various wildlife species.

5.4 - Soil Protection

5.4.1 - Rutting restriction, general (7/16)

Operations are to cease immediately if equipment and weather conditions result in rutting of roads and/or skid trails which is 12 inches or greater in depth and 50 feet in length. The Unit Manager or his/her representative may restrict hauling and/or skidding if ruts exceed the specified depth. With the Unit Manager or his/her representative's approval, the Purchaser may return to the area when the risk of rutting has decreased.



TIMBER SALE MAP

This information provided by authority of Part 525, 1994 PA 451, as amended

Sale Number	Year
61-046-18-01	18

Forest Management Unit Traverse City FMU	County Manistee	Mapped By Patrick Cotant	Date 07/24/2018	Page 1	of 1
Township 24N	Range 14W	Section(s) and Subdivision(s) Sec 25 - SESW Sec 36 - E1/2NE, W1/2NW	Scale 1:15,840		
Cruised By Patrick Cotant					

Cover Type				Density			
A = Aspen	H = Hemlock	N = Marsh	U = Upland Brush	0 = Non Stocked	5 = Pole Timber Medium		
B = Paper Birch	J = Jack Pine	O = Oak	UM = Upland Mixed	1 = Seedling Sapling Poor	6 = Pole Timber Well		
C = Cedar	L = Lowland Brush	P = Lowland Poplar	V = Bog or Marsh	2 = Seedling Sapling Medium	7 = Saw Timber Poor		
D = Treed Bog	LM = Lowland Mixed	Q = Mixed Swamp Conifer	W = White Pine	3 = Seedling Sapling Wall	8 = Saw Timber Medium		
E = Swamp Hoewoods	M = Mpl. Bch, Brch	R = Red Pine	X = Non Stocked	4 = Pole Timber Poor	9 = Saw Timber Wall		
F = Spruce Fir	MC = Mixed Conifer	S = Black Spruce	Z = Water				
G = Grass	MD = Mixed Deciduous	T = Tamarack					

PU	Acres
1	24.5

Bear Sign Mix

Compartment 038
24.5 Acres

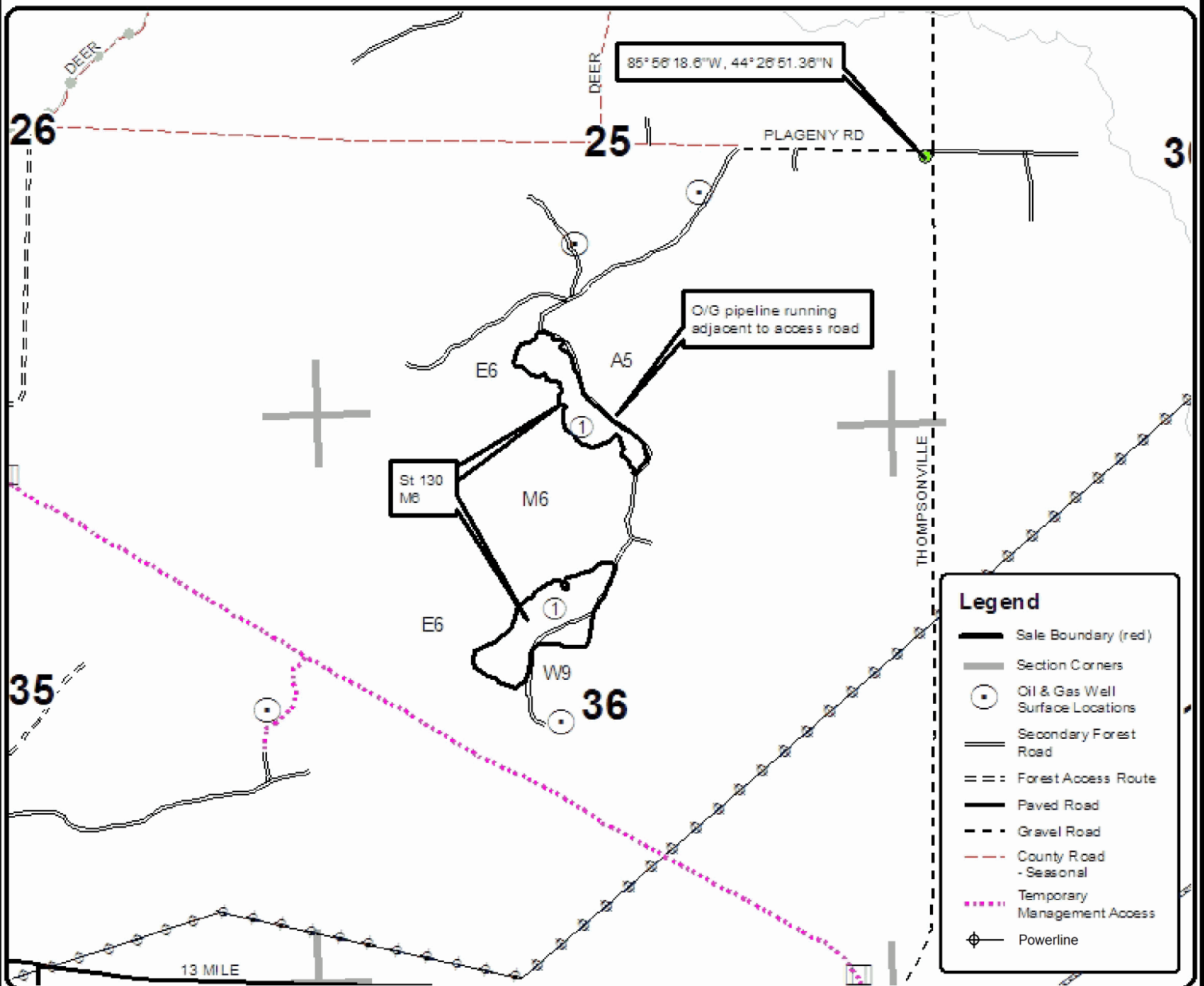
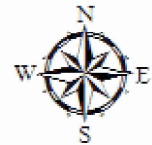

Legend	
	Sale Boundary (red)
	Section Corners
	Oil & Gas Well Surface Locations
	Secondary Forest Road
	Forest Access Route
	Paved Road
	Gravel Road
	County Road - Seasonal
	Temporary Management Access
	Powerline

TIMBER SALE INFORMATION

Curveball Mix (61-048-18)

T24N, R14W, SEC. 34; T24N, R14W, SEC. 35.
Manistee County (Advertised Price \$170,911.50)

A timber sale contract for this lump sum, sealed bid timber sale will be awarded to the responsible bidder offering the highest sealed bid price. Bids must be at or above the following advertised price for each species:

<u>PRODUCTS & SPECIES</u>	<u>ESTIMATED UNITS*</u>		<u>ADVERTISED PRICE</u>
Sawtimber			
B. T. Aspen	93.40	MBF	\$ 109.00 / MBF
Beech	1.60	MBF	\$ 119.00 / MBF
Black Cherry	35.10	MBF	\$ 154.00 / MBF
Red Maple	96.40	MBF	\$ 114.00 / MBF
Red Pine	853.80	MBF	\$ 109.00 / MBF
Sugar Maple	11.80	MBF	\$ 272.00 / MBF
White Pine	60.90	MBF	\$ 59.00 / MBF
Pulpwood			
B. T. Aspen	280.00	Cords	\$ 20.55 / Cord
Mixed Hardwood	768.00	Cords	\$ 18.90 / Cord
Red Pine	394.00	Cords	\$ 39.85 / Cord
White Pine	573.00	Cords	\$ 14.50 / Cord

* The total volume is statistically estimated within plus (+) or minus (-) 7.44 percent. The estimated units are final and not subject to adjustment. Prospective bidders are urged to examine this timber and to make their own estimates of quantity and quality.

BOND AND PAYMENT SCHEDULE:

1. A bond in the amount of \$8,546.00 to insure faithful performance of the conditions of the contract will be deposited by the successful bidder within 21 days of the sale award.
2. Cutting in any sale or unit without the required advance payment would be considered a trespass.
3. Total payment must be paid in advance or according to the following schedule:
 - (a) Ten percent (10%) of the sale value must be paid within 21 days of the sale award.
 - (b) The 10% down payment will be credited towards the first unit cut.
 - (c) Payment for each of the following units must be made before cutting begins in that unit:

PAYMENT UNIT NUMBER	PERCENT OF TOTAL SALE VALUE
01	3.6%
02	16.2%
03	5.8%
04	16.5%
05	30.1%
06	19.4%
07	8.4%

4. If no cutting takes place, the 10% down payment will not be refunded.
5. Operations on the contract issued will terminate on 06/30/2021.

Description of Timber by Payment Unit (PU)

PU	MARKET GROUP	PRODUCT	QUANTITY	UNIT	ACRES	ADVERTISE PRICE
1	B. T. Aspen	Sawtimber	27.3	MBF	5.3	\$6,201.30
	Red Maple		10.4	MBF		
	B. T. Aspen	Pulpwood	68.0	Cords		
	Mixed Hardwood		34.0	Cords		
	<i>Red Maple</i>		<i>34.0</i>	<i>Cords</i>		
2	B. T. Aspen	Sawtimber	11.9	MBF	17.3	\$27,670.25
	Beech		1.6	MBF		
	Black Cherry		11.2	MBF		
	Red Maple		30.6	MBF		
	Sugar Maple		10.8	MBF		
	White Pine		60.9	MBF		
	B. T. Aspen	Pulpwood	27.0	Cords		
	Mixed Hardwood		295.0	Cords		
	<i>Beech</i>		<i>4.0</i>	<i>Cords</i>		
	<i>Black Cherry</i>		<i>77.0</i>	<i>Cords</i>		
	<i>Red Maple</i>		<i>157.0</i>	<i>Cords</i>		
	<i>Sugar Maple</i>		<i>57.0</i>	<i>Cords</i>		
	White Pine		573.0	Cords		
3	Red Pine	Sawtimber	73.8	MBF	4.6	\$9,877.30
	Red Pine	Pulpwood	46.0	Cords		
4	Black Cherry	Sawtimber	1.6	MBF	13.8	\$28,178.40
	Red Maple		3.7	MBF		
	Red Pine		209.6	MBF		
	Mixed Hardwood	Pulpwood	57.0	Cords		
	<i>Black Cherry</i>		<i>16.0</i>	<i>Cords</i>		
	<i>Red Maple</i>		<i>41.0</i>	<i>Cords</i>		
	Red Pine		90.0	Cords		
5	Black Cherry	Sawtimber	8.0	MBF	18.5	\$51,488.45
	Red Maple		33.7	MBF		
	Red Pine		340.5	MBF		
	Sugar Maple		1.0	MBF		
	Mixed Hardwood	Pulpwood	134.0	Cords		
	<i>Black Cherry</i>		<i>39.0</i>	<i>Cords</i>		
	<i>Red Maple</i>		<i>80.0</i>	<i>Cords</i>		
	<i>Sugar Maple</i>		<i>15.0</i>	<i>Cords</i>		
Red Pine		163.0	Cords			
6	Black Cherry	Sawtimber	7.0	MBF	14.5	\$33,078.85
	Red Maple		12.1	MBF		
	Red Pine		229.9	MBF		
	Mixed Hardwood	Pulpwood	94.0	Cords		
	<i>Black Cherry</i>		<i>54.0</i>	<i>Cords</i>		
	<i>Red Maple</i>		<i>40.0</i>	<i>Cords</i>		
	Red Pine		95.0	Cords		
7	B. T. Aspen	Sawtimber	54.2	MBF	19.1	\$14,416.95
	Black Cherry		7.3	MBF		
	Red Maple		5.9	MBF		
	B. T. Aspen	Pulpwood	185.0	Cords		
	Mixed Hardwood		154.0	Cords		
	<i>Black Cherry</i>		<i>56.0</i>	<i>Cords</i>		
	<i>Red Maple</i>		<i>98.0</i>	<i>Cords</i>		
TOTAL:			1,153.0	MBF		
TOTAL:			2,015.0	Cords		

Sale Specific Conditions & Requirements

Sale Name: Curveball Mix

Sale Number: 61-048-18 Seq#: 1

1 - Sale Area

1.2 - Boundaries

1.2.1 - Painted boundaries (1/14)

The sale boundary and Payment Unit boundaries are marked and identified by red and yellow paint. Exterior sale boundary lines against state are marked with red paint. Interior Payment Unit boundaries are marked with yellow paint. The painted boundary line trees are not Included Timber and are to be protected. Yellow painted trees designating an interior Payment Unit boundary are only to be cut when all surrounding Payment Units have been paid.

2 - Timber Specifications

2.1 - Included Timber

2.1.1 - Clearcut unit(s) with unmerchantable trees (6/14)

Within Payment Unit(s) 4, 5 & 6, cut all trees that are two (2) inches or more at DBH.

2.1.2 - Clearcut unit(s) w/o unmerchantable trees (8/11)

Within Payment Unit(s) 1 & 7, cut all trees which meet minimum piece specifications in 2.2 Utilization, except do not cut white pine, red oak and sugar maple within Payment Unit 1. In addition, do not cut any green marked trees, conifer species or paper birch within Payment Unit 7.

2.1.7 - Leave tree marked unit(s) (6/14)

Within Payment Unit(s) 2 & 3, all trees which meet minimum piece specifications in 2.2 - Utilization are designated for cutting, except do not cut trees marked with green paint above and below stump height. In addition, within Payment Unit 3, do not cut any hardwood species.

2.2 - Utilization

2.2.2 - Chipping required (2/18)

Payment Unit's 4, 5, & 6 must be chip harvested to facilitate subsequent planting operations. The Purchaser has the option to produce sawlogs or pulpwood bolts, but the remaining portion of the trees must be chipped and hauled. The requirement to retain approximately 1/6 to 1/3 of tree tops and limbs less than four inches in diameter does not apply (G. C. & R. 2.2). This is to create a clean site in order to efficiently facilitate planting operations.

2.2.3 - Stump heights (4/07)

Stump heights within Payment Units 4, 5 & 6 shall not exceed 6 inches for all trees. This is in order to facilitate planting operations. Stump heights within Payment Units 1, 2, 3 & 7 shall not exceed 12 inches for trees greater than 14 inches at DBH and 6 inches for all other trees.

3 - Payments

3.4 - Damaged Timber

3.4.1 - Damaged timber (6/14)

General Condition and Requirement 3.4 Damaged Timber, defines liquidated damages for undesignated live merchantable trees which are cut or injured.

No damage is acceptable to merchantable trees. Within the sale area, if more than 5% of trees (> 4.5" DBH) within a specified area of the sale are damaged, liquidated damages will be assessed for all trees damaged. Rates will be in accordance with General Condition and Requirement 3.4 Damaged Timber.

4 - Transportation

4.1 - Construction

4.1.11 - Permits (2/12)

The Purchaser will secure any necessary permits that may be required.

4.1.12 - No new roads (1/12)

No new roads will be permitted in any Payment Unit. All operations are limited to existing roads. Skid trails only will be allowed.

5 - Operations

5.2 - Conduct of Operations

5.2.1 - Slash

5.2.1.8 - Slash height (12/08)

No slash or tree tops may exceed 24 inches in height.

5.2.2 - Hazard Trees/Snags

5.2.2.1 - Den trees (10/16)

Obvious hollow and/or den trees shall be protected and left standing unless they are a safety hazard.

5.2.4 - Dead and Down Creation

5.2.4.2 - Dead and down creation, hare and grouse (1/14)

To improve habitat for snowshoe hare, grouse, and other species, the Purchaser is to leave two, 10 inch diameter or larger log size pieces, on the ground for every two acres within Payment Units 1, 2, & 7. They should be scattered throughout these units or positioned per the sale administrators instructions. If possible, the logs or trees should be felled so they overlap. Note these pieces should have a minimum length of eight feet. They can be of any tree species and can be an un-merchantable piece of wood or a full tree.

5.2.29 - Shrub protection (9/07)

Do not cut or damage hawthorn, witch-hazel or juneberry. These woody-shrub plants are highly beneficial to various wildlife species.

5.3 - Stream Protection

5.3.1 - Operating near stream (7/04)

No tracked or wheeled vehicles shall be operated within 50 feet of the E-type/lowland and intermittent creek identified on the Timber Sale Map running east to west along southern sale boundary. No crossings will be approved.

5.4 - Soil Protection

5.4.1 - Rutting restriction, general (7/16)

Operations are to cease immediately if equipment and weather conditions result in rutting of roads and/or skid trails which is 12 inches or greater in depth and 50 feet in length. The Unit Manager or his/her representative may restrict hauling and/or skidding if ruts exceed the specified depth. With the Unit Manager or his/her representative's approval, the Purchaser may return to the area when the risk of rutting has decreased.

6 - Safety and Fire Prevention

6.2 - Signing

6.2.1 - Road posting (9/09)

The Purchaser is responsible for posting and maintaining caution signs on Plageny Rd prior to beginning operations. The road must be posted at appropriate distances from the sale area to warn of logging activity and truck traffic. Signs must be removed when harvest operations are suspended or completed. The Purchaser will provide these signs.



TIMBER SALE MAP

This information provided by authority of Part 525, 1994 PA 451, as amended.

Sale Number	Year
61-048-18-01	2018

Forest Management Unit Traverse City FMU	County Manistee	Mapped By Patrick Cotant	Date 09/07/2018	Page 1	of 1
Township 24N	Range 14W	Section(s) and Subdivision(s) Sec 34 - N1/2NE Sec 35 - NW1/4, NWNE	Scale 1:15,840		

Cover Type

A = Aspen	H = Hemlock	N = Marsh	U = Upland Brush
B = Paper Birch	J = Jack Pine	O = Oak	UM = Upland Mixed
C = Cedar	L = Lowland Brush	P = Lowland Poplar	V = Bog or Marsh
D = Treed Bog	LM = Lowland Mixed	Q = Mixed Swamp Conifer	W = White Pine
E = Swamp Hdwoods	M = Mpl. Bch, Broch	R = Red Pine	X = Non Stocked
F = Spruce Fir	MC = Mixed Conifer	S = Black Spruce	Z = Water
G = Grass	MD = Mixed Deciduous	T = Tamarack	

Density

0 = Non Stocked	5 = Pole Timber Medium
1 = Seedling Sapling Poor	6 = Pole Timber Well
2 = Seedling Sapling Medium	7 = Saw Timber Poor
3 = Seedling Sapling Well	8 = Saw Timber Medium
4 = Pole Timber Poor	9 = Saw Timber Well

PU Acres

1	5.3	St159
2	17.3	St34
3	4.6	St56
4	13.8	St56
5	18.5	St56
6	14.5	St56
7	19.1	St63

Curveball Mix

Compartment 038

93.1 Acres

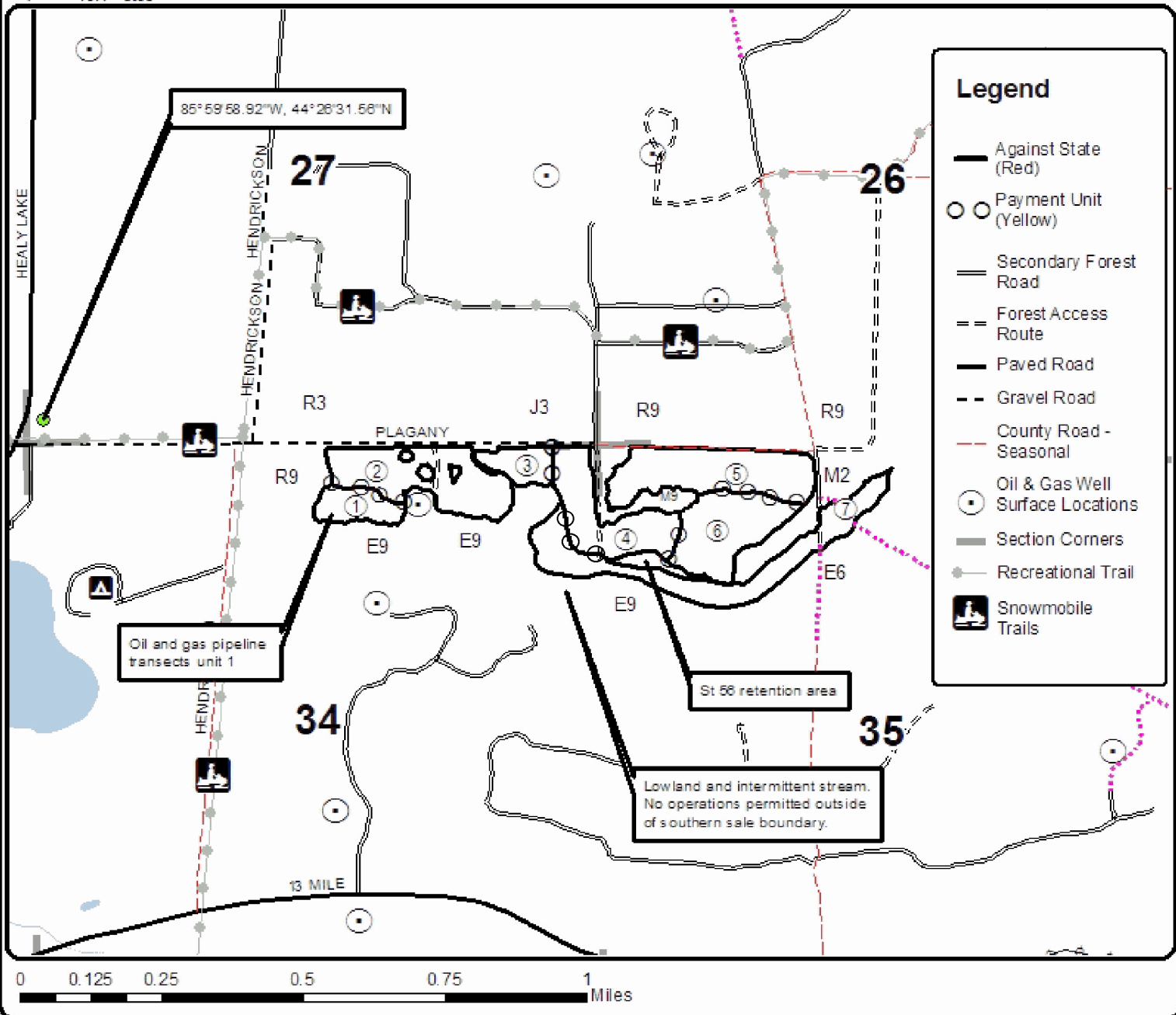
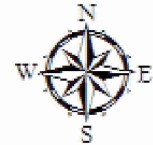

TIMBER SALE INFORMATION

Wheelhouse Pine (61-054-18)
 T24N, R14W, SEC. 34; T24N, R14W, SEC. 35.
 Manistee County (Advertised Price \$171,821.15)

A timber sale contract for this lump sum, sealed bid timber sale will be awarded to the responsible bidder offering the highest sealed bid price. Bids must be at or above the following advertised price for each species:

<u>PRODUCTS & SPECIES</u>	<u>ESTIMATED UNITS*</u>		<u>ADVERTISED PRICE</u>
Sawtimber			
Black Cherry	21.60	MBF	\$ 154.00 / MBF
Red Maple	19.80	MBF	\$ 114.00 / MBF
Red Pine	1,133.80	MBF	\$ 109.00 / MBF
White Pine	54.00	MBF	\$ 59.00 / MBF
Pulpwood			
Mixed Hardwood	650.00	Cords	\$ 18.90 / Cord
Red Pine	351.00	Cords	\$ 39.85 / Cord
White Pine	910.00	Cords	\$ 14.50 / Cord

* The total volume is statistically estimated within plus (+) or minus (-) 6.19 percent. The estimated units are final and not subject to adjustment. Prospective bidders are urged to examine this timber and to make their own estimates of quantity and quality.

BOND AND PAYMENT SCHEDULE:

1. A bond in the amount of \$8,591.00 to insure faithful performance of the conditions of the contract will be deposited by the successful bidder within 21 days of the sale award.
2. Cutting in any sale or unit without the required advance payment would be considered a trespass.
3. Total payment must be paid in advance or according to the following schedule:
 - (a) Ten percent (10%) of the sale value must be paid within 21 days of the sale award.
 - (b) The 10% down payment will be credited towards the first unit cut.
 - (c) Payment for each of the following units must be made before cutting begins in that unit:

PAYMENT UNIT NUMBER	PERCENT OF TOTAL SALE VALUE
01	39.0%
02	47.5%
03	13.5%

4. If no cutting takes place, the 10% down payment will not be refunded.
5. Operations on the contract issued will terminate on 12/31/2020.

Description of Timber by Payment Unit (PU)

PU	MARKET GROUP	PRODUCT	QUANTITY	UNIT	ACRES	ADVERTISE PRICE
1	Black Cherry	Sawtimber	7.2	MBF	27.6	\$67,041.60
	Red Maple		6.4	MBF		
	Red Pine		511.3	MBF		
	Mixed Hardwood	Pulpwood	168.0	Cords		
	<i>Black Cherry</i>		80.0	<i>Cords</i>		
	<i>Red Maple</i>		88.0	<i>Cords</i>		
	Red Pine		158.0	Cords		
2	Black Cherry	Sawtimber	8.7	MBF	33.6	\$81,616.75
	Red Maple		7.7	MBF		
	Red Pine		622.5	MBF		
	Mixed Hardwood	Pulpwood	204.0	Cords		
	<i>Black Cherry</i>		97.0	<i>Cords</i>		
	<i>Red Maple</i>		107.0	<i>Cords</i>		
	Red Pine		193.0	Cords		
3	Black Cherry	Sawtimber	5.7	MBF	34.4	\$23,162.80
	Red Maple		5.7	MBF		
	White Pine		54.0	MBF		
	Mixed Hardwood	Pulpwood	278.0	Cords		
	<i>Black Cherry</i>		156.0	<i>Cords</i>		
	<i>Red Maple</i>		122.0	<i>Cords</i>		
	White Pine		910.0	Cords		
TOTAL:			1,229.2	MBF		
TOTAL:			1,911.0	Cords		

Sale Specific Conditions & Requirements

Sale Name: Wheelhouse Pine

Sale Number: 61-054-18 Seq#: 1

1 - Sale Area

1.2 - Boundaries

1.2.1 - Painted boundaries (1/14)

The sale boundary and Payment Unit boundaries are marked and identified by red and yellow paint. Exterior sale boundary lines against state are marked with red paint. Retention areas within the sale are marked with red paint. Interior Payment Unit boundaries are marked with yellow paint. The painted boundary line trees are not Included Timber and are to be protected. Yellow painted trees designating an interior Payment Unit boundary are only to be cut when all surrounding Payment Units have been paid.

2 - Timber Specifications

2.1 - Included Timber

2.1.1 - Clearcut unit(s) with unmerchantable trees (6/14)

Within Payment Unit(s) 1 & 2, cut all trees that are two (2) inches or more at DBH.

2.1.7 - Leave tree marked unit(s) (6/14)

Within Payment Unit(s) 3, all trees which meet minimum piece specifications in 2.2 - Utilization are designated for cutting, except do not cut trees marked with green paint above and below stump height.

2.2 - Utilization

2.2.2 - Chipping required (2/18)

Payment Unit's 1 & 2 must be chip harvested to facilitate subsequent planting operations. The Purchaser has the option to produce sawlogs or pulpwood bolts, but the remaining portion of the trees must be chipped and hauled. The requirement to retain approximately 1/6 to 1/3 of tree tops and limbs less than four inches in diameter still applies (G. C. & R. 2.2).

2.2.3 - Stump heights (4/07)

Stump heights within Payment Unit(s) 1 & 2 shall not exceed 6 inches for all trees. This is in order to facilitate planting operations.

3 - Payments

3.4 - Damaged Timber

3.4.1 - Damaged timber (6/14)

General Condition and Requirement 3.4 Damaged Timber, defines liquidated damages for undesignated live merchantable trees which are cut or injured. In addition, extreme care should be taken to avoid damage to tree seedlings and saplings.

No damage is acceptable to merchantable trees. Within Payment Unit 3, if more than 5% of trees (> 4.5" DBH) within a specified area of the sale are damaged, liquidated damages will be assessed for all trees damaged. Rates will be in accordance with General Condition and Requirement 3.4 Damaged Timber.

4 - Transportation

4.1 - Construction

4.1.11 - Permits (2/12)

The Purchaser will secure any necessary permits that may be required.

4.1.12 - No new roads (1/12)

No new roads will be permitted in any Payment Unit. All operations are limited to existing roads. Skid trails only will be allowed.

5 - Operations

5.2 - Conduct of Operations

5.2.1 - Slash

5.2.1.8 - Slash height (12/08)

No slash or tree tops may exceed 24 inches in height.

5.2.2 - Hazard Trees/Snags

5.2.2.1 - Den trees (10/16)

Obvious hollow and/or den trees shall be protected and left standing unless they are a safety hazard.

5.2.29 - Shrub protection (9/07)

Do not cut or damage hawthorn, witch-hazel, or juneberry within Payment Unit 3. These woody-shrub plants are highly beneficial to various wildlife species.

5.4 - Soil Protection

5.4.1 - Rutting restriction, general (7/16)

Operations are to cease immediately if equipment and weather conditions result in rutting of roads and/or skid trails which is 12 inches or greater in depth and 50 feet in length. The Unit Manager or his/her representative may restrict hauling and/or skidding if ruts exceed the specified depth. With the Unit Manager or his/her representative's approval, the Purchaser may return to the area when the risk of rutting has decreased.

5.8 - Protection of Endangered Species

5.8.5 - Protection of raptor nests (3/13)

All trees with raptor nests will be protected if found during harvesting operations. Notification will be made to the Unit Manager or his/her representative who will notify the Wildlife Biologist so an on-site evaluation and recommendation can be made, if necessary. A stick nest was found within Payment Unit 3, but was determined to be inactive by the Wildlife Biologist. If the nest is found to be active when sale is opened, adjustments will need to be made to sale operations.

6 - Safety and Fire Prevention

6.2 - Signing

6.2.1 - Road posting (9/09)

The Purchaser is responsible for posting and maintaining caution signs on 13 Mile Road prior to beginning operations. The road must be posted at appropriate distances from its intersection with Cedar Road to warn of logging activity and truck traffic. Signs must be removed when harvest operations are suspended or completed. The Purchaser will provide these signs.



TIMBER SALE MAP

This information provided by authority of Part 525, 1994 PA 451, as amended.

Forest Management Unit Traverse City FMU	County Manistee	Mapped By Patrick Cotant	Date 09/10/2018	Page 1	of 1
Township 24N	Range 14W	Section(s) and Subdivision(s) Sec 34-SENE, NESE Sec 35-SWNW, NWSW	Scale 1:15,840		

Cover Type

A = Aspen	H = Hemlock	N = Marsh	U = Upland Brush
B = Paper Birch	J = Jack Pine	O = Oak	UM = Upland Mixed
C = Cedar	L = Lowland Brush	P = Lowland Poplar	V = Bog or Marsh
D = Treed Bog	LM = Lowland Mixed	Q = Mixed Swamp Conifer	W = White Pine
E = Swamp Howwoods	M = Mpl. Bch, Brch	R = Red Pine	X = Non Stocked
F = Spruce Fir	MC = Mixed Conifer	S = Black Spruce	Z = Water
G = Grass	MD = Mixed Deciduous	T = Tamarack	

Density

0 = Non Stocked	5 = Pole Timber Medium
1 = Seedling Sapling Poor	6 = Pole Timber Well
2 = Seedling Sapling Medium	7 = Saw Timber Poor
3 = Seedling Sapling Well	8 = Saw Timber Medium
4 = Pole Timber Poor	9 = Saw Timber Well

PU Acres

1	27.6	St68 R9
2	33.6	St68 R9
3	34.4	St77 W6

Wheelhouse Pine

Compartment 038

95.6 Acres

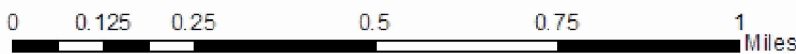
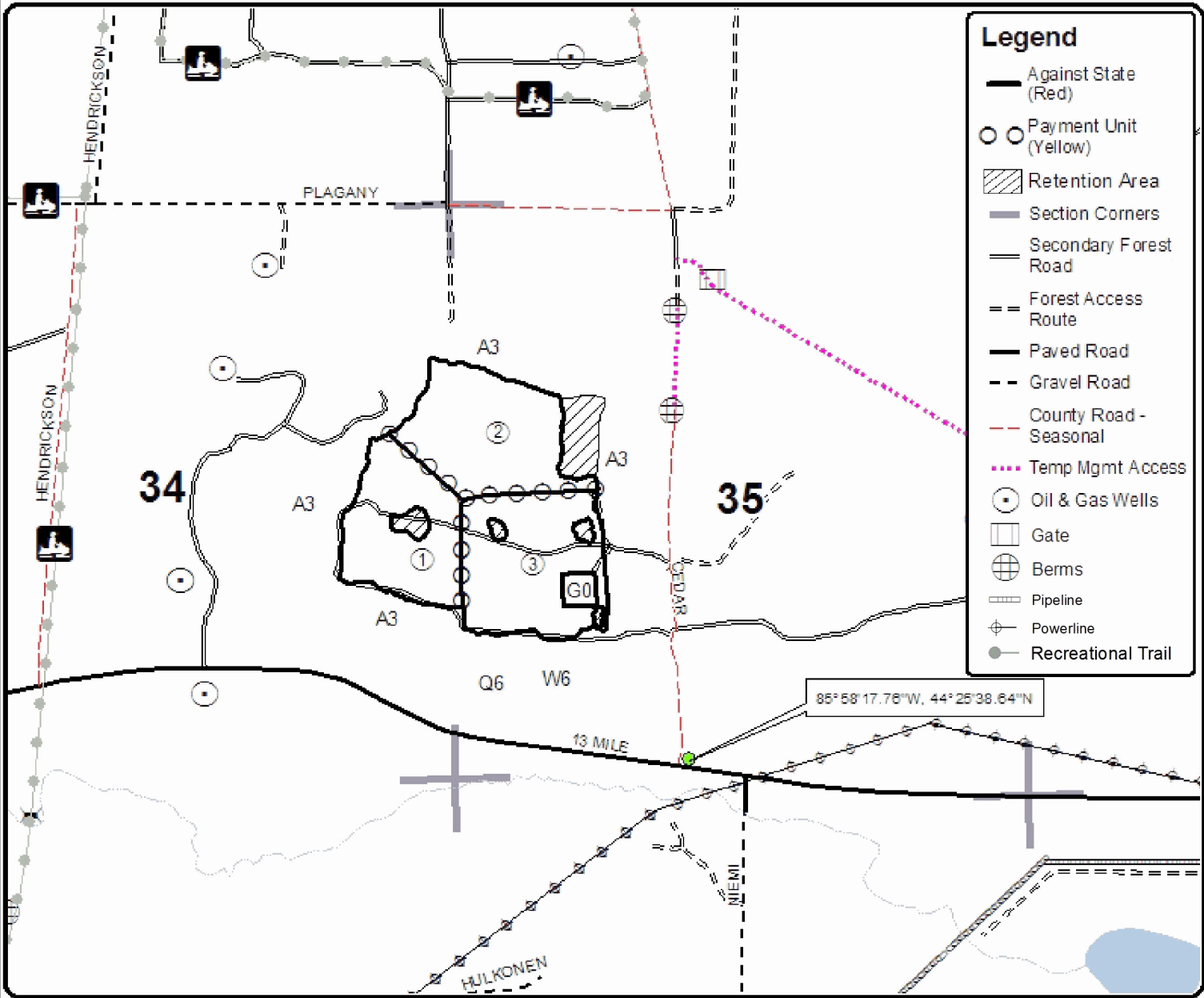
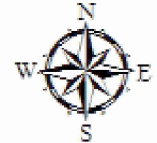

April Snow Aspen (61-026-18)
T27N, R13W, SEC. 30; Benzie COUNTY

In response to the notice of sale to be held 4:00 p.m. (local time) on November 8, 2018, I am hereby submitting my sealed bid (firm offer) for the following forest products to be cut. Bids for individual species must be at or above the advertised price. All non-responsive bid forms may be rejected.

<u>PRODUCTS & SPECIES</u>	<u>ESTIMATED VOLUME*</u>	<u>ADVERTISED PRICE</u>	<u>BID PRICE/UNIT</u>
Sawtimber			
Black Cherry	14.10 MBF	\$ 154.00/MBF	\$ _____
Mixed Aspen	58.20 MBF	\$ 109.00/MBF	\$ _____
Red Maple	25.50 MBF	\$ 114.00/MBF	\$ _____
Sugar Maple	27.00 MBF	\$ 272.00/MBF	\$ _____
Pulpwood			
Mixed Aspen	546.00 Cords	\$ 20.55/Cord	\$ _____
Mixed Hardwood	682.00 Cords	\$ 18.90/Cord	\$ _____
Red Pine	3.00 Cords	\$ 39.85/Cord	\$ _____

*The volumes are statistically estimated within plus (+) or minus (-) 15.07 percent. These estimated volumes are final and not subject to adjustment. Prospective bidders are urged to examine this timber and to make their own estimates of quantity and quality.

I understand that any or all bids may be rejected. All bids must be signed and all bid items must be bid or the bid form may be rejected. I also understand that consideration and awarding a contract will be based upon my past performance and ability to complete the contract based upon equipment and staffing subject to my control.

FEDERAL ID: _____ or SOCIAL SECURITY NUMBER: _____

Company or individual bidding: _____

Company representative's name: _____

Address: _____

City: _____ State: _____ Zip: _____

IF AVAILABLE, PLEASE PLACE THE PERSONALIZED LABEL FROM YOUR PROSPECTUS IN THE ABOVE BOX.

Individual or company representative's signature: _____ Date: _____

Phone number : _____ Email (optional): _____

THE WINNING BIDDER MUST COMPLETE THE VERIFICATION OF WORKER'S DISABILITY COMPENSATION ACT COMPLIANCE (ON REVERSE SIDE IF DOUBLE SIDED) WITHIN 21 DAYS OF SALE AWARD DATE



FOR DEPARTMENT USE ONLY
Sale Number (XX – XXX – XX – XX)
Forest Management Unit:

TIMBER SALE VERIFICATION OF WORKER'S DISABILITY COMPENSATION ACT COMPLIANCE

*As required by Act 317, P.A. 1969 (Worker's Compensation) and
Part 5 of Act 451 of 1994, as amended.*

VERIFICATION OF WORKER'S DISABILITY COMPENSATION ACT COMPLIANCE

- This verification must be completed and submitted within 21 days of contract award and prior to the issuance of the timber sale contract.
- In addition, if boxes 2B or 2C are checked, then Notice of Exclusion or Certificate of Insurance must be submitted within twenty-one (21) days of the contract award and prior to the issuance of the timber sale contract.
- All information must be typed or printed except for written signatures.

Please Check Appropriate Categories:

1. My business is organized as (you **must** check one of the boxes below):
 - A. Sole Proprietorship (individual)
 - B. Partnership
 - C. Corporation

2. You **must** check one of the boxes below:
 - A. I certify my business is a sole proprietorship and it has no employees but the sole proprietor. I am not subject to the Worker's Compensation Laws.
 - B. I certify my business has satisfied its obligation to the Worker's Compensation Act through the use of an approved Notice of Exclusion (BWC-337, Rev. 5/96). I will provide a copy of the Notice of Exclusion within 21 days of the contract award. (For questions or a copy of the BWC-337, please call the Worker's Compensation Bureau at 517-322-1195).
 - C. I certify my business has a Worker's Compensation Policy. I will provide an original Certificate of Insurance within twenty-one (21) days of the contract award.

3. If you have checked item 2(A) or 2(B), you **must** indicate the number of **both** full-time and part-time employees, other than yourself, including family members and active partners (if none, you must enter "0").

_____ Full-time Employees

_____ Part-time Employees

Name of Business		Federal ID (or) Social Security No.	
Address		Telephone ()	
City	State	ZIP	

I hereby certify that the above information is true and correct. I agree to notify the Michigan DNR of any changes that occur in factors affecting my coverage during any of my present and future operations.

Signature of Owner or Authorized Representative

Title

Date

Please complete the "SEALED BID" information on the next page

Crossfire Aspen (61-016-18)
T27N, R13W, SEC. 29; Benzie COUNTY

In response to the notice of sale to be held 4:00 p.m. (local time) on November 8, 2018, I am hereby submitting my sealed bid (firm offer) for the following forest products to be cut. Bids for individual species must be at or above the advertised price. All non-responsive bid forms may be rejected.

<u>PRODUCTS & SPECIES</u>	<u>ESTIMATED VOLUME*</u>	<u>ADVERTISED PRICE</u>	<u>BID PRICE/UNIT</u>
Sawtimber			
B. T. Aspen	41.30 MBF	\$ 109.00/MBF	\$ _____
Basswood	11.70 MBF	\$ 114.00/MBF	\$ _____
Black Cherry	0.90 MBF	\$ 154.00/MBF	\$ _____
Red Maple	20.20 MBF	\$ 114.00/MBF	\$ _____
Red Oak	7.40 MBF	\$ 234.00/MBF	\$ _____
Sugar Maple	19.20 MBF	\$ 272.00/MBF	\$ _____
White Pine	1.20 MBF	\$ 59.00/MBF	\$ _____
Pulpwood			
Basswood	34.00 Cords	\$ 24.55/Cord	\$ _____
Mixed Aspen	334.00 Cords	\$ 20.55/Cord	\$ _____
Mixed Hardwood	335.00 Cords	\$ 18.90/Cord	\$ _____
Red Oak	28.00 Cords	\$ 18.30/Cord	\$ _____
White Pine	31.00 Cords	\$ 14.50/Cord	\$ _____

*The volumes are statistically estimated within plus (+) or minus (-) 15.76 percent. These estimated volumes are final and not subject to adjustment. Prospective bidders are urged to examine this timber and to make their own estimates of quantity and quality.

I understand that any or all bids may be rejected. All bids must be signed and all bid items must be bid or the bid form may be rejected. I also understand that consideration and awarding a contract will be based upon my past performance and ability to complete the contract based upon equipment and staffing subject to my control.

FEDERAL ID: ____ - ____ - ____ or SOCIAL SECURITY NUMBER: ____ - ____ - ____

Company or individual bidding: _____

Company representative's name: _____

Address: _____

City: _____ State: _____ Zip: _____

IF AVAILABLE, PLEASE PLACE THE PERSONALIZED LABEL FROM YOUR PROSPECTUS IN THE ABOVE BOX.

Individual or company representative's signature: _____ Date: _____

Phone number : _____ Email (optional): _____

THE WINNING BIDDER MUST COMPLETE THE VERIFICATION OF WORKER'S DISABILITY COMPENSATION ACT COMPLIANCE (ON REVERSE SIDE IF DOUBLE SIDED) WITHIN 21 DAYS OF SALE AWARD DATE



FOR DEPARTMENT USE ONLY	
Sale Number (XX - XXX - XX - XX)	
Forest Management Unit:	

TIMBER SALE VERIFICATION OF WORKER'S DISABILITY COMPENSATION ACT COMPLIANCE

As required by Act 317, P.A. 1969 (Worker's Compensation) and
Part 5 of Act 451 of 1994, as amended.

VERIFICATION OF WORKER'S DISABILITY COMPENSATION ACT COMPLIANCE

- This verification must be completed and submitted within 21 days of contract award and prior to the issuance of the timber sale contract.
- In addition, if boxes 2B or 2C are checked, then Notice of Exclusion or Certificate of Insurance must be submitted within twenty-one (21) days of the contract award and prior to the issuance of the timber sale contract.
- All information must be typed or printed except for written signatures.

Please Check Appropriate Categories:

1. My business is organized as (you **must** check one of the boxes below):
 - A. Sole Proprietorship (individual)
 - B. Partnership
 - C. Corporation
2. You **must** check one of the boxes below:
 - A. I certify my business is a sole proprietorship and it has no employees but the sole proprietor. I am not subject to the Worker's Compensation Laws.
 - B. I certify my business has satisfied its obligation to the Worker's Compensation Act through the use of an approved Notice of Exclusion (BWC-337, Rev. 5/96). I will provide a copy of the Notice of Exclusion within 21 days of the contract award. (For questions or a copy of the BWC-337, please call the Worker's Compensation Bureau at 517-322-1195).
 - C. I certify my business has a Worker's Compensation Policy. I will provide an original Certificate of Insurance within twenty-one (21) days of the contract award.
3. If you have checked item 2(A) or 2(B), you **must** indicate the number of **both** full-time and part-time employees, other than yourself, including family members and active partners (if none, you must enter "0").

_____ Full-time Employees

_____ Part-time Employees

Name of Business		Federal ID (or) Social Security No.	
Address		Telephone ()	
City	State	ZIP	

I hereby certify that the above information is true and correct. I agree to notify the Michigan DNR of any changes that occur in factors affecting my coverage during any of my present and future operations.

Signature of Owner or Authorized Representative

Title

Date

Please complete the "SEALED BID" information on the next page

Bear Sign Mix (61-046-18)
T24N, R14W, SEC. 25; T24N, R14W, SEC. 36; Manistee COUNTY

In response to the notice of sale to be held 4:00 p.m. (local time) on November 8, 2018, I am hereby submitting my sealed bid (firm offer) for the following forest products to be cut. Bids for individual species must be at or above the advertised price. All non-responsive bid forms may be rejected.

<u>PRODUCTS & SPECIES</u>	<u>ESTIMATED VOLUME*</u>	<u>ADVERTISED PRICE</u>	<u>BID PRICE/UNIT</u>
Sawtimber			
B. T. Aspen	17.20 MBF	\$ 109.00/MBF	\$ _____
Black Cherry	11.80 MBF	\$ 154.00/MBF	\$ _____
Red Maple	29.20 MBF	\$ 114.00/MBF	\$ _____
Pulpwood			
B. T. Aspen	236.00 Cords	\$ 20.55/Cord	\$ _____
Mixed Hardwood	312.00 Cords	\$ 18.90/Cord	\$ _____

*The volumes are statistically estimated within plus (+) or minus (-) 14.34 percent. These estimated volumes are final and not subject to adjustment. Prospective bidders are urged to examine this timber and to make their own estimates of quantity and quality.

I understand that any or all bids may be rejected. All bids must be signed and all bid items must be bid or the bid form may be rejected. I also understand that consideration and awarding a contract will be based upon my past performance and ability to complete the contract based upon equipment and staffing subject to my control.

FEDERAL ID: _____ or SOCIAL SECURITY NUMBER: _____

Company or individual bidding: _____

Company representative's name: _____

Address: _____

City: _____ State: _____ Zip: _____

IF AVAILABLE, PLEASE PLACE THE PERSONALIZED LABEL FROM YOUR PROSPECTUS IN THE ABOVE BOX.

Individual or company representative's signature: _____ Date: _____

Phone number : _____ Email (optional): _____

THE WINNING BIDDER MUST COMPLETE THE VERIFICATION OF WORKER'S DISABILITY COMPENSATION ACT COMPLIANCE (ON REVERSE SIDE IF DOUBLE SIDED) WITHIN 21 DAYS OF SALE AWARD DATE



FOR DEPARTMENT USE ONLY	
Sale Number (XX - XXX - XX - XX)	
Forest Management Unit:	

TIMBER SALE VERIFICATION OF WORKER'S DISABILITY COMPENSATION ACT COMPLIANCE

As required by Act 317, P.A. 1969 (Worker's Compensation) and
Part 5 of Act 451 of 1994, as amended.

VERIFICATION OF WORKER'S DISABILITY COMPENSATION ACT COMPLIANCE

- This verification must be completed and submitted within 21 days of contract award and prior to the issuance of the timber sale contract.
- In addition, if boxes 2B or 2C are checked, then Notice of Exclusion or Certificate of Insurance must be submitted within twenty-one (21) days of the contract award and prior to the issuance of the timber sale contract.
- All information must be typed or printed except for written signatures.

Please Check Appropriate Categories:

1. My business is organized as (you **must** check one of the boxes below):
 - A. Sole Proprietorship (individual)
 - B. Partnership
 - C. Corporation
2. You **must** check one of the boxes below:
 - A. I certify my business is a sole proprietorship and it has no employees but the sole proprietor. I am not subject to the Worker's Compensation Laws.
 - B. I certify my business has satisfied its obligation to the Worker's Compensation Act through the use of an approved Notice of Exclusion (BWC-337, Rev. 5/96). I will provide a copy of the Notice of Exclusion within 21 days of the contract award. (For questions or a copy of the BWC-337, please call the Worker's Compensation Bureau at 517-322-1195).
 - C. I certify my business has a Worker's Compensation Policy. I will provide an original Certificate of Insurance within twenty-one (21) days of the contract award.
3. If you have checked item 2(A) or 2(B), you **must** indicate the number of **both** full-time and part-time employees, other than yourself, including family members and active partners (if none, you must enter "0").

_____ Full-time Employees

_____ Part-time Employees

Name of Business		Federal ID (or) Social Security No.	
Address		Telephone ()	
City	State	ZIP	

I hereby certify that the above information is true and correct. I agree to notify the Michigan DNR of any changes that occur in factors affecting my coverage during any of my present and future operations.

Signature of Owner or Authorized Representative

Title

Date

Please complete the "SEALED BID" information on the next page

Curveball Mix (61-048-18)
T24N, R14W, SEC. 34; T24N, R14W, SEC. 35; Manistee COUNTY

In response to the notice of sale to be held 4:00 p.m. (local time) on November 8, 2018, I am hereby submitting my sealed bid (firm offer) for the following forest products to be cut. Bids for individual species must be at or above the advertised price. All non-responsive bid forms may be rejected.

<u>PRODUCTS & SPECIES</u>	<u>ESTIMATED VOLUME*</u>	<u>ADVERTISED PRICE</u>	<u>BID PRICE/UNIT</u>
Sawtimber			
B. T. Aspen	93.40 MBF	\$ 109.00/MBF	\$ _____
Beech	1.60 MBF	\$ 119.00/MBF	\$ _____
Black Cherry	35.10 MBF	\$ 154.00/MBF	\$ _____
Red Maple	96.40 MBF	\$ 114.00/MBF	\$ _____
Red Pine	853.80 MBF	\$ 109.00/MBF	\$ _____
Sugar Maple	11.80 MBF	\$ 272.00/MBF	\$ _____
White Pine	60.90 MBF	\$ 59.00/MBF	\$ _____
Pulpwood			
B. T. Aspen	280.00 Cords	\$ 20.55/Cord	\$ _____
Mixed Hardwood	768.00 Cords	\$ 18.90/Cord	\$ _____
Red Pine	394.00 Cords	\$ 39.85/Cord	\$ _____
White Pine	573.00 Cords	\$ 14.50/Cord	\$ _____

*The volumes are statistically estimated within plus (+) or minus (-) 7.44 percent. These estimated volumes are final and not subject to adjustment. Prospective bidders are urged to examine this timber and to make their own estimates of quantity and quality.

I understand that any or all bids may be rejected. All bids must be signed and all bid items must be bid or the bid form may be rejected. I also understand that consideration and awarding a contract will be based upon my past performance and ability to complete the contract based upon equipment and staffing subject to my control.

FEDERAL ID: _____ or SOCIAL SECURITY NUMBER: _____

Company or individual bidding: _____

Company representative's name: _____

Address: _____

City: _____ State: _____ Zip: _____

IF AVAILABLE, PLEASE PLACE THE PERSONALIZED LABEL FROM YOUR PROSPECTUS IN THE ABOVE BOX.

Individual or company representative's signature: _____ Date: _____

Phone number : _____ Email (optional): _____

THE WINNING BIDDER MUST COMPLETE THE VERIFICATION OF WORKER'S DISABILITY COMPENSATION ACT COMPLIANCE (ON REVERSE SIDE IF DOUBLE SIDED) WITHIN 21 DAYS OF SALE AWARD DATE



FOR DEPARTMENT USE ONLY
Sale Number (XX - XXX - XX - XX)
Forest Management Unit:

TIMBER SALE VERIFICATION OF WORKER'S DISABILITY COMPENSATION ACT COMPLIANCE

*As required by Act 317, P.A. 1969 (Worker's Compensation) and
Part 5 of Act 451 of 1994, as amended.*

VERIFICATION OF WORKER'S DISABILITY COMPENSATION ACT COMPLIANCE

- This verification must be completed and submitted within 21 days of contract award and prior to the issuance of the timber sale contract.
- In addition, if boxes 2B or 2C are checked, then Notice of Exclusion or Certificate of Insurance must be submitted within twenty-one (21) days of the contract award and prior to the issuance of the timber sale contract.
- All information must be typed or printed except for written signatures.

Please Check Appropriate Categories:

1. My business is organized as (you **must** check one of the boxes below):
 - A. Sole Proprietorship (individual)
 - B. Partnership
 - C. Corporation

2. You **must** check one of the boxes below:
 - A. I certify my business is a sole proprietorship and it has no employees but the sole proprietor. I am not subject to the Worker's Compensation Laws.
 - B. I certify my business has satisfied its obligation to the Worker's Compensation Act through the use of an approved Notice of Exclusion (BWC-337, Rev. 5/96). I will provide a copy of the Notice of Exclusion within 21 days of the contract award. (For questions or a copy of the BWC-337, please call the Worker's Compensation Bureau at 517-322-1195).
 - C. I certify my business has a Worker's Compensation Policy. I will provide an original Certificate of Insurance within twenty-one (21) days of the contract award.

3. If you have checked item 2(A) or 2(B), you **must** indicate the number of **both** full-time and part-time employees, other than yourself, including family members and active partners (if none, you must enter "0").

_____ Full-time Employees

_____ Part-time Employees

Name of Business		Federal ID (or) Social Security No.	
Address		Telephone ()	
City	State	ZIP	

I hereby certify that the above information is true and correct. I agree to notify the Michigan DNR of any changes that occur in factors affecting my coverage during any of my present and future operations.

Signature of Owner or Authorized Representative

Title

Date

Please complete the "SEALED BID" information on the next page

Wheelhouse Pine (61-054-18)
T24N, R14W, SEC. 34; T24N, R14W, SEC. 35; Manistee COUNTY

In response to the notice of sale to be held 4:00 p.m. (local time) on November 8, 2018, I am hereby submitting my sealed bid (firm offer) for the following forest products to be cut. Bids for individual species must be at or above the advertised price. All non-responsive bid forms may be rejected.

<u>PRODUCTS & SPECIES</u>	<u>ESTIMATED VOLUME*</u>	<u>ADVERTISED PRICE</u>	<u>BID PRICE/UNIT</u>
Sawtimber			
Black Cherry	21.60 MBF	\$ 154.00/MBF	\$ _____
Red Maple	19.80 MBF	\$ 114.00/MBF	\$ _____
Red Pine	1,133.80 MBF	\$ 109.00/MBF	\$ _____
White Pine	54.00 MBF	\$ 59.00/MBF	\$ _____
Pulpwood			
Mixed Hardwood	650.00 Cords	\$ 18.90/Cord	\$ _____
Red Pine	351.00 Cords	\$ 39.85/Cord	\$ _____
White Pine	910.00 Cords	\$ 14.50/Cord	\$ _____

*The volumes are statistically estimated within plus (+) or minus (-) 6.19 percent. These estimated volumes are final and not subject to adjustment. Prospective bidders are urged to examine this timber and to make their own estimates of quantity and quality.

I understand that any or all bids may be rejected. All bids must be signed and all bid items must be bid or the bid form may be rejected. I also understand that consideration and awarding a contract will be based upon my past performance and ability to complete the contract based upon equipment and staffing subject to my control.

FEDERAL ID: _____ or SOCIAL SECURITY NUMBER: _____

Company or individual bidding: _____

Company representative's name: _____

Address: _____

City: _____ State: _____ Zip: _____

IF AVAILABLE, PLEASE PLACE THE PERSONALIZED LABEL FROM YOUR PROSPECTUS IN THE ABOVE BOX.

Individual or company representative's signature: _____ Date: _____

Phone number : _____ Email (optional): _____

THE WINNING BIDDER MUST COMPLETE THE VERIFICATION OF WORKER'S DISABILITY COMPENSATION ACT COMPLIANCE (ON REVERSE SIDE IF DOUBLE SIDED) WITHIN 21 DAYS OF SALE AWARD DATE



FOR DEPARTMENT USE ONLY
Sale Number (XX - XXX - XX - XX)
Forest Management Unit:

TIMBER SALE VERIFICATION OF WORKER'S DISABILITY COMPENSATION ACT COMPLIANCE

*As required by Act 317, P.A. 1969 (Worker's Compensation) and
Part 5 of Act 451 of 1994, as amended.*

VERIFICATION OF WORKER'S DISABILITY COMPENSATION ACT COMPLIANCE

- This verification must be completed and submitted within 21 days of contract award and prior to the issuance of the timber sale contract.
- In addition, if boxes 2B or 2C are checked, then Notice of Exclusion or Certificate of Insurance must be submitted within twenty-one (21) days of the contract award and prior to the issuance of the timber sale contract.
- All information must be typed or printed except for written signatures.

Please Check Appropriate Categories:

1. My business is organized as (you **must** check one of the boxes below):
 - A. Sole Proprietorship (individual)
 - B. Partnership
 - C. Corporation

2. You **must** check one of the boxes below:
 - A. I certify my business is a sole proprietorship and it has no employees but the sole proprietor. I am not subject to the Worker's Compensation Laws.
 - B. I certify my business has satisfied its obligation to the Worker's Compensation Act through the use of an approved Notice of Exclusion (BWC-337, Rev. 5/96). I will provide a copy of the Notice of Exclusion within 21 days of the contract award. (For questions or a copy of the BWC-337, please call the Worker's Compensation Bureau at 517-322-1195).
 - C. I certify my business has a Worker's Compensation Policy. I will provide an original Certificate of Insurance within twenty-one (21) days of the contract award.

3. If you have checked item 2(A) or 2(B), you **must** indicate the number of **both** full-time and part-time employees, other than yourself, including family members and active partners (if none, you must enter "0").

_____ Full-time Employees

_____ Part-time Employees

Name of Business		Federal ID (or) Social Security No.	
Address		Telephone ()	
City	State	ZIP	

I hereby certify that the above information is true and correct. I agree to notify the Michigan DNR of any changes that occur in factors affecting my coverage during any of my present and future operations.

Signature of Owner or Authorized Representative

Title

Date

Please complete the "SEALED BID" information on the next page