



**DEPARTMENT OF NATURAL RESOURCES
STATE OF MICHIGAN**

TIMBER SALE PROSPECTUS #6623

SCHEDULED SALE DATE AND TIME: 10:00 a.m. (local time) on May 19, 2020.

LOCATION: ATLANTA MGMT UNIT, 13501 M 33, ATLANTA, MI 49709.

PROSPECTUS NOTE: It is recommended that for the duration of the "Stay Home, Stay Safe" executive order that bidders submit their bids through the Online Bidding System (<https://www2.dnr.state.mi.us/VMSONlineBidding/>). If you need to register, contact Jake Reid (ReidJ6@michigan.gov, 517-284-5908) or Donovan Asselin (AsselinD@michigan.gov, 517-930-1326). Paper bids will still be accepted during this time, either dropped in the bid box at the bid location or by mailing. If mailing, please allow for additional time.

The bidder is advised to inspect the sale area and review the location, estimated volumes, operating costs and contract terms of proposed sales. Please be aware that some landowners may request 60 days or more notice for access across their land.

Shannon 'Iggins Popple (54-010-19) / T31N, R07E, SEC. 17, SWNW.

T31N, R07E, SEC. 18, SENE.

T31N, R07E, SEC. 4, NWSW.

T31N, R07E, SEC. 5, S1/2NE, N1/2SE.

Alpena County, Advertised Price \$28,321.55, 69.5 Acres, Aspen, Spruce/Fir/Tamarack.

Nichol's End (54-013-19) / T29N, R06E, SEC. 14, SWSW.

T29N, R06E, SEC. 15, SENE, E1/2SE.

T29N, R06E, SEC. 23, NWNW.

Alpena County, Advertised Price \$15,756.95, 32.8 Acres, Aspen, Spruce/Fir/Tamarack.

Devils Ridge Mix (54-022-19) / T30N, R08E, SEC. 17, NWNW, SESW, SWSE.

T30N, R08E, SEC. 20, NW.

T30N, R08E, SEC. 8, NESW, S1/2SW.

Alpena County, Advertised Price \$6,613.65, 27.5 Acres, Aspen, Hardwood.

SALE NOTE: Extensive road work is required on this sale (see spec 4.2.3 for details). The advertised price has been reduced by the estimate cost of this road work to off-set the additional expense.

A recreation site such as a trail, pathway, or campground is within the sale area or the vicinity. Certain restrictions/specifications may be applicable including time restrictions.

Lay Road Ridge Country Mix (54-024-19) / T30N, R08E, SEC. 5, N1/2SW, NWSE.

Alpena County, Advertised Price \$11,655.45, 25.4 Acres, Aspen, White Pine.

Pine-Oak Scramble (54-033-19) / T30N, R08E, SEC. 16, W1/2NW,SWSW.

T30N, R08E, SEC. 17, E1/2NE,E1/2SE.

T30N, R08E, SEC. 20, NENE.

T30N, R08E, SEC. 21, NWNW.

T30N, R08E, SEC. 8 , SESE.

T30N, R08E, SEC. 9 , SWSW.

Alpena County, Advertised Price \$37,276.45, 80.0 Acres, Hardwood, Red Pine.

SALE NOTE: Spec. 5.2.3.1 requires that Payment Units 1-3 be harvested using full tree skidding during snow off conditions.

Spec. 5.2.3.2 requires that Payment Units 5 and 6 be harvested during the period of Dec. 1 through March 31.

A recreation site such as a trail, pathway, or campground is within the sale area or the vicinity. Certain restrictions/specifications may be applicable including time restrictions.

BID INSTRUCTIONS (VER. 07/02/2018):

1. Scheduled Bid Location, Date, and Time (2/11)

Bids must be received by the Unit Manager, ATLANTA OFFICE, 13501 M 33, ATLANTA, MI 49709, no later than 10:00 a.m. (local time) on May 19, 2020. For further information concerning this sale, contact Cody Stevens at 989-785-4251 extension 5240.

2. Bidder's Qualifications (5/16)

Purchaser shall obtain workers compensation insurance to cover claims under Michigan's Worker's Disability Compensation Act of 1969 or similar employee benefit act of any other state applicable to an employee. If all or part of a timber sale was prepared by a private contractor, the contractor and that contractor's company are not permitted to bid on the timber sale contract. Bids will not be accepted from individuals or companies appearing on the DNR/FRD No-Bid List. This list contains the names of purchasers who previously failed to execute a contract within 21-days or who have a history of poor performance.

3. Preparation of Sealed Bids (5/16)

Bid Forms may be completed online thru Michigan DNR Timber Sale Online Bidding (OLB) at www.michigan.gov/timberbidding or by completing the hardcopy Bid Form found in the Timber Sale Prospectus. Hardcopy Bid Forms shall be manually signed in ink. Registration in OLB is considered your 'signature' for all bids submitted thru that system. Bid prices must be entered for each species and product in the Bid Price column for all material subject to bidding and all fill-in blanks must be completed. If erasures or other changes appear on the hardcopy Bid Form, each erasure or change must be initialed by the person signing the bid.

4. Submission of Sealed Bids (5/16)

Bid forms may be obtained from the Unit Manager or thru OLB. Bids may be submitted hardcopy or thru OLB. All hardcopy bids must be submitted on the bid form and in an envelope clearly identified as described in this section. NOTE: Only one bid form per bid envelope. Sealed bids must be submitted to the Unit office designated in the prospectus and must be submitted at or prior to the time established in the prospectus. The envelope should show on the outside (a) the sale name or number and (b) the date and time of bid opening, as shown in the prospectus. Bids received after the time specified in the sale prospectus are late bids and will be rejected.

It is possible for a bidder to submit multiple bids on a single sale. For example, a bid may be submitted hardcopy and a bid may be submitted thru OLB. Or, two bidders from the same company could both submit bids on the same sale. If this were to happen, the State would accept all bids received and award the contract accordingly. All bidding and contractual requirements would apply to all bids received.

5. Public Opening of Sealed Bids (7/16)

If conditions permit, the sealed bids will be publicly opened and posted at the time and place set in the prospectus.

If a bidder, present at a bid opening, has submitted bids on more than one sale, that bidder may withdraw their unopened bid envelopes or announce the withdrawal of their online bid after being declared the successful bidder on one sale.

6. Award of Contract (1/11)

Award of the contract will be made to the Bidder whose bid, conforming to the prospectus, is most advantageous to the State of Michigan on the basis of total value at rates bid for the estimated quantities. The State reserves the right to reject any bid or waive any minor irregularity in bids received. A written award mailed (or otherwise furnished) to the successful Bidder shall be deemed to result in a binding contract without further action by either party.

7. Down Payment (1/11)

The Bidder to whom award is made must make a down payment within 21 days of the sale award. The amount of the down payment will be calculated as shown in the Bond and Payment Schedule of this prospectus. Only cash may be used to meet this requirement.

8. Performance Security (1/11)

As guarantee of faithful performance, a cash bond, certificate of deposit, surety bond or irrevocable letter of credit (LOC) is required within 21 days of the sale award. The amount of the performance security is shown in the Bond and

Payment Schedule of this prospectus. If an LOC or surety is used, the coverage must extend for at least 6 months beyond the contract expiration.

9. Timber Sale Contract (7/18)

Additional conditions and requirements common to all timber sales are listed on the timber sale contract (R4031) and are available on line at www.michigan.gov/timber. Contact the Unit Manager for additional information or a sample contract. Within 21 days of the date of the award letter, the bidder must sign the contract and provide the required down payment, performance security, and verification of worker's disability compensation. The down payment and performance security shall be in accordance with the provisions of the timber sale contract, in the sums stated in this prospectus. If these actions are not taken, then the Bidder, the Bidder's corporation, and the corporation's principals may not be permitted to bid on State timber sales for a period of 3 months after the first offense, 6 months after the second offense, and 1 year after the third offense. An offense will only be counted against the Bidder for 5 years. In addition, the Bidder certifies that if awarded this contract, the Bidder will complete the timber sale contract in accordance with its terms and any modifications thereof including requirements to purchase, cut, and remove the included timber by the expiration date.

Payment Unit values in the State Forest Timber Sale Contract are calculated based on the advertised value of the Payment Unit as a percentage of the total advertised value of the contract. The advertised value of each Payment Unit is given in the Description of Timber by Payment Unit table on the Timber Sale Information page. For example, if the value of Payment Unit 1 is advertised as \$1,500 and the total Timber Sale value is advertised as \$10,000, the contract price for Payment Unit 1 will be 15% of the total bid price ($\$1,500/\$10,000 * 100$).

10. Disclaimer of Estimates and Bidder's Warranty of Inspection (7/16)

Before submitting this bid, the Bidder is advised and cautioned to inspect the sale area, review the requirements of the sale contract, and take other steps as may be reasonably necessary to ascertain the location, estimated volumes, construction estimates, and operating costs of the proposed sale. Failure to do so will not relieve the Bidder from responsibility for completing the contract.

The Bidder warrants that this bid is submitted solely on the basis of the Bidder's examination and inspection of the quality and quantity of the timber offered for sale and the Bidder's opinion of the value thereof and the costs of recovery. No reliance should be placed on the State of Michigan's estimates of timber quality, quantity or costs of recovery. Bidder further acknowledges that the State of Michigan: (i) expressly disclaims any warranty of fitness of timber for any purpose; (ii) offers this timber as is without any warranty of quality (merchantability) or quantity and (iii) expressly disclaims any warranty as to the quantity or quality of timber sold.

11. Certification and Chain-of-Custody (10/14)

Unless otherwise indicated in the contract under section 7 – Other Conditions of the Sale Specific Conditions & Requirements, the area encompassed by this timber sale is certified to the standards of the Forest Stewardship Council (FSC) - Certificate #SCS-FM/COC-00090N and the Sustainable Forestry Initiative (SFI) - Certificate #NSF-SFIS-5Y031-SF5. Forest products from this sale may be delivered to the mill as "FSC 100% and / or SFI certified" as long as the contractor hauling the forest products is chain-of-custody (COC) certified or covered under a COC certificate from the destination mill. The purchaser is responsible for maintaining COC after leaving the sale area.

12. Good Neighbor Authority (GNA) Requirements (7/16)

If the name of this timber sales contains the acronym GNA, it is authorized by the Good Neighbor Authority (GNA) and covered by various agreements between the U.S. Forest Service and the State. The timber sale occurs on federal land and the following conditions apply:

GNA contracts on US Forest Service land will not be awarded to purchasers on the Federal list of excluded parties. The System for Award Management (SAM) will be checked for active excluded parties prior to award of contract. In addition, the Bidder to whom award is made must complete an Assurance Regarding Felony Conviction or Tax Delinquent Status for Corporate Applicants (AD-3031).

13. Good Neighbor Authority (GNA) Requirements, con't (9/16)

Bidder certifies, by signing this bid form, that to the best of Bidder's knowledge that the following representations are accurate and complete.

- a. That the Bidder and its principals are not presently debarred, suspended, proposed for debarment, declared ineligible, or voluntary excluded from timber sales (covered transactions) by any Federal department or agency.
- b. That the Bidder and its principals have not within a 3-year period preceding this bid been convicted of or had a civil judgment rendered against them for commission of fraud or a criminal offense in connection with obtaining , attempting to obtain, or performing a public (Federal, State, or local) transaction or contract under a public transaction; violation of Federal or State antitrust statutes or commission of embezzlement, theft, forgery, bribery, falsification or destruction of records, making false statements, or receiving stolen property.
- c. That the Bidder and its principals are not presently indicted for or otherwise criminally or civilly charged by a governmental entity (Federal, State, or local) with commission of any of the offenses enumerated in paragraph b of this certification.
- d. That the Bidder and its principals have not within a 3-year period preceding this bid had one or more public transactions (Federal, State, or local) terminated for breach or default of a timber or forest product contract.

Bidders that cannot certify this requirement, in whole or in part, shall submit an explanation with their bid.

DAN EICHINGER
Director

TIMBER SALE INFORMATION

Shannon Iggins Popple (54-010-19)

T31N, R07E, SEC. 17; T31N, R07E, SEC. 18; T31N, R07E, SEC. 4; T31N, R07E, SEC. 5.

Alpena County (Advertised Price \$28,321.55)

A timber sale contract for this lump sum, sealed bid timber sale will be awarded to the responsible bidder offering the highest sealed bid price. Bids must be at or above the following advertised price for each species:

<u>PRODUCTS & SPECIES</u>	<u>ESTIMATED UNITS*</u>		<u>ADVERTISED PRICE</u>
Sawtimber			
Mixed Aspen	17.00	MBF	\$ 58.00 / MBF
Pulpwood			
Balsam Fir	207.00	Cords	\$ 19.10 / Cord
Mixed Aspen	1,251.00	Cords	\$ 17.60 / Cord
Mixed Hardwood	44.00	Cords	\$ 17.05 / Cord
Red Pine	10.00	Cords	\$ 42.45 / Cord
White Pine	3.00	Cords	\$ 22.45 / Cord
White Spruce	13.00	Cords	\$ 9.40 / Cord

* The total volume is statistically estimated within plus (+) or minus (-) 12.39 percent. The estimated units are final and not subject to adjustment. Prospective bidders are urged to examine this timber and to make their own estimates of quantity and quality.

BOND AND PAYMENT SCHEDULE:

1. A bond in the amount of \$1,416.00 to insure faithful performance of the conditions of the contract will be deposited by the successful bidder within 21 days of the sale award.
2. Cutting in any sale or unit without the required advance payment would be considered a trespass.
3. Total payment must be paid in advance or according to the following schedule :
 - (a) Ten percent (10%) of the sale value must be paid within 21 days of the sale award.
 - (b) The 10% down payment will be credited towards the first unit cut.
 - (c) Payment for each of the following units must be made before cutting begins in that unit:

PAYMENT UNIT NUMBER	PERCENT OF TOTAL SALE VALUE
01	34.7%
02	36.3%
03	29.0%
4. If no cutting takes place, the 10% down payment will not be refunded.
5. Operations on the contract issued will terminate on 12/31/2023.

Description of Timber by Payment Unit (PU)

PU	MARKET GROUP	PRODUCT	QUANTITY	UNIT	ACRES	ADVERTISE PRICE
1	Mixed Aspen	Sawtimber	4.2	MBF	24.3	\$9,822.65
	<i>B. T. Aspen</i>		2.2	<i>MBF</i>		
	<i>Quaking Aspen</i>		2.0	<i>MBF</i>		
	Balsam Fir	Pulpwood	81.0	Cords		
	Mixed Aspen		427.0	Cords		
	Mixed Hardwood		18.0	Cords		
	Red Pine		3.0	Cords		
	White Pine		2.0	Cords		
	White Spruce		4.0	Cords		
2	Mixed Aspen	Sawtimber	4.4	MBF	25.2	\$10,257.60
	<i>B. T. Aspen</i>		2.3	<i>MBF</i>		
	<i>Quaking Aspen</i>		2.1	<i>MBF</i>		
	Balsam Fir	Pulpwood	83.0	Cords		
	Mixed Aspen		444.0	Cords		
	Mixed Hardwood		20.0	Cords		
	Red Pine		4.0	Cords		
	White Pine		2.0	Cords		
	White Spruce		5.0	Cords		
3	Mixed Aspen	Sawtimber	8.4	MBF	20.0	\$8,221.30
	<i>B. T. Aspen</i>		0.5	<i>MBF</i>		
	<i>Quaking Aspen</i>		7.9	<i>MBF</i>		
	Balsam Fir	Pulpwood	43.0	Cords		
	Mixed Aspen		380.0	Cords		
	Mixed Hardwood		6.0	Cords		
	Red Pine		2.0	Cords		
	White Spruce		4.0	Cords		
	TOTAL:			17.0		
TOTAL:			1,528.0	Cords		

Sale Specific Conditions & Requirements

Sale Name: Shannon 'Iggins Popple

Sale Number: 54-010-19 Seq#: 2

1 - Sale Area

1.2 - Boundaries

1.2.1 - Painted boundaries (1/14)

The sale boundary and Payment Unit boundaries are marked and identified by blue, red and yellow paint. Exterior sale boundary lines against private property are marked with blue paint. Exterior sale boundary lines against state are marked with red paint. Interior Payment Unit boundaries are marked with yellow paint. The painted boundary line trees are not Included Timber and are to be protected. Yellow painted trees designating an interior Payment Unit boundary are only to be cut when all surrounding Payment Units have been paid.

2 - Timber Specifications

2.1 - Included Timber

2.1.2 - Clearcut unit(s) w/o unmerchantable trees (8/11)

Within Payment Unit(s) 1-3, cut all trees which meet minimum piece specifications in 2.2 Utilization, except do not cut trees marked with green paint.

Special protection trees identified in accordance with condition 3.4.2, within clearcutting unit boundaries, are not Included Timber, and are to be protected.

2.1.15 - Hazard trees near roads (7/13)

Cut and remove all standing dead trees within 66 feet of the cleared portion of Shannon and Glennie Roads. These trees must be scattered back into the sale area.

3 - Payments

3.3 - Pre-measured Sales

3.3.4 - Dividing payment units (7/14)

Payment Unit(s) \$25,000 in value or greater may be divided at the request of the Purchaser and upon approval of the Unit Manager. Dividing Payment Units is a contract modification which requires a Timber Sale Contract Supplement. There will be only one division per Payment Unit.

3.4 - Damaged Timber

3.4.2 - Special Protection Trees (4/14)

The Purchaser shall not cut live or dead special protection trees within cutting units or clearings. Special protection trees are white pine eighteen (18) inches or more at DBH and all green marked trees. If the Purchaser's operations have cut or damaged special protection trees through carelessness, the Purchaser shall pay \$200 as fixed, agreed and liquidated damages for each special protection tree cut or damaged. Such payment does not constitute ownership of the undesignated timber.

4 - Transportation

4.1 - Construction

4.1.3 - Slash and earthen piles (8/04)

Piles or windrows of earth along roads and landings that have been widened or constructed shall be leveled. Slash from road maintenance or construction, including stumps, shall be dispersed throughout the sale.

4.1.6 - Road construction (1/09)

Improvements of existing roads shall be done in such a way as to minimize the environmental and visual impacts. Merchantable trees shall be cut and utilized unless otherwise directed. Non-merchantable trees shall be severed and laid flat on the ground. Slash shall be scattered, and not left in windrows and kept a minimum of 10 feet back from the road edge. Stumps shall be set upright, not left on edge, and be moved at least 10 feet away from the road edge. Disturbed soil shall be feathered into the woods and not left in berms or windrows.

4.1.12 - No new roads (1/12)

No new roads will be permitted in any Payment Unit. All operations are limited to existing roads. Skid trails only will be allowed.

4.2 - Maintenance

4.2.5 - Two wheel drive condition (2/04)

All existing trail roads on and adjacent to the sale area must be passable by two-wheel drive traffic for the duration of the sale.

5 - Operations

5.1 - Notification

5.1.1 - Pre-sale conference (10/16)

A pre-sale conference between the Purchaser and sale administrator is required prior to beginning any operations a Payment Unit to determine landing and road locations. The Unit Manager or his/her representative must be contacted at least 10 days in advance to schedule the conference.

5.1.4 - Post-sale conference (10/16)

A post-sale conference on site between the Purchaser and sale administrator is required 5 days prior to the completion of active logging operations to determine clean-up and repair of landings, road edges, and the fulfillment of other contract specifications.

5.2 - Conduct of Operations

5.2.2 - Hazard Trees/Snags

5.2.2.1 - Den trees (10/16)

Obvious hollow and/or den trees shall be protected and left standing unless they are a safety hazard.

5.2.3 - Operating Restrictions

5.2.3.11 - Coppice regeneration protection (4/10)

Timber harvesting in any Payment Unit must be completed before significant deciduous sprouting occurs in that Payment Unit so as to minimize damage to the new regeneration. Any post harvest operations, such as skidding, forwarding or chipping, must be completed before sprouting of regeneration occurs or within 30 calendar days of severing/cutting stem(s). If it is anticipated that these activities will be delayed, then products shall be carried to one central location or left in place in the stand. The Unit Manager or his/her representative may cease such operations if sprouting occurs before the operation is complete. If the Purchaser damages sprouting regeneration due to slow operations, liquidated damages will be assessed at \$200 for all acreage within the specified portion of the sale area that was damaged.

5.2.4 - Dead and Down Creation

5.2.4.6 - Dead and down creation, other (9/09)

To improve habitat for snowshoe hare and other species, the Purchaser must push over one live tree representative of the largest size class within view. These trees should be tipped over with the root ball attached so that the base of the tree is suspended off the ground. If it is impossible or impractical to push these trees over, they may be severed or partially severed at the stump. Whenever possible the stem of the tree should rest above ground level.

Furthermore tops, slash or any kind of harvest debris should be placed over the tree to create a cavity. These wildlife trees should be located on the ground for every 200 feet along the wetland edge. These trees may count both toward this condition and with those specified in condition 5.2.4.7, below.

5.2.4.7 - Dead and down creation: hare, grouse, deer and other species (5/15)

To improve horizontal cover habitat for snowshoe hare, grouse, deer, and other species, the Purchaser is to push over live, merchantable trees representative of the largest size class within view. These trees will be evenly scattered throughout the unit, preferably at least two chains from any roads, two-tracks, or trails open to vehicles and should be left at about one tree for every two acres. These trees should be tipped over with the root ball still attached so the base of the tree is suspended off the ground. The crown of the fallen tree should be at or near ground level after it is pushed over. If it is

impossible or impractical to push these trees over, they may be severed or partially severed at the stump. Whenever possible the stem of the tree should rest above ground level.

5.2.17 - Timber Mats and Interlocking Composite Mats (3/18)

Some roads or skid trails may require extra protection such as that afforded by timber mats, interlocking composite mats, or another approved system. Approximately 60 feet of road or trail may need extra protection at locations shown on the Timber Sale Map.

If available, mats may be borrowed from the DNR. A Timber Sale Contract Supplement will be used to document the Purchaser's use of the DNR's mats. Timber mats are available from various field offices. Composite mats are only available from the Grayling field office. The Purchaser is responsible for picking up and hauling the mats to and from the site. The composite mats will require DNR staff onsite for installation and removal. Contact the sale administrator to schedule at least 30 days before desired install/removal date regarding availability. All mats must be cleaned prior to drop off. This may include, but is not limited to, power washing and brushing to remove mud and debris. A charge of \$400.00 per timber mat and \$2,000.00 per composite mat will be assessed for all damaged or non-returned mats. Damage for the crane/timber mats is defined as three or more broken cants. Damage for the composite mats is defined as cracked or broken mats.

5.2.22 - Operating Caution

5.2.22.1 - Operating caution (6/11)

It is recommended, but not required, that within Payment Unit(s) 1 - 2, cutting, skidding, and hauling occur during dry summer or frozen winter conditions. The reason for the recommendation is to avoid damage to fragile saturated soils. The Purchaser must use the utmost caution to avoid rutting these soils.

5.2.32 - Decking/landing restoration (9/13)

All decking and landing areas must have the surface area restored to a condition equal to or better than before. This is to ensure the proper regeneration of the stand. Wood debris, chips and "cookies" from trimmings must be removed or scattered away from landing and loading areas and may not be windrowed on the edge. Wood chips must not exceed a depth of 4" above the original grade over an area of ¼ acre or greater.

5.2.38 - No decking against live trees (2/04)

Cut products may not be decked against unmarked or designated leave trees.

5.4 - Soil Protection

5.4.1 - Rutting restriction, general (7/16)

Operations are to cease immediately if equipment and weather conditions result in rutting of roads and/or skid trails which is 12 inches or greater in depth and 50 feet in length. The Unit Manager or his/her representative may restrict hauling and/or skidding if ruts exceed the specified depth. With the Unit Manager or his/her representative's approval, the Purchaser may return to the area when the risk of rutting has decreased.

5.4.6 - Wet area protection (5/10)

No harvesting operations, including skidding and felling, are to take place within drainages. Care must be taken by the Purchaser to identify and avoid operating in these areas of the timber sale.

5.8 - Protection of Endangered Species

5.8.5 - Protection of raptor nests (3/13)

All trees with raptor nests will be protected if found during harvesting operations. Notification will be made to the Unit Manager or his/her representative who will notify the Wildlife Biologist so an on-site evaluation and recommendation can be made, if necessary.

6 - Safety and Fire Prevention

6.2 - Signing

6.2.1 - Road posting (9/09)

The Purchaser is responsible for posting and maintaining caution signs on Shannon Road prior to beginning operations. The road must be posted at appropriate distances on either side of the sale area to warn of logging activity and truck traffic. Signs must be removed when harvest operations are suspended or completed. The Purchaser will provide these signs.



TIMBER SALE MAP

This information provided by authority of Part 525, 1994 PA 451, as amended.

Sale Number	Year
54 - 010	19

Forest Management Unit Atlanta	County Alpena	Mapped By Natzke	Date 08/25/2019	Page 1	of 2
Township 31N	Range 07W	Section(s) and Subdivision(s) S.4: NWSW, S.5: S2NE, N2SE, S.17: SWNW, S.18: SENE	Scale 1:15,840		

Cover Type				Density			
A = Aspen	H = Hemlock	N = Marsh	U = Upland Brush	0 = Non Stocked	5 = Pole Timber Medium		
B = Paper Birch	J = Jack Pine	O = Oak	UM = Upland Mixed	1 = Seedling Sapling Poor	6 = Pole Timber Well		
C = Cedar	L = Lowland Brush	P = Lowland Poplar	V = Bog or Marsh	2 = Seedling Sapling Medium	7 = Saw Timber Poor		
D = Treed Bog	LM = Lowland Mixed	Q = Mixed Swamp Conifer	W = White Pine	3 = Seedling Sapling Well	8 = Saw Timber Medium		
E = Swamp Hdwoods	M = Mpl, Bch, Brch	R = Red Pine	X = Non Stocked	4 = Pole Timber Poor	9 = Saw Timber Well		
F = Spruce Fir	MC = Mixed Conifer	S = Black Spruce	Z = Water				
G = Grass	MD = Mixed Deciduous	T = Tamarack					

PU	Acres
1	24.3
2	25.2
3	20.0

Shannon 'Iggins Popple

Compartment 101
69.5 Acres

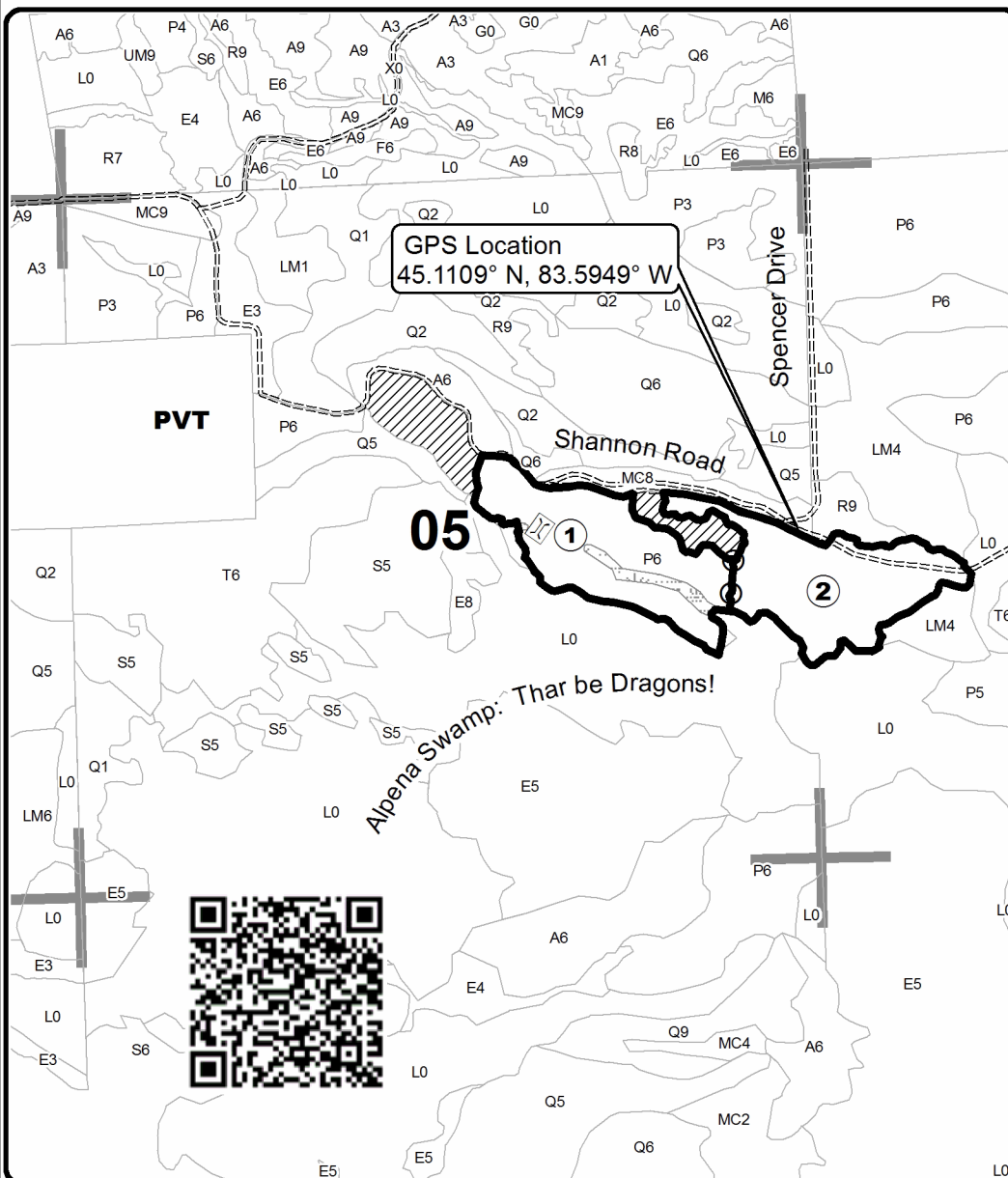

Legend

- Against State (Red)
- Payment Unit (Yellow)
- Retention Area
- Unpaved Roads
- Wetland Swale
- Stand Boundaries
- Payment Unit Number
- Swale Crossing
- Section Corners



Locator Map
1:150,000

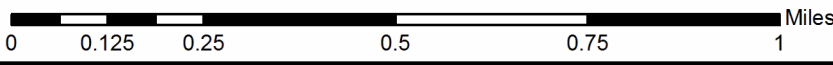
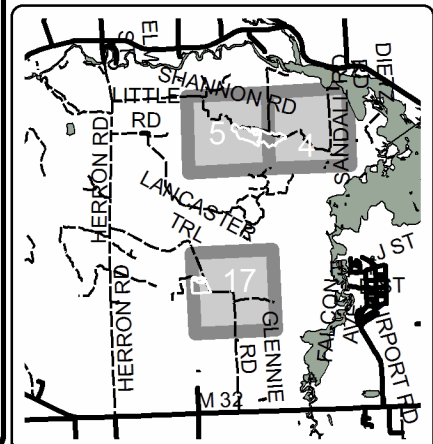



TIMBER SALE MAP

This information provided by authority of Part 525, 1994 PA 451, as amended.

Forest Management Unit Atlanta	County Alpena	Mapped By Natzke	Date 08/25/2019	Page 2	of 2
Township 31N	Range 07W	Section(s) and Subdivision(s) S.4: NWSW, S.5: S2NE, N2SE, S.17: SWNW, S.18: SENE	Scale 1:7,920		
Cruised By Natzke					

Cover Type				Density	
A = Aspen	H = Hemlock	N = Marsh	U = Upland Brush	0 = Non Stocked	5 = Pole Timber Medium
B = Paper Birch	J = Jack Pine	O = Oak	UM = Upland Mixed	1 = Seedling Sapling Poor	6 = Pole Timber Well
C = Cedar	L = Lowland Brush	P = Lowland Poplar	V = Bog or Marsh	2 = Seedling Sapling Medium	7 = Saw Timber Poor
D = Treed Bog	LM = Lowland Mixed	Q = Mixed Swamp Conifer	W = White Pine	3 = Seedling Sapling Well	8 = Saw Timber Medium
E = Swamp Hdwoods	M = Mpl, Bch, Brch	R = Red Pine	X = Non Stocked	4 = Pole Timber Poor	9 = Saw Timber Well
F = Spruce Fir	MC = Mixed Conifer	S = Black Spruce	Z = Water		
G = Grass	MD = Mixed Deciduous	T = Tamarack			

PU	Acres
1	24.3
2	25.2
3	20.0

Shannon 'Iggins Popple

Compartment 101

69.5 Acres

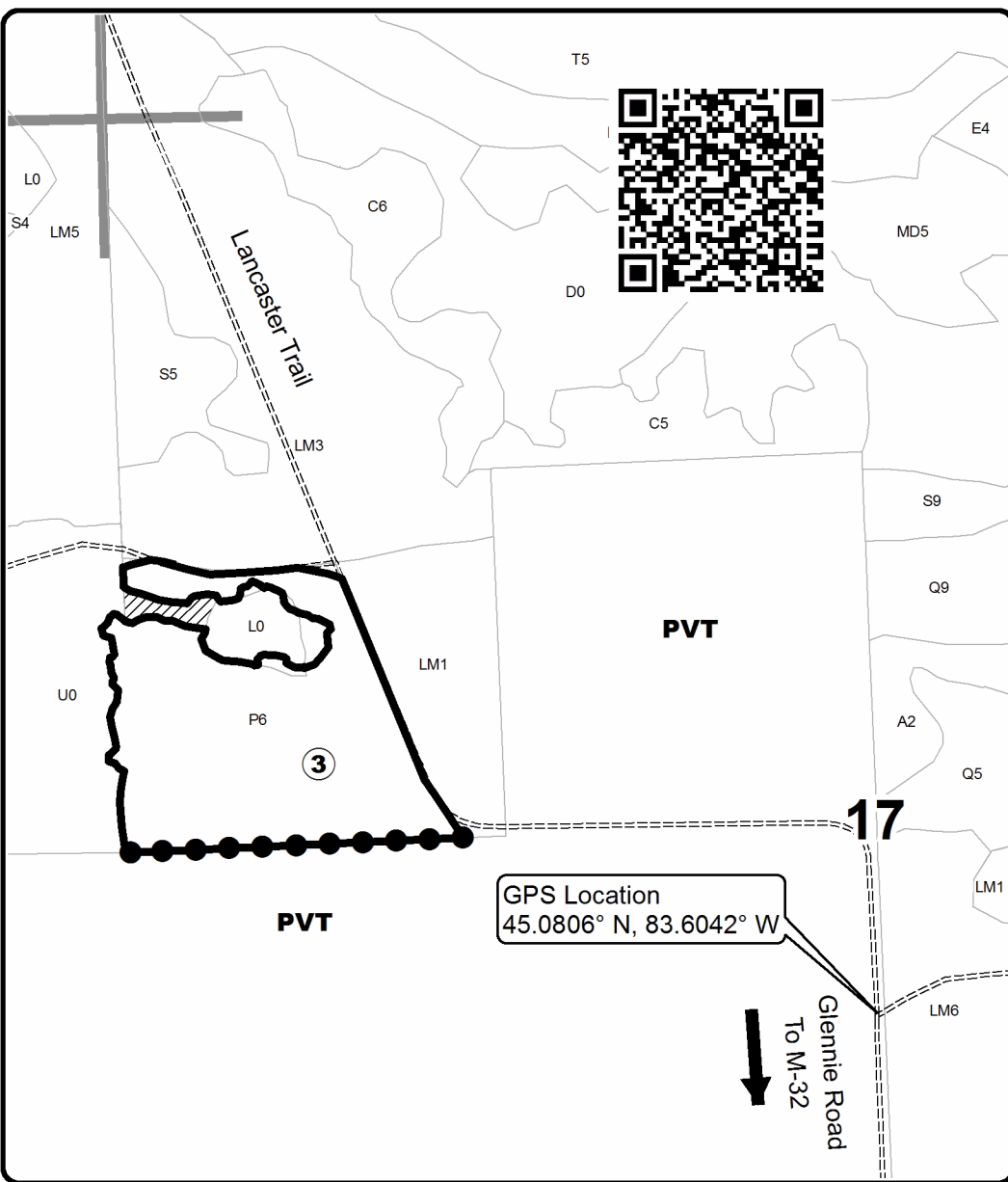

Legend

- Against State (Red)
- Private Line (Blue)
- Retention Area
- Unpaved Roads
- Wetland Swale
- Stand Boundaries
- Payment Unit Number
- Section Corners

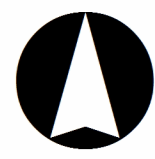

Locator Map
1:150,000

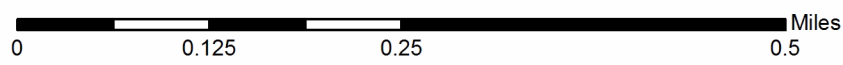
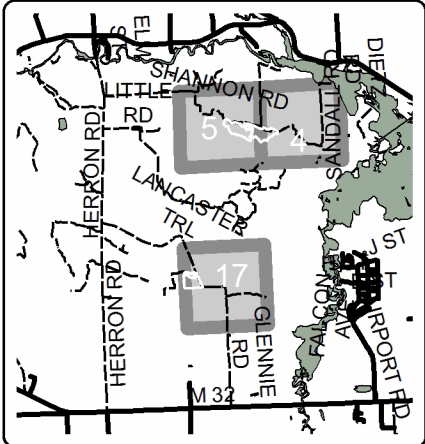

TIMBER SALE INFORMATION

Nichol's End (54-013-19)

T29N, R06E, SEC. 14; T29N, R06E, SEC. 15; T29N, R06E, SEC. 23.
Alpena County (Advertised Price \$15,756.95)

A timber sale contract for this lump sum, sealed bid timber sale will be awarded to the responsible bidder offering the highest sealed bid price. Bids must be at or above the following advertised price for each species:

<u>PRODUCTS & SPECIES</u>	<u>ESTIMATED UNITS*</u>	<u>ADVERTISED PRICE</u>
Sawtimber		
Mixed Aspen	22.60 MBF	\$ 58.00 / MBF
Red Oak	4.60 MBF	\$ 147.00 / MBF
Pulpwood		
Balsam Fir	85.00 Cords	\$ 19.10 / Cord
Mixed Aspen	574.00 Cords	\$ 17.60 / Cord
Mixed Hardwood	66.00 Cords	\$ 17.05 / Cord
Mixed Oak	29.00 Cords	\$ 24.55 / Cord
White Spruce	22.00 Cords	\$ 9.40 / Cord

* The total volume is statistically estimated within plus (+) or minus (-) 17.56 percent. The estimated units are final and not subject to adjustment. Prospective bidders are urged to examine this timber and to make their own estimates of quantity and quality.

BOND AND PAYMENT SCHEDULE:

1. A bond in the amount of \$788.00 to insure faithful performance of the conditions of the contract will be deposited by the successful bidder within 21 days of the sale award.
2. Cutting in any sale or unit without the required advance payment would be considered a trespass.
3. Total payment must be paid in advance or according to the following schedule :
 - (a) Ten percent (10%) of the sale value must be paid within 21 days of the sale award.
 - (b) The 10% down payment will be credited towards the first unit cut.
 - (c) Payment for each of the following units must be made before cutting begins in that unit:

PAYMENT UNIT NUMBER	PERCENT OF TOTAL SALE VALUE
01	16.6%
02	34.1%
03	49.3%
4. If no cutting takes place, the 10% down payment will not be refunded.
5. Operations on the contract issued will terminate on 06/30/2023.

Description of Timber by Payment Unit (PU)

PU	MARKET GROUP	PRODUCT	QUANTITY	UNIT	ACRES	ADVERTISE PRICE
1	Red Oak	Sawtimber	1.9	MBF	7.6	\$2,610.95
	Balsam Fir	Pulpwood	34.0	Cords		
	Mixed Aspen		64.0	Cords		
	Mixed Hardwood		19.0	Cords		
	Mixed Oak		6.0	Cords		
	White Spruce		9.0	Cords		
	2	Mixed Aspen	Sawtimber	7.8		
<i>Quaking Aspen</i>			7.8	<i>MBF</i>		
Red Oak			0.9	MBF		
Balsam Fir		Pulpwood	50.0	Cords		
Mixed Aspen			193.0	Cords		
Mixed Hardwood			16.0	Cords		
Mixed Oak			5.0	Cords		
White Spruce			5.0	Cords		
3	Mixed Aspen	Sawtimber	14.8	MBF	12.6	\$7,766.95
	<i>B. T. Aspen</i>		13.3	<i>MBF</i>		
	<i>Quaking Aspen</i>		1.5	<i>MBF</i>		
	Red Oak		1.8	MBF		
	Balsam Fir	Pulpwood	1.0	Cords		
	Mixed Aspen		317.0	Cords		
	Mixed Hardwood		31.0	Cords		
	Mixed Oak		18.0	Cords		
	White Spruce		8.0	Cords		
	TOTAL:			27.2		
TOTAL:			776.0	Cords		

Sale Specific Conditions & Requirements

Sale Name: Nichol's End

Sale Number: 54-013-19 Seq#: 2

1 - Sale Area

1.2 - Boundaries

1.2.1 - Painted boundaries (1/14)

The sale boundaries are marked and identified by blue and red paint. Exterior sale boundary lines against private property are marked with blue paint. Exterior sale boundary lines against state are marked with red paint. The painted boundary line trees are not Included Timber and are to be protected. The western edge of the oil well acts as the Payment Unit line between Payment Units 2 and 3; it is not painted and is included timber.

2 - Timber Specifications

2.1 - Included Timber

2.1.1 - Clearcut unit(s) with unmerchantable trees (6/14)

Within Payment Unit(s) 1-3, cut all trees that are two (2) inches or more at DBH, except do not cut any cedar, red pine, or white pine.

Special protection trees identified in accordance with condition 3.4.2, within clearcutting unit boundaries, are not Included Timber and are to be protected.

2.2 - Utilization

2.2.6 - Roundwood operation required (5/07)

The skidding of whole trees or tree segments with limbs attached is prohibited within Payment Units 1-3. All products must be produced as roundwood and forwarded to existing roads or landing areas in final product length.

3 - Payments

3.4 - Damaged Timber

3.4.1 - Damaged timber (6/14)

General Condition and Requirement 3.4 Damaged Timber, defines liquidated damages for undesignated live merchantable trees which are cut or injured. In addition, extreme care should be taken to avoid damage to tree seedlings and saplings.

Within Payment Unit 1, if more than 25% of the oak tree seedlings or saplings (1/4" to 4.5" DBH) within a specified portion of the sale area are damaged, liquidated damages will be assessed at \$200 per acre for all acreage within that specified portion of the sale area that was damaged.

No damage is acceptable to undesignated merchantable trees. Within the sale area, if more than 5% of trees (> 4.5" DBH) within a specified area of the sale are damaged, liquidated damages will be assessed for all trees damaged. Rates will be in accordance with General Condition and Requirement 3.4 Damaged Timber.

3.4.2 - Special Protection Trees (4/14)

The Purchaser shall not cut live or dead special protection trees within cutting units or clearings. Special protection trees are red pine and white pine, twenty six (26) inches or more at DBH. If the Purchaser's operations have cut or damaged special protection trees through carelessness, the Purchaser shall pay \$250 as fixed, agreed and liquidated damages for each special protection tree cut or damaged. Such payment does not constitute ownership of the undesignated timber.

4 - Transportation

4.1 - Construction

4.1.3 - Slash and earthen piles (8/04)

Piles or windrows of earth along roads and landings that have been widened or constructed shall be leveled. Slash from road maintenance or construction, including stumps, shall be dispersed throughout the sale.

4.1.6 - Road construction (1/09)

Improvements of existing roads shall be done in such a way as to minimize the environmental and visual impacts. Merchantable trees shall be cut and utilized unless otherwise directed. Non-merchantable trees shall be severed and laid flat on the ground. Slash shall be scattered, and not left in windrows and kept a minimum of 10 feet back from the road edge. Stumps shall be set upright, not left on edge, and be moved at least 10 feet away from the road edge. Disturbed soil shall be feathered into the woods and not left in berms or windrows.

4.1.12 - No new roads (1/12)

No new roads will be permitted in any Payment Unit. All operations are limited to existing roads. Skid trails only will be allowed.

4.2 - Maintenance

4.2.5 - Two wheel drive condition (2/04)

All existing trail roads on and adjacent to the sale area must be passable by two-wheel drive traffic for the duration of the sale.

5 - Operations

5.1 - Notification

5.1.1 - Pre-sale conference (10/16)

A pre-sale conference on site between the Purchaser and sale administrator is required prior to beginning operations in any Payment Unit. This conference will be used to determine landing and road access locations. The Unit Manager or his/her representative must be contacted at least 5 business days in advance to schedule the conference.

5.1.3 - Well heads and natural gas pipelines (11/15)

The Purchaser is responsible for contacting the gas or pipeline company 30 days prior to operating equipment in the vicinity of well heads or natural gas pipelines. Contact the sale administrator for details.

5.1.4 - Post-sale conference (10/16)

A post-sale conference on site between the Purchaser and sale administrator is required 5 days prior to the completion of active logging operations to determine clean-up and repair of landings, road edges, and the fulfillment of other contract specifications.

5.2 - Conduct of Operations

5.2.1 - Slash

5.2.1.10 - No slash in openings (5/10)

No brush or logging debris is to be left in the oil well openings which are indicated by G0 on the Timber Sale Map. Any damage to the opening shall be repaired according to specifications of the Unit Manager or his/her representative.

5.2.2 - Hazard Trees/Snags

5.2.2.1 - Den trees (10/16)

Obvious hollow and/or den trees shall be protected and left standing unless they are a safety hazard.

5.2.3 - Operating Restrictions

5.2.3.2 - Operating restrictions (9/11)

Within Payment Unit(s) 1, soils must be either be in dry or frozen conditions. This restriction is due to areas of saturated soils in Payment Unit 1.

Note: There is a harvesting restriction period to protect the Eastern Massasauga Rattlesnake (see spec 5.8.8 for details).

5.2.3.11 - Coppice regeneration protection (4/10)

Timber harvesting in any Payment Unit must be completed before significant deciduous sprouting occurs in that Payment Unit so as to minimize damage to the new regeneration. Any post harvest operations must be completed before sprouting of regeneration occurs. The Unit Manager or his/her representative may cease such operations if sprouting occurs before the operation is complete.

5.2.4 - Dead and Down Creation

5.2.4.6 - Dead and down creation, other (9/09)

To encourage reptiles and amphibians, within Payment Unit(s) 1-3, create one brush pile for every 2 acres. Brush piles must be at least 6 feet by 6 feet, with a thickness of 4 feet, and dense enough to substantially shade the ground. These brush piles will preferably be placed near lowland edges and at least 2 chains away from any roads, two-tracks, or trails open to vehicles.

5.2.4.7 - Dead and down creation: hare, grouse, deer and other species (5/15)

To improve horizontal cover habitat for snowshoe hare, grouse, deer, and other species, the Purchaser is to push over one tree 10 inches in DBH or greater for every 2 acres within Payment Units 2 and 3. Along lowland edges, conifers are preferred in order to provide a longer benefit period for snowshoe hare and other species. In upland areas, further away from lowland edges, deciduous trees are preferable for the benefit of grouse and other species. These trees should be tipped over with the root ball still attached so the base of the tree is suspended off the ground. The crown of the fallen tree should be at or near ground level after it is pushed over. These pushed over trees will preferably be at least 2 chains away from any road, two-track, or trail open to vehicles.

5.2.32 - Decking/landing restoration (9/13)

All decking and landing areas must have the surface area restored to a condition equal to or better than before. This is to ensure the proper regeneration of the stand. Wood debris, chips and "cookies" from trimmings must be removed or scattered away from landing and loading areas and may not be windrowed on the edge.

5.2.33 - Gas well re-vegetation (12/08)

In the event that the gas well is utilized for a landing, the site must be re-vegetated with a seeding mixture specified by the Unit Manager or his/her representative.

5.2.43 - Opening protection (12/08)

No activities are permitted in openings marked on the Timber Sale Map with the letter "G". Any damage to the openings shall be repaired according to specifications of the Unit Manager or his/her representative.

5.4 - Soil Protection

5.4.1 - Rutting restriction, general (7/16)

Operations are to cease immediately if equipment and weather conditions result in rutting of roads and/or skid trails which is 12 inches or greater in depth and 50 feet in length. The Unit Manager or his/her representative may restrict hauling and/or skidding if ruts exceed the specified depth. With the Unit Manager or his/her representative's approval, the Purchaser may return to the area when the risk of rutting has decreased.

5.8 - Protection of Endangered Species

5.8.5 - Protection of raptor nests (3/13)

All trees with raptor nests will be protected if found during harvesting operations. Notification will be made to the Unit Manager or his/her representative who will notify the Wildlife Biologist so an on-site evaluation and recommendation can be made, if necessary.

5.8.8 - Protected species, other (2/12)

Within Payment Unit(s) 1-3, no harvest activities shall occur during the period of April 1 to October 1. In addition, wood cut during the operational period must be hauled prior to April 1, or within 6 months of piling, whichever comes first. This restriction is to protect the habitat of the threatened Eastern Massasauga Rattlesnake.

6 - Safety and Fire Prevention

6.2 - Signing

6.2.1 - Road posting (9/09)

The Purchaser is responsible for posting and maintaining caution signs on forest roads prior to beginning operations. The road must be posted at appropriate distances from the sale area to warn of logging activity and truck traffic. Signs must be removed when harvest operations are suspended or completed. The Purchaser will provide these signs.



TIMBER SALE MAP

This information provided by authority of Part 525, 1994 PA 451, as amended.

Sale Number	Year
54-013	19

Forest Management Unit Atlanta	County Alpena	Mapped By D. Parris	Date 6/24/2019	Page 1	of 1
Township 29N		Range 06E		Section(s) and Subdivision(s) Sec 14 SWSW; Sec 15 SENE, E1/2SE; Sec 23 NWNW	

Scale	1:7,920
-------	---------

Cover Type				Density	
A = Aspen	H = Hemlock	N = Marsh	U = Upland Brush	0 = Non Stocked	5 = Pole Timber Medium
B = Paper Birch	J = Jack Pine	O = Oak	UM = Upland Mixed	1 = Seedling Sapling Poor	6 = Pole Timber Well
C = Cedar	L = Lowland Brush	P = Lowland Poplar	V = Bog or Marsh	2 = Seedling Sapling Medium	7 = Saw Timber Poor
D = Treed Bog	LM = Lowland Mixed	Q = Mixed Swamp Conifer	W = White Pine	3 = Seedling Sapling Well	8 = Saw Timber Medium
E = Swamp Hdwoods	M = Mpl, Bch, Brch	R = Red Pine	X = Non Stocked	4 = Pole Timber Poor	9 = Saw Timber Well
F = Spruce Fir	MC = Mixed Conifer	S = Black Spruce	Z = Water		
G = Grass	MD = Mixed Deciduous	T = Tamarack			

PU	Acres
1	7.6
2	12.6
3	12.6

Nichol's End

Compartment 79

32.8 Acres

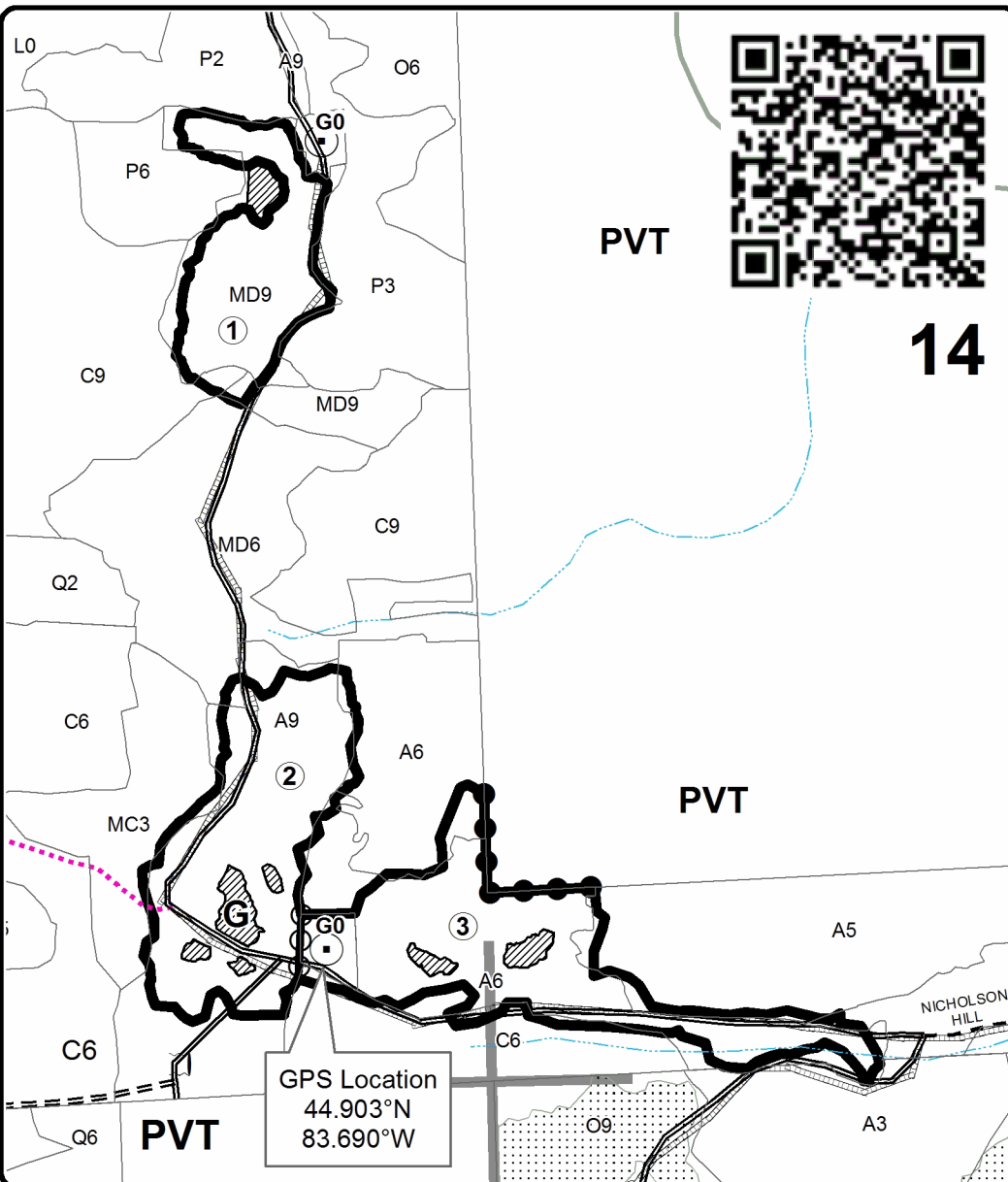
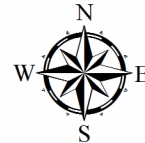

Legend

- Against State (Red)
- Payment Unit (Not Painted)
- Private Line (Blue)
- Payment Unit
- ▨ Retention Area (Red)
- Stand Boundaries
- ⋯ Nearby Timber Sales
- ⊙ Oil & Gas Well Surface Locations
- == Secondary Forest Road
- == Forest Access Route
- - Gravel Road
- Private Road
- ⋯ Temporary Management Access
- ▭ Pipeline
- ⋯ Intermittent Stream
- Section Corners

Locator Map
1:200,000

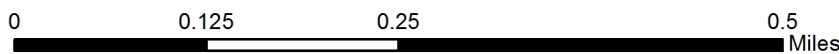
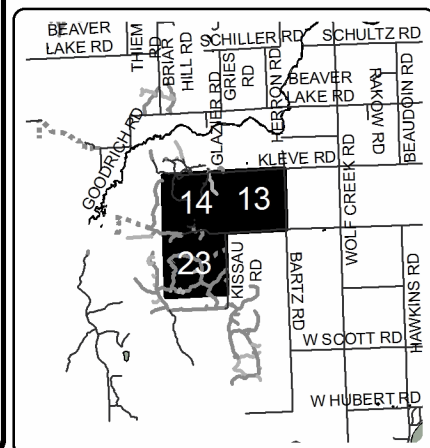

TIMBER SALE INFORMATION

Devils Ridge Mix (54-022-19)
T30N, R08E, SEC. 17; T30N, R08E, SEC. 20; T30N, R08E, SEC. 8.
Alpena County (Advertised Price \$6,613.65)

SALE NOTE: Extensive road work is required on this sale (see spec 4.2.3 for details). The advertised price has been reduced by the estimate cost of this road work to off-set the additional expense.

A recreation site such as a trail, pathway, or campground is within the sale area or the vicinity. Certain restrictions/specifications may be applicable including time restrictions.

A timber sale contract for this lump sum, sealed bid timber sale will be awarded to the responsible bidder offering the highest sealed bid price. Bids must be at or above the following advertised price for each species:

<u>PRODUCTS & SPECIES</u>	<u>ESTIMATED UNITS*</u>	<u>ADVERTISED PRICE</u>
Sawtimber		
B. T. Aspen	10.60 MBF	\$ 51.00 / MBF
Red Maple	3.20 MBF	\$ 62.00 / MBF
Pulpwood		
Balsam Fir	39.00 Cords	\$ 16.60 / Cord
Jack Pine	1.00 Cords	\$ 15.05 / Cord
Mixed Aspen	187.00 Cords	\$ 15.25 / Cord
Mixed Spruce	11.00 Cords	\$ 8.15 / Cord
Paper Birch	61.00 Cords	\$ 10.75 / Cord
Red Maple	104.00 Cords	\$ 14.80 / Cord
Red Pine	1.00 Cords	\$ 36.85 / Cord
White Pine	2.00 Cords	\$ 19.50 / Cord

* The total volume is statistically estimated within plus (+) or minus (-) 16.25 percent. The estimated units are final and not subject to adjustment. Prospective bidders are urged to examine this timber and to make their own estimates of quantity and quality.

BOND AND PAYMENT SCHEDULE:

1. A bond in the amount of \$331.00 to insure faithful performance of the conditions of the contract will be deposited by the successful bidder within 21 days of the sale award.
2. Cutting in any sale or unit without the required advance payment would be considered a trespass.
3. Total payment must be paid in advance or according to the following schedule :
 - (a) Ten percent (10%) of the sale value must be paid within 21 days of the sale award.
 - (b) The 10% down payment will be credited towards the first unit cut.
 - (c) Payment for each of the following units must be made before cutting begins in that unit:

PAYMENT UNIT NUMBER	PERCENT OF TOTAL SALE VALUE
01	38.7%
02	27.5%
03	33.8%

4. If no cutting takes place, the 10% down payment will not be refunded.
5. Operations on the contract issued will terminate on 12/31/2022.

Description of Timber by Payment Unit (PU)

PU	MARKET GROUP	PRODUCT	QUANTITY	UNIT	ACRES	ADVERTISE PRICE
1	B. T. Aspen	Sawtimber	2.8	MBF	9.7	\$2,562.75
	Red Maple		0.5	MBF		
	Balsam Fir	Pulpwood	30.0	Cords		
	Jack Pine		1.0	Cords		
	Mixed Aspen		74.0	Cords		
	Mixed Spruce		5.0	Cords		
	Paper Birch		16.0	Cords		
	Red Maple		31.0	Cords		
	Red Pine		1.0	Cords		
	White Pine		2.0	Cords		
	2	B. T. Aspen	Sawtimber	4.0		
Red Maple			0.8	MBF		
Balsam Fir		Pulpwood	1.0	Cords		
Mixed Aspen			41.0	Cords		
Mixed Spruce			1.0	Cords		
Paper Birch			23.0	Cords		
Red Maple			45.0	Cords		
3		B. T. Aspen	Sawtimber	3.8	MBF	8.4
	Red Maple		1.9	MBF		
	Balsam Fir	Pulpwood	8.0	Cords		
	Mixed Aspen		72.0	Cords		
	Mixed Spruce		5.0	Cords		
	Paper Birch		22.0	Cords		
	Red Maple		28.0	Cords		
	TOTAL:			13.8	MBF	
TOTAL:			406.0	Cords		

Sale Specific Conditions & Requirements

Sale Name: Devils Ridge Mix

Sale Number: 54-022-19 Seq#: 2

1 - Sale Area

1.2 - Boundaries

1.2.1 - Painted boundaries (1/14)

The sale boundaries are marked and identified red paint. Exterior sale boundary lines against state are marked with red paint. The painted boundary line trees are not Included Timber and are to be protected.

2 - Timber Specifications

2.1 - Included Timber

2.1.1 - Clearcut unit(s) with unmerchantable trees (6/14)

Within Payment Unit(s) 1-3, cut all trees that are two (2) inches or more at DBH, except do not cut any cedar, oak, red pine, or white pine; unless the tree has been marked with orange paint.

2.2 - Utilization

2.2.6 - Roundwood operation required (5/07)

The skidding of whole trees or tree segments with limbs attached is prohibited within all Payment Units. All products must be produced as roundwood and forwarded to existing roads or landing areas in final product length.

3 - Payments

3.4 - Damaged Timber

3.4.1 - Damaged timber (7/16)

General Condition and Requirement 3.4 Damaged Timber, defines liquidated damages for undesignated live merchantable trees which are cut or injured. In addition, extreme care should be taken to avoid damage to tree seedlings and saplings.

Within the sale area, if more than 25% of the oak and pine tree seedlings or saplings (1/4" to 4.5" DBH) within a specified portion of the sale area are damaged, liquidated damages will be assessed at \$200 per acre for all acreage within that specified portion of the sale area that was damaged.

No damage is acceptable to undesignated live merchantable trees. Within the sale area, if more than 5% of undesignated live merchantable trees (> 4.5" DBH) within a specified area of the sale are damaged, liquidated damages will be assessed for all trees damaged. Rates will be in accordance with General Condition and Requirement 3.4 Damaged Timber.

4 - Transportation

4.1 - Construction

4.1.2 - Stream crossings, specific (3/11)

A stream runs along the south edge of the northern portion of Payment Unit 1. Crossing the stream with harvesting and forwarding equipment will require the installation of a portable bridge, which may be borrowed from the DNR. The location where the bridge is required is shown on the Timber Sale Map. This installation must be performed in accordance with the specifications on the appropriate permits which shall be provided by the DNR.

4.1.3 - Slash and earthen piles (8/04)

Piles or windrows of earth along roads and landings that have been widened or constructed shall be leveled. Slash from road maintenance or construction, including stumps, shall be dispersed throughout the sale.

4.1.6 - Road construction (1/09)

Improvements of existing roads shall be done in such a way as to minimize the environmental and visual impacts. Merchantable trees shall be cut and utilized unless otherwise directed. Non-merchantable trees shall be severed and laid flat on the ground. Slash shall be scattered, and not left in windrows and kept a minimum of 10 feet back from the road edge. Stumps shall be set upright, not left on edge, and be moved at least 10 feet away from the road edge. Disturbed soil shall be

feathered into the woods and not left in berms or windrows.

4.1.12 - No new roads (1/12)

No new roads will be permitted in any Payment Unit. All operations are limited to existing roads. Skid trails only will be allowed.

4.2 - Maintenance

4.2.3 - Road maintenance (8/13)

The following road maintenance is required: Devils Lake Trail must be improved to allow for safe hauling and harvesting operations. At close of sale, the Purchaser shall leave Devils Lake Trail in a condition that is equal to or better than its condition prior to beginning sale operations. Pre-existing holes and washouts will be identified and marked during the pre-sale conference. The Purchaser must repair all forest road damage resulting from harvest operations and hauling at the close of sale operations and/or prior to any suspension in harvest activities that will last more than 15 calendar days. The Purchaser will be required to repair all holes/washouts that are determined to have been created by sale operations. Repairs made to forest roads prior to and at the close of sale operations, will require holes and washouts to be filled with a 3-minus limestone base, overlaid with 4 inches of 23A limestone, followed by grading. Damages will be assessed if grading/repair does not occur.

Note: Portions of the Devils Lake Trail overlap with the snowmobile trail (see spec 5.2.41 for details).

4.2.5 - Two wheel drive condition (2/04)

All existing trail roads on and adjacent to the sale area must be passable by two-wheel drive traffic for the duration of the sale.

5 - Operations

5.1 - Notification

5.1.1 - Pre-sale conference (10/16)

A pre-sale conference on site between the Purchaser and sale administrator is required prior to beginning any operations within a Payment Unit to determine landing and road locations. An assessment of Devils Lake Trail will be made at the pre-sale conference in accordance with spec 4.2.3.

5.1.4 - Post-sale conference (10/16)

A post-sale conference on site between the Purchaser and sale administrator is required 5 business days prior to the completion of active logging operations to determine clean-up and repair of landings, road edges, and the fulfillment of other contract specifications. Remedial road work required on Devils Lake Trail in accordance with spec 4.2.3 will be determined at this conference.

5.2 - Conduct of Operations

5.2.2 - Hazard Trees/Snags

5.2.2.1 - Den trees (10/16)

Obvious hollow and/or den trees shall be protected and left standing unless they are a safety hazard.

5.2.3 - Operating Restrictions

5.2.3.4 - Oak wilt restriction, no exceptions (1/18)

Within Payment Unit(s) 1-3, cutting, skidding, hauling within the sale and brushing of access roads to the sale are not permitted during the period of April 15 to July 15. No exceptions will be granted. This is necessary to reduce the spread of oak wilt.

5.2.3.11 - Coppice regeneration protection (4/10)

Timber harvesting in any Payment Unit must be completed before significant deciduous tree sprouting occurs in that Payment Unit so as to minimize damage to the new regeneration. Any post harvest operations, such as chipping, must be completed before sprouting of regeneration occurs. If it is anticipated that chipping will be delayed, then tops shall be carried to one central location or left unchipped. The Unit Manager or his/her representative may cease such operations if sprouting occurs before the operation is complete.

5.2.4 - Dead and Down Creation

5.2.4.7 - Dead and down creation: hare, grouse, deer and other species (5/15)

To improve horizontal cover habitat for snowshoe hare, grouse, deer, and other species, the Purchaser is to push over one tree, 12 inches or greater at DBH, for every 2 acres. Conifers designated for harvest are preferred. These trees should be tipped over with the root ball still attached so the base of the tree is suspended off the ground. The crown of the fallen tree should be at or near ground level after it is pushed over.

In addition, to encourage cottontail rabbit populations, the Purchaser is to create one brush pile throughout the sale for every 2 acres. Each brush pile should be constructed from at least 6 tops. Brush piles should be spread evenly throughout the sale. Pushed over trees and brush piles are to be located near the edge of the harvested stand and out of sight of those using forest roads where possible.

5.2.17 - Timber Mats and Interlocking Composite Mats (3/18)

A stream runs along the south edge of the northern portion of Payment Unit 1. A bridge is required for harvesting and forwarding equipment to cross this stream. The location where the bridge is required is shown on the Timber Sale Map.

If by the Michigan Department of Environment, Great Lakes, and Energy (EGLE) permitting standards, a bridge constructed of timber mats is found to be adequate for protecting the stream crossing, then a portable bridge will not be required as outlined in spec 4.1.2. The MDNR will supply all necessary permits. Contact the MDNR Atlanta office 30 days prior to bridge construction to allow time for obtaining the necessary stream crossing permits. This installation must be performed in accordance with the specifications on the appropriate permits which shall be provided by the DNR.

Timber mats are available from various field offices. If available, timber mats may be borrowed from the DNR. A Timber Sale Contract Supplement will be used to document the Purchaser's use of the DNR's mats. The Purchaser is responsible for picking up and hauling the mats to and from the site. Contact the sale administrator to schedule at least 30 days before the desired install/removal date regarding availability and pick up. All mats must be cleaned prior to drop off. This may include, but is not limited to, power washing and brushing to remove mud and debris. A charge of \$400.00 per timber mat will be assessed for all damaged or non-returned mats. Damage for the crane/timber mats is defined as three or more broken cants.

5.2.32 - Decking/landing restoration (9/13)

All decking and landing areas must have the surface area restored to a condition equal to or better than before. This is to ensure the proper regeneration of the stand. Wood debris, chips and "cookies" from trimmings must be removed or scattered away from landing and loading areas and may not be windrowed on the edge.

5.2.38 - No decking against live trees (2/04)

Cut products may not be decked against unmarked or designated leave trees.

5.2.41 - Snowmobile trail protection (9/11)

The Devils Lake Loop/LP468 snowmobile trail is shown on the Timber Sale Map. Do not cut or damage posts with orange trail markers or traffic control signs. If the trail is used, it must be maintained and restored to a condition equal to or better than before the sale. The road maintenance/restoration must be done prior to December 1. If the trail is used for hauling, it must be graded to the satisfaction of the Unit Manager or his/her representative prior to December 1. The snowmobile trail may not be used for any timber sale operations from December 1 to March 31. The snowmobile trail may only be crossed at right angles. Maintain a 20 foot wide slash, debris, and rut free zone daily using the snowmobile trail as the centerline. All wood decked along the snowmobile trail will need to be at least 10 feet from the trails edge. All stumps within 10 feet of the snowmobile trail must be cut at ground level.

Note: Portions of this snowmobile trail overlap with the Devils Lake Trail as discussed in sale spec 4.2.3.

5.4 - Soil Protection

5.4.1 - Rutting restriction, general (7/16)

Operations are to cease immediately if equipment and weather conditions result in rutting of roads and/or skid trails which is 12 inches or greater in depth and 50 feet in length. The Unit Manager or his/her representative may restrict hauling and/or skidding if ruts exceed the specified depth. With the Unit Manager or his/her representative's approval, the Purchaser may return to the area when the risk of rutting has decreased.

5.8 - Protection of Endangered Species

5.8.3 - Red shoulder hawk or goshawk (2/16)

In the event that an active red shoulder hawk or goshawk nest is found, the contract may be amended to protect the nest site until the nest is determined to be inactive. The value of the trees in this excluded area will be refunded or credited to the Purchaser. The nest will be buffered with a five-chain radius (eight acre) protection area, centered on the nest tree, in which there will be no cutting or new roads constructed. Avoid human disturbance, including loading and skidding, in the protection area.

An additional zone of five chains (ten chains centered on the active nest tree) will be established in which there is no management activity from March 15 to July 15. Limit biomass harvesting and chipping operations within this ten-chain zone, retain the maximum one-third of residues per the Woody Biomass Harvesting Guidelines (Michigan DNR 2010). Nests determined to be inactive will be protected with a one-chain no-harvest buffer.

6 - Safety and Fire Prevention

6.2 - Signing

6.2.3 - Recreational trail posting (2/10)

The Purchaser is responsible for posting and maintaining caution signs on Devils Lake Trail and the Devils Lake Loop/LP468 snowmobile trail prior to beginning operations. The trail must be posted at appropriate distances from the sale area to warn of logging activity and truck traffic at both ends of the trail. Signs must be removed when harvest operations are suspended or completed. The Purchaser will provide these signs.

7 - Other Conditions

7.3 - Contract Modifications

7.3.2 - Modification for oak wilt (2/05)

Within the sale area, there may be patches of oak wilt. If oak wilt is identified within the sale area, this contract may be modified. The following modifications could occur: time of cutting, species to cut, volume to harvest, or various others dealing with the treatment of oak wilt. If a species is not specified in this contract, it shall be paid for at the average price received for that species and product.



TIMBER SALE MAP

This information provided by authority of Part 525, 1994 PA 451, as amended.

Forest Management Unit Atlanta		County Alpena	Mapped By D. Parris	Date 08/27/2019	Page 1	of 2
Township 30N	Range 08E	Section(s) and Subdivision(s) Sec 8 NESW, S1/2SW; Sec 17 NWNW, SESW, SWSE; Sec 20 NW		Scale 1:7,920		

Cover Type				Density			
A = Aspen	H = Hemlock	N = Marsh	U = Upland Brush	0 = Non Stocked	5 = Pole Timber Medium		
B = Paper Birch	J = Jack Pine	O = Oak	UM = Upland Mixed	1 = Seedling Sapling Poor	6 = Pole Timber Well		
C = Cedar	L = Lowland Brush	P = Lowland Poplar	V = Bog or Marsh	2 = Seedling Sapling Medium	7 = Saw Timber Poor		
D = Treed Bog	LM = Lowland Mixed	Q = Mixed Swamp Conifer	W = White Pine	3 = Seedling Sapling Well	8 = Saw Timber Medium		
E = Swamp Hdwoods	M = Mpl, Bch, Brch	R = Red Pine	X = Non Stocked	4 = Pole Timber Poor	9 = Saw Timber Well		
F = Spruce Fir	MC = Mixed Conifer	S = Black Spruce	Z = Water				
G = Grass	MD = Mixed Deciduous	T = Tamarack					

PU	Acres
1	9.7
2	9.4
3	8.4

Devils Ridge Mix

Compartment 89

27.5 Acres

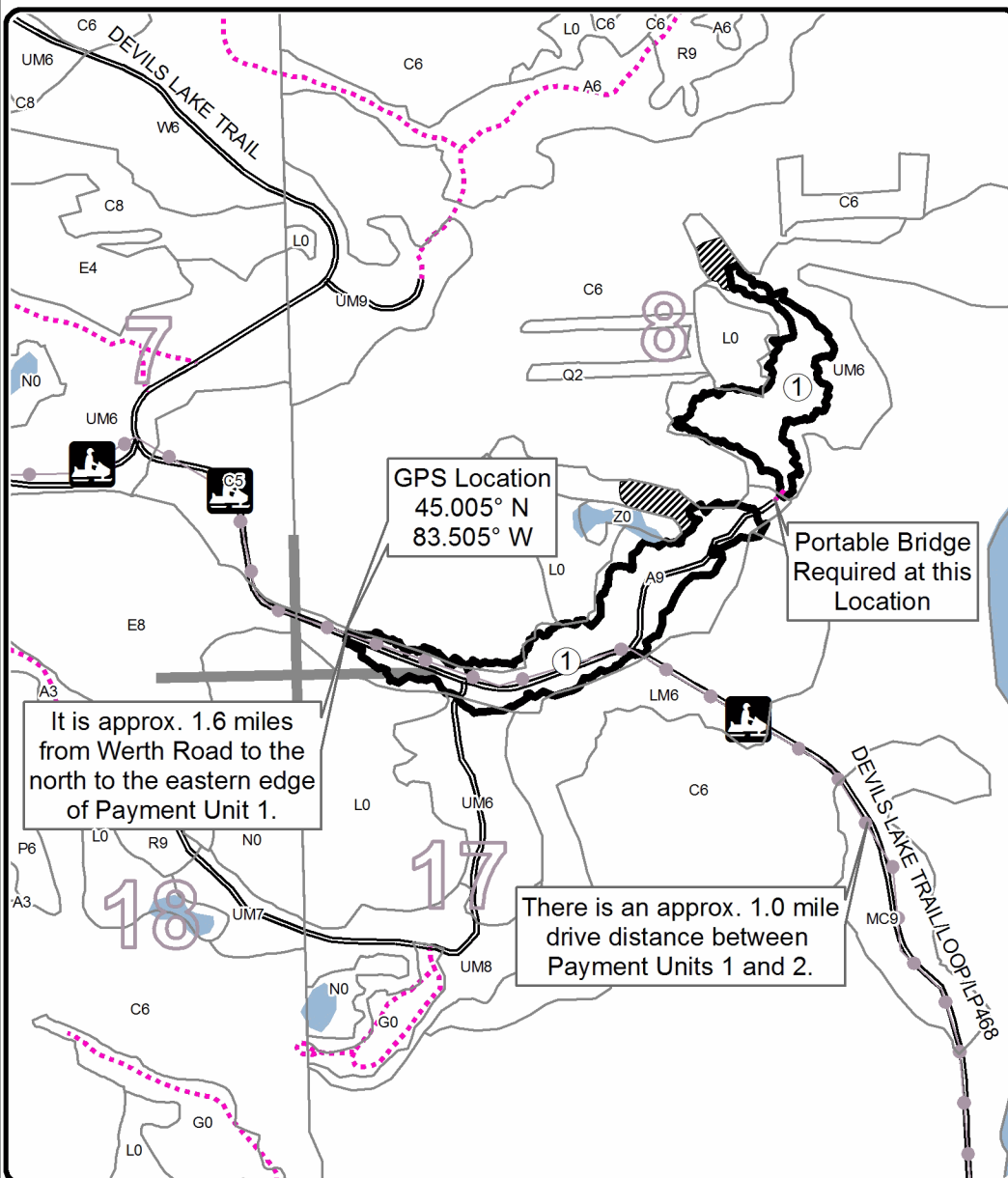
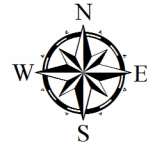

It is approx. 1.6 miles from Werth Road to the north to the eastern edge of Payment Unit 1.

There is an approx. 1.0 mile drive distance between Payment Units 1 and 2.

Legend

- Against State (Red)
- Stand Boundaries
- ▨ Retention Area
- Payment Unit
- Secondary Forest Road
- ⋯ Temporary Management Access
- Recreational Trail
- Lakes
- Section Corners



Locator Map
1:200,000

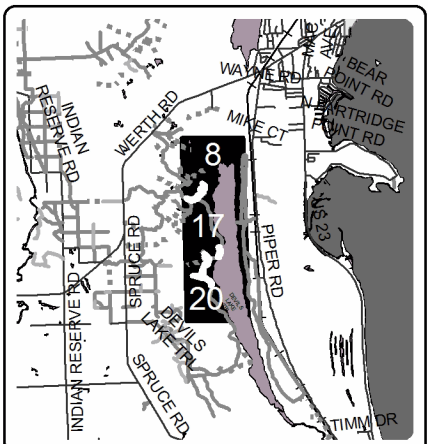



TIMBER SALE MAP

This information provided by authority of Part 525, 1994 PA 451, as amended.

Forest Management Unit Atlanta		County Alpena	Mapped By D. Parris	Date 08/27/2019	Page 2	of 2
Township 30N	Range 08E	Section(s) and Subdivision(s) Sec 8 NESW, S1/2SW; Sec 17 NWNW, SESW, SWSE; Sec 20 NW		Scale 1:7,920		

Cover Type				Density	
A = Aspen	H = Hemlock	N = Marsh	U = Upland Brush	0 = Non Stocked	5 = Pole Timber Medium
B = Paper Birch	J = Jack Pine	O = Oak	UM = Upland Mixed	1 = Seedling Sapling Poor	6 = Pole Timber Well
C = Cedar	L = Lowland Brush	P = Lowland Poplar	V = Bog or Marsh	2 = Seedling Sapling Medium	7 = Saw Timber Poor
D = Tread Bog	LM = Lowland Mixed	Q = Mixed Swamp Conifer	W = White Pine	3 = Seedling Sapling Well	8 = Saw Timber Medium
E = Swamp Hdwoods	M = Mpl, Bch, Brch	R = Red Pine	X = Non Stocked	4 = Pole Timber Poor	9 = Saw Timber Well
F = Spruce Fir	MC = Mixed Conifer	S = Black Spruce	Z = Water		
G = Grass	MD = Mixed Deciduous	T = Tamarack			

PU	Acres
1	9.7
2	9.4
3	8.4

Devils Ridge Mix

Compartment 89

27.5 Acres

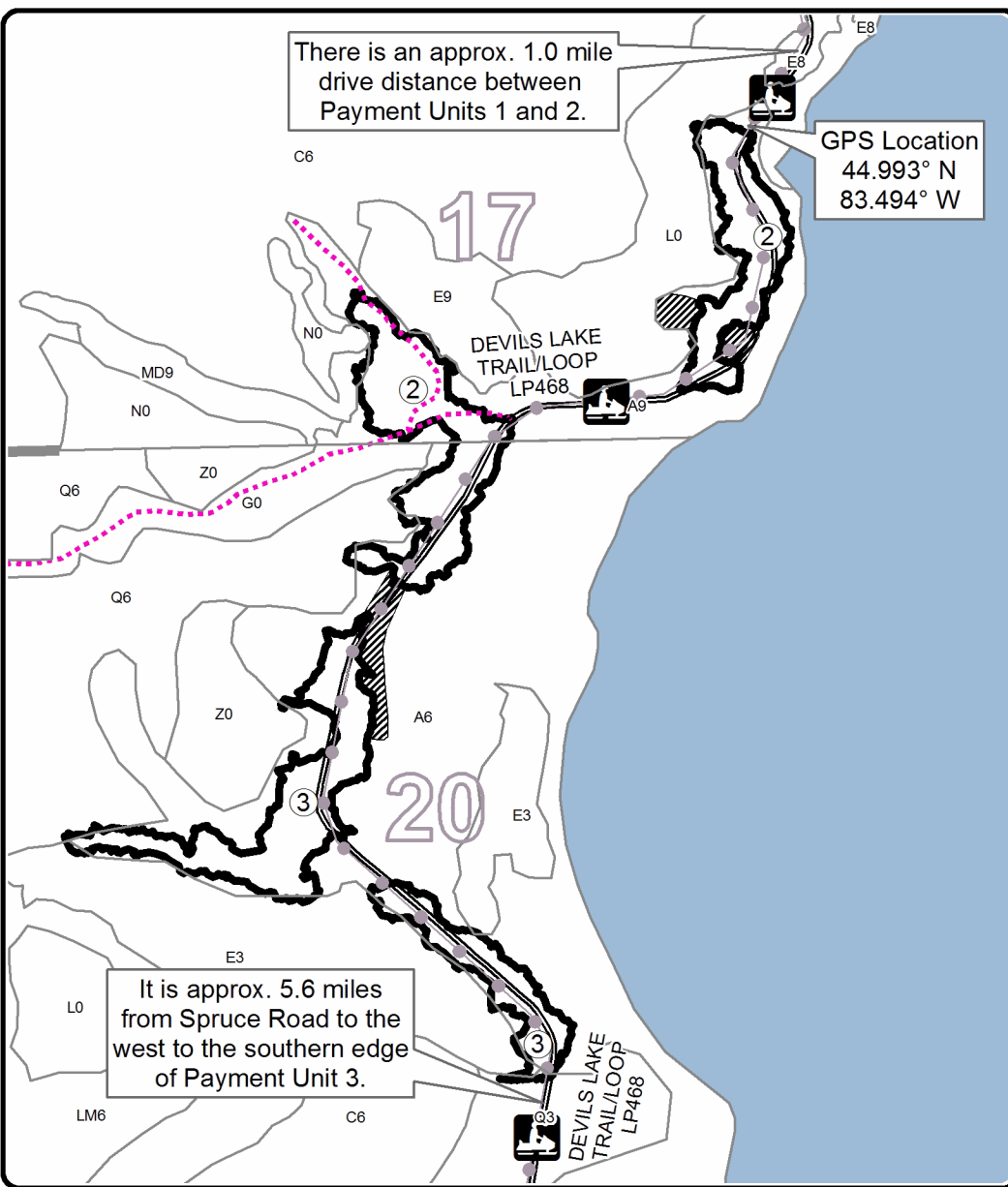
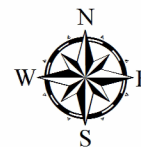

GPS Location
44.993° N
83.494° W

Legend

- Against State (Red)
- Stand Boundaries
- ▨ Retention Area
- Payment Unit
- Secondary Forest Road
- ⋯ Temporary Management Access
- Recreational Trail
- Lakes
- Section Corners



Locator Map
1:200,000

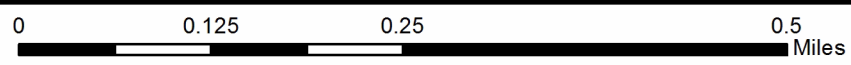
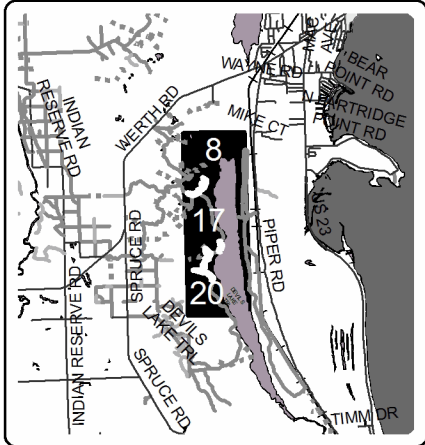

TIMBER SALE INFORMATION

Lay Road Ridge Country Mix (54-024-19)
 T30N, R08E, SEC. 5.
 Alpena County (Advertised Price \$11,655.45)

A timber sale contract for this lump sum, sealed bid timber sale will be awarded to the responsible bidder offering the highest sealed bid price. Bids must be at or above the following advertised price for each species:

<u>PRODUCTS & SPECIES</u>	<u>ESTIMATED UNITS*</u>		<u>ADVERTISED PRICE</u>
Sawtimber			
B. T. Aspen	13.60	MBF	\$ 58.00 / MBF
Bl/R/Hybrid Oak	2.50	MBF	\$ 69.00 / MBF
Red Maple	3.50	MBF	\$ 72.00 / MBF
Red Pine	5.10	MBF	\$ 100.00 / MBF
White Pine	12.20	MBF	\$ 61.00 / MBF
Pulpwood			
Balsam Fir	26.00	Cords	\$ 19.10 / Cord
Bl/R/Hybrid Oak	9.00	Cords	\$ 24.55 / Cord
Jack Pine	16.00	Cords	\$ 17.30 / Cord
Mixed Aspen	220.00	Cords	\$ 17.60 / Cord
Mixed Spruce	2.00	Cords	\$ 9.40 / Cord
Paper Birch	19.00	Cords	\$ 12.35 / Cord
Red Maple	83.00	Cords	\$ 17.05 / Cord
Red Pine	19.00	Cords	\$ 42.45 / Cord
Tamarack	2.00	Cords	\$ 14.00 / Cord
White Pine	81.00	Cords	\$ 22.45 / Cord

* The total volume is statistically estimated within plus (+) or minus (-) 17.52 percent. The estimated units are final and not subject to adjustment. Prospective bidders are urged to examine this timber and to make their own estimates of quantity and quality.

BOND AND PAYMENT SCHEDULE:

1. A bond in the amount of \$583.00 to insure faithful performance of the conditions of the contract will be deposited by the successful bidder within 21 days of the sale award.
2. Cutting in any sale or unit without the required advance payment would be considered a trespass.
3. Total payment must be paid in advance or according to the following schedule :
 - (a) Ten percent (10%) of the sale value must be paid within 21 days of the sale award.
 - (b) The 10% down payment will be credited towards the first unit cut.
 - (c) Payment for each of the following units must be made before cutting begins in that unit:

PAYMENT UNIT NUMBER	PERCENT OF TOTAL SALE VALUE
01	32.6%
02	21.8%
03	45.6%
4. If no cutting takes place, the 10% down payment will not be refunded.
5. Operations on the contract issued will terminate on 12/31/2022.

Description of Timber by Payment Unit (PU)

PU	MARKET GROUP	PRODUCT	QUANTITY	UNIT	ACRES	ADVERTISE PRICE	
1	B. T. Aspen	Sawtimber	8.2	MBF	8.8	\$3,797.75	
	Red Maple		2.8	MBF			
	Red Pine		0.8	MBF			
	White Pine		0.4	MBF			
	Balsam Fir		Pulpwood	4.0			Cords
	Mixed Aspen			99.0			Cords
	Paper Birch			7.0			Cords
	Red Maple			41.0			Cords
	Red Pine			6.0			Cords
	White Pine			7.0			Cords
	White Pine			7.0			Cords
2	B. T. Aspen	Sawtimber	3.8	MBF	6.8	\$2,537.90	
	Bl/R/Hybrid Oak		1.1	MBF			
	White Pine		1.2	MBF			
	Balsam Fir		Pulpwood	18.0			Cords
	Bl/R/Hybrid Oak			5.0			Cords
	Jack Pine			4.0			Cords
	Mixed Aspen			60.0			Cords
	Paper Birch			2.0			Cords
	Red Maple			6.0			Cords
	Red Pine			2.0			Cords
	Tamarack			2.0			Cords
	White Pine			15.0			Cords
	3			B. T. Aspen			Sawtimber
Bl/R/Hybrid Oak		1.4	MBF				
Red Maple		0.7	MBF				
Red Pine		4.3	MBF				
White Pine		10.6	MBF				
Balsam Fir		Pulpwood	4.0	Cords			
Bl/R/Hybrid Oak			4.0	Cords			
Jack Pine			12.0	Cords			
Mixed Aspen			61.0	Cords			
Mixed Spruce			2.0	Cords			
Paper Birch			10.0	Cords			
Red Maple			36.0	Cords			
Red Pine			11.0	Cords			
White Pine			59.0	Cords			
TOTAL:			36.9	MBF			
TOTAL:			477.0	Cords			

Sale Specific Conditions & Requirements

Sale Name: Lay Road Ridge Country Mix

Sale Number: 54-024-19 Seq#: 2

1 - Sale Area

1.2 - Boundaries

1.2.1 - Painted boundaries (1/14)

The sale boundary and Payment Unit boundaries are marked and identified by blue, red, and orange paint. Exterior sale boundary lines against private property are marked with blue paint. Exterior sale boundary lines against state are marked with red paint. Interior Payment Unit boundaries are marked with orange paint. The painted boundary line trees are not Included Timber and are to be protected. Orange painted trees designating an interior Payment Unit boundary are only to be cut when all surrounding Payment Units have been paid.

2 - Timber Specifications

2.1 - Included Timber

2.1.1 - Clearcut unit(s) with unmerchantable trees (6/14)

Within Payment Unit(s) 1-3, cut all trees that are two (2) inches or more at DBH, except do not cut any green marked trees or cedar; unless marked with yellow paint.

Within Payment Unit 1, do not cut any pine; unless marked with yellow paint.

Within Payment Unit 3, do not cut any red pine; unless marked with yellow paint.

Special protection trees identified in accordance with condition 3.4.2, within clearcutting unit boundaries, are not Included Timber and are to be protected.

2.2 - Utilization

2.2.6 - Roundwood operation required (5/07)

The skidding of whole trees or tree segments with limbs attached is prohibited within Payment Unit(s) 1-3. All products must be produced as roundwood and forwarded to existing roads or landing areas in final product length.

3 - Payments

3.4 - Damaged Timber

3.4.1 - Damaged timber (7/16)

General Condition and Requirement 3.4 Damaged Timber, defines liquidated damages for undesignated live merchantable trees which are cut or injured. In addition, extreme care should be taken to avoid damage to tree seedlings and saplings.

Within the sale area, if more than 25% of the oak and pine tree seedlings or saplings (1/4" to 4.5" DBH) within a specified portion of the sale area are damaged, liquidated damages will be assessed at \$200 per acre for all acreage within that specified portion of the sale area that was damaged.

No damage is acceptable to undesignated live merchantable trees. Within the sale area, if more than 5% of trees (greater than 4.5" DBH and less than 20" DBH) within a specified area of the sale are damaged, liquidated damages will be assessed for all trees damaged. Rates will be in accordance with General Condition and Requirement 3.4 Damaged Timber.

3.4.2 - Special Protection Trees (4/14)

The Purchaser shall not cut live or dead special protection trees within cutting units or clearings. Special protection trees are any red pine or white pine twenty (20) inches or more at DBH within Payment Unit 1, green marked trees within Payment Units 2 and 3, and red pine twenty (20) inches or more at DBH within Payment Unit 3. If the Purchaser's operations have cut or damaged special protection trees through carelessness, the Purchaser shall pay \$100 per damaged tree as fixed, agreed and liquidated damages for each special protection tree cut or damaged. Such payment does not constitute ownership of the undesignated timber.

4 - Transportation

4.1 - Construction

4.1.3 - Slash and earthen piles (8/04)

Piles or windrows of earth along roads and landings that have been widened or constructed shall be leveled. Slash from road maintenance or construction, including stumps, shall be dispersed throughout the sale.

4.1.6 - Road construction (1/09)

Improvements of existing roads shall be done in such a way as to minimize the environmental and visual impacts. Merchantable trees shall be cut and utilized unless otherwise directed. Non-merchantable trees shall be severed and laid flat on the ground. Slash shall be scattered, and not left in windrows and kept a minimum of 10 feet back from the road edge. Stumps shall be set upright, not left on edge, and be moved at least 10 feet away from the road edge. Disturbed soil shall be feathered into the woods and not left in berms or windrows.

4.1.7 - Road closure (10/11)

The forest road within Payment Unit 2 must be blocked off to vehicle traffic at the drainage ditch upon completion of the sale. This forest road must also be blocked off east of the drainage ditch if at any point the harvest operations within Payment Units 1 and/or 2 are to cease more than 15 days.

4.1.12 - No new roads (1/12)

No new roads will be permitted in any Payment Unit. All operations are limited to existing roads. Skid trails only will be allowed.

5 - Operations

5.1 - Notification

5.1.1 - Pre-sale conference (10/16)

A pre-sale conference on site between the Purchaser and sale administrator is required prior to beginning any operations within a Payment Unit to determine landing and road locations. The Unit Manager or his/her representative must be contacted at least 5 days in advance to schedule the conference.

5.1.4 - Post-sale conference (10/16)

A post-sale conference on site between the Purchaser and sale administrator is required 5 days prior to the completion of active logging operations to determine clean-up and repair of landings, road edges, and the fulfillment of other contract specifications.

5.2 - Conduct of Operations

5.2.2 - Hazard Trees/Snags

5.2.2.1 - Den trees (10/16)

Obvious hollow and/or den trees shall be protected and left standing unless they are a safety hazard.

5.2.3 - Operating Restrictions

5.2.3.3 - Bark slippage restriction (3/09)

Within Payment Unit(s) 1 and 3, unless changed by written agreement, cutting and skidding are not permitted during the period of April 15 to July 15. This restriction is because of bark slippage.

5.2.3.4 - Oak wilt restriction, no exceptions (1/18)

Within Payment Unit(s) 1 and 3, cutting, skidding, hauling within the sale, and brushing of access roads to the sale are not permitted during the period of April 15 to July 15. No exceptions will be granted. This is necessary to reduce the spread of oak wilt.

5.2.3.11 - Coppice regeneration protection (4/10)

Timber harvesting in any Payment Unit must be completed before significant tree sprouting occurs in that Payment Unit so as to minimize damage to the new regeneration. Any post harvest operations, such as chipping, must be completed before sprouting of regeneration occurs. If it is anticipated that chipping will be delayed, then tops shall be carried to one central location or left unchipped. The Unit Manager or his/her representative may cease such operations if sprouting

occurs before the operation is complete.

5.2.4 - Dead and Down Creation

5.2.4.7 - Dead and down creation: hare, grouse, deer and other species (5/15)

To improve horizontal cover habitat for snowshoe hare, grouse, deer, and other species, the Purchaser is to push over 1 merchantable deciduous tree, 12 inches at DBH or greater, for every 2 acres. Pushing the trees over is preferred to cutting. These trees should be tipped over with the root ball still attached so the base of the tree is suspended off the ground. The crown of the fallen tree should be at or near ground level after it is pushed over.

In addition, to encourage cottontail rabbit populations, the Purchaser is to create one brush pile throughout the sale for every 2 acres. Each brush pile should be constructed from 6 tops. Brush piles should be spread out evenly throughout the sale.

5.2.17 - Timber Mats and Interlocking Composite Mats (3/18)

To forward wood over the drainage ditch in Payment Unit 2, and possibly another drainage ditch blocking access to the south end of Payment Unit 3, place large rock (i.e. 4 inch cobble) in the drainage ditch where the forwarder will cross. Place crane mats lengthwise over the large rock for the forwarder to ride over. The large rock will permit proper drainage. The large rock is to be moved to the drainage banks post harvest to prevent erosion. This process must be used unless other methods are approved by the sale administrator. The Purchaser will supply the rock or cobble.

Timber mats are available from various field offices. If available, mats may be borrowed from the DNR. A Timber Sale Contract Supplement will be used to document the Purchaser's use of the DNR's mats. The Purchaser is responsible for picking up and hauling the mats to and from the site. Contact the sale administrator to schedule at least 30 days before desired install/removal date regarding availability. All mats must be cleaned prior to drop off. This may include, but is not limited to, power washing and brushing to remove mud and debris. A charge of \$400.00 per timber mat will be assessed for all damaged or non-returned mats. Damage for the crane/timber mats is defined as three or more broken cants.

5.2.32 - Decking/landing restoration (9/13)

All decking and landing areas must have the surface area restored to a condition equal to or better than before. This is to ensure the proper regeneration of the stand. Wood debris, chips and "cookies" from trimmings must be removed or scattered away from landing and loading areas and may not be windrowed on the edge.

5.2.38 - No decking against live trees (2/04)

Cut products may not be decked against unmarked or designated leave trees.

5.4 - Soil Protection

5.4.1 - Rutting restriction, general (7/16)

Operations are to cease immediately if equipment and weather conditions result in rutting of roads and/or skid trails which is 12 inches or greater in depth and 50 feet in length. The Unit Manager or his/her representative may restrict hauling and/or skidding if ruts exceed the specified depth. With the Unit Manager or his/her representative's approval, the Purchaser may return to the area when the risk of rutting has decreased.

5.4.5 - Soil caution (11/04)

Areas of de-vegetated exposed sandy soils are present within Payment Unit 2. Careful selection of operational routes must be implemented to limit damage to forest floor vegetation and minimize the exposure of more sandy soil.

5.8 - Protection of Endangered Species

5.8.5 - Protection of raptor nests (3/13)

All trees with raptor nests will be protected if found during harvesting operations. Notification will be made to the Unit Manager or his/her representative who will notify the Wildlife Biologist so an on-site evaluation and recommendation can be made, if necessary.

6 - Safety and Fire Prevention

6.2 - Signing

6.2.1 - Road posting (9/09)

The Purchaser is responsible for posting and maintaining caution signs on the forest roads prior to beginning operations. The road must be posted at appropriate distances from the sale area to warn of logging activity and truck traffic. Signs must be removed when harvest operations are suspended or completed. The Purchaser will provide these signs.



TIMBER SALE MAP

This information provided by authority of Part 525, 1994 PA 451, as amended.

Forest Management Unit Atlanta		County Alpena	Mapped By D. Parris	Date 08/27/2019	Page 1	of 1
Township 30N	Range 08E	Section(s) and Subdivision(s) Sec 5 N1/2SW,NWSE		Scale 1:7,920		

Cover Type				Density	
A = Aspen	H = Hemlock	N = Marsh	U = Upland Brush	0 = Non Stocked	5 = Pole Timber Medium
B = Paper Birch	J = Jack Pine	O = Oak	UM = Upland Mixed	1 = Seedling Sapling Poor	6 = Pole Timber Well
C = Cedar	L = Lowland Brush	P = Lowland Poplar	V = Bog or Marsh	2 = Seedling Sapling Medium	7 = Saw Timber Poor
D = Tread Bog	LM = Lowland Mixed	Q = Mixed Swamp Conifer	W = White Pine	3 = Seedling Sapling Well	8 = Saw Timber Medium
E = Swamp Hdwoods	M = Mpl, Bch, Brch	R = Red Pine	X = Non Stocked	4 = Pole Timber Poor	9 = Saw Timber Well
F = Spruce Fir	MC = Mixed Conifer	S = Black Spruce	Z = Water		
G = Grass	MD = Mixed Deciduous	T = Tamarack			

PU	Acres
1	8.8
2	6.8
3	9.8

Lay Road Ridge Country Mix

Compartment 89
25.4 Acres

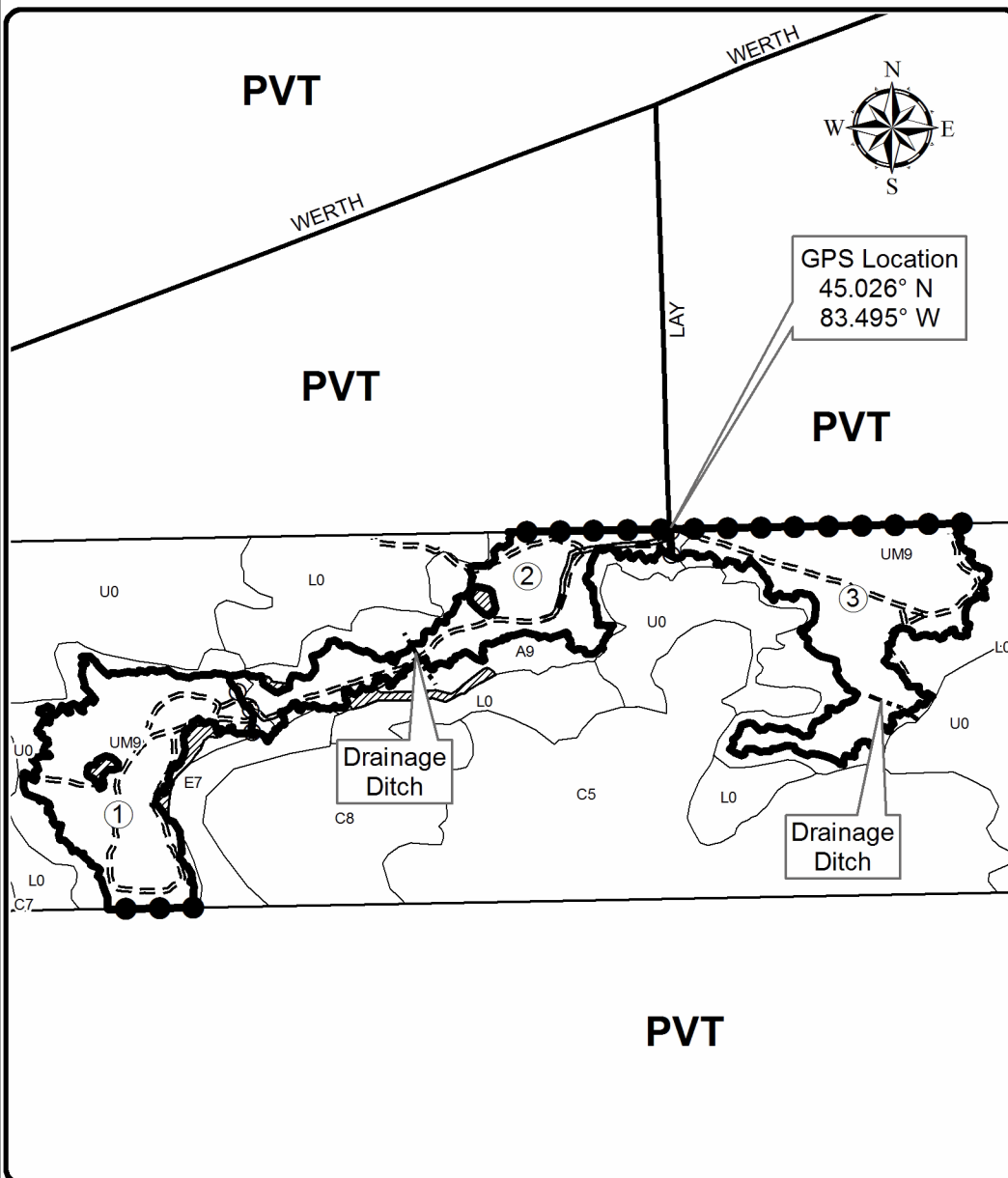

Legend

- Against State (Red)
- Payment Unit (Orange)
- Private Line (Blue)
- Stand Boundaries
- ▨ Retention Area
- Payment Unit
- Secondary Forest Road
- Paved Road
- - - Drainage Ditch
- Closed Roads (Temporary Management Access)

Locator Map
1:100,000

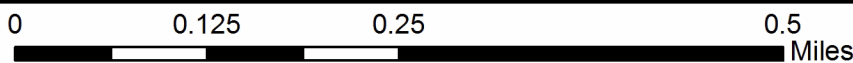
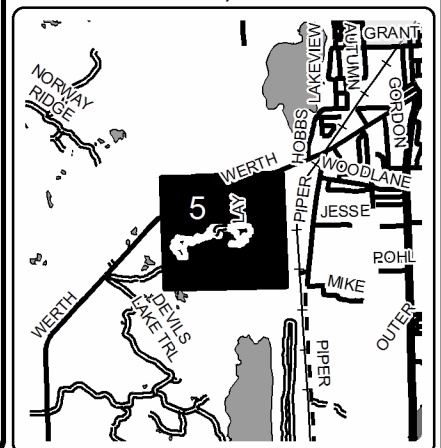

TIMBER SALE INFORMATION

Pine-Oak Scramble (54-033-19)

T30N, R08E, SEC. 16; T30N, R08E, SEC. 17; T30N, R08E, SEC. 20; T30N, R08E, SEC. 21; T30N, R08E, SEC. 8; T30N, R08E, SEC. 9.

SALE NOTE: Spec. 5.2.3.1 requires that Payment Units 1-3 be harvested using full tree skidding during snow off conditions .
Spec. 5.2.3.2 requires that Payment Units 5 and 6 be harvested during the period of Dec. 1 through March 31.

A recreation site such as a trail, pathway, or campground is within the sale area or the vicinity. Certain restrictions/specifications may be applicable including time restrictions.

A timber sale contract for this lump sum, sealed bid timber sale will be awarded to the responsible bidder offering the highest sealed bid price. Bids must be at or above the following advertised price for each species:

<u>PRODUCTS & SPECIES</u>	<u>ESTIMATED UNITS*</u>		<u>ADVERTISED PRICE</u>
Sawtimber			
BI/R/Hybrid Oak	28.40	MBF	\$ 69.00 / MBF
Red Pine	130.00	MBF	\$ 100.00 / MBF
White Pine	8.60	MBF	\$ 61.00 / MBF
Pulpwood			
B. T. Aspen	39.00	Cords	\$ 17.60 / Cord
BI/R/Hybrid Oak	385.00	Cords	\$ 24.55 / Cord
Black Spruce	2.00	Cords	\$ 9.40 / Cord
Jack Pine	116.00	Cords	\$ 17.30 / Cord
Mixed Hardwood	8.00	Cords	\$ 17.05 / Cord
Red Pine	185.00	Cords	\$ 42.45 / Cord
White Pine	73.00	Cords	\$ 22.45 / Cord

* The total volume is statistically estimated within plus (+) or minus (-) 13.22 percent. The estimated units are final and not subject to adjustment. Prospective bidders are urged to examine this timber and to make their own estimates of quantity and quality.

BOND AND PAYMENT SCHEDULE:

1. A bond in the amount of \$1,864.00 to insure faithful performance of the conditions of the contract will be deposited by the successful bidder within 21 days of the sale award.
2. Cutting in any sale or unit without the required advance payment would be considered a trespass.
3. Total payment must be paid in advance or according to the following schedule :
 - (a) Ten percent (10%) of the sale value must be paid within 21 days of the sale award.
 - (b) The 10% down payment will be credited towards the first unit cut.
 - (c) Payment for each of the following units must be made before cutting begins in that unit:

PAYMENT UNIT NUMBER	PERCENT OF TOTAL SALE VALUE
01	8.5%
02	6.6%
03	7.6%
04	19.9%
05	35.0%
06	22.4%

4. If no cutting takes place, the 10% down payment will not be refunded.
5. Operations on the contract issued will terminate on 06/30/2023.

Description of Timber by Payment Unit (PU)

PU	MARKET GROUP	PRODUCT	QUANTITY	UNIT	ACRES	ADVERTISE PRICE
1	BI/R/Hybrid Oak Red Pine	Sawtimber	1.3	MBF	10.1	\$3,174.40
			7.6	MBF		
	B. T. Aspen BI/R/Hybrid Oak Jack Pine Mixed Hardwood Red Pine White Pine	Pulpwood	7.0	Cords		
			36.0	Cords		
			41.0	Cords		
			2.0	Cords		
			13.0	Cords		
			1.0	Cords		
			1.0	Cords		
2	BI/R/Hybrid Oak Red Pine	Sawtimber	1.1	MBF	7.7	\$2,468.05
			5.9	MBF		
	B. T. Aspen BI/R/Hybrid Oak Black Spruce Jack Pine Mixed Hardwood Red Pine White Pine	Pulpwood	5.0	Cords		
			28.0	Cords		
			1.0	Cords		
			31.0	Cords		
			2.0	Cords		
			10.0	Cords		
			1.0	Cords		
3	BI/R/Hybrid Oak Red Pine	Sawtimber	1.1	MBF	9.0	\$2,845.25
			6.8	MBF		
	B. T. Aspen BI/R/Hybrid Oak Black Spruce Jack Pine Mixed Hardwood Red Pine White Pine	Pulpwood	6.0	Cords		
			32.0	Cords		
			1.0	Cords		
			36.0	Cords		
			2.0	Cords		
			12.0	Cords		
			1.0	Cords		
4	BI/R/Hybrid Oak Red Pine White Pine	Sawtimber	14.7	MBF	16.5	\$7,419.20
			24.5	MBF		
			0.8	MBF		
	BI/R/Hybrid Oak Mixed Hardwood Red Pine White Pine	Pulpwood	97.0	Cords		
			2.0	Cords		
			33.0	Cords		
			4.0	Cords		
5	BI/R/Hybrid Oak Red Pine White Pine	Sawtimber	6.7	MBF	19.2	\$13,014.45
			55.2	MBF		
			5.1	MBF		
	B. T. Aspen BI/R/Hybrid Oak Jack Pine Red Pine White Pine	Pulpwood	3.0	Cords		
			107.0	Cords		
			3.0	Cords		
			76.0	Cords		
			34.0	Cords		
6	BI/R/Hybrid Oak Red Pine White Pine	Sawtimber	3.5	MBF	17.5	\$8,355.10
			30.0	MBF		
			2.7	MBF		
	B. T. Aspen BI/R/Hybrid Oak Jack Pine Red Pine White Pine	Pulpwood	18.0	Cords		
			85.0	Cords		
			5.0	Cords		
			41.0	Cords		
			32.0	Cords		
TOTAL:			167.0	MBF		
TOTAL:			808.0	Cords		

Sale Specific Conditions & Requirements

Sale Name: Pine-Oak Scramble

Sale Number: 54-033-19 Seq#: 2

1 - Sale Area

1.2 - Boundaries

1.2.1 - Painted boundaries (9/19)

The sale boundary and Payment Unit boundaries are marked and identified by blue, red and yellow paint. Exterior sale boundary lines against private property are marked with blue paint. Exterior sale boundary lines against state are marked with red paint. Interior Payment Unit boundaries are marked with yellow paint. Retention patches are marked with red paint; no harvesting activities may occur within these areas. The painted boundary line trees are not Included Timber and are to be protected, with the exception of east boundaries of Payment Units 1, 3, and 6, where the eastern boundary trees marked in red adjacent to the underground natural gas pipelines are to be harvested. Yellow painted trees designating an interior Payment Unit boundary are only to be cut when all surrounding Payment Units have been paid.

2 - Timber Specifications

2.1 - Included Timber

2.1.1 - Clearcut unit(s) with unmerchantable trees (6/14)

Within Payment Unit(s) 1-6, cut all trees that are two (2) inches or more at DBH. In addition, within Payment Unit(s) 4-6, do not cut any oak or pine which do not meet minimum piece specifications in 2.2 Utilization.

2.2 - Utilization

2.2.3 - Stump heights (4/07)

Stump heights within Payment Unit(s) 5 and 6 shall not exceed 6 inches for all trees. This is in order to facilitate planting operations should the natural regeneration management objective fail.

2.2.6 - Roundwood operation required (5/07)

The skidding of whole trees or tree segments with limbs attached is prohibited within Payment Unit(s) 4-6. All products must be produced as roundwood and forwarded to existing roads or landing areas in final product length.

3 - Payments

3.4 - Damaged Timber

3.4.1 - Damaged timber (7/16)

General Condition and Requirement 3.4 Damaged Timber, defines liquidated damages for undesignated live merchantable trees which are cut or injured. In addition, extreme care should be taken to avoid damage to tree seedlings and saplings.

Within the Payment Units 4-6, if more than 25% of the pine and oak tree seedlings or saplings (1/4" to 4.5" DBH) within a specified portion of the sale area are damaged, liquidated damages will be assessed at \$200 per acre for all acreage within that specified portion of the sale area that was damaged.

4 - Transportation

4.1 - Construction

4.1.3 - Slash and earthen piles (8/04)

Piles or windrows of earth along roads and landings that have been widened or constructed shall be leveled. Slash from road maintenance or construction, including stumps, shall be dispersed throughout the sale.

4.1.6 - Road construction (1/09)

Improvements of existing roads shall be done in such a way as to minimize the environmental and visual impacts. Merchantable trees shall be cut and utilized unless otherwise directed. Non-merchantable trees shall be severed and laid flat on the ground. Slash shall be scattered, and not left in windrows and kept a minimum of 10 feet back from the road edge. Stumps shall be set upright, not left on edge, and be moved at least 10 feet away from the road edge. Disturbed soil shall be feathered into the woods and not left in berms or windrows.

4.1.12 - No new roads (1/12)

No new roads will be permitted in any Payment Unit. All operations are limited to existing roads. Skid trails only will be allowed.

4.2 - Maintenance

4.2.2 - Fill material (4/07)

To maintain roads, fill material may be needed in areas where "holes" exist or may be expected to develop. This fill material should be placed before trucking begins. Material used to upgrade roads must be approved by the Sale Administrator or Unit Manager before being placed.

4.2.3 - Road maintenance (8/13)

The following road maintenance is required: within 15 days of completion of hauling, or if no hauling occurs for 15 days, the road must be maintained and graded. This includes cleaning of drainage areas, grading, crowning and filling with gravel, if necessary. Damages will be assessed if grading/repair does not occur.

4.2.5 - Two wheel drive condition (2/04)

All existing trail roads on and adjacent to the sale area must be passable by two-wheel drive traffic for the duration of the sale.

5 - Operations

5.1 - Notification

5.1.1 - Pre-sale conference (10/16)

A pre-sale conference on site between the Purchaser and sale administrator is required prior to beginning any operations within a Payment Unit to determine landing and road locations. The Unit Manager or his/her representative must be contacted at least 5 days in advance to schedule the conference.

5.1.3 - Well heads and natural gas pipelines (11/15)

The Purchaser is responsible for contacting the DTE Gas Company at least 30 days prior to operating equipment in the vicinity of well heads or natural gas pipelines. Underground natural gas lines run along the eastern edge of Payment Units 1, 3 and 5. This sale requires the Purchaser to haul timber over the pipelines and out to Piper Road to the east. The Purchaser is required to contact Bob Wenderski, local technician with DTE Energy at (989) 370-8258, prior to beginning operations to ensure necessary safety precautions are taken when working within the vicinity of these gas lines.

5.1.4 - Post-sale conference (10/16)

A post-sale conference on site between the Purchaser and sale administrator is required 5 days prior to the completion of active logging operations to determine clean-up and repair of landings, road edges, and the fulfillment of other contract specifications.

5.2 - Conduct of Operations

5.2.1 - Slash

5.2.1.10 - No slash in openings (5/10)

No brush or logging debris is to be left within the pipeline right-of-way to the east of Payment Units 1, 3 and 6. In addition, as a safety precaution, no operations are to take place in these natural gas pipeline right-of-way. Any damage to the opening shall be repaired according to specifications of the Unit Manager or his/her representative.

5.2.2 - Hazard Trees/Snags

5.2.2.1 - Den trees (10/16)

Obvious hollow and/or den trees shall be protected and left standing unless they are a safety hazard.

5.2.3 - Operating Restrictions

5.2.3.1 - Operating restrictions (9/11)

Within Payment Unit(s) 1-3, whole tree skidding is required and must take place during snow off, unfrozen ground conditions, unless changed by written agreement. This restriction is for the promotion of soil scarification for the creation of a mineral soil seedbed to enhance jack pine regeneration.

5.2.3.2 - Operating restrictions (9/11)

Within Payment Unit(s) 5 and 6, unless changed by written agreement, cutting, skidding, and hauling are limited to the period of December 1 to March 31. This restriction is to maximize oak stump sprouting.

5.2.3.5 - Oak wilt restriction (1/18)

Within Payment Unit(s) 1-6, unless changed by written agreement, cutting, skidding, hauling within the sale and brushing of access roads to the sale are not permitted during the period of April 15 to July 15. Operations may be allowed if specific steps are taken to prevent damaging uncut oak during the high risk period. Those steps may include completing all road brushing before April 15th and clearing a tree-length buffer along uncut oak cover before April 15th. This is necessary to reduce the spread of oak wilt. For more information, contact the Unit Manager or his/her representative.

5.2.3.6 - Bark beetle restriction (12/08)

In the event drought creates a high risk of pine bark beetle infestation, pine is not to be cut during the period March 1 through July 1, unless all portions of trees greater than two inches in diameter are removed from the sale area, reduced to chips, or treated to the satisfaction of the Unit Manager or his/her representative, within fifteen days of being severed from the stump. Pine log decks, pulpwood piles and treetops that are piled for chipping in the fall or winter within a 1/4 mile of susceptible sites must be removed before March 15. Residual slash must not be placed in piles or rows and must be spread over the site for quick drying. The Department of Natural Resources will exercise this specification if the risk of damage warrants.

5.2.3.11 - Coppice regeneration protection (4/10)

Timber harvesting in any Payment Unit must be completed before significant tree sprouting occurs in that Payment Unit so as to minimize damage to the new regeneration. Any post harvest operations, such as chipping, must be completed before sprouting of regeneration occurs. If it is anticipated that chipping will be delayed, then tops shall be carried to one central location or left unchipped. The Unit Manager or his/her representative may cease such operations if sprouting occurs before the operation is complete.

5.2.32 - Decking/landing restoration (9/13)

All decking and landing areas must have the surface area restored to a condition equal to or better than before. This is to ensure the proper regeneration of the stand. Wood debris, chips and "cookies" from trimmings must be removed or scattered away from landing and loading areas and may not be windrowed on the edge.

5.2.38 - No decking against live trees (2/04)

Cut products may not be decked against unmarked or designated leave trees.

5.2.39 - ORV trail/route protection (4/18)

An ORV trail or route runs through or along the edge of all Payment Units and is shown on the Timber Sale Map. Do not cut trees or damage posts with ORV markers. Trees with ORV markers shall be cut off above the markers and at least 5 feet above ground. All stumps within 5 feet of the trail must be cut flush with the ground. Maintain a 20 foot wide slash, debris, and rut free zone daily using the ORV trail or route as the centerline. Do not run equipment down the ORV trail or route. Skidding across the trail or route may only occur in locations approved by the sale administrator.

5.4 - Soil Protection

5.4.1 - Rutting restriction, general (7/16)

Operations are to cease immediately if equipment and weather conditions result in rutting of roads and/or skid trails which is 12 inches or greater in depth and 50 feet in length. The Unit Manager or his/her representative may restrict hauling and/or skidding if ruts exceed the specified depth. With the Unit Manager or his/her representative's approval, the Purchaser may return to the area when the risk of rutting has decreased.

5.4.5 - Soil caution (11/04)

Care must be taken to minimize soil damage due to the sandy soils.

5.8 - Protection of Endangered Species

5.8.5 - Protection of raptor nests (3/13)

All trees with raptor nests will be protected if found during harvesting operations. Notification will be made to the Unit Manager or his/her representative who will notify the Wildlife Biologist so an on-site evaluation and recommendation can be made, if necessary.

6 - Safety and Fire Prevention

6.2 - Signing

6.2.1 - Road posting (9/09)

The Purchaser is responsible for posting and maintaining caution signs on forest roads prior to beginning operations. The road must be posted at appropriate distances from the sale area to warn of logging activity and truck traffic. Signs must be removed when harvest operations are suspended or completed. The Purchaser will provide these signs.

6.2.3 - Recreational trail posting (2/10)

The Purchaser is responsible for posting and maintaining caution signs on the ORV trails prior to beginning operations. The trail must be posted at appropriate distances from the sale area to warn of logging activity and truck traffic at both ends of the trail. Signs must be removed when harvest operations are suspended or completed. The Purchaser will provide these signs.



TIMBER SALE MAP

This information provided by authority of Part 525, 1994 PA 451, as amended.

Sale Number	Year
54-033	19

Forest Management Unit Atlanta	County Alpena	Mapped By Dale Parris Cruised By D. Parris	Date 9/30/2019	Page 1	of 1
-----------------------------------	------------------	---	-------------------	-----------	---------

Township 30N	Range 08E	Section(s) and Subdivision(s) S8 SESE; S9 SWSW; S16 W1/2NW, SWSW; S17 E1/2NE, E1/2SE; S20 NENE; S21 NWNW	Scale 1:15,840
-----------------	--------------	--	-------------------

Cover Type

A = Aspen	H = Hemlock	N = Marsh	U = Upland Brush
B = Paper Birch	J = Jack Pine	O = Oak	UM = Upland Mixed
C = Cedar	L = Lowland Brush	P = Lowland Poplar	V = Bog or Marsh
D = Tread Bog	LM = Lowland Mixed	Q = Mixed Swamp Conifer	W = White Pine
E = Swamp Hdwoods	M = Mpl, Bch, Brch	R = Red Pine	X = Non Stocked
F = Spruce Fir	MC = Mixed Conifer	S = Black Spruce	Z = Water
G = Grass	MD = Mixed Deciduous	T = Tamarack	

Density

0 = Non Stocked	5 = Pole Timber Medium
1 = Seedling Sapling Poor	6 = Pole Timber Well
2 = Seedling Sapling Medium	7 = Saw Timber Poor
3 = Seedling Sapling Well	8 = Saw Timber Medium
4 = Pole Timber Poor	9 = Saw Timber Well

PU	Acres	PU	Acres
1	10.1	4	16.5
2	7.7	5	19.2
3	9.0	6	17.5

Pine-Oak Scramble

Compartment 89

80.0 Acres

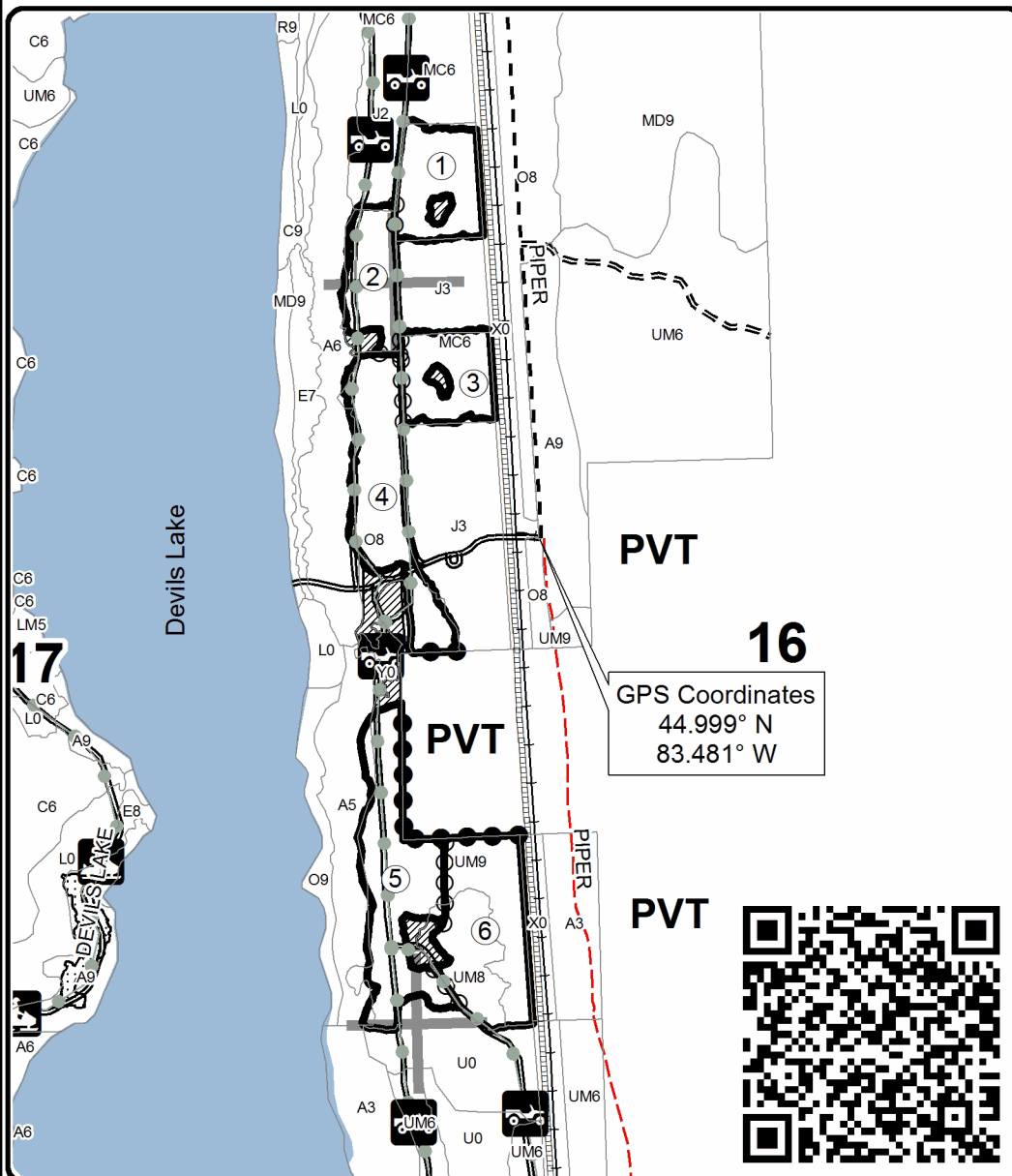
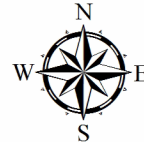

GPS Coordinates
44.999° N
83.481° W



Legend

- Against State (Red)
- Payment Unit (Yellow)
- Private Line (Blue)
- Retention Area
- Stand Boundaries
- Nearby Timber Sales
- Payment Unit
- Secondary Forest Road
- Forest Access Route
- Gravel Road
- County Road - Seasonal
- Recreational Trail
- Pipeline
- Railroad
- Stream
- Lakes and Rivers
- Section Corners

Locator Map 1:150,000

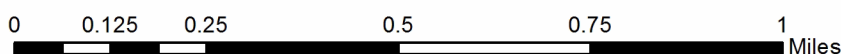
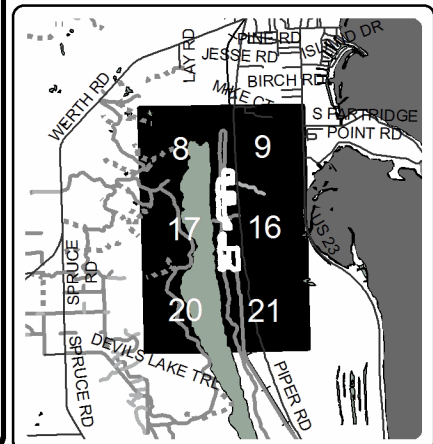

Devlis Ridge Mix (54-022-19)
T30N, R08E, SEC. 17; T30N, R08E, SEC. 20; T30N, R08E, SEC. 8; Alpena

In response to the notice of sale to be held 10:00 a.m. (local time) on May 19, 2020, I am hereby submitting my sealed bid (firm offer) for the following forest products to be cut. Bids for individual species must be at or above the advertised price. All non-responsive bid forms may be rejected.

<u>PRODUCTS & SPECIES</u>	<u>ESTIMATED VOLUME*</u>	<u>ADVERTISED PRICE</u>	<u>BID PRICE/UNIT</u>
Sawtimber			
B. T. Aspen	10.60 MBF	\$ 51.00/MBF	\$ _____
Red Maple	3.20 MBF	\$ 62.00/MBF	\$ _____
Pulpwood			
Balsam Fir	39.00 Cords	\$ 16.60/Cord	\$ _____
Jack Pine	1.00 Cords	\$ 15.05/Cord	\$ _____
Mixed Aspen	187.00 Cords	\$ 15.25/Cord	\$ _____
Mixed Spruce	11.00 Cords	\$ 8.15/Cord	\$ _____
Paper Birch	61.00 Cords	\$ 10.75/Cord	\$ _____
Red Maple	104.00 Cords	\$ 14.80/Cord	\$ _____
Red Pine	1.00 Cords	\$ 36.85/Cord	\$ _____
White Pine	2.00 Cords	\$ 19.50/Cord	\$ _____

*The volumes are statistically estimated within plus (+) or minus (-) 16.25 percent. These estimated volumes are final and not subject to adjustment. Prospective bidders are urged to examine this timber and to make their own estimates of quantity and quality.

I understand that any or all bids may be rejected. All bids must be signed and all bid items must be bid or the bid form may be rejected. I also understand that consideration and awarding a contract will be based upon my past performance and ability to complete the contract based upon equipment and staffing subject to my control.

FEDERAL ID: _____ - _____ or SOCIAL SECURITY NUMBER: _____ - _____ - _____

Company or individual bidding: _____

Company representative's name: _____

Address: _____

City: _____ State: _____ Zip: _____

IF AVAILABLE, PLEASE PLACE THE PERSONALIZED LABEL FROM YOUR PROSPECTUS IN THE ABOVE BOX.

Individual or company representative's signature: _____ Date: _____

Phone number : _____ Email (optional): _____

THE WINNING BIDDER MUST COMPLETE THE VERIFICATION OF WORKER'S DISABILITY COMPENSATION ACT COMPLIANCE (ON REVERSE SIDE IF DOUBLE SIDED) WITHIN 21 DAYS OF SALE AWARD DATE



FOR DEPARTMENT USE ONLY
Sale Number (XX - XXX - XX - XX)
Forest Management Unit:

TIMBER SALE VERIFICATION OF WORKER'S DISABILITY COMPENSATION ACT COMPLIANCE

*As required by Act 317, P.A. 1969 (Worker's Compensation) and
Part 5 of Act 451 of 1994, as amended.*

VERIFICATION OF WORKER'S DISABILITY COMPENSATION ACT COMPLIANCE

- This verification must be completed and submitted within 21 days of contract award and prior to the issuance of the timber sale contract.
- In addition, if boxes 2B or 2C are checked, then Notice of Exclusion or Certificate of Insurance must be submitted within twenty-one (21) days of the contract award and prior to the issuance of the timber sale contract.
- All information must be typed or printed except for written signatures.

Please Check Appropriate Categories:

1. My business is organized as (you **must** check one of the boxes below):
 - A. Sole Proprietorship (individual)
 - B. Partnership
 - C. Corporation

2. You **must** check one of the boxes below:
 - A. I certify my business is a sole proprietorship and it has no employees but the sole proprietor. I am not subject to the Worker's Compensation Laws.
 - B. I certify my business has satisfied its obligation to the Worker's Compensation Act through the use of an approved Notice of Exclusion (BWC-337, Rev. 5/96). I will provide a copy of the Notice of Exclusion within 21 days of the contract award. (For questions or a copy of the BWC-337, please call the Worker's Compensation Bureau at 517-322-1195).
 - C. I certify my business has a Worker's Compensation Policy. I will provide an original Certificate of Insurance within twenty-one (21) days of the contract award.

3. If you have checked item 2(A) or 2(B), you **must** indicate the number of **both** full-time and part-time employees, other than yourself, including family members and active partners (if none, you must enter "0").

_____ Full-time Employees

_____ Part-time Employees

Name of Business		Federal ID (or) Social Security No.	
Address		Telephone ()	
City	State	ZIP	

I hereby certify that the above information is true and correct. I agree to notify the Michigan DNR of any changes that occur in factors affecting my coverage during any of my present and future operations.

Signature of Owner or Authorized Representative

Title

Date

Please complete the "SEALED BID" information on the next page

Nichol's End (54-013-19)

T29N, R06E, SEC. 14; T29N, R06E, SEC. 15; T29N, R06E, SEC. 23; Alpena

In response to the notice of sale to be held 10:00 a.m. (local time) on May 19, 2020, I am hereby submitting my sealed bid (firm offer) for the following forest products to be cut. Bids for individual species must be at or above the advertised price. All non-responsive bid forms may be rejected.

<u>PRODUCTS & SPECIES</u>	<u>ESTIMATED VOLUME*</u>	<u>ADVERTISED PRICE</u>	<u>BID PRICE/UNIT</u>
Sawtimber			
Mixed Aspen	22.60 MBF	\$ 58.00/MBF	\$ _____
Red Oak	4.60 MBF	\$ 147.00/MBF	\$ _____
Pulpwood			
Balsam Fir	85.00 Cords	\$ 19.10/Cord	\$ _____
Mixed Aspen	574.00 Cords	\$ 17.60/Cord	\$ _____
Mixed Hardwood	66.00 Cords	\$ 17.05/Cord	\$ _____
Mixed Oak	29.00 Cords	\$ 24.55/Cord	\$ _____
White Spruce	22.00 Cords	\$ 9.40/Cord	\$ _____

*The volumes are statistically estimated within plus (+) or minus (-) 17.56 percent. These estimated volumes are final and not subject to adjustment. Prospective bidders are urged to examine this timber and to make their own estimates of quantity and quality.

I understand that any or all bids may be rejected. All bids must be signed and all bid items must be bid or the bid form may be rejected. I also understand that consideration and awarding a contract will be based upon my past performance and ability to complete the contract based upon equipment and staffing subject to my control.

FEDERAL ID: _____ or SOCIAL SECURITY NUMBER: _____

Company or individual bidding: _____

Company representative's name: _____

Address: _____

City: _____ State: _____ Zip: _____

IF AVAILABLE, PLEASE PLACE THE PERSONALIZED LABEL FROM YOUR PROSPECTUS IN THE ABOVE BOX.

Individual or company representative's signature: _____ Date: _____

Phone number : _____ Email (optional): _____

THE WINNING BIDDER MUST COMPLETE THE VERIFICATION OF WORKER'S DISABILITY COMPENSATION ACT COMPLIANCE (ON REVERSE SIDE IF DOUBLE SIDED) WITHIN 21 DAYS OF SALE AWARD DATE



FOR DEPARTMENT USE ONLY	
Sale Number (XX - XXX - XX - XX)	
Forest Management Unit:	

TIMBER SALE VERIFICATION OF WORKER'S DISABILITY COMPENSATION ACT COMPLIANCE

As required by Act 317, P.A. 1969 (Worker's Compensation) and
Part 5 of Act 451 of 1994, as amended.

VERIFICATION OF WORKER'S DISABILITY COMPENSATION ACT COMPLIANCE

- This verification must be completed and submitted within 21 days of contract award and prior to the issuance of the timber sale contract.
- In addition, if boxes 2B or 2C are checked, then Notice of Exclusion or Certificate of Insurance must be submitted within twenty-one (21) days of the contract award and prior to the issuance of the timber sale contract.
- All information must be typed or printed except for written signatures.

Please Check Appropriate Categories:

1. My business is organized as (you **must** check one of the boxes below):
 - A. Sole Proprietorship (individual)
 - B. Partnership
 - C. Corporation
2. You **must** check one of the boxes below:
 - A. I certify my business is a sole proprietorship and it has no employees but the sole proprietor. I am not subject to the Worker's Compensation Laws.
 - B. I certify my business has satisfied its obligation to the Worker's Compensation Act through the use of an approved Notice of Exclusion (BWC-337, Rev. 5/96). I will provide a copy of the Notice of Exclusion within 21 days of the contract award. (For questions or a copy of the BWC-337, please call the Worker's Compensation Bureau at 517-322-1195).
 - C. I certify my business has a Worker's Compensation Policy. I will provide an original Certificate of Insurance within twenty-one (21) days of the contract award.
3. If you have checked item 2(A) or 2(B), you **must** indicate the number of **both** full-time and part-time employees, other than yourself, including family members and active partners (if none, you must enter "0").

_____ Full-time Employees

_____ Part-time Employees

Name of Business		Federal ID (or) Social Security No.	
Address		Telephone ()	
City	State	ZIP	

I hereby certify that the above information is true and correct. I agree to notify the Michigan DNR of any changes that occur in factors affecting my coverage during any of my present and future operations.

Signature of Owner or Authorized Representative

Title

Date

Please complete the "SEALED BID" information on the next page

Pine-Oak Scramble (54-033-19)

T30N, R08E, SEC. 16; T30N, R08E, SEC. 17; T30N, R08E, SEC. 20; T30N, R08E,

In response to the notice of sale to be held 10:00 a.m. (local time) on May 19, 2020, I am hereby submitting my sealed bid (firm offer) for the following forest products to be cut. Bids for individual species must be at or above the advertised price. All non-responsive bid forms may be rejected.

<u>PRODUCTS & SPECIES</u>	<u>ESTIMATED VOLUME*</u>	<u>ADVERTISED PRICE</u>	<u>BID PRICE/UNIT</u>
Sawtimber			
Bl/R/Hybrid Oak	28.40 MBF	\$ 69.00/MBF	\$ _____
Red Pine	130.00 MBF	\$ 100.00/MBF	\$ _____
White Pine	8.60 MBF	\$ 61.00/MBF	\$ _____
Pulpwood			
B. T. Aspen	39.00 Cords	\$ 17.60/Cord	\$ _____
Bl/R/Hybrid Oak	385.00 Cords	\$ 24.55/Cord	\$ _____
Black Spruce	2.00 Cords	\$ 9.40/Cord	\$ _____
Jack Pine	116.00 Cords	\$ 17.30/Cord	\$ _____
Mixed Hardwood	8.00 Cords	\$ 17.05/Cord	\$ _____
Red Pine	185.00 Cords	\$ 42.45/Cord	\$ _____
White Pine	73.00 Cords	\$ 22.45/Cord	\$ _____

*The volumes are statistically estimated within plus (+) or minus (-) 13.22 percent. These estimated volumes are final and not subject to adjustment. Prospective bidders are urged to examine this timber and to make their own estimates of quantity and quality.

I understand that any or all bids may be rejected. All bids must be signed and all bid items must be bid or the bid form may be rejected. I also understand that consideration and awarding a contract will be based upon my past performance and ability to complete the contract based upon equipment and staffing subject to my control.

FEDERAL ID: _____ or SOCIAL SECURITY NUMBER: _____

Company or individual bidding: _____

Company representative's name: _____

Address: _____

City: _____ State: _____ Zip: _____

IF AVAILABLE, PLEASE PLACE THE PERSONALIZED LABEL FROM YOUR PROSPECTUS IN THE ABOVE BOX.

Individual or company representative's signature: _____ Date: _____

Phone number : _____ Email (optional): _____

THE WINNING BIDDER MUST COMPLETE THE VERIFICATION OF WORKER'S DISABILITY COMPENSATION ACT COMPLIANCE (ON REVERSE SIDE IF DOUBLE SIDED) WITHIN 21 DAYS OF SALE AWARD DATE



FOR DEPARTMENT USE ONLY	
Sale Number (XX - XXX - XX - XX)	
Forest Management Unit:	

TIMBER SALE VERIFICATION OF WORKER'S DISABILITY COMPENSATION ACT COMPLIANCE

As required by Act 317, P.A. 1969 (Worker's Compensation) and
Part 5 of Act 451 of 1994, as amended.

VERIFICATION OF WORKER'S DISABILITY COMPENSATION ACT COMPLIANCE

- This verification must be completed and submitted within 21 days of contract award and prior to the issuance of the timber sale contract.
- In addition, if boxes 2B or 2C are checked, then Notice of Exclusion or Certificate of Insurance must be submitted within twenty-one (21) days of the contract award and prior to the issuance of the timber sale contract.
- All information must be typed or printed except for written signatures.

Please Check Appropriate Categories:

1. My business is organized as (you **must** check one of the boxes below):
 - A. Sole Proprietorship (individual)
 - B. Partnership
 - C. Corporation
2. You **must** check one of the boxes below:
 - A. I certify my business is a sole proprietorship and it has no employees but the sole proprietor. I am not subject to the Worker's Compensation Laws.
 - B. I certify my business has satisfied its obligation to the Worker's Compensation Act through the use of an approved Notice of Exclusion (BWC-337, Rev. 5/96). I will provide a copy of the Notice of Exclusion within 21 days of the contract award. (For questions or a copy of the BWC-337, please call the Worker's Compensation Bureau at 517-322-1195).
 - C. I certify my business has a Worker's Compensation Policy. I will provide an original Certificate of Insurance within twenty-one (21) days of the contract award.
3. If you have checked item 2(A) or 2(B), you **must** indicate the number of **both** full-time and part-time employees, other than yourself, including family members and active partners (if none, you must enter "0").

_____ Full-time Employees

_____ Part-time Employees

Name of Business		Federal ID (or) Social Security No.	
Address		Telephone ()	
City	State	ZIP	

I hereby certify that the above information is true and correct. I agree to notify the Michigan DNR of any changes that occur in factors affecting my coverage during any of my present and future operations.

Signature of Owner or Authorized Representative

Title

Date

Please complete the "SEALED BID" information on the next page

Lay Road Ridge Country Mix (54-024-19)
T30N, R08E, SEC. 5; Alpena COUNTY

In response to the notice of sale to be held 10:00 a.m. (local time) on May 19, 2020, I am hereby submitting my sealed bid (firm offer) for the following forest products to be cut. Bids for individual species must be at or above the advertised price. All non-responsive bid forms may be rejected.

<u>PRODUCTS & SPECIES</u>	<u>ESTIMATED VOLUME*</u>	<u>ADVERTISED PRICE</u>	<u>BID PRICE/UNIT</u>
Sawtimber			
B. T. Aspen	13.60 MBF	\$ 58.00/MBF	\$ _____
Bl/R/Hybrid Oak	2.50 MBF	\$ 69.00/MBF	\$ _____
Red Maple	3.50 MBF	\$ 72.00/MBF	\$ _____
Red Pine	5.10 MBF	\$ 100.00/MBF	\$ _____
White Pine	12.20 MBF	\$ 61.00/MBF	\$ _____
Pulpwood			
Balsam Fir	26.00 Cords	\$ 19.10/Cord	\$ _____
Bl/R/Hybrid Oak	9.00 Cords	\$ 24.55/Cord	\$ _____
Jack Pine	16.00 Cords	\$ 17.30/Cord	\$ _____
Mixed Aspen	220.00 Cords	\$ 17.60/Cord	\$ _____
Mixed Spruce	2.00 Cords	\$ 9.40/Cord	\$ _____
Paper Birch	19.00 Cords	\$ 12.35/Cord	\$ _____
Red Maple	83.00 Cords	\$ 17.05/Cord	\$ _____
Red Pine	19.00 Cords	\$ 42.45/Cord	\$ _____
Tamarack	2.00 Cords	\$ 14.00/Cord	\$ _____
White Pine	81.00 Cords	\$ 22.45/Cord	\$ _____

*The volumes are statistically estimated within plus (+) or minus (-) 17.52 percent. These estimated volumes are final and not subject to adjustment. Prospective bidders are urged to examine this timber and to make their own estimates of quantity and quality.

I understand that any or all bids may be rejected. All bids must be signed and all bid items must be bid or the bid form may be rejected. I also understand that consideration and awarding a contract will be based upon my past performance and ability to complete the contract based upon equipment and staffing subject to my control.

FEDERAL ID: ____ - ____ - ____ or SOCIAL SECURITY NUMBER: ____ - ____ - ____

Company or individual bidding: _____

Company representative's name: _____

Address: _____

City: _____ State: _____ Zip: _____

IF AVAILABLE, PLEASE PLACE THE PERSONALIZED LABEL FROM YOUR PROSPECTUS IN THE ABOVE BOX.

Individual or company representative's signature: _____ Date: _____

Phone number : _____ Email (optional): _____

THE WINNING BIDDER MUST COMPLETE THE VERIFICATION OF WORKER'S DISABILITY COMPENSATION ACT COMPLIANCE (ON REVERSE SIDE IF DOUBLE SIDED) WITHIN 21 DAYS OF SALE AWARD DATE



FOR DEPARTMENT USE ONLY	
Sale Number (XX - XXX - XX - XX)	
Forest Management Unit:	

TIMBER SALE VERIFICATION OF WORKER'S DISABILITY COMPENSATION ACT COMPLIANCE

As required by Act 317, P.A. 1969 (Worker's Compensation) and
Part 5 of Act 451 of 1994, as amended.

VERIFICATION OF WORKER'S DISABILITY COMPENSATION ACT COMPLIANCE

- This verification must be completed and submitted within 21 days of contract award and prior to the issuance of the timber sale contract.
- In addition, if boxes 2B or 2C are checked, then Notice of Exclusion or Certificate of Insurance must be submitted within twenty-one (21) days of the contract award and prior to the issuance of the timber sale contract.
- All information must be typed or printed except for written signatures.

Please Check Appropriate Categories:

1. My business is organized as (you **must** check one of the boxes below):
 - A. Sole Proprietorship (individual)
 - B. Partnership
 - C. Corporation
2. You **must** check one of the boxes below:
 - A. I certify my business is a sole proprietorship and it has no employees but the sole proprietor. I am not subject to the Worker's Compensation Laws.
 - B. I certify my business has satisfied its obligation to the Worker's Compensation Act through the use of an approved Notice of Exclusion (BWC-337, Rev. 5/96). I will provide a copy of the Notice of Exclusion within 21 days of the contract award. (For questions or a copy of the BWC-337, please call the Worker's Compensation Bureau at 517-322-1195).
 - C. I certify my business has a Worker's Compensation Policy. I will provide an original Certificate of Insurance within twenty-one (21) days of the contract award.
3. If you have checked item 2(A) or 2(B), you **must** indicate the number of **both** full-time and part-time employees, other than yourself, including family members and active partners (if none, you must enter "0").

_____ Full-time Employees

_____ Part-time Employees

Name of Business		Federal ID (or) Social Security No.	
Address		Telephone ()	
City	State	ZIP	

I hereby certify that the above information is true and correct. I agree to notify the Michigan DNR of any changes that occur in factors affecting my coverage during any of my present and future operations.

Signature of Owner or Authorized Representative

Title

Date

Please complete the "SEALED BID" information on the next page

Shannon 'Iggins Popple (54-010-19)
T31N, R07E, SEC. 17; T31N, R07E, SEC. 18; T31N, R07E, SEC. 4; T31N, R07E,

In response to the notice of sale to be held 10:00 a.m. (local time) on May 19, 2020, I am hereby submitting my sealed bid (firm offer) for the following forest products to be cut. Bids for individual species must be at or above the advertised price. All non-responsive bid forms may be rejected.

<u>PRODUCTS & SPECIES</u>	<u>ESTIMATED VOLUME*</u>	<u>ADVERTISED PRICE</u>	<u>BID PRICE/UNIT</u>
Sawtimber			
Mixed Aspen	17.00 MBF	\$ 58.00/MBF	\$ _____
Pulpwood			
Balsam Fir	207.00 Cords	\$ 19.10/Cord	\$ _____
Mixed Aspen	1,251.00 Cords	\$ 17.60/Cord	\$ _____
Mixed Hardwood	44.00 Cords	\$ 17.05/Cord	\$ _____
Red Pine	10.00 Cords	\$ 42.45/Cord	\$ _____
White Pine	3.00 Cords	\$ 22.45/Cord	\$ _____
White Spruce	13.00 Cords	\$ 9.40/Cord	\$ _____

*The volumes are statistically estimated within plus (+) or minus (-) 12.39 percent. These estimated volumes are final and not subject to adjustment. Prospective bidders are urged to examine this timber and to make their own estimates of quantity and quality.

I understand that any or all bids may be rejected. All bids must be signed and all bid items must be bid or the bid form may be rejected. I also understand that consideration and awarding a contract will be based upon my past performance and ability to complete the contract based upon equipment and staffing subject to my control.

FEDERAL ID: _____ or SOCIAL SECURITY NUMBER: _____

Company or individual bidding: _____

Company representative's name: _____

Address: _____

City: _____ State: _____ Zip: _____

IF AVAILABLE, PLEASE PLACE THE PERSONALIZED LABEL FROM YOUR PROSPECTUS IN THE ABOVE BOX.

Individual or company representative's signature: _____ Date: _____

Phone number : _____ Email (optional): _____

THE WINNING BIDDER MUST COMPLETE THE VERIFICATION OF WORKER'S DISABILITY COMPENSATION ACT COMPLIANCE (ON REVERSE SIDE IF DOUBLE SIDED) WITHIN 21 DAYS OF SALE AWARD DATE



FOR DEPARTMENT USE ONLY
Sale Number (XX - XXX - XX - XX)
Forest Management Unit:

TIMBER SALE VERIFICATION OF WORKER'S DISABILITY COMPENSATION ACT COMPLIANCE

*As required by Act 317, P.A. 1969 (Worker's Compensation) and
Part 5 of Act 451 of 1994, as amended.*

VERIFICATION OF WORKER'S DISABILITY COMPENSATION ACT COMPLIANCE

- This verification must be completed and submitted within 21 days of contract award and prior to the issuance of the timber sale contract.
- In addition, if boxes 2B or 2C are checked, then Notice of Exclusion or Certificate of Insurance must be submitted within twenty-one (21) days of the contract award and prior to the issuance of the timber sale contract.
- All information must be typed or printed except for written signatures.

Please Check Appropriate Categories:

1. My business is organized as (you **must** check one of the boxes below):
 - A. Sole Proprietorship (individual)
 - B. Partnership
 - C. Corporation
2. You **must** check one of the boxes below:
 - A. I certify my business is a sole proprietorship and it has no employees but the sole proprietor. I am not subject to the Worker's Compensation Laws.
 - B. I certify my business has satisfied its obligation to the Worker's Compensation Act through the use of an approved Notice of Exclusion (BWC-337, Rev. 5/96). I will provide a copy of the Notice of Exclusion within 21 days of the contract award. (For questions or a copy of the BWC-337, please call the Worker's Compensation Bureau at 517-322-1195).
 - C. I certify my business has a Worker's Compensation Policy. I will provide an original Certificate of Insurance within twenty-one (21) days of the contract award.
3. If you have checked item 2(A) or 2(B), you **must** indicate the number of **both** full-time and part-time employees, other than yourself, including family members and active partners (if none, you must enter "0").

_____ Full-time Employees

_____ Part-time Employees

Name of Business		Federal ID (or) Social Security No.	
Address		Telephone ()	
City	State	ZIP	

I hereby certify that the above information is true and correct. I agree to notify the Michigan DNR of any changes that occur in factors affecting my coverage during any of my present and future operations.

Signature of Owner or Authorized Representative

Title

Date

Please complete the "SEALED BID" information on the next page