



**DEPARTMENT OF NATURAL RESOURCES
STATE OF MICHIGAN**

TIMBER SALE PROSPECTUS #6527

SCHEDULED SALE DATE AND TIME: 3:00 p.m. (local time) on October 29, 2019.

LOCATION: ESCANABA MGMT UNIT, 6833 HWY'S 2, 41 & M-35, GLADSTONE, MI 49837.

PROSPECTUS NOTE: The bidder is advised to inspect the sale area and review the location, estimated volumes, operating costs and contract terms of proposed sales. Please be aware that some landowners may request 60 days or more notice for access across their land.

Notice is hereby given that bids will be received by the Unit Manager, ESCANABA MANAGEMENT UNIT, for certain timber on the following described lands:

ATV CENTRAL (33-003-19) / T37N, R24W, SEC. 16, SW.

T37N, R24W, SEC. 17, SENE, SE.

Delta County, Advertised Price \$63,312.70, 88.0 Acres, Hardwood, Red Pine.

SALE NOTE: The timber sale access is off the 7 Mile Marsh Road and the Forest Islands ORV trail. This is part of the ATV trail and route and will have to be considered for all operational purposes.

A recreation site such as a trail, pathway, or campground is within the sale area or the vicinity. Certain restrictions/specifications may be applicable including time restrictions.

Surrounded SBW (33-026-19) / T36N, R27W, SEC. 19, NESE, S1/2SE.

T36N, R27W, SEC. 30, NE.

Menominee County, Advertised Price \$28,877.45, 154.2 Acres, Hardwood, Spruce/Fir/Tamarack.

SALE NOTE: There is no access into the sale through state land. The only access into the sale is through private property. Two of the landowners have indicated they would work with the Purchaser to allow access, but it is the Purchaser's responsibility to get permission. There are other access routes through other private landowners as well, but those landowners weren't contacted. The Purchaser is required to install two new culverts prior to hauling. The balsam fir and spruce have been heavily defoliated by the spruce budworm, causing some mortality.

Access may be through private land.

Basswood Hill (33-034-19) / T37N, R27W, SEC. 6, S1/2SW.

T37N, R27W, SEC. 7, NW, NWNE, N1/2SW, SWSW.

Menominee County, Advertised Price \$28,209.90, 84.4 Acres, Hardwood, Aspen.

SALE NOTE: The spruce and balsam fir within Payment Units 4 and 5 is being defoliated by the spruce budworm.

WHAT'S LEFT (33-036-19) / T36N, R27W, SEC. 5, W1/2NW.

T36N, R27W, SEC. 6, N1/2NE, SENE.

T37N, R27W, SEC. 32, SWSW.

Menominee County, Advertised Price \$18,254.00, 47.3 Acres, Hardwood, Aspen.

SALE NOTE: The eastern Larch beetle has caused some tamarack mortality within Payment Units 3 and 4, these units should be harvested as soon as possible to prevent further loss of product.

Tamarack Galore (33-038-19) / T40N, R26W, SEC. 23, SESE.

T40N, R26W, SEC. 24, SWSW.

T40N, R26W, SEC. 25, NWNW.

T40N, R26W, SEC. 26, NE.

Menominee County, Advertised Price \$34,816.65, 86.8 Acres, Spruce/Fir/Tamarack, N White Cedar.

BID INSTRUCTIONS (VER. 07/02/2018):

1. Scheduled Bid Location, Date, and Time (2/11)

Bids must be received by the Unit Manager, ESCANABA OFFICE, 6833 Hwy's 2, 41 & M-35, Gladstone, MI 49837, no later than 3:00 p.m. (local time) on October 29, 2019. For further information concerning this sale, contact Eric Thompson at 906-786-2354.

2. Bidder's Qualifications (5/16)

Purchaser shall obtain workers compensation insurance to cover claims under Michigan's Worker's Disability Compensation Act of 1969 or similar employee benefit act of any other state applicable to an employee. If all or part of a timber sale was prepared by a private contractor, the contractor and that contractor's company are not permitted to bid on the timber sale contract. Bids will not be accepted from individuals or companies appearing on the DNR/FRD No-Bid List. This list contains the names of purchasers who previously failed to execute a contract within 21-days or who have a history of poor performance.

3. Preparation of Sealed Bids (5/16)

Bid Forms may be completed online thru Michigan DNR Timber Sale Online Bidding (OLB) at www.michigan.gov/timberbidding or by completing the hardcopy Bid Form found in the Timber Sale Prospectus. Hardcopy Bid Forms shall be manually signed in ink. Registration in OLB is considered your 'signature' for all bids submitted thru that system. Bid prices must be entered for each species and product in the Bid Price column for all material subject to bidding and all fill-in blanks must be completed. If erasures or other changes appear on the hardcopy Bid Form, each erasure or change must be initialed by the person signing the bid.

4. Submission of Sealed Bids (5/16)

Bid forms may be obtained from the Unit Manager or thru OLB. Bids may be submitted hardcopy or thru OLB. All hardcopy bids must be submitted on the bid form and in an envelope clearly identified as described in this section. NOTE: Only one bid form per bid envelope. Sealed bids must be submitted to the Unit office designated in the prospectus and must be submitted at or prior to the time established in the prospectus. The envelope should show on the outside (a) the sale name or number and (b) the date and time of bid opening, as shown in the prospectus. Bids received after the time specified in the sale prospectus are late bids and will be rejected.

It is possible for a bidder to submit multiple bids on a single sale. For example, a bid may be submitted hardcopy and a bid may be submitted thru OLB. Or, two bidders from the same company could both submit bids on the same sale. If this were to happen, the State would accept all bids received and award the contract accordingly. All bidding and contractual requirements would apply to all bids received.

5. Public Opening of Sealed Bids (7/16)

If conditions permit, the sealed bids will be publicly opened and posted at the time and place set in the prospectus.

If a bidder, present at a bid opening, has submitted bids on more than one sale, that bidder may withdraw their unopened bid envelopes or announce the withdrawal of their online bid after being declared the successful bidder on one sale.

6. Award of Contract (1/11)

Award of the contract will be made to the Bidder whose bid, conforming to the prospectus, is most advantageous to the State of Michigan on the basis of total value at rates bid for the estimated quantities. The State reserves the right to reject any bid or waive any minor irregularity in bids received. A written award mailed (or otherwise furnished) to the successful Bidder shall be deemed to result in a binding contract without further action by either party.

7. Down Payment (1/11)

The Bidder to whom award is made must make a down payment within 21 days of the sale award. The amount of the down payment will be calculated as shown in the Bond and Payment Schedule of this prospectus. Only cash may be used to meet this requirement.

8. Performance Security (1/11)

As guarantee of faithful performance, a cash bond, certificate of deposit, surety bond or irrevocable letter of credit (LOC) is required within 21 days of the sale award. The amount of the performance security is shown in the Bond and

Payment Schedule of this prospectus. If an LOC or surety is used, the coverage must extend for at least 6 months beyond the contract expiration.

9. Timber Sale Contract (7/18)

Additional conditions and requirements common to all timber sales are listed on the timber sale contract (R4031) and are available on line at www.michigan.gov/timber. Contact the Unit Manager for additional information or a sample contract. Within 21 days of the date of the award letter, the bidder must sign the contract and provide the required down payment, performance security, and verification of worker's disability compensation. The down payment and performance security shall be in accordance with the provisions of the timber sale contract, in the sums stated in this prospectus. If these actions are not taken, then the Bidder, the Bidder's corporation, and the corporation's principals may not be permitted to bid on State timber sales for a period of 3 months after the first offense, 6 months after the second offense, and 1 year after the third offense. An offense will only be counted against the Bidder for 5 years. In addition, the Bidder certifies that if awarded this contract, the Bidder will complete the timber sale contract in accordance with its terms and any modifications thereof including requirements to purchase, cut, and remove the included timber by the expiration date.

Payment Unit values in the State Forest Timber Sale Contract are calculated based on the advertised value of the Payment Unit as a percentage of the total advertised value of the contract. The advertised value of each Payment Unit is given in the Description of Timber by Payment Unit table on the Timber Sale Information page. For example, if the value of Payment Unit 1 is advertised as \$1,500 and the total Timber Sale value is advertised as \$10,000, the contract price for Payment Unit 1 will be 15% of the total bid price ($\$1,500/\$10,000 * 100$).

10. Disclaimer of Estimates and Bidder's Warranty of Inspection (7/16)

Before submitting this bid, the Bidder is advised and cautioned to inspect the sale area, review the requirements of the sale contract, and take other steps as may be reasonably necessary to ascertain the location, estimated volumes, construction estimates, and operating costs of the proposed sale. Failure to do so will not relieve the Bidder from responsibility for completing the contract.

The Bidder warrants that this bid is submitted solely on the basis of the Bidder's examination and inspection of the quality and quantity of the timber offered for sale and the Bidder's opinion of the value thereof and the costs of recovery. No reliance should be placed on the State of Michigan's estimates of timber quality, quantity or costs of recovery. Bidder further acknowledges that the State of Michigan: (i) expressly disclaims any warranty of fitness of timber for any purpose; (ii) offers this timber as is without any warranty of quality (merchantability) or quantity and (iii) expressly disclaims any warranty as to the quantity or quality of timber sold.

11. Certification and Chain-of-Custody (10/14)

Unless otherwise indicated in the contract under section 7 – Other Conditions of the Sale Specific Conditions & Requirements, the area encompassed by this timber sale is certified to the standards of the Forest Stewardship Council (FSC) - Certificate #SCS-FM/COC-00090N and the Sustainable Forestry Initiative (SFI) - Certificate #NSF-SFIS-5Y031-SF5. Forest products from this sale may be delivered to the mill as "FSC 100% and / or SFI certified" as long as the contractor hauling the forest products is chain-of-custody (COC) certified or covered under a COC certificate from the destination mill. The purchaser is responsible for maintaining COC after leaving the sale area.

12. Good Neighbor Authority (GNA) Requirements (7/16)

If the name of this timber sales contains the acronym GNA, it is authorized by the Good Neighbor Authority (GNA) and covered by various agreements between the U.S. Forest Service and the State. The timber sale occurs on federal land and the following conditions apply:

GNA contracts on US Forest Service land will not be awarded to purchasers on the Federal list of excluded parties. The System for Award Management (SAM) will be checked for active excluded parties prior to award of contract. In addition, the Bidder to whom award is made must complete an Assurance Regarding Felony Conviction or Tax Delinquent Status for Corporate Applicants (AD-3031).

13. Good Neighbor Authority (GNA) Requirements, con't (9/16)

Bidder certifies, by signing this bid form, that to the best of Bidder's knowledge that the following representations are accurate and complete.

- a. That the Bidder and its principals are not presently debarred, suspended, proposed for debarment, declared ineligible, or voluntary excluded from timber sales (covered transactions) by any Federal department or agency.
- b. That the Bidder and its principals have not within a 3-year period preceding this bid been convicted of or had a civil judgment rendered against them for commission of fraud or a criminal offense in connection with obtaining, attempting to obtain, or performing a public (Federal, State, or local) transaction or contract under a public transaction; violation of Federal or State antitrust statutes or commission of embezzlement, theft, forgery, bribery, falsification or destruction of records, making false statements, or receiving stolen property.
- c. That the Bidder and its principals are not presently indicted for or otherwise criminally or civilly charged by a governmental entity (Federal, State, or local) with commission of any of the offenses enumerated in paragraph b of this certification.
- d. That the Bidder and its principals have not within a 3-year period preceding this bid had one or more public transactions (Federal, State, or local) terminated for breach or default of a timber or forest product contract.

Bidders that cannot certify this requirement, in whole or in part, shall submit an explanation with their bid.

DAN EICHINGER
Director

TIMBER SALE INFORMATION

ATV CENTRAL (33-003-19)

T37N, R24W, SEC. 16; T37N, R24W, SEC. 17.

Delta County (Advertised Price \$63,312.70)

SALE NOTE: The timber sale access is off the 7 Mile Marsh Road and the Forest Islands ORV trail. This is part of the ATV trail and route and will have to be considered for all operational purposes.

A recreation site such as a trail, pathway, or campground is within the sale area or the vicinity. Certain restrictions/specifications may be applicable including time restrictions.

A timber sale contract for this lump sum, sealed bid timber sale will be awarded to the responsible bidder offering the highest sealed bid price. Bids must be at or above the following advertised price for each species:

<u>PRODUCTS & SPECIES</u>	<u>ESTIMATED UNITS*</u>	<u>ADVERTISED PRICE</u>
Sawtimber		
Green Ash	37.80 MBF	\$ 86.00 / MBF
Red Maple	21.90 MBF	\$ 177.00 / MBF
Pulpwood		
B. T. Aspen	54.00 Cords	\$ 30.25 / Cord
Balsam Fir	14.00 Cords	\$ 23.20 / Cord
Black Ash	98.00 Cords	\$ 26.85 / Cord
Black Spruce	61.00 Cords	\$ 29.00 / Cord
Green Ash	216.00 Cords	\$ 26.85 / Cord
Mixed Hardwood	310.00 Cords	\$ 26.85 / Cord
Red Pine	441.00 Cords	\$ 50.65 / Cord
Tamarack	81.00 Cords	\$ 13.75 / Cord
White Pine	315.00 Cords	\$ 38.90 / Cord

* The total volume is statistically estimated within plus (+) or minus (-) 12.94 percent. The estimated units are final and not subject to adjustment. Prospective bidders are urged to examine this timber and to make their own estimates of quantity and quality.

BOND AND PAYMENT SCHEDULE:

1. A bond in the amount of \$3,166.00 to insure faithful performance of the conditions of the contract will be deposited by the successful bidder within 21 days of the sale award.
2. Cutting in any sale or unit without the required advance payment would be considered a trespass.
3. Total payment must be paid in advance or according to the following schedule:
 - (a) Ten percent (10%) of the sale value must be paid within 21 days of the sale award.
 - (b) The 10% down payment will be credited towards the first unit cut.
 - (c) Payment for each of the following units must be made before cutting begins in that unit:

PAYMENT UNIT NUMBER	PERCENT OF TOTAL SALE VALUE
01	56.5%
02	6.4%
03	37.1%

4. If no cutting takes place, the 10% down payment will not be refunded.
5. Operations on the contract issued will terminate on 12/31/2022.

Description of Timber by Payment Unit (PU)

PU	MARKET GROUP	PRODUCT	QUANTITY	UNIT	ACRES	ADVERTISE PRICE
1	Red Maple	Sawtimber	2.5	MBF	38.6	\$35,786.35
	B. T. Aspen	Pulpwood	54.0	Cords		
	Balsam Fir		5.0	Cords		
	Mixed Hardwood		40.0	Cords		
	Red Pine		437.0	Cords		
	White Pine		267.0	Cords		
2	Black Spruce	Pulpwood	61.0	Cords	21.0	\$4,032.70
	Mixed Hardwood		15.0	Cords		
	Red Pine		4.0	Cords		
	Tamarack		81.0	Cords		
	White Pine		14.0	Cords		
3	Green Ash	Sawtimber	37.8	MBF	28.4	\$23,493.65
	Red Maple		19.4	MBF		
	Balsam Fir	Pulpwood	9.0	Cords		
	Black Ash		98.0	Cords		
	Green Ash		216.0	Cords		
	Mixed Hardwood		255.0	Cords		
	White Pine		34.0	Cords		
TOTAL:			59.7	MBF		
TOTAL:			1,590.0	Cords		

Sale Specific Conditions & Requirements

Sale Name: ATV CENTRAL

Sale Number: 33-003-19 Seq#: 1

1 - Sale Area

1.2 - Boundaries

1.2.1 - Painted boundaries (1/14)

The sale boundary and Payment Unit boundaries are marked and identified red and yellow paint. Exterior sale boundary lines against state are marked with red paint. Interior Payment Unit boundaries are marked with yellow paint. The painted boundary line trees are not Included Timber and are to be protected unless marked with orange paint. Yellow painted trees designating an interior Payment Unit boundary are only to be cut when all surrounding Payment Units have been paid.

2 - Timber Specifications

2.1 - Included Timber

2.1.1 - Clearcut unit(s) with unmerchantable trees (6/14)

Within Payment Unit(s) 2 and 3, cut all trees that are three (3) inches or more at DBH with the following exceptions:

Unit 2- Do not cut any cedar.

Unit 3- Do not cut cedar, yellow birch and hemlock.

2.1.7 - Leave tree marked unit(s) (6/14)

Within Payment Unit(s) 1, all trees, which meet minimum piece specifications in 2.2 Utilization, are designated for cutting except do not cut cedar, hemlock and trees marked with green paint above and below stump height.

2.1.9 - Harvest exception (12/08)

Do not cut within Payment Unit 1, any cedar or hemlock trees other than those that are necessary to remove in order to operate within the sale area. Every effort must be made to preserve the existing cedar and hemlock and to leave an intact stand upon sale completion. All cut cedar and hemlock shall be piled separately by products and scaled in the woods unless other scaling arrangements are agreed to by the Unit Manager or his/her representative. Stumpage price for cedar shall be \$50.00 per cord for posts and pulpwood, and \$100.00 per cord for bolts and sawlogs. Stumpage price for hemlock shall be \$50.00 per cord.

3 - Payments

3.3 - Pre-measured Sales

3.3.4 - Dividing payment units (7/14)

Payment Unit(s) with a contract bid value of \$18,000 or greater may be divided at the request of the Purchaser and upon approval of the Unit Manager. Dividing Payment Units is a contract modification which requires a Timber Sale Contract Supplement. There will be only one division per Payment Unit.

3.4 - Damaged Timber

3.4.1 - Damaged timber (7/16)

General Condition and Requirement 3.4 Damaged Timber, defines liquidated damages for undesignated live merchantable trees which are cut or injured. In addition, within Payment Unit 1 extreme care should be taken to avoid damage to tree seedlings and saplings.

Within the sale area, if more than 25% of the tree seedlings or saplings (1/4" to 4.5" DBH) within a specified portion of the sale area are damaged, liquidated damages will be assessed at \$100 per acre for all acreage within that specified portion of the sale area that was damaged.

4 - Transportation

4.1 - Construction

4.1.5 - Culverts (5/14)

Roads may require the installation of culverts for cross drainage or at natural drainage-ways. If culverts are needed in these

locations, their placement will be specified by the sale administrator and they shall be installed prior to hauling. The culverts shall be new, corrugated metal or plastic gauge. Culverts will be a minimum of 18 inches in diameter and 24 feet in length. If culverts are removed, fill shall be removed from wetland soils as specified. Soils shall be maintained and left in a non-erodible condition, with water bars, seed, fertilizer, mulch, and slash installed as directed by the sale administrator and as specified in the BMP manual. Stream crossing permits, if needed, will be obtained by the DNR.

4.1.6 - Road construction (1/09)

Construction of new roads or improvements of existing roads shall be done in such a way as to minimize the environmental and visual impacts. Merchantable trees shall be cut and utilized unless otherwise directed. Non-merchantable trees shall be severed and laid flat on the ground. Slash shall be scattered, and not left in windrows and kept a minimum of 10 feet back from the road edge. Stumps shall be set upright, not left on edge, and be moved at least 10 feet away from the road edge. Disturbed soil shall be feathered into the woods and not left in berms or windrows.

4.1.7 - Road closure (10/11)

All new roads built into the sale must be blocked to vehicle traffic upon completion of the sale. Overgrown roads that are reopened shall be considered new roads. In general, this will require constructing a four (4') foot high berm of stumps and logs covered with earth. These roads must be rendered impassable to cars and trucks. Contact the sale administrator for specific details of design and placement.

4.2 - Maintenance

4.2.1 - Hauling restriction (12/08)

Hauling may be restricted on forest roads by the Unit Manager or his/her representative. The restriction may occur during spring breakup.

4.2.2 - Fill material (4/07)

To maintain roads, fill material may be needed in areas where "holes" exist or may be expected to develop. This fill material should be placed before trucking begins. Contact the sale administrator regarding the availability of onsite sand or gravel from adjacent State-owned lands.

4.2.4 - Grading (10/16)

For completion of the sale, state forest roads must be graded. In general, this will require a road grader or bull dozer to shape up the roads after forest products have been hauled off site. This includes cleaning of drainage areas, grading, crowning and filling with gravel, if necessary. The grading equipment to be used must be approved by the Unit Manager or his/her representative.

5 - Operations

5.2 - Conduct of Operations

5.2.3 - Operating Restrictions

5.2.3.1 - Operating restrictions (9/11)

Within Payment Unit(s) 2 and 3, unless changed by written agreement, cutting, skidding, and hauling are limited to the period of 12/01 to 03/31 or frozen ground conditions. This restriction is because these Payment Unit(s) are low and wet ground during the summer months.

5.2.3.6 - Bark beetle restriction (12/08)

In the event drought creates a high risk of pine bark beetle infestation, pine is not to be cut during the period March 1 through July 1, unless all portions of trees greater than two inches in diameter are removed from the sale area, reduced to chips, or treated to the satisfaction of the Unit Manager or his/her representative, within fifteen days of being severed from the stump. Pine log decks, pulpwood piles and treetops that are piled for chipping in the fall or winter within a 1/4 mile of susceptible sites must be removed before March 15. Residual slash must not be placed in piles or rows and must be spread over the site for quick drying. The Department of Natural Resources will exercise this specification if the risk of damage warrants.

5.2.38 - No decking against live trees (2/04)

Cut products may not be decked against unmarked or designated leave trees.

5.2.39 - ORV trail/route protection (4/18)

The Forest Island trail is an ORV trail or route and is shown on the Timber Sale Map. Do not cut trees or damage posts with

yellow ORV markers. Maintain a 20 foot wide slash, debris, and rut free zone daily using the ORV trail or route as the centerline. Skidding across the trail or route may only occur in locations approved by the sale administrator.

5.4 - Soil Protection

5.4.1 - Rutting restriction, general (7/16)

Operations are to cease immediately if equipment and weather conditions result in rutting of roads and/or skid trails which is 12 inches or greater in depth and 50 feet in length. The Unit Manager or his/her representative may restrict hauling and/or skidding if ruts exceed the specified depth. With the Unit Manager or his/her representative's approval, the Purchaser may return to the area when the risk of rutting has decreased.

6 - Safety and Fire Prevention

6.2 - Signing

6.2.1 - Road posting (9/09)

The Purchaser is responsible for posting and maintaining caution signs on the 7 Mile Marsh road prior to beginning operations. The road must be posted at appropriate distances from the sale area to warn of logging activity and truck traffic. Signs must be removed when harvest operations are suspended or completed. The Purchaser will provide these signs.

6.2.3 - Recreational trail posting (2/10)

The Purchaser is responsible for posting and maintaining caution signs on the Forest Island ORV trail prior to beginning operations. The trail must be posted at appropriate distances from the sale area to warn of logging activity and truck traffic at both ends of the trail. Signs must be removed when harvest operations are suspended or completed. The Purchaser will provide these signs.



TIMBER SALE MAP

This information provided by authority of Part 525, 1994 PA 451, as amended.

Forest Management Unit Escanaba	County Delta	Mapped By Racine	Date 08/27/2019	Page 1	of 1
Township 37N	Range 24W	Section(s) and Subdivision(s) 16) SW 17) SENE, SE	Scale 1:15,840		

Cover Type				Density	
A = Aspen	H = Hemlock	N = Marsh	U = Upland Brush	0 = Non Stocked	5 = Pole Timber Medium
B = Paper Birch	J = Jack Pine	O = Oak	UM = Upland Mixed	1 = Seedling Sapling Poor	6 = Pole Timber Well
C = Cedar	L = Lowland Brush	P = Lowland Poplar	V = Bog or Marsh	2 = Seedling Sapling Medium	7 = Saw Timber Poor
D = Treed Bog	LM = Lowland Mixed	Q = Mixed Swamp Conifer	W = White Pine	3 = Seedling Sapling Well	8 = Saw Timber Medium
E = Swamp Hdwoods	M = Mpl, Bch, Brch	R = Red Pine	X = Non Stocked	4 = Pole Timber Poor	9 = Saw Timber Well
F = Spruce Fir	MC = Mixed Conifer	S = Black Spruce	Z = Water		
G = Grass	MD = Mixed Deciduous	T = Tamarack			

PU	Acres
1	38.6
2	21
3	28.4



ATV Central

Compartment 77

88 Acres

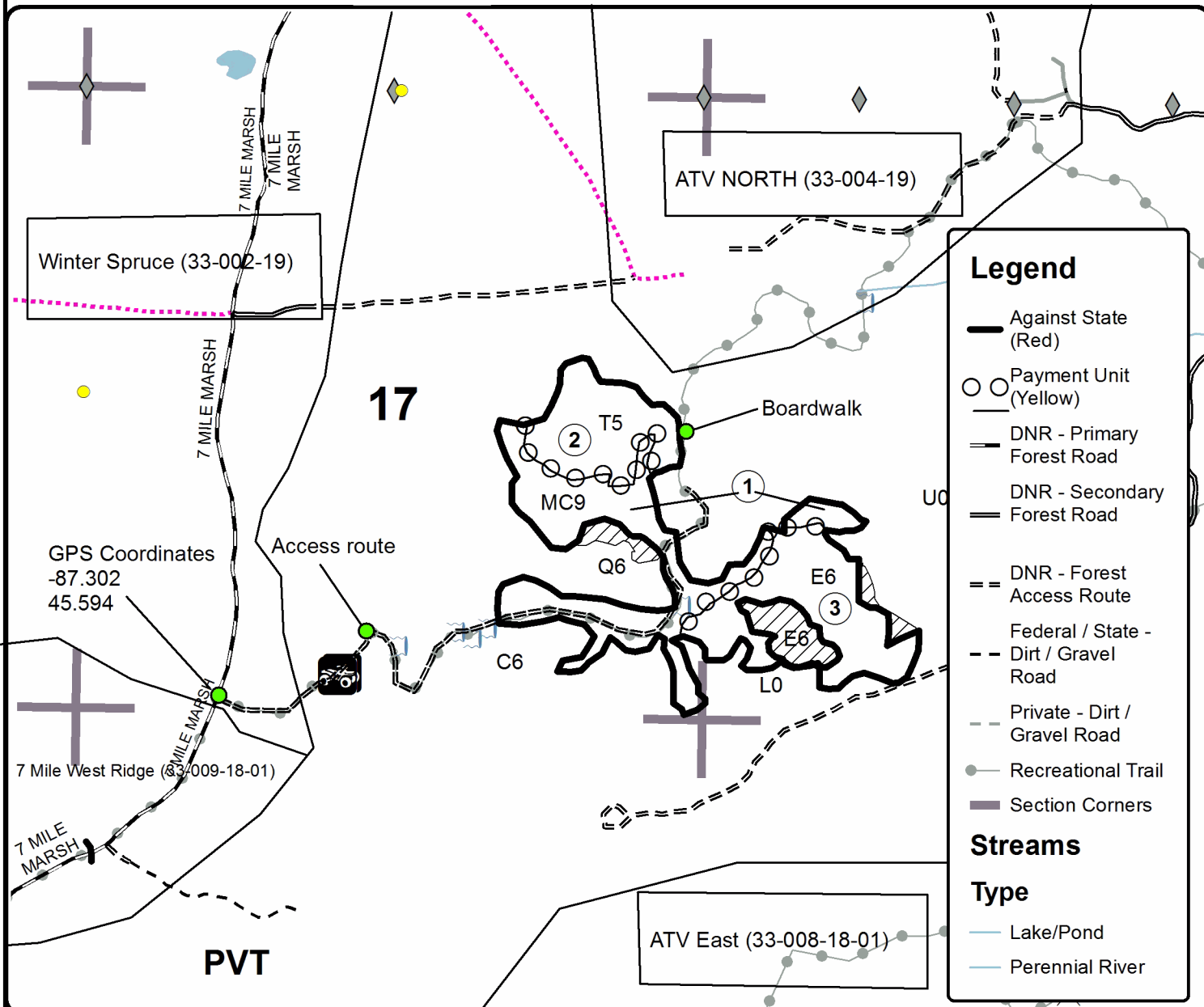
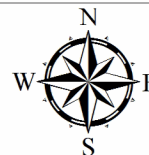

Legend

- Against State (Red)
- Payment Unit (Yellow)
- DNR - Primary Forest Road
- DNR - Secondary Forest Road
- == DNR - Forest Access Route
- - - Federal / State - Dirt / Gravel Road
- - - Private - Dirt / Gravel Road
- Recreational Trail
- Section Corners

Streams

Type

- Lake/Pond
- Perennial River

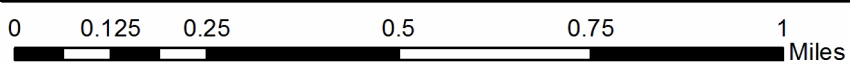

TIMBER SALE INFORMATION

Surrounded SBW (33-026-19)

T36N, R27W, SEC. 19; T36N, R27W, SEC. 30.
Menominee County (Advertised Price \$28,877.45)

SALE NOTE: There is no access into the sale through state land. The only access into the sale is through private property. Two of the landowners have indicated they would work with the Purchaser to allow access, but it is the Purchaser's responsibility to get permission. There are other access routes through other private landowners as well, but those landowners weren't contacted. The Purchaser is required to install two new culverts prior to hauling. The balsam fir and spruce have been heavily defoliated by the spruce budworm, causing some mortality.

Access may be through private land.

A timber sale contract for this lump sum, sealed bid timber sale will be awarded to the responsible bidder offering the highest sealed bid price. Bids must be at or above the following advertised price for each species:

<u>PRODUCTS & SPECIES</u>	<u>ESTIMATED UNITS*</u>		<u>ADVERTISED PRICE</u>
Sawtimber			
Green Ash	31.70	MBF	\$ 40.00 / MBF
Red Maple	3.20	MBF	\$ 83.00 / MBF
Sugar Maple	0.40	MBF	\$ 125.00 / MBF
Pulpwood			
Balsam Fir	174.00	Cords	\$ 10.85 / Cord
Mixed Hardwood	1,604.00	Cords	\$ 12.50 / Cord
Mixed Spruce	207.00	Cords	\$ 13.55 / Cord
N. White Cedar	51.00	Cords	\$ 10.15 / Cord
Quaking Aspen	78.00	Cords	\$ 14.10 / Cord
Tamarack	92.00	Cords	\$ 6.40 / Cord
White Pine	19.00	Cords	\$ 18.15 / Cord

* The total volume is statistically estimated within plus (+) or minus (-) 8.75 percent. The estimated units are final and not subject to adjustment. Prospective bidders are urged to examine this timber and to make their own estimates of quantity and quality.

BOND AND PAYMENT SCHEDULE:

1. A bond in the amount of \$1,444.00 to insure faithful performance of the conditions of the contract will be deposited by the successful bidder within 21 days of the sale award.
2. Cutting in any sale or unit without the required advance payment would be considered a trespass.
3. Total payment must be paid in advance or according to the following schedule:
 - (a) Ten percent (10%) of the sale value must be paid within 21 days of the sale award.
 - (b) The 10% down payment will be credited towards the first unit cut.
 - (c) Payment for each of the following units must be made before cutting begins in that unit:

PAYMENT UNIT NUMBER	PERCENT OF TOTAL SALE VALUE
01	24.5%
02	12.7%
03	16.6%
04	12.3%
05	18.4%
06	6.3%
07	9.2%

4. If no cutting takes place, the 10% down payment will not be refunded.
5. Operations on the contract issued will terminate on 06/30/2023.

Description of Timber by Payment Unit (PU)

PU	MARKET GROUP	PRODUCT	QUANTITY	UNIT	ACRES	ADVERTISE PRICE
1	Balsam Fir	Pulpwood	76.0	Cords	40.9	\$7,066.55
	Mixed Hardwood		440.0	Cords		
	Mixed Spruce		33.0	Cords		
	Quaking Aspen		20.0	Cords		
	Tamarack		2.0	Cords		
2	Balsam Fir	Pulpwood	22.0	Cords	17.2	\$3,665.60
	Mixed Hardwood		58.0	Cords		
	Mixed Spruce		118.0	Cords		
	N. White Cedar		11.0	Cords		
	Quaking Aspen		5.0	Cords		
	Tamarack		90.0	Cords		
	White Pine		19.0	Cords		
3	Green Ash	Sawtimber	4.5	MBF	26.9	\$4,802.75
	Red Maple		0.5	MBF		
	Balsam Fir	Pulpwood	37.0	Cords		
	Mixed Hardwood		278.0	Cords		
	Mixed Spruce		26.0	Cords		
	Quaking Aspen		25.0	Cords		
4	Green Ash	Sawtimber	11.3	MBF	13.6	\$3,543.70
	Red Maple		0.5	MBF		
	Balsam Fir	Pulpwood	2.0	Cords		
	Mixed Hardwood		219.0	Cords		
	Mixed Spruce		2.0	Cords		
	N. White Cedar		26.0	Cords		
5	Green Ash	Sawtimber	12.7	MBF	33.3	\$5,312.20
	Balsam Fir	Pulpwood	11.0	Cords		
	Mixed Hardwood		358.0	Cords		
	Mixed Spruce		5.0	Cords		
	N. White Cedar		14.0	Cords		
6	Green Ash	Sawtimber	0.7	MBF	6.1	\$1,816.30
	Red Maple		0.4	MBF		
	Sugar Maple		0.4	MBF		
	Balsam Fir	Pulpwood	11.0	Cords		
	Mixed Hardwood		106.0	Cords		
	Mixed Spruce		13.0	Cords		
	Quaking Aspen		6.0	Cords		
7	Green Ash	Sawtimber	2.5	MBF	16.2	\$2,670.35
	Red Maple		1.8	MBF		
	Balsam Fir	Pulpwood	15.0	Cords		
	Mixed Hardwood		145.0	Cords		
	Mixed Spruce		10.0	Cords		
	Quaking Aspen		22.0	Cords		
TOTAL:			35.3	MBF		
TOTAL:			2,225.0	Cords		

Sale Specific Conditions & Requirements

Sale Name: Surrounded SBW

Sale Number: 33-026-19 Seq#: 2

1 - Sale Area

1.2 - Boundaries

1.2.1 - Painted boundaries (1/14)

The sale boundary and Payment Unit boundaries are marked and identified by blue, red, and yellow paint. Exterior sale boundary lines against private property are marked with blue paint. Exterior sale boundary lines against state are marked with red paint. Interior Payment Unit boundaries are marked with yellow paint. Retention patches are bounded by red paint; no harvesting activities may occur within them. The painted boundary line trees are not Included Timber and are to be protected. Yellow painted trees designating an interior Payment Unit boundary are only to be cut when all surrounding Payment Units have been paid for.

2 - Timber Specifications

2.1 - Included Timber

2.1.1 - Clearcut unit(s) with unmerchantable trees (6/14)

Within Payment Unit(s) 1 - 5, and 7, cut all trees that are three (3) inches or more at DBH, with the following exceptions:

- Within Payment Unit 1, do not cut cedar, hemlock, or white pine.
- Within Payment Unit 3, do not cut cedar and hemlock.
- Within Payment Units 4 and 5, do not cut trees marked with green paint.
- Within Payment Unit 7, do not cut cedar, hemlock, and trees marked with green paint.

Within Payment Unit(s) 6, cut all trees that are four (4) inches or more at DBH, except do not cut cedar, hemlock, or any trees marked with green paint.

3 - Payments

3.3 - Pre-measured Sales

3.3.4 - Dividing payment units (7/14)

Payment Unit(s) \$18,000 in value or greater may be divided at the request of the Purchaser and upon approval of the Unit Manager. Dividing Payment Units is a contract modification which requires a Timber Sale Contract Supplement. There will be only one division per Payment Unit.

4 - Transportation

4.1 - Construction

4.1.1 - Stream crossings, general (3/11)

All stream crossing structures will be temporary and therefore, shall be provided by the Purchaser, and must be removed upon completion of the sale. All permits for stream crossings will be provided by the Purchaser. There is a small creek/drain that flows through Payment Unit 6. If access is from the north, a temporary crossing must be installed. Timber mats would span the creek/drain and would allow the Purchaser to skid across the creek/drain. This creek/drain may only be crossed in one location. The crossing must be approved by the sale administrator.

4.1.8 - Road work (1) (8/07)

The following road work is required prior to any hauling taking place: The Purchaser must purchase and install two (2) new 18" X 24' corrugated steel culverts. The culvert locations are shown on the Timber Sale Map. Each culvert must be covered by a minimum of 12 inches of gravel. Gravel is available within the sale area. No permits are required for these culvert installations; they are to improve cross drainage.

4.2 - Maintenance

4.2.1 - Hauling restriction (12/08)

Hauling may be restricted on forest roads by the Unit Manager or his/her representative. The restriction may occur during spring breakup or during other wet weather conditions.

4.2.4 - Grading (10/16)

For completion of the sale, state forest roads must be graded. In general, this will require a road grader or bull dozer to shape up the roads after forest products have been hauled off site. This includes cleaning of drainage areas, grading, crowning and filling with gravel, if necessary. The grading equipment to be used must be approved by the Unit Manager or his/her representative.

4.4 - Access

4.4.1 - Private property access (3/11)

Permission for access across private land is the responsibility of the Purchaser. Should the Purchaser desire to cross private land, a copy of the written permission from the private land-owner may be required by the DNR. Two different landowners have indicated they would work with the Purchaser to allow access, but the Purchaser will be responsible for getting permission. There are other access routes into the sale through different landowners, but they were not contacted.

To obtain the landowners contact information, contact Dan (ext. 223) or Dustin (ext. 224) at 906-753-6317, at the Stephenson Field Office.

5 - Operations

5.2 - Conduct of Operations

5.2.3 - Operating Restrictions

5.2.3.1 - Operating restrictions (9/11)

Within Payment Unit(s) 1 - 7, cutting and skidding are limited to the period of December 1 to March 31, unless there is an extended dry or frozen period and the sale administrator allows harvesting during that period of time. This restriction is because of low wet ground within Payment Units 1-5. Within Payments Units 6 and 7, low ground must be crossed in order to skid the wood to the access road.

5.4 - Soil Protection

5.4.1 - Rutting restriction, general (7/16)

Operations are to cease immediately if equipment and weather conditions result in rutting of roads and/or skid trails which is 12 inches or greater in depth and 50 feet in length. The Unit Manager or his/her representative may restrict hauling and/or skidding if ruts exceed the specified depth. With the Unit Manager or his/her representative's approval, the Purchaser may return to the area when the risk of rutting has decreased.

7 - Other Conditions

7.2 - Extensions

7.2.5 - Weather related extension (1/13)

If weather conditions during the operating period of this contract prevent harvesting, this sale may qualify for a weather related extension. If approved, the normal extension fee would be waived. To qualify, there must be a documented attempt each year to harvest in the difficult portion of the sale.

7.5 - Loss

7.5.1 - Deteriorating timber (7/09)

The sale area has received damage from the spruce budworm. The spruce budworm has caused extensive balsam fir and spruce defoliation with some mortality. The Purchaser should harvest the wood as soon as possible. The Department of Natural Resources is held free of responsibility of any further damage or deterioration due to delay in harvesting.



TIMBER SALE MAP

This information provided by authority of Part 525, 1994 PA 451, as amended.

Forest Management Unit Escanaba Management Unit		County Menominee County	Mapped By Beaudo		Date 1/7/2019	Page 1 of 1	
Township 36N	Range 27W	Section(s) and Subdivision(s) Sec 19 - S1/2SE, NESE; Sec 30 - NE 1/4.			Scale 1:15,840		
Cruised By Salter, Beaudo							

Cover Type				Density			
A = Aspen	H = Hemlock	N = Marsh	U = Upland Brush	0 = Non Stocked	5 = Pole Timber Medium		
B = Paper Birch	J = Jack Pine	O = Oak	UM = Upland Mixed	1 = Seedling Sapling Poor	6 = Pole Timber Well		
C = Cedar	L = Lowland Brush	P = Lowland Poplar	V = Bog or Marsh	2 = Seedling Sapling Medium	7 = Saw Timber Poor		
D = Treed Bog	LM = Lowland Mixed	Q = Mixed Swamp Conifer	W = White Pine	3 = Seedling Sapling Well	8 = Saw Timber Medium		
E = Swamp Hdwoods	M = Mpl, Bch, Brch	R = Red Pine	X = Non Stocked	4 = Pole Timber Poor	9 = Saw Timber Well		
F = Spruce Fir	MC = Mixed Conifer	S = Black Spruce	Z = Water				
G = Grass	MD = Mixed Deciduous	T = Tamarack					

PU	Acres	PU	Acres
1	40.9	5	33.3
2	17.2	6	6.1
3	26.9	7	16.2
4	13.6		

Surrounded SBW
Compartment 16
154.2 Acres

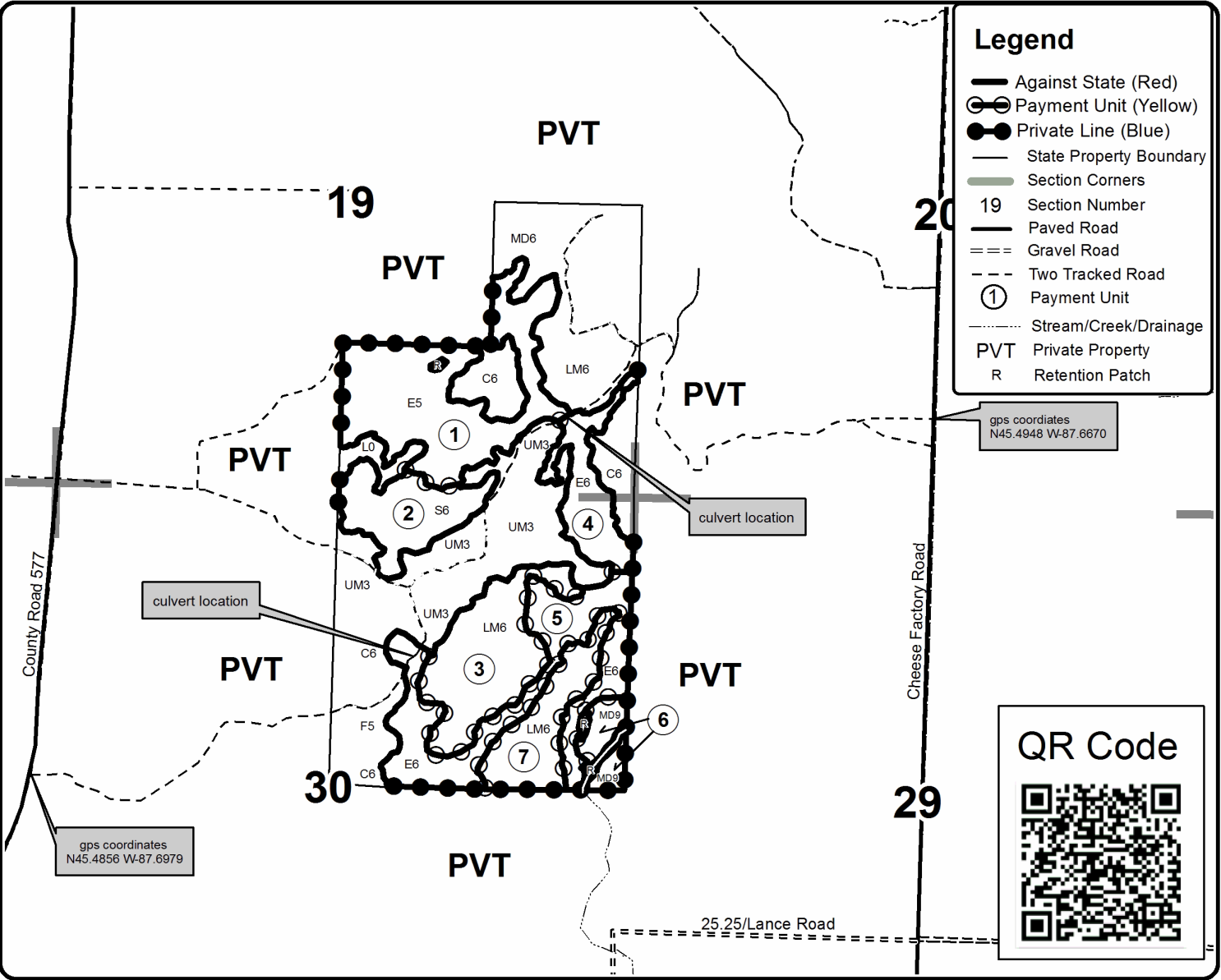
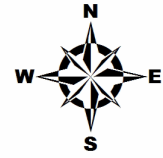

Legend

- Against State (Red)
- ⊙ Payment Unit (Yellow)
- Private Line (Blue)
- State Property Boundary
- Section Corners
- 19 Section Number
- Paved Road
- Gravel Road
- - - Two Tracked Road
- ① Payment Unit
- Stream/Creek/Drainage
- PVT Private Property
- R Retention Patch

gps coordinates
N45.4948 W-87.6870

gps coordinates
N45.4856 W-87.6979

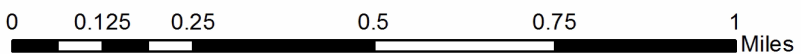

TIMBER SALE INFORMATION

Basswood Hill (33-034-19)
 T37N, R27W, SEC. 6; T37N, R27W, SEC. 7.
 Menominee County (Advertised Price \$28,209.90)

SALE NOTE: The spruce and balsam fir within Payment Units 4 and 5 is being defoliated by the spruce budworm.

A timber sale contract for this lump sum, sealed bid timber sale will be awarded to the responsible bidder offering the highest sealed bid price. Bids must be at or above the following advertised price for each species:

<u>PRODUCTS & SPECIES</u>	<u>ESTIMATED UNITS*</u>	<u>ADVERTISED PRICE</u>
Sawtimber		
Basswood	35.90 MBF	\$ 108.00 / MBF
Sugar Maple	0.50 MBF	\$ 268.00 / MBF
White Ash	5.00 MBF	\$ 84.00 / MBF
Pulpwood		
Balsam Fir	65.00 Cords	\$ 23.20 / Cord
Basswood	577.00 Cords	\$ 10.85 / Cord
Mixed Aspen	283.00 Cords	\$ 30.25 / Cord
Mixed Hardwood	215.00 Cords	\$ 26.85 / Cord
Mixed Spruce	35.00 Cords	\$ 29.00 / Cord
N. White Cedar	26.00 Cords	\$ 21.75 / Cord
Tamarack	7.00 Cords	\$ 13.75 / Cord

* The total volume is statistically estimated within plus (+) or minus (-) 15.67 percent. The estimated units are final and not subject to adjustment. Prospective bidders are urged to examine this timber and to make their own estimates of quantity and quality.

BOND AND PAYMENT SCHEDULE:

1. A bond in the amount of \$1,410.00 to insure faithful performance of the conditions of the contract will be deposited by the successful bidder within 21 days of the sale award.
2. Cutting in any sale or unit without the required advance payment would be considered a trespass.
3. Total payment must be paid in advance or according to the following schedule:
 - (a) Ten percent (10%) of the sale value must be paid within 21 days of the sale award.
 - (b) The 10% down payment will be credited towards the first unit cut.
 - (c) Payment for each of the following units must be made before cutting begins in that unit:

<u>PAYMENT UNIT NUMBER</u>	<u>PERCENT OF TOTAL SALE VALUE</u>
01	17.8%
02	12.1%
03	9.1%
04	41.3%
05	19.7%
4. If no cutting takes place, the 10% down payment will not be refunded.
5. Operations on the contract issued will terminate on 09/30/2022.

Description of Timber by Payment Unit (PU)

PU	MARKET GROUP	PRODUCT	QUANTITY	UNIT	ACRES	ADVERTISE PRICE
1	Basswood	Sawtimber	7.5	MBF	15.9	\$5,021.70
	White Ash		3.4	MBF		
	Basswood	Pulpwood	201.0	Cords		
	Mixed Hardwood		65.0	Cords		
2	Basswood	Sawtimber	10.9	MBF	14.8	\$3,412.70
	Sugar Maple		0.5	MBF		
	White Ash		0.8	MBF		
	Basswood	Pulpwood	138.0	Cords		
	Mixed Hardwood		20.0	Cords		
3	Basswood	Sawtimber	3.0	MBF	11.4	\$2,570.35
	Basswood	Pulpwood	113.0	Cords		
	Mixed Hardwood		38.0	Cords		
4	Basswood	Sawtimber	12.4	MBF	27.3	\$11,634.75
	White Ash		0.8	MBF		
	Balsam Fir	Pulpwood	43.0	Cords		
	Basswood		100.0	Cords		
	Mixed Aspen		220.0	Cords		
	Mixed Hardwood		35.0	Cords		
	Mixed Spruce		19.0	Cords		
5	Basswood	Sawtimber	2.1	MBF	15.0	\$5,570.40
	Balsam Fir	Pulpwood	22.0	Cords		
	Basswood		25.0	Cords		
	Mixed Aspen		63.0	Cords		
	Mixed Hardwood		57.0	Cords		
	Mixed Spruce		16.0	Cords		
	N. White Cedar		26.0	Cords		
	Tamarack		7.0	Cords		
TOTAL:			41.4	MBF		
TOTAL:			1,208.0	Cords		

Sale Specific Conditions & Requirements

Sale Name: Basswood Hill

Sale Number: 33-034-19 Seq#: 1

1 - Sale Area

1.2 - Boundaries

1.2.1 - Painted boundaries (1/14)

The sale boundary and Payment Unit boundaries are marked and identified by red and yellow paint. Exterior sale boundary lines against state are marked with red paint. Interior Payment Unit boundaries are marked with yellow paint. The painted boundary line trees are not Included Timber and are to be protected, unless marked with orange paint. Yellow painted trees designating an interior Payment Unit boundary are only to be cut when all surrounding Payment Units have been paid for.

2 - Timber Specifications

2.1 - Included Timber

2.1.1 - Clearcut unit(s) with unmerchantable trees (6/14)

Within Payment Unit(s) 4 and 5, cut all trees that are three (3) inches or more at DBH.

2.1.3 - Cut tree marked unit(s) (12/08)

Within Payment Unit(s) 1, 2 and 3, all trees are designated for cutting when marked with orange paint above and below stump height, regardless of merchantability.

3 - Payments

3.3 - Pre-measured Sales

3.3.4 - Dividing payment units (7/14)

Payment Unit(s) \$18,000 in value or greater may be divided at the request of the Purchaser and upon approval of the Unit Manager. Dividing Payment Units is a contract modification which requires a Timber Sale Contract Supplement. There will be only one division per Payment Unit.

4 - Transportation

4.2 - Maintenance

4.2.1 - Hauling restriction (12/08)

Hauling may be restricted on forest roads by the Unit Manager or his/her representative. The restriction may occur during spring breakup or during other wet weather conditions.

4.2.4 - Grading (10/16)

For completion of the sale, state forest roads must be graded. In general, this will require a road grader or bull dozer to shape up the roads after forest products have been hauled off site. This includes cleaning of drainage areas, grading, crowning and filling with gravel, if necessary. The grading equipment to be used must be approved by the Unit Manager or his/her representative.

5 - Operations

5.2 - Conduct of Operations

5.2.3 - Operating Restrictions

5.2.3.3 - Bark slippage restriction (3/09)

Within Payment Unit(s) 1, 2 and 3, unless changed by written agreement, cutting and skidding are not permitted during the period of April 15 to July 15. This restriction is because of bark slippage.

5.2.22 - Operating Caution

5.2.22.1 - Operating caution (6/11)

It is recommended, but not required, that within Payment Unit(s) 5, cutting and skidding occur during dry summer or frozen winter conditions. The reason for the recommendation is because the southern half of the Payment Unit is lower

and wetter. The northern half of the Payment Unit is higher and drier and more suitable for cutting throughout the year.

5.4 - Soil Protection

5.4.1 - Rutting restriction, general (7/16)

Operations are to cease immediately if equipment and weather conditions result in rutting of roads and/or skid trails which is 12 inches or greater in depth and 50 feet in length. The Unit Manager or his/her representative may restrict hauling and/or skidding if ruts exceed the specified depth. With the Unit Manager or his/her representative's approval, the Purchaser may return to the area when the risk of rutting has decreased.

5.4.2 - Skid trails (2/04)

Skid trails up and down slopes should be avoided. If however this is unavoidable, these trails will be left in a non-erodible condition using water bars, logs, and slash. Placing of slash on these skid trails while logging is ongoing may alleviate need for any further action. At the direction of the sale administrator, seed, fertilizer, and mulch may also be required.

6 - Safety and Fire Prevention

6.2 - Signing

6.2.1 - Road posting (9/09)

The Purchaser is responsible for posting and maintaining caution signs on the West Branch of the DeTemple Road prior to beginning operations. The road must be posted at appropriate distances from the sale area to warn of logging activity and truck traffic. Signs must be removed when harvest operations are suspended or completed. The Purchaser will provide these signs.

7 - Other Conditions

7.5 - Loss

7.5.1 - Deteriorating timber (7/09)

The sale area has received damage from the spruce budworm; especially within Payment Unit(s) 4 and 5. The Purchaser should harvest the wood as soon as possible. The Department of Natural Resources is held free of responsibility of any further damage or deterioration due to delay in harvesting.



TIMBER SALE MAP

This information provided by authority of Part 525, 1994 PA 451, as amended.

Forest Management Unit Escanaba Management Unit		County Menominee County	Mapped By Beaudo	Date 8/18/2019	Page 1 of 1	
Township 37N	Range 27W	Section(s) and Subdivision(s) Sec 6 - S1/2SW; Sec 7 - NW, NWNE, N1/2SW, SWSW.		Scale 1:15,840		
Cruised By Salter, Beaudo						

Cover Type				Density			
A = Aspen	H = Hemlock	N = Marsh	U = Upland Brush	0 = Non Stocked	5 = Pole Timber Medium		
B = Paper Birch	J = Jack Pine	O = Oak	UM = Upland Mixed	1 = Seedling Sapling Poor	6 = Pole Timber Well		
C = Cedar	L = Lowland Brush	P = Lowland Poplar	V = Bog or Marsh	2 = Seedling Sapling Medium	7 = Saw Timber Poor		
D = Treed Bog	LM = Lowland Mixed	Q = Mixed Swamp Conifer	W = White Pine	3 = Seedling Sapling Well	8 = Saw Timber Medium		
E = Swamp Hdwoods	M = Mpl, Bch, Brch	R = Red Pine	X = Non Stocked	4 = Pole Timber Poor	9 = Saw Timber Well		
F = Spruce Fir	MC = Mixed Conifer	S = Black Spruce	Z = Water				
G = Grass	MD = Mixed Deciduous	T = Tamarack					

PU	Acres
1	15.9
2	14.8
3	11.4
4	27.3
5	15.0

Basswood Hill
Compartment 2
84.4 Acres

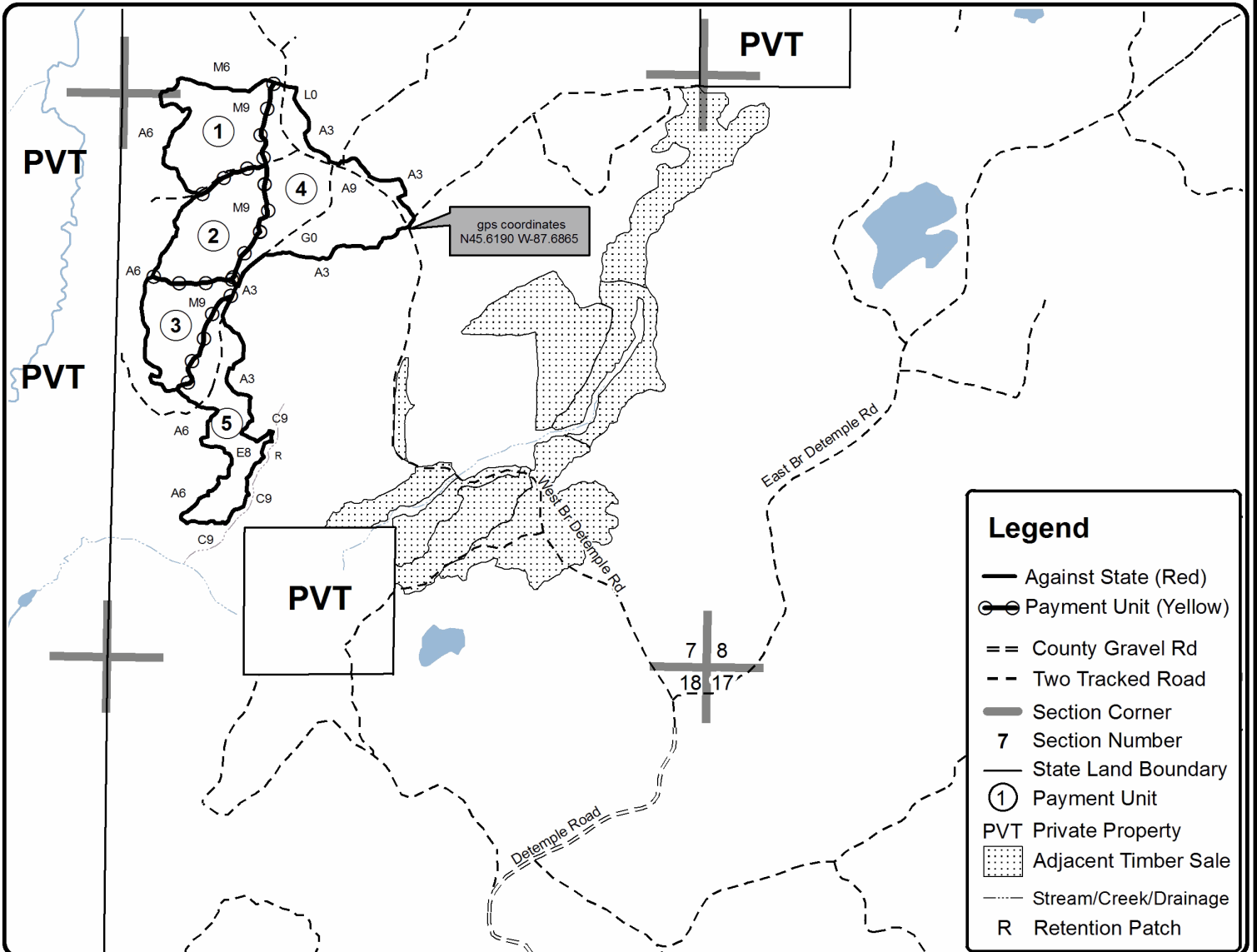

Legend

- Against State (Red)
- Payment Unit (Yellow)
- County Gravel Rd
- Two Tracked Road
- Section Corner
- 7** Section Number
- State Land Boundary
- ①** Payment Unit
- PVT** Private Property
- Adjacent Timber Sale
- Stream/Creek/Drainage
- R** Retention Patch

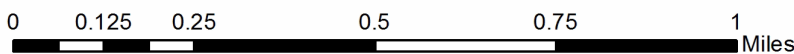

TIMBER SALE INFORMATION

WHAT'S LEFT (33-036-19)

T36N, R27W, SEC. 5; T36N, R27W, SEC. 6; T37N, R27W, SEC. 32.
Menominee County (Advertised Price \$18,254.00)

SALE NOTE: The eastern Larch beetle has caused some tamarack mortality within Payment Units 3 and 4, these units should be harvested as soon as possible to prevent further loss of product.

A timber sale contract for this lump sum, sealed bid timber sale will be awarded to the responsible bidder offering the highest sealed bid price. Bids must be at or above the following advertised price for each species:

<u>PRODUCTS & SPECIES</u>	<u>ESTIMATED UNITS*</u>	<u>ADVERTISED PRICE</u>
Sawtimber		
Green Ash	2.40 MBF	\$ 80.00 / MBF
Pulpwood		
Balsam Fir	14.00 Cords	\$ 21.65 / Cord
Mixed Hardwood	415.00 Cords	\$ 25.05 / Cord
Mixed Spruce	31.00 Cords	\$ 27.05 / Cord
N. White Cedar	37.00 Cords	\$ 20.30 / Cord
Quaking Aspen	193.00 Cords	\$ 28.25 / Cord
Tamarack	25.00 Cords	\$ 12.85 / Cord

* The total volume is statistically estimated within plus (+) or minus (-) 12.45 percent. The estimated units are final and not subject to adjustment. Prospective bidders are urged to examine this timber and to make their own estimates of quantity and quality.

BOND AND PAYMENT SCHEDULE:

1. A bond in the amount of \$913.00 to insure faithful performance of the conditions of the contract will be deposited by the successful bidder within 21 days of the sale award.
2. Cutting in any sale or unit without the required advance payment would be considered a trespass.
3. Total payment must be paid in advance or according to the following schedule:
 - (a) Ten percent (10%) of the sale value must be paid within 21 days of the sale award.
 - (b) The 10% down payment will be credited towards the first unit cut.
 - (c) Payment for each of the following units must be made before cutting begins in that unit:

<u>PAYMENT UNIT NUMBER</u>	<u>PERCENT OF TOTAL SALE VALUE</u>
01	32.1%
02	38.1%
03	14.0%
04	15.8%
4. If no cutting takes place, the 10% down payment will not be refunded.
5. Operations on the contract issued will terminate on 06/30/2022.

Description of Timber by Payment Unit (PU)

PU	MARKET GROUP	PRODUCT	QUANTITY	UNIT	ACRES	ADVERTISE PRICE
1	Green Ash	Sawtimber	2.4	MBF	11.8	\$5,863.25
	Balsam Fir	Pulpwood	1.0	Cords		
	Mixed Hardwood		141.0	Cords		
	Mixed Spruce		1.0	Cords		
	Quaking Aspen		74.0	Cords		
2	Balsam Fir	Pulpwood	6.0	Cords	12.6	\$6,942.15
	Mixed Hardwood		140.0	Cords		
	Quaking Aspen		117.0	Cords		
3	Balsam Fir	Pulpwood	2.0	Cords	14.3	\$2,562.35
	Mixed Hardwood		77.0	Cords		
	Mixed Spruce		3.0	Cords		
	N. White Cedar		9.0	Cords		
	Quaking Aspen		2.0	Cords		
	Tamarack		21.0	Cords		
4	Balsam Fir	Pulpwood	5.0	Cords	8.6	\$2,886.25
	Mixed Hardwood		57.0	Cords		
	Mixed Spruce		27.0	Cords		
	N. White Cedar		28.0	Cords		
	Tamarack		4.0	Cords		
TOTAL:			2.4	MBF		
TOTAL:			715.0	Cords		

Sale Specific Conditions & Requirements

Sale Name: WHAT'S LEFT

Sale Number: 33-036-19 Seq#: 1

1 - Sale Area

1.2 - Boundaries

1.2.1 - Painted boundaries (1/14)

The sale boundary and Payment Unit boundaries are marked and identified by blue, red and yellow paint. Exterior sale boundary lines against private property are marked with blue paint. Exterior sale boundary lines against state are marked with red paint. Retention patches are marked with red paint; no harvesting activities may occur within these areas. Interior Payment Unit boundaries are marked with yellow paint. Yellow painted trees designating an interior Payment Unit boundary are only to be cut when all surrounding Payment Units have been paid for.

2 - Timber Specifications

2.1 - Included Timber

2.1.1 - Clearcut unit(s) with unmerchantable trees (6/14)

Within Payment Unit(s) 1 and 2, cut all trees that are three (3) inches or more at DBH; except do not cut white oak, red pine, white pine and trees marked with green paint.

Within Payment Units 3 and 4, cut all trees that are four (4) inches or more at DBH; except do not cut trees marked with green paint.

3 - Payments

3.3 - Pre-measured Sales

3.3.4 - Dividing payment units (7/14)

Payment Unit(s) \$18,000 in value and greater may be divided at the request of the Purchaser and upon approval of the Unit Manager. Dividing Payment Units is a contract modification which requires a Timber Sale Contract Supplement. There will be only one division per Payment Unit.

4 - Transportation

4.2 - Maintenance

4.2.1 - Hauling restriction (12/08)

Hauling may be restricted on forest roads by the Unit Manager or his/her representative. The restriction may occur during spring breakup or during other wet weather conditions.

4.2.4 - Grading (10/16)

For completion of the sale, state forest roads must be graded. In general, this will require a road grader or bull dozer to shape up the roads after forest products have been hauled off site. This includes cleaning of drainage areas, grading, crowning and filling with gravel, if necessary. The grading equipment to be used must be approved by the Unit Manager or his/her representative.

5 - Operations

5.2 - Conduct of Operations

5.2.3 - Operating Restrictions

5.2.3.1 - Operating restrictions (9/11)

Within Payment Unit(s) 3 and 4, cutting and skidding are limited to the period of December 1st to March 31st, unless there is an extended dry or frozen period and the sale administrator approves harvesting during that period of time. This restriction is because of low wet ground throughout each of these Payment Unit(s).

5.4 - Soil Protection

5.4.1 - Rutting restriction, general (7/16)

Operations are to cease immediately if equipment and weather conditions result in rutting of roads and/or skid trails which is 12 inches or greater in depth and 50 feet in length. The Unit Manager or his/her representative may restrict hauling and/or skidding if ruts exceed the specified depth. With the Unit Manager or his/her representative's approval, the Purchaser may return to the area when the risk of rutting has decreased.

7 - Other Conditions

7.5 - Loss

7.5.1 - Deteriorating timber (7/09)

The sale area has received damage from the eastern larch beetle. The Purchaser should harvest the wood as soon as possible. The Department of Natural Resources is held free of responsibility of any further damage or deterioration due to delay in harvesting.



TIMBER SALE MAP

This information provided by authority of Part 525, 1994 PA 451, as amended.

Forest Management Unit		County	Mapped By	Date	Page of	
Escanaba Management Unit		Menominee County	Beaudo	8/13/2019	1	1
Township	Range	Section(s) and Subdivision(s)		Scale		
36N 37N	27W	T36N R27W Sec 5 - W1/2NW, Sec 6 - N1/2NE, SENE; T37N R27W Sec 32 - SWSW.		1:15,840		

Cover Type				Density			
A = Aspen	H = Hemlock	N = Marsh	U = Upland Brush	0 = Non Stocked	5 = Pole Timber Medium		
B = Paper Birch	J = Jack Pine	O = Oak	UM = Upland Mixed	1 = Seedling Sapling Poor	6 = Pole Timber Well		
C = Cedar	L = Lowland Brush	P = Lowland Poplar	V = Bog or Marsh	2 = Seedling Sapling Medium	7 = Saw Timber Poor		
D = Treed Bog	LM = Lowland Mixed	Q = Mixed Swamp Conifer	W = White Pine	3 = Seedling Sapling Well	8 = Saw Timber Medium		
E = Swamp Hdwoods	M = Mpl, Bch, Brch	R = Red Pine	X = Non Stocked	4 = Pole Timber Poor	9 = Saw Timber Well		
F = Spruce Fir	MC = Mixed Conifer	S = Black Spruce	Z = Water				
G = Grass	MD = Mixed Deciduous	T = Tamarack					

PU	Acres
1	11.8
2	12.6
3	14.3
4	8.6

What's Left
Compartment 13
47.3 Acres

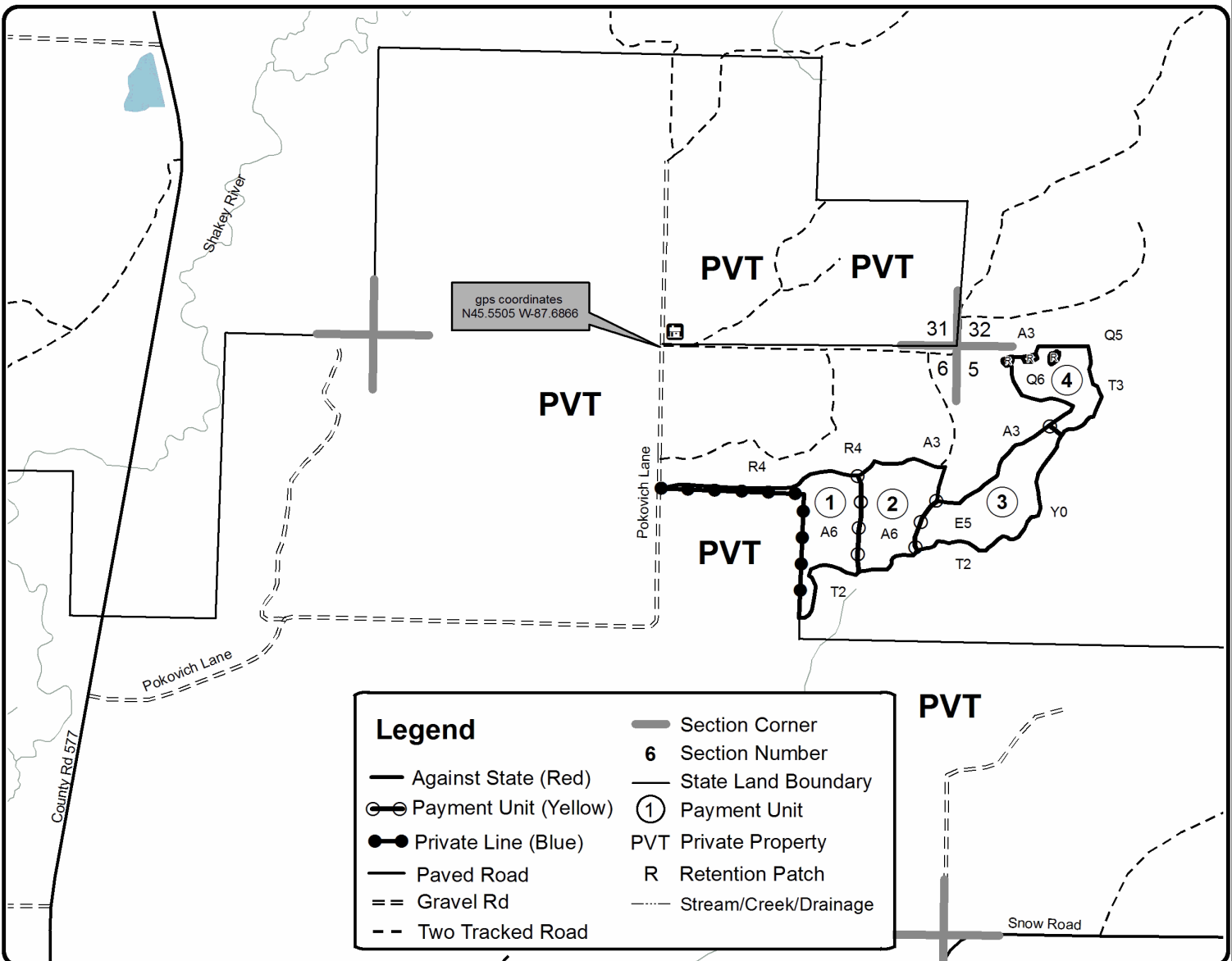

Legend	
	Section Corner
	Section Number
	Against State (Red)
	Payment Unit (Yellow)
	Private Line (Blue)
	Paved Road
	Gravel Rd
	Two Tracked Road
	Payment Unit
	PVT Private Property
	R Retention Patch
	Stream/Creek/Drainage

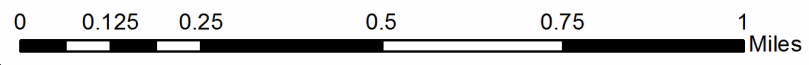

TIMBER SALE INFORMATION

Tamarack Galore (33-038-19)

T40N, R26W, SEC. 23; T40N, R26W, SEC. 24; T40N, R26W, SEC. 25; T40N, R26W, SEC. 26.
Menominee County (Advertised Price \$34,816.65)

A timber sale contract for this lump sum, sealed bid timber sale will be awarded to the responsible bidder offering the highest sealed bid price. Bids must be at or above the following advertised price for each species:

<u>PRODUCTS & SPECIES</u>	<u>ESTIMATED UNITS*</u>	<u>ADVERTISED PRICE</u>
Pulpwood		
Balsam Fir	1.00 Cords	\$ 23.20 / Cord
Black Spruce	236.00 Cords	\$ 29.00 / Cord
N. White Cedar	311.00 Cords	\$ 21.75 / Cord
Paper Birch	3.00 Cords	\$ 15.30 / Cord
Red Maple	15.00 Cords	\$ 26.85 / Cord
Tamarack	1,361.00 Cords	\$ 13.75 / Cord
White Pine	52.00 Cords	\$ 38.90 / Cord

* The total volume is statistically estimated within plus (+) or minus (-) 11.67 percent. The estimated units are final and not subject to adjustment. Prospective bidders are urged to examine this timber and to make their own estimates of quantity and quality.

BOND AND PAYMENT SCHEDULE:

1. A bond in the amount of \$1,741.00 to insure faithful performance of the conditions of the contract will be deposited by the successful bidder within 21 days of the sale award.
2. Cutting in any sale or unit without the required advance payment would be considered a trespass.
3. Total payment must be paid in advance or according to the following schedule:
 - (a) Ten percent (10%) of the sale value must be paid within 21 days of the sale award.
 - (b) The 10% down payment will be credited towards the first unit cut.
 - (c) Payment for each of the following units must be made before cutting begins in that unit:

<u>PAYMENT UNIT NUMBER</u>	<u>PERCENT OF TOTAL SALE VALUE</u>
01	28.7%
02	27.2%
03	27.5%
04	16.6%

4. If no cutting takes place, the 10% down payment will not be refunded.
5. Operations on the contract issued will terminate on 06/30/2023.

Description of Timber by Payment Unit (PU)

PU	MARKET GROUP	PRODUCT	QUANTITY	UNIT	ACRES	ADVERTISE PRICE
1	Balsam Fir	Pulpwood	1.0	Cords	24.8	\$9,977.25
	Black Spruce		68.0	Cords		
	N. White Cedar		88.0	Cords		
	Paper Birch		1.0	Cords		
	Red Maple		5.0	Cords		
	Tamarack		388.0	Cords		
	White Pine		15.0	Cords		
	2		Black Spruce	Pulpwood		
N. White Cedar		85.0	Cords			
Paper Birch		1.0	Cords			
Red Maple		4.0	Cords			
Tamarack		372.0	Cords			
White Pine		14.0	Cords			
3		Black Spruce	Pulpwood		65.0	Cords
	N. White Cedar	86.0		Cords		
	Paper Birch	1.0		Cords		
	Red Maple	4.0		Cords		
	Tamarack	375.0		Cords		
	White Pine	14.0		Cords		
	4	Black Spruce		Pulpwood	39.0	Cords
N. White Cedar		52.0	Cords			
Red Maple		2.0	Cords			
Tamarack		226.0	Cords			
White Pine		9.0	Cords			
TOTAL:			1,979.0		Cords	

Sale Specific Conditions & Requirements

Sale Name: Tamarack Galore

Sale Number: 33-038-19 Seq#: 1

1 - Sale Area

1.2 - Boundaries

1.2.1 - Painted boundaries (1/14)

The sale boundary and Payment Unit boundaries are marked and identified by blue, red and yellow paint. Exterior sale boundary lines against private property are marked with blue paint. Exterior sale boundary lines against state are marked with red paint. Retention patches are marked with red paint; no harvesting activities may occur within these areas. Interior Payment Unit boundaries are marked with yellow paint. The painted boundary line trees are not Included Timber and are to be protected. Yellow painted trees designating an interior Payment Unit boundary are only to be cut when all surrounding Payment Units have been paid for.

2 - Timber Specifications

2.1 - Included Timber

2.1.1 - Clearcut unit(s) with unmerchantable trees (6/14)

Within Payment Unit(s) 1 - 4, cut all trees that are three (3) inches or more at DBH; except do not cut trees marked with green paint.

3 - Payments

3.3 - Pre-measured Sales

3.3.4 - Dividing payment units (7/14)

Payment Unit(s) \$18,000 in value and greater may be divided at the request of the Purchaser and upon approval of the Unit Manager. Dividing Payment Units is a contract modification which requires a Timber Sale Contract Supplement. There will be only one division per Payment Unit.

4 - Transportation

4.2 - Maintenance

4.2.1 - Hauling restriction (12/08)

Hauling may be restricted on forest roads by the Unit Manager or his/her representative. The restriction may occur during spring breakup and during other wet weather conditions.

4.2.4 - Grading (10/16)

For completion of the sale, state forest roads must be graded. In general, this will require a road grader or bull dozer to shape up the roads after forest products have been hauled off site. This includes cleaning of drainage areas, grading, crowning and filling with gravel, if necessary. The grading equipment to be used must be approved by the Unit Manager or his/her representative.

5 - Operations

5.2 - Conduct of Operations

5.2.3 - Operating Restrictions

5.2.3.1 - Operating restrictions (9/11)

Within Payment Unit(s) 1 - 4 cutting and skidding are limited to the period of December 1st to March 31st, unless there is an extended dry or frozen period and the sale administrator allows harvesting during that time period. This restriction is because of low wet ground throughout the sale area.

5.4 - Soil Protection

5.4.1 - Rutting restriction, general (7/16)

Operations are to cease immediately if equipment and weather conditions result in rutting of roads and/or skid trails which is

12 inches or greater in depth and 50 feet in length. The Unit Manager or his/her representative may restrict hauling and/or skidding if ruts exceed the specified depth. With the Unit Manager or his/her representative's approval, the Purchaser may return to the area when the risk of rutting has decreased.

6 - Safety and Fire Prevention

6.2 - Signing

6.2.1 - Road posting (9/09)

The Purchaser is responsible for posting and maintaining caution signs on the 47 Mile Creek Road prior to beginning operations. The road must be posted at appropriate distances from the sale area to warn of logging activity and truck traffic. Signs must be removed when harvest operations are suspended or completed. The Purchaser will provide these signs.

7 - Other Conditions

7.2 - Extensions

7.2.5 - Weather related extension (1/13)

If weather conditions during the operating period of this contract prevent harvesting, this sale may qualify for a weather related extension. If approved, the normal extension fee would be waived. To qualify, there must be a documented attempt each year to harvest in the difficult portion of the sale.



TIMBER SALE MAP

This information provided by authority of Part 525, 1994 PA 451, as amended.

Forest Management Unit Escanaba Management Unit	County Menominee County	Mapped By Beaudo	Date 9/3/2019	Page 1	of 1
Township 40N	Range 26W	Section(s) and Subdivision(s) Sec 23 - SESE; Sec 24 - SWSW; Sec 25 - NWNW; Sec 26 - NE.	Scale 1:15,840		
Cruised By Salter, Beaudo					

Cover Type				Density			
A = Aspen	H = Hemlock	N = Marsh	U = Upland Brush	0 = Non Stocked	5 = Pole Timber Medium		
B = Paper Birch	J = Jack Pine	O = Oak	UM = Upland Mixed	1 = Seedling Sapling Poor	6 = Pole Timber Well		
C = Cedar	L = Lowland Brush	P = Lowland Poplar	V = Bog or Marsh	2 = Seedling Sapling Medium	7 = Saw Timber Poor		
D = Treed Bog	LM = Lowland Mixed	Q = Mixed Swamp Conifer	W = White Pine	3 = Seedling Sapling Well	8 = Saw Timber Medium		
E = Swamp Hdwoods	M = Mpl, Bch, Brch	R = Red Pine	X = Non Stocked	4 = Pole Timber Poor	9 = Saw Timber Well		
F = Spruce Fir	MC = Mixed Conifer	S = Black Spruce	Z = Water				
G = Grass	MD = Mixed Deciduous	T = Tamarack					

PU	Acres	PU	Acres
1	24.8	3	23.9
2	23.7	4	14.4

Tamarack Galore
Compartment 70
86.8 Acres

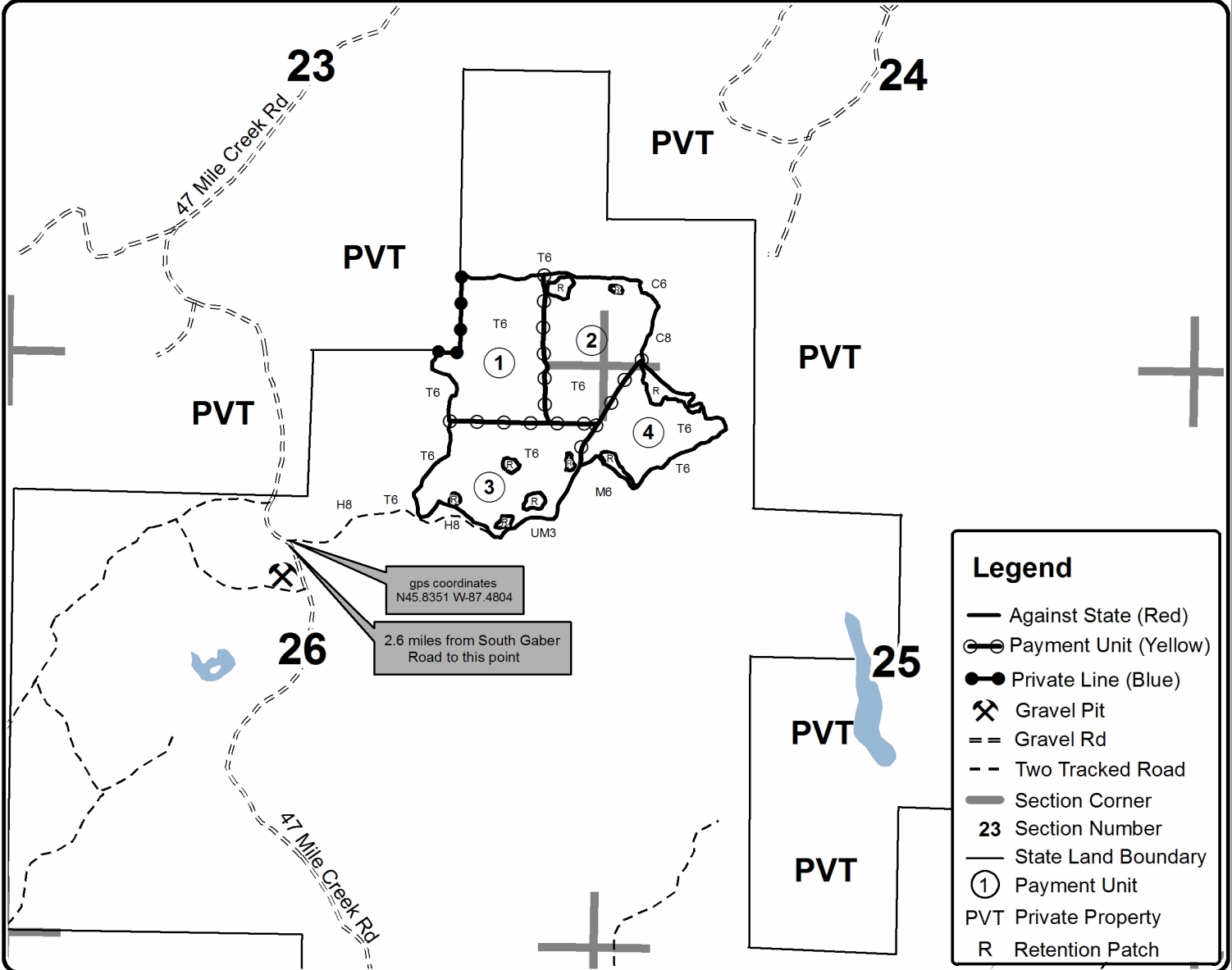
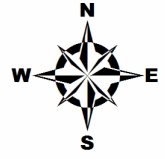

Legend

- Against State (Red)
- Payment Unit (Yellow)
- Private Line (Blue)
- ⊗ Gravel Pit
- == Gravel Rd
- - Two Tracked Road
- Section Corner
- 23** Section Number
- State Land Boundary
- ① Payment Unit
- PVT Private Property
- R Retention Patch

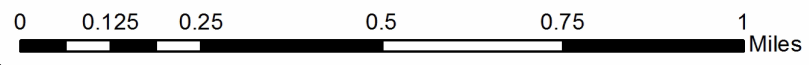

ATV CENTRAL (33-003-19)
T37N, R24W, SEC. 16; T37N, R24W, SEC. 17; Delta COUNTY

In response to the notice of sale to be held 3:00 p.m. (local time) on October 29, 2019, I am hereby submitting my sealed bid (firm offer) for the following forest products to be cut. Bids for individual species must be at or above the advertised price. All non-responsive bid forms may be rejected.

<u>PRODUCTS & SPECIES</u>	<u>ESTIMATED VOLUME*</u>	<u>ADVERTISED PRICE</u>	<u>BID PRICE/UNIT</u>
Sawtimber			
Green Ash	37.80 MBF	\$ 86.00/MBF	\$ _____
Red Maple	21.90 MBF	\$ 177.00/MBF	\$ _____
Pulpwood			
B. T. Aspen	54.00 Cords	\$ 30.25/Cord	\$ _____
Balsam Fir	14.00 Cords	\$ 23.20/Cord	\$ _____
Black Ash	98.00 Cords	\$ 26.85/Cord	\$ _____
Black Spruce	61.00 Cords	\$ 29.00/Cord	\$ _____
Green Ash	216.00 Cords	\$ 26.85/Cord	\$ _____
Mixed Hardwood	310.00 Cords	\$ 26.85/Cord	\$ _____
Red Pine	441.00 Cords	\$ 50.65/Cord	\$ _____
Tamarack	81.00 Cords	\$ 13.75/Cord	\$ _____
White Pine	315.00 Cords	\$ 38.90/Cord	\$ _____

*The volumes are statistically estimated within plus (+) or minus (-) 12.94 percent. These estimated volumes are final and not subject to adjustment. Prospective bidders are urged to examine this timber and to make their own estimates of quantity and quality.

I understand that any or all bids may be rejected. All bids must be signed and all bid items must be bid or the bid form may be rejected. I also understand that consideration and awarding a contract will be based upon my past performance and ability to complete the contract based upon equipment and staffing subject to my control.

FEDERAL ID: _____ or SOCIAL SECURITY NUMBER: _____

Company or individual bidding: _____

Company representative's name: _____

Address: _____

City: _____ State: _____ Zip: _____

IF AVAILABLE, PLEASE PLACE THE PERSONALIZED LABEL FROM YOUR PROSPECTUS IN THE ABOVE BOX.

Individual or company representative's signature: _____ Date: _____

Phone number : _____ Email (optional): _____

THE WINNING BIDDER MUST COMPLETE THE VERIFICATION OF WORKER'S DISABILITY COMPENSATION ACT COMPLIANCE (ON REVERSE SIDE IF DOUBLE SIDED) WITHIN 21 DAYS OF SALE AWARD DATE



FOR DEPARTMENT USE ONLY
Sale Number (XX - XXX - XX - XX)
Forest Management Unit:

TIMBER SALE VERIFICATION OF WORKER'S DISABILITY COMPENSATION ACT COMPLIANCE

*As required by Act 317, P.A. 1969 (Worker's Compensation) and
Part 5 of Act 451 of 1994, as amended.*

VERIFICATION OF WORKER'S DISABILITY COMPENSATION ACT COMPLIANCE

- This verification must be completed and submitted within 21 days of contract award and prior to the issuance of the timber sale contract.
- In addition, if boxes 2B or 2C are checked, then Notice of Exclusion or Certificate of Insurance must be submitted within twenty-one (21) days of the contract award and prior to the issuance of the timber sale contract.
- All information must be typed or printed except for written signatures.

Please Check Appropriate Categories:

1. My business is organized as (you **must** check one of the boxes below):
 - A. Sole Proprietorship (individual)
 - B. Partnership
 - C. Corporation

2. You **must** check one of the boxes below:
 - A. I certify my business is a sole proprietorship and it has no employees but the sole proprietor. I am not subject to the Worker's Compensation Laws.
 - B. I certify my business has satisfied its obligation to the Worker's Compensation Act through the use of an approved Notice of Exclusion (BWC-337, Rev. 5/96). I will provide a copy of the Notice of Exclusion within 21 days of the contract award. (For questions or a copy of the BWC-337, please call the Worker's Compensation Bureau at 517-322-1195).
 - C. I certify my business has a Worker's Compensation Policy. I will provide an original Certificate of Insurance within twenty-one (21) days of the contract award.

3. If you have checked item 2(A) or 2(B), you **must** indicate the number of **both** full-time and part-time employees, other than yourself, including family members and active partners (if none, you must enter "0").

_____ Full-time Employees

_____ Part-time Employees

Name of Business		Federal ID (or) Social Security No.	
Address		Telephone ()	
City	State	ZIP	

I hereby certify that the above information is true and correct. I agree to notify the Michigan DNR of any changes that occur in factors affecting my coverage during any of my present and future operations.

Signature of Owner or Authorized Representative

Title

Date

Please complete the "SEALED BID" information on the next page

WHAT'S LEFT (33-036-19)

T36N, R27W, SEC. 5; T36N, R27W, SEC. 6; T37N, R27W, SEC. 32; Menominee

In response to the notice of sale to be held 3:00 p.m. (local time) on October 29, 2019, I am hereby submitting my sealed bid (firm offer) for the following forest products to be cut. Bids for individual species must be at or above the advertised price. All non-responsive bid forms may be rejected.

<u>PRODUCTS & SPECIES</u>	<u>ESTIMATED VOLUME*</u>	<u>ADVERTISED PRICE</u>	<u>BID PRICE/UNIT</u>
Sawtimber			
Green Ash	2.40 MBF	\$ 80.00/MBF	\$ _____
Pulpwood			
Balsam Fir	14.00 Cords	\$ 21.65/Cord	\$ _____
Mixed Hardwood	415.00 Cords	\$ 25.05/Cord	\$ _____
Mixed Spruce	31.00 Cords	\$ 27.05/Cord	\$ _____
N. White Cedar	37.00 Cords	\$ 20.30/Cord	\$ _____
Quaking Aspen	193.00 Cords	\$ 28.25/Cord	\$ _____
Tamarack	25.00 Cords	\$ 12.85/Cord	\$ _____

*The volumes are statistically estimated within plus (+) or minus (-) 12.45 percent. These estimated volumes are final and not subject to adjustment. Prospective bidders are urged to examine this timber and to make their own estimates of quantity and quality.

I understand that any or all bids may be rejected. All bids must be signed and all bid items must be bid or the bid form may be rejected. I also understand that consideration and awarding a contract will be based upon my past performance and ability to complete the contract based upon equipment and staffing subject to my control.

FEDERAL ID: _____ or SOCIAL SECURITY NUMBER: _____

Company or individual bidding: _____

Company representative's name: _____

Address: _____

City: _____ State: _____ Zip: _____

IF AVAILABLE, PLEASE PLACE THE PERSONALIZED LABEL FROM YOUR PROSPECTUS IN THE ABOVE BOX.

Individual or company representative's signature: _____ Date: _____

Phone number : _____ Email (optional): _____

THE WINNING BIDDER MUST COMPLETE THE VERIFICATION OF WORKER'S DISABILITY COMPENSATION ACT COMPLIANCE (ON REVERSE SIDE IF DOUBLE SIDED) WITHIN 21 DAYS OF SALE AWARD DATE



FOR DEPARTMENT USE ONLY
Sale Number (XX - XXX - XX - XX)
Forest Management Unit:

TIMBER SALE VERIFICATION OF WORKER'S DISABILITY COMPENSATION ACT COMPLIANCE

*As required by Act 317, P.A. 1969 (Worker's Compensation) and
Part 5 of Act 451 of 1994, as amended.*

VERIFICATION OF WORKER'S DISABILITY COMPENSATION ACT COMPLIANCE

- This verification must be completed and submitted within 21 days of contract award and prior to the issuance of the timber sale contract.
- In addition, if boxes 2B or 2C are checked, then Notice of Exclusion or Certificate of Insurance must be submitted within twenty-one (21) days of the contract award and prior to the issuance of the timber sale contract.
- All information must be typed or printed except for written signatures.

Please Check Appropriate Categories:

1. My business is organized as (you **must** check one of the boxes below):
 - A. Sole Proprietorship (individual)
 - B. Partnership
 - C. Corporation

2. You **must** check one of the boxes below:
 - A. I certify my business is a sole proprietorship and it has no employees but the sole proprietor. I am not subject to the Worker's Compensation Laws.
 - B. I certify my business has satisfied its obligation to the Worker's Compensation Act through the use of an approved Notice of Exclusion (BWC-337, Rev. 5/96). I will provide a copy of the Notice of Exclusion within 21 days of the contract award. (For questions or a copy of the BWC-337, please call the Worker's Compensation Bureau at 517-322-1195).
 - C. I certify my business has a Worker's Compensation Policy. I will provide an original Certificate of Insurance within twenty-one (21) days of the contract award.

3. If you have checked item 2(A) or 2(B), you **must** indicate the number of **both** full-time and part-time employees, other than yourself, including family members and active partners (if none, you must enter "0").

_____ Full-time Employees

_____ Part-time Employees

Name of Business		Federal ID (or) Social Security No.	
Address		Telephone ()	
City	State	ZIP	

I hereby certify that the above information is true and correct. I agree to notify the Michigan DNR of any changes that occur in factors affecting my coverage during any of my present and future operations.

Signature of Owner or Authorized Representative

Title

Date

Please complete the "SEALED BID" information on the next page

Basswood Hill (33-034-19)
T37N, R27W, SEC. 6; T37N, R27W, SEC. 7; Menominee COUNTY

In response to the notice of sale to be held 3:00 p.m. (local time) on October 29, 2019, I am hereby submitting my sealed bid (firm offer) for the following forest products to be cut. Bids for individual species must be at or above the advertised price. All non-responsive bid forms may be rejected.

<u>PRODUCTS & SPECIES</u>	<u>ESTIMATED VOLUME*</u>	<u>ADVERTISED PRICE</u>	<u>BID PRICE/UNIT</u>
Sawtimber			
Basswood	35.90 MBF	\$ 108.00/MBF	\$ _____
Sugar Maple	0.50 MBF	\$ 268.00/MBF	\$ _____
White Ash	5.00 MBF	\$ 84.00/MBF	\$ _____
Pulpwood			
Balsam Fir	65.00 Cords	\$ 23.20/Cord	\$ _____
Basswood	577.00 Cords	\$ 10.85/Cord	\$ _____
Mixed Aspen	283.00 Cords	\$ 30.25/Cord	\$ _____
Mixed Hardwood	215.00 Cords	\$ 26.85/Cord	\$ _____
Mixed Spruce	35.00 Cords	\$ 29.00/Cord	\$ _____
N. White Cedar	26.00 Cords	\$ 21.75/Cord	\$ _____
Tamarack	7.00 Cords	\$ 13.75/Cord	\$ _____

*The volumes are statistically estimated within plus (+) or minus (-) 15.67 percent. These estimated volumes are final and not subject to adjustment. Prospective bidders are urged to examine this timber and to make their own estimates of quantity and quality.

I understand that any or all bids may be rejected. All bids must be signed and all bid items must be bid or the bid form may be rejected. I also understand that consideration and awarding a contract will be based upon my past performance and ability to complete the contract based upon equipment and staffing subject to my control.

FEDERAL ID: _____ or SOCIAL SECURITY NUMBER: _____

Company or individual bidding: _____

Company representative's name: _____

Address: _____

City: _____ State: _____ Zip: _____

IF AVAILABLE, PLEASE PLACE THE PERSONALIZED LABEL FROM YOUR PROSPECTUS IN THE ABOVE BOX.

Individual or company representative's signature: _____ Date: _____

Phone number : _____ Email (optional): _____

THE WINNING BIDDER MUST COMPLETE THE VERIFICATION OF WORKER'S DISABILITY COMPENSATION ACT COMPLIANCE (ON REVERSE SIDE IF DOUBLE SIDED) WITHIN 21 DAYS OF SALE AWARD DATE



FOR DEPARTMENT USE ONLY	
Sale Number (XX - XXX - XX - XX)	
Forest Management Unit:	

TIMBER SALE VERIFICATION OF WORKER'S DISABILITY COMPENSATION ACT COMPLIANCE

As required by Act 317, P.A. 1969 (Worker's Compensation) and
Part 5 of Act 451 of 1994, as amended.

VERIFICATION OF WORKER'S DISABILITY COMPENSATION ACT COMPLIANCE

- This verification must be completed and submitted within 21 days of contract award and prior to the issuance of the timber sale contract.
- In addition, if boxes 2B or 2C are checked, then Notice of Exclusion or Certificate of Insurance must be submitted within twenty-one (21) days of the contract award and prior to the issuance of the timber sale contract.
- All information must be typed or printed except for written signatures.

Please Check Appropriate Categories:

1. My business is organized as (you **must** check one of the boxes below):
 - A. Sole Proprietorship (individual)
 - B. Partnership
 - C. Corporation
2. You **must** check one of the boxes below:
 - A. I certify my business is a sole proprietorship and it has no employees but the sole proprietor. I am not subject to the Worker's Compensation Laws.
 - B. I certify my business has satisfied its obligation to the Worker's Compensation Act through the use of an approved Notice of Exclusion (BWC-337, Rev. 5/96). I will provide a copy of the Notice of Exclusion within 21 days of the contract award. (For questions or a copy of the BWC-337, please call the Worker's Compensation Bureau at 517-322-1195).
 - C. I certify my business has a Worker's Compensation Policy. I will provide an original Certificate of Insurance within twenty-one (21) days of the contract award.
3. If you have checked item 2(A) or 2(B), you **must** indicate the number of **both** full-time and part-time employees, other than yourself, including family members and active partners (if none, you must enter "0").

_____ Full-time Employees

_____ Part-time Employees

Name of Business		Federal ID (or) Social Security No.	
Address		Telephone ()	
City	State	ZIP	

I hereby certify that the above information is true and correct. I agree to notify the Michigan DNR of any changes that occur in factors affecting my coverage during any of my present and future operations.

Signature of Owner or Authorized Representative

Title

Date

Please complete the "SEALED BID" information on the next page

Tamarack Galore (33-038-19)

T40N, R26W, SEC. 23; T40N, R26W, SEC. 24; T40N, R26W, SEC. 25; T40N,

In response to the notice of sale to be held 3:00 p.m. (local time) on October 29, 2019, I am hereby submitting my sealed bid (firm offer) for the following forest products to be cut. Bids for individual species must be at or above the advertised price. All non-responsive bid forms may be rejected.

<u>PRODUCTS & SPECIES</u>	<u>ESTIMATED VOLUME*</u>	<u>ADVERTISED PRICE</u>	<u>BID PRICE/UNIT</u>
Pulpwood			
Balsam Fir	1.00 Cords	\$ 23.20/Cord	\$ _____
Black Spruce	236.00 Cords	\$ 29.00/Cord	\$ _____
N. White Cedar	311.00 Cords	\$ 21.75/Cord	\$ _____
Paper Birch	3.00 Cords	\$ 15.30/Cord	\$ _____
Red Maple	15.00 Cords	\$ 26.85/Cord	\$ _____
Tamarack	1,361.00 Cords	\$ 13.75/Cord	\$ _____
White Pine	52.00 Cords	\$ 38.90/Cord	\$ _____

*The volumes are statistically estimated within plus (+) or minus (-) 11.67 percent. These estimated volumes are final and not subject to adjustment. Prospective bidders are urged to examine this timber and to make their own estimates of quantity and quality.

I understand that any or all bids may be rejected. All bids must be signed and all bid items must be bid or the bid form may be rejected. I also understand that consideration and awarding a contract will be based upon my past performance and ability to complete the contract based upon equipment and staffing subject to my control.

FEDERAL ID: ___ - ___ - ___ or SOCIAL SECURITY NUMBER: ___ - ___ - ___

Company or individual bidding: _____

Company representative's name: _____

Address: _____

City: _____ State: _____ Zip: _____

IF AVAILABLE, PLEASE PLACE THE PERSONALIZED LABEL FROM YOUR PROSPECTUS IN THE ABOVE BOX.

Individual or company representative's signature: _____ Date: _____

Phone number : _____ Email (optional): _____

THE WINNING BIDDER MUST COMPLETE THE VERIFICATION OF WORKER'S DISABILITY COMPENSATION ACT COMPLIANCE (ON REVERSE SIDE IF DOUBLE SIDED) WITHIN 21 DAYS OF SALE AWARD DATE



FOR DEPARTMENT USE ONLY	
Sale Number (XX – XXX – XX – XX)	
Forest Management Unit:	

**TIMBER SALE
VERIFICATION OF WORKER'S DISABILITY
COMPENSATION ACT COMPLIANCE**

*As required by Act 317, P.A. 1969 (Worker's Compensation) and
Part 5 of Act 451 of 1994, as amended.*

- VERIFICATION OF WORKER'S DISABILITY COMPENSATION ACT COMPLIANCE**
- This verification must be completed and submitted within 21 days of contract award and prior to the issuance of the timber sale contract.
 - In addition, if boxes 2B or 2C are checked, then Notice of Exclusion or Certificate of Insurance must be submitted within twenty-one (21) days of the contract award and prior to the issuance of the timber sale contract.
 - All information must be typed or printed except for written signatures.

Please Check Appropriate Categories:

1. My business is organized as (you **must** check one of the boxes below):
 - A. Sole Proprietorship (individual)
 - B. Partnership
 - C. Corporation
2. You **must** check one of the boxes below:
 - A. I certify my business is a sole proprietorship and it has no employees but the sole proprietor. I am not subject to the Worker's Compensation Laws.
 - B. I certify my business has satisfied its obligation to the Worker's Compensation Act through the use of an approved Notice of Exclusion (BWC-337, Rev. 5/96). I will provide a copy of the Notice of Exclusion within 21 days of the contract award. (For questions or a copy of the BWC-337, please call the Worker's Compensation Bureau at 517-322-1195).
 - C. I certify my business has a Worker's Compensation Policy. I will provide an original Certificate of Insurance within twenty-one (21) days of the contract award.
3. If you have checked item 2(A) or 2(B), you **must** indicate the number of **both** full-time and part-time employees, other than yourself, including family members and active partners (if none, you must enter "0").

_____ Full-time Employees

_____ Part-time Employees

Name of Business		Federal ID (or) Social Security No.	
Address		Telephone ()	
City	State	ZIP	

I hereby certify that the above information is true and correct. I agree to notify the Michigan DNR of any changes that occur in factors affecting my coverage during any of my present and future operations.

Signature of Owner or Authorized Representative

Title

Date

Surrounded SBW (33-026-19)
T36N, R27W, SEC. 19; T36N, R27W, SEC. 30; Menominee COUNTY

In response to the notice of sale to be held 3:00 p.m. (local time) on October 29, 2019, I am hereby submitting my sealed bid (firm offer) for the following forest products to be cut. Bids for individual species must be at or above the advertised price. All non-responsive bid forms may be rejected.

<u>PRODUCTS & SPECIES</u>	<u>ESTIMATED VOLUME*</u>	<u>ADVERTISED PRICE</u>	<u>BID PRICE/UNIT</u>
Sawtimber			
Green Ash	31.70 MBF	\$ 40.00/MBF	\$ _____
Red Maple	3.20 MBF	\$ 83.00/MBF	\$ _____
Sugar Maple	0.40 MBF	\$ 125.00/MBF	\$ _____
Pulpwood			
Balsam Fir	174.00 Cords	\$ 10.85/Cord	\$ _____
Mixed Hardwood	1,604.00 Cords	\$ 12.50/Cord	\$ _____
Mixed Spruce	207.00 Cords	\$ 13.55/Cord	\$ _____
N. White Cedar	51.00 Cords	\$ 10.15/Cord	\$ _____
Quaking Aspen	78.00 Cords	\$ 14.10/Cord	\$ _____
Tamarack	92.00 Cords	\$ 6.40/Cord	\$ _____
White Pine	19.00 Cords	\$ 18.15/Cord	\$ _____

*The volumes are statistically estimated within plus (+) or minus (-) 8.75 percent. These estimated volumes are final and not subject to adjustment. Prospective bidders are urged to examine this timber and to make their own estimates of quantity and quality.

I understand that any or all bids may be rejected. All bids must be signed and all bid items must be bid or the bid form may be rejected. I also understand that consideration and awarding a contract will be based upon my past performance and ability to complete the contract based upon equipment and staffing subject to my control.

FEDERAL ID: _____ or SOCIAL SECURITY NUMBER: _____

Company or individual bidding: _____

Company representative's name: _____

Address: _____

City: _____ State: _____ Zip: _____

IF AVAILABLE, PLEASE PLACE THE PERSONALIZED LABEL FROM YOUR PROSPECTUS IN THE ABOVE BOX.

Individual or company representative's signature: _____ Date: _____

Phone number : _____ Email (optional): _____

THE WINNING BIDDER MUST COMPLETE THE VERIFICATION OF WORKER'S DISABILITY COMPENSATION ACT COMPLIANCE (ON REVERSE SIDE IF DOUBLE SIDED) WITHIN 21 DAYS OF SALE AWARD DATE



FOR DEPARTMENT USE ONLY	
Sale Number (XX - XXX - XX - XX)	
Forest Management Unit:	

TIMBER SALE VERIFICATION OF WORKER'S DISABILITY COMPENSATION ACT COMPLIANCE

As required by Act 317, P.A. 1969 (Worker's Compensation) and
Part 5 of Act 451 of 1994, as amended.

VERIFICATION OF WORKER'S DISABILITY COMPENSATION ACT COMPLIANCE

- This verification must be completed and submitted within 21 days of contract award and prior to the issuance of the timber sale contract.
- In addition, if boxes 2B or 2C are checked, then Notice of Exclusion or Certificate of Insurance must be submitted within twenty-one (21) days of the contract award and prior to the issuance of the timber sale contract.
- All information must be typed or printed except for written signatures.

Please Check Appropriate Categories:

1. My business is organized as (you **must** check one of the boxes below):
 - A. Sole Proprietorship (individual)
 - B. Partnership
 - C. Corporation
2. You **must** check one of the boxes below:
 - A. I certify my business is a sole proprietorship and it has no employees but the sole proprietor. I am not subject to the Worker's Compensation Laws.
 - B. I certify my business has satisfied its obligation to the Worker's Compensation Act through the use of an approved Notice of Exclusion (BWC-337, Rev. 5/96). I will provide a copy of the Notice of Exclusion within 21 days of the contract award. (For questions or a copy of the BWC-337, please call the Worker's Compensation Bureau at 517-322-1195).
 - C. I certify my business has a Worker's Compensation Policy. I will provide an original Certificate of Insurance within twenty-one (21) days of the contract award.
3. If you have checked item 2(A) or 2(B), you **must** indicate the number of **both** full-time and part-time employees, other than yourself, including family members and active partners (if none, you must enter "0").

_____ Full-time Employees

_____ Part-time Employees

Name of Business		Federal ID (or) Social Security No.	
Address		Telephone ()	
City	State	ZIP	

I hereby certify that the above information is true and correct. I agree to notify the Michigan DNR of any changes that occur in factors affecting my coverage during any of my present and future operations.

Signature of Owner or Authorized Representative

Title

Date

Please complete the "SEALED BID" information on the next page