



**DEPARTMENT OF NATURAL RESOURCES  
STATE OF MICHIGAN**

**TIMBER SALE PROSPECTUS #6611**

SCHEDULED SALE DATE AND TIME: 2:00 p.m. (local time) on May 20, 2020.

LOCATION: SHINGLETON MGMT UNIT, PO BOX 67, M 28 WEST, SHINGLETON, MI 49884.

PROSPECTUS NOTE: It is recommended that for the duration of the "Stay Home, Stay Safe" executive order that bidders submit their bids through the Online Bidding System (<https://www.dnr.state.mi.us/VMSONlineBidding/>). If you need to register, contact Jake Reid (ReidJ6@michigan.gov, 517-284-5908) or Donovan Asselin (AsselinD@michigan.gov, 517-930-1326). Paper bids will still be accepted during this time, either dropped in the bid box at the bid location or by mailing. If mailing, please allow for additional time.

The bidder is advised to inspect the sale area and review the location, estimated volumes, operating costs and contract terms of proposed sales. Please be aware that some landowners may request 60 days or more notice for access across their land.

Noble Lake Sale (41-012-19) / T47N, R17W, SEC. 19, NW,W1/2NE,SW,NWSE,S1/2SE.

T47N, R17W, SEC. 30, N1/2NW,N1/2NE.

Alger County, Advertised Price \$69,269.15, 270.6 Acres, Hardwood, Aspen.

SALE NOTE: Road work is required on this sale, the advertised price of this sale has been adjusted to reflect the estimated scope of work (see spec 4.1.8 for details).

Within Payment Unit(s) 1, 2, 4, 5, 6, 7 and 10, harvesting shall not be permitted during the period of April 15 to July 15 because of bark slippage (see spec 5.2.3.3 for details).

Rosemund Rd sale (41-013-19) / T47N, R17W, SEC. 30, S1/2NW,SW,SWSE.

T47N, R17W, SEC. 31, NW,W1/2NE,SWSW.

Alger County, Advertised Price \$63,548.10, 256.4 Acres, Hardwood, Spruce/Fir/Tamarack.

SALE NOTE: Harvesting is not permitted during the period of April 15 to July 15 because of bark slippage (see spec 5.2.3.3 for details).

Permission for access across private land is the responsibility of the Purchaser (see spec 4.4.1 for details).

Access may be through private land.

Out W/Old In W/New Hardwoods (41-023-19) / T47N, R17W, SEC. 1, SWSW.

T47N, R17W, SEC. 11, SESE.

T47N, R17W, SEC. 12, NW,SWNE,SW,N1/2SE,SWSE.

T47N, R17W, SEC. 13, N1/2NW,SE,SW,NWNE.

T47N, R17W, SEC. 14, SWNW.

Alger County, Advertised Price \$74,744.85, 330.2 Acres, Hardwood, Spruce/Fir/Tamarack.

SALE NOTE: Road work is required on this sale. See Sale Spec 4.1.8 for additional information.

Within Payment Unit(s) 1-12, 14, and 17, harvesting is not permitted during the period of April 15 to July 15 because of bark slippage.

GNA Bell Bass (41-821-19) / T43N, R17W, SEC. 4 , NW,NESW.

T44N, R17W, SEC. 28, SWSW.

T44N, R17W, SEC. 29, S1/2NW,SWNE,N1/2SW,SESW,SE.

T44N, R17W, SEC. 30, S1/2NE,N1/2SE.

T44N, R17W, SEC. 32, NE,E1/2SW,N1/2SE,SWSE.

T44N, R17W, SEC. 33, W1/2NW,SW.

Schoolcraft County, Advertised Price \$143,069.05, 390.2 Acres, Aspen, Red Pine.

SALE NOTE: This is a Good Neighbor Authority (GNA) timber sale on national forest land. This timber sale was set-up and is being advertised by the Michigan DNR for the US Forest Service. The contract will be awarded and administered by the Michigan DNR. Note the additional Sale Specific Conditions & Requirements containing the acronym 'GNA'.

Within Payment Units 17-20, harvesting is not permitted from March 1 through August 31 due to sensitive/wet soils on access road to the north (see spec 5.2.3.1).

Payment Units 14 and 15 may require a stream crossing, unless access can be obtained from the south (see spec 4.1.2). If access from the south cannot be obtained, these Payment Units will need to be harvested in the winter when the soils are frozen.

A recreation site such as a trail, pathway, or campground is within the sale area or the vicinity. Certain restrictions/specifications may be applicable including time restrictions. Access may be through other public land.

## BID INSTRUCTIONS (VER. 07/02/2018):

### 1. Scheduled Bid Location, Date, and Time (2/11)

Bids must be received by the Unit Manager, SHINGLETON OFFICE, PO Box 67 M 28 West, Shingleton, MI 49884, no later than 2:00 p.m. (local time) on May 20, 2020. For further information concerning this sale, contact Robert Burnham at 906-452-6227 extension 240.

### 2. Bidder's Qualifications (5/16)

Purchaser shall obtain workers compensation insurance to cover claims under Michigan's Worker's Disability Compensation Act of 1969 or similar employee benefit act of any other state applicable to an employee. If all or part of a timber sale was prepared by a private contractor, the contractor and that contractor's company are not permitted to bid on the timber sale contract. Bids will not be accepted from individuals or companies appearing on the DNR/FRD No-Bid List. This list contains the names of purchasers who previously failed to execute a contract within 21-days or who have a history of poor performance.

### 3. Preparation of Sealed Bids (5/16)

Bid Forms may be completed online thru Michigan DNR Timber Sale Online Bidding (OLB) at [www.michigan.gov/timberbidding](http://www.michigan.gov/timberbidding) or by completing the hardcopy Bid Form found in the Timber Sale Prospectus. Hardcopy Bid Forms shall be manually signed in ink. Registration in OLB is considered your 'signature' for all bids submitted thru that system. Bid prices must be entered for each species and product in the Bid Price column for all material subject to bidding and all fill-in blanks must be completed. If erasures or other changes appear on the hardcopy Bid Form, each erasure or change must be initialed by the person signing the bid.

### 4. Submission of Sealed Bids (5/16)

Bid forms may be obtained from the Unit Manager or thru OLB. Bids may be submitted hardcopy or thru OLB. All hardcopy bids must be submitted on the bid form and in an envelope clearly identified as described in this section. NOTE: Only one bid form per bid envelope. Sealed bids must be submitted to the Unit office designated in the prospectus and must be submitted at or prior to the time established in the prospectus. The envelope should show on the outside (a) the sale name or number and (b) the date and time of bid opening, as shown in the prospectus. Bids received after the time specified in the sale prospectus are late bids and will be rejected.

It is possible for a bidder to submit multiple bids on a single sale. For example, a bid may be submitted hardcopy and a bid may be submitted thru OLB. Or, two bidders from the same company could both submit bids on the same sale. If this were to happen, the State would accept all bids received and award the contract accordingly. All bidding and contractual requirements would apply to all bids received.

### 5. Public Opening of Sealed Bids (7/16)

If conditions permit, the sealed bids will be publicly opened and posted at the time and place set in the prospectus.

If a bidder, present at a bid opening, has submitted bids on more than one sale, that bidder may withdraw their unopened bid envelopes or announce the withdrawal of their online bid after being declared the successful bidder on one sale.

### 6. Award of Contract (1/11)

Award of the contract will be made to the Bidder whose bid, conforming to the prospectus, is most advantageous to the State of Michigan on the basis of total value at rates bid for the estimated quantities. The State reserves the right to reject any bid or waive any minor irregularity in bids received. A written award mailed (or otherwise furnished) to the successful Bidder shall be deemed to result in a binding contract without further action by either party.

### 7. Down Payment (1/11)

The Bidder to whom award is made must make a down payment within 21 days of the sale award. The amount of the down payment will be calculated as shown in the Bond and Payment Schedule of this prospectus. Only cash may be used to meet this requirement.

### 8. Performance Security (1/11)

As guarantee of faithful performance, a cash bond, certificate of deposit, surety bond or irrevocable letter of credit (LOC) is required within 21 days of the sale award. The amount of the performance security is shown in the Bond and

Payment Schedule of this prospectus. If an LOC or surety is used, the coverage must extend for at least 6 months beyond the contract expiration.

#### 9. Timber Sale Contract (7/18)

Additional conditions and requirements common to all timber sales are listed on the timber sale contract (R4031) and are available on line at [www.michigan.gov/timber](http://www.michigan.gov/timber). Contact the Unit Manager for additional information or a sample contract. Within 21 days of the date of the award letter, the bidder must sign the contract and provide the required down payment, performance security, and verification of worker's disability compensation. The down payment and performance security shall be in accordance with the provisions of the timber sale contract, in the sums stated in this prospectus. If these actions are not taken, then the Bidder, the Bidder's corporation, and the corporation's principals may not be permitted to bid on State timber sales for a period of 3 months after the first offense, 6 months after the second offense, and 1 year after the third offense. An offense will only be counted against the Bidder for 5 years. In addition, the Bidder certifies that if awarded this contract, the Bidder will complete the timber sale contract in accordance with its terms and any modifications thereof including requirements to purchase, cut, and remove the included timber by the expiration date.

Payment Unit values in the State Forest Timber Sale Contract are calculated based on the advertised value of the Payment Unit as a percentage of the total advertised value of the contract. The advertised value of each Payment Unit is given in the Description of Timber by Payment Unit table on the Timber Sale Information page. For example, if the value of Payment Unit 1 is advertised as \$1,500 and the total Timber Sale value is advertised as \$10,000, the contract price for Payment Unit 1 will be 15% of the total bid price ( $\$1,500/\$10,000 * 100$ ).

#### 10. Disclaimer of Estimates and Bidder's Warranty of Inspection (7/16)

Before submitting this bid, the Bidder is advised and cautioned to inspect the sale area, review the requirements of the sale contract, and take other steps as may be reasonably necessary to ascertain the location, estimated volumes, construction estimates, and operating costs of the proposed sale. Failure to do so will not relieve the Bidder from responsibility for completing the contract.

The Bidder warrants that this bid is submitted solely on the basis of the Bidder's examination and inspection of the quality and quantity of the timber offered for sale and the Bidder's opinion of the value thereof and the costs of recovery. No reliance should be placed on the State of Michigan's estimates of timber quality, quantity or costs of recovery. Bidder further acknowledges that the State of Michigan: (i) expressly disclaims any warranty of fitness of timber for any purpose; (ii) offers this timber as is without any warranty of quality (merchantability) or quantity and (iii) expressly disclaims any warranty as to the quantity or quality of timber sold.

#### 11. Certification and Chain-of-Custody (10/14)

Unless otherwise indicated in the contract under section 7 – Other Conditions of the Sale Specific Conditions & Requirements, the area encompassed by this timber sale is certified to the standards of the Forest Stewardship Council (FSC) - Certificate #SCS-FM/COC-00090N and the Sustainable Forestry Initiative (SFI) - Certificate #NSF-SFIS-5Y031-SF5. Forest products from this sale may be delivered to the mill as "FSC 100% and / or SFI certified" as long as the contractor hauling the forest products is chain-of-custody (COC) certified or covered under a COC certificate from the destination mill. The purchaser is responsible for maintaining COC after leaving the sale area.

#### 12. Good Neighbor Authority (GNA) Requirements (7/16)

If the name of this timber sales contains the acronym GNA, it is authorized by the Good Neighbor Authority (GNA) and covered by various agreements between the U.S. Forest Service and the State. The timber sale occurs on federal land and the following conditions apply:

GNA contracts on US Forest Service land will not be awarded to purchasers on the Federal list of excluded parties. The System for Award Management (SAM) will be checked for active excluded parties prior to award of contract. In addition, the Bidder to whom award is made must complete an Assurance Regarding Felony Conviction or Tax Delinquent Status for Corporate Applicants (AD-3031).

#### 13. Good Neighbor Authority (GNA) Requirements, con't (9/16)

Bidder certifies, by signing this bid form, that to the best of Bidder's knowledge that the following representations are accurate and complete.

- a. That the Bidder and its principals are not presently debarred, suspended, proposed for debarment, declared ineligible, or voluntary excluded from timber sales (covered transactions) by any Federal department or agency.
- b. That the Bidder and its principals have not within a 3-year period preceding this bid been convicted of or had a civil judgment rendered against them for commission of fraud or a criminal offense in connection with obtaining , attempting to obtain, or performing a public (Federal, State, or local) transaction or contract under a public transaction; violation of Federal or State antitrust statutes or commission of embezzlement, theft, forgery, bribery, falsification or destruction of records, making false statements, or receiving stolen property.
- c. That the Bidder and its principals are not presently indicted for or otherwise criminally or civilly charged by a governmental entity (Federal, State, or local) with commission of any of the offenses enumerated in paragraph b of this certification.
- d. That the Bidder and its principals have not within a 3-year period preceding this bid had one or more public transactions (Federal, State, or local) terminated for breach or default of a timber or forest product contract.

Bidders that cannot certify this requirement, in whole or in part, shall submit an explanation with their bid.

DAN EICHINGER  
Director



# TIMBER SALE INFORMATION

Noble Lake Sale (41-012-19)  
T47N, R17W, SEC. 19; T47N, R17W, SEC. 30.  
Alger County (Advertised Price \$69,269.15)

SALE NOTE: Road work is required on this sale, the advertised price of this sale has been adjusted to reflect the estimated scope of work (see spec 4.1.8 for details).

Within Payment Unit(s) 1, 2, 4, 5, 6, 7 and 10, harvesting shall not be permitted during the period of April 15 to July 15 because of bark slippage (see spec 5.2.3.3 for details).

A timber sale contract for this lump sum, sealed bid timber sale will be awarded to the responsible bidder offering the highest sealed bid price. Bids must be at or above the following advertised price for each species:

<u>PRODUCTS &amp; SPECIES</u>	<u>ESTIMATED UNITS*</u>		<u>ADVERTISED PRICE</u>
<b>Sawtimber</b>			
Basswood	68.10	MBF	\$ 91.00 / MBF
Black Cherry	0.70	MBF	\$ 125.00 / MBF
Paper Birch	0.50	MBF	\$ 39.00 / MBF
Red Maple	15.30	MBF	\$ 99.00 / MBF
Sugar Maple	101.50	MBF	\$ 230.00 / MBF
<b>Pulpwood</b>			
Balsam Fir	109.00	Cords	\$ 8.60 / Cord
Mixed Aspen	275.00	Cords	\$ 16.75 / Cord
Mixed Hardwood	2,440.00	Cords	\$ 12.50 / Cord
Paper Birch	14.00	Cords	\$ 8.20 / Cord
White Pine	6.00	Cords	\$ 11.90 / Cord
White Spruce	121.00	Cords	\$ 15.50 / Cord

\* The total volume is statistically estimated within plus (+) or minus (-) 14.35 percent. The estimated units are final and not subject to adjustment. Prospective bidders are urged to examine this timber and to make their own estimates of quantity and quality.

**BOND AND PAYMENT SCHEDULE:**

1. A bond in the amount of \$3,463.00 to insure faithful performance of the conditions of the contract will be deposited by the successful bidder within 21 days of the sale award.
2. Cutting in any sale or unit without the required advance payment would be considered a trespass.
3. Total payment must be paid in advance or according to the following schedule :
  - (a) Ten percent (10%) of the sale value must be paid within 21 days of the sale award.
  - (b) The 10% down payment will be credited towards the first unit cut.
  - (c) Payment for each of the following units must be made before cutting begins in that unit:

PAYMENT UNIT NUMBER	PERCENT OF TOTAL SALE VALUE
01	19.3%
02	9.3%
03	0.8%
04	8.4%
05	19.3%
06	12.1%
07	3.3%
08	5.0%
09	0.9%
10	18.0%
11	2.0%
12	1.6%

4. If no cutting takes place, the 10% down payment will not be refunded.
5. Operations on the contract issued will terminate on 06/30/2023.

**Description of Timber by Payment Unit (PU)**

PU	MARKET GROUP	PRODUCT	QUANTITY	UNIT	ACRES	ADVERTISE PRICE	
1		Sawtimber	12.3	MBF	33.8	\$13,482.05	
			0.1	MBF			
			22.8	MBF			
		Pulpwood	Mixed Aspen	23.0			Cords
			Mixed Hardwood	529.0			Cords
			White Spruce	7.0			Cords
2		Sawtimber	6.7	MBF	30.1	\$6,419.20	
			0.1	MBF			
			8.4	MBF			
		Pulpwood	Mixed Aspen	30.0			Cords
			Mixed Hardwood	269.0			Cords
3		Pulpwood	Mixed Aspen	17.0	1.8	\$547.25	
			<i>Quaking Aspen</i>	17.0			<i>Cords</i>
			Mixed Hardwood	21.0			Cords
4		Sawtimber	2.5	MBF	18.9	\$5,811.25	
			11.7	MBF			
		Pulpwood	Mixed Aspen	13.0			Cords
			Mixed Hardwood	214.0			Cords
5		Sawtimber	10.6	MBF	30.0	\$13,334.70	
			0.1	MBF			
			0.7	MBF			
		Pulpwood	Sugar Maple	36.8			MBF
			Balsam Fir	13.0			Cords
			Mixed Hardwood	297.0			Cords
6		Sawtimber	1.9	MBF	60.7	\$8,359.30	
			0.2	MBF			
			0.1	MBF			
			6.6	MBF			
			1.6	MBF			
			Pulpwood	Balsam Fir			34.0
		Mixed Aspen		56.0			Cords
		Mixed Hardwood		447.0			Cords
		Paper Birch		1.0			Cords
		White Spruce		20.0			Cords
		7		Sawtimber			3.0
0.2	MBF						
1.1	MBF						
Pulpwood	Mixed Aspen			19.0	Cords		
	Mixed Hardwood			115.0	Cords		
8		Pulpwood	Balsam Fir	27.0	10.0	\$3,470.35	
			Mixed Aspen	25.0			Cords
			Mixed Hardwood	169.0			Cords
			White Pine	6.0			Cords
			White Spruce	41.0			Cords
9		Pulpwood	Balsam Fir	7.0	1.6	\$604.60	
			Mixed Hardwood	27.0			Cords
			Paper Birch	12.0			Cords
			White Spruce	7.0			Cords
10		Sawtimber	31.1	MBF	41.9	\$12,486.40	
			0.4	MBF			
			8.0	MBF			
		Pulpwood	Sugar Maple	19.1			MBF
			Balsam Fir	25.0			Cords
			Mixed Aspen	22.0			Cords
			Mixed Hardwood	293.0			Cords



**Description of Timber by Payment Unit (PU), con't**

PU	MARKET GROUP	PRODUCT	QUANTITY	UNIT	ACRES	ADVERTISE PRICE
10 con't	Paper Birch	Pulpwood	1.0	Cords		
	White Spruce		13.0	Cords		
11	Balsam Fir	Pulpwood	3.0	Cords	15.9	\$1,350.80
	Mixed Aspen		50.0	Cords		
	Mixed Hardwood		8.0	Cords		
	White Spruce		25.0	Cords		
12	Mixed Aspen	Pulpwood	20.0	Cords	10.9	\$1,096.50
	<i>Quaking Aspen</i>		20.0	<i>Cords</i>		
	Mixed Hardwood		51.0	Cords		
	White Spruce		8.0	Cords		
TOTAL:			186.1	MBF		
TOTAL:			2,965.0	Cords		

# Sale Specific Conditions & Requirements

**Sale Name: Noble Lake Sale**

**Sale Number: 41-012-19 Seq#: 2**

## 1 - Sale Area

### 1.2 - Boundaries

#### 1.2.1 - Painted boundaries (9/19)

The sale boundary and Payment Unit boundaries are marked and identified by blue, red and yellow paint. Exterior sale boundary lines against private property are marked with blue paint. Exterior sale boundary lines against state are marked with red paint. Interior Payment Unit boundaries are marked with yellow paint. The painted boundary line trees are not Included Timber and are to be protected unless marked with orange paint.

## 2 - Timber Specifications

### 2.1 - Included Timber

#### 2.1.2 - Clearcut unit(s) w/o unmerchantable trees (8/11)

Within Payment Unit(s) 3, 8, 9, 11 and 12, cut all trees which meet minimum piece specifications in 2.2 Utilization, except do not cut any oak, hemlock, cedar, apple and elm.

Special protection trees identified in accordance with condition 3.4.2, within clearcutting unit boundaries, are not Included Timber and are to be protected.

#### 2.1.4 - Designated timber unit(s) (6/17)

Within Payment Unit(s) 1, 2, 4, 5, 6, 7 and 10, all trees are designated for cutting when marked with orange paint above and below stump height regardless of merchantability. In addition, cut all aspen. Also, within Payment Units 5 and 10, cut all balsam fir.

Special protection trees identified in accordance with condition 3.4.2, within Payment Unit boundaries, are not Included Timber and are to be protected.

## 3 - Payments

### 3.3 - Pre-measured Sales

#### 3.3.4 - Dividing payment units (7/14)

Payment Unit(s) exceeding \$15,000 in value may be divided at the request of the Purchaser and upon approval of the Unit Manager. Dividing Payment Units is a contract modification which requires a Timber Sale Contract Supplement.

### 3.4 - Damaged Timber

#### 3.4.2 - Special Protection Trees (4/14)

The Purchaser shall not cut live or dead special protection trees within cutting units or clearings. Special protection trees are hemlock and oak. If the Purchaser's operations have cut or damaged special protection trees through carelessness, the Purchaser shall pay \$100 as fixed, agreed and liquidated damages for each special protection tree cut or damaged. Such payment does not constitute ownership of the undesignated timber.

## 4 - Transportation

### 4.1 - Construction

#### 4.1.6 - Road construction (1/09)

Construction of new roads or improvements of existing roads shall be done in such a way as to minimize the environmental and visual impacts. Merchantable trees shall be cut and utilized unless otherwise directed. Non-merchantable trees shall be severed and laid flat on the ground. Slash shall be scattered, and not left in windrows and kept a minimum of 10 feet back from the road edge. Stumps shall be set upright, not left on edge, and be moved at least 10 feet away from the road edge. Disturbed soil shall be feathered into the woods and not left in berms or windrows.

#### 4.1.7 - Road closure (10/11)

All new roads built into the sale must be blocked to vehicle traffic upon completion of the sale. Overgrown roads that are reopened shall be considered new roads. These roads must be rendered impassable to cars and trucks. In general, this will require constructing a four (4') foot high berm of stumps and logs covered with earth. All stumps from road building and landing construction must be reserved to block any newly constructed roads upon completion of the sale. These stumps must be scattered along the road system to prohibit vehicular movement. Contact the sale administrator for specific details of design and placement.

#### 4.1.8 - Road work (1) (8/07)

The following road work is required: 500 cubic yards of breaker run gravel must be purchased, hauled and spread on the Noble Lake Road between the sale area and H-58. Prior to placement the road may need to be crowned and ditched. Exact locations will be determined at the Pre-Sale meeting by the Contract Administrator. All work must be done before hauling begins.

#### 4.1.10 - Oversight (12/08)

The Unit Manager, or his/her representative, must be present when the road improvement project is initiated.

### 4.2 - Maintenance

#### 4.2.4 - Grading (10/16)

For completion of the sale, state forest roads must be graded. In general, this will require a road grader or bull dozer to shape up the roads after forest products have been hauled off site. This includes cleaning of drainage areas, grading, crowning and filling with gravel, if necessary. The grading equipment to be used must be approved by the Unit Manager or his/her representative.

## 5 - Operations

### 5.1 - Notification

#### 5.1.1 - Pre-sale conference (10/16)

A pre-sale conference between the Purchaser and sale administrator is required prior to beginning any operations to determine landing and road locations. The Unit Manager or his/her representative must be contacted at least 5 days in advance to schedule the conference.

### 5.2 - Conduct of Operations

#### 5.2.2 - Hazard Trees/Snags

##### 5.2.2.1 - Den trees (10/16)

Obvious hollow and/or den trees shall be protected and left standing unless they are a safety hazard.

#### 5.2.3 - Operating Restrictions

##### 5.2.3.3 - Bark slippage restriction (3/09)

Within Payment Unit(s) 1, 2, 4, 5, 6, 7 and 10, unless changed by written agreement cutting and skidding are not permitted during the period of April 15 to July 15. This restriction is because of bark slippage.

#### 5.2.32 - Decking/landing restoration (9/13)

All decking and landing areas must have the surface area restored to a condition equal to or better than before. This is to ensure the proper regeneration of the stand. Wood debris, chips and "cookies" from trimmings must be removed or scattered away from landing and loading areas and may not be windrowed on the edge.

#### 5.2.38 - No decking against live trees (2/04)

Cut products may not be decked against unmarked or designated leave trees.

### 5.4 - Soil Protection

#### 5.4.1 - Rutting restriction, general (7/16)

Operations are to cease immediately if equipment and weather conditions result in rutting of roads and/or skid trails which is 12 inches or greater in depth and 50 feet in length. The Unit Manager or his/her representative may restrict hauling and/or skidding if ruts exceed the specified depth. With the Unit Manager or his/her representative's approval, the Purchaser may return to the area when the risk of rutting has decreased.

## 5.8 - Protection of Endangered Species

### 5.8.3 - Red shoulder hawk or goshawk (2/16)

In the event that an active red shoulder hawk or goshawk nest is found, the contract may be amended to protect the nest site until the nest is determined to be inactive. The value of the trees in this excluded area will be refunded or credited to the Purchaser. The nest will be buffered with a five-chain radius (eight acre) protection area, centered on the nest tree, in which there will be no cutting or new roads constructed. Avoid human disturbance, including loading and skidding, in the protection area.

An additional zone of five chains (ten chains centered on the active nest tree) will be established in which there is no management activity from April 1 to July 30. Limit biomass harvesting and chipping operations within this ten-chain zone, retain the maximum one-third of residues per the Woody Biomass Harvesting Guidelines (Michigan DNR 2010). Nests determined to be inactive will be protected with a one-chain no-harvest buffer.



# TIMBER SALE MAP

This information provided by authority of Part 5, 1994 PA 451, as amended.

Sale Number	Year
41-12-19-01	2019

Forest Management Shingleton	County Alger	Mapped By Molin	Date 9/25/19	Page 1	of 1
Crused By UPLMWS	Compartment Number 177	Township 47N	Range 17W	Section(s) and Subdivision(s) 19-NW, W1/2NE, SW,NWSE, S1/2SE 30-N1/2NW, N1/2NE	

Cover Type				Density	
A = Aspen	J = Jack Pine	O = Oak	U = Upland Brush	0 = Non Stocked	5 = Pole Timber Medium
B = Paper Birch	K = Rock	P = Lowland Poplar	UM = Upland Mix Forest	1 = Seedling Sapling Poor	6 = Pole Timber Well
C = Cedar	L = Lowland Brush	Q = Mixed Swamp Conifer	V = Bog or Marsh	2 = Seedling Sapling Medium	7 = Saw Timber Poor
D = Treed Bog	LM = Lowland Mix Forest	R = Red Pine	W = White Pine	3 = Seedling Sapling Well	8 = Saw Timber Medium
E = Swamp Hardwoods	M = Maple, Beech, Birch	S = Black Spruce	X = Non Stocked	4 = Pole Timber Poor	9 = Saw Timber Well
F = Spruce/Fir	MC = Mixed Conifer	T = Tamarack	Y = Sand		
G = Grass	MD = Mixed Deciduous	Z = Water			
H = Hemlock	N = Marsh				

## Noble Lake Sale

270.6 acres

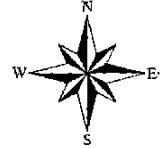

- Legend**
- Blue private line
  - Red boundary line
  - Yellow unit line
  - No cut stands
  - Survey corner
  - 2-Track

- Acres**
- U1 - 33.8
  - U2 - 30.1
  - U3 - 1.8
  - U4 - 18.9
  - U5 - 30.0
  - U6 - 69.7
  - U7 - 15.0
  - U8 - 10.0
  - U9 - 1.6
  - U10 - 41.9
  - U11 - 15.9
  - U12 - 10.9

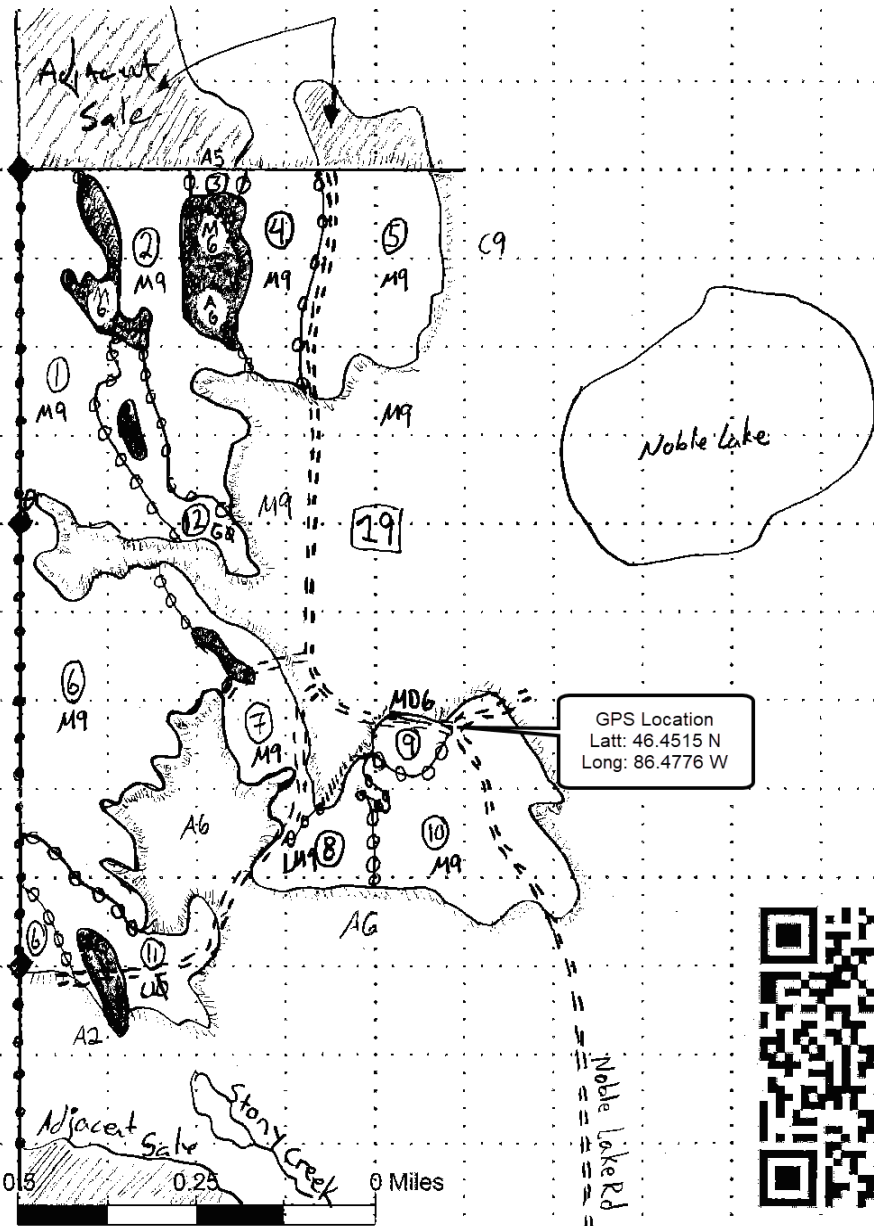



## TIMBER SALE INFORMATION

Rosemund Rd sale (41-013-19)  
 T47N, R17W, SEC. 30; T47N, R17W, SEC. 31.  
 Alger County (Advertised Price \$63,548.10)

SALE NOTE: Harvesting is not permitted during the period of April 15 to July 15 because of bark slippage (see spec 5.2.3.3 for details).

Permission for access across private land is the responsibility of the Purchaser (see spec 4.4.1 for details).

Access may be through private land.

A timber sale contract for this lump sum, sealed bid timber sale will be awarded to the responsible bidder offering the highest sealed bid price. Bids must be at or above the following advertised price for each species:

<u>PRODUCTS &amp; SPECIES</u>	<u>ESTIMATED UNITS*</u>	<u>ADVERTISED PRICE</u>
<b>Sawtimber</b>		
Basswood	39.40 MBF	\$ 98.00 / MBF
Black Cherry	2.60 MBF	\$ 134.00 / MBF
Paper Birch	0.20 MBF	\$ 42.00 / MBF
Red Maple	16.20 MBF	\$ 107.00 / MBF
Sugar Maple	91.80 MBF	\$ 247.00 / MBF
Yellow Birch	0.20 MBF	\$ 94.00 / MBF
<b>Pulpwood</b>		
Balsam Fir	126.00 Cords	\$ 9.25 / Cord
Mixed Hardwood	2,063.00 Cords	\$ 13.40 / Cord
Paper Birch	9.00 Cords	\$ 8.80 / Cord
Quaking Aspen	195.00 Cords	\$ 17.95 / Cord
White Spruce	151.00 Cords	\$ 16.65 / Cord

\* The total volume is statistically estimated within plus (+) or minus (-) 17.10 percent. The estimated units are final and not subject to adjustment. Prospective bidders are urged to examine this timber and to make their own estimates of quantity and quality.

**BOND AND PAYMENT SCHEDULE:**

1. A bond in the amount of \$3,177.00 to insure faithful performance of the conditions of the contract will be deposited by the successful bidder within 21 days of the sale award.
2. Cutting in any sale or unit without the required advance payment would be considered a trespass.
3. Total payment must be paid in advance or according to the following schedule :
  - (a) Ten percent (10%) of the sale value must be paid within 21 days of the sale award.
  - (b) The 10% down payment will be credited towards the first unit cut.
  - (c) Payment for each of the following units must be made before cutting begins in that unit:

PAYMENT UNIT NUMBER	PERCENT OF TOTAL SALE VALUE
01	3.0%
02	14.1%
03	22.3%
04	24.2%
05	8.1%
06	4.0%
07	2.1%
08	5.6%
09	9.6%
10	3.9%
11	3.1%

4. If no cutting takes place, the 10% down payment will not be refunded.
5. Operations on the contract issued will terminate on 06/30/2023.

**Description of Timber by Payment Unit (PU)**

PU	MARKET GROUP	PRODUCT	QUANTITY	UNIT	ACRES	ADVERTISE PRICE
1	Basswood	Sawtimber	0.5	MBF	10.5	\$1,909.90
	Black Cherry		0.3	MBF		
	Red Maple		1.7	MBF		
	Sugar Maple		3.0	MBF		
	Mixed Hardwood	Pulpwood	67.0	Cords		
2	Basswood	Sawtimber	6.4	MBF	43.4	\$8,960.65
	Black Cherry		0.2	MBF		
	Red Maple		0.8	MBF		
	Sugar Maple		16.4	MBF		
	Yellow Birch	0.2	MBF			
	Mixed Hardwood	Pulpwood	279.0	Cords		
	Quaking Aspen		23.0	Cords		
3	Basswood	Sawtimber	7.6	MBF	53.0	\$14,186.40
	Black Cherry		0.7	MBF		
	Paper Birch		0.1	MBF		
	Red Maple		2.1	MBF		
	Sugar Maple		26.0	MBF		
	Mixed Hardwood	Pulpwood	475.0	Cords		
	Paper Birch		1.0	Cords		
	Quaking Aspen		18.0	Cords		
4	Basswood	Sawtimber	19.2	MBF	46.8	\$15,283.20
	Black Cherry		0.7	MBF		
	Paper Birch		0.1	MBF		
	Red Maple		0.4	MBF		
	Sugar Maple		34.5	MBF		
	Balsam Fir	Pulpwood	18.0	Cords		
	Mixed Hardwood		336.0	Cords		
	Paper Birch		8.0	Cords		
5	Basswood	Sawtimber	3.3	MBF	16.9	\$5,138.25
	Red Maple		0.8	MBF		
	Sugar Maple		5.4	MBF		
	Balsam Fir	Pulpwood	14.0	Cords		
	Mixed Hardwood		240.0	Cords		
	White Spruce		3.0	Cords		
6	Basswood	Sawtimber	0.8	MBF	13.8	\$2,547.00
	Red Maple		1.4	MBF		
	Sugar Maple		0.2	MBF		
	Balsam Fir	Pulpwood	15.0	Cords		
	Mixed Hardwood		118.0	Cords		
	White Spruce		33.0	Cords		
7	Red Maple	Sawtimber	2.4	MBF	9.2	\$1,358.55
	Sugar Maple		0.6	MBF		
	Balsam Fir	Pulpwood	8.0	Cords		
	Mixed Hardwood		47.0	Cords		
	White Spruce		15.0	Cords		
8	Basswood	Sawtimber	0.1	MBF	18.8	\$3,571.25
	Black Cherry		0.4	MBF		
	Red Maple		0.9	MBF		
	Sugar Maple		0.1	MBF		
	Balsam Fir		Pulpwood	13.0		
	Mixed Hardwood	121.0		Cords		
	Quaking Aspen	36.0		Cords		
	White Spruce	60.0		Cords		
	9	Basswood	Sawtimber	1.5		
Black Cherry		0.3		MBF		



**Description of Timber by Payment Unit (PU), con't**

PU	MARKET GROUP	PRODUCT	QUANTITY	UNIT	ACRES	ADVERTISE PRICE
9 con't	Red Maple	Sawtimber	1.9	MBF		
	Sugar Maple		4.0	MBF		
	Balsam Fir	Pulpwood	12.0	Cords		
	Mixed Hardwood		210.0	Cords		
	Quaking Aspen		100.0	Cords		
10	Red Maple	Sawtimber	3.8	MBF	12.8	\$2,506.45
	Sugar Maple		1.6	MBF		
	Balsam Fir	Pulpwood	9.0	Cords		
	Mixed Hardwood		121.0	Cords		
11	Balsam Fir	Pulpwood	37.0	Cords	4.9	\$1,987.95
	Mixed Hardwood		49.0	Cords		
	Quaking Aspen		18.0	Cords		
	White Spruce		40.0	Cords		
TOTAL:			150.4	MBF		
TOTAL:			2,544.0	Cords		

# Sale Specific Conditions & Requirements

**Sale Name: Rosemund Rd sale**

**Sale Number: 41-013-19 Seq#: 2**

## 1 - Sale Area

### 1.2 - Boundaries

#### 1.2.1 - Painted boundaries (9/19)

The sale boundary and Payment Unit boundaries are marked and identified by blue, red and yellow paint. Exterior sale boundary lines against private property are marked with blue paint. Exterior sale boundary lines against state are marked with red paint. Interior Payment Unit boundaries are marked with yellow paint. The painted boundary line trees are not Included Timber and are to be protected unless marked with orange paint.

## 2 - Timber Specifications

### 2.1 - Included Timber

#### 2.1.2 - Clearcut unit(s) w/o unmerchantable trees (8/11)

Within Payment Unit(s) 11, cut all trees which meet minimum piece specifications in 2.2 Utilization, except do not cut any cedar, hemlock, oak or birch.

#### 2.1.3 - Cut tree marked unit(s) (12/08)

Within Payment Unit(s) 1-10, all trees are designated for cutting when marked with orange paint above and below stump height, regardless of merchantability. Also, within Payment Unit(s) 4-10, cut all balsam fir. In addition within Payment Unit(s) 5-9, cut all spruce.

## 3 - Payments

### 3.3 - Pre-measured Sales

#### 3.3.4 - Dividing payment units (7/14)

Payment Unit(s) exceeding \$15,000.00 in value may be divided at the request of the Purchaser and upon approval of the Unit Manager. Dividing Payment Units is a contract modification which requires a Timber Sale Contract Supplement.

### 3.4 - Damaged Timber

#### 3.4.2 - Special Protection Trees (4/14)

The Purchaser shall not cut live or dead special protection trees within cutting units or clearings. Special protection trees are hemlock. If the Purchaser's operations have cut or damaged special protection trees through carelessness, the Purchaser shall pay \$100 as fixed, agreed and liquidated damages for each special protection tree cut or damaged. Such payment does not constitute ownership of the undesignated timber.

## 4 - Transportation

### 4.1 - Construction

#### 4.1.3 - Slash and earthen piles (8/04)

Piles or windrows of earth along roads and landings that have been widened or constructed shall be leveled. Slash from road maintenance or construction, including stumps, shall be dispersed throughout the sale.

#### 4.1.6 - Road construction (1/09)

Construction of new roads or improvements of existing roads shall be done in such a way as to minimize the environmental and visual impacts. Merchantable trees shall be cut and utilized unless otherwise directed. Non-merchantable trees shall be severed and laid flat on the ground. Slash shall be scattered, and not left in windrows and kept a minimum of 10 feet back from the road edge. Stumps shall be set upright, not left on edge, and be moved at least 10 feet away from the road edge. Disturbed soil shall be feathered into the woods and not left in berms or windrows.

#### 4.1.7 - Road closure (10/11)

All new roads built into the sale must be blocked to vehicle traffic upon completion of the sale. Overgrown roads that are reopened shall be considered new roads. In general, this will require constructing a four (4') foot high berm of stumps and logs covered with earth. These roads must be rendered impassable to cars and trucks. Contact the sale administrator for

specific details of design and placement.

#### 4.2 - Maintenance

##### 4.2.2 - Fill material (4/07)

To maintain roads, fill material may be needed in areas where "holes" exist or may be expected to develop. This fill material should be placed before trucking begins.

##### 4.2.4 - Grading (10/16)

For completion of the sale, state forest roads must be graded. In general, this will require a road grader or bull dozer to shape up the roads after forest products have been hauled off site. This includes cleaning of drainage areas, grading, crowning and filling with gravel, if necessary. The grading equipment to be used must be approved by the Unit Manager or his/her representative.

#### 4.4 - Access

##### 4.4.1 - Private property access (3/11)

Permission for access across private land is the responsibility of the Purchaser. Should the Purchaser desire to cross private land, a copy of the written permission from the private land-owner will be required by the DNR. Contact the sale administrator for details.

### 5 - Operations

#### 5.1 - Notification

##### 5.1.1 - Pre-sale conference (10/16)

A pre-sale conference on site between the Purchaser and sale administrator is required prior to beginning any sale operations to determine landing and road locations. The Unit Manager or his/her representative must be contacted at least 5 days in advance to schedule the conference.

#### 5.2 - Conduct of Operations

##### 5.2.2 - Hazard Trees/Snags

###### 5.2.2.1 - Den trees (10/16)

Obvious hollow and/or den trees shall be protected and left standing unless they are a safety hazard.

##### 5.2.3 - Operating Restrictions

###### 5.2.3.3 - Bark slippage restriction (3/09)

Within Payment Unit(s) 1-10, unless changed by written agreement, cutting and skidding are not permitted during the period of April 15 to July 15. This restriction is because of bark slippage.

##### 5.2.32 - Decking/landing restoration (9/13)

All decking and landing areas must have the surface area restored to a condition equal to or better than before. This is to ensure the proper regeneration of the stand. Wood debris, chips and "cookies" from trimmings must be removed or scattered away from landing and loading areas and may not be windrowed on the edge.

##### 5.2.38 - No decking against live trees (2/04)

Cut products may not be decked against unmarked or designated leave trees.

#### 5.4 - Soil Protection

##### 5.4.1 - Rutting restriction, general (7/16)

Operations are to cease immediately if equipment and weather conditions result in rutting of roads and/or skid trails which is 12 inches or greater in depth and 50 feet in length. The Unit Manager or his/her representative may restrict hauling and/or skidding if ruts exceed the specified depth. With the Unit Manager or his/her representative's approval, the Purchaser may return to the area when the risk of rutting has decreased.

#### 5.8 - Protection of Endangered Species

##### 5.8.3 - Red shoulder hawk or goshawk (2/16)

In the event that an active red shoulder hawk or goshawk nest is found, the contract may be amended to protect the nest site

until the nest is determined to be inactive. The value of the trees in this excluded area will be refunded or credited to the Purchaser. The nest will be buffered with a five-chain radius (eight acre) protection area, centered on the nest tree, in which there will be no cutting or new roads constructed. Avoid human disturbance, including loading and skidding, in the protection area.

An additional zone of five chains (ten chains centered on the active nest tree) will be established in which there is no management activity from April 1 to July 30 (UP). Limit biomass harvesting and chipping operations within this ten-chain zone, retain the maximum one-third of residues per the Woody Biomass Harvesting Guidelines (Michigan DNR 2010). Nests determined to be inactive will be protected with a one-chain no-harvest buffer.



Sale Number	Year
41-13-19-01	2019

# TIMBER SALE MAP

This information provided by authority of Part 5, 1994 PA 451, as amended.

Forest Management Shingleton	County Alger	Mapped By Molin	Date 9/25/19	Page 1	of 1
Compartment Number 177	Township 47N	Range 17W	Section(s) and Subdivision(s) 30-S1/2NW, SW,SWSE 31-NW,W1/2NE,SWSW		

Cover Type				Density	
A = Aspen	J = Jack Pine	O = Oak	U = Upland Brush	0 = Non Stocked	5 = Pole Timber Medium
B = Paper Birch	K = Rock	P = Lowland Poplar	UM = Upland Mix Forest	1 = Seedling Sapling Poor	6 = Pole Timber Well
C = Cedar	L = Lowland Brush	Q = Mixed Swamp Conifer	V = Bog or Marsh	2 = Seedling Sapling Medium	7 = Saw Timber Poor
D = Treed Bog	LM = Lowland Mix Forest	R = Red Pine	W = White Pine	3 = Seedling Sapling Well	8 = Saw Timber Medium
E = Swamp Hardwoods	M = Maple, Beech, Birch	S = Black Spruce	X = Non Stocked	4 = Pole Timber Poor	9 = Saw Timber Well
F = Spruce/Fir	MC = Mixed Conifer	T = Tamarack	Y = Sand		
G = Grass	MD = Mixed Deciduous		Z = Water		
H = Hemlock	N = Marsh				

Rosemund Rd Sale  
256.4 acres

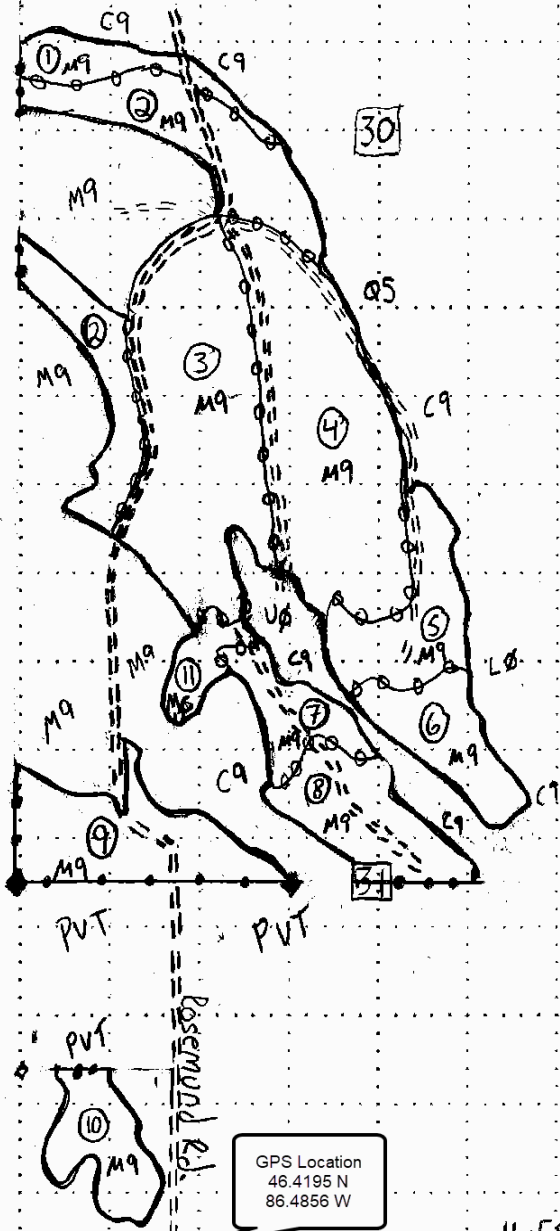
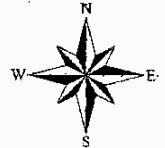

Legend

- Blue Private line
- Red Boundary line
- Yellow Unit line

Unit	Acres
1	10.5
2	43.4
3	53.0
4	46.8
5	16.9
6	13.8
7	9.2
8	13.8
9	26.3
10	12.8
11	4.9

GPS Location  
46.4195 N  
86.4856 W

H-58

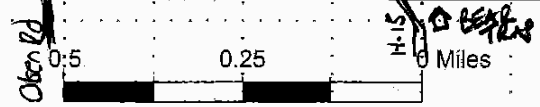



## TIMBER SALE INFORMATION

### Out W/Old In W/New Hardwoods (41-023-19)

T47N, R17W, SEC. 1; T47N, R17W, SEC. 11; T47N, R17W, SEC. 12; T47N, R17W, SEC. 13; T47N, R17W, SEC. 14.  
Alger County (Advertised Price \$74,744.85)

SALE NOTE: Road work is required on this sale. See Sale Spec 4.1.8 for additional information.

Within Payment Unit(s) 1-12, 14, and 17, harvesting is not permitted during the period of April 15 to July 15 because of bark slippage.

A timber sale contract for this lump sum, sealed bid timber sale will be awarded to the responsible bidder offering the highest sealed bid price. Bids must be at or above the following advertised price for each species:

<u>PRODUCTS &amp; SPECIES</u>	<u>ESTIMATED UNITS*</u>		<u>ADVERTISED PRICE</u>
<b>Sawtimber</b>			
Basswood	12.10	MBF	\$ 95.00 / MBF
Black Cherry	9.90	MBF	\$ 130.00 / MBF
Red Maple	14.80	MBF	\$ 104.00 / MBF
Sugar Maple	139.10	MBF	\$ 240.00 / MBF
<b>Pulpwood</b>			
Balsam Fir	221.00	Cords	\$ 8.95 / Cord
Basswood	124.00	Cords	\$ 6.35 / Cord
Mixed Hardwood	2,354.00	Cords	\$ 13.00 / Cord
Quaking Aspen	38.00	Cords	\$ 17.40 / Cord
White Pine	5.00	Cords	\$ 12.40 / Cord
White Spruce	204.00	Cords	\$ 16.15 / Cord

\* The estimated units are final and not subject to adjustment. Prospective bidders are urged to examine this timber and to make their own estimates of quantity and quality.

### **BOND AND PAYMENT SCHEDULE:**

1. A bond in the amount of \$3,737.00 to insure faithful performance of the conditions of the contract will be deposited by the successful bidder within 21 days of the sale award.
2. Cutting in any sale or unit without the required advance payment would be considered a trespass.
3. Total payment must be paid in advance or according to the following schedule :
  - (a) Ten percent (10%) of the sale value must be paid within 21 days of the sale award.
  - (b) The 10% down payment will be credited towards the first unit cut.

(c) Payment for each of the following units must be made before cutting begins in that unit:

PAYMENT UNIT NUMBER	PERCENT OF TOTAL SALE VALUE
01	2.8%
02	2.9%
03	6.2%
04	2.7%
05	8.7%
06	12.7%
07	14.3%
08	6.1%
09	4.7%
10	10.1%
11	9.0%
12	2.6%
13	6.1%
14	1.3%
15	0.0%
16	0.3%
17	9.5%

4. If no cutting takes place, the 10% down payment will not be refunded.
5. Operations on the contract issued will terminate on 06/30/2023.

**Description of Timber by Payment Unit (PU)**

PU	MARKET GROUP	PRODUCT	QUANTITY	UNIT	ACRES	ADVERTISE PRICE
1	Black Cherry	Sawtimber	2.0	MBF	9.4	\$2,099.70
	Red Maple		2.2	MBF		
	Sugar Maple		2.9	MBF		
	Balsam Fir	Pulpwood	2.0	Cords		
	Mixed Hardwood		69.0	Cords		
2	Black Cherry	Sawtimber	0.8	MBF	16.1	\$2,135.50
	Red Maple		1.7	MBF		
	Sugar Maple		1.6	MBF		
	Balsam Fir	Pulpwood	6.0	Cords		
	Mixed Hardwood		109.0	Cords		
3	Black Cherry	Sawtimber	1.2	MBF	24.9	\$4,628.40
	Red Maple		2.1	MBF		
	Sugar Maple		8.3	MBF		
	Mixed Hardwood	Pulpwood	174.0	Cords		
4	Black Cherry	Sawtimber	0.3	MBF	18.0	\$2,050.80
	Red Maple		1.7	MBF		
	Sugar Maple		2.5	MBF		
	Mixed Hardwood	Pulpwood	95.0	Cords		
5	Basswood	Sawtimber	0.3	MBF	18.9	\$6,478.95
	Black Cherry		0.5	MBF		
	Sugar Maple		13.8	MBF		
	Basswood	Pulpwood	7.0	Cords		
	Mixed Hardwood		233.0	Cords		
6	Basswood	Sawtimber	3.6	MBF	30.5	\$9,529.00
	Black Cherry		0.5	MBF		
	Sugar Maple		20.8	MBF		
	Basswood	Pulpwood	12.0	Cords		
	Mixed Hardwood		269.0	Cords		
	Quaking Aspen		32.0	Cords		
7	Black Cherry	Sawtimber	0.2	MBF	35.5	\$10,700.40
	Red Maple		0.9	MBF		
	Sugar Maple		26.0	MBF		
	Basswood	Pulpwood	8.0	Cords		
	Mixed Hardwood		330.0	Cords		
8	Basswood	Sawtimber	0.1	MBF	17.2	\$4,572.25
	Red Maple		0.1	MBF		
	Sugar Maple		11.9	MBF		
	Basswood	Pulpwood	1.0	Cords		
	Mixed Hardwood		130.0	Cords		
9	Black Cherry	Sawtimber	0.1	MBF	16.0	\$3,498.00
	Sugar Maple		7.1	MBF		
	Mixed Hardwood	Pulpwood	137.0	Cords		
10	Basswood	Sawtimber	5.6	MBF	30.3	\$7,524.90
	Black Cherry		0.1	MBF		
	Sugar Maple		14.6	MBF		
	Basswood	Pulpwood	54.0	Cords		
	Mixed Hardwood		241.0	Cords		
11	Basswood	Sawtimber	2.5	MBF	30.8	\$6,740.25
	Red Maple		1.4	MBF		
	Sugar Maple		15.5	MBF		
	Balsam Fir	Pulpwood	9.0	Cords		
	Basswood		32.0	Cords		
	Mixed Hardwood		173.0	Cords		
	Quaking Aspen		6.0	Cords		
12	Balsam Fir	Pulpwood	84.0	Cords	16.3	\$1,963.15



**Description of Timber by Payment Unit (PU), con't**

PU	MARKET GROUP	PRODUCT	QUANTITY	UNIT	ACRES	ADVERTISE PRICE
12 con't	Mixed Hardwood	Pulpwood	82.0	Cords		
	White Spruce		9.0	Cords		
13	Balsam Fir	Pulpwood	108.0	Cords	7.9	\$4,527.35
	Basswood		10.0	Cords		
	Mixed Hardwood		22.0	Cords		
	White Pine		5.0	Cords		
	White Spruce		195.0	Cords		
14	Black Cherry	Sawtimber	0.2	MBF	10.5	\$998.40
	Red Maple		1.0	MBF		
	Sugar Maple		0.3	MBF		
	Balsam Fir	Pulpwood	12.0	Cords		
	Mixed Hardwood		53.0	Cords		
15	Mixed Hardwood	Pulpwood	2.0	Cords	2.3	\$26.00
	<i>Black Cherry</i>		1.0	<i>Cords</i>		
	<i>Red Maple</i>		1.0	<i>Cords</i>		
16	Mixed Hardwood	Pulpwood	15.0	Cords	19.3	\$195.00
	<i>Black Cherry</i>		10.0	<i>Cords</i>		
	<i>Ironwood</i>		2.0	<i>Cords</i>		
	<i>Sugar Maple</i>		3.0	<i>Cords</i>		
17	Black Cherry	Sawtimber	4.0	MBF	26.3	\$7,076.80
	Red Maple		3.7	MBF		
	Sugar Maple		13.8	MBF		
	Mixed Hardwood	Pulpwood	220.0	Cords		
TOTAL:			175.9	MBF		
TOTAL:			2,946.0	Cords		

## Sale Specific Conditions & Requirements

**Sale Name: Out W/Old In W/New Hardwoods**

**Sale Number: 41-023-19 Seq#: 1**

### 1 - Sale Area

#### 1.2 - Boundaries

##### 1.2.1 - Painted boundaries (9/19)

The sale boundary and Payment Unit boundaries are marked and identified by blue, red and yellow paint. Exterior sale boundary lines against private property are marked with blue paint. Exterior sale boundary lines against state are marked with red paint. Interior Payment Unit boundaries are marked with yellow paint. The painted boundary line trees are not Included Timber and are to be protected unless marked with orange paint.

### 2 - Timber Specifications

#### 2.1 - Included Timber

##### 2.1.1 - Clearcut unit(s) with unmerchantable trees (6/14)

Within Payment Unit(s) 13, 15 and 16, cut all trees that are two (2) inches or more at DBH, except do not cut oak and hemlock.

Special protection trees identified in accordance with condition 3.4.2, within clearcutting unit boundaries, are not Included Timber and are to be protected.

##### 2.1.3 - Cut tree marked unit(s) (12/08)

Within Payment Unit(s) 1-12, 14 and 17, all trees are designated for cutting when marked with orange paint above and below stump height, regardless of merchantability. In addition within Payment Units 12 and 14, cut all balsam fir.

### 3 - Payments

#### 3.3 - Pre-measured Sales

##### 3.3.4 - Dividing payment units (7/14)

Payment Unit(s) with a value over \$15,000 may be divided at the request of the Purchaser and upon approval of the Unit Manager. Dividing Payment Units is a contract modification which requires a Timber Sale Contract Supplement.

#### 3.4 - Damaged Timber

##### 3.4.2 - Special Protection Trees (4/14)

The Purchaser shall not cut live or dead special protection trees within cutting units or clearings. Special protection trees are oak and hemlock. If the Purchaser's operations have cut or damaged special protection trees through carelessness, the Purchaser shall pay \$100 as fixed, agreed and liquidated damages for each special protection tree cut or damaged. Such payment does not constitute ownership of the undesignated timber.

### 4 - Transportation

#### 4.1 - Construction

##### 4.1.3 - Slash and earthen piles (8/04)

Piles or windrows of earth along roads and landings that have been widened or constructed shall be leveled. Slash from road maintenance or construction, including stumps, shall be dispersed throughout the sale.

##### 4.1.4 - Timber removed for construction (12/09)

Trees cut or damaged in the process of pre-approved road, landing or skid trail construction will be decked in an area separate from other Designated Timber and not removed until measured by the sale administrator. Payment will be made at the specified Purchase Unit Price.

##### 4.1.6 - Road construction (1/09)

Construction of new roads or improvements of existing roads shall be done in such a way as to minimize the environmental and visual impacts. Merchantable trees shall be cut and utilized unless otherwise directed. Non-merchantable trees shall be severed and laid flat on the ground. Slash shall be scattered, and not left in windrows and kept a minimum of 10 feet back

from the road edge. Stumps shall be set upright, not left on edge, and be moved at least 10 feet away from the road edge. Disturbed soil shall be feathered into the woods and not left in berms or windrows.

#### 4.1.7 - Road closure (10/11)

All new roads built into the sale must be blocked to vehicle traffic upon completion of the sale. Overgrown roads that are reopened shall be considered new roads. These roads must be rendered impassable to cars and trucks. In general, this will require constructing a four (4') foot high berm of stumps and logs covered with earth. Contact the sale administrator for specific details of design and placement.

#### 4.1.8 - Road work (1) (8/07)

The following road work is required: 400 cubic yards of breaker run gravel must be purchased, hauled and spread between H-58 and the Sale Area. Most of the work will be on the two-track running east west in Payment Units 10 and 11. Prior to hauling the road must be ditched and crowned. Exact location of the work will be determined at the pre-sale meeting. All work is at the Purchasers expense and no deductions will be given.

#### 4.1.10 - Oversight (12/08)

The Unit Manager, or his/her representative, must be present when the road improvement project is initiated.

### 4.2 - Maintenance

#### 4.2.4 - Grading (10/16)

For completion of the sale, state forest roads must be graded. In general, this will require a road grader or bull dozer to shape up the roads after forest products have been hauled off site. This includes cleaning of drainage areas, grading, crowning and filling with gravel, if necessary. The grading equipment to be used must be approved by the Unit Manager or his/her representative.

## 5 - Operations

### 5.1 - Notification

#### 5.1.1 - Pre-sale conference (10/16)

A pre-sale conference on site between the Purchaser and sale administrator is required prior to beginning any operations to determine landing and road locations. The Unit Manager or his/her representative must be contacted at least 5 days in advance to schedule the conference.

### 5.2 - Conduct of Operations

#### 5.2.2 - Hazard Trees/Snags

##### 5.2.2.1 - Den trees (10/16)

Obvious hollow and/or den trees shall be protected and left standing unless they are a safety hazard.

#### 5.2.3 - Operating Restrictions

##### 5.2.3.3 - Bark slippage restriction (3/09)

Within Payment Unit(s) 1-12, 14 and 17, unless changed by written agreement, cutting and skidding are not permitted during the period of April 15 to July 15. This restriction is because of bark slippage.

#### 5.2.32 - Decking/landing restoration (9/13)

All decking and landing areas must have the surface area restored to a condition equal to or better than before. This is to ensure the proper regeneration of the stand. Wood debris, chips and "cookies" from trimmings must be removed or scattered away from landing and loading areas and may not be windrowed on the edge.

#### 5.2.38 - No decking against live trees (2/04)

Cut products may not be decked against unmarked or designated leave trees.

### 5.4 - Soil Protection

#### 5.4.1 - Rutting restriction, general (7/16)

Operations are to cease immediately if equipment and weather conditions result in rutting of roads and/or skid trails which is 12 inches or greater in depth and 50 feet in length. The Unit Manager or his/her representative may restrict hauling and/or skidding if ruts exceed the specified depth. With the Unit Manager or his/her representative's approval, the Purchaser may

return to the area when the risk of rutting has decreased.

## 5.8 - Protection of Endangered Species

### 5.8.3 - Red shoulder hawk or goshawk (2/16)

In the event that an active red shoulder hawk or goshawk nest is found, the contract may be amended to protect the nest site until the nest is determined to be inactive. The value of the trees in this excluded area will be refunded or credited to the Purchaser. The nest will be buffered with a five-chain radius (eight acre) protection area, centered on the nest tree, in which there will be no cutting or new roads constructed. Avoid human disturbance, including loading and skidding, in the protection area.

An additional zone of five chains (ten chains centered on the active nest tree) will be established in which there is no management activity from April 1 to July 30. Limit biomass harvesting and chipping operations within this ten-chain zone, retain the maximum one-third of residues per the Woody Biomass Harvesting Guidelines (Michigan DNR 2010). Nests determined to be inactive will be protected with a one-chain no-harvest buffer.

### 5.8.5 - Protection of raptor nests (3/13)

There is a Red Tailed Hawk nest between Payment Units 5 and 7 along the two track road. As indicated on the Timber Sale Map, this area is red lined out as a no cut area. The two track road cannot be used within the area that is red lined out for sale operations. All trees with raptor nests will be protected if found during harvesting operations. Notification will be made to the Unit Manager or his/her representative who will notify the Wildlife Biologist so an on-site evaluation and recommendation can be made, if necessary.



# TIMBER SALE MAP

This information provided by authority of Part 525, 1994 PA 451, as amended.

Forest Management Unit Shingleton	County Alger	Mapped By Steve Tuovila	Date 9/30/2019	Page 1	of 2
Township see below	Range see below	Section(s) and Subdivision(s) see below	Scale 1:15,840		

Cover Type				Density	
A = Aspen	H = Hemlock	N = Marsh	U = Upland Brush	0 = Non Stocked	5 = Pole Timber Medium
B = Paper Birch	J = Jack Pine	O = Oak	UM = Upland Mixed	1 = Seedling Sapling Poor	6 = Pole Timber Well
C = Cedar	L = Lowland Brush	P = Lowland Poplar	V = Bog or Marsh	2 = Seedling Sapling Medium	7 = Saw Timber Poor
D = Treed Bog	LM = Lowland Mixed	Q = Mixed Swamp Conifer	W = White Pine	3 = Seedling Sapling Well	8 = Saw Timber Medium
E = Swamp Hdwoods	M = Mpl, Bch, Brch	R = Red Pine	X = Non Stocked	4 = Pole Timber Poor	9 = Saw Timber Well
F = Spruce Fir	MC = Mixed Conifer	S = Black Spruce	Z = Water		
G = Grass	MD = Mixed Deciduous	T = Tamarack			

## Out W/Old In W/New Hardwoods

T47N-R17W

SW 1/4 of NE 1/4, W 1/2 of SE 1/4, & W 1/2 Sect. 12  
 N 1/2 of NW 1/4, NW 1/4 of NE 1/4, & SE 1/4 of NW 1/4 Sect. 13  
 SW 1/4 of NW 1/4 Sect. 14

map 1 of 2  
 330.2 Acres

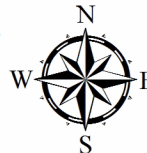

PU Acres	PU	PU Acres	PU
1	9.4	9	16.0
2	16.1	10	30.3
3	24.9	11	30.8
4	18.0	12	16.3
5	18.9	13	7.9
6	30.5	14	10.5
7	35.5	15	2.3
8	17.2	16	19.3

GPS Location  
 Latt: 46.4901 N  
 Long: 86.3860 W

Legend	
	Against State (Red)
	Payment Unit (Yellow)
	Payment Unit/Rd (Yellow)
	Private Boundary (Blue)
	Excluded Area (Red)
	Paved County Rd
	Forest Access Route
	Adjacent Stand Boundary
	Intermittent Stream

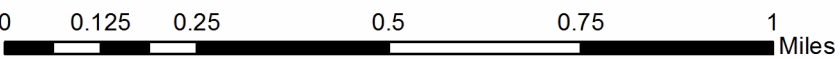
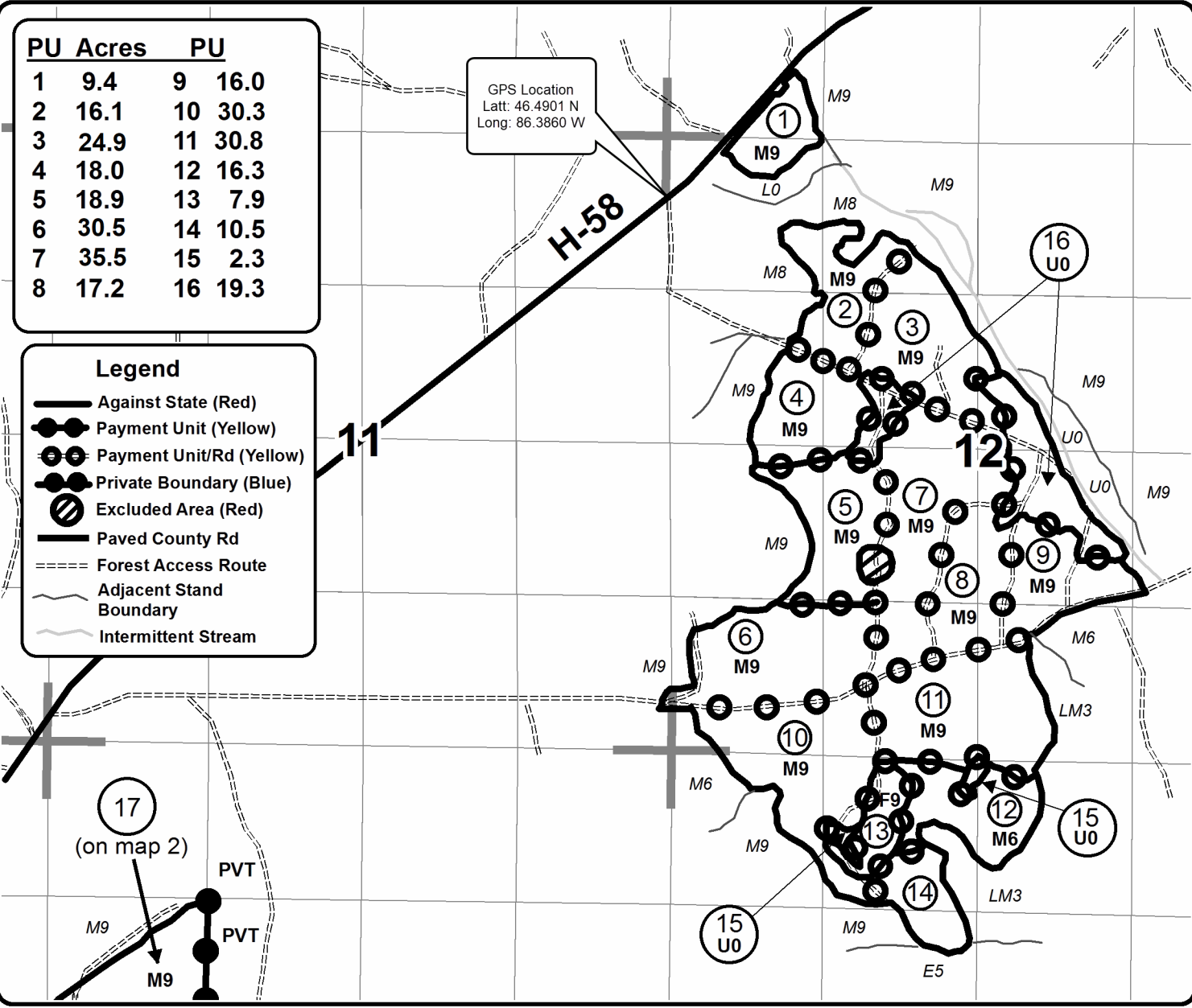



# TIMBER SALE MAP

This information provided by authority of Part 525, 1994 PA 451, as amended.

Forest Management Unit Shingleton	County Alger	Mapped By Steve Tuovila	Date 9/30/2019	Page 2	of 2
Township see below	Range see below	Section(s) and Subdivision(s) see below	Scale 1:15,840		

Cover Type				Density	
A = Aspen	H = Hemlock	N = Marsh	U = Upland Brush	0 = Non Stocked	5 = Pole Timber Medium
B = Paper Birch	J = Jack Pine	O = Oak	UM = Upland Mixed	1 = Seedling Sapling Poor	6 = Pole Timber Well
C = Cedar	L = Lowland Brush	P = Lowland Poplar	V = Bog or Marsh	2 = Seedling Sapling Medium	7 = Saw Timber Poor
D = Treed Bog	LM = Lowland Mixed	Q = Mixed Swamp Conifer	W = White Pine	3 = Seedling Sapling Well	8 = Saw Timber Medium
E = Swamp Hdwoods	M = Mpl. Bch, Brch	R = Red Pine	X = Non Stocked	4 = Pole Timber Poor	9 = Saw Timber Well
F = Spruce Fir	MC = Mixed Conifer	S = Black Spruce	Z = Water		
G = Grass	MD = Mixed Deciduous	T = Tamarack			

## Out W/Old In W/New Hardwoods

map 2 of 2  
330.2 Acres

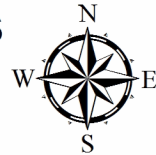

T47N-R17W

SW 1/4 of NE 1/4, W 1/2 of SE 1/4, & W 1/2 Sect. 12  
N 1/2 of NW 1/4, NW 1/4 of NE 1/4, & SE 1/4 of NW 1/4 Sect. 13  
SW 1/4 of NW 1/4 Sect. 14

PU Acres	PU Acres
1 9.4	10 30.3
2 16.1	11 30.8
3 24.9	12 16.3
4 18.0	13 7.9
5 18.9	14 10.5
6 30.5	15 2.3
7 35.5	16 19.3
8 17.2	17 26.3
9 16.0	

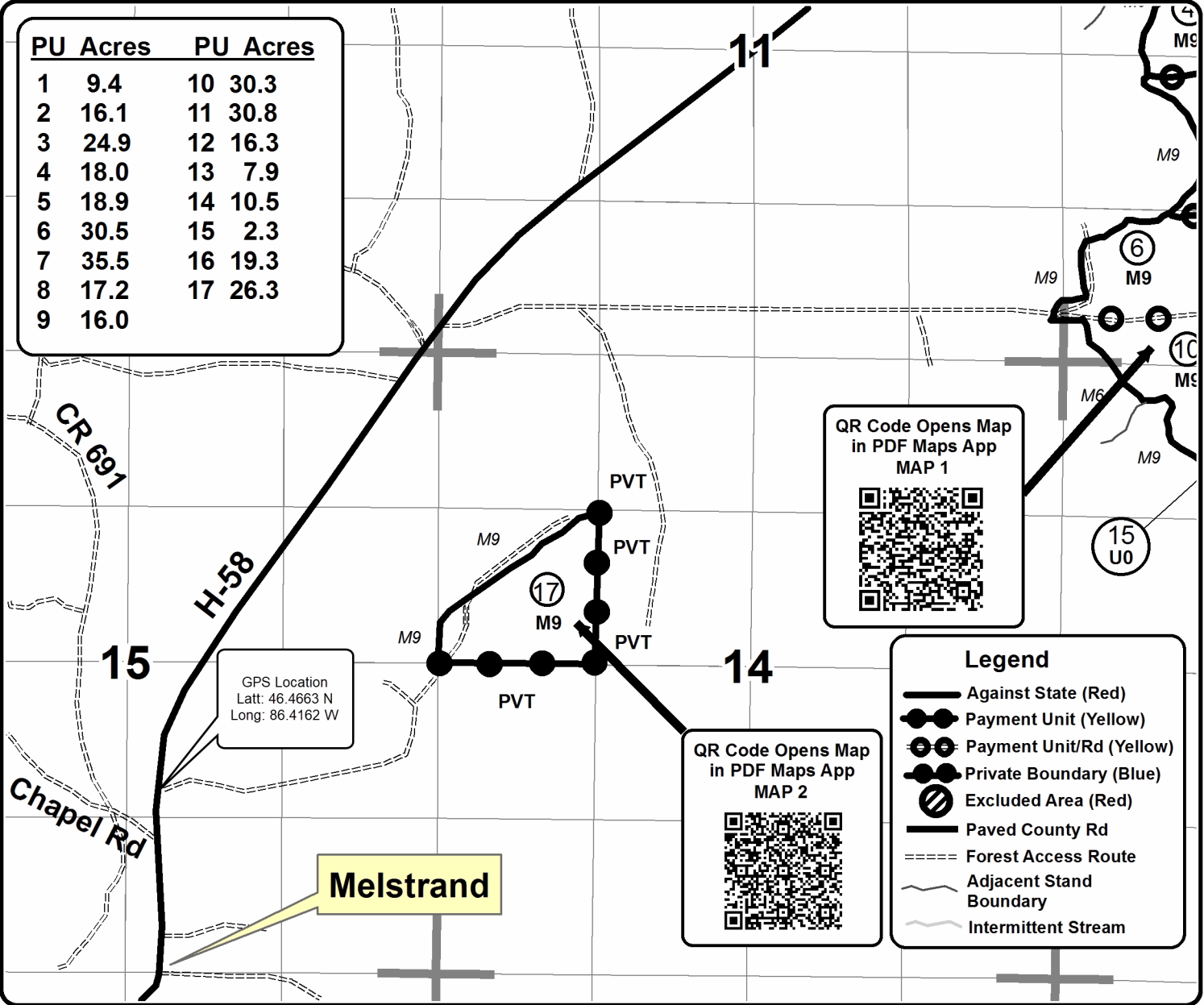

QR Code Opens Map in PDF Maps App MAP 1

QR Code Opens Map in PDF Maps App MAP 2

**Legend**

- Against State (Red)
- Payment Unit (Yellow)
- Payment Unit/Rd (Yellow)
- Private Boundary (Blue)
- ⊘ Excluded Area (Red)
- Paved County Rd
- Forest Access Route
- Adjacent Stand Boundary
- ~ Intermittent Stream

GPS Location  
Latt: 46.4663 N  
Long: 86.4162 W

Melstrand

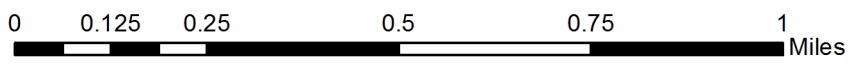

## TIMBER SALE INFORMATION

### GNA Bell Bass (41-821-19)

T43N, R17W, SEC. 4; T44N, R17W, SEC. 28; T44N, R17W, SEC. 29; T44N, R17W, SEC. 30; T44N, R17W, SEC. 32; T44N, R17W, SEC. 33.

**SALE NOTE:** This is a Good Neighbor Authority (GNA) timber sale on national forest land. This timber sale was set-up and is being advertised by the Michigan DNR for the US Forest Service. The contract will be awarded and administered by the Michigan DNR. Note the additional Sale Specific Conditions & Requirements containing the acronym 'GNA'.

Within Payment Units 17-20, harvesting is not permitted from March 1 through August 31 due to sensitive/wet soils on access road to the north (see spec 5.2.3.1).

Payment Units 14 and 15 may require a stream crossing, unless access can be obtained from the south (see spec 4.1.2). If access from the south cannot be obtained, these Payment Units will need to be harvested in the winter when the soils are frozen.

A recreation site such as a trail, pathway, or campground is within the sale area or the vicinity. Certain restrictions/specifications may be applicable including time restrictions. Access may be through other public land.

A timber sale contract for this lump sum, sealed bid timber sale will be awarded to the responsible bidder offering the highest sealed bid price. Bids must be at or above the following advertised price for each species:

<u>PRODUCTS &amp; SPECIES</u>	<u>ESTIMATED UNITS*</u>	<u>ADVERTISED PRICE</u>
Sawtimber		
Black Cherry	1.70 MBF	\$ 148.00 / MBF
Paper Birch	1.90 MBF	\$ 46.00 / MBF
Red Maple	15.20 MBF	\$ 117.00 / MBF
Sugar Maple	0.50 MBF	\$ 272.00 / MBF
Pulpwood		
Balsam Fir	104.00 Cords	\$ 10.20 / Cord
Hemlock	101.00 Cords	\$ 13.75 / Cord
Jack Pine	354.00 Cords	\$ 19.70 / Cord
Mixed Aspen	2,633.00 Cords	\$ 19.75 / Cord
Mixed Hardwood	715.00 Cords	\$ 14.75 / Cord
Paper Birch	286.00 Cords	\$ 9.70 / Cord
Red Pine	1,367.00 Cords	\$ 45.75 / Cord
White Pine	233.00 Cords	\$ 14.05 / Cord
White Spruce	14.00 Cords	\$ 18.30 / Cord

\* The estimated units are final and not subject to adjustment. Prospective bidders are urged to examine this timber and to make their own estimates of quantity and quality.

### **BOND AND PAYMENT SCHEDULE:**

1. A bond in the amount of \$7,153.00 to insure faithful performance of the conditions of the contract will be deposited by the successful bidder within 21 days of the sale award.
2. Cutting in any sale or unit without the required advance payment would be considered a trespass.
3. Total payment must be paid in advance or according to the following schedule:
  - (a) Ten percent (10%) of the sale value must be paid within 21 days of the sale award.
  - (b) The 10% down payment will be credited towards the first unit cut.

(c) Payment for each of the following units must be made before cutting begins in that unit:

PAYMENT UNIT NUMBER	PERCENT OF TOTAL SALE VALUE
01	4.0%
02	1.1%
03	2.9%
04	8.0%
05	9.1%
06	18.0%
07	1.1%
08	7.3%
09	1.3%
10	1.2%
11	5.7%
12	5.7%
13	5.4%
14	1.5%
15	1.4%
16	5.0%
17	6.2%
18	8.3%
19	3.6%
20	3.2%

4. If no cutting takes place, the 10% down payment will not be refunded.

5. Operations on the contract issued will terminate on 12/31/2023.



**Description of Timber by Payment Unit (PU)**

PU	MARKET GROUP	PRODUCT	QUANTITY	UNIT	ACRES	ADVERTISE PRICE
1	Black Cherry Red Maple Sugar Maple Balsam Fir Mixed Hardwood	Sawtimber	1.7	MBF	25.7	\$5,700.65
			10.2	MBF		
			0.5	MBF		
		12.0	Cords			
		271.0	Cords			
2	Balsam Fir Mixed Aspen Mixed Hardwood Red Pine White Spruce	Pulpwood	51.0	Cords	18.0	\$1,532.45
			5.0	Cords		
			3.0	Cords		
			17.0	Cords		
			5.0	Cords		
3	Balsam Fir Mixed Aspen Mixed Hardwood Red Pine	Pulpwood	28.0	Cords	14.2	\$4,129.85
			31.0	Cords		
			2.0	Cords		
			70.0	Cords		
4	Hemlock Mixed Aspen Mixed Hardwood Paper Birch Red Pine White Pine White Spruce	Pulpwood	15.0	Cords	16.3	\$11,488.20
			313.0	Cords		
			21.0	Cords		
			6.0	Cords		
			55.0	Cords		
			146.0	Cords		
			9.0	Cords		
			9.0	Cords		
5	Jack Pine Mixed Aspen Red Pine	Pulpwood	93.0	Cords	32.9	\$13,029.10
			55.0	Cords		
			221.0	Cords		
6	Jack Pine Mixed Aspen Red Pine	Pulpwood	133.0	Cords	47.4	\$25,587.85
			146.0	Cords		
			439.0	Cords		
7	Balsam Fir Mixed Aspen Mixed Hardwood Paper Birch	Pulpwood	2.0	Cords	4.5	\$1,638.70
			31.0	Cords		
			59.0	Cords		
			14.0	Cords		
8	Jack Pine Mixed Aspen Red Pine White Pine	Pulpwood	119.0	Cords	16.7	\$10,416.10
			29.0	Cords		
			159.0	Cords		
			16.0	Cords		
9	Mixed Aspen <i>Quaking Aspen</i> Mixed Hardwood Paper Birch Red Pine	Pulpwood	15.0	Cords	8.1	\$1,851.45
			15.0	Cords		
			50.0	Cords		
			56.0	Cords		
			6.0	Cords		
10	Mixed Aspen <i>Quaking Aspen</i> Mixed Hardwood Paper Birch	Pulpwood	57.0	Cords	13.1	\$1,664.05
			57.0	Cords		
			24.0	Cords		
			19.0	Cords		
11	Balsam Fir Mixed Aspen Mixed Hardwood Paper Birch Red Pine White Pine	Pulpwood	8.0	Cords	24.4	\$8,202.85
			65.0	Cords		
			18.0	Cords		
			6.0	Cords		
			139.0	Cords		
			11.0	Cords		
12	Paper Birch Red Maple	Sawtimber	1.8	MBF	34.3	\$8,116.60
			0.5	MBF		
	Balsam Fir Mixed Aspen Mixed Hardwood	Pulpwood	1.0	Cords		
			342.0	Cords		
			14.0	Cords		
			14.0	Cords		

**Description of Timber by Payment Unit (PU), con't**

PU	MARKET GROUP	PRODUCT	QUANTITY	UNIT	ACRES	ADVERTISE PRICE
12 con't	Paper Birch	Pulpwood	23.0	Cords		
	Red Pine		14.0	Cords		
	White Pine		10.0	Cords		
13	Balsam Fir	Pulpwood	2.0	Cords	33.1	\$7,726.20
	Jack Pine		6.0	Cords		
	Mixed Aspen		324.0	Cords		
	Mixed Hardwood		26.0	Cords		
	Paper Birch		83.0	Cords		
14	Red Maple	Sawtimber	3.7	MBF	14.9	\$2,192.85
	Hemlock	Pulpwood	43.0	Cords		
	Mixed Hardwood		72.0	Cords		
	Paper Birch		11.0	Cords		
15	Paper Birch	Sawtimber	0.1	MBF	13.7	\$2,050.70
	Red Maple		0.8	MBF		
	Hemlock	Pulpwood	43.0	Cords		
	Mixed Hardwood		89.0	Cords		
	Paper Birch		5.0	Cords		
16	Mixed Aspen	Pulpwood	336.0	Cords	20.5	\$7,199.80
	<i>Quaking Aspen</i>		336.0	<i>Cords</i>		
	Mixed Hardwood		6.0	Cords		
	Paper Birch		49.0	Cords		
17	Mixed Aspen	Pulpwood	418.0	Cords	23.7	\$8,814.40
	<i>Quaking Aspen</i>		418.0	<i>Cords</i>		
	Mixed Hardwood		30.0	Cords		
	Paper Birch		12.0	Cords		
18	Mixed Aspen	Pulpwood	182.0	Cords	10.6	\$11,905.95
	<i>B. T. Aspen</i>		182.0	<i>Cords</i>		
	Mixed Hardwood		15.0	Cords		
	Red Pine		171.0	Cords		
	White Pine		19.0	Cords		
19	Jack Pine	Pulpwood	3.0	Cords	9.6	\$5,182.80
	Mixed Aspen		95.0	Cords		
	Mixed Hardwood		5.0	Cords		
	Red Pine		62.0	Cords		
	White Pine		24.0	Cords		
20	Mixed Aspen	Pulpwood	189.0	Cords	8.5	\$4,638.50
	<i>Quaking Aspen</i>		189.0	<i>Cords</i>		
	Mixed Hardwood		10.0	Cords		
	Paper Birch		2.0	Cords		
	Red Pine		14.0	Cords		
	White Pine		7.0	Cords		
TOTAL:			19.3	MBF		
TOTAL:			5,807.0	Cords		

## Sale Specific Conditions & Requirements

Sale Name: GNA Bell Bass

Sale Number: 41-821-19 Seq#: 2

### 1 - Sale Area

#### 1.2 - Boundaries

##### 1.2.1 - Painted boundaries (9/19)

The sale boundary and Payment Unit boundaries are marked and identified by orange paint. Exterior sale boundary lines against USFS are marked with orange paint. Interior Payment Unit boundaries are marked with orange paint. Retention patches are marked with orange paint, no harvesting activities may occur within these areas. The painted boundary line trees are not Included Timber and are to be protected.

### 2 - Timber Specifications

#### 2.1 - Included Timber

##### 2.1.1 - Clearcut unit(s) with unmerchantable trees (6/14)

Within Payment Unit(s) 4 & 9, cut all trees that are two (2) inches or more at DBH, except do not cut trees marked in green paint. In addition, within Payment Unit 9, do not cut hemlock.

##### 2.1.2 - Clearcut unit(s) w/o unmerchantable trees (8/11)

Within Payment Unit(s) 13, cut all trees which meet minimum piece specifications in 2.2 Utilization, except do not cut oak, hemlock, red pine and white pine.

##### 2.1.3 - Cut tree marked unit(s) (12/08)

Within Payment Unit(s) 1-3, 5, 10-12, 14 & 15, all trees are designated for cutting when marked with blue paint above and below stump height, regardless of merchantability. In addition, within Payment Units 1 and 2, cut all balsam fir which meet minimum piece specifications in 2.2 Utilization. Also, within Payment Units 3 and 5, cut all jack pine, aspen and balsam fir which meet minimum piece specifications in 2.2 Utilization. Furthermore, within Payment Unit 11, cut all jack pine and balsam fir which meet minimum piece specifications in 2.2 Utilization.

##### 2.1.4 - Designated timber unit(s) (6/17)

Within Payment Unit(s) 16 & 17, all aspen, paper birch and red maple trees are designated for cutting which meet minimum piece specifications in 2.2 - Utilization.

##### 2.1.7 - Leave tree marked unit(s) (6/14)

Within Payment Unit(s) 6-8 and 18-20, all trees which meet minimum piece specifications in 2.2 Utilization are designated for cutting, except do not cut trees marked with green paint above and below stump height. In addition, within Payment Units 6 & 7, do not cut white pine and hemlock. Also, within Payment Unit 8, do not cut hemlock. Furthermore, within Payment Units 18 & 19, do not cut hemlock and oak.

#### 2.2 - Utilization

##### 2.2.12 - GNA, cut and remove Included Timber (3/18)

Unless provided otherwise herein, the DNR agrees to sell and permit Purchaser to cut and remove Included Timber and Purchaser agrees to purchase, cut, and remove Included Timber.

### 3 - Payments

#### 3.3 - Pre-measured Sales

##### 3.3.4 - Dividing payment units (7/14)

Payment Unit(s) that are \$15,000 or more in value, may be divided at the request of the Purchaser and upon approval of the Unit Manager. Dividing Payment Units is a contract modification which requires a Timber Sale Contract Supplement.

#### 3.4 - Damaged Timber

##### 3.4.1 - Damaged timber (7/16)

General Condition and Requirement 3.4 Damaged Timber, defines liquidated damages for undesignated live merchantable trees which are cut or injured. In addition, extreme care should be taken to avoid damage to white pine and hemlock tree

seedlings and saplings.

Within Payment Units 6, 13, 19 & 20, if more than 25% of the white pine and hemlock tree seedlings or saplings (1/4" to 4.5" DBH) within a specified portion of the sale area are damaged, liquidated damages will be assessed at \$500 per acre for all acreage within that specified portion of the sale area that was damaged.

## **4 - Transportation**

### 4.1 - Construction

#### 4.1.2 - Stream crossings, specific (3/11)

Payment Units 14 & 15 will require a stream crossing unless accessed from the south. The crossing will require the installation of a portable bridge which may be borrowed from the DNR if available. This installation will be performed in accordance with the specifications on the appropriate permits which shall be provided by the DNR. Allow 30 - 60 days to process the permit.

#### 4.1.3 - Slash and earthen piles (8/04)

Piles or windrows of earth along roads and landings that have been widened or constructed shall be leveled. Slash from road maintenance or construction, including stumps, shall be dispersed throughout the sale.

#### 4.1.4 - Timber removed for construction (12/09)

Trees cut or damaged in the process of pre-approved road, landing or skid trail construction will be decked in an area separate from other Designated Timber and not removed until measured by the sale administrator. Payment will be made at the specified Purchase Unit Price.

#### 4.1.6 - Road construction (1/09)

Construction of new roads or improvements of existing roads shall be done in such a way as to minimize the environmental and visual impacts. Merchantable trees shall be cut and utilized unless otherwise directed. Non-merchantable trees shall be severed and laid flat on the ground. Slash shall be scattered, and not left in windrows and kept a minimum of 10 feet back from the road edge. Stumps shall be set upright, not left on edge, and be moved at least 10 feet away from the road edge. Disturbed soil shall be feathered into the woods and not left in berms or windrows.

#### 4.1.7 - Road closure (10/11)

All new roads built into the sale must be blocked to vehicle traffic upon completion of the sale. Overgrown roads that are reopened shall be considered new roads. In general, this will require constructing a four (4') foot high berm of stumps and logs covered with earth. Stumps and brush must be placed along the remainder of the trail. These roads must be rendered impassable to cars and trucks. All stumps from road building and landing construction must be reserved to block any newly constructed roads upon completion of the sale. These stumps must be scattered along the road system to prohibit vehicular movement. Contact the sale administrator for specific details of design and placement.

### 4.2 - Maintenance

#### 4.2.4 - Grading (10/16)

For completion of the sale, USFS roads must be graded. In general, this will require a road grader or bull dozer to shape up the roads after forest products have been hauled off site. This includes cleaning of drainage areas, grading, crowning and filling with gravel, if necessary. The grading equipment to be used must be approved by the Unit Manager or his/her representative.

## **5 - Operations**

### 5.1 - Notification

#### 5.1.1 - Pre-sale conference (10/16)

A pre-sale conference on site between the Purchaser and sale administrator is required prior to beginning any operations to determine landing and road locations. The Unit Manager or his/her representative must be contacted at least 5 days in advance to schedule the conference.

### 5.2 - Conduct of Operations

#### 5.2.2 - Hazard Trees/Snags

#### 5.2.2.1 - Den trees (10/16)

Obvious hollow and/or den trees shall be protected and left standing unless they are a safety hazard.

#### 5.2.3 - Operating Restrictions

##### 5.2.3.1 - Operating restrictions (9/11)

Within Payment Unit(s) 17-20, unless changed by written agreement, cutting, skidding, and hauling are not permitted from March 1 through August 31. This restriction is because of a raptor nest in the area.

##### 5.2.3.2 - Operating restrictions (9/11)

Within Payment Unit(s) 14 & 15, unless changed by written agreement, cutting, skidding, and hauling are restricted to frozen winter conditions if the units are accessed from the north. If access is from the south, these units can be harvested any time of year. This restriction is because sensitive/wet soils on the access road to the north.

##### 5.2.3.6 - Bark beetle restriction (12/08)

In the event drought creates a high risk of pine bark beetle infestation, pine is not to be cut during the period March 1 through July 1, unless all portions of trees greater than two inches in diameter are removed from the sale area, reduced to chips, or treated to the satisfaction of the Unit Manager or his/her representative, within fifteen days of being severed from the stump. Pine log decks, pulpwood piles and treetops that are piled for chipping in the fall or winter within a 1/4 mile of susceptible sites must be removed before March 15. Residual slash must not be placed in piles or rows and must be spread over the site for quick drying. The Department of Natural Resources will exercise this specification if the risk of damage warrants.

##### 5.2.32 - Decking/landing restoration (9/13)

All decking and landing areas must have the surface area restored to a condition equal to or better than before. This is to ensure the proper regeneration of the stand. Wood debris, chips and "cookies" from trimmings must be removed or scattered away from landing and loading areas and may not be windrowed on the edge.

##### 5.2.38 - No decking against live trees (2/04)

Cut products may not be decked against unmarked or designated leave trees.

#### 5.4 - Soil Protection

##### 5.4.1 - Rutting restriction, general (7/16)

Operations are to cease immediately if equipment and weather conditions result in rutting of roads and/or skid trails which is 12 inches or greater in depth and 50 feet in length. The Unit Manager or his/her representative may restrict hauling and/or skidding if ruts exceed the specified depth. With the Unit Manager or his/her representative's approval, the Purchaser may return to the area when the risk of rutting has decreased.

#### 5.6 - Debris and Waste Material

##### 5.6.2 - GNA, equipment cleaning (1/16)

(a) Areas, known by the DNR prior to timber sale advertisement, that are infested with invasive species of concern are shown on the Timber Sale Map. A current list of invasive species of concern and a map showing the extent of known infestations is available from the DNR. For purposes of this provision, "Off-Road Equipment" includes all logging and construction machinery, except for log trucks, chip vans, service vehicles, water trucks, pickup trucks, cars, and similar vehicles.

(b) Purchaser shall adhere to the following requirements with regard to cleaning "Off-Road Equipment":

(i) Prior to moving Off-Road Equipment onto the Sale Area, Purchaser shall identify the location of the equipment's most recent operation. Purchaser shall not move any Off-Road Equipment that last operated in an area infested with one or more invasive species of concern onto Sale Area without having cleaned such equipment of seeds, soil, vegetative matter, and other debris that could contain or hold seeds, and having notified the DNR, as provided in (iii). If the location of prior operation cannot be identified, then Purchaser shall assume that the location is infested with invasive species of concern.

(ii) Prior to moving Off-Road Equipment from a cutting unit that is shown on the Timber Sale Map to be infested with invasive species of concern to, or through any other area that is shown as being free of invasive species of concern, or infested with a different invasive species, Purchaser shall clean such equipment of seeds, soil, vegetative matter, and other debris that could

contain or hold seeds, and shall notify the DNR, as provided in (iii).

(iii) Prior to moving any Off-Road Equipment subject to the cleaning requirements set forth above, Purchaser shall advise DNR of its cleaning measures and make the equipment available for inspection. DNR shall have 2 days, excluding weekends and State holidays, to inspect equipment after it has been made available. After satisfactory inspection or after such 2 day period, Purchaser may move the equipment as planned. Equipment shall be considered clean when a visual inspection does not disclose seeds, soil, vegetative matter, and other debris that could contain or hold seeds. Purchaser shall not be required to disassemble equipment unless so directed by the DNR after inspection.

(iv) If Purchaser desires to clean Off-Road Equipment on National Forest land, such as at the end of a project or prior to moving to, or through an area that is free of invasive species of concern, Purchaser shall obtain prior approval from the Unit Manager or his/her representative as to the location for such cleaning and measures, if any, for controlling impacts.

(v) Unit Manager or his/her representative may order delay, interruption, or modification of this Contract pursuant to Condition & Requirement 7.3 or 7.3.4.

(c) Nothing contained in this Condition & Requirement shall be interpreted as creating any warranty on the part of the DNR that all locations of invasive species of concern have been described herein, elsewhere in this Contract, or designated on the ground. Following sale advertisement, additional locations may be described or designated, and other species may be added to the list of invasive species of concern. In such event, the Unit Manager or his/her representative may order delay, interruption, or modification of this Contract pursuant to Condition & Requirement 7.3 or 7.3.4.

(d) The parties shall promptly communicate with one another with respect to description or designation of additional locations; discovery of locations of new species or new infestation; and, addition of species to the list of invasive species of concern.

## 5.7 - Protection of Historical Sites

### 5.7.1 - Historical sites (7/12)

The Purchaser shall not cut live or dead trees or operate equipment within historical sites. Historical sites are excluded with the boundary lines. The Purchaser shall protect historical sites from damage by the Purchaser's operations. If Purchaser's operations have cut or damaged historical sites through carelessness, the Purchaser shall pay \$1000 as fixed, agreed and liquidated damages for each acre or part thereof cut or damaged. In order to avoid the historical site, Payment Units 14 and 15 will require a temporary road through the units. Contact the Sale Administrator for specific details.

## 5.8 - Protection of Endangered Species

### 5.8.3 - Red shoulder hawk or goshawk (2/16)

In the event that an active red shoulder hawk or goshawk nest is found, the contract may be amended to protect the nest site until the nest is determined to be inactive. The value of the trees in this excluded area will be refunded or credited to the Purchaser. The nest will be buffered with a five-chain radius (eight acre) protection area, centered on the nest tree, in which there will be no cutting or new roads constructed. Avoid human disturbance, including loading and skidding, in the protection area.

An additional zone of five chains (ten chains centered on the active nest tree) will be established in which there is no management activity from April 1 to July 30. Limit biomass harvesting and chipping operations within this ten-chain zone, retain the maximum one-third of residues per the Woody Biomass Harvesting Guidelines (Michigan DNR 2010). Nests determined to be inactive will be protected with a one-chain no-harvest buffer.

## 6 - Safety and Fire Prevention

### 6.2 - Signing

#### 6.2.1 - Road posting (9/09)

The Purchaser is responsible for posting and maintaining caution signs on Bass Lake Road prior to beginning operations. The road must be posted at appropriate distances from the sale area to warn of logging activity and truck traffic. Signs must be removed when harvest operations are suspended or completed. The Purchaser will provide these signs.

## 7 - Other Conditions

SKIP

7.1.1 - GNA, title (7/16)

General Condition & Requirement 7.1 is inapplicable. The following applies to this contract.

All right, title, and interest in and to any Included Timber shall remain in USDA Forest Service with the State of Michigan acting on behalf of the USDA Forest Service under this GNA contract, until it has been Measured, removed from Sale Area or other authorized cutting area, and paid for, at which time title shall vest in Purchaser. Title to any Included Timber that has been Measured and paid for, but not removed from Sale Area or other authorized cutting area by Purchaser on or prior to Termination Date, shall remain in USDA Forest Service.

7.3 - Contract Modifications

7.3.4 - GNA, contract suspension and modification (5/16)

(a) The Unit Manager may, by written order, delay or interrupt authorized operations under this contract or, notwithstanding Condition & Requirement 7.3, modify this contract, in whole or in part:

(i) To prevent environmental degradation or resource damage, including, but not limited to, harm to habitat, plants, animals, cultural resources, or cave resources;

(ii) To ensure consistency with land and resource management plans or other documents prepared pursuant to the National Environmental Policy Act of 1969, 42 USC 4321-4347;

(iii) To conduct environmental analysis, including, but not limited to, engaging in consultation pursuant to the Endangered Species Act of 1973, 16 USC 1531, et seq.; or

(iv) Upon agreement of the Forest Service, due to administrative appeal or litigation, regardless of whether the Unit Manager's order is required by a court order or this contract is named in such a proceeding.

(b) In the event of an order delaying or interrupting Purchaser's Operations under this Condition & Requirement, Purchaser's remedy shall be:

(i) a no cost contract extension,

(ii) reimbursement for Out-of-Pocket Expenses,

however, the foregoing remedies shall be available only to the extent that the Unit Manager's order was the sole and exclusive cause of the delay or interruption of Purchaser's operations.

(c) Remedies awarded to the Purchaser shall not be duplicative, and the Unit Manager shall have the right to structure remedies provided herein to avoid duplicative compensation.

(d) Purchaser agrees that this Condition & Requirement, and the remedies provided herein shall apply regardless of any finding by any court that the DNR failed to comply with any statute, regulation and/or policy in connection with awarding, advertising, or authorizing this sale, or a similar sale.

7.5 - Loss

7.5.2 - GNA, liability for loss (7/16)

If Included Timber is destroyed or damaged by an unexpected event that changes the nature of Included Timber, such as wind, flood, insects, disease, or similar cause, the Purchaser shall bear the timber value loss resulting from such destruction or damage.

Deterioration or loss of timber value due to delay or interruption under 7.3.4 - GNA, contract suspension and modification, shall be borne by the party holding title. In this event, Included Timber to which USDA Forest Service holds title, Purchaser of the State GNA contract will not be obligated to remove and pay for such timber. This Subsection shall not be construed to relieve either party of liability for negligence.

## 7.10 - Certified Timber

### 7.10.1 - Non-certified timber (2/16)

The area encompassed by this timber sale is not certified to the standards of the Forest Stewardship Council (FSC) or the Sustainable Forestry Initiative (SFI). Forest products from this sale may not be delivered to the mill as "FSC and / or SFI certified". The lands within this sale belong to the National Forest system and are being managed by the State as part of a Good Neighbor Authority (GNA) agreement.





Sale Number	Year
41-821	19

### TIMBER SALE MAP

This information provided by authority of Part 5, 1994 PA 451, as amended.

Forest Management Unit Shingleton	County Schoolcraft	Mapped By S. Kentner Cruised By Unit Staff	Date 9/23/19	Page 1	of 2
Township 44 N	Range 17 W	Section(s) and Subdivision(s) 30: E 1/2 29: 32: 33: W 1/2			

Cover Type				Density	
A = Aspen	J = Jack Pine	O = Oak	U = Upland Brush	0 = Non Stocked	5 = Pole Timber Medium
B = Paper Birch	K = Rock	P = Lowland Poplar	UM = Upland Mix Forest	1 = Seedling Sapling Poor	6 = Pole Timber Well
C = Cedar	L = Lowland Brush	Q = Mixed Swamp Conifer	V = Bog or Marsh	2 = Seedling Sapling Medium	7 = Saw Timber Poor
D = Treed Bog	LM = Lowland Mix Forest	R = Red Pine	W = White Pine	3 = Seedling Sapling Well	8 = Saw Timber Medium
E = Swamp Hardwoods	M = Maple, Beech, Birch	S = Black Spruce	X = Non Stocked	4 = Pole Timber Poor	9 = Saw Timber Well
F = Spruce/Fir	MC = Mixed Conifer	T = Tamarack	Y = Sand		
G = Grass	MD = Mixed Deciduous		Z = Water		
H = Hemlock	N = Marsh				

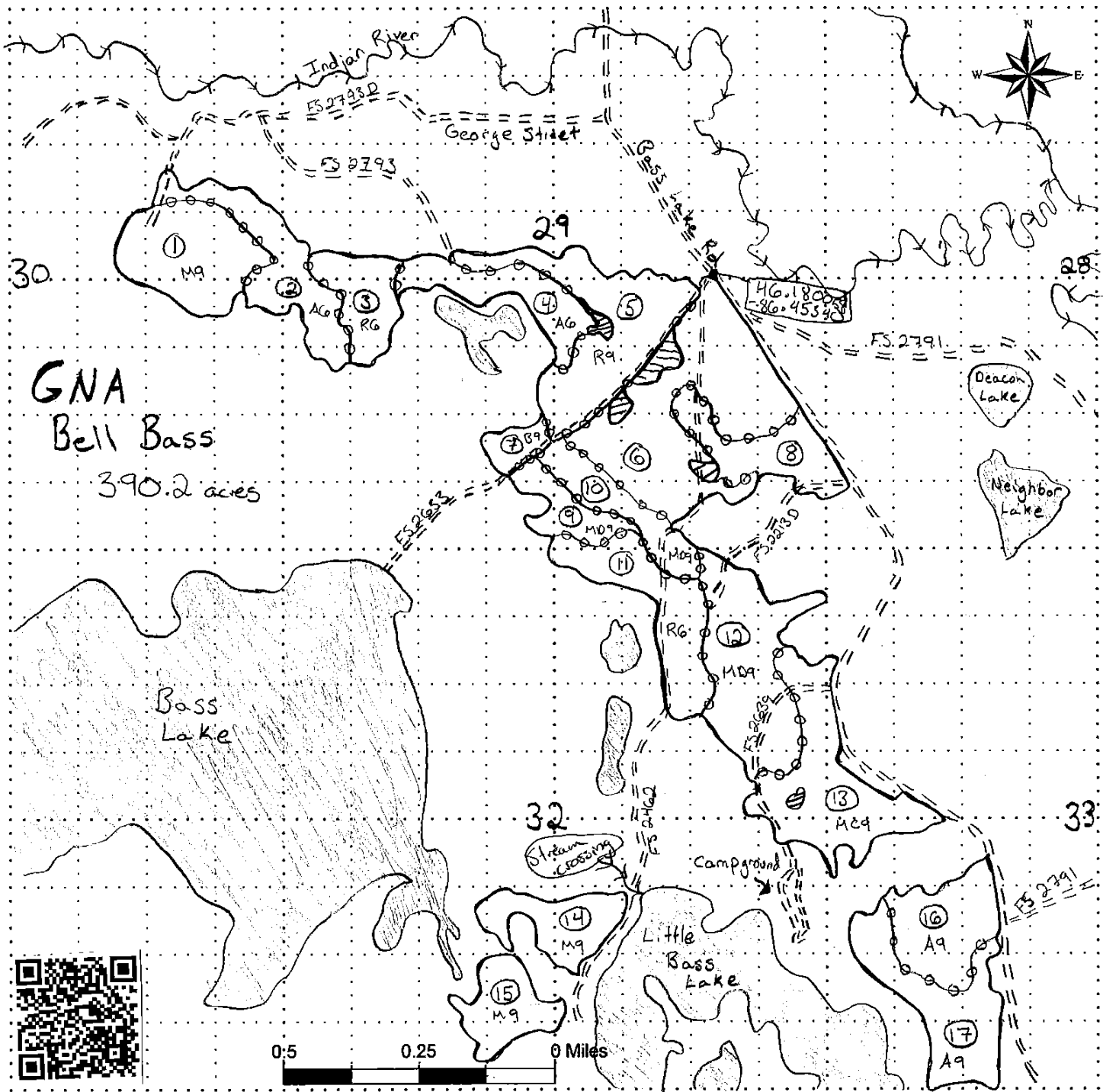



# TIMBER SALE MAP

This information provided by authority of Part 5, 1994 PA 451, as amended.

Sale Number	41-821	Year	19
Date	9/23/19	Page	2 of 2

Forest Management Unit Shingleton	County Schoolcraft	Mapped By S. Kentner	Date 9/23/19
Township 43 N	Range 17 W	Cruised By Unit Staff	Page 2 of 2
Section(s) and Subdivision(s) 4: NW/4			

Cover Type				Density	
A = Aspen	J = Jack Pine	O = Oak	U = Upland Brush	0 = Non Stocked	5 = Pole Timber Medium
B = Paper Birch	K = Rock	P = Lowland Poplar	UM = Upland Mix Forest	1 = Seedling Sapling Poor	6 = Pole Timber Well
C = Cedar	L = Lowland Brush	Q = Mixed Swamp Conifer	V = Bog or Marsh	2 = Seedling Sapling Medium	7 = Saw Timber Poor
D = Treed Bog	LM = Lowland Mix Forest	R = Red Pine	W = White Pine	3 = Seedling Sapling Well	8 = Saw Timber Medium
E = Swamp Hardwoods	M = Maple, Beech, Birch	S = Black Spruce	X = Non Stocked	4 = Pole Timber Poor	9 = Saw Timber Well
F = Spruce/Fir	MC = Mixed Conifer	T = Tamarack	Y = Sand		
G = Grass	MD = Mixed Deciduous		Z = Water		
H = Hemlock	N = Marsh				

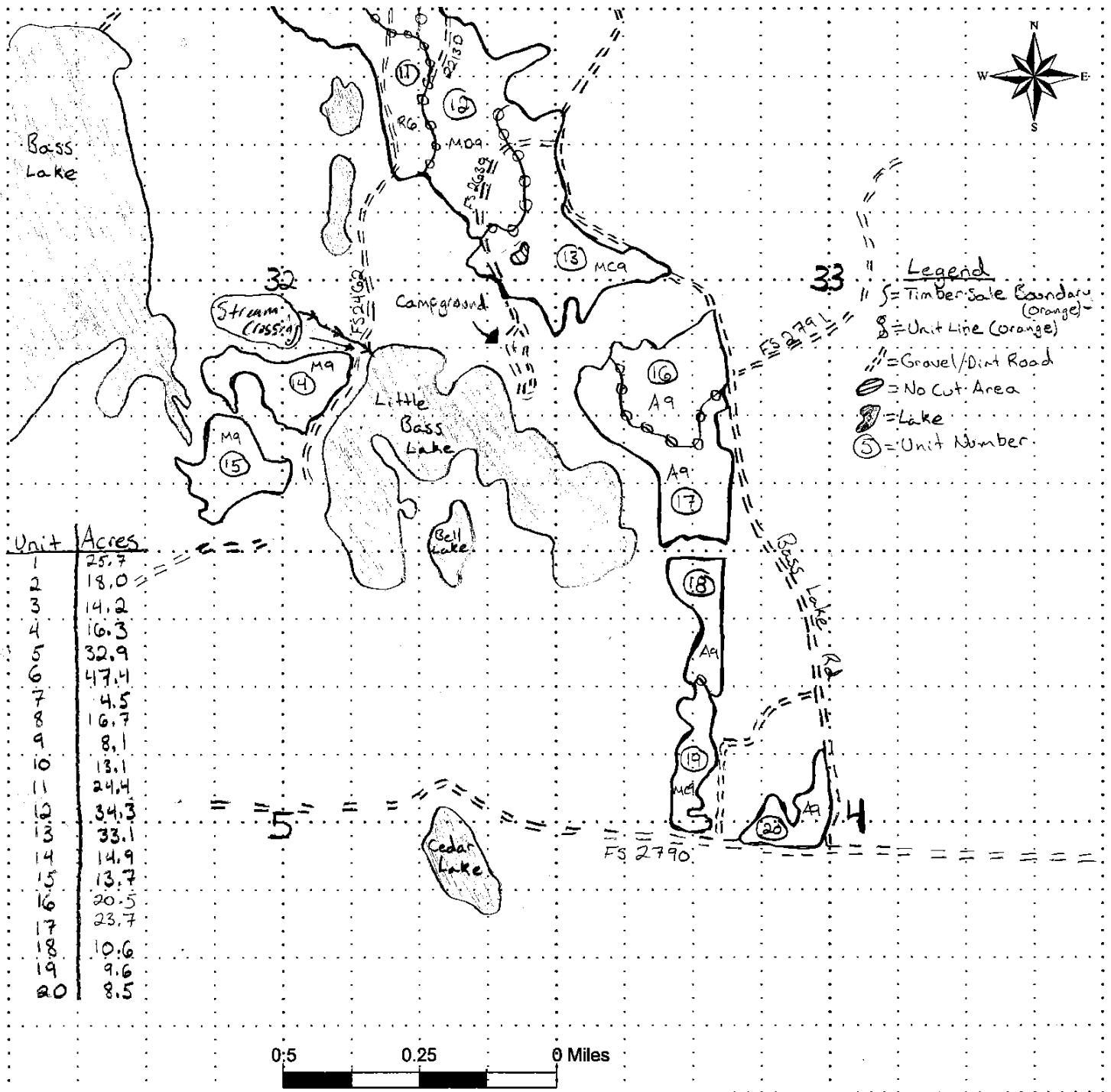

Out W/Old In W/New Hardwoods (41-023-19)  
T47N, R17W, SEC. 1; T47N, R17W, SEC. 11; T47N, R17W, SEC. 12; T47N, R17W,

In response to the notice of sale to be held 2:00 p.m. (local time) on May 20, 2020, I am hereby submitting my sealed bid ( firm offer) for the following forest products to be cut. Bids for individual species must be at or above the advertised price. All non-responsive bid forms may be rejected.

<u>PRODUCTS &amp; SPECIES</u>	<u>ESTIMATED VOLUME*</u>	<u>ADVERTISED PRICE</u>	<u>BID PRICE/UNIT</u>
<b>Sawtimber</b>			
Basswood	12.10 MBF	\$ 95.00/MBF	\$ _____
Black Cherry	9.90 MBF	\$ 130.00/MBF	\$ _____
Red Maple	14.80 MBF	\$ 104.00/MBF	\$ _____
Sugar Maple	139.10 MBF	\$ 240.00/MBF	\$ _____
<b>Pulpwood</b>			
Balsam Fir	221.00 Cords	\$ 8.95/Cord	\$ _____
Basswood	124.00 Cords	\$ 6.35/Cord	\$ _____
Mixed Hardwood	2,354.00 Cords	\$ 13.00/Cord	\$ _____
Quaking Aspen	38.00 Cords	\$ 17.40/Cord	\$ _____
White Pine	5.00 Cords	\$ 12.40/Cord	\$ _____
White Spruce	204.00 Cords	\$ 16.15/Cord	\$ _____

\*These estimated volumes are final and not subject to adjustment. Prospective bidders are urged to examine this timber and to make their own estimates of quantity and quality.

I understand that any or all bids may be rejected. All bids must be signed and all bid items must be bid or the bid form may be rejected. I also understand that consideration and awarding a contract will be based upon my past performance and ability to complete the contract based upon equipment and staffing subject to my control.

FEDERAL ID: \_\_\_\_\_ or SOCIAL SECURITY NUMBER: \_\_\_\_\_

Company or individual bidding: \_\_\_\_\_

Company representative's name: \_\_\_\_\_

Address: \_\_\_\_\_

City: \_\_\_\_\_ State: \_\_\_\_\_ Zip: \_\_\_\_\_

IF AVAILABLE, PLEASE PLACE THE PERSONALIZED LABEL FROM YOUR PROSPECTUS IN THE ABOVE BOX.

Individual or company representative's signature: \_\_\_\_\_ Date: \_\_\_\_\_

Phone number : \_\_\_\_\_ Email (optional): \_\_\_\_\_

**THE WINNING BIDDER MUST COMPLETE THE VERIFICATION OF WORKER'S DISABILITY COMPENSATION ACT COMPLIANCE (ON REVERSE SIDE IF DOUBLE SIDED) WITHIN 21 DAYS OF SALE AWARD DATE**



FOR DEPARTMENT USE ONLY	
Sale Number (XX - XXX - XX - XX)	
Forest Management Unit:	

# TIMBER SALE VERIFICATION OF WORKER'S DISABILITY COMPENSATION ACT COMPLIANCE

As required by Act 317, P.A. 1969 (Worker's Compensation) and  
Part 5 of Act 451 of 1994, as amended.

## VERIFICATION OF WORKER'S DISABILITY COMPENSATION ACT COMPLIANCE

- This verification must be completed and submitted within 21 days of contract award and prior to the issuance of the timber sale contract.
- In addition, if boxes 2B or 2C are checked, then Notice of Exclusion or Certificate of Insurance must be submitted within twenty-one (21) days of the contract award and prior to the issuance of the timber sale contract.
- All information must be typed or printed except for written signatures.

Please Check Appropriate Categories:

1. My business is organized as (you **must** check one of the boxes below):
  - A.  Sole Proprietorship (individual)
  - B.  Partnership
  - C.  Corporation
2. You **must** check one of the boxes below:
  - A.  I certify my business is a sole proprietorship and it has no employees but the sole proprietor. I am not subject to the Worker's Compensation Laws.
  - B.  I certify my business has satisfied its obligation to the Worker's Compensation Act through the use of an approved Notice of Exclusion (BWC-337, Rev. 5/96). I will provide a copy of the Notice of Exclusion within 21 days of the contract award. (For questions or a copy of the BWC-337, please call the Worker's Compensation Bureau at 517-322-1195).
  - C.  I certify my business has a Worker's Compensation Policy. I will provide an original Certificate of Insurance within twenty-one (21) days of the contract award.
3. If you have checked item 2(A) or 2(B), you **must** indicate the number of **both** full-time and part-time employees, other than yourself, including family members and active partners (if none, you must enter "0").

\_\_\_\_\_ Full-time Employees

\_\_\_\_\_ Part-time Employees

Name of Business		Federal ID (or) Social Security No.	
Address		Telephone (       )	
City	State	ZIP	

*I hereby certify that the above information is true and correct. I agree to notify the Michigan DNR of any changes that occur in factors affecting my coverage during any of my present and future operations.*

\_\_\_\_\_  
Signature of Owner or Authorized Representative

\_\_\_\_\_  
Title

\_\_\_\_\_  
Date

Please complete the "SEALED BID" information on the next page

Noble Lake Sale (41-012-19)  
T47N, R17W, SEC. 19; T47N, R17W, SEC. 30; Alger COUNTY

In response to the notice of sale to be held 2:00 p.m. (local time) on May 20, 2020, I am hereby submitting my sealed bid ( firm offer) for the following forest products to be cut. Bids for individual species must be at or above the advertised price. All non-responsive bid forms may be rejected.

<u>PRODUCTS &amp; SPECIES</u>	<u>ESTIMATED VOLUME*</u>	<u>ADVERTISED PRICE</u>	<u>BID PRICE/UNIT</u>
<b>Sawtimber</b>			
Basswood	68.10 MBF	\$ 91.00/MBF	\$ _____
Black Cherry	0.70 MBF	\$ 125.00/MBF	\$ _____
Paper Birch	0.50 MBF	\$ 39.00/MBF	\$ _____
Red Maple	15.30 MBF	\$ 99.00/MBF	\$ _____
Sugar Maple	101.50 MBF	\$ 230.00/MBF	\$ _____
<b>Pulpwood</b>			
Balsam Fir	109.00 Cords	\$ 8.60/Cord	\$ _____
Mixed Aspen	275.00 Cords	\$ 16.75/Cord	\$ _____
Mixed Hardwood	2,440.00 Cords	\$ 12.50/Cord	\$ _____
Paper Birch	14.00 Cords	\$ 8.20/Cord	\$ _____
White Pine	6.00 Cords	\$ 11.90/Cord	\$ _____
White Spruce	121.00 Cords	\$ 15.50/Cord	\$ _____

\*The volumes are statistically estimated within plus (+) or minus (-) 14.35 percent. These estimated volumes are final and not subject to adjustment. Prospective bidders are urged to examine this timber and to make their own estimates of quantity and quality.

I understand that any or all bids may be rejected. All bids must be signed and all bid items must be bid or the bid form may be rejected. I also understand that consideration and awarding a contract will be based upon my past performance and ability to complete the contract based upon equipment and staffing subject to my control.

FEDERAL ID: \_\_\_\_\_ or SOCIAL SECURITY NUMBER: \_\_\_\_\_

Company or individual bidding: \_\_\_\_\_

Company representative's name: \_\_\_\_\_

Address: \_\_\_\_\_

City: \_\_\_\_\_ State: \_\_\_\_\_ Zip: \_\_\_\_\_

IF AVAILABLE, PLEASE PLACE THE PERSONALIZED LABEL FROM YOUR PROSPECTUS IN THE ABOVE BOX.

Individual or company representative's signature: \_\_\_\_\_ Date: \_\_\_\_\_

Phone number : \_\_\_\_\_ Email (optional): \_\_\_\_\_

**THE WINNING BIDDER MUST COMPLETE THE VERIFICATION OF WORKER'S DISABILITY COMPENSATION ACT COMPLIANCE (ON REVERSE SIDE IF DOUBLE SIDED) WITHIN 21 DAYS OF SALE AWARD DATE**



FOR DEPARTMENT USE ONLY	
Sale Number (XX - XXX - XX - XX)	
Forest Management Unit:	

## TIMBER SALE VERIFICATION OF WORKER'S DISABILITY COMPENSATION ACT COMPLIANCE

As required by Act 317, P.A. 1969 (Worker's Compensation) and  
Part 5 of Act 451 of 1994, as amended.

### VERIFICATION OF WORKER'S DISABILITY COMPENSATION ACT COMPLIANCE

- This verification must be completed and submitted within 21 days of contract award and prior to the issuance of the timber sale contract.
- In addition, if boxes 2B or 2C are checked, then Notice of Exclusion or Certificate of Insurance must be submitted within twenty-one (21) days of the contract award and prior to the issuance of the timber sale contract.
- All information must be typed or printed except for written signatures.

Please Check Appropriate Categories:

1. My business is organized as (you **must** check one of the boxes below):
  - A.  Sole Proprietorship (individual)
  - B.  Partnership
  - C.  Corporation
2. You **must** check one of the boxes below:
  - A.  I certify my business is a sole proprietorship and it has no employees but the sole proprietor. I am not subject to the Worker's Compensation Laws.
  - B.  I certify my business has satisfied its obligation to the Worker's Compensation Act through the use of an approved Notice of Exclusion (BWC-337, Rev. 5/96). I will provide a copy of the Notice of Exclusion within 21 days of the contract award. (For questions or a copy of the BWC-337, please call the Worker's Compensation Bureau at 517-322-1195).
  - C.  I certify my business has a Worker's Compensation Policy. I will provide an original Certificate of Insurance within twenty-one (21) days of the contract award.
3. If you have checked item 2(A) or 2(B), you **must** indicate the number of **both** full-time and part-time employees, other than yourself, including family members and active partners (if none, you must enter "0").

\_\_\_\_\_ Full-time Employees

\_\_\_\_\_ Part-time Employees

Name of Business		Federal ID (or) Social Security No.	
Address		Telephone (       )	
City	State	ZIP	

*I hereby certify that the above information is true and correct. I agree to notify the Michigan DNR of any changes that occur in factors affecting my coverage during any of my present and future operations.*

\_\_\_\_\_  
Signature of Owner or Authorized Representative

\_\_\_\_\_  
Title

\_\_\_\_\_  
Date

Please complete the "SEALED BID" information on the next page

Rosemund Rd sale (41-013-19)  
T47N, R17W, SEC. 30; T47N, R17W, SEC. 31; Alger COUNTY

In response to the notice of sale to be held 2:00 p.m. (local time) on May 20, 2020, I am hereby submitting my sealed bid ( firm offer) for the following forest products to be cut. Bids for individual species must be at or above the advertised price. All non-responsive bid forms may be rejected.

<u>PRODUCTS &amp; SPECIES</u>	<u>ESTIMATED VOLUME*</u>	<u>ADVERTISED PRICE</u>	<u>BID PRICE/UNIT</u>
<b>Sawtimber</b>			
Basswood	39.40 MBF	\$ 98.00/MBF	\$ _____
Black Cherry	2.60 MBF	\$ 134.00/MBF	\$ _____
Paper Birch	0.20 MBF	\$ 42.00/MBF	\$ _____
Red Maple	16.20 MBF	\$ 107.00/MBF	\$ _____
Sugar Maple	91.80 MBF	\$ 247.00/MBF	\$ _____
Yellow Birch	0.20 MBF	\$ 94.00/MBF	\$ _____
<b>Pulpwood</b>			
Balsam Fir	126.00 Cords	\$ 9.25/Cord	\$ _____
Mixed Hardwood	2,063.00 Cords	\$ 13.40/Cord	\$ _____
Paper Birch	9.00 Cords	\$ 8.80/Cord	\$ _____
Quaking Aspen	195.00 Cords	\$ 17.95/Cord	\$ _____
White Spruce	151.00 Cords	\$ 16.65/Cord	\$ _____

\*The volumes are statistically estimated within plus (+) or minus (-) 17.10 percent. These estimated volumes are final and not subject to adjustment. Prospective bidders are urged to examine this timber and to make their own estimates of quantity and quality.

I understand that any or all bids may be rejected. All bids must be signed and all bid items must be bid or the bid form may be rejected. I also understand that consideration and awarding a contract will be based upon my past performance and ability to complete the contract based upon equipment and staffing subject to my control.

FEDERAL ID: \_\_\_\_\_ or SOCIAL SECURITY NUMBER: \_\_\_\_\_

Company or individual bidding: \_\_\_\_\_

Company representative's name: \_\_\_\_\_

Address: \_\_\_\_\_

City: \_\_\_\_\_ State: \_\_\_\_\_ Zip: \_\_\_\_\_

IF AVAILABLE, PLEASE PLACE THE PERSONALIZED LABEL FROM YOUR PROSPECTUS IN THE ABOVE BOX.

Individual or company representative's signature: \_\_\_\_\_ Date: \_\_\_\_\_

Phone number : \_\_\_\_\_ Email (optional): \_\_\_\_\_

**THE WINNING BIDDER MUST COMPLETE THE VERIFICATION OF WORKER'S DISABILITY COMPENSATION ACT COMPLIANCE (ON REVERSE SIDE IF DOUBLE SIDED) WITHIN 21 DAYS OF SALE AWARD DATE**



# TIMBER SALE VERIFICATION OF WORKER'S DISABILITY COMPENSATION ACT COMPLIANCE

As required by Act 317, P.A. 1969 (Worker's Compensation) and  
Part 5 of Act 451 of 1994, as amended.

FOR DEPARTMENT USE ONLY	
Sale Number (XX - XXX - XX - XX)	
Forest Management Unit:	

## VERIFICATION OF WORKER'S DISABILITY COMPENSATION ACT COMPLIANCE

- This verification must be completed and submitted within 21 days of contract award and prior to the issuance of the timber sale contract.
- In addition, if boxes 2B or 2C are checked, then Notice of Exclusion or Certificate of Insurance must be submitted within twenty-one (21) days of the contract award and prior to the issuance of the timber sale contract.
- All information must be typed or printed except for written signatures.

Please Check Appropriate Categories:

1. My business is organized as (you **must** check one of the boxes below):
  - A.  Sole Proprietorship (individual)
  - B.  Partnership
  - C.  Corporation
2. You **must** check one of the boxes below:
  - A.  I certify my business is a sole proprietorship and it has no employees but the sole proprietor. I am not subject to the Worker's Compensation Laws.
  - B.  I certify my business has satisfied its obligation to the Worker's Compensation Act through the use of an approved Notice of Exclusion (BWC-337, Rev. 5/96). I will provide a copy of the Notice of Exclusion within 21 days of the contract award. (For questions or a copy of the BWC-337, please call the Worker's Compensation Bureau at 517-322-1195).
  - C.  I certify my business has a Worker's Compensation Policy. I will provide an original Certificate of Insurance within twenty-one (21) days of the contract award.
3. If you have checked item 2(A) or 2(B), you **must** indicate the number of **both** full-time and part-time employees, other than yourself, including family members and active partners (if none, you must enter "0").

\_\_\_\_\_ Full-time Employees

\_\_\_\_\_ Part-time Employees

Name of Business		Federal ID (or) Social Security No.	
Address		Telephone (       )	
City	State	ZIP	

*I hereby certify that the above information is true and correct. I agree to notify the Michigan DNR of any changes that occur in factors affecting my coverage during any of my present and future operations.*

\_\_\_\_\_  
Signature of Owner or Authorized Representative

\_\_\_\_\_  
Title

\_\_\_\_\_  
Date

Please complete the "SEALED BID" information on the next page



GNA Bell Bass (41-821-19)

T43N, R17W, SEC. 4; T44N, R17W, SEC. 28; T44N, R17W, SEC. 29; T44N, R17W,

In response to the notice of sale to be held 2:00 p.m. (local time) on May 20, 2020, I am hereby submitting my sealed bid ( firm offer) for the following forest products to be cut. Bids for individual species must be at or above the advertised price. All non-responsive bid forms may be rejected.

<u>PRODUCTS &amp; SPECIES</u>	<u>ESTIMATED VOLUME*</u>	<u>ADVERTISED PRICE</u>	<u>BID PRICE/UNIT</u>
<b>Sawtimber</b>			
Black Cherry	1.70 MBF	\$ 148.00/MBF	\$ _____
Paper Birch	1.90 MBF	\$ 46.00/MBF	\$ _____
Red Maple	15.20 MBF	\$ 117.00/MBF	\$ _____
Sugar Maple	0.50 MBF	\$ 272.00/MBF	\$ _____
<b>Pulpwood</b>			
Balsam Fir	104.00 Cords	\$ 10.20/Cord	\$ _____
Hemlock	101.00 Cords	\$ 13.75/Cord	\$ _____
Jack Pine	354.00 Cords	\$ 19.70/Cord	\$ _____
Mixed Aspen	2,633.00 Cords	\$ 19.75/Cord	\$ _____
Mixed Hardwood	715.00 Cords	\$ 14.75/Cord	\$ _____
Paper Birch	286.00 Cords	\$ 9.70/Cord	\$ _____
Red Pine	1,367.00 Cords	\$ 45.75/Cord	\$ _____
White Pine	233.00 Cords	\$ 14.05/Cord	\$ _____
White Spruce	14.00 Cords	\$ 18.30/Cord	\$ _____

\*These estimated volumes are final and not subject to adjustment. Prospective bidders are urged to examine this timber and to make their own estimates of quantity and quality.

I understand that any or all bids may be rejected. All bids must be signed and all bid items must be bid or the bid form may be rejected. I also understand that consideration and awarding a contract will be based upon my past performance and ability to complete the contract based upon equipment and staffing subject to my control.

FEDERAL ID: \_\_\_\_\_ - \_\_\_\_\_ or SOCIAL SECURITY NUMBER: \_\_\_\_\_ - \_\_\_\_\_ - \_\_\_\_\_

Company or individual bidding: \_\_\_\_\_

Company representative's name: \_\_\_\_\_

Address: \_\_\_\_\_

City: \_\_\_\_\_ State: \_\_\_\_\_ Zip: \_\_\_\_\_

IF AVAILABLE, PLEASE PLACE THE PERSONALIZED LABEL FROM YOUR PROSPECTUS IN THE ABOVE BOX.

Individual or company representative's signature: \_\_\_\_\_ Date: \_\_\_\_\_

Phone number : \_\_\_\_\_ Email (optional): \_\_\_\_\_

**THE WINNING BIDDER MUST COMPLETE THE VERIFICATION OF WORKER'S DISABILITY COMPENSATION ACT COMPLIANCE (ON REVERSE SIDE IF DOUBLE SIDED) WITHIN 21 DAYS OF SALE AWARD DATE**



<b>FOR DEPARTMENT USE ONLY</b>
Sale Number (XX - XXX - XX - XX)
Forest Management Unit:

## TIMBER SALE VERIFICATION OF WORKER'S DISABILITY COMPENSATION ACT COMPLIANCE

*As required by Act 317, P.A. 1969 (Worker's Compensation) and  
Part 5 of Act 451 of 1994, as amended.*

### VERIFICATION OF WORKER'S DISABILITY COMPENSATION ACT COMPLIANCE

- This verification must be completed and submitted within 21 days of contract award and prior to the issuance of the timber sale contract.
- In addition, if boxes 2B or 2C are checked, then Notice of Exclusion or Certificate of Insurance must be submitted within twenty-one (21) days of the contract award and prior to the issuance of the timber sale contract.
- All information must be typed or printed except for written signatures.

Please Check Appropriate Categories:

1. My business is organized as (you **must** check one of the boxes below):
  - A.  Sole Proprietorship (individual)
  - B.  Partnership
  - C.  Corporation
2. You **must** check one of the boxes below:
  - A.  I certify my business is a sole proprietorship and it has no employees but the sole proprietor. I am not subject to the Worker's Compensation Laws.
  - B.  I certify my business has satisfied its obligation to the Worker's Compensation Act through the use of an approved Notice of Exclusion (BWC-337, Rev. 5/96). I will provide a copy of the Notice of Exclusion within 21 days of the contract award. (For questions or a copy of the BWC-337, please call the Worker's Compensation Bureau at 517-322-1195).
  - C.  I certify my business has a Worker's Compensation Policy. I will provide an original Certificate of Insurance within twenty-one (21) days of the contract award.
3. If you have checked item 2(A) or 2(B), you **must** indicate the number of **both** full-time and part-time employees, other than yourself, including family members and active partners (if none, you must enter "0").

\_\_\_\_\_ Full-time Employees

\_\_\_\_\_ Part-time Employees

Name of Business		Federal ID (or) Social Security No.	
Address		Telephone (       )	
City	State	ZIP	

*I hereby certify that the above information is true and correct. I agree to notify the Michigan DNR of any changes that occur in factors affecting my coverage during any of my present and future operations.*

\_\_\_\_\_  
Signature of Owner or Authorized Representative

\_\_\_\_\_  
Title

\_\_\_\_\_  
Date

**Please complete the "SEALED BID" information on the next page**