



**DEPARTMENT OF NATURAL RESOURCES
STATE OF MICHIGAN**

TIMBER SALE PROSPECTUS #6505

SCHEDULED SALE DATE AND TIME: 3:00 p.m. (local time) on October 15, 2019.

LOCATION: ESCANABA MGMT UNIT, 6833 HWY'S 2, 41 & M-35, GLADSTONE, MI 49837.

PROSPECTUS NOTE: The bidder is advised to inspect the sale area and review the location, estimated volumes, operating costs and contract terms of proposed sales. Please be aware that some landowners may request 60 days or more notice for access across their land.

Notice is hereby given that bids will be received by the Unit Manager, ESCANABA MANAGEMENT UNIT, for certain timber on the following described lands:

West DeTemple Blend (33-029-19) / T37N, R27W, SEC. 7 , SENW,NENE,S1/2NE,NESW,SE.
T37N, R27W, SEC. 8 , NWNW.

Menominee County, Advertised Price \$34,029.50, 92.5 Acres, Hardwood, Spruce/Fir/Tamarack.

SALE NOTE: Spruce budworm is present within the sale and has caused some balsam fir and spruce mortality.

Watered Down Oak (33-033-19) / T34N, R29W, SEC. 1 , NW,SWNE,NWSW.
T34N, R29W, SEC. 2 , E1/2NE,NESE.
T35N, R29W, SEC. 36, SESW.

Menominee County, Advertised Price \$90,097.00, 149.4 Acres, Hardwood, White Pine.

SALE NOTE: The Purchaser will need to purchase and install two new culverts and haul and spread a minimum of 300 yards of gravel onto the access roads. There is access into this sale through state land, but the best access is through private property to the east of Payment Unit 9.

Wolf Chase (33-003-18) / T36N, R25W, SEC. 1 , S1/2SW,SE.
T36N, R25W, SEC. 1 , W1/2NW,NENE,S1/2NE,NESW.
T36N, R25W, SEC. 11, NENE.
T36N, R25W, SEC. 2 , SENW,NE,NESE,S1/2SE.

Menominee County, Advertised Price \$275,953.95, 308.1 Acres, Hardwood, Spruce/Fir/Tamarack.

SALE NOTE: The Forest Islands ORV Trail runs through the sale area.

Within Payment Units 2, 4, 5, 10, and 14, operations are limited to the period of 12/1 to 3/15, unless frozen ground conditions exist.

Harvesting Payment Units 3, 7, 8, 9, 12, and 13 is recommended during dry summer or frozen winter conditions.

A recreation site such as a trail, pathway, or campground is within the sale area or the vicinity. Certain restrictions/specifications may be applicable including time restrictions. Access may be through private land.

BID INSTRUCTIONS (VER. 07/02/2018):

1. Scheduled Bid Location, Date, and Time (2/11)

Bids must be received by the Unit Manager, ESCANABA OFFICE, 6833 Hwy's 2, 41 & M-35, Gladstone, MI 49837, no later than 3:00 p.m. (local time) on October 15, 2019. For further information concerning this sale, contact Eric Thompson at 906-786-2354.

2. Bidder's Qualifications (5/16)

Purchaser shall obtain workers compensation insurance to cover claims under Michigan's Worker's Disability Compensation Act of 1969 or similar employee benefit act of any other state applicable to an employee. If all or part of a timber sale was prepared by a private contractor, the contractor and that contractor's company are not permitted to bid on the timber sale contract. Bids will not be accepted from individuals or companies appearing on the DNR/FRD No-Bid List. This list contains the names of purchasers who previously failed to execute a contract within 21-days or who have a history of poor performance.

3. Preparation of Sealed Bids (5/16)

Bid Forms may be completed online thru Michigan DNR Timber Sale Online Bidding (OLB) at www.michigan.gov/timberbidding or by completing the hardcopy Bid Form found in the Timber Sale Prospectus. Hardcopy Bid Forms shall be manually signed in ink. Registration in OLB is considered your 'signature' for all bids submitted thru that system. Bid prices must be entered for each species and product in the Bid Price column for all material subject to bidding and all fill-in blanks must be completed. If erasures or other changes appear on the hardcopy Bid Form, each erasure or change must be initialed by the person signing the bid.

4. Submission of Sealed Bids (5/16)

Bid forms may be obtained from the Unit Manager or thru OLB. Bids may be submitted hardcopy or thru OLB. All hardcopy bids must be submitted on the bid form and in an envelope clearly identified as described in this section. NOTE: Only one bid form per bid envelope. Sealed bids must be submitted to the Unit office designated in the prospectus and must be submitted at or prior to the time established in the prospectus. The envelope should show on the outside (a) the sale name or number and (b) the date and time of bid opening, as shown in the prospectus. Bids received after the time specified in the sale prospectus are late bids and will be rejected.

It is possible for a bidder to submit multiple bids on a single sale. For example, a bid may be submitted hardcopy and a bid may be submitted thru OLB. Or, two bidders from the same company could both submit bids on the same sale. If this were to happen, the State would accept all bids received and award the contract accordingly. All bidding and contractual requirements would apply to all bids received.

5. Public Opening of Sealed Bids (7/16)

If conditions permit, the sealed bids will be publicly opened and posted at the time and place set in the prospectus.

If a bidder, present at a bid opening, has submitted bids on more than one sale, that bidder may withdraw their unopened bid envelopes or announce the withdrawal of their online bid after being declared the successful bidder on one sale.

6. Award of Contract (1/11)

Award of the contract will be made to the Bidder whose bid, conforming to the prospectus, is most advantageous to the State of Michigan on the basis of total value at rates bid for the estimated quantities. The State reserves the right to reject any bid or waive any minor irregularity in bids received. A written award mailed (or otherwise furnished) to the successful Bidder shall be deemed to result in a binding contract without further action by either party.

7. Down Payment (1/11)

The Bidder to whom award is made must make a down payment within 21 days of the sale award. The amount of the down payment will be calculated as shown in the Bond and Payment Schedule of this prospectus. Only cash may be used to meet this requirement.

8. Performance Security (1/11)

As guarantee of faithful performance, a cash bond, certificate of deposit, surety bond or irrevocable letter of credit (LOC) is required within 21 days of the sale award. The amount of the performance security is shown in the Bond and

Payment Schedule of this prospectus. If an LOC or surety is used, the coverage must extend for at least 6 months beyond the contract expiration.

9. Timber Sale Contract (7/18)

Additional conditions and requirements common to all timber sales are listed on the timber sale contract (R4031) and are available on line at www.michigan.gov/timber. Contact the Unit Manager for additional information or a sample contract. Within 21 days of the date of the award letter, the bidder must sign the contract and provide the required down payment, performance security, and verification of worker's disability compensation. The down payment and performance security shall be in accordance with the provisions of the timber sale contract, in the sums stated in this prospectus. If these actions are not taken, then the Bidder, the Bidder's corporation, and the corporation's principals may not be permitted to bid on State timber sales for a period of 3 months after the first offense, 6 months after the second offense, and 1 year after the third offense. An offense will only be counted against the Bidder for 5 years. In addition, the Bidder certifies that if awarded this contract, the Bidder will complete the timber sale contract in accordance with its terms and any modifications thereof including requirements to purchase, cut, and remove the included timber by the expiration date.

Payment Unit values in the State Forest Timber Sale Contract are calculated based on the advertised value of the Payment Unit as a percentage of the total advertised value of the contract. The advertised value of each Payment Unit is given in the Description of Timber by Payment Unit table on the Timber Sale Information page. For example, if the value of Payment Unit 1 is advertised as \$1,500 and the total Timber Sale value is advertised as \$10,000, the contract price for Payment Unit 1 will be 15% of the total bid price ($\$1,500/\$10,000 * 100$).

10. Disclaimer of Estimates and Bidder's Warranty of Inspection (7/16)

Before submitting this bid, the Bidder is advised and cautioned to inspect the sale area, review the requirements of the sale contract, and take other steps as may be reasonably necessary to ascertain the location, estimated volumes, construction estimates, and operating costs of the proposed sale. Failure to do so will not relieve the Bidder from responsibility for completing the contract.

The Bidder warrants that this bid is submitted solely on the basis of the Bidder's examination and inspection of the quality and quantity of the timber offered for sale and the Bidder's opinion of the value thereof and the costs of recovery. No reliance should be placed on the State of Michigan's estimates of timber quality, quantity or costs of recovery. Bidder further acknowledges that the State of Michigan: (i) expressly disclaims any warranty of fitness of timber for any purpose; (ii) offers this timber as is without any warranty of quality (merchantability) or quantity and (iii) expressly disclaims any warranty as to the quantity or quality of timber sold.

11. Certification and Chain-of-Custody (10/14)

Unless otherwise indicated in the contract under section 7 – Other Conditions of the Sale Specific Conditions & Requirements, the area encompassed by this timber sale is certified to the standards of the Forest Stewardship Council (FSC) - Certificate #SCS-FM/COC-00090N and the Sustainable Forestry Initiative (SFI) - Certificate #NSF-SFIS-5Y031-SF5. Forest products from this sale may be delivered to the mill as "FSC 100% and / or SFI certified" as long as the contractor hauling the forest products is chain-of-custody (COC) certified or covered under a COC certificate from the destination mill. The purchaser is responsible for maintaining COC after leaving the sale area.

12. Good Neighbor Authority (GNA) Requirements (7/16)

If the name of this timber sales contains the acronym GNA, it is authorized by the Good Neighbor Authority (GNA) and covered by various agreements between the U.S. Forest Service and the State. The timber sale occurs on federal land and the following conditions apply:

GNA contracts on US Forest Service land will not be awarded to purchasers on the Federal list of excluded parties. The System for Award Management (SAM) will be checked for active excluded parties prior to award of contract. In addition, the Bidder to whom award is made must complete an Assurance Regarding Felony Conviction or Tax Delinquent Status for Corporate Applicants (AD-3031).

13. Good Neighbor Authority (GNA) Requirements, con't (9/16)

Bidder certifies, by signing this bid form, that to the best of Bidder's knowledge that the following representations are accurate and complete.

- a. That the Bidder and its principals are not presently debarred, suspended, proposed for debarment, declared ineligible, or voluntary excluded from timber sales (covered transactions) by any Federal department or agency.
- b. That the Bidder and its principals have not within a 3-year period preceding this bid been convicted of or had a civil judgment rendered against them for commission of fraud or a criminal offense in connection with obtaining, attempting to obtain, or performing a public (Federal, State, or local) transaction or contract under a public transaction; violation of Federal or State antitrust statutes or commission of embezzlement, theft, forgery, bribery, falsification or destruction of records, making false statements, or receiving stolen property.
- c. That the Bidder and its principals are not presently indicted for or otherwise criminally or civilly charged by a governmental entity (Federal, State, or local) with commission of any of the offenses enumerated in paragraph b of this certification.
- d. That the Bidder and its principals have not within a 3-year period preceding this bid had one or more public transactions (Federal, State, or local) terminated for breach or default of a timber or forest product contract.

Bidders that cannot certify this requirement, in whole or in part, shall submit an explanation with their bid.

DAN EICHINGER
Director

TIMBER SALE INFORMATION

West DeTemple Blend (33-029-19)
 T37N, R27W, SEC. 7; T37N, R27W, SEC. 8.
 Menominee County (Advertised Price \$34,029.50)

SALE NOTE: Spruce budworm is present within the sale and has caused some balsam fir and spruce mortality.

A timber sale contract for this lump sum, sealed bid timber sale will be awarded to the responsible bidder offering the highest sealed bid price. Bids must be at or above the following advertised price for each species:

<u>PRODUCTS & SPECIES</u>	<u>ESTIMATED UNITS*</u>	<u>ADVERTISED PRICE</u>
Sawtimber		
Basswood	8.80 MBF	\$ 100.00 / MBF
Red Maple	1.60 MBF	\$ 167.00 / MBF
White Ash	2.20 MBF	\$ 72.00 / MBF
Pulpwood		
Balsam Fir	108.00 Cords	\$ 21.70 / Cord
Mixed Aspen	182.00 Cords	\$ 28.25 / Cord
Mixed Hardwood	880.00 Cords	\$ 25.95 / Cord
White Pine	2.00 Cords	\$ 35.60 / Cord
White Spruce	87.00 Cords	\$ 26.80 / Cord

* The total volume is statistically estimated within plus (+) or minus (-) 12.08 percent. The estimated units are final and not subject to adjustment. Prospective bidders are urged to examine this timber and to make their own estimates of quantity and quality.

BOND AND PAYMENT SCHEDULE:

1. A bond in the amount of \$1,701.00 to insure faithful performance of the conditions of the contract will be deposited by the successful bidder within 21 days of the sale award.
2. Cutting in any sale or unit without the required advance payment would be considered a trespass.
3. Total payment must be paid in advance or according to the following schedule:
 - (a) Ten percent (10%) of the sale value must be paid within 21 days of the sale award.
 - (b) The 10% down payment will be credited towards the first unit cut.
 - (c) Payment for each of the following units must be made before cutting begins in that unit:

<u>PAYMENT UNIT NUMBER</u>	<u>PERCENT OF TOTAL SALE VALUE</u>
01	19.7%
02	19.4%
03	19.5%
04	13.7%
05	4.6%
06	23.1%

4. If no cutting takes place, the 10% down payment will not be refunded.
5. Operations on the contract issued will terminate on 09/30/2022.

Description of Timber by Payment Unit (PU)

PU	MARKET GROUP	PRODUCT	QUANTITY	UNIT	ACRES	ADVERTISE PRICE
1	Balsam Fir	Pulpwood	22.0	Cords	17.7	\$6,708.05
	Mixed Aspen		8.0	Cords		
	Mixed Hardwood		219.0	Cords		
	White Spruce		12.0	Cords		
2	Basswood	Sawtimber	0.9	MBF	13.2	\$6,587.40
	Red Maple		0.7	MBF		
	Balsam Fir	Pulpwood	13.0	Cords		
	Mixed Hardwood		224.0	Cords		
	White Pine		2.0	Cords		
	White Spruce		8.0	Cords		
3	Basswood	Sawtimber	2.9	MBF	19.6	\$6,641.85
	White Ash		2.2	MBF		
	Balsam Fir	Pulpwood	3.0	Cords		
	Mixed Aspen		24.0	Cords		
	Mixed Hardwood		209.0	Cords		
	White Spruce		1.0	Cords		
4	Basswood	Sawtimber	3.5	MBF	11.4	\$4,655.55
	Balsam Fir	Pulpwood	36.0	Cords		
	Mixed Aspen		68.0	Cords		
	Mixed Hardwood		37.0	Cords		
	White Spruce		24.0	Cords		
5	Basswood	Sawtimber	1.5	MBF	10.3	\$1,558.20
	Mixed Aspen	Pulpwood	3.0	Cords		
	Mixed Hardwood		51.0	Cords		
6	Red Maple	Sawtimber	0.9	MBF	20.3	\$7,878.45
	Balsam Fir	Pulpwood	34.0	Cords		
	Mixed Aspen		79.0	Cords		
	Mixed Hardwood		140.0	Cords		
	White Spruce		42.0	Cords		
TOTAL:			12.6	MBF		
TOTAL:			1,259.0	Cords		

Sale Specific Conditions & Requirements

Sale Name: West DeTemple Blend

Sale Number: 33-029-19 Seq#: 1

1 - Sale Area

1.2 - Boundaries

1.2.1 - Painted boundaries (1/14)

The sale boundary and Payment Unit boundaries are marked and identified by blue, red and yellow paint. Exterior sale boundary lines against private property are marked with blue paint. Exterior sale boundary lines against state are marked with red paint. Interior Payment Unit boundaries are marked with yellow paint. The painted boundary line trees are not Included Timber and are to be protected, unless marked with orange paint. Yellow painted trees designating an interior Payment Unit boundary are only to be cut when all surrounding Payment Units have been paid for.

2 - Timber Specifications

2.1 - Included Timber

2.1.1 - Clearcut unit(s) with unmerchantable trees (6/14)

Within Payment Unit(s) 1, 2, 4 and 6, cut all trees that are three (3) inches or more at DBH, except do not cut cedar and hemlock within Payment Units 1 and 2.

2.1.3 - Cut tree marked unit(s) (12/08)

Within Payment Unit(s) 3 and 5, all trees are designated for cutting when marked with orange paint above and below stump height, regardless of merchantability.

2.1.9 - Harvest exception (12/08)

Do not cut any cedar trees within Payment Units 1 and 2, other than those that are necessary to remove in order to operate within the sale area. Every effort must be made to preserve the existing cedar and to leave an intact stand upon sale completion. All cut cedar shall be piled separately by products and scaled in the woods unless other scaling arrangements are agreed to by the Unit Manager or his/her representative. Stumpage price for cedar shall be \$60.00 per cord.

3 - Payments

3.3 - Pre-measured Sales

3.3.4 - Dividing payment units (7/14)

Payment Unit(s) \$18,000 in value or greater may be divided at the request of the Purchaser and upon approval of the Unit Manager. Dividing Payment Units is a contract modification which requires a Timber Sale Contract Supplement. There will be only one division per Payment Unit.

4 - Transportation

4.2 - Maintenance

4.2.1 - Hauling restriction (12/08)

Hauling may be restricted on forest roads by the Unit Manager or his/her representative. The restriction may occur during spring breakup or during other wet weather conditions.

4.2.4 - Grading (10/16)

For completion of the sale, state forest roads must be graded. In general, this will require a road grader or bull dozer to shape up the roads after forest products have been hauled off site. This includes cleaning of drainage areas, grading, crowning and filling with gravel, if necessary. The grading equipment to be used must be approved by the Unit Manager or his/her representative.

5 - Operations

5.2 - Conduct of Operations

5.2.3 - Operating Restrictions

5.2.3.1 - Operating restrictions (9/11)

Within Payment Unit(s) 1 and 2, cutting and skidding are limited to the period of December 1 to March 31, unless there is an extended dry or frozen period and the sale administrator allows harvesting during that period of time. This restriction is because of low wet ground within both of these Payment Units.

5.2.3.3 - Bark slippage restriction (3/09)

Within Payment Unit(s) 3 and 5, cutting and skidding are not permitted during the period of April 15 to July 15. This restriction is because of bark slippage.

5.4 - Soil Protection

5.4.1 - Rutting restriction, general (7/16)

Operations are to cease immediately if equipment and weather conditions result in rutting of roads and/or skid trails which is 12 inches or greater in depth and 50 feet in length. The Unit Manager or his/her representative may restrict hauling and/or skidding if ruts exceed the specified depth. With the Unit Manager or his/her representative's approval, the Purchaser may return to the area when the risk of rutting has decreased.

5.4.2 - Skid trails (2/04)

Skid trails up and down slopes should be avoided. If however this is unavoidable, these trails will be left in a non-erodible condition using water bars, logs, and slash. Placing of slash on these skid trails while logging is ongoing may alleviate need for any further action. At the direction of the sale administrator, seed, fertilizer, and mulch may also be required.



TIMBER SALE MAP

This information provided by authority of Part 525, 1994 PA 451, as amended.

Forest Management Unit Escanaba Management Unit		County Menominee County	Mapped By Beaudo	Date 7/12/2019	Page 1	of 1
Township 37N	Range 27W	Section(s) and Subdivision(s) Sec 7 - NENE, S1/2NE, SE, SENW, NESW; Sec 8 - NWNW.		Scale 1:15,840		

Cover Type				Density	
A = Aspen	H = Hemlock	N = Marsh	U = Upland Brush	0 = Non Stocked	5 = Pole Timber Medium
B = Paper Birch	J = Jack Pine	O = Oak	UM = Upland Mixed	1 = Seedling Sapling Poor	6 = Pole Timber Well
C = Cedar	L = Lowland Brush	P = Lowland Poplar	V = Bog or Marsh	2 = Seedling Sapling Medium	7 = Saw Timber Poor
D = Treed Bog	LM = Lowland Mixed	Q = Mixed Swamp Conifer	W = White Pine	3 = Seedling Sapling Well	8 = Saw Timber Medium
E = Swamp Hdwoods	M = Mpl, Bch, Brch	R = Red Pine	X = Non Stocked	4 = Pole Timber Poor	9 = Saw Timber Well
F = Spruce Fir	MC = Mixed Conifer	S = Black Spruce	Z = Water		
G = Grass	MD = Mixed Deciduous	T = Tamarack			

PU	Acres	PU	Acres
1	17.7	4	11.4
2	13.2	5	10.3
3	19.6	6	20.3

West Detemple Blend Compartment 2 92.5 Acres

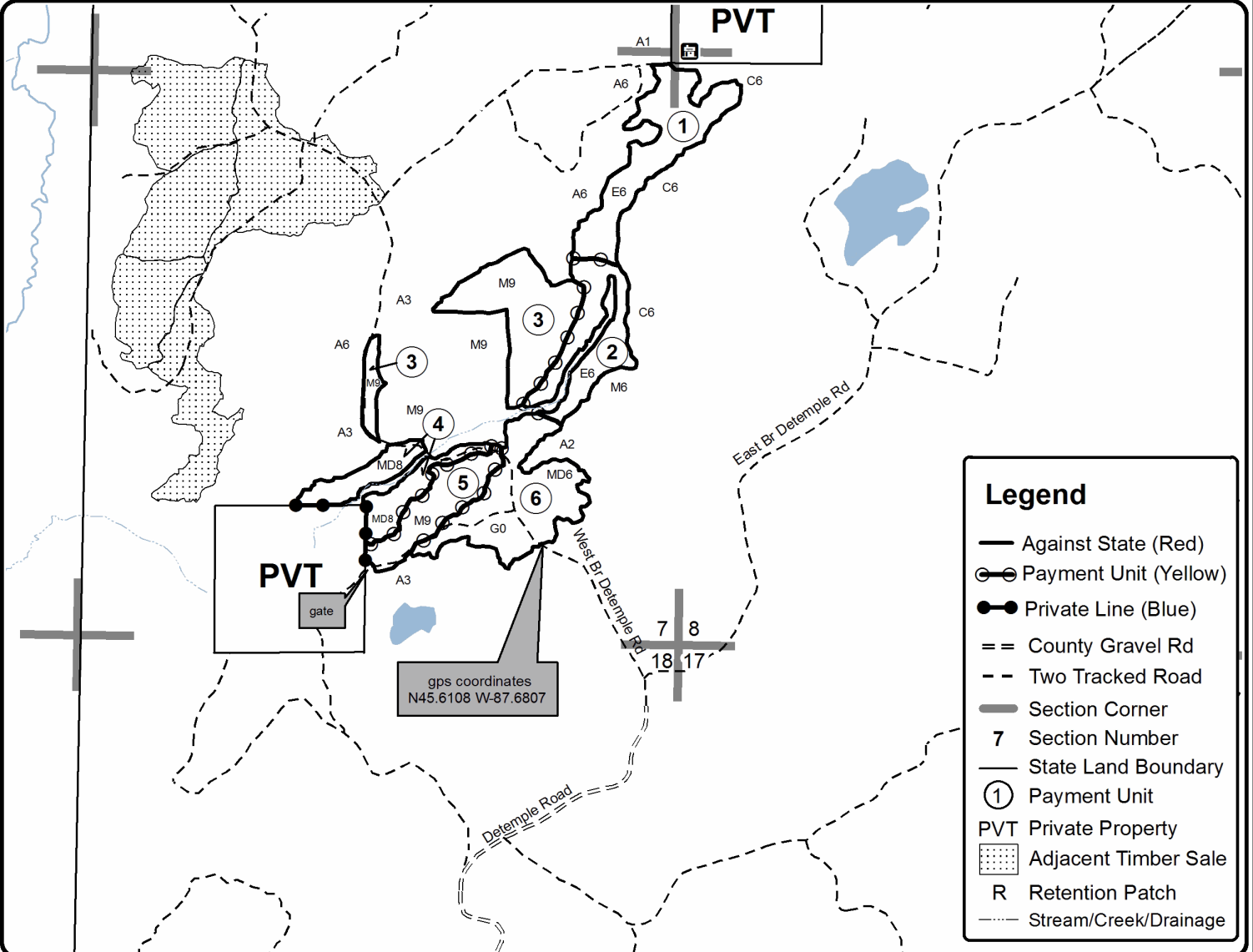

Legend

- Against State (Red)
- Payment Unit (Yellow)
- Private Line (Blue)
- == County Gravel Rd
- - Two Tracked Road
- Section Corner
- 7 Section Number
- State Land Boundary
- ① Payment Unit
- PVT Private Property
- ▤ Adjacent Timber Sale
- R Retention Patch
- Stream/Creek/Drainage

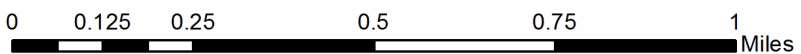

TIMBER SALE INFORMATION

Watered Down Oak (33-033-19)

T34N, R29W, SEC. 1; T34N, R29W, SEC. 2; T35N, R29W, SEC. 36.
Menominee County (Advertised Price \$90,097.00)

SALE NOTE: The Purchaser will need to purchase and install two new culverts and haul and spread a minimum of 300 yards of gravel onto the access roads. There is access into this sale through state land, but the best access is through private property to the east of Payment Unit 9.

A timber sale contract for this lump sum, sealed bid timber sale will be awarded to the responsible bidder offering the highest sealed bid price. Bids must be at or above the following advertised price for each species:

<u>PRODUCTS & SPECIES</u>	<u>ESTIMATED UNITS*</u>	<u>ADVERTISED PRICE</u>
Sawtimber		
Northern Pin Oak	11.70 MBF	\$ 125.00 / MBF
Red Maple	3.80 MBF	\$ 167.00 / MBF
Red Oak	154.70 MBF	\$ 162.00 / MBF
White Oak	9.10 MBF	\$ 111.00 / MBF
Pulpwood		
Balsam Fir	31.00 Cords	\$ 21.70 / Cord
Mixed Aspen	238.00 Cords	\$ 28.25 / Cord
Mixed Hardwood	301.00 Cords	\$ 25.95 / Cord
Mixed Oak	1,061.00 Cords	\$ 29.15 / Cord
Mixed Spruce	10.00 Cords	\$ 26.80 / Cord
Red Pine	77.00 Cords	\$ 47.35 / Cord
Tamarack	7.00 Cords	\$ 13.65 / Cord
White Pine	331.00 Cords	\$ 35.60 / Cord

* The total volume is statistically estimated within plus (+) or minus (-) 9.83 percent. The estimated units are final and not subject to adjustment. Prospective bidders are urged to examine this timber and to make their own estimates of quantity and quality.

BOND AND PAYMENT SCHEDULE:

1. A bond in the amount of \$4,505.00 to insure faithful performance of the conditions of the contract will be deposited by the successful bidder within 21 days of the sale award.
2. Cutting in any sale or unit without the required advance payment would be considered a trespass.
3. Total payment must be paid in advance or according to the following schedule:
 - (a) Ten percent (10%) of the sale value must be paid within 21 days of the sale award.
 - (b) The 10% down payment will be credited towards the first unit cut.
 - (c) Payment for each of the following units must be made before cutting begins in that unit:

PAYMENT UNIT NUMBER	PERCENT OF TOTAL SALE VALUE
01	12.9%
02	16.1%
03	17.3%
04	15.0%
05	8.3%
06	7.0%
07	4.4%
08	5.6%
09	13.4%

4. If no cutting takes place, the 10% down payment will not be refunded.
5. Operations on the contract issued will terminate on 09/30/2022.

Description of Timber by Payment Unit (PU)

PU	MARKET GROUP	PRODUCT	QUANTITY	UNIT	ACRES	ADVERTISE PRICE
1	Northern Pin Oak Red Maple Red Oak Balsam Fir Mixed Aspen Mixed Hardwood Mixed Oak Mixed Spruce Red Pine	Sawtimber	0.7	MBF	15.4	\$11,666.40
			0.9	MBF		
			22.0	MBF		
		Pulpwood	17.0	Cords		
			42.0	Cords		
			83.0	Cords		
			134.0	Cords		
			4.0	Cords		
			3.0	Cords		
2	Northern Pin Oak Red Maple Red Oak White Oak Balsam Fir Mixed Aspen Mixed Hardwood Mixed Oak Red Pine White Pine	Sawtimber	3.1	MBF	13.3	\$14,467.90
			2.4	MBF		
			26.9	MBF		
			1.2	MBF		
		Pulpwood	10.0	Cords		
			28.0	Cords		
			93.0	Cords		
			160.0	Cords		
			3.0	Cords		
			27.0	Cords		
3	Northern Pin Oak Red Maple Red Oak Balsam Fir Mixed Aspen Mixed Hardwood Mixed Oak Red Pine White Pine	Sawtimber	2.9	MBF	19.3	\$15,550.75
			0.5	MBF		
			23.7	MBF		
		Pulpwood	1.0	Cords		
			62.0	Cords		
			80.0	Cords		
			180.0	Cords		
			21.0	Cords		
			33.0	Cords		
4	Northern Pin Oak Red Oak White Oak Balsam Fir Mixed Aspen Mixed Hardwood Mixed Oak Mixed Spruce Red Pine Tamarack White Pine	Sawtimber	2.8	MBF	32.5	\$13,485.00
			26.4	MBF		
			2.9	MBF		
		Pulpwood	1.0	Cords		
			57.0	Cords		
			14.0	Cords		
			146.0	Cords		
			2.0	Cords		
			10.0	Cords		
			1.0	Cords		
			49.0	Cords		
5	Red Oak White Oak Mixed Aspen Mixed Hardwood Mixed Oak White Pine	Sawtimber	20.7	MBF	9.6	\$7,502.40
			4.2	MBF		
		Pulpwood	7.0	Cords		
			13.0	Cords		
			86.0	Cords		
			18.0	Cords		
6	Red Oak Mixed Hardwood Mixed Oak White Pine	Sawtimber	13.1	MBF	9.7	\$6,312.05
		Pulpwood	3.0	Cords		
			80.0	Cords		
			50.0	Cords		
7	Northern Pin Oak Red Oak Mixed Aspen Mixed Hardwood Mixed Oak Mixed Spruce Red Pine	Sawtimber	2.2	MBF	8.9	\$3,977.05
			4.1	MBF		
		Pulpwood	24.0	Cords		
			6.0	Cords		
			64.0	Cords		
			1.0	Cords		
	3.0	Cords				

Description of Timber by Payment Unit (PU), con't

PU	MARKET GROUP	PRODUCT	QUANTITY	UNIT	ACRES	ADVERTISE PRICE
	Tamarack		2.0	Cords		
	White Pine		4.0	Cords		
8	Red Oak	Sawtimber	12.4	MBF	9.8	\$5,056.65
	White Oak		0.8	MBF		
	Balsam Fir	Pulpwood	2.0	Cords		
	Mixed Hardwood		4.0	Cords		
	Mixed Oak		32.0	Cords		
	Mixed Spruce		3.0	Cords		
	Red Pine		3.0	Cords		
	Tamarack		4.0	Cords		
	White Pine		45.0	Cords		
9	Red Oak	Sawtimber	5.4	MBF		
	Mixed Aspen	Pulpwood	18.0	Cords		
	Mixed Hardwood		5.0	Cords		
	Mixed Oak		179.0	Cords		
	Red Pine		34.0	Cords		
	White Pine		105.0	Cords		
TOTAL:			179.3	MBF		
TOTAL:			2,056.0	Cords		

Sale Specific Conditions & Requirements

Sale Name: Watered Down Oak

Sale Number: 33-033-19 Seq#: 1

1 - Sale Area

1.2 - Boundaries

1.2.1 - Painted boundaries (1/14)

The sale boundary and Payment Unit boundaries are marked and identified by blue, red and yellow paint. Exterior sale boundary lines against private property are marked with blue paint. Exterior sale boundary lines against state are marked with red paint. Retention patches are marked with red paint; no harvesting activities may occur within these areas. Interior Payment Unit boundaries are marked with yellow paint. The painted boundary line trees are not Included Timber and are to be protected. Yellow painted trees designating an interior Payment Unit boundary are only to be cut when all surrounding Payment Units have been paid for.

2 - Timber Specifications

2.1 - Included Timber

2.1.1 - Clearcut unit(s) with unmerchantable trees (6/14)

Within Payment Unit(s) 1, 2, 3, 7, 8 and 9, cut all trees that are three (3) inches or more at DBH, except do not cut trees marked with orange paint. In addition, within Payment Units 1 and 4, do not cut cedar.

Within Payment Unit(s) 4, 5 and 6, cut all trees four (4) inches or more at DBH, except do not cut trees marked with orange paint.

3 - Payments

3.3 - Pre-measured Sales

3.3.4 - Dividing payment units (7/14)

Payment Unit(s) \$18,000 in value and greater may be divided at the request of the Purchaser and upon approval of the Unit Manager. Dividing Payment Units is a contract modification which requires a Timber Sale Contract Supplement. There will be only one division per Payment Unit.

4 - Transportation

4.1 - Construction

4.1.8 - Road work (1) (8/07)

The following road work is required: the Purchaser must purchase and install two new corrugated steel 18" x 24' culverts. One of the culverts will be installed between Payment Units 3 and 7, and the other culvert will be installed between Payment Units 7 and 9. The exact locations will be identified during the Pre-sale meeting. No permits will be required to install the culverts; they are to replace culverts that are crushed to improve cross drainage. The culverts must have a minimum of twelve (12) inches of gravel placed over them. The Purchaser must also haul and spread a minimum of 300 yards of gravel on the access roads, including over the culverts. The areas that require gravel will also be identified during the Pre-sale meeting. All road work must be completed prior to any hauling taking place. Gravel is available from a state pit a few miles from the sale area.

4.2 - Maintenance

4.2.1 - Hauling restriction (12/08)

Hauling may be restricted on forest roads by the Unit Manager or his/her representative. The restriction may occur during spring breakup or during other wet weather conditions.

4.2.4 - Grading (10/16)

For completion of the sale, state forest roads must be graded. In general, this will require a road grader or bull dozer to shape up the roads after forest products have been hauled off site. This includes cleaning of drainage areas, grading, crowning and filling with gravel, if necessary. The grading equipment to be used must be approved by the Unit Manager or his/her representative.

4.4 - Access

4.4.1 - Private property access (3/11)

Permission for access across private land is the responsibility of the Purchaser. Should the Purchaser desire to cross private land, a copy of the written permission from the private land-owner will be required by the DNR.

There is access into the entire sale through state land coming in from the west off of the Oak Hill Road. The access road into Payment Unit 4 has a low stretch that will require a significant amount of gravel to get access into the sale area. The best access into the sale is through private property to the east of Payment Unit 9 off of the Sturgeon Landing Road. The landowner has been contacted and they have indicated they would allow access, but it is the responsibility of the Purchaser to contact the landowner and get written permission.

5 - Operations

5.2 - Conduct of Operations

5.2.22 - Operating Caution

5.2.22.1 - Operating caution (6/11)

It is recommended, but not required, that within Payment Unit(s) 8, cutting and skidding occur during dry summer or frozen winter conditions. The reason for the recommendation is because of low wet ground between Payment Units 8 and 9, and there is also some wet areas within Payment Unit 8.

5.4 - Soil Protection

5.4.1 - Rutting restriction, general (7/16)

Operations are to cease immediately if equipment and weather conditions result in rutting of roads and/or skid trails which is 12 inches or greater in depth and 50 feet in length. The Unit Manager or his/her representative may restrict hauling and/or skidding if ruts exceed the specified depth. With the Unit Manager or his/her representative's approval, the Purchaser may return to the area when the risk of rutting has decreased.

7 - Other Conditions

7.3 - Contract Modifications

7.3.2 - Modification for oak wilt (2/05)

Within the sale area, there may be patches of oak wilt. If oak wilt is identified within the sale area, this contract may be modified. The following modifications could occur: time of cutting, species to cut, volume to harvest, or various others dealing with the treatment of oak wilt. If a species is not specified in this contract, it shall be paid for at the average price received for that species and product.



TIMBER SALE MAP

This information provided by authority of Part 525, 1994 PA 451, as amended.

Forest Management Unit Escanaba Management Unit	County Menominee County	Mapped By Beaudo	Date 7/29/2019	Page 1	of 1
Township 34N 35N	Range 29W	Section(s) and Subdivision(s) 34N29W sec 1 - NW, SWNE, NWSW; sec 2 - E1/2NE, NESE. 35N29W sec 36 - SESW.	Scale 1:15,840		

Cover Type				Density			
A = Aspen	H = Hemlock	N = Marsh	U = Upland Brush	0 = Non Stocked	5 = Pole Timber Medium		
B = Paper Birch	J = Jack Pine	O = Oak	UM = Upland Mixed	1 = Seedling Sapling Poor	6 = Pole Timber Well		
C = Cedar	L = Lowland Brush	P = Lowland Poplar	V = Bog or Marsh	2 = Seedling Sapling Medium	7 = Saw Timber Poor		
D = Treed Bog	LM = Lowland Mixed	Q = Mixed Swamp Conifer	W = White Pine	3 = Seedling Sapling Well	8 = Saw Timber Medium		
E = Swamp Hdwoods	M = Mpl, Bch, Brch	R = Red Pine	X = Non Stocked	4 = Pole Timber Poor	9 = Saw Timber Well		
F = Spruce Fir	MC = Mixed Conifer	S = Black Spruce	Z = Water				
G = Grass	MD = Mixed Deciduous	T = Tamarack					

PU	Acres	PU	Acres
1	15.4	6	9.7
2	13.3	7	8.9
3	19.3	8	9.8
4	32.5	9	30.9
5	9.6		

Watered Down Oak
Compartment 28
149.4 Acres

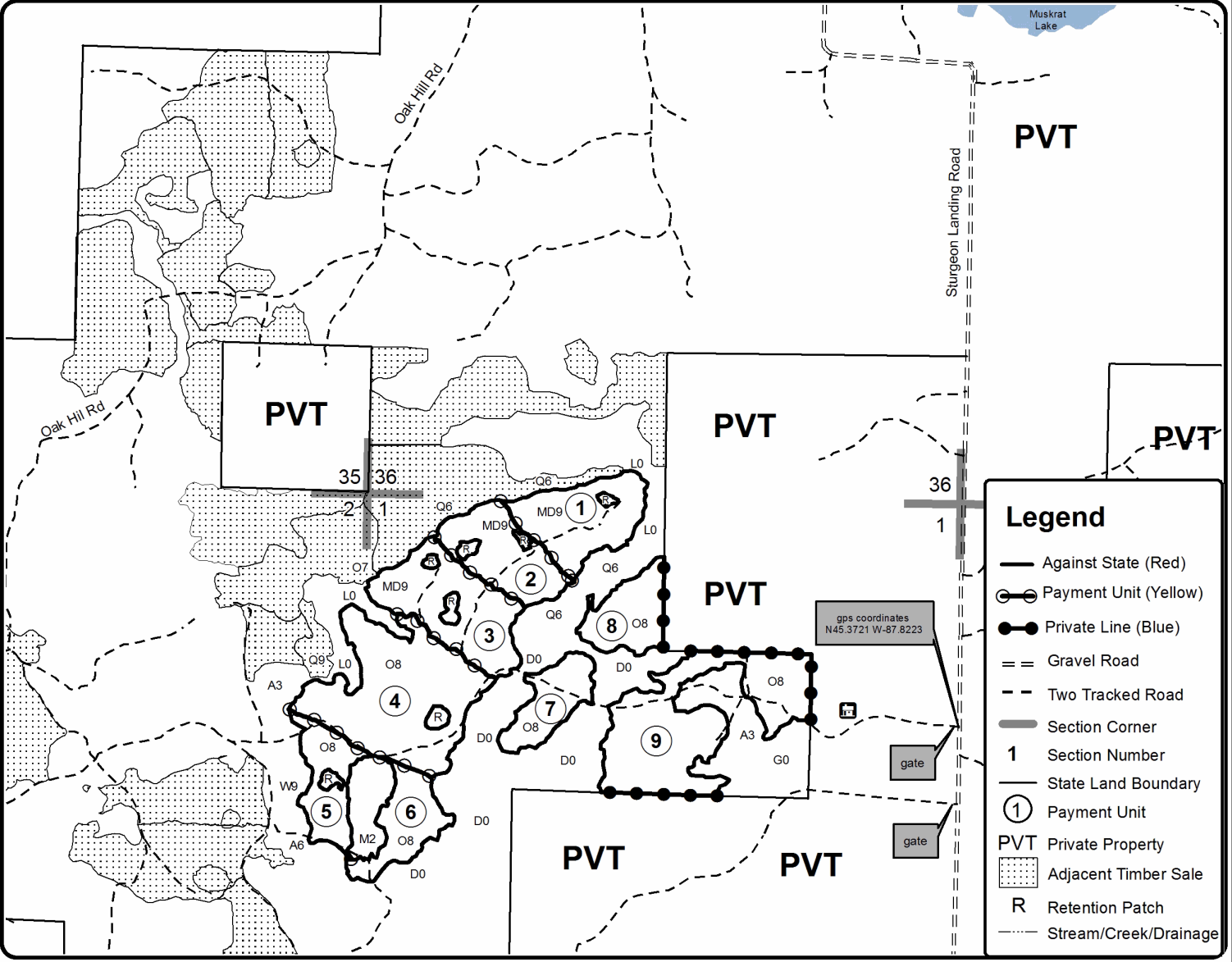
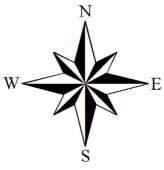

Legend

- Against State (Red)
- Payment Unit (Yellow)
- Private Line (Blue)
- == Gravel Road
- - Two Tracked Road
- Section Corner
- 1 Section Number
- State Land Boundary
- ① Payment Unit
- PVT Private Property
- ▨ Adjacent Timber Sale
- R Retention Patch
- Stream/Creek/Drainage

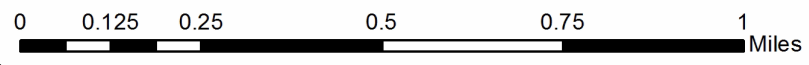

TIMBER SALE INFORMATION

Wolf Chase (33-003-18)

T36N, R25W, SEC. 1; T36N, R25W, SEC. 11; T36N, R25W, SEC. 2.
Menominee County (Advertised Price \$275,953.95)

SALE NOTE: The Forest Islands ORV Trail runs through the sale area.

Within Payment Units 2, 4, 5, 10, and 14, operations are limited to the period of 12/1 to 3/15, unless frozen ground conditions exist.

Harvesting Payment Units 3, 7, 8, 9, 12, and 13 is recommended during dry summer or frozen winter conditions.

A recreation site such as a trail, pathway, or campground is within the sale area or the vicinity. Certain restrictions/specifications may be applicable including time restrictions. Access may be through private land.

A timber sale contract for this mixed, sealed bid timber sale will be awarded to the responsible bidder offering the highest sealed bid price. Bids must be at or above the following advertised price for each species:

<u>PRODUCTS & SPECIES</u>	<u>ESTIMATED UNITS*</u>	<u>ADVERTISED PRICE</u>
Sawtimber		
Black Ash	2.30 MBF	\$ 56.00 / MBF
Green Ash	41.40 MBF	\$ 86.00 / MBF
Paper Birch	39.50 MBF	\$ 84.00 / MBF
Red Maple	248.60 MBF	\$ 179.00 / MBF
Sugar Maple	7.70 MBF	\$ 285.00 / MBF
White Ash	5.90 MBF	\$ 77.00 / MBF
Yellow Birch	16.90 MBF	\$ 100.00 / MBF
Pulpwood		
Balsam Fir	487.00 Cords	\$ 23.25 / Cord
Mixed Hardwood	5,219.00 Cords	\$ 27.85 / Cord
Mixed Spruce	385.00 Cords	\$ 28.70 / Cord
N. White Cedar	211.00 Cords	\$ 20.25 / Cord
Quaking Aspen	421.00 Cords	\$ 30.30 / Cord
Red Pine	118.00 Cords	\$ 50.70 / Cord
White Pine	770.00 Cords	\$ 38.15 / Cord

* The estimated units are final and not subject to adjustment. Prospective bidders are urged to examine this timber and to make their own estimates of quantity and quality.

BOND AND PAYMENT SCHEDULE:

1. A bond in the amount of \$13,798.00 to insure faithful performance of the conditions of the contract will be deposited by the successful bidder within 21 days of the sale award.
2. Cutting in any sale or unit without the required advance payment would be considered a trespass.
3. Total payment must be paid in advance or according to the following schedule:
 - (a) Ten percent (10%) of the sale value must be paid within 21 days of the sale award.
 - (b) The 10% down payment will be credited towards the first unit cut.
 - (c) Payment for each of the following units must be made before cutting begins in that unit:

PAYMENT UNIT NUMBER	PERCENT OF TOTAL SALE VALUE
01	2.3%
02	3.5%
03	17.8%
04	5.5%
05	4.3%
06	1.6%
07	2.2%
08	15.1%
09	11.0%
10	6.7%
11	0.8%
12	6.6%
13	5.9%
14	16.7%

4. If no cutting takes place, the 10% down payment will not be refunded.
5. Operations on the contract issued will terminate on 09/30/2022.

Description of Timber by Payment Unit (PU)

PU	MARKET GROUP	PRODUCT	QUANTITY	UNIT	ACRES	ADVERTISE PRICE																																																																																																																																																																																																			
1	Red Pine	Pulpwood	40.0	Cords	18.6	\$6,453.40																																																																																																																																																																																																			
	White Pine		116.0	Cords			2	Mixed Hardwood	Pulpwood	12.0	Cords	5.9	\$9,666.60	<i>Red Maple</i>	12.0	<i>Cords</i>	Mixed Spruce	94.0	Cords	Red Pine	21.0	Cords	White Pine	146.0	Cords	3	Paper Birch	Sawtimber	1.8	MBF	48.6	\$48,688.40	Red Maple	72.1	MBF	Sugar Maple	7.7	MBF	White Ash	2.4	MBF	Yellow Birch	1.8	MBF	Balsam Fir	26.0	Cords	Mixed Hardwood	Pulpwood	1,122.0	Cords	Mixed Spruce	9.0	Cords	Quaking Aspen	15.0	Cords	Red Pine	10.0	Cords	4	Red Maple	Sawtimber	17.0	MBF	15.3	\$15,201.85	Yellow Birch		8.5	MBF	Balsam Fir	Pulpwood	42.0	Cords	Mixed Hardwood		371.0	Cords	5	Green Ash	Sawtimber	1.4	MBF	11.0	\$11,942.95	Red Maple	11.5	MBF	Yellow Birch	2.8	MBF	Balsam Fir	Pulpwood	6.0	Cords	Mixed Hardwood	243.0	Cords	Mixed Spruce	15.0	Cords	N. White Cedar	106.0	Cords	6	Mixed Hardwood	Pulpwood	15.0	Cords	7.8	\$4,538.75	<i>Paper Birch</i>	5.0	<i>Cords</i>	<i>Red Maple</i>	10.0	<i>Cords</i>	Quaking Aspen	7.0	Cords	Red Pine	47.0	Cords	White Pine	40.0	Cords	7	Black Ash	Sawtimber	1.4	MBF	15.8	\$6,083.45	Green Ash	8.2	MBF	Paper Birch	1.5	MBF	Balsam Fir	Pulpwood	1.0	Cords	Mixed Hardwood	175.0	Cords	Mixed Spruce	3.0	Cords	White Pine	5.0	Cords	8	Green Ash	Sawtimber	5.0	MBF	35.2	\$41,580.20	Paper Birch	4.8	MBF	Red Maple	50.4	MBF	Yellow Birch	2.9	MBF	Balsam Fir	Pulpwood	61.0	Cords	Mixed Hardwood	697.0	Cords	White Pine	278.0	Cords	9	Green Ash	Sawtimber	9.3	MBF	39.1	\$30,431.40	Paper Birch	2.4	MBF	Red Maple	11.1	MBF	White Ash	3.5	MBF	Yellow Birch	0.9	MBF	Balsam Fir	Pulpwood	150.0
2	Mixed Hardwood	Pulpwood	12.0	Cords	5.9	\$9,666.60																																																																																																																																																																																																			
	<i>Red Maple</i>		12.0	<i>Cords</i>																																																																																																																																																																																																					
	Mixed Spruce		94.0	Cords																																																																																																																																																																																																					
	Red Pine		21.0	Cords																																																																																																																																																																																																					
	White Pine		146.0	Cords																																																																																																																																																																																																					
3	Paper Birch	Sawtimber	1.8	MBF	48.6	\$48,688.40																																																																																																																																																																																																			
	Red Maple		72.1	MBF																																																																																																																																																																																																					
	Sugar Maple		7.7	MBF																																																																																																																																																																																																					
	White Ash		2.4	MBF																																																																																																																																																																																																					
	Yellow Birch		1.8	MBF																																																																																																																																																																																																					
	Balsam Fir		26.0	Cords																																																																																																																																																																																																					
	Mixed Hardwood	Pulpwood	1,122.0	Cords																																																																																																																																																																																																					
	Mixed Spruce		9.0	Cords																																																																																																																																																																																																					
	Quaking Aspen		15.0	Cords																																																																																																																																																																																																					
	Red Pine		10.0	Cords																																																																																																																																																																																																					
	4		Red Maple	Sawtimber			17.0	MBF	15.3	\$15,201.85																																																																																																																																																																																															
			Yellow Birch				8.5	MBF																																																																																																																																																																																																	
Balsam Fir		Pulpwood	42.0	Cords																																																																																																																																																																																																					
Mixed Hardwood			371.0	Cords																																																																																																																																																																																																					
5	Green Ash	Sawtimber	1.4	MBF	11.0	\$11,942.95																																																																																																																																																																																																			
	Red Maple		11.5	MBF																																																																																																																																																																																																					
	Yellow Birch		2.8	MBF																																																																																																																																																																																																					
	Balsam Fir	Pulpwood	6.0	Cords																																																																																																																																																																																																					
	Mixed Hardwood		243.0	Cords																																																																																																																																																																																																					
	Mixed Spruce		15.0	Cords																																																																																																																																																																																																					
	N. White Cedar		106.0	Cords																																																																																																																																																																																																					
6	Mixed Hardwood	Pulpwood	15.0	Cords	7.8	\$4,538.75																																																																																																																																																																																																			
	<i>Paper Birch</i>		5.0	<i>Cords</i>																																																																																																																																																																																																					
	<i>Red Maple</i>		10.0	<i>Cords</i>																																																																																																																																																																																																					
	Quaking Aspen		7.0	Cords																																																																																																																																																																																																					
	Red Pine		47.0	Cords																																																																																																																																																																																																					
	White Pine		40.0	Cords																																																																																																																																																																																																					
	7		Black Ash	Sawtimber			1.4	MBF	15.8	\$6,083.45																																																																																																																																																																																															
Green Ash		8.2	MBF																																																																																																																																																																																																						
Paper Birch		1.5	MBF																																																																																																																																																																																																						
Balsam Fir		Pulpwood	1.0	Cords																																																																																																																																																																																																					
Mixed Hardwood			175.0	Cords																																																																																																																																																																																																					
Mixed Spruce			3.0	Cords																																																																																																																																																																																																					
White Pine			5.0	Cords																																																																																																																																																																																																					
8			Green Ash	Sawtimber	5.0	MBF	35.2	\$41,580.20																																																																																																																																																																																																	
	Paper Birch	4.8	MBF																																																																																																																																																																																																						
	Red Maple	50.4	MBF																																																																																																																																																																																																						
	Yellow Birch	2.9	MBF																																																																																																																																																																																																						
	Balsam Fir	Pulpwood	61.0	Cords																																																																																																																																																																																																					
	Mixed Hardwood		697.0	Cords																																																																																																																																																																																																					
	White Pine		278.0	Cords																																																																																																																																																																																																					
	9		Green Ash	Sawtimber	9.3	MBF			39.1	\$30,431.40																																																																																																																																																																																															
Paper Birch		2.4	MBF																																																																																																																																																																																																						
Red Maple		11.1	MBF																																																																																																																																																																																																						
White Ash		3.5	MBF																																																																																																																																																																																																						
Yellow Birch		0.9	MBF																																																																																																																																																																																																						
Balsam Fir		Pulpwood	150.0	Cords																																																																																																																																																																																																					
Mixed Hardwood			572.0	Cords																																																																																																																																																																																																					

Description of Timber by Payment Unit (PU), con't

PU	MARKET GROUP	PRODUCT	QUANTITY	UNIT	ACRES	ADVERTISE PRICE
9 con't	Quaking Aspen	Pulpwood	253.0	Cords		
10	Green Ash	Sawtimber	2.4	MBF	17.9	\$18,457.75
	Red Maple		18.9	MBF		
	Balsam Fir	Pulpwood	30.0	Cords		
	Mixed Hardwood		389.0	Cords		
	Mixed Spruce		23.0	Cords		
	N. White Cedar		101.0	Cords		
	Quaking Aspen		7.0	Cords		
	White Pine		11.0	Cords		
11	Balsam Fir	Pulpwood	8.0	Cords	4.9	\$2,139.75
	Mixed Hardwood		65.0	Cords		
	Mixed Spruce		5.0	Cords		
12	Paper Birch	Sawtimber	1.4	MBF	29.6	\$18,256.45
	Red Maple		11.4	MBF		
	Balsam Fir	Pulpwood	90.0	Cords		
	Mixed Hardwood		186.0	Cords		
	Mixed Spruce		182.0	Cords		
	Quaking Aspen		100.0	Cords		
	White Pine		15.0	Cords		
	13		Red Maple	Sawtimber		
Balsam Fir		Pulpwood	20.0	Cords		
Mixed Hardwood			419.0	Cords		
Mixed Spruce			14.0	Cords		
Quaking Aspen			24.0	Cords		
14	Black Ash	Sawtimber	0.9	MBF	41.5	\$46,117.35
	Green Ash		15.1	MBF		
	Paper Birch		27.6	MBF		
	Red Maple		38.7	MBF		
	Balsam Fir	Pulpwood	53.0	Cords		
	Mixed Hardwood		953.0	Cords		
	Mixed Spruce		40.0	Cords		
	N. White Cedar		4.0	Cords		
	Quaking Aspen		15.0	Cords		
	White Pine		159.0	Cords		
	TOTAL:			362.3		
TOTAL:			7,611.0	Cords		

Sale Specific Conditions & Requirements

Sale Name: Wolf Chase

Sale Number: 33-003-18 Seq#: 2

1 - Sale Area

1.2 - Boundaries

1.2.1 - Painted boundaries (1/14)

The sale boundary and Payment Unit boundaries are marked and identified by blue, red and yellow paint. Exterior sale boundary lines against private property are marked with blue paint. Exterior sale boundary lines against state are marked with red paint. Interior Payment Unit boundaries are marked with yellow paint. The painted boundary line trees are not Included Timber and are to be protected unless marked with orange paint. Yellow painted trees designating an interior Payment Unit boundary are only to be cut when all surrounding Payment Units have been paid.

2 - Timber Specifications

2.1 - Included Timber

2.1.1 - Clearcut unit(s) with unmerchantable trees (6/14)

Within Payment Unit(s) 2-5 and 7-14, cut all trees that are three (3) inches or more at DBH, with the following exceptions:

- Within Payment Unit 2, do not cut any trees marked with green paint.
- Within Payment Unit 3, do not cut cedar, white pine, hemlock and trees marked with green paint.
- Within Payment Unit 4, do not cut cedar, white pine and trees marked with green paint.
- Within Payment Units 5 and 10, do not cut any hemlock.
- Within Payment Unit 7, do not cut any standing hemlock or cedar. In addition, all merchantable blown down trees are designated for cutting, including cedar. Merchantable blown down trees will be scaled at the time of harvest, and payment will be made at the bid price and product category for each species.
- Within Payment Unit 8, do not cut any cedar, hemlock and trees marked with green paint.
- Within Payment Unit 9, do not cut any cedar, hemlock and white pine.
- Within Payment Unit 11, do not cut any pine and cedar.
- Within Payment Unit 13, do not cut any pine, hemlock and cedar.
- Within Payment Unit 14, do not cut any hemlock and cedar.

2.1.3 - Cut tree marked unit(s) (12/08)

Within Payment Unit(s) 1 and 6, all trees are designated for cutting when marked with orange paint above and below stump height, regardless of merchantability.

2.1.9 - Harvest exception (12/08)

Do not cut cedar in Payment Units 8 and 14, and hemlock in Payment Units 3 and 8, other than those that are necessary to remove in order to operate within the sale area. Every effort must be made to preserve the existing cedar and hemlock and to leave an intact stand upon sale completion. All cut cedar and hemlock shall be piled separately by products and scaled in the woods unless other scaling arrangements are agreed to by the Unit Manager or his/her representative. Stumpage price for cedar shall be \$50.00 per cord for posts and pulpwood, and \$100.00 per cord for bolts and sawlogs. Stumpage price for hemlock shall be \$50.00 per cord for posts and pulpwood, and \$100.00 per cord for bolts and sawlogs. Salvaged wood from Payment Unit 7 will be scaled at the time of harvest and be paid for at the specified Purchase Unit Price.

2.1.11 - Description of timber note (2/04)

Note that trees leaning 45 degrees or greater will be considered blowdown. This applies to Payment Unit 7.

2.2 - Utilization

2.2.1 - Utilization (2/04)

All listed board foot volumes of sawlog size products in this contract have been determined using a top diameter inside bark of 10 inches.

2.2.3 - Stump heights (4/07)

Stump heights within the Sale Area shall not exceed 12 inches for trees greater than 10 inches DBH and 4 inches for trees smaller than 10 inches DBH.

3 - Payments

3.3 - Pre-measured Sales

3.3.4 - Dividing payment units (7/14)

Payment Unit(s) valued at more than \$20,000 may be divided at the request of the Purchaser and upon approval of the Unit Manager. Dividing Payment Units is a contract modification which requires a Timber Sale Contract Supplement. There will be only one division per Payment Unit.

3.4 - Damaged Timber

3.4.1 - Damaged timber (6/14)

General Condition and Requirement 3.4 Damaged Timber, defines liquidated damages for undesignated live merchantable trees which are cut or injured.

Within Payment Unit 1, if more than 25% of the tree seedlings or saplings (1/4" to 4.5" DBH) are damaged, liquidated damages will be assessed at \$100 per acre for all acreage within that specified portion of the sale area that was damaged.

4 - Transportation

4.1 - Construction

4.1.3 - Slash and earthen piles (8/04)

Piles or windrows of earth along roads and landings that have been widened or constructed shall be leveled. Slash from road maintenance or construction, including stumps, shall be dispersed over a large enough area so that they are less than 24 inches in height.

4.1.4 - Timber removed for construction (12/09)

Trees cut or damaged in the process of pre-approved road, landing or skid trail construction will be decked in an area separate from other Designated Timber and not removed until measured by the sale administrator. Payment will be made at the specified Purchase Unit Price.

4.1.5 - Culverts (5/14)

Roads may require the installation of culverts for cross drainage or at natural drainage-ways. If culverts are needed in these locations, their placement will be specified by the sale administrator and they shall be installed prior to hauling. The culverts shall be new, corrugated metal or plastic gauge. Culverts will be a minimum of 12 inches in diameter and 24 feet in length. If culverts are removed, fill shall be removed from wetland soils as specified. Soils shall be maintained and left in a non-erodible condition, with water bars, seed, fertilizer, mulch, and slash installed as directed by the sale administrator and as specified in the BMP manual. Stream crossing permits, if needed, will be obtained by the DNR.

4.1.6 - Road construction (1/09)

Construction of new roads or improvements of existing roads shall be done in such a way as to minimize the environmental and visual impacts. Merchantable trees shall be cut and utilized unless otherwise directed. Non-merchantable trees shall be severed and laid flat on the ground. Slash shall be scattered, and not left in windrows and kept a minimum of 10 feet back from the road edge be chipped, utilized or spread evenly over the area of the sale. Stumps shall be set upright, not left on edge, and be moved at least 10 feet away from the road edge. Disturbed soil shall be feathered into the woods and not left in berms or windrows.

4.2 - Maintenance

4.2.3 - Road maintenance (8/13)

The following road maintenance is required: Within 60 days of completion of hauling, or if no hauling occurs for 60 days, the road must be maintained and graded. This includes cleaning of drainage areas, grading, crowning and filling with gravel, if necessary. Damages will be assessed if grading/repair does not occur.

4.2.4 - Grading (10/16)

For completion of the sale, state forest roads must be graded. In general, this will require a road grader or bull dozer to shape up the roads after forest products have been hauled off site. The grading equipment to be used must be approved by the Unit Manager or his/her representative.

5 - Operations

5.2 - Conduct of Operations

5.2.1 - Slash

5.2.1.8 - Slash height (12/08)

No slash or tree tops may exceed 24 inches in height.

5.2.3 - Operating Restrictions

5.2.3.2 - Operating restrictions (9/11)

Within Payment Unit(s) 2, 4, 5, 10, and 14, unless changed by written agreement, cutting, skidding, and hauling are limited to the period of December 1 to March 15, unless frozen ground condition exist. This restriction is because of the wet nature of these stands and potential for rutting.

5.2.22 - Operating Caution

5.2.22.1 - Operating caution (6/11)

It is recommended, but not required, that within Payment Unit(s) 3, 7, 8, 9, 12, and 13, cutting, skidding, and hauling occur during dry summer or frozen winter conditions. The reason for the recommendation is because of the potential for rutting within the Units.

5.2.38 - No decking against live trees (2/04)

Cut products may not be decked against unmarked or designated leave trees.

5.2.39 - ORV trail/route protection (4/18)

The Forest Islands Trail is an ORV trail or route and is shown on the Timber Sale Map. Do not cut trees or damage posts with yellow ORV markers.

5.4 - Soil Protection

5.4.1 - Rutting restriction, general (7/16)

Operations are to cease immediately if equipment and weather conditions result in rutting of roads and/or skid trails which is 12 inches or greater in depth and 50 feet in length. The Unit Manager or his/her representative may restrict hauling and/or skidding if ruts exceed the specified depth. With the Unit Manager or his/her representative's approval, the Purchaser may return to the area when the risk of rutting has decreased.

5.7 - Protection of Historical Sites

5.7.2 - Potential historical site(s) (9/06)

The State Historic Preservation Office has identified the potential for a historic site within the boundary of this timber sale. Note that if the site is discovered during operations, General Condition and Requirement 5.7 - Protection of Historical Sites will apply.

6 - Safety and Fire Prevention

6.2 - Signing

6.2.1 - Road posting (9/09)

The Purchaser is responsible for posting and maintaining caution signs on the North Branch of the North Fox Road prior to beginning operations. The road must be posted at appropriate distances from the sale area to warn of logging activity and truck traffic. Signs must be removed when harvest operations are suspended or completed. The Purchaser will provide these signs.

6.2.3 - Recreational trail posting (2/10)

The Purchaser is responsible for posting and maintaining caution signs on the Forest Islands ORV trail prior to beginning operations. The trail must be posted at appropriate distances from the sale area to warn of logging activity and truck traffic at both ends of the trail. Signs must be removed when harvest operations are suspended or completed. The Purchaser will provide these signs.



TIMBER SALE MAP

This information provided by authority of Part 525, 1994 PA 451, as amended.

Sale Number	Year
33 - 003	18

Forest Management Unit Escanaba Management Unit	County Menominee	Mapped By Collins	Date 06/26/2018	Page 1	of 1
Township 36N	Range 25W	Section(s) and Subdivision(s) Sec 1 SE 1/4, NENE, SWNE, SENE, NWNW, SWNW NESW, SWSW, SESW Sec 2 NE 1/4, SENW, NESE, SWSE, SESE Sec11 NENE	Scale 1:15,840		

Cover Type				Density			
A = Aspen	H = Hemlock	N = Marsh	U = Upland Brush	0 = Non Stocked	5 = Pole Timber Medium		
B = Paper Birch	J = Jack Pine	O = Oak	UM = Upland Mixed	1 = Seedling Sapling Poor	6 = Pole Timber Well		
C = Cedar	L = Lowland Brush	P = Lowland Poplar	V = Bog or Marsh	2 = Seedling Sapling Medium	7 = Saw Timber Poor		
D = Treed Bog	LM = Lowland Mixed	Q = Mixed Swamp Conifer	W = White Pine	3 = Seedling Sapling Well	8 = Saw Timber Medium		
E = Swamp Hdwoods	M = Mpl, Bch, Brch	R = Red Pine	X = Non Stocked	4 = Pole Timber Poor	9 = Saw Timber Well		
F = Spruce Fir	MC = Mixed Conifer	S = Black Spruce	Z = Water				
G = Grass	MD = Mixed Deciduous	T = Tamarack					

Wolf Chase

Compartment 39

308.1 Acres

PU	Acres	PU	Acres	PU	Acres
1	18.6	6	7.8	11	4.9
2	5.9	7	15.8	12	29.6
3	48.6	8	35.2	13	16.9
4	15.3	9	39.1	14	41.5
5	11	10	17.2		



Legend

- ◆ Survey Corners
- Primary Forest Road
- == Secondary Forest Road
- == Forest Access Route
- - - County Road - Seasonal
- Private
- Intermittent Stream
- ▨ Retention Area
- Against State (Red)
- Payment Unit (Yellow)
- Private Line (Blue)
- Section Corners
- Recreational Trail

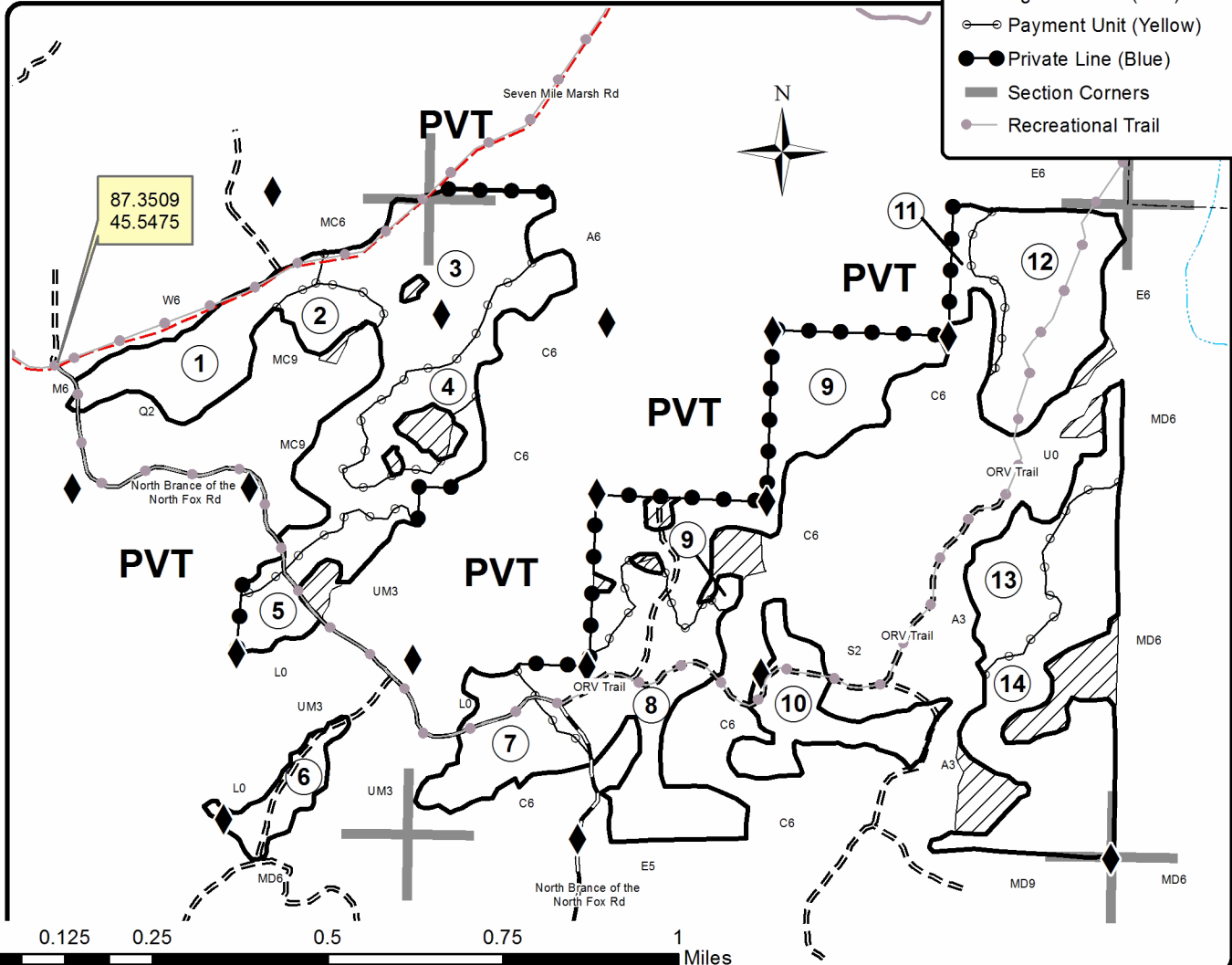

Wolf Chase (33-003-18)

T36N, R25W, SEC. 1; T36N, R25W, SEC. 11; T36N, R25W, SEC. 2; Menominee

In response to the notice of sale to be held 3:00 p.m. (local time) on October 15, 2019, I am hereby submitting my sealed bid (firm offer) for the following forest products to be cut. Bids for individual species must be at or above the advertised price. All non-responsive bid forms may be rejected.

<u>PRODUCTS & SPECIES</u>	<u>ESTIMATED VOLUME*</u>	<u>ADVERTISED PRICE</u>	<u>BID PRICE/UNIT</u>
Sawtimber			
Black Ash	2.30 MBF	\$ 56.00/MBF	\$ _____
Green Ash	41.40 MBF	\$ 86.00/MBF	\$ _____
Paper Birch	39.50 MBF	\$ 84.00/MBF	\$ _____
Red Maple	248.60 MBF	\$ 179.00/MBF	\$ _____
Sugar Maple	7.70 MBF	\$ 285.00/MBF	\$ _____
White Ash	5.90 MBF	\$ 77.00/MBF	\$ _____
Yellow Birch	16.90 MBF	\$ 100.00/MBF	\$ _____
Pulpwood			
Balsam Fir	487.00 Cords	\$ 23.25/Cord	\$ _____
Mixed Hardwood	5,219.00 Cords	\$ 27.85/Cord	\$ _____
Mixed Spruce	385.00 Cords	\$ 28.70/Cord	\$ _____
N. White Cedar	211.00 Cords	\$ 20.25/Cord	\$ _____
Quaking Aspen	421.00 Cords	\$ 30.30/Cord	\$ _____
Red Pine	118.00 Cords	\$ 50.70/Cord	\$ _____
White Pine	770.00 Cords	\$ 38.15/Cord	\$ _____

*These estimated volumes are final and not subject to adjustment. Prospective bidders are urged to examine this timber and to make their own estimates of quantity and quality.

I understand that any or all bids may be rejected. All bids must be signed and all bid items must be bid or the bid form may be rejected. I also understand that consideration and awarding a contract will be based upon my past performance and ability to complete the contract based upon equipment and staffing subject to my control.

FEDERAL ID: ____ - ____ - ____ or SOCIAL SECURITY NUMBER: ____ - ____ - ____

Company or individual bidding: _____

Company representative's name: _____

Address: _____

City: _____ State: _____ Zip: _____

IF AVAILABLE, PLEASE PLACE THE PERSONALIZED LABEL FROM YOUR PROSPECTUS IN THE ABOVE BOX.

Individual or company representative's signature: _____ Date: _____

Phone number : _____ Email (optional): _____

THE WINNING BIDDER MUST COMPLETE THE VERIFICATION OF WORKER'S DISABILITY COMPENSATION ACT COMPLIANCE (ON REVERSE SIDE IF DOUBLE SIDED) WITHIN 21 DAYS OF SALE AWARD DATE



FOR DEPARTMENT USE ONLY
Sale Number (XX - XXX - XX - XX)
Forest Management Unit:

TIMBER SALE VERIFICATION OF WORKER'S DISABILITY COMPENSATION ACT COMPLIANCE

*As required by Act 317, P.A. 1969 (Worker's Compensation) and
Part 5 of Act 451 of 1994, as amended.*

VERIFICATION OF WORKER'S DISABILITY COMPENSATION ACT COMPLIANCE

- This verification must be completed and submitted within 21 days of contract award and prior to the issuance of the timber sale contract.
- In addition, if boxes 2B or 2C are checked, then Notice of Exclusion or Certificate of Insurance must be submitted within twenty-one (21) days of the contract award and prior to the issuance of the timber sale contract.
- All information must be typed or printed except for written signatures.

Please Check Appropriate Categories:

1. My business is organized as (you **must** check one of the boxes below):
 - A. Sole Proprietorship (individual)
 - B. Partnership
 - C. Corporation

2. You **must** check one of the boxes below:
 - A. I certify my business is a sole proprietorship and it has no employees but the sole proprietor. I am not subject to the Worker's Compensation Laws.
 - B. I certify my business has satisfied its obligation to the Worker's Compensation Act through the use of an approved Notice of Exclusion (BWC-337, Rev. 5/96). I will provide a copy of the Notice of Exclusion within 21 days of the contract award. (For questions or a copy of the BWC-337, please call the Worker's Compensation Bureau at 517-322-1195).
 - C. I certify my business has a Worker's Compensation Policy. I will provide an original Certificate of Insurance within twenty-one (21) days of the contract award.

3. If you have checked item 2(A) or 2(B), you **must** indicate the number of **both** full-time and part-time employees, other than yourself, including family members and active partners (if none, you must enter "0").

_____ Full-time Employees

_____ Part-time Employees

Name of Business		Federal ID (or) Social Security No.	
Address		Telephone ()	
City	State	ZIP	

I hereby certify that the above information is true and correct. I agree to notify the Michigan DNR of any changes that occur in factors affecting my coverage during any of my present and future operations.

Signature of Owner or Authorized Representative

Title

Date

Please complete the "SEALED BID" information on the next page

West DeTemple Blend (33-029-19)
T37N, R27W, SEC. 7; T37N, R27W, SEC. 8; Menominee COUNTY

In response to the notice of sale to be held 3:00 p.m. (local time) on October 15, 2019, I am hereby submitting my sealed bid (firm offer) for the following forest products to be cut. Bids for individual species must be at or above the advertised price. All non-responsive bid forms may be rejected.

<u>PRODUCTS & SPECIES</u>	<u>ESTIMATED VOLUME*</u>	<u>ADVERTISED PRICE</u>	<u>BID PRICE/UNIT</u>
Sawtimber			
Basswood	8.80 MBF	\$ 100.00/MBF	\$ _____
Red Maple	1.60 MBF	\$ 167.00/MBF	\$ _____
White Ash	2.20 MBF	\$ 72.00/MBF	\$ _____
Pulpwood			
Balsam Fir	108.00 Cords	\$ 21.70/Cord	\$ _____
Mixed Aspen	182.00 Cords	\$ 28.25/Cord	\$ _____
Mixed Hardwood	880.00 Cords	\$ 25.95/Cord	\$ _____
White Pine	2.00 Cords	\$ 35.60/Cord	\$ _____
White Spruce	87.00 Cords	\$ 26.80/Cord	\$ _____

*The volumes are statistically estimated within plus (+) or minus (-) 12.08 percent. These estimated volumes are final and not subject to adjustment. Prospective bidders are urged to examine this timber and to make their own estimates of quantity and quality.

I understand that any or all bids may be rejected. All bids must be signed and all bid items must be bid or the bid form may be rejected. I also understand that consideration and awarding a contract will be based upon my past performance and ability to complete the contract based upon equipment and staffing subject to my control.

FEDERAL ID: _____ or SOCIAL SECURITY NUMBER: _____

Company or individual bidding: _____

Company representative's name: _____

Address: _____

City: _____ State: _____ Zip: _____

IF AVAILABLE, PLEASE PLACE THE PERSONALIZED LABEL FROM YOUR PROSPECTUS IN THE ABOVE BOX.

Individual or company representative's signature: _____ Date: _____

Phone number : _____ Email (optional): _____

THE WINNING BIDDER MUST COMPLETE THE VERIFICATION OF WORKER'S DISABILITY COMPENSATION ACT COMPLIANCE (ON REVERSE SIDE IF DOUBLE SIDED) WITHIN 21 DAYS OF SALE AWARD DATE



FOR DEPARTMENT USE ONLY
Sale Number (XX - XXX - XX - XX)
Forest Management Unit:

TIMBER SALE VERIFICATION OF WORKER'S DISABILITY COMPENSATION ACT COMPLIANCE

*As required by Act 317, P.A. 1969 (Worker's Compensation) and
Part 5 of Act 451 of 1994, as amended.*

VERIFICATION OF WORKER'S DISABILITY COMPENSATION ACT COMPLIANCE

- This verification must be completed and submitted within 21 days of contract award and prior to the issuance of the timber sale contract.
- In addition, if boxes 2B or 2C are checked, then Notice of Exclusion or Certificate of Insurance must be submitted within twenty-one (21) days of the contract award and prior to the issuance of the timber sale contract.
- All information must be typed or printed except for written signatures.

Please Check Appropriate Categories:

1. My business is organized as (you **must** check one of the boxes below):
 - A. Sole Proprietorship (individual)
 - B. Partnership
 - C. Corporation
2. You **must** check one of the boxes below:
 - A. I certify my business is a sole proprietorship and it has no employees but the sole proprietor. I am not subject to the Worker's Compensation Laws.
 - B. I certify my business has satisfied its obligation to the Worker's Compensation Act through the use of an approved Notice of Exclusion (BWC-337, Rev. 5/96). I will provide a copy of the Notice of Exclusion within 21 days of the contract award. (For questions or a copy of the BWC-337, please call the Worker's Compensation Bureau at 517-322-1195).
 - C. I certify my business has a Worker's Compensation Policy. I will provide an original Certificate of Insurance within twenty-one (21) days of the contract award.
3. If you have checked item 2(A) or 2(B), you **must** indicate the number of **both** full-time and part-time employees, other than yourself, including family members and active partners (if none, you must enter "0").

_____ Full-time Employees

_____ Part-time Employees

Name of Business		Federal ID (or) Social Security No.	
Address		Telephone ()	
City	State	ZIP	

I hereby certify that the above information is true and correct. I agree to notify the Michigan DNR of any changes that occur in factors affecting my coverage during any of my present and future operations.

Signature of Owner or Authorized Representative

Title

Date

Please complete the "SEALED BID" information on the next page

Watered Down Oak (33-033-19)

T34N, R29W, SEC. 1; T34N, R29W, SEC. 2; T35N, R29W, SEC. 36; Menominee

In response to the notice of sale to be held 3:00 p.m. (local time) on October 15, 2019, I am hereby submitting my sealed bid (firm offer) for the following forest products to be cut. Bids for individual species must be at or above the advertised price. All non-responsive bid forms may be rejected.

<u>PRODUCTS & SPECIES</u>	<u>ESTIMATED VOLUME*</u>	<u>ADVERTISED PRICE</u>	<u>BID PRICE/UNIT</u>
Sawtimber			
Northern Pin Oak	11.70 MBF	\$ 125.00/MBF	\$ _____
Red Maple	3.80 MBF	\$ 167.00/MBF	\$ _____
Red Oak	154.70 MBF	\$ 162.00/MBF	\$ _____
White Oak	9.10 MBF	\$ 111.00/MBF	\$ _____
Pulpwood			
Balsam Fir	31.00 Cords	\$ 21.70/Cord	\$ _____
Mixed Aspen	238.00 Cords	\$ 28.25/Cord	\$ _____
Mixed Hardwood	301.00 Cords	\$ 25.95/Cord	\$ _____
Mixed Oak	1,061.00 Cords	\$ 29.15/Cord	\$ _____
Mixed Spruce	10.00 Cords	\$ 26.80/Cord	\$ _____
Red Pine	77.00 Cords	\$ 47.35/Cord	\$ _____
Tamarack	7.00 Cords	\$ 13.65/Cord	\$ _____
White Pine	331.00 Cords	\$ 35.60/Cord	\$ _____

*The volumes are statistically estimated within plus (+) or minus (-) 9.83 percent. These estimated volumes are final and not subject to adjustment. Prospective bidders are urged to examine this timber and to make their own estimates of quantity and quality.

I understand that any or all bids may be rejected. All bids must be signed and all bid items must be bid or the bid form may be rejected. I also understand that consideration and awarding a contract will be based upon my past performance and ability to complete the contract based upon equipment and staffing subject to my control.

FEDERAL ID: ____ - ____ - ____ or SOCIAL SECURITY NUMBER: ____ - ____ - ____

Company or individual bidding: _____

Company representative's name: _____

Address: _____

City: _____ State: _____ Zip: _____

IF AVAILABLE, PLEASE PLACE THE PERSONALIZED LABEL FROM YOUR PROSPECTUS IN THE ABOVE BOX.

Individual or company representative's signature: _____ Date: _____

Phone number : _____ Email (optional): _____

THE WINNING BIDDER MUST COMPLETE THE VERIFICATION OF WORKER'S DISABILITY COMPENSATION ACT COMPLIANCE (ON REVERSE SIDE IF DOUBLE SIDED) WITHIN 21 DAYS OF SALE AWARD DATE



FOR DEPARTMENT USE ONLY	
Sale Number (XX - XXX - XX - XX)	
Forest Management Unit:	

TIMBER SALE VERIFICATION OF WORKER'S DISABILITY COMPENSATION ACT COMPLIANCE

As required by Act 317, P.A. 1969 (Worker's Compensation) and
Part 5 of Act 451 of 1994, as amended.

VERIFICATION OF WORKER'S DISABILITY COMPENSATION ACT COMPLIANCE

- This verification must be completed and submitted within 21 days of contract award and prior to the issuance of the timber sale contract.
- In addition, if boxes 2B or 2C are checked, then Notice of Exclusion or Certificate of Insurance must be submitted within twenty-one (21) days of the contract award and prior to the issuance of the timber sale contract.
- All information must be typed or printed except for written signatures.

Please Check Appropriate Categories:

1. My business is organized as (you **must** check one of the boxes below):
 - A. Sole Proprietorship (individual)
 - B. Partnership
 - C. Corporation
2. You **must** check one of the boxes below:
 - A. I certify my business is a sole proprietorship and it has no employees but the sole proprietor. I am not subject to the Worker's Compensation Laws.
 - B. I certify my business has satisfied its obligation to the Worker's Compensation Act through the use of an approved Notice of Exclusion (BWC-337, Rev. 5/96). I will provide a copy of the Notice of Exclusion within 21 days of the contract award. (For questions or a copy of the BWC-337, please call the Worker's Compensation Bureau at 517-322-1195).
 - C. I certify my business has a Worker's Compensation Policy. I will provide an original Certificate of Insurance within twenty-one (21) days of the contract award.
3. If you have checked item 2(A) or 2(B), you **must** indicate the number of **both** full-time and part-time employees, other than yourself, including family members and active partners (if none, you must enter "0").

_____ Full-time Employees

_____ Part-time Employees

Name of Business		Federal ID (or) Social Security No.	
Address		Telephone ()	
City	State	ZIP	

I hereby certify that the above information is true and correct. I agree to notify the Michigan DNR of any changes that occur in factors affecting my coverage during any of my present and future operations.

Signature of Owner or Authorized Representative

Title

Date

Please complete the "SEALED BID" information on the next page