



**DEPARTMENT OF NATURAL RESOURCES
STATE OF MICHIGAN**

TIMBER SALE PROSPECTUS #6540

SCHEDULED SALE DATE AND TIME: 8:30 a.m. (local time) on November 6, 2019.

LOCATION: CRYSTAL FALLS MGMT UNIT, 1420 US 2 WEST, CRYSTAL FALLS, MI 49920.

PROSPECTUS NOTE: The bidder is advised to inspect the sale area and review the location, estimated volumes, operating costs and contract terms of proposed sales. Please be aware that some landowners may request 60 days or more notice for access across their land.

Notice is hereby given that bids will be received by the Unit Manager, CRYSTAL FALLS MANAGEMENT UNIT, for certain timber on the following described lands:

Tromp Swamp Mix (12-004-19) / T44N, R29W, SEC. 23, S1/2NW,SENE,SW,N1/2SE,SWSE.

T44N, R29W, SEC. 24, SWNW,NWSW.

Dickinson County, Advertised Price \$20,931.70, 74.8 Acres, Spruce/Fir/Tamarack, Aspen.

SALE NOTE: This sale may require temporary bridge installation and extensive road work. In addition, this sale has some over mature stands with timber breaking up. Operation caution (5.2.22.1) and operation restriction (5.2.3.1) specs are included due to saturated soils. In addition, the Purchaser will be required to obtain stream crossing permits (4.1.1). Note that Payment Unit 6 is an optional unit and will be scaled at contract prices, if harvested.

Rub Line Pine Mix (12-011-19) / T44N, R29W, SEC. 21, S1/2SE.

T44N, R29W, SEC. 27, S1/2SW,SWSE.

T44N, R29W, SEC. 28, N1/2NW,SENE,NE,SW,NWSE,S1/2SE.

T44N, R29W, SEC. 29, E1/2SE.

T44N, R29W, SEC. 33, NENE.

T44N, R29W, SEC. 34, N1/2NW,N1/2NE,SWNE.

Dickinson County, Advertised Price \$416,120.55, 360.2 Acres, Red Pine, Aspen.

SALE NOTE: A portion of this sale is located along the Big Wheel Rd. See specs 4.2.4 and 5.2.41 for details on grading and snowmobile trail protection.

GEMMA East (12-017-19) / T43N, R28W, SEC. 11, NENE,S1/2NE.

T43N, R28W, SEC. 12, NW,N1/2SW,SESW.

Dickinson County, Advertised Price \$69,325.85, 104.1 Acres, Aspen, Spruce/Fir/Tamarack.

SALE NOTE: Operations are limited to the period of December 1 - March 30, though some operations may be permitted from May 1 to July 1 if approved by Wildlife (see spec 5.2.3.1). Payment Units must be cut in numerical order (see spec 3.6.1). Payment Unit 1 will be scaled by the sale administrator (see spec 3.2.1). If roads are damaged or rutted, blading and re-seeding will be required by the Purchaser (see spec 5.2.40).

A recreation site such as a trail, pathway, or campground is within the sale area or the vicinity. Certain restrictions/specifications may be applicable including time restrictions.

BID INSTRUCTIONS (VER. 07/02/2018):

1. Scheduled Bid Location, Date, and Time (2/11)

Bids must be received by the Unit Manager, CRYSTAL FALLS OFFICE, 1420 US 2 West, Crystal Falls, MI 49920, no later than 8:30 a.m. (local time) on November 6, 2019. For further information concerning this sale, contact Dan McNamee at 906-875-6622.

2. Bidder's Qualifications (5/16)

Purchaser shall obtain workers compensation insurance to cover claims under Michigan's Worker's Disability Compensation Act of 1969 or similar employee benefit act of any other state applicable to an employee. If all or part of a timber sale was prepared by a private contractor, the contractor and that contractor's company are not permitted to bid on the timber sale contract. Bids will not be accepted from individuals or companies appearing on the DNR/FRD No-Bid List. This list contains the names of purchasers who previously failed to execute a contract within 21-days or who have a history of poor performance.

3. Preparation of Sealed Bids (5/16)

Bid Forms may be completed online thru Michigan DNR Timber Sale Online Bidding (OLB) at www.michigan.gov/timberbidding or by completing the hardcopy Bid Form found in the Timber Sale Prospectus. Hardcopy Bid Forms shall be manually signed in ink. Registration in OLB is considered your 'signature' for all bids submitted thru that system. Bid prices must be entered for each species and product in the Bid Price column for all material subject to bidding and all fill-in blanks must be completed. If erasures or other changes appear on the hardcopy Bid Form, each erasure or change must be initialed by the person signing the bid.

4. Submission of Sealed Bids (5/16)

Bid forms may be obtained from the Unit Manager or thru OLB. Bids may be submitted hardcopy or thru OLB. All hardcopy bids must be submitted on the bid form and in an envelope clearly identified as described in this section. NOTE: Only one bid form per bid envelope. Sealed bids must be submitted to the Unit office designated in the prospectus and must be submitted at or prior to the time established in the prospectus. The envelope should show on the outside (a) the sale name or number and (b) the date and time of bid opening, as shown in the prospectus. Bids received after the time specified in the sale prospectus are late bids and will be rejected.

It is possible for a bidder to submit multiple bids on a single sale. For example, a bid may be submitted hardcopy and a bid may be submitted thru OLB. Or, two bidders from the same company could both submit bids on the same sale. If this were to happen, the State would accept all bids received and award the contract accordingly. All bidding and contractual requirements would apply to all bids received.

5. Public Opening of Sealed Bids (7/16)

If conditions permit, the sealed bids will be publicly opened and posted at the time and place set in the prospectus.

If a bidder, present at a bid opening, has submitted bids on more than one sale, that bidder may withdraw their unopened bid envelopes or announce the withdrawal of their online bid after being declared the successful bidder on one sale.

6. Award of Contract (1/11)

Award of the contract will be made to the Bidder whose bid, conforming to the prospectus, is most advantageous to the State of Michigan on the basis of total value at rates bid for the estimated quantities. The State reserves the right to reject any bid or waive any minor irregularity in bids received. A written award mailed (or otherwise furnished) to the successful Bidder shall be deemed to result in a binding contract without further action by either party.

7. Down Payment (1/11)

The Bidder to whom award is made must make a down payment within 21 days of the sale award. The amount of the down payment will be calculated as shown in the Bond and Payment Schedule of this prospectus. Only cash may be used to meet this requirement.

8. Performance Security (1/11)

As guarantee of faithful performance, a cash bond, certificate of deposit, surety bond or irrevocable letter of credit (LOC) is required within 21 days of the sale award. The amount of the performance security is shown in the Bond and

Payment Schedule of this prospectus. If an LOC or surety is used, the coverage must extend for at least 6 months beyond the contract expiration.

9. Timber Sale Contract (7/18)

Additional conditions and requirements common to all timber sales are listed on the timber sale contract (R4031) and are available on line at www.michigan.gov/timber. Contact the Unit Manager for additional information or a sample contract. Within 21 days of the date of the award letter, the bidder must sign the contract and provide the required down payment, performance security, and verification of worker's disability compensation. The down payment and performance security shall be in accordance with the provisions of the timber sale contract, in the sums stated in this prospectus. If these actions are not taken, then the Bidder, the Bidder's corporation, and the corporation's principals may not be permitted to bid on State timber sales for a period of 3 months after the first offense, 6 months after the second offense, and 1 year after the third offense. An offense will only be counted against the Bidder for 5 years. In addition, the Bidder certifies that if awarded this contract, the Bidder will complete the timber sale contract in accordance with its terms and any modifications thereof including requirements to purchase, cut, and remove the included timber by the expiration date.

Payment Unit values in the State Forest Timber Sale Contract are calculated based on the advertised value of the Payment Unit as a percentage of the total advertised value of the contract. The advertised value of each Payment Unit is given in the Description of Timber by Payment Unit table on the Timber Sale Information page. For example, if the value of Payment Unit 1 is advertised as \$1,500 and the total Timber Sale value is advertised as \$10,000, the contract price for Payment Unit 1 will be 15% of the total bid price ($\$1,500/\$10,000 * 100$).

10. Disclaimer of Estimates and Bidder's Warranty of Inspection (7/16)

Before submitting this bid, the Bidder is advised and cautioned to inspect the sale area, review the requirements of the sale contract, and take other steps as may be reasonably necessary to ascertain the location, estimated volumes, construction estimates, and operating costs of the proposed sale. Failure to do so will not relieve the Bidder from responsibility for completing the contract.

The Bidder warrants that this bid is submitted solely on the basis of the Bidder's examination and inspection of the quality and quantity of the timber offered for sale and the Bidder's opinion of the value thereof and the costs of recovery. No reliance should be placed on the State of Michigan's estimates of timber quality, quantity or costs of recovery. Bidder further acknowledges that the State of Michigan: (i) expressly disclaims any warranty of fitness of timber for any purpose; (ii) offers this timber as is without any warranty of quality (merchantability) or quantity and (iii) expressly disclaims any warranty as to the quantity or quality of timber sold.

11. Certification and Chain-of-Custody (10/14)

Unless otherwise indicated in the contract under section 7 – Other Conditions of the Sale Specific Conditions & Requirements, the area encompassed by this timber sale is certified to the standards of the Forest Stewardship Council (FSC) - Certificate #SCS-FM/COC-00090N and the Sustainable Forestry Initiative (SFI) - Certificate #NSF-SFIS-5Y031-SF5. Forest products from this sale may be delivered to the mill as "FSC 100% and / or SFI certified" as long as the contractor hauling the forest products is chain-of-custody (COC) certified or covered under a COC certificate from the destination mill. The purchaser is responsible for maintaining COC after leaving the sale area.

12. Good Neighbor Authority (GNA) Requirements (7/16)

If the name of this timber sales contains the acronym GNA, it is authorized by the Good Neighbor Authority (GNA) and covered by various agreements between the U.S. Forest Service and the State. The timber sale occurs on federal land and the following conditions apply:

GNA contracts on US Forest Service land will not be awarded to purchasers on the Federal list of excluded parties. The System for Award Management (SAM) will be checked for active excluded parties prior to award of contract. In addition, the Bidder to whom award is made must complete an Assurance Regarding Felony Conviction or Tax Delinquent Status for Corporate Applicants (AD-3031).

13. Good Neighbor Authority (GNA) Requirements, con't (9/16)

Bidder certifies, by signing this bid form, that to the best of Bidder's knowledge that the following representations are accurate and complete.

- a. That the Bidder and its principals are not presently debarred, suspended, proposed for debarment, declared ineligible, or voluntary excluded from timber sales (covered transactions) by any Federal department or agency.
- b. That the Bidder and its principals have not within a 3-year period preceding this bid been convicted of or had a civil judgment rendered against them for commission of fraud or a criminal offense in connection with obtaining, attempting to obtain, or performing a public (Federal, State, or local) transaction or contract under a public transaction; violation of Federal or State antitrust statutes or commission of embezzlement, theft, forgery, bribery, falsification or destruction of records, making false statements, or receiving stolen property.
- c. That the Bidder and its principals are not presently indicted for or otherwise criminally or civilly charged by a governmental entity (Federal, State, or local) with commission of any of the offenses enumerated in paragraph b of this certification.
- d. That the Bidder and its principals have not within a 3-year period preceding this bid had one or more public transactions (Federal, State, or local) terminated for breach or default of a timber or forest product contract.

Bidders that cannot certify this requirement, in whole or in part, shall submit an explanation with their bid.

DAN EICHINGER
Director

TIMBER SALE INFORMATION

Tromp Swamp Mix (12-004-19)
 T44N, R29W, SEC. 23; T44N, R29W, SEC. 24.
 Dickinson County (Advertised Price \$20,931.70)

SALE NOTE: This sale may require temporary bridge installation and extensive road work. In addition, this sale has some over mature stands with timber breaking up. Operation caution (5.2.22.1) and operation restriction (5.2.3.1) specs are included due to saturated soils. In addition, the Purchaser will be required to obtain stream crossing permits (4.1.1). Note that Payment Unit 6 is an optional unit and will be scaled at contract prices, if harvested.

A timber sale contract for this lump sum, sealed bid timber sale will be awarded to the responsible bidder offering the highest sealed bid price. Bids must be at or above the following advertised price for each species:

<u>PRODUCTS & SPECIES</u>	<u>ESTIMATED UNITS*</u>	<u>ADVERTISED PRICE</u>
Sawtimber		
Paper Birch	9.30 MBF	\$ 56.00 / MBF
Pulpwood		
Balsam Fir	83.00 Cords	\$ 13.65 / Cord
Mixed Aspen	331.00 Cords	\$ 24.00 / Cord
Mixed Hardwood	81.00 Cords	\$ 14.80 / Cord
Mixed Spruce	452.00 Cords	\$ 17.20 / Cord
Paper Birch	146.00 Cords	\$ 13.30 / Cord
Tamarack	133.00 Cords	\$ 3.15 / Cord

* The total volume is statistically estimated within plus (+) or minus (-) 12.64 percent. The estimated units are final and not subject to adjustment. Prospective bidders are urged to examine this timber and to make their own estimates of quantity and quality.

BOND AND PAYMENT SCHEDULE:

1. A bond in the amount of \$1,675.00 to insure faithful performance of the conditions of the contract will be deposited by the successful bidder within 21 days of the sale award.
2. Cutting in any sale or unit without the required advance payment would be considered a trespass.
3. Total payment must be paid in advance or according to the following schedule:
 - (a) Ten percent (10%) of the sale value must be paid within 21 days of the sale award.
 - (b) The 10% down payment will be credited towards the first unit cut.
 - (c) Payment for each of the following units must be made before cutting begins in that unit:

<u>PAYMENT UNIT NUMBER</u>	<u>PERCENT OF TOTAL SALE VALUE</u>
01	45.7%
02	6.9%
03	27.9%
04	12.7%
05	6.8%
4. If no cutting takes place, the 10% down payment will not be refunded.
5. Operations on the contract issued will terminate on 06/30/2022.

Description of Timber by Payment Unit (PU)

PU	MARKET GROUP	PRODUCT	QUANTITY	UNIT	ACRES	ADVERTISE PRICE
1	Balsam Fir	Pulpwood	35.0	Cords	34.5	\$9,586.15
	Mixed Aspen		170.0	Cords		
	Mixed Hardwood		10.0	Cords		
	Mixed Spruce		273.0	Cords		
	Paper Birch		3.0	Cords		
	Tamarack		46.0	Cords		
2	Balsam Fir	Pulpwood	5.0	Cords	3.3	\$1,436.25
	Mixed Aspen		57.0	Cords		
3	Paper Birch	Sawtimber	9.3	MBF	17.4	\$5,842.20
	Balsam Fir	Pulpwood	26.0	Cords		
	Mixed Aspen		60.0	Cords		
	Mixed Hardwood		69.0	Cords		
	Mixed Spruce		49.0	Cords		
	Paper Birch		125.0	Cords		
4	Balsam Fir	Pulpwood	17.0	Cords	11.6	\$2,648.45
	Mixed Aspen		44.0	Cords		
	Mixed Hardwood		2.0	Cords		
	Mixed Spruce		65.0	Cords		
	Paper Birch		16.0	Cords		
5	Mixed Spruce	Pulpwood	65.0	Cords	8.0	\$1,418.65
	<i>Black Spruce</i>		65.0	<i>Cords</i>		
	Paper Birch		2.0	Cords		
	Tamarack		87.0	Cords		
TOTAL:			9.3	MBF		
TOTAL:			1,226.0	Cords		

Sale Specific Conditions & Requirements

Sale Name: Tromp Swamp Mix

Sale Number: 12-004-19 Seq#: 1

1 - Sale Area

1.2 - Boundaries

1.2.1 - Painted boundaries (1/14)

The sale boundary and Payment Unit boundaries are marked and identified by blue, red and yellow paint. Exterior sale boundary lines against private property are marked with blue paint. Exterior sale boundary lines against state are marked with red paint. Interior Payment Unit boundaries are marked with yellow paint.

2 - Timber Specifications

2.1 - Included Timber

2.1.1 - Clearcut unit(s) with unmerchantable trees (6/14)

Within Payment Unit(s) 1-5, cut all trees that are two (2) inches or more at DBH, except do not cut cedar. In addition, within Payment Units 1 & 4, do not cut any pine. Also, within Payment Units 2 & 3, do not cut white pine.

2.1.11 - Description of timber note (2/04)

Note that Payment Unit 6 is an optional unit. If the Purchaser elects to harvest this optional unit, the unit will be scaled and products will be paid for at contract prices. The cutting specifications for Payment Unit 6 will be to cut all trees that are two (2) or more inches at DBH, except cedar and any pine. A timber sale contract amendment must be signed by the Unit Manager and the Purchaser before harvesting operations begin.

3 - Payments

3.2 - Scaled Sales

3.2.1 - Scale location (2/04)

Forest products will be placed for measurement at location approved by the Unit Manager or his/her representative when cutting Payment Unit 6.

4 - Transportation

4.1 - Construction

4.1.1 - Stream crossings, general (3/11)

All stream crossing structures will be temporary and therefore, shall be provided by the Purchaser, and must be removed upon completion of the sale. All permits for stream crossings will be provided by the Purchaser.

4.1.4 - Timber removed for construction (12/09)

Trees cut or damaged in the process of pre-approved road, landing or skid trail construction will be decked in an area separate from other Designated Timber and not removed until measured by the sale administrator. Payment will be made at the specified Purchase Unit Price.

4.1.6 - Road construction (1/09)

Construction of new roads or improvements of existing roads shall be done in such a way as to minimize the environmental and visual impacts. Merchantable trees shall be cut and utilized unless otherwise directed. Non-merchantable trees shall be severed and laid flat on the ground. Slash shall be scattered, and not left in windrows and kept a minimum of 10 feet back from the road edge. Stumps shall be set upright, not left on edge, and be moved at least 10 feet away from the road edge. Disturbed soil shall be feathered into the woods and not left in berms or windrows.

4.1.7 - Road closure (10/11)

All new roads built into the sale must be blocked to vehicle traffic upon completion of the sale. Overgrown roads that are reopened shall be considered new roads. In general, this will require constructing a four (4') foot high berm of stumps and logs covered with earth. Contact the sale administrator for specific details of design and placement.

5 - Operations

5.1 - Notification

5.1.1 - Pre-sale conference (10/16)

A pre-sale conference between the Purchaser and sale administrator is required prior to beginning any operations. The Unit Manager or his/her representative must be contacted at least 10 days in advance to schedule the conference.

5.2 - Conduct of Operations

5.2.1 - Slash

5.2.1.13 - Dispose of slash as directed (12/05)

Slash is to be disposed of as directed by sale administrator.

5.2.3 - Operating Restrictions

5.2.3.1 - Operating restrictions (9/11)

Within Payment Unit(s) 1, unless changed by written agreement, cutting and skidding are limited to frozen ground conditions. This restriction is due to the saturated soils.

5.2.22 - Operating Caution

5.2.22.1 - Operating caution (6/11)

It is recommended, but not required, that within Payment Unit(s) 2-5, cutting, skidding, and hauling occur during dry summer or frozen winter conditions. The reason for the recommendation is because of saturated soils within or adjacent to the units.

5.2.32 - Decking/landing restoration (9/13)

All decking and landing areas must have the surface area restored to a condition equal to or better than before. This is to ensure the proper regeneration of the stand. Wood debris, chips and "cookies" from trimmings must be removed or scattered away from landing and loading areas and may not be windrowed on the edge.

5.2.41 - Snowmobile trail protection (9/11)

The Big Wheel Rd is a snowmobile trail and is shown on the Timber Sale Map. Do not cut or damage posts with orange trail markers or traffic control signs. If the trail is used, it must be maintained and restored to a condition equal to or better than before the sale. The road maintenance/restoration must be done prior to December 1. If the trail is used for hauling, it must be graded to the satisfaction of the Unit Manager or his/her representative prior to December 1st. If the trail/road is to be used for hauling during the snowmobile season, then a snow covered base must be left on the trail.

5.4 - Soil Protection

5.4.1 - Rutting restriction, general (7/16)

Operations are to cease immediately if equipment and weather conditions result in rutting of roads and/or skid trails which is 12 inches or greater in depth and 50 feet in length. The Unit Manager or his/her representative may restrict hauling and/or skidding if ruts exceed the specified depth. With the Unit Manager or his/her representative's approval, the Purchaser may return to the area when the risk of rutting has decreased.

5.4.3 - Erosion control (12/08)

Skid trails or haul roads may require erosion control structures or berms per direction of the Unit Manager or his/her representative.

6 - Safety and Fire Prevention

6.2 - Signing

6.2.1 - Road posting (9/09)

The Purchaser is responsible for posting and maintaining caution signs on the Big Wheel Rd prior to beginning operations. The road must be posted at appropriate distances from the sale area to warn of logging activity and truck traffic. Signs must be removed when harvest operations are suspended or completed.

7 - Other Conditions

7.2 - Extensions

7.2.5 - Weather related extension (1/13)

If weather conditions during the operating period of this contract prevent harvesting, this sale may qualify for a weather related extension. If approved, the normal extension fee would be waived. To qualify, there must be a documented attempt each year to harvest in the difficult portion of the sale.



TIMBER SALE MAP

This information provided by authority of Part 525, 1994 PA 451, as amended.

Sale Number	Year
12-004	19

Forest Management Unit Crystal Falls	County Dickinson	Mapped By Jacob Siler	Date 12/21/2018	Page 1	of 1
Township 44N	Range 29W	Section(s) and Subdivision(s) S1/2NW,SENE,SW,N1/2SE,SWSE Sec 23, & SWNW,NWSW Sec24 & S1/2SE Sec22	Scale 1:15,840		

Cover Type				Density	
A = Aspen	H = Hemlock	N = Marsh	U = Upland Brush	0 = Non Stocked	5 = Pole Timber Medium
B = Paper Birch	J = Jack Pine	O = Oak	UM = Upland Mixed	1 = Seedling Sapling Poor	6 = Pole Timber Well
C = Cedar	L = Lowland Brush	P = Lowland Poplar	V = Bog or Marsh	2 = Seedling Sapling Medium	7 = Saw Timber Poor
D = Tread Bog	LM = Lowland Mixed	Q = Mixed Swamp Conifer	W = White Pine	3 = Seedling Sapling Well	8 = Saw Timber Medium
E = Swamp Hdwoods	M = Mpl, Bch, Brch	R = Red Pine	X = Non Stocked	4 = Pole Timber Poor	9 = Saw Timber Well
F = Spruce Fir	MC = Mixed Conifer	S = Black Spruce	Z = Water		
G = Grass	MD = Mixed Deciduous	T = Tamarack			

PU	Acres	PU	Acres
1:	34.5	4:	11.6
2:	3.3	5:	8.0
3:	17.4	6:	7.6 ← (Optional)

Tromp Swamp Mix Compartment 10 74.8 Acres

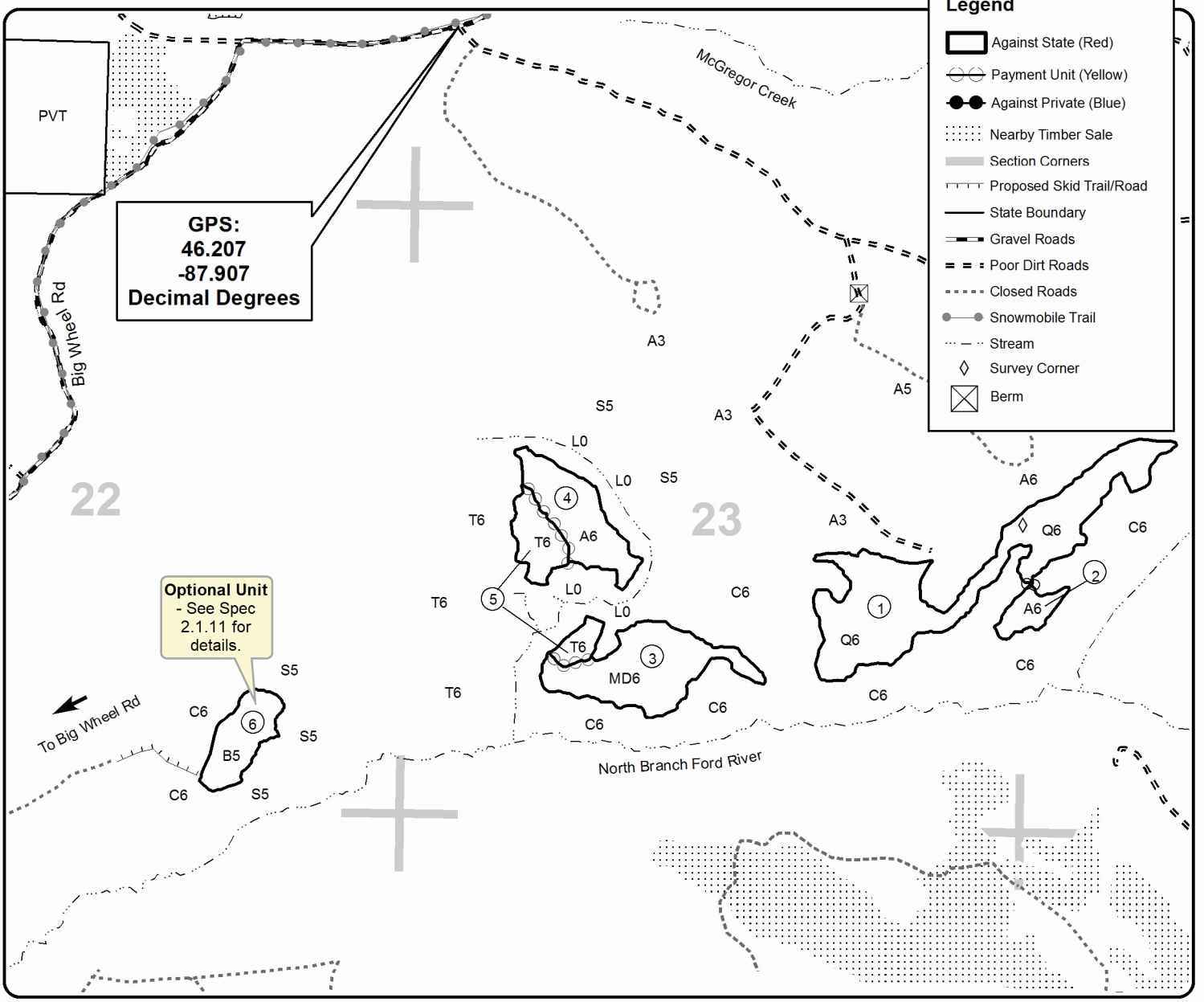

GPS:
46.207
-87.907
Decimal Degrees

Optional Unit
- See Spec
2.1.11 for
details.

TIMBER SALE INFORMATION

Rub Line Pine Mix (12-011-19)

T44N, R29W, SEC. 21; T44N, R29W, SEC. 27; T44N, R29W, SEC. 28; T44N, R29W, SEC. 29; T44N, R29W, SEC. 33; T44N, R29W, SEC. 34.

SALE NOTE: A portion of this sale is located along the Big Wheel Rd. See specs 4.2.4 and 5.2.41 for details on grading and snowmobile trail protection.

A timber sale contract for this lump sum, sealed bid timber sale will be awarded to the responsible bidder offering the highest sealed bid price. Bids must be at or above the following advertised price for each species:

<u>PRODUCTS & SPECIES</u>	<u>ESTIMATED UNITS*</u>		<u>ADVERTISED PRICE</u>
Sawtimber			
Paper Birch	10.80	MBF	\$ 84.00 / MBF
Red Maple	1.50	MBF	\$ 116.00 / MBF
Sugar Maple	1.40	MBF	\$ 359.00 / MBF
Pulpwood			
Balsam Fir	253.00	Cords	\$ 20.50 / Cord
Jack Pine	16.00	Cords	\$ 26.60 / Cord
Mixed Aspen	1,472.00	Cords	\$ 45.40 / Cord
Mixed Hardwood	582.00	Cords	\$ 22.20 / Cord
Mixed Spruce	428.00	Cords	\$ 25.80 / Cord
Red Pine	5,724.00	Cords	\$ 54.55 / Cord
Tamarack	11.00	Cords	\$ 4.75 / Cord
White Pine	154.00	Cords	\$ 37.90 / Cord

* The total volume is statistically estimated within plus (+) or minus (-) 9.80 percent. The estimated units are final and not subject to adjustment. Prospective bidders are urged to examine this timber and to make their own estimates of quantity and quality.

BOND AND PAYMENT SCHEDULE:

1. A bond in the amount of \$20,806.00 to insure faithful performance of the conditions of the contract will be deposited by the successful bidder within 21 days of the sale award.
2. Cutting in any sale or unit without the required advance payment would be considered a trespass.
3. Total payment must be paid in advance or according to the following schedule:
 - (a) Ten percent (10%) of the sale value must be paid within 21 days of the sale award.
 - (b) The 10% down payment will be credited towards the first unit cut.
 - (c) Payment for each of the following units must be made before cutting begins in that unit:

PAYMENT UNIT NUMBER	PERCENT OF TOTAL SALE VALUE
01	11.4%
02	11.2%
03	12.5%
04	11.9%
05	12.4%
06	1.4%
07	3.6%
08	3.0%
09	3.9%
10	1.9%
11	6.2%
12	4.3%
13	7.4%
14	2.5%
15	6.4%

4. If no cutting takes place, the 10% down payment will not be refunded.
5. Operations on the contract issued will terminate on 06/30/2024.

Description of Timber by Payment Unit (PU)

PU	MARKET GROUP	PRODUCT	QUANTITY	UNIT	ACRES	ADVERTISE PRICE
1	Mixed Aspen	Pulpwood	19.0	Cords	28.2	\$47,426.15
	<i>Quaking Aspen</i>		19.0	<i>Cords</i>		
	Mixed Spruce		52.0	Cords		
	Red Pine		829.0	Cords		
2	Mixed Aspen	Pulpwood	7.0	Cords	21.1	\$46,443.50
	<i>Quaking Aspen</i>		7.0	<i>Cords</i>		
	Mixed Spruce		16.0	Cords		
	Red Pine		838.0	Cords		
3	Mixed Aspen	Pulpwood	8.0	Cords	23.1	\$51,872.20
	<i>Quaking Aspen</i>		8.0	<i>Cords</i>		
	Red Pine		938.0	Cords		
	White Pine		9.0	Cords		
4	Mixed Spruce	Pulpwood	10.0	Cords	23.7	\$49,492.55
	<i>White Spruce</i>		10.0	<i>Cords</i>		
	Red Pine		897.0	Cords		
	White Pine		8.0	Cords		
5	Jack Pine	Pulpwood	14.0	Cords	25.9	\$52,274.80
	Mixed Aspen		6.0	Cords		
	Mixed Spruce		7.0	Cords		
	Red Pine		898.0	Cords		
	White Pine		65.0	Cords		
6	Paper Birch	Sawtimber	1.0	MBF	14.2	\$5,617.85
	Mixed Aspen	Pulpwood	27.0	Cords		
	Mixed Hardwood		4.0	Cords		
	Mixed Spruce		147.0	Cords		
	Red Pine		2.0	Cords		
	Tamarack		11.0	Cords		
	White Pine		7.0	Cords		
7	Balsam Fir	Pulpwood	2.0	Cords	29.9	\$14,793.85
	Mixed Aspen		2.0	Cords		
	Mixed Spruce		27.0	Cords		
	Red Pine		231.0	Cords		
	White Pine		36.0	Cords		
8	Jack Pine	Pulpwood	2.0	Cords	23.5	\$12,463.05
	Mixed Aspen		4.0	Cords		
	Mixed Spruce		33.0	Cords		
	Red Pine		203.0	Cords		
	White Pine		8.0	Cords		
9	Mixed Hardwood	Pulpwood	5.0	Cords	33.9	\$16,043.05
	<i>Paper Birch</i>		5.0	<i>Cords</i>		
	Mixed Spruce		1.0	Cords		
	Red Pine		277.0	Cords		
	White Pine		21.0	Cords		
10	Paper Birch	Sawtimber	0.8	MBF	15.8	\$7,781.10
	Balsam Fir	Pulpwood	25.0	Cords		
	Mixed Aspen		113.0	Cords		
	Mixed Hardwood		41.0	Cords		
	Mixed Spruce		45.0	Cords		
11	Paper Birch	Sawtimber	6.9	MBF	30.9	\$25,817.00
	Red Maple		1.5	MBF		
	Sugar Maple		1.4	MBF		
	Balsam Fir	Pulpwood	62.0	Cords		
	Mixed Aspen		314.0	Cords		
	Mixed Hardwood		393.0	Cords		
	Mixed Spruce		12.0	Cords		

Description of Timber by Payment Unit (PU), con't

PU	MARKET GROUP	PRODUCT	QUANTITY	UNIT	ACRES	ADVERTISE PRICE
12	Paper Birch	Sawtimber	1.6	MBF	14.5	\$18,059.30
	Balsam Fir	Pulpwood	47.0	Cords		
	Mixed Aspen		342.0	Cords		
	Mixed Hardwood		53.0	Cords		
	Mixed Spruce		10.0	Cords		
13	Paper Birch	Sawtimber	0.5	MBF	26.1	\$30,634.40
	Balsam Fir	Pulpwood	92.0	Cords		
	Mixed Aspen		606.0	Cords		
	Mixed Hardwood		41.0	Cords		
	Mixed Spruce		11.0	Cords		
14	Balsam Fir	Pulpwood	22.0	Cords	15.8	\$10,572.85
	Mixed Aspen		11.0	Cords		
	Mixed Hardwood		12.0	Cords		
	Mixed Spruce		18.0	Cords		
	Red Pine		163.0	Cords		
15	Balsam Fir	Pulpwood	3.0	Cords	33.6	\$26,828.90
	Mixed Aspen		13.0	Cords		
	Mixed Hardwood		33.0	Cords		
	Mixed Spruce		39.0	Cords		
	Red Pine		448.0	Cords		
TOTAL:			13.7	MBF		
TOTAL:			8,640.0	Cords		

Sale Specific Conditions & Requirements

Sale Name: Rub Line Pine Mix

Sale Number: 12-011-19 Seq#: 1

1 - Sale Area

1.2 - Boundaries

1.2.1 - Painted boundaries (1/14)

The sale boundary and Payment Unit boundaries are marked and identified by blue, red and yellow paint. Exterior sale boundary lines against private property are marked with blue paint. Exterior sale boundary lines against state are marked with red paint. Interior exclusion areas are marked with red paint; these areas are not to be entered or operated in (see Timber Sale Map). Interior Payment Unit boundaries are marked with yellow paint. The painted boundary line trees are not Included Timber and are to be protected, unless marked with orange paint. Yellow painted trees designating an interior Payment Unit boundary are only to be cut when all surrounding Payment Units have been paid.

2 - Timber Specifications

2.1 - Included Timber

2.1.1 - Clearcut unit(s) with unmerchantable trees (6/14)

Within Payment Unit(s) 6 and 10-13, cut all trees that are two (2) inches or more at DBH, except do not cut cedar, oak, hemlock, and pine. In addition, do not cut sub-merchantable conifers in Payment Units 10-13.

Within Payment Unit(s) 1-5, cut all trees two (2) inches or more at DBH.

2.1.3 - Cut tree marked unit(s) (12/08)

Within Payment Unit(s) 7, 8, 9, 14 and 15, red pine and white pine are designated for cutting when marked with orange paint above and below stump height, regardless of merchantability. In addition, cut all other species two (2) inches or more at DBH, except do not cut cedar, hemlock, and oak.

2.2 - Utilization

2.2.3 - Stump heights (4/07)

Stump heights within Payment Unit(s) 1-5 shall not exceed 12 inches for trees greater than 10 inches DBH and 6 inches for trees smaller than 10 inches DBH. This is in order to facilitate planting operations.

3 - Payments

3.4 - Damaged Timber

3.4.1 - Damaged timber (6/14)

General Condition and Requirement 3.4 Damaged Timber, defines liquidated damages for undesigned live merchantable trees which are cut or injured.

No damage is acceptable to merchantable trees. Within the sale area, if more than 5% of trees (> 4.5" DBH) within a specified area of the sale are damaged, liquidated damages will be assessed for all trees damaged. Rates will be in accordance with General Condition and Requirement 3.4 Damaged Timber.

Also, extreme care should be taken to avoid damage to tree seedlings and saplings. Within Payment Units 10-13, if more than 10% of the tree seedlings or saplings (1/4-4.5") within a specified area of the sale are damaged, liquidated damages will be assessed at \$100.00 per acre for all acreage within that specified portion of the sale area that was damaged.

4 - Transportation

4.1 - Construction

4.1.3 - Slash and earthen piles (8/04)

Piles or windrows of earth along roads and landings that have been widened or constructed shall be leveled. Slash from road maintenance or construction, including stumps, shall be dispersed throughout the sale, chipped, utilized, or otherwise removed from the sale.

4.1.6 - Road construction (1/09)

Construction of new roads or improvements of existing roads shall be done in such a way as to minimize the environmental and visual impacts. Merchantable trees shall be cut and utilized unless otherwise directed. Non-merchantable trees shall be severed and laid flat on the ground. Slash shall be scattered, and not left in windrows and kept a minimum of 10 feet back from the road edge. Stumps shall be set upright, not left on edge, and be moved at least 10 feet away from the road edge. Disturbed soil shall be feathered into the woods and not left in berms or windrows.

4.1.7 - Road closure (10/11)

All new roads built into the sale must be blocked to vehicle traffic upon completion of the sale. Overgrown roads that are reopened shall be considered new roads. In general, this will require constructing a four (4') foot high berm of stumps and logs covered with earth. Temporary berms may be required if no sale activity occurs for 30 or more consecutive days. Contact the sale administrator for specific details of design and placement.

4.2 - Maintenance

4.2.4 - Grading (10/16)

For completion of the sale, the Big Wheel Rd must be graded where hauling has occurred. In general, this will require a road grader or bull dozer to shape up the roads after forest products have been hauled off site. This includes cleaning of drainage areas, grading, crowning and filling with gravel, if necessary. The grading equipment to be used must be approved by the Unit Manager or his/her representative.

4.2.5 - Two wheel drive condition (2/04)

All existing trail roads on and adjacent to the sale area must be passable by two-wheel drive traffic for the duration of the sale.

5 - Operations

5.2 - Conduct of Operations

5.2.1 - Slash

5.2.1.8 - Slash height (12/08)

No slash or tree tops may exceed 24 inches in height.

5.2.1.11 - Slash for reforestation (5/07)

To facilitate reforestation, Payment Unit(s) 1-5 and 10-13 shall be left with slash evenly distributed. Bunched tops within the cutting area shall be broken up and scattered. Stumps shall be cut low to the ground. Processing sites shall not be left with a compacted layer of slash; tops from these sites shall be hauled back into the cut area and scattered.

5.2.3 - Operating Restrictions

5.2.3.3 - Bark slippage restriction (3/09)

Within Payment Unit(s) 7-9, 14 and 15, unless changed by written agreement, cutting and skidding are not permitted during the period of April 15 to July 15. This restriction is because of bark slippage.

5.2.3.11 - Coppice regeneration protection (4/10)

Timber harvesting in any Payment Unit must be completed before significant aspen sprouting occurs in that Payment Unit so as to minimize damage to the new regeneration. Any post harvest operations, such as chipping, must be completed before sprouting of regeneration occurs. If it is anticipated that chipping will be delayed, then tops shall be carried to one central location or left unchipped. The Unit Manager or his/her representative may cease such operations if sprouting occurs before the operation is complete.

5.2.22 - Operating Caution

5.2.22.1 - Operating caution (6/11)

It is recommended, but not required, that within Payment Unit(s) 6, cutting, skidding, and hauling occur during dry summer or frozen winter conditions. The reason for the recommendation is because of wet ground.

5.2.41 - Snowmobile trail protection (9/11)

The Big Wheel Rd is a snowmobile trail and is shown on the Timber Sale Map. Do not cut or damage posts with orange trail markers or traffic control signs. If the trail is used, it must be maintained and restored to a condition equal to or better than

before the sale. The road maintenance/restoration must be done prior to December 1. If the trail is used for hauling, it must be graded to the satisfaction of the Unit Manager or his/her representative prior to December 1st. If the trail is used for hauling during the snowmobile season, then a snow covered base must be left on the trail. In addition, if the trail is used during snowmobile season, no hauling will be permitted on Fridays, Saturdays, or Sundays. Maintain a 20 foot wide slash, debris and rut free zone daily using the snowmobile trail as the centerline.

5.4 - Soil Protection

5.4.1 - Rutting restriction, general (7/16)

Operations are to cease immediately if equipment and weather conditions result in rutting of roads and/or skid trails which is 12 inches or greater in depth and 50 feet in length. The Unit Manager or his/her representative may restrict hauling and/or skidding if ruts exceed the specified depth. With the Unit Manager or his/her representative's approval, the Purchaser may return to the area when the risk of rutting has decreased.

6 - Safety and Fire Prevention

6.2 - Signing

6.2.1 - Road posting (9/09)

The Purchaser is responsible for posting and maintaining caution signs on Big Wheel Rd and Nature TRL prior to beginning operations. The road must be posted at appropriate distances from the sale area to warn of logging activity and truck traffic. Signs must be removed when harvest operations are suspended or completed. The Purchaser will provide these signs.

6.2.2 - Snowmobile trail posting (8/09)

The Purchaser is responsible for posting and maintaining caution signs on Big Wheel Rd prior to beginning operations during the snowmobile season (approximately December 1 to March 31). The trail must be posted at appropriate distances from the sale area to warn of logging activity and truck traffic. Signs must be removed when harvest operations are suspended or completed. The Purchaser will provide these signs.



TIMBER SALE MAP

This information provided by authority of Part 525, 1994 PA 451, as amended.

Forest Management Unit Crystal Falls		County Dickinson	Mapped By Jacob Siler	Date 07/23/19	Page 1	of 2
Township 44N	Range 29W	Section(s) and Subdivision(s) Sections: 21, 27, 28, 29, 33 & 34		Scale 1:15,840		

Cover Type				Density	
A = Aspen	H = Hemlock	N = Marsh	U = Upland Brush	0 = Non Stocked	5 = Pole Timber Medium
B = Paper Birch	J = Jack Pine	O = Oak	UM = Upland Mixed	1 = Seedling Sapling Poor	6 = Pole Timber Well
C = Cedar	L = Lowland Brush	P = Lowland Poplar	V = Bog or Marsh	2 = Seedling Sapling Medium	7 = Saw Timber Poor
D = Treed Bog	LM = Lowland Mixed	Q = Mixed Swamp Conifer	W = White Pine	3 = Seedling Sapling Well	8 = Saw Timber Medium
E = Swamp Hdwoods	M = Mpl, Bch, Brch	R = Red Pine	X = Non Stocked	4 = Pole Timber Poor	9 = Saw Timber Well
F = Spruce Fir	MC = Mixed Conifer	S = Black Spruce	Z = Water		
G = Grass	MD = Mixed Deciduous	T = Tamarack			

PU: Acres

1: 28.2	7: 29.9	13: 26.1
2: 21.1	8: 23.5	14: 15.8
3: 23.1	9: 33.9	15: 33.6
4: 23.7	10: 15.8	
5: 25.9	11: 30.9	
6: 14.2	12: 14.5	

Rub Line Pine Mix

Compartment 10

360.2 Acres

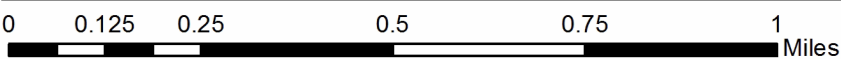
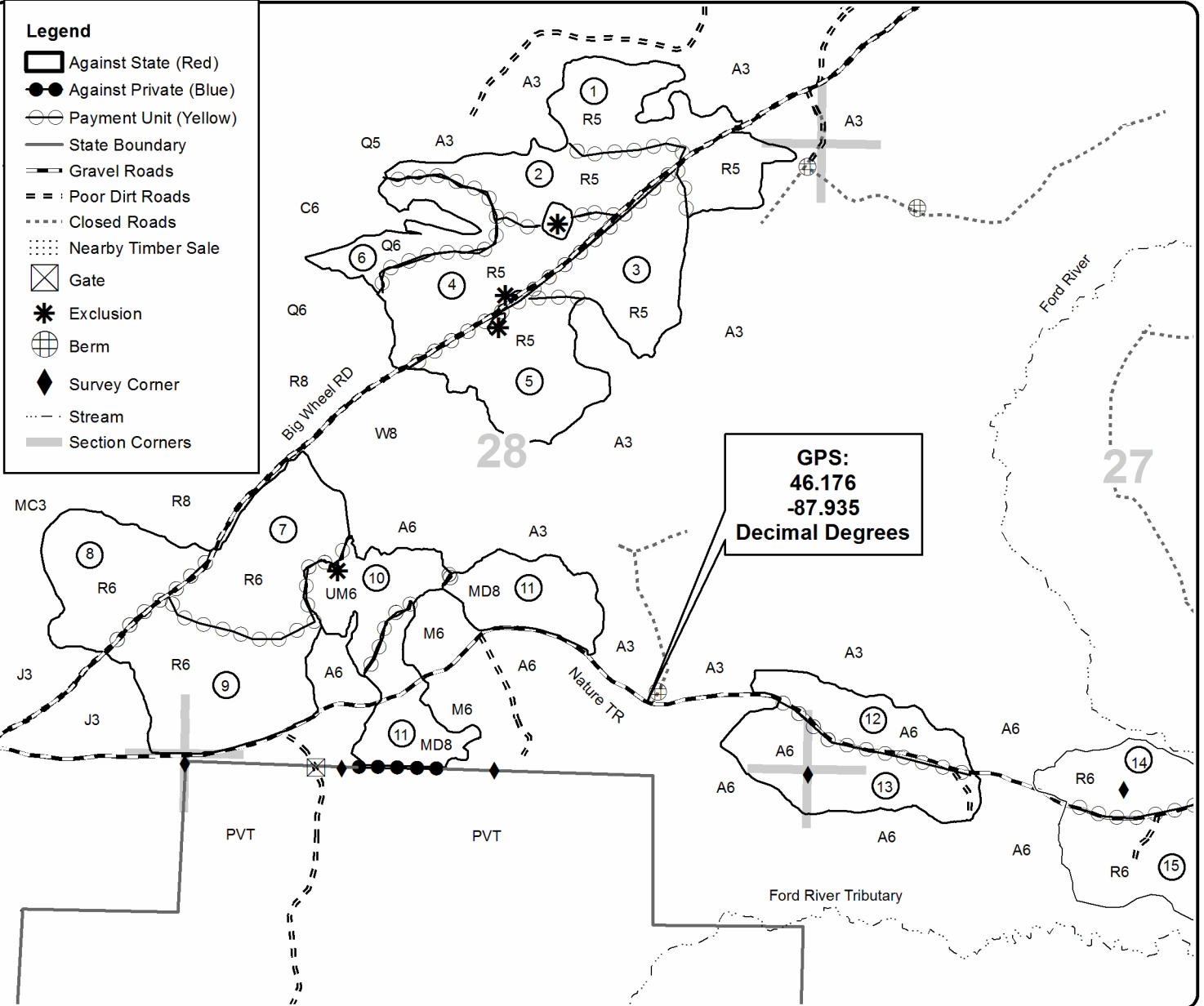



TIMBER SALE MAP

This information provided by authority of Part 525, 1994 PA 451, as amended.

Forest Management Unit Crystal Falls		County Dickinson	Mapped By Jacob Siler	Date 07/23/19	Page 2	of 2
Township 44N	Range 29W	Section(s) and Subdivision(s) Sections: 21, 27, 28, 29, 33 & 34		Scale 1:15,840		

Cover Type				Density			
A = Aspen	H = Hemlock	N = Marsh	U = Upland Brush	0 = Non Stocked	5 = Pole Timber Medium		
B = Paper Birch	J = Jack Pine	O = Oak	UM = Upland Mixed	1 = Seedling Sapling Poor	6 = Pole Timber Well		
C = Cedar	L = Lowland Brush	P = Lowland Poplar	V = Bog or Marsh	2 = Seedling Sapling Medium	7 = Saw Timber Poor		
D = Tread Bog	LM = Lowland Mixed	Q = Mixed Swamp Conifer	W = White Pine	3 = Seedling Sapling Well	8 = Saw Timber Medium		
E = Swamp Hdwoods	M = Mpl, Bch, Brch	R = Red Pine	X = Non Stocked	4 = Pole Timber Poor	9 = Saw Timber Well		
F = Spruce Fir	MC = Mixed Conifer	S = Black Spruce	Z = Water				
G = Grass	MD = Mixed Deciduous	T = Tamarack					

PU: Acres

1: 28.2	7: 29.9	13: 26.1
2: 21.1	8: 23.5	14: 15.8
3: 23.1	9: 33.9	15: 33.6
4: 23.7	10: 15.8	
5: 25.9	11: 30.9	
6: 14.2	12: 14.5	

Rub Line Pine Mix Compartment 10 360.2 Acres

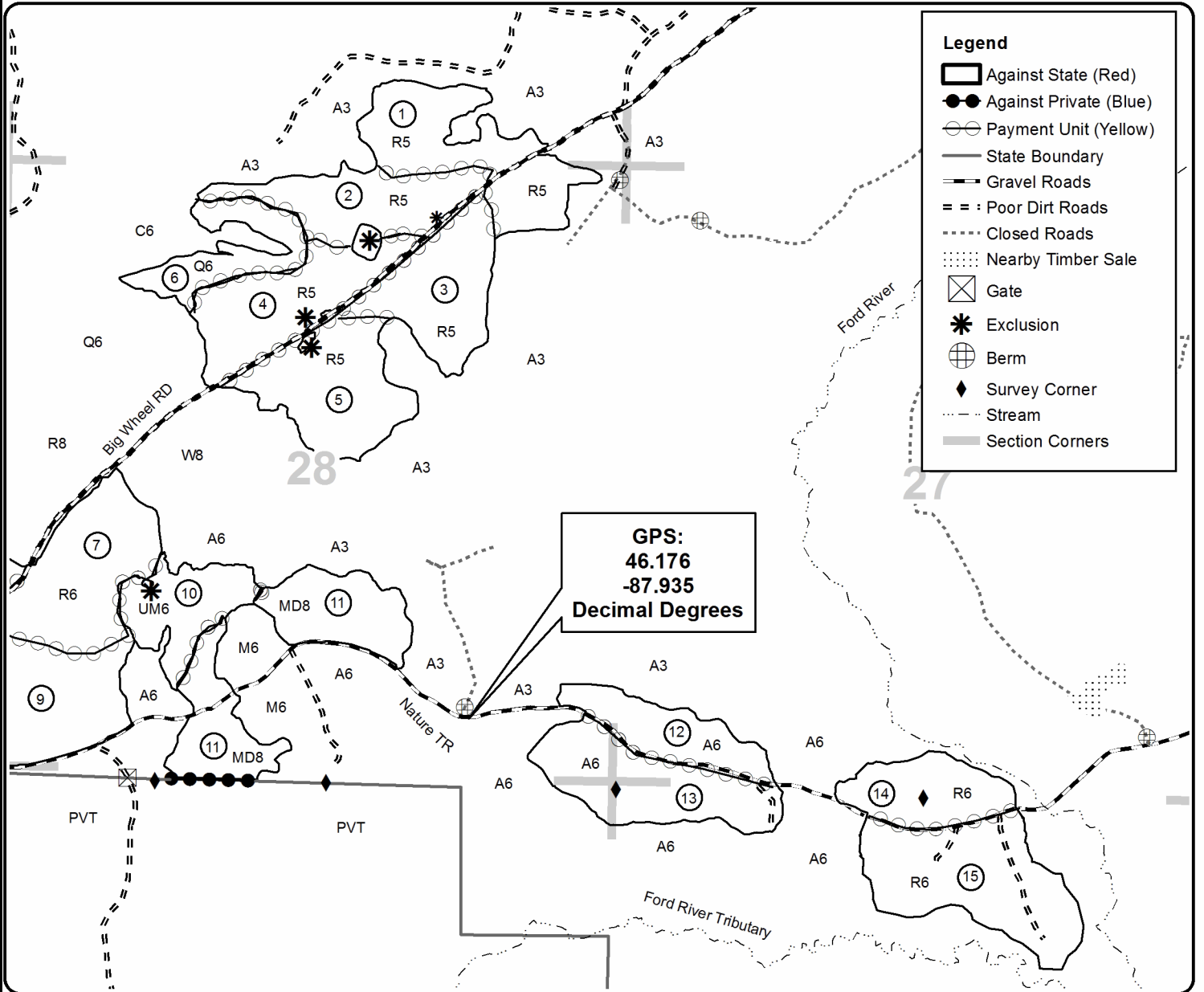

GPS:
46.176
-87.935
Decimal Degrees

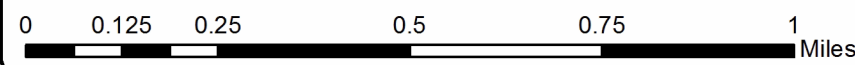

TIMBER SALE INFORMATION

GEMMA East (12-017-19)

T43N, R28W, SEC. 11; T43N, R28W, SEC. 12.
Dickinson County (Advertised Price \$69,325.85)

SALE NOTE: Operations are limited to the period of December 1 - March 30, though some operations may be permitted from May 1 to July 1 if approved by Wildlife (see spec 5.2.3.1). Payment Units must be cut in numerical order (see spec 3.6.1). Payment Unit 1 will be scaled by the sale administrator (see spec 3.2.1). If roads are damaged or rutted, blading and re-seeding will be required by the Purchaser (see spec 5.2.40).

A recreation site such as a trail, pathway, or campground is within the sale area or the vicinity. Certain restrictions/specifications may be applicable including time restrictions.

A timber sale contract for this lump sum, sealed bid timber sale will be awarded to the responsible bidder offering the highest sealed bid price. Bids must be at or above the following advertised price for each species:

<u>PRODUCTS & SPECIES</u>	<u>ESTIMATED UNITS*</u>	<u>ADVERTISED PRICE</u>
Pulpwood		
Balsam Fir	179.00 Cords	\$ 20.50 / Cord
Mixed Aspen	1,270.00 Cords	\$ 45.40 / Cord
Mixed Hardwood	28.00 Cords	\$ 22.20 / Cord
Mixed Spruce	285.00 Cords	\$ 25.80 / Cord
Tamarack	5.00 Cords	\$ 4.75 / Cord

* The total volume is statistically estimated within plus (+) or minus (-) 12.59 percent. The estimated units are final and not subject to adjustment. Prospective bidders are urged to examine this timber and to make their own estimates of quantity and quality.

BOND AND PAYMENT SCHEDULE:

1. A bond in the amount of \$6,933.00 to insure faithful performance of the conditions of the contract will be deposited by the successful bidder within 21 days of the sale award.
2. Cutting in any sale or unit without the required advance payment would be considered a trespass.
3. Total payment must be paid in advance or according to the following schedule:
 - (a) Ten percent (10%) of the sale value must be paid within 21 days of the sale award.
 - (b) The 10% down payment will be credited towards the first unit cut.
 - (c) Payment for each of the following units must be made before cutting begins in that unit:

<u>PAYMENT UNIT NUMBER</u>	<u>PERCENT OF TOTAL SALE VALUE</u>
01	1.7%
02	23.2%
03	36.0%
04	39.1%
4. If no cutting takes place, the 10% down payment will not be refunded.
5. Operations on the contract issued will terminate on 06/30/2022.

Description of Timber by Payment Unit (PU)

PU	MARKET GROUP	PRODUCT	QUANTITY	UNIT	ACRES	ADVERTISE PRICE
1	Mixed Aspen	Pulpwood	26.0	Cords	21.8	\$1,180.40
	<i>Quaking Aspen</i>		26.0	<i>Cords</i>		
2	Balsam Fir	Pulpwood	27.0	Cords	13.2	\$16,102.70
	Mixed Aspen		335.0	Cords		
	Mixed Hardwood		13.0	Cords		
	Mixed Spruce		2.0	Cords		
3	Balsam Fir	Pulpwood	38.0	Cords	20.3	\$24,983.60
	Mixed Aspen		519.0	Cords		
	Mixed Hardwood		8.0	Cords		
	Mixed Spruce		18.0	Cords		
4	Balsam Fir	Pulpwood	114.0	Cords	48.8	\$27,059.15
	Mixed Aspen		390.0	Cords		
	Mixed Hardwood		7.0	Cords		
	Mixed Spruce		265.0	Cords		
	Tamarack		5.0	Cords		
TOTAL:			1,767.0	Cords		

Sale Specific Conditions & Requirements

Sale Name: GEMMA East

Sale Number: 12-017-19 Seq#: 1

1 - Sale Area

1.2 - Boundaries

1.2.1 - Painted boundaries (1/14)

The sale boundary and Payment Unit boundaries are marked and identified by red and yellow paint. Exterior sale boundary lines against state are marked with red paint. Interior Payment Unit boundaries are marked with yellow paint. Yellow painted trees designating an interior Payment Unit boundary are only to be cut when all surrounding Payment Units have been paid.

2 - Timber Specifications

2.1 - Included Timber

2.1.1 - Clearcut unit(s) with unmerchantable trees (6/14)

Within Payment Unit(s) 1-4, cut all mixed aspen and mixed hardwood trees that are two (2) inches or more at DBH, except leave one cherry tree per acre, where available. In addition, cut all softwoods four (4) inches or more at DBH, except do not cut cedar, white pine, and red pine.

3 - Payments

3.2 - Scaled Sales

3.2.1 - Scale location (2/04)

Forest products will be placed for measurement for Payment Unit 1 at location designated by the sale administrator.

3.3 - Pre-measured Sales

3.3.4 - Dividing payment units (7/14)

Payment Unit(s) 4 may be divided at the request of the Purchaser and upon approval of the Unit Manager. Dividing Payment Units is a contract modification which requires a Timber Sale Contract Supplement. There will be only one division per Payment Unit.

3.6 - Payment Unit Cutting Schedule

3.6.1 - Order of cutting (1/09)

Payment Units shall be cut in numerical order unless the Unit Manager and Wildlife manager approves.

4 - Transportation

4.1 - Construction

4.1.6 - Road construction (1/09)

Construction of new roads or improvements of existing roads shall be done in such a way as to minimize the environmental and visual impacts. Merchantable trees shall be cut and utilized unless otherwise directed. Non-merchantable trees shall be severed and laid flat on the ground. Slash shall be scattered, and not left in windrows and kept a minimum of 10 feet back from the road edge. Stumps shall be set upright, not left on edge, and be moved at least 10 feet away from the road edge. Disturbed soil shall be feathered into the woods and not left in berms or windrows.

4.2 - Maintenance

4.2.1 - Hauling restriction (12/08)

Hauling may be restricted on forest roads by the Unit Manager or his/her representative. The restriction may occur during prolonged wet or warm weather.

4.3 - Public Right-of-Way

4.3.2 - County R-O-W (12/06)

The county must be contacted prior to decking along the county road R-O-W. This applies to Payment Units 1B & 4, and County Road 581.

4.4 - Access

4.4.3 - Access gate (12/08)

The access gate must be closed at the completion of each day unless otherwise approved by the Unit Manager or his/her representative.

5 - Operations

5.2 - Conduct of Operations

5.2.3 - Operating Restrictions

5.2.3.1 - Operating restrictions (9/11)

Within Payment Unit(s) 1-4, unless changed by written agreement, cutting, skidding, and hauling are limited to the period of December 1 to March 30. Some operations may be permitted from May 1 to July 1 with Wildlife approval. This restriction is to limit road disturbance to hunter walking trails.

5.2.4 - Dead and Down Creation

5.2.4.2 - Dead and down creation, hare and grouse (1/14)

To improve habitat for snowshoe hare, grouse, and other species, the Purchaser is to leave a minimum of one pile of slash at least 15 feet wide and 4 feet tall on the ground for every unit.

5.2.31 - Landing locations (9/13)

Landing areas are to be agreed upon between the operator and sale administrator prior to beginning operations. Landings must be confined to these designated sites unless otherwise authorized by the Unit Manager or his/her representative.

5.2.40 - Pathway protection (10/10)

The closed roads shown on the Timber Sale Map also serve as hunter walking trails. The trails must be kept slash, debris, and rut free daily. If these roads are damaged, the Purchaser will be required to level, disc and seed before the sale can be closed.

5.4 - Soil Protection

5.4.1 - Rutting restriction, general (7/16)

Operations are to cease immediately if equipment and weather conditions result in rutting of roads and/or skid trails which is 12 inches or greater in depth and 50 feet in length. The Unit Manager or his/her representative may restrict hauling and/or skidding if ruts exceed the specified depth. With the Unit Manager or his/her representative's approval, the Purchaser may return to the area when the risk of rutting has decreased. If roads are rutted 12 inches or greater and require leveling, re-seeding post harvest operations will also be required.

6 - Safety and Fire Prevention

6.2 - Signing

6.2.1 - Road posting (9/09)

The Purchaser is responsible for posting and maintaining caution signs on County Road 581 prior to beginning operations. The road must be posted 200 feet from the sale area to warn of logging activity and truck traffic. Signs must be removed when harvest operations are suspended or completed. In addition, all access roads must be posted to warn hunters of logging activity if harvesting operations occurs between December 1 and January 1. The Purchaser will provide these signs.

7 - Other Conditions

7.2 - Extensions

7.2.2 - No extensions (3/09)

There will be no extensions granted on this contract. This sale has post-harvesting treatments scheduled for planting of roads and openings.



TIMBER SALE MAP

This information provided by authority of Part 525, 1994 PA 451, as amended.

Sale Number	Year
12-017	19

Forest Management Unit	County	Mapped By	Date	Page	of
Crystal Falls Management Unit	Dickinson Co.	Debbie Goupell	9/13/19	1	1
Township	Range	Section(s) and Subdivision(s)	Scale		
43N	28W	Sec 11: NENE, S1/2NE, Sec 12: NW1/4,N1/2SW,SESW	1:15,840		

Cover Type				Density	
A = Aspen	H = Hemlock	N = Marsh	U = Upland Brush	0 = Non Stocked	5 = Pole Timber Medium
B = Paper Birch	J = Jack Pine	O = Oak	UM = Upland Mixed	1 = Seedling Sapling Poor	6 = Pole Timber Well
C = Cedar	L = Lowland Brush	P = Lowland Poplar	V = Bog or Marsh	2 = Seedling Sapling Medium	7 = Saw Timber Poor
D = Treed Bog	LM = Lowland Mixed	Q = Mixed Swamp Conifer	W = White Pine	3 = Seedling Sapling Well	8 = Saw Timber Medium
E = Swamp Hdwoods	M = Mpl, Bch, Brch	R = Red Pine	X = Non Stocked	4 = Pole Timber Poor	9 = Saw Timber Well
F = Spruce Fir	MC = Mixed Conifer	S = Black Spruce	Z = Water		
G = Grass	MD = Mixed Deciduous	T = Tamarack			

PU	Acres
1	21.8
2	13.2
3	20.3
4	48.8

GEMMA East

Compartment 36

104.1 Acres

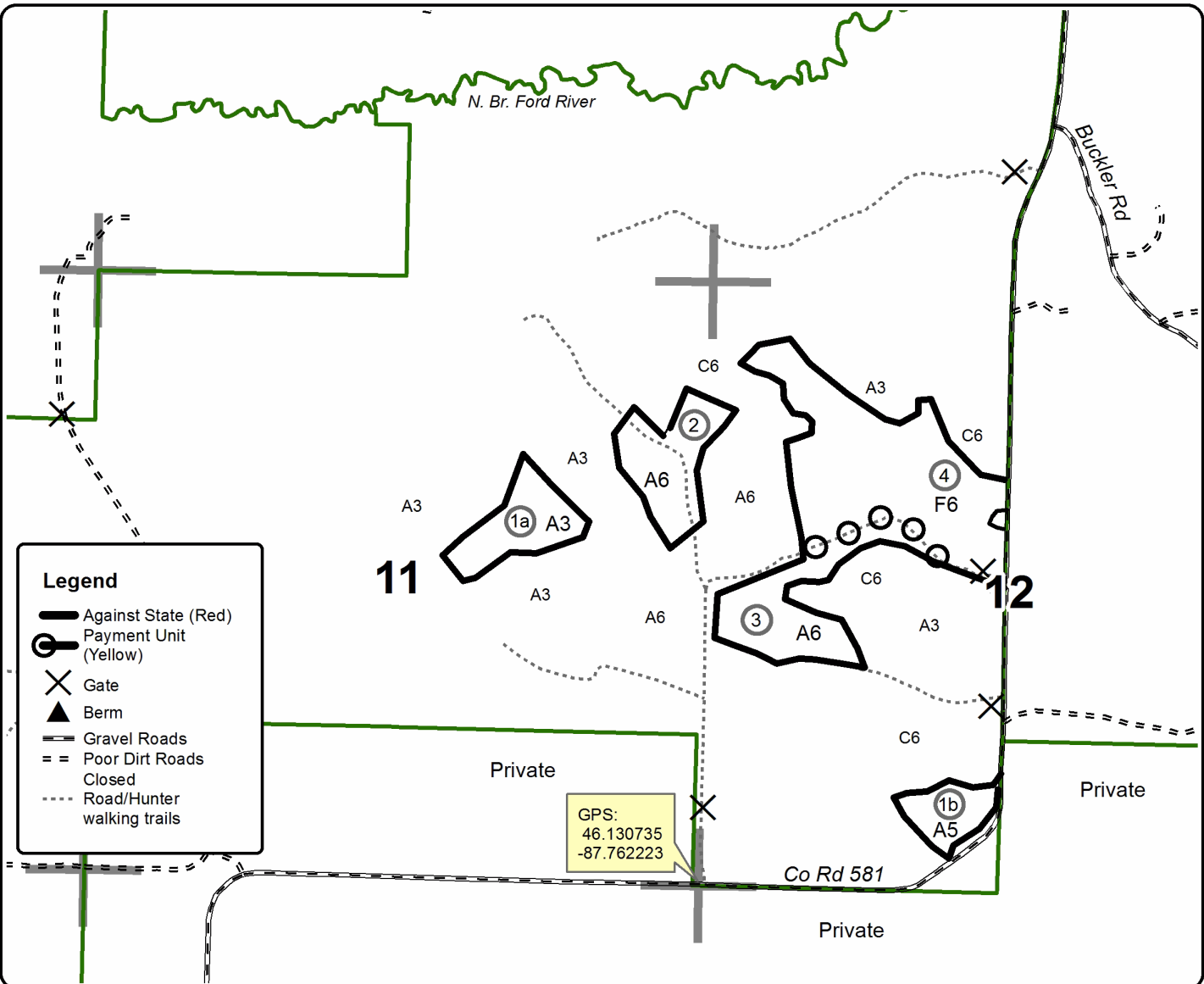

Tromp Swamp Mix (12-004-19)
T44N, R29W, SEC. 23; T44N, R29W, SEC. 24; Dickinson COUNTY

In response to the notice of sale to be held 8:30 a.m. (local time) on November 6, 2019, I am hereby submitting my sealed bid (firm offer) for the following forest products to be cut. Bids for individual species must be at or above the advertised price. All non-responsive bid forms may be rejected.

<u>PRODUCTS & SPECIES</u>	<u>ESTIMATED VOLUME*</u>	<u>ADVERTISED PRICE</u>	<u>BID PRICE/UNIT</u>
Sawtimber			
Paper Birch	9.30 MBF	\$ 56.00/MBF	\$ _____
Pulpwood			
Balsam Fir	83.00 Cords	\$ 13.65/Cord	\$ _____
Mixed Aspen	331.00 Cords	\$ 24.00/Cord	\$ _____
Mixed Hardwood	81.00 Cords	\$ 14.80/Cord	\$ _____
Mixed Spruce	452.00 Cords	\$ 17.20/Cord	\$ _____
Paper Birch	146.00 Cords	\$ 13.30/Cord	\$ _____
Tamarack	133.00 Cords	\$ 3.15/Cord	\$ _____

*The volumes are statistically estimated within plus (+) or minus (-) 12.64 percent. These estimated volumes are final and not subject to adjustment. Prospective bidders are urged to examine this timber and to make their own estimates of quantity and quality.

I understand that any or all bids may be rejected. All bids must be signed and all bid items must be bid or the bid form may be rejected. I also understand that consideration and awarding a contract will be based upon my past performance and ability to complete the contract based upon equipment and staffing subject to my control.

FEDERAL ID: _____ or SOCIAL SECURITY NUMBER: _____

Company or individual bidding: _____

Company representative's name: _____

Address: _____

City: _____ State: _____ Zip: _____

IF AVAILABLE, PLEASE PLACE THE PERSONALIZED LABEL FROM YOUR PROSPECTUS IN THE ABOVE BOX.

Individual or company representative's signature: _____ Date: _____

Phone number : _____ Email (optional): _____

THE WINNING BIDDER MUST COMPLETE THE VERIFICATION OF WORKER'S DISABILITY COMPENSATION ACT COMPLIANCE (ON REVERSE SIDE IF DOUBLE SIDED) WITHIN 21 DAYS OF SALE AWARD DATE



FOR DEPARTMENT USE ONLY	
Sale Number (XX - XXX - XX - XX)	
Forest Management Unit:	

TIMBER SALE VERIFICATION OF WORKER'S DISABILITY COMPENSATION ACT COMPLIANCE

As required by Act 317, P.A. 1969 (Worker's Compensation) and
Part 5 of Act 451 of 1994, as amended.

VERIFICATION OF WORKER'S DISABILITY COMPENSATION ACT COMPLIANCE

- This verification must be completed and submitted within 21 days of contract award and prior to the issuance of the timber sale contract.
- In addition, if boxes 2B or 2C are checked, then Notice of Exclusion or Certificate of Insurance must be submitted within twenty-one (21) days of the contract award and prior to the issuance of the timber sale contract.
- All information must be typed or printed except for written signatures.

Please Check Appropriate Categories:

1. My business is organized as (you **must** check one of the boxes below):
 - A. Sole Proprietorship (individual)
 - B. Partnership
 - C. Corporation
2. You **must** check one of the boxes below:
 - A. I certify my business is a sole proprietorship and it has no employees but the sole proprietor. I am not subject to the Worker's Compensation Laws.
 - B. I certify my business has satisfied its obligation to the Worker's Compensation Act through the use of an approved Notice of Exclusion (BWC-337, Rev. 5/96). I will provide a copy of the Notice of Exclusion within 21 days of the contract award. (For questions or a copy of the BWC-337, please call the Worker's Compensation Bureau at 517-322-1195).
 - C. I certify my business has a Worker's Compensation Policy. I will provide an original Certificate of Insurance within twenty-one (21) days of the contract award.
3. If you have checked item 2(A) or 2(B), you **must** indicate the number of **both** full-time and part-time employees, other than yourself, including family members and active partners (if none, you must enter "0").

_____ Full-time Employees

_____ Part-time Employees

Name of Business		Federal ID (or) Social Security No.	
Address		Telephone ()	
City	State	ZIP	

I hereby certify that the above information is true and correct. I agree to notify the Michigan DNR of any changes that occur in factors affecting my coverage during any of my present and future operations.

Signature of Owner or Authorized Representative

Title

Date

Please complete the "SEALED BID" information on the next page

Rub Line Pine Mix (12-011-19)

T44N, R29W, SEC. 21; T44N, R29W, SEC. 27; T44N, R29W, SEC. 28; T44N,

In response to the notice of sale to be held 8:30 a.m. (local time) on November 6, 2019, I am hereby submitting my sealed bid (firm offer) for the following forest products to be cut. Bids for individual species must be at or above the advertised price. All non-responsive bid forms may be rejected.

<u>PRODUCTS & SPECIES</u>	<u>ESTIMATED VOLUME*</u>	<u>ADVERTISED PRICE</u>	<u>BID PRICE/UNIT</u>
Sawtimber			
Paper Birch	10.80 MBF	\$ 84.00/MBF	\$ _____
Red Maple	1.50 MBF	\$ 116.00/MBF	\$ _____
Sugar Maple	1.40 MBF	\$ 359.00/MBF	\$ _____
Pulpwood			
Balsam Fir	253.00 Cords	\$ 20.50/Cord	\$ _____
Jack Pine	16.00 Cords	\$ 26.60/Cord	\$ _____
Mixed Aspen	1,472.00 Cords	\$ 45.40/Cord	\$ _____
Mixed Hardwood	582.00 Cords	\$ 22.20/Cord	\$ _____
Mixed Spruce	428.00 Cords	\$ 25.80/Cord	\$ _____
Red Pine	5,724.00 Cords	\$ 54.55/Cord	\$ _____
Tamarack	11.00 Cords	\$ 4.75/Cord	\$ _____
White Pine	154.00 Cords	\$ 37.90/Cord	\$ _____

*The volumes are statistically estimated within plus (+) or minus (-) 9.80 percent. These estimated volumes are final and not subject to adjustment. Prospective bidders are urged to examine this timber and to make their own estimates of quantity and quality.

I understand that any or all bids may be rejected. All bids must be signed and all bid items must be bid or the bid form may be rejected. I also understand that consideration and awarding a contract will be based upon my past performance and ability to complete the contract based upon equipment and staffing subject to my control.

FEDERAL ID: _____ or SOCIAL SECURITY NUMBER: _____

Company or individual bidding: _____

Company representative's name: _____

Address: _____

City: _____ State: _____ Zip: _____

IF AVAILABLE, PLEASE PLACE THE PERSONALIZED LABEL FROM YOUR PROSPECTUS IN THE ABOVE BOX.

Individual or company representative's signature: _____ Date: _____

Phone number : _____ Email (optional): _____

THE WINNING BIDDER MUST COMPLETE THE VERIFICATION OF WORKER'S DISABILITY COMPENSATION ACT COMPLIANCE (ON REVERSE SIDE IF DOUBLE SIDED) WITHIN 21 DAYS OF SALE AWARD DATE



FOR DEPARTMENT USE ONLY
Sale Number (XX - XXX - XX - XX)
Forest Management Unit:

TIMBER SALE VERIFICATION OF WORKER'S DISABILITY COMPENSATION ACT COMPLIANCE

*As required by Act 317, P.A. 1969 (Worker's Compensation) and
Part 5 of Act 451 of 1994, as amended.*

VERIFICATION OF WORKER'S DISABILITY COMPENSATION ACT COMPLIANCE

- This verification must be completed and submitted within 21 days of contract award and prior to the issuance of the timber sale contract.
- In addition, if boxes 2B or 2C are checked, then Notice of Exclusion or Certificate of Insurance must be submitted within twenty-one (21) days of the contract award and prior to the issuance of the timber sale contract.
- All information must be typed or printed except for written signatures.

Please Check Appropriate Categories:

1. My business is organized as (you **must** check one of the boxes below):
 - A. Sole Proprietorship (individual)
 - B. Partnership
 - C. Corporation

2. You **must** check one of the boxes below:
 - A. I certify my business is a sole proprietorship and it has no employees but the sole proprietor. I am not subject to the Worker's Compensation Laws.
 - B. I certify my business has satisfied its obligation to the Worker's Compensation Act through the use of an approved Notice of Exclusion (BWC-337, Rev. 5/96). I will provide a copy of the Notice of Exclusion within 21 days of the contract award. (For questions or a copy of the BWC-337, please call the Worker's Compensation Bureau at 517-322-1195).
 - C. I certify my business has a Worker's Compensation Policy. I will provide an original Certificate of Insurance within twenty-one (21) days of the contract award.

3. If you have checked item 2(A) or 2(B), you **must** indicate the number of **both** full-time and part-time employees, other than yourself, including family members and active partners (if none, you must enter "0").

_____ Full-time Employees

_____ Part-time Employees

Name of Business		Federal ID (or) Social Security No.	
Address		Telephone ()	
City	State	ZIP	

I hereby certify that the above information is true and correct. I agree to notify the Michigan DNR of any changes that occur in factors affecting my coverage during any of my present and future operations.

Signature of Owner or Authorized Representative

Title

Date

Please complete the "SEALED BID" information on the next page

GEMMA East (12-017-19)
T43N, R28W, SEC. 11; T43N, R28W, SEC. 12; Dickinson COUNTY

In response to the notice of sale to be held 8:30 a.m. (local time) on November 6, 2019, I am hereby submitting my sealed bid (firm offer) for the following forest products to be cut. Bids for individual species must be at or above the advertised price. All non-responsive bid forms may be rejected.

<u>PRODUCTS & SPECIES</u>	<u>ESTIMATED VOLUME*</u>	<u>ADVERTISED PRICE</u>	<u>BID PRICE/UNIT</u>
Pulpwood			
Balsam Fir	179.00 Cords	\$ 20.50/Cord	\$ _____
Mixed Aspen	1,270.00 Cords	\$ 45.40/Cord	\$ _____
Mixed Hardwood	28.00 Cords	\$ 22.20/Cord	\$ _____
Mixed Spruce	285.00 Cords	\$ 25.80/Cord	\$ _____
Tamarack	5.00 Cords	\$ 4.75/Cord	\$ _____

*The volumes are statistically estimated within plus (+) or minus (-) 12.59 percent. These estimated volumes are final and not subject to adjustment. Prospective bidders are urged to examine this timber and to make their own estimates of quantity and quality.

I understand that any or all bids may be rejected. All bids must be signed and all bid items must be bid or the bid form may be rejected. I also understand that consideration and awarding a contract will be based upon my past performance and ability to complete the contract based upon equipment and staffing subject to my control.

FEDERAL ID: _____ or SOCIAL SECURITY NUMBER: _____ Company or individual bidding: _____ Company representative's name: _____ Address: _____ City: _____ State: _____ Zip: _____

IF AVAILABLE, PLEASE PLACE THE PERSONALIZED LABEL FROM YOUR PROSPECTUS IN THE ABOVE BOX.

Individual or company representative's signature: _____ Date: _____

Phone number : _____ Email (optional): _____

THE WINNING BIDDER MUST COMPLETE THE VERIFICATION OF WORKER'S DISABILITY COMPENSATION ACT COMPLIANCE (ON REVERSE SIDE IF DOUBLE SIDED) WITHIN 21 DAYS OF SALE AWARD DATE



FOR DEPARTMENT USE ONLY
Sale Number (XX - XXX - XX - XX)
Forest Management Unit:

TIMBER SALE VERIFICATION OF WORKER'S DISABILITY COMPENSATION ACT COMPLIANCE

*As required by Act 317, P.A. 1969 (Worker's Compensation) and
Part 5 of Act 451 of 1994, as amended.*

VERIFICATION OF WORKER'S DISABILITY COMPENSATION ACT COMPLIANCE

- This verification must be completed and submitted within 21 days of contract award and prior to the issuance of the timber sale contract.
- In addition, if boxes 2B or 2C are checked, then Notice of Exclusion or Certificate of Insurance must be submitted within twenty-one (21) days of the contract award and prior to the issuance of the timber sale contract.
- All information must be typed or printed except for written signatures.

Please Check Appropriate Categories:

1. My business is organized as (you **must** check one of the boxes below):
 - A. Sole Proprietorship (individual)
 - B. Partnership
 - C. Corporation

2. You **must** check one of the boxes below:
 - A. I certify my business is a sole proprietorship and it has no employees but the sole proprietor. I am not subject to the Worker's Compensation Laws.
 - B. I certify my business has satisfied its obligation to the Worker's Compensation Act through the use of an approved Notice of Exclusion (BWC-337, Rev. 5/96). I will provide a copy of the Notice of Exclusion within 21 days of the contract award. (For questions or a copy of the BWC-337, please call the Worker's Compensation Bureau at 517-322-1195).
 - C. I certify my business has a Worker's Compensation Policy. I will provide an original Certificate of Insurance within twenty-one (21) days of the contract award.

3. If you have checked item 2(A) or 2(B), you **must** indicate the number of **both** full-time and part-time employees, other than yourself, including family members and active partners (if none, you must enter "0").

_____ Full-time Employees

_____ Part-time Employees

Name of Business		Federal ID (or) Social Security No.	
Address		Telephone ()	
City	State	ZIP	

I hereby certify that the above information is true and correct. I agree to notify the Michigan DNR of any changes that occur in factors affecting my coverage during any of my present and future operations.

Signature of Owner or Authorized Representative

Title

Date

Please complete the "SEALED BID" information on the next page