



**DEPARTMENT OF NATURAL RESOURCES
STATE OF MICHIGAN**

TIMBER SALE PROSPECTUS #6747

SCHEDULED SALE DATE AND TIME: 3:00 p.m. (local time) on November 24, 2020.

LOCATION: **BALDWIN FIELD OFFICE, 2468 W 24TH STREET, BALDWIN, MI 49304.**

PROSPECTUS NOTE: The bidder is advised to inspect the sale area and review the location, estimated volumes, operating costs and contract terms of proposed sales. Please be aware that some landowners may request 60 days or more notice for access across their land.

Notice is hereby given that bids will be received by the Unit Manager, CADILLAC MANAGEMENT UNIT, for certain timber on the following described lands:

Bear Bait Aspen (63-005-20) / T24N, R08W, SEC. 7 , NWNW,S1/2NW,N1/2SW,SESW,W1/2SE.

T24N, R09W, SEC. 12, E1/2NE,NESE.

Wexford County, Advertised Price \$55,647.35, 83.8 Acres, Aspen, White Pine.

SALE NOTE: Operations are limited to dry summer or winter cut only (see spec 5.2.3.1).

Wood Tick Mix (63-006-20) / T24N, R08W, SEC. 17, SWSW.

T24N, R08W, SEC. 18, SESE.

T24N, R08W, SEC. 19, E1/2NE,SE.

T24N, R08W, SEC. 20, W1/2NW,NWSW.

T24N, R08W, SEC. 30, NWNE.

Missaukee County, Advertised Price \$158,193.30, 197.9 Acres, Hardwood, Aspen.

SALE NOTE: Oak wilt specifications apply to Payment Units 1 and 2 (see spec 5.2.3.5).

A recreation site such as a trail, pathway, or campground is within the sale area or the vicinity. Certain restrictions/specifications may be applicable including time restrictions.

Lost Channel Locks Aspen (63-007-20) / T24N, R08W, SEC. 19, SESE.

T24N, R08W, SEC. 20, SENW,S1/2NE,SW,SE.

Missaukee County, Advertised Price \$89,184.90, 116.5 Acres, Hardwood, Aspen.

SALE NOTE: Road work will be needed to access this sale off of state land (see spec 4.1.8).

BID INSTRUCTIONS (VER. 07/02/2018):

1. Scheduled Bid Location, Date, and Time (2/11)

Bids must be received by the Unit Manager, BALDWIN FIELD OFFICE, 2468 W 24th Street, Baldwin, MI 49304, no later than 3:00 p.m. (local time) on November 24, 2020. For further information concerning this sale, contact Tom Peterson at 231-878-4143 extension .

2. Bidder's Qualifications (5/16)

Purchaser shall obtain workers compensation insurance to cover claims under Michigan's Worker's Disability Compensation Act of 1969 or similar employee benefit act of any other state applicable to an employee. If all or part of a timber sale was prepared by a private contractor, the contractor and that contractor's company are not permitted to bid on the timber sale contract. Bids will not be accepted from individuals or companies appearing on the DNR/FRD No-Bid List. This list contains the names of purchasers who previously failed to execute a contract within 21-days or who have a history of poor performance.

3. Preparation of Sealed Bids (5/16)

Bid Forms may be completed online thru Michigan DNR Timber Sale Online Bidding (OLB) at www.michigan.gov/timberbidding or by completing the hardcopy Bid Form found in the Timber Sale Prospectus . Hardcopy Bid Forms shall be manually signed in ink. Registration in OLB is considered your 'signature' for all bids submitted thru that system. Bid prices must be entered for each species and product in the Bid Price column for all material subject to bidding and all fill-in blanks must be completed. If erasures or other changes appear on the hardcopy Bid Form, each erasure or change must be initialed by the person signing the bid.

4. Submission of Sealed Bids (5/16)

Bid forms may be obtained from the Unit Manager or thru OLB. Bids may be submitted hardcopy or thru OLB. All hardcopy bids must be submitted on the bid form and in an envelope clearly identified as described in this section. NOTE: Only one bid form per bid envelope. Sealed bids must be submitted to the Unit office designated in the prospectus and must be submitted at or prior to the time established in the prospectus. The envelope should show on the outside (a) the sale name or number and (b) the date and time of bid opening, as shown in the prospectus. Bids received after the time specified in the sale prospectus are late bids and will be rejected.

It is possible for a bidder to submit multiple bids on a single sale. For example, a bid may be submitted hardcopy and a bid may be submitted thru OLB. Or, two bidders from the same company could both submit bids on the same sale. If this were to happen, the State would accept all bids received and award the contract accordingly. All bidding and contractual requirements would apply to all bids received.

5. Public Opening of Sealed Bids (7/16)

If conditions permit, the sealed bids will be publicly opened and posted at the time and place set in the prospectus.

If a bidder, present at a bid opening, has submitted bids on more than one sale, that bidder may withdraw their unopened bid envelopes or announce the withdrawal of their online bid after being declared the successful bidder on one sale.

6. Award of Contract (1/11)

Award of the contract will be made to the Bidder whose bid, conforming to the prospectus, is most advantageous to the State of Michigan on the basis of total value at rates bid for the estimated quantities. The State reserves the right to reject any bid or waive any minor irregularity in bids received. A written award mailed (or otherwise furnished) to the successful Bidder shall be deemed to result in a binding contract without further action by either party.

7. Down Payment (1/11)

The Bidder to whom award is made must make a down payment within 21 days of the sale award. The amount of the down payment will be calculated as shown in the Bond and Payment Schedule of this prospectus. Only cash may be used to meet this requirement.

8. Performance Security (1/11)

As guarantee of faithful performance, a cash bond, certificate of deposit, surety bond or irrevocable letter of credit (LOC) is required within 21 days of the sale award. The amount of the performance security is shown in the Bond and

Payment Schedule of this prospectus. If an LOC or surety is used, the coverage must extend for at least 6 months beyond the contract expiration.

9. Timber Sale Contract (7/18)

Additional conditions and requirements common to all timber sales are listed on the timber sale contract (R4031) and are available on line at www.michigan.gov/timber. Contact the Unit Manager for additional information or a sample contract. Within 21 days of the date of the award letter, the bidder must sign the contract and provide the required down payment, performance security, and verification of worker's disability compensation. The down payment and performance security shall be in accordance with the provisions of the timber sale contract, in the sums stated in this prospectus. If these actions are not taken, then the Bidder, the Bidder's corporation, and the corporation's principals may not be permitted to bid on State timber sales for a period of 3 months after the first offense, 6 months after the second offense, and 1 year after the third offense. An offense will only be counted against the Bidder for 5 years. In addition, the Bidder certifies that if awarded this contract, the Bidder will complete the timber sale contract in accordance with its terms and any modifications thereof including requirements to purchase, cut, and remove the included timber by the expiration date.

Payment Unit values in the State Forest Timber Sale Contract are calculated based on the advertised value of the Payment Unit as a percentage of the total advertised value of the contract. The advertised value of each Payment Unit is given in the Description of Timber by Payment Unit table on the Timber Sale Information page. For example, if the value of Payment Unit 1 is advertised as \$1,500 and the total Timber Sale value is advertised as \$10,000, the contract price for Payment Unit 1 will be 15% of the total bid price ($\$1,500/\$10,000 * 100$).

10. Disclaimer of Estimates and Bidder's Warranty of Inspection (7/16)

Before submitting this bid, the Bidder is advised and cautioned to inspect the sale area, review the requirements of the sale contract, and take other steps as may be reasonably necessary to ascertain the location, estimated volumes, construction estimates, and operating costs of the proposed sale. Failure to do so will not relieve the Bidder from responsibility for completing the contract.

The Bidder warrants that this bid is submitted solely on the basis of the Bidder's examination and inspection of the quality and quantity of the timber offered for sale and the Bidder's opinion of the value thereof and the costs of recovery. No reliance should be placed on the State of Michigan's estimates of timber quality, quantity or costs of recovery. Bidder further acknowledges that the State of Michigan: (i) expressly disclaims any warranty of fitness of timber for any purpose; (ii) offers this timber as is without any warranty of quality (merchantability) or quantity and (iii) expressly disclaims any warranty as to the quantity or quality of timber sold.

11. Certification and Chain-of-Custody (10/14)

Unless otherwise indicated in the contract under section 7 – Other Conditions of the Sale Specific Conditions & Requirements, the area encompassed by this timber sale is certified to the standards of the Forest Stewardship Council (FSC) - Certificate #SCS-FM/COC-00090N and the Sustainable Forestry Initiative (SFI) - Certificate #NSF-SFIS-5Y031-SF5. Forest products from this sale may be delivered to the mill as "FSC 100% and / or SFI certified" as long as the contractor hauling the forest products is chain-of-custody (COC) certified or covered under a COC certificate from the destination mill. The purchaser is responsible for maintaining COC after leaving the sale area.

12. Good Neighbor Authority (GNA) Requirements (7/16)

If the name of this timber sales contains the acronym GNA, it is authorized by the Good Neighbor Authority (GNA) and covered by various agreements between the U.S. Forest Service and the State. The timber sale occurs on federal land and the following conditions apply:

GNA contracts on US Forest Service land will not be awarded to purchasers on the Federal list of excluded parties. The System for Award Management (SAM) will be checked for active excluded parties prior to award of contract. In addition, the Bidder to whom award is made must complete an Assurance Regarding Felony Conviction or Tax Delinquent Status for Corporate Applicants (AD-3031).

13. Good Neighbor Authority (GNA) Requirements, con't (9/16)

Bidder certifies, by signing this bid form, that to the best of Bidder's knowledge that the following representations are accurate and complete.

- a. That the Bidder and its principals are not presently debarred, suspended, proposed for debarment, declared ineligible, or voluntary excluded from timber sales (covered transactions) by any Federal department or agency.
- b. That the Bidder and its principals have not within a 3-year period preceding this bid been convicted of or had a civil judgment rendered against them for commission of fraud or a criminal offense in connection with obtaining , attempting to obtain, or performing a public (Federal, State, or local) transaction or contract under a public transaction; violation of Federal or State antitrust statutes or commission of embezzlement, theft, forgery, bribery, falsification or destruction of records, making false statements, or receiving stolen property.
- c. That the Bidder and its principals are not presently indicted for or otherwise criminally or civilly charged by a governmental entity (Federal, State, or local) with commission of any of the offenses enumerated in paragraph b of this certification.
- d. That the Bidder and its principals have not within a 3-year period preceding this bid had one or more public transactions (Federal, State, or local) terminated for breach or default of a timber or forest product contract.

Bidders that cannot certify this requirement, in whole or in part, shall submit an explanation with their bid.

DAN EICHINGER
Director

TIMBER SALE INFORMATION

Bear Bait Aspen (63-005-20)
T24N, R08W, SEC. 7; T24N, R09W, SEC. 12.
Wexford County (Advertised Price \$55,647.35)

SALE NOTE: Operations are limited to dry summer or winter cut only (see spec 5.2.3.1).

A timber sale contract for this lump sum, sealed bid timber sale will be awarded to the responsible bidder offering the highest sealed bid price. All units of volume listed below were estimated using the T-Sale computer program and our traditional volume equations. Bids must be at or above the following advertised price for each product and species:

<u>PRODUCTS & SPECIES</u>	<u>ESTIMATED UNITS*</u>	<u>ADVERTISED PRICE</u>
Sawtimber		
Mixed Aspen	264.5 MBF	\$ 79.00 / MBF
Red Maple	29.7 MBF	\$ 74.00 / MBF
Red Oak	1.2 MBF	\$ 167.00 / MBF
White Pine	112.8 MBF	\$ 58.00 / MBF
Pulpwood		
Balsam Fir	389 Cords	\$ 7.95 / Cord
Mixed Aspen	1,194 Cords	\$ 11.70 / Cord
Mixed Hardwood	438 Cords	\$ 9.65 / Cord
Mixed Oak	30 Cords	\$ 12.50 / Cord
Red Pine	6 Cords	\$ 35.80 / Cord
White Pine	339 Cords	\$ 11.60 / Cord

* The total volume is statistically estimated within plus (+) or minus (-) 9.75 percent. There are an estimated 3,211 cords on this timber sale, plus or minus 313 cords at the 95% confidence level. The estimated units are final and not subject to adjustment. Prospective bidders are urged to examine this timber and to make their own estimates of quantity and quality.

BOND AND PAYMENT SCHEDULE:

1. A bond in the amount of \$2,782.00 to insure faithful performance of the conditions of the contract will be deposited by the successful bidder within 21 days of the sale award.
2. Cutting in any sale or unit without the required advance payment would be considered a trespass.
3. Total payment must be paid in advance or according to the following schedule :
 - (a) Ten percent (10%) of the sale value must be paid within 21 days of the sale award.
 - (b) The 10% down payment will be credited towards the first unit cut.
 - (c) Payment for each of the following units must be made before cutting begins in that unit:

PAYMENT UNIT NUMBER	PERCENT OF TOTAL SALE VALUE
01	35.5%
02	18.1%
03	27.6%
04	18.8%
4. If no cutting takes place, the 10% down payment will not be refunded.
5. Operations on the contract issued will terminate on 12/31/2023.

SALE STATISTICS

SALE VOLUMES

VOLUME		STATISTICAL RANGE IN CORDS		
TOTAL CUBIC FEET	TOTAL CORDS	PERCENT ERROR	MINIMUM	MAXIMUM
253,701	3,211	9.75%	2,898	3,525

VDU VOLUMES

A VDU is a Volume Determination Unit. Volumes and their associated statistics are calculated at the VDU level and summarized to the sale level. There is often a one to one relationship between a VDU and a Payment Unit, but not always, depending on the cruise design. Refer to the VDU TO PAYMENT UNIT table.

VDU	VOLUME		PERCENT ERROR	RANGE IN CORDS	
	TOTAL CUBIC FEET	TOTAL CORDS		MINIMUM	MAXIMUM
1	81,101	1,027	15.29%	870	1,184
3	120,933	1,531	12.79%	1,335	1,727
15	51,666	654	25.03%	490	818
TOTAL:	253,701	3,211		2,695	3,728

VDU TO PAYMENT UNIT

When a VDU is associated with more than one Payment Unit (PU), the VDU volumes are assigned to the PU based on acres of the VDU within the PU.

VDU	VDU ACRES	PU	PU ACRES
1	23.2	1	23.2
3	38.9	1	1.8
		2	14.7
		3	22.4
15	21.7	4	21.7
TOTAL:	83.8		83.8

DESCRIPTION OF TIMBER BY PAYMENT UNIT (PU)

PU	MARKET GROUP	PRODUCT	QUANTITY	UNIT	ACRES	ADVERTISE PRICE
1	Mixed Aspen	Sawtimber	99.0	MBF	25.0	\$19,704.40
	<i>B. T. Aspen</i>		93.9	<i>MBF</i>		
	<i>Quaking Aspen</i>		5.1	<i>MBF</i>		
	Red Maple		4.0	MBF		
	White Pine		58.0	MBF		
	Balsam Fir	Pulpwood	177	Cords		
	<i>Balsam Fir</i>	<i>Sawtimber</i>	8.3	<i>MBF</i>		
	<i>Balsam Fir</i>	<i>Pulpwood</i>	160	<i>Cords</i>		
	Mixed Aspen		340	Cords		
	<i>B. T. Aspen</i>		313	<i>Cords</i>		
	<i>Quaking Aspen</i>		27	<i>Cords</i>		
	Mixed Hardwood		93	Cords		
	<i>Paper Birch</i>	<i>Sawtimber</i>	1.4	<i>MBF</i>		
	<i>Sugar Maple</i>		1.1	<i>MBF</i>		
	<i>Paper Birch</i>	<i>Pulpwood</i>	35	<i>Cords</i>		
	<i>Red Maple</i>		46	<i>Cords</i>		
	<i>Sugar Maple</i>		5	<i>Cords</i>		
	<i>White Ash</i>		2	<i>Cords</i>		
	Mixed Oak		4	Cords		
	<i>Red Oak</i>		3	<i>Cords</i>		
	<i>White Oak</i>		1	<i>Cords</i>		
White Pine		163	Cords			
2	Mixed Aspen	Sawtimber	55.0	MBF	14.7	\$10,082.10
	<i>B. T. Aspen</i>		13.2	<i>MBF</i>		
	<i>Quaking Aspen</i>		41.8	<i>MBF</i>		
	Red Maple		6.8	MBF		
	White Pine		7.9	MBF		
	Balsam Fir	Pulpwood	57	Cords		
	<i>Balsam Fir</i>	<i>Sawtimber</i>	1.6	<i>MBF</i>		
	<i>Balsam Fir</i>	<i>Pulpwood</i>	54	<i>Cords</i>		
	Mixed Aspen		283	Cords		
	<i>B. T. Aspen</i>		66	<i>Cords</i>		
	<i>Quaking Aspen</i>		217	<i>Cords</i>		
	Mixed Hardwood		73	Cords		
	<i>Red Maple</i>		73	<i>Cords</i>		
	Mixed Oak		6	Cords		
	<i>White Oak</i>		6	<i>Cords</i>		
White Pine		20	Cords			
3	Mixed Aspen	Sawtimber	83.7	MBF	22.4	\$15,373.00
	<i>B. T. Aspen</i>		20.0	<i>MBF</i>		
	<i>Quaking Aspen</i>		63.7	<i>MBF</i>		
	Red Maple		10.4	MBF		
	White Pine		12.1	MBF		
	Balsam Fir	Pulpwood	87	Cords		
	<i>Balsam Fir</i>	<i>Sawtimber</i>	2.5	<i>MBF</i>		
	<i>Balsam Fir</i>	<i>Pulpwood</i>	82	<i>Cords</i>		
	Mixed Aspen		432	Cords		
	<i>B. T. Aspen</i>		101	<i>Cords</i>		
	<i>Quaking Aspen</i>		331	<i>Cords</i>		
	Mixed Hardwood		111	Cords		
	<i>Red Maple</i>		111	<i>Cords</i>		
	Mixed Oak		9	Cords		
	<i>White Oak</i>		9	<i>Cords</i>		
White Pine		31	Cords			
4	Mixed Aspen	Sawtimber	26.8	MBF	21.7	\$10,487.85
	<i>B. T. Aspen</i>		1.6	<i>MBF</i>		

DESCRIPTION OF TIMBER BY PAYMENT UNIT (PU), CON'T

PU	MARKET GROUP	PRODUCT	QUANTITY	UNIT	ACRES	ADVERTISE PRICE
4 con't	<i>Quaking Aspen</i>	<i>Sawtimber</i>	25.2	<i>MBF</i>		
	Red Maple		8.5	MBF		
	Red Oak		1.2	MBF		
	White Pine		34.8	MBF		
	Balsam Fir	Pulpwood	68	Cords		
	<i>Balsam Fir</i>	<i>Sawtimber</i>	2.3	<i>MBF</i>		
	<i>Balsam Fir</i>	<i>Pulpwood</i>	63	<i>Cords</i>		
	Mixed Aspen		139	Cords		
	<i>B. T. Aspen</i>		18	<i>Cords</i>		
	<i>Quaking Aspen</i>		121	<i>Cords</i>		
	Mixed Hardwood		161	Cords		
	<i>Black Cherry</i>		11	<i>Cords</i>		
	<i>Red Maple</i>		150	<i>Cords</i>		
	Mixed Oak		11	Cords		
	<i>Red Oak</i>		11	<i>Cords</i>		
	Red Pine		6	Cords		
	<i>Red Pine</i>	<i>Sawtimber</i>	2.6	<i>MBF</i>		
	<i>Red Pine</i>	<i>Pulpwood</i>	1	<i>Cords</i>		
	White Pine		125	Cords		
TOTAL:			408.2	MBF		
TOTAL:			2,396	Cords		

Sale Specific Conditions & Requirements

Sale Name: Bear Bait Aspen

Sale Number: 63-005-20 Seq#: 1

1 - Sale Area

1.2 - Boundaries

1.2.1 - Painted boundaries (9/19)

The sale boundary and Payment Unit boundaries are marked and identified by blue, red and yellow paint. Exterior sale boundary lines against private property are marked with blue paint. Exterior sale boundary lines against state are marked with red paint. Interior Payment Unit boundaries are marked with yellow paint. The painted boundary line trees are not Included Timber. Yellow painted trees designating an interior Payment Unit boundary are only to be cut when all surrounding Payment Units have been paid.

2 - Timber Specifications

2.1 - Included Timber

2.1.1 - Clearcut unit(s) with unmerchantable trees (6/14)

Within Payment Unit(s) 1-4, cut all trees that are two (2) inches or more at DBH, with the following exceptions:

- Within Payment Units 1, 2, and 3, do not white pine over 26 inches at DBH, or any cedar or hemlock.
- Within Payment Unit 4, do not cut white pine over 26 inches at DBH, or any white oak or cedar.

2.2 - Utilization

2.2.3 - Stump heights (4/07)

Stump heights within the Sale Area shall not exceed 12 inches for trees greater than 10 inches DBH and 4 inches for trees smaller than 10 inches DBH.

2.2.11 - Chipping restriction (9/14)

If chipping occurs on this sale, then no woody debris present on the ground at the start of the sale may be chipped. In addition, brush or chips may not be stored or stockpiled on-site for more than 30 days.

3 - Payments

3.3 - Pre-measured Sales

3.3.4 - Dividing payment units (7/14)

Payment Unit(s) may be divided at the request of the Purchaser and upon approval of the Unit Manager. Dividing Payment Units is a contract modification which requires a Timber Sale Contract Amendment. There will be only one division per Payment Unit if payment unit is greater than \$25,000.

4 - Transportation

4.1 - Construction

4.1.3 - Slash and earthen piles (8/04)

Piles or windrows of earth along roads and landings that have been widened or constructed shall be leveled. Slash from road maintenance or construction, including stumps, shall be dispersed throughout the sale.

4.1.11 - Permits (2/12)

The Purchaser will secure any necessary county road permits that may be required.

4.1.12 - No new roads (1/12)

No new roads will be permitted in any Payment Unit. All operations are limited to existing roads. Skid trails only will be allowed.

4.2 - Maintenance

4.2.5 - Two wheel drive condition (2/04)

All existing trail roads on and adjacent to the sale area must be passable by two-wheel drive traffic for the duration of the

sale.

5 - Operations

5.1 - Notification

5.1.1 - Pre-sale conference (10/16)

A pre-sale conference on site between the Purchaser and sale administrator is required prior to beginning any operations to determine landing and road locations. The Unit Manager or his/her representative must be contacted at least 5 days in advance to schedule the conference.

5.2 - Conduct of Operations

5.2.1 - Slash

5.2.1.8 - Slash height (12/08)

No slash or tree tops may exceed 24 inches in height.

5.2.3 - Operating Restrictions

5.2.3.1 - Operating restrictions (9/11)

Within Payment Unit(s) 1, 2, 3, and 4, unless changed by written agreement, cutting and skidding are limited to dry summer or winter cut only. This restriction is in place to protect the wet soils and reduce rutting in the sale area.

5.2.4 - Dead and Down Creation

5.2.4.4 - Dead and down creation, grouse (6/18)

To encourage grouse and other wildlife, in Payment Unit(s) 1, 2, 3 and 4, leave one, 12" diameter or larger log-length (8 foot minimum) piece on the ground for every 2 acres. These trees will be evenly scattered throughout the unit, preferably at least two chains from any roads, two-tracks, or trails open to vehicles. This can be an unmerchantable piece or a full tree. Each log must be clearly identified by a piece of blue flagging.

5.2.29 - Shrub protection (1/20)

Do not cut or damage hawthorn, witch-hazel, dogwood or junberry. These woody-shrub plants are highly beneficial to various wildlife species.

5.2.32 - Decking/landing restoration (9/13)

All decking and landing areas must have the surface area restored to a condition equal to or better than before. This is to ensure the proper regeneration of the stand. Wood debris, chips and "cookies" from trimmings must be removed or scattered away from landing and loading areas and may not be windrowed on the edge.

5.2.41 - Snowmobile trail protection (9/11)

The snowmobile trail must be protected. The snowmobile trail does not show up on Timber Sale Map. The snowmobile trail is to the south of timber sale. The snowmobile is part of a seasonal county road and will be used for hauling, this is the only access to the timber sale. Do not cut or damage posts with orange trail markers or traffic control signs. If the trail is used, it must be maintained and restored to a condition equal to or better than before the sale. The road maintenance/restoration must be done prior to December 1. If the trail is used for hauling, it must be graded to the satisfaction of the Unit Manager or his/her representative prior to December 1st. If the trail road is to be used for hauling during the snowmobile season, then a snow covered base must be left on the trail.

5.4 - Soil Protection

5.4.1 - Rutting restriction, general (7/16)

Operations are to cease immediately if equipment and weather conditions result in rutting of roads and/or skid trails which is 12 inches or greater in depth and 50 feet in length. The Unit Manager or his/her representative may restrict hauling and/or skidding if ruts exceed the specified depth. With the Unit Manager or his/her representative's approval, the Purchaser may return to the area when the risk of rutting has decreased.

6 - Safety and Fire Prevention

6.2 - Signing

6.2.1 - Road posting (9/09)

The Purchaser is responsible for posting and maintaining caution signs on all roads affected by timber sale prior to beginning operations. The road must be posted at appropriate distances from the sale area to warn of logging activity and truck traffic. Signs must be removed when harvest operations are suspended or completed. The Purchaser will provide these signs.

6.2.2 - Snowmobile trail posting (8/09)

The Purchaser is responsible for posting and maintaining caution signs on the snowmobile trail prior to beginning operations during the snowmobile season (approximately December 1 to March 31). The trail must be posted at appropriate distances from the sale area to warn of logging activity and truck traffic. Signs must be removed when harvest operations are suspended or completed. The Purchaser will provide these signs. Note that the timber sale will need to be signed for hauling purposes only, and is not affected by the snowmobile trail.



Sale Number	Year
63-005	20

TIMBER SALE MAP

This information provided by authority of Part 525, 1994 PA 451, as amended.

Forest Management Unit	County	Mapped By	Date	Page	of
Cadillac Management Unit	Missaukee	Tom Peterson	07/22/2020	1	1
Township	Range	Section(s) and Subdivision(s)	Scale		
24N	08W	Sec 7 - W1/2NW, SENW, NWSW, E1/2SW, W1/2SE	1:15,840		

Cover Type				Density	
A = Aspen	H = Hemlock	N = Marsh	U = Upland Brush	0 = Non Stocked	5 = Pole Timber Medium
B = Paper Birch	J = Jack Pine	O = Oak	UM = Upland Mixed	1 = Seedling Sapling Poor	6 = Pole Timber Well
C = Cedar	L = Lowland Brush	P = Lowland Poplar	V = Bog or Marsh	2 = Seedling Sapling Medium	7 = Saw Timber Poor
D = Treed Bog	LM = Lowland Mixed	Q = Mixed Swamp Conifer	W = White Pine	3 = Seedling Sapling Well	8 = Saw Timber Medium
E = Swamp Hdwoods	M = Mpl, Bch, Brch	R = Red Pine	X = Non Stocked	4 = Pole Timber Poor	9 = Saw Timber Well
F = Spruce Fir	MC = Mixed Conifer	S = Black Spruce	Z = Water		
G = Grass	MD = Mixed Deciduous	T = Tamarack			

PU	Acres	PU	Acres
1	25.0	4	21.7
2	14.7		
3	22.4		

Bear Bait Aspen

Compartment 63118
83.8 Acres

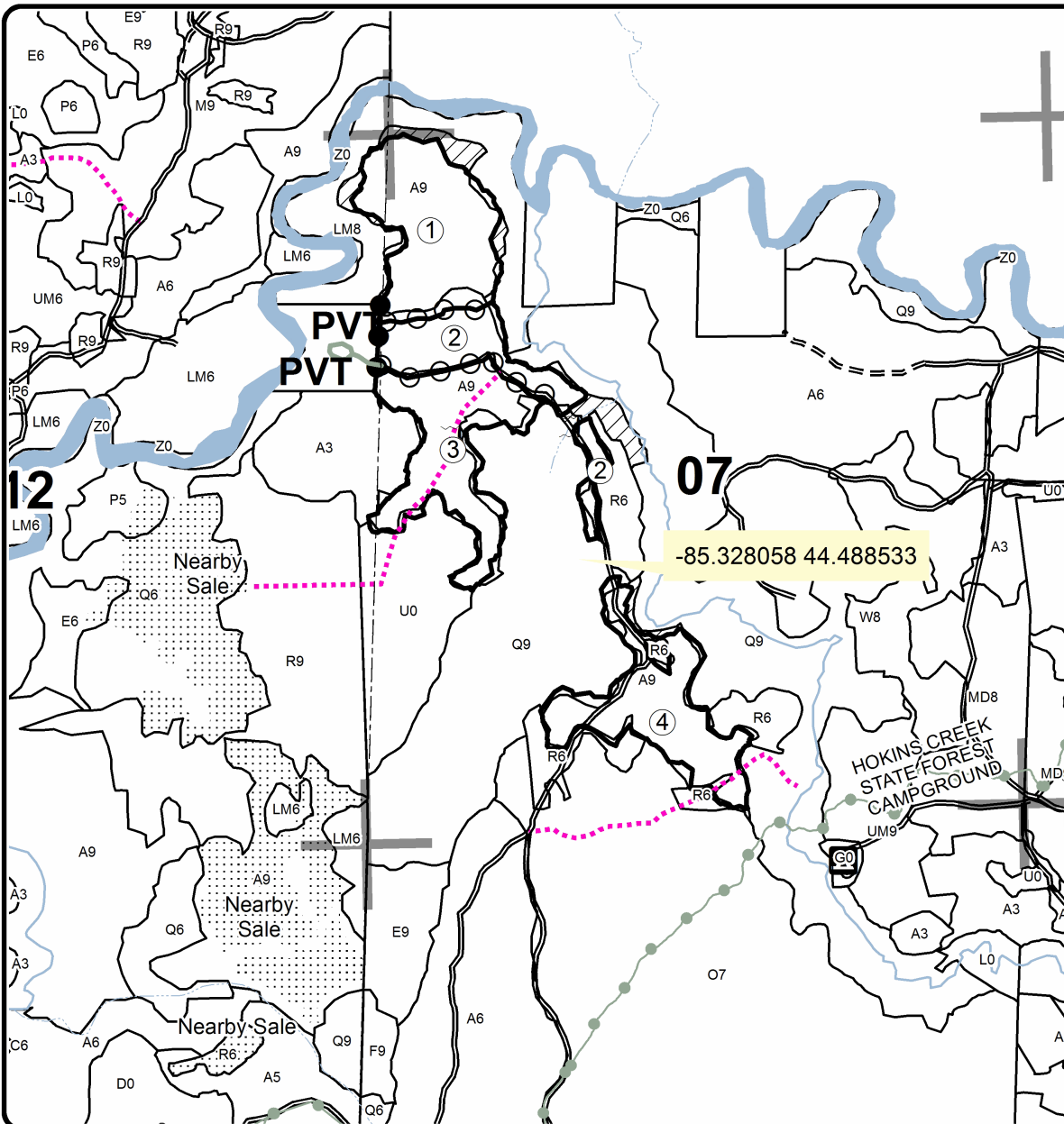

Legend

- Recreational Trails
- Primary Forest Road
- Secondary Forest Road
- Forest Access Route
- Paved Road
- Gravel Road
- County Road - Seasonal
- Private
- Temporary Management Access
- Retention Area
- Against State (Red)
- Payment Unit (Yellow)
- Private Line (Blue)

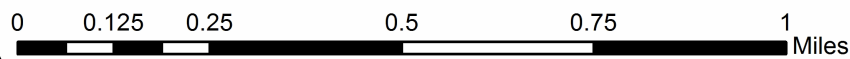

TIMBER SALE INFORMATION

Wood Tick Mix (63-006-20)

T24N, R08W, SEC. 17; T24N, R08W, SEC. 18; T24N, R08W, SEC. 19; T24N, R08W, SEC. 20; T24N, R08W, SEC. 30.
Missaukee County (Advertised Price \$158,193.30)

SALE NOTE: Oak wilt specifications apply to Payment Units 1 and 2 (see spec 5.2.3.5).

A recreation site such as a trail, pathway, or campground is within the sale area or the vicinity. Certain restrictions/specifications may be applicable including time restrictions.

A timber sale contract for this lump sum, sealed bid timber sale will be awarded to the responsible bidder offering the highest sealed bid price. All units of volume listed below were estimated using the T-Sale computer program and our traditional volume equations. Bids must be at or above the following advertised price for each product and species:

<u>PRODUCTS & SPECIES</u>	<u>ESTIMATED UNITS*</u>	<u>ADVERTISED PRICE</u>
Sawtimber		
Black Cherry	3.2 MBF	\$ 208.00 / MBF
Mixed Aspen	189.0 MBF	\$ 79.00 / MBF
Paper Birch	1.7 MBF	\$ 28.00 / MBF
Red Maple	29.0 MBF	\$ 74.00 / MBF
Red Oak	482.6 MBF	\$ 167.00 / MBF
Red Pine	57.0 MBF	\$ 82.00 / MBF
White Pine	53.3 MBF	\$ 58.00 / MBF
Pulpwood		
Balsam Fir	18 Cords	\$ 7.95 / Cord
Mixed Aspen	1,207 Cords	\$ 11.70 / Cord
Mixed Hardwood	748 Cords	\$ 9.65 / Cord
Mixed Oak	1,641 Cords	\$ 12.50 / Cord
Red Pine	211 Cords	\$ 35.80 / Cord
White Pine	215 Cords	\$ 11.60 / Cord

* The total volume is statistically estimated within plus (+) or minus (-) 7.85 percent. There are an estimated 5,671 cords on this timber sale, plus or minus 445 cords at the 95% confidence level. The estimated units are final and not subject to adjustment. Prospective bidders are urged to examine this timber and to make their own estimates of quantity and quality.

BOND AND PAYMENT SCHEDULE:

1. A bond in the amount of \$7,910.00 to insure faithful performance of the conditions of the contract will be deposited by the successful bidder within 21 days of the sale award.
2. Cutting in any sale or unit without the required advance payment would be considered a trespass.
3. Total payment must be paid in advance or according to the following schedule :
 - (a) Ten percent (10%) of the sale value must be paid within 21 days of the sale award.
 - (b) The 10% down payment will be credited towards the first unit cut.
 - (c) Payment for each of the following units must be made before cutting begins in that unit:

PAYMENT UNIT NUMBER	PERCENT OF TOTAL SALE VALUE
01	27.1%
02	41.5%
03	7.0%
04	17.1%
05	7.3%
4. If no cutting takes place, the 10% down payment will not be refunded.
5. Operations on the contract issued will terminate on 12/31/2023.

SALE STATISTICS

SALE VOLUMES

VOLUME		STATISTICAL RANGE IN CORDS		
TOTAL CUBIC FEET	TOTAL CORDS	PERCENT ERROR	MINIMUM	MAXIMUM
448,042	5,671	7.85%	5,226	6,117

VDU VOLUMES

A VDU is a Volume Determination Unit. Volumes and their associated statistics are calculated at the VDU level and summarized to the sale level. There is often a one to one relationship between a VDU and a Payment Unit, but not always, depending on the cruise design. Refer to the VDU TO PAYMENT UNIT table.

VDU	VOLUME		PERCENT ERROR	RANGE IN CORDS	
	TOTAL CUBIC FEET	TOTAL CORDS		MINIMUM	MAXIMUM
43	254,427	3,221	12.00%	2,834	3,607
50	47,850	606	17.47%	500	712
57	121,542	1,539	12.15%	1,352	1,725
71	24,190	306	22.05%	239	374
TOTAL:	448,009	5,671		4,924	6,418

VDU TO PAYMENT UNIT

When a VDU is associated with more than one Payment Unit (PU), the VDU volumes are assigned to the PU based on acres of the VDU within the PU.

VDU	VDU ACRES	PU	PU ACRES
43	114.0	1	45.0
		2	69.0
50	17.2	3	17.2
57	49.2	4	49.2
71	17.5	5	17.5
TOTAL:	197.9		197.9

DESCRIPTION OF TIMBER BY PAYMENT UNIT (PU)

PU	MARKET GROUP	PRODUCT	QUANTITY	UNIT	ACRES	ADVERTISE PRICE	
1	Mixed Aspen	Sawtimber	25.9	MBF	45.0	\$42,874.70	
	<i>B. T. Aspen</i>		25.9	<i>MBF</i>			
	Red Maple		4.4	MBF			
	Red Oak		182.4	MBF			
	Mixed Aspen		Pulpwood	96			Cords
	<i>B. T. Aspen</i>			96			<i>Cords</i>
	Mixed Hardwood			160			Cords
	<i>Beech</i>			5			<i>Cords</i>
	<i>Red Maple</i>			155			<i>Cords</i>
	Mixed Oak			590			Cords
	<i>Red Oak</i>			590			<i>Cords</i>
2	Mixed Aspen	Sawtimber	39.7	MBF	69.0	\$65,748.10	
	<i>B. T. Aspen</i>		39.7	<i>MBF</i>			
	Red Maple		6.8	MBF			
	Red Oak		279.7	MBF			
	Mixed Aspen		Pulpwood	148			Cords
	<i>B. T. Aspen</i>			148			<i>Cords</i>
	Mixed Hardwood			244			Cords
	<i>Beech</i>			7			<i>Cords</i>
	<i>Red Maple</i>			237			<i>Cords</i>
	Mixed Oak			905			Cords
<i>Red Oak</i>	905	<i>Cords</i>					
3	Mixed Aspen	Sawtimber	45.8	MBF	17.2	\$11,042.65	
	<i>B. T. Aspen</i>		45.8	<i>MBF</i>			
	Red Maple		6.3	MBF			
	Red Oak		7.0	MBF			
	White Pine		8.3	MBF			
	Balsam Fir		Pulpwood	4			Cords
	Mixed Aspen			220			Cords
	<i>B. T. Aspen</i>			220			<i>Cords</i>
	Mixed Hardwood			149			Cords
	<i>Beech</i>			7			<i>Cords</i>
	<i>Paper Birch</i>			13			<i>Cords</i>
	<i>Red Maple</i>			129			<i>Cords</i>
	Mixed Oak			34			Cords
	<i>Red Oak</i>			34			<i>Cords</i>
	Red Pine		4	Cords			
White Pine	60	Cords					
4	Black Cherry	Sawtimber	3.2	MBF	49.2	\$27,024.05	
	Mixed Aspen		77.6	MBF			
	<i>B. T. Aspen</i>		22.2	<i>MBF</i>			
	<i>Quaking Aspen</i>		55.4	<i>MBF</i>			
	Paper Birch		1.7	MBF			
	Red Maple		11.5	MBF			
	Red Oak		13.5	MBF			
	Red Pine		4.9	MBF			
	White Pine		45.0	MBF			
	Balsam Fir		Pulpwood	14			Cords
	Mixed Aspen			743			Cords
	<i>B. T. Aspen</i>			138			<i>Cords</i>
	<i>Quaking Aspen</i>			605			<i>Cords</i>
	Mixed Hardwood			195			Cords
	<i>Black Cherry</i>			13			<i>Cords</i>
	<i>Paper Birch</i>			8			<i>Cords</i>
	<i>Red Maple</i>			174			<i>Cords</i>
Mixed Oak	112	Cords					

DESCRIPTION OF TIMBER BY PAYMENT UNIT (PU), CON'T

PU	MARKET GROUP	PRODUCT	QUANTITY	UNIT	ACRES	ADVERTISE PRICE
4 con't	<i>White Oak</i>	<i>Sawtimber</i>	1.9	<i>MBF</i>		
	<i>Red Oak</i>	<i>Pulpwood</i>	75	<i>Cords</i>		
	<i>White Oak</i>		33	<i>Cords</i>		
	Red Pine		5	Cords		
	White Pine		155	Cords		
5	Red Pine	Sawtimber	52.1	MBF	17.5	\$11,503.80
	Red Pine	Pulpwood	202	Cords		
TOTAL:			815.8	MBF		
TOTAL:			4,040	Cords		

Sale Specific Conditions & Requirements

Sale Name: Wood Tick Mix

Sale Number: 63-006-20 Seq#: 1

1 - Sale Area

1.2 - Boundaries

1.2.1 - Painted boundaries (9/19)

The sale boundary and Payment Unit boundaries are marked and identified by blue, red and yellow paint. Exterior sale boundary lines against private property are marked with blue paint. Exterior sale boundary lines against state are marked with red paint. Interior Payment Unit boundaries are marked with yellow paint. Retention patches are marked with red paint; no harvesting activities may occur within these areas. The painted boundary line trees are not Included Timber and are to be protected unless marked with orange paint (Payment Unit 5 only). Yellow painted trees designating an interior Payment Unit boundary are only to be cut when all surrounding Payment Units have been paid.

2 - Timber Specifications

2.1 - Included Timber

2.1.1 - Clearcut unit(s) with unmerchantable trees (6/14)

Within Payment Unit(s) 1-4, cut all trees that are two (2) inches or more at DBH. In addition, within Payments Units 1 and 2, do not cut any white pine, red pine, hemlock, or white oak. Also, within Payment Units 3 and 4, do not cut any pine less than 4 inches at DBH, or any cedar or hemlock.

2.1.3 - Cut tree marked unit(s) (12/08)

Within Payment Unit(s) 5, all trees are designated for cutting when marked with orange paint above and below stump height, regardless of merchantability.

2.2 - Utilization

2.2.3 - Stump heights (4/07)

Stump heights within the Sale Area shall not exceed 12 inches for trees greater than 10 inches DBH and 4 inches for trees smaller than 10 inches DBH.

2.2.11 - Chipping restriction (9/14)

If chipping occurs on this sale, then no woody debris present on the ground at the start of the sale may be chipped. In addition, brush or chips may not be stored or stockpiled on-site for more than 30 days.

3 - Payments

3.3 - Pre-measured Sales

3.3.4 - Dividing payment units (7/14)

Payment Unit(s) greater than \$25,000 may be divided at the request of the Purchaser and upon approval of the Unit Manager. Dividing Payment Units is a contract modification which requires a Timber Sale Contract Amendment. There will be only one division per Payment Unit.

4 - Transportation

4.1 - Construction

4.1.3 - Slash and earthen piles (8/04)

Piles or windrows of earth along roads and landings that have been widened or constructed shall be leveled. Slash from road maintenance or construction, including stumps, shall be dispersed throughout the sale.

4.1.11 - Permits (2/12)

The Purchaser will secure any necessary county road permits that may be required.

4.1.12 - No new roads (1/12)

No new roads will be permitted in any Payment Unit. All operations are limited to existing roads. Skid trails only will be allowed.

4.2 - Maintenance

4.2.5 - Two wheel drive condition (2/04)

All existing trail roads on and adjacent to the sale area must be passable by two-wheel drive traffic for the duration of the sale.

5 - Operations

5.1 - Notification

5.1.1 - Pre-sale conference (10/16)

A pre-sale conference on site between the Purchaser and sale administrator is required prior to beginning any operations to determine landing and road locations. The Unit Manager or his/her representative must be contacted at least 5 days in advance to schedule the conference.

5.2 - Conduct of Operations

5.2.1 - Slash

5.2.1.8 - Slash height (12/08)

No slash or tree tops may exceed 24 inches in height.

5.2.3 - Operating Restrictions

5.2.3.5 - Oak wilt restriction (1/18)

Within Payment Unit(s) 1 & 2, unless changed by written agreement, cutting, skidding, hauling within the sale and brushing of access roads to the sale are not permitted during the period of April 15 to July 15. Operations may be allowed if specific steps are taken to prevent damaging uncut oak during the high risk period. Those steps may include completing all road brushing before April 15th and clearing a tree-length buffer along uncut oak cover before April 15th. This is necessary to reduce the spread of oak wilt. For more information, contact the Unit Manager or his/her representative.

5.2.4 - Dead and Down Creation

5.2.4.4 - Dead and down creation, grouse (6/18)

To encourage grouse and other wildlife, in Payment Unit(s) 1-4, leave one, 12" diameter or larger log-length (8 foot minimum) piece on the ground for every 2 acres. These trees will be evenly scattered throughout the unit, preferably at least two chains from any roads, two-tracks, or trails open to vehicles.

5.2.20 - Equipment width (2/04)

Only equipment with a maximum width outside tires of 104 inches is to be used in Payment Unit 5. Equipment used to thin red pine must be capable of moving through cut rows without damaging residual trees.

5.2.29 - Shrub protection (1/20)

Do not cut or damage hawthorn, witch-hazel, dogwood or juneberry. These woody-shrub plants are highly beneficial to various wildlife species.

5.2.32 - Decking/landing restoration (9/13)

All decking and landing areas must have the surface area restored to a condition equal to or better than before. This is to ensure the proper regeneration of the stand. Wood debris, chips and "cookies" from trimmings must be removed or scattered away from landing and loading areas and may not be windrowed on the edge.

5.2.38 - No decking against live trees (2/04)

Cut products may not be decked against unmarked or designated leave trees.

5.2.40 - Pathway protection (10/10)

The trail is a horse / walking trail and is shown on the Timber Sale Map. Do not cut trees or damage posts with blue pathway markers. Maintain a 20-foot wide slash, debris, and rut free zone daily, using the pathway as the centerline. Do not run equipment down the pathway. Skidding across the trail may only occur in locations approved by the sale administrator.

5.2.41 - Snowmobile trail protection (9/11)

The snowmobile trail is shown on the Timber Sale Map. This spec will only affect the snowmobile trail if it is used for hauling. Do not cut or damage posts with orange trail markers or traffic control signs. If the trail is used, it must be maintained and

restored to a condition equal to or better than before the sale. The road maintenance / restoration must be done prior to December 1. If the trail is used for hauling, it must be graded to the satisfaction of the Unit Manager or his/her representative prior to December 1st. If the trail road is to be used for hauling during the snowmobile season, then a snow covered base must be left on the trail.

5.4 - Soil Protection

5.4.1 - Rutting restriction, general (7/16)

Operations are to cease immediately if equipment and weather conditions result in rutting of roads and/or skid trails which is 12 inches or greater in depth and 50 feet in length. The Unit Manager or his/her representative may restrict hauling and/or skidding if ruts exceed the specified depth. With the Unit Manager or his/her representative's approval, the Purchaser may return to the area when the risk of rutting has decreased.

6 - Safety and Fire Prevention

6.2 - Signing

6.2.1 - Road posting (9/09)

The Purchaser is responsible for posting and maintaining caution signs on Tuesdale Road prior to beginning operations. The road must be posted at appropriate distances from the sale area to warn of logging activity and truck traffic. Signs must be removed when harvest operations are suspended or completed. The Purchaser will provide these signs.

6.2.2 - Snowmobile trail posting (8/09)

The Purchaser is responsible for posting and maintaining caution signs on the snowmobile trail prior to beginning operations during the snowmobile season (approximately December 1 to March 31). The trail must be posted at appropriate distances from the sale area to warn of logging activity and truck traffic. Signs must be removed when harvest operations are suspended or completed. The Purchaser will provide these signs. If the Purchaser does not use the snowmobile trail for hauling, this spec does not apply.

6.2.3 - Recreational trail posting (2/10)

The Purchaser is responsible for posting and maintaining caution signs on horse trail prior to beginning operations. The trail must be posted at appropriate distances from the sale area to warn of logging activity and truck traffic at both ends of the trail. Signs must be removed when harvest operations are suspended or completed. The Purchaser will provide these signs.



TIMBER SALE MAP

This information provided by authority of Part 525, 1994 PA 451, as amended.

Forest Management Unit Cadillac Management Unit		County Missaukee County	Mapped By Tom Peterson	Date 08/03/2020	Page 1	of 1
Township 24N	Range 08W	Section(s) and Subdivision(s) Sections: 17, 18, 19, 20 & 30 - Various Location		Scale 1:15,840		

Cover Type				Density	
A = Aspen	H = Hemlock	N = Marsh	U = Upland Brush	0 = Non Stocked	5 = Pole Timber Medium
B = Paper Birch	J = Jack Pine	O = Oak	UM = Upland Mixed	1 = Seeding Sapling Poor	6 = Pole Timber Well
C = Cedar	L = Lowland Brush	P = Lowland Poplar	V = Bog or Marsh	2 = Seeding Sapling Medium	7 = Saw Timber Poor
D = Treed Bog	LM = Lowland Mixed	Q = Mixed Swamp Conifer	W = White Pine	3 = Seeding Sapling Well	8 = Saw Timber Medium
E = Swamp Hardwoods	M = Mpl. Ech. Birch	R = Red Pine	X = Non Stocked	4 = Pole Timber Poor	9 = Saw Timber Well
F = Spruce Fir	MC = Mixed Conifer	S = Black Spruce	Z = Water		
G = Cress	MD = Mixed Deciduous	T = Tamarack			

PU	Acres	PU	Acres
1	45.0	4	49.2
2	69.0	5	17.5
3	17.2		

Wood Tick Mix

Compartment 118

197.9 Acres

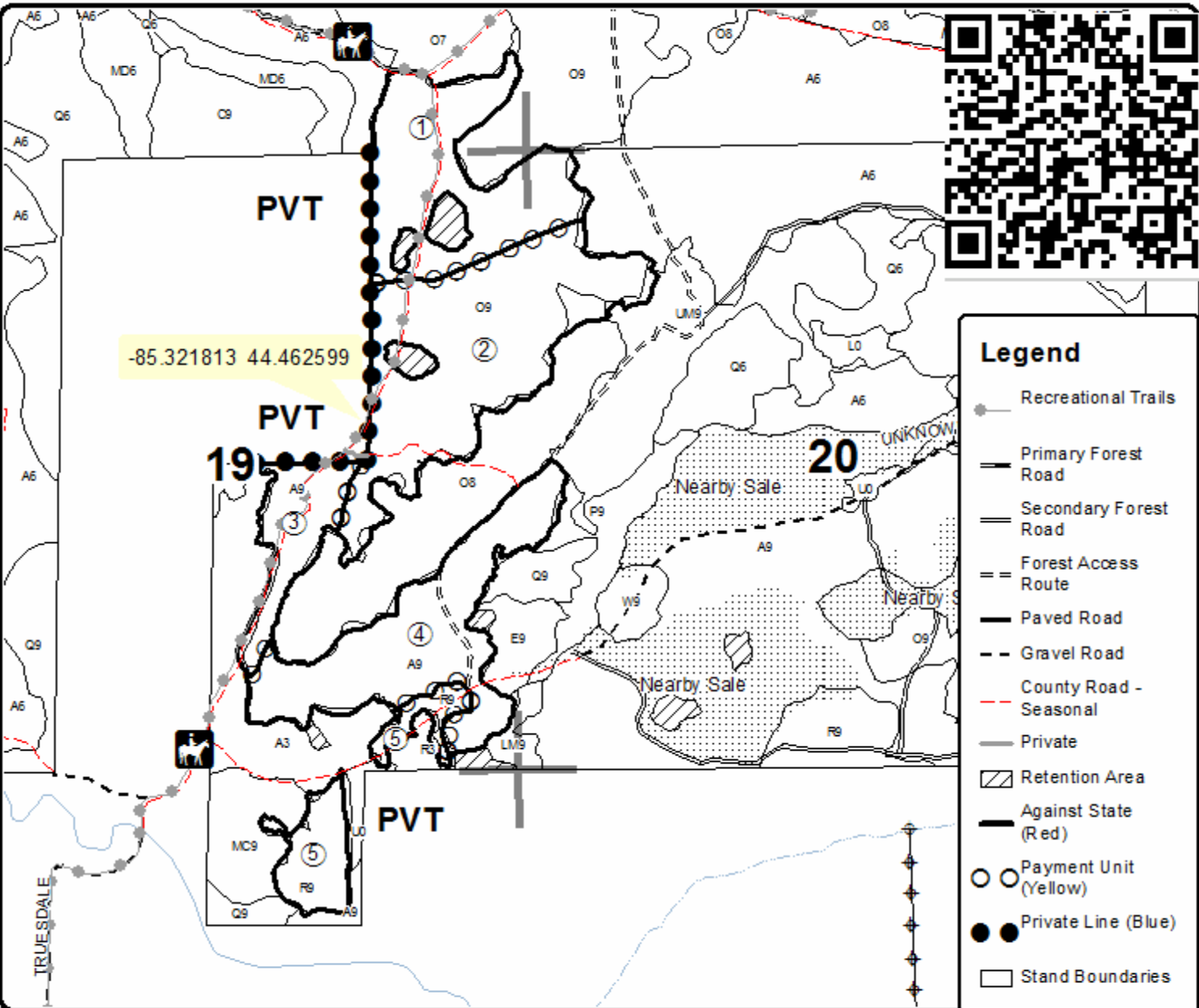

Legend

- Recreational Trails
- Primary Forest Road
- Secondary Forest Road
- Forest Access Route
- Paved Road
- Gravel Road
- County Road - Seasonal
- Private
- Retention Area
- Against State (Red)
- Payment Unit (Yellow)
- Private Line (Blue)
- Stand Boundaries

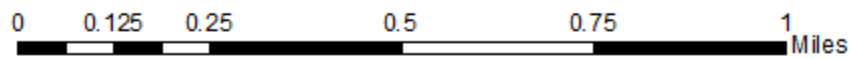

TIMBER SALE INFORMATION

Lost Channel Locks Aspen (63-007-20)
T24N, R08W, SEC. 19; T24N, R08W, SEC. 20.
Missaukee County (Advertised Price \$89,184.90)

SALE NOTE: Road work will be needed to access this sale off of state land (see spec 4.1.8).

A timber sale contract for this lump sum, sealed bid timber sale will be awarded to the responsible bidder offering the highest sealed bid price. All units of volume listed below were estimated using the T-Sale computer program and our traditional volume equations. Bids must be at or above the following advertised price for each product and species:

<u>PRODUCTS & SPECIES</u>	<u>ESTIMATED UNITS*</u>	<u>ADVERTISED PRICE</u>
Sawtimber		
Basswood	8.3 MBF	\$ 58.00 / MBF
Beech	45.0 MBF	\$ 44.00 / MBF
Black Cherry	5.9 MBF	\$ 208.00 / MBF
Mixed Aspen	193.3 MBF	\$ 79.00 / MBF
Paper Birch	0.7 MBF	\$ 28.00 / MBF
Red Maple	133.4 MBF	\$ 74.00 / MBF
Red Oak	72.4 MBF	\$ 167.00 / MBF
Red Pine	21.0 MBF	\$ 82.00 / MBF
Sugar Maple	31.2 MBF	\$ 165.00 / MBF
White Pine	51.0 MBF	\$ 58.00 / MBF
Pulpwood		
Balsam Fir	14 Cords	\$ 7.95 / Cord
Mixed Aspen	1,026 Cords	\$ 11.70 / Cord
Mixed Hardwood	2,036 Cords	\$ 9.65 / Cord
Mixed Oak	255 Cords	\$ 12.50 / Cord
Red Pine	20 Cords	\$ 35.80 / Cord
White Pine	237 Cords	\$ 11.60 / Cord

* The total volume is statistically estimated within plus (+) or minus (-) 8.47 percent. There are an estimated 4,713 cords on this timber sale, plus or minus 399 cords at the 95% confidence level. The estimated units are final and not subject to adjustment. Prospective bidders are urged to examine this timber and to make their own estimates of quantity and quality.

BOND AND PAYMENT SCHEDULE:

1. A bond in the amount of \$4,459.00 to insure faithful performance of the conditions of the contract will be deposited by the successful bidder within 21 days of the sale award.
2. Cutting in any sale or unit without the required advance payment would be considered a trespass.
3. Total payment must be paid in advance or according to the following schedule :
 - (a) Ten percent (10%) of the sale value must be paid within 21 days of the sale award.
 - (b) The 10% down payment will be credited towards the first unit cut.
 - (c) Payment for each of the following units must be made before cutting begins in that unit:

PAYMENT UNIT NUMBER	PERCENT OF TOTAL SALE VALUE
01	32.3%
02	35.2%
03	32.5%
4. If no cutting takes place, the 10% down payment will not be refunded.
5. Operations on the contract issued will terminate on 12/31/2023.

SALE STATISTICS

SALE VOLUMES

VOLUME		STATISTICAL RANGE IN CORDS		
TOTAL CUBIC FEET	TOTAL CORDS	PERCENT ERROR	MINIMUM	MAXIMUM
372,321	4,713	8.47%	4,314	5,112

VDU VOLUMES

A VDU is a Volume Determination Unit. Volumes and their associated statistics are calculated at the VDU level and summarized to the sale level. There is often a one to one relationship between a VDU and a Payment Unit, but not always, depending on the cruise design. Refer to the VDU TO PAYMENT UNIT table.

VDU	VOLUME		PERCENT ERROR	RANGE IN CORDS	
	TOTAL CUBIC FEET	TOTAL CORDS		MINIMUM	MAXIMUM
63	256,015	3,241	9.63%	2,929	3,553
70	116,288	1,472	14.91%	1,253	1,691
TOTAL:	372,303	4,713		4,181	5,244

VDU TO PAYMENT UNIT

When a VDU is associated with more than one Payment Unit (PU), the VDU volumes are assigned to the PU based on acres of the VDU within the PU.

VDU	VDU ACRES	PU	PU ACRES
63	86.6	1	41.4
		2	45.2
70	29.9	3	29.9
TOTAL:	116.5		116.5

DESCRIPTION OF TIMBER BY PAYMENT UNIT (PU)

PU	MARKET GROUP	PRODUCT	QUANTITY	UNIT	ACRES	ADVERTISE PRICE			
1	Basswood	Sawtimber	1.6	MBF	41.4	\$28,770.80			
	Beech		1.3	MBF					
	Black Cherry		1.7	MBF					
	Mixed Aspen		70.7	MBF					
	<i>B. T. Aspen</i>		27.1	<i>MBF</i>					
	<i>Quaking Aspen</i>		43.6	<i>MBF</i>					
	Red Maple		34.2	MBF					
	Red Oak		24.1	MBF					
	Red Pine		10.0	MBF					
	Sugar Maple		3.6	MBF					
	White Pine		24.4	MBF					
	Balsam Fir		Pulpwood	7			Cords		
	<i>Balsam Fir</i>			<i>Sawtimber</i>			0.9	<i>MBF</i>	
	<i>Balsam Fir</i>	<i>Pulpwood</i>		5			<i>Cords</i>		
	Mixed Aspen	445		Cords					
	<i>B. T. Aspen</i>	215		<i>Cords</i>					
	<i>Quaking Aspen</i>	230		<i>Cords</i>					
	Mixed Hardwood	525		Cords					
	<i>Basswood</i>	1		<i>Cords</i>					
	<i>Beech</i>	38		<i>Cords</i>					
	<i>Black Cherry</i>	13		<i>Cords</i>					
	<i>Paper Birch</i>	2		<i>Cords</i>					
	<i>Red Maple</i>	452		<i>Cords</i>					
	<i>Sugar Maple</i>	19		<i>Cords</i>					
	Mixed Oak	104		Cords					
	<i>Red Oak</i>	93		<i>Cords</i>					
	<i>White Oak</i>	11		<i>Cords</i>					
	Red Pine	10		Cords					
	White Pine	113		Cords					
	2	Basswood		Sawtimber			1.7	MBF	45.2
		Beech	1.5				MBF		
		Black Cherry	1.9				MBF		
Mixed Aspen		77.2	MBF						
<i>B. T. Aspen</i>		29.6	<i>MBF</i>						
<i>Quaking Aspen</i>		47.6	<i>MBF</i>						
Red Maple		37.3	MBF						
Red Oak		26.4	MBF						
Red Pine		11.0	MBF						
Sugar Maple		3.9	MBF						
White Pine		26.6	MBF						
Balsam Fir		Pulpwood	7		Cords				
<i>Balsam Fir</i>			<i>Sawtimber</i>		0.9	<i>MBF</i>			
<i>Balsam Fir</i>			<i>Pulpwood</i>	5	<i>Cords</i>				
Mixed Aspen			487	Cords					
<i>B. T. Aspen</i>			235	<i>Cords</i>					
<i>Quaking Aspen</i>			252	<i>Cords</i>					
Mixed Hardwood			575	Cords					
<i>Basswood</i>			2	<i>Cords</i>					
<i>Beech</i>			41	<i>Cords</i>					
<i>Black Cherry</i>			15	<i>Cords</i>					
<i>Paper Birch</i>			3	<i>Cords</i>					
<i>Red Maple</i>			493	<i>Cords</i>					
<i>Sugar Maple</i>			21	<i>Cords</i>					
Mixed Oak			115	Cords					
<i>Red Oak</i>			102	<i>Cords</i>					
<i>White Oak</i>			13	<i>Cords</i>					

DESCRIPTION OF TIMBER BY PAYMENT UNIT (PU), CON'T

PU	MARKET GROUP	PRODUCT	QUANTITY	UNIT	ACRES	ADVERTISE PRICE	
2 con't	Red Pine	Pulpwood	10	Cords			
	White Pine		124	Cords			
3	Basswood	Sawtimber	5.0	MBF	29.9	\$28,962.00	
	Beech		42.2	MBF			
	Black Cherry		2.3	MBF			
	Mixed Aspen		45.4	MBF			
	<i>B. T. Aspen</i>		45.4	<i>MBF</i>			
	Paper Birch		0.7	MBF			
	Red Maple		61.9	MBF			
	Red Oak		21.9	MBF			
	Sugar Maple		23.7	MBF			
	Mixed Aspen		Pulpwood	94			Cords
	<i>B. T. Aspen</i>			94			<i>Cords</i>
	Mixed Hardwood			936			Cords
	<i>Basswood</i>			8			<i>Cords</i>
	<i>Beech</i>	321		<i>Cords</i>			
	<i>Black Cherry</i>	10		<i>Cords</i>			
	<i>Paper Birch</i>	4		<i>Cords</i>			
	<i>Red Maple</i>	415	<i>Cords</i>				
	<i>Sugar Maple</i>	178	<i>Cords</i>				
	Mixed Oak	36	Cords				
	<i>Red Oak</i>	36	<i>Cords</i>				
TOTAL:			562.2	MBF			
TOTAL:			3,588	Cords			

Sale Specific Conditions & Requirements

Sale Name: Lost Channel Locks Aspen

Sale Number: 63-007-20 Seq#: 1

1 - Sale Area

1.2 - Boundaries

1.2.1 - Painted boundaries (9/19)

The sale boundary and Payment Unit boundaries are marked and identified by red paint. Exterior sale boundary lines against state are marked with red paint. Retention patches are marked with red paint; no harvesting activities may occur within these areas. The painted boundary line trees are not Included Timber.

2 - Timber Specifications

2.1 - Included Timber

2.1.1 - Clearcut unit(s) with unmerchantable trees (6/14)

Within Payment Unit(s) 1 and 2, cut all trees that are two (2) inches or more at DBH.

2.1.7 - Leave tree marked unit(s) (6/14)

Within Payment Unit(s) 3, cut all trees that are two (2) inches or more at DBH, except do not cut hemlock or any trees marked with green paint above and below stump height.

2.2 - Utilization

2.2.3 - Stump heights (4/07)

Stump heights within the Sale Area shall not exceed 12 inches for trees greater than 10 inches DBH and 4 inches for trees smaller than 10 inches DBH.

2.2.11 - Chipping restriction (9/14)

If chipping occurs on this sale, then no woody debris present on the ground at the start of the sale may be chipped. In addition, brush or chips may not be stored or stockpiled on-site for more than 30 days.

3 - Payments

3.3 - Pre-measured Sales

3.3.4 - Dividing payment units (7/14)

Payment Unit(s) may be divided at the request of the Purchaser and upon approval of the Unit Manager. Dividing Payment Units is a contract modification which requires a Timber Sale Contract Amendment. There will be only one division per Payment Unit.

4 - Transportation

4.1 - Construction

4.1.3 - Slash and earthen piles (8/04)

Piles or windrows of earth along roads and landings that have been widened or constructed shall be leveled. Slash from road maintenance or construction, including stumps, shall be dispersed throughout the sale.

4.1.8 - Road work (1) (8/07)

The following road work is required: A 1,000 foot section of road work will be required to get trucks in and out of the sale. This section is currently impassable due to a mud hole. Contact the sale administrator for additional information.

4.1.11 - Permits (2/12)

The Purchaser will secure any necessary county road permits that may be required.

4.2 - Maintenance

4.2.5 - Two wheel drive condition (2/04)

All existing trail roads on and adjacent to the sale area must be passable by two-wheel drive traffic for the duration of the sale.

5 - Operations

5.1 - Notification

5.1.1 - Pre-sale conference (10/16)

A pre-sale conference on site between the Purchaser and sale administrator is required prior to beginning any operations to determine landing and road locations. The Unit Manager or his/her representative must be contacted at least 5 days in advance to schedule the conference.

5.2 - Conduct of Operations

5.2.1 - Slash

5.2.1.8 - Slash height (12/08)

No slash or tree tops may exceed 24 inches in height.

5.2.3 - Operating Restrictions

5.2.3.4 - Oak wilt restriction, no exceptions (1/18)

Within Payment Unit(s) 3, cutting and skidding are not permitted during the period of April 15 to July 15. No exceptions will be granted. This is necessary to reduce the spread of oak wilt.

5.2.4 - Dead and Down Creation

5.2.4.4 - Dead and down creation, grouse (6/18)

To encourage grouse and other wildlife, in Payment Unit(s) 1, 2 and 3, leave one, 12" diameter or larger log-length (8 foot minimum) piece on the ground for every 2 acres. These trees will be evenly scattered throughout the unit, preferably at least two chains from any roads, two-tracks, or trails open to vehicles. This can be an unmerchantable piece or a full tree.

5.2.32 - Decking/landing restoration (9/13)

All decking and landing areas must have the surface area restored to a condition equal to or better than before. This is to ensure the proper regeneration of the stand. Wood debris, chips and "cookies" from trimmings must be removed or scattered away from landing and loading areas and may not be windrowed on the edge.

5.4 - Soil Protection

5.4.1 - Rutting restriction, general (7/16)

Operations are to cease immediately if equipment and weather conditions result in rutting of roads and/or skid trails which is 12 inches or greater in depth and 50 feet in length. The Unit Manager or his/her representative may restrict hauling and/or skidding if ruts exceed the specified depth. With the Unit Manager or his/her representative's approval, the Purchaser may return to the area when the risk of rutting has decreased.

6 - Safety and Fire Prevention

6.2 - Signing

6.2.1 - Road posting (9/09)

The Purchaser is responsible for posting and maintaining caution signs on state two tracks prior to beginning operations. The road must be posted at appropriate distances from the sale area to warn of logging activity and truck traffic. Signs must be removed when harvest operations are suspended or completed. The Purchaser will provide these signs.



Sale Number	Year
63-007	20

TIMBER SALE MAP

This information provided by authority of Part 525, 1994 PA 451, as amended.

Forest Management Unit Cadillac Management Unit	County Missaukee County	Mapped By Tom Peterson	Date 8/14/2020	Page 1	of 1
Township 24N	Range 08W	Section(s) and Subdivision(s) Sec 20 - S1/2, SENW, S1/2NE	Scale 1:15,840		

Cover Type				Density			
A = Aspen	H = Hemlock	N = Marsh	U = Upland Brush	0 = Non Stocked	5 = Pole Timber Medium		
B = Paper Birch	J = Jack Pine	O = Oak	UM = Upland Mixed	1 = Seedling Sapling Poor	6 = Pole Timber Well		
C = Cedar	L = Lowland Brush	P = Lowland Poplar	V = Bog or Marsh	2 = Seedling Sapling Medium	7 = Saw Timber Poor		
D = Treed Bog	LM = Lowland Mixed	Q = Mixed Swamp Conifer	W = White Pine	3 = Seedling Sapling Well	8 = Saw Timber Medium		
E = Swamp Hdwoods	M = Mpl, Bch, Brch	R = Red Pine	X = Non Stocked	4 = Pole Timber Poor	9 = Saw Timber Well		
F = Spruce Fir	MC = Mixed Conifer	S = Black Spruce	Z = Water				
G = Grass	MD = Mixed Deciduous	T = Tamarack					

PU	Acres
1	41.4
2	45.2
3	29.9

Lost Channel Locks Aspen

Compartment 63118

116.5 Acres

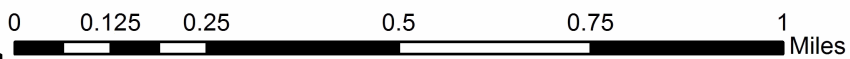
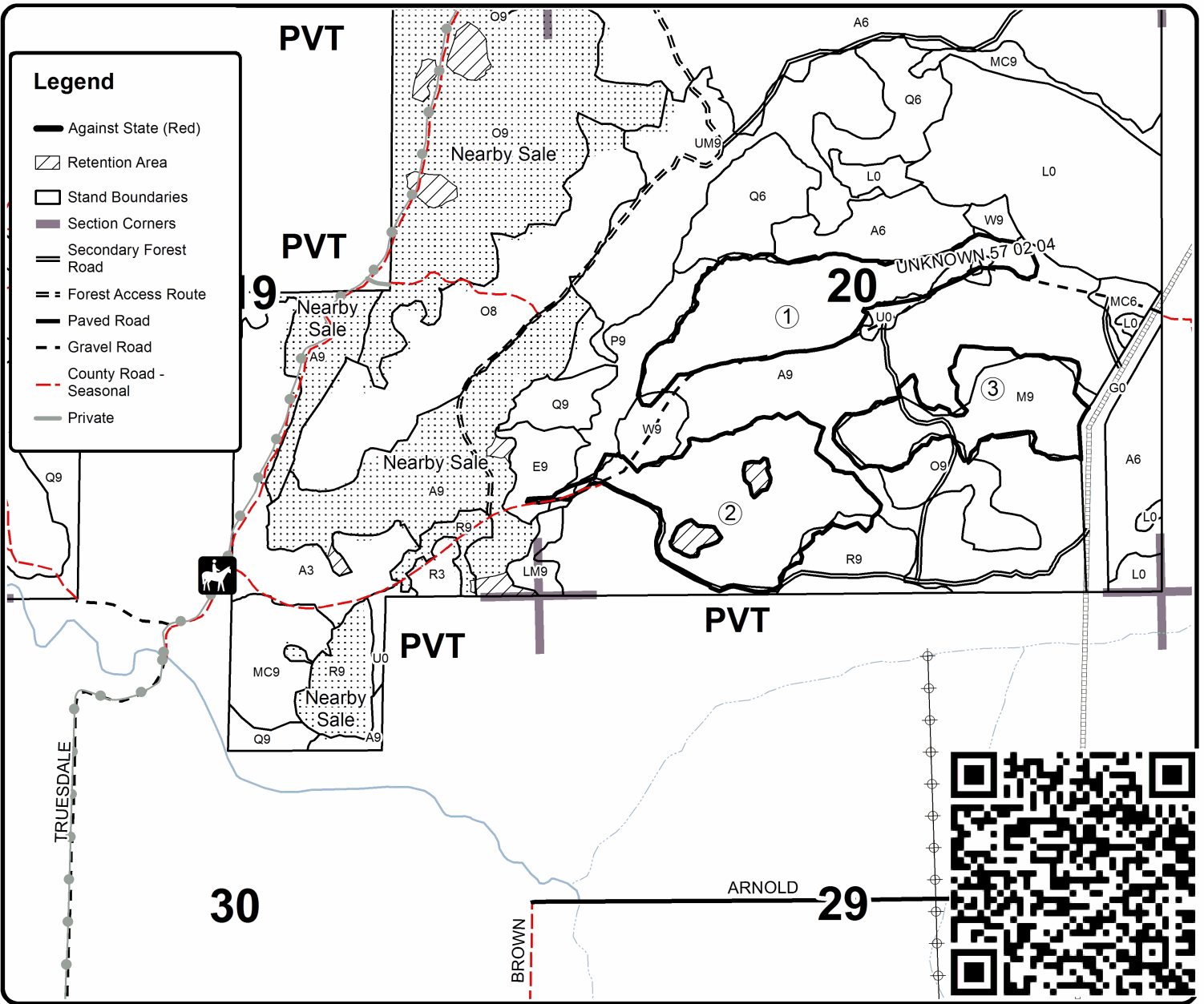

Bear Bait Aspen (63-005-20)
T24N, R08W, SEC. 7; T24N, R09W, SEC. 12; Wexford COUNTY

In response to the notice of sale to be held 3:00 p.m. (local time) on November 24, 2020, I am hereby submitting my sealed bid (firm offer) for the following forest products to be cut. Bids for individual species must be at or above the advertised price. All non-responsive bid forms may be rejected.

<u>PRODUCTS & SPECIES</u>	<u>ESTIMATED VOLUME*</u>	<u>ADVERTISED PRICE</u>	<u>BID PRICE/UNIT</u>
Sawtimber			
Mixed Aspen	264.5 MBF	\$ 79.00/MBF	\$ _____
Red Maple	29.7 MBF	\$ 74.00/MBF	\$ _____
Red Oak	1.2 MBF	\$ 167.00/MBF	\$ _____
White Pine	112.8 MBF	\$ 58.00/MBF	\$ _____
Pulpwood			
Balsam Fir	389 Cords	\$ 7.95/Cord	\$ _____
Mixed Aspen	1,194 Cords	\$ 11.70/Cord	\$ _____
Mixed Hardwood	438 Cords	\$ 9.65/Cord	\$ _____
Mixed Oak	30 Cords	\$ 12.50/Cord	\$ _____
Red Pine	6 Cords	\$ 35.80/Cord	\$ _____
White Pine	339 Cords	\$ 11.60/Cord	\$ _____

*The volumes are statistically estimated within plus (+) or minus (-) 9.75 percent at 95% confidence level. These estimated volumes are final and not subject to adjustment. Prospective bidders are urged to examine this timber and to make their own estimates of quantity and quality.

I understand that any or all bids may be rejected. All bids must be signed and all bid items must be bid or the bid form may be rejected. I also understand that consideration and awarding a contract will be based upon my past performance and ability to complete the contract based upon equipment and staffing subject to my control.

FEDERAL ID: _____ or SOCIAL SECURITY NUMBER: _____

Company or individual bidding: _____

Company representative's name: _____

Address: _____

City: _____ State: _____ Zip: _____

IF AVAILABLE, PLEASE PLACE THE PERSONALIZED LABEL FROM YOUR PROSPECTUS IN THE ABOVE BOX.

Individual or company representative's signature: _____ Date: _____

Phone number : _____ Email (optional): _____

THE WINNING BIDDER MUST COMPLETE THE VERIFICATION OF WORKER'S DISABILITY COMPENSATION ACT COMPLIANCE (ON REVERSE SIDE IF DOUBLE SIDED) WITHIN 21 DAYS OF SALE AWARD DATE



FOR DEPARTMENT USE ONLY	
Sale Number (XX - XXX - XX - XX)	
Forest Management Unit:	

TIMBER SALE VERIFICATION OF WORKER'S DISABILITY COMPENSATION ACT COMPLIANCE

As required by Act 317, P.A. 1969 (Worker's Compensation) and
Part 5 of Act 451 of 1994, as amended.

VERIFICATION OF WORKER'S DISABILITY COMPENSATION ACT COMPLIANCE

- This verification must be completed and submitted within 21 days of contract award and prior to the issuance of the timber sale contract.
- In addition, if boxes 2B or 2C are checked, then Notice of Exclusion or Certificate of Insurance must be submitted within twenty-one (21) days of the contract award and prior to the issuance of the timber sale contract.
- All information must be typed or printed except for written signatures.

Please Check Appropriate Categories:

1. My business is organized as (you **must** check one of the boxes below):
 - A. Sole Proprietorship (individual)
 - B. Partnership
 - C. Corporation
2. You **must** check one of the boxes below:
 - A. I certify my business is a sole proprietorship and it has no employees but the sole proprietor. I am not subject to the Worker's Compensation Laws.
 - B. I certify my business has satisfied its obligation to the Worker's Compensation Act through the use of an approved Notice of Exclusion (BWC-337, Rev. 5/96). I will provide a copy of the Notice of Exclusion within 21 days of the contract award. (For questions or a copy of the BWC-337, please call the Worker's Compensation Bureau at 517-322-1195).
 - C. I certify my business has a Worker's Compensation Policy. I will provide an original Certificate of Insurance within twenty-one (21) days of the contract award.
3. If you have checked item 2(A) or 2(B), you **must** indicate the number of **both** full-time and part-time employees, other than yourself, including family members and active partners (if none, you must enter "0").

_____ Full-time Employees

_____ Part-time Employees

Name of Business		Federal ID (or) Social Security No.	
Address		Telephone ()	
City	State	ZIP	

I hereby certify that the above information is true and correct. I agree to notify the Michigan DNR of any changes that occur in factors affecting my coverage during any of my present and future operations.

Signature of Owner or Authorized Representative

Title

Date

Please complete the "SEALED BID" information on the next page

Wood Tick Mix (63-006-20)

T24N, R08W, SEC. 17; T24N, R08W, SEC. 18; T24N, R08W, SEC. 19; T24N,

In response to the notice of sale to be held 3:00 p.m. (local time) on November 24, 2020, I am hereby submitting my sealed bid (firm offer) for the following forest products to be cut. Bids for individual species must be at or above the advertised price. All non-responsive bid forms may be rejected.

<u>PRODUCTS & SPECIES</u>	<u>ESTIMATED VOLUME*</u>	<u>ADVERTISED PRICE</u>	<u>BID PRICE/UNIT</u>
Sawtimber			
Black Cherry	3.2 MBF	\$ 208.00/MBF	\$ _____
Mixed Aspen	189.0 MBF	\$ 79.00/MBF	\$ _____
Paper Birch	1.7 MBF	\$ 28.00/MBF	\$ _____
Red Maple	29.0 MBF	\$ 74.00/MBF	\$ _____
Red Oak	482.6 MBF	\$ 167.00/MBF	\$ _____
Red Pine	57.0 MBF	\$ 82.00/MBF	\$ _____
White Pine	53.3 MBF	\$ 58.00/MBF	\$ _____
Pulpwood			
Balsam Fir	18 Cords	\$ 7.95/Cord	\$ _____
Mixed Aspen	1,207 Cords	\$ 11.70/Cord	\$ _____
Mixed Hardwood	748 Cords	\$ 9.65/Cord	\$ _____
Mixed Oak	1,641 Cords	\$ 12.50/Cord	\$ _____
Red Pine	211 Cords	\$ 35.80/Cord	\$ _____
White Pine	215 Cords	\$ 11.60/Cord	\$ _____

*The volumes are statistically estimated within plus (+) or minus (-) 7.85 percent at 95% confidence level. These estimated volumes are final and not subject to adjustment. Prospective bidders are urged to examine this timber and to make their own estimates of quantity and quality.

I understand that any or all bids may be rejected. All bids must be signed and all bid items must be bid or the bid form may be rejected. I also understand that consideration and awarding a contract will be based upon my past performance and ability to complete the contract based upon equipment and staffing subject to my control.

FEDERAL ID: _____ or SOCIAL SECURITY NUMBER: _____

Company or individual bidding: _____

Company representative's name: _____

Address: _____

City: _____ State: _____ Zip: _____

IF AVAILABLE, PLEASE PLACE THE PERSONALIZED LABEL FROM YOUR PROSPECTUS IN THE ABOVE BOX.

Individual or company representative's signature: _____ Date: _____

Phone number : _____ Email (optional): _____

THE WINNING BIDDER MUST COMPLETE THE VERIFICATION OF WORKER'S DISABILITY COMPENSATION ACT COMPLIANCE (ON REVERSE SIDE IF DOUBLE SIDED) WITHIN 21 DAYS OF SALE AWARD DATE



TIMBER SALE VERIFICATION OF WORKER'S DISABILITY COMPENSATION ACT COMPLIANCE

As required by Act 317, P.A. 1969 (Worker's Compensation) and
Part 5 of Act 451 of 1994, as amended.

FOR DEPARTMENT USE ONLY	
Sale Number (XX - XXX - XX - XX)	
Forest Management Unit:	

VERIFICATION OF WORKER'S DISABILITY COMPENSATION ACT COMPLIANCE

- This verification must be completed and submitted within 21 days of contract award and prior to the issuance of the timber sale contract.
- In addition, if boxes 2B or 2C are checked, then Notice of Exclusion or Certificate of Insurance must be submitted within twenty-one (21) days of the contract award and prior to the issuance of the timber sale contract.
- All information must be typed or printed except for written signatures.

Please Check Appropriate Categories:

1. My business is organized as (you **must** check one of the boxes below):
 - A. Sole Proprietorship (individual)
 - B. Partnership
 - C. Corporation
2. You **must** check one of the boxes below:
 - A. I certify my business is a sole proprietorship and it has no employees but the sole proprietor. I am not subject to the Worker's Compensation Laws.
 - B. I certify my business has satisfied its obligation to the Worker's Compensation Act through the use of an approved Notice of Exclusion (BWC-337, Rev. 5/96). I will provide a copy of the Notice of Exclusion within 21 days of the contract award. (For questions or a copy of the BWC-337, please call the Worker's Compensation Bureau at 517-322-1195).
 - C. I certify my business has a Worker's Compensation Policy. I will provide an original Certificate of Insurance within twenty-one (21) days of the contract award.
3. If you have checked item 2(A) or 2(B), you **must** indicate the number of **both** full-time and part-time employees, other than yourself, including family members and active partners (if none, you must enter "0").

_____ Full-time Employees

_____ Part-time Employees

Name of Business		Federal ID (or) Social Security No.	
Address		Telephone ()	
City	State	ZIP	

I hereby certify that the above information is true and correct. I agree to notify the Michigan DNR of any changes that occur in factors affecting my coverage during any of my present and future operations.

Signature of Owner or Authorized Representative

Title

Date

Please complete the "SEALED BID" information on the next page

Lost Channel Locks Aspen (63-007-20)
T24N, R08W, SEC. 19; T24N, R08W, SEC. 20; Missaukee COUNTY

In response to the notice of sale to be held 3:00 p.m. (local time) on November 24, 2020, I am hereby submitting my sealed bid (firm offer) for the following forest products to be cut. Bids for individual species must be at or above the advertised price. All non-responsive bid forms may be rejected.

<u>PRODUCTS & SPECIES</u>	<u>ESTIMATED VOLUME*</u>	<u>ADVERTISED PRICE</u>	<u>BID PRICE/UNIT</u>
Sawtimber			
Basswood	8.3 MBF	\$ 58.00/MBF	\$ _____
Beech	45.0 MBF	\$ 44.00/MBF	\$ _____
Black Cherry	5.9 MBF	\$ 208.00/MBF	\$ _____
Mixed Aspen	193.3 MBF	\$ 79.00/MBF	\$ _____
Paper Birch	0.7 MBF	\$ 28.00/MBF	\$ _____
Red Maple	133.4 MBF	\$ 74.00/MBF	\$ _____
Red Oak	72.4 MBF	\$ 167.00/MBF	\$ _____
Red Pine	21.0 MBF	\$ 82.00/MBF	\$ _____
Sugar Maple	31.2 MBF	\$ 165.00/MBF	\$ _____
White Pine	51.0 MBF	\$ 58.00/MBF	\$ _____
Pulpwood			
Balsam Fir	14 Cords	\$ 7.95/Cord	\$ _____
Mixed Aspen	1,026 Cords	\$ 11.70/Cord	\$ _____
Mixed Hardwood	2,036 Cords	\$ 9.65/Cord	\$ _____
Mixed Oak	255 Cords	\$ 12.50/Cord	\$ _____
Red Pine	20 Cords	\$ 35.80/Cord	\$ _____
White Pine	237 Cords	\$ 11.60/Cord	\$ _____

*The volumes are statistically estimated within plus (+) or minus (-) 8.47 percent at 95% confidence level. These estimated volumes are final and not subject to adjustment. Prospective bidders are urged to examine this timber and to make their own estimates of quantity and quality.

I understand that any or all bids may be rejected. All bids must be signed and all bid items must be bid or the bid form may be rejected. I also understand that consideration and awarding a contract will be based upon my past performance and ability to complete the contract based upon equipment and staffing subject to my control.

FEDERAL ID: ____ - ____ - ____ or SOCIAL SECURITY NUMBER: ____ - ____ - ____

Company or individual bidding: _____

Company representative's name: _____

Address: _____

City: _____ State: _____ Zip: _____

IF AVAILABLE, PLEASE PLACE THE PERSONALIZED LABEL FROM YOUR PROSPECTUS IN THE ABOVE BOX.

Individual or company representative's signature: _____ Date: _____

Phone number : _____ Email (optional): _____

THE WINNING BIDDER MUST COMPLETE THE VERIFICATION OF WORKER'S DISABILITY COMPENSATION ACT COMPLIANCE (ON REVERSE SIDE IF DOUBLE SIDED) WITHIN 21 DAYS OF SALE AWARD DATE



TIMBER SALE VERIFICATION OF WORKER'S DISABILITY COMPENSATION ACT COMPLIANCE

As required by Act 317, P.A. 1969 (Worker's Compensation) and
Part 5 of Act 451 of 1994, as amended.

FOR DEPARTMENT USE ONLY
Sale Number (XX - XXX - XX - XX)
Forest Management Unit:

VERIFICATION OF WORKER'S DISABILITY COMPENSATION ACT COMPLIANCE

- This verification must be completed and submitted within 21 days of contract award and prior to the issuance of the timber sale contract.
- In addition, if boxes 2B or 2C are checked, then Notice of Exclusion or Certificate of Insurance must be submitted within twenty-one (21) days of the contract award and prior to the issuance of the timber sale contract.
- All information must be typed or printed except for written signatures.

Please Check Appropriate Categories:

1. My business is organized as (you **must** check one of the boxes below):
 - A. Sole Proprietorship (individual)
 - B. Partnership
 - C. Corporation
2. You **must** check one of the boxes below:
 - A. I certify my business is a sole proprietorship and it has no employees but the sole proprietor. I am not subject to the Worker's Compensation Laws.
 - B. I certify my business has satisfied its obligation to the Worker's Compensation Act through the use of an approved Notice of Exclusion (BWC-337, Rev. 5/96). I will provide a copy of the Notice of Exclusion within 21 days of the contract award. (For questions or a copy of the BWC-337, please call the Worker's Compensation Bureau at 517-322-1195).
 - C. I certify my business has a Worker's Compensation Policy. I will provide an original Certificate of Insurance within twenty-one (21) days of the contract award.
3. If you have checked item 2(A) or 2(B), you **must** indicate the number of **both** full-time and part-time employees, other than yourself, including family members and active partners (if none, you must enter "0").

_____ Full-time Employees

_____ Part-time Employees

Name of Business		Federal ID (or) Social Security No.	
Address		Telephone ()	
City	State	ZIP	

I hereby certify that the above information is true and correct. I agree to notify the Michigan DNR of any changes that occur in factors affecting my coverage during any of my present and future operations.

Signature of Owner or Authorized Representative

Title

Date

Please complete the "SEALED BID" information on the next page