



**DEPARTMENT OF NATURAL RESOURCES
STATE OF MICHIGAN**

TIMBER SALE PROSPECTUS #6909

SCHEDULED SALE DATE AND TIME: 3:00 p.m. (local time) on July 27, 2021.

LOCATION: INDIAN RIVER FIELD OFFICE, 6984 WILSON, INDIAN RIVER, MI 49749.

PROSPECTUS NOTE: The bidder is advised to inspect the sale area and review the location, estimated volumes, operating costs and contract terms of proposed sales. Please be aware that some landowners may request 60 days or more notice for access across their land.

Notice is hereby given that bids will be received by the Unit Manager, GAYLORD MANAGEMENT UNIT, for certain timber on the following described lands:

Oh Wells Aspen (52-111-20) / T35N, R01W, SEC. 35, SWNE,N1/2SW,N1/2SE.

Cheboygan County, Advertised Price \$14,241.80, 46.0 Acres, Aspen, White Pine.

SALE NOTE: This is an aspen regeneration harvest with generally smaller diameters. Accessible in all seasons but will need snowplowing in the winter.

A recreation site such as a trail, pathway, or campground is within the sale area or the vicinity. Certain restrictions/specifications may be applicable including time restrictions.

Lawless Red Pine (52-120-20) / T33N, R03W, SEC. 11, S1/2NW.

Cheboygan County, Advertised Price \$18,006.00, 46.5 Acres, Red Pine.

SALE NOTE: Variable volume. Good access. Minimal timing restrictions.

A recreation site such as a trail, pathway, or campground is within the sale area or the vicinity. Certain restrictions/specifications may be applicable including time restrictions.

TNT Mix (52-122-20) / T35N, R02W, SEC. 11, SENW,SWNE,SW.

T35N, R02W, SEC. 14, NENW.

Cheboygan County, Advertised Price \$38,246.15, 82.0 Acres, Aspen, Hardwood.

SALE NOTE: Note that access requires crossing Scott Creek. The DNR may help obtain permits but will require advanced notice.

Whole Lotta Pine (52-129-20) / T35N, R02W, SEC. 1, NWNW,S1/2NW,N1/2SW,SWSW.

T35N, R02W, SEC. 11, NENW,NE.

T35N, R02W, SEC. 12, N1/2NW,SEW.

T35N, R02W, SEC. 2, N1/2NE,SWNE,SE.

T36N, R02W, SEC. 35, SESE.

Cheboygan County, Advertised Price \$86,571.70, 167.6 Acres, Red Pine, White Pine.

SALE NOTE: High volume red pine sale. Very tall, large DBH pine in Payment Units 5, 6, and 11. Good access to all Payment Units. Some harvest time restrictions.

BID INSTRUCTIONS (VER. 07/02/2018):

1. Scheduled Bid Location, Date, and Time (2/11)

Bids must be received by the Unit Manager, INDIAN RIVER OFFICE, 6984 Wilson, Indian River, MI 49749, no later than 3:00 p.m. (local time) on July 27, 2021. For further information concerning this sale, contact Lucas Merrick at 989-732-3541 extension 5440.

2. Bidder's Qualifications (5/16)

Purchaser shall obtain workers compensation insurance to cover claims under Michigan's Worker's Disability Compensation Act of 1969 or similar employee benefit act of any other state applicable to an employee. If all or part of a timber sale was prepared by a private contractor, the contractor and that contractor's company are not permitted to bid on the timber sale contract. Bids will not be accepted from individuals or companies appearing on the DNR/FRD No-Bid List. This list contains the names of purchasers who previously failed to execute a contract within 21-days or who have a history of poor performance.

3. Preparation of Sealed Bids (5/16)

Bid Forms may be completed online thru Michigan DNR Timber Sale Online Bidding (OLB) at www.michigan.gov/timberbidding or by completing the hardcopy Bid Form found in the Timber Sale Prospectus. Hardcopy Bid Forms shall be manually signed in ink. Registration in OLB is considered your 'signature' for all bids submitted thru that system. Bid prices must be entered for each species and product in the Bid Price column for all material subject to bidding and all fill-in blanks must be completed. If erasures or other changes appear on the hardcopy Bid Form, each erasure or change must be initialed by the person signing the bid.

4. Submission of Sealed Bids (5/16)

Bid forms may be obtained from the Unit Manager or thru OLB. Bids may be submitted hardcopy or thru OLB. All hardcopy bids must be submitted on the bid form and in an envelope clearly identified as described in this section. NOTE: Only one bid form per bid envelope. Sealed bids must be submitted to the Unit office designated in the prospectus and must be submitted at or prior to the time established in the prospectus. The envelope should show on the outside (a) the sale name or number and (b) the date and time of bid opening, as shown in the prospectus. Bids received after the time specified in the sale prospectus are late bids and will be rejected.

It is possible for a bidder to submit multiple bids on a single sale. For example, a bid may be submitted hardcopy and a bid may be submitted thru OLB. Or, two bidders from the same company could both submit bids on the same sale. If this were to happen, the State would accept all bids received and award the contract accordingly. All bidding and contractual requirements would apply to all bids received.

5. Public Opening of Sealed Bids (7/16)

If conditions permit, the sealed bids will be publicly opened and posted at the time and place set in the prospectus.

If a bidder, present at a bid opening, has submitted bids on more than one sale, that bidder may withdraw their unopened bid envelopes or announce the withdrawal of their online bid after being declared the successful bidder on one sale.

6. Award of Contract (1/11)

Award of the contract will be made to the Bidder whose bid, conforming to the prospectus, is most advantageous to the State of Michigan on the basis of total value at rates bid for the estimated quantities. The State reserves the right to reject any bid or waive any minor irregularity in bids received. A written award mailed (or otherwise furnished) to the successful Bidder shall be deemed to result in a binding contract without further action by either party.

7. Down Payment (1/11)

The Bidder to whom award is made must make a down payment within 21 days of the sale award. The amount of the down payment will be calculated as shown in the Bond and Payment Schedule of this prospectus. Only cash may be used to meet this requirement.

8. Performance Security (1/11)

As guarantee of faithful performance, a cash bond, certificate of deposit, surety bond or irrevocable letter of credit (LOC) is required within 21 days of the sale award. The amount of the performance security is shown in the Bond and

Payment Schedule of this prospectus. If an LOC or surety is used, the coverage must extend for at least 6 months beyond the contract expiration.

9. Timber Sale Contract (7/18)

Additional conditions and requirements common to all timber sales are listed on the timber sale contract (R4031) and are available on line at www.michigan.gov/timber. Contact the Unit Manager for additional information or a sample contract. Within 21 days of the date of the award letter, the bidder must sign the contract and provide the required down payment, performance security, and verification of worker's disability compensation. The down payment and performance security shall be in accordance with the provisions of the timber sale contract, in the sums stated in this prospectus. If these actions are not taken, then the Bidder, the Bidder's corporation, and the corporation's principals may not be permitted to bid on State timber sales for a period of 3 months after the first offense, 6 months after the second offense, and 1 year after the third offense. An offense will only be counted against the Bidder for 5 years. In addition, the Bidder certifies that if awarded this contract, the Bidder will complete the timber sale contract in accordance with its terms and any modifications thereof including requirements to purchase, cut, and remove the included timber by the expiration date.

Payment Unit values in the State Forest Timber Sale Contract are calculated based on the advertised value of the Payment Unit as a percentage of the total advertised value of the contract. The advertised value of each Payment Unit is given in the Description of Timber by Payment Unit table on the Timber Sale Information page. For example, if the value of Payment Unit 1 is advertised as \$1,500 and the total Timber Sale value is advertised as \$10,000, the contract price for Payment Unit 1 will be 15% of the total bid price ($\$1,500/\$10,000 * 100$).

10. Disclaimer of Estimates and Bidder's Warranty of Inspection (7/16)

Before submitting this bid, the Bidder is advised and cautioned to inspect the sale area, review the requirements of the sale contract, and take other steps as may be reasonably necessary to ascertain the location, estimated volumes, construction estimates, and operating costs of the proposed sale. Failure to do so will not relieve the Bidder from responsibility for completing the contract.

The Bidder warrants that this bid is submitted solely on the basis of the Bidder's examination and inspection of the quality and quantity of the timber offered for sale and the Bidder's opinion of the value thereof and the costs of recovery. No reliance should be placed on the State of Michigan's estimates of timber quality, quantity or costs of recovery. Bidder further acknowledges that the State of Michigan: (i) expressly disclaims any warranty of fitness of timber for any purpose; (ii) offers this timber as is without any warranty of quality (merchantability) or quantity and (iii) expressly disclaims any warranty as to the quantity or quality of timber sold.

11. Certification and Chain-of-Custody (10/14)

Unless otherwise indicated in the contract under section 7 – Other Conditions of the Sale Specific Conditions & Requirements, the area encompassed by this timber sale is certified to the standards of the Forest Stewardship Council (FSC) - Certificate #SCS-FM/COC-00090N and the Sustainable Forestry Initiative (SFI) - Certificate #NSF-SFIS-5Y031-SF5. Forest products from this sale may be delivered to the mill as "FSC 100% and / or SFI certified" as long as the contractor hauling the forest products is chain-of-custody (COC) certified or covered under a COC certificate from the destination mill. The purchaser is responsible for maintaining COC after leaving the sale area.

12. Good Neighbor Authority (GNA) Requirements (7/16)

If the name of this timber sales contains the acronym GNA, it is authorized by the Good Neighbor Authority (GNA) and covered by various agreements between the U.S. Forest Service and the State. The timber sale occurs on federal land and the following conditions apply:

GNA contracts on US Forest Service land will not be awarded to purchasers on the Federal list of excluded parties. The System for Award Management (SAM) will be checked for active excluded parties prior to award of contract. In addition, the Bidder to whom award is made must complete an Assurance Regarding Felony Conviction or Tax Delinquent Status for Corporate Applicants (AD-3031).

13. Good Neighbor Authority (GNA) Requirements, con't (9/16)

Bidder certifies, by signing this bid form, that to the best of Bidder's knowledge that the following representations are accurate and complete.

- a. That the Bidder and its principals are not presently debarred, suspended, proposed for debarment, declared ineligible, or voluntary excluded from timber sales (covered transactions) by any Federal department or agency.
- b. That the Bidder and its principals have not within a 3-year period preceding this bid been convicted of or had a civil judgment rendered against them for commission of fraud or a criminal offense in connection with obtaining , attempting to obtain, or performing a public (Federal, State, or local) transaction or contract under a public transaction; violation of Federal or State antitrust statutes or commission of embezzlement, theft, forgery, bribery, falsification or destruction of records, making false statements, or receiving stolen property.
- c. That the Bidder and its principals are not presently indicted for or otherwise criminally or civilly charged by a governmental entity (Federal, State, or local) with commission of any of the offenses enumerated in paragraph b of this certification.
- d. That the Bidder and its principals have not within a 3-year period preceding this bid had one or more public transactions (Federal, State, or local) terminated for breach or default of a timber or forest product contract.

Bidders that cannot certify this requirement, in whole or in part, shall submit an explanation with their bid.

DAN EICHINGER
Director

TIMBER SALE INFORMATION

Oh Wells Aspen (52-111-20)
 T35N, R01W, SEC. 35.
 Cheboygan County (Advertised Price \$14,241.80)

SALE NOTE: This is an aspen regeneration harvest with generally smaller diameters. Accessible in all seasons but will need snowplowing in the winter.

A recreation site such as a trail, pathway, or campground is within the sale area or the vicinity. Certain restrictions/specifications may be applicable including time restrictions.

A timber sale contract for this lump sum, sealed bid timber sale will be awarded to the responsible bidder offering the highest sealed bid price. All units of volume listed below were estimated using the T-Sale computer program and our traditional volume equations. Bids must be at or above the following advertised price for each product and species:

<u>PRODUCTS & SPECIES</u>	<u>ESTIMATED UNITS*</u>	<u>ADVERTISED PRICE</u>
Sawtimber		
B. T. Aspen	24.0 MBF	\$ 39.00 / MBF
Pulpwood		
Balsam Fir	23 Cords	\$ 14.70 / Cord
Mixed Aspen	754 Cords	\$ 15.25 / Cord
Mixed Hardwood	32 Cords	\$ 16.70 / Cord
White Pine	49 Cords	\$ 16.80 / Cord
White Spruce	9 Cords	\$ 12.40 / Cord

* The total volume is statistically estimated within plus (+) or minus (-) 16.94 percent. There are an estimated 916 cords on this timber sale, plus or minus 155 cords at the 95% confidence level. The estimated units are final and not subject to adjustment. Prospective bidders are urged to examine this timber and to make their own estimates of quantity and quality.

BOND AND PAYMENT SCHEDULE:

1. A bond in the amount of \$712.00 to insure faithful performance of the conditions of the contract will be deposited by the successful bidder within 21 days of the sale award.
2. Cutting in any sale or unit without the required advance payment would be considered a trespass.
3. Total payment must be paid in advance or according to the following schedule :
 - (a) Ten percent (10%) of the sale value must be paid within 21 days of the sale award.
 - (b) The 10% down payment will be credited towards the first unit cut.
 - (c) Payment for each of the following units must be made before cutting begins in that unit:

PAYMENT UNIT NUMBER	PERCENT OF TOTAL SALE VALUE
01	37.4%
02	62.6%
4. If no cutting takes place, the 10% down payment will not be refunded.
5. Operations on the contract issued will terminate on 06/30/2024.

SALE STATISTICS

SALE VOLUMES

VOLUME		STATISTICAL RANGE IN CORDS		
TOTAL CUBIC FEET	TOTAL CORDS	PERCENT ERROR	MINIMUM	MAXIMUM
72,334	916	16.94%	761	1,071

VDU VOLUMES

A VDU is a Volume Determination Unit. Volumes and their associated statistics are calculated at the VDU level and summarized to the sale level. There is often a one to one relationship between a VDU and a Payment Unit, but not always, depending on the cruise design. Refer to the VDU TO PAYMENT UNIT table.

VDU	VOLUME		PERCENT ERROR	RANGE IN CORDS	
	TOTAL CUBIC FEET	TOTAL CORDS		MINIMUM	MAXIMUM
47	45,291	573	22.60%	444	703
61	27,073	343	26.13%	253	432
TOTAL:	72,364	916		697	1,135

VDU TO PAYMENT UNIT

When a VDU is associated with more than one Payment Unit (PU), the VDU volumes are assigned to the PU based on acres of the VDU within the PU.

VDU	VDU ACRES	PU	PU ACRES
47	28.3	2	28.3
61	17.7	1	17.7
TOTAL:	46.0		46.0

DESCRIPTION OF TIMBER BY PAYMENT UNIT (PU)

PU	MARKET GROUP	PRODUCT	QUANTITY	UNIT	ACRES	ADVERTISE PRICE
1	B. T. Aspen	Sawtimber	7.2	MBF	17.7	\$5,331.30
	Balsam Fir	Pulpwood	2	Cords		
	<i>Balsam Fir</i>		2	<i>Cords</i>		
	Mixed Aspen		274	Cords		
	<i>B. T. Aspen</i>		267	<i>Cords</i>		
	<i>Quaking Aspen</i>		7	<i>Cords</i>		
	Mixed Hardwood		2	Cords		
	<i>Red Maple</i>		2	<i>Cords</i>		
	White Pine		43	Cords		
	<i>White Pine</i>	<i>Sawtimber</i>	6.5	<i>MBF</i>		
	<i>White Pine</i>	<i>Pulpwood</i>	30	<i>Cords</i>		
	White Spruce		7	Cords		
	<i>White Spruce</i>	<i>Sawtimber</i>	1.4	<i>MBF</i>		
	<i>White Spruce</i>	<i>Pulpwood</i>	4	<i>Cords</i>		
2	B. T. Aspen	Sawtimber	16.8	MBF	28.3	\$8,910.50
	Balsam Fir	Pulpwood	21	Cords		
	<i>Balsam Fir</i>	<i>Sawtimber</i>	1.0	<i>MBF</i>		
	<i>Balsam Fir</i>	<i>Pulpwood</i>	19	<i>Cords</i>		
	Mixed Aspen		480	Cords		
	<i>Quaking Aspen</i>	<i>Sawtimber</i>	3.2	<i>MBF</i>		
	<i>B. T. Aspen</i>	<i>Pulpwood</i>	356	<i>Cords</i>		
	<i>Quaking Aspen</i>		118	<i>Cords</i>		
	Mixed Hardwood		30	Cords		
	<i>Red Maple</i>	<i>Sawtimber</i>	1.6	<i>MBF</i>		
	<i>Sugar Maple</i>		1.0	<i>MBF</i>		
	<i>Paper Birch</i>	<i>Pulpwood</i>	5	<i>Cords</i>		
	<i>Red Maple</i>		13	<i>Cords</i>		
	<i>Sugar Maple</i>		7	<i>Cords</i>		
	White Pine		6	Cords		
	<i>White Pine</i>		6	<i>Cords</i>		
	White Spruce		2	Cords		
	<i>White Spruce</i>		2	<i>Cords</i>		
	TOTAL:			24.0		
TOTAL:			867	Cords		

Sale Specific Conditions & Requirements

Sale Name: Oh Wells Aspen

Sale Number: 52-111-20 Seq#: 2

1 - Sale Area

1.2 - Boundaries

1.2.1 - Painted boundaries (9/19)

The sale boundary and Payment Unit boundaries are marked and identified by red paint. Exterior sale boundary lines against state are marked with red paint. The painted boundary line trees are not Included Timber and are to be protected.

2 - Timber Specifications

2.1 - Included Timber

2.1.1 - Clearcut unit(s) with unmerchantable trees (6/14)

Within Payment Unit(s) 1 and 2, cut all trees that are two (2) inches or more at DBH, except oak and red pine.

3 - Payments

3.3 - Pre-measured Sales

3.3.4 - Dividing payment units (7/14)

Payment Unit(s) 2 may be divided at the request of the Purchaser and upon approval of the Unit Manager. Dividing Payment Units is a contract modification which requires a Timber Sale Contract Amendment.

4 - Transportation

4.1 - Construction

4.1.3 - Slash and earthen piles (8/04)

Piles or windrows of earth along roads and landings that have been widened or constructed shall be leveled. Slash from road maintenance or construction, including stumps, shall be dispersed throughout the Sale Area if not otherwise utilized.

4.1.7 - Road closure (10/11)

All new roads built into the sale must be blocked to vehicle traffic upon completion of the sale. Overgrown roads that are reopened shall be considered new roads. In general, this will require constructing a four (4') foot high berm of stumps and logs covered with earth. These roads must be rendered impassable to cars and trucks. Contact the sale administrator for specific details of design and placement.

4.2 - Maintenance

4.2.5 - Two wheel drive condition (2/04)

All existing trail roads on and adjacent to the sale area must be passable by two-wheel drive traffic for the duration of the sale.

5 - Operations

5.2 - Conduct of Operations

5.2.1 - Slash

5.2.1.10 - No slash in openings (5/10)

No brush or logging debris is to be left in the wildlife openings which are indicated by G0 and U0 on the Timber Sale Map. These openings may be used as landing locations if they are not planted or actively maintained when the Payment Units are opened. Any damage to the opening shall be repaired according to specifications of the Unit Manager or his/her representative.

5.2.4 - Dead and Down Creation

5.2.4.4 - Dead and down creation, grouse (6/18)

To encourage grouse and other wildlife, in Payment Unit(s) 1 and 2, leave one 12" or larger diameter (or largest diameter

trees within stand) whole tree on the ground for every 2 acres, preferably maple or if no hardwoods are present, a white pine species. These will be evenly scattered throughout the Payment Unit.

5.2.40 - Pathway protection (10/10)

The Trail shown on the Timber Sale Map is a Horse Trail. Do not cut trees or damage posts with blue pathway markers. The trail must be always kept free of debris and passable by horses. Horses are to be given the right-of-way to equipment and log trucks.

5.4 - Soil Protection

5.4.1 - Rutting restriction, general (7/16)

Operations are to cease immediately if equipment and weather conditions result in rutting of roads and/or skid trails which is 12 inches or greater in depth and 50 feet in length. The Unit Manager or his/her representative may restrict hauling and/or skidding if ruts exceed the specified depth. With the Unit Manager or his/her representative's approval, the Purchaser may return to the area when the risk of rutting has decreased.

6 - Safety and Fire Prevention

6.2 - Signing

6.2.1 - Road posting (9/09)

The Purchaser is responsible for posting and maintaining caution signs on access routes, including the Horse Trail, prior to beginning operations. The road must be posted at appropriate distances from the Sale Area to warn of logging activity and truck traffic. Signs must be removed when harvest operations are suspended or completed. The Purchaser will provide these signs.



Sale Number	Year
52 - 111	20

TIMBER SALE MAP

This information provided by authority of Part 525, 1994 PA 451, as amended.

Forest Management Unit Gaylord Management Unit	County Cheboygan	Mapped By TSP	Date 07/31/2020	Page 1	of 1
Township 35N	Range 01W	Section(s) and Subdivision(s) Sec 25: SWNE, N1/2SW, N1/2SE	Scale 1:15,840		

Cover Type				Density	
A = Aspen	H = Hemlock	N = Marsh	U = Upland Brush	0 = Non Stocked	5 = Pole Timber Medium
B = Paper Birch	J = Jack Pine	O = Oak	UM = Upland Mixed	1 = Seedling Sapling Poor	6 = Pole Timber Well
C = Cedar	L = Lowland Brush	P = Lowland Poplar	V = Bog or Marsh	2 = Seedling Sapling Medium	7 = Saw Timber Poor
D = Treed Bog	LM = Lowland Mixed	Q = Mixed Swamp Conifer	W = White Pine	3 = Seedling Sapling Well	8 = Saw Timber Medium
E = Swamp Hdwoods	M = Mpl, Bch, Brch	R = Red Pine	X = Non Stocked	4 = Pole Timber Poor	9 = Saw Timber Well
F = Spruce Fir	MC = Mixed Conifer	S = Black Spruce	Z = Water		
G = Grass	MD = Mixed Deciduous	T = Tamarack			

PU	Acres
1	17.7
2	28.3

Oh Wells Aspen

Compartment 184

46 Acres

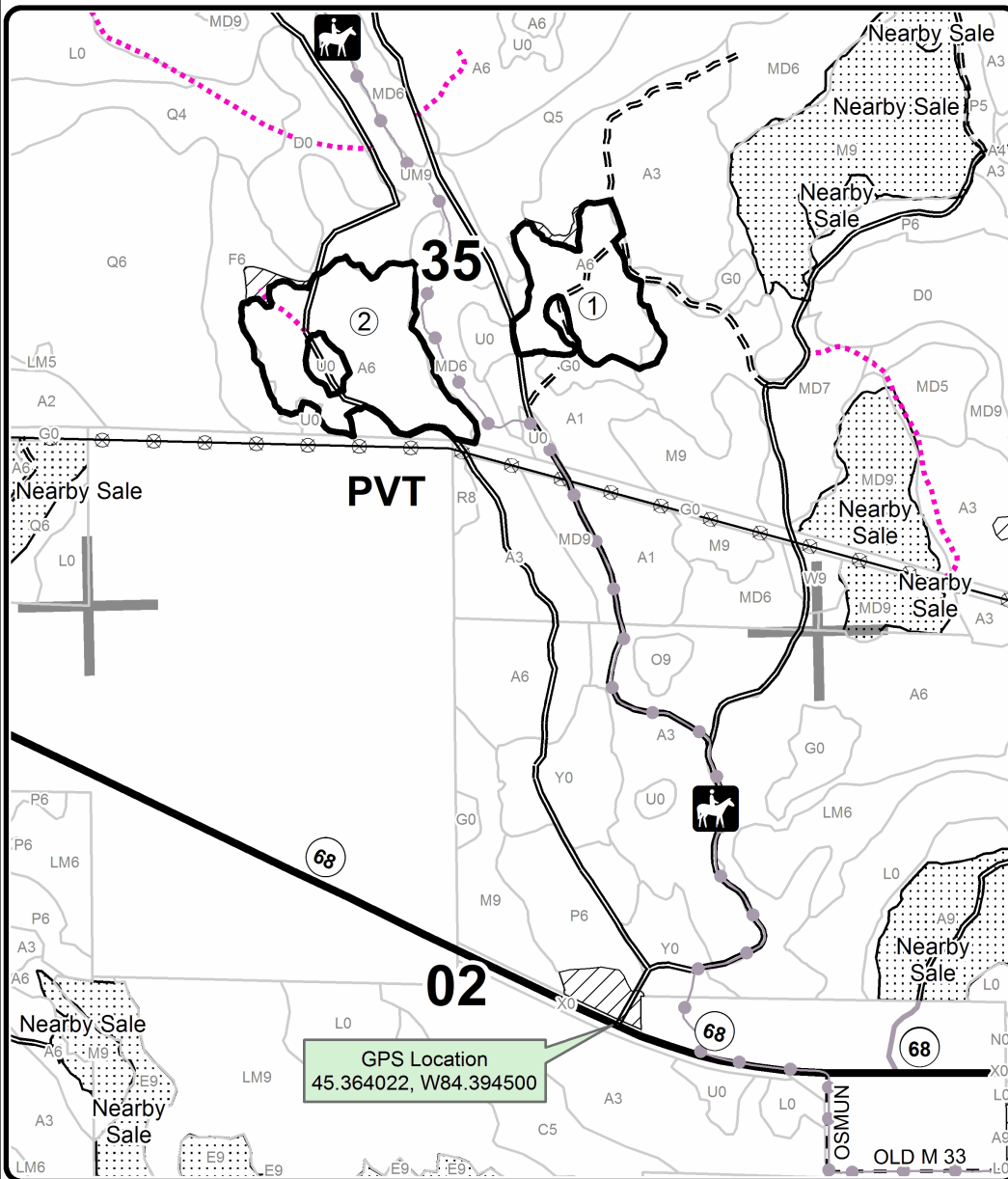

Legend

- Against State (Red)
- Recreational Trail
- Highway
- Secondary Forest Road
- == Forest Access Route
- - Gravel Road
- Private
- ⋯ Temporary Management Access
- ⊗ Powerline
- ▨ Retention Area
- Stand Boundaries
- ▤ Nearby Timber Sales
- Section Corners

Locator Map
1:200,000

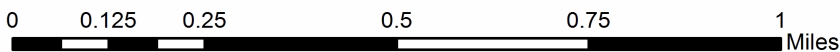
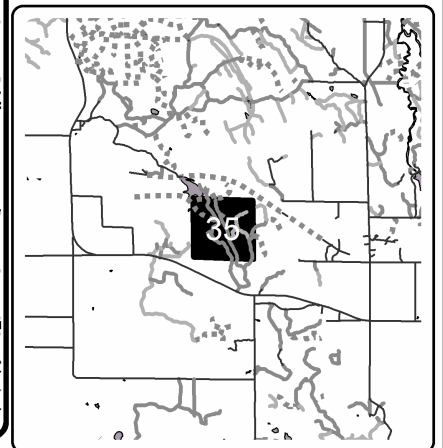

TIMBER SALE INFORMATION

Lawless Red Pine (52-120-20)
T33N, R03W, SEC. 11.
Cheboygan County (Advertised Price \$18,006.00)

SALE NOTE: Variable volume. Good access. Minimal timing restrictions.

A recreation site such as a trail, pathway, or campground is within the sale area or the vicinity. Certain restrictions/specifications may be applicable including time restrictions.

A timber sale contract for this lump sum, sealed bid timber sale will be awarded to the responsible bidder offering the highest sealed bid price. All units of volume listed below were estimated using the T-Sale computer program and our traditional volume equations. Bids must be at or above the following advertised price for each product and species:

<u>PRODUCTS & SPECIES</u>	<u>ESTIMATED UNITS*</u>	<u>ADVERTISED PRICE</u>
Sawtimber		
Red Pine	45.5 MBF	\$ 102.00 / MBF
Pulpwood		
Red Pine	300 Cords	\$ 44.55 / Cord

* The total volume is statistically estimated within plus (+) or minus (-) 20.09 percent. There are an estimated 391 cords on this timber sale, plus or minus 79 cords at the 95% confidence level. The estimated units are final and not subject to adjustment. Prospective bidders are urged to examine this timber and to make their own estimates of quantity and quality.

BOND AND PAYMENT SCHEDULE:

1. A bond in the amount of \$900.00 to insure faithful performance of the conditions of the contract will be deposited by the successful bidder within 21 days of the sale award.
2. Cutting in any sale or unit without the required advance payment would be considered a trespass.
3. Total payment must be paid in advance or according to the following schedule :
 - (a) Ten percent (10%) of the sale value must be paid within 21 days of the sale award.
 - (b) The 10% down payment will be credited towards the first unit cut.
 - (c) Payment for each of the following units must be made before cutting begins in that unit:

PAYMENT UNIT NUMBER	PERCENT OF TOTAL SALE VALUE
01	58.8%
02	41.2%

4. If no cutting takes place, the 10% down payment will not be refunded.
5. Operations on the contract issued will terminate on 06/30/2024.

SALE STATISTICS

SALE VOLUMES

VOLUME		STATISTICAL RANGE IN CORDS		
TOTAL CUBIC FEET	TOTAL CORDS	PERCENT ERROR	MINIMUM	MAXIMUM
30,925	391	20.09%	313	470

VDU VOLUMES

A VDU is a Volume Determination Unit. Volumes and their associated statistics are calculated at the VDU level and summarized to the sale level. There is often a one to one relationship between a VDU and a Payment Unit, but not always, depending on the cruise design. Refer to the VDU TO PAYMENT UNIT table.

VDU	VOLUME			RANGE IN CORDS	
	TOTAL CUBIC FEET	TOTAL CORDS	PERCENT ERROR	MINIMUM	MAXIMUM
32	18,170	230	25.83%	171	289
44	12,751	161	32.53%	109	214
TOTAL:	30,921	391		279	503

VDU TO PAYMENT UNIT

When a VDU is associated with more than one Payment Unit (PU), the VDU volumes are assigned to the PU based on acres of the VDU within the PU.

VDU	VDU ACRES	PU	PU ACRES
32	26.6	1	26.6
44	19.9	2	19.9
TOTAL:	46.5		46.5

DESCRIPTION OF TIMBER BY PAYMENT UNIT (PU)

PU	MARKET GROUP	PRODUCT	QUANTITY	UNIT	ACRES	ADVERTISE PRICE
1	Red Pine	Sawtimber	27.4	MBF	26.6	\$10,591.05
	Red Pine	Pulpwood	175	Cords		
2	Red Pine	Sawtimber	18.1	MBF	19.9	\$7,414.95
	Red Pine	Pulpwood	125	Cords		
TOTAL:			45.5	MBF		
TOTAL:			300	Cords		

Sale Specific Conditions & Requirements

Sale Name: Lawless Red Pine

Sale Number: 52-120-20 Seq#: 2

1 - Sale Area

1.2 - Boundaries

1.2.1 - Painted boundaries (9/19)

The sale boundary and Payment Unit boundaries are marked and identified by blue and red paint. Exterior sale boundary lines against private property are marked with blue paint. Exterior sale boundary lines against state are marked with red paint. The painted boundary line trees are not Included Timber and are to be protected unless marked with orange paint.

2 - Timber Specifications

2.1 - Included Timber

2.1.3 - Cut tree marked unit(s) (12/08)

Within Payment Unit(s) 1 and 2, all trees are designated for cutting when marked with orange paint above and below stump height, regardless of merchantability. Additional, red pine removed for operations after approval by the sale administrator must be decked separately and scaled by a DNR Forester.

2.2 - Utilization

2.2.6 - Roundwood operation required (5/07)

The skidding of whole trees or tree segments with limbs attached is prohibited. All products must be produced as roundwood and forwarded to existing roads or landing areas in final product length.

3 - Payments

3.3 - Pre-measured Sales

3.3.4 - Dividing payment units (7/14)

Payment Unit(s) may be divided at the request of the Purchaser and upon approval of the Unit Manager. Dividing Payment Units is a contract modification which requires a Timber Sale Contract Amendment.

3.4 - Damaged Timber

3.4.1 - Damaged timber (7/16)

General Condition and Requirement 3.4 Damaged Timber, defines liquidated damages for undesignated live merchantable trees which are cut or injured.

No damage is acceptable to undesignated live merchantable trees. Within the Sale Area, if more than 5% of trees (> 4.5" DBH) within a specified area of the sale are damaged, liquidated damages will be assessed for all trees damaged. Rates will be in accordance with General Condition and Requirement 3.4 Damaged Timber.

4 - Transportation

4.1 - Construction

4.1.6 - Road construction (1/09)

Construction of new roads or improvements of existing roads shall be done in such a way as to minimize the environmental and visual impacts. Merchantable trees shall be cut and utilized unless otherwise directed. Non-merchantable trees shall be severed and laid flat on the ground. Slash shall be scattered, and not left in windrows and kept a minimum of 10 feet back from the road edge. Stumps shall be set upright, not left on edge, and be moved at least 10 feet away from the road edge. Disturbed soil shall be feathered into the woods and not left in berms or windrows.

4.1.7 - Road closure (10/11)

All new roads built into the sale must be blocked to vehicle traffic upon completion of the sale. Overgrown roads that are reopened shall be considered new roads. In general, this will require constructing a four (4') foot high berm of stumps and logs covered with earth. Stumps and brush must be placed along the remainder of the trail. These roads must be rendered impassable to cars and trucks. Contact the sale administrator for specific details of design and placement.

4.1.11 - Permits (2/12)

The Purchaser will secure any necessary permits that may be required.

5 - Operations

5.1 - Notification

5.1.6 - Utility R.O.W. (4/19)

It is the responsibility of the Purchaser to obtain permission from the utility company to utilize the power line and pipeline R.O.W. for operations. Consumers Power Company maintains the Power Line and Michigan Consolidated Gas maintains the Pipeline. The Purchaser is also responsible to notify MISS DIG of operations.

5.2 - Conduct of Operations

5.2.2 - Hazard Trees/Snags

5.2.2.1 - Den trees (10/16)

Obvious hollow and/or den trees shall be protected and left standing unless they are a safety hazard.

5.2.3 - Operating Restrictions

5.2.3.3 - Bark slippage restriction (3/09)

Within Payment Unit(s) 1 and 2, unless changed by verbal agreement, cutting and skidding are not permitted during the period of April 15 to July 15. This restriction is because of bark slippage. Due to the low density of residual timber, this does not require written permission, but verbal consent must be obtained from the Administering Forester or Unit Manager prior to operating during bark slip. Poor performance will result in payment for damages and/or halting of operations.

5.2.3.6 - Bark beetle restriction (12/08)

In the event drought creates a high risk of pine bark beetle infestation, pine is not to be cut during the period March 1 through July 1, unless all portions of trees greater than two inches in diameter are removed from the sale area, reduced to chips, or treated to the satisfaction of the Unit Manager or his/her representative, within fifteen days of being severed from the stump. Pine log decks, pulpwood piles and treetops that are piled for chipping in the fall or winter within a 1/4 mile of susceptible sites must be removed before March 15. Residual slash must not be placed in piles or rows and must be spread over the site for quick drying. The Department of Natural Resources will exercise this specification if the risk of damage warrants.

5.2.32 - Decking/landing restoration (9/13)

All decking and landing areas must have the surface area restored to a condition equal to or better than before. This is to ensure the proper regeneration of the stand. Wood debris, chips, and "cookies" from trimmings must be removed or scattered away from landing and loading areas and may not be windrowed on the edge.

5.2.38 - No decking against live trees (2/04)

Cut products may not be decked against unmarked or designated leave trees.

5.2.41 - Snowmobile trail protection (9/11)

Snowmobile Trail 765 is shown on the Timber Sale Map. Do not cut or damage posts with orange trail markers or traffic control signs. No decking of forest products will be permitted along the snowmobile trail during the period of December 1 to March 31. If trail is used for hauling during snowmobile season a snow-covered base must be left on shared portion of haul route.

5.8 - Protection of Endangered Species

5.8.5 - Protection of raptor nests (3/13)

All trees with raptor nests will be protected if found during harvesting operations. Notification will be made to the Unit Manager or his/her representative who will notify the Wildlife Biologist so an on-site evaluation and recommendation can be made, if necessary.

6 - Safety and Fire Prevention

6.2 - Signing

6.2.1 - Road posting (9/09)

The Purchaser is responsible for posting and maintaining caution signs on Entrance/Haul Routes prior to beginning operations. The road must be posted at appropriate distances from the Sale Area to warn of logging activity and truck traffic. Signs must be removed when harvest operations are suspended or completed. The Purchaser will provide these signs.

6.2.2 - Snowmobile trail posting (8/09)

The Purchaser is responsible for posting and maintaining caution signs on Snowmobile Trail 765 if the trail diverges from the County Roads prior to beginning operations during the snowmobile season (approximately December 1 to March 31). The trail must be posted at appropriate distances from the Sale Area to warn of logging activity and truck traffic. Signs must be removed when harvest operations are suspended or completed. The Purchaser will provide these signs.



TIMBER SALE MAP

This information provided by authority of Part 525, 1994 PA 451, as amended.

Sale Number	Year
52 - 120	20

Forest Management Unit Gaylord	County Cheboygan	Mapped By TSP	Date 09/01/2020	Page 1	of 1
Township 33N	Range 03W	Section(s) and Subdivision(s) Sec 11: S1/2NW	Scale 1:7,920		

Cover Type				Density	
A = Aspen	H = Hemlock	N = Marsh	U = Upland Brush	0 = Non Stocked	5 = Pole Timber Medium
B = Paper Birch	J = Jack Pine	O = Oak	UM = Upland Mixed	1 = Seedling Sapling Poor	6 = Pole Timber Well
C = Cedar	L = Lowland Brush	P = Lowland Poplar	V = Bog or Marsh	2 = Seedling Sapling Medium	7 = Saw Timber Poor
D = Treed Bog	LM = Lowland Mixed	Q = Mixed Swamp Conifer	W = White Pine	3 = Seedling Sapling Well	8 = Saw Timber Medium
E = Swamp Hdwoods	M = Mpl, Bch, Brch	R = Red Pine	X = Non Stocked	4 = Pole Timber Poor	9 = Saw Timber Well
F = Spruce Fir	MC = Mixed Conifer	S = Black Spruce	Z = Water		
G = Grass	MD = Mixed Deciduous	T = Tamarack			

PU	Acres
1	26.6
2	19.9

Lawless Red Pine

Compartment 156

46.5 Acres

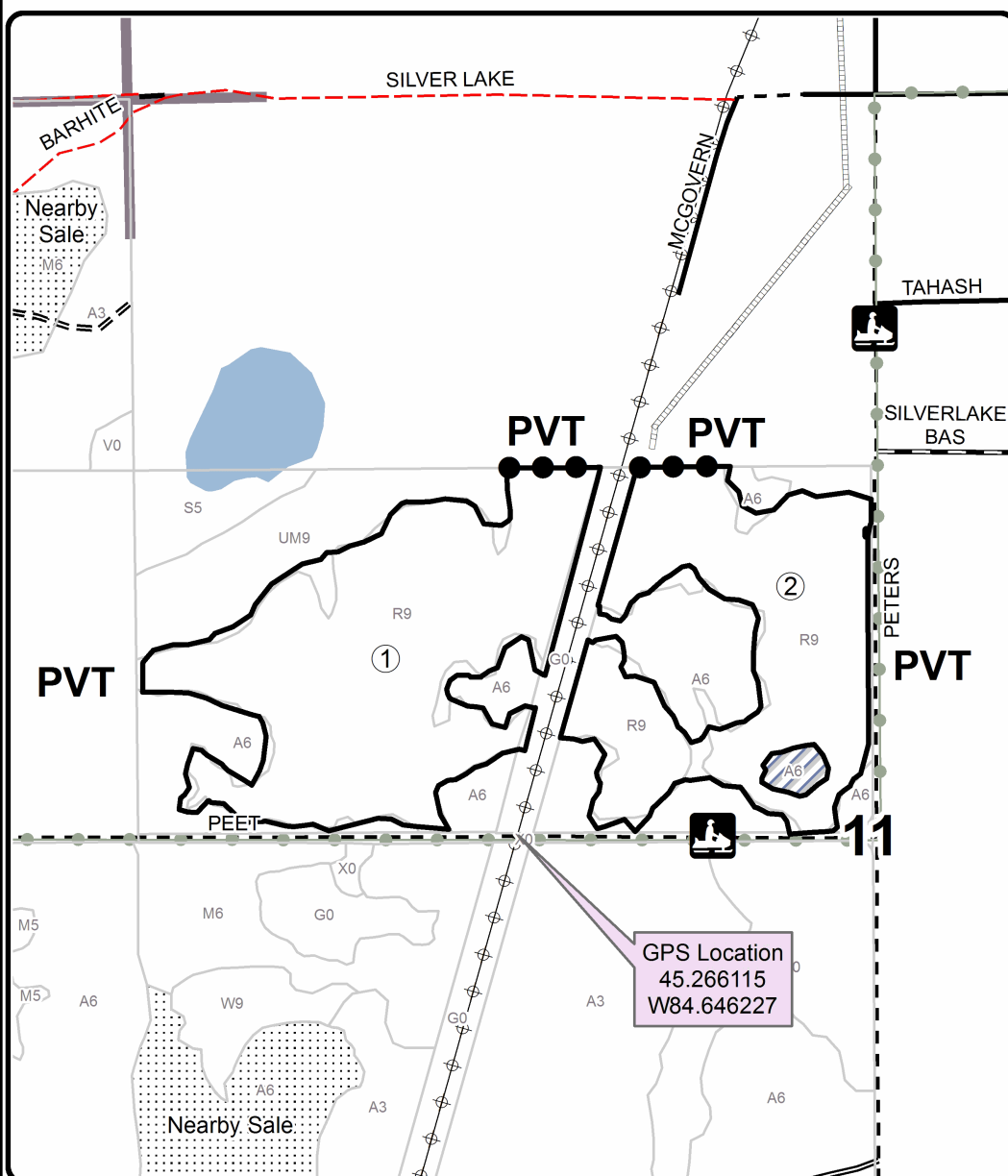
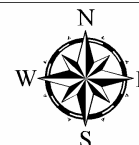

Legend

- Against State (Red)
- Private Line (Blue)
- Excluded Acreage (No Paint)
- Nearby Timber Sales
- Stand Boundaries
- Recreational Trail
- Primary Forest Road
- Secondary Forest Road
- Forest Access Route
- Paved Road
- Gravel Road
- County Road - Seasonal
- Pipeline
- Powerline
- Lakes and Rivers
- Section Corners

Locator Map
1:200,000

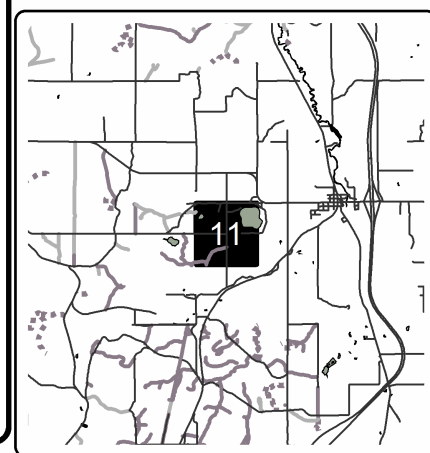

TIMBER SALE INFORMATION

TNT Mix (52-122-20)

T35N, R02W, SEC. 11; T35N, R02W, SEC. 14.
Cheboygan County (Advertised Price \$38,246.15)

SALE NOTE: Note that access requires crossing Scott Creek. The DNR may help obtain permits but will require advanced notice.

A timber sale contract for this lump sum, sealed bid timber sale will be awarded to the responsible bidder offering the highest sealed bid price. All units of volume listed below were estimated using the T-Sale computer program and our traditional volume equations. Bids must be at or above the following advertised price for each product and species:

<u>PRODUCTS & SPECIES</u>	<u>ESTIMATED UNITS*</u>		<u>ADVERTISED PRICE</u>	
Sawtimber				
Mixed Aspen	153.7	MBF	\$	39.00 / MBF
Red Maple	48.9	MBF	\$	67.00 / MBF
Red Oak	0.9	MBF	\$	90.00 / MBF
Red Pine	24.3	MBF	\$	80.00 / MBF
White Pine	16.7	MBF	\$	27.00 / MBF
Pulpwood				
Balsam Fir	331	Cords	\$	14.70 / Cord
Black Spruce	11	Cords	\$	12.40 / Cord
Jack Pine	165	Cords	\$	10.15 / Cord
Mixed Aspen	758	Cords	\$	15.25 / Cord
Mixed Hardwood	360	Cords	\$	16.70 / Cord
Paper Birch	52	Cords	\$	7.65 / Cord
Red Oak	3	Cords	\$	9.30 / Cord
Red Pine	20	Cords	\$	35.00 / Cord
White Pine	67	Cords	\$	16.80 / Cord

* The total volume is statistically estimated within plus (+) or minus (-) 11.42 percent. There are an estimated 2,250 cords on this timber sale, plus or minus 257 cords at the 95% confidence level. The estimated units are final and not subject to adjustment. Prospective bidders are urged to examine this timber and to make their own estimates of quantity and quality.

BOND AND PAYMENT SCHEDULE:

1. A bond in the amount of \$1,912.00 to insure faithful performance of the conditions of the contract will be deposited by the successful bidder within 21 days of the sale award.
2. Cutting in any sale or unit without the required advance payment would be considered a trespass.
3. Total payment must be paid in advance or according to the following schedule :
 - (a) Ten percent (10%) of the sale value must be paid within 21 days of the sale award.
 - (b) The 10% down payment will be credited towards the first unit cut.
 - (c) Payment for each of the following units must be made before cutting begins in that unit:

PAYMENT UNIT NUMBER	PERCENT OF TOTAL SALE VALUE
01	19.0%
02	0.7%
03	15.1%
04	12.1%
05	2.2%
06	17.6%
07	3.2%
08	30.1%

4. If no cutting takes place, the 10% down payment will not be refunded.
5. Operations on the contract issued will terminate on 06/30/2025.

SALE STATISTICS

SALE VOLUMES

VOLUME		STATISTICAL RANGE IN CORDS		
TOTAL CUBIC FEET	TOTAL CORDS	PERCENT ERROR	MINIMUM	MAXIMUM
177,762	2,250	11.42%	1,993	2,507

VDU VOLUMES

A VDU is a Volume Determination Unit. Volumes and their associated statistics are calculated at the VDU level and summarized to the sale level. There is often a one to one relationship between a VDU and a Payment Unit, but not always, depending on the cruise design. Refer to the VDU TO PAYMENT UNIT table.

VDU	VOLUME		PERCENT ERROR	RANGE IN CORDS	
	TOTAL CUBIC FEET	TOTAL CORDS		MINIMUM	MAXIMUM
26	43,798	554	21.72%	434	675
46	8,295	105	31.13%	72	138
49	10,523	133	37.90%	83	184
50	27,919	353	22.79%	273	434
57	101,768	1,288	18.44%	1,051	1,526
87	1,122	14	57.07%	6	22
88	35,550	450	32.29%	305	595
92	28,266	358	27.21%	260	455
94	72,024	912	29.54%	642	1,181
TOTAL:	329,264	4,168		3,126	5,210

VDU TO PAYMENT UNIT

When a VDU is associated with more than one Payment Unit (PU), the VDU volumes are assigned to the PU based on acres of the VDU within the PU.

VDU	VDU ACRES	PU	PU ACRES
26	6.4	4	0.2
		6	5.9
		7	0.3
46	4.7	5	4.5
		6	0.2
49	4.6	7	4.5
		8	0.1
50	6.3	5	0.1
		6	6.2
57	20.0	7	0.3
		8	19.7
87	1.4	2	1.4
88	14.4	1	14.4
92	14.0	3	14.0
94	10.2	4	9.1
		6	1.1
TOTAL:	82.0		82.0

DESCRIPTION OF TIMBER BY PAYMENT UNIT (PU)

PU	MARKET GROUP	PRODUCT	QUANTITY	UNIT	ACRES	ADVERTISE PRICE
1	Mixed Aspen	Sawtimber	38.6	MBF	14.4	\$7,274.85
	<i>B. T. Aspen</i>		31.4	<i>MBF</i>		
	<i>Quaking Aspen</i>		7.2	<i>MBF</i>		
	Red Maple		3.0	MBF		
	Balsam Fir	Pulpwood	32	Cords		
	<i>Balsam Fir</i>		32	<i>Cords</i>		
	Mixed Aspen		274	Cords		
	<i>B. T. Aspen</i>		163	<i>Cords</i>		
	<i>Quaking Aspen</i>		111	<i>Cords</i>		
	Mixed Hardwood		46	Cords		
	<i>Basswood</i>		2	<i>Cords</i>		
	<i>Black Cherry</i>		2	<i>Cords</i>		
	<i>Red Maple</i>		40	<i>Cords</i>		
	<i>Sugar Maple</i>		2	<i>Cords</i>		
	Paper Birch		11	Cords		
	<i>Paper Birch</i>		11	<i>Cords</i>		
	White Pine		4	Cords		
2	Mixed Hardwood	Pulpwood	15	Cords	1.4	\$250.50
	<i>Sugar Maple</i>	<i>Sawtimber</i>	0.8	<i>MBF</i>		
	<i>Sugar Maple</i>	<i>Pulpwood</i>	13	<i>Cords</i>		
3	Mixed Aspen	Sawtimber	39.9	MBF	14.0	\$5,790.75
	<i>B. T. Aspen</i>		22.5	<i>MBF</i>		
	<i>Quaking Aspen</i>		17.4	<i>MBF</i>		
	Balsam Fir	Pulpwood	18	Cords		
	<i>Balsam Fir</i>	<i>Sawtimber</i>	3.4	<i>MBF</i>		
	<i>Balsam Fir</i>	<i>Pulpwood</i>	11	<i>Cords</i>		
	Mixed Aspen		245	Cords		
	<i>B. T. Aspen</i>		93	<i>Cords</i>		
	<i>Balsam Poplar</i>		10	<i>Cords</i>		
	<i>Quaking Aspen</i>		142	<i>Cords</i>		
	Mixed Hardwood		14	Cords		
	<i>Ironwood</i>		2	<i>Cords</i>		
	<i>Red Maple</i>		6	<i>Cords</i>		
	<i>White Ash</i>		6	<i>Cords</i>		
4	Mixed Aspen	Sawtimber	31.4	MBF	9.3	\$4,646.85
	<i>B. T. Aspen</i>		1.2	<i>MBF</i>		
	<i>Quaking Aspen</i>		30.2	<i>MBF</i>		
	Red Maple		1.7	MBF		
	Red Oak		0.8	MBF		
	Red Pine		0.2	MBF		
	White Pine		0.4	MBF		
	Balsam Fir	Pulpwood	47	Cords		
	<i>Balsam Fir</i>	<i>Sawtimber</i>	4.9	<i>MBF</i>		
	<i>Balsam Fir</i>	<i>Pulpwood</i>	37	<i>Cords</i>		
	Jack Pine		3	Cords		
	<i>Jack Pine</i>		3	<i>Cords</i>		
	Mixed Aspen		100	Cords		
	<i>B. T. Aspen</i>		2	<i>Cords</i>		
	<i>Quaking Aspen</i>		98	<i>Cords</i>		
	Mixed Hardwood		55	Cords		
	<i>Red Maple</i>		55	<i>Cords</i>		
	Red Oak		3	Cords		
	White Pine		1	Cords		
5	Mixed Aspen	Sawtimber	0.8	MBF	4.6	\$844.05
	<i>B. T. Aspen</i>		0.8	<i>MBF</i>		
	Red Pine		0.9	MBF		

DESCRIPTION OF TIMBER BY PAYMENT UNIT (PU), CON'T

PU	MARKET GROUP	PRODUCT	QUANTITY	UNIT	ACRES	ADVERTISE PRICE
5 con't	White Pine	Sawtimber	1.8	MBF		
	Balsam Fir	Pulpwood	4	Cords		
	<i>Balsam Fir</i>	<i>Sawtimber</i>	0.5	<i>MBF</i>		
	<i>Balsam Fir</i>	<i>Pulpwood</i>	3	<i>Cords</i>		
	Jack Pine		19	Cords		
	<i>Jack Pine</i>	<i>Sawtimber</i>	0.4	<i>MBF</i>		
	<i>Jack Pine</i>	<i>Pulpwood</i>	18	<i>Cords</i>		
	Mixed Aspen		10	Cords		
	<i>B. T. Aspen</i>		7	<i>Cords</i>		
	<i>Balsam Poplar</i>		1	<i>Cords</i>		
	<i>Quaking Aspen</i>		2	<i>Cords</i>		
	Mixed Hardwood		3	Cords		
	<i>Red Maple</i>		3	<i>Cords</i>		
	Red Pine		2	Cords		
	White Pine		10	Cords		
	6	Mixed Aspen	Sawtimber	9.4		
<i>B. T. Aspen</i>			2.4	<i>MBF</i>		
<i>Quaking Aspen</i>			7.0	<i>MBF</i>		
Red Maple			2.6	MBF		
Red Oak			0.1	MBF		
Red Pine			19.9	MBF		
White Pine			11.9	MBF		
Balsam Fir		Pulpwood	54	Cords		
<i>Balsam Fir</i>		<i>Sawtimber</i>	5.9	<i>MBF</i>		
<i>Balsam Fir</i>		<i>Pulpwood</i>	42	<i>Cords</i>		
Jack Pine			112	Cords		
<i>Jack Pine</i>		<i>Sawtimber</i>	7.5	<i>MBF</i>		
<i>Jack Pine</i>		<i>Pulpwood</i>	97	<i>Cords</i>		
Mixed Aspen			33	Cords		
<i>B. T. Aspen</i>			3	<i>Cords</i>		
<i>Quaking Aspen</i>			30	<i>Cords</i>		
Mixed Hardwood			47	Cords		
<i>Red Maple</i>			47	<i>Cords</i>		
Red Pine			17	Cords		
White Pine			28	Cords		
7		Mixed Aspen	Sawtimber	1.9	MBF	5.1
	<i>Quaking Aspen</i>		1.9	<i>MBF</i>		
	Red Maple		1.5	MBF		
	Red Pine		0.3	MBF		
	White Pine		0.6	MBF		
	Balsam Fir	Pulpwood	10	Cords		
	<i>Balsam Fir</i>	<i>Sawtimber</i>	1.0	<i>MBF</i>		
	<i>Balsam Fir</i>	<i>Pulpwood</i>	8	<i>Cords</i>		
	Black Spruce		6	Cords		
	<i>Black Spruce</i>	<i>Sawtimber</i>	0.8	<i>MBF</i>		
	<i>Black Spruce</i>	<i>Pulpwood</i>	4	<i>Cords</i>		
	Jack Pine		29	Cords		
	<i>Jack Pine</i>		29	<i>Cords</i>		
	Mixed Aspen		5	Cords		
	<i>Quaking Aspen</i>		5	<i>Cords</i>		
	Mixed Hardwood		14	Cords		
	<i>Red Maple</i>		14	<i>Cords</i>		
	White Pine		11	Cords		
8	Mixed Aspen	Sawtimber	31.7	MBF	19.8	\$11,456.35
	<i>Quaking Aspen</i>		31.7	<i>MBF</i>		
	Red Maple		40.1	MBF		

DESCRIPTION OF TIMBER BY PAYMENT UNIT (PU), CON'T

PU	MARKET GROUP	PRODUCT	QUANTITY	UNIT	ACRES	ADVERTISE PRICE
8 con't	Red Pine	Sawtimber	3.0	MBF		
	White Pine		2.0	MBF		
	Balsam Fir	Pulpwood	166	Cords		
	<i>Balsam Fir</i>	<i>Sawtimber</i>	4.6	<i>MBF</i>		
	<i>Balsam Fir</i>	<i>Pulpwood</i>	157	<i>Cords</i>		
	Black Spruce		5	Cords		
	<i>Black Spruce</i>		5	<i>Cords</i>		
	Jack Pine		1	Cords		
	<i>Jack Pine</i>		1	<i>Cords</i>		
	Mixed Aspen		91	Cords		
	<i>Quaking Aspen</i>		91	<i>Cords</i>		
	Mixed Hardwood		166	Cords		
	<i>Sugar Maple</i>	<i>Sawtimber</i>	1.4	<i>MBF</i>		
	<i>Beech</i>	<i>Pulpwood</i>	2	<i>Cords</i>		
	<i>Red Maple</i>		154	<i>Cords</i>		
	<i>Sugar Maple</i>		7	<i>Cords</i>		
	Paper Birch		41	Cords		
	<i>Paper Birch</i>	<i>Sawtimber</i>	4.3	<i>MBF</i>		
	<i>Paper Birch</i>	<i>Pulpwood</i>	32	<i>Cords</i>		
	Red Pine		1	Cords		
White Pine		13	Cords			
TOTAL:			244.5	MBF		
TOTAL:			1,766	Cords		

Sale Specific Conditions & Requirements

Sale Name: TNT Mix

Sale Number: 52-122-20 Seq#: 2

1 - Sale Area

1.2 - Boundaries

1.2.1 - Painted boundaries (9/19)

The sale boundary and Payment Unit boundaries are marked and identified by blue, red, and yellow paint. Exterior sale boundary lines against private property are marked with blue paint. Exterior sale boundary lines against state are marked with red paint. Interior Payment Unit boundaries are marked with yellow paint. The painted boundary line trees are not Included Timber and are to be protected unless marked with orange paint. Yellow painted trees designating an interior Payment Unit boundary are only to be cut when all surrounding Payment Units have been paid except the Payment Unit Lines around Payment Unit 2 are to be left intact.

2 - Timber Specifications

2.1 - Included Timber

2.1.1 - Clearcut unit(s) with unmerchantable trees (6/14)

Within Payment Unit(s) 1, 3 - 5, 7, and 8, cut all trees that are two (2) inches or more at DBH except any trees which are 26" or greater at DBH.

In addition, the following conditions apply:

In Payment Unit 1 and 5, do not cut any oak.

In Payment Unit 3, do not cut any oak, pine, or apple.

In Payment Unit 4, do not cut any pine.

In Payment Unit 7, do not cut any oak or red pine.

2.1.3 - Cut tree marked unit(s) (12/08)

Within Payment Unit(s) 2, all trees are designated for cutting when marked with orange paint above and below stump height, regardless of merchantability.

2.1.7 - Leave tree marked unit(s) (6/14)

Within Payment Unit(s) 6, cut all trees that are two (2) inches or more at DBH except any trees marked with green paint above and below stump height.

3 - Payments

3.4 - Damaged Timber

3.4.1 - Damaged timber (7/16)

General Condition and Requirement 3.4 Damaged Timber, defines liquidated damages for undesignated live merchantable trees which are cut or injured.

No damage is acceptable to undesignated live merchantable trees. Within the Sale Area, if more than 5% of trees (> 4.5" DBH) within a specified area of the sale are damaged, liquidated damages will be assessed for all trees damaged. Rates will be in accordance with General Condition and Requirement 3.4 Damaged Timber.

4 - Transportation

4.1 - Construction

4.1.2 - Stream crossings, specific (3/11)

The crossing at Scott Creek will require the installation of a culvert or portable bridge which may be borrowed from the DNR. This installation will be performed in accordance with the specifications on the appropriate permits which shall be provided by the DNR. The DNR must be given adequate notice to obtain the necessary permits.

4.1.3 - Slash and earthen piles (8/04)

Piles or windrows of earth along roads and landings that have been widened or constructed shall be leveled. Slash from road

maintenance or construction, including stumps, shall be dispersed throughout the sale unless otherwise utilized.

4.1.7 - Road closure (10/11)

All new roads built into the sale must be blocked to vehicle traffic upon completion of the sale. Overgrown roads that are reopened shall be considered new roads. In general, this will require constructing a four (4') foot high berm of stumps and logs covered with earth. A berm is required in the proximity of Scott Creek. Temporary berms may be required if no sale activity occurs for 30 or more consecutive days. Contact the sale administrator for specific details of design and placement.

4.1.11 - Permits (2/12)

The Purchaser will secure any necessary highway and stream crossing permits that may be required.

5 - Operations

5.2 - Conduct of Operations

5.2.1 - Slash

5.2.1.10 - No slash in openings (5/10)

No brush or logging debris is to be left in the maintained wildlife openings which are indicated by G0 or U0 on the Timber Sale Map. Any damage to the opening shall be repaired according to specifications of the Unit Manager or his/her representative.

5.2.2 - Hazard Trees/Snags

5.2.2.1 - Den trees (10/16)

Obvious hollow and/or den trees shall be protected and left standing unless they are a safety hazard.

5.2.3 - Operating Restrictions

5.2.3.1 - Operating restrictions (9/11)

Within Payment Unit(s) 4, 7, and 8, cutting, skidding, and hauling are to occur during dry summer or frozen winter conditions. This restriction is to limit the potential for rutting within the Payment Units and along access routes.

5.2.3.2 - Operating restrictions (9/11)

Within Payment Unit(s) 6, cutting, skidding, and hauling are to occur in dry summer months. This restriction is to promote scarification and natural pine regeneration.

5.2.29 - Shrub protection (1/20)

Do not cut or damage hawthorn, witch-hazel, dogwood, or junberry. These woody-shrub plants are highly beneficial to various wildlife species.

5.2.32 - Decking/landing restoration (9/13)

All decking and landing areas must have the surface area restored to a condition equal to or better than before. This is to ensure the proper regeneration of the stand. Wood debris, chips, and "cookies" from trimmings must be removed or scattered away from landing and loading areas and may not be windrowed on the edge.

5.4 - Soil Protection

5.4.1 - Rutting restriction, general (7/16)

Operations are to cease immediately if equipment and weather conditions result in rutting of roads and/or skid trails which is 12 inches or greater in depth and 50 feet in length. The Unit Manager or his/her representative may restrict hauling and/or skidding if ruts exceed the specified depth. With the Unit Manager or his/her representative's approval, the Purchaser may return to the area when the risk of rutting has decreased.

5.8 - Protection of Endangered Species

5.8.5 - Protection of raptor nests (3/13)

All trees with raptor nests will be protected if found during harvesting operations. Notification will be made to the Unit Manager or his/her representative who will notify the Wildlife Biologist so an on-site evaluation and recommendation can be made, if necessary.

6 - Safety and Fire Prevention

6.2 - Signing

6.2.1 - Road posting (9/09)

The Purchaser is responsible for posting and maintaining caution signs on the haul route prior to beginning operations. The road must be posted at appropriate distances from the Sale Area to warn of logging activity and truck traffic. Signs must be removed when harvest operations are suspended or completed. The Purchaser will provide these signs.



TIMBER SALE MAP

This information provided by authority of Part 525, 1994 PA 451, as amended.

Forest Management Unit Gaylord		County Cheboygan	Mapped By TSP	Date 09/10/2020	Page 1	of 1
Township 35N	Range 02W	Section(s) and Subdivision(s) Sec 11: SENW, SWNE, SW; 14: NENW		Scale 1:15,840		

Cover Type				Density			
A = Aspen	H = Hemlock	N = Marsh	U = Upland Brush	0 = Non Stocked	5 = Pole Timber Medium		
B = Paper Birch	J = Jack Pine	O = Oak	UM = Upland Mixed	1 = Seedling Sapling Poor	6 = Pole Timber Well		
C = Cedar	L = Lowland Brush	P = Lowland Poplar	V = Bog or Marsh	2 = Seedling Sapling Medium	7 = Saw Timber Poor		
D = Treed Bog	LM = Lowland Mixed	Q = Mixed Swamp Conifer	W = White Pine	3 = Seedling Sapling Well	8 = Saw Timber Medium		
E = Swamp Hdwoods	M = Mpl, Bch, Brch	R = Red Pine	X = Non Stocked	4 = Pole Timber Poor	9 = Saw Timber Well		
F = Spruce Fir	MC = Mixed Conifer	S = Black Spruce	Z = Water				
G = Grass	MD = Mixed Deciduous	T = Tamarack					

PU	Acres	PU	Acres
1	14.4	5	4.6
2	1.4	6	13.4
3	14	7	5.1
4	9.3	8	19.8

TNT Mix

Compartment 177

82 Acres

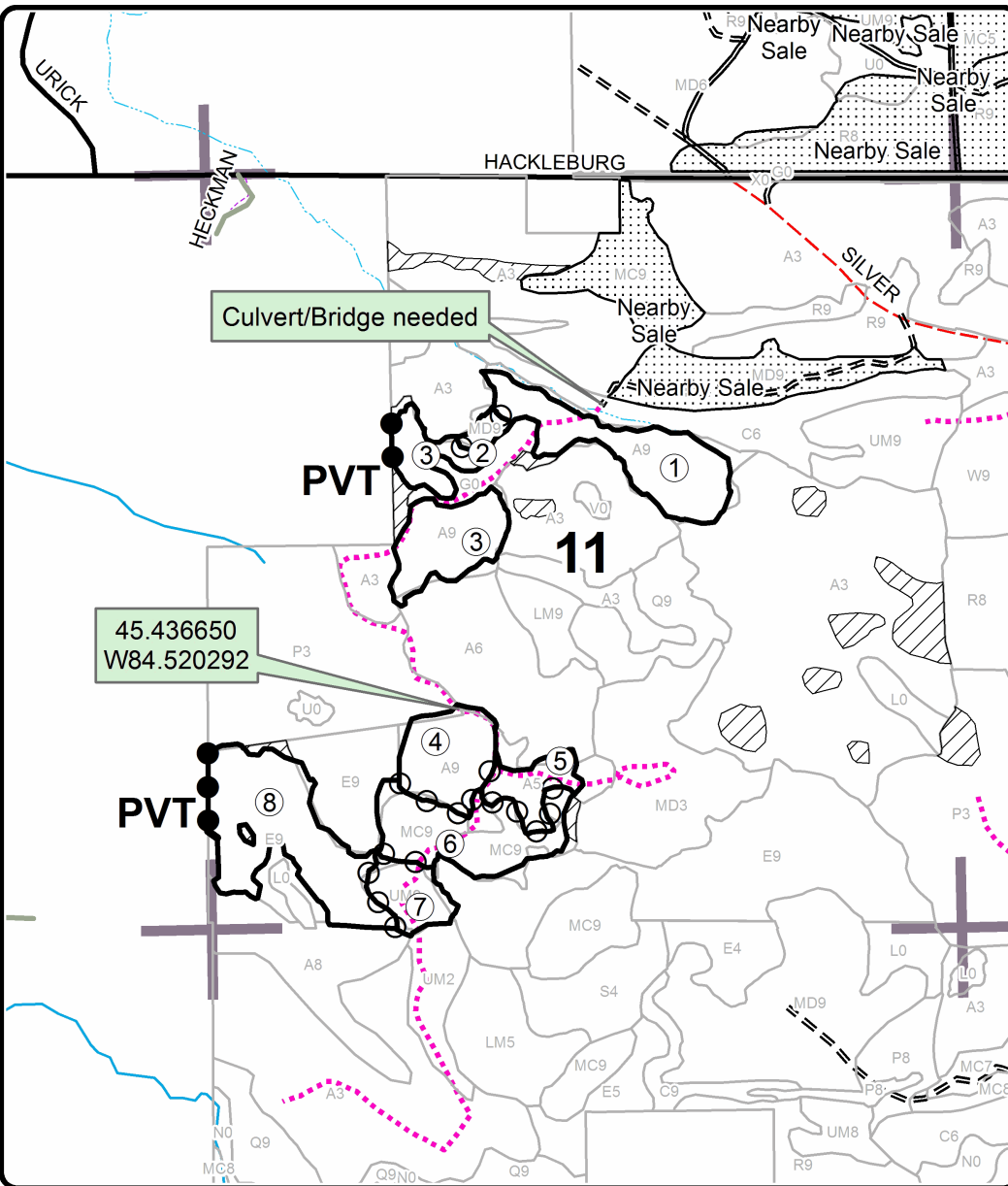
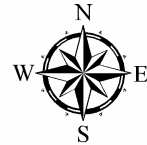

Legend

- Against State (Red)
- ○ Payment Unit (Yellow)
- ● Private Line (Blue)
- ▨ Retention Area
- ▤ Nearby Timber Sales
- ▭ Stand Boundaries
- Secondary Forest Road
- == Forest Access Route
- Paved Road
- - - County Road - Seasonal
- Private
- ⋯ Temporary Management Access
- ⋯ Intermittent Stream
- Perennial River
- Section Corners

Locator Map

1:200,000

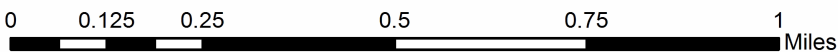
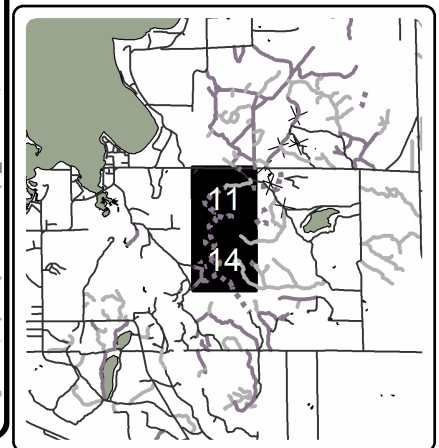

TIMBER SALE INFORMATION

Whole Lotta Pine (52-129-20)

T35N, R02W, SEC. 1; T35N, R02W, SEC. 11; T35N, R02W, SEC. 12; T35N, R02W, SEC. 2; T36N, R02W, SEC. 35.
Cheboygan County (Advertised Price \$86,571.70)

SALE NOTE: High volume red pine sale. Very tall, large DBH pine in Payment Units 5, 6, and 11. Good access to all Payment Units. Some harvest time restrictions.

A timber sale contract for this lump sum, sealed bid timber sale will be awarded to the responsible bidder offering the highest sealed bid price. All units of volume listed below were estimated using the T-Sale computer program and our traditional volume equations. Bids must be at or above the following advertised price for each product and species:

<u>PRODUCTS & SPECIES</u>	<u>ESTIMATED UNITS*</u>	<u>ADVERTISED PRICE</u>
Sawtimber		
B. T. Aspen	10.2 MBF	\$ 39.00 / MBF
Red Oak	78.9 MBF	\$ 90.00 / MBF
Red Pine	332.9 MBF	\$ 80.00 / MBF
White Pine	75.2 MBF	\$ 33.00 / MBF
Pulpwood		
B. T. Aspen	494 Cords	\$ 15.25 / Cord
Balsam Fir	7 Cords	\$ 14.70 / Cord
Jack Pine	340 Cords	\$ 10.15 / Cord
Red Maple	148 Cords	\$ 16.70 / Cord
Red Oak	285 Cords	\$ 9.30 / Cord
Red Pine	743 Cords	\$ 35.00 / Cord
White Pine	461 Cords	\$ 16.80 / Cord

* The total volume is statistically estimated within plus (+) or minus (-) 11.39 percent. There are an estimated 3,473 cords on this timber sale, plus or minus 396 cords at the 95% confidence level. The estimated units are final and not subject to adjustment. Prospective bidders are urged to examine this timber and to make their own estimates of quantity and quality.

BOND AND PAYMENT SCHEDULE:

1. A bond in the amount of \$8,657.00 to insure faithful performance of the conditions of the contract will be deposited by the successful bidder within 21 days of the sale award.
2. Cutting in any sale or unit without the required advance payment would be considered a trespass.
3. Total payment must be paid in advance or according to the following schedule :
 - (a) Ten percent (10%) of the sale value must be paid within 21 days of the sale award.
 - (b) The 10% down payment will be credited towards the first unit cut.
 - (c) Payment for each of the following units must be made before cutting begins in that unit:

PAYMENT UNIT NUMBER	PERCENT OF TOTAL SALE VALUE
01	2.2%
02	1.6%
03	11.7%
04	2.0%
05	23.0%
06	12.2%
07	2.4%
08	17.2%
09	9.0%
10	5.5%
11	8.3%
12	4.9%

4. If no cutting takes place, the 10% down payment will not be refunded.
5. Operations on the contract issued will terminate on 06/30/2024.

SALE STATISTICS

SALE VOLUMES

VOLUME		STATISTICAL RANGE IN CORDS		
TOTAL CUBIC FEET	TOTAL CORDS	PERCENT ERROR	MINIMUM	MAXIMUM
274,367	3,473	11.39%	3,077	3,869

VDU VOLUMES

A VDU is a Volume Determination Unit. Volumes and their associated statistics are calculated at the VDU level and summarized to the sale level. There is often a one to one relationship between a VDU and a Payment Unit, but not always, depending on the cruise design. Refer to the VDU TO PAYMENT UNIT table.

VDU	VOLUME		PERCENT ERROR	RANGE IN CORDS	
	TOTAL CUBIC FEET	TOTAL CORDS		MINIMUM	MAXIMUM
8	11,210	142	49.60%	72	212
11	46,191	585	24.20%	443	726
16	9,093	115	44.80%	64	167
21	29,617	375	28.46%	268	482
28	19,497	247	25.64%	184	310
33	20,200	256	40.55%	152	359
34	7,710	98	40.87%	58	137
41	36,119	457	22.51%	354	560
43	47,890	606	27.51%	439	773
54	13,825	175	32.55%	118	232
84	3,634	46	58.25%	19	73
430	29,380	372	34.60%	243	501
TOTAL:	274,367	3,473		2,414	4,532

VDU TO PAYMENT UNIT

When a VDU is associated with more than one Payment Unit (PU), the VDU volumes are assigned to the PU based on acres of the VDU within the PU.

VDU	VDU ACRES	PU	PU ACRES
8	15.0	1	15.0
11	29.1	3	29.1
16	7.6	2	7.6
21	11.3	11	11.3
28	22.2	9	22.2
33	13.5	12	13.5
34	11.3	7	11.3
41	15.2	8	15.2
43	17.5	5	17.5
54	8.1	10	8.1
84	3.1	4	3.1
430	13.7	6	13.7
TOTAL:	167.6		167.6

DESCRIPTION OF TIMBER BY PAYMENT UNIT (PU)

PU	MARKET GROUP	PRODUCT	QUANTITY	UNIT	ACRES	ADVERTISE PRICE
1	B. T. Aspen	Pulpwood	95	Cords	15.0	\$1,925.80
	Jack Pine		47	Cords		
2	B. T. Aspen	Pulpwood	45	Cords	7.6	\$1,396.75
	Jack Pine		70	Cords		
3	B. T. Aspen	Sawtimber	2.2	MBF	29.1	\$10,159.25
	Red Oak		31.2	MBF		
	Red Pine		5.5	MBF		
	White Pine	6.8	MBF			
	B. T. Aspen	Pulpwood	112	Cords		
	Jack Pine		129	Cords		
	Red Oak		135	Cords		
	Red Pine		19	Cords		
	White Pine		99	Cords		
4	Red Pine	Sawtimber	9.1	MBF	3.1	\$1,708.00
	Red Pine	Pulpwood	28	Cords		
5	Red Oak	Sawtimber	34.8	MBF	17.5	\$19,929.90
	Red Pine		129.8	MBF		
	White Pine		10.8	MBF		
	Red Maple	Pulpwood	7	Cords		
	Red Oak		86	Cords		
	Red Pine		132	Cords		
	White Pine		31	Cords		
6	Red Pine	Sawtimber	51.4	MBF	13.7	\$10,577.30
	White Pine		26.9	MBF		
	Red Pine	Pulpwood	108	Cords		
	White Pine		107	Cords		
7	Red Pine	Sawtimber	6.9	MBF	11.3	\$2,120.85
	B. T. Aspen	Pulpwood	27	Cords		
	Jack Pine		22	Cords		
	Red Pine		19	Cords		
	White Pine		16	Cords		
8	B. T. Aspen	Sawtimber	2.8	MBF	15.2	\$14,911.15
	Red Oak		6.7	MBF		
	Red Pine		60.6	MBF		
	White Pine	1.6	MBF			
	B. T. Aspen	Pulpwood	39	Cords		
	Red Oak		26	Cords		
	Red Pine		236	Cords		
	White Pine		12	Cords		
9	B. T. Aspen	Sawtimber	2.5	MBF	22.2	\$7,764.10
	Red Pine		35.5	MBF		
	White Pine		1.8	MBF		
	B. T. Aspen	Pulpwood	15	Cords		
	Jack Pine		19	Cords		
	Red Pine		116	Cords		
	White Pine		17	Cords		
10	Red Pine	Sawtimber	17.8	MBF	8.1	\$4,726.30
	White Pine		2.7	MBF		
	B. T. Aspen	Pulpwood	48	Cords		
	Red Maple		10	Cords		
	Red Pine		57	Cords		
	White Pine		19	Cords		
11	B. T. Aspen	Sawtimber	2.0	MBF	11.3	\$7,148.10
	Red Oak		0.9	MBF		
	Red Pine		16.3	MBF		

DESCRIPTION OF TIMBER BY PAYMENT UNIT (PU), CON'T

PU	MARKET GROUP	PRODUCT	QUANTITY	UNIT	ACRES	ADVERTISE PRICE
11 con't	White Pine	Sawtimber	21.2	MBF		
	B. T. Aspen	Pulpwood	25	Cords		
	Jack Pine		47	Cords		
	Red Maple		52	Cords		
	Red Oak		12	Cords		
	Red Pine		28	Cords		
	White Pine		129	Cords		
12	B. T. Aspen	Sawtimber	0.7	MBF	13.5	\$4,204.20
	Red Oak		5.3	MBF		
	White Pine		3.4	MBF		
	B. T. Aspen	Pulpwood	88	Cords		
	Balsam Fir		7	Cords		
	Jack Pine		6	Cords		
	Red Maple		79	Cords		
	Red Oak		26	Cords		
	White Pine		31	Cords		
TOTAL:			497.2	MBF		
TOTAL:			2,478	Cords		

Sale Specific Conditions & Requirements

Sale Name: Whole Lotta Pine

Sale Number: 52-129-20 Seq#: 1

1 - Sale Area

1.2 - Boundaries

1.2.1 - Painted boundaries (9/19)

The sale boundary and Payment Unit boundaries are marked and identified by red and yellow paint. Exterior sale boundary lines against state are marked with red paint. Interior Payment Unit boundaries are marked with yellow paint. Retention patches are marked with teal paint; no harvesting activities may occur within these areas.

2 - Timber Specifications

2.1 - Included Timber

2.1.1 - Clearcut unit(s) with unmerchantable trees (6/14)

Within Payment Unit(s) 5 and 7 - 9, cut all trees that are two (2) inches or more at DBH.

2.1.2 - Clearcut unit(s) w/o unmerchantable trees (8/11)

Within Payment Unit(s) 1 - 3, 6, 11, and 12, cut all trees which meet minimum piece specifications in 2.2 Utilization except for the following:

Within Payment Unit 1 and 2, do not cut oak species, white pine, or red pine.

Within Payment Unit 3, do not cut white oak or teal marked trees.

Within Payment Unit 6, do not cut oak species or teal marked trees.

Within Payment Unit 11, do not cut white oak or teal marked trees.

Within Payment Unit 12, do not cut pine species > 22" DBH or teal marked trees.

2.1.3 - Cut tree marked unit(s) (12/08)

Within Payment Unit(s) 4, all trees are designated for cutting when marked with orange paint above and below stump height, regardless of merchantability.

2.1.8 - Designated plantation row unit(s) (12/08)

Within Payment Unit(s) 10, all red pine trees which meet minimum piece specifications in 2.2 Utilization, within designated plantation rows are designated for cutting. Designated plantation rows are every third row. Also remove all other trees species, except oak, from the entire Payment Unit.

2.2 - Utilization

2.2.3 - Stump heights (4/07)

Stump heights within Payment Unit(s) 5 and 7 - 9 shall not exceed 12 inches for trees greater than 10 inches at DBH and 4 inches for trees smaller than 10 inches at DBH. This is to facilitate planting operations.

4 - Transportation

4.1 - Construction

4.1.3 - Slash and earthen piles (8/04)

Piles or windrows of earth along roads and landings that have been widened or constructed shall be leveled. Slash from road maintenance or construction, including stumps, shall be dispersed throughout the Sale Area.

4.1.6 - Road construction (1/09)

Construction of new roads or improvements of existing roads shall be done in such a way as to minimize the environmental and visual impacts. Merchantable trees shall be cut and utilized unless otherwise directed. Non-merchantable trees shall be severed and laid flat on the ground. Slash shall be scattered, and not left in windrows and kept a minimum of 10 feet back from the road edge. Stumps shall be set upright, not left on edge, and be moved at least 10 feet away from the road edge. Disturbed soil shall be feathered into the woods and not left in berms or windrows.

4.1.7 - Road closure (10/11)

All new roads built into the sale must be blocked to vehicle traffic upon completion of the sale. Overgrown roads that are reopened shall be considered new roads. In general, this will require constructing a four (4') foot high berm of stumps and logs covered with earth. These roads must be rendered impassable to cars and trucks. All stumps from road building and landing construction must be reserved to block any newly constructed roads upon completion of the sale. These stumps must be scattered along the road system to prohibit vehicular movement. Contact the sale administrator for specific details of design and placement.

4.2 - Maintenance

4.2.4 - Grading (10/16)

For completion of the sale, state forest roads must be graded. In general, this will require a road grader or bulldozer to shape up the roads after forest products have been hauled off site. This includes cleaning of drainage areas, grading, crowning, and filling with gravel, if necessary. The grading equipment to be used must be approved by the Unit Manager or his/her representative.

5 - Operations

5.1 - Notification

5.1.1 - Pre-sale conference (10/16)

A pre-sale conference between the Purchaser and sale administrator is required prior to beginning any operations to determine landing and road locations. The Unit Manager or his/her representative must be contacted at least 2 days in advance to schedule the conference.

5.1.4 - Post-sale conference (10/16)

A post-sale conference on site between the Purchaser and sale administrator is required 5 days prior to the completion of active logging operations to determine clean-up and repair of landings, road edges, and the fulfillment of other contract specifications.

5.2 - Conduct of Operations

5.2.1 - Slash

5.2.1.8 - Slash height (12/08)

No slash or tree tops in Payment Unit 5 may exceed 24 inches in height.

5.2.2 - Hazard Trees/Snags

5.2.2.1 - Den trees (10/16)

Obvious hollow and/or den trees shall be protected and left standing unless they are a safety hazard.

5.2.3 - Operating Restrictions

5.2.3.1 - Operating restrictions (9/11)

Within Payment Unit(s) 2 and 3, unless changed by written agreement, cutting, skidding, and hauling are limited to the period of no ground snow-cover. This restriction is for soil scarification and to promote natural Jack Pine regeneration.

5.2.3.5 - Oak wilt restriction (1/18)

Within Payment Unit(s) 1 - 3 and 10 - 12 unless changed by written agreement, cutting, skidding, hauling within the sale and brushing of access roads to the sale are not permitted during the period of April 15 to July 15. Operations may be allowed if specific steps are taken to prevent damaging uncut oak during the high risk period. Those steps may include completing all road brushing before April 15th and clearing a tree-length buffer along uncut oak cover before April 15th. This is necessary to reduce the spread of oak wilt. For more information, contact the Unit Manager or his/her representative.

5.2.32 - Decking/landing restoration (9/13)

All decking and landing areas must have the surface area restored to a condition equal to or better than before. This is to ensure the proper regeneration of the stand.

5.4 - Soil Protection

5.4.1 - Rutting restriction, general (7/16)

Operations are to cease immediately if equipment and weather conditions result in rutting of roads and/or skid trails which is 12 inches or greater in depth and 50 feet in length. The Unit Manager or his/her representative may restrict hauling and/or skidding if ruts exceed the specified depth. With the Unit Manager or his/her representative's approval, the Purchaser may return to the area when the risk of rutting has decreased.

5.8 - Protection of Endangered Species

5.8.5 - Protection of raptor nests (3/13)

All trees with raptor nests will be protected if found during harvesting operations. Notification will be made to the Unit Manager or his/her representative who will notify the Wildlife Biologist so an on-site evaluation and recommendation can be made, if necessary.

6 - Safety and Fire Prevention

6.2 - Signing

6.2.1 - Road posting (9/09)

The Purchaser is responsible for posting and maintaining caution signs on Hackleburg Road prior to beginning operations. The road must be posted at appropriate distances from the Sale Area to warn of logging activity and truck traffic. Signs must be removed when harvest operations are suspended or completed. The Purchaser will provide these signs.



TIMBER SALE MAP

This information provided by authority of Part 525, 1994 PA 451, as amended.

Forest Management Unit Gaylord		County Cheboygan	Mapped By TSP	Date 10/06/2020	Page 1	of 1
Township 35N & 36N	Range 02W	Section(s) and Subdivision(s) 35N 1: NWNW,S1/2NW,N1/2SW,SWSW; 2: N1/2NE,SWNE,SE; 11: NENW,NE; 12: N1/2NW,SENW; 36N 35: SESE			Scale 1:15,840	
Cruised By Scheele						

Cover Type				Density			
A = Aspen	H = Hemlock	N = Marsh	U = Upland Brush	0 = Non Stocked	5 = Pole Timber Medium		
B = Paper Birch	J = Jack Pine	O = Oak	UM = Upland Mixed	1 = Seedling Sapling Poor	6 = Pole Timber Well		
C = Cedar	L = Lowland Brush	P = Lowland Poplar	V = Bog or Marsh	2 = Seedling Sapling Medium	7 = Saw Timber Poor		
D = Treed Bog	LM = Lowland Mixed	Q = Mixed Swamp Conifer	W = White Pine	3 = Seedling Sapling Well	8 = Saw Timber Medium		
E = Swamp Hdwoods	M = Mpl, Bch, Brch	R = Red Pine	X = Non Stocked	4 = Pole Timber Poor	9 = Saw Timber Well		
F = Spruce Fir	MC = Mixed Conifer	S = Black Spruce	Z = Water				
G = Grass	MD = Mixed Deciduous	T = Tamarack					

PU	Acres	PU	Acres	PU	Acres
1	15	5	17.5	9	22.2
2	7.6	6	13.7	10	8.1
3	29.1	7	11.3	11	11.3
4	3.1	8	15.2	12	13.5

Whole Lotta Pine

Compartment 177
167.6 Acres

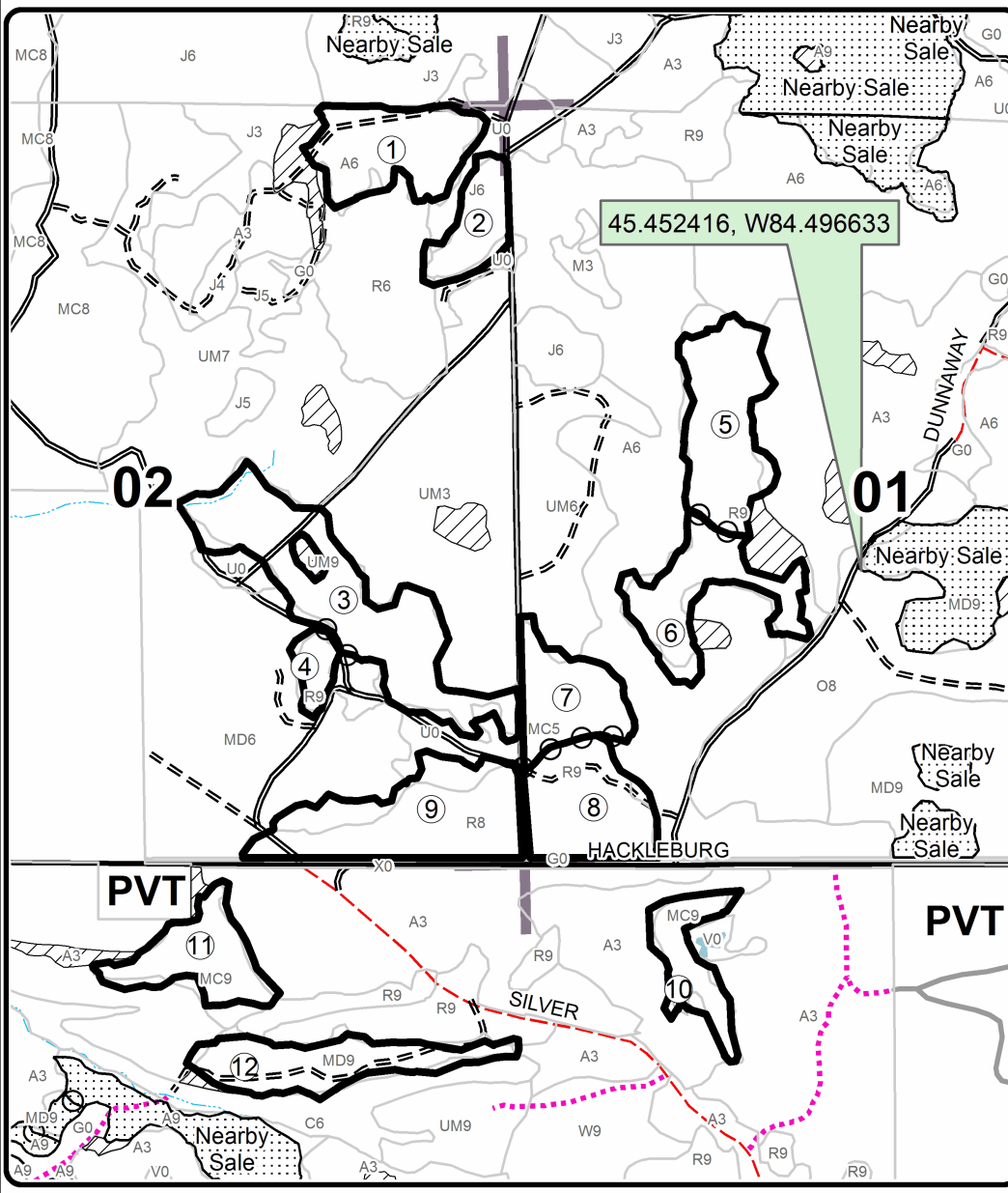

Legend

- Against State (Red)
- Payment Unit (Yellow)
- Retention Area
- Nearby Timber Sales
- Stand Boundaries
- Secondary Forest Road
- Forest Access Route
- Paved Road
- County Road - Seasonal
- Private
- Temporary Management Access
- Intermittent Stream
- Section Corners

Locator Map
1:200,000

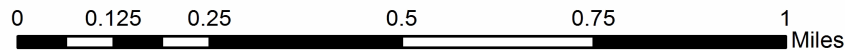
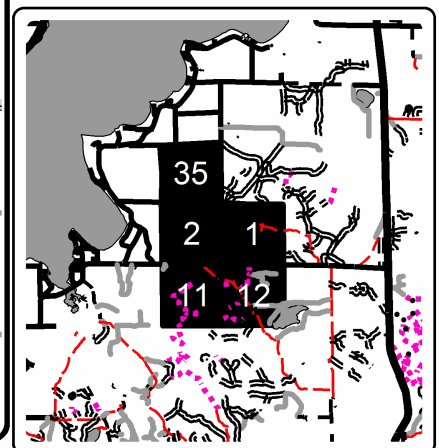

Whole Lotta Pine (52-129-20)

T35N, R02W, SEC. 1; T35N, R02W, SEC. 11; T35N, R02W, SEC. 12; T35N, R02W,

In response to the notice of sale to be held 3:00 p.m. (local time) on July 27, 2021, I am hereby submitting my sealed bid (firm offer) for the following forest products to be cut. Bids for individual species must be at or above the advertised price. All non-responsive bid forms may be rejected.

<u>PRODUCTS & SPECIES</u>	<u>ESTIMATED VOLUME*</u>	<u>ADVERTISED PRICE</u>	<u>BID PRICE/UNIT</u>
Sawtimber			
B. T. Aspen	10.2 MBF	\$ 39.00/MBF	\$ _____
Red Oak	78.9 MBF	\$ 90.00/MBF	\$ _____
Red Pine	332.9 MBF	\$ 80.00/MBF	\$ _____
White Pine	75.2 MBF	\$ 33.00/MBF	\$ _____
Pulpwood			
B. T. Aspen	494 Cords	\$ 15.25/Cord	\$ _____
Balsam Fir	7 Cords	\$ 14.70/Cord	\$ _____
Jack Pine	340 Cords	\$ 10.15/Cord	\$ _____
Red Maple	148 Cords	\$ 16.70/Cord	\$ _____
Red Oak	285 Cords	\$ 9.30/Cord	\$ _____
Red Pine	743 Cords	\$ 35.00/Cord	\$ _____
White Pine	461 Cords	\$ 16.80/Cord	\$ _____

*The volumes are statistically estimated within plus (+) or minus (-) 11.39 percent at 95% confidence level. These estimated volumes are final and not subject to adjustment. Prospective bidders are urged to examine this timber and to make their own estimates of quantity and quality.

I understand that any or all bids may be rejected. All bids must be signed and all bid items must be bid or the bid form may be rejected. I also understand that consideration and awarding a contract will be based upon my past performance and ability to complete the contract based upon equipment and staffing subject to my control .

FEDERAL ID: _____ or SOCIAL SECURITY NUMBER: _____

Company or individual bidding: _____

Company representative's name: _____

Address: _____

City: _____ State: _____ Zip: _____

IF AVAILABLE, PLEASE PLACE THE PERSONALIZED LABEL FROM YOUR PROSPECTUS IN THE ABOVE BOX.

Individual or company representative's signature: _____ Date: _____

Phone number : _____ Email (optional): _____

THE WINNING BIDDER MUST COMPLETE THE VERIFICATION OF WORKER'S DISABILITY COMPENSATION ACT COMPLIANCE (ON REVERSE SIDE IF DOUBLE SIDED) WITHIN 21 DAYS OF SALE AWARD DATE



FOR DEPARTMENT USE ONLY	
Sale Number (XX - XXX - XX - XX)	
Forest Management Unit:	

TIMBER SALE VERIFICATION OF WORKER'S DISABILITY COMPENSATION ACT COMPLIANCE

As required by Act 317, P.A. 1969 (Worker's Compensation) and
Part 5 of Act 451 of 1994, as amended.

VERIFICATION OF WORKER'S DISABILITY COMPENSATION ACT COMPLIANCE

- This verification must be completed and submitted within 21 days of contract award and prior to the issuance of the timber sale contract.
- In addition, if boxes 2B or 2C are checked, then Notice of Exclusion or Certificate of Insurance must be submitted within twenty-one (21) days of the contract award and prior to the issuance of the timber sale contract.
- All information must be typed or printed except for written signatures.

Please Check Appropriate Categories:

1. My business is organized as (you **must** check one of the boxes below):
 - A. Sole Proprietorship (individual)
 - B. Partnership
 - C. Corporation
2. You **must** check one of the boxes below:
 - A. I certify my business is a sole proprietorship and it has no employees but the sole proprietor. I am not subject to the Worker's Compensation Laws.
 - B. I certify my business has satisfied its obligation to the Worker's Compensation Act through the use of an approved Notice of Exclusion (BWC-337, Rev. 5/96). I will provide a copy of the Notice of Exclusion within 21 days of the contract award. (For questions or a copy of the BWC-337, please call the Worker's Compensation Bureau at 517-322-1195).
 - C. I certify my business has a Worker's Compensation Policy. I will provide an original Certificate of Insurance within twenty-one (21) days of the contract award.
3. If you have checked item 2(A) or 2(B), you **must** indicate the number of **both** full-time and part-time employees, other than yourself, including family members and active partners (if none, you must enter "0").

_____ Full-time Employees

_____ Part-time Employees

Name of Business		Federal ID (or) Social Security No.	
Address		Telephone ()	
City	State	ZIP	

I hereby certify that the above information is true and correct. I agree to notify the Michigan DNR of any changes that occur in factors affecting my coverage during any of my present and future operations.

Signature of Owner or Authorized Representative

Title

Date

Please complete the "SEALED BID" information on the next page

Oh Wells Aspen (52-111-20)
T35N, R01W, SEC. 35; Cheboygan COUNTY

In response to the notice of sale to be held 3:00 p.m. (local time) on July 27, 2021, I am hereby submitting my sealed bid (firm offer) for the following forest products to be cut. Bids for individual species must be at or above the advertised price. All non-responsive bid forms may be rejected.

<u>PRODUCTS & SPECIES</u>	<u>ESTIMATED VOLUME*</u>	<u>ADVERTISED PRICE</u>	<u>BID PRICE/UNIT</u>
Sawtimber			
B. T. Aspen	24.0 MBF	\$ 39.00/MBF	\$ _____
Pulpwood			
Balsam Fir	23 Cords	\$ 14.70/Cord	\$ _____
Mixed Aspen	754 Cords	\$ 15.25/Cord	\$ _____
Mixed Hardwood	32 Cords	\$ 16.70/Cord	\$ _____
White Pine	49 Cords	\$ 16.80/Cord	\$ _____
White Spruce	9 Cords	\$ 12.40/Cord	\$ _____

*The volumes are statistically estimated within plus (+) or minus (-) 16.94 percent at 95% confidence level. These estimated volumes are final and not subject to adjustment. Prospective bidders are urged to examine this timber and to make their own estimates of quantity and quality.

I understand that any or all bids may be rejected. All bids must be signed and all bid items must be bid or the bid form may be rejected. I also understand that consideration and awarding a contract will be based upon my past performance and ability to complete the contract based upon equipment and staffing subject to my control.

FEDERAL ID: _____ - _____ or SOCIAL SECURITY NUMBER: _____ - _____ - _____

Company or individual bidding: _____

Company representative's name: _____

Address: _____

City: _____ State: _____ Zip: _____

IF AVAILABLE, PLEASE PLACE THE PERSONALIZED LABEL FROM YOUR PROSPECTUS IN THE ABOVE BOX.

Individual or company representative's signature: _____ Date: _____

Phone number : _____ Email (optional): _____

THE WINNING BIDDER MUST COMPLETE THE VERIFICATION OF WORKER'S DISABILITY COMPENSATION ACT COMPLIANCE (ON REVERSE SIDE IF DOUBLE SIDED) WITHIN 21 DAYS OF SALE AWARD DATE



FOR DEPARTMENT USE ONLY	
Sale Number (XX - XXX - XX - XX)	
Forest Management Unit:	

TIMBER SALE VERIFICATION OF WORKER'S DISABILITY COMPENSATION ACT COMPLIANCE

As required by Act 317, P.A. 1969 (Worker's Compensation) and
Part 5 of Act 451 of 1994, as amended.

VERIFICATION OF WORKER'S DISABILITY COMPENSATION ACT COMPLIANCE

- This verification must be completed and submitted within 21 days of contract award and prior to the issuance of the timber sale contract.
- In addition, if boxes 2B or 2C are checked, then Notice of Exclusion or Certificate of Insurance must be submitted within twenty-one (21) days of the contract award and prior to the issuance of the timber sale contract.
- All information must be typed or printed except for written signatures.

Please Check Appropriate Categories:

1. My business is organized as (you **must** check one of the boxes below):
 - A. Sole Proprietorship (individual)
 - B. Partnership
 - C. Corporation
2. You **must** check one of the boxes below:
 - A. I certify my business is a sole proprietorship and it has no employees but the sole proprietor. I am not subject to the Worker's Compensation Laws.
 - B. I certify my business has satisfied its obligation to the Worker's Compensation Act through the use of an approved Notice of Exclusion (BWC-337, Rev. 5/96). I will provide a copy of the Notice of Exclusion within 21 days of the contract award. (For questions or a copy of the BWC-337, please call the Worker's Compensation Bureau at 517-322-1195).
 - C. I certify my business has a Worker's Compensation Policy. I will provide an original Certificate of Insurance within twenty-one (21) days of the contract award.
3. If you have checked item 2(A) or 2(B), you **must** indicate the number of **both** full-time and part-time employees, other than yourself, including family members and active partners (if none, you must enter "0").

_____ Full-time Employees

_____ Part-time Employees

Name of Business		Federal ID (or) Social Security No.	
Address		Telephone ()	
City	State	ZIP	

I hereby certify that the above information is true and correct. I agree to notify the Michigan DNR of any changes that occur in factors affecting my coverage during any of my present and future operations.

Signature of Owner or Authorized Representative

Title

Date

Please complete the "SEALED BID" information on the next page

Lawless Red Pine (52-120-20)
T33N, R03W, SEC. 11; Cheboygan COUNTY

In response to the notice of sale to be held 3:00 p.m. (local time) on July 27, 2021, I am hereby submitting my sealed bid (firm offer) for the following forest products to be cut. Bids for individual species must be at or above the advertised price. All non-responsive bid forms may be rejected.

<u>PRODUCTS & SPECIES</u>	<u>ESTIMATED VOLUME*</u>	<u>ADVERTISED PRICE</u>	<u>BID PRICE/UNIT</u>
Sawtimber Red Pine	45.5 MBF	\$ 102.00/MBF	\$ _____
Pulpwood Red Pine	300 Cords	\$ 44.55/Cord	\$ _____

*The volumes are statistically estimated within plus (+) or minus (-) 20.09 percent at 95% confidence level. These estimated volumes are final and not subject to adjustment. Prospective bidders are urged to examine this timber and to make their own estimates of quantity and quality.

I understand that any or all bids may be rejected. All bids must be signed and all bid items must be bid or the bid form may be rejected. I also understand that consideration and awarding a contract will be based upon my past performance and ability to complete the contract based upon equipment and staffing subject to my control .

FEDERAL ID: ____ - ____ - ____ or SOCIAL SECURITY NUMBER: ____ - ____ - ____

Company or individual bidding: _____

Company representative's name: _____

Address: _____

City: _____ State: _____ Zip: _____

IF AVAILABLE, PLEASE PLACE THE PERSONALIZED LABEL FROM YOUR PROSPECTUS IN THE ABOVE BOX.

Individual or company representative's signature : _____ Date: _____

Phone number : _____ Email (optional): _____

THE WINNING BIDDER MUST COMPLETE THE VERIFICATION OF WORKER'S DISABILITY COMPENSATION ACT COMPLIANCE (ON REVERSE SIDE IF DOUBLE SIDED) WITHIN 21 DAYS OF SALE AWARD DATE



FOR DEPARTMENT USE ONLY
Sale Number (XX - XXX - XX - XX)
Forest Management Unit:

TIMBER SALE VERIFICATION OF WORKER'S DISABILITY COMPENSATION ACT COMPLIANCE

*As required by Act 317, P.A. 1969 (Worker's Compensation) and
Part 5 of Act 451 of 1994, as amended.*

VERIFICATION OF WORKER'S DISABILITY COMPENSATION ACT COMPLIANCE

- This verification must be completed and submitted within 21 days of contract award and prior to the issuance of the timber sale contract.
- In addition, if boxes 2B or 2C are checked, then Notice of Exclusion or Certificate of Insurance must be submitted within twenty-one (21) days of the contract award and prior to the issuance of the timber sale contract.
- All information must be typed or printed except for written signatures.

Please Check Appropriate Categories:

1. My business is organized as (you **must** check one of the boxes below):
 - A. Sole Proprietorship (individual)
 - B. Partnership
 - C. Corporation
2. You **must** check one of the boxes below:
 - A. I certify my business is a sole proprietorship and it has no employees but the sole proprietor. I am not subject to the Worker's Compensation Laws.
 - B. I certify my business has satisfied its obligation to the Worker's Compensation Act through the use of an approved Notice of Exclusion (BWC-337, Rev. 5/96). I will provide a copy of the Notice of Exclusion within 21 days of the contract award. (For questions or a copy of the BWC-337, please call the Worker's Compensation Bureau at 517-322-1195).
 - C. I certify my business has a Worker's Compensation Policy. I will provide an original Certificate of Insurance within twenty-one (21) days of the contract award.
3. If you have checked item 2(A) or 2(B), you **must** indicate the number of **both** full-time and part-time employees, other than yourself, including family members and active partners (if none, you must enter "0").

_____ Full-time Employees

_____ Part-time Employees

Name of Business		Federal ID (or) Social Security No.	
Address		Telephone ()	
City	State	ZIP	

I hereby certify that the above information is true and correct. I agree to notify the Michigan DNR of any changes that occur in factors affecting my coverage during any of my present and future operations.

Signature of Owner or Authorized Representative

Title

Date

Please complete the "SEALED BID" information on the next page

TNT Mix (52-122-20)
T35N, R02W, SEC. 11; T35N, R02W, SEC. 14; Cheboygan COUNTY

In response to the notice of sale to be held 3:00 p.m. (local time) on July 27, 2021, I am hereby submitting my sealed bid (firm offer) for the following forest products to be cut. Bids for individual species must be at or above the advertised price. All non-responsive bid forms may be rejected.

<u>PRODUCTS & SPECIES</u>	<u>ESTIMATED VOLUME*</u>	<u>ADVERTISED PRICE</u>	<u>BID PRICE/UNIT</u>
Sawtimber			
Mixed Aspen	153.7 MBF	\$ 39.00/MBF	\$ _____
Red Maple	48.9 MBF	\$ 67.00/MBF	\$ _____
Red Oak	0.9 MBF	\$ 90.00/MBF	\$ _____
Red Pine	24.3 MBF	\$ 80.00/MBF	\$ _____
White Pine	16.7 MBF	\$ 27.00/MBF	\$ _____
Pulpwood			
Balsam Fir	331 Cords	\$ 14.70/Cord	\$ _____
Black Spruce	11 Cords	\$ 12.40/Cord	\$ _____
Jack Pine	165 Cords	\$ 10.15/Cord	\$ _____
Mixed Aspen	758 Cords	\$ 15.25/Cord	\$ _____
Mixed Hardwood	360 Cords	\$ 16.70/Cord	\$ _____
Paper Birch	52 Cords	\$ 7.65/Cord	\$ _____
Red Oak	3 Cords	\$ 9.30/Cord	\$ _____
Red Pine	20 Cords	\$ 35.00/Cord	\$ _____
White Pine	67 Cords	\$ 16.80/Cord	\$ _____

*The volumes are statistically estimated within plus (+) or minus (-) 11.42 percent at 95% confidence level. These estimated volumes are final and not subject to adjustment. Prospective bidders are urged to examine this timber and to make their own estimates of quantity and quality.

I understand that any or all bids may be rejected. All bids must be signed and all bid items must be bid or the bid form may be rejected. I also understand that consideration and awarding a contract will be based upon my past performance and ability to complete the contract based upon equipment and staffing subject to my control .

FEDERAL ID: _____ - _____ or SOCIAL SECURITY NUMBER: _____ - _____ - _____

Company or individual bidding: _____

Company representative's name: _____

Address: _____

City: _____ State: _____ Zip: _____

IF AVAILABLE, PLEASE PLACE THE PERSONALIZED LABEL FROM YOUR PROSPECTUS IN THE ABOVE BOX.

Individual or company representative's signature: _____ Date: _____

Phone number : _____ Email (optional): _____

THE WINNING BIDDER MUST COMPLETE THE VERIFICATION OF WORKER'S DISABILITY COMPENSATION ACT COMPLIANCE (ON REVERSE SIDE IF DOUBLE SIDED) WITHIN 21 DAYS OF SALE AWARD DATE



FOR DEPARTMENT USE ONLY
Sale Number (XX - XXX - XX - XX)
Forest Management Unit:

TIMBER SALE VERIFICATION OF WORKER'S DISABILITY COMPENSATION ACT COMPLIANCE

*As required by Act 317, P.A. 1969 (Worker's Compensation) and
Part 5 of Act 451 of 1994, as amended.*

VERIFICATION OF WORKER'S DISABILITY COMPENSATION ACT COMPLIANCE

- This verification must be completed and submitted within 21 days of contract award and prior to the issuance of the timber sale contract.
- In addition, if boxes 2B or 2C are checked, then Notice of Exclusion or Certificate of Insurance must be submitted within twenty-one (21) days of the contract award and prior to the issuance of the timber sale contract.
- All information must be typed or printed except for written signatures.

Please Check Appropriate Categories:

1. My business is organized as (you **must** check one of the boxes below):
 - A. Sole Proprietorship (individual)
 - B. Partnership
 - C. Corporation
2. You **must** check one of the boxes below:
 - A. I certify my business is a sole proprietorship and it has no employees but the sole proprietor. I am not subject to the Worker's Compensation Laws.
 - B. I certify my business has satisfied its obligation to the Worker's Compensation Act through the use of an approved Notice of Exclusion (BWC-337, Rev. 5/96). I will provide a copy of the Notice of Exclusion within 21 days of the contract award. (For questions or a copy of the BWC-337, please call the Worker's Compensation Bureau at 517-322-1195).
 - C. I certify my business has a Worker's Compensation Policy. I will provide an original Certificate of Insurance within twenty-one (21) days of the contract award.
3. If you have checked item 2(A) or 2(B), you **must** indicate the number of **both** full-time and part-time employees, other than yourself, including family members and active partners (if none, you must enter "0").

_____ Full-time Employees

_____ Part-time Employees

Name of Business		Federal ID (or) Social Security No.	
Address		Telephone ()	
City	State	ZIP	

I hereby certify that the above information is true and correct. I agree to notify the Michigan DNR of any changes that occur in factors affecting my coverage during any of my present and future operations.

Signature of Owner or Authorized Representative

Title

Date

Please complete the "SEALED BID" information on the next page