



**DEPARTMENT OF NATURAL RESOURCES
STATE OF MICHIGAN**

TIMBER SALE PROSPECTUS #6703

SCHEDULED SALE DATE AND TIME: 4:00 p.m. (local time) on March 22, 2021.

LOCATION: KALKASKA FIELD OFFICE, 2089 NORTH BIRCH STREET, KALKASKA, MI 49646.

PROSPECTUS NOTE: It is recommended that for the duration of the "Stay Home, Stay Safe" executive order that bidders submit their bids through the Online Bidding System (<https://www.dnr.state.mi.us/VMSONlineBidding/>). If you need to register, contact Jake Reid (ReidJ6@michigan.gov, 517-284-5908) or Donovan Asselin (AsselinD@michigan.gov, 517-930-1326). Paper bids will still be accepted during this time, either dropped in the bid box at the bid location or by mailing. If mailing, please allow for additional time.

The bidder is advised to inspect the sale area and review the location, estimated volumes, operating costs and contract terms of proposed sales. Please be aware that some landowners may request 60 days or more notice for access across their land.

Torq & Octane (61-109-20) / T27N, R08W, SEC. 35, E1/2NW,NE.

T27N, R08W, SEC. 36, NW,SWNE,SW,NWSE.

Kalkaska County, Advertised Price \$31,478.50, 174.5 Acres, Hardwood, Aspen.

Karura Mix (61-132-20) / T25N, R08W, SEC. 26, S1/2NW,S1/2NE,SW,NESE.

T25N, R08W, SEC. 35, N1/2NW.

Kalkaska County, Advertised Price \$73,515.40, 171.6 Acres, Aspen, Hardwood.

SALE NOTE: Please note that parts of Payment Units 1 and 2 have some very steep slopes, which may require certain equipment or operations during dry, snow-free conditions.

131 Boom Boom Oak (61-625-20) / T26N, R04W, SEC. 31, W1/2NW,NWSW.

T26N, R05W, SEC. 25, SESE.

T26N, R05W, SEC. 36, NE,NESE.

Crawford County, Advertised Price \$53,227.20, 101.1 Acres, Hardwood, Red Oak.

SALE NOTE: This sale is on or adjacent to active training areas and is therefore subject to military timing restrictions and requires chipping, unless waived by Camp Grayling.

131 Tank Tank Aspen (61-626-20) / T26N, R05W, SEC. 27, SWSE.

T26N, R05W, SEC. 33, E1/2SE.

T26N, R05W, SEC. 34, NW,W1/2NE,SW.

Kalkaska County, Advertised Price \$75,172.15, 148.6 Acres, Aspen, Hardwood.

SALE NOTE: This sale is on or adjacent to active training areas and is therefore subject to military timing restrictions and requires chipping, unless waived by Camp Grayling.

BID INSTRUCTIONS (VER. 07/02/2018):

1. Scheduled Bid Location, Date, and Time (2/11)

Bids must be received by the Unit Manager, KALKASKA OFFICE, 2089 North Birch Street, Kalkaska, MI 49646, no later than 4:00 p.m. (local time) on March 22, 2021. For further information concerning this sale, contact David Lemmien at 231-922-6040.

2. Bidder's Qualifications (5/16)

Purchaser shall obtain workers compensation insurance to cover claims under Michigan's Worker's Disability Compensation Act of 1969 or similar employee benefit act of any other state applicable to an employee. If all or part of a timber sale was prepared by a private contractor, the contractor and that contractor's company are not permitted to bid on the timber sale contract. Bids will not be accepted from individuals or companies appearing on the DNR/FRD No-Bid List. This list contains the names of purchasers who previously failed to execute a contract within 21-days or who have a history of poor performance.

3. Preparation of Sealed Bids (5/16)

Bid Forms may be completed online thru Michigan DNR Timber Sale Online Bidding (OLB) at www.michigan.gov/timberbidding or by completing the hardcopy Bid Form found in the Timber Sale Prospectus. Hardcopy Bid Forms shall be manually signed in ink. Registration in OLB is considered your 'signature' for all bids submitted thru that system. Bid prices must be entered for each species and product in the Bid Price column for all material subject to bidding and all fill-in blanks must be completed. If erasures or other changes appear on the hardcopy Bid Form, each erasure or change must be initialed by the person signing the bid.

4. Submission of Sealed Bids (5/16)

Bid forms may be obtained from the Unit Manager or thru OLB. Bids may be submitted hardcopy or thru OLB. All hardcopy bids must be submitted on the bid form and in an envelope clearly identified as described in this section. NOTE: Only one bid form per bid envelope. Sealed bids must be submitted to the Unit office designated in the prospectus and must be submitted at or prior to the time established in the prospectus. The envelope should show on the outside (a) the sale name or number and (b) the date and time of bid opening, as shown in the prospectus. Bids received after the time specified in the sale prospectus are late bids and will be rejected.

It is possible for a bidder to submit multiple bids on a single sale. For example, a bid may be submitted hardcopy and a bid may be submitted thru OLB. Or, two bidders from the same company could both submit bids on the same sale. If this were to happen, the State would accept all bids received and award the contract accordingly. All bidding and contractual requirements would apply to all bids received.

5. Public Opening of Sealed Bids (7/16)

If conditions permit, the sealed bids will be publicly opened and posted at the time and place set in the prospectus.

If a bidder, present at a bid opening, has submitted bids on more than one sale, that bidder may withdraw their unopened bid envelopes or announce the withdrawal of their online bid after being declared the successful bidder on one sale.

6. Award of Contract (1/11)

Award of the contract will be made to the Bidder whose bid, conforming to the prospectus, is most advantageous to the State of Michigan on the basis of total value at rates bid for the estimated quantities. The State reserves the right to reject any bid or waive any minor irregularity in bids received. A written award mailed (or otherwise furnished) to the successful Bidder shall be deemed to result in a binding contract without further action by either party.

7. Down Payment (1/11)

The Bidder to whom award is made must make a down payment within 21 days of the sale award. The amount of the down payment will be calculated as shown in the Bond and Payment Schedule of this prospectus. Only cash may be used to meet this requirement.

8. Performance Security (1/11)

As guarantee of faithful performance, a cash bond, certificate of deposit, surety bond or irrevocable letter of credit (LOC) is required within 21 days of the sale award. The amount of the performance security is shown in the Bond and

Payment Schedule of this prospectus. If an LOC or surety is used, the coverage must extend for at least 6 months beyond the contract expiration.

9. Timber Sale Contract (7/18)

Additional conditions and requirements common to all timber sales are listed on the timber sale contract (R4031) and are available on line at www.michigan.gov/timber. Contact the Unit Manager for additional information or a sample contract. Within 21 days of the date of the award letter, the bidder must sign the contract and provide the required down payment, performance security, and verification of worker's disability compensation. The down payment and performance security shall be in accordance with the provisions of the timber sale contract, in the sums stated in this prospectus. If these actions are not taken, then the Bidder, the Bidder's corporation, and the corporation's principals may not be permitted to bid on State timber sales for a period of 3 months after the first offense, 6 months after the second offense, and 1 year after the third offense. An offense will only be counted against the Bidder for 5 years. In addition, the Bidder certifies that if awarded this contract, the Bidder will complete the timber sale contract in accordance with its terms and any modifications thereof including requirements to purchase, cut, and remove the included timber by the expiration date.

Payment Unit values in the State Forest Timber Sale Contract are calculated based on the advertised value of the Payment Unit as a percentage of the total advertised value of the contract. The advertised value of each Payment Unit is given in the Description of Timber by Payment Unit table on the Timber Sale Information page. For example, if the value of Payment Unit 1 is advertised as \$1,500 and the total Timber Sale value is advertised as \$10,000, the contract price for Payment Unit 1 will be 15% of the total bid price ($\$1,500/\$10,000 * 100$).

10. Disclaimer of Estimates and Bidder's Warranty of Inspection (7/16)

Before submitting this bid, the Bidder is advised and cautioned to inspect the sale area, review the requirements of the sale contract, and take other steps as may be reasonably necessary to ascertain the location, estimated volumes, construction estimates, and operating costs of the proposed sale. Failure to do so will not relieve the Bidder from responsibility for completing the contract.

The Bidder warrants that this bid is submitted solely on the basis of the Bidder's examination and inspection of the quality and quantity of the timber offered for sale and the Bidder's opinion of the value thereof and the costs of recovery. No reliance should be placed on the State of Michigan's estimates of timber quality, quantity or costs of recovery. Bidder further acknowledges that the State of Michigan: (i) expressly disclaims any warranty of fitness of timber for any purpose; (ii) offers this timber as is without any warranty of quality (merchantability) or quantity and (iii) expressly disclaims any warranty as to the quantity or quality of timber sold.

11. Certification and Chain-of-Custody (10/14)

Unless otherwise indicated in the contract under section 7 – Other Conditions of the Sale Specific Conditions & Requirements, the area encompassed by this timber sale is certified to the standards of the Forest Stewardship Council (FSC) - Certificate #SCS-FM/COC-00090N and the Sustainable Forestry Initiative (SFI) - Certificate #NSF-SFIS-5Y031-SF5. Forest products from this sale may be delivered to the mill as "FSC 100% and / or SFI certified" as long as the contractor hauling the forest products is chain-of-custody (COC) certified or covered under a COC certificate from the destination mill. The purchaser is responsible for maintaining COC after leaving the sale area.

12. Good Neighbor Authority (GNA) Requirements (7/16)

If the name of this timber sales contains the acronym GNA, it is authorized by the Good Neighbor Authority (GNA) and covered by various agreements between the U.S. Forest Service and the State. The timber sale occurs on federal land and the following conditions apply:

GNA contracts on US Forest Service land will not be awarded to purchasers on the Federal list of excluded parties. The System for Award Management (SAM) will be checked for active excluded parties prior to award of contract. In addition, the Bidder to whom award is made must complete an Assurance Regarding Felony Conviction or Tax Delinquent Status for Corporate Applicants (AD-3031).

13. Good Neighbor Authority (GNA) Requirements, con't (9/16)

Bidder certifies, by signing this bid form, that to the best of Bidder's knowledge that the following representations are accurate and complete.

- a. That the Bidder and its principals are not presently debarred, suspended, proposed for debarment, declared ineligible, or voluntary excluded from timber sales (covered transactions) by any Federal department or agency.
- b. That the Bidder and its principals have not within a 3-year period preceding this bid been convicted of or had a civil judgment rendered against them for commission of fraud or a criminal offense in connection with obtaining , attempting to obtain, or performing a public (Federal, State, or local) transaction or contract under a public transaction; violation of Federal or State antitrust statutes or commission of embezzlement, theft, forgery, bribery, falsification or destruction of records, making false statements, or receiving stolen property.
- c. That the Bidder and its principals are not presently indicted for or otherwise criminally or civilly charged by a governmental entity (Federal, State, or local) with commission of any of the offenses enumerated in paragraph b of this certification.
- d. That the Bidder and its principals have not within a 3-year period preceding this bid had one or more public transactions (Federal, State, or local) terminated for breach or default of a timber or forest product contract.

Bidders that cannot certify this requirement, in whole or in part, shall submit an explanation with their bid.

DAN EICHINGER
Director

TIMBER SALE INFORMATION

Torq & Octane (61-109-20)

T27N, R08W, SEC. 35; T27N, R08W, SEC. 36.
Kalkaska County (Advertised Price \$31,478.50)

A timber sale contract for this lump sum, sealed bid timber sale will be awarded to the responsible bidder offering the highest sealed bid price. All units of volume listed below were estimated using the T-Sale computer program and our traditional volume equations. Bids must be at or above the following advertised price for each product and species:

<u>PRODUCTS & SPECIES</u>	<u>ESTIMATED UNITS*</u>	<u>ADVERTISED PRICE</u>
Sawtimber		
B. T. Aspen	15.7 MBF	\$ 78.00 / MBF
Red Maple	30.8 MBF	\$ 114.00 / MBF
Red Pine	14.0 MBF	\$ 78.00 / MBF
White Pine	69.1 MBF	\$ 41.00 / MBF
Pulpwood		
B. T. Aspen	654 Cords	\$ 12.40 / Cord
Balsam Fir	7 Cords	\$ 7.05 / Cord
Jack Pine	15 Cords	\$ 8.00 / Cord
Mixed Hardwood	741 Cords	\$ 11.55 / Cord
Red Oak	63 Cords	\$ 8.70 / Cord
Red Pine	31 Cords	\$ 27.50 / Cord
White Pine	393 Cords	\$ 10.90 / Cord
White Spruce	29 Cords	\$ 10.20 / Cord

* The total volume is statistically estimated within plus (+) or minus (-) 13.76 percent. There are an estimated 2,192 cords on this timber sale, plus or minus 302 cords at the 95% confidence level. The estimated units are final and not subject to adjustment. Prospective bidders are urged to examine this timber and to make their own estimates of quantity and quality.

BOND AND PAYMENT SCHEDULE:

1. A bond in the amount of \$1,574.00 to insure faithful performance of the conditions of the contract will be deposited by the successful bidder within 21 days of the sale award.
2. Cutting in any sale or unit without the required advance payment would be considered a trespass.
3. Total payment must be paid in advance or according to the following schedule :
 - (a) Ten percent (10%) of the sale value must be paid within 21 days of the sale award.
 - (b) The 10% down payment will be credited towards the first unit cut.
 - (c) Payment for each of the following units must be made before cutting begins in that unit:

PAYMENT UNIT NUMBER	PERCENT OF TOTAL SALE VALUE
01	27.7%
02	11.7%
03	32.2%
04	28.4%
4. If no cutting takes place, the 10% down payment will not be refunded.
5. Operations on the contract issued will terminate on 03/31/2023.

SALE STATISTICS

SALE VOLUMES

VOLUME		STATISTICAL RANGE IN CORDS		
TOTAL CUBIC FEET	TOTAL CORDS	PERCENT ERROR	MINIMUM	MAXIMUM
173,192	2,192	13.76%	1,891	2,494

VDU VOLUMES

A VDU is a Volume Determination Unit. Volumes and their associated statistics are calculated at the VDU level and summarized to the sale level. There is often a one to one relationship between a VDU and a Payment Unit, but not always, depending on the cruise design. Refer to the VDU TO PAYMENT UNIT table.

VDU	VOLUME		PERCENT ERROR	RANGE IN CORDS	
	TOTAL CUBIC FEET	TOTAL CORDS		MINIMUM	MAXIMUM
6	50,600	641	23.58%	489	792
52	11,779	149	28.83%	106	192
53	9,504	120	50.15%	60	181
54	46,894	594	22.56%	460	728
60	54,415	689	23.08%	530	848
TOTAL:	173,192	2,192		1,645	2,740

VDU TO PAYMENT UNIT

When a VDU is associated with more than one Payment Unit (PU), the VDU volumes are assigned to the PU based on acres of the VDU within the PU.

VDU	VDU ACRES	PU	PU ACRES
6	60.7	4	60.7
52	9.6	2	9.6
53	21.1	2	21.1
54	53.0	1	53.0
60	30.1	3	30.1
TOTAL:	174.5		174.5

DESCRIPTION OF TIMBER BY PAYMENT UNIT (PU)

PU	MARKET GROUP	PRODUCT	QUANTITY	UNIT	ACRES	ADVERTISE PRICE
1	B. T. Aspen	Sawtimber	5.0	MBF	53.0	\$8,718.70
	Red Maple		8.5	MBF		
	Red Pine		4.5	MBF		
	White Pine		12.4	MBF		
	B. T. Aspen	Pulpwood	280	Cords		
	Jack Pine		3	Cords		
	Mixed Hardwood		140	Cords		
	<i>Black Cherry</i>		28	Cords		
	<i>Red Maple</i>		112	Cords		
	Red Pine		12	Cords		
White Pine		97	Cords			
2	Red Maple	Sawtimber	6.1	MBF	30.7	\$3,668.90
	B. T. Aspen	Pulpwood	27	Cords		
	Jack Pine		3	Cords		
	Mixed Hardwood		216	Cords		
	<i>Black Cherry</i>	Sawtimber	2.1	MBF		
	<i>Sugar Maple</i>		1.1	MBF		
	<i>Black Cherry</i>	Pulpwood	55	Cords		
	<i>Red Maple</i>		136	Cords		
	<i>Sugar Maple</i>		19	Cords		
	White Pine		11	Cords		
3	B. T. Aspen	Sawtimber	8.7	MBF	30.1	\$10,154.90
	Red Maple		13.7	MBF		
	White Pine		31.1	MBF		
	B. T. Aspen	Pulpwood	137	Cords		
	Balsam Fir		7	Cords		
	Mixed Hardwood		269	Cords		
	<i>Black Cherry</i>		30	Cords		
	<i>Paper Birch</i>		8	Cords		
	<i>Red Maple</i>		231	Cords		
	Red Oak		22	Cords		
	<i>Red Oak</i>	Sawtimber	2.4	MBF		
	<i>Red Oak</i>	Pulpwood	17	Cords		
	White Pine		119	Cords		
	White Spruce		29	Cords		
4	B. T. Aspen	Sawtimber	2.0	MBF	60.7	\$8,936.00
	Red Maple		2.5	MBF		
	Red Pine		9.5	MBF		
	White Pine		25.6	MBF		
	B. T. Aspen	Pulpwood	210	Cords		
	Jack Pine		9	Cords		
	Mixed Hardwood		116	Cords		
	<i>Beech</i>	Sawtimber	1.0	MBF		
	<i>Beech</i>	Pulpwood	4	Cords		
	<i>Black Cherry</i>		53	Cords		
	<i>Red Maple</i>		57	Cords		
	Red Oak		41	Cords		
	<i>Red Oak</i>	Sawtimber	5.1	MBF		
	<i>Red Oak</i>	Pulpwood	31	Cords		
Red Pine		19	Cords			
White Pine		166	Cords			
TOTAL:			129.6	MBF		
TOTAL:			1,933	Cords		

Sale Specific Conditions & Requirements

Sale Name: Torq & Octane

Sale Number: 61-109-20 Seq#: 1

1 - Sale Area

1.2 - Boundaries

1.2.1 - Painted boundaries (9/19)

The sale boundary and Payment Unit boundaries are marked and identified by red and yellow paint. Exterior sale boundary lines against state are marked with red paint. Interior Payment Unit boundaries are marked with yellow paint. Retention patches are marked with red paint; no harvesting activities may occur within these areas. Yellow painted trees designating an interior Payment Unit boundary are only to be cut when all surrounding Payment Units have been paid.

2 - Timber Specifications

2.1 - Included Timber

2.1.1 - Clearcut unit(s) with unmerchantable trees (6/14)

Within Payment Unit(s) 1-4, cut all trees that are two (2) inches or more at DBH, except within Payment Unit 3, do not cut any white oak, yellow birch, cedar, and hemlock.

2.2 - Utilization

2.2.2 - Chipping required (2/18)

Payment Unit 2 must be chip harvested to facilitate subsequent planting operations. The Purchaser has the option to produce sawlogs or pulpwood bolts, but the remaining portion of the trees must be chipped and hauled. If market conditions limit the practicality of chipping, the producer may skid all remaining topwood out of these payment units and scatter in locations approved by the sale administrator. If the deadline is not met, damages will be collected determined by the cost to complete this work. The requirement to retain approximately 1/6 to 1/3 of tree tops and limbs less than four inches in diameter is still applicable (G. C. & R. 2.2).

2.2.3 - Stump heights (4/07)

Stump heights within Payment Unit 2 shall not exceed 6 inches for all trees. This is in order to facilitate planting operations.

4 - Transportation

4.1 - Construction

4.1.3 - Slash and earthen piles (8/04)

Piles or windrows of earth along roads and landings that have been widened or constructed shall be leveled. Slash from road maintenance or construction, including stumps, shall be dispersed throughout the sale.

4.1.6 - Road construction (1/09)

Construction of new roads or improvements of existing roads shall be done in such a way as to minimize the environmental and visual impacts. Merchantable trees shall be cut and utilized unless otherwise directed. Non-merchantable trees shall be severed and laid flat on the ground. Slash shall be scattered, and not left in windrows and kept a minimum of 10 feet back from the road edge. Stumps shall be set upright, not left on edge, and be moved at least 10 feet away from the road edge. Disturbed soil shall be feathered into the woods and not left in berms or windrows.

4.2 - Maintenance

4.2.5 - Two wheel drive condition (2/04)

All existing trail roads on and adjacent to the sale area must be passable by two-wheel drive traffic for the duration of the sale.

5 - Operations

5.1 - Notification

5.1.1 - Pre-sale conference (10/16)

A pre-sale conference on site between the Purchaser and sale administrator is required prior to beginning any operations a

Payment Unit to determine landing and road locations. The Unit Manager or his/her representative must be contacted at least 5 days in advance to schedule the conference.

5.1.3 - Well heads and natural gas pipelines (11/15)

The Purchaser is responsible for contacting the gas or pipeline company prior to operating equipment in the vicinity of well heads or natural gas pipelines.

5.1.4 - Post-sale conference (10/16)

A post-sale conference on site between the Purchaser and sale administrator is required 5 days prior to the completion of active logging operations to determine clean-up and repair of landings, road edges, and the fulfillment of other contract specifications.

5.1.6 - Utility R.O.W. (4/19)

It is the responsibility of the Purchaser to obtain permission from the utility company to utilize the pipeline R.O.W. for operations.

5.2 - Conduct of Operations

5.2.22 - Operating Caution

5.2.22.1 - Operating caution (6/11)

It is recommended, but not required, that within Payment Unit(s) 3, cutting, skidding, and hauling occur during dry summer or frozen winter conditions. The reason for the recommendation is because of wet areas within the unit.

5.2.32 - Decking/landing restoration (9/13)

All decking and landing areas must have the surface area restored to a condition equal to or better than before. This is to ensure the proper regeneration of the stand. Wood debris, chips and "cookies" from trimmings must be removed or scattered away from landing and loading areas and may not be windrowed on the edge.

5.4 - Soil Protection

5.4.1 - Rutting restriction, general (7/16)

Operations are to cease immediately if equipment and weather conditions result in rutting of roads and/or skid trails which is 12 inches or greater in depth and 50 feet in length. The Unit Manager or his/her representative may restrict hauling and/or skidding if ruts exceed the specified depth. With the Unit Manager or his/her representative's approval, the Purchaser may return to the area when the risk of rutting has decreased.



TIMBER SALE MAP

This information provided by authority of Part 525, 1994 PA 451, as amended.

Sale Number	Year
61-109	20

Forest Management Unit Traverse City	County Kalkaska	Mapped By Roell	Date 03/27/2020	Page 1	of 1
Township 27N	Range 08W	Section(s) and Subdivision(s) N1/2 of Sec 35, and Sec 36	Scale 1:15,840		

Cover Type				Density	
A = Aspen	H = Hemlock	N = Marsh	U = Upland Brush	0 = Non Stocked	5 = Pole Timber Medium
B = Paper Birch	J = Jack Pine	O = Oak	UM = Upland Mixed	1 = Seeding Sapling Poor	6 = Pole Timber Well
C = Cedar	L = Lowland Brush	P = Lowland Poplar	V = Bog or Marsh	2 = Seeding Sapling Medium	7 = Saw Timber Poor
D = Tread Bog	LM = Lowland Mixed	Q = Mixed Swamp Conifer	W = White Pine	3 = Seeding Sapling Well	8 = Saw Timber Medium
E = Swamp Hardwoods	M = Mpl. Ech. Birch	R = Red Pine	X = Non Stocked	4 = Pole Timber Poor	9 = Saw Timber Well
F = Spruce Fir	MC = Mixed Conifer	S = Black Spruce	Z = Water		
G = Creas	MD = Mixed Deciduous	T = Tamarack			

PU	Acres	PU	Acres
1	53	4	60.7
2	30.7		
3	30.1		

Torq & Octane Compartment 157 174.5 Acres

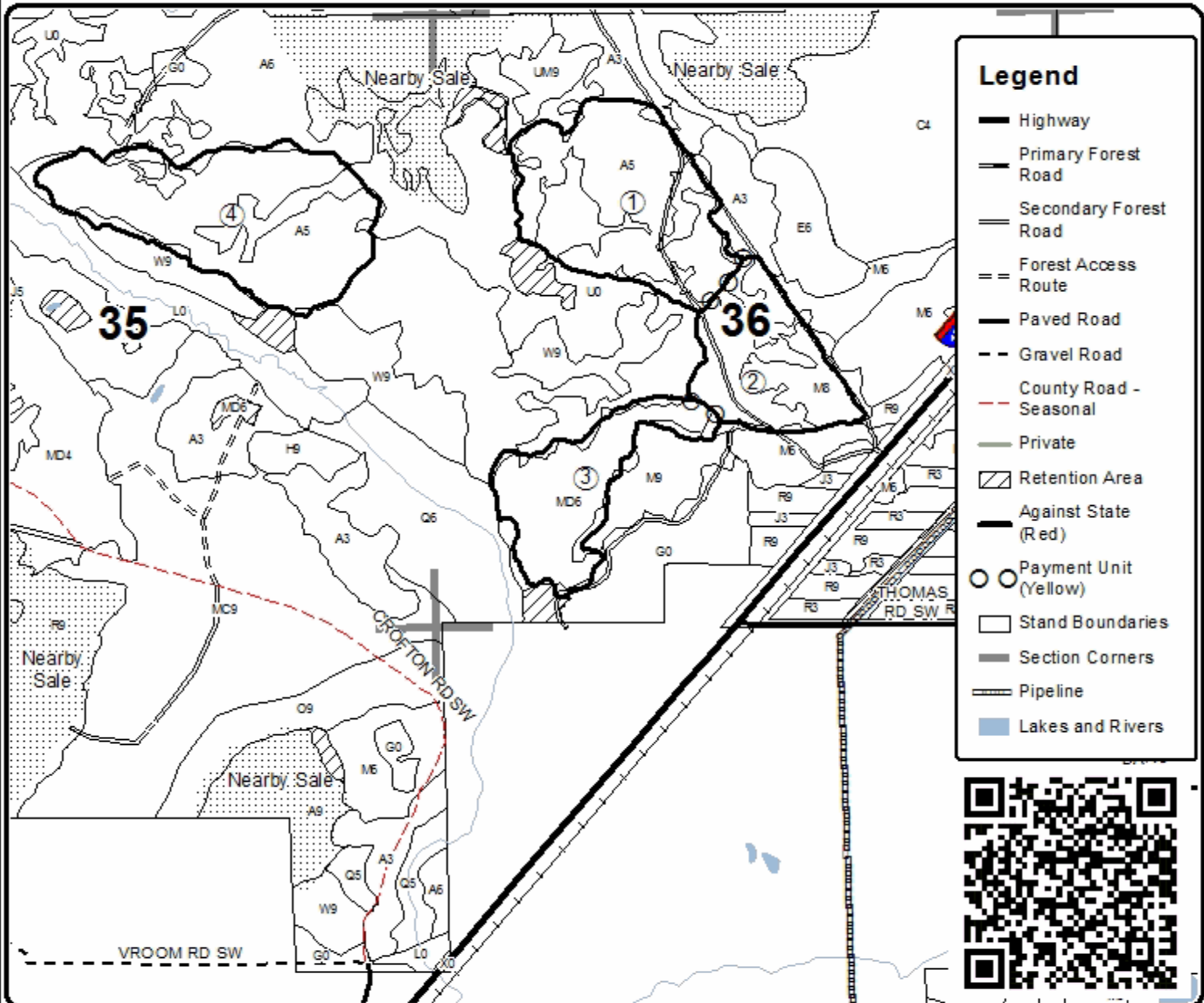

Legend

- Highway
- Primary Forest Road
- Secondary Forest Road
- Forest Access Route
- Paved Road
- Gravel Road
- County Road - Seasonal
- Private
- Retention Area
- Against State (Red)
- Payment Unit (Yellow)
- Stand Boundaries
- Section Corners
- Pipeline
- Lakes and Rivers

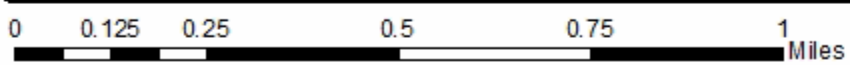

TIMBER SALE INFORMATION

Karura Mix (61-132-20)

T25N, R08W, SEC. 26; T25N, R08W, SEC. 35.
Kalkaska County (Advertised Price \$73,515.40)

SALE NOTE: Please note that parts of Payment Units 1 and 2 have some very steep slopes, which may require certain equipment or operations during dry, snow-free conditions.

A timber sale contract for this lump sum, sealed bid timber sale will be awarded to the responsible bidder offering the highest sealed bid price. All units of volume listed below were estimated using the T-Sale computer program and our traditional volume equations. Bids must be at or above the following advertised price for each product and species:

<u>PRODUCTS & SPECIES</u>	<u>ESTIMATED UNITS*</u>	<u>ADVERTISED PRICE</u>
Sawtimber		
Basswood	1.3 MBF	\$ 67.00 / MBF
Beech	1.6 MBF	\$ 49.00 / MBF
Mixed Aspen	87.8 MBF	\$ 78.00 / MBF
Red Maple	63.4 MBF	\$ 114.00 / MBF
Red Oak	108.5 MBF	\$ 122.00 / MBF
Red Pine	88.7 MBF	\$ 78.00 / MBF
Sugar Maple	5.8 MBF	\$ 157.00 / MBF
White Pine	104.1 MBF	\$ 41.00 / MBF
Pulpwood		
Balsam Fir	9 Cords	\$ 7.05 / Cord
Beech	100 Cords	\$ 11.55 / Cord
Jack Pine	2 Cords	\$ 8.00 / Cord
Mixed Aspen	1,289 Cords	\$ 12.40 / Cord
Mixed Hardwood	593 Cords	\$ 11.55 / Cord
Red Oak	394 Cords	\$ 8.70 / Cord
Red Pine	98 Cords	\$ 27.50 / Cord
White Pine	344 Cords	\$ 10.90 / Cord

* The total volume is statistically estimated within plus (+) or minus (-) 8.45 percent. There are an estimated 3,749 cords on this timber sale, plus or minus 317 cords at the 95% confidence level. The estimated units are final and not subject to adjustment. Prospective bidders are urged to examine this timber and to make their own estimates of quantity and quality.

BOND AND PAYMENT SCHEDULE:

1. A bond in the amount of \$7,352.00 to insure faithful performance of the conditions of the contract will be deposited by the successful bidder within 21 days of the sale award.
2. Cutting in any sale or unit without the required advance payment would be considered a trespass.
3. Total payment must be paid in advance or according to the following schedule :
 - (a) Ten percent (10%) of the sale value must be paid within 21 days of the sale award.
 - (b) The 10% down payment will be credited towards the first unit cut.
 - (c) Payment for each of the following units must be made before cutting begins in that unit:

PAYMENT UNIT NUMBER	PERCENT OF TOTAL SALE VALUE
01	15.6%
02	20.7%
03	4.4%
04	10.3%
05	7.4%
06	2.6%
07	9.3%
08	9.0%
09	9.6%
10	3.8%
11	7.3%

4. If no cutting takes place, the 10% down payment will not be refunded.
5. Operations on the contract issued will terminate on 04/14/2024.

SALE STATISTICS

SALE VOLUMES

VOLUME			STATISTICAL RANGE IN CORDS	
TOTAL CUBIC FEET	TOTAL CORDS	PERCENT ERROR	MINIMUM	MAXIMUM
296,172	3,749	8.45%	3,432	4,066

VDU VOLUMES

A VDU is a Volume Determination Unit. Volumes and their associated statistics are calculated at the VDU level and summarized to the sale level. There is often a one to one relationship between a VDU and a Payment Unit, but not always, depending on the cruise design. Refer to the VDU TO PAYMENT UNIT table.

VDU	VOLUME			RANGE IN CORDS	
	TOTAL CUBIC FEET	TOTAL CORDS	PERCENT ERROR	MINIMUM	MAXIMUM
13	133,210	1,686	17.61%	1,389	1,983
18	29,349	372	34.56%	243	500
19	21,662	274	36.75%	173	375
20	5,728	73	101.98%	1	146
21	921,551	11,665	11.05%	10,376	12,954
22	7,805	99	41.97%	57	140
821	11,439	145	50.53%	72	218
TOTAL:	1,130,743	14,313		12,310	16,317

VDU TO PAYMENT UNIT

When a VDU is associated with more than one Payment Unit (PU), the VDU volumes are assigned to the PU based on acres of the VDU within the PU.

VDU	VDU ACRES	PU	PU ACRES
13	38.4	1	7.4
		2	31.0
18	15.1	8	15.1
19	12.6	1	12.6
20	3.8	1	3.8
21	92.1	3	8.4
		4	19.6
		5	14.2
		7	17.7
		9	18.3
22	3.9	11	13.9
		6	3.9
821	5.7	10	5.7
TOTAL:	171.6		171.6

DESCRIPTION OF TIMBER BY PAYMENT UNIT (PU)

PU	MARKET GROUP	PRODUCT	QUANTITY	UNIT	ACRES	ADVERTISE PRICE
1	Basswood	Sawtimber	0.3	MBF	23.8	\$11,458.55
	Beech		0.3	MBF		
	Mixed Aspen		10.0	MBF		
	<i>B. T. Aspen</i>		10.0	<i>MBF</i>		
	Red Maple		4.4	MBF		
	Red Oak		33.0	MBF		
	Red Pine		15.2	MBF		
	Sugar Maple		3.1	MBF		
	White Pine		6.5	MBF		
	Beech		Pulpwood	19		
	Mixed Aspen	86		Cords		
	<i>B. T. Aspen</i>	86		<i>Cords</i>		
	Mixed Hardwood	94		Cords		
	<i>Basswood</i>	1		<i>Cords</i>		
	<i>Ironwood</i>	2		<i>Cords</i>		
	<i>Red Maple</i>	56		<i>Cords</i>		
	<i>Sugar Maple</i>	35		<i>Cords</i>		
	Red Oak	120	Cords			
Red Pine	17	Cords				
White Pine	27	Cords				
2	Basswood	Sawtimber	1.0	MBF	31.0	\$15,290.35
	Beech		1.3	MBF		
	Mixed Aspen		12.1	MBF		
	<i>B. T. Aspen</i>		12.1	<i>MBF</i>		
	Red Maple		6.5	MBF		
	Red Oak		60.0	MBF		
	Red Pine		5.4	MBF		
	Sugar Maple		2.7	MBF		
	White Pine		1.9	MBF		
	Beech		Pulpwood	81		
	Mixed Aspen	76		Cords		
	<i>B. T. Aspen</i>	76		<i>Cords</i>		
	Mixed Hardwood	82		Cords		
	<i>Basswood</i>	3		<i>Cords</i>		
	<i>Red Maple</i>	48		<i>Cords</i>		
	<i>Sugar Maple</i>	31		<i>Cords</i>		
	Red Oak	222		Cords		
	Red Pine	5	Cords			
White Pine	31	Cords				
3	Mixed Aspen	Sawtimber	5.4	MBF	8.4	\$3,238.45
	<i>B. T. Aspen</i>		5.3	<i>MBF</i>		
	<i>Quaking Aspen</i>		0.1	<i>MBF</i>		
	Red Maple		3.9	MBF		
	Red Oak		1.4	MBF		
	Red Pine		3.6	MBF		
	White Pine		5.5	MBF		
	Mixed Aspen	Pulpwood	90	Cords		
	<i>B. T. Aspen</i>		81	<i>Cords</i>		
	<i>Quaking Aspen</i>		9	<i>Cords</i>		
	Mixed Hardwood		27	Cords		
	<i>Red Maple</i>		27	<i>Cords</i>		
	Red Oak		5	Cords		
	Red Pine		3	Cords		
White Pine	13	Cords				
4	Mixed Aspen	Sawtimber	12.6	MBF	19.6	\$7,547.75
	<i>B. T. Aspen</i>		12.4	<i>MBF</i>		

DESCRIPTION OF TIMBER BY PAYMENT UNIT (PU), CON'T

PU	MARKET GROUP	PRODUCT	QUANTITY	UNIT	ACRES	ADVERTISE PRICE
4 con't	<i>Quaking Aspen</i>	<i>Sawtimber</i>	0.2	<i>MBF</i>		
	Red Maple		9.1	MBF		
	Red Oak		3.3	MBF		
	Red Pine		8.3	MBF		
	White Pine		12.7	MBF		
	Balsam Fir	Pulpwood	1	Cords		
	Jack Pine		2	Cords		
	Mixed Aspen		209	Cords		
	<i>B. T. Aspen</i>		188	<i>Cords</i>		
	<i>Quaking Aspen</i>		21	<i>Cords</i>		
	Mixed Hardwood		62	Cords		
	<i>Red Maple</i>		62	<i>Cords</i>		
	Red Oak		11	Cords		
	Red Pine		7	Cords		
	White Pine		31	Cords		
5	Mixed Aspen	Sawtimber	9.0	MBF	14.2	\$5,450.05
	<i>B. T. Aspen</i>		8.9	<i>MBF</i>		
	<i>Quaking Aspen</i>		0.1	<i>MBF</i>		
	Red Maple		6.6	MBF		
	Red Oak		2.4	MBF		
	Red Pine		6.0	MBF		
	White Pine		9.2	MBF		
	Balsam Fir	Pulpwood	1	Cords		
	Mixed Aspen		151	Cords		
	<i>B. T. Aspen</i>		136	<i>Cords</i>		
	<i>Quaking Aspen</i>		15	<i>Cords</i>		
	Mixed Hardwood		46	Cords		
	<i>Black Cherry</i>		1	<i>Cords</i>		
	<i>Red Maple</i>		45	<i>Cords</i>		
	Red Oak		8	Cords		
Red Pine		5	Cords			
White Pine		22	Cords			
6	Mixed Aspen	Sawtimber	2.0	MBF	3.9	\$1,938.40
	<i>B. T. Aspen</i>		2.0	<i>MBF</i>		
	Red Maple		1.9	MBF		
	Red Pine		4.7	MBF		
	White Pine		12.4	MBF		
	Balsam Fir	Pulpwood	4	Cords		
	Mixed Aspen		22	Cords		
	<i>B. T. Aspen</i>		22	<i>Cords</i>		
	Mixed Hardwood		12	Cords		
	<i>Red Maple</i>		12	<i>Cords</i>		
	Red Pine		2	Cords		
White Pine		18	Cords			
7	Mixed Aspen	Sawtimber	11.2	MBF	17.7	\$6,812.20
	<i>B. T. Aspen</i>		11.1	<i>MBF</i>		
	<i>Quaking Aspen</i>		0.1	<i>MBF</i>		
	Red Maple		8.2	MBF		
	Red Oak		3.0	MBF		
	Red Pine		7.5	MBF		
	White Pine		11.5	MBF		
	Balsam Fir	Pulpwood	1	Cords		
	Mixed Aspen		188	Cords		
	<i>B. T. Aspen</i>		170	<i>Cords</i>		
	<i>Quaking Aspen</i>		18	<i>Cords</i>		
	Mixed Hardwood		57	Cords		

DESCRIPTION OF TIMBER BY PAYMENT UNIT (PU), CON'T

PU	MARKET GROUP	PRODUCT	QUANTITY	UNIT	ACRES	ADVERTISE PRICE
7 con't	<i>Black Cherry</i>	<i>Pulpwood</i>	1	<i>Cords</i>		
	<i>Red Maple</i>		56	<i>Cords</i>		
	Red Oak		10	Cords		
	Red Pine		7	Cords		
	White Pine		28	Cords		
8	Mixed Aspen	Sawtimber	5.0	MBF	15.1	\$6,580.15
	<i>B. T. Aspen</i>		5.0	<i>MBF</i>		
	Red Maple		7.8	MBF		
	Red Pine	13.1	MBF			
	White Pine	8.9	MBF			
	Mixed Aspen	Pulpwood	117	Cords		
	<i>B. T. Aspen</i>		117	<i>Cords</i>		
	Mixed Hardwood		109	Cords		
	<i>Red Maple</i>		109	<i>Cords</i>		
	Red Pine		22	Cords		
White Pine	55		Cords			
9	Mixed Aspen		Sawtimber	11.6	MBF	18.3
	<i>B. T. Aspen</i>	11.5		<i>MBF</i>		
	<i>Quaking Aspen</i>	0.1		<i>MBF</i>		
	Red Maple	8.5	MBF			
	Red Oak	3.1	MBF			
	Red Pine	7.8	MBF			
	White Pine	11.9	MBF			
	Balsam Fir	Pulpwood	1	Cords		
	Mixed Aspen		195	Cords		
	<i>B. T. Aspen</i>		176	<i>Cords</i>		
	<i>Quaking Aspen</i>		19	<i>Cords</i>		
	Mixed Hardwood		59	Cords		
	<i>Black Cherry</i>		1	<i>Cords</i>		
	<i>Red Maple</i>		58	<i>Cords</i>		
	Red Oak		10	Cords		
	Red Pine		7	Cords		
	White Pine		29	Cords		
10	Red Pine	Sawtimber	11.2	MBF	5.7	\$2,795.20
	White Pine		14.6	MBF		
	Mixed Aspen	Pulpwood	7	Cords		
	<i>B. T. Aspen</i>		7	<i>Cords</i>		
	Red Pine		18	Cords		
	White Pine		68	Cords		
11	Mixed Aspen	Sawtimber	8.9	MBF	13.9	\$5,353.90
	<i>B. T. Aspen</i>		8.8	<i>MBF</i>		
	<i>Quaking Aspen</i>		0.1	<i>MBF</i>		
	Red Maple	6.5	MBF			
	Red Oak	2.3	MBF			
	Red Pine	5.9	MBF			
	White Pine	9.0	MBF			
	Balsam Fir	Pulpwood	1	Cords		
	Mixed Aspen		148	Cords		
	<i>B. T. Aspen</i>		134	<i>Cords</i>		
	<i>Quaking Aspen</i>		14	<i>Cords</i>		
	Mixed Hardwood		45	Cords		
	<i>Black Cherry</i>		1	<i>Cords</i>		
	<i>Red Maple</i>		44	<i>Cords</i>		
	Red Oak		8	Cords		
	Red Pine		5	Cords		
White Pine	22		Cords			

TOTAL:	461.2	MBF
--------	-------	-----

TOTAL:	2,829	Cords
--------	-------	-------

Sale Specific Conditions & Requirements

Sale Name: Karura Mix

Sale Number: 61-132-20 Seq#: 1

1 - Sale Area

1.2 - Boundaries

1.2.1 - Painted boundaries (9/19)

The sale boundary and Payment Unit boundaries are marked and identified by blue, red and yellow paint. Exterior sale boundary lines against private property are marked with blue paint. Exterior sale boundary lines against state are marked with red paint. Interior Payment Unit boundaries are marked with yellow paint. The painted boundary and payment unit line trees are not Included Timber and are to be protected.

2 - Timber Specifications

2.1 - Included Timber

2.1.1 - Clearcut unit(s) with unmerchantable trees (6/14)

Within Payment Unit(s) 3, 4, 5, 7, 9, and 11, cut all trees that are two (2) inches or more at DBH, except do not cut white pine less than 8" at DBH or oak less than 8" at DBH.

2.1.3 - Cut tree marked unit(s) (12/08)

Within Payment Unit(s) 6, 8, and 10, all trees are designated for cutting when marked with orange paint above and below stump height, regardless of merchantability. In addition, cut all aspen.

2.1.7 - Leave tree marked unit(s) (6/14)

Within Payment Unit(s) 1 and 2, all trees which meet minimum piece specifications in 2.2 Utilization are designated for cutting, except do not cut trees marked with green paint above and below stump height.

3 - Payments

3.3 - Pre-measured Sales

3.3.4 - Dividing payment units (7/14)

Payment Unit(s) greater than \$20,000 may be divided at the request of the Purchaser and upon approval of the Unit Manager. Dividing Payment Units is a contract modification which requires a Timber Sale Contract Amendment. There will be only one division per Payment Unit.

3.4 - Damaged Timber

3.4.1 - Damaged timber (7/16)

General Condition and Requirement 3.4 Damaged Timber, defines liquidated damages for undesignated live merchantable trees which are cut or injured. In addition, extreme care should be taken to avoid damage to tree seedlings and saplings.

Within the sale area, if more than 25% of the tree seedlings or saplings (1/4" to 4.5" DBH) within a specified portion of the sale area are damaged, liquidated damages will be assessed at \$300 per acre for all acreage within that specified portion of the sale area that was damaged.

This only applies to regeneration of desirable species such as white pine, white oak, and sugar maple. This does not apply to beech or ironwood.

4 - Transportation

4.1 - Construction

4.1.6 - Road construction (1/09)

Construction of new roads or improvements of existing roads shall be done in such a way as to minimize the environmental and visual impacts. Merchantable trees shall be cut and utilized unless otherwise directed. Non-merchantable trees shall be severed and laid flat on the ground. Slash shall be scattered, and not left in windrows and kept a minimum of 10 feet back from the road edge. Stumps shall be set upright, not left on edge, and be moved at least 10 feet away from the road edge.

Disturbed soil shall be feathered into the woods and not left in berms or windrows.

4.1.7 - Road closure (10/11)

All new roads built into the sale must be blocked to vehicle traffic within 30 days of completion of hauling. Overgrown roads that are reopened shall be considered new roads. In general, this will require constructing a four (4') foot high berm of stumps and logs covered with earth. These roads must be rendered impassable to cars, trucks and ORVs. All stumps from road building and landing construction must be reserved to block any newly constructed roads upon completion of the sale. These stumps must be scattered along the road system to prohibit vehicular movement. Temporary berms may be required if no sale activity occurs for 30 or more consecutive days. Contact the sale administrator for specific details of design and placement.

4.4 - Access

4.4.3 - Access gate (12/08)

The access gate (if used) must be locked at the completion of each day unless otherwise approved by the Unit Manager or Sale Administrator. Most, if not all, of the sale is accessible without using a gate.

5 - Operations

5.1 - Notification

5.1.1 - Pre-sale conference (10/16)

A pre-sale conference on site between the Purchaser and sale administrator is required prior to beginning any operations to determine landing locations and review sale specifications. The Sale Administrator must be contacted at least 5 days in advance to schedule the conference.

5.2 - Conduct of Operations

5.2.1 - Slash

5.2.1.8 - Slash height (12/08)

No slash or tree tops may exceed 36 inches in height.

5.2.3 - Operating Restrictions

5.2.3.4 - Oak wilt restriction, no exceptions (1/18)

Within Payment Units 1-11, cutting, skidding, hauling within the sale and brushing of access roads to the sale are not permitted during the period of April 15 to July 15. No exceptions will be granted. This is necessary to reduce the spread of oak wilt. There are no exceptions because these units contain residual oak.

5.2.22 - Operating Caution

5.2.22.1 - Operating caution (6/11)

It is recommended, but not required, that within Payment Unit(s) 1 and 2, cutting and skidding occur during dry or snow-free conditions. The reason for the recommendation is because these units have some steep slopes.

5.2.29 - Shrub protection (1/20)

Do not cut or damage hawthorn, witch-hazel, dogwood or junberry. These woody-shrub plants are highly beneficial to various wildlife species.

5.2.31 - Landing locations (9/13)

Landing locations must be approved by the Sale Administrator prior to beginning any operations.

5.2.32 - Decking/landing restoration (9/13)

All decking and landing areas must have the surface area restored to a condition equal to or better than before. This is to ensure the proper regeneration of the stand. Wood debris, chips and "cookies" from trimmings must be removed or scattered away from landing and loading areas and may not be windrowed on the edge.

5.2.38 - No decking against live trees (2/04)

Cut products may not be decked against unmarked or designated leave trees.

5.4 - Soil Protection

5.4.1 - Rutting restriction, general (7/16)

Operations are to cease immediately if equipment and weather conditions result in rutting of roads and/or skid trails which is 12 inches or greater in depth and 50 feet in length. The Unit Manager or his/her representative may restrict hauling and/or skidding if ruts exceed the specified depth. With the Unit Manager or his/her representative's approval, the Purchaser may return to the area when the risk of rutting has decreased.

5.4.2 - Skid trails (2/04)

Skid trails up and down slopes should be avoided. If however this is unavoidable, these trails will be left in a non-erodible condition using water bars, logs, and slash. Placing of slash on these skid trails while logging is ongoing may alleviate need for any further action. At the direction of the sale administrator, seed, fertilizer, and mulch may also be required.

5.7 - Protection of Historical Sites

5.7.2 - Potential historical site(s) (9/06)

The State Historic Preservation Office has identified the potential for a historic site within the boundary of this timber sale. Note that if the site is discovered during operations, General Condition and Requirement 5.7 - Protection of Historical Sites will apply.

5.8 - Protection of Endangered Species

5.8.5 - Protection of raptor nests (3/13)

All trees with raptor nests will be protected if found during harvesting operations. Notification will be made to the Unit Manager or his/her representative who will notify the Wildlife Biologist so an on-site evaluation and recommendation can be made, if necessary.

6 - Safety and Fire Prevention

6.2 - Signing

6.2.1 - Road posting (9/09)

The Purchaser is responsible for posting and maintaining caution signs on Creighton Road and the state forest road at the south end of the sale prior to beginning operations. The road must be posted at appropriate distances from the sale area to warn of logging activity and truck traffic. Signs must be removed when harvest operations are suspended or completed. The Purchaser will provide these signs.



TIMBER SALE MAP

This information provided by authority of Part 525, 1994 PA 451, as amended.

Sale Number	Year
61-132	20

Forest Management Unit Traverse City	County Kalkaska	Mapped By Armstrong	Date 9/17/2020	Page 1	of 1
Township 25N	Range 8W	Section(s) and Subdivision(s) Sec. 26: S1/2NW, S1/2NE, SW, NESE Sec. 35: N1/2NW	Scale 1:15,840		

Cover Type				Density	
A = Aspen	H = Hemlock	N = Marsh	U = Upland Brush	0 = Non Stocked	5 = Pole Timber Medium
B = Paper Birch	J = Jack Pine	O = Oak	UM = Upland Mixed	1 = Seedling Sapling Poor	6 = Pole Timber Well
C = Cedar	L = Lowland Brush	P = Lowland Poplar	V = Bog or Marsh	2 = Seedling Sapling Medium	7 = Saw Timber Poor
D = Treed Bog	LM = Lowland Mixed	Q = Mixed Swamp Conifer	W = White Pine	3 = Seedling Sapling Well	8 = Saw Timber Medium
E = Swamp Hdwoods	M = Mpl, Bch, Brch	R = Red Pine	X = Non Stocked	4 = Pole Timber Poor	9 = Saw Timber Well
F = Spruce Fir	MC = Mixed Conifer	S = Black Spruce	Z = Water		
G = Grass	MD = Mixed Deciduous	T = Tamarack			

PU	Acres	PU	Acres	PU	Acres
1	23.8	5	14.2	9	18.3
2	31.0	6	3.9	10	5.7
3	8.4	7	17.7	11	13.9
4	19.6	8	15.1		

Karura Mix Compartment 246 171.6 acres

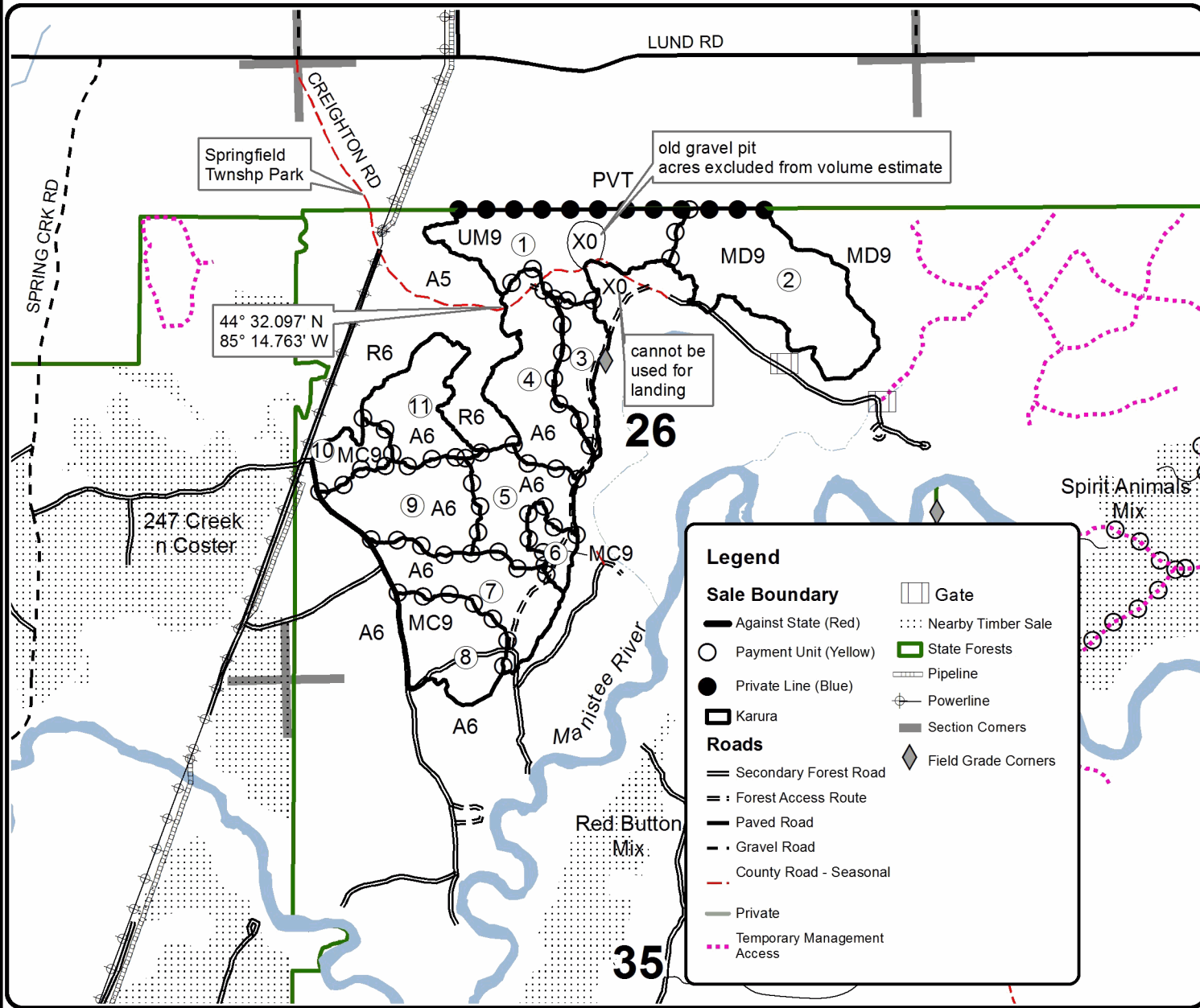

Legend

Sale Boundary

- Against State (Red)
- Payment Unit (Yellow)
- Private Line (Blue)
- Karura
- Secondary Forest Road
- Forest Access Route
- Paved Road
- Gravel Road
- County Road - Seasonal
- Private
- Temporary Management Access

Roads

- Gate
- Nearby Timber Sale
- State Forests
- Pipeline
- Powerline
- Section Corners
- Field Grade Corners

TIMBER SALE INFORMATION

131 Boom Boom Oak (61-625-20)
 T26N, R04W, SEC. 31; T26N, R05W, SEC. 25; T26N, R05W, SEC. 36.
 Crawford County (Advertised Price \$53,227.20)

SALE NOTE: This sale is on or adjacent to active training areas and is therefore subject to military timing restrictions and requires chipping, unless waived by Camp Grayling.

A timber sale contract for this lump sum, sealed bid timber sale will be awarded to the responsible bidder offering the highest sealed bid price. All units of volume listed below were estimated using the T-Sale computer program and our traditional volume equations. Bids must be at or above the following advertised price for each product and species:

<u>PRODUCTS & SPECIES</u>	<u>ESTIMATED UNITS*</u>	<u>ADVERTISED PRICE</u>
Sawtimber		
Mixed Aspen	10.5 MBF	\$ 78.00 / MBF
Red Maple	2.7 MBF	\$ 114.00 / MBF
Red Oak	214.2 MBF	\$ 122.00 / MBF
Red Pine	54.0 MBF	\$ 78.00 / MBF
White Oak	50.3 MBF	\$ 71.00 / MBF
Pulpwood		
Jack Pine	212 Cords	\$ 8.00 / Cord
Misc. Species 1	281 Cords	\$ 2.75 / Cord
Mixed Aspen	117 Cords	\$ 12.40 / Cord
Mixed Oak	1,260 Cords	\$ 8.70 / Cord
Red Maple	61 Cords	\$ 11.55 / Cord
Red Pine	83 Cords	\$ 27.50 / Cord
White Pine	29 Cords	\$ 10.90 / Cord

* The total volume is statistically estimated within plus (+) or minus (-) 11.35 percent. There are an estimated 2,703 cords on this timber sale, plus or minus 307 cords at the 95% confidence level. The estimated units are final and not subject to adjustment. Prospective bidders are urged to examine this timber and to make their own estimates of quantity and quality.

BOND AND PAYMENT SCHEDULE:

- A bond in the amount of \$3,726.00 to insure faithful performance of the conditions of the contract will be deposited by the successful bidder within 21 days of the sale award.
- Cutting in any sale or unit without the required advance payment would be considered a trespass.
- Total payment must be paid in advance or according to the following schedule :
 - Ten percent (10%) of the sale value must be paid within 21 days of the sale award.
 - The remainder is due before cutting begins.
 - Payment for each of the following units must be made before cutting begins in that unit:

PAYMENT UNIT NUMBER	PERCENT OF TOTAL SALE VALUE
01	100.0%
- If no cutting takes place, the 10% down payment will not be refunded.
- Operations on the contract issued will terminate on 04/14/2024.

SALE STATISTICS

SALE VOLUMES

VOLUME		STATISTICAL RANGE IN CORDS		
TOTAL CUBIC FEET	TOTAL CORDS	PERCENT ERROR	MINIMUM	MAXIMUM
213,574	2,703	11.35%	2,397	3,010

VDU VOLUMES

A VDU is a Volume Determination Unit. Volumes and their associated statistics are calculated at the VDU level and summarized to the sale level. There is often a one to one relationship between a VDU and a Payment Unit, but not always, depending on the cruise design. Refer to the VDU TO PAYMENT UNIT table.

VDU	VOLUME		PERCENT ERROR	RANGE IN CORDS	
	TOTAL CUBIC FEET	TOTAL CORDS		MINIMUM	MAXIMUM
7	30,336	384	15.17%	326	442
8	183,248	2,320	13.17%	2,014	2,625
TOTAL:	213,584	2,704		2,340	3,067

VDU TO PAYMENT UNIT

When a VDU is associated with more than one Payment Unit (PU), the VDU volumes are assigned to the PU based on acres of the VDU within the PU.

VDU	VDU ACRES	PU	PU ACRES
7	17.1	1	17.1
8	84.0	1	84.0
TOTAL:	101.1		101.1

DESCRIPTION OF TIMBER BY PAYMENT UNIT (PU)

PU	MARKET GROUP	PRODUCT	QUANTITY	UNIT	ACRES	ADVERTISE PRICE
1	Mixed Aspen	Sawtimber	10.5	MBF	101.1	\$53,227.20
	<i>B. T. Aspen</i>		7.2	<i>MBF</i>		
	<i>Quaking Aspen</i>		3.3	<i>MBF</i>		
	Red Maple		2.7	MBF		
	Red Oak		214.2	MBF		
	Red Pine		54.0	MBF		
	White Oak		50.3	MBF		
	Jack Pine	Pulpwood	212	Cords		
	Misc. Species 1		281	Cords		
	<i>Misc. Species 1</i>	<i>Sawtimber</i>	1.4	<i>MBF</i>		
	<i>Misc. Species 1</i>	<i>Pulpwood</i>	278	<i>Cords</i>		
	Mixed Aspen		117	Cords		
	<i>B. T. Aspen</i>		104	<i>Cords</i>		
	<i>Quaking Aspen</i>		13	<i>Cords</i>		
	Mixed Oak		1,260	Cords		
	<i>Red Oak</i>		871	<i>Cords</i>		
	<i>White Oak</i>		389	<i>Cords</i>		
	Red Maple		61	Cords		
	Red Pine		83	Cords		
	White Pine		29	Cords		
TOTAL:			331.7	MBF		
TOTAL:			2,043	Cords		

Sale Specific Conditions & Requirements

Sale Name: 131 Boom Boom Oak

Sale Number: 61-625-20 Seq#: 1

1 - Sale Area

1.2 - Boundaries

1.2.1 - Painted boundaries (9/19)

The sale boundary is marked and identified by red paint. Note that there are 4 retention areas that are marked with red paint; no harvesting activities may occur within these areas. The painted boundary line trees are not Included Timber and are to be protected.

2 - Timber Specifications

2.1 - Included Timber

2.1.1 - Clearcut unit(s) with unmerchantable trees (6/14)

Within Payment Unit(s) 1, cut all trees that are two (2) inches or more at DBH, except do not cut or damage trees that are marked with green paint.

2.2 - Utilization

2.2.2 - Chipping required (2/18)

This area must be chip harvested to meet National Guard requirements. However, the chipping requirement may be waived with military approval if the Purchaser can demonstrate that site can be sufficiently prepared for future military training. The Purchaser has the option to produce sawlogs or pulpwood bolts, but the remaining portion of the trees must be chipped. The requirement to retain approximately 1/6 to 1/3 of tree tops and limbs less than four inches in diameter does not apply (G. C. & R. 2.2). This is due to National Guard requirements.

2.2.3 - Stump heights (4/07)

Stump heights within the Sale Area shall not exceed 12 inches for trees greater than 10 inches DBH and 4 inches for trees smaller than 10 inches DBH. This is in order to facilitate military requirements.

3 - Payments

3.3 - Pre-measured Sales

3.3.4 - Dividing payment units (7/14)

Payment Unit(s) may be divided at the request of the Purchaser and upon approval of the Unit Manager. Dividing Payment Units is a contract modification which requires a Timber Sale Contract Amendment. Payment Unit 1 can be divided along the existing trails shown on the Timber Sale Map into three Payment Units, if desired.

4 - Transportation

4.1 - Construction

4.1.6 - Road construction (1/09)

Construction of new roads or improvements of existing roads shall be done in such a way as to minimize the environmental and visual impacts. Merchantable trees shall be cut and utilized unless otherwise directed. Non-merchantable trees shall be severed and laid flat on the ground. Slash shall be scattered, and not left in windrows and kept a minimum of 10 feet back from the road edge. Stumps shall be set upright, not left on edge, and be moved at least 10 feet away from the road edge. Disturbed soil shall be feathered into the woods and not left in berms or windrows.

4.1.7 - Road closure (10/11)

All new roads built into the sale must be blocked to vehicle traffic within 30 days of completion of hauling. In general, this will require constructing a four (4') foot high berm of stumps and logs covered with earth. Stumps and brush must be placed along the remainder of the trail where they are readily available. These roads must be rendered impassable to cars, trucks and ORVs.

5 - Operations

5.1 - Notification

5.1.5 - National Guard notification (2/15)

This sale is upon lands utilized for training by the Michigan National Guard - Camp Grayling. A minimum of five (5) business days prior to opening this sale, the producer must request that the sale administrator contact the military for information regarding training plans that may impact sale operations.

5.2 - Conduct of Operations

5.2.2 - Hazard Trees/Snags

5.2.2.1 - Den trees (10/16)

Obvious hollow and/or den trees shall be protected and left standing unless they are a safety hazard. Standing dead trees that are sound and aren't hollowed out can be cut and utilized, only those that are hollowed out need to be left intact. contact sale administrator for further details.

5.2.3 - Operating Restrictions

5.2.3.4 - Oak wilt restriction, no exceptions (1/18)

Within Payment Unit(s) 1, cutting, skidding, hauling within the sale and brushing of access roads to the sale are not permitted during the period of April 15 to July 15. No exceptions will be granted. This is necessary to reduce the spread of oak wilt.

5.2.3.7 - National Guard training restriction (1/09)

Operations on this contract may not be allowed during National Guard training operations. Typically, the restricted period is from May 1 to October 31. The contractor must check with the Unit Manager (or sale administrator) who will coordinate the cutting schedule with the Military.

5.2.3.11 - Coppice regeneration protection (4/10)

Timber harvesting in any Payment Unit must be completed before significant aspen sprouting occurs in that Payment Unit so as to minimize damage to the new regeneration. Any post harvest operations, such as chipping, must be completed before sprouting of regeneration occurs. If it is anticipated that chipping will be delayed, then tops shall be carried to one central location or left unchipped. The Unit Manager or his/her representative may cease such operations if sprouting occurs before the operation is complete.

5.2.32 - Decking/landing restoration (9/13)

All decking and landing areas must have the surface area restored to a condition equal to or better than before. This is to ensure the proper regeneration of the stand. Wood debris, chips and "cookies" from trimmings must be removed or scattered away from landing and loading areas and may not be windrowed on the edge.

5.2.38 - No decking against live trees (2/04)

Cut products may not be decked against unmarked or designated leave trees.

5.8 - Protection of Endangered Species

5.8.5 - Protection of raptor nests (3/13)

All trees with raptor nests will be protected if found during harvesting operations. Notification will be made to the Unit Manager or his/her representative who will notify the Wildlife Biologist so an on-site evaluation and recommendation can be made, if necessary.

6 - Safety and Fire Prevention

6.2 - Signing

6.2.1 - Road posting (9/09)

The Purchaser is responsible for posting and maintaining caution signs on impacted road systems prior to beginning operations. The road must be posted at appropriate distances from the sale area to warn of logging activity and truck traffic. Signs must be removed when harvest operations are suspended or completed. The Purchaser will provide these signs.

SKIP

6.4 - Unexploded ordinance (7/15)

Be aware that the sale area could contain UXO (unexploded ordinances). Do not touch, or drive over any metal objects. If any objects are found, please flag the area and notify the Unit Manager or his/her representative, so that they can make arrangements with the Military.

7 - Other Conditions

7.10 - Certified Timber

7.10.1 - Non-certified timber (2/16)

The area encompassed by this timber sale is not certified to the standards of the Forest Stewardship Council (FSC) or the Sustainable Forestry Initiative (SFI). Forest products from this sale may not be delivered to the mill as "FSC and / or SFI certified". The lands within this sale are managed for military training.



TIMBER SALE MAP

This information provided by authority of Part 525, 1994 PA 451, as amended.

Sale Number	Year
61 - 625	20

Forest Management Unit Traverse City	County Kalkaska	Mapped By Standerfer	Date 9/4/2020	Page 1	of 1
Township 26N	Range 04 & 05W	Section(s) and Subdivision(s) 25 (SESE) & 36 (NE 1/4) & 31 (SWNW,NWSW) See proposal	Scale 1:15,840		

Cover Type				Density	
A = Aspen	H = Hemlock	N = Marsh	U = Upland Brush	0 = Non Stocked	5 = Pole Timber Medium
B = Paper Birch	J = Jack Pine	O = Oak	UM = Upland Mixed	1 = Seedling Sapling Poor	6 = Pole Timber Well
C = Cedar	L = Lowland Brush	P = Lowland Poplar	V = Bog or Marsh	2 = Seedling Sapling Medium	7 = Saw Timber Poor
D = Treed Bog	LM = Lowland Mixed	Q = Mixed Swamp Conifer	W = White Pine	3 = Seedling Sapling Well	8 = Saw Timber Medium
E = Swamp Hdwoods	M = Mpl, Bch, Brch	R = Red Pine	X = Non Stocked	4 = Pole Timber Poor	9 = Saw Timber Well
F = Spruce Fir	MC = Mixed Conifer	S = Black Spruce	Z = Water		
G = Grass	MD = Mixed Deciduous	T = Tamarack			

PU Acres
1 101.1



QR Code for
Avenza maps

131 Boom Boom Oak Compartment 131 101.1 Acres

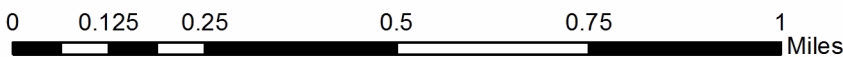
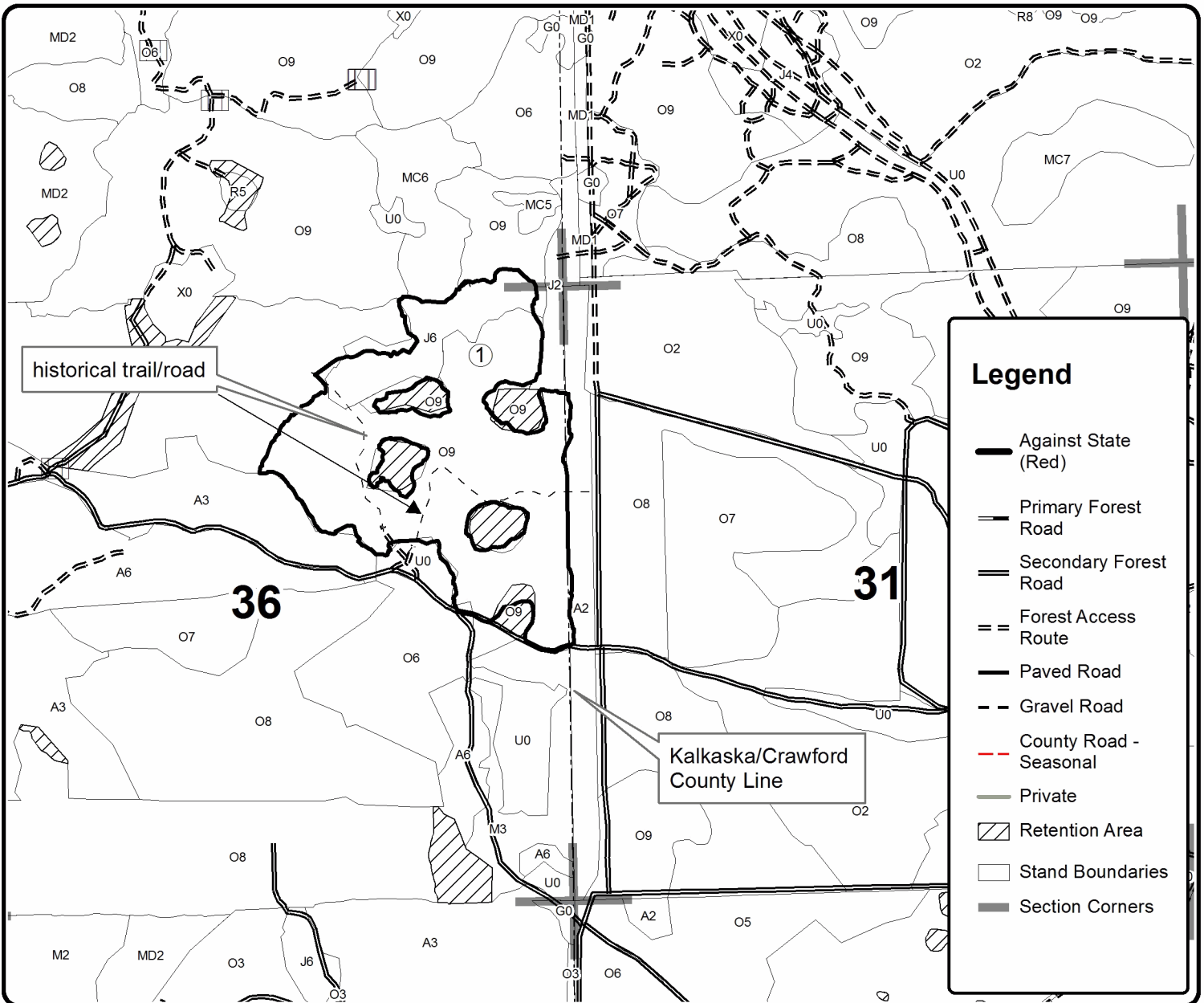

TIMBER SALE INFORMATION

131 Tank Tank Aspen (61-626-20)
 T26N, R05W, SEC. 27; T26N, R05W, SEC. 33; T26N, R05W, SEC. 34.
 Kalkaska County (Advertised Price \$75,172.15)

SALE NOTE: This sale is on or adjacent to active training areas and is therefore subject to military timing restrictions and requires chipping, unless waived by Camp Grayling.

A timber sale contract for this lump sum, sealed bid timber sale will be awarded to the responsible bidder offering the highest sealed bid price. All units of volume listed below were estimated using the T-Sale computer program and our traditional volume equations. Bids must be at or above the following advertised price for each product and species:

<u>PRODUCTS & SPECIES</u>	<u>ESTIMATED UNITS*</u>	<u>ADVERTISED PRICE</u>
Sawtimber		
B. T. Aspen	38.1 MBF	\$ 78.00 / MBF
Red Maple	2.0 MBF	\$ 114.00 / MBF
Red Oak	132.0 MBF	\$ 122.00 / MBF
Red Pine	182.8 MBF	\$ 78.00 / MBF
White Oak	67.1 MBF	\$ 71.00 / MBF
Pulpwood		
Jack Pine	696 Cords	\$ 8.00 / Cord
Misc. Species 1	158 Cords	\$ 2.75 / Cord
Mixed Aspen	1,266 Cords	\$ 12.40 / Cord
Mixed Oak	1,027 Cords	\$ 8.70 / Cord
Red Maple	121 Cords	\$ 11.55 / Cord
Red Pine	175 Cords	\$ 27.50 / Cord

* The total volume is statistically estimated within plus (+) or minus (-) 8.73 percent. There are an estimated 4,303 cords on this timber sale, plus or minus 376 cords at the 95% confidence level. The estimated units are final and not subject to adjustment. Prospective bidders are urged to examine this timber and to make their own estimates of quantity and quality.

BOND AND PAYMENT SCHEDULE:

1. A bond in the amount of \$5,262.00 to insure faithful performance of the conditions of the contract will be deposited by the successful bidder within 21 days of the sale award.
2. Cutting in any sale or unit without the required advance payment would be considered a trespass.
3. Total payment must be paid in advance or according to the following schedule :
 - (a) Ten percent (10%) of the sale value must be paid within 21 days of the sale award.
 - (b) The 10% down payment will be credited towards the first unit cut.
 - (c) Payment for each of the following units must be made before cutting begins in that unit:

PAYMENT UNIT NUMBER	PERCENT OF TOTAL SALE VALUE
01	29.2%
02	31.0%
03	11.0%
04	17.2%
05	11.6%
4. If no cutting takes place, the 10% down payment will not be refunded.
5. Operations on the contract issued will terminate on 04/14/2024.

SALE STATISTICS

SALE VOLUMES

VOLUME		STATISTICAL RANGE IN CORDS		
TOTAL CUBIC FEET	TOTAL CORDS	PERCENT ERROR	MINIMUM	MAXIMUM
339,961	4,303	8.73%	3,928	4,679

VDU VOLUMES

A VDU is a Volume Determination Unit. Volumes and their associated statistics are calculated at the VDU level and summarized to the sale level. There is often a one to one relationship between a VDU and a Payment Unit, but not always, depending on the cruise design. Refer to the VDU TO PAYMENT UNIT table.

VDU	VOLUME		PERCENT ERROR	RANGE IN CORDS	
	TOTAL CUBIC FEET	TOTAL CORDS		MINIMUM	MAXIMUM
36	29,270	371	27.75%	268	473
41	217,392	2,752	19.12%	2,226	3,278
42	92,327	1,169	11.31%	1,037	1,301
142	219,320	2,776	14.40%	2,376	3,176
TOTAL:	558,309	7,067		5,906	8,228

VDU TO PAYMENT UNIT

When a VDU is associated with more than one Payment Unit (PU), the VDU volumes are assigned to the PU based on acres of the VDU within the PU.

VDU	VDU ACRES	PU	PU ACRES
36	17.2	2	17.2
41	50.5	4	30.1
		5	20.4
42	40.1	1	40.1
142	40.8	2	28.1
		3	12.7
TOTAL:	148.6		148.6

DESCRIPTION OF TIMBER BY PAYMENT UNIT (PU)

PU	MARKET GROUP	PRODUCT	QUANTITY	UNIT	ACRES	ADVERTISE PRICE
1	B. T. Aspen	Sawtimber	2.9	MBF	40.1	\$21,932.65
	Red Oak		61.9	MBF		
	Red Pine	35.5	MBF			
	White Oak	18.8	MBF			
	Misc. Species 1	Pulpwood	43	Cords		
	Mixed Aspen		390	Cords		
	<i>B. T. Aspen</i>		390	Cords		
	Mixed Oak		437	Cords		
	<i>Red Oak</i>		374	Cords		
	<i>White Oak</i>		63	Cords		
	Red Maple		24	Cords		
	Red Pine		37	Cords		
	2		B. T. Aspen	Sawtimber		
Red Maple		1.4	MBF			
Red Oak		45.0	MBF			
Red Pine		19.7	MBF			
White Oak		33.3	MBF			
Jack Pine		Pulpwood	134	Cords		
Misc. Species 1			45	Cords		
Mixed Aspen			592	Cords		
<i>B. T. Aspen</i>			584	Cords		
<i>Quaking Aspen</i>			8	Cords		
Mixed Oak			232	Cords		
<i>Red Oak</i>			149	Cords		
<i>White Oak</i>			83	Cords		
Red Maple			56	Cords		
Red Pine	14	Cords				
3	B. T. Aspen	Sawtimber	7.2	MBF	12.7	\$8,291.45
	Red Maple		0.6	MBF		
	Red Oak	20.4	MBF			
	Red Pine	7.0	MBF			
	White Oak	15.0	MBF			
	Jack Pine	Pulpwood	23	Cords		
	Misc. Species 1		15	Cords		
	Mixed Aspen		165	Cords		
	<i>B. T. Aspen</i>		161	Cords		
	<i>Quaking Aspen</i>		4	Cords		
	Mixed Oak		98	Cords		
	<i>Red Oak</i>		60	Cords		
	<i>White Oak</i>		38	Cords		
Red Maple	26		Cords			
Red Pine	5	Cords				
4	Red Oak	Sawtimber	2.8	MBF	30.1	\$12,893.90
	Red Pine		71.9	MBF		
	Jack Pine	Pulpwood	321	Cords		
	Misc. Species 1		33	Cords		
	Mixed Aspen		71	Cords		
	<i>B. T. Aspen</i>		71	Cords		
	Mixed Oak		155	Cords		
	<i>Red Oak</i>		142	Cords		
	<i>White Oak</i>		13	Cords		
	Red Maple		9	Cords		
	Red Pine		71	Cords		
5	Red Oak	Sawtimber	1.9	MBF	20.4	\$8,732.90
	Red Pine		48.7	MBF		
	Jack Pine	Pulpwood	218	Cords		

DESCRIPTION OF TIMBER BY PAYMENT UNIT (PU), CON'T

PU	MARKET GROUP	PRODUCT	QUANTITY	UNIT	ACRES	ADVERTISE PRICE
5 con't	Misc. Species 1	Pulpwood	22	Cords		
	Mixed Aspen		48	Cords		
	<i>B. T. Aspen</i>		48	<i>Cords</i>		
	Mixed Oak		105	Cords		
	<i>Red Oak</i>		97	<i>Cords</i>		
	<i>White Oak</i>		8	<i>Cords</i>		
	Red Maple		6	Cords		
	Red Pine		48	Cords		
TOTAL:			422.0	MBF		
TOTAL:			3,443	Cords		

Sale Specific Conditions & Requirements

Sale Name: 131 Tank Tank Aspen

Sale Number: 61-626-20 Seq#: 1

1 - Sale Area

1.2 - Boundaries

1.2.1 - Painted boundaries (9/19)

The sale boundary and Payment Unit boundaries are marked and identified by red and yellow paint. Exterior sale boundary lines against state are marked with red paint. Interior Payment Unit boundaries are marked with yellow paint, with the exception of the boundary between Payment Units 2 and 3, which is unpainted and identified by the forest road. The painted boundary line trees are not Included Timber and are to be protected unless marked with orange paint. Yellow painted trees designating an interior Payment Unit boundary are only to be cut when all surrounding Payment Units have been paid for and they are designated for removal in both adjacent payment units.

2 - Timber Specifications

2.1 - Included Timber

2.1.2 - Clearcut unit(s) w/o unmerchantable trees (8/11)

Within Payment Unit(s) 1-5, cut all trees which meet minimum piece specifications in 2.2 Utilization, except do not cut white pine or any trees marked with green paint. In addition, within Payment Units 4 and 5, do not cut any red pine trees over 22" at DBH.

2.2 - Utilization

2.2.2 - Chipping required (2/18)

This area must be chip harvested to meet National Guard requirements. However, the chipping requirement may be waived with military approval, if the Purchaser can demonstrate that the site can be sufficiently prepared for future military training. The Purchaser has the option to produce sawlogs or pulpwood bolts, but the remaining portion of the trees must be chipped. The requirement to retain approximately 1/6 to 1/3 of tree tops and limbs less than four inches in diameter does not apply (G. C. & R. 2.2). This is due to National Guard requirements.

2.2.3 - Stump heights (4/07)

Stump heights within the Sale Area shall not exceed 12 inches for trees greater than 10 inches DBH and 4 inches for trees smaller than 10 inches DBH. This is in order to facilitate military requirements.

3 - Payments

3.3 - Pre-measured Sales

3.3.4 - Dividing payment units (7/14)

Payment Unit(s) over \$20,000 in value may be divided at the request of the Purchaser and upon approval of the Unit Manager. Dividing Payment Units is a contract modification which requires a Timber Sale Contract Amendment. There will be only one division per Payment Unit.

4 - Transportation

4.1 - Construction

4.1.6 - Road construction (1/09)

Construction of new roads or improvements of existing roads shall be done in such a way as to minimize the environmental and visual impacts. Merchantable trees shall be cut and utilized unless otherwise directed. Non-merchantable trees shall be severed and laid flat on the ground. Slash shall be scattered, and not left in windrows and kept a minimum of 10 feet back from the road edge. Stumps shall be set upright, not left on edge, and be moved at least 10 feet away from the road edge. Disturbed soil shall be feathered into the woods and not left in berms or windrows.

4.1.7 - Road closure (10/11)

All new roads built into the sale must be blocked to vehicle traffic within 30 days of completion of hauling. In general, this will require constructing a four (4') foot high berm of stumps and logs covered with earth. Stumps and brush must be placed along

the remainder of the trail where they are readily available. These roads must be rendered impassable to cars, trucks and ORVs.

5 - Operations

5.1 - Notification

5.1.5 - National Guard notification (2/15)

This sale is upon lands utilized for training by the Michigan National Guard - Camp Grayling. A minimum of five (5) business days prior to opening this sale, the producer must request that the sale administrator contact the military for information regarding training plans that may impact sale operations.

5.2 - Conduct of Operations

5.2.2 - Hazard Trees/Snags

5.2.2.1 - Den trees (10/16)

Obvious hollow and/or den trees shall be protected and left standing unless they are a safety hazard. Standing dead oak can be cut and utilized however hollowed out trees should be left uncut.

5.2.3 - Operating Restrictions

5.2.3.5 - Oak wilt restriction (1/18)

Within Payment Units 1-5, unless changed by written agreement, cutting, skidding, hauling within the sale and brushing of access roads to the sale are not permitted during the period of April 15 to July 15. Operations may be allowed if specific steps are taken to prevent damaging uncut oak during the high risk period. Those steps may include completing all road brushing before April 15th and clearing a tree-length buffer along uncut oak cover before April 15th. This is necessary to reduce the spread of oak wilt. For more information, contact the Unit Manager or his/her representative.

5.2.3.7 - National Guard training restriction (1/09)

Operations on this contract may not be allowed during National Guard training operations. Typically, the restricted period is from May 1 to October 31. The Purchaser must check with the Unit Manager or sale administrator, who will coordinate the cutting schedule with the Military. All harvest equipment must be removed from the sale area during the period of May 1 to October 31.

5.2.3.11 - Coppice regeneration protection (4/10)

Timber harvesting in any Payment Unit must be completed before significant aspen sprouting occurs in that Payment Unit so as to minimize damage to the new regeneration. Any post harvest operations, such as chipping, must be completed before sprouting of regeneration occurs. If it is anticipated that chipping will be delayed, then tops shall be carried to one central location or left unchipped. The Unit Manager or his/her representative may cease such operations if sprouting occurs before the operation is complete.

5.2.32 - Decking/landing restoration (9/13)

All decking and landing areas must have the surface area restored to a condition equal to or better than before. This is to ensure the proper regeneration of the stand. Wood debris, chips and "cookies" from trimmings must be removed or scattered away from landing and loading areas and may not be windrowed on the edge.

5.2.38 - No decking against live trees (2/04)

Cut products may not be decked against unmarked or designated leave trees.

5.8 - Protection of Endangered Species

5.8.5 - Protection of raptor nests (3/13)

All trees with raptor nests will be protected if found during harvesting operations. Notification will be made to the Unit Manager or his/her representative who will notify the Wildlife Biologist so an on-site evaluation and recommendation can be made, if necessary.

6 - Safety and Fire Prevention

6.2 - Signing

6.2.1 - Road posting (9/09)

The Purchaser is responsible for posting and maintaining caution signs on impacted roads prior to beginning operations. The road must be posted at appropriate distances from the sale area to warn of logging activity and truck traffic. Signs must be removed when harvest operations are suspended or completed. The Purchaser will provide these signs.

SKIP

6.4 - Unexploded ordinance (7/15)

Be aware that the sale area could contain UXO (unexploded ordinances). Do not touch, or drive over any metal objects. If any objects are found, please flag the area and notify the Unit Manager or his/her representative, so that they can make arrangements with the Military.

7 - Other Conditions

7.10 - Certified Timber

7.10.1 - Non-certified timber (2/16)

The area encompassed by this timber sale is not certified to the standards of the Forest Stewardship Council (FSC) or the Sustainable Forestry Initiative (SFI). Forest products from this sale may not be delivered to the mill as "FSC and / or SFI certified". The lands within this sale are managed for military training.



TIMBER SALE MAP

This information provided by authority of Part 525, 1994 PA 451, as amended.

Forest Management Unit Traverse City	County Kalkaska	Mapped By Standerfer	Date 9/4/2020	Page 1	of 1
Township 26N	Range 05W	Section(s) and Subdivision(s) 34 - W1/2 & NE1/4 (see proposal)	Scale 1:15,840		

Cover Type				Density	
A = Aspen	H = Hemlock	N = Marsh	U = Upland Brush	0 = Non Stocked	5 = Pole Timber Medium
B = Paper Birch	J = Jack Pine	O = Oak	UM = Upland Mixed	1 = Seedling Sapling Poor	6 = Pole Timber Well
C = Cedar	L = Lowland Brush	P = Lowland Poplar	V = Bog or Marsh	2 = Seedling Sapling Medium	7 = Saw Timber Poor
D = Treed Bog	LM = Lowland Mixed	Q = Mixed Swamp Conifer	W = White Pine	3 = Seedling Sapling Well	8 = Saw Timber Medium
E = Swamp Hdwoods	M = Mpl, Bch, Brch	R = Red Pine	X = Non Stocked	4 = Pole Timber Poor	9 = Saw Timber Well
F = Spruce Fir	MC = Mixed Conifer	S = Black Spruce	Z = Water		
G = Grass	MD = Mixed Deciduous	T = Tamarack			

PU	Acres	PU	Acres
1	40.1	4	30.1
2	45.3	5	20.4
3	12.7		

131 Tank Tank Aspen

Compartment 131

148.6 Acres

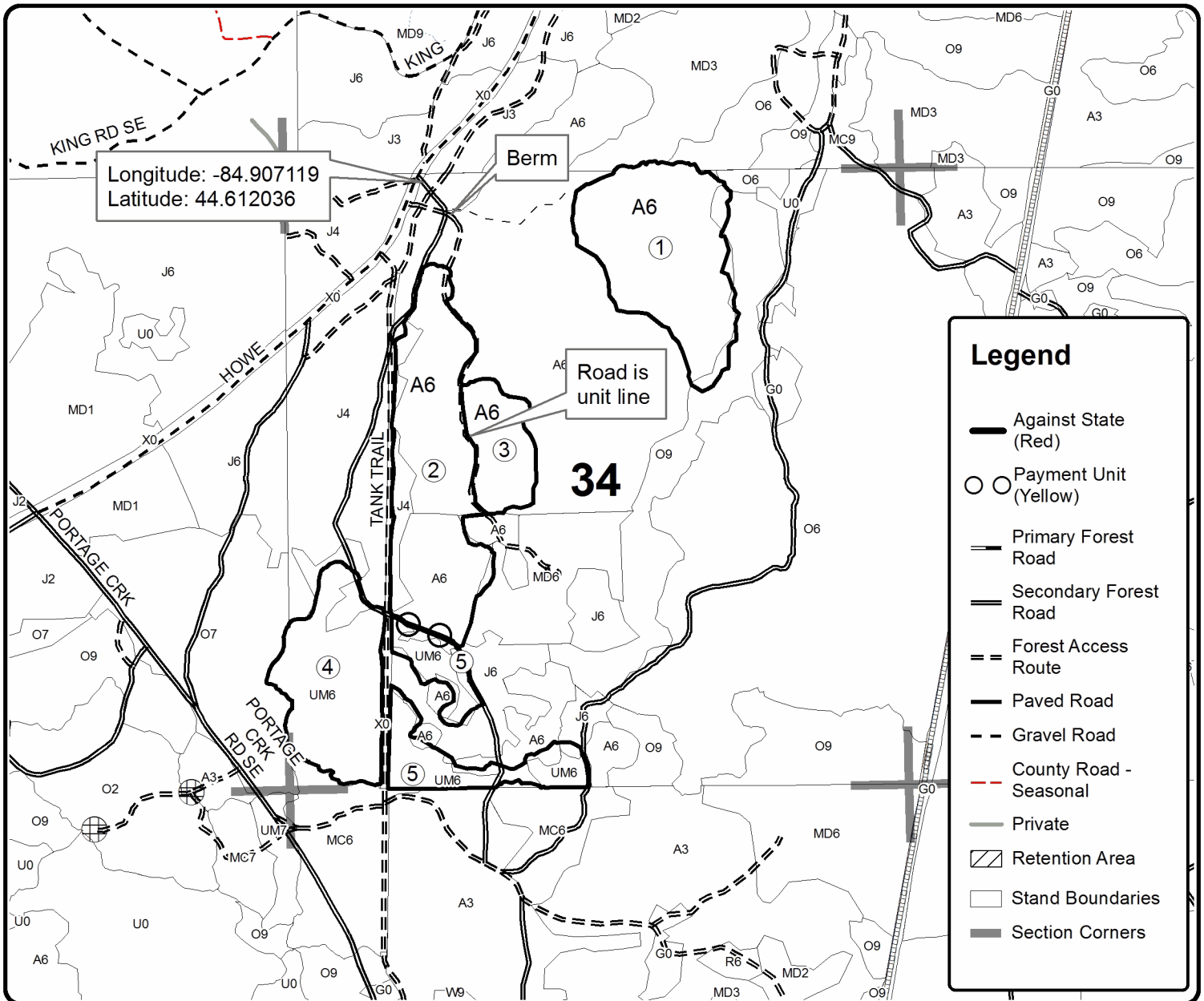

Legend

- Against State (Red)
- Payment Unit (Yellow)
- Primary Forest Road
- Secondary Forest Road
- Forest Access Route
- Paved Road
- Gravel Road
- County Road - Seasonal
- Private
- Retention Area
- Stand Boundaries
- Section Corners

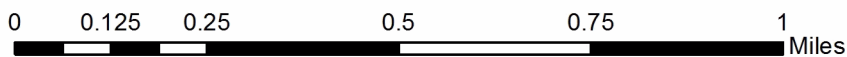

Torq & Octane (61-109-20)
T27N, R08W, SEC. 35; T27N, R08W, SEC. 36; Kalkaska COUNTY

In response to the notice of sale to be held 4:00 p.m. (local time) on March 22, 2021, I am hereby submitting my sealed bid (firm offer) for the following forest products to be cut. Bids for individual species must be at or above the advertised price. All non-responsive bid forms may be rejected.

<u>PRODUCTS & SPECIES</u>	<u>ESTIMATED VOLUME*</u>	<u>ADVERTISED PRICE</u>	<u>BID PRICE/UNIT</u>
Sawtimber			
B. T. Aspen	15.7 MBF	\$ 78.00/MBF	\$ _____
Red Maple	30.8 MBF	\$ 114.00/MBF	\$ _____
Red Pine	14.0 MBF	\$ 78.00/MBF	\$ _____
White Pine	69.1 MBF	\$ 41.00/MBF	\$ _____
Pulpwood			
B. T. Aspen	654 Cords	\$ 12.40/Cord	\$ _____
Balsam Fir	7 Cords	\$ 7.05/Cord	\$ _____
Jack Pine	15 Cords	\$ 8.00/Cord	\$ _____
Mixed Hardwood	741 Cords	\$ 11.55/Cord	\$ _____
Red Oak	63 Cords	\$ 8.70/Cord	\$ _____
Red Pine	31 Cords	\$ 27.50/Cord	\$ _____
White Pine	393 Cords	\$ 10.90/Cord	\$ _____
White Spruce	29 Cords	\$ 10.20/Cord	\$ _____

*The volumes are statistically estimated within plus (+) or minus (-) 13.76 percent at 95% confidence level. These estimated volumes are final and not subject to adjustment. Prospective bidders are urged to examine this timber and to make their own estimates of quantity and quality.

I understand that any or all bids may be rejected. All bids must be signed and all bid items must be bid or the bid form may be rejected. I also understand that consideration and awarding a contract will be based upon my past performance and ability to complete the contract based upon equipment and staffing subject to my control.

FEDERAL ID: ____ - ____ - ____ or SOCIAL SECURITY NUMBER: ____ - ____ - ____

Company or individual bidding: _____

Company representative's name: _____

Address: _____

City: _____ State: _____ Zip: _____

IF AVAILABLE, PLEASE PLACE THE PERSONALIZED LABEL FROM YOUR PROSPECTUS IN THE ABOVE BOX.

Individual or company representative's signature: _____ Date: _____

Phone number : _____ Email (optional): _____

THE WINNING BIDDER MUST COMPLETE THE VERIFICATION OF WORKER'S DISABILITY COMPENSATION ACT COMPLIANCE (ON REVERSE SIDE IF DOUBLE SIDED) WITHIN 21 DAYS OF SALE AWARD DATE

Karura Mix (61-132-20)
T25N, R08W, SEC. 26; T25N, R08W, SEC. 35; Kalkaska COUNTY

In response to the notice of sale to be held 4:00 p.m. (local time) on March 22, 2021, I am hereby submitting my sealed bid (firm offer) for the following forest products to be cut. Bids for individual species must be at or above the advertised price. All non-responsive bid forms may be rejected.

<u>PRODUCTS & SPECIES</u>	<u>ESTIMATED VOLUME*</u>	<u>ADVERTISED PRICE</u>	<u>BID PRICE/UNIT</u>
Sawtimber			
Basswood	1.3 MBF	\$ 67.00/MBF	\$ _____
Beech	1.6 MBF	\$ 49.00/MBF	\$ _____
Mixed Aspen	87.8 MBF	\$ 78.00/MBF	\$ _____
Red Maple	63.4 MBF	\$ 114.00/MBF	\$ _____
Red Oak	108.5 MBF	\$ 122.00/MBF	\$ _____
Red Pine	88.7 MBF	\$ 78.00/MBF	\$ _____
Sugar Maple	5.8 MBF	\$ 157.00/MBF	\$ _____
White Pine	104.1 MBF	\$ 41.00/MBF	\$ _____
Pulpwood			
Balsam Fir	9 Cords	\$ 7.05/Cord	\$ _____
Beech	100 Cords	\$ 11.55/Cord	\$ _____
Jack Pine	2 Cords	\$ 8.00/Cord	\$ _____
Mixed Aspen	1,289 Cords	\$ 12.40/Cord	\$ _____
Mixed Hardwood	593 Cords	\$ 11.55/Cord	\$ _____
Red Oak	394 Cords	\$ 8.70/Cord	\$ _____
Red Pine	98 Cords	\$ 27.50/Cord	\$ _____
White Pine	344 Cords	\$ 10.90/Cord	\$ _____

*The volumes are statistically estimated within plus (+) or minus (-) 8.45 percent at 95% confidence level. These estimated volumes are final and not subject to adjustment. Prospective bidders are urged to examine this timber and to make their own estimates of quantity and quality.

I understand that any or all bids may be rejected. All bids must be signed and all bid items must be bid or the bid form may be rejected. I also understand that consideration and awarding a contract will be based upon my past performance and ability to complete the contract based upon equipment and staffing subject to my control.

FEDERAL ID: ___ - ___ - ___ or SOCIAL SECURITY NUMBER: ___ - ___ - ___

Company or individual bidding: _____

Company representative's name: _____

Address: _____

City: _____ State: _____ Zip: _____

IF AVAILABLE, PLEASE PLACE THE PERSONALIZED LABEL FROM YOUR PROSPECTUS IN THE ABOVE BOX.

Individual or company representative's signature: _____ Date: _____

Phone number : _____ Email (optional): _____

THE WINNING BIDDER MUST COMPLETE THE VERIFICATION OF WORKER'S DISABILITY COMPENSATION ACT COMPLIANCE (ON REVERSE SIDE IF DOUBLE SIDED) WITHIN 21 DAYS OF SALE AWARD DATE



FOR DEPARTMENT USE ONLY	
Sale Number (XX - XXX - XX - XX)	
Forest Management Unit:	

TIMBER SALE VERIFICATION OF WORKER'S DISABILITY COMPENSATION ACT COMPLIANCE

As required by Act 317, P.A. 1969 (Worker's Compensation) and
Part 5 of Act 451 of 1994, as amended.

VERIFICATION OF WORKER'S DISABILITY COMPENSATION ACT COMPLIANCE

- This verification must be completed and submitted within 21 days of contract award and prior to the issuance of the timber sale contract.
- In addition, if boxes 2B or 2C are checked, then Notice of Exclusion or Certificate of Insurance must be submitted within twenty-one (21) days of the contract award and prior to the issuance of the timber sale contract.
- All information must be typed or printed except for written signatures.

Please Check Appropriate Categories:

1. My business is organized as (you **must** check one of the boxes below):
 - A. Sole Proprietorship (individual)
 - B. Partnership
 - C. Corporation
2. You **must** check one of the boxes below:
 - A. I certify my business is a sole proprietorship and it has no employees but the sole proprietor. I am not subject to the Worker's Compensation Laws.
 - B. I certify my business has satisfied its obligation to the Worker's Compensation Act through the use of an approved Notice of Exclusion (BWC-337, Rev. 5/96). I will provide a copy of the Notice of Exclusion within 21 days of the contract award. (For questions or a copy of the BWC-337, please call the Worker's Compensation Bureau at 517-322-1195).
 - C. I certify my business has a Worker's Compensation Policy. I will provide an original Certificate of Insurance within twenty-one (21) days of the contract award.
3. If you have checked item 2(A) or 2(B), you **must** indicate the number of **both** full-time and part-time employees, other than yourself, including family members and active partners (if none, you must enter "0").

_____ Full-time Employees

_____ Part-time Employees

Name of Business		Federal ID (or) Social Security No.	
Address		Telephone ()	
City	State	ZIP	

I hereby certify that the above information is true and correct. I agree to notify the Michigan DNR of any changes that occur in factors affecting my coverage during any of my present and future operations.

Signature of Owner or Authorized Representative

Title

Date

Please complete the "SEALED BID" information on the next page

131 Boom Boom Oak (61-625-20)
T26N, R04W, SEC. 31; T26N, R05W, SEC. 25; T26N, R05W, SEC. 36; Crawford

In response to the notice of sale to be held 4:00 p.m. (local time) on March 22, 2021, I am hereby submitting my sealed bid (firm offer) for the following forest products to be cut. Bids for individual species must be at or above the advertised price. All non-responsive bid forms may be rejected.

<u>PRODUCTS & SPECIES</u>	<u>ESTIMATED VOLUME*</u>	<u>ADVERTISED PRICE</u>	<u>BID PRICE/UNIT</u>
Sawtimber			
Mixed Aspen	10.5 MBF	\$ 78.00/MBF	\$ _____
Red Maple	2.7 MBF	\$ 114.00/MBF	\$ _____
Red Oak	214.2 MBF	\$ 122.00/MBF	\$ _____
Red Pine	54.0 MBF	\$ 78.00/MBF	\$ _____
White Oak	50.3 MBF	\$ 71.00/MBF	\$ _____
Pulpwood			
Jack Pine	212 Cords	\$ 8.00/Cord	\$ _____
Misc. Species 1	281 Cords	\$ 2.75/Cord	\$ _____
Mixed Aspen	117 Cords	\$ 12.40/Cord	\$ _____
Mixed Oak	1,260 Cords	\$ 8.70/Cord	\$ _____
Red Maple	61 Cords	\$ 11.55/Cord	\$ _____
Red Pine	83 Cords	\$ 27.50/Cord	\$ _____
White Pine	29 Cords	\$ 10.90/Cord	\$ _____

*The volumes are statistically estimated within plus (+) or minus (-) 11.35 percent at 95% confidence level. These estimated volumes are final and not subject to adjustment. Prospective bidders are urged to examine this timber and to make their own estimates of quantity and quality.

I understand that any or all bids may be rejected. All bids must be signed and all bid items must be bid or the bid form may be rejected. I also understand that consideration and awarding a contract will be based upon my past performance and ability to complete the contract based upon equipment and staffing subject to my control.

FEDERAL ID: ____ - ____ - ____ or SOCIAL SECURITY NUMBER: ____ - ____ - ____

Company or individual bidding: _____

Company representative's name: _____

Address: _____

City: _____ State: _____ Zip: _____

IF AVAILABLE, PLEASE PLACE THE PERSONALIZED LABEL FROM YOUR PROSPECTUS IN THE ABOVE BOX.

Individual or company representative's signature: _____ Date: _____

Phone number : _____ Email (optional): _____

THE WINNING BIDDER MUST COMPLETE THE VERIFICATION OF WORKER'S DISABILITY COMPENSATION ACT COMPLIANCE (ON REVERSE SIDE IF DOUBLE SIDED) WITHIN 21 DAYS OF SALE AWARD DATE



TIMBER SALE VERIFICATION OF WORKER'S DISABILITY COMPENSATION ACT COMPLIANCE

As required by Act 317, P.A. 1969 (Worker's Compensation) and
Part 5 of Act 451 of 1994, as amended.

FOR DEPARTMENT USE ONLY	
Sale Number (XX - XXX - XX - XX)	
Forest Management Unit:	

VERIFICATION OF WORKER'S DISABILITY COMPENSATION ACT COMPLIANCE

- This verification must be completed and submitted within 21 days of contract award and prior to the issuance of the timber sale contract.
- In addition, if boxes 2B or 2C are checked, then Notice of Exclusion or Certificate of Insurance must be submitted within twenty-one (21) days of the contract award and prior to the issuance of the timber sale contract.
- All information must be typed or printed except for written signatures.

Please Check Appropriate Categories:

1. My business is organized as (you **must** check one of the boxes below):
 - A. Sole Proprietorship (individual)
 - B. Partnership
 - C. Corporation
2. You **must** check one of the boxes below:
 - A. I certify my business is a sole proprietorship and it has no employees but the sole proprietor. I am not subject to the Worker's Compensation Laws.
 - B. I certify my business has satisfied its obligation to the Worker's Compensation Act through the use of an approved Notice of Exclusion (BWC-337, Rev. 5/96). I will provide a copy of the Notice of Exclusion within 21 days of the contract award. (For questions or a copy of the BWC-337, please call the Worker's Compensation Bureau at 517-322-1195).
 - C. I certify my business has a Worker's Compensation Policy. I will provide an original Certificate of Insurance within twenty-one (21) days of the contract award.
3. If you have checked item 2(A) or 2(B), you **must** indicate the number of **both** full-time and part-time employees, other than yourself, including family members and active partners (if none, you must enter "0").

_____ Full-time Employees

_____ Part-time Employees

Name of Business		Federal ID (or) Social Security No.	
Address		Telephone ()	
City	State	ZIP	

I hereby certify that the above information is true and correct. I agree to notify the Michigan DNR of any changes that occur in factors affecting my coverage during any of my present and future operations.

Signature of Owner or Authorized Representative

Title

Date

Please complete the "SEALED BID" information on the next page

131 Tank Tank Aspen (61-626-20)
T26N, R05W, SEC. 27; T26N, R05W, SEC. 33; T26N, R05W, SEC. 34; Kalkaska

In response to the notice of sale to be held 4:00 p.m. (local time) on March 22, 2021, I am hereby submitting my sealed bid (firm offer) for the following forest products to be cut. Bids for individual species must be at or above the advertised price. All non-responsive bid forms may be rejected.

<u>PRODUCTS & SPECIES</u>	<u>ESTIMATED VOLUME*</u>	<u>ADVERTISED PRICE</u>	<u>BID PRICE/UNIT</u>
Sawtimber			
B. T. Aspen	38.1 MBF	\$ 78.00/MBF	\$ _____
Red Maple	2.0 MBF	\$ 114.00/MBF	\$ _____
Red Oak	132.0 MBF	\$ 122.00/MBF	\$ _____
Red Pine	182.8 MBF	\$ 78.00/MBF	\$ _____
White Oak	67.1 MBF	\$ 71.00/MBF	\$ _____
Pulpwood			
Jack Pine	696 Cords	\$ 8.00/Cord	\$ _____
Misc. Species 1	158 Cords	\$ 2.75/Cord	\$ _____
Mixed Aspen	1,266 Cords	\$ 12.40/Cord	\$ _____
Mixed Oak	1,027 Cords	\$ 8.70/Cord	\$ _____
Red Maple	121 Cords	\$ 11.55/Cord	\$ _____
Red Pine	175 Cords	\$ 27.50/Cord	\$ _____

*The volumes are statistically estimated within plus (+) or minus (-) 8.73 percent at 95% confidence level. These estimated volumes are final and not subject to adjustment. Prospective bidders are urged to examine this timber and to make their own estimates of quantity and quality.

I understand that any or all bids may be rejected. All bids must be signed and all bid items must be bid or the bid form may be rejected. I also understand that consideration and awarding a contract will be based upon my past performance and ability to complete the contract based upon equipment and staffing subject to my control .

FEDERAL ID: _____ or SOCIAL SECURITY NUMBER: _____

Company or individual bidding: _____

Company representative's name: _____

Address: _____

City: _____ State: _____ Zip: _____

IF AVAILABLE, PLEASE PLACE THE PERSONALIZED LABEL FROM YOUR PROSPECTUS IN THE ABOVE BOX.

Individual or company representative's signature: _____ Date: _____

Phone number : _____ Email (optional): _____

THE WINNING BIDDER MUST COMPLETE THE VERIFICATION OF WORKER'S DISABILITY COMPENSATION ACT COMPLIANCE (ON REVERSE SIDE IF DOUBLE SIDED) WITHIN 21 DAYS OF SALE AWARD DATE



FOR DEPARTMENT USE ONLY	
Sale Number (XX - XXX - XX - XX)	
Forest Management Unit:	

TIMBER SALE VERIFICATION OF WORKER'S DISABILITY COMPENSATION ACT COMPLIANCE

As required by Act 317, P.A. 1969 (Worker's Compensation) and
Part 5 of Act 451 of 1994, as amended.

VERIFICATION OF WORKER'S DISABILITY COMPENSATION ACT COMPLIANCE

- This verification must be completed and submitted within 21 days of contract award and prior to the issuance of the timber sale contract.
- In addition, if boxes 2B or 2C are checked, then Notice of Exclusion or Certificate of Insurance must be submitted within twenty-one (21) days of the contract award and prior to the issuance of the timber sale contract.
- All information must be typed or printed except for written signatures.

Please Check Appropriate Categories:

1. My business is organized as (you **must** check one of the boxes below):
 - A. Sole Proprietorship (individual)
 - B. Partnership
 - C. Corporation
2. You **must** check one of the boxes below:
 - A. I certify my business is a sole proprietorship and it has no employees but the sole proprietor. I am not subject to the Worker's Compensation Laws.
 - B. I certify my business has satisfied its obligation to the Worker's Compensation Act through the use of an approved Notice of Exclusion (BWC-337, Rev. 5/96). I will provide a copy of the Notice of Exclusion within 21 days of the contract award. (For questions or a copy of the BWC-337, please call the Worker's Compensation Bureau at 517-322-1195).
 - C. I certify my business has a Worker's Compensation Policy. I will provide an original Certificate of Insurance within twenty-one (21) days of the contract award.
3. If you have checked item 2(A) or 2(B), you **must** indicate the number of **both** full-time and part-time employees, other than yourself, including family members and active partners (if none, you must enter "0").

_____ Full-time Employees

_____ Part-time Employees

Name of Business		Federal ID (or) Social Security No.	
Address		Telephone ()	
City	State	ZIP	

I hereby certify that the above information is true and correct. I agree to notify the Michigan DNR of any changes that occur in factors affecting my coverage during any of my present and future operations.

Signature of Owner or Authorized Representative

Title

Date

Please complete the "SEALED BID" information on the next page