



**DEPARTMENT OF NATURAL RESOURCES
STATE OF MICHIGAN**

TIMBER SALE PROSPECTUS #6942

SCHEDULED SALE DATE AND TIME: 2:00 p.m. (local time) on September 29, 2021.

LOCATION: SHINGLETON MGMT UNIT, PO BOX 67, M 28 WEST, SHINGLETON, MI 49884.

PROSPECTUS NOTE: Both sales on this Prospectus are Good Neighbor Authority (GNA) timber sales on national forest land. These timber sales were set-up and are being advertised by the Michigan DNR for the US Forest Service. The contracts will be awarded and administered by the Michigan DNR. Please note that the additional Sale Specific Conditions & Requirements containing the acronym 'GNA.' All units of volume listed for these sales were estimated using the Inventory Manager computer program and the new Michigan taper model.

The bidder is advised to inspect the sale area and review the location, estimated volumes, operating costs and contract terms of proposed sales. Please be aware that some landowners may request 60 days or more notice for access across their land.

GNA2 Lakes Camp East (41-819-21) / T42N, R19W, SEC. 17, S1/2SE.

T42N, R19W, SEC. 20, NE, NESE, S1/2SE.

T42N, R19W, SEC. 21, NWNW, S1/2NW, NWSW, S1/2SW.

T42N, R19W, SEC. 28, NW, W1/2NE, N1/2SW, NWSE.

T42N, R19W, SEC. 29, NE, NESE.

Delta County, Advertised Price \$277,962.50, 329.4 Acres, Hardwood, Sugar Maple.

SALE NOTE: This is a Good Neighbor Authority (GNA) timber sale on national forest land.

The county must be contacted prior to crossing or harvesting in the county road R-O-W. This applies to County Road 442.

Within Payment Units 1-10, harvesting is limited to frozen conditions (generally this period is December 1 through March 31) because of sensitive soils. If dry summer conditions persist this spec can be waived by amendment. If dry summer logging does occur, additional gravel will be required to make roads suitable for trucking. Up to 400 cubic yards of 3" minus breaker run gravel will be required at Purchaser's expense.

County Road 442 is a snowmobile trail and is shown on the Timber Sale Map. See Sale Spec 5.2.41 for additional information.

Equipment will need to be cleaned before entering the sale. See Sale Spec 5.6.2 for specific instructions.

A recreation site such as a trail, pathway, or campground is within the sale area or the vicinity. Certain restrictions/specifications may be applicable including time restrictions. Access may be through other public land.

GNA2 Lakes Camp West (41-820-21) / T42N, R19W, SEC. 17, S1/2SW,SWSE.

T42N, R19W, SEC. 19, NW,NE,N1/2SW,SESW,N1/2SE,SWSE.

T42N, R19W, SEC. 20, NW,W1/2NE,SW,W1/2SE.

Delta County, Advertised Price \$299,059.50, 528.3 Acres, Hardwood, Red Pine.

SALE NOTE: This is a Good Neighbor Authority (GNA) timber sale on national forest land.

The county must be contacted prior to crossing/harvesting in county road R-O-W.

Within Payment Unit(s) 5, 9 & 12-16, harvesting is limited to frozen conditions (generally this period is Dec. 1 through March 31) because of sensitive soils. If dry summer conditions persist this spec can be waived by amendment for Units 12-16. If this occurs, additional gravel may be required (up to 100 cubic yards) to make roads suitable for logging.

Within Payment Unit(s) 3, 4, 7, 8 & 11-16, harvesting is not permitted during period of April 15 to July 15 because of bark slippage.

Within Payment Unit(s) 1, 3, 4, 7, 8, 10, 11, 12 & 14, harvesting is not permitted during period of March 1 to August 31 due to hawk nests near Units.

Equipment will need to be cleaned before entering the sale. See Sale Spec 5.6.2 for specific instructions.

A recreation site such as a trail, pathway, or campground is within the sale area or the vicinity. Certain restrictions/specifications may be applicable including time restrictions. Access may be through other public land.

BID INSTRUCTIONS (VER. 07/02/2018):

1. Scheduled Bid Location, Date, and Time (2/11)

Bids must be received by the Unit Manager, SHINGLETON OFFICE, PO Box 67 M 28 West, Shingleton, MI 49884, no later than 2:00 p.m. (local time) on September 29, 2021. For further information concerning this sale, contact Robert Burnham at 906-420-1645 extension .

2. Bidder's Qualifications (5/16)

Purchaser shall obtain workers compensation insurance to cover claims under Michigan's Worker's Disability Compensation Act of 1969 or similar employee benefit act of any other state applicable to an employee. If all or part of a timber sale was prepared by a private contractor, the contractor and that contractor's company are not permitted to bid on the timber sale contract. Bids will not be accepted from individuals or companies appearing on the DNR/FRD No-Bid List. This list contains the names of purchasers who previously failed to execute a contract within 21-days or who have a history of poor performance.

3. Preparation of Sealed Bids (5/16)

Bid Forms may be completed online thru Michigan DNR Timber Sale Online Bidding (OLB) at www.michigan.gov/timberbidding or by completing the hardcopy Bid Form found in the Timber Sale Prospectus . Hardcopy Bid Forms shall be manually signed in ink. Registration in OLB is considered your 'signature' for all bids submitted thru that system. Bid prices must be entered for each species and product in the Bid Price column for all material subject to bidding and all fill-in blanks must be completed. If erasures or other changes appear on the hardcopy Bid Form, each erasure or change must be initialed by the person signing the bid.

4. Submission of Sealed Bids (5/16)

Bid forms may be obtained from the Unit Manager or thru OLB. Bids may be submitted hardcopy or thru OLB. All hardcopy bids must be submitted on the bid form and in an envelope clearly identified as described in this section. NOTE: Only one bid form per bid envelope. Sealed bids must be submitted to the Unit office designated in the prospectus and must be submitted at or prior to the time established in the prospectus. The envelope should show on the outside (a) the sale name or number and (b) the date and time of bid opening, as shown in the prospectus. Bids received after the time specified in the sale prospectus are late bids and will be rejected.

It is possible for a bidder to submit multiple bids on a single sale. For example, a bid may be submitted hardcopy and a bid may be submitted thru OLB. Or, two bidders from the same company could both submit bids on the same sale. If this were to happen, the State would accept all bids received and award the contract accordingly. All bidding and contractual requirements would apply to all bids received.

5. Public Opening of Sealed Bids (7/16)

If conditions permit, the sealed bids will be publicly opened and posted at the time and place set in the prospectus.

If a bidder, present at a bid opening, has submitted bids on more than one sale, that bidder may withdraw their unopened bid envelopes or announce the withdrawal of their online bid after being declared the successful bidder on one sale.

6. Award of Contract (1/11)

Award of the contract will be made to the Bidder whose bid, conforming to the prospectus, is most advantageous to the State of Michigan on the basis of total value at rates bid for the estimated quantities. The State reserves the right to reject any bid or waive any minor irregularity in bids received. A written award mailed (or otherwise furnished) to the successful Bidder shall be deemed to result in a binding contract without further action by either party.

7. Down Payment (1/11)

The Bidder to whom award is made must make a down payment within 21 days of the sale award. The amount of the down payment will be calculated as shown in the Bond and Payment Schedule of this prospectus. Only cash may be used to meet this requirement.

8. Performance Security (1/11)

As guarantee of faithful performance, a cash bond, certificate of deposit, surety bond or irrevocable letter of credit (LOC) is required within 21 days of the sale award. The amount of the performance security is shown in the Bond and

Payment Schedule of this prospectus. If an LOC or surety is used, the coverage must extend for at least 6 months beyond the contract expiration.

9. Timber Sale Contract (7/18)

Additional conditions and requirements common to all timber sales are listed on the timber sale contract (R4031) and are available on line at www.michigan.gov/timber. Contact the Unit Manager for additional information or a sample contract. Within 21 days of the date of the award letter, the bidder must sign the contract and provide the required down payment, performance security, and verification of worker's disability compensation. The down payment and performance security shall be in accordance with the provisions of the timber sale contract, in the sums stated in this prospectus. If these actions are not taken, then the Bidder, the Bidder's corporation, and the corporation's principals may not be permitted to bid on State timber sales for a period of 3 months after the first offense, 6 months after the second offense, and 1 year after the third offense. An offense will only be counted against the Bidder for 5 years. In addition, the Bidder certifies that if awarded this contract, the Bidder will complete the timber sale contract in accordance with its terms and any modifications thereof including requirements to purchase, cut, and remove the included timber by the expiration date.

Payment Unit values in the State Forest Timber Sale Contract are calculated based on the advertised value of the Payment Unit as a percentage of the total advertised value of the contract. The advertised value of each Payment Unit is given in the Description of Timber by Payment Unit table on the Timber Sale Information page. For example, if the value of Payment Unit 1 is advertised as \$1,500 and the total Timber Sale value is advertised as \$10,000, the contract price for Payment Unit 1 will be 15% of the total bid price ($\$1,500/\$10,000 * 100$).

10. Disclaimer of Estimates and Bidder's Warranty of Inspection (7/16)

Before submitting this bid, the Bidder is advised and cautioned to inspect the sale area, review the requirements of the sale contract, and take other steps as may be reasonably necessary to ascertain the location, estimated volumes, construction estimates, and operating costs of the proposed sale. Failure to do so will not relieve the Bidder from responsibility for completing the contract.

The Bidder warrants that this bid is submitted solely on the basis of the Bidder's examination and inspection of the quality and quantity of the timber offered for sale and the Bidder's opinion of the value thereof and the costs of recovery. No reliance should be placed on the State of Michigan's estimates of timber quality, quantity or costs of recovery. Bidder further acknowledges that the State of Michigan: (i) expressly disclaims any warranty of fitness of timber for any purpose; (ii) offers this timber as is without any warranty of quality (merchantability) or quantity and (iii) expressly disclaims any warranty as to the quantity or quality of timber sold.

11. Certification and Chain-of-Custody (10/14)

Unless otherwise indicated in the contract under section 7 – Other Conditions of the Sale Specific Conditions & Requirements, the area encompassed by this timber sale is certified to the standards of the Forest Stewardship Council (FSC) - Certificate #SCS-FM/COC-00090N and the Sustainable Forestry Initiative (SFI) - Certificate #NSF-SFIS-5Y031-SF5. Forest products from this sale may be delivered to the mill as "FSC 100% and / or SFI certified" as long as the contractor hauling the forest products is chain-of-custody (COC) certified or covered under a COC certificate from the destination mill. The purchaser is responsible for maintaining COC after leaving the sale area.

12. Good Neighbor Authority (GNA) Requirements (7/16)

If the name of this timber sales contains the acronym GNA, it is authorized by the Good Neighbor Authority (GNA) and covered by various agreements between the U.S. Forest Service and the State. The timber sale occurs on federal land and the following conditions apply:

GNA contracts on US Forest Service land will not be awarded to purchasers on the Federal list of excluded parties. The System for Award Management (SAM) will be checked for active excluded parties prior to award of contract. In addition, the Bidder to whom award is made must complete an Assurance Regarding Felony Conviction or Tax Delinquent Status for Corporate Applicants (AD-3031).

13. Good Neighbor Authority (GNA) Requirements, con't (9/16)

Bidder certifies, by signing this bid form, that to the best of Bidder's knowledge that the following representations are accurate and complete.

- a. That the Bidder and its principals are not presently debarred, suspended, proposed for debarment, declared ineligible, or voluntary excluded from timber sales (covered transactions) by any Federal department or agency.
- b. That the Bidder and its principals have not within a 3-year period preceding this bid been convicted of or had a civil judgment rendered against them for commission of fraud or a criminal offense in connection with obtaining , attempting to obtain, or performing a public (Federal, State, or local) transaction or contract under a public transaction; violation of Federal or State antitrust statutes or commission of embezzlement, theft, forgery, bribery, falsification or destruction of records, making false statements, or receiving stolen property.
- c. That the Bidder and its principals are not presently indicted for or otherwise criminally or civilly charged by a governmental entity (Federal, State, or local) with commission of any of the offenses enumerated in paragraph b of this certification.
- d. That the Bidder and its principals have not within a 3-year period preceding this bid had one or more public transactions (Federal, State, or local) terminated for breach or default of a timber or forest product contract.

Bidders that cannot certify this requirement, in whole or in part, shall submit an explanation with their bid.

DAN EICHINGER
Director

TIMBER SALE INFORMATION

GNA2 Lakes Camp East (41-819-21)

T42N, R19W, SEC. 17; T42N, R19W, SEC. 20; T42N, R19W, SEC. 21; T42N, R19W, SEC. 28; T42N, R19W, SEC. 29.
Delta County (Advertised Price \$277,962.50)

SALE NOTE: This is a Good Neighbor Authority (GNA) timber sale on national forest land.

The county must be contacted prior to crossing or harvesting in the county road R-O-W. This applies to County Road 442.

Within Payment Units 1-10, harvesting is limited to frozen conditions (generally this period is December 1 through March 31) because of sensitive soils. If dry summer conditions persist this spec can be waived by amendment. If dry summer logging does occur, additional gravel will be required to make roads suitable for trucking. Up to 400 cubic yards of 3" minus breaker run gravel will be required at Purchaser's expense.

County Road 442 is a snowmobile trail and is shown on the Timber Sale Map. See Sale Spec 5.2.41 for additional information.

Equipment will need to be cleaned before entering the sale. See Sale Spec 5.6.2 for specific instructions.

A recreation site such as a trail, pathway, or campground is within the sale area or the vicinity. Certain restrictions/specifications may be applicable including time restrictions. Access may be through other public land.

A timber sale contract for this lump sum, sealed bid timber sale will be awarded to the responsible bidder offering the highest sealed bid price. All units of volume listed below were estimated using the Inventory Manager computer program and the new Michigan taper model. Bids must be at or above the following advertised price for each product and species:

<u>PRODUCTS & SPECIES</u>	<u>ESTIMATED UNITS*</u>	<u>ADVERTISED PRICE</u>
Sawtimber		
Basswood	16.5 MBF	\$ 49.00 / MBF
Black Cherry	72.6 MBF	\$ 91.00 / MBF
Red Maple	419.0 MBF	\$ 98.00 / MBF
Sugar Maple	544.7 MBF	\$ 340.00 / MBF
Yellow Birch	4.9 MBF	\$ 38.00 / MBF
Pulpwood		
Balsam Fir	49 Cords	\$ 11.85 / Cord
Mixed Aspen	17 Cords	\$ 23.35 / Cord
Mixed Hardwood	2,827 Cords	\$ 15.20 / Cord
Mixed Spruce	12 Cords	\$ 11.90 / Cord
Tamarack	4 Cords	\$ 2.60 / Cord

* The total volume is statistically estimated within plus (+) or minus (-) 2.87 percent. There are an estimated 5,433 cords on this timber sale, plus or minus 156 cords at the 95% confidence level. The estimated units are final and not subject to adjustment. Prospective bidders are urged to examine this timber and to make their own estimates of quantity and quality.

BOND AND PAYMENT SCHEDULE:

1. A bond in the amount of \$13,898.00 to insure faithful performance of the conditions of the contract will be deposited by the successful bidder within 21 days of the sale award.
2. Cutting in any sale or unit without the required advance payment would be considered a trespass.
3. Total payment must be paid in advance or according to the following schedule :
 - (a) Ten percent (10%) of the sale value must be paid within 21 days of the sale award.
 - (b) The 10% down payment will be credited towards the first unit cut.
 - (c) Payment for each of the following units must be made before cutting begins in that unit:

PAYMENT UNIT NUMBER	PERCENT OF TOTAL SALE VALUE
01	13.6%
02	13.3%
03	5.1%
04	9.5%
05	7.2%
06	3.8%
07	6.2%
08	25.9%
09	15.0%
10	0.4%

4. If no cutting takes place, the 10% down payment will not be refunded.
5. Operations on the contract issued will terminate on 06/30/2025.

SALE STATISTICS

Volumes were calculated in cubic feet using the Michigan taper model. Cubic foot volume includes all wood inside bark for the product indicated. For display purposes, cubic feet were converted to cords and MBF using a simple conversion factor, e.g. 79 cubic feet per cord and 185 cubic feet per MBF. The cubic foot volumes are precise; the cords and MBF volumes are not. Cubic foot volume cannot be directly converted to cords or boards with precision.

SALE VOLUMES

The total estimated sale volume may not equal the sum of the species/products due to the nature of statistical calculations associated with double sampling methodology.

VOLUME			STATISTICAL RANGE IN CORDS	
TOTAL CUBIC FEET	TOTAL CORDS	PERCENT ERROR	MINIMUM	MAXIMUM
429,202	5,433	2.87%	5,277	5,589

VDU VOLUMES

A VDU is a Volume Determination Unit. Volumes and their associated statistics are calculated at the VDU level and summarized to the sale level. There is often a one to one relationship between a VDU and a Payment Unit, but not always, depending on the cruise design. Refer to the VDU TO PAYMENT UNIT table.

VDU	VOLUME			RANGE IN CORDS	
	TOTAL CUBIC FEET	TOTAL CORDS	PERCENT ERROR	MINIMUM	MAXIMUM
1	112,017	1,418	5.67%	1,337	1,498
2	67,947	860	5.91%	809	911
3	31,205	395	8.40%	362	428
4	16,654	211	12.03%	185	236
5	141,488	1,791	5.26%	1,697	1,885
6	21,098	267	10.37%	239	295
16	6,525	83	25.82%	61	104
TOTAL:	396,935	5,024		4,692	5,357

VDU TO PAYMENT UNIT

When a VDU is associated with more than one Payment Unit (PU), the VDU volumes are assigned to the PU based on acres of the VDU within the PU.

VDU	VDU ACRES	PU	PU ACRES
1	106.1	1	45.0
		2	44.2
		3	16.9
2	51.2	4	29.1
		5	22.1
3	19.1	7	19.1
4	11.1	6	11.1
5	119.4	8	67.4
		9	52.0
6	16.9	8	16.9
16	5.6	10	5.6
TOTAL:	329.4		329.4

DESCRIPTION OF TIMBER BY PAYMENT UNIT (PU)

PU	MARKET GROUP	PRODUCT	QUANTITY	UNIT	ACRES	ADVERTISE PRICE
1	Basswood	Sawtimber	7.0	MBF	45.0	\$37,738.50
	Black Cherry		9.3	MBF		
	Red Maple		43.3	MBF		
	Sugar Maple		80.7	MBF		
	Yellow Birch		1.7	MBF		
	Mixed Hardwood		Pulpwood	316		
	<i>Basswood</i>	6		<i>Cords</i>		
	<i>Beech</i>	67		<i>Cords</i>		
	<i>Black Cherry</i>	15		<i>Cords</i>		
	<i>Ironwood</i>	1		<i>Cords</i>		
	<i>Red Maple</i>	58		<i>Cords</i>		
	<i>Sugar Maple</i>	161		<i>Cords</i>		
	<i>Yellow Birch</i>	8	<i>Cords</i>			
2	Basswood	Sawtimber	6.9	MBF	44.2	\$37,060.10
	Black Cherry		9.2	MBF		
	Red Maple		42.5	MBF		
	Sugar Maple		79.2	MBF		
	Yellow Birch		1.7	MBF		
	Mixed Hardwood		Pulpwood	311		
	<i>Basswood</i>	7		<i>Cords</i>		
	<i>Beech</i>	66		<i>Cords</i>		
	<i>Black Cherry</i>	15		<i>Cords</i>		
	<i>Ironwood</i>	1		<i>Cords</i>		
	<i>Red Maple</i>	57		<i>Cords</i>		
	<i>Sugar Maple</i>	158		<i>Cords</i>		
	<i>Yellow Birch</i>	7	<i>Cords</i>			
3	Basswood	Sawtimber	2.6	MBF	16.9	\$14,170.90
	Black Cherry		3.5	MBF		
	Red Maple		16.2	MBF		
	Sugar Maple		30.3	MBF		
	Yellow Birch		0.7	MBF		
	Mixed Hardwood		Pulpwood	119		
	<i>Basswood</i>	3		<i>Cords</i>		
	<i>Beech</i>	25		<i>Cords</i>		
	<i>Black Cherry</i>	6		<i>Cords</i>		
	<i>Red Maple</i>	22		<i>Cords</i>		
	<i>Sugar Maple</i>	60		<i>Cords</i>		
	<i>Yellow Birch</i>	3		<i>Cords</i>		
	4	Black Cherry	Sawtimber	2.5		
Red Maple		77.6		MBF		
Sugar Maple		43.7		MBF		
Yellow Birch		0.5		MBF		
Mixed Hardwood		Pulpwood	239	Cords		
<i>Beech</i>			17	<i>Cords</i>		
<i>Black Cherry</i>			5	<i>Cords</i>		
<i>Red Maple</i>			123	<i>Cords</i>		
<i>Sugar Maple</i>			93	<i>Cords</i>		
<i>Yellow Birch</i>			1	<i>Cords</i>		
Mixed Spruce			2	Cords		
<i>White Spruce</i>			2	<i>Cords</i>		
5			Black Cherry	Sawtimber	1.9	MBF
	Red Maple	59.0	MBF			
	Sugar Maple	33.2	MBF			
	Yellow Birch	0.3	MBF			
	Mixed Hardwood	Pulpwood	181	Cords		
	<i>Beech</i>		13	<i>Cords</i>		

DESCRIPTION OF TIMBER BY PAYMENT UNIT (PU), CON'T

PU	MARKET GROUP	PRODUCT	QUANTITY	UNIT	ACRES	ADVERTISE PRICE	
5 con't	<i>Black Cherry</i>	<i>Pulpwood</i>	4	<i>Cords</i>			
	<i>Red Maple</i>		93	<i>Cords</i>			
	<i>Sugar Maple</i>		71	<i>Cords</i>			
	Mixed Spruce		1	Cords			
	<i>White Spruce</i>		1	<i>Cords</i>			
6	Red Maple	Sawtimber	20.4	MBF	11.1	\$10,431.60	
	Sugar Maple	Pulpwood	18.9	MBF			
	Mixed Hardwood		132	Cords			
	<i>Beech</i>		5	<i>Cords</i>			
	<i>Black Cherry</i>		3	<i>Cords</i>			
	<i>Red Maple</i>		47	<i>Cords</i>			
	<i>Sugar Maple</i>		77	<i>Cords</i>			
7	Black Cherry		Sawtimber	2.5	MBF	19.1	\$17,314.95
	Red Maple	Pulpwood	41.3	MBF			
	Sugar Maple		26.7	MBF			
	Balsam Fir		2	Cords			
	Mixed Aspen		13	Cords			
	<i>B. T. Aspen</i>		13	<i>Cords</i>			
	Mixed Hardwood		236	Cords			
	<i>Beech</i>		8	<i>Cords</i>			
	<i>Black Cherry</i>		2	<i>Cords</i>			
	<i>Red Maple</i>		127	<i>Cords</i>			
	<i>Sugar Maple</i>		99	<i>Cords</i>			
	Mixed Spruce		4	Cords			
	<i>White Spruce</i>		4	<i>Cords</i>			
	8		Black Cherry	Sawtimber	29.8		
Red Maple			Pulpwood	69.0	MBF		
Sugar Maple		148.9		MBF			
Mixed Hardwood		782		Cords			
<i>Beech</i>		20		<i>Cords</i>			
<i>Black Cherry</i>		28		<i>Cords</i>			
<i>Ironwood</i>		6		<i>Cords</i>			
<i>Red Maple</i>		179		<i>Cords</i>			
<i>Sugar Maple</i>		549		<i>Cords</i>			
9	Black Cherry	Sawtimber		13.9	MBF	52.0	\$41,791.90
	Red Maple	Pulpwood	49.7	MBF			
	Sugar Maple		83.1	MBF			
	Mixed Hardwood		487	Cords			
	<i>Beech</i>		16	<i>Cords</i>			
	<i>Black Cherry</i>		12	<i>Cords</i>			
	<i>Red Maple</i>		130	<i>Cords</i>			
<i>Sugar Maple</i>	329		<i>Cords</i>				
10	Balsam Fir	Pulpwood	47	Cords	5.6	\$1,085.05	
	Mixed Aspen		4	Cords			
	<i>Quaking Aspen</i>		4	<i>Cords</i>			
	Mixed Hardwood		24	Cords			
	<i>Black Cherry</i>		5	<i>Cords</i>			
	<i>Red Maple</i>		19	<i>Cords</i>			
	Mixed Spruce		5	Cords			
	<i>Black Spruce</i>		5	<i>Cords</i>			
	Tamarack		4	Cords			
TOTAL:			1,057.7	MBF			
TOTAL:			2,909	Cords			

Sale Specific Conditions & Requirements

Sale Name: GNA2 Lakes Camp East

Sale Number: 41-819-21 Seq#: 1

1 - Sale Area

1.2 - Boundaries

1.2.1 - Painted boundaries (9/19)

The sale boundary and Payment Unit boundaries are marked and identified by orange paint. Exterior sale boundary lines against Federal land are marked with orange paint. Interior Payment Unit boundaries are marked with orange paint. The painted boundary line trees are not Included Timber and are to be protected.

2 - Timber Specifications

2.1 - Included Timber

2.1.3 - Cut tree marked unit(s) (12/08)

Within Payment Unit(s) 1-9, all trees are designated for cutting when marked with blue paint above and below stump height, regardless of merchantability.

2.1.4 - Designated timber unit(s) (6/17)

Within Payment Unit(s) 10, all aspen trees are designated for cutting which meet minimum piece specifications in 2.2 - Utilization. In addition, cut all trees marked in blue paint regardless of merchantability.

2.2 - Utilization

2.2.12 - GNA, cut and remove Included Timber (3/18)

Unless provided otherwise herein, the DNR agrees to sell and permit Purchaser to cut and remove Included Timber and Purchaser agrees to purchase, cut, and remove Included Timber.

3 - Payments

3.3 - Pre-measured Sales

3.3.4 - Dividing payment units (7/14)

Payment Unit(s) with a value over \$20,000 may be divided at the request of the Purchaser and upon approval of the Unit Manager. Dividing Payment Units is a contract modification which requires a Timber Sale Contract Amendment.

3.4 - Damaged Timber

3.4.3 - Special Protection Areas (8/11)

The Purchaser shall protect special protection areas from damage by the Purchaser's operations. Special protection areas are excluded from the Sale Area with orange paint, and they are shown on the Timber Sale Map. The Purchaser shall not operate in or cut live or dead trees within special protection areas. If the Purchaser's operations have cut or damaged special protection areas through carelessness, the Purchaser shall pay \$10,000 as fixed, agreed, and liquidated damages for each acre or part thereof cut or damaged. Such payment does not constitute ownership of the undesignated timber.

4 - Transportation

4.1 - Construction

4.1.3 - Slash and earthen piles (8/04)

Piles or windrows of earth along roads and landings that have been widened or constructed shall be leveled. Slash from road maintenance or construction, including stumps, shall be dispersed throughout the sale.

4.1.4 - Timber removed for construction (12/09)

Trees cut or damaged in the process of pre-approved road, landing or skid trail construction will be decked in an area separate from other Designated Timber and not removed until measured by the sale administrator. Payment will be made at the specified Purchase Unit Price.

4.1.6 - Road construction (1/09)

Construction of new roads or improvements of existing roads shall be done in such a way as to minimize the environmental and visual impacts. Merchantable trees shall be cut and utilized unless otherwise directed. Non-merchantable trees shall be severed and laid flat on the ground. Slash shall be scattered, and not left in windrows and kept a minimum of 10 feet back from the road edge. Stumps shall be set upright, not left on edge, and be moved at least 10 feet away from the road edge. Disturbed soil shall be feathered into the woods and not left in berms or windrows. Forest Service Road cannot be opened up beyond Payment Unit 1. Forest Service Road 2348 must be used to harvest Payment Units 6, 7, and 10.

4.1.7 - Road closure (10/11)

All new roads built into the sale must be blocked to vehicle traffic upon completion of the sale. Overgrown roads that are reopened shall be considered new roads. In general, this will require constructing a four (4') foot high berm of stumps and logs covered with earth. Stumps and brush must be placed along the remainder of the trail. These roads must be rendered impassable to cars and trucks. All stumps from road building and landing construction must be reserved to block any newly constructed roads upon completion of the sale. These stumps must be scattered along the road system to prohibit vehicular movement. Contact the sale administrator for specific details of design and placement.

4.2 - Maintenance

4.2.4 - Grading (10/16)

For completion of the sale, Forest Service roads must be graded. In general, this will require a road grader or bulldozer to shape up the roads after forest products have been hauled off site. This includes cleaning of drainage areas, grading, crowning, and filling with gravel, if necessary. The grading equipment to be used must be approved by the Unit Manager or his/her representative.

4.3 - Public Right-of-Way

4.3.2 - County R-O-W (12/06)

The county must be contacted prior to crossing or harvesting in the county road R-O-W. This applies to County Road 442.

5 - Operations

5.1 - Notification

5.1.1 - Pre-sale conference (10/16)

A pre-sale conference on site between the Purchaser and sale administrator is required prior to beginning any operations to determine landing and road locations. The Unit Manager or his/her representative must be contacted at least 10 days in advance to schedule the conference.

5.1.4 - Post-sale conference (10/16)

A post-sale conference on site between the Purchaser and sale administrator is required 5 days prior to the completion of active logging operations to determine clean-up and repair of landings, road edges, and the fulfillment of other contract specifications.

5.2 - Conduct of Operations

5.2.2 - Hazard Trees/Snags

5.2.2.1 - Den trees (10/16)

Obvious hollow and/or den trees shall be protected and left standing unless they are a safety hazard.

5.2.3 - Operating Restrictions

5.2.3.1 - Operating restrictions (9/11)

Within Payment Unit(s) 1-10, unless changed by written agreement, cutting, skidding, and hauling are limited to frozen conditions, generally this period is December 1 thru March 31. This restriction is because of sensitive soils. If dry summer conditions persist this spec can be waived by amendment. If dry summer logging does occur additional gravel will be required to make roads suitable for trucking. Up to 400 cubic yards of 3" minus breaker run gravel will be required at the loggers expense.

5.2.32 - Decking/landing restoration (9/13)

All decking and landing areas must have the surface area restored to a condition equal to or better than before. This is to ensure the proper regeneration of the stand. Wood debris, chips, and "cookies" from trimmings must be removed or scattered

away from landing and loading areas and may not be windrowed on the edge.

5.2.37 - No decking areas (12/08)

No decking is allowed on County Road 442.

5.2.38 - No decking against live trees (2/04)

Cut products may not be decked against unmarked or designated leave trees.

5.2.41 - Snowmobile trail protection (9/11)

County Road 442 is a snowmobile trail and is shown on the Timber Sale Map. Do not cut or damage posts with orange trail markers or traffic control signs. If the trail road is to be used for hauling during the snowmobile season, then a snow-covered base must be left on the trail. Maintain a 20-foot-wide slash, debris, and rut free zone daily using the snowmobile trail as the centerline. No decking of forest products will be permitted along the snowmobile trail.

5.4 - Soil Protection

5.4.1 - Rutting restriction, general (7/16)

Operations are to cease immediately if equipment and weather conditions result in rutting of roads and/or skid trails which is 12 inches or greater in depth and 50 feet in length. The Unit Manager or his/her representative may restrict hauling and/or skidding if ruts exceed the specified depth. With the Unit Manager or his/her representative's approval, the Purchaser may return to the area when the risk of rutting has decreased.

5.4.4 - Slope protection (9/19)

Skid trails and roads on slopes shall be water barred with slash, stumps, and/or clean straw bales native to the area as soon as use is complete to prevent erosion. slash and stumps as soon as use is complete to prevent erosion.

5.6 - Debris and Waste Material

5.6.2 - GNA, equipment cleaning (1/16)

(a) Areas, known by the DNR prior to timber sale advertisement, that are infested with invasive species of concern are shown on the Timber Sale Map. A current list of invasive species of concern and a map showing the extent of known infestations is available from the DNR. For purposes of this provision, "Off-Road Equipment" includes all logging and construction machinery, except for log trucks, chip vans, service vehicles, water trucks, pickup trucks, cars, and similar vehicles.

(b) Purchaser shall adhere to the following requirements with regard to cleaning "Off-Road Equipment":

(i) Prior to moving Off-Road Equipment onto the Sale Area, Purchaser shall identify the location of the equipment's most recent operation. Purchaser shall not move any Off-Road Equipment that last operated in an area infested with one or more invasive species of concern onto Sale Area without having cleaned such equipment of seeds, soil, vegetative matter, and other debris that could contain or hold seeds, and having notified the DNR, as provided in (iii). If the location of prior operation cannot be identified, then Purchaser shall assume that the location is infested with invasive species of concern.

(ii) Prior to moving Off-Road Equipment from a cutting unit that is shown on the Timber Sale Map to be infested with invasive species of concern to, or through any other area that is shown as being free of invasive species of concern, or infested with a different invasive species, Purchaser shall clean such equipment of seeds, soil, vegetative matter, and other debris that could contain or hold seeds, and shall notify the DNR, as provided in (iii).

(iii) Prior to moving any Off-Road Equipment subject to the cleaning requirements set forth above, Purchaser shall advise DNR of its cleaning measures and make the equipment available for inspection. DNR shall have 2 days, excluding weekends and State holidays, to inspect equipment after it has been made available. After satisfactory inspection or after such 2 day period, Purchaser may move the equipment as planned. Equipment shall be considered clean when a visual inspection does not disclose seeds, soil, vegetative matter, and other debris that could contain or hold seeds. Purchaser shall not be required to disassemble equipment unless so directed by the DNR after inspection.

(iv) If Purchaser desires to clean Off-Road Equipment on National Forest land, such as at the end of a project or prior to moving to, or through an area that is free of invasive species of concern, Purchaser shall obtain prior approval from the Unit Manager or his/her representative as to the location for such cleaning and measures, if any, for controlling impacts.

(v) Unit Manager or his/her representative may order delay, interruption, or modification of this Contract pursuant to Condition & Requirement 7.3 or 7.3.4.

(c) Nothing contained in this Condition & Requirement shall be interpreted as creating any warranty on the part of the DNR that all locations of invasive species of concern have been described herein, elsewhere in this Contract, or designated on the ground. Following sale advertisement, additional locations may be described or designated, and other species may be added to the list of invasive species of concern. In such event, the Unit Manager or his/her representative may order delay, interruption, or modification of this Contract pursuant to Condition & Requirement 7.3 or 7.3.4.

(d) The parties shall promptly communicate with one another with respect to description or designation of additional locations; discovery of locations of new species or new infestation; and, addition of species to the list of invasive species of concern.

5.8 - Protection of Endangered Species

5.8.3 - Red shoulder hawk or goshawk (2/16)

In the event that an active red shoulder hawk or goshawk nest is found, the contract may be amended to protect the nest site until the nest is determined to be inactive. The value of the trees in this excluded area will be refunded or credited to the Purchaser. The nest will be buffered with a five-chain radius (eight acre) protection area, centered on the nest tree, in which there will be no cutting or new roads constructed. Avoid human disturbance, including loading and skidding, in the protection area.

An additional zone of five chains (ten chains centered on the active nest tree) will be established in which there is no management activity from April 1 to July 30. Limit biomass harvesting and chipping operations within this ten-chain zone, retain the maximum one-third of residues per the Woody Biomass Harvesting Guidelines (Michigan DNR 2010). Nests determined to be inactive will be protected with a one-chain no-harvest buffer.

6 - Safety and Fire Prevention

6.2 - Signing

6.2.1 - Road posting (10/20)

The Purchaser is responsible for posting and maintaining caution signs on County Road 442 prior to beginning operations. The road must be posted at appropriate distances from the Sale Area determined by the Delta County Road Commission to warn of logging activity and truck traffic. Signs must be removed when harvest operations are suspended or completed. The Purchaser will provide these signs.

6.2.2 - Snowmobile trail posting (10/20)

The Purchaser is responsible for posting and maintaining caution signs on the snowmobile trail (County Road 442) prior to beginning operations during the snowmobile season (approximately December 1 to March 31). The trail must be posted at appropriate distances from the Sale Area to warn of logging activity and truck traffic. Signs must be removed when harvest operations are suspended or completed. The Purchaser will provide these signs.

7 - Other Conditions

SKIP

7.1.1 - GNA, title (7/16)

General Condition & Requirement 7.1 is inapplicable. The following applies to this contract.

All right, title, and interest in and to any Included Timber shall remain in USDA Forest Service with the State of Michigan acting on behalf of the USDA Forest Service under this GNA contract, until it has been Measured, removed from Sale Area or other authorized cutting area, and paid for, at which time title shall vest in Purchaser. Title to any Included Timber that has been Measured and paid for, but not removed from Sale Area or other authorized cutting area by Purchaser on or prior to Termination Date, shall remain in USDA Forest Service.

7.3 - Contract Modifications

7.3.4 - GNA, contract suspension and modification (5/16)

(a) The Unit Manager may, by written order, delay or interrupt authorized operations under this contract or, notwithstanding

Condition & Requirement 7.3, modify this contract, in whole or in part:

(i) To prevent environmental degradation or resource damage, including, but not limited to, harm to habitat, plants, animals, cultural resources, or cave resources;

(ii) To ensure consistency with land and resource management plans or other documents prepared pursuant to the National Environmental Policy Act of 1969, 42 USC 4321-4347;

(iii) To conduct environmental analysis, including, but not limited to, engaging in consultation pursuant to the Endangered Species Act of 1973, 16 USC 1531, et seq.; or

(iv) Upon agreement of the Forest Service, due to administrative appeal or litigation, regardless of whether the Unit Manager's order is required by a court order or this contract is named in such a proceeding.

(b) In the event of an order delaying or interrupting Purchaser's Operations under this Condition & Requirement, Purchaser's remedy shall be:

(i) a no cost contract extension,

(ii) reimbursement for Out-of-Pocket Expenses,

however, the foregoing remedies shall be available only to the extent that the Unit Manager's order was the sole and exclusive cause of the delay or interruption of Purchaser's operations.

(c) Remedies awarded to the Purchaser shall not be duplicative, and the Unit Manager shall have the right to structure remedies provided herein to avoid duplicative compensation.

(d) Purchaser agrees that this Condition & Requirement, and the remedies provided herein shall apply regardless of any finding by any court that the DNR failed to comply with any statute, regulation and/or policy in connection with awarding, advertising, or authorizing this sale, or a similar sale.

7.5 - Loss

7.5.2 - GNA, liability for loss (7/16)

If Included Timber is destroyed or damaged by an unexpected event that changes the nature of Included Timber, such as wind, flood, insects, disease, or similar cause, the Purchaser shall bear the timber value loss resulting from such destruction or damage.

Deterioration or loss of timber value due to delay or interruption under 7.3.4 - GNA, contract suspension and modification, shall be borne by the party holding title. In this event, Included Timber to which USDA Forest Service holds title, Purchaser of the State GNA contract will not be obligated to remove and pay for such timber. This Subsection shall not be construed to relieve either party of liability for negligence.

7.10 - Certified Timber

7.10.1 - Non-certified timber (2/16)

The area encompassed by this timber sale is not certified to the standards of the Forest Stewardship Council (FSC) or the Sustainable Forestry Initiative (SFI). Forest products from this sale may not be delivered to the mill as "FSC and / or SFI certified". The lands within this sale belong to the National Forest system and are being managed by the State as part of a Good Neighbor Authority (GNA) agreement.



TIMBER SALE MAP

This information provided by authority of Part 5, 1994 PA 451, as amended.

Sale Number	Year
41-819	21

Forest Management Unit Shingleton	County Delta	Mapped By Burnham	Date 9/1/2021	Page 1	of 1
--------------------------------------	-----------------	----------------------	------------------	-----------	---------

Compartment Number 7911086&7911087	Township 42N	Range 19W	Section(s) and Subdivision(s) 17-S1/2SE, 29-NE, NWSE 20-NE, E1/2SE, SWSE, 21-NW, NW, S1/2NW, NWSW 28-NW, W1/2NE, N1/2SW	Scale: ... 4" = 1 mile
---------------------------------------	-----------------	--------------	--	--------------------------------

Cover Type			
A = Aspen	J = Jack Pine	O = Oak	U = Upland Brush
B = Paper Birch	K = Rock	P = Lowland Poplar	UM = Upland Mix Forest
C = Cedar	L = Lowland Brush	Q = Mixed Swamp Conifer	V = Bog or Marsh
D = Treed Bog	LM = Lowland Mix Forest	R = Red Pine	W = White Pine
E = Swamp Hardwoods	M = Maple, Beech, Birch	S = Black Spruce	X = Non Stocked
F = Spruce/Fir	MC = Mixed Conifer	T = Tamarack	Y = Sand
G = Grass	MD = Mixed Deciduous		Z = Water
H = Hemlock	N = Marsh		

Density	
0 = Non Stocked	5 = Pole Timber Medium
1 = Seedling Sapling Poor	6 = Pole Timber Well
2 = Seedling Sapling Medium	7 = Saw Timber Poor
3 = Seedling Sapling Well	8 = Saw Timber Medium
4 = Pole Timber Poor	9 = Saw Timber Well

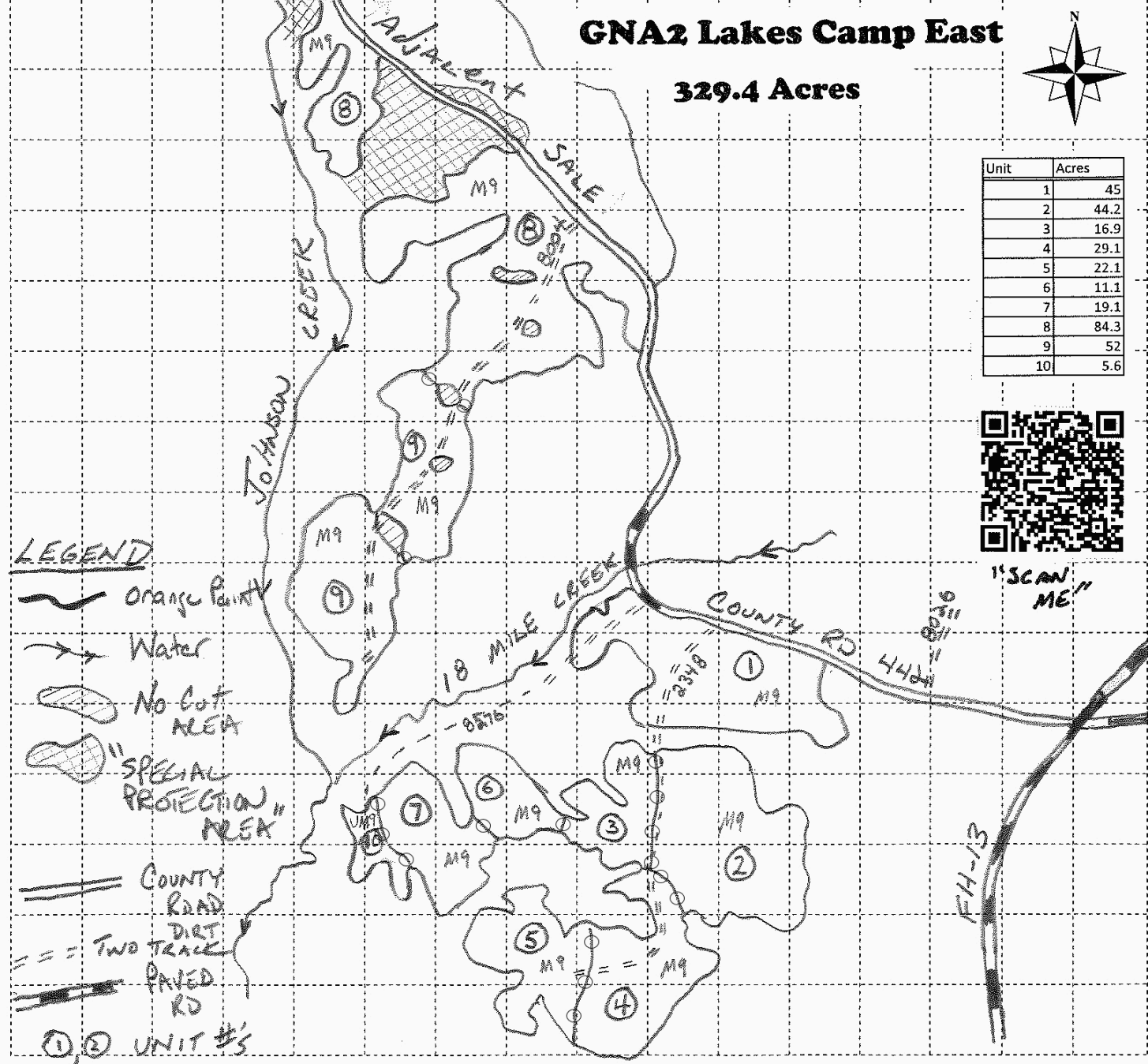

Unit	Acres
1	45
2	44.2
3	16.9
4	29.1
5	22.1
6	11.1
7	19.1
8	84.3
9	5.2
10	5.6

LEGEND

- Orange Paint
- Water
- No Cut Area
- "SPECIAL PROTECTION AREA"
- COUNTY ROAD
- DIRT TRACK
- PAVED RD
- ①, ② UNIT #'S
- Interior Payment Boundaries Orange



"SCAN ME!"

TIMBER SALE INFORMATION

GNA2 Lakes Camp West (41-820-21)

T42N, R19W, SEC. 17; T42N, R19W, SEC. 19; T42N, R19W, SEC. 20.
Delta County (Advertised Price \$299,059.50)

SALE NOTE: This is a Good Neighbor Authority (GNA) timber sale on national forest land.

The county must be contacted prior to crossing/harvesting in county road R-O-W.

Within Payment Unit(s) 5, 9 & 12-16, harvesting is limited to frozen conditions (generally this period is Dec. 1 through March 31) because of sensitive soils. If dry summer conditions persist this spec can be waived by amendment for Units 12-16. If this occurs, additional gravel may be required (up to 100 cubic yards) to make roads suitable for logging.

Within Payment Unit(s) 3, 4, 7, 8 & 11-16, harvesting is not permitted during period of April 15 to July 15 because of bark slippage.

Within Payment Unit(s) 1, 3, 4, 7, 8, 10, 11, 12 & 14, harvesting is not permitted during period of March 1 to August 31 due to hawk nests near Units.

Equipment will need to be cleaned before entering the sale. See Sale Spec 5.6.2 for specific instructions.

A recreation site such as a trail, pathway, or campground is within the sale area or the vicinity. Certain restrictions/specifications may be applicable including time restrictions. Access may be through other public land.

A timber sale contract for this lump sum, sealed bid timber sale will be awarded to the responsible bidder offering the highest sealed bid price. All units of volume listed below were estimated using the Inventory Manager computer program and the new Michigan taper model. Bids must be at or above the following advertised price for each product and species:

<u>PRODUCTS & SPECIES</u>	<u>ESTIMATED UNITS*</u>	<u>ADVERTISED PRICE</u>
Sawtimber		
Basswood	1.1 MBF	\$ 49.00 / MBF
Black Cherry	132.9 MBF	\$ 91.00 / MBF
Red Maple	457.5 MBF	\$ 98.00 / MBF
Sugar Maple	338.6 MBF	\$ 340.00 / MBF
Yellow Birch	2.1 MBF	\$ 38.00 / MBF
Pulpwood		
Balsam Fir	297 Cords	\$ 11.85 / Cord
Mixed Aspen	163 Cords	\$ 23.35 / Cord
Mixed Hardwood	3,460 Cords	\$ 15.20 / Cord
Mixed Spruce	153 Cords	\$ 11.90 / Cord
N. White Cedar	13 Cords	\$ 4.45 / Cord
Paper Birch	128 Cords	\$ 12.00 / Cord
Red Pine	1,657 Cords	\$ 38.05 / Cord
Tamarack	8 Cords	\$ 2.60 / Cord
White Pine	38 Cords	\$ 12.40 / Cord

* The total volume is statistically estimated within plus (+) or minus (-) 2.52 percent. There are an estimated 8,149 cords on this timber sale, plus or minus 206 cords at the 95% confidence level. The estimated units are final and not subject to adjustment. Prospective bidders are urged to examine this timber and to make their own estimates of quantity and quality.

BOND AND PAYMENT SCHEDULE:

1. A bond in the amount of \$14,953.00 to insure faithful performance of the conditions of the contract will be deposited by the successful bidder within 21 days of the sale award.
2. Cutting in any sale or unit without the required advance payment would be considered a trespass.
3. Total payment must be paid in advance or according to the following schedule:
 - (a) Ten percent (10%) of the sale value must be paid within 21 days of the sale award.
 - (b) The 10% down payment will be credited towards the first unit cut.

(c) Payment for each of the following units must be made before cutting begins in that unit:

PAYMENT UNIT NUMBER	PERCENT OF TOTAL SALE VALUE
01	0.2%
02	0.8%
03	0.4%
04	1.6%
05	6.5%
06	4.2%
07	6.5%
08	9.1%
09	3.5%
10	7.2%
11	5.1%
12	9.3%
13	7.5%
14	11.8%
15	12.5%
16	13.8%

4. If no cutting takes place, the 10% down payment will not be refunded.

5. Operations on the contract issued will terminate on 06/30/2025.

SALE STATISTICS

Volumes were calculated in cubic feet using the Michigan taper model. Cubic foot volume includes all wood inside bark for the product indicated. For display purposes, cubic feet were converted to cords and MBF using a simple conversion factor, e.g. 79 cubic feet per cord and 185 cubic feet per MBF. The cubic foot volumes are precise; the cords and MBF volumes are not. Cubic foot volume cannot be directly converted to cords or boards with precision.

SALE VOLUMES

The total estimated sale volume may not equal the sum of the species/products due to the nature of statistical calculations associated with double sampling methodology.

VOLUME		STATISTICAL RANGE IN CORDS		
TOTAL CUBIC FEET	TOTAL CORDS	PERCENT ERROR	MINIMUM	MAXIMUM
643,774	8,149	2.52%	7,943	8,355

VDU VOLUMES

A VDU is a Volume Determination Unit. Volumes and their associated statistics are calculated at the VDU level and summarized to the sale level. There is often a one to one relationship between a VDU and a Payment Unit, but not always, depending on the cruise design. Refer to the VDU TO PAYMENT UNIT table.

VDU	VOLUME			RANGE IN CORDS	
	TOTAL CUBIC FEET	TOTAL CORDS	PERCENT ERROR	MINIMUM	MAXIMUM
7	276,781	3,504	4.17%	3,357	3,650
8	68,679	869	6.11%	816	922
9	36,404	461	7.75%	425	497
10	15,249	193	14.25%	166	221
11	52,786	668	8.38%	612	724
12	2,075	26	30.43%	18	34
13	115,677	1,464	5.76%	1,380	1,549
14	43,655	553	7.91%	509	596
15	3,404	43	9.09%	39	47
TOTAL:	614,712	7,781		7,323	8,240

VDU TO PAYMENT UNIT

When a VDU is associated with more than one Payment Unit (PU), the VDU volumes are assigned to the PU based on acres of the VDU within the PU.

VDU	VDU ACRES	PU	PU ACRES
7	248.7	12	49.1
		14	62.2
		15	65.8
		16	71.6
8	70.0	7	29.2
		8	40.8
9	38.4	13	38.4
10	13.8	4	13.8
11	29.3	9	29.3
12	5.0	3	5.0
13	103.8	2	4.9
		6	25.0
		10	43.3
		11	30.6
14	17.4	5	17.4
15	1.9	1	1.9
TOTAL:	528.3		528.3

DESCRIPTION OF TIMBER BY PAYMENT UNIT (PU)

PU	MARKET GROUP	PRODUCT	QUANTITY	UNIT	ACRES	ADVERTISE PRICE
1	Mixed Spruce	Pulpwood	43	Cords	1.9	\$511.70
	<i>White Spruce</i>		43	<i>Cords</i>		
2	Red Maple	Sawtimber	0.8	MBF	4.9	\$2,437.00
	Sugar Maple		0.3	MBF		
	Balsam Fir	Pulpwood	1	Cords		
	Mixed Hardwood		10	Cords		
	<i>Beech</i>		1	<i>Cords</i>		
	<i>Black Cherry</i>		1	<i>Cords</i>		
	<i>Red Maple</i>		7	<i>Cords</i>		
	<i>Sugar Maple</i>		1	<i>Cords</i>		
	Red Pine		55	Cords		
3	Black Cherry	Sawtimber	0.7	MBF	5.0	\$1,183.70
	Sugar Maple		2.4	MBF		
	Mixed Hardwood	Pulpwood	20	Cords		
	<i>Black Cherry</i>		2	<i>Cords</i>		
	<i>Sugar Maple</i>		18	<i>Cords</i>		
4	Black Cherry	Sawtimber	1.6	MBF	13.8	\$4,802.70
	Red Maple		13.2	MBF		
	Sugar Maple	3.2	MBF			
	Balsam Fir	Pulpwood	30	Cords		
	Mixed Hardwood		120	Cords		
	<i>Beech</i>		13	<i>Cords</i>		
	<i>Black Cherry</i>		1	<i>Cords</i>		
	<i>Red Maple</i>		81	<i>Cords</i>		
	<i>Sugar Maple</i>		25	<i>Cords</i>		
	Paper Birch		8	Cords		
5	Balsam Fir		Pulpwood	15	Cords	17.4
	Mixed Aspen	14		Cords		
	<i>Quaking Aspen</i>	14		<i>Cords</i>		
	Mixed Hardwood	3		Cords		
	<i>Red Maple</i>	3		<i>Cords</i>		
	Mixed Spruce	17		Cords		
	<i>Black Spruce</i>	3		<i>Cords</i>		
	<i>White Spruce</i>	14		<i>Cords</i>		
	Red Pine	494		Cords		
	Tamarack	8		Cords		
6	Red Maple	Sawtimber	4.3	MBF	25.0	\$12,481.05
	Sugar Maple		1.4	MBF		
	Balsam Fir	Pulpwood	7	Cords		
	Mixed Aspen		2	Cords		
	<i>Quaking Aspen</i>		2	<i>Cords</i>		
	Mixed Hardwood		51	Cords		
	<i>Beech</i>		6	<i>Cords</i>		
	<i>Black Cherry</i>		6	<i>Cords</i>		
	<i>Red Maple</i>		36	<i>Cords</i>		
	<i>Sugar Maple</i>		3	<i>Cords</i>		
	Red Pine		280	Cords		
	White Pine		2	Cords		
7	Black Cherry	Sawtimber	9.3	MBF	29.2	\$19,508.30
	Red Maple		36.4	MBF		
	Sugar Maple		35.5	MBF		
	Mixed Hardwood	Pulpwood	199	Cords		
	<i>Beech</i>		48	<i>Cords</i>		
	<i>Black Cherry</i>		14	<i>Cords</i>		
	<i>Ironwood</i>		1	<i>Cords</i>		

DESCRIPTION OF TIMBER BY PAYMENT UNIT (PU), CON'T

PU	MARKET GROUP	PRODUCT	QUANTITY	UNIT	ACRES	ADVERTISE PRICE
7 con't	<i>Red Maple</i> <i>Sugar Maple</i>	<i>Pulpwood</i>	69 67	<i>Cords</i> <i>Cords</i>		
8	Black Cherry Red Maple Sugar Maple Mixed Hardwood <i>Beech</i> <i>Black Cherry</i> <i>Ironwood</i> <i>Red Maple</i> <i>Sugar Maple</i>	Sawtimber Pulpwood	13.1 50.9 49.5 280 67 20 2 97 94	MBF MBF MBF Cords <i>Cords</i> <i>Cords</i> <i>Cords</i> <i>Cords</i> <i>Cords</i>	40.8	\$27,266.30
9	Red Maple Balsam Fir Mixed Aspen <i>Balsam Poplar</i> <i>Quaking Aspen</i> Mixed Hardwood <i>Beech</i> <i>Black Cherry</i> <i>Red Maple</i> <i>Sugar Maple</i> <i>Yellow Birch</i> Mixed Spruce <i>Black Spruce</i> <i>White Spruce</i> N. White Cedar Paper Birch White Pine	Sawtimber Pulpwood	9.9 155 138 18 120 99 2 1 85 5 6 93 75 18 13 120 31	MBF Cords Cords <i>Cords</i> <i>Cords</i> Cords <i>Cords</i> <i>Cords</i> <i>Cords</i> <i>Cords</i> <i>Cords</i> Cords <i>Cords</i> <i>Cords</i> Cords Cords Cords	29.3	\$10,523.00
10	Red Maple Sugar Maple Balsam Fir Mixed Aspen <i>Quaking Aspen</i> Mixed Hardwood <i>Beech</i> <i>Black Cherry</i> <i>Red Maple</i> <i>Sugar Maple</i> Red Pine White Pine	Sawtimber Pulpwood	7.5 2.5 12 3 3 89 10 11 63 5 485 3	MBF MBF Cords Cords <i>Cords</i> Cords <i>Cords</i> <i>Cords</i> <i>Cords</i> <i>Cords</i> Cords Cords	43.3	\$21,641.50
11	Red Maple Sugar Maple Balsam Fir Mixed Aspen <i>Quaking Aspen</i> Mixed Hardwood <i>Beech</i> <i>Black Cherry</i> <i>Red Maple</i> <i>Sugar Maple</i> Red Pine White Pine	Sawtimber Pulpwood	5.3 1.7 8 2 2 64 7 8 45 4 343 2	MBF MBF Cords Cords <i>Cords</i> Cords <i>Cords</i> <i>Cords</i> <i>Cords</i> <i>Cords</i> Cords Cords	30.6	\$15,287.65
12	Black Cherry Red Maple Sugar Maple Balsam Fir	Sawtimber Pulpwood	20.1 56.2 40.2 13	MBF MBF MBF Cords	49.1	\$27,953.15

DESCRIPTION OF TIMBER BY PAYMENT UNIT (PU), CON'T

PU	MARKET GROUP	PRODUCT	QUANTITY	UNIT	ACRES	ADVERTISE PRICE
12 con't	Mixed Hardwood	Pulpwood	447	Cords		
	<i>Beech</i>		19	<i>Cords</i>		
	<i>Black Cherry</i>		25	<i>Cords</i>		
	<i>Red Maple</i>		226	<i>Cords</i>		
	<i>Sugar Maple</i>		176	<i>Cords</i>		
	<i>Yellow Birch</i>		1	<i>Cords</i>		
13	Basswood	Sawtimber	1.1	MBF	38.4	\$22,401.70
	Black Cherry		6.5	MBF		
	Red Maple		44.7	MBF		
	Sugar Maple		38.5	MBF		
	Yellow Birch		2.1	MBF		
	Balsam Fir	Pulpwood	2	Cords		
	Mixed Aspen		4	Cords		
	<i>Balsam Poplar</i>		4	<i>Cords</i>		
	Mixed Hardwood		269	Cords		
	<i>Basswood</i>		1	<i>Cords</i>		
	<i>Beech</i>		18	<i>Cords</i>		
	<i>Black Cherry</i>		8	<i>Cords</i>		
	<i>Red Maple</i>		121	<i>Cords</i>		
	<i>Sugar Maple</i>		115	<i>Cords</i>		
	<i>Yellow Birch</i>		6	<i>Cords</i>		
14	Black Cherry	Sawtimber	25.4	MBF	62.2	\$35,384.45
	Red Maple		71.2	MBF		
	Sugar Maple		50.9	MBF		
	Balsam Fir	Pulpwood	17	Cords		
	Mixed Hardwood		565	Cords		
	<i>Beech</i>		24	<i>Cords</i>		
	<i>Black Cherry</i>		32	<i>Cords</i>		
	<i>Red Maple</i>		286	<i>Cords</i>		
	<i>Sugar Maple</i>		222	<i>Cords</i>		
	<i>Yellow Birch</i>		1	<i>Cords</i>		
	15		Black Cherry	Sawtimber		
Red Maple		75.3	MBF			
Sugar Maple		53.9	MBF			
Balsam Fir		Pulpwood	18	Cords		
Mixed Hardwood			596	Cords		
<i>Beech</i>			25	<i>Cords</i>		
<i>Black Cherry</i>			33	<i>Cords</i>		
<i>Red Maple</i>			302	<i>Cords</i>		
<i>Sugar Maple</i>			235	<i>Cords</i>		
<i>Yellow Birch</i>			1	<i>Cords</i>		
16	Black Cherry	Sawtimber	29.3	MBF	71.6	\$40,681.45
	Red Maple		81.8	MBF		
	Sugar Maple		58.6	MBF		
	Balsam Fir	Pulpwood	19	Cords		
	Mixed Hardwood		648	Cords		
	<i>Beech</i>		27	<i>Cords</i>		
	<i>Black Cherry</i>		36	<i>Cords</i>		
	<i>Red Maple</i>		329	<i>Cords</i>		
	<i>Sugar Maple</i>		255	<i>Cords</i>		
	<i>Yellow Birch</i>		1	<i>Cords</i>		
TOTAL:			932.2	MBF		
TOTAL:			5,917	Cords		

Sale Specific Conditions & Requirements

Sale Name: GNA2 Lakes Camp West

Sale Number: 41-820-21 Seq#: 1

1 - Sale Area

1.2 - Boundaries

1.2.1 - Painted boundaries (9/19)

The sale boundary and Payment Unit boundaries are marked and identified by red and orange paint. Exterior sale boundary lines against private property are marked with red paint. Exterior sale boundary lines against federal land is marked with orange paint. Interior Payment Unit boundaries are marked with orange paint. The painted boundary line trees are not Included Timber and are to be protected.

2 - Timber Specifications

2.1 - Included Timber

2.1.2 - Clearcut unit(s) w/o unmerchantable trees (8/11)

Within Payment Unit(s) 1, cut all trees which meet minimum piece specifications in 2.2 Utilization.

2.1.3 - Cut tree marked unit(s) (12/08)

Within Payment Unit(s) 2-4, 6-8, and 10-16, all trees are designated for cutting when marked with blue paint above and below stump height, regardless of merchantability.

2.1.4 - Designated timber unit(s) (6/17)

Within Payment Unit(s) 5, all spruce and fir are designated for cutting which meet minimum piece specifications in 2.2 - Utilization. In addition, cut all trees marked in blue paint.

2.1.7 - Leave tree marked unit(s) (6/14)

Within Payment Unit(s) 9, all trees, which meet minimum piece specifications in 2.2 Utilization, are designated for cutting, except trees marked with green paint above and below stump height.

2.2 - Utilization

2.2.12 - GNA, cut and remove Included Timber (3/18)

Unless provided otherwise herein, the DNR agrees to sell and permit Purchaser to cut and remove Included Timber and Purchaser agrees to purchase, cut, and remove Included Timber.

3 - Payments

3.3 - Pre-measured Sales

3.3.4 - Dividing payment units (7/14)

Payment Unit(s) with a value greater than \$20,000 may be divided at the request of the Purchaser and upon approval of the Unit Manager. Dividing Payment Units is a contract modification which requires a Timber Sale Contract Amendment. There will be only one division per Payment Unit.

3.4 - Damaged Timber

3.4.3 - Special Protection Areas (8/11)

The Purchaser shall protect special protection areas from damage by the Purchaser's operations. Special protection areas are excluded from the Sale Area with orange paint and shown on the Timber Sale Map. The Purchaser shall not operate in or cut live or dead trees within special protection areas. If the Purchaser's operations have cut or damaged special protection areas through carelessness, the Purchaser shall pay \$10,000 as fixed, agreed, and liquidated damages for each acre or part thereof cut or damaged. Such payment does not constitute ownership of the undesignated timber.

4 - Transportation

4.1 - Construction

4.1.3 - Slash and earthen piles (8/04)

Piles or windrows of earth along roads and landings that have been widened or constructed shall be leveled. Slash from road maintenance or construction, including stumps, shall be dispersed throughout the sale.

4.1.4 - Timber removed for construction (12/09)

Trees cut or damaged in the process of pre-approved road, landing or skid trail construction will be decked in an area separate from other Designated Timber and not removed until measured by the sale administrator. Payment will be made at the specified Purchase Unit Price.

4.1.6 - Road construction (1/09)

Construction of new roads or improvements of existing roads shall be done in such a way as to minimize the environmental and visual impacts. Merchantable trees shall be cut and utilized unless otherwise directed. Non-merchantable trees shall be severed and laid flat on the ground. Slash shall be scattered, and not left in windrows and kept a minimum of 10 feet back from the road edge. Stumps shall be set upright, not left on edge, and be moved at least 10 feet away from the road edge. Disturbed soil shall be feathered into the woods and not left in berms or windrows.

4.1.7 - Road closure (10/11)

All new roads built into the sale must be blocked to vehicle traffic upon completion of the sale. Overgrown roads that are reopened shall be considered new roads. Forest Service Road 2023 will need to be closed/bermed once Payment Unit 5 is complete. In general, this will require constructing a four (4') foot high berm of stumps and logs covered with earth. Stumps and brush must be placed along the remainder of the trail. These roads must be rendered impassable to cars and trucks. All stumps from road building and landing construction must be reserved to block any newly constructed roads upon completion of the sale. These stumps must be scattered along the road system to prohibit vehicular movement. Contact the sale administrator for specific details of design and placement.

4.2 - Maintenance

4.2.4 - Grading (10/16)

For completion of the sale, Forest Service roads must be graded. In general, this will require a road grader or bulldozer to shape up the roads after forest products have been hauled off site. This includes cleaning of drainage areas, grading, crowning, and filling with gravel, if necessary. The grading equipment to be used must be approved by the Unit Manager or his/her representative.

4.3 - Public Right-of-Way

4.3.2 - County R-O-W (12/06)

The county must be contacted prior to crossing or harvesting in the county road R-O-W.

5 - Operations

5.1 - Notification

5.1.1 - Pre-sale conference (10/16)

A pre-sale conference on site between the Purchaser and sale administrator is required prior to beginning any operations to determine landing and road locations. The Unit Manager or his/her representative must be contacted at least 10 days in advance to schedule the conference.

5.1.4 - Post-sale conference (10/16)

A post-sale conference on site between the Purchaser and sale administrator is required 5 days prior to the completion of active logging operations to determine clean-up and repair of landings, road edges, and the fulfillment of other contract specifications.

5.2 - Conduct of Operations

5.2.2 - Hazard Trees/Snags

5.2.2.1 - Den trees (10/16)

Obvious hollow and/or den trees shall be protected and left standing unless they are a safety hazard.

5.2.3 - Operating Restrictions

5.2.3.1 - Operating restrictions (9/11)

Within Payment Unit(s) 5, 9, and 12-16, unless changed by written agreement, cutting, skidding, and hauling are limited to

frozen conditions, this period is generally from December 1 to March 31. This restriction is because of sensitive soils. If dry summer conditions persist this spec can be waived by amendment for Units 12-16. If this occurs additional gravel may be required (up to 100 cubic yards) to make roads suitable for logging.

5.2.3.2 - Operating restrictions (9/11)

Within Payment Unit(s) 1, 3, 4, 7, 8, 10, 11, 12 & 14, unless changed by written agreement, cutting, skidding, and hauling are not permitted during the period of March 1 to August 31. This restriction is because of an active hawk nest near these Units. Note: Nests are generally checked for activity by June 1; if the nests are not active, the restriction can be waived for the remainder of the period.

5.2.3.3 - Bark slippage restriction (3/09)

Within Payment Unit(s) 3, 4, 7, 8, and 11-16, unless changed by written agreement, cutting and skidding are not permitted during the period of April 15 to July 15. This restriction is because of bark slippage.

5.2.3.6 - Bark beetle restriction (12/08)

In the event drought creates a high risk of pine bark beetle infestation, pine is not to be cut during the period March 1 through July 1, unless all portions of trees greater than two inches in diameter are removed from the sale area, reduced to chips, or treated to the satisfaction of the Unit Manager or his/her representative, within fifteen days of being severed from the stump. Pine log decks, pulpwood piles and treetops that are piled for chipping in the fall or winter within a 1/4 mile of susceptible sites must be removed before March 15. Residual slash must not be placed in piles or rows and must be spread over the site for quick drying. The Department of Natural Resources will exercise this specification if the risk of damage warrants.

5.2.32 - Decking/landing restoration (9/13)

All decking and landing areas must have the surface area restored to a condition equal to or better than before. This is to ensure the proper regeneration of the stand. Wood debris, chips, and "cookies" from trimmings must be removed or scattered away from landing and loading areas and may not be windrowed on the edge.

5.2.37 - No decking areas (12/08)

No decking is allowed along County Rd 442.

5.2.38 - No decking against live trees (2/04)

Cut products may not be decked against unmarked or designated leave trees.

5.2.41 - Snowmobile trail protection (9/11)

County Road 442 is a snowmobile trail and is shown on the Timber Sale Map. Do not cut or damage posts with orange trail markers or traffic control signs. If the trail road is to be used for hauling during the snowmobile season, then a snow-covered base must be left on the trail. Maintain a 20-foot-wide slash, debris, and rut free zone daily using the snowmobile trail as the centerline.

5.4 - Soil Protection

5.4.1 - Rutting restriction, general (7/16)

Operations are to cease immediately if equipment and weather conditions result in rutting of roads and/or skid trails which is 12 inches or greater in depth and 50 feet in length. The Unit Manager or his/her representative may restrict hauling and/or skidding if ruts exceed the specified depth. With the Unit Manager or his/her representative's approval, the Purchaser may return to the area when the risk of rutting has decreased.

5.4.4 - Slope protection (9/19)

Skid trails and roads on slopes shall be water barred with slash and stumps as soon as use is complete to prevent erosion.

5.6 - Debris and Waste Material

5.6.2 - GNA, equipment cleaning (1/16)

(a) Areas, known by the DNR prior to timber sale advertisement, that are infested with invasive species of concern are shown on the Timber Sale Map. A current list of invasive species of concern and a map showing the extent of known infestations is available from the DNR. For purposes of this provision, "Off-Road Equipment" includes all logging and construction machinery, except for log trucks, chip vans, service vehicles, water trucks, pickup trucks, cars, and similar vehicles.

(b) Purchaser shall adhere to the following requirements with regard to cleaning "Off-Road Equipment":

(i) Prior to moving Off-Road Equipment onto the Sale Area, Purchaser shall identify the location of the equipment's most recent operation. Purchaser shall not move any Off-Road Equipment that last operated in an area infested with one or more invasive species of concern onto Sale Area without having cleaned such equipment of seeds, soil, vegetative matter, and other debris that could contain or hold seeds, and having notified the DNR, as provided in (iii). If the location of prior operation cannot be identified, then Purchaser shall assume that the location is infested with invasive species of concern.

(ii) Prior to moving Off-Road Equipment from a cutting unit that is shown on the Timber Sale Map to be infested with invasive species of concern to, or through any other area that is shown as being free of invasive species of concern, or infested with a different invasive species, Purchaser shall clean such equipment of seeds, soil, vegetative matter, and other debris that could contain or hold seeds, and shall notify the DNR, as provided in (iii).

(iii) Prior to moving any Off-Road Equipment subject to the cleaning requirements set forth above, Purchaser shall advise DNR of its cleaning measures and make the equipment available for inspection. DNR shall have 2 days, excluding weekends and State holidays, to inspect equipment after it has been made available. After satisfactory inspection or after such 2 day period, Purchaser may move the equipment as planned. Equipment shall be considered clean when a visual inspection does not disclose seeds, soil, vegetative matter, and other debris that could contain or hold seeds. Purchaser shall not be required to disassemble equipment unless so directed by the DNR after inspection.

(iv) If Purchaser desires to clean Off-Road Equipment on National Forest land, such as at the end of a project or prior to moving to, or through an area that is free of invasive species of concern, Purchaser shall obtain prior approval from the Unit Manager or his/her representative as to the location for such cleaning and measures, if any, for controlling impacts.

(v) Unit Manager or his/her representative may order delay, interruption, or modification of this Contract pursuant to Condition & Requirement 7.3 or 7.3.4.

(c) Nothing contained in this Condition & Requirement shall be interpreted as creating any warranty on the part of the DNR that all locations of invasive species of concern have been described herein, elsewhere in this Contract, or designated on the ground. Following sale advertisement, additional locations may be described or designated, and other species may be added to the list of invasive species of concern. In such event, the Unit Manager or his/her representative may order delay, interruption, or modification of this Contract pursuant to Condition & Requirement 7.3 or 7.3.4.

(d) The parties shall promptly communicate with one another with respect to description or designation of additional locations; discovery of locations of new species or new infestation; and, addition of species to the list of invasive species of concern.

5.8 - Protection of Endangered Species

5.8.3 - Red shoulder hawk or goshawk (2/16)

In the event that an active red shoulder hawk or goshawk nest is found, the contract may be amended to protect the nest site until the nest is determined to be inactive. The value of the trees in this excluded area will be refunded or credited to the Purchaser. The nest will be buffered with a five-chain radius (eight acre) protection area, centered on the nest tree, in which there will be no cutting or new roads constructed. Avoid human disturbance, including loading and skidding, in the protection area.

An additional zone of five chains (ten chains centered on the active nest tree) will be established in which there is no management activity from April 1 to July 30. Limit biomass harvesting and chipping operations within this ten-chain zone, retain the maximum one-third of residues per the Woody Biomass Harvesting Guidelines (Michigan DNR 2010). Nests determined to be inactive will be protected with a one-chain no-harvest buffer.

6 - Safety and Fire Prevention

6.2 - Signing

6.2.1 - Road posting (10/20)

The Purchaser is responsible for posting and maintaining caution signs on County Road 442 prior to beginning operations. The road must be posted at appropriate distances from the Sale Area to be determined by the Delta County Road Commission to

warn of logging activity and truck traffic. Signs must be removed when harvest operations are suspended or completed. The Purchaser will provide these signs.

6.2.2 - Snowmobile trail posting (10/20)

The Purchaser is responsible for posting and maintaining caution signs on County Road 442 prior to beginning operations during the snowmobile season (approximately December 1 to March 31). The trail must be posted at appropriate distances from the Sale Area to warn of logging activity and truck traffic. Signs must be removed when harvest operations are suspended or completed. The Purchaser will provide these signs.

7 - Other Conditions

SKIP

7.1.1 - GNA, title (7/16)

General Condition & Requirement 7.1 is inapplicable. The following applies to this contract.

All right, title, and interest in and to any Included Timber shall remain in USDA Forest Service with the State of Michigan acting on behalf of the USDA Forest Service under this GNA contract, until it has been Measured, removed from Sale Area or other authorized cutting area, and paid for, at which time title shall vest in Purchaser. Title to any Included Timber that has been Measured and paid for, but not removed from Sale Area or other authorized cutting area by Purchaser on or prior to Termination Date, shall remain in USDA Forest Service.

7.3 - Contract Modifications

7.3.4 - GNA, contract suspension and modification (5/16)

(a) The Unit Manager may, by written order, delay or interrupt authorized operations under this contract or, notwithstanding Condition & Requirement 7.3, modify this contract, in whole or in part:

(i) To prevent environmental degradation or resource damage, including, but not limited to, harm to habitat, plants, animals, cultural resources, or cave resources;

(ii) To ensure consistency with land and resource management plans or other documents prepared pursuant to the National Environmental Policy Act of 1969, 42 USC 4321-4347;

(iii) To conduct environmental analysis, including, but not limited to, engaging in consultation pursuant to the Endangered Species Act of 1973, 16 USC 1531, et seq.; or

(iv) Upon agreement of the Forest Service, due to administrative appeal or litigation, regardless of whether the Unit Manager's order is required by a court order or this contract is named in such a proceeding.

(b) In the event of an order delaying or interrupting Purchaser's Operations under this Condition & Requirement, Purchaser's remedy shall be:

(i) a no cost contract extension,

(ii) reimbursement for Out-of-Pocket Expenses,

however, the foregoing remedies shall be available only to the extent that the Unit Manager's order was the sole and exclusive cause of the delay or interruption of Purchaser's operations.

(c) Remedies awarded to the Purchaser shall not be duplicative, and the Unit Manager shall have the right to structure remedies provided herein to avoid duplicative compensation.

(d) Purchaser agrees that this Condition & Requirement, and the remedies provided herein shall apply regardless of any finding by any court that the DNR failed to comply with any statute, regulation and/or policy in connection with awarding, advertising, or authorizing this sale, or a similar sale.

7.5 - Loss

7.5.2 - GNA, liability for loss (7/16)

If Included Timber is destroyed or damaged by an unexpected event that changes the nature of Included Timber, such as wind, flood, insects, disease, or similar cause, the Purchaser shall bear the timber value loss resulting from such destruction or damage.

Deterioration or loss of timber value due to delay or interruption under 7.3.4 - GNA, contract suspension and modification, shall be borne by the party holding title. In this event, Included Timber to which USDA Forest Service holds title, Purchaser of the State GNA contract will not be obligated to remove and pay for such timber. This Subsection shall not be construed to relieve either party of liability for negligence.

7.10 - Certified Timber

7.10.1 - Non-certified timber (2/16)

The area encompassed by this timber sale is not certified to the standards of the Forest Stewardship Council (FSC) or the Sustainable Forestry Initiative (SFI). Forest products from this sale may not be delivered to the mill as "FSC and / or SFI certified". The lands within this sale belong to the National Forest system and are being managed by the State as part of a Good Neighbor Authority (GNA) agreement.



TIMBER SALE MAP

This information provided by authority of Part 5, 1994 PA 451, as amended.

Sale Number	Year
41-820	21

Forest Management Unit Shingleton	County Delta	Mapped By Burnham	Date 9/1/2021	Page 1	of 1
--------------------------------------	-----------------	----------------------	------------------	-----------	---------

Compartment Number 7911108	Township 42N	Range 19W	Section(s) and Subdivision(s) 17-S1/2SW, SWSE 19-NE, NW, N1/2SE, SWSE, N1/2SW, SE5W 20-SW, NW, W1/2NE, W1/2SE	Scale: [... 4"] = 1 mile
-------------------------------	-----------------	--------------	--	--------------------------------

Cover Type			
A = Aspen	J = Jack Pine	O = Oak	U = Upland Brush
B = Paper Birch	K = Rock	P = Lowland Poplar	UM = Upland Mix Forest
C = Cedar	L = Lowland Brush	Q = Mixed Swamp Conifer	V = Bog or Marsh
D = Treed Bog	LM = Lowland Mix Forest	R = Red Pine	W = White Pine
E = Swamp Hardwoods	M = Maple, Beech, Birch	S = Black Spruce	X = Non Stocked
F = Spruce/Fir	MC = Mixed Conifer	T = Tamarack	Y = Sand
G = Grass	MD = Mixed Deciduous		Z = Water
H = Hemlock	N = Marsh		

Density	
0 = Non Stocked	5 = Pole Timber Medium
1 = Seedling Sapling Poor	6 = Pole Timber Well
2 = Seedling Sapling Medium	7 = Saw Timber Poor
3 = Seedling Sapling Well	8 = Saw Timber Medium
4 = Pole Timber Poor	9 = Saw Timber Well

GNA2 Lakes Camp West

528.3 Acres



LEGEND
 RED PAINT PUT BOUNDARY
 ORANGE PAINT
 NO CUT AREA
 "SPECIAL PROTECTION AREA"
 == TWO TRACK
 --- TEMP ROAD

Interior Payment Boundaries Orange

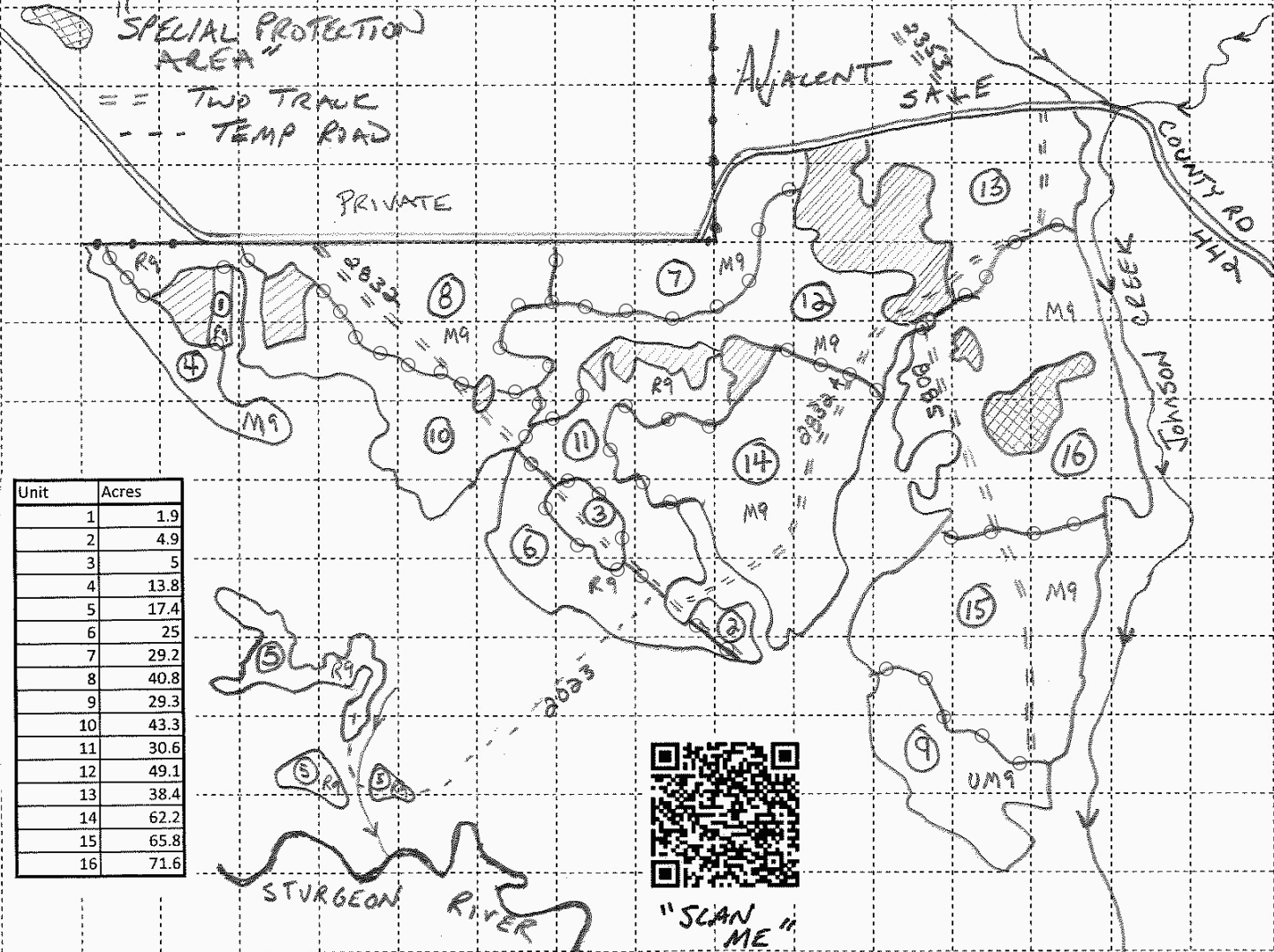

Unit	Acres
1	1.9
2	4.9
3	5
4	13.8
5	17.4
6	25
7	29.2
8	40.8
9	29.3
10	43.3
11	30.6
12	49.1
13	38.4
14	62.2
15	65.8
16	71.6

GNA2 Lakes Camp East (41-819-21)

T42N, R19W, SEC. 17; T42N, R19W, SEC. 20; T42N, R19W, SEC. 21; T42N,

In response to the notice of sale to be held 2:00 p.m. (local time) on September 29, 2021, I am hereby submitting my sealed bid (firm offer) for the following forest products to be cut. Bids for individual species must be at or above the advertised price. All non-responsive bid forms may be rejected.

<u>PRODUCTS & SPECIES</u>	<u>ESTIMATED VOLUME*</u>	<u>ADVERTISED PRICE</u>	<u>BID PRICE/UNIT</u>
Sawtimber			
Basswood	16.5 MBF	\$ 49.00/MBF	\$ _____
Black Cherry	72.6 MBF	\$ 91.00/MBF	\$ _____
Red Maple	419.0 MBF	\$ 98.00/MBF	\$ _____
Sugar Maple	544.7 MBF	\$ 340.00/MBF	\$ _____
Yellow Birch	4.9 MBF	\$ 38.00/MBF	\$ _____
Pulpwood			
Balsam Fir	49 Cords	\$ 11.85/Cord	\$ _____
Mixed Aspen	17 Cords	\$ 23.35/Cord	\$ _____
Mixed Hardwood	2,827 Cords	\$ 15.20/Cord	\$ _____
Mixed Spruce	12 Cords	\$ 11.90/Cord	\$ _____
Tamarack	4 Cords	\$ 2.60/Cord	\$ _____

*The volumes are statistically estimated within plus (+) or minus (-) 2.87 percent at 95% confidence level. These estimated volumes are final and not subject to adjustment. Prospective bidders are urged to examine this timber and to make their own estimates of quantity and quality.

I understand that any or all bids may be rejected. All bids must be signed and all bid items must be bid or the bid form may be rejected. I also understand that consideration and awarding a contract will be based upon my past performance and ability to complete the contract based upon equipment and staffing subject to my control.

FEDERAL ID: _____ or SOCIAL SECURITY NUMBER: _____

Company or individual bidding: _____

Company representative's name: _____

Address: _____

City: _____ State: _____ Zip: _____

IF AVAILABLE, PLEASE PLACE THE PERSONALIZED LABEL FROM YOUR PROSPECTUS IN THE ABOVE BOX.

Individual or company representative's signature: _____ Date: _____

Phone number : _____ Email (optional): _____

THE WINNING BIDDER MUST COMPLETE THE VERIFICATION OF WORKER'S DISABILITY COMPENSATION ACT COMPLIANCE (ON REVERSE SIDE IF DOUBLE SIDED) WITHIN 21 DAYS OF SALE AWARD DATE



FOR DEPARTMENT USE ONLY	
Sale Number (XX - XXX - XX - XX)	
Forest Management Unit:	

TIMBER SALE VERIFICATION OF WORKER'S DISABILITY COMPENSATION ACT COMPLIANCE

As required by Act 317, P.A. 1969 (Worker's Compensation) and
Part 5 of Act 451 of 1994, as amended.

VERIFICATION OF WORKER'S DISABILITY COMPENSATION ACT COMPLIANCE

- This verification must be completed and submitted within 21 days of contract award and prior to the issuance of the timber sale contract.
- In addition, if boxes 2B or 2C are checked, then Notice of Exclusion or Certificate of Insurance must be submitted within twenty-one (21) days of the contract award and prior to the issuance of the timber sale contract.
- All information must be typed or printed except for written signatures.

Please Check Appropriate Categories:

1. My business is organized as (you **must** check one of the boxes below):
 - A. Sole Proprietorship (individual)
 - B. Partnership
 - C. Corporation
2. You **must** check one of the boxes below:
 - A. I certify my business is a sole proprietorship and it has no employees but the sole proprietor. I am not subject to the Worker's Compensation Laws.
 - B. I certify my business has satisfied its obligation to the Worker's Compensation Act through the use of an approved Notice of Exclusion (BWC-337, Rev. 5/96). I will provide a copy of the Notice of Exclusion within 21 days of the contract award. (For questions or a copy of the BWC-337, please call the Worker's Compensation Bureau at 517-322-1195).
 - C. I certify my business has a Worker's Compensation Policy. I will provide an original Certificate of Insurance within twenty-one (21) days of the contract award.
3. If you have checked item 2(A) or 2(B), you **must** indicate the number of **both** full-time and part-time employees, other than yourself, including family members and active partners (if none, you must enter "0").

_____ Full-time Employees

_____ Part-time Employees

Name of Business		Federal ID (or) Social Security No.	
Address		Telephone ()	
City	State	ZIP	

I hereby certify that the above information is true and correct. I agree to notify the Michigan DNR of any changes that occur in factors affecting my coverage during any of my present and future operations.

Signature of Owner or Authorized Representative

Title

Date

Please complete the "SEALED BID" information on the next page

GNA2 Lakes Camp West (41-820-21)
T42N, R19W, SEC. 17; T42N, R19W, SEC. 19; T42N, R19W, SEC. 20; Delta

In response to the notice of sale to be held 2:00 p.m. (local time) on September 29, 2021, I am hereby submitting my sealed bid (firm offer) for the following forest products to be cut. Bids for individual species must be at or above the advertised price. All non-responsive bid forms may be rejected.

<u>PRODUCTS & SPECIES</u>	<u>ESTIMATED VOLUME*</u>	<u>ADVERTISED PRICE</u>	<u>BID PRICE/UNIT</u>
Sawtimber			
Basswood	1.1 MBF	\$ 49.00/MBF	\$ _____
Black Cherry	132.9 MBF	\$ 91.00/MBF	\$ _____
Red Maple	457.5 MBF	\$ 98.00/MBF	\$ _____
Sugar Maple	338.6 MBF	\$ 340.00/MBF	\$ _____
Yellow Birch	2.1 MBF	\$ 38.00/MBF	\$ _____
Pulpwood			
Balsam Fir	297 Cords	\$ 11.85/Cord	\$ _____
Mixed Aspen	163 Cords	\$ 23.35/Cord	\$ _____
Mixed Hardwood	3,460 Cords	\$ 15.20/Cord	\$ _____
Mixed Spruce	153 Cords	\$ 11.90/Cord	\$ _____
N. White Cedar	13 Cords	\$ 4.45/Cord	\$ _____
Paper Birch	128 Cords	\$ 12.00/Cord	\$ _____
Red Pine	1,657 Cords	\$ 38.05/Cord	\$ _____
Tamarack	8 Cords	\$ 2.60/Cord	\$ _____
White Pine	38 Cords	\$ 12.40/Cord	\$ _____

*The volumes are statistically estimated within plus (+) or minus (-) 2.52 percent at 95% confidence level. These estimated volumes are final and not subject to adjustment. Prospective bidders are urged to examine this timber and to make their own estimates of quantity and quality.

I understand that any or all bids may be rejected. All bids must be signed and all bid items must be bid or the bid form may be rejected. I also understand that consideration and awarding a contract will be based upon my past performance and ability to complete the contract based upon equipment and staffing subject to my control.

FEDERAL ID: _____ - _____ or SOCIAL SECURITY NUMBER: _____ - _____ - _____

Company or individual bidding: _____

Company representative's name: _____

Address: _____

City: _____ State: _____ Zip: _____

IF AVAILABLE, PLEASE PLACE THE PERSONALIZED LABEL FROM YOUR PROSPECTUS IN THE ABOVE BOX.

Individual or company representative's signature: _____ Date: _____

Phone number : _____ Email (optional): _____

THE WINNING BIDDER MUST COMPLETE THE VERIFICATION OF WORKER'S DISABILITY COMPENSATION ACT COMPLIANCE (ON REVERSE SIDE IF DOUBLE SIDED) WITHIN 21 DAYS OF SALE AWARD DATE



FOR DEPARTMENT USE ONLY
Sale Number (XX - XXX - XX - XX)
Forest Management Unit:

TIMBER SALE VERIFICATION OF WORKER'S DISABILITY COMPENSATION ACT COMPLIANCE

*As required by Act 317, P.A. 1969 (Worker's Compensation) and
Part 5 of Act 451 of 1994, as amended.*

VERIFICATION OF WORKER'S DISABILITY COMPENSATION ACT COMPLIANCE

- This verification must be completed and submitted within 21 days of contract award and prior to the issuance of the timber sale contract.
- In addition, if boxes 2B or 2C are checked, then Notice of Exclusion or Certificate of Insurance must be submitted within twenty-one (21) days of the contract award and prior to the issuance of the timber sale contract.
- All information must be typed or printed except for written signatures.

Please Check Appropriate Categories:

1. My business is organized as (you **must** check one of the boxes below):
 - A. Sole Proprietorship (individual)
 - B. Partnership
 - C. Corporation
2. You **must** check one of the boxes below:
 - A. I certify my business is a sole proprietorship and it has no employees but the sole proprietor. I am not subject to the Worker's Compensation Laws.
 - B. I certify my business has satisfied its obligation to the Worker's Compensation Act through the use of an approved Notice of Exclusion (BWC-337, Rev. 5/96). I will provide a copy of the Notice of Exclusion within 21 days of the contract award. (For questions or a copy of the BWC-337, please call the Worker's Compensation Bureau at 517-322-1195).
 - C. I certify my business has a Worker's Compensation Policy. I will provide an original Certificate of Insurance within twenty-one (21) days of the contract award.
3. If you have checked item 2(A) or 2(B), you **must** indicate the number of **both** full-time and part-time employees, other than yourself, including family members and active partners (if none, you must enter "0").

_____ Full-time Employees

_____ Part-time Employees

Name of Business		Federal ID (or) Social Security No.	
Address		Telephone ()	
City	State	ZIP	

I hereby certify that the above information is true and correct. I agree to notify the Michigan DNR of any changes that occur in factors affecting my coverage during any of my present and future operations.

Signature of Owner or Authorized Representative

Title

Date

Please complete the "SEALED BID" information on the next page