



**DEPARTMENT OF NATURAL RESOURCES
STATE OF MICHIGAN**

TIMBER SALE PROSPECTUS #6799

SCHEDULED SALE DATE AND TIME: 3:00 p.m. (local time) on February 25, 2021.

LOCATION: GAYLORD MGMT UNIT, 1732 WEST M 32, GAYLORD, MI 49735.

PROSPECTUS NOTE: The bidder is advised to inspect the sale area and review the location, estimated volumes, operating costs and contract terms of proposed sales. Please be aware that some landowners may request 60 days or more notice for access across their land.

Notice is hereby given that bids will be received by the Unit Manager, GAYLORD MANAGEMENT UNIT, for certain timber on the following described lands:

Marshmallow Mix (52-021-20) / T30N, R02W, SEC. 29, S1/2SW,W1/2SE.

T30N, R02W, SEC. 30, SESE.

Otsego County, Advertised Price \$36,241.60, 107.9 Acres, White Pine, Aspen.

SALE NOTE: Good Access and operating terrain.

A recreation site such as a trail, pathway, or campground is within the sale area or the vicinity. Certain restrictions/specifications may be applicable including time restrictions.

Poplar Pine (52-025-20) / T29N, R02W, SEC. 5 , SENW,S1/2NE.

Otsego County, Advertised Price \$12,700.20, 30.1 Acres, Aspen, White Pine.

SALE NOTE: No restrictions and good operating terrain.

Access may be through private or other public land.

Safari Hardwoods (52-027-20) / T33N, R06W, SEC. 10, NESE.

T33N, R06W, SEC. 11, SWNW,W1/2SW.

Charlevoix County, Advertised Price \$23,067.15, 62.4 Acres, Hardwood, Sugar Maple.

SALE NOTE: There is non-designated recreational use throughout the area.

BID INSTRUCTIONS (VER. 07/02/2018):

1. Scheduled Bid Location, Date, and Time (2/11)

Bids must be received by the Unit Manager, GAYLORD OFFICE, 1732 West M 32, Gaylord, MI 49735, no later than 3:00 p.m. (local time) on February 25, 2021. For further information concerning this sale, contact Lucas Merrick at 989-732-3541 extension 5440.

2. Bidder's Qualifications (5/16)

Purchaser shall obtain workers compensation insurance to cover claims under Michigan's Worker's Disability Compensation Act of 1969 or similar employee benefit act of any other state applicable to an employee. If all or part of a timber sale was prepared by a private contractor, the contractor and that contractor's company are not permitted to bid on the timber sale contract. Bids will not be accepted from individuals or companies appearing on the DNR/FRD No-Bid List. This list contains the names of purchasers who previously failed to execute a contract within 21-days or who have a history of poor performance.

3. Preparation of Sealed Bids (5/16)

Bid Forms may be completed online thru Michigan DNR Timber Sale Online Bidding (OLB) at www.michigan.gov/timberbidding or by completing the hardcopy Bid Form found in the Timber Sale Prospectus. Hardcopy Bid Forms shall be manually signed in ink. Registration in OLB is considered your 'signature' for all bids submitted thru that system. Bid prices must be entered for each species and product in the Bid Price column for all material subject to bidding and all fill-in blanks must be completed. If erasures or other changes appear on the hardcopy Bid Form, each erasure or change must be initialed by the person signing the bid.

4. Submission of Sealed Bids (5/16)

Bid forms may be obtained from the Unit Manager or thru OLB. Bids may be submitted hardcopy or thru OLB. All hardcopy bids must be submitted on the bid form and in an envelope clearly identified as described in this section. NOTE: Only one bid form per bid envelope. Sealed bids must be submitted to the Unit office designated in the prospectus and must be submitted at or prior to the time established in the prospectus. The envelope should show on the outside (a) the sale name or number and (b) the date and time of bid opening, as shown in the prospectus. Bids received after the time specified in the sale prospectus are late bids and will be rejected.

It is possible for a bidder to submit multiple bids on a single sale. For example, a bid may be submitted hardcopy and a bid may be submitted thru OLB. Or, two bidders from the same company could both submit bids on the same sale. If this were to happen, the State would accept all bids received and award the contract accordingly. All bidding and contractual requirements would apply to all bids received.

5. Public Opening of Sealed Bids (7/16)

If conditions permit, the sealed bids will be publicly opened and posted at the time and place set in the prospectus.

If a bidder, present at a bid opening, has submitted bids on more than one sale, that bidder may withdraw their unopened bid envelopes or announce the withdrawal of their online bid after being declared the successful bidder on one sale.

6. Award of Contract (1/11)

Award of the contract will be made to the Bidder whose bid, conforming to the prospectus, is most advantageous to the State of Michigan on the basis of total value at rates bid for the estimated quantities. The State reserves the right to reject any bid or waive any minor irregularity in bids received. A written award mailed (or otherwise furnished) to the successful Bidder shall be deemed to result in a binding contract without further action by either party.

7. Down Payment (1/11)

The Bidder to whom award is made must make a down payment within 21 days of the sale award. The amount of the down payment will be calculated as shown in the Bond and Payment Schedule of this prospectus. Only cash may be used to meet this requirement.

8. Performance Security (1/11)

As guarantee of faithful performance, a cash bond, certificate of deposit, surety bond or irrevocable letter of credit (LOC) is required within 21 days of the sale award. The amount of the performance security is shown in the Bond and

Payment Schedule of this prospectus. If an LOC or surety is used, the coverage must extend for at least 6 months beyond the contract expiration.

9. Timber Sale Contract (7/18)

Additional conditions and requirements common to all timber sales are listed on the timber sale contract (R4031) and are available on line at www.michigan.gov/timber. Contact the Unit Manager for additional information or a sample contract. Within 21 days of the date of the award letter, the bidder must sign the contract and provide the required down payment, performance security, and verification of worker's disability compensation. The down payment and performance security shall be in accordance with the provisions of the timber sale contract, in the sums stated in this prospectus. If these actions are not taken, then the Bidder, the Bidder's corporation, and the corporation's principals may not be permitted to bid on State timber sales for a period of 3 months after the first offense, 6 months after the second offense, and 1 year after the third offense. An offense will only be counted against the Bidder for 5 years. In addition, the Bidder certifies that if awarded this contract, the Bidder will complete the timber sale contract in accordance with its terms and any modifications thereof including requirements to purchase, cut, and remove the included timber by the expiration date.

Payment Unit values in the State Forest Timber Sale Contract are calculated based on the advertised value of the Payment Unit as a percentage of the total advertised value of the contract. The advertised value of each Payment Unit is given in the Description of Timber by Payment Unit table on the Timber Sale Information page. For example, if the value of Payment Unit 1 is advertised as \$1,500 and the total Timber Sale value is advertised as \$10,000, the contract price for Payment Unit 1 will be 15% of the total bid price ($\$1,500/\$10,000 * 100$).

10. Disclaimer of Estimates and Bidder's Warranty of Inspection (7/16)

Before submitting this bid, the Bidder is advised and cautioned to inspect the sale area, review the requirements of the sale contract, and take other steps as may be reasonably necessary to ascertain the location, estimated volumes, construction estimates, and operating costs of the proposed sale. Failure to do so will not relieve the Bidder from responsibility for completing the contract.

The Bidder warrants that this bid is submitted solely on the basis of the Bidder's examination and inspection of the quality and quantity of the timber offered for sale and the Bidder's opinion of the value thereof and the costs of recovery. No reliance should be placed on the State of Michigan's estimates of timber quality, quantity or costs of recovery. Bidder further acknowledges that the State of Michigan: (i) expressly disclaims any warranty of fitness of timber for any purpose; (ii) offers this timber as is without any warranty of quality (merchantability) or quantity and (iii) expressly disclaims any warranty as to the quantity or quality of timber sold.

11. Certification and Chain-of-Custody (10/14)

Unless otherwise indicated in the contract under section 7 – Other Conditions of the Sale Specific Conditions & Requirements, the area encompassed by this timber sale is certified to the standards of the Forest Stewardship Council (FSC) - Certificate #SCS-FM/COC-00090N and the Sustainable Forestry Initiative (SFI) - Certificate #NSF-SFIS-5Y031-SF5. Forest products from this sale may be delivered to the mill as "FSC 100% and / or SFI certified" as long as the contractor hauling the forest products is chain-of-custody (COC) certified or covered under a COC certificate from the destination mill. The purchaser is responsible for maintaining COC after leaving the sale area.

12. Good Neighbor Authority (GNA) Requirements (7/16)

If the name of this timber sales contains the acronym GNA, it is authorized by the Good Neighbor Authority (GNA) and covered by various agreements between the U.S. Forest Service and the State. The timber sale occurs on federal land and the following conditions apply:

GNA contracts on US Forest Service land will not be awarded to purchasers on the Federal list of excluded parties. The System for Award Management (SAM) will be checked for active excluded parties prior to award of contract. In addition, the Bidder to whom award is made must complete an Assurance Regarding Felony Conviction or Tax Delinquent Status for Corporate Applicants (AD-3031).

13. Good Neighbor Authority (GNA) Requirements, con't (9/16)

Bidder certifies, by signing this bid form, that to the best of Bidder's knowledge that the following representations are accurate and complete.

- a. That the Bidder and its principals are not presently debarred, suspended, proposed for debarment, declared ineligible, or voluntary excluded from timber sales (covered transactions) by any Federal department or agency.
- b. That the Bidder and its principals have not within a 3-year period preceding this bid been convicted of or had a civil judgment rendered against them for commission of fraud or a criminal offense in connection with obtaining , attempting to obtain, or performing a public (Federal, State, or local) transaction or contract under a public transaction; violation of Federal or State antitrust statutes or commission of embezzlement, theft, forgery, bribery, falsification or destruction of records, making false statements, or receiving stolen property.
- c. That the Bidder and its principals are not presently indicted for or otherwise criminally or civilly charged by a governmental entity (Federal, State, or local) with commission of any of the offenses enumerated in paragraph b of this certification.
- d. That the Bidder and its principals have not within a 3-year period preceding this bid had one or more public transactions (Federal, State, or local) terminated for breach or default of a timber or forest product contract.

Bidders that cannot certify this requirement, in whole or in part, shall submit an explanation with their bid.

DAN EICHINGER
Director

TIMBER SALE INFORMATION

Marshmallow Mix (52-021-20)
T30N, R02W, SEC. 29; T30N, R02W, SEC. 30.
Otsego County (Advertised Price \$36,241.60)

SALE NOTE: Good Access and operating terrain.

A recreation site such as a trail, pathway, or campground is within the sale area or the vicinity. Certain restrictions/specifications may be applicable including time restrictions.

A timber sale contract for this lump sum, sealed bid timber sale will be awarded to the responsible bidder offering the highest sealed bid price. All units of volume listed below were estimated using the T-Sale computer program and our traditional volume equations. Bids must be at or above the following advertised price for each product and species:

<u>PRODUCTS & SPECIES</u>	<u>ESTIMATED UNITS*</u>	<u>ADVERTISED PRICE</u>
Sawtimber		
BI/R/Hybrid Oak	3.5 MBF	\$ 61.00 / MBF
Mixed Aspen	86.5 MBF	\$ 44.00 / MBF
Red Maple	30.8 MBF	\$ 50.00 / MBF
Red Pine	133.3 MBF	\$ 85.00 / MBF
White Pine	142.0 MBF	\$ 26.00 / MBF
Pulpwood		
Balsam Fir	50 Cords	\$ 13.10 / Cord
BI/R/Hybrid Oak	11 Cords	\$ 10.50 / Cord
Mixed Aspen	303 Cords	\$ 12.95 / Cord
Mixed Hardwood	188 Cords	\$ 15.70 / Cord
Paper Birch	8 Cords	\$ 7.65 / Cord
Red Pine	95 Cords	\$ 34.15 / Cord
White Pine	354 Cords	\$ 13.30 / Cord

* The total volume is statistically estimated within plus (+) or minus (-) 18.74 percent. There are an estimated 1,799 cords on this timber sale, plus or minus 337 cords at the 95% confidence level. The estimated units are final and not subject to adjustment. Prospective bidders are urged to examine this timber and to make their own estimates of quantity and quality.

BOND AND PAYMENT SCHEDULE:

1. A bond in the amount of \$1,812.00 to insure faithful performance of the conditions of the contract will be deposited by the successful bidder within 21 days of the sale award.
2. Cutting in any sale or unit without the required advance payment would be considered a trespass.
3. Total payment must be paid in advance or according to the following schedule :
 - (a) Ten percent (10%) of the sale value must be paid within 21 days of the sale award.
 - (b) The 10% down payment will be credited towards the first unit cut.
 - (c) Payment for each of the following units must be made before cutting begins in that unit:

PAYMENT UNIT NUMBER	PERCENT OF TOTAL SALE VALUE
01	12.7%
02	51.3%
03	16.3%
04	19.7%
4. If no cutting takes place, the 10% down payment will not be refunded.
5. Operations on the contract issued will terminate on 12/31/2022.

SALE STATISTICS

SALE VOLUMES

VOLUME		STATISTICAL RANGE IN CORDS		
TOTAL CUBIC FEET	TOTAL CORDS	PERCENT ERROR	MINIMUM	MAXIMUM
142,131	1,799	18.74%	1,462	2,136

VDU VOLUMES

A VDU is a Volume Determination Unit. Volumes and their associated statistics are calculated at the VDU level and summarized to the sale level. There is often a one to one relationship between a VDU and a Payment Unit, but not always, depending on the cruise design. Refer to the VDU TO PAYMENT UNIT table.

VDU	VOLUME		PERCENT ERROR	RANGE IN CORDS	
	TOTAL CUBIC FEET	TOTAL CORDS		MINIMUM	MAXIMUM
17	37,027	469	24.29%	355	583
22	7,489	95	54.87%	43	147
69	30,028	380	36.63%	241	519
70	34,349	435	33.24%	290	579
77	33,212	420	31.44%	288	553
TOTAL:	142,105	1,799		1,217	2,381

VDU TO PAYMENT UNIT

When a VDU is associated with more than one Payment Unit (PU), the VDU volumes are assigned to the PU based on acres of the VDU within the PU.

VDU	VDU ACRES	PU	PU ACRES
17	46.6	1	20.9
		2	0.2
		3	23.5
		4	2.0
22	11.8	4	11.8
69	9.5	1	0.3
		2	9.2
70	13.0	1	0.7
		2	12.3
77	27.0	3	6.1
		4	20.9
TOTAL:	107.9		107.9

DESCRIPTION OF TIMBER BY PAYMENT UNIT (PU)

PU	MARKET GROUP	PRODUCT	QUANTITY	UNIT	ACRES	ADVERTISE PRICE	
1	BI/R/Hybrid Oak	Sawtimber	1.2	MBF	21.9	\$4,619.95	
	Mixed Aspen		10.4	MBF			
	<i>B. T. Aspen</i>		7.8	<i>MBF</i>			
	<i>Quaking Aspen</i>		2.6	<i>MBF</i>			
	Red Maple		1.9	MBF			
	Red Pine		13.7	MBF			
	White Pine		24.6	MBF			
	Balsam Fir		Pulpwood	1			Cords
	<i>Balsam Fir</i>			1			<i>Cords</i>
	BI/R/Hybrid Oak		3	Cords			
	Mixed Aspen		44	Cords			
	<i>B. T. Aspen</i>		16	<i>Cords</i>			
	<i>Quaking Aspen</i>		28	<i>Cords</i>			
	Mixed Hardwood		10	Cords			
	<i>Black Cherry</i>	4	<i>Cords</i>				
	<i>Red Maple</i>	6	<i>Cords</i>				
	Paper Birch	2	Cords				
	<i>Paper Birch</i>	Sawtimber	0.2	<i>MBF</i>			
	<i>Paper Birch</i>		Pulpwood	2			<i>Cords</i>
	Red Pine	15		Cords			
White Pine	67	Cords					
2	Mixed Aspen	Sawtimber	4.9	MBF	21.7	\$18,570.20	
	<i>B. T. Aspen</i>		4.9	<i>MBF</i>			
	Red Maple		15.9	MBF			
	Red Pine		107.1	MBF			
	White Pine		89.7	MBF			
	BI/R/Hybrid Oak		Pulpwood	2			Cords
	Mixed Aspen			19			Cords
	<i>B. T. Aspen</i>			14			<i>Cords</i>
	<i>Quaking Aspen</i>			5			<i>Cords</i>
	Mixed Hardwood			58			Cords
	<i>Black Cherry</i>			4			<i>Cords</i>
	<i>Red Maple</i>			54			<i>Cords</i>
	Red Pine			65			Cords
	White Pine			205			Cords
3	BI/R/Hybrid Oak	Sawtimber		1.6	MBF	29.6	\$5,909.75
	Mixed Aspen		22.8	MBF			
	<i>B. T. Aspen</i>		15.3	<i>MBF</i>			
	<i>Quaking Aspen</i>		7.5	<i>MBF</i>			
	Red Maple		3.8	MBF			
	Red Pine		11.5	MBF			
	White Pine		22.8	MBF			
	Balsam Fir		Pulpwood	12	Cords		
	<i>Balsam Fir</i>			Sawtimber	1.6		
	<i>Balsam Fir</i>		Pulpwood		9		
	BI/R/Hybrid Oak			3	Cords		
	Mixed Aspen		78	Cords			
	<i>B. T. Aspen</i>		29	<i>Cords</i>			
	<i>Quaking Aspen</i>		49	<i>Cords</i>			
	Mixed Hardwood		30	Cords			
	<i>Black Cherry</i>		Sawtimber	0.5	<i>MBF</i>		
	<i>Black Cherry</i>			Pulpwood	8		
	<i>Red Maple</i>		21		<i>Cords</i>		
Paper Birch	3	Cords					
<i>Paper Birch</i>	Sawtimber	0.2	<i>MBF</i>				
<i>Paper Birch</i>		Pulpwood	3	<i>Cords</i>			

DESCRIPTION OF TIMBER BY PAYMENT UNIT (PU), CON'T

PU	MARKET GROUP	PRODUCT	QUANTITY	UNIT	ACRES	ADVERTISE PRICE	
3 con't	Red Pine	Pulpwood	14	Cords			
	White Pine		66	Cords			
4	Bl/R/Hybrid Oak	Sawtimber	0.7	MBF	34.7	\$7,134.05	
	Mixed Aspen		48.4	MBF			
	<i>B. T. Aspen</i>		31.2	<i>MBF</i>			
	<i>Quaking Aspen</i>		17.2	<i>MBF</i>			
	Red Maple		9.2	MBF			
	Red Pine		1.0	MBF			
	White Pine		4.9	MBF			
	Balsam Fir		Pulpwood	37			Cords
	<i>Balsam Fir</i>		<i>Sawtimber</i>	5.6			<i>MBF</i>
	<i>Balsam Fir</i>		<i>Pulpwood</i>	26			<i>Cords</i>
	Bl/R/Hybrid Oak			3			Cords
	Mixed Aspen			162			Cords
	<i>B. T. Aspen</i>			57			<i>Cords</i>
	<i>Quaking Aspen</i>			105			<i>Cords</i>
	Mixed Hardwood			90			Cords
	<i>Black Cherry</i>		<i>Sawtimber</i>	2.5			<i>MBF</i>
	<i>Black Cherry</i>		<i>Pulpwood</i>	19			<i>Cords</i>
	<i>Red Maple</i>			66			<i>Cords</i>
	Paper Birch			2			Cords
	<i>Paper Birch</i>			2			<i>Cords</i>
	Red Pine			1			Cords
	White Pine			16			Cords
	TOTAL:			396.1			MBF
TOTAL:			1,008	Cords			

Sale Specific Conditions & Requirements

Sale Name: Marshmallow Mix

Sale Number: 52-021-20 Seq#: 1

1 - Sale Area

1.2 - Boundaries

1.2.1 - Painted boundaries (9/19)

The sale boundary and Payment Unit boundaries are marked and identified by blue, red and yellow paint. Exterior sale boundary lines against private property are marked with blue paint. Exterior sale boundary lines against state are marked with red paint. Interior Payment Unit boundaries are marked with yellow paint. Retention patches are marked with red X's; no harvesting activities may occur within these areas. The painted boundary line trees are not Included Timber and are to be protected. Yellow painted trees designating an interior Payment Unit boundary are only to be cut when all surrounding Payment Units have been paid.

2 - Timber Specifications

2.1 - Included Timber

2.1.1 - Clearcut unit(s) with unmerchantable trees (6/14)

Within Payment Unit(s) 1- 4, cut all trees that are two (2) inches or more at DBH, except do not cut any pine 26 inches at DBH or greater.

2.2 - Utilization

2.2.2 - Chipping required (2/18)

Payment Units 1 & 2 must be chip harvested to facilitate subsequent planting operations. The Purchaser has the option to produce sawlogs or pulpwood bolts, but the remaining portion of the trees must be chipped and hauled. Products may be produced as roundwood and forwarded to decking areas in final product length, but the tops must be left intact and skidded to the landing for chipping in order to minimize the amount of residual slash. A chipping exemption can be obtained if proposed operations are determined to be suitable for planting by reforestation staff. This exemption must be granted in writing. If market conditions limit the practicality of chipping, the producer may skid all remaining topwood out of these payment units and scatter in the adjacent payment units (3 & 4). This can only be done if approved by the sale administrator. The requirement to retain approximately 1/6 to 1/3 of tree tops and limbs less than four inches in diameter is still applicable (G. C. & R. 2.2).

2.2.3 - Stump heights (4/07)

Stump heights within Payment Unit(s) 1 & 2 shall not exceed 6 inches for all trees. This is in order to facilitate planting operations. If harvested during snow on conditions, the Purchaser may be required to come back after the snow melts to cut stumps to required height.

3 - Payments

3.3 - Pre-measured Sales

3.3.4 - Dividing payment units (7/14)

Payment Unit(s) may be divided at the request of the Purchaser and upon approval of the Unit Manager. Dividing Payment Units is a contract modification which requires a Timber Sale Contract Amendment. There will be only one division per Payment Unit.

4 - Transportation

4.1 - Construction

4.1.3 - Slash and earthen piles (8/04)

Piles or windrows of earth along roads and landings that have been widened or constructed shall be leveled. Slash from road maintenance or construction, including stumps, shall be dispersed throughout the sale, chipped, utilized or otherwise removed from the sale.

4.1.6 - Road construction (1/09)

Construction of new roads or improvements of existing roads shall be done in such a way as to minimize the environmental and visual impacts. Merchantable trees shall be cut and utilized unless otherwise directed. Non-merchantable trees shall be severed and laid flat on the ground. Slash shall be scattered, and not left in windrows and kept a minimum of 10 feet back from the road edge. Stumps shall be set upright, not left on edge, and be moved at least 10 feet away from the road edge. Disturbed soil shall be feathered into the woods and not left in berms or windrows.

4.1.7 - Road closure (10/11)

All new roads built into the sale must be blocked to vehicle traffic upon completion of the sale. In general, this will require constructing a four (4') foot high berm of stumps and logs covered with earth. These roads must be rendered impassable to cars and trucks. All stumps from road building and landing construction must be reserved to block any newly constructed roads upon completion of the sale. Temporary berms may be required if no sale activity occurs for 30 or more consecutive days. Contact the sale administrator for specific details of design and placement.

4.2 - Maintenance

4.2.5 - Two wheel drive condition (2/04)

All existing trail roads on and adjacent to the sale area must be passable by two-wheel drive traffic for the duration of the sale.

5 - Operations

5.1 - Notification

5.1.1 - Pre-sale conference (10/16)

A pre-sale conference between the Purchaser and sale administrator is required prior to beginning any operations to determine landing locations, roads and sale specifications. The Unit Manager or his/her representative must be contacted at least 5 days in advance to schedule the conference.

5.1.3 - Well heads and natural gas pipelines (11/15)

The Purchaser is responsible for contacting the gas or pipeline company 14 days prior to operating equipment in the vicinity of well heads or natural gas pipelines. This includes contacting Miss Dig for locating underground utilities.

5.1.4 - Post-sale conference (10/16)

A post-sale conference on site between the Purchaser and sale administrator is required 5 days prior to the completion of active logging operations to determine clean-up and repair of landings, road edges, and the fulfillment of other contract specifications.

5.2 - Conduct of Operations

5.2.1 - Slash

5.2.1.8 - Slash height (12/08)

No slash or tree tops may exceed 36 inches in height. This only applies to Payment Units 3 & 4.

5.2.1.13 - Dispose of slash as directed (12/05)

Slash is to be disposed of as directed by the Sale Administrator.

5.2.2 - Hazard Trees/Snags

5.2.2.1 - Den trees (10/16)

Obvious hollow and/or den trees shall be protected and left standing unless they are a safety hazard.

5.2.3 - Operating Restrictions

5.2.3.6 - Bark beetle restriction (12/08)

In the event drought creates a high risk of pine bark beetle infestation, pine is not to be cut during the period March 1 through July 1, unless all portions of trees greater than two inches in diameter are removed from the sale area, reduced to chips, or treated to the satisfaction of the Unit Manager or his/her representative, within fifteen days of being severed from the stump. Pine log decks, pulpwood piles and treetops that are piled for chipping in the fall or winter within a 1/4 mile of susceptible sites must be removed before March 15. Residual slash must not be placed in piles or rows and must be spread over the site for quick drying. The Department of Natural Resources will exercise this specification if the risk of damage warrants.

5.2.29 - Shrub protection (1/20)

Do not cut or damage hawthorn, witch-hazel, dogwood or juneberry. These woody-shrub plants are highly beneficial to various wildlife species.

5.2.32 - Decking/landing restoration (9/13)

All decking and landing areas must have the surface area restored to a condition equal to or better than before. This is to ensure the proper regeneration of the stand. Wood debris, chips and "cookies" from trimmings must be removed or scattered away from landing and loading areas and may not be windrowed on the edge.

5.2.39 - ORV trail/route protection (4/18)

The North Branch is an ORV route and is shown on the Timber Sale Map. Trees with yellow ORV markers shall be cut off above the markers and at least 5 feet above ground. All stumps within 5 feet of the trail must be cut flush with the ground. Maintain a 20 foot wide slash, debris, and rut free zone daily using the ORV trail or route as the centerline. Do not run equipment down the ORV trail or route. Skidding across the trail or route may only occur in locations approved by the sale administrator.

5.4 - Soil Protection

5.4.1 - Rutting restriction, general (7/16)

Operations are to cease immediately if equipment and weather conditions result in rutting of roads and/or skid trails which is 12 inches or greater in depth and 50 feet in length. The Unit Manager or his/her representative may restrict hauling and/or skidding if ruts exceed the specified depth. With the Unit Manager or his/her representative's approval, the Purchaser may return to the area when the risk of rutting has decreased.

5.8 - Protection of Endangered Species

5.8.5 - Protection of raptor nests (3/13)

All trees with raptor nests will be protected if found during harvesting operations. Notification will be made to the Unit Manager or his/her representative who will notify the Wildlife Biologist so an on-site evaluation and recommendation can be made, if necessary.

6 - Safety and Fire Prevention

6.2 - Signing

6.2.3 - Recreational trail posting (2/10)

The Purchaser is responsible for posting and maintaining caution signs on the North Branch ORV route prior to beginning operations. The trail must be posted at appropriate distances from the sale area to warn of logging activity and truck traffic at both ends of the trail. Signs must be removed when harvest operations are suspended or completed. The purchaser is responsible for the signs.

8 - Performance and Settlement

8.3 - Uncompleted or Terminated Contracts

8.3.1 - Completion of contract, chipping (1/16)

In addition to cutting, all chipping must be completed by the contract expiration date. If chipping has not been completed, an extension fee or damages may be charged per General Condition & Requirement 7.2 and 8.3.



TIMBER SALE MAP

This information provided by authority of Part 525, 1994 PA 451, as amended.

Sale Number	Year
52-021	2020

Forest Management Unit	County	Mapped By	Date	Page	of
Gaylord Management Unit	Otsego	Kubitskey	8/3/2020	1	1
		Cruised By			
		Kubitskey			

Township	Range	Section(s) and Subdivision(s)	Scale
30N	02W	Sec. 29 S1/2SW, W1/2SE & Sec. 30 SESE	1:15,840

Cover Type				Density			
A = Aspen	H = Hemlock	N = Marsh	U = Upland Brush	0 = Non Stocked	5 = Pole Timber Medium		
B = Paper Birch	J = Jack Pine	O = Oak	UM = Upland Mixed	1 = Seedling Sapling Poor	6 = Pole Timber Well		
C = Cedar	L = Lowland Brush	P = Lowland Poplar	V = Bog or Marsh	2 = Seedling Sapling Medium	7 = Saw Timber Poor		
D = Treed Bog	LM = Lowland Mixed	Q = Mixed Swamp Conifer	W = White Pine	3 = Seedling Sapling Well	8 = Saw Timber Medium		
E = Swamp Hdwoods	M = Mpl, Bch, Brch	R = Red Pine	X = Non Stocked	4 = Pole Timber Poor	9 = Saw Timber Well		
F = Spruce Fir	MC = Mixed Conifer	S = Black Spruce	Z = Water				
G = Grass	MD = Mixed Deciduous	T = Tamarack					

PU	Acres	PU	Acres
1	21.9	4	34.7
2	21.7		
3	29.6		

Marshmallow Mix Compartment 26 107.9 Acres

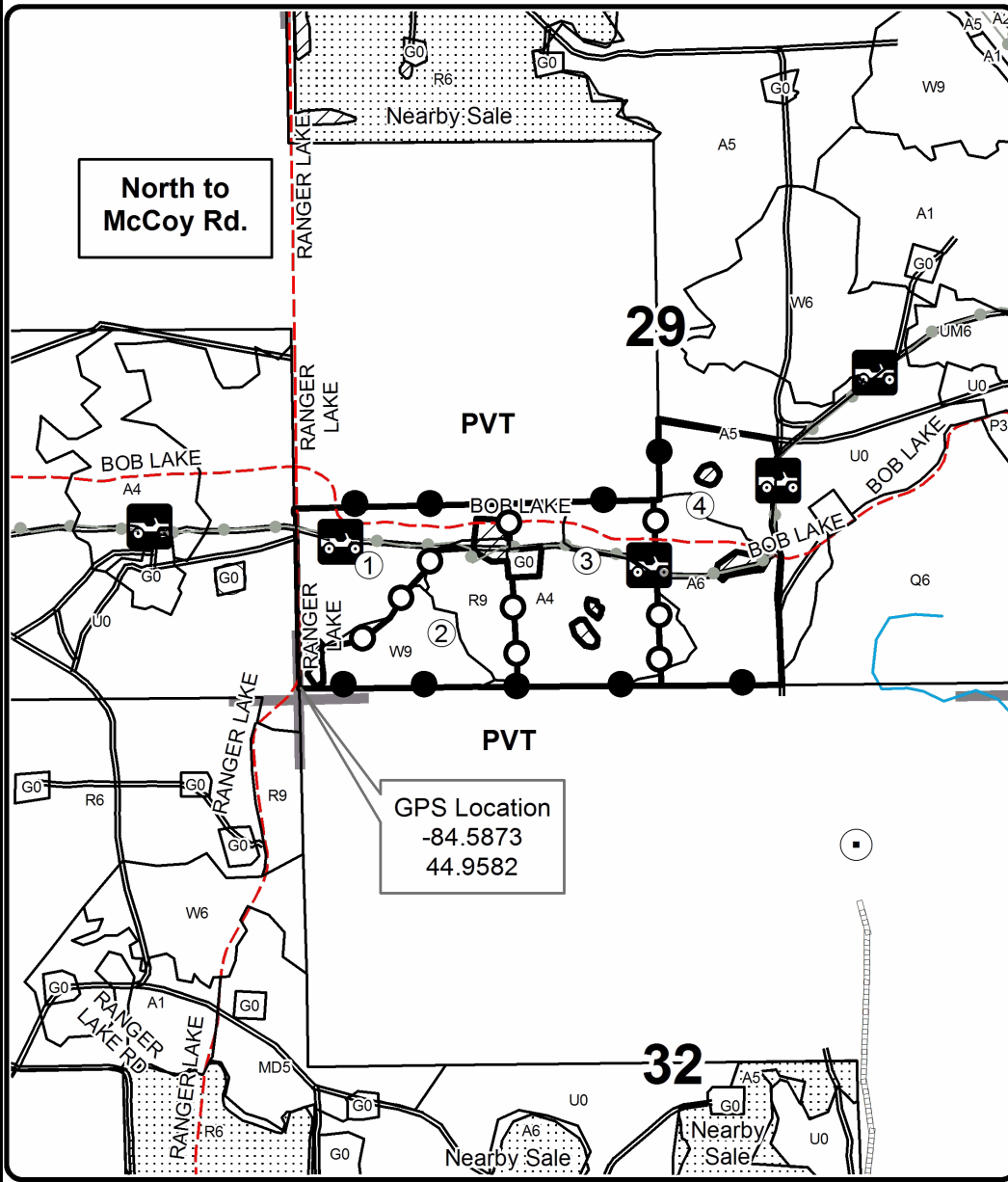
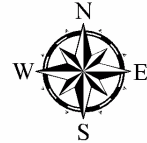

Legend

- Against State (Red)
- ○ Payment Unit (Yellow)
- ● Private Line (Blue)
- ▨ Retention Area (Red X's)
- ▤ Nearby Timber Sales
- Stand Boundaries
- Recreational Trail
- Oil & Gas Well Surface Locations
- Secondary Forest Road
- - Gravel Road
- - County Road - Seasonal
- Private
- Perennial River
- Section Corners

Locator Map
1:200,000

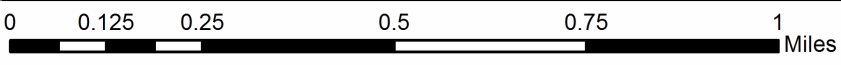
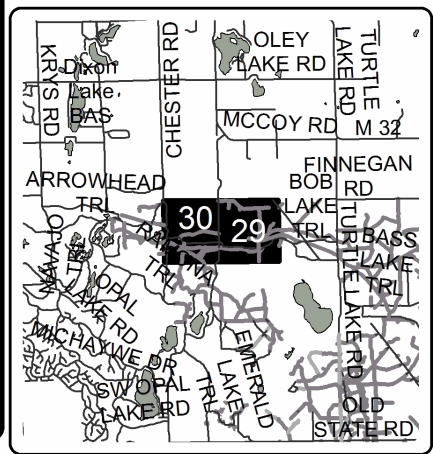

TIMBER SALE INFORMATION

Poplar Pine (52-025-20)

T29N, R02W, SEC. 5.

Otsego County (Advertised Price \$12,700.20)

SALE NOTE: No restrictions and good operating terrain.

Access may be through private or other public land.

A timber sale contract for this lump sum, sealed bid timber sale will be awarded to the responsible bidder offering the highest sealed bid price. All units of volume listed below were estimated using the T-Sale computer program and our traditional volume equations. Bids must be at or above the following advertised price for each product and species:

<u>PRODUCTS & SPECIES</u>	<u>ESTIMATED UNITS*</u>	<u>ADVERTISED PRICE</u>
Sawtimber		
Mixed Aspen	57.5 MBF	\$ 44.00 / MBF
Red Pine	22.1 MBF	\$ 85.00 / MBF
White Pine	12.2 MBF	\$ 26.00 / MBF
Pulpwood		
Balsam Fir	44 Cords	\$ 13.10 / Cord
Jack Pine	2 Cords	\$ 10.20 / Cord
Mixed Aspen	258 Cords	\$ 12.95 / Cord
Mixed Hardwood	70 Cords	\$ 15.70 / Cord
Paper Birch	29 Cords	\$ 7.65 / Cord
Red Pine	25 Cords	\$ 34.15 / Cord
White Pine	140 Cords	\$ 13.30 / Cord

* The total volume is statistically estimated within plus (+) or minus (-) 18.92 percent. There are an estimated 752 cords on this timber sale, plus or minus 142 cords at the 95% confidence level. The estimated units are final and not subject to adjustment. Prospective bidders are urged to examine this timber and to make their own estimates of quantity and quality.

BOND AND PAYMENT SCHEDULE:

- A bond in the amount of \$635.00 to insure faithful performance of the conditions of the contract will be deposited by the successful bidder within 21 days of the sale award.
- Cutting in any sale or unit without the required advance payment would be considered a trespass.
- Total payment must be paid in advance or according to the following schedule :
 - Ten percent (10%) of the sale value must be paid within 21 days of the sale award.
 - The 10% down payment will be credited towards the first unit cut.
 - Payment for each of the following units must be made before cutting begins in that unit:

PAYMENT UNIT NUMBER	PERCENT OF TOTAL SALE VALUE
01	45.6%
02	54.4%
- If no cutting takes place, the 10% down payment will not be refunded.
- Operations on the contract issued will terminate on 12/31/2022.

SALE STATISTICS

SALE VOLUMES

VOLUME		STATISTICAL RANGE IN CORDS		
TOTAL CUBIC FEET	TOTAL CORDS	PERCENT ERROR	MINIMUM	MAXIMUM
59,397	752	18.92%	610	894

VDU VOLUMES

A VDU is a Volume Determination Unit. Volumes and their associated statistics are calculated at the VDU level and summarized to the sale level. There is often a one to one relationship between a VDU and a Payment Unit, but not always, depending on the cruise design. Refer to the VDU TO PAYMENT UNIT table.

VDU	VOLUME		PERCENT ERROR	RANGE IN CORDS	
	TOTAL CUBIC FEET	TOTAL CORDS		MINIMUM	MAXIMUM
29	59,376	752	18.92%	609	894
TOTAL:	59,376	752		609	894

VDU TO PAYMENT UNIT

When a VDU is associated with more than one Payment Unit (PU), the VDU volumes are assigned to the PU based on acres of the VDU within the PU.

VDU	VDU ACRES	PU	PU ACRES
29	30.1	1	13.7
		2	16.4
TOTAL:	30.1		30.1

DESCRIPTION OF TIMBER BY PAYMENT UNIT (PU)

PU	MARKET GROUP	PRODUCT	QUANTITY	UNIT	ACRES	ADVERTISE PRICE
1	Mixed Aspen	Sawtimber	26.1	MBF	13.7	\$5,789.15
	<i>B. T. Aspen</i>		2.0	<i>MBF</i>		
	<i>Quaking Aspen</i>		24.1	<i>MBF</i>		
	Red Pine		10.1	MBF		
	White Pine		5.6	MBF		
	Balsam Fir	Pulpwood	20	Cords		
	<i>Balsam Fir</i>	<i>Sawtimber</i>	1.6	<i>MBF</i>		
	<i>Balsam Fir</i>	<i>Pulpwood</i>	17	<i>Cords</i>		
	Jack Pine		1	Cords		
	Mixed Aspen		118	Cords		
	<i>B. T. Aspen</i>		3	<i>Cords</i>		
	<i>Quaking Aspen</i>		115	<i>Cords</i>		
	Mixed Hardwood		32	Cords		
	<i>Red Maple</i>	<i>Sawtimber</i>	3.3	<i>MBF</i>		
	<i>Black Cherry</i>	<i>Pulpwood</i>	1	<i>Cords</i>		
	<i>Red Maple</i>		24	<i>Cords</i>		
	Paper Birch		14	Cords		
	<i>Paper Birch</i>	<i>Sawtimber</i>	1.9	<i>MBF</i>		
	<i>Paper Birch</i>	<i>Pulpwood</i>	10	<i>Cords</i>		
	Red Pine		11	Cords		
White Pine		64	Cords			
2	Mixed Aspen	Sawtimber	31.4	MBF	16.4	\$6,926.75
	<i>B. T. Aspen</i>		2.5	<i>MBF</i>		
	<i>Quaking Aspen</i>		28.9	<i>MBF</i>		
	Red Pine		12.0	MBF		
	White Pine		6.6	MBF		
	Balsam Fir	Pulpwood	24	Cords		
	<i>Balsam Fir</i>	<i>Sawtimber</i>	1.9	<i>MBF</i>		
	<i>Balsam Fir</i>	<i>Pulpwood</i>	20	<i>Cords</i>		
	Jack Pine		1	Cords		
	Mixed Aspen		140	Cords		
	<i>B. T. Aspen</i>		3	<i>Cords</i>		
	<i>Quaking Aspen</i>		137	<i>Cords</i>		
	Mixed Hardwood		39	Cords		
	<i>Red Maple</i>	<i>Sawtimber</i>	3.9	<i>MBF</i>		
	<i>Black Cherry</i>	<i>Pulpwood</i>	2	<i>Cords</i>		
	<i>Red Maple</i>		29	<i>Cords</i>		
	Paper Birch		15	Cords		
	<i>Paper Birch</i>	<i>Sawtimber</i>	2.2	<i>MBF</i>		
	<i>Paper Birch</i>	<i>Pulpwood</i>	11	<i>Cords</i>		
	Red Pine		14	Cords		
White Pine		76	Cords			
TOTAL:			91.8	MBF		
TOTAL:			569	Cords		

Sale Specific Conditions & Requirements

Sale Name: Poplar Pine

Sale Number: 52-025-20 Seq#: 1

1 - Sale Area

1.2 - Boundaries

1.2.1 - Painted boundaries (9/19)

The sale boundary and Payment Unit boundaries are marked and identified by blue, red and yellow paint. Exterior sale boundary lines against private property are marked with blue paint. Exterior sale boundary lines against state are marked with red paint. Interior Payment Unit boundaries are marked with yellow paint. Interior retention islands are marked with Red X's; no harvesting activities may occur within these areas. The painted boundary line trees are not Included Timber and are to be protected unless marked with orange paint. Yellow painted trees designating an interior Payment Unit boundary are only to be cut when all surrounding Payment Units have been paid.

2 - Timber Specifications

2.1 - Included Timber

2.1.1 - Clearcut unit(s) with unmerchantable trees (6/14)

Within Payment Unit(s) 1 & 2, cut all trees that are two (2) inches or more at DBH, except do not cut white pine greater than 20" at DBH.

2.1.11 - Description of timber note (2/04)

Note that Mixed Hardwood pulpwood contains red maple and black cherry.

3 - Payments

3.3 - Pre-measured Sales

3.3.4 - Dividing payment units (7/14)

Payment Unit(s) may be divided at the request of the Purchaser and upon approval of the Unit Manager. Dividing Payment Units is a contract modification which requires a Timber Sale Contract Amendment. There will be only one division per Payment Unit.

3.4 - Damaged Timber

3.4.1 - Damaged timber (7/16)

General Condition and Requirement 3.4 Damaged Timber, defines liquidated damages for undesignated live merchantable trees which are cut or injured. No damage is acceptable to undesignated live merchantable trees. Within the sale area, if more than 10% of trees (> 4.5" DBH) within a specified area of the sale are damaged, liquidated damages will be assessed for all trees damaged. Rates will be in accordance with General Condition and Requirement 3.4 Damaged Timber.

4 - Transportation

4.1 - Construction

4.1.3 - Slash and earthen piles (8/04)

Piles or windrows of earth along roads and landings that have been widened or constructed shall be leveled. Slash from road maintenance or construction, including stumps, shall be dispersed throughout the sale.

4.1.12 - No new roads (1/12)

No new roads will be permitted into the sale area. All operations are limited to existing roads. Skid trails only will be allowed.

4.2 - Maintenance

4.2.4 - Grading (10/16)

For completion of the sale, state forest roads must be graded. In general, this will require a road grader or bull dozer to shape up the roads after forest products have been hauled off site. This includes cleaning of drainage areas, grading, crowning and filling with gravel, if necessary. The grading equipment to be used must be approved by the Unit Manager or his/her representative. See the Timber Sale Map for road classification.

4.4 - Access

4.4.1 - Private property access (3/11)

Permission for access across private land is the responsibility of the Purchaser.

5 - Operations

5.1 - Notification

5.1.1 - Pre-sale conference (10/16)

A pre-sale conference on site between the Purchaser and sale administrator is required prior to beginning any operations to review sale specifications and to determine landing locations. The Unit Manager or his/her representative must be contacted at least 5 days in advance to schedule the conference.

5.1.3 - Well heads and natural gas pipelines (11/15)

The Purchaser is responsible for contacting the gas or pipeline company 15 days prior to operating equipment in the vicinity of well heads or natural gas pipelines. This also will require contacting MISS DIG to identify any underground utilities.

5.1.4 - Post-sale conference (10/16)

A post-sale conference on site between the Purchaser and sale administrator is required 5 days prior to the completion of active logging operations to determine clean-up and repair of landings, road edges, and the fulfillment of other contract specifications.

5.2 - Conduct of Operations

5.2.1 - Slash

5.2.1.8 - Slash height (12/08)

No slash or tree tops may exceed 36 inches in height.

5.2.1.13 - Dispose of slash as directed (12/05)

Slash is to be disposed of as directed by the Sale Administrator.

5.2.2 - Hazard Trees/Snags

5.2.2.1 - Den trees (10/16)

Obvious hollow and/or den trees shall be protected and left standing unless they are a safety hazard.

5.2.29 - Shrub protection (1/20)

Do not cut or damage hawthorn, witch-hazel, dogwood or junberry. These woody-shrub plants are highly beneficial to various wildlife species.

5.2.32 - Decking/landing restoration (9/13)

All decking and landing areas must have the surface area restored to a condition equal to or better than before. This is to ensure the proper regeneration of the stand. Wood debris, chips and "cookies" from trimmings must be removed or scattered away from landing and loading areas and may not be windrowed on the edge.

5.4 - Soil Protection

5.4.1 - Rutting restriction, general (7/16)

Operations are to cease immediately if equipment and weather conditions result in rutting of roads and/or skid trails which is 12 inches or greater in depth and 50 feet in length. The Unit Manager or his/her representative may restrict hauling and/or skidding if ruts exceed the specified depth. With the Unit Manager or his/her representative's approval, the Purchaser may return to the area when the risk of rutting has decreased.

5.8 - Protection of Endangered Species

5.8.5 - Protection of raptor nests (3/13)

All trees with raptor nests will be protected if found during harvesting operations. Notification will be made to the Unit Manager or his/her representative who will notify the Wildlife Biologist so an on-site evaluation and recommendation can be made, if necessary.



TIMBER SALE MAP

This information provided by authority of Part 525, 1994 PA 451, as amended.

Forest Management Unit Gaylord Management Unit		County Otsego	Mapped By Trevor Kubitskey	Date 9/9/2020	Page 1	of 1
Township 29N	Range 02W	Section(s) and Subdivision(s) Sec. 5, SENW, S1/2NE		Scale 1:7,920		

Cover Type				Density			
A = Aspen	H = Hemlock	N = Marsh	U = Upland Brush	0 = Non Stocked	5 = Pole Timber Medium		
B = Paper Birch	J = Jack Pine	O = Oak	UM = Upland Mixed	1 = Seedling Sapling Poor	6 = Pole Timber Well		
C = Cedar	L = Lowland Brush	P = Lowland Poplar	V = Bog or Marsh	2 = Seedling Sapling Medium	7 = Saw Timber Poor		
D = Treed Bog	LM = Lowland Mixed	Q = Mixed Swamp Conifer	W = White Pine	3 = Seedling Sapling Well	8 = Saw Timber Medium		
E = Swamp Hdwoods	M = Mpl, Bch, Brch	R = Red Pine	X = Non Stocked	4 = Pole Timber Poor	9 = Saw Timber Well		
F = Spruce Fir	MC = Mixed Conifer	S = Black Spruce	Z = Water				
G = Grass	MD = Mixed Deciduous	T = Tamarack					

PU	Acres
1	13.7
2	16.4

Poplar Pine

Compartment 12

30.1 Acres

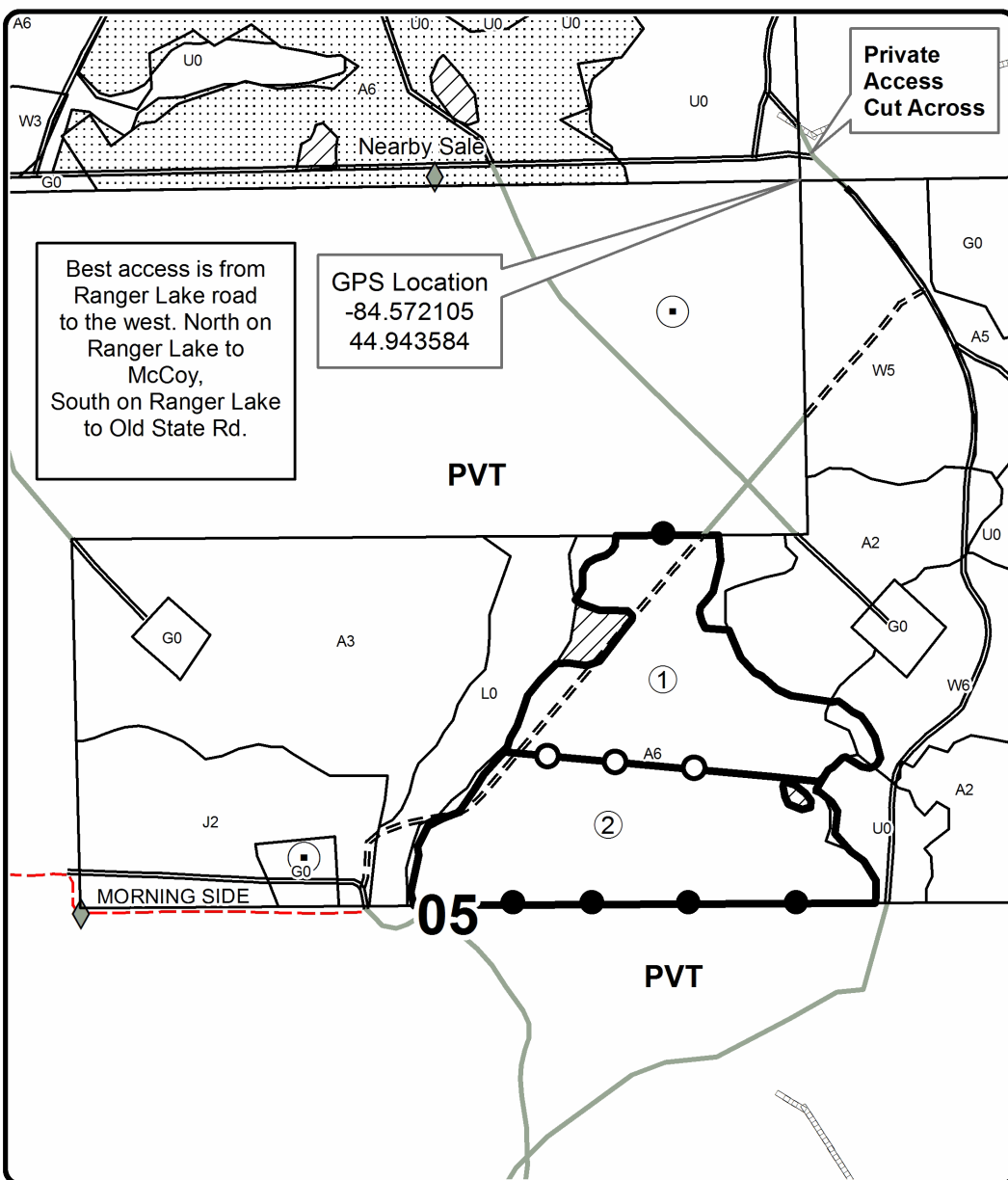
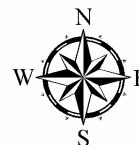

Legend

- Against State (Red)
- Payment Unit (Yellow)
- Private Line (Blue)
- Nearby Timber Sales
- Retention Area (Red)
- Stand Boundaries
- PU_Label
- PVT Private**
 - Oil & Gas Well Surface Locations
 - Secondary Forest Road
 - Forest Access Route
 - County Road - Seasonal
 - Private
 - DNR - Management Access
 - Pipeline
 - Powerline

Locator Map

1:150,000

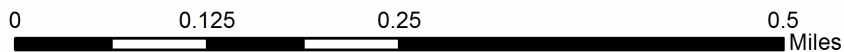
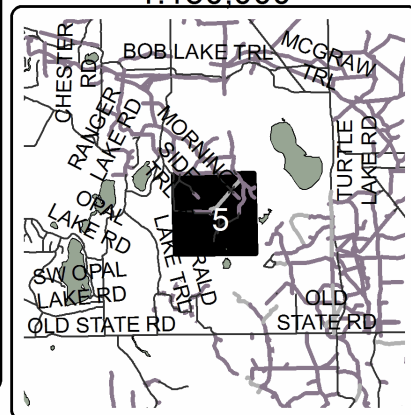

TIMBER SALE INFORMATION

Safari Hardwoods (52-027-20)
T33N, R06W, SEC. 10; T33N, R06W, SEC. 11.
Charlevoix County (Advertised Price \$23,067.15)

SALE NOTE: There is non-designated recreational use throughout the area.

A timber sale contract for this lump sum, sealed bid timber sale will be awarded to the responsible bidder offering the highest sealed bid price. All units of volume listed below were estimated using the T-Sale computer program and our traditional volume equations. Bids must be at or above the following advertised price for each product and species:

<u>PRODUCTS & SPECIES</u>	<u>ESTIMATED UNITS*</u>	<u>ADVERTISED PRICE</u>
Sawtimber		
Basswood	74.8 MBF	\$ 36.00 / MBF
Red Maple	11.6 MBF	\$ 50.00 / MBF
Sugar Maple	60.6 MBF	\$ 236.00 / MBF
Pulpwood		
Basswood	166 Cords	\$ 5.55 / Cord
Misc. Species 1	12 Cords	\$ 5.50 / Cord
Mixed Hardwood	268 Cords	\$ 15.70 / Cord
Quaking Aspen	23 Cords	\$ 12.95 / Cord

* The total volume is statistically estimated within plus (+) or minus (-) 13.57 percent. There are an estimated 764 cords on this timber sale, plus or minus 104 cords at the 95% confidence level. The estimated units are final and not subject to adjustment. Prospective bidders are urged to examine this timber and to make their own estimates of quantity and quality.

BOND AND PAYMENT SCHEDULE:

- A bond in the amount of \$1,153.00 to insure faithful performance of the conditions of the contract will be deposited by the successful bidder within 21 days of the sale award.
- Cutting in any sale or unit without the required advance payment would be considered a trespass.
- Total payment must be paid in advance or according to the following schedule :
 - Ten percent (10%) of the sale value must be paid within 21 days of the sale award.
 - The 10% down payment will be credited towards the first unit cut.
 - Payment for each of the following units must be made before cutting begins in that unit:

PAYMENT UNIT NUMBER	PERCENT OF TOTAL SALE VALUE
01	54.3%
02	45.7%
- If no cutting takes place, the 10% down payment will not be refunded.
- Operations on the contract issued will terminate on 12/31/2022.

SALE STATISTICS

SALE VOLUMES

VOLUME		STATISTICAL RANGE IN CORDS		
TOTAL CUBIC FEET	TOTAL CORDS	PERCENT ERROR	MINIMUM	MAXIMUM
60,359	764	13.57%	660	868

VDU VOLUMES

A VDU is a Volume Determination Unit. Volumes and their associated statistics are calculated at the VDU level and summarized to the sale level. There is often a one to one relationship between a VDU and a Payment Unit, but not always, depending on the cruise design. Refer to the VDU TO PAYMENT UNIT table.

VDU	VOLUME			RANGE IN CORDS	
	TOTAL CUBIC FEET	TOTAL CORDS	PERCENT ERROR	MINIMUM	MAXIMUM
6	60,372	764	13.57%	660	868
TOTAL:	60,372	764		660	868

VDU TO PAYMENT UNIT

When a VDU is associated with more than one Payment Unit (PU), the VDU volumes are assigned to the PU based on acres of the VDU within the PU.

VDU	VDU ACRES	PU	PU ACRES
6	62.4	1	33.9
		2	28.5
TOTAL:	62.4		62.4

DESCRIPTION OF TIMBER BY PAYMENT UNIT (PU)

PU	MARKET GROUP	PRODUCT	QUANTITY	UNIT	ACRES	ADVERTISE PRICE
1	Basswood	Sawtimber	40.6	MBF	33.9	\$12,526.60
	Red Maple		6.3	MBF		
	Sugar Maple		32.9	MBF		
	Basswood	Pulpwood	90	Cords		
	Misc. Species 1		7	Cords		
	Mixed Hardwood		146	Cords		
	<i>Beech</i>	<i>Sawtimber</i>	<i>0.5</i>	<i>MBF</i>		
	<i>Black Cherry</i>		<i>2.0</i>	<i>MBF</i>		
	<i>Beech</i>	<i>Pulpwood</i>	<i>12</i>	<i>Cords</i>		
	<i>Black Cherry</i>		<i>7</i>	<i>Cords</i>		
	<i>Ironwood</i>		<i>1</i>	<i>Cords</i>		
	<i>Red Maple</i>		<i>11</i>	<i>Cords</i>		
	<i>Sugar Maple</i>		<i>110</i>	<i>Cords</i>		
	Quaking Aspen		12	Cords		
	<i>Quaking Aspen</i>	<i>Sawtimber</i>	<i>4.1</i>	<i>MBF</i>		
	<i>Quaking Aspen</i>	<i>Pulpwood</i>	<i>4</i>	<i>Cords</i>		
	2	Basswood	Sawtimber	34.2		
Red Maple			5.3	MBF		
Sugar Maple			27.7	MBF		
Basswood		Pulpwood	76	Cords		
Misc. Species 1			5	Cords		
Mixed Hardwood			122	Cords		
<i>Beech</i>		<i>Sawtimber</i>	<i>0.4</i>	<i>MBF</i>		
<i>Black Cherry</i>			<i>1.7</i>	<i>MBF</i>		
<i>Beech</i>		<i>Pulpwood</i>	<i>10</i>	<i>Cords</i>		
<i>Black Cherry</i>			<i>5</i>	<i>Cords</i>		
<i>Ironwood</i>			<i>1</i>	<i>Cords</i>		
<i>Red Maple</i>			<i>10</i>	<i>Cords</i>		
<i>Sugar Maple</i>			<i>92</i>	<i>Cords</i>		
Quaking Aspen			11	Cords		
<i>Quaking Aspen</i>		<i>Sawtimber</i>	<i>3.4</i>	<i>MBF</i>		
<i>Quaking Aspen</i>		<i>Pulpwood</i>	<i>4</i>	<i>Cords</i>		
TOTAL:			147.0	MBF		
TOTAL:			469	Cords		

Sale Specific Conditions & Requirements

Sale Name: Safari Hardwoods

Sale Number: 52-027-20 Seq#: 2

1 - Sale Area

1.2 - Boundaries

1.2.1 - Painted boundaries (9/19)

The sale boundary and Payment Unit boundaries are marked and identified by blue, red and yellow paint, along with roads. Exterior sale boundary lines against private property are marked with blue paint. Exterior sale boundary lines against state are marked with red paint, with the exception of the southeast portion of the sale boundary, which is unpainted and identified by Sunterra Trail and Erickson Road. Interior Payment Unit boundaries are marked with yellow paint. Regeneration gaps are marked with green paint. The painted boundary line trees are not Included Timber and are to be protected unless marked with orange paint. Yellow painted trees designating an interior Payment Unit boundary are only to be cut when all surrounding Payment Units have been paid.

2 - Timber Specifications

2.1 - Included Timber

2.1.3 - Cut tree marked unit(s) (12/08)

Within Payment Unit(s) 1 and 2, all trees are designated for cutting when marked with orange paint above and below stump height, regardless of merchantability. In addition, cut all beech trees unless marked with pink or red paint. Also, cut all standing dead ash. Furthermore, within the green painted regeneration gaps, cut all trees two (2) inches or more at DBH.

2.1.11 - Description of timber note (2/04)

Note that Miscellaneous Species #1 = dead ash.

3 - Payments

3.3 - Pre-measured Sales

3.3.4 - Dividing payment units (7/14)

Payment Unit(s) may be divided at the request of the Purchaser and upon approval of the Unit Manager. Dividing Payment Units is a contract modification which requires a Timber Sale Contract Amendment.

3.4 - Damaged Timber

3.4.1 - Damaged timber (7/16)

General Condition and Requirement 3.4 Damaged Timber, defines liquidated damages for undesignated live merchantable trees which are cut or injured. No damage is acceptable to undesignated live merchantable trees. Within the sale area, if more than 5% of trees (> 4.5" DBH) within a specified area of the sale are damaged, liquidated damages will be assessed for all trees damaged. Rates will be in accordance with General Condition and Requirement 3.4 Damaged Timber.

4 - Transportation

4.1 - Construction

4.1.3 - Slash and earthen piles (8/04)

Piles or windrows of earth along roads and landings that have been widened or constructed shall be leveled. Slash from road maintenance or construction, including stumps, shall be dispersed throughout the sale.

4.1.6 - Road construction (1/09)

Construction of new roads or improvements of existing roads shall be done in such a way as to minimize the environmental and visual impacts. Merchantable trees shall be cut and utilized unless otherwise directed. Non-merchantable trees shall be severed and laid flat on the ground. Slash shall be scattered, and not left in windrows and kept a minimum of 10 feet back from the road edge. Stumps shall be set upright, not left on edge, and be moved at least 10 feet away from the road edge. Disturbed soil shall be feathered into the woods and not left in berms or windrows.

4.1.7 - Road closure (10/11)

All new roads built into the sale must be blocked to vehicle traffic upon completion of the sale. Overgrown roads that are

reopened shall be considered new roads. In general, this will require constructing a four (4') foot high berm of stumps and logs covered with earth. Stumps and brush must be placed along the remainder of the trail. These roads must be rendered impassable to cars and trucks. Contact the sale administrator for specific details of design and placement.

4.2 - Maintenance

4.2.5 - Two wheel drive condition (2/04)

All existing trail roads on and adjacent to the sale area must be passable by two-wheel drive traffic for the duration of the sale.

5 - Operations

5.1 - Notification

5.1.1 - Pre-sale conference (10/16)

A pre-sale conference on site between the Purchaser and sale administrator is required prior to beginning any operations to determine landing and road locations. The Unit Manager or his/her representative must be contacted at least 5 days in advance to schedule the conference.

5.1.4 - Post-sale conference (10/16)

A post-sale conference on site between the Purchaser and sale administrator is required 5 days prior to the completion of active logging operations to determine clean-up and repair of landings, road edges, and the fulfillment of other contract specifications.

5.2 - Conduct of Operations

5.2.1 - Slash

5.2.1.8 - Slash height (12/08)

No slash or tree tops may exceed 36 inches in height.

5.2.3 - Operating Restrictions

5.2.3.3 - Bark slippage restriction (3/09)

Within Payment Unit(s) 1 and 2, unless changed by written agreement, cutting and skidding are not permitted during the period of April 15 to July 15. This restriction is because of bark slippage.

5.2.32 - Decking/landing restoration (9/13)

All decking and landing areas must have the surface area restored to a condition equal to or better than before. This is to ensure the proper regeneration of the stand. Wood debris, chips and "cookies" from trimmings must be removed or scattered away from landing and loading areas and may not be windrowed on the edge.

5.2.38 - No decking against live trees (2/04)

Cut products may not be decked against unmarked or designated leave trees.

5.4 - Soil Protection

5.4.1 - Rutting restriction, general (7/16)

Operations are to cease immediately if equipment and weather conditions result in rutting of roads and/or skid trails which is 12 inches or greater in depth and 50 feet in length. The Unit Manager or his/her representative may restrict hauling and/or skidding if ruts exceed the specified depth. With the Unit Manager or his/her representative's approval, the Purchaser may return to the area when the risk of rutting has decreased.

5.4.4 - Slope protection (9/19)

Skid trails and roads on slopes shall be water barred with slash and stumps as soon as use is complete to prevent erosion.

5.8 - Protection of Endangered Species

5.8.5 - Protection of raptor nests (3/13)

All trees with raptor nests will be protected if found during harvesting operations. Notification will be made to the Unit Manager or his/her representative who will notify the Wildlife Biologist so an on-site evaluation and recommendation can be made, if necessary.

6 - Safety and Fire Prevention

6.2 - Signing

6.2.1 - Road posting (9/09)

The Purchaser is responsible for posting and maintaining caution signs on Sunterra Trail and Erickson Rd prior to beginning operations. The road must be posted at appropriate distances from the sale area to warn of logging activity and truck traffic. Signs must be removed when harvest operations are suspended or completed. The Purchaser will provide these signs.

Existing state roads are legal accesses for private homes adjacent to state land. Roads will be left in drivable condition for health and safety.



TIMBER SALE MAP

This information provided by authority of Part 525, 1994 PA 451, as amended.

Forest Management Unit Gaylord	County Charlevoix	Mapped By Matt Foster	Date 9/24/2020	Page 1	of 1
Township 33N	Range 06W	Section(s) and Subdivision(s) Sec. 10: NESE; Sec. 11: SWNW, W1/2SW	Scale 1:15,840		

Cover Type				Density			
A = Aspen	H = Hemlock	N = Marsh	U = Upland Brush	0 = Non Stocked	5 = Pole Timber Medium		
B = Paper Birch	J = Jack Pine	O = Oak	UM = Upland Mixed	1 = Seedling Sapling Poor	6 = Pole Timber Well		
C = Cedar	L = Lowland Brush	P = Lowland Poplar	V = Bog or Marsh	2 = Seedling Sapling Medium	7 = Saw Timber Poor		
D = Treed Bog	LM = Lowland Mixed	Q = Mixed Swamp Conifer	W = White Pine	3 = Seedling Sapling Well	8 = Saw Timber Medium		
E = Swamp Hdwoods	M = Mpl, Bch, Brch	R = Red Pine	X = Non Stocked	4 = Pole Timber Poor	9 = Saw Timber Well		
F = Spruce Fir	MC = Mixed Conifer	S = Black Spruce	Z = Water				
G = Grass	MD = Mixed Deciduous	T = Tamarack					

PU	Acres
1	33.9
2	28.5

Safari Hardwoods

Compartment 38
62.4 Acres

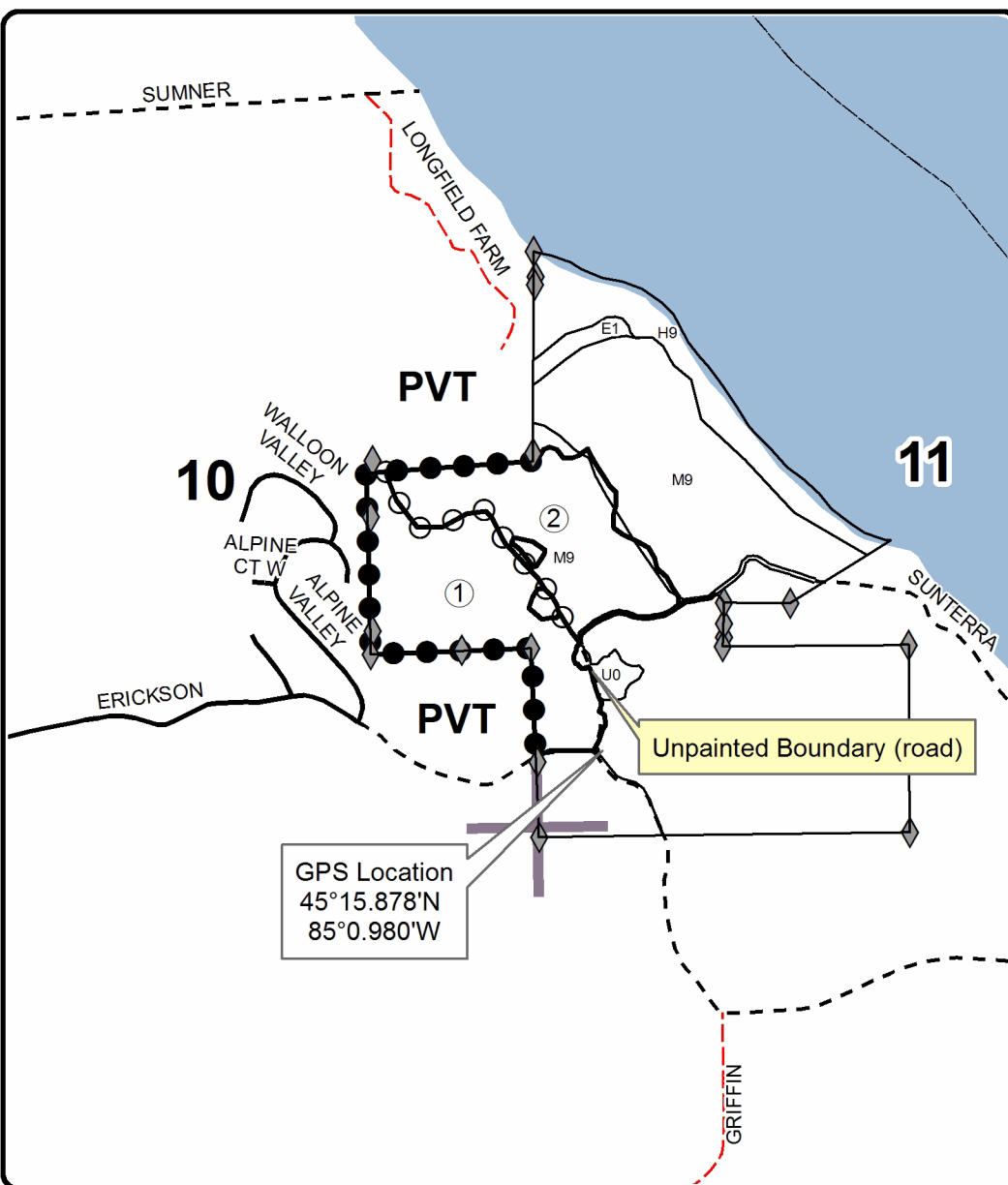
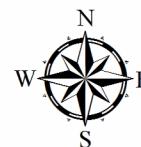

Legend

- Sale Boundary (Red)
- Payment Unit (Yellow)
- Private Line (Blue)
- Stand Boundaries
- ◆ Field Grade Corners
- Secondary Forest Road
- Paved Road
- Gravel Road
- County Road - Seasonal
- Lakes and Rivers
- Section Corners
- PU_Label

Locator Map
1:200,000

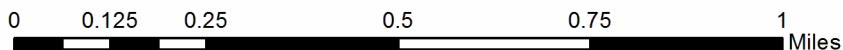
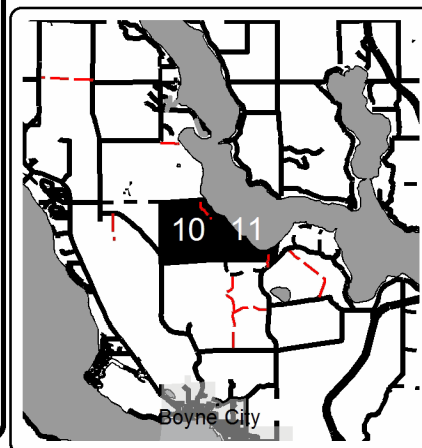

Marshmallow Mix (52-021-20)
T30N, R02W, SEC. 29; T30N, R02W, SEC. 30; Otsego COUNTY

In response to the notice of sale to be held 3:00 p.m. (local time) on February 25, 2021, I am hereby submitting my sealed bid (firm offer) for the following forest products to be cut. Bids for individual species must be at or above the advertised price. All non-responsive bid forms may be rejected.

<u>PRODUCTS & SPECIES</u>	<u>ESTIMATED VOLUME*</u>	<u>ADVERTISED PRICE</u>	<u>BID PRICE/UNIT</u>
Sawtimber			
Bl/R/Hybrid Oak	3.5 MBF	\$ 61.00/MBF	\$ _____
Mixed Aspen	86.5 MBF	\$ 44.00/MBF	\$ _____
Red Maple	30.8 MBF	\$ 50.00/MBF	\$ _____
Red Pine	133.3 MBF	\$ 85.00/MBF	\$ _____
White Pine	142.0 MBF	\$ 26.00/MBF	\$ _____
Pulpwood			
Balsam Fir	50 Cords	\$ 13.10/Cord	\$ _____
Bl/R/Hybrid Oak	11 Cords	\$ 10.50/Cord	\$ _____
Mixed Aspen	303 Cords	\$ 12.95/Cord	\$ _____
Mixed Hardwood	188 Cords	\$ 15.70/Cord	\$ _____
Paper Birch	8 Cords	\$ 7.65/Cord	\$ _____
Red Pine	95 Cords	\$ 34.15/Cord	\$ _____
White Pine	354 Cords	\$ 13.30/Cord	\$ _____

*The volumes are statistically estimated within plus (+) or minus (-) 18.74 percent at 95% confidence level. These estimated volumes are final and not subject to adjustment. Prospective bidders are urged to examine this timber and to make their own estimates of quantity and quality.

I understand that any or all bids may be rejected. All bids must be signed and all bid items must be bid or the bid form may be rejected. I also understand that consideration and awarding a contract will be based upon my past performance and ability to complete the contract based upon equipment and staffing subject to my control.

FEDERAL ID: ____ - ____ - ____ or SOCIAL SECURITY NUMBER: ____ - ____ - ____

Company or individual bidding: _____

Company representative's name: _____

Address: _____

City: _____ State: _____ Zip: _____

IF AVAILABLE, PLEASE PLACE THE PERSONALIZED LABEL FROM YOUR PROSPECTUS IN THE ABOVE BOX.

Individual or company representative's signature: _____ Date: _____

Phone number : _____ Email (optional): _____

THE WINNING BIDDER MUST COMPLETE THE VERIFICATION OF WORKER'S DISABILITY COMPENSATION ACT COMPLIANCE (ON REVERSE SIDE IF DOUBLE SIDED) WITHIN 21 DAYS OF SALE AWARD DATE



FOR DEPARTMENT USE ONLY
Sale Number (XX – XXX – XX – XX)
Forest Management Unit:

TIMBER SALE VERIFICATION OF WORKER'S DISABILITY COMPENSATION ACT COMPLIANCE

*As required by Act 317, P.A. 1969 (Worker's Compensation) and
Part 5 of Act 451 of 1994, as amended.*

VERIFICATION OF WORKER'S DISABILITY COMPENSATION ACT COMPLIANCE

- This verification must be completed and submitted within 21 days of contract award and prior to the issuance of the timber sale contract.
- In addition, if boxes 2B or 2C are checked, then Notice of Exclusion or Certificate of Insurance must be submitted within twenty-one (21) days of the contract award and prior to the issuance of the timber sale contract.
- All information must be typed or printed except for written signatures.

Please Check Appropriate Categories:

1. My business is organized as (you **must** check one of the boxes below):
 - A. Sole Proprietorship (individual)
 - B. Partnership
 - C. Corporation
2. You **must** check one of the boxes below:
 - A. I certify my business is a sole proprietorship and it has no employees but the sole proprietor. I am not subject to the Worker's Compensation Laws.
 - B. I certify my business has satisfied its obligation to the Worker's Compensation Act through the use of an approved Notice of Exclusion (BWC-337, Rev. 5/96). I will provide a copy of the Notice of Exclusion within 21 days of the contract award. (For questions or a copy of the BWC-337, please call the Worker's Compensation Bureau at 517-322-1195).
 - C. I certify my business has a Worker's Compensation Policy. I will provide an original Certificate of Insurance within twenty-one (21) days of the contract award.
3. If you have checked item 2(A) or 2(B), you **must** indicate the number of **both** full-time and part-time employees, other than yourself, including family members and active partners (if none, you must enter "0").

_____ Full-time Employees

_____ Part-time Employees

Name of Business		Federal ID (or) Social Security No.	
Address		Telephone ()	
City	State	ZIP	

I hereby certify that the above information is true and correct. I agree to notify the Michigan DNR of any changes that occur in factors affecting my coverage during any of my present and future operations.

Signature of Owner or Authorized Representative

Title

Date

Please complete the "SEALED BID" information on the next page

Poplar Pine (52-025-20)
T29N, R02W, SEC. 5; Otsego COUNTY

In response to the notice of sale to be held 3:00 p.m. (local time) on February 25, 2021, I am hereby submitting my sealed bid (firm offer) for the following forest products to be cut. Bids for individual species must be at or above the advertised price. All non-responsive bid forms may be rejected.

<u>PRODUCTS & SPECIES</u>	<u>ESTIMATED VOLUME*</u>	<u>ADVERTISED PRICE</u>	<u>BID PRICE/UNIT</u>
Sawtimber			
Mixed Aspen	57.5 MBF	\$ 44.00/MBF	\$ _____
Red Pine	22.1 MBF	\$ 85.00/MBF	\$ _____
White Pine	12.2 MBF	\$ 26.00/MBF	\$ _____
Pulpwood			
Balsam Fir	44 Cords	\$ 13.10/Cord	\$ _____
Jack Pine	2 Cords	\$ 10.20/Cord	\$ _____
Mixed Aspen	258 Cords	\$ 12.95/Cord	\$ _____
Mixed Hardwood	70 Cords	\$ 15.70/Cord	\$ _____
Paper Birch	29 Cords	\$ 7.65/Cord	\$ _____
Red Pine	25 Cords	\$ 34.15/Cord	\$ _____
White Pine	140 Cords	\$ 13.30/Cord	\$ _____

*The volumes are statistically estimated within plus (+) or minus (-) 18.92 percent at 95% confidence level. These estimated volumes are final and not subject to adjustment. Prospective bidders are urged to examine this timber and to make their own estimates of quantity and quality.

I understand that any or all bids may be rejected. All bids must be signed and all bid items must be bid or the bid form may be rejected. I also understand that consideration and awarding a contract will be based upon my past performance and ability to complete the contract based upon equipment and staffing subject to my control.

FEDERAL ID: _____ - _____ or SOCIAL SECURITY NUMBER: _____ - _____ - _____

Company or individual bidding: _____

Company representative's name: _____

Address: _____

City: _____ State: _____ Zip: _____

IF AVAILABLE, PLEASE PLACE THE PERSONALIZED LABEL FROM YOUR PROSPECTUS IN THE ABOVE BOX.

Individual or company representative's signature: _____ Date: _____

Phone number : _____ Email (optional): _____

THE WINNING BIDDER MUST COMPLETE THE VERIFICATION OF WORKER'S DISABILITY COMPENSATION ACT COMPLIANCE (ON REVERSE SIDE IF DOUBLE SIDED) WITHIN 21 DAYS OF SALE AWARD DATE



FOR DEPARTMENT USE ONLY
Sale Number (XX - XXX - XX - XX)
Forest Management Unit:

TIMBER SALE VERIFICATION OF WORKER'S DISABILITY COMPENSATION ACT COMPLIANCE

*As required by Act 317, P.A. 1969 (Worker's Compensation) and
Part 5 of Act 451 of 1994, as amended.*

VERIFICATION OF WORKER'S DISABILITY COMPENSATION ACT COMPLIANCE

- This verification must be completed and submitted within 21 days of contract award and prior to the issuance of the timber sale contract.
- In addition, if boxes 2B or 2C are checked, then Notice of Exclusion or Certificate of Insurance must be submitted within twenty-one (21) days of the contract award and prior to the issuance of the timber sale contract.
- All information must be typed or printed except for written signatures.

Please Check Appropriate Categories:

1. My business is organized as (you **must** check one of the boxes below):
 - A. Sole Proprietorship (individual)
 - B. Partnership
 - C. Corporation

2. You **must** check one of the boxes below:
 - A. I certify my business is a sole proprietorship and it has no employees but the sole proprietor. I am not subject to the Worker's Compensation Laws.
 - B. I certify my business has satisfied its obligation to the Worker's Compensation Act through the use of an approved Notice of Exclusion (BWC-337, Rev. 5/96). I will provide a copy of the Notice of Exclusion within 21 days of the contract award. (For questions or a copy of the BWC-337, please call the Worker's Compensation Bureau at 517-322-1195).
 - C. I certify my business has a Worker's Compensation Policy. I will provide an original Certificate of Insurance within twenty-one (21) days of the contract award.

3. If you have checked item 2(A) or 2(B), you **must** indicate the number of **both** full-time and part-time employees, other than yourself, including family members and active partners (if none, you must enter "0").

_____ Full-time Employees

_____ Part-time Employees

Name of Business		Federal ID (or) Social Security No.	
Address		Telephone ()	
City	State	ZIP	

I hereby certify that the above information is true and correct. I agree to notify the Michigan DNR of any changes that occur in factors affecting my coverage during any of my present and future operations.

Signature of Owner or Authorized Representative

Title

Date

Please complete the "SEALED BID" information on the next page

Safari Hardwoods (52-027-20)
T33N, R06W, SEC. 10; T33N, R06W, SEC. 11; Charlevoix COUNTY

In response to the notice of sale to be held 3:00 p.m. (local time) on February 25, 2021, I am hereby submitting my sealed bid (firm offer) for the following forest products to be cut. Bids for individual species must be at or above the advertised price. All non-responsive bid forms may be rejected.

<u>PRODUCTS & SPECIES</u>	<u>ESTIMATED VOLUME*</u>	<u>ADVERTISED PRICE</u>	<u>BID PRICE/UNIT</u>
Sawtimber			
Basswood	74.8 MBF	\$ 36.00/MBF	\$ _____
Red Maple	11.6 MBF	\$ 50.00/MBF	\$ _____
Sugar Maple	60.6 MBF	\$ 236.00/MBF	\$ _____
Pulpwood			
Basswood	166 Cords	\$ 5.55/Cord	\$ _____
Misc. Species 1	12 Cords	\$ 5.50/Cord	\$ _____
Mixed Hardwood	268 Cords	\$ 15.70/Cord	\$ _____
Quaking Aspen	23 Cords	\$ 12.95/Cord	\$ _____

*The volumes are statistically estimated within plus (+) or minus (-) 13.57 percent at 95% confidence level. These estimated volumes are final and not subject to adjustment. Prospective bidders are urged to examine this timber and to make their own estimates of quantity and quality.

I understand that any or all bids may be rejected. All bids must be signed and all bid items must be bid or the bid form may be rejected. I also understand that consideration and awarding a contract will be based upon my past performance and ability to complete the contract based upon equipment and staffing subject to my control.

FEDERAL ID: _____ or SOCIAL SECURITY NUMBER: _____
 Company or individual bidding: _____
 Company representative's name: _____
 Address: _____
 City: _____ State: _____ Zip: _____

IF AVAILABLE, PLEASE PLACE THE PERSONALIZED LABEL FROM YOUR PROSPECTUS IN THE ABOVE BOX.

Individual or company representative's signature: _____ Date: _____
Phone number : _____ Email (optional): _____

THE WINNING BIDDER MUST COMPLETE THE VERIFICATION OF WORKER'S DISABILITY COMPENSATION ACT COMPLIANCE (ON REVERSE SIDE IF DOUBLE SIDED) WITHIN 21 DAYS OF SALE AWARD DATE



FOR DEPARTMENT USE ONLY
Sale Number (XX - XXX - XX - XX)
Forest Management Unit:

TIMBER SALE VERIFICATION OF WORKER'S DISABILITY COMPENSATION ACT COMPLIANCE

*As required by Act 317, P.A. 1969 (Worker's Compensation) and
Part 5 of Act 451 of 1994, as amended.*

VERIFICATION OF WORKER'S DISABILITY COMPENSATION ACT COMPLIANCE

- This verification must be completed and submitted within 21 days of contract award and prior to the issuance of the timber sale contract.
- In addition, if boxes 2B or 2C are checked, then Notice of Exclusion or Certificate of Insurance must be submitted within twenty-one (21) days of the contract award and prior to the issuance of the timber sale contract.
- All information must be typed or printed except for written signatures.

Please Check Appropriate Categories:

1. My business is organized as (you **must** check one of the boxes below):
 - A. Sole Proprietorship (individual)
 - B. Partnership
 - C. Corporation
2. You **must** check one of the boxes below:
 - A. I certify my business is a sole proprietorship and it has no employees but the sole proprietor. I am not subject to the Worker's Compensation Laws.
 - B. I certify my business has satisfied its obligation to the Worker's Compensation Act through the use of an approved Notice of Exclusion (BWC-337, Rev. 5/96). I will provide a copy of the Notice of Exclusion within 21 days of the contract award. (For questions or a copy of the BWC-337, please call the Worker's Compensation Bureau at 517-322-1195).
 - C. I certify my business has a Worker's Compensation Policy. I will provide an original Certificate of Insurance within twenty-one (21) days of the contract award.
3. If you have checked item 2(A) or 2(B), you **must** indicate the number of **both** full-time and part-time employees, other than yourself, including family members and active partners (if none, you must enter "0").

_____ Full-time Employees

_____ Part-time Employees

Name of Business		Federal ID (or) Social Security No.	
Address		Telephone ()	
City	State	ZIP	

I hereby certify that the above information is true and correct. I agree to notify the Michigan DNR of any changes that occur in factors affecting my coverage during any of my present and future operations.

Signature of Owner or Authorized Representative

Title

Date

Please complete the "SEALED BID" information on the next page