



**DEPARTMENT OF NATURAL RESOURCES
STATE OF MICHIGAN**

TIMBER SALE PROSPECTUS #6834

SCHEDULED SALE DATE AND TIME: 3:00 p.m. (local time) on March 15, 2021.

LOCATION: ESCANABA MGMT UNIT, 6833 HWY'S 2, 41 & M-35, GLADSTONE, MI 49837.

PROSPECTUS NOTE: The bidder is advised to inspect the sale area and review the location, estimated volumes, operating costs and contract terms of proposed sales. Please be aware that some landowners may request 60 days or more notice for access across their land.

Notice is hereby given that bids will be received by the Unit Manager, ESCANABA MANAGEMENT UNIT, for certain timber on the following described lands:

Highway Cleanup (33-021-21) / T35N, R25W, SEC. 13, SWSW.

T35N, R25W, SEC. 14, E1/2SE.

T35N, R25W, SEC. 23, S1/2NW,E1/2NE,N1/2SW.

Menominee County, Advertised Price \$21,093.10, 62.9 Acres, Hardwood, Spruce/Fir/Tamarack.

SALE NOTE: Spruce budworm is present and is causing balsam fir and spruce defoliation. Emerald ash borer may be causing ash mortality within Payment Units 3 and 4. There is an active eagles nest in Payment Unit 1, so the period of time harvesting activities can occur is limited.

Old Mill Mix (33-022-21) / T35N, R25W, SEC. 12, SWSW.

T35N, R25W, SEC. 13, NW,W1/2NE,N1/2SW,SESW.

T35N, R25W, SEC. 14, NESE.

Menominee County, Advertised Price \$49,144.10, 194.1 Acres, Hardwood, Spruce/Fir/Tamarack.

SALE NOTE: Emerald ash borer is close to this sale, if not currently within it. The Purchaser should harvest this sale as soon as possible to prevent any loss of forest products. There is an old township landfill within Payment Unit 11 that needs to be protected. The access gates will be unlocked prior to the bid opening.

Limpert South (33-004-20) / T36N, R24W, SEC. 5 , NENW.

T37N, R24W, SEC. 31, E1/2NW,NE.

T37N, R24W, SEC. 32, W1/2NW,NWSW,SESW.

T37N, R24W, SEC. 33, NENW,S1/2NW,N1/2NE,N1/2SW,SWSE.

Delta County, Advertised Price \$41,280.95, 149.4 Acres, Hardwood, Spruce/Fir/Tamarack.

SALE NOTE: If access through private property is not possible, access to the north end of Payment Unit 9 is possible via creation of a winter road from Limpert Road.

A recreation site such as a trail, pathway, or campground is within the sale area or the vicinity. Certain restrictions/specifications may be applicable including time restrictions. Access may be through private land.

BID INSTRUCTIONS (VER. 07/02/2018):

1. Scheduled Bid Location, Date, and Time (2/11)

Bids must be received by the Unit Manager, ESCANABA OFFICE, 6833 Hwy's 2, 41 & M-35, Gladstone, MI 49837, no later than 3:00 p.m. (local time) on March 15, 2021. For further information concerning this sale, contact Eric Thompson at 906-789-8231.

2. Bidder's Qualifications (5/16)

Purchaser shall obtain workers compensation insurance to cover claims under Michigan's Worker's Disability Compensation Act of 1969 or similar employee benefit act of any other state applicable to an employee. If all or part of a timber sale was prepared by a private contractor, the contractor and that contractor's company are not permitted to bid on the timber sale contract. Bids will not be accepted from individuals or companies appearing on the DNR/FRD No-Bid List. This list contains the names of purchasers who previously failed to execute a contract within 21-days or who have a history of poor performance.

3. Preparation of Sealed Bids (5/16)

Bid Forms may be completed online thru Michigan DNR Timber Sale Online Bidding (OLB) at www.michigan.gov/timberbidding or by completing the hardcopy Bid Form found in the Timber Sale Prospectus. Hardcopy Bid Forms shall be manually signed in ink. Registration in OLB is considered your 'signature' for all bids submitted thru that system. Bid prices must be entered for each species and product in the Bid Price column for all material subject to bidding and all fill-in blanks must be completed. If erasures or other changes appear on the hardcopy Bid Form, each erasure or change must be initialed by the person signing the bid.

4. Submission of Sealed Bids (5/16)

Bid forms may be obtained from the Unit Manager or thru OLB. Bids may be submitted hardcopy or thru OLB. All hardcopy bids must be submitted on the bid form and in an envelope clearly identified as described in this section. NOTE: Only one bid form per bid envelope. Sealed bids must be submitted to the Unit office designated in the prospectus and must be submitted at or prior to the time established in the prospectus. The envelope should show on the outside (a) the sale name or number and (b) the date and time of bid opening, as shown in the prospectus. Bids received after the time specified in the sale prospectus are late bids and will be rejected.

It is possible for a bidder to submit multiple bids on a single sale. For example, a bid may be submitted hardcopy and a bid may be submitted thru OLB. Or, two bidders from the same company could both submit bids on the same sale. If this were to happen, the State would accept all bids received and award the contract accordingly. All bidding and contractual requirements would apply to all bids received.

5. Public Opening of Sealed Bids (7/16)

If conditions permit, the sealed bids will be publicly opened and posted at the time and place set in the prospectus.

If a bidder, present at a bid opening, has submitted bids on more than one sale, that bidder may withdraw their unopened bid envelopes or announce the withdrawal of their online bid after being declared the successful bidder on one sale.

6. Award of Contract (1/11)

Award of the contract will be made to the Bidder whose bid, conforming to the prospectus, is most advantageous to the State of Michigan on the basis of total value at rates bid for the estimated quantities. The State reserves the right to reject any bid or waive any minor irregularity in bids received. A written award mailed (or otherwise furnished) to the successful Bidder shall be deemed to result in a binding contract without further action by either party.

7. Down Payment (1/11)

The Bidder to whom award is made must make a down payment within 21 days of the sale award. The amount of the down payment will be calculated as shown in the Bond and Payment Schedule of this prospectus. Only cash may be used to meet this requirement.

8. Performance Security (1/11)

As guarantee of faithful performance, a cash bond, certificate of deposit, surety bond or irrevocable letter of credit (LOC) is required within 21 days of the sale award. The amount of the performance security is shown in the Bond and

Payment Schedule of this prospectus. If an LOC or surety is used, the coverage must extend for at least 6 months beyond the contract expiration.

9. Timber Sale Contract (7/18)

Additional conditions and requirements common to all timber sales are listed on the timber sale contract (R4031) and are available on line at www.michigan.gov/timber. Contact the Unit Manager for additional information or a sample contract. Within 21 days of the date of the award letter, the bidder must sign the contract and provide the required down payment, performance security, and verification of worker's disability compensation. The down payment and performance security shall be in accordance with the provisions of the timber sale contract, in the sums stated in this prospectus. If these actions are not taken, then the Bidder, the Bidder's corporation, and the corporation's principals may not be permitted to bid on State timber sales for a period of 3 months after the first offense, 6 months after the second offense, and 1 year after the third offense. An offense will only be counted against the Bidder for 5 years. In addition, the Bidder certifies that if awarded this contract, the Bidder will complete the timber sale contract in accordance with its terms and any modifications thereof including requirements to purchase, cut, and remove the included timber by the expiration date.

Payment Unit values in the State Forest Timber Sale Contract are calculated based on the advertised value of the Payment Unit as a percentage of the total advertised value of the contract. The advertised value of each Payment Unit is given in the Description of Timber by Payment Unit table on the Timber Sale Information page. For example, if the value of Payment Unit 1 is advertised as \$1,500 and the total Timber Sale value is advertised as \$10,000, the contract price for Payment Unit 1 will be 15% of the total bid price ($\$1,500/\$10,000 * 100$).

10. Disclaimer of Estimates and Bidder's Warranty of Inspection (7/16)

Before submitting this bid, the Bidder is advised and cautioned to inspect the sale area, review the requirements of the sale contract, and take other steps as may be reasonably necessary to ascertain the location, estimated volumes, construction estimates, and operating costs of the proposed sale. Failure to do so will not relieve the Bidder from responsibility for completing the contract.

The Bidder warrants that this bid is submitted solely on the basis of the Bidder's examination and inspection of the quality and quantity of the timber offered for sale and the Bidder's opinion of the value thereof and the costs of recovery. No reliance should be placed on the State of Michigan's estimates of timber quality, quantity or costs of recovery. Bidder further acknowledges that the State of Michigan: (i) expressly disclaims any warranty of fitness of timber for any purpose; (ii) offers this timber as is without any warranty of quality (merchantability) or quantity and (iii) expressly disclaims any warranty as to the quantity or quality of timber sold.

11. Certification and Chain-of-Custody (10/14)

Unless otherwise indicated in the contract under section 7 – Other Conditions of the Sale Specific Conditions & Requirements, the area encompassed by this timber sale is certified to the standards of the Forest Stewardship Council (FSC) - Certificate #SCS-FM/COC-00090N and the Sustainable Forestry Initiative (SFI) - Certificate #NSF-SFIS-5Y031-SF5. Forest products from this sale may be delivered to the mill as "FSC 100% and / or SFI certified" as long as the contractor hauling the forest products is chain-of-custody (COC) certified or covered under a COC certificate from the destination mill. The purchaser is responsible for maintaining COC after leaving the sale area.

12. Good Neighbor Authority (GNA) Requirements (7/16)

If the name of this timber sales contains the acronym GNA, it is authorized by the Good Neighbor Authority (GNA) and covered by various agreements between the U.S. Forest Service and the State. The timber sale occurs on federal land and the following conditions apply:

GNA contracts on US Forest Service land will not be awarded to purchasers on the Federal list of excluded parties. The System for Award Management (SAM) will be checked for active excluded parties prior to award of contract. In addition, the Bidder to whom award is made must complete an Assurance Regarding Felony Conviction or Tax Delinquent Status for Corporate Applicants (AD-3031).

13. Good Neighbor Authority (GNA) Requirements, con't (9/16)

Bidder certifies, by signing this bid form, that to the best of Bidder's knowledge that the following representations are accurate and complete.

- a. That the Bidder and its principals are not presently debarred, suspended, proposed for debarment, declared ineligible, or voluntary excluded from timber sales (covered transactions) by any Federal department or agency.
- b. That the Bidder and its principals have not within a 3-year period preceding this bid been convicted of or had a civil judgment rendered against them for commission of fraud or a criminal offense in connection with obtaining , attempting to obtain, or performing a public (Federal, State, or local) transaction or contract under a public transaction; violation of Federal or State antitrust statutes or commission of embezzlement, theft, forgery, bribery, falsification or destruction of records, making false statements, or receiving stolen property.
- c. That the Bidder and its principals are not presently indicted for or otherwise criminally or civilly charged by a governmental entity (Federal, State, or local) with commission of any of the offenses enumerated in paragraph b of this certification.
- d. That the Bidder and its principals have not within a 3-year period preceding this bid had one or more public transactions (Federal, State, or local) terminated for breach or default of a timber or forest product contract.

Bidders that cannot certify this requirement, in whole or in part, shall submit an explanation with their bid.

DAN EICHINGER
Director

TIMBER SALE INFORMATION

Highway Cleanup (33-021-21)

T35N, R25W, SEC. 13; T35N, R25W, SEC. 14; T35N, R25W, SEC. 23.
Menominee County (Advertised Price \$21,093.10)

SALE NOTE: Spruce budworm is present and is causing balsam fir and spruce defoliation. Emerald ash borer may be causing ash mortality within Payment Units 3 and 4. There is an active eagles nest in Payment Unit 1, so the period of time harvesting activities can occur is limited.

A timber sale contract for this lump sum, sealed bid timber sale will be awarded to the responsible bidder offering the highest sealed bid price. All units of volume listed below were estimated using the T-Sale computer program and our traditional volume equations. Bids must be at or above the following advertised price for each product and species:

<u>PRODUCTS & SPECIES</u>	<u>ESTIMATED UNITS*</u>	<u>ADVERTISED PRICE</u>
Sawtimber		
Green Ash	39.9 MBF	\$ 54.00 / MBF
Paper Birch	2.0 MBF	\$ 57.00 / MBF
Red Maple	7.0 MBF	\$ 76.00 / MBF
Pulpwood		
Balsam Fir	113 Cords	\$ 13.45 / Cord
Mixed Hardwood	783 Cords	\$ 17.45 / Cord
Mixed Spruce	67 Cords	\$ 14.65 / Cord
N. White Cedar	168 Cords	\$ 11.50 / Cord
Quaking Aspen	6 Cords	\$ 17.65 / Cord
Tamarack	6 Cords	\$ 12.05 / Cord
White Pine	1 Cords	\$ 17.55 / Cord

* The total volume is statistically estimated within plus (+) or minus (-) 14.38 percent. There are an estimated 1,240 cords on this timber sale, plus or minus 178 cords at the 95% confidence level. The estimated units are final and not subject to adjustment. Prospective bidders are urged to examine this timber and to make their own estimates of quantity and quality.

BOND AND PAYMENT SCHEDULE:

1. A bond in the amount of \$1,055.00 to insure faithful performance of the conditions of the contract will be deposited by the successful bidder within 21 days of the sale award.
2. Cutting in any sale or unit without the required advance payment would be considered a trespass.
3. Total payment must be paid in advance or according to the following schedule :
 - (a) Ten percent (10%) of the sale value must be paid within 21 days of the sale award.
 - (b) The 10% down payment will be credited towards the first unit cut.
 - (c) Payment for each of the following units must be made before cutting begins in that unit:

PAYMENT UNIT NUMBER	PERCENT OF TOTAL SALE VALUE
01	12.4%
02	39.3%
03	24.3%
04	24.0%

4. If no cutting takes place, the 10% down payment will not be refunded.
5. Operations on the contract issued will terminate on 06/30/2024.

SALE STATISTICS

SALE VOLUMES

VOLUME		STATISTICAL RANGE IN CORDS		
TOTAL CUBIC FEET	TOTAL CORDS	PERCENT ERROR	MINIMUM	MAXIMUM
97,929	1,240	14.38%	1,061	1,418

VDU VOLUMES

A VDU is a Volume Determination Unit. Volumes and their associated statistics are calculated at the VDU level and summarized to the sale level. There is often a one to one relationship between a VDU and a Payment Unit, but not always, depending on the cruise design. Refer to the VDU TO PAYMENT UNIT table.

VDU	VOLUME		PERCENT ERROR	RANGE IN CORDS	
	TOTAL CUBIC FEET	TOTAL CORDS		MINIMUM	MAXIMUM
44	13,817	175	33.09%	117	233
50	37,881	480	24.08%	364	595
60	92,509	1,171	21.00%	925	1,417
TOTAL:	144,207	1,825		1,406	2,245

VDU TO PAYMENT UNIT

When a VDU is associated with more than one Payment Unit (PU), the VDU volumes are assigned to the PU based on acres of the VDU within the PU.

VDU	VDU ACRES	PU	PU ACRES
44	16.1	1	16.1
50	16.5	2	16.5
60	30.3	3	15.2
		4	15.1
TOTAL:	62.9		62.9

DESCRIPTION OF TIMBER BY PAYMENT UNIT (PU)

PU	MARKET GROUP	PRODUCT	QUANTITY	UNIT	ACRES	ADVERTISE PRICE
1	Balsam Fir	Pulpwood	86	Cords	16.1	\$2,625.85
	Mixed Hardwood		58	Cords		
	<i>Balsam Poplar</i>		28	<i>Cords</i>		
	<i>Black Ash</i>		2	<i>Cords</i>		
	<i>Green Ash</i>		1	<i>Cords</i>		
	<i>Paper Birch</i>		24	<i>Cords</i>		
	<i>Red Maple</i>		3	<i>Cords</i>		
	Mixed Spruce		30	Cords		
	<i>White Spruce</i>		30	<i>Cords</i>		
	White Pine		1	Cords		
	2		Green Ash	Sawtimber		
Paper Birch		2.0	MBF			
Red Maple		4.8	MBF			
Balsam Fir		Pulpwood	24	Cords		
Mixed Hardwood			304	Cords		
<i>Balsam Poplar</i>			8	<i>Cords</i>		
<i>Black Ash</i>			38	<i>Cords</i>		
<i>Green Ash</i>			90	<i>Cords</i>		
<i>Paper Birch</i>			53	<i>Cords</i>		
<i>Red Maple</i>			107	<i>Cords</i>		
<i>Sugar Maple</i>			2	<i>Cords</i>		
<i>Yellow Birch</i>			6	<i>Cords</i>		
Mixed Spruce			23	Cords		
<i>Black Spruce</i>			4	<i>Cords</i>		
<i>White Spruce</i>			19	<i>Cords</i>		
N. White Cedar			82	Cords		
Tamarack			2	Cords		
3	Green Ash	Sawtimber	11.9	MBF	15.2	\$5,126.60
	Red Maple		1.1	MBF		
	Balsam Fir	Pulpwood	2	Cords		
	Mixed Hardwood		212	Cords		
	<i>Balsam Poplar</i>		6	<i>Cords</i>		
	<i>Black Ash</i>		16	<i>Cords</i>		
	<i>Black Cherry</i>		1	<i>Cords</i>		
	<i>Green Ash</i>		150	<i>Cords</i>		
	<i>Paper Birch</i>		9	<i>Cords</i>		
	<i>Red Maple</i>		18	<i>Cords</i>		
	<i>Yellow Birch</i>		12	<i>Cords</i>		
	Mixed Spruce		7	Cords		
	<i>Black Spruce</i>		4	<i>Cords</i>		
	<i>White Spruce</i>		3	<i>Cords</i>		
	N. White Cedar		43	Cords		
	Quaking Aspen		3	Cords		
Tamarack	2	Cords				
4	Green Ash	Sawtimber	11.9	MBF	15.1	\$5,060.80
	Red Maple		1.1	MBF		
	Balsam Fir	Pulpwood	1	Cords		
	Mixed Hardwood		209	Cords		
	<i>Balsam Poplar</i>		6	<i>Cords</i>		
	<i>Black Ash</i>		15	<i>Cords</i>		
	<i>Black Cherry</i>		1	<i>Cords</i>		
	<i>Green Ash</i>		150	<i>Cords</i>		
	<i>Paper Birch</i>		9	<i>Cords</i>		
	<i>Red Maple</i>		17	<i>Cords</i>		
	<i>Yellow Birch</i>		11	<i>Cords</i>		
	Mixed Spruce		7	Cords		

DESCRIPTION OF TIMBER BY PAYMENT UNIT (PU), CON'T

PU	MARKET GROUP	PRODUCT	QUANTITY	UNIT	ACRES	ADVERTISE PRICE
4 con't	<i>Black Spruce</i>	<i>Pulpwood</i>	4	<i>Cords</i>		
	<i>White Spruce</i>		3	<i>Cords</i>		
	N. White Cedar		43	Cords		
	Quaking Aspen		3	Cords		
	Tamarack		2	Cords		
TOTAL:			48.9	MBF		
TOTAL:			1,144	Cords		

Sale Specific Conditions & Requirements

Sale Name: Highway Cleanup

Sale Number: 33-021-21 Seq#: 1

1 - Sale Area

1.2 - Boundaries

1.2.1 - Painted boundaries (9/19)

The sale boundary and Payment Unit boundaries are marked and identified by blue, red, and yellow paint. Exterior sale boundary lines against private property are marked with blue paint. Exterior sale boundary lines against state are marked with red paint. Interior Payment Unit boundaries are marked with yellow paint. Retention patches are marked with red paint; no harvesting activities may occur within these areas. The painted boundary line trees are not Included Timber and are to be protected. Yellow painted trees designating an interior Payment Unit boundary are only to be cut when all surrounding Payment Units have been paid for.

2 - Timber Specifications

2.1 - Included Timber

2.1.1 - Clearcut unit(s) with unmerchantable trees (6/14)

Within Payment Unit(s) 1 - 4, cut all trees that are three (3) inches or more at DBH. In addition, the following exceptions apply:

- Within Payment Unit 1, do not cut cedar, hemlock, or trees marked with green paint.
- Within Payment Unit 2, do not cut hemlock, cedar greater than twelve (12) inches at DBH, or white pine greater than twenty (20) inches at DBH.

3 - Payments

3.3 - Pre-measured Sales

3.3.4 - Dividing payment units (7/14)

Payment Unit(s) \$18,000 in value or greater may be divided at the request of the Purchaser and upon approval of the Unit Manager. Dividing Payment Units is a contract modification which requires a Timber Sale Contract Amendment. There will be only one division per Payment Unit.

4 - Transportation

4.2 - Maintenance

4.2.1 - Hauling restriction (12/08)

Hauling may be restricted on forest roads by the Unit Manager or his/her representative. The restriction may occur during spring breakup or during other wet weather conditions.

4.2.4 - Grading (10/16)

For completion of the sale, state forest roads must be graded. In general, this will require a road grader or bulldozer to shape up the roads after forest products have been hauled off site. This includes cleaning of drainage areas, grading, crowning and filling with gravel, if necessary. The grading equipment to be used must be approved by the Unit Manager or his/her representative.

4.3 - Public Right-of-Way

4.3.1 - MDOT R-O-W (11/14)

The Michigan Department of Transportation (MDOT) must be contacted prior to harvesting timber within the MDOT right-of-way. The Purchaser must contact Dan Kari with MDOT at 906-875-6644, a minimum of two weeks prior to harvesting Payment Units 3 and 4. There may be certain restrictions on accessing these Payment Units off of M-35 or signs being required along the highway. All requirements from MDOT will be followed.

4.4 - Access

4.4.3 - Access gate (12/08)

There is an access gate on the road into Payment Units 1 and 2. This gate should remain locked, except when there is active logging and hauling taking place. A key will be provided to the Purchaser.

5 - Operations

5.1 - Notification

5.1.6 - Utility R.O.W. (4/19)

It is the responsibility of the Purchaser to obtain permission from the utility company to utilize the power line and underground utilities R.O.W. for operations. There is a power line on the southern end of Payment Units 1 and 2. There is also an underground utility running through Payment Units 3 and 4.

5.2 - Conduct of Operations

5.2.3 - Operating Restrictions

5.2.3.1 - Operating restrictions (9/11)

Within Payment Unit(s) 2, 3 and 4, cutting and skidding are limited to the period of December 1 to March 31, unless there is an extended dry or frozen period and the sale administrator allows harvesting during that period of time. This restriction is because of areas of low wet ground within each of the Payment Units.

5.8 - Protection of Endangered Species

5.8.6 - Protection of eagle nests (5/12)

To protect an active eagle's nest, all harvesting operations within Payment Unit 1 are limited to the period of September 1 through December 31. Harvesting operations may be able to take place if the nest is not active in a given year and it is approved by the Unit Manager or his/her representative.

7 - Other Conditions

7.5 - Loss

7.5.1 - Deteriorating timber (7/09)

The sale area has received damage from spruce budworm and possibly emerald ash borer. The Purchaser should harvest the wood as soon as possible. The Department of Natural Resources is held free of responsibility of any further damage or deterioration due to delay in harvesting.



TIMBER SALE MAP

This information provided by authority of Part 525, 1994 PA 451, as amended.

Forest Management Unit Escanaba Management Unit	County Menominee County	Mapped By Beaudo	Date 11/2/2020	Page 1	of 1
Township 35N	Range 25W	Section(s) and Subdivision(s) Sec 13 - SWSW; Sec 14 - E1/2SE; Sec 23 - S1/2NW, E1/2NE, N1/2SW.	Scale 1:15,840		

Cover Type				Density	
A = Aspen	H = Hemlock	N = Marsh	U = Upland Brush	0 = Non Stocked	5 = Pole Timber Medium
B = Paper Birch	J = Jack Pine	O = Oak	UM = Upland Mixed	1 = Seedling Sapling Poor	6 = Pole Timber Well
C = Cedar	L = Lowland Brush	P = Lowland Poplar	V = Bog or Marsh	2 = Seedling Sapling Medium	7 = Saw Timber Poor
D = Treed Bog	LM = Lowland Mixed	Q = Mixed Swamp Conifer	W = White Pine	3 = Seedling Sapling Well	8 = Saw Timber Medium
E = Swamp Hdwoods	M = Mpl, Bch, Brch	R = Red Pine	X = Non Stocked	4 = Pole Timber Poor	9 = Saw Timber Well
F = Spruce Fir	MC = Mixed Conifer	S = Black Spruce	Z = Water		
G = Grass	MD = Mixed Deciduous	T = Tamarack			

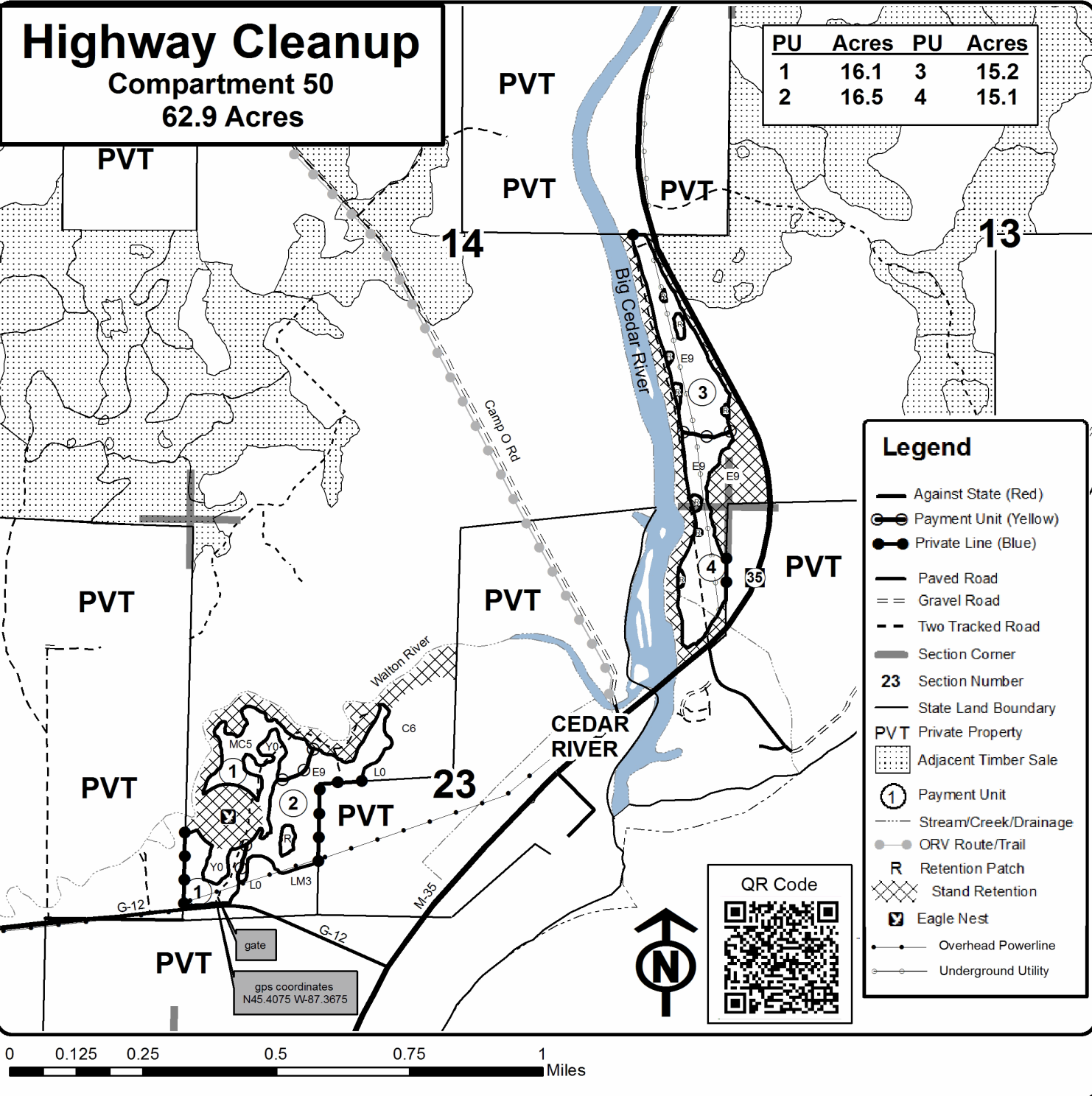

TIMBER SALE INFORMATION

Old Mill Mix (33-022-21)

T35N, R25W, SEC. 12; T35N, R25W, SEC. 13; T35N, R25W, SEC. 14.
Menominee County (Advertised Price \$49,144.10)

SALE NOTE: Emerald ash borer is close to this sale, if not currently within it. The Purchaser should harvest this sale as soon as possible to prevent any loss of forest products. There is an old township landfill within Payment Unit 11 that needs to be protected. The access gates will be unlocked prior to the bid opening.

A timber sale contract for this lump sum, sealed bid timber sale will be awarded to the responsible bidder offering the highest sealed bid price. All units of volume listed below were estimated using the T-Sale computer program and our traditional volume equations. Bids must be at or above the following advertised price for each product and species:

<u>PRODUCTS & SPECIES</u>	<u>ESTIMATED UNITS*</u>	<u>ADVERTISED PRICE</u>
Sawtimber		
Green Ash	7.0 MBF	\$ 54.00 / MBF
Red Maple	14.9 MBF	\$ 76.00 / MBF
Pulpwood		
Balsam Fir	345 Cords	\$ 13.45 / Cord
Mixed Aspen	290 Cords	\$ 17.65 / Cord
Mixed Hardwood	1,355 Cords	\$ 17.45 / Cord
Mixed Spruce	419 Cords	\$ 14.65 / Cord
N. White Cedar	267 Cords	\$ 11.50 / Cord
Tamarack	290 Cords	\$ 12.05 / Cord
White Pine	87 Cords	\$ 17.55 / Cord

* The total volume is statistically estimated within plus (+) or minus (-) 9.49 percent. There are an estimated 3,133 cords on this timber sale, plus or minus 297 cords at the 95% confidence level. The estimated units are final and not subject to adjustment. Prospective bidders are urged to examine this timber and to make their own estimates of quantity and quality.

BOND AND PAYMENT SCHEDULE:

1. A bond in the amount of \$2,457.00 to insure faithful performance of the conditions of the contract will be deposited by the successful bidder within 21 days of the sale award.
2. Cutting in any sale or unit without the required advance payment would be considered a trespass.
3. Total payment must be paid in advance or according to the following schedule :
 - (a) Ten percent (10%) of the sale value must be paid within 21 days of the sale award.
 - (b) The 10% down payment will be credited towards the first unit cut.
 - (c) Payment for each of the following units must be made before cutting begins in that unit:

PAYMENT UNIT NUMBER	PERCENT OF TOTAL SALE VALUE
01	3.0%
02	5.0%
03	15.7%
04	6.9%
05	5.6%
06	4.2%
07	2.7%
08	9.1%
09	14.2%
10	17.6%
11	16.0%

4. If no cutting takes place, the 10% down payment will not be refunded.
5. Operations on the contract issued will terminate on 06/30/2025.

SALE STATISTICS

SALE VOLUMES

VOLUME		STATISTICAL RANGE IN CORDS		
TOTAL CUBIC FEET	TOTAL CORDS	PERCENT ERROR	MINIMUM	MAXIMUM
247,517	3,133	9.49%	2,836	3,430

VDU VOLUMES

A VDU is a Volume Determination Unit. Volumes and their associated statistics are calculated at the VDU level and summarized to the sale level. There is often a one to one relationship between a VDU and a Payment Unit, but not always, depending on the cruise design. Refer to the VDU TO PAYMENT UNIT table.

VDU	VOLUME		PERCENT ERROR	RANGE IN CORDS	
	TOTAL CUBIC FEET	TOTAL CORDS		MINIMUM	MAXIMUM
62	7,450	94	23.36%	72	116
65	12,150	154	23.42%	118	190
66	36,711	465	20.70%	369	561
67	78,005	987	18.99%	800	1,175
68	9,654	122	35.10%	79	165
69	6,652	84	30.97%	58	110
71	33,852	429	30.84%	296	561
72	19,592	248	23.32%	190	306
710	164,873	2,087	19.16%	1,687	2,487
TOTAL:	368,938	4,670		3,670	5,671

VDU TO PAYMENT UNIT

When a VDU is associated with more than one Payment Unit (PU), the VDU volumes are assigned to the PU based on acres of the VDU within the PU.

VDU	VDU ACRES	PU	PU ACRES
62	8.2	1	8.2
65	13.2	2	13.2
66	30.3	3	30.3
67	42.0	4	23.2
		5	18.8
68	6.8	6	6.8
69	6.2	7	6.2
71	23.9	9	23.9
72	9.4	8	9.4
710	54.1	10	28.3
		11	25.8
TOTAL:	194.1		194.1

DESCRIPTION OF TIMBER BY PAYMENT UNIT (PU)

PU	MARKET GROUP	PRODUCT	QUANTITY	UNIT	ACRES	ADVERTISE PRICE
1	Balsam Fir	Pulpwood	8	Cords	8.2	\$1,494.45
	Mixed Hardwood		63	Cords		
	<i>Black Ash</i>		8	Cords		
	<i>Green Ash</i>		9	Cords		
	<i>Paper Birch</i>		5	Cords		
	<i>Red Maple</i>		26	Cords		
	<i>Yellow Birch</i>		15	Cords		
	N. White Cedar		25	Cords		
2	Balsam Fir	Pulpwood	9	Cords	13.2	\$2,442.35
	Mixed Hardwood		104	Cords		
	<i>Green Ash</i>		28	Cords		
	<i>Paper Birch</i>		4	Cords		
	<i>Red Maple</i>		63	Cords		
	<i>Yellow Birch</i>		9	Cords		
	Mixed Spruce		9	Cords		
	<i>Black Spruce</i>		9	Cords		
	N. White Cedar		28	Cords		
	White Pine		3	Cords		
	3		Mixed Hardwood	Pulpwood		
<i>Black Ash</i>		29	Cords			
<i>Green Ash</i>		170	Cords			
<i>Red Maple</i>		159	Cords			
<i>Yellow Birch</i>		39	Cords			
N. White Cedar		68	Cords			
4	Balsam Fir	Pulpwood	2	Cords	23.2	\$3,405.00
	Mixed Hardwood		8	Cords		
	<i>Paper Birch</i>		2	Cords		
	<i>Red Maple</i>		6	Cords		
	Mixed Spruce		69	Cords		
	<i>Black Spruce</i>		69	Cords		
	Tamarack		147	Cords		
	White Pine		26	Cords		
5	Balsam Fir	Pulpwood	2	Cords	18.8	\$2,766.55
	Mixed Hardwood		6	Cords		
	<i>Paper Birch</i>		1	Cords		
	<i>Red Maple</i>		5	Cords		
	Mixed Spruce		56	Cords		
	<i>Black Spruce</i>		56	Cords		
	Tamarack		120	Cords		
White Pine	21	Cords				
6	Red Maple	Sawtimber	0.8	MBF	6.8	\$2,065.35
	Balsam Fir	Pulpwood	4	Cords		
	Mixed Hardwood		104	Cords		
	<i>Black Ash</i>		5	Cords		
	<i>Green Ash</i>		4	Cords		
	<i>Paper Birch</i>		4	Cords		
	<i>Red Maple</i>		91	Cords		
	Mixed Spruce		3	Cords		
	<i>White Spruce</i>		3	Cords		
	N. White Cedar		8	Cords		
7	Red Maple	Sawtimber	0.5	MBF	6.2	\$1,315.80
	Balsam Fir	Pulpwood	2	Cords		
	Mixed Hardwood		12	Cords		
	<i>Red Maple</i>		8	Cords		
	<i>Yellow Birch</i>		4	Cords		

DESCRIPTION OF TIMBER BY PAYMENT UNIT (PU), CON'T

PU	MARKET GROUP	PRODUCT	QUANTITY	UNIT	ACRES	ADVERTISE PRICE
7 con't	N. White Cedar Tamarack White Pine	Pulpwood	10 23 37	Cords Cords Cords		
8	Green Ash Red Maple Balsam Fir Mixed Hardwood <i>Black Ash</i> <i>Green Ash</i> <i>Paper Birch</i> <i>Red Maple</i> <i>Yellow Birch</i> Mixed Spruce <i>White Spruce</i> N. White Cedar	Sawtimber Pulpwood	4.2 5.4 6 194 7 57 24 97 9 5 5 24	MBF MBF Cords Cords Cords Cords Cords Cords Cords Cords Cords Cords	9.4	\$4,452.45
9	Red Maple Balsam Fir Mixed Aspen <i>Balsam Poplar</i> Mixed Hardwood <i>Black Ash</i> <i>Paper Birch</i> <i>Red Maple</i> Mixed Spruce <i>Black Spruce</i> <i>White Spruce</i>	Sawtimber Pulpwood	2.9 139 4 4 250 3 104 143 31 20 11	MBF Cords Cords Cords Cords Cords Cords Cords Cords Cords Cords	23.9	\$6,977.20
10	Green Ash Red Maple Balsam Fir Mixed Aspen <i>B. T. Aspen</i> <i>Balsam Poplar</i> <i>Quaking Aspen</i> Mixed Hardwood <i>Black Ash</i> <i>Green Ash</i> <i>Paper Birch</i> <i>Red Maple</i> <i>Sugar Maple</i> <i>Yellow Birch</i> Mixed Spruce <i>Black Spruce</i> <i>White Spruce</i> N. White Cedar	Sawtimber Pulpwood	1.5 2.8 90 150 19 47 84 113 22 4 46 38 2 1 129 2 127 54	MBF MBF Cords Cords Cords Cords Cords Cords Cords Cords Cords Cords Cords Cords Cords Cords Cords Cords	28.3	\$8,634.50
11	Green Ash Red Maple Balsam Fir Mixed Aspen <i>B. T. Aspen</i> <i>Balsam Poplar</i> <i>Quaking Aspen</i> Mixed Hardwood <i>Black Ash</i> <i>Green Ash</i> <i>Paper Birch</i> <i>Red Maple</i>	Sawtimber Pulpwood	1.3 2.5 83 136 17 43 76 104 20 4 42 35	MBF MBF Cords Cords Cords Cords Cords Cords Cords Cords Cords Cords Cords	25.8	\$7,880.80

DESCRIPTION OF TIMBER BY PAYMENT UNIT (PU), CON'T

PU	MARKET GROUP	PRODUCT	QUANTITY	UNIT	ACRES	ADVERTISE PRICE
11 con't	<i>Sugar Maple</i>	<i>Pulpwood</i>	2	<i>Cords</i>		
	<i>Yellow Birch</i>		1	<i>Cords</i>		
	Mixed Spruce		117	<i>Cords</i>		
	<i>Black Spruce</i>		1	<i>Cords</i>		
	<i>White Spruce</i>		116	<i>Cords</i>		
	N. White Cedar		50	<i>Cords</i>		
TOTAL:			21.9	MBF		
TOTAL:			3,053	Cords		

Sale Specific Conditions & Requirements

Sale Name: Old Mill Mix

Sale Number: 33-022-21 Seq#: 1

1 - Sale Area

1.2 - Boundaries

1.2.1 - Painted boundaries (9/19)

The sale boundary and Payment Unit boundaries are marked and identified by blue, red and yellow paint. Exterior sale boundary lines against private property are marked with blue paint. Exterior sale boundary lines against state are marked with red paint. Interior Payment Unit boundaries are marked with yellow paint. Retention patches are marked with red paint; no harvesting activities may occur within these areas. The painted boundary line trees are not Included Timber and are to be protected. Yellow painted trees designating an interior Payment Unit boundary are only to be cut when all surrounding Payment Units have been paid for.

2 - Timber Specifications

2.1 - Included Timber

2.1.1 - Clearcut unit(s) with unmerchantable trees (6/14)

Within Payment Unit(s) 1 - 3 and 6 - 11, cut all trees that are three (3) inches or more at DBH; except do not cut hemlock. In addition, the following exceptions apply:

- Within Payment Unit 3, do not cut white pine or trees marked with green paint.
- Within Payment Units 6 and 7, do not cut trees marked with green paint.
- Within Payment Unit 9, do not cut cedar.
- Within Payment Units 10 and 11, do not cut cedar greater than twelve (12) inches at DBH.

2.1.2 - Clearcut unit(s) w/o unmerchantable trees (8/11)

Within Payment Unit(s) 4 and 5, cut all trees which meet minimum piece specifications in 2.2 Utilization; except do not cut cedar.

2.1.9 - Harvest exception (12/08)

Do not cut any cedar trees within Payment Unit 9 other than those that are necessary to remove in order to operate within the sale area. Every effort must be made to preserve the existing cedar and to leave an intact stand upon sale completion. All cut cedar shall be piled separately by products and scaled in the woods unless other scaling arrangements are agreed to by the Unit Manager or his/her representative. Stumpage price for cedar shall be \$25.00 per cord for posts and pulpwood, and \$50.00 per cord for bolts and sawlogs.

3 - Payments

3.3 - Pre-measured Sales

3.3.4 - Dividing payment units (7/14)

Payment Unit(s) \$18,000 in value or greater may be divided at the request of the Purchaser and upon approval of the Unit Manager. Dividing Payment Units is a contract modification which requires a Timber Sale Contract Amendment. There will be only one division per Payment Unit.

4 - Transportation

4.2 - Maintenance

4.2.1 - Hauling restriction (12/08)

Hauling may be restricted on forest roads by the Unit Manager or his/her representative. The restriction may occur during spring breakup or during other wet weather conditions.

4.2.4 - Grading (10/16)

For completion of the sale, state forest roads must be graded. In general, this will require a road grader or bulldozer to shape up the roads after forest products have been hauled off site. This includes cleaning of drainage areas, grading, crowning and filling with gravel, if necessary. The grading equipment to be used must be approved by the Unit Manager or his/her

representative.

4.4 - Access

4.4.3 - Access gate (12/08)

The access gate must be locked at the completion of each day unless otherwise approved by the Unit Manager or his/her representative.

5 - Operations

5.2 - Conduct of Operations

5.2.3 - Operating Restrictions

5.2.3.1 - Operating restrictions (9/11)

Within Payment Unit(s) 1, 3, 4, 5 and 7, cutting and skidding are limited to the period of December 1 to March 31, unless there is an extended dry or frozen period and the sale administrator allows harvesting during that period of time. This restriction is because of low wet ground through Payment Units 3, 4, 5 and 7. Payment Unit 1, could be cut during the summer months but access to it will cross low wet ground.

5.2.22 - Operating Caution

5.2.22.1 - Operating caution (6/11)

It is recommended, but not required, that within Payment Unit(s) 2 and 6, cutting and skidding occur during dry summer or frozen winter conditions. The reason for the recommendation is because of areas of low wet ground within each of the Payment Units.

5.5 - Protection of Improvements

5.5.3 - Protection of improvements detail (10/13)

There is an old Township Landfill within the excluded area in Payment Unit 11. No activities may occur on the landfill and all venting must be protected. No trees will be felled within the opening.

6 - Safety and Fire Prevention

6.2 - Signing

6.2.1 - Road posting (10/20)

The Purchaser is responsible for posting and maintaining caution signs on Old Mill Road prior to beginning operations. The road must be posted at appropriate distances from the sale area to warn of logging activity and truck traffic. Signs must be removed when harvest operations are suspended or completed. The Purchaser will provide these signs.



TIMBER SALE MAP

This information provided by authority of Part 525, 1994 PA 451, as amended.

Forest Management Unit Escanaba Management Unit	County Menominee County	Mapped By Beaudo	Date 11/10/2020	Page 1	of 1
Township 35N	Range 25W	Section(s) and Subdivision(s) Sec 12 - SWSW; Sec 13 - NW, W1/2NE, N1/2SW, SESW; Sec 14 - NESE.	Scale 1:15,840		

Cover Type				Density	
A = Aspen	H = Hemlock	N = Marsh	U = Upland Brush	0 = Non Stocked	5 = Pole Timber Medium
B = Paper Birch	J = Jack Pine	O = Oak	UM = Upland Mixed	1 = Seedling Sapling Poor	6 = Pole Timber Well
C = Cedar	L = Lowland Brush	P = Lowland Poplar	V = Bog or Marsh	2 = Seedling Sapling Medium	7 = Saw Timber Poor
D = Treed Bog	LM = Lowland Mixed	Q = Mixed Swamp Conifer	W = White Pine	3 = Seedling Sapling Well	8 = Saw Timber Medium
E = Swamp Hdwoods	M = Mpl, Bch, Brch	R = Red Pine	X = Non Stocked	4 = Pole Timber Poor	9 = Saw Timber Well
F = Spruce Fir	MC = Mixed Conifer	S = Black Spruce	Z = Water		
G = Grass	MD = Mixed Deciduous	T = Tamarack			

Old Mill Mix Compartment 50 194.1 Acres

PU	Acres	PU	Acres
1	8.2	7	6.2
2	13.2	8	9.4
3	30.3	9	23.9
4	23.2	10	28.3
5	18.8	11	25.8
6	6.8		

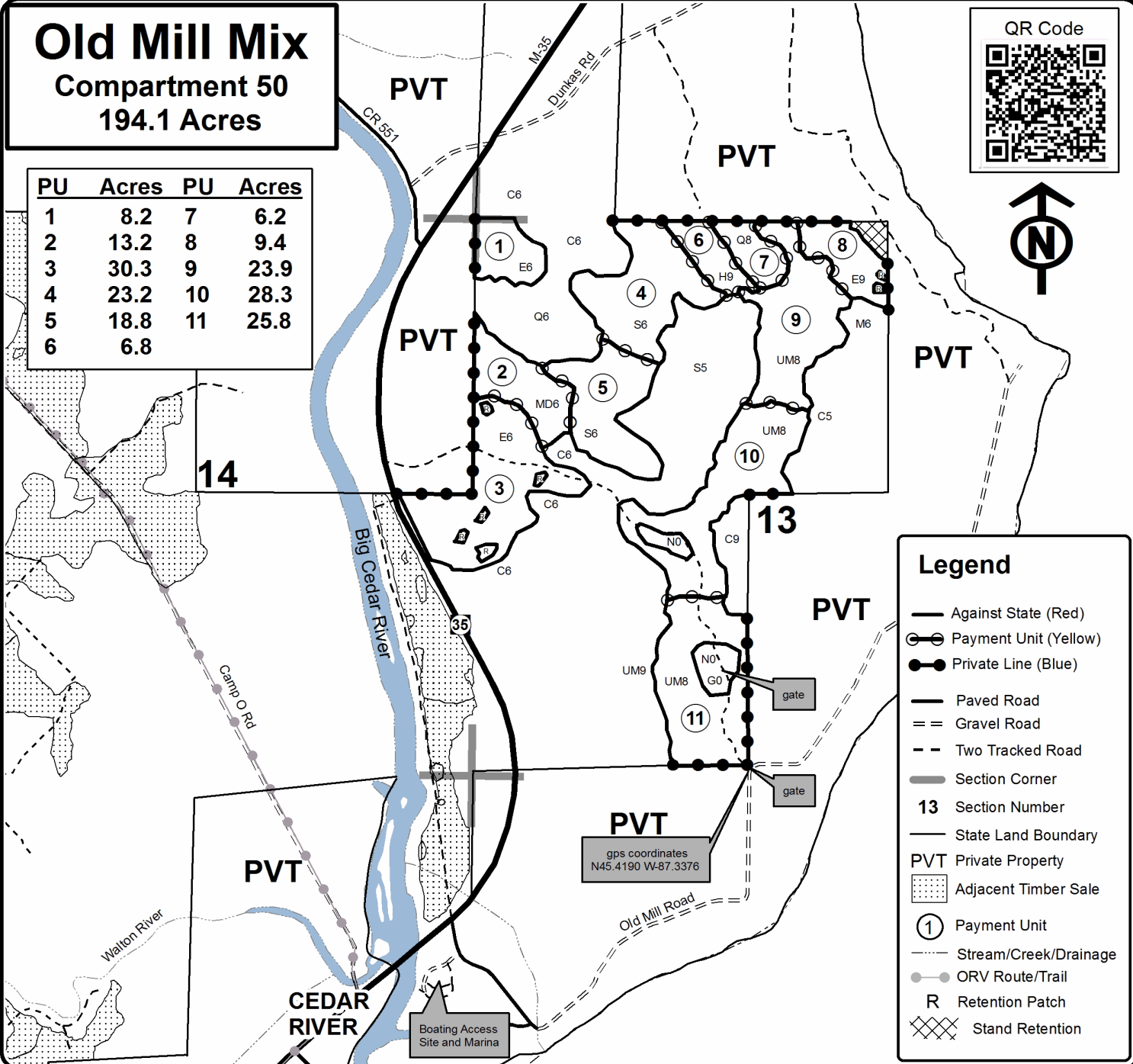

Legend

- Against State (Red)
- ⊙ Payment Unit (Yellow)
- Private Line (Blue)
- Paved Road
- == Gravel Road
- - Two Tracked Road
- Section Corner
- 13 Section Number
- State Land Boundary
- PVT Private Property
- ▨ Adjacent Timber Sale
- ① Payment Unit
- Stream/Creek/Drainage
- ORV Route/Trail
- R Retention Patch
- ▩ Stand Retention

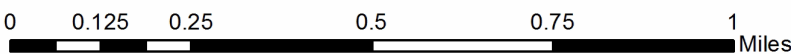

TIMBER SALE INFORMATION

Limpert South (33-004-20)

T36N, R24W, SEC. 5; T37N, R24W, SEC. 31; T37N, R24W, SEC. 32; T37N, R24W, SEC. 33.
Delta County (Advertised Price \$41,280.95)

SALE NOTE: If access through private property is not possible, access to the north end of Payment Unit 9 is possible via creation of a winter road from Limpert Road.

A recreation site such as a trail, pathway, or campground is within the sale area or the vicinity. Certain restrictions/specifications may be applicable including time restrictions. Access may be through private land.

A timber sale contract for this lump sum, sealed bid timber sale will be awarded to the responsible bidder offering the highest sealed bid price. All units of volume listed below were estimated using the T-Sale computer program and our traditional volume equations. Bids must be at or above the following advertised price for each product and species:

<u>PRODUCTS & SPECIES</u>	<u>ESTIMATED UNITS*</u>		<u>ADVERTISED PRICE</u>
Sawtimber			
Basswood	0.8	MBF	\$ 41.00 / MBF
Black Ash	1.0	MBF	\$ 23.00 / MBF
Green Ash	33.9	MBF	\$ 35.00 / MBF
Paper Birch	1.3	MBF	\$ 36.00 / MBF
Red Maple	43.4	MBF	\$ 48.00 / MBF
Sugar Maple	2.5	MBF	\$ 84.00 / MBF
Yellow Birch	3.2	MBF	\$ 27.00 / MBF
Pulpwood			
Balsam Fir	280	Cords	\$ 8.55 / Cord
Mixed Aspen	520	Cords	\$ 11.25 / Cord
Mixed Hardwood	1,568	Cords	\$ 11.10 / Cord
Mixed Spruce	403	Cords	\$ 9.30 / Cord
N. White Cedar	107	Cords	\$ 7.30 / Cord
Red Pine	20	Cords	\$ 26.70 / Cord
Tamarack	45	Cords	\$ 7.65 / Cord
White Pine	588	Cords	\$ 11.15 / Cord

* The total volume is statistically estimated within plus (+) or minus (-) 7.84 percent. There are an estimated 3,991 cords on this timber sale, plus or minus 313 cords at the 95% confidence level. The estimated units are final and not subject to adjustment. Prospective bidders are urged to examine this timber and to make their own estimates of quantity and quality.

BOND AND PAYMENT SCHEDULE:

1. A bond in the amount of \$2,064.00 to insure faithful performance of the conditions of the contract will be deposited by the successful bidder within 21 days of the sale award.
2. Cutting in any sale or unit without the required advance payment would be considered a trespass.
3. Total payment must be paid in advance or according to the following schedule :
 - (a) Ten percent (10%) of the sale value must be paid within 21 days of the sale award.
 - (b) The 10% down payment will be credited towards the first unit cut.
 - (c) Payment for each of the following units must be made before cutting begins in that unit:

PAYMENT UNIT NUMBER	PERCENT OF TOTAL SALE VALUE
01	15.4%
02	7.5%
03	6.4%
04	2.8%
05	16.5%
06	5.9%
07	8.1%
08	13.4%
09	12.3%
10	3.8%
11	5.7%
12	2.2%

4. If no cutting takes place, the 10% down payment will not be refunded.
5. Operations on the contract issued will terminate on 09/30/2024.

SALE STATISTICS**SALE VOLUMES**

VOLUME			STATISTICAL RANGE IN CORDS	
TOTAL CUBIC FEET	TOTAL CORDS	PERCENT ERROR	MINIMUM	MAXIMUM
315,253	3,991	7.84%	3,678	4,303

VDU VOLUMES

A VDU is a Volume Determination Unit. Volumes and their associated statistics are calculated at the VDU level and summarized to the sale level. There is often a one to one relationship between a VDU and a Payment Unit, but not always, depending on the cruise design. Refer to the VDU TO PAYMENT UNIT table.

VDU	VOLUME			RANGE IN CORDS	
	TOTAL CUBIC FEET	TOTAL CORDS	PERCENT ERROR	MINIMUM	MAXIMUM
14	44,524	564	28.87%	401	726
15	23,945	303	28.87%	216	391
19	8,074	102	16.94%	85	120
20	17,064	216	22.40%	168	264
32	45,330	574	14.18%	492	655
41	18,913	239	22.90%	185	294
68	31,150	394	41.53%	231	558
72	11,716	148	35.12%	96	200
75	28,835	365	18.82%	296	434
77	41,491	525	13.59%	454	597
78	38,418	486	18.90%	394	578
84	5,846	74	28.59%	53	95
TOTAL:	315,305	3,991		3,070	4,912

VDU TO PAYMENT UNIT

When a VDU is associated with more than one Payment Unit (PU), the VDU volumes are assigned to the PU based on acres of the VDU within the PU.

VDU	VDU ACRES	PU	PU ACRES
14	19.6	1	19.6
15	9.7	2	9.7
19	3.8	4	3.8
20	7.7	3	7.7
32	18.4	5	18.4
41	11.1	6	11.1
68	12.0	11	12.0
72	6.9	10	6.9
75	10.7	7	10.7
77	22.9	8	22.9
78	19.3	9	19.3
84	7.3	12	7.3
TOTAL:	149.4		149.4

DESCRIPTION OF TIMBER BY PAYMENT UNIT (PU)

PU	MARKET GROUP	PRODUCT	QUANTITY	UNIT	ACRES	ADVERTISE PRICE
1	Red Maple	Sawtimber	0.9	MBF	19.6	\$6,377.00
	Balsam Fir	Pulpwood	7	Cords		
	Mixed Hardwood		11	Cords		
	<i>Paper Birch</i>		6	<i>Cords</i>		
	<i>Red Maple</i>		5	<i>Cords</i>		
	Mixed Spruce		41	Cords		
	<i>Black Spruce</i>		41	<i>Cords</i>		
	Red Pine		12	Cords		
	Tamarack		7	Cords		
	White Pine		484	Cords		
2	Balsam Fir	Pulpwood	2	Cords	9.7	\$3,114.60
	Mixed Hardwood		12	Cords		
	<i>Red Maple</i>		12	<i>Cords</i>		
	Mixed Spruce		156	Cords		
	<i>Black Spruce</i>		156	<i>Cords</i>		
	Red Pine		8	Cords		
	Tamarack		30	Cords		
	White Pine		96	Cords		
3	Paper Birch	Sawtimber	0.6	MBF	7.7	\$2,630.10
	Red Maple		11.4	MBF		
	Balsam Fir	Pulpwood	4	Cords		
	Mixed Aspen		8	Cords		
	<i>Quaking Aspen</i>		8	<i>Cords</i>		
	Mixed Hardwood		141	Cords		
	<i>Black Cherry</i>		2	<i>Cords</i>		
	<i>Green Ash</i>		10	<i>Cords</i>		
	<i>Paper Birch</i>		13	<i>Cords</i>		
	<i>Red Maple</i>		116	<i>Cords</i>		
	Mixed Spruce		40	Cords		
<i>Black Spruce</i>		40	<i>Cords</i>			
4	Green Ash	Sawtimber	1.1	MBF	3.8	\$1,138.60
	Red Maple		0.4	MBF		
	Balsam Fir	Pulpwood	5	Cords		
	Mixed Aspen		1	Cords		
	<i>Quaking Aspen</i>		1	<i>Cords</i>		
	Mixed Hardwood		90	Cords		
	<i>Black Ash</i>		11	<i>Cords</i>		
	<i>Green Ash</i>		65	<i>Cords</i>		
	<i>Paper Birch</i>		1	<i>Cords</i>		
	<i>Red Maple</i>		13	<i>Cords</i>		
	Mixed Spruce		3	Cords		
	<i>Black Spruce</i>		3	<i>Cords</i>		
	5	Black Ash	Sawtimber	1.0		
Green Ash			13.9	MBF		
Red Maple			16.7	MBF		
Yellow Birch			3.2	MBF		
Mixed Hardwood		Pulpwood	446	Cords		
<i>Black Ash</i>			101	<i>Cords</i>		
<i>Green Ash</i>			151	<i>Cords</i>		
<i>Red Maple</i>			171	<i>Cords</i>		
<i>Yellow Birch</i>			23	<i>Cords</i>		
Mixed Spruce			5	Cords		
<i>Black Spruce</i>			5	<i>Cords</i>		
N. White Cedar			45	Cords		
White Pine			8	Cords		
6	Paper Birch	Sawtimber	0.7	MBF	11.1	\$2,445.95

DESCRIPTION OF TIMBER BY PAYMENT UNIT (PU), CON'T

PU	MARKET GROUP	PRODUCT	QUANTITY	UNIT	ACRES	ADVERTISE PRICE
6 con't	Red Maple	Sawtimber	4.6	MBF		
	Balsam Fir	Pulpwood	17	Cords		
	Mixed Aspen		6	Cords		
	<i>Quaking Aspen</i>		6	<i>Cords</i>		
	Mixed Hardwood		91	Cords		
	<i>Green Ash</i>		12	<i>Cords</i>		
	<i>Paper Birch</i>		39	<i>Cords</i>		
	<i>Red Maple</i>		40	<i>Cords</i>		
	Mixed Spruce		71	Cords		
	<i>White Spruce</i>		71	<i>Cords</i>		
	N. White Cedar		35	Cords		
	Tamarack		8	Cords		
7	Green Ash	Sawtimber	14.1	MBF	10.7	\$3,353.85
	Red Maple		6.9	MBF		
	Balsam Fir	Pulpwood	5	Cords		
	Mixed Hardwood		224	Cords		
	<i>Black Ash</i>		46	<i>Cords</i>		
	<i>Green Ash</i>		133	<i>Cords</i>		
	<i>Red Maple</i>		45	<i>Cords</i>		
8	Basswood	Sawtimber	0.8	MBF	22.9	\$5,516.80
	Green Ash		1.3	MBF		
	Sugar Maple		2.5	MBF		
	Balsam Fir	Pulpwood	113	Cords		
	Mixed Aspen		151	Cords		
	<i>Balsam Poplar</i>		20	<i>Cords</i>		
	<i>Quaking Aspen</i>		131	<i>Cords</i>		
	Mixed Hardwood		188	Cords		
	<i>Basswood</i>		8	<i>Cords</i>		
	<i>Black Ash</i>		12	<i>Cords</i>		
	<i>Black Cherry</i>		4	<i>Cords</i>		
	<i>Green Ash</i>		116	<i>Cords</i>		
	<i>Ironwood</i>		2	<i>Cords</i>		
	<i>Paper Birch</i>		4	<i>Cords</i>		
	<i>Red Maple</i>		9	<i>Cords</i>		
	<i>Sugar Maple</i>		31	<i>Cords</i>		
	<i>Yellow Birch</i>		2	<i>Cords</i>		
	Mixed Spruce		34	Cords		
<i>White Spruce</i>		34	<i>Cords</i>			
N. White Cedar		22	Cords			
9	Green Ash	Sawtimber	1.5	MBF	19.3	\$5,061.05
	Balsam Fir	Pulpwood	109	Cords		
	Mixed Aspen		190	Cords		
	<i>Balsam Poplar</i>		58	<i>Cords</i>		
	<i>Quaking Aspen</i>		132	<i>Cords</i>		
	Mixed Hardwood		127	Cords		
	<i>Black Ash</i>		3	<i>Cords</i>		
	<i>Green Ash</i>		92	<i>Cords</i>		
	<i>Paper Birch</i>		7	<i>Cords</i>		
	<i>Red Maple</i>		25	<i>Cords</i>		
	Mixed Spruce		53	Cords		
	<i>White Spruce</i>		53	<i>Cords</i>		
	N. White Cedar		5	Cords		
10	Green Ash	Sawtimber	2.0	MBF	6.9	\$1,585.60
	Balsam Fir	Pulpwood	2	Cords		
	Mixed Hardwood		135	Cords		
	<i>Black Ash</i>		76	<i>Cords</i>		

DESCRIPTION OF TIMBER BY PAYMENT UNIT (PU), CON'T

PU	MARKET GROUP	PRODUCT	QUANTITY	UNIT	ACRES	ADVERTISE PRICE
10 con't	<i>Green Ash</i> <i>Paper Birch</i>	<i>Pulpwood</i>	50 9	<i>Cords</i> <i>Cords</i>		
11	Balsam Fir Mixed Aspen <i>Balsam Poplar</i> <i>Quaking Aspen</i> Mixed Hardwood <i>Box Elder</i> <i>Paper Birch</i> <i>Red Maple</i>	Pulpwood	13 161 9 152 39 2 27 10	Cords Cords <i>Cords</i> <i>Cords</i> Cords <i>Cords</i> <i>Cords</i> <i>Cords</i>	12.0	\$2,355.30
12	Red Maple Balsam Fir Mixed Aspen <i>Balsam Poplar</i> Mixed Hardwood <i>Green Ash</i> <i>Ironwood</i> <i>Red Maple</i> <i>Yellow Birch</i>	Sawtimber Pulpwood	2.5 3 3 3 64 4 2 57 1	MBF Cords Cords <i>Cords</i> Cords <i>Cords</i> <i>Cords</i> <i>Cords</i> <i>Cords</i>	7.3	\$889.80
TOTAL:			86.1	MBF		
TOTAL:			3,531	Cords		

Sale Specific Conditions & Requirements

Sale Name: Limpert South

Sale Number: 33-004-20 Seq#: 2

1 - Sale Area

1.2 - Boundaries

1.2.1 - Painted boundaries (9/19)

The sale boundary and Payment Unit boundaries are marked and identified by blue, red and yellow paint. Exterior sale boundary lines against private property are marked with blue paint. Exterior sale boundary lines against state are marked with red paint. Interior Payment Unit boundaries are marked with yellow paint. Retention patches and stream buffers are marked with red paint; no harvesting activities may occur within these areas. The painted boundary line trees are not Included Timber and are to be protected unless marked with orange paint. Yellow painted trees designating an interior Payment Unit boundary are only to be cut when all surrounding Payment Units have been paid.

2 - Timber Specifications

2.1 - Included Timber

2.1.1 - Clearcut unit(s) with unmerchantable trees (6/14)

Within Payment Unit(s) 2, 3, 4, 5, 6, 7, 8, 9, 10 and 11, cut all trees that are three (3) inches or more at DBH, with the following exceptions:

- Within Payment Unit 2, leave all hemlock and cedar.
- Within Payment Unit 3, leave all hemlock, pine and cedar.
- Within Payment Unit 5 and 8, leave all hemlock and green marked trees.
- Within Payment Units 6 and 9, leave all green marked trees.
- Within Payment Units 7, 10 and 11, leave all cedar.

2.1.3 - Cut tree marked unit(s) (12/08)

Within Payment Unit(s) 12, all trees are designated for cutting when marked with orange paint above and below stump height, regardless of merchantability.

2.1.5 - Overstory removal unit(s) (8/11)

Within Payment Unit(s) 1, all white pine with a diameter greater than 7 inches at 12 inches above ground level, which meet minimum piece specifications in 2.2 Utilization, are designated for cutting, except do not cut green marked trees. In addition, all other trees greater than 3 inches at DBH are designated for cutting, except do not cut cedar and hemlock

2.1.9 - Harvest exception (12/08)

Do not cut any cedar or hemlock in the units that require them to be left (see specification 2.1.1) other than those that are necessary to remove in order to operate within the sale area. Every effort must be made to preserve the existing cedar and hemlock and to leave an intact stand upon sale completion. All cut cedar and hemlock shall be piled separately by products and scaled in the woods unless other scaling arrangements are agreed to by the Unit Manager or his/her representative. Stumpage price for cedar and hemlock shall be \$50.00 per cord for posts and pulpwood, and \$100.00 per cord for bolts and sawlogs.

3 - Payments

3.3 - Pre-measured Sales

3.3.4 - Dividing payment units (7/14)

Payment Unit(s) with a purchase value of \$18,000 or more may be divided at the request of the Purchaser and upon approval of the Unit Manager. Dividing Payment Units is a contract modification which requires a Timber Sale Contract Amendment. There will be only one division per Payment Unit.

4 - Transportation

4.1 - Construction

4.1.1 - Stream crossings, general (3/11)

All stream crossing structures will be temporary and therefore, shall be provided by the Purchaser, and must be removed upon

completion of the sale. All permits for stream crossings will be provided by the DNR.

4.1.5 - Culverts (5/14)

Roads may require the installation of culverts for cross drainage or at natural drainage-ways. If culverts are needed in these locations, their placement will be specified by the sale administrator and they shall be installed prior to hauling. The culverts shall be new corrugated metal. Culverts will be a minimum of 18 inches in diameter and 24 feet in length. If culverts are removed, fill shall be removed from wetland soils as specified. Soils shall be maintained and left in a non-erodible condition, with water bars, seed, fertilizer, mulch, and slash installed as directed by the sale administrator and as specified in the BMP manual. Stream crossing permits, if needed, will be obtained by the DNR.

4.1.6 - Road construction (1/09)

Construction of new roads or improvements of existing roads shall be done in such a way as to minimize the environmental and visual impacts. Merchantable trees shall be cut and utilized unless otherwise directed. Non-merchantable trees shall be severed and laid flat on the ground. Slash shall be scattered, and not left in windrows and kept a minimum of 10 feet back from the road edge. Stumps shall be set upright, not left on edge, and be moved at least 10 feet away from the road edge. Disturbed soil shall be feathered into the woods and not left in berms or windrows.

4.1.7 - Road closure (10/11)

All new roads built into the sale must be blocked to vehicle traffic upon completion of the sale. Overgrown roads that are reopened shall be considered new roads. In general, this will require constructing a four (4') foot high berm of stumps and logs covered with earth. Stumps and brush must be placed along the remainder of the trail. These roads must be rendered impassable to cars and trucks. Temporary berms may be required if no sale activity occurs for 30 or more consecutive days. Contact the sale administrator for specific details of design and placement.

4.2 - Maintenance

4.2.4 - Grading (10/16)

For completion of the sale, state forest roads must be graded. In general, this will require a road grader or bull dozer to shape up the roads after forest products have been hauled off site. This includes cleaning of drainage areas, grading, crowning and filling with gravel, if necessary. The grading equipment to be used must be approved by the Unit Manager or his/her representative.

4.4 - Access

4.4.1 - Private property access (3/11)

Permission for access across private land is the responsibility of the Purchaser. Should the Purchaser desire to cross private land, a copy of the written permission from the private land-owner may be required by the DNR.

5 - Operations

5.2 - Conduct of Operations

5.2.2 - Hazard Trees/Snags

5.2.2.1 - Den trees (10/16)

Obvious hollow and/or den trees shall be protected and left standing unless they are a safety hazard.

5.2.3 - Operating Restrictions

5.2.3.1 - Operating restrictions (9/11)

Within Payment Unit(s) 2, 3, 4, 5, 7, 10 and 11 cutting, skidding, and hauling are limited to the period of December 1 to March 31, or during frozen ground conditions, unless otherwise approved by the unit manager. This restriction is due to low wet ground within the units.

5.2.3.3 - Bark slippage restriction (3/09)

Within Payment Unit(s) 12, cutting and skidding are not permitted during the period of April 15 to July 15. This restriction is because of bark slippage.

5.2.38 - No decking against live trees (2/04)

Cut products may not be decked against unmarked or designated leave trees.

5.4 - Soil Protection

5.4.1 - Rutting restriction, general (7/16)

Operations are to cease immediately if equipment and weather conditions result in rutting of roads and/or skid trails which is 12 inches or greater in depth and 50 feet in length. The Unit Manager or his/her representative may restrict hauling and/or skidding if ruts exceed the specified depth. With the Unit Manager or his/her representative's approval, the Purchaser may return to the area when the risk of rutting has decreased.

6 - Safety and Fire Prevention

6.2 - Signing

6.2.3 - Recreational trail posting (2/10)

The Purchaser is responsible for posting and maintaining caution signs on the Deer Pond Road prior to beginning operations. The trail must be posted at appropriate distances from the sale area to warn of logging activity and truck traffic at both ends of the trail. Signs must be removed when harvest operations are suspended or completed. The Purchaser will provide these signs.



Sale Number	Year
33 - 004	20

TIMBER SALE MAP

This information provided by authority of Part 525, 1994 PA 451, as amended.

Forest Management Unit Escanaba	County Delta	Mapped By Urlich	Date 07/22/2020	Page 1	of 2
Township 37N	Range 24W	Section(s) and Subdivision(s) Sec31 E1/2NW,NE Sec32 W1/2NW,NWSW,SESW Sec33 NENW,S1/2NW,N1/2NE, N1/2SW,SWSE	Scale 1:15,840		

Cover Type				Density	
A = Aspen	H = Hemlock	N = Marsh	U = Upland Brush	0 = Non Stocked	5 = Pole Timber Medium
B = Paper Birch	J = Jack Pine	O = Oak	UM = Upland Mixed	1 = Seeding Sapling Poor	6 = Pole Timber Well
C = Cedar	L = Lowland Brush	P = Lowland Poplar	V = Bog or Marsh	2 = Seeding Sapling Medium	7 = Saw Timber Poor
D = Treed Bog	LM = Lowland Mixed	Q = Mixed Swamp Conifer	W = White Pine	3 = Seeding Sapling Well	8 = Saw Timber Medium
E = Swamp Hardwoods	M = Mpl. Ech. Birch	R = Red Pine	X = Non Stocked	4 = Pole Timber Poor	9 = Saw Timber Well
F = Spruce Fir	MC = Mixed Conifer	S = Black Spruce	Z = Water		
G = Creas	MD = Mixed Deciduous	T = Tamarack			

PU	Acres	PU	Acres	Limpert South (west stands) Compartment 074 149.4 Acres
1	19.6	4	3.8	
2	9.7	5	18.4	
3	7.7	6	11.1	

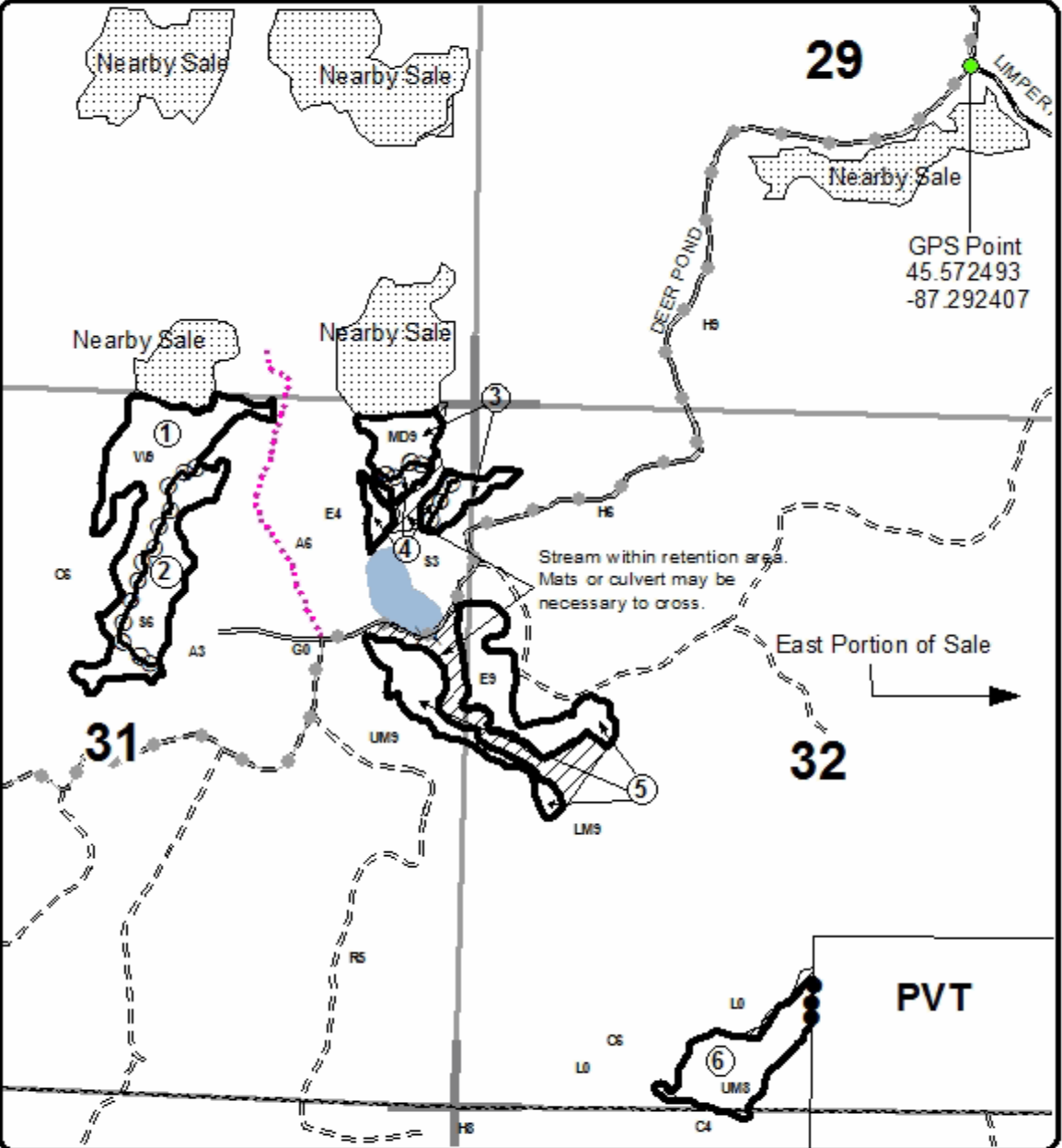

Legend

- Recreational Trails
- Highway
- Primary Forest Road
- Secondary Forest Road
- Forest Access Route
- Paved Road
- Gravel Road
- County Road - Seasonal
- Private
- DNR - Management Access
- Temporary Management Access
- Retention Area
- Against State (Red)
- Payment Unit (Yellow)
- Private Line (Blue)
- Section Corners

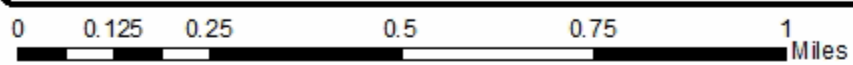



TIMBER SALE MAP

This information provided by authority of Part 525, 1994 PA 451 as amended.

Sale Number	Year
33 - 004	20

Forest Management Unit Escanaba	County Delta	Mapped By Urich	Date 07/22/2020	Page 2	of 2
Township 37N	Range 24W	Section(s) and Subdivision(s) Sec31 E1/2NW,NE Sec32 W1/2NW,NWSW,SESW Sec33 NENW,S1/2NW,N1/2NE, N1/2SW,SWSE	Scale 1:15,840		

Cover Type				Density			
A = Aspen	H = Hemlock	N = Marsh	U = Upland Brush	0 = Non Stocked	5 = Pole Timber Medium		
B = Paper Birch	J = Jack Pine	O = Oak	UM = Upland Mixed	1 = Seeding Sapling Poor	6 = Pole Timber Well		
C = Cedar	L = Lowland Brush	P = Lowland Poplar	V = Bog or Marsh	2 = Seeding Sapling Medium	7 = Saw Timber Poor		
D = Treed Bog	LM = Lowland Mixed	Q = Mixed Swamp Conifer	W = White Pine	3 = Seeding Sapling Well	8 = Saw Timber Medium		
E = Swamp Hardwoods	M = Mpl. Ech. Birch	R = Red Pine	X = Non Stocked	4 = Pole Timber Poor	9 = Saw Timber Well		
F = Spruce Fir	MC = Mixed Conifer	S = Black Spruce	Z = Water				
G = Cress	MD = Mixed Deciduous	T = Tamarack					

PU	Acres	PU	Acres
7	10.7	10	6.9
8	22.9	11	12
9	19.3	12	7.3

Limpert South (east stands)

Compartment 074
149.4 Acres

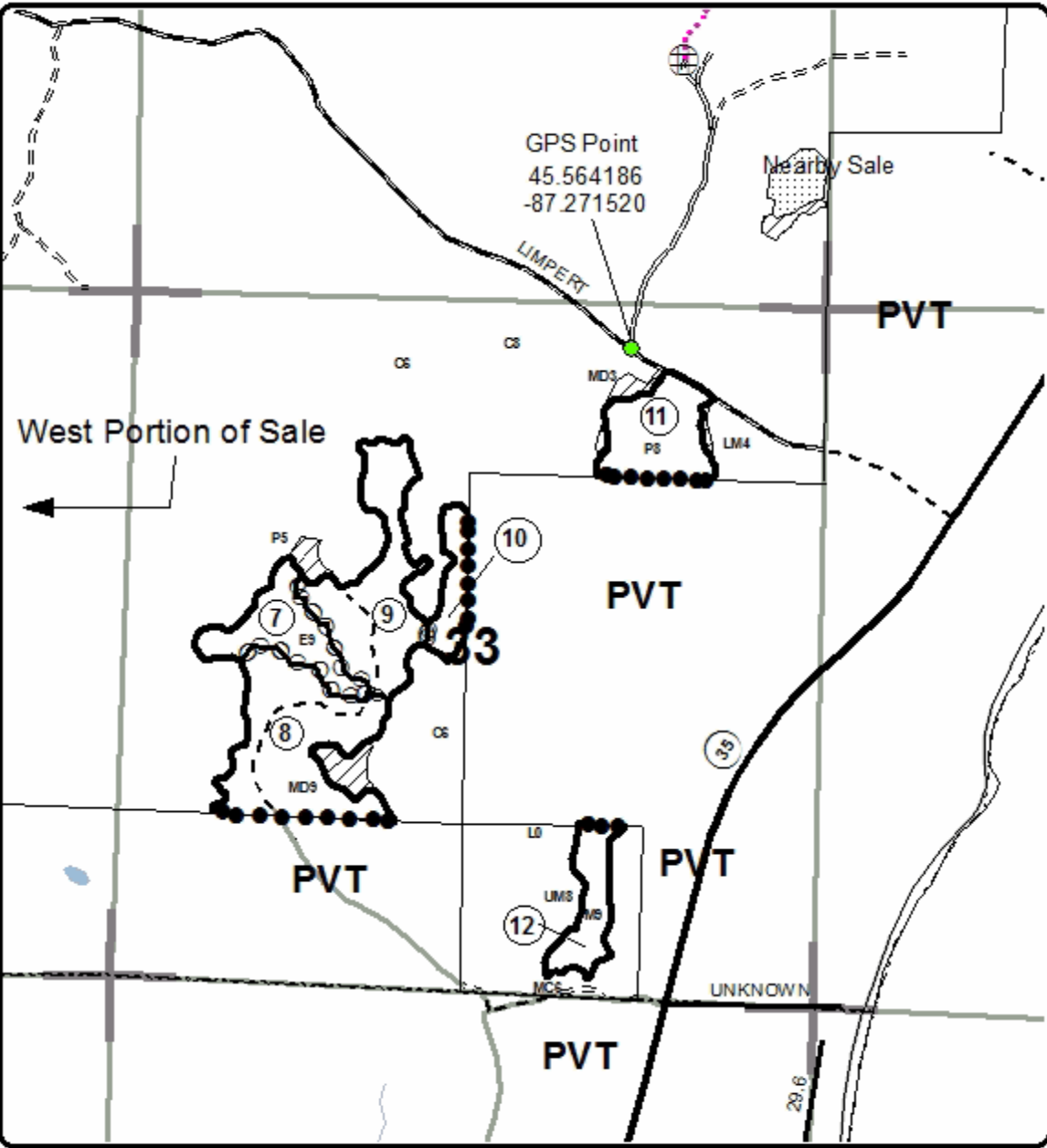

Legend

- Highway
- Primary Forest Road
- Secondary Forest Road
- Forest Access Route
- Paved Road
- Gravel Road
- County Road - Seasonal
- Private
- DNR - Management Access
- Temporary Management Access
- Retention Area
- Against State (Red)
- Payment Unit (Yellow)
- Private Line (Blue)
- Section Corners

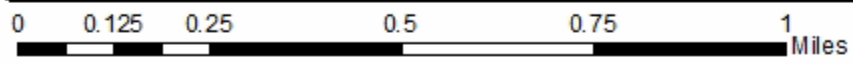



TIMBER SALE MAP

This information provided by authority of Part 525, 1994 PA 451 as amended.

Sale Number	Year
33 - 004	20

Forest Management Unit Escanaba	County Delta	Mapped By Urlich	Date 07/22/2020	Page 1	of 2
Township 37N	Range 24W	Section(s) and Subdivision(s) Sec31 E1/2NW,NE Sec32 W1/2NW,NWSW,SESW Sec33 NENW,S1/2NW,N1/2NE, N1/2SW,SWSE	Scale 1:15,840		

Cover Type				Density	
A = Aspen	H = Hemlock	N = Marsh	U = Upland Brush	0 = Non Stocked	5 = Pole Timber Medium
B = Paper Birch	J = Jack Pine	O = Oak	UM = Upland Mixed	1 = Seeding Sapling Poor	6 = Pole Timber Well
C = Cedar	L = Lowland Birch	P = Lowland Poplar	V = Bog or Marsh	2 = Seeding Sapling Medium	7 = Saw Timber Poor
D = Tread Bog	LM = Lowland Mixed	Q = Mixed Swamp Conifer	W = White Pine	3 = Seeding Sapling Well	8 = Saw Timber Medium
E = Swamp Hardwoods	M = Mpl. Ech. Birch	R = Red Pine	X = Non Stocked	4 = Pole Timber Poor	9 = Saw Timber Well
F = Spruce Fir	MC = Mixed Conifer	S = Black Spruce	Z = Water		
G = Cress	MD = Mixed Deciduous	T = Tamarack			

PU	Acres	PU	Acres
1	19.6	4	3.8
2	9.7	5	18.4
3	7.7	6	11.1

Limpert South (west stands)

Compartment 074
149.4 Acres

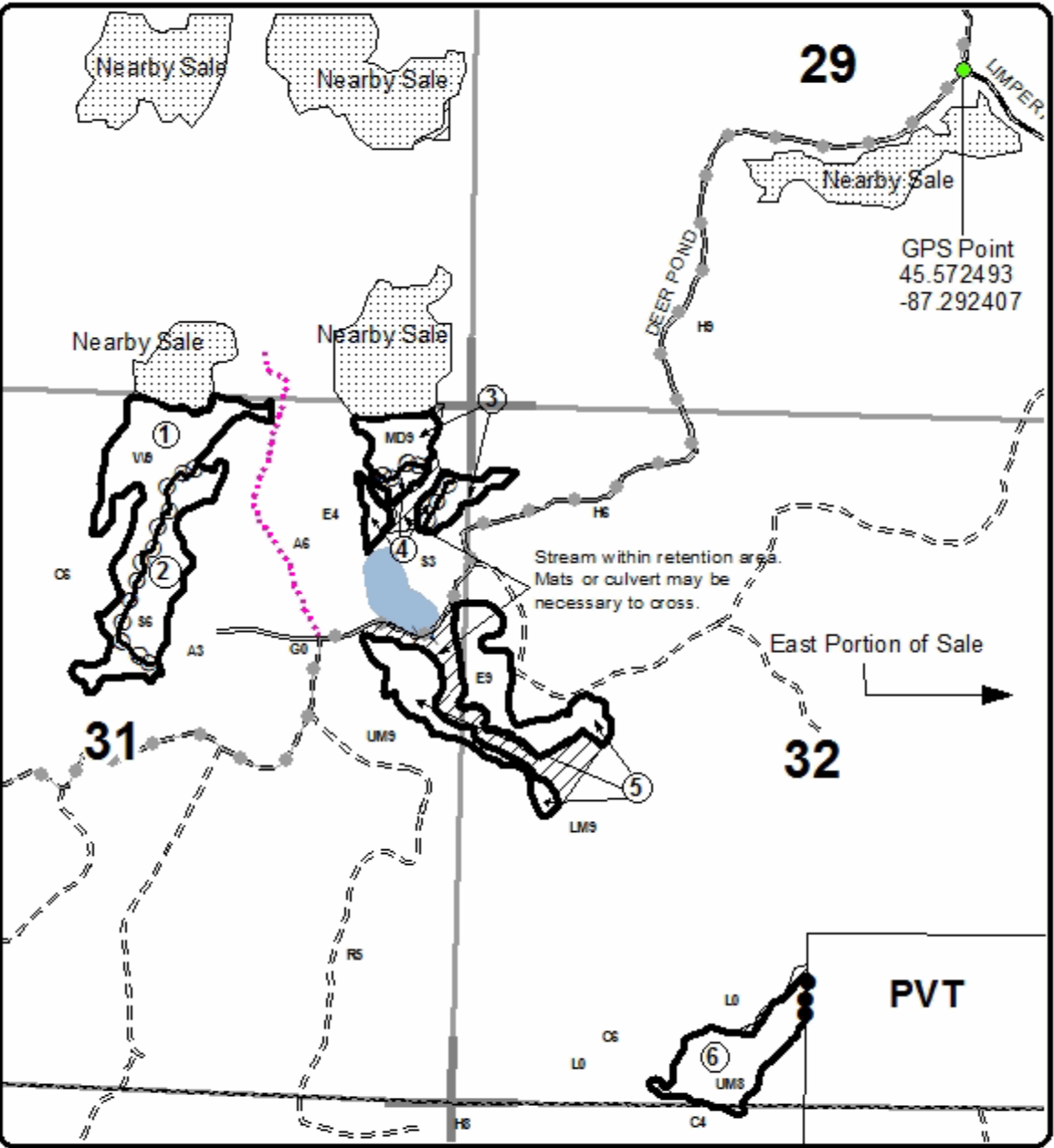

Legend

- Recreational Trails
- Highway
- Primary Forest Road
- Secondary Forest Road
- Forest Access Route
- Paved Road
- Gravel Road
- County Road - Seasonal
- Private
- DNR - Management Access
- Temporary Management Access
- Retention Area
- Against State (Red)
- Payment Unit (Yellow)
- Private Line (Blue)
- Section Corners

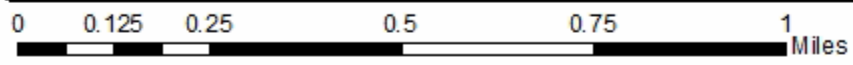



TIMBER SALE MAP

This information provided by authority of Part 525, 1994 PA 451, as amended.

Sale Number	Year
33 - 004	20

Forest Management Unit Escanaba	County Delta	Mapped By Urich	Date 07/22/2020	Page 2	of 2
Township 37N	Range 24W	Section(s) and Subdivision(s) Sec31 E1/2NW,NE Sec32 W1/2NW,NWSW,SESW Sec33 NENW,S1/2NW,N1/2NE, N1/2SW,SWSE	Scale 1:15,840		

Cover Type				Density			
A = Aspen	H = Hemlock	N = Marsh	U = Upland Brush	0 = Non Stocked	5 = Pole Timber Medium		
B = Paper Birch	J = Jack Pine	O = Oak	UM = Upland Mixed	1 = Seeding Sapling Poor	6 = Pole Timber Well		
C = Cedar	L = Lowland Brush	P = Lowland Poplar	V = Bog or Marsh	2 = Seeding Sapling Medium	7 = Saw Timber Poor		
D = Treed Bog	LM = Lowland Mixed	Q = Mixed Swamp Conifer	W = White Pine	3 = Seeding Sapling Well	8 = Saw Timber Medium		
E = Swamp Hardwoods	M = Mpl. Ech. Birch	R = Red Pine	X = Non Stocked	4 = Pole Timber Poor	9 = Saw Timber Well		
F = Spruce Fir	MC = Mixed Conifer	S = Black Spruce	Z = Water				
G = Cress	MD = Mixed Deciduous	T = Tamarack					

PU	Acres	PU	Acres
7	10.7	10	6.9
8	22.9	11	12
9	19.3	12	7.3

Limpert South (east stands)
Compartment 074
149.4 Acres

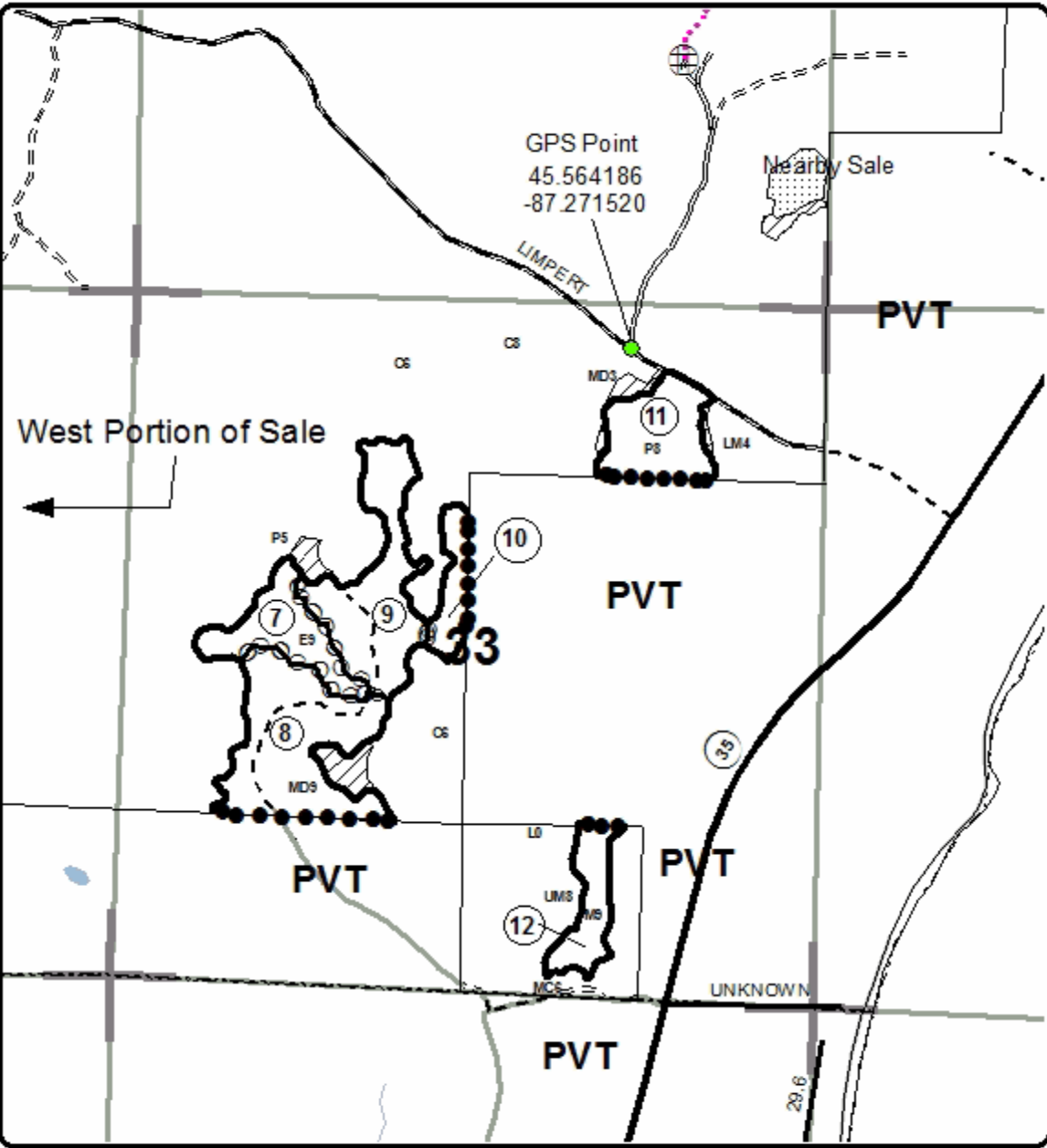

Legend

- Highway
- Primary Forest Road
- Secondary Forest Road
- Forest Access Route
- Paved Road
- Gravel Road
- County Road - Seasonal
- Private
- DNR - Management Access
- Temporary Management Access
- Retention Area
- Against State (Red)
- Payment Unit (Yellow)
- Private Line (Blue)
- Section Corners

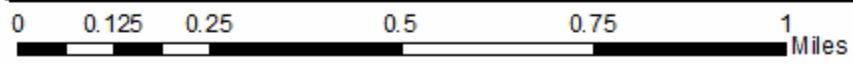

Highway Cleanup (33-021-21)

T35N, R25W, SEC. 13; T35N, R25W, SEC. 14; T35N, R25W, SEC. 23; Menominee

In response to the notice of sale to be held 3:00 p.m. (local time) on March 15, 2021, I am hereby submitting my sealed bid (firm offer) for the following forest products to be cut. Bids for individual species must be at or above the advertised price. All non-responsive bid forms may be rejected.

<u>PRODUCTS & SPECIES</u>	<u>ESTIMATED VOLUME*</u>	<u>ADVERTISED PRICE</u>	<u>BID PRICE/UNIT</u>
Sawtimber			
Green Ash	39.9 MBF	\$ 54.00/MBF	\$ _____
Paper Birch	2.0 MBF	\$ 57.00/MBF	\$ _____
Red Maple	7.0 MBF	\$ 76.00/MBF	\$ _____
Pulpwood			
Balsam Fir	113 Cords	\$ 13.45/Cord	\$ _____
Mixed Hardwood	783 Cords	\$ 17.45/Cord	\$ _____
Mixed Spruce	67 Cords	\$ 14.65/Cord	\$ _____
N. White Cedar	168 Cords	\$ 11.50/Cord	\$ _____
Quaking Aspen	6 Cords	\$ 17.65/Cord	\$ _____
Tamarack	6 Cords	\$ 12.05/Cord	\$ _____
White Pine	1 Cords	\$ 17.55/Cord	\$ _____

*The volumes are statistically estimated within plus (+) or minus (-) 14.38 percent at 95% confidence level. These estimated volumes are final and not subject to adjustment. Prospective bidders are urged to examine this timber and to make their own estimates of quantity and quality.

I understand that any or all bids may be rejected. All bids must be signed and all bid items must be bid or the bid form may be rejected. I also understand that consideration and awarding a contract will be based upon my past performance and ability to complete the contract based upon equipment and staffing subject to my control.

FEDERAL ID: _____ - _____ or SOCIAL SECURITY NUMBER: _____ - _____ - _____

Company or individual bidding: _____

Company representative's name: _____

Address: _____

City: _____ State: _____ Zip: _____

IF AVAILABLE, PLEASE PLACE THE PERSONALIZED LABEL FROM YOUR PROSPECTUS IN THE ABOVE BOX.

Individual or company representative's signature: _____ Date: _____

Phone number : _____ Email (optional): _____

THE WINNING BIDDER MUST COMPLETE THE VERIFICATION OF WORKER'S DISABILITY COMPENSATION ACT COMPLIANCE (ON REVERSE SIDE IF DOUBLE SIDED) WITHIN 21 DAYS OF SALE AWARD DATE



FOR DEPARTMENT USE ONLY
Sale Number (XX - XXX - XX - XX)
Forest Management Unit:

TIMBER SALE VERIFICATION OF WORKER'S DISABILITY COMPENSATION ACT COMPLIANCE

*As required by Act 317, P.A. 1969 (Worker's Compensation) and
Part 5 of Act 451 of 1994, as amended.*

VERIFICATION OF WORKER'S DISABILITY COMPENSATION ACT COMPLIANCE

- This verification must be completed and submitted within 21 days of contract award and prior to the issuance of the timber sale contract.
- In addition, if boxes 2B or 2C are checked, then Notice of Exclusion or Certificate of Insurance must be submitted within twenty-one (21) days of the contract award and prior to the issuance of the timber sale contract.
- All information must be typed or printed except for written signatures.

Please Check Appropriate Categories:

1. My business is organized as (you **must** check one of the boxes below):
 - A. Sole Proprietorship (individual)
 - B. Partnership
 - C. Corporation
2. You **must** check one of the boxes below:
 - A. I certify my business is a sole proprietorship and it has no employees but the sole proprietor. I am not subject to the Worker's Compensation Laws.
 - B. I certify my business has satisfied its obligation to the Worker's Compensation Act through the use of an approved Notice of Exclusion (BWC-337, Rev. 5/96). I will provide a copy of the Notice of Exclusion within 21 days of the contract award. (For questions or a copy of the BWC-337, please call the Worker's Compensation Bureau at 517-322-1195).
 - C. I certify my business has a Worker's Compensation Policy. I will provide an original Certificate of Insurance within twenty-one (21) days of the contract award.
3. If you have checked item 2(A) or 2(B), you **must** indicate the number of **both** full-time and part-time employees, other than yourself, including family members and active partners (if none, you must enter "0").

_____ Full-time Employees

_____ Part-time Employees

Name of Business		Federal ID (or) Social Security No.	
Address		Telephone ()	
City	State	ZIP	

I hereby certify that the above information is true and correct. I agree to notify the Michigan DNR of any changes that occur in factors affecting my coverage during any of my present and future operations.

Signature of Owner or Authorized Representative

Title

Date

Please complete the "SEALED BID" information on the next page

Old Mill Mix (33-022-21)

T35N, R25W, SEC. 12; T35N, R25W, SEC. 13; T35N, R25W, SEC. 14; Menominee

In response to the notice of sale to be held 3:00 p.m. (local time) on March 15, 2021, I am hereby submitting my sealed bid (firm offer) for the following forest products to be cut. Bids for individual species must be at or above the advertised price. All non-responsive bid forms may be rejected.

<u>PRODUCTS & SPECIES</u>	<u>ESTIMATED VOLUME*</u>	<u>ADVERTISED PRICE</u>	<u>BID PRICE/UNIT</u>
Sawtimber			
Green Ash	7.0 MBF	\$ 54.00/MBF	\$ _____
Red Maple	14.9 MBF	\$ 76.00/MBF	\$ _____
Pulpwood			
Balsam Fir	345 Cords	\$ 13.45/Cord	\$ _____
Mixed Aspen	290 Cords	\$ 17.65/Cord	\$ _____
Mixed Hardwood	1,355 Cords	\$ 17.45/Cord	\$ _____
Mixed Spruce	419 Cords	\$ 14.65/Cord	\$ _____
N. White Cedar	267 Cords	\$ 11.50/Cord	\$ _____
Tamarack	290 Cords	\$ 12.05/Cord	\$ _____
White Pine	87 Cords	\$ 17.55/Cord	\$ _____

*The volumes are statistically estimated within plus (+) or minus (-) 9.49 percent at 95% confidence level. These estimated volumes are final and not subject to adjustment. Prospective bidders are urged to examine this timber and to make their own estimates of quantity and quality.

I understand that any or all bids may be rejected. All bids must be signed and all bid items must be bid or the bid form may be rejected. I also understand that consideration and awarding a contract will be based upon my past performance and ability to complete the contract based upon equipment and staffing subject to my control.

FEDERAL ID: ____ - ____ - ____ or SOCIAL SECURITY NUMBER: ____ - ____ - ____

Company or individual bidding: _____

Company representative's name: _____

Address: _____

City: _____ State: _____ Zip: _____

IF AVAILABLE, PLEASE PLACE THE PERSONALIZED LABEL FROM YOUR PROSPECTUS IN THE ABOVE BOX.

Individual or company representative's signature: _____ Date: _____

Phone number : _____ Email (optional): _____

THE WINNING BIDDER MUST COMPLETE THE VERIFICATION OF WORKER'S DISABILITY COMPENSATION ACT COMPLIANCE (ON REVERSE SIDE IF DOUBLE SIDED) WITHIN 21 DAYS OF SALE AWARD DATE



TIMBER SALE VERIFICATION OF WORKER'S DISABILITY COMPENSATION ACT COMPLIANCE

As required by Act 317, P.A. 1969 (Worker's Compensation) and
Part 5 of Act 451 of 1994, as amended.

FOR DEPARTMENT USE ONLY	
Sale Number (XX - XXX - XX - XX)	
Forest Management Unit:	

VERIFICATION OF WORKER'S DISABILITY COMPENSATION ACT COMPLIANCE

- This verification must be completed and submitted within 21 days of contract award and prior to the issuance of the timber sale contract.
- In addition, if boxes 2B or 2C are checked, then Notice of Exclusion or Certificate of Insurance must be submitted within twenty-one (21) days of the contract award and prior to the issuance of the timber sale contract.
- All information must be typed or printed except for written signatures.

Please Check Appropriate Categories:

1. My business is organized as (you **must** check one of the boxes below):
 - A. Sole Proprietorship (individual)
 - B. Partnership
 - C. Corporation
2. You **must** check one of the boxes below:
 - A. I certify my business is a sole proprietorship and it has no employees but the sole proprietor. I am not subject to the Worker's Compensation Laws.
 - B. I certify my business has satisfied its obligation to the Worker's Compensation Act through the use of an approved Notice of Exclusion (BWC-337, Rev. 5/96). I will provide a copy of the Notice of Exclusion within 21 days of the contract award. (For questions or a copy of the BWC-337, please call the Worker's Compensation Bureau at 517-322-1195).
 - C. I certify my business has a Worker's Compensation Policy. I will provide an original Certificate of Insurance within twenty-one (21) days of the contract award.
3. If you have checked item 2(A) or 2(B), you **must** indicate the number of **both** full-time and part-time employees, other than yourself, including family members and active partners (if none, you must enter "0").

_____ Full-time Employees

_____ Part-time Employees

Name of Business		Federal ID (or) Social Security No.	
Address		Telephone ()	
City	State	ZIP	

I hereby certify that the above information is true and correct. I agree to notify the Michigan DNR of any changes that occur in factors affecting my coverage during any of my present and future operations.

Signature of Owner or Authorized Representative

Title

Date

Please complete the "SEALED BID" information on the next page

Limpert South (33-004-20)

T36N, R24W, SEC. 5; T37N, R24W, SEC. 31; T37N, R24W, SEC. 32; T37N, R24W,

In response to the notice of sale to be held 3:00 p.m. (local time) on March 15, 2021, I am hereby submitting my sealed bid (firm offer) for the following forest products to be cut. Bids for individual species must be at or above the advertised price. All non-responsive bid forms may be rejected.

<u>PRODUCTS & SPECIES</u>	<u>ESTIMATED VOLUME*</u>	<u>ADVERTISED PRICE</u>	<u>BID PRICE/UNIT</u>
Sawtimber			
Basswood	0.8 MBF	\$ 41.00/MBF	\$ _____
Black Ash	1.0 MBF	\$ 23.00/MBF	\$ _____
Green Ash	33.9 MBF	\$ 35.00/MBF	\$ _____
Paper Birch	1.3 MBF	\$ 36.00/MBF	\$ _____
Red Maple	43.4 MBF	\$ 48.00/MBF	\$ _____
Sugar Maple	2.5 MBF	\$ 84.00/MBF	\$ _____
Yellow Birch	3.2 MBF	\$ 27.00/MBF	\$ _____
Pulpwood			
Balsam Fir	280 Cords	\$ 8.55/Cord	\$ _____
Mixed Aspen	520 Cords	\$ 11.25/Cord	\$ _____
Mixed Hardwood	1,568 Cords	\$ 11.10/Cord	\$ _____
Mixed Spruce	403 Cords	\$ 9.30/Cord	\$ _____
N. White Cedar	107 Cords	\$ 7.30/Cord	\$ _____
Red Pine	20 Cords	\$ 26.70/Cord	\$ _____
Tamarack	45 Cords	\$ 7.65/Cord	\$ _____
White Pine	588 Cords	\$ 11.15/Cord	\$ _____

*The volumes are statistically estimated within plus (+) or minus (-) 7.84 percent at 95% confidence level. These estimated volumes are final and not subject to adjustment. Prospective bidders are urged to examine this timber and to make their own estimates of quantity and quality.

I understand that any or all bids may be rejected. All bids must be signed and all bid items must be bid or the bid form may be rejected. I also understand that consideration and awarding a contract will be based upon my past performance and ability to complete the contract based upon equipment and staffing subject to my control.

FEDERAL ID: ____ - ____ - ____ or SOCIAL SECURITY NUMBER: ____ - ____ - ____

Company or individual bidding: _____

Company representative's name: _____

Address: _____

City: _____ State: _____ Zip: _____

IF AVAILABLE, PLEASE PLACE THE PERSONALIZED LABEL FROM YOUR PROSPECTUS IN THE ABOVE BOX.

Individual or company representative's signature: _____ Date: _____

Phone number : _____ Email (optional): _____

THE WINNING BIDDER MUST COMPLETE THE VERIFICATION OF WORKER'S DISABILITY COMPENSATION ACT COMPLIANCE (ON REVERSE SIDE IF DOUBLE SIDED) WITHIN 21 DAYS OF SALE AWARD DATE



FOR DEPARTMENT USE ONLY
Sale Number (XX - XXX - XX - XX)
Forest Management Unit:

TIMBER SALE VERIFICATION OF WORKER'S DISABILITY COMPENSATION ACT COMPLIANCE

*As required by Act 317, P.A. 1969 (Worker's Compensation) and
Part 5 of Act 451 of 1994, as amended.*

VERIFICATION OF WORKER'S DISABILITY COMPENSATION ACT COMPLIANCE

- This verification must be completed and submitted within 21 days of contract award and prior to the issuance of the timber sale contract.
- In addition, if boxes 2B or 2C are checked, then Notice of Exclusion or Certificate of Insurance must be submitted within twenty-one (21) days of the contract award and prior to the issuance of the timber sale contract.
- All information must be typed or printed except for written signatures.

Please Check Appropriate Categories:

1. My business is organized as (you **must** check one of the boxes below):
 - A. Sole Proprietorship (individual)
 - B. Partnership
 - C. Corporation
2. You **must** check one of the boxes below:
 - A. I certify my business is a sole proprietorship and it has no employees but the sole proprietor. I am not subject to the Worker's Compensation Laws.
 - B. I certify my business has satisfied its obligation to the Worker's Compensation Act through the use of an approved Notice of Exclusion (BWC-337, Rev. 5/96). I will provide a copy of the Notice of Exclusion within 21 days of the contract award. (For questions or a copy of the BWC-337, please call the Worker's Compensation Bureau at 517-322-1195).
 - C. I certify my business has a Worker's Compensation Policy. I will provide an original Certificate of Insurance within twenty-one (21) days of the contract award.
3. If you have checked item 2(A) or 2(B), you **must** indicate the number of **both** full-time and part-time employees, other than yourself, including family members and active partners (if none, you must enter "0").

_____ Full-time Employees

_____ Part-time Employees

Name of Business		Federal ID (or) Social Security No.	
Address		Telephone ()	
City	State	ZIP	

I hereby certify that the above information is true and correct. I agree to notify the Michigan DNR of any changes that occur in factors affecting my coverage during any of my present and future operations.

Signature of Owner or Authorized Representative

Title

Date

Please complete the "SEALED BID" information on the next page