



**DEPARTMENT OF NATURAL RESOURCES
STATE OF MICHIGAN**

TIMBER SALE PROSPECTUS #6861

SCHEDULED SALE DATE AND TIME: 9:00 a.m. (local time) on May 7, 2021.

LOCATION: GRAYLING MGMT UNIT, 1955 HARTWICK PINES ROAD, GRAYLING, MI 49738.

PROSPECTUS NOTE: The bidder is advised to inspect the sale area and review the location, estimated volumes, operating costs and contract terms of proposed sales. Please be aware that some landowners may request 60 days or more notice for access across their land.

Notice is hereby given that bids will be received by the Unit Manager, GRAYLING MANAGEMENT UNIT, for certain timber on the following described lands:

Nameless Oak (72-005-20) / T27N, R01E, SEC. 27, NESE.

T27N, R01E, SEC. 36, E1/2NW,NWNE,S1/2NE,E1/2SW,SE.

Oscoda County, Advertised Price \$86,571.15, 132.5 Acres, Hardwood, Red Oak.

SALE NOTE: Oak wilt timing restrictions are in place for this sale.

A recreation site such as a trail, pathway, or campground is within the sale area or the vicinity. Certain restrictions/specifications may be applicable including time restrictions.

Cherry Creek Do-Over (72-011-20) / T26N, R01E, SEC. 1, N1/2NW,SENE,NE.

T26N, R01E, SEC. 36, N1/2SW,SESW,SWSE.

Oscoda County, Advertised Price \$40,416.85, 162.0 Acres, Red Pine, White Pine.

SALE NOTE: Sale contains trees over 18" at DBH. Payment Units 1 and 2 are accessed by the Mio to Meadows MCCCT trail that is sandy in places. Payment Units 3-5 had high error associated with the cruise due to large open areas and sparsely scattered merchantable trees.

A recreation site such as a trail, pathway, or campground is within the sale area or the vicinity. Certain restrictions/specifications may be applicable including time restrictions.

Medioakre Mix (72-016-20) / T26N, R03W, SEC. 14, NESW,NWSE,S1/2SE.

T26N, R03W, SEC. 15, E1/2SW,SE.

T26N, R03W, SEC. 22, NWNE.

T26N, R03W, SEC. 23, NENE.

Crawford County, Advertised Price \$47,199.00, 121.7 Acres, Hardwood, Jack Pine.

Muskat KW (72-020-20) / T27N, R02E, SEC. 18, NWNW.

T27N, R02E, SEC. 7, NENW,S1/2NW,NWNE,S1/2NE,SW,SE.

Oscoda County, Advertised Price \$110,155.90, 336.4 Acres, Jack Pine, Red Pine.

SALE NOTE: A recreation site such as a trail, pathway, or campground is within the sale area or the vicinity. Certain restrictions/specifications may be applicable including time restrictions.

Quarter Quorners Mix (72-032-20) / T25N, R04W, SEC. 32, NENW,S1/2NW,NE.

Crawford County, Advertised Price \$250,869.85, 173.3 Acres, Hardwood, Red Pine.

SALE NOTE: Additional chip wood volume available; ask sale administrator for more details. Access is by Snowmobile Trail/ORV route - timing restrictions may be enforced. Residual BA in Payment Units 3 is 10-20 square feet.

A recreation site such as a trail, pathway, or campground is within the sale area or the vicinity. Certain restrictions/specifications may be applicable including time restrictions.

Hissing Hognose Mix (72-035-20) / T27N, R01E, SEC. 18, W1/2SW.

T27N, R01W, SEC. 13, S1/2SE.

T27N, R01W, SEC. 24, W1/2NW,S1/2NE,N1/2SE.

Crawford County, Advertised Price \$42,240.30, 84.9 Acres, Hardwood, Red Pine.

SALE NOTE: A recreation site such as a trail, pathway, or campground is within the sale area or the vicinity. Certain restrictions/specifications may be applicable including time restrictions.

BID INSTRUCTIONS (VER. 07/02/2018):

1. Scheduled Bid Location, Date, and Time (2/11)

Bids must be received by the Unit Manager, GRAYLING OFFICE, 1955 HARTWICK PINES ROAD, GRAYLING, MI 49738, no later than 9:00 a.m. (local time) on May 7, 2021. For further information concerning this sale, contact Thomas Barnes at 989-348-6371 extension 7440.

2. Bidder's Qualifications (5/16)

Purchaser shall obtain workers compensation insurance to cover claims under Michigan's Worker's Disability Compensation Act of 1969 or similar employee benefit act of any other state applicable to an employee. If all or part of a timber sale was prepared by a private contractor, the contractor and that contractor's company are not permitted to bid on the timber sale contract. Bids will not be accepted from individuals or companies appearing on the DNR/FRD No-Bid List. This list contains the names of purchasers who previously failed to execute a contract within 21-days or who have a history of poor performance.

3. Preparation of Sealed Bids (5/16)

Bid Forms may be completed online thru Michigan DNR Timber Sale Online Bidding (OLB) at www.michigan.gov/timberbidding or by completing the hardcopy Bid Form found in the Timber Sale Prospectus. Hardcopy Bid Forms shall be manually signed in ink. Registration in OLB is considered your 'signature' for all bids submitted thru that system. Bid prices must be entered for each species and product in the Bid Price column for all material subject to bidding and all fill-in blanks must be completed. If erasures or other changes appear on the hardcopy Bid Form, each erasure or change must be initialed by the person signing the bid.

4. Submission of Sealed Bids (5/16)

Bid forms may be obtained from the Unit Manager or thru OLB. Bids may be submitted hardcopy or thru OLB. All hardcopy bids must be submitted on the bid form and in an envelope clearly identified as described in this section. NOTE: Only one bid form per bid envelope. Sealed bids must be submitted to the Unit office designated in the prospectus and must be submitted at or prior to the time established in the prospectus. The envelope should show on the outside (a) the sale name or number and (b) the date and time of bid opening, as shown in the prospectus. Bids received after the time specified in the sale prospectus are late bids and will be rejected.

It is possible for a bidder to submit multiple bids on a single sale. For example, a bid may be submitted hardcopy and a bid may be submitted thru OLB. Or, two bidders from the same company could both submit bids on the same sale. If this were to happen, the State would accept all bids received and award the contract accordingly. All bidding and contractual requirements would apply to all bids received.

5. Public Opening of Sealed Bids (7/16)

If conditions permit, the sealed bids will be publicly opened and posted at the time and place set in the prospectus.

If a bidder, present at a bid opening, has submitted bids on more than one sale, that bidder may withdraw their unopened bid envelopes or announce the withdrawal of their online bid after being declared the successful bidder on one sale.

6. Award of Contract (1/11)

Award of the contract will be made to the Bidder whose bid, conforming to the prospectus, is most advantageous to the State of Michigan on the basis of total value at rates bid for the estimated quantities. The State reserves the right to reject any bid or waive any minor irregularity in bids received. A written award mailed (or otherwise furnished) to the successful Bidder shall be deemed to result in a binding contract without further action by either party.

7. Down Payment (1/11)

The Bidder to whom award is made must make a down payment within 21 days of the sale award. The amount of the down payment will be calculated as shown in the Bond and Payment Schedule of this prospectus. Only cash may be used to meet this requirement.

8. Performance Security (1/11)

As guarantee of faithful performance, a cash bond, certificate of deposit, surety bond or irrevocable letter of credit (LOC) is required within 21 days of the sale award. The amount of the performance security is shown in the Bond and

Payment Schedule of this prospectus. If an LOC or surety is used, the coverage must extend for at least 6 months beyond the contract expiration.

9. Timber Sale Contract (7/18)

Additional conditions and requirements common to all timber sales are listed on the timber sale contract (R4031) and are available on line at www.michigan.gov/timber. Contact the Unit Manager for additional information or a sample contract. Within 21 days of the date of the award letter, the bidder must sign the contract and provide the required down payment, performance security, and verification of worker's disability compensation. The down payment and performance security shall be in accordance with the provisions of the timber sale contract, in the sums stated in this prospectus. If these actions are not taken, then the Bidder, the Bidder's corporation, and the corporation's principals may not be permitted to bid on State timber sales for a period of 3 months after the first offense, 6 months after the second offense, and 1 year after the third offense. An offense will only be counted against the Bidder for 5 years. In addition, the Bidder certifies that if awarded this contract, the Bidder will complete the timber sale contract in accordance with its terms and any modifications thereof including requirements to purchase, cut, and remove the included timber by the expiration date.

Payment Unit values in the State Forest Timber Sale Contract are calculated based on the advertised value of the Payment Unit as a percentage of the total advertised value of the contract. The advertised value of each Payment Unit is given in the Description of Timber by Payment Unit table on the Timber Sale Information page. For example, if the value of Payment Unit 1 is advertised as \$1,500 and the total Timber Sale value is advertised as \$10,000, the contract price for Payment Unit 1 will be 15% of the total bid price ($\$1,500/\$10,000 * 100$).

10. Disclaimer of Estimates and Bidder's Warranty of Inspection (7/16)

Before submitting this bid, the Bidder is advised and cautioned to inspect the sale area, review the requirements of the sale contract, and take other steps as may be reasonably necessary to ascertain the location, estimated volumes, construction estimates, and operating costs of the proposed sale. Failure to do so will not relieve the Bidder from responsibility for completing the contract.

The Bidder warrants that this bid is submitted solely on the basis of the Bidder's examination and inspection of the quality and quantity of the timber offered for sale and the Bidder's opinion of the value thereof and the costs of recovery. No reliance should be placed on the State of Michigan's estimates of timber quality, quantity or costs of recovery. Bidder further acknowledges that the State of Michigan: (i) expressly disclaims any warranty of fitness of timber for any purpose; (ii) offers this timber as is without any warranty of quality (merchantability) or quantity and (iii) expressly disclaims any warranty as to the quantity or quality of timber sold.

11. Certification and Chain-of-Custody (10/14)

Unless otherwise indicated in the contract under section 7 – Other Conditions of the Sale Specific Conditions & Requirements, the area encompassed by this timber sale is certified to the standards of the Forest Stewardship Council (FSC) - Certificate #SCS-FM/COC-00090N and the Sustainable Forestry Initiative (SFI) - Certificate #NSF-SFIS-5Y031-SF5. Forest products from this sale may be delivered to the mill as "FSC 100% and / or SFI certified" as long as the contractor hauling the forest products is chain-of-custody (COC) certified or covered under a COC certificate from the destination mill. The purchaser is responsible for maintaining COC after leaving the sale area.

12. Good Neighbor Authority (GNA) Requirements (7/16)

If the name of this timber sales contains the acronym GNA, it is authorized by the Good Neighbor Authority (GNA) and covered by various agreements between the U.S. Forest Service and the State. The timber sale occurs on federal land and the following conditions apply:

GNA contracts on US Forest Service land will not be awarded to purchasers on the Federal list of excluded parties. The System for Award Management (SAM) will be checked for active excluded parties prior to award of contract. In addition, the Bidder to whom award is made must complete an Assurance Regarding Felony Conviction or Tax Delinquent Status for Corporate Applicants (AD-3031).

13. Good Neighbor Authority (GNA) Requirements, con't (9/16)

Bidder certifies, by signing this bid form, that to the best of Bidder's knowledge that the following representations are accurate and complete.

- a. That the Bidder and its principals are not presently debarred, suspended, proposed for debarment, declared ineligible, or voluntary excluded from timber sales (covered transactions) by any Federal department or agency.
- b. That the Bidder and its principals have not within a 3-year period preceding this bid been convicted of or had a civil judgment rendered against them for commission of fraud or a criminal offense in connection with obtaining , attempting to obtain, or performing a public (Federal, State, or local) transaction or contract under a public transaction; violation of Federal or State antitrust statutes or commission of embezzlement, theft, forgery, bribery, falsification or destruction of records, making false statements, or receiving stolen property.
- c. That the Bidder and its principals are not presently indicted for or otherwise criminally or civilly charged by a governmental entity (Federal, State, or local) with commission of any of the offenses enumerated in paragraph b of this certification.
- d. That the Bidder and its principals have not within a 3-year period preceding this bid had one or more public transactions (Federal, State, or local) terminated for breach or default of a timber or forest product contract.

Bidders that cannot certify this requirement, in whole or in part, shall submit an explanation with their bid.

DAN EICHINGER
Director

TIMBER SALE INFORMATION

Nameless Oak (72-005-20)
T27N, R01E, SEC. 27; T27N, R01E, SEC. 36.
Oscoda County (Advertised Price \$86,571.15)

SALE NOTE: Oak wilt timing restrictions are in place for this sale.

A recreation site such as a trail, pathway, or campground is within the sale area or the vicinity. Certain restrictions/specifications may be applicable including time restrictions.

A timber sale contract for this lump sum, sealed bid timber sale will be awarded to the responsible bidder offering the highest sealed bid price. All units of volume listed below were estimated using the T-Sale computer program and our traditional volume equations. Bids must be at or above the following advertised price for each product and species:

<u>PRODUCTS & SPECIES</u>	<u>ESTIMATED UNITS*</u>	<u>ADVERTISED PRICE</u>
Sawtimber		
Bl/R/Hybrid Oak	109.2 MBF	\$ 136.00 / MBF
Mixed Aspen	2.8 MBF	\$ 31.00 / MBF
Red Oak	228.9 MBF	\$ 110.00 / MBF
Red Pine	57.9 MBF	\$ 91.00 / MBF
White Oak	31.2 MBF	\$ 63.00 / MBF
White Pine	34.5 MBF	\$ 35.00 / MBF
Pulpwood		
Balsam Fir	8 Cords	\$ 12.80 / Cord
Mixed Aspen	68 Cords	\$ 14.05 / Cord
Mixed Oak	1,087 Cords	\$ 20.50 / Cord
Red Maple	43 Cords	\$ 20.40 / Cord
Red Pine	261 Cords	\$ 33.85 / Cord
White Pine	322 Cords	\$ 15.40 / Cord

* The total volume is statistically estimated within plus (+) or minus (-) 11.81 percent. There are an estimated 2,717 cords on this timber sale, plus or minus 321 cords at the 95% confidence level. The estimated units are final and not subject to adjustment. Prospective bidders are urged to examine this timber and to make their own estimates of quantity and quality.

BOND AND PAYMENT SCHEDULE:

1. A bond in the amount of \$4,329.00 to insure faithful performance of the conditions of the contract will be deposited by the successful bidder within 21 days of the sale award.
 2. Cutting in any sale or unit without the required advance payment would be considered a trespass.
 3. Total payment must be paid in advance or according to the following schedule :
 - (a) Ten percent (10%) of the sale value must be paid within 21 days of the sale award.
 - (b) The 10% down payment will be credited towards the first unit cut.
 - (c) Payment for each of the following units must be made before cutting begins in that unit:
- | PAYMENT UNIT NUMBER | PERCENT OF TOTAL SALE VALUE |
|---------------------|-----------------------------|
| 01 | 14.8% |
| 02 | 15.7% |
| 03 | 14.6% |
| 04 | 28.8% |
| 05 | 13.9% |
| 06 | 12.2% |
4. If no cutting takes place, the 10% down payment will not be refunded.
 5. Operations on the contract issued will terminate on 09/30/2023.

SALE STATISTICS

SALE VOLUMES

VOLUME		STATISTICAL RANGE IN CORDS		
TOTAL CUBIC FEET	TOTAL CORDS	PERCENT ERROR	MINIMUM	MAXIMUM
214,652	2,717	11.81%	2,396	3,038

VDU VOLUMES

A VDU is a Volume Determination Unit. Volumes and their associated statistics are calculated at the VDU level and summarized to the sale level. There is often a one to one relationship between a VDU and a Payment Unit, but not always, depending on the cruise design. Refer to the VDU TO PAYMENT UNIT table.

VDU	VOLUME		PERCENT ERROR	RANGE IN CORDS	
	TOTAL CUBIC FEET	TOTAL CORDS		MINIMUM	MAXIMUM
7	28,756	364	29.26%	257	471
32	68,090	862	14.34%	738	985
37	96,578	1,223	21.40%	961	1,484
63	21,188	268	32.07%	182	354
TOTAL:	214,611	2,717		2,139	3,294

VDU TO PAYMENT UNIT

When a VDU is associated with more than one Payment Unit (PU), the VDU volumes are assigned to the PU based on acres of the VDU within the PU.

VDU	VDU ACRES	PU	PU ACRES
7	17.6	5	17.6
32	35.0	1	17.0
		2	18.0
37	69.2	3	23.4
		4	45.8
63	10.7	6	10.7
TOTAL:	132.5		132.5

DESCRIPTION OF TIMBER BY PAYMENT UNIT (PU)

PU	MARKET GROUP	PRODUCT	QUANTITY	UNIT	ACRES	ADVERTISE PRICE	
1	BI/R/Hybrid Oak	Sawtimber	5.6	MBF	17.0	\$12,812.65	
	Red Oak		45.2	MBF			
	Red Pine		5.5	MBF			
	White Oak		4.6	MBF			
	White Pine		3.0	MBF			
	Mixed Aspen		Pulpwood	10			Cords
	<i>B. T. Aspen</i>			10			<i>Cords</i>
	Mixed Oak			179			Cords
	<i>BI/R/Hybrid Oak</i>			22			<i>Cords</i>
	<i>Red Oak</i>			141			<i>Cords</i>
	<i>White Oak</i>			16			<i>Cords</i>
	Red Maple			5			Cords
	Red Pine			43			Cords
	White Pine			53			Cords
2	BI/R/Hybrid Oak	Sawtimber		6.0	MBF	18.0	\$13,611.75
	Red Oak		47.8	MBF			
	Red Pine		5.9	MBF			
	White Oak		4.8	MBF			
	White Pine		3.2	MBF			
	Mixed Aspen		Pulpwood	11	Cords		
	<i>B. T. Aspen</i>			11	<i>Cords</i>		
	Mixed Oak			190	Cords		
	<i>BI/R/Hybrid Oak</i>			24	<i>Cords</i>		
	<i>Red Oak</i>			150	<i>Cords</i>		
	<i>White Oak</i>			16	<i>Cords</i>		
	Red Maple			5	Cords		
	Red Pine			46	Cords		
	White Pine			57	Cords		
3	BI/R/Hybrid Oak	Sawtimber		14.9	MBF	23.4	\$12,676.45
	Mixed Aspen		0.6	MBF			
	<i>B. T. Aspen</i>		0.6	<i>MBF</i>			
	Red Oak		22.8	MBF			
	Red Pine		14.7	MBF			
	White Oak		4.9	MBF			
	White Pine		7.3	MBF			
	Mixed Aspen		Pulpwood	10	Cords		
	<i>B. T. Aspen</i>			10	<i>Cords</i>		
	Mixed Oak			152	Cords		
	<i>BI/R/Hybrid Oak</i>			87	<i>Cords</i>		
	<i>Red Oak</i>			49	<i>Cords</i>		
	<i>White Oak</i>			16	<i>Cords</i>		
	Red Maple			10	Cords		
Red Pine	57	Cords					
White Pine	54	Cords					
4	BI/R/Hybrid Oak	Sawtimber		29.3	MBF	45.8	\$24,839.65
	Mixed Aspen		1.1	MBF			
	<i>B. T. Aspen</i>		1.1	<i>MBF</i>			
	Red Oak		44.6	MBF			
	Red Pine		28.8	MBF			
	White Oak		9.6	MBF			
	White Pine		14.2	MBF			
	Mixed Aspen		Pulpwood	19	Cords		
	<i>B. T. Aspen</i>			19	<i>Cords</i>		
	Mixed Oak			298	Cords		
	<i>BI/R/Hybrid Oak</i>			170	<i>Cords</i>		
	<i>Red Oak</i>			97	<i>Cords</i>		

DESCRIPTION OF TIMBER BY PAYMENT UNIT (PU), CON'T

PU	MARKET GROUP	PRODUCT	QUANTITY	UNIT	ACRES	ADVERTISE PRICE	
4 con't	<i>White Oak</i>	<i>Pulpwood</i>	31	<i>Cords</i>			
	Red Maple		20	Cords			
	Red Pine		112	Cords			
	White Pine		105	Cords			
5	Mixed Aspen	Sawtimber	1.1	MBF	17.6	\$12,030.25	
	<i>Quaking Aspen</i>		1.1	<i>MBF</i>			
	Red Oak		68.5	MBF			
	Red Pine		3.0	MBF			
	White Oak		2.8	MBF			
	White Pine		6.8	MBF			
	Balsam Fir		Pulpwood	8			Cords
	Mixed Aspen			18			Cords
	<i>B. T. Aspen</i>			4			<i>Cords</i>
	<i>Quaking Aspen</i>			14			<i>Cords</i>
	Mixed Oak			131			Cords
	<i>Red Oak</i>			101			<i>Cords</i>
	<i>White Oak</i>			30			<i>Cords</i>
	Red Pine			3			Cords
	White Pine			41			Cords
	6			BI/R/Hybrid Oak			Sawtimber
White Oak		4.5	MBF				
Mixed Oak		Pulpwood	137	Cords			
<i>BI/R/Hybrid Oak</i>			110	<i>Cords</i>			
<i>White Oak</i>			27	<i>Cords</i>			
Red Maple			3	Cords			
White Pine			12	Cords			
TOTAL:			464.5	MBF			
TOTAL:			1,789	Cords			

Sale Specific Conditions & Requirements

Sale Name: Nameless Oak

Sale Number: 72-005-20 Seq#: 2

1 - Sale Area

1.2 - Boundaries

1.2.1 - Painted boundaries (9/19)

The sale boundary and Payment Unit boundaries are marked and identified by blue, red, and yellow paint, as well as Cherry Creek Road and Ruth Road. Exterior sale boundary lines against private property are marked with blue paint. Exterior sale boundary lines against state are marked with red paint or are unmarked and designated by Ruth Road or Cherry Creek Road. Interior Payment Unit boundaries are marked with yellow paint. Retention patches are marked with red paint; no harvesting activities may occur within these areas. The painted boundary line trees are not Included Timber and are to be protected. Yellow painted trees designating an interior Payment Unit boundary are only to be cut when all surrounding Payment Units have been paid.

2 - Timber Specifications

2.1 - Included Timber

2.1.1 - Clearcut unit(s) with unmerchantable trees (6/14)

Within Payment Unit(s) 6, cut all trees that are two (2) inches or more at DBH.

2.1.5 - Overstory removal unit(s) (8/11)

Within Payment Unit(s) 1-5, all trees which meet minimum piece specifications in 2.2 Utilization, are designated for cutting. In addition, cut all red maple trees that are two (2) inches or more at DBH.

2.2 - Utilization

2.2.3 - Stump heights (4/07)

Stump heights within Payment Unit 6 shall not exceed 6 inches for all trees. This is to facilitate anticipated planting operations.

3 - Payments

3.3 - Pre-measured Sales

3.3.4 - Dividing payment units (7/14)

Payment Unit(s) may be divided at the request of the Purchaser and upon approval of the Unit Manager. Dividing Payment Units is a contract modification which requires a Timber Sale Contract Amendment. There will be only one division per Payment Unit.

3.4 - Damaged Timber

3.4.1 - Damaged timber (7/16)

General Condition and Requirement 3.4 Damaged Timber, defines liquidated damages for undesignated live merchantable trees which are cut or injured. In addition, reasonable care should be taken to avoid damage to oak and aspen seedlings and saplings.

Within Payment Units 1-5, if more than 25% of the tree seedlings or saplings (1/4" to 4.5" DBH) within a specified portion of the Sale Area are damaged, liquidated damages will be assessed at \$300 per acre for all acreage within that specified portion of the Sale Area that was damaged.

Trees cut cleanly in skid rows for operability will not be counted as damaged timber.

4 - Transportation

4.1 - Construction

4.1.3 - Slash and earthen piles (8/04)

Piles or windrows of earth along roads and landings that have been widened or constructed shall be leveled. Slash from road maintenance or construction, including stumps, shall be dispersed throughout the sale.

4.1.6 - Road construction (1/09)

Construction of new roads or improvements of existing roads shall be done in such a way as to minimize the environmental and visual impacts. Merchantable trees shall be cut and utilized unless otherwise directed. Non-merchantable trees shall be severed and laid flat on the ground. Slash shall be scattered, and not left in windrows and kept a minimum of 10 feet back from the road edge. Stumps shall be set upright, not left on edge, and be moved at least 10 feet away from the road edge. Disturbed soil shall be feathered into the woods and not left in berms or windrows.

4.1.7 - Road closure (10/11)

All new roads built into the sale must be blocked to vehicle traffic upon completion of the sale. All new roads built into the sale must be blocked to vehicle traffic within 30 days of completion of hauling. Overgrown roads that are reopened shall be considered new roads. In general, this will require constructing a four (4') foot high berm of stumps and logs covered with earth. Stumps and brush must be placed along the remainder of the trail. These roads must be rendered impassable to cars and trucks. Contact the sale administrator for specific details of design and placement.

4.1.11 - Permits (2/12)

The Purchaser will secure any necessary permits that may be required.

5 - Operations

5.1 - Notification

5.1.1 - Pre-sale conference (10/16)

A pre-sale conference on site between the Purchaser and sale administrator is required prior to beginning any operations to determine landing and road locations. The Unit Manager or his/her representative must be contacted at least 5 days in advance to schedule the conference.

5.2 - Conduct of Operations

5.2.1 - Slash

5.2.1.11 - Slash for reforestation (5/07)

To facilitate reforestation, Payment Unit 6 shall be left with slash evenly distributed. Bunched tops within the cutting area shall be broken up and scattered. Stumps shall be cut low to the ground. Processing sites shall not be left with a compacted layer of slash; tops from these sites shall be hauled back into the cut area and scattered.

5.2.2 - Hazard Trees/Snags

5.2.2.1 - Den trees (10/16)

Obvious hollow and/or den trees shall be protected and left standing unless they are a safety hazard.

5.2.3 - Operating Restrictions

5.2.3.5 - Oak wilt restriction (1/18)

Within Payment Units 1-6, unless changed by written agreement, cutting, skidding, hauling within the sale and brushing of access roads to the sale are not permitted during the period of April 15 to July 15. Operations may be allowed if specific steps are taken to prevent damaging uncut oak during the high risk period. Those steps may include completing all road brushing before April 15th and clearing a tree-length buffer along uncut oak cover before April 15th. This is necessary to reduce the spread of oak wilt. For more information, contact the Unit Manager or his/her representative.

5.2.32 - Decking/landing restoration (9/13)

All decking and landing areas must have the surface area restored to a condition equal to or better than before. This is to ensure the proper regeneration of the stand. Wood debris, chips, and "cookies" from trimmings must be removed or scattered away from landing and loading areas and may not be windrowed on the edge.

5.2.38 - No decking against live trees (2/04)

Cut products may not be decked against unmarked or designated leave trees.

5.2.39 - ORV trail/route protection (4/18)

The MCCCT (Michigan Cross-Country Cycle Trail) is shown on the Timber Sale Map. Do not damage posts with MCCCT

markers. Trees with MCCCT markers shall be cut off above the markers and at least 5 feet above ground. All stumps within 5 feet of the trail must be cut flush with the ground. Maintain a 20-foot-wide slash, debris, and rut free zone daily using the MCCCT as the centerline. Do not run equipment down the trail. Skidding across the trail or route may only occur in locations approved by the sale administrator.

5.4 - Soil Protection

5.4.3 - Erosion control (12/08)

Skid trails or haul roads may require erosion control structures or berms per direction of the Unit Manager or his/her representative.

6 - Safety and Fire Prevention

6.2 - Signing

6.2.1 - Road posting (9/09)

The Purchaser is responsible for posting and maintaining caution signs on Cherry Creek, Townline, Hanson, and Ruth Road prior to beginning operations. The road must be posted at appropriate distances from the Sale Area to warn of logging activity and truck traffic. Signs must be removed when harvest operations are suspended or completed. The Purchaser will provide these signs.

6.2.3 - Recreational trail posting (2/10)

The Purchaser is responsible for posting and maintaining caution signs on the MCCCT prior to beginning operations. The trail must be posted at appropriate distances from the Sale Area to warn of logging activity and truck traffic at both ends of the trail. Signs must be removed when harvest operations are suspended or completed. The Purchaser will provide these signs.



TIMBER SALE MAP

This information provided by authority of Part 525, 1994 PA 451, as amended.

Forest Management Unit Grayling	County Oscoda	Mapped By Mittig	Date 11/25/2020	Page 1	of 2
Township 27N	Range 01E	Section(s) and Subdivision(s) Sec 7: 27 NESE Sec 36: E1/2NW,NWNE,S1/2NE,E1/2SW,SE	Scale 1:15,840		

Cover Type				Density			
A = Aspen	H = Hemlock	N = Marsh	U = Upland Brush	0 = Non Stocked	5 = Pole Timber Medium		
B = Paper Birch	J = Jack Pine	O = Oak	UM = Upland Mixed	1 = Seedling Sapling Poor	6 = Pole Timber Well		
C = Cedar	L = Lowland Brush	P = Lowland Poplar	V = Bog or Marsh	2 = Seedling Sapling Medium	7 = Saw Timber Poor		
D = Treed Bog	LM = Lowland Mixed	Q = Mixed Swamp Conifer	W = White Pine	3 = Seedling Sapling Well	8 = Saw Timber Medium		
E = Swamp Hdwoods	M = Mpl, Bch, Brch	R = Red Pine	X = Non Stocked	4 = Pole Timber Poor	9 = Saw Timber Well		
F = Spruce Fir	MC = Mixed Conifer	S = Black Spruce	Z = Water				
G = Grass	MD = Mixed Deciduous	T = Tamarack					

PU	Acres	PU	Acres
1	17	4	45.8
2	18	5	17.6
3	23.4	6	10.7

Nameless Oak

Compartment 002

132.5 Acres

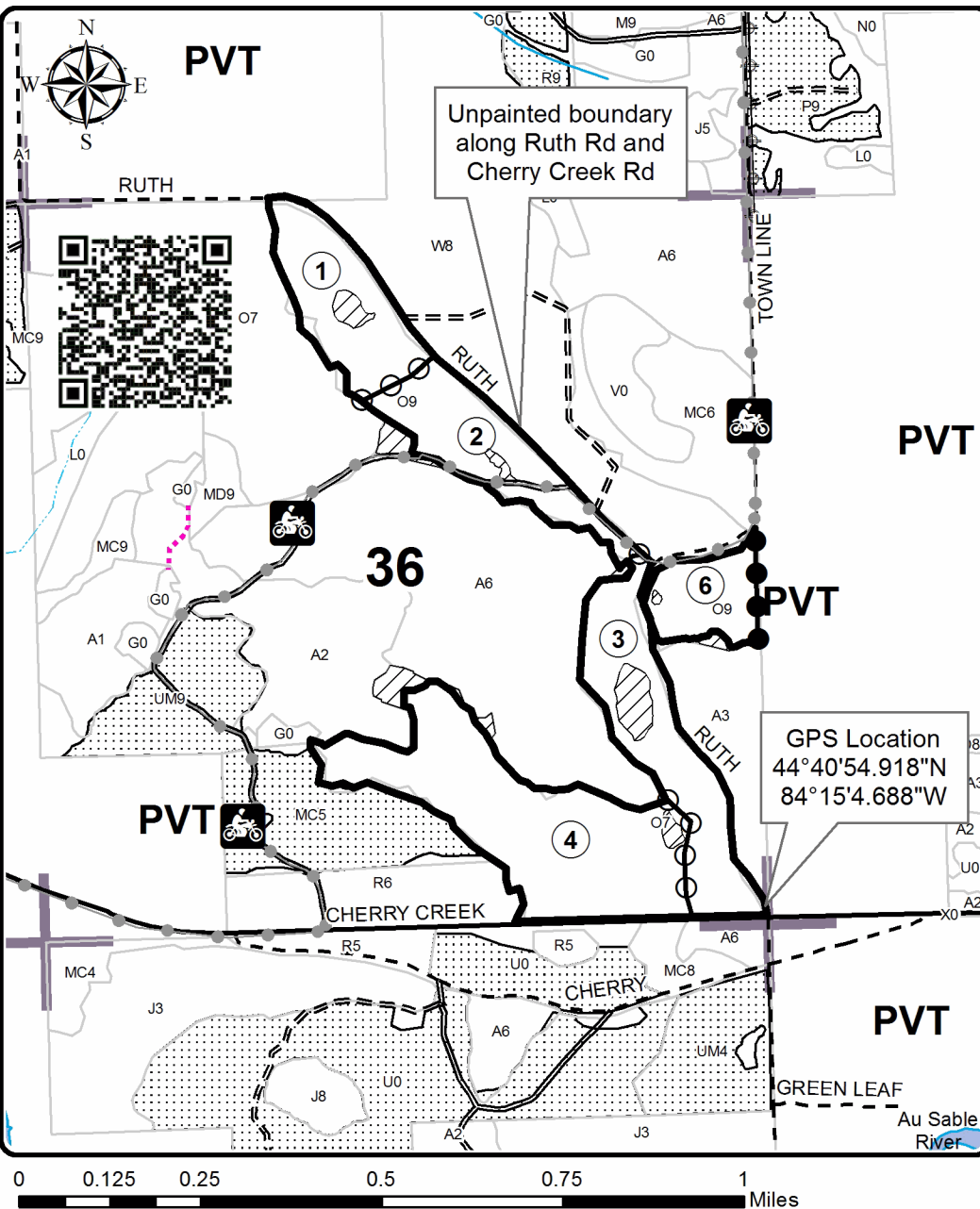

Legend

- Against State (Red)
- Payment Unit (Yellow)
- Private Line (Blue)
- Payment Unit
- Retention Area
- Stand Boundaries
- Nearby Timber Sales
- Recreational Trail
- Secondary Forest Road
- Forest Access Route
- Paved Road
- Gravel Road
- Temporary Management Access
- Intermittent Stream
- Perennial River
- Lakes and Rivers
- Section Corners

Locator Map

1:200,000

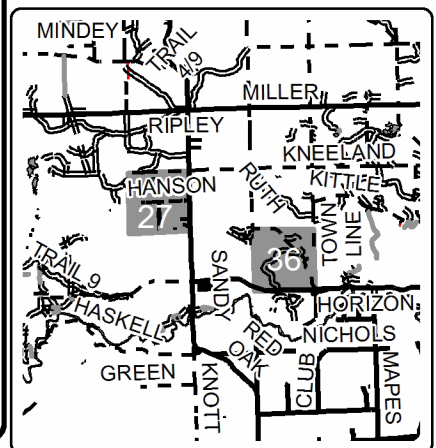



TIMBER SALE MAP

This information provided by authority of Part 525, 1994 PA 451, as amended.

Forest Management Unit Grayling		County Oscoda	Mapped By Mittig	Date 11/25/2020	Page 2	of 2
Township 27N	Range 01E	Section(s) and Subdivision(s) Sec 27: NESE Sec 36: E1/2NW,NWNE,S1/2NE,E1/2SW,SE		Scale 1:12,000		

Cover Type				Density	
A = Aspen	H = Hemlock	N = Marsh	U = Upland Brush	0 = Non Stocked	5 = Pole Timber Medium
B = Paper Birch	J = Jack Pine	O = Oak	UM = Upland Mixed	1 = Seedling Sapling Poor	6 = Pole Timber Well
C = Cedar	L = Lowland Brush	P = Lowland Poplar	V = Bog or Marsh	2 = Seedling Sapling Medium	7 = Saw Timber Poor
D = Tread Bog	LM = Lowland Mixed	Q = Mixed Swamp Conifer	W = White Pine	3 = Seedling Sapling Well	8 = Saw Timber Medium
E = Swamp Hdwoods	M = Mpl, Bch, Brch	R = Red Pine	X = Non Stocked	4 = Pole Timber Poor	9 = Saw Timber Well
F = Spruce Fir	MC = Mixed Conifer	S = Black Spruce	Z = Water		
G = Grass	MD = Mixed Deciduous	T = Tamarack			

PU	Acres	PU	Acres
1	17	4	45.8
2	18	5	17.6
3	23.4	6	10.7

Nameless Oak

Compartment 002
132.5 Acres

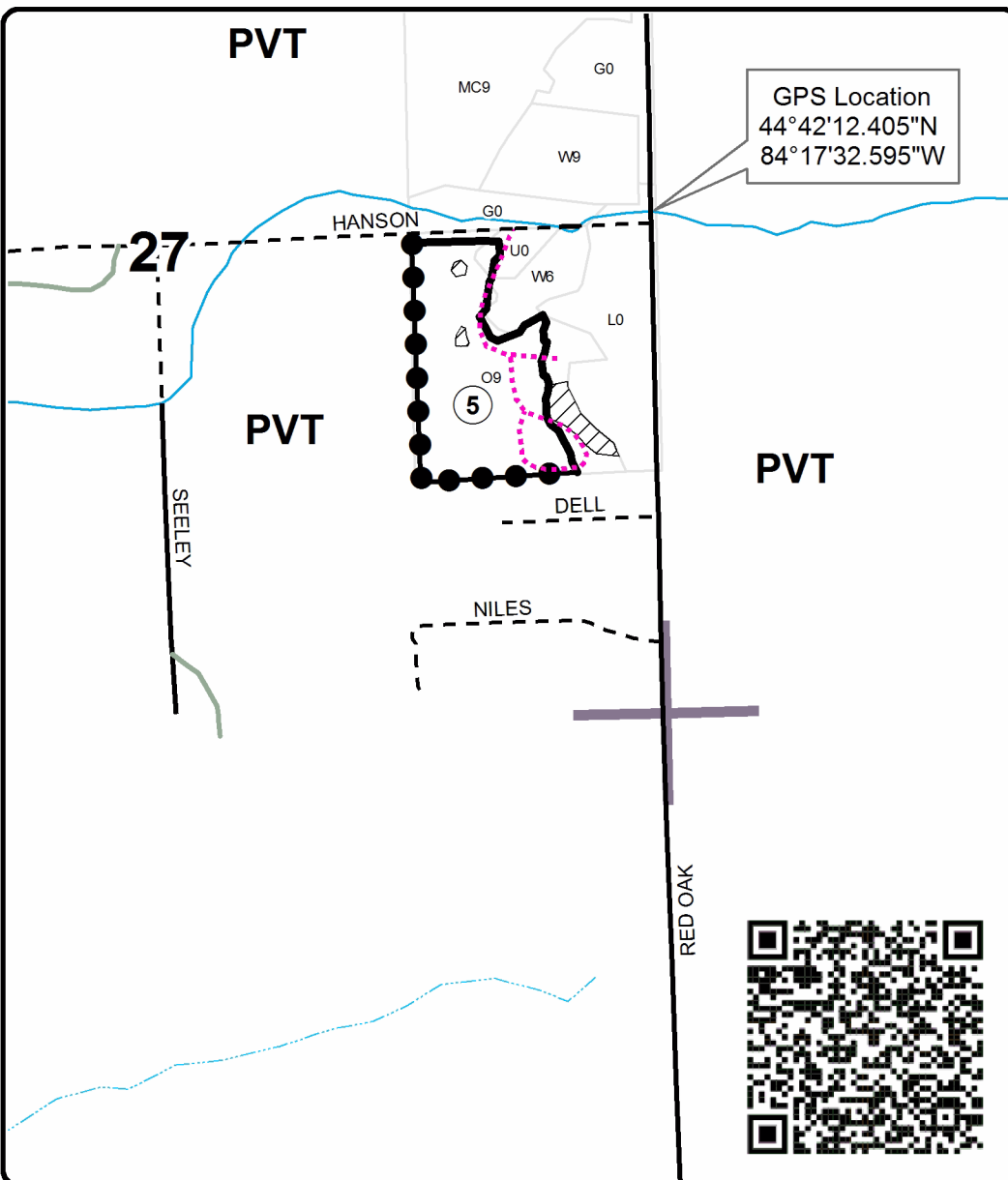
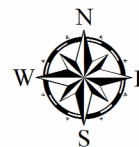

Legend

- Against State (Red)
- Private Line (Blue)
- Payment Unit
- Retention Area
- Stand Boundaries
- Paved Road
- Gravel Road
- Private
- Temporary Management Access
- Intermittent Stream
- Perennial River
- Section Corners

Locator Map

1:200,000

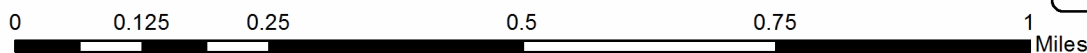
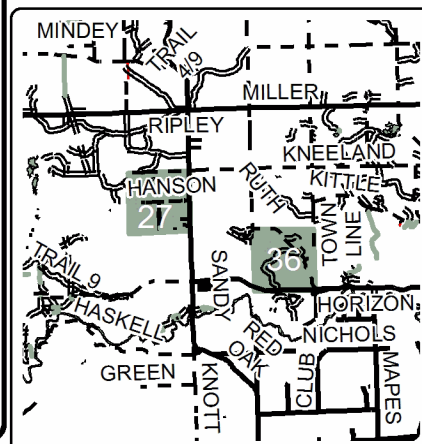

TIMBER SALE INFORMATION

Cherry Creek Do-Over (72-011-20)
T26N, R01E, SEC. 1; T27N, R01E, SEC. 36.
Oscoda County (Advertised Price \$40,416.85)

SALE NOTE: Sale contains trees over 18" at DBH. Payment Units 1 and 2 are accessed by the Mio to Meadows MCCCT trail that is sandy in places. Payment Units 3-5 had high error associated with the cruise due to large open areas and sparsely scattered merchantable trees.

A recreation site such as a trail, pathway, or campground is within the sale area or the vicinity. Certain restrictions/specifications may be applicable including time restrictions.

A timber sale contract for this lump sum, sealed bid timber sale will be awarded to the responsible bidder offering the highest sealed bid price. All units of volume listed below were estimated using the T-Sale computer program and our traditional volume equations. Bids must be at or above the following advertised price for each product and species:

<u>PRODUCTS & SPECIES</u>	<u>ESTIMATED UNITS*</u>		<u>ADVERTISED PRICE</u>
Sawtimber			
Red Pine	200.3	MBF	\$ 91.00 / MBF
White Pine	54.2	MBF	\$ 35.00 / MBF
Pulpwood			
Balsam Fir	4	Cords	\$ 12.80 / Cord
Jack Pine	90	Cords	\$ 15.30 / Cord
Mixed Aspen	124	Cords	\$ 14.05 / Cord
Mixed Hardwood	88	Cords	\$ 20.40 / Cord
Mixed Oak	96	Cords	\$ 20.50 / Cord
Red Pine	275	Cords	\$ 33.85 / Cord
White Pine	263	Cords	\$ 15.40 / Cord

* The total volume is statistically estimated within plus (+) or minus (-) 13.66 percent. There are an estimated 1,451 cords on this timber sale, plus or minus 198 cords at the 95% confidence level. The estimated units are final and not subject to adjustment. Prospective bidders are urged to examine this timber and to make their own estimates of quantity and quality.

BOND AND PAYMENT SCHEDULE:

1. A bond in the amount of \$2,021.00 to insure faithful performance of the conditions of the contract will be deposited by the successful bidder within 21 days of the sale award.
2. Cutting in any sale or unit without the required advance payment would be considered a trespass.
3. Total payment must be paid in advance or according to the following schedule :
 - (a) Ten percent (10%) of the sale value must be paid within 21 days of the sale award.
 - (b) The 10% down payment will be credited towards the first unit cut.
 - (c) Payment for each of the following units must be made before cutting begins in that unit:

PAYMENT UNIT NUMBER	PERCENT OF TOTAL SALE VALUE
01	43.7%
02	38.4%
03	2.0%
04	10.1%
05	5.8%

4. If no cutting takes place, the 10% down payment will not be refunded.
5. Operations on the contract issued will terminate on 06/30/2023.

SALE STATISTICS

SALE VOLUMES

VOLUME		STATISTICAL RANGE IN CORDS		
TOTAL CUBIC FEET	TOTAL CORDS	PERCENT ERROR	MINIMUM	MAXIMUM
114,590	1,451	13.66%	1,252	1,649

VDU VOLUMES

A VDU is a Volume Determination Unit. Volumes and their associated statistics are calculated at the VDU level and summarized to the sale level. There is often a one to one relationship between a VDU and a Payment Unit, but not always, depending on the cruise design. Refer to the VDU TO PAYMENT UNIT table.

VDU	VOLUME		PERCENT ERROR	RANGE IN CORDS	
	TOTAL CUBIC FEET	TOTAL CORDS		MINIMUM	MAXIMUM
38	36,079	457	25.14%	342	572
41	14,860	188	43.49%	106	270
59	2,694	34	64.73%	12	56
60	56,390	714	18.07%	585	843
64	4,535	57	80.33%	11	104
TOTAL:	114,558	1,450		1,056	1,844

VDU TO PAYMENT UNIT

When a VDU is associated with more than one Payment Unit (PU), the VDU volumes are assigned to the PU based on acres of the VDU within the PU.

VDU	VDU ACRES	PU	PU ACRES
38	25.7	2	25.7
41	84.3	4	67.3
		5	17.0
59	13.9	3	13.9
60	20.8	1	20.8
64	17.3	5	17.3
TOTAL:	162.0		162.0

DESCRIPTION OF TIMBER BY PAYMENT UNIT (PU)

PU	MARKET GROUP	PRODUCT	QUANTITY	UNIT	ACRES	ADVERTISE PRICE
1	Red Pine	Sawtimber	80.5	MBF	20.8	\$17,659.40
	White Pine		38.7	MBF		
	Balsam Fir	Pulpwood	2	Cords		
	Mixed Aspen		115	Cords		
	<i>B. T. Aspen</i>	<i>Sawtimber</i>	19.1	<i>MBF</i>		
	<i>B. T. Aspen</i>	<i>Pulpwood</i>	77	<i>Cords</i>		
	Mixed Hardwood		84	Cords		
	<i>Red Maple</i>	<i>Sawtimber</i>	14.1	<i>MBF</i>		
	<i>Red Maple</i>	<i>Pulpwood</i>	56	<i>Cords</i>		
	Mixed Oak		59	Cords		
	<i>Northern Pin Oak</i>	<i>Sawtimber</i>	9.3	<i>MBF</i>		
	<i>Northern Pin Oak</i>	<i>Pulpwood</i>	40	<i>Cords</i>		
	Red Pine		59	Cords		
	White Pine		157	Cords		
2	Red Pine	Sawtimber	95.5	MBF	25.7	\$15,535.00
	Balsam Fir	Pulpwood	1	Cords		
	Jack Pine		77	Cords		
	Mixed Aspen		4	Cords		
	<i>B. T. Aspen</i>		4	<i>Cords</i>		
	Mixed Oak		24	Cords		
	<i>Northern Pin Oak</i>	<i>Sawtimber</i>	0.7	<i>MBF</i>		
	<i>Northern Pin Oak</i>	<i>Pulpwood</i>	23	<i>Cords</i>		
	Red Pine		144	Cords		
	White Pine		15	Cords		
3	Red Pine	Sawtimber	2.8	MBF	13.9	\$790.85
	White Pine		3.0	MBF		
	Red Pine	Pulpwood	5	Cords		
	White Pine		17	Cords		
4	Red Pine	Sawtimber	13.3	MBF	67.3	\$4,083.35
	White Pine		8.1	MBF		
	Jack Pine	Pulpwood	1	Cords		
	Mixed Aspen		2	Cords		
	<i>Quaking Aspen</i>		2	<i>Cords</i>		
	Mixed Hardwood		3	Cords		
	<i>Black Cherry</i>		3	<i>Cords</i>		
	Mixed Oak		5	Cords		
	<i>Northern Pin Oak</i>		5	<i>Cords</i>		
	Red Pine		49	Cords		
	White Pine		47	Cords		
5	Red Pine	Sawtimber	8.2	MBF	34.3	\$2,348.25
	White Pine		4.4	MBF		
	Balsam Fir	Pulpwood	1	Cords		
	Jack Pine		12	Cords		
	Mixed Aspen		3	Cords		
	<i>Quaking Aspen</i>		3	<i>Cords</i>		
	Mixed Hardwood		1	Cords		
	<i>Black Cherry</i>		1	<i>Cords</i>		
	Mixed Oak		8	Cords		
	<i>Northern Pin Oak</i>		7	<i>Cords</i>		
	<i>White Oak</i>		1	<i>Cords</i>		
	Red Pine		18	Cords		
	White Pine		27	Cords		
TOTAL:			254.5	MBF		
TOTAL:			940	Cords		

Sale Specific Conditions & Requirements

Sale Name: Cherry Creek Do-Over

Sale Number: 72-011-20 Seq#: 2

1 - Sale Area

1.2 - Boundaries

1.2.1 - Painted boundaries (9/19)

The sale boundary and Payment Unit boundaries are marked and identified by blue, red, and yellow paint or unmarked and identified by existing roads. Exterior sale boundary lines against private property are marked with blue paint except the east boundary of Payment Unit 5 is unmarked and identified by Townline Road. Exterior sale boundary lines against state are marked with red paint. Interior Payment Unit boundaries are marked with yellow paint except the south boundary of Payment Unit 3 is unmarked and identified by Cherry Lane. Retention patches are marked with red paint; no harvesting activities may occur within these areas. The painted boundary line trees are not Included Timber and are to be protected. Yellow painted trees designating an interior Payment Unit boundary are only to be cut when all surrounding Payment Units have been paid.

2 - Timber Specifications

2.1 - Included Timber

2.1.1 - Clearcut unit(s) with unmerchantable trees (6/14)

Within Payment Unit(s) 1, 2, 4, and 5, cut all trees that are two (2) inches or more at DBH except do not cut trees greater than 26 inches at DBH.

2.1.5 - Overstory removal unit(s) (8/11)

Within Payment Unit(s) 3, all trees which meet minimum piece specifications in 2.2 Utilization, are designated for cutting.

2.2 - Utilization

2.2.2 - Chipping required (2/18)

Payment Units 2, 4 and 5 must be chip harvested to facilitate subsequent planting operations. The Purchaser has the option to produce sawlogs or pulpwood bolts, but the remaining portion of the trees must be chipped and hauled. If market conditions limit the practicality of chipping, tops and slash must be arranged in a way that will not inhibit future planting operations, as directed by the sale administrator. A chipping exemption can be obtained if proposed operations are determined to be suitable for planting by reforestation staff. The requirement to retain approximately 1/6 to 1/3 of tree tops and limbs less than four inches in diameter is still applicable (G. C. & R. 2.2).

2.2.3 - Stump heights (4/07)

Stump heights within Payment Unit(s) 2, 4 and 5 shall not exceed 6 inches for all trees. This is to facilitate planting operations.

3 - Payments

3.3 - Pre-measured Sales

3.3.4 - Dividing payment units (7/14)

Payment Unit(s) may be divided at the request of the Purchaser and upon approval of the Unit Manager. Dividing Payment Units is a contract modification which requires a Timber Sale Contract Amendment.

3.4 - Damaged Timber

3.4.1 - Damaged timber (7/16)

General Condition and Requirement 3.4 Damaged Timber, defines liquidated damages for undesignated live merchantable trees which are cut or injured. In addition, extreme care should be taken to avoid damage to tree seedlings and saplings in Payment Unit 3.

Within the Payment Unit 3, if more than 50% of the tree seedlings or saplings (1/4" to 4.5" DBH) within a specified portion of the Sale Area are damaged, liquidated damages will be assessed at \$300 per acre for all acreage within that specified portion of the Sale Area that was damaged.

No damage is acceptable to undesignated live merchantable trees. Rates will be in accordance with General Condition and Requirement 3.4 Damaged Timber, or at a rate of \$200 per sawtimber tree, whichever is greater.

4 - Transportation

4.1 - Construction

4.1.6 - Road construction (1/09)

Construction of new roads or improvements of existing roads shall be done in such a way as to minimize the environmental and visual impacts. Merchantable trees shall be cut and utilized unless otherwise directed. Non-merchantable trees shall be severed and laid flat on the ground. Slash shall be scattered, and not left in windrows and kept a minimum of 10 feet back from the road edge. Stumps shall be set upright, not left on edge, and be moved at least 10 feet away from the road edge. Disturbed soil shall be feathered into the woods and not left in berms or windrows.

4.1.7 - Road closure (10/11)

All new roads built into the sale must be blocked to vehicle traffic upon completion of the sale. Overgrown roads that are reopened shall be considered new roads. In general, this will require constructing a four (4') foot high berm of stumps and logs covered with earth. Stumps and brush must be placed along the remainder of the trail. These roads must be rendered impassable to cars and trucks. All stumps from road building and landing construction must be reserved to block any newly constructed roads upon completion of the sale. These stumps must be scattered along the road system to prohibit vehicular movement. Contact the sale administrator for specific details of design and placement.

4.1.11 - Permits (2/12)

The Purchaser will secure any necessary permits that may be required.

5 - Operations

5.2 - Conduct of Operations

5.2.2 - Hazard Trees/Snags

5.2.2.1 - Den trees (10/16)

Obvious hollow and/or den trees shall be protected and left standing unless they are a safety hazard.

5.2.3 - Operating Restrictions

5.2.3.5 - Oak wilt restriction (1/18)

Within Payment Unit 2, unless changed by written agreement, cutting, skidding, hauling within the sale and brushing of access roads to the sale are not permitted during the period of April 15 to July 15. Operations may be allowed if specific steps are taken to prevent damaging uncut oak during the high risk period. Those steps may include completing all road brushing before April 15th and clearing a tree-length buffer along uncut oak cover before April 15th. This is necessary to reduce the spread of oak wilt. For more information, contact the Unit Manager or his/her representative.

5.2.32 - Decking/landing restoration (9/13)

All decking and landing areas must have the surface area restored to a condition equal to or better than before. This is to ensure the proper regeneration of the stand. Wood debris, chips, and "cookies" from trimmings must be removed or scattered away from landing and loading areas and may not be windrowed on the edge.

5.2.39 - ORV trail/route protection (4/18)

The MCCCT is an ORV trail or route and is shown on the Timber Sale Map. Do not cut trees or damage posts with yellow ORV markers. All stumps within 5 feet of the trail must be cut flush with the ground. Maintain a 20-foot-wide slash, debris, and rut free zone daily using the ORV trail or route as the centerline.

5.2.43 - Opening protection (12/08)

No activities are permitted in openings marked on the Timber Sale Map with the letter "G". Any damage to the openings shall be repaired according to specifications of the Unit Manager or his/her representative.

5.4 - Soil Protection

5.4.1 - Rutting restriction, general (7/16)

Operations are to cease immediately if equipment and weather conditions result in rutting of roads and/or skid trails which is 12 inches or greater in depth and 50 feet in length. The Unit Manager or his/her representative may restrict hauling and/or

skidding if ruts exceed the specified depth. With the Unit Manager or his/her representative's approval, the Purchaser may return to the area when the risk of rutting has decreased.

6 - Safety and Fire Prevention

6.2 - Signing

6.2.1 - Road posting (9/09)

The Purchaser is responsible for posting and maintaining caution signs on Cherry Creek Road prior to beginning operations. The road must be posted at appropriate distances from the Sale Area to warn of logging activity and truck traffic. Signs must be removed when harvest operations are suspended or completed. The Purchaser will provide these signs.

6.2.3 - Recreational trail posting (2/10)

The Purchaser is responsible for posting and maintaining caution signs on MCCCT Trail prior to beginning operations. The trail must be posted at appropriate distances from the Sale Area to warn of logging activity and truck traffic at both ends of the trail. Signs must be removed when harvest operations are suspended or completed. The Purchaser will provide these signs.



TIMBER SALE MAP

This information provided by authority of Part 525, 1994 PA 451, as amended.

Sale Number	Year
72 - 011	20

Forest Management Unit Grayling		County Oscoda	Mapped By Scott McClarren	Date 09/23/2020	Page 1	of 1
Township 27N 26N	Range 01E	Section(s) and Subdivision(s) Sec. 36: N1/2SW, SESW, SWSE Sec. 1: N1/2NW, SENW, NE		Scale 1:15,840		

Cover Type				Density	
A = Aspen	H = Hemlock	N = Marsh	U = Upland Brush	0 = Non Stocked	5 = Pole Timber Medium
B = Paper Birch	J = Jack Pine	O = Oak	UM = Upland Mixed	1 = Seedling Sapling Poor	6 = Pole Timber Well
C = Cedar	L = Lowland Brush	P = Lowland Poplar	V = Bog or Marsh	2 = Seedling Sapling Medium	7 = Saw Timber Poor
D = Treed Bog	LM = Lowland Mixed	Q = Mixed Swamp Conifer	W = White Pine	3 = Seedling Sapling Well	8 = Saw Timber Medium
E = Swamp Hdwoods	M = Mpl. Bch, Brch	R = Red Pine	X = Non Stocked	4 = Pole Timber Poor	9 = Saw Timber Well
F = Spruce Fir	MC = Mixed Conifer	S = Black Spruce	Z = Water		
G = Grass	MD = Mixed Deciduous	T = Tamarack			

PU	Acres	PU	Acres
1	20.8	4	67.3
2	25.7	5	34.3
3	13.9		

Cherry Creek Do-Over

Compartment 02

162 Acres

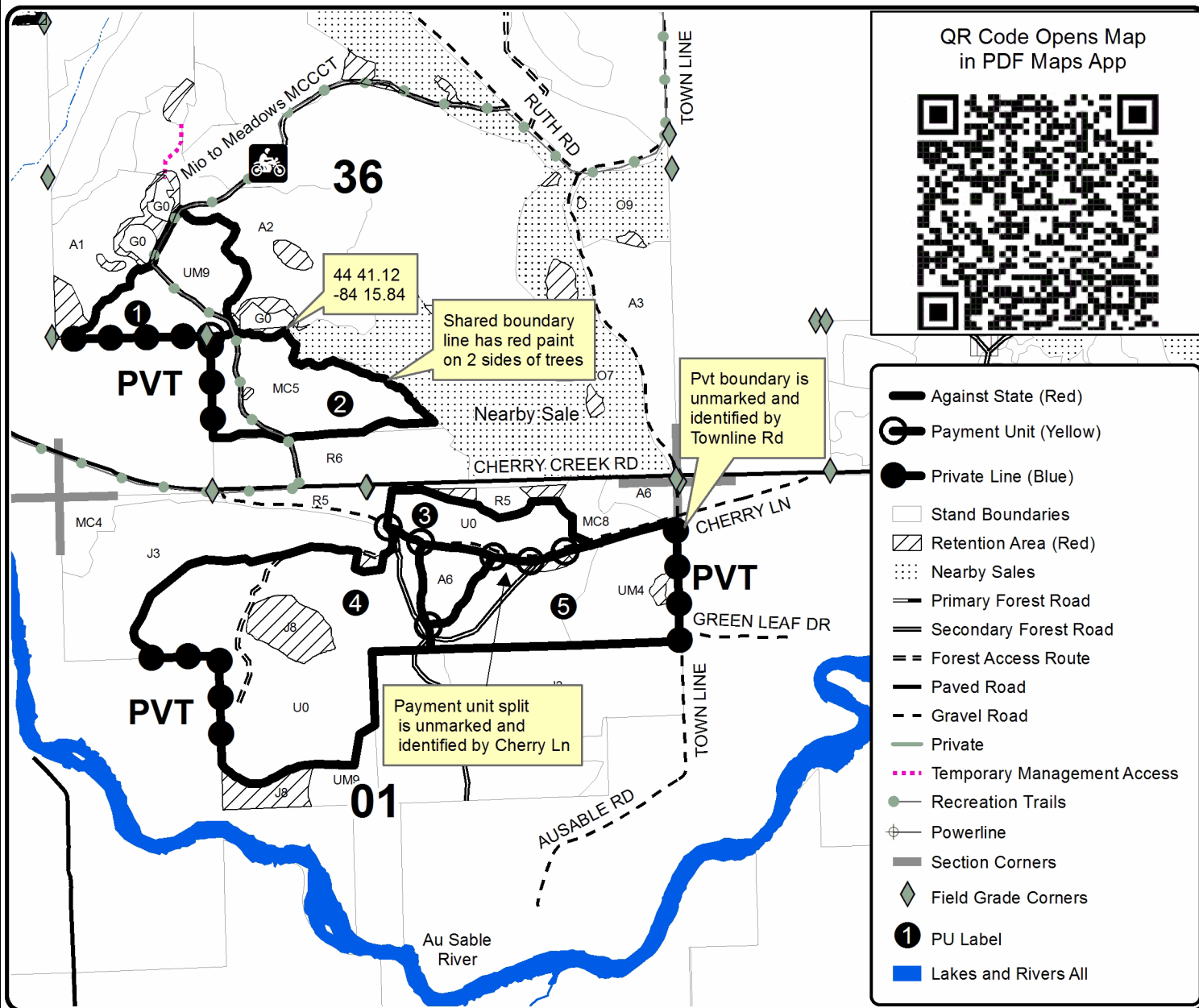
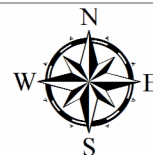

TIMBER SALE INFORMATION

Medioakre Mix (72-016-20)

T26N, R03W, SEC. 14; T26N, R03W, SEC. 15; T26N, R03W, SEC. 22; T26N, R03W, SEC. 23.
Crawford County (Advertised Price \$47,199.00)

A timber sale contract for this lump sum, sealed bid timber sale will be awarded to the responsible bidder offering the highest sealed bid price. All units of volume listed below were estimated using the T-Sale computer program and our traditional volume equations. Bids must be at or above the following advertised price for each product and species:

<u>PRODUCTS & SPECIES</u>	<u>ESTIMATED UNITS*</u>	<u>ADVERTISED PRICE</u>
Sawtimber		
BI/R/Hybrid Oak	17.5 MBF	\$ 136.00 / MBF
Red Pine	94.5 MBF	\$ 91.00 / MBF
White Oak	19.5 MBF	\$ 63.00 / MBF
Pulpwood		
B. T. Aspen	28 Cords	\$ 14.05 / Cord
BI/R/Hybrid Oak	399 Cords	\$ 20.50 / Cord
Jack Pine	552 Cords	\$ 15.30 / Cord
Red Maple	18 Cords	\$ 20.40 / Cord
Red Pine	354 Cords	\$ 33.85 / Cord
White Oak	266 Cords	\$ 20.50 / Cord
White Pine	11 Cords	\$ 15.40 / Cord

* The total volume is statistically estimated within plus (+) or minus (-) 9.44 percent. There are an estimated 1,890 cords on this timber sale, plus or minus 178 cords at the 95% confidence level. The estimated units are final and not subject to adjustment. Prospective bidders are urged to examine this timber and to make their own estimates of quantity and quality.

BOND AND PAYMENT SCHEDULE:

1. A bond in the amount of \$2,360.00 to insure faithful performance of the conditions of the contract will be deposited by the successful bidder within 21 days of the sale award.
2. Cutting in any sale or unit without the required advance payment would be considered a trespass.
3. Total payment must be paid in advance or according to the following schedule :
 - (a) Ten percent (10%) of the sale value must be paid within 21 days of the sale award.
 - (b) The 10% down payment will be credited towards the first unit cut.
 - (c) Payment for each of the following units must be made before cutting begins in that unit:

PAYMENT UNIT NUMBER	PERCENT OF TOTAL SALE VALUE
01	6.0%
02	19.8%
03	23.1%
04	35.5%
05	4.6%
06	11.0%
4. If no cutting takes place, the 10% down payment will not be refunded.
5. Operations on the contract issued will terminate on 06/30/2023.

SALE STATISTICS

SALE VOLUMES

VOLUME			STATISTICAL RANGE IN CORDS	
TOTAL CUBIC FEET	TOTAL CORDS	PERCENT ERROR	MINIMUM	MAXIMUM
149,334	1,890	9.44%	1,712	2,069

VDU VOLUMES

A VDU is a Volume Determination Unit. Volumes and their associated statistics are calculated at the VDU level and summarized to the sale level. There is often a one to one relationship between a VDU and a Payment Unit, but not always, depending on the cruise design. Refer to the VDU TO PAYMENT UNIT table.

VDU	VOLUME		PERCENT ERROR	RANGE IN CORDS	
	TOTAL CUBIC FEET	TOTAL CORDS		MINIMUM	MAXIMUM
22	45,101	571	19.80%	458	684
25	11,803	149	41.05%	88	211
28	9,069	115	38.92%	70	159
30	10,697	135	19.62%	109	162
39	6,826	86	31.95%	59	114
41	58,191	737	14.26%	632	842
44	7,647	97	29.20%	69	125
TOTAL:	149,334	1,890		1,484	2,297

VDU TO PAYMENT UNIT

When a VDU is associated with more than one Payment Unit (PU), the VDU volumes are assigned to the PU based on acres of the VDU within the PU.

VDU	VDU ACRES	PU	PU ACRES
22	30.4	2	2.2
		4	28.2
25	16.5	1	14.4
		3	2.1
28	10.5	6	10.5
30	12.6	6	12.6
39	5.9	1	0.1
		3	5.8
41	36.9	2	14.2
		3	14.4
		4	8.3
44	8.9	5	8.9
TOTAL:	121.7		121.7

DESCRIPTION OF TIMBER BY PAYMENT UNIT (PU)

PU	MARKET GROUP	PRODUCT	QUANTITY	UNIT	ACRES	ADVERTISE PRICE
1	BI/R/Hybrid Oak	Sawtimber	0.6	MBF	14.5	\$2,811.25
	Red Pine		3.0	MBF		
	White Oak		0.1	MBF		
	BI/R/Hybrid Oak	Pulpwood	35	Cords		
	Jack Pine		38	Cords		
	Red Pine		11	Cords		
	White Oak		35	Cords		
	White Pine		4	Cords		
	2	BI/R/Hybrid Oak	Sawtimber	3.0		
Red Pine			24.2	MBF		
White Oak			5.1	MBF		
BI/R/Hybrid Oak		Pulpwood	65	Cords		
Jack Pine			47	Cords		
Red Maple			4	Cords		
Red Pine			99	Cords		
White Oak			45	Cords		
3		BI/R/Hybrid Oak	Sawtimber	4.3	MBF	22.3
	Red Pine		24.9	MBF		
	White Oak		8.1	MBF		
	BI/R/Hybrid Oak	Pulpwood	91	Cords		
	Jack Pine		49	Cords		
	Red Maple		4	Cords		
	Red Pine		99	Cords		
	White Oak		71	Cords		
	White Pine		3	Cords		
4	BI/R/Hybrid Oak	Sawtimber	2.3	MBF	36.5	\$16,809.30
	Red Pine		42.4	MBF		
	White Oak		4.5	MBF		
	BI/R/Hybrid Oak	Pulpwood	61	Cords		
	Jack Pine		337	Cords		
	Red Maple		5	Cords		
	Red Pine		140	Cords		
	White Oak		54	Cords		
	5	BI/R/Hybrid Oak	Sawtimber	4.2		
B. T. Aspen		Pulpwood	10	Cords		
BI/R/Hybrid Oak			47	Cords		
Jack Pine			27	Cords		
White Pine			4	Cords		
6	BI/R/Hybrid Oak	Sawtimber	3.1	MBF	23.1	\$5,179.55
	White Oak		1.7	MBF		
	B. T. Aspen	Pulpwood	18	Cords		
	BI/R/Hybrid Oak		100	Cords		
	Jack Pine		54	Cords		
	Red Maple		5	Cords		
	Red Pine		5	Cords		
	White Oak		61	Cords		
	TOTAL:			131.5		
TOTAL:			1,628	Cords		

Sale Specific Conditions & Requirements

Sale Name: Medioakre Mix

Sale Number: 72-016-20 Seq#: 2

1 - Sale Area

1.2 - Boundaries

1.2.1 - Painted boundaries (9/19)

The sale boundary and Payment Unit boundaries are marked and identified by red and yellow paint. Exterior sale boundary lines against state are marked with red paint. Interior Payment Unit boundaries are marked with yellow paint. The painted boundary line trees are not Included Timber and are to be protected. Yellow painted trees designating an interior Payment Unit boundary are only to be cut when all surrounding Payment Units have been paid.

2 - Timber Specifications

2.1 - Included Timber

2.1.1 - Clearcut unit(s) with unmerchantable trees (6/14)

Within Payment Unit(s) 1-6, cut all trees that are two (2) inches or more at DBH, except those with green paint; those are witness trees and shall be protected.

3 - Payments

3.3 - Pre-measured Sales

3.3.4 - Dividing payment units (7/14)

Payment Unit(s) may be divided at the request of the Purchaser and upon approval of the Unit Manager. Dividing Payment Units is a contract modification which requires a Timber Sale Contract Amendment. There will be only one division per Payment Unit.

3.4 - Damaged Timber

3.4.1 - Damaged timber (7/16)

General Condition and Requirement 3.4 Damaged Timber, defines liquidated damages for undesignated live merchantable trees which are cut or injured. In addition, extreme care should be taken to avoid damage to tree seedlings and saplings.

Within the Sale Area, if more than 50% of the tree seedlings or saplings (1/4" to 4.5" DBH) within a specified portion of the Sale Area are damaged, liquidated damages will be assessed at \$300 per acre for all acreage within that specified portion of the Sale Area that was damaged.

This damage criteria does not apply to the paths machinery has to make when harvesting; paths for machinery and felling are expected and necessary.

4 - Transportation

4.1 - Construction

4.1.6 - Road construction (1/09)

Construction of new roads or improvements of existing roads shall be done in such a way as to minimize the environmental and visual impacts. Merchantable trees shall be cut and utilized unless otherwise directed. Non-merchantable trees shall be severed and laid flat on the ground. Slash shall be scattered, and not left in windrows and kept a minimum of 10 feet back from the road edge. Stumps shall be set upright, not left on edge, and be moved at least 10 feet away from the road edge. Disturbed soil shall be feathered into the woods and not left in berms or windrows.

4.1.7 - Road closure (10/11)

All new roads built into the sale must be blocked to vehicle traffic upon completion of the sale. Overgrown roads that are reopened shall be considered new roads. In general, this will require constructing a four (4') foot high berm of stumps and logs covered with earth. These roads must be rendered impassable to cars and trucks. All stumps from road building and landing construction must be reserved to block any newly constructed roads upon completion of the sale. These stumps must be scattered along the road system to prohibit vehicular movement. Contact the sale administrator for specific details of

design and placement.

4.1.11 - Permits (2/12)

The Purchaser will secure any necessary permits that may be required.

4.2 - Maintenance

4.2.5 - Two wheel drive condition (2/04)

All existing trail roads on and adjacent to the sale area must be passable by two-wheel drive traffic for the duration of the sale.

5 - Operations

5.1 - Notification

5.1.1 - Pre-sale conference (10/16)

A pre-sale conference between the Purchaser and sale administrator is required prior to beginning any operations to determine landing and road locations. The Unit Manager or his/her representative must be contacted at least three days in advance to schedule the conference.

5.2 - Conduct of Operations

5.2.2 - Hazard Trees/Snags

5.2.2.1 - Den trees (10/16)

Obvious hollow and/or den trees shall be protected and left standing unless they are a safety hazard.

5.2.3 - Operating Restrictions

5.2.3.5 - Oak wilt restriction (1/18)

Within Payment Unit(s) 1-6, unless changed by written agreement, cutting, skidding, hauling within the sale and brushing of access roads to the sale are not permitted during the period of April 15 to July 15. Operations may be allowed if specific steps are taken to prevent damaging uncut oak during the high risk period. Those steps may include completing all road brushing before April 15th and clearing a tree-length buffer along uncut oak cover before April 15th. This is necessary to reduce the spread of oak wilt. For more information, contact the Unit Manager or his/her representative.

5.2.32 - Decking/landing restoration (9/13)

All decking and landing areas must have the surface area restored to a condition equal to or better than before. This is to ensure the proper regeneration of the stand. Wood debris, chips, and "cookies" from trimmings must be removed or scattered away from landing and loading areas and may not be windrowed on the edge.

5.4 - Soil Protection

5.4.3 - Erosion control (12/08)

Skid trails or haul roads may require erosion control structures or berms per direction of the Unit Manager or his/her representative.

5.8 - Protection of Endangered Species

5.8.5 - Protection of raptor nests (3/13)

All trees with raptor nests will be protected if found during harvesting operations. Notification will be made to the Unit Manager or his/her representative who will notify the Wildlife Biologist so an on-site evaluation and recommendation can be made, if necessary.

6 - Safety and Fire Prevention

6.2 - Signing

6.2.1 - Road posting (9/09)

The Purchaser is responsible for posting and maintaining caution signs on Stately Lake Road, Barker Lake Road, and M-72 (dependent on which roads the loggers decide to use) prior to beginning operations. The road must be posted at appropriate distances from the Sale Area to warn of logging activity and truck traffic. Signs must be removed when harvest operations are suspended or completed. The Purchaser will provide these signs.



TIMBER SALE MAP

This information provided by authority of Part 525, 1994 PA 451, as amended.

Forest Management Unit Grayling		County Crawford	Mapped By Mittig	Date 05/26/2020	Page 1	of 1
Township 26N	Range 03W	Section(s) and Subdivision(s) Sec 15 E1/2SW,SE, Sec 14 NESW,NWSE,S1/2SE		Scale 1:15,840		

Cover Type				Density			
A = Aspen	H = Hemlock	N = Marsh	U = Upland Brush	0 = Non Stocked	5 = Pole Timber Medium		
B = Paper Birch	J = Jack Pine	O = Oak	UM = Upland Mixed	1 = Seedling Sapling Poor	6 = Pole Timber Well		
C = Cedar	L = Lowland Brush	P = Lowland Poplar	V = Bog or Marsh	2 = Seedling Sapling Medium	7 = Saw Timber Poor		
D = Treed Bog	LM = Lowland Mixed	Q = Mixed Swamp Conifer	W = White Pine	3 = Seedling Sapling Well	8 = Saw Timber Medium		
E = Swamp Hdwoods	M = Mpl, Bch, Brch	R = Red Pine	X = Non Stocked	4 = Pole Timber Poor	9 = Saw Timber Well		
F = Spruce Fir	MC = Mixed Conifer	S = Black Spruce	Z = Water				
G = Grass	MD = Mixed Deciduous	T = Tamarack					

Locator Map
1:200,000

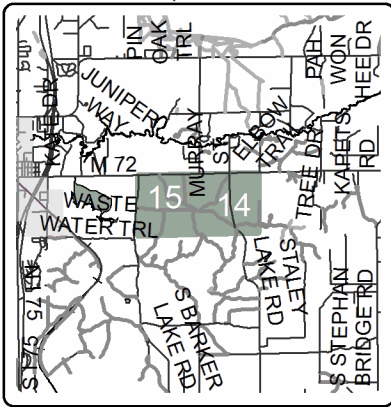

Medioakre Mix Compartment 235 121.7 Acres

PU	Acres	PU	Acres
1	14.5	4	36.5
2	16.4	5	8.9
3	22.3	6	23.1

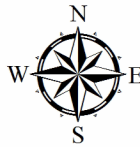

Legend

- Against State (Red)
- Payment Unit (Yellow)
- Retention Area
- Payment Unit
- Nearby Timber Sales
- Stand Boundaries
- Highway
- Secondary Forest Road
- Section Corners

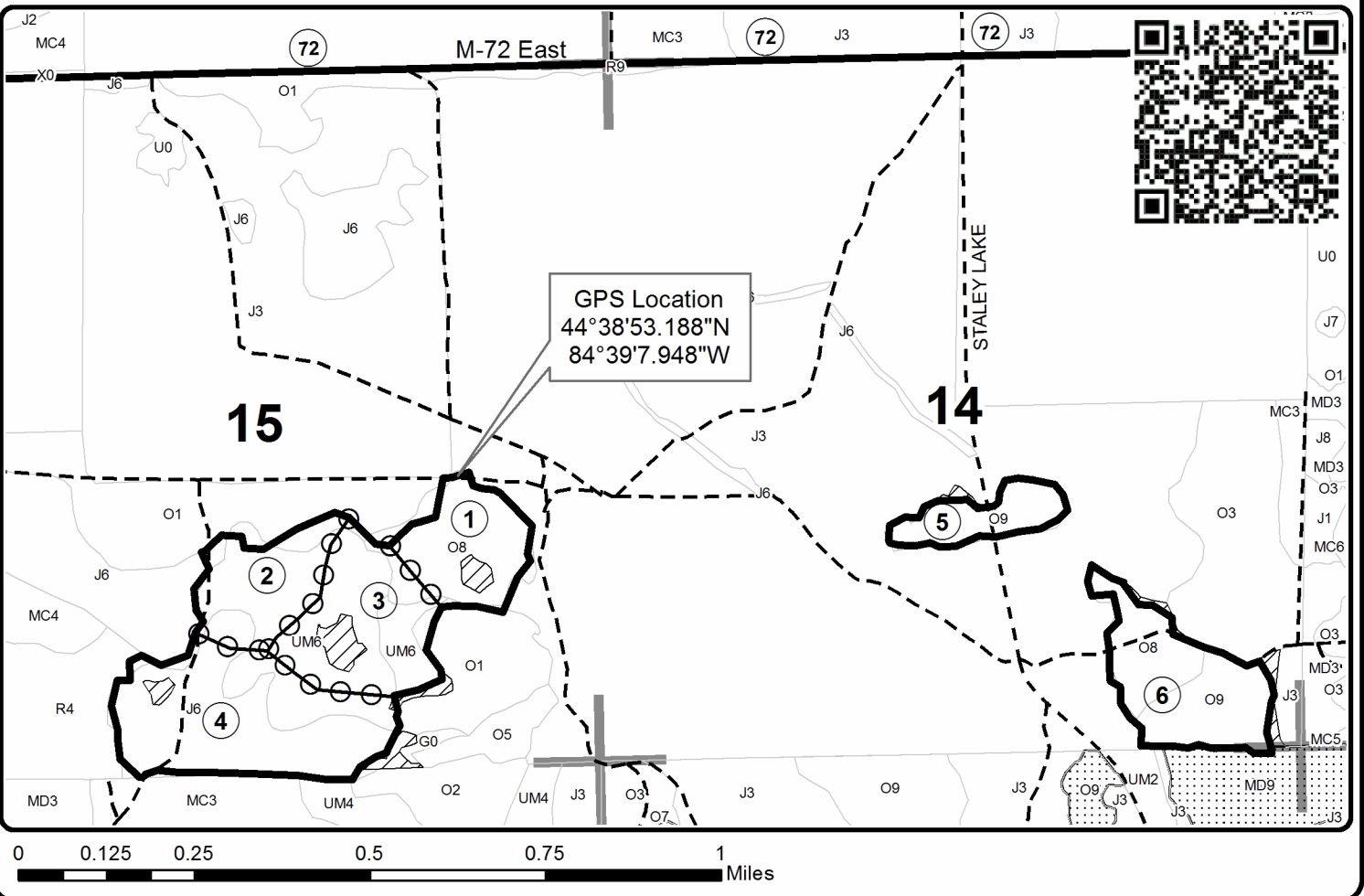

TIMBER SALE INFORMATION

Muskrat KW (72-020-20)

T27N, R02E, SEC. 18; T27N, R02E, SEC. 7.
Oscoda County (Advertised Price \$ 110,155.90)

SALE NOTE: A recreation site such as a trail, pathway, or campground is within the sale area or the vicinity. Certain restrictions/specifications may be applicable including time restrictions.

A timber sale contract for this lump sum, sealed bid timber sale will be awarded to the responsible bidder offering the highest sealed bid price. All units of volume listed below were estimated using the T-Sale computer program and our traditional volume equations. Bids must be at or above the following advertised price for each product and species:

<u>PRODUCTS & SPECIES</u>	<u>ESTIMATED UNITS*</u>	<u>ADVERTISED PRICE</u>
Sawtimber		
Northern Pin Oak	29.7 MBF	\$ 136.00 / MBF
Red Pine	239.6 MBF	\$ 91.00 / MBF
Pulpwood		
B. T. Aspen	93 Cords	\$ 14.05 / Cord
Jack Pine	4,522 Cords	\$ 15.30 / Cord
Northern Pin Oak	340 Cords	\$ 20.50 / Cord
Red Maple	11 Cords	\$ 20.40 / Cord
Red Pine	193 Cords	\$ 33.85 / Cord
White Pine	6 Cords	\$ 15.40 / Cord

* The total volume is statistically estimated within plus (+) or minus (-) 8.98 percent. There are an estimated 5,704 cords on this timber sale, plus or minus 512 cords at the 95% confidence level. The estimated units are final and not subject to adjustment. Prospective bidders are urged to examine this timber and to make their own estimates of quantity and quality.

BOND AND PAYMENT SCHEDULE:

1. A bond in the amount of \$5,508.00 to insure faithful performance of the conditions of the contract will be deposited by the successful bidder within 21 days of the sale award.
2. Cutting in any sale or unit without the required advance payment would be considered a trespass.
3. Total payment must be paid in advance or according to the following schedule :
 - (a) Ten percent (10%) of the sale value must be paid within 21 days of the sale award.
 - (b) The 10% down payment will be credited towards the first unit cut.
 - (c) Payment for each of the following units must be made before cutting begins in that unit:

PAYMENT UNIT NUMBER	PERCENT OF TOTAL SALE VALUE
01	11.8%
02	11.5%
03	13.3%
04	5.5%
05	3.1%
06	13.7%
07	11.7%
08	10.0%
09	9.1%
10	10.3%

4. If no cutting takes place, the 10% down payment will not be refunded.
5. Operations on the contract issued will terminate on 09/30/2023.

SALE STATISTICS

SALE VOLUMES

VOLUME		STATISTICAL RANGE IN CORDS		
TOTAL CUBIC FEET	TOTAL CORDS	PERCENT ERROR	MINIMUM	MAXIMUM
450,591	5,704	8.98%	5,191	6,216

VDU VOLUMES

A VDU is a Volume Determination Unit. Volumes and their associated statistics are calculated at the VDU level and summarized to the sale level. There is often a one to one relationship between a VDU and a Payment Unit, but not always, depending on the cruise design. Refer to the VDU TO PAYMENT UNIT table.

VDU	VOLUME		PERCENT ERROR	RANGE IN CORDS	
	TOTAL CUBIC FEET	TOTAL CORDS		MINIMUM	MAXIMUM
1	380,646	4,818	8.74%	4,397	5,239
2	6,707	85	41.03%	50	120
3	15,460	196	19.63%	157	234
4	30,818	390	18.20%	319	461
5	16,985	215	23.42%	165	265
TOTAL:	450,616	5,704		5,088	6,320

VDU TO PAYMENT UNIT

When a VDU is associated with more than one Payment Unit (PU), the VDU volumes are assigned to the PU based on acres of the VDU within the PU.

VDU	VDU ACRES	PU	PU ACRES
1	269.5	1	41.0
		2	39.9
		3	45.9
		7	40.6
		8	34.8
		9	31.5
2	6.2	10	35.8
		4	6.2
		3	24.4
		4	12.2
		5	24.1
TOTAL:	336.4		336.4

DESCRIPTION OF TIMBER BY PAYMENT UNIT (PU)

PU	MARKET GROUP	PRODUCT	QUANTITY	UNIT	ACRES	ADVERTISE PRICE
1	Northern Pin Oak	Sawtimber	2.9	MBF	41.0	\$13,036.85
	Red Pine		18.5	MBF		
	B. T. Aspen	Pulpwood	11	Cords		
	<i>B. T. Aspen</i>	<i>Sawtimber</i>	1.2	<i>MBF</i>		
	<i>B. T. Aspen</i>	<i>Pulpwood</i>	9	<i>Cords</i>		
	Jack Pine		635	Cords		
	<i>Jack Pine</i>	<i>Sawtimber</i>	4.8	<i>MBF</i>		
	<i>Jack Pine</i>	<i>Pulpwood</i>	625	<i>Cords</i>		
	Northern Pin Oak		30	Cords		
	Red Pine		14	Cords		
	2	Northern Pin Oak	Sawtimber	2.8		
Red Pine			18.0	MBF		
B. T. Aspen		Pulpwood	11	Cords		
<i>B. T. Aspen</i>		<i>Sawtimber</i>	1.2	<i>MBF</i>		
<i>B. T. Aspen</i>		<i>Pulpwood</i>	9	<i>Cords</i>		
Jack Pine			617	Cords		
<i>Jack Pine</i>		<i>Sawtimber</i>	4.6	<i>MBF</i>		
<i>Jack Pine</i>		<i>Pulpwood</i>	608	<i>Cords</i>		
Northern Pin Oak			29	Cords		
Red Pine			14	Cords		
3		Northern Pin Oak	Sawtimber	3.2	MBF	45.9
	Red Pine		20.7	MBF		
	B. T. Aspen	Pulpwood	13	Cords		
	<i>B. T. Aspen</i>	<i>Sawtimber</i>	1.3	<i>MBF</i>		
	<i>B. T. Aspen</i>	<i>Pulpwood</i>	10	<i>Cords</i>		
	Jack Pine		711	Cords		
	<i>Jack Pine</i>	<i>Sawtimber</i>	5.3	<i>MBF</i>		
	<i>Jack Pine</i>	<i>Pulpwood</i>	700	<i>Cords</i>		
	Northern Pin Oak		34	Cords		
	Red Pine		16	Cords		
	4	Northern Pin Oak	Sawtimber	7.2	MBF	
Red Pine			3.2	MBF		
B. T. Aspen		Pulpwood	17	Cords		
<i>B. T. Aspen</i>		<i>Sawtimber</i>	4.6	<i>MBF</i>		
<i>B. T. Aspen</i>		<i>Pulpwood</i>	8	<i>Cords</i>		
Jack Pine			169	Cords		
<i>Jack Pine</i>		<i>Sawtimber</i>	15.6	<i>MBF</i>		
<i>Jack Pine</i>		<i>Pulpwood</i>	138	<i>Cords</i>		
Northern Pin Oak			85	Cords		
Red Pine			3	Cords		
White Pine			6	Cords		
<i>White Pine</i>		<i>Sawtimber</i>	0.6	<i>MBF</i>		
<i>White Pine</i>		<i>Pulpwood</i>	5	<i>Cords</i>		
5		Jack Pine	Pulpwood	144	Cords	24.4
	<i>Jack Pine</i>		144	<i>Cords</i>		
	Northern Pin Oak		40	Cords		
	Red Pine		11	Cords		
6	Northern Pin Oak	Sawtimber	3.7	MBF	12.2	\$15,024.50
	Red Pine		114.9	MBF		
	Jack Pine	Pulpwood	38	Cords		
	<i>Jack Pine</i>	<i>Sawtimber</i>	6.6	<i>MBF</i>		
	<i>Jack Pine</i>	<i>Pulpwood</i>	25	<i>Cords</i>		
	Northern Pin Oak		17	Cords		
	Red Maple		11	Cords		
	<i>Red Maple</i>	<i>Sawtimber</i>	2.1	<i>MBF</i>		
	<i>Red Maple</i>	<i>Pulpwood</i>	7	<i>Cords</i>		

DESCRIPTION OF TIMBER BY PAYMENT UNIT (PU), CON'T

PU	MARKET GROUP	PRODUCT	QUANTITY	UNIT	ACRES	ADVERTISE PRICE
6 con't	Red Pine	Pulpwood	86	Cords		
7	Northern Pin Oak	Sawtimber	2.8	MBF	40.6	\$12,897.95
	Red Pine		18.3	MBF		
	B. T. Aspen	Pulpwood	11	Cords		
	<i>B. T. Aspen</i>	<i>Sawtimber</i>	1.2	<i>MBF</i>		
	<i>B. T. Aspen</i>	<i>Pulpwood</i>	9	<i>Cords</i>		
	Jack Pine		628	Cords		
	<i>Jack Pine</i>	<i>Sawtimber</i>	4.7	<i>MBF</i>		
	<i>Jack Pine</i>	<i>Pulpwood</i>	619	<i>Cords</i>		
	Northern Pin Oak		30	Cords		
	Red Pine		14	Cords		
	8	Northern Pin Oak	Sawtimber	2.4		
Red Pine			15.7	MBF		
B. T. Aspen		Pulpwood	10	Cords		
<i>B. T. Aspen</i>		<i>Sawtimber</i>	1.0	<i>MBF</i>		
<i>B. T. Aspen</i>		<i>Pulpwood</i>	8	<i>Cords</i>		
Jack Pine			538	Cords		
<i>Jack Pine</i>		<i>Sawtimber</i>	4.0	<i>MBF</i>		
<i>Jack Pine</i>		<i>Pulpwood</i>	530	<i>Cords</i>		
Northern Pin Oak			26	Cords		
Red Pine			12	Cords		
9		Northern Pin Oak	Sawtimber	2.2	MBF	31.5
	Red Pine		14.2	MBF		
	B. T. Aspen	Pulpwood	9	Cords		
	<i>B. T. Aspen</i>	<i>Sawtimber</i>	0.9	<i>MBF</i>		
	<i>B. T. Aspen</i>	<i>Pulpwood</i>	7	<i>Cords</i>		
	Jack Pine		487	Cords		
	<i>Jack Pine</i>	<i>Sawtimber</i>	3.7	<i>MBF</i>		
	<i>Jack Pine</i>	<i>Pulpwood</i>	480	<i>Cords</i>		
	Northern Pin Oak		23	Cords		
	Red Pine		11	Cords		
	10	Northern Pin Oak	Sawtimber	2.5	MBF	
Red Pine			16.1	MBF		
B. T. Aspen		Pulpwood	10	Cords		
<i>B. T. Aspen</i>		<i>Sawtimber</i>	1.0	<i>MBF</i>		
<i>B. T. Aspen</i>		<i>Pulpwood</i>	8	<i>Cords</i>		
Jack Pine			554	Cords		
<i>Jack Pine</i>		<i>Sawtimber</i>	4.2	<i>MBF</i>		
<i>Jack Pine</i>		<i>Pulpwood</i>	546	<i>Cords</i>		
Northern Pin Oak			26	Cords		
Red Pine			12	Cords		
TOTAL:			269.3	MBF		
TOTAL:			5,163	Cords		

Sale Specific Conditions & Requirements

Sale Name: Muskrat KW

Sale Number: 72-020-20 Seq#: 2

1 - Sale Area

1.2 - Boundaries

1.2.1 - Painted boundaries (9/19)

The sale boundary and Payment Unit boundaries are marked and identified by red and yellow paint, or designated by adjacent roads (see Timber Sale Map). Exterior sale boundary lines against state are marked with red paint, with the exception of the boundaries called out on the Timber Sales Map, which are unpainted and identified by the adjacent roads. Interior Payment Unit boundaries are marked with yellow paint. Retention patches are marked with red paint; no harvesting activities may occur within these areas. Yellow painted trees designating an interior Payment Unit boundary are only to be cut when all surrounding Payment Units have been paid.

2 - Timber Specifications

2.1 - Included Timber

2.1.1 - Clearcut unit(s) with unmerchantable trees (6/14)

Within Payment Unit(s) 1-10, cut all trees that are two (2) inches or more at DBH.

2.2 - Utilization

2.2.2 - Chipping required (2/18)

Payment Units 1-10 must be chip harvested to meet Kirtland's Warbler habitat requirements. Products may be produced as roundwood and forwarded to decking areas in final product length, but the tops must be left intact and skidded to the landing for chipping to minimize the amount of residual slash. If market conditions limit the practicality of chipping, tops, and slash must be arranged in a way that will not inhibit future planting operations, as directed by the sale administrator. The requirement to retain approximately 1/6 to 1/3 of tree tops and limbs less than four inches in diameter does not apply (G. C. & R. 2.2). This is because of Kirtland's Warbler management.

2.2.3 - Stump heights (4/07)

Stump heights within the Sale Area shall not exceed 6 inches for all trees. This is to facilitate planting operations.

3 - Payments

3.3 - Pre-measured Sales

3.3.4 - Dividing payment units (7/14)

Payment Unit(s) may be divided at the request of the Purchaser and upon approval of the Unit Manager. Dividing Payment Units is a contract modification which requires a Timber Sale Contract Amendment.

4 - Transportation

4.1 - Construction

4.1.3 - Slash and earthen piles (8/04)

Piles or windrows of earth along roads and landings that have been widened or constructed shall be leveled. Slash from road maintenance or construction, including stumps, shall be utilized or dispersed throughout the sale.

4.1.6 - Road construction (1/09)

Construction of new roads or improvements of existing roads shall be done in such a way as to minimize the environmental and visual impacts. Merchantable trees shall be cut and utilized unless otherwise directed. Non-merchantable trees shall be severed and laid flat on the ground. Slash shall be scattered, and not left in windrows and kept a minimum of 10 feet back from the road edge or utilized. Stumps shall be set upright, not left on edge, and be moved at least 10 feet away from the road edge. Disturbed soil shall be feathered into the woods and not left in berms or windrows.

4.1.7 - Road closure (10/11)

All new roads built into the sale must be blocked to vehicle traffic upon completion of the sale. Overgrown roads that are reopened shall be considered new roads. In general, this will require constructing a four (4') foot high berm of stumps and

logs covered with earth. All stumps from road building and landing construction must be reserved to block any newly constructed roads upon completion of the sale. These stumps must be scattered along the road system to prohibit vehicular movement. Temporary berms may be required if no sale activity occurs for 30 or more consecutive days. Contact the sale administrator for specific details of design and placement.

5 - Operations

5.1 - Notification

5.1.1 - Pre-sale conference (10/16)

A pre-sale conference between the Purchaser and sale administrator is required prior to beginning any operations to determine landing and road locations. The Unit Manager or his/her representative must be contacted at least 5 days in advance to schedule the conference.

5.1.4 - Post-sale conference (10/16)

A post-sale conference on site between the Purchaser and sale administrator is required 5 days prior to the completion of active logging operations to determine clean-up and repair of landings, road edges, and the fulfillment of other contract specifications.

5.1.6 - Utility R.O.W. (4/19)

It is the responsibility of the Purchaser to obtain permission from the utility company to utilize the Consumers Energy power line R.O.W. for operations. Contact Sam Chansler with Consumer's Energy at 269-207-8797.

5.2 - Conduct of Operations

5.2.1 - Slash

5.2.1.8 - Slash height (12/08)

No slash or tree tops may exceed 48 inches in height.

5.2.2 - Hazard Trees/Snags

5.2.2.1 - Den trees (10/16)

Obvious hollow and/or den trees shall be protected and left standing unless they are a safety hazard.

5.2.32 - Decking/landing restoration (9/13)

All decking and landing areas must have the surface area restored to a condition equal to or better than before. This is to ensure the proper regeneration of the stand. Wood debris, chips, and "cookies" from trimmings must be removed or scattered away from landing and loading areas and may not be windrowed on the edge.

5.2.41 - Snowmobile trail protection (9/11)

Trail 4/9 is a snowmobile trail and is shown on the Timber Sale Map. Do not cut or damage posts with orange trail markers or traffic control signs. If the trail is used, it must be maintained and restored to a condition equal to or better than before the sale. The road maintenance/restoration must be done prior to December 1. If the trail is used for hauling, it must be graded to the satisfaction of the Unit Manager or his/her representative prior to December 1. The snowmobile trail may not be used for any timber sale operations from December 1 to March 31 without written approval of the Unit Manager. If the trail road is to be used for hauling during the snowmobile season, then a snow-covered base must be left on the trail. The snowmobile trail may only be crossed at right angles. Maintain a 20-foot-wide slash, debris, and rut free zone daily using the snowmobile trail as the centerline. No decking of forest products will be permitted along the snowmobile trail. In addition, any trees cut within 5 feet of the trail must have the stumps cut flush at ground level.

5.4 - Soil Protection

5.4.1 - Rutting restriction, general (7/16)

Operations are to cease immediately if equipment and weather conditions result in rutting of roads and/or skid trails which is 12 inches or greater in depth and 50 feet in length. The Unit Manager or his/her representative may restrict hauling and/or skidding if ruts exceed the specified depth. With the Unit Manager or his/her representative's approval, the Purchaser may return to the area when the risk of rutting has decreased.

5.8 - Protection of Endangered Species

5.8.1 - Kirtland's warbler (1) (10/12)

This sale is adjacent to a young jack pine stand which may be used by the endangered Kirtland's Warbler. The Department reserves the right to temporarily restrict all harvesting operations in a buffer zone of up to 500 feet if it is determined that Warbler territory has been established in the adjacent stand. The restricted period, if put into effect, would apply from May 1 to August 15.

6 - Safety and Fire Prevention

6.2 - Signing

6.2.1 - Road posting (9/09)

The Purchaser is responsible for posting and maintaining caution signs on Townline, Helmer Lake and Muskrat Lake Roads prior to beginning operations. The road must be posted at appropriate distances from the Sale Area to warn of logging activity and truck traffic. Signs must be removed when harvest operations are suspended or completed. The Purchaser will provide these signs.

6.2.2 - Snowmobile trail posting (8/09)

The Purchaser is responsible for posting and maintaining caution signs on Trail 4/9 prior to beginning operations during the snowmobile season (approximately December 1 to March 31). The trail must be posted at appropriate distances from the Sale Area to warn of logging activity and truck traffic. Signs must be removed when harvest operations are suspended or completed. The Purchaser will provide these signs.

7 - Other Conditions

7.2 - Extensions

7.2.2 - No extensions (3/09)

There will be no extensions granted on this contract. The purpose of this sale is to create habitat for the endangered Kirtland's Warbler. This sale is already scheduled for planting.



TIMBER SALE MAP

This information provided by authority of Part 525, 1994 PA 451, as amended.

Forest Management Unit Grayling		County Oscoda	Mapped By Ehlert	Date 07/28/2020	Page 1	of 1
Township 27N	Range 02E	Section(s) and Subdivision(s) Sec 18- NWNW Sec 7-NENW, S1/2NW, NWNE, S1/2NE, SW, SE		Scale 1:15,840		

Cover Type				Density			
A = Aspen	H = Hemlock	N = Marsh	U = Upland Brush	0 = Non Stocked	5 = Pole Timber Medium		
B = Paper Birch	J = Jack Pine	O = Oak	UM = Upland Mixed	1 = Seedling Sapling Poor	6 = Pole Timber Well		
C = Cedar	L = Lowland Brush	P = Lowland Poplar	V = Bog or Marsh	2 = Seedling Sapling Medium	7 = Saw Timber Poor		
D = Treed Bog	LM = Lowland Mixed	Q = Mixed Swamp Conifer	W = White Pine	3 = Seedling Sapling Well	8 = Saw Timber Medium		
E = Swamp Hdwoods	M = Mpl, Bch, Brch	R = Red Pine	X = Non Stocked	4 = Pole Timber Poor	9 = Saw Timber Well		
F = Spruce Fir	MC = Mixed Conifer	S = Black Spruce	Z = Water				
G = Grass	MD = Mixed Deciduous	T = Tamarack					

PU	Acres	PU	Acres
1	41	6	12.2
2	39.9	7	40.6
3	45.9	8	34.8
4	30.3	9	31.5
5	24.4	10	35.8

Muskrat KW
Compartment 009
336.4 Acres

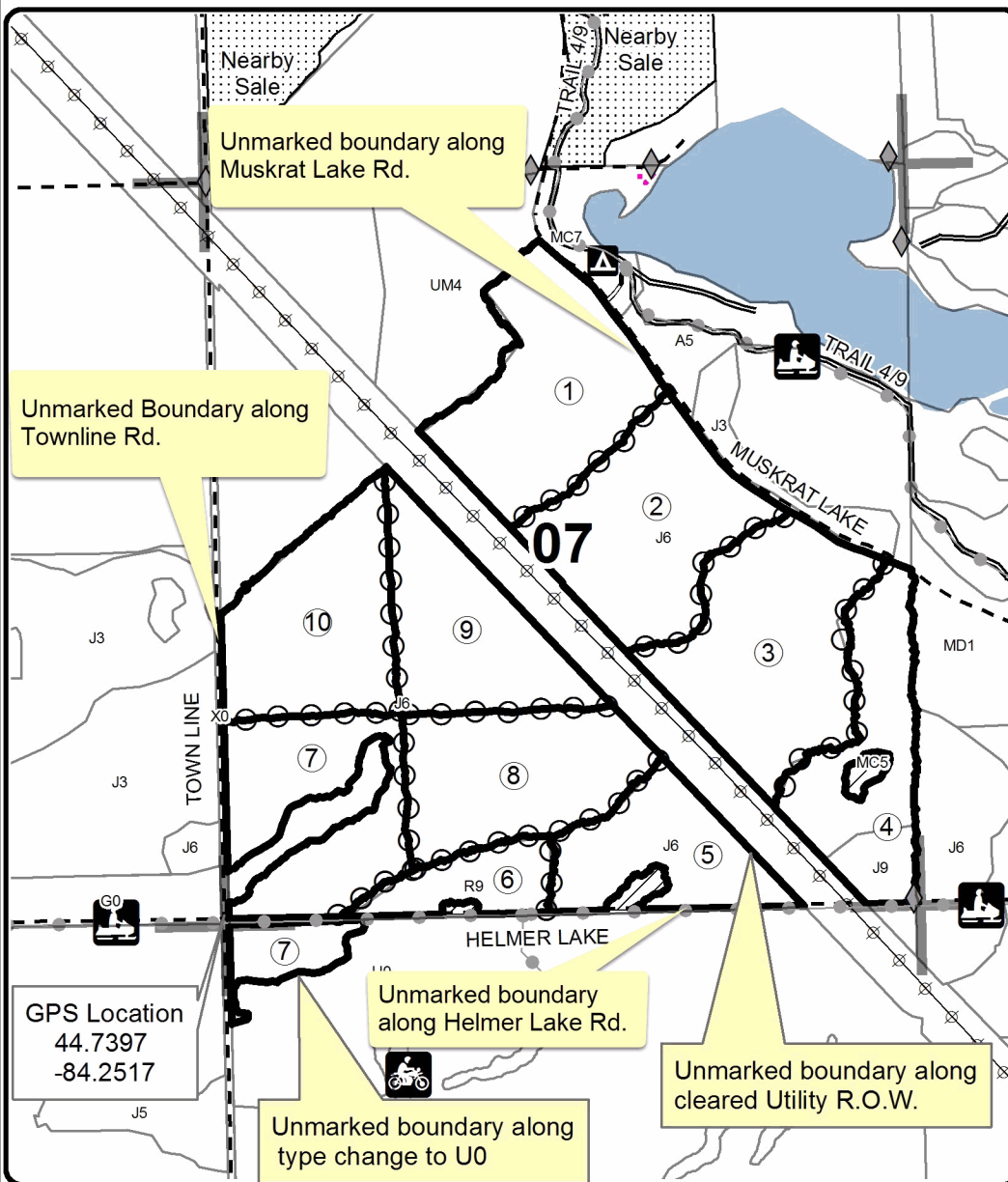
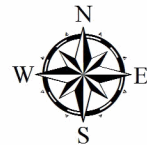

Legend

- Against State (Red/Designated)
- Payment Unit (Yellow)
- ▨ Retention Area (Red)
- Stand Boundaries
- ▤ Nearby Timber Sales
- Recreational Trail
- Primary Forest Road
- Secondary Forest Road
- - Gravel Road
- ⋯ Temporary Management Access
- Lakes and Rivers
- ◆ Field Grade Corners
- Section Corners
- ⚡ Powerline
- ▲ State Forest Campgrounds

Locator Map
1:200,000

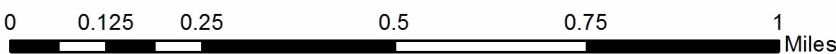
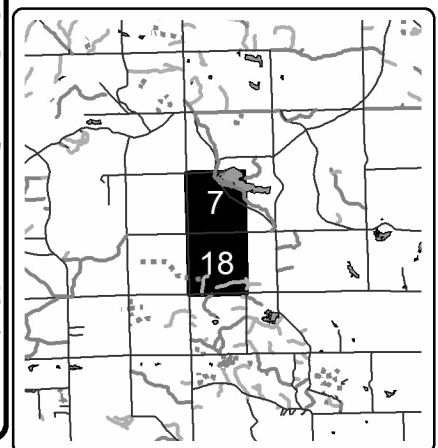

TIMBER SALE INFORMATION

Quarter Quorners Mix (72-032-20)
 T25N, R04W, SEC. 32.
 Crawford County (Advertised Price \$250,869.85)

SALE NOTE: Additional chip wood volume available; ask sale administrator for more details. Access is by Snowmobile Trail/ORV route - timing restrictions may be enforced. Residual BA in Payment Units 3 is 10-20 square feet.

A recreation site such as a trail, pathway, or campground is within the sale area or the vicinity. Certain restrictions/specifications may be applicable including time restrictions.

A timber sale contract for this lump sum, sealed bid timber sale will be awarded to the responsible bidder offering the highest sealed bid price. All units of volume listed below were estimated using the T-Sale computer program and our traditional volume equations. Bids must be at or above the following advertised price for each product and species:

<u>PRODUCTS & SPECIES</u>	<u>ESTIMATED UNITS*</u>		<u>ADVERTISED PRICE</u>
Sawtimber			
BI/R/Hybrid Oak	130.0	MBF	\$ 99.00 / MBF
Jack Pine	1.7	MBF	\$ 23.00 / MBF
Mixed Aspen	5.1	MBF	\$ 31.00 / MBF
Northern Pin Oak	10.9	MBF	\$ 88.00 / MBF
Red Maple	49.9	MBF	\$ 41.00 / MBF
Red Oak	218.1	MBF	\$ 110.00 / MBF
Red Pine	1,576.8	MBF	\$ 91.00 / MBF
White Oak	95.4	MBF	\$ 63.00 / MBF
White Pine	56.5	MBF	\$ 35.00 / MBF
Pulpwood			
Balsam Fir	5	Cords	\$ 12.80 / Cord
Jack Pine	15	Cords	\$ 15.30 / Cord
Mixed Aspen	135	Cords	\$ 14.05 / Cord
Mixed Oak	1,234	Cords	\$ 20.50 / Cord
Red Maple	633	Cords	\$ 20.40 / Cord
Red Pine	516	Cords	\$ 33.85 / Cord
White Pine	95	Cords	\$ 15.40 / Cord

* The total volume is statistically estimated within plus (+) or minus (-) 6.33 percent. There are an estimated 7,101 cords on this timber sale, plus or minus 450 cords at the 95% confidence level. The estimated units are final and not subject to adjustment. Prospective bidders are urged to examine this timber and to make their own estimates of quantity and quality.

BOND AND PAYMENT SCHEDULE:

1. A bond in the amount of \$12,543.00 to insure faithful performance of the conditions of the contract will be deposited by the successful bidder within 21 days of the sale award.
2. Cutting in any sale or unit without the required advance payment would be considered a trespass.
3. Total payment must be paid in advance or according to the following schedule :
 - (a) Ten percent (10%) of the sale value must be paid within 21 days of the sale award.
 - (b) The 10% down payment will be credited towards the first unit cut.
 - (c) Payment for each of the following units must be made before cutting begins in that unit:

PAYMENT UNIT NUMBER	PERCENT OF TOTAL SALE VALUE
01	13.0%
02	23.3%
03	13.0%
04	14.5%
05	15.3%
06	20.9%

4. If no cutting takes place, the 10% down payment will not be refunded.
5. Operations on the contract issued will terminate on 06/30/2023.

SALE STATISTICS

SALE VOLUMES

VOLUME			STATISTICAL RANGE IN CORDS	
TOTAL CUBIC FEET	TOTAL CORDS	PERCENT ERROR	MINIMUM	MAXIMUM
560,995	7,101	6.33%	6,652	7,551

VDU VOLUMES

A VDU is a Volume Determination Unit. Volumes and their associated statistics are calculated at the VDU level and summarized to the sale level. There is often a one to one relationship between a VDU and a Payment Unit, but not always, depending on the cruise design. Refer to the VDU TO PAYMENT UNIT table.

VDU	VOLUME			RANGE IN CORDS	
	TOTAL CUBIC FEET	TOTAL CORDS	PERCENT ERROR	MINIMUM	MAXIMUM
19	6,281	80	36.55%	50	109
23	147,240	1,864	12.43%	1,632	2,095
25	78,423	993	21.17%	783	1,203
26	95,898	1,214	10.51%	1,086	1,341
43	53,175	673	20.25%	537	809
44	74,726	946	20.22%	755	1,137
57	67,450	854	12.89%	744	964
73	37,802	479	29.81%	336	621
TOTAL:	560,995	7,101		5,922	8,280

VDU TO PAYMENT UNIT

When a VDU is associated with more than one Payment Unit (PU), the VDU volumes are assigned to the PU based on acres of the VDU within the PU.

VDU	VDU ACRES	PU	PU ACRES
19	3.8	6	3.8
23	39.2	1	6.3
		2	32.9
25	29.6	4	0.1
		5	29.4
		6	0.1
26	30.8	2	0.2
		3	30.5
		4	0.1
43	15.4	1	1.4
		6	14.0
44	18.7	4	18.7
57	22.2	1	12.4
		6	9.8
73	13.6	1	1.6
		6	12.0
TOTAL:	173.3		173.3

DESCRIPTION OF TIMBER BY PAYMENT UNIT (PU)

PU	MARKET GROUP	PRODUCT	QUANTITY	UNIT	ACRES	ADVERTISE PRICE	
1	BI/R/Hybrid Oak	Sawtimber	15.4	MBF	21.7	\$32,734.95	
	Jack Pine		0.3	MBF			
	Mixed Aspen		0.3	MBF			
	<i>B. T. Aspen</i>		0.2	MBF			
	<i>Quaking Aspen</i>		0.1	MBF			
	Northern Pin Oak		1.6	MBF			
	Red Maple		14.7	MBF			
	Red Oak		53.0	MBF			
	Red Pine		172.1	MBF			
	White Oak		11.4	MBF			
	White Pine		5.7	MBF			
	Balsam Fir		Pulpwood	1			Cords
	Jack Pine			2			Cords
	Mixed Aspen			10			Cords
	<i>B. T. Aspen</i>			5			Cords
	<i>Quaking Aspen</i>			5			Cords
	Mixed Oak			138			Cords
	<i>BI/R/Hybrid Oak</i>			42			Cords
	<i>Northern Pin Oak</i>			10			Cords
	<i>Red Oak</i>	50		Cords			
	<i>White Oak</i>	36		Cords			
	Red Maple	102		Cords			
	<i>Red Maple</i>	102		Cords			
	Red Pine	83		Cords			
	White Pine	9		Cords			
	2	BI/R/Hybrid Oak		Sawtimber			7.1
Jack Pine		1.4			MBF		
Mixed Aspen		0.6			MBF		
<i>Quaking Aspen</i>		0.6	MBF				
Red Maple		13.0	MBF				
Red Oak		4.1	MBF				
Red Pine		483.7	MBF				
White Oak		8.7	MBF				
White Pine		29.6	MBF				
Jack Pine		Pulpwood	9		Cords		
Mixed Aspen			20		Cords		
<i>Quaking Aspen</i>			20		Cords		
Mixed Oak			98		Cords		
<i>BI/R/Hybrid Oak</i>			40		Cords		
<i>Red Oak</i>			10		Cords		
<i>White Oak</i>			48		Cords		
Red Maple			171		Cords		
<i>Red Maple</i>			171		Cords		
Red Pine			131		Cords		
White Pine	46		Cords				
3	BI/R/Hybrid Oak		Sawtimber	58.9	MBF	30.5	\$32,627.45
	Mixed Aspen			2.5	MBF		
	<i>B. T. Aspen</i>			2.5	MBF		
	Red Maple			5.3	MBF		
	Red Oak			101.8	MBF		
	White Oak			57.9	MBF		
	Mixed Aspen	Pulpwood		1	Cords		
	<i>B. T. Aspen</i>			1	Cords		
	Mixed Oak			546	Cords		
	<i>BI/R/Hybrid Oak</i>			113	Cords		
	<i>Red Oak</i>			159	Cords		

DESCRIPTION OF TIMBER BY PAYMENT UNIT (PU), CON'T

PU	MARKET GROUP	PRODUCT	QUANTITY	UNIT	ACRES	ADVERTISE PRICE
3 con't	<i>White Oak</i>	<i>Pulpwood</i>	274	<i>Cords</i>		
	Red Maple		22	Cords		
	<i>Red Maple</i>		22	<i>Cords</i>		
4	BI/R/Hybrid Oak	Sawtimber	3.6	MBF	18.9	\$36,330.50
	Northern Pin Oak		3.9	MBF		
	Red Maple		0.9	MBF		
	Red Oak		0.3	MBF		
	Red Pine		310.0	MBF		
	White Oak		1.1	MBF		
	White Pine		10.9	MBF		
	Mixed Aspen	Pulpwood	22	Cords		
	<i>B. T. Aspen</i>		9	<i>Cords</i>		
	<i>Quaking Aspen</i>		13	<i>Cords</i>		
	Mixed Oak		107	Cords		
	<i>BI/R/Hybrid Oak</i>		20	<i>Cords</i>		
	<i>Northern Pin Oak</i>		63	<i>Cords</i>		
	<i>Red Oak</i>		1	<i>Cords</i>		
	<i>White Oak</i>		23	<i>Cords</i>		
	Red Maple		38	Cords		
	<i>Red Maple</i>		38	<i>Cords</i>		
	Red Pine		92	Cords		
	White Pine		33	Cords		
5	BI/R/Hybrid Oak	Sawtimber	16.1	MBF	29.4	\$38,345.60
	Red Pine		328.6	MBF		
	White Pine		10.3	MBF		
	Jack Pine	Pulpwood	4	Cords		
	Mixed Aspen		18	Cords		
	<i>B. T. Aspen</i>		8	<i>Cords</i>		
	<i>Quaking Aspen</i>		10	<i>Cords</i>		
	Mixed Oak		122	Cords		
	<i>BI/R/Hybrid Oak</i>		85	<i>Cords</i>		
	<i>White Oak</i>		37	<i>Cords</i>		
	Red Maple		52	Cords		
	<i>Red Maple</i>		52	<i>Cords</i>		
	Red Pine		74	Cords		
	White Pine		7	Cords		
6	BI/R/Hybrid Oak	Sawtimber	28.9	MBF	39.7	\$52,434.00
	Mixed Aspen		1.7	MBF		
	<i>B. T. Aspen</i>		1.7	<i>MBF</i>		
	Northern Pin Oak		5.4	MBF		
	Red Maple		16.0	MBF		
	Red Oak		58.9	MBF		
	Red Pine		282.4	MBF		
	White Oak		16.3	MBF		
	Balsam Fir	Pulpwood	4	Cords		
	Mixed Aspen		64	Cords		
	<i>B. T. Aspen</i>		54	<i>Cords</i>		
	<i>Quaking Aspen</i>		10	<i>Cords</i>		
	Mixed Oak		223	Cords		
	<i>BI/R/Hybrid Oak</i>		69	<i>Cords</i>		
	<i>Northern Pin Oak</i>		52	<i>Cords</i>		
	<i>Red Oak</i>		53	<i>Cords</i>		
	<i>White Oak</i>		49	<i>Cords</i>		
	Red Maple		248	Cords		
	<i>Paper Birch</i>		5	<i>Cords</i>		
	<i>Red Maple</i>		243	<i>Cords</i>		

DESCRIPTION OF TIMBER BY PAYMENT UNIT (PU), CON'T

PU	MARKET GROUP	PRODUCT	QUANTITY	UNIT	ACRES	ADVERTISE PRICE
6 con't	Red Pine	Pulpwood	136	Cords		
TOTAL:			2,144.4	MBF		
TOTAL:			2,633	Cords		

Sale Specific Conditions & Requirements

Sale Name: Quarter Quorners Mix

Sale Number: 72-032-20 Seq#: 2

1 - Sale Area

1.2 - Boundaries

1.2.1 - Painted boundaries (9/19)

The sale boundary and Payment Unit boundaries are marked and identified by red and yellow paint. Exterior sale boundary lines against state are marked with red paint. Interior Payment Unit boundaries are marked with yellow paint. Retention patches are marked with red paint; no harvesting activities may occur within these areas. The painted boundary line trees adjacent to A2 (young aspen) stands are Included Timber and should be harvested. All other boundary trees are not Included Timber and are to be protected. Yellow painted trees designating an interior Payment Unit boundary are only to be cut when all surrounding Payment Units have been paid.

2 - Timber Specifications

2.1 - Included Timber

2.1.1 - Clearcut unit(s) with unmerchantable trees (6/14)

Within Payment Unit(s) 1 - 6, cut all trees that are two (2) inches or more at DBH, except within Payment Unit 3, do not cut any conifers.

2.2 - Utilization

2.2.2 - Chipping required (2/18)

This area must be chip harvested to facilitate subsequent planting operations. If market conditions limit the practicality of chipping, tops and slash must be arranged in a way that will not inhibit future planting operations, as directed by the sale administrator. A chipping exemption can be obtained if proposed operations are determined to be suitable for planting by reforestation staff. This exemption must be granted in writing. The requirement to retain approximately 1/6 to 1/3 of tree tops and limbs less than four inches in diameter is still applicable (G. C. & R. 2.2).

2.2.3 - Stump heights (4/07)

Stump heights within the Sale Area shall not exceed 6 inches for all trees. This is to facilitate planting operations. A written waiver of this requirement may be obtained if wet summer weather makes winter logging necessary.

3 - Payments

3.3 - Pre-measured Sales

3.3.4 - Dividing payment units (7/14)

Payment Unit(s) may be divided at the request of the Purchaser and upon approval of the Unit Manager. Dividing Payment Units is a contract modification which requires a Timber Sale Contract Amendment. There will be only one division per Payment Unit.

3.4 - Damaged Timber

3.4.1 - Damaged timber (7/16)

General Condition and Requirement 3.4 Damaged Timber, defines liquidated damages for undesignated live merchantable trees which are cut or injured. No damage is acceptable to undesignated live merchantable trees. Within Payment Unit 3, if more than 10% of trees (> 4.5" DBH) within a specified area of the sale are damaged, liquidated damages will be assessed for all trees damaged. Rates will be in accordance with General Condition and Requirement 3.4 Damaged Timber, or at a rate of \$50 per sawtimber tree and \$10 per pole sized tree, whichever is greater.

4 - Transportation

4.1 - Construction

4.1.3 - Slash and earthen piles (8/04)

Piles or windrows of earth along roads and landings that have been widened or constructed shall be leveled. Slash from road

maintenance or construction, including stumps, shall be dispersed throughout the sale.

4.1.6 - Road construction (1/09)

Construction of new roads or improvements of existing roads shall be done in such a way as to minimize the environmental and visual impacts. Merchantable trees shall be cut and utilized unless otherwise directed. Non-merchantable trees shall be severed and laid flat on the ground. Slash shall be scattered, and not left in windrows and kept a minimum of 10 feet back from the road edge. Stumps shall be set upright, not left on edge, and be moved at least 10 feet away from the road edge. Disturbed soil shall be feathered into the woods and not left in berms or windrows.

4.1.7 - Road closure (10/11)

All new roads built into the sale must be blocked to vehicle traffic upon completion of the sale. Overgrown roads that are reopened shall be considered new roads. In general, this will require constructing a four (4') foot high berm of stumps and logs covered with earth. These roads must be rendered impassable to cars and trucks. Temporary berms may be required if no sale activity occurs for 30 or more consecutive days. Contact the sale administrator for specific details of design and placement.

4.1.11 - Permits (2/12)

The Purchaser will secure any necessary highway permits that may be required.

5 - Operations

5.1 - Notification

5.1.1 - Pre-sale conference (10/16)

A pre-sale conference between the Purchaser and sale administrator is required prior to beginning any operations. The Unit Manager or his/her representative must be contacted at least 10 days in advance to schedule the conference.

5.1.3 - Well heads and natural gas pipelines (11/15)

The Purchaser is responsible for contacting the gas or pipeline company 30 days prior to operating equipment in the vicinity of well heads or natural gas pipelines. Contact Greg Dodge with Brietburn at 231-735-6106.

5.1.4 - Post-sale conference (10/16)

A post-sale conference on site between the Purchaser and sale administrator is required 5 days prior to the completion of active logging operations to determine clean-up and repair of landings, road edges, and the fulfillment of other contract specifications.

5.1.6 - Utility R.O.W. (4/19)

It is the responsibility of the Purchaser to obtain permission from the utility company to utilize the power line R.O.W. for operations.

5.2 - Conduct of Operations

5.2.1 - Slash

5.2.1.8 - Slash height (12/08)

No slash or tree tops may exceed 24 inches in height.

5.2.2 - Hazard Trees/Snags

5.2.2.1 - Den trees (10/16)

Obvious hollow and/or den trees shall be protected and left standing unless they are a safety hazard.

5.2.3 - Operating Restrictions

5.2.3.5 - Oak wilt restriction (1/18)

Within Payment Unit(s) 1 - 6, unless changed by written agreement, cutting, skidding, hauling within the sale and brushing of access roads to the sale are not permitted during the period of April 15 to July 15. Operations may be allowed if specific steps are taken to prevent damaging uncut oak during the high risk period. Those steps may include completing all road brushing before April 15th and clearing a tree-length buffer along uncut oak cover before April 15th. This is necessary to reduce the spread of oak wilt. For more information, contact the Unit Manager or his/her representative.

5.2.32 - Decking/landing restoration (9/13)

All decking and landing areas must have the surface area restored to a condition equal to or better than before. This is to ensure the proper regeneration of the stand. Wood debris, chips, and "cookies" from trimmings must be removed or scattered away from landing and loading areas and may not be windrowed on the edge.

5.2.38 - No decking against live trees (2/04)

Cut products may not be decked against unmarked or designated leave trees.

5.2.39 - ORV trail/route protection (4/18)

The LP 6 is an ORV trail or route and is shown on the Timber Sale Map. Do not cut trees or damage posts with yellow ORV markers. Maintain a 20-foot-wide slash, debris, and rut free zone daily using the ORV trail or route as the centerline. Do not run equipment down the ORV trail or route. Skidding across the trail or route may only occur in locations approved by the sale administrator.

5.2.41 - Snowmobile trail protection (9/11)

The LP 6 is a snowmobile trail and is shown on the Timber Sale Map. Do not cut or damage posts with orange trail markers or traffic control signs. If the trail is used, it must be maintained and restored to a condition equal to or better than before the sale. The road maintenance/restoration must be done prior to December 1. If the trail is used for hauling, it must be graded to the satisfaction of the Unit Manager or his/her representative prior to December 1st. The snowmobile trail may not be used for any timber sale operations from December 1 to March 31 without written approval of Unit Manager. If the trail road is to be used for hauling during the snowmobile season, then a snow-covered base must be left on the trail. The snowmobile trail may only be crossed at right angles. Maintain a 20-foot-wide slash, debris, and rut free zone daily using the snowmobile trail as the centerline. No decking of forest products will be permitted along the snowmobile trail. In addition, any trees cut within 5 feet of the trail must be cut flush at ground level

6 - Safety and Fire Prevention

6.2 - Signing

6.2.2 - Snowmobile trail posting (8/09)

The Purchaser is responsible for posting and maintaining caution signs on snowmobile trail LP 6 prior to beginning operations during the snowmobile season (approximately December 1 to March 31). The trail must be posted at appropriate distances from the Sale Area to warn of logging activity and truck traffic. Signs must be removed when harvest operations are suspended or completed. The Purchaser will provide these signs.

6.2.3 - Recreational trail posting (2/10)

The Purchaser is responsible for posting and maintaining caution signs on West Higgins Trail prior to beginning operations. The trail must be posted at appropriate distances from the Sale Area to warn of logging activity and truck traffic at both ends of the trail. Signs must be removed when harvest operations are suspended or completed. The Purchaser will provide these signs.



TIMBER SALE MAP

This information provided by authority of Part 525, 1994 PA 451, as amended.

Forest Management Unit Grayling	County Crawford	Mapped By Derek Nellis	Date 9/03/2020	Page 1	of 1
Township 25N	Range 04W	Section(s) and Subdivision(s) Sec 32 - NENW,S1/2NW,NE	Scale 1:7,920		

Cover Type				Density	
A = Aspen	H = Hemlock	N = Marsh	U = Upland Brush	0 = Non Stocked	5 = Pole Timber Medium
B = Paper Birch	J = Jack Pine	O = Oak	UM = Upland Mixed	1 = Seedling Sapling Poor	6 = Pole Timber Well
C = Cedar	L = Lowland Brush	P = Lowland Poplar	V = Bog or Marsh	2 = Seedling Sapling Medium	7 = Saw Timber Poor
D = Treed Bog	LM = Lowland Mixed	Q = Mixed Swamp Conifer	W = White Pine	3 = Seedling Sapling Well	8 = Saw Timber Medium
E = Swamp Hdwoods	M = Mpl, Bch, Brch	R = Red Pine	X = Non Stocked	4 = Pole Timber Poor	9 = Saw Timber Well
F = Spruce Fir	MC = Mixed Conifer	S = Black Spruce	Z = Water		
G = Grass	MD = Mixed Deciduous	T = Tamarack			

PU	Acres	PU	Acres
1	21.7	4	18.9
2	33.1	5	29.4
3	30.5	6	39.7

Quarter Quorners Mix

Compartment 193

173.3 Acres

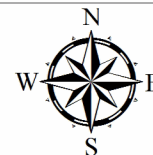

Legend	
Against State (Red)	Stand boundary
Payment Unit (Yellow)	Primary Forest Road
Powerline	Secondary Forest Road
Pipeline	Forest Access Route
Payment Unit Label	Nearby Sales
Motorcycle Trails	Retention Area
ORV Routes	
Snowmobile Trails	
Recreational Trails	

TIMBER SALE INFORMATION

Hissing Hognose Mix (72-035-20)
 T27N, R01E, SEC. 18; T27N, R01W, SEC. 13; T27N, R01W, SEC. 24.
 Crawford County (Advertised Price \$42,240.30)

SALE NOTE: A recreation site such as a trail, pathway, or campground is within the sale area or the vicinity. Certain restrictions/specifications may be applicable including time restrictions.

A timber sale contract for this lump sum, sealed bid timber sale will be awarded to the responsible bidder offering the highest sealed bid price. All units of volume listed below were estimated using the T-Sale computer program and our traditional volume equations. Bids must be at or above the following advertised price for each product and species:

<u>PRODUCTS & SPECIES</u>	<u>ESTIMATED UNITS*</u>	<u>ADVERTISED PRICE</u>
Sawtimber		
BI/R/Hybrid Oak	74.2 MBF	\$ 136.00 / MBF
Mixed Aspen	12.8 MBF	\$ 31.00 / MBF
Red Oak	22.7 MBF	\$ 110.00 / MBF
Red Pine	103.9 MBF	\$ 91.00 / MBF
White Oak	10.8 MBF	\$ 63.00 / MBF
White Pine	8.4 MBF	\$ 35.00 / MBF
Pulpwood		
Jack Pine	139 Cords	\$ 15.30 / Cord
Misc. Species 1	105 Cords	\$ 5.50 / Cord
Mixed Aspen	142 Cords	\$ 14.05 / Cord
Mixed Hardwood	82 Cords	\$ 20.40 / Cord
Mixed Oak	473 Cords	\$ 20.50 / Cord
Red Pine	76 Cords	\$ 33.85 / Cord
White Pine	12 Cords	\$ 15.40 / Cord

* The total volume is statistically estimated within plus (+) or minus (-) 12.62 percent. There are an estimated 1,593 cords on this timber sale, plus or minus 201 cords at the 95% confidence level. The estimated units are final and not subject to adjustment. Prospective bidders are urged to examine this timber and to make their own estimates of quantity and quality.

BOND AND PAYMENT SCHEDULE:

- A bond in the amount of \$2,112.00 to insure faithful performance of the conditions of the contract will be deposited by the successful bidder within 21 days of the sale award.
- Cutting in any sale or unit without the required advance payment would be considered a trespass.
- Total payment must be paid in advance or according to the following schedule :
 - Ten percent (10%) of the sale value must be paid within 21 days of the sale award.
 - The 10% down payment will be credited towards the first unit cut.
 - Payment for each of the following units must be made before cutting begins in that unit:

PAYMENT UNIT NUMBER	PERCENT OF TOTAL SALE VALUE
01	31.2%
02	18.9%
03	21.4%
04	28.5%
- If no cutting takes place, the 10% down payment will not be refunded.
- Operations on the contract issued will terminate on 06/30/2023.

SALE STATISTICS

SALE VOLUMES

VOLUME		STATISTICAL RANGE IN CORDS		
TOTAL CUBIC FEET	TOTAL CORDS	PERCENT ERROR	MINIMUM	MAXIMUM
125,831	1,593	12.62%	1,392	1,794

VDU VOLUMES

A VDU is a Volume Determination Unit. Volumes and their associated statistics are calculated at the VDU level and summarized to the sale level. There is often a one to one relationship between a VDU and a Payment Unit, but not always, depending on the cruise design. Refer to the VDU TO PAYMENT UNIT table.

VDU	VOLUME		PERCENT ERROR	RANGE IN CORDS	
	TOTAL CUBIC FEET	TOTAL CORDS		MINIMUM	MAXIMUM
27	42,755	541	16.49%	452	630
36	23,092	292	43.94%	164	421
219	22,468	284	21.26%	224	345
222	37,517	475	22.52%	368	582
TOTAL:	125,831	1,593		1,208	1,978

VDU TO PAYMENT UNIT

When a VDU is associated with more than one Payment Unit (PU), the VDU volumes are assigned to the PU based on acres of the VDU within the PU.

VDU	VDU ACRES	PU	PU ACRES
27	26.8	1	26.8
36	10.5	4	10.5
219	12.6	2	12.6
222	35.0	3	35.0
TOTAL:	84.9		84.9

DESCRIPTION OF TIMBER BY PAYMENT UNIT (PU)

PU	MARKET GROUP	PRODUCT	QUANTITY	UNIT	ACRES	ADVERTISE PRICE			
1	BI/R/Hybrid Oak	Sawtimber	38.3	MBF	26.8	\$12,772.10			
	<i>BI/R/Hybrid Oak</i>		38.3	<i>MBF</i>					
	Red Oak		15.8	MBF					
	Misc. Species 1	Pulpwood	105	Cords					
	<i>Misc. Species 1</i>	<i>Sawtimber</i>	14.4	<i>MBF</i>					
	<i>Misc. Species 1</i>	<i>Pulpwood</i>	76	<i>Cords</i>					
	Mixed Hardwood		2	Cords					
	<i>Red Maple</i>		2	<i>Cords</i>					
	Mixed Oak		254	Cords					
	<i>BI/R/Hybrid Oak</i>		152	<i>Cords</i>					
	<i>Red Oak</i>		78	<i>Cords</i>					
	<i>White Oak</i>		24	<i>Cords</i>					
	2	BI/R/Hybrid Oak	Sawtimber	32.7			MBF	12.6	\$7,999.10
<i>BI/R/Hybrid Oak</i>			32.7	<i>MBF</i>					
White Oak			5.3	MBF					
Mixed Hardwood		Pulpwood	5	Cords					
<i>Red Maple</i>			5	<i>Cords</i>					
Mixed Oak			152	Cords					
<i>BI/R/Hybrid Oak</i>			114	<i>Cords</i>					
<i>White Oak</i>			38	<i>Cords</i>					
3	BI/R/Hybrid Oak	Sawtimber	3.2	MBF	35.0	\$9,038.75			
	<i>BI/R/Hybrid Oak</i>		2.3	<i>MBF</i>					
	<i>Northern Pin Oak</i>		0.9	<i>MBF</i>					
	Red Oak		6.9	MBF					
	Red Pine		2.1	MBF					
	White Oak		5.5	MBF					
	White Pine		4.0	MBF					
	Jack Pine	Pulpwood	139	Cords					
	<i>Jack Pine</i>	<i>Sawtimber</i>	6.1	<i>MBF</i>					
	<i>Jack Pine</i>	<i>Pulpwood</i>	127	<i>Cords</i>					
	Mixed Aspen		142	Cords					
	<i>B. T. Aspen</i>	<i>Sawtimber</i>	6.1	<i>MBF</i>					
	<i>Quaking Aspen</i>		6.7	<i>MBF</i>					
	<i>B. T. Aspen</i>	<i>Pulpwood</i>	50	<i>Cords</i>					
	<i>Quaking Aspen</i>		67	<i>Cords</i>					
	Mixed Hardwood		75	Cords					
	<i>Red Maple</i>	<i>Sawtimber</i>	3.8	<i>MBF</i>					
	<i>Black Cherry</i>	<i>Pulpwood</i>	6	<i>Cords</i>					
	<i>Red Maple</i>		61	<i>Cords</i>					
	Mixed Oak		67	Cords					
	<i>BI/R/Hybrid Oak</i>		9	<i>Cords</i>					
	<i>Northern Pin Oak</i>		5	<i>Cords</i>					
	<i>Red Oak</i>		11	<i>Cords</i>					
	<i>White Oak</i>		42	<i>Cords</i>					
	Red Pine		1	Cords					
	White Pine		7	Cords					
	4	Red Pine	Sawtimber	101.8			MBF	10.5	\$12,033.55
		White Pine		4.4			MBF		
		Red Pine	Pulpwood	75			Cords		
		White Pine		5			Cords		
TOTAL:			220.0	MBF					
TOTAL:			1,029	Cords					

Sale Specific Conditions & Requirements

Sale Name: Hissing Hognose Mix

Sale Number: 72-035-20 Seq#: 2

1 - Sale Area

1.2 - Boundaries

1.2.1 - Painted boundaries (9/19)

The sale boundary and Payment Unit boundaries are marked and identified by blue and red paint or unmarked and identified by existing roads. Exterior sale boundary lines against private property are marked with blue paint except in Payment Unit 3 the private line is unmarked and identified by the snowmobile trail and Payment Unit 4 private line is unmarked and identified by Hideaway Road. Exterior sale boundary lines against state are marked with red paint except for Payment Unit 2 is identified by an unnamed forest road and by Walsh Road. The painted boundary line trees are not Included Timber and are to be protected.

2 - Timber Specifications

2.1 - Included Timber

2.1.1 - Clearcut unit(s) with unmerchantable trees (6/14)

Within Payment Unit(s) 1, 3, and 4, cut all trees that are two (2) inches or more at DBH, except within Payment Unit 1, do not cut white oak, red pine, and white pine.

2.1.2 - Clearcut unit(s) w/o unmerchantable trees (8/11)

Within Payment Unit(s) 2, cut all trees which meet minimum piece specifications in 2.2 Utilization, except do not cut red pine and white pine.

2.1.11 - Description of timber note (2/04)

Note that Misc. Species 1 = standing dead oak; which is designated for cutting.

2.2 - Utilization

2.2.2 - Chipping required (2/18)

Payment Unit 4 must be chip harvested to facilitate subsequent planting operations. If market conditions limit the practicality of chipping, tops and slash must be arranged in a way that will not inhibit future planting operations, as directed by the sale administrator. A chipping exemption can be obtained if proposed operations are determined to be suitable for planting by reforestation staff. This exemption must be granted in writing. The requirement to retain approximately 1/6 to 1/3 of tree tops and limbs less than four inches in diameter is still applicable (G. C. & R. 2.2).

2.2.3 - Stump heights (4/07)

Stump heights within Payment Unit(s) 4 shall not exceed 6 inches for all trees. This is to facilitate planting operations.

3 - Payments

3.3 - Pre-measured Sales

3.3.4 - Dividing payment units (7/14)

Payment Unit(s) may be divided at the request of the Purchaser and upon approval of the Unit Manager. Dividing Payment Units is a contract modification which requires a Timber Sale Contract Amendment. There will be only one division per Payment Unit.

3.4 - Damaged Timber

3.4.1 - Damaged timber (7/16)

General Condition and Requirement 3.4 Damaged Timber, defines liquidated damages for undesignated live merchantable trees which are cut or injured. In addition, extreme care should be taken to avoid damage to tree seedlings and saplings. Within the Sale Area, if more than 50% of the tree seedlings or saplings (1/4" to 4.5" DBH) within a specified portion of the Sale Area are damaged, liquidated damages will be assessed at \$300.00 per acre for all acreage within that specified portion of the Sale Area that was damaged.

4 - Transportation

4.1 - Construction

4.1.3 - Slash and earthen piles (8/04)

Piles or windrows of earth along roads and landings that have been widened or constructed shall be leveled. Slash from road maintenance or construction, including stumps, shall be dispersed throughout the sale.

4.1.6 - Road construction (1/09)

Construction of new roads or improvements of existing roads shall be done in such a way as to minimize the environmental and visual impacts. Merchantable trees shall be cut and utilized unless otherwise directed. Non-merchantable trees shall be severed and laid flat on the ground. Slash shall be scattered, and not left in windrows and kept a minimum of 10 feet back from the road edge. Stumps shall be set upright, not left on edge, and be moved at least 10 feet away from the road edge. Disturbed soil shall be feathered into the woods and not left in berms or windrows.

4.1.7 - Road closure (10/11)

All new roads built into the sale must be blocked to vehicle traffic upon completion of the sale. Overgrown roads that are reopened shall be considered new roads. In general, this will require constructing a four (4') foot high berm of stumps and logs covered with earth. These roads must be rendered impassable to cars and trucks. Temporary berms may be required if no sale activity occurs for 30 or more consecutive days. Contact the sale administrator for specific details of design and placement.

4.1.11 - Permits (2/12)

The Purchaser will secure any necessary highway permits that may be required.

5 - Operations

5.1 - Notification

5.1.4 - Post-sale conference (10/16)

A post-sale conference on site between the Purchaser and sale administrator is required 5 days prior to the completion of active logging operations to determine clean-up and repair of landings, road edges, and the fulfillment of other contract specifications.

5.2 - Conduct of Operations

5.2.2 - Hazard Trees/Snags

5.2.2.1 - Den trees (10/16)

Obvious hollow and/or den trees shall be protected and left standing unless they are a safety hazard.

5.2.3 - Operating Restrictions

5.2.3.5 - Oak wilt restriction (1/18)

Within Payment Unit(s) 1, 2, and 4, unless changed by written agreement, cutting, skidding, hauling within the sale and brushing of access roads to the sale are not permitted during the period of April 15 to July 15. Operations may be allowed if specific steps are taken to prevent damaging uncut oak during the high risk period. Those steps may include completing all road brushing before April 15th and clearing a tree-length buffer along uncut oak cover before April 15th. This is necessary to reduce the spread of oak wilt. For more information, contact the Unit Manager or his/her representative.

5.2.4 - Dead and Down Creation

5.2.4.4 - Dead and down creation, grouse (6/18)

To encourage grouse and other wildlife, in Payment Unit(s) 3, leave one, 12" or larger diameter (or largest diameter trees within stand) whole tree on the ground for every 2 acres, preferably a hardwood species such as oak or maple or if no hardwoods are present, a pine species (white or red). These trees will be evenly scattered throughout the Payment Unit, preferably at least two chains from any roads, two-tracks, or trails open to vehicles.

5.2.32 - Decking/landing restoration (9/13)

All decking and landing areas must have the surface area restored to a condition equal to or better than before. This is to ensure the proper regeneration of the stand. Wood debris, chips, and "cookies" from trimmings must be removed or scattered away from landing and loading areas and may not be windrowed on the edge.

5.2.38 - No decking against live trees (2/04)

Cut products may not be decked against unmarked or designated leave trees.

5.2.40 - Pathway protection (10/10)

The Shore-to-shore trail is a hiking and horseback riding trail and is shown on the Timber Sale Map. Do not cut trees or damage posts with blue pathway markers. Maintain a rut and slash free zone within 10 feet of the trail. Do not deck wood along the trail. Do not run equipment down the pathway. Do not operate equipment along the trail during scheduled trail rides. The sale administrator will provide a minimum of two weeks notice of when scheduled trail rides are to occur.

5.2.41 - Snowmobile trail protection (9/11)

The LP 9 and LP 409 are snowmobile trails and are shown on the Timber Sale Map. Do not cut or damage posts with orange trail markers or traffic control signs. If the trails are used, they must be maintained and restored to a condition equal to or better than before the sale. The road maintenance/restoration must be done prior to December 1. If the trails are used for hauling, they must be graded to the satisfaction of the Unit Manager or his/her representative prior to December 1. If the trail road is to be used for hauling during the snowmobile season, then a snow-covered base must be left on the trail. The snowmobile trails may not be used for any timber sale operations from December 1 to March 31 without written approval of the Unit Manager. The snowmobile trail may only be crossed at right angles. Maintain a 20-foot-wide slash, debris, and rut free zone daily using the snowmobile trail as the centerline. No decking of forest products will be permitted along the snowmobile trail. All stumps within 20 feet of the snowmobile trail must be cut at ground level.

5.4 - Soil Protection

5.4.1 - Rutting restriction, general (7/16)

Operations are to cease immediately if equipment and weather conditions result in rutting of roads and/or skid trails which is 12 inches or greater in depth and 50 feet in length. The Unit Manager or his/her representative may restrict hauling and/or skidding if ruts exceed the specified depth. With the Unit Manager or his/her representative's approval, the Purchaser may return to the area when the risk of rutting has decreased.

6 - Safety and Fire Prevention

6.2 - Signing

6.2.2 - Snowmobile trail posting (8/09)

The Purchaser is responsible for posting and maintaining caution signs on snowmobile trails LP 9 and LP 409 prior to beginning operations during the snowmobile season (approximately December 1 to March 31). The trail must be posted at appropriate distances from the Sale Area to warn of logging activity and truck traffic. Signs must be removed when harvest operations are suspended or completed. The Purchaser will provide these signs.

6.2.3 - Recreational trail posting (2/10)

The Purchaser is responsible for posting and maintaining caution signs on the Shore-to-shore Trail prior to beginning operations. The trail must be posted at appropriate distances from the Sale Area to warn of logging activity and truck traffic at both ends of the trail. Signs must be removed when harvest operations are suspended or completed. The Purchaser will provide these signs.



Sale Number	Year
72 - 035	20

TIMBER SALE MAP

This information provided by authority of Part 525, 1994 PA 451, as amended.

Forest Management Unit	County	Mapped By	Date	Page	of
Grayling	Crawford	Derek Nellis	9/08/2020	1	1
Township	Range	Section(s) and Subdivision(s)	Scale		
27N	01W	Sec 13 - S1/2SE Sec 24 - W1/2NW,S1/2NE,N1/2SE	1:15,840		

Cover Type				Density	
A = Aspen	H = Hemlock	N = Marsh	U = Upland Brush	0 = Non Stocked	5 = Pole Timber Medium
B = Paper Birch	J = Jack Pine	O = Oak	UM = Upland Mixed	1 = Seedling Sapling Poor	6 = Pole Timber Well
C = Cedar	L = Lowland Brush	P = Lowland Poplar	V = Bog or Marsh	2 = Seedling Sapling Medium	7 = Saw Timber Poor
D = Treed Bog	LM = Lowland Mixed	Q = Mixed Swamp Conifer	W = White Pine	3 = Seedling Sapling Well	8 = Saw Timber Medium
E = Swamp Hdwoods	M = Mpl. Bch. Brch	R = Red Pine	X = Non Stocked	4 = Pole Timber Poor	9 = Saw Timber Well
F = Spruce Fir	MC = Mixed Conifer	S = Black Spruce	Z = Water		
G = Grass	MD = Mixed Deciduous	T = Tamarack			

PU	Acres	PU	Acres
1	26.8	4	10.5
2	12.6		
3	35.0		

Hissing Hognose Mix

Compartment 286

84.9 Acres

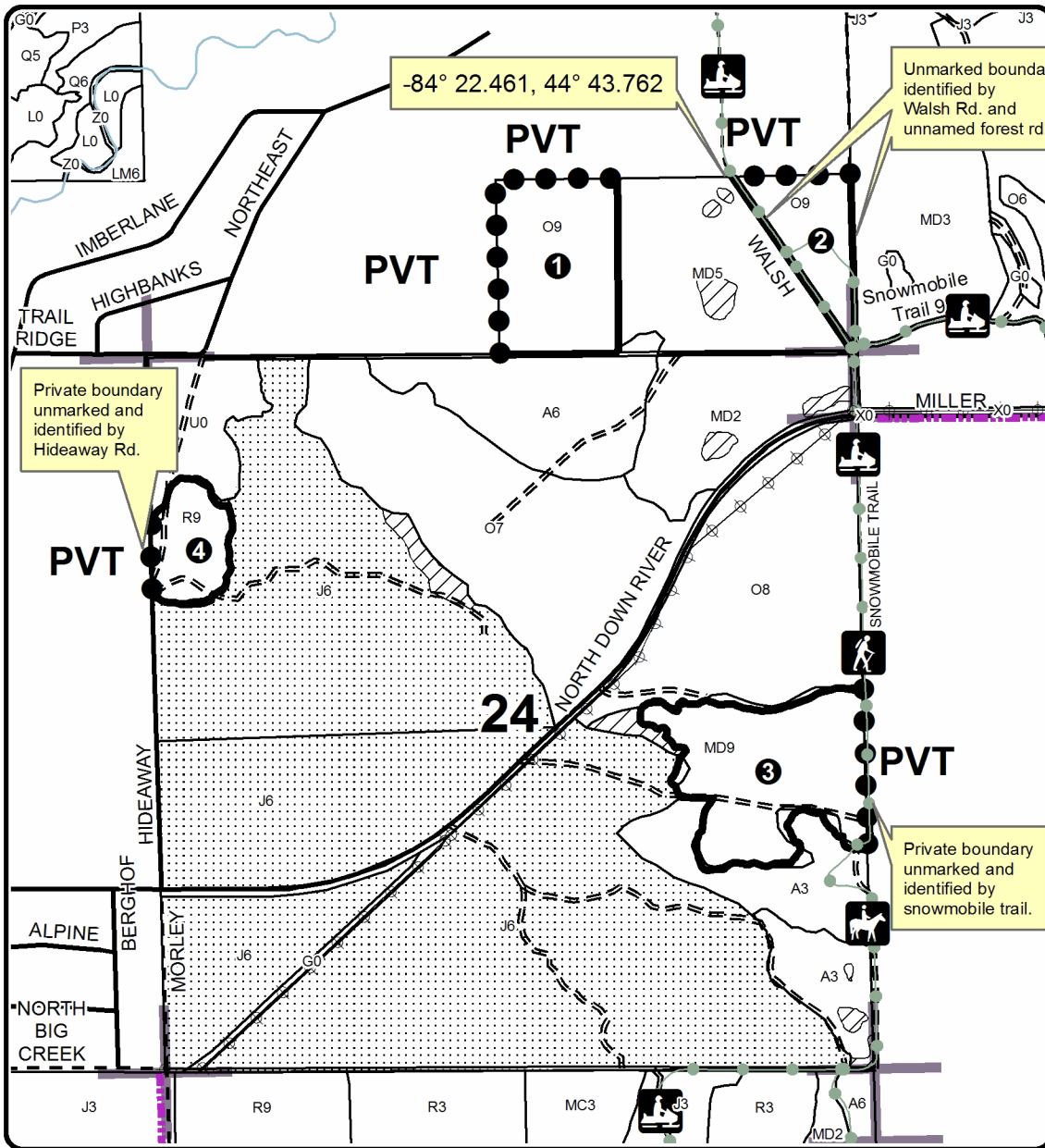

Legend

- Against State (Red)
- Private Line (Blue)
- ① Payment Unit Label
- ⚡ Powerline
- Pipeline
- Recreational Trails
- Primary Forest Road
- Secondary Forest Road
- == Forest Access Route
- Paved Road
- - - Gravel Road
- Stream
- ▨ Retention Area
- Stand Boundaries
- ⋯ Nearby Sales
- 01** Section Numbers
- Section Corners

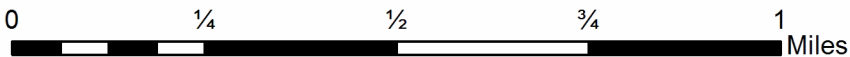

Quarter Quorners Mix (72-032-20)
T25N, R04W, SEC. 32; Crawford COUNTY

In response to the notice of sale to be held 9:00 a.m. (local time) on May 7, 2021, I am hereby submitting my sealed bid (firm offer) for the following forest products to be cut. Bids for individual species must be at or above the advertised price. All non-responsive bid forms may be rejected.

<u>PRODUCTS & SPECIES</u>	<u>ESTIMATED VOLUME*</u>	<u>ADVERTISED PRICE</u>	<u>BID PRICE/UNIT</u>
Sawtimber			
Bl/R/Hybrid Oak	130.0 MBF	\$ 99.00/MBF	\$ _____
Jack Pine	1.7 MBF	\$ 23.00/MBF	\$ _____
Mixed Aspen	5.1 MBF	\$ 31.00/MBF	\$ _____
Northern Pin Oak	10.9 MBF	\$ 88.00/MBF	\$ _____
Red Maple	49.9 MBF	\$ 41.00/MBF	\$ _____
Red Oak	218.1 MBF	\$ 110.00/MBF	\$ _____
Red Pine	1,576.8 MBF	\$ 91.00/MBF	\$ _____
White Oak	95.4 MBF	\$ 63.00/MBF	\$ _____
White Pine	56.5 MBF	\$ 35.00/MBF	\$ _____
Pulpwood			
Balsam Fir	5 Cords	\$ 12.80/Cord	\$ _____
Jack Pine	15 Cords	\$ 15.30/Cord	\$ _____
Mixed Aspen	135 Cords	\$ 14.05/Cord	\$ _____
Mixed Oak	1,234 Cords	\$ 20.50/Cord	\$ _____
Red Maple	633 Cords	\$ 20.40/Cord	\$ _____
Red Pine	516 Cords	\$ 33.85/Cord	\$ _____
White Pine	95 Cords	\$ 15.40/Cord	\$ _____

*The volumes are statistically estimated within plus (+) or minus (-) 6.33 percent at 95% confidence level. These estimated volumes are final and not subject to adjustment. Prospective bidders are urged to examine this timber and to make their own estimates of quantity and quality.

I understand that any or all bids may be rejected. All bids must be signed and all bid items must be bid or the bid form may be rejected. I also understand that consideration and awarding a contract will be based upon my past performance and ability to complete the contract based upon equipment and staffing subject to my control.

FEDERAL ID: ___ - ___ - ___ or SOCIAL SECURITY NUMBER: ___ - ___ - ___

Company or individual bidding: _____

Company representative's name: _____

Address: _____

City: _____ State: _____ Zip: _____

IF AVAILABLE, PLEASE PLACE THE PERSONALIZED LABEL FROM YOUR PROSPECTUS IN THE ABOVE BOX.

Individual or company representative's signature: _____ Date: _____

Phone number : _____ Email (optional): _____

THE WINNING BIDDER MUST COMPLETE THE VERIFICATION OF WORKER'S DISABILITY COMPENSATION ACT COMPLIANCE (ON REVERSE SIDE IF DOUBLE SIDED) WITHIN 21 DAYS OF SALE AWARD DATE



FOR DEPARTMENT USE ONLY	
Sale Number (XX - XXX - XX - XX)	
Forest Management Unit:	

TIMBER SALE VERIFICATION OF WORKER'S DISABILITY COMPENSATION ACT COMPLIANCE

As required by Act 317, P.A. 1969 (Worker's Compensation) and
Part 5 of Act 451 of 1994, as amended.

VERIFICATION OF WORKER'S DISABILITY COMPENSATION ACT COMPLIANCE

- This verification must be completed and submitted within 21 days of contract award and prior to the issuance of the timber sale contract.
- In addition, if boxes 2B or 2C are checked, then Notice of Exclusion or Certificate of Insurance must be submitted within twenty-one (21) days of the contract award and prior to the issuance of the timber sale contract.
- All information must be typed or printed except for written signatures.

Please Check Appropriate Categories:

1. My business is organized as (you **must** check one of the boxes below):
 - A. Sole Proprietorship (individual)
 - B. Partnership
 - C. Corporation
2. You **must** check one of the boxes below:
 - A. I certify my business is a sole proprietorship and it has no employees but the sole proprietor. I am not subject to the Worker's Compensation Laws.
 - B. I certify my business has satisfied its obligation to the Worker's Compensation Act through the use of an approved Notice of Exclusion (BWC-337, Rev. 5/96). I will provide a copy of the Notice of Exclusion within 21 days of the contract award. (For questions or a copy of the BWC-337, please call the Worker's Compensation Bureau at 517-322-1195).
 - C. I certify my business has a Worker's Compensation Policy. I will provide an original Certificate of Insurance within twenty-one (21) days of the contract award.
3. If you have checked item 2(A) or 2(B), you **must** indicate the number of **both** full-time and part-time employees, other than yourself, including family members and active partners (if none, you must enter "0").

_____ Full-time Employees

_____ Part-time Employees

Name of Business		Federal ID (or) Social Security No.	
Address		Telephone ()	
City	State	ZIP	

I hereby certify that the above information is true and correct. I agree to notify the Michigan DNR of any changes that occur in factors affecting my coverage during any of my present and future operations.

Signature of Owner or Authorized Representative

Title

Date

Please complete the "SEALED BID" information on the next page

Cherry Creek Do-Over (72-011-20)
T26N, R01E, SEC. 1; T27N, R01E, SEC. 36; Oscoda COUNTY

In response to the notice of sale to be held 9:00 a.m. (local time) on May 7, 2021, I am hereby submitting my sealed bid (firm offer) for the following forest products to be cut. Bids for individual species must be at or above the advertised price. All non-responsive bid forms may be rejected.

<u>PRODUCTS & SPECIES</u>	<u>ESTIMATED VOLUME*</u>	<u>ADVERTISED PRICE</u>	<u>BID PRICE/UNIT</u>
Sawtimber			
Red Pine	200.3 MBF	\$ 91.00/MBF	\$ _____
White Pine	54.2 MBF	\$ 35.00/MBF	\$ _____
Pulpwood			
Balsam Fir	4 Cords	\$ 12.80/Cord	\$ _____
Jack Pine	90 Cords	\$ 15.30/Cord	\$ _____
Mixed Aspen	124 Cords	\$ 14.05/Cord	\$ _____
Mixed Hardwood	88 Cords	\$ 20.40/Cord	\$ _____
Mixed Oak	96 Cords	\$ 20.50/Cord	\$ _____
Red Pine	275 Cords	\$ 33.85/Cord	\$ _____
White Pine	263 Cords	\$ 15.40/Cord	\$ _____

*The volumes are statistically estimated within plus (+) or minus (-) 13.66 percent at 95% confidence level. These estimated volumes are final and not subject to adjustment. Prospective bidders are urged to examine this timber and to make their own estimates of quantity and quality.

I understand that any or all bids may be rejected. All bids must be signed and all bid items must be bid or the bid form may be rejected. I also understand that consideration and awarding a contract will be based upon my past performance and ability to complete the contract based upon equipment and staffing subject to my control.

FEDERAL ID: ____ - ____ - ____ or SOCIAL SECURITY NUMBER: ____ - ____ - ____

Company or individual bidding: _____

Company representative's name: _____

Address: _____

City: _____ State: _____ Zip: _____

IF AVAILABLE, PLEASE PLACE THE PERSONALIZED LABEL FROM YOUR PROSPECTUS IN THE ABOVE BOX.

Individual or company representative's signature: _____ Date: _____

Phone number : _____ Email (optional): _____

THE WINNING BIDDER MUST COMPLETE THE VERIFICATION OF WORKER'S DISABILITY COMPENSATION ACT COMPLIANCE (ON REVERSE SIDE IF DOUBLE SIDED) WITHIN 21 DAYS OF SALE AWARD DATE



FOR DEPARTMENT USE ONLY	
Sale Number (XX - XXX - XX - XX)	
Forest Management Unit:	

TIMBER SALE VERIFICATION OF WORKER'S DISABILITY COMPENSATION ACT COMPLIANCE

As required by Act 317, P.A. 1969 (Worker's Compensation) and
Part 5 of Act 451 of 1994, as amended.

VERIFICATION OF WORKER'S DISABILITY COMPENSATION ACT COMPLIANCE

- This verification must be completed and submitted within 21 days of contract award and prior to the issuance of the timber sale contract.
- In addition, if boxes 2B or 2C are checked, then Notice of Exclusion or Certificate of Insurance must be submitted within twenty-one (21) days of the contract award and prior to the issuance of the timber sale contract.
- All information must be typed or printed except for written signatures.

Please Check Appropriate Categories:

1. My business is organized as (you **must** check one of the boxes below):
 - A. Sole Proprietorship (individual)
 - B. Partnership
 - C. Corporation
2. You **must** check one of the boxes below:
 - A. I certify my business is a sole proprietorship and it has no employees but the sole proprietor. I am not subject to the Worker's Compensation Laws.
 - B. I certify my business has satisfied its obligation to the Worker's Compensation Act through the use of an approved Notice of Exclusion (BWC-337, Rev. 5/96). I will provide a copy of the Notice of Exclusion within 21 days of the contract award. (For questions or a copy of the BWC-337, please call the Worker's Compensation Bureau at 517-322-1195).
 - C. I certify my business has a Worker's Compensation Policy. I will provide an original Certificate of Insurance within twenty-one (21) days of the contract award.
3. If you have checked item 2(A) or 2(B), you **must** indicate the number of **both** full-time and part-time employees, other than yourself, including family members and active partners (if none, you must enter "0").

_____ Full-time Employees

_____ Part-time Employees

Name of Business		Federal ID (or) Social Security No.	
Address		Telephone ()	
City	State	ZIP	

I hereby certify that the above information is true and correct. I agree to notify the Michigan DNR of any changes that occur in factors affecting my coverage during any of my present and future operations.

Signature of Owner or Authorized Representative

Title

Date

Please complete the "SEALED BID" information on the next page

Nameless Oak (72-005-20)
T27N, R01E, SEC. 27; T27N, R01E, SEC. 36; Oscoda COUNTY

In response to the notice of sale to be held 9:00 a.m. (local time) on May 7, 2021, I am hereby submitting my sealed bid (firm offer) for the following forest products to be cut. Bids for individual species must be at or above the advertised price. All non-responsive bid forms may be rejected.

<u>PRODUCTS & SPECIES</u>	<u>ESTIMATED VOLUME*</u>	<u>ADVERTISED PRICE</u>	<u>BID PRICE/UNIT</u>
Sawtimber			
Bl/R/Hybrid Oak	109.2 MBF	\$ 136.00/MBF	\$ _____
Mixed Aspen	2.8 MBF	\$ 31.00/MBF	\$ _____
Red Oak	228.9 MBF	\$ 110.00/MBF	\$ _____
Red Pine	57.9 MBF	\$ 91.00/MBF	\$ _____
White Oak	31.2 MBF	\$ 63.00/MBF	\$ _____
White Pine	34.5 MBF	\$ 35.00/MBF	\$ _____
Pulpwood			
Balsam Fir	8 Cords	\$ 12.80/Cord	\$ _____
Mixed Aspen	68 Cords	\$ 14.05/Cord	\$ _____
Mixed Oak	1,087 Cords	\$ 20.50/Cord	\$ _____
Red Maple	43 Cords	\$ 20.40/Cord	\$ _____
Red Pine	261 Cords	\$ 33.85/Cord	\$ _____
White Pine	322 Cords	\$ 15.40/Cord	\$ _____

*The volumes are statistically estimated within plus (+) or minus (-) 11.81 percent at 95% confidence level. These estimated volumes are final and not subject to adjustment. Prospective bidders are urged to examine this timber and to make their own estimates of quantity and quality.

I understand that any or all bids may be rejected. All bids must be signed and all bid items must be bid or the bid form may be rejected. I also understand that consideration and awarding a contract will be based upon my past performance and ability to complete the contract based upon equipment and staffing subject to my control.

FEDERAL ID: ____ - ____ - ____ or SOCIAL SECURITY NUMBER: ____ - ____ - ____

Company or individual bidding: _____

Company representative's name: _____

Address: _____

City: _____ State: _____ Zip: _____

IF AVAILABLE, PLEASE PLACE THE PERSONALIZED LABEL FROM YOUR PROSPECTUS IN THE ABOVE BOX.

Individual or company representative's signature: _____ Date: _____

Phone number : _____ Email (optional): _____

THE WINNING BIDDER MUST COMPLETE THE VERIFICATION OF WORKER'S DISABILITY COMPENSATION ACT COMPLIANCE (ON REVERSE SIDE IF DOUBLE SIDED) WITHIN 21 DAYS OF SALE AWARD DATE



FOR DEPARTMENT USE ONLY
Sale Number (XX - XXX - XX - XX)
Forest Management Unit:

TIMBER SALE VERIFICATION OF WORKER'S DISABILITY COMPENSATION ACT COMPLIANCE

*As required by Act 317, P.A. 1969 (Worker's Compensation) and
Part 5 of Act 451 of 1994, as amended.*

VERIFICATION OF WORKER'S DISABILITY COMPENSATION ACT COMPLIANCE

- This verification must be completed and submitted within 21 days of contract award and prior to the issuance of the timber sale contract.
- In addition, if boxes 2B or 2C are checked, then Notice of Exclusion or Certificate of Insurance must be submitted within twenty-one (21) days of the contract award and prior to the issuance of the timber sale contract.
- All information must be typed or printed except for written signatures.

Please Check Appropriate Categories:

1. My business is organized as (you **must** check one of the boxes below):
 - A. Sole Proprietorship (individual)
 - B. Partnership
 - C. Corporation
2. You **must** check one of the boxes below:
 - A. I certify my business is a sole proprietorship and it has no employees but the sole proprietor. I am not subject to the Worker's Compensation Laws.
 - B. I certify my business has satisfied its obligation to the Worker's Compensation Act through the use of an approved Notice of Exclusion (BWC-337, Rev. 5/96). I will provide a copy of the Notice of Exclusion within 21 days of the contract award. (For questions or a copy of the BWC-337, please call the Worker's Compensation Bureau at 517-322-1195).
 - C. I certify my business has a Worker's Compensation Policy. I will provide an original Certificate of Insurance within twenty-one (21) days of the contract award.
3. If you have checked item 2(A) or 2(B), you **must** indicate the number of **both** full-time and part-time employees, other than yourself, including family members and active partners (if none, you must enter "0").

_____ Full-time Employees

_____ Part-time Employees

Name of Business		Federal ID (or) Social Security No.	
Address		Telephone ()	
City	State	ZIP	

I hereby certify that the above information is true and correct. I agree to notify the Michigan DNR of any changes that occur in factors affecting my coverage during any of my present and future operations.

Signature of Owner or Authorized Representative

Title

Date

Please complete the "SEALED BID" information on the next page

Medioakre Mix (72-016-20)

T26N, R03W, SEC. 14; T26N, R03W, SEC. 15; T26N, R03W, SEC. 22; T26N,

In response to the notice of sale to be held 9:00 a.m. (local time) on May 7, 2021, I am hereby submitting my sealed bid (firm offer) for the following forest products to be cut. Bids for individual species must be at or above the advertised price. All non-responsive bid forms may be rejected.

<u>PRODUCTS & SPECIES</u>	<u>ESTIMATED VOLUME*</u>	<u>ADVERTISED PRICE</u>	<u>BID PRICE/UNIT</u>
Sawtimber			
BI/R/Hybrid Oak	17.5 MBF	\$ 136.00/MBF	\$ _____
Red Pine	94.5 MBF	\$ 91.00/MBF	\$ _____
White Oak	19.5 MBF	\$ 63.00/MBF	\$ _____
Pulpwood			
B. T. Aspen	28 Cords	\$ 14.05/Cord	\$ _____
BI/R/Hybrid Oak	399 Cords	\$ 20.50/Cord	\$ _____
Jack Pine	552 Cords	\$ 15.30/Cord	\$ _____
Red Maple	18 Cords	\$ 20.40/Cord	\$ _____
Red Pine	354 Cords	\$ 33.85/Cord	\$ _____
White Oak	266 Cords	\$ 20.50/Cord	\$ _____
White Pine	11 Cords	\$ 15.40/Cord	\$ _____

*The volumes are statistically estimated within plus (+) or minus (-) 9.44 percent at 95% confidence level. These estimated volumes are final and not subject to adjustment. Prospective bidders are urged to examine this timber and to make their own estimates of quantity and quality.

I understand that any or all bids may be rejected. All bids must be signed and all bid items must be bid or the bid form may be rejected. I also understand that consideration and awarding a contract will be based upon my past performance and ability to complete the contract based upon equipment and staffing subject to my control.

FEDERAL ID: _____ or SOCIAL SECURITY NUMBER: _____

Company or individual bidding: _____

Company representative's name: _____

Address: _____

City: _____ State: _____ Zip: _____

IF AVAILABLE, PLEASE PLACE THE PERSONALIZED LABEL FROM YOUR PROSPECTUS IN THE ABOVE BOX.

Individual or company representative's signature: _____ Date: _____

Phone number : _____ Email (optional): _____

THE WINNING BIDDER MUST COMPLETE THE VERIFICATION OF WORKER'S DISABILITY COMPENSATION ACT COMPLIANCE (ON REVERSE SIDE IF DOUBLE SIDED) WITHIN 21 DAYS OF SALE AWARD DATE



FOR DEPARTMENT USE ONLY	
Sale Number (XX - XXX - XX - XX)	
Forest Management Unit:	

TIMBER SALE VERIFICATION OF WORKER'S DISABILITY COMPENSATION ACT COMPLIANCE

As required by Act 317, P.A. 1969 (Worker's Compensation) and
Part 5 of Act 451 of 1994, as amended.

VERIFICATION OF WORKER'S DISABILITY COMPENSATION ACT COMPLIANCE

- This verification must be completed and submitted within 21 days of contract award and prior to the issuance of the timber sale contract.
- In addition, if boxes 2B or 2C are checked, then Notice of Exclusion or Certificate of Insurance must be submitted within twenty-one (21) days of the contract award and prior to the issuance of the timber sale contract.
- All information must be typed or printed except for written signatures.

Please Check Appropriate Categories:

1. My business is organized as (you **must** check one of the boxes below):
 - A. Sole Proprietorship (individual)
 - B. Partnership
 - C. Corporation
2. You **must** check one of the boxes below:
 - A. I certify my business is a sole proprietorship and it has no employees but the sole proprietor. I am not subject to the Worker's Compensation Laws.
 - B. I certify my business has satisfied its obligation to the Worker's Compensation Act through the use of an approved Notice of Exclusion (BWC-337, Rev. 5/96). I will provide a copy of the Notice of Exclusion within 21 days of the contract award. (For questions or a copy of the BWC-337, please call the Worker's Compensation Bureau at 517-322-1195).
 - C. I certify my business has a Worker's Compensation Policy. I will provide an original Certificate of Insurance within twenty-one (21) days of the contract award.
3. If you have checked item 2(A) or 2(B), you **must** indicate the number of **both** full-time and part-time employees, other than yourself, including family members and active partners (if none, you must enter "0").

_____ Full-time Employees

_____ Part-time Employees

Name of Business		Federal ID (or) Social Security No.	
Address		Telephone ()	
City	State	ZIP	

I hereby certify that the above information is true and correct. I agree to notify the Michigan DNR of any changes that occur in factors affecting my coverage during any of my present and future operations.

Signature of Owner or Authorized Representative

Title

Date

Please complete the "SEALED BID" information on the next page

Hissing Hognose Mix (72-035-20)

T27N, R01E, SEC. 18; T27N, R01W, SEC. 13; T27N, R01W, SEC. 24; Crawford

In response to the notice of sale to be held 9:00 a.m. (local time) on May 7, 2021, I am hereby submitting my sealed bid (firm offer) for the following forest products to be cut. Bids for individual species must be at or above the advertised price. All non-responsive bid forms may be rejected.

<u>PRODUCTS & SPECIES</u>	<u>ESTIMATED VOLUME*</u>	<u>ADVERTISED PRICE</u>	<u>BID PRICE/UNIT</u>
Sawtimber			
Bl/R/Hybrid Oak	74.2 MBF	\$ 136.00/MBF	\$ _____
Mixed Aspen	12.8 MBF	\$ 31.00/MBF	\$ _____
Red Oak	22.7 MBF	\$ 110.00/MBF	\$ _____
Red Pine	103.9 MBF	\$ 91.00/MBF	\$ _____
White Oak	10.8 MBF	\$ 63.00/MBF	\$ _____
White Pine	8.4 MBF	\$ 35.00/MBF	\$ _____
Pulpwood			
Jack Pine	139 Cords	\$ 15.30/Cord	\$ _____
Misc. Species 1	105 Cords	\$ 5.50/Cord	\$ _____
Mixed Aspen	142 Cords	\$ 14.05/Cord	\$ _____
Mixed Hardwood	82 Cords	\$ 20.40/Cord	\$ _____
Mixed Oak	473 Cords	\$ 20.50/Cord	\$ _____
Red Pine	76 Cords	\$ 33.85/Cord	\$ _____
White Pine	12 Cords	\$ 15.40/Cord	\$ _____

*The volumes are statistically estimated within plus (+) or minus (-) 12.62 percent at 95% confidence level. These estimated volumes are final and not subject to adjustment. Prospective bidders are urged to examine this timber and to make their own estimates of quantity and quality.

I understand that any or all bids may be rejected. All bids must be signed and all bid items must be bid or the bid form may be rejected. I also understand that consideration and awarding a contract will be based upon my past performance and ability to complete the contract based upon equipment and staffing subject to my control.

FEDERAL ID: _____ or SOCIAL SECURITY NUMBER: _____

Company or individual bidding: _____

Company representative's name: _____

Address: _____

City: _____ State: _____ Zip: _____

IF AVAILABLE, PLEASE PLACE THE PERSONALIZED LABEL FROM YOUR PROSPECTUS IN THE ABOVE BOX.

Individual or company representative's signature: _____ Date: _____

Phone number : _____ Email (optional): _____

THE WINNING BIDDER MUST COMPLETE THE VERIFICATION OF WORKER'S DISABILITY COMPENSATION ACT COMPLIANCE (ON REVERSE SIDE IF DOUBLE SIDED) WITHIN 21 DAYS OF SALE AWARD DATE



FOR DEPARTMENT USE ONLY	
Sale Number (XX - XXX - XX - XX)	
Forest Management Unit:	

TIMBER SALE VERIFICATION OF WORKER'S DISABILITY COMPENSATION ACT COMPLIANCE

As required by Act 317, P.A. 1969 (Worker's Compensation) and
Part 5 of Act 451 of 1994, as amended.

VERIFICATION OF WORKER'S DISABILITY COMPENSATION ACT COMPLIANCE

- This verification must be completed and submitted within 21 days of contract award and prior to the issuance of the timber sale contract.
- In addition, if boxes 2B or 2C are checked, then Notice of Exclusion or Certificate of Insurance must be submitted within twenty-one (21) days of the contract award and prior to the issuance of the timber sale contract.
- All information must be typed or printed except for written signatures.

Please Check Appropriate Categories:

1. My business is organized as (you **must** check one of the boxes below):
 - A. Sole Proprietorship (individual)
 - B. Partnership
 - C. Corporation
2. You **must** check one of the boxes below:
 - A. I certify my business is a sole proprietorship and it has no employees but the sole proprietor. I am not subject to the Worker's Compensation Laws.
 - B. I certify my business has satisfied its obligation to the Worker's Compensation Act through the use of an approved Notice of Exclusion (BWC-337, Rev. 5/96). I will provide a copy of the Notice of Exclusion within 21 days of the contract award. (For questions or a copy of the BWC-337, please call the Worker's Compensation Bureau at 517-322-1195).
 - C. I certify my business has a Worker's Compensation Policy. I will provide an original Certificate of Insurance within twenty-one (21) days of the contract award.
3. If you have checked item 2(A) or 2(B), you **must** indicate the number of **both** full-time and part-time employees, other than yourself, including family members and active partners (if none, you must enter "0").

_____ Full-time Employees

_____ Part-time Employees

Name of Business		Federal ID (or) Social Security No.	
Address		Telephone ()	
City	State	ZIP	

I hereby certify that the above information is true and correct. I agree to notify the Michigan DNR of any changes that occur in factors affecting my coverage during any of my present and future operations.

Signature of Owner or Authorized Representative

Title

Date

Please complete the "SEALED BID" information on the next page

Muskrat KW (72-020-20)
T27N, R02E, SEC. 18; T27N, R02E, SEC. 7; Oscoda COUNTY

In response to the notice of sale to be held 9:00 a.m. (local time) on May 7, 2021, I am hereby submitting my sealed bid (firm offer) for the following forest products to be cut. Bids for individual species must be at or above the advertised price. All non-responsive bid forms may be rejected.

<u>PRODUCTS & SPECIES</u>	<u>ESTIMATED VOLUME*</u>	<u>ADVERTISED PRICE</u>	<u>BID PRICE/UNIT</u>
Sawtimber			
Northern Pin Oak	29.7 MBF	\$ 136.00/MBF	\$ _____
Red Pine	239.6 MBF	\$ 91.00/MBF	\$ _____
Pulpwood			
B. T. Aspen	93 Cords	\$ 14.05/Cord	\$ _____
Jack Pine	4,522 Cords	\$ 15.30/Cord	\$ _____
Northern Pin Oak	340 Cords	\$ 20.50/Cord	\$ _____
Red Maple	11 Cords	\$ 20.40/Cord	\$ _____
Red Pine	193 Cords	\$ 33.85/Cord	\$ _____
White Pine	6 Cords	\$ 15.40/Cord	\$ _____

*The volumes are statistically estimated within plus (+) or minus (-) 8.98 percent at 95% confidence level. These estimated volumes are final and not subject to adjustment. Prospective bidders are urged to examine this timber and to make their own estimates of quantity and quality.

I understand that any or all bids may be rejected. All bids must be signed and all bid items must be bid or the bid form may be rejected. I also understand that consideration and awarding a contract will be based upon my past performance and ability to complete the contract based upon equipment and staffing subject to my control .

FEDERAL ID: ____ - ____ - ____ or SOCIAL SECURITY NUMBER: ____ - ____ - ____

Company or individual bidding: _____

Company representative's name: _____

Address: _____

City: _____ State: _____ Zip: _____

IF AVAILABLE, PLEASE PLACE THE PERSONALIZED LABEL FROM YOUR PROSPECTUS IN THE ABOVE BOX.

Individual or company representative's signature: _____ Date: _____

Phone number : _____ Email (optional): _____

THE WINNING BIDDER MUST COMPLETE THE VERIFICATION OF WORKER'S DISABILITY COMPENSATION ACT COMPLIANCE (ON REVERSE SIDE IF DOUBLE SIDED) WITHIN 21 DAYS OF SALE AWARD DATE



TIMBER SALE VERIFICATION OF WORKER'S DISABILITY COMPENSATION ACT COMPLIANCE

As required by Act 317, P.A. 1969 (Worker's Compensation) and
Part 5 of Act 451 of 1994, as amended.

FOR DEPARTMENT USE ONLY	
Sale Number (XX - XXX - XX - XX)	
Forest Management Unit:	

VERIFICATION OF WORKER'S DISABILITY COMPENSATION ACT COMPLIANCE

- This verification must be completed and submitted within 21 days of contract award and prior to the issuance of the timber sale contract.
- In addition, if boxes 2B or 2C are checked, then Notice of Exclusion or Certificate of Insurance must be submitted within twenty-one (21) days of the contract award and prior to the issuance of the timber sale contract.
- All information must be typed or printed except for written signatures.

Please Check Appropriate Categories:

1. My business is organized as (you **must** check one of the boxes below):
 - A. Sole Proprietorship (individual)
 - B. Partnership
 - C. Corporation
2. You **must** check one of the boxes below:
 - A. I certify my business is a sole proprietorship and it has no employees but the sole proprietor. I am not subject to the Worker's Compensation Laws.
 - B. I certify my business has satisfied its obligation to the Worker's Compensation Act through the use of an approved Notice of Exclusion (BWC-337, Rev. 5/96). I will provide a copy of the Notice of Exclusion within 21 days of the contract award. (For questions or a copy of the BWC-337, please call the Worker's Compensation Bureau at 517-322-1195).
 - C. I certify my business has a Worker's Compensation Policy. I will provide an original Certificate of Insurance within twenty-one (21) days of the contract award.
3. If you have checked item 2(A) or 2(B), you **must** indicate the number of **both** full-time and part-time employees, other than yourself, including family members and active partners (if none, you must enter "0").

_____ Full-time Employees

_____ Part-time Employees

Name of Business		Federal ID (or) Social Security No.	
Address		Telephone ()	
City	State	ZIP	

I hereby certify that the above information is true and correct. I agree to notify the Michigan DNR of any changes that occur in factors affecting my coverage during any of my present and future operations.

Signature of Owner or Authorized Representative

Title

Date

Please complete the "SEALED BID" information on the next page