



**DEPARTMENT OF NATURAL RESOURCES  
STATE OF MICHIGAN**

**TIMBER SALE PROSPECTUS #6929**

SCHEDULED SALE DATE AND TIME: 3:00 p.m. (local time) on October 27, 2021.

LOCATION: ESCANABA MGMT UNIT, 6833 HWY'S 2, 41 & M-35, GLADSTONE, MI 49837.

PROSPECTUS NOTE: The bidder is advised to inspect the sale area and review the location, estimated volumes, operating costs and contract terms of proposed sales. Please be aware that some landowners may request 60 days or more notice for access across their land.

Notice is hereby given that bids will be received by the Unit Manager, ESCANABA MANAGEMENT UNIT, for certain timber on the following described lands:

Engineer Maple (33-004-21) / T43N, R22W, SEC. 17, SWSE.

T43N, R22W, SEC. 20, SENW,N1/2NE,SWNE,N1/2SW.

Delta County, Advertised Price \$26,735.45, 81.2 Acres, Hardwood, Sugar Maple.

SALE NOTE: All units of volume listed for this sale were estimated using the Inventory Manager computer program and the new Michigan taper model.

See Sale Spec 4.4.1 for easier access to some Payment Units through private property.

Access may be through private land.

MAKOSKY MIX (33-006-21) / T38N, R24W, SEC. 26, SW.

T38N, R24W, SEC. 35, NW,NE,SW,NWSE.

Delta County, Advertised Price \$52,294.60, 146.0 Acres, Hardwood, Aspen.

SALE NOTE: All units of volume listed for this sale were estimated using the Inventory Manager computer program and the new Michigan taper model.

See Sale Spec 7.5.1 for forest health and harvesting due Emerald Ash Borer.

## BID INSTRUCTIONS (VER. 07/02/2018):

### 1. Scheduled Bid Location, Date, and Time (2/11)

Bids must be received by the Unit Manager, ESCANABA OFFICE, 6833 Hwy's 2, 41 & M-35, Gladstone, MI 49837, no later than 3:00 p.m. (local time) on October 27, 2021. For further information concerning this sale, contact Eric Thompson at 906-789-8231.

### 2. Bidder's Qualifications (5/16)

Purchaser shall obtain workers compensation insurance to cover claims under Michigan's Worker's Disability Compensation Act of 1969 or similar employee benefit act of any other state applicable to an employee. If all or part of a timber sale was prepared by a private contractor, the contractor and that contractor's company are not permitted to bid on the timber sale contract. Bids will not be accepted from individuals or companies appearing on the DNR/FRD No-Bid List. This list contains the names of purchasers who previously failed to execute a contract within 21-days or who have a history of poor performance.

### 3. Preparation of Sealed Bids (5/16)

Bid Forms may be completed online thru Michigan DNR Timber Sale Online Bidding (OLB) at [www.michigan.gov/timberbidding](http://www.michigan.gov/timberbidding) or by completing the hardcopy Bid Form found in the Timber Sale Prospectus. Hardcopy Bid Forms shall be manually signed in ink. Registration in OLB is considered your 'signature' for all bids submitted thru that system. Bid prices must be entered for each species and product in the Bid Price column for all material subject to bidding and all fill-in blanks must be completed. If erasures or other changes appear on the hardcopy Bid Form, each erasure or change must be initialed by the person signing the bid.

### 4. Submission of Sealed Bids (5/16)

Bid forms may be obtained from the Unit Manager or thru OLB. Bids may be submitted hardcopy or thru OLB. All hardcopy bids must be submitted on the bid form and in an envelope clearly identified as described in this section. NOTE: Only one bid form per bid envelope. Sealed bids must be submitted to the Unit office designated in the prospectus and must be submitted at or prior to the time established in the prospectus. The envelope should show on the outside (a) the sale name or number and (b) the date and time of bid opening, as shown in the prospectus. Bids received after the time specified in the sale prospectus are late bids and will be rejected.

It is possible for a bidder to submit multiple bids on a single sale. For example, a bid may be submitted hardcopy and a bid may be submitted thru OLB. Or, two bidders from the same company could both submit bids on the same sale. If this were to happen, the State would accept all bids received and award the contract accordingly. All bidding and contractual requirements would apply to all bids received.

### 5. Public Opening of Sealed Bids (7/16)

If conditions permit, the sealed bids will be publicly opened and posted at the time and place set in the prospectus.

If a bidder, present at a bid opening, has submitted bids on more than one sale, that bidder may withdraw their unopened bid envelopes or announce the withdrawal of their online bid after being declared the successful bidder on one sale.

### 6. Award of Contract (1/11)

Award of the contract will be made to the Bidder whose bid, conforming to the prospectus, is most advantageous to the State of Michigan on the basis of total value at rates bid for the estimated quantities. The State reserves the right to reject any bid or waive any minor irregularity in bids received. A written award mailed (or otherwise furnished) to the successful Bidder shall be deemed to result in a binding contract without further action by either party.

### 7. Down Payment (1/11)

The Bidder to whom award is made must make a down payment within 21 days of the sale award. The amount of the down payment will be calculated as shown in the Bond and Payment Schedule of this prospectus. Only cash may be used to meet this requirement.

### 8. Performance Security (1/11)

As guarantee of faithful performance, a cash bond, certificate of deposit, surety bond or irrevocable letter of credit (LOC) is required within 21 days of the sale award. The amount of the performance security is shown in the Bond and

Payment Schedule of this prospectus. If an LOC or surety is used, the coverage must extend for at least 6 months beyond the contract expiration.

#### 9. Timber Sale Contract (7/18)

Additional conditions and requirements common to all timber sales are listed on the timber sale contract (R4031) and are available on line at [www.michigan.gov/timber](http://www.michigan.gov/timber). Contact the Unit Manager for additional information or a sample contract. Within 21 days of the date of the award letter, the bidder must sign the contract and provide the required down payment, performance security, and verification of worker's disability compensation. The down payment and performance security shall be in accordance with the provisions of the timber sale contract, in the sums stated in this prospectus. If these actions are not taken, then the Bidder, the Bidder's corporation, and the corporation's principals may not be permitted to bid on State timber sales for a period of 3 months after the first offense, 6 months after the second offense, and 1 year after the third offense. An offense will only be counted against the Bidder for 5 years. In addition, the Bidder certifies that if awarded this contract, the Bidder will complete the timber sale contract in accordance with its terms and any modifications thereof including requirements to purchase, cut, and remove the included timber by the expiration date.

Payment Unit values in the State Forest Timber Sale Contract are calculated based on the advertised value of the Payment Unit as a percentage of the total advertised value of the contract. The advertised value of each Payment Unit is given in the Description of Timber by Payment Unit table on the Timber Sale Information page. For example, if the value of Payment Unit 1 is advertised as \$1,500 and the total Timber Sale value is advertised as \$10,000, the contract price for Payment Unit 1 will be 15% of the total bid price ( $\$1,500/\$10,000 * 100$ ).

#### 10. Disclaimer of Estimates and Bidder's Warranty of Inspection (7/16)

Before submitting this bid, the Bidder is advised and cautioned to inspect the sale area, review the requirements of the sale contract, and take other steps as may be reasonably necessary to ascertain the location, estimated volumes, construction estimates, and operating costs of the proposed sale. Failure to do so will not relieve the Bidder from responsibility for completing the contract.

The Bidder warrants that this bid is submitted solely on the basis of the Bidder's examination and inspection of the quality and quantity of the timber offered for sale and the Bidder's opinion of the value thereof and the costs of recovery. No reliance should be placed on the State of Michigan's estimates of timber quality, quantity or costs of recovery. Bidder further acknowledges that the State of Michigan: (i) expressly disclaims any warranty of fitness of timber for any purpose; (ii) offers this timber as is without any warranty of quality (merchantability) or quantity and (iii) expressly disclaims any warranty as to the quantity or quality of timber sold.

#### 11. Certification and Chain-of-Custody (10/14)

Unless otherwise indicated in the contract under section 7 – Other Conditions of the Sale Specific Conditions & Requirements, the area encompassed by this timber sale is certified to the standards of the Forest Stewardship Council (FSC) - Certificate #SCS-FM/COC-00090N and the Sustainable Forestry Initiative (SFI) - Certificate # NSF-SFIS-5Y031-SF5. Forest products from this sale may be delivered to the mill as "FSC 100% and / or SFI certified" as long as the contractor hauling the forest products is chain-of-custody (COC) certified or covered under a COC certificate from the destination mill. The purchaser is responsible for maintaining COC after leaving the sale area.

#### 12. Good Neighbor Authority (GNA) Requirements (7/16)

If the name of this timber sales contains the acronym GNA, it is authorized by the Good Neighbor Authority (GNA) and covered by various agreements between the U.S. Forest Service and the State. The timber sale occurs on federal land and the following conditions apply:

GNA contracts on US Forest Service land will not be awarded to purchasers on the Federal list of excluded parties. The System for Award Management (SAM) will be checked for active excluded parties prior to award of contract. In addition, the Bidder to whom award is made must complete an Assurance Regarding Felony Conviction or Tax Delinquent Status for Corporate Applicants (AD-3031).

#### 13. Good Neighbor Authority (GNA) Requirements, con't (9/16)

Bidder certifies, by signing this bid form, that to the best of Bidder's knowledge that the following representations are accurate and complete.

- a. That the Bidder and its principals are not presently debarred, suspended, proposed for debarment, declared ineligible, or voluntary excluded from timber sales (covered transactions) by any Federal department or agency.
- b. That the Bidder and its principals have not within a 3-year period preceding this bid been convicted of or had a civil judgment rendered against them for commission of fraud or a criminal offense in connection with obtaining , attempting to obtain, or performing a public (Federal, State, or local) transaction or contract under a public transaction; violation of Federal or State antitrust statutes or commission of embezzlement, theft, forgery, bribery, falsification or destruction of records, making false statements, or receiving stolen property.
- c. That the Bidder and its principals are not presently indicted for or otherwise criminally or civilly charged by a governmental entity (Federal, State, or local) with commission of any of the offenses enumerated in paragraph b of this certification.
- d. That the Bidder and its principals have not within a 3-year period preceding this bid had one or more public transactions (Federal, State, or local) terminated for breach or default of a timber or forest product contract.

Bidders that cannot certify this requirement, in whole or in part, shall submit an explanation with their bid.

DAN EICHINGER  
Director

## TIMBER SALE INFORMATION

### Engineer Maple (33-004-21)

T43N, R22W, SEC. 17; T43N, R22W, SEC. 20.  
Delta County (Advertised Price \$26,735.45)

SALE NOTE: All units of volume listed for this sale were estimated using the Inventory Manager computer program and the new Michigan taper model.

See Sale Spec 4.4.1 for easier access to some Payment Units through private property.

Access may be through private land.

A timber sale contract for this lump sum, sealed bid timber sale will be awarded to the responsible bidder offering the highest sealed bid price. All units of volume listed below were estimated using the Inventory Manager computer program and the new Michigan taper model. Bids must be at or above the following advertised price for each product and species:

<u>PRODUCTS &amp; SPECIES</u>	<u>ESTIMATED UNITS*</u>	<u>ADVERTISED PRICE</u>
<b>Sawtimber</b>		
Basswood	18.9 MBF	\$ 33.00 / MBF
Green Ash	2.4 MBF	\$ 31.00 / MBF
Paper Birch	0.9 MBF	\$ 56.00 / MBF
Red Maple	99.7 MBF	\$ 75.00 / MBF
Sugar Maple	36.7 MBF	\$ 114.00 / MBF
Yellow Birch	19.5 MBF	\$ 31.00 / MBF
<b>Pulpwood</b>		
Balsam Fir	54 Cords	\$ 12.70 / Cord
Mixed Hardwood	814 Cords	\$ 15.30 / Cord
Mixed Spruce	11 Cords	\$ 12.65 / Cord
Quaking Aspen	26 Cords	\$ 17.00 / Cord

\* The total volume is statistically estimated within plus (+) or minus (-) 9.65 percent. There are an estimated 1,437 cords on this timber sale, plus or minus 139 cords at the 95% confidence level. The estimated units are final and not subject to adjustment. Prospective bidders are urged to examine this timber and to make their own estimates of quantity and quality.

### **BOND AND PAYMENT SCHEDULE:**

1. A bond in the amount of \$1,337.00 to insure faithful performance of the conditions of the contract will be deposited by the successful bidder within 21 days of the sale award.
2. Cutting in any sale or unit without the required advance payment would be considered a trespass.
3. Total payment must be paid in advance or according to the following schedule :
  - (a) Ten percent (10%) of the sale value must be paid within 21 days of the sale award.
  - (b) The 10% down payment will be credited towards the first unit cut.
  - (c) Payment for each of the following units must be made before cutting begins in that unit:

PAYMENT UNIT NUMBER	PERCENT OF TOTAL SALE VALUE
01	19.3%
02	31.1%
03	21.9%
04	24.3%
05	3.4%

4. If no cutting takes place, the 10% down payment will not be refunded.

5. Operations on the contract issued will terminate on 09/30/2024.

### **SALE STATISTICS**

Volumes were calculated in cubic feet using the Michigan taper model. Cubic foot volume includes all wood inside bark for the product indicated. For display purposes, cubic feet were converted to cords and MBF using a simple conversion factor, e.g. 79 cubic feet per cord and 185 cubic feet per MBF. The cubic foot volumes are precise; the cords and MBF volumes are not. Cubic foot volume cannot be directly converted to cords or boards with precision.

## SALE VOLUMES

The total estimated sale volume may not equal the sum of the species/products due to the nature of statistical calculations associated with double sampling methodology.

VOLUME			STATISTICAL RANGE IN CORDS	
TOTAL CUBIC FEET	TOTAL CORDS	PERCENT ERROR	MINIMUM	MAXIMUM
113,517	1,437	9.65%	1,298	1,576

## VDU VOLUMES

A VDU is a Volume Determination Unit. Volumes and their associated statistics are calculated at the VDU level and summarized to the sale level. There is often a one to one relationship between a VDU and a Payment Unit, but not always, depending on the cruise design. Refer to the VDU TO PAYMENT UNIT table.

	VOLUME			RANGE IN CORDS	
VDU	TOTAL CUBIC FEET	TOTAL CORDS	PERCENT ERROR	MINIMUM	MAXIMUM
4	3,421	43	24.74%	33	54
18	35,821	453	12.47%	397	510
19	46,707	591	16.99%	491	692
23	13,631	173	18.78%	140	205
<b>TOTAL:</b>	<b>99,580</b>	<b>1,261</b>		<b>1,060</b>	<b>1,461</b>

## VDU TO PAYMENT UNIT

When a VDU is associated with more than one Payment Unit (PU), the VDU volumes are assigned to the PU based on acres of the VDU within the PU.

VDU	VDU ACRES	PU	PU ACRES
4	2.0	5	2.0
18	27.4	2	27.4
19	28.5	3	13.5
		4	15.0
23	23.3	1	23.3
<b>TOTAL:</b>	<b>81.2</b>		<b>81.2</b>

**DESCRIPTION OF TIMBER BY PAYMENT UNIT (PU)**

PU	MARKET GROUP	PRODUCT	QUANTITY	UNIT	ACRES	ADVERTISE PRICE
1	Basswood	Sawtimber	8.2	MBF	23.3	\$5,170.80
	Sugar Maple		30.1	MBF		
	Mixed Hardwood	Pulpwood	96	Cords		
	<i>Basswood</i>		4	<i>Cords</i>		
	<i>Red Maple</i>		8	<i>Cords</i>		
	<i>Sugar Maple</i>		84	<i>Cords</i>		
2	Basswood	Sawtimber	10.7	MBF	27.4	\$8,300.25
	Red Maple		26.0	MBF		
	Sugar Maple		2.6	MBF		
	Balsam Fir	Pulpwood	24	Cords		
	Mixed Hardwood		318	Cords		
	<i>Basswood</i>		5	<i>Cords</i>		
	<i>Black Ash</i>		30	<i>Cords</i>		
	<i>Green Ash</i>		7	<i>Cords</i>		
	<i>Paper Birch</i>		8	<i>Cords</i>		
	<i>Red Maple</i>		214	<i>Cords</i>		
	<i>Sugar Maple</i>		34	<i>Cords</i>		
	<i>Yellow Birch</i>		20	<i>Cords</i>		
	Mixed Spruce		7	Cords		
	<i>Black Spruce</i>		7	<i>Cords</i>		
	Quaking Aspen		26	Cords		
3	Green Ash	Sawtimber	1.1	MBF	13.5	\$5,859.00
	Red Maple		32.7	MBF		
	Sugar Maple		1.9	MBF		
	Yellow Birch		9.2	MBF		
	Balsam Fir	Pulpwood	14	Cords		
	Mixed Hardwood		176	Cords		
	<i>Green Ash</i>		2	<i>Cords</i>		
	<i>Paper Birch</i>		9	<i>Cords</i>		
	<i>Red Maple</i>		146	<i>Cords</i>		
	<i>Sugar Maple</i>		5	<i>Cords</i>		
	<i>Yellow Birch</i>		14	<i>Cords</i>		
4	Green Ash	Sawtimber	1.3	MBF	15.0	\$6,508.20
	Red Maple		36.3	MBF		
	Sugar Maple		2.1	MBF		
	Yellow Birch		10.3	MBF		
	Balsam Fir	Pulpwood	16	Cords		
	Mixed Hardwood		195	Cords		
	<i>Green Ash</i>		2	<i>Cords</i>		
	<i>Paper Birch</i>		9	<i>Cords</i>		
	<i>Red Maple</i>		163	<i>Cords</i>		
	<i>Sugar Maple</i>		6	<i>Cords</i>		
	<i>Yellow Birch</i>		15	<i>Cords</i>		
5	Paper Birch	Sawtimber	0.9	MBF	2.0	\$897.20
	Red Maple		4.7	MBF		
	Mixed Hardwood	Pulpwood	29	Cords		
	<i>Paper Birch</i>		8	<i>Cords</i>		
	<i>Red Maple</i>		21	<i>Cords</i>		
	Mixed Spruce		4	Cords		
<i>White Spruce</i>	4	<i>Cords</i>				
TOTAL:			178.1	MBF		
TOTAL:			905	Cords		

# Sale Specific Conditions & Requirements

**Sale Name: Engineer Maple**

**Sale Number: 33-004-21 Seq#: 1**

## 1 - Sale Area

### 1.2 - Boundaries

#### 1.2.1 - Painted boundaries (9/19)

The sale boundary and Payment Unit boundaries are marked and identified by blue, red, and yellow paint. Exterior sale boundary lines against private property are marked with blue paint. Exterior sale boundary lines against state are marked with red paint. Interior Payment Unit boundaries are marked with yellow paint. Retention patches are marked with red paint; no harvesting activities may occur within these areas. The painted boundary line trees are not Included Timber and are to be protected unless marked with orange paint. Yellow painted trees designating an interior Payment Unit boundary are only to be cut when all surrounding Payment Units have been paid.

## 2 - Timber Specifications

### 2.1 - Included Timber

#### 2.1.1 - Clearcut unit(s) with unmerchantable trees (6/14)

Within Payment Unit(s) 2 and 5, cut all trees that are three (3) inches or more at DBH, except northern white cedar. In addition, within Payment Unit 2 leave all trees marked with green paint above and below stump height.

#### 2.1.3 - Cut tree marked unit(s) (12/08)

Within Payment Unit(s) 1, all trees are designated for cutting when marked with orange paint above and below stump height, regardless of merchantability.

#### 2.1.7 - Leave tree marked unit(s) (6/14)

Within Payment Unit(s) 3 and 4, cut all trees that are three (3) inches or more at DBH, except northern white cedar and trees marked with green paint above and below stump height.

## 3 - Payments

### 3.3 - Pre-measured Sales

#### 3.3.4 - Dividing payment units (7/14)

Payment Unit(s) with a contract bid value of \$18,000 or greater may be divided at the request of the Purchaser and upon approval of the Unit Manager. Dividing Payment Units is a contract modification which requires a Timber Sale Contract Amendment.

## 4 - Transportation

### 4.1 - Construction

#### 4.1.7 - Road closure (10/11)

All new roads built into the sale must be blocked to vehicle traffic upon completion of the sale. Overgrown roads that are reopened shall be considered new roads. In general, this will require constructing double earthen berms at strategic locations. These roads must be rendered impassable to cars and trucks. Contact the sale administrator for specific details of design and placement.

### 4.2 - Maintenance

#### 4.2.2 - Fill material (4/07)

To maintain roads, fill material may be needed in areas where "holes" exist or may be expected to develop. This fill material should be placed before trucking begins. Contact the sale administrator regarding the availability of onsite sand or gravel from adjacent State-owned lands.

#### 4.2.4 - Grading (10/16)

For completion of the sale, state forest roads must be graded. In general, this will require a road grader or bulldozer to shape up the roads after forest products have been hauled off site. This includes cleaning of drainage areas, grading, crowning, and filling with gravel, if necessary. The grading equipment to be used must be approved by the Unit Manager or his/her



representative.

#### 4.4 - Access

##### 4.4.1 - Private property access (3/11)

Permission for access across private land is the responsibility of the Purchaser.

### 5 - Operations

#### 5.2 - Conduct of Operations

##### 5.2.2 - Hazard Trees/Snags

###### 5.2.2.1 - Den trees (10/16)

Obvious hollow and/or den trees shall be protected and left standing unless they are a safety hazard.

##### 5.2.3 - Operating Restrictions

###### 5.2.3.2 - Operating restrictions (9/11)

Within Payment Unit(s) 3-5, unless changed by written agreement, cutting, skidding, and hauling are limited to the period of December 1 to March 31, or dry summer or frozen winter conditions. This restriction is because access is through low wet ground.

###### 5.2.3.3 - Bark slippage restriction (3/09)

Within Payment Unit(s) 1, unless changed by written agreement, cutting and skidding are not permitted during the period of April 15 to July 15. This restriction is because of bark slippage.

##### 5.2.38 - No decking against live trees (2/04)

Cut products may not be decked against unmarked or designated leave trees.

#### 5.4 - Soil Protection

##### 5.4.1 - Rutting restriction, general (7/16)

Operations are to cease immediately if equipment and weather conditions result in rutting of roads and/or skid trails which is 12 inches or greater in depth and 50 feet in length. The Unit Manager or his/her representative may restrict hauling and/or skidding if ruts exceed the specified depth. With the Unit Manager or his/her representative's approval, the Purchaser may return to the area when the risk of rutting has decreased.

#### 5.8 - Protection of Endangered Species

##### 5.8.5 - Protection of raptor nests (3/13)

All trees with raptor nests will be protected if found during harvesting operations. Notification will be made to the Unit Manager or his/her representative who will notify the Wildlife Biologist so an on-site evaluation and recommendation can be made, if necessary.

### 6 - Safety and Fire Prevention

#### 6.2 - Signing

##### 6.2.1 - Road posting (10/20)

The Purchaser is responsible for posting and maintaining caution signs on the Engineer Road and County Road 432 prior to beginning operations. The road must be posted at appropriate distances from the Sale Area to warn of logging activity and truck traffic. Signs must be removed when harvest operations are suspended or completed. The Purchaser will provide these signs.



Sale Number	Year
33 - 004	21

# TIMBER SALE MAP

This information provided by authority of Part 525, 1994 PA 451 as amended.

Forest Management Unit Escanaba	County Delta	Mapped By Urlich	Date 05/06/2021	Page 1	of 1
Township 43N	Range 22W	Section(s) and Subdivision(s) SWSE Sec.17, SENW,N1/2NE,SWNE,N1/2SW Sec.20	Scale 1:7,920		

Cover Type				Density	
A = Aspen	H = Hemlock	N = Marsh	U = Upland Brush	0 = Non Stocked	5 = Pole Timber Medium
B = Paper Birch	J = Jack Pine	O = Oak	UM = Upland Mixed	1 = Seedling Sapling Poor	6 = Pole Timber Well
C = Cedar	L = Lowland Brush	P = Lowland Poplar	V = Bog or Marsh	2 = Seedling Sapling Medium	7 = Saw Timber Poor
D = Treed Bog	LM = Lowland Mixed	Q = Mixed Swamp Conifer	W = White Pine	3 = Seedling Sapling Well	8 = Saw Timber Medium
E = Swamp Hardwoods	M = Mpl. Ech. Birch	R = Red Pine	X = Non Stocked	4 = Pole Timber Poor	9 = Saw Timber Well
F = Spruce Fir	MC = Mixed Conifer	S = Black Spruce	Z = Water		
G = Cress	MD = Mixed Deciduous	T = Tamarack			

PU	Acres	PU	Acres
1	23.3	4	15
2	27.4	5	2
3	13.5		

## Engineer Maple

### Compartment 98

81.2 Acres



### Legend

- Primary Forest Road
- Forest Access Route
- Gravel Road
- Private
- Against State (Red)
- Payment Unit (Yellow)
- Private Line (Blue)
- Section Corners
- Retention Area

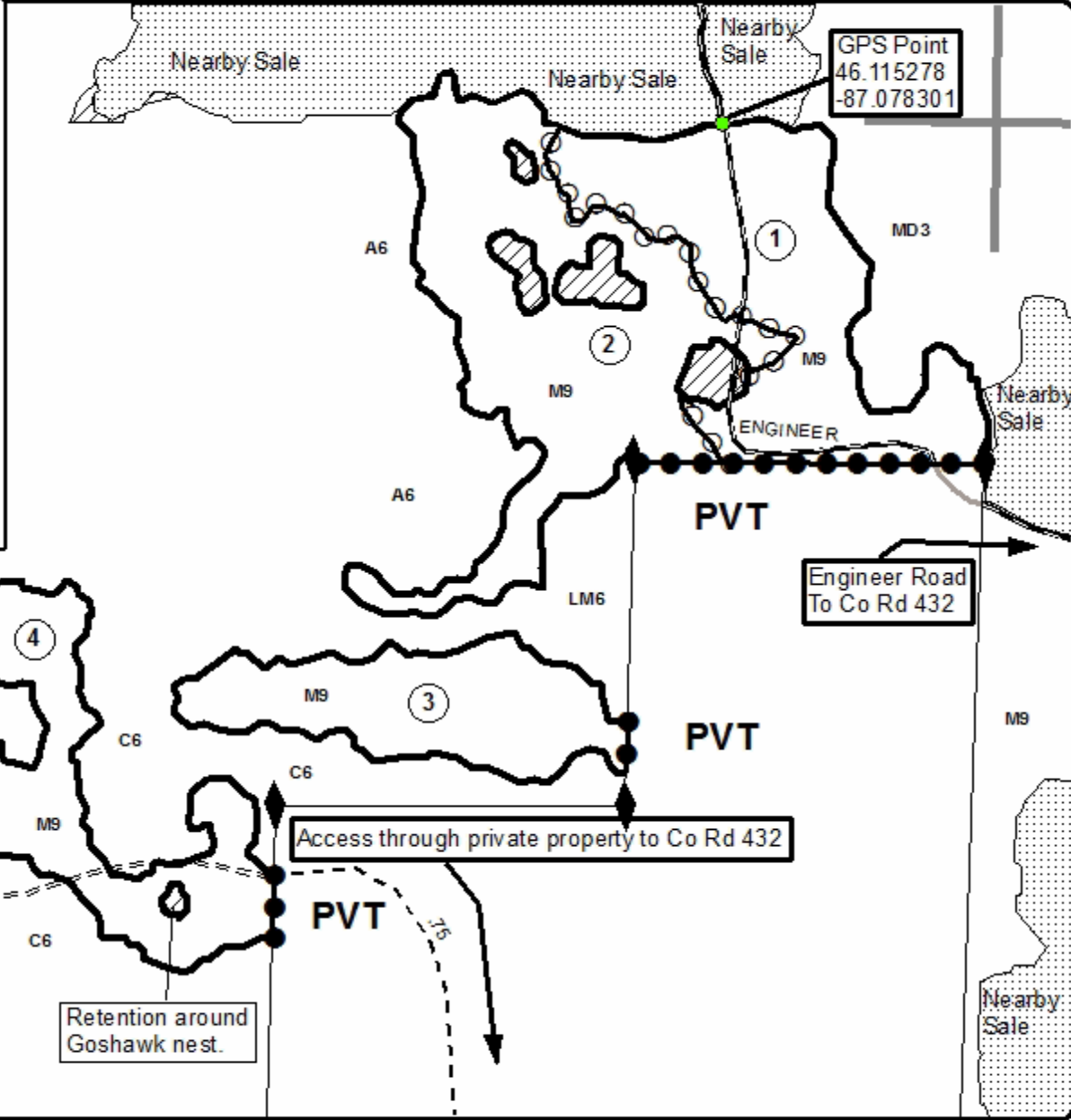

## TIMBER SALE INFORMATION

### MAKOSKY MIX (33-006-21)

T38N, R24W, SEC. 26; T38N, R24W, SEC. 35.  
Delta County (Advertised Price \$52,294.60)

SALE NOTE: All units of volume listed for this sale were estimated using the Inventory Manager computer program and the new Michigan taper model.

See Sale Spec 7.5.1 for forest health and harvesting due Emerald Ash Borer.

A timber sale contract for this lump sum, sealed bid timber sale will be awarded to the responsible bidder offering the highest sealed bid price. All units of volume listed below were estimated using the Inventory Manager computer program and the new Michigan taper model. Bids must be at or above the following advertised price for each product and species:

<u>PRODUCTS &amp; SPECIES</u>	<u>ESTIMATED UNITS*</u>	<u>ADVERTISED PRICE</u>
<b>Sawtimber</b>		
Black Ash	5.0 MBF	\$ 22.00 / MBF
Green Ash	34.7 MBF	\$ 30.00 / MBF
Paper Birch	11.5 MBF	\$ 56.00 / MBF
Red Maple	61.0 MBF	\$ 75.00 / MBF
Yellow Birch	4.7 MBF	\$ 28.00 / MBF
<b>Pulpwood</b>		
Balsam Fir	483 Cords	\$ 12.70 / Cord
Hemlock	51 Cords	\$ 12.70 / Cord
Mixed Aspen	803 Cords	\$ 17.00 / Cord
Mixed Hardwood	1,512 Cords	\$ 15.30 / Cord
Red Pine	5 Cords	\$ 42.60 / Cord
White Pine	32 Cords	\$ 18.65 / Cord
White Spruce	112 Cords	\$ 12.65 / Cord

\* The total volume is statistically estimated within plus (+) or minus (-) 5.11 percent. There are an estimated 4,242 cords on this timber sale, plus or minus 217 cords at the 95% confidence level. The estimated units are final and not subject to adjustment. Prospective bidders are urged to examine this timber and to make their own estimates of quantity and quality.

### **BOND AND PAYMENT SCHEDULE:**

1. A bond in the amount of \$2,615.00 to insure faithful performance of the conditions of the contract will be deposited by the successful bidder within 21 days of the sale award.
2. Cutting in any sale or unit without the required advance payment would be considered a trespass.
3. Total payment must be paid in advance or according to the following schedule :
  - (a) Ten percent (10%) of the sale value must be paid within 21 days of the sale award.
  - (b) The 10% down payment will be credited towards the first unit cut.
  - (c) Payment for each of the following units must be made before cutting begins in that unit:

PAYMENT UNIT NUMBER	PERCENT OF TOTAL SALE VALUE
01	9.6%
02	5.2%
03	7.3%
04	1.0%
05	6.9%
06	2.9%
07	17.3%
08	28.1%
09	19.8%
10	1.9%

4. If no cutting takes place, the 10% down payment will not be refunded.
5. Operations on the contract issued will terminate on 12/31/2025.

### **SALE STATISTICS**

Volumes were calculated in cubic feet using the Michigan taper model. Cubic foot volume includes all wood inside bark for the product indicated. For display purposes, cubic feet were converted to cords and MBF using a simple conversion factor, e.g. 79 cubic feet per cord and 185 cubic feet per MBF. The cubic foot volumes are precise; the cords and MBF volumes are not. Cubic foot volume cannot be directly converted to cords or boards with precision.

### SALE VOLUMES

The total estimated sale volume may not equal the sum of the species/products due to the nature of statistical calculations associated with double sampling methodology.

VOLUME			STATISTICAL RANGE IN CORDS	
TOTAL CUBIC FEET	TOTAL CORDS	PERCENT ERROR	MINIMUM	MAXIMUM
335,110	4,242	5.11%	4,025	4,459

### VDU VOLUMES

A VDU is a Volume Determination Unit. Volumes and their associated statistics are calculated at the VDU level and summarized to the sale level. There is often a one to one relationship between a VDU and a Payment Unit, but not always, depending on the cruise design. Refer to the VDU TO PAYMENT UNIT table.

VDU	VOLUME			RANGE IN CORDS	
	TOTAL CUBIC FEET	TOTAL CORDS	PERCENT ERROR	MINIMUM	MAXIMUM
4	236,268	2,991	6.20%	2,805	3,176
31	25,410	322	15.29%	272	371
46	4,855	61	24.77%	46	77
49	18,635	236	17.31%	195	277
56	19,090	242	18.97%	196	288
79	13,217	167	23.44%	128	207
<b>TOTAL:</b>	<b>317,474</b>	<b>4,019</b>		<b>3,643</b>	<b>4,394</b>

### VDU TO PAYMENT UNIT

When a VDU is associated with more than one Payment Unit (PU), the VDU volumes are assigned to the PU based on acres of the VDU within the PU.

VDU	VDU ACRES	PU	PU ACRES
4	82.9	6	3.6
		7	21.0
		8	34.2
		9	24.1
31	21.4	1	21.4
46	8.7	10	8.7
49	16.5	3	14.5
		4	2.0
56	8.4	5	8.4
79	8.1	2	8.1
<b>TOTAL:</b>	<b>146.0</b>		<b>146.0</b>

**DESCRIPTION OF TIMBER BY PAYMENT UNIT (PU)**

PU	MARKET GROUP	PRODUCT	QUANTITY	UNIT	ACRES	ADVERTISE PRICE	
1	Paper Birch	Sawtimber	2.6	MBF	21.4	\$5,030.00	
	Red Maple		4.2	MBF			
	Yellow Birch		1.1	MBF			
	Balsam Fir		Pulpwood	58			Cords
	Mixed Aspen			9			Cords
	<i>Quaking Aspen</i>			9			<i>Cords</i>
	Mixed Hardwood			223			Cords
	<i>Beech</i>			5			<i>Cords</i>
	<i>Black Ash</i>			5			<i>Cords</i>
	<i>Green Ash</i>			4			<i>Cords</i>
	<i>Paper Birch</i>			91			<i>Cords</i>
	<i>Red Maple</i>			117			<i>Cords</i>
	<i>Yellow Birch</i>			1			<i>Cords</i>
	White Pine		10	Cords			
White Spruce	4	Cords					
2	Paper Birch	Sawtimber	4.5	MBF	8.1	\$2,701.85	
	Red Maple		1.2	MBF			
	Balsam Fir		Pulpwood	16			Cords
	Mixed Aspen			5			Cords
	<i>Quaking Aspen</i>			5			<i>Cords</i>
	Mixed Hardwood			126			Cords
	<i>Paper Birch</i>			43			<i>Cords</i>
	<i>Red Maple</i>			83			<i>Cords</i>
	White Pine			5			Cords
	White Spruce			4			Cords
	3			Black Ash			Sawtimber
Paper Birch		2.0		MBF			
Red Maple		16.3	MBF				
Balsam Fir		Pulpwood	10	Cords			
Mixed Hardwood			135	Cords			
<i>Black Ash</i>			47	<i>Cords</i>			
<i>Paper Birch</i>			7	<i>Cords</i>			
<i>Red Maple</i>			81	<i>Cords</i>			
White Spruce			22	Cords			
4			Black Ash	Sawtimber	0.2	MBF	
	Paper Birch		0.3		MBF		
	Red Maple	2.2	MBF				
	Balsam Fir	Pulpwood	1		Cords		
	Mixed Hardwood		19		Cords		
	<i>Black Ash</i>		7		<i>Cords</i>		
	<i>Paper Birch</i>		1		<i>Cords</i>		
	<i>Red Maple</i>		11		<i>Cords</i>		
	White Spruce		3		Cords		
	5		Balsam Fir		Pulpwood	47	Cords
Mixed Aspen			59	Cords			
<i>Quaking Aspen</i>		59	<i>Cords</i>				
Mixed Hardwood		112	Cords				
<i>Black Ash</i>		18	<i>Cords</i>				
<i>Paper Birch</i>		20	<i>Cords</i>				
<i>Red Maple</i>		74	<i>Cords</i>				
White Spruce		25	Cords				
6	Black Ash	Sawtimber	0.1	MBF	3.6	\$1,533.20	
	Green Ash		1.5	MBF			
	Paper Birch		0.1	MBF			
	Red Maple		1.6	MBF			
	Yellow Birch		0.2	MBF			

**DESCRIPTION OF TIMBER BY PAYMENT UNIT (PU), CON'T**

PU	MARKET GROUP	PRODUCT	QUANTITY	UNIT	ACRES	ADVERTISE PRICE
6 con't	Balsam Fir	Pulpwood	15	Cords		
	Mixed Aspen		31	Cords		
	<i>Balsam Poplar</i>		7	<i>Cords</i>		
	<i>Quaking Aspen</i>		24	<i>Cords</i>		
	Mixed Hardwood		40	Cords		
	<i>Black Ash</i>		5	<i>Cords</i>		
	<i>Green Ash</i>		13	<i>Cords</i>		
	<i>Paper Birch</i>		1	<i>Cords</i>		
	<i>Red Maple</i>		20	<i>Cords</i>		
	<i>Yellow Birch</i>		1	<i>Cords</i>		
	White Spruce		2	Cords		
7	Black Ash	Sawtimber	0.8	MBF	21.0	\$9,036.55
	Green Ash		8.8	MBF		
	Paper Birch		0.5	MBF		
	Red Maple		9.4	MBF		
	Yellow Birch		0.9	MBF		
	Balsam Fir	Pulpwood	89	Cords		
	Mixed Aspen		185	Cords		
	<i>Balsam Poplar</i>		43	<i>Cords</i>		
	<i>Quaking Aspen</i>		142	<i>Cords</i>		
	Mixed Hardwood		228	Cords		
	<i>Black Ash</i>		28	<i>Cords</i>		
	<i>Green Ash</i>		75	<i>Cords</i>		
	<i>Paper Birch</i>		4	<i>Cords</i>		
	<i>Red Maple</i>		116	<i>Cords</i>		
	<i>Yellow Birch</i>		5	<i>Cords</i>		
	White Pine		3	Cords		
	White Spruce		14	Cords		
8	Black Ash	Sawtimber	1.3	MBF	34.2	\$14,674.95
	Green Ash		14.3	MBF		
	Paper Birch		0.9	MBF		
	Red Maple		15.3	MBF		
	Yellow Birch		1.5	MBF		
	Balsam Fir	Pulpwood	145	Cords		
	Mixed Aspen		302	Cords		
	<i>Balsam Poplar</i>		70	<i>Cords</i>		
	<i>Quaking Aspen</i>		232	<i>Cords</i>		
	Mixed Hardwood		368	Cords		
	<i>Black Ash</i>		45	<i>Cords</i>		
	<i>Green Ash</i>		121	<i>Cords</i>		
	<i>Paper Birch</i>		6	<i>Cords</i>		
	<i>Red Maple</i>		187	<i>Cords</i>		
	<i>Yellow Birch</i>		9	<i>Cords</i>		
	White Pine		5	Cords		
	White Spruce		22	Cords		
9	Black Ash	Sawtimber	0.9	MBF	24.1	\$10,345.45
	Green Ash		10.1	MBF		
	Paper Birch		0.6	MBF		
	Red Maple		10.8	MBF		
	Yellow Birch		1.0	MBF		
	Balsam Fir	Pulpwood	102	Cords		
	Mixed Aspen		212	Cords		
	<i>Balsam Poplar</i>		49	<i>Cords</i>		
	<i>Quaking Aspen</i>		163	<i>Cords</i>		
	Mixed Hardwood		261	Cords		
	<i>Black Ash</i>		32	<i>Cords</i>		

**DESCRIPTION OF TIMBER BY PAYMENT UNIT (PU), CON'T**

PU	MARKET GROUP	PRODUCT	QUANTITY	UNIT	ACRES	ADVERTISE PRICE
9 con't	<i>Green Ash</i>	<i>Pulpwood</i>	86	<i>Cords</i>		
	<i>Paper Birch</i>		4	<i>Cords</i>		
	<i>Red Maple</i>		133	<i>Cords</i>		
	<i>Yellow Birch</i>		6	<i>Cords</i>		
	White Pine		3	Cords		
	White Spruce		16	Cords		
10	Hemlock	Pulpwood	51	Cords	8.7	\$972.60
	Red Pine		5	Cords		
	White Pine		6	Cords		
TOTAL:			116.9	MBF		
TOTAL:			2,998	Cords		

# Sale Specific Conditions & Requirements

**Sale Name: MAKOSKY MIX**

**Sale Number: 33-006-21 Seq#: 1**

## 1 - Sale Area

### 1.2 - Boundaries

#### 1.2.1 - Painted boundaries (9/19)

The sale boundary and Payment Unit boundaries are marked and identified by blue, red, and yellow paint. Exterior sale boundary lines against private property are marked with blue paint. Exterior sale boundary lines against state are marked with red paint. Interior Payment Unit boundaries are marked with yellow paint. Retention patches are marked with red paint; no harvesting activities may occur within these areas. The painted boundary line trees are not Included Timber and are to be protected unless marked with orange paint. Yellow painted trees designating an interior Payment Unit boundary are only to be cut when all surrounding Payment Units have been paid.

## 2 - Timber Specifications

### 2.1 - Included Timber

#### 2.1.1 - Clearcut unit(s) with unmerchantable trees (6/14)

Within Payment Unit(s) 5-9, cut all trees that are three (3) inches or more at DBH with the following exceptions:

- Within Payment Unit 5: do not cut any hemlock.
- Within Payment Unit 6-9: do not cut any cedar except those cedar trees identified in cutting specification 2.1.9.

#### 2.1.2 - Clearcut unit(s) w/o unmerchantable trees (8/11)

Within Payment Unit(s) 1-4, cut all trees which meet minimum piece specifications in 2.2 Utilization with the following exceptions:

- Within Payment Unit 1 and 2 do not cut any hemlock trees.
- Within Payment Unit 3 and 4 do not cut any hemlock and/or cedar trees.

#### 2.1.4 - Designated timber unit(s) (6/17)

Within Payment Unit(s) 10, all trees are designated for cutting which meet minimum piece specifications in 2.2 - Utilization regardless of merchantability except, pine and hemlock trees are only designated for cutting when marked with orange paint above and below stump height.

#### 2.1.9 - Harvest exception (12/08)

Do not cut any cedar trees within Payment Units 6-10 other than those that are necessary to remove in order to operate within the sale area. Every effort must be made to preserve the existing cedar and to leave an intact stand upon sale completion. All cut cedar shall be piled separately by products and scaled in the woods unless other scaling arrangements are agreed to by the Unit Manager or his/her representative. Stumpage price for cedar shall be \$50.00 per cord for posts and pulpwood, and \$100.00 per cord for bolts and sawlogs.

#### 2.1.11 - Description of timber note (2/04)

Note that mixed hardwood pulpwood volume consists of balm, red maple, black ash, green ash, paper birch, yellow birch and beech.

## 3 - Payments

### 3.3 - Pre-measured Sales

#### 3.3.4 - Dividing payment units (7/14)

Payment Unit(s) with a bid value of \$18,000 dollars or greater may be divided at the request of the Purchaser and upon approval of the Unit Manager. Dividing Payment Units is a contract modification which requires a Timber Sale Contract Amendment. There will be only one division per Payment Unit.

### 3.4 - Damaged Timber

#### 3.4.1 - Damaged timber (7/16)

General Condition and Requirement 3.4 Damaged Timber, defines liquidated damages for undesignated live merchantable trees which are cut or injured. In addition, within Payment Unit 10 extreme care should be taken to avoid damage to tree



seedlings and saplings.

Within the Sale Area, if more than 25% percent of the tree seedlings or saplings 1/4" to 4.5" DBH within a specified portion of the Sale Area are damaged, liquidated damages will be assessed at 100 dollars per acre for all acreage within that specified portion of the Sale Area that was damaged.

#### **4 - Transportation**

##### 4.1 - Construction

###### 4.1.1 - Stream crossings, general (3/11)

All stream crossing structures will be temporary and therefore, shall be provided by the Purchaser, and must be removed upon completion of the sale. All permits for stream crossings will be provided by the DNR.

###### 4.1.5 - Culverts (5/14)

Roads may require the installation of culverts for cross drainage or at natural drainage-ways. If culverts are needed in these locations, their placement will be specified by the sale administrator, and they shall be installed prior to hauling. The culverts shall be new, corrugated metal. Culverts will be a minimum of 18 inches in diameter and 24 feet in length. If culverts are removed, fill shall be removed from wetland soils as specified. Soils shall be maintained and left in a non-erodible condition, with water bars, seed, fertilizer, mulch, and slash installed as directed by the sale administrator and as specified in the BMP manual. Stream crossing permits, if needed, will be obtained by the DNR.

###### 4.1.6 - Road construction (1/09)

Construction of new roads or improvements of existing roads shall be done in such a way as to minimize the environmental and visual impacts. Merchantable trees shall be cut and utilized unless otherwise directed. Non-merchantable trees shall be severed and laid flat on the ground. Slash shall be scattered, and not left in windrows and kept a minimum of 10 feet back from the road edge. Stumps shall be set upright, not left on edge, and be moved at least 10 feet away from the road edge. Disturbed soil shall be feathered into the woods and not left in berms or windrows.

###### 4.1.7 - Road closure (10/11)

All new roads built into the sale must be blocked to vehicle traffic upon completion of the sale. Overgrown roads that are reopened shall be considered new roads. In general, this will require constructing a four (4') foot high berm of stumps and logs covered with earth. Stumps and brush must be placed along the remainder of the trail. These roads must be rendered impassable to cars and trucks. Contact the sale administrator for specific details of design and placement.

##### 4.2 - Maintenance

###### 4.2.1 - Hauling restriction (12/08)

Hauling may be restricted on forest roads by the Unit Manager or his/her representative. The restriction may occur during spring break up and may occur during wet weather conditions.

###### 4.2.2 - Fill material (4/07)

To maintain roads, fill material may be needed in areas where "holes" exist or may be expected to develop. This fill material should be placed before trucking begins. Contact the sale administrator regarding the availability of onsite sand or gravel from adjacent State-owned lands.

###### 4.2.4 - Grading (10/16)

For completion of the sale, state forest roads must be graded. In general, this will require a road grader or bulldozer to shape up the roads after forest products have been hauled off site. This includes cleaning of drainage areas, grading, crowning, and filling with gravel, if necessary. The grading equipment to be used must be approved by the Unit Manager or his/her representative.

###### 4.2.5 - Two wheel drive condition (2/04)

All existing trail roads on and adjacent to the sale area must be passable by two-wheel drive traffic for the duration of the sale.

#### **5 - Operations**

##### 5.2 - Conduct of Operations

###### 5.2.2 - Hazard Trees/Snags

#### 5.2.2.1 - Den trees (10/16)

Obvious hollow and/or den trees shall be protected and left standing unless they are a safety hazard.

#### 5.2.3 - Operating Restrictions

##### 5.2.3.1 - Operating restrictions (9/11)

Within Payment Unit(s) 3 and 6-9, unless changed by written agreement, cutting, skidding, and hauling are limited to the period of December 1 to March 31. This restriction is because of low and wet ground conditions within the Payment Unit and low ground access to Payment Unit 3.

##### 5.2.3.2 - Operating restrictions (9/11)

Within Payment Unit(s) 10, unless changed by written agreement, cutting, skidding, and hauling are limited to the period of July 1 to December 1. This restriction is because the ground needs to be scarified during non-bark slippage time period.

#### 5.2.22 - Operating Caution

##### 5.2.22.1 - Operating caution (6/11)

It is recommended, but not required, that within Payment Unit(s) 4, cutting, skidding, and hauling occur during frozen winter conditions. The reason for the recommendation is because the Payment Unit and access have low and wet ground.

#### 5.4 - Soil Protection

##### 5.4.1 - Rutting restriction, general (7/16)

Operations are to cease immediately if equipment and weather conditions result in rutting of roads and/or skid trails which is 12 inches or greater in depth and 50 feet in length. The Unit Manager or his/her representative may restrict hauling and/or skidding if ruts exceed the specified depth. With the Unit Manager or his/her representative's approval, the Purchaser may return to the area when the risk of rutting has decreased.

### 7 - Other Conditions

#### 7.5 - Loss

##### 7.5.1 - Deteriorating timber (7/09)

The sale area has received damage from Emerald Ash Borer (EAB). The Purchaser should harvest the wood as soon as possible. The Department of Natural Resources is held free of responsibility of any further damage or deterioration due to delay in harvesting.



# TIMBER SALE MAP

This information provided by authority of Part 525, 1994 PA 451, as amended.

Forest Management Unit Escanaba	County Delta	Mapped By Racine	Date 07/02/2021	Page 1	of 1
Township 38N	Range 24W	Section(s) and Subdivision(s) 26) SW 35) NW,NE,SW,NWSE	Scale 1:15,840		

Cover Type				Density	
A = Aspen	H = Hemlock	N = Marsh	U = Upland Brush	0 = Non Stocked	5 = Pole Timber Medium
B = Paper Birch	J = Jack Pine	O = Oak	UM = Upland Mixed	1 = Seedling Sapling Poor	6 = Pole Timber Well
C = Cedar	L = Lowland Brush	P = Lowland Poplar	V = Bog or Marsh	2 = Seedling Sapling Medium	7 = Saw Timber Poor
D = Treed Bog	LM = Lowland Mixed	Q = Mixed Swamp Conifer	W = White Pine	3 = Seedling Sapling Well	8 = Saw Timber Medium
E = Swamp Hdwoods	M = Mpl, Bch, Brch	R = Red Pine	X = Non Stocked	4 = Pole Timber Poor	9 = Saw Timber Well
F = Spruce Fir	MC = Mixed Conifer	S = Black Spruce	Z = Water		
G = Grass	MD = Mixed Deciduous	T = Tamarack			



## MAKOSKY MIX

### Compartment 081

146 Acres

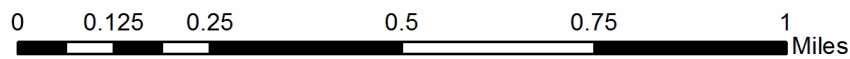
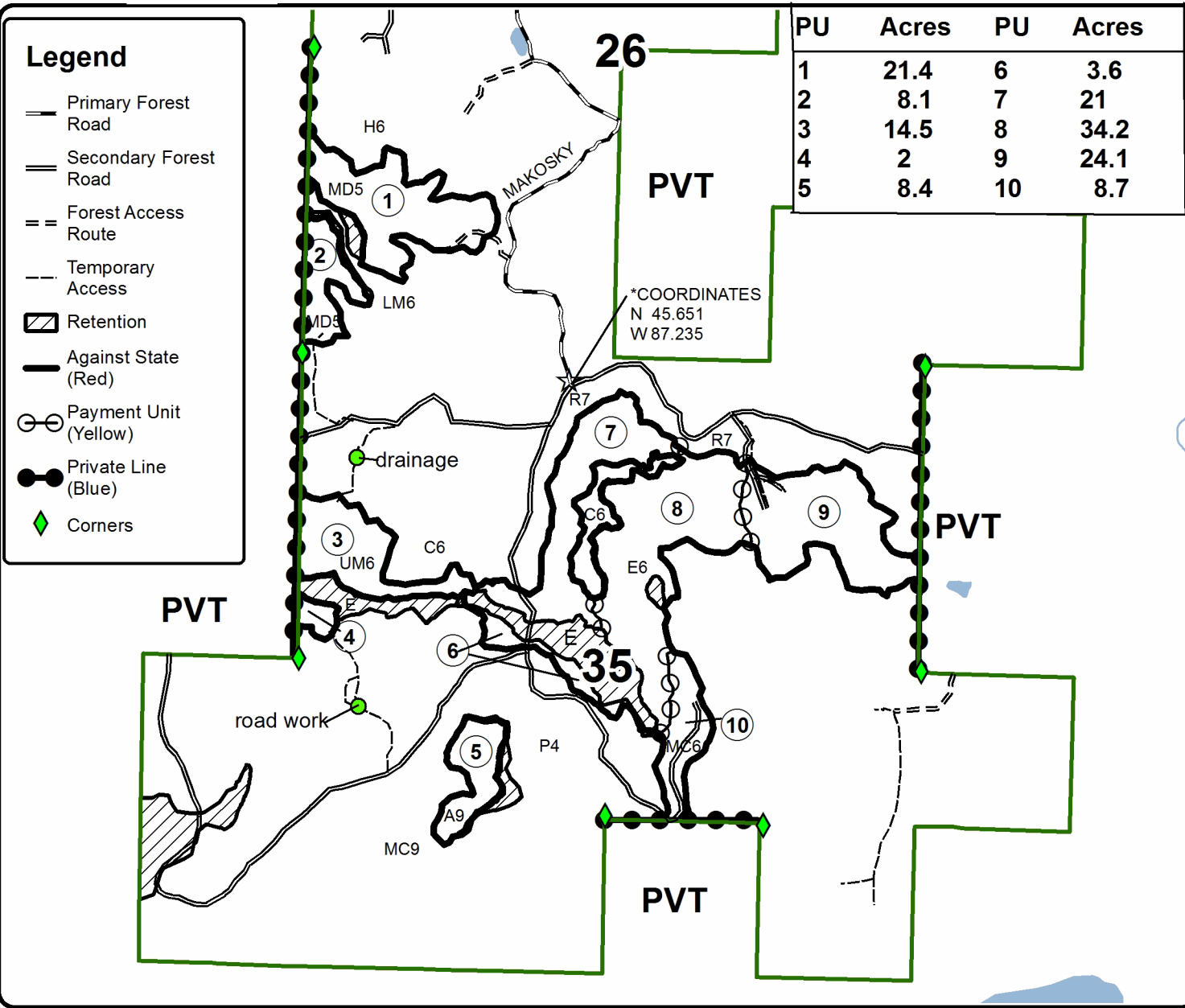



Engineer Maple (33-004-21)  
T43N, R22W, SEC. 17; T43N, R22W, SEC. 20; Delta COUNTY

In response to the notice of sale to be held 3:00 p.m. (local time) on October 27, 2021, I am hereby submitting my sealed bid (firm offer) for the following forest products to be cut. Bids for individual species must be at or above the advertised price. All non-responsive bid forms may be rejected.

<u>PRODUCTS &amp; SPECIES</u>	<u>ESTIMATED VOLUME*</u>	<u>ADVERTISED PRICE</u>	<u>BID PRICE/UNIT</u>
<b>Sawtimber</b>			
Basswood	18.9 MBF	\$ 33.00/MBF	\$ _____
Green Ash	2.4 MBF	\$ 31.00/MBF	\$ _____
Paper Birch	0.9 MBF	\$ 56.00/MBF	\$ _____
Red Maple	99.7 MBF	\$ 75.00/MBF	\$ _____
Sugar Maple	36.7 MBF	\$ 114.00/MBF	\$ _____
Yellow Birch	19.5 MBF	\$ 31.00/MBF	\$ _____
<b>Pulpwood</b>			
Balsam Fir	54 Cords	\$ 12.70/Cord	\$ _____
Mixed Hardwood	814 Cords	\$ 15.30/Cord	\$ _____
Mixed Spruce	11 Cords	\$ 12.65/Cord	\$ _____
Quaking Aspen	26 Cords	\$ 17.00/Cord	\$ _____

\*The volumes are statistically estimated within plus (+) or minus (-) 9.65 percent at 95% confidence level. These estimated volumes are final and not subject to adjustment. Prospective bidders are urged to examine this timber and to make their own estimates of quantity and quality.

I understand that any or all bids may be rejected. All bids must be signed and all bid items must be bid or the bid form may be rejected. I also understand that consideration and awarding a contract will be based upon my past performance and ability to complete the contract based upon equipment and staffing subject to my control.

FEDERAL ID: \_\_\_\_\_ or SOCIAL SECURITY NUMBER: \_\_\_\_\_

Company or individual bidding: \_\_\_\_\_

Company representative's name: \_\_\_\_\_

Address: \_\_\_\_\_

City: \_\_\_\_\_ State: \_\_\_\_\_ Zip: \_\_\_\_\_

IF AVAILABLE, PLEASE PLACE THE PERSONALIZED LABEL FROM YOUR PROSPECTUS IN THE ABOVE BOX.

Individual or company representative's signature: \_\_\_\_\_ Date: \_\_\_\_\_

Phone number : \_\_\_\_\_ Email (optional): \_\_\_\_\_

**THE WINNING BIDDER MUST COMPLETE THE VERIFICATION OF WORKER'S DISABILITY COMPENSATION ACT COMPLIANCE (ON REVERSE SIDE IF DOUBLE SIDED) WITHIN 21 DAYS OF SALE AWARD DATE**



<b>FOR DEPARTMENT USE ONLY</b>
Sale Number (XX - XXX - XX - XX)
Forest Management Unit:

## TIMBER SALE VERIFICATION OF WORKER'S DISABILITY COMPENSATION ACT COMPLIANCE

*As required by Act 317, P.A. 1969 (Worker's Compensation) and  
Part 5 of Act 451 of 1994, as amended.*

### VERIFICATION OF WORKER'S DISABILITY COMPENSATION ACT COMPLIANCE

- This verification must be completed and submitted within 21 days of contract award and prior to the issuance of the timber sale contract.
- In addition, if boxes 2B or 2C are checked, then Notice of Exclusion or Certificate of Insurance must be submitted within twenty-one (21) days of the contract award and prior to the issuance of the timber sale contract.
- All information must be typed or printed except for written signatures.

Please Check Appropriate Categories:

1. My business is organized as (you **must** check one of the boxes below):
  - A.  Sole Proprietorship (individual)
  - B.  Partnership
  - C.  Corporation
2. You **must** check one of the boxes below:
  - A.  I certify my business is a sole proprietorship and it has no employees but the sole proprietor. I am not subject to the Worker's Compensation Laws.
  - B.  I certify my business has satisfied its obligation to the Worker's Compensation Act through the use of an approved Notice of Exclusion (BWC-337, Rev. 5/96). I will provide a copy of the Notice of Exclusion within 21 days of the contract award. (For questions or a copy of the BWC-337, please call the Worker's Compensation Bureau at 517-322-1195).
  - C.  I certify my business has a Worker's Compensation Policy. I will provide an original Certificate of Insurance within twenty-one (21) days of the contract award.
3. If you have checked item 2(A) or 2(B), you **must** indicate the number of **both** full-time and part-time employees, other than yourself, including family members and active partners (if none, you must enter "0").

\_\_\_\_\_ Full-time Employees

\_\_\_\_\_ Part-time Employees

Name of Business		Federal ID (or) Social Security No.	
Address		Telephone (       )	
City	State	ZIP	

*I hereby certify that the above information is true and correct. I agree to notify the Michigan DNR of any changes that occur in factors affecting my coverage during any of my present and future operations.*

\_\_\_\_\_  
Signature of Owner or Authorized Representative

\_\_\_\_\_  
Title

\_\_\_\_\_  
Date

**Please complete the "SEALED BID" information on the next page**

MAKOSKY MIX (33-006-21)  
T38N, R24W, SEC. 26; T38N, R24W, SEC. 35; Delta COUNTY

In response to the notice of sale to be held 3:00 p.m. (local time) on October 27, 2021, I am hereby submitting my sealed bid (firm offer) for the following forest products to be cut. Bids for individual species must be at or above the advertised price. All non-responsive bid forms may be rejected.

<u>PRODUCTS &amp; SPECIES</u>	<u>ESTIMATED VOLUME*</u>	<u>ADVERTISED PRICE</u>	<u>BID PRICE/UNIT</u>
<b>Sawtimber</b>			
Black Ash	5.0 MBF	\$ 22.00/MBF	\$ _____
Green Ash	34.7 MBF	\$ 30.00/MBF	\$ _____
Paper Birch	11.5 MBF	\$ 56.00/MBF	\$ _____
Red Maple	61.0 MBF	\$ 75.00/MBF	\$ _____
Yellow Birch	4.7 MBF	\$ 28.00/MBF	\$ _____
<b>Pulpwood</b>			
Balsam Fir	483 Cords	\$ 12.70/Cord	\$ _____
Hemlock	51 Cords	\$ 12.70/Cord	\$ _____
Mixed Aspen	803 Cords	\$ 17.00/Cord	\$ _____
Mixed Hardwood	1,512 Cords	\$ 15.30/Cord	\$ _____
Red Pine	5 Cords	\$ 42.60/Cord	\$ _____
White Pine	32 Cords	\$ 18.65/Cord	\$ _____
White Spruce	112 Cords	\$ 12.65/Cord	\$ _____

\*The volumes are statistically estimated within plus (+) or minus (-) 5.11 percent at 95% confidence level. These estimated volumes are final and not subject to adjustment. Prospective bidders are urged to examine this timber and to make their own estimates of quantity and quality.

I understand that any or all bids may be rejected. All bids must be signed and all bid items must be bid or the bid form may be rejected. I also understand that consideration and awarding a contract will be based upon my past performance and ability to complete the contract based upon equipment and staffing subject to my control.

FEDERAL ID: \_\_\_\_ - \_\_\_\_ - \_\_\_\_ or SOCIAL SECURITY NUMBER: \_\_\_\_ - \_\_\_\_ - \_\_\_\_

Company or individual bidding: \_\_\_\_\_

Company representative's name: \_\_\_\_\_

Address: \_\_\_\_\_

City: \_\_\_\_\_ State: \_\_\_\_\_ Zip: \_\_\_\_\_

IF AVAILABLE, PLEASE PLACE THE PERSONALIZED LABEL FROM YOUR PROSPECTUS IN THE ABOVE BOX.

Individual or company representative's signature: \_\_\_\_\_ Date: \_\_\_\_\_

Phone number : \_\_\_\_\_ Email (optional): \_\_\_\_\_

**THE WINNING BIDDER MUST COMPLETE THE VERIFICATION OF WORKER'S DISABILITY COMPENSATION ACT COMPLIANCE (ON REVERSE SIDE IF DOUBLE SIDED) WITHIN 21 DAYS OF SALE AWARD DATE**



FOR DEPARTMENT USE ONLY	
Sale Number (XX - XXX - XX - XX)	
Forest Management Unit:	

# TIMBER SALE VERIFICATION OF WORKER'S DISABILITY COMPENSATION ACT COMPLIANCE

As required by Act 317, P.A. 1969 (Worker's Compensation) and  
Part 5 of Act 451 of 1994, as amended.

## VERIFICATION OF WORKER'S DISABILITY COMPENSATION ACT COMPLIANCE

- This verification must be completed and submitted within 21 days of contract award and prior to the issuance of the timber sale contract.
- In addition, if boxes 2B or 2C are checked, then Notice of Exclusion or Certificate of Insurance must be submitted within twenty-one (21) days of the contract award and prior to the issuance of the timber sale contract.
- All information must be typed or printed except for written signatures.

Please Check Appropriate Categories:

1. My business is organized as (you **must** check one of the boxes below):
  - A.  Sole Proprietorship (individual)
  - B.  Partnership
  - C.  Corporation
2. You **must** check one of the boxes below:
  - A.  I certify my business is a sole proprietorship and it has no employees but the sole proprietor. I am not subject to the Worker's Compensation Laws.
  - B.  I certify my business has satisfied its obligation to the Worker's Compensation Act through the use of an approved Notice of Exclusion (BWC-337, Rev. 5/96). I will provide a copy of the Notice of Exclusion within 21 days of the contract award. (For questions or a copy of the BWC-337, please call the Worker's Compensation Bureau at 517-322-1195).
  - C.  I certify my business has a Worker's Compensation Policy. I will provide an original Certificate of Insurance within twenty-one (21) days of the contract award.
3. If you have checked item 2(A) or 2(B), you **must** indicate the number of **both** full-time and part-time employees, other than yourself, including family members and active partners (if none, you must enter "0").

\_\_\_\_\_ Full-time Employees

\_\_\_\_\_ Part-time Employees

Name of Business		Federal ID (or) Social Security No.	
Address		Telephone (       )	
City	State	ZIP	

*I hereby certify that the above information is true and correct. I agree to notify the Michigan DNR of any changes that occur in factors affecting my coverage during any of my present and future operations.*

\_\_\_\_\_  
Signature of Owner or Authorized Representative

\_\_\_\_\_  
Title

\_\_\_\_\_  
Date

Please complete the "SEALED BID" information on the next page