



**DEPARTMENT OF NATURAL RESOURCES
STATE OF MICHIGAN**

TIMBER SALE PROSPECTUS #7034

SCHEDULED SALE DATE AND TIME: 9:00 a.m. (local time) on March 24, 2022.

LOCATION: GRAYLING MGMT UNIT, 1955 HARTWICK PINES ROAD, GRAYLING, MI 49738.

PROSPECTUS NOTE: The bidder is advised to inspect the sale area and review the location, estimated volumes, operating costs and contract terms of proposed sales. Please be aware that some landowners may request 60 days or more notice for access across their land.

Notice is hereby given that bids will be received by the Unit Manager, GRAYLING MANAGEMENT UNIT, for certain timber on the following described lands:

In the Rough (72-012-21) / T25N, R03W, SEC. 4 , SENW,W1/2NE,NESW,W1/2SE.

T25N, R03W, SEC. 6 , N1/2NE.

Crawford County, Advertised Price \$44,390.60, 85.6 Acres, Hardwood, Aspen.

SALE NOTE: All units of volume listed for this sale were estimated using the Inventory Manager computer program and the new Michigan taper model.

- See sale spec 5.2.3.5 for information on oak wilt restrictions.
- See sale spec 4.1.11 for information on permits for railroad right-of-ways.
- See sale spec 5.1.3 for information on receiving permission to operate near pipelines.

Sale has some Class A road access.

Joel's Yard Expansion (72-013-21) / T26N, R03W, SEC. 1 , N1/2NW.

T26N, R03W, SEC. 12, S1/2SW,SE.

T26N, R03W, SEC. 2 , NENE.

Crawford County, Advertised Price \$29,464.25, 87.3 Acres, Jack Pine, Aspen.

SALE NOTE: All units of volume listed for this sale were estimated using the Inventory Manager computer program and the new Michigan taper model.

- See sale specs 2.2.2 and 2.2.3 for information on chipping and stump height requirements.

Sale has Class A road access.

Elbow Trail is used as an access to homes north of Payment Units 2 and 3 and will likely require gravel in areas, especially if used during break up.

Pipeline HWs (72-030-21) / T28N, R03W, SEC. 31, S1/2SW,SWSE.

Crawford County, Advertised Price \$40,747.40, 29.8 Acres, Hardwood, Sugar Maple.

SALE NOTE: All units of volume listed for this sale were estimated using the Inventory Manager computer program and the new Michigan taper model.

The beech component in this lower-quality hardwoods stand is breaking up. The site will be converted to Red Pine management. There is a heavy understory of beech and ironwood that must be cut cleanly in order to facilitate follow-up planting operations. CR-612 from I-75 to Old 27 was a Class-A road in 2021.

A recreation site such as a trail, pathway, or campground is within the sale area or the vicinity. Certain restrictions/specifications may be applicable including time restrictions.

Gypsy Rain Oak (72-607-21) / T27N, R02W, SEC. 22, SESW.

T27N, R02W, SEC. 27, N1/2NW,SE,NE,NESW,NWSE.

Crawford County, Advertised Price \$52,735.65, 100.8 Acres, Hardwood, Red Pine.

SALE NOTE: Sale is on military land and is non-certified timber. Sale contains military sale specs as well as timing restrictions. Sale also contains oak wilt timing restrictions.

M72 West (72-628-21) / T26N, R04W, SEC. 10, NE,NESE.

T26N, R04W, SEC. 11, W1/2NW.

Crawford County, Advertised Price \$37,699.95, 107.2 Acres, Hardwood, White Pine.

SALE NOTE: All units of volume listed for this sale were estimated using the Inventory Manager computer program and the new Michigan taper model.

See sale spec 7.5.1 for information on declining oak.

The sale is on Hanson Refuge Lands that are managed for Military training. M-72 is a class-A road.

A recreation site such as a trail, pathway, or campground is within the sale area or the vicinity. Certain restrictions/specifications may be applicable including time restrictions.

BID INSTRUCTIONS (VER. 07/02/2018):

1. Scheduled Bid Location, Date, and Time (2/11)

Bids must be received by the Unit Manager, GRAYLING OFFICE, 1955 HARTWICK PINES ROAD, GRAYLING, MI 49738, no later than 9:00 a.m. (local time) on March 24, 2022. For further information concerning this sale, contact Thomas Barnes at 989-348-6371 extension 7440.

2. Bidder's Qualifications (5/16)

Purchaser shall obtain workers compensation insurance to cover claims under Michigan's Worker's Disability Compensation Act of 1969 or similar employee benefit act of any other state applicable to an employee. If all or part of a timber sale was prepared by a private contractor, the contractor and that contractor's company are not permitted to bid on the timber sale contract. Bids will not be accepted from individuals or companies appearing on the DNR/FRD No-Bid List. This list contains the names of purchasers who previously failed to execute a contract within 21-days or who have a history of poor performance.

3. Preparation of Sealed Bids (5/16)

Bid Forms may be completed online thru Michigan DNR Timber Sale Online Bidding (OLB) at www.michigan.gov/timberbidding or by completing the hardcopy Bid Form found in the Timber Sale Prospectus. Hardcopy Bid Forms shall be manually signed in ink. Registration in OLB is considered your 'signature' for all bids submitted thru that system. Bid prices must be entered for each species and product in the Bid Price column for all material subject to bidding and all fill-in blanks must be completed. If erasures or other changes appear on the hardcopy Bid Form, each erasure or change must be initialed by the person signing the bid.

4. Submission of Sealed Bids (5/16)

Bid forms may be obtained from the Unit Manager or thru OLB. Bids may be submitted hardcopy or thru OLB. All hardcopy bids must be submitted on the bid form and in an envelope clearly identified as described in this section. NOTE: Only one bid form per bid envelope. Sealed bids must be submitted to the Unit office designated in the prospectus and must be submitted at or prior to the time established in the prospectus. The envelope should show on the outside (a) the sale name or number and (b) the date and time of bid opening, as shown in the prospectus. Bids received after the time specified in the sale prospectus are late bids and will be rejected.

It is possible for a bidder to submit multiple bids on a single sale. For example, a bid may be submitted hardcopy and a bid may be submitted thru OLB. Or, two bidders from the same company could both submit bids on the same sale. If this were to happen, the State would accept all bids received and award the contract accordingly. All bidding and contractual requirements would apply to all bids received.

5. Public Opening of Sealed Bids (7/16)

If conditions permit, the sealed bids will be publicly opened and posted at the time and place set in the prospectus.

If a bidder, present at a bid opening, has submitted bids on more than one sale, that bidder may withdraw their unopened bid envelopes or announce the withdrawal of their online bid after being declared the successful bidder on one sale.

6. Award of Contract (1/11)

Award of the contract will be made to the Bidder whose bid, conforming to the prospectus, is most advantageous to the State of Michigan on the basis of total value at rates bid for the estimated quantities. The State reserves the right to reject any bid or waive any minor irregularity in bids received. A written award mailed (or otherwise furnished) to the successful Bidder shall be deemed to result in a binding contract without further action by either party.

7. Down Payment (1/11)

The Bidder to whom award is made must make a down payment within 21 days of the sale award. The amount of the down payment will be calculated as shown in the Bond and Payment Schedule of this prospectus. Only cash may be used to meet this requirement.

8. Performance Security (1/11)

As guarantee of faithful performance, a cash bond, certificate of deposit, surety bond or irrevocable letter of credit (LOC) is required within 21 days of the sale award. The amount of the performance security is shown in the Bond and

Payment Schedule of this prospectus. If an LOC or surety is used, the coverage must extend for at least 6 months beyond the contract expiration.

9. Timber Sale Contract (7/18)

Additional conditions and requirements common to all timber sales are listed on the timber sale contract (R4031) and are available on line at www.michigan.gov/timber. Contact the Unit Manager for additional information or a sample contract. Within 21 days of the date of the award letter, the bidder must sign the contract and provide the required down payment, performance security, and verification of worker's disability compensation. The down payment and performance security shall be in accordance with the provisions of the timber sale contract, in the sums stated in this prospectus. If these actions are not taken, then the Bidder, the Bidder's corporation, and the corporation's principals may not be permitted to bid on State timber sales for a period of 3 months after the first offense, 6 months after the second offense, and 1 year after the third offense. An offense will only be counted against the Bidder for 5 years. In addition, the Bidder certifies that if awarded this contract, the Bidder will complete the timber sale contract in accordance with its terms and any modifications thereof including requirements to purchase, cut, and remove the included timber by the expiration date.

Payment Unit values in the State Forest Timber Sale Contract are calculated based on the advertised value of the Payment Unit as a percentage of the total advertised value of the contract. The advertised value of each Payment Unit is given in the Description of Timber by Payment Unit table on the Timber Sale Information page. For example, if the value of Payment Unit 1 is advertised as \$1,500 and the total Timber Sale value is advertised as \$10,000, the contract price for Payment Unit 1 will be 15% of the total bid price ($\$1,500/\$10,000 * 100$).

10. Disclaimer of Estimates and Bidder's Warranty of Inspection (7/16)

Before submitting this bid, the Bidder is advised and cautioned to inspect the sale area, review the requirements of the sale contract, and take other steps as may be reasonably necessary to ascertain the location, estimated volumes, construction estimates, and operating costs of the proposed sale. Failure to do so will not relieve the Bidder from responsibility for completing the contract.

The Bidder warrants that this bid is submitted solely on the basis of the Bidder's examination and inspection of the quality and quantity of the timber offered for sale and the Bidder's opinion of the value thereof and the costs of recovery. No reliance should be placed on the State of Michigan's estimates of timber quality, quantity or costs of recovery. Bidder further acknowledges that the State of Michigan: (i) expressly disclaims any warranty of fitness of timber for any purpose; (ii) offers this timber as is without any warranty of quality (merchantability) or quantity and (iii) expressly disclaims any warranty as to the quantity or quality of timber sold.

11. Certification and Chain-of-Custody (10/14)

Unless otherwise indicated in the contract under section 7 – Other Conditions of the Sale Specific Conditions & Requirements, the area encompassed by this timber sale is certified to the standards of the Forest Stewardship Council (FSC) - Certificate #SCS-FM/COC-00090N and the Sustainable Forestry Initiative (SFI) - Certificate #NSF-SFIS-5Y031-SF5. Forest products from this sale may be delivered to the mill as "FSC 100% and / or SFI certified" as long as the contractor hauling the forest products is chain-of-custody (COC) certified or covered under a COC certificate from the destination mill. The purchaser is responsible for maintaining COC after leaving the sale area.

12. Good Neighbor Authority (GNA) Requirements (7/16)

If the name of this timber sales contains the acronym GNA, it is authorized by the Good Neighbor Authority (GNA) and covered by various agreements between the U.S. Forest Service and the State. The timber sale occurs on federal land and the following conditions apply:

GNA contracts on US Forest Service land will not be awarded to purchasers on the Federal list of excluded parties. The System for Award Management (SAM) will be checked for active excluded parties prior to award of contract. In addition, the Bidder to whom award is made must complete an Assurance Regarding Felony Conviction or Tax Delinquent Status for Corporate Applicants (AD-3031).

13. Good Neighbor Authority (GNA) Requirements, con't (9/16)

Bidder certifies, by signing this bid form, that to the best of Bidder's knowledge that the following representations are accurate and complete.

- a. That the Bidder and its principals are not presently debarred, suspended, proposed for debarment, declared ineligible, or voluntary excluded from timber sales (covered transactions) by any Federal department or agency.
- b. That the Bidder and its principals have not within a 3-year period preceding this bid been convicted of or had a civil judgment rendered against them for commission of fraud or a criminal offense in connection with obtaining , attempting to obtain, or performing a public (Federal, State, or local) transaction or contract under a public transaction; violation of Federal or State antitrust statutes or commission of embezzlement, theft, forgery, bribery, falsification or destruction of records, making false statements, or receiving stolen property.
- c. That the Bidder and its principals are not presently indicted for or otherwise criminally or civilly charged by a governmental entity (Federal, State, or local) with commission of any of the offenses enumerated in paragraph b of this certification.
- d. That the Bidder and its principals have not within a 3-year period preceding this bid had one or more public transactions (Federal, State, or local) terminated for breach or default of a timber or forest product contract.

Bidders that cannot certify this requirement, in whole or in part, shall submit an explanation with their bid.

DAN EICHINGER
Director

TIMBER SALE INFORMATION

In the Rough (72-012-21)
T25N, R03W, SEC. 4; T25N, R03W, SEC. 6.
Crawford County (Advertised Price \$44,390.60)

SALE NOTE: All units of volume listed for this sale were estimated using the Inventory Manager computer program and the new Michigan taper model.

- See sale spec 5.2.3.5 for information on oak wilt restrictions.
- See sale spec 4.1.11 for information on permits for railroad right-of-ways.
- See sale spec 5.1.3 for information on receiving permission to operate near pipelines.

Sale has some Class A road access.

A timber sale contract for this lump sum, sealed bid timber sale will be awarded to the responsible bidder offering the highest sealed bid price. All units of volume listed below were estimated using the Inventory Manager computer program and the new Michigan taper model. Bids must be at or above the following advertised price for each product and species:

<u>PRODUCTS & SPECIES</u>	<u>ESTIMATED UNITS*</u>	<u>ADVERTISED PRICE</u>
Sawtimber		
Bl/R/Hybrid Oak	143.0 MBF	\$ 100.00 / MBF
Red Pine	20.0 MBF	\$ 89.00 / MBF
White Oak	16.6 MBF	\$ 73.00 / MBF
White Pine	11.1 MBF	\$ 57.00 / MBF
Pulpwood		
Jack Pine	38 Cords	\$ 15.90 / Cord
Misc. Species 1	55 Cords	\$ 5.50 / Cord
Mixed Aspen	226 Cords	\$ 25.10 / Cord
Mixed Hardwood	461 Cords	\$ 24.75 / Cord
Mixed Oak	337 Cords	\$ 22.95 / Cord
Red Pine	14 Cords	\$ 31.10 / Cord
White Pine	15 Cords	\$ 20.50 / Cord

* The total volume is statistically estimated within plus (+) or minus (-) 8.90 percent. There are an estimated 1,618 cords on this timber sale, plus or minus 144 cords at the 95% confidence level. The estimated units are final and not subject to adjustment. Prospective bidders are urged to examine this timber and to make their own estimates of quantity and quality.

BOND AND PAYMENT SCHEDULE:

1. A bond in the amount of \$2,220.00 to insure faithful performance of the conditions of the contract will be deposited by the successful bidder within 21 days of the sale award.
2. Cutting in any sale or unit without the required advance payment would be considered a trespass.
3. Total payment must be paid in advance or according to the following schedule:
 - (a) Ten percent (10%) of the sale value must be paid within 21 days of the sale award.
 - (b) The 10% down payment will be credited towards the first unit cut.
 - (c) Payment for each of the following units must be made before cutting begins in that unit:

<u>PAYMENT UNIT NUMBER</u>	<u>PERCENT OF TOTAL SALE VALUE</u>
01	9.1%
02	82.2%
03	8.7%

4. If no cutting takes place, the 10% down payment will not be refunded.
5. Operations on the contract issued will terminate on 06/30/2024.

SALE STATISTICS

Volumes were calculated in cubic feet using the Michigan taper model. Cubic foot volume includes all wood inside bark for the product indicated. For display purposes, cubic feet were converted to cords and MBF using a simple conversion factor, e.g. 79 cubic feet per cord and 185 cubic feet per MBF. The cubic foot volumes are precise; the cords and MBF volumes are not. Cubic foot volume cannot be directly converted to cords or boards with precision.

SALE VOLUMES

The total estimated sale volume may not equal the sum of the species/products due to the nature of statistical calculations associated with double sampling methodology.

VOLUME			STATISTICAL RANGE IN CORDS	
TOTAL CUBIC FEET	TOTAL CORDS	PERCENT ERROR	MINIMUM	MAXIMUM
127,823	1,618	8.90%	1,474	1,762

VDU VOLUMES

A VDU is a Volume Determination Unit. Volumes and their associated statistics are calculated at the VDU level and summarized to the sale level. There is often a one to one relationship between a VDU and a Payment Unit, but not always, depending on the cruise design. Refer to the VDU TO PAYMENT UNIT table.

	VOLUME			RANGE IN CORDS	
VDU	TOTAL CUBIC FEET	TOTAL CORDS	PERCENT ERROR	MINIMUM	MAXIMUM
3	12,400	157	16.12%	132	182
19	98,968	1,253	10.59%	1,120	1,385
20	9,274	117	15.56%	99	136
TOTAL:	120,642	1,527		1,351	1,703

VDU TO PAYMENT UNIT

When a VDU is associated with more than one Payment Unit (PU), the VDU volumes are assigned to the PU based on acres of the VDU within the PU.

VDU	VDU ACRES	PU	PU ACRES
3	19.4	1	19.4
19	57.0	2	57.0
20	9.2	3	9.2
TOTAL:	85.6		85.6

DESCRIPTION OF TIMBER BY PAYMENT UNIT (PU)

PU	MARKET GROUP	PRODUCT	QUANTITY	UNIT	ACRES	ADVERTISE PRICE
1	BI/R/Hybrid Oak	Sawtimber	13.4	MBF	19.4	\$4,027.65
	Red Pine		3.0	MBF		
	White Pine		0.9	MBF		
	Jack Pine	Pulpwood	24	Cords		
	<i>Jack Pine</i>	<i>Sawtimber</i>	0.7	<i>MBF</i>		
	<i>Jack Pine</i>	<i>Pulpwood</i>	23	<i>Cords</i>		
	Misc. Species 1		20	Cords		
	<i>Misc. Species 1</i>	<i>Sawtimber</i>	8.8	<i>MBF</i>		
	<i>Misc. Species 1</i>	<i>Pulpwood</i>	2	<i>Cords</i>		
	Mixed Aspen		13	Cords		
	<i>Quaking Aspen</i>		13	<i>Cords</i>		
	Mixed Hardwood		30	Cords		
	<i>Black Cherry</i>		30	<i>Cords</i>		
	Mixed Oak		33	Cords		
	<i>BI/R/Hybrid Oak</i>		33	<i>Cords</i>		
	Red Pine		1	Cords		
	White Pine		1	Cords		
	2	BI/R/Hybrid Oak	Sawtimber	108.8		
Red Pine			17.0	MBF		
White Oak			16.2	MBF		
White Pine			10.2	MBF		
Jack Pine		Pulpwood	14	Cords		
<i>Jack Pine</i>		<i>Sawtimber</i>	1.9	<i>MBF</i>		
<i>Jack Pine</i>		<i>Pulpwood</i>	10	<i>Cords</i>		
Misc. Species 1			35	Cords		
<i>Misc. Species 1</i>		<i>Sawtimber</i>	16.5	<i>MBF</i>		
<i>Misc. Species 1</i>		<i>Pulpwood</i>	2	<i>Cords</i>		
Mixed Aspen			200	Cords		
<i>Quaking Aspen</i>		<i>Sawtimber</i>	22.8	<i>MBF</i>		
<i>B. T. Aspen</i>		<i>Pulpwood</i>	58	<i>Cords</i>		
<i>Quaking Aspen</i>			96	<i>Cords</i>		
Mixed Hardwood			427	Cords		
<i>Red Maple</i>		<i>Sawtimber</i>	21.4	<i>MBF</i>		
<i>Black Cherry</i>		<i>Pulpwood</i>	4	<i>Cords</i>		
<i>Red Maple</i>			380	<i>Cords</i>		
Mixed Oak			247	Cords		
<i>BI/R/Hybrid Oak</i>			170	<i>Cords</i>		
<i>White Oak</i>			77	<i>Cords</i>		
Red Pine			12	Cords		
White Pine			14	Cords		
3	BI/R/Hybrid Oak	Sawtimber	20.8	MBF	9.2	\$3,873.75
	White Oak		0.4	MBF		
	Mixed Aspen	Pulpwood	13	Cords		
	<i>Quaking Aspen</i>		13	<i>Cords</i>		
	Mixed Hardwood		4	Cords		
	<i>Red Maple</i>		4	<i>Cords</i>		
	Mixed Oak		57	Cords		
	<i>BI/R/Hybrid Oak</i>		51	<i>Cords</i>		
	<i>White Oak</i>		6	<i>Cords</i>		
Red Pine		1	Cords			
TOTAL:			190.7	MBF		
TOTAL:			1,146	Cords		

Sale Specific Conditions & Requirements

Sale Name: In the Rough

Sale Number: 72-012-21 Seq#: 2

1 - Sale Area

1.2 - Boundaries

1.2.1 - Painted boundaries (9/19)

The sale boundary and Payment Unit boundaries are marked and identified by blue and red paint or are unmarked and identified by existing roads or the railway. Exterior sale boundary lines against private property are marked with blue paint except for the following exceptions: the southwest boundary of Payment Unit 2 is unmarked and identified by the railway, the north boundary of Payment Unit 2 is unmarked and identified by 4 Mile Road, and the south boundary of Payment Unit 3 is unmarked and identified by 5 Mile Road. Exterior sale boundary lines against state are marked with red paint. Retention patches are marked with red paint; no harvesting activities may occur within these areas. The painted boundary line trees are not Included Timber and are to be protected.

2 - Timber Specifications

2.1 - Included Timber

2.1.1 - Clearcut unit(s) with unmerchantable trees (6/14)

Within Payment Unit(s) 1-3, cut all trees that are two (2) inches or more at DBH, except in Payment Units 2 and 3, do not cut trees marked with green paint.

2.1.11 - Description of timber note (2/04)

Note that Misc. Species 1 = dead oak.

2.2 - Utilization

2.2.3 - Stump heights (4/07)

Stump heights within Payment Unit(s) 1 and 2 shall not exceed 6 inches for all trees. This is to facilitate planting operations. A written waiver of this requirement may be obtained if wet summer weather makes winter logging necessary.

3 - Payments

3.3 - Pre-measured Sales

3.3.4 - Dividing payment units (7/14)

Payment Unit(s) may be divided at the request of the Purchaser and upon approval of the Unit Manager. Dividing Payment Units is a contract modification which requires a Timber Sale Contract Amendment.

4 - Transportation

4.1 - Construction

4.1.6 - Road construction (1/09)

Construction of new roads or improvements of existing roads shall be done in such a way as to minimize the environmental and visual impacts. Merchantable trees shall be cut and utilized unless otherwise directed. Non-merchantable trees shall be severed and laid flat on the ground. Slash shall be scattered, and not left in windrows and kept a minimum of 10 feet back from the road edge. Stumps shall be set upright, not left on edge, and be moved at least 10 feet away from the road edge. Disturbed soil shall be feathered into the woods and not left in berms or windrows.

4.1.7 - Road closure (10/11)

All new roads built into the sale must be blocked to vehicle traffic upon completion of the sale. Overgrown roads that are reopened shall be considered new roads. In general, this will require constructing a four (4') foot high berm of stumps and logs covered with earth. Stumps and brush must be placed along the remainder of the trail. These roads must be rendered impassable to cars and trucks. All stumps from road building and landing construction must be reserved to block any newly constructed roads upon completion of the sale. These stumps must be scattered along the road system to prohibit vehicular movement. Contact the sale administrator for specific details of design and placement.

4.1.11 - Permits (2/12)

The DNR will secure any necessary railroad right-of-way permits that may be required. Permit for operating in railroad right-of-way must be obtained through Lake States Railway Company. Contact: Helen Huneycutt, huneycuh@lsrc.com, (989)393-9803.

5 - Operations

5.1 - Notification

5.1.3 - Well heads and natural gas pipelines (11/15)

The Purchaser is responsible for contacting the pipeline company prior to operating equipment in the vicinity of well heads or natural gas pipelines. Contact DTE Energy at 1-800-363-9541.

5.2 - Conduct of Operations

5.2.2 - Hazard Trees/Snags

5.2.2.1 - Den trees (10/16)

Obvious hollow and/or den trees shall be protected and left standing unless they are a safety hazard.

5.2.3 - Operating Restrictions

5.2.3.5 - Oak wilt restriction (1/18)

Within Payment Unit(s) 1-3, unless changed by written agreement, cutting, skidding, hauling within the sale and brushing of access roads to the sale are not permitted during the period of April 15 to July 15. Operations may be allowed if specific steps are taken to prevent damaging uncut oak during the high risk period. Those steps may include completing all road brushing before April 15th and clearing a tree-length buffer along uncut oak cover before April 15th. This is necessary to reduce the spread of oak wilt. For more information, contact the Unit Manager or his/her representative.

5.2.4 - Dead and Down Creation

5.2.4.4 - Dead and down creation, grouse (6/18)

To encourage grouse and other wildlife, in Payment Unit(s) 1 and 2, leave one 12" or larger diameter (or largest diameter trees within stand) whole tree on the ground for every 2 acres, preferably a hardwood species such as oak or maple or if no hardwoods are present, a pine species (white or red). These will be evenly scattered throughout the Payment Unit, preferably at least two chains from any roads, two-tracks, or trails open to vehicles.

5.2.29 - Shrub protection (1/20)

Reasonable care should be taken to avoid cutting or damaging hawthorn or juneberry. These woody-shrub plants are highly beneficial to various wildlife species.

5.2.32 - Decking/landing restoration (9/13)

All decking and landing areas must have the surface area restored to a condition equal to or better than before. This is to ensure the proper regeneration of the stand. Wood debris, chips, and "cookies" from trimmings must be removed or scattered away from landing and loading areas and may not be windrowed on the edge.

5.2.37 - No decking areas (12/08)

No decking is allowed within 50 feet of the railroad without permission of Lake States Railway Company.

6 - Safety and Fire Prevention

6.2 - Signing

6.2.1 - Road posting (10/20)

The Purchaser is responsible for posting and maintaining caution signs on 4 Mile Road and 5 Mile Road prior to beginning operations. The road must be posted at appropriate distances from the Sale Area to warn of logging activity and truck traffic. Signs must be removed when harvest operations are suspended or completed. The Purchaser will provide these signs.



TIMBER SALE MAP

This information provided by authority of Part 525, 1994 PA 451, as amended.

Forest Management Unit Grayling	County Crawford	Mapped By Scott McClarren	Date 10/06/2021	Page 1	of 2
Township 25N	Range 03W	Section(s) and Subdivision(s) Sec. 6 N1/2NE, Sec. 4 SENW, W1/2NE, NESW, W1/2SE	Scale 1:7,920		

Cover Type				Density	
A = Aspen	H = Hemlock	N = Marsh	U = Upland Brush	0 = Non Stocked	5 = Pole Timber Medium
B = Paper Birch	J = Jack Pine	O = Oak	UM = Upland Mixed	1 = Seedling Sapling Poor	6 = Pole Timber Well
C = Cedar	L = Lowland Brush	P = Lowland Poplar	V = Bog or Marsh	2 = Seedling Sapling Medium	7 = Saw Timber Poor
D = Treed Bog	LM = Lowland Mixed	Q = Mixed Swamp Conifer	W = White Pine	3 = Seedling Sapling Well	8 = Saw Timber Medium
E = Swamp Hdwoods	M = Mpl, Bch, Brch	R = Red Pine	X = Non Stocked	4 = Pole Timber Poor	9 = Saw Timber Well
F = Spruce Fir	MC = Mixed Conifer	S = Black Spruce	Z = Water		
G = Grass	MD = Mixed Deciduous	T = Tamarack			

PU	Acres
1	19.4
2	57
3	9.2

In the Rough

Compartment 224

85.6 Acres

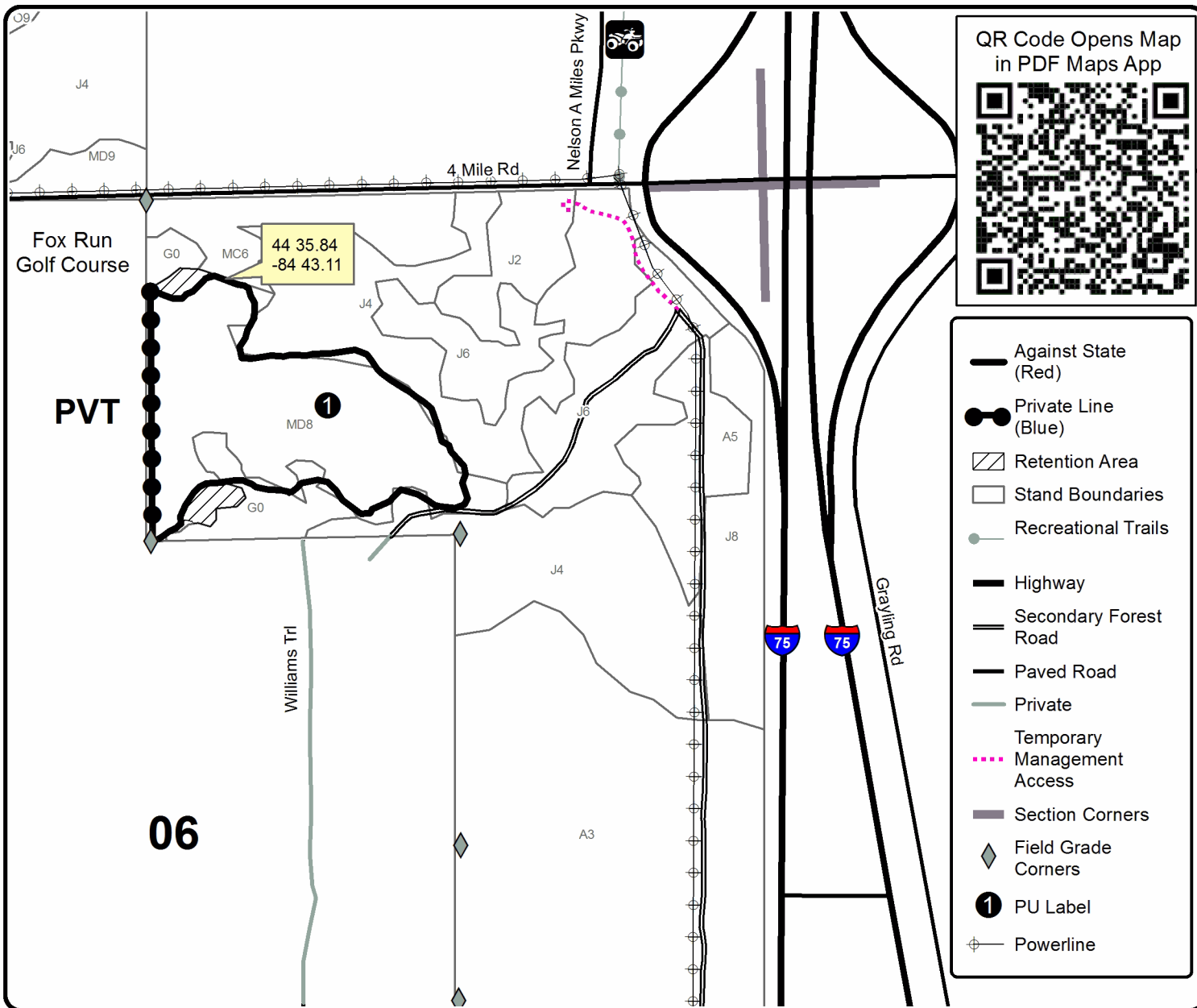
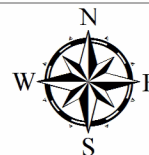

QR Code Opens Map in PDF Maps App

- Against State (Red)
- Private Line (Blue)
- Retention Area
- Stand Boundaries
- Recreational Trails
- Highway
- Secondary Forest Road
- Paved Road
- Private
- Temporary Management Access
- Section Corners
- Field Grade Corners
- PU Label
- Powerline



TIMBER SALE MAP

This information provided by authority of Part 525, 1994 PA 451, as amended.

Sale Number	Year
72 - 012	21

Forest Management Unit	County	Mapped By	Date	Page	of
Grayling	Crawford	Scott McClarren	10/06/2021	2	2
Township	Range	Section(s) and Subdivision(s)	Scale		
25N	03W	Sec. 6 N1/2NE, Sec. 4 SENW, W1/2NE, NESW, W1/2SE	1:15,840		

Cover Type				Density	
A = Aspen	H = Hemlock	N = Marsh	U = Upland Brush	0 = Non Stocked	5 = Pole Timber Medium
B = Paper Birch	J = Jack Pine	O = Oak	UM = Upland Mixed	1 = Seedling Sapling Poor	6 = Pole Timber Well
C = Cedar	L = Lowland Brush	P = Lowland Poplar	V = Bog or Marsh	2 = Seedling Sapling Medium	7 = Saw Timber Poor
D = Treed Bog	LM = Lowland Mixed	Q = Mixed Swamp Conifer	W = White Pine	3 = Seedling Sapling Well	8 = Saw Timber Medium
E = Swamp Hdwoods	M = Mpl. Bch, Brch	R = Red Pine	X = Non Stocked	4 = Pole Timber Poor	9 = Saw Timber Well
F = Spruce Fir	MC = Mixed Conifer	S = Black Spruce	Z = Water		
G = Grass	MD = Mixed Deciduous	T = Tamarack			

PU	Acres
1	19.4
2	57
3	9.2

In the Rough

Compartment 224

85.6 Acres

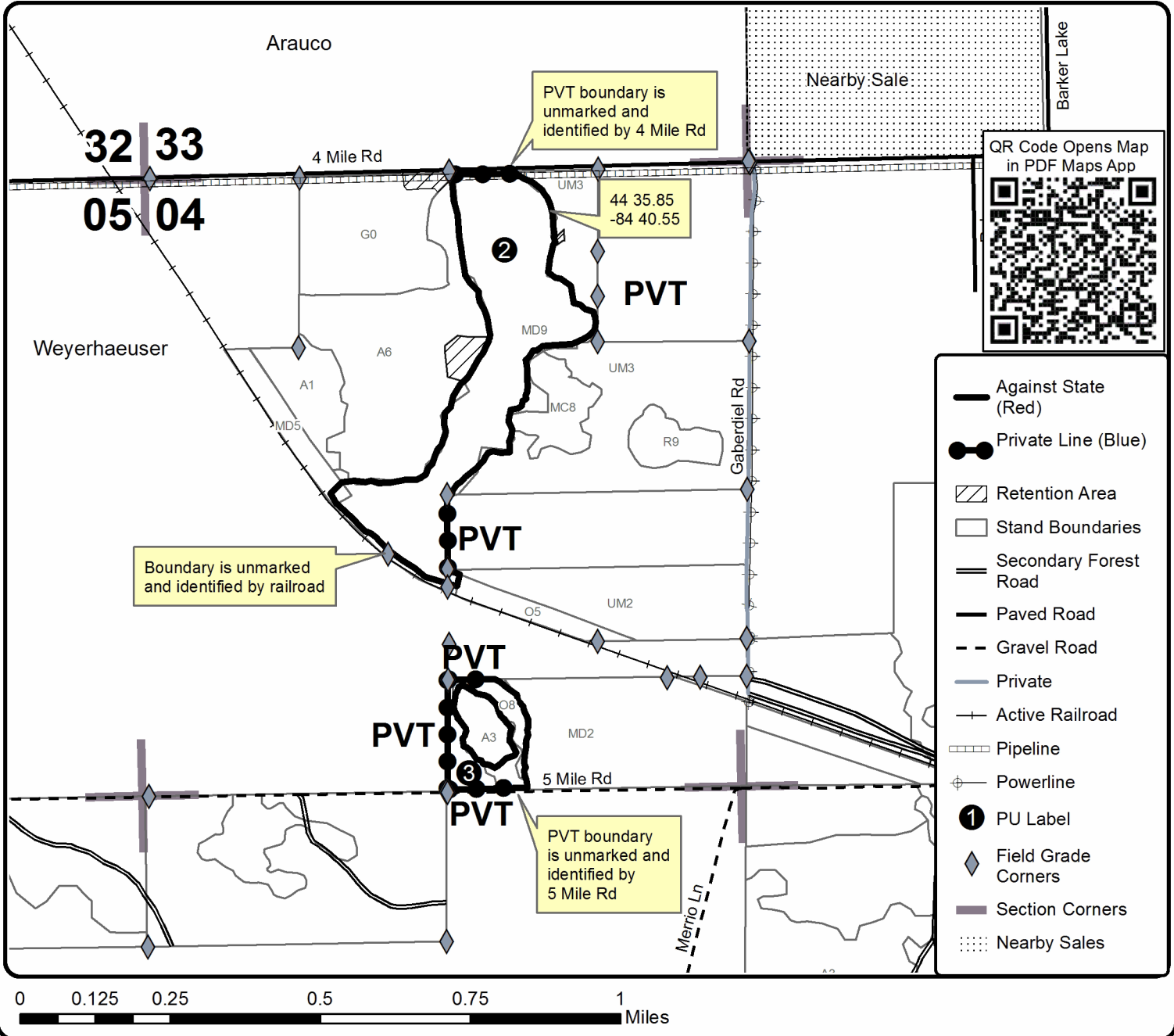
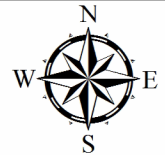

TIMBER SALE INFORMATION

Joel's Yard Expansion (72-013-21)

T26N, R03W, SEC. 1; T26N, R03W, SEC. 12; T26N, R03W, SEC. 2.
Crawford County (Advertised Price \$29,464.25)

SALE NOTE: All units of volume listed for this sale were estimated using the Inventory Manager computer program and the new Michigan taper model.

- See sale specs 2.2.2 and 2.2.3 for information on chipping and stump height requirements.

Sale has Class A road access.

Elbow Trail is used as an access to homes north of Payment Units 2 and 3 and will likely require gravel in areas, especially if used during break up.

A timber sale contract for this lump sum, sealed bid timber sale will be awarded to the responsible bidder offering the highest sealed bid price. All units of volume listed below were estimated using the Inventory Manager computer program and the new Michigan taper model. Bids must be at or above the following advertised price for each product and species:

<u>PRODUCTS & SPECIES</u>	<u>ESTIMATED UNITS*</u>	<u>ADVERTISED PRICE</u>
Sawtimber		
Northern Pin Oak	11.2 MBF	\$ 100.00 / MBF
Red Pine	45.0 MBF	\$ 89.00 / MBF
White Oak	1.7 MBF	\$ 73.00 / MBF
Pulpwood		
Jack Pine	732 Cords	\$ 15.90 / Cord
Mixed Aspen	304 Cords	\$ 25.10 / Cord
Northern Pin Oak	33 Cords	\$ 22.95 / Cord
Red Pine	122 Cords	\$ 31.10 / Cord
White Oak	2 Cords	\$ 22.95 / Cord
White Pine	17 Cords	\$ 20.50 / Cord

* The total volume is statistically estimated within plus (+) or minus (-) 8.16 percent. There are an estimated 1,376 cords on this timber sale, plus or minus 112 cords at the 95% confidence level. The estimated units are final and not subject to adjustment. Prospective bidders are urged to examine this timber and to make their own estimates of quantity and quality.

BOND AND PAYMENT SCHEDULE:

1. A bond in the amount of \$1,473.00 to insure faithful performance of the conditions of the contract will be deposited by the successful bidder within 21 days of the sale award.
2. Cutting in any sale or unit without the required advance payment would be considered a trespass.
3. Total payment must be paid in advance or according to the following schedule :
 - (a) Ten percent (10%) of the sale value must be paid within 21 days of the sale award.
 - (b) The 10% down payment will be credited towards the first unit cut.
 - (c) Payment for each of the following units must be made before cutting begins in that unit:

PAYMENT UNIT NUMBER	PERCENT OF TOTAL SALE VALUE
01	46.0%
02	16.7%
03	37.3%

4. If no cutting takes place, the 10% down payment will not be refunded.
5. Operations on the contract issued will terminate on 06/30/2024.

SALE STATISTICS

Volumes were calculated in cubic feet using the Michigan taper model. Cubic foot volume includes all wood inside bark for the product indicated. For display purposes, cubic feet were converted to cords and MBF using a simple conversion factor, e.g. 79 cubic feet per cord and 185 cubic feet per MBF. The cubic foot volumes are precise; the cords and MBF volumes are not. Cubic foot volume cannot be directly converted to cords or boards with precision.

SALE VOLUMES

The total estimated sale volume may not equal the sum of the species/products due to the nature of statistical calculations associated with double sampling methodology.

VOLUME			STATISTICAL RANGE IN CORDS	
TOTAL CUBIC FEET	TOTAL CORDS	PERCENT ERROR	MINIMUM	MAXIMUM
108,676	1,376	8.16%	1,263	1,488

VDU VOLUMES

A VDU is a Volume Determination Unit. Volumes and their associated statistics are calculated at the VDU level and summarized to the sale level. There is often a one to one relationship between a VDU and a Payment Unit, but not always, depending on the cruise design. Refer to the VDU TO PAYMENT UNIT table.

	VOLUME			RANGE IN CORDS	
VDU	TOTAL CUBIC FEET	TOTAL CORDS	PERCENT ERROR	MINIMUM	MAXIMUM
1	39,220	496	14.03%	427	566
26	65,358	827	9.98%	745	910
TOTAL:	104,578	1,324		1,172	1,476

VDU TO PAYMENT UNIT

When a VDU is associated with more than one Payment Unit (PU), the VDU volumes are assigned to the PU based on acres of the VDU within the PU.

VDU	VDU ACRES	PU	PU ACRES
1	19.8	1	19.8
26	67.5	2	20.9
		3	46.6
TOTAL:	87.3		87.3

DESCRIPTION OF TIMBER BY PAYMENT UNIT (PU)

PU	MARKET GROUP	PRODUCT	QUANTITY	UNIT	ACRES	ADVERTISE PRICE
1	Red Pine	Sawtimber	31.9	MBF	19.8	\$13,552.45
	White Oak		1.7	MBF		
	Jack Pine	Pulpwood	55	Cords		
	<i>Jack Pine</i>	<i>Sawtimber</i>	2.6	<i>MBF</i>		
	<i>Jack Pine</i>	<i>Pulpwood</i>	50	<i>Cords</i>		
	Mixed Aspen		304	Cords		
	<i>B. T. Aspen</i>	<i>Sawtimber</i>	11.4	<i>MBF</i>		
	<i>Quaking Aspen</i>		27.3	<i>MBF</i>		
	<i>B. T. Aspen</i>	<i>Pulpwood</i>	121	<i>Cords</i>		
	<i>Quaking Aspen</i>		105	<i>Cords</i>		
	Northern Pin Oak		17	Cords		
	Red Pine		53	Cords		
	White Oak		2	Cords		
	2	Northern Pin Oak	Sawtimber	3.5		
Red Pine			4.1	MBF		
Jack Pine		Pulpwood	210	Cords		
<i>Jack Pine</i>		<i>Sawtimber</i>	15.8	<i>MBF</i>		
<i>Jack Pine</i>		<i>Pulpwood</i>	178	<i>Cords</i>		
Northern Pin Oak			5	Cords		
Red Pine			21	Cords		
White Pine			5	Cords		
3		Northern Pin Oak	Sawtimber	7.7	MBF	46.6
	Red Pine		9.0	MBF		
	Jack Pine	Pulpwood	467	Cords		
	<i>Jack Pine</i>	<i>Sawtimber</i>	35.1	<i>MBF</i>		
	<i>Jack Pine</i>	<i>Pulpwood</i>	397	<i>Cords</i>		
	Northern Pin Oak		11	Cords		
	Red Pine		48	Cords		
	White Pine		12	Cords		
TOTAL:			57.9	MBF		
TOTAL:			1,210	Cords		

Sale Specific Conditions & Requirements

Sale Name: Joel's Yard Expansion

Sale Number: 72-013-21 Seq#: 2

1 - Sale Area

1.2 - Boundaries

1.2.1 - Painted boundaries (9/19)

The sale boundary and Payment Unit boundaries are marked and identified by red and yellow paint or are unmarked and identified by existing roads. Exterior sale boundary lines against private property are unmarked and identified by Whirlpool Road, S. Thendara Road, and M-72. Exterior sale boundary lines against state are marked with red paint except along North Down River Road and M-72. Interior Payment Unit boundaries are marked with yellow paint. Retention patches are marked with red paint; no harvesting activities may occur within these areas. The painted boundary line trees are not Included Timber and are to be protected. Yellow painted trees designating an interior Payment Unit boundary are only to be cut when all surrounding Payment Units have been paid.

2 - Timber Specifications

2.1 - Included Timber

2.1.1 - Clearcut unit(s) with unmerchantable trees (6/14)

Within Payment Unit(s) 1-3, cut all trees that are two (2) inches or more at DBH, except do not cut trees marked with green paint, and in Payment Unit 1 do not cut white pine or Allegheny Plum if found. Special protection trees identified in accordance with condition 3.4.2, within clearcutting unit boundaries, are not Included Timber and are to be protected.

2.2 - Utilization

2.2.2 - Chipping required (2/18)

Payment Units 2 and 3 must be chip harvested to facilitate subsequent planting operations. The Purchaser has the option to produce sawlogs or pulpwood bolts, but the remaining portion of the trees must be chipped and hauled. If market conditions limit the practicality of chipping, tops and slash must be arranged in a way that will not inhibit future planting operations, as directed by the sale administrator. A chipping exemption can be obtained if proposed operations are determined to be suitable for planting by reforestation staff. The requirement to retain approximately 1/6 to 1/3 of tree tops and limbs less than four inches in diameter is still applicable (G. C. & R. 2.2).

2.2.3 - Stump heights (4/07)

Stump heights within Payment Unit(s) 2 and 3 shall not exceed 6 inches for all trees. This is to facilitate planting operations.

3 - Payments

3.3 - Pre-measured Sales

3.3.4 - Dividing payment units (7/14)

Payment Unit(s) may be divided at the request of the Purchaser and upon approval of the Unit Manager. Dividing Payment Units is a contract modification which requires a Timber Sale Contract Amendment.

3.4 - Damaged Timber

3.4.1 - Damaged timber (7/16)

General Condition and Requirement 3.4 Damaged Timber, defines liquidated damages for undesignated live merchantable trees which are cut or injured. In addition, extreme care should be taken to avoid damage to pine seedlings and saplings in Payment Unit 1.

Within Payment Unit 1, if more than 25% of the pine seedlings or saplings (1/4" to 4.5" DBH) within a specified portion of the Sale Area are damaged, liquidated damages will be assessed at \$300 per acre for all acreage within that specified portion of the Sale Area that was damaged.

No damage is acceptable to undesignated live merchantable trees. Rates will be in accordance with General Condition and Requirement 3.4 Damaged Timber.

3.4.2 - Special Protection Trees (4/14)

The Purchaser shall not cut live or dead special protection trees within cutting units or clearings. Special protection trees are

Alleghany Plum located along North Down River Road in Payment Unit 1. If the Purchaser's operations have cut or damaged special protection trees through carelessness, the Purchaser shall pay \$500 as fixed, agreed and liquidated damages for each special protection tree cut or damaged. Such payment does not constitute ownership of the undesignated timber. The timber sale administrator will identify at pre-sale meeting.

4 - Transportation

4.1 - Construction

4.1.6 - Road construction (1/09)

Construction of new roads or improvements of existing roads shall be done in such a way as to minimize the environmental and visual impacts. Merchantable trees shall be cut and utilized unless otherwise directed. Non-merchantable trees shall be severed and laid flat on the ground. Slash shall be scattered, and not left in windrows and kept a minimum of 10 feet back from the road edge. Stumps shall be set upright, not left on edge, and be moved at least 10 feet away from the road edge. Disturbed soil shall be feathered into the woods and not left in berms or windrows.

4.1.7 - Road closure (10/11)

All new roads built into the sale must be blocked to vehicle traffic upon completion of the sale. Overgrown roads that are reopened shall be considered new roads. In general, this will require constructing a four (4') foot high berm of stumps and logs covered with earth. Stumps and brush must be placed along the remainder of the trail. These roads must be rendered impassable to cars and trucks. All stumps from road building and landing construction must be reserved to block any newly constructed roads upon completion of the sale. These stumps must be scattered along the road system to prohibit vehicular movement. Contact the sale administrator for specific details of design and placement.

4.1.11 - Permits (2/12)

The Purchaser will secure any necessary permits that may be required.

4.2 - Maintenance

4.2.2 - Fill material (4/07)

To maintain roads, fill material may be needed in areas where "holes" exist or may be expected to develop. This fill material should be placed before trucking begins.

4.2.5 - Two wheel drive condition (2/04)

All existing trail roads on and adjacent to the sale area must be passable by two-wheel drive traffic for the duration of the sale.

5 - Operations

5.1 - Notification

5.1.1 - Pre-sale conference (10/16)

A pre-sale conference on site between the Purchaser and sale administrator is required prior to beginning any operations to determine landing and road locations as well as identifying a potential Alleghany Plum location.

5.2 - Conduct of Operations

5.2.2 - Hazard Trees/Snags

5.2.2.1 - Den trees (10/16)

Obvious hollow and/or den trees shall be protected and left standing unless they are a safety hazard.

5.2.4 - Dead and Down Creation

5.2.4.4 - Dead and down creation, grouse (6/18)

To encourage grouse and other wildlife, in Payment Unit(s) 1, leave one 12" or larger diameter (or largest diameter trees within stand) whole tree on the ground for every 2 acres, preferably a hardwood species such as oak or maple or if no hardwoods are present, a pine species (white or red). These will be evenly scattered throughout the Payment Unit.

These trees will be evenly scattered throughout the Payment Unit, preferably at least two chains from any roads, two-tracks, or trails open to vehicles.

5.2.29 - Shrub protection (1/20)

Reasonable care should be taken to avoid cutting or damaging hawthorn and junberry. These woody-shrub plants are highly beneficial to various wildlife species.

5.2.32 - Decking/landing restoration (9/13)

All decking and landing areas must have the surface area restored to a condition equal to or better than before. This is to ensure the proper regeneration of the stand. Wood debris, chips, and "cookies" from trimmings must be removed or scattered away from landing and loading areas and may not be windrowed on the edge.

6 - Safety and Fire Prevention

6.2 - Signing

6.2.1 - Road posting (10/20)

The Purchaser is responsible for posting and maintaining caution signs on M-72 and North Down River Road prior to beginning operations. The road must be posted at appropriate distances from the Sale Area to warn of logging activity and truck traffic. Signs must be removed when harvest operations are suspended or completed. The Purchaser will provide these signs.



Sale Number	Year
72 - 013	21

TIMBER SALE MAP

This information provided by authority of Part 525, 1994 PA 451, as amended.

Forest Management Unit	County	Mapped By	Date	Page	of
Grayling	Crawford	Scott McClarren/Money bros	10/07/2021	1	2
Township	Range	Section(s) and Subdivision(s)	Scale		
26N	03W	Sec. 1: N1/2NW, Sec. 2: NENE, Sec 12: S1/2SW,SE	1:7,920		

Cover Type				Density	
A = Aspen	H = Hemlock	N = Marsh	U = Upland Brush	0 = Non Stocked	5 = Pole Timber Medium
B = Paper Birch	J = Jack Pine	O = Oak	UM = Upland Mixed	1 = Seedling Sapling Poor	6 = Pole Timber Well
C = Cedar	L = Lowland Brush	P = Lowland Poplar	V = Bog or Marsh	2 = Seedling Sapling Medium	7 = Saw Timber Poor
D = Treed Bog	LM = Lowland Mixed	Q = Mixed Swamp Conifer	W = White Pine	3 = Seedling Sapling Well	8 = Saw Timber Medium
E = Swamp Hdwoods	M = Mpl, Bch, Brch	R = Red Pine	X = Non Stocked	4 = Pole Timber Poor	9 = Saw Timber Well
F = Spruce Fir	MC = Mixed Conifer	S = Black Spruce	Z = Water		
G = Grass	MD = Mixed Deciduous	T = Tamarack			

PU	Acres
1	19.8
2	20.9
3	46.6

Joel's Yard Expansion

Compartment 236

87.3 Acres

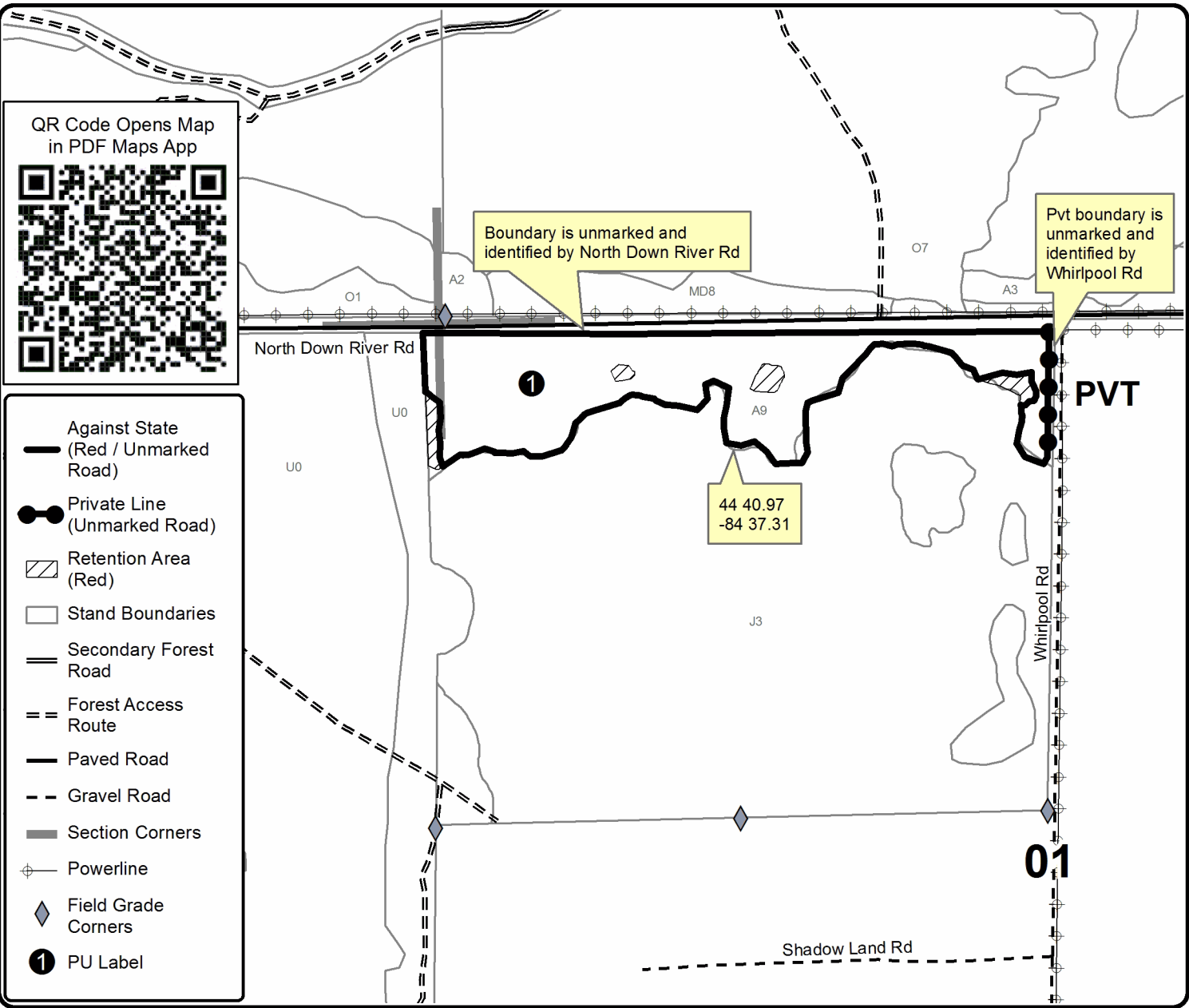



Sale Number	Year
72 - 013	21

TIMBER SALE MAP

This information provided by authority of Part 525, 1994 PA 451, as amended.

Forest Management Unit	County	Mapped By	Date	Page	of
Grayling	Crawford	Scott McClarren/Money bros	10/07/2021	2	2
Township	Range	Section(s) and Subdivision(s)	Scale		
26N	03W	Sec. 1: N1/2NW, Sec. 2: NENE, Sec 12: S1/2SW,SE	1:7,920		

Cover Type				Density	
A = Aspen	H = Hemlock	N = Marsh	U = Upland Brush	0 = Non Stocked	5 = Pole Timber Medium
B = Paper Birch	J = Jack Pine	O = Oak	UM = Upland Mixed	1 = Seedling Sapling Poor	6 = Pole Timber Well
C = Cedar	L = Lowland Brush	P = Lowland Poplar	V = Bog or Marsh	2 = Seedling Sapling Medium	7 = Saw Timber Poor
D = Treed Bog	LM = Lowland Mixed	Q = Mixed Swamp Conifer	W = White Pine	3 = Seedling Sapling Well	8 = Saw Timber Medium
E = Swamp Hdwoods	M = Mpl. Bch, Brch	R = Red Pine	X = Non Stocked	4 = Pole Timber Poor	9 = Saw Timber Well
F = Spruce Fir	MC = Mixed Conifer	S = Black Spruce	Z = Water		
G = Grass	MD = Mixed Deciduous	T = Tamarack			

PU	Acres
1	19.8
2	20.9
3	46.6

Joel's Yard Expansion

Compartment 236

87.3 Acres

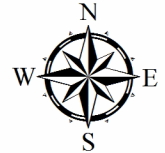

Payment Unit (Yellow)	Stand Boundaries	Section Corners
Against State (Red / Unmarked Road)	Highway	Field Grade Corners
Private Line (Unmarked Roads)	Secondary Forest Road	PU Label
Retention Area (Red)	Gravel Road	State Forest Campgrounds
	River	

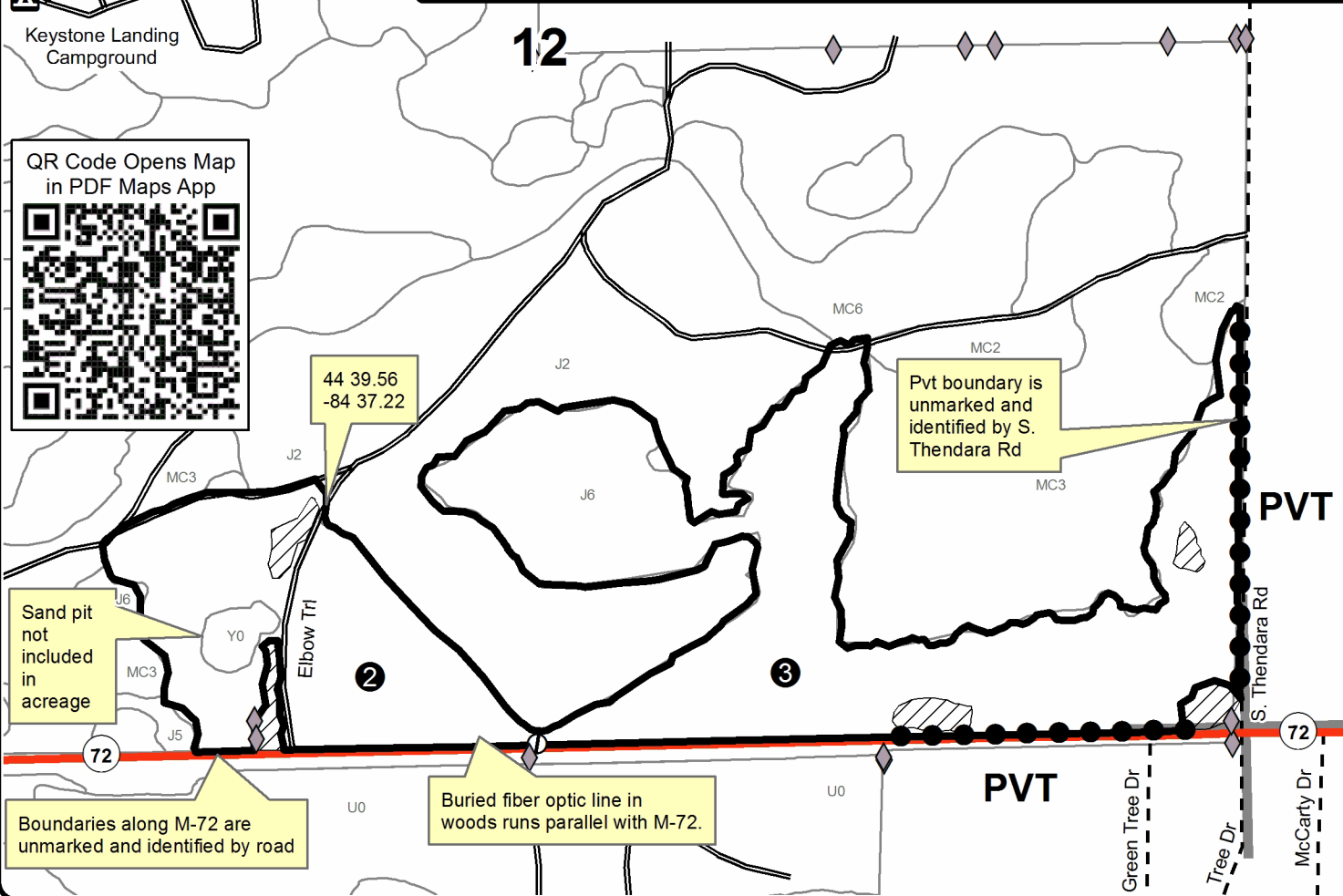

QR Code Opens Map in PDF Maps App

44 39.56
-84 37.22

Pvt boundary is unmarked and identified by S. Thendara Rd

Sand pit not included in acreage

Boundaries along M-72 are unmarked and identified by road

Buried fiber optic line in woods runs parallel with M-72.



TIMBER SALE INFORMATION

Pipeline HWs (72-030-21)

T28N, R03W, SEC. 31.

Crawford County (Advertised Price \$40,747.40)

SALE NOTE: All units of volume listed for this sale were estimated using the Inventory Manager computer program and the new Michigan taper model.

The beech component in this lower-quality hardwoods stand is breaking up. The site will be converted to Red Pine management. There is a heavy understory of beech and ironwood that must be cut cleanly in order to facilitate follow-up planting operations. CR-612 from I-75 to Old 27 was a Class-A road in 2021.

A recreation site such as a trail, pathway, or campground is within the sale area or the vicinity. Certain restrictions/specifications may be applicable including time restrictions.

A timber sale contract for this lump sum, sealed bid timber sale will be awarded to the responsible bidder offering the highest sealed bid price. All units of volume listed below were estimated using the Inventory Manager computer program and the new Michigan taper model. Bids must be at or above the following advertised price for each product and species:

<u>PRODUCTS & SPECIES</u>	<u>ESTIMATED UNITS*</u>	<u>ADVERTISED PRICE</u>
Sawtimber		
Beech	3.9 MBF	\$ 69.00 / MBF
Red Maple	9.1 MBF	\$ 50.00 / MBF
Red Pine	8.5 MBF	\$ 89.00 / MBF
Sugar Maple	119.1 MBF	\$ 165.00 / MBF
White Pine	8.5 MBF	\$ 57.00 / MBF
Pulpwood		
Misc. Species 1	2 Cords	\$ 5.50 / Cord
Mixed Aspen	136 Cords	\$ 25.10 / Cord
Mixed Hardwood	620 Cords	\$ 24.75 / Cord
Red Pine	7 Cords	\$ 31.10 / Cord
White Pine	7 Cords	\$ 20.50 / Cord

* The total volume is statistically estimated within plus (+) or minus (-) 7.71 percent. There are an estimated 1,126 cords on this timber sale, plus or minus 87 cords at the 95% confidence level. The estimated units are final and not subject to adjustment. Prospective bidders are urged to examine this timber and to make their own estimates of quantity and quality.

BOND AND PAYMENT SCHEDULE:

1. A bond in the amount of \$2,037.00 to insure faithful performance of the conditions of the contract will be deposited by the successful bidder within 21 days of the sale award.
2. Cutting in any sale or unit without the required advance payment would be considered a trespass.
3. Total payment must be paid in advance or according to the following schedule :
 - (a) Ten percent (10%) of the sale value must be paid within 21 days of the sale award.
 - (b) The 10% down payment will be credited towards the first unit cut.

(c) Payment for each of the following units must be made before cutting begins in that unit:

PAYMENT UNIT NUMBER	PERCENT OF TOTAL SALE VALUE
01	45.0%
02	55.0%

4. If no cutting takes place, the 10% down payment will not be refunded.
5. Operations on the contract issued will terminate on 06/30/2024.

SALE STATISTICS

Volumes were calculated in cubic feet using the Michigan taper model. Cubic foot volume includes all wood inside bark for the product indicated. For display purposes, cubic feet were converted to cords and MBF using a simple conversion factor, e.g. 79 cubic feet per cord and 185 cubic feet per MBF. The cubic foot volumes are precise; the cords and MBF volumes are not. Cubic foot volume cannot be directly converted to cords or boards with precision.

SALE VOLUMES

The total estimated sale volume may not equal the sum of the species/products due to the nature of statistical calculations associated with double sampling methodology.

VOLUME			STATISTICAL RANGE IN CORDS	
TOTAL CUBIC FEET	TOTAL CORDS	PERCENT ERROR	MINIMUM	MAXIMUM
88,930	1,126	7.71%	1,039	1,213

VDU VOLUMES

A VDU is a Volume Determination Unit. Volumes and their associated statistics are calculated at the VDU level and summarized to the sale level. There is often a one to one relationship between a VDU and a Payment Unit, but not always, depending on the cruise design. Refer to the VDU TO PAYMENT UNIT table.

	VOLUME			RANGE IN CORDS	
VDU	TOTAL CUBIC FEET	TOTAL CORDS	PERCENT ERROR	MINIMUM	MAXIMUM
19	84,583	1,071	7.72%	988	1,153
TOTAL:	84,583	1,071		988	1,153

VDU TO PAYMENT UNIT

When a VDU is associated with more than one Payment Unit (PU), the VDU volumes are assigned to the PU based on acres of the VDU within the PU.

VDU	VDU ACRES	PU	PU ACRES
19	29.8	1	13.4
		2	16.4
TOTAL:	29.8		29.8

DESCRIPTION OF TIMBER BY PAYMENT UNIT (PU)

PU	MARKET GROUP	PRODUCT	QUANTITY	UNIT	ACRES	ADVERTISE PRICE
1	Beech	Sawtimber	1.8	MBF	13.4	\$18,324.65
	Red Maple		4.1	MBF		
	Red Pine		3.8	MBF		
	Sugar Maple		53.6	MBF		
	White Pine		3.8	MBF		
	Misc. Species 1	Pulpwood	1	Cords		
	Mixed Aspen		61	Cords		
	<i>B. T. Aspen</i>		46	<i>Cords</i>		
	<i>Quaking Aspen</i>		15	<i>Cords</i>		
	Mixed Hardwood		279	Cords		
	<i>Beech</i>		38	<i>Cords</i>		
	<i>Red Maple</i>		10	<i>Cords</i>		
	<i>Sugar Maple</i>		231	<i>Cords</i>		
	Red Pine		3	Cords		
	White Pine		3	Cords		
2	Beech	Sawtimber	2.1	MBF	16.4	\$22,422.75
	Red Maple		5.0	MBF		
	Red Pine		4.7	MBF		
	Sugar Maple		65.5	MBF		
	White Pine		4.7	MBF		
	Misc. Species 1	Pulpwood	1	Cords		
	Mixed Aspen		75	Cords		
	<i>B. T. Aspen</i>		56	<i>Cords</i>		
	<i>Quaking Aspen</i>		19	<i>Cords</i>		
	Mixed Hardwood		341	Cords		
	<i>Beech</i>		46	<i>Cords</i>		
	<i>Red Maple</i>		13	<i>Cords</i>		
	<i>Sugar Maple</i>		282	<i>Cords</i>		
	Red Pine		4	Cords		
	White Pine		4	Cords		
TOTAL:			149.1	MBF		
TOTAL:			772	Cords		

Sale Specific Conditions & Requirements

Sale Name: Pipeline HWs

Sale Number: 72-030-21 Seq#: 2

1 - Sale Area

1.2 - Boundaries

1.2.1 - Painted boundaries (9/19)

The sale boundary and Payment Unit boundaries are marked and identified by blue and red paint and designated unpainted boundaries as shown on the Timber Sale Map. Exterior sale boundary lines against private property are marked with blue paint. Exterior sale boundary lines against state are marked with red paint in addition to an unpainted boundary designated as the I-75 ROW fence. Interior Payment Unit boundaries are unpainted and designated as the cleared pipeline corridor. The painted boundary line trees are not Included Timber and are to be protected.

2 - Timber Specifications

2.1 - Included Timber

2.1.1 - Clearcut unit(s) with unmerchantable trees (6/14)

Within Payment Unit(s) 1 and 2, cut all trees that are one (1) inch or more at DBH, including standing dead hardwoods.

2.1.11 - Description of timber note (2/04)

Note that Misc species 1 = dead mixed hardwoods.

2.2 - Utilization

2.2.2 - Chipping required (2/18)

This area must be chip harvested to facilitate subsequent planting operations. The Purchaser has the option to produce sawlogs or pulpwood bolts, but the remaining portion of the trees must be chipped and hauled. A chipping exemption can be obtained if proposed operations are determined to be suitable for planting by reforestation staff. This exemption must be granted in writing. The requirement to retain approximately 1/6 to 1/3 of tree tops and limbs less than four inches in diameter is still applicable (G. C. & R. 2.2).

2.2.3 - Stump heights (4/07)

Stump heights within the Sale Area shall not exceed 6 inches for all trees. This is to facilitate planting operations.

3 - Payments

3.3 - Pre-measured Sales

3.3.4 - Dividing payment units (7/14)

Payment Unit(s) may be divided at the request of the Purchaser and upon approval of the Unit Manager. Dividing Payment Units is a contract modification which requires a Timber Sale Contract Amendment.

4 - Transportation

4.1 - Construction

4.1.3 - Slash and earthen piles (8/04)

Piles or windrows of earth along roads and landings that have been widened or constructed shall be leveled. Slash from road maintenance or construction, including stumps, shall be chipped, utilized, or otherwise removed from the sale.

4.1.6 - Road construction (1/09)

Construction of new roads or improvements of existing roads shall be done in such a way as to minimize the environmental and visual impacts. Merchantable trees shall be cut and utilized unless otherwise directed. Non-merchantable trees shall be severed and laid flat on the ground. Slash shall be chipped, utilized, or scattered a minimum of 10 feet back from the road edge. Stumps shall be set upright, not left on edge, and be moved at least 10 feet away from the road edge. Disturbed soil shall be feathered into the woods and not left in berms or windrows.

4.1.7 - Road closure (10/11)

All new roads built into the sale must be blocked to vehicle traffic upon completion of the sale. Overgrown roads that are

reopened shall be considered new roads. In general, this will require constructing a four (4') foot high berm of stumps and logs covered with earth. Stumps and brush must also be placed along the first 50 feet of trail behind the berms. These roads must be rendered impassable to cars and trucks. Contact the sale administrator for specific details of design and placement.

4.1.11 - Permits (2/12)

The Purchaser will secure any necessary permits that may be required.

5 - Operations

5.1 - Notification

5.1.1 - Pre-sale conference (10/16)

A pre-sale conference on site between the Purchaser and sale administrator is required prior to beginning any operations. The Unit Manager or his/her representative must be contacted at least 5 days in advance to schedule the conference.

5.1.3 - Well heads and natural gas pipelines (11/15)

The Purchaser is responsible for contacting the pipeline company prior to operating equipment in the vicinity of well heads or natural gas pipelines. Contact DTE at (231) 258-3750 to coordinate operations around the pipeline. Operations may begin away from the pipeline after the Pre-Work meeting, but plan for at least ten days after the initial pipeline contact to allow DTE time to armor the planned pipeline crossing.

5.1.4 - Post-sale conference (10/16)

A post-sale conference on site between the Purchaser and sale administrator is required prior to the completion of active logging operations to determine clean-up and repair of landings, road edges, and the fulfillment of other contract specifications.

5.2 - Conduct of Operations

5.2.2 - Hazard Trees/Snags

5.2.2.1 - Den trees (10/16)

Obvious hollow and/or den trees shall be protected and left standing unless they are a safety hazard. This spec applies to protecting the aspen snags.

5.2.38 - No decking against live trees (2/04)

Cut products may not be decked against unmarked or designated leave trees.

5.2.43 - Opening protection (2/21)

No off-road activities are permitted in either of the openings marked on the Timber Sale Map with the letter "G". Equipment may use the existing road through the north opening. Most of the south opening is on Hartwick Pines State Park lands and it cannot be used for any purposes.

5.4 - Soil Protection

5.4.1 - Rutting restriction, general (7/16)

Operations are to cease immediately if equipment and weather conditions result in rutting of roads and/or skid trails which is 12 inches or greater in depth and 50 feet in length. The Unit Manager or his/her representative may restrict hauling and/or skidding if ruts exceed the specified depth. With the Unit Manager or his/her representative's approval, the Purchaser may return to the area when the risk of rutting has decreased.

5.5 - Protection of Improvements

5.5.3 - Protection of improvements detail (10/13)

Protect the I-75 ROW fence that forms the sale's east boundary. The fence has deadfalls on it from the beech breaking up, but avoid doing additional damage during harvest operations.

6 - Safety and Fire Prevention

6.2 - Signing

6.2.1 - Road posting (10/20)

The Purchaser is responsible for posting and maintaining caution signs on the woods road haul route prior to beginning operations. The road must be posted where the haul route turns off CR 612 and approximately 200 feet south of the Sale

Area to warn of logging activity and truck traffic. Signs must be removed when harvest operations are suspended or completed. The Purchaser will provide these signs.

7 - Other Conditions

7.5 - Loss

7.5.1 - Deteriorating timber (7/09)

The sale area has received damage from Beech Bark Disease. The Purchaser should harvest the wood as soon as possible. The Department of Natural Resources is held free of responsibility of any further damage or deterioration due to delay in harvesting.



TIMBER SALE MAP

This information provided by authority of Part 525, 1994 PA 451, as amended.

Forest Management Unit Grayling	County Crawford	Mapped By Charlebois	Date 10/26/2021	Page 1	of 1
Township 28N	Range 03W	Section(s) and Subdivision(s) Section 31: SWSE, S1/2SW	Scale 1:15,840		

Cover Type				Density	
A = Aspen	H = Hemlock	N = Marsh	U = Upland Brush	0 = Non Stocked	5 = Pole Timber Medium
B = Paper Birch	J = Jack Pine	O = Oak	UM = Upland Mixed	1 = Seedling Sapling Poor	6 = Pole Timber Well
C = Cedar	L = Lowland Brush	P = Lowland Poplar	V = Bog or Marsh	2 = Seedling Sapling Medium	7 = Saw Timber Poor
D = Treed Bog	LM = Lowland Mixed	Q = Mixed Swamp Conifer	W = White Pine	3 = Seedling Sapling Well	8 = Saw Timber Medium
E = Swamp Hdwoods	M = Mpl, Bch, Brch	R = Red Pine	X = Non Stocked	4 = Pole Timber Poor	9 = Saw Timber Well
F = Spruce Fir	MC = Mixed Conifer	S = Black Spruce	Z = Water		
G = Grass	MD = Mixed Deciduous	T = Tamarack			

PU Acres

1	13.4
2	16.4

Pipeline HWs

Compartment 216
29.8 Acres



scan for geo-PDF map

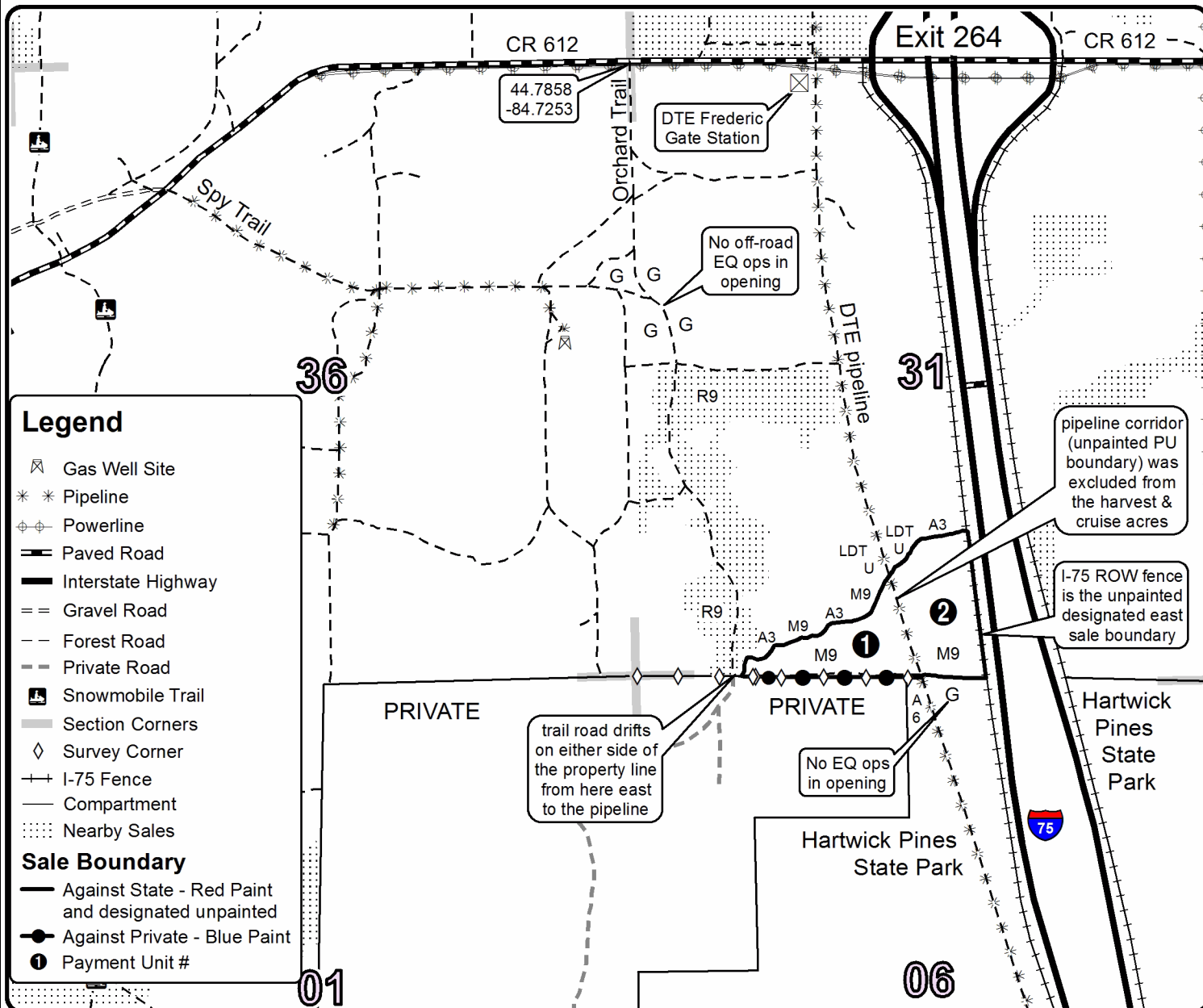

TIMBER SALE INFORMATION

Gypsy Rain Oak (72-607-21)
T27N, R02W, SEC. 22; T27N, R02W, SEC. 27.
Crawford County (Advertised Price \$52,735.65)

SALE NOTE: Sale is on military land and is non-certified timber. Sale contains military sale specs as well as timing restrictions. Sale also contains oak wilt timing restrictions.

A timber sale contract for this lump sum, sealed bid timber sale will be awarded to the responsible bidder offering the highest sealed bid price. All units of volume listed below were estimated using the Inventory Manager computer program and the new Michigan taper model. Bids must be at or above the following advertised price for each product and species:

<u>PRODUCTS & SPECIES</u>	<u>ESTIMATED UNITS*</u>	<u>ADVERTISED PRICE</u>
Sawtimber		
BI/R/Hybrid Oak	47.4 MBF	\$ 100.00 / MBF
Red Pine	131.6 MBF	\$ 89.00 / MBF
White Oak	120.0 MBF	\$ 73.00 / MBF
Pulpwood		
B. T. Aspen	201 Cords	\$ 25.10 / Cord
Jack Pine	133 Cords	\$ 15.90 / Cord
Mixed Oak	503 Cords	\$ 22.95 / Cord
Red Maple	242 Cords	\$ 24.75 / Cord
Red Pine	91 Cords	\$ 31.10 / Cord

* The total volume is statistically estimated within plus (+) or minus (-) 5.46 percent. There are an estimated 1,940 cords on this timber sale, plus or minus 106 cords at the 95% confidence level. The estimated units are final and not subject to adjustment. Prospective bidders are urged to examine this timber and to make their own estimates of quantity and quality.

BOND AND PAYMENT SCHEDULE:

1. A bond in the amount of \$2,637.00 to insure faithful performance of the conditions of the contract will be deposited by the successful bidder within 21 days of the sale award.
2. Cutting in any sale or unit without the required advance payment would be considered a trespass.
3. Total payment must be paid in advance or according to the following schedule :
 - (a) Ten percent (10%) of the sale value must be paid within 21 days of the sale award.
 - (b) The 10% down payment will be credited towards the first unit cut.
 - (c) Payment for each of the following units must be made before cutting begins in that unit:

PAYMENT UNIT NUMBER	PERCENT OF TOTAL SALE VALUE
01	9.8%
02	23.9%
03	26.6%
04	39.7%
4. If no cutting takes place, the 10% down payment will not be refunded.
5. Operations on the contract issued will terminate on 03/31/2024.

SALE STATISTICS

Volumes were calculated in cubic feet using the Michigan taper model. Cubic foot volume includes all wood inside bark for the product indicated. For display purposes, cubic feet were converted to cords and MBF using a simple conversion factor, e.g. 79 cubic feet per cord and 185 cubic feet per MBF. The cubic foot volumes are precise; the cords and MBF volumes are not. Cubic foot volume cannot be directly converted to cords or boards with precision.

SALE VOLUMES

The total estimated sale volume may not equal the sum of the species/products due to the nature of statistical calculations associated with double sampling methodology.

VOLUME		STATISTICAL RANGE IN CORDS		
TOTAL CUBIC FEET	TOTAL CORDS	PERCENT ERROR	MINIMUM	MAXIMUM
153,267	1,940	5.46%	1,834	2,046

VDU VOLUMES

A VDU is a Volume Determination Unit. Volumes and their associated statistics are calculated at the VDU level and summarized to the sale level. There is often a one to one relationship between a VDU and a Payment Unit, but not always, depending on the cruise design. Refer to the VDU TO PAYMENT UNIT table.

VDU	VOLUME		PERCENT ERROR	RANGE IN CORDS	
	TOTAL CUBIC FEET	TOTAL CORDS		MINIMUM	MAXIMUM
54	14,998	190	21.01%	150	230
58	24,840	314	8.94%	286	343
61	6,111	77	19.63%	62	93
62	39,435	499	9.39%	452	546
63	54,420	689	9.77%	622	756
TOTAL:	139,804	1,770		1,572	1,967

VDU TO PAYMENT UNIT

When a VDU is associated with more than one Payment Unit (PU), the VDU volumes are assigned to the PU based on acres of the VDU within the PU.

VDU	VDU ACRES	PU	PU ACRES
54	14.1	1	14.1
58	26.7	2	26.7
61	4.2	2	4.2
62	21.2	3	21.0
		4	0.2
63	34.6	4	34.6
TOTAL:	100.8		100.8

DESCRIPTION OF TIMBER BY PAYMENT UNIT (PU)

PU	MARKET GROUP	PRODUCT	QUANTITY	UNIT	ACRES	ADVERTISE PRICE
1	BI/R/Hybrid Oak	Sawtimber	5.0	MBF	14.1	\$5,159.60
	White Oak		17.1	MBF		
	B. T. Aspen	Pulpwood	45	Cords		
	<i>B. T. Aspen</i>	<i>Sawtimber</i>	13.7	<i>MBF</i>		
	<i>B. T. Aspen</i>	<i>Pulpwood</i>	18	<i>Cords</i>		
	Jack Pine		11	Cords		
	<i>Jack Pine</i>		11	<i>Cords</i>		
	Mixed Oak		67	Cords		
	<i>BI/R/Hybrid Oak</i>		9	<i>Cords</i>		
	<i>White Oak</i>		58	<i>Cords</i>		
	Red Maple		23	Cords		
	<i>Red Maple</i>	<i>Sawtimber</i>	3.0	<i>MBF</i>		
	<i>Red Maple</i>	<i>Pulpwood</i>	17	<i>Cords</i>		
	2	BI/R/Hybrid Oak	Sawtimber	2.2		
Red Pine			48.3	MBF		
White Oak			51.6	MBF		
B. T. Aspen		Pulpwood	22	Cords		
<i>B. T. Aspen</i>		<i>Sawtimber</i>	5.6	<i>MBF</i>		
<i>B. T. Aspen</i>		<i>Pulpwood</i>	11	<i>Cords</i>		
Jack Pine			22	Cords		
<i>Jack Pine</i>		<i>Sawtimber</i>	5.7	<i>MBF</i>		
<i>Jack Pine</i>		<i>Pulpwood</i>	11	<i>Cords</i>		
Mixed Oak			116	Cords		
<i>BI/R/Hybrid Oak</i>			9	<i>Cords</i>		
<i>White Oak</i>			107	<i>Cords</i>		
Red Maple			11	Cords		
<i>Red Maple</i>			11	<i>Cords</i>		
Red Pine		16	Cords			
3	BI/R/Hybrid Oak	Sawtimber	11.3	MBF	21.0	\$14,021.25
	Red Pine		32.5	MBF		
	White Oak		27.9	MBF		
	B. T. Aspen	Pulpwood	63	Cords		
	<i>B. T. Aspen</i>	<i>Sawtimber</i>	22.0	<i>MBF</i>		
	<i>B. T. Aspen</i>	<i>Pulpwood</i>	19	<i>Cords</i>		
	Jack Pine		68	Cords		
	<i>Jack Pine</i>	<i>Sawtimber</i>	13.9	<i>MBF</i>		
	<i>Jack Pine</i>	<i>Pulpwood</i>	36	<i>Cords</i>		
	<i>White Pine</i>		4	<i>Cords</i>		
	Mixed Oak		151	Cords		
	<i>BI/R/Hybrid Oak</i>		27	<i>Cords</i>		
	<i>White Oak</i>		124	<i>Cords</i>		
	Red Maple		54	Cords		
<i>Red Maple</i>	<i>Sawtimber</i>	11.0	<i>MBF</i>			
<i>Red Maple</i>	<i>Pulpwood</i>	32	<i>Cords</i>			
Red Pine		16	Cords			
4	BI/R/Hybrid Oak	Sawtimber	28.9	MBF	34.8	\$20,960.00
	Red Pine		50.8	MBF		
	White Oak		23.4	MBF		
	B. T. Aspen	Pulpwood	71	Cords		
	<i>B. T. Aspen</i>	<i>Sawtimber</i>	17.4	<i>MBF</i>		
	<i>B. T. Aspen</i>	<i>Pulpwood</i>	36	<i>Cords</i>		
	Jack Pine		32	Cords		
	<i>Jack Pine</i>	<i>Sawtimber</i>	7.0	<i>MBF</i>		
	<i>Jack Pine</i>	<i>Pulpwood</i>	18	<i>Cords</i>		
	Mixed Oak		169	Cords		
	<i>BI/R/Hybrid Oak</i>		92	<i>Cords</i>		

DESCRIPTION OF TIMBER BY PAYMENT UNIT (PU), CON'T

PU	MARKET GROUP	PRODUCT	QUANTITY	UNIT	ACRES	ADVERTISE PRICE
4 con't	<i>White Oak</i>	<i>Pulpwood</i>	77	<i>Cords</i>		
	Red Maple		155	Cords		
	<i>Red Maple</i>	<i>Sawtimber</i>	12.8	<i>MBF</i>		
	<i>Red Maple</i>	<i>Pulpwood</i>	129	<i>Cords</i>		
	Red Pine		59	Cords		
TOTAL:			299.0	MBF		
TOTAL:			1,171	Cords		

Sale Specific Conditions & Requirements

Sale Name: Gypsy Rain Oak

Sale Number: 72-607-21 Seq#: 2

1 - Sale Area

1.2 - Boundaries

1.2.1 - Painted boundaries (9/19)

The sale boundary and Payment Unit boundaries are marked and identified by red and yellow paint or are unmarked and identified by existing roads. Exterior sale boundary line against private property is unmarked and identified by Wakely Bridge Road. Exterior sale boundary lines against state are marked with red paint. Interior Payment Unit boundaries are marked with yellow paint. Retention patches are marked with red paint; no harvesting activities may occur within these areas. The painted boundary line trees are not Included Timber and are to be protected. Yellow painted trees designating an interior Payment Unit boundary are only to be cut when all surrounding Payment Units have been paid.

2 - Timber Specifications

2.1 - Included Timber

2.1.1 - Clearcut unit(s) with unmerchantable trees (6/14)

Within Payment Unit(s) 3 and 4, cut all trees that are two (2) inches or more at DBH, except do not cut green marked trees.

2.1.5 - Overstory removal unit(s) (8/11)

Within Payment Unit(s) 1 and 2, all which meet minimum piece specifications in 2.2 Utilization, are designated for cutting, except do not cut trees marked with green paint.

2.2 - Utilization

2.2.2 - Chipping required (2/18)

Payment Units 1-4 must be chip harvested to meet National Guard requirements. However, the chipping requirement could be waived with military approval if chip markets are depressed. The Purchaser has the option to produce sawlogs or pulpwood bolts, but the remaining portion of the trees must be chipped and hauled. The requirement to retain approximately 1/6 to 1/3 of tree tops and limbs less than four inches in diameter does not apply (G. C. & R. 2.2). This is because this is military land.

2.2.3 - Stump heights (4/07)

Stump heights within the Sale Area shall not exceed 6 inches for all trees. This is to facilitate military requirements. A written waiver of this requirement may be obtained if wet summer weather makes winter logging necessary.

3 - Payments

3.3 - Pre-measured Sales

3.3.4 - Dividing payment units (7/14)

Payment Unit(s) may be divided at the request of the Purchaser and upon approval of the Unit Manager. Dividing Payment Units is a contract modification which requires a Timber Sale Contract Amendment.

3.4 - Damaged Timber

3.4.1 - Damaged timber (7/16)

General Condition and Requirement 3.4 Damaged Timber, defines liquidated damages for undesignated live merchantable trees which are cut or injured. In addition, extreme care should be taken to avoid damage to tree seedlings and saplings. Within Payment Units 1 and 2, if more than 30% of the tree seedlings or saplings (1/4" to 4.5" DBH) within a specified portion of the Sale Area are damaged, liquidated damages will be assessed at \$300 per acre for all acreage within that specified portion of the Sale Area that was damaged.

Within the Sale Area, if more than 5% of trees (> 4.5" DBH) within a specified area of the sale are damaged, liquidated damages will be assessed for all trees damaged. Rates will be in accordance with General Condition and Requirement 3.4 Damaged Timber.

Seedlings and saplings cut cleanly in skid trails will not be counted as damaged timber.

4 - Transportation

4.1 - Construction

4.1.7 - Road closure (10/11)

All new roads built into the sale must be blocked to vehicle traffic upon completion of the sale. All new roads built into the sale must be blocked to vehicle traffic within 30 days of completion of hauling. Overgrown roads that are reopened shall be considered new roads. Some existing roads may also need to be closed, see the Timber Sale Map for locations. In general, this will require constructing double earthen berms at strategic locations. In general, this will require constructing a four (4') foot high berm of stumps and logs covered with earth. Stumps and brush must be placed along the remainder of the trail. Berms must also be placed at intervals of not over 50 feet and at all junctions. These roads must be rendered impassable to cars and trucks. All stumps from road building and landing construction must be reserved to block any newly constructed roads upon completion of the sale. These stumps must be scattered along the road system to prohibit vehicular movement. Temporary berms may be required if no sale activity occurs for 30 or more consecutive days. Contact the sale administrator for specific details of design and placement.

4.1.11 - Permits (2/12)

The Purchaser will secure any necessary permits that may be required.

5 - Operations

5.2 - Conduct of Operations

5.2.2 - Hazard Trees/Snags

5.2.2.1 - Den trees (10/16)

Obvious hollow and/or den trees shall be protected and left standing unless they are a safety hazard.

5.2.3 - Operating Restrictions

5.2.3.4 - Oak wilt restriction, no exceptions (1/18)

Within Payment Unit(s) 1 and 2, cutting and skidding within the sale and brushing of access roads to the sale are not permitted during the period of April 15 to July 15. No exceptions will be granted. Hauling may be permitted if brushing of access roads is completed prior to restricted period. This is necessary to reduce the spread of oak wilt.

5.2.3.5 - Oak wilt restriction (1/18)

Within Payment Unit(s) 3 and 4, unless changed by written agreement, cutting, skidding, hauling within the sale and brushing of access roads to the sale are not permitted during the period of April 15 to July 15. Operations may be allowed if specific steps are taken to prevent damaging uncut oak during the high risk period. Those steps may include completing all road brushing before April 15th and clearing a tree-length buffer along uncut oak cover before April 15th. This is necessary to reduce the spread of oak wilt. For more information, contact the Unit Manager or his/her representative.

5.2.3.7 - National Guard training restriction (1/09)

Operations on this contract may not be allowed during National Guard training operations. Typically, the restricted period is from May 1 to October 31. The contractor must check with the Unit Manager who will coordinate the cutting schedule with the military.

5.2.29 - Shrub protection (1/20)

Reasonable care should be taken to avoid cutting or damaging hawthorn or juneberry. These woody-shrub plants are highly beneficial to various wildlife species.

5.2.32 - Decking/landing restoration (9/13)

All decking and landing areas must have the surface area restored to a condition equal to or better than before. This is to ensure the proper regeneration of the stand. Wood debris, chips, and "cookies" from trimmings must be removed or scattered away from landing and loading areas and may not be windrowed on the edge.

5.8 - Protection of Endangered Species

5.8.3 - Red shoulder hawk or goshawk (2/16)

In the event that an active red shoulder hawk or goshawk nest is found, the contract may be amended to protect the nest site

until the nest is determined to be inactive. The value of the trees in this excluded area will be refunded or credited to the Purchaser. The nest will be buffered with a five-chain radius (eight acre) protection area, centered on the nest tree, in which there will be no cutting or new roads constructed. Avoid human disturbance, including loading and skidding, in the protection area.

An additional zone of five chains (ten chains centered on the active nest tree) will be established in which there is no management activity from March 15 to July 15. Limit biomass harvesting and chipping operations within this ten-chain zone, retain the maximum one-third of residues per the Woody Biomass Harvesting Guidelines (Michigan DNR 2010). Nests determined to be inactive will be protected with a one-chain no-harvest buffer.

6 - Safety and Fire Prevention

6.2 - Signing

6.2.1 - Road posting (10/20)

The Purchaser is responsible for posting and maintaining caution signs on Wakely Bridge Road prior to beginning operations. The road must be posted at appropriate distances from the Sale Area to warn of logging activity and truck traffic. Signs must be removed when harvest operations are suspended or completed. The Purchaser will provide these signs.

7 - Other Conditions

7.10 - Certified Timber

7.10.1 - Non-certified timber (2/16)

The area encompassed by this timber sale is not certified to the standards of the Forest Stewardship Council (FSC) or the Sustainable Forestry Initiative (SFI). Forest products from this sale may not be delivered to the mill as "FSC and / or SFI certified". The lands within this sale are managed for military training.



TIMBER SALE MAP

This information provided by authority of Part 525, 1994 PA 451, as amended.

Forest Management Unit Grayling	County Crawford	Mapped By Scott McClarren	Date 07/23/2021	Page 1	of 1
Township 27N	Range 02W	Section(s) and Subdivision(s) Sec 27, NE, NWSE, E1/2NW	Scale 1:15,840		

Cover Type				Density	
A = Aspen	H = Hemlock	N = Marsh	U = Upland Brush	0 = Non Stocked	5 = Pole Timber Medium
B = Paper Birch	J = Jack Pine	O = Oak	UM = Upland Mixed	1 = Seedling Sapling Poor	6 = Pole Timber Well
C = Cedar	L = Lowland Brush	P = Lowland Poplar	V = Bog or Marsh	2 = Seedling Sapling Medium	7 = Saw Timber Poor
D = Treed Bog	LM = Lowland Mixed	Q = Mixed Swamp Conifer	W = White Pine	3 = Seedling Sapling Well	8 = Saw Timber Medium
E = Swamp Hdwoods	M = Mpl, Bch, Brch	R = Red Pine	X = Non Stocked	4 = Pole Timber Poor	9 = Saw Timber Well
F = Spruce Fir	MC = Mixed Conifer	S = Black Spruce	Z = Water		
G = Grass	MD = Mixed Deciduous	T = Tamarack			

PU	Acres	PU	Acres
1	14.1	4	34.8
2	30.9		
3	21		

Gypsy Rain Oak

Compartment 258

100.8 Acres

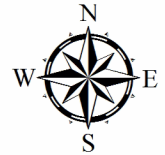

QR Code Opens Map in PDF Maps App

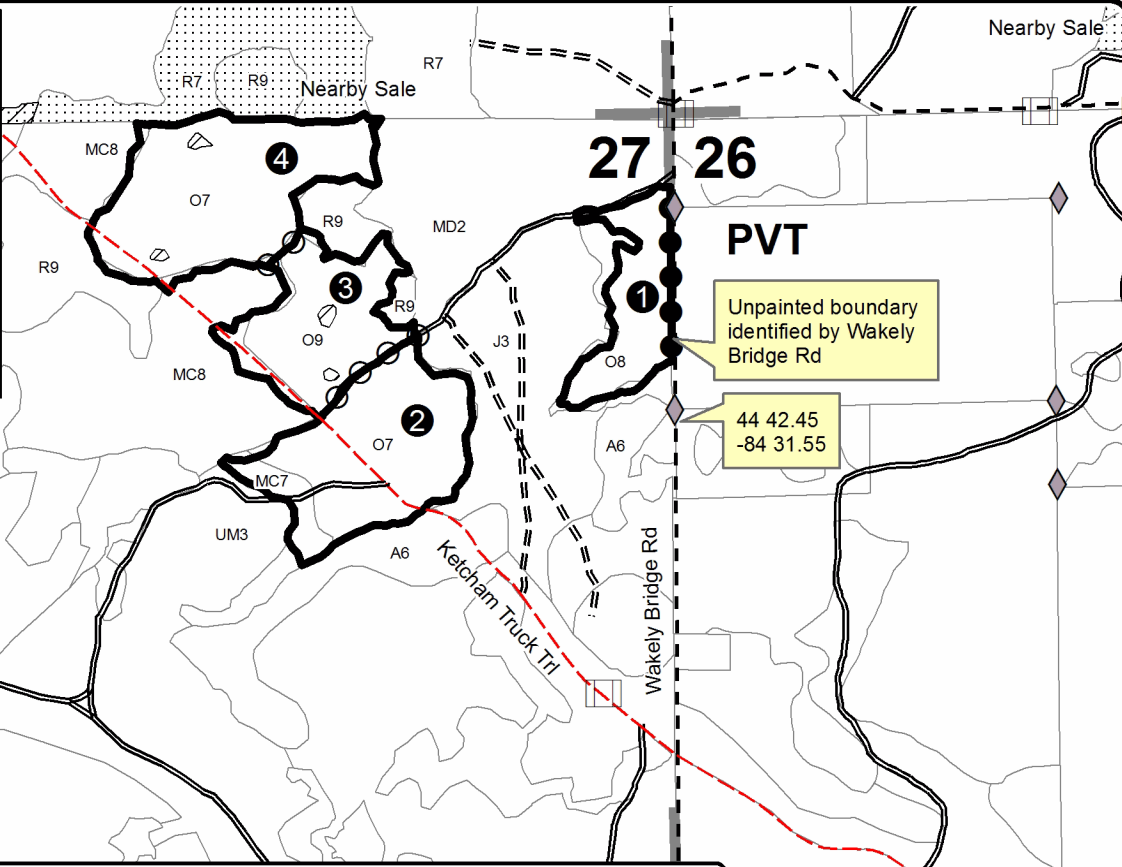

Against State (Red)	Camp Grayling Gates	Secondary Forest Road	Gravel Road
Payment Unit (Yellow)	PU Label	Forest Access Route	County Road - Seasonal
Private Line (road)	Field Grade Corners	Paved Road	Private
Retention Area	Section Corners		
Stand Boundaries			

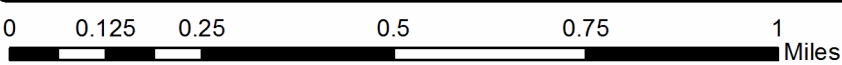

TIMBER SALE INFORMATION

M72 West (72-628-21)

T26N, R04W, SEC. 10; T26N, R04W, SEC. 11.
Crawford County (Advertised Price \$37,699.95)

SALE NOTE: All units of volume listed for this sale were estimated using the Inventory Manager computer program and the new Michigan taper model.

See sale spec 7.5.1 for information on declining oak.

The sale is on Hanson Refuge Lands that are managed for Military training. M-72 is a class-A road.

A recreation site such as a trail, pathway, or campground is within the sale area or the vicinity. Certain restrictions/specifications may be applicable including time restrictions.

A timber sale contract for this lump sum, sealed bid timber sale will be awarded to the responsible bidder offering the highest sealed bid price. All units of volume listed below were estimated using the Inventory Manager computer program and the new Michigan taper model. Bids must be at or above the following advertised price for each product and species:

<u>PRODUCTS & SPECIES</u>	<u>ESTIMATED UNITS*</u>	<u>ADVERTISED PRICE</u>
Sawtimber		
BI/R/Hybrid Oak	8.8 MBF	\$ 100.00 / MBF
Northern Pin Oak	177.0 MBF	\$ 100.00 / MBF
Red Pine	31.6 MBF	\$ 89.00 / MBF
White Pine	45.6 MBF	\$ 57.00 / MBF
Pulpwood		
B. T. Aspen	2 Cords	\$ 25.10 / Cord
Black Spruce	16 Cords	\$ 13.15 / Cord
Jack Pine	17 Cords	\$ 15.90 / Cord
Misc. Species 1	276 Cords	\$ 5.50 / Cord
Mixed Hardwood	32 Cords	\$ 24.75 / Cord
Mixed Oak	289 Cords	\$ 22.95 / Cord
Red Pine	34 Cords	\$ 31.10 / Cord
White Pine	155 Cords	\$ 20.50 / Cord

* The total volume is statistically estimated within plus (+) or minus (-) 6.33 percent. There are an estimated 1,356 cords on this timber sale, plus or minus 86 cords at the 95% confidence level. The estimated units are final and not subject to adjustment. Prospective bidders are urged to examine this timber and to make their own estimates of quantity and quality.

BOND AND PAYMENT SCHEDULE:

1. A bond in the amount of \$1,885.00 to insure faithful performance of the conditions of the contract will be deposited by the successful bidder within 21 days of the sale award.
2. Cutting in any sale or unit without the required advance payment would be considered a trespass.
3. Total payment must be paid in advance or according to the following schedule :
 - (a) Ten percent (10%) of the sale value must be paid within 21 days of the sale award.
 - (b) The 10% down payment will be credited towards the first unit cut.
 - (c) Payment for each of the following units must be made before cutting begins in that unit:

PAYMENT UNIT NUMBER	PERCENT OF TOTAL SALE VALUE
01	7.6%
02	33.3%
03	59.1%
4. If no cutting takes place, the 10% down payment will not be refunded.
5. Operations on the contract issued will terminate on 06/30/2024.

SALE STATISTICS

Volumes were calculated in cubic feet using the Michigan taper model. Cubic foot volume includes all wood inside bark for the product indicated. For display purposes, cubic feet were converted to cords and MBF using a simple conversion factor, e.g. 79 cubic feet per cord and 185 cubic feet per MBF. The cubic foot volumes are precise; the cords and MBF volumes are not. Cubic foot volume cannot be directly converted to cords or boards with precision.

SALE VOLUMES

The total estimated sale volume may not equal the sum of the species/products due to the nature of statistical calculations associated with double sampling methodology.

VOLUME			STATISTICAL RANGE IN CORDS	
TOTAL CUBIC FEET	TOTAL CORDS	PERCENT ERROR	MINIMUM	MAXIMUM
107,088	1,356	6.33%	1,270	1,441

VDU VOLUMES

A VDU is a Volume Determination Unit. Volumes and their associated statistics are calculated at the VDU level and summarized to the sale level. There is often a one to one relationship between a VDU and a Payment Unit, but not always, depending on the cruise design. Refer to the VDU TO PAYMENT UNIT table.

	VOLUME			RANGE IN CORDS	
VDU	TOTAL CUBIC FEET	TOTAL CORDS	PERCENT ERROR	MINIMUM	MAXIMUM
1	6,712	85	24.05%	65	105
3	63,810	808	7.27%	749	866
6	22,806	289	17.29%	239	339
7	13,230	167	17.82%	138	197
TOTAL:	106,558	1,349		1,190	1,508

VDU TO PAYMENT UNIT

When a VDU is associated with more than one Payment Unit (PU), the VDU volumes are assigned to the PU based on acres of the VDU within the PU.

VDU	VDU ACRES	PU	PU ACRES
1	3.4	1	3.4
3	55.4	2	34.3
		3	21.1
6	17.6	3	17.6
7	30.8	3	30.8
TOTAL:	107.2		107.2

DESCRIPTION OF TIMBER BY PAYMENT UNIT (PU)

PU	MARKET GROUP	PRODUCT	QUANTITY	UNIT	ACRES	ADVERTISE PRICE
1	Northern Pin Oak	Sawtimber	1.0	MBF	3.4	\$2,855.55
	Red Pine		18.7	MBF		
	Black Spruce	Pulpwood	10	Cords		
	Jack Pine		7	Cords		
	<i>Jack Pine</i>		7	<i>Cords</i>		
	Mixed Hardwood		2	Cords		
	<i>Red Maple</i>		2	<i>Cords</i>		
	Mixed Oak		5	Cords		
	<i>Northern Pin Oak</i>		5	<i>Cords</i>		
	Red Pine		22	Cords		
2	BI/R/Hybrid Oak	Sawtimber	5.4	MBF	34.3	\$12,566.90
	Northern Pin Oak		50.2	MBF		
	Red Pine		7.5	MBF		
	White Pine		22.4	MBF		
	B. T. Aspen	Pulpwood	1	Cords		
	Black Spruce		4	Cords		
	Jack Pine		4	Cords		
	<i>Jack Pine</i>		4	<i>Cords</i>		
	Misc. Species 1		130	Cords		
	Mixed Hardwood		7	Cords		
	<i>Red Maple</i>		7	<i>Cords</i>		
	Mixed Oak		93	Cords		
	<i>White Oak</i>	<i>Sawtimber</i>	0.4	<i>MBF</i>		
	<i>Northern Pin Oak</i>	<i>Pulpwood</i>	88	<i>Cords</i>		
	<i>White Oak</i>		4	<i>Cords</i>		
	Red Pine		7	Cords		
	White Pine		82	Cords		
3	BI/R/Hybrid Oak	Sawtimber	3.4	MBF	69.5	\$22,300.45
	Northern Pin Oak		125.8	MBF		
	Red Pine		5.4	MBF		
	White Pine		23.2	MBF		
	B. T. Aspen	Pulpwood	1	Cords		
	Black Spruce		2	Cords		
	Jack Pine		6	Cords		
	<i>Jack Pine</i>	<i>Sawtimber</i>	0.6	<i>MBF</i>		
	<i>Jack Pine</i>	<i>Pulpwood</i>	5	<i>Cords</i>		
	Misc. Species 1		146	Cords		
	Mixed Hardwood		23	Cords		
	<i>Red Maple</i>	<i>Sawtimber</i>	1.0	<i>MBF</i>		
	<i>Black Cherry</i>	<i>Pulpwood</i>	4	<i>Cords</i>		
	<i>Red Maple</i>		17	<i>Cords</i>		
	Mixed Oak		192	Cords		
	<i>White Oak</i>	<i>Sawtimber</i>	0.3	<i>MBF</i>		
	<i>Northern Pin Oak</i>	<i>Pulpwood</i>	189	<i>Cords</i>		
	<i>White Oak</i>		2	<i>Cords</i>		
	Red Pine		5	Cords		
White Pine		73	Cords			
TOTAL:			263.0	MBF		
TOTAL:			822	Cords		

Sale Specific Conditions & Requirements

Sale Name: M72 West

Sale Number: 72-628-21 Seq#: 2

1 - Sale Area

1.2 - Boundaries

1.2.1 - Painted boundaries (9/19)

The sale boundary and Payment Unit boundaries are marked and identified by blue, red, and yellow paint and designated unpainted boundaries as shown on the Timber Sale Map. Exterior sale boundary lines against private property are marked with blue paint. Exterior sale boundary lines against state are marked with red paint in addition to unpainted boundaries designated as the Snowmobile Trail on the east side and the powerline corridor and M-72 on the south side. Interior Payment Unit boundaries are marked with yellow paint in addition to an unpainted boundary designated as the mapped forest road that crosses through the Sale Area. The blue, red, and yellow painted boundary line trees are not Included Timber and are to be protected unless also marked with orange paint.

2 - Timber Specifications

2.1 - Included Timber

2.1.1 - Clearcut unit(s) with unmerchantable trees (6/14)

Within Payment Unit(s) 2 and 3, cut all trees that are one (1) inch or more at DBH, except green-marked trees. In addition, cut and utilize all standing dead oak trees that the top hasn't broke out of.

2.1.3 - Cut tree marked unit(s) (12/08)

Within Payment Unit(s) 1, red and white pine are designated for cutting when marked with orange paint above and below stump height, regardless of merchantability. In addition, cut all red maple, black spruce, jack pine and oak that contain at least one merchantable stick.

2.1.11 - Description of timber note (2/04)

Note that Misc Species 1 = standing dead oak that the top hasn't broke out of.

2.2 - Utilization

2.2.2 - Chipping required (2/18)

This area must be chip harvested to facilitate subsequent planting operations and to meet National Guard requirements. However, the chipping requirement could be waived with Military approval if chip markets are depressed and if proposed operations are determined to be suitable for planting by reforestation staff. This exemption must be granted in writing. The Purchaser has the option to produce sawlogs or pulpwood bolts, but the remaining portion of the trees must be chipped and hauled. The requirement to retain approximately 1/6 to 1/3 of tree tops and limbs less than four inches in diameter does not apply (G. C. & R. 2.2) because the sale is on lands managed for Military training.

2.2.3 - Stump heights (4/07)

Stump heights within the Sale Area shall not exceed 6 inches for all trees. This is to facilitate planting operations and meet Military requirements.

3 - Payments

3.3 - Pre-measured Sales

3.3.4 - Dividing payment units (7/14)

Payment Unit(s) 2 and 3 may be divided at the request of the Purchaser and upon approval of the Unit Manager. Dividing Payment Units is a contract modification which requires a Timber Sale Contract Amendment.

3.4 - Damaged Timber

3.4.1 - Damaged timber (7/16)

General Condition and Requirement 3.4 Damaged Timber, defines liquidated damages for undesignated live merchantable trees which are cut or injured.

No damage is acceptable to undesignated live merchantable trees. Within Payment Unit 1, if more than 10% of trees (> 4.5"

DBH) within a specified area of the sale are damaged, liquidated damages will be assessed for all trees damaged. Rates will be in accordance with General Condition and Requirement 3.4 Damaged Timber, or at a rate of \$50 per sawtimber tree and \$20 per pole sized tree, whichever is greater.

4 - Transportation

4.1 - Construction

4.1.3 - Slash and earthen piles (8/04)

Piles or windrows of earth along roads and landings that have been widened or constructed shall be leveled. Slash from road maintenance or construction, including stumps, shall be chipped, utilized, or dispersed into the sale.

4.1.6 - Road construction (1/09)

Construction of new roads or improvements of existing roads shall be done in such a way as to minimize the environmental and visual impacts. Merchantable trees shall be cut and utilized unless otherwise directed. Non-merchantable trees shall be severed and laid flat on the ground. Slash shall be chipped, utilized, or scattered a minimum of 10 feet back from the road edge. Stumps shall be set upright, not left on edge, and be moved at least 10 feet away from the road edge. Disturbed soil shall be feathered into the woods and not left in berms or windrows.

4.1.7 - Road closure (10/11)

All new roads built into the sale must be blocked to vehicle traffic upon completion of the sale. Overgrown roads that are reopened shall be considered new roads. In general, this will require constructing a four (4') foot high berm of stumps and logs covered with earth. Stumps and brush must also be placed along the first 50 feet of trail behind the berm. These roads must be rendered impassable to cars and trucks. Contact the sale administrator for specific details of design and placement.

4.1.11 - Permits (2/12)

The Purchaser will secure any necessary permits that may be required.

5 - Operations

5.1 - Notification

5.1.1 - Pre-sale conference (10/16)

A pre-sale conference on site between the Purchaser and sale administrator is required prior to beginning any operations. The Unit Manager or his/her representative must be contacted at least 5 days in advance to schedule the conference.

5.1.4 - Post-sale conference (10/16)

A post-sale conference on site between the Purchaser and sale administrator is required prior to the completion of active logging operations to determine clean-up and repair of landings, road edges, and the fulfillment of other contract specifications.

5.1.5 - National Guard notification (2/15)

This sale is upon lands utilized for training by the Michigan National Guard - Camp Grayling. A minimum of five (5) business days prior to opening this sale, the producer must request that the sale administrator contact the military for information regarding training plans that may impact sale operations.

5.2 - Conduct of Operations

5.2.2 - Hazard Trees/Snags

5.2.2.1 - Den trees (10/16)

Obvious hollow and/or den trees shall be protected and left standing unless they are a safety hazard. This spec is intended to protect the standing dead oak that had their tops broke out.

5.2.3 - Operating Restrictions

5.2.3.3 - Bark slippage restriction (3/09)

Within Payment Unit(s) 1, unless changed by written agreement, cutting and skidding are not permitted during the period of April 15 to July 15. This restriction is because of bark slippage.

5.2.3.5 - Oak wilt restriction (1/18)

Within Payment Unit(s) 2 and 3 unless changed by written agreement, cutting, skidding, hauling within the sale and brushing of access roads to the sale are not permitted during the period of April 15 to July 15. Operations may be allowed

if specific steps are taken to prevent damaging uncut oak during the high risk period. Those steps may include completing all road brushing before April 15th and clearing a tree-length buffer along uncut oak cover before April 15th. This is necessary to reduce the spread of oak wilt. For more information, contact the Unit Manager or his/her representative.

5.2.3.7 - National Guard training restriction (1/09)

Operations on this contract may not be allowed during National Guard training operations. Typically, the restricted period is from May 1 to October 31. Regardless of the time of year, the contractor must check with the Sale Administrator who will coordinate the cutting schedule with the Military. All harvest equipment and timber products may need to be removed from the Sale Area during the period of May 1 to October 31.

5.2.22 - Operating Caution

5.2.22.1 - Operating caution (6/11)

It is recommended, but not required, that within Payment Unit(s) 1, cutting and skidding occur during dry summer or frozen winter conditions. The reason for the recommendation is because the ground there has a seasonal high-water table.

5.2.38 - No decking against live trees (2/04)

Cut products may not be decked against unmarked or designated leave trees.

5.2.39 - ORV trail/route protection (4/18)

The Blue Bear is a dual ORV route and snowmobile trail and is shown on the Timber Sale Map. Do not cut trees or damage posts with orange ORV markers. All stumps within 5 feet of the trail must be cut flush with the ground. Maintain a 20-foot-wide slash, debris, and rut free zone daily using the ORV route as the centerline.

5.2.41 - Snowmobile trail protection (9/11)

The Blue Bear #7 is a dual snowmobile trail and ORV route and is shown on the Timber Sale Map. Do not cut or damage posts with orange trail markers or traffic control signs. If the trail is used, it must be maintained and restored to a condition equal to or better than before the sale. The road maintenance/restoration must be done prior to December 1. If the trail is used for hauling, it must be graded to the satisfaction of the Unit Manager or his/her representative prior to December 1. The snowmobile trail may not be used for any timber sale operations from December 1 to March 31 without written approval of Unit Manager. If the trail road is to be used for hauling during the snowmobile season, then a snow-covered base must be left on the trail. The snowmobile trail may only be crossed at right angles. Maintain a 20-foot-wide slash, debris, and rut free zone daily using the snowmobile trail as the centerline. No decking of forest products will be permitted along the snowmobile trail. In addition, any trees cut within 5 feet of the trail must be cut flush at ground level.

5.4 - Soil Protection

5.4.1 - Rutting restriction, general (7/16)

Operations are to cease immediately if equipment and weather conditions result in rutting of roads and/or skid trails which is 12 inches or greater in depth and 50 feet in length. The Unit Manager or his/her representative may restrict hauling and/or skidding if ruts exceed the specified depth. With the Unit Manager or his/her representative's approval, the Purchaser may return to the area when the risk of rutting has decreased.

5.5 - Protection of Improvements

5.5.3 - Protection of improvements detail (10/13)

The following are specific protection measures for this sale. The Blue Bear Trailhead Parking Lot may not be used for landing or decking without prior approval of the Unit Manager or his/her representative.

5.8 - Protection of Endangered Species

5.8.6 - Protection of eagle nests (5/12)

To protect an active eagle's nest, all harvesting operations within 660 feet of the nests are limited to the period of September 1 through December 31. At the time of timber sale preparation, known nest locations were outside of the harvest area and if found to be active would restrict operations on 9 acres along the north edge of Payment Unit 3. If a new active nest is found, the contract may be amended to protect the nest site. The nest will be buffered with a 330-foot radius (eight acre) protection area, centered on the nest tree, in which there will be no cutting or new roads constructed. The value of the trees in this excluded area will be refunded or credited to the Purchaser. Avoid human disturbance, including loading and skidding, in the protection area. The additional 660-foot radius seasonal operating restriction would also be applied to new active nests.

6 - Safety and Fire Prevention

6.2 - Signing

6.2.2 - Snowmobile trail posting (10/20)

The Purchaser is responsible for posting and maintaining caution signs on Blue Bear Snowmobile Trail prior to beginning operations during the snowmobile season (approximately December 1 to March 31). The trail must be posted at appropriate distances from the Sale Area to warn of logging activity and truck traffic. Signs must be removed when harvest operations are suspended or completed. The Purchaser will provide these signs.

6.2.3 - Recreational trail posting (10/20)

The Purchaser is responsible for posting and maintaining caution signs on the Blue Bear ORV route prior to beginning operations. The trail must be posted at appropriate distances from the Sale Area to warn of logging activity and truck traffic at both ends of the trail. Signs must be removed when harvest operations are suspended or completed. The Purchaser will provide these signs.

7 - Other Conditions

7.5 - Loss

7.5.1 - Deteriorating timber (7/09)

The sale area has received damage from age-related decline and mortality in the northern pin oak. The Purchaser should harvest the wood as soon as possible. The Department of Natural Resources is held free of responsibility of any further damage or deterioration due to delay in harvesting.

7.10 - Certified Timber

7.10.1 - Non-certified timber (2/16)

The area encompassed by this timber sale is not certified to the standards of the Forest Stewardship Council (FSC) or the Sustainable Forestry Initiative (SFI). Forest products from this sale may not be delivered to the mill as "FSC and / or SFI certified". The lands within this sale are managed for Military training.



TIMBER SALE MAP

This information provided by authority of Part 525, 1994 PA 451, as amended.

Forest Management Unit Grayling	County Crawford	Mapped By Charlebois	Date 09/24/2021	Page 1	of 1
Township 26N	Range 04W	Section(s) and Subdivision(s) Section 10: NE, NESE; Section 11: W1/2NW	Scale 1:7,920		

Cover Type				Density	
A = Aspen	H = Hemlock	N = Marsh	U = Upland Brush	0 = Non Stocked	5 = Pole Timber Medium
B = Paper Birch	J = Jack Pine	O = Oak	UM = Upland Mixed	1 = Seedling Sapling Poor	6 = Pole Timber Well
C = Cedar	L = Lowland Brush	P = Lowland Poplar	V = Bog or Marsh	2 = Seedling Sapling Medium	7 = Saw Timber Poor
D = Treed Bog	LM = Lowland Mixed	Q = Mixed Swamp Conifer	W = White Pine	3 = Seedling Sapling Well	8 = Saw Timber Medium
E = Swamp Hdwoods	M = Mpl, Bch, Brch	R = Red Pine	X = Non Stocked	4 = Pole Timber Poor	9 = Saw Timber Well
F = Spruce Fir	MC = Mixed Conifer	S = Black Spruce	Z = Water		
G = Grass	MD = Mixed Deciduous	T = Tamarack			

PU	Acres
1	3.4
2	34.3
3	69.5

M72 West

Compartment 203

107.2 Acres



scan for geo-PDF map



Legend

- Utility Line
- Highway
- Paved Road
- Forest Road
- Closed Road
- Cover Type Line
- Snowmobile Trail
- ORV Route
- Section Corners
- Survey Corner
- Lake
- Payment Unit #
- Sale Boundary
 - Against State - Red Paint & designated unpainted
 - Against Private - Blue Paint
 - Payment Unit - Yellow Paint
 - Payment Unit - designated unpainted along forest road

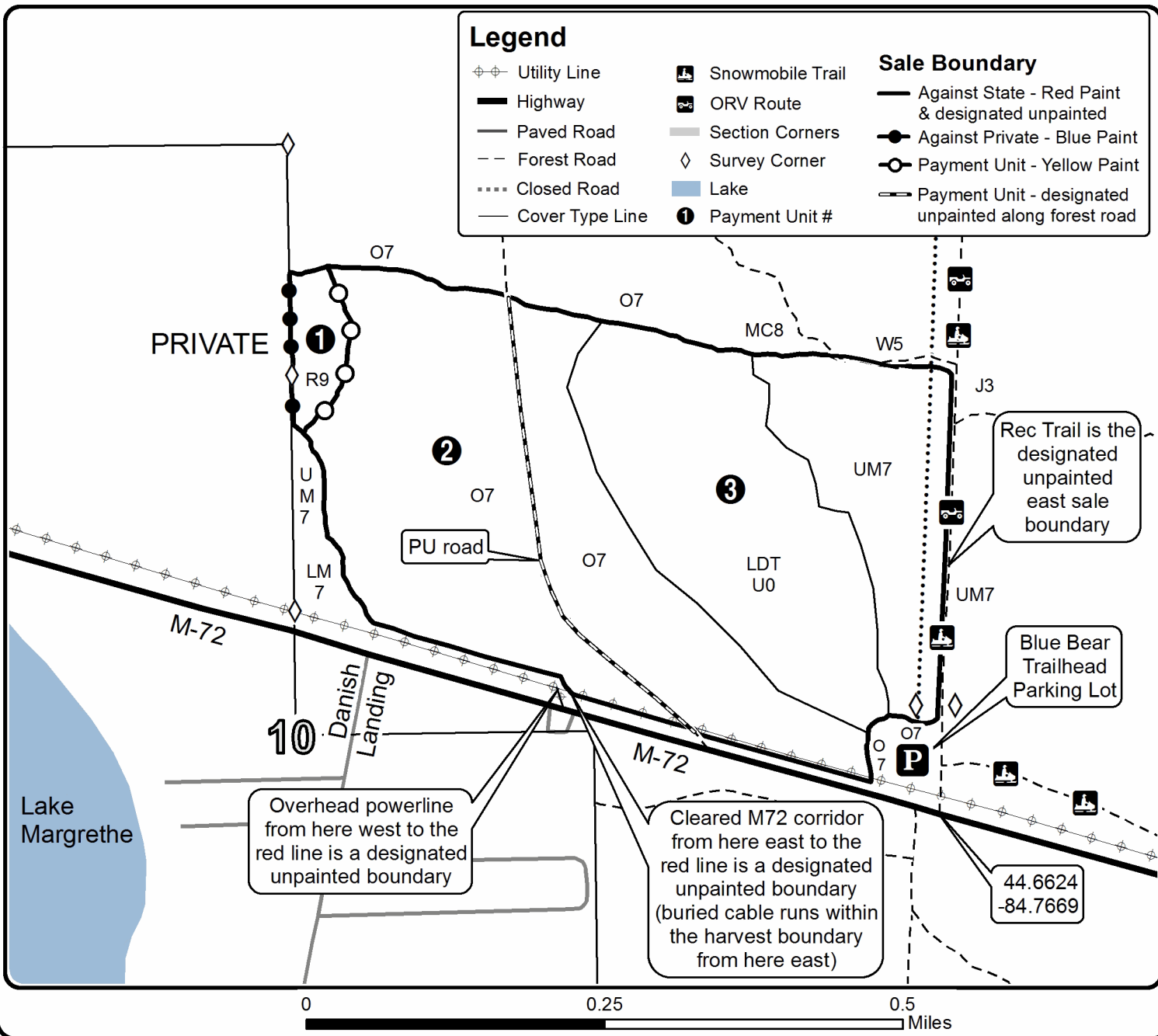

Gypsy Rain Oak (72-607-21)
T27N, R02W, SEC. 22; T27N, R02W, SEC. 27; Crawford COUNTY

In response to the notice of sale to be held 9:00 a.m. (local time) on March 24, 2022, I am hereby submitting my sealed bid (firm offer) for the following forest products to be cut. Bids for individual species must be at or above the advertised price. All non-responsive bid forms may be rejected.

<u>PRODUCTS & SPECIES</u>	<u>ESTIMATED VOLUME*</u>	<u>ADVERTISED PRICE</u>	<u>BID PRICE/UNIT</u>
Sawtimber			
Bl/R/Hybrid Oak	47.4 MBF	\$ 100.00/MBF	\$ _____
Red Pine	131.6 MBF	\$ 89.00/MBF	\$ _____
White Oak	120.0 MBF	\$ 73.00/MBF	\$ _____
Pulpwood			
B. T. Aspen	201 Cords	\$ 25.10/Cord	\$ _____
Jack Pine	133 Cords	\$ 15.90/Cord	\$ _____
Mixed Oak	503 Cords	\$ 22.95/Cord	\$ _____
Red Maple	242 Cords	\$ 24.75/Cord	\$ _____
Red Pine	91 Cords	\$ 31.10/Cord	\$ _____

*The volumes are statistically estimated within plus (+) or minus (-) 5.46 percent at 95% confidence level. These estimated volumes are final and not subject to adjustment. Prospective bidders are urged to examine this timber and to make their own estimates of quantity and quality.

I understand that any or all bids may be rejected. All bids must be signed and all bid items must be bid or the bid form may be rejected. I also understand that consideration and awarding a contract will be based upon my past performance and ability to complete the contract based upon equipment and staffing subject to my control.

FEDERAL ID: ____ - ____ - ____ or SOCIAL SECURITY NUMBER: ____ - ____ - ____

Company or individual bidding: _____

Company representative's name: _____

Address: _____

City: _____ State: _____ Zip: _____

IF AVAILABLE, PLEASE PLACE THE PERSONALIZED LABEL FROM YOUR PROSPECTUS IN THE ABOVE BOX.

Individual or company representative's signature: _____ Date: _____

Phone number : _____ Email (optional): _____

THE WINNING BIDDER MUST COMPLETE THE VERIFICATION OF WORKER'S DISABILITY COMPENSATION ACT COMPLIANCE (ON REVERSE SIDE IF DOUBLE SIDED) WITHIN 21 DAYS OF SALE AWARD DATE



FOR DEPARTMENT USE ONLY	
Sale Number (XX - XXX - XX - XX)	
Forest Management Unit:	

TIMBER SALE VERIFICATION OF WORKER'S DISABILITY COMPENSATION ACT COMPLIANCE

As required by Act 317, P.A. 1969 (Worker's Compensation) and
Part 5 of Act 451 of 1994, as amended.

VERIFICATION OF WORKER'S DISABILITY COMPENSATION ACT COMPLIANCE

- This verification must be completed and submitted within 21 days of contract award and prior to the issuance of the timber sale contract.
- In addition, if boxes 2B or 2C are checked, then Notice of Exclusion or Certificate of Insurance must be submitted within twenty-one (21) days of the contract award and prior to the issuance of the timber sale contract.
- All information must be typed or printed except for written signatures.

Please Check Appropriate Categories:

1. My business is organized as (you **must** check one of the boxes below):
 - A. Sole Proprietorship (individual)
 - B. Partnership
 - C. Corporation
2. You **must** check one of the boxes below:
 - A. I certify my business is a sole proprietorship and it has no employees but the sole proprietor. I am not subject to the Worker's Compensation Laws.
 - B. I certify my business has satisfied its obligation to the Worker's Compensation Act through the use of an approved Notice of Exclusion (BWC-337, Rev. 5/96). I will provide a copy of the Notice of Exclusion within 21 days of the contract award. (For questions or a copy of the BWC-337, please call the Worker's Compensation Bureau at 517-322-1195).
 - C. I certify my business has a Worker's Compensation Policy. I will provide an original Certificate of Insurance within twenty-one (21) days of the contract award.
3. If you have checked item 2(A) or 2(B), you **must** indicate the number of **both** full-time and part-time employees, other than yourself, including family members and active partners (if none, you must enter "0").

_____ Full-time Employees

_____ Part-time Employees

Name of Business		Federal ID (or) Social Security No.	
Address		Telephone ()	
City	State	ZIP	

I hereby certify that the above information is true and correct. I agree to notify the Michigan DNR of any changes that occur in factors affecting my coverage during any of my present and future operations.

Signature of Owner or Authorized Representative

Title

Date

Please complete the "SEALED BID" information on the next page

Joel's Yard Expansion (72-013-21)
T26N, R03W, SEC. 1; T26N, R03W, SEC. 12; T26N, R03W, SEC. 2; Crawford

In response to the notice of sale to be held 9:00 a.m. (local time) on March 24, 2022, I am hereby submitting my sealed bid (firm offer) for the following forest products to be cut. Bids for individual species must be at or above the advertised price. All non-responsive bid forms may be rejected.

<u>PRODUCTS & SPECIES</u>	<u>ESTIMATED VOLUME*</u>	<u>ADVERTISED PRICE</u>	<u>BID PRICE/UNIT</u>
Sawtimber			
Northern Pin Oak	11.2 MBF	\$ 100.00/MBF	\$ _____
Red Pine	45.0 MBF	\$ 89.00/MBF	\$ _____
White Oak	1.7 MBF	\$ 73.00/MBF	\$ _____
Pulpwood			
Jack Pine	732 Cords	\$ 15.90/Cord	\$ _____
Mixed Aspen	304 Cords	\$ 25.10/Cord	\$ _____
Northern Pin Oak	33 Cords	\$ 22.95/Cord	\$ _____
Red Pine	122 Cords	\$ 31.10/Cord	\$ _____
White Oak	2 Cords	\$ 22.95/Cord	\$ _____
White Pine	17 Cords	\$ 20.50/Cord	\$ _____

*The volumes are statistically estimated within plus (+) or minus (-) 8.16 percent at 95% confidence level. These estimated volumes are final and not subject to adjustment. Prospective bidders are urged to examine this timber and to make their own estimates of quantity and quality.

I understand that any or all bids may be rejected. All bids must be signed and all bid items must be bid or the bid form may be rejected. I also understand that consideration and awarding a contract will be based upon my past performance and ability to complete the contract based upon equipment and staffing subject to my control.

FEDERAL ID: ____ - ____ - ____ or SOCIAL SECURITY NUMBER: ____ - ____ - ____

Company or individual bidding: _____

Company representative's name: _____

Address: _____

City: _____ State: _____ Zip: _____

IF AVAILABLE, PLEASE PLACE THE PERSONALIZED LABEL FROM YOUR PROSPECTUS IN THE ABOVE BOX.

Individual or company representative's signature: _____ Date: _____

Phone number : _____ Email (optional): _____

THE WINNING BIDDER MUST COMPLETE THE VERIFICATION OF WORKER'S DISABILITY COMPENSATION ACT COMPLIANCE (ON REVERSE SIDE IF DOUBLE SIDED) WITHIN 21 DAYS OF SALE AWARD DATE



TIMBER SALE VERIFICATION OF WORKER'S DISABILITY COMPENSATION ACT COMPLIANCE

As required by Act 317, P.A. 1969 (Worker's Compensation) and
Part 5 of Act 451 of 1994, as amended.

FOR DEPARTMENT USE ONLY	
Sale Number (XX - XXX - XX - XX)	
Forest Management Unit:	

VERIFICATION OF WORKER'S DISABILITY COMPENSATION ACT COMPLIANCE

- This verification must be completed and submitted within 21 days of contract award and prior to the issuance of the timber sale contract.
- In addition, if boxes 2B or 2C are checked, then Notice of Exclusion or Certificate of Insurance must be submitted within twenty-one (21) days of the contract award and prior to the issuance of the timber sale contract.
- All information must be typed or printed except for written signatures.

Please Check Appropriate Categories:

1. My business is organized as (you **must** check one of the boxes below):
 - A. Sole Proprietorship (individual)
 - B. Partnership
 - C. Corporation
2. You **must** check one of the boxes below:
 - A. I certify my business is a sole proprietorship and it has no employees but the sole proprietor. I am not subject to the Worker's Compensation Laws.
 - B. I certify my business has satisfied its obligation to the Worker's Compensation Act through the use of an approved Notice of Exclusion (BWC-337, Rev. 5/96). I will provide a copy of the Notice of Exclusion within 21 days of the contract award. (For questions or a copy of the BWC-337, please call the Worker's Compensation Bureau at 517-322-1195).
 - C. I certify my business has a Worker's Compensation Policy. I will provide an original Certificate of Insurance within twenty-one (21) days of the contract award.
3. If you have checked item 2(A) or 2(B), you **must** indicate the number of **both** full-time and part-time employees, other than yourself, including family members and active partners (if none, you must enter "0").

_____ Full-time Employees

_____ Part-time Employees

Name of Business		Federal ID (or) Social Security No.	
Address		Telephone ()	
City	State	ZIP	

I hereby certify that the above information is true and correct. I agree to notify the Michigan DNR of any changes that occur in factors affecting my coverage during any of my present and future operations.

Signature of Owner or Authorized Representative

Title

Date

Please complete the "SEALED BID" information on the next page

In the Rough (72-012-21)
T25N, R03W, SEC. 4; T25N, R03W, SEC. 6; Crawford COUNTY

In response to the notice of sale to be held 9:00 a.m. (local time) on March 24, 2022, I am hereby submitting my sealed bid (firm offer) for the following forest products to be cut. Bids for individual species must be at or above the advertised price. All non-responsive bid forms may be rejected.

<u>PRODUCTS & SPECIES</u>	<u>ESTIMATED VOLUME*</u>	<u>ADVERTISED PRICE</u>	<u>BID PRICE/UNIT</u>
Sawtimber			
BI/R/Hybrid Oak	143.0 MBF	\$ 100.00/MBF	\$ _____
Red Pine	20.0 MBF	\$ 89.00/MBF	\$ _____
White Oak	16.6 MBF	\$ 73.00/MBF	\$ _____
White Pine	11.1 MBF	\$ 57.00/MBF	\$ _____
Pulpwood			
Jack Pine	38 Cords	\$ 15.90/Cord	\$ _____
Misc. Species 1	55 Cords	\$ 5.50/Cord	\$ _____
Mixed Aspen	226 Cords	\$ 25.10/Cord	\$ _____
Mixed Hardwood	461 Cords	\$ 24.75/Cord	\$ _____
Mixed Oak	337 Cords	\$ 22.95/Cord	\$ _____
Red Pine	14 Cords	\$ 31.10/Cord	\$ _____
White Pine	15 Cords	\$ 20.50/Cord	\$ _____

*The volumes are statistically estimated within plus (+) or minus (-) 8.90 percent at 95% confidence level. These estimated volumes are final and not subject to adjustment. Prospective bidders are urged to examine this timber and to make their own estimates of quantity and quality.

I understand that any or all bids may be rejected. All bids must be signed and all bid items must be bid or the bid form may be rejected. I also understand that consideration and awarding a contract will be based upon my past performance and ability to complete the contract based upon equipment and staffing subject to my control .

FEDERAL ID: _____ or SOCIAL SECURITY NUMBER: _____

Company or individual bidding: _____

Company representative's name: _____

Address: _____

City: _____ State: _____ Zip: _____

IF AVAILABLE, PLEASE PLACE THE PERSONALIZED LABEL FROM YOUR PROSPECTUS IN THE ABOVE BOX.

Individual or company representative's signature: _____ Date: _____

Phone number : _____ Email (optional): _____

THE WINNING BIDDER MUST COMPLETE THE VERIFICATION OF WORKER'S DISABILITY COMPENSATION ACT COMPLIANCE (ON REVERSE SIDE IF DOUBLE SIDED) WITHIN 21 DAYS OF SALE AWARD DATE



FOR DEPARTMENT USE ONLY	
Sale Number (XX - XXX - XX - XX)	
Forest Management Unit:	

TIMBER SALE VERIFICATION OF WORKER'S DISABILITY COMPENSATION ACT COMPLIANCE

As required by Act 317, P.A. 1969 (Worker's Compensation) and
Part 5 of Act 451 of 1994, as amended.

VERIFICATION OF WORKER'S DISABILITY COMPENSATION ACT COMPLIANCE

- This verification must be completed and submitted within 21 days of contract award and prior to the issuance of the timber sale contract.
- In addition, if boxes 2B or 2C are checked, then Notice of Exclusion or Certificate of Insurance must be submitted within twenty-one (21) days of the contract award and prior to the issuance of the timber sale contract.
- All information must be typed or printed except for written signatures.

Please Check Appropriate Categories:

1. My business is organized as (you **must** check one of the boxes below):
 - A. Sole Proprietorship (individual)
 - B. Partnership
 - C. Corporation
2. You **must** check one of the boxes below:
 - A. I certify my business is a sole proprietorship and it has no employees but the sole proprietor. I am not subject to the Worker's Compensation Laws.
 - B. I certify my business has satisfied its obligation to the Worker's Compensation Act through the use of an approved Notice of Exclusion (BWC-337, Rev. 5/96). I will provide a copy of the Notice of Exclusion within 21 days of the contract award. (For questions or a copy of the BWC-337, please call the Worker's Compensation Bureau at 517-322-1195).
 - C. I certify my business has a Worker's Compensation Policy. I will provide an original Certificate of Insurance within twenty-one (21) days of the contract award.
3. If you have checked item 2(A) or 2(B), you **must** indicate the number of **both** full-time and part-time employees, other than yourself, including family members and active partners (if none, you must enter "0").

_____ Full-time Employees

_____ Part-time Employees

Name of Business		Federal ID (or) Social Security No.	
Address		Telephone ()	
City	State	ZIP	

I hereby certify that the above information is true and correct. I agree to notify the Michigan DNR of any changes that occur in factors affecting my coverage during any of my present and future operations.

Signature of Owner or Authorized Representative

Title

Date

Please complete the "SEALED BID" information on the next page

Pipeline HWs (72-030-21)
T28N, R03W, SEC. 31; Crawford COUNTY

In response to the notice of sale to be held 9:00 a.m. (local time) on March 24, 2022, I am hereby submitting my sealed bid (firm offer) for the following forest products to be cut. Bids for individual species must be at or above the advertised price. All non-responsive bid forms may be rejected.

<u>PRODUCTS & SPECIES</u>	<u>ESTIMATED VOLUME*</u>	<u>ADVERTISED PRICE</u>	<u>BID PRICE/UNIT</u>
Sawtimber			
Beech	3.9 MBF	\$ 69.00/MBF	\$ _____
Red Maple	9.1 MBF	\$ 50.00/MBF	\$ _____
Red Pine	8.5 MBF	\$ 89.00/MBF	\$ _____
Sugar Maple	119.1 MBF	\$ 165.00/MBF	\$ _____
White Pine	8.5 MBF	\$ 57.00/MBF	\$ _____
Pulpwood			
Misc. Species 1	2 Cords	\$ 5.50/Cord	\$ _____
Mixed Aspen	136 Cords	\$ 25.10/Cord	\$ _____
Mixed Hardwood	620 Cords	\$ 24.75/Cord	\$ _____
Red Pine	7 Cords	\$ 31.10/Cord	\$ _____
White Pine	7 Cords	\$ 20.50/Cord	\$ _____

*The volumes are statistically estimated within plus (+) or minus (-) 7.71 percent at 95% confidence level. These estimated volumes are final and not subject to adjustment. Prospective bidders are urged to examine this timber and to make their own estimates of quantity and quality.

I understand that any or all bids may be rejected. All bids must be signed and all bid items must be bid or the bid form may be rejected. I also understand that consideration and awarding a contract will be based upon my past performance and ability to complete the contract based upon equipment and staffing subject to my control.

FEDERAL ID: _____ or SOCIAL SECURITY NUMBER: _____

Company or individual bidding: _____

Company representative's name: _____

Address: _____

City: _____ State: _____ Zip: _____

IF AVAILABLE, PLEASE PLACE THE PERSONALIZED LABEL FROM YOUR PROSPECTUS IN THE ABOVE BOX.

Individual or company representative's signature: _____ Date: _____

Phone number : _____ Email (optional): _____

THE WINNING BIDDER MUST COMPLETE THE VERIFICATION OF WORKER'S DISABILITY COMPENSATION ACT COMPLIANCE (ON REVERSE SIDE IF DOUBLE SIDED) WITHIN 21 DAYS OF SALE AWARD DATE



FOR DEPARTMENT USE ONLY
Sale Number (XX - XXX - XX - XX)
Forest Management Unit:

TIMBER SALE VERIFICATION OF WORKER'S DISABILITY COMPENSATION ACT COMPLIANCE

*As required by Act 317, P.A. 1969 (Worker's Compensation) and
Part 5 of Act 451 of 1994, as amended.*

VERIFICATION OF WORKER'S DISABILITY COMPENSATION ACT COMPLIANCE

- This verification must be completed and submitted within 21 days of contract award and prior to the issuance of the timber sale contract.
- In addition, if boxes 2B or 2C are checked, then Notice of Exclusion or Certificate of Insurance must be submitted within twenty-one (21) days of the contract award and prior to the issuance of the timber sale contract.
- All information must be typed or printed except for written signatures.

Please Check Appropriate Categories:

1. My business is organized as (you **must** check one of the boxes below):
 - A. Sole Proprietorship (individual)
 - B. Partnership
 - C. Corporation

2. You **must** check one of the boxes below:
 - A. I certify my business is a sole proprietorship and it has no employees but the sole proprietor. I am not subject to the Worker's Compensation Laws.
 - B. I certify my business has satisfied its obligation to the Worker's Compensation Act through the use of an approved Notice of Exclusion (BWC-337, Rev. 5/96). I will provide a copy of the Notice of Exclusion within 21 days of the contract award. (For questions or a copy of the BWC-337, please call the Worker's Compensation Bureau at 517-322-1195).
 - C. I certify my business has a Worker's Compensation Policy. I will provide an original Certificate of Insurance within twenty-one (21) days of the contract award.

3. If you have checked item 2(A) or 2(B), you **must** indicate the number of **both** full-time and part-time employees, other than yourself, including family members and active partners (if none, you must enter "0").

_____ Full-time Employees

_____ Part-time Employees

Name of Business		Federal ID (or) Social Security No.	
Address		Telephone ()	
City	State	ZIP	

I hereby certify that the above information is true and correct. I agree to notify the Michigan DNR of any changes that occur in factors affecting my coverage during any of my present and future operations.

Signature of Owner or Authorized Representative

Title

Date

Please complete the "SEALED BID" information on the next page

M72 West (72-628-21)
T26N, R04W, SEC. 10; T26N, R04W, SEC. 11; Crawford COUNTY

In response to the notice of sale to be held 9:00 a.m. (local time) on March 24, 2022, I am hereby submitting my sealed bid (firm offer) for the following forest products to be cut. Bids for individual species must be at or above the advertised price. All non-responsive bid forms may be rejected.

<u>PRODUCTS & SPECIES</u>	<u>ESTIMATED VOLUME*</u>	<u>ADVERTISED PRICE</u>	<u>BID PRICE/UNIT</u>
Sawtimber			
Bl/R/Hybrid Oak	8.8 MBF	\$ 100.00/MBF	\$ _____
Northern Pin Oak	177.0 MBF	\$ 100.00/MBF	\$ _____
Red Pine	31.6 MBF	\$ 89.00/MBF	\$ _____
White Pine	45.6 MBF	\$ 57.00/MBF	\$ _____
Pulpwood			
B. T. Aspen	2 Cords	\$ 25.10/Cord	\$ _____
Black Spruce	16 Cords	\$ 13.15/Cord	\$ _____
Jack Pine	17 Cords	\$ 15.90/Cord	\$ _____
Misc. Species 1	276 Cords	\$ 5.50/Cord	\$ _____
Mixed Hardwood	32 Cords	\$ 24.75/Cord	\$ _____
Mixed Oak	289 Cords	\$ 22.95/Cord	\$ _____
Red Pine	34 Cords	\$ 31.10/Cord	\$ _____
White Pine	155 Cords	\$ 20.50/Cord	\$ _____

*The volumes are statistically estimated within plus (+) or minus (-) 6.33 percent at 95% confidence level. These estimated volumes are final and not subject to adjustment. Prospective bidders are urged to examine this timber and to make their own estimates of quantity and quality.

I understand that any or all bids may be rejected. All bids must be signed and all bid items must be bid or the bid form may be rejected. I also understand that consideration and awarding a contract will be based upon my past performance and ability to complete the contract based upon equipment and staffing subject to my control.

FEDERAL ID: ____ - ____ - ____ or SOCIAL SECURITY NUMBER: ____ - ____ - ____

Company or individual bidding: _____

Company representative's name: _____

Address: _____

City: _____ State: _____ Zip: _____

IF AVAILABLE, PLEASE PLACE THE PERSONALIZED LABEL FROM YOUR PROSPECTUS IN THE ABOVE BOX.

Individual or company representative's signature: _____ Date: _____

Phone number : _____ Email (optional): _____

THE WINNING BIDDER MUST COMPLETE THE VERIFICATION OF WORKER'S DISABILITY COMPENSATION ACT COMPLIANCE (ON REVERSE SIDE IF DOUBLE SIDED) WITHIN 21 DAYS OF SALE AWARD DATE



FOR DEPARTMENT USE ONLY	
Sale Number (XX - XXX - XX - XX)	
Forest Management Unit:	

TIMBER SALE VERIFICATION OF WORKER'S DISABILITY COMPENSATION ACT COMPLIANCE

As required by Act 317, P.A. 1969 (Worker's Compensation) and
Part 5 of Act 451 of 1994, as amended.

VERIFICATION OF WORKER'S DISABILITY COMPENSATION ACT COMPLIANCE

- This verification must be completed and submitted within 21 days of contract award and prior to the issuance of the timber sale contract.
- In addition, if boxes 2B or 2C are checked, then Notice of Exclusion or Certificate of Insurance must be submitted within twenty-one (21) days of the contract award and prior to the issuance of the timber sale contract.
- All information must be typed or printed except for written signatures.

Please Check Appropriate Categories:

1. My business is organized as (you **must** check one of the boxes below):
 - A. Sole Proprietorship (individual)
 - B. Partnership
 - C. Corporation
2. You **must** check one of the boxes below:
 - A. I certify my business is a sole proprietorship and it has no employees but the sole proprietor. I am not subject to the Worker's Compensation Laws.
 - B. I certify my business has satisfied its obligation to the Worker's Compensation Act through the use of an approved Notice of Exclusion (BWC-337, Rev. 5/96). I will provide a copy of the Notice of Exclusion within 21 days of the contract award. (For questions or a copy of the BWC-337, please call the Worker's Compensation Bureau at 517-322-1195).
 - C. I certify my business has a Worker's Compensation Policy. I will provide an original Certificate of Insurance within twenty-one (21) days of the contract award.
3. If you have checked item 2(A) or 2(B), you **must** indicate the number of **both** full-time and part-time employees, other than yourself, including family members and active partners (if none, you must enter "0").

_____ Full-time Employees

_____ Part-time Employees

Name of Business		Federal ID (or) Social Security No.	
Address		Telephone ()	
City	State	ZIP	

I hereby certify that the above information is true and correct. I agree to notify the Michigan DNR of any changes that occur in factors affecting my coverage during any of my present and future operations.

Signature of Owner or Authorized Representative

Title

Date

Please complete the "SEALED BID" information on the next page