



**DEPARTMENT OF NATURAL RESOURCES
STATE OF MICHIGAN**

TIMBER SALE PROSPECTUS #6974

SCHEDULED SALE DATE AND TIME: 4:00 p.m. (local time) on January 27, 2022.

LOCATION: TRAVERSE CITY MGMT UNIT, 2122 M 37 SOUTH, TRAVERSE CITY, MI 49685.

PROSPECTUS NOTE: The bidder is advised to inspect the sale area and review the location, estimated volumes, operating costs and contract terms of proposed sales. Please be aware that some landowners may request 60 days or more notice for access across their land.

Notice is hereby given that bids will be received by the Unit Manager, TRAVERSE CITY MANAGEMENT UNIT, for certain timber on the following described lands:

Two Bears Harvest (61-056-21) / T25N, R14W, SEC. 10, NWNW.

T25N, R14W, SEC. 3, SENW, S1/2NE, NESW, S1/2SW, NWSE.

Benzie County, Advertised Price \$93,402.60, 84.8 Acres, Aspen, White Pine.

SALE NOTE: All units of volume listed for this sale were estimated using the Inventory Manager computer program and the new Michigan taper model.

Advanced sugar maple regeneration exists in locations throughout this sale. There is a desire to protect this regeneration, where possible, from logging activity damage.

A recreation site such as a trail, pathway, or campground is within the sale area or the vicinity. Certain restrictions/specifications may be applicable including time restrictions.

Old Monarch Mix (61-057-21) / T25N, R14W, SEC. 10, NW, W1/2NE, SW.

T25N, R14W, SEC. 15, NW, NWSW.

T25N, R14W, SEC. 3, SESW, SWSE.

Benzie County, Advertised Price \$122,554.00, 127.6 Acres, Aspen, White Pine.

SALE NOTE: All units of volume listed for this sale were estimated using the Inventory Manager computer program and the new Michigan taper model.

See sale spec 2.1.7 for information on protecting sugar maple regeneration.

A recreation site such as a trail, pathway, or campground is within the sale area or the vicinity. Certain restrictions/specifications may be applicable including time restrictions.

Pioneer Pine (61-065-21) / T25N, R14W, SEC. 10, N1/2NW, SWNW.

T25N, R14W, SEC. 15, S1/2NW, N1/2SW, NWSE.

T25N, R14W, SEC. 3, SWSW.

Benzie County, Advertised Price \$83,248.05, 114.8 Acres, Red Pine, Jack Pine.

SALE NOTE: All units of volume listed for this sale were estimated using the Inventory Manager computer program and the new Michigan taper model.

A recreation site such as a trail, pathway, or campground is within the sale area or the vicinity. Certain restrictions/specifications may be applicable including time restrictions.

Homecoming Aspen (61-067-21) / T26N, R10W, SEC. 19, NESW,S1/2SW,W1/2SE.

T26N, R10W, SEC. 30, NW,NWNE,N1/2SW.

Grand Traverse County, Advertised Price \$57,988.60, 124.4 Acres, Aspen, Hardwood.

SALE NOTE: All units of volume listed for this sale were estimated using the Inventory Manager computer program and the new Michigan taper model.

A recreation site such as a trail, pathway, or campground is within the sale area or the vicinity. Certain restrictions/specifications may be applicable including time restrictions.

Perla Road Mix (61-071-21) / T26N, R10W, SEC. 20, SENW,S1/2NE,N1/2SW,SESW,NWSE.

T26N, R10W, SEC. 21, SWNW,N1/2SW.

Grand Traverse County, Advertised Price \$41,985.20, 132.8 Acres, Red Pine, Hardwood.

SALE NOTE: All units of volume listed for this sale were estimated using the Inventory Manager computer program and the new Michigan taper model.

A recreation site such as a trail, pathway, or campground is within the sale area or the vicinity. Certain restrictions/specifications may be applicable including time restrictions.

BID INSTRUCTIONS (VER. 07/02/2018):

1. Scheduled Bid Location, Date, and Time (2/11)

Bids must be received by the Unit Manager, TRAVERSE CITY OFFICE, 2122 M 37 South, Traverse City, MI 49685, no later than 4:00 p.m. (local time) on January 27, 2022. For further information concerning this sale, contact David Lemmien at 231-922-6040.

2. Bidder's Qualifications (5/16)

Purchaser shall obtain workers compensation insurance to cover claims under Michigan's Worker's Disability Compensation Act of 1969 or similar employee benefit act of any other state applicable to an employee. If all or part of a timber sale was prepared by a private contractor, the contractor and that contractor's company are not permitted to bid on the timber sale contract. Bids will not be accepted from individuals or companies appearing on the DNR/FRD No-Bid List. This list contains the names of purchasers who previously failed to execute a contract within 21-days or who have a history of poor performance.

3. Preparation of Sealed Bids (5/16)

Bid Forms may be completed online thru Michigan DNR Timber Sale Online Bidding (OLB) at www.michigan.gov/timberbidding or by completing the hardcopy Bid Form found in the Timber Sale Prospectus. Hardcopy Bid Forms shall be manually signed in ink. Registration in OLB is considered your 'signature' for all bids submitted thru that system. Bid prices must be entered for each species and product in the Bid Price column for all material subject to bidding and all fill-in blanks must be completed. If erasures or other changes appear on the hardcopy Bid Form, each erasure or change must be initialed by the person signing the bid.

4. Submission of Sealed Bids (5/16)

Bid forms may be obtained from the Unit Manager or thru OLB. Bids may be submitted hardcopy or thru OLB. All hardcopy bids must be submitted on the bid form and in an envelope clearly identified as described in this section. NOTE: Only one bid form per bid envelope. Sealed bids must be submitted to the Unit office designated in the prospectus and must be submitted at or prior to the time established in the prospectus. The envelope should show on the outside (a) the sale name or number and (b) the date and time of bid opening, as shown in the prospectus. Bids received after the time specified in the sale prospectus are late bids and will be rejected.

It is possible for a bidder to submit multiple bids on a single sale. For example, a bid may be submitted hardcopy and a bid may be submitted thru OLB. Or, two bidders from the same company could both submit bids on the same sale. If this were to happen, the State would accept all bids received and award the contract accordingly. All bidding and contractual requirements would apply to all bids received.

5. Public Opening of Sealed Bids (7/16)

If conditions permit, the sealed bids will be publicly opened and posted at the time and place set in the prospectus.

If a bidder, present at a bid opening, has submitted bids on more than one sale, that bidder may withdraw their unopened bid envelopes or announce the withdrawal of their online bid after being declared the successful bidder on one sale.

6. Award of Contract (1/11)

Award of the contract will be made to the Bidder whose bid, conforming to the prospectus, is most advantageous to the State of Michigan on the basis of total value at rates bid for the estimated quantities. The State reserves the right to reject any bid or waive any minor irregularity in bids received. A written award mailed (or otherwise furnished) to the successful Bidder shall be deemed to result in a binding contract without further action by either party.

7. Down Payment (1/11)

The Bidder to whom award is made must make a down payment within 21 days of the sale award. The amount of the down payment will be calculated as shown in the Bond and Payment Schedule of this prospectus. Only cash may be used to meet this requirement.

8. Performance Security (1/11)

As guarantee of faithful performance, a cash bond, certificate of deposit, surety bond or irrevocable letter of credit (LOC) is required within 21 days of the sale award. The amount of the performance security is shown in the Bond and

Payment Schedule of this prospectus. If an LOC or surety is used, the coverage must extend for at least 6 months beyond the contract expiration.

9. Timber Sale Contract (7/18)

Additional conditions and requirements common to all timber sales are listed on the timber sale contract (R4031) and are available on line at www.michigan.gov/timber. Contact the Unit Manager for additional information or a sample contract. Within 21 days of the date of the award letter, the bidder must sign the contract and provide the required down payment, performance security, and verification of worker's disability compensation. The down payment and performance security shall be in accordance with the provisions of the timber sale contract, in the sums stated in this prospectus. If these actions are not taken, then the Bidder, the Bidder's corporation, and the corporation's principals may not be permitted to bid on State timber sales for a period of 3 months after the first offense, 6 months after the second offense, and 1 year after the third offense. An offense will only be counted against the Bidder for 5 years. In addition, the Bidder certifies that if awarded this contract, the Bidder will complete the timber sale contract in accordance with its terms and any modifications thereof including requirements to purchase, cut, and remove the included timber by the expiration date.

Payment Unit values in the State Forest Timber Sale Contract are calculated based on the advertised value of the Payment Unit as a percentage of the total advertised value of the contract. The advertised value of each Payment Unit is given in the Description of Timber by Payment Unit table on the Timber Sale Information page. For example, if the value of Payment Unit 1 is advertised as \$1,500 and the total Timber Sale value is advertised as \$10,000, the contract price for Payment Unit 1 will be 15% of the total bid price ($\$1,500/\$10,000 * 100$).

10. Disclaimer of Estimates and Bidder's Warranty of Inspection (7/16)

Before submitting this bid, the Bidder is advised and cautioned to inspect the sale area, review the requirements of the sale contract, and take other steps as may be reasonably necessary to ascertain the location, estimated volumes, construction estimates, and operating costs of the proposed sale. Failure to do so will not relieve the Bidder from responsibility for completing the contract.

The Bidder warrants that this bid is submitted solely on the basis of the Bidder's examination and inspection of the quality and quantity of the timber offered for sale and the Bidder's opinion of the value thereof and the costs of recovery. No reliance should be placed on the State of Michigan's estimates of timber quality, quantity or costs of recovery. Bidder further acknowledges that the State of Michigan: (i) expressly disclaims any warranty of fitness of timber for any purpose; (ii) offers this timber as is without any warranty of quality (merchantability) or quantity and (iii) expressly disclaims any warranty as to the quantity or quality of timber sold.

11. Certification and Chain-of-Custody (10/14)

Unless otherwise indicated in the contract under section 7 – Other Conditions of the Sale Specific Conditions & Requirements, the area encompassed by this timber sale is certified to the standards of the Forest Stewardship Council (FSC) - Certificate #SCS-FM/COC-00090N and the Sustainable Forestry Initiative (SFI) - Certificate #NSF-SFIS-5Y031-SF5. Forest products from this sale may be delivered to the mill as "FSC 100% and / or SFI certified" as long as the contractor hauling the forest products is chain-of-custody (COC) certified or covered under a COC certificate from the destination mill. The purchaser is responsible for maintaining COC after leaving the sale area.

12. Good Neighbor Authority (GNA) Requirements (7/16)

If the name of this timber sales contains the acronym GNA, it is authorized by the Good Neighbor Authority (GNA) and covered by various agreements between the U.S. Forest Service and the State. The timber sale occurs on federal land and the following conditions apply:

GNA contracts on US Forest Service land will not be awarded to purchasers on the Federal list of excluded parties. The System for Award Management (SAM) will be checked for active excluded parties prior to award of contract. In addition, the Bidder to whom award is made must complete an Assurance Regarding Felony Conviction or Tax Delinquent Status for Corporate Applicants (AD-3031).

13. Good Neighbor Authority (GNA) Requirements, con't (9/16)

Bidder certifies, by signing this bid form, that to the best of Bidder's knowledge that the following representations are accurate and complete.

- a. That the Bidder and its principals are not presently debarred, suspended, proposed for debarment, declared ineligible, or voluntary excluded from timber sales (covered transactions) by any Federal department or agency.
- b. That the Bidder and its principals have not within a 3-year period preceding this bid been convicted of or had a civil judgment rendered against them for commission of fraud or a criminal offense in connection with obtaining , attempting to obtain, or performing a public (Federal, State, or local) transaction or contract under a public transaction; violation of Federal or State antitrust statutes or commission of embezzlement, theft, forgery, bribery, falsification or destruction of records, making false statements, or receiving stolen property.
- c. That the Bidder and its principals are not presently indicted for or otherwise criminally or civilly charged by a governmental entity (Federal, State, or local) with commission of any of the offenses enumerated in paragraph b of this certification.
- d. That the Bidder and its principals have not within a 3-year period preceding this bid had one or more public transactions (Federal, State, or local) terminated for breach or default of a timber or forest product contract.

Bidders that cannot certify this requirement, in whole or in part, shall submit an explanation with their bid.

DAN EICHINGER
Director

TIMBER SALE INFORMATION

Two Bears Harvest (61-056-21)
T25N, R14W, SEC. 10; T25N, R14W, SEC. 3.
Benzie County (Advertised Price \$93,402.60)

SALE NOTE: All units of volume listed for this sale were estimated using the Inventory Manager computer program and the new Michigan taper model.

Advanced sugar maple regeneration exists in locations throughout this sale. There is a desire to protect this regeneration, where possible, from logging activity damage.

A recreation site such as a trail, pathway, or campground is within the sale area or the vicinity. Certain restrictions/specifications may be applicable including time restrictions.

A timber sale contract for this lump sum, sealed bid timber sale will be awarded to the responsible bidder offering the highest sealed bid price. All units of volume listed below were estimated using the Inventory Manager computer program and the new Michigan taper model. Bids must be at or above the following advertised price for each product and species:

<u>PRODUCTS & SPECIES</u>	<u>ESTIMATED UNITS*</u>	<u>ADVERTISED PRICE</u>
Sawtimber		
B. T. Aspen	422.4 MBF	\$ 94.00 / MBF
Basswood	11.9 MBF	\$ 87.00 / MBF
Black Cherry	19.0 MBF	\$ 147.00 / MBF
Quaking Aspen	93.0 MBF	\$ 94.00 / MBF
Red Maple	60.4 MBF	\$ 126.00 / MBF
Sugar Maple	14.5 MBF	\$ 206.00 / MBF
White Pine	140.6 MBF	\$ 34.00 / MBF
Pulpwood		
B. T. Aspen	1,172 Cords	\$ 12.80 / Cord
Basswood	18 Cords	\$ 13.85 / Cord
Black Cherry	147 Cords	\$ 13.45 / Cord
Ironwood	23 Cords	\$ 13.45 / Cord
Quaking Aspen	137 Cords	\$ 12.80 / Cord
Red Maple	88 Cords	\$ 13.45 / Cord
Sugar Maple	42 Cords	\$ 13.45 / Cord
White Pine	334 Cords	\$ 14.10 / Cord

* The total volume is statistically estimated within plus (+) or minus (-) 5.90 percent. There are an estimated 3,508 cords on this timber sale, plus or minus 207 cords at the 95% confidence level. The estimated units are final and not subject to adjustment. Prospective bidders are urged to examine this timber and to make their own estimates of quantity and quality.

BOND AND PAYMENT SCHEDULE:

1. A bond in the amount of \$4,670.00 to insure faithful performance of the conditions of the contract will be deposited by the successful bidder within 21 days of the sale award.
2. Cutting in any sale or unit without the required advance payment would be considered a trespass.
3. Total payment must be paid in advance or according to the following schedule :
 - (a) Ten percent (10%) of the sale value must be paid within 21 days of the sale award.
 - (b) The 10% down payment will be credited towards the first unit cut.
 - (c) Payment for each of the following units must be made before cutting begins in that unit:

PAYMENT UNIT NUMBER	PERCENT OF TOTAL SALE VALUE
01	36.0%
02	43.9%
03	20.1%
4. If no cutting takes place, the 10% down payment will not be refunded.
5. Operations on the contract issued will terminate on 04/14/2024.

SALE STATISTICS

Volumes were calculated in cubic feet using the Michigan taper model. Cubic foot volume includes all wood inside bark for the product indicated. For display purposes, cubic feet were converted to cords and MBF using a simple conversion factor, e.g. 79 cubic feet per cord and 185 cubic feet per MBF. The cubic foot volumes are precise; the cords and MBF volumes are not. Cubic foot volume cannot be directly converted to cords or boards with precision.

SALE VOLUMES

The total estimated sale volume may not equal the sum of the species/products due to the nature of statistical calculations associated with double sampling methodology.

VOLUME			STATISTICAL RANGE IN CORDS	
TOTAL CUBIC FEET	TOTAL CORDS	PERCENT ERROR	MINIMUM	MAXIMUM
277,155	3,508	5.90%	3,301	3,715

VDU VOLUMES

A VDU is a Volume Determination Unit. Volumes and their associated statistics are calculated at the VDU level and summarized to the sale level. There is often a one to one relationship between a VDU and a Payment Unit, but not always, depending on the cruise design. Refer to the VDU TO PAYMENT UNIT table.

	VOLUME			RANGE IN CORDS	
VDU	TOTAL CUBIC FEET	TOTAL CORDS	PERCENT ERROR	MINIMUM	MAXIMUM
13	219,031	2,773	6.59%	2,590	2,955
17	56,266	712	13.23%	618	806
TOTAL:	275,297	3,485		3,208	3,762

VDU TO PAYMENT UNIT

When a VDU is associated with more than one Payment Unit (PU), the VDU volumes are assigned to the PU based on acres of the VDU within the PU.

VDU	VDU ACRES	PU	PU ACRES
13	66.1	1	29.8
		2	36.3
17	18.7	3	18.7
TOTAL:	84.8		84.8

DESCRIPTION OF TIMBER BY PAYMENT UNIT (PU)

PU	MARKET GROUP	PRODUCT	QUANTITY	UNIT	ACRES	ADVERTISE PRICE				
1	B. T. Aspen	Sawtimber	176.0	MBF	29.8	\$33,621.90				
	Black Cherry		8.6	MBF						
	Quaking Aspen		38.9	MBF						
	Red Maple		0.9	MBF						
	Sugar Maple		6.5	MBF						
	White Pine		52.7	MBF						
	B. T. Aspen	Pulpwood	428	Cords						
	Basswood		6	Cords						
	Black Cherry		66	Cords						
	Ironwood		10	Cords						
	Quaking Aspen		52	Cords						
	Red Maple		6	Cords						
	Sugar Maple		16	Cords						
	White Pine		97	Cords						
	2		B. T. Aspen	Sawtimber			214.3	MBF	36.3	\$41,001.10
			Black Cherry				10.4	MBF		
Quaking Aspen		47.4	MBF							
Red Maple		1.1	MBF							
Sugar Maple		8.0	MBF							
White Pine		64.2	MBF							
B. T. Aspen		Pulpwood	522	Cords						
Basswood			7	Cords						
Black Cherry			81	Cords						
Ironwood			13	Cords						
Quaking Aspen			64	Cords						
Red Maple			8	Cords						
Sugar Maple			19	Cords						
White Pine			119	Cords						
3			B. T. Aspen	Sawtimber	32.1	MBF	18.7	\$18,779.60		
			Basswood		11.9	MBF				
	Quaking Aspen	6.7	MBF							
	Red Maple	58.4	MBF							
	White Pine	23.7	MBF							
	B. T. Aspen	Pulpwood	222	Cords						
	Basswood		5	Cords						
	Quaking Aspen		21	Cords						
	Red Maple		74	Cords						
	Sugar Maple		7	Cords						
	White Pine		118	Cords						
	TOTAL:			761.8	MBF					
	TOTAL:			1,961	Cords					

Sale Specific Conditions & Requirements

Sale Name: Two Bears Harvest

Sale Number: 61-056-21 Seq#: 1

1 - Sale Area

1.2 - Boundaries

1.2.1 - Painted boundaries (9/19)

The sale boundary and Payment Unit boundaries are marked and identified by red paint. Exterior sale boundary lines against state are marked with red paint. Retention patches are marked with red paint; no harvesting activities may occur within these areas. The painted boundary line trees are not Included Timber and are to be protected.

2 - Timber Specifications

2.1 - Included Timber

2.1.7 - Leave tree marked unit(s) (6/14)

Within Payment Unit(s) 1-3, all red maple, aspen, sugar maple, cherry, basswood, beech, white pine, jack pine and ironwood trees, which meet minimum piece specifications in 2.2 Utilization, are designated for cutting. Except, do not cut any trees marked with green paint above and below stump height or any other tree species that is not specifically designated for cutting as discussed above.

2.2 - Utilization

2.2.3 - Stump heights (4/07)

Stump heights within the Sale Area shall not exceed 12 inches for trees greater than 10 inches at DBH and 4 inches for trees smaller than 10 inches at DBH.

4 - Transportation

4.1 - Construction

4.1.3 - Slash and earthen piles (8/04)

Piles or windrows of earth along roads and landings that have been widened or constructed shall be leveled. Slash from road maintenance or construction, including stumps, shall be dispersed throughout the sale, chipped, utilized or removed from the sale unless otherwise specified by DNR sale administrator.

5 - Operations

5.2 - Conduct of Operations

5.2.1 - Slash

5.2.1.8 - Slash height (12/08)

No slash or tree tops may exceed 24 inches in height.

5.2.4 - Dead and Down Creation

5.2.4.3 - Dead and down creation, dead trees (6/07)

Except as provided for in General Condition and Requirement 5.2.2, no dead trees, standing or down, are to be cut, skidded, or processed.

5.2.4.4 - Dead and down creation, grouse (6/18)

To encourage grouse and other wildlife, in Payment Unit(s) 1-3, leave one, 12" diameter or larger log-length (8 foot minimum) piece on the ground for every 2 acres, preferably a hardwood species such as maple. These trees will be evenly scattered throughout the Payment Unit, preferably at least two chains from any roads, two-tracks, or trails open to vehicles. This can be an unmerchantable piece or a full tree.

5.2.41 - Snowmobile trail protection (9/11)

The Betsie River snowmobile trail is shown on the Timber Sale Map. Do not cut or damage posts with orange trail markers or traffic control signs. If the trail is used, it must be maintained and restored to a condition equal to or better than before the

sale. The road maintenance/restoration must be done prior to December 1. If the trail is used for hauling, it must be graded to the satisfaction of the Unit Manager or his/her representative prior to December 1. If the trail road is to be used for hauling during the snowmobile season, then a snow-covered base must be left on the trail. The snowmobile trail may only be crossed at right angles. Maintain a 20-foot-wide slash, debris, and rut free zone daily using the snowmobile trail as the centerline. No decking of forest products will be permitted along the snowmobile trail. All stumps within 20 feet of the snowmobile trail must be cut at ground level. In addition, any trees cut within 5 feet of the trail must have the stumps removed and be disposed of according to the direction of the Unit Manager or his/her representative.

6 - Safety and Fire Prevention

6.2 - Signing

6.2.2 - Snowmobile trail posting (10/20)

The Purchaser is responsible for posting and maintaining caution signs on Betsie River snowmobile trail prior to beginning operations during the snowmobile season (approximately December 1 to March 31). The trail must be posted at appropriate distances from the Sale Area to warn of logging activity and truck traffic. Signs must be removed when harvest operations are suspended or completed. The Purchaser will provide these signs.



Sale Number	Year
61 - 056	21

TIMBER SALE MAP

This information provided by authority of Part 525, 1994 PA 451 as amended.

Forest Management Unit Traverse City	County Benzie	Mapped By Craig Allen	Date 09/29/2021	Page 1	of 1
Township 25N	Range 14W	Section(s) and Subdivision(s) Sec.3; SENW,S1/2NE,NESW,S1/2SW,NWSE Sec.10;NWNW	Scale 1:15,840		

Cover Type				Density	
A = Aspen	H = Hemlock	N = Marsh	U = Upland Brush	0 = Non Stocked	5 = Pole Timber Medium
B = Paper Birch	J = Jack Pine	O = Oak	UM = Upland Mixed	1 = Seeding Sapling Poor	6 = Pole Timber Well
C = Cedar	L = Lowland Brush	P = Lowland Poplar	V = Bog or Marsh	2 = Seeding Sapling Medium	7 = Saw Timber Poor
D = Treed Bog	LM = Lowland Mixed	Q = Mixed Swamp Conifer	W = White Pine	3 = Seeding Sapling Well	8 = Saw Timber Medium
E = Swamp Hardwoods	M = Mpl. Ech. Birch	R = Red Pine	X = Non Stocked	4 = Pole Timber Poor	9 = Saw Timber Well
F = Spruce Fir	MC = Mixed Conifer	S = Black Spruce	Z = Water		
G = Cress	MD = Mixed Deciduous	T = Tamarack			

PU	Acres
1	29.8
2	36.3
3	18.7

Two Bears Harvest

Compartment 25

84.8 Acres

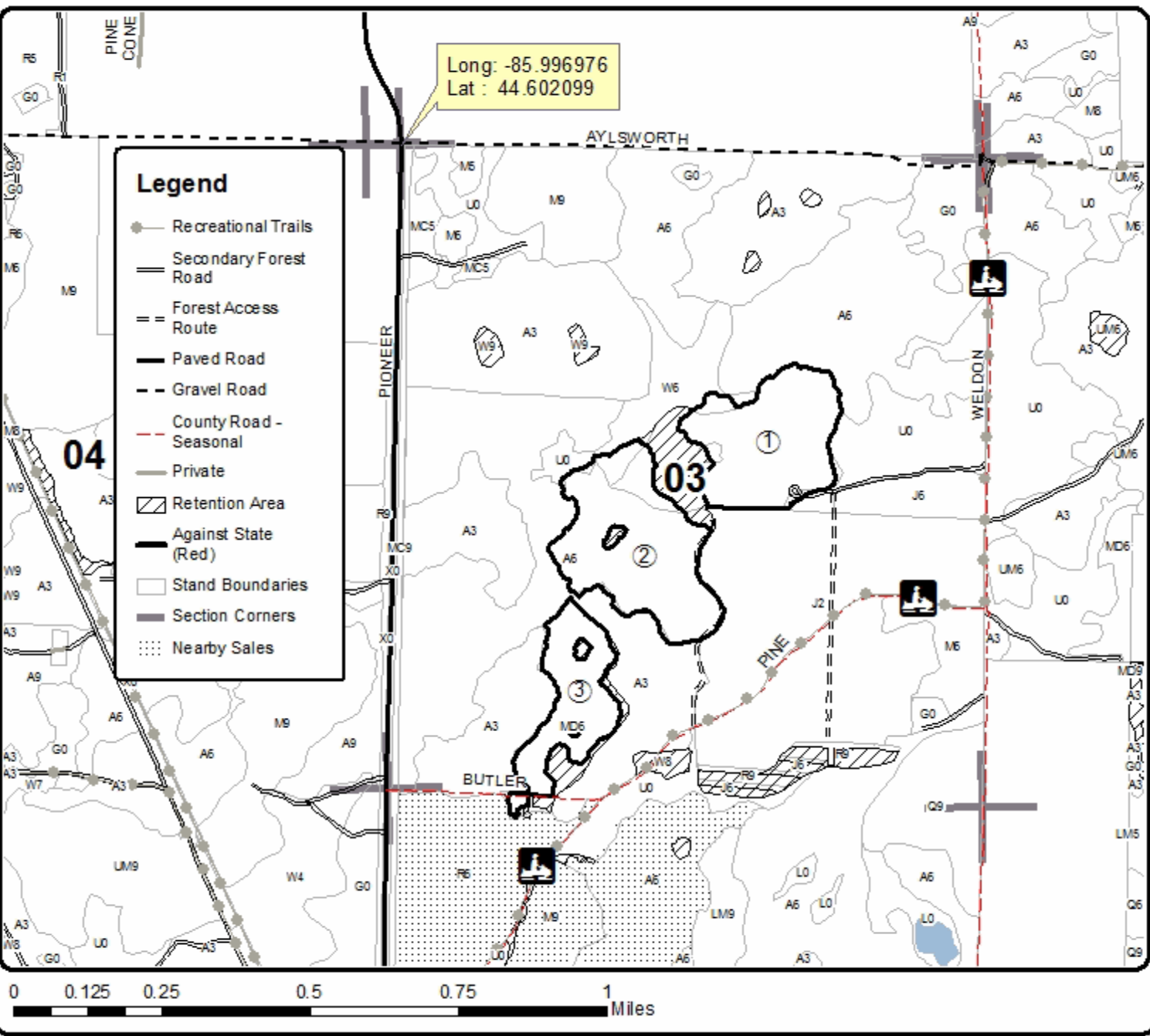

TIMBER SALE INFORMATION

Old Monarch Mix (61-057-21)
T25N, R14W, SEC. 10; T25N, R14W, SEC. 15; T25N, R14W, SEC. 3.
Benzie County (Advertised Price \$122,554.00)

SALE NOTE: All units of volume listed for this sale were estimated using the Inventory Manager computer program and the new Michigan taper model.

See sale spec 2.1.7 for information on protecting sugar maple regeneration.

A recreation site such as a trail, pathway, or campground is within the sale area or the vicinity. Certain restrictions/specifications may be applicable including time restrictions.

A timber sale contract for this lump sum, sealed bid timber sale will be awarded to the responsible bidder offering the highest sealed bid price. All units of volume listed below were estimated using the Inventory Manager computer program and the new Michigan taper model. Bids must be at or above the following advertised price for each product and species:

<u>PRODUCTS & SPECIES</u>	<u>ESTIMATED UNITS*</u>		<u>ADVERTISED PRICE</u>
Sawtimber			
B. T. Aspen	523.5	MBF	\$ 94.00 / MBF
Basswood	2.0	MBF	\$ 87.00 / MBF
Beech	15.5	MBF	\$ 90.00 / MBF
Black Cherry	30.3	MBF	\$ 147.00 / MBF
Quaking Aspen	16.1	MBF	\$ 94.00 / MBF
Red Maple	108.6	MBF	\$ 126.00 / MBF
Sugar Maple	31.7	MBF	\$ 206.00 / MBF
White Pine	214.6	MBF	\$ 34.00 / MBF
Pulpwood			
B. T. Aspen	1,421	Cords	\$ 12.80 / Cord
Basswood	7	Cords	\$ 13.85 / Cord
Beech	13	Cords	\$ 13.45 / Cord
Black Cherry	56	Cords	\$ 13.45 / Cord
Ironwood	31	Cords	\$ 13.45 / Cord
Quaking Aspen	157	Cords	\$ 12.80 / Cord
Red Maple	446	Cords	\$ 13.45 / Cord
Sugar Maple	109	Cords	\$ 13.45 / Cord
White Pine	652	Cords	\$ 14.10 / Cord

* The total volume is statistically estimated within plus (+) or minus (-) 5.30 percent. There are an estimated 4,867 cords on this timber sale, plus or minus 258 cords at the 95% confidence level. The estimated units are final and not subject to adjustment. Prospective bidders are urged to examine this timber and to make their own estimates of quantity and quality.

BOND AND PAYMENT SCHEDULE:

1. A bond in the amount of \$6,128.00 to insure faithful performance of the conditions of the contract will be deposited by the successful bidder within 21 days of the sale award.
2. Cutting in any sale or unit without the required advance payment would be considered a trespass.
3. Total payment must be paid in advance or according to the following schedule :
 - (a) Ten percent (10%) of the sale value must be paid within 21 days of the sale award.
 - (b) The 10% down payment will be credited towards the first unit cut.
 - (c) Payment for each of the following units must be made before cutting begins in that unit:

PAYMENT UNIT NUMBER	PERCENT OF TOTAL SALE VALUE
01	36.2%
02	4.1%
03	8.5%
04	40.5%
05	2.1%
06	8.6%
4. If no cutting takes place, the 10% down payment will not be refunded.
5. Operations on the contract issued will terminate on 04/14/2024.

SALE STATISTICS

Volumes were calculated in cubic feet using the Michigan taper model. Cubic foot volume includes all wood inside bark for the product indicated. For display purposes, cubic feet were converted to cords and MBF using a simple conversion factor, e.g. 79 cubic feet per cord and 185 cubic feet per MBF. The cubic foot volumes are precise; the cords and MBF volumes are not. Cubic foot volume cannot be directly converted to cords or boards with precision.

SALE VOLUMES

The total estimated sale volume may not equal the sum of the species/products due to the nature of statistical calculations associated with double sampling methodology.

VOLUME			STATISTICAL RANGE IN CORDS	
TOTAL CUBIC FEET	TOTAL CORDS	PERCENT ERROR	MINIMUM	MAXIMUM
384,512	4,867	5.30%	4,609	5,126

VDU VOLUMES

A VDU is a Volume Determination Unit. Volumes and their associated statistics are calculated at the VDU level and summarized to the sale level. There is often a one to one relationship between a VDU and a Payment Unit, but not always, depending on the cruise design. Refer to the VDU TO PAYMENT UNIT table.

VDU	VOLUME			RANGE IN CORDS	
	TOTAL CUBIC FEET	TOTAL CORDS	PERCENT ERROR	MINIMUM	MAXIMUM
28	20,794	263	21.99%	205	321
31	142,744	1,807	8.09%	1,661	1,953
52	153,890	1,948	9.53%	1,762	2,134
59	6,841	87	22.96%	67	106
68	30,869	391	15.99%	328	453
931	22,063	279	11.44%	247	311
TOTAL:	377,201	4,775		4,271	5,279

VDU TO PAYMENT UNIT

When a VDU is associated with more than one Payment Unit (PU), the VDU volumes are assigned to the PU based on acres of the VDU within the PU.

VDU	VDU ACRES	PU	PU ACRES
28	14.4	3	14.4
31	39.4	1	39.4
52	41.7	4	41.7
59	7.5	5	7.5
68	16.6	6	16.6
931	8.0	2	8.0
TOTAL:	127.6		127.6

DESCRIPTION OF TIMBER BY PAYMENT UNIT (PU)

PU	MARKET GROUP	PRODUCT	QUANTITY	UNIT	ACRES	ADVERTISE PRICE	
1	B. T. Aspen	Sawtimber	158.9	MBF	39.4	\$44,390.55	
			24.4	MBF			
			62.9	MBF			
			97.2	MBF			
	B. T. Aspen	Pulpwood	711	Cords			
			11	Cords			
			14	Cords			
			85	Cords			
			123	Cords			
			37	Cords			
			139	Cords			
2	B. T. Aspen	Sawtimber	6.6	MBF	8.0	\$4,979.35	
			9.2	MBF			
	B. T. Aspen	Pulpwood	209	Cords			
			39	Cords			
3	B. T. Aspen	Sawtimber	14.3	MBF	14.4	\$10,395.90	
			Beech	15.5			MBF
			Black Cherry	1.9			MBF
			Red Maple	13.4			MBF
			Sugar Maple	18.7			MBF
			B. T. Aspen	9			Cords
	B. T. Aspen	Pulpwood	Beech	13			Cords
			Black Cherry	2			Cords
			Ironwood	4			Cords
			Red Maple	84			Cords
			Sugar Maple	25			Cords
4	B. T. Aspen	Sawtimber	308.7	MBF	41.7	\$49,792.60	
			Quaking Aspen	16.1			MBF
			Red Maple	9.0			MBF
			White Pine	112.0			MBF
	B. T. Aspen	Pulpwood	294	Cords			
			Basswood	5			Cords
			Black Cherry	37			Cords
			Ironwood	13			Cords
			Quaking Aspen	51			Cords
			Red Maple	153			Cords
			Sugar Maple	4			Cords
			White Pine	500			Cords
5	Basswood	Sawtimber	2.0	MBF	7.5	\$2,513.95	
			Red Maple	4.9			MBF
			Sugar Maple	3.9			MBF
			White Pine	5.4			MBF
	Basswood	Pulpwood	2	Cords			
			Red Maple	25			Cords
			Sugar Maple	14			Cords
			White Pine	13			Cords
6	B. T. Aspen	Sawtimber	35.0	MBF	16.6	\$10,481.65	
			Black Cherry	4.0			MBF
			Red Maple	9.2			MBF
			Sugar Maple	9.1			MBF
	B. T. Aspen	Pulpwood	198	Cords			
			Black Cherry	6			Cords
			Quaking Aspen	21			Cords
			Red Maple	22			Cords
			Sugar Maple	29			Cords

TOTAL:	942.3	MBF
--------	-------	-----

TOTAL:	2,892	Cords
--------	-------	-------

Sale Specific Conditions & Requirements

Sale Name: Old Monarch Mix

Sale Number: 61-057-21 Seq#: 1

1 - Sale Area

1.2 - Boundaries

1.2.1 - Painted boundaries (9/19)

The sale boundary and Payment Unit boundaries are marked and identified by red and yellow paint. Exterior sale boundary lines against state are marked with red paint. Interior Payment Unit boundaries are marked with yellow or red paint. Retention patches are marked with red paint; no harvesting activities may occur within these areas. The painted boundary line trees are not Included Timber and are to be protected. Yellow painted trees designating an interior Payment Unit boundary are only to be cut when all surrounding Payment Units have been paid.

2 - Timber Specifications

2.1 - Included Timber

2.1.3 - Cut tree marked unit(s) (12/08)

Within Payment Unit(s) 3 and 5, all trees are designated for cutting when marked with orange paint above and below stump height, regardless of merchantability. Also, any ironwood tree can be cut in these Payment Units to provide more room as needed for harvest equipment operations.

2.1.7 - Leave tree marked unit(s) (6/14)

Within Payment Unit(s) 1, 2, 4, and 6, all red maple, sugar maple, aspen, cherry, beech, ironwood, basswood, and white pine trees which meet minimum piece specifications in 2.2 Utilization, are designated for cutting. Except, In Payment Units 2 and 6, do not cut any white pine trees. Also, within all Payment Units do not cut any tree marked with green paint above and below stump height and as much as possible, protect advance sugar maple regeneration in the understory.

2.2 - Utilization

2.2.3 - Stump heights (4/07)

Stump heights within the Sale Area shall not exceed 12 inches for trees greater than 10 inches at DBH and 4 inches for trees smaller than 10 inches at DBH.

2.2.5 - Limbed tree skidding (1/09)

The skidding of whole trees or tree segments with limbs attached is prohibited in Payment Units 3 and 5, unless approved by the Unit Manager or his/her representative.

4 - Transportation

4.1 - Construction

4.1.3 - Slash and earthen piles (8/04)

Piles or windrows of earth along roads and landings that have been widened or constructed shall be leveled. Slash from road maintenance or construction, including stumps, shall be dispersed throughout the sale, chipped, utilized or removed from the sale unless otherwise specified by the DNR sale administrator.

5 - Operations

5.2 - Conduct of Operations

5.2.1 - Slash

5.2.1.8 - Slash height (12/08)

No slash or tree tops may exceed 24 inches in height.

5.2.3 - Operating Restrictions

5.2.3.3 - Bark slippage restriction (3/09)

Within Payment Unit(s) 3 and 5, unless changed by written agreement, cutting and skidding are not permitted during the

period of April 15 to July 15. This restriction is because of bark slippage.

5.2.4 - Dead and Down Creation

5.2.4.3 - Dead and down creation, dead trees (6/07)

Except as provided for in General Condition and Requirement 5.2.2, no dead trees, standing or down, are to be cut, skidded, or processed.

5.2.4.4 - Dead and down creation, grouse (6/18)

To encourage grouse and other wildlife, in Payment Unit(s) 1, 2, 4, and 6 leave one 12" or larger diameter (or largest diameter trees within stand) whole tree on the ground for every 2 acres, preferably a hardwood species such as maple or if no hardwoods are present, a white pine. These will be evenly scattered throughout the Payment Unit. These trees will be evenly scattered throughout the Payment Unit, preferably at least two chains from any roads, two-tracks, or trails open to vehicles.

5.2.41 - Snowmobile trail protection (9/11)

The Betsie River is a snowmobile trail and is shown on the Timber Sale Map. Do not cut or damage posts with orange trail markers or traffic control signs. If the trail is used, it must be maintained and restored to a condition equal to or better than before the sale. The road maintenance/restoration must be done prior to December 1. If the trail is used for hauling, it must be graded to the satisfaction of the Unit Manager or his/her representative prior to December 1. If the trail road is to be used for hauling during the snowmobile season, then a snow-covered base must be left on the trail. The snowmobile trail may only be crossed at right angles. Maintain a 20-foot-wide slash, debris, and rut free zone daily using the snowmobile trail as the centerline. No decking of forest products will be permitted along the snowmobile trail. All stumps within 20 feet of the snowmobile trail must be cut at ground level. In addition, any trees cut within 5 feet of the trail must have the stumps removed and be disposed of according to the direction of the Unit Manager or his/her representative.



TIMBER SALE MAP

This information provided by authority of Part 525, 1994 PA 451, as amended.

Forest Management Unit Traverse City	County Benzie	Mapped By Craig Allen	Date 09/30/2021	Page 1	of 1
Township 25N	Range 14W	Section(s) and Subdivision(s) Sec.3;SESW,SWSE. Sec.10; NW,W1/2NE, SW. Sec.15;NW,NWWSW	Scale 1:15,840		

Cover Type				Density	
A = Aspen	H = Hemlock	N = Marsh	U = Upland Brush	0 = Non Stocked	5 = Pole Timber Medium
B = Paper Birch	J = Jack Pine	O = Oak	UM = Upland Mixed	1 = Seeding Sapling Poor	6 = Pole Timber Well
C = Cedar	L = Lowland Brush	P = Lowland Poplar	V = Bog or Marsh	2 = Seeding Sapling Medium	7 = Saw Timber Poor
D = Treed Bog	LM = Lowland Mixed	Q = Mixed Swamp Conifer	W = White Pine	3 = Seeding Sapling Well	8 = Saw Timber Medium
E = Swamp Hardwoods	M = Mpl. Ech. Birch	R = Red Pine	X = Non Stocked	4 = Pole Timber Poor	9 = Saw Timber Well
F = Spruce Fir	MC = Mixed Conifer	S = Black Spruce	Z = Water		
G = Creas	MD = Mixed Deciduous	T = Tamarack			

PU	Acres	PU	Acres
1	39.4	4	41.7
2	8	5	7.5
3	14.4	6	16.6

Old Monarch Mix

Compartment 25

127.6 Acres

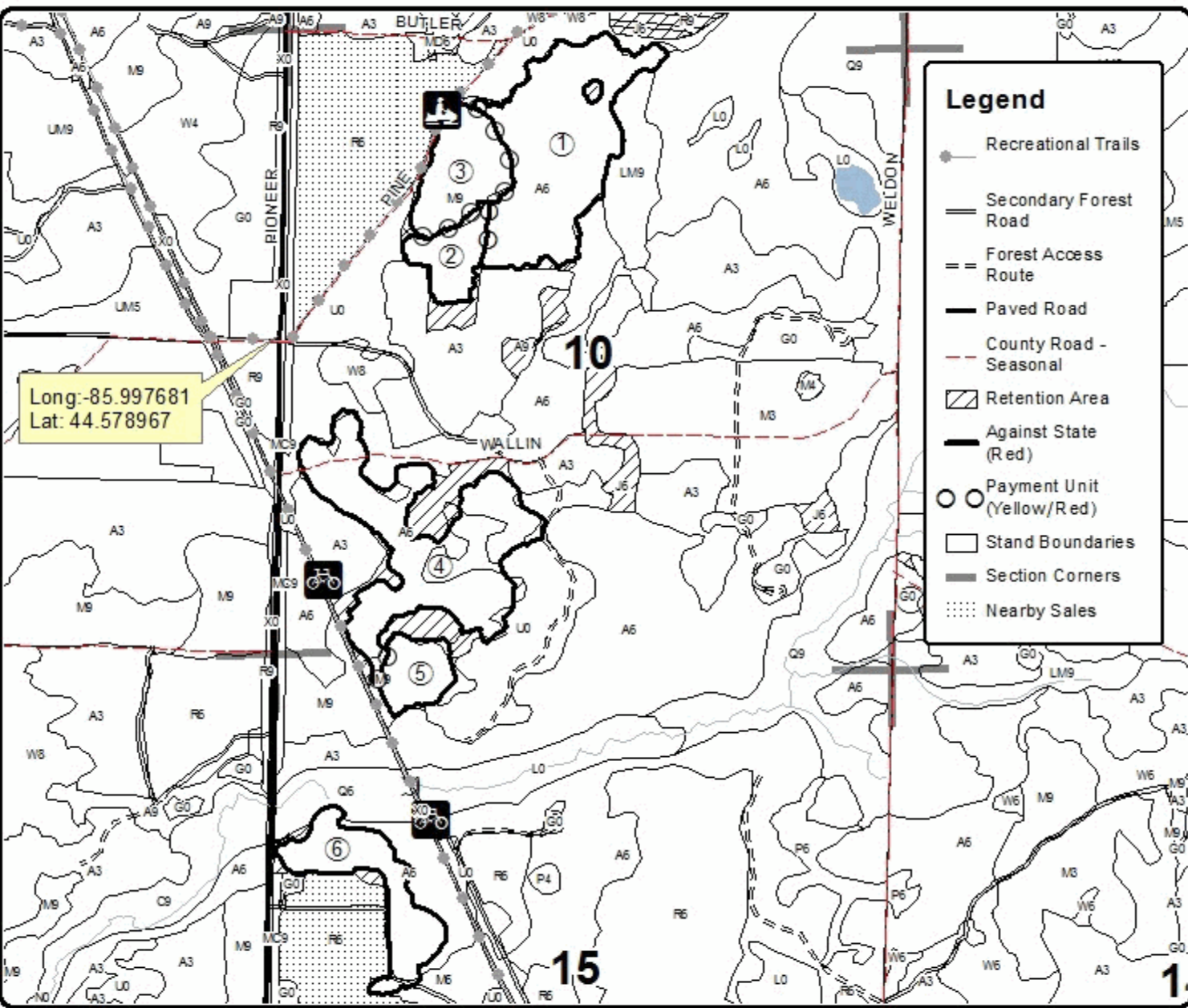

TIMBER SALE INFORMATION

Pioneer Pine (61-065-21)

T25N, R14W, SEC. 10; T25N, R14W, SEC. 15; T25N, R14W, SEC. 3.
Benzie County (Advertised Price \$83,248.05)

SALE NOTE: All units of volume listed for this sale were estimated using the Inventory Manager computer program and the new Michigan taper model.

A recreation site such as a trail, pathway, or campground is within the sale area or the vicinity. Certain restrictions/specifications may be applicable including time restrictions.

A timber sale contract for this lump sum, sealed bid timber sale will be awarded to the responsible bidder offering the highest sealed bid price. All units of volume listed below were estimated using the Inventory Manager computer program and the new Michigan taper model. Bids must be at or above the following advertised price for each product and species:

<u>PRODUCTS & SPECIES</u>	<u>ESTIMATED UNITS*</u>	<u>ADVERTISED PRICE</u>
Sawtimber		
Red Pine	69.0 MBF	\$ 84.00 / MBF
Pulpwood		
Jack Pine	25 Cords	\$ 9.25 / Cord
Red Pine	2,312 Cords	\$ 33.40 / Cord

* The total volume is statistically estimated within plus (+) or minus (-) 4.38 percent. There are an estimated 2,502 cords on this timber sale, plus or minus 110 cords at the 95% confidence level. The estimated units are final and not subject to adjustment. Prospective bidders are urged to examine this timber and to make their own estimates of quantity and quality.

BOND AND PAYMENT SCHEDULE:

1. A bond in the amount of \$4,162.00 to insure faithful performance of the conditions of the contract will be deposited by the successful bidder within 21 days of the sale award.
2. Cutting in any sale or unit without the required advance payment would be considered a trespass.
3. Total payment must be paid in advance or according to the following schedule :
 - (a) Ten percent (10%) of the sale value must be paid within 21 days of the sale award.
 - (b) The 10% down payment will be credited towards the first unit cut.
 - (c) Payment for each of the following units must be made before cutting begins in that unit:

PAYMENT UNIT NUMBER	PERCENT OF TOTAL SALE VALUE
01	64.4%
02	26.2%
03	3.8%
04	5.6%
4. If no cutting takes place, the 10% down payment will not be refunded.
5. Operations on the contract issued will terminate on 04/14/2024.

SALE STATISTICS

Volumes were calculated in cubic feet using the Michigan taper model. Cubic foot volume includes all wood inside bark for the product indicated. For display purposes, cubic feet were converted to cords and MBF using a simple conversion factor, e.g. 79 cubic feet per cord and 185 cubic feet per MBF. The cubic foot volumes are precise; the cords and MBF volumes are not. Cubic foot volume cannot be directly converted to cords or boards with precision.

SALE VOLUMES

The total estimated sale volume may not equal the sum of the species/products due to the nature of statistical calculations associated with double sampling methodology.

VOLUME		STATISTICAL RANGE IN CORDS		
TOTAL CUBIC FEET	TOTAL CORDS	PERCENT ERROR	MINIMUM	MAXIMUM
197,650	2,502	4.38%	2,392	2,612

VDU VOLUMES

A VDU is a Volume Determination Unit. Volumes and their associated statistics are calculated at the VDU level and summarized to the sale level. There is often a one to one relationship between a VDU and a Payment Unit, but not always, depending on the cruise design. Refer to the VDU TO PAYMENT UNIT table.

VDU	VOLUME		PERCENT ERROR	RANGE IN CORDS	
	TOTAL CUBIC FEET	TOTAL CORDS		MINIMUM	MAXIMUM
24	128,198	1,623	5.26%	1,537	1,708
70	10,645	135	27.09%	98	171
77	49,436	626	7.59%	578	673
79	7,374	93	32.59%	63	124
TOTAL:	195,653	2,477		2,277	2,676

VDU TO PAYMENT UNIT

When a VDU is associated with more than one Payment Unit (PU), the VDU volumes are assigned to the PU based on acres of the VDU within the PU.

VDU	VDU ACRES	PU	PU ACRES
24	50.6	1	50.6
70	8.9	4	8.9
77	48.7	2	48.7
79	6.6	3	6.6
TOTAL:	114.8		114.8

DESCRIPTION OF TIMBER BY PAYMENT UNIT (PU)

PU	MARKET GROUP	PRODUCT	QUANTITY	UNIT	ACRES	ADVERTISE PRICE
1	Jack Pine	Pulpwood	25	Cords	50.6	\$53,571.05
	Red Pine		1,597	Cords		
2	Red Pine	Sawtimber	54.7	MBF	48.7	\$21,829.20
	Red Pine	Pulpwood	516	Cords		
3	Red Pine	Sawtimber	5.5	MBF	6.6	\$3,200.80
	Red Pine	Pulpwood	82	Cords		
4	Red Pine	Sawtimber	8.8	MBF	8.9	\$4,647.00
	Red Pine	Pulpwood	117	Cords		
TOTAL:			69.0	MBF		
TOTAL:			2,337	Cords		

Sale Specific Conditions & Requirements

Sale Name: Pioneer Pine

Sale Number: 61-065-21 Seq#: 1

1 - Sale Area

1.2 - Boundaries

1.2.1 - Painted boundaries (9/19)

The sale boundary and Payment Unit boundaries are marked and identified by red paint. Exterior sale boundary lines against state are marked with red paint. The painted boundary line trees are not Included Timber and are to be protected.

2 - Timber Specifications

2.1 - Included Timber

2.1.3 - Cut tree marked unit(s) (12/08)

Within Payment Unit(s) 2-4, all trees are designated for cutting when marked with orange paint above and below stump height, regardless of merchantability.

2.1.8 - Designated plantation row unit(s) (12/08)

Within Payment Unit(s) 1, all red pine trees which meet minimum piece specifications in 2.2 Utilization, within designated plantation rows are designated for cutting. Designated plantation rows are every third row. Begin with the third row in from the outside of the plantation, then continue every third row. Because of the variability of row direction, it shall be the responsibility of the producer to maintain the third-row sequence.

2.2 - Utilization

2.2.3 - Stump heights (4/07)

Stump heights within the Sale Area shall not exceed 6 inches for all trees.

4 - Transportation

4.1 - Construction

4.1.3 - Slash and earthen piles (8/04)

Piles or windrows of earth along roads and landings that have been widened or constructed shall be leveled. Slash from road maintenance or construction, including stumps, shall be dispersed throughout the sale as agreed by the DNR sale administrator.

5 - Operations

5.2 - Conduct of Operations

5.2.1 - Slash

5.2.1.8 - Slash height (12/08)

No slash or tree tops may exceed 24 inches in height.

5.2.3 - Operating Restrictions

5.2.3.6 - Bark beetle restriction (12/08)

In the event drought creates a high risk of pine bark beetle infestation, pine is not to be cut during the period March 1 through July 1, unless all portions of trees greater than two inches in diameter are removed from the sale area, reduced to chips, or treated to the satisfaction of the Unit Manager or his/her representative, within fifteen days of being severed from the stump. Pine log decks, pulpwood piles and treetops that are piled for chipping in the fall or winter within a 1/4 mile of susceptible sites must be removed before March 15. Residual slash must not be placed in piles or rows and must be spread over the site for quick drying. The Department of Natural Resources will exercise this specification if the risk of damage warrants.

5.2.38 - No decking against live trees (2/04)

Cut products may not be decked against unmarked or designated leave trees.

5.2.40 - Pathway protection (10/10)

The Betsie Valley Trail is a bike/ hiking (and no wheeled motorized) trail and is shown on the Timber Sale Map. Absolutely no logging equipment or vehicles of any kind are allowed on this trail or crossing this trail at any time.

5.2.41 - Snowmobile trail protection (9/11)

The Betsie River snowmobile trail is shown on the Timber Sale Map. Do not cut or damage posts with orange trail markers or traffic control signs. If the trail is used, it must be maintained and restored to a condition equal to or better than before the sale. The road maintenance/restoration must be done prior to December 1. If the trail is used for hauling, it must be graded to the satisfaction of the Unit Manager or his/her representative prior to December 1. If the trail road is to be used for hauling during the snowmobile season, then a snow-covered base must be left on the trail. The snowmobile trail may only be crossed at right angles. Maintain a 20-foot-wide slash, debris, and rut free zone daily using the snowmobile trail as the centerline. No decking of forest products will be permitted along the snowmobile trail. All stumps within 20 feet of the snowmobile trail must be cut at ground level. In addition, any trees cut within 5 feet of the trail must have the stumps removed and be disposed of according to the direction of the Unit Manager or his/her representative.

6 - Safety and Fire Prevention

6.2 - Signing

6.2.2 - Snowmobile trail posting (10/20)

The Purchaser is responsible for posting and maintaining caution signs on the Betsie River snowmobile trail prior to beginning operations during the snowmobile season (approximately December 1 to March 31). The trail must be posted at appropriate distances from the Sale Area to warn of logging activity and truck traffic. Signs must be removed when harvest operations are suspended or completed. The Purchaser will provide these signs.



TIMBER SALE MAP

This information provided by authority of Part 525, 1994 PA 451 as amended.

Sale Number	Year
61 - 065	21

Forest Management Unit Traverse City	County Benzie	Mapped By Craig Allen	Date 09/29/2021	Page 1	of 2
Township 25N	Range 14W	Section(s) and Subdivision(s) Sec.3; SWSW, Sec.10; N1/2NW,SWNW, Sec.15; S 1/2NW, N1/2SW,NWSE	Scale 1:15,840		

Cover Type				Density	
A = Aspen	H = Hemlock	N = Marsh	U = Upland Brush	0 = Non Stocked	5 = Pole Timber Medium
B = Paper Birch	J = Jack Pine	O = Oak	UM = Upland Mixed	1 = Seeding Sapling Poor	6 = Pole Timber Well
C = Cedar	L = Lowland Brush	P = Lowland Poplar	V = Bog or Marsh	2 = Seeding Sapling Medium	7 = Saw Timber Poor
D = Treed Bog	LM = Lowland Mixed	Q = Mixed Swamp Conifer	W = White Pine	3 = Seeding Sapling Well	8 = Saw Timber Medium
E = Swamp Hardwoods	M = Mpl. Ech. Birch	R = Red Pine	X = Non Stocked	4 = Pole Timber Poor	9 = Saw Timber Well
F = Spruce Fir	MC = Mixed Conifer	S = Black Spruce	Z = Water		
G = Creas	MD = Mixed Deciduous	T = Tamarack			

PU	Acres	PU	Acres
1	50.6	4	8.9
2	48.7		
3	6.6		

Pioneer Pine

Compartment 25

114.8 Acres

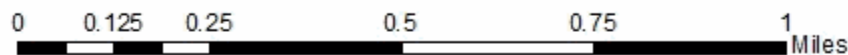
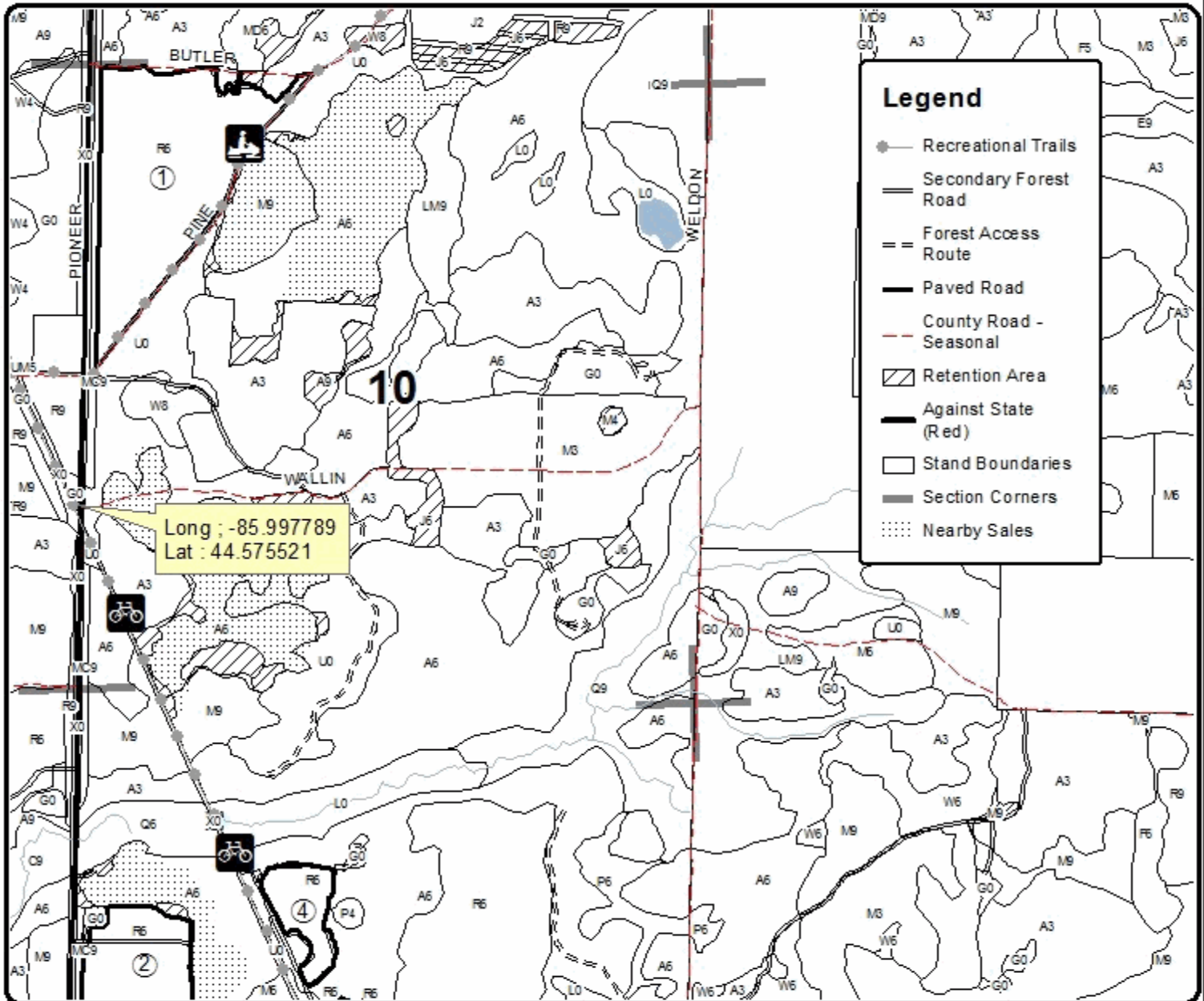



TIMBER SALE MAP

This information provided by authority of Part 525, 1994 PA 451, as amended.

Sale Number	Year
61 - 065	21

Forest Management Unit Traverse City	County Benzie	Mapped By Craig Allen	Date 09/29/2021	Page 2	of 2
Township 25N	Range 14W	Section(s) and Subdivision(s) Sec.3; SWSW, Sec.10; N1/2NW,SWNW, Sec.15; S1/2NW, N1/2SW,NWSE	Scale 1:15,840		

Cover Type				Density	
A = Aspen	H = Hemlock	N = Marsh	U = Upland Brush	0 = Non Stocked	5 = Pole Timber Medium
B = Paper Birch	J = Jack Pine	O = Oak	UM = Upland Mixed	1 = Seeding Sapling Poor	6 = Pole Timber Well
C = Cedar	L = Lowland Brush	P = Lowland Poplar	V = Bog or Marsh	2 = Seeding Sapling Medium	7 = Saw Timber Poor
D = Tread Bog	LM = Lowland Mixed	Q = Mixed Swamp Conifer	W = White Pine	3 = Seeding Sapling Well	8 = Saw Timber Medium
E = Swamp Hardwoods	M = Mpl. Ech. Bich	R = Red Pine	X = Non Stocked	4 = Pole Timber Poor	9 = Saw Timber Well
F = Spruce Fir	MC = Mixed Conifer	S = Black Spruce	Z = Water		
C = Cress	MD = Mixed Deciduous	T = Tamarack			

PU	Acres	PU	Acres
1	50.6	4	8.9
2	48.7		
3	6.6		

Pioneer Pine

Compartment 25

114.8 Acres

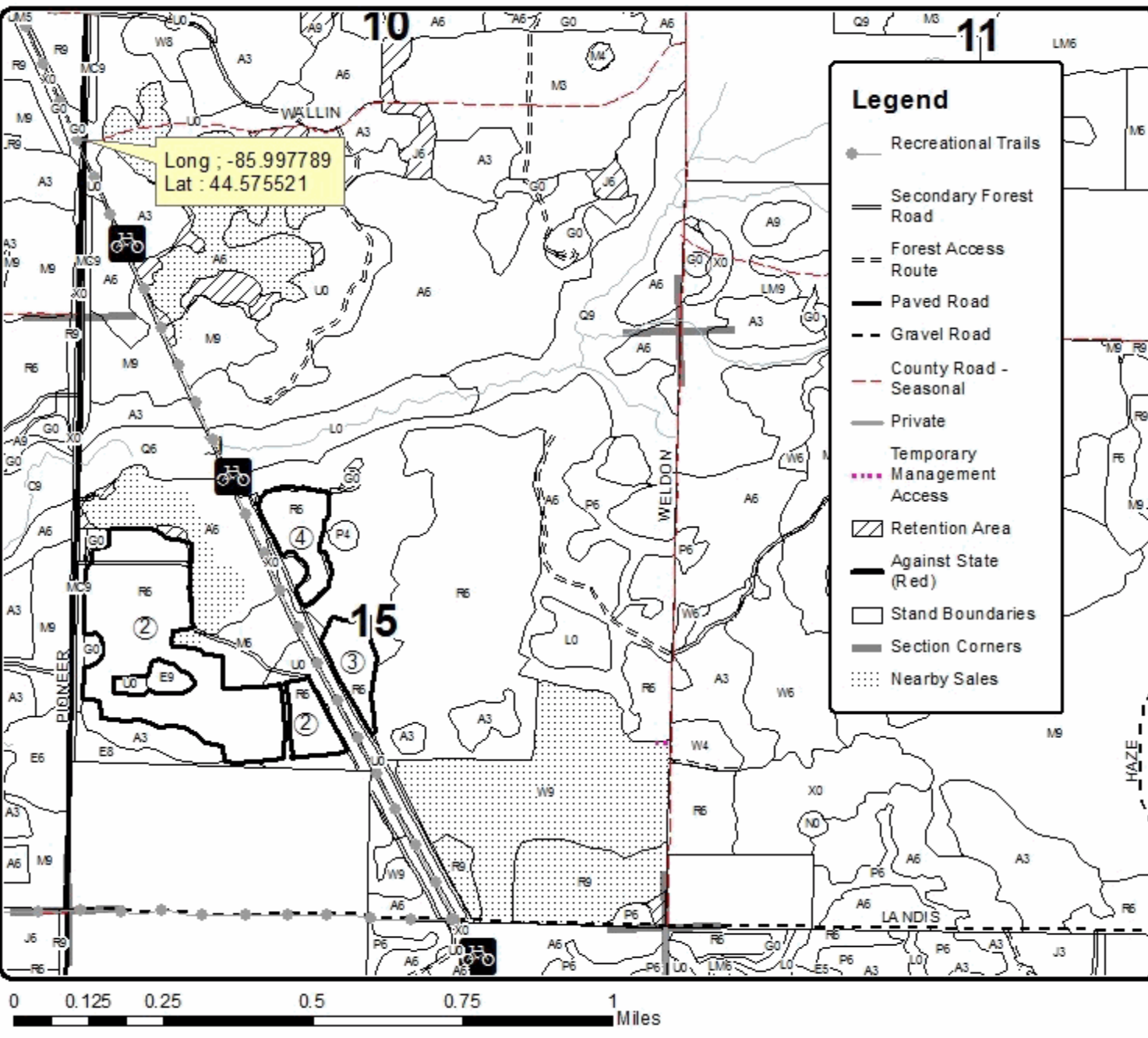

TIMBER SALE INFORMATION

Homecoming Aspen (61-067-21)
 T26N, R10W, SEC. 19; T26N, R10W, SEC. 30.
 Grand Traverse County (Advertised Price \$57,988.60)

SALE NOTE: All units of volume listed for this sale were estimated using the Inventory Manager computer program and the new Michigan taper model.

A recreation site such as a trail, pathway, or campground is within the sale area or the vicinity. Certain restrictions/specifications may be applicable including time restrictions.

A timber sale contract for this lump sum, sealed bid timber sale will be awarded to the responsible bidder offering the highest sealed bid price. All units of volume listed below were estimated using the Inventory Manager computer program and the new Michigan taper model. Bids must be at or above the following advertised price for each product and species:

<u>PRODUCTS & SPECIES</u>	<u>ESTIMATED UNITS*</u>	<u>ADVERTISED PRICE</u>
Sawtimber		
Black Cherry	3.0 MBF	\$ 123.00 / MBF
Mixed Aspen	216.1 MBF	\$ 79.00 / MBF
Red Maple	137.5 MBF	\$ 106.00 / MBF
Red Oak	14.4 MBF	\$ 92.00 / MBF
Red Pine	22.6 MBF	\$ 71.00 / MBF
White Pine	37.4 MBF	\$ 29.00 / MBF
Pulpwood		
Mixed Aspen	794 Cords	\$ 10.75 / Cord
Mixed Hardwood	594 Cords	\$ 11.30 / Cord
Mixed Oak	57 Cords	\$ 12.70 / Cord
Red Pine	96 Cords	\$ 28.05 / Cord
White Pine	278 Cords	\$ 11.85 / Cord

* The total volume is statistically estimated within plus (+) or minus (-) 6.57 percent. There are an estimated 2,767 cords on this timber sale, plus or minus 182 cords at the 95% confidence level. The estimated units are final and not subject to adjustment. Prospective bidders are urged to examine this timber and to make their own estimates of quantity and quality.

BOND AND PAYMENT SCHEDULE:

1. A bond in the amount of \$2,899.00 to insure faithful performance of the conditions of the contract will be deposited by the successful bidder within 21 days of the sale award.
2. Cutting in any sale or unit without the required advance payment would be considered a trespass.
3. Total payment must be paid in advance or according to the following schedule :
 - (a) Ten percent (10%) of the sale value must be paid within 21 days of the sale award.
 - (b) The 10% down payment will be credited towards the first unit cut.
 - (c) Payment for each of the following units must be made before cutting begins in that unit:

PAYMENT UNIT NUMBER	PERCENT OF TOTAL SALE VALUE
01	34.9%
02	2.6%
03	3.8%
04	43.4%
05	2.6%
06	12.5%
07	0.2%

4. If no cutting takes place, the 10% down payment will not be refunded.
5. Operations on the contract issued will terminate on 04/14/2025.

SALE STATISTICS

Volumes were calculated in cubic feet using the Michigan taper model. Cubic foot volume includes all wood inside bark for the product indicated. For display purposes, cubic feet were converted to cords and MBF using a simple conversion factor, e.g. 79 cubic feet per cord and 185 cubic feet per MBF. The cubic foot volumes are precise; the cords and MBF volumes are not. Cubic foot volume cannot be directly converted to cords or boards with precision.

SALE VOLUMES

The total estimated sale volume may not equal the sum of the species/products due to the nature of statistical calculations associated with double sampling methodology.

VOLUME			STATISTICAL RANGE IN CORDS	
TOTAL CUBIC FEET	TOTAL CORDS	PERCENT ERROR	MINIMUM	MAXIMUM
218,618	2,767	6.57%	2,585	2,949

VDU VOLUMES

A VDU is a Volume Determination Unit. Volumes and their associated statistics are calculated at the VDU level and summarized to the sale level. There is often a one to one relationship between a VDU and a Payment Unit, but not always, depending on the cruise design. Refer to the VDU TO PAYMENT UNIT table.

	VOLUME			RANGE IN CORDS	
VDU	TOTAL CUBIC FEET	TOTAL CORDS	PERCENT ERROR	MINIMUM	MAXIMUM
56	76,814	972	13.26%	843	1,101
59	9,870	125	32.88%	84	166
71	881	11	47.14%	6	16
73	5,831	74	26.40%	54	93
75	31,279	396	11.81%	349	443
90	4,199	53	36.85%	34	73
91	82,935	1,050	9.46%	950	1,149
TOTAL:	211,809	2,681		2,321	3,042

VDU TO PAYMENT UNIT

When a VDU is associated with more than one Payment Unit (PU), the VDU volumes are assigned to the PU based on acres of the VDU within the PU.

VDU	VDU ACRES	PU	PU ACRES
56	21.6	1	21.6
59	15.6	2	15.6
71	7.3	7	7.3
73	10.1	3	10.1
75	16.4	6	16.4
90	13.4	5	13.4
91	40.0	4	40.0
TOTAL:	124.4		124.4

DESCRIPTION OF TIMBER BY PAYMENT UNIT (PU)

PU	MARKET GROUP	PRODUCT	QUANTITY	UNIT	ACRES	ADVERTISE PRICE
1	Black Cherry	Sawtimber	3.0	MBF	21.6	\$20,228.85
	Mixed Aspen	Pulpwood	65.9	MBF		
	<i>B. T. Aspen</i>		65.9	<i>MBF</i>		
	Red Maple		53.3	MBF		
	Red Oak		14.4	MBF		
	Mixed Aspen		502	Cords		
	<i>B. T. Aspen</i>		450	<i>Cords</i>		
	<i>Quaking Aspen</i>		52	<i>Cords</i>		
	Mixed Hardwood		139	Cords		
	<i>Black Cherry</i>		2	<i>Cords</i>		
	<i>Red Maple</i>		137	<i>Cords</i>		
	Mixed Oak		29	Cords		
	<i>Red Oak</i>		29	<i>Cords</i>		
	White Pine		29	Cords		
2	White Pine		Sawtimber	12.5	MBF	15.6
	Mixed Aspen	Pulpwood	10	Cords		
	<i>Quaking Aspen</i>	10	<i>Cords</i>			
	Mixed Hardwood	32	Cords			
	<i>Black Cherry</i>	16	<i>Cords</i>			
	<i>Red Maple</i>	16	<i>Cords</i>			
	White Pine	58	Cords			
	3	Red Pine	Sawtimber	17.8	MBF	
Mixed Aspen		Pulpwood	6	Cords		
<i>B. T. Aspen</i>		6	<i>Cords</i>			
Mixed Oak		2	Cords			
<i>Red Oak</i>		2	<i>Cords</i>			
Red Pine		31	Cords			
4	Mixed Aspen	Sawtimber	112.7	MBF	40.0	\$25,154.90
	<i>B. T. Aspen</i>	101.0	<i>MBF</i>			
	<i>Quaking Aspen</i>	11.7	<i>MBF</i>			
	Red Maple	79.2	MBF			
	Red Pine	4.8	MBF			
	Mixed Aspen	Pulpwood	195	Cords		
	<i>B. T. Aspen</i>	112	<i>Cords</i>			
	<i>Quaking Aspen</i>	83	<i>Cords</i>			
	Mixed Hardwood	411	Cords			
	<i>Black Cherry</i>	70	<i>Cords</i>			
	<i>Paper Birch</i>	11	<i>Cords</i>			
	<i>Red Maple</i>	330	<i>Cords</i>			
	Red Pine	12	Cords			
	White Pine	37	Cords			
5	Red Pine	Pulpwood	53	Cords	13.4	\$1,486.65
6	Mixed Aspen	Sawtimber	37.5	MBF	16.4	\$7,236.05
	<i>B. T. Aspen</i>	37.5	<i>MBF</i>			
	Red Maple	5.0	MBF			
	White Pine	24.9	MBF			
	Mixed Aspen	Pulpwood	81	Cords		
	<i>B. T. Aspen</i>	67	<i>Cords</i>			
	<i>Quaking Aspen</i>	14	<i>Cords</i>			
	Mixed Hardwood	8	Cords			
	<i>Black Cherry</i>	3	<i>Cords</i>			
	<i>Red Maple</i>	5	<i>Cords</i>			
	Mixed Oak	26	Cords			
	<i>Red Oak</i>	13	<i>Cords</i>			
	<i>White Oak</i>	13	<i>Cords</i>			
	White Pine	146	Cords			

DESCRIPTION OF TIMBER BY PAYMENT UNIT (PU), CON'T

PU	MARKET GROUP	PRODUCT	QUANTITY	UNIT	ACRES	ADVERTISE PRICE
7	Mixed Hardwood	Pulpwood	4	Cords	7.3	\$140.00
	<i>Black Cherry</i>		4	<i>Cords</i>		
	White Pine		8	Cords		
TOTAL:			431.0	MBF		
TOTAL:			1,819	Cords		

Sale Specific Conditions & Requirements

Sale Name: Homecoming Aspen

Sale Number: 61-067-21 Seq#: 1

1 - Sale Area

1.2 - Boundaries

1.2.1 - Painted boundaries (9/19)

The sale boundary and Payment Unit boundaries are marked and identified by red and yellow paint. Exterior sale boundary lines against state land are marked with red paint. Interior Payment Unit boundaries are marked with yellow paint, except the boundary between Payment Units 1 and 2 is marked with red paint as marked on the Timber Sale Map. Retention patches are marked with double red paint marks; no harvesting activities may occur within these areas. The painted boundary line trees are not Included Timber and are to be protected unless marked with orange paint.

2 - Timber Specifications

2.1 - Included Timber

2.1.1 - Clearcut unit(s) with unmerchantable trees (6/14)

Within Payment Unit(s) 1 and 4, cut all trees that are two (2) inches or more at DBH, except for any trees marked with green paint. In addition,

- Within Payment Unit 1: do not cut any white oak;
- Within Payment Unit 4: do not cut any red pine unless marked with orange paint, any white pine greater than 18" at DBH, or any oak. Maple and pine saplings (less than 4.6" at DBH) may be left standing if undamaged.

2.1.2 - Clearcut unit(s) w/o unmerchantable trees (8/11)

Within Payment Unit(s) 2 and 7, cut all trees which meet minimum piece specifications in 2.2 Utilization, except for oaks or any trees marked with green paint. Do not cut any witch hazel or juneberry.

2.1.3 - Cut tree marked unit(s) (12/08)

Within Payment Unit(s) 3 and 5, all trees are designated for cutting when marked with orange paint above and below stump height, regardless of merchantability.

2.1.7 - Leave tree marked unit(s) (6/14)

Within Payment Unit(s) 6, all trees, which meet minimum piece specifications in 2.2 Utilization, are designated for cutting except trees marked with green paint above and below stump height.

4 - Transportation

4.1 - Construction

4.1.6 - Road construction (1/09)

Construction of new roads or improvements of existing roads shall be done in such a way as to minimize the environmental and visual impacts. Merchantable trees shall be cut and utilized unless otherwise directed. Non-merchantable trees shall be severed and laid flat on the ground. Slash shall be scattered, and not left in windrows and kept a minimum of 10 feet back from the road edge. Stumps shall be set upright, not left on edge, and be moved at least 30 feet away from the road edge. Disturbed soil shall be feathered into the woods and not left in berms or windrows.

4.1.7 - Road closure (10/11)

All new roads built into the sale must be blocked to vehicle traffic upon completion of the sale. In general, this will require constructing a four (4') foot high berm of stumps and logs covered with earth. All stumps from road building and landing construction must be reserved to block any newly constructed roads upon completion of the sale. These stumps must be scattered along the road system to prohibit vehicular movement. Contact the sale administrator for specific details of design and placement.

4.1.8 - Road work (1) (8/07)

The following road work is required: On the "Sale Access Route" shown on the Timber Sale Map through Payment Units 3 and 4, the Purchaser must ditch and crown a 150-yard-long portion of this road plus several other short stretches as designated by the sale administrator. After initial reshaping, the Purchaser is required to purchase and spread at least 200 cubic yards of pit run gravel with maximum stone size of 6 inches in diameter. Alternatively for the 150-yard portion of road

the Purchaser may reroute that portion to adjacent higher ground as approved by the timber sale administrator and cap that stretch with 23A crushed gravel at least 4" deep and 10' wide. Gravel placement will be as designated by the sale administrator.

4.4 - Access

4.4.4 - Restricted access (10/05)

Payment Units 1 and 2 must be accessed via the existing forest road running north from Blair Townhall Road. Access via Freedom Road will not be allowed to avoid conflicts with other users and resource values.

5 - Operations

5.2 - Conduct of Operations

5.2.1 - Slash

5.2.1.8 - Slash height (12/08)

No slash or tree tops may exceed 24 inches in height.

5.2.3 - Operating Restrictions

5.2.3.3 - Bark slippage restriction (3/09)

Within Payment Unit(s) 3 and 5, unless changed by written agreement, cutting and skidding are not permitted during the period of April 15 to July 15. This restriction is because of bark slippage.

5.2.3.4 - Oak wilt restriction, no exceptions (1/18)

Within Payment Unit(s) 1, 2, 4, 6, and 7, cutting, skidding, hauling within the sale and brushing of access roads to the sale are not permitted during the period of April 15 to July 15. No exceptions will be granted. This is necessary to reduce the spread of oak wilt.

5.2.3.6 - Bark beetle restriction (12/08)

In the event drought creates a high risk of pine bark beetle infestation, pine is not to be cut during the period March 1 through July 1, unless all portions of trees greater than two inches in diameter are removed from the sale area, reduced to chips, or treated to the satisfaction of the Unit Manager or his/her representative, within fifteen days of being severed from the stump. Pine log decks, pulpwood piles and treetops that are piled for chipping in the fall or winter within a 1/4 mile of susceptible sites must be removed before March 15. Residual slash must not be placed in piles or rows and must be spread over the site for quick drying. The Department of Natural Resources will exercise this specification if the risk of damage warrants.

5.2.4 - Dead and Down Creation

5.2.4.1 - Dead and down creation, marked trees (10/13)

All trees marked with an orange "X" must be felled and left on site for wildlife. Either cut these trees at 4 feet above ground level and place the cut trunk against the resulting high stump or cut at ground level and place the cut trunk against a small nearby tree retained for this purpose.

5.2.22 - Operating Caution

5.2.22.1 - Operating caution (6/11)

It is recommended, but not required, that within Payment Unit(s) 3-5, cutting, skidding, and hauling occur during dry summer or frozen winter conditions. The reason for the recommendation is because soil may be saturated in these Payment Units during wet periods, resulting in a high risk of rutting.

5.2.38 - No decking against live trees (2/04)

Cut products may not be decked against unmarked or designated leave trees.

5.3 - Stream Protection

5.3.1 - Operating near stream (7/04)

No tracked or wheeled vehicles shall be operated within 50 feet of Jaxon Creek (west of Payment Units 1 and 6, as shown on the Timber Sale Map). Timber sale operation in this area may not go beyond the painted timber sale boundaries.

5.4 - Soil Protection

5.4.6 - Wet area protection (5/10)

No harvesting operations, including skidding and felling, are to take place within the "N" types to the southeast of Payment Unit 6. All equipment, trees and tops should be kept out of this area. Care must be taken by the Purchaser to identify and avoid operating in these areas of the timber sale.

6 - Safety and Fire Prevention

6.2 - Signing

6.2.1 - Road posting (10/20)

The Purchaser is responsible for posting and maintaining caution signs on Blair Townhall Road prior to beginning operations. The road must be posted approximately 350 feet from the Sale Area to warn of logging activity and truck traffic. Signs must be removed when harvest operations are suspended or completed. The Purchaser will provide these signs.



TIMBER SALE MAP

This information provided by authority of Part 525, 1994 PA 451 as amended.

Sale Number	Year
61-067	21

Forest Management Unit Traverse City	County Grand Traverse	Mapped By Tim Webb	Date 09/23/2021	Page 1	of 1
Township 26N	Range 10W	Section(s) and Subdivision(s) Sec. 19: NESW,S1/2SW,W 1/2SE; Sec. 30: NESW,S1/2SW,W1/2SE	Scale 1:15,840		

Cover Type				Density	
A = Aspen	H = Hemlock	N = Marsh	U = Upland Brush	0 = Non Stocked	5 = Pole Timber Medium
B = Paper Birch	J = Jack Pine	O = Oak	UM = Upland Mixed	1 = Seeding Sapling Poor	6 = Pole Timber Well
C = Cedar	L = Lowland Brush	P = Lowland Poplar	V = Bog or Marsh	2 = Seeding Sapling Medium	7 = Saw Timber Poor
D = Treed Bog	LM = Lowland Mixed	Q = Mixed Swamp Conifer	W = White Pine	3 = Seeding Sapling Well	8 = Saw Timber Medium
E = Swamp Hardwoods	M = Mpl. Ech. Birch	R = Red Pine	X = Non Stocked	4 = Pole Timber Poor	9 = Saw Timber Well
F = Spruce Fir	MC = Mixed Conifer	S = Black Spruce	Z = Water		
G = Creas	MD = Mixed Deciduous	T = Tamarack			

PU	Acres	PU	Acres	PU	Acres
1	21.6	4	40.0	7	7.3
2	15.6	5	13.4		
3	10.1	6	16.4		

Homecoming Aspen

Compartment 61050
124.4 Acres

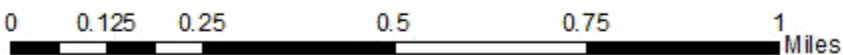
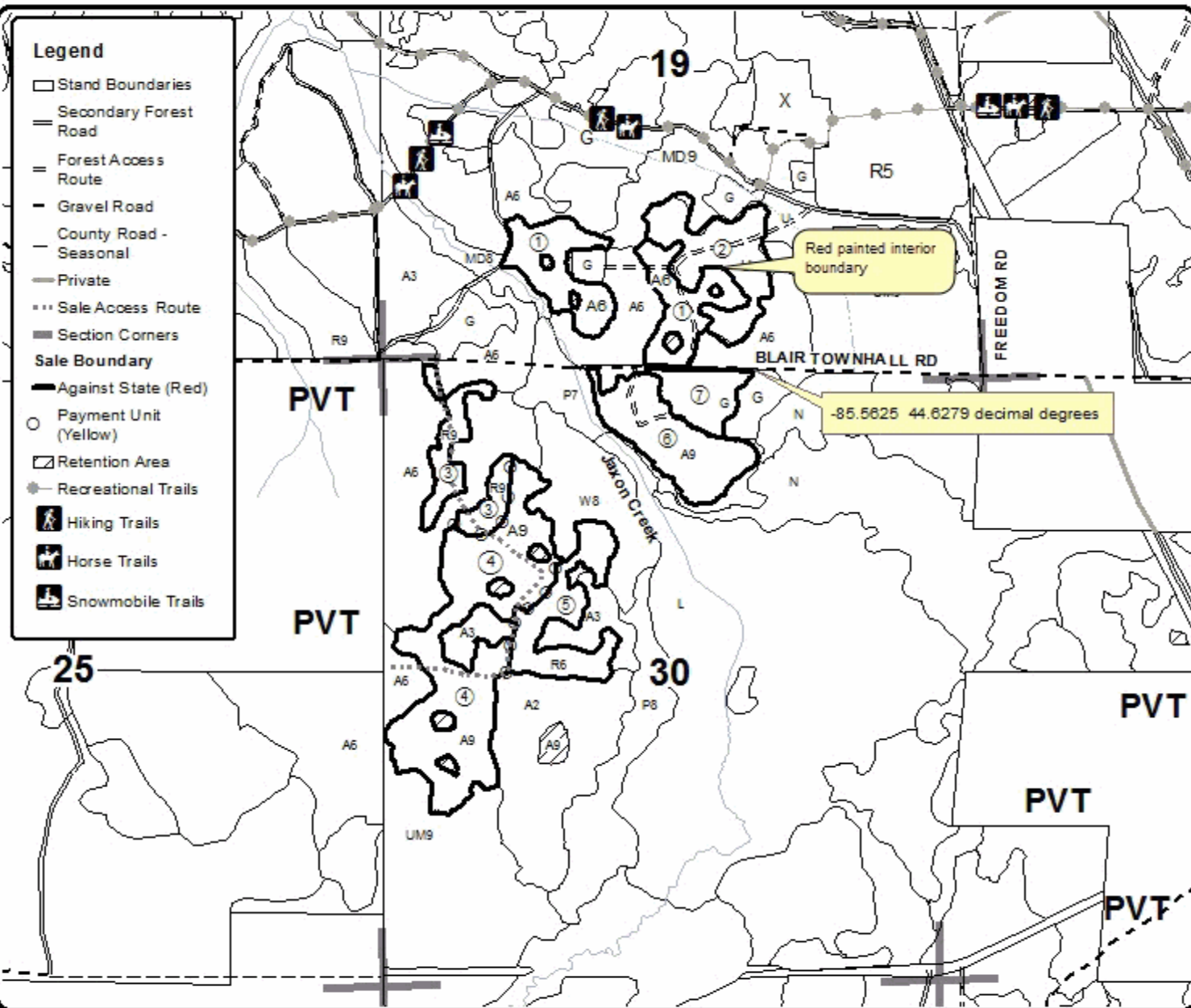

TIMBER SALE INFORMATION

Perla Road Mix (61-071-21)

T26N, R10W, SEC. 20; T26N, R10W, SEC. 21.
Grand Traverse County (Advertised Price \$41,985.20)

SALE NOTE: All units of volume listed for this sale were estimated using the Inventory Manager computer program and the new Michigan taper model.

A recreation site such as a trail, pathway, or campground is within the sale area or the vicinity. Certain restrictions/specifications may be applicable including time restrictions.

A timber sale contract for this lump sum, sealed bid timber sale will be awarded to the responsible bidder offering the highest sealed bid price. All units of volume listed below were estimated using the Inventory Manager computer program and the new Michigan taper model. Bids must be at or above the following advertised price for each product and species:

<u>PRODUCTS & SPECIES</u>	<u>ESTIMATED UNITS*</u>	<u>ADVERTISED PRICE</u>
Sawtimber		
B. T. Aspen	4.8 MBF	\$ 94.00 / MBF
Beech	14.8 MBF	\$ 90.00 / MBF
Red Maple	15.5 MBF	\$ 126.00 / MBF
Red Oak	54.7 MBF	\$ 110.00 / MBF
Red Pine	44.6 MBF	\$ 84.00 / MBF
Sugar Maple	4.2 MBF	\$ 206.00 / MBF
White Pine	11.3 MBF	\$ 34.00 / MBF
Pulpwood		
Mixed Aspen	181 Cords	\$ 12.80 / Cord
Mixed Hardwood	216 Cords	\$ 13.45 / Cord
Mixed Oak	270 Cords	\$ 15.10 / Cord
Red Pine	521 Cords	\$ 33.40 / Cord
White Pine	38 Cords	\$ 14.10 / Cord

* The total volume is statistically estimated within plus (+) or minus (-) 6.02 percent. There are an estimated 1,556 cords on this timber sale, plus or minus 94 cords at the 95% confidence level. The estimated units are final and not subject to adjustment. Prospective bidders are urged to examine this timber and to make their own estimates of quantity and quality.

BOND AND PAYMENT SCHEDULE:

1. A bond in the amount of \$2,099.00 to insure faithful performance of the conditions of the contract will be deposited by the successful bidder within 21 days of the sale award.
2. Cutting in any sale or unit without the required advance payment would be considered a trespass.
3. Total payment must be paid in advance or according to the following schedule :
 - (a) Ten percent (10%) of the sale value must be paid within 21 days of the sale award.
 - (b) The 10% down payment will be credited towards the first unit cut.
 - (c) Payment for each of the following units must be made before cutting begins in that unit:

PAYMENT UNIT NUMBER	PERCENT OF TOTAL SALE VALUE
01	7.1%
02	8.2%
03	8.0%
04	2.3%
05	10.8%
06	42.0%
07	21.6%
4. If no cutting takes place, the 10% down payment will not be refunded.
5. Operations on the contract issued will terminate on 04/14/2024.

SALE STATISTICS

Volumes were calculated in cubic feet using the Michigan taper model. Cubic foot volume includes all wood inside bark for the product indicated. For display purposes, cubic feet were converted to cords and MBF using a simple conversion factor, e.g. 79 cubic feet per cord and 185 cubic feet per MBF. The cubic foot volumes are precise; the cords and MBF volumes are not. Cubic foot volume cannot be directly converted to cords or boards with precision.

SALE VOLUMES

The total estimated sale volume may not equal the sum of the species/products due to the nature of statistical calculations associated with double sampling methodology.

VOLUME			STATISTICAL RANGE IN CORDS	
TOTAL CUBIC FEET	TOTAL CORDS	PERCENT ERROR	MINIMUM	MAXIMUM
122,948	1,556	6.02%	1,463	1,650

VDU VOLUMES

A VDU is a Volume Determination Unit. Volumes and their associated statistics are calculated at the VDU level and summarized to the sale level. There is often a one to one relationship between a VDU and a Payment Unit, but not always, depending on the cruise design. Refer to the VDU TO PAYMENT UNIT table.

	VOLUME			RANGE IN CORDS	
VDU	TOTAL CUBIC FEET	TOTAL CORDS	PERCENT ERROR	MINIMUM	MAXIMUM
65	9,351	118	22.34%	92	145
81	13,575	172	16.50%	143	200
83	7,883	100	12.25%	88	112
87	40,149	508	11.10%	452	565
93	4,228	54	30.75%	37	70
111	31,071	393	13.01%	342	444
265	14,099	178	14.65%	152	205
TOTAL:	120,357	1,524		1,306	1,741

VDU TO PAYMENT UNIT

When a VDU is associated with more than one Payment Unit (PU), the VDU volumes are assigned to the PU based on acres of the VDU within the PU.

VDU	VDU ACRES	PU	PU ACRES
65	20.9	1	20.9
81	10.0	5	10.0
83	7.2	3	7.2
87	51.7	6	51.7
93	8.7	4	8.7
111	25.5	7	25.5
265	8.8	2	8.8
TOTAL:	132.8		132.8

DESCRIPTION OF TIMBER BY PAYMENT UNIT (PU)

PU	MARKET GROUP	PRODUCT	QUANTITY	UNIT	ACRES	ADVERTISE PRICE	
1	Red Maple	Sawtimber	3.4	MBF	20.9	\$2,973.40	
	Red Oak		11.3	MBF			
	White Pine		3.3	MBF			
	Mixed Aspen		Pulpwood	23			Cords
	<i>B. T. Aspen</i>			20			<i>Cords</i>
	<i>Quaking Aspen</i>			3			<i>Cords</i>
	Mixed Hardwood			4			Cords
	<i>Red Maple</i>			4			<i>Cords</i>
	Mixed Oak			52			Cords
	<i>Red Oak</i>			52			<i>Cords</i>
	White Pine			4			Cords
	<i>White Pine</i>			4			<i>Cords</i>
2	B. T. Aspen	Sawtimber		2.8	MBF	8.8	\$3,446.45
	Red Oak			8.9	MBF		
	White Pine			6.4	MBF		
	Mixed Aspen		Pulpwood	57	Cords		
	<i>B. T. Aspen</i>			57	<i>Cords</i>		
	Mixed Hardwood			21	Cords		
	<i>Red Maple</i>			21	<i>Cords</i>		
	Mixed Oak			44	Cords		
	<i>Red Oak</i>			38	<i>Cords</i>		
	<i>White Oak</i>			6	<i>Cords</i>		
	White Pine			22	Cords		
	<i>White Pine</i>			22	<i>Cords</i>		
3	Red Pine	Sawtimber		5.5	MBF	7.2	\$3,343.30
	Red Pine	Pulpwood		85	Cords		
	White Pine			3	Cords		
	<i>White Pine</i>		3	<i>Cords</i>			
4	B. T. Aspen	Sawtimber	2.0	MBF	8.7	\$976.00	
	Red Oak		0.9	MBF			
	White Pine		1.6	MBF			
	Mixed Aspen		Pulpwood	35			Cords
	<i>B. T. Aspen</i>			35			<i>Cords</i>
	Mixed Oak			7			Cords
	<i>Red Oak</i>			5			<i>Cords</i>
	<i>White Oak</i>			2			<i>Cords</i>
	Red Pine			2			Cords
	White Pine			1			Cords
<i>White Pine</i>	1	<i>Cords</i>					
5	Beech	Sawtimber		9.4	MBF	10.0	\$4,536.95
	<i>Beech</i>			8.8	<i>MBF</i>		
	<i>Ironwood</i>		0.6	<i>MBF</i>			
	Red Maple		5.8	MBF			
	Red Oak		11.0	MBF			
	Mixed Hardwood		Pulpwood	77	Cords		
	<i>Beech</i>			21	<i>Cords</i>		
	<i>Black Cherry</i>			4	<i>Cords</i>		
	<i>Ironwood</i>			4	<i>Cords</i>		
	<i>Red Maple</i>			48	<i>Cords</i>		
	Mixed Oak			31	Cords		
	<i>Red Oak</i>			28	<i>Cords</i>		
	<i>White Oak</i>			3	<i>Cords</i>		
	Red Pine			4	Cords		
	White Pine			8	Cords		
	<i>Jack Pine</i>			2	<i>Cords</i>		
	<i>White Pine</i>			6	<i>Cords</i>		

DESCRIPTION OF TIMBER BY PAYMENT UNIT (PU), CON'T

PU	MARKET GROUP	PRODUCT	QUANTITY	UNIT	ACRES	ADVERTISE PRICE	
6	Red Pine	Sawtimber	39.1	MBF	51.7	\$17,646.40	
	Red Pine	Pulpwood	430	Cords			
7	Beech	Sawtimber	5.4	MBF	25.5	\$9,062.70	
	<i>Beech</i>		5.4	<i>MBF</i>			
	Red Maple	6.3	MBF				
	Red Oak	22.6	MBF				
	Sugar Maple	4.2	MBF				
	Mixed Aspen	Pulpwood	66	Cords			
	<i>B. T. Aspen</i>		66	<i>Cords</i>			
	Mixed Hardwood		114	Cords			
	<i>Beech</i>		22	<i>Cords</i>			
	<i>Ironwood</i>		4	<i>Cords</i>			
	<i>Red Maple</i>		68	<i>Cords</i>			
	<i>Sugar Maple</i>		20	<i>Cords</i>			
	Mixed Oak		136	Cords			
	<i>Red Oak</i>		134	<i>Cords</i>			
	<i>White Oak</i>		2	<i>Cords</i>			
TOTAL:			149.9	MBF			
TOTAL:			1,226	Cords			

Sale Specific Conditions & Requirements

Sale Name: Perla Road Mix

Sale Number: 61-071-21 Seq#: 1

1 - Sale Area

1.2 - Boundaries

1.2.1 - Painted boundaries (9/19)

The sale boundary and Payment Unit boundaries are marked and identified by blue, red, and yellow paint. Exterior sale boundary lines against private property are marked with blue paint. Exterior sale boundary lines against state land are marked with red paint. Interior Payment Unit boundaries are marked with yellow paint. Retention patches are marked with red paint; no harvesting activities may occur within these areas. The painted boundary line trees are not Included Timber and are to be protected unless marked with orange paint. Note: for Payment Unit 6 the red-painted outer boundary encompasses alternating east-west oriented strips of both mature (R6) and immature (R3) planted red pine. Only the mature strips of red pine plantation are marked and included in the Payment Unit acreage.

2 - Timber Specifications

2.1 - Included Timber

2.1.1 - Clearcut unit(s) with unmerchantable trees (6/14)

Within Payment Unit(s) 2, cut all trees that are two (2) inches or more at DBH, except for trees marked with green paint.

2.1.3 - Cut tree marked unit(s) (12/08)

Within Payment Unit(s) 1, 4, and 6, all trees are designated for cutting when marked with orange paint above and below stump height, regardless of merchantability. In addition, within Payment Unit 4, cut all aspen greater than 2" at DBH unless marked with green paint.

2.1.7 - Leave tree marked unit(s) (6/14)

Within Payment Unit(s) 5 and 7, cut all trees that are two (2) inches or more at DBH, except for trees marked with green paint above and below stump height.

2.1.8 - Designated plantation row unit(s) (12/08)

Within Payment Unit(s) 3, all trees which meet minimum piece specifications in 2.2 Utilization, within designated plantation rows are designated for cutting. Designated plantation rows begin with the third row in from the outside of the plantation, then continue every third-row. Because of the variability of row direction, it shall be the responsibility of the Purchaser to maintain the third-row sequence.

2.2 - Utilization

2.2.4 - Skidding length (2/14)

Skidding of unlimbed tops or lengths over 17 feet is not permissible within Payment Units 1, 3, 4, and 6 unless approved by the Unit Manager or his/her representative.

4 - Transportation

4.1 - Construction

4.1.12 - No new roads (1/12)

No new roads will be permitted in any Payment Unit. All operations are limited to existing roads. Skid trails only will be allowed.

4.2 - Maintenance

4.2.5 - Two wheel drive condition (2/04)

All existing trail roads on and adjacent to the sale area must be passable by two-wheel drive traffic for the duration of the sale.

5 - Operations

5.1 - Notification

5.1.3 - Well heads and natural gas pipelines (11/15)

The Purchaser is responsible for contacting the pipeline company 30 days prior to operating equipment in the vicinity of well heads or natural gas pipelines. Contact Karla Shawhan-Bonnee of DTE Energy at 231-590-0126. The Purchaser is also responsible for contacting MISS DIG for any necessary buried utility location.

5.1.6 - Utility R.O.W. (4/19)

It is the responsibility of the Purchaser to obtain permission from the utility company to utilize the power line R.O.W. for operations.

5.2 - Conduct of Operations

5.2.1 - Slash

5.2.1.8 - Slash height (12/08)

No slash or tree tops may exceed 24 inches in height.

5.2.3 - Operating Restrictions

5.2.3.4 - Oak wilt restriction, no exceptions (1/18)

Within all Payment Units cutting, skidding, hauling within the sale and brushing of access roads to the sale are not permitted during the period of April 15 to July 15. No exceptions will be granted. This is necessary to reduce the spread of oak wilt.

5.2.3.6 - Bark beetle restriction (12/08)

In the event drought creates a high risk of pine bark beetle infestation, pine is not to be cut during the period March 1 through July 1, unless all portions of trees greater than two inches in diameter are removed from the sale area, reduced to chips, or treated to the satisfaction of the Unit Manager or his/her representative, within fifteen days of being severed from the stump. Pine log decks, pulpwood piles and treetops that are piled for chipping in the fall or winter within a 1/4 mile of susceptible sites must be removed before March 15. Residual slash must not be placed in piles or rows and must be spread over the site for quick drying. The Department of Natural Resources will exercise this specification if the risk of damage warrants.

5.2.4 - Dead and Down Creation

5.2.4.1 - Dead and down creation, marked trees (10/13)

All trees marked with an orange "X" must be felled and left on site for wildlife. Either cut these trees at 4 feet above ground level and place the cut trunk against the resulting high stump or cut at ground level and place the cut trunk against a small nearby tree retained for this purpose.

5.2.38 - No decking against live trees (2/04)

Cut products may not be decked against unmarked or designated leave trees.

5.2.40 - Pathway protection (10/10)

The Shore to Shore riding/hiking trail is shown on the Timber Sale Map. Do not cut trees or damage posts with blue pathway markers. Maintain a 20-foot-wide slash, debris, and rut free zone daily, using the pathway as the centerline. Skidding across the trail may only occur in locations approved by the sale administrator.

5.2.41 - Snowmobile trail protection (9/11)

A snowmobile trail is shown on the Timber Sale Map. Do not cut or damage posts with orange trail markers or traffic control signs. If the trail is used, it must be maintained and restored to a condition equal to or better than before the sale. If the trail is used for hauling, it must be graded to the satisfaction of the Unit Manager or his/her representative prior to December 1. If the trail road is to be used for hauling during the snowmobile season, then a snow-covered base must be left on the trail. The snowmobile trail may only be crossed at right angles. Maintain a 20-foot-wide slash, debris, and rut free zone daily using the snowmobile trail as the centerline. All stumps within 20 feet of the snowmobile trail must be cut at ground level. In addition, any trees cut within 5 feet of the trail must have the stumps removed and be disposed of according to the direction of the Unit Manager or his/her representative.

5.4 - Soil Protection

5.4.3 - Erosion control (12/08)

Skid trails or haul roads may require erosion control structures or berms per direction of the Unit Manager or his/her

representative.

5.7 - Protection of Historical Sites

5.7.1 - Historical sites (7/12)

The Purchaser shall not cut live or dead trees or operate equipment within historical sites. Historical sites are indicated by an "H" on the Timber Sale Map, within Payment Unit 6. The Purchaser shall protect historical sites from damage by the Purchaser's operations. If Purchaser's operations have cut or damaged historical sites through carelessness, the Purchaser shall pay \$300 as fixed, agreed and liquidated damages for each acre or part thereof cut or damaged.

6 - Safety and Fire Prevention

6.2 - Signing

6.2.1 - Road posting (10/20)

The Purchaser is responsible for posting and maintaining caution signs on Perla Road, Freedom Road, and Blair Townhall Road prior to beginning operations. The road must be posted at appropriate distances from the Sale Area to warn of logging activity and truck traffic. Signs must be removed when harvest operations are suspended or completed. The Purchaser will provide these signs.

6.2.3 - Recreational trail posting (10/20)

The Purchaser is responsible for posting and maintaining caution signs on the Shore to Shore Trail and the snowmobile trail prior to beginning operations. The trail must be posted at appropriate distances from the Sale Area to warn of logging activity and truck traffic at both ends of the trail. Signs must be removed when harvest operations are suspended or completed. The Purchaser will provide these signs.



Sale Number	Year
61-071	21

TIMBER SALE MAP

This information provided by authority of Part 525, 1994 PA 451 as amended.

Forest Management Unit Traverse City	County Grand Traverse	Mapped By Tim Webb	Date 09/30/2021	Page 1	of 1
Township 26N	Range 10W	Section(s) and Subdivision(s) S. 21: SWNW, N1/2SW; S. 20: SENW, S1/2NE, N1/2SW, SESW, NWSE	Scale 1:15,840		

Cover Type				Density	
A = Aspen	H = Hemlock	N = Marsh	U = Upland Brush	0 = Non Stocked	5 = Pole Timber Medium
B = Paper Birch	J = Jack Pine	O = Oak	UM = Upland Mixed	1 = Seeding Sapling Poor	6 = Pole Timber Well
C = Cedar	L = Lowland Brush	P = Lowland Poplar	V = Bog or Marsh	2 = Seeding Sapling Medium	7 = Saw Timber Poor
D = Treed Bog	LM = Lowland Mixed	Q = Mixed Swamp Conifer	W = White Pine	3 = Seeding Sapling Well	8 = Saw Timber Medium
E = Swamp Hardwoods	M = Mpl. Ech. Birch	R = Red Pine	X = Non Stocked	4 = Pole Timber Poor	9 = Saw Timber Well
F = Spruce Fir	MC = Mixed Conifer	S = Black Spruce	Z = Water		
G = Creas	MD = Mixed Deciduous	T = Tamarack			

PU	Acres	PU	Acres	PU	Acres
1	20.9	4	8.7	7	25.5
2	8.8	5	10.0		
3	7.2	6	51.7		

Perla Road Mix
 Compartment 61050
 132.8 Acres

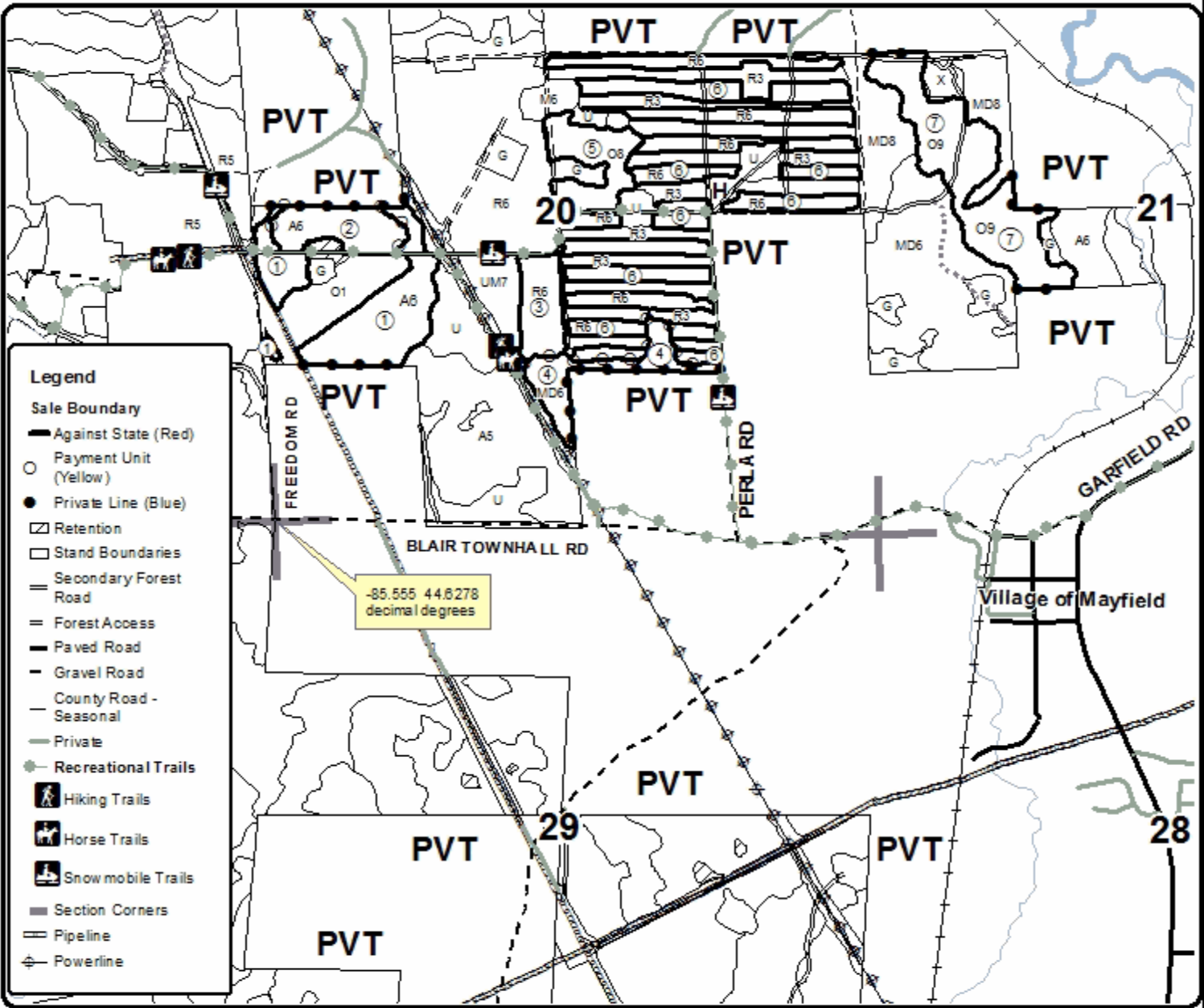

Legend

- Sale Boundary
- Against State (Red)
- Payment Unit (Yellow)
- Private Line (Blue)
- ▨ Retention
- Stand Boundaries
- Secondary Forest Road
- Forest Access
- Paved Road
- Gravel Road
- County Road - Seasonal
- Private
- Recreational Trails
- 🚶 Hiking Trails
- 🐎 Horse Trails
- 🚙 Snow mobile Trails
- Section Corners
- Pipeline
- ⚡ Powerline

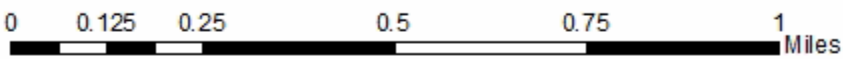

Two Bears Harvest (61-056-21)
T25N, R14W, SEC. 10; T25N, R14W, SEC. 3; Benzie COUNTY

In response to the notice of sale to be held 4:00 p.m. (local time) on January 27, 2022, I am hereby submitting my sealed bid (firm offer) for the following forest products to be cut. Bids for individual species must be at or above the advertised price. All non-responsive bid forms may be rejected.

<u>PRODUCTS & SPECIES</u>	<u>ESTIMATED VOLUME*</u>	<u>ADVERTISED PRICE</u>	<u>BID PRICE/UNIT</u>
Sawtimber			
B. T. Aspen	422.4 MBF	\$ 94.00/MBF	\$ _____
Basswood	11.9 MBF	\$ 87.00/MBF	\$ _____
Black Cherry	19.0 MBF	\$ 147.00/MBF	\$ _____
Quaking Aspen	93.0 MBF	\$ 94.00/MBF	\$ _____
Red Maple	60.4 MBF	\$ 126.00/MBF	\$ _____
Sugar Maple	14.5 MBF	\$ 206.00/MBF	\$ _____
White Pine	140.6 MBF	\$ 34.00/MBF	\$ _____
Pulpwood			
B. T. Aspen	1,172 Cords	\$ 12.80/Cord	\$ _____
Basswood	18 Cords	\$ 13.85/Cord	\$ _____
Black Cherry	147 Cords	\$ 13.45/Cord	\$ _____
Ironwood	23 Cords	\$ 13.45/Cord	\$ _____
Quaking Aspen	137 Cords	\$ 12.80/Cord	\$ _____
Red Maple	88 Cords	\$ 13.45/Cord	\$ _____
Sugar Maple	42 Cords	\$ 13.45/Cord	\$ _____
White Pine	334 Cords	\$ 14.10/Cord	\$ _____

*The volumes are statistically estimated within plus (+) or minus (-) 5.90 percent at 95% confidence level. These estimated volumes are final and not subject to adjustment. Prospective bidders are urged to examine this timber and to make their own estimates of quantity and quality.

I understand that any or all bids may be rejected. All bids must be signed and all bid items must be bid or the bid form may be rejected. I also understand that consideration and awarding a contract will be based upon my past performance and ability to complete the contract based upon equipment and staffing subject to my control.

FEDERAL ID: ____ - ____ - ____ or SOCIAL SECURITY NUMBER: ____ - ____ - ____

Company or individual bidding: _____

Company representative's name: _____

Address: _____

City: _____ State: _____ Zip: _____

IF AVAILABLE, PLEASE PLACE THE PERSONALIZED LABEL FROM YOUR PROSPECTUS IN THE ABOVE BOX.

Individual or company representative's signature: _____ Date: _____

Phone number : _____ Email (optional): _____

THE WINNING BIDDER MUST COMPLETE THE VERIFICATION OF WORKER'S DISABILITY COMPENSATION ACT COMPLIANCE (ON REVERSE SIDE IF DOUBLE SIDED) WITHIN 21 DAYS OF SALE AWARD DATE



FOR DEPARTMENT USE ONLY	
Sale Number (XX - XXX - XX - XX)	
Forest Management Unit:	

TIMBER SALE VERIFICATION OF WORKER'S DISABILITY COMPENSATION ACT COMPLIANCE

As required by Act 317, P.A. 1969 (Worker's Compensation) and
Part 5 of Act 451 of 1994, as amended.

VERIFICATION OF WORKER'S DISABILITY COMPENSATION ACT COMPLIANCE

- This verification must be completed and submitted within 21 days of contract award and prior to the issuance of the timber sale contract.
- In addition, if boxes 2B or 2C are checked, then Notice of Exclusion or Certificate of Insurance must be submitted within twenty-one (21) days of the contract award and prior to the issuance of the timber sale contract.
- All information must be typed or printed except for written signatures.

Please Check Appropriate Categories:

1. My business is organized as (you **must** check one of the boxes below):
 - A. Sole Proprietorship (individual)
 - B. Partnership
 - C. Corporation
2. You **must** check one of the boxes below:
 - A. I certify my business is a sole proprietorship and it has no employees but the sole proprietor. I am not subject to the Worker's Compensation Laws.
 - B. I certify my business has satisfied its obligation to the Worker's Compensation Act through the use of an approved Notice of Exclusion (BWC-337, Rev. 5/96). I will provide a copy of the Notice of Exclusion within 21 days of the contract award. (For questions or a copy of the BWC-337, please call the Worker's Compensation Bureau at 517-322-1195).
 - C. I certify my business has a Worker's Compensation Policy. I will provide an original Certificate of Insurance within twenty-one (21) days of the contract award.
3. If you have checked item 2(A) or 2(B), you **must** indicate the number of **both** full-time and part-time employees, other than yourself, including family members and active partners (if none, you must enter "0").

_____ Full-time Employees

_____ Part-time Employees

Name of Business		Federal ID (or) Social Security No.	
Address		Telephone ()	
City	State	ZIP	

I hereby certify that the above information is true and correct. I agree to notify the Michigan DNR of any changes that occur in factors affecting my coverage during any of my present and future operations.

Signature of Owner or Authorized Representative

Title

Date

Please complete the "SEALED BID" information on the next page

Old Monarch Mix (61-057-21)
T25N, R14W, SEC. 10; T25N, R14W, SEC. 15; T25N, R14W, SEC. 3; Benzie

In response to the notice of sale to be held 4:00 p.m. (local time) on January 27, 2022, I am hereby submitting my sealed bid (firm offer) for the following forest products to be cut. Bids for individual species must be at or above the advertised price. All non-responsive bid forms may be rejected.

<u>PRODUCTS & SPECIES</u>	<u>ESTIMATED VOLUME*</u>	<u>ADVERTISED PRICE</u>	<u>BID PRICE/UNIT</u>
Sawtimber			
B. T. Aspen	523.5 MBF	\$ 94.00/MBF	\$ _____
Basswood	2.0 MBF	\$ 87.00/MBF	\$ _____
Beech	15.5 MBF	\$ 90.00/MBF	\$ _____
Black Cherry	30.3 MBF	\$ 147.00/MBF	\$ _____
Quaking Aspen	16.1 MBF	\$ 94.00/MBF	\$ _____
Red Maple	108.6 MBF	\$ 126.00/MBF	\$ _____
Sugar Maple	31.7 MBF	\$ 206.00/MBF	\$ _____
White Pine	214.6 MBF	\$ 34.00/MBF	\$ _____
Pulpwood			
B. T. Aspen	1,421 Cords	\$ 12.80/Cord	\$ _____
Basswood	7 Cords	\$ 13.85/Cord	\$ _____
Beech	13 Cords	\$ 13.45/Cord	\$ _____
Black Cherry	56 Cords	\$ 13.45/Cord	\$ _____
Ironwood	31 Cords	\$ 13.45/Cord	\$ _____
Quaking Aspen	157 Cords	\$ 12.80/Cord	\$ _____
Red Maple	446 Cords	\$ 13.45/Cord	\$ _____
Sugar Maple	109 Cords	\$ 13.45/Cord	\$ _____
White Pine	652 Cords	\$ 14.10/Cord	\$ _____

*The volumes are statistically estimated within plus (+) or minus (-) 5.30 percent at 95% confidence level. These estimated volumes are final and not subject to adjustment. Prospective bidders are urged to examine this timber and to make their own estimates of quantity and quality.

I understand that any or all bids may be rejected. All bids must be signed and all bid items must be bid or the bid form may be rejected. I also understand that consideration and awarding a contract will be based upon my past performance and ability to complete the contract based upon equipment and staffing subject to my control.

FEDERAL ID: _____ or SOCIAL SECURITY NUMBER: _____

Company or individual bidding: _____

Company representative's name: _____

Address: _____

City: _____ State: _____ Zip: _____

IF AVAILABLE, PLEASE PLACE THE PERSONALIZED LABEL FROM YOUR PROSPECTUS IN THE ABOVE BOX.

Individual or company representative's signature: _____ Date: _____

Phone number : _____ Email (optional): _____

THE WINNING BIDDER MUST COMPLETE THE VERIFICATION OF WORKER'S DISABILITY COMPENSATION ACT COMPLIANCE (ON REVERSE SIDE IF DOUBLE SIDED) WITHIN 21 DAYS OF SALE AWARD DATE



TIMBER SALE VERIFICATION OF WORKER'S DISABILITY COMPENSATION ACT COMPLIANCE

As required by Act 317, P.A. 1969 (Worker's Compensation) and
Part 5 of Act 451 of 1994, as amended.

FOR DEPARTMENT USE ONLY	
Sale Number (XX - XXX - XX - XX)	
Forest Management Unit:	

VERIFICATION OF WORKER'S DISABILITY COMPENSATION ACT COMPLIANCE

- This verification must be completed and submitted within 21 days of contract award and prior to the issuance of the timber sale contract.
- In addition, if boxes 2B or 2C are checked, then Notice of Exclusion or Certificate of Insurance must be submitted within twenty-one (21) days of the contract award and prior to the issuance of the timber sale contract.
- All information must be typed or printed except for written signatures.

Please Check Appropriate Categories:

1. My business is organized as (you **must** check one of the boxes below):
 - A. Sole Proprietorship (individual)
 - B. Partnership
 - C. Corporation
2. You **must** check one of the boxes below:
 - A. I certify my business is a sole proprietorship and it has no employees but the sole proprietor. I am not subject to the Worker's Compensation Laws.
 - B. I certify my business has satisfied its obligation to the Worker's Compensation Act through the use of an approved Notice of Exclusion (BWC-337, Rev. 5/96). I will provide a copy of the Notice of Exclusion within 21 days of the contract award. (For questions or a copy of the BWC-337, please call the Worker's Compensation Bureau at 517-322-1195).
 - C. I certify my business has a Worker's Compensation Policy. I will provide an original Certificate of Insurance within twenty-one (21) days of the contract award.
3. If you have checked item 2(A) or 2(B), you **must** indicate the number of **both** full-time and part-time employees, other than yourself, including family members and active partners (if none, you must enter "0").

_____ Full-time Employees

_____ Part-time Employees

Name of Business		Federal ID (or) Social Security No.	
Address		Telephone ()	
City	State	ZIP	

I hereby certify that the above information is true and correct. I agree to notify the Michigan DNR of any changes that occur in factors affecting my coverage during any of my present and future operations.

Signature of Owner or Authorized Representative

Title

Date

Please complete the "SEALED BID" information on the next page

Pioneer Pine (61-065-21)

T25N, R14W, SEC. 10; T25N, R14W, SEC. 15; T25N, R14W, SEC. 3; Benzie

In response to the notice of sale to be held 4:00 p.m. (local time) on January 27, 2022, I am hereby submitting my sealed bid (firm offer) for the following forest products to be cut. Bids for individual species must be at or above the advertised price. All non-responsive bid forms may be rejected.

<u>PRODUCTS & SPECIES</u>	<u>ESTIMATED VOLUME*</u>	<u>ADVERTISED PRICE</u>	<u>BID PRICE/UNIT</u>
Sawtimber			
Red Pine	69.0 MBF	\$ 84.00/MBF	\$ _____
Pulpwood			
Jack Pine	25 Cords	\$ 9.25/Cord	\$ _____
Red Pine	2,312 Cords	\$ 33.40/Cord	\$ _____

*The volumes are statistically estimated within plus (+) or minus (-) 4.38 percent at 95% confidence level. These estimated volumes are final and not subject to adjustment. Prospective bidders are urged to examine this timber and to make their own estimates of quantity and quality.

I understand that any or all bids may be rejected. All bids must be signed and all bid items must be bid or the bid form may be rejected. I also understand that consideration and awarding a contract will be based upon my past performance and ability to complete the contract based upon equipment and staffing subject to my control.

FEDERAL ID: _____ - _____ or SOCIAL SECURITY NUMBER: _____ - _____ - _____

Company or individual bidding: _____

Company representative's name: _____

Address: _____

City: _____ State: _____ Zip: _____

IF AVAILABLE, PLEASE PLACE THE PERSONALIZED LABEL FROM YOUR PROSPECTUS IN THE ABOVE BOX.

Individual or company representative's signature: _____ Date: _____

Phone number : _____ Email (optional): _____

THE WINNING BIDDER MUST COMPLETE THE VERIFICATION OF WORKER'S DISABILITY COMPENSATION ACT COMPLIANCE (ON REVERSE SIDE IF DOUBLE SIDED) WITHIN 21 DAYS OF SALE AWARD DATE



FOR DEPARTMENT USE ONLY	
Sale Number (XX - XXX - XX - XX)	
Forest Management Unit:	

TIMBER SALE VERIFICATION OF WORKER'S DISABILITY COMPENSATION ACT COMPLIANCE

As required by Act 317, P.A. 1969 (Worker's Compensation) and
Part 5 of Act 451 of 1994, as amended.

VERIFICATION OF WORKER'S DISABILITY COMPENSATION ACT COMPLIANCE

- This verification must be completed and submitted within 21 days of contract award and prior to the issuance of the timber sale contract.
- In addition, if boxes 2B or 2C are checked, then Notice of Exclusion or Certificate of Insurance must be submitted within twenty-one (21) days of the contract award and prior to the issuance of the timber sale contract.
- All information must be typed or printed except for written signatures.

Please Check Appropriate Categories:

1. My business is organized as (you **must** check one of the boxes below):
 - A. Sole Proprietorship (individual)
 - B. Partnership
 - C. Corporation
2. You **must** check one of the boxes below:
 - A. I certify my business is a sole proprietorship and it has no employees but the sole proprietor. I am not subject to the Worker's Compensation Laws.
 - B. I certify my business has satisfied its obligation to the Worker's Compensation Act through the use of an approved Notice of Exclusion (BWC-337, Rev. 5/96). I will provide a copy of the Notice of Exclusion within 21 days of the contract award. (For questions or a copy of the BWC-337, please call the Worker's Compensation Bureau at 517-322-1195).
 - C. I certify my business has a Worker's Compensation Policy. I will provide an original Certificate of Insurance within twenty-one (21) days of the contract award.
3. If you have checked item 2(A) or 2(B), you **must** indicate the number of **both** full-time and part-time employees, other than yourself, including family members and active partners (if none, you must enter "0").

_____ Full-time Employees

_____ Part-time Employees

Name of Business		Federal ID (or) Social Security No.	
Address		Telephone ()	
City	State	ZIP	

I hereby certify that the above information is true and correct. I agree to notify the Michigan DNR of any changes that occur in factors affecting my coverage during any of my present and future operations.

Signature of Owner or Authorized Representative

Title

Date

Please complete the "SEALED BID" information on the next page

Homecoming Aspen (61-067-21)
T26N, R10W, SEC. 19; T26N, R10W, SEC. 30; Grand Traverse COUNTY

In response to the notice of sale to be held 4:00 p.m. (local time) on January 27, 2022, I am hereby submitting my sealed bid (firm offer) for the following forest products to be cut. Bids for individual species must be at or above the advertised price. All non-responsive bid forms may be rejected.

<u>PRODUCTS & SPECIES</u>	<u>ESTIMATED VOLUME*</u>	<u>ADVERTISED PRICE</u>	<u>BID PRICE/UNIT</u>
Sawtimber			
Black Cherry	3.0 MBF	\$ 123.00/MBF	\$ _____
Mixed Aspen	216.1 MBF	\$ 79.00/MBF	\$ _____
Red Maple	137.5 MBF	\$ 106.00/MBF	\$ _____
Red Oak	14.4 MBF	\$ 92.00/MBF	\$ _____
Red Pine	22.6 MBF	\$ 71.00/MBF	\$ _____
White Pine	37.4 MBF	\$ 29.00/MBF	\$ _____
Pulpwood			
Mixed Aspen	794 Cords	\$ 10.75/Cord	\$ _____
Mixed Hardwood	594 Cords	\$ 11.30/Cord	\$ _____
Mixed Oak	57 Cords	\$ 12.70/Cord	\$ _____
Red Pine	96 Cords	\$ 28.05/Cord	\$ _____
White Pine	278 Cords	\$ 11.85/Cord	\$ _____

*The volumes are statistically estimated within plus (+) or minus (-) 6.57 percent at 95% confidence level. These estimated volumes are final and not subject to adjustment. Prospective bidders are urged to examine this timber and to make their own estimates of quantity and quality.

I understand that any or all bids may be rejected. All bids must be signed and all bid items must be bid or the bid form may be rejected. I also understand that consideration and awarding a contract will be based upon my past performance and ability to complete the contract based upon equipment and staffing subject to my control.

FEDERAL ID: _____ or SOCIAL SECURITY NUMBER: _____

Company or individual bidding: _____

Company representative's name: _____

Address: _____

City: _____ State: _____ Zip: _____

IF AVAILABLE, PLEASE PLACE THE PERSONALIZED LABEL FROM YOUR PROSPECTUS IN THE ABOVE BOX.

Individual or company representative's signature: _____ Date: _____

Phone number : _____ Email (optional): _____

THE WINNING BIDDER MUST COMPLETE THE VERIFICATION OF WORKER'S DISABILITY COMPENSATION ACT COMPLIANCE (ON REVERSE SIDE IF DOUBLE SIDED) WITHIN 21 DAYS OF SALE AWARD DATE



FOR DEPARTMENT USE ONLY
Sale Number (XX - XXX - XX - XX)
Forest Management Unit:

TIMBER SALE VERIFICATION OF WORKER'S DISABILITY COMPENSATION ACT COMPLIANCE

*As required by Act 317, P.A. 1969 (Worker's Compensation) and
Part 5 of Act 451 of 1994, as amended.*

VERIFICATION OF WORKER'S DISABILITY COMPENSATION ACT COMPLIANCE

- This verification must be completed and submitted within 21 days of contract award and prior to the issuance of the timber sale contract.
- In addition, if boxes 2B or 2C are checked, then Notice of Exclusion or Certificate of Insurance must be submitted within twenty-one (21) days of the contract award and prior to the issuance of the timber sale contract.
- All information must be typed or printed except for written signatures.

Please Check Appropriate Categories:

1. My business is organized as (you **must** check one of the boxes below):
 - A. Sole Proprietorship (individual)
 - B. Partnership
 - C. Corporation
2. You **must** check one of the boxes below:
 - A. I certify my business is a sole proprietorship and it has no employees but the sole proprietor. I am not subject to the Worker's Compensation Laws.
 - B. I certify my business has satisfied its obligation to the Worker's Compensation Act through the use of an approved Notice of Exclusion (BWC-337, Rev. 5/96). I will provide a copy of the Notice of Exclusion within 21 days of the contract award. (For questions or a copy of the BWC-337, please call the Worker's Compensation Bureau at 517-322-1195).
 - C. I certify my business has a Worker's Compensation Policy. I will provide an original Certificate of Insurance within twenty-one (21) days of the contract award.
3. If you have checked item 2(A) or 2(B), you **must** indicate the number of **both** full-time and part-time employees, other than yourself, including family members and active partners (if none, you must enter "0").

_____ Full-time Employees

_____ Part-time Employees

Name of Business		Federal ID (or) Social Security No.	
Address		Telephone ()	
City	State	ZIP	

I hereby certify that the above information is true and correct. I agree to notify the Michigan DNR of any changes that occur in factors affecting my coverage during any of my present and future operations.

Signature of Owner or Authorized Representative

Title

Date

Please complete the "SEALED BID" information on the next page

Perla Road Mix (61-071-21)
T26N, R10W, SEC. 20; T26N, R10W, SEC. 21; Grand Traverse COUNTY

In response to the notice of sale to be held 4:00 p.m. (local time) on January 27, 2022, I am hereby submitting my sealed bid (firm offer) for the following forest products to be cut. Bids for individual species must be at or above the advertised price. All non-responsive bid forms may be rejected.

<u>PRODUCTS & SPECIES</u>	<u>ESTIMATED VOLUME*</u>	<u>ADVERTISED PRICE</u>	<u>BID PRICE/UNIT</u>
Sawtimber			
B. T. Aspen	4.8 MBF	\$ 94.00/MBF	\$ _____
Beech	14.8 MBF	\$ 90.00/MBF	\$ _____
Red Maple	15.5 MBF	\$ 126.00/MBF	\$ _____
Red Oak	54.7 MBF	\$ 110.00/MBF	\$ _____
Red Pine	44.6 MBF	\$ 84.00/MBF	\$ _____
Sugar Maple	4.2 MBF	\$ 206.00/MBF	\$ _____
White Pine	11.3 MBF	\$ 34.00/MBF	\$ _____
Pulpwood			
Mixed Aspen	181 Cords	\$ 12.80/Cord	\$ _____
Mixed Hardwood	216 Cords	\$ 13.45/Cord	\$ _____
Mixed Oak	270 Cords	\$ 15.10/Cord	\$ _____
Red Pine	521 Cords	\$ 33.40/Cord	\$ _____
White Pine	38 Cords	\$ 14.10/Cord	\$ _____

*The volumes are statistically estimated within plus (+) or minus (-) 6.02 percent at 95% confidence level. These estimated volumes are final and not subject to adjustment. Prospective bidders are urged to examine this timber and to make their own estimates of quantity and quality.

I understand that any or all bids may be rejected. All bids must be signed and all bid items must be bid or the bid form may be rejected. I also understand that consideration and awarding a contract will be based upon my past performance and ability to complete the contract based upon equipment and staffing subject to my control.

FEDERAL ID: ____ - ____ - ____ or SOCIAL SECURITY NUMBER: ____ - ____ - ____

Company or individual bidding: _____

Company representative's name: _____

Address: _____

City: _____ State: _____ Zip: _____

IF AVAILABLE, PLEASE PLACE THE PERSONALIZED LABEL FROM YOUR PROSPECTUS IN THE ABOVE BOX.

Individual or company representative's signature: _____ Date: _____

Phone number : _____ Email (optional): _____

THE WINNING BIDDER MUST COMPLETE THE VERIFICATION OF WORKER'S DISABILITY COMPENSATION ACT COMPLIANCE (ON REVERSE SIDE IF DOUBLE SIDED) WITHIN 21 DAYS OF SALE AWARD DATE



FOR DEPARTMENT USE ONLY	
Sale Number (XX - XXX - XX - XX)	
Forest Management Unit:	

TIMBER SALE VERIFICATION OF WORKER'S DISABILITY COMPENSATION ACT COMPLIANCE

As required by Act 317, P.A. 1969 (Worker's Compensation) and
Part 5 of Act 451 of 1994, as amended.

VERIFICATION OF WORKER'S DISABILITY COMPENSATION ACT COMPLIANCE

- This verification must be completed and submitted within 21 days of contract award and prior to the issuance of the timber sale contract.
- In addition, if boxes 2B or 2C are checked, then Notice of Exclusion or Certificate of Insurance must be submitted within twenty-one (21) days of the contract award and prior to the issuance of the timber sale contract.
- All information must be typed or printed except for written signatures.

Please Check Appropriate Categories:

1. My business is organized as (you **must** check one of the boxes below):
 - A. Sole Proprietorship (individual)
 - B. Partnership
 - C. Corporation
2. You **must** check one of the boxes below:
 - A. I certify my business is a sole proprietorship and it has no employees but the sole proprietor. I am not subject to the Worker's Compensation Laws.
 - B. I certify my business has satisfied its obligation to the Worker's Compensation Act through the use of an approved Notice of Exclusion (BWC-337, Rev. 5/96). I will provide a copy of the Notice of Exclusion within 21 days of the contract award. (For questions or a copy of the BWC-337, please call the Worker's Compensation Bureau at 517-322-1195).
 - C. I certify my business has a Worker's Compensation Policy. I will provide an original Certificate of Insurance within twenty-one (21) days of the contract award.
3. If you have checked item 2(A) or 2(B), you **must** indicate the number of **both** full-time and part-time employees, other than yourself, including family members and active partners (if none, you must enter "0").

_____ Full-time Employees

_____ Part-time Employees

Name of Business		Federal ID (or) Social Security No.	
Address		Telephone ()	
City	State	ZIP	

I hereby certify that the above information is true and correct. I agree to notify the Michigan DNR of any changes that occur in factors affecting my coverage during any of my present and future operations.

Signature of Owner or Authorized Representative

Title

Date

Please complete the "SEALED BID" information on the next page