



DEPARTMENT OF NATURAL RESOURCES
STATE OF MICHIGAN

TIMBER SALE PROSPECTUS #6779

SCHEDULED SALE DATE AND TIME: 9:00 a.m. (local time) on January 8, 2021.

LOCATION: GRAYLING MGMT UNIT, 1955 HARTWICK PINES ROAD, GRAYLING, MI 49738.

PROSPECTUS NOTE: The bidder is advised to inspect the sale area and review the location, estimated volumes, operating costs and contract terms of proposed sales. Please be aware that some landowners may request 60 days or more notice for access across their land.

Notice is hereby given that bids will be received by the Unit Manager, GRAYLING MANAGEMENT UNIT, for certain timber on the following described lands:

Tetris Pine Final (72-009-20) / T27N, R01E, SEC. 26, SESE.

T27N, R01E, SEC. 28, N1/2NE, SENE.

T27N, R01E, SEC. 35, N1/2NE.

Oscoda County, Advertised Price \$166,818.00, 162.4 Acres, Red Pine, White Pine.

SALE NOTE: Permission to cross the corner of private property to access Payment Units 1-3 is the responsibility of the Purchaser.

A recreation site such as a trail, pathway, or campground is within the sale area or the vicinity. Certain restrictions/specifications may be applicable including time restrictions. Access may be through private land.

Surveyor's Stone Mix (72-010-20) / T27N, R01E, SEC. 25, NWNW, SENE, SE.

Oscoda County, Advertised Price \$45,947.60, 78.0 Acres, White Pine, Red Pine.

SALE NOTE: Harvesting during dry summer or frozen winter conditions is recommended, but not required. The sale contains stricter rutting restrictions due to lowland areas and harvesting within a RMZ.

Timber crane mats and/or interlocking composite mats are available if needed. There is an intermediate stream that splits Payment Unit 5 that will need to be forwarded across, however the stream was dry during summer sale layout and crane mats should suffice. The DNR will provide the crossing permit from the DEQ, and the Purchaser will be responsible for implementing it.

A recreation site such as a trail, pathway, or campground is within the sale area or the vicinity. Certain restrictions/specifications may be applicable including time restrictions.

Abandoned Circus Mixed HW's (72-012-20) / T28N, R03W, SEC. 8, S1/2NW, SENE, N1/2SE, SWSE.

T28N, R03W, SEC. 9, NENW, SWNW, N1/2NE, SENE.

Crawford County, Advertised Price \$20,210.90, 100.2 Acres, Hardwood, Aspen.

SALE NOTE: Payment Units 1 and 2 are adjacent to a nearby sale where both sides of the boundary trees are marked with red paint where the sales touch.

Sherman Rd is weight restricted if hauling out the road to the south. You can get to the non-restricted portion of Sherman Rd if hauling north through the private drive. Permission must be granted from private landowner to haul out their drive. Gas pipelines and well heads are within the sale vicinity. Contact Linn Operating at 231-922-7302 prior to operations.

Access may be through private land.

First Time Red Pine (72-013-20) / T28N, R03W, SEC. 17, SWSE.

T28N, R03W, SEC. 9 , E1/2NW,N1/2NE,SENE.

Crawford County, Advertised Price \$32,457.00, 67.1 Acres, Red Pine, Aspen.

SALE NOTE: Payment Units 1 and 2 are adjacent to a nearby sale where both sides of the boundary trees are marked with red paint where the sales touch.

Sherman Rd is weight restricted if hauling out the road to the south. You can get to the non-restricted portion of Sherman Rd if hauling north through the private drive. Permission must be granted from the private landowner to haul out their drive.

Gas pipelines and well heads are within the sale vicinity. Contact Linn Operating at 231-922-7302 prior to operations.

Access may be through private land.

BID INSTRUCTIONS (VER. 07/02/2018):

1. Scheduled Bid Location, Date, and Time (2/11)

Bids must be received by the Unit Manager, GRAYLING OFFICE, 1955 HARTWICK PINES ROAD, GRAYLING, MI 49738, no later than 9:00 a.m. (local time) on January 8, 2021. For further information concerning this sale, contact Thomas Barnes at 989-348-6371 extension 7440.

2. Bidder's Qualifications (5/16)

Purchaser shall obtain workers compensation insurance to cover claims under Michigan's Worker's Disability Compensation Act of 1969 or similar employee benefit act of any other state applicable to an employee. If all or part of a timber sale was prepared by a private contractor, the contractor and that contractor's company are not permitted to bid on the timber sale contract. Bids will not be accepted from individuals or companies appearing on the DNR/FRD No-Bid List. This list contains the names of purchasers who previously failed to execute a contract within 21-days or who have a history of poor performance.

3. Preparation of Sealed Bids (5/16)

Bid Forms may be completed online thru Michigan DNR Timber Sale Online Bidding (OLB) at www.michigan.gov/timberbidding or by completing the hardcopy Bid Form found in the Timber Sale Prospectus. Hardcopy Bid Forms shall be manually signed in ink. Registration in OLB is considered your 'signature' for all bids submitted thru that system. Bid prices must be entered for each species and product in the Bid Price column for all material subject to bidding and all fill-in blanks must be completed. If erasures or other changes appear on the hardcopy Bid Form, each erasure or change must be initialed by the person signing the bid.

4. Submission of Sealed Bids (5/16)

Bid forms may be obtained from the Unit Manager or thru OLB. Bids may be submitted hardcopy or thru OLB. All hardcopy bids must be submitted on the bid form and in an envelope clearly identified as described in this section. NOTE: Only one bid form per bid envelope. Sealed bids must be submitted to the Unit office designated in the prospectus and must be submitted at or prior to the time established in the prospectus. The envelope should show on the outside (a) the sale name or number and (b) the date and time of bid opening, as shown in the prospectus. Bids received after the time specified in the sale prospectus are late bids and will be rejected.

It is possible for a bidder to submit multiple bids on a single sale. For example, a bid may be submitted hardcopy and a bid may be submitted thru OLB. Or, two bidders from the same company could both submit bids on the same sale. If this were to happen, the State would accept all bids received and award the contract accordingly. All bidding and contractual requirements would apply to all bids received.

5. Public Opening of Sealed Bids (7/16)

If conditions permit, the sealed bids will be publicly opened and posted at the time and place set in the prospectus.

If a bidder, present at a bid opening, has submitted bids on more than one sale, that bidder may withdraw their unopened bid envelopes or announce the withdrawal of their online bid after being declared the successful bidder on one sale.

6. Award of Contract (1/11)

Award of the contract will be made to the Bidder whose bid, conforming to the prospectus, is most advantageous to the State of Michigan on the basis of total value at rates bid for the estimated quantities. The State reserves the right to reject any bid or waive any minor irregularity in bids received. A written award mailed (or otherwise furnished) to the successful Bidder shall be deemed to result in a binding contract without further action by either party.

7. Down Payment (1/11)

The Bidder to whom award is made must make a down payment within 21 days of the sale award. The amount of the down payment will be calculated as shown in the Bond and Payment Schedule of this prospectus. Only cash may be used to meet this requirement.

8. Performance Security (1/11)

As guarantee of faithful performance, a cash bond, certificate of deposit, surety bond or irrevocable letter of credit (LOC) is required within 21 days of the sale award. The amount of the performance security is shown in the Bond and

Payment Schedule of this prospectus. If an LOC or surety is used, the coverage must extend for at least 6 months beyond the contract expiration.

9. Timber Sale Contract (7/18)

Additional conditions and requirements common to all timber sales are listed on the timber sale contract (R4031) and are available on line at www.michigan.gov/timber. Contact the Unit Manager for additional information or a sample contract. Within 21 days of the date of the award letter, the bidder must sign the contract and provide the required down payment, performance security, and verification of worker's disability compensation. The down payment and performance security shall be in accordance with the provisions of the timber sale contract, in the sums stated in this prospectus. If these actions are not taken, then the Bidder, the Bidder's corporation, and the corporation's principals may not be permitted to bid on State timber sales for a period of 3 months after the first offense, 6 months after the second offense, and 1 year after the third offense. An offense will only be counted against the Bidder for 5 years. In addition, the Bidder certifies that if awarded this contract, the Bidder will complete the timber sale contract in accordance with its terms and any modifications thereof including requirements to purchase, cut, and remove the included timber by the expiration date.

Payment Unit values in the State Forest Timber Sale Contract are calculated based on the advertised value of the Payment Unit as a percentage of the total advertised value of the contract. The advertised value of each Payment Unit is given in the Description of Timber by Payment Unit table on the Timber Sale Information page. For example, if the value of Payment Unit 1 is advertised as \$1,500 and the total Timber Sale value is advertised as \$10,000, the contract price for Payment Unit 1 will be 15% of the total bid price ($\$1,500/\$10,000 * 100$).

10. Disclaimer of Estimates and Bidder's Warranty of Inspection (7/16)

Before submitting this bid, the Bidder is advised and cautioned to inspect the sale area, review the requirements of the sale contract, and take other steps as may be reasonably necessary to ascertain the location, estimated volumes, construction estimates, and operating costs of the proposed sale. Failure to do so will not relieve the Bidder from responsibility for completing the contract.

The Bidder warrants that this bid is submitted solely on the basis of the Bidder's examination and inspection of the quality and quantity of the timber offered for sale and the Bidder's opinion of the value thereof and the costs of recovery. No reliance should be placed on the State of Michigan's estimates of timber quality, quantity or costs of recovery. Bidder further acknowledges that the State of Michigan: (i) expressly disclaims any warranty of fitness of timber for any purpose; (ii) offers this timber as is without any warranty of quality (merchantability) or quantity and (iii) expressly disclaims any warranty as to the quantity or quality of timber sold.

11. Certification and Chain-of-Custody (10/14)

Unless otherwise indicated in the contract under section 7 – Other Conditions of the Sale Specific Conditions & Requirements, the area encompassed by this timber sale is certified to the standards of the Forest Stewardship Council (FSC) - Certificate #SCS-FM/COC-00090N and the Sustainable Forestry Initiative (SFI) - Certificate #NSF-SFIS-5Y031-SF5. Forest products from this sale may be delivered to the mill as "FSC 100% and / or SFI certified" as long as the contractor hauling the forest products is chain-of-custody (COC) certified or covered under a COC certificate from the destination mill. The purchaser is responsible for maintaining COC after leaving the sale area.

12. Good Neighbor Authority (GNA) Requirements (7/16)

If the name of this timber sales contains the acronym GNA, it is authorized by the Good Neighbor Authority (GNA) and covered by various agreements between the U.S. Forest Service and the State. The timber sale occurs on federal land and the following conditions apply:

GNA contracts on US Forest Service land will not be awarded to purchasers on the Federal list of excluded parties. The System for Award Management (SAM) will be checked for active excluded parties prior to award of contract. In addition, the Bidder to whom award is made must complete an Assurance Regarding Felony Conviction or Tax Delinquent Status for Corporate Applicants (AD-3031).

13. Good Neighbor Authority (GNA) Requirements, con't (9/16)

Bidder certifies, by signing this bid form, that to the best of Bidder's knowledge that the following representations are accurate and complete.

- a. That the Bidder and its principals are not presently debarred, suspended, proposed for debarment, declared ineligible, or voluntary excluded from timber sales (covered transactions) by any Federal department or agency.
- b. That the Bidder and its principals have not within a 3-year period preceding this bid been convicted of or had a civil judgment rendered against them for commission of fraud or a criminal offense in connection with obtaining , attempting to obtain, or performing a public (Federal, State, or local) transaction or contract under a public transaction; violation of Federal or State antitrust statutes or commission of embezzlement, theft, forgery, bribery, falsification or destruction of records, making false statements, or receiving stolen property.
- c. That the Bidder and its principals are not presently indicted for or otherwise criminally or civilly charged by a governmental entity (Federal, State, or local) with commission of any of the offenses enumerated in paragraph b of this certification.
- d. That the Bidder and its principals have not within a 3-year period preceding this bid had one or more public transactions (Federal, State, or local) terminated for breach or default of a timber or forest product contract.

Bidders that cannot certify this requirement, in whole or in part, shall submit an explanation with their bid.

DAN EICHINGER
Director

TIMBER SALE INFORMATION

Tetris Pine Final (72-009-20)
 T27N, R01E, SEC. 26; T27N, R01E, SEC. 28; T27N, R01E, SEC. 35.
 Oscoda County (Advertised Price \$166,818.00)

SALE NOTE: Permission to cross the corner of private property to access Payment Units 1-3 is the responsibility of the Purchaser.

A recreation site such as a trail, pathway, or campground is within the sale area or the vicinity. Certain restrictions/specifications may be applicable including time restrictions. Access may be through private land.

A timber sale contract for this lump sum, sealed bid timber sale will be awarded to the responsible bidder offering the highest sealed bid price. All units of volume listed below were estimated using the T-Sale computer program and our traditional volume equations. Bids must be at or above the following advertised price for each product and species:

<u>PRODUCTS & SPECIES</u>	<u>ESTIMATED UNITS*</u>	<u>ADVERTISED PRICE</u>
Sawtimber		
Red Oak	39.8 MBF	\$ 108.00 / MBF
Red Pine	1,270.3 MBF	\$ 84.00 / MBF
White Pine	55.2 MBF	\$ 33.00 / MBF
Pulpwood		
Balsam Fir	12 Cords	\$ 13.10 / Cord
Bl/R/Hybrid Oak	101 Cords	\$ 17.50 / Cord
Black Spruce	22 Cords	\$ 17.55 / Cord
Jack Pine	95 Cords	\$ 13.50 / Cord
Mixed Aspen	18 Cords	\$ 15.20 / Cord
Red Maple	7 Cords	\$ 20.70 / Cord
Red Pine	1,130 Cords	\$ 35.20 / Cord
White Pine	628 Cords	\$ 16.25 / Cord

* The total volume is statistically estimated within plus (+) or minus (-) 10.11 percent. There are an estimated 4,746 cords on this timber sale, plus or minus 480 cords at the 95% confidence level. The estimated units are final and not subject to adjustment. Prospective bidders are urged to examine this timber and to make their own estimates of quantity and quality.

BOND AND PAYMENT SCHEDULE:

1. A bond in the amount of \$8,341.00 to insure faithful performance of the conditions of the contract will be deposited by the successful bidder within 21 days of the sale award.
2. Cutting in any sale or unit without the required advance payment would be considered a trespass.
3. Total payment must be paid in advance or according to the following schedule :
 - (a) Ten percent (10%) of the sale value must be paid within 21 days of the sale award.
 - (b) The 10% down payment will be credited towards the first unit cut.
 - (c) Payment for each of the following units must be made before cutting begins in that unit:

PAYMENT UNIT NUMBER	PERCENT OF TOTAL SALE VALUE
01	25.2%
02	26.0%
03	21.9%
04	11.7%
05	15.2%

4. If no cutting takes place, the 10% down payment will not be refunded.
5. Operations on the contract issued will terminate on 03/31/2023.

SALE STATISTICS

SALE VOLUMES

VOLUME		STATISTICAL RANGE IN CORDS		
TOTAL CUBIC FEET	TOTAL CORDS	PERCENT ERROR	MINIMUM	MAXIMUM
374,903	4,746	10.11%	4,266	5,225

VDU VOLUMES

A VDU is a Volume Determination Unit. Volumes and their associated statistics are calculated at the VDU level and summarized to the sale level. There is often a one to one relationship between a VDU and a Payment Unit, but not always, depending on the cruise design. Refer to the VDU TO PAYMENT UNIT table.

VDU	VOLUME		PERCENT ERROR	RANGE IN CORDS	
	TOTAL CUBIC FEET	TOTAL CORDS		MINIMUM	MAXIMUM
1	250,454	3,170	12.74%	2,766	3,574
29	124,457	1,575	16.47%	1,316	1,835
TOTAL:	374,910	4,746		4,082	5,409

VDU TO PAYMENT UNIT

When a VDU is associated with more than one Payment Unit (PU), the VDU volumes are assigned to the PU based on acres of the VDU within the PU.

VDU	VDU ACRES	PU	PU ACRES
1	94.7	1	32.6
		2	33.7
		3	28.4
29	67.7	4	29.5
		5	38.2
TOTAL:	162.4		162.4

DESCRIPTION OF TIMBER BY PAYMENT UNIT (PU)

PU	MARKET GROUP	PRODUCT	QUANTITY	UNIT	ACRES	ADVERTISE PRICE
1	Red Pine	Sawtimber	379.3	MBF	32.6	\$41,981.70
	White Pine		3.6	MBF		
	Balsam Fir	Pulpwood	4	Cords		
	<i>Balsam Fir</i>	<i>Sawtimber</i>	0.4	<i>MBF</i>		
	<i>Balsam Fir</i>	<i>Pulpwood</i>	3	<i>Cords</i>		
	BI/R/Hybrid Oak		1	Cords		
	<i>BI/R/Hybrid Oak</i>		1	<i>Cords</i>		
	Black Spruce		8	Cords		
	Jack Pine		33	Cords		
	<i>Jack Pine</i>	<i>Sawtimber</i>	0.9	<i>MBF</i>		
	<i>Jack Pine</i>	<i>Pulpwood</i>	31	<i>Cords</i>		
	Mixed Aspen		7	Cords		
	<i>Quaking Aspen</i>	<i>Sawtimber</i>	0.4	<i>MBF</i>		
	<i>B. T. Aspen</i>	<i>Pulpwood</i>	2	<i>Cords</i>		
	<i>Quaking Aspen</i>		4	<i>Cords</i>		
	Red Maple		2	Cords		
	<i>Red Maple</i>	<i>Sawtimber</i>	1.0	<i>MBF</i>		
	Red Pine	Pulpwood	253	Cords		
	White Pine		18	Cords		
	2	Red Pine	Sawtimber	392.1		
White Pine			3.7	MBF		
Balsam Fir		Pulpwood	4	Cords		
<i>Balsam Fir</i>		<i>Sawtimber</i>	0.5	<i>MBF</i>		
<i>Balsam Fir</i>		<i>Pulpwood</i>	3	<i>Cords</i>		
BI/R/Hybrid Oak			1	Cords		
<i>BI/R/Hybrid Oak</i>			1	<i>Cords</i>		
Black Spruce			7	Cords		
Jack Pine			34	Cords		
<i>Jack Pine</i>		<i>Sawtimber</i>	0.9	<i>MBF</i>		
<i>Jack Pine</i>		<i>Pulpwood</i>	32	<i>Cords</i>		
Mixed Aspen			7	Cords		
<i>Quaking Aspen</i>		<i>Sawtimber</i>	0.4	<i>MBF</i>		
<i>B. T. Aspen</i>		<i>Pulpwood</i>	2	<i>Cords</i>		
<i>Quaking Aspen</i>			4	<i>Cords</i>		
Red Maple			3	Cords		
<i>Red Maple</i>		<i>Sawtimber</i>	1.1	<i>MBF</i>		
<i>Red Maple</i>		<i>Pulpwood</i>	1	<i>Cords</i>		
Red Pine			262	Cords		
White Pine			18	Cords		
3	Red Pine	Sawtimber	330.4	MBF	28.4	\$36,545.30
	White Pine		3.1	MBF		
	Balsam Fir	Pulpwood	4	Cords		
	<i>Balsam Fir</i>	<i>Sawtimber</i>	0.4	<i>MBF</i>		
	<i>Balsam Fir</i>	<i>Pulpwood</i>	3	<i>Cords</i>		
	BI/R/Hybrid Oak		1	Cords		
	<i>BI/R/Hybrid Oak</i>		1	<i>Cords</i>		
	Black Spruce		7	Cords		
	Jack Pine		29	Cords		
	<i>Jack Pine</i>	<i>Sawtimber</i>	0.8	<i>MBF</i>		
	<i>Jack Pine</i>	<i>Pulpwood</i>	27	<i>Cords</i>		
	Mixed Aspen		5	Cords		
	<i>Quaking Aspen</i>	<i>Sawtimber</i>	0.3	<i>MBF</i>		
	<i>B. T. Aspen</i>	<i>Pulpwood</i>	1	<i>Cords</i>		
	<i>Quaking Aspen</i>		3	<i>Cords</i>		
	Red Maple		2	Cords		
	<i>Red Maple</i>	<i>Sawtimber</i>	0.9	<i>MBF</i>		

DESCRIPTION OF TIMBER BY PAYMENT UNIT (PU), CON'T

PU	MARKET GROUP	PRODUCT	QUANTITY	UNIT	ACRES	ADVERTISE PRICE
3 con't	Red Pine	Pulpwood	220	Cords		
	White Pine		15	Cords		
4	Red Oak	Sawtimber	17.3	MBF	29.5	\$19,545.65
	Red Pine		73.4	MBF		
	White Pine		19.5	MBF		
	BI/R/Hybrid Oak	Pulpwood	42	Cords		
	<i>BI/R/Hybrid Oak</i>		4	<i>Cords</i>		
	<i>Red Oak</i>		38	<i>Cords</i>		
	Red Pine		172	Cords		
	White Pine		251	Cords		
5	Red Oak	Sawtimber	22.5	MBF	38.2	\$25,380.40
	Red Pine		95.1	MBF		
	White Pine		25.3	MBF		
	BI/R/Hybrid Oak	Pulpwood	56	Cords		
	<i>BI/R/Hybrid Oak</i>		7	<i>Cords</i>		
	<i>Red Oak</i>		49	<i>Cords</i>		
	Red Pine		223	Cords		
	White Pine		326	Cords		
TOTAL:			1,365.3	MBF		
TOTAL:			2,015	Cords		

Sale Specific Conditions & Requirements

Sale Name: Tetris Pine Final

Sale Number: 72-009-20 Seq#: 2

1 - Sale Area

1.2 - Boundaries

1.2.1 - Painted boundaries (9/19)

The sale boundary and Payment Unit boundaries are marked and identified by blue, red and yellow paint, or are unmarked and identified by roads. Exterior sale boundary lines against private property are marked with blue paint, with the exception of the northwest corner of Payment Unit 1, which is unmarked and identified by the unnamed forest road. Exterior sale boundary lines against state are marked with red paint. Interior Payment Unit boundaries are marked with yellow paint. Retention patches are marked with red paint; no harvesting activities may occur within these areas. The painted boundary line trees are not Included Timber and are to be protected. Yellow painted trees designating an interior Payment Unit boundary are only to be cut when all surrounding Payment Units have been paid.

2 - Timber Specifications

2.1 - Included Timber

2.1.1 - Clearcut unit(s) with unmerchantable trees (6/14)

Within Payment Unit(s) 1-5, cut all trees that are two (2) inches or more at DBH, except do not cut red or white pine greater than 26 inches at DBH.

2.2 - Utilization

2.2.2 - Chipping required (2/18)

The sale area must be chip harvested to facilitate subsequent planting operations. The Purchaser has the option to produce sawlogs or pulpwood bolts, but the remaining portion of the trees must be chipped and hauled. If market conditions limit the practicality of chipping, tops and slash must be arranged in a way that will not inhibit future planting operations, as directed by the sale administrator. A chipping exemption can be obtained if proposed operations are determined to be suitable for planting by reforestation staff. This exemption must be granted in writing. The requirement to retain approximately 1/6 to 1/3 of tree tops and limbs less than four inches in diameter is still applicable (G. C. & R. 2.2).

2.2.3 - Stump heights (4/07)

Stump heights within sale area shall not exceed 6 inches for all trees. This is in order to facilitate planting operations.

3 - Payments

3.3 - Pre-measured Sales

3.3.4 - Dividing payment units (7/14)

Payment Unit(s) may be divided at the request of the Purchaser and upon approval of the Unit Manager. Dividing Payment Units is a contract modification which requires a Timber Sale Contract Amendment.

3.4 - Damaged Timber

3.4.1 - Damaged timber (7/16)

General Condition and Requirement 3.4 Damaged Timber, defines liquidated damages for undesignated live merchantable trees which are cut or injured.

No damage is acceptable to undesignated legacy trees. Rates will be in accordance with General Condition and Requirement 3.4 Damaged Timber, or at a rate of \$200.00 per sawtimber tree, whichever is greater.

4 - Transportation

4.1 - Construction

4.1.6 - Road construction (1/09)

Construction of new roads or improvements of existing roads shall be done in such a way as to minimize the environmental

and visual impacts. Merchantable trees shall be cut and utilized unless otherwise directed. Non-merchantable trees shall be severed and laid flat on the ground. Slash shall be scattered, and not left in windrows and kept a minimum of 10 feet back from the road edge. Stumps shall be set upright, not left on edge, and be moved at least 10 feet away from the road edge. Disturbed soil shall be feathered into the woods and not left in berms or windrows.

4.1.7 - Road closure (10/11)

All new roads built into the sale must be blocked to vehicle traffic upon completion of the sale. Overgrown roads that are reopened shall be considered new roads. In general, this will require constructing a four (4') foot high berm of stumps and logs covered with earth. Stumps and brush must be placed along the remainder of the trail. These roads must be rendered impassable to cars and trucks. All stumps from road building and landing construction must be reserved to block any newly constructed roads upon completion of the sale. These stumps must be scattered along the road system to prohibit vehicular movement. Contact the sale administrator for specific details of design and placement.

4.1.11 - Permits (2/12)

The Purchaser will secure any necessary permits that may be required.

4.4 - Access

4.4.1 - Private property access (3/11)

Permission for access across private land is the responsibility of the Purchaser.

5 - Operations

5.1 - Notification

5.1.4 - Post-sale conference (10/16)

A post-sale conference on site between the Purchaser and sale administrator is required 5 days prior to the completion of active logging operations to determine clean-up and repair of landings, road edges, and the fulfillment of other contract specifications.

5.2 - Conduct of Operations

5.2.2 - Hazard Trees/Snags

5.2.2.1 - Den trees (10/16)

Obvious hollow and/or den trees shall be protected and left standing unless they are a safety hazard.

5.2.3 - Operating Restrictions

5.2.3.5 - Oak wilt restriction (1/18)

Within Payment Unit(s) 4 and 5, unless changed by written agreement, cutting, skidding, hauling within the sale and brushing of access roads to the sale are not permitted during the period of April 15 to July 15. Operations may be allowed if specific steps are taken to prevent damaging uncut oak during the high risk period. Those steps may include completing all road brushing before April 15th and clearing a tree-length buffer along uncut oak cover before April 15th. This is necessary to reduce the spread of oak wilt. For more information, contact the Unit Manager or his/her representative.

5.2.32 - Decking/landing restoration (9/13)

All decking and landing areas must have the surface area restored to a condition equal to or better than before. This is to ensure the proper regeneration of the stand. Wood debris, chips and "cookies" from trimmings must be removed or scattered away from landing and loading areas and may not be windrowed on the edge.

5.2.41 - Snowmobile trail protection (9/11)

The Trail 9 is a snowmobile trail and is shown on the Timber Sale Map. Do not cut or damage posts with orange trail markers or traffic control signs. If the trail is used, it must be maintained and restored to a condition equal to or better than before the sale. The road maintenance/restoration must be done prior to December 1. If the trail is used for hauling, it must be graded to the satisfaction of the Unit Manager or his/her representative prior to December 1st. If the trail road is to be used for hauling during the snowmobile season, then a snow covered base must be left on the trail. The snowmobile trail may not be used for any timber sale operations from December 1 to March 31 without written approval of Unit Manager. Maintain a 20 foot wide slash, debris, and rut free zone daily using the snowmobile trail as the centerline. No decking of forest products will be permitted along the snowmobile trail. In addition, any trees cut within 5 feet of the trail must be cut flush at ground level.

5.4 - Soil Protection

5.4.1 - Rutting restriction, general (7/16)

Operations are to cease immediately if equipment and weather conditions result in rutting of roads and/or skid trails which is 12 inches or greater in depth and 50 feet in length. The Unit Manager or his/her representative may restrict hauling and/or skidding if ruts exceed the specified depth. With the Unit Manager or his/her representative's approval, the Purchaser may return to the area when the risk of rutting has decreased.

5.8 - Protection of Endangered Species

5.8.3 - Red shoulder hawk or goshawk (2/16)

In the event that an active red shoulder hawk or goshawk nest is found, the contract may be amended to protect the nest site until the nest is determined to be inactive. The value of the trees in this excluded area will be refunded or credited to the Purchaser. The nest will be buffered with a five-chain radius (eight acre) protection area, centered on the nest tree, in which there will be no cutting or new roads constructed. Avoid human disturbance, including loading and skidding, in the protection area.

An additional zone of five chains (ten chains centered on the active nest tree) will be established in which there is no management activity from March 15 to July 15. Limit biomass harvesting and chipping operations within this ten-chain zone, retain the maximum one-third of residues per the Woody Biomass Harvesting Guidelines (Michigan DNR 2010). Nests determined to be inactive will be protected with a one-chain no-harvest buffer.

6 - Safety and Fire Prevention

6.2 - Signing

6.2.1 - Road posting (9/09)

The Purchaser is responsible for posting and maintaining caution signs on Ruth Road prior to beginning operations. The road must be posted at appropriate distances from the sale area to warn of logging activity and truck traffic. Signs must be removed when harvest operations are suspended or completed. The Purchaser will provide these signs.

6.2.2 - Snowmobile trail posting (8/09)

The Purchaser is responsible for posting and maintaining caution signs on Trail 9 prior to beginning operations during the snowmobile season (approximately December 1 to March 31). The trail must be posted at appropriate distances from the sale area to warn of logging activity and truck traffic. Signs must be removed when harvest operations are suspended or completed. The DNR will provide these signs.



TIMBER SALE MAP

This information provided by authority of Part 525, 1994 PA 451, as amended.

Forest Management Unit Grayling		County Oscoda	Mapped By Scott McClarren	Date 09/25/2020	Page 1	of 2
Township 27N	Range 01E	Section(s) and Subdivision(s) Sec. 26: SESE Sec. 28: N1/2NE, SENE Sec. 35: N1/2NE.		Scale 1:15,840		

Cover Type				Density	
A = Aspen	H = Hemlock	N = Marsh	U = Upland Brush	0 = Non Stocked	5 = Pole Timber Medium
B = Paper Birch	J = Jack Pine	O = Oak	UM = Upland Mixed	1 = Seedling Sapling Poor	6 = Pole Timber Well
C = Cedar	L = Lowland Brush	P = Lowland Poplar	V = Bog or Marsh	2 = Seedling Sapling Medium	7 = Saw Timber Poor
D = Treed Bog	LM = Lowland Mixed	Q = Mixed Swamp Conifer	W = White Pine	3 = Seedling Sapling Well	8 = Saw Timber Medium
E = Swamp Hdwoods	M = Mpl, Bch, Brch	R = Red Pine	X = Non Stocked	4 = Pole Timber Poor	9 = Saw Timber Well
F = Spruce Fir	MC = Mixed Conifer	S = Black Spruce	Z = Water		
G = Grass	MD = Mixed Deciduous	T = Tamarack			

PU	Acres	PU	Acres
1	32.6	4	29.5
2	33.7	5	38.2
3	28.4		

Tetris Pine Final

Compartment 02

162.4 Acres

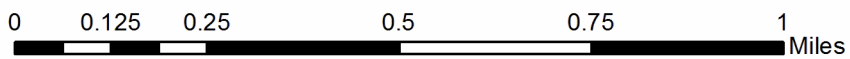
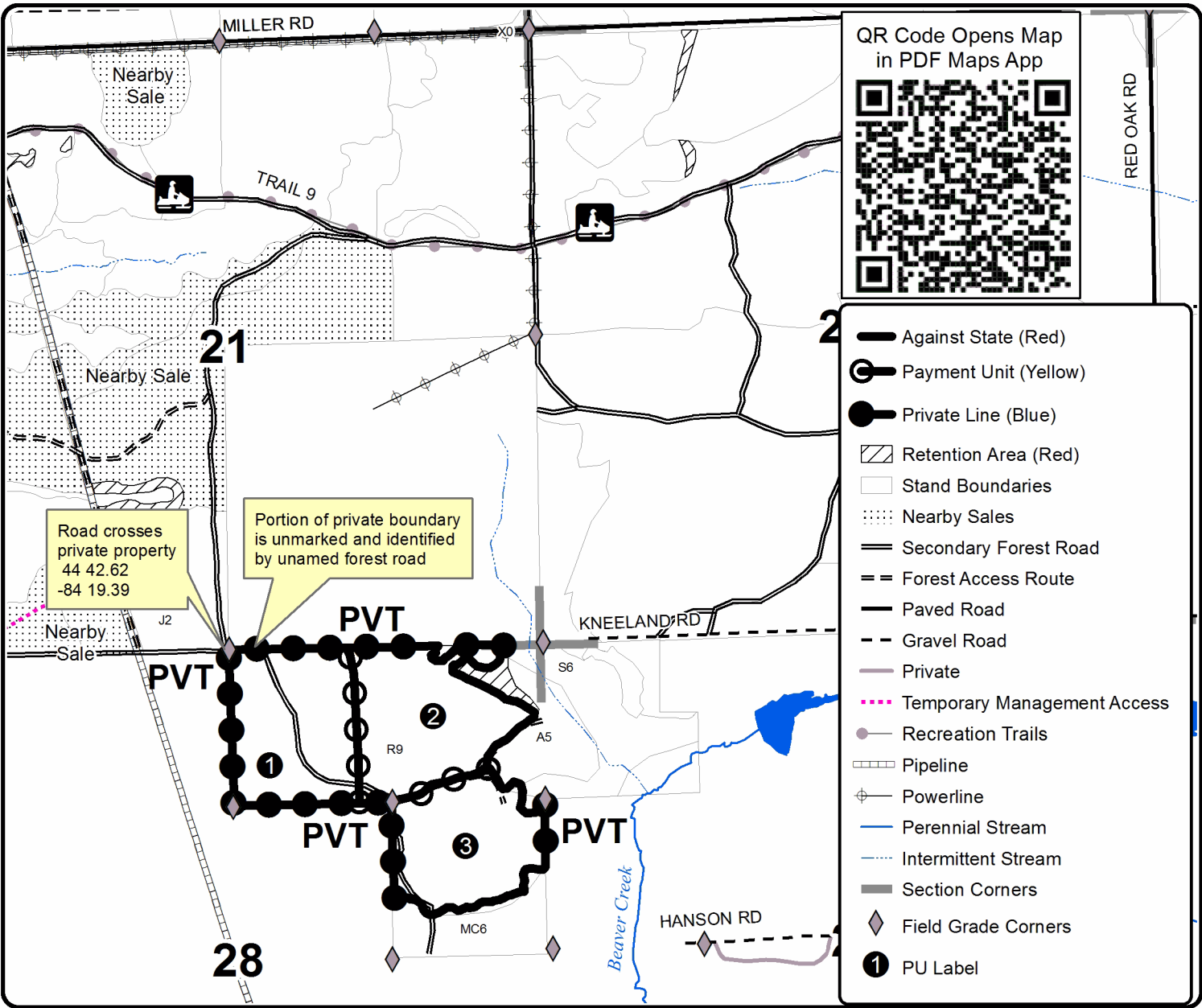
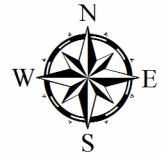



Sale Number	Year
72 - 009	20

TIMBER SALE MAP

This information provided by authority of Part 525, 1994 PA 451, as amended.

Forest Management Unit	County	Mapped By	Date	Page	of
Grayling	Oscoda	Scott McClarren	09/25/2020	2	2
Township	Range	Section(s) and Subdivision(s)	Scale		
27N	01E	Sec. 26: SESE Sec. 28: N1/2NE, SENE Sec. 35: N1/2NE.	1:7,920		

Cover Type				Density	
A = Aspen	H = Hemlock	N = Marsh	U = Upland Brush	0 = Non Stocked	5 = Pole Timber Medium
B = Paper Birch	J = Jack Pine	O = Oak	UM = Upland Mixed	1 = Seedling Sapling Poor	6 = Pole Timber Well
C = Cedar	L = Lowland Brush	P = Lowland Poplar	V = Bog or Marsh	2 = Seedling Sapling Medium	7 = Saw Timber Poor
D = Treed Bog	LM = Lowland Mixed	Q = Mixed Swamp Conifer	W = White Pine	3 = Seedling Sapling Well	8 = Saw Timber Medium
E = Swamp Hdwoods	M = Mpl, Bch, Brch	R = Red Pine	X = Non Stocked	4 = Pole Timber Poor	9 = Saw Timber Well
F = Spruce Fir	MC = Mixed Conifer	S = Black Spruce	Z = Water		
G = Grass	MD = Mixed Deciduous	T = Tamarack			

PU	Acres	PU	Acres
1	32.6	4	29.5
2	33.7	5	38.2
3	28.4		

Tetris Pine Final

Compartment 02

162.4 Acres

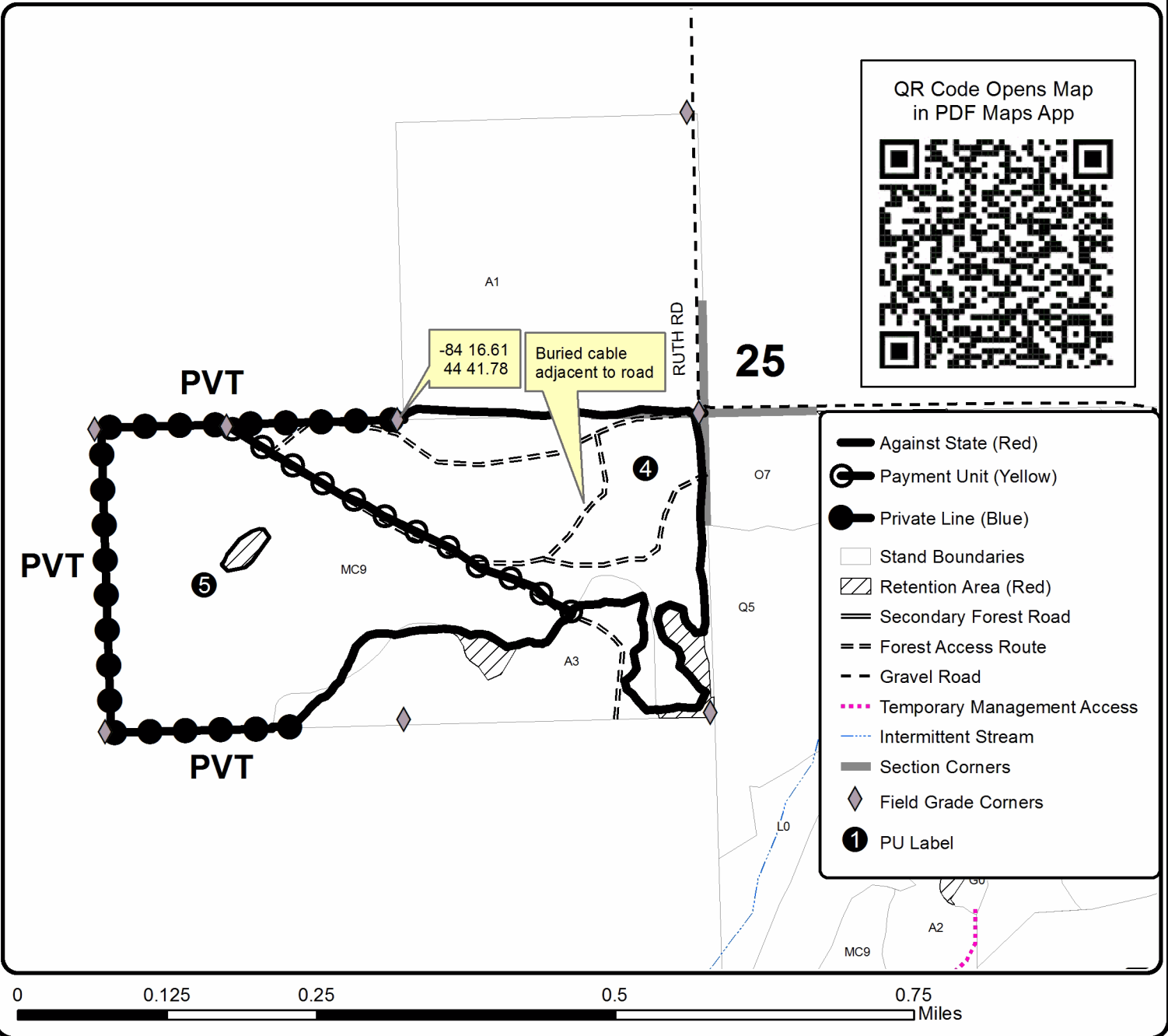

TIMBER SALE INFORMATION

Surveyor's Stone Mix (72-010-20)
T27N, R01E, SEC. 25.
Oscoda County (Advertised Price \$45,947.60)

SALE NOTE: Harvesting during dry summer or frozen winter conditions is recommended, but not required. The sale contains stricter rutting restrictions due to lowland areas and harvesting within a RMZ.

Timber crane mats and/or interlocking composite mats are available if needed. There is an intermediate stream that splits Payment Unit 5 that will need to be forwarded across, however the stream was dry during summer sale layout and crane mats should suffice. The DNR will provide the crossing permit from the DEQ, and the Purchaser will be responsible for implementing it.

A recreation site such as a trail, pathway, or campground is within the sale area or the vicinity. Certain restrictions/specifications may be applicable including time restrictions.

A timber sale contract for this lump sum, sealed bid timber sale will be awarded to the responsible bidder offering the highest sealed bid price. All units of volume listed below were estimated using the T-Sale computer program and our traditional volume equations. Bids must be at or above the following advertised price for each product and species:

<u>PRODUCTS & SPECIES</u>	<u>ESTIMATED UNITS*</u>	<u>ADVERTISED PRICE</u>
Sawtimber		
Red Oak	19.8 MBF	\$ 108.00 / MBF
Red Pine	184.7 MBF	\$ 84.00 / MBF
White Pine	148.0 MBF	\$ 33.00 / MBF
Pulpwood		
Balsam Fir	39 Cords	\$ 13.10 / Cord
Jack Pine	77 Cords	\$ 13.50 / Cord
Mixed Aspen	434 Cords	\$ 15.20 / Cord
Mixed Hardwood	131 Cords	\$ 20.70 / Cord
Mixed Oak	24 Cords	\$ 17.50 / Cord
Red Pine	220 Cords	\$ 35.20 / Cord
White Pine	270 Cords	\$ 16.25 / Cord

* The total volume is statistically estimated within plus (+) or minus (-) 14.08 percent. There are an estimated 1,898 cords on this timber sale, plus or minus 267 cords at the 95% confidence level. The estimated units are final and not subject to adjustment. Prospective bidders are urged to examine this timber and to make their own estimates of quantity and quality.

BOND AND PAYMENT SCHEDULE:

1. A bond in the amount of \$2,297.00 to insure faithful performance of the conditions of the contract will be deposited by the successful bidder within 21 days of the sale award.
 2. Cutting in any sale or unit without the required advance payment would be considered a trespass.
 3. Total payment must be paid in advance or according to the following schedule :
 - (a) Ten percent (10%) of the sale value must be paid within 21 days of the sale award.
 - (b) The 10% down payment will be credited towards the first unit cut.
 - (c) Payment for each of the following units must be made before cutting begins in that unit:
- | PAYMENT UNIT NUMBER | PERCENT OF TOTAL SALE VALUE |
|---------------------|-----------------------------|
| 01 | 6.6% |
| 02 | 32.7% |
| 03 | 26.1% |
| 04 | 18.2% |
| 05 | 16.4% |
4. If no cutting takes place, the 10% down payment will not be refunded.
 5. Operations on the contract issued will terminate on 03/31/2024.

SALE STATISTICS

SALE VOLUMES

VOLUME		STATISTICAL RANGE IN CORDS		
TOTAL CUBIC FEET	TOTAL CORDS	PERCENT ERROR	MINIMUM	MAXIMUM
149,933	1,898	14.08%	1,631	2,165

VDU VOLUMES

A VDU is a Volume Determination Unit. Volumes and their associated statistics are calculated at the VDU level and summarized to the sale level. There is often a one to one relationship between a VDU and a Payment Unit, but not always, depending on the cruise design. Refer to the VDU TO PAYMENT UNIT table.

VDU	VOLUME		PERCENT ERROR	RANGE IN CORDS	
	TOTAL CUBIC FEET	TOTAL CORDS		MINIMUM	MAXIMUM
18	10,444	132	36.58%	84	181
19	44,019	557	19.58%	448	666
23	16,614	210	74.22%	54	366
24	54,076	685	23.87%	521	848
28	15,539	197	20.86%	156	238
30	9,140	116	50.21%	58	174
404	87	1	200.00%	1	3
TOTAL:	149,918	1,898		1,319	2,476

VDU TO PAYMENT UNIT

When a VDU is associated with more than one Payment Unit (PU), the VDU volumes are assigned to the PU based on acres of the VDU within the PU.

VDU	VDU ACRES	PU	PU ACRES
18	5.0	1	5.0
19	17.9	2	10.7
		3	6.9
		4	0.3
		4	9.4
23	9.4	4	9.4
24	30.7	2	15.5
		3	15.2
28	8.1	5	8.1
30	3.9	4	3.9
404	3.0	4	3.0
TOTAL:	78.0		78.0

DESCRIPTION OF TIMBER BY PAYMENT UNIT (PU)

PU	MARKET GROUP	PRODUCT	QUANTITY	UNIT	ACRES	ADVERTISE PRICE
1	Red Pine	Sawtimber	12.0	MBF	5.0	\$3,051.00
	White Pine		18.9	MBF		
	Balsam Fir	Pulpwood	4	Cords		
	<i>Balsam Fir</i>		4	<i>Cords</i>		
	Mixed Aspen		2	Cords		
	<i>Quaking Aspen</i>		2	<i>Cords</i>		
	Mixed Hardwood		32	Cords		
	<i>Red Maple</i>	<i>Sawtimber</i>	5.7	<i>MBF</i>		
	<i>Paper Birch</i>	<i>Pulpwood</i>	5	<i>Cords</i>		
	<i>Red Maple</i>		16	<i>Cords</i>		
	Mixed Oak		2	Cords		
	<i>Northern Pin Oak</i>	<i>Sawtimber</i>	0.7	<i>MBF</i>		
	<i>Northern Pin Oak</i>	<i>Pulpwood</i>	1	<i>Cords</i>		
	Red Pine		8	Cords		
	White Pine		22	Cords		
2	Red Oak	Sawtimber	10.2	MBF	26.2	\$14,918.95
	Red Pine		48.5	MBF		
	White Pine		58.9	MBF		
	Balsam Fir	Pulpwood	17	Cords		
	<i>Balsam Fir</i>	<i>Sawtimber</i>	0.7	<i>MBF</i>		
	<i>Balsam Fir</i>	<i>Pulpwood</i>	16	<i>Cords</i>		
	Jack Pine		16	Cords		
	<i>Jack Pine</i>	<i>Sawtimber</i>	0.5	<i>MBF</i>		
	<i>Jack Pine</i>	<i>Pulpwood</i>	15	<i>Cords</i>		
	Mixed Aspen		220	Cords		
	<i>B. T. Aspen</i>	<i>Sawtimber</i>	16.3	<i>MBF</i>		
	<i>Quaking Aspen</i>		7.7	<i>MBF</i>		
	<i>B. T. Aspen</i>	<i>Pulpwood</i>	88	<i>Cords</i>		
	<i>Quaking Aspen</i>		84	<i>Cords</i>		
	Mixed Hardwood		47	Cords		
	<i>Red Maple</i>	<i>Sawtimber</i>	3.3	<i>MBF</i>		
	<i>Black Cherry</i>	<i>Pulpwood</i>	4	<i>Cords</i>		
	<i>Paper Birch</i>		2	<i>Cords</i>		
	<i>Red Maple</i>		34	<i>Cords</i>		
	Mixed Oak		11	Cords		
	<i>Red Oak</i>		11	<i>Cords</i>		
	Red Pine		39	Cords		
	White Pine		91	Cords		
3	Red Oak	Sawtimber	9.6	MBF	22.1	\$12,000.35
	Red Pine		34.9	MBF		
	White Pine		41.4	MBF		
	Balsam Fir	Pulpwood	17	Cords		
	<i>Balsam Fir</i>	<i>Sawtimber</i>	0.7	<i>MBF</i>		
	<i>Balsam Fir</i>	<i>Pulpwood</i>	16	<i>Cords</i>		
	Jack Pine		11	Cords		
	<i>Jack Pine</i>	<i>Sawtimber</i>	0.3	<i>MBF</i>		
	<i>Jack Pine</i>	<i>Pulpwood</i>	10	<i>Cords</i>		
	Mixed Aspen		208	Cords		
	<i>B. T. Aspen</i>	<i>Sawtimber</i>	16.0	<i>MBF</i>		
	<i>Quaking Aspen</i>		7.1	<i>MBF</i>		
	<i>B. T. Aspen</i>	<i>Pulpwood</i>	80	<i>Cords</i>		
	<i>Quaking Aspen</i>		82	<i>Cords</i>		
	Mixed Hardwood		37	Cords		
	<i>Red Maple</i>	<i>Sawtimber</i>	2.4	<i>MBF</i>		
	<i>Black Cherry</i>	<i>Pulpwood</i>	3	<i>Cords</i>		
	<i>Paper Birch</i>		2	<i>Cords</i>		

DESCRIPTION OF TIMBER BY PAYMENT UNIT (PU), CON'T

PU	MARKET GROUP	PRODUCT	QUANTITY	UNIT	ACRES	ADVERTISE PRICE
3 con't	<i>Red Maple</i>	<i>Pulpwood</i>	27	<i>Cords</i>		
	Mixed Oak		11	Cords		
	<i>Red Oak</i>		11	<i>Cords</i>		
	Red Pine		29	Cords		
	White Pine		71	Cords		
4	Red Pine	Sawtimber	40.3	MBF	16.6	\$8,384.50
	White Pine		28.8	MBF		
	Jack Pine	Pulpwood	51	Cords		
	<i>Jack Pine</i>	<i>Sawtimber</i>	6.4	<i>MBF</i>		
	<i>Jack Pine</i>	<i>Pulpwood</i>	38	<i>Cords</i>		
	Mixed Aspen		3	Cords		
	<i>Quaking Aspen</i>	<i>Sawtimber</i>	0.7	<i>MBF</i>		
	<i>B. T. Aspen</i>	<i>Pulpwood</i>	1	<i>Cords</i>		
	<i>Quaking Aspen</i>		1	<i>Cords</i>		
	Mixed Hardwood		11	Cords		
	<i>Red Maple</i>	<i>Sawtimber</i>	0.1	<i>MBF</i>		
	<i>Black Cherry</i>	<i>Pulpwood</i>	10	<i>Cords</i>		
	<i>Red Maple</i>		1	<i>Cords</i>		
	Red Pine		48	Cords		
	White Pine		86	Cords		
5	Red Pine	Sawtimber	49.0	MBF	8.1	\$7,557.30
	Mixed Hardwood	Pulpwood	3	Cords		
	<i>Red Maple</i>	<i>Sawtimber</i>	1.2	<i>MBF</i>		
	<i>Red Maple</i>	<i>Pulpwood</i>	1	<i>Cords</i>		
	Red Pine		96	Cords		
TOTAL:			352.5	MBF		
TOTAL:			1,193	Cords		

Sale Specific Conditions & Requirements

Sale Name: Surveyor's Stone Mix

Sale Number: 72-010-20 Seq#: 2

1 - Sale Area

1.2 - Boundaries

1.2.1 - Painted boundaries (9/19)

The sale boundary and Payment Unit boundaries are marked and identified by blue, red, and yellow paint ,or are unmarked and identified by existing roads. Exterior sale boundary lines against private property are marked with blue paint, with the exception of the north boundary of Payment Unit 1, which is unmarked and identified by Kneeland Rd. Exterior sale boundary lines against state are marked with red paint, with the following exceptions - the west boundary of Payment Unit 1 is unmarked and identified by Ruth Rd, the east boundary of Payment Units 2 and 3 is unmarked and identified by Townline Road, and the east boundary of Payment Unit 4 is unmarked and identified by the maintained wildlife opening. Interior Payment Unit boundaries are marked with yellow paint. Retention patches are marked with red paint; no harvesting activities may occur within these areas. Lowland tag alder patches without merchantable trees were excluded from the sale area and are marked with red paint. The painted boundary line trees are not Included Timber and are to be protected. Yellow painted trees designating an interior Payment Unit boundary are only to be cut when all surrounding Payment Units have been paid.

2 - Timber Specifications

2.1 - Included Timber

2.1.1 - Clearcut unit(s) with unmerchantable trees (6/14)

Within Payment Unit(s) 1-4, cut all trees that are two (2) inches or more at DBH, except do not cut red pine, white pine, and oak greater than 26 inches at DBH. In addition, within Payment Unit 1, do not cut any cedar.

2.1.3 - Cut tree marked unit(s) (12/08)

Within Payment Unit(s) 5, all trees are designated for cutting when marked with orange paint above and below stump height, regardless of merchantability. In addition, cut all aspen and red maple which meet minimum piece specifications in 2.2 - Utilization.

2.2 - Utilization

2.2.2 - Chipping required (2/18)

Payment Unit 4 must be chip harvested to facilitate subsequent planting operations. The Purchaser has the option to produce sawlogs or pulpwood bolts, but the remaining portion of the trees must be chipped and hauled. If market conditions limit the practicality of chipping, tops and slash must be arranged in a way that will not inhibit future planting operations, as directed by the sale administrator. A chipping exemption can be obtained if proposed operations are determined to be suitable for planting by reforestation staff. The requirement to retain approximately 1/6 to 1/3 of tree tops and limbs less than four inches in diameter is still applicable (G. C. & R. 2.2).

2.2.3 - Stump heights (4/07)

Stump heights within Payment Unit 4 shall not exceed 6 inches for all trees. This is in order to facilitate planting operations. A written waiver of this requirement may be obtained if wet summer weather makes winter logging necessary.

3 - Payments

3.3 - Pre-measured Sales

3.3.4 - Dividing payment units (7/14)

Payment Unit(s) may be divided at the request of the Purchaser and upon approval of the Unit Manager. Dividing Payment Units is a contract modification which requires a Timber Sale Contract Amendment.

3.4 - Damaged Timber

3.4.1 - Damaged timber (7/16)

General Condition and Requirement 3.4 Damaged Timber, defines liquidated damages for undesignated live merchantable trees which are cut or injured.

No damage is acceptable to undesignated legacy trees (>26" at DBH). Rates will be in accordance with General Condition and Requirement 3.4 Damaged Timber, or at a rate of \$200.00 per sawtimber tree, whichever is greater.

4 - Transportation

4.1 - Construction

4.1.2 - Stream crossings, specific (3/11)

The intermittent stream crossing in Payment Unit 5 will require the use of crane mats which may be borrowed from the DNR. This installation will be performed in accordance with the specifications on the appropriate permits which shall be provided by the DNR.

4.1.6 - Road construction (1/09)

Construction of new roads or improvements of existing roads shall be done in such a way as to minimize the environmental and visual impacts. Merchantable trees shall be cut and utilized unless otherwise directed. Non-merchantable trees shall be severed and laid flat on the ground. Slash shall be scattered, and not left in windrows and kept a minimum of 10 feet back from the road edge. Stumps shall be set upright, not left on edge, and be moved at least 10 feet away from the road edge. Disturbed soil shall be feathered into the woods and not left in berms or windrows.

4.1.7 - Road closure (10/11)

All new roads built into the sale must be blocked to vehicle traffic upon completion of the sale. Overgrown roads that are reopened shall be considered new roads. In general, this will require constructing a four (4') foot high berm of stumps and logs covered with earth. Stumps and brush must be placed along the remainder of the trail. These roads must be rendered impassable to cars and trucks. All stumps from road building and landing construction must be reserved to block any newly constructed roads upon completion of the sale. These stumps must be scattered along the road system to prohibit vehicular movement. Contact the sale administrator for specific details of design and placement.

4.1.11 - Permits (2/12)

The DNR will secure any necessary stream crossing permits that may be required. The Purchaser will secure any road permits that may be required.

5 - Operations

5.1 - Notification

5.1.1 - Pre-sale conference (10/16)

A pre-sale conference on site between the Purchaser and sale administrator is required prior to beginning any operations to determine landings, road locations, stream crossings, RMZ's, and to schedule timber/composite mat usage. The Unit Manager or his/her representative must be contacted at least 10 days in advance to schedule the conference.

5.1.4 - Post-sale conference (10/16)

A post-sale conference on site between the Purchaser and sale administrator is required 5 days prior to the completion of active logging operations to determine clean-up and repair of landings, road edges, and the fulfillment of other contract specifications.

5.2 - Conduct of Operations

5.2.1 - Slash

5.2.1.10 - No slash in openings (5/10)

No brush or logging debris is to be left in the maintained wildlife opening which is identified on the Timber Sale Map. Any damage to the opening shall be repaired according to specifications of the Unit Manager or his/her representative.

5.2.2 - Hazard Trees/Snags

5.2.2.1 - Den trees (10/16)

Obvious hollow and/or den trees shall be protected and left standing unless they are a safety hazard.

5.2.3 - Operating Restrictions

5.2.3.3 - Bark slippage restriction (3/09)

Within Payment Unit(s) 5, unless changed by written agreement, cutting and skidding are not permitted during the period

of April 15 to July 15. This restriction is because of bark slippage.

5.2.3.6 - Bark beetle restriction (12/08)

In the event drought creates a high risk of pine bark beetle infestation, pine is not to be cut during the period March 1 through July 1, unless all portions of trees greater than two inches in diameter are removed from the sale area, reduced to chips, or treated to the satisfaction of the Unit Manager or his/her representative, within fifteen days of being severed from the stump. Pine log decks, pulpwood piles and treetops that are piled for chipping in the fall or winter within a 1/4 mile of susceptible sites must be removed before March 15. Residual slash must not be placed in piles or rows and must be spread over the site for quick drying. The Department of Natural Resources will exercise this specification if the risk of damage warrants.

5.2.4 - Dead and Down Creation

5.2.4.4 - Dead and down creation, grouse (6/18)

To encourage grouse and other wildlife, in Payment Unit(s) 2 and 3, leave one, 12" or larger diameter (or largest diameter trees within stand) whole tree on the ground for every 2 acres, preferably a hardwood species such as oak or maple or if no hardwoods are present, a pine species (white or red). These trees will be evenly scattered throughout the unit, preferably at least two chains from any roads, two-tracks, or trails open to vehicles.

5.2.17 - Timber Mats and Interlocking Composite Mats (3/18)

Some roads or skid trails may require extra protection such as that afforded by timber mats, interlocking composite mats, or another approved system. If available, mats may be borrowed from the DNR. A Timber Sale Contract Supplement will be used to document the Purchaser's use of the DNR's mats. Contact the sale administrator regarding availability and pick-up. Timber mats are available from various field offices. Composite mats are only available from the Grayling field office. The Purchaser is responsible for picking up and hauling the mats to and from the site. The composite mats will require DNR staff onsite for installation and removal. Contact the sale administrator to schedule at least 30 days before desired install/removal date. All mats must be cleaned prior to drop off. This may include, but is not limited to, power washing and brushing to remove mud and debris. A charge of \$400.00 per timber mat and \$2,000.00 per composite mat will be assessed for all damaged or non-returned mats. Damage for the crane/timber mats is defined as three or more broken cants. Damage for the composite mats is defined as cracked or broken mats.

5.2.22 - Operating Caution

5.2.22.1 - Operating caution (6/11)

It is recommended, but not required, that within Payment Unit(s) 1-4, cutting, skidding, and hauling occur during frozen winter conditions. The reason for the recommendation is to help mitigate rutting issues while maximizing aspen sprouting response.

5.2.32 - Decking/landing restoration (9/13)

All decking and landing areas must have the surface area restored to a condition equal to or better than before. This is to ensure the proper regeneration of the stand. Wood debris, chips and "cookies" from trimmings must be removed or scattered away from landing and loading areas and may not be windrowed on the edge.

5.2.38 - No decking against live trees (2/04)

Cut products may not be decked against unmarked or designated leave trees.

5.2.39 - ORV trail/route protection (4/18)

Townline Rd is an ORV trail or route and is shown on the Timber Sale Map. Do not cut trees or damage posts with yellow ORV markers. All stumps within 5 feet of the trail must be cut flush with the ground. Maintain a 20 foot wide slash, debris, and rut free zone daily using the ORV trail or route as the centerline.

5.3 - Stream Protection

5.3.1 - Operating near stream (7/04)

No tracked or wheeled vehicles shall be operated within 25 feet of the intermittent creek within Payment Unit 5, except at an approved crossing.

5.4 - Soil Protection

5.4.1 - Rutting restriction, general (7/16)

Operations are to cease immediately if equipment and weather conditions result in rutting of roads and/or skid trails which is 6

inches or greater in depth and 25 feet in length. The Unit Manager or his/her representative may restrict hauling and/or skidding if ruts exceed the specified depth. With the Unit Manager or his/her representative's approval, the Purchaser may return to the area when the risk of rutting has decreased.

6 - Safety and Fire Prevention

6.2 - Signing

6.2.1 - Road posting (9/09)

The Purchaser is responsible for posting and maintaining caution signs on Townline Road, Kittle Rd, and Kneeland Road prior to beginning operations. The road must be posted at appropriate distances from the sale area to warn of logging activity and truck traffic. Signs must be removed when harvest operations are suspended or completed. The Purchaser will provide these signs.

7 - Other Conditions

7.2 - Extensions

7.2.5 - Weather related extension (1/13)

If weather conditions during the operating period of this contract prevent harvesting, this sale may qualify for a weather related extension. If approved, the normal extension fee would be waived. To qualify, there must be a documented attempt each year to harvest in the difficult portion of the sale.



TIMBER SALE MAP

This information provided by authority of Part 525, 1994 PA 451, as amended.

Forest Management Unit Grayling		County Oscoda	Mapped By Scott McClarren	Date 09/28/2020	Page 1	of 2
Township 27N	Range 01E	Section(s) and Subdivision(s) Sec. 25: NWNW, SENE, SE		Scale 1:7,920		

Cover Type				Density	
A = Aspen	H = Hemlock	N = Marsh	U = Upland Brush	0 = Non Stocked	5 = Pole Timber Medium
B = Paper Birch	J = Jack Pine	O = Oak	UM = Upland Mixed	1 = Seedling Sapling Poor	6 = Pole Timber Well
C = Cedar	L = Lowland Brush	P = Lowland Poplar	V = Bog or Marsh	2 = Seedling Sapling Medium	7 = Saw Timber Poor
D = Treed Bog	LM = Lowland Mixed	Q = Mixed Swamp Conifer	W = White Pine	3 = Seedling Sapling Well	8 = Saw Timber Medium
E = Swamp Hdwoods	M = Mpl, Bch, Brch	R = Red Pine	X = Non Stocked	4 = Pole Timber Poor	9 = Saw Timber Well
F = Spruce Fir	MC = Mixed Conifer	S = Black Spruce	Z = Water		
G = Grass	MD = Mixed Deciduous	T = Tamarack			

PU	Acres	PU	Acres
1	5	4	16.6
2	26.2	5	8.1
3	22.1		

Surveyor's Stone Mix

Compartment 02

78 Acres

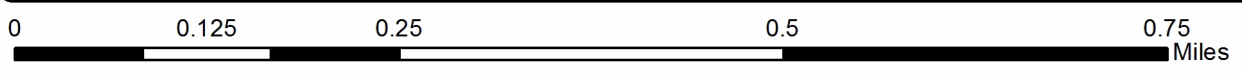
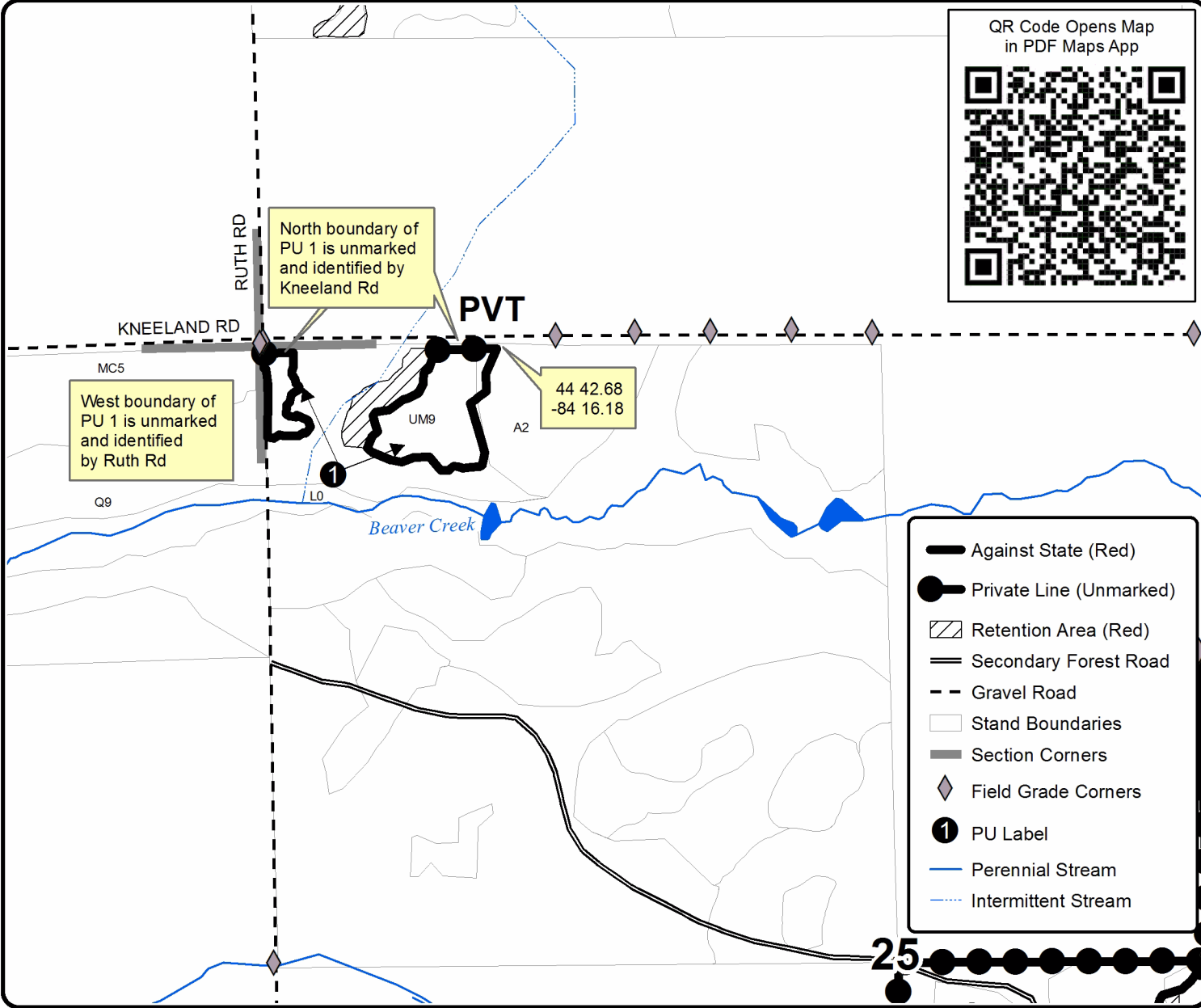
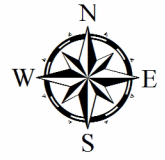



TIMBER SALE MAP

This information provided by authority of Part 525, 1994 PA 451, as amended.

Sale Number	Year
72 - 010	20

Forest Management Unit	County	Mapped By	Date	Page	of
Grayling	Oscoda	Scott McClarren	09/29/2020	2	2
Cruised By	Scott McClarren				
Township	Range	Section(s) and Subdivision(s)	Scale		
27N	01E	Sec. 25: NWNW, SENE, SE	1:7,920		

Cover Type

A = Aspen	H = Hemlock	N = Marsh	U = Upland Brush
B = Paper Birch	J = Jack Pine	O = Oak	UM = Upland Mixed
C = Cedar	L = Lowland Brush	P = Lowland Poplar	V = Bog or Marsh
D = Treed Bog	LM = Lowland Mixed	Q = Mixed Swamp Conifer	W = White Pine
E = Swamp Hdwoods	M = Mpl. Bch, Brch	R = Red Pine	X = Non Stocked
F = Spruce Fir	MC = Mixed Conifer	S = Black Spruce	Z = Water
G = Grass	MD = Mixed Deciduous	T = Tamarack	

Density

0 = Non Stocked	5 = Pole Timber Medium
1 = Seedling Sapling Poor	6 = Pole Timber Well
2 = Seedling Sapling Medium	7 = Saw Timber Poor
3 = Seedling Sapling Well	8 = Saw Timber Medium
4 = Pole Timber Poor	9 = Saw Timber Well

PU	Acres	PU	Acres
1	5	4	16.6
2	26.2	5	8.1
3	22.1		

Surveyor's Stone Mix

Compartment 02

78 Acres



QR Code Opens Map in PDF Maps App

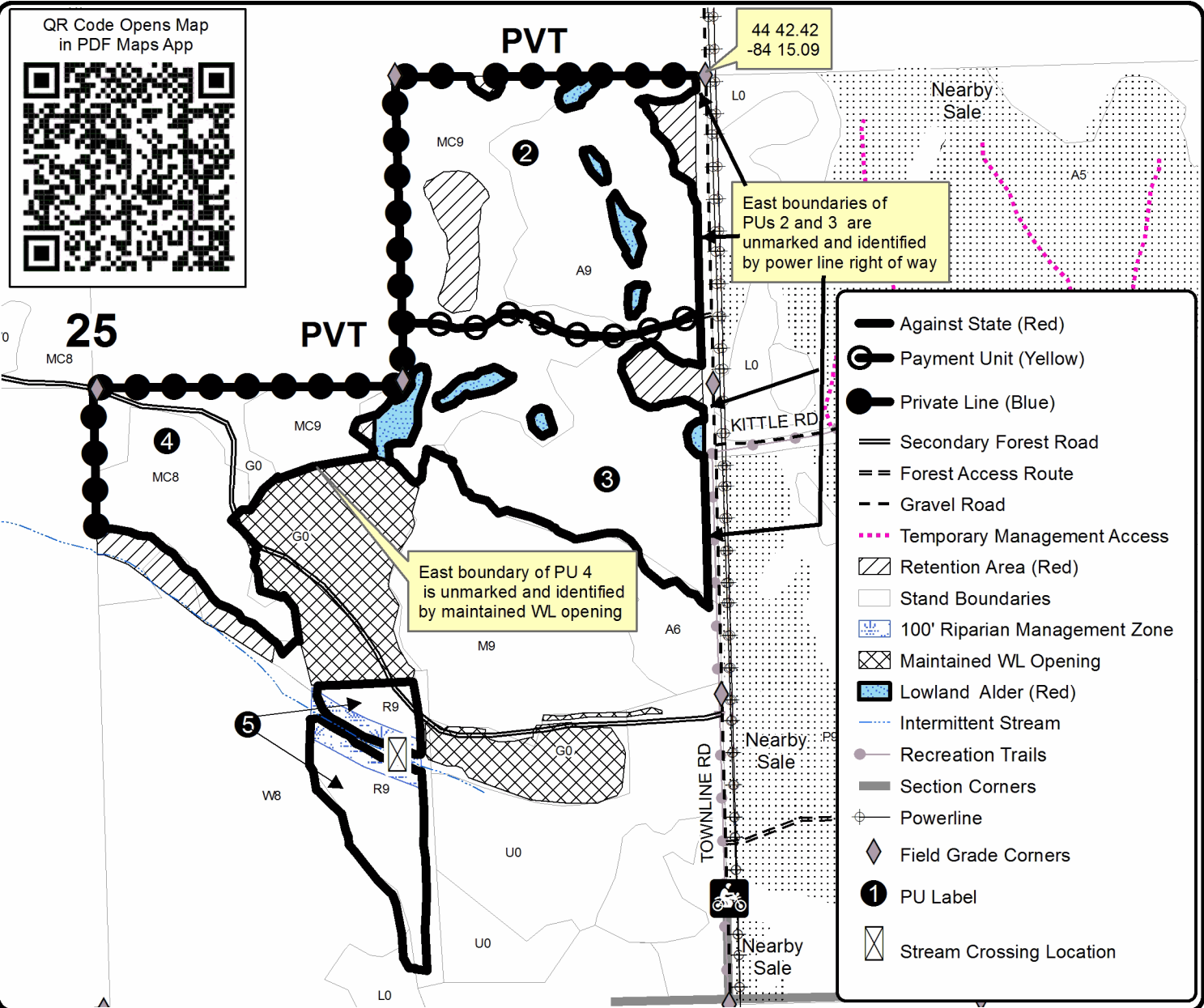

- Against State (Red)
- Payment Unit (Yellow)
- Private Line (Blue)
- Secondary Forest Road
- Forest Access Route
- Gravel Road
- Temporary Management Access
- Retention Area (Red)
- Stand Boundaries
- 100' Riparian Management Zone
- Maintained WL Opening
- Lowland Alder (Red)
- Intermittent Stream
- Recreation Trails
- Section Corners
- Powerline
- Field Grade Corners
- PU Label
- Stream Crossing Location

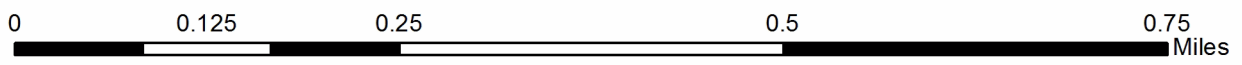

TIMBER SALE INFORMATION

Abandoned Circus Mixed HW's (72-012-20)
 T28N, R03W, SEC. 8; T28N, R03W, SEC. 9.
 Crawford County (Advertised Price \$20,210.90)

SALE NOTE: Payment Units 1 and 2 are adjacent to a nearby sale where both sides of the boundary trees are marked with red paint where the sales touch.

Sherman Rd is weight restricted if hauling out the road to the south. You can get to the non-restricted portion of Sherman Rd if hauling north through the private drive. Permission must be granted from private landowner to haul out their drive. Gas pipelines and well heads are within the sale vicinity. Contact Linn Operating at 231-922-7302 prior to operations.

Access may be through private land.

A timber sale contract for this lump sum, sealed bid timber sale will be awarded to the responsible bidder offering the highest sealed bid price. All units of volume listed below were estimated using the T-Sale computer program and our traditional volume equations. Bids must be at or above the following advertised price for each product and species:

<u>PRODUCTS & SPECIES</u>	<u>ESTIMATED UNITS*</u>	<u>ADVERTISED PRICE</u>
Sawtimber		
Red Maple	39.0 MBF	\$ 35.00 / MBF
Sugar Maple	24.2 MBF	\$ 117.00 / MBF
Pulpwood		
European Larch	61 Cords	\$ 10.20 / Cord
Jack Pine	1 Cords	\$ 13.50 / Cord
Mixed Aspen	380 Cords	\$ 15.20 / Cord
Mixed Hardwood	438 Cords	\$ 20.70 / Cord
Red Pine	6 Cords	\$ 35.20 / Cord
White Pine	20 Cords	\$ 16.25 / Cord

* The total volume is statistically estimated within plus (+) or minus (-) 15.75 percent. There are an estimated 1,033 cords on this timber sale, plus or minus 163 cords at the 95% confidence level. The estimated units are final and not subject to adjustment. Prospective bidders are urged to examine this timber and to make their own estimates of quantity and quality.

BOND AND PAYMENT SCHEDULE:

1. A bond in the amount of \$1,011.00 to insure faithful performance of the conditions of the contract will be deposited by the successful bidder within 21 days of the sale award.
2. Cutting in any sale or unit without the required advance payment would be considered a trespass.
3. Total payment must be paid in advance or according to the following schedule :
 - (a) Ten percent (10%) of the sale value must be paid within 21 days of the sale award.
 - (b) The 10% down payment will be credited towards the first unit cut.
 - (c) Payment for each of the following units must be made before cutting begins in that unit:

PAYMENT UNIT NUMBER	PERCENT OF TOTAL SALE VALUE
01	9.5%
02	20.2%
03	14.8%
04	10.1%
05	45.4%
4. If no cutting takes place, the 10% down payment will not be refunded.
5. Operations on the contract issued will terminate on 03/31/2023.

SALE STATISTICS

SALE VOLUMES

VOLUME		STATISTICAL RANGE IN CORDS		
TOTAL CUBIC FEET	TOTAL CORDS	PERCENT ERROR	MINIMUM	MAXIMUM
81,590	1,033	15.75%	870	1,195

VDU VOLUMES

A VDU is a Volume Determination Unit. Volumes and their associated statistics are calculated at the VDU level and summarized to the sale level. There is often a one to one relationship between a VDU and a Payment Unit, but not always, depending on the cruise design. Refer to the VDU TO PAYMENT UNIT table.

VDU	VOLUME		PERCENT ERROR	RANGE IN CORDS	
	TOTAL CUBIC FEET	TOTAL CORDS		MINIMUM	MAXIMUM
5	32,927	417	26.13%	308	526
17	8,540	108	17.59%	89	127
19	6,273	79	60.85%	31	128
27	25,533	323	26.41%	238	409
421	8,311	105	64.33%	38	173
TOTAL:	81,583	1,033		703	1,362

VDU TO PAYMENT UNIT

When a VDU is associated with more than one Payment Unit (PU), the VDU volumes are assigned to the PU based on acres of the VDU within the PU.

VDU	VDU ACRES	PU	PU ACRES
5	12.8	5	12.8
17	4.8	2	4.8
19	10.8	1	10.8
27	41.8	3	24.8
		4	17.0
421	30.0	2	30.0
TOTAL:	100.2		100.2

DESCRIPTION OF TIMBER BY PAYMENT UNIT (PU)

PU	MARKET GROUP	PRODUCT	QUANTITY	UNIT	ACRES	ADVERTISE PRICE
1	Sugar Maple	Sawtimber	5.3	MBF	10.8	\$1,921.90
	Mixed Aspen	Pulpwood	23	Cords		
	<i>B. T. Aspen</i>	<i>Sawtimber</i>	9.0	<i>MBF</i>		
	<i>B. T. Aspen</i>	<i>Pulpwood</i>	5	<i>Cords</i>		
	Mixed Hardwood		46	Cords		
	<i>Beech</i>	<i>Sawtimber</i>	1.4	<i>MBF</i>		
	<i>Beech</i>	<i>Pulpwood</i>	5	<i>Cords</i>		
	<i>Ironwood</i>		7	<i>Cords</i>		
	<i>Sugar Maple</i>		31	<i>Cords</i>		
	2	Sugar Maple	Sawtimber	8.4		
European Larch		Pulpwood	61	Cords		
<i>European Larch</i>		<i>Sawtimber</i>	6.4	<i>MBF</i>		
<i>European Larch</i>		<i>Pulpwood</i>	48	<i>Cords</i>		
Jack Pine			1	Cords		
Mixed Aspen			76	Cords		
<i>B. T. Aspen</i>		<i>Sawtimber</i>	3.9	<i>MBF</i>		
<i>Quaking Aspen</i>			7.0	<i>MBF</i>		
<i>B. T. Aspen</i>		<i>Pulpwood</i>	20	<i>Cords</i>		
<i>Quaking Aspen</i>			34	<i>Cords</i>		
Mixed Hardwood			53	Cords		
<i>Beech</i>		<i>Sawtimber</i>	0.7	<i>MBF</i>		
<i>Beech</i>		<i>Pulpwood</i>	3	<i>Cords</i>		
<i>Black Cherry</i>			4	<i>Cords</i>		
<i>Sugar Maple</i>			45	<i>Cords</i>		
Red Pine			6	Cords		
<i>Red Pine</i>		<i>Sawtimber</i>	1.0	<i>MBF</i>		
<i>Red Pine</i>		<i>Pulpwood</i>	4	<i>Cords</i>		
3		Red Maple	Sawtimber	1.6	MBF	24.8
	Mixed Aspen	Pulpwood	166	Cords		
	<i>B. T. Aspen</i>	<i>Sawtimber</i>	0.6	<i>MBF</i>		
	<i>Quaking Aspen</i>		22.7	<i>MBF</i>		
	<i>B. T. Aspen</i>	<i>Pulpwood</i>	7	<i>Cords</i>		
	<i>Quaking Aspen</i>		113	<i>Cords</i>		
	Mixed Hardwood		10	Cords		
	<i>Black Cherry</i>		4	<i>Cords</i>		
	<i>Red Maple</i>		6	<i>Cords</i>		
	White Pine		12	Cords		
	<i>White Pine</i>	<i>Sawtimber</i>	2.7	<i>MBF</i>		
<i>White Pine</i>	<i>Pulpwood</i>	7	<i>Cords</i>			
4	Red Maple	Sawtimber	1.1	MBF	17.0	\$2,040.70
	Mixed Aspen	Pulpwood	115	Cords		
	<i>B. T. Aspen</i>	<i>Sawtimber</i>	0.4	<i>MBF</i>		
	<i>Quaking Aspen</i>		15.5	<i>MBF</i>		
	<i>B. T. Aspen</i>	<i>Pulpwood</i>	5	<i>Cords</i>		
	<i>Quaking Aspen</i>		78	<i>Cords</i>		
	Mixed Hardwood		6	Cords		
	<i>Black Cherry</i>		2	<i>Cords</i>		
	<i>Red Maple</i>		4	<i>Cords</i>		
	White Pine		8	Cords		
	<i>White Pine</i>	<i>Sawtimber</i>	1.9	<i>MBF</i>		
<i>White Pine</i>	<i>Pulpwood</i>	4	<i>Cords</i>			
5	Red Maple	Sawtimber	36.3	MBF	12.8	\$9,185.10
	Sugar Maple		10.5	MBF		
	Mixed Hardwood	Pulpwood	323	Cords		
	<i>Beech</i>	<i>Sawtimber</i>	27.2	<i>MBF</i>		
	<i>Beech</i>	<i>Pulpwood</i>	68	<i>Cords</i>		

DESCRIPTION OF TIMBER BY PAYMENT UNIT (PU), CON'T

PU	MARKET GROUP	PRODUCT	QUANTITY	UNIT	ACRES	ADVERTISE PRICE
5 con't	<i>Red Maple</i>	<i>Pulpwood</i>	110	<i>Cords</i>		
	<i>Sugar Maple</i>		91	<i>Cords</i>		
TOTAL:			63.2	MBF		
TOTAL:			906	Cords		

Sale Specific Conditions & Requirements

Sale Name: Abandoned Circus Mixed HW's

Sale Number: 72-012-20 Seq#: 2

1 - Sale Area

1.2 - Boundaries

1.2.1 - Painted boundaries (9/19)

The sale boundary and Payment Unit boundaries are marked and identified by blue, red, and yellow paint, or unmarked and identified by existing roads. Exterior sale boundary lines against private property are marked with blue paint. Exterior sale boundary lines against state are marked with red paint, with the exception of the north boundary of Payment Unit 1 and the west boundary of Payment Unit 5, which are unpainted and identified by the unnamed forest road and Roberts Road, respectively. Interior Payment Unit boundaries are marked with yellow paint, with the exception of the boundary between Payment Units 3 and 4, which is unpainted and identified by the unnamed forest road. Retention patches are marked with red paint; no harvesting activities may occur within these areas. The painted boundary line trees are not Included Timber and are to be protected. Yellow painted trees designating an interior Payment Unit boundary are only to be cut when all surrounding Payment Units have been paid.

2 - Timber Specifications

2.1 - Included Timber

2.1.1 - Clearcut unit(s) with unmerchantable trees (6/14)

Within Payment Unit(s) 2-5, cut all trees that are two (2) inches or more at DBH.

2.1.3 - Cut tree marked unit(s) (12/08)

Within Payment Unit(s) 1, all trees are designated for cutting when marked with orange paint above and below stump height, regardless of merchantability.

2.2 - Utilization

2.2.2 - Chipping required (2/18)

Payment Unit 2 must be chip harvested to facilitate subsequent planting operations. The Purchaser has the option to produce sawlogs or pulpwood bolts, but the remaining portion of the trees must be chipped and hauled. If market conditions limit the practicality of chipping, tops and slash must be arranged in a way that will not inhibit future planting operations, as directed by the sale administrator. A chipping exemption can be obtained if proposed operations are determined to be suitable for planting by reforestation staff. The requirement to retain approximately 1/6 to 1/3 of tree tops and limbs less than four inches in diameter is still applicable (G. C. & R. 2.2).

2.2.3 - Stump heights (4/07)

Stump heights within Payment Unit 2 shall not exceed 6 inches for all trees. This is in order to facilitate planting operations.

3 - Payments

3.4 - Damaged Timber

3.4.1 - Damaged timber (7/16)

General Condition and Requirement 3.4 Damaged Timber, defines liquidated damages for undesignated live merchantable trees which are cut or injured. Within Payment Unit 1, if more than 5% of trees (> 4.5" DBH) within a specified area of the sale are damaged, liquidated damages will be assessed for all trees damaged. Rates will be in accordance with General Condition and Requirement 3.4 Damaged Timber.

4 - Transportation

4.1 - Construction

4.1.6 - Road construction (1/09)

Construction of new roads or improvements of existing roads shall be done in such a way as to minimize the environmental and visual impacts. Merchantable trees shall be cut and utilized unless otherwise directed. Non-merchantable trees shall be severed and laid flat on the ground. Slash shall be scattered, and not left in windrows and kept a minimum of 10 feet back

from the road edge. Stumps shall be set upright, not left on edge, and be moved at least 10 feet away from the road edge. Disturbed soil shall be feathered into the woods and not left in berms or windrows.

4.1.7 - Road closure (10/11)

All new roads built into the sale must be blocked to vehicle traffic upon completion of the sale. Overgrown roads that are reopened shall be considered new roads. In general, this will require constructing a four (4') foot high berm of stumps and logs covered with earth. Stumps and brush must be placed along the remainder of the trail. These roads must be rendered impassable to cars and trucks. All stumps from road building and landing construction must be reserved to block any newly constructed roads upon completion of the sale. These stumps must be scattered along the road system to prohibit vehicular movement. Contact the sale administrator for specific details of design and placement.

4.1.11 - Permits (2/12)

The Purchaser will secure any necessary road permits that may be required.

4.4 - Access

4.4.1 - Private property access (3/11)

Permission for access across private land is the responsibility of the Purchaser.

5 - Operations

5.1 - Notification

5.1.3 - Well heads and natural gas pipelines (11/15)

The Purchaser is responsible for contacting the gas company prior to operating equipment in the vicinity of well heads or natural gas pipelines. Contact Linn Operating Inc at (231)922-7302.

5.2 - Conduct of Operations

5.2.2 - Hazard Trees/Snags

5.2.2.1 - Den trees (10/16)

Obvious hollow and/or den trees shall be protected and left standing unless they are a safety hazard.

5.2.3 - Operating Restrictions

5.2.3.3 - Bark slippage restriction (3/09)

Within Payment Unit(s) 1, unless changed by written agreement, cutting and skidding are not permitted during the period of April 15 to July 15. This restriction is because of bark slippage.

5.2.4 - Dead and Down Creation

5.2.4.4 - Dead and down creation, grouse (6/18)

To encourage grouse and other wildlife, in Payment Unit(s) 3 and 4, leave one, 12" or larger diameter (or largest diameter trees within stand) whole tree on the ground for every 2 acres, preferably a hardwood species such as oak or maple or if no hardwoods are present, a pine species (white or red). These trees will be evenly scattered throughout the unit, preferably at least two chains from any roads, two-tracks, or trails open to vehicles.

5.2.29 - Shrub protection (1/20)

Reasonable care should be taken to avoid cutting or damaging hawthorn or juneberry. These woody-shrub plants are highly beneficial to various wildlife species.

5.2.31 - Landing locations (9/13)

The landing area for Payment Unit 1 has been painted in and is marked on the Timber Sale Map with the letter "L". The landing must be confined to this designated site unless otherwise authorized by the Unit Manager or his/her representative.

5.2.32 - Decking/landing restoration (9/13)

All decking and landing areas must have the surface area restored to a condition equal to or better than before. This is to ensure the proper regeneration of the stand. Wood debris, chips and "cookies" from trimmings must be removed or scattered away from landing and loading areas and may not be windrowed on the edge.

5.2.37 - No decking areas (12/08)

No decking is allowed within 50 feet of injection sites without permission of the pipeline company.

5.2.38 - No decking against live trees (2/04)

Cut products may not be decked against unmarked or designated leave trees.

5.4 - Soil Protection

5.4.1 - Rutting restriction, general (7/16)

Operations are to cease immediately if equipment and weather conditions result in rutting of roads and/or skid trails which is 12 inches or greater in depth and 50 feet in length. The Unit Manager or his/her representative may restrict hauling and/or skidding if ruts exceed the specified depth. With the Unit Manager or his/her representative's approval, the Purchaser may return to the area when the risk of rutting has decreased.

6 - Safety and Fire Prevention

6.2 - Signing

6.2.1 - Road posting (9/09)

The Purchaser is responsible for posting and maintaining caution signs on haul routes prior to beginning operations. The road must be posted at appropriate distances from the sale area to warn of logging activity and truck traffic. Signs must be removed when harvest operations are suspended or completed. The Purchaser will provide these signs.



TIMBER SALE MAP

This information provided by authority of Part 525, 1994 PA 451, as amended.

Forest Management Unit Grayling	County Crawford	Mapped By Scott McClarren	Date 09/17/2020	Page 1	of 1
Township 28N	Range 03W	Section(s) and Subdivision(s) Sec. 8, S1/2NW, SENE, N1/2SE, SWSE Sec. 9, NENW, SWNW, N1/2NE, SENE	Scale 1:15,840		

Cover Type				Density	
A = Aspen	H = Hemlock	N = Marsh	U = Upland Brush	0 = Non Stocked	5 = Pole Timber Medium
B = Paper Birch	J = Jack Pine	O = Oak	UM = Upland Mixed	1 = Seedling Sapling Poor	6 = Pole Timber Well
C = Cedar	L = Lowland Brush	P = Lowland Poplar	V = Bog or Marsh	2 = Seedling Sapling Medium	7 = Saw Timber Poor
D = Treed Bog	LM = Lowland Mixed	Q = Mixed Swamp Conifer	W = White Pine	3 = Seedling Sapling Well	8 = Saw Timber Medium
E = Swamp Hdwoods	M = Mpl, Bch, Brch	R = Red Pine	X = Non Stocked	4 = Pole Timber Poor	9 = Saw Timber Well
F = Spruce Fir	MC = Mixed Conifer	S = Black Spruce	Z = Water		
G = Grass	MD = Mixed Deciduous	T = Tamarack			

PU	Acres	PU	Acres
1	10.8	4	17
2	34.8	5	12.8
3	24.8		

Abandoned Circus Mixed HW's

Compartment 214

100.2 Acres

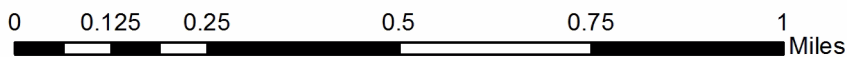
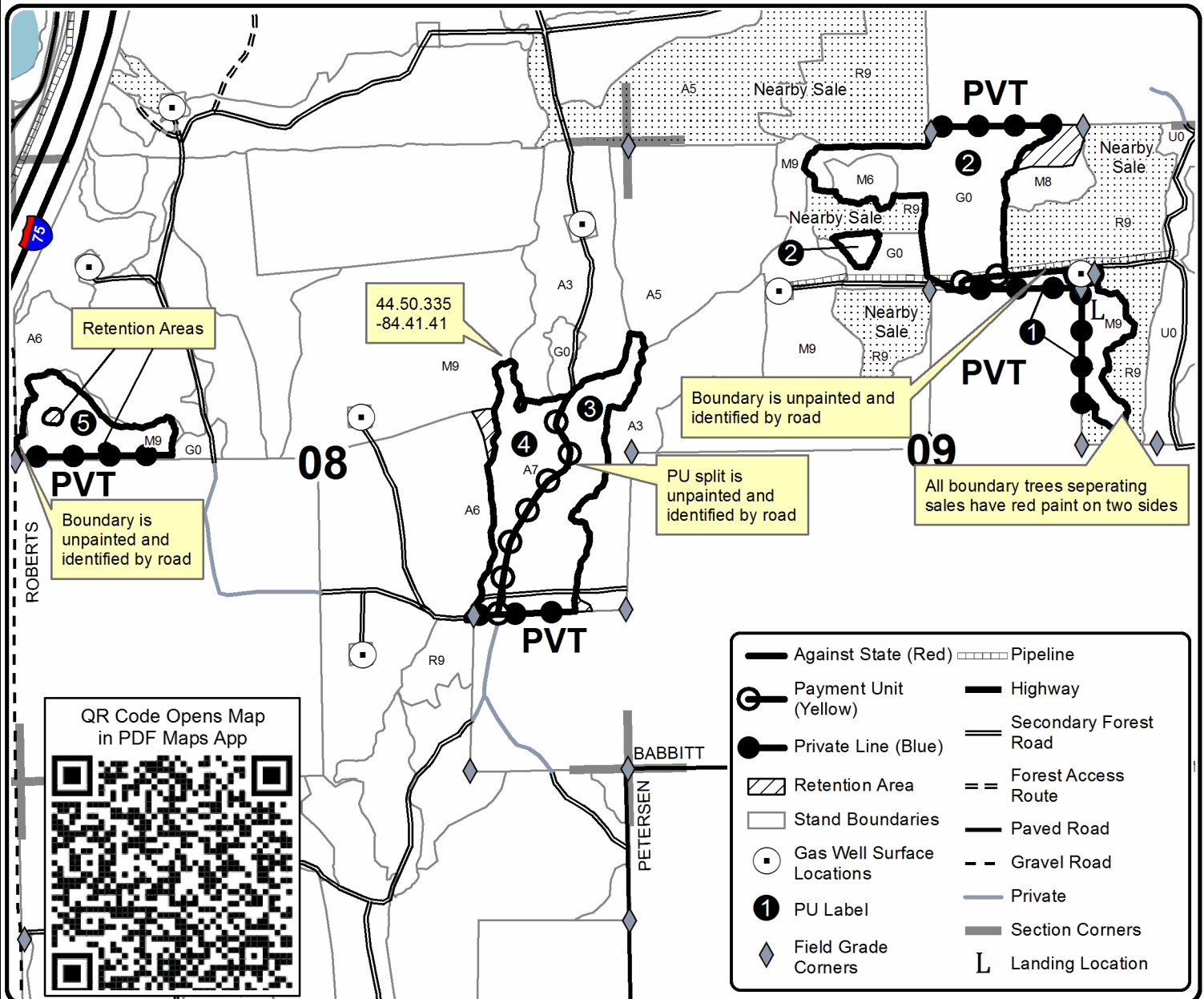

TIMBER SALE INFORMATION

First Time Red Pine (72-013-20)
 T28N, R03W, SEC. 17; T28N, R03W, SEC. 9.
 Crawford County (Advertised Price \$32,457.00)

SALE NOTE: Payment Units 1 and 2 are adjacent to a nearby sale where both sides of the boundary trees are marked with red paint where the sales touch.

Sherman Rd is weight restricted if hauling out the road to the south. You can get to the non-restricted portion of Sherman Rd if hauling north through the private drive. Permission must be granted from the private landowner to haul out their drive.

Gas pipelines and well heads are within the sale vicinity. Contact Linn Operating at 231-922-7302 prior to operations.

Access may be through private land.

A timber sale contract for this lump sum, sealed bid timber sale will be awarded to the responsible bidder offering the highest sealed bid price. All units of volume listed below were estimated using the T-Sale computer program and our traditional volume equations. Bids must be at or above the following advertised price for each product and species:

<u>PRODUCTS & SPECIES</u>	<u>ESTIMATED UNITS*</u>	<u>ADVERTISED PRICE</u>
Sawtimber		
Red Pine	132.3 MBF	\$ 84.00 / MBF
Sugar Maple	2.5 MBF	\$ 117.00 / MBF
Pulpwood		
Mixed Hardwood	15 Cords	\$ 20.70 / Cord
Quaking Aspen	26 Cords	\$ 15.20 / Cord
Red Pine	578 Cords	\$ 35.20 / Cord

* The total volume is statistically estimated within plus (+) or minus (-) 10.22 percent. There are an estimated 889 cords on this timber sale, plus or minus 91 cords at the 95% confidence level. The estimated units are final and not subject to adjustment. Prospective bidders are urged to examine this timber and to make their own estimates of quantity and quality.

BOND AND PAYMENT SCHEDULE:

1. A bond in the amount of \$1,623.00 to insure faithful performance of the conditions of the contract will be deposited by the successful bidder within 21 days of the sale award.
2. Cutting in any sale or unit without the required advance payment would be considered a trespass.
3. Total payment must be paid in advance or according to the following schedule :
 - (a) Ten percent (10%) of the sale value must be paid within 21 days of the sale award.
 - (b) The 10% down payment will be credited towards the first unit cut.
 - (c) Payment for each of the following units must be made before cutting begins in that unit:

PAYMENT UNIT NUMBER	PERCENT OF TOTAL SALE VALUE
01	57.0%
02	11.1%
03	16.4%
04	14.5%
05	0.5%
06	0.5%

4. If no cutting takes place, the 10% down payment will not be refunded.
5. Operations on the contract issued will terminate on 03/31/2023.

SALE STATISTICS

SALE VOLUMES

VOLUME		STATISTICAL RANGE IN CORDS		
TOTAL CUBIC FEET	TOTAL CORDS	PERCENT ERROR	MINIMUM	MAXIMUM
70,192	889	10.22%	798	979

VDU VOLUMES

A VDU is a Volume Determination Unit. Volumes and their associated statistics are calculated at the VDU level and summarized to the sale level. There is often a one to one relationship between a VDU and a Payment Unit, but not always, depending on the cruise design. Refer to the VDU TO PAYMENT UNIT table.

VDU	VOLUME		PERCENT ERROR	RANGE IN CORDS	
	TOTAL CUBIC FEET	TOTAL CORDS		MINIMUM	MAXIMUM
18	7,726	98	18.54%	80	116
20	12,048	153	24.60%	115	190
22	39,397	499	12.41%	437	561
56	11,044	140	37.88%	87	193
TOTAL:	70,215	889		718	1,059

VDU TO PAYMENT UNIT

When a VDU is associated with more than one Payment Unit (PU), the VDU volumes are assigned to the PU based on acres of the VDU within the PU.

VDU	VDU ACRES	PU	PU ACRES
18	7.4	2	7.4
20	10.6	3	10.6
22	40.6	1	40.6
56	8.5	4	7.9
		5	0.3
		6	0.3
TOTAL:	67.1		67.1

DESCRIPTION OF TIMBER BY PAYMENT UNIT (PU)

PU	MARKET GROUP	PRODUCT	QUANTITY	UNIT	ACRES	ADVERTISE PRICE
1	Red Pine	Sawtimber	89.6	MBF	40.6	\$18,483.20
	Sugar Maple		0.5	MBF		
	Mixed Hardwood	Pulpwood	9	Cords		
	<i>Black Cherry</i>		1	Cords		
	<i>Ironwood</i>		1	Cords		
	<i>Red Maple</i>		6	Cords		
	<i>Sugar Maple</i>		1	Cords		
	Quaking Aspen		10	Cords		
	<i>Quaking Aspen</i>	Sawtimber	1.0	MBF		
	<i>Quaking Aspen</i>	Pulpwood	8	Cords		
Red Pine		300	Cords			
2	Red Pine	Sawtimber	13.5	MBF	7.4	\$3,590.20
	Sugar Maple		0.7	MBF		
	Mixed Hardwood	Pulpwood	1	Cords		
	<i>Sugar Maple</i>		1	Cords		
	Quaking Aspen		2	Cords		
	<i>Quaking Aspen</i>	Sawtimber	0.7	MBF		
	<i>Quaking Aspen</i>	Pulpwood	1	Cords		
	Red Pine		66	Cords		
3	Red Pine	Sawtimber	18.5	MBF	10.6	\$5,331.20
	Sugar Maple		1.3	MBF		
	Mixed Hardwood	Pulpwood	5	Cords		
	<i>Ironwood</i>		1	Cords		
	<i>Sugar Maple</i>		4	Cords		
	Quaking Aspen		14	Cords		
	<i>Quaking Aspen</i>	Sawtimber	0.9	MBF		
	<i>Quaking Aspen</i>	Pulpwood	12	Cords		
	Red Pine		94	Cords		
4	Red Pine	Sawtimber	9.9	MBF	7.9	\$4,703.60
	Red Pine	Pulpwood	110	Cords		
5	Red Pine	Sawtimber	0.4	MBF	0.3	\$174.40
	Red Pine	Pulpwood	4	Cords		
6	Red Pine	Sawtimber	0.4	MBF	0.3	\$174.40
	Red Pine	Pulpwood	4	Cords		
TOTAL:			134.8	MBF		
TOTAL:			619	Cords		

Sale Specific Conditions & Requirements

Sale Name: First Time Red Pine

Sale Number: 72-013-20 Seq#: 2

1 - Sale Area

1.2 - Boundaries

1.2.1 - Painted boundaries (9/19)

The sale boundary and Payment Unit boundaries are marked and identified by blue, red, and yellow paint, along with roads. Exterior sale boundary lines against private property are marked with blue paint. Exterior sale boundary lines against state are marked with red paint, with the exception of a portion of the boundary of Payment Unit 1 and the east side of Payment Unit 4, which are unpainted and identified by the unnamed forest roads. Interior Payment Unit boundaries are marked with yellow paint. The painted boundary line trees are not Included Timber and are to be protected unless marked with orange paint.

2 - Timber Specifications

2.1 - Included Timber

2.1.3 - Cut tree marked unit(s) (12/08)

Within Payment Unit(s) 4, 5, & 6, all trees are designated for cutting when marked with orange paint above and below stump height, regardless of merchantability.

2.1.8 - Designated plantation row unit(s) (12/08)

Within Payment Unit(s) 1, 2, & 3, all trees which meet minimum piece specifications in 2.2 Utilization, within designated plantation rows are designated for cutting. Designated plantation rows begin with the third row in from the outside of the plantation, then continue every third row. Within Payment Units 1 and 3, start in the 3rd row from the east. Within Payment Unit 2, start in the 3rd row from the south.

3 - Payments

3.3 - Pre-measured Sales

3.3.4 - Dividing payment units (7/14)

Payment Unit(s) may be divided at the request of the Purchaser and upon approval of the Unit Manager. Dividing Payment Units is a contract modification which requires a Timber Sale Contract Amendment.

3.4 - Damaged Timber

3.4.1 - Damaged timber (7/16)

General Condition and Requirement 3.4 Damaged Timber, defines liquidated damages for undesignated live merchantable trees which are cut or injured.

Within the sale area, if more than 5% of trees (> 4.5" DBH) within a specified area of the sale are damaged, liquidated damages will be assessed for all trees damaged. Rates will be in accordance with General Condition and Requirement 3.4 Damaged Timber.

4 - Transportation

4.1 - Construction

4.1.6 - Road construction (1/09)

Construction of new roads or improvements of existing roads shall be done in such a way as to minimize the environmental and visual impacts. Merchantable trees shall be cut and utilized unless otherwise directed. Non-merchantable trees shall be severed and laid flat on the ground. Slash shall be scattered, and not left in windrows and kept a minimum of 10 feet back from the road edge. Stumps shall be set upright, not left on edge, and be moved at least 10 feet away from the road edge. Disturbed soil shall be feathered into the woods and not left in berms or windrows.

4.1.7 - Road closure (10/11)

All new roads built into the sale must be blocked to vehicle traffic upon completion of the sale. Overgrown roads that are reopened shall be considered new roads. In general, this will require constructing a four (4') foot high berm of stumps and

logs covered with earth. Stumps and brush must be placed along the remainder of the trail. These roads must be rendered impassable to cars and trucks. All stumps from road building and landing construction must be reserved to block any newly constructed roads upon completion of the sale. These stumps must be scattered along the road system to prohibit vehicular movement. Contact the sale administrator for specific details of design and placement.

4.1.11 - Permits (2/12)

The Purchaser will secure any necessary road permits that may be required.

4.4 - Access

4.4.1 - Private property access (3/11)

Permission for access across private land is the responsibility of the Purchaser.

5 - Operations

5.1 - Notification

5.1.3 - Well heads and natural gas pipelines (11/15)

The Purchaser is responsible for contacting the gas company prior to operating equipment in the vicinity of well heads or natural gas pipelines. Contact Linn Operating Inc at (231) 922-7302.

5.2 - Conduct of Operations

5.2.3 - Operating Restrictions

5.2.3.3 - Bark slippage restriction (3/09)

Within Payment Unit(s) 1-4, unless changed by written agreement, cutting and skidding are not permitted during the period of April 15 to July 15. This restriction is because of bark slippage.

5.2.3.6 - Bark beetle restriction (12/08)

In the event drought creates a high risk of pine bark beetle infestation, pine is not to be cut during the period March 1 through July 1, unless all portions of trees greater than two inches in diameter are removed from the sale area, reduced to chips, or treated to the satisfaction of the Unit Manager or his/her representative, within fifteen days of being severed from the stump. Pine log decks, pulpwood piles and treetops that are piled for chipping in the fall or winter within a 1/4 mile of susceptible sites must be removed before March 15. Residual slash must not be placed in piles or rows and must be spread over the site for quick drying. The Department of Natural Resources will exercise this specification if the risk of damage warrants.

5.2.32 - Decking/landing restoration (9/13)

All decking and landing areas must have the surface area restored to a condition equal to or better than before. This is to ensure the proper regeneration of the stand. Wood debris, chips and "cookies" from trimmings must be removed or scattered away from landing and loading areas and may not be windrowed on the edge.

5.2.37 - No decking areas (12/08)

No decking is allowed within 50 feet of injection sites without permission of the pipeline company.

5.2.38 - No decking against live trees (2/04)

Cut products may not be decked against unmarked or designated leave trees.

5.4 - Soil Protection

5.4.1 - Rutting restriction, general (7/16)

Operations are to cease immediately if equipment and weather conditions result in rutting of roads and/or skid trails which is 12 inches or greater in depth and 50 feet in length. The Unit Manager or his/her representative may restrict hauling and/or skidding if ruts exceed the specified depth. With the Unit Manager or his/her representative's approval, the Purchaser may return to the area when the risk of rutting has decreased.

5.8 - Protection of Endangered Species

5.8.3 - Red shoulder hawk or goshawk (2/16)

In the event that an active red shoulder hawk or goshawk nest is found, the contract may be amended to protect the nest site until the nest is determined to be inactive. The value of the trees in this excluded area will be refunded or credited to the

Purchaser. The nest will be buffered with a five-chain radius (eight acre) protection area, centered on the nest tree, in which there will be no cutting or new roads constructed. Avoid human disturbance, including loading and skidding, in the protection area.

An additional zone of five chains (ten chains centered on the active nest tree) will be established in which there is no management activity from March 15 to July 15. Limit biomass harvesting and chipping operations within this ten-chain zone, retain the maximum one-third of residues per the Woody Biomass Harvesting Guidelines (Michigan DNR 2010). Nests determined to be inactive will be protected with a one-chain no-harvest buffer.

6 - Safety and Fire Prevention

6.2 - Signing

6.2.1 - Road posting (9/09)

The Purchaser is responsible for posting and maintaining caution signs on haul routes prior to beginning operations. The road must be posted at appropriate distances from the sale area to warn of logging activity and truck traffic. Signs must be removed when harvest operations are suspended or completed. The Purchaser will provide these signs.



TIMBER SALE MAP

This information provided by authority of Part 525, 1994 PA 451, as amended.

Forest Management Unit Grayling		County Crawford	Mapped By Scott McClarren	Date 09/17/2020	Page 1	of 2
Township 28N	Range 03W	Section(s) and Subdivision(s) Sec. 9, E1/2NW, N1/2NE, SENE Sec.17, SWSE	Cruised By Scott McClarren	Scale 1:7,920		

Cover Type				Density	
A = Aspen	H = Hemlock	N = Marsh	U = Upland Brush	0 = Non Stocked	5 = Pole Timber Medium
B = Paper Birch	J = Jack Pine	O = Oak	UM = Upland Mixed	1 = Seedling Sapling Poor	6 = Pole Timber Well
C = Cedar	L = Lowland Brush	P = Lowland Poplar	V = Bog or Marsh	2 = Seedling Sapling Medium	7 = Saw Timber Poor
D = Treed Bog	LM = Lowland Mixed	Q = Mixed Swamp Conifer	W = White Pine	3 = Seedling Sapling Well	8 = Saw Timber Medium
E = Swamp Hdwoods	M = Mpl. Bch, Brch	R = Red Pine	X = Non Stocked	4 = Pole Timber Poor	9 = Saw Timber Well
F = Spruce Fir	MC = Mixed Conifer	S = Black Spruce	Z = Water		
G = Grass	MD = Mixed Deciduous	T = Tamarack			

PU	Acres	PU	Acres
1	40.6	4	7.9
2	7.4	5	0.3
3	10.6	6	0.3

First Time Red Pine Compartment 214 67.1 Acres

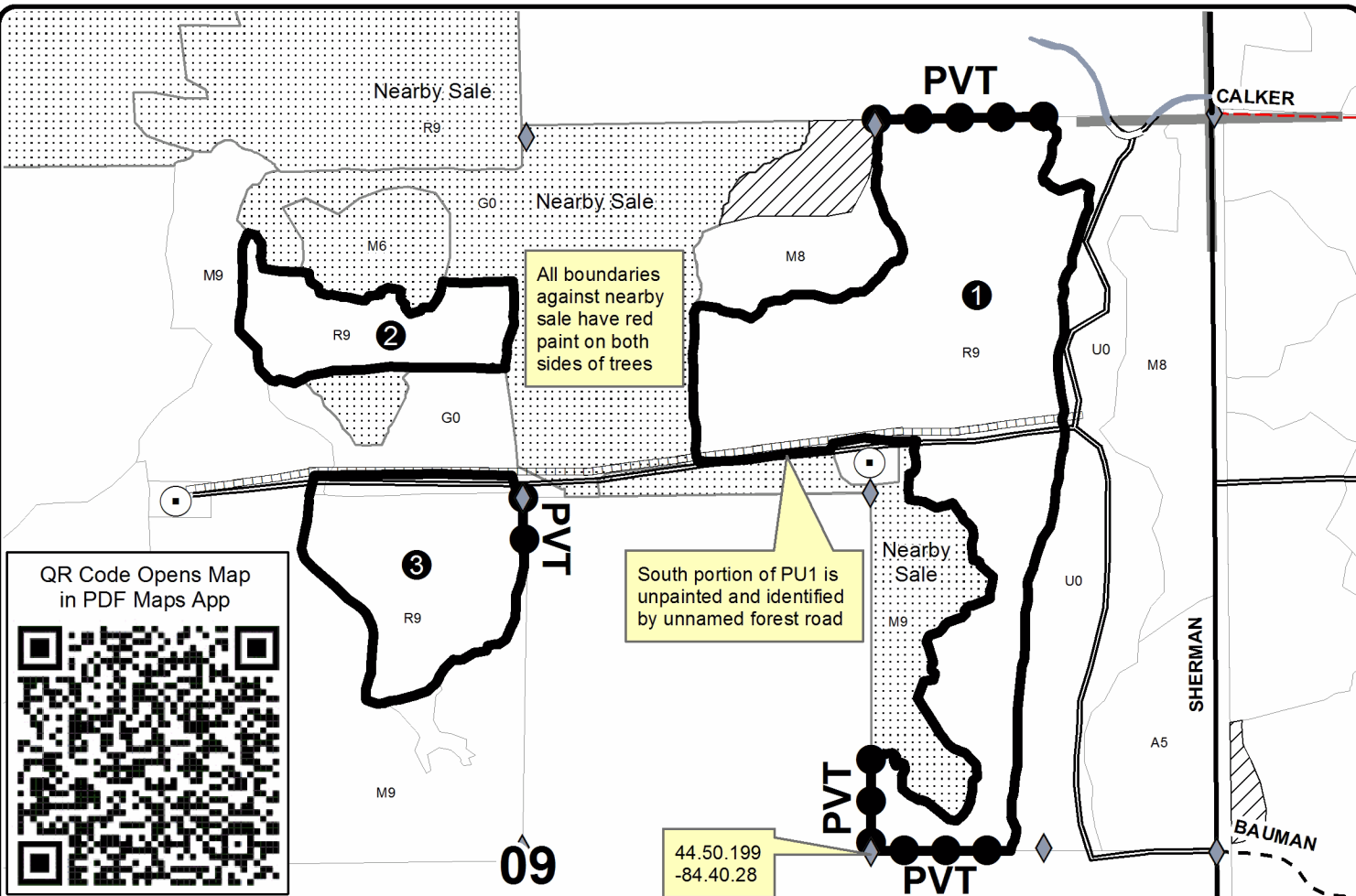
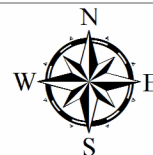

QR Code Opens Map in PDF Maps App

Against State (Red)	Secondary Forest Road	Pipeline
Private Line (Blue)	Paved Road	Section Corners
Retention Area for Nearby Sale (Red)	Gravel Road	Field Grade Corners
Stand Boundaries	County Road - Seasonal	Gas Well Surface Locations
Nearby Sales	Private	PU Label





TIMBER SALE MAP

This information provided by authority of Part 525, 1994 PA 451, as amended.

Sale Number	Year
72 - 013	20

Forest Management Unit	County	Mapped By	Date	Page	of
Grayling	Crawford	Scott McClarren	09/17/2020	2	2
Township	Range	Section(s) and Subdivision(s)	Scale		
28N	03W	Sec. 9, E1/2NW, N1/2NE, SENE Sec.17, SWSE	1:7,920		

Cover Type				Density	
A = Aspen	H = Hemlock	N = Marsh	U = Upland Brush	0 = Non Stocked	5 = Pole Timber Medium
B = Paper Birch	J = Jack Pine	O = Oak	UM = Upland Mixed	1 = Seedling Sapling Poor	6 = Pole Timber Well
C = Cedar	L = Lowland Brush	P = Lowland Poplar	V = Bog or Marsh	2 = Seedling Sapling Medium	7 = Saw Timber Poor
D = Treed Bog	LM = Lowland Mixed	Q = Mixed Swamp Conifer	W = White Pine	3 = Seedling Sapling Well	8 = Saw Timber Medium
E = Swamp Hdwoods	M = Mpl, Bch, Brch	R = Red Pine	X = Non Stocked	4 = Pole Timber Poor	9 = Saw Timber Well
F = Spruce Fir	MC = Mixed Conifer	S = Black Spruce	Z = Water		
G = Grass	MD = Mixed Deciduous	T = Tamarack			

PU	Acres	PU	Acres
1	40.6	4	7.9
2	7.4	5	0.3
3	10.6	6	0.3

First Time Red Pine

Compartment 214

67.1 Acres

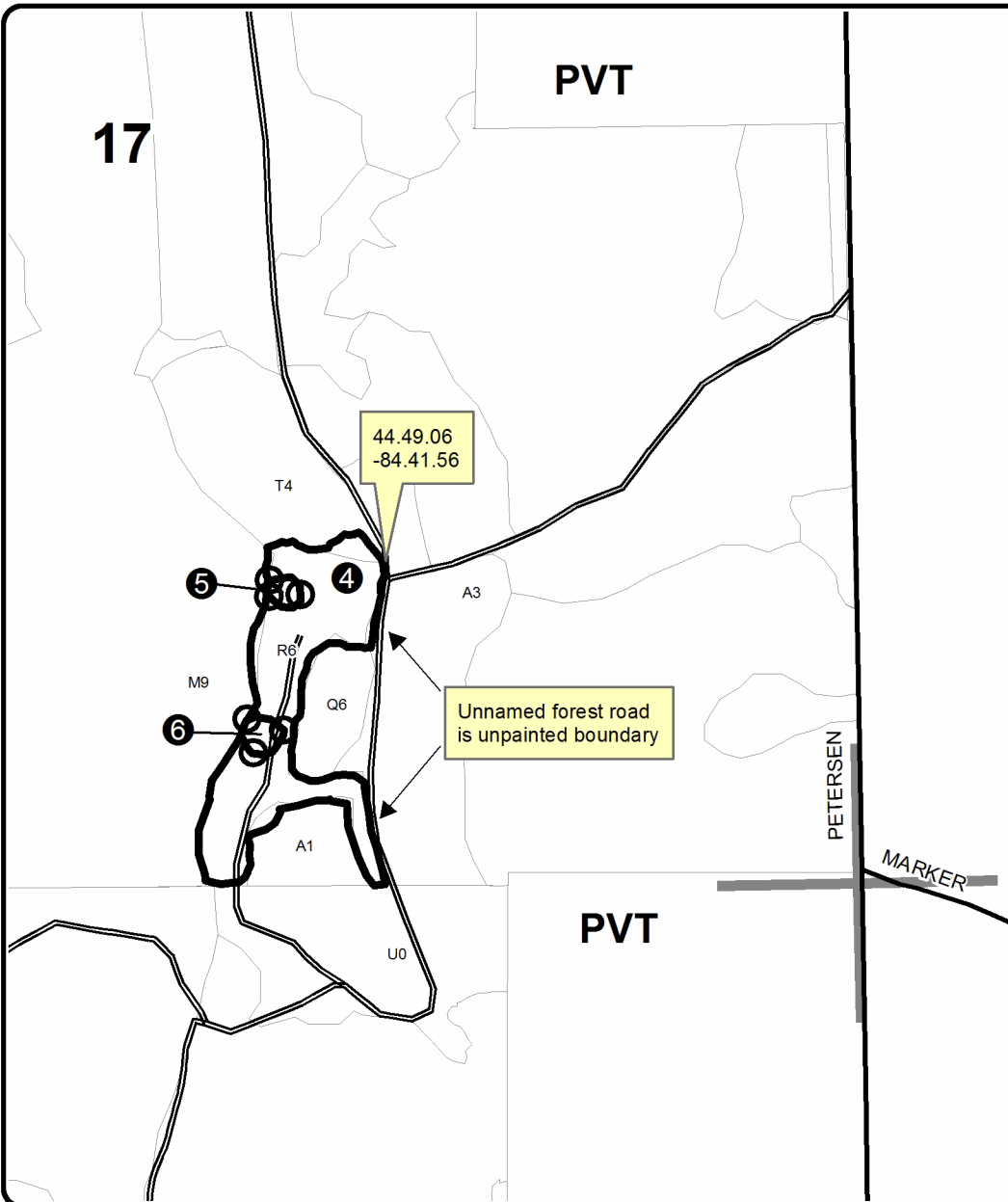

Legend

- Against State (Red)
- ⊙ Payment Unit (Yellow)
- == Secondary Forest Road
- Paved Road
- Stand Boundaries
- Section Corners
- ① PU_Label

Surveyor's Stone Mix (72-010-20)
T27N, R01E, SEC. 25; Oscoda COUNTY

In response to the notice of sale to be held 9:00 a.m. (local time) on January 8, 2021, I am hereby submitting my sealed bid (firm offer) for the following forest products to be cut. Bids for individual species must be at or above the advertised price. All non-responsive bid forms may be rejected.

<u>PRODUCTS & SPECIES</u>	<u>ESTIMATED VOLUME*</u>	<u>ADVERTISED PRICE</u>	<u>BID PRICE/UNIT</u>
Sawtimber			
Red Oak	19.8 MBF	\$ 108.00/MBF	\$ _____
Red Pine	184.7 MBF	\$ 84.00/MBF	\$ _____
White Pine	148.0 MBF	\$ 33.00/MBF	\$ _____
Pulpwood			
Balsam Fir	39 Cords	\$ 13.10/Cord	\$ _____
Jack Pine	77 Cords	\$ 13.50/Cord	\$ _____
Mixed Aspen	434 Cords	\$ 15.20/Cord	\$ _____
Mixed Hardwood	131 Cords	\$ 20.70/Cord	\$ _____
Mixed Oak	24 Cords	\$ 17.50/Cord	\$ _____
Red Pine	220 Cords	\$ 35.20/Cord	\$ _____
White Pine	270 Cords	\$ 16.25/Cord	\$ _____

*The volumes are statistically estimated within plus (+) or minus (-) 14.08 percent at 95% confidence level. These estimated volumes are final and not subject to adjustment. Prospective bidders are urged to examine this timber and to make their own estimates of quantity and quality.

I understand that any or all bids may be rejected. All bids must be signed and all bid items must be bid or the bid form may be rejected. I also understand that consideration and awarding a contract will be based upon my past performance and ability to complete the contract based upon equipment and staffing subject to my control.

FEDERAL ID: _____ or SOCIAL SECURITY NUMBER: _____

Company or individual bidding: _____

Company representative's name: _____

Address: _____

City: _____ State: _____ Zip: _____

IF AVAILABLE, PLEASE PLACE THE PERSONALIZED LABEL FROM YOUR PROSPECTUS IN THE ABOVE BOX.

Individual or company representative's signature: _____ Date: _____

Phone number : _____ Email (optional): _____

THE WINNING BIDDER MUST COMPLETE THE VERIFICATION OF WORKER'S DISABILITY COMPENSATION ACT COMPLIANCE (ON REVERSE SIDE IF DOUBLE SIDED) WITHIN 21 DAYS OF SALE AWARD DATE



FOR DEPARTMENT USE ONLY	
Sale Number (XX - XXX - XX - XX)	
Forest Management Unit:	

TIMBER SALE VERIFICATION OF WORKER'S DISABILITY COMPENSATION ACT COMPLIANCE

As required by Act 317, P.A. 1969 (Worker's Compensation) and
Part 5 of Act 451 of 1994, as amended.

VERIFICATION OF WORKER'S DISABILITY COMPENSATION ACT COMPLIANCE

- This verification must be completed and submitted within 21 days of contract award and prior to the issuance of the timber sale contract.
- In addition, if boxes 2B or 2C are checked, then Notice of Exclusion or Certificate of Insurance must be submitted within twenty-one (21) days of the contract award and prior to the issuance of the timber sale contract.
- All information must be typed or printed except for written signatures.

Please Check Appropriate Categories:

1. My business is organized as (you **must** check one of the boxes below):
 - A. Sole Proprietorship (individual)
 - B. Partnership
 - C. Corporation
2. You **must** check one of the boxes below:
 - A. I certify my business is a sole proprietorship and it has no employees but the sole proprietor. I am not subject to the Worker's Compensation Laws.
 - B. I certify my business has satisfied its obligation to the Worker's Compensation Act through the use of an approved Notice of Exclusion (BWC-337, Rev. 5/96). I will provide a copy of the Notice of Exclusion within 21 days of the contract award. (For questions or a copy of the BWC-337, please call the Worker's Compensation Bureau at 517-322-1195).
 - C. I certify my business has a Worker's Compensation Policy. I will provide an original Certificate of Insurance within twenty-one (21) days of the contract award.
3. If you have checked item 2(A) or 2(B), you **must** indicate the number of **both** full-time and part-time employees, other than yourself, including family members and active partners (if none, you must enter "0").

_____ Full-time Employees

_____ Part-time Employees

Name of Business		Federal ID (or) Social Security No.	
Address		Telephone ()	
City	State	ZIP	

I hereby certify that the above information is true and correct. I agree to notify the Michigan DNR of any changes that occur in factors affecting my coverage during any of my present and future operations.

Signature of Owner or Authorized Representative

Title

Date

Please complete the "SEALED BID" information on the next page

Abandoned Circus Mixed HW's (72-012-20)
T28N, R03W, SEC. 8; T28N, R03W, SEC. 9; Crawford COUNTY

In response to the notice of sale to be held 9:00 a.m. (local time) on January 8, 2021, I am hereby submitting my sealed bid (firm offer) for the following forest products to be cut. Bids for individual species must be at or above the advertised price. All non-responsive bid forms may be rejected.

<u>PRODUCTS & SPECIES</u>	<u>ESTIMATED VOLUME*</u>	<u>ADVERTISED PRICE</u>	<u>BID PRICE/UNIT</u>
Sawtimber			
Red Maple	39.0 MBF	\$ 35.00/MBF	\$ _____
Sugar Maple	24.2 MBF	\$ 117.00/MBF	\$ _____
Pulpwood			
European Larch	61 Cords	\$ 10.20/Cord	\$ _____
Jack Pine	1 Cords	\$ 13.50/Cord	\$ _____
Mixed Aspen	380 Cords	\$ 15.20/Cord	\$ _____
Mixed Hardwood	438 Cords	\$ 20.70/Cord	\$ _____
Red Pine	6 Cords	\$ 35.20/Cord	\$ _____
White Pine	20 Cords	\$ 16.25/Cord	\$ _____

*The volumes are statistically estimated within plus (+) or minus (-) 15.75 percent at 95% confidence level. These estimated volumes are final and not subject to adjustment. Prospective bidders are urged to examine this timber and to make their own estimates of quantity and quality.

I understand that any or all bids may be rejected. All bids must be signed and all bid items must be bid or the bid form may be rejected. I also understand that consideration and awarding a contract will be based upon my past performance and ability to complete the contract based upon equipment and staffing subject to my control.

FEDERAL ID: ____ - ____ - ____ or SOCIAL SECURITY NUMBER: ____ - ____ - ____

Company or individual bidding: _____

Company representative's name: _____

Address: _____

City: _____ State: _____ Zip: _____

IF AVAILABLE, PLEASE PLACE THE PERSONALIZED LABEL FROM YOUR PROSPECTUS IN THE ABOVE BOX.

Individual or company representative's signature: _____ Date: _____

Phone number : _____ Email (optional): _____

THE WINNING BIDDER MUST COMPLETE THE VERIFICATION OF WORKER'S DISABILITY COMPENSATION ACT COMPLIANCE (ON REVERSE SIDE IF DOUBLE SIDED) WITHIN 21 DAYS OF SALE AWARD DATE



FOR DEPARTMENT USE ONLY	
Sale Number (XX - XXX - XX - XX)	
Forest Management Unit:	

TIMBER SALE VERIFICATION OF WORKER'S DISABILITY COMPENSATION ACT COMPLIANCE

As required by Act 317, P.A. 1969 (Worker's Compensation) and
Part 5 of Act 451 of 1994, as amended.

VERIFICATION OF WORKER'S DISABILITY COMPENSATION ACT COMPLIANCE

- This verification must be completed and submitted within 21 days of contract award and prior to the issuance of the timber sale contract.
- In addition, if boxes 2B or 2C are checked, then Notice of Exclusion or Certificate of Insurance must be submitted within twenty-one (21) days of the contract award and prior to the issuance of the timber sale contract.
- All information must be typed or printed except for written signatures.

Please Check Appropriate Categories:

1. My business is organized as (you **must** check one of the boxes below):
 - A. Sole Proprietorship (individual)
 - B. Partnership
 - C. Corporation
2. You **must** check one of the boxes below:
 - A. I certify my business is a sole proprietorship and it has no employees but the sole proprietor. I am not subject to the Worker's Compensation Laws.
 - B. I certify my business has satisfied its obligation to the Worker's Compensation Act through the use of an approved Notice of Exclusion (BWC-337, Rev. 5/96). I will provide a copy of the Notice of Exclusion within 21 days of the contract award. (For questions or a copy of the BWC-337, please call the Worker's Compensation Bureau at 517-322-1195).
 - C. I certify my business has a Worker's Compensation Policy. I will provide an original Certificate of Insurance within twenty-one (21) days of the contract award.
3. If you have checked item 2(A) or 2(B), you **must** indicate the number of **both** full-time and part-time employees, other than yourself, including family members and active partners (if none, you must enter "0").

_____ Full-time Employees

_____ Part-time Employees

Name of Business		Federal ID (or) Social Security No.	
Address		Telephone ()	
City	State	ZIP	

I hereby certify that the above information is true and correct. I agree to notify the Michigan DNR of any changes that occur in factors affecting my coverage during any of my present and future operations.

Signature of Owner or Authorized Representative

Title

Date

Please complete the "SEALED BID" information on the next page

First Time Red Pine (72-013-20)
T28N, R03W, SEC. 17; T28N, R03W, SEC. 9; Crawford COUNTY

In response to the notice of sale to be held 9:00 a.m. (local time) on January 8, 2021, I am hereby submitting my sealed bid (firm offer) for the following forest products to be cut. Bids for individual species must be at or above the advertised price. All non-responsive bid forms may be rejected.

<u>PRODUCTS & SPECIES</u>	<u>ESTIMATED VOLUME*</u>	<u>ADVERTISED PRICE</u>	<u>BID PRICE/UNIT</u>
Sawtimber			
Red Pine	132.3 MBF	\$ 84.00/MBF	\$ _____
Sugar Maple	2.5 MBF	\$ 117.00/MBF	\$ _____
Pulpwood			
Mixed Hardwood	15 Cords	\$ 20.70/Cord	\$ _____
Quaking Aspen	26 Cords	\$ 15.20/Cord	\$ _____
Red Pine	578 Cords	\$ 35.20/Cord	\$ _____

*The volumes are statistically estimated within plus (+) or minus (-) 10.22 percent at 95% confidence level. These estimated volumes are final and not subject to adjustment. Prospective bidders are urged to examine this timber and to make their own estimates of quantity and quality.

I understand that any or all bids may be rejected. All bids must be signed and all bid items must be bid or the bid form may be rejected. I also understand that consideration and awarding a contract will be based upon my past performance and ability to complete the contract based upon equipment and staffing subject to my control .

FEDERAL ID: _____ - _____ or SOCIAL SECURITY NUMBER: _____ - _____ - _____

Company or individual bidding: _____

Company representative's name: _____

Address: _____

City: _____ State: _____ Zip: _____

IF AVAILABLE, PLEASE PLACE THE PERSONALIZED LABEL FROM YOUR PROSPECTUS IN THE ABOVE BOX.

Individual or company representative's signature: _____ Date: _____

Phone number : _____ Email (optional): _____

THE WINNING BIDDER MUST COMPLETE THE VERIFICATION OF WORKER'S DISABILITY COMPENSATION ACT COMPLIANCE (ON REVERSE SIDE IF DOUBLE SIDED) WITHIN 21 DAYS OF SALE AWARD DATE



FOR DEPARTMENT USE ONLY

Sale Number (XX - XXX - XX - XX)
Forest Management Unit:

**TIMBER SALE
VERIFICATION OF WORKER'S DISABILITY
COMPENSATION ACT COMPLIANCE**

*As required by Act 317, P.A. 1969 (Worker's Compensation) and
Part 5 of Act 451 of 1994, as amended.*

VERIFICATION OF WORKER'S DISABILITY COMPENSATION ACT COMPLIANCE

- This verification must be completed and submitted within 21 days of contract award and prior to the issuance of the timber sale contract.
- In addition, if boxes 2B or 2C are checked, then Notice of Exclusion or Certificate of Insurance must be submitted within twenty-one (21) days of the contract award and prior to the issuance of the timber sale contract.
- All information must be typed or printed except for written signatures.

Please Check Appropriate Categories:

1. My business is organized as (you **must** check one of the boxes below):
 - A. Sole Proprietorship (individual)
 - B. Partnership
 - C. Corporation
2. You **must** check one of the boxes below:
 - A. I certify my business is a sole proprietorship and it has no employees but the sole proprietor. I am not subject to the Worker's Compensation Laws.
 - B. I certify my business has satisfied its obligation to the Worker's Compensation Act through the use of an approved Notice of Exclusion (BWC-337, Rev. 5/96). I will provide a copy of the Notice of Exclusion within 21 days of the contract award. (For questions or a copy of the BWC-337, please call the Worker's Compensation Bureau at 517-322-1195).
 - C. I certify my business has a Worker's Compensation Policy. I will provide an original Certificate of Insurance within twenty-one (21) days of the contract award.
3. If you have checked item 2(A) or 2(B), you **must** indicate the number of **both** full-time and part-time employees, other than yourself, including family members and active partners (if none, you must enter "0").

_____ Full-time Employees

_____ Part-time Employees

Name of Business		Federal ID (or) Social Security No.	
Address		Telephone ()	
City	State	ZIP	

I hereby certify that the above information is true and correct. I agree to notify the Michigan DNR of any changes that occur in factors affecting my coverage during any of my present and future operations.

Signature of Owner or Authorized Representative

Title

Date

Please complete the "SEALED BID" information on the next page

Tetris Pine Final (72-009-20)
T27N, R01E, SEC. 26; T27N, R01E, SEC. 28; T27N, R01E, SEC. 35; Oscoda

In response to the notice of sale to be held 9:00 a.m. (local time) on January 8, 2021, I am hereby submitting my sealed bid (firm offer) for the following forest products to be cut. Bids for individual species must be at or above the advertised price. All non-responsive bid forms may be rejected.

<u>PRODUCTS & SPECIES</u>	<u>ESTIMATED VOLUME*</u>	<u>ADVERTISED PRICE</u>	<u>BID PRICE/UNIT</u>
Sawtimber			
Red Oak	39.8 MBF	\$ 108.00/MBF	\$ _____
Red Pine	1,270.3 MBF	\$ 84.00/MBF	\$ _____
White Pine	55.2 MBF	\$ 33.00/MBF	\$ _____
Pulpwood			
Balsam Fir	12 Cords	\$ 13.10/Cord	\$ _____
Bl/R/Hybrid Oak	101 Cords	\$ 17.50/Cord	\$ _____
Black Spruce	22 Cords	\$ 17.55/Cord	\$ _____
Jack Pine	95 Cords	\$ 13.50/Cord	\$ _____
Mixed Aspen	18 Cords	\$ 15.20/Cord	\$ _____
Red Maple	7 Cords	\$ 20.70/Cord	\$ _____
Red Pine	1,130 Cords	\$ 35.20/Cord	\$ _____
White Pine	628 Cords	\$ 16.25/Cord	\$ _____

*The volumes are statistically estimated within plus (+) or minus (-) 10.11 percent at 95% confidence level. These estimated volumes are final and not subject to adjustment. Prospective bidders are urged to examine this timber and to make their own estimates of quantity and quality.

I understand that any or all bids may be rejected. All bids must be signed and all bid items must be bid or the bid form may be rejected. I also understand that consideration and awarding a contract will be based upon my past performance and ability to complete the contract based upon equipment and staffing subject to my control.

FEDERAL ID: _____ or SOCIAL SECURITY NUMBER: _____

Company or individual bidding: _____

Company representative's name: _____

Address: _____

City: _____ State: _____ Zip: _____

IF AVAILABLE, PLEASE PLACE THE PERSONALIZED LABEL FROM YOUR PROSPECTUS IN THE ABOVE BOX.

Individual or company representative's signature: _____ Date: _____

Phone number : _____ Email (optional): _____

THE WINNING BIDDER MUST COMPLETE THE VERIFICATION OF WORKER'S DISABILITY COMPENSATION ACT COMPLIANCE (ON REVERSE SIDE IF DOUBLE SIDED) WITHIN 21 DAYS OF SALE AWARD DATE



FOR DEPARTMENT USE ONLY	
Sale Number (XX - XXX - XX - XX)	
Forest Management Unit:	

TIMBER SALE VERIFICATION OF WORKER'S DISABILITY COMPENSATION ACT COMPLIANCE

As required by Act 317, P.A. 1969 (Worker's Compensation) and
Part 5 of Act 451 of 1994, as amended.

VERIFICATION OF WORKER'S DISABILITY COMPENSATION ACT COMPLIANCE

- This verification must be completed and submitted within 21 days of contract award and prior to the issuance of the timber sale contract.
- In addition, if boxes 2B or 2C are checked, then Notice of Exclusion or Certificate of Insurance must be submitted within twenty-one (21) days of the contract award and prior to the issuance of the timber sale contract.
- All information must be typed or printed except for written signatures.

Please Check Appropriate Categories:

1. My business is organized as (you **must** check one of the boxes below):
 - A. Sole Proprietorship (individual)
 - B. Partnership
 - C. Corporation
2. You **must** check one of the boxes below:
 - A. I certify my business is a sole proprietorship and it has no employees but the sole proprietor. I am not subject to the Worker's Compensation Laws.
 - B. I certify my business has satisfied its obligation to the Worker's Compensation Act through the use of an approved Notice of Exclusion (BWC-337, Rev. 5/96). I will provide a copy of the Notice of Exclusion within 21 days of the contract award. (For questions or a copy of the BWC-337, please call the Worker's Compensation Bureau at 517-322-1195).
 - C. I certify my business has a Worker's Compensation Policy. I will provide an original Certificate of Insurance within twenty-one (21) days of the contract award.
3. If you have checked item 2(A) or 2(B), you **must** indicate the number of **both** full-time and part-time employees, other than yourself, including family members and active partners (if none, you must enter "0").

_____ Full-time Employees

_____ Part-time Employees

Name of Business		Federal ID (or) Social Security No.	
Address		Telephone ()	
City	State	ZIP	

I hereby certify that the above information is true and correct. I agree to notify the Michigan DNR of any changes that occur in factors affecting my coverage during any of my present and future operations.

Signature of Owner or Authorized Representative

Title

Date

Please complete the "SEALED BID" information on the next page