



**DEPARTMENT OF NATURAL RESOURCES
STATE OF MICHIGAN**

TIMBER SALE PROSPECTUS #6968

SCHEDULED SALE DATE AND TIME: 9:00 a.m. (local time) on January 12, 2022.

LOCATION: ROSCOMMON MGMT UNIT, PO BOX 218, ROSCOMMON, MI 48653.

PROSPECTUS NOTE: The bidder is advised to inspect the sale area and review the location, estimated volumes, operating costs and contract terms of proposed sales. Please be aware that some landowners may request 60 days or more notice for access across their land.

Notice is hereby given that bids will be received by the Unit Manager, ROSCOMMON MANAGEMENT UNIT, for certain timber on the following described lands:

One and Done (71-001-21) / T21N, R02E, SEC. 11, NWNE,S1/2NE,E1/2SW,W1/2SE.
T21N, R02E, SEC. 12, S1/2NW,SWNE,N1/2SW,NWSE.
Ogemaw County, Advertised Price \$89,797.55, 111.3 Acres, Hardwood, Aspen.

SALE NOTE: All units of volume listed for this sale were estimated using the Inventory Manager computer program and the new Michigan taper model.

Saints Alive (71-007-21) / T24N, R03W, SEC. 22, N1/2SE.
Roscommon County, Advertised Price \$10,831.40, 16.1 Acres, Hardwood, Jack Pine.

SALE NOTE: All units of volume listed for this sale were estimated using the Inventory Manager computer program and the new Michigan taper model.

C30 Leftovers (71-009-21) / T23N, R02W, SEC. 18, SWNE,SWSW,NWSE.
T23N, R03W, SEC. 10, SESW,SWSE.
T23N, R03W, SEC. 12, N1/2SE.
T23N, R03W, SEC. 13, SENW,N1/2SW.
Roscommon County, Advertised Price \$105,215.70, 122.2 Acres, Aspen, Hardwood.

SALE NOTE: All units of volume listed for this sale were estimated using the Inventory Manager computer program and the new Michigan taper model.

County Line Jack (71-010-21) / T22N, R04W, SEC. 6 , NW,NWNE,NESW.
Roscommon County, Advertised Price \$15,289.05, 56.3 Acres, Jack Pine, Hardwood.

SALE NOTE: All units of volume listed for this sale were estimated using the Inventory Manager computer program and the new Michigan taper model.

- See sale spec 5.2.22.1 for operational recommendations due to seasonally wet soils.
- See sale spec 5.2.17 for information on the need of mats for extra protection.
- See sale spec 4.1.11 for information on permits required for sale access.
- See sale spec 5.1.6 for information to use of R.O.W. easement for access to sale.

5 Year Rotation Mix (71-012-21) / T24N, R03W, SEC. 11, N1/2SW,N1/2SE,SESE.

T24N, R03W, SEC. 12, SWSW.

T24N, R03W, SEC. 13, E1/2NW,SWNE.

T24N, R03W, SEC. 15, S1/2SE.

T24N, R03W, SEC. 23, NESE.

T24N, R03W, SEC. 24, S1/2SW,SE.

Roscommon County, Advertised Price \$140,912.35, 141.0 Acres, Red Pine, Hardwood.

SALE NOTE: All units of volume listed for this sale were estimated using the Inventory Manager computer program and the new Michigan taper model.

A recreation site such as a trail, pathway, or campground is within the sale area or the vicinity. Certain restrictions/specifications may be applicable including time restrictions.

Peninsula Harvest (71-015-21) / T22N, R04W, SEC. 31, E1/2NE.

T22N, R04W, SEC. 32, W1/2NW.

Roscommon County, Advertised Price \$5,336.55, 7.8 Acres, Aspen, Hardwood.

SALE NOTE: All units of volume listed for this sale were estimated using the Inventory Manager computer program and the new Michigan taper model.

BID INSTRUCTIONS (VER. 07/02/2018):

1. Scheduled Bid Location, Date, and Time (2/11)

Bids must be received by the Unit Manager, ROSCOMMON OFFICE, PO BOX 218, ROSCOMMON, MI 48653, no later than 9:00 a.m. (local time) on January 12, 2022. For further information concerning this sale, contact Doug Bates at 989-275-4622 extension 2740.

2. Bidder's Qualifications (5/16)

Purchaser shall obtain workers compensation insurance to cover claims under Michigan's Worker's Disability Compensation Act of 1969 or similar employee benefit act of any other state applicable to an employee. If all or part of a timber sale was prepared by a private contractor, the contractor and that contractor's company are not permitted to bid on the timber sale contract. Bids will not be accepted from individuals or companies appearing on the DNR/FRD No-Bid List. This list contains the names of purchasers who previously failed to execute a contract within 21-days or who have a history of poor performance.

3. Preparation of Sealed Bids (5/16)

Bid Forms may be completed online thru Michigan DNR Timber Sale Online Bidding (OLB) at www.michigan.gov/timberbidding or by completing the hardcopy Bid Form found in the Timber Sale Prospectus. Hardcopy Bid Forms shall be manually signed in ink. Registration in OLB is considered your 'signature' for all bids submitted thru that system. Bid prices must be entered for each species and product in the Bid Price column for all material subject to bidding and all fill-in blanks must be completed. If erasures or other changes appear on the hardcopy Bid Form, each erasure or change must be initialed by the person signing the bid.

4. Submission of Sealed Bids (5/16)

Bid forms may be obtained from the Unit Manager or thru OLB. Bids may be submitted hardcopy or thru OLB. All hardcopy bids must be submitted on the bid form and in an envelope clearly identified as described in this section. NOTE: Only one bid form per bid envelope. Sealed bids must be submitted to the Unit office designated in the prospectus and must be submitted at or prior to the time established in the prospectus. The envelope should show on the outside (a) the sale name or number and (b) the date and time of bid opening, as shown in the prospectus. Bids received after the time specified in the sale prospectus are late bids and will be rejected.

It is possible for a bidder to submit multiple bids on a single sale. For example, a bid may be submitted hardcopy and a bid may be submitted thru OLB. Or, two bidders from the same company could both submit bids on the same sale. If this were to happen, the State would accept all bids received and award the contract accordingly. All bidding and contractual requirements would apply to all bids received.

5. Public Opening of Sealed Bids (7/16)

If conditions permit, the sealed bids will be publicly opened and posted at the time and place set in the prospectus.

If a bidder, present at a bid opening, has submitted bids on more than one sale, that bidder may withdraw their unopened bid envelopes or announce the withdrawal of their online bid after being declared the successful bidder on one sale.

6. Award of Contract (1/11)

Award of the contract will be made to the Bidder whose bid, conforming to the prospectus, is most advantageous to the State of Michigan on the basis of total value at rates bid for the estimated quantities. The State reserves the right to reject any bid or waive any minor irregularity in bids received. A written award mailed (or otherwise furnished) to the successful Bidder shall be deemed to result in a binding contract without further action by either party.

7. Down Payment (1/11)

The Bidder to whom award is made must make a down payment within 21 days of the sale award. The amount of the down payment will be calculated as shown in the Bond and Payment Schedule of this prospectus. Only cash may be used to meet this requirement.

8. Performance Security (1/11)

As guarantee of faithful performance, a cash bond, certificate of deposit, surety bond or irrevocable letter of credit (LOC) is required within 21 days of the sale award. The amount of the performance security is shown in the Bond and

Payment Schedule of this prospectus. If an LOC or surety is used, the coverage must extend for at least 6 months beyond the contract expiration.

9. Timber Sale Contract (7/18)

Additional conditions and requirements common to all timber sales are listed on the timber sale contract (R4031) and are available on line at www.michigan.gov/timber. Contact the Unit Manager for additional information or a sample contract. Within 21 days of the date of the award letter, the bidder must sign the contract and provide the required down payment, performance security, and verification of worker's disability compensation. The down payment and performance security shall be in accordance with the provisions of the timber sale contract, in the sums stated in this prospectus. If these actions are not taken, then the Bidder, the Bidder's corporation, and the corporation's principals may not be permitted to bid on State timber sales for a period of 3 months after the first offense, 6 months after the second offense, and 1 year after the third offense. An offense will only be counted against the Bidder for 5 years. In addition, the Bidder certifies that if awarded this contract, the Bidder will complete the timber sale contract in accordance with its terms and any modifications thereof including requirements to purchase, cut, and remove the included timber by the expiration date.

Payment Unit values in the State Forest Timber Sale Contract are calculated based on the advertised value of the Payment Unit as a percentage of the total advertised value of the contract. The advertised value of each Payment Unit is given in the Description of Timber by Payment Unit table on the Timber Sale Information page. For example, if the value of Payment Unit 1 is advertised as \$1,500 and the total Timber Sale value is advertised as \$10,000, the contract price for Payment Unit 1 will be 15% of the total bid price ($\$1,500/\$10,000 * 100$).

10. Disclaimer of Estimates and Bidder's Warranty of Inspection (7/16)

Before submitting this bid, the Bidder is advised and cautioned to inspect the sale area, review the requirements of the sale contract, and take other steps as may be reasonably necessary to ascertain the location, estimated volumes, construction estimates, and operating costs of the proposed sale. Failure to do so will not relieve the Bidder from responsibility for completing the contract.

The Bidder warrants that this bid is submitted solely on the basis of the Bidder's examination and inspection of the quality and quantity of the timber offered for sale and the Bidder's opinion of the value thereof and the costs of recovery. No reliance should be placed on the State of Michigan's estimates of timber quality, quantity or costs of recovery. Bidder further acknowledges that the State of Michigan: (i) expressly disclaims any warranty of fitness of timber for any purpose; (ii) offers this timber as is without any warranty of quality (merchantability) or quantity and (iii) expressly disclaims any warranty as to the quantity or quality of timber sold.

11. Certification and Chain-of-Custody (10/14)

Unless otherwise indicated in the contract under section 7 – Other Conditions of the Sale Specific Conditions & Requirements, the area encompassed by this timber sale is certified to the standards of the Forest Stewardship Council (FSC) - Certificate #SCS-FM/COC-00090N and the Sustainable Forestry Initiative (SFI) - Certificate #NSF-SFIS-5Y031-SF5. Forest products from this sale may be delivered to the mill as "FSC 100% and / or SFI certified" as long as the contractor hauling the forest products is chain-of-custody (COC) certified or covered under a COC certificate from the destination mill. The purchaser is responsible for maintaining COC after leaving the sale area.

12. Good Neighbor Authority (GNA) Requirements (7/16)

If the name of this timber sales contains the acronym GNA, it is authorized by the Good Neighbor Authority (GNA) and covered by various agreements between the U.S. Forest Service and the State. The timber sale occurs on federal land and the following conditions apply:

GNA contracts on US Forest Service land will not be awarded to purchasers on the Federal list of excluded parties. The System for Award Management (SAM) will be checked for active excluded parties prior to award of contract. In addition, the Bidder to whom award is made must complete an Assurance Regarding Felony Conviction or Tax Delinquent Status for Corporate Applicants (AD-3031).

13. Good Neighbor Authority (GNA) Requirements, con't (9/16)

Bidder certifies, by signing this bid form, that to the best of Bidder's knowledge that the following representations are accurate and complete.

- a. That the Bidder and its principals are not presently debarred, suspended, proposed for debarment, declared ineligible, or voluntary excluded from timber sales (covered transactions) by any Federal department or agency.
- b. That the Bidder and its principals have not within a 3-year period preceding this bid been convicted of or had a civil judgment rendered against them for commission of fraud or a criminal offense in connection with obtaining , attempting to obtain, or performing a public (Federal, State, or local) transaction or contract under a public transaction; violation of Federal or State antitrust statutes or commission of embezzlement, theft, forgery, bribery, falsification or destruction of records, making false statements, or receiving stolen property.
- c. That the Bidder and its principals are not presently indicted for or otherwise criminally or civilly charged by a governmental entity (Federal, State, or local) with commission of any of the offenses enumerated in paragraph b of this certification.
- d. That the Bidder and its principals have not within a 3-year period preceding this bid had one or more public transactions (Federal, State, or local) terminated for breach or default of a timber or forest product contract.

Bidders that cannot certify this requirement, in whole or in part, shall submit an explanation with their bid.

DAN EICHINGER
Director

TIMBER SALE INFORMATION

One and Done (71-001-21)
T21N, R02E, SEC. 11; T21N, R02E, SEC. 12.
Ogemaw County (Advertised Price \$89,797.55)

SALE NOTE: All units of volume listed for this sale were estimated using the Inventory Manager computer program and the new Michigan taper model.

A timber sale contract for this lump sum, sealed bid timber sale will be awarded to the responsible bidder offering the highest sealed bid price. All units of volume listed below were estimated using the Inventory Manager computer program and the new Michigan taper model. Bids must be at or above the following advertised price for each product and species:

<u>PRODUCTS & SPECIES</u>	<u>ESTIMATED UNITS*</u>	<u>ADVERTISED PRICE</u>
Sawtimber		
B. T. Aspen	153.9 MBF	\$ 68.00 / MBF
Bl/R/Hybrid Oak	459.6 MBF	\$ 80.00 / MBF
Red Maple	44.2 MBF	\$ 63.00 / MBF
Red Pine	10.8 MBF	\$ 92.00 / MBF
White Oak	41.1 MBF	\$ 69.00 / MBF
White Pine	81.9 MBF	\$ 46.00 / MBF
Pulpwood		
Balsam Fir	33 Cords	\$ 17.90 / Cord
Mixed Aspen	442 Cords	\$ 19.80 / Cord
Mixed Hardwood	244 Cords	\$ 15.35 / Cord
Mixed Oak	489 Cords	\$ 14.55 / Cord
Red Pine	20 Cords	\$ 34.40 / Cord
White Pine	524 Cords	\$ 21.55 / Cord

* The total volume is statistically estimated within plus (+) or minus (-) 5.22 percent. There are an estimated 3,553 cords on this timber sale, plus or minus 186 cords at the 95% confidence level. The estimated units are final and not subject to adjustment. Prospective bidders are urged to examine this timber and to make their own estimates of quantity and quality.

BOND AND PAYMENT SCHEDULE:

1. A bond in the amount of \$4,490.00 to insure faithful performance of the conditions of the contract will be deposited by the successful bidder within 21 days of the sale award.
2. Cutting in any sale or unit without the required advance payment would be considered a trespass.
3. Total payment must be paid in advance or according to the following schedule :
 - (a) Ten percent (10%) of the sale value must be paid within 21 days of the sale award.
 - (b) The 10% down payment will be credited towards the first unit cut.
 - (c) Payment for each of the following units must be made before cutting begins in that unit:

PAYMENT UNIT NUMBER	PERCENT OF TOTAL SALE VALUE
01	14.2%
02	16.4%
03	19.2%
04	14.5%
05	7.4%
06	15.6%
07	12.7%

4. If no cutting takes place, the 10% down payment will not be refunded.
5. Operations on the contract issued will terminate on 03/31/2024.

SALE STATISTICS

Volumes were calculated in cubic feet using the Michigan taper model. Cubic foot volume includes all wood inside bark for the product indicated. For display purposes, cubic feet were converted to cords and MBF using a simple conversion factor, e.g. 79 cubic feet per cord and 185 cubic feet per MBF. The cubic foot volumes are precise; the cords and MBF volumes are not. Cubic foot volume cannot be directly converted to cords or boards with precision.

SALE VOLUMES

The total estimated sale volume may not equal the sum of the species/products due to the nature of statistical calculations associated with double sampling methodology.

VOLUME			STATISTICAL RANGE IN CORDS	
TOTAL CUBIC FEET	TOTAL CORDS	PERCENT ERROR	MINIMUM	MAXIMUM
280,710	3,553	5.22%	3,368	3,739

VDU VOLUMES

A VDU is a Volume Determination Unit. Volumes and their associated statistics are calculated at the VDU level and summarized to the sale level. There is often a one to one relationship between a VDU and a Payment Unit, but not always, depending on the cruise design. Refer to the VDU TO PAYMENT UNIT table.

	VOLUME			RANGE IN CORDS	
VDU	TOTAL CUBIC FEET	TOTAL CORDS	PERCENT ERROR	MINIMUM	MAXIMUM
184	41,151	521	12.21%	457	585
202	57,871	733	12.28%	643	823
206	90,252	1,142	9.59%	1,033	1,252
220	74,036	937	8.38%	859	1,016
TOTAL:	263,310	3,333		2,991	3,675

VDU TO PAYMENT UNIT

When a VDU is associated with more than one Payment Unit (PU), the VDU volumes are assigned to the PU based on acres of the VDU within the PU.

VDU	VDU ACRES	PU	PU ACRES
184	14.5	1	14.5
202	27.8	4	18.4
		5	9.4
206	29.9	2	13.8
		3	16.1
220	39.1	6	21.5
		7	17.6
TOTAL:	111.3		111.3

DESCRIPTION OF TIMBER BY PAYMENT UNIT (PU)

PU	MARKET GROUP	PRODUCT	QUANTITY	UNIT	ACRES	ADVERTISE PRICE					
1	B. T. Aspen	Sawtimber	39.1	MBF	14.5	\$12,735.50					
	BI/R/Hybrid Oak		19.5	MBF							
	Red Maple		25.7	MBF							
	Red Pine		4.8	MBF							
	White Pine		24.7	MBF							
	Balsam Fir		Pulpwood	15			Cords				
	Mixed Aspen			70			Cords				
	<i>B. T. Aspen</i>			70			Cords				
	Mixed Hardwood			135			Cords				
	<i>Black Cherry</i>			14			Cords				
	<i>Red Maple</i>			121			Cords				
	Mixed Oak			18			Cords				
	<i>BI/R/Hybrid Oak</i>			18			Cords				
	Red Pine			8			Cords				
	White Pine			49			Cords				
2	B. T. Aspen	Sawtimber	45.0	MBF	13.8	\$14,753.00					
	BI/R/Hybrid Oak		76.1	MBF							
	Red Maple		7.5	MBF							
	White Oak		12.2	MBF							
	White Pine		1.2	MBF							
	Mixed Aspen		Pulpwood	121			Cords				
	<i>B. T. Aspen</i>			121			Cords				
	Mixed Hardwood			37			Cords				
	<i>Red Maple</i>			37			Cords				
	Mixed Oak			80			Cords				
	<i>BI/R/Hybrid Oak</i>			62			Cords				
	<i>White Oak</i>			18			Cords				
	White Pine			5			Cords				
	3			B. T. Aspen			Sawtimber	52.4	MBF	16.1	\$17,192.85
				BI/R/Hybrid Oak				88.8	MBF		
Red Maple		8.7	MBF								
White Oak		14.2	MBF								
White Pine		1.4	MBF								
Mixed Aspen		Pulpwood	142	Cords							
<i>B. T. Aspen</i>			142	Cords							
Mixed Hardwood			44	Cords							
<i>Red Maple</i>			44	Cords							
Mixed Oak			92	Cords							
<i>BI/R/Hybrid Oak</i>			72	Cords							
<i>White Oak</i>			20	Cords							
White Pine			5	Cords							
4			B. T. Aspen	Sawtimber	11.5	MBF		18.4	\$13,047.55		
			BI/R/Hybrid Oak		75.7	MBF					
	Red Maple	1.5	MBF								
	White Oak	4.7	MBF								
	White Pine	13.6	MBF								
	Balsam Fir	Pulpwood	12		Cords						
	Mixed Aspen		64		Cords						
	<i>B. T. Aspen</i>		34		Cords						
	<i>Quaking Aspen</i>		30		Cords						
	Mixed Hardwood		6		Cords						
	<i>Black Cherry</i>		3		Cords						
	<i>Red Maple</i>		3		Cords						
	Mixed Oak		75		Cords						
	<i>BI/R/Hybrid Oak</i>		72		Cords						
	<i>White Oak</i>		3		Cords						

DESCRIPTION OF TIMBER BY PAYMENT UNIT (PU), CON'T

PU	MARKET GROUP	PRODUCT	QUANTITY	UNIT	ACRES	ADVERTISE PRICE
4 con't	White Pine	Pulpwood	116	Cords		
5	B. T. Aspen	Sawtimber	5.9	MBF	9.4	\$6,644.80
	BI/R/Hybrid Oak		38.6	MBF		
	Red Maple		0.8	MBF		
	White Oak		2.4	MBF		
	White Pine		7.0	MBF		
	Balsam Fir	Pulpwood	6	Cords		
	Mixed Aspen		32	Cords		
	<i>B. T. Aspen</i>		17	<i>Cords</i>		
	<i>Quaking Aspen</i>		15	<i>Cords</i>		
	Mixed Hardwood		2	Cords		
	<i>Black Cherry</i>		1	<i>Cords</i>		
	<i>Red Maple</i>		1	<i>Cords</i>		
	Mixed Oak		38	Cords		
	<i>BI/R/Hybrid Oak</i>		37	<i>Cords</i>		
	<i>White Oak</i>		1	<i>Cords</i>		
	White Pine		60	Cords		
6	BI/R/Hybrid Oak	Sawtimber	88.5	MBF	21.5	\$13,992.40
	Red Pine		3.3	MBF		
	White Oak		4.2	MBF		
	White Pine		18.7	MBF		
	Mixed Aspen	Pulpwood	7	Cords		
	<i>B. T. Aspen</i>		7	<i>Cords</i>		
	Mixed Hardwood		11	Cords		
	<i>Red Maple</i>		11	<i>Cords</i>		
	Mixed Oak		102	Cords		
	<i>BI/R/Hybrid Oak</i>		94	<i>Cords</i>		
	<i>White Oak</i>		8	<i>Cords</i>		
	Red Pine		7	Cords		
	White Pine		159	Cords		
7	BI/R/Hybrid Oak	Sawtimber	72.4	MBF	17.6	\$11,431.45
	Red Pine		2.7	MBF		
	White Oak		3.4	MBF		
	White Pine		15.3	MBF		
	Mixed Aspen	Pulpwood	6	Cords		
	<i>B. T. Aspen</i>		6	<i>Cords</i>		
	Mixed Hardwood		9	Cords		
	<i>Red Maple</i>		9	<i>Cords</i>		
	Mixed Oak		84	Cords		
	<i>BI/R/Hybrid Oak</i>		77	<i>Cords</i>		
	<i>White Oak</i>		7	<i>Cords</i>		
	Red Pine		5	Cords		
	White Pine		130	Cords		
TOTAL:			791.5	MBF		
TOTAL:			1,752	Cords		

Sale Specific Conditions & Requirements

Sale Name: One and Done

Sale Number: 71-001-21 Seq#: 1

1 - Sale Area

1.2 - Boundaries

1.2.1 - Painted boundaries (9/19)

The sale boundary and Payment Unit boundaries are marked and identified by blue, red, and yellow paint. Exterior sale boundary lines against private property are marked with blue paint. Exterior sale boundary lines against state are marked with red paint. Interior Payment Unit boundaries are marked with yellow paint. Retention patches are marked with red paint; no harvesting activities may occur within these areas. The painted boundary line trees are not Included Timber and are to be protected. Yellow painted trees designating an interior Payment Unit boundary are only to be cut when all surrounding Payment Units have been paid.

2 - Timber Specifications

2.1 - Included Timber

2.1.1 - Clearcut unit(s) with unmerchantable trees (6/14)

Within Payment Unit(s) 1-5, cut all trees that are two (2) inches or more at DBH, except those marked with green paint.

2.1.7 - Leave tree marked unit(s) (6/14)

Within Payment Unit(s) 6 and 7, cut all trees that are two (2) inches or more at DBH, except do not cut trees marked with green paint above and below stump height, or any white pine 4 inches or less at DBH.

2.2 - Utilization

2.2.3 - Stump heights (4/07)

Stump heights within the Sale Area shall not exceed 12 inches for trees greater than 10 inches at DBH and 4 inches for trees smaller than 10 inches at DBH.

3 - Payments

3.3 - Pre-measured Sales

3.3.4 - Dividing payment units (7/14)

Payment Unit(s) may be divided at the request of the Purchaser and upon approval of the Unit Manager. Dividing Payment Units is a contract modification which requires a Timber Sale Contract Amendment.

3.4 - Damaged Timber

3.4.1 - Damaged timber (7/16)

General Condition and Requirement 3.4 Damaged Timber, defines liquidated damages for undesignated live merchantable trees which are cut or injured. In addition, extreme care should be taken to avoid damage to white pine seedlings and saplings in Payment Units 6 and 7. Within Payment Units 6 and 7, if more than 33% of the tree seedlings or saplings (1/4" to 4.5" DBH) within a specified portion of the Sale Area are damaged, liquidated damages will be assessed at \$300 per acre for all acreage within that specified portion of the Sale Area that was damaged.

Within all Payment Units, should chipping occur in a Payment Unit, this must be done before sprouting of new regeneration. If more than 33% of the newly sprouted tree seedlings within a specified portion of the Sale Area are damaged, liquidated damages will be assessed at \$300 per acre for all acreage within that specified portion of the Sale Area that was damaged. No damage is acceptable to undesignated live merchantable trees. Within the Sale Area, if more than 5% of trees (> 4.5" DBH) within a specified area of the sale are damaged, liquidated damages will be assessed for all trees damaged. Rates will be in accordance with General Condition and Requirement 3.4 Damaged Timber.

4 - Transportation

4.1 - Construction

4.1.6 - Road construction (1/09)

Construction of new roads or improvements of existing roads shall be done in such a way as to minimize the environmental and visual impacts. Merchantable trees shall be cut and utilized unless otherwise directed. Non-merchantable trees shall be severed and laid flat on the ground. Slash shall be scattered, and not left in windrows and kept a minimum of 10 feet back from the road edge. Stumps shall be set upright, not left on edge, and be moved at least 10 feet away from the road edge. Disturbed soil shall be feathered into the woods and not left in berms or windrows.

4.1.7 - Road closure (10/11)

All new roads built into the sale must be blocked to vehicle traffic upon completion of the sale. Overgrown roads that are reopened shall be considered new roads. In general, this will require constructing a four (4') foot high berm of stumps and logs covered with earth. These roads must be rendered impassable to cars and trucks. Contact the sale administrator for specific details of design and placement.

4.2 - Maintenance

4.2.3 - Road maintenance (8/13)

The following road maintenance may be needed: Within 60 days of completion of hauling, or if no hauling occurs for 60 days, the road must be maintained and graded. This includes cleaning of drainage areas, grading, crowning, and filling with gravel, if necessary. Damages will be assessed if grading/repair does not occur.

4.2.5 - Two wheel drive condition (2/04)

All existing trail roads on and adjacent to the sale area must be passable by two-wheel drive traffic for the duration of the sale.

5 - Operations

5.1 - Notification

5.1.1 - Pre-sale conference (10/16)

A pre-sale conference between the Purchaser and sale administrator is required prior to beginning any operations to determine landing and road locations. The Unit Manager or his/her representative must be contacted at least 2 days in advance to schedule the conference.

5.1.4 - Post-sale conference (10/16)

A post-sale conference on site between the Purchaser and sale administrator is required 5 days prior to the completion of active logging operations to determine clean-up and repair of landings, road edges, and the fulfillment of other contract specifications.

5.2 - Conduct of Operations

5.2.1 - Slash

5.2.1.8 - Slash height (12/08)

No slash or tree tops may exceed 24 inches in height. Slash/tops are not to be left in "windrows" from processing activities but must be scattered uniformly over the Sale Area.

5.2.3 - Operating Restrictions

5.2.3.11 - Coppice regeneration protection (4/10)

Timber harvesting in any Payment Unit must be completed before significant sprouting occurs in that Payment Unit to minimize damage to the new regeneration. Any post harvest operations, such as chipping, must be completed before sprouting of regeneration occurs. If it is anticipated that chipping will be delayed, then tops shall be carried to one central location or left unchipped. Should damages occur to the new regeneration, the damages will be assessed per Specification 3.4. 1 - Damaged Timber. If it is anticipated that chipping will be delayed, then tops shall be carried to one central location, preferably the landing. A third-party entity may be brought in to chip the tops/slash, before new sprouting occurs, should the contract holder fail to present in a timely manner arrangements approved by the Department for protecting the new regeneration. The Unit Manager or his/her representative may also cease such operations if sprouting occurs before the operation is complete and the Payment Unit(s) will be counted as incomplete with liquidated damages assessed accordingly.

5.2.4 - Dead and Down Creation

5.2.4.2 - Dead and down creation, hare and grouse (1/14)

To improve habitat for snowshoe hare, grouse, and other species, the Purchaser is to leave two 10-inch diameter or larger log size pieces on the ground for every two acres. They should be scattered throughout the sale or positioned per the sale administrator's instructions. If possible, the logs or trees should be felled so they overlap. Note these pieces should have a minimum length of five feet. They can be of any tree species and can be an un-merchantable piece of wood or a full tree. This should be done in Payment Units 1-3. Additionally, in Payment Unit 1, at least 5 brush piles should be left along the lowland border.

5.2.32 - Decking/landing restoration (9/13)

All decking and landing areas must have the surface area restored to a condition equal to or better than before. This is to ensure the proper regeneration of the stand. Wood debris, chips, and "cookies" from trimmings must be removed or scattered away from landing and loading areas and may not be windrowed on the edge.

5.4 - Soil Protection

5.4.1 - Rutting restriction, general (7/16)

Operations are to cease immediately if equipment and weather conditions result in rutting of roads and/or skid trails which is 12 inches or greater in depth and 50 feet in length. The Unit Manager or his/her representative may restrict hauling and/or skidding if ruts exceed the specified depth. With the Unit Manager or his/her representative's approval, the Purchaser may return to the area when the risk of rutting has decreased. The biggest threat of rutting is in Payment Unit 1.



TIMBER SALE MAP

This information provided by authority of Part 525, 1994 PA 451, as amended.

Forest Management Unit Roscommon	County Ogemaw	Mapped By Martell	Date 12/30/20	Page 1	of 1
Township 21N	Range 02E	Section(s) and Subdivision(s) Sec. 11 - NWNE, S1/2NE, E1/2SW, W1/2SE Sec. 12 - S1/2NW, SWNE, N1/2SW, NWSE	Scale 1:15,840		

Cover Type				Density	
A = Aspen	H = Hemlock	N = Marsh	U = Upland Brush	0 = Non Stocked	5 = Pole Timber Medium
B = Paper Birch	J = Jack Pine	O = Oak	UM = Upland Mixed	1 = Seedling Sapling Poor	6 = Pole Timber Well
C = Cedar	L = Lowland Brush	P = Lowland Poplar	V = Bog or Marsh	2 = Seedling Sapling Medium	7 = Saw Timber Poor
D = Treed Bog	LM = Lowland Mixed	Q = Mixed Swamp Conifer	W = White Pine	3 = Seedling Sapling Well	8 = Saw Timber Medium
E = Swamp Hdwoods	M = Mpl, Bch, Brch	R = Red Pine	X = Non Stocked	4 = Pole Timber Poor	9 = Saw Timber Well
F = Spruce Fir	MC = Mixed Conifer	S = Black Spruce	Z = Water		
G = Grass	MD = Mixed Deciduous	T = Tamarack			

PU	Acres	PU	Acres
1	14.5	5	9.4
2	13.8	6	21.5
3	16.1	7	17.6
4	18.4		

One and Done Compartment 90 111.3 Acres

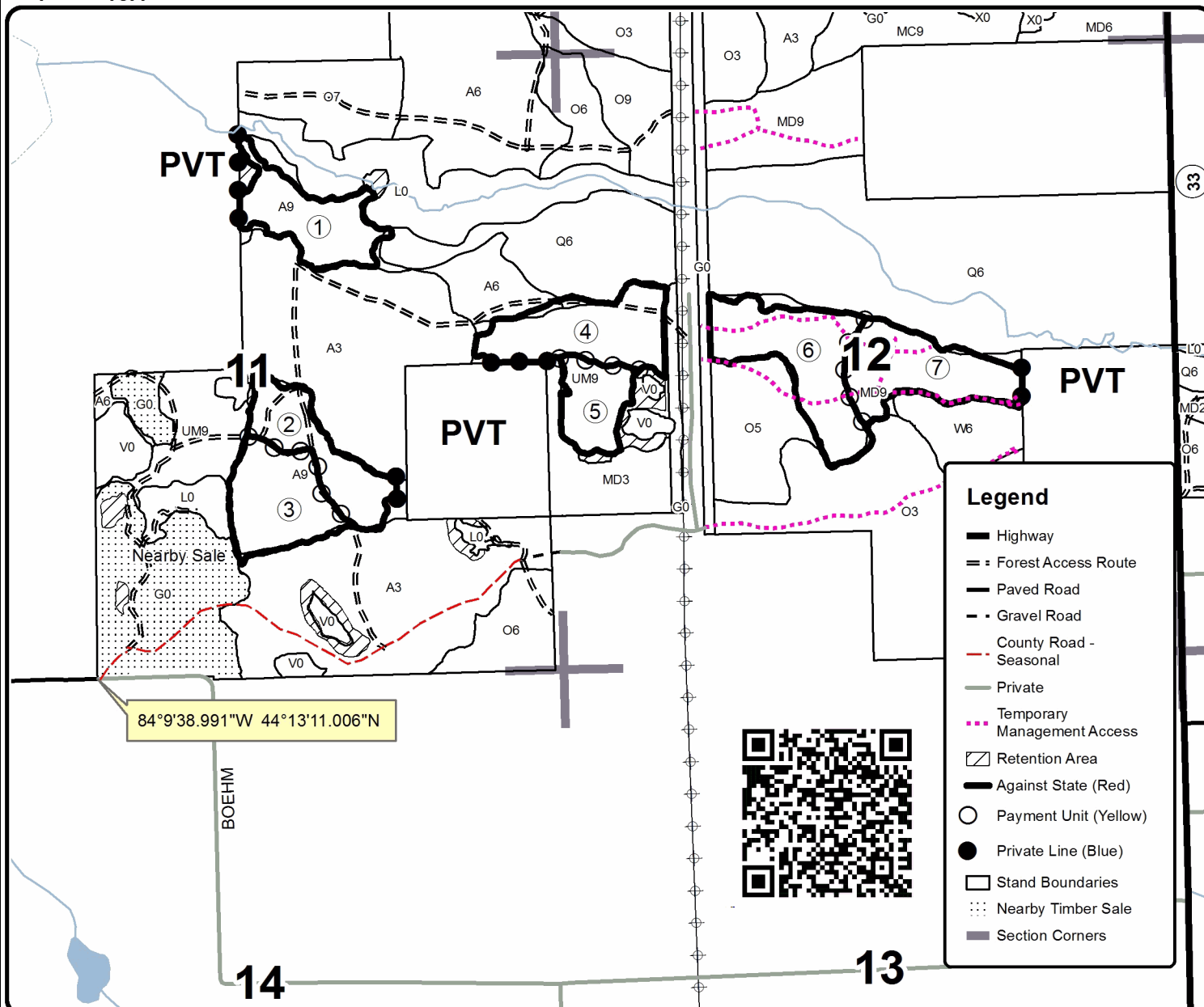
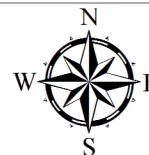

84°9'38.991"W 44°13'11.006"N



Legend

- Highway
- Forest Access Route
- Paved Road
- Gravel Road
- County Road - Seasonal
- Private
- Temporary Management Access
- Retention Area
- Against State (Red)
- Payment Unit (Yellow)
- Private Line (Blue)
- Stand Boundaries
- Nearby Timber Sale
- Section Corners

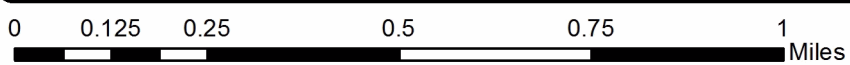

TIMBER SALE INFORMATION

Saints Alive (71-007-21)

T24N, R03W, SEC. 22.

Roscommon County (Advertised Price \$10,831.40)

SALE NOTE: All units of volume listed for this sale were estimated using the Inventory Manager computer program and the new Michigan taper model.

A timber sale contract for this lump sum, sealed bid timber sale will be awarded to the responsible bidder offering the highest sealed bid price. All units of volume listed below were estimated using the Inventory Manager computer program and the new Michigan taper model. Bids must be at or above the following advertised price for each product and species:

<u>PRODUCTS & SPECIES</u>	<u>ESTIMATED UNITS*</u>	<u>ADVERTISED PRICE</u>
Sawtimber		
B. T. Aspen	12.4 MBF	\$ 68.00 / MBF
Jack Pine	17.5 MBF	\$ 28.00 / MBF
Red Maple	7.1 MBF	\$ 63.00 / MBF
Red Oak	25.9 MBF	\$ 128.00 / MBF
Pulpwood		
Jack Pine	107 Cords	\$ 13.80 / Cord
Mixed Aspen	42 Cords	\$ 19.80 / Cord
Mixed Hardwood	103 Cords	\$ 15.35 / Cord
Mixed Oak	68 Cords	\$ 14.55 / Cord
Red Pine	8 Cords	\$ 34.40 / Cord
White Pine	27 Cords	\$ 21.55 / Cord

* The total volume is statistically estimated within plus (+) or minus (-) 14.15 percent. There are an estimated 510 cords on this timber sale, plus or minus 72 cords at the 95% confidence level. The estimated units are final and not subject to adjustment. Prospective bidders are urged to examine this timber and to make their own estimates of quantity and quality.

BOND AND PAYMENT SCHEDULE:

1. A bond in the amount of \$542.00 to insure faithful performance of the conditions of the contract will be deposited by the successful bidder within 21 days of the sale award.
2. Cutting in any sale or unit without the required advance payment would be considered a trespass.
3. Total payment must be paid in advance or according to the following schedule :
 - (a) Ten percent (10%) of the sale value must be paid within 21 days of the sale award.
 - (b) The 10% down payment will be credited towards the first unit cut.
 - (c) Payment for each of the following units must be made before cutting begins in that unit:

PAYMENT UNIT NUMBER	PERCENT OF TOTAL SALE VALUE
01	57.1%
02	42.9%
4. If no cutting takes place, the 10% down payment will not be refunded.
5. Operations on the contract issued will terminate on 03/31/2024.

SALE STATISTICS

Volumes were calculated in cubic feet using the Michigan taper model. Cubic foot volume includes all wood inside bark for the product indicated. For display purposes, cubic feet were converted to cords and MBF using a simple conversion factor, e.g. 79 cubic feet per cord and 185 cubic feet per MBF. The cubic foot volumes are precise; the cords and MBF volumes are not. Cubic foot volume cannot be directly converted to cords or boards with precision.

SALE VOLUMES

The total estimated sale volume may not equal the sum of the species/products due to the nature of statistical calculations associated with double sampling methodology.

VOLUME		STATISTICAL RANGE IN CORDS		
TOTAL CUBIC FEET	TOTAL CORDS	PERCENT ERROR	MINIMUM	MAXIMUM
40,285	510	14.15%	438	582

VDU VOLUMES

A VDU is a Volume Determination Unit. Volumes and their associated statistics are calculated at the VDU level and summarized to the sale level. There is often a one to one relationship between a VDU and a Payment Unit, but not always, depending on the cruise design. Refer to the VDU TO PAYMENT UNIT table.

VDU	VOLUME		PERCENT ERROR	RANGE IN CORDS	
	TOTAL CUBIC FEET	TOTAL CORDS		MINIMUM	MAXIMUM
7	18,425	233	24.01%	177	289
9	19,590	248	16.31%	208	288
TOTAL:	38,016	481		385	578

VDU TO PAYMENT UNIT

When a VDU is associated with more than one Payment Unit (PU), the VDU volumes are assigned to the PU based on acres of the VDU within the PU.

VDU	VDU ACRES	PU	PU ACRES
7	6.3	1	6.3
9	9.8	2	9.8
TOTAL:	16.1		16.1

DESCRIPTION OF TIMBER BY PAYMENT UNIT (PU)

PU	MARKET GROUP	PRODUCT	QUANTITY	UNIT	ACRES	ADVERTISE PRICE
1	B. T. Aspen	Sawtimber	12.4	MBF	6.3	\$6,189.45
	Red Maple		7.1	MBF		
	Red Oak		18.6	MBF		
	Mixed Aspen	Pulpwood	36	Cords		
	<i>B. T. Aspen</i>		36	<i>Cords</i>		
	Mixed Hardwood		56	Cords		
	<i>Red Maple</i>		56	<i>Cords</i>		
	Mixed Oak		65	Cords		
	<i>BI/R/Hybrid Oak</i>		22	<i>Cords</i>		
	<i>Red Oak</i>		37	<i>Cords</i>		
<i>White Oak</i>		6	<i>Cords</i>			
2	Jack Pine	Sawtimber	17.5	MBF	9.8	\$4,641.95
	Red Oak		7.3	MBF		
	Jack Pine	Pulpwood	107	Cords		
	Mixed Aspen		6	Cords		
	<i>Quaking Aspen</i>		6	<i>Cords</i>		
	Mixed Hardwood		47	Cords		
	<i>Black Cherry</i>	Sawtimber	3.6	<i>MBF</i>		
	<i>Black Cherry</i>	Pulpwood	5	<i>Cords</i>		
	<i>Red Maple</i>		35	<i>Cords</i>		
	Mixed Oak		3	Cords		
	<i>Red Oak</i>		3	<i>Cords</i>		
	Red Pine		8	Cords		
	White Pine		27	Cords		
	<i>White Pine</i>	Sawtimber	7.4	<i>MBF</i>		
<i>White Pine</i>	Pulpwood	12	<i>Cords</i>			
TOTAL:			62.9	MBF		
TOTAL:			355	Cords		

Sale Specific Conditions & Requirements

Sale Name: Saints Alive

Sale Number: 71-007-21 Seq#: 1

1 - Sale Area

1.2 - Boundaries

1.2.1 - Painted boundaries (9/19)

The sale boundary and Payment Unit boundaries are marked and identified by blue and red paint. Exterior sale boundary lines against private property are marked with blue paint. Exterior sale boundary lines against state are marked with red paint. The painted boundary line trees are not Included Timber and are to be protected.

2 - Timber Specifications

2.1 - Included Timber

2.1.1 - Clearcut unit(s) with unmerchantable trees (6/14)

Within Payment Unit(s) 1 and 2, cut all trees that are two (2) inches or more at DBH, except do not cut any red pine and white pine regardless of size. In addition, within Payment Unit 1, do not cut any oak 18 inches and greater at DBH.

2.2 - Utilization

2.2.3 - Stump heights (4/07)

Stump heights within the Sale Area shall not exceed 6 inches in height for reforestation purposes.

2.2.10 - No chipping tops and limbs (8/16)

Within Payment Unit(s) 2, chipping of the bole, 2-inches in diameter or greater, is allowed. Chipping of limbs or portions of the tree less than 2-inches in diameter is not permitted. Limbs and the remaining top must be left on site and scattered.

3 - Payments

3.3 - Pre-measured Sales

3.3.4 - Dividing payment units (7/14)

Payment Unit(s) may be divided at the request of the Purchaser and upon approval of the Unit Manager. Dividing Payment Units is a contract modification which requires a Timber Sale Contract Amendment.

4 - Transportation

4.1 - Construction

4.1.12 - No new roads (1/12)

No new roads will be permitted in any Payment Unit. Skid trails only will be allowed.

4.2 - Maintenance

4.2.3 - Road maintenance (8/13)

The following road maintenance is required: Within 60 days of completion of hauling, or if no hauling occurs for 60 days, the road must be maintained and graded. This includes cleaning of drainage areas, grading, crowning, and filling with gravel, if necessary. Damages will be assessed if grading/repair does not occur.

4.2.5 - Two wheel drive condition (2/04)

All existing trail roads on and adjacent to the sale area must be passable by two-wheel drive traffic for the duration of the sale.

5 - Operations

5.1 - Notification

5.1.1 - Pre-sale conference (10/16)

A pre-sale conference between the Purchaser and sale administrator is required prior to beginning any operations to determine landing and road locations.

5.1.4 - Post-sale conference (10/16)

A post-sale conference on site between the Purchaser and sale administrator is required prior to the completion of active logging operations to determine clean-up and repair of landings, road edges, and the fulfillment of other contract specifications.

5.2 - Conduct of Operations

5.2.1 - Slash

5.2.1.8 - Slash height (12/08)

No slash or tree tops may exceed 24 inches in height. Any slash/tops remaining on site must be scattered uniformly over the entire Sale Area and not left in "windrows" from harvest operations.

5.2.2 - Hazard Trees/Snags

5.2.2.1 - Den trees (10/16)

Obvious hollow and/or den trees shall be protected and left standing unless they are a safety hazard.

5.2.4 - Dead and Down Creation

5.2.4.3 - Dead and down creation, dead trees (6/07)

Except as provided for in General Condition and Requirement 5.2.2, no dead trees, standing or down, are to be cut, skidded, or processed.

5.2.30 - Landing/road top soil protection (2/15)

Top soil on new landings must be removed, stockpiled and saved. Upon completion of the timber sale, soil must be evenly distributed back over the area for revegetation.

5.2.32 - Decking/landing restoration (9/13)

All decking and landing areas must have the surface area restored to a condition equal to or better than before. This is to ensure the proper regeneration of the stand. Wood debris, chips, and "cookies" from trimmings must be removed or scattered away from landing and loading areas and may not be windrowed on the edge.

5.4 - Soil Protection

5.4.1 - Rutting restriction, general (7/16)

Operations are to cease immediately if equipment and weather conditions result in rutting of roads and/or skid trails which is 12 inches or greater in depth and 50 feet in length. The Unit Manager or his/her representative may restrict hauling and/or skidding if ruts exceed the specified depth. With the Unit Manager or his/her representative's approval, the Purchaser may return to the area when the risk of rutting has decreased.

6 - Safety and Fire Prevention

6.2 - Signing

6.2.1 - Road posting (10/20)

The Purchaser is responsible for posting and maintaining caution signs on County Road 100 prior to beginning operations. The road must be posted at appropriate distances from the Sale Area to warn of logging activity and truck traffic. Signs must be removed when harvest operations are suspended or completed. The Purchaser will provide these signs.



TIMBER SALE MAP

This information provided by authority of Part 525, 1994 PA 451, as amended.

Forest Management Unit Roscommon Management Unit		County Roscommon County	Mapped By Lewicki	Date 9/29/21	Page 1	of 1
Township 24N	Range 03W	Section(s) and Subdivision(s) S.22 N1/2SE		Scale 1:15,840		

Cover Type				Density			
A = Aspen	H = Hemlock	N = Marsh	U = Upland Brush	0 = Non Stocked	5 = Pole Timber Medium		
B = Paper Birch	J = Jack Pine	O = Oak	UM = Upland Mixed	1 = Seedling Sapling Poor	6 = Pole Timber Well		
C = Cedar	L = Lowland Brush	P = Lowland Poplar	V = Bog or Marsh	2 = Seedling Sapling Medium	7 = Saw Timber Poor		
D = Treed Bog	LM = Lowland Mixed	Q = Mixed Swamp Conifer	W = White Pine	3 = Seedling Sapling Well	8 = Saw Timber Medium		
E = Swamp Hdwoods	M = Mpl, Bch, Brch	R = Red Pine	X = Non Stocked	4 = Pole Timber Poor	9 = Saw Timber Well		
F = Spruce Fir	MC = Mixed Conifer	S = Black Spruce	Z = Water				
G = Grass	MD = Mixed Deciduous	T = Tamarack					

PU	Acres
1	6.3
2	9.8

Saints Alive

Compartment 032

16.1 Acres

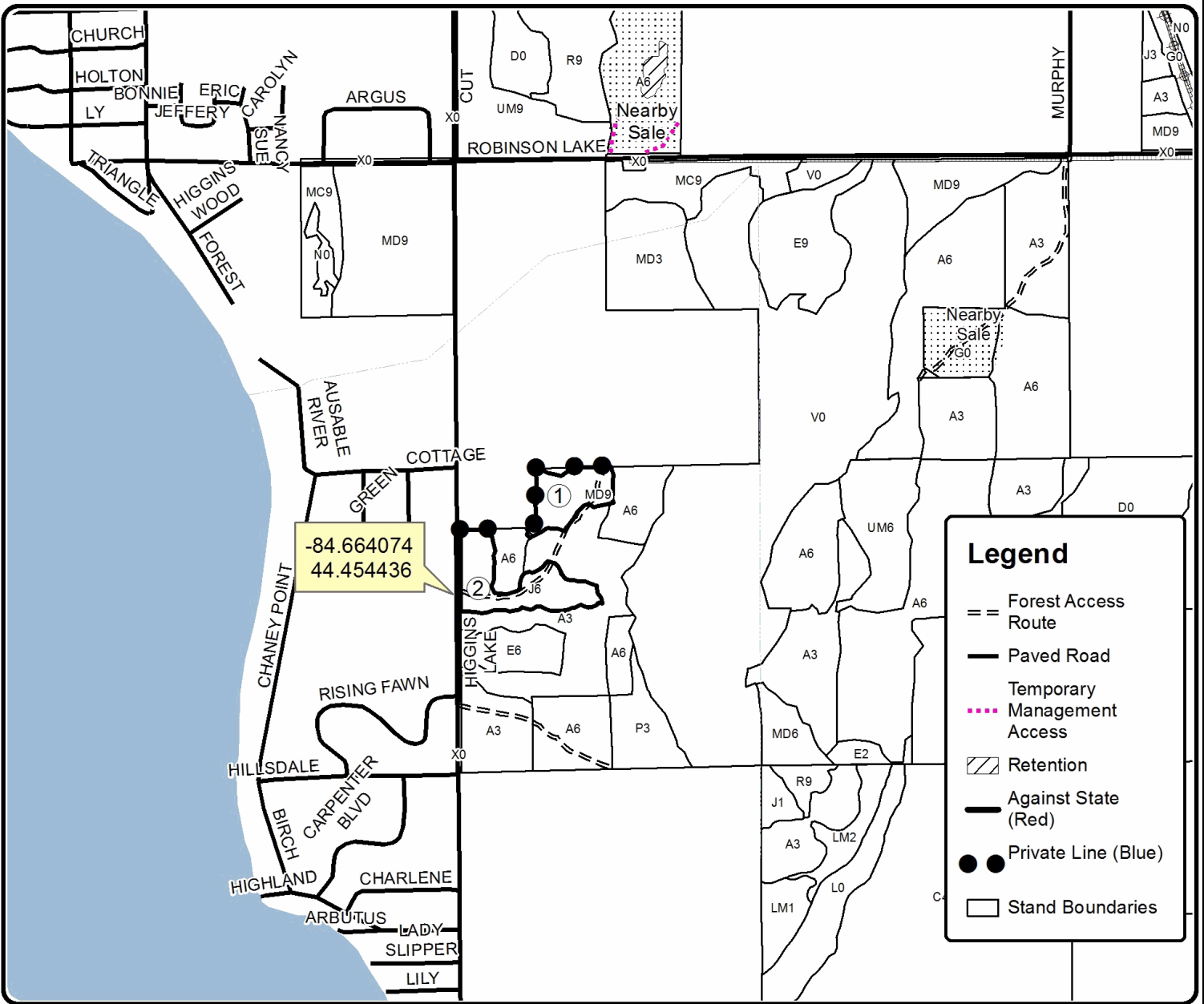

TIMBER SALE INFORMATION

C30 Leftovers (71-009-21)

T23N, R02W, SEC. 18; T23N, R03W, SEC. 10; T23N, R03W, SEC. 12; T23N, R03W, SEC. 13.
Roscommon County (Advertised Price \$105,215.70)

SALE NOTE: All units of volume listed for this sale were estimated using the Inventory Manager computer program and the new Michigan taper model.

A timber sale contract for this lump sum, sealed bid timber sale will be awarded to the responsible bidder offering the highest sealed bid price. All units of volume listed below were estimated using the Inventory Manager computer program and the new Michigan taper model. Bids must be at or above the following advertised price for each product and species:

<u>PRODUCTS & SPECIES</u>	<u>ESTIMATED UNITS*</u>	<u>ADVERTISED PRICE</u>
Sawtimber		
BI/R/Hybrid Oak	92.1 MBF	\$ 80.00 / MBF
Black Cherry	15.2 MBF	\$ 136.00 / MBF
Mixed Aspen	316.1 MBF	\$ 68.00 / MBF
Red Maple	63.2 MBF	\$ 63.00 / MBF
Red Oak	37.9 MBF	\$ 128.00 / MBF
Red Pine	33.1 MBF	\$ 92.00 / MBF
White Pine	18.4 MBF	\$ 46.00 / MBF
Pulpwood		
Balsam Fir	62 Cords	\$ 17.90 / Cord
Jack Pine	52 Cords	\$ 13.80 / Cord
Mixed Aspen	2,217 Cords	\$ 19.80 / Cord
Mixed Hardwood	436 Cords	\$ 15.35 / Cord
Mixed Oak	394 Cords	\$ 14.55 / Cord
Red Pine	19 Cords	\$ 34.40 / Cord
White Pine	128 Cords	\$ 21.55 / Cord

* The total volume is statistically estimated within plus (+) or minus (-) 4.24 percent. There are an estimated 4,575 cords on this timber sale, plus or minus 194 cords at the 95% confidence level. The estimated units are final and not subject to adjustment. Prospective bidders are urged to examine this timber and to make their own estimates of quantity and quality.

BOND AND PAYMENT SCHEDULE:

1. A bond in the amount of \$5,261.00 to insure faithful performance of the conditions of the contract will be deposited by the successful bidder within 21 days of the sale award.
2. Cutting in any sale or unit without the required advance payment would be considered a trespass.
3. Total payment must be paid in advance or according to the following schedule :
 - (a) Ten percent (10%) of the sale value must be paid within 21 days of the sale award.
 - (b) The 10% down payment will be credited towards the first unit cut.
 - (c) Payment for each of the following units must be made before cutting begins in that unit:

PAYMENT UNIT NUMBER	PERCENT OF TOTAL SALE VALUE
01	18.1%
02	10.5%
03	25.5%
04	2.2%
05	1.0%
06	15.0%
07	27.7%
4. If no cutting takes place, the 10% down payment will not be refunded.
5. Operations on the contract issued will terminate on 03/31/2024.

SALE STATISTICS

Volumes were calculated in cubic feet using the Michigan taper model. Cubic foot volume includes all wood inside bark for the product indicated. For display purposes, cubic feet were converted to cords and MBF using a simple conversion factor, e.g. 79 cubic feet per cord and 185 cubic feet per MBF. The cubic foot volumes are precise; the cords and MBF volumes are not. Cubic foot volume cannot be directly converted to cords or boards with precision.

SALE VOLUMES

The total estimated sale volume may not equal the sum of the species/products due to the nature of statistical calculations associated with double sampling methodology.

VOLUME			STATISTICAL RANGE IN CORDS	
TOTAL CUBIC FEET	TOTAL CORDS	PERCENT ERROR	MINIMUM	MAXIMUM
361,411	4,575	4.24%	4,380	4,769

VDU VOLUMES

A VDU is a Volume Determination Unit. Volumes and their associated statistics are calculated at the VDU level and summarized to the sale level. There is often a one to one relationship between a VDU and a Payment Unit, but not always, depending on the cruise design. Refer to the VDU TO PAYMENT UNIT table.

	VOLUME			RANGE IN CORDS	
VDU	TOTAL CUBIC FEET	TOTAL CORDS	PERCENT ERROR	MINIMUM	MAXIMUM
29	2,372	30	33.33%	20	40
46	59,432	752	6.66%	702	802
57	96,594	1,223	5.99%	1,149	1,296
94	37,485	474	15.23%	402	547
153	59,105	748	12.58%	654	842
176	10,722	136	29.10%	96	175
178	86,788	1,099	9.32%	996	1,201
TOTAL:	352,497	4,462		4,020	4,904

VDU TO PAYMENT UNIT

When a VDU is associated with more than one Payment Unit (PU), the VDU volumes are assigned to the PU based on acres of the VDU within the PU.

VDU	VDU ACRES	PU	PU ACRES
29	2.1	5	2.1
46	14.0	6	14.0
57	23.1	7	23.1
94	20.8	2	20.8
153	25.6	1	25.6
176	11.1	4	11.1
178	25.5	3	25.5
TOTAL:	122.2		122.2

DESCRIPTION OF TIMBER BY PAYMENT UNIT (PU)

PU	MARKET GROUP	PRODUCT	QUANTITY	UNIT	ACRES	ADVERTISE PRICE		
1	BI/R/Hybrid Oak	Sawtimber	73.3	MBF	25.6	\$19,067.10		
	Mixed Aspen		51.6	MBF				
	<i>B. T. Aspen</i>		9.5	<i>MBF</i>				
	<i>Quaking Aspen</i>		42.1	<i>MBF</i>				
	Red Maple		36.9	MBF				
	White Pine		7.8	MBF				
	Mixed Aspen		Pulpwood	117			Cords	
	<i>B. T. Aspen</i>			39			<i>Cords</i>	
	<i>Quaking Aspen</i>			78			<i>Cords</i>	
	Mixed Hardwood			102			Cords	
	<i>Black Cherry</i>			8			<i>Cords</i>	
	<i>Red Maple</i>			94			<i>Cords</i>	
	Mixed Oak			138			Cords	
	<i>White Oak</i>			Sawtimber			3.7	<i>MBF</i>
	<i>BI/R/Hybrid Oak</i>						Pulpwood	123
	<i>White Oak</i>	8						<i>Cords</i>
White Pine	52	Cords						
2	BI/R/Hybrid Oak	Sawtimber	9.6	MBF	20.8	\$11,004.90		
	Mixed Aspen		24.3	MBF				
	<i>Quaking Aspen</i>		24.3	<i>MBF</i>				
	Red Maple		2.9	MBF				
	Red Pine		18.2	MBF				
	Balsam Fir		Pulpwood	17			Cords	
	Mixed Aspen			196			Cords	
	<i>Quaking Aspen</i>			196			<i>Cords</i>	
	Mixed Hardwood			88			Cords	
	<i>Black Cherry</i>			22			<i>Cords</i>	
	<i>Red Maple</i>			66			<i>Cords</i>	
	Mixed Oak			28			Cords	
	<i>BI/R/Hybrid Oak</i>			28			<i>Cords</i>	
	Red Pine	4		Cords				
White Pine	30	Cords						
3	BI/R/Hybrid Oak	Sawtimber	3.7	MBF	25.5	\$26,844.10		
	Black Cherry		15.2	MBF				
	Mixed Aspen		117.9	MBF				
	<i>B. T. Aspen</i>		104.9	<i>MBF</i>				
	<i>Quaking Aspen</i>		13.0	<i>MBF</i>				
	Red Maple		13.9	MBF				
	Red Pine		10.5	MBF				
	White Pine		4.4	MBF				
	Balsam Fir		Pulpwood	23			Cords	
	Mixed Aspen			529			Cords	
	<i>B. T. Aspen</i>			418			<i>Cords</i>	
	<i>Quaking Aspen</i>			111			<i>Cords</i>	
	Mixed Hardwood			132			Cords	
	<i>Black Cherry</i>			12			<i>Cords</i>	
	<i>Red Maple</i>			120			<i>Cords</i>	
	Mixed Oak			42			Cords	
	<i>BI/R/Hybrid Oak</i>	42		<i>Cords</i>				
Red Pine	1	Cords						
White Pine	40	Cords						
4	Red Maple	Sawtimber	2.6	MBF	11.1	\$2,353.45		
	White Pine		4.2	MBF				
	Balsam Fir	Pulpwood	17	Cords				
	Jack Pine		52	Cords				
	<i>Jack Pine</i>		Sawtimber	8.6			<i>MBF</i>	

DESCRIPTION OF TIMBER BY PAYMENT UNIT (PU), CON'T

PU	MARKET GROUP	PRODUCT	QUANTITY	UNIT	ACRES	ADVERTISE PRICE
4 con't	<i>Jack Pine</i>	<i>Pulpwood</i>	35	<i>Cords</i>		
	Mixed Aspen		32	<i>Cords</i>		
	<i>Quaking Aspen</i>		32	<i>Cords</i>		
	Mixed Hardwood		18	<i>Cords</i>		
	<i>Red Maple</i>		18	<i>Cords</i>		
	White Pine		3	<i>Cords</i>		
5	Mixed Aspen	Sawtimber	1.8	MBF	2.1	\$1,076.35
	<i>B. T. Aspen</i>		1.8	<i>MBF</i>		
	Red Maple		0.2	MBF		
	Red Pine	Pulpwood	4.4	MBF		
	Mixed Aspen		2	<i>Cords</i>		
	<i>B. T. Aspen</i>		2	<i>Cords</i>		
	Mixed Hardwood		1	<i>Cords</i>		
	<i>Red Maple</i>		1	<i>Cords</i>		
	Red Pine		14	<i>Cords</i>		
6	BI/R/Hybrid Oak	Sawtimber	5.5	MBF	14.0	\$15,766.85
	Mixed Aspen		39.7	MBF		
	<i>B. T. Aspen</i>		39.7	<i>MBF</i>		
	White Pine	Pulpwood	2.0	MBF		
	Balsam Fir		5	<i>Cords</i>		
	Mixed Aspen		552	<i>Cords</i>		
	<i>B. T. Aspen</i>		552	<i>Cords</i>		
	Mixed Hardwood		32	<i>Cords</i>		
	<i>Red Maple</i>		32	<i>Cords</i>		
	Mixed Oak		66	<i>Cords</i>		
	<i>BI/R/Hybrid Oak</i>		66	<i>Cords</i>		
	White Pine		3	<i>Cords</i>		
	7		Mixed Aspen	Sawtimber		
<i>B. T. Aspen</i>		80.8	<i>MBF</i>			
Red Maple		6.7	MBF			
Red Oak		Pulpwood	37.9	MBF		
Mixed Aspen			789	<i>Cords</i>		
<i>B. T. Aspen</i>			789	<i>Cords</i>		
Mixed Hardwood			63	<i>Cords</i>		
<i>Red Maple</i>			63	<i>Cords</i>		
Mixed Oak			120	<i>Cords</i>		
<i>BI/R/Hybrid Oak</i>			50	<i>Cords</i>		
<i>Red Oak</i>			70	<i>Cords</i>		
TOTAL:			576.0	MBF		
TOTAL:			3,308	Cords		

Sale Specific Conditions & Requirements

Sale Name: C30 Leftovers

Sale Number: 71-009-21 Seq#: 1

1 - Sale Area

1.2 - Boundaries

1.2.1 - Painted boundaries (9/19)

The sale boundary and Payment Unit boundaries are marked and identified by blue, red, and yellow paint. Exterior sale boundary lines against private property are marked with blue paint. Exterior sale boundary lines against state are marked with red paint. Interior Payment Unit boundaries are marked with yellow paint. Retention patches are marked with red paint; no harvesting activities may occur within these areas. The painted boundary line trees are not Included Timber and are to be protected. Yellow painted trees designating an interior Payment Unit boundary are only to be cut when all surrounding Payment Units have been paid.

2 - Timber Specifications

2.1 - Included Timber

2.1.1 - Clearcut unit(s) with unmerchantable trees (6/14)

Within Payment Unit(s) 1-4, cut all trees that are two (2) inches or more at DBH, except trees marked with green paint.

2.1.3 - Cut tree marked unit(s) (12/08)

Within Payment Unit(s) 5, all trees are designated for cutting when marked with orange paint above and below stump height, regardless of merchantability.

2.2 - Utilization

2.2.3 - Stump heights (4/07)

Stump heights within the Sale Area shall not exceed 12 inches for trees greater than 10 inches at DBH and 4 inches for trees smaller than 10 inches at DBH.

2.2.6 - Roundwood operation required (3/21)

The skidding of whole trees or tree segments with limbs attached is prohibited within Payment Unit 5. All products must be produced as roundwood and forwarded to existing roads or landing areas in final product length.

2.2.9 - No chipping permitted (12/08)

Within Payment Unit(s) 4 and 5, all wood must be removed by whole tree, tree segment, or roundwood. No chipping is permitted, and the tops must be left scattered evenly throughout the Payment Unit area.

3 - Payments

3.3 - Pre-measured Sales

3.3.4 - Dividing payment units (7/14)

Payment Unit(s) may be divided at the request of the Purchaser and upon approval of the Unit Manager. Dividing Payment Units is a contract modification which requires a Timber Sale Contract Amendment.

3.4 - Damaged Timber

3.4.1 - Damaged timber (7/16)

General Condition and Requirement 3.4 Damaged Timber, defines liquidated damages for undesigned live merchantable trees which are cut or injured. No damage is acceptable to undesigned live merchantable trees. Within the Sale Area, if more than 5% of the residual trees (> 4.5" DBH) within a specified area of the sale are damaged, liquidated damages will be assessed for all trees damaged. Rates will be in accordance with General Condition and Requirement 3.4 Damaged Timber.

4 - Transportation

4.1 - Construction

4.1.6 - Road construction (1/09)

Construction of new roads or improvements of existing roads shall be done in such a way as to minimize the environmental and visual impacts. Merchantable trees shall be cut and utilized unless otherwise directed. Non-merchantable trees shall be severed and laid flat on the ground. Slash shall be scattered, and not left in windrows and kept a minimum of 10 feet back from the road edge. Stumps shall be set upright, not left on edge, and be moved at least 10 feet away from the road edge. Disturbed soil shall be feathered into the woods and not left in berms or windrows.

4.1.7 - Road closure (10/11)

All new roads built into the sale must be blocked to vehicle traffic upon completion of the sale. In general, this will require constructing a four (4') foot high berm of stumps and logs covered with earth. Stumps and brush must be placed along the remainder of the trail. These roads must be rendered impassable to cars and trucks. Contact the sale administrator for specific details of design and placement.

4.2 - Maintenance

4.2.1 - Hauling restriction (12/08)

Hauling may be restricted on forest roads by the Unit Manager or his/her representative. The restriction may occur during wet weather conditions.

4.2.3 - Road maintenance (8/13)

The following road maintenance is required: Within 60 days of completion of hauling, or if no hauling occurs for 60 days, the road must be maintained and graded. This includes cleaning of drainage areas, grading, crowning, and filling with gravel, if necessary. Damages will be assessed if grading/repair does not occur.

4.2.5 - Two wheel drive condition (2/04)

All existing trail roads on and adjacent to the sale area must be passable by two-wheel drive traffic for the duration of the sale.

5 - Operations

5.1 - Notification

5.1.1 - Pre-sale conference (10/16)

A pre-sale conference between the Purchaser and sale administrator is required prior to beginning any operations to determine landing and road locations.

5.1.3 - Well heads and natural gas pipelines (11/15)

The Purchaser is responsible for contacting the pipeline company 10 days prior to operating equipment in the vicinity of well heads or natural gas pipelines. Contact DTE Energy.

5.1.4 - Post-sale conference (10/16)

A post-sale conference on site between the Purchaser and sale administrator is required prior to the completion of active logging operations to determine clean-up and repair of landings, road edges, and the fulfillment of other contract specifications.

5.2 - Conduct of Operations

5.2.1 - Slash

5.2.1.8 - Slash height (12/08)

No slash or tree tops may exceed 24 inches in height. Any slash/tops left on the sale must be scattered uniformly over the entire Sale Area and not left in "windrows" from harvesting operations.

5.2.2 - Hazard Trees/Snags

5.2.2.1 - Den trees (10/16)

Obvious hollow and/or den trees shall be protected and left standing unless they are a safety hazard.

5.2.3 - Operating Restrictions

5.2.3.3 - Bark slippage restriction (3/09)

Within Payment Unit(s) 5, are not permitted during the period of April 15 to July 15. This restriction is because of bark slippage.

5.2.4 - Dead and Down Creation

5.2.4.2 - Dead and down creation, hare and grouse (1/14)

To improve habitat for snowshoe hare, grouse, and other species, the Purchaser is to leave two trees, nine (9) inches or larger in diameter on the ground for every two acres within Payment Unit(s) 1-3 and 6-7. They should be scattered throughout the sale or positioned per the sale administrator's instructions. If possible, the logs or trees should be felled so they overlap. Note these pieces should have a minimum length of five feet. They can be of any tree species and can be an un-merchantable piece of wood or a full tree.

5.2.4.3 - Dead and down creation, dead trees (6/07)

Except as provided for in General Condition and Requirement 5.2.2, no dead trees, standing or down, are to be cut, skidded, or processed.

5.2.4.4 - Dead and down creation, grouse (6/18)

To encourage grouse and other wildlife, in Payment Unit(s) 1-3 leave at least 1 large top pile per every 2 acres. These will be evenly spaced throughout the Payment Units.

5.2.32 - Decking/landing restoration (9/13)

All decking and landing areas must have the surface area restored to a condition equal to or better than before. This is to ensure the proper regeneration of the stand. Wood debris, chips, and "cookies" from trimmings must be removed or scattered away from landing and loading areas and may not be windrowed on the edge.

5.2.38 - No decking against live trees (2/04)

Cut products may not be decked against unmarked or designated leave trees.



TIMBER SALE MAP

This information provided by authority of Part 525, 1994 PA 451, as amended.

Forest Management Unit	County	Mapped By	Date	Page	of
Roscommon Management Unit	Roscommon County	Lewicki	9/28/21	1	2
Township	Range	Section(s) and Subdivision(s)	Scale		
23N	02W & 03W	S.12 N1/2SE S.13 SENW;N1/2SW S.18 SWNE;SWSW;NWSE	1:15,840		

Cover Type				Density	
A = Aspen	H = Hemlock	N = Marsh	U = Upland Brush	0 = Non Stocked	5 = Pole Timber Medium
B = Paper Birch	J = Jack Pine	O = Oak	UM = Upland Mixed	1 = Seedling Sapling Poor	6 = Pole Timber Well
C = Cedar	L = Lowland Brush	P = Lowland Poplar	V = Bog or Marsh	2 = Seedling Sapling Medium	7 = Saw Timber Poor
D = Treed Bog	LM = Lowland Mixed	Q = Mixed Swamp Conifer	W = White Pine	3 = Seedling Sapling Well	8 = Saw Timber Medium
E = Swamp Hdwoods	M = Mpl, Bch, Brch	R = Red Pine	X = Non Stocked	4 = Pole Timber Poor	9 = Saw Timber Well
F = Spruce Fir	MC = Mixed Conifer	S = Black Spruce	Z = Water		
G = Grass	MD = Mixed Deciduous	T = Tamarack			

PU	Acres	PU	Acres	PU	Acres
1	25.6	4	11.1	7	23.1
2	20.8	5	2.1		
3	25.5	6	14.0		

C30 Leftovers
Compartment 30
122.2 Acres

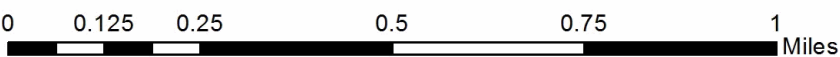
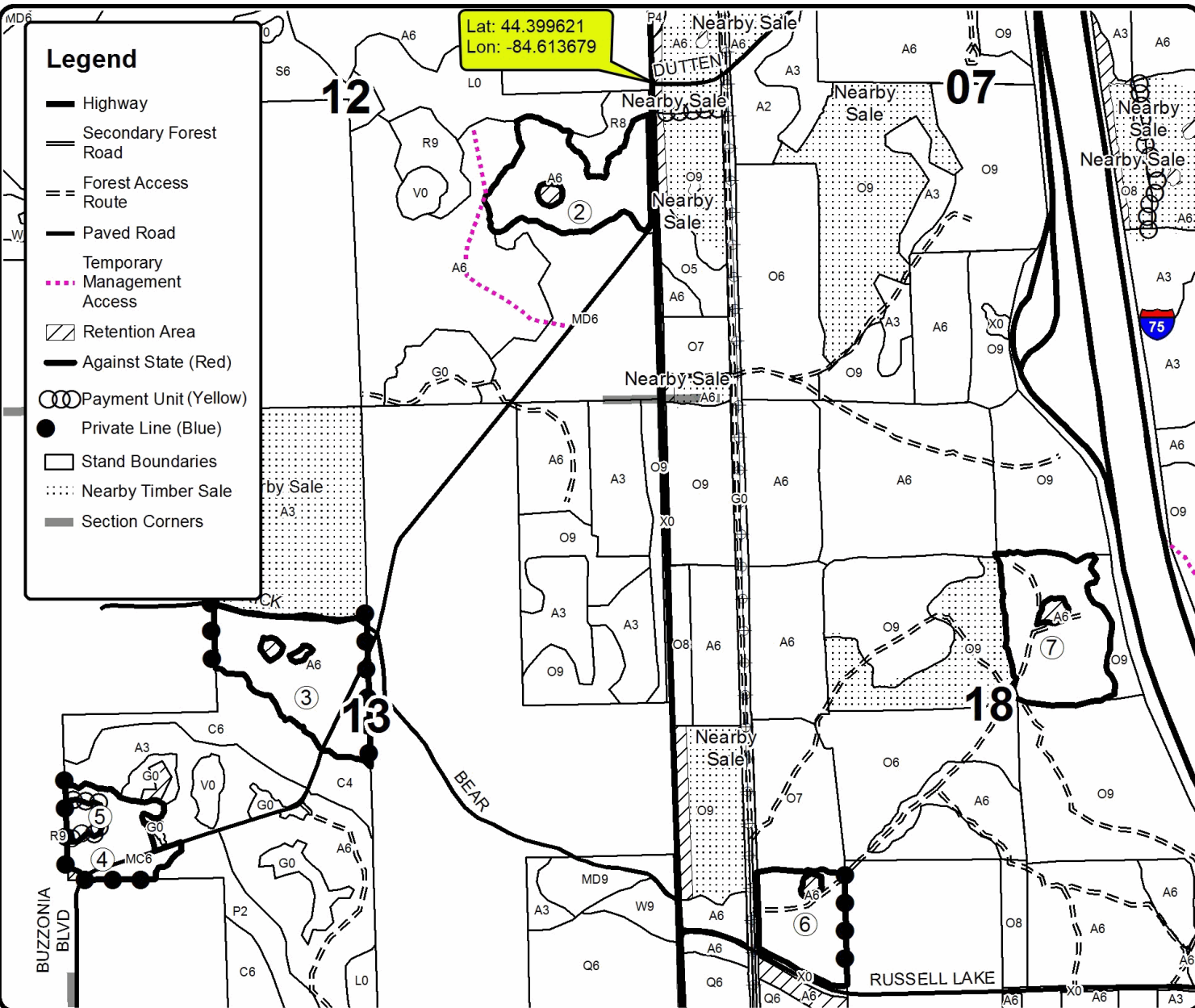
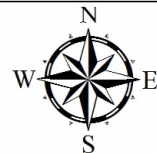



Sale Number	Year
71-009	21

TIMBER SALE MAP

This information provided by authority of Part 525, 1994 PA 451, as amended.

Forest Management Unit	County	Mapped By	Date	Page	of
Roscommon Management Unit	Roscommon County	Lewicki	9/28/21	2	2
Township	Range	Section(s) and Subdivision(s)	Scale		
23N	03W	S. 10 SESW;SWSE	1:15,840		

Cover Type				Density	
A = Aspen	H = Hemlock	N = Marsh	U = Upland Brush	0 = Non Stocked	5 = Pole Timber Medium
B = Paper Birch	J = Jack Pine	O = Oak	UM = Upland Mixed	1 = Seedling Sapling Poor	6 = Pole Timber Well
C = Cedar	L = Lowland Brush	P = Lowland Poplar	V = Bog or Marsh	2 = Seedling Sapling Medium	7 = Saw Timber Poor
D = Treed Bog	LM = Lowland Mixed	Q = Mixed Swamp Conifer	W = White Pine	3 = Seedling Sapling Well	8 = Saw Timber Medium
E = Swamp Hdwoods	M = Mpl, Bch, Brch	R = Red Pine	X = Non Stocked	4 = Pole Timber Poor	9 = Saw Timber Well
F = Spruce Fir	MC = Mixed Conifer	S = Black Spruce	Z = Water		
G = Grass	MD = Mixed Deciduous	T = Tamarack			

PU	Acres	PU	Acres	PU	Acres
1	25.6	4	11.1	7	23.1
2	20.8	5	2.1		
3	25.5	6	14.0		

C30 Leftovers
Compartment 30
122.2 Acres

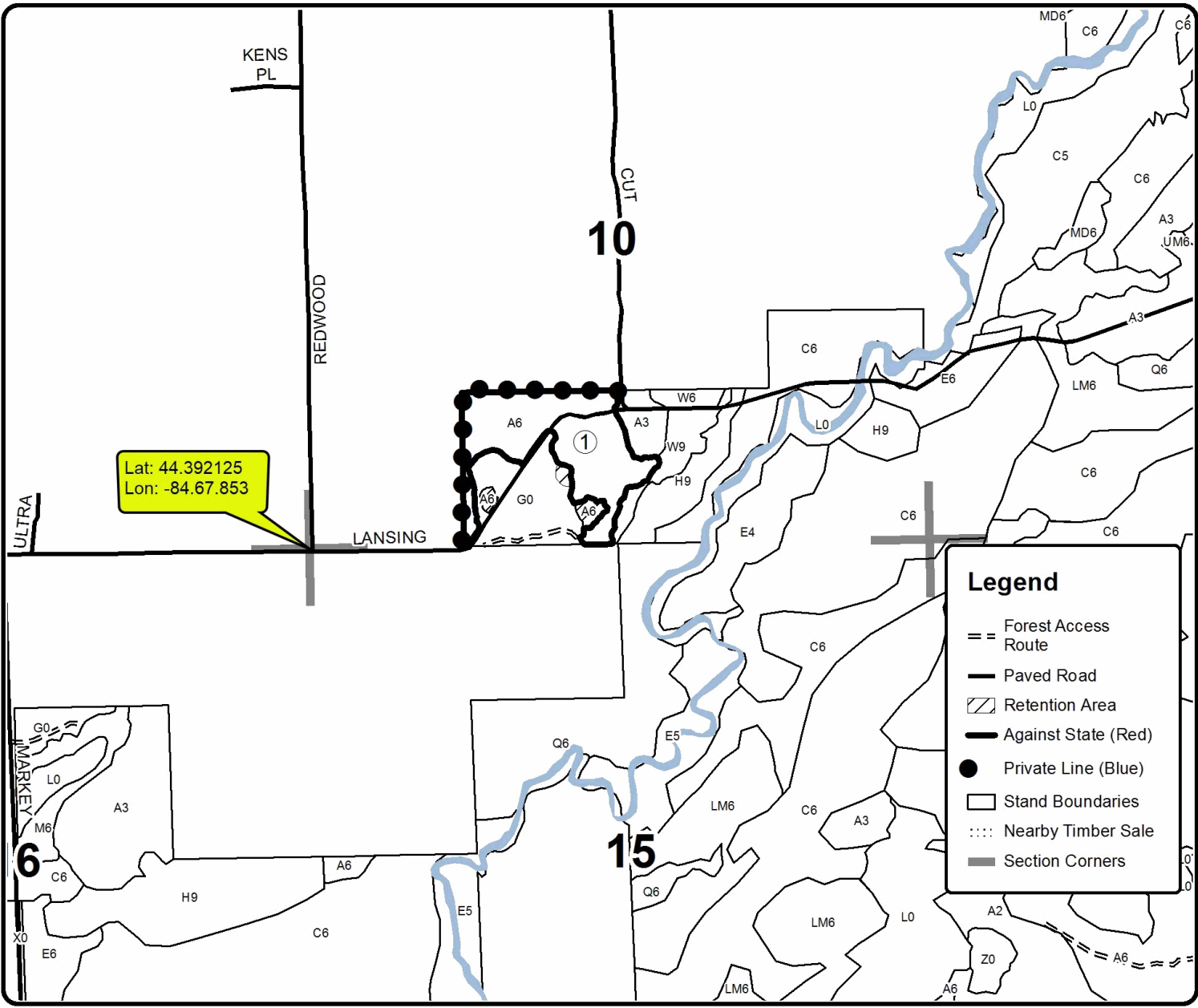

TIMBER SALE INFORMATION

County Line Jack (71-010-21)

T22N, R04W, SEC. 6.

Roscommon County (Advertised Price \$15,289.05)

SALE NOTE: All units of volume listed for this sale were estimated using the Inventory Manager computer program and the new Michigan taper model.

- See sale spec 5.2.22.1 for operational recommendations due to seasonally wet soils.
- See sale spec 5.2.17 for information on the need of mats for extra protection.
- See sale spec 4.1.11 for information on permits required for sale access.
- See sale spec 5.1.6 for information to use of R.O.W. easement for access to sale.

A timber sale contract for this lump sum, sealed bid timber sale will be awarded to the responsible bidder offering the highest sealed bid price. All units of volume listed below were estimated using the Inventory Manager computer program and the new Michigan taper model. Bids must be at or above the following advertised price for each product and species:

<u>PRODUCTS & SPECIES</u>	<u>ESTIMATED UNITS*</u>	<u>ADVERTISED PRICE</u>
Sawtimber		
Jack Pine	87.3 MBF	\$ 23.00 / MBF
Red Pine	19.5 MBF	\$ 75.00 / MBF
Pulpwood		
Jack Pine	685 Cords	\$ 11.30 / Cord
Quaking Aspen	32 Cords	\$ 16.20 / Cord
Red Maple	250 Cords	\$ 12.55 / Cord
Red Pine	15 Cords	\$ 28.15 / Cord

* The total volume is statistically estimated within plus (+) or minus (-) 8.30 percent. There are an estimated 1,212 cords on this timber sale, plus or minus 101 cords at the 95% confidence level. The estimated units are final and not subject to adjustment. Prospective bidders are urged to examine this timber and to make their own estimates of quantity and quality.

BOND AND PAYMENT SCHEDULE:

1. A bond in the amount of \$764.00 to insure faithful performance of the conditions of the contract will be deposited by the successful bidder within 21 days of the sale award.
2. Cutting in any sale or unit without the required advance payment would be considered a trespass.
3. Total payment must be paid in advance or according to the following schedule :
 - (a) Ten percent (10%) of the sale value must be paid within 21 days of the sale award.
 - (b) The 10% down payment will be credited towards the first unit cut.
 - (c) Payment for each of the following units must be made before cutting begins in that unit:

PAYMENT UNIT NUMBER	PERCENT OF TOTAL SALE VALUE
01	24.2%
02	31.2%
03	44.6%

4. If no cutting takes place, the 10% down payment will not be refunded.
5. Operations on the contract issued will terminate on 03/31/2025.

SALE STATISTICS

Volumes were calculated in cubic feet using the Michigan taper model. Cubic foot volume includes all wood inside bark for the product indicated. For display purposes, cubic feet were converted to cords and MBF using a simple conversion factor, e.g. 79 cubic feet per cord and 185 cubic feet per MBF. The cubic foot volumes are precise; the cords and MBF volumes are not. Cubic foot volume cannot be directly converted to cords or boards with precision.

SALE VOLUMES

The total estimated sale volume may not equal the sum of the species/products due to the nature of statistical calculations associated with double sampling methodology.

VOLUME			STATISTICAL RANGE IN CORDS	
TOTAL CUBIC FEET	TOTAL CORDS	PERCENT ERROR	MINIMUM	MAXIMUM
95,756	1,212	8.30%	1,111	1,313

VDU VOLUMES

A VDU is a Volume Determination Unit. Volumes and their associated statistics are calculated at the VDU level and summarized to the sale level. There is often a one to one relationship between a VDU and a Payment Unit, but not always, depending on the cruise design. Refer to the VDU TO PAYMENT UNIT table.

	VOLUME			RANGE IN CORDS	
VDU	TOTAL CUBIC FEET	TOTAL CORDS	PERCENT ERROR	MINIMUM	MAXIMUM
1	94,547	1,197	8.31%	1,097	1,296
TOTAL:	94,547	1,197		1,097	1,296

VDU TO PAYMENT UNIT

When a VDU is associated with more than one Payment Unit (PU), the VDU volumes are assigned to the PU based on acres of the VDU within the PU.

VDU	VDU ACRES	PU	PU ACRES
1	56.3	1	13.6
		2	17.5
		3	25.2
TOTAL:	56.3		56.3

DESCRIPTION OF TIMBER BY PAYMENT UNIT (PU)

PU	MARKET GROUP	PRODUCT	QUANTITY	UNIT	ACRES	ADVERTISE PRICE
1	Jack Pine	Sawtimber	21.1	MBF	13.6	\$3,697.50
	Red Pine		4.7	MBF		
	Jack Pine	Pulpwood	165	Cords		
	Quaking Aspen		8	Cords		
	Red Maple		60	Cords		
	<i>Red Maple</i>	<i>Sawtimber</i>	2.2	<i>MBF</i>		
	<i>Red Maple</i>	<i>Pulpwood</i>	56	<i>Cords</i>		
	Red Pine		4	Cords		
2	Jack Pine	Sawtimber	27.1	MBF	17.5	\$4,769.35
	Red Pine		6.1	MBF		
	Jack Pine	Pulpwood	213	Cords		
	Quaking Aspen		10	Cords		
	Red Maple		78	Cords		
	<i>Red Maple</i>	<i>Sawtimber</i>	2.8	<i>MBF</i>		
	<i>Red Maple</i>	<i>Pulpwood</i>	72	<i>Cords</i>		
	Red Pine		5	Cords		
3	Jack Pine	Sawtimber	39.1	MBF	25.2	\$6,822.20
	Red Pine		8.7	MBF		
	Jack Pine	Pulpwood	307	Cords		
	Quaking Aspen		14	Cords		
	Red Maple		112	Cords		
	<i>Red Maple</i>	<i>Sawtimber</i>	4.0	<i>MBF</i>		
	<i>Red Maple</i>	<i>Pulpwood</i>	104	<i>Cords</i>		
	Red Pine		6	Cords		
TOTAL:			106.8	MBF		
TOTAL:			982	Cords		

Sale Specific Conditions & Requirements

Sale Name: County Line Jack

Sale Number: 71-010-21 Seq#: 1

1 - Sale Area

1.2 - Boundaries

1.2.1 - Painted boundaries (9/19)

The sale boundary and Payment Unit boundaries are marked and identified by red paint. Exterior sale boundary lines against state are marked with red paint. The painted boundary line trees are not Included Timber and are to be protected.

2 - Timber Specifications

2.1 - Included Timber

2.1.1 - Clearcut unit(s) with unmerchantable trees (6/14)

Within Payment Unit(s) 1-3, cut all trees that are two (2) inches or more at DBH.

2.2 - Utilization

2.2.10 - No chipping tops and limbs (8/16)

Within Payment Unit(s) 1-3, chipping of the bole, 2-inches in diameter or greater, is allowed. Chipping of limbs or portions of the tree less than 2-inches in diameter is not permitted. Limbs and the remaining top must be left on site and scattered.

4 - Transportation

4.1 - Construction

4.1.6 - Road construction (1/09)

Construction of new roads or improvements of existing roads shall be done in such a way as to minimize the environmental and visual impacts. Merchantable trees shall be cut and utilized unless otherwise directed. Non-merchantable trees shall be severed and laid flat on the ground. Slash shall be scattered, and not left in windrows and kept a minimum of 10 feet back from the road edge. Stumps shall be set upright, not left on edge, and be moved at least 10 feet away from the road edge. Disturbed soil shall be feathered into the woods and not left in berms or windrows.

4.1.7 - Road closure (10/11)

All new roads built into the sale must be blocked to vehicle traffic upon completion of the sale. Overgrown roads that are reopened shall be considered new roads. In general, this will require constructing a four (4') foot high berm of stumps and logs covered with earth. Stumps and brush must be placed along the remainder of the trail. These roads must be rendered impassable to cars and trucks. Contact the sale administrator for specific details of design and placement.

4.1.11 - Permits (2/12)

The DNR will secure any necessary driveway/highway permits that may be required. Access from M-55 may require a driveway permit to be obtained by the DNR if an existing forest road east of Payment Unit 2 can be used and the amount of work needed to bring it up to hauling standards requires one. Any needed work will be completed by the Purchaser.

5 - Operations

5.1 - Notification

5.1.6 - Utility R.O.W. (4/19)

It is the responsibility of the Purchaser to obtain permission from the utility company to utilize the R.O.W. for operations. An easement runs along the south side of M-55. Multiple utilities present both above and below ground north of the sale and could possibly be used to access Payment Unit 2. Feasibility of this will be determined by the timber sale administrator and no soil disturbance is to be done in this area without administrator approval. Contact MISSDIG prior to beginning operations if new driveway access from M-55 is planned.

5.2 - Conduct of Operations

5.2.1 - Slash

5.2.1.11 - Slash for reforestation (3/21)

To facilitate reforestation, the Sale Area shall be left with slash evenly distributed. Bunched tops within the cutting area shall be broken up and scattered evenly over the Sale Area and not left in "windrow" piles from harvesting activities. Stumps shall be cut low to the ground. Processing sites shall not be left with a compacted layer of slash; tops from these sites shall be hauled back into the cut area and scattered.

5.2.4 - Dead and Down Creation

5.2.4.7 - Dead and down creation: hare, grouse, deer and other species (5/15)

To improve horizontal cover habitat for snowshoe hare, grouse, deer, and other species, the Purchaser is to push over five (5) jack pine trees with a minimum DBH of six (6) inches along adjacent lowland edges of Payment Unit 3. These trees should be tipped over with the root ball still attached so the base of the tree is suspended off the ground. The crown of the fallen tree should be at or near ground level after it is pushed over. The Purchaser is also required to leave ten (10) brush piles along adjacent lowland edges. These piles should have large wood pieces or a large stump at the bottom of the pile to create air pockets/cavities within the brush pile.

5.2.17 - Timber Mats and Interlocking Composite Mats (10/20)

Crossing wet areas to reach certain portions of Payment Unit 3, will require extra protection such as that afforded by timber mats, interlocking composite mats, or another approved system. If available, mats may be borrowed from the DNR. A Timber Sale Contract Supplement will be used to document the Purchaser's use of the DNR's mats. Contact the sale administrator regarding availability and pick-up. Timber mats are available from various field offices. Composite mats are only available from the Grayling field office and the Marquette ICC. The Purchaser is responsible for picking up and hauling the mats to and from the site. The composite mats will require DNR staff onsite for installation and removal. Contact the sale administrator to schedule at least 30 days before desired install/removal date. All mats must be cleaned prior to drop off. This may include, but is not limited to, power washing and brushing to remove mud and debris. A charge of \$700.00 per timber mat and \$2,000.00 per composite mat will be assessed for all damaged or non-returned mats. Damage for the crane/timber mats is defined as three or more broken cants. Damage for the composite mats is defined as cracked or broken mats.

5.2.22 - Operating Caution

5.2.22.1 - Operating caution (6/11)

It is recommended, but not required, that within Payment Unit(s) 1-3, cutting, skidding, and hauling occur during dry summer or frozen winter conditions. The reason for the recommendation is because of seasonally saturated soils.

5.2.31 - Landing locations (9/13)

Recommended landing areas are marked on the Timber Sale Map with the letter "L". Landings must be confined to these designated sites unless otherwise authorized by the Unit Manager or his/her representative.

5.2.32 - Decking/landing restoration (9/13)

All decking and landing areas must have the surface area restored to a condition equal to or better than before. This is to ensure the proper regeneration of the stand. Wood debris, chips, and "cookies" from trimmings must be removed or scattered away from landing and loading areas and may not be windrowed on the edge.

5.4 - Soil Protection

5.4.1 - Rutting restriction, general (7/16)

Operations are to cease immediately if equipment and weather conditions result in rutting of roads and/or skid trails which is 12 inches or greater in depth and 50 feet in length. The Unit Manager or his/her representative may restrict hauling and/or skidding if ruts exceed the specified depth. With the Unit Manager or his/her representative's approval, the Purchaser may return to the area when the risk of rutting has decreased.

5.4.5 - Soil caution (11/04)

Care must be taken to minimize soil damage due to seasonally saturated soils.

7 - Other Conditions

7.2 - Extensions

7.2.5 - Weather related extension (1/13)

If weather conditions during the operating period of this contract prevent harvesting, this sale may qualify for a weather related extension. If approved, the normal extension fee would be waived. To qualify, there must be a documented attempt each year to harvest in the difficult portion of the sale.

7.5 - Loss

7.5.1 - Deteriorating timber (7/09)

The sale area has received damage from windthrow or jack pine budworm. The Purchaser should harvest the wood as soon as possible. The Department of Natural Resources is held free of responsibility of any further damage or deterioration due to delay in harvesting.



Sale Number	Year
71 - 010	21

TIMBER SALE MAP

This information provided by authority of Part 525, 1994 PA 451, as amended.

Forest Management Unit Roscommon	County Roscommon	Mapped By Scott Shooltz	Date 09/30/2021	Page 1	of 1
Township 22N	Range 04W	Section(s) and Subdivision(s) Sections: 6 Subdivisions: NW, NWNE, NESW	Scale 1:15,840		

Cover Type				Density	
A = Aspen	H = Hemlock	N = Marsh	U = Upland Brush	0 = Non Stocked	5 = Pole Timber Medium
B = Paper Birch	J = Jack Pine	O = Oak	UM = Upland Mixed	1 = Seedling Sapling Poor	6 = Pole Timber Well
C = Cedar	L = Lowland Brush	P = Lowland Poplar	V = Bog or Marsh	2 = Seedling Sapling Medium	7 = Saw Timber Poor
D = Treed Bog	LM = Lowland Mixed	Q = Mixed Swamp Conifer	W = White Pine	3 = Seedling Sapling Well	8 = Saw Timber Medium
E = Swamp Hardwoods	M = Mpl. Ech. Birch	R = Red Pine	X = Non Stocked	4 = Pole Timber Poor	9 = Saw Timber Well
F = Spruce Fir	MC = Mixed Conifer	S = Black Spruce	Z = Water		
G = Creas	MD = Mixed Deciduous	T = Tamarack			

PU	Acres
1	13.6
2	17.5
3	25.2

County Line Jack

Compartment 10

56.3 Acres

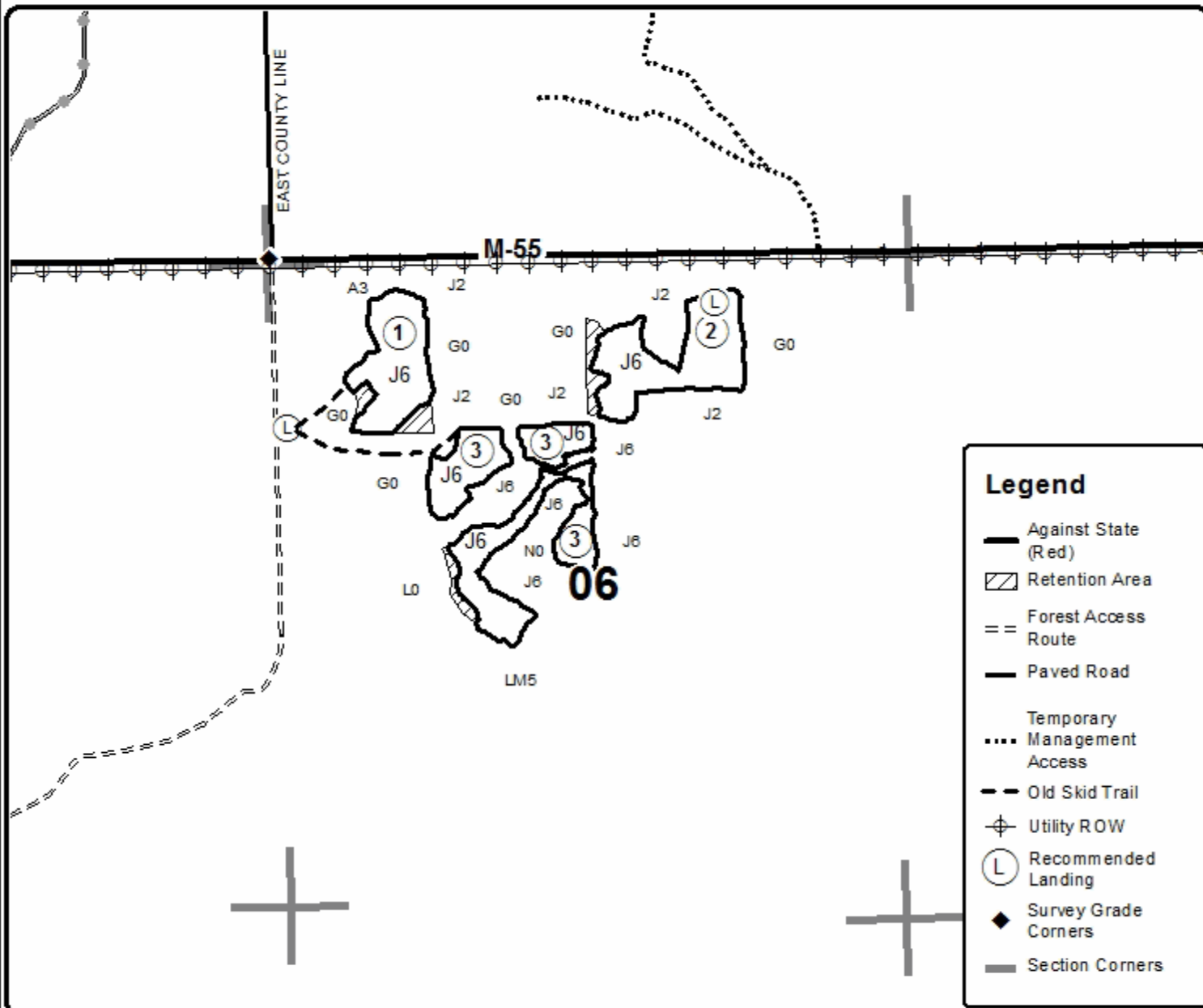

TIMBER SALE INFORMATION

5 Year Rotation Mix (71-012-21)

T24N, R03W, SEC. 11; T24N, R03W, SEC. 12; T24N, R03W, SEC. 13; T24N, R03W, SEC. 15; T24N, R03W, SEC. 23; T24N, R03W, SEC. 24.

SALE NOTE: All units of volume listed for this sale were estimated using the Inventory Manager computer program and the new Michigan taper model.

A recreation site such as a trail, pathway, or campground is within the sale area or the vicinity. Certain restrictions/specifications may be applicable including time restrictions.

A timber sale contract for this lump sum, sealed bid timber sale will be awarded to the responsible bidder offering the highest sealed bid price. All units of volume listed below were estimated using the Inventory Manager computer program and the new Michigan taper model. Bids must be at or above the following advertised price for each product and species:

<u>PRODUCTS & SPECIES</u>	<u>ESTIMATED UNITS*</u>	<u>ADVERTISED PRICE</u>
Sawtimber		
BI/R/Hybrid Oak	273.8 MBF	\$ 80.00 / MBF
Jack Pine	15.7 MBF	\$ 28.00 / MBF
Mixed Aspen	157.0 MBF	\$ 68.00 / MBF
Red Maple	14.7 MBF	\$ 63.00 / MBF
Red Pine	266.1 MBF	\$ 92.00 / MBF
White Oak	12.3 MBF	\$ 69.00 / MBF
White Pine	12.4 MBF	\$ 46.00 / MBF
Pulpwood		
Balsam Fir	3 Cords	\$ 17.90 / Cord
Jack Pine	61 Cords	\$ 13.80 / Cord
Mixed Aspen	440 Cords	\$ 19.80 / Cord
Mixed Hardwood	225 Cords	\$ 15.35 / Cord
Mixed Oak	445 Cords	\$ 14.55 / Cord
Red Pine	1,768 Cords	\$ 34.40 / Cord
White Pine	33 Cords	\$ 21.55 / Cord

* The total volume is statistically estimated within plus (+) or minus (-) 5.99 percent. There are an estimated 4,633 cords on this timber sale, plus or minus 278 cords at the 95% confidence level. The estimated units are final and not subject to adjustment. Prospective bidders are urged to examine this timber and to make their own estimates of quantity and quality.

BOND AND PAYMENT SCHEDULE:

1. A bond in the amount of \$7,046.00 to insure faithful performance of the conditions of the contract will be deposited by the successful bidder within 21 days of the sale award.
2. Cutting in any sale or unit without the required advance payment would be considered a trespass.
3. Total payment must be paid in advance or according to the following schedule :
 - (a) Ten percent (10%) of the sale value must be paid within 21 days of the sale award.
 - (b) The 10% down payment will be credited towards the first unit cut.
 - (c) Payment for each of the following units must be made before cutting begins in that unit:

<u>PAYMENT UNIT NUMBER</u>	<u>PERCENT OF TOTAL SALE VALUE</u>
01	1.8%
02	2.7%
03	2.1%
04	3.2%
05	1.7%
06	4.3%
07	6.4%
08	4.7%
09	4.1%
10	33.8%
11	30.5%
12	4.7%

4. If no cutting takes place, the 10% down payment will not be refunded.
5. Operations on the contract issued will terminate on 03/31/2024.

SALE STATISTICS

Volumes were calculated in cubic feet using the Michigan taper model. Cubic foot volume includes all wood inside bark for the product indicated. For display purposes, cubic feet were converted to cords and MBF using a simple conversion factor, e.g. 79 cubic feet per cord and 185 cubic feet per MBF. The cubic foot volumes are precise; the cords and MBF volumes are not. Cubic foot volume cannot be directly converted to cords or boards with precision.

SALE VOLUMES

The total estimated sale volume may not equal the sum of the species/products due to the nature of statistical calculations associated with double sampling methodology.

VOLUME			STATISTICAL RANGE IN CORDS	
TOTAL CUBIC FEET	TOTAL CORDS	PERCENT ERROR	MINIMUM	MAXIMUM
365,992	4,633	5.99%	4,355	4,911

VDU VOLUMES

A VDU is a Volume Determination Unit. Volumes and their associated statistics are calculated at the VDU level and summarized to the sale level. There is often a one to one relationship between a VDU and a Payment Unit, but not always, depending on the cruise design. Refer to the VDU TO PAYMENT UNIT table.

VDU	VOLUME			RANGE IN CORDS	
	TOTAL CUBIC FEET	TOTAL CORDS	PERCENT ERROR	MINIMUM	MAXIMUM
38	18,656	236	29.02%	168	305
45	17,850	226	35.87%	145	307
47	22,564	286	25.06%	214	357
50	196,484	2,487	8.66%	2,272	2,702
80	29,864	378	17.24%	313	443
140	8,719	110	14.18%	95	126
141	9,802	124	30.55%	86	162
145	8,497	108	20.09%	86	129
146	13,868	176	26.90%	128	223
211	8,556	108	10.21%	97	119
212	18,431	233	14.37%	200	267
TOTAL:	353,293	4,472		3,803	5,141

VDU TO PAYMENT UNIT

When a VDU is associated with more than one Payment Unit (PU), the VDU volumes are assigned to the PU based on acres of the VDU within the PU.

VDU	VDU ACRES	PU	PU ACRES
38	7.8	8	7.8
45	4.7	9	4.7
47	12.5	12	12.5
50	48.8	10	25.7
		11	23.1
80	16.3	7	16.3
140	8.3	3	8.3
141	9.1	2	9.1
145	5.2	1	5.2
146	9.8	4	9.8
211	5.1	5	5.1
212	13.4	6	13.4
TOTAL:	141.0		141.0

DESCRIPTION OF TIMBER BY PAYMENT UNIT (PU)

PU	MARKET GROUP	PRODUCT	QUANTITY	UNIT	ACRES	ADVERTISE PRICE
1	BI/R/Hybrid Oak	Sawtimber	14.5	MBF	5.2	\$2,562.00
	Mixed Aspen		2.0	MBF		
	<i>B. T. Aspen</i>		2.0	<i>MBF</i>		
	White Oak		1.0	MBF		
	Mixed Aspen	Pulpwood	3	Cords		
	<i>B. T. Aspen</i>		3	<i>Cords</i>		
	Mixed Oak		64	Cords		
	<i>BI/R/Hybrid Oak</i>		34	<i>Cords</i>		
	<i>White Oak</i>		30	<i>Cords</i>		
	Red Pine		6	Cords		
2	BI/R/Hybrid Oak	Sawtimber	29.6	MBF	9.1	\$3,784.25
	Red Pine		1.1	MBF		
	White Oak		7.0	MBF		
	Mixed Oak	Pulpwood	43	Cords		
	<i>BI/R/Hybrid Oak</i>		28	<i>Cords</i>		
	<i>White Oak</i>		15	<i>Cords</i>		
	Red Pine		6	Cords		
3	BI/R/Hybrid Oak	Sawtimber	11.6	MBF	8.3	\$2,916.00
	Mixed Aspen		16.0	MBF		
	<i>B. T. Aspen</i>		16.0	<i>MBF</i>		
	Jack Pine	Pulpwood	7	Cords		
	Mixed Aspen		20	Cords		
	<i>B. T. Aspen</i>		20	<i>Cords</i>		
	Mixed Oak		28	Cords		
<i>BI/R/Hybrid Oak</i>		28	<i>Cords</i>			
4	BI/R/Hybrid Oak	Sawtimber	14.4	MBF	9.8	\$4,456.95
	Jack Pine		1.9	MBF		
	Mixed Aspen		18.3	MBF		
	<i>B. T. Aspen</i>		13.2	<i>MBF</i>		
	<i>Quaking Aspen</i>		5.1	<i>MBF</i>		
	White Oak		4.3	MBF		
	Jack Pine	Pulpwood	9	Cords		
	Mixed Aspen		54	Cords		
	<i>B. T. Aspen</i>		33	<i>Cords</i>		
	<i>Quaking Aspen</i>		21	<i>Cords</i>		
	Mixed Hardwood		10	Cords		
	<i>Red Maple</i>		10	<i>Cords</i>		
	Mixed Oak		25	Cords		
	<i>BI/R/Hybrid Oak</i>		19	<i>Cords</i>		
<i>White Oak</i>		6	<i>Cords</i>			
5	BI/R/Hybrid Oak	Sawtimber	10.8	MBF	5.1	\$2,360.20
	Jack Pine		3.3	MBF		
	Mixed Aspen		2.8	MBF		
	<i>Quaking Aspen</i>		2.8	<i>MBF</i>		
	White Pine		1.3	MBF		
	Jack Pine	Pulpwood	9	Cords		
	Mixed Aspen		12	Cords		
	<i>Quaking Aspen</i>		12	<i>Cords</i>		
	Mixed Hardwood		9	Cords		
	<i>Red Maple</i>		9	<i>Cords</i>		
	Mixed Oak		39	Cords		
<i>BI/R/Hybrid Oak</i>		39	<i>Cords</i>			
White Pine		4	Cords			
6	BI/R/Hybrid Oak	Sawtimber	30.0	MBF	13.4	\$6,077.90
	Jack Pine		2.7	MBF		
	Mixed Aspen		15.3	MBF		

DESCRIPTION OF TIMBER BY PAYMENT UNIT (PU), CON'T

PU	MARKET GROUP	PRODUCT	QUANTITY	UNIT	ACRES	ADVERTISE PRICE
6 con't	<i>B. T. Aspen</i>	<i>Sawtimber</i>	15.3	<i>MBF</i>		
	Red Pine		0.9	MBF		
	White Pine		8.1	MBF		
	Balsam Fir	Pulpwood	3	Cords		
	Jack Pine		19	Cords		
	Mixed Aspen		50	Cords		
	<i>B. T. Aspen</i>		44	<i>Cords</i>		
	<i>Quaking Aspen</i>		6	<i>Cords</i>		
	Mixed Hardwood		6	Cords		
	<i>Red Maple</i>		6	<i>Cords</i>		
	Mixed Oak		33	Cords		
	<i>BI/R/Hybrid Oak</i>		33	<i>Cords</i>		
	Red Pine		1	Cords		
	White Pine		9	Cords		
7	BI/R/Hybrid Oak	Sawtimber	26.9	MBF	16.3	\$9,083.70
	Mixed Aspen		32.0	MBF		
	<i>B. T. Aspen</i>		6.6	<i>MBF</i>		
	<i>Quaking Aspen</i>		25.4	<i>MBF</i>		
	Red Maple		6.8	MBF		
	White Pine		3.0	MBF		
	Mixed Aspen	Pulpwood	107	Cords		
	<i>B. T. Aspen</i>		58	<i>Cords</i>		
	<i>Quaking Aspen</i>		49	<i>Cords</i>		
	Mixed Hardwood		90	Cords		
	<i>Red Maple</i>		90	<i>Cords</i>		
	Mixed Oak		37	Cords		
	<i>BI/R/Hybrid Oak</i>		37	<i>Cords</i>		
	White Pine		7	Cords		
8	BI/R/Hybrid Oak	Sawtimber	33.6	MBF	7.8	\$6,561.85
	Mixed Aspen		26.3	MBF		
	<i>B. T. Aspen</i>		3.5	<i>MBF</i>		
	<i>Quaking Aspen</i>		22.8	<i>MBF</i>		
	Red Maple		6.5	MBF		
	Mixed Aspen	Pulpwood	26	Cords		
	<i>B. T. Aspen</i>		2	<i>Cords</i>		
	<i>Quaking Aspen</i>		24	<i>Cords</i>		
	Mixed Hardwood		51	Cords		
	<i>Red Maple</i>		51	<i>Cords</i>		
	Mixed Oak		26	Cords		
	<i>BI/R/Hybrid Oak</i>		26	<i>Cords</i>		
9	BI/R/Hybrid Oak	Sawtimber	16.9	MBF	4.7	\$5,783.00
	Jack Pine		6.4	MBF		
	Mixed Aspen		33.0	MBF		
	<i>Quaking Aspen</i>		33.0	<i>MBF</i>		
	Red Maple		1.4	MBF		
	Jack Pine	Pulpwood	12	Cords		
	Mixed Aspen		52	Cords		
	<i>Quaking Aspen</i>		52	<i>Cords</i>		
	Mixed Hardwood		15	Cords		
	<i>Red Maple</i>		15	<i>Cords</i>		
	Mixed Oak		31	Cords		
	<i>BI/R/Hybrid Oak</i>		31	<i>Cords</i>		
White Pine		2	Cords			
10	BI/R/Hybrid Oak	Sawtimber	23.5	MBF	25.7	\$47,737.20
	Mixed Aspen		6.0	MBF		
	<i>Quaking Aspen</i>		6.0	<i>MBF</i>		

DESCRIPTION OF TIMBER BY PAYMENT UNIT (PU), CON'T

PU	MARKET GROUP	PRODUCT	QUANTITY	UNIT	ACRES	ADVERTISE PRICE
10 con't	Red Pine	Sawtimber	139.1	MBF		
	Mixed Aspen	Pulpwood	24	Cords		
	<i>Quaking Aspen</i>		24	<i>Cords</i>		
	Mixed Oak		18	Cords		
	<i>Bl/R/Hybrid Oak</i>		18	<i>Cords</i>		
	Red Pine		924	Cords		
	White Pine		6	Cords		
11	Bl/R/Hybrid Oak		Sawtimber	21.2	MBF	23.1
	Mixed Aspen	Pulpwood	5.3	MBF		
	<i>Quaking Aspen</i>		5.3	<i>MBF</i>		
	Red Pine		125.0	MBF		
	Mixed Aspen		22	Cords		
	<i>Quaking Aspen</i>		22	<i>Cords</i>		
	Mixed Oak		17	Cords		
	<i>Bl/R/Hybrid Oak</i>		17	<i>Cords</i>		
	Red Pine		831	Cords		
	White Pine		5	Cords		
12	Bl/R/Hybrid Oak		Sawtimber	40.8	MBF	12.5
	Jack Pine	Pulpwood	1.4	MBF		
	Jack Pine		5	Cords		
	Mixed Aspen		70	Cords		
	<i>Quaking Aspen</i>		70	<i>Cords</i>		
	Mixed Hardwood		44	Cords		
	<i>Black Cherry</i>		9	<i>Cords</i>		
	<i>Red Maple</i>		35	<i>Cords</i>		
	Mixed Oak		84	Cords		
	<i>Bl/R/Hybrid Oak</i>		84	<i>Cords</i>		
TOTAL:			752.0	MBF		
TOTAL:			2,975	Cords		

Sale Specific Conditions & Requirements

Sale Name: 5 Year Rotation Mix

Sale Number: 71-012-21 Seq#: 1

1 - Sale Area

1.2 - Boundaries

1.2.1 - Painted boundaries (9/19)

The sale boundary and Payment Unit boundaries are marked and identified by blue, red, and yellow paint. Exterior sale boundary lines against private property are marked with blue paint. Exterior sale boundary lines against state are marked with red paint. Interior Payment Unit boundaries are marked with yellow paint. Retention patches are marked with red paint; no harvesting activities may occur within these areas. Red or blue painted boundary line trees are not to be cut. Yellow painted trees designating an interior Payment Unit boundary are only to be cut when all surrounding Payment Units have been paid.

2 - Timber Specifications

2.1 - Included Timber

2.1.1 - Clearcut unit(s) with unmerchantable trees (6/14)

Within Payment Unit(s) 1 and 3-12, cut all trees that are two (2) inches or more at DBH.

Except:

- Within Payment Unit 1, do not cut any white pine or oak under 5 inches at DBH and any white oak 12 inches or greater at DBH.
- Within Payment Unit 3, do not cut any white oak 12 inches at DBH or larger.
- Within Payment Unit 5, do not cut any trees marked with green paint.
- Within Payment Unit 7, do not cut any trees marked with green paint or any red pine.
- Within Payment Unit 8, do not cut any white oak, white pine, or any red oak under 5 inches at DBH or over 24 inches at DBH.
- Within Payment Unit 12, do not cut any oak under 5 inches at DBH.

2.1.5 - Overstory removal unit(s) (8/11)

Within Payment Unit(s) 2, all trees which meet minimum piece specifications in 2.2 Utilization, are designated for cutting, except trees marked with green paint.

2.1.11 - Description of timber note (2/04)

Note that dead oak with limbs still intact were cruised and are to be cut in Payment Unit 5. All dead oak was cruised as pulpwood.

2.2 - Utilization

2.2.2 - Chipping required (2/18)

Payment Units 10 and 11 must be chip harvested to facilitate future silvicultural activities. Products may be produced as roundwood and forwarded to decking areas in final product length, but the tops must be left intact and skidded to the landing for chipping to minimize the amount of residual slash. If market conditions limit the practicality of chipping, a chipping exemption may be obtained if proposed operations are determined to be suitable for planting by reforestation staff. Tops and slash must be arranged in a way that will not inhibit future planting operations, i.e. "windrows", as directed by the sale administrator. This exemption must be granted in writing. If the deadline is not met, damages will be collected determined by the cost to complete this work. The requirement to retain approximately 1/6 to 1/3 of tree tops and limbs less than four inches in diameter is still applicable (G. C. & R. 2.2).

2.2.3 - Stump heights (4/07)

Stump heights within the Sale Area shall not exceed 6 inches for all trees.

2.2.6 - Roundwood operation required (3/21)

The skidding of whole trees or tree segments with limbs attached is prohibited within Payment Unit 2. All products must be produced as roundwood and forwarded to existing roads or landing areas in final product length.

2.2.9 - No chipping permitted (12/08)

Within Payment Unit(s) 1, no chipping is permitted. Tops must be evenly distributed across the Payment Unit to inhibit illegal ORV activity. Contact the sale administrator for specifics.

3 - Payments

3.3 - Pre-measured Sales

3.3.4 - Dividing payment units (7/14)

Payment Unit(s) may be divided at the request of the Purchaser and upon approval of the Unit Manager. Dividing Payment Units is a contract modification which requires a Timber Sale Contract Amendment.

3.4 - Damaged Timber

3.4.1 - Damaged timber (7/16)

General Condition and Requirement 3.4 Damaged Timber, defines liquidated damages for undesignated live merchantable trees which are cut or injured. In addition, extreme care should be taken to avoid damage to tree seedlings and saplings that are designated to be left.

Within Payment Units 1, 2, 8, and 12, if more than 33% of the tree seedlings or saplings (1/4" to 4.5" DBH) designated to be left within a specified portion of the Sale Area are damaged, liquidated damages will be assessed at \$300 per acre for all acreage within that specified portion of the Sale Area that was damaged.

Within all Payment Units, should chipping occur in a Payment Unit, this must be done before sprouting of new regeneration. If more than 33% of the newly sprouted tree seedlings within a specified portion of the Sale Area are damaged, liquidated damages will be assessed at \$300 per acre for all acreage within that specified portion of the Sale Area that was damaged. No damage is acceptable to undesignated live merchantable trees. Within the Sale Area, if more than 5% of trees (> 4.5" DBH) within a specified area of the sale are damaged, liquidated damages will be assessed for all trees damaged. Rates will be in accordance with General Condition and Requirement 3.4 Damaged Timber.

4 - Transportation

4.1 - Construction

4.1.6 - Road construction (1/09)

Construction of new roads or improvements of existing roads shall be done in such a way as to minimize the environmental and visual impacts. Merchantable trees shall be cut and utilized unless otherwise directed. Non-merchantable trees shall be severed and laid flat on the ground. Slash shall be scattered, and not left in windrows and kept a minimum of 10 feet back from the road edge. Stumps shall be set upright, not left on edge, and be moved at least 10 feet away from the road edge. Disturbed soil shall be feathered into the woods and not left in berms or windrows.

4.1.7 - Road closure (10/11)

All new roads built into the sale must be blocked to vehicle traffic upon completion of the sale. Overgrown roads that are reopened shall be considered new roads. In general, this will require constructing a four (4') foot high berm of stumps and logs covered with earth. These roads must be rendered impassable to cars and trucks. Contact the sale administrator for specific details of design and placement.

4.2 - Maintenance

4.2.3 - Road maintenance (8/13)

The following road maintenance is required: Within 60 days of completion of hauling, or if no hauling occurs for 60 days, the road must be maintained and graded. This includes cleaning of drainage areas, grading, crowning, and filling with gravel, if necessary. Damages will be assessed if grading/repair does not occur.

4.2.5 - Two wheel drive condition (2/04)

All existing trail roads on and adjacent to the sale area must be passable by two-wheel drive traffic for the duration of the sale.

5 - Operations

5.1 - Notification

5.1.1 - Pre-sale conference (10/16)

A pre-sale conference between the Purchaser and sale administrator is required prior to beginning any operations to determine

landing and road locations. The Unit Manager or his/her representative must be contacted in advance to schedule the conference.

5.1.4 - Post-sale conference (10/16)

A post-sale conference on site between the Purchaser and sale administrator is required 5 days prior to the completion of active logging operations to determine clean-up and repair of landings, road edges, and the fulfillment of other contract specifications.

5.2 - Conduct of Operations

5.2.1 - Slash

5.2.1.8 - Slash height (12/08)

No slash or tree tops may exceed 24 inches in height. Any remaining slash/tops must be scattered uniformly over the Sale Area and not left in "windrows" from harvesting operations.

5.2.3 - Operating Restrictions

5.2.3.1 - Operating restrictions (9/11)

Within Payment Unit(s) 7, unless changed by written agreement, cutting, skidding, and hauling are not permitted during the period of December 1 through April 15. This restriction is because of the Roscommon Cross Country Ski Headquarters groomed cross country ski trail within the Payment Unit.

5.2.3.5 - Oak wilt restriction (1/18)

Within the Sale Area, unless changed by written agreement, cutting, skidding, hauling within the sale and brushing of access roads to the sale are not permitted during the period of April 15 to July 15. Operations may be allowed if specific steps are taken to prevent damaging uncut oak during the high risk period. Those steps may include completing all road brushing before April 15th and clearing a tree-length buffer along uncut oak cover before April 15th. This is necessary to reduce the spread of oak wilt. For more information, contact the Unit Manager or his/her representative.

5.2.3.6 - Bark beetle restriction (12/08)

In the event drought creates a high risk of pine bark beetle infestation, pine is not to be cut during the period March 1 through July 1, unless all portions of trees greater than two inches in diameter are removed from the sale area, reduced to chips, or treated to the satisfaction of the Unit Manager or his/her representative, within fifteen days of being severed from the stump. Pine log decks, pulpwood piles and treetops that are piled for chipping in the fall or winter within a 1/4 mile of susceptible sites must be removed before March 15. Residual slash must not be placed in piles or rows and must be spread over the site for quick drying. The Department of Natural Resources will exercise this specification if the risk of damage warrants.

5.2.3.11 - Coppice regeneration protection (4/10)

Timber harvesting in any Payment Unit must be completed before significant sprouting occurs in that Payment Unit to minimize damage to the new regeneration. Any post harvest operations, such as chipping, must be completed before sprouting of regeneration occurs. If it is anticipated that chipping will be delayed, then tops shall be carried to one central location or left unchipped. Should damages occur to the new regeneration, the damages will be assessed per Specification 3.4. 1 - Damaged Timber. If it is anticipated that chipping will be delayed, then tops shall be carried to one central location, preferably the landing. A third-party entity may be brought in to chip the tops/slash, before new sprouting occurs, should the contract holder fail to present in a timely manner arrangements approved by the Department for protecting the new regeneration. The Unit Manager or his/her representative may also cease such operations if sprouting occurs before the operation is complete and the Payment Unit(s) will be counted as incomplete with liquidated damages assessed accordingly.

5.2.32 - Decking/landing restoration (9/13)

All decking and landing areas must have the surface area restored to a condition equal to or better than before. This is to ensure the proper regeneration of the stand. Wood debris, chips, and "cookies" from trimmings must be removed or scattered away from landing and loading areas and may not be windrowed on the edge.

5.2.40 - Pathway protection (10/10)

The Roscommon Cross Country Ski Headquarters trail is shown on the Timber Sale Map. Do not cut trees or damage posts with blue pathway markers. Maintain a 20-foot-wide slash, debris, and rut free zone daily, using the pathway as the centerline. Do not run equipment down the pathway. Skidding across the trail may only occur in locations approved by the

sale administrator.

6 - Safety and Fire Prevention

6.2 - Signing

6.2.1 - Road posting (10/20)

The Purchaser is responsible for posting and maintaining caution signs on all county roads affected by the sale prior to beginning operations. The road must be posted at appropriate distances from the Sale Area to warn of logging activity and truck traffic. Signs must be removed when harvest operations are suspended or completed. The Purchaser will provide these signs.



TIMBER SALE MAP

This information provided by authority of Part 525, 1994 PA 451, as amended.

Forest Management Unit Roscommon	County Roscommon	Mapped By Martell	Date 6/3/21	Page 2	of 2
Township 24N	Range 03W	Section(s) and Subdivision(s) Sec. 23 - NESE; Sec. 24 - S1/2SW,SE	Scale 1:15,840		

Cover Type				Density	
A = Aspen	H = Hemlock	N = Marsh	U = Upland Brush	0 = Non Stocked	5 = Pole Timber Medium
B = Paper Birch	J = Jack Pine	O = Oak	UM = Upland Mixed	1 = Seedling Sapling Poor	6 = Pole Timber Well
C = Cedar	L = Lowland Brush	P = Lowland Poplar	V = Bog or Marsh	2 = Seedling Sapling Medium	7 = Saw Timber Poor
D = Treed Bog	LM = Lowland Mixed	Q = Mixed Swamp Conifer	W = White Pine	3 = Seedling Sapling Well	8 = Saw Timber Medium
E = Swamp Hdwoods	M = Mpl, Bch, Brch	R = Red Pine	X = Non Stocked	4 = Pole Timber Poor	9 = Saw Timber Well
F = Spruce Fir	MC = Mixed Conifer	S = Black Spruce	Z = Water		
G = Grass	MD = Mixed Deciduous	T = Tamarack			

PU	Acres	PU	Acres
1	5.2	7	16.3
2	9.1	8	7.8
3	8.3	9	4.7
4	9.8	10	25.7
5	5.1	11	23.1
6	13.4	12	12.5

5 Year Rotation Mix

Compartment 32

141 Acres

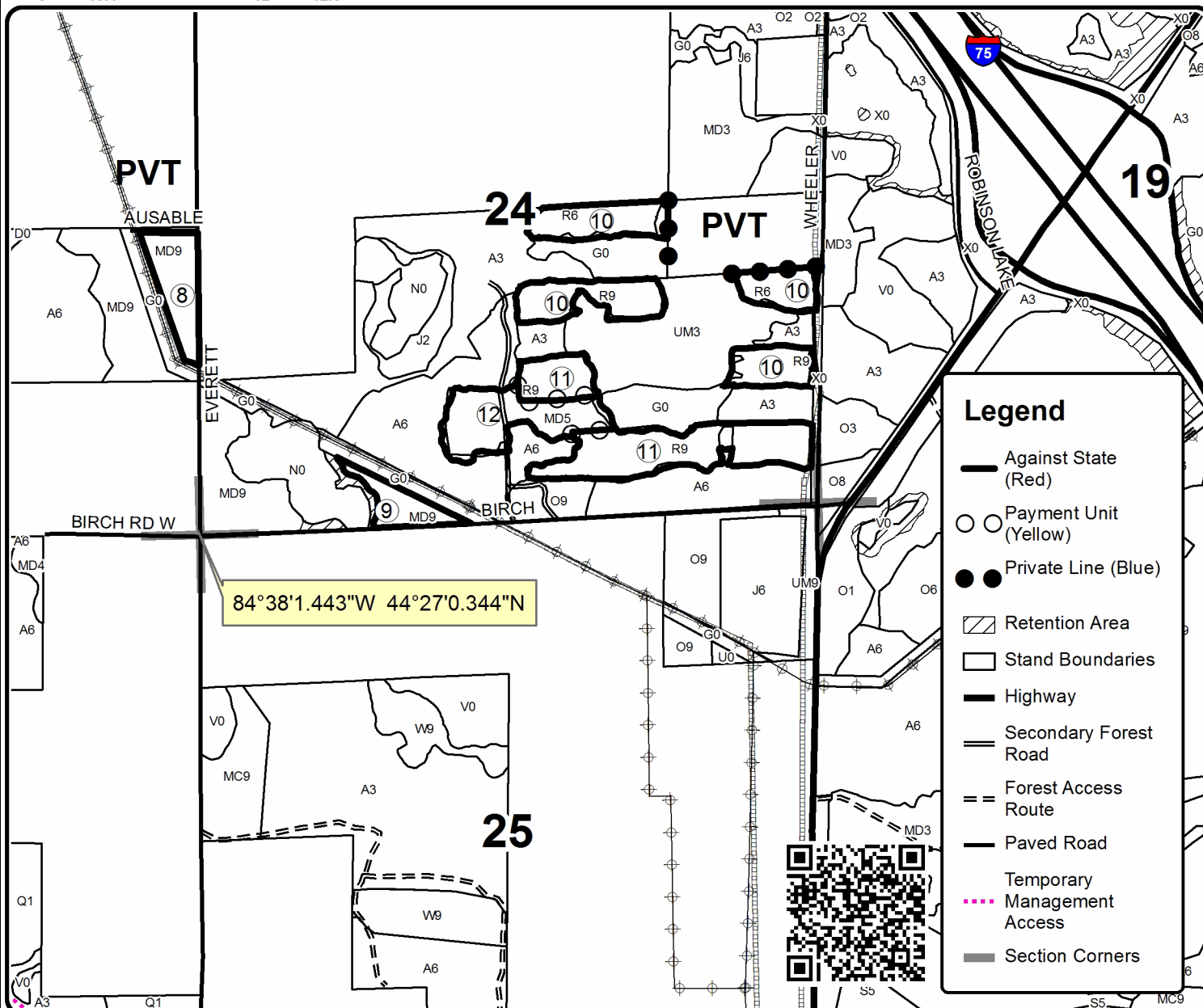
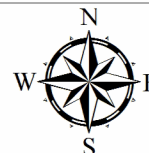

Legend

- Against State (Red)
- Payment Unit (Yellow)
- Private Line (Blue)
- Retention Area
- Stand Boundaries
- Highway
- Secondary Forest Road
- Forest Access Route
- Paved Road
- Temporary Management Access
- Section Corners

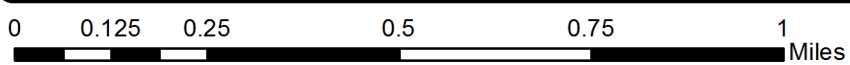



TIMBER SALE MAP

This information provided by authority of Part 525, 1994 PA 451, as amended.

Sale Number	Year
71-012	21

Forest Management Unit	County	Mapped By	Date	Page	of
Roscommon	Roscommon	Martell	6/3/21	1	2
Township	Range	Section(s) and Subdivision(s)	Scale		
24N	03W	Sec. 11 - N1/2SW,N1/2SE,SESE; Sec. 12 - SWSW; Sec. 13 - E1/2NW,SWNE; Sec. 15 - S1/2SE	1:15,840		

Cover Type

A = Aspen	H = Hemlock	N = Marsh	U = Upland Brush
B = Paper Birch	J = Jack Pine	O = Oak	UM = Upland Mixed
C = Cedar	L = Lowland Brush	P = Lowland Poplar	V = Bog or Marsh
D = Treed Bog	LM = Lowland Mixed	Q = Mixed Swamp Conifer	W = White Pine
E = Swamp Hdwoods	M = Mpl. Bch. Brch	R = Red Pine	X = Non Stocked
F = Spruce Fir	MC = Mixed Conifer	S = Black Spruce	Z = Water
G = Grass	MD = Mixed Deciduous	T = Tamarack	

Density

0 = Non Stocked	5 = Pole Timber Medium
1 = Seedling Sapling Poor	6 = Pole Timber Well
2 = Seedling Sapling Medium	7 = Saw Timber Poor
3 = Seedling Sapling Well	8 = Saw Timber Medium
4 = Pole Timber Poor	9 = Saw Timber Well

PU	Acres	PU	Acres
1	5.2	7	16.3
2	9.1	8	7.8
3	8.3	9	4.7
4	9.8	10	25.7
5	5.1	11	23.1
6	13.4	12	12.5

5 Year Rotation Mix

Compartment 32

141 Acres

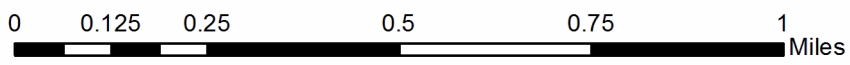
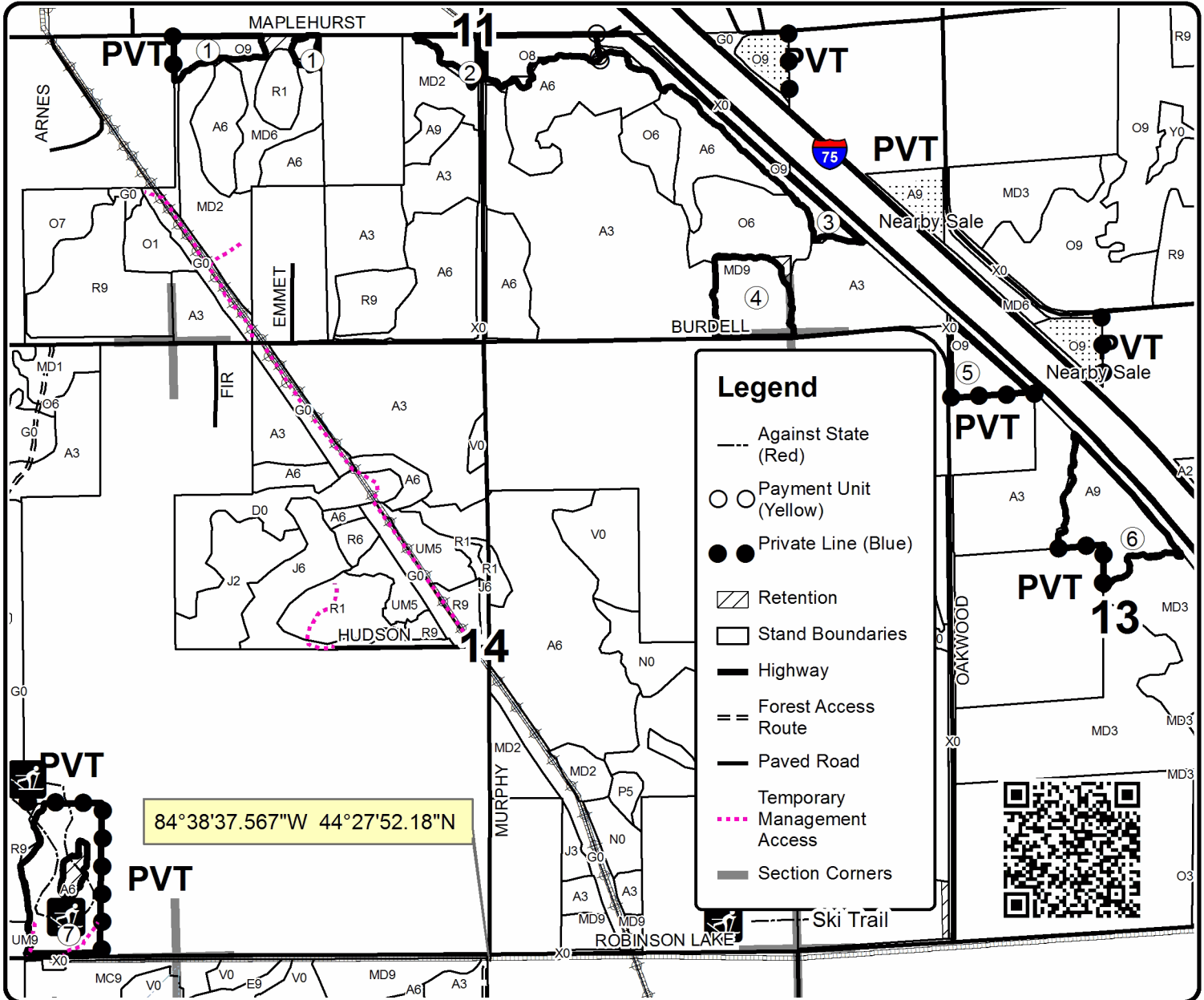

TIMBER SALE INFORMATION

Peninsula Harvest (71-015-21)
T22N, R04W, SEC. 31; T22N, R04W, SEC. 32.
Roscommon County (Advertised Price \$5,336.55)

SALE NOTE: All units of volume listed for this sale were estimated using the Inventory Manager computer program and the new Michigan taper model.

A timber sale contract for this lump sum, sealed bid timber sale will be awarded to the responsible bidder offering the highest sealed bid price. All units of volume listed below were estimated using the Inventory Manager computer program and the new Michigan taper model. Bids must be at or above the following advertised price for each product and species:

<u>PRODUCTS & SPECIES</u>	<u>ESTIMATED UNITS*</u>	<u>ADVERTISED PRICE</u>
Sawtimber		
B. T. Aspen	16.5 MBF	\$ 68.00 / MBF
Bl/R/Hybrid Oak	7.1 MBF	\$ 80.00 / MBF
Red Maple	8.7 MBF	\$ 63.00 / MBF
Red Pine	9.1 MBF	\$ 92.00 / MBF
Pulpwood		
B. T. Aspen	71 Cords	\$ 19.80 / Cord
Balsam Fir	3 Cords	\$ 17.90 / Cord
Bl/R/Hybrid Oak	6 Cords	\$ 14.55 / Cord
Mixed Hardwood	23 Cords	\$ 15.35 / Cord
Red Pine	8 Cords	\$ 34.40 / Cord
White Pine	4 Cords	\$ 21.55 / Cord

* The total volume is statistically estimated within plus (+) or minus (-) 27.27 percent. There are an estimated 211 cords on this timber sale, plus or minus 58 cords at the 95% confidence level. The estimated units are final and not subject to adjustment. Prospective bidders are urged to examine this timber and to make their own estimates of quantity and quality.

BOND AND PAYMENT SCHEDULE:

1. A bond in the amount of \$267.00 to insure faithful performance of the conditions of the contract will be deposited by the successful bidder within 21 days of the sale award.
2. Cutting in any sale or unit without the required advance payment would be considered a trespass.
3. Total payment must be paid in advance or according to the following schedule :
 - (a) Ten percent (10%) of the sale value must be paid within 21 days of the sale award.
 - (b) The remainder is due before cutting begins.
 - (c) Payment for each of the following units must be made before cutting begins in that unit:

PAYMENT UNIT NUMBER	PERCENT OF TOTAL SALE VALUE
01	100.0%
4. If no cutting takes place, the 10% down payment will not be refunded.
5. Operations on the contract issued will terminate on 03/31/2024.

SALE STATISTICS

Volumes were calculated in cubic feet using the Michigan taper model. Cubic foot volume includes all wood inside bark for the product indicated. For display purposes, cubic feet were converted to cords and MBF using a simple conversion factor, e.g. 79 cubic feet per cord and 185 cubic feet per MBF. The cubic foot volumes are precise; the cords and MBF volumes are not. Cubic foot volume cannot be directly converted to cords or boards with precision.

SALE VOLUMES

The total estimated sale volume may not equal the sum of the species/products due to the nature of statistical calculations associated with double sampling methodology.

VOLUME		STATISTICAL RANGE IN CORDS		
TOTAL CUBIC FEET	TOTAL CORDS	PERCENT ERROR	MINIMUM	MAXIMUM
16,664	211	27.27%	153	268

VDU VOLUMES

A VDU is a Volume Determination Unit. Volumes and their associated statistics are calculated at the VDU level and summarized to the sale level. There is often a one to one relationship between a VDU and a Payment Unit, but not always, depending on the cruise design. Refer to the VDU TO PAYMENT UNIT table.

VDU	VOLUME		PERCENT ERROR	RANGE IN CORDS	
	TOTAL CUBIC FEET	TOTAL CORDS		MINIMUM	MAXIMUM
176	15,565	197	27.27%	143	251
TOTAL:	15,565	197		143	251

VDU TO PAYMENT UNIT

When a VDU is associated with more than one Payment Unit (PU), the VDU volumes are assigned to the PU based on acres of the VDU within the PU.

VDU	VDU ACRES	PU	PU ACRES
176	7.8	1	7.8
TOTAL:	7.8		7.8

DESCRIPTION OF TIMBER BY PAYMENT UNIT (PU)

PU	MARKET GROUP	PRODUCT	QUANTITY	UNIT	ACRES	ADVERTISE PRICE	
1	B. T. Aspen	Sawtimber	16.5	MBF	7.8	\$5,336.55	
	BI/R/Hybrid Oak		7.1	MBF			
	Red Maple		8.7	MBF			
	Red Pine		9.1	MBF			
	B. T. Aspen	Pulpwood	71	Cords			
	Balsam Fir		3	Cords			
	BI/R/Hybrid Oak		6	Cords			
	Mixed Hardwood		23	Cords			
	<i>Black Cherry</i>		<i>Sawtimber</i>	0.9			<i>MBF</i>
	<i>Black Cherry</i>		<i>Pulpwood</i>	2			<i>Cords</i>
	<i>Red Maple</i>			19			<i>Cords</i>
	Red Pine			8			Cords
	White Pine			4			Cords
	<i>White Pine</i>		<i>Sawtimber</i>	1.6			<i>MBF</i>
	<i>White Pine</i>		<i>Pulpwood</i>	1			<i>Cords</i>
TOTAL:			41.4	MBF			
TOTAL:			115	Cords			

Sale Specific Conditions & Requirements

Sale Name: Peninsula Harvest

Sale Number: 71-015-21 Seq#: 1

1 - Sale Area

1.2 - Boundaries

1.2.1 - Painted boundaries (9/19)

The sale boundary and Payment Unit boundaries are marked and identified by red paint. The painted boundary line trees are not Included Timber and are to be protected.

2 - Timber Specifications

2.1 - Included Timber

2.1.3 - Cut tree marked unit(s) (12/08)

Within Payment Unit(s) 1, all trees are designated for cutting when marked with orange paint above and below stump height, regardless of merchantability. All aspen is designated for cutting.

2.2 - Utilization

2.2.3 - Stump heights (4/07)

Stump heights within the Sale Area shall not exceed 12 inches for trees greater than 10 inches at DBH and 4 inches for trees smaller than 10 inches at DBH.

2.2.6 - Roundwood operation required (3/21)

The skidding of whole trees or tree segments with limbs attached is prohibited. All products must be produced as roundwood and forwarded to existing roads or landing areas in final product length.

2.2.9 - No chipping permitted (12/08)

Within Payment Unit(s) 1, all wood must be removed by whole tree, tree segment, or roundwood. No chipping is permitted.

3 - Payments

3.3 - Pre-measured Sales

3.3.4 - Dividing payment units (7/14)

Payment Unit(s) may be divided at the request of the Purchaser and upon approval of the Unit Manager. Dividing Payment Units is a contract modification which requires a Timber Sale Contract Amendment. There will be only one division per Payment Unit.

3.4 - Damaged Timber

3.4.1 - Damaged timber (7/16)

General Condition and Requirement 3.4 Damaged Timber, defines liquidated damages for undesignated live merchantable trees which are cut or injured.

No damage is acceptable to undesignated live merchantable trees. Within the Sale Area, if more than 5% of trees (> 4.5" DBH) within a specified area of the sale are damaged, liquidated damages will be assessed for all trees damaged. Rates will be in accordance with General Condition and Requirement 3.4 Damaged Timber.

4 - Transportation

4.1 - Construction

4.1.3 - Slash and earthen piles (8/04)

Piles or windrows of earth along roads and landings that have been widened or constructed shall be leveled. Slash from road maintenance or construction, including stumps, shall be dispersed throughout the sale.

4.1.6 - Road construction (1/09)

Improvements of existing roads shall be done in such a way as to minimize the environmental and visual impacts.

Merchantable trees shall be cut and utilized unless otherwise directed. Non-merchantable trees shall be severed and laid flat

on the ground. Slash shall be scattered, and not left in windrows and kept a minimum of 10 feet back from the road edge. Stumps shall be set upright, not left on edge, and be moved at least 10 feet away from the road edge. Disturbed soil shall be feathered into the woods and not left in berms or windrows.

4.1.12 - No new roads (1/12)

No new roads will be permitted. All operations are limited to existing roads.

4.2 - Maintenance

4.2.3 - Road maintenance (8/13)

The following road maintenance is required: Within 60 days of completion of hauling, or if no hauling occurs for 60 days, the road must be maintained and graded. This includes cleaning of drainage areas, grading, crowning, and filling with gravel, if necessary. Damages will be assessed if grading/repair does not occur.

4.2.5 - Two wheel drive condition (2/04)

All existing trail roads on and adjacent to the sale area must be passable by two-wheel drive traffic for the duration of the sale.

5 - Operations

5.1 - Notification

5.1.1 - Pre-sale conference (10/16)

A pre-sale conference between the Purchaser and sale administrator is required prior to beginning any operations to determine landing and road locations.

5.1.4 - Post-sale conference (10/16)

A post-sale conference on site between the Purchaser and sale administrator is required prior to the completion of active logging operations to determine clean-up and repair of landings, road edges, and the fulfillment of other contract specifications.

5.2 - Conduct of Operations

5.2.1 - Slash

5.2.1.8 - Slash height (12/08)

No slash or tree tops may exceed 24 inches in height. Remaining slash/tops must be scattered uniformly over the Sale Area and not left in "windrows" from harvesting operations.

5.2.2 - Hazard Trees/Snags

5.2.2.1 - Den trees (10/16)

Obvious hollow and/or den trees shall be protected and left standing unless they are a safety hazard.

5.2.3 - Operating Restrictions

5.2.3.4 - Oak wilt restriction, no exceptions (1/18)

Within Payment Unit(s) 1, cutting, skidding, hauling within the sale and brushing of access roads to the sale are not permitted during the period of April 15 to July 15. No exceptions will be granted. This is necessary to reduce the spread of oak wilt.

5.2.4 - Dead and Down Creation

5.2.4.3 - Dead and down creation, dead trees (6/07)

Except as provided for in General Condition and Requirement 5.2.2, no dead trees, standing or down, are to be cut, skidded, or processed.

5.2.30 - Landing/road top soil protection (2/15)

Top soil on landings must be removed, stockpiled and saved. Upon completion of the timber sale, soil must be evenly distributed back over the area for revegetation.

5.2.32 - Decking/landing restoration (9/13)

All decking and landing areas must have the surface area restored to a condition equal to or better than before. This is to ensure the proper regeneration of the stand. Wood debris, chips, and "cookies" from trimmings must be removed or scattered

away from landing and loading areas and may not be windrowed on the edge.

5.2.38 - No decking against live trees (2/04)

Cut products may not be decked against unmarked or designated leave trees.

5.4 - Soil Protection

5.4.1 - Rutting restriction, general (7/16)

Operations are to cease immediately if equipment and weather conditions result in rutting of roads which is 12 inches or greater in depth and 50 feet in length. The Unit Manager or his/her representative may restrict hauling and/or skidding if ruts exceed the specified depth. With the Unit Manager or his/her representative's approval, the Purchaser may return to the area when the risk of rutting has decreased.



TIMBER SALE MAP

This information provided by authority of Part 525, 1994 PA 451, as amended.

Forest Management Unit Roscommon Management Unit	County Roscommon County	Mapped By Lewicki	Date 09/21/2021	Page 1	of 1
Township 22N	Range 04W	Section(s) and Subdivision(s) S.31 E1/2NE S.32 W1/2NW	Scale 1:15,840		

Cover Type				Density	
A = Aspen	H = Hemlock	N = Marsh	U = Upland Brush	0 = Non Stocked	5 = Pole Timber Medium
B = Paper Birch	J = Jack Pine	O = Oak	UM = Upland Mixed	1 = Seedling Sapling Poor	6 = Pole Timber Well
C = Cedar	L = Lowland Brush	P = Lowland Poplar	V = Bog or Marsh	2 = Seedling Sapling Medium	7 = Saw Timber Poor
D = Treed Bog	LM = Lowland Mixed	Q = Mixed Swamp Conifer	W = White Pine	3 = Seedling Sapling Well	8 = Saw Timber Medium
E = Swamp Hdwoods	M = Mpl, Bch, Brch	R = Red Pine	X = Non Stocked	4 = Pole Timber Poor	9 = Saw Timber Well
F = Spruce Fir	MC = Mixed Conifer	S = Black Spruce	Z = Water		
G = Grass	MD = Mixed Deciduous	T = Tamarack			

PU Acres
1 7.8

Pennisula Harvest Compartment 12 7.8 Acres

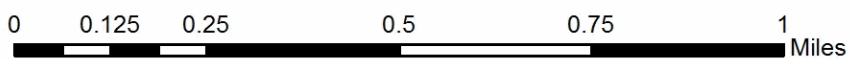
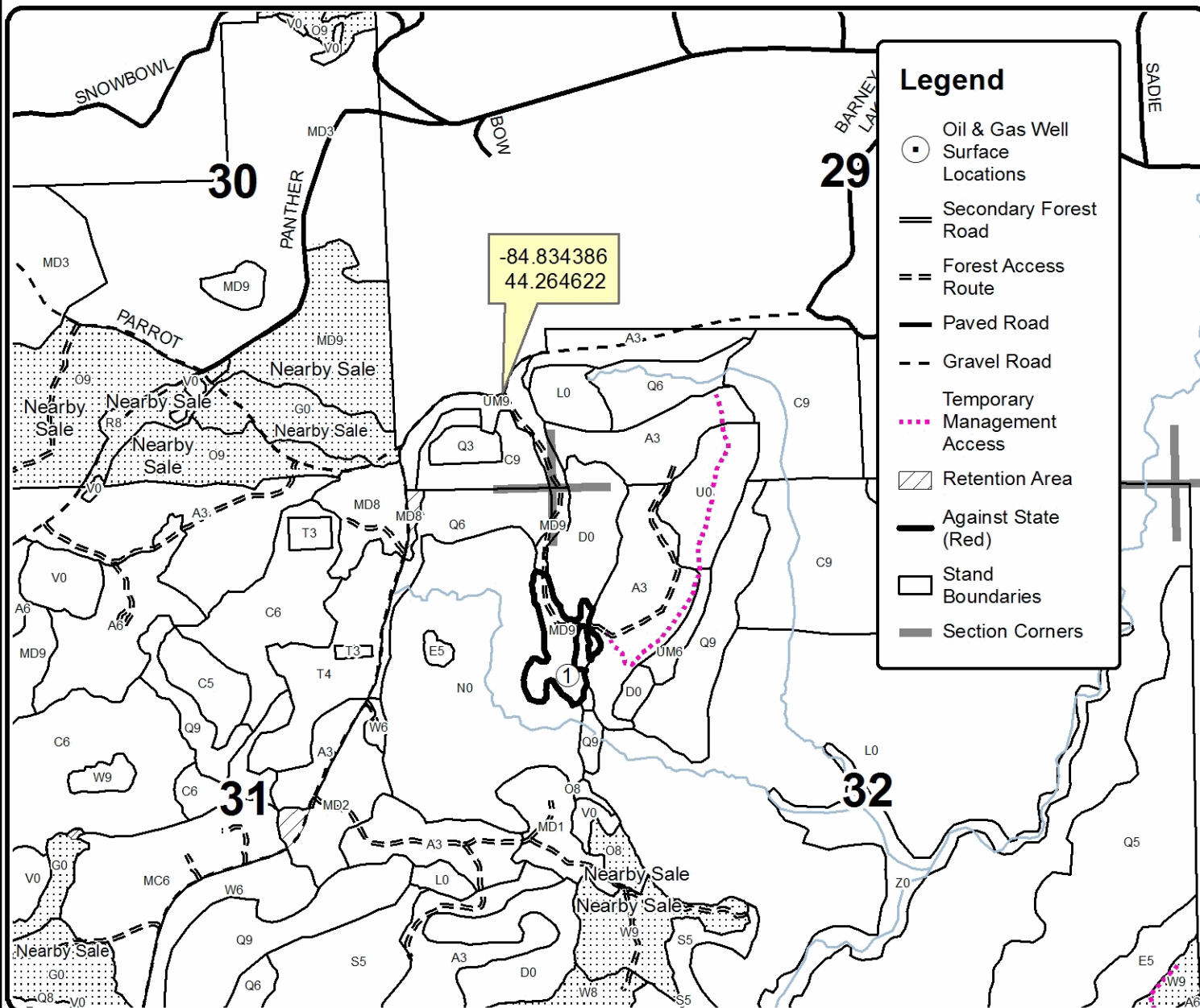
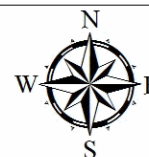

One and Done (71-001-21)
T21N, R02E, SEC. 11; T21N, R02E, SEC. 12; Ogemaw COUNTY

In response to the notice of sale to be held 9:00 a.m. (local time) on January 12, 2022, I am hereby submitting my sealed bid (firm offer) for the following forest products to be cut. Bids for individual species must be at or above the advertised price. All non-responsive bid forms may be rejected.

<u>PRODUCTS & SPECIES</u>	<u>ESTIMATED VOLUME*</u>	<u>ADVERTISED PRICE</u>	<u>BID PRICE/UNIT</u>
Sawtimber			
B. T. Aspen	153.9 MBF	\$ 68.00/MBF	\$ _____
Bl/R/Hybrid Oak	459.6 MBF	\$ 80.00/MBF	\$ _____
Red Maple	44.2 MBF	\$ 63.00/MBF	\$ _____
Red Pine	10.8 MBF	\$ 92.00/MBF	\$ _____
White Oak	41.1 MBF	\$ 69.00/MBF	\$ _____
White Pine	81.9 MBF	\$ 46.00/MBF	\$ _____
Pulpwood			
Balsam Fir	33 Cords	\$ 17.90/Cord	\$ _____
Mixed Aspen	442 Cords	\$ 19.80/Cord	\$ _____
Mixed Hardwood	244 Cords	\$ 15.35/Cord	\$ _____
Mixed Oak	489 Cords	\$ 14.55/Cord	\$ _____
Red Pine	20 Cords	\$ 34.40/Cord	\$ _____
White Pine	524 Cords	\$ 21.55/Cord	\$ _____

*The volumes are statistically estimated within plus (+) or minus (-) 5.22 percent at 95% confidence level. These estimated volumes are final and not subject to adjustment. Prospective bidders are urged to examine this timber and to make their own estimates of quantity and quality.

I understand that any or all bids may be rejected. All bids must be signed and all bid items must be bid or the bid form may be rejected. I also understand that consideration and awarding a contract will be based upon my past performance and ability to complete the contract based upon equipment and staffing subject to my control.

FEDERAL ID: ____ - ____ - ____ or SOCIAL SECURITY NUMBER: ____ - ____ - ____

Company or individual bidding: _____

Company representative's name: _____

Address: _____

City: _____ State: _____ Zip: _____

IF AVAILABLE, PLEASE PLACE THE PERSONALIZED LABEL FROM YOUR PROSPECTUS IN THE ABOVE BOX.

Individual or company representative's signature: _____ Date: _____

Phone number : _____ Email (optional): _____

THE WINNING BIDDER MUST COMPLETE THE VERIFICATION OF WORKER'S DISABILITY COMPENSATION ACT COMPLIANCE (ON REVERSE SIDE IF DOUBLE SIDED) WITHIN 21 DAYS OF SALE AWARD DATE

Saints Alive (71-007-21)
T24N, R03W, SEC. 22; Roscommon COUNTY

In response to the notice of sale to be held 9:00 a.m. (local time) on January 12, 2022, I am hereby submitting my sealed bid (firm offer) for the following forest products to be cut. Bids for individual species must be at or above the advertised price. All non-responsive bid forms may be rejected.

<u>PRODUCTS & SPECIES</u>	<u>ESTIMATED VOLUME*</u>	<u>ADVERTISED PRICE</u>	<u>BID PRICE/UNIT</u>
Sawtimber			
B. T. Aspen	12.4 MBF	\$ 68.00/MBF	\$ _____
Jack Pine	17.5 MBF	\$ 28.00/MBF	\$ _____
Red Maple	7.1 MBF	\$ 63.00/MBF	\$ _____
Red Oak	25.9 MBF	\$ 128.00/MBF	\$ _____
Pulpwood			
Jack Pine	107 Cords	\$ 13.80/Cord	\$ _____
Mixed Aspen	42 Cords	\$ 19.80/Cord	\$ _____
Mixed Hardwood	103 Cords	\$ 15.35/Cord	\$ _____
Mixed Oak	68 Cords	\$ 14.55/Cord	\$ _____
Red Pine	8 Cords	\$ 34.40/Cord	\$ _____
White Pine	27 Cords	\$ 21.55/Cord	\$ _____

*The volumes are statistically estimated within plus (+) or minus (-) 14.15 percent at 95% confidence level. These estimated volumes are final and not subject to adjustment. Prospective bidders are urged to examine this timber and to make their own estimates of quantity and quality.

I understand that any or all bids may be rejected. All bids must be signed and all bid items must be bid or the bid form may be rejected. I also understand that consideration and awarding a contract will be based upon my past performance and ability to complete the contract based upon equipment and staffing subject to my control.

FEDERAL ID: _____ or SOCIAL SECURITY NUMBER: _____ Company or individual bidding: _____ Company representative's name: _____ Address: _____ City: _____ State: _____ Zip: _____

IF AVAILABLE, PLEASE PLACE THE PERSONALIZED LABEL FROM YOUR PROSPECTUS IN THE ABOVE BOX.

Individual or company representative's signature: _____ Date: _____

Phone number : _____ Email (optional): _____

THE WINNING BIDDER MUST COMPLETE THE VERIFICATION OF WORKER'S DISABILITY COMPENSATION ACT COMPLIANCE (ON REVERSE SIDE IF DOUBLE SIDED) WITHIN 21 DAYS OF SALE AWARD DATE



FOR DEPARTMENT USE ONLY	
Sale Number (XX - XXX - XX - XX)	
Forest Management Unit:	

TIMBER SALE VERIFICATION OF WORKER'S DISABILITY COMPENSATION ACT COMPLIANCE

As required by Act 317, P.A. 1969 (Worker's Compensation) and
Part 5 of Act 451 of 1994, as amended.

VERIFICATION OF WORKER'S DISABILITY COMPENSATION ACT COMPLIANCE

- This verification must be completed and submitted within 21 days of contract award and prior to the issuance of the timber sale contract.
- In addition, if boxes 2B or 2C are checked, then Notice of Exclusion or Certificate of Insurance must be submitted within twenty-one (21) days of the contract award and prior to the issuance of the timber sale contract.
- All information must be typed or printed except for written signatures.

Please Check Appropriate Categories:

1. My business is organized as (you **must** check one of the boxes below):
 - A. Sole Proprietorship (individual)
 - B. Partnership
 - C. Corporation
2. You **must** check one of the boxes below:
 - A. I certify my business is a sole proprietorship and it has no employees but the sole proprietor. I am not subject to the Worker's Compensation Laws.
 - B. I certify my business has satisfied its obligation to the Worker's Compensation Act through the use of an approved Notice of Exclusion (BWC-337, Rev. 5/96). I will provide a copy of the Notice of Exclusion within 21 days of the contract award. (For questions or a copy of the BWC-337, please call the Worker's Compensation Bureau at 517-322-1195).
 - C. I certify my business has a Worker's Compensation Policy. I will provide an original Certificate of Insurance within twenty-one (21) days of the contract award.
3. If you have checked item 2(A) or 2(B), you **must** indicate the number of **both** full-time and part-time employees, other than yourself, including family members and active partners (if none, you must enter "0").

_____ Full-time Employees

_____ Part-time Employees

Name of Business		Federal ID (or) Social Security No.	
Address		Telephone ()	
City	State	ZIP	

I hereby certify that the above information is true and correct. I agree to notify the Michigan DNR of any changes that occur in factors affecting my coverage during any of my present and future operations.

Signature of Owner or Authorized Representative

Title

Date

Please complete the "SEALED BID" information on the next page

C30 Leftovers (71-009-21)

T23N, R02W, SEC. 18; T23N, R03W, SEC. 10; T23N, R03W, SEC. 12; T23N,

In response to the notice of sale to be held 9:00 a.m. (local time) on January 12, 2022, I am hereby submitting my sealed bid (firm offer) for the following forest products to be cut. Bids for individual species must be at or above the advertised price. All non-responsive bid forms may be rejected.

<u>PRODUCTS & SPECIES</u>	<u>ESTIMATED VOLUME*</u>	<u>ADVERTISED PRICE</u>	<u>BID PRICE/UNIT</u>
Sawtimber			
Bl/R/Hybrid Oak	92.1 MBF	\$ 80.00/MBF	\$ _____
Black Cherry	15.2 MBF	\$ 136.00/MBF	\$ _____
Mixed Aspen	316.1 MBF	\$ 68.00/MBF	\$ _____
Red Maple	63.2 MBF	\$ 63.00/MBF	\$ _____
Red Oak	37.9 MBF	\$ 128.00/MBF	\$ _____
Red Pine	33.1 MBF	\$ 92.00/MBF	\$ _____
White Pine	18.4 MBF	\$ 46.00/MBF	\$ _____
Pulpwood			
Balsam Fir	62 Cords	\$ 17.90/Cord	\$ _____
Jack Pine	52 Cords	\$ 13.80/Cord	\$ _____
Mixed Aspen	2,217 Cords	\$ 19.80/Cord	\$ _____
Mixed Hardwood	436 Cords	\$ 15.35/Cord	\$ _____
Mixed Oak	394 Cords	\$ 14.55/Cord	\$ _____
Red Pine	19 Cords	\$ 34.40/Cord	\$ _____
White Pine	128 Cords	\$ 21.55/Cord	\$ _____

*The volumes are statistically estimated within plus (+) or minus (-) 4.24 percent at 95% confidence level. These estimated volumes are final and not subject to adjustment. Prospective bidders are urged to examine this timber and to make their own estimates of quantity and quality.

I understand that any or all bids may be rejected. All bids must be signed and all bid items must be bid or the bid form may be rejected. I also understand that consideration and awarding a contract will be based upon my past performance and ability to complete the contract based upon equipment and staffing subject to my control.

FEDERAL ID: _____ or SOCIAL SECURITY NUMBER: _____

Company or individual bidding: _____

Company representative's name: _____

Address: _____

City: _____ State: _____ Zip: _____

IF AVAILABLE, PLEASE PLACE THE PERSONALIZED LABEL FROM YOUR PROSPECTUS IN THE ABOVE BOX.

Individual or company representative's signature: _____ Date: _____

Phone number : _____ Email (optional): _____

THE WINNING BIDDER MUST COMPLETE THE VERIFICATION OF WORKER'S DISABILITY COMPENSATION ACT COMPLIANCE (ON REVERSE SIDE IF DOUBLE SIDED) WITHIN 21 DAYS OF SALE AWARD DATE



FOR DEPARTMENT USE ONLY	
Sale Number (XX - XXX - XX - XX)	
Forest Management Unit:	

TIMBER SALE VERIFICATION OF WORKER'S DISABILITY COMPENSATION ACT COMPLIANCE

As required by Act 317, P.A. 1969 (Worker's Compensation) and
Part 5 of Act 451 of 1994, as amended.

VERIFICATION OF WORKER'S DISABILITY COMPENSATION ACT COMPLIANCE

- This verification must be completed and submitted within 21 days of contract award and prior to the issuance of the timber sale contract.
- In addition, if boxes 2B or 2C are checked, then Notice of Exclusion or Certificate of Insurance must be submitted within twenty-one (21) days of the contract award and prior to the issuance of the timber sale contract.
- All information must be typed or printed except for written signatures.

Please Check Appropriate Categories:

1. My business is organized as (you **must** check one of the boxes below):
 - A. Sole Proprietorship (individual)
 - B. Partnership
 - C. Corporation
2. You **must** check one of the boxes below:
 - A. I certify my business is a sole proprietorship and it has no employees but the sole proprietor. I am not subject to the Worker's Compensation Laws.
 - B. I certify my business has satisfied its obligation to the Worker's Compensation Act through the use of an approved Notice of Exclusion (BWC-337, Rev. 5/96). I will provide a copy of the Notice of Exclusion within 21 days of the contract award. (For questions or a copy of the BWC-337, please call the Worker's Compensation Bureau at 517-322-1195).
 - C. I certify my business has a Worker's Compensation Policy. I will provide an original Certificate of Insurance within twenty-one (21) days of the contract award.
3. If you have checked item 2(A) or 2(B), you **must** indicate the number of **both** full-time and part-time employees, other than yourself, including family members and active partners (if none, you must enter "0").

_____ Full-time Employees

_____ Part-time Employees

Name of Business		Federal ID (or) Social Security No.	
Address		Telephone ()	
City	State	ZIP	

I hereby certify that the above information is true and correct. I agree to notify the Michigan DNR of any changes that occur in factors affecting my coverage during any of my present and future operations.

Signature of Owner or Authorized Representative

Title

Date

Please complete the "SEALED BID" information on the next page

5 Year Rotation Mix (71-012-21)

T24N, R03W, SEC. 11; T24N, R03W, SEC. 12; T24N, R03W, SEC. 13; T24N,

In response to the notice of sale to be held 9:00 a.m. (local time) on January 12, 2022, I am hereby submitting my sealed bid (firm offer) for the following forest products to be cut. Bids for individual species must be at or above the advertised price. All non-responsive bid forms may be rejected.

<u>PRODUCTS & SPECIES</u>	<u>ESTIMATED VOLUME*</u>	<u>ADVERTISED PRICE</u>	<u>BID PRICE/UNIT</u>
Sawtimber			
Bl/R/Hybrid Oak	273.8 MBF	\$ 80.00/MBF	\$ _____
Jack Pine	15.7 MBF	\$ 28.00/MBF	\$ _____
Mixed Aspen	157.0 MBF	\$ 68.00/MBF	\$ _____
Red Maple	14.7 MBF	\$ 63.00/MBF	\$ _____
Red Pine	266.1 MBF	\$ 92.00/MBF	\$ _____
White Oak	12.3 MBF	\$ 69.00/MBF	\$ _____
White Pine	12.4 MBF	\$ 46.00/MBF	\$ _____
Pulpwood			
Balsam Fir	3 Cords	\$ 17.90/Cord	\$ _____
Jack Pine	61 Cords	\$ 13.80/Cord	\$ _____
Mixed Aspen	440 Cords	\$ 19.80/Cord	\$ _____
Mixed Hardwood	225 Cords	\$ 15.35/Cord	\$ _____
Mixed Oak	445 Cords	\$ 14.55/Cord	\$ _____
Red Pine	1,768 Cords	\$ 34.40/Cord	\$ _____
White Pine	33 Cords	\$ 21.55/Cord	\$ _____

*The volumes are statistically estimated within plus (+) or minus (-) 5.99 percent at 95% confidence level. These estimated volumes are final and not subject to adjustment. Prospective bidders are urged to examine this timber and to make their own estimates of quantity and quality.

I understand that any or all bids may be rejected. All bids must be signed and all bid items must be bid or the bid form may be rejected. I also understand that consideration and awarding a contract will be based upon my past performance and ability to complete the contract based upon equipment and staffing subject to my control.

FEDERAL ID: _____ or SOCIAL SECURITY NUMBER: _____

Company or individual bidding: _____

Company representative's name: _____

Address: _____

City: _____ State: _____ Zip: _____

IF AVAILABLE, PLEASE PLACE THE PERSONALIZED LABEL FROM YOUR PROSPECTUS IN THE ABOVE BOX.

Individual or company representative's signature: _____ Date: _____

Phone number : _____ Email (optional): _____

THE WINNING BIDDER MUST COMPLETE THE VERIFICATION OF WORKER'S DISABILITY COMPENSATION ACT COMPLIANCE (ON REVERSE SIDE IF DOUBLE SIDED) WITHIN 21 DAYS OF SALE AWARD DATE



FOR DEPARTMENT USE ONLY	
Sale Number (XX - XXX - XX - XX)	
Forest Management Unit:	

TIMBER SALE VERIFICATION OF WORKER'S DISABILITY COMPENSATION ACT COMPLIANCE

As required by Act 317, P.A. 1969 (Worker's Compensation) and
Part 5 of Act 451 of 1994, as amended.

VERIFICATION OF WORKER'S DISABILITY COMPENSATION ACT COMPLIANCE

- This verification must be completed and submitted within 21 days of contract award and prior to the issuance of the timber sale contract.
- In addition, if boxes 2B or 2C are checked, then Notice of Exclusion or Certificate of Insurance must be submitted within twenty-one (21) days of the contract award and prior to the issuance of the timber sale contract.
- All information must be typed or printed except for written signatures.

Please Check Appropriate Categories:

1. My business is organized as (you **must** check one of the boxes below):
 - A. Sole Proprietorship (individual)
 - B. Partnership
 - C. Corporation
2. You **must** check one of the boxes below:
 - A. I certify my business is a sole proprietorship and it has no employees but the sole proprietor. I am not subject to the Worker's Compensation Laws.
 - B. I certify my business has satisfied its obligation to the Worker's Compensation Act through the use of an approved Notice of Exclusion (BWC-337, Rev. 5/96). I will provide a copy of the Notice of Exclusion within 21 days of the contract award. (For questions or a copy of the BWC-337, please call the Worker's Compensation Bureau at 517-322-1195).
 - C. I certify my business has a Worker's Compensation Policy. I will provide an original Certificate of Insurance within twenty-one (21) days of the contract award.
3. If you have checked item 2(A) or 2(B), you **must** indicate the number of **both** full-time and part-time employees, other than yourself, including family members and active partners (if none, you must enter "0").

_____ Full-time Employees

_____ Part-time Employees

Name of Business		Federal ID (or) Social Security No.	
Address		Telephone ()	
City	State	ZIP	

I hereby certify that the above information is true and correct. I agree to notify the Michigan DNR of any changes that occur in factors affecting my coverage during any of my present and future operations.

Signature of Owner or Authorized Representative

Title

Date

Please complete the "SEALED BID" information on the next page

Peninsula Harvest (71-015-21)
T22N, R04W, SEC. 31; T22N, R04W, SEC. 32; Roscommon COUNTY

In response to the notice of sale to be held 9:00 a.m. (local time) on January 12, 2022, I am hereby submitting my sealed bid (firm offer) for the following forest products to be cut. Bids for individual species must be at or above the advertised price. All non-responsive bid forms may be rejected.

<u>PRODUCTS & SPECIES</u>	<u>ESTIMATED VOLUME*</u>	<u>ADVERTISED PRICE</u>	<u>BID PRICE/UNIT</u>
Sawtimber			
B. T. Aspen	16.5 MBF	\$ 68.00/MBF	\$ _____
Bl/R/Hybrid Oak	7.1 MBF	\$ 80.00/MBF	\$ _____
Red Maple	8.7 MBF	\$ 63.00/MBF	\$ _____
Red Pine	9.1 MBF	\$ 92.00/MBF	\$ _____
Pulpwood			
B. T. Aspen	71 Cords	\$ 19.80/Cord	\$ _____
Balsam Fir	3 Cords	\$ 17.90/Cord	\$ _____
Bl/R/Hybrid Oak	6 Cords	\$ 14.55/Cord	\$ _____
Mixed Hardwood	23 Cords	\$ 15.35/Cord	\$ _____
Red Pine	8 Cords	\$ 34.40/Cord	\$ _____
White Pine	4 Cords	\$ 21.55/Cord	\$ _____

*The volumes are statistically estimated within plus (+) or minus (-) 27.27 percent at 95% confidence level. These estimated volumes are final and not subject to adjustment. Prospective bidders are urged to examine this timber and to make their own estimates of quantity and quality.

I understand that any or all bids may be rejected. All bids must be signed and all bid items must be bid or the bid form may be rejected. I also understand that consideration and awarding a contract will be based upon my past performance and ability to complete the contract based upon equipment and staffing subject to my control.

FEDERAL ID: _____ - _____ or SOCIAL SECURITY NUMBER: _____ - _____ - _____

Company or individual bidding: _____

Company representative's name: _____

Address: _____

City: _____ State: _____ Zip: _____

IF AVAILABLE, PLEASE PLACE THE PERSONALIZED LABEL FROM YOUR PROSPECTUS IN THE ABOVE BOX.

Individual or company representative's signature: _____ Date: _____

Phone number : _____ Email (optional): _____

THE WINNING BIDDER MUST COMPLETE THE VERIFICATION OF WORKER'S DISABILITY COMPENSATION ACT COMPLIANCE (ON REVERSE SIDE IF DOUBLE SIDED) WITHIN 21 DAYS OF SALE AWARD DATE



FOR DEPARTMENT USE ONLY	
Sale Number (XX - XXX - XX - XX)	
Forest Management Unit:	

TIMBER SALE VERIFICATION OF WORKER'S DISABILITY COMPENSATION ACT COMPLIANCE

As required by Act 317, P.A. 1969 (Worker's Compensation) and
Part 5 of Act 451 of 1994, as amended.

VERIFICATION OF WORKER'S DISABILITY COMPENSATION ACT COMPLIANCE

- This verification must be completed and submitted within 21 days of contract award and prior to the issuance of the timber sale contract.
- In addition, if boxes 2B or 2C are checked, then Notice of Exclusion or Certificate of Insurance must be submitted within twenty-one (21) days of the contract award and prior to the issuance of the timber sale contract.
- All information must be typed or printed except for written signatures.

Please Check Appropriate Categories:

1. My business is organized as (you **must** check one of the boxes below):
 - A. Sole Proprietorship (individual)
 - B. Partnership
 - C. Corporation
2. You **must** check one of the boxes below:
 - A. I certify my business is a sole proprietorship and it has no employees but the sole proprietor. I am not subject to the Worker's Compensation Laws.
 - B. I certify my business has satisfied its obligation to the Worker's Compensation Act through the use of an approved Notice of Exclusion (BWC-337, Rev. 5/96). I will provide a copy of the Notice of Exclusion within 21 days of the contract award. (For questions or a copy of the BWC-337, please call the Worker's Compensation Bureau at 517-322-1195).
 - C. I certify my business has a Worker's Compensation Policy. I will provide an original Certificate of Insurance within twenty-one (21) days of the contract award.
3. If you have checked item 2(A) or 2(B), you **must** indicate the number of **both** full-time and part-time employees, other than yourself, including family members and active partners (if none, you must enter "0").

_____ Full-time Employees

_____ Part-time Employees

Name of Business		Federal ID (or) Social Security No.	
Address		Telephone ()	
City	State	ZIP	

I hereby certify that the above information is true and correct. I agree to notify the Michigan DNR of any changes that occur in factors affecting my coverage during any of my present and future operations.

Signature of Owner or Authorized Representative

Title

Date

Please complete the "SEALED BID" information on the next page

County Line Jack (71-010-21)
T22N, R04W, SEC. 6; Roscommon COUNTY

In response to the notice of sale to be held 9:00 a.m. (local time) on January 12, 2022, I am hereby submitting my sealed bid (firm offer) for the following forest products to be cut. Bids for individual species must be at or above the advertised price. All non-responsive bid forms may be rejected.

<u>PRODUCTS & SPECIES</u>	<u>ESTIMATED VOLUME*</u>	<u>ADVERTISED PRICE</u>	<u>BID PRICE/UNIT</u>
Sawtimber			
Jack Pine	87.3 MBF	\$ 23.00/MBF	\$ _____
Red Pine	19.5 MBF	\$ 75.00/MBF	\$ _____
Pulpwood			
Jack Pine	685 Cords	\$ 11.30/Cord	\$ _____
Quaking Aspen	32 Cords	\$ 16.20/Cord	\$ _____
Red Maple	250 Cords	\$ 12.55/Cord	\$ _____
Red Pine	15 Cords	\$ 28.15/Cord	\$ _____

*The volumes are statistically estimated within plus (+) or minus (-) 8.30 percent at 95% confidence level. These estimated volumes are final and not subject to adjustment. Prospective bidders are urged to examine this timber and to make their own estimates of quantity and quality.

I understand that any or all bids may be rejected. All bids must be signed and all bid items must be bid or the bid form may be rejected. I also understand that consideration and awarding a contract will be based upon my past performance and ability to complete the contract based upon equipment and staffing subject to my control.

FEDERAL ID: _____ - _____ or SOCIAL SECURITY NUMBER: _____ - _____ - _____

Company or individual bidding: _____

Company representative's name: _____

Address: _____

City: _____ State: _____ Zip: _____

IF AVAILABLE, PLEASE PLACE THE PERSONALIZED LABEL FROM YOUR PROSPECTUS IN THE ABOVE BOX.

Individual or company representative's signature: _____ Date: _____

Phone number : _____ Email (optional): _____

THE WINNING BIDDER MUST COMPLETE THE VERIFICATION OF WORKER'S DISABILITY COMPENSATION ACT COMPLIANCE (ON REVERSE SIDE IF DOUBLE SIDED) WITHIN 21 DAYS OF SALE AWARD DATE



FOR DEPARTMENT USE ONLY
Sale Number (XX - XXX - XX - XX)
Forest Management Unit:

TIMBER SALE VERIFICATION OF WORKER'S DISABILITY COMPENSATION ACT COMPLIANCE

*As required by Act 317, P.A. 1969 (Worker's Compensation) and
Part 5 of Act 451 of 1994, as amended.*

VERIFICATION OF WORKER'S DISABILITY COMPENSATION ACT COMPLIANCE

- This verification must be completed and submitted within 21 days of contract award and prior to the issuance of the timber sale contract.
- In addition, if boxes 2B or 2C are checked, then Notice of Exclusion or Certificate of Insurance must be submitted within twenty-one (21) days of the contract award and prior to the issuance of the timber sale contract.
- All information must be typed or printed except for written signatures.

Please Check Appropriate Categories:

1. My business is organized as (you **must** check one of the boxes below):
 - A. Sole Proprietorship (individual)
 - B. Partnership
 - C. Corporation

2. You **must** check one of the boxes below:
 - A. I certify my business is a sole proprietorship and it has no employees but the sole proprietor. I am not subject to the Worker's Compensation Laws.
 - B. I certify my business has satisfied its obligation to the Worker's Compensation Act through the use of an approved Notice of Exclusion (BWC-337, Rev. 5/96). I will provide a copy of the Notice of Exclusion within 21 days of the contract award. (For questions or a copy of the BWC-337, please call the Worker's Compensation Bureau at 517-322-1195).
 - C. I certify my business has a Worker's Compensation Policy. I will provide an original Certificate of Insurance within twenty-one (21) days of the contract award.

3. If you have checked item 2(A) or 2(B), you **must** indicate the number of **both** full-time and part-time employees, other than yourself, including family members and active partners (if none, you must enter "0").

_____ Full-time Employees

_____ Part-time Employees

Name of Business		Federal ID (or) Social Security No.	
Address		Telephone ()	
City	State	ZIP	

I hereby certify that the above information is true and correct. I agree to notify the Michigan DNR of any changes that occur in factors affecting my coverage during any of my present and future operations.

Signature of Owner or Authorized Representative

Title

Date

Please complete the "SEALED BID" information on the next page