



**DEPARTMENT OF NATURAL RESOURCES
STATE OF MICHIGAN
TIMBER SALE PROSPECTUS #7190**

SCHEDULED SALE DATE AND TIME: 9:00 a.m. (local time) on March 21, 2023.

LOCATION: GAYLORD MGMT UNIT, 1732 WEST M 32, GAYLORD, MI 49735.

PROSPECTUS NOTE: All bid openings for the Gaylord Management Unit (Gaylord Field Office and Indian River Field Office) will be held at the Gaylord Field Office regardless of sale location within the unit. All payments and contract executions will now be handled through the Gaylord Field Office. The Indian River Field Office will no longer accept payments or hard paper copies of timber sale bids. Payments for all contracts, use permits, bonds, etc. should be sent to the Gaylord Field Office.

The bidder is advised to inspect the sale area and review the location, estimated volumes, operating costs and contract terms of proposed sales. Please be aware that some landowners may request 60 days or more notice for access across their land.

Notice is hereby given that bids will be received by the Unit Manager, GAYLORD MANAGEMENT UNIT, for certain timber on the following described lands:

Wycamp Red Pine (52-102-23) / T38N, R05W, SEC. 28, S1/2NW,N1/2SW.

Emmet County, Advertised Price \$44,399.55, 50.5 Acres, Red Pine.

SALE NOTE: HRD harvest guidelines included with this timber sale contract. Also, seasonal harvest restrictions exist during the barkslip season.

Up North Mix (52-101-22) / T34N, R03W, SEC. 14, SWSW.

T34N, R03W, SEC. 23, NW,NE,N1/2SW.

Cheboygan County, Advertised Price \$267,871.00, 175.9 Acres, White Pine, Hardwood.

SALE NOTE: There are recreation trails present in sale. Units 5, 6 and 7 have chipping and stump height restrictions for reforestation.

A recreation site such as a trail, pathway, or campground is within the sale area or the vicinity. Certain restrictions/specifications may be applicable including time restrictions.

Elmer Dudd Red Pine (52-110-22) / T34N, R02W, SEC. 17, SW.

Cheboygan County, Advertised Price \$22,481.30, 20.7 Acres, Red Pine.

SALE NOTE: Bark slip restriction. Some decline and mortality in red pine. Potential for RSH nest restrictions to be imposed.

Stimpson Road Aspen Mix (52-124-22) / T38N, R03W, SEC. 5 , NENE.

T39N, R03W, SEC. 19, N1/2SE.

T39N, R03W, SEC. 28, NWSW.

T39N, R03W, SEC. 29, SW,NESE,S1/2SE.

T39N, R03W, SEC. 30, NESE.

T39N, R03W, SEC. 32, NWNE,NESW,SE.

T39N, R03W, SEC. 33, W1/2SW.

Cheboygan County, Advertised Price \$138,880.70, 259.8 Acres, Aspen, Spruce/Fir/Tamarack.

SALE NOTE: This is a large sale consisting of mostly rocky, low ground, but operable terrain. There is good access to most Payment Units. Some Payment Units have larger diameter timber that is past maturity. In addition, there are some individual trees and areas of blowdown.

BID INSTRUCTIONS (VER. 10/10/2022):

1. Scheduled Bid Location, Date, and Time (2/11)

Bids must be received by the Unit Manager, GAYLORD OFFICE, 1732 West M 32, Gaylord, MI 49735, no later than 9:00 a.m. (local time) on March 21, 2023. For further information concerning this sale, contact Lucas Merrick at 989-732-3541 extension 5440.

2. Bidder's Qualifications (10/22)

If all or part of a timber sale was prepared by a private contractor, the contractor and that contractor's company are not permitted to bid on the timber sale. A person must be 18 years of age or older to purchase timber. Permanent employees of the Department of Natural Resources or members of their immediate household may not bid. Former employees, in the permanent or seasonal class, may not bid until 3 months after the last day of active duty. Bids will not be accepted from individuals or companies appearing on the DNR/FRD No-Bid List. This list contains the names of purchasers who previously failed to execute a contract within 21-days or who have a history of poor performance.

3. Preparation of Sealed Bids (5/16)

Bid Forms may be completed online thru Michigan DNR Timber Sale Online Bidding (OLB) at www.michigan.gov/timberbidding or by completing the hardcopy Bid Form found in the Timber Sale Prospectus. Hardcopy Bid Forms shall be manually signed in ink. Registration in OLB is considered your 'signature' for all bids submitted thru that system. Bid prices must be entered for each species and product in the Bid Price column for all material subject to bidding and all fill-in blanks must be completed. If erasures or other changes appear on the hardcopy Bid Form, each erasure or change must be initialed by the person signing the bid.

4. Submission of Sealed Bids (5/16)

Bid forms may be obtained from the Unit Manager or thru OLB. Bids may be submitted hardcopy or thru OLB. All hardcopy bids must be submitted on the bid form and in an envelope clearly identified as described in this section. NOTE: Only one bid form per bid envelope. Sealed bids must be submitted to the Unit office designated in the prospectus and must be submitted at or prior to the time established in the prospectus. The envelope should show on the outside (a) the sale name or number and (b) the date and time of bid opening, as shown in the prospectus. Bids received after the time specified in the sale prospectus are late bids and will be rejected.

It is possible for a bidder to submit multiple bids on a single sale. For example, a bid may be submitted hardcopy and a bid may be submitted thru OLB. Or, two bidders from the same company could both submit bids on the same sale. If this were to happen, the State would accept all bids received and award the contract accordingly. All bidding and contractual requirements would apply to all bids received.

5. Public Opening of Sealed Bids (7/16)

If conditions permit, the sealed bids will be publicly opened and posted at the time and place set in the prospectus.

If a bidder, present at a bid opening, has submitted bids on more than one sale, that bidder may withdraw their unopened bid envelopes or announce the withdrawal of their online bid after being declared the successful bidder on one sale.

6. Award of Contract (1/11)

Award of the contract will be made to the Bidder whose bid, conforming to the prospectus, is most advantageous to the State of Michigan on the basis of total value at rates bid for the estimated quantities. The State reserves the right to reject any bid or waive any minor irregularity in bids received. A written award mailed (or otherwise furnished) to the successful Bidder shall be deemed to result in a binding contract without further action by either party.

7. Down Payment (1/11)

The Bidder to whom award is made must make a down payment within 21 days of the sale award. The amount of the down payment will be calculated as shown in the Bond and Payment Schedule of this prospectus. Only cash may be used to meet this requirement.

8. Performance Security (1/11)

As guarantee of faithful performance, a cash bond, certificate of deposit, surety bond or irrevocable letter of credit (LOC) is required within 21 days of the sale award. The amount of the performance security is shown in the Bond and

Payment Schedule of this prospectus. If an LOC or surety is used, the coverage must extend for at least 6 months beyond the contract expiration.

9. Worker's Compensation (10/22)

Purchaser shall obtain worker's compensation insurance to cover claims under Michigan's Worker's Disability Compensation Act of 1969 or similar employee benefit act of any other state applicable to an employee. Verification of Worker's Disability Compensation Act Compliance must be completed and submitted within 21 days of contract award and prior to the issuance of the timber sale contract. In addition, if applicable, Notice of Exclusion or Certificate of Insurance must also be submitted.

10. Timber Sale Contract (10/22)

Additional conditions and requirements common to all timber sales are listed on the timber sale contract (R4031) and are available on line at www.michigan.gov/timber. Contact the Unit Manager for additional information or a sample contract. Within 21 days of the date of the award letter, the bidder must sign the contract and provide the required down payment, performance security, and verification of worker's disability compensation. The down payment and performance security shall be in accordance with the provisions of the timber sale contract, in the sums stated in this prospectus. If these actions are not taken, then the Bidder, the Bidder's corporation, and the corporation's principals may not be permitted to bid on State timber sales for a period of 3 months after the first offense, 6 months after the second offense, and 1 year after the third offense. An offense will only be counted against the Bidder for 5 years. In addition, the Bidder certifies that if awarded this contract, the Bidder will complete the timber sale contract in accordance with its terms and any modifications thereof including requirements to purchase, cut, and remove the included timber by the expiration date.

Payment Unit values in the State Forest Timber Sale Contract are calculated based on the advertised value of the Payment Unit as a percentage of the total advertised value of the contract. The advertised value of each Payment Unit is given in the Description of Timber by Payment Unit table on the Timber Sale Information page. For example, if the value of Payment Unit 1 is advertised as \$1,500 and the total Timber Sale value is advertised as \$10,000, the contract price for Payment Unit 1 will be 15% of the total bid price ($\$1,500/\$10,000 * 100$).

11. Disclaimer of Estimates and Bidder's Warranty of Inspection (10/22)

Before submitting this bid, the Bidder is advised and cautioned to inspect the sale area, review the requirements of the sale contract, and take other steps as may be reasonably necessary to ascertain the location, estimated volumes, construction estimates, and operating costs of the proposed sale. Failure to do so will not relieve the Bidder from responsibility for completing the contract.

The Bidder warrants that this bid is submitted solely on the basis of the Bidder's examination and inspection of the quality and quantity of the timber offered for sale and the Bidder's opinion of the value thereof and the costs of recovery. No reliance should be placed on the State of Michigan's estimates of timber quality, quantity or costs of recovery. Bidder further acknowledges that the State of Michigan: (i) expressly disclaims any warranty of fitness of timber for any purpose; (ii) offers this timber as is without any warranty of quality (merchantability) or quantity and (iii) expressly disclaims any warranty as to the quantity or quality of timber sold.

12. Certification and Chain-of-Custody (10/22)

Unless otherwise indicated in the contract under section 7 – Other Conditions of the Sale Specific Conditions & Requirements, the area encompassed by this timber sale is certified to the standards of the Forest Stewardship Council (FSC) - Certificate #SCS-FM/COC-00090N and the Sustainable Forestry Initiative (SFI) - Certificate #NSF-SFIS-5Y031-SF5. Forest products from this sale may be delivered to the mill as "FSC 100% and / or SFI certified" as long as the contractor hauling the forest products is chain-of-custody (COC) certified or covered under a COC certificate from the destination mill. The purchaser is responsible for maintaining COC after leaving the sale area.

13. Good Neighbor Authority (GNA) Requirements (10/22)

If the name of this timber sales contains the acronym GNA, it is authorized by the Good Neighbor Authority (GNA) and covered by various agreements between the U.S. Forest Service and the State. The timber sale occurs on federal land and the following conditions apply:

GNA contracts on US Forest Service land will not be awarded to purchasers on the Federal list of excluded parties. The System for Award Management (SAM) will be checked for active excluded parties prior to award of contract. In

addition, the Bidder to whom award is made must complete an Assurance Regarding Felony Conviction or Tax Delinquent Status for Corporate Applicants (AD-3031).

14. Good Neighbor Authority (GNA) Requirements, con't (10/22)

Bidder certifies, by signing this bid form, that to the best of Bidder's knowledge that the following representations are accurate and complete.

- a. That the Bidder and its principals are not presently debarred, suspended, proposed for debarment, declared ineligible, or voluntary excluded from timber sales (covered transactions) by any Federal department or agency.
- b. That the Bidder and its principals have not within a 3-year period preceding this bid been convicted of or had a civil judgment rendered against them for commission of fraud or a criminal offense in connection with obtaining , attempting to obtain, or performing a public (Federal, State, or local) transaction or contract under a public transaction; violation of Federal or State antitrust statutes or commission of embezzlement, theft, forgery, bribery, falsification or destruction of records, making false statements, or receiving stolen property.
- c. That the Bidder and its principals are not presently indicted for or otherwise criminally or civilly charged by a governmental entity (Federal, State, or local) with commission of any of the offenses enumerated in paragraph b of this certification.
- d. That the Bidder and its principals have not within a 3-year period preceding this bid had one or more public transactions (Federal, State, or local) terminated for breach or default of a timber or forest product contract.

Bidders that cannot certify this requirement, in whole or in part, shall submit an explanation with their bid.

SHANNON LOTT, Acting
Director

TIMBER SALE INFORMATION

Wycamp Red Pine (52-102-23)
T38N, R05W, SEC. 28.
Emmet County (Advertised Price \$44,399.55)

SALE NOTE: HRD harvest guidelines included with this timber sale contract. Also, seasonal harvest restrictions exist during the barkslip season.

A timber sale contract for this lump sum, sealed bid timber sale will be awarded to the responsible bidder offering the highest sealed bid price. All units of volume listed below were estimated using the Inventory Manager computer program and the new Michigan taper model. Bids must be at or above the following advertised price for each product and species:

<u>PRODUCTS & SPECIES</u>	<u>ESTIMATED UNITS*</u>	<u>ADVERTISED PRICE</u>
Sawtimber		
Red Pine	63.8 MBF	\$ 141.00 / MBF
Pulpwood		
Red Pine	675 Cords	\$ 52.45 / Cord

* The total volume is statistically estimated within plus (+) or minus (-) 13.36 percent. There are an estimated 824 cords on this timber sale, plus or minus 110 cords at the 95% confidence level. The estimated units are final and not subject to adjustment. Prospective bidders are urged to examine this timber and to make their own estimates of quantity and quality.

BOND AND PAYMENT SCHEDULE:

1. A bond in the amount of \$2,220.00 to insure faithful performance of the conditions of the contract will be deposited by the successful bidder within 21 days of the sale award.
2. Cutting in any sale or unit without the required advance payment would be considered a trespass.
3. Total payment must be paid in advance or according to the following schedule :
 - (a) Ten percent (10%) of the sale value must be paid within 21 days of the sale award.
 - (b) The remainder is due before cutting begins.
 - (c) Payment for each of the following units must be made before cutting begins in that unit:

PAYMENT UNIT NUMBER	PERCENT OF TOTAL SALE VALUE
01	100.0%
4. If no cutting takes place, the 10% down payment will not be refunded.
5. Operations on the contract issued will terminate on 03/31/2026.

SALE STATISTICS

Volumes were calculated in cubic feet using the Michigan taper model. Cubic foot volume includes all wood inside bark for the product indicated. For display purposes, cubic feet were converted to cords and MBF using a simple conversion factor, e.g. 79 cubic feet per cord and 185 cubic feet per MBF. The cubic foot volumes are precise; the cords and MBF volumes are not. Cubic foot volume cannot be directly converted to cords or boards with precision.

SALE VOLUMES

The total estimated sale volume may not equal the sum of the species/products due to the nature of statistical calculations associated with double sampling methodology.

VOLUME		STATISTICAL RANGE IN CORDS		
TOTAL CUBIC FEET	TOTAL CORDS	PERCENT ERROR	MINIMUM	MAXIMUM
65,094	824	13.36%	714	934

VDU VOLUMES

A VDU is a Volume Determination Unit. Volumes and their associated statistics are calculated at the VDU level and summarized to the sale level. There is often a one to one relationship between a VDU and a Payment Unit, but not always, depending on the cruise design. Refer to the VDU TO PAYMENT UNIT table.

VDU	VOLUME		PERCENT ERROR	RANGE IN CORDS	
	TOTAL CUBIC FEET	TOTAL CORDS		MINIMUM	MAXIMUM
11	65,094	824	13.36%	714	934
TOTAL:	65,094	824		714	934

VDU TO PAYMENT UNIT

When a VDU is associated with more than one Payment Unit (PU), the VDU volumes are assigned to the PU based on acres of the VDU within the PU.

VDU	VDU ACRES	PU	PU ACRES
11	50.5	1	50.5
TOTAL:	50.5		50.5

DESCRIPTION OF TIMBER BY PAYMENT UNIT (PU)

PU	MARKET GROUP	PRODUCT	QUANTITY	UNIT	ACRES	ADVERTISE PRICE
1	Red Pine	Sawtimber	63.8	MBF	50.5	\$44,399.55
	Red Pine	Pulpwood	675	Cords		
TOTAL:			63.8	MBF		
TOTAL:			675	Cords		

Sale Specific Conditions & Requirements

Sale Name: Wycamp Red Pine

Sale Number: 52-102-23 Seq#: 1

1 - Sale Area

1.2 - Boundaries

1.2.1 - Painted boundaries (9/19)

The sale boundary is marked and identified by red paint. Exterior sale boundary lines adjacent to state-owned land are marked with red paint. The painted boundary line trees are not Included Timber and are to be protected and not cut.

2 - Timber Specifications

2.1 - Included Timber

2.1.8 - Designated plantation row unit(s) (12/08)

Within Payment Unit(s) 1, all red pine trees which meet minimum piece specifications in 2.2 Utilization, within designated plantation rows are designated for cutting. Designated plantation rows begin with the third row in from the outside of the plantation, then continue every third row. Because of the variability of row direction, it shall be the responsibility of the producer to maintain the third row sequence. Any hardwood or aspen tree that blocks equipment within the cut rows may be felled and left intact on site. Do not cut any oak trees.

2.2 - Utilization

2.2.3 - Stump heights (4/07)

Stump heights within the Sale Area shall not exceed 6 inches for all trees. This is in order to facilitate possible future planting operations.

2.2.6 - Roundwood operation required (3/21)

The skidding of whole trees or tree segments with limbs attached is prohibited. All products must be produced as roundwood and forwarded to existing roads or landing areas in final product length.

2.2.8 - Utilization and removal (5/14)

All products meeting standards set forth in General Condition and Requirement 2.2 - Utilization must be removed from the sale area. Retain on site between 1/6 and 1/3 of the slash from harvested trees (tree tops and limbs less than four inches in diameter). This is because of biomass retention guidelines.

3 - Payments

3.3 - Pre-measured Sales

3.3.4 - Dividing payment units (7/14)

Payment Unit(s) 1 may be divided at the request of the Purchaser and upon approval of the Unit Manager. Dividing Payment Units is a contract modification which requires a Timber Sale Contract Amendment. There will be only one division per Payment Unit.

3.4 - Damaged Timber

3.4.1 - Damaged timber (7/16)

General Condition and Requirement 3.4 Damaged Timber, defines liquidated damages for undesignated live merchantable trees which are cut or injured. No damage is acceptable to undesignated live merchantable trees. Within the sale area, if more than 5% of trees (> 4.5" DBH) within a specified area of the sale are damaged, liquidated damages will be assessed for all trees damaged. Rates will be in accordance with General Condition and Requirement 3.4 Damaged Timber.

4 - Transportation

4.1 - Construction

4.1.3 - Slash and earthen piles (8/04)

Piles or windrows of earth along roads and landings that have been widened or constructed shall be leveled. Slash from road maintenance or construction, including stumps, shall be dispersed throughout the sale.

4.1.6 - Road construction (1/09)

Construction of new roads or improvements of existing roads shall be done in such a way as to minimize the environmental and visual impacts. Merchantable trees shall be cut and utilized unless otherwise directed. Non-merchantable trees shall be severed and laid flat on the ground. Slash shall be scattered, and not left in windrows and kept a minimum of 10 feet back from the road edge. Stumps shall be set upright, not left on edge, and be moved at least 10 feet away from the road edge. Disturbed soil shall be feathered into the woods and not left in berms or windrows.

4.1.7 - Road closure (10/11)

All new roads built into the sale must be blocked to vehicle traffic upon completion of the sale. In general, this will require constructing a four (4') foot high berm of stumps and logs covered with earth.

4.2 - Maintenance

4.2.3 - Road maintenance (8/13)

The following road maintenance is required: the forest trail access road leading to the sale area must be maintained and graded on a daily basis. This includes cleaning of drainage areas, grading, crowning and filling with gravel, if necessary. Damages may be assessed if grading/repair does not occur.

5 - Operations

5.1 - Notification

5.1.1 - Pre-sale conference (10/16)

A pre-sale conference between the Purchaser and sale administrator is required prior to beginning any operations to discuss contract specs and to determine landing and road locations.

5.2 - Conduct of Operations

5.2.1 - Slash

5.2.1.1 - Slash within sale area (9/16)

No trees are to be felled outside the sale area and all slash is to be kept at least 10 feet back from the red paint line. If sale boundary lines are along a public road or highway, then slash must be removed 50' from these lines per General Condition & Requirement 5.2.1.

5.2.3 - Operating Restrictions

5.2.3.3 - Bark slippage restriction (3/09)

Within Payment Unit(s) 1, unless changed by written agreement, cutting and skidding are not permitted during the period of April 15 to July 15. This restriction is because of potential damage to residual trees during bark slippage season.

5.2.3.6 - Bark beetle restriction (12/08)

In the event drought creates a high risk of pine bark beetle infestation, pine is not to be cut during the period March 1 through July 1, unless all portions of trees greater than two inches in diameter are removed from the sale area, reduced to chips, or treated to the satisfaction of the Unit Manager or his/her representative, within fifteen days of being severed from the stump. Pine log decks, pulpwood piles and treetops that are piled for chipping in the fall or winter within a 1/4 mile of susceptible sites must be removed before March 15. Residual slash must not be placed in piles or rows and must be spread over the site for quick drying. The Department of Natural Resources will exercise this specification if the risk of damage warrants.

5.2.3.14 - heterobasidion root disease (HRD) (3/21)

This plantation is at risk of infection by the root rot fungus, *Heterobasidion irregulare*. To prevent the spread of this disease, cutting operations within Payment Unit(s) 1 and 2 are restricted to the period of January 1st through February 28th. Cutting may only occur outside this period with written permission of the Unit Manager or with the application of a preventative pesticide. Consultation with a forest health specialist will determine if cutting can occur prior to January 1 without pesticide application, dependent upon current and forecasted snow cover. Cellu-Treat and RotStop C are currently the only EPA registered products available in the United States for the control of *Heterobasidion*. Both products are a water-soluble powder that must be applied to the stump, in accordance with the product label. Dye must be added to these products to provide visible evidence of adequate coverage. Application of these pesticides requires licensing by the Michigan Department of Agriculture and Rural Development. All applicators are required to: provide to the Sale

Administrator notification of application per requirements in 40 CFR 170.120; and document and provide to the Sale Administrator annually, by December 31 and prior to closure of sale, the volume of product used and acres treated.

5.2.32 - Decking/landing restoration (9/13)

All decking and landing areas must have the surface area restored to a condition equal to or better than before. This is to ensure the proper regeneration of the stand. Slash, stumps, wood debris, chips and "cookies" from trimmings must be removed or scattered away from landing and loading areas and may not be windrowed on the edge.

5.4 - Soil Protection

5.4.1 - Rutting restriction, general (7/16)

Operations are to cease immediately if equipment and weather conditions result in rutting of roads which is 12 inches or greater in depth and 50 feet in length. The Unit Manager or his/her representative may restrict hauling and/or skidding if ruts exceed the specified depth. With the Unit Manager or his/her representative's approval, the Purchaser may return to the area when the risk of rutting has decreased.

5.8 - Protection of Endangered Species

5.8.5 - Protection of raptor nests (3/13)

All trees with raptor nests will be protected if found during harvesting operations. Notification will be made to the Unit Manager or his/her representative who will notify the Wildlife Biologist so an on-site evaluation and recommendation can be made, if necessary.

6 - Safety and Fire Prevention

6.2 - Signing

6.2.1 - Road posting (10/20)

The Purchaser is responsible for posting and maintaining caution signs on the forest trail road leading to the sale area prior to beginning operations. The road must be posted at appropriate distances from the sale area to warn of logging activity and truck traffic. Signs must be removed when harvest operations are suspended or completed. The Purchaser will provide these signs.



TIMBER SALE MAP

This information provided by authority of Part 5, 1994 PA 451, as amended.

Sale Number	Year
52-102-23	2023

Forest Management Unit GAYLORD-NORTH	County EMMET	Mapped By STACKS	Date 11/18/22	Page 1	of 1
Compartment Number 108	Township T38N	Range R05W	Section(s) and Subdivision(s) 28 5 1/2 NW, N 1/2 SW		

Cover Type				Density	
A = Aspen	J = Jack Pine	O = Oak	U = Upland Brush	0 = Non Stocked	5 = Pole Timber Medium
B = Paper Birch	K = Rock	P = Lowland Poplar	UM = Upland Mix Forest	1 = Seedling Sapling Poor	6 = Pole Timber Well
C = Cedar	L = Lowland Brush	Q = Mixed Swamp Conifer	V = Bog or Marsh	2 = Seedling Sapling Medium	7 = Saw Timber Poor
D = Tread Bog	LM = Lowland Mix Forest	R = Red Pine	W = White Pine	3 = Seedling Sapling Well	8 = Saw Timber Medium
E = Swamp Hardwoods	M = Maple, Beech, Birch	S = Black Spruce	X = Non Stocked	4 = Pole Timber Poor	9 = Saw Timber Well
F = Spruce/Fir	MC = Mixed Conifer	T = Tamarack	Y = Sand		
G = Grass	MD = Mixed Deciduous	Z = Water			
H = Hemlock	N = Marsh				

WYCAMPTON RED PINE

50.5 ACRES

EMMET COUNTY

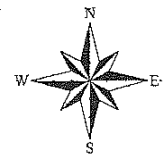

P.U. - ACRES
1 - 50.5

WILMANS RD.

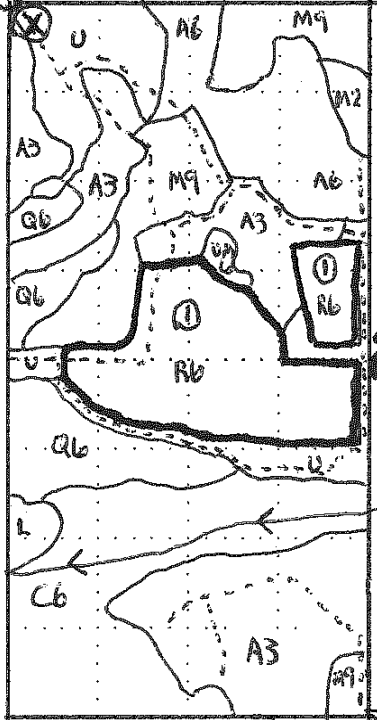

28 PRIVATE

- SALE BOUNDARY:**
 PUBLIC (RED) - ———
 PRIVATE (BLUE) - ———
PAYMENT UNIT:
 (YELLOW) - 00000
 P.U. NUMBER - ①
 COUNTY ROAD - ———
 SEASONAL C. R. - - - - -
 FOREST TRAIL ROAD - - - - -
 SNOWMOBILE TRAIL - [Symbol]
 RETENTION AREA - [Symbol]
 STREAM - ←
- RD. ① - 84.934663
45.664242

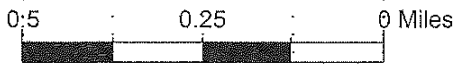
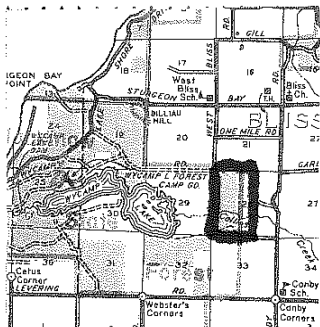

TIMBER SALE INFORMATION

Up North Mix (52-101-22)

T34N, R03W, SEC. 14; T34N, R03W, SEC. 23.
Cheboygan County (Advertised Price \$267,871.00)

SALE NOTE: There are recreation trails present in sale. Units 5, 6 and 7 have chipping and stump height restrictions for reforestation.

A recreation site such as a trail, pathway, or campground is within the sale area or the vicinity. Certain restrictions/specifications may be applicable including time restrictions.

A timber sale contract for this lump sum, sealed bid timber sale will be awarded to the responsible bidder offering the highest sealed bid price. All units of volume listed below were estimated using the Inventory Manager computer program and the new Michigan taper model. Bids must be at or above the following advertised price for each product and species:

<u>PRODUCTS & SPECIES</u>	<u>ESTIMATED UNITS*</u>		<u>ADVERTISED PRICE</u>
Sawtimber			
B. T. Aspen	113.8	MBF	\$ 58.00 / MBF
Basswood	280.7	MBF	\$ 67.00 / MBF
Beech	5.1	MBF	\$ 58.00 / MBF
Red Maple	77.5	MBF	\$ 112.00 / MBF
Red Pine	148.2	MBF	\$ 141.00 / MBF
Sugar Maple	135.0	MBF	\$ 299.00 / MBF
White Pine	1,011.9	MBF	\$ 45.00 / MBF
Pulpwood			
B. T. Aspen	432	Cords	\$ 21.75 / Cord
Basswood	481	Cords	\$ 13.95 / Cord
Mixed Hardwood	993	Cords	\$ 17.35 / Cord
Red Pine	386	Cords	\$ 52.45 / Cord
White Pine	2,260	Cords	\$ 32.35 / Cord

* The total volume is statistically estimated within plus (+) or minus (-) 9.49 percent. There are an estimated 8,610 cords on this timber sale, plus or minus 818 cords at the 95% confidence level. The estimated units are final and not subject to adjustment. Prospective bidders are urged to examine this timber and to make their own estimates of quantity and quality.

BOND AND PAYMENT SCHEDULE:

1. A bond in the amount of \$13,394.00 to insure faithful performance of the conditions of the contract will be deposited by the successful bidder within 21 days of the sale award.
2. Cutting in any sale or unit without the required advance payment would be considered a trespass.
3. Total payment must be paid in advance or according to the following schedule :
 - (a) Ten percent (10%) of the sale value must be paid within 21 days of the sale award.
 - (b) The 10% down payment will be credited towards the first unit cut.
 - (c) Payment for each of the following units must be made before cutting begins in that unit:

PAYMENT UNIT NUMBER	PERCENT OF TOTAL SALE VALUE
01	17.3%
02	1.9%
03	7.6%
04	12.8%
05	18.7%
06	22.0%
07	19.7%
4. If no cutting takes place, the 10% down payment will not be refunded.
5. Operations on the contract issued will terminate on 03/31/2026.

SALE STATISTICS

Volumes were calculated in cubic feet using the Michigan taper model. Cubic foot volume includes all wood inside bark for the product indicated. For display purposes, cubic feet were converted to cords and MBF using a simple conversion factor, e.g. 79 cubic feet per cord and 185 cubic feet per MBF. The cubic foot volumes are precise; the cords and MBF volumes are not. Cubic foot volume cannot be directly converted to cords or boards with precision.

SALE VOLUMES

The total estimated sale volume may not equal the sum of the species/products due to the nature of statistical calculations associated with double sampling methodology.

VOLUME			STATISTICAL RANGE IN CORDS	
TOTAL CUBIC FEET	TOTAL CORDS	PERCENT ERROR	MINIMUM	MAXIMUM
680,190	8,610	9.49%	7,792	9,428

VDU VOLUMES

A VDU is a Volume Determination Unit. Volumes and their associated statistics are calculated at the VDU level and summarized to the sale level. There is often a one to one relationship between a VDU and a Payment Unit, but not always, depending on the cruise design. Refer to the VDU TO PAYMENT UNIT table.

	VOLUME			RANGE IN CORDS	
VDU	TOTAL CUBIC FEET	TOTAL CORDS	PERCENT ERROR	MINIMUM	MAXIMUM
5	12,958	164	33.17%	110	218
6	37,400	473	58.69%	196	751
11	6,065	77	141.18%	32	185
12	66,495	842	13.74%	726	957
20	11,273	143	30.72%	99	187
26	463,623	5,869	11.41%	5,199	6,538
105	82,376	1,043	16.40%	872	1,214
TOTAL:	680,190	8,610		7,169	10,051

VDU TO PAYMENT UNIT

When a VDU is associated with more than one Payment Unit (PU), the VDU volumes are assigned to the PU based on acres of the VDU within the PU.

VDU	VDU ACRES	PU	PU ACRES
5	5.1	2	5.1
6	16.9	4	16.9
11	2.5	5	2.5
12	13.2	3	13.2
20	6.4	4	6.4
26	108.2	5	31.9
		6	40.3
		7	36.0
105	23.6	1	23.6
TOTAL:	175.9		175.9

DESCRIPTION OF TIMBER BY PAYMENT UNIT (PU)

PU	MARKET GROUP	PRODUCT	QUANTITY	UNIT	ACRES	ADVERTISE PRICE	
1	B. T. Aspen	Sawtimber	2.4	MBF	23.6	\$46,259.55	
	Basswood		92.9	MBF			
	Beech		4.2	MBF			
	Red Maple		19.3	MBF			
	Sugar Maple		94.0	MBF			
	B. T. Aspen	Pulpwood	5	Cords			
	Basswood		160	Cords			
	Mixed Hardwood		406	Cords			
	<i>Beech</i>		27	<i>Cords</i>			
	<i>Ironwood</i>		13	<i>Cords</i>			
	<i>Red Maple</i>		64	<i>Cords</i>			
<i>Sugar Maple</i>	302	<i>Cords</i>					
2	Basswood	Sawtimber	30.9	MBF	5.1	\$5,091.70	
	Beech		0.9	MBF			
	Sugar Maple		5.8	MBF			
	Basswood	Pulpwood	45	Cords			
	Mixed Hardwood		35	Cords			
	<i>Beech</i>		2	<i>Cords</i>			
<i>Sugar Maple</i>	33	<i>Cords</i>					
3	B. T. Aspen	Sawtimber	53.4	MBF	13.2	\$20,400.30	
	Red Maple		3.3	MBF			
	White Pine		150.2	MBF			
	B. T. Aspen	Pulpwood	68	Cords			
	Basswood		22	Cords			
	Mixed Hardwood		36	Cords			
	<i>Black Cherry</i>		22	<i>Cords</i>			
	<i>Ironwood</i>		9	<i>Cords</i>			
	<i>Red Maple</i>		5	<i>Cords</i>			
	White Pine		240	Cords			
4	Red Pine	Sawtimber	117.7	MBF	23.3	\$34,156.10	
	Red Pine	Pulpwood	320	Cords			
	White Pine	24	Cords				
5	B. T. Aspen	Sawtimber	17.1	MBF	34.4	\$50,177.05	
	Basswood		49.3	MBF			
	Red Maple		18.0	MBF			
	Red Pine		9.0	MBF			
	Sugar Maple		15.5	MBF			
	White Pine		254.1	MBF			
	B. T. Aspen		Pulpwood	106			Cords
	Basswood			80			Cords
	Mixed Hardwood			178			Cords
	<i>Black Cherry</i>			31			<i>Cords</i>
	<i>Ironwood</i>			3			<i>Cords</i>
	<i>Red Maple</i>			83			<i>Cords</i>
	<i>Sugar Maple</i>			61			<i>Cords</i>
	Red Pine			19			Cords
White Pine	588	Cords					
6	B. T. Aspen	Sawtimber		21.6	MBF	40.3	\$59,065.75
	Basswood		56.8	MBF			
	Red Maple		19.5	MBF			
	Red Pine		11.4	MBF			
	Sugar Maple		10.4	MBF			
	White Pine		320.9	MBF			
	B. T. Aspen		Pulpwood	134	Cords		
	Basswood			92	Cords		
	Mixed Hardwood			178	Cords		

DESCRIPTION OF TIMBER BY PAYMENT UNIT (PU), CON'T

PU	MARKET GROUP	PRODUCT	QUANTITY	UNIT	ACRES	ADVERTISE PRICE				
6 con't	<i>Black Cherry</i>	<i>Pulpwood</i>	38	<i>Cords</i>						
	<i>Ironwood</i>		4	<i>Cords</i>						
	<i>Red Maple</i>		89	<i>Cords</i>						
	<i>Sugar Maple</i>		47	<i>Cords</i>						
	Red Pine		25	Cords						
	White Pine		744	Cords						
7	B. T. Aspen	Sawtimber	19.3	MBF	36.0	\$52,720.55				
	Basswood		50.8	MBF						
	Red Maple		17.4	MBF						
	Red Pine		10.1	MBF						
	Sugar Maple		9.3	MBF						
	White Pine		286.7	MBF						
	B. T. Aspen	Pulpwood	119	Cords						
	Basswood		82	Cords						
	Mixed Hardwood		160	Cords						
	<i>Black Cherry</i>		35	<i>Cords</i>						
	<i>Ironwood</i>		4	<i>Cords</i>						
	<i>Red Maple</i>		79	<i>Cords</i>						
	<i>Sugar Maple</i>		42	<i>Cords</i>						
	Red Pine		22	Cords						
	White Pine		664	Cords						
	TOTAL:			1,772.2			MBF			
	TOTAL:			4,552			Cords			

Sale Specific Conditions & Requirements

Sale Name: Up North Mix

Sale Number: 52-101-22 Seq#: 2

1 - Sale Area

1.2 - Boundaries

1.2.1 - Painted boundaries (9/19)

The sale boundary and Payment Unit boundaries are marked and identified by blue, red and yellow paint. Exterior sale boundary lines against private property are marked with blue paint. Exterior sale boundary lines against state are marked with red paint. Interior Payment Unit boundaries are marked with yellow paint. Retention patches are marked with red paint; no harvesting activities may occur within these areas. The painted boundary line trees are not Included Timber and are to be protected unless marked with orange paint. Yellow painted trees designating an interior Payment Unit boundary are only to be cut when all surrounding Payment Units have been paid.

2 - Timber Specifications

2.1 - Included Timber

2.1.1 - Clearcut unit(s) with unmerchantable trees (6/14)

Within Payment Unit(s) 1, 3, 5, 6 and 7, cut all trees that are two (2) inches or more at DBH. Do not cut oak in PU 1 or PU 3. Do not cut green marked legacy trees.

2.1.3 - Cut tree marked unit(s) (12/08)

Within Payment Unit(s) 2 and 4, all trees are designated for cutting when marked with orange paint above and below stump height, regardless of merchantability.

2.2 - Utilization

2.2.2 - Chipping required (2/18)

Payment Units 5, 6 and 7 must be chip harvested to facilitate subsequent planting operations. The Purchaser has the option to produce sawlogs or pulpwood bolts, but the remaining portion of the trees must be chipped and hauled. Products may be produced as roundwood and forwarded to decking areas in final product length, but the tops must be left intact and skidded to the landing for chipping in order to minimize the amount of residual slash. If market conditions limit the practicality of chipping, tops and slash must be arranged in a way that will not inhibit future planting operations, as directed by the sale administrator. A chipping exemption can be obtained if proposed operations are determined to be suitable for planting by reforestation staff. This exemption must be granted in writing. The requirement to retain approximately 1/6 to 1/3 of tree tops and limbs less than four inches in diameter is still applicable (G. C. & R. 2.2).

2.2.3 - Stump heights (4/07)

Stump heights within Payment Units 5, 6 and 7 shall not exceed 12 inches for trees greater than 10 inches DBH and 4 inches for trees smaller than 10 inches DBH. This is in order to facilitate planting operations.

3 - Payments

3.3 - Pre-measured Sales

3.3.4 - Dividing payment units (7/14)

Payment Unit(s) 1, 5, 6 and 7 may be divided at the request of the Purchaser and upon approval of the Unit Manager. Dividing Payment Units is a contract modification which requires a Timber Sale Contract Amendment. There will be only one division per Payment Unit.

3.4 - Damaged Timber

3.4.1 - Damaged timber (7/16)

General Condition and Requirement 3.4 Damaged Timber, defines liquidated damages for undesignated live merchantable trees which are cut or injured.

No damage is acceptable to undesignated live merchantable trees. Within the sale area, if more than 5% of trees (> 4.5" DBH) within a specified area of the sale are damaged, liquidated damages will be assessed for all trees damaged. Rates will

be in accordance with General Condition and Requirement 3.4 Damaged Timber.

4 - Transportation

4.1 - Construction

4.1.4 - Timber removed for construction (12/09)

Trees cut or damaged in the process of pre-approved road, landing or skid trail construction will be decked in an area separate from other Designated Timber and not removed until measured by the sale administrator. Payment will be made at the specified Purchase Unit Price.

4.1.7 - Road closure (10/11)

All new roads built into the sale must be blocked to vehicle traffic within 30 days of completion of hauling. Overgrown roads that are reopened shall be considered new roads. In general, this will require constructing a four (4') foot high berm of stumps and logs covered with earth. These roads must be rendered impassable to cars and trucks. All stumps from road building and landing construction must be reserved to block any newly constructed roads upon completion of the sale. These stumps must be scattered along the road system to prohibit vehicular movement. Contact the sale administrator for specific details of design and placement.

4.2 - Maintenance

4.2.5 - Two wheel drive condition (2/04)

All existing trail roads on and adjacent to the sale area must be passable by two-wheel drive traffic for the duration of the sale.

5 - Operations

5.1 - Notification

5.1.1 - Pre-sale conference (10/16)

A pre-sale conference on site between the Purchaser and sale administrator is required prior to beginning any operations to determine landing and road locations. The Unit Manager or his/her representative must be contacted at least 3 days in advance to schedule the conference.

5.2 - Conduct of Operations

5.2.2 - Hazard Trees/Snags

5.2.2.1 - Den trees (10/16)

Obvious hollow and/or den trees shall be protected and left standing unless they are a safety hazard.

5.2.3 - Operating Restrictions

5.2.3.3 - Bark slippage restriction (3/09)

Within Payment Unit(s) 2 and 4, unless changed by written agreement, cutting and skidding are not permitted during the period of April 15 to July 15. This restriction is because of bark slippage.

5.2.3.6 - Bark beetle restriction (12/08)

In the event drought creates a high risk of pine bark beetle infestation, pine is not to be cut during the period March 1 through July 1, unless all portions of trees greater than two inches in diameter are removed from the sale area, reduced to chips, or treated to the satisfaction of the Unit Manager or his/her representative, within fifteen days of being severed from the stump. Pine log decks, pulpwood piles and treetops that are piled for chipping in the fall or winter within a 1/4 mile of susceptible sites must be removed before March 15. Residual slash must not be placed in piles or rows and must be spread over the site for quick drying. The Department of Natural Resources will exercise this specification if the risk of damage warrants.

5.2.39 - ORV trail/route protection (4/18)

The ORV trail is shown on the Timber Sale Map. Do not cut trees or damage posts with yellow ORV markers. Trees with yellow ORV markers shall be cut off above the markers and at least 5 feet above ground. All stumps within 5 feet of the trail must be cut flush with the ground. Maintain a 20 foot wide slash, debris, and rut free zone daily using the ORV trail or route as the centerline. Do not run equipment down the ORV trail or route. Skidding across the trail or route may only occur in

locations approved by the sale administrator.

5.2.41 - Snowmobile trail protection (9/11)

The snowmobile trail is shown on the Timber Sale Map. Do not cut or damage posts with orange trail markers or traffic control signs. The road maintenance/restoration must be done prior to December 1. If the trail is used for hauling, it must be graded to the satisfaction of the Unit Manager or his/her representative prior to December 1st. If the trail road is to be used for hauling during the snowmobile season, then a snow covered base must be left on the trail. The snowmobile trail may only be crossed at right angles. Maintain a 20 foot wide slash, debris, and rut free zone daily using the snowmobile trail as the centerline. No decking of forest products will be permitted along the snowmobile trail. All stumps within 20 feet of the snowmobile trail must be cut at ground level.

5.4 - Soil Protection

5.4.1 - Rutting restriction, general (7/16)

Operations are to cease immediately if equipment and weather conditions result in rutting of roads and/or skid trails which is 12 inches or greater in depth and 50 feet in length. The Unit Manager or his/her representative may restrict hauling and/or skidding if ruts exceed the specified depth. With the Unit Manager or his/her representative's approval, the Purchaser may return to the area when the risk of rutting has decreased.

5.8 - Protection of Endangered Species

5.8.5 - Protection of raptor nests (3/13)

All trees with raptor nests will be protected if found during harvesting operations. Notification will be made to the Unit Manager or his/her representative who will notify the Wildlife Biologist so an on-site evaluation and recommendation can be made, if necessary.

6 - Safety and Fire Prevention

6.2 - Signing

6.2.2 - Snowmobile trail posting (10/20)

The Purchaser is responsible for posting and maintaining caution signs on snowmobile trail prior to beginning operations during the snowmobile season (approximately December 1 to March 31). The trail must be posted at appropriate distances from the sale area to warn of logging activity and truck traffic. Signs must be removed when harvest operations are suspended or completed. The Purchaser will provide these signs.

6.2.3 - Recreational trail posting (10/20)

The Purchaser is responsible for posting and maintaining caution signs on the motorcycle trail prior to beginning operations. The trail must be posted at appropriate distances from the sale area to warn of logging activity and truck traffic at both ends of the trail. Signs must be removed when harvest operations are suspended or completed. The Purchaser will provide these signs.



TIMBER SALE MAP

This information provided by authority of Part 525, 1994 PA 451, as amended.

Sale Number	Year
52-101	22

Forest Management Unit	County	Mapped By	Date	Page	of
GFMU - Indian River Field Office	Cheboygan County	Harig	08/31/2022	1	1
Township		Range		Section(s) and Subdivision(s)	
34N		03W		14: SWSW 23: NW1/4, NE1/4, N1/2SW	
Scale				1:15,840	

Cover Type				Density	
A = Aspen	H = Hemlock	N = Marsh	U = Upland Brush	0 = Non Stocked	5 = Pole Timber Medium
B = Paper Birch	J = Jack Pine	O = Oak	UM = Upland Mixed	1 = Seedling Sapling Poor	6 = Pole Timber Well
C = Cedar	L = Lowland Brush	P = Lowland Poplar	V = Bog or Marsh	2 = Seedling Sapling Medium	7 = Saw Timber Poor
D = Treed Bog	LM = Lowland Mixed	Q = Mixed Swamp Conifer	W = White Pine	3 = Seedling Sapling Well	8 = Saw Timber Medium
E = Swamp Hdwoods	M = Mpl. Bch, Brch	R = Red Pine	X = Non Stocked	4 = Pole Timber Poor	9 = Saw Timber Well
F = Spruce Fir	MC = Mixed Conifer	S = Black Spruce	Z = Water		
G = Grass	MD = Mixed Deciduous	T = Tamarack			

PU	Acres	PU	Acres
1	23.6	5	34.4
2	5.1	6	40.3
3	13.2	7	36.0
4	23.3		

Up North Mix Compartment 154 175.9 Acres

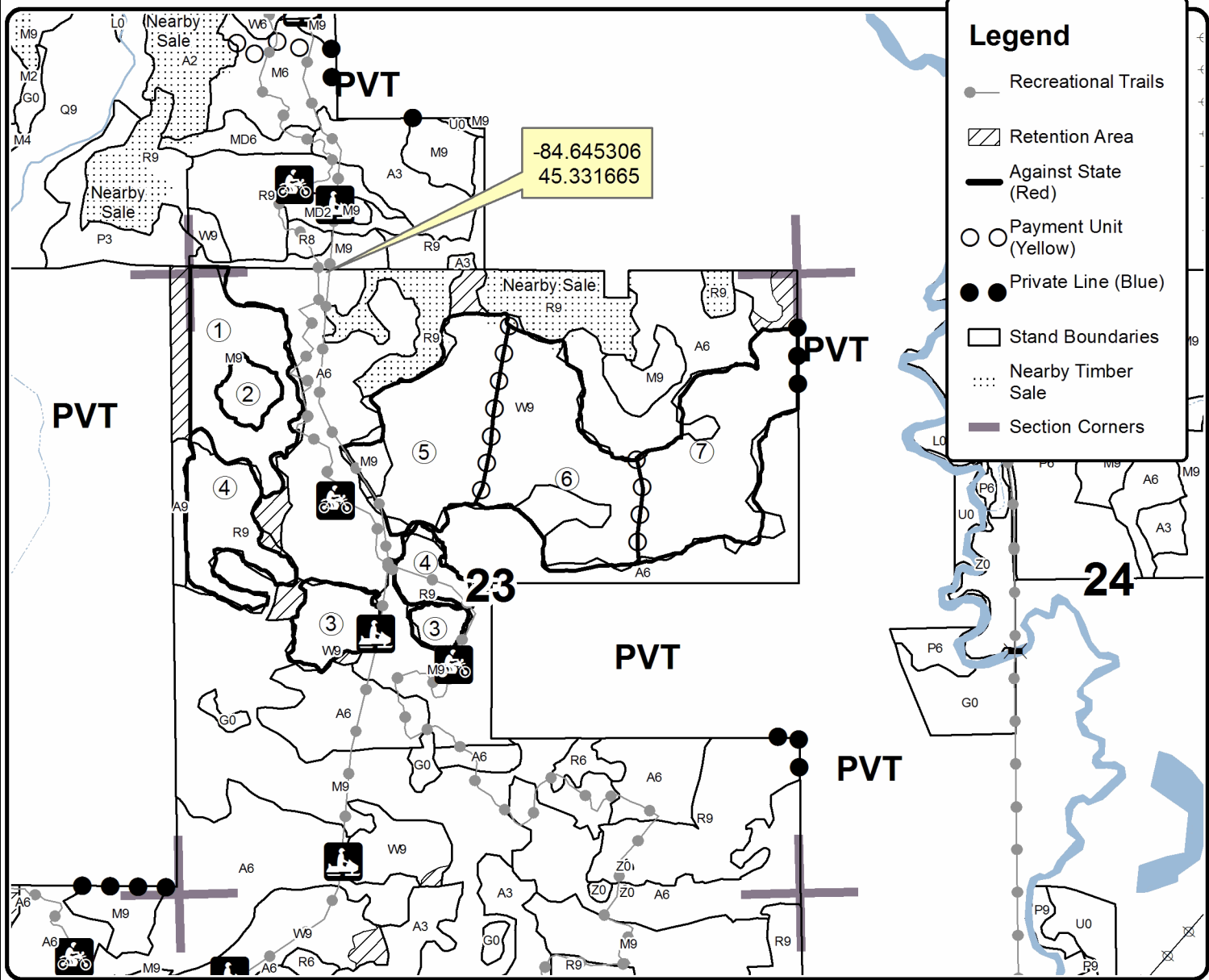
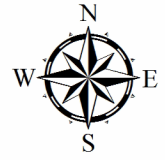

Legend

- Recreational Trails
- Retention Area
- Against State (Red)
- Payment Unit (Yellow)
- Private Line (Blue)
- Stand Boundaries
- Nearby Timber Sale
- Section Corners

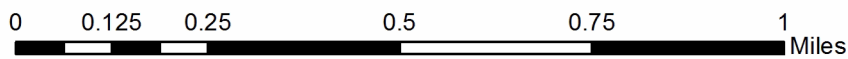

TIMBER SALE INFORMATION

Elmer Dudd Red Pine (52-110-22)
T34N, R02W, SEC. 17.
Cheboygan County (Advertised Price \$22,481.30)

SALE NOTE: Bark slip restriction. Some decline and mortality in red pine. Potential for RSH nest restrictions to be imposed.

A timber sale contract for this lump sum, sealed bid timber sale will be awarded to the responsible bidder offering the highest sealed bid price. All units of volume listed below were estimated using the Inventory Manager computer program and the new Michigan taper model. Bids must be at or above the following advertised price for each product and species:

<u>PRODUCTS & SPECIES</u>	<u>ESTIMATED UNITS*</u>	<u>ADVERTISED PRICE</u>
Sawtimber		
Red Pine	14.2 MBF	\$ 174.00 / MBF
Pulpwood		
Red Pine	310 Cords	\$ 64.55 / Cord

* The total volume is statistically estimated within plus (+) or minus (-) 43.72 percent. There are an estimated 344 cords on this timber sale, plus or minus 150 cords at the 95% confidence level. The estimated units are final and not subject to adjustment. Prospective bidders are urged to examine this timber and to make their own estimates of quantity and quality.

BOND AND PAYMENT SCHEDULE:

1. A bond in the amount of \$1,124.00 to insure faithful performance of the conditions of the contract will be deposited by the successful bidder within 21 days of the sale award.
2. Cutting in any sale or unit without the required advance payment would be considered a trespass.
3. Total payment must be paid in advance or according to the following schedule :
 - (a) Ten percent (10%) of the sale value must be paid within 21 days of the sale award.
 - (b) The remainder is due before cutting begins.
 - (c) Payment for each of the following units must be made before cutting begins in that unit:

PAYMENT UNIT NUMBER	PERCENT OF TOTAL SALE VALUE
01	100.0%
4. If no cutting takes place, the 10% down payment will not be refunded.
5. Operations on the contract issued will terminate on 06/30/2025.

SALE STATISTICS

Volumes were calculated in cubic feet using the Michigan taper model. Cubic foot volume includes all wood inside bark for the product indicated. For display purposes, cubic feet were converted to cords and MBF using a simple conversion factor, e.g. 79 cubic feet per cord and 185 cubic feet per MBF. The cubic foot volumes are precise; the cords and MBF volumes are not. Cubic foot volume cannot be directly converted to cords or boards with precision.

SALE VOLUMES

The total estimated sale volume may not equal the sum of the species/products due to the nature of statistical calculations associated with double sampling methodology.

VOLUME		STATISTICAL RANGE IN CORDS		
TOTAL CUBIC FEET	TOTAL CORDS	PERCENT ERROR	MINIMUM	MAXIMUM
27,171	344	43.72%	194	494

VDU VOLUMES

A VDU is a Volume Determination Unit. Volumes and their associated statistics are calculated at the VDU level and summarized to the sale level. There is often a one to one relationship between a VDU and a Payment Unit, but not always, depending on the cruise design. Refer to the VDU TO PAYMENT UNIT table.

VDU	VOLUME			RANGE IN CORDS	
	TOTAL CUBIC FEET	TOTAL CORDS	PERCENT ERROR	MINIMUM	MAXIMUM
1	27,171	344	43.73%	194	494
TOTAL:	27,171	344		194	494

VDU TO PAYMENT UNIT

When a VDU is associated with more than one Payment Unit (PU), the VDU volumes are assigned to the PU based on acres of the VDU within the PU.

VDU	VDU ACRES	PU	PU ACRES
1	20.7	1	20.7
TOTAL:	20.7		20.7

DESCRIPTION OF TIMBER BY PAYMENT UNIT (PU)

PU	MARKET GROUP	PRODUCT	QUANTITY	UNIT	ACRES	ADVERTISE PRICE
1	Red Pine	Sawtimber	14.2	MBF	20.7	\$22,481.30
	Red Pine	Pulpwood	310	Cords		
TOTAL:			14.2	MBF		
TOTAL:			310	Cords		

Sale Specific Conditions & Requirements

Sale Name: Elmer Dudd Red Pine

Sale Number: 52-110-22 Seq#: 2

1 - Sale Area

1.2 - Boundaries

1.2.1 - Painted boundaries (9/19)

The sale boundary and Payment Unit boundaries are marked and identified by red paint. Exterior sale boundary lines against state are marked with red paint. The painted boundary line trees are not Included Timber and are to be protected unless marked with orange paint.

2 - Timber Specifications

2.1 - Included Timber

2.1.3 - Cut tree marked unit(s) (12/08)

Within Payment Unit(s) 1, all trees are designated for cutting when marked with orange paint above and below stump height, regardless of merchantability. Any dead trees marked with orange may be harvested or left standing at the discretion of the Purchaser.

3 - Payments

3.4 - Damaged Timber

3.4.1 - Damaged timber (7/16)

General Condition and Requirement 3.4 Damaged Timber, defines liquidated damages for undesignated live merchantable trees which are cut or injured.

No damage is acceptable to undesignated live merchantable trees. Within the sale area, if more than 5 % of trees (> 4.5" DBH) within a specified area of the sale are damaged, liquidated damages will be assessed for all trees damaged. Rates will be in accordance with General Condition and Requirement 3.4 Damaged Timber.

5 - Operations

5.2 - Conduct of Operations

5.2.1 - Slash

5.2.1.13 - Dispose of slash as directed (12/05)

Slash is to be disposed of as directed by the DNR Sale Administrator.

5.2.3 - Operating Restrictions

5.2.3.3 - Bark slippage restriction (3/09)

Within Payment Unit(s) 1, unless changed by written agreement, cutting and skidding are not permitted during the period of April 15 to July 15. This restriction is because of bark slippage.

5.2.3.13 - Heterobasidion root disease (HRD) (7/19)

This plantation is at risk of infection by the root rot fungus, Heterobasidion irregulare. To prevent the spread of this disease, cutting operations within payment units 1 are restricted to the period of January 1st through March 31st. Cutting may only occur outside this period with written permission of the Unit Manager or with the application of a preventative pesticide. Consultation with a forest health specialist will determine if cutting can occur prior to January 1 without pesticide application, dependent upon current and forecasted snow cover. Cellu-Treat and RotStop C are currently the only EPA registered products available in the United States for the control of Heterobasidion. Both products are a water-soluble powder that must be applied to the stump, in accordance with the product label. Dye must be added to these products to provide visible evidence of adequate coverage. Application of these pesticides requires licensing by the Michigan Department of Agriculture and Rural Development. All applicators are required to: provide to the Sale Administrator notification of application per requirements in 40 CFR 170.120; and document and provide to the Sale Administrator annually, by December 31 and prior to closure of sale, the volume of product used and acres treated.

5.2.38 - No decking against live trees (2/04)

Cut products may not be decked against unmarked or designated leave trees.

5.8 - Protection of Endangered Species

5.8.3 - Red shoulder hawk or goshawk (2/16)

In the event that an active red shoulder hawk or goshawk nest is found, the contract may be amended to protect the nest site until the nest is determined to be inactive. The value of the trees in this excluded area will be refunded or credited to the Purchaser. The nest will be buffered with a five-chain radius (eight acre) protection area, centered on the nest tree, in which there will be no cutting or new roads constructed. Avoid human disturbance, including loading and skidding, in the protection area.

An additional zone of five chains (ten chains centered on the active nest tree) will be established in which there is no management activity from March 15 to July 15 (NLP). Limit biomass harvesting and chipping operations within this ten-chain zone, retain the maximum one-third of residues per the Woody Biomass Harvesting Guidelines (Michigan DNR 2010). Nests determined to be inactive will be protected with a one-chain no-harvest buffer.

5.8.5 - Protection of raptor nests (3/13)

All trees with raptor nests will be protected if found during harvesting operations. Notification will be made to the Unit Manager or his/her representative who will notify the Wildlife Biologist so an on-site evaluation and recommendation can be made, if necessary.

6 - Safety and Fire Prevention

6.2 - Signing

6.2.1 - Road posting (10/20)

The Purchaser is responsible for posting and maintaining caution signs on Dunham Road prior to beginning operations. The road must be posted at appropriate distances from the sale area to warn of logging activity and truck traffic. Signs must be removed when harvest operations are suspended or completed. The Purchaser will provide these signs.



TIMBER SALE MAP

This information provided by authority of Part 525, 1994 PA 451, as amended.

Forest Management Unit Gaylord		County Cheboygan	Mapped By TSP	Date 07/21/2022	Page 1	of 1
Township 34N	Range 02W	Section(s) and Subdivision(s) 17: SW		Scale 1:7,920		

Cover Type				Density	
A = Aspen	H = Hemlock	N = Marsh	U = Upland Brush	0 = Non Stocked	5 = Pole Timber Medium
B = Paper Birch	J = Jack Pine	O = Oak	UM = Upland Mixed	1 = Seedling Sapling Poor	6 = Pole Timber Well
C = Cedar	L = Lowland Brush	P = Lowland Poplar	V = Bog or Marsh	2 = Seedling Sapling Medium	7 = Saw Timber Poor
D = Treed Bog	LM = Lowland Mixed	Q = Mixed Swamp Conifer	W = White Pine	3 = Seedling Sapling Well	8 = Saw Timber Medium
E = Swamp Hdwoods	M = Mpl, Bch, Brch	R = Red Pine	X = Non Stocked	4 = Pole Timber Poor	9 = Saw Timber Well
F = Spruce Fir	MC = Mixed Conifer	S = Black Spruce	Z = Water		
G = Grass	MD = Mixed Deciduous	T = Tamarack			

PU	Acres
1	20.7

Elmer Dudd Red Pine

Compartment 170

20.7 Acres

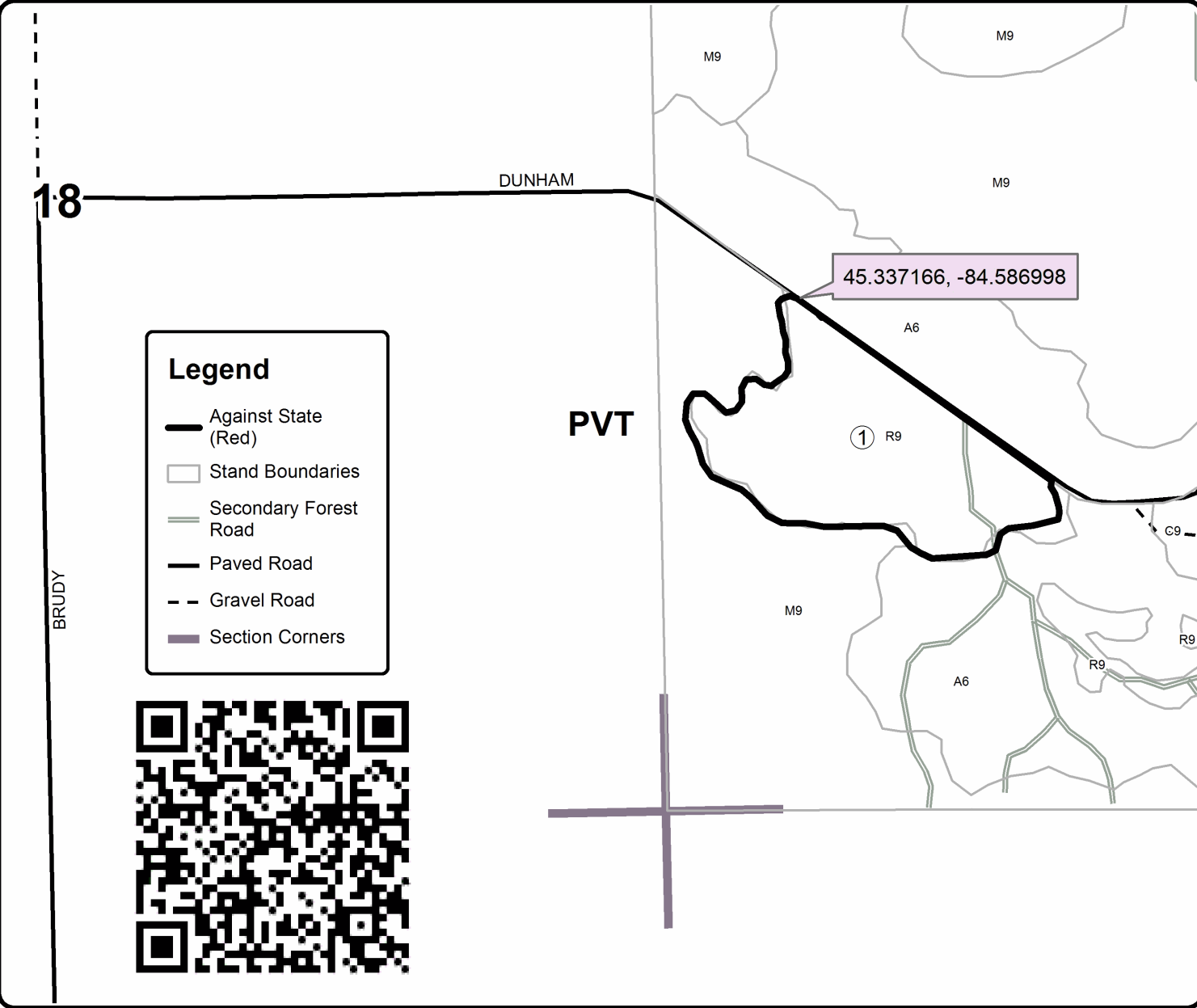

Legend

- Against State (Red)
- Stand Boundaries
- Secondary Forest Road
- Paved Road
- Gravel Road
- Section Corners

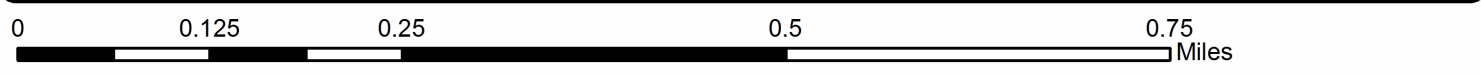

TIMBER SALE INFORMATION

Stimpson Road Aspen Mix (52-124-22)

T38N, R03W, SEC. 5; T39N, R03W, SEC. 19; T39N, R03W, SEC. 28; T39N, R03W, SEC. 29; T39N, R03W, SEC. 30; T39N, R03W, SEC. 32; T39N, R03W, SEC. 33.

SALE NOTE: This is a large sale consisting of mostly rocky, low ground, but operable terrain. There is good access to most Payment Units. Some Payment Units have larger diameter timber that is past maturity. In addition, there are some individual trees and areas of blowdown.

A timber sale contract for this lump sum, sealed bid timber sale will be awarded to the responsible bidder offering the highest sealed bid price. All units of volume listed below were estimated using the Inventory Manager computer program and the new Michigan taper model. Bids must be at or above the following advertised price for each product and species:

<u>PRODUCTS & SPECIES</u>	<u>ESTIMATED UNITS*</u>		<u>ADVERTISED PRICE</u>
Sawtimber			
Mixed Aspen	440.1	MBF	\$ 58.00 / MBF
N. White Cedar	74.9	MBF	\$ 33.00 / MBF
Red Maple	25.9	MBF	\$ 112.00 / MBF
Red Pine	11.3	MBF	\$ 141.00 / MBF
White Spruce	95.4	MBF	\$ 28.00 / MBF
Pulpwood			
Balsam Fir	886	Cords	\$ 20.80 / Cord
Balsam Poplar	163	Cords	\$ 21.75 / Cord
Mixed Aspen	2,293	Cords	\$ 21.75 / Cord
Mixed Hardwood	770	Cords	\$ 17.35 / Cord
N. White Cedar	557	Cords	\$ 18.90 / Cord
Red Pine	53	Cords	\$ 52.45 / Cord
White Pine	17	Cords	\$ 32.35 / Cord
White Spruce	290	Cords	\$ 16.05 / Cord

* The total volume is statistically estimated within plus (+) or minus (-) 9.08 percent. There are an estimated 6,788 cords on this timber sale, plus or minus 616 cords at the 95% confidence level. The estimated units are final and not subject to adjustment. Prospective bidders are urged to examine this timber and to make their own estimates of quantity and quality.

BOND AND PAYMENT SCHEDULE:

1. A bond in the amount of \$13,888.00 to insure faithful performance of the conditions of the contract will be deposited by the successful bidder within 21 days of the sale award.
2. Cutting in any sale or unit without the required advance payment would be considered a trespass.
3. Total payment must be paid in advance or according to the following schedule :
 - (a) Ten percent (10%) of the sale value must be paid within 21 days of the sale award.
 - (b) The 10% down payment will be credited towards the first unit cut.
 - (c) Payment for each of the following units must be made before cutting begins in that unit:

PAYMENT UNIT NUMBER	PERCENT OF TOTAL SALE VALUE
01	7.3%
02	3.1%
03	16.8%
04	12.0%
05	9.7%
06	11.1%
07	40.0%
4. If no cutting takes place, the 10% down payment will not be refunded.
5. Operations on the contract issued will terminate on 06/30/2027.

SALE STATISTICS

Volumes were calculated in cubic feet using the Michigan taper model. Cubic foot volume includes all wood inside bark for the product indicated. For display purposes, cubic feet were converted to cords and MBF using a simple conversion factor, e.g. 79 cubic feet per cord and 185 cubic feet per MBF. The cubic foot volumes are precise; the cords and MBF volumes are not. Cubic foot volume cannot be directly converted to cords or boards with precision.

SALE VOLUMES

The total estimated sale volume may not equal the sum of the species/products due to the nature of statistical calculations associated with double sampling methodology.

VOLUME			STATISTICAL RANGE IN CORDS	
TOTAL CUBIC FEET	TOTAL CORDS	PERCENT ERROR	MINIMUM	MAXIMUM
536,270	6,788	9.08%	6,172	7,405

VDU VOLUMES

A VDU is a Volume Determination Unit. Volumes and their associated statistics are calculated at the VDU level and summarized to the sale level. There is often a one to one relationship between a VDU and a Payment Unit, but not always, depending on the cruise design. Refer to the VDU TO PAYMENT UNIT table.

	VOLUME			RANGE IN CORDS	
VDU	TOTAL CUBIC FEET	TOTAL CORDS	PERCENT ERROR	MINIMUM	MAXIMUM
2	41,252	522	34.66%	341	703
17	6,339	80	108.56%	7	167
25	64,572	817	23.39%	626	1,009
26	85,009	1,076	26.93%	786	1,366
63	50,735	642	25.19%	480	804
73	225,354	2,853	13.53%	2,467	3,239
93	63,009	798	30.35%	556	1,040
TOTAL:	536,270	6,788		5,249	8,327

VDU TO PAYMENT UNIT

When a VDU is associated with more than one Payment Unit (PU), the VDU volumes are assigned to the PU based on acres of the VDU within the PU.

VDU	VDU ACRES	PU	PU ACRES
2	18.6	1	18.6
17	4.2	2	4.2
25	47.3	4	47.3
26	40.8	3	40.8
63	17.8	5	17.8
73	100.4	7	100.4
93	30.7	6	30.7
TOTAL:	259.8		259.8

DESCRIPTION OF TIMBER BY PAYMENT UNIT (PU)

PU	MARKET GROUP	PRODUCT	QUANTITY	UNIT	ACRES	ADVERTISE PRICE
1	Mixed Aspen	Sawtimber	3.4	MBF	18.6	\$10,089.15
	<i>B. T. Aspen</i>		2.1	<i>MBF</i>		
	<i>Quaking Aspen</i>		1.3	<i>MBF</i>		
	N. White Cedar		9.4	MBF		
	White Spruce		8.9	MBF		
	Balsam Fir	Pulpwood	65	Cords		
	<i>Balsam Fir</i>		65	<i>Cords</i>		
	Mixed Aspen		251	Cords		
	<i>B. T. Aspen</i>		81	<i>Cords</i>		
	<i>Quaking Aspen</i>		170	<i>Cords</i>		
	Mixed Hardwood		40	Cords		
	<i>Red Maple</i>		33	<i>Cords</i>		
	<i>White Ash</i>		7	<i>Cords</i>		
	N. White Cedar		78	Cords		
	White Spruce		22	Cords		
	<i>Tamarack</i>		7	<i>Cords</i>		
	<i>White Spruce</i>		15	<i>Cords</i>		
2	Red Pine	Sawtimber	11.3	MBF	4.2	\$4,373.15
	Red Pine	Pulpwood	53	Cords		
3	Mixed Aspen	Sawtimber	52.9	MBF	40.8	\$23,275.80
	<i>B. T. Aspen</i>		12.1	<i>MBF</i>		
	<i>Quaking Aspen</i>		40.8	<i>MBF</i>		
	Red Maple		8.5	MBF		
	Balsam Fir	Pulpwood	104	Cords		
	<i>Balsam Fir</i>	<i>Sawtimber</i>	4.2	<i>MBF</i>		
	<i>Balsam Fir</i>	<i>Pulpwood</i>	96	<i>Cords</i>		
	Balsam Poplar		23	Cords		
	<i>Balsam Poplar</i>		23	<i>Cords</i>		
	Mixed Aspen		644	Cords		
	<i>B. T. Aspen</i>		378	<i>Cords</i>		
	<i>Quaking Aspen</i>		266	<i>Cords</i>		
	Mixed Hardwood		149	Cords		
	<i>Sugar Maple</i>	<i>Sawtimber</i>	1.2	<i>MBF</i>		
	<i>White Ash</i>		2.1	<i>MBF</i>		
	<i>Red Maple</i>	<i>Pulpwood</i>	135	<i>Cords</i>		
	<i>Sugar Maple</i>		3	<i>Cords</i>		
	<i>White Ash</i>		5	<i>Cords</i>		
	4	Mixed Aspen	Sawtimber	47.6		
<i>B. T. Aspen</i>			6.6	<i>MBF</i>		
<i>Quaking Aspen</i>			41.0	<i>MBF</i>		
White Spruce			3.9	MBF		
Balsam Fir		Pulpwood	195	Cords		
<i>Balsam Fir</i>			195	<i>Cords</i>		
Balsam Poplar			50	Cords		
<i>Balsam Poplar</i>		<i>Sawtimber</i>	3.1	<i>MBF</i>		
<i>Balsam Poplar</i>		<i>Pulpwood</i>	44	<i>Cords</i>		
Mixed Aspen			302	Cords		
<i>B. T. Aspen</i>			11	<i>Cords</i>		
<i>Quaking Aspen</i>			291	<i>Cords</i>		
Mixed Hardwood			109	Cords		
<i>Sugar Maple</i>		<i>Sawtimber</i>	2.1	<i>MBF</i>		
<i>White Ash</i>			6.3	<i>MBF</i>		
<i>Paper Birch</i>		<i>Pulpwood</i>	22	<i>Cords</i>		
<i>Red Maple</i>			43	<i>Cords</i>		
<i>Sugar Maple</i>			3	<i>Cords</i>		
<i>White Ash</i>			24	<i>Cords</i>		

DESCRIPTION OF TIMBER BY PAYMENT UNIT (PU), CON'T

PU	MARKET GROUP	PRODUCT	QUANTITY	UNIT	ACRES	ADVERTISE PRICE
4 con't	White Spruce	Pulpwood	13	Cords		
	<i>White Spruce</i>		13	<i>Cords</i>		
5	Mixed Aspen	Sawtimber	82.0	MBF	17.8	\$13,414.70
	<i>B. T. Aspen</i>		71.9	<i>MBF</i>		
	<i>Quaking Aspen</i>		10.1	<i>MBF</i>		
	N. White Cedar		5.7	MBF		
	White Spruce		6.4	MBF		
	Balsam Fir	Pulpwood	22	Cords		
	<i>Balsam Fir</i>	<i>Sawtimber</i>	2.1	<i>MBF</i>		
	<i>Balsam Fir</i>	<i>Pulpwood</i>	18	<i>Cords</i>		
	Balsam Poplar		9	Cords		
	<i>Balsam Poplar</i>		9	<i>Cords</i>		
	Mixed Aspen		195	Cords		
	<i>B. T. Aspen</i>		124	<i>Cords</i>		
	<i>Quaking Aspen</i>		71	<i>Cords</i>		
	Mixed Hardwood		36	Cords		
	<i>Paper Birch</i>		9	<i>Cords</i>		
	<i>Red Maple</i>		22	<i>Cords</i>		
	<i>White Ash</i>		5	<i>Cords</i>		
	N. White Cedar		42	Cords		
	White Pine		17	Cords		
	<i>White Pine</i>	<i>Sawtimber</i>	3.3	<i>MBF</i>		
	<i>White Pine</i>	<i>Pulpwood</i>	10	<i>Cords</i>		
	White Spruce		89	Cords		
	<i>White Spruce</i>		89	<i>Cords</i>		
6	Mixed Aspen	Sawtimber	40.9	MBF	30.7	\$15,470.60
	<i>Quaking Aspen</i>		40.9	<i>MBF</i>		
	N. White Cedar		14.6	MBF		
	Red Maple		11.2	MBF		
	White Spruce		7.0	MBF		
	Balsam Fir	Pulpwood	101	Cords		
	<i>Balsam Fir</i>		101	<i>Cords</i>		
	Mixed Aspen		140	Cords		
	<i>Quaking Aspen</i>		140	<i>Cords</i>		
	Mixed Hardwood		195	Cords		
	<i>Red Maple</i>		195	<i>Cords</i>		
	N. White Cedar		120	Cords		
	White Spruce		23	Cords		
	<i>White Spruce</i>		23	<i>Cords</i>		
7	Mixed Aspen	Sawtimber	213.3	MBF	100.4	\$55,575.50
	<i>B. T. Aspen</i>		29.4	<i>MBF</i>		
	<i>Quaking Aspen</i>		183.9	<i>MBF</i>		
	N. White Cedar		45.2	MBF		
	Red Maple		6.2	MBF		
	White Spruce		69.2	MBF		
	Balsam Fir	Pulpwood	399	Cords		
	<i>Balsam Fir</i>	<i>Sawtimber</i>	5.5	<i>MBF</i>		
	<i>Balsam Fir</i>	<i>Pulpwood</i>	388	<i>Cords</i>		
	Balsam Poplar		81	Cords		
	<i>Balsam Poplar</i>		81	<i>Cords</i>		
	Mixed Aspen		761	Cords		
	<i>B. T. Aspen</i>		12	<i>Cords</i>		
	<i>Quaking Aspen</i>		749	<i>Cords</i>		
	Mixed Hardwood		241	Cords		
	<i>Paper Birch</i>		27	<i>Cords</i>		
	<i>Red Maple</i>		214	<i>Cords</i>		

DESCRIPTION OF TIMBER BY PAYMENT UNIT (PU), CON'T

PU	MARKET GROUP	PRODUCT	QUANTITY	UNIT	ACRES	ADVERTISE PRICE
7 con't	N. White Cedar	Pulpwood	317	Cords		
	White Spruce		143	Cords		
	<i>White Spruce</i>		143	<i>Cords</i>		
TOTAL:			647.6	MBF		
TOTAL:			5,029	Cords		

Sale Specific Conditions & Requirements

Sale Name: Stimpson Road Aspen Mix

Sale Number: 52-124-22 Seq#: 2

1 - Sale Area

1.2 - Boundaries

1.2.1 - Painted boundaries (9/19)

The sale boundary and Payment Unit boundaries are marked and identified by blue, red and yellow paint. Exterior sale boundary lines against private property are marked with blue paint. Exterior sale boundary lines against state are marked with red paint. Interior Payment Unit boundaries are marked with yellow paint. Retention patches are marked with teal paint; no harvesting activities may occur within these areas. The painted boundary line trees are not Included Timber and are to be protected. Yellow painted trees designating an interior Payment Unit boundary are only to be cut when all surrounding Payment Units have been paid.

2 - Timber Specifications

2.1 - Included Timber

2.1.2 - Clearcut unit(s) w/o unmerchantable trees (8/11)

Within Payment Unit(s) 1 and 3-7, cut all trees which meet minimum piece specifications in 2.2 Utilization, with the following exceptions:

- Within Payment Unit 1, do not cut oak or any pine species.
- Within Payment Unit 3, do not cut oak, white pine, cedar, or any apple species.
- Within Payment Unit 4, do not cut white pine.
- Within Payment Unit 5, do not cut white pine greater than 20 inches at DBH or any apple species
- Within Payment Unit 6, do not cut white pine and hemlock.
- Within Payment Unit 7, do not cut any pine species or hemlock.

2.1.3 - Cut tree marked unit(s) (12/08)

Within Payment Unit(s) 2, all trees are designated for cutting when marked with orange paint above and below stump height, regardless of merchantability.

3 - Payments

3.3 - Pre-measured Sales

3.3.4 - Dividing payment units (7/14)

Payment Unit(s) 7 may be divided at the request of the Purchaser and upon approval of the Unit Manager. Dividing Payment Units is a contract modification which requires a Timber Sale Contract Amendment.

3.6 - Payment Unit Cutting Schedule

3.6.1 - Order of cutting (1/09)

Payment Units shall be cut in numerical order, unless the sale is paid in full or unless approved by the Unit Manager or his/her representative.

4 - Transportation

4.1 - Construction

4.1.3 - Slash and earthen piles (8/04)

Piles or windrows of earth along roads and landings that have been widened or constructed shall be leveled. Slash from road maintenance or construction, including stumps, shall be dispersed throughout the sale.

4.1.6 - Road construction (1/09)

Construction of new roads or improvements of existing roads shall be done in such a way as to minimize the environmental and visual impacts. Merchantable trees shall be cut and utilized unless otherwise directed. Non-merchantable trees shall be severed and laid flat on the ground. Slash shall be scattered, and not left in windrows and kept a minimum of 10 feet back from the road edge. Stumps shall be set upright, not left on edge, and be moved at least 10 feet away from the road edge.

Disturbed soil shall be feathered into the woods and not left in berms or windrows.

4.1.7 - Road closure (10/11)

All new roads built into the sale must be blocked to vehicle traffic upon completion of the sale. Overgrown roads that are reopened shall be considered new roads. In general, this will require constructing a four (4') foot high berm of stumps and logs covered with earth. These roads must be rendered impassable to cars and trucks. Contact the sale administrator for further specific details of design and placement.

4.1.11 - Permits (2/12)

The Purchaser will secure any necessary highway and stream crossing permits that may be required. The Purchaser is also responsible for contacting Miss DIG prior to operating along Stimpson RD.

4.2 - Maintenance

4.2.4 - Grading (10/16)

For completion of the sale, state forest roads must be graded. In general, this will require a road grader or bull dozer to shape up the roads after forest products have been hauled off site. This includes cleaning of drainage areas, grading, crowning and filling with gravel, if necessary. The grading equipment to be used must be approved by the Unit Manager or his/her representative.

5 - Operations

5.1 - Notification

5.1.1 - Pre-sale conference (10/16)

A pre-sale conference on site between the Purchaser and sale administrator is required prior to beginning any operations to determine landing and road locations. The Unit Manager or his/her representative must be contacted at least 3 days in advance to schedule the conference.

5.1.4 - Post-sale conference (10/16)

A post-sale conference on site between the Purchaser and sale administrator is required 3 days prior to the completion of active logging operations to determine clean-up and repair of landings, road edges, and the fulfillment of other contract specifications.

5.2 - Conduct of Operations

5.2.1 - Slash

5.2.1.13 - Dispose of slash as directed (12/05)

Slash is to be disposed of as directed by the Sale Administrator.

5.2.2 - Hazard Trees/Snags

5.2.2.1 - Den trees (10/16)

Obvious hollow and/or den trees shall be protected and left standing unless they are a safety hazard.

5.2.4 - Dead and Down Creation

5.2.4.5 - Dead and down creation, reptiles and amphibians (2/05)

To encourage reptiles and amphibians, within Payment Unit(s) 4, 6, and 7, leave one, 14" DBH or greater full-length tree on the ground, with the top still intact, for every 5 acres. These trees shall be evenly scattered throughout the Payment Unit(s) and identified by blue flagging.

5.2.22 - Operating Caution

5.2.22.1 - Operating caution (6/11)

It is recommended, but not required, that within Payment Unit(s) 1 and 3 - 7, cutting, skidding, and hauling occur during dry summer or frozen winter conditions with tracked equipment. The reason for the recommendation is due to the wetter soil conditions.

5.2.29 - Shrub protection (1/20)

Do not cut or damage hawthorn, witch-hazel, dogwood or juneberry. These woody-shrub plants are highly beneficial to

various wildlife species.

5.2.32 - Decking/landing restoration (9/13)

All decking and landing areas must have the surface area restored to a condition equal to or better than before. This is to ensure the proper regeneration of the stand. Wood debris, chips and "cookies" from trimmings must be removed or scattered away from landing and loading areas and may not be windrowed on the edge.

5.2.37 - No decking areas (12/08)

No decking is allowed within the non-forested area located on the south side of access road to Payment Unit 2.

5.4 - Soil Protection

5.4.1 - Rutting restriction, general (7/16)

Operations are to cease immediately if equipment and weather conditions result in rutting of roads and/or skid trails which is 12 inches or greater in depth and 50 feet in length. The Unit Manager or his/her representative may restrict hauling and/or skidding if ruts exceed the specified depth. With the Unit Manager or his/her representative's approval, the Purchaser may return to the area when the risk of rutting has decreased.

5.4.6 - Wet area protection (5/10)

No harvesting operations, including skidding and felling, are to take place within vernal pond areas or drainages within Payment Unit 4. When harvesting occurs, there should be no disturbance to the vernal pond depressions. All equipment, trees and tops should be kept out of this areas. Equipment should only be used when the soil is in a dry or frozen condition. Care must be taken by the Purchaser to identify and avoid operating in these areas of the timber sale.

In addition, there are 2 old water diversion ditches running perpendicular from Stimpson Road located within Payment Units 3 and 4. These ditches must be kept clear of debris during harvesting activities.

5.7 - Protection of Historical Sites

5.7.2 - Potential historical site(s) (9/06)

The State Historic Preservation Office has identified the potential for a historic site within the boundary of this timber sale. Note that if the site is discovered during operations, General Condition and Requirement 5.7 - Protection of Historical Sites will apply.

5.8 - Protection of Endangered Species

5.8.5 - Protection of raptor nests (3/13)

All trees with raptor nests will be protected if found during harvesting operations. Notification will be made to the Unit Manager or his/her representative who will notify the Wildlife Biologist so an on-site evaluation and recommendation can be made, if necessary.

6 - Safety and Fire Prevention

6.2 - Signing

6.2.1 - Road posting (10/20)

The Purchaser is responsible for posting and maintaining caution signs on Stimpson Road prior to beginning operations. The road must be posted at appropriate distances from the sale area to warn of logging activity and truck traffic. Signs must be removed when harvest operations are suspended or completed.

6.2.3 - Recreational trail posting (10/20)

The Purchaser is responsible for posting and maintaining caution signs on the horse trail prior to beginning operations. The trail must be posted at appropriate distances from the sale area to warn of logging activity and truck traffic at both ends of the trail. Signs must be removed when harvest operations are suspended or completed.

7 - Other Conditions

7.5 - Loss

7.5.1 - Deteriorating timber (7/09)

The sale area has received damage from individual tree windthrow and general over maturity. The Purchaser should harvest the wood as soon as possible. The Department of Natural Resources is held free of responsibility of any further damage or

deterioration due to delay in harvesting.



TIMBER SALE MAP

This information provided by authority of Part 525, 1994 PA 451, as amended.

Forest Management Unit Gaylord	County Cheboygan	Mapped By TSP	Date 09/29/2022	Page 2	of 2
Township 38 & 39 N	Range 03W	Section(s) and Subdivision(s) 38N 03W 5: NENE; 39N 03W 19: N1/2SE; 28: NWSW; 29: SW, NESE, S1/2SE; 30: NESE; 32: NWNE, NESW, SE; 33: W1/2SW	Scale 1:15,840		
Cruised By Scheele					

Cover Type				Density			
A = Aspen	H = Hemlock	N = Marsh	U = Upland Brush	0 = Non Stocked	5 = Pole Timber Medium		
B = Paper Birch	J = Jack Pine	O = Oak	UM = Upland Mixed	1 = Seedling Sapling Poor	6 = Pole Timber Well		
C = Cedar	L = Lowland Brush	P = Lowland Poplar	V = Bog or Marsh	2 = Seedling Sapling Medium	7 = Saw Timber Poor		
D = Treed Bog	LM = Lowland Mixed	Q = Mixed Swamp Conifer	W = White Pine	3 = Seedling Sapling Well	8 = Saw Timber Medium		
E = Swamp Hdwoods	M = Mpl, Bch, Brch	R = Red Pine	X = Non Stocked	4 = Pole Timber Poor	9 = Saw Timber Well		
F = Spruce Fir	MC = Mixed Conifer	S = Black Spruce	Z = Water				
G = Grass	MD = Mixed Deciduous	T = Tamarack					

PU	Acres	PU	Acres
1	18.6	5	17.8
2	4.2	6	30.7
3	40.8	7	100.4
4	47.3		

Stimpson Road Aspen Mix

Compartment 136

259.8 Acres

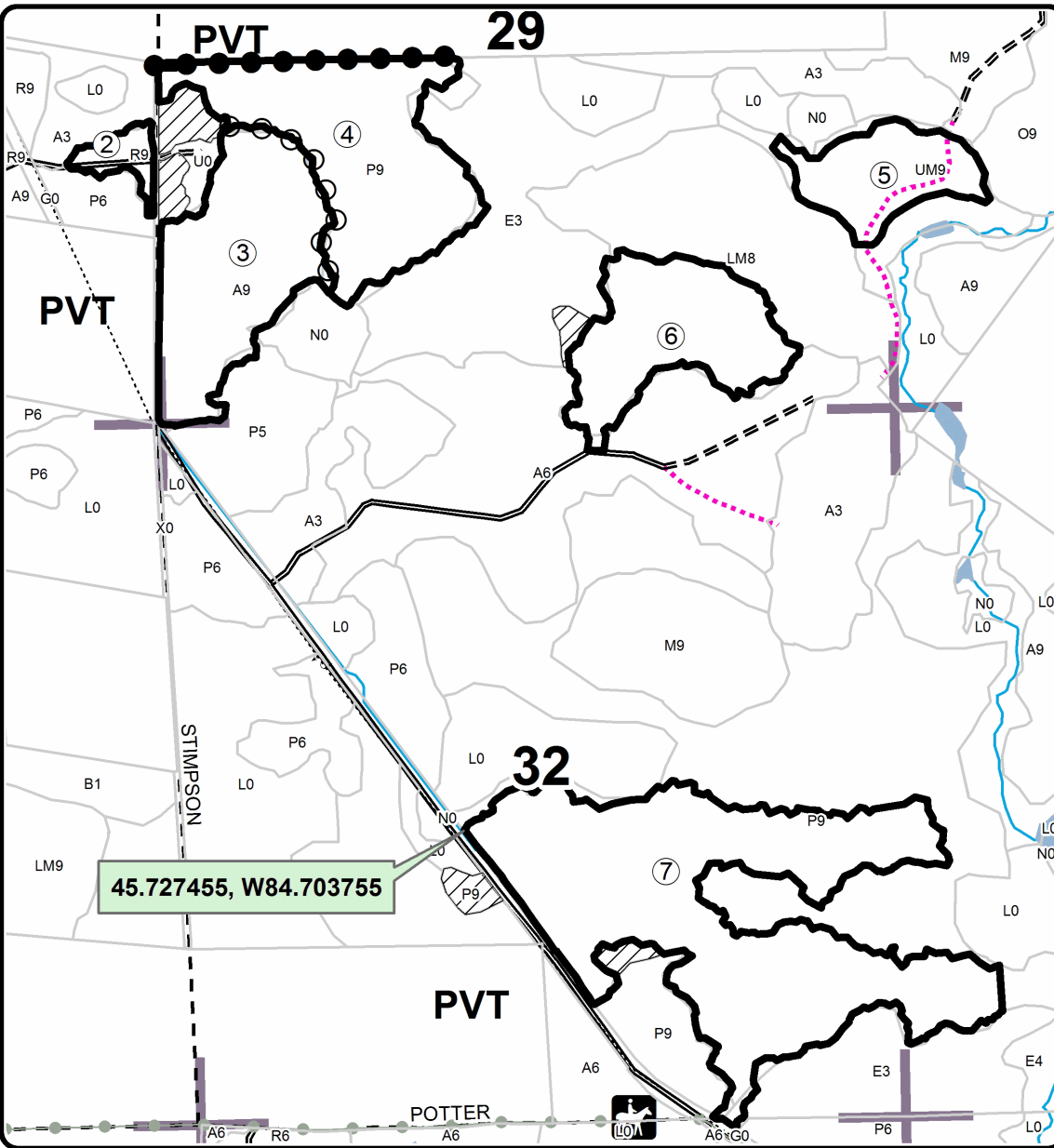
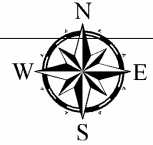

Legend

- Against State (Red)
- Payment Unit (Yellow)
- Private Line (Blue)
- ▨ Retention Area
- Stand Boundaries
- - - Utility Line
- Recreational Trail
- Secondary Forest Road
- - - Forest Access Route
- - - Gravel Road
- · · Temporary Management Access
- Perennial River
- Lakes and Rivers
- Section Corners

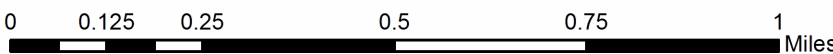
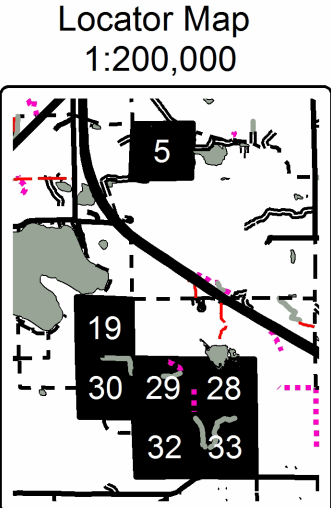



TIMBER SALE MAP

This information provided by authority of Part 525, 1994 PA 451, as amended.

Forest Management Unit Gaylord		County Cheboygan	Mapped By TSP	Date 09/29/2022	Page 1	of 2
Township 38 & 39 N	Range 03W	Section(s) and Subdivision(s) 38N 03W 5: NENE; 39N 03W 19: N1/2SE; 28: NWSW; 29: SW, NESE, S1/2SE; 30: NESE; 32: NWNE, NESW, SE; 33: W1/2SW		Scale 1:15,840		

Cover Type				Density	
A = Aspen	H = Hemlock	N = Marsh	U = Upland Brush	0 = Non Stocked	5 = Pole Timber Medium
B = Paper Birch	J = Jack Pine	O = Oak	UM = Upland Mixed	1 = Seedling Sapling Poor	6 = Pole Timber Well
C = Cedar	L = Lowland Brush	P = Lowland Poplar	V = Bog or Marsh	2 = Seedling Sapling Medium	7 = Saw Timber Poor
D = Treed Bog	LM = Lowland Mixed	Q = Mixed Swamp Conifer	W = White Pine	3 = Seedling Sapling Well	8 = Saw Timber Medium
E = Swamp Hdwoods	M = Mpl, Bch, Brch	R = Red Pine	X = Non Stocked	4 = Pole Timber Poor	9 = Saw Timber Well
F = Spruce Fir	MC = Mixed Conifer	S = Black Spruce	Z = Water		
G = Grass	MD = Mixed Deciduous	T = Tamarack			

PU	Acres	PU	Acres
1	18.6	5	17.8
2	4.2	6	30.7
3	40.8	7	100.4
4	47.3		

Stimpson Road Aspen Mix

Compartment 136
259.8 Acres

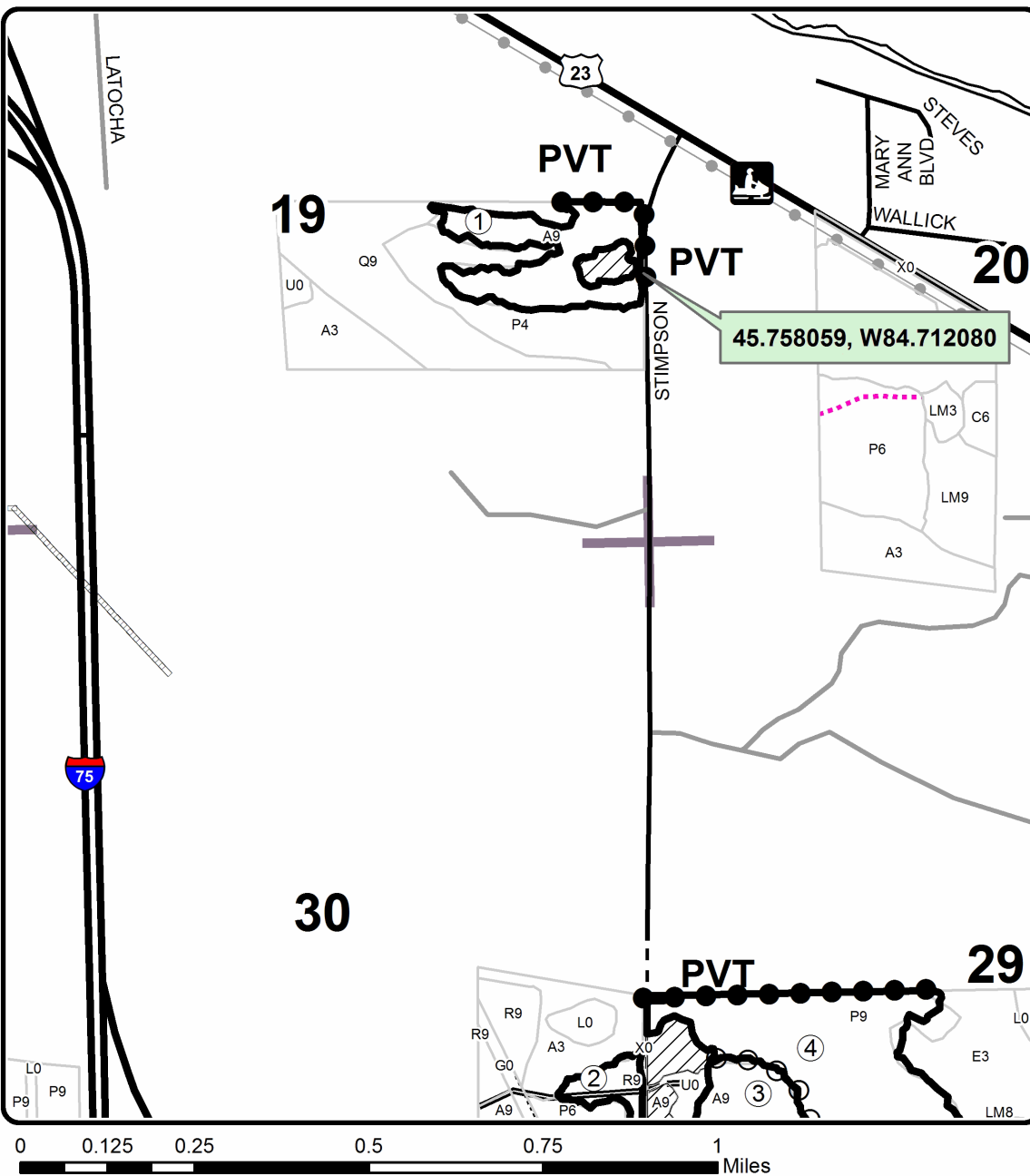
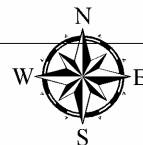

Legend

- Against State (Red)
- Payment Unit (Yellow)
- Private Line (Blue)
- ▨ Retention Area
- Stand Boundaries
- - - Utility Line
- Recreational Trail
- == Highways
- == Secondary Forest Road
- == Forest Access Route
- == Paved Road
- - - Gravel Road
- Private
- ... Temporary Management Access
- Section Corners

Locator Map
1:200,000

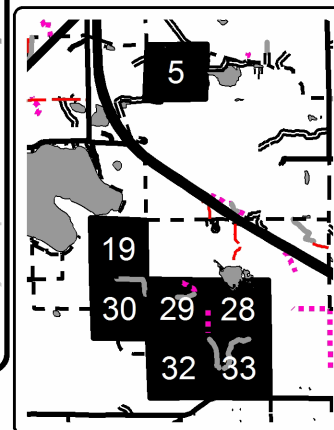

Wycamp Red Pine (52-102-23)
T38N, R05W, SEC. 28; Emmet COUNTY

In response to the notice of sale to be held 9:00 a.m. (local time) on March 21, 2023, I am hereby submitting my sealed bid (firm offer) for the following forest products to be cut. Bids for individual species must be at or above the advertised price. All non-responsive bid forms may be rejected.

<u>PRODUCTS & SPECIES</u>	<u>ESTIMATED VOLUME*</u>	<u>ADVERTISED PRICE</u>	<u>BID PRICE/UNIT</u>
Sawtimber Red Pine	63.8 MBF	\$ 141.00/MBF	\$ _____
Pulpwood Red Pine	675 Cords	\$ 52.45/Cord	\$ _____

*The volumes are statistically estimated within plus (+) or minus (-) 13.36 percent at 95% confidence level. These estimated volumes are final and not subject to adjustment. Prospective bidders are urged to examine this timber and to make their own estimates of quantity and quality.

I understand that any or all bids may be rejected. All bids must be signed and all bid items must be bid or the bid form may be rejected. I also understand that consideration and awarding a contract will be based upon my past performance and ability to complete the contract based upon equipment and staffing subject to my control .

FEDERAL ID: ____ - ____ - ____ or SOCIAL SECURITY NUMBER: ____ - ____ - ____

Company or individual bidding: _____

Company representative's name: _____

Address: _____

City: _____ State: _____ Zip: _____

IF AVAILABLE, PLEASE PLACE THE PERSONALIZED LABEL FROM YOUR PROSPECTUS IN THE ABOVE BOX.

Individual or company representative's signature: _____ Date: _____

Phone number : _____ Email (optional): _____

THE WINNING BIDDER MUST COMPLETE THE VERIFICATION OF WORKER'S DISABILITY COMPENSATION ACT COMPLIANCE (ON REVERSE SIDE IF DOUBLE SIDED) WITHIN 21 DAYS OF SALE AWARD DATE

Up North Mix (52-101-22)
T34N, R03W, SEC. 14; T34N, R03W, SEC. 23; Cheboygan COUNTY

In response to the notice of sale to be held 9:00 a.m. (local time) on March 21, 2023, I am hereby submitting my sealed bid (firm offer) for the following forest products to be cut. Bids for individual species must be at or above the advertised price. All non-responsive bid forms may be rejected.

<u>PRODUCTS & SPECIES</u>	<u>ESTIMATED VOLUME*</u>	<u>ADVERTISED PRICE</u>	<u>BID PRICE/UNIT</u>
Sawtimber			
B. T. Aspen	113.8 MBF	\$ 58.00/MBF	\$ _____
Basswood	280.7 MBF	\$ 67.00/MBF	\$ _____
Beech	5.1 MBF	\$ 58.00/MBF	\$ _____
Red Maple	77.5 MBF	\$ 112.00/MBF	\$ _____
Red Pine	148.2 MBF	\$ 141.00/MBF	\$ _____
Sugar Maple	135.0 MBF	\$ 299.00/MBF	\$ _____
White Pine	1,011.9 MBF	\$ 45.00/MBF	\$ _____
Pulpwood			
B. T. Aspen	432 Cords	\$ 21.75/Cord	\$ _____
Basswood	481 Cords	\$ 13.95/Cord	\$ _____
Mixed Hardwood	993 Cords	\$ 17.35/Cord	\$ _____
Red Pine	386 Cords	\$ 52.45/Cord	\$ _____
White Pine	2,260 Cords	\$ 32.35/Cord	\$ _____

*The volumes are statistically estimated within plus (+) or minus (-) 9.49 percent at 95% confidence level. These estimated volumes are final and not subject to adjustment. Prospective bidders are urged to examine this timber and to make their own estimates of quantity and quality.

I understand that any or all bids may be rejected. All bids must be signed and all bid items must be bid or the bid form may be rejected. I also understand that consideration and awarding a contract will be based upon my past performance and ability to complete the contract based upon equipment and staffing subject to my control.

FEDERAL ID: ____ - ____ - ____ or SOCIAL SECURITY NUMBER: ____ - ____ - ____

Company or individual bidding: _____

Company representative's name: _____

Address: _____

City: _____ State: _____ Zip: _____

IF AVAILABLE, PLEASE PLACE THE PERSONALIZED LABEL FROM YOUR PROSPECTUS IN THE ABOVE BOX.

Individual or company representative's signature: _____ Date: _____

Phone number : _____ Email (optional): _____

THE WINNING BIDDER MUST COMPLETE THE VERIFICATION OF WORKER'S DISABILITY COMPENSATION ACT COMPLIANCE (ON REVERSE SIDE IF DOUBLE SIDED) WITHIN 21 DAYS OF SALE AWARD DATE

Elmer Dudd Red Pine (52-110-22)
T34N, R02W, SEC. 17; Cheboygan COUNTY

In response to the notice of sale to be held 9:00 a.m. (local time) on March 21, 2023, I am hereby submitting my sealed bid (firm offer) for the following forest products to be cut. Bids for individual species must be at or above the advertised price. All non-responsive bid forms may be rejected.

<u>PRODUCTS & SPECIES</u>	<u>ESTIMATED VOLUME*</u>	<u>ADVERTISED PRICE</u>	<u>BID PRICE/UNIT</u>
Sawtimber Red Pine	14.2 MBF	\$ 174.00/MBF	\$ _____
Pulpwood Red Pine	310 Cords	\$ 64.55/Cord	\$ _____

*The volumes are statistically estimated within plus (+) or minus (-) 43.72 percent at 95% confidence level. These estimated volumes are final and not subject to adjustment. Prospective bidders are urged to examine this timber and to make their own estimates of quantity and quality.

I understand that any or all bids may be rejected. All bids must be signed and all bid items must be bid or the bid form may be rejected. I also understand that consideration and awarding a contract will be based upon my past performance and ability to complete the contract based upon equipment and staffing subject to my control .

FEDERAL ID: ____ - ____ - ____ or SOCIAL SECURITY NUMBER: ____ - ____ - ____

Company or individual bidding: _____

Company representative's name: _____

Address: _____

City: _____ State: _____ Zip: _____

IF AVAILABLE, PLEASE PLACE THE PERSONALIZED LABEL FROM YOUR PROSPECTUS IN THE ABOVE BOX.

Individual or company representative's signature : _____ Date: _____

Phone number : _____ Email (optional): _____

THE WINNING BIDDER MUST COMPLETE THE VERIFICATION OF WORKER'S DISABILITY COMPENSATION ACT COMPLIANCE (ON REVERSE SIDE IF DOUBLE SIDED) WITHIN 21 DAYS OF SALE AWARD DATE



FOR DEPARTMENT USE ONLY	
Sale Number (XX - XXX - XX - XX)	
Forest Management Unit:	

TIMBER SALE VERIFICATION OF WORKER'S DISABILITY COMPENSATION ACT COMPLIANCE

As required by Act 317, P.A. 1969 (Worker's Compensation) and
Part 5 of Act 451 of 1994, as amended.

VERIFICATION OF WORKER'S DISABILITY COMPENSATION ACT COMPLIANCE

- This verification must be completed and submitted within 21 days of contract award and prior to the issuance of the timber sale contract.
- In addition, if boxes 2B or 2C are checked, then Notice of Exclusion or Certificate of Insurance must be submitted within twenty-one (21) days of the contract award and prior to the issuance of the timber sale contract.
- All information must be typed or printed except for written signatures.

Please Check Appropriate Categories:

1. My business is organized as (you **must** check one of the boxes below):
 - A. Sole Proprietorship (individual)
 - B. Partnership
 - C. Corporation
2. You **must** check one of the boxes below:
 - A. I certify my business is a sole proprietorship and it has no employees but the sole proprietor. I am not subject to the Worker's Compensation Laws.
 - B. I certify my business has satisfied its obligation to the Worker's Compensation Act through the use of an approved Notice of Exclusion (BWC-337, Rev. 5/96). I will provide a copy of the Notice of Exclusion within 21 days of the contract award. (For questions or a copy of the BWC-337, please call the Worker's Compensation Bureau at 517-322-1195).
 - C. I certify my business has a Worker's Compensation Policy. I will provide an original Certificate of Insurance within twenty-one (21) days of the contract award.
3. If you have checked item 2(A) or 2(B), you **must** indicate the number of **both** full-time and part-time employees, other than yourself, including family members and active partners (if none, you must enter "0").

_____ Full-time Employees

_____ Part-time Employees

Name of Business		Federal ID (or) Social Security No.	
Address		Telephone ()	
City	State	ZIP	

I hereby certify that the above information is true and correct. I agree to notify the Michigan DNR of any changes that occur in factors affecting my coverage during any of my present and future operations.

Signature of Owner or Authorized Representative

Title

Date

Please complete the "SEALED BID" information on the next page

Stimpson Road Aspen Mix (52-124-22)
T38N, R03W, SEC. 5; T39N, R03W, SEC. 19; T39N, R03W, SEC. 28; T39N, R03W,

In response to the notice of sale to be held 9:00 a.m. (local time) on March 21, 2023, I am hereby submitting my sealed bid (firm offer) for the following forest products to be cut. Bids for individual species must be at or above the advertised price. All non-responsive bid forms may be rejected.

<u>PRODUCTS & SPECIES</u>	<u>ESTIMATED VOLUME*</u>	<u>ADVERTISED PRICE</u>	<u>BID PRICE/UNIT</u>
Sawtimber			
Mixed Aspen	440.1 MBF	\$ 58.00/MBF	\$ _____
N. White Cedar	74.9 MBF	\$ 33.00/MBF	\$ _____
Red Maple	25.9 MBF	\$ 112.00/MBF	\$ _____
Red Pine	11.3 MBF	\$ 141.00/MBF	\$ _____
White Spruce	95.4 MBF	\$ 28.00/MBF	\$ _____
Pulpwood			
Balsam Fir	886 Cords	\$ 20.80/Cord	\$ _____
Balsam Poplar	163 Cords	\$ 21.75/Cord	\$ _____
Mixed Aspen	2,293 Cords	\$ 21.75/Cord	\$ _____
Mixed Hardwood	770 Cords	\$ 17.35/Cord	\$ _____
N. White Cedar	557 Cords	\$ 18.90/Cord	\$ _____
Red Pine	53 Cords	\$ 52.45/Cord	\$ _____
White Pine	17 Cords	\$ 32.35/Cord	\$ _____
White Spruce	290 Cords	\$ 16.05/Cord	\$ _____

*The volumes are statistically estimated within plus (+) or minus (-) 9.08 percent at 95% confidence level. These estimated volumes are final and not subject to adjustment. Prospective bidders are urged to examine this timber and to make their own estimates of quantity and quality.

I understand that any or all bids may be rejected. All bids must be signed and all bid items must be bid or the bid form may be rejected. I also understand that consideration and awarding a contract will be based upon my past performance and ability to complete the contract based upon equipment and staffing subject to my control.

FEDERAL ID: _____ - _____ or SOCIAL SECURITY NUMBER: _____ - _____ - _____

Company or individual bidding: _____

Company representative's name: _____

Address: _____

City: _____ State: _____ Zip: _____

IF AVAILABLE, PLEASE PLACE THE PERSONALIZED LABEL FROM YOUR PROSPECTUS IN THE ABOVE BOX.

Individual or company representative's signature: _____ Date: _____

Phone number : _____ Email (optional): _____

THE WINNING BIDDER MUST COMPLETE THE VERIFICATION OF WORKER'S DISABILITY COMPENSATION ACT COMPLIANCE (ON REVERSE SIDE IF DOUBLE SIDED) WITHIN 21 DAYS OF SALE AWARD DATE



FOR DEPARTMENT USE ONLY
Sale Number (XX - XXX - XX - XX)
Forest Management Unit:

TIMBER SALE VERIFICATION OF WORKER'S DISABILITY COMPENSATION ACT COMPLIANCE

*As required by Act 317, P.A. 1969 (Worker's Compensation) and
Part 5 of Act 451 of 1994, as amended.*

VERIFICATION OF WORKER'S DISABILITY COMPENSATION ACT COMPLIANCE

- This verification must be completed and submitted within 21 days of contract award and prior to the issuance of the timber sale contract.
- In addition, if boxes 2B or 2C are checked, then Notice of Exclusion or Certificate of Insurance must be submitted within twenty-one (21) days of the contract award and prior to the issuance of the timber sale contract.
- All information must be typed or printed except for written signatures.

Please Check Appropriate Categories:

1. My business is organized as (you **must** check one of the boxes below):
 - A. Sole Proprietorship (individual)
 - B. Partnership
 - C. Corporation

2. You **must** check one of the boxes below:
 - A. I certify my business is a sole proprietorship and it has no employees but the sole proprietor. I am not subject to the Worker's Compensation Laws.
 - B. I certify my business has satisfied its obligation to the Worker's Compensation Act through the use of an approved Notice of Exclusion (BWC-337, Rev. 5/96). I will provide a copy of the Notice of Exclusion within 21 days of the contract award. (For questions or a copy of the BWC-337, please call the Worker's Compensation Bureau at 517-322-1195).
 - C. I certify my business has a Worker's Compensation Policy. I will provide an original Certificate of Insurance within twenty-one (21) days of the contract award.

3. If you have checked item 2(A) or 2(B), you **must** indicate the number of **both** full-time and part-time employees, other than yourself, including family members and active partners (if none, you must enter "0").

_____ Full-time Employees

_____ Part-time Employees

Name of Business		Federal ID (or) Social Security No.	
Address		Telephone ()	
City	State	ZIP	

I hereby certify that the above information is true and correct. I agree to notify the Michigan DNR of any changes that occur in factors affecting my coverage during any of my present and future operations.

Signature of Owner or Authorized Representative

Title

Date

Please complete the "SEALED BID" information on the next page