



**DEPARTMENT OF NATURAL RESOURCES
STATE OF MICHIGAN
TIMBER SALE PROSPECTUS #7183**

SCHEDULED SALE DATE AND TIME: 2:00 p.m. (local time) on August 7, 2023.

LOCATION: **GWINN MGMT UNIT, 410 WEST M 35, GWINN, MI 49841.**

PROSPECTUS NOTE: The bidder is advised to inspect the sale area and review the location, estimated volumes, operating costs and contract terms of proposed sales. Please be aware that some landowners may request 60 days or more notice for access across their land.

Notice is hereby given that bids will be received by the Unit Manager, GWINN MANAGEMENT UNIT, for certain timber on the following described lands:

Mikko's Maze Aspen (32-010-22) / T44N, R25W, SEC. 31, SENW,NE,SW,SE.

Marquette County, Advertised Price \$102,279.50, 173.7 Acres, Aspen, Spruce/Fir/Tamarack.

SALE NOTE: Please note specs related to snow and ORV trails used for hauling in this area .

A recreation site such as a trail, pathway, or campground is within the sale area or the vicinity. Certain restrictions/specifications may be applicable including time restrictions.

Duke's Doodles GEMS (32-025-22) / T44N, R26W, SEC. 10, SESE.

T44N, R26W, SEC. 11, SWSW.

T44N, R26W, SEC. 13, SWSW.

T44N, R26W, SEC. 14, NWNW,S1/2NW,SWNE,W1/2SW,SE.

T44N, R26W, SEC. 15, NE,N1/2SE.

T44N, R26W, SEC. 22, SENE.

T44N, R26W, SEC. 23, NW,N1/2NE,SWNE,N1/2SW,SESW.

T44N, R26W, SEC. 24, E1/2SW,W1/2SE.

Marquette County, Advertised Price \$168,174.85, 217.8 Acres, Aspen, Spruce/Fir/Tamarack.

SALE NOTE: A recreation site such as a trail, pathway, or campground is within the sale area or the vicinity. Certain restrictions/specifications may be applicable including time restrictions.

Pointer's Paradise GEMS (32-026-22) / T44N, R26W, SEC. 26, N1/2NW,SENE,W1/2NE,SE.

T44N, R26W, SEC. 35, E1/2NW,N1/2NE,SWNE.

Marquette County, Advertised Price \$103,160.30, 128.3 Acres, Aspen, Spruce/Fir/Tamarack.

SALE NOTE: Payment units 1 and 4 have soft ground in areas see spec 5.2.22.1. Operations are restricted throughout this sale due to hunting season and nesting see spec 5.2.3.1.

A recreation site such as a trail, pathway, or campground is within the sale area or the vicinity. Certain restrictions/specifications may be applicable including time restrictions.

BID INSTRUCTIONS (VER. 10/10/2022):

1. Scheduled Bid Location, Date, and Time (2/11)

Bids must be received by the Unit Manager, GWINN OFFICE, 410 WEST M 35, GWINN, MI 49841, no later than 2:00 p.m. (local time) on August 7, 2023. For further information concerning this sale, contact Kristen Matson at 906-346-9201 extension 103.

2. Bidder's Qualifications (10/22)

If all or part of a timber sale was prepared by a private contractor, the contractor and that contractor's company are not permitted to bid on the timber sale. A person must be 18 years of age or older to purchase timber. Permanent employees of the Department of Natural Resources or members of their immediate household may not bid. Former employees, in the permanent or seasonal class, may not bid until 3 months after the last day of active duty. Bids will not be accepted from individuals or companies appearing on the DNR/FRD No-Bid List. This list contains the names of purchasers who previously failed to execute a contract within 21-days or who have a history of poor performance.

3. Preparation of Sealed Bids (5/16)

Bid Forms may be completed online thru Michigan DNR Timber Sale Online Bidding (OLB) at www.michigan.gov/timberbidding or by completing the hardcopy Bid Form found in the Timber Sale Prospectus. Hardcopy Bid Forms shall be manually signed in ink. Registration in OLB is considered your 'signature' for all bids submitted thru that system. Bid prices must be entered for each species and product in the Bid Price column for all material subject to bidding and all fill-in blanks must be completed. If erasures or other changes appear on the hardcopy Bid Form, each erasure or change must be initialed by the person signing the bid.

4. Submission of Sealed Bids (5/16)

Bid forms may be obtained from the Unit Manager or thru OLB. Bids may be submitted hardcopy or thru OLB. All hardcopy bids must be submitted on the bid form and in an envelope clearly identified as described in this section. NOTE: Only one bid form per bid envelope. Sealed bids must be submitted to the Unit office designated in the prospectus and must be submitted at or prior to the time established in the prospectus. The envelope should show on the outside (a) the sale name or number and (b) the date and time of bid opening, as shown in the prospectus. Bids received after the time specified in the sale prospectus are late bids and will be rejected.

It is possible for a bidder to submit multiple bids on a single sale. For example, a bid may be submitted hardcopy and a bid may be submitted thru OLB. Or, two bidders from the same company could both submit bids on the same sale. If this were to happen, the State would accept all bids received and award the contract accordingly. All bidding and contractual requirements would apply to all bids received.

5. Public Opening of Sealed Bids (7/16)

If conditions permit, the sealed bids will be publicly opened and posted at the time and place set in the prospectus.

If a bidder, present at a bid opening, has submitted bids on more than one sale, that bidder may withdraw their unopened bid envelopes or announce the withdrawal of their online bid after being declared the successful bidder on one sale.

6. Award of Contract (1/11)

Award of the contract will be made to the Bidder whose bid, conforming to the prospectus, is most advantageous to the State of Michigan on the basis of total value at rates bid for the estimated quantities. The State reserves the right to reject any bid or waive any minor irregularity in bids received. A written award mailed (or otherwise furnished) to the successful Bidder shall be deemed to result in a binding contract without further action by either party.

7. Down Payment (1/11)

The Bidder to whom award is made must make a down payment within 21 days of the sale award. The amount of the down payment will be calculated as shown in the Bond and Payment Schedule of this prospectus. Only cash may be used to meet this requirement.

8. Performance Security (1/11)

As guarantee of faithful performance, a cash bond, certificate of deposit, surety bond or irrevocable letter of credit (LOC) is required within 21 days of the sale award. The amount of the performance security is shown in the Bond and

Payment Schedule of this prospectus. If an LOC or surety is used, the coverage must extend for at least 6 months beyond the contract expiration.

9. Worker's Compensation (10/22)

Purchaser shall obtain worker's compensation insurance to cover claims under Michigan's Worker's Disability Compensation Act of 1969 or similar employee benefit act of any other state applicable to an employee. Verification of Worker's Disability Compensation Act Compliance must be completed and submitted within 21 days of contract award and prior to the issuance of the timber sale contract. In addition, if applicable, Notice of Exclusion or Certificate of Insurance must also be submitted.

10. Timber Sale Contract (10/22)

Additional conditions and requirements common to all timber sales are listed on the timber sale contract (R4031) and are available on line at www.michigan.gov/timber. Contact the Unit Manager for additional information or a sample contract. Within 21 days of the date of the award letter, the bidder must sign the contract and provide the required down payment, performance security, and verification of worker's disability compensation. The down payment and performance security shall be in accordance with the provisions of the timber sale contract, in the sums stated in this prospectus. If these actions are not taken, then the Bidder, the Bidder's corporation, and the corporation's principals may not be permitted to bid on State timber sales for a period of 3 months after the first offense, 6 months after the second offense, and 1 year after the third offense. An offense will only be counted against the Bidder for 5 years. In addition, the Bidder certifies that if awarded this contract, the Bidder will complete the timber sale contract in accordance with its terms and any modifications thereof including requirements to purchase, cut, and remove the included timber by the expiration date.

Payment Unit values in the State Forest Timber Sale Contract are calculated based on the advertised value of the Payment Unit as a percentage of the total advertised value of the contract. The advertised value of each Payment Unit is given in the Description of Timber by Payment Unit table on the Timber Sale Information page. For example, if the value of Payment Unit 1 is advertised as \$1,500 and the total Timber Sale value is advertised as \$10,000, the contract price for Payment Unit 1 will be 15% of the total bid price ($\$1,500/\$10,000 * 100$).

11. Disclaimer of Estimates and Bidder's Warranty of Inspection (10/22)

Before submitting this bid, the Bidder is advised and cautioned to inspect the sale area, review the requirements of the sale contract, and take other steps as may be reasonably necessary to ascertain the location, estimated volumes, construction estimates, and operating costs of the proposed sale. Failure to do so will not relieve the Bidder from responsibility for completing the contract.

The Bidder warrants that this bid is submitted solely on the basis of the Bidder's examination and inspection of the quality and quantity of the timber offered for sale and the Bidder's opinion of the value thereof and the costs of recovery. No reliance should be placed on the State of Michigan's estimates of timber quality, quantity or costs of recovery. Bidder further acknowledges that the State of Michigan: (i) expressly disclaims any warranty of fitness of timber for any purpose; (ii) offers this timber as is without any warranty of quality (merchantability) or quantity and (iii) expressly disclaims any warranty as to the quantity or quality of timber sold.

12. Certification and Chain-of-Custody (10/22)

Unless otherwise indicated in the contract under section 7 – Other Conditions of the Sale Specific Conditions & Requirements, the area encompassed by this timber sale is certified to the standards of the Forest Stewardship Council (FSC) - Certificate #SCS-FM/COC-00090N and the Sustainable Forestry Initiative (SFI) - Certificate #NSF-SFIS-5Y031-SF5. Forest products from this sale may be delivered to the mill as "FSC 100% and / or SFI certified" as long as the contractor hauling the forest products is chain-of-custody (COC) certified or covered under a COC certificate from the destination mill. The purchaser is responsible for maintaining COC after leaving the sale area.

13. Good Neighbor Authority (GNA) Requirements (10/22)

If the name of this timber sales contains the acronym GNA, it is authorized by the Good Neighbor Authority (GNA) and covered by various agreements between the U.S. Forest Service and the State. The timber sale occurs on federal land and the following conditions apply:

GNA contracts on US Forest Service land will not be awarded to purchasers on the Federal list of excluded parties. The System for Award Management (SAM) will be checked for active excluded parties prior to award of contract. In

addition, the Bidder to whom award is made must complete an Assurance Regarding Felony Conviction or Tax Delinquent Status for Corporate Applicants (AD-3031).

14. Good Neighbor Authority (GNA) Requirements, con't (10/22)

Bidder certifies, by signing this bid form, that to the best of Bidder's knowledge that the following representations are accurate and complete.

- a. That the Bidder and its principals are not presently debarred, suspended, proposed for debarment, declared ineligible, or voluntary excluded from timber sales (covered transactions) by any Federal department or agency.
- b. That the Bidder and its principals have not within a 3-year period preceding this bid been convicted of or had a civil judgment rendered against them for commission of fraud or a criminal offense in connection with obtaining , attempting to obtain, or performing a public (Federal, State, or local) transaction or contract under a public transaction; violation of Federal or State antitrust statutes or commission of embezzlement, theft, forgery, bribery, falsification or destruction of records, making false statements, or receiving stolen property.
- c. That the Bidder and its principals are not presently indicted for or otherwise criminally or civilly charged by a governmental entity (Federal, State, or local) with commission of any of the offenses enumerated in paragraph b of this certification.
- d. That the Bidder and its principals have not within a 3-year period preceding this bid had one or more public transactions (Federal, State, or local) terminated for breach or default of a timber or forest product contract.

Bidders that cannot certify this requirement, in whole or in part, shall submit an explanation with their bid.

SHANNON LOTT, Acting
Director

TIMBER SALE INFORMATION

Mikko's Maze Aspen (32-010-22)
 T44N, R25W, SEC. 31.
 Marquette County (Advertised Price \$102,279.50)

SALE NOTE: Please note specs related to snow and ORV trails used for hauling in this area .

A recreation site such as a trail, pathway, or campground is within the sale area or the vicinity. Certain restrictions/specifications may be applicable including time restrictions.

A timber sale contract for this lump sum, sealed bid timber sale will be awarded to the responsible bidder offering the highest sealed bid price. All units of volume listed below were estimated using the Inventory Manager computer program and the new Michigan taper model. Bids must be at or above the following advertised price for each product and species:

<u>PRODUCTS & SPECIES</u>	<u>ESTIMATED UNITS*</u>	<u>ADVERTISED PRICE</u>
Sawtimber		
Basswood	0.8 MBF	\$ 35.00 / MBF
Paper Birch	4.6 MBF	\$ 64.00 / MBF
Red Maple	1.9 MBF	\$ 137.00 / MBF
Red Pine	22.1 MBF	\$ 221.00 / MBF
Sugar Maple	8.3 MBF	\$ 173.00 / MBF
Pulpwood		
Balsam Fir	680 Cords	\$ 15.90 / Cord
Mixed Aspen	2,364 Cords	\$ 25.25 / Cord
Mixed Hardwood	309 Cords	\$ 15.70 / Cord
Mixed Spruce	608 Cords	\$ 23.15 / Cord
Red Pine	16 Cords	\$ 68.05 / Cord
Tamarack	158 Cords	\$ 30.75 / Cord

* The total volume is statistically estimated within plus (+) or minus (-) 13.10 percent. There are an estimated 4,176 cords on this timber sale, plus or minus 547 cords at the 95% confidence level. The estimated units are final and not subject to adjustment. Prospective bidders are urged to examine this timber and to make their own estimates of quantity and quality.

BOND AND PAYMENT SCHEDULE:

1. A bond in the amount of \$5,114.00 to insure faithful performance of the conditions of the contract will be deposited by the successful bidder within 21 days of the sale award.
2. Cutting in any sale or unit without the required advance payment would be considered a trespass.
3. Total payment must be paid in advance or according to the following schedule :
 - (a) Ten percent (10%) of the sale value must be paid within 21 days of the sale award.
 - (b) The 10% down payment will be credited towards the first unit cut.
 - (c) Payment for each of the following units must be made before cutting begins in that unit:

PAYMENT UNIT NUMBER	PERCENT OF TOTAL SALE VALUE
01	31.1%
02	14.2%
03	2.2%
04	3.5%
05	33.7%
06	8.4%
07	5.8%
08	1.1%

4. If no cutting takes place, the 10% down payment will not be refunded.
5. Operations on the contract issued will terminate on 08/31/2026.

SALE STATISTICS

Volumes were calculated in cubic feet using the Michigan taper model. Cubic foot volume includes all wood inside bark for the product indicated. For display purposes, cubic feet were converted to cords and MBF using a simple conversion factor, e.g. 79 cubic feet per cord and 185 cubic feet per MBF. The cubic foot volumes are precise; the cords and MBF volumes are not. Cubic foot volume cannot be directly converted to cords or boards with precision.

SALE VOLUMES

The total estimated sale volume may not equal the sum of the species/products due to the nature of statistical calculations associated with double sampling methodology.

VOLUME			STATISTICAL RANGE IN CORDS	
TOTAL CUBIC FEET	TOTAL CORDS	PERCENT ERROR	MINIMUM	MAXIMUM
329,912	4,176	13.10%	3,629	4,723

VDU VOLUMES

A VDU is a Volume Determination Unit. Volumes and their associated statistics are calculated at the VDU level and summarized to the sale level. There is often a one to one relationship between a VDU and a Payment Unit, but not always, depending on the cruise design. Refer to the VDU TO PAYMENT UNIT table.

	VOLUME			RANGE IN CORDS	
VDU	TOTAL CUBIC FEET	TOTAL CORDS	PERCENT ERROR	MINIMUM	MAXIMUM
19	48,469	614	32.14%	416	811
22	263,740	3,338	15.81%	2,811	3,866
44	8,346	106	78.88%	22	189
56	5,349	68	109.94%	0	142
64	4,007	51	16.75%	42	59
TOTAL:	329,912	4,176		3,292	5,067

VDU TO PAYMENT UNIT

When a VDU is associated with more than one Payment Unit (PU), the VDU volumes are assigned to the PU based on acres of the VDU within the PU.

VDU	VDU ACRES	PU	PU ACRES
19	29.7	1	29.7
22	131.1	1	29.3
		2	24.1
		4	5.9
		5	57.4
		6	14.4
		6	14.4
44	5.0	3	5.0
56	4.1	7	4.1
64	3.8	8	3.8
TOTAL:	173.7		173.7

DESCRIPTION OF TIMBER BY PAYMENT UNIT (PU)

PU	MARKET GROUP	PRODUCT	QUANTITY	UNIT	ACRES	ADVERTISE PRICE
1	Paper Birch	Sawtimber	2.6	MBF	59.0	\$31,844.95
	Balsam Fir	Pulpwood	179	Cords		
	Mixed Aspen		536	Cords		
	<i>B. T. Aspen</i>		26	<i>Cords</i>		
	<i>Balsam Poplar</i>		29	<i>Cords</i>		
	<i>Quaking Aspen</i>		481	<i>Cords</i>		
	Mixed Hardwood		139	Cords		
	<i>Basswood</i>		1	<i>Cords</i>		
	<i>Black Ash</i>		34	<i>Cords</i>		
	<i>Black Cherry</i>		5	<i>Cords</i>		
	<i>Paper Birch</i>		5	<i>Cords</i>		
	<i>Red Maple</i>		94	<i>Cords</i>		
	Mixed Spruce		366	Cords		
	<i>Black Spruce</i>		206	<i>Cords</i>		
	<i>White Spruce</i>		160	<i>Cords</i>		
	Tamarack		151	Cords		
2	Paper Birch	Sawtimber	0.5	MBF	24.1	\$14,489.60
	Balsam Fir	Pulpwood	119	Cords		
	Mixed Aspen		433	Cords		
	<i>B. T. Aspen</i>		21	<i>Cords</i>		
	<i>Balsam Poplar</i>		24	<i>Cords</i>		
	<i>Quaking Aspen</i>		388	<i>Cords</i>		
	Mixed Hardwood		16	Cords		
	<i>Basswood</i>		1	<i>Cords</i>		
	<i>Black Cherry</i>		4	<i>Cords</i>		
	<i>Red Maple</i>		11	<i>Cords</i>		
	Mixed Spruce		57	Cords		
	<i>White Spruce</i>		57	<i>Cords</i>		
	Tamarack		2	Cords		
	3	Red Maple	Sawtimber	1.9		
Sugar Maple			3.7	MBF		
Mixed Hardwood		Pulpwood	85	Cords		
<i>Red Maple</i>			7	<i>Cords</i>		
<i>Sugar Maple</i>			78	<i>Cords</i>		
4	Paper Birch	Sawtimber	0.1	MBF	5.9	\$3,530.90
	Balsam Fir	Pulpwood	29	Cords		
	Mixed Aspen		106	Cords		
	<i>B. T. Aspen</i>		5	<i>Cords</i>		
	<i>Balsam Poplar</i>		6	<i>Cords</i>		
	<i>Quaking Aspen</i>		95	<i>Cords</i>		
	Mixed Hardwood		4	Cords		
	<i>Black Cherry</i>		1	<i>Cords</i>		
	<i>Red Maple</i>		3	<i>Cords</i>		
	Mixed Spruce		14	Cords		
	<i>White Spruce</i>		14	<i>Cords</i>		
5	Paper Birch	Sawtimber	1.1	MBF	57.4	\$34,437.15
	Balsam Fir	Pulpwood	282	Cords		
	Mixed Aspen		1,030	Cords		
	<i>B. T. Aspen</i>		51	<i>Cords</i>		
	<i>Balsam Poplar</i>		55	<i>Cords</i>		
	<i>Quaking Aspen</i>		924	<i>Cords</i>		
	Mixed Hardwood		37	Cords		
	<i>Basswood</i>		2	<i>Cords</i>		
	<i>Black Cherry</i>		10	<i>Cords</i>		
	<i>Red Maple</i>		25	<i>Cords</i>		
	Mixed Spruce		137	Cords		

DESCRIPTION OF TIMBER BY PAYMENT UNIT (PU), CON'T

PU	MARKET GROUP	PRODUCT	QUANTITY	UNIT	ACRES	ADVERTISE PRICE
5 con't	<i>White Spruce</i> Tamarack	<i>Pulpwood</i>	137 4	<i>Cords</i> Cords		
6	Paper Birch Balsam Fir Mixed Aspen <i>B. T. Aspen</i> <i>Balsam Poplar</i> <i>Quaking Aspen</i> Mixed Hardwood <i>Black Cherry</i> <i>Red Maple</i> Mixed Spruce <i>White Spruce</i> Tamarack	Sawtimber Pulpwood	0.3 71 259 13 14 232 8 2 6 34 34 1	MBF Cords Cords <i>Cords</i> <i>Cords</i> <i>Cords</i> Cords <i>Cords</i> <i>Cords</i> Cords <i>Cords</i> Cords	14.4	\$8,631.30
7	Red Pine Red Pine	Sawtimber Pulpwood	22.1 16	MBF Cords	4.1	\$5,972.90
8	Basswood Sugar Maple Mixed Hardwood <i>Basswood</i> <i>Sugar Maple</i>	Sawtimber Pulpwood	0.8 4.6 20 2 18	MBF MBF Cords <i>Cords</i> <i>Cords</i>	3.8	\$1,137.80
TOTAL:			37.7	MBF		
TOTAL:			4,135	Cords		

Sale Specific Conditions & Requirements

Sale Name: Mikko's Maze Aspen

Sale Number: 32-010-22 Seq#: 1

1 - Sale Area

1.2 - Boundaries

1.2.1 - Painted boundaries (9/19)

The sale boundary and Payment Unit boundaries are marked and identified by blue, red, and green paint. Exterior sale boundary lines against private are marked with blue paint. Exterior sale boundary lines against state are marked with red paint. Interior Payment Unit boundaries are marked with green paint. Green painted trees designating an interior Payment Unit boundary are only to be cut when all surrounding Payment Units have been paid.

2 - Timber Specifications

2.1 - Included Timber

2.1.1 - Clearcut unit(s) with unmerchantable trees (6/14)

Within Payment Unit(s) 1, 2, 4, 5, and 6., cut all trees that are two (2) inches or more at DBH except red pine, white pine, cedar, oak, and hemlock.

2.1.3 - Cut tree marked unit(s) (12/08)

Within Payment Unit(s) 3, 7, and 8, all trees are designated for cutting when marked with orange paint above and below stump height, regardless of merchantability.

2.2 - Utilization

2.2.4 - Skidding length (2/14)

Skidding of unlimbed tops is not permissible within unit 3, 7, and 8. Skidding of unlimbed tops or lengths over 17 feet is not permissible, unless approved by the Unit Manager or his/her representative.

3 - Payments

3.3 - Pre-measured Sales

3.3.4 - Dividing payment units (7/14)

Payment Unit(s) 1 and 5 may be divided at the request of the Purchaser and upon approval of the Unit Manager. Dividing Payment Units is a contract modification which requires a Timber Sale Contract Amendment. There will be only one division per Payment Unit.

3.4 - Damaged Timber

3.4.1 - Damaged timber (7/16)

General Condition and Requirement 3.4 Damaged Timber, defines liquidated damages for undesignated live merchantable trees which are cut or injured. In addition, extreme care should be taken to avoid damage to tree seedlings and saplings.

Within the payment units 5, 7, and 8, if more than 25% of the tree seedlings or saplings (1/4" to 4.5" DBH) within a specified portion of the sale area are damaged, liquidated damages will be assessed at \$250 per acre for all acreage within that specified portion of the sale area that was damaged.

No damage is acceptable to undesignated live merchantable trees. Within the sale area, if more than 5% of trees (> 4.5" DBH) within a specified area of the sale are damaged, liquidated damages will be assessed for all trees damaged. Rates will be in accordance with General Condition and Requirement 3.4 Damaged Timber.

4 - Transportation

4.1 - Construction

4.1.3 - Slash and earthen piles (8/04)

Piles or windrows of earth along roads and landings that have been widened or constructed shall be leveled. Slash from road

maintenance or construction, including stumps, shall be dispersed throughout the sale.

4.1.4 - Timber removed for construction (12/09)

Trees cut or damaged in the process of pre-approved road, landing or skid trail construction will be decked in an area separate from other Designated Timber and not removed until measured by the sale administrator. Payment will be made at the specified Purchase Unit Price.

4.1.6 - Road construction (1/09)

Construction of new roads or improvements of existing roads shall be done in such a way as to minimize the environmental and visual impacts. Merchantable trees shall be cut and utilized unless otherwise directed. Non-merchantable trees shall be severed and laid flat on the ground. Slash shall be scattered, and not left in windrows and kept a minimum of 10 feet back from the road edge. Stumps shall be set upright, not left on edge, and be moved at least 10 feet away from the road edge. Disturbed soil shall be feathered into the woods and not left in berms or windrows.

4.1.7 - Road closure (10/11)

All new roads built into the sale must be blocked to vehicle traffic upon completion of the sale. Overgrown roads that are reopened shall be considered new roads. In general, this will require constructing a four (4') foot high berm of stumps and logs covered with earth. Contact the sale administrator for specific details of design and placement.

4.2 - Maintenance

4.2.1 - Hauling restriction (12/08)

Hauling may be restricted on forest roads by the Unit Manager or his/her representative. The restriction may occur during wet weather conditions.

4.2.2 - Fill material (4/07)

To maintain roads, fill material may be needed in areas where "holes" exist or may be expected to develop. This fill material should be placed before trucking begins.

4.2.3 - Road maintenance (8/13)

The following road maintenance may be needed: Within 60 days of completion of hauling, or if no hauling occurs for 60 days, the road must be maintained and graded. This includes cleaning of drainage areas, grading, crowning and filling with gravel, if necessary. Damages will be assessed if grading/repair does not occur.

4.2.4 - Grading (10/16)

For completion of the sale, state forest roads must be graded. In general, this will require a road grader or bull dozer to shape up the roads after forest products have been hauled off site. This includes cleaning of drainage areas, grading, crowning and filling with gravel, if necessary. The grading equipment to be used must be approved by the Unit Manager or his/her representative.

5 - Operations

5.1 - Notification

5.1.1 - Pre-sale conference (10/16)

A pre-sale conference between the Purchaser and sale administrator is required prior to beginning any operations. The Unit Manager or his/her representative must be contacted at least 3 business days in advance to schedule the conference.

5.2 - Conduct of Operations

5.2.1 - Slash

5.2.1.11 - Slash for reforestation (3/21)

To facilitate reforestation, shall be left with slash evenly distributed. Bunched tops within the cutting area shall be broken up and scattered. Stumps shall be cut low to the ground. Processing sites shall not be left with a compacted layer of slash; tops from these sites shall be hauled back into the cut area and scattered.

5.2.2 - Hazard Trees/Snags

5.2.2.1 - Den trees (10/16)

Obvious hollow and/or den trees shall be protected and left standing unless they are a safety hazard.

5.2.3 - Operating Restrictions

5.2.3.1 - Operating restrictions (9/11)

Within Payment Unit(s) 1, unless changed by written agreement, cutting, skidding, and hauling are . Limited to the period of 12/15 to 4/1. This restriction is due to low ground conditions across most of the unit.

5.2.3.3 - Bark slippage restriction (3/09)

Within Payment Unit(s) 3, 7, and 8, unless changed by written agreement, cutting and skidding are not permitted during the period of April 15 to July 15. This restriction is because of bark slippage.

5.2.3.11 - Coppice regeneration protection (4/10)

Timber harvesting in any Payment Unit must be completed before significant aspen sprouting occurs in that Payment Unit so as to minimize damage to the new regeneration. Any post harvest operations, such as chipping, must be completed before sprouting of regeneration occurs. If it is anticipated that chipping will be delayed, then tops shall be carried to one central location or left unchipped. The Unit Manager or his/her representative may cease such operations if sprouting occurs before the operation is complete.

5.2.4 - Dead and Down Creation

5.2.4.4 - Dead and down creation, grouse (6/18)

To encourage grouse and other wildlife, in Payment Unit(s) 1, 2, 4, 5, and 6 leave one, 12" diameter or larger log-length (8 foot minimum) piece on the ground for every 2 acres. These trees will be evenly scattered throughout the unit, preferably at least two chains from any roads, two-tracks, or trails open to vehicles.

5.2.29 - Shrub protection (1/20)

Do not cut or damage hawthorn, witch-hazel, dogwood or juneberry. These woody-shrub plants are highly beneficial to various wildlife species.

5.2.32 - Decking/landing restoration (9/13)

All decking and landing areas must have the surface area restored to a condition equal to or better than before. This is to ensure the proper regeneration of the stand. Wood debris, chips and "cookies" from trimmings must be removed or scattered away from landing and loading areas and may not be windrowed on the edge.

5.2.37 - No decking areas (12/08)

No decking is allowed within 50 feet of the centennial road or snowmobile trail without permission of the County and Unit Manager or his/her representative.

5.2.38 - No decking against live trees (2/04)

Cut products may not be decked against unmarked or designated leave trees.

5.2.39 - ORV trail/route protection (4/18)

Gwinn/Arnold ORV route is shown on the Timber Sale Map. Do not cut trees or damage posts with yellow ORV markers. All stumps within 5 feet of the trail must be cut flush with the ground. Maintain a 20 foot wide slash, debris, and rut free zone daily using the ORV trail or route as the centerline. Do not run equipment down the ORV trail or route. Skidding across the trail or route may only occur in locations approved by the sale administrator.

5.2.41 - Snowmobile trail protection (9/11)

Trail 33 is a snowmobile trail and is shown on the Timber Sale Map. Do not cut or damage posts with orange trail markers or traffic control signs. If the trail is used, it must be maintained and restored to a condition equal to or better than before the sale. The road maintenance/restoration must be done prior to December 1. If the trail is used for hauling, it must be graded to the satisfaction of the Unit Manager or his/her representative prior to December 1st. If the trail road is to be used for hauling during the snowmobile season, then a snow covered base must be left on the trail. Maintain a 20 foot wide slash, debris, and rut free zone daily using the snowmobile trail as the centerline. No decking of forest products will be permitted along the snowmobile trail. All stumps within 20 feet of the snowmobile trail must be cut at ground level.

5.4 - Soil Protection

5.4.1 - Rutting restriction, general (7/16)

Operations are to cease immediately if equipment and weather conditions result in rutting of roads and/or skid trails which is 12 inches or greater in depth and 50 feet in length. The Unit Manager or his/her representative may restrict hauling and/or

skidding if ruts exceed the specified depth. With the Unit Manager or his/her representative's approval, the Purchaser may return to the area when the risk of rutting has decreased.

5.4.2 - Skid trails (2/04)

Skid trails up and down slopes should be avoided. If however this is unavoidable, these trails will be left in a non-erodible condition using water bars, logs, and slash. Placing of slash on these skid trails while logging is ongoing may alleviate need for any further action. At the direction of the sale administrator, seed, fertilizer, and mulch may also be required.

5.8 - Protection of Endangered Species

5.8.5 - Protection of raptor nests (3/13)

All trees with raptor nests will be protected if found during harvesting operations. Notification will be made to the Unit Manager or his/her representative who will notify the Wildlife Biologist so an on-site evaluation and recommendation can be made, if necessary.

6 - Safety and Fire Prevention

6.2 - Signing

6.2.1 - Road posting (10/20)

The Purchaser is responsible for posting and maintaining caution signs on County Road 557 and access road. prior to beginning operations. The road must be posted at appropriate distances from the sale area to warn of logging activity and truck traffic. Signs must be removed when harvest operations are suspended or completed. The Purchaser will provide these signs.

6.2.2 - Snowmobile trail posting (10/20)

The Purchaser is responsible for posting and maintaining caution signs on Trail 33 prior to beginning operations during the snowmobile season (approximately December 1 to March 31). The trail must be posted at appropriate distances from the sale area to warn of logging activity and truck traffic. Signs must be removed when harvest operations are suspended or completed. The Purchaser will provide these signs.

6.2.3 - Recreational trail posting (10/20)

The Purchaser is responsible for posting and maintaining caution signs on Gwinn/Arnold ORV route prior to beginning operations. The trail must be posted at appropriate distances from the sale area to warn of logging activity and truck traffic at both ends of the trail. Signs must be removed when harvest operations are suspended or completed. The Purchaser will provide these signs.

7 - Other Conditions

7.5 - Loss

7.5.1 - Deteriorating timber (7/09)

The sale area has received damage from Spruce Budworm. The Purchaser should harvest the wood as soon as possible. The Department of Natural Resources is held free of responsibility of any further damage or deterioration due to delay in harvesting.



TIMBER SALE MAP

This information provided by authority of Part 525, 1994 PA 451, as amended.

Sale Number	Year
32-010	22

Forest Management Unit Gwinn FMU	County Marquette	Mapped By Rick Hill	Date 7/27/2022	Page 1	of 1
Township 44N	Range 25W	Section(s) and Subdivision(s) Section 31	Cruised By Rick Hill		

Scale	1:15,840
-------	----------

Cover Type				Density			
A = Aspen	H = Hemlock	N = Marsh	U = Upland Brush	0 = Non Stocked	5 = Pole Timber Medium		
B = Paper Birch	J = Jack Pine	O = Oak	UM = Upland Mixed	1 = Seeding Sapling Poor	6 = Pole Timber Well		
C = Cedar	L = Lowland Brush	P = Lowland Poplar	V = Bog or Marsh	2 = Seeding Sapling Medium	7 = Saw Timber Poor		
D = Tread Bog	LM = Lowland Mixed	Q = Mixed Swamp Conifer	W = White Pine	3 = Seeding Sapling Well	8 = Saw Timber Medium		
E = Swamp Hdwoods	M = Mpl, Boh, Broh	R = Red Pine	X = Non Stocked	4 = Pole Timber Poor	9 = Saw Timber Well		
F = Spruce Fir	MC = Mixed Conifer	S = Black Spruce	Z = Water				
G = Grass	MD = Mixed Deciduous	T = Tamarack					

PU	Acres	PU	Acres
1	59	5	51.4
2	24.2	6	14.4
3	5	7	4.1
4	5.9	8	3.8

Mikko's Maze Aspen

Compartment 53
173.7 Acres

Legend

- Recreational Trail
- Survey Corners
- Field Grade Corners
- Secondary Forest Road
- Forest Access Route
- Paved Road
- Private
- Perennial River
- Payment U nit (Green)
- Private Line (Blue)
- Against State (Red)

QR Code for PDF Maps



Locator Map
1:250,000

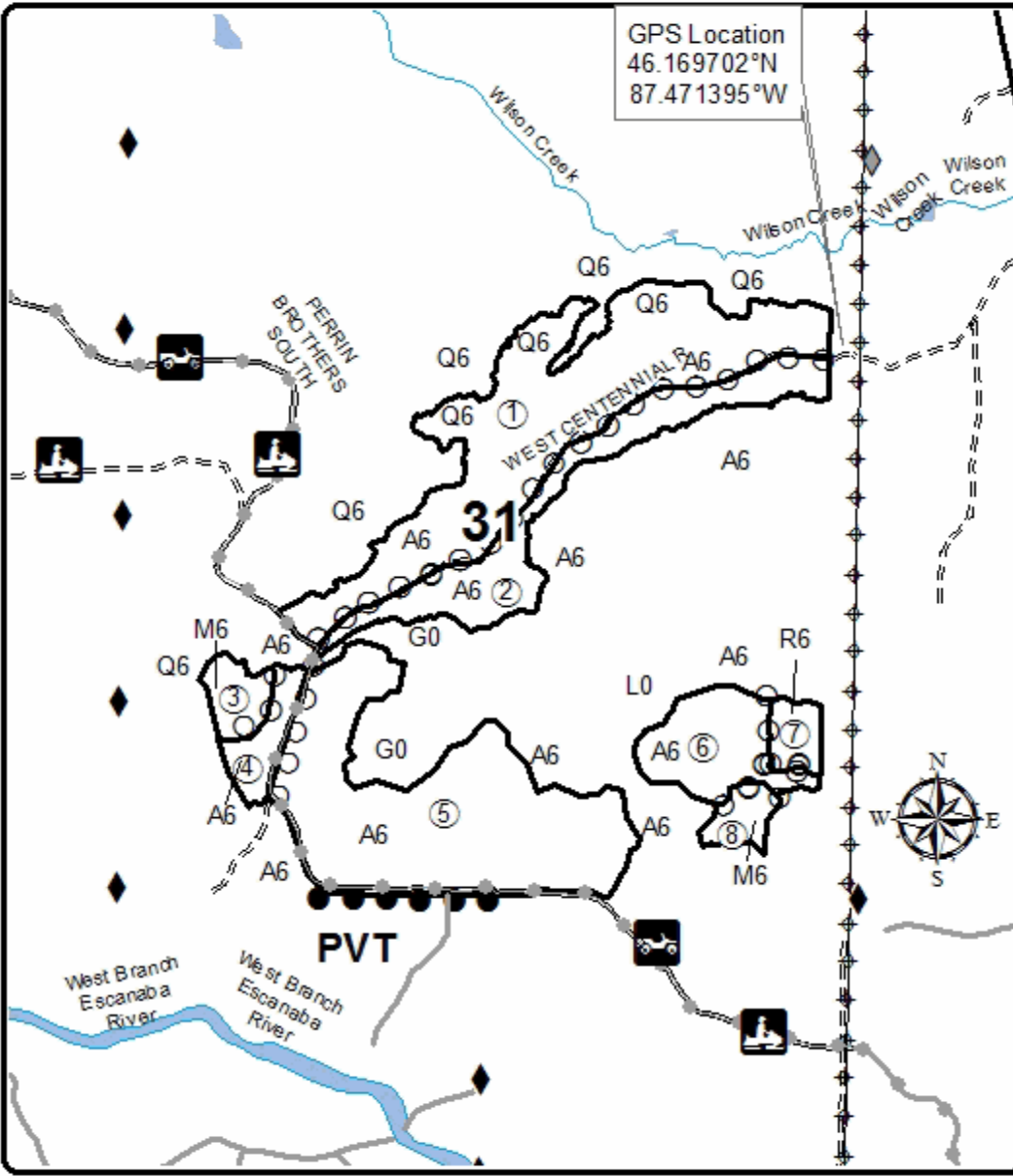
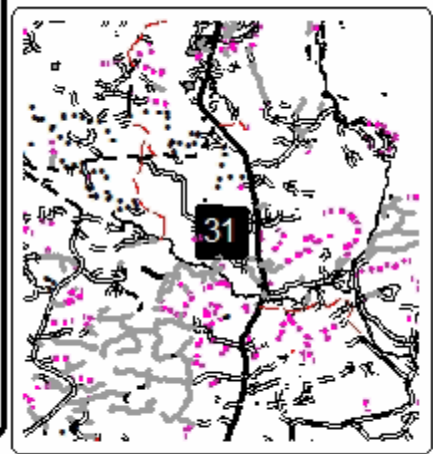

TIMBER SALE INFORMATION

Duke's Doodles GEMS (32-025-22)

T44N, R26W, SEC. 10; T44N, R26W, SEC. 11; T44N, R26W, SEC. 13; T44N, R26W, SEC. 14; T44N, R26W, SEC. 15; T44N, R26W, SEC. 22; T44N, R26W, SEC. 23; T44N, R26W, SEC. 24.

SALE NOTE: A recreation site such as a trail, pathway, or campground is within the sale area or the vicinity. Certain restrictions/specifications may be applicable including time restrictions.

A timber sale contract for this lump sum, sealed bid timber sale will be awarded to the responsible bidder offering the highest sealed bid price. All units of volume listed below were estimated using the Inventory Manager computer program and the new Michigan taper model. Bids must be at or above the following advertised price for each product and species:

<u>PRODUCTS & SPECIES</u>	<u>ESTIMATED UNITS*</u>	<u>ADVERTISED PRICE</u>
Sawtimber		
Basswood	31.5 MBF	\$ 35.00 / MBF
Paper Birch	9.5 MBF	\$ 64.00 / MBF
Red Maple	32.0 MBF	\$ 137.00 / MBF
Sugar Maple	29.8 MBF	\$ 173.00 / MBF
Pulpwood		
Balsam Fir	1,057 Cords	\$ 15.90 / Cord
Mixed Aspen	4,427 Cords	\$ 25.25 / Cord
Mixed Hardwood	1,079 Cords	\$ 15.70 / Cord
Mixed Spruce	394 Cords	\$ 23.15 / Cord
Tamarack	74 Cords	\$ 30.75 / Cord

* The total volume is statistically estimated within plus (+) or minus (-) 9.14 percent. There are an estimated 7,041 cords on this timber sale, plus or minus 644 cords at the 95% confidence level. The estimated units are final and not subject to adjustment. Prospective bidders are urged to examine this timber and to make their own estimates of quantity and quality.

BOND AND PAYMENT SCHEDULE:

1. A bond in the amount of \$8,409.00 to insure faithful performance of the conditions of the contract will be deposited by the successful bidder within 21 days of the sale award.
2. Cutting in any sale or unit without the required advance payment would be considered a trespass.
3. Total payment must be paid in advance or according to the following schedule :
 - (a) Ten percent (10%) of the sale value must be paid within 21 days of the sale award.
 - (b) The 10% down payment will be credited towards the first unit cut.

(c) Payment for each of the following units must be made before cutting begins in that unit:

PAYMENT UNIT NUMBER	PERCENT OF TOTAL SALE VALUE
01	15.0%
02	14.5%
03	7.2%
04	18.4%
05	22.5%
06	3.9%
07	8.2%
08	3.4%
09	2.8%
10	4.1%

4. If no cutting takes place, the 10% down payment will not be refunded.
5. Operations on the contract issued will terminate on 08/31/2026.

SALE STATISTICS

Volumes were calculated in cubic feet using the Michigan taper model. Cubic foot volume includes all wood inside bark for the product indicated. For display purposes, cubic feet were converted to cords and MBF using a simple conversion factor, e.g. 79 cubic feet per cord and 185 cubic feet per MBF. The cubic foot volumes are precise; the cords and MBF volumes are not. Cubic foot volume cannot be directly converted to cords or boards with precision.

SALE VOLUMES

The total estimated sale volume may not equal the sum of the species/products due to the nature of statistical calculations associated with double sampling methodology.

VOLUME			STATISTICAL RANGE IN CORDS	
TOTAL CUBIC FEET	TOTAL CORDS	PERCENT ERROR	MINIMUM	MAXIMUM
556,261	7,041	9.14%	6,398	7,685

VDU VOLUMES

A VDU is a Volume Determination Unit. Volumes and their associated statistics are calculated at the VDU level and summarized to the sale level. There is often a one to one relationship between a VDU and a Payment Unit, but not always, depending on the cruise design. Refer to the VDU TO PAYMENT UNIT table.

	VOLUME			RANGE IN CORDS	
VDU	TOTAL CUBIC FEET	TOTAL CORDS	PERCENT ERROR	MINIMUM	MAXIMUM
1	11,362	144	39.00%	88	200
18	23,147	293	50.17%	146	440
76	223,160	2,825	11.35%	2,504	3,145
77	78,942	999	32.13%	678	1,320
95	120,220	1,522	18.21%	1,245	1,799
148	24,087	305	60.39%	121	489
153	51,351	650	21.78%	508	792
170	23,992	304	69.06%	94	513
TOTAL:	556,261	7,041		5,384	8,699

VDU TO PAYMENT UNIT

When a VDU is associated with more than one Payment Unit (PU), the VDU volumes are assigned to the PU based on acres of the VDU within the PU.

VDU	VDU ACRES	PU	PU ACRES
1	9.8	9	9.8
18	7.1	10	7.1
76	85.9	2	31.1
		3	15.4
		4	39.4
77	20.0	1	20.0
95	41.2	5	41.2
148	17.7	8	17.7
153	27.0	7	27.0
170	9.1	6	9.1
TOTAL:	217.8		217.8

DESCRIPTION OF TIMBER BY PAYMENT UNIT (PU)

PU	MARKET GROUP	PRODUCT	QUANTITY	UNIT	ACRES	ADVERTISE PRICE
1	Basswood	Sawtimber	23.0	MBF	20.0	\$25,205.75
	Balsam Fir	Pulpwood	137	Cords		
	Mixed Aspen		824	Cords		
	<i>B. T. Aspen</i>		52	<i>Cords</i>		
	<i>Balsam Poplar</i>		21	<i>Cords</i>		
	<i>Quaking Aspen</i>		751	<i>Cords</i>		
	Mixed Hardwood		74	Cords		
	<i>Basswood</i>		22	<i>Cords</i>		
	<i>Ironwood</i>		7	<i>Cords</i>		
	<i>Sugar Maple</i>		45	<i>Cords</i>		
	Mixed Spruce		11	Cords		
	<i>White Spruce</i>		11	<i>Cords</i>		
	2	Basswood	Sawtimber	1.6		
Paper Birch			1.8	MBF		
Balsam Fir		Pulpwood	131	Cords		
Mixed Aspen			791	Cords		
<i>Balsam Poplar</i>			52	<i>Cords</i>		
<i>Quaking Aspen</i>			739	<i>Cords</i>		
Mixed Hardwood			23	Cords		
<i>Basswood</i>			1	<i>Cords</i>		
<i>Paper Birch</i>			12	<i>Cords</i>		
<i>Red Maple</i>			10	<i>Cords</i>		
Mixed Spruce			45	Cords		
<i>Black Spruce</i>			27	<i>Cords</i>		
<i>White Spruce</i>			18	<i>Cords</i>		
Tamarack			27	Cords		
3	Basswood	Sawtimber	0.8	MBF	15.4	\$12,098.85
	Paper Birch		0.9	MBF		
	Balsam Fir	Pulpwood	65	Cords		
	Mixed Aspen		392	Cords		
	<i>Balsam Poplar</i>		26	<i>Cords</i>		
	<i>Quaking Aspen</i>		366	<i>Cords</i>		
	Mixed Hardwood		11	Cords		
	<i>Paper Birch</i>		6	<i>Cords</i>		
	<i>Red Maple</i>		5	<i>Cords</i>		
	Mixed Spruce		22	Cords		
	<i>Black Spruce</i>		13	<i>Cords</i>		
	<i>White Spruce</i>		9	<i>Cords</i>		
	Tamarack		13	Cords		
4	Basswood	Sawtimber	2.0	MBF	39.4	\$31,018.40
	Paper Birch		2.3	MBF		
	Balsam Fir	Pulpwood	166	Cords		
	Mixed Aspen		1,003	Cords		
	<i>Balsam Poplar</i>		66	<i>Cords</i>		
	<i>Quaking Aspen</i>		937	<i>Cords</i>		
	Mixed Hardwood		30	Cords		
	<i>Basswood</i>		1	<i>Cords</i>		
	<i>Paper Birch</i>		16	<i>Cords</i>		
	<i>Red Maple</i>		13	<i>Cords</i>		
	Mixed Spruce		57	Cords		
	<i>Black Spruce</i>		34	<i>Cords</i>		
	<i>White Spruce</i>		23	<i>Cords</i>		
	Tamarack		34	Cords		
5	Paper Birch	Sawtimber	2.6	MBF	41.2	\$37,857.40
	Red Maple		6.7	MBF		
	Sugar Maple		12.6	MBF		

DESCRIPTION OF TIMBER BY PAYMENT UNIT (PU), CON'T

PU	MARKET GROUP	PRODUCT	QUANTITY	UNIT	ACRES	ADVERTISE PRICE
5 con't	Balsam Fir	Pulpwood	156	Cords		
	Mixed Aspen		1,001	Cords		
	<i>Balsam Poplar</i>		154	Cords		
	<i>Quaking Aspen</i>		847	Cords		
	Mixed Hardwood		263	Cords		
	<i>Basswood</i>		10	Cords		
	<i>Black Ash</i>		20	Cords		
	<i>Paper Birch</i>		38	Cords		
	<i>Red Maple</i>		58	Cords		
	<i>Sugar Maple</i>		137	Cords		
	Mixed Spruce		117	Cords		
	<i>White Spruce</i>		117	Cords		
6	Basswood	Sawtimber	2.2	MBF	9.1	\$6,528.25
	Red Maple		3.3	MBF		
	Balsam Fir	Pulpwood	51	Cords		
	Mixed Aspen		113	Cords		
	<i>Balsam Poplar</i>		99	Cords		
	<i>Quaking Aspen</i>		14	Cords		
	Mixed Hardwood		75	Cords		
	<i>Basswood</i>		13	Cords		
	<i>Black Cherry</i>		9	Cords		
	<i>Red Maple</i>		15	Cords		
	<i>Sugar Maple</i>		31	Cords		
	<i>Yellow Birch</i>		7	Cords		
	Mixed Spruce		50	Cords		
	<i>White Spruce</i>		50	Cords		
7	Balsam Fir		Pulpwood	197	Cords	27.0
	Mixed Aspen	281		Cords		
	<i>Balsam Poplar</i>	183		Cords		
	<i>Quaking Aspen</i>	98		Cords		
	Mixed Hardwood	123		Cords		
	<i>Black Cherry</i>	66		Cords		
	<i>Ironwood</i>	8		Cords		
	<i>Paper Birch</i>	7		Cords		
	<i>Red Maple</i>	4		Cords		
	<i>Sugar Maple</i>	38		Cords		
	Mixed Spruce	70		Cords		
	<i>White Spruce</i>	70		Cords		
	8	Paper Birch		Sawtimber	1.9	
Sugar Maple			2.7	MBF		
Balsam Fir		Pulpwood	125	Cords		
Mixed Aspen			22	Cords		
<i>Quaking Aspen</i>			22	Cords		
Mixed Hardwood			149	Cords		
<i>Black Cherry</i>			6	Cords		
<i>Paper Birch</i>			9	Cords		
<i>Red Maple</i>			102	Cords		
<i>Sugar Maple</i>			32	Cords		
Mixed Spruce			8	Cords		
<i>White Spruce</i>			8	Cords		
9	Basswood		Sawtimber	1.9	MBF	9.8
	Red Maple		3.8	MBF		
	Sugar Maple		14.5	MBF		
	Mixed Hardwood	Pulpwood	98	Cords		
	<i>Basswood</i>		5	Cords		
	<i>Red Maple</i>		24	Cords		

DESCRIPTION OF TIMBER BY PAYMENT UNIT (PU), CON'T

PU	MARKET GROUP	PRODUCT	QUANTITY	UNIT	ACRES	ADVERTISE PRICE
9 con't	<i>Sugar Maple</i>	<i>Pulpwood</i>	69	<i>Cords</i>		
10	Red Maple Balsam Fir Mixed Hardwood <i>Red Maple</i> Mixed Spruce <i>White Spruce</i>	Sawtimber Pulpwood	18.2 29 233 233 14 14	MBF Cords Cords <i>Cords</i> Cords <i>Cords</i>	7.1	\$6,936.70
TOTAL:			102.8	MBF		
TOTAL:			7,031	Cords		

Sale Specific Conditions & Requirements

Sale Name: Duke's Doodles GEMS

Sale Number: 32-025-22 Seq#: 1

1 - Sale Area

1.2 - Boundaries

1.2.1 - Painted boundaries (9/19)

The sale boundary and Payment Unit boundaries are marked and identified by red, and yellow paint. Exterior sale boundary lines against state are marked with red paint. Interior Payment Unit boundaries are marked with yellow paint. The painted boundary line trees are not Included Timber and are to be protected unless marked with orange paint. Yellow painted trees designating an interior Payment Unit boundary are only to be cut when all surrounding Payment Units have been paid.

2 - Timber Specifications

2.1 - Included Timber

2.1.1 - Clearcut unit(s) with unmerchantable trees (6/14)

Within Payment Unit(s) 1-8 and 10, cut all trees that are two (2) inches or more at DBH, with the following exceptions:

- Within Payment Units 2-4, do not cut spruce larger than 26 inches at DBH.
- Within Payment Units 5 and 6, do not cut cedar, hemlock, and white pine.
- Within Payment Unit 8, do not cut cedar, yellow birch, and maple, unless marked with orange paint above and below stump height, regardless of merchantability.
- Within Payment Unit 10, do not cut cedar, hemlock, yellow birch, and cherry.

2.1.3 - Cut tree marked unit(s) (12/08)

Within Payment Unit(s) 9, all trees are designated for cutting when marked with orange paint above and below stump height, regardless of merchantability. In addition, all merchantable spruce and fir are designated for cutting.

2.2 - Utilization

2.2.4 - Skidding length (2/14)

Within Payment Unit 9, skidding of unlimbed tops, or lengths over 17 feet is not permissible, unless approved by unit manager and or his/her representative.

3 - Payments

3.4 - Damaged Timber

3.4.1 - Damaged timber (7/16)

General Condition and Requirement 3.4 Damaged Timber, defines liquidated damages for undesignated live merchantable trees which are cut or injured. In addition, extreme care should be taken to avoid damage to tree seedlings and saplings within Payment Unit 9. No damage is acceptable to undesignated live merchantable trees. Within the sale area, if more than 5% of trees (> 4.5" DBH) within a specified area of the sale are damaged, liquidated damages will be assessed for all trees damaged. Rates will be in accordance with General Condition and Requirement 3.4 Damaged Timber.

4 - Transportation

4.1 - Construction

4.1.3 - Slash and earthen piles (8/04)

Piles or windrows of earth along roads and landings that have been widened or constructed shall be leveled. Slash from road maintenance or construction, including stumps, shall be dispersed throughout the sale.

4.1.4 - Timber removed for construction (12/09)

Trees cut or damaged in the process of pre-approved road, landing or skid trail construction will be decked in an area separate from other Designated Timber and not removed until measured by the sale administrator. Payment will be made at the specified Purchase Unit Price.

4.1.6 - Road construction (1/09)

Construction of new roads or improvements of existing roads shall be done in such a way as to minimize the environmental

and visual impacts. Merchantable trees shall be cut and utilized unless otherwise directed. Non-merchantable trees shall be severed and laid flat on the ground. Slash shall be scattered, and not left in windrows and kept a minimum of 10 feet back from the road edge. Stumps shall be set upright, not left on edge, and be moved at least 10 feet away from the road edge. Disturbed soil shall be feathered into the woods and not left in berms or windrows.

4.1.7 - Road closure (10/11)

All new roads built into the sale must be blocked to vehicle traffic upon completion of the sale. Overgrown roads that are reopened shall be considered new roads. In general, this will require constructing a four (4') foot high berm of stumps and logs covered with earth. Contact the sale administrator for specific details of design and placement.

4.2 - Maintenance

4.2.2 - Fill material (4/07)

To maintain roads, fill material may be needed in areas where "holes" exist or may be expected to develop. This fill material should be placed before trucking begins. Depending on the time of year, multiple areas may require fill material for access across the sale area. Contact the sale administrator regarding the availability of onsite sand or gravel from adjacent State-owned lands.

4.2.4 - Grading (10/16)

For completion of the sale, state forest roads must be graded. In general, this will require a road grader or bull dozer to shape up the roads after forest products have been hauled off site. This includes cleaning of drainage areas, grading, crowning and filling with gravel, if necessary. The grading equipment to be used must be approved by the Unit Manager or his/her representative.

4.4 - Access

4.4.3 - Access gate (12/08)

The access gate(s) must be locked at the completion of each day unless otherwise approved by the Unit Manager or his/her representative.

5 - Operations

5.1 - Notification

5.1.1 - Pre-sale conference (10/16)

A pre-sale conference between the Purchaser and sale administrator is required prior to beginning any operations. The Unit Manager or his/her representative must be contacted at least 3 business days in advance to schedule the conference.

5.2 - Conduct of Operations

5.2.1 - Slash

5.2.1.11 - Slash for reforestation (3/21)

To facilitate reforestation, Payment Unit(s) 1-8, and 10, shall be left with slash evenly distributed. Bunched tops within the cutting area shall be broken up and scattered. Stumps shall be cut low to the ground. Processing sites shall not be left with a compacted layer of slash; tops from these sites shall be hauled back into the cut area and scattered.

5.2.2 - Hazard Trees/Snags

5.2.2.1 - Den trees (10/16)

Obvious hollow and/or den trees shall be protected and left standing unless they are a safety hazard.

5.2.3 - Operating Restrictions

5.2.3.1 - Operating restrictions (9/11)

Within Payment Unit(s) 1-10, unless changed by written agreement, cutting, skidding, and hauling are not permitted during the period of April 1 to July 14, and September 15 to October 31. This restriction is to protect grouse and woodcock nesting habitat, and hunting season in the GEMS area.

5.2.3.3 - Bark slippage restriction (3/09)

Within Payment Unit(s) 8-10, unless changed by written agreement, cutting and skidding are not permitted during the period of April 15 to July 15. This restriction is because of bark slippage.

5.2.4 - Dead and Down Creation

5.2.4.4 - Dead and down creation, grouse (6/18)

To encourage grouse and other wildlife, in Payment Unit(s) 1-10, leave one, 12" diameter or larger log-length (8 foot minimum) piece on the ground for every 2 acres. These will be evenly scattered throughout the unit.

5.2.22 - Operating Caution

5.2.22.1 - Operating caution (6/11)

It is recommended, but not required, that within Payment Unit(s) 2-4, cutting, skidding, and hauling occur during dry summer or frozen winter conditions. The reason for the recommendation is because of wet ground.

5.2.32 - Decking/landing restoration (9/13)

All decking and landing areas must have the surface area restored to a condition equal to or better than before. This is to ensure the proper regeneration of the stand. Wood debris, chips and "cookies" from trimmings must be removed or scattered away from landing and loading areas and may not be windrowed on the edge.

5.2.37 - No decking areas (12/08)

No decking is allowed within 50 feet of Perrin Brothers Road without permission of the County and Unit Manager or his/her representative.

5.2.38 - No decking against live trees (2/04)

Cut products may not be decked against unmarked or designated leave trees.

5.2.39 - ORV trail/route protection (4/18)

The Perrin Brothers Trail is an ORV trail or route and is shown on the Timber Sale Map. Do not cut trees or damage posts with yellow ORV markers. All stumps within 5 feet of the trail must be cut flush with the ground. Maintain a 20-foot-wide slash, debris, and rut free zone daily using the ORV trail or route as the centerline.

5.2.40 - Pathway protection (10/10)

The GEMS Trails are recreational trails and are shown on the Timber Sale Map. Do not cut trees or damage posts with blue pathway markers. Maintain a 20-foot-wide slash debris, and rut free zone daily, using the pathway as the centerline.

5.2.41 - Snowmobile trail protection (9/11)

The Perrin Brothers Road is a snowmobile trail and is shown on the Timber Sale Map. Do not cut or damage posts with orange trail markers or traffic control signs. If the trail is used for hauling, it must be graded to the satisfaction of the Unit Manager or his/her representative prior to December 1. If Perrin Brothers Road is to be used for hauling during the snowmobile season, then a snow-covered base must be left on the trail. Maintain a 20-foot-wide slash, debris, and rut free zone daily using the snowmobile trail as the centerline. All stumps within 20 feet of the snowmobile trail must be cut at ground level.

5.4 - Soil Protection

5.4.1 - Rutting restriction, general (7/16)

Operations are to cease immediately if equipment and weather conditions result in rutting of roads and/or skid trails which is 12 inches or greater in depth and 50 feet in length. The Unit Manager or his/her representative may restrict hauling and/or skidding if ruts exceed the specified depth. With the Unit Manager or his/her representative's approval, the Purchaser may return to the area when the risk of rutting has decreased.

5.4.2 - Skid trails (2/04)

Skid trails up and down slopes should be avoided. If however this is unavoidable, these trails will be left in a non-erodible condition using water bars, logs, and slash. Placing of slash on these skid trails while logging is ongoing may alleviate need for any further action. At the direction of the sale administrator, seed, fertilizer, and mulch may also be required.

5.8 - Protection of Endangered Species

5.8.5 - Protection of raptor nests (3/13)

All trees with raptor nests will be protected if found during harvesting operations. Notification will be made to the Unit Manager or his/her representative who will notify the Wildlife Biologist so an on-site evaluation and recommendation can be made, if necessary.

6 - Safety and Fire Prevention

6.2 - Signing

6.2.1 - Road posting (10/20)

The Purchaser is responsible for posting and maintaining caution signs on Perrin Brothers Trail, north from both directions prior to beginning operations. The road must be posted approximately 350 feet from the sale area to warn of logging activity and truck traffic. Signs must be removed when harvest operations are suspended or completed. The Purchaser will provide these signs.

7 - Other Conditions

7.5 - Loss

7.5.1 - Deteriorating timber (7/09)

The sale area has received damage from Spruce Budworm. The Purchaser should harvest the wood as soon as possible. The Department of Natural Resources is held free of responsibility of any further damage or deterioration due to delay in harvesting.



TIMBER SALE MAP

This information provided by authority of Part 525, 1994 PA 451, as amended.

Forest Management Unit Gwinn Management Unit	County Marquette	Mapped By Brolin	Date 09/27/2022	Page 1	of 1
Township 44N	Range 26W	Section(s) and Subdivision(s) Sections 10, 11, 13, 14, 15, 22, 23, and 24	Scale 1:31,680		

Cover Type				Density	
A = Aspen	H = Hemlock	N = Marsh	U = Upland Brush	0 = Non Stocked	5 = Pole Timber Medium
B = Paper Birch	J = Jack Pine	O = Oak	UM = Upland Mixed	1 = Seedling Sapling Poor	6 = Pole Timber Well
C = Cedar	L = Lowland Brush	P = Lowland Poplar	V = Bog or Marsh	2 = Seedling Sapling Medium	7 = Saw Timber Poor
D = Treed Bog	LM = Lowland Mixed	Q = Mixed Swamp Conifer	W = White Pine	3 = Seedling Sapling Well	8 = White Timber Medium
E = Swamp Hdwoods	M = Mpl, Bch, Brch	R = Red Pine	X = Non Stocked	4 = Pole Timber Poor	9 = Saw Timber Well
F = Spruce Fir	MC = Mixed Conifer	S = Black Spruce	Z = Water		
G = Grass	MD = Mixed Deciduous	T = Tamarack			

PU Acres	PU Acres
1 20.0	6 9.1
2 31.1	7 27.0
3 15.4	8 17.7
4 39.4	9 9.8
5 41.2	10 7.1

Duke's Doodles GEMS

Compartment 51

217.8 Acres



QR code for PDF Maps app

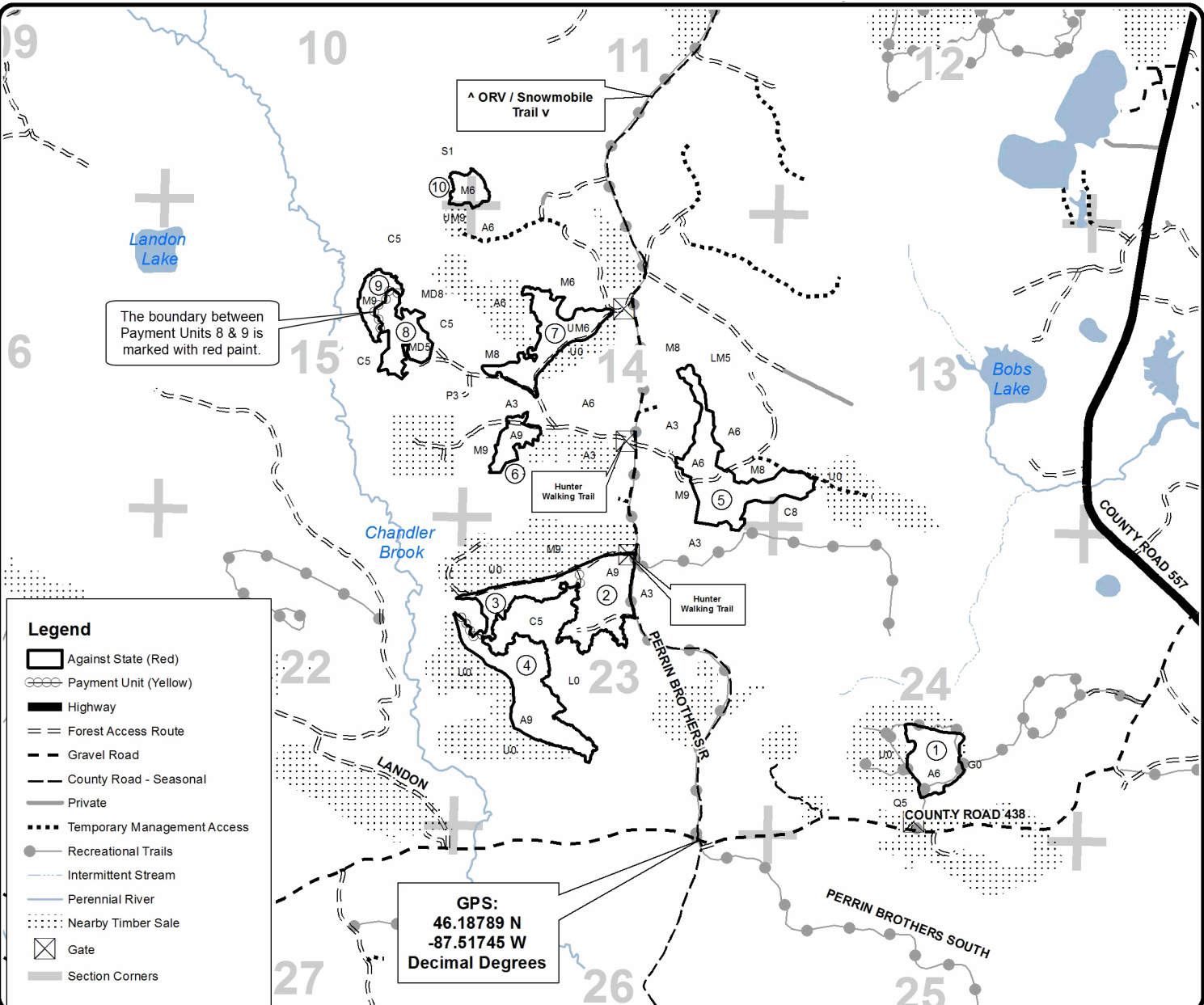

The boundary between Payment Units 8 & 9 is marked with red paint.

GPS:
 46.18789 N
 -87.51745 W
 Decimal Degrees

Legend

- Against State (Red)
- Payment Unit (Yellow)
- Highway
- Forest Access Route
- Gravel Road
- County Road - Seasonal
- Private
- Temporary Management Access
- Recreational Trails
- Intermittent Stream
- Perennial River
- Nearby Timber Sale
- Gate
- Section Corners

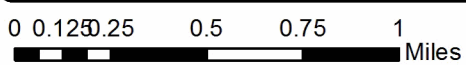

TIMBER SALE INFORMATION

Pointer's Paradise GEMS (32-026-22)
 T44N, R26W, SEC. 26; T44N, R26W, SEC. 35.
 Marquette County (Advertised Price \$103,160.30)

SALE NOTE: Payment units 1 and 4 have soft ground in areas see spec 5.2.22.1. Operations are restricted throughout this sale due to hunting season and nesting see spec 5.2.3.1.

A recreation site such as a trail, pathway, or campground is within the sale area or the vicinity. Certain restrictions/specifications may be applicable including time restrictions.

A timber sale contract for this lump sum, sealed bid timber sale will be awarded to the responsible bidder offering the highest sealed bid price. All units of volume listed below were estimated using the Inventory Manager computer program and the new Michigan taper model. Bids must be at or above the following advertised price for each product and species:

<u>PRODUCTS & SPECIES</u>	<u>ESTIMATED UNITS*</u>	<u>ADVERTISED PRICE</u>
Sawtimber		
Basswood	8.0 MBF	\$ 35.00 / MBF
Paper Birch	19.5 MBF	\$ 64.00 / MBF
Red Maple	5.0 MBF	\$ 137.00 / MBF
Sugar Maple	25.9 MBF	\$ 173.00 / MBF
Pulpwood		
Balsam Fir	990 Cords	\$ 15.90 / Cord
Mixed Aspen	2,635 Cords	\$ 25.25 / Cord
Mixed Hardwood	622 Cords	\$ 15.70 / Cord
Mixed Spruce	158 Cords	\$ 23.15 / Cord
Tamarack	25 Cords	\$ 30.75 / Cord

* The total volume is statistically estimated within plus (+) or minus (-) 10.86 percent. There are an estimated 4,361 cords on this timber sale, plus or minus 474 cords at the 95% confidence level. The estimated units are final and not subject to adjustment. Prospective bidders are urged to examine this timber and to make their own estimates of quantity and quality.

BOND AND PAYMENT SCHEDULE:

1. A bond in the amount of \$5,158.00 to insure faithful performance of the conditions of the contract will be deposited by the successful bidder within 21 days of the sale award.
2. Cutting in any sale or unit without the required advance payment would be considered a trespass.
3. Total payment must be paid in advance or according to the following schedule :
 - (a) Ten percent (10%) of the sale value must be paid within 21 days of the sale award.
 - (b) The 10% down payment will be credited towards the first unit cut.
 - (c) Payment for each of the following units must be made before cutting begins in that unit:

PAYMENT UNIT NUMBER	PERCENT OF TOTAL SALE VALUE
01	12.9%
02	14.3%
03	18.6%
04	23.0%
05	9.6%
06	21.6%

4. If no cutting takes place, the 10% down payment will not be refunded.
5. Operations on the contract issued will terminate on 08/31/2026.

SALE STATISTICS

Volumes were calculated in cubic feet using the Michigan taper model. Cubic foot volume includes all wood inside bark for the product indicated. For display purposes, cubic feet were converted to cords and MBF using a simple conversion factor, e.g. 79 cubic feet per cord and 185 cubic feet per MBF. The cubic foot volumes are precise; the cords and MBF volumes are not. Cubic foot volume cannot be directly converted to cords or boards with precision.

SALE VOLUMES

The total estimated sale volume may not equal the sum of the species/products due to the nature of statistical calculations associated with double sampling methodology.

VOLUME			STATISTICAL RANGE IN CORDS	
TOTAL CUBIC FEET	TOTAL CORDS	PERCENT ERROR	MINIMUM	MAXIMUM
344,495	4,361	10.86%	3,887	4,834

VDU VOLUMES

A VDU is a Volume Determination Unit. Volumes and their associated statistics are calculated at the VDU level and summarized to the sale level. There is often a one to one relationship between a VDU and a Payment Unit, but not always, depending on the cruise design. Refer to the VDU TO PAYMENT UNIT table.

	VOLUME			RANGE IN CORDS	
VDU	TOTAL CUBIC FEET	TOTAL CORDS	PERCENT ERROR	MINIMUM	MAXIMUM
1	188,774	2,390	13.86%	2,058	2,721
2	114,141	1,445	18.79%	1,173	1,716
223	41,580	526	24.30%	398	654
TOTAL:	344,495	4,361		3,630	5,091

VDU TO PAYMENT UNIT

When a VDU is associated with more than one Payment Unit (PU), the VDU volumes are assigned to the PU based on acres of the VDU within the PU.

VDU	VDU ACRES	PU	PU ACRES
1	60.3	2	15.4
		3	20.0
		4	24.9
2	42.0	5	12.9
		6	29.1
223	26.0	1	26.0
TOTAL:	128.3		128.3

DESCRIPTION OF TIMBER BY PAYMENT UNIT (PU)

PU	MARKET GROUP	PRODUCT	QUANTITY	UNIT	ACRES	ADVERTISE PRICE
1	Paper Birch	Sawtimber	16.0	MBF	26.0	\$13,294.25
	Red Maple		4.0	MBF		
	Sugar Maple		14.3	MBF		
	Balsam Fir	Pulpwood	90	Cords		
	Mixed Aspen		194	Cords		
	<i>B. T. Aspen</i>		10	Cords		
	<i>Quaking Aspen</i>		184	Cords		
	Mixed Hardwood		152	Cords		
	<i>Balsam Poplar</i>		7	Cords		
	<i>Black Ash</i>		4	Cords		
	<i>Paper Birch</i>		53	Cords		
	<i>Red Maple</i>		25	Cords		
	<i>Sugar Maple</i>		56	Cords		
	<i>Yellow Birch</i>		7	Cords		
	Mixed Spruce		23	Cords		
	<i>Black Spruce</i>		10	Cords		
	<i>White Spruce</i>		13	Cords		
2	Paper Birch	Sawtimber	0.9	MBF	15.4	\$14,750.80
	Red Maple		0.3	MBF		
	Sugar Maple		0.8	MBF		
	Balsam Fir	Pulpwood	131	Cords		
	Mixed Aspen		429	Cords		
	<i>B. T. Aspen</i>		8	Cords		
	<i>Quaking Aspen</i>		421	Cords		
	Mixed Hardwood		65	Cords		
	<i>Balsam Poplar</i>		20	Cords		
	<i>Black Ash</i>		3	Cords		
	<i>Black Cherry</i>		4	Cords		
	<i>Ironwood</i>		2	Cords		
	<i>Paper Birch</i>		3	Cords		
	<i>Red Maple</i>		27	Cords		
	<i>Sugar Maple</i>		6	Cords		
	Mixed Spruce		17	Cords		
	<i>White Spruce</i>	Sawtimber	2.9	MBF		
<i>White Spruce</i>	Pulpwood	11	Cords			
Tamarack		6	Cords			
3	Paper Birch	Sawtimber	1.2	MBF	20.0	\$19,139.70
	Red Maple		0.3	MBF		
	Sugar Maple		1.0	MBF		
	Balsam Fir	Pulpwood	170	Cords		
	Mixed Aspen		557	Cords		
	<i>B. T. Aspen</i>		10	Cords		
	<i>Quaking Aspen</i>		547	Cords		
	Mixed Hardwood		83	Cords		
	<i>Balsam Poplar</i>		26	Cords		
	<i>Black Ash</i>		4	Cords		
	<i>Black Cherry</i>		5	Cords		
	<i>Ironwood</i>		2	Cords		
	<i>Paper Birch</i>		4	Cords		
	<i>Red Maple</i>		35	Cords		
	<i>Sugar Maple</i>		7	Cords		
	Mixed Spruce		23	Cords		
	<i>White Spruce</i>	Sawtimber	3.8	MBF		
<i>White Spruce</i>	Pulpwood	15	Cords			
Tamarack		8	Cords			
4	Paper Birch	Sawtimber	1.4	MBF	24.9	\$23,841.90

DESCRIPTION OF TIMBER BY PAYMENT UNIT (PU), CON'T

PU	MARKET GROUP	PRODUCT	QUANTITY	UNIT	ACRES	ADVERTISE PRICE
4 con't	Red Maple	Sawtimber	0.4	MBF		
	Sugar Maple		1.3	MBF		
	Balsam Fir	Pulpwood	212	Cords		
	Mixed Aspen		693	Cords		
	<i>B. T. Aspen</i>		12	<i>Cords</i>		
	<i>Quaking Aspen</i>		681	<i>Cords</i>		
	Mixed Hardwood		103	Cords		
	<i>Balsam Poplar</i>		33	<i>Cords</i>		
	<i>Black Ash</i>		6	<i>Cords</i>		
	<i>Black Cherry</i>		5	<i>Cords</i>		
	<i>Ironwood</i>		2	<i>Cords</i>		
	<i>Paper Birch</i>		5	<i>Cords</i>		
	<i>Red Maple</i>		43	<i>Cords</i>		
	<i>Sugar Maple</i>		9	<i>Cords</i>		
	Mixed Spruce		28	Cords		
	<i>White Spruce</i>	<i>Sawtimber</i>	4.7	<i>MBF</i>		
	<i>White Spruce</i>	<i>Pulpwood</i>	19	<i>Cords</i>		
Tamarack		11	Cords			
5	Basswood	Sawtimber	2.5	MBF	12.9	\$9,901.20
	Sugar Maple		2.6	MBF		
	Balsam Fir	Pulpwood	119	Cords		
	Mixed Aspen		235	Cords		
	<i>B. T. Aspen</i>		61	<i>Cords</i>		
	<i>Quaking Aspen</i>		174	<i>Cords</i>		
	Mixed Hardwood		67	Cords		
	<i>Basswood</i>		3	<i>Cords</i>		
	<i>Paper Birch</i>		3	<i>Cords</i>		
	<i>Red Maple</i>		12	<i>Cords</i>		
	<i>Sugar Maple</i>		49	<i>Cords</i>		
	Mixed Spruce		21	Cords		
	<i>Black Spruce</i>		3	<i>Cords</i>		
	<i>White Spruce</i>		18	<i>Cords</i>		
	6	Basswood	Sawtimber	5.5		
Sugar Maple			5.9	MBF		
Balsam Fir		Pulpwood	268	Cords		
Mixed Aspen			527	Cords		
<i>B. T. Aspen</i>			136	<i>Cords</i>		
<i>Quaking Aspen</i>			391	<i>Cords</i>		
Mixed Hardwood			152	Cords		
<i>Basswood</i>			8	<i>Cords</i>		
<i>Paper Birch</i>			8	<i>Cords</i>		
<i>Red Maple</i>			27	<i>Cords</i>		
<i>Sugar Maple</i>			109	<i>Cords</i>		
Mixed Spruce			46	Cords		
<i>Black Spruce</i>			7	<i>Cords</i>		
<i>White Spruce</i>			39	<i>Cords</i>		
TOTAL:			58.4	MBF		
TOTAL:			4,430	Cords		

Sale Specific Conditions & Requirements

Sale Name: Pointer's Paradise GEMS

Sale Number: 32-026-22 Seq#: 1

1 - Sale Area

1.2 - Boundaries

1.2.1 - Painted boundaries (9/19)

The sale boundary and Payment Unit boundaries are marked and identified by red and yellow paint. Exterior sale boundary lines against state are marked with red paint. Interior Payment Unit boundaries are marked with yellow paint. Retention patches are marked with red paint; no harvesting activities may occur within these areas. The painted boundary line trees are not Included Timber and are to be protected. Some red lines in this sale are adjacent to recent clear cuts and may be designated to be cut by sale administrator. Yellow painted trees designating an interior Payment Unit boundary are only to be cut when all surrounding Payment Units have been paid.

2 - Timber Specifications

2.1 - Included Timber

2.1.1 - Clearcut unit(s) with unmerchantable trees (6/14)

Within Payment Unit(s) 1-6, cut all trees that are two (2) inches or more at DBH except DO NOT CUT cedar and hemlock.

3 - Payments

3.4 - Damaged Timber

3.4.1 - Damaged timber (7/16)

General Condition and Requirement 3.4 Damaged Timber, defines liquidated damages for undesignated live merchantable trees which are cut or injured. No damage is acceptable to undesignated live merchantable trees. Within the sale area, if more than 5% of trees (> 4.5" DBH) within a specified area of the sale are damaged, liquidated damages will be assessed for all trees damaged. Rates will be in accordance with General Condition and Requirement 3.4 Damaged Timber.

4 - Transportation

4.1 - Construction

4.1.3 - Slash and earthen piles (8/04)

Piles or windrows of earth along roads and landings that have been widened or constructed shall be leveled. Slash from road maintenance or construction, including stumps, shall be dispersed throughout the sale.

4.1.4 - Timber removed for construction (12/09)

Trees cut or damaged in the process of pre-approved road, landing or skid trail construction will be decked in an area separate from other Designated Timber and not removed until measured by the sale administrator. Payment will be made at the specified Purchase Unit Price.

4.1.6 - Road construction (1/09)

Construction of new roads or improvements of existing roads shall be done in such a way as to minimize the environmental and visual impacts. Merchantable trees shall be cut and utilized unless otherwise directed. Non-merchantable trees shall be severed and laid flat on the ground. Slash shall be scattered, and not left in windrows and kept a minimum of 10 feet back from the road edge. Stumps shall be set upright, not left on edge, and be moved at least 10 feet away from the road edge. Disturbed soil shall be feathered into the woods and not left in berms or windrows.

4.1.7 - Road closure (10/11)

All new roads built into the sale must be blocked to vehicle traffic upon completion of the sale. Overgrown roads that are reopened shall be considered new roads. In general, this will require constructing a four (4') foot high berm of stumps and logs covered with earth. Contact the sale administrator for specific details of design and placement.

4.2 - Maintenance

4.2.1 - Hauling restriction (12/08)

Hauling may be restricted on forest roads by the Unit Manager or his/her representative. The restriction may occur during

spring breakup or may occur during wet weather conditions.

4.2.2 - Fill material (4/07)

To maintain roads, fill material may be needed in areas where "holes" exist or may be expected to develop. This fill material should be placed before trucking begins. Obtaining gravel is the responsibility of the purchaser.

4.2.3 - Road maintenance (8/13)

The following road maintenance is required: Within 60 days of completion of hauling, or if no hauling occurs for 60 days, the road must be maintained and graded. This includes cleaning of drainage areas, grading, crowning and filling with gravel, if necessary. Damages will be assessed if grading/repair does not occur.

4.2.4 - Grading (10/16)

For completion of the sale, state forest roads must be graded. In general, this will require a road grader or bull dozer to shape up the roads after forest products have been hauled off site. This includes cleaning of drainage areas, grading, crowning and filling with gravel, if necessary. The grading equipment to be used must be approved by the Unit Manager or his/her representative.

4.3 - Public Right-of-Way

4.3.2 - County R-O-W (12/06)

The county must be contacted prior to harvesting in the county road R-O-W. This applies to Payment Unit 1 and County Road 438.

4.4 - Access

4.4.3 - Access gate (12/08)

The access gate must be locked at the completion of each day unless otherwise approved by the sale administrator or his/her representative.

5 - Operations

5.1 - Notification

5.1.1 - Pre-sale conference (10/16)

A pre-sale conference on site between the Purchaser and sale administrator is required prior to beginning any operations. The Unit Manager or his/her representative must be contacted at least 3 business days in advance to schedule the conference.

5.2 - Conduct of Operations

5.2.1 - Slash

5.2.1.11 - Slash for reforestation (3/21)

To facilitate reforestation, the Sale Area shall be left with slash evenly distributed. Bunched tops within the cutting area shall be broken up and scattered. Stumps shall be cut low to the ground. Processing sites shall not be left with a compacted layer of slash; tops from these sites shall be hauled back into the cut area and scattered.

5.2.2 - Hazard Trees/Snags

5.2.2.1 - Den trees (10/16)

Obvious hollow and/or den trees shall be protected and left standing unless they are a safety hazard.

5.2.3 - Operating Restrictions

5.2.3.1 - Operating restrictions (9/11)

Within Payment Unit(s) 1-6, unless changed by written agreement, cutting, skidding, and hauling are not permitted during the period of April 1 through July 15, and September 15, through October 31. This restriction is to protect grouse and woodcock nesting habitat, hunting season within the GEMS area.

5.2.4 - Dead and Down Creation

5.2.4.4 - Dead and down creation, grouse (6/18)

To encourage grouse and other wildlife, in Payment Unit(s) 1-6 leave one, 12" diameter or larger log-length (8 foot minimum) piece on the ground for every 2 acres. These will be evenly scattered throughout the unit.

5.2.22 - Operating Caution

5.2.22.1 - Operating caution (6/11)

It is recommended, but not required, that within Payment Unit(s) 1 and 4, cutting, skidding, and hauling occur during dry summer or frozen winter conditions. The reason for the recommendation is because of soft ground within the payment units.

5.2.32 - Decking/landing restoration (9/13)

All decking and landing areas must have the surface area restored to a condition equal to or better than before. This is to ensure the proper regeneration of the stand. Wood debris, chips and "cookies" from trimmings must be removed or scattered away from landing and loading areas and may not be windrowed on the edge.

5.2.37 - No decking areas (12/08)

No decking is allowed within 50 feet of County Road 438 without permission of the Unit Manager or his/her representative and the county.

5.2.38 - No decking against live trees (2/04)

Cut products may not be decked against unmarked or designated leave trees.

5.2.40 - Pathway protection (10/10)

The Chandler Brook Chase is a hunter walking trail and is shown on the Timber Sale Map. Do not cut trees or damage posts with blue pathway markers. Maintain a 20-foot wide slash, debris, and rut free zone daily, using the pathway as the centerline.

5.4 - Soil Protection

5.4.1 - Rutting restriction, general (7/16)

Operations are to cease immediately if equipment and weather conditions result in rutting of roads and/or skid trails which is 12 inches or greater in depth and 50 feet in length. The Unit Manager or his/her representative may restrict hauling and/or skidding if ruts exceed the specified depth. With the Unit Manager or his/her representative's approval, the Purchaser may return to the area when the risk of rutting has decreased.

5.4.2 - Skid trails (2/04)

Skid trails up and down slopes should be avoided. If however this is unavoidable, these trails will be left in a non-erodible condition using water bars, logs, and slash. Placing of slash on these skid trails while logging is ongoing may alleviate need for any further action. At the direction of the sale administrator, seed, fertilizer, and mulch may also be required.

5.4.6 - Wet area protection (5/10)

No harvesting operations, including skidding and felling, are to take place within the vernal pool area identified within PU 2. Care must be taken by the Purchaser to identify and avoid operating in these areas of the timber sale.

5.8 - Protection of Endangered Species

5.8.5 - Protection of raptor nests (3/13)

All trees with raptor nests will be protected if found during harvesting operations. Notification will be made to the Unit Manager or his/her representative who will notify the Wildlife Biologist so an on-site evaluation and recommendation can be made, if necessary.

6 - Safety and Fire Prevention

6.2 - Signing

6.2.1 - Road posting (10/20)

The Purchaser is responsible for posting and maintaining caution signs on County Road 438 from both directions, access roads entering the active sale, and Perrin Brothers South Road from both directions prior to beginning operations. The road must be posted at appropriate distances from the sale area to warn of logging activity and truck traffic. Signs must be removed when harvest operations are suspended or completed. The Purchaser will provide these signs.

7 - Other Conditions

7.5 - Loss

7.5.1 - Deteriorating timber (7/09)

The sale area has received damage from Spruce budworm. The Purchaser should harvest the wood as soon as possible. The Department of Natural Resources is held free of responsibility of any further damage or deterioration due to delay in harvesting.



TIMBER SALE MAP

This information provided by authority of Part 525, 1994 PA 451, as amended.

Sale Number	Year
32-026	22

Forest Management Unit	County	Mapped By	Date	Page	of
Gwinn Management Unit	Marquette	Brolin	09/12/2022	1	1
		Cruised By			
		Wilson			

Township	Range	Section(s) and Subdivision(s)	Scale
44N	26W	Sections 26 and 35	1:15,840

Cover Type				Density			
A = Aspen	H = Hemlock	N = Marsh	U = Upland Brush	0 = Non Stocked	5 = Pole Timber Medium		
B = Paper Birch	J = Jack Pine	O = Oak	UM = Upland Mixed	1 = Seeding Sapling Poor	6 = Pole Timber Well		
C = Cedar	L = Lowland Brush	P = Lowland Poplar	V = Bog or Marsh	2 = Seeding Sapling Medium	7 = Saw Timber Poor		
D = Tread Bog	LM = Lowland Mixed	Q = Mixed Swamp Conifer	W = White Pine	3 = Seeding Sapling Well	8 = Saw Timber Medium		
E = Swamp Hdwoods	M = Mpl. Bch. Birch	R = Red Pine	X = Non Stocked	4 = Pole Timber Poor	9 = Saw Timber Well		
F = Spruce Fir	MC = Mixed Conifer	S = Black Spruce	Z = Water				
G = Grass	MD = Mixed Deciduous	T = Tamarack					

PU Acres

1	26.0
2	15.4
3	20.1
4	24.9
5	12.9
6	28.0

Pointer's Paradise GEMS

Compartment 51

128.3 Acres

QR code for PDF Maps app

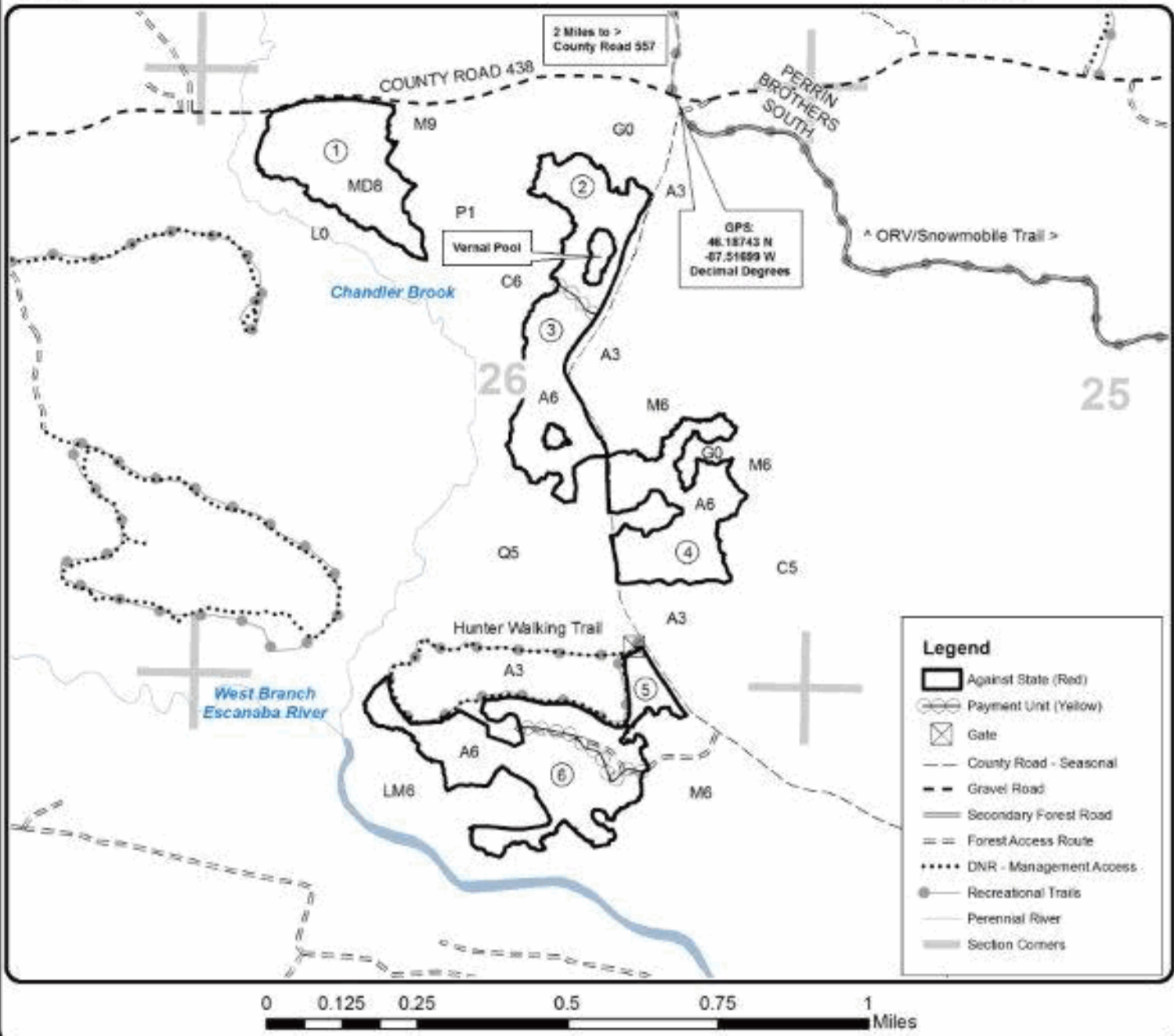

Mikko's Maze Aspen (32-010-22)
T44N, R25W, SEC. 31; Marquette COUNTY

In response to the notice of sale to be held 2:00 p.m. (local time) on August 7, 2023, I am hereby submitting my sealed bid (firm offer) for the following forest products to be cut. Bids for individual species must be at or above the advertised price. All non-responsive bid forms may be rejected.

<u>PRODUCTS & SPECIES</u>	<u>ESTIMATED VOLUME*</u>	<u>ADVERTISED PRICE</u>	<u>BID PRICE/UNIT</u>
Sawtimber			
Basswood	0.8 MBF	\$ 35.00/MBF	\$ _____
Paper Birch	4.6 MBF	\$ 64.00/MBF	\$ _____
Red Maple	1.9 MBF	\$ 137.00/MBF	\$ _____
Red Pine	22.1 MBF	\$ 221.00/MBF	\$ _____
Sugar Maple	8.3 MBF	\$ 173.00/MBF	\$ _____
Pulpwood			
Balsam Fir	680 Cords	\$ 15.90/Cord	\$ _____
Mixed Aspen	2,364 Cords	\$ 25.25/Cord	\$ _____
Mixed Hardwood	309 Cords	\$ 15.70/Cord	\$ _____
Mixed Spruce	608 Cords	\$ 23.15/Cord	\$ _____
Red Pine	16 Cords	\$ 68.05/Cord	\$ _____
Tamarack	158 Cords	\$ 30.75/Cord	\$ _____

*The volumes are statistically estimated within plus (+) or minus (-) 13.10 percent at 95% confidence level. These estimated volumes are final and not subject to adjustment. Prospective bidders are urged to examine this timber and to make their own estimates of quantity and quality.

I understand that any or all bids may be rejected. All bids must be signed and all bid items must be bid or the bid form may be rejected. I also understand that consideration and awarding a contract will be based upon my past performance and ability to complete the contract based upon equipment and staffing subject to my control.

FEDERAL ID: _____ or SOCIAL SECURITY NUMBER: _____

Company or individual bidding: _____

Company representative's name: _____

Address: _____

City: _____ State: _____ Zip: _____

IF AVAILABLE, PLEASE PLACE THE PERSONALIZED LABEL FROM YOUR PROSPECTUS IN THE ABOVE BOX.

Individual or company representative's signature: _____ Date: _____

Phone number : _____ Email (optional): _____

THE WINNING BIDDER MUST COMPLETE THE VERIFICATION OF WORKER'S DISABILITY COMPENSATION ACT COMPLIANCE (ON REVERSE SIDE IF DOUBLE SIDED) WITHIN 21 DAYS OF SALE AWARD DATE



TIMBER SALE VERIFICATION OF WORKER'S DISABILITY COMPENSATION ACT COMPLIANCE

As required by Act 317, P.A. 1969 (Worker's Compensation) and
Part 5 of Act 451 of 1994, as amended.

FOR DEPARTMENT USE ONLY	
Sale Number (XX - XXX - XX - XX)	
Forest Management Unit:	

VERIFICATION OF WORKER'S DISABILITY COMPENSATION ACT COMPLIANCE

- This verification must be completed and submitted within 21 days of contract award and prior to the issuance of the timber sale contract.
- In addition, if boxes 2B or 2C are checked, then Notice of Exclusion or Certificate of Insurance must be submitted within twenty-one (21) days of the contract award and prior to the issuance of the timber sale contract.
- All information must be typed or printed except for written signatures.

Please Check Appropriate Categories:

1. My business is organized as (you **must** check one of the boxes below):
 - A. Sole Proprietorship (individual)
 - B. Partnership
 - C. Corporation
2. You **must** check one of the boxes below:
 - A. I certify my business is a sole proprietorship and it has no employees but the sole proprietor. I am not subject to the Worker's Compensation Laws.
 - B. I certify my business has satisfied its obligation to the Worker's Compensation Act through the use of an approved Notice of Exclusion (BWC-337, Rev. 5/96). I will provide a copy of the Notice of Exclusion within 21 days of the contract award. (For questions or a copy of the BWC-337, please call the Worker's Compensation Bureau at 517-322-1195).
 - C. I certify my business has a Worker's Compensation Policy. I will provide an original Certificate of Insurance within twenty-one (21) days of the contract award.
3. If you have checked item 2(A) or 2(B), you **must** indicate the number of **both** full-time and part-time employees, other than yourself, including family members and active partners (if none, you must enter "0").

_____ Full-time Employees

_____ Part-time Employees

Name of Business		Federal ID (or) Social Security No.	
Address		Telephone ()	
City	State	ZIP	

I hereby certify that the above information is true and correct. I agree to notify the Michigan DNR of any changes that occur in factors affecting my coverage during any of my present and future operations.

Signature of Owner or Authorized Representative

Title

Date

Please complete the "SEALED BID" information on the next page

Duke's Doodles GEMS (32-025-22)
T44N, R26W, SEC. 10; T44N, R26W, SEC. 11; T44N, R26W, SEC. 13; T44N,

In response to the notice of sale to be held 2:00 p.m. (local time) on August 7, 2023, I am hereby submitting my sealed bid (firm offer) for the following forest products to be cut. Bids for individual species must be at or above the advertised price. All non-responsive bid forms may be rejected.

<u>PRODUCTS & SPECIES</u>	<u>ESTIMATED VOLUME*</u>	<u>ADVERTISED PRICE</u>	<u>BID PRICE/UNIT</u>
Sawtimber			
Basswood	31.5 MBF	\$ 35.00/MBF	\$ _____
Paper Birch	9.5 MBF	\$ 64.00/MBF	\$ _____
Red Maple	32.0 MBF	\$ 137.00/MBF	\$ _____
Sugar Maple	29.8 MBF	\$ 173.00/MBF	\$ _____
Pulpwood			
Balsam Fir	1,057 Cords	\$ 15.90/Cord	\$ _____
Mixed Aspen	4,427 Cords	\$ 25.25/Cord	\$ _____
Mixed Hardwood	1,079 Cords	\$ 15.70/Cord	\$ _____
Mixed Spruce	394 Cords	\$ 23.15/Cord	\$ _____
Tamarack	74 Cords	\$ 30.75/Cord	\$ _____

*The volumes are statistically estimated within plus (+) or minus (-) 9.14 percent at 95% confidence level. These estimated volumes are final and not subject to adjustment. Prospective bidders are urged to examine this timber and to make their own estimates of quantity and quality.

I understand that any or all bids may be rejected. All bids must be signed and all bid items must be bid or the bid form may be rejected. I also understand that consideration and awarding a contract will be based upon my past performance and ability to complete the contract based upon equipment and staffing subject to my control.

FEDERAL ID: ____ - ____ - ____ or SOCIAL SECURITY NUMBER: ____ - ____ - ____

Company or individual bidding: _____

Company representative's name: _____

Address: _____

City: _____ State: _____ Zip: _____

IF AVAILABLE, PLEASE PLACE THE PERSONALIZED LABEL FROM YOUR PROSPECTUS IN THE ABOVE BOX.

Individual or company representative's signature: _____ Date: _____

Phone number : _____ Email (optional): _____

THE WINNING BIDDER MUST COMPLETE THE VERIFICATION OF WORKER'S DISABILITY COMPENSATION ACT COMPLIANCE (ON REVERSE SIDE IF DOUBLE SIDED) WITHIN 21 DAYS OF SALE AWARD DATE



FOR DEPARTMENT USE ONLY	
Sale Number (XX - XXX - XX - XX)	
Forest Management Unit:	

TIMBER SALE VERIFICATION OF WORKER'S DISABILITY COMPENSATION ACT COMPLIANCE

As required by Act 317, P.A. 1969 (Worker's Compensation) and
Part 5 of Act 451 of 1994, as amended.

VERIFICATION OF WORKER'S DISABILITY COMPENSATION ACT COMPLIANCE

- This verification must be completed and submitted within 21 days of contract award and prior to the issuance of the timber sale contract.
- In addition, if boxes 2B or 2C are checked, then Notice of Exclusion or Certificate of Insurance must be submitted within twenty-one (21) days of the contract award and prior to the issuance of the timber sale contract.
- All information must be typed or printed except for written signatures.

Please Check Appropriate Categories:

1. My business is organized as (you **must** check one of the boxes below):
 - A. Sole Proprietorship (individual)
 - B. Partnership
 - C. Corporation
2. You **must** check one of the boxes below:
 - A. I certify my business is a sole proprietorship and it has no employees but the sole proprietor. I am not subject to the Worker's Compensation Laws.
 - B. I certify my business has satisfied its obligation to the Worker's Compensation Act through the use of an approved Notice of Exclusion (BWC-337, Rev. 5/96). I will provide a copy of the Notice of Exclusion within 21 days of the contract award. (For questions or a copy of the BWC-337, please call the Worker's Compensation Bureau at 517-322-1195).
 - C. I certify my business has a Worker's Compensation Policy. I will provide an original Certificate of Insurance within twenty-one (21) days of the contract award.
3. If you have checked item 2(A) or 2(B), you **must** indicate the number of **both** full-time and part-time employees, other than yourself, including family members and active partners (if none, you must enter "0").

_____ Full-time Employees

_____ Part-time Employees

Name of Business		Federal ID (or) Social Security No.	
Address		Telephone ()	
City	State	ZIP	

I hereby certify that the above information is true and correct. I agree to notify the Michigan DNR of any changes that occur in factors affecting my coverage during any of my present and future operations.

Signature of Owner or Authorized Representative

Title

Date

Please complete the "SEALED BID" information on the next page

Pointer's Paradise GEMS (32-026-22)
T44N, R26W, SEC. 26; T44N, R26W, SEC. 35; Marquette COUNTY

In response to the notice of sale to be held 2:00 p.m. (local time) on August 7, 2023, I am hereby submitting my sealed bid (firm offer) for the following forest products to be cut. Bids for individual species must be at or above the advertised price. All non-responsive bid forms may be rejected.

<u>PRODUCTS & SPECIES</u>	<u>ESTIMATED VOLUME*</u>	<u>ADVERTISED PRICE</u>	<u>BID PRICE/UNIT</u>
Sawtimber			
Basswood	8.0 MBF	\$ 35.00/MBF	\$ _____
Paper Birch	19.5 MBF	\$ 64.00/MBF	\$ _____
Red Maple	5.0 MBF	\$ 137.00/MBF	\$ _____
Sugar Maple	25.9 MBF	\$ 173.00/MBF	\$ _____
Pulpwood			
Balsam Fir	990 Cords	\$ 15.90/Cord	\$ _____
Mixed Aspen	2,635 Cords	\$ 25.25/Cord	\$ _____
Mixed Hardwood	622 Cords	\$ 15.70/Cord	\$ _____
Mixed Spruce	158 Cords	\$ 23.15/Cord	\$ _____
Tamarack	25 Cords	\$ 30.75/Cord	\$ _____

*The volumes are statistically estimated within plus (+) or minus (-) 10.86 percent at 95% confidence level. These estimated volumes are final and not subject to adjustment. Prospective bidders are urged to examine this timber and to make their own estimates of quantity and quality.

I understand that any or all bids may be rejected. All bids must be signed and all bid items must be bid or the bid form may be rejected. I also understand that consideration and awarding a contract will be based upon my past performance and ability to complete the contract based upon equipment and staffing subject to my control.

FEDERAL ID: ____ - ____ - ____ or SOCIAL SECURITY NUMBER: ____ - ____ - ____

Company or individual bidding: _____

Company representative's name: _____

Address: _____

City: _____ State: _____ Zip: _____

IF AVAILABLE, PLEASE PLACE THE PERSONALIZED LABEL FROM YOUR PROSPECTUS IN THE ABOVE BOX.

Individual or company representative's signature: _____ Date: _____

Phone number : _____ Email (optional): _____

THE WINNING BIDDER MUST COMPLETE THE VERIFICATION OF WORKER'S DISABILITY COMPENSATION ACT COMPLIANCE (ON REVERSE SIDE IF DOUBLE SIDED) WITHIN 21 DAYS OF SALE AWARD DATE



FOR DEPARTMENT USE ONLY	
Sale Number (XX - XXX - XX - XX)	
Forest Management Unit:	

TIMBER SALE VERIFICATION OF WORKER'S DISABILITY COMPENSATION ACT COMPLIANCE

As required by Act 317, P.A. 1969 (Worker's Compensation) and
Part 5 of Act 451 of 1994, as amended.

VERIFICATION OF WORKER'S DISABILITY COMPENSATION ACT COMPLIANCE

- This verification must be completed and submitted within 21 days of contract award and prior to the issuance of the timber sale contract.
- In addition, if boxes 2B or 2C are checked, then Notice of Exclusion or Certificate of Insurance must be submitted within twenty-one (21) days of the contract award and prior to the issuance of the timber sale contract.
- All information must be typed or printed except for written signatures.

Please Check Appropriate Categories:

1. My business is organized as (you **must** check one of the boxes below):
 - A. Sole Proprietorship (individual)
 - B. Partnership
 - C. Corporation
2. You **must** check one of the boxes below:
 - A. I certify my business is a sole proprietorship and it has no employees but the sole proprietor. I am not subject to the Worker's Compensation Laws.
 - B. I certify my business has satisfied its obligation to the Worker's Compensation Act through the use of an approved Notice of Exclusion (BWC-337, Rev. 5/96). I will provide a copy of the Notice of Exclusion within 21 days of the contract award. (For questions or a copy of the BWC-337, please call the Worker's Compensation Bureau at 517-322-1195).
 - C. I certify my business has a Worker's Compensation Policy. I will provide an original Certificate of Insurance within twenty-one (21) days of the contract award.
3. If you have checked item 2(A) or 2(B), you **must** indicate the number of **both** full-time and part-time employees, other than yourself, including family members and active partners (if none, you must enter "0").

_____ Full-time Employees

_____ Part-time Employees

Name of Business		Federal ID (or) Social Security No.	
Address		Telephone ()	
City	State	ZIP	

I hereby certify that the above information is true and correct. I agree to notify the Michigan DNR of any changes that occur in factors affecting my coverage during any of my present and future operations.

Signature of Owner or Authorized Representative

Title

Date

Please complete the "SEALED BID" information on the next page