



**DEPARTMENT OF NATURAL RESOURCES  
STATE OF MICHIGAN  
TIMBER SALE PROSPECTUS #7174**

SCHEDULED SALE DATE AND TIME: 9:00 a.m. (local time) on December 13, 2022.

LOCATION: ROSCOMMON MGMT UNIT, PO BOX 218, ROSCOMMON, MI 48653.

PROSPECTUS NOTE: The bidder is advised to inspect the sale area and review the location, estimated volumes, operating costs and contract terms of proposed sales. Please be aware that some landowners may request 60 days or more notice for access across their land.

Notice is hereby given that bids will be received by the Unit Manager, ROSCOMMON MANAGEMENT UNIT, for certain timber on the following described lands:

Aqua Aspen (71-018-22) / T23N, R01W, SEC. 10, NESW,S1/2SW,NWSE,S1/2SE.  
T23N, R01W, SEC. 15, N1/2NW,N1/2NE.  
T23N, R01W, SEC. 16, NENE.  
T23N, R01W, SEC. 9 , SESE.

Roscommon County, Advertised Price \$69,379.35, 86.5 Acres, Aspen, Hardwood.

SALE NOTE: A recreation site such as a trail, pathway, or campground is within the sale area or the vicinity. Certain restrictions/specifications may be applicable including time restrictions.

Lost and Found Aspen Hardwoods (71-020-22) / T24N, R02E, SEC. 1 , S1/2SE.  
T24N, R02E, SEC. 8 , SWNW.

Ogemaw County, Advertised Price \$46,801.45, 46.4 Acres, Hardwood, Aspen.

SALE NOTE: A recreation site such as a trail, pathway, or campground is within the sale area or the vicinity. Certain restrictions/specifications may be applicable including time restrictions.

McGregor School Red Pine (71-021-22) / T24N, R02E, SEC. 10, W1/2NE,NWSE.  
T24N, R02E, SEC. 8 , N1/2NE,SWNE.  
T24N, R02E, SEC. 9 , SESW,SWSE.

Ogemaw County, Advertised Price \$61,872.95, 66.8 Acres, Red Pine, Aspen.

Damon's Last Ridge (71-024-22) / T24N, R01E, SEC. 1 , NWSW,S1/2SW.  
T24N, R01E, SEC. 11, E1/2SE.  
T24N, R01E, SEC. 12, N1/2NW,SEW,W1/2NE.  
T24N, R01E, SEC. 2 , NW,NESE,S1/2SE.

Ogemaw County, Advertised Price \$204,475.85, 204.5 Acres, Aspen, Hardwood.

## BID INSTRUCTIONS (VER. 10/10/2022):

### 1. Scheduled Bid Location, Date, and Time (2/11)

Bids must be received by the Unit Manager, ROSCOMMON OFFICE, PO BOX 218, ROSCOMMON, MI 48653, no later than 9:00 a.m. (local time) on December 13, 2022. For further information concerning this sale, contact Doug Bates at 989-275-4622 extension 2740.

### 2. Bidder's Qualifications (10/22)

If all or part of a timber sale was prepared by a private contractor, the contractor and that contractor's company are not permitted to bid on the timber sale. A person must be 18 years of age or older to purchase timber. Permanent employees of the Department of Natural Resources or members of their immediate household may not bid. Former employees, in the permanent or seasonal class, may not bid until 3 months after the last day of active duty. Bids will not be accepted from individuals or companies appearing on the DNR/FRD No-Bid List. This list contains the names of purchasers who previously failed to execute a contract within 21-days or who have a history of poor performance.

### 3. Preparation of Sealed Bids (5/16)

Bid Forms may be completed online thru Michigan DNR Timber Sale Online Bidding (OLB) at [www.michigan.gov/timberbidding](http://www.michigan.gov/timberbidding) or by completing the hardcopy Bid Form found in the Timber Sale Prospectus. Hardcopy Bid Forms shall be manually signed in ink. Registration in OLB is considered your 'signature' for all bids submitted thru that system. Bid prices must be entered for each species and product in the Bid Price column for all material subject to bidding and all fill-in blanks must be completed. If erasures or other changes appear on the hardcopy Bid Form, each erasure or change must be initialed by the person signing the bid.

### 4. Submission of Sealed Bids (5/16)

Bid forms may be obtained from the Unit Manager or thru OLB. Bids may be submitted hardcopy or thru OLB. All hardcopy bids must be submitted on the bid form and in an envelope clearly identified as described in this section. NOTE: Only one bid form per bid envelope. Sealed bids must be submitted to the Unit office designated in the prospectus and must be submitted at or prior to the time established in the prospectus. The envelope should show on the outside (a) the sale name or number and (b) the date and time of bid opening, as shown in the prospectus. Bids received after the time specified in the sale prospectus are late bids and will be rejected.

It is possible for a bidder to submit multiple bids on a single sale. For example, a bid may be submitted hardcopy and a bid may be submitted thru OLB. Or, two bidders from the same company could both submit bids on the same sale. If this were to happen, the State would accept all bids received and award the contract accordingly. All bidding and contractual requirements would apply to all bids received.

### 5. Public Opening of Sealed Bids (7/16)

If conditions permit, the sealed bids will be publicly opened and posted at the time and place set in the prospectus.

If a bidder, present at a bid opening, has submitted bids on more than one sale, that bidder may withdraw their unopened bid envelopes or announce the withdrawal of their online bid after being declared the successful bidder on one sale.

### 6. Award of Contract (1/11)

Award of the contract will be made to the Bidder whose bid, conforming to the prospectus, is most advantageous to the State of Michigan on the basis of total value at rates bid for the estimated quantities. The State reserves the right to reject any bid or waive any minor irregularity in bids received. A written award mailed (or otherwise furnished) to the successful Bidder shall be deemed to result in a binding contract without further action by either party.

### 7. Down Payment (1/11)

The Bidder to whom award is made must make a down payment within 21 days of the sale award. The amount of the down payment will be calculated as shown in the Bond and Payment Schedule of this prospectus. Only cash may be used to meet this requirement.

### 8. Performance Security (1/11)

As guarantee of faithful performance, a cash bond, certificate of deposit, surety bond or irrevocable letter of credit (LOC) is required within 21 days of the sale award. The amount of the performance security is shown in the Bond and

Payment Schedule of this prospectus. If an LOC or surety is used, the coverage must extend for at least 6 months beyond the contract expiration.

#### 9. Worker's Compensation (10/22)

Purchaser shall obtain worker's compensation insurance to cover claims under Michigan's Worker's Disability Compensation Act of 1969 or similar employee benefit act of any other state applicable to an employee. Verification of Worker's Disability Compensation Act Compliance must be completed and submitted within 21 days of contract award and prior to the issuance of the timber sale contract. In addition, if applicable, Notice of Exclusion or Certificate of Insurance must also be submitted.

#### 10. Timber Sale Contract (10/22)

Additional conditions and requirements common to all timber sales are listed on the timber sale contract (R4031) and are available on line at [www.michigan.gov/timber](http://www.michigan.gov/timber). Contact the Unit Manager for additional information or a sample contract. Within 21 days of the date of the award letter, the bidder must sign the contract and provide the required down payment, performance security, and verification of worker's disability compensation. The down payment and performance security shall be in accordance with the provisions of the timber sale contract, in the sums stated in this prospectus. If these actions are not taken, then the Bidder, the Bidder's corporation, and the corporation's principals may not be permitted to bid on State timber sales for a period of 3 months after the first offense, 6 months after the second offense, and 1 year after the third offense. An offense will only be counted against the Bidder for 5 years. In addition, the Bidder certifies that if awarded this contract, the Bidder will complete the timber sale contract in accordance with its terms and any modifications thereof including requirements to purchase, cut, and remove the included timber by the expiration date.

Payment Unit values in the State Forest Timber Sale Contract are calculated based on the advertised value of the Payment Unit as a percentage of the total advertised value of the contract. The advertised value of each Payment Unit is given in the Description of Timber by Payment Unit table on the Timber Sale Information page. For example, if the value of Payment Unit 1 is advertised as \$1,500 and the total Timber Sale value is advertised as \$10,000, the contract price for Payment Unit 1 will be 15% of the total bid price ( $\$1,500/\$10,000 * 100$ ).

#### 11. Disclaimer of Estimates and Bidder's Warranty of Inspection (10/22)

Before submitting this bid, the Bidder is advised and cautioned to inspect the sale area, review the requirements of the sale contract, and take other steps as may be reasonably necessary to ascertain the location, estimated volumes, construction estimates, and operating costs of the proposed sale. Failure to do so will not relieve the Bidder from responsibility for completing the contract.

The Bidder warrants that this bid is submitted solely on the basis of the Bidder's examination and inspection of the quality and quantity of the timber offered for sale and the Bidder's opinion of the value thereof and the costs of recovery. No reliance should be placed on the State of Michigan's estimates of timber quality, quantity or costs of recovery. Bidder further acknowledges that the State of Michigan: (i) expressly disclaims any warranty of fitness of timber for any purpose; (ii) offers this timber as is without any warranty of quality (merchantability) or quantity and (iii) expressly disclaims any warranty as to the quantity or quality of timber sold.

#### 12. Certification and Chain-of-Custody (10/22)

Unless otherwise indicated in the contract under section 7 – Other Conditions of the Sale Specific Conditions & Requirements, the area encompassed by this timber sale is certified to the standards of the Forest Stewardship Council (FSC) - Certificate #SCS-FM/COC-00090N and the Sustainable Forestry Initiative (SFI) - Certificate #NSF-SFIS-5Y031-SF5. Forest products from this sale may be delivered to the mill as "FSC 100% and / or SFI certified" as long as the contractor hauling the forest products is chain-of-custody (COC) certified or covered under a COC certificate from the destination mill. The purchaser is responsible for maintaining COC after leaving the sale area.

#### 13. Good Neighbor Authority (GNA) Requirements (10/22)

If the name of this timber sales contains the acronym GNA, it is authorized by the Good Neighbor Authority (GNA) and covered by various agreements between the U.S. Forest Service and the State. The timber sale occurs on federal land and the following conditions apply:

GNA contracts on US Forest Service land will not be awarded to purchasers on the Federal list of excluded parties. The System for Award Management (SAM) will be checked for active excluded parties prior to award of contract. In

addition, the Bidder to whom award is made must complete an Assurance Regarding Felony Conviction or Tax Delinquent Status for Corporate Applicants (AD-3031).

14. Good Neighbor Authority (GNA) Requirements, con't (10/22)

Bidder certifies, by signing this bid form, that to the best of Bidder's knowledge that the following representations are accurate and complete.

- a. That the Bidder and its principals are not presently debarred, suspended, proposed for debarment, declared ineligible, or voluntary excluded from timber sales (covered transactions) by any Federal department or agency.
- b. That the Bidder and its principals have not within a 3-year period preceding this bid been convicted of or had a civil judgment rendered against them for commission of fraud or a criminal offense in connection with obtaining , attempting to obtain, or performing a public (Federal, State, or local) transaction or contract under a public transaction; violation of Federal or State antitrust statutes or commission of embezzlement, theft, forgery, bribery, falsification or destruction of records, making false statements, or receiving stolen property.
- c. That the Bidder and its principals are not presently indicted for or otherwise criminally or civilly charged by a governmental entity (Federal, State, or local) with commission of any of the offenses enumerated in paragraph b of this certification.
- d. That the Bidder and its principals have not within a 3-year period preceding this bid had one or more public transactions (Federal, State, or local) terminated for breach or default of a timber or forest product contract.

Bidders that cannot certify this requirement, in whole or in part, shall submit an explanation with their bid.

DAN EICHINGER  
Director

## TIMBER SALE INFORMATION

Aqua Aspen (71-018-22)

T23N, R01W, SEC. 10; T23N, R01W, SEC. 15; T23N, R01W, SEC. 16; T23N, R01W, SEC. 9.  
Roscommon County (Advertised Price \$69,379.35)

SALE NOTE: A recreation site such as a trail, pathway, or campground is within the sale area or the vicinity. Certain restrictions/specifications may be applicable including time restrictions.

A timber sale contract for this lump sum, sealed bid timber sale will be awarded to the responsible bidder offering the highest sealed bid price. All units of volume listed below were estimated using the Inventory Manager computer program and the new Michigan taper model. Bids must be at or above the following advertised price for each product and species:

<u>PRODUCTS &amp; SPECIES</u>	<u>ESTIMATED UNITS*</u>		<u>ADVERTISED PRICE</u>
Sawtimber			
BI/R/Hybrid Oak	35.6	MBF	\$ 105.00 / MBF
Mixed Aspen	103.1	MBF	\$ 72.00 / MBF
Red Maple	37.1	MBF	\$ 68.00 / MBF
Red Pine	21.3	MBF	\$ 92.00 / MBF
White Oak	24.7	MBF	\$ 52.00 / MBF
White Pine	11.8	MBF	\$ 69.00 / MBF
Pulpwood			
Balsam Fir	122	Cords	\$ 26.00 / Cord
Black Spruce	14	Cords	\$ 17.50 / Cord
Jack Pine	4	Cords	\$ 11.85 / Cord
Mixed Aspen	1,203	Cords	\$ 26.05 / Cord
Mixed Hardwood	741	Cords	\$ 14.40 / Cord
Mixed Oak	227	Cords	\$ 16.20 / Cord
Red Pine	4	Cords	\$ 35.20 / Cord
White Pine	68	Cords	\$ 34.50 / Cord

\* The total volume is statistically estimated within plus (+) or minus (-) 14.74 percent. There are an estimated 2,981 cords on this timber sale, plus or minus 440 cords at the 95% confidence level. The estimated units are final and not subject to adjustment. Prospective bidders are urged to examine this timber and to make their own estimates of quantity and quality.

### **BOND AND PAYMENT SCHEDULE:**

1. A bond in the amount of \$3,469.00 to insure faithful performance of the conditions of the contract will be deposited by the successful bidder within 21 days of the sale award.
2. Cutting in any sale or unit without the required advance payment would be considered a trespass.
3. Total payment must be paid in advance or according to the following schedule :
  - (a) Ten percent (10%) of the sale value must be paid within 21 days of the sale award.
  - (b) The 10% down payment will be credited towards the first unit cut.
  - (c) Payment for each of the following units must be made before cutting begins in that unit:
 

PAYMENT UNIT NUMBER	PERCENT OF TOTAL SALE VALUE
01	47.5%
02	24.2%
03	28.3%
4. If no cutting takes place, the 10% down payment will not be refunded.
5. Operations on the contract issued will terminate on 12/31/2024.

### **SALE STATISTICS**

Volumes were calculated in cubic feet using the Michigan taper model. Cubic foot volume includes all wood inside bark for the product indicated. For display purposes, cubic feet were converted to cords and MBF using a simple conversion factor, e.g. 79 cubic feet per cord and 185 cubic feet per MBF. The cubic foot volumes are precise; the cords and MBF volumes are not. Cubic foot volume cannot be directly converted to cords or boards with precision.

## SALE VOLUMES

The total estimated sale volume may not equal the sum of the species/products due to the nature of statistical calculations associated with double sampling methodology.

VOLUME			STATISTICAL RANGE IN CORDS	
TOTAL CUBIC FEET	TOTAL CORDS	PERCENT ERROR	MINIMUM	MAXIMUM
235,500	2,981	14.74%	2,541	3,421

## VDU VOLUMES

A VDU is a Volume Determination Unit. Volumes and their associated statistics are calculated at the VDU level and summarized to the sale level. There is often a one to one relationship between a VDU and a Payment Unit, but not always, depending on the cruise design. Refer to the VDU TO PAYMENT UNIT table.

	VOLUME			RANGE IN CORDS	
VDU	TOTAL CUBIC FEET	TOTAL CORDS	PERCENT ERROR	MINIMUM	MAXIMUM
121	124,447	1,575	20.43%	1,253	1,897
125	111,053	1,406	22.38%	1,091	1,720
<b>TOTAL:</b>	<b>235,500</b>	<b>2,981</b>		<b>2,345</b>	<b>3,617</b>

## VDU TO PAYMENT UNIT

When a VDU is associated with more than one Payment Unit (PU), the VDU volumes are assigned to the PU based on acres of the VDU within the PU.

VDU	VDU ACRES	PU	PU ACRES
121	49.3	1	0.2
		2	22.6
		3	26.5
125	37.2	1	37.2
<b>TOTAL:</b>	<b>86.5</b>		<b>86.5</b>

**DESCRIPTION OF TIMBER BY PAYMENT UNIT (PU)**

PU	MARKET GROUP	PRODUCT	QUANTITY	UNIT	ACRES	ADVERTISE PRICE	
1	BI/R/Hybrid Oak	Sawtimber	9.5	MBF	37.4	\$32,948.20	
	Mixed Aspen		69.2	MBF			
	<i>B. T. Aspen</i>		51.9	<i>MBF</i>			
	<i>Quaking Aspen</i>		17.3	<i>MBF</i>			
	Red Maple		37.1	MBF			
	Red Pine		5.7	MBF			
	White Oak		0.1	MBF			
	White Pine		3.7	MBF			
	Balsam Fir		Pulpwood	122			Cords
	Mixed Aspen			554			Cords
	<i>B. T. Aspen</i>	184		<i>Cords</i>			
	<i>Quaking Aspen</i>	370		<i>Cords</i>			
	Mixed Hardwood	352		Cords			
	<i>Red Maple</i>	352		<i>Cords</i>			
	Mixed Oak	46		Cords			
	<i>BI/R/Hybrid Oak</i>	46	<i>Cords</i>				
	Red Pine	2	Cords				
White Pine	5	Cords					
2	BI/R/Hybrid Oak	Sawtimber	12.0	MBF	22.6	\$16,764.05	
	Mixed Aspen		15.6	MBF			
	<i>B. T. Aspen</i>		11.8	<i>MBF</i>			
	<i>Quaking Aspen</i>		3.8	<i>MBF</i>			
	Red Pine		7.2	MBF			
	White Oak		11.3	MBF			
	White Pine		3.7	MBF			
	Black Spruce		Pulpwood	6			Cords
	Jack Pine			2			Cords
	Mixed Aspen			299			Cords
	<i>B. T. Aspen</i>	39		<i>Cords</i>			
	<i>Quaking Aspen</i>	260		<i>Cords</i>			
	Mixed Hardwood	179		Cords			
	<i>Beech</i>	5		<i>Cords</i>			
	<i>Red Maple</i>	174	<i>Cords</i>				
	Mixed Oak	83	Cords				
	<i>BI/R/Hybrid Oak</i>	71	<i>Cords</i>				
<i>White Oak</i>	12	<i>Cords</i>					
Red Pine	1	Cords					
White Pine	29	Cords					
3	BI/R/Hybrid Oak	Sawtimber	14.1	MBF	26.5	\$19,667.10	
	Mixed Aspen		18.3	MBF			
	<i>B. T. Aspen</i>		13.9	<i>MBF</i>			
	<i>Quaking Aspen</i>		4.4	<i>MBF</i>			
	Red Pine		8.4	MBF			
	White Oak		13.3	MBF			
	White Pine		4.4	MBF			
	Black Spruce		Pulpwood	8			Cords
	Jack Pine			2			Cords
	Mixed Aspen			350			Cords
	<i>B. T. Aspen</i>	45		<i>Cords</i>			
	<i>Quaking Aspen</i>	305		<i>Cords</i>			
	Mixed Hardwood	210		Cords			
	<i>Beech</i>	6		<i>Cords</i>			
	<i>Red Maple</i>	204	<i>Cords</i>				
	Mixed Oak	98	Cords				
	<i>BI/R/Hybrid Oak</i>	83	<i>Cords</i>				
<i>White Oak</i>	15	<i>Cords</i>					

**DESCRIPTION OF TIMBER BY PAYMENT UNIT (PU), CON'T**

PU	MARKET GROUP	PRODUCT	QUANTITY	UNIT	ACRES	ADVERTISE PRICE
3 con't	Red Pine	Pulpwood	1	Cords		
	White Pine		34	Cords		
TOTAL:			233.6	MBF		
TOTAL:			2,383	Cords		



# Sale Specific Conditions & Requirements

**Sale Name: Aqua Aspen**

**Sale Number: 71-018-22 Seq#: 1**

## 1 - Sale Area

### 1.2 - Boundaries

#### 1.2.1 - Painted boundaries (9/19)

The sale boundary and Payment Unit boundaries are marked and identified by red and yellow paint. Exterior sale boundary lines against state are marked with red paint. Interior Payment Unit boundaries are marked with yellow paint. Retention patches are marked with red paint; no harvesting activities may occur within these areas. The painted boundary line trees are not Included Timber and are to be protected. Yellow painted trees designating an interior Payment Unit boundary are only to be cut when all surrounding Payment Units have been paid.

## 2 - Timber Specifications

### 2.1 - Included Timber

#### 2.1.1 - Clearcut unit(s) with unmerchantable trees (6/14)

Within Payment Unit(s) 1-3, cut all trees that are one (1) inch or more at DBH, except trees marked with green paint above and below stump height.

### 2.2 - Utilization

#### 2.2.3 - Stump heights (4/07)

Stump heights within the Sale Area shall not exceed 12 inches for trees greater than 10 inches DBH and 4 inches for trees smaller than 10 inches DBH.

## 3 - Payments

### 3.3 - Pre-measured Sales

#### 3.3.4 - Dividing payment units (7/14)

Payment Unit(s) may be divided at the request of the Purchaser and upon approval of the Unit Manager. Dividing Payment Units is a contract modification which requires a Timber Sale Contract Amendment.

### 3.4 - Damaged Timber

#### 3.4.1 - Damaged timber (7/16)

General Condition and Requirement 3.4 Damaged Timber, defines liquidated damages for undesignated live merchantable trees which are cut or injured. In addition, within all Payment Units, if chipping occurs in a Payment Unit, chipping must be completed before the sprouting of new regeneration. If more than 33% of the newly sprouted tree seedlings within a specified portion of the Sale Area are damaged, liquidated damages will be assessed at \$300 per acre for all acreage within that specified portion of the Sale Area that was damaged.

## 4 - Transportation

### 4.1 - Construction

#### 4.1.6 - Road construction (1/09)

Construction of new roads or improvements of existing roads shall be done in such a way as to minimize the environmental and visual impacts. Merchantable trees shall be cut and utilized unless otherwise directed. Non-merchantable trees shall be severed and laid flat on the ground. Slash shall be scattered, and not left in windrows and kept a minimum of 10 feet back from the road edge. Stumps shall be set upright, not left on edge, and be moved at least 10 feet away from the road edge. Disturbed soil shall be feathered into the woods and not left in berms or windrows.

#### 4.1.7 - Road closure (10/11)

All new roads built into the sale must be blocked to vehicle traffic upon completion of the sale. Overgrown roads that are reopened shall be considered new roads. In general, this will require constructing a four (4') foot high berm of stumps and logs covered with earth. These roads must be rendered impassable to cars and trucks. Contact the sale administrator for

specific details of design and placement.

## 4.2 - Maintenance

### 4.2.3 - Road maintenance (8/13)

The following road maintenance may be needed: Within 60 days of completion of hauling, or if no hauling occurs for 60 days, the road must be maintained and graded to the condition prior to usage. This includes cleaning of drainage areas, grading, crowning and filling with gravel, if necessary. Damages will be assessed if grading/repair does not occur.

### 4.2.5 - Two wheel drive condition (2/04)

All existing trail roads on and adjacent to the sale area must be passable by two-wheel drive traffic for the duration of the sale.

## 5 - Operations

### 5.1 - Notification

#### 5.1.1 - Pre-sale conference (10/16)

A pre-sale conference between the Purchaser and sale administrator is required prior to beginning any operations to determine landing and road locations. The Unit Manager or his/her representative must be contacted in advance to schedule the conference.

#### 5.1.4 - Post-sale conference (10/16)

A post-sale conference on site between the Purchaser and sale administrator is required prior to the completion of active logging operations to determine clean-up and repair of landings, road edges, and the fulfillment of other contract specifications.

### 5.2 - Conduct of Operations

#### 5.2.1 - Slash

##### 5.2.1.8 - Slash height (12/08)

No slash or tree tops may exceed 24 inches in height. If not chipped, slash and tops must be scattered evenly throughout the sale area and may not be left in distinct windrows or piles from harvesting operations.

#### 5.2.3 - Operating Restrictions

##### 5.2.3.5 - Oak wilt restriction (1/18)

Within the sale area, unless changed by written agreement, cutting, skidding, hauling within the sale and brushing of access roads to the sale are not permitted during the period of April 15 to July 15. Operations may be allowed if specific steps are taken to prevent damaging uncut oak during the high risk period. Those steps may include completing all road brushing before April 15th and clearing a tree-length buffer along uncut oak cover before April 15th. This is necessary to reduce the spread of oak wilt. For more information, contact the Unit Manager or his/her representative.

##### 5.2.3.11 - Coppice regeneration protection (4/10)

Timber harvesting in any Payment Unit must be completed before significant aspen sprouting occurs in that Payment Unit so as to minimize damage to the new regeneration. Any post harvest operations, such as chipping, must be completed before sprouting of regeneration occurs. Should damages occur to the new regeneration, the damages will be assessed per Specification 3.4.1 - Damaged Timber. If it is anticipated that chipping will be delayed, then tops shall be carried to one central location, preferably the landing. A third-party entity may be brought in to chip the tops/slash, before new sprouting occurs, should the contract holder fail to present in a timely manner arrangements approved by the Unit Manager for protecting the new regeneration. The Unit Manager or his/her representative may also cease such operations if sprouting occurs before the operation is complete and the Payment Unit(s) will be counted as incomplete with liquidated damages assessed accordingly.

#### 5.2.4 - Dead and Down Creation

##### 5.2.4.4 - Dead and down creation, grouse (6/18)

To encourage grouse and other wildlife, in Payment Unit(s) 1, 2, and 3, leave one 9" diameter or larger log-length (8 foot minimum) piece on the ground for every 4 acres. These trees will be evenly scattered throughout the unit, preferably at least two chains from any roads, two-tracks, or trails open to vehicles. This can be an unmerchantable piece or a full tree.

#### 5.2.17 - Timber Mats and Interlocking Composite Mats (10/20)

Some skid trails may require extra protection such as that afforded by timber mats or another approved system. If available, mats may be borrowed from the DNR. A Timber Sale Contract Supplement will be used to document the Purchaser's use of the DNR's mats. Contact the sale administrator regarding availability and pick-up. The Purchaser is responsible for picking up and hauling the mats to and from the site. All mats must be cleaned prior to drop off. This may include, but is not limited to, power washing and brushing to remove mud and debris. A charge of \$700.00 per timber mat may be assessed for all damaged or non-returned mats. Damage for the crane/timber mats is defined as three or more broken cants. Damage for the composite mats is defined as cracked or broken mats.

#### 5.2.32 - Decking/landing restoration (9/13)

All decking and landing areas must have the surface area restored to a condition equal to or better than before. This is to ensure the proper regeneration of the stand. Wood debris, chips and "cookies" from trimmings must be removed or scattered away from landing and loading areas and may not be windrowed on the edge.

#### 5.2.39 - ORV trail/route protection (4/18)

There is an ORV trail that is shown on the Timber Sale Map. Trees with yellow ORV markers shall be cut off above the markers and at least 5 feet above ground. Do not run equipment down the ORV trail or route. Skidding across the trail or route may only occur in locations approved by the sale administrator.

## 6 - Safety and Fire Prevention

### 6.2 - Signing

#### 6.2.1 - Road posting (10/20)

The Purchaser is responsible for posting and maintaining caution signs on F-97 prior to beginning operations. The road must be posted at appropriate distances from the sale area to warn of logging activity and truck traffic. Signs must be removed when harvest operations are suspended or completed. The Purchaser will provide these signs.

#### 6.2.3 - Recreational trail posting (10/20)

The Purchaser is responsible for posting and maintaining caution signs on the ORV trail prior to beginning operations. The trail must be posted to warn of logging activity and truck traffic at both ends of the trail. Signs must be removed when harvest operations are suspended or completed.



# TIMBER SALE MAP

This information provided by authority of Part 525, 1994 PA 451, as amended.

Sale Number	Year
71 - 018	22

Forest Management Unit Roscommon	County Roscommon	Mapped By Martell	Date 8/25/22	Page 1	of 1
Township 23N	Range 01W	Section(s) and Subdivision(s) Sec. 10 - NESW, S1/2SW, NWSE, S1/2SE; Sec. 15 - N1/2NW, N1/2NE; Sec. 9 - SESE; Sec. 16 - NENE	Scale 1:15,840		

Cover Type				Density	
A = Aspen	H = Hemlock	N = Marsh	U = Upland Brush	0 = Non Stocked	5 = Pole Timber Medium
B = Paper Birch	J = Jack Pine	O = Oak	UM = Upland Mixed	1 = Seedling Sapling Poor	6 = Pole Timber Well
C = Cedar	L = Lowland Mixed	P = Lowland Poplar	V = Bog or Marsh	2 = Seedling Sapling Medium	7 = Saw Timber Poor
D = Treed Bog	LM = Lowland Mixed	Q = Mixed Swamp Conifer	W = White Pine	3 = Seedling Sapling Well	8 = Saw Timber Medium
E = Swamp Hdwoods	M = Mpl, Bch, Brch	R = Red Pine	X = Non Stocked	4 = Pole Timber Poor	9 = Saw Timber Well
F = Spruce Fir	MC = Mixed Conifer	S = Black Spruce	Z = Water		
G = Grass	MD = Mixed Deciduous	T = Tamarack			

PU	Acres
1	37.4
2	22.6
3	26.5

## Aqua Aspen Compartment 59 86.5 Acres

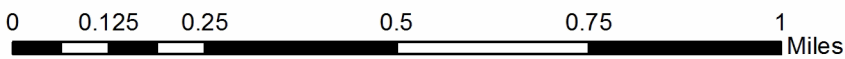
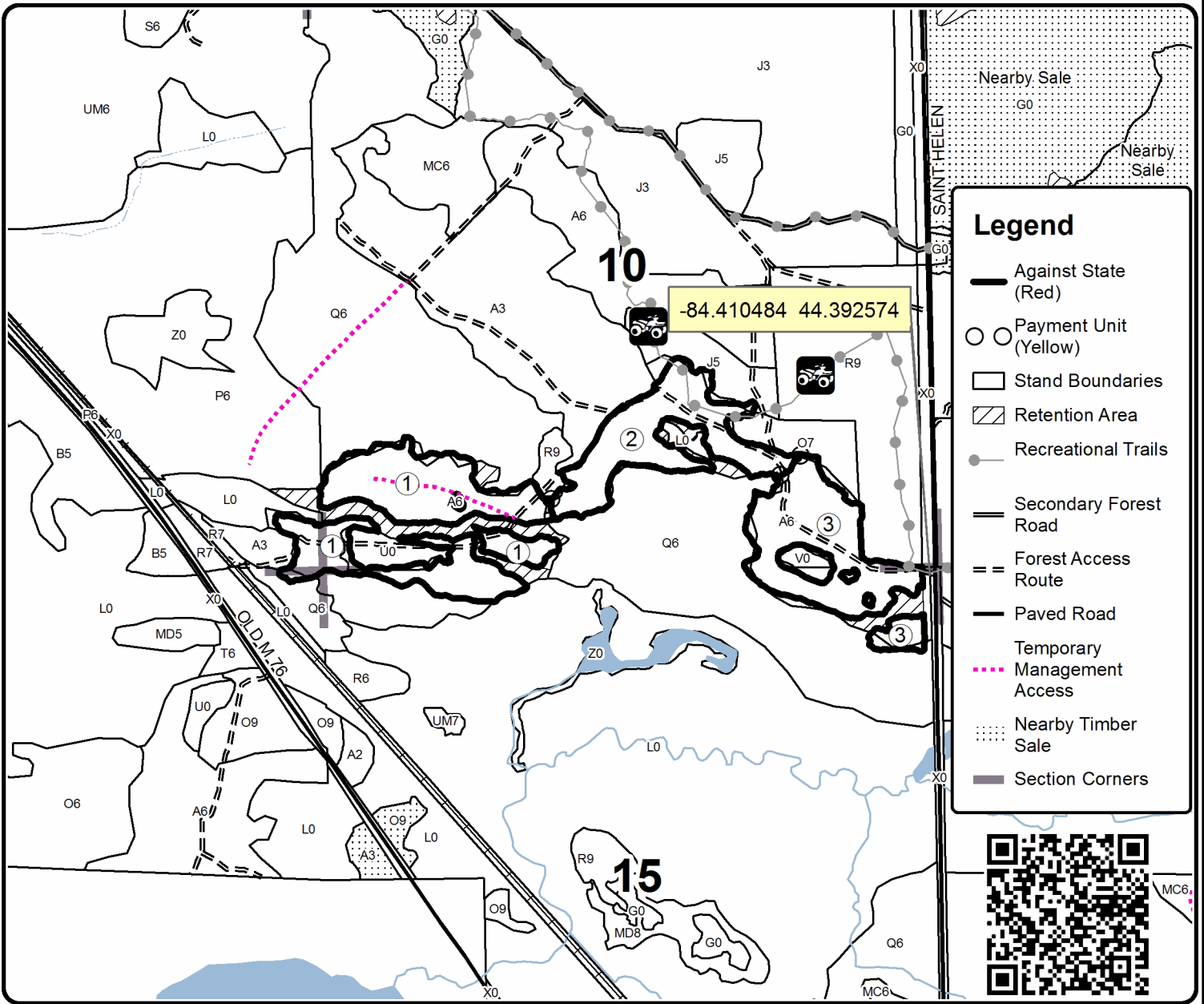
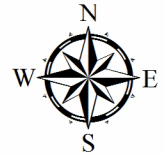

## TIMBER SALE INFORMATION

### Lost and Found Aspen Hardwoods (71-020-22)

T24N, R02E, SEC. 1; T24N, R02E, SEC. 8.

Ogemaw County (Advertised Price \$46,801.45)

SALE NOTE: A recreation site such as a trail, pathway, or campground is within the sale area or the vicinity. Certain restrictions/specifications may be applicable including time restrictions.

A timber sale contract for this lump sum, sealed bid timber sale will be awarded to the responsible bidder offering the highest sealed bid price. All units of volume listed below were estimated using the Inventory Manager computer program and the new Michigan taper model. Bids must be at or above the following advertised price for each product and species:

<u>PRODUCTS &amp; SPECIES</u>	<u>ESTIMATED UNITS*</u>	<u>ADVERTISED PRICE</u>
<b>Sawtimber</b>		
B. T. Aspen	117.3 MBF	\$ 72.00 / MBF
Bl/R/Hybrid Oak	38.9 MBF	\$ 105.00 / MBF
Quaking Aspen	49.6 MBF	\$ 72.00 / MBF
Red Maple	13.8 MBF	\$ 68.00 / MBF
Red Oak	41.7 MBF	\$ 99.00 / MBF
Red Pine	49.2 MBF	\$ 92.00 / MBF
Sugar Maple	14.5 MBF	\$ 237.00 / MBF
White Oak	7.2 MBF	\$ 52.00 / MBF
White Pine	24.9 MBF	\$ 59.00 / MBF
<b>Pulpwood</b>		
Balsam Fir	5 Cords	\$ 26.00 / Cord
Jack Pine	19 Cords	\$ 11.85 / Cord
Mixed Aspen	188 Cords	\$ 26.05 / Cord
Mixed Hardwood	356 Cords	\$ 14.40 / Cord
Mixed Oak	122 Cords	\$ 16.20 / Cord
Red Pine	31 Cords	\$ 35.20 / Cord
White Pine	69 Cords	\$ 34.50 / Cord

\* The total volume is statistically estimated within plus (+) or minus (-) 20.60 percent. There are an estimated 1,550 cords on this timber sale, plus or minus 319 cords at the 95% confidence level. The estimated units are final and not subject to adjustment. Prospective bidders are urged to examine this timber and to make their own estimates of quantity and quality.

### **BOND AND PAYMENT SCHEDULE:**

1. A bond in the amount of \$2,340.00 to insure faithful performance of the conditions of the contract will be deposited by the successful bidder within 21 days of the sale award.
2. Cutting in any sale or unit without the required advance payment would be considered a trespass.
3. Total payment must be paid in advance or according to the following schedule :
  - (a) Ten percent (10%) of the sale value must be paid within 21 days of the sale award.
  - (b) The 10% down payment will be credited towards the first unit cut.
  - (c) Payment for each of the following units must be made before cutting begins in that unit:
 

PAYMENT UNIT NUMBER	PERCENT OF TOTAL SALE VALUE
01	24.2%
02	47.6%
03	28.2%
4. If no cutting takes place, the 10% down payment will not be refunded.
5. Operations on the contract issued will terminate on 12/31/2024.

### **SALE STATISTICS**

Volumes were calculated in cubic feet using the Michigan taper model. Cubic foot volume includes all wood inside bark for the product indicated. For display purposes, cubic feet were converted to cords and MBF using a simple conversion factor, e.g. 79 cubic feet per cord and 185 cubic feet per MBF. The cubic foot volumes are precise; the cords and MBF volumes are not. Cubic foot volume cannot be directly converted to cords or boards with precision.

## SALE VOLUMES

The total estimated sale volume may not equal the sum of the species/products due to the nature of statistical calculations associated with double sampling methodology.

VOLUME			STATISTICAL RANGE IN CORDS	
TOTAL CUBIC FEET	TOTAL CORDS	PERCENT ERROR	MINIMUM	MAXIMUM
122,419	1,550	20.60%	1,230	1,869

## VDU VOLUMES

A VDU is a Volume Determination Unit. Volumes and their associated statistics are calculated at the VDU level and summarized to the sale level. There is often a one to one relationship between a VDU and a Payment Unit, but not always, depending on the cruise design. Refer to the VDU TO PAYMENT UNIT table.

	VOLUME			RANGE IN CORDS	
VDU	TOTAL CUBIC FEET	TOTAL CORDS	PERCENT ERROR	MINIMUM	MAXIMUM
5	89,099	1,128	27.23%	821	1,435
89	33,321	422	36.38%	268	575
<b>TOTAL:</b>	<b>122,419</b>	<b>1,550</b>		<b>1,089</b>	<b>2,010</b>

## VDU TO PAYMENT UNIT

When a VDU is associated with more than one Payment Unit (PU), the VDU volumes are assigned to the PU based on acres of the VDU within the PU.

VDU	VDU ACRES	PU	PU ACRES
5	33.9	2	21.3
		3	12.6
89	12.5	1	12.5
<b>TOTAL:</b>	<b>46.4</b>		<b>46.4</b>

**DESCRIPTION OF TIMBER BY PAYMENT UNIT (PU)**

PU	MARKET GROUP	PRODUCT	QUANTITY	UNIT	ACRES	ADVERTISE PRICE		
1	B. T. Aspen	Sawtimber	3.4	MBF	12.5	\$11,306.75		
	BI/R/Hybrid Oak		7.7	MBF				
	Quaking Aspen		12.1	MBF				
	Red Maple		2.5	MBF				
	Red Pine		24.7	MBF				
	White Oak		7.2	MBF				
	White Pine		24.9	MBF				
	Balsam Fir		Pulpwood	5			Cords	
	Jack Pine			19			Cords	
	<i>Jack Pine</i>			<i>Sawtimber</i>			6.8	<i>MBF</i>
	<i>Jack Pine</i>			<i>Pulpwood</i>			5	<i>Cords</i>
	Mixed Aspen			26			Cords	
	<i>B. T. Aspen</i>			2			<i>Cords</i>	
	<i>Quaking Aspen</i>		24	<i>Cords</i>				
	Mixed Hardwood	86	Cords					
	<i>Red Maple</i>	86	<i>Cords</i>					
	Mixed Oak	22	Cords					
	<i>BI/R/Hybrid Oak</i>	9	<i>Cords</i>					
	<i>White Oak</i>	13	<i>Cords</i>					
	Red Pine	28	Cords					
White Pine	43	Cords						
2	B. T. Aspen	Sawtimber	71.6	MBF	21.3	\$22,325.00		
	BI/R/Hybrid Oak		19.6	MBF				
	Quaking Aspen		23.6	MBF				
	Red Maple		7.1	MBF				
	Red Oak		26.2	MBF				
	Red Pine		15.4	MBF				
	Sugar Maple		9.1	MBF				
	Mixed Aspen		Pulpwood	102			Cords	
	<i>B. T. Aspen</i>			70			<i>Cords</i>	
	<i>Quaking Aspen</i>			32			<i>Cords</i>	
	Mixed Hardwood			171			Cords	
	<i>Basswood</i>			<i>Sawtimber</i>			2.3	<i>MBF</i>
	<i>Beech</i>			2.9			<i>MBF</i>	
	<i>Paper Birch</i>		5.9	<i>MBF</i>				
	<i>Basswood</i>	<i>Pulpwood</i>	10	<i>Cords</i>				
	<i>Beech</i>	10	<i>Cords</i>					
	<i>Paper Birch</i>	25	<i>Cords</i>					
	<i>Red Maple</i>	63	<i>Cords</i>					
	<i>Sugar Maple</i>	40	<i>Cords</i>					
	Mixed Oak	63	Cords					
<i>BI/R/Hybrid Oak</i>	44	<i>Cords</i>						
<i>Red Oak</i>	19	<i>Cords</i>						
Red Pine	2	Cords						
White Pine	16	Cords						
3	B. T. Aspen	Sawtimber	42.3	MBF	12.6	\$13,184.10		
	BI/R/Hybrid Oak		11.6	MBF				
	Quaking Aspen		13.9	MBF				
	Red Maple		4.2	MBF				
	Red Oak		15.5	MBF				
	Red Pine		9.1	MBF				
	Sugar Maple		5.4	MBF				
	Mixed Aspen		Pulpwood	60			Cords	
	<i>B. T. Aspen</i>			41			<i>Cords</i>	
	<i>Quaking Aspen</i>			19			<i>Cords</i>	
	Mixed Hardwood			100			Cords	

**DESCRIPTION OF TIMBER BY PAYMENT UNIT (PU), CON'T**

PU	MARKET GROUP	PRODUCT	QUANTITY	UNIT	ACRES	ADVERTISE PRICE
3 con't	<i>Basswood</i>	<i>Sawtimber</i>	1.3	<i>MBF</i>		
	<i>Beech</i>		1.7	<i>MBF</i>		
	<i>Paper Birch</i>		3.5	<i>MBF</i>		
	<i>Basswood</i>	<i>Pulpwood</i>	6	<i>Cords</i>		
	<i>Beech</i>		6	<i>Cords</i>		
	<i>Paper Birch</i>		15	<i>Cords</i>		
	<i>Red Maple</i>		37	<i>Cords</i>		
	<i>Sugar Maple</i>		23	<i>Cords</i>		
	Mixed Oak		37	<i>Cords</i>		
	<i>B/I/R/Hybrid Oak</i>		26	<i>Cords</i>		
	<i>Red Oak</i>	11	<i>Cords</i>			
	Red Pine		1	<i>Cords</i>		
	White Pine		10	<i>Cords</i>		
	TOTAL:			357.1	MBF	
TOTAL:			791	Cords		



## Sale Specific Conditions & Requirements

**Sale Name: Lost and Found Aspen Hardwoods**

**Sale Number: 71-020-22 Seq#: 1**

### 1 - Sale Area

#### 1.2 - Boundaries

##### 1.2.1 - Painted boundaries (9/19)

The sale boundary and Payment Unit boundaries are marked and identified by blue, red and yellow paint. Exterior sale boundary lines against private property are marked with blue paint. Exterior sale boundary lines against state are marked with red paint. Interior Payment Unit boundaries are marked with yellow paint. Retention patches are marked with red paint; no harvesting activities may occur within these areas. The painted boundary line trees are not Included Timber and are to be protected. Yellow painted trees designating an interior Payment Unit boundary are only to be cut when all surrounding Payment Units have been paid.

### 2 - Timber Specifications

#### 2.1 - Included Timber

##### 2.1.1 - Clearcut unit(s) with unmerchantable trees (6/14)

Within Payment Unit(s) 1-3, cut all trees that are two (2) inches or more at DBH.

EXCEPTION: In Payment Unit 1, do not cut any green marked trees marked above and below stump height.

#### 2.2 - Utilization

##### 2.2.3 - Stump heights (4/07)

Stump heights within the Sale Area shall not exceed 12 inches for trees greater than 10 inches DBH and 4 inches for trees smaller than 10 inches DBH.

### 3 - Payments

#### 3.3 - Pre-measured Sales

##### 3.3.4 - Dividing payment units (7/14)

Payment Unit(s) may be divided at the request of the Purchaser and upon approval of the Unit Manager. Dividing Payment Units is a contract modification which requires a Timber Sale Contract Amendment.

#### 3.4 - Damaged Timber

##### 3.4.1 - Damaged timber (7/16)

General Condition and Requirement 3.4 Damaged Timber, defines liquidated damages for undesignated live merchantable trees which are cut or injured. In addition, extreme care should be taken to avoid damage to white pine seedlings and saplings.

Within Payment Unit 1, if more than 33% of the tree seedlings or saplings (1/4" to 4.5" DBH) within a specified portion of the sale area are damaged, liquidated damages will be assessed at \$300 per acre for all acreage within that specified portion of the sale area that was damaged.

In addition, within all Payment Units, should chipping occur in a Payment Unit, this must be done before sprouting of new regeneration occurs. If more than 33% of the newly sprouted tree seedlings within a specified portion of the Sale Area are damaged, liquidated damages will be assessed at \$300 per acre for all acreage within that specified portion of the Sale Area that was damaged.

### 4 - Transportation

#### 4.1 - Construction

##### 4.1.6 - Road construction (1/09)

Construction of new roads or improvements of existing roads shall be done in such a way as to minimize the environmental and visual impacts. Merchantable trees shall be cut and utilized unless otherwise directed. Non-merchantable trees shall be

severed and laid flat on the ground. Slash shall be scattered, and not left in windrows and kept a minimum of 10 feet back from the road edge. Stumps shall be set upright, not left on edge, and be moved at least 10 feet away from the road edge. Disturbed soil shall be feathered into the woods and not left in berms or windrows.

#### 4.1.7 - Road closure (10/11)

All new roads built into the sale must be blocked to vehicle traffic upon completion of the sale. Overgrown roads that are reopened shall be considered new roads. In general, this will require constructing a four (4') foot high berm of stumps and logs covered with earth. These roads must be rendered impassable to cars and trucks. Contact the sale administrator for specific details of design and placement.

### 4.2 - Maintenance

#### 4.2.3 - Road maintenance (8/13)

The following road maintenance is required: Within 60 days of completion of hauling, or if no hauling occurs for 60 days, the road must be maintained and graded to the condition prior to usage. This includes cleaning of drainage areas, grading, crowning and filling with gravel, if necessary. Damages will be assessed if grading/repair does not occur.

#### 4.2.5 - Two wheel drive condition (2/04)

All existing trail roads on and adjacent to the sale area must be passable by two-wheel drive traffic for the duration of the sale.

## 5 - Operations

### 5.1 - Notification

#### 5.1.1 - Pre-sale conference (10/16)

A pre-sale conference between the Purchaser and sale administrator is required prior to beginning any operations to determine landing and road locations. The Unit Manager or his/her representative must be contacted in advance to schedule the conference.

#### 5.1.4 - Post-sale conference (10/16)

A post-sale conference on site between the Purchaser and sale administrator is required prior to the completion of active logging operations to determine clean-up and repair of landings, road edges, and the fulfillment of other contract specifications.

### 5.2 - Conduct of Operations

#### 5.2.1 - Slash

##### 5.2.1.8 - Slash height (12/08)

No slash or tree tops may exceed 24 inches in height. If tops and slash are not chipped, they must be spread evenly throughout the Payment Units, and not left in windrows from harvesting/processing operations.

#### 5.2.3 - Operating Restrictions

##### 5.2.3.5 - Oak wilt restriction (1/18)

Within the sale area, unless changed by written agreement, cutting, skidding, hauling within the sale and brushing of access roads to the sale are not permitted during the period of April 15 to July 15. Operations may be allowed if specific steps are taken to prevent damaging uncut oak during the high risk period. Those steps may include completing all road brushing before April 15th and clearing a tree-length buffer along uncut oak cover before April 15th. This is necessary to reduce the spread of oak wilt. For more information, contact the Unit Manager or his/her representative.

##### 5.2.3.11 - Coppice regeneration protection (4/10)

Timber harvesting in any Payment Unit must be completed before significant aspen sprouting occurs in that Payment Unit so as to minimize damage to the new regeneration. Any post harvest operations, such as chipping, must be completed before sprouting of regeneration occurs. Should damages occur to the new regeneration, the damages will be assessed per Specification 3.4.1 - Damaged Timber. If it is anticipated that chipping will be delayed, then tops shall be carried to one central location, preferably the landing. A third-party entity may be brought in to chip the tops/slash, before new sprouting occurs, should the contract holder fail to present in a timely manner arrangements approved by the Unit Manager for protecting the new regeneration. The Unit Manager or his/her representative may also cease such operations if sprouting occurs before the operation is complete and the Payment Unit(s) will be counted as incomplete with liquidated damages assessed accordingly.

## 5.2.4 - Dead and Down Creation

### 5.2.4.2 - Dead and down creation, hare and grouse (1/14)

To improve habitat for snowshoe hare, grouse, and other species, the Purchaser is to leave two 9 inch diameter or larger log size pieces on the ground for every 4 acres in Payment Units 2 and 3. They should be scattered throughout the sale or positioned per the sale administrators instructions. If possible, the logs or trees should be felled so they overlap. Note these pieces should have a minimum length of five feet. They can be of any tree species and can be an un-merchantable piece of wood or a full tree.

### 5.2.32 - Decking/landing restoration (9/13)

All decking and landing areas must have the surface area restored to a condition equal to or better than before. This is to ensure the proper regeneration of the stand. Wood debris, chips and "cookies" from trimmings must be removed or scattered away from landing and loading areas and may not be windrowed on the edge.

### 5.2.41 - Snowmobile trail protection (9/11)

There is a snowmobile trail that is shown on the Timber Sale Map. Do not cut or damage posts with orange trail markers or traffic control signs. If the trail is used, it must be maintained and restored to a condition equal to or better than before the sale. If the trail road is to be used for hauling during the snowmobile season, then a snow covered base must be left on the trail. The snowmobile trail road is not to be used for skidding and/or forwarding of wood to a landing during the snowmobile season.

## 6 - Safety and Fire Prevention

### 6.2 - Signing

#### 6.2.1 - Road posting (10/20)

The Purchaser is responsible for posting and maintaining caution signs on the snowmobile trail, M-33, Gilford Ranch Trail, and Fairview Road prior to beginning operations. The road must be posted at appropriate distances from the sale area to warn of logging activity and truck traffic. Signs must be removed when harvest operations are suspended or completed. The Purchaser will provide these signs.



Sale Number	Year
71 - 020	22

# TIMBER SALE MAP

This information provided by authority of Part 525, 1994 PA 451, as amended.

Forest Management Unit Roscommon	County Ogemaw	Mapped By Martell	Date 9/27/22	Page 1	of 2
Township 24N	Range 02E	Section(s) and Subdivision(s) Sec. 1 - S1/2SE; Sec. 8 - SWNW	Scale 1:7,920		

Cover Type				Density	
A = Aspen	H = Hemlock	N = Marsh	U = Upland Brush	0 = Non Stocked	5 = Pole Timber Medium
B = Paper Birch	J = Jack Pine	O = Oak	UM = Upland Mixed	1 = Seedling Sapling Poor	6 = Pole Timber Well
C = Cedar	L = Lowland Brush	P = Lowland Poplar	V = Bog or Marsh	2 = Seedling Sapling Medium	7 = Saw Timber Poor
D = Treed Bog	LM = Lowland Mixed	Q = Mixed Swamp Conifer	W = White Pine	3 = Seedling Sapling Well	8 = Saw Timber Medium
E = Swamp Hdwoods	M = Mpl, Bch, Brch	R = Red Pine	X = Non Stocked	4 = Pole Timber Poor	9 = Saw Timber Well
F = Spruce Fir	MD = Mixed Deciduous	S = Black Spruce	Z = Water		
G = Grass		T = Tamarack			

PU	Acres
1	12.5
2	21.3
3	12.6

## Lost and Found Aspen Hardwoods

### Compartment 88 46.4 Acres

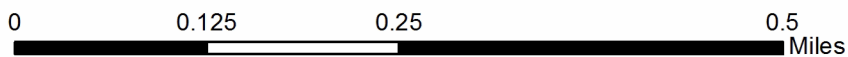
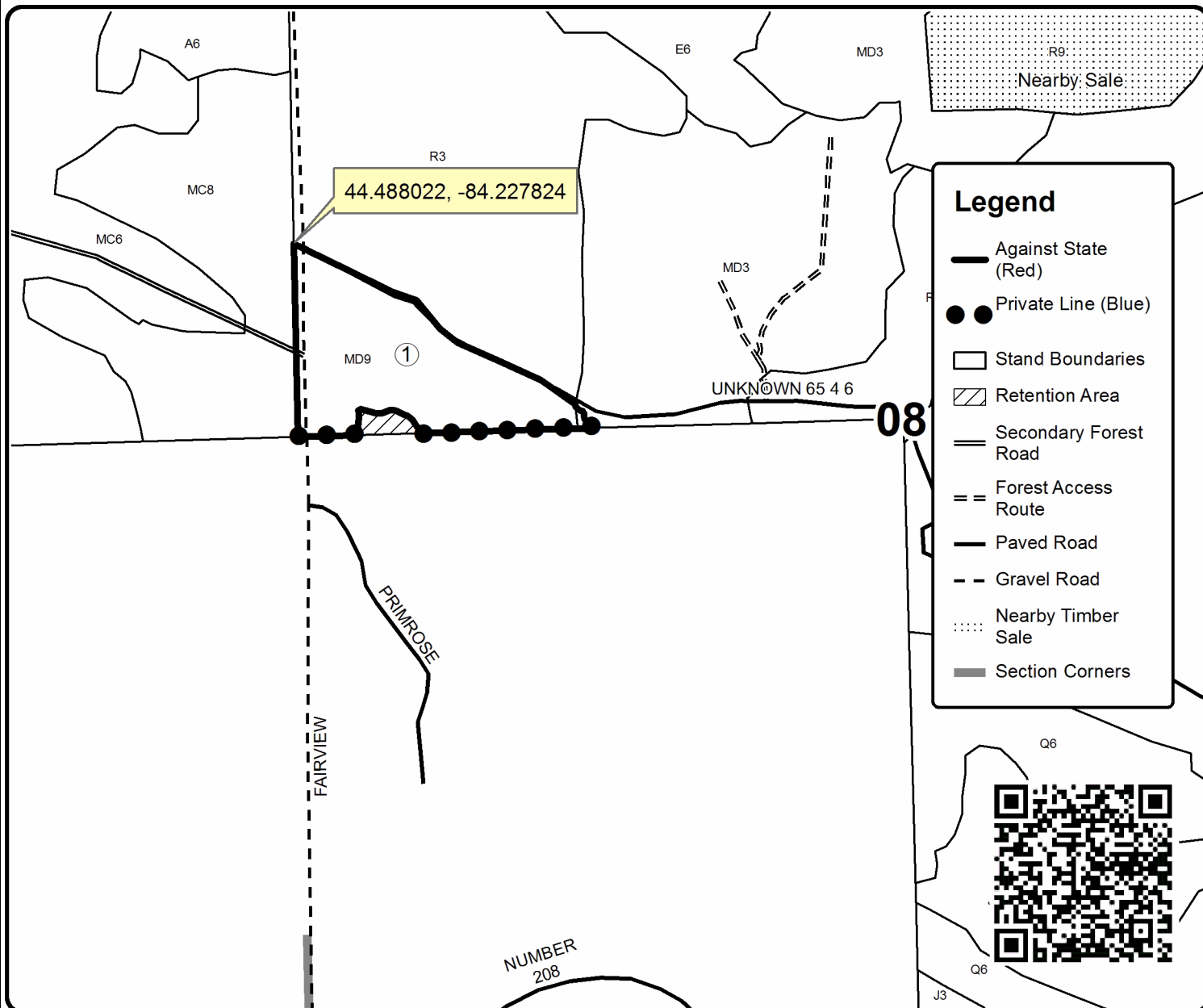
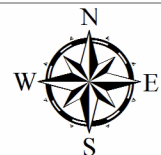



# TIMBER SALE MAP

This information provided by authority of Part 525, 1994 PA 451, as amended.

Sale Number	Year
71 - 020	22

Forest Management Unit	County	Mapped By	Date	Page	of
Roscommon	Ogemaw	Martell	9/27/22	2	2
Township	Range	Section(s) and Subdivision(s)	Scale		
24N	02E	Sec. 1 - S1/2SE; Sec. 8 - SWNW	1:7,920		

Cover Type				Density	
A = Aspen	H = Hemlock	N = Marsh	U = Upland Brush	0 = Non Stocked	5 = Pole Timber Medium
B = Paper Birch	J = Jack Pine	O = Oak	UM = Upland Mixed	1 = Seedling Sapling Poor	6 = Pole Timber Well
C = Cedar	L = Lowland Brush	P = Lowland Poplar	V = Bog or Marsh	2 = Seedling Sapling Medium	7 = Saw Timber Poor
D = Treed Bog	LM = Lowland Mixed	Q = Mixed Swamp Conifer	W = White Pine	3 = Seedling Sapling Well	8 = Saw Timber Medium
E = Swamp Hdwoods	M = Mpl, Bch, Brch	R = Red Pine	X = Non Stocked	4 = Pole Timber Poor	9 = Saw Timber Well
F = Spruce Fir	MC = Mixed Conifer	S = Black Spruce	Z = Water		
G = Grass	MD = Mixed Deciduous	T = Tamarack			

PU	Acres
1	12.5
2	21.3
3	12.6

## Lost and Found Aspen Hardwoods

### Compartment 88

### 46.4 Acres

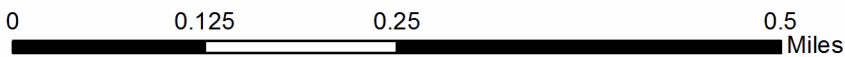
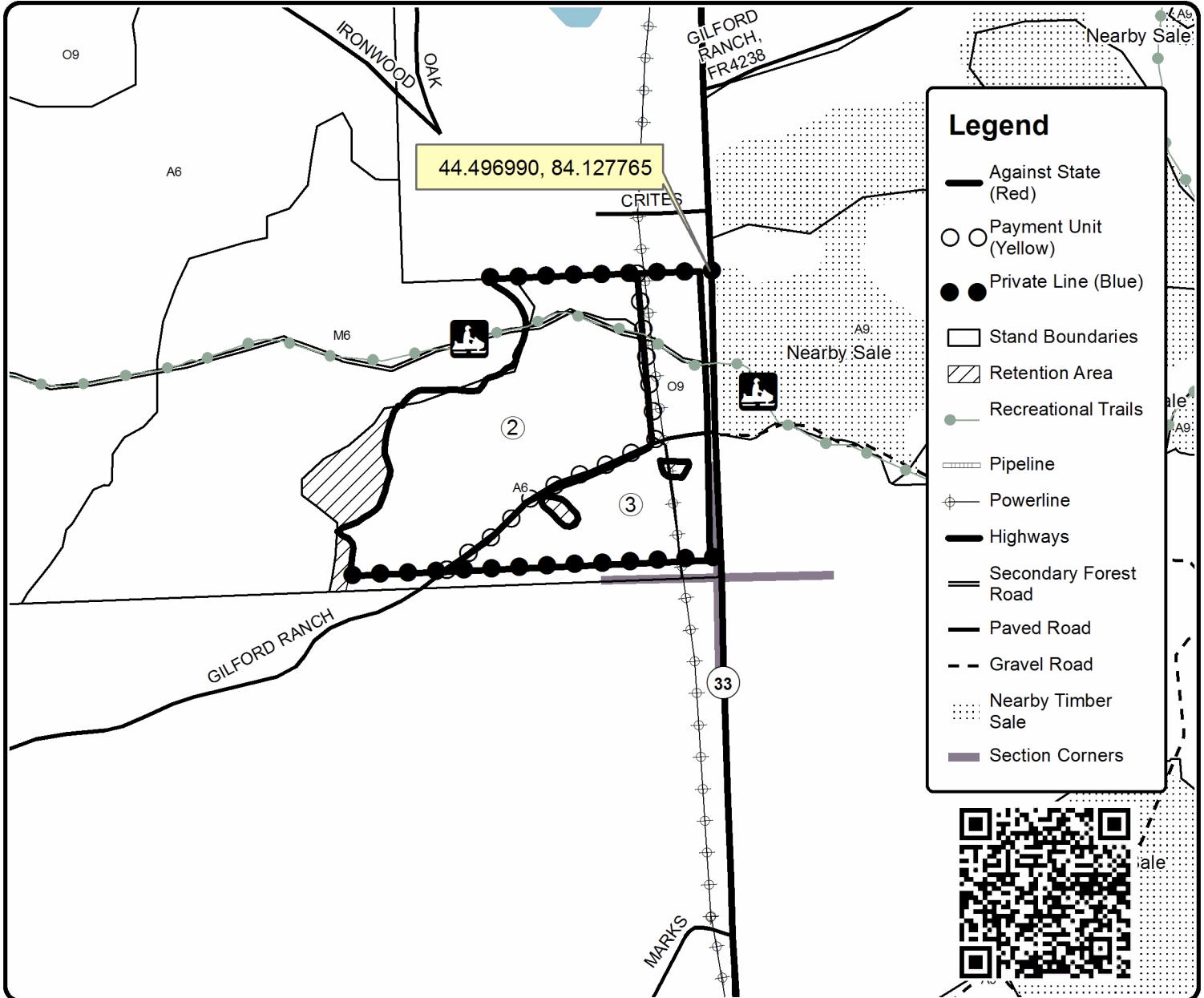



## TIMBER SALE INFORMATION

McGregor School Red Pine (71-021-22)  
 T24N, R02E, SEC. 10; T24N, R02E, SEC. 8; T24N, R02E, SEC. 9.  
 Ogemaw County (Advertised Price \$61,872.95)

A timber sale contract for this lump sum, sealed bid timber sale will be awarded to the responsible bidder offering the highest sealed bid price. All units of volume listed below were estimated using the Inventory Manager computer program and the new Michigan taper model. Bids must be at or above the following advertised price for each product and species:

<u>PRODUCTS &amp; SPECIES</u>	<u>ESTIMATED UNITS*</u>	<u>ADVERTISED PRICE</u>
Sawtimber		
Quaking Aspen	12.3 MBF	\$ 72.00 / MBF
Red Pine	357.0 MBF	\$ 92.00 / MBF
Pulpwood		
Jack Pine	8 Cords	\$ 11.85 / Cord
Mixed Oak	32 Cords	\$ 16.20 / Cord
Quaking Aspen	33 Cords	\$ 26.05 / Cord
Red Maple	7 Cords	\$ 14.40 / Cord
Red Pine	746 Cords	\$ 35.20 / Cord
White Pine	9 Cords	\$ 34.50 / Cord

\* The total volume is statistically estimated within plus (+) or minus (-) 26.92 percent. There are an estimated 1,641 cords on this timber sale, plus or minus 442 cords at the 95% confidence level. The estimated units are final and not subject to adjustment. Prospective bidders are urged to examine this timber and to make their own estimates of quantity and quality.

### **BOND AND PAYMENT SCHEDULE:**

1. A bond in the amount of \$3,094.00 to insure faithful performance of the conditions of the contract will be deposited by the successful bidder within 21 days of the sale award.
2. Cutting in any sale or unit without the required advance payment would be considered a trespass.
3. Total payment must be paid in advance or according to the following schedule :
  - (a) Ten percent (10%) of the sale value must be paid within 21 days of the sale award.
  - (b) The 10% down payment will be credited towards the first unit cut.
  - (c) Payment for each of the following units must be made before cutting begins in that unit:
 

PAYMENT UNIT NUMBER	PERCENT OF TOTAL SALE VALUE
01	22.1%
02	7.0%
03	70.9%
4. If no cutting takes place, the 10% down payment will not be refunded.
5. Operations on the contract issued will terminate on 12/31/2024.

### **SALE STATISTICS**

Volumes were calculated in cubic feet using the Michigan taper model. Cubic foot volume includes all wood inside bark for the product indicated. For display purposes, cubic feet were converted to cords and MBF using a simple conversion factor, e.g. 79 cubic feet per cord and 185 cubic feet per MBF. The cubic foot volumes are precise; the cords and MBF volumes are not. Cubic foot volume cannot be directly converted to cords or boards with precision.

### **SALE VOLUMES**

The total estimated sale volume may not equal the sum of the species/products due to the nature of statistical calculations associated with double sampling methodology.

VOLUME		STATISTICAL RANGE IN CORDS		
TOTAL CUBIC FEET	TOTAL CORDS	PERCENT ERROR	MINIMUM	MAXIMUM
129,639	1,641	26.92%	1,199	2,083

## VDU VOLUMES

A VDU is a Volume Determination Unit. Volumes and their associated statistics are calculated at the VDU level and summarized to the sale level. There is often a one to one relationship between a VDU and a Payment Unit, but not always, depending on the cruise design. Refer to the VDU TO PAYMENT UNIT table.

VDU	VOLUME		PERCENT ERROR	RANGE IN CORDS	
	TOTAL CUBIC FEET	TOTAL CORDS		MINIMUM	MAXIMUM
27	5,388	68	83.46%	11	125
28	84,410	1,068	32.93%	717	1,420
69	9,017	114	103.84%	4	233
77	30,824	390	31.47%	267	513
<b>TOTAL:</b>	<b>129,639</b>	<b>1,641</b>		<b>991</b>	<b>2,291</b>

## VDU TO PAYMENT UNIT

When a VDU is associated with more than one Payment Unit (PU), the VDU volumes are assigned to the PU based on acres of the VDU within the PU.

VDU	VDU ACRES	PU	PU ACRES
27	2.4	3	2.4
28	26.9	3	26.9
69	7.1	2	7.1
77	30.4	1	30.4
<b>TOTAL:</b>	<b>66.8</b>		<b>66.8</b>

## DESCRIPTION OF TIMBER BY PAYMENT UNIT (PU)

PU	MARKET GROUP	PRODUCT	QUANTITY	UNIT	ACRES	ADVERTISE PRICE
1	Red Pine	Sawtimber	40.4	MBF	30.4	\$13,687.70
	Mixed Oak	Pulpwood	14	Cords		
	White Oak	Sawtimber	2.1	MBF		
	BI/R/Hybrid Oak	Pulpwood	7	Cords		
	White Oak		3	Cords		
	Red Pine		268	Cords		
	White Pine		9	Cords		
2	Red Pine	Sawtimber	33.3	MBF	7.1	\$4,330.80
	Red Pine	Pulpwood	36	Cords		
3	Quaking Aspen	Sawtimber	12.3	MBF	29.3	\$43,854.45
	Red Pine		283.3	MBF		
	Jack Pine	Pulpwood	8	Cords		
	Jack Pine	Sawtimber	1.5	MBF		
	Jack Pine	Pulpwood	5	Cords		
	Mixed Oak		18	Cords		
	BI/R/Hybrid Oak		18	Cords		
	Quaking Aspen		33	Cords		
	Red Maple		7	Cords		
	Red Pine		442	Cords		
	TOTAL:			369.3		
TOTAL:			835	Cords		



## Sale Specific Conditions & Requirements

**Sale Name: McGregor School Red Pine**

**Sale Number: 71-021-22 Seq#: 1**

### 1 - Sale Area

#### 1.2 - Boundaries

##### 1.2.1 - Painted boundaries (9/19)

The sale boundary and Payment Unit boundaries are marked and identified by blue and red paint. Exterior sale boundary lines against private property are marked with blue paint. Exterior sale boundary lines against state are marked with red paint. The painted boundary line trees are not Included Timber and are to be protected unless marked with orange.

### 2 - Timber Specifications

#### 2.1 - Included Timber

##### 2.1.1 - Clearcut unit(s) with unmerchantable trees (6/14)

Within Payment Unit(s) 3, cut all trees that are 1 inch or more at DBH.

##### 2.1.3 - Cut tree marked unit(s) (12/08)

Within Payment Unit(s) 1 and 2, all trees are designated for cutting when marked with orange paint above and below stump height, regardless of merchantability. Additionally, cut all jack pine in Payment Unit 2.

#### 2.2 - Utilization

##### 2.2.2 - Chipping required (2/18)

Payment Unit 3 must be chip harvested to facilitate future silvicultural activities. The Purchaser has the option to produce sawlogs or pulpwood bolts, but the remaining portion of the trees must be chipped and hauled. Products may be produced as roundwood and forwarded to decking areas in final product length, but the tops must be left intact and skidded to the landing for chipping in order to minimize the amount of residual slash. If market conditions limit the practicality of chipping, it is possible, but not guaranteed, that a chipping exemption could be obtained if proposed operations are determined to be suitable for planting by reforestation staff. This exemption must be granted in writing. If the sale deadline is not met, damages will be collected determined by the cost to complete this work. The requirement to retain approximately 1/6 to 1/3 of tree tops and limbs less than four inches in diameter is still applicable (G. C. & R. 2.2).

##### 2.2.3 - Stump heights (4/07)

Stump heights within the Sale Area shall not exceed 6 inches for all trees.

##### 2.2.6 - Roundwood operation required (3/21)

The skidding of whole trees or tree segments with limbs attached is prohibited within Payment Unit(s) 1 and 2. All products must be produced as roundwood and forwarded to existing roads or landing areas in final product length.

##### 2.2.9 - No chipping permitted (12/08)

Within Payment Unit(s) 1 and 2, no chipping is permitted.

### 3 - Payments

#### 3.3 - Pre-measured Sales

##### 3.3.4 - Dividing payment units (7/14)

Payment Unit(s) may be divided at the request of the Purchaser and upon approval of the Unit Manager. Dividing Payment Units is a contract modification which requires a Timber Sale Contract Amendment.

#### 3.4 - Damaged Timber

##### 3.4.1 - Damaged timber (7/16)

General Condition and Requirement 3.4 Damaged Timber, defines liquidated damages for undesigned live merchantable trees which are cut or injured. No damage is acceptable to undesigned live merchantable trees. Within the sale area, if more than 5% of trees (> 4.5" DBH) within a specified area of the sale are damaged, liquidated damages will be assessed for all trees damaged. Rates will be in accordance with General Condition and Requirement 3.4 Damaged Timber.

## 4 - Transportation

### 4.1 - Construction

#### 4.1.6 - Road construction (1/09)

Construction of new roads or improvements of existing roads shall be done in such a way as to minimize the environmental and visual impacts. Merchantable trees shall be cut and utilized unless otherwise directed. Non-merchantable trees shall be severed and laid flat on the ground. Slash shall be scattered, and not left in windrows and kept a minimum of 10 feet back from the road edge. Stumps shall be set upright, not left on edge, and be moved at least 10 feet away from the road edge. Disturbed soil shall be feathered into the woods and not left in berms or windrows.

#### 4.1.7 - Road closure (10/11)

All new roads built into the sale must be blocked to vehicle traffic upon completion of the sale. Overgrown roads that are reopened shall be considered new roads. In general, this will require constructing a four (4') foot high berm of stumps and logs covered with earth. These roads must be rendered impassable to cars and trucks. Contact the sale administrator for specific details of design and placement.

### 4.2 - Maintenance

#### 4.2.3 - Road maintenance (8/13)

The following road maintenance may be needed: Within 60 days of completion of hauling, or if no hauling occurs for 60 days, the road must be maintained and graded to the condition prior to usage. This includes cleaning of drainage areas, grading, crowning and filling with gravel, if necessary. Damages will be assessed if grading/repair does not occur.

#### 4.2.5 - Two wheel drive condition (2/04)

All existing trail roads on and adjacent to the sale area must be passable by two-wheel drive traffic for the duration of the sale.

## 5 - Operations

### 5.1 - Notification

#### 5.1.1 - Pre-sale conference (10/16)

A pre-sale conference between the Purchaser and sale administrator is required prior to beginning any operations to determine landing and road locations. The Unit Manager or his/her representative must be contacted in advance to schedule the conference.

#### 5.1.4 - Post-sale conference (10/16)

A post-sale conference on site between the Purchaser and sale administrator is required prior to the completion of active logging operations to determine clean-up and repair of landings, road edges, and the fulfillment of other contract specifications.

### 5.2 - Conduct of Operations

#### 5.2.1 - Slash

##### 5.2.1.8 - Slash height (12/08)

No slash or tree tops may exceed 24 inches in height.

#### 5.2.3 - Operating Restrictions

##### 5.2.3.3 - Bark slippage restriction (3/09)

Within Payment Unit(s) 1 and 2, unless changed by written agreement, cutting and skidding are not permitted during the period of April 15 to July 15. This restriction is because of bark slippage.

##### 5.2.3.6 - Bark beetle restriction (12/08)

In the event drought creates a high risk of pine bark beetle infestation, pine is not to be cut during the period March 1 through July 1, unless all portions of trees greater than two inches in diameter are removed from the sale area, reduced to chips, or treated to the satisfaction of the Unit Manager or his/her representative, within fifteen days of being severed from the stump. Pine log decks, pulpwood piles and treetops that are piled for chipping in the fall or winter within a 1/4 mile of susceptible sites must be removed before March 15. Residual slash must not be placed in piles or rows and must be spread over the site for quick drying. The Department of Natural Resources will exercise this specification if the risk

of damage warrants.

#### 5.2.32 - Decking/landing restoration (9/13)

All decking and landing areas must have the surface area restored to a condition equal to or better than before. This is to ensure the proper regeneration of the stand. Wood debris, chips and "cookies" from trimmings must be removed or scattered away from landing and loading areas and may not be windrowed on the edge.

#### 5.7 - Protection of Historical Sites

##### 5.7.2 - Potential historical site(s) (9/06)

The State Historic Preservation Office has identified the potential for a historic site within the boundary of this timber sale. Note that if the site is discovered during operations, General Condition and Requirement 5.7 - Protection of Historical Sites will apply.

### **6 - Safety and Fire Prevention**

#### 6.2 - Signing

##### 6.2.1 - Road posting (10/20)

The Purchaser is responsible for posting and maintaining caution signs on Nye Road, McGregor Road, and Gilford Ranch Trail prior to beginning operations. The road must be posted at appropriate distances from the sale area to warn of logging activity and truck traffic. Signs must be removed when harvest operations are suspended or completed. The Purchaser will provide these signs.



# TIMBER SALE MAP

This information provided by authority of Part 525, 1994 PA 451, as amended.

Forest Management Unit Roscommon	County Ogemaw	Mapped By Martell	Date 9/27/22	Page 1	of 2
Township 24N	Range 02E	Section(s) and Subdivision(s) Sec. 8 - N1/2NE,SWNE; Sec. 9 - SESW,SWSE; Sec. 10 - W1/2NE,NWSE	Scale 1:15,840		

Cover Type				Density	
A = Aspen	H = Hemlock	N = Marsh	U = Upland Brush	0 = Non Stocked	5 = Pole Timber Medium
B = Paper Birch	J = Jack Pine	O = Oak	UM = Upland Mixed	1 = Seedling Sapling Poor	6 = Pole Timber Well
C = Cedar	L = Lowland Brush	P = Lowland Poplar	V = Bog or Marsh	2 = Seedling Sapling Medium	7 = Saw Timber Poor
D = Treed Bog	LM = Lowland Mixed	Q = Mixed Swamp Conifer	W = White Pine	3 = Seedling Sapling Well	8 = Saw Timber Medium
E = Swamp Hdwoods	M = Mpl, Bch, Brch	R = Red Pine	X = Non Stocked	4 = Pole Timber Poor	9 = Saw Timber Well
F = Spruce Fir	MC = Mixed Conifer	S = Black Spruce	Z = Water		
G = Grass	MD = Mixed Deciduous	T = Tamarack			

PU	Acres
1	30.4
2	7.1
3	29.3

## McGregor School Red Pine

### Compartment 88

66.8 Acres

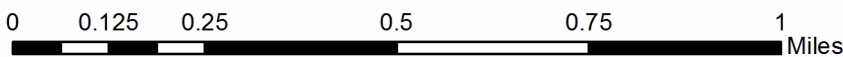
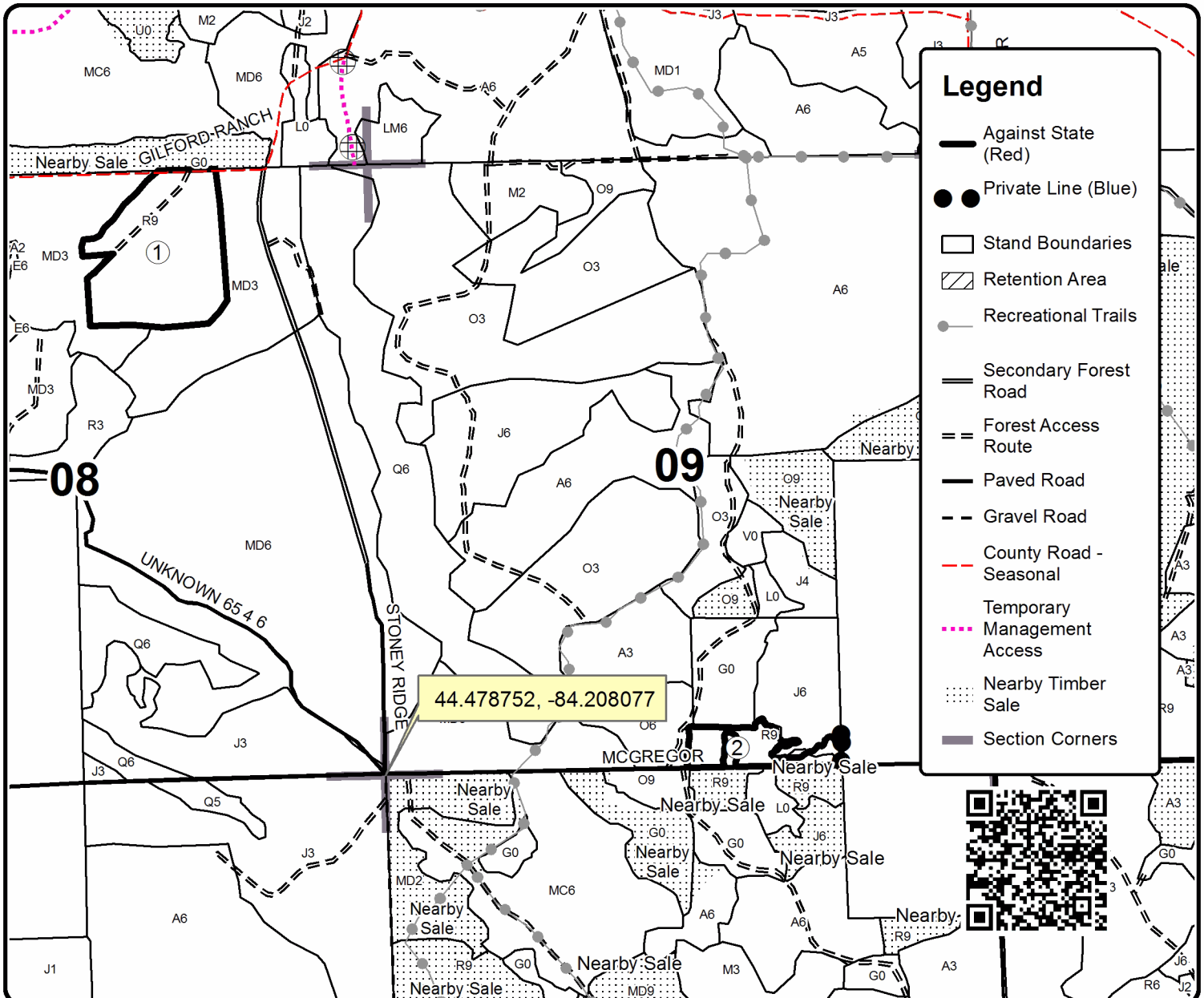
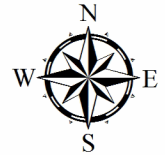





## TIMBER SALE INFORMATION

### Damon's Last Ridge (71-024-22)

T24N, R01E, SEC. 1; T24N, R01E, SEC. 11; T24N, R01E, SEC. 12; T24N, R01E, SEC. 2.  
Ogemaw County (Advertised Price \$204,475.85)

A timber sale contract for this lump sum, sealed bid timber sale will be awarded to the responsible bidder offering the highest sealed bid price. All units of volume listed below were estimated using the Inventory Manager computer program and the new Michigan taper model. Bids must be at or above the following advertised price for each product and species:

<u>PRODUCTS &amp; SPECIES</u>	<u>ESTIMATED UNITS*</u>	<u>ADVERTISED PRICE</u>
<b>Sawtimber</b>		
B. T. Aspen	433.6 MBF	\$ 72.00 / MBF
BI/R/Hybrid Oak	147.5 MBF	\$ 105.00 / MBF
Jack Pine	16.7 MBF	\$ 21.00 / MBF
Quaking Aspen	91.7 MBF	\$ 72.00 / MBF
Red Maple	72.2 MBF	\$ 68.00 / MBF
Red Oak	362.6 MBF	\$ 99.00 / MBF
Red Pine	188.4 MBF	\$ 92.00 / MBF
White Oak	58.4 MBF	\$ 52.00 / MBF
<b>Pulpwood</b>		
Jack Pine	71 Cords	\$ 11.85 / Cord
Mixed Aspen	2,050 Cords	\$ 26.05 / Cord
Mixed Hardwood	924 Cords	\$ 14.40 / Cord
Mixed Oak	1,038 Cords	\$ 16.20 / Cord
Red Pine	142 Cords	\$ 35.20 / Cord
White Pine	8 Cords	\$ 34.50 / Cord

\* The total volume is statistically estimated within plus (+) or minus (-) 10.32 percent. There are an estimated 7,154 cords on this timber sale, plus or minus 739 cords at the 95% confidence level. The estimated units are final and not subject to adjustment. Prospective bidders are urged to examine this timber and to make their own estimates of quantity and quality.

### **BOND AND PAYMENT SCHEDULE:**

1. A bond in the amount of \$10,224.00 to insure faithful performance of the conditions of the contract will be deposited by the successful bidder within 21 days of the sale award.
2. Cutting in any sale or unit without the required advance payment would be considered a trespass.
3. Total payment must be paid in advance or according to the following schedule :
  - (a) Ten percent (10%) of the sale value must be paid within 21 days of the sale award.
  - (b) The 10% down payment will be credited towards the first unit cut.
  - (c) Payment for each of the following units must be made before cutting begins in that unit:
 

PAYMENT UNIT NUMBER	PERCENT OF TOTAL SALE VALUE
01	2.5%
02	9.6%
03	3.3%
04	13.2%
05	12.2%
06	18.6%
07	19.1%
08	17.1%
09	4.4%
4. If no cutting takes place, the 10% down payment will not be refunded.
5. Operations on the contract issued will terminate on 12/31/2024.

### **SALE STATISTICS**

Volumes were calculated in cubic feet using the Michigan taper model. Cubic foot volume includes all wood inside bark for the product indicated. For display purposes, cubic feet were converted to cords and MBF using a simple conversion factor, e.g. 79 cubic feet per cord and 185 cubic feet per MBF. The cubic foot volumes are precise; the cords and MBF volumes are not. Cubic foot volume cannot be directly converted to cords or boards with precision.

## SALE VOLUMES

The total estimated sale volume may not equal the sum of the species/products due to the nature of statistical calculations associated with double sampling methodology.

VOLUME			STATISTICAL RANGE IN CORDS	
TOTAL CUBIC FEET	TOTAL CORDS	PERCENT ERROR	MINIMUM	MAXIMUM
565,205	7,154	10.32%	6,416	7,893

## VDU VOLUMES

A VDU is a Volume Determination Unit. Volumes and their associated statistics are calculated at the VDU level and summarized to the sale level. There is often a one to one relationship between a VDU and a Payment Unit, but not always, depending on the cruise design. Refer to the VDU TO PAYMENT UNIT table.

	VOLUME			RANGE IN CORDS	
VDU	TOTAL CUBIC FEET	TOTAL CORDS	PERCENT ERROR	MINIMUM	MAXIMUM
10	59,193	749	27.84%	541	958
11	17,053	216	46.02%	117	315
40	21,833	276	42.27%	160	393
48	195,582	2,476	18.59%	2,016	2,936
53	258,344	3,270	11.50%	2,894	3,646
77	13,199	167	58.16%	70	264
<b>TOTAL:</b>	<b>565,205</b>	<b>7,154</b>		<b>5,796</b>	<b>8,513</b>

## VDU TO PAYMENT UNIT

When a VDU is associated with more than one Payment Unit (PU), the VDU volumes are assigned to the PU based on acres of the VDU within the PU.

VDU	VDU ACRES	PU	PU ACRES
10	24.9	2	24.9
11	12.0	3	12.0
40	14.8	9	14.8
48	57.8	7	30.3
		8	27.5
53	81.4	4	24.4
		5	22.6
		6	34.4
77	13.6	1	13.6
<b>TOTAL:</b>	<b>204.5</b>		<b>204.5</b>



**DESCRIPTION OF TIMBER BY PAYMENT UNIT (PU)**

PU	MARKET GROUP	PRODUCT	QUANTITY	UNIT	ACRES	ADVERTISE PRICE
1	BI/R/Hybrid Oak	Sawtimber	3.7	MBF	13.6	\$5,147.50
	Red Pine		32.1	MBF		
	Jack Pine	Pulpwood	24	Cords		
	Mixed Hardwood		4	Cords		
	<i>Red Maple</i>		4	<i>Cords</i>		
	Mixed Oak		23	Cords		
	<i>BI/R/Hybrid Oak</i>		23	<i>Cords</i>		
	Red Pine		31	Cords		
2	B. T. Aspen	Sawtimber	38.7	MBF	24.9	\$19,650.90
	BI/R/Hybrid Oak		18.0	MBF		
	Jack Pine	4.9	MBF			
	Quaking Aspen	11.7	MBF			
	Red Maple	14.9	MBF			
	Red Pine	27.3	MBF			
	Jack Pine	Pulpwood	9	Cords		
	Mixed Aspen		203	Cords		
	<i>B. T. Aspen</i>		174	<i>Cords</i>		
	<i>Quaking Aspen</i>		29	<i>Cords</i>		
	Mixed Hardwood		263	Cords		
	<i>Black Cherry</i>		23	<i>Cords</i>		
	<i>Red Maple</i>		240	<i>Cords</i>		
	Mixed Oak		36	Cords		
	<i>BI/R/Hybrid Oak</i>		36	<i>Cords</i>		
	Red Pine		21	Cords		
3	BI/R/Hybrid Oak	Sawtimber	4.2	MBF	12.0	\$6,784.40
	Red Pine		44.4	MBF		
	Mixed Hardwood	Pulpwood	19	Cords		
	<i>Black Cherry</i>		14	<i>Cords</i>		
	<i>Red Maple</i>		5	<i>Cords</i>		
	Mixed Oak		49	Cords		
	<i>BI/R/Hybrid Oak</i>		49	<i>Cords</i>		
	Red Pine		26	Cords		
	White Pine		8	Cords		
	<i>White Pine</i>		2.6	<i>MBF</i>		
<i>White Pine</i>	3	<i>Cords</i>				
4	B. T. Aspen	Sawtimber	60.9	MBF	24.4	\$27,057.45
	BI/R/Hybrid Oak		22.5	MBF		
	Jack Pine	1.4	MBF			
	Quaking Aspen	16.2	MBF			
	Red Maple	9.9	MBF			
	Red Oak	59.2	MBF			
	White Oak	12.6	MBF			
	Jack Pine	Pulpwood	4	Cords		
	Mixed Aspen		315	Cords		
	<i>B. T. Aspen</i>		260	<i>Cords</i>		
	<i>Quaking Aspen</i>		55	<i>Cords</i>		
	Mixed Hardwood		129	Cords		
	<i>Red Maple</i>		129	<i>Cords</i>		
	Mixed Oak		112	Cords		
	<i>BI/R/Hybrid Oak</i>		48	<i>Cords</i>		
	<i>Red Oak</i>		41	<i>Cords</i>		
<i>White Oak</i>	23		<i>Cords</i>			
5	B. T. Aspen	Sawtimber	56.4	MBF	22.6	\$25,044.85
	BI/R/Hybrid Oak		20.8	MBF		
	Jack Pine		1.3	MBF		
	Quaking Aspen		15.0	MBF		

**DESCRIPTION OF TIMBER BY PAYMENT UNIT (PU), CON'T**

PU	MARKET GROUP	PRODUCT	QUANTITY	UNIT	ACRES	ADVERTISE PRICE	
5 con't	Red Maple	Sawtimber	9.2	MBF			
	Red Oak		54.8	MBF			
	White Oak		11.6	MBF			
	Jack Pine		Pulpwood	3			Cords
	Mixed Aspen			292			Cords
	<i>B. T. Aspen</i>			241			Cords
	<i>Quaking Aspen</i>			51			Cords
	Mixed Hardwood			120			Cords
	<i>Red Maple</i>			120			Cords
	Mixed Oak			103			Cords
	<i>BI/R/Hybrid Oak</i>			44			Cords
	<i>Red Oak</i>			38			Cords
	<i>White Oak</i>			21			Cords
6	B. T. Aspen	Sawtimber	85.9	MBF	34.4	\$38,093.70	
	BI/R/Hybrid Oak		31.7	MBF			
	Jack Pine		2.0	MBF			
	Quaking Aspen		22.8	MBF			
	Red Maple		13.9	MBF			
	Red Oak		83.4	MBF			
	White Oak		17.6	MBF			
	Jack Pine		Pulpwood	5			Cords
	Mixed Aspen			443			Cords
	<i>B. T. Aspen</i>			366			Cords
	<i>Quaking Aspen</i>			77			Cords
	Mixed Hardwood			182			Cords
	<i>Red Maple</i>			182			Cords
	Mixed Oak			158			Cords
	<i>BI/R/Hybrid Oak</i>			67			Cords
	<i>Red Oak</i>			58			Cords
	<i>White Oak</i>			33			Cords
7	B. T. Aspen	Sawtimber	100.5	MBF	30.3	\$38,640.00	
	BI/R/Hybrid Oak		13.9	MBF			
	Quaking Aspen		13.6	MBF			
	Red Maple		12.7	MBF			
	Red Oak		86.6	MBF			
	Red Pine		19.7	MBF			
	White Oak		8.7	MBF			
	Mixed Aspen		Pulpwood	418			Cords
	<i>B. T. Aspen</i>			345			Cords
	<i>Quaking Aspen</i>			73			Cords
	Mixed Hardwood			103			Cords
	<i>Black Cherry</i>			4			Cords
	<i>Red Maple</i>			99			Cords
	Mixed Oak			265			Cords
	<i>BI/R/Hybrid Oak</i>			107			Cords
	<i>Red Oak</i>			119			Cords
	<i>White Oak</i>			39			Cords
Red Pine	17	Cords					
8	B. T. Aspen	Sawtimber	91.2	MBF	27.5	\$35,053.25	
	BI/R/Hybrid Oak		12.7	MBF			
	Quaking Aspen		12.4	MBF			
	Red Maple		11.6	MBF			
	Red Oak		78.6	MBF			
	Red Pine		17.9	MBF			
	White Oak		7.9	MBF			
	Mixed Aspen		Pulpwood	379			Cords

**DESCRIPTION OF TIMBER BY PAYMENT UNIT (PU), CON'T**

PU	MARKET GROUP	PRODUCT	QUANTITY	UNIT	ACRES	ADVERTISE PRICE
8 con't	<i>B. T. Aspen</i>	<i>Pulpwood</i>	313	<i>Cords</i>		
	<i>Quaking Aspen</i>		66	<i>Cords</i>		
	Mixed Hardwood		92	<i>Cords</i>		
	<i>Black Cherry</i>		3	<i>Cords</i>		
	<i>Red Maple</i>		89	<i>Cords</i>		
	Mixed Oak		239	<i>Cords</i>		
	<i>BI/R/Hybrid Oak</i>		97	<i>Cords</i>		
	<i>Red Oak</i>		107	<i>Cords</i>		
	<i>White Oak</i>		35	<i>Cords</i>		
	Red Pine		16	<i>Cords</i>		
9	BI/R/Hybrid Oak	Sawtimber	20.0	MBF	14.8	\$9,003.80
	Jack Pine		7.1	MBF		
	Red Pine		47.0	MBF		
	Jack Pine	Pulpwood	26	<i>Cords</i>		
	Mixed Hardwood		12	<i>Cords</i>		
	<i>Red Maple</i>		12	<i>Cords</i>		
	Mixed Oak		53	<i>Cords</i>		
	<i>BI/R/Hybrid Oak</i>		53	<i>Cords</i>		
	Red Pine		31	<i>Cords</i>		
TOTAL:			1,371.1	MBF		
TOTAL:			4,233	<i>Cords</i>		

# Sale Specific Conditions & Requirements

**Sale Name: Damon's Last Ridge**

**Sale Number: 71-024-22 Seq#: 1**

## 1 - Sale Area

### 1.2 - Boundaries

#### 1.2.1 - Painted boundaries (9/19)

The sale boundary and Payment Unit boundaries are marked and identified by red and yellow paint. Exterior sale boundary lines against state are marked with red paint. Interior Payment Unit boundaries are marked with yellow paint. Retention patches are marked with red paint; no harvesting activities may occur within these areas. The painted boundary line trees are not Included Timber and are to be protected. Yellow painted trees designating an interior Payment Unit boundary are only to be cut when all surrounding Payment Units have been paid.

## 2 - Timber Specifications

### 2.1 - Included Timber

#### 2.1.1 - Clearcut unit(s) with unmerchantable trees (6/14)

Within Payment Unit(s) 1-9, cut all trees that are two (2) inches or more at DBH.

EXCEPTION: Within Payment Units 2 and 3 do not cut any white oak over 10 inches DBH.

Within Payment Units 4-8 do not cut any tree marked in green paint above and below stump height.

### 2.2 - Utilization

#### 2.2.2 - Chipping required (2/18)

Payment Units 1, 3, and 9 must be chip harvested to facilitate future silvicultural activities. Products may be produced as roundwood and forwarded to decking areas in final product length, but the tops must be left intact and skidded to the landing for chipping in order to minimize the amount of residual slash. If market conditions limit the practicality of chipping, tops and slash must be arranged in a way that will not inhibit future planting operations, as directed by the sale administrator. In some situations, it is possible that a chipping exemption can be obtained if proposed operations are determined to be suitable for planting by reforestation staff. This exemption must be granted in writing. If the deadline is not met, damages will be collected determined by the cost to complete this work. The requirement to retain approximately 1/6 to 1/3 of tree tops and limbs less than four inches in diameter is still applicable (G. C. & R. 2.2).

#### 2.2.3 - Stump heights (4/07)

Stump heights within the Sale Area shall not exceed 6 inches for all trees. This is especially important in Payment Units 1 and 3 for subsequent cultivation activities to take place.

## 3 - Payments

### 3.3 - Pre-measured Sales

#### 3.3.4 - Dividing payment units (7/14)

Payment Unit(s) may be divided at the request of the Purchaser and upon approval of the Unit Manager. Dividing Payment Units is a contract modification which requires a Timber Sale Contract Amendment.

### 3.4 - Damaged Timber

#### 3.4.1 - Damaged timber (7/16)

General Condition and Requirement 3.4 Damaged Timber, defines liquidated damages for undesignated live merchantable trees which are cut or injured. In addition, within Payment Units 2 and 4-8, should chipping occur in a Payment Unit, this must be done before sprouting of new regeneration. If more than 33% of the newly sprouted tree seedlings within a specified portion of the Sale Area are damaged, liquidated damages will be assessed at \$500 per acre for all acreage within that specified portion of the Sale Area that was damaged.

No damage is acceptable to undesignated live merchantable trees. Within the sale area, if more than 5% of trees (> 4.5" DBH) within a specified area of the sale are damaged, liquidated damages will be assessed for all trees damaged. Rates will be in accordance with General Condition and Requirement 3.4 Damaged Timber.

## 4 - Transportation

### 4.1 - Construction

#### 4.1.6 - Road construction (1/09)

Construction of new roads or improvements of existing roads shall be done in such a way as to minimize the environmental and visual impacts. Merchantable trees shall be cut and utilized unless otherwise directed. Non-merchantable trees shall be severed and laid flat on the ground. Slash shall be scattered, and not left in windrows and kept a minimum of 10 feet back from the road edge. Stumps shall be set upright, not left on edge, and be moved at least 10 feet away from the road edge. Disturbed soil shall be feathered into the woods and not left in berms or windrows.

#### 4.1.7 - Road closure (10/11)

All new roads built into the sale must be blocked to vehicle traffic upon completion of the sale. Overgrown roads that are reopened shall be considered new roads. In general, this will require constructing a four (4') foot high berm of stumps and logs covered with earth. These roads must be rendered impassable to cars and trucks. Contact the sale administrator for specific details of design and placement.

### 4.2 - Maintenance

#### 4.2.3 - Road maintenance (8/13)

The following road maintenance may be needed: Within 60 days of completion of hauling, or if no hauling occurs for 60 days, the road must be maintained and graded to the condition prior to usage. This includes cleaning of drainage areas, grading, crowning and filling with gravel, if necessary. Damages will be assessed if grading/repair does not occur.

#### 4.2.5 - Two wheel drive condition (2/04)

All existing trail roads on and adjacent to the sale area must be passable by two-wheel drive traffic for the duration of the sale.

## 5 - Operations

### 5.1 - Notification

#### 5.1.1 - Pre-sale conference (10/16)

A pre-sale conference between the Purchaser and sale administrator is required prior to beginning any operations to determine landing and road locations. The Unit Manager or his/her representative must be contacted in advance to schedule the conference.

#### 5.1.3 - Well heads and natural gas pipelines (11/15)

The Purchaser is responsible for contacting the gas or pipeline company prior to operating equipment in the vicinity of well heads or natural gas pipelines. The pipeline is along the eastern edge of Payment Unit 8 and crosses Gilford Ranch Trail just east of the Timber Sale.

### 5.2 - Conduct of Operations

#### 5.2.1 - Slash

##### 5.2.1.8 - Slash height (12/08)

No slash or tree tops may exceed 24 inches in height. If Payment Units are not chipped, tops and slash must be evenly distributed across the Payment Unit and may not be left in windrows or thick mats.

##### 5.2.1.11 - Slash for reforestation (3/21)

If Payment Units 2 and 4-8 are not chipped, they shall be left with slash evenly distributed so as not to inhibit reforestation of the stand. Bunched tops within the cutting area shall be broken up and scattered. Processing sites shall not be left with a compacted layer/windrow of slash.

#### 5.2.2 - Hazard Trees/Snags

##### 5.2.2.1 - Den trees (10/16)

Obvious hollow and/or den trees shall be protected and left standing unless they are a safety hazard.

### 5.2.3 - Operating Restrictions

#### 5.2.3.5 - Oak wilt restriction (1/18)

Within the sale area, unless changed by written agreement, cutting, skidding, hauling within the sale and brushing of access roads to the sale are not permitted during the period of April 15 to July 15. Operations may be allowed if specific steps are taken to prevent damaging uncut oak during the high risk period. Those steps may include completing all road brushing before April 15th and clearing a tree-length buffer along uncut oak cover before April 15th. This is necessary to reduce the spread of oak wilt. For more information, contact the Unit Manager or his/her representative.

#### 5.2.3.11 - Coppice regeneration protection (4/10)

Timber harvesting in Payment Units 2 and 4-8 must be completed before significant aspen sprouting occurs in that Payment Unit so as to minimize damage to the new regeneration. Any post harvest operations, such as chipping, must be completed before sprouting of regeneration occurs. Should damages occur to the new regeneration, the damages will be assessed per Specification 3.4.1 - Damaged Timber. If it is anticipated that chipping will be delayed, then tops shall be carried to one central location, preferably the landing. A third-party entity may be brought in to chip the tops/slash, before new sprouting occurs, should the contract holder fail to present in a timely manner arrangements approved by the Unit Manager for protecting the new regeneration. The Unit Manager or his/her representative may also cease such operations if sprouting occurs before the operation is complete and the Payment Unit(s) will be counted as incomplete with liquidated damages assessed accordingly.

### 5.2.4 - Dead and Down Creation

#### 5.2.4.2 - Dead and down creation, hare and grouse (1/14)

To improve habitat for snowshoe hare, grouse, and other species, the Purchaser is to leave two logs, nine (9) inches or larger in diameter on the ground for every four acres in Payment Units 2 and 4-8. They should be scattered throughout the sale or positioned per the sale administrators instructions. If possible, the logs or trees should be felled so they overlap. Note these pieces should have a minimum length of five feet. They can be of any tree species and can be an un-merchantable piece of wood or a full tree.

#### 5.2.32 - Decking/landing restoration (9/13)

All decking and landing areas must have the surface area restored to a condition equal to or better than before. This is to ensure the proper regeneration of the stand. Wood debris, chips and "cookies" from trimmings must be removed or scattered away from landing and loading areas and may not be windrowed on the edge.

### 5.4 - Soil Protection

#### 5.4.3 - Erosion control (12/08)

Skid trails or haul roads may require erosion control structures or berms per direction of the Unit Manager or his/her representative.

## 6 - Safety and Fire Prevention

### 6.2 - Signing

#### 6.2.1 - Road posting (10/20)

The Purchaser is responsible for posting and maintaining caution signs on Gilford Ranch Trail, County Line Road, and Tower Road prior to beginning operations. The road must be posted at appropriate distances from the sale area to warn of logging activity and truck traffic. Signs must be removed when harvest operations are suspended or completed. The Purchaser will provide these signs.



# TIMBER SALE MAP

This information provided by authority of Part 525, 1994 PA 451, as amended.

Forest Management Unit Roscommon	County Ogemaw	Mapped By Martell	Date 10/3/22	Page 1	of 2
Township 24N	Range 01E	Section(s) and Subdivision(s) Sec. 1 - NWSW,S1/2SW; Sec. 2 - NW,NESE,S1/2SE; Sec. 11 - E1/2SE; Sec. 12 - N1/2NW,SE,SW,W1/2NE	Scale 1:15,840		

Cover Type				Density	
A = Aspen	H = Hemlock	N = Marsh	U = Upland Brush	0 = Non Stocked	5 = Pole Timber Medium
B = Paper Birch	J = Jack Pine	O = Oak	UM = Upland Mixed	1 = Seedling Sapling Poor	6 = Pole Timber Well
C = Cedar	L = Lowland Brush	P = Lowland Poplar	V = Bog or Marsh	2 = Seedling Sapling Medium	7 = Saw Timber Poor
D = Treed Bog	LM = Lowland Mixed	Q = Mixed Swamp Conifer	W = White Pine	3 = Seedling Sapling Well	8 = Saw Timber Medium
E = Swamp Hdwoods	M = Mpl, Bch, Brch	R = Red Pine	X = Non Stocked	4 = Pole Timber Poor	9 = Saw Timber Well
F = Spruce Fir	MC = Mixed Conifer	S = Black Spruce	Z = Water		
G = Grass	MD = Mixed Deciduous	T = Tamarack			

PU	Acres	PU	Acres
1	13.6	6	34.4
2	24.9	7	30.3
3	12.0	8	27.5
4	24.4	9	14.8
5	22.6		

## Damon's Last Ridge Compartment 76 204.5 Acres

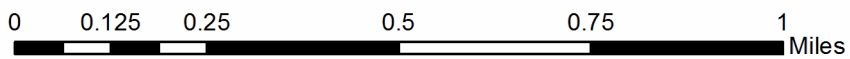
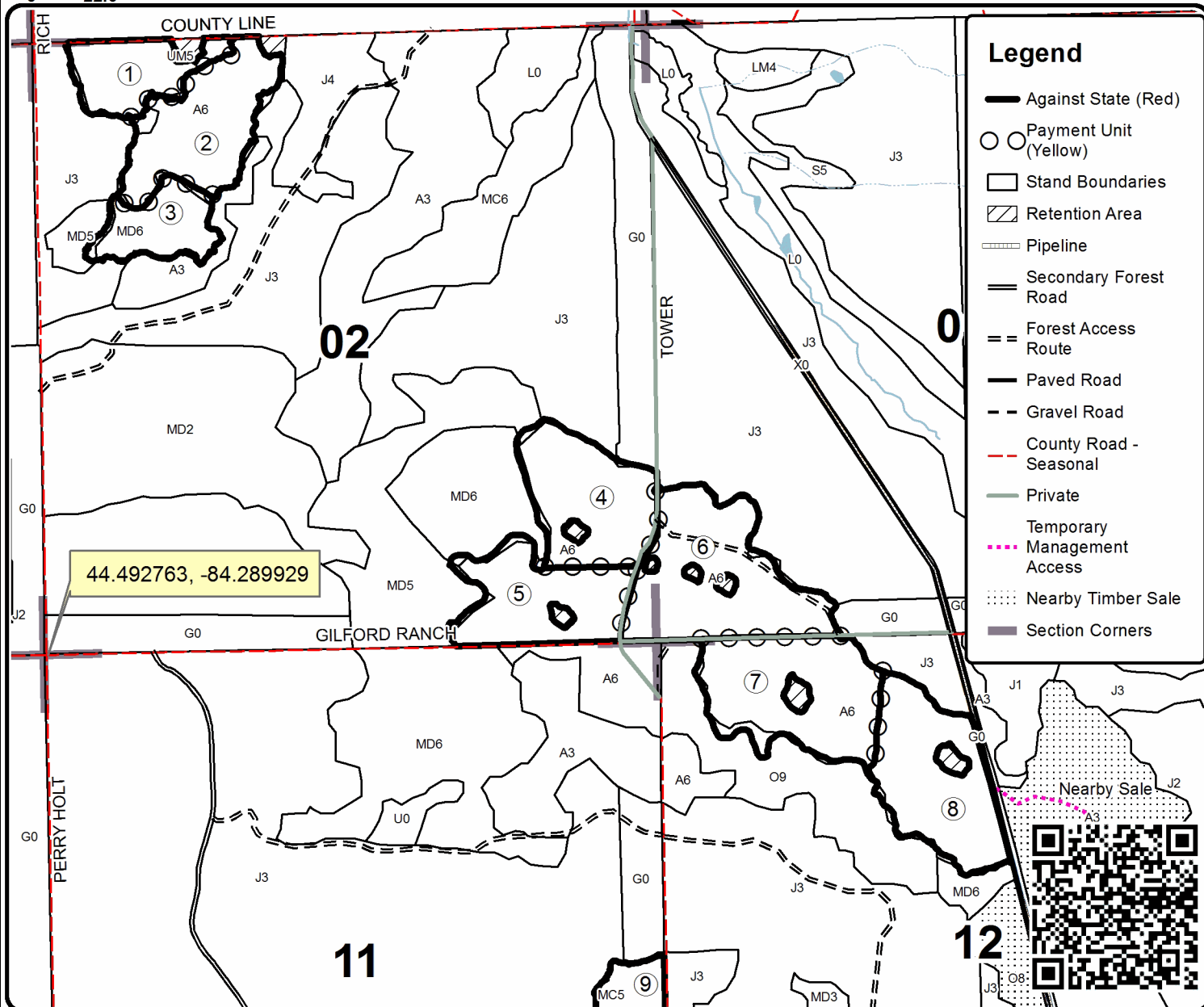
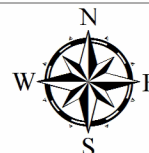



# TIMBER SALE MAP

This information provided by authority of Part 525, 1994 PA 451, as amended.

Sale Number	Year
71 - 024	22

Forest Management Unit	County	Mapped By	Date	Page	of
Roscommon	Ogemaw	Martell	10/3/22	2	2
Township	Range	Section(s) and Subdivision(s)	Scale		
24N	01E	Sec. 1 - NWSW,S1/2SW; Sec. 2 - NW,NESE,S1/2SE; Sec. 11 - E1/2SE; Sec. 12 - N1/2NW,SESWW1/2NE	1:15,840		

### Cover Type

A = Aspen	H = Hemlock	N = Marsh	U = Upland Brush
B = Paper Birch	J = Jack Pine	O = Oak	UM = Upland Mixed
C = Cedar	L = Lowland Brush	P = Lowland Poplar	V = Bog or Marsh
D = Treed Bog	LM = Lowland Mixed	Q = Mixed Swamp Conifer	W = White Pine
E = Swamp Hdwoods	M = Mpl. Bch, Brch	R = Red Pine	X = Non Stocked
F = Spruce Fir	MC = Mixed Conifer	S = Black Spruce	Z = Water
G = Grass	MD = Mixed Deciduous	T = Tamarack	

### Density

0 = Non Stocked	5 = Pole Timber Medium
1 = Seedling Sapling Poor	6 = Pole Timber Well
2 = Seedling Sapling Medium	7 = Saw Timber Poor
3 = Seedling Sapling Well	8 = Saw Timber Medium
4 = Pole Timber Poor	9 = Saw Timber Well

PU	Acres	PU	Acres
1	13.6	6	34.4
2	24.9	7	30.3
3	12.0	8	27.5
4	24.4	9	14.8
5	22.6		

## Damon's Last Ridge

### Compartment 76

### 204.5 Acres

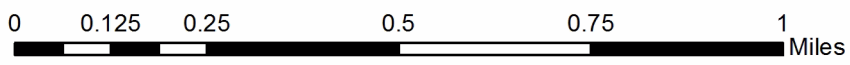
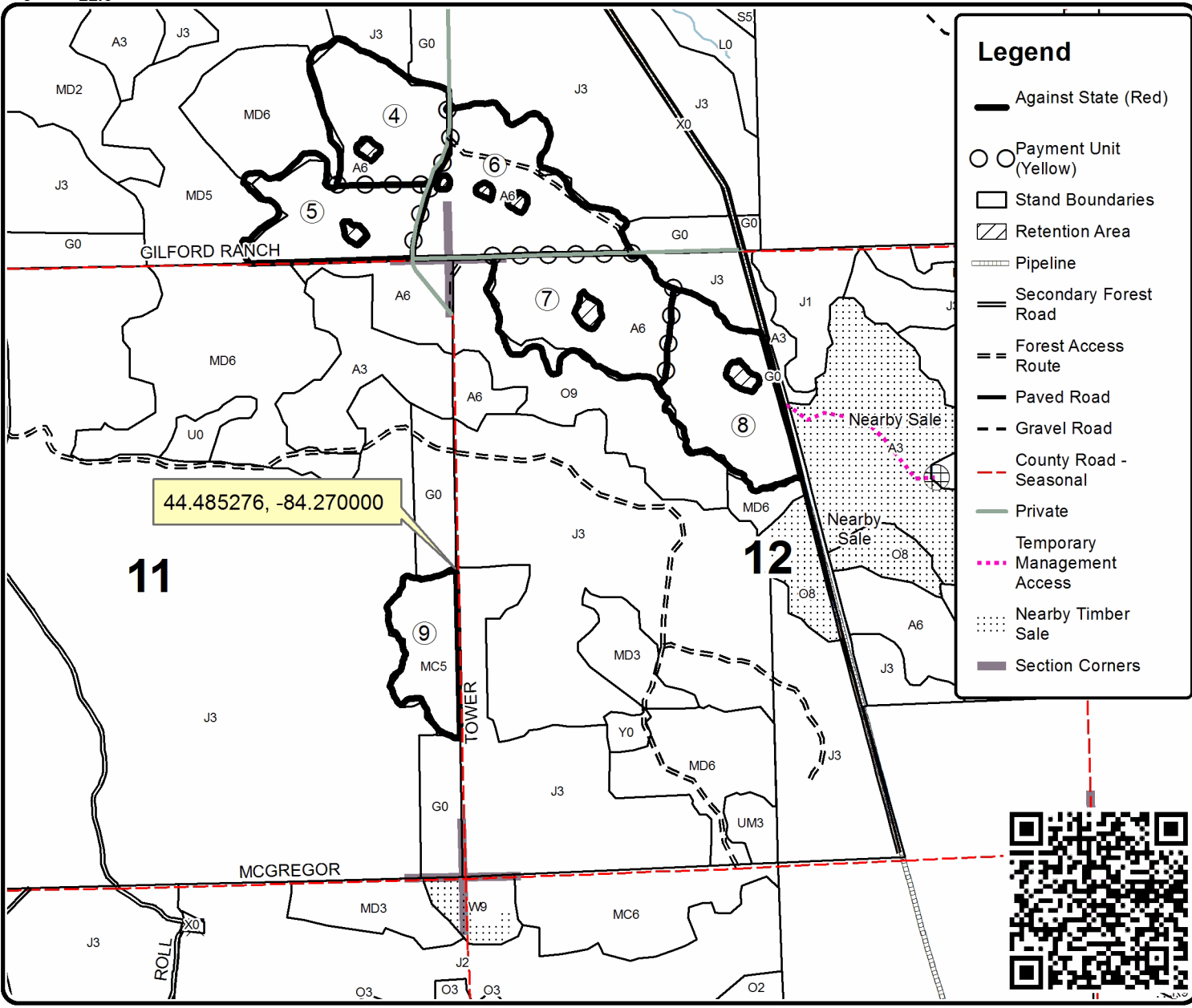



Aqua Aspen (71-018-22)

T23N, R01W, SEC. 10; T23N, R01W, SEC. 15; T23N, R01W, SEC. 16; T23N,

In response to the notice of sale to be held 9:00 a.m. (local time) on December 13, 2022, I am hereby submitting my sealed bid (firm offer) for the following forest products to be cut. Bids for individual species must be at or above the advertised price. All non-responsive bid forms may be rejected.

<u>PRODUCTS &amp; SPECIES</u>	<u>ESTIMATED VOLUME*</u>	<u>ADVERTISED PRICE</u>	<u>BID PRICE/UNIT</u>
<b>Sawtimber</b>			
Bl/R/Hybrid Oak	35.6 MBF	\$ 105.00/MBF	\$ _____
Mixed Aspen	103.1 MBF	\$ 72.00/MBF	\$ _____
Red Maple	37.1 MBF	\$ 68.00/MBF	\$ _____
Red Pine	21.3 MBF	\$ 92.00/MBF	\$ _____
White Oak	24.7 MBF	\$ 52.00/MBF	\$ _____
White Pine	11.8 MBF	\$ 69.00/MBF	\$ _____
<b>Pulpwood</b>			
Balsam Fir	122 Cords	\$ 26.00/Cord	\$ _____
Black Spruce	14 Cords	\$ 17.50/Cord	\$ _____
Jack Pine	4 Cords	\$ 11.85/Cord	\$ _____
Mixed Aspen	1,203 Cords	\$ 26.05/Cord	\$ _____
Mixed Hardwood	741 Cords	\$ 14.40/Cord	\$ _____
Mixed Oak	227 Cords	\$ 16.20/Cord	\$ _____
Red Pine	4 Cords	\$ 35.20/Cord	\$ _____
White Pine	68 Cords	\$ 34.50/Cord	\$ _____

\*The volumes are statistically estimated within plus (+) or minus (-) 14.74 percent at 95% confidence level. These estimated volumes are final and not subject to adjustment. Prospective bidders are urged to examine this timber and to make their own estimates of quantity and quality.

I understand that any or all bids may be rejected. All bids must be signed and all bid items must be bid or the bid form may be rejected. I also understand that consideration and awarding a contract will be based upon my past performance and ability to complete the contract based upon equipment and staffing subject to my control.

FEDERAL ID: \_\_\_\_\_ - \_\_\_\_\_ or SOCIAL SECURITY NUMBER: \_\_\_\_\_ - \_\_\_\_\_ - \_\_\_\_\_

Company or individual bidding: \_\_\_\_\_

Company representative's name: \_\_\_\_\_

Address: \_\_\_\_\_

City: \_\_\_\_\_ State: \_\_\_\_\_ Zip: \_\_\_\_\_

IF AVAILABLE, PLEASE PLACE THE PERSONALIZED LABEL FROM YOUR PROSPECTUS IN THE ABOVE BOX.

Individual or company representative's signature: \_\_\_\_\_ Date: \_\_\_\_\_

Phone number : \_\_\_\_\_ Email (optional): \_\_\_\_\_

**THE WINNING BIDDER MUST COMPLETE THE VERIFICATION OF WORKER'S DISABILITY COMPENSATION ACT COMPLIANCE (ON REVERSE SIDE IF DOUBLE SIDED) WITHIN 21 DAYS OF SALE AWARD DATE**



FOR DEPARTMENT USE ONLY	
Sale Number (XX - XXX - XX - XX)	
Forest Management Unit:	

## TIMBER SALE VERIFICATION OF WORKER'S DISABILITY COMPENSATION ACT COMPLIANCE

As required by Act 317, P.A. 1969 (Worker's Compensation) and  
Part 5 of Act 451 of 1994, as amended.

### VERIFICATION OF WORKER'S DISABILITY COMPENSATION ACT COMPLIANCE

- This verification must be completed and submitted within 21 days of contract award and prior to the issuance of the timber sale contract.
- In addition, if boxes 2B or 2C are checked, then Notice of Exclusion or Certificate of Insurance must be submitted within twenty-one (21) days of the contract award and prior to the issuance of the timber sale contract.
- All information must be typed or printed except for written signatures.

Please Check Appropriate Categories:

1. My business is organized as (you **must** check one of the boxes below):
  - A.  Sole Proprietorship (individual)
  - B.  Partnership
  - C.  Corporation
2. You **must** check one of the boxes below:
  - A.  I certify my business is a sole proprietorship and it has no employees but the sole proprietor. I am not subject to the Worker's Compensation Laws.
  - B.  I certify my business has satisfied its obligation to the Worker's Compensation Act through the use of an approved Notice of Exclusion (BWC-337, Rev. 5/96). I will provide a copy of the Notice of Exclusion within 21 days of the contract award. (For questions or a copy of the BWC-337, please call the Worker's Compensation Bureau at 517-322-1195).
  - C.  I certify my business has a Worker's Compensation Policy. I will provide an original Certificate of Insurance within twenty-one (21) days of the contract award.
3. If you have checked item 2(A) or 2(B), you **must** indicate the number of **both** full-time and part-time employees, other than yourself, including family members and active partners (if none, you must enter "0").

\_\_\_\_\_ Full-time Employees

\_\_\_\_\_ Part-time Employees

Name of Business		Federal ID (or) Social Security No.	
Address		Telephone (       )	
City	State	ZIP	

*I hereby certify that the above information is true and correct. I agree to notify the Michigan DNR of any changes that occur in factors affecting my coverage during any of my present and future operations.*

\_\_\_\_\_  
Signature of Owner or Authorized Representative

\_\_\_\_\_  
Title

\_\_\_\_\_  
Date

Please complete the "SEALED BID" information on the next page

Lost and Found Aspen Hardwoods (71-020-22)  
T24N, R02E, SEC. 1; T24N, R02E, SEC. 8; Ogemaw COUNTY

In response to the notice of sale to be held 9:00 a.m. (local time) on December 13, 2022, I am hereby submitting my sealed bid (firm offer) for the following forest products to be cut. Bids for individual species must be at or above the advertised price. All non-responsive bid forms may be rejected.

<u>PRODUCTS &amp; SPECIES</u>	<u>ESTIMATED VOLUME*</u>	<u>ADVERTISED PRICE</u>	<u>BID PRICE/UNIT</u>
<b>Sawtimber</b>			
B. T. Aspen	117.3 MBF	\$ 72.00/MBF	\$ _____
Bl/R/Hybrid Oak	38.9 MBF	\$ 105.00/MBF	\$ _____
Quaking Aspen	49.6 MBF	\$ 72.00/MBF	\$ _____
Red Maple	13.8 MBF	\$ 68.00/MBF	\$ _____
Red Oak	41.7 MBF	\$ 99.00/MBF	\$ _____
Red Pine	49.2 MBF	\$ 92.00/MBF	\$ _____
Sugar Maple	14.5 MBF	\$ 237.00/MBF	\$ _____
White Oak	7.2 MBF	\$ 52.00/MBF	\$ _____
White Pine	24.9 MBF	\$ 59.00/MBF	\$ _____
<b>Pulpwood</b>			
Balsam Fir	5 Cords	\$ 26.00/Cord	\$ _____
Jack Pine	19 Cords	\$ 11.85/Cord	\$ _____
Mixed Aspen	188 Cords	\$ 26.05/Cord	\$ _____
Mixed Hardwood	356 Cords	\$ 14.40/Cord	\$ _____
Mixed Oak	122 Cords	\$ 16.20/Cord	\$ _____
Red Pine	31 Cords	\$ 35.20/Cord	\$ _____
White Pine	69 Cords	\$ 34.50/Cord	\$ _____

\*The volumes are statistically estimated within plus (+) or minus (-) 20.60 percent at 95% confidence level. These estimated volumes are final and not subject to adjustment. Prospective bidders are urged to examine this timber and to make their own estimates of quantity and quality.

I understand that any or all bids may be rejected. All bids must be signed and all bid items must be bid or the bid form may be rejected. I also understand that consideration and awarding a contract will be based upon my past performance and ability to complete the contract based upon equipment and staffing subject to my control.

FEDERAL ID: \_\_\_\_ - \_\_\_\_ - \_\_\_\_ or SOCIAL SECURITY NUMBER: \_\_\_\_ - \_\_\_\_ - \_\_\_\_

Company or individual bidding: \_\_\_\_\_

Company representative's name: \_\_\_\_\_

Address: \_\_\_\_\_

City: \_\_\_\_\_ State: \_\_\_\_\_ Zip: \_\_\_\_\_

IF AVAILABLE, PLEASE PLACE THE PERSONALIZED LABEL FROM YOUR PROSPECTUS IN THE ABOVE BOX.

Individual or company representative's signature: \_\_\_\_\_ Date: \_\_\_\_\_

Phone number : \_\_\_\_\_ Email (optional): \_\_\_\_\_

**THE WINNING BIDDER MUST COMPLETE THE VERIFICATION OF WORKER'S DISABILITY COMPENSATION ACT COMPLIANCE (ON REVERSE SIDE IF DOUBLE SIDED) WITHIN 21 DAYS OF SALE AWARD DATE**



McGregor School Red Pine (71-021-22)  
T24N, R02E, SEC. 10; T24N, R02E, SEC. 8; T24N, R02E, SEC. 9; Ogemaw

In response to the notice of sale to be held 9:00 a.m. (local time) on December 13, 2022, I am hereby submitting my sealed bid (firm offer) for the following forest products to be cut. Bids for individual species must be at or above the advertised price. All non-responsive bid forms may be rejected.

<u>PRODUCTS &amp; SPECIES</u>	<u>ESTIMATED VOLUME*</u>	<u>ADVERTISED PRICE</u>	<u>BID PRICE/UNIT</u>
<b>Sawtimber</b>			
Quaking Aspen	12.3 MBF	\$ 72.00/MBF	\$ _____
Red Pine	357.0 MBF	\$ 92.00/MBF	\$ _____
<b>Pulpwood</b>			
Jack Pine	8 Cords	\$ 11.85/Cord	\$ _____
Mixed Oak	32 Cords	\$ 16.20/Cord	\$ _____
Quaking Aspen	33 Cords	\$ 26.05/Cord	\$ _____
Red Maple	7 Cords	\$ 14.40/Cord	\$ _____
Red Pine	746 Cords	\$ 35.20/Cord	\$ _____
White Pine	9 Cords	\$ 34.50/Cord	\$ _____

\*The volumes are statistically estimated within plus (+) or minus (-) 26.92 percent at 95% confidence level. These estimated volumes are final and not subject to adjustment. Prospective bidders are urged to examine this timber and to make their own estimates of quantity and quality.

I understand that any or all bids may be rejected. All bids must be signed and all bid items must be bid or the bid form may be rejected. I also understand that consideration and awarding a contract will be based upon my past performance and ability to complete the contract based upon equipment and staffing subject to my control.

FEDERAL ID: \_\_\_\_ - \_\_\_\_ - \_\_\_\_ or SOCIAL SECURITY NUMBER: \_\_\_\_ - \_\_\_\_ - \_\_\_\_

Company or individual bidding: \_\_\_\_\_

Company representative's name: \_\_\_\_\_

Address: \_\_\_\_\_

City: \_\_\_\_\_ State: \_\_\_\_\_ Zip: \_\_\_\_\_

IF AVAILABLE, PLEASE PLACE THE PERSONALIZED LABEL FROM YOUR PROSPECTUS IN THE ABOVE BOX.

Individual or company representative's signature: \_\_\_\_\_ Date: \_\_\_\_\_

Phone number : \_\_\_\_\_ Email (optional): \_\_\_\_\_

**THE WINNING BIDDER MUST COMPLETE THE VERIFICATION OF WORKER'S DISABILITY COMPENSATION ACT COMPLIANCE (ON REVERSE SIDE IF DOUBLE SIDED) WITHIN 21 DAYS OF SALE AWARD DATE**



# TIMBER SALE VERIFICATION OF WORKER'S DISABILITY COMPENSATION ACT COMPLIANCE

As required by Act 317, P.A. 1969 (Worker's Compensation) and  
Part 5 of Act 451 of 1994, as amended.

FOR DEPARTMENT USE ONLY	
Sale Number (XX - XXX - XX - XX)	
Forest Management Unit:	

## VERIFICATION OF WORKER'S DISABILITY COMPENSATION ACT COMPLIANCE

- This verification must be completed and submitted within 21 days of contract award and prior to the issuance of the timber sale contract.
- In addition, if boxes 2B or 2C are checked, then Notice of Exclusion or Certificate of Insurance must be submitted within twenty-one (21) days of the contract award and prior to the issuance of the timber sale contract.
- All information must be typed or printed except for written signatures.

Please Check Appropriate Categories:

1. My business is organized as (you **must** check one of the boxes below):
  - A.  Sole Proprietorship (individual)
  - B.  Partnership
  - C.  Corporation
2. You **must** check one of the boxes below:
  - A.  I certify my business is a sole proprietorship and it has no employees but the sole proprietor. I am not subject to the Worker's Compensation Laws.
  - B.  I certify my business has satisfied its obligation to the Worker's Compensation Act through the use of an approved Notice of Exclusion (BWC-337, Rev. 5/96). I will provide a copy of the Notice of Exclusion within 21 days of the contract award. (For questions or a copy of the BWC-337, please call the Worker's Compensation Bureau at 517-322-1195).
  - C.  I certify my business has a Worker's Compensation Policy. I will provide an original Certificate of Insurance within twenty-one (21) days of the contract award.
3. If you have checked item 2(A) or 2(B), you **must** indicate the number of **both** full-time and part-time employees, other than yourself, including family members and active partners (if none, you must enter "0").

\_\_\_\_\_ Full-time Employees

\_\_\_\_\_ Part-time Employees

Name of Business		Federal ID (or) Social Security No.	
Address		Telephone (       )	
City	State	ZIP	

*I hereby certify that the above information is true and correct. I agree to notify the Michigan DNR of any changes that occur in factors affecting my coverage during any of my present and future operations.*

\_\_\_\_\_  
Signature of Owner or Authorized Representative

\_\_\_\_\_  
Title

\_\_\_\_\_  
Date

Please complete the "SEALED BID" information on the next page

Damon's Last Ridge (71-024-22)

T24N, R01E, SEC. 1; T24N, R01E, SEC. 11; T24N, R01E, SEC. 12; T24N, R01E,

In response to the notice of sale to be held 9:00 a.m. (local time) on December 13, 2022, I am hereby submitting my sealed bid (firm offer) for the following forest products to be cut. Bids for individual species must be at or above the advertised price. All non-responsive bid forms may be rejected.

<u>PRODUCTS &amp; SPECIES</u>	<u>ESTIMATED VOLUME*</u>	<u>ADVERTISED PRICE</u>	<u>BID PRICE/UNIT</u>
<b>Sawtimber</b>			
B. T. Aspen	433.6 MBF	\$ 72.00/MBF	\$ _____
Bl/R/Hybrid Oak	147.5 MBF	\$ 105.00/MBF	\$ _____
Jack Pine	16.7 MBF	\$ 21.00/MBF	\$ _____
Quaking Aspen	91.7 MBF	\$ 72.00/MBF	\$ _____
Red Maple	72.2 MBF	\$ 68.00/MBF	\$ _____
Red Oak	362.6 MBF	\$ 99.00/MBF	\$ _____
Red Pine	188.4 MBF	\$ 92.00/MBF	\$ _____
White Oak	58.4 MBF	\$ 52.00/MBF	\$ _____
<b>Pulpwood</b>			
Jack Pine	71 Cords	\$ 11.85/Cord	\$ _____
Mixed Aspen	2,050 Cords	\$ 26.05/Cord	\$ _____
Mixed Hardwood	924 Cords	\$ 14.40/Cord	\$ _____
Mixed Oak	1,038 Cords	\$ 16.20/Cord	\$ _____
Red Pine	142 Cords	\$ 35.20/Cord	\$ _____
White Pine	8 Cords	\$ 34.50/Cord	\$ _____

\*The volumes are statistically estimated within plus (+) or minus (-) 10.32 percent at 95% confidence level. These estimated volumes are final and not subject to adjustment. Prospective bidders are urged to examine this timber and to make their own estimates of quantity and quality.

I understand that any or all bids may be rejected. All bids must be signed and all bid items must be bid or the bid form may be rejected. I also understand that consideration and awarding a contract will be based upon my past performance and ability to complete the contract based upon equipment and staffing subject to my control.

FEDERAL ID: \_\_\_\_\_ - \_\_\_\_\_ or SOCIAL SECURITY NUMBER: \_\_\_\_\_ - \_\_\_\_\_ - \_\_\_\_\_

Company or individual bidding: \_\_\_\_\_

Company representative's name: \_\_\_\_\_

Address: \_\_\_\_\_

City: \_\_\_\_\_ State: \_\_\_\_\_ Zip: \_\_\_\_\_

IF AVAILABLE, PLEASE PLACE THE PERSONALIZED LABEL FROM YOUR PROSPECTUS IN THE ABOVE BOX.

Individual or company representative's signature: \_\_\_\_\_ Date: \_\_\_\_\_

Phone number : \_\_\_\_\_ Email (optional): \_\_\_\_\_

**THE WINNING BIDDER MUST COMPLETE THE VERIFICATION OF WORKER'S DISABILITY COMPENSATION ACT COMPLIANCE (ON REVERSE SIDE IF DOUBLE SIDED) WITHIN 21 DAYS OF SALE AWARD DATE**



FOR DEPARTMENT USE ONLY	
Sale Number (XX - XXX - XX - XX)	
Forest Management Unit:	

## TIMBER SALE VERIFICATION OF WORKER'S DISABILITY COMPENSATION ACT COMPLIANCE

As required by Act 317, P.A. 1969 (Worker's Compensation) and  
Part 5 of Act 451 of 1994, as amended.

### VERIFICATION OF WORKER'S DISABILITY COMPENSATION ACT COMPLIANCE

- This verification must be completed and submitted within 21 days of contract award and prior to the issuance of the timber sale contract.
- In addition, if boxes 2B or 2C are checked, then Notice of Exclusion or Certificate of Insurance must be submitted within twenty-one (21) days of the contract award and prior to the issuance of the timber sale contract.
- All information must be typed or printed except for written signatures.

Please Check Appropriate Categories:

1. My business is organized as (you **must** check one of the boxes below):
  - A.  Sole Proprietorship (individual)
  - B.  Partnership
  - C.  Corporation
2. You **must** check one of the boxes below:
  - A.  I certify my business is a sole proprietorship and it has no employees but the sole proprietor. I am not subject to the Worker's Compensation Laws.
  - B.  I certify my business has satisfied its obligation to the Worker's Compensation Act through the use of an approved Notice of Exclusion (BWC-337, Rev. 5/96). I will provide a copy of the Notice of Exclusion within 21 days of the contract award. (For questions or a copy of the BWC-337, please call the Worker's Compensation Bureau at 517-322-1195).
  - C.  I certify my business has a Worker's Compensation Policy. I will provide an original Certificate of Insurance within twenty-one (21) days of the contract award.
3. If you have checked item 2(A) or 2(B), you **must** indicate the number of **both** full-time and part-time employees, other than yourself, including family members and active partners (if none, you must enter "0").

\_\_\_\_\_ Full-time Employees

\_\_\_\_\_ Part-time Employees

Name of Business		Federal ID (or) Social Security No.	
Address		Telephone (       )	
City	State	ZIP	

*I hereby certify that the above information is true and correct. I agree to notify the Michigan DNR of any changes that occur in factors affecting my coverage during any of my present and future operations.*

\_\_\_\_\_  
Signature of Owner or Authorized Representative

\_\_\_\_\_  
Title

\_\_\_\_\_  
Date

Please complete the "SEALED BID" information on the next page