



**DEPARTMENT OF NATURAL RESOURCES
STATE OF MICHIGAN
TIMBER SALE PROSPECTUS #7159**

SCHEDULED SALE DATE AND TIME: 9:00 a.m. (local time) on February 2, 2023.

LOCATION: BARAGA MGMT UNIT, 427 US 41 NORTH, BARAGA, MI 49908.

PROSPECTUS NOTE: Contact Dan McNamee 906-235-5830 for questions regarding timber sales 12-012-22 Miners Mix or 12-015-22 Pipeline Post.

The bidder is advised to inspect the sale area and review the location, estimated volumes, operating costs and contract terms of proposed sales. Please be aware that some landowners may request 60 days or more notice for access across their land.

Notice is hereby given that bids will be received by the Unit Manager, CRYSTAL FALLS MANAGEMENT UNIT, for certain timber on the following described lands:

Miners Mix (12-012-22) / T41N, R29W, SEC. 10, N1/2NW.
T41N, R29W, SEC. 17, N1/2NW, SENW, NWNE.
T41N, R29W, SEC. 18, NENE.
T41N, R29W, SEC. 3, SW, N1/2SE.
T41N, R29W, SEC. 4, S1/2SE.
T41N, R29W, SEC. 7, SESE.
T41N, R29W, SEC. 8, E1/2NE, S1/2SW, SESE.
T41N, R29W, SEC. 9, N1/2NW, SWNW, N1/2NE, NWSW, SWSE.
Dickinson County, Advertised Price \$103,832.40, 162.4 Acres, Aspen, Red Pine.

SALE NOTE: This sale has operation restrictions and cautions, see specs 5.2.3 and 5.2.22.

A recreation site such as a trail, pathway, or campground is within the sale area or the vicinity. Certain restrictions/specifications may be applicable including time restrictions. Access may be through private land.

Pipeline Post (12-015-22) / T43N, R28W, SEC. 21, NESW, N1/2SE, SESE.
T43N, R28W, SEC. 28, N1/2NW, SENW, N1/2NE, SWNE, SW.
T43N, R28W, SEC. 28, SWSE.
T43N, R28W, SEC. 33, NWNE.
Dickinson County, Advertised Price \$46,913.30, 214.9 Acres, Aspen, Hardwood.

SALE NOTE: Escanaba & Lake Superior Railroad will need to be contacted for permission to cross their tracks to access Payment Unit 1. Road construction will be needed to access Payment Unit 1. Enbridge Pipeline will need to be contacted for permit/permission prior to crossing, hauling or operating within their easement. Payment Unit 1 is recommended for winter or dry summer operations.

BID INSTRUCTIONS (VER. 10/10/2022):

1. Scheduled Bid Location, Date, and Time (2/11)

Bids must be received by the Unit Manager, BARAGA OFFICE, 427 US 41 North, Baraga, MI 49908, no later than 9:00 a.m. (local time) on February 2, 2023. For further information concerning this sale, contact Brad Carlson at 906-353-6651.

2. Bidder's Qualifications (10/22)

If all or part of a timber sale was prepared by a private contractor, the contractor and that contractor's company are not permitted to bid on the timber sale. A person must be 18 years of age or older to purchase timber. Permanent employees of the Department of Natural Resources or members of their immediate household may not bid. Former employees, in the permanent or seasonal class, may not bid until 3 months after the last day of active duty. Bids will not be accepted from individuals or companies appearing on the DNR/FRD No-Bid List. This list contains the names of purchasers who previously failed to execute a contract within 21-days or who have a history of poor performance.

3. Preparation of Sealed Bids (5/16)

Bid Forms may be completed online thru Michigan DNR Timber Sale Online Bidding (OLB) at www.michigan.gov/timberbidding or by completing the hardcopy Bid Form found in the Timber Sale Prospectus. Hardcopy Bid Forms shall be manually signed in ink. Registration in OLB is considered your 'signature' for all bids submitted thru that system. Bid prices must be entered for each species and product in the Bid Price column for all material subject to bidding and all fill-in blanks must be completed. If erasures or other changes appear on the hardcopy Bid Form, each erasure or change must be initialed by the person signing the bid.

4. Submission of Sealed Bids (5/16)

Bid forms may be obtained from the Unit Manager or thru OLB. Bids may be submitted hardcopy or thru OLB. All hardcopy bids must be submitted on the bid form and in an envelope clearly identified as described in this section. NOTE: Only one bid form per bid envelope. Sealed bids must be submitted to the Unit office designated in the prospectus and must be submitted at or prior to the time established in the prospectus. The envelope should show on the outside (a) the sale name or number and (b) the date and time of bid opening, as shown in the prospectus. Bids received after the time specified in the sale prospectus are late bids and will be rejected.

It is possible for a bidder to submit multiple bids on a single sale. For example, a bid may be submitted hardcopy and a bid may be submitted thru OLB. Or, two bidders from the same company could both submit bids on the same sale. If this were to happen, the State would accept all bids received and award the contract accordingly. All bidding and contractual requirements would apply to all bids received.

5. Public Opening of Sealed Bids (7/16)

If conditions permit, the sealed bids will be publicly opened and posted at the time and place set in the prospectus.

If a bidder, present at a bid opening, has submitted bids on more than one sale, that bidder may withdraw their unopened bid envelopes or announce the withdrawal of their online bid after being declared the successful bidder on one sale.

6. Award of Contract (1/11)

Award of the contract will be made to the Bidder whose bid, conforming to the prospectus, is most advantageous to the State of Michigan on the basis of total value at rates bid for the estimated quantities. The State reserves the right to reject any bid or waive any minor irregularity in bids received. A written award mailed (or otherwise furnished) to the successful Bidder shall be deemed to result in a binding contract without further action by either party.

7. Down Payment (1/11)

The Bidder to whom award is made must make a down payment within 21 days of the sale award. The amount of the down payment will be calculated as shown in the Bond and Payment Schedule of this prospectus. Only cash may be used to meet this requirement.

8. Performance Security (1/11)

As guarantee of faithful performance, a cash bond, certificate of deposit, surety bond or irrevocable letter of credit (LOC) is required within 21 days of the sale award. The amount of the performance security is shown in the Bond and

Payment Schedule of this prospectus. If an LOC or surety is used, the coverage must extend for at least 6 months beyond the contract expiration.

9. Worker's Compensation (10/22)

Purchaser shall obtain worker's compensation insurance to cover claims under Michigan's Worker's Disability Compensation Act of 1969 or similar employee benefit act of any other state applicable to an employee. Verification of Worker's Disability Compensation Act Compliance must be completed and submitted within 21 days of contract award and prior to the issuance of the timber sale contract. In addition, if applicable, Notice of Exclusion or Certificate of Insurance must also be submitted.

10. Timber Sale Contract (10/22)

Additional conditions and requirements common to all timber sales are listed on the timber sale contract (R4031) and are available on line at www.michigan.gov/timber. Contact the Unit Manager for additional information or a sample contract. Within 21 days of the date of the award letter, the bidder must sign the contract and provide the required down payment, performance security, and verification of worker's disability compensation. The down payment and performance security shall be in accordance with the provisions of the timber sale contract, in the sums stated in this prospectus. If these actions are not taken, then the Bidder, the Bidder's corporation, and the corporation's principals may not be permitted to bid on State timber sales for a period of 3 months after the first offense, 6 months after the second offense, and 1 year after the third offense. An offense will only be counted against the Bidder for 5 years. In addition, the Bidder certifies that if awarded this contract, the Bidder will complete the timber sale contract in accordance with its terms and any modifications thereof including requirements to purchase, cut, and remove the included timber by the expiration date.

Payment Unit values in the State Forest Timber Sale Contract are calculated based on the advertised value of the Payment Unit as a percentage of the total advertised value of the contract. The advertised value of each Payment Unit is given in the Description of Timber by Payment Unit table on the Timber Sale Information page. For example, if the value of Payment Unit 1 is advertised as \$1,500 and the total Timber Sale value is advertised as \$10,000, the contract price for Payment Unit 1 will be 15% of the total bid price ($\$1,500/\$10,000 * 100$).

11. Disclaimer of Estimates and Bidder's Warranty of Inspection (10/22)

Before submitting this bid, the Bidder is advised and cautioned to inspect the sale area, review the requirements of the sale contract, and take other steps as may be reasonably necessary to ascertain the location, estimated volumes, construction estimates, and operating costs of the proposed sale. Failure to do so will not relieve the Bidder from responsibility for completing the contract.

The Bidder warrants that this bid is submitted solely on the basis of the Bidder's examination and inspection of the quality and quantity of the timber offered for sale and the Bidder's opinion of the value thereof and the costs of recovery. No reliance should be placed on the State of Michigan's estimates of timber quality, quantity or costs of recovery. Bidder further acknowledges that the State of Michigan: (i) expressly disclaims any warranty of fitness of timber for any purpose; (ii) offers this timber as is without any warranty of quality (merchantability) or quantity and (iii) expressly disclaims any warranty as to the quantity or quality of timber sold.

12. Certification and Chain-of-Custody (10/22)

Unless otherwise indicated in the contract under section 7 – Other Conditions of the Sale Specific Conditions & Requirements, the area encompassed by this timber sale is certified to the standards of the Forest Stewardship Council (FSC) - Certificate #SCS-FM/COC-00090N and the Sustainable Forestry Initiative (SFI) - Certificate #NSF-SFIS-5Y031-SF5. Forest products from this sale may be delivered to the mill as "FSC 100% and / or SFI certified" as long as the contractor hauling the forest products is chain-of-custody (COC) certified or covered under a COC certificate from the destination mill. The purchaser is responsible for maintaining COC after leaving the sale area.

13. Good Neighbor Authority (GNA) Requirements (10/22)

If the name of this timber sales contains the acronym GNA, it is authorized by the Good Neighbor Authority (GNA) and covered by various agreements between the U.S. Forest Service and the State. The timber sale occurs on federal land and the following conditions apply:

GNA contracts on US Forest Service land will not be awarded to purchasers on the Federal list of excluded parties. The System for Award Management (SAM) will be checked for active excluded parties prior to award of contract. In

addition, the Bidder to whom award is made must complete an Assurance Regarding Felony Conviction or Tax Delinquent Status for Corporate Applicants (AD-3031).

14. Good Neighbor Authority (GNA) Requirements, con't (10/22)

Bidder certifies, by signing this bid form, that to the best of Bidder's knowledge that the following representations are accurate and complete.

- a. That the Bidder and its principals are not presently debarred, suspended, proposed for debarment, declared ineligible, or voluntary excluded from timber sales (covered transactions) by any Federal department or agency.
- b. That the Bidder and its principals have not within a 3-year period preceding this bid been convicted of or had a civil judgment rendered against them for commission of fraud or a criminal offense in connection with obtaining , attempting to obtain, or performing a public (Federal, State, or local) transaction or contract under a public transaction; violation of Federal or State antitrust statutes or commission of embezzlement, theft, forgery, bribery, falsification or destruction of records, making false statements, or receiving stolen property.
- c. That the Bidder and its principals are not presently indicted for or otherwise criminally or civilly charged by a governmental entity (Federal, State, or local) with commission of any of the offenses enumerated in paragraph b of this certification.
- d. That the Bidder and its principals have not within a 3-year period preceding this bid had one or more public transactions (Federal, State, or local) terminated for breach or default of a timber or forest product contract.

Bidders that cannot certify this requirement, in whole or in part, shall submit an explanation with their bid.

DAN EICHINGER
Director

TIMBER SALE INFORMATION

Miners Mix (12-012-22)

T41N, R29W, SEC. 10; T41N, R29W, SEC. 17; T41N, R29W, SEC. 18; T41N, R29W, SEC. 3; T41N, R29W, SEC. 4; T41N, R29W, SEC. 7; T41N, R29W, SEC. 8; T41N, R29W, SEC. 9.

SALE NOTE: This sale has operation restrictions and cautions, see specs 5.2.3 and 5.2.22.

A recreation site such as a trail, pathway, or campground is within the sale area or the vicinity. Certain restrictions/specifications may be applicable including time restrictions. Access may be through private land.

A timber sale contract for this lump sum, sealed bid timber sale will be awarded to the responsible bidder offering the highest sealed bid price. All units of volume listed below were estimated using the Inventory Manager computer program and the new Michigan taper model. Bids must be at or above the following advertised price for each product and species:

<u>PRODUCTS & SPECIES</u>	<u>ESTIMATED UNITS*</u>	<u>ADVERTISED PRICE</u>
Sawtimber		
Basswood	2.1 MBF	\$ 91.00 / MBF
Paper Birch	20.1 MBF	\$ 83.00 / MBF
Red Maple	40.3 MBF	\$ 127.00 / MBF
Red Pine	198.4 MBF	\$ 98.00 / MBF
Sugar Maple	21.8 MBF	\$ 229.00 / MBF
Yellow Birch	1.9 MBF	\$ 65.00 / MBF
Pulpwood		
Balsam Fir	79 Cords	\$ 8.65 / Cord
Mixed Aspen	1,659 Cords	\$ 26.80 / Cord
Mixed Hardwood	750 Cords	\$ 10.65 / Cord
Red Pine	494 Cords	\$ 37.75 / Cord
White Pine	6 Cords	\$ 12.70 / Cord
White Spruce	35 Cords	\$ 12.55 / Cord

* The total volume is statistically estimated within plus (+) or minus (-) 13.23 percent. There are an estimated 3,544 cords on this timber sale, plus or minus 469 cords at the 95% confidence level. The estimated units are final and not subject to adjustment. Prospective bidders are urged to examine this timber and to make their own estimates of quantity and quality.

BOND AND PAYMENT SCHEDULE:

1. A bond in the amount of \$7,268.00 to insure faithful performance of the conditions of the contract will be deposited by the successful bidder within 21 days of the sale award.
2. Cutting in any sale or unit without the required advance payment would be considered a trespass.
3. Total payment must be paid in advance or according to the following schedule :
 - (a) Ten percent (10%) of the sale value must be paid within 21 days of the sale award.
 - (b) The 10% down payment will be credited towards the first unit cut.
 - (c) Payment for each of the following units must be made before cutting begins in that unit:

PAYMENT UNIT NUMBER	PERCENT OF TOTAL SALE VALUE
01	12.8%
02	8.1%
03	10.2%
04	8.9%
05	9.1%
06	12.4%
07	6.2%
08	6.1%
09	13.6%
10	7.8%
11	4.8%

4. If no cutting takes place, the 10% down payment will not be refunded.
5. Operations on the contract issued will terminate on 06/30/2025.

SALE STATISTICS

Volumes were calculated in cubic feet using the Michigan taper model. Cubic foot volume includes all wood inside bark for the product indicated. For display purposes, cubic feet were converted to cords and MBF using a simple conversion factor, e.g. 79 cubic feet per cord and 185 cubic feet per MBF. The cubic foot volumes are precise; the cords and MBF volumes are not. Cubic foot volume cannot be directly converted to cords or boards with precision.

SALE VOLUMES

The total estimated sale volume may not equal the sum of the species/products due to the nature of statistical calculations associated with double sampling methodology.

VOLUME			STATISTICAL RANGE IN CORDS	
TOTAL CUBIC FEET	TOTAL CORDS	PERCENT ERROR	MINIMUM	MAXIMUM
279,948	3,544	13.23%	3,075	4,013

VDU VOLUMES

A VDU is a Volume Determination Unit. Volumes and their associated statistics are calculated at the VDU level and summarized to the sale level. There is often a one to one relationship between a VDU and a Payment Unit, but not always, depending on the cruise design. Refer to the VDU TO PAYMENT UNIT table.

VDU	VOLUME		PERCENT ERROR	RANGE IN CORDS	
	TOTAL CUBIC FEET	TOTAL CORDS		MINIMUM	MAXIMUM
11	27,119	343	35.77%	220	466
12	20,775	263	53.40%	123	403
17	31,056	393	47.07%	208	578
26	19,015	241	66.50%	81	401
35	39,694	502	41.22%	295	710
42	21,980	278	23.83%	212	345
49	28,932	366	42.26%	211	521
50	11,216	142	63.80%	51	233
55	26,348	334	54.33%	152	515
58	18,847	239	33.07%	160	317
71	11,498	146	54.38%	66	225
103	15,114	191	38.97%	117	266
501	4,632	59	63.76%	21	96
502	3,722	47	128.30%	13	108
TOTAL:	279,948	3,544		1,905	5,182

VDU TO PAYMENT UNIT

When a VDU is associated with more than one Payment Unit (PU), the VDU volumes are assigned to the PU based on acres of the VDU within the PU.

VDU	VDU ACRES	PU	PU ACRES
11	13.3	2	13.3
12	10.7	11	10.7
17	11.0	3	11.0
26	10.9	7	10.9
35	15.1	6	15.1
42	9.3	8	9.3
49	9.7	4	9.7
50	6.6	5	6.6
55	13.0	9	13.0
58	24.5	10	24.5
71	16.2	1	16.2
103	12.3	1	12.3
501	5.0	5	5.0
502	4.8	5	4.8
TOTAL:	162.4		162.4

DESCRIPTION OF TIMBER BY PAYMENT UNIT (PU)

PU	MARKET GROUP	PRODUCT	QUANTITY	UNIT	ACRES	ADVERTISE PRICE
1	Red Pine	Sawtimber	16.6	MBF	28.5	\$13,314.85
	Mixed Hardwood	Pulpwood	27	Cords		
	<i>Black Cherry</i>		2	Cords		
	<i>Red Maple</i>		25	Cords		
	Red Pine		302	Cords		
2	Balsam Fir	Pulpwood	17	Cords	13.3	\$8,365.45
	Mixed Aspen		285	Cords		
	<i>B. T. Aspen</i>		130	Cords		
	<i>Quaking Aspen</i>		155	Cords		
	Mixed Hardwood		38	Cords		
	<i>Paper Birch</i>		8	Cords		
	<i>Red Maple</i>		30	Cords		
	White Spruce		14	Cords		
3	Paper Birch	Sawtimber	1.6	MBF	11.0	\$10,586.80
	Mixed Aspen	Pulpwood	371	Cords		
	<i>B. T. Aspen</i>		198	Cords		
	<i>Quaking Aspen</i>		173	Cords		
	Mixed Hardwood		48	Cords		
	<i>Paper Birch</i>		5	Cords		
	<i>Red Maple</i>		43	Cords		
4	Balsam Fir	Pulpwood	15	Cords	9.7	\$9,233.80
	Mixed Aspen		325	Cords		
	<i>Quaking Aspen</i>		325	Cords		
	Mixed Hardwood		37	Cords		
	<i>Paper Birch</i>		9	Cords		
5	Paper Birch	Sawtimber	1.0	MBF	16.4	\$9,434.55
	Red Maple		2.1	MBF		
	Red Pine		57.2	MBF		
	Balsam Fir	Pulpwood	3	Cords		
	Mixed Aspen		33	Cords		
	<i>Quaking Aspen</i>		33	Cords		
	Mixed Hardwood		38	Cords		
	<i>Paper Birch</i>		13	Cords		
	<i>Red Maple</i>		25	Cords		
	Red Pine		56	Cords		
	White Spruce		4	Cords		
6	Paper Birch	Sawtimber	2.2	MBF	15.1	\$12,837.80
	Red Maple		2.7	MBF		
	Red Pine		21.4	MBF		
	Balsam Fir	Pulpwood	6	Cords		
	Mixed Aspen		321	Cords		
	<i>B. T. Aspen</i>		204	Cords		
	<i>Quaking Aspen</i>		117	Cords		
	Mixed Hardwood		117	Cords		
	<i>Paper Birch</i>		39	Cords		
	<i>Red Maple</i>		69	Cords		
	<i>Sugar Maple</i>		9	Cords		
	Red Pine		6	Cords		
	White Spruce		7	Cords		
7	Red Maple	Sawtimber	1.2	MBF	10.9	\$6,451.45
	Sugar Maple		1.9	MBF		
	Balsam Fir	Pulpwood	11	Cords		
	Mixed Aspen		193	Cords		
	<i>B. T. Aspen</i>		173	Cords		

DESCRIPTION OF TIMBER BY PAYMENT UNIT (PU), CON'T

PU	MARKET GROUP	PRODUCT	QUANTITY	UNIT	ACRES	ADVERTISE PRICE
7 con't	<i>Quaking Aspen</i> Mixed Hardwood <i>Paper Birch</i> <i>Red Maple</i> <i>Sugar Maple</i>	<i>Pulpwood</i>	20 56 16 29 11	<i>Cords</i> Cords <i>Cords</i> <i>Cords</i> <i>Cords</i>		
8	Paper Birch Red Maple Red Pine Sugar Maple Yellow Birch Balsam Fir Mixed Hardwood <i>Basswood</i> <i>Paper Birch</i> <i>Red Maple</i> <i>Sugar Maple</i> <i>Yellow Birch</i> Red Pine	Sawtimber Pulpwood	3.5 19.0 7.4 1.5 1.9 3 209 4 33 156 15 1 6	MBF MBF MBF MBF MBF Cords Cords <i>Cords</i> <i>Cords</i> <i>Cords</i> <i>Cords</i> <i>Cords</i> Cords	9.3	\$6,374.00
9	Red Pine Red Pine White Pine	Sawtimber Pulpwood	95.8 124 6	MBF Cords Cords	13.0	\$14,145.60
10	Basswood Paper Birch Red Maple Sugar Maple Mixed Aspen <i>B. T. Aspen</i> <i>Quaking Aspen</i> Mixed Hardwood <i>Basswood</i> <i>Ironwood</i> <i>Paper Birch</i> <i>Red Maple</i> <i>Sugar Maple</i> <i>Yellow Birch</i> White Spruce	Sawtimber Pulpwood	2.1 5.4 15.3 15.9 18 13 5 118 1 7 12 53 40 5 10	MBF MBF MBF MBF Cords <i>Cords</i> <i>Cords</i> Cords <i>Cords</i> <i>Cords</i> <i>Cords</i> <i>Cords</i> <i>Cords</i> <i>Cords</i> Cords	24.5	\$8,088.10
11	Paper Birch Sugar Maple Balsam Fir Mixed Aspen <i>Quaking Aspen</i> Mixed Hardwood <i>Paper Birch</i> <i>Red Maple</i> <i>Sugar Maple</i>	Sawtimber Pulpwood	6.4 2.5 24 113 113 62 9 33 20	MBF MBF Cords Cords <i>Cords</i> Cords <i>Cords</i> <i>Cords</i> <i>Cords</i>	10.7	\$5,000.00
TOTAL:			284.6	MBF		
TOTAL:			3,023	Cords		

Sale Specific Conditions & Requirements

Sale Name: Miners Mix

Sale Number: 12-012-22 Seq#: 1

1 - Sale Area

1.2 - Boundaries

1.2.1 - Painted boundaries (9/19)

The sale boundary and Payment Unit boundaries are marked and identified by blue, red and yellow paint. Exterior sale boundary lines against private property are marked with blue paint. Exterior sale boundary lines against state are marked with red paint. Interior Payment Unit boundaries are marked with yellow paint. Retention patches are marked with red paint; no harvesting activities may occur within these areas. The painted boundary line trees are not Included Timber and are to be protected unless marked with orange paint. Yellow painted trees designating an interior Payment Unit boundary are only to be cut when all surrounding Payment Units have been paid.

2 - Timber Specifications

2.1 - Included Timber

2.1.1 - Clearcut unit(s) with unmerchantable trees (6/14)

Within Payment Unit(s) 2, 3, 4, 6, 7 and 11, cut all trees that are two (2) inches or more at DBH, with the following exceptions:

- Within Payment Units 2, 7 and 11, do not cut red pine, white pine, cedar, hemlock and oak.
- Within Payment Unit 3, do not cut white pine, cedar, hemlock and oak. Also, do not cut sub-merchantable spruce and fir.
- Within Payment Unit 4, do not cut pine, cedar, and hemlock. Also, do not cut sub-merchantable spruce and fir.
- Within Payment Unit 6, do not cut white pine, cedar, hemlock and oak. Also, do not cut green marked trees and spruce/fir measuring 6 inches or less at stump height.

2.1.3 - Cut tree marked unit(s) (12/08)

Within Payment Unit(s) 1, 9 and 10, all trees are designated for cutting when marked with orange paint above and below stump height, regardless of merchantability.

Within Payment Unit(s) 8 and 5, all red and white pine are designated for cutting when marked with orange paint above and below stump height, regardless of merchantability. Additionally, cut all other species 2 inches or greater at DBH, except do not cut cedar, hemlock and oak, or spruce/fir measuring 6 inches or less at stump height.

3 - Payments

3.4 - Damaged Timber

3.4.1 - Damaged timber (7/16)

General Condition and Requirement 3.4 Damaged Timber, defines liquidated damages for undesignated live merchantable trees which are cut or injured.

4 - Transportation

4.1 - Construction

4.1.1 - Stream crossings, general (3/11)

All stream crossing structures will be temporary and therefore, shall be provided by the Purchaser, and must be removed upon completion of the sale. All permits for stream crossings will be provided by the DNR.

4.1.2 - Stream crossings, specific (3/11)

The Mitchell Creek crossing between Payment Units 10 and 11 will require the installation of a temporary crossing. This installation will be performed in accordance with the specifications on the appropriate permits which will be obtained/provided by the DNR. The Purchaser must give adequate notice of intended crossing date and desired method. It is recommended that a notice be given no less than 60 days in advance of intended permit use.

4.1.6 - Road construction (1/09)

All new roads must be approved by the timber sale administrator. Construction of new roads or improvements of existing

roads shall be done in such a way as to minimize the environmental and visual impacts. Merchantable trees shall be cut and utilized unless otherwise directed. Non-merchantable trees shall be severed and laid flat on the ground. Slash shall be scattered, and not left in windrows and kept a minimum of 10 feet back from the road edge. be chipped, utilized or otherwise removed from the sale. Stumps shall be set upright, not left on edge, and be moved at least 10 feet away from the road edge. Disturbed soil shall be feathered into the woods and not left in berms or windrows.

4.1.7 - Road closure (10/11)

All new roads built into the sale must be blocked to vehicle traffic upon completion of the sale. Overgrown roads that are reopened shall be considered new roads. In general, this will require constructing a four (4') foot high berm of stumps and logs covered with earth. These roads must be rendered impassable to cars and trucks. Contact the sale administrator for specific details of design and placement.

4.2 - Maintenance

4.2.1 - Hauling restriction (12/08)

Hauling may be restricted on forest roads by the Unit Manager or his/her representative. The restriction may occur during spring breakup or during wet weather conditions.

4.2.5 - Two wheel drive condition (2/04)

All existing trail roads on and adjacent to the sale area must be passable by two-wheel drive traffic for the duration of the sale.

5 - Operations

5.1 - Notification

5.1.1 - Pre-sale conference (10/16)

A pre-sale conference between the Purchaser and sale administrator is required prior to beginning any operations. The Unit Manager or his/her representative must be contacted at least 10 days in advance to schedule the conference.

5.2 - Conduct of Operations

5.2.1 - Slash

5.2.1.13 - Dispose of slash as directed (12/05)

Slash is to be disposed of as directed by the Sale Administrator.

5.2.3 - Operating Restrictions

5.2.3.1 - Operating restrictions (9/11)

Within Payment Unit(s) 2-7, 9, and 11, unless changed by written agreement, cutting, skidding, and hauling are not permitted from March 1 to May 15. This restriction is to avoid resource damage during spring break up conditions. If prolonged wet weather conditions occur throughout the operating season, the sale administrator may suspend operations until favorable weather and ground conditions are present.

Within Payment Unit(s) 8 and 10, cutting, skidding and hauling are limited to frozen ground conditions. Frozen ground conditions are to be determined by the timber sale administrator.

5.2.3.3 - Bark slippage restriction (3/09)

Within Payment Unit(s) 1, 5, 9, and 10, unless changed by written agreement, cutting and skidding are not permitted during the period of April 15 to July 15. This restriction is because of bark slippage.

5.2.22 - Operating Caution

5.2.22.1 - Operating caution (6/11)

It is recommended, but not required, that within Payment Unit(s) 2, cutting, skidding, and hauling occur during dry summer or frozen winter conditions. The reason for the recommendation is because of wet ground.

5.2.37 - No decking areas (12/08)

No decking is allowed along Snowmobile Trail Number 5 or in boat launch area identified on sale map.

5.2.41 - Snowmobile trail protection (9/11)

Snowmobile Trail Number 5 is shown on the Timber Sale Map. Do not cut or damage posts with orange trail markers or traffic control signs. If the trail is used, it must be maintained and restored to a condition equal to or better than before the sale. The road maintenance/restoration must be done prior to December 1. If the trail road is to be used for hauling during the snowmobile season, then a snow covered base must be left on the trail. Maintain a 20 foot wide slash, debris, and rut free zone daily using the snowmobile trail as the centerline. No decking of forest products will be permitted along the snowmobile trail.

5.4 - Soil Protection

5.4.1 - Rutting restriction, general (7/16)

The Unit Manager or his/her representative may restrict hauling and/or skidding if ruts exceed the specified depth. With the Unit Manager or his/her representative's approval, the Purchaser may return to the area when the risk of rutting has decreased.

6 - Safety and Fire Prevention

6.2 - Signing

6.2.1 - Road posting (10/20)

The Purchaser is responsible for posting and maintaining caution signs on Groveland Mine Rd, Snowmobile Trail Number 5 and Merriman East Rd. prior to beginning operations. The road must be posted at appropriate distances from the sale area to warn of logging activity and truck traffic. Signs must be removed when harvest operations are suspended or completed. The Purchaser will provide these signs.

6.2.2 - Snowmobile trail posting (10/20)

The Purchaser is responsible for posting and maintaining caution signs on Snowmobile Trail Number 5 prior to beginning operations during the snowmobile season (approximately December 1 to March 31). The trail must be posted at appropriate distances from the sale area to warn of logging activity and truck traffic. Signs must be removed when harvest operations are suspended or completed. The Purchaser will provide these signs.



TIMBER SALE MAP

This information provided by authority of Part 525, 1994 PA 451, as amended.

Forest Management Unit Crystal Falls	County Dickinson	Mapped By Jacob Siler	Date 03/24/2022	Page 1	of 2
Township 41N	Range 29W	Section(s) and Subdivision(s) Sections: 3, 4, 7, 8, 9, 10, 17, & 18	Scale 1:15,840		

Cover Type				Density	
A = Aspen	H = Hemlock	N = Marsh	U = Upland Brush	0 = Non Stocked	5 = Pole Timber Medium
B = Paper Birch	J = Jack Pine	O = Oak	UM = Upland Mixed	1 = Seedling Sapling Poor	6 = Pole Timber Well
C = Cedar	L = Lowland Brush	P = Lowland Poplar	V = Bog or Marsh	2 = Seedling Sapling Medium	7 = Saw Timber Poor
D = Treed Bog	LM = Lowland Mixed	Q = Mixed Swamp Conifer	W = White Pine	3 = Seedling Sapling Well	8 = Saw Timber Medium
E = Swamp Hdwoods	M = Mpl, Bch, Brch	R = Red Pine	X = Non Stocked	4 = Pole Timber Poor	9 = Saw Timber Well
F = Spruce Fir	MC = Mixed Conifer	S = Black Spruce	Z = Water		
G = Grass	MD = Mixed Deciduous	T = Tamarack			

Miners Mix

Compartment 72, 71, 113

162.4 Acres

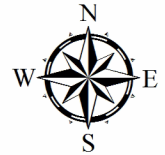

PU	Acres	PU	Acres
1	28.5	7	10.9
2	13.3	8	9.3
3	11.0	9	13.0
4	9.7	10	24.5
5	16.4	11	10.7
6	15.1		

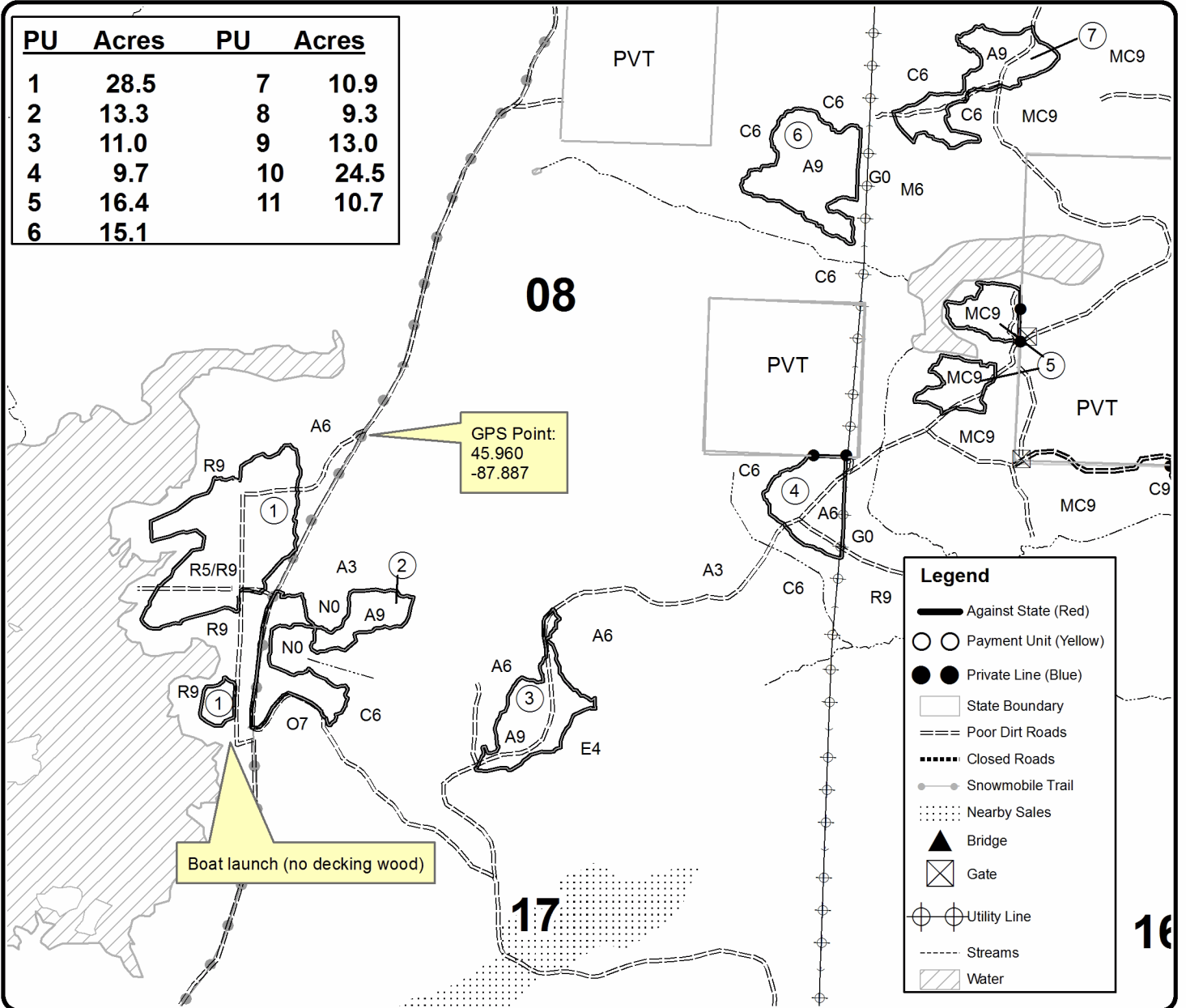

Legend	
	Against State (Red)
	Payment Unit (Yellow)
	Private Line (Blue)
	State Boundary
	Poor Dirt Roads
	Closed Roads
	Snowmobile Trail
	Nearby Sales
	Bridge
	Gate
	Utility Line
	Streams
	Water

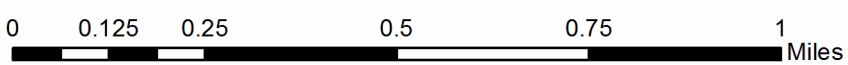



TIMBER SALE MAP

This information provided by authority of Part 525, 1994 PA 451, as amended.

Sale Number	Year
12 - 012	22

Forest Management Unit	County	Mapped By	Date	Page	of
Crystal Falls	Dickinson	Jacob Siler	03/24/2022	2	2
Township	Range	Section(s) and Subdivision(s)	Scale		
41N	29W	Sections: 3, 4, 7, 8, 9, 10, 17, & 18	1:15,840		

Cover Type				Density			
A = Aspen	H = Hemlock	N = Marsh	U = Upland Brush	0 = Non Stocked	5 = Pole Timber Medium		
B = Paper Birch	J = Jack Pine	O = Oak	UM = Upland Mixed	1 = Seedling Sapling Poor	6 = Pole Timber Well		
C = Cedar	L = Lowland Brush	P = Lowland Poplar	V = Bog or Marsh	2 = Seedling Sapling Medium	7 = Saw Timber Poor		
D = Treed Bog	LM = Lowland Mixed	Q = Mixed Swamp Conifer	W = White Pine	3 = Seedling Sapling Well	8 = Saw Timber Medium		
E = Swamp Hdwoods	M = Mpl, Bch, Brch	R = Red Pine	X = Non Stocked	4 = Pole Timber Poor	9 = Saw Timber Well		
F = Spruce Fir	MC = Mixed Conifer	S = Black Spruce	Z = Water				
G = Grass	MD = Mixed Deciduous	T = Tamarack					

Miners Mix

Compartment 72, 71, 113

162.4 Acres



PU	Acres	PU	Acres
1	28.5	7	10.9
2	13.3	8	9.3
3	11.0	9	13.0
4	9.7	10	24.5
5	16.4	11	10.7
6	15.1		

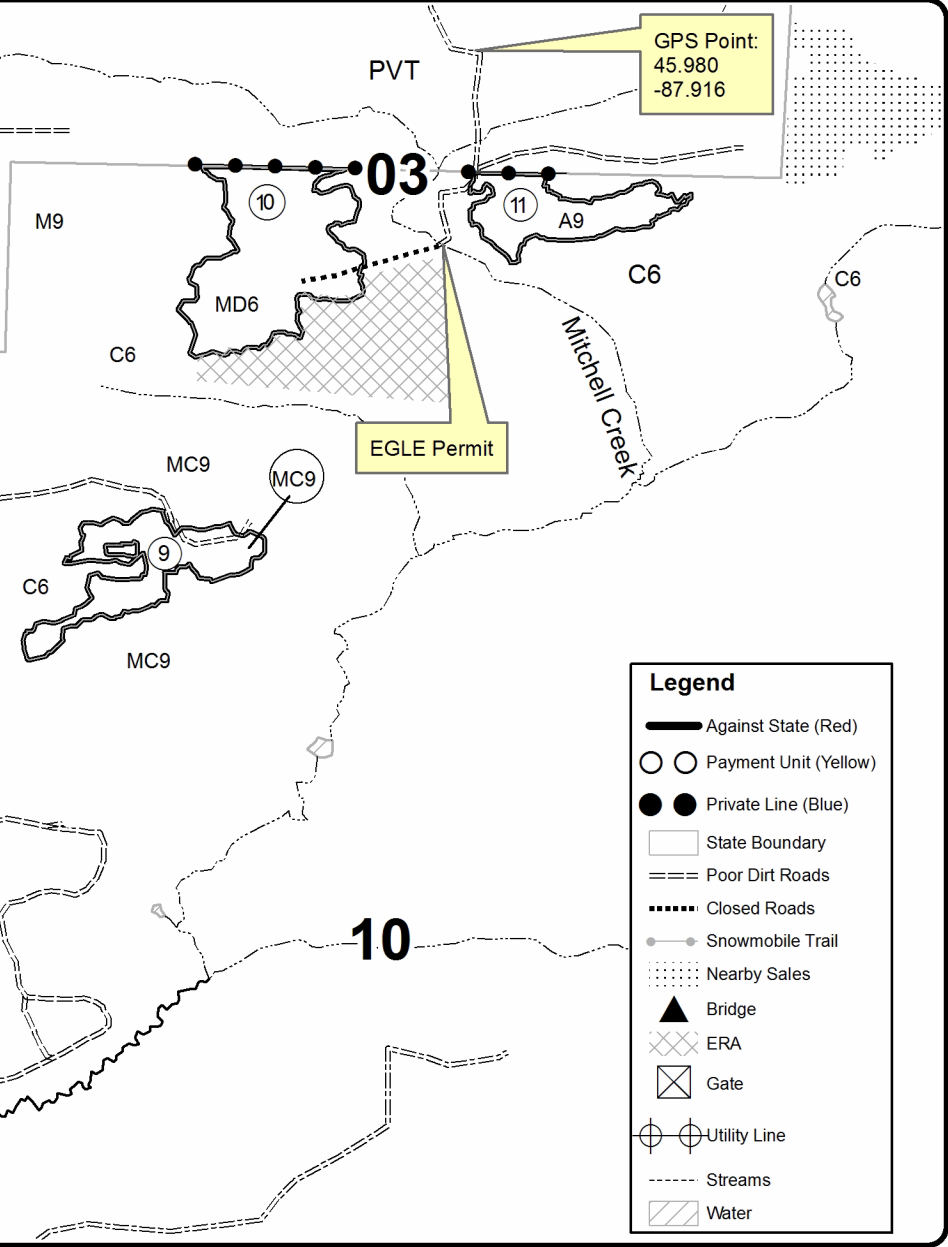

Legend	
	Against State (Red)
	Payment Unit (Yellow)
	Private Line (Blue)
	State Boundary
	Poor Dirt Roads
	Closed Roads
	Snowmobile Trail
	Nearby Sales
	Bridge
	ERA
	Gate
	Utility Line
	Streams
	Water

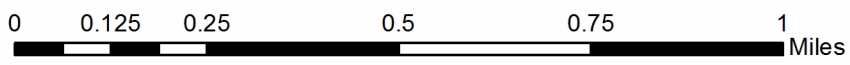

TIMBER SALE INFORMATION

Pipeline Post (12-015-22)

T43N, R28W, SEC. 21; T43N, R28W, SEC. 28; T43N, R28W, SEC. 33.
Dickinson County (Advertised Price \$46,913.30)

SALE NOTE: Escanaba & Lake Superior Railroad will need to be contacted for permission to cross their tracks to access Payment Unit 1. Road construction will be needed to access Payment Unit 1. Enbridge Pipeline will need to be contacted for permit/permission prior to crossing, hauling or operating within their easement. Payment Unit 1 is recommended for winter or dry summer operations.

A timber sale contract for this lump sum, sealed bid timber sale will be awarded to the responsible bidder offering the highest sealed bid price. All units of volume listed below were estimated using the Inventory Manager computer program and the new Michigan taper model. Bids must be at or above the following advertised price for each product and species:

<u>PRODUCTS & SPECIES</u>	<u>ESTIMATED UNITS*</u>	<u>ADVERTISED PRICE</u>
Sawtimber		
Paper Birch	17.9 MBF	\$ 83.00 / MBF
Red Pine	27.1 MBF	\$ 98.00 / MBF
Pulpwood		
Balsam Fir	128 Cords	\$ 8.65 / Cord
Jack Pine	283 Cords	\$ 34.95 / Cord
Mixed Aspen	737 Cords	\$ 26.80 / Cord
Mixed Hardwood	560 Cords	\$ 10.65 / Cord
Mixed Spruce	333 Cords	\$ 12.55 / Cord
Red Pine	38 Cords	\$ 37.75 / Cord
White Pine	35 Cords	\$ 12.70 / Cord

* The total volume is statistically estimated within plus (+) or minus (-) 13.09 percent. There are an estimated 2,226 cords on this timber sale, plus or minus 292 cords at the 95% confidence level. The estimated units are final and not subject to adjustment. Prospective bidders are urged to examine this timber and to make their own estimates of quantity and quality.

BOND AND PAYMENT SCHEDULE:

1. A bond in the amount of \$4,691.00 to insure faithful performance of the conditions of the contract will be deposited by the successful bidder within 21 days of the sale award.
2. Cutting in any sale or unit without the required advance payment would be considered a trespass.
3. Total payment must be paid in advance or according to the following schedule :
 - (a) Ten percent (10%) of the sale value must be paid within 21 days of the sale award.
 - (b) The 10% down payment will be credited towards the first unit cut.
 - (c) Payment for each of the following units must be made before cutting begins in that unit:

PAYMENT UNIT NUMBER	PERCENT OF TOTAL SALE VALUE
01	13.3%
02	3.3%
03	8.1%
04	10.2%
05	14.3%
06	38.9%
07	11.9%
4. If no cutting takes place, the 10% down payment will not be refunded.
5. Operations on the contract issued will terminate on 06/30/2026.

SALE STATISTICS

Volumes were calculated in cubic feet using the Michigan taper model. Cubic foot volume includes all wood inside bark for the product indicated. For display purposes, cubic feet were converted to cords and MBF using a simple conversion factor, e.g. 79 cubic feet per cord and 185 cubic feet per MBF. The cubic foot volumes are precise; the cords and MBF volumes are not. Cubic foot volume cannot be directly converted to cords or boards with precision.

SALE VOLUMES

The total estimated sale volume may not equal the sum of the species/products due to the nature of statistical calculations associated with double sampling methodology.

VOLUME			STATISTICAL RANGE IN CORDS	
TOTAL CUBIC FEET	TOTAL CORDS	PERCENT ERROR	MINIMUM	MAXIMUM
175,887	2,226	13.09%	1,935	2,518

VDU VOLUMES

A VDU is a Volume Determination Unit. Volumes and their associated statistics are calculated at the VDU level and summarized to the sale level. There is often a one to one relationship between a VDU and a Payment Unit, but not always, depending on the cruise design. Refer to the VDU TO PAYMENT UNIT table.

	VOLUME			RANGE IN CORDS	
VDU	TOTAL CUBIC FEET	TOTAL CORDS	PERCENT ERROR	MINIMUM	MAXIMUM
9	24,660	312	27.51%	226	398
32	20,186	256	45.19%	140	371
33	55,840	707	27.59%	512	902
37	30,177	382	38.76%	234	530
40	7,895	100	38.42%	62	138
45	21,736	275	32.13%	187	364
48	15,393	195	39.45%	118	272
TOTAL:	175,887	2,226		1,478	2,974

VDU TO PAYMENT UNIT

When a VDU is associated with more than one Payment Unit (PU), the VDU volumes are assigned to the PU based on acres of the VDU within the PU.

VDU	VDU ACRES	PU	PU ACRES
9	31.2	1	31.2
32	21.9	7	21.9
33	70.7	6	70.7
37	40.4	5	40.4
40	13.8	2	13.8
45	28.1	3	28.1
48	8.8	4	8.8
TOTAL:	214.9		214.9

DESCRIPTION OF TIMBER BY PAYMENT UNIT (PU)

PU	MARKET GROUP	PRODUCT	QUANTITY	UNIT	ACRES	ADVERTISE PRICE	
1	Balsam Fir	Pulpwood	38	Cords	31.2	\$6,252.70	
	Jack Pine		25	Cords			
	Mixed Aspen		133	Cords			
	<i>Quaking Aspen</i>		133	Cords			
	Mixed Hardwood		4	Cords			
	<i>Paper Birch</i>		2	Cords			
	<i>Red Maple</i>		2	Cords			
	Mixed Spruce		115	Cords			
	<i>Black Spruce</i>		54	Cords			
	<i>White Spruce</i>		61	Cords			
2	Paper Birch	Sawtimber	9.0	MBF	13.8	\$1,556.40	
	Mixed Hardwood	Pulpwood	76	Cords			
	<i>Basswood</i>	Sawtimber	0.8	MBF			
	<i>Sugar Maple</i>		4.3	MBF			
	<i>White Ash</i>		2.0	MBF			
	<i>Basswood</i>	Pulpwood	1	Cords			
	<i>Paper Birch</i>		21	Cords			
	<i>Sugar Maple</i>		35	Cords			
	<i>White Ash</i>		4	Cords			
	3	Balsam Fir	Pulpwood	26			Cords
Mixed Aspen		45		Cords			
<i>Quaking Aspen</i>		45		Cords			
Mixed Hardwood		129		Cords			
<i>Paper Birch</i>		25		Cords			
<i>Red Maple</i>		104		Cords			
Mixed Spruce		80		Cords			
<i>Black Spruce</i>		63		Cords			
<i>White Spruce</i>		17		Cords			
4	Red Pine	Sawtimber	4.2	MBF	8.8	\$4,804.50	
	Balsam Fir	Pulpwood	22	Cords			
	Jack Pine		64	Cords			
	Mixed Aspen		38	Cords			
	<i>Quaking Aspen</i>		38	Cords			
	Mixed Spruce		13	Cords			
	<i>White Spruce</i>		13	Cords			
	Red Pine		9	Cords			
	White Pine		35	Cords			
5	Paper Birch		Sawtimber	5.0	MBF	40.4	\$6,706.20
	Balsam Fir	Pulpwood	16	Cords			
	Mixed Aspen		149	Cords			
	<i>B. T. Aspen</i>		23	Cords			
	<i>Quaking Aspen</i>		126	Cords			
	Mixed Hardwood		158	Cords			
	<i>Paper Birch</i>		28	Cords			
	<i>Red Maple</i>		130	Cords			
	Mixed Spruce		38	Cords			
	<i>Black Spruce</i>		30	Cords			
<i>White Spruce</i>	8		Cords				
6	Paper Birch	Sawtimber	1.3	MBF	70.7	\$18,199.25	
	Balsam Fir	Pulpwood	21	Cords			
	Jack Pine		194	Cords			
	Mixed Aspen		345	Cords			
	<i>Quaking Aspen</i>		345	Cords			
	Mixed Hardwood		92	Cords			
	<i>Red Maple</i>		Sawtimber	2.0			MBF
	<i>Paper Birch</i>			Pulpwood			22

DESCRIPTION OF TIMBER BY PAYMENT UNIT (PU), CON'T

PU	MARKET GROUP	PRODUCT	QUANTITY	UNIT	ACRES	ADVERTISE PRICE
6 con't	<i>Red Maple</i>	<i>Pulpwood</i>	66	<i>Cords</i>		
	Mixed Spruce		72	<i>Cords</i>		
	<i>Black Spruce</i>		35	<i>Cords</i>		
	<i>White Spruce</i>		37	<i>Cords</i>		
7	Paper Birch	Sawtimber	2.6	MBF	21.9	\$5,585.50
	Red Pine		22.9	MBF		
	Balsam Fir	Pulpwood	5	<i>Cords</i>		
	Mixed Aspen		27	<i>Cords</i>		
	<i>B. T. Aspen</i>		23	<i>Cords</i>		
	<i>Quaking Aspen</i>		4	<i>Cords</i>		
	Mixed Hardwood		101	<i>Cords</i>		
	<i>Paper Birch</i>		71	<i>Cords</i>		
	<i>Red Maple</i>		30	<i>Cords</i>		
	Mixed Spruce		15	<i>Cords</i>		
	<i>Black Spruce</i>		15	<i>Cords</i>		
	Red Pine		29	<i>Cords</i>		
	TOTAL:			45.0		
TOTAL:			2,114	Cords		

Sale Specific Conditions & Requirements

Sale Name: Pipeline Post

Sale Number: 12-015-22 Seq#: 1

1 - Sale Area

1.2 - Boundaries

1.2.1 - Painted boundaries (9/19)

The sale boundary and Payment Unit boundaries are marked and identified by blue and red. Exterior sale boundary lines against private property are marked with blue paint. Exterior sale boundary lines against state are marked with red paint. The painted boundary line trees are not Included Timber and are to be protected unless marked with orange paint.

2 - Timber Specifications

2.1 - Included Timber

2.1.1 - Clearcut unit(s) with unmerchantable trees (6/14)

Within Payment Unit(s) 1 and 4 - 6, cut all trees that are two (2) inches or more at DBH, with the following exceptions:

- Within Payment Unit 1, do not cut cherry, red pine, white pine, cedar, oak, and hemlock.
- Within Payment Units 3, 5 and 6, do not cut red pine, white pine, cedar, oak, hemlock, or any green painted white birch trees.

2.1.3 - Cut tree marked unit(s) (12/08)

Within Payment Unit(s) 2 & 7, all trees are designated for cutting when marked with orange paint above and below stump height, regardless of merchantability. In addition, within Payment Unit 7, all other species which meet minimum piece specifications are designated for cutting, except do not cut white pine, unmarked red pine, cedar and white birch 8" at DBH and smaller.

4 - Transportation

4.1 - Construction

4.1.6 - Road construction (1/09)

Construction of new roads or improvements of existing roads shall be done in such a way as to minimize the environmental and visual impacts. Merchantable trees shall be cut and utilized unless otherwise directed. Non-merchantable trees shall be severed and laid flat on the ground. Slash shall be scattered, and not left in windrows and kept a minimum of 10 feet back from the road edge. Stumps shall be set upright, not left on edge, and be moved at least 10 feet away from the road edge. Disturbed soil shall be feathered into the woods and not left in berms or windrows.

4.1.7 - Road closure (10/11)

All new roads built into the sale may be blocked to vehicle traffic upon completion of the sale. In general, this will require constructing a four (4') foot high berm of stumps and logs covered with earth.

4.2 - Maintenance

4.2.1 - Hauling restriction (12/08)

Hauling may be restricted on forest roads by the Unit Manager or his representative. The restriction may occur during spring breakup or prolonged wet weather conditions.

4.2.4 - Grading (10/16)

For completion of the sale, state forest roads must be graded. In general, this will require a road grader or bull dozer to shape up the roads after forest products have been hauled off site. This includes cleaning of drainage areas, grading, crowning and filling with gravel, if necessary. The grading equipment to be used must be approved by the Unit Manager or his/her representative.

4.2.5 - Two wheel drive condition (2/04)

All existing trail roads on and adjacent to the sale area must be passable by two-wheel drive traffic for the duration of the sale.

5 - Operations

5.1 - Notification

5.1.3 - Well heads and natural gas pipelines (11/15)

The Purchaser is responsible for contacting the Enbridge pipeline company 30 days prior to operating equipment in the vicinity of well heads or natural gas pipelines. Enbridge will require a site visit and permit to allow operations in and crossing of pipeline right of way. Call Lisa Depew at 219-789-8782 or email glr.crossings@enbridge.com.

5.1.7 - Railroad R.O.W. (3/16)

Escanaba & Lake Superior Railroad Company owns the railroad that will need to be crossed to access Payment Unit 1. Please contact Bob Anderson at 906.542.3214 in order to acquire permission and permit to construct a crossing.

5.2 - Conduct of Operations

5.2.1 - Slash

5.2.1.8 - Slash height (12/08)

No slash or tops in Payment Unit 4 may exceed 24 inches in height.

5.2.3 - Operating Restrictions

5.2.3.3 - Bark slippage restriction (3/09)

Within Payment Unit(s) 2, 3, 4, 6, and 7, unless changed by written agreement, cutting and skidding are not permitted during the period of April 15 to July 15. This restriction is because of bark slippage.

5.2.22 - Operating Caution

5.2.22.1 - Operating caution (6/11)

It is recommended, but not required, that within Payment Unit(s) 1, cutting and skidding occur during dry summer or frozen winter conditions. The reason for the recommendation is because of wet soils, particularly in the east half.

5.2.32 - Decking/landing restoration (9/13)

All decking and landing areas must have the surface area restored to a condition equal to or better than before. This is to ensure the proper regeneration of the stand. Wood debris, chips and "cookies" from trimmings must be removed or scattered away from landing and loading areas and may not be windrowed on the edge.

5.2.37 - No decking areas (12/08)

No decking is allowed on the pipeline without written permission from Enbridge Pipeline.

5.2.38 - No decking against live trees (2/04)

Cut products may not be decked against unmarked or designated leave trees.

5.4 - Soil Protection

5.4.1 - Rutting restriction, general (7/16)

Operations are to cease immediately if equipment and weather conditions result in rutting of roads and/or skid trails which is 12 inches or greater in depth and 50 feet in length. The Unit Manager or his/her representative may restrict hauling and/or skidding if ruts exceed the specified depth. With the Unit Manager or his/her representative's approval, the Purchaser may return to the area when the risk of rutting has decreased.

6 - Safety and Fire Prevention

6.2 - Signing

6.2.1 - Road posting (10/20)

The Purchaser is responsible for posting and maintaining caution signs on Turner Road prior to beginning operations. The road must be posted at appropriate distances from the sale area to warn of logging activity and truck traffic. Signs must be removed when harvest operations are suspended or completed. The Purchaser will provide these signs.



TIMBER SALE MAP

This information provided by authority of Part 525, 1994 PA 451, as amended.

Sale Number	Year
12-015-20	2022

Forest Management Unit	County	Mapped By	Date	Page	of
Crystal Falls Management Unit	Dickinson Co.	Debbie Goupell	9/2/2022	1	2
Township	Range	Section(s) and Subdivision(s)	Scale		
43N	28W	Sec 21: N1/2SE,SESE,NWSW Sec 28:N1/2NW,NWNW,SE,SWNE,SW1/4,SWSE Sec 33: NWNE	1:15,840		

Cover Type				Density	
A = Aspen	H = Hemlock	N = Marsh	U = Upland Brush	0 = Non Stocked	5 = Pole Timber Medium
B = Paper Birch	J = Jack Pine	O = Oak	UM = Upland Mixed	1 = Seedling Sapling Poor	6 = Pole Timber Well
C = Cedar	L = Lowland Brush	P = Lowland Poplar	V = Bog or Marsh	2 = Seedling Sapling Medium	7 = Saw Timber Poor
D = Tread Bog	LM = Lowland Mixed	Q = Mixed Swamp Conifer	W = White Pine	3 = Seedling Sapling Well	8 = Saw Timber Medium
E = Swamp Hdwoods	M = Mpl, Bch, Brch	R = Red Pine	X = Non Stocked	4 = Pole Timber Poor	9 = Saw Timber Well
F = Spruce Fir	MC = Mixed Conifer	S = Black Spruce	Z = Water		
G = Grass	MD = Mixed Deciduous	T = Tamarack			

PU	Acres	PU	Acres
1	31.2	5	40.4
2	13.8	6	70.7
3	28.1	7	21.9
4	8.8		

Pipeline Post Compartment 37 Acres 214.9

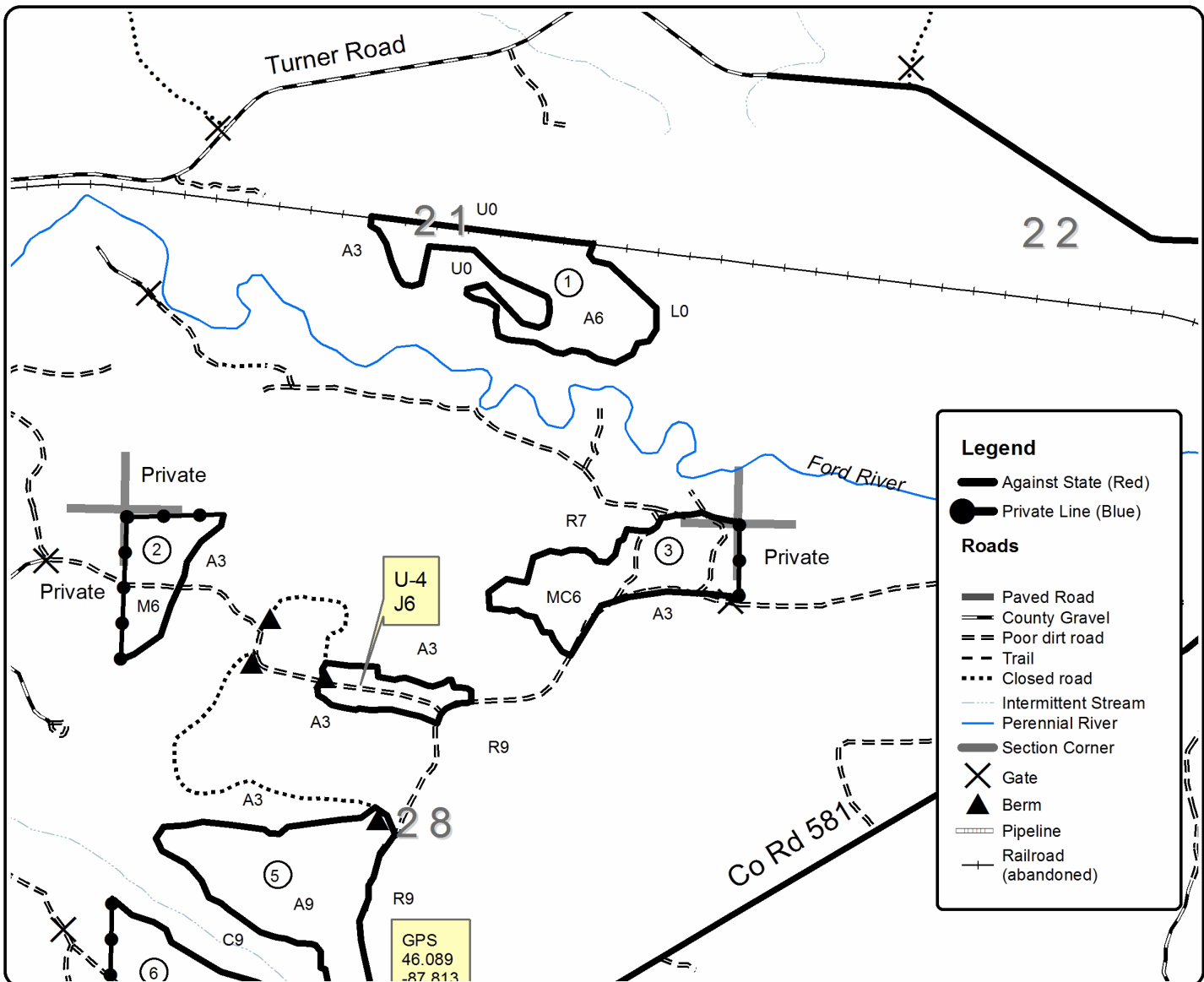



TIMBER SALE MAP

This information provided by authority of Part 525, 1994 PA 451, as amended.

Sale Number	Year
12-015-20	2022

Forest Management Unit	County	Mapped By	Date	Page	of
Crystal Falls Management Unit	Dickinson Co.	Debbie Goupell	9/2/2022	2	2
Township	Range	Section(s) and Subdivision(s)	Scale		
43N	28W	Sec 21: N1/2SE, SESE, NWSW Sec 28: N1/2NW, NWNW, SENW, SWNE, SW1/4, SWSE Sec 33: NWNE	1:15,840		

Cover Type				Density	
A = Aspen	H = Hemlock	N = Marsh	U = Upland Brush	0 = Non Stocked	5 = Pole Timber Medium
B = Paper Birch	J = Jack Pine	O = Oak	UM = Upland Mixed	1 = Seedling Sapling Poor	6 = Pole Timber Well
C = Cedar	L = Lowland Brush	P = Lowland Poplar	V = Bog or Marsh	2 = Seedling Sapling Medium	7 = Saw Timber Poor
D = Treed Bog	LM = Lowland Mixed	Q = Mixed Swamp Conifer	W = White Pine	3 = Seedling Sapling Well	8 = Saw Timber Medium
E = Swamp Hdwoods	M = Mpl, Bch, Brch	R = Red Pine	X = Non Stocked	4 = Pole Timber Poor	9 = Saw Timber Well
F = Spruce Fir	MC = Mixed Conifer	S = Black Spruce	Z = Water		
G = Grass	MD = Mixed Deciduous	T = Tamarack			

PU	Acres	PU	Acres
1	31.2	5	40.4
2	13.8	6	70.7
3	28.1	7	21.9
4	8.8		

Pipeline Post Compartment 37 Acres 214.9

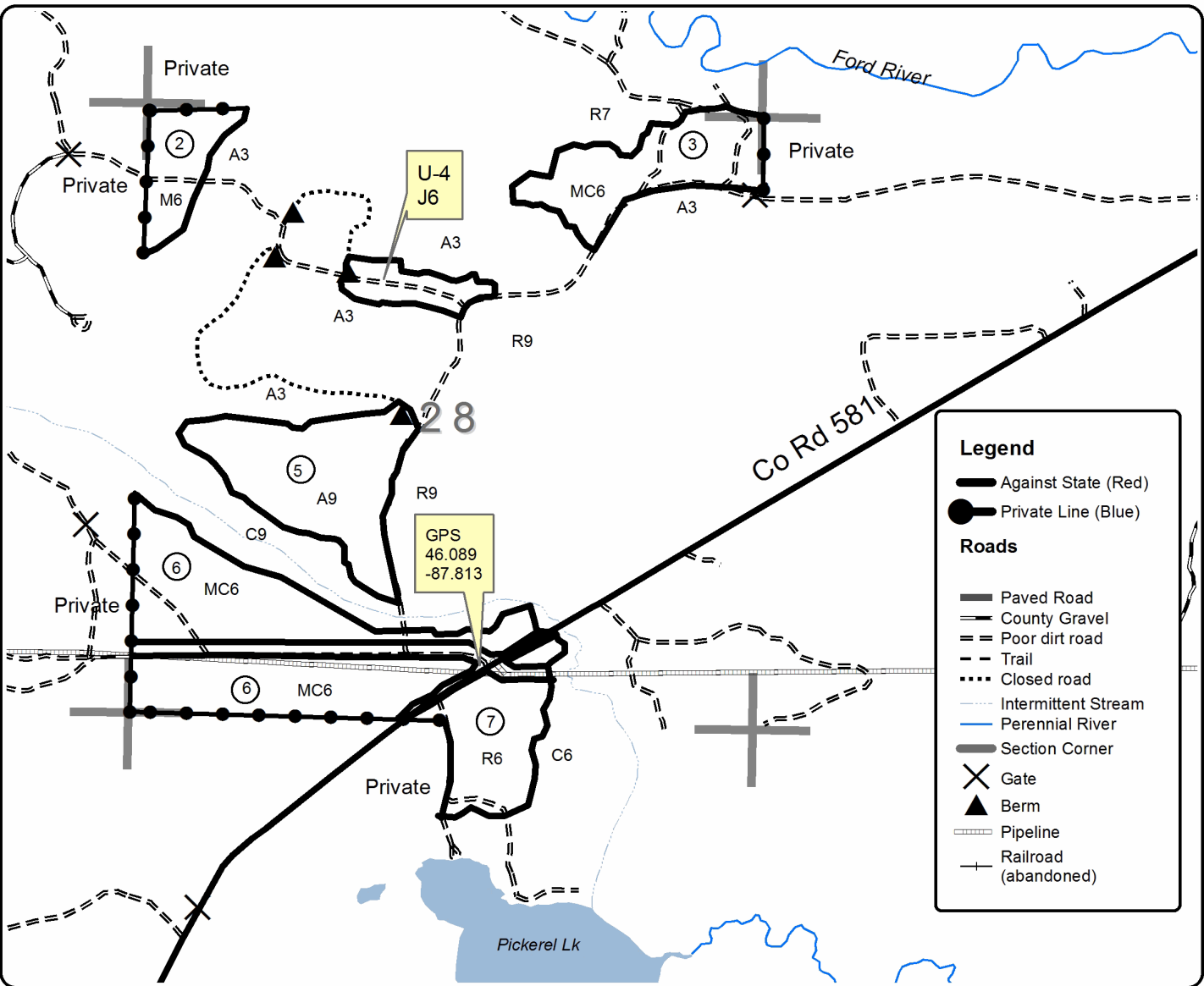
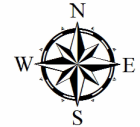

Legend

- Against State (Red)
- Private Line (Blue)

Roads

- Paved Road
- County Gravel
- Poor dirt road
- Trail
- Closed road
- Intermittent Stream
- Perennial River
- Section Corner
- Gate
- Berm
- Pipeline
- Railroad (abandoned)

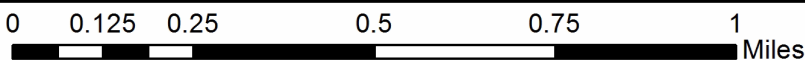

Miners Mix (12-012-22)

T41N, R29W, SEC. 10; T41N, R29W, SEC. 17; T41N, R29W, SEC. 18; T41N,

In response to the notice of sale to be held 9:00 a.m. (local time) on February 2, 2023, I am hereby submitting my sealed bid (firm offer) for the following forest products to be cut. Bids for individual species must be at or above the advertised price. All non-responsive bid forms may be rejected.

<u>PRODUCTS & SPECIES</u>	<u>ESTIMATED VOLUME*</u>	<u>ADVERTISED PRICE</u>	<u>BID PRICE/UNIT</u>
Sawtimber			
Basswood	2.1 MBF	\$ 91.00/MBF	\$ _____
Paper Birch	20.1 MBF	\$ 83.00/MBF	\$ _____
Red Maple	40.3 MBF	\$ 127.00/MBF	\$ _____
Red Pine	198.4 MBF	\$ 98.00/MBF	\$ _____
Sugar Maple	21.8 MBF	\$ 229.00/MBF	\$ _____
Yellow Birch	1.9 MBF	\$ 65.00/MBF	\$ _____
Pulpwood			
Balsam Fir	79 Cords	\$ 8.65/Cord	\$ _____
Mixed Aspen	1,659 Cords	\$ 26.80/Cord	\$ _____
Mixed Hardwood	750 Cords	\$ 10.65/Cord	\$ _____
Red Pine	494 Cords	\$ 37.75/Cord	\$ _____
White Pine	6 Cords	\$ 12.70/Cord	\$ _____
White Spruce	35 Cords	\$ 12.55/Cord	\$ _____

*The volumes are statistically estimated within plus (+) or minus (-) 13.23 percent at 95% confidence level. These estimated volumes are final and not subject to adjustment. Prospective bidders are urged to examine this timber and to make their own estimates of quantity and quality.

I understand that any or all bids may be rejected. All bids must be signed and all bid items must be bid or the bid form may be rejected. I also understand that consideration and awarding a contract will be based upon my past performance and ability to complete the contract based upon equipment and staffing subject to my control.

FEDERAL ID: ____ - ____ - ____ or SOCIAL SECURITY NUMBER: ____ - ____ - ____

Company or individual bidding: _____

Company representative's name: _____

Address: _____

City: _____ State: _____ Zip: _____

IF AVAILABLE, PLEASE PLACE THE PERSONALIZED LABEL FROM YOUR PROSPECTUS IN THE ABOVE BOX.

Individual or company representative's signature: _____ Date: _____

Phone number : _____ Email (optional): _____

THE WINNING BIDDER MUST COMPLETE THE VERIFICATION OF WORKER'S DISABILITY COMPENSATION ACT COMPLIANCE (ON REVERSE SIDE IF DOUBLE SIDED) WITHIN 21 DAYS OF SALE AWARD DATE



TIMBER SALE VERIFICATION OF WORKER'S DISABILITY COMPENSATION ACT COMPLIANCE

As required by Act 317, P.A. 1969 (Worker's Compensation) and
Part 5 of Act 451 of 1994, as amended.

FOR DEPARTMENT USE ONLY	
Sale Number (XX - XXX - XX - XX)	
Forest Management Unit:	

VERIFICATION OF WORKER'S DISABILITY COMPENSATION ACT COMPLIANCE

- This verification must be completed and submitted within 21 days of contract award and prior to the issuance of the timber sale contract.
- In addition, if boxes 2B or 2C are checked, then Notice of Exclusion or Certificate of Insurance must be submitted within twenty-one (21) days of the contract award and prior to the issuance of the timber sale contract.
- All information must be typed or printed except for written signatures.

Please Check Appropriate Categories:

1. My business is organized as (you **must** check one of the boxes below):
 - A. Sole Proprietorship (individual)
 - B. Partnership
 - C. Corporation
2. You **must** check one of the boxes below:
 - A. I certify my business is a sole proprietorship and it has no employees but the sole proprietor. I am not subject to the Worker's Compensation Laws.
 - B. I certify my business has satisfied its obligation to the Worker's Compensation Act through the use of an approved Notice of Exclusion (BWC-337, Rev. 5/96). I will provide a copy of the Notice of Exclusion within 21 days of the contract award. (For questions or a copy of the BWC-337, please call the Worker's Compensation Bureau at 517-322-1195).
 - C. I certify my business has a Worker's Compensation Policy. I will provide an original Certificate of Insurance within twenty-one (21) days of the contract award.
3. If you have checked item 2(A) or 2(B), you **must** indicate the number of **both** full-time and part-time employees, other than yourself, including family members and active partners (if none, you must enter "0").

_____ Full-time Employees

_____ Part-time Employees

Name of Business		Federal ID (or) Social Security No.	
Address		Telephone ()	
City	State	ZIP	

I hereby certify that the above information is true and correct. I agree to notify the Michigan DNR of any changes that occur in factors affecting my coverage during any of my present and future operations.

Signature of Owner or Authorized Representative

Title

Date

Please complete the "SEALED BID" information on the next page

Pipeline Post (12-015-22)

T43N, R28W, SEC. 21; T43N, R28W, SEC. 28; T43N, R28W, SEC. 33; Dickinson

In response to the notice of sale to be held 9:00 a.m. (local time) on February 2, 2023, I am hereby submitting my sealed bid (firm offer) for the following forest products to be cut. Bids for individual species must be at or above the advertised price. All non-responsive bid forms may be rejected.

<u>PRODUCTS & SPECIES</u>	<u>ESTIMATED VOLUME*</u>	<u>ADVERTISED PRICE</u>	<u>BID PRICE/UNIT</u>
Sawtimber			
Paper Birch	17.9 MBF	\$ 83.00/MBF	\$ _____
Red Pine	27.1 MBF	\$ 98.00/MBF	\$ _____
Pulpwood			
Balsam Fir	128 Cords	\$ 8.65/Cord	\$ _____
Jack Pine	283 Cords	\$ 34.95/Cord	\$ _____
Mixed Aspen	737 Cords	\$ 26.80/Cord	\$ _____
Mixed Hardwood	560 Cords	\$ 10.65/Cord	\$ _____
Mixed Spruce	333 Cords	\$ 12.55/Cord	\$ _____
Red Pine	38 Cords	\$ 37.75/Cord	\$ _____
White Pine	35 Cords	\$ 12.70/Cord	\$ _____

*The volumes are statistically estimated within plus (+) or minus (-) 13.09 percent at 95% confidence level. These estimated volumes are final and not subject to adjustment. Prospective bidders are urged to examine this timber and to make their own estimates of quantity and quality.

I understand that any or all bids may be rejected. All bids must be signed and all bid items must be bid or the bid form may be rejected. I also understand that consideration and awarding a contract will be based upon my past performance and ability to complete the contract based upon equipment and staffing subject to my control.

FEDERAL ID: ____ - ____ - ____ or SOCIAL SECURITY NUMBER: ____ - ____ - ____

Company or individual bidding: _____

Company representative's name: _____

Address: _____

City: _____ State: _____ Zip: _____

IF AVAILABLE, PLEASE PLACE THE PERSONALIZED LABEL FROM YOUR PROSPECTUS IN THE ABOVE BOX.

Individual or company representative's signature: _____ Date: _____

Phone number : _____ Email (optional): _____

THE WINNING BIDDER MUST COMPLETE THE VERIFICATION OF WORKER'S DISABILITY COMPENSATION ACT COMPLIANCE (ON REVERSE SIDE IF DOUBLE SIDED) WITHIN 21 DAYS OF SALE AWARD DATE



FOR DEPARTMENT USE ONLY
Sale Number (XX - XXX - XX - XX)
Forest Management Unit:

TIMBER SALE VERIFICATION OF WORKER'S DISABILITY COMPENSATION ACT COMPLIANCE

*As required by Act 317, P.A. 1969 (Worker's Compensation) and
Part 5 of Act 451 of 1994, as amended.*

VERIFICATION OF WORKER'S DISABILITY COMPENSATION ACT COMPLIANCE

- This verification must be completed and submitted within 21 days of contract award and prior to the issuance of the timber sale contract.
- In addition, if boxes 2B or 2C are checked, then Notice of Exclusion or Certificate of Insurance must be submitted within twenty-one (21) days of the contract award and prior to the issuance of the timber sale contract.
- All information must be typed or printed except for written signatures.

Please Check Appropriate Categories:

1. My business is organized as (you **must** check one of the boxes below):
 - A. Sole Proprietorship (individual)
 - B. Partnership
 - C. Corporation
2. You **must** check one of the boxes below:
 - A. I certify my business is a sole proprietorship and it has no employees but the sole proprietor. I am not subject to the Worker's Compensation Laws.
 - B. I certify my business has satisfied its obligation to the Worker's Compensation Act through the use of an approved Notice of Exclusion (BWC-337, Rev. 5/96). I will provide a copy of the Notice of Exclusion within 21 days of the contract award. (For questions or a copy of the BWC-337, please call the Worker's Compensation Bureau at 517-322-1195).
 - C. I certify my business has a Worker's Compensation Policy. I will provide an original Certificate of Insurance within twenty-one (21) days of the contract award.
3. If you have checked item 2(A) or 2(B), you **must** indicate the number of **both** full-time and part-time employees, other than yourself, including family members and active partners (if none, you must enter "0").

_____ Full-time Employees

_____ Part-time Employees

Name of Business		Federal ID (or) Social Security No.	
Address		Telephone ()	
City	State	ZIP	

I hereby certify that the above information is true and correct. I agree to notify the Michigan DNR of any changes that occur in factors affecting my coverage during any of my present and future operations.

Signature of Owner or Authorized Representative

Title

Date

Please complete the "SEALED BID" information on the next page