



**DEPARTMENT OF NATURAL RESOURCES  
STATE OF MICHIGAN  
TIMBER SALE PROSPECTUS #7139**

SCHEDULED SALE DATE AND TIME: 4:00 p.m. (local time) on April 4, 2023.

LOCATION: TRAVERSE CITY MGMT UNIT, 2122 M 37 SOUTH, TRAVERSE CITY, MI 49685.

PROSPECTUS NOTE: Effective immediately: all bid openings for the Traverse City Management Unit (Kalkaska Field Office and Traverse City Field Office) will be held at the Traverse City Field Office regardless of sale location within the unit. All payments will now be handled through the Traverse City Field Office. The Kalkaska Field Office will no longer accept payments or hard paper copies of timber sale bids. Payments for all contracts, use permits, bonds, etc. should be sent to the Traverse City Field Office.

The bidder is advised to inspect the sale area and review the location, estimated volumes, operating costs and contract terms of proposed sales. Please be aware that some landowners may request 60 days or more notice for access across their land.

Notice is hereby given that bids will be received by the Unit Manager, TRAVERSE CITY MANAGEMENT UNIT, for certain timber on the following described lands:

Checkerboard Mix (61-025-22) / T25N, R14W, SEC. 32, NW,SW.

Benzie County, Advertised Price \$22,586.85, 47.3 Acres, Spruce/Fir/Tamarack, Hardwood.

Habbler Road Aspen (61-046-22) / T26N, R13W, SEC. 3, NWSW,S1/2SE.

T26N, R13W, SEC. 4, N1/2NW,NWNE,SENE,NESE.

T26N, R13W, SEC. 5, NENW,NE.

Benzie County, Advertised Price \$94,815.60, 122.0 Acres, Aspen, Hardwood.

SALE NOTE: A recreation site such as a trail, pathway, or campground is within the sale area or the vicinity. Certain restrictions/specifications may be applicable including time restrictions.

Radio Red (61-052-22) / T26N, R09W, SEC. 14, SENE,NESE.

Grand Traverse County, Advertised Price \$16,274.75, 11.9 Acres, Red Pine, Hardwood.

SALE NOTE: Overstory removal with large red pine.

A recreation site such as a trail, pathway, or campground is within the sale area or the vicinity. Certain restrictions/specifications may be applicable including time restrictions.

East Side Pine (61-053-22) / T26N, R09W, SEC. 13, E1/2NW,NE,N1/2SE.

Grand Traverse County, Advertised Price \$71,876.70, 101.4 Acres, Red Pine, Jack Pine.

SALE NOTE: Mixed pine final harvest. Tops must be chipped to prepare site for planting operations.

Blair Townhall Mix (61-054-22) / T26N, R11W, SEC. 24, E1/2NW,W1/2NE,NESW,NWSE,S1/2SE.

Grand Traverse County, Advertised Price \$112,444.00, 89.0 Acres, Hardwood, Aspen.

SALE NOTE: A recreation site such as a trail, pathway, or campground is within the sale area or the vicinity. Certain restrictions/specifications may be applicable including time restrictions.

Ascension Aspen (61-056-22) / T26N, R13W, SEC. 7 , NW,NWSW.

T26N, R14W, SEC. 12, E1/2NE.

Benzie County, Advertised Price \$24,578.30, 53.3 Acres, Aspen, Hardwood.

SALE NOTE: A recreation site such as a trail, pathway, or campground is within the sale area or the vicinity.  
Certain restrictions/specifications may be applicable including time restrictions.

## BID INSTRUCTIONS (VER. 10/10/2022):

### 1. Scheduled Bid Location, Date, and Time (2/11)

Bids must be received by the Unit Manager, TRAVERSE CITY OFFICE, 2122 M 37 South, Traverse City, MI 49685, no later than 4:00 p.m. (local time) on April 4, 2023. For further information concerning this sale, contact Patrick Cotant at 231-649-0544.

### 2. Bidder's Qualifications (10/22)

If all or part of a timber sale was prepared by a private contractor, the contractor and that contractor's company are not permitted to bid on the timber sale. A person must be 18 years of age or older to purchase timber. Permanent employees of the Department of Natural Resources or members of their immediate household may not bid. Former employees, in the permanent or seasonal class, may not bid until 3 months after the last day of active duty. Bids will not be accepted from individuals or companies appearing on the DNR/FRD No-Bid List. This list contains the names of purchasers who previously failed to execute a contract within 21-days or who have a history of poor performance.

### 3. Preparation of Sealed Bids (5/16)

Bid Forms may be completed online thru Michigan DNR Timber Sale Online Bidding (OLB) at [www.michigan.gov/timberbidding](http://www.michigan.gov/timberbidding) or by completing the hardcopy Bid Form found in the Timber Sale Prospectus. Hardcopy Bid Forms shall be manually signed in ink. Registration in OLB is considered your 'signature' for all bids submitted thru that system. Bid prices must be entered for each species and product in the Bid Price column for all material subject to bidding and all fill-in blanks must be completed. If erasures or other changes appear on the hardcopy Bid Form, each erasure or change must be initialed by the person signing the bid.

### 4. Submission of Sealed Bids (5/16)

Bid forms may be obtained from the Unit Manager or thru OLB. Bids may be submitted hardcopy or thru OLB. All hardcopy bids must be submitted on the bid form and in an envelope clearly identified as described in this section. NOTE: Only one bid form per bid envelope. Sealed bids must be submitted to the Unit office designated in the prospectus and must be submitted at or prior to the time established in the prospectus. The envelope should show on the outside (a) the sale name or number and (b) the date and time of bid opening, as shown in the prospectus. Bids received after the time specified in the sale prospectus are late bids and will be rejected.

It is possible for a bidder to submit multiple bids on a single sale. For example, a bid may be submitted hardcopy and a bid may be submitted thru OLB. Or, two bidders from the same company could both submit bids on the same sale. If this were to happen, the State would accept all bids received and award the contract accordingly. All bidding and contractual requirements would apply to all bids received.

### 5. Public Opening of Sealed Bids (7/16)

If conditions permit, the sealed bids will be publicly opened and posted at the time and place set in the prospectus.

If a bidder, present at a bid opening, has submitted bids on more than one sale, that bidder may withdraw their unopened bid envelopes or announce the withdrawal of their online bid after being declared the successful bidder on one sale.

### 6. Award of Contract (1/11)

Award of the contract will be made to the Bidder whose bid, conforming to the prospectus, is most advantageous to the State of Michigan on the basis of total value at rates bid for the estimated quantities. The State reserves the right to reject any bid or waive any minor irregularity in bids received. A written award mailed (or otherwise furnished) to the successful Bidder shall be deemed to result in a binding contract without further action by either party.

### 7. Down Payment (1/11)

The Bidder to whom award is made must make a down payment within 21 days of the sale award. The amount of the down payment will be calculated as shown in the Bond and Payment Schedule of this prospectus. Only cash may be used to meet this requirement.

### 8. Performance Security (1/11)

As guarantee of faithful performance, a cash bond, certificate of deposit, surety bond or irrevocable letter of credit (LOC) is required within 21 days of the sale award. The amount of the performance security is shown in the Bond and

Payment Schedule of this prospectus. If an LOC or surety is used, the coverage must extend for at least 6 months beyond the contract expiration.

#### 9. Worker's Compensation (10/22)

Purchaser shall obtain worker's compensation insurance to cover claims under Michigan's Worker's Disability Compensation Act of 1969 or similar employee benefit act of any other state applicable to an employee. Verification of Worker's Disability Compensation Act Compliance must be completed and submitted within 21 days of contract award and prior to the issuance of the timber sale contract. In addition, if applicable, Notice of Exclusion or Certificate of Insurance must also be submitted.

#### 10. Timber Sale Contract (10/22)

Additional conditions and requirements common to all timber sales are listed on the timber sale contract (R4031) and are available on line at [www.michigan.gov/timber](http://www.michigan.gov/timber). Contact the Unit Manager for additional information or a sample contract. Within 21 days of the date of the award letter, the bidder must sign the contract and provide the required down payment, performance security, and verification of worker's disability compensation. The down payment and performance security shall be in accordance with the provisions of the timber sale contract, in the sums stated in this prospectus. If these actions are not taken, then the Bidder, the Bidder's corporation, and the corporation's principals may not be permitted to bid on State timber sales for a period of 3 months after the first offense, 6 months after the second offense, and 1 year after the third offense. An offense will only be counted against the Bidder for 5 years. In addition, the Bidder certifies that if awarded this contract, the Bidder will complete the timber sale contract in accordance with its terms and any modifications thereof including requirements to purchase, cut, and remove the included timber by the expiration date.

Payment Unit values in the State Forest Timber Sale Contract are calculated based on the advertised value of the Payment Unit as a percentage of the total advertised value of the contract. The advertised value of each Payment Unit is given in the Description of Timber by Payment Unit table on the Timber Sale Information page. For example, if the value of Payment Unit 1 is advertised as \$1,500 and the total Timber Sale value is advertised as \$10,000, the contract price for Payment Unit 1 will be 15% of the total bid price ( $\$1,500/\$10,000 * 100$ ).

#### 11. Disclaimer of Estimates and Bidder's Warranty of Inspection (10/22)

Before submitting this bid, the Bidder is advised and cautioned to inspect the sale area, review the requirements of the sale contract, and take other steps as may be reasonably necessary to ascertain the location, estimated volumes, construction estimates, and operating costs of the proposed sale. Failure to do so will not relieve the Bidder from responsibility for completing the contract.

The Bidder warrants that this bid is submitted solely on the basis of the Bidder's examination and inspection of the quality and quantity of the timber offered for sale and the Bidder's opinion of the value thereof and the costs of recovery. No reliance should be placed on the State of Michigan's estimates of timber quality, quantity or costs of recovery. Bidder further acknowledges that the State of Michigan: (i) expressly disclaims any warranty of fitness of timber for any purpose; (ii) offers this timber as is without any warranty of quality (merchantability) or quantity and (iii) expressly disclaims any warranty as to the quantity or quality of timber sold.

#### 12. Certification and Chain-of-Custody (10/22)

Unless otherwise indicated in the contract under section 7 – Other Conditions of the Sale Specific Conditions & Requirements, the area encompassed by this timber sale is certified to the standards of the Forest Stewardship Council (FSC) - Certificate #SCS-FM/COC-00090N and the Sustainable Forestry Initiative (SFI) - Certificate #NSF-SFIS-5Y031-SF5. Forest products from this sale may be delivered to the mill as "FSC 100% and / or SFI certified" as long as the contractor hauling the forest products is chain-of-custody (COC) certified or covered under a COC certificate from the destination mill. The purchaser is responsible for maintaining COC after leaving the sale area.

#### 13. Good Neighbor Authority (GNA) Requirements (10/22)

If the name of this timber sales contains the acronym GNA, it is authorized by the Good Neighbor Authority (GNA) and covered by various agreements between the U.S. Forest Service and the State. The timber sale occurs on federal land and the following conditions apply:

GNA contracts on US Forest Service land will not be awarded to purchasers on the Federal list of excluded parties. The System for Award Management (SAM) will be checked for active excluded parties prior to award of contract. In

addition, the Bidder to whom award is made must complete an Assurance Regarding Felony Conviction or Tax Delinquent Status for Corporate Applicants (AD-3031).

14. Good Neighbor Authority (GNA) Requirements, con't (10/22)

Bidder certifies, by signing this bid form, that to the best of Bidder's knowledge that the following representations are accurate and complete.

- a. That the Bidder and its principals are not presently debarred, suspended, proposed for debarment, declared ineligible, or voluntary excluded from timber sales (covered transactions) by any Federal department or agency.
- b. That the Bidder and its principals have not within a 3-year period preceding this bid been convicted of or had a civil judgment rendered against them for commission of fraud or a criminal offense in connection with obtaining , attempting to obtain, or performing a public (Federal, State, or local) transaction or contract under a public transaction; violation of Federal or State antitrust statutes or commission of embezzlement, theft, forgery, bribery, falsification or destruction of records, making false statements, or receiving stolen property.
- c. That the Bidder and its principals are not presently indicted for or otherwise criminally or civilly charged by a governmental entity (Federal, State, or local) with commission of any of the offenses enumerated in paragraph b of this certification.
- d. That the Bidder and its principals have not within a 3-year period preceding this bid had one or more public transactions (Federal, State, or local) terminated for breach or default of a timber or forest product contract.

Bidders that cannot certify this requirement, in whole or in part, shall submit an explanation with their bid.

SHANNON LOTT, Acting  
Director



# TIMBER SALE INFORMATION

Checkerboard Mix (61-025-22)  
T25N, R14W, SEC. 32.  
Benzie County (Advertised Price \$22,586.85)

A timber sale contract for this lump sum, sealed bid timber sale will be awarded to the responsible bidder offering the highest sealed bid price. All units of volume listed below were estimated using the Inventory Manager computer program and the new Michigan taper model. Bids must be at or above the following advertised price for each product and species:

<u>PRODUCTS &amp; SPECIES</u>	<u>ESTIMATED UNITS*</u>	<u>ADVERTISED PRICE</u>
<b>Sawtimber</b>		
Basswood	2.8 MBF	\$ 105.00 / MBF
Quaking Aspen	19.9 MBF	\$ 101.00 / MBF
Red Maple	15.8 MBF	\$ 143.00 / MBF
Sugar Maple	5.2 MBF	\$ 280.00 / MBF
White Pine	10.4 MBF	\$ 64.00 / MBF
White Spruce	29.5 MBF	\$ 31.00 / MBF
<b>Pulpwood</b>		
B. T. Aspen	15 Cords	\$ 20.75 / Cord
Basswood	39 Cords	\$ 18.10 / Cord
Mixed Hardwood	192 Cords	\$ 23.55 / Cord
Quaking Aspen	137 Cords	\$ 20.75 / Cord
Red Maple	45 Cords	\$ 23.55 / Cord
Sugar Maple	22 Cords	\$ 23.55 / Cord
White Pine	6 Cords	\$ 26.55 / Cord
White Spruce	272 Cords	\$ 17.90 / Cord

\* The total volume is statistically estimated within plus (+) or minus (-) 18.50 percent. There are an estimated 918 cords on this timber sale, plus or minus 170 cords at the 95% confidence level. The estimated units are final and not subject to adjustment. Prospective bidders are urged to examine this timber and to make their own estimates of quantity and quality.

### **BOND AND PAYMENT SCHEDULE:**

1. A bond in the amount of \$1,129.00 to insure faithful performance of the conditions of the contract will be deposited by the successful bidder within 21 days of the sale award.
2. Cutting in any sale or unit without the required advance payment would be considered a trespass.
3. Total payment must be paid in advance or according to the following schedule :
  - (a) Ten percent (10%) of the sale value must be paid within 21 days of the sale award.
  - (b) The 10% down payment will be credited towards the first unit cut.
  - (c) Payment for each of the following units must be made before cutting begins in that unit:

PAYMENT UNIT NUMBER	PERCENT OF TOTAL SALE VALUE
01	21.1%
02	39.2%
03	21.7%
04	4.5%
05	13.5%

4. If no cutting takes place, the 10% down payment will not be refunded.
5. Operations on the contract issued will terminate on 12/31/2025.

### **SALE STATISTICS**

Volumes were calculated in cubic feet using the Michigan taper model. Cubic foot volume includes all wood inside bark for the product indicated. For display purposes, cubic feet were converted to cords and MBF using a simple conversion factor, e.g. 79 cubic feet per cord and 185 cubic feet per MBF. The cubic foot volumes are precise; the cords and MBF volumes are not. Cubic foot volume cannot be directly converted to cords or boards with precision.

### **SALE VOLUMES**

The total estimated sale volume may not equal the sum of the species/products due to the nature of statistical calculations associated with double sampling methodology.

VOLUME		STATISTICAL RANGE IN CORDS		
TOTAL CUBIC FEET	TOTAL CORDS	PERCENT ERROR	MINIMUM	MAXIMUM
72,517	918	18.50%	748	1,088

## VDU VOLUMES

A VDU is a Volume Determination Unit. Volumes and their associated statistics are calculated at the VDU level and summarized to the sale level. There is often a one to one relationship between a VDU and a Payment Unit, but not always, depending on the cruise design. Refer to the VDU TO PAYMENT UNIT table.

VDU	VOLUME		PERCENT ERROR	RANGE IN CORDS	
	TOTAL CUBIC FEET	TOTAL CORDS		MINIMUM	MAXIMUM
27	2,783	35	38.19%	22	49
47	56,559	716	25.44%	534	898
55	13,174	167	31.45%	114	219
<b>TOTAL:</b>	<b>72,517</b>	<b>918</b>		<b>670</b>	<b>1,166</b>

## VDU TO PAYMENT UNIT

When a VDU is associated with more than one Payment Unit (PU), the VDU volumes are assigned to the PU based on acres of the VDU within the PU.

VDU	VDU ACRES	PU	PU ACRES
27	2.0	4	2.0
47	37.0	2	19.5
		3	10.8
		5	6.7
55	8.3	1	8.3
<b>TOTAL:</b>	<b>47.3</b>		<b>47.3</b>



**DESCRIPTION OF TIMBER BY PAYMENT UNIT (PU)**

PU	MARKET GROUP	PRODUCT	QUANTITY	UNIT	ACRES	ADVERTISE PRICE
1	Basswood	Sawtimber	2.8	MBF	8.3	\$4,767.45
	Quaking Aspen		7.2	MBF		
	Sugar Maple		5.2	MBF		
	B. T. Aspen	Pulpwood	9	Cords		
	Basswood		23	Cords		
	Mixed Hardwood		55	Cords		
	<i>American Elm</i>	<i>Sawtimber</i>	3.3	<i>MBF</i>		
	<i>American Elm</i>	<i>Pulpwood</i>	3	<i>Cords</i>		
	<i>Black Cherry</i>		23	<i>Cords</i>		
	<i>Ironwood</i>		22	<i>Cords</i>		
	Quaking Aspen		3	Cords		
	Red Maple		6	Cords		
	Sugar Maple		8	Cords		
2	Quaking Aspen	Sawtimber	6.7	MBF	19.5	\$8,871.50
	Red Maple		8.3	MBF		
	White Spruce		15.6	MBF		
	B. T. Aspen	Pulpwood	3	Cords		
	Basswood		8	Cords		
	Mixed Hardwood		70	Cords		
	<i>Black Cherry</i>		66	<i>Cords</i>		
	<i>Ironwood</i>		4	<i>Cords</i>		
	Quaking Aspen		69	Cords		
	Red Maple		21	Cords		
	Sugar Maple		7	Cords		
	White Spruce		144	Cords		
	3	Quaking Aspen	Sawtimber	3.7		
Red Maple			4.6	MBF		
White Spruce			8.6	MBF		
B. T. Aspen		Pulpwood	2	Cords		
Basswood			5	Cords		
Mixed Hardwood			38	Cords		
<i>Black Cherry</i>			36	<i>Cords</i>		
<i>Ironwood</i>			2	<i>Cords</i>		
Quaking Aspen			39	Cords		
Red Maple			11	Cords		
Sugar Maple			4	Cords		
White Spruce			79	Cords		
4		White Pine	Sawtimber	10.4	MBF	2.0
	Mixed Hardwood	Pulpwood	6	Cords		
	<i>Black Cherry</i>		5	<i>Cords</i>		
	<i>Ironwood</i>		1	<i>Cords</i>		
	Quaking Aspen		2	Cords		
	White Pine		6	Cords		
5	Quaking Aspen	Sawtimber	2.3	MBF	6.7	\$3,038.60
	Red Maple		2.9	MBF		
	White Spruce		5.3	MBF		
	B. T. Aspen	Pulpwood	1	Cords		
	Basswood		3	Cords		
	Mixed Hardwood		23	Cords		
	<i>Black Cherry</i>		22	<i>Cords</i>		
	<i>Ironwood</i>		1	<i>Cords</i>		
	Quaking Aspen		24	Cords		
	Red Maple		7	Cords		
	Sugar Maple		3	Cords		
	White Spruce		49	Cords		

TOTAL:	83.6	MBF
--------	------	-----

TOTAL:	728	Cords
--------	-----	-------

# Sale Specific Conditions & Requirements

**Sale Name: Checkerboard Mix**

**Sale Number: 61-025-22 Seq#: 1**

## 1 - Sale Area

### 1.2 - Boundaries

#### 1.2.1 - Painted boundaries (9/19)

The sale boundary and Payment Unit boundaries are marked and identified by red and yellow paint. Exterior sale boundary lines against state are marked with red paint. Also, a very small retention island within payment unit 1 is marked with red paint; no harvesting activities may occur in this retention area. Interior Payment Unit boundaries are marked with yellow paint. The painted boundary line trees are not Included Timber and are to be protected. Yellow painted trees designating an interior Payment Unit boundary are only to be cut when all surrounding Payment Units have been paid.

## 2 - Timber Specifications

### 2.1 - Included Timber

#### 2.1.3 - Cut tree marked unit(s) (12/08)

Within Payment Unit(s) 4, all trees are designated for cutting when marked with orange paint above and below stump height, regardless of merchantability. Also, within Payment Unit 4, any ironwood tree is designated for cutting regardless of merchantability.

#### 2.1.7 - Leave tree marked unit(s) (6/14)

Within Payment Unit(s) 1, 2, 3, and 5, all aspen, maple, cherry, beech, ironwood, basswood and spruce trees are designated for cutting regardless of merchantability. Except, do not cut any trees marked with green paint above and below stump height or any other tree species not specifically designated for cutting. Also, please try to protect young spruce seedlings within these units from damage as much as possible.

#### 2.1.11 - Description of timber note (2/04)

Note that mixed hardwood pulpwood = cherry and ironwood pulpwood.

### 2.2 - Utilization

#### 2.2.3 - Stump heights (4/07)

Stump heights within the Sale Area shall not exceed 12 inches for trees greater than 10 inches DBH and 4 inches for trees smaller than 10 inches DBH.

## 4 - Transportation

### 4.1 - Construction

#### 4.1.3 - Slash and earthen piles (8/04)

Piles or windrows of earth along roads and landings that have been widened or constructed shall be leveled. Slash from road maintenance or construction, including stumps, shall be dispersed throughout the sale, chipped, utilized or otherwise removed from the sale as determined by the DNR sale Administrator.

## 5 - Operations

### 5.2 - Conduct of Operations

#### 5.2.1 - Slash

##### 5.2.1.8 - Slash height (12/08)

No slash or tree tops may exceed 24 inches in height.

#### 5.2.4 - Dead and Down Creation

##### 5.2.4.3 - Dead and down creation, dead trees (6/07)

Except as provided for in General Condition and Requirement 5.2.2, no dead trees, standing or down, are to be cut, skidded, or processed.

5.2.4.4 - Dead and down creation, grouse (6/18)

To encourage grouse and other wildlife, in Payment Unit(s) 1 - 5 leave one 12" or larger diameter (or largest diameter trees within stand) whole tree on the ground for every 2 acres, preferably a hardwood species such as maple or cherry (no aspen). These trees will be evenly scattered throughout the unit, preferably at least two chains from any roads, two-tracks, or trails open to vehicles. This can be an unmerchantable piece or a full tree.

5.2.32 - Decking/landing restoration (9/13)

All decking and landing areas must have the surface area restored to a condition equal to or better than before. This is to ensure the proper regeneration of the stand. Wood debris, chips and "cookies" from trimmings must be removed or scattered away from landing and loading areas and may not be windrowed on the edge.

5.2.38 - No decking against live trees (2/04)

Cut products may not be decked against unmarked or designated leave trees.



# TIMBER SALE MAP

This information provided by authority of Part 525, 1994 PA 451 as amended.

Sale Number	Year
61 - 025	22

Forest Management Unit Traverse City	County Benzie	Mapped By Craig Allen	Date 09/22/2022	Page 1	of 2
Township 25N	Range 14W	Section(s) and Subdivision(s) Sec. 32, NW1/4, SW1/4	Scale 1:15,840		

Cover Type				Density	
A = Aspen	H = Hemlock	N = Marsh	U = Upland Brush	0 = Non Stocked	5 = Pole Timber Medium
B = Paper Birch	J = Jack Pine	O = Oak	UM = Upland Mixed	1 = Seeding Sapling Poor	6 = Pole Timber Well
C = Cedar	L = Lowland Brush	P = Lowland Poplar	V = Bog or Marsh	2 = Seeding Sapling Medium	7 = Saw Timber Poor
D = Tread Bog	LM = Lowland Mixed	Q = Mixed Swamp Conifer	W = White Pine	3 = Seeding Sapling Well	8 = Saw Timber Medium
E = Swamp Hardwoods	M = Mpl. Ech. Birch	R = Red Pine	X = Non Stocked	4 = Pole Timber Poor	9 = Saw Timber Well
F = Spruce Fir	MC = Mixed Conifer	S = Black Spruce	Z = Water		
G = Creas	MD = Mixed Deciduous	T = Tamarack			

PU	Acres	PU	Acres
1	8.3	4	2.0
2	19.5	5	6.7
3	10.8		

## Checkerboard Mix

### Compartment 29

47.3 Acres

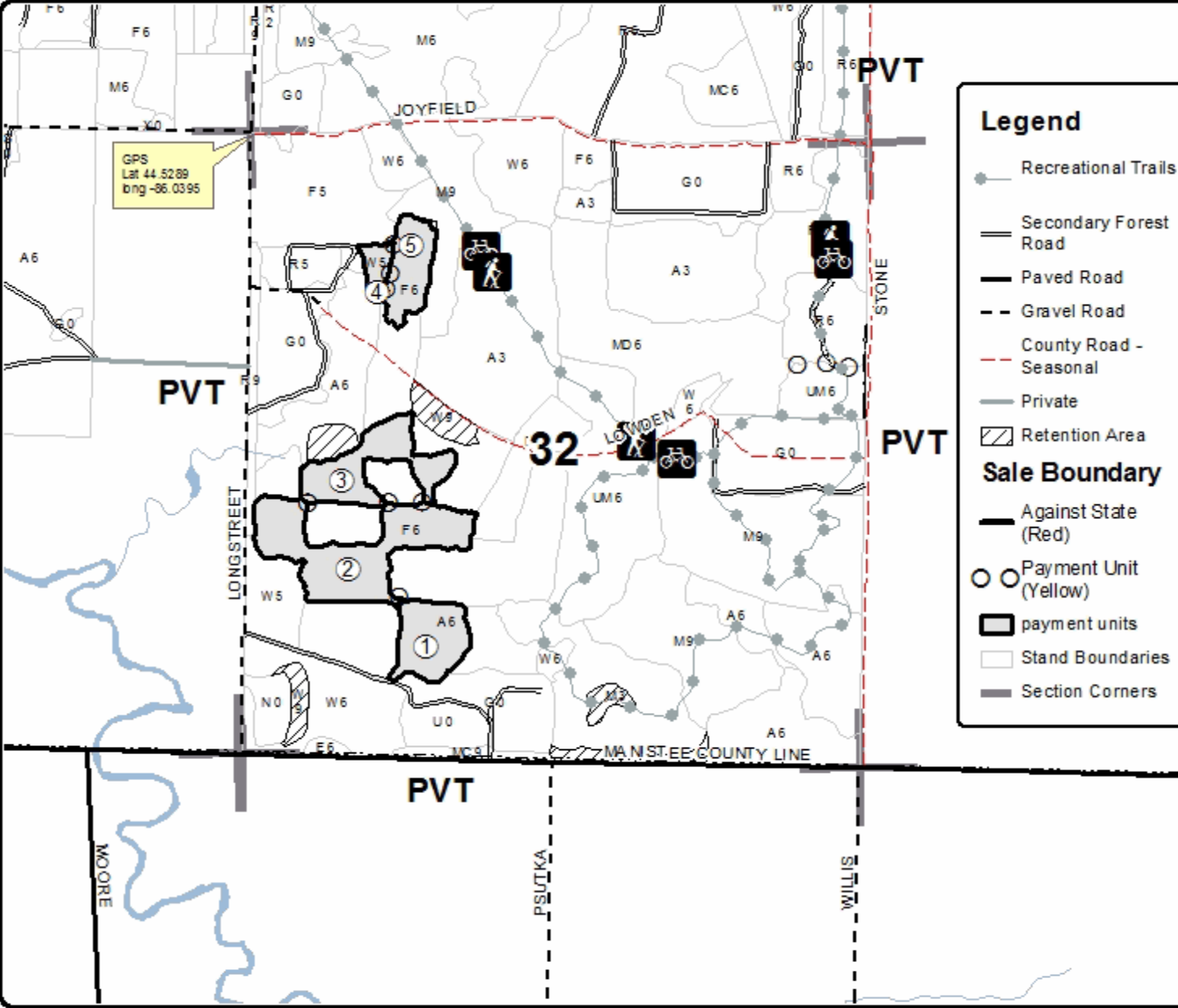

### Legend

- Recreational Trails
- Secondary Forest Road
- Paved Road
- Gravel Road
- County Road - Seasonal
- Private
- Retention Area
- Sale Boundary**
  - Against State (Red)
- Payment Unit (Yellow)
- payment units
- Stand Boundaries
- Section Corners

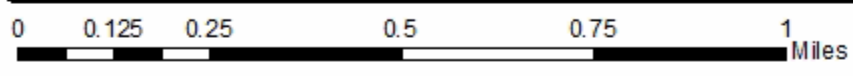



## TIMBER SALE INFORMATION

Habblers Road Aspen (61-046-22)  
 T26N, R13W, SEC. 3; T26N, R13W, SEC. 4; T26N, R13W, SEC. 5.  
 Benzie County (Advertised Price \$94,815.60)

SALE NOTE: A recreation site such as a trail, pathway, or campground is within the sale area or the vicinity. Certain restrictions/specifications may be applicable including time restrictions.

A timber sale contract for this lump sum, sealed bid timber sale will be awarded to the responsible bidder offering the highest sealed bid price. All units of volume listed below were estimated using the Inventory Manager computer program and the new Michigan taper model. Bids must be at or above the following advertised price for each product and species:

<u>PRODUCTS &amp; SPECIES</u>	<u>ESTIMATED UNITS*</u>	<u>ADVERTISED PRICE</u>
<b>Sawtimber</b>		
Basswood	30.2 MBF	\$ 105.00 / MBF
Beech	9.1 MBF	\$ 110.00 / MBF
Black Cherry	5.7 MBF	\$ 154.00 / MBF
Mixed Aspen	94.4 MBF	\$ 101.00 / MBF
Red Maple	106.7 MBF	\$ 143.00 / MBF
Red Pine	7.3 MBF	\$ 115.00 / MBF
Sugar Maple	36.5 MBF	\$ 280.00 / MBF
White Pine	43.3 MBF	\$ 64.00 / MBF
<b>Pulpwood</b>		
Jack Pine	14 Cords	\$ 20.35 / Cord
Mixed Aspen	1,499 Cords	\$ 20.75 / Cord
Mixed Hardwood	737 Cords	\$ 23.55 / Cord
Red Oak	3 Cords	\$ 21.65 / Cord
Red Pine	8 Cords	\$ 49.25 / Cord
White Pine	73 Cords	\$ 26.55 / Cord

\* The total volume is statistically estimated within plus (+) or minus (-) 14.15 percent. There are an estimated 2,995 cords on this timber sale, plus or minus 424 cords at the 95% confidence level. The estimated units are final and not subject to adjustment. Prospective bidders are urged to examine this timber and to make their own estimates of quantity and quality.

**BOND AND PAYMENT SCHEDULE:**

1. A bond in the amount of \$4,741.00 to insure faithful performance of the conditions of the contract will be deposited by the successful bidder within 21 days of the sale award.
2. Cutting in any sale or unit without the required advance payment would be considered a trespass.
3. Total payment must be paid in advance or according to the following schedule :
  - (a) Ten percent (10%) of the sale value must be paid within 21 days of the sale award.
  - (b) The 10% down payment will be credited towards the first unit cut.
  - (c) Payment for each of the following units must be made before cutting begins in that unit:

PAYMENT UNIT NUMBER	PERCENT OF TOTAL SALE VALUE
01	2.6%
02	13.6%
03	11.4%
04	8.5%
05	7.7%
06	22.8%
07	11.1%
08	17.1%
09	1.9%
10	3.3%

4. If no cutting takes place, the 10% down payment will not be refunded.
5. Operations on the contract issued will terminate on 04/15/2025.

**SALE STATISTICS**

Volumes were calculated in cubic feet using the Michigan taper model. Cubic foot volume includes all wood inside bark for the product indicated. For display purposes, cubic feet were converted to cords and MBF using a simple conversion factor, e.g. 79 cubic feet per cord and 185 cubic feet per MBF. The cubic foot volumes are precise; the cords and MBF volumes are not. Cubic foot volume cannot be directly converted to cords or boards with precision.

### SALE VOLUMES

The total estimated sale volume may not equal the sum of the species/products due to the nature of statistical calculations associated with double sampling methodology.

VOLUME			STATISTICAL RANGE IN CORDS	
TOTAL CUBIC FEET	TOTAL CORDS	PERCENT ERROR	MINIMUM	MAXIMUM
236,581	2,995	14.15%	2,571	3,419

### VDU VOLUMES

A VDU is a Volume Determination Unit. Volumes and their associated statistics are calculated at the VDU level and summarized to the sale level. There is often a one to one relationship between a VDU and a Payment Unit, but not always, depending on the cruise design. Refer to the VDU TO PAYMENT UNIT table.

VDU	VOLUME			RANGE IN CORDS	
	TOTAL CUBIC FEET	TOTAL CORDS	PERCENT ERROR	MINIMUM	MAXIMUM
45	81,860	1,036	24.02%	787	1,285
71	41,316	523	16.14%	439	607
99	59,117	748	23.14%	575	921
149	4,635	59	141.58%	24	142
152	7,601	96	113.36%	13	205
157	42,052	532	39.10%	324	740
<b>TOTAL:</b>	<b>236,581</b>	<b>2,995</b>		<b>2,088</b>	<b>3,901</b>

### VDU TO PAYMENT UNIT

When a VDU is associated with more than one Payment Unit (PU), the VDU volumes are assigned to the PU based on acres of the VDU within the PU.

VDU	VDU ACRES	PU	PU ACRES
45	35.2	3	14.5
		4	10.9
		5	9.8
71	36.7	6	36.7
99	19.8	7	7.8
		8	12.0
149	2.4	9	2.4
152	4.9	10	4.9
157	23.0	1	3.7
		2	19.3
<b>TOTAL:</b>	<b>122.0</b>		<b>122.0</b>



**DESCRIPTION OF TIMBER BY PAYMENT UNIT (PU)**

PU	MARKET GROUP	PRODUCT	QUANTITY	UNIT	ACRES	ADVERTISE PRICE	
1	Black Cherry	Sawtimber	0.4	MBF	3.7	\$2,421.85	
	Mixed Aspen		7.2	MBF			
	<i>B. T. Aspen</i>		4.9	<i>MBF</i>			
	<i>Quaking Aspen</i>		2.3	<i>MBF</i>			
	Sugar Maple		0.5	MBF			
	Mixed Aspen		Pulpwood	65			Cords
	<i>B. T. Aspen</i>			40			<i>Cords</i>
	<i>Quaking Aspen</i>			25			<i>Cords</i>
	Mixed Hardwood			5			Cords
	<i>Beech</i>			1			<i>Cords</i>
	<i>Red Maple</i>			2			<i>Cords</i>
	<i>Sugar Maple</i>			2			<i>Cords</i>
	White Pine			1			Cords
	2		Black Cherry	Sawtimber			2.0
Mixed Aspen		37.6	MBF				
<i>B. T. Aspen</i>		25.4	<i>MBF</i>				
<i>Quaking Aspen</i>		12.2	<i>MBF</i>				
Sugar Maple		2.7	MBF				
Mixed Aspen		Pulpwood	340		Cords		
<i>B. T. Aspen</i>			209		<i>Cords</i>		
<i>Quaking Aspen</i>			131		<i>Cords</i>		
Mixed Hardwood			34		Cords		
<i>Beech</i>			6		<i>Cords</i>		
<i>Black Cherry</i>			3		<i>Cords</i>		
<i>Red Maple</i>			13		<i>Cords</i>		
<i>Sugar Maple</i>			12		<i>Cords</i>		
White Pine		5	Cords				
3	Mixed Aspen	Sawtimber	14.1	MBF	14.5	\$10,763.95	
	<i>B. T. Aspen</i>		14.1	<i>MBF</i>			
	Red Maple		6.0	MBF			
	Mixed Aspen		Pulpwood	293			Cords
	<i>B. T. Aspen</i>			201			<i>Cords</i>
	<i>Quaking Aspen</i>			92			<i>Cords</i>
	Mixed Hardwood			102			Cords
	<i>Beech</i>			4			<i>Cords</i>
	<i>Black Cherry</i>			17			<i>Cords</i>
	<i>Red Maple</i>			63			<i>Cords</i>
	<i>Sugar Maple</i>			18			<i>Cords</i>
4	Mixed Aspen	Sawtimber	10.6	MBF	10.9	\$8,068.90	
	<i>B. T. Aspen</i>		10.6	<i>MBF</i>			
	Red Maple		4.5	MBF			
	Mixed Aspen		Pulpwood	220			Cords
	<i>B. T. Aspen</i>			151			<i>Cords</i>
	<i>Quaking Aspen</i>			69			<i>Cords</i>
	Mixed Hardwood			76			Cords
	<i>Beech</i>			3			<i>Cords</i>
	<i>Black Cherry</i>			12			<i>Cords</i>
	<i>Red Maple</i>			48			<i>Cords</i>
	<i>Sugar Maple</i>			13			<i>Cords</i>
5	Mixed Aspen	Sawtimber	9.5	MBF	9.8	\$7,279.25	
	<i>B. T. Aspen</i>		9.5	<i>MBF</i>			
	Red Maple		4.1	MBF			
	Mixed Aspen		Pulpwood	198			Cords
	<i>B. T. Aspen</i>			136			<i>Cords</i>
	<i>Quaking Aspen</i>			62			<i>Cords</i>
	Mixed Hardwood			69			Cords



**DESCRIPTION OF TIMBER BY PAYMENT UNIT (PU), CON'T**

PU	MARKET GROUP	PRODUCT	QUANTITY	UNIT	ACRES	ADVERTISE PRICE
9 con't	<i>Jack Pine</i>	<i>Sawtimber</i>	0.6	<i>MBF</i>		
	<i>Jack Pine</i>	<i>Pulpwood</i>	1	<i>Cords</i>		
	Mixed Aspen		8	Cords		
	<i>B. T. Aspen</i>		8	<i>Cords</i>		
	Mixed Hardwood		20	Cords		
	<i>Red Maple</i>		12	<i>Cords</i>		
	<i>Sugar Maple</i>		8	<i>Cords</i>		
	White Pine		11	Cords		
10	Red Maple	Sawtimber	1.6	MBF	4.9	\$3,171.15
	Red Pine		7.3	MBF		
	White Pine		6.8	MBF		
	Jack Pine	Pulpwood	12	Cords		
	<i>Jack Pine</i>		12	<i>Cords</i>		
	Mixed Hardwood		2	Cords		
	<i>Red Maple</i>		2	<i>Cords</i>		
	Red Pine		8	Cords		
	White Pine		37	Cords		
TOTAL:			333.2	MBF		
TOTAL:			2,334	Cords		

# Sale Specific Conditions & Requirements

**Sale Name: Habbler Road Aspen**

**Sale Number: 61-046-22 Seq#: 1**

## 1 - Sale Area

### 1.2 - Boundaries

#### 1.2.1 - Painted boundaries (9/19)

The sale boundary and Payment Unit boundaries are marked and identified by blue, red and yellow paint. Exterior sale boundary lines against private property are marked with blue paint. Exterior sale boundary lines against state land are marked with red paint. Interior Payment Unit boundaries are marked with yellow paint. Retention patches are marked with double red paint marks; no harvesting activities may occur within these areas. The painted boundary line trees are not Included Timber and are to be protected unless marked with orange paint.

## 2 - Timber Specifications

### 2.1 - Included Timber

#### 2.1.1 - Clearcut unit(s) with unmerchantable trees (6/14)

Within Payment Unit(s) 1, 2, 3, 4, 5 and 9, cut all trees that are two (2) inches or more at DBH except for the following:

- units 1 and 2: do not cut any white pine greater than 10" dbh, any red pine, or any hemlock;
- units 3, 4 and 5: do not cut any conifers, oak, elm or yellow birch;
- unit 9: do not cut any red pine, oak, hemlock, or any trees marked with green paint.

#### 2.1.3 - Cut tree marked unit(s) (12/08)

Within Payment Unit(s) 6 and 10, all trees are designated for cutting when marked with orange paint above and below stump height, regardless of merchantability. Sapling trees (less than 4.6" dbh) may be cut as necessary to facilitate harvest of designated timber, but must be severed at ground level and laid flat on the ground, and not left bent, broken or damaged.

#### 2.1.4 - Designated timber unit(s) (6/17)

Within Payment Unit(s) 7 and 8, all aspen, maple, ironwood, beech and cherry trees greater than 2" dbh, and all white pine greater than 6" and less than 20" dbh, are designated for cutting regardless of merchantability.

### 2.2 - Utilization

#### 2.2.4 - Skidding length (2/14)

Within payment units 6 and 10, skidding of unlimbed tops or lengths over 17 feet is not permissible unless approved by the Unit Manager or his/her representative.

## 4 - Transportation

### 4.1 - Construction

#### 4.1.3 - Slash and earthen piles (8/04)

Piles or windrows of earth along roads and landings that have been widened or constructed shall be leveled. Slash from road maintenance or construction, including stumps, shall be chipped, utilized or dispersed throughout the sale.

#### 4.1.12 - No new roads (1/12)

No new roads will be permitted in any Payment Unit. All operations are limited to existing roads. Skid trails only will be allowed.

## 5 - Operations

### 5.2 - Conduct of Operations

#### 5.2.1 - Slash

##### 5.2.1.8 - Slash height (12/08)

No slash or tree tops may exceed 24 inches in height. Within payment unit 10, slash must be placed on the side of the unit away from the county road rights of way.

### 5.2.3 - Operating Restrictions

#### 5.2.3.3 - Bark slippage restriction (3/09)

Within Payment Unit(s) 6, cutting and skidding are not permitted during the period of April 15 to July 15. This restriction is because of bark slippage.

#### 5.2.3.6 - Bark beetle restriction (12/08)

In the event drought creates a high risk of pine bark beetle infestation, pine is not to be cut during the period March 1 through July 1, unless all portions of trees greater than two inches in diameter are removed from the sale area, reduced to chips, or treated to the satisfaction of the Unit Manager or his/her representative, within fifteen days of being severed from the stump. Pine log decks, pulpwood piles and treetops that are piled for chipping in the fall or winter within a 1/4 mile of susceptible sites must be removed before March 15. Residual slash must not be placed in piles or rows and must be spread over the site for quick drying. The Department of Natural Resources will exercise this specification if the risk of damage warrants.

#### 5.2.3.11 - Coppice regeneration protection (4/10)

Timber harvesting in any Payment Unit must be completed before significant aspen sprouting occurs in that Payment Unit so as to minimize damage to the new regeneration. Any post harvest operations, such as chipping, must be completed before sprouting of regeneration occurs. If it is anticipated that chipping will be delayed, then tops shall be carried to one central location or left unchipped. The Unit Manager or his/her representative may cease such operations if sprouting occurs before the operation is complete.

### 5.2.4 - Dead and Down Creation

#### 5.2.4.1 - Dead and down creation, marked trees (10/13)

All trees marked with an orange "X" must be felled and left on site for wildlife. Either cut these trees at 4 feet above ground level and place the cut trunk alongside the resulting high stump or cut at ground level and place the cut trunk against a small nearby tree retained for this purpose.

In addition to these marked trees, in payment units 7 and 8 the producer must select at least one entire cut tree per acre to leave on site in the same fashion for wildlife. These trees should be well distributed throughout the unit and must be greater than 10" dbh.

#### 5.2.31 - Landing locations (9/13)

A recommended landing for payment units 7 and 8 is marked on the Timber Sale Map with the letter "L". An approximate forwarding route from these payment units to the recommended landing is also shown on the map. Using this location will avoid trucks having to negotiate a narrow culvert or a steep hill on Bronson Lake Road, and will avoid potential conflicts with the Shore to Shore Trail.

#### 5.2.38 - No decking against live trees (2/04)

Cut products may not be decked against unmarked or designated leave trees.

#### 5.2.40 - Pathway protection (10/10)

The Shore to Shore riding/hiking trail is shown on the Timber Sale Map, coincident with Burnt Mill and Bronson Lake roads. Do not cut trees or damage posts with blue pathway markers. Maintain a 20-foot wide slash, debris, and rut free zone daily, using the pathway as the centerline.

### 5.4 - Soil Protection

#### 5.4.3 - Erosion control (12/08)

Skid trails or haul roads may require erosion control structures or berms per direction of the Unit Manager or his/her representative.

#### 5.4.6 - Wet area protection (5/10)

No harvesting operations, including skidding and felling, are to take place within the area between payment unit 1 and Bowers Road. This unit should be forwarded north to Oakley Road to avoid the wet area. In addition, there are wet areas immediately south of units 3, 5, and 7, and north, west and south of unit 8. Care must be taken by the Purchaser to identify and avoid operating in these areas of the timber sale.

## 6 - Safety and Fire Prevention

## 6.2 - Signing

### 6.2.1 - Road posting (10/20)

The Purchaser is responsible for posting and maintaining caution signs on Oakley, Bowers, Bronson Lake, Reynolds, and Fewins roads prior to beginning operations. The road must be posted at appropriate distances from the sale area to warn of logging activity and truck traffic. Signs must be removed when harvest operations are suspended or completed. The Purchaser will provide these signs.



# TIMBER SALE MAP

This information provided by authority of Part 525, 1994 PA 451, as amended.

Sale Number	Year
61-046	22

Forest Management Unit Traverse City	County Benzie	Mapped By Tim Webb	Date 9/16/2022	Page 1	of 2
Township 26N	Range 13W	Section(s) and Subdivision(s) Sec. 3: NWSW, S1/2SE; Sec. 4: N1/2NW, NWNE, SENE, NESE; Sec. 5: NENW, NE	Scale 1:15,840		

Cover Type				Density	
A = Aspen	H = Hemlock	N = Marsh	U = Upland Brush	0 = Non Stocked	5 = Pole Timber Medium
B = Paper Birch	J = Jack Pine	O = Oak	UM = Upland Mixed	1 = Seeding Sapling Poor	6 = Pole Timber Well
C = Cedar	L = Lowland Brush	P = Lowland Poplar	V = Bog or Marsh	2 = Seeding Sapling Medium	7 = Saw Timber Poor
D = Tread Bog	LM = Lowland Mixed	Q = Mixed Swamp Conifer	W = White Pine	3 = Seeding Sapling Well	8 = Saw Timber Medium
E = Swamp Hdwoods	M = Mpl, Bch, Bach	R = Red Pine	X = Non Stocked	4 = Pole Timber Poor	9 = Saw Timber Well
F = Spruce Fir	MC = Mixed Conifer	S = Black Spruce	Z = Water		
G = Grass	MD = Mixed Deciduous	T = Tamarack			

PU	Acres	PU	Acres	PU	Acres
1	3.7	5	9.8	9	2.4
2	19.3	6	36.7	10	4.9
3	14.5	7	7.8		
4	10.9	8	12.0		

## Habblers Road Aspen

Compartment 61013  
122.0 acres

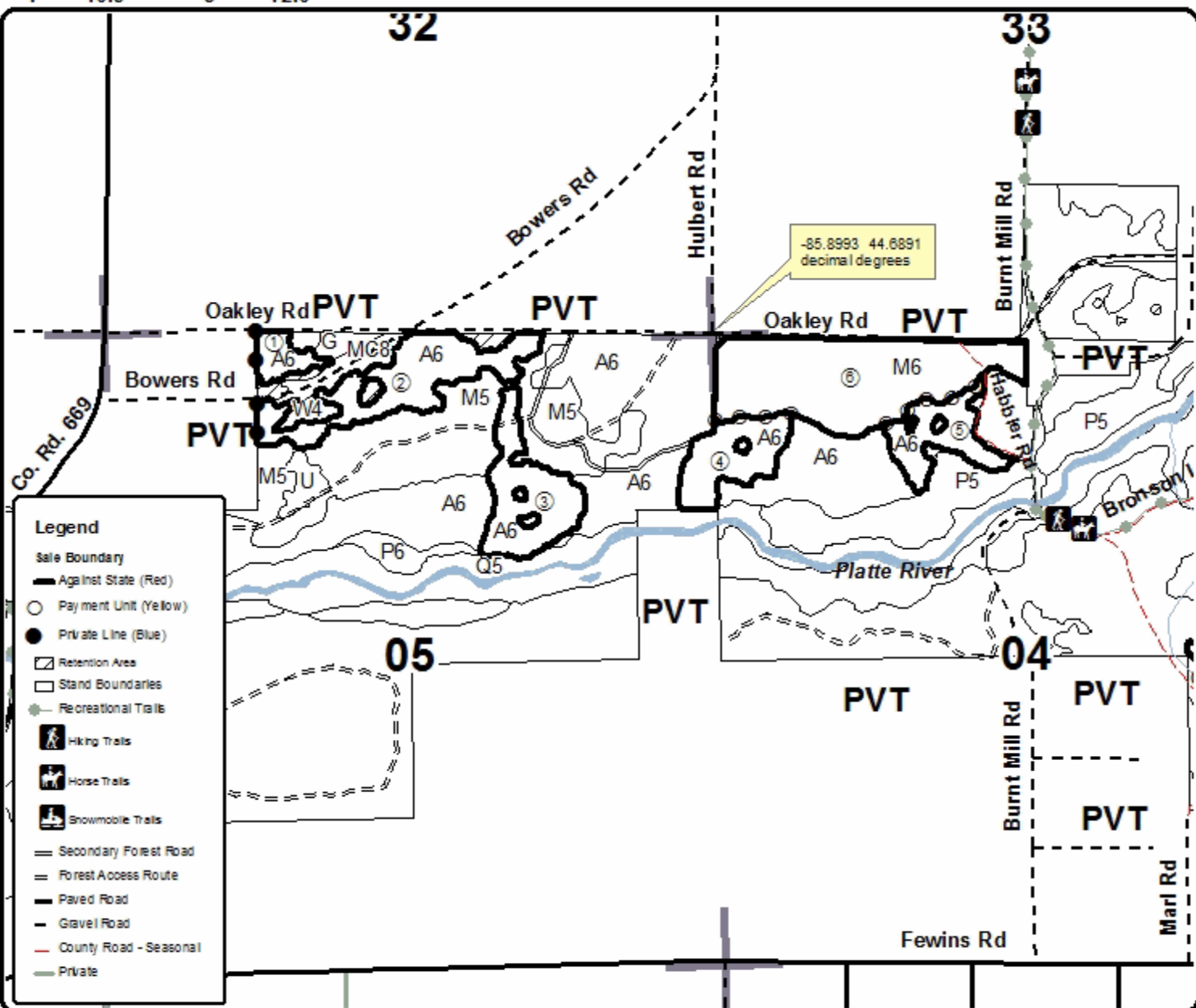

**Legend**

- Sale Boundary
- Against State (Red)
- Payment Unit (Yellow)
- Private Line (Blue)
- Retention Area
- Stand Boundaries
- Recreational Trails
  - Hiking Trails
  - Horse Trails
  - Snowmobile Trails
- Secondary Forest Road
- Forest Access Route
- Paved Road
- Gravel Road
- County Road - Seasonal
- Private

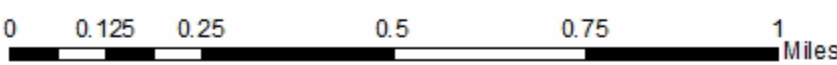



# TIMBER SALE MAP

This information provided by authority of Part 525, 1994 PA 451, as amended.

Sale Number	Year
61-046	22

Forest Management Unit Traverse City	County Benzie	Mapped By Tim Webb	Date 9/16/2022	Page 2	of 2
Township 26N	Range 13W	Section(s) and Subdivision(s) Sec. 3: NWSW, S1/2SE; Sec. 4: N1/2NW, NWNE, SENE, NESE; Sec. 5: NENW, NE	Scale 1:15,840		

Cover Type				Density	
A = Aspen	H = Hemlock	N = Marsh	U = Upland Brush	0 = Non Stocked	5 = Pole Timber Medium
B = Paper Birch	J = Jack Pine	O = Oak	UM = Upland Mixed	1 = Seeding Sapling Poor	6 = Pole Timber Well
C = Cedar	L = Lowland Brush	P = Lowland Poplar	V = Bog or Marsh	2 = Seeding Sapling Medium	7 = Saw Timber Poor
D = Tread Bog	LM = Lowland Mixed	Q = Mixed Swamp Conifer	W = White Pine	3 = Seeding Sapling Well	8 = Saw Timber Medium
E = Swamp Hdwoods	M = Mpl, Boh, Bach	R = Red Pine	X = Non Stocked	4 = Pole Timber Poor	9 = Saw Timber Well
F = Spruce Fir	MC = Mixed Conifer	S = Black Spruce	Z = Water		
G = Grass	MD = Mixed Deciduous	T = Tamarack			

PU	Acres	PU	Acres	PU	Acres
1	3.7	5	9.8	9	2.4
2	19.3	6	36.7	10	4.9
3	14.5	7	7.8		
4	10.9	8	12.0		

## Habblers Road Aspen

### Compartment 61013

122.0 acres

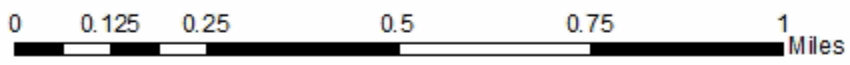
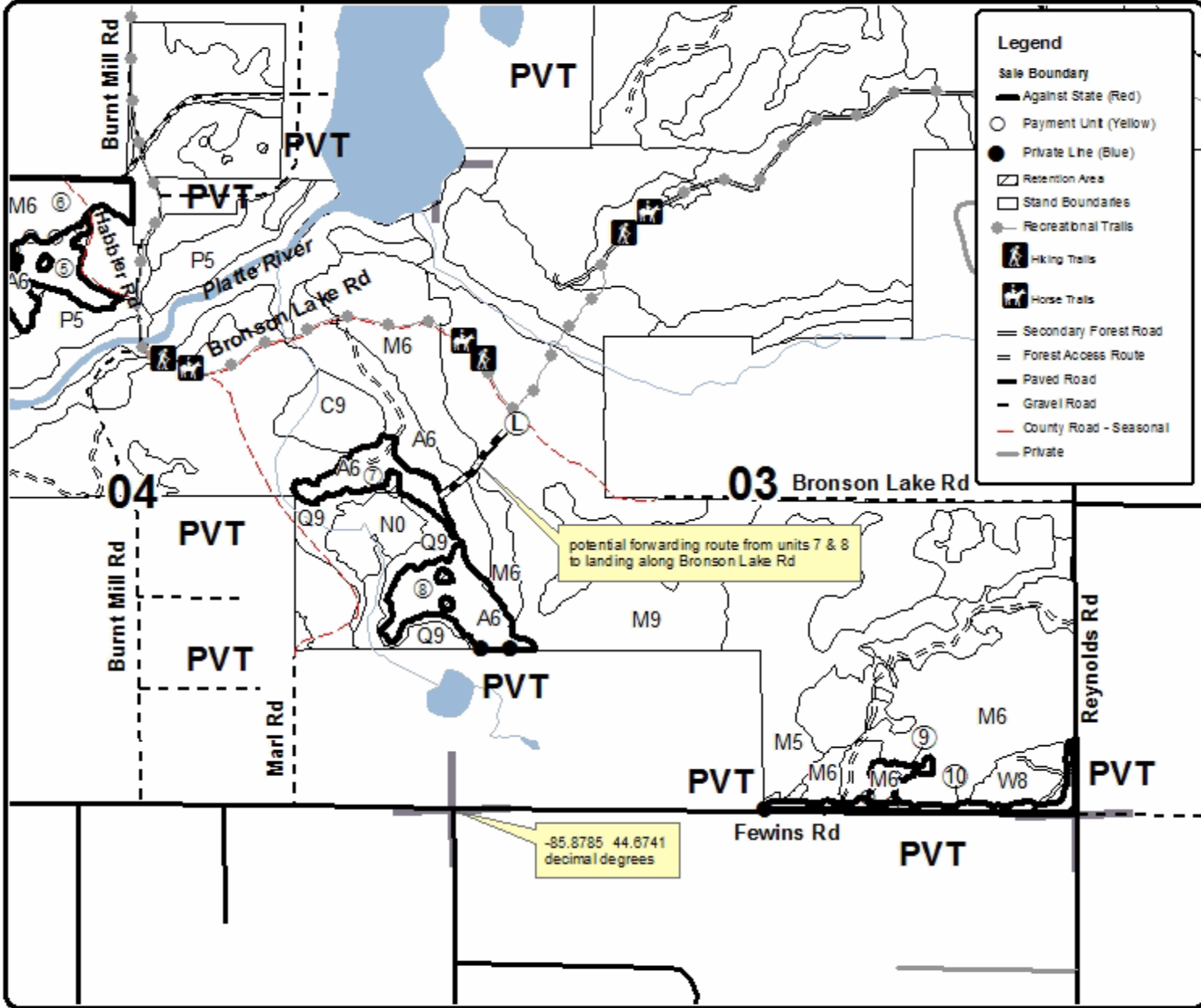



**TIMBER SALE INFORMATION**

Radio Red (61-052-22)

T26N, R09W, SEC. 14.

Grand Traverse County (Advertised Price \$16,274.75)

SALE NOTE: Overstory removal with large red pine.

A recreation site such as a trail, pathway, or campground is within the sale area or the vicinity. Certain restrictions/specifications may be applicable including time restrictions.

A timber sale contract for this lump sum, sealed bid timber sale will be awarded to the responsible bidder offering the highest sealed bid price. All units of volume listed below were estimated using the Inventory Manager computer program and the new Michigan taper model. Bids must be at or above the following advertised price for each product and species:

<u>PRODUCTS &amp; SPECIES</u>	<u>ESTIMATED UNITS*</u>	<u>ADVERTISED PRICE</u>
Sawtimber		
Red Pine	114.8 MBF	\$ 115.00 / MBF
Pulpwood		
Red Maple	5 Cords	\$ 23.55 / Cord
Red Pine	60 Cords	\$ 49.25 / Cord

\* The total volume is statistically estimated within plus (+) or minus (-) 39.57 percent. There are an estimated 325 cords on this timber sale, plus or minus 129 cords at the 95% confidence level. The estimated units are final and not subject to adjustment. Prospective bidders are urged to examine this timber and to make their own estimates of quantity and quality.

**BOND AND PAYMENT SCHEDULE:**

- A bond in the amount of \$1,000.00 to insure faithful performance of the conditions of the contract will be deposited by the successful bidder within 21 days of the sale award.
- Cutting in any sale or unit without the required advance payment would be considered a trespass.
- Total payment must be paid in advance or according to the following schedule :
  - Ten percent (10%) of the sale value must be paid within 21 days of the sale award.
  - The remainder is due before cutting begins.
  - Payment for each of the following units must be made before cutting begins in that unit:
 

PAYMENT UNIT NUMBER	PERCENT OF TOTAL SALE VALUE
01	100.0%
- If no cutting takes place, the 10% down payment will not be refunded.
- Operations on the contract issued will terminate on 04/15/2025.

**SALE STATISTICS**

Volumes were calculated in cubic feet using the Michigan taper model. Cubic foot volume includes all wood inside bark for the product indicated. For display purposes, cubic feet were converted to cords and MBF using a simple conversion factor, e.g. 79 cubic feet per cord and 185 cubic feet per MBF. The cubic foot volumes are precise; the cords and MBF volumes are not. Cubic foot volume cannot be directly converted to cords or boards with precision.

**SALE VOLUMES**

The total estimated sale volume may not equal the sum of the species/products due to the nature of statistical calculations associated with double sampling methodology.

VOLUME		STATISTICAL RANGE IN CORDS		
TOTAL CUBIC FEET	TOTAL CORDS	PERCENT ERROR	MINIMUM	MAXIMUM
25,690	325	39.57%	196	454

**VDU VOLUMES**

A VDU is a Volume Determination Unit. Volumes and their associated statistics are calculated at the VDU level and summarized to the sale level. There is often a one to one relationship between a VDU and a Payment Unit, but not always, depending on the cruise design. Refer to the VDU TO PAYMENT UNIT table.

VDU	VOLUME		PERCENT ERROR	RANGE IN CORDS	
	TOTAL CUBIC FEET	TOTAL CORDS		MINIMUM	MAXIMUM
126	25,690	325	39.58%	196	454
<b>TOTAL:</b>	<b>25,690</b>	<b>325</b>		<b>196</b>	<b>454</b>

**VDU TO PAYMENT UNIT**

When a VDU is associated with more than one Payment Unit (PU), the VDU volumes are assigned to the PU based on acres of the VDU within the PU.

VDU	VDU ACRES	PU	PU ACRES
126	11.9	1	11.9
<b>TOTAL:</b>	<b>11.9</b>		<b>11.9</b>

**DESCRIPTION OF TIMBER BY PAYMENT UNIT (PU)**

PU	MARKET GROUP	PRODUCT	QUANTITY	UNIT	ACRES	ADVERTISE PRICE
1	Red Pine	Sawtimber	114.8	MBF	11.9	\$16,274.75
	Red Maple	Pulpwood	5	Cords		
	<i>Red Maple</i>	<i>Sawtimber</i>	<i>0.8</i>	<i>MBF</i>		
	<i>Red Maple</i>	<i>Pulpwood</i>	<i>3</i>	<i>Cords</i>		
	Red Pine		60	Cords		
TOTAL:			114.8	MBF		
TOTAL:			65	Cords		

# Sale Specific Conditions & Requirements

**Sale Name: Radio Red**

**Sale Number: 61-052-22 Seq#: 1**

## 1 - Sale Area

### 1.2 - Boundaries

#### 1.2.1 - Painted boundaries (9/19)

The sale boundary is identified with red paint. The painted boundary line trees are not Included Timber and are to be protected.

## 2 - Timber Specifications

### 2.1 - Included Timber

#### 2.1.7 - Leave tree marked unit(s) (6/14)

Within Payment Unit(s) 1, all trees greater than 8 inches at DBH are designated for cutting, except do not cut trees marked with green paint above and below stump height. Special protection trees identified in accordance with condition 3.4.2, within clearcutting unit boundaries, are not Included Timber and are to be protected.

### 2.2 - Utilization

#### 2.2.6 - Roundwood operation required (3/21)

The skidding of whole trees or tree segments with limbs attached is prohibited. All products must be produced as roundwood and forwarded to existing roads or landing areas in final product length. Trees must be harvested with in-woods processor (feller bunching harvester will not be allowed) in order to retain existing understory.

## 3 - Payments

### 3.4 - Damaged Timber

#### 3.4.1 - Damaged timber (7/16)

General Condition and Requirement 3.4 Damaged Timber, defines liquidated damages for undesignated live merchantable trees which are cut or injured. In addition, extreme care should be taken to avoid damage to tree seedlings and saplings. Advanced regeneration is present in the understory and is desirable for the future stand.

#### 3.4.2 - Special Protection Trees (4/14)

The Purchaser shall not cut live or dead special protection trees within cutting units or clearings. Special protection trees are marked with green paint. If the Purchaser's operations have cut or damaged special protection trees through carelessness, the Purchaser shall pay \$50 as fixed, agreed and liquidated damages for each special protection tree cut or damaged. Such payment does not constitute ownership of the undesignated timber.

## 4 - Transportation

### 4.1 - Construction

#### 4.1.12 - No new roads (1/12)

No new roads will be permitted in any Payment Unit. All operations are limited to existing roads. Skid trails only will be allowed.

### 4.2 - Maintenance

#### 4.2.5 - Two wheel drive condition (2/04)

All existing trail roads on and adjacent to the sale area must be passable by two-wheel drive traffic for the duration of the sale.

## 5 - Operations

### 5.1 - Notification

#### 5.1.1 - Pre-sale conference (10/16)

A pre-sale conference on site between the Purchaser and sale administrator is required prior to beginning any operations a

Payment Unit to determine landing and road locations. The Unit Manager or his/her representative must be contacted at least 3 days in advance to schedule the conference.

#### 5.1.4 - Post-sale conference (10/16)

A post-sale conference on site between the Purchaser and sale administrator is required 3 days prior to the completion of active logging operations to determine clean-up and repair of landings, road edges, and the fulfillment of other contract specifications.

### 5.2 - Conduct of Operations

#### 5.2.1 - Slash

##### 5.2.1.8 - Slash height (12/08)

No slash or tree tops may exceed 30 inches in height.

#### 5.2.2 - Hazard Trees/Snags

##### 5.2.2.1 - Den trees (10/16)

Obvious hollow and/or den trees shall be protected and left standing unless they are a safety hazard.

#### 5.2.3 - Operating Restrictions

##### 5.2.3.4 - Oak wilt restriction, no exceptions (1/18)

Within Payment Unit 1, cutting, skidding, hauling within the sale and brushing of access roads to the sale are not permitted during the period of April 15 to July 15. No exceptions will be granted. This is necessary to reduce the spread of oak wilt.

#### 5.2.38 - No decking against live trees (2/04)

Cut products may not be decked against unmarked or designated leave trees.

#### 5.2.39 - ORV trail/route protection (4/18)

The motorcycle trail is shown on the Timber Sale Map. Do not cut trees or damage posts with yellow ORV markers. All stumps within 5 feet of the trail must be cut off at least 5 feet above ground level. Maintain a 20-foot-wide slash, debris, and rut free zone daily using the ORV trail or route as the centerline. Do not run equipment down the ORV trail or route. Skidding across the trail or route may only occur in locations approved by the sale administrator.

### 5.4 - Soil Protection

#### 5.4.1 - Rutting restriction, general (7/16)

Operations are to cease immediately if equipment and weather conditions result in rutting of roads and/or skid trails which is 12 inches or greater in depth and 50 feet in length. The Unit Manager or his/her representative may restrict hauling and/or skidding if ruts exceed the specified depth. With the Unit Manager or his/her representative's approval, the Purchaser may return to the area when the risk of rutting has decreased.

## 6 - Safety and Fire Prevention

### 6.2 - Signing

#### 6.2.1 - Road posting (10/20)

The Purchaser is responsible for posting and maintaining caution signs on Jack Pine Road prior to beginning operations. The road must be posted at appropriate distances from the sale area to warn of logging activity and truck traffic. Signs must be removed when harvest operations are suspended or completed. The Purchaser will provide these signs.

#### 6.2.3 - Recreational trail posting (10/20)

The Purchaser is responsible for posting and maintaining caution signs on the motorcycle trail prior to beginning operations. The trail must be posted at appropriate distances from the sale area to warn of logging activity and truck traffic at both ends of the trail. Signs must be removed when harvest operations are suspended or completed. The Purchaser will provide these signs.



# TIMBER SALE MAP

This information provided by authority of Part 525, 1994 PA 451, as amended.

<b>Sale Number</b> 61-051	<b>Year</b> 22
<b>Date</b> 09/30/2022	<b>Page</b> of 1 of 1
<b>Scale</b> 1:15,840	

<b>Forest Management Unit</b> Traverse City	<b>County</b> Grand Traverse	<b>Mapped By</b> Ruppen
<b>Township</b> 26N	<b>Range</b> 9 W	<b>Section(s) and Subdivision(s)</b> Sec 14 SENE, NESE
		<b>Cruised By</b> Ruppen

Cover Type				Density	
A = Aspen	H = Hemlock	N = Marsh	U = Upland Brush	0 = Non Stocked	5 = Pole Timber Medium
B = Paper Birch	J = Jack Pine	O = Oak	UM = Upland Mixed	1 = Seeding Sapling Poor	6 = Pole Timber Well
C = Cedar	L = Lowland Brush	P = Lowland Poplar	V = Bog or Marsh	2 = Seeding Sapling Medium	7 = Saw Timber Poor
D = Tread Bog	LM = Lowland Mixed	Q = Mixed Swamp Conifer	W = White Pine	3 = Seeding Sapling Well	8 = Saw Timber Medium
E = Swamp Hdwoods	M = Mpl, Bch, Bach	R = Red Pine	X = Non Stocked	4 = Pole Timber Poor	9 = Saw Timber Well
F = Spruce Fir	MC = Mixed Conifer	S = Black Spruce	Z = Water		
G = Green	MD = Mixed Deciduous	T = Tamarack			

**PU Acres**  
1 11.9

**Radio Red**  
Compartment 52  
11.9 Acres

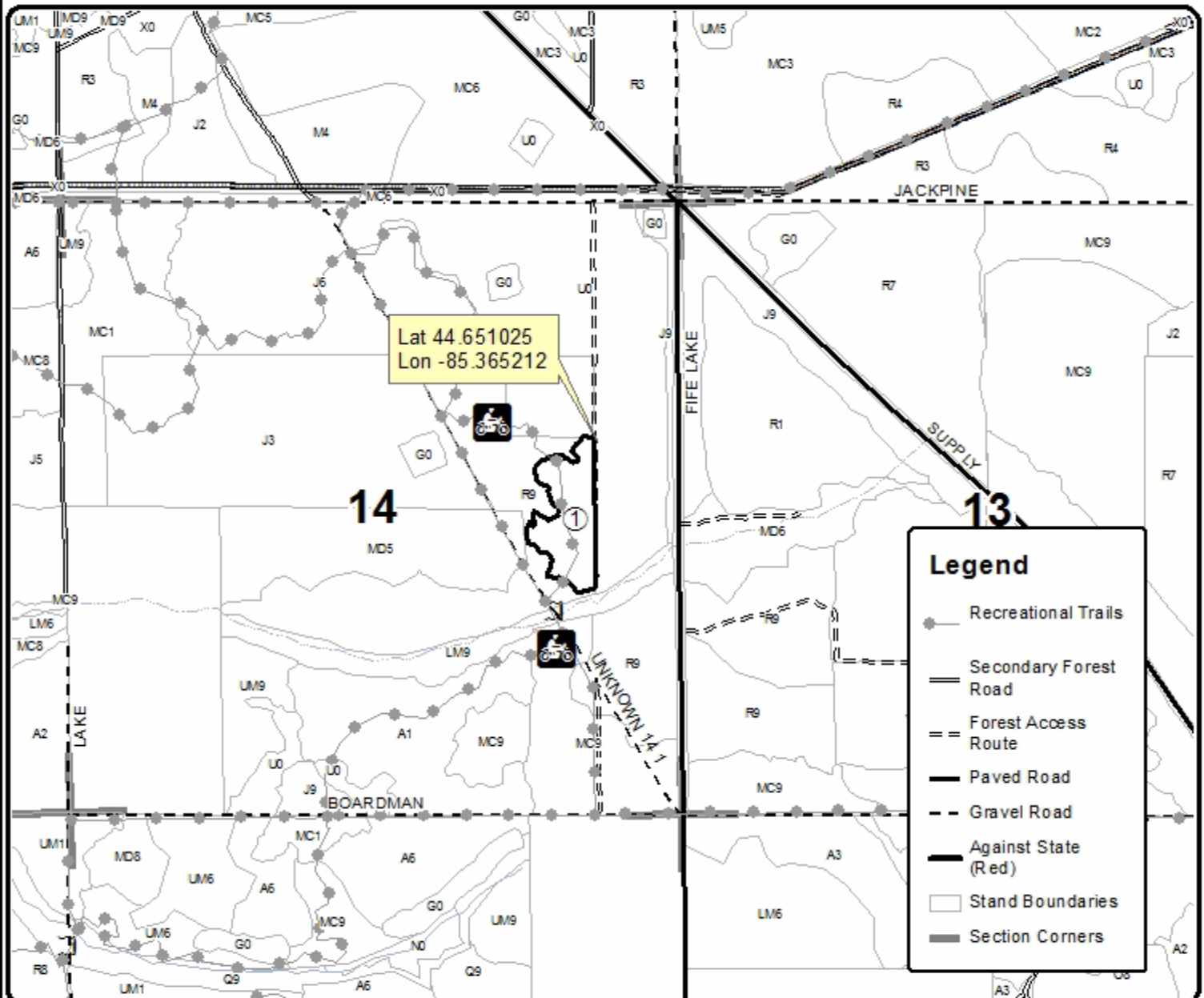

**Legend**

- Recreational Trails
- Secondary Forest Road
- Forest Access Route
- Paved Road
- Gravel Road
- Against State (Red)
- Stand Boundaries
- Section Corners

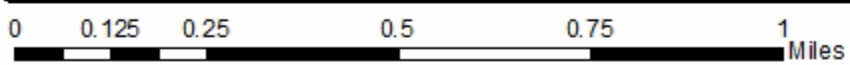



## TIMBER SALE INFORMATION

East Side Pine (61-053-22)

T26N, R09W, SEC. 13.

Grand Traverse County (Advertised Price \$71,876.70)

SALE NOTE: Mixed pine final harvest. Tops must be chipped to prepare site for planting operations.

A timber sale contract for this lump sum, sealed bid timber sale will be awarded to the responsible bidder offering the highest sealed bid price. All units of volume listed below were estimated using the Inventory Manager computer program and the new Michigan taper model. Bids must be at or above the following advertised price for each product and species:

<u>PRODUCTS &amp; SPECIES</u>	<u>ESTIMATED UNITS*</u>	<u>ADVERTISED PRICE</u>
Sawtimber		
Black Cherry	3.1 MBF	\$ 154.00 / MBF
Red Maple	14.8 MBF	\$ 143.00 / MBF
Red Pine	345.5 MBF	\$ 115.00 / MBF
White Pine	11.2 MBF	\$ 64.00 / MBF
Pulpwood		
Black Cherry	10 Cords	\$ 23.55 / Cord
Jack Pine	240 Cords	\$ 20.35 / Cord
Red Maple	85 Cords	\$ 23.55 / Cord
Red Pine	429 Cords	\$ 49.25 / Cord
White Pine	22 Cords	\$ 26.55 / Cord

\* The total volume is statistically estimated within plus (+) or minus (-) 26.83 percent. There are an estimated 1,532 cords on this timber sale, plus or minus 411 cords at the 95% confidence level. The estimated units are final and not subject to adjustment. Prospective bidders are urged to examine this timber and to make their own estimates of quantity and quality.

### **BOND AND PAYMENT SCHEDULE:**

1. A bond in the amount of \$3,594.00 to insure faithful performance of the conditions of the contract will be deposited by the successful bidder within 21 days of the sale award.
2. Cutting in any sale or unit without the required advance payment would be considered a trespass.
3. Total payment must be paid in advance or according to the following schedule :
  - (a) Ten percent (10%) of the sale value must be paid within 21 days of the sale award.
  - (b) The 10% down payment will be credited towards the first unit cut.
  - (c) Payment for each of the following units must be made before cutting begins in that unit:
 

PAYMENT UNIT NUMBER	PERCENT OF TOTAL SALE VALUE
01	76.9%
02	23.1%
4. If no cutting takes place, the 10% down payment will not be refunded.
5. Operations on the contract issued will terminate on 04/15/2025.

### **SALE STATISTICS**

Volumes were calculated in cubic feet using the Michigan taper model. Cubic foot volume includes all wood inside bark for the product indicated. For display purposes, cubic feet were converted to cords and MBF using a simple conversion factor, e.g. 79 cubic feet per cord and 185 cubic feet per MBF. The cubic foot volumes are precise; the cords and MBF volumes are not. Cubic foot volume cannot be directly converted to cords or boards with precision.

### **SALE VOLUMES**

The total estimated sale volume may not equal the sum of the species/products due to the nature of statistical calculations associated with double sampling methodology.

VOLUME		STATISTICAL RANGE IN CORDS		
TOTAL CUBIC FEET	TOTAL CORDS	PERCENT ERROR	MINIMUM	MAXIMUM
121,030	1,532	26.83%	1,121	1,943

**VDU VOLUMES**

A VDU is a Volume Determination Unit. Volumes and their associated statistics are calculated at the VDU level and summarized to the sale level. There is often a one to one relationship between a VDU and a Payment Unit, but not always, depending on the cruise design. Refer to the VDU TO PAYMENT UNIT table.

VDU	VOLUME		PERCENT ERROR	RANGE IN CORDS	
	TOTAL CUBIC FEET	TOTAL CORDS		MINIMUM	MAXIMUM
145	121,030	1,532	19.98%	1,226	1,838
146	0	0	0.00%	0	0
<b>TOTAL:</b>	<b>121,030</b>	<b>1,532</b>		<b>1,226</b>	<b>1,838</b>

**VDU TO PAYMENT UNIT**

When a VDU is associated with more than one Payment Unit (PU), the VDU volumes are assigned to the PU based on acres of the VDU within the PU.

VDU	VDU ACRES	PU	PU ACRES
145	64.5	1	49.6
		2	14.9
146	36.9	2	36.9
<b>TOTAL:</b>	<b>101.4</b>		<b>101.4</b>

**DESCRIPTION OF TIMBER BY PAYMENT UNIT (PU)**

PU	MARKET GROUP	PRODUCT	QUANTITY	UNIT	ACRES	ADVERTISE PRICE	
1	Black Cherry	Sawtimber	2.4	MBF	49.6	\$55,293.45	
	Red Maple		11.4	MBF			
	Red Pine		265.7	MBF			
	White Pine		8.6	MBF			
	Black Cherry		Pulpwood	8			Cords
	Jack Pine	185		Cords			
	<i>Jack Pine</i>	<i>Sawtimber</i>		13.3			<i>MBF</i>
	<i>Jack Pine</i>	<i>Pulpwood</i>		158			<i>Cords</i>
	Red Maple	65		Cords			
	Red Pine	330		Cords			
	White Pine	17		Cords			
	2	Black Cherry	Sawtimber	0.7			MBF
Red Maple		3.4		MBF			
Red Pine		79.8		MBF			
White Pine		2.6	MBF				
Black Cherry		Pulpwood	2	Cords			
Jack Pine			55	Cords			
<i>Jack Pine</i>			<i>Sawtimber</i>	4.0	<i>MBF</i>		
<i>Jack Pine</i>			<i>Pulpwood</i>	47	<i>Cords</i>		
Red Maple			20	Cords			
Red Pine		99	Cords				
White Pine		5	Cords				
<b>TOTAL:</b>			374.6	MBF			
<b>TOTAL:</b>			786	Cords			



## Sale Specific Conditions & Requirements

**Sale Name: East Side Pine**

**Sale Number: 61-053-22 Seq#: 1**

### 1 - Sale Area

#### 1.2 - Boundaries

##### 1.2.1 - Painted boundaries (9/19)

The sale boundary and Payment Unit boundaries are marked and identified red and yellow paint. Exterior sale boundary lines against state are marked with red paint. Interior Payment Unit boundaries are marked with yellow paint. The painted boundary line trees are not Included Timber and are to be protected but cut the red marked jack pine along the road on the north boundary. . Yellow painted trees designating an interior Payment Unit boundary are only to be cut when all surrounding Payment Units have been paid.

### 2 - Timber Specifications

#### 2.1 - Included Timber

##### 2.1.1 - Clearcut unit(s) with unmerchantable trees (6/14)

Within Payment Unit(s) #'s 1 and 2 , cut all trees that are one (1) inches or more at DBH except trees that are marked with green paint at and below breast height. Special protection trees identified in accordance with condition 3.4.2, within clearcutting unit boundaries, are not Included Timber and are to be protected.

#### 2.2 - Utilization

##### 2.2.2 - Chipping required (2/18)

This area must be chip harvested to facilitate subsequent planting operations. The Purchaser has the option to produce sawlogs or pulpwood bolts, but the remaining portion of the trees must be chipped and hauled. Products may be produced as roundwood and forwarded to decking areas in final product length, but the tops must be left intact and skidded to the landing for chipping in order to minimize the amount of residual slash. The requirement to retain approximately 1/6 to 1/3 of tree tops and limbs less than four inches in diameter does not apply (G. C. & R. 2.2). This is because the slash would interfere with the planting operation and site prep.

##### 2.2.3 - Stump heights (4/07)

Stump heights within the Sale Area shall not exceed 6 inches for all trees. This is in order to facilitate planting operations.

### 3 - Payments

#### 3.4 - Damaged Timber

##### 3.4.2 - Special Protection Trees (4/14)

The Purchaser shall not cut live or dead special protection trees within cutting units or clearings. Special protection trees are marked with green paint . If the Purchaser's operations have cut or damaged special protection trees through carelessness, the Purchaser shall pay \$50 as fixed, agreed and liquidated damages for each special protection tree cut or damaged. Such payment does not constitute ownership of the undesignated timber.

### 4 - Transportation

#### 4.1 - Construction

##### 4.1.12 - No new roads (1/12)

No new roads will be permitted in any Payment Unit. . All operations are limited to existing roads. Skid trails only will be allowed.

#### 4.2 - Maintenance

##### 4.2.4 - Grading (10/16)

For completion of the sale, state forest roads must be graded. In general, this will require a road grader or bull dozer to shape up the roads after forest products have been hauled off site. This includes cleaning of drainage areas, grading, crowning and filling with gravel, if necessary. The grading equipment to be used must be approved by the Unit Manager or his/her

representative.

## **5 - Operations**

### 5.1 - Notification

#### 5.1.1 - Pre-sale conference (10/16)

A pre-sale conference on site between the Purchaser and sale administrator is required prior to beginning any operations to determine landing and road locations. The Unit Manager or his/her representative must be contacted at least 3 days in advance to schedule the conference.

#### 5.1.4 - Post-sale conference (10/16)

A post-sale conference on site between the Purchaser and sale administrator is required 3 days prior to the completion of active logging operations to determine clean-up and repair of landings, road edges, and the fulfillment of other contract specifications.

### 5.2 - Conduct of Operations

#### 5.2.38 - No decking against live trees (2/04)

Cut products may not be decked against unmarked or designated leave trees.

### 5.4 - Soil Protection

#### 5.4.1 - Rutting restriction, general (7/16)

Operations are to cease immediately if equipment and weather conditions result in rutting of roads and/or skid trails which is 12 inches or greater in depth and 50 feet in length. The Unit Manager or his/her representative may restrict hauling and/or skidding if ruts exceed the specified depth. With the Unit Manager or his/her representative's approval, the Purchaser may return to the area when the risk of rutting has decreased.

## **6 - Safety and Fire Prevention**

### 6.2 - Signing

#### 6.2.1 - Road posting (10/20)

The Purchaser is responsible for posting and maintaining caution signs on adjacent forest roads prior to beginning operations. The road must be posted at appropriate distances from the sale area to warn of logging activity and truck traffic. Signs must be removed when harvest operations are suspended or completed. The Purchaser will provide these signs.



# TIMBER SALE MAP

This information provided by authority of Part 525, 1994 PA 451, as amended.

Sale Number	Year
61-053	22

Forest Management Unit Traverse City	County Grand Traverse	Mapped By Ruppen	Date 09/30/2022	Page 1	of 1
Township 26 N		Range 9 W		Section(s) and Subdivision(s) Sec 13 E1/2NW, NNE, N1/2SE	

Scale  
1:15,840

Cover Type				Density	
A = Aspen	H = Hemlock	N = Marsh	U = Upland Brush	0 = Non Stocked	5 = Pole Timber Medium
B = Paper Birch	J = Jack Pine	O = Oak	UM = Upland Mixed	1 = Seeding Sapling Poor	6 = Pole Timber Well
C = Cedar	L = Lowland Brush	P = Lowland Poplar	V = Bog or Marsh	2 = Seeding Sapling Medium	7 = Saw Timber Poor
D = Tread Bog	LM = Lowland Mixed	Q = Mixed Swamp Conifer	W = White Pine	3 = Seeding Sapling Well	8 = Saw Timber Medium
E = Swamp Hdwoods	M = Mpl, Bch, Bach	R = Red Pine	X = Non Stocked	4 = Pole Timber Poor	9 = Saw Timber Well
F = Spruce Fir	MC = Mixed Conifer	S = Black Spruce	Z = Water		
G = Grass	MD = Mixed Deciduous	T = Tamarack			

### PU Acres

1	49.7
2	51.7

## East Side Pine

Compartment 52

101.4 Acres

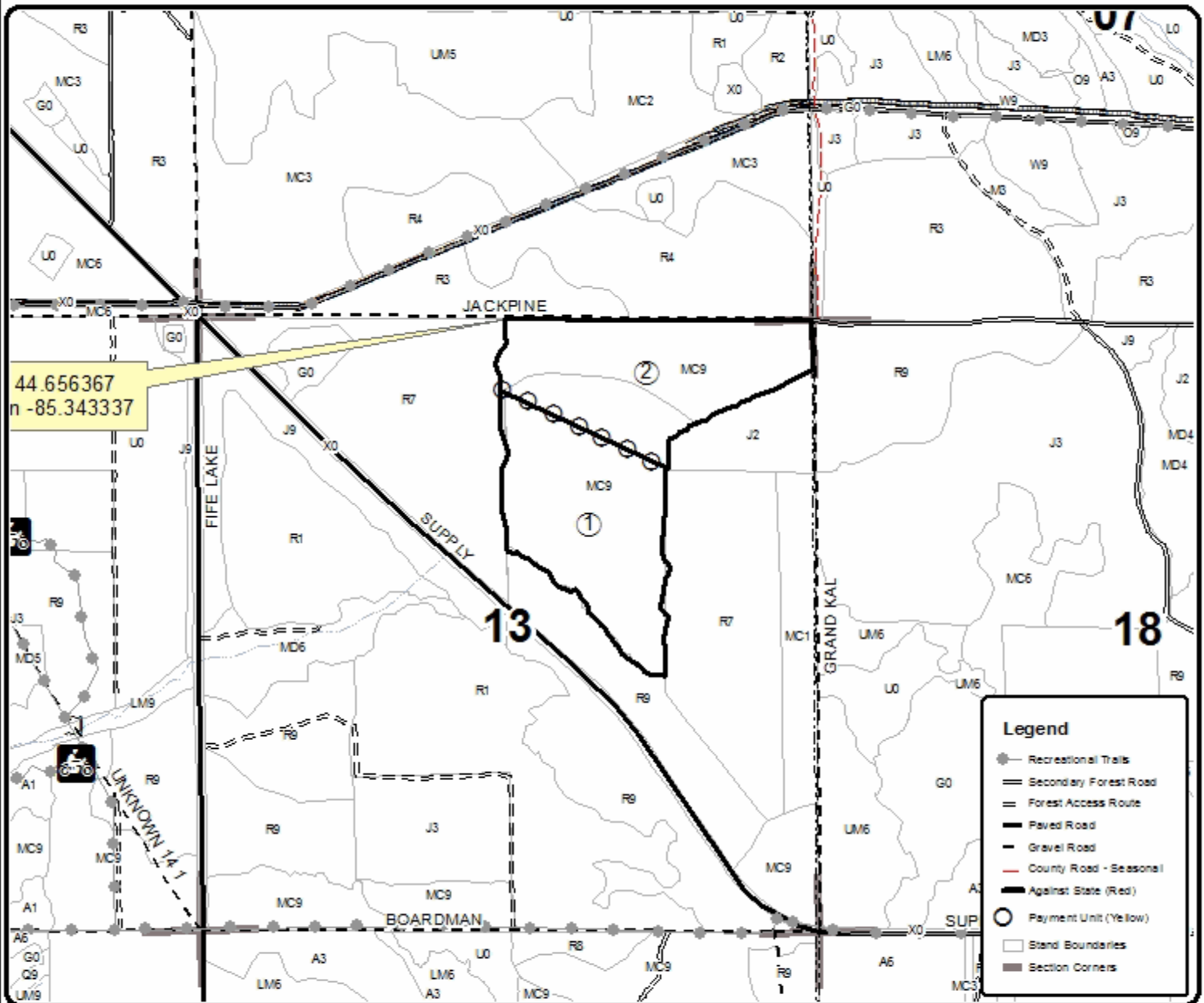

44.656367  
n -85.343337



## TIMBER SALE INFORMATION

Blair Townhall Mix (61-054-22)

T26N, R11W, SEC. 24.

Grand Traverse County (Advertised Price \$112,444.00)

SALE NOTE: A recreation site such as a trail, pathway, or campground is within the sale area or the vicinity. Certain restrictions/specifications may be applicable including time restrictions.

A timber sale contract for this lump sum, sealed bid timber sale will be awarded to the responsible bidder offering the highest sealed bid price. All units of volume listed below were estimated using the Inventory Manager computer program and the new Michigan taper model. Bids must be at or above the following advertised price for each product and species:

<u>PRODUCTS &amp; SPECIES</u>	<u>ESTIMATED UNITS*</u>	<u>ADVERTISED PRICE</u>
<b>Sawtimber</b>		
B. T. Aspen	179.5 MBF	\$ 101.00 / MBF
Beech	3.0 MBF	\$ 110.00 / MBF
Black Cherry	22.2 MBF	\$ 154.00 / MBF
Paper Birch	3.3 MBF	\$ 50.00 / MBF
Red Maple	274.8 MBF	\$ 143.00 / MBF
Red Oak	82.6 MBF	\$ 117.00 / MBF
Sugar Maple	4.5 MBF	\$ 280.00 / MBF
White Pine	35.0 MBF	\$ 64.00 / MBF
<b>Pulpwood</b>		
B. T. Aspen	370 Cords	\$ 20.75 / Cord
Beech	33 Cords	\$ 23.55 / Cord
Black Cherry	60 Cords	\$ 23.55 / Cord
Paper Birch	6 Cords	\$ 18.00 / Cord
Red Maple	904 Cords	\$ 23.55 / Cord
Red Oak	137 Cords	\$ 21.65 / Cord
Sugar Maple	38 Cords	\$ 23.55 / Cord
White Pine	106 Cords	\$ 26.55 / Cord

\* The total volume is statistically estimated within plus (+) or minus (-) 12.95 percent. There are an estimated 3,044 cords on this timber sale, plus or minus 394 cords at the 95% confidence level. The estimated units are final and not subject to adjustment. Prospective bidders are urged to examine this timber and to make their own estimates of quantity and quality.

### **BOND AND PAYMENT SCHEDULE:**

1. A bond in the amount of \$5,622.00 to insure faithful performance of the conditions of the contract will be deposited by the successful bidder within 21 days of the sale award.
2. Cutting in any sale or unit without the required advance payment would be considered a trespass.
3. Total payment must be paid in advance or according to the following schedule :
  - (a) Ten percent (10%) of the sale value must be paid within 21 days of the sale award.
  - (b) The 10% down payment will be credited towards the first unit cut.
  - (c) Payment for each of the following units must be made before cutting begins in that unit:
 

PAYMENT UNIT NUMBER	PERCENT OF TOTAL SALE VALUE
01	28.8%
02	11.4%
03	28.3%
04	31.5%
4. If no cutting takes place, the 10% down payment will not be refunded.
5. Operations on the contract issued will terminate on 09/30/2025.

### **SALE STATISTICS**

Volumes were calculated in cubic feet using the Michigan taper model. Cubic foot volume includes all wood inside bark for the product indicated. For display purposes, cubic feet were converted to cords and MBF using a simple conversion factor, e.g. 79 cubic feet per cord and 185 cubic feet per MBF. The cubic foot volumes are precise; the cords and MBF volumes are not. Cubic foot volume cannot be directly converted to cords or boards with precision.

## SALE VOLUMES

The total estimated sale volume may not equal the sum of the species/products due to the nature of statistical calculations associated with double sampling methodology.

VOLUME			STATISTICAL RANGE IN CORDS	
TOTAL CUBIC FEET	TOTAL CORDS	PERCENT ERROR	MINIMUM	MAXIMUM
240,491	3,044	12.95%	2,650	3,439

## VDU VOLUMES

A VDU is a Volume Determination Unit. Volumes and their associated statistics are calculated at the VDU level and summarized to the sale level. There is often a one to one relationship between a VDU and a Payment Unit, but not always, depending on the cruise design. Refer to the VDU TO PAYMENT UNIT table.

	VOLUME			RANGE IN CORDS	
VDU	TOTAL CUBIC FEET	TOTAL CORDS	PERCENT ERROR	MINIMUM	MAXIMUM
119	74,789	947	19.17%	765	1,128
125	23,222	294	40.97%	174	414
138	68,027	861	23.54%	658	1,064
146	74,453	942	23.84%	718	1,167
<b>TOTAL:</b>	<b>240,491</b>	<b>3,044</b>		<b>2,315</b>	<b>3,774</b>

## VDU TO PAYMENT UNIT

When a VDU is associated with more than one Payment Unit (PU), the VDU volumes are assigned to the PU based on acres of the VDU within the PU.

VDU	VDU ACRES	PU	PU ACRES
119	24.4	1	24.4
125	17.1	2	17.1
138	24.6	3	24.6
146	22.9	4	22.9
<b>TOTAL:</b>	<b>89.0</b>		<b>89.0</b>

**DESCRIPTION OF TIMBER BY PAYMENT UNIT (PU)**

PU	MARKET GROUP	PRODUCT	QUANTITY	UNIT	ACRES	ADVERTISE PRICE
1	B. T. Aspen	Sawtimber	51.0	MBF	24.4	\$32,421.15
	Red Maple		53.0	MBF		
	Red Oak		64.7	MBF		
	B. T. Aspen	Pulpwood	100	Cords		
	Beech		20	Cords		
	Red Maple		288	Cords		
	Red Oak		129	Cords		
2	B. T. Aspen	Sawtimber	27.7	MBF	17.1	\$12,867.65
	Beech		3.0	MBF		
	Red Maple		32.8	MBF		
	Sugar Maple	4.0	MBF			
	B. T. Aspen	Pulpwood	18	Cords		
	Beech		13	Cords		
	Red Maple		117	Cords		
	Sugar Maple		21	Cords		
3	B. T. Aspen	Sawtimber	74.5	MBF	24.6	\$31,837.05
	Black Cherry		12.7	MBF		
	Red Maple		63.8	MBF		
	Sugar Maple		0.5	MBF		
	White Pine		35.0	MBF		
	B. T. Aspen	Pulpwood	182	Cords		
	Black Cherry		22	Cords		
	Red Maple		142	Cords		
	Sugar Maple		17	Cords		
	White Pine		106	Cords		
4	B. T. Aspen	Sawtimber	26.3	MBF	22.9	\$35,318.15
	Black Cherry		9.5	MBF		
	Paper Birch		3.3	MBF		
	Red Maple		125.2	MBF		
	Red Oak		17.9	MBF		
	B. T. Aspen	Pulpwood	70	Cords		
	Black Cherry		38	Cords		
	Paper Birch		6	Cords		
	Red Maple		357	Cords		
	Red Oak		8	Cords		
TOTAL:			604.9	MBF		
TOTAL:			1,654	Cords		

## Sale Specific Conditions & Requirements

**Sale Name: Blair Townhall Mix**

**Sale Number: 61-054-22 Seq#: 1**

### 1 - Sale Area

#### 1.2 - Boundaries

##### 1.2.1 - Painted boundaries (9/19)

The sale boundary and Payment Unit boundaries are marked and identified by red and yellow paint. Exterior sale boundary lines against state are marked with red paint. Interior Payment Unit boundaries are marked with yellow paint. The painted boundary line trees are not Included Timber and are to be protected unless marked with orange paint. Yellow painted trees designating an interior Payment Unit boundary are only to be cut when all surrounding Payment Units have been paid.

### 2 - Timber Specifications

#### 2.1 - Included Timber

##### 2.1.3 - Cut tree marked unit(s) (12/08)

Within Payment Unit(s) 2, all trees are designated for cutting when marked with orange paint above and below stump height, regardless of merchantability. In addition, all beech and aspen are to be harvested.

##### 2.1.7 - Leave tree marked unit(s) (6/14)

Within Payment Unit(s) 1, 3 & 4, cut all trees that are two (2) inches or more at DBH except do not cut trees marked with green paint above and below stump height. In addition, do not cut any hemlock or balsam fir regardless of size, and do not cut any white pine <4.5" DBH.

#### 2.2 - Utilization

##### 2.2.3 - Stump heights (4/07)

Stump heights within the Sale Area shall not exceed 12 inches for trees greater than 10 inches DBH and 4 inches for trees smaller than 10 inches DBH.

##### 2.2.5 - Limbed tree skidding (1/09)

The skidding of whole trees or tree segments with limbs attached is prohibited within payment unit 2.

### 3 - Payments

#### 3.4 - Damaged Timber

##### 3.4.1 - Damaged timber (7/16)

General Condition and Requirement 3.4 Damaged Timber, defines liquidated damages for undesignated live merchantable trees which are cut or injured. In addition, extreme care should be taken to avoid damage to tree seedlings and saplings.

No damage is acceptable to undesignated live merchantable trees. Within the sale area, if more than 5% of trees (> 4.5" DBH) within a specified area of the sale are damaged, liquidated damages will be assessed for all trees damaged. Rates will be in accordance with General Condition and Requirement 3.4 Damaged Timber.

### 4 - Transportation

#### 4.1 - Construction

##### 4.1.11 - Permits (2/12)

The Purchaser will secure any necessary permits that may be required.

##### 4.1.12 - No new roads (1/12)

No new roads will be permitted in any Payment Unit. All operations are limited to existing roads. Skid trails only will be allowed.

### 5 - Operations



## 5.2 - Conduct of Operations

### 5.2.1 - Slash

#### 5.2.1.8 - Slash height (12/08)

No slash or tree tops may exceed 24 inches in height.

### 5.2.2 - Hazard Trees/Snags

#### 5.2.2.1 - Den trees (10/16)

Obvious hollow and/or den trees shall be protected and left standing unless they are a safety hazard.

### 5.2.3 - Operating Restrictions

#### 5.2.3.4 - Oak wilt restriction, no exceptions (1/18)

Within Payment Unit(s) 1, 2, 3 & 4 cutting, skidding, hauling within the sale and brushing of access roads to the sale are not permitted during the period of April 15 to July 15. No exceptions will be granted. This is necessary to reduce the spread of oak wilt. This spec will also cover the bark slip restricted period for payment unit 2.

### 5.2.4 - Dead and Down Creation

#### 5.2.4.2 - Dead and down creation, hare and grouse (1/14)

To improve habitat for snowshoe hare, grouse, and other species, the Purchaser is to leave two 14 inch diameter or larger log size pieces on the ground for every two acres. They should be scattered throughout the sale or positioned per the sale administrators instructions. If possible, the logs or trees should be felled so they overlap. Note these pieces should have a minimum length of eight feet. They can be of any tree species and can be an un-merchantable piece of wood or a full tree.

#### 5.2.29 - Shrub protection (1/20)

Do not cut or damage hawthorn, witch-hazel or juneberry. These woody-shrub plants are highly beneficial to various wildlife species.

#### 5.2.40 - Pathway protection (10/10)

The Boardman River Trail is a biking and hiking trail and is shown on the Timber Sale Map. The shore-to-shore trail is a designated equestrian trail and is also show on the timber sale map. Do not cut trees or damage posts with yellow 'triangular' pathway markers, or trees and/or posts with shore-to-shore trail making on them. Maintain a 20-foot wide slash, debris, and rut free zone daily, using both pathways as the centerline. Do not run equipment down the pathways. Skidding across the trails may only occur in locations approved by the sale administrator.

#### 5.2.41 - Snowmobile trail protection (9/11)

The snowmobile trail is shown on the Timber Sale Map. Do not cut or damage posts with orange trail markers or traffic control signs. If the trail is used, it must be maintained and restored to a condition equal to or better than before the sale. The road maintenance/restoration must be done prior to December 1. If the trail is used for hauling, it must be graded to the satisfaction of the Unit Manager or his/her representative prior to December 1st. The snowmobile trail may not be used for any timber sale operations from December 1 to March 31. A small portion of the trail may be approved for use to allow hauling operations to access nearby forest access routes leading to Blair Townhall Rd. The snowmobile trail may only be crossed at right angles. Maintain a 20 foot wide slash, debris, and rut free zone daily using the snowmobile trail as the centerline. No decking of forest products will be permitted along the snowmobile trail. All stumps within 20 feet of the snowmobile trail must be cut at ground level.

## 5.4 - Soil Protection

### 5.4.1 - Rutting restriction, general (7/16)

Operations are to cease immediately if equipment and weather conditions result in rutting of roads and/or skid trails which is 12 inches or greater in depth and 50 feet in length. The Unit Manager or his/her representative may restrict hauling and/or skidding if ruts exceed the specified depth. With the Unit Manager or his/her representative's approval, the Purchaser may return to the area when the risk of rutting has decreased.

## 5.8 - Protection of Endangered Species

### 5.8.5 - Protection of raptor nests (3/13)

Two unoccupied stick nests were found during timber sale preparation within payment unit 3. The nests appear to be degraded did not look like there were recently utilized by raptors. The trees themselves were marked with green paint along with all trees in a 50' radius in order to protect the nests. All trees with raptor nests will be protected if found during harvesting operations. Notification will be made to the Unit Manager or his/her representative who will notify the Wildlife Biologist so an on-site evaluation and recommendation can be made, if necessary. The above referenced nests should be evaluated by sale administrator prior to any sale operations being done in Unit 3.

## **6 - Safety and Fire Prevention**

### **6.2 - Signing**

#### **6.2.2 - Snowmobile trail posting (10/20)**

The Purchaser is responsible for posting and maintaining caution signs on the snowmobile trail (which also is the trail bed for the shore-to-shore trail) prior to beginning operations during the snowmobile season (approximately December 1 to March 31). The trail must be posted at appropriate distances from the sale area to warn of logging activity and truck traffic. Signs must be removed when harvest operations are suspended or completed. The Purchaser will provide these signs.

#### **6.2.3 - Recreational trail posting (10/20)**

The Purchaser is responsible for posting and maintaining caution signs on the Boardman River Trail prior to beginning operations. The trail must be posted at appropriate distances from the sale area to warn of logging activity and truck traffic at both ends of the trail. Signs must be removed when harvest operations are suspended or completed. The Purchaser will provide these signs.



# TIMBER SALE MAP

This information provided by authority of Part 525, 1994 PA 451, as amended.

Forest Management Unit Traverse City FMU	County Grand Traverse	Mapped By Cotant	Date 09/20/2022	Page 1	of 1
Township 26N	Range 11W	Section(s) and Subdivision(s) Sec 24 - E1/2NW,W1/2NE,NESW,NWSE,S1/2SE	Scale 1:15,840		

Cover Type				Density	
A = Aspen	H = Hemlock	N = Marsh	U = Upland Brush	0 = Non Stocked	5 = Pole Timber Medium
B = Paper Birch	J = Jack Pine	O = Oak	UM = Upland Mixed	1 = Seedling Sapling Poor	6 = Pole Timber Well
C = Cedar	L = Lowland Brush	P = Lowland Poplar	V = Bog or Marsh	2 = Seedling Sapling Medium	7 = Saw Timber Poor
D = Treed Bog	LM = Lowland Mixed	Q = Mixed Swamp Conifer	W = White Pine	3 = Seedling Sapling Well	8 = Saw Timber Medium
E = Swamp Hdwoods	M = Mpl. Bch, Brch	R = Red Pine	X = Non Stocked	4 = Pole Timber Poor	9 = Saw Timber Well
F = Spruce Fir	MC = Mixed Conifer	S = Black Spruce	Z = Water		
G = Grass	MD = Mixed Deciduous	T = Tamarack			

PU	Acres	PU	Acres
1	24.4	4	22.9
2	17.1		
3	24.6		

## Blair Townhall Mix

### Compartment 049

89 Acres

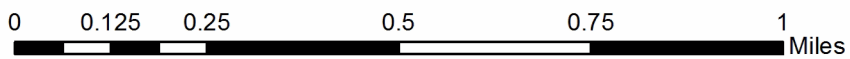
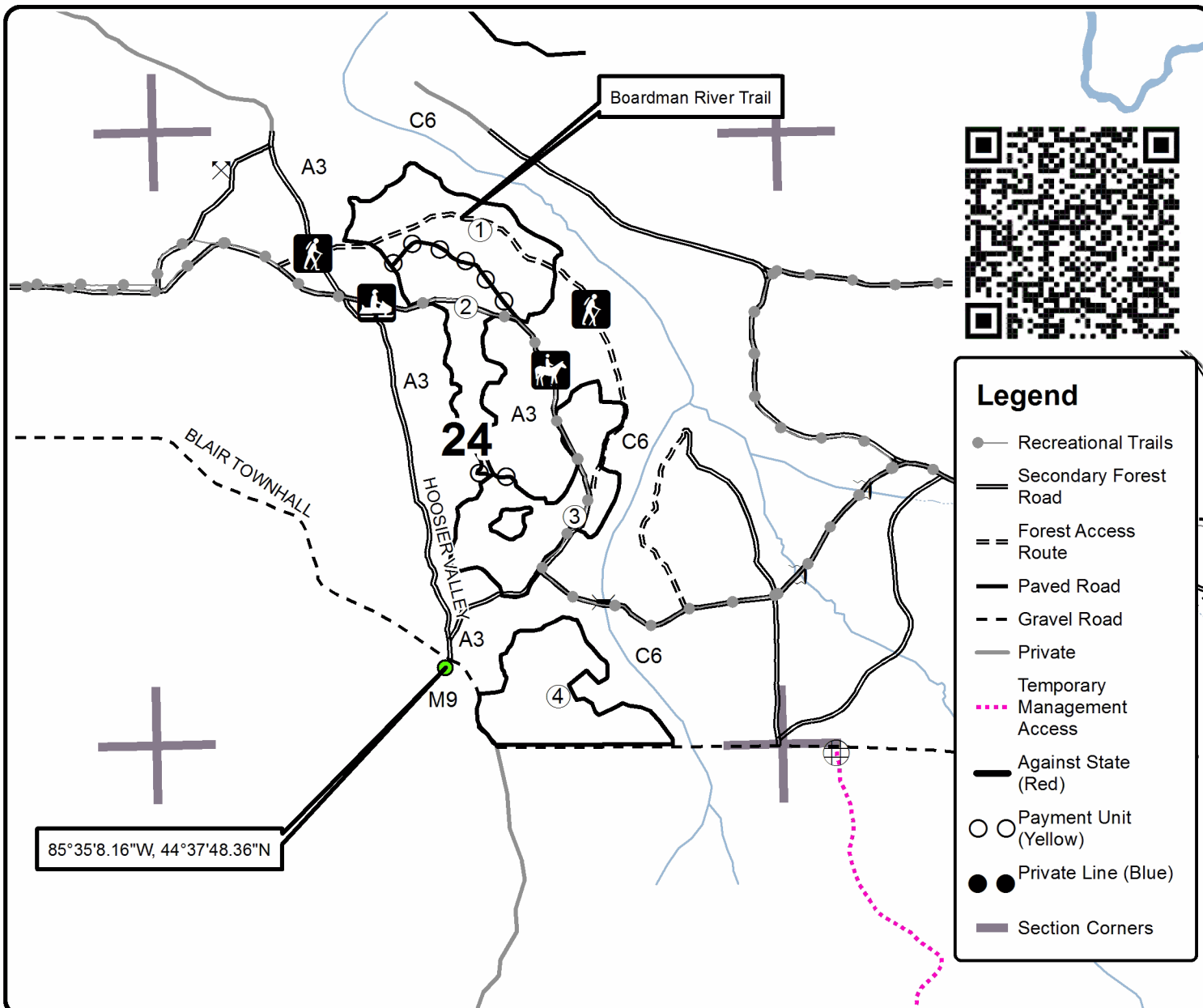
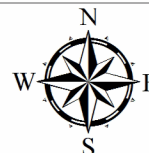



## TIMBER SALE INFORMATION

Ascension Aspen (61-056-22)  
T26N, R13W, SEC. 7; T26N, R14W, SEC. 12.  
Benzie County (Advertised Price \$24,578.30)

SALE NOTE: A recreation site such as a trail, pathway, or campground is within the sale area or the vicinity. Certain restrictions/specifications may be applicable including time restrictions.

A timber sale contract for this lump sum, sealed bid timber sale will be awarded to the responsible bidder offering the highest sealed bid price. All units of volume listed below were estimated using the Inventory Manager computer program and the new Michigan taper model. Bids must be at or above the following advertised price for each product and species:

<u>PRODUCTS &amp; SPECIES</u>	<u>ESTIMATED UNITS*</u>	<u>ADVERTISED PRICE</u>
Sawtimber		
Mixed Aspen	79.2 MBF	\$ 101.00 / MBF
Red Maple	4.3 MBF	\$ 143.00 / MBF
Pulpwood		
Mixed Aspen	657 Cords	\$ 20.75 / Cord
Mixed Hardwood	99 Cords	\$ 23.55 / Cord

\* The total volume is statistically estimated within plus (+) or minus (-) 30.88 percent. There are an estimated 881 cords on this timber sale, plus or minus 272 cords at the 95% confidence level. The estimated units are final and not subject to adjustment. Prospective bidders are urged to examine this timber and to make their own estimates of quantity and quality.

### **BOND AND PAYMENT SCHEDULE:**

1. A bond in the amount of \$1,229.00 to insure faithful performance of the conditions of the contract will be deposited by the successful bidder within 21 days of the sale award.
2. Cutting in any sale or unit without the required advance payment would be considered a trespass.
3. Total payment must be paid in advance or according to the following schedule :
  - (a) Ten percent (10%) of the sale value must be paid within 21 days of the sale award.
  - (b) The 10% down payment will be credited towards the first unit cut.
  - (c) Payment for each of the following units must be made before cutting begins in that unit:
 

PAYMENT UNIT NUMBER	PERCENT OF TOTAL SALE VALUE
01	79.1%
02	20.9%
4. If no cutting takes place, the 10% down payment will not be refunded.
5. Operations on the contract issued will terminate on 04/15/2025.

### **SALE STATISTICS**

Volumes were calculated in cubic feet using the Michigan taper model. Cubic foot volume includes all wood inside bark for the product indicated. For display purposes, cubic feet were converted to cords and MBF using a simple conversion factor, e.g. 79 cubic feet per cord and 185 cubic feet per MBF. The cubic foot volumes are precise; the cords and MBF volumes are not. Cubic foot volume cannot be directly converted to cords or boards with precision.

### **SALE VOLUMES**

The total estimated sale volume may not equal the sum of the species/products due to the nature of statistical calculations associated with double sampling methodology.

VOLUME		STATISTICAL RANGE IN CORDS		
TOTAL CUBIC FEET	TOTAL CORDS	PERCENT ERROR	MINIMUM	MAXIMUM
69,631	881	30.88%	609	1,154

## VDU VOLUMES

A VDU is a Volume Determination Unit. Volumes and their associated statistics are calculated at the VDU level and summarized to the sale level. There is often a one to one relationship between a VDU and a Payment Unit, but not always, depending on the cruise design. Refer to the VDU TO PAYMENT UNIT table.

VDU	VOLUME		PERCENT ERROR	RANGE IN CORDS	
	TOTAL CUBIC FEET	TOTAL CORDS		MINIMUM	MAXIMUM
23	15,357	194	51.11%	95	294
223	54,274	687	24.39%	519	855
<b>TOTAL:</b>	<b>69,631</b>	<b>881</b>		<b>614</b>	<b>1,148</b>

## VDU TO PAYMENT UNIT

When a VDU is associated with more than one Payment Unit (PU), the VDU volumes are assigned to the PU based on acres of the VDU within the PU.

VDU	VDU ACRES	PU	PU ACRES
23	29.2	2	29.2
223	24.1	1	24.1
<b>TOTAL:</b>	<b>53.3</b>		<b>53.3</b>

## DESCRIPTION OF TIMBER BY PAYMENT UNIT (PU)

PU	MARKET GROUP	PRODUCT	QUANTITY	UNIT	ACRES	ADVERTISE PRICE
1	Mixed Aspen	Sawtimber	57.4	MBF	24.1	\$19,439.05
	<i>B. T. Aspen</i>		57.4	<i>MBF</i>		
	Red Maple		4.3	MBF		
	Mixed Aspen	Pulpwood	537	Cords		
	<i>B. T. Aspen</i>		357	<i>Cords</i>		
	<i>Quaking Aspen</i>		180	<i>Cords</i>		
	Mixed Hardwood		80	Cords		
	<i>Basswood</i>		3	<i>Cords</i>		
	<i>Black Cherry</i>		13	<i>Cords</i>		
	<i>Ironwood</i>		3	<i>Cords</i>		
	<i>Red Maple</i>		36	<i>Cords</i>		
	<i>Sugar Maple</i>		25	<i>Cords</i>		
2	Mixed Aspen	Sawtimber	21.8	MBF	29.2	\$5,139.25
	<i>B. T. Aspen</i>		8.1	<i>MBF</i>		
	<i>Quaking Aspen</i>		13.7	<i>MBF</i>		
	Mixed Aspen	Pulpwood	120	Cords		
	<i>B. T. Aspen</i>		37	<i>Cords</i>		
	<i>Quaking Aspen</i>		83	<i>Cords</i>		
	Mixed Hardwood		19	Cords		
	<i>Ironwood</i>		19	<i>Cords</i>		
TOTAL:			83.5	MBF		
TOTAL:			756	Cords		

# Sale Specific Conditions & Requirements

**Sale Name: Ascension Aspen**

**Sale Number: 61-056-22 Seq#: 1**

## 1 - Sale Area

### 1.2 - Boundaries

#### 1.2.1 - Painted boundaries (9/19)

The sale boundary and Payment Unit boundaries are marked and identified by red and yellow paint. Exterior sale boundary lines against state land are marked with red paint. Interior Payment Unit boundaries are marked with yellow paint. The painted boundary line trees are not Included Timber and are to be protected.

## 2 - Timber Specifications

### 2.1 - Included Timber

#### 2.1.1 - Clearcut unit(s) with unmerchantable trees (6/14)

Within Payment Unit(s) 1, cut all trees that are two (2) inches or more at DBH except do not cut any elm or any conifers.

#### 2.1.4 - Designated timber unit(s) (6/17)

Within Payment Unit(s) 2, all aspen and ironwood trees are designated for cutting which meet minimum piece specifications in 2.2 - Utilization. Ironwood saplings (less than 4.6" dbh) may be cut as necessary to facilitate harvest of designated timber, but must be cut at ground level or uprooted and laid flat on the ground, and not left standing bent or broken.

### 2.2 - Utilization

#### 2.2.4 - Skidding length (2/14)

Skidding of unlimbed tops or lengths over 17 feet is not permissible within payment unit 2 unless approved by the Unit Manager or his/her representative.

## 4 - Transportation

### 4.1 - Construction

#### 4.1.3 - Slash and earthen piles (8/04)

Piles or windrows of earth along roads and landings that have been widened or constructed shall be leveled. Slash from road maintenance or construction, including stumps, shall be dispersed throughout the sale.

#### 4.1.8 - Road work (1) (8/07)

The following road work is required: an access road from Steamhauler Road to a radio tower as shown on the timber sale map needs to be restored by the producer. This will consist of clearing brush and sapling trees, overhanging limbs, and fallen trees and limbs from the road to create an average 10-foot wide passable roadway. Light blading of the road surface will be required except on slopes where soil exposure may create an erosion risk.

#### 4.1.12 - No new roads (1/12)

No new roads will be permitted in any Payment Unit. All operations are limited to existing roads. Skid trails only will be allowed.

## 5 - Operations

### 5.2 - Conduct of Operations

#### 5.2.1 - Slash

##### 5.2.1.8 - Slash height (12/08)

No slash or tree tops may exceed 24 inches in height.

#### 5.2.3 - Operating Restrictions

##### 5.2.3.3 - Bark slippage restriction (3/09)

Within Payment Unit(s) 2, unless changed by written agreement, cutting and skidding are not permitted during the period of April 15 to July 15. This restriction is because of bark slippage.

## 5.2.4 - Dead and Down Creation

### 5.2.4.6 - Dead and down creation, other (9/09)

To create grouse habitat, within Payment Unit 1, all trees marked with an orange 'X' will be cut at breast height and left with the bole of the tree touching the stump. These are for drumming logs. The slash height requirement does not apply to these drumming logs and the tops should be left intact.

### 5.2.38 - No decking against live trees (2/04)

Cut products may not be decked against unmarked or designated leave trees.

### 5.2.41 - Snowmobile trail protection (9/11)

The Platte River snowmobile trail is shown on the Timber Sale Map. Do not cut or damage posts with orange trail markers or traffic control signs. If the trail is used for hauling, it must be graded to the satisfaction of the Unit Manager or his/her representative prior to December 1st. If the trail road is to be used for hauling during the snowmobile season, then a snow covered base must be left on the trail. Maintain a 20 foot wide slash, debris, and rut free zone daily using the snowmobile trail as the centerline. Any trees cut within 5 feet of the trail must have the stumps removed and be disposed of according to the direction of the Unit Manager or his/her representative.

## 5.4 - Soil Protection

### 5.4.3 - Erosion control (12/08)

Skid trails or haul roads may require erosion control structures or berms per direction of the Unit Manager or his/her representative.

## 6 - Safety and Fire Prevention

### 6.2 - Signing

#### 6.2.1 - Road posting (10/20)

The Purchaser is responsible for posting and maintaining caution signs on Steamhauler and Fewins roads prior to beginning operations. The road must be posted at appropriate distances from the sale area to warn of logging activity and truck traffic. Signs must be removed when harvest operations are suspended or completed. The Purchaser will provide these signs.





# TIMBER SALE MAP

This information provided by authority of Part 525, 1994 PA 451, as amended.

Sale Number	Year
61-056	22

Forest Management Unit	County	Mapped By	Date	Page	of
Traverse City	Benzie	Tim Webb	09/22/2022	1	1
		Cruised By			
		Tim Webb			

Township	Range	Section(s) and Subdivision(s)	Scale
26N	13W; 14W	S.7: NW,NWSW; S.12: E1/2NE	1:15,840

Cover Type				Density	
A = Aspen	H = Hemlock	N = Marsh	U = Upland Brush	0 = Non Stocked	5 = Pole Timber Medium
B = Paper Birch	J = Jack Pine	O = Oak	UM = Upland Mixed	1 = Seeding Sapling Poor	6 = Pole Timber Well
C = Cedar	L = Lowland Brush	P = Lowland Poplar	V = Bog or Marsh	2 = Seeding Sapling Medium	7 = Saw Timber Poor
D = Tread Bog	LM = Lowland Mixed	Q = Mixed Swamp Conifer	W = White Pine	3 = Seeding Sapling Well	8 = Saw Timber Medium
E = Swamp Hdwoods	M = Mpl, Bch, Bach	R = Red Pine	X = Non Stocked	4 = Pole Timber Poor	9 = Saw Timber Well
F = Spruce Fir	MC = Mixed Conifer	S = Black Spruce	Z = Water		
G = Grass	MD = Mixed Deciduous	T = Tamarack			

PU	Acres
1	24.1
2	29.2

## Ascension Aspen

Compartment 61013

53.3 acres

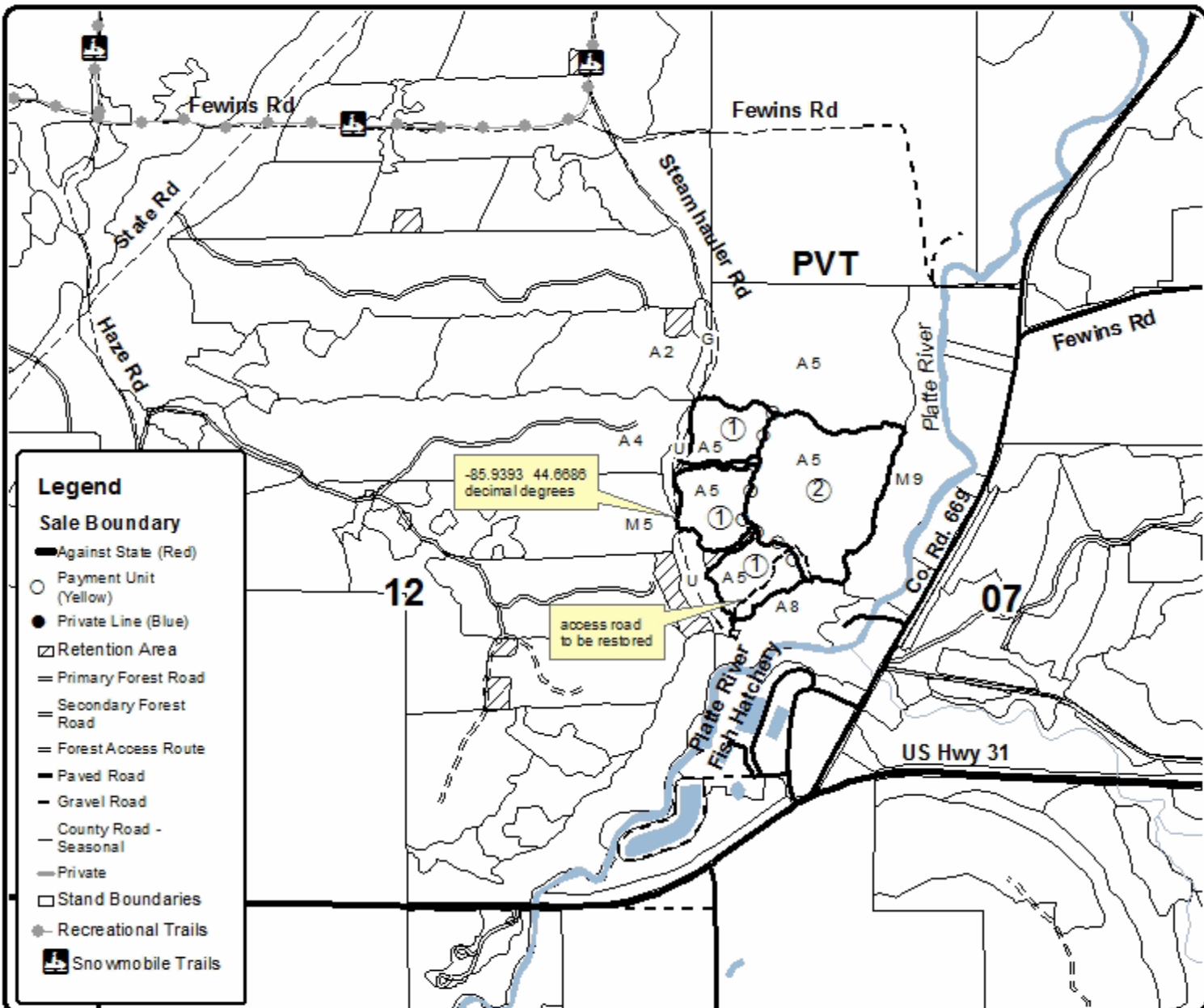

**Legend**

**Sale Boundary**

- Against State (Red)
- Payment Unit (Yellow)
- Private Line (Blue)
- ▭ Retention Area
- ▬ Primary Forest Road
- ▬ Secondary Forest Road
- ▬ Forest Access Route
- ▬ Paved Road
- ▬ Gravel Road
- ▬ County Road - Seasonal
- ▬ Private
- Stand Boundaries
- ◆ Recreational Trails
- ⊞ Snowmobile Trails

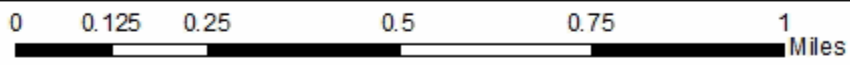



Checkerboard Mix (61-025-22)  
T25N, R14W, SEC. 32; Benzie COUNTY

In response to the notice of sale to be held 4:00 p.m. (local time) on April 4, 2023, I am hereby submitting my sealed bid (firm offer) for the following forest products to be cut. Bids for individual species must be at or above the advertised price. All non-responsive bid forms may be rejected.

<u>PRODUCTS &amp; SPECIES</u>	<u>ESTIMATED VOLUME*</u>	<u>ADVERTISED PRICE</u>	<u>BID PRICE/UNIT</u>
<b>Sawtimber</b>			
Basswood	2.8 MBF	\$ 105.00/MBF	\$ _____
Quaking Aspen	19.9 MBF	\$ 101.00/MBF	\$ _____
Red Maple	15.8 MBF	\$ 143.00/MBF	\$ _____
Sugar Maple	5.2 MBF	\$ 280.00/MBF	\$ _____
White Pine	10.4 MBF	\$ 64.00/MBF	\$ _____
White Spruce	29.5 MBF	\$ 31.00/MBF	\$ _____
<b>Pulpwood</b>			
B. T. Aspen	15 Cords	\$ 20.75/Cord	\$ _____
Basswood	39 Cords	\$ 18.10/Cord	\$ _____
Mixed Hardwood	192 Cords	\$ 23.55/Cord	\$ _____
Quaking Aspen	137 Cords	\$ 20.75/Cord	\$ _____
Red Maple	45 Cords	\$ 23.55/Cord	\$ _____
Sugar Maple	22 Cords	\$ 23.55/Cord	\$ _____
White Pine	6 Cords	\$ 26.55/Cord	\$ _____
White Spruce	272 Cords	\$ 17.90/Cord	\$ _____

\*The volumes are statistically estimated within plus (+) or minus (-) 18.50 percent at 95% confidence level. These estimated volumes are final and not subject to adjustment. Prospective bidders are urged to examine this timber and to make their own estimates of quantity and quality.

I understand that any or all bids may be rejected. All bids must be signed and all bid items must be bid or the bid form may be rejected. I also understand that consideration and awarding a contract will be based upon my past performance and ability to complete the contract based upon equipment and staffing subject to my control.

FEDERAL ID: \_\_\_\_\_ - \_\_\_\_\_ or SOCIAL SECURITY NUMBER: \_\_\_\_\_ - \_\_\_\_\_ - \_\_\_\_\_

Company or individual bidding: \_\_\_\_\_

Company representative's name: \_\_\_\_\_

Address: \_\_\_\_\_

City: \_\_\_\_\_ State: \_\_\_\_\_ Zip: \_\_\_\_\_

IF AVAILABLE, PLEASE PLACE THE PERSONALIZED LABEL FROM YOUR PROSPECTUS IN THE ABOVE BOX.

Individual or company representative's signature: \_\_\_\_\_ Date: \_\_\_\_\_

Phone number : \_\_\_\_\_ Email (optional): \_\_\_\_\_

**THE WINNING BIDDER MUST COMPLETE THE VERIFICATION OF WORKER'S DISABILITY COMPENSATION ACT COMPLIANCE (ON REVERSE SIDE IF DOUBLE SIDED) WITHIN 21 DAYS OF SALE AWARD DATE**



<b>FOR DEPARTMENT USE ONLY</b>	
Sale Number (XX - XXX - XX - XX)	
Forest Management Unit:	

# TIMBER SALE VERIFICATION OF WORKER'S DISABILITY COMPENSATION ACT COMPLIANCE

As required by Act 317, P.A. 1969 (Worker's Compensation) and  
Part 5 of Act 451 of 1994, as amended.

## VERIFICATION OF WORKER'S DISABILITY COMPENSATION ACT COMPLIANCE

- This verification must be completed and submitted within 21 days of contract award and prior to the issuance of the timber sale contract.
- In addition, if boxes 2B or 2C are checked, then Notice of Exclusion or Certificate of Insurance must be submitted within twenty-one (21) days of the contract award and prior to the issuance of the timber sale contract.
- All information must be typed or printed except for written signatures.

Please Check Appropriate Categories:

1. My business is organized as (you **must** check one of the boxes below):
  - A.  Sole Proprietorship (individual)
  - B.  Partnership
  - C.  Corporation
2. You **must** check one of the boxes below:
  - A.  I certify my business is a sole proprietorship and it has no employees but the sole proprietor. I am not subject to the Worker's Compensation Laws.
  - B.  I certify my business has satisfied its obligation to the Worker's Compensation Act through the use of an approved Notice of Exclusion (BWC-337, Rev. 5/96). I will provide a copy of the Notice of Exclusion within 21 days of the contract award. (For questions or a copy of the BWC-337, please call the Worker's Compensation Bureau at 517-322-1195).
  - C.  I certify my business has a Worker's Compensation Policy. I will provide an original Certificate of Insurance within twenty-one (21) days of the contract award.
3. If you have checked item 2(A) or 2(B), you **must** indicate the number of **both** full-time and part-time employees, other than yourself, including family members and active partners (if none, you must enter "0").

\_\_\_\_\_ Full-time Employees

\_\_\_\_\_ Part-time Employees

Name of Business		Federal ID (or) Social Security No.	
Address		Telephone (       )	
City	State	ZIP	

*I hereby certify that the above information is true and correct. I agree to notify the Michigan DNR of any changes that occur in factors affecting my coverage during any of my present and future operations.*

\_\_\_\_\_  
Signature of Owner or Authorized Representative

\_\_\_\_\_  
Title

\_\_\_\_\_  
Date

Please complete the "SEALED BID" information on the next page

Habblers Road Aspen (61-046-22)  
T26N, R13W, SEC. 3; T26N, R13W, SEC. 4; T26N, R13W, SEC. 5; Benzie

In response to the notice of sale to be held 4:00 p.m. (local time) on April 4, 2023, I am hereby submitting my sealed bid (firm offer) for the following forest products to be cut. Bids for individual species must be at or above the advertised price. All non-responsive bid forms may be rejected.

<u>PRODUCTS &amp; SPECIES</u>	<u>ESTIMATED VOLUME*</u>	<u>ADVERTISED PRICE</u>	<u>BID PRICE/UNIT</u>
<b>Sawtimber</b>			
Basswood	30.2 MBF	\$ 105.00/MBF	\$ _____
Beech	9.1 MBF	\$ 110.00/MBF	\$ _____
Black Cherry	5.7 MBF	\$ 154.00/MBF	\$ _____
Mixed Aspen	94.4 MBF	\$ 101.00/MBF	\$ _____
Red Maple	106.7 MBF	\$ 143.00/MBF	\$ _____
Red Pine	7.3 MBF	\$ 115.00/MBF	\$ _____
Sugar Maple	36.5 MBF	\$ 280.00/MBF	\$ _____
White Pine	43.3 MBF	\$ 64.00/MBF	\$ _____
<b>Pulpwood</b>			
Jack Pine	14 Cords	\$ 20.35/Cord	\$ _____
Mixed Aspen	1,499 Cords	\$ 20.75/Cord	\$ _____
Mixed Hardwood	737 Cords	\$ 23.55/Cord	\$ _____
Red Oak	3 Cords	\$ 21.65/Cord	\$ _____
Red Pine	8 Cords	\$ 49.25/Cord	\$ _____
White Pine	73 Cords	\$ 26.55/Cord	\$ _____

\*The volumes are statistically estimated within plus (+) or minus (-) 14.15 percent at 95% confidence level. These estimated volumes are final and not subject to adjustment. Prospective bidders are urged to examine this timber and to make their own estimates of quantity and quality.

I understand that any or all bids may be rejected. All bids must be signed and all bid items must be bid or the bid form may be rejected. I also understand that consideration and awarding a contract will be based upon my past performance and ability to complete the contract based upon equipment and staffing subject to my control.

FEDERAL ID: \_\_\_\_\_ - \_\_\_\_\_ or SOCIAL SECURITY NUMBER: \_\_\_\_\_ - \_\_\_\_\_ - \_\_\_\_\_

Company or individual bidding: \_\_\_\_\_

Company representative's name: \_\_\_\_\_

Address: \_\_\_\_\_

City: \_\_\_\_\_ State: \_\_\_\_\_ Zip: \_\_\_\_\_

IF AVAILABLE, PLEASE PLACE THE PERSONALIZED LABEL FROM YOUR PROSPECTUS IN THE ABOVE BOX.

Individual or company representative's signature: \_\_\_\_\_ Date: \_\_\_\_\_

Phone number : \_\_\_\_\_ Email (optional): \_\_\_\_\_

**THE WINNING BIDDER MUST COMPLETE THE VERIFICATION OF WORKER'S DISABILITY COMPENSATION ACT COMPLIANCE (ON REVERSE SIDE IF DOUBLE SIDED) WITHIN 21 DAYS OF SALE AWARD DATE**



<b>FOR DEPARTMENT USE ONLY</b>
Sale Number (XX - XXX - XX - XX)
Forest Management Unit:

## TIMBER SALE VERIFICATION OF WORKER'S DISABILITY COMPENSATION ACT COMPLIANCE

*As required by Act 317, P.A. 1969 (Worker's Compensation) and  
Part 5 of Act 451 of 1994, as amended.*

### VERIFICATION OF WORKER'S DISABILITY COMPENSATION ACT COMPLIANCE

- This verification must be completed and submitted within 21 days of contract award and prior to the issuance of the timber sale contract.
- In addition, if boxes 2B or 2C are checked, then Notice of Exclusion or Certificate of Insurance must be submitted within twenty-one (21) days of the contract award and prior to the issuance of the timber sale contract.
- All information must be typed or printed except for written signatures.

Please Check Appropriate Categories:

1. My business is organized as (you **must** check one of the boxes below):
  - A.  Sole Proprietorship (individual)
  - B.  Partnership
  - C.  Corporation
  
2. You **must** check one of the boxes below:
  - A.  I certify my business is a sole proprietorship and it has no employees but the sole proprietor. I am not subject to the Worker's Compensation Laws.
  - B.  I certify my business has satisfied its obligation to the Worker's Compensation Act through the use of an approved Notice of Exclusion (BWC-337, Rev. 5/96). I will provide a copy of the Notice of Exclusion within 21 days of the contract award. (For questions or a copy of the BWC-337, please call the Worker's Compensation Bureau at 517-322-1195).
  - C.  I certify my business has a Worker's Compensation Policy. I will provide an original Certificate of Insurance within twenty-one (21) days of the contract award.
  
3. If you have checked item 2(A) or 2(B), you **must** indicate the number of **both** full-time and part-time employees, other than yourself, including family members and active partners (if none, you must enter "0").

\_\_\_\_\_ Full-time Employees

\_\_\_\_\_ Part-time Employees

Name of Business		Federal ID (or) Social Security No.	
Address		Telephone (       )	
City	State	ZIP	

*I hereby certify that the above information is true and correct. I agree to notify the Michigan DNR of any changes that occur in factors affecting my coverage during any of my present and future operations.*

\_\_\_\_\_  
Signature of Owner or Authorized Representative

\_\_\_\_\_  
Title

\_\_\_\_\_  
Date

**Please complete the "SEALED BID" information on the next page**

Radio Red (61-052-22)

T26N, R09W, SEC. 14; Grand Traverse COUNTY

In response to the notice of sale to be held 4:00 p.m. (local time) on April 4, 2023, I am hereby submitting my sealed bid (firm offer) for the following forest products to be cut. Bids for individual species must be at or above the advertised price. All non-responsive bid forms may be rejected.

<u>PRODUCTS &amp; SPECIES</u>	<u>ESTIMATED VOLUME*</u>	<u>ADVERTISED PRICE</u>	<u>BID PRICE/UNIT</u>
Sawtimber			
Red Pine	114.8 MBF	\$ 115.00/MBF	\$ _____
Pulpwood			
Red Maple	5 Cords	\$ 23.55/Cord	\$ _____
Red Pine	60 Cords	\$ 49.25/Cord	\$ _____

\*The volumes are statistically estimated within plus (+) or minus (-) 39.57 percent at 95% confidence level. These estimated volumes are final and not subject to adjustment. Prospective bidders are urged to examine this timber and to make their own estimates of quantity and quality.

I understand that any or all bids may be rejected. All bids must be signed and all bid items must be bid or the bid form may be rejected. I also understand that consideration and awarding a contract will be based upon my past performance and ability to complete the contract based upon equipment and staffing subject to my control.

FEDERAL ID: \_\_\_\_\_ - \_\_\_\_\_ or SOCIAL SECURITY NUMBER: \_\_\_\_\_ - \_\_\_\_\_ - \_\_\_\_\_

Company or individual bidding: \_\_\_\_\_

Company representative's name: \_\_\_\_\_

Address: \_\_\_\_\_

City: \_\_\_\_\_ State: \_\_\_\_\_ Zip: \_\_\_\_\_

IF AVAILABLE, PLEASE PLACE THE PERSONALIZED LABEL FROM YOUR PROSPECTUS IN THE ABOVE BOX.

Individual or company representative's signature: \_\_\_\_\_ Date: \_\_\_\_\_

Phone number : \_\_\_\_\_ Email (optional): \_\_\_\_\_

**THE WINNING BIDDER MUST COMPLETE THE VERIFICATION OF WORKER'S DISABILITY COMPENSATION ACT COMPLIANCE (ON REVERSE SIDE IF DOUBLE SIDED) WITHIN 21 DAYS OF SALE AWARD DATE**



<b>FOR DEPARTMENT USE ONLY</b>	
Sale Number (XX - XXX - XX - XX)	
Forest Management Unit:	

# TIMBER SALE VERIFICATION OF WORKER'S DISABILITY COMPENSATION ACT COMPLIANCE

As required by Act 317, P.A. 1969 (Worker's Compensation) and  
Part 5 of Act 451 of 1994, as amended.

## VERIFICATION OF WORKER'S DISABILITY COMPENSATION ACT COMPLIANCE

- This verification must be completed and submitted within 21 days of contract award and prior to the issuance of the timber sale contract.
- In addition, if boxes 2B or 2C are checked, then Notice of Exclusion or Certificate of Insurance must be submitted within twenty-one (21) days of the contract award and prior to the issuance of the timber sale contract.
- All information must be typed or printed except for written signatures.

Please Check Appropriate Categories:

1. My business is organized as (you **must** check one of the boxes below):
  - A.  Sole Proprietorship (individual)
  - B.  Partnership
  - C.  Corporation
2. You **must** check one of the boxes below:
  - A.  I certify my business is a sole proprietorship and it has no employees but the sole proprietor. I am not subject to the Worker's Compensation Laws.
  - B.  I certify my business has satisfied its obligation to the Worker's Compensation Act through the use of an approved Notice of Exclusion (BWC-337, Rev. 5/96). I will provide a copy of the Notice of Exclusion within 21 days of the contract award. (For questions or a copy of the BWC-337, please call the Worker's Compensation Bureau at 517-322-1195).
  - C.  I certify my business has a Worker's Compensation Policy. I will provide an original Certificate of Insurance within twenty-one (21) days of the contract award.
3. If you have checked item 2(A) or 2(B), you **must** indicate the number of **both** full-time and part-time employees, other than yourself, including family members and active partners (if none, you must enter "0").

\_\_\_\_\_ Full-time Employees

\_\_\_\_\_ Part-time Employees

Name of Business		Federal ID (or) Social Security No.	
Address		Telephone (       )	
City	State	ZIP	

*I hereby certify that the above information is true and correct. I agree to notify the Michigan DNR of any changes that occur in factors affecting my coverage during any of my present and future operations.*

\_\_\_\_\_  
Signature of Owner or Authorized Representative

\_\_\_\_\_  
Title

\_\_\_\_\_  
Date

Please complete the "SEALED BID" information on the next page



East Side Pine (61-053-22)  
T26N, R09W, SEC. 13; Grand Traverse COUNTY

In response to the notice of sale to be held 4:00 p.m. (local time) on April 4, 2023, I am hereby submitting my sealed bid (firm offer) for the following forest products to be cut. Bids for individual species must be at or above the advertised price. All non-responsive bid forms may be rejected.

<u>PRODUCTS &amp; SPECIES</u>	<u>ESTIMATED VOLUME*</u>	<u>ADVERTISED PRICE</u>	<u>BID PRICE/UNIT</u>
<b>Sawtimber</b>			
Black Cherry	3.1 MBF	\$ 154.00/MBF	\$ _____
Red Maple	14.8 MBF	\$ 143.00/MBF	\$ _____
Red Pine	345.5 MBF	\$ 115.00/MBF	\$ _____
White Pine	11.2 MBF	\$ 64.00/MBF	\$ _____
<b>Pulpwood</b>			
Black Cherry	10 Cords	\$ 23.55/Cord	\$ _____
Jack Pine	240 Cords	\$ 20.35/Cord	\$ _____
Red Maple	85 Cords	\$ 23.55/Cord	\$ _____
Red Pine	429 Cords	\$ 49.25/Cord	\$ _____
White Pine	22 Cords	\$ 26.55/Cord	\$ _____

\*The volumes are statistically estimated within plus (+) or minus (-) 26.83 percent at 95% confidence level. These estimated volumes are final and not subject to adjustment. Prospective bidders are urged to examine this timber and to make their own estimates of quantity and quality.

I understand that any or all bids may be rejected. All bids must be signed and all bid items must be bid or the bid form may be rejected. I also understand that consideration and awarding a contract will be based upon my past performance and ability to complete the contract based upon equipment and staffing subject to my control.

FEDERAL ID: \_\_\_\_ - \_\_\_\_ - \_\_\_\_ or SOCIAL SECURITY NUMBER: \_\_\_\_ - \_\_\_\_ - \_\_\_\_

Company or individual bidding: \_\_\_\_\_

Company representative's name: \_\_\_\_\_

Address: \_\_\_\_\_

City: \_\_\_\_\_ State: \_\_\_\_\_ Zip: \_\_\_\_\_

IF AVAILABLE, PLEASE PLACE THE PERSONALIZED LABEL FROM YOUR PROSPECTUS IN THE ABOVE BOX.

Individual or company representative's signature: \_\_\_\_\_ Date: \_\_\_\_\_

Phone number : \_\_\_\_\_ Email (optional): \_\_\_\_\_

**THE WINNING BIDDER MUST COMPLETE THE VERIFICATION OF WORKER'S DISABILITY COMPENSATION ACT COMPLIANCE (ON REVERSE SIDE IF DOUBLE SIDED) WITHIN 21 DAYS OF SALE AWARD DATE**



<b>FOR DEPARTMENT USE ONLY</b>	
Sale Number (XX - XXX - XX - XX)	
Forest Management Unit:	

# TIMBER SALE VERIFICATION OF WORKER'S DISABILITY COMPENSATION ACT COMPLIANCE

As required by Act 317, P.A. 1969 (Worker's Compensation) and  
Part 5 of Act 451 of 1994, as amended.

## VERIFICATION OF WORKER'S DISABILITY COMPENSATION ACT COMPLIANCE

- This verification must be completed and submitted within 21 days of contract award and prior to the issuance of the timber sale contract.
- In addition, if boxes 2B or 2C are checked, then Notice of Exclusion or Certificate of Insurance must be submitted within twenty-one (21) days of the contract award and prior to the issuance of the timber sale contract.
- All information must be typed or printed except for written signatures.

Please Check Appropriate Categories:

1. My business is organized as (you **must** check one of the boxes below):
  - A.  Sole Proprietorship (individual)
  - B.  Partnership
  - C.  Corporation
2. You **must** check one of the boxes below:
  - A.  I certify my business is a sole proprietorship and it has no employees but the sole proprietor. I am not subject to the Worker's Compensation Laws.
  - B.  I certify my business has satisfied its obligation to the Worker's Compensation Act through the use of an approved Notice of Exclusion (BWC-337, Rev. 5/96). I will provide a copy of the Notice of Exclusion within 21 days of the contract award. (For questions or a copy of the BWC-337, please call the Worker's Compensation Bureau at 517-322-1195).
  - C.  I certify my business has a Worker's Compensation Policy. I will provide an original Certificate of Insurance within twenty-one (21) days of the contract award.
3. If you have checked item 2(A) or 2(B), you **must** indicate the number of **both** full-time and part-time employees, other than yourself, including family members and active partners (if none, you must enter "0").

\_\_\_\_\_ Full-time Employees

\_\_\_\_\_ Part-time Employees

Name of Business		Federal ID (or) Social Security No.	
Address		Telephone (       )	
City	State	ZIP	

*I hereby certify that the above information is true and correct. I agree to notify the Michigan DNR of any changes that occur in factors affecting my coverage during any of my present and future operations.*

\_\_\_\_\_  
Signature of Owner or Authorized Representative

\_\_\_\_\_  
Title

\_\_\_\_\_  
Date

Please complete the "SEALED BID" information on the next page

Blair Townhall Mix (61-054-22)  
T26N, R11W, SEC. 24; Grand Traverse COUNTY

In response to the notice of sale to be held 4:00 p.m. (local time) on April 4, 2023, I am hereby submitting my sealed bid (firm offer) for the following forest products to be cut. Bids for individual species must be at or above the advertised price. All non-responsive bid forms may be rejected.

<u>PRODUCTS &amp; SPECIES</u>	<u>ESTIMATED VOLUME*</u>	<u>ADVERTISED PRICE</u>	<u>BID PRICE/UNIT</u>
<b>Sawtimber</b>			
B. T. Aspen	179.5 MBF	\$ 101.00/MBF	\$ _____
Beech	3.0 MBF	\$ 110.00/MBF	\$ _____
Black Cherry	22.2 MBF	\$ 154.00/MBF	\$ _____
Paper Birch	3.3 MBF	\$ 50.00/MBF	\$ _____
Red Maple	274.8 MBF	\$ 143.00/MBF	\$ _____
Red Oak	82.6 MBF	\$ 117.00/MBF	\$ _____
Sugar Maple	4.5 MBF	\$ 280.00/MBF	\$ _____
White Pine	35.0 MBF	\$ 64.00/MBF	\$ _____
<b>Pulpwood</b>			
B. T. Aspen	370 Cords	\$ 20.75/Cord	\$ _____
Beech	33 Cords	\$ 23.55/Cord	\$ _____
Black Cherry	60 Cords	\$ 23.55/Cord	\$ _____
Paper Birch	6 Cords	\$ 18.00/Cord	\$ _____
Red Maple	904 Cords	\$ 23.55/Cord	\$ _____
Red Oak	137 Cords	\$ 21.65/Cord	\$ _____
Sugar Maple	38 Cords	\$ 23.55/Cord	\$ _____
White Pine	106 Cords	\$ 26.55/Cord	\$ _____

\*The volumes are statistically estimated within plus (+) or minus (-) 12.95 percent at 95% confidence level. These estimated volumes are final and not subject to adjustment. Prospective bidders are urged to examine this timber and to make their own estimates of quantity and quality.

I understand that any or all bids may be rejected. All bids must be signed and all bid items must be bid or the bid form may be rejected. I also understand that consideration and awarding a contract will be based upon my past performance and ability to complete the contract based upon equipment and staffing subject to my control.

FEDERAL ID: \_\_\_\_ - \_\_\_\_ - \_\_\_\_ or SOCIAL SECURITY NUMBER: \_\_\_\_ - \_\_\_\_ - \_\_\_\_

Company or individual bidding: \_\_\_\_\_

Company representative's name: \_\_\_\_\_

Address: \_\_\_\_\_

City: \_\_\_\_\_ State: \_\_\_\_\_ Zip: \_\_\_\_\_

IF AVAILABLE, PLEASE PLACE THE PERSONALIZED LABEL FROM YOUR PROSPECTUS IN THE ABOVE BOX.

Individual or company representative's signature: \_\_\_\_\_ Date: \_\_\_\_\_

Phone number : \_\_\_\_\_ Email (optional): \_\_\_\_\_

**THE WINNING BIDDER MUST COMPLETE THE VERIFICATION OF WORKER'S DISABILITY COMPENSATION ACT COMPLIANCE (ON REVERSE SIDE IF DOUBLE SIDED) WITHIN 21 DAYS OF SALE AWARD DATE**



FOR DEPARTMENT USE ONLY	
Sale Number (XX - XXX - XX - XX)	
Forest Management Unit:	

# TIMBER SALE VERIFICATION OF WORKER'S DISABILITY COMPENSATION ACT COMPLIANCE

As required by Act 317, P.A. 1969 (Worker's Compensation) and  
Part 5 of Act 451 of 1994, as amended.

## VERIFICATION OF WORKER'S DISABILITY COMPENSATION ACT COMPLIANCE

- This verification must be completed and submitted within 21 days of contract award and prior to the issuance of the timber sale contract.
- In addition, if boxes 2B or 2C are checked, then Notice of Exclusion or Certificate of Insurance must be submitted within twenty-one (21) days of the contract award and prior to the issuance of the timber sale contract.
- All information must be typed or printed except for written signatures.

Please Check Appropriate Categories:

1. My business is organized as (you **must** check one of the boxes below):
  - A.  Sole Proprietorship (individual)
  - B.  Partnership
  - C.  Corporation
2. You **must** check one of the boxes below:
  - A.  I certify my business is a sole proprietorship and it has no employees but the sole proprietor. I am not subject to the Worker's Compensation Laws.
  - B.  I certify my business has satisfied its obligation to the Worker's Compensation Act through the use of an approved Notice of Exclusion (BWC-337, Rev. 5/96). I will provide a copy of the Notice of Exclusion within 21 days of the contract award. (For questions or a copy of the BWC-337, please call the Worker's Compensation Bureau at 517-322-1195).
  - C.  I certify my business has a Worker's Compensation Policy. I will provide an original Certificate of Insurance within twenty-one (21) days of the contract award.
3. If you have checked item 2(A) or 2(B), you **must** indicate the number of **both** full-time and part-time employees, other than yourself, including family members and active partners (if none, you must enter "0").

\_\_\_\_\_ Full-time Employees

\_\_\_\_\_ Part-time Employees

Name of Business		Federal ID (or) Social Security No.	
Address		Telephone (       )	
City	State	ZIP	

*I hereby certify that the above information is true and correct. I agree to notify the Michigan DNR of any changes that occur in factors affecting my coverage during any of my present and future operations.*

\_\_\_\_\_  
Signature of Owner or Authorized Representative

\_\_\_\_\_  
Title

\_\_\_\_\_  
Date

Please complete the "SEALED BID" information on the next page

Ascension Aspen (61-056-22)  
T26N, R13W, SEC. 7; T26N, R14W, SEC. 12; Benzie COUNTY

In response to the notice of sale to be held 4:00 p.m. (local time) on April 4, 2023, I am hereby submitting my sealed bid (firm offer) for the following forest products to be cut. Bids for individual species must be at or above the advertised price. All non-responsive bid forms may be rejected.

<u>PRODUCTS &amp; SPECIES</u>	<u>ESTIMATED VOLUME*</u>	<u>ADVERTISED PRICE</u>	<u>BID PRICE/UNIT</u>
<b>Sawtimber</b>			
Mixed Aspen	79.2 MBF	\$ 101.00/MBF	\$ _____
Red Maple	4.3 MBF	\$ 143.00/MBF	\$ _____
<b>Pulpwood</b>			
Mixed Aspen	657 Cords	\$ 20.75/Cord	\$ _____
Mixed Hardwood	99 Cords	\$ 23.55/Cord	\$ _____

\*The volumes are statistically estimated within plus (+) or minus (-) 30.88 percent at 95% confidence level. These estimated volumes are final and not subject to adjustment. Prospective bidders are urged to examine this timber and to make their own estimates of quantity and quality.

I understand that any or all bids may be rejected. All bids must be signed and all bid items must be bid or the bid form may be rejected. I also understand that consideration and awarding a contract will be based upon my past performance and ability to complete the contract based upon equipment and staffing subject to my control.

FEDERAL ID: \_\_\_\_\_ - \_\_\_\_\_ or SOCIAL SECURITY NUMBER: \_\_\_\_\_ - \_\_\_\_\_ - \_\_\_\_\_  
 Company or individual bidding: \_\_\_\_\_  
 Company representative's name: \_\_\_\_\_  
 Address: \_\_\_\_\_  
 City: \_\_\_\_\_ State: \_\_\_\_\_ Zip: \_\_\_\_\_

IF AVAILABLE, PLEASE PLACE THE PERSONALIZED LABEL FROM YOUR PROSPECTUS IN THE ABOVE BOX.

Individual or company representative's signature: \_\_\_\_\_ Date: \_\_\_\_\_

Phone number : \_\_\_\_\_ Email (optional): \_\_\_\_\_

**THE WINNING BIDDER MUST COMPLETE THE VERIFICATION OF WORKER'S DISABILITY COMPENSATION ACT COMPLIANCE (ON REVERSE SIDE IF DOUBLE SIDED) WITHIN 21 DAYS OF SALE AWARD DATE**



<b>FOR DEPARTMENT USE ONLY</b>
Sale Number (XX - XXX - XX - XX)
Forest Management Unit:

## TIMBER SALE VERIFICATION OF WORKER'S DISABILITY COMPENSATION ACT COMPLIANCE

*As required by Act 317, P.A. 1969 (Worker's Compensation) and  
Part 5 of Act 451 of 1994, as amended.*

### VERIFICATION OF WORKER'S DISABILITY COMPENSATION ACT COMPLIANCE

- This verification must be completed and submitted within 21 days of contract award and prior to the issuance of the timber sale contract.
- In addition, if boxes 2B or 2C are checked, then Notice of Exclusion or Certificate of Insurance must be submitted within twenty-one (21) days of the contract award and prior to the issuance of the timber sale contract.
- All information must be typed or printed except for written signatures.

Please Check Appropriate Categories:

1. My business is organized as (you **must** check one of the boxes below):
  - A.  Sole Proprietorship (individual)
  - B.  Partnership
  - C.  Corporation
  
2. You **must** check one of the boxes below:
  - A.  I certify my business is a sole proprietorship and it has no employees but the sole proprietor. I am not subject to the Worker's Compensation Laws.
  - B.  I certify my business has satisfied its obligation to the Worker's Compensation Act through the use of an approved Notice of Exclusion (BWC-337, Rev. 5/96). I will provide a copy of the Notice of Exclusion within 21 days of the contract award. (For questions or a copy of the BWC-337, please call the Worker's Compensation Bureau at 517-322-1195).
  - C.  I certify my business has a Worker's Compensation Policy. I will provide an original Certificate of Insurance within twenty-one (21) days of the contract award.
  
3. If you have checked item 2(A) or 2(B), you **must** indicate the number of **both** full-time and part-time employees, other than yourself, including family members and active partners (if none, you must enter "0").

\_\_\_\_\_ Full-time Employees

\_\_\_\_\_ Part-time Employees

Name of Business		Federal ID (or) Social Security No.	
Address		Telephone (       )	
City	State	ZIP	

*I hereby certify that the above information is true and correct. I agree to notify the Michigan DNR of any changes that occur in factors affecting my coverage during any of my present and future operations.*

\_\_\_\_\_  
Signature of Owner or Authorized Representative

\_\_\_\_\_  
Title

\_\_\_\_\_  
Date

**Please complete the "SEALED BID" information on the next page**