



**DEPARTMENT OF NATURAL RESOURCES
STATE OF MICHIGAN
TIMBER SALE PROSPECTUS #7244**

SCHEDULED SALE DATE AND TIME: **9:00 a.m. (local time) on April 17, 2023.**

LOCATION: **GRAYLING MGMT UNIT, 1955 HARTWICK PINES ROAD, GRAYLING, MI 49738.**

PROSPECTUS NOTE: The bidder is advised to inspect the sale area and review the location, estimated volumes, operating costs and contract terms of proposed sales. Please be aware that some landowners may request 60 days or more notice for access across their land.

Notice is hereby given that bids will be received by the Unit Manager, GRAYLING MANAGEMENT UNIT, for certain timber on the following described lands:

SE Comp 167 (72-002-22) / T27N, R04W, SEC. 25, SWNW,W1/2SW.

T27N, R04W, SEC. 26, SENE,E1/2SE.

Crawford County, Advertised Price \$40,575.20, 67.3 Acres, Red Pine, White Pine.

SALE NOTE: Dry summer or frozen winter harvest is recommended because there is some low ground within the sale area and because access across State land involves crossing areas of low ground on a 2.5 mile-long temporary haul route.

Draw Down Mixed Pine (72-003-22) / T27N, R04W, SEC. 14, E1/2NE,NESE,S1/2SE.

T27N, R04W, SEC. 22, E1/2NE.

T27N, R04W, SEC. 23, NW,NWNE,S1/2NE,N1/2SW,SE.

Crawford County, Advertised Price \$100,133.75, 167.4 Acres, Red Pine, White Pine.

SALE NOTE: This sale contract will be for 3 years due to seasonal high water, sensitive soils, and challenging access.

Comp 170 HDWD (72-004-22) / T28N, R04W, SEC. 8 , NE.

Crawford County, Advertised Price \$25,849.85, 44.4 Acres, Sugar Maple, Hardwood.

SALE NOTE: Mixed Hardwood pulp contains beech, paper birch, oak, and iron wood.

Deward & Manistee (72-024-22) / T28N, R04W, SEC. 5 , S1/2SW,SWSE.

T28N, R04W, SEC. 6 , SESE.

T28N, R04W, SEC. 7 , N1/2NE.

T28N, R04W, SEC. 8 , NW,NWNE.

Crawford County, Advertised Price \$78,293.35, 121.6 Acres, Jack Pine, Red Pine.

SALE NOTE: There is a considerable amount of regen and brush that must be cut in Payment Units 3, 4 & 5 in order to facilitate subsequent RP planting. Those PUs also have extensive pipeline and wellsite interface. There is some low ground in the west side of PU 1.

West 167 Oak (72-027-22) / T27N, R04W, SEC. 26, SWNW,NWSW.

T27N, R04W, SEC. 27, NENE,S1/2NE,SE.

T27N, R04W, SEC. 34, N1/2NE.

Crawford County, Advertised Price \$111,205.70, 100.7 Acres, Hardwood, Red Oak.

SALE NOTE: The oak was heavily defoliated in spring of 2022. Dormant harvest was specified in order to give the stressed, aging oak its best shot at sprouting vigorously. The most direct access will require keying through the Sand Hill Road gate off Pollack Bridge Road. Alternate access could be established to the southwest by re-opening a berm on the Williams Tract fenceline.

White & 612 Pine (72-622-19) / T28N, R03W, SEC. 26, NWSW,S1/2SW.

Crawford County, Advertised Price \$5,913.75, 43.5 Acres, Red Pine, Aspen.

SALE NOTE: This harvest involves thinning a planted windbreak along White Road and CR 612, and clearcutting scotch pine that has been invading the area around the Military Medivac Landing Zone (LZ Charlie). Chipping is required to reduce the scotch pine seed source.

A recreation site such as a trail, pathway, or campground is within the sale area or the vicinity. Certain restrictions/specifications may be applicable including time restrictions.

BID INSTRUCTIONS (VER. 10/10/2022):

1. Scheduled Bid Location, Date, and Time (2/11)

Bids must be received by the Unit Manager, GRAYLING OFFICE, 1955 HARTWICK PINES ROAD, GRAYLING, MI 49738, no later than 9:00 a.m. (local time) on April 17, 2023. For further information concerning this sale, contact Thomas Barnes at 989-348-6371 extension 7440.

2. Bidder's Qualifications (10/22)

If all or part of a timber sale was prepared by a private contractor, the contractor and that contractor's company are not permitted to bid on the timber sale. A person must be 18 years of age or older to purchase timber. Permanent employees of the Department of Natural Resources or members of their immediate household may not bid. Former employees, in the permanent or seasonal class, may not bid until 3 months after the last day of active duty. Bids will not be accepted from individuals or companies appearing on the DNR/FRD No-Bid List. This list contains the names of purchasers who previously failed to execute a contract within 21-days or who have a history of poor performance.

3. Preparation of Sealed Bids (5/16)

Bid Forms may be completed online thru Michigan DNR Timber Sale Online Bidding (OLB) at www.michigan.gov/timberbidding or by completing the hardcopy Bid Form found in the Timber Sale Prospectus. Hardcopy Bid Forms shall be manually signed in ink. Registration in OLB is considered your 'signature' for all bids submitted thru that system. Bid prices must be entered for each species and product in the Bid Price column for all material subject to bidding and all fill-in blanks must be completed. If erasures or other changes appear on the hardcopy Bid Form, each erasure or change must be initialed by the person signing the bid.

4. Submission of Sealed Bids (5/16)

Bid forms may be obtained from the Unit Manager or thru OLB. Bids may be submitted hardcopy or thru OLB. All hardcopy bids must be submitted on the bid form and in an envelope clearly identified as described in this section. NOTE: Only one bid form per bid envelope. Sealed bids must be submitted to the Unit office designated in the prospectus and must be submitted at or prior to the time established in the prospectus. The envelope should show on the outside (a) the sale name or number and (b) the date and time of bid opening, as shown in the prospectus. Bids received after the time specified in the sale prospectus are late bids and will be rejected.

It is possible for a bidder to submit multiple bids on a single sale. For example, a bid may be submitted hardcopy and a bid may be submitted thru OLB. Or, two bidders from the same company could both submit bids on the same sale. If this were to happen, the State would accept all bids received and award the contract accordingly. All bidding and contractual requirements would apply to all bids received.

5. Public Opening of Sealed Bids (7/16)

If conditions permit, the sealed bids will be publicly opened and posted at the time and place set in the prospectus.

If a bidder, present at a bid opening, has submitted bids on more than one sale, that bidder may withdraw their unopened bid envelopes or announce the withdrawal of their online bid after being declared the successful bidder on one sale.

6. Award of Contract (1/11)

Award of the contract will be made to the Bidder whose bid, conforming to the prospectus, is most advantageous to the State of Michigan on the basis of total value at rates bid for the estimated quantities. The State reserves the right to reject any bid or waive any minor irregularity in bids received. A written award mailed (or otherwise furnished) to the successful Bidder shall be deemed to result in a binding contract without further action by either party.

7. Down Payment (1/11)

The Bidder to whom award is made must make a down payment within 21 days of the sale award. The amount of the down payment will be calculated as shown in the Bond and Payment Schedule of this prospectus. Only cash may be used to meet this requirement.

8. Performance Security (1/11)

As guarantee of faithful performance, a cash bond, certificate of deposit, surety bond or irrevocable letter of credit (LOC) is required within 21 days of the sale award. The amount of the performance security is shown in the Bond and

Payment Schedule of this prospectus. If an LOC or surety is used, the coverage must extend for at least 6 months beyond the contract expiration.

9. Worker's Compensation (10/22)

Purchaser shall obtain worker's compensation insurance to cover claims under Michigan's Worker's Disability Compensation Act of 1969 or similar employee benefit act of any other state applicable to an employee. Verification of Worker's Disability Compensation Act Compliance must be completed and submitted within 21 days of contract award and prior to the issuance of the timber sale contract. In addition, if applicable, Notice of Exclusion or Certificate of Insurance must also be submitted.

10. Timber Sale Contract (10/22)

Additional conditions and requirements common to all timber sales are listed on the timber sale contract (R4031) and are available on line at www.michigan.gov/timber. Contact the Unit Manager for additional information or a sample contract. Within 21 days of the date of the award letter, the bidder must sign the contract and provide the required down payment, performance security, and verification of worker's disability compensation. The down payment and performance security shall be in accordance with the provisions of the timber sale contract, in the sums stated in this prospectus. If these actions are not taken, then the Bidder, the Bidder's corporation, and the corporation's principals may not be permitted to bid on State timber sales for a period of 3 months after the first offense, 6 months after the second offense, and 1 year after the third offense. An offense will only be counted against the Bidder for 5 years. In addition, the Bidder certifies that if awarded this contract, the Bidder will complete the timber sale contract in accordance with its terms and any modifications thereof including requirements to purchase, cut, and remove the included timber by the expiration date.

Payment Unit values in the State Forest Timber Sale Contract are calculated based on the advertised value of the Payment Unit as a percentage of the total advertised value of the contract. The advertised value of each Payment Unit is given in the Description of Timber by Payment Unit table on the Timber Sale Information page. For example, if the value of Payment Unit 1 is advertised as \$1,500 and the total Timber Sale value is advertised as \$10,000, the contract price for Payment Unit 1 will be 15% of the total bid price ($\$1,500/\$10,000 * 100$).

11. Disclaimer of Estimates and Bidder's Warranty of Inspection (10/22)

Before submitting this bid, the Bidder is advised and cautioned to inspect the sale area, review the requirements of the sale contract, and take other steps as may be reasonably necessary to ascertain the location, estimated volumes, construction estimates, and operating costs of the proposed sale. Failure to do so will not relieve the Bidder from responsibility for completing the contract.

The Bidder warrants that this bid is submitted solely on the basis of the Bidder's examination and inspection of the quality and quantity of the timber offered for sale and the Bidder's opinion of the value thereof and the costs of recovery. No reliance should be placed on the State of Michigan's estimates of timber quality, quantity or costs of recovery. Bidder further acknowledges that the State of Michigan: (i) expressly disclaims any warranty of fitness of timber for any purpose; (ii) offers this timber as is without any warranty of quality (merchantability) or quantity and (iii) expressly disclaims any warranty as to the quantity or quality of timber sold.

12. Certification and Chain-of-Custody (10/22)

Unless otherwise indicated in the contract under section 7 – Other Conditions of the Sale Specific Conditions & Requirements, the area encompassed by this timber sale is certified to the standards of the Forest Stewardship Council (FSC) - Certificate #SCS-FM/COC-00090N and the Sustainable Forestry Initiative (SFI) - Certificate #NSF-SFIS-5Y031-SF5. Forest products from this sale may be delivered to the mill as "FSC 100% and / or SFI certified" as long as the contractor hauling the forest products is chain-of-custody (COC) certified or covered under a COC certificate from the destination mill. The purchaser is responsible for maintaining COC after leaving the sale area.

13. Good Neighbor Authority (GNA) Requirements (10/22)

If the name of this timber sales contains the acronym GNA, it is authorized by the Good Neighbor Authority (GNA) and covered by various agreements between the U.S. Forest Service and the State. The timber sale occurs on federal land and the following conditions apply:

GNA contracts on US Forest Service land will not be awarded to purchasers on the Federal list of excluded parties. The System for Award Management (SAM) will be checked for active excluded parties prior to award of contract. In

addition, the Bidder to whom award is made must complete an Assurance Regarding Felony Conviction or Tax Delinquent Status for Corporate Applicants (AD-3031).

14. Good Neighbor Authority (GNA) Requirements, con't (10/22)

Bidder certifies, by signing this bid form, that to the best of Bidder's knowledge that the following representations are accurate and complete.

- a. That the Bidder and its principals are not presently debarred, suspended, proposed for debarment, declared ineligible, or voluntary excluded from timber sales (covered transactions) by any Federal department or agency.
- b. That the Bidder and its principals have not within a 3-year period preceding this bid been convicted of or had a civil judgment rendered against them for commission of fraud or a criminal offense in connection with obtaining , attempting to obtain, or performing a public (Federal, State, or local) transaction or contract under a public transaction; violation of Federal or State antitrust statutes or commission of embezzlement, theft, forgery, bribery, falsification or destruction of records, making false statements, or receiving stolen property.
- c. That the Bidder and its principals are not presently indicted for or otherwise criminally or civilly charged by a governmental entity (Federal, State, or local) with commission of any of the offenses enumerated in paragraph b of this certification.
- d. That the Bidder and its principals have not within a 3-year period preceding this bid had one or more public transactions (Federal, State, or local) terminated for breach or default of a timber or forest product contract.

Bidders that cannot certify this requirement, in whole or in part, shall submit an explanation with their bid.

SHANNON LOTT, Acting
Director

TIMBER SALE INFORMATION

SE Comp 167 (72-002-22)
T27N, R04W, SEC. 25; T27N, R04W, SEC. 26.
Crawford County (Advertised Price \$40,575.20)

SALE NOTE: Dry summer or frozen winter harvest is recommended because there is some low ground within the sale area and because access across State land involves crossing areas of low ground on a 2.5 mile-long temporary haul route.

A timber sale contract for this lump sum, sealed bid timber sale will be awarded to the responsible bidder offering the highest sealed bid price. All units of volume listed below were estimated using the Inventory Manager computer program and the new Michigan taper model. Bids must be at or above the following advertised price for each product and species:

<u>PRODUCTS & SPECIES</u>	<u>ESTIMATED UNITS*</u>	<u>ADVERTISED PRICE</u>
Sawtimber		
Red Pine	91.3 MBF	\$ 119.00 / MBF
White Pine	17.4 MBF	\$ 74.00 / MBF
Pulpwood		
Black Spruce	133 Cords	\$ 20.15 / Cord
Jack Pine	205 Cords	\$ 19.80 / Cord
Mixed Hardwood	79 Cords	\$ 28.85 / Cord
Northern Pin Oak	14 Cords	\$ 27.05 / Cord
Quaking Aspen	76 Cords	\$ 26.05 / Cord
Red Pine	314 Cords	\$ 38.70 / Cord
White Pine	195 Cords	\$ 25.10 / Cord

* The total volume is statistically estimated within plus (+) or minus (-) 13.94 percent. There are an estimated 1,282 cords on this timber sale, plus or minus 179 cords at the 95% confidence level. The estimated units are final and not subject to adjustment. Prospective bidders are urged to examine this timber and to make their own estimates of quantity and quality.

BOND AND PAYMENT SCHEDULE:

1. A bond in the amount of \$2,029.00 to insure faithful performance of the conditions of the contract will be deposited by the successful bidder within 21 days of the sale award.
2. Cutting in any sale or unit without the required advance payment would be considered a trespass.
3. Total payment must be paid in advance or according to the following schedule :
 - (a) Ten percent (10%) of the sale value must be paid within 21 days of the sale award.
 - (b) The 10% down payment will be credited towards the first unit cut.
 - (c) Payment for each of the following units must be made before cutting begins in that unit:

PAYMENT UNIT NUMBER	PERCENT OF TOTAL SALE VALUE
01	24.8%
02	18.4%
03	15.5%
04	41.3%
4. If no cutting takes place, the 10% down payment will not be refunded.
5. Operations on the contract issued will terminate on 06/30/2025.

SALE STATISTICS

Volumes were calculated in cubic feet using the Michigan taper model. Cubic foot volume includes all wood inside bark for the product indicated. For display purposes, cubic feet were converted to cords and MBF using a simple conversion factor, e.g. 79 cubic feet per cord and 185 cubic feet per MBF. The cubic foot volumes are precise; the cords and MBF volumes are not. Cubic foot volume cannot be directly converted to cords or boards with precision.

SALE VOLUMES

The total estimated sale volume may not equal the sum of the species/products due to the nature of statistical calculations associated with double sampling methodology.

VOLUME		STATISTICAL RANGE IN CORDS		
TOTAL CUBIC FEET	TOTAL CORDS	PERCENT ERROR	MINIMUM	MAXIMUM
101,316	1,282	13.94%	1,104	1,461

VDU VOLUMES

A VDU is a Volume Determination Unit. Volumes and their associated statistics are calculated at the VDU level and summarized to the sale level. There is often a one to one relationship between a VDU and a Payment Unit, but not always, depending on the cruise design. Refer to the VDU TO PAYMENT UNIT table.

VDU	VOLUME		PERCENT ERROR	RANGE IN CORDS	
	TOTAL CUBIC FEET	TOTAL CORDS		MINIMUM	MAXIMUM
58	16,940	214	28.66%	153	276
59	26,129	331	22.32%	257	405
61	30,738	389	38.99%	237	541
63	27,509	348	21.07%	275	422
TOTAL:	101,316	1,282		922	1,643

VDU TO PAYMENT UNIT

When a VDU is associated with more than one Payment Unit (PU), the VDU volumes are assigned to the PU based on acres of the VDU within the PU.

VDU	VDU ACRES	PU	PU ACRES
58	8.3	2	8.3
59	17.8	2	3.6
		3	14.2
61	22.2	4	22.2
63	19.0	1	19.0
TOTAL:	67.3		67.3

DESCRIPTION OF TIMBER BY PAYMENT UNIT (PU)

PU	MARKET GROUP	PRODUCT	QUANTITY	UNIT	ACRES	ADVERTISE PRICE
1	Red Pine	Sawtimber	20.6	MBF	19.0	\$10,081.55
	White Pine		9.0	MBF		
	Jack Pine	Pulpwood	34	Cords		
	Mixed Hardwood		54	Cords		
	<i>Red Maple</i>	<i>Sawtimber</i>	3.0	<i>MBF</i>		
	<i>Black Cherry</i>	<i>Pulpwood</i>	12	<i>Cords</i>		
	<i>Red Maple</i>		36	<i>Cords</i>		
	Quaking Aspen		49	Cords		
	Red Pine		29	Cords		
	White Pine		93	Cords		
2	Red Pine	Sawtimber	5.8	MBF	11.9	\$7,454.05
	White Pine		4.7	MBF		
	Black Spruce	Pulpwood	127	Cords		
	Jack Pine		40	Cords		
	Mixed Hardwood		17	Cords		
	<i>Red Maple</i>	<i>Sawtimber</i>	0.1	<i>MBF</i>		
	<i>Red Maple</i>	<i>Pulpwood</i>	17	<i>Cords</i>		
	Quaking Aspen		5	Cords		
	Red Pine		45	Cords		
	White Pine		28	Cords		
3	Red Pine	Sawtimber	4.1	MBF	14.2	\$6,269.20
	White Pine		3.7	MBF		
	Black Spruce	Pulpwood	6	Cords		
	Jack Pine		131	Cords		
	Mixed Hardwood		8	Cords		
	<i>Red Maple</i>	<i>Sawtimber</i>	0.5	<i>MBF</i>		
	<i>Red Maple</i>	<i>Pulpwood</i>	7	<i>Cords</i>		
	Northern Pin Oak		2	Cords		
	Quaking Aspen		22	Cords		
	Red Pine		2	Cords		
White Pine		74	Cords			
4	Red Pine	Sawtimber	60.8	MBF	22.2	\$16,770.40
	Northern Pin Oak	Pulpwood	12	Cords		
	Red Pine		238	Cords		
TOTAL:			108.7	MBF		
TOTAL:			1,016	Cords		

Sale Specific Conditions & Requirements

Sale Name: SE Comp 167

Sale Number: 72-002-22 Seq#: 2

1 - Sale Area

1.2 - Boundaries

1.2.1 - Painted boundaries (9/19)

The sale boundary and Payment Unit boundaries are marked and identified by blue, red and yellow paint. Exterior sale boundary lines against private property are marked with blue paint. Exterior sale boundary lines against state are marked with red paint. Interior Retention Areas are bounded by red paint and are to be left. Interior Payment Unit boundaries are marked with yellow paint, in addition to a short segment of back-to-back redline between PU 1 & 2 as shown on the timbersale map. The painted boundary line trees are not Included Timber and are to be protected. Yellow & red painted trees designating an interior Payment Unit boundary are only to be cut when all surrounding Payment Units have been paid and if the trees meet the Timber Specifications of both PUs.

2 - Timber Specifications

2.1 - Included Timber

2.1.1 - Clearcut unit(s) with unmerchantable trees (6/14)

Within Payment Unit(s) 1, cut all trees that are two (2) inches or more at DBH except oak and green-marked trees.

2.1.2 - Clearcut unit(s) w/o unmerchantable trees (8/11)

Within Payment Unit(s) 2 & 3, cut all trees which meet minimum piece specifications in 2.2 Utilization except green-marked trees.

2.1.8 - Designated plantation row unit(s) (12/08)

Within Payment Unit(s) 4, all trees which meet minimum piece specifications in 2.2 Utilization, within designated plantation rows are designated for cutting. Designated plantation rows are identified by orange paint.

2.1.11 - Description of timber note (2/04)

Note that all Aspen, Jack Pine and Spruce were cruised as pulp.

2.2 - Utilization

2.2.3 - Stump heights (4/07)

Stump heights within Payment Unit 4 shall not exceed 12 inches for all trees. Stump heights within Payment Units 1, 2 & 3 shall not exceed 12 inches for trees less than 20 inches in diameter at stump height and 18 inches for trees larger than that.

2.2.6 - Roundwood operation required (3/21)

The skidding of whole trees or tree segments with limbs attached is prohibited within Payment Unit 4. All products must be produced as roundwood and forwarded to existing roads or landing areas in final product length.

3 - Payments

3.3 - Pre-measured Sales

3.3.4 - Dividing payment units (7/14)

Payment Unit(s) 4 may be divided at the request of the Purchaser and upon approval of the Unit Manager. Dividing Payment Units is a contract modification which requires a Timber Sale Contract Amendment. There will be only one division per Payment Unit.

3.4 - Damaged Timber

3.4.1 - Damaged timber (7/16)

General Condition and Requirement 3.4 Damaged Timber, defines liquidated damages for undesignated live merchantable trees which are cut or injured. In addition, reasonable care should be taken to avoid damage to tree seedlings and saplings.

Within Payment Units 2 & 3, if more than 20% of the seedlings or saplings (1/4" to 4.5" DBH) within a specified portion of the sale area are damaged, liquidated damages will be assessed at \$300 per acre for all acreage within that specified portion of

the sale area that was damaged. Cleanly-cut operable paths will be accepted through areas of dense regen.

No damage is acceptable to undesignated live merchantable trees. Within the sale area, if more than 10% of trees (> 4.5" DBH) within a specified area of the sale are damaged, liquidated damages will be assessed for all trees damaged. Rates will be in accordance with General Condition and Requirement 3.4 Damaged Timber.

4 - Transportation

4.1 - Construction

4.1.6 - Road construction (1/09)

Construction of new roads and landings or improvements of existing roads shall be done in such a way as to minimize the environmental and visual impacts. Merchantable trees shall be cut and utilized unless otherwise directed. Non-merchantable trees shall be severed and laid flat on the ground. Slash shall be chipped, utilized or scattered back into the sale area, not left in piles or windrows, and be kept a minimum of 10 feet back from the road edge. Stumps shall be set upright, not left on edge, and be moved at least 10 feet away from the road edge. Disturbed soil shall be feathered into the woods and not left in berms or windrows.

4.1.7 - Road closure (10/11)

All new roads built into the sale must be blocked to vehicle traffic upon completion of the sale. Overgrown roads that are reopened shall be considered new roads. In general, closure will require constructing a four (4') foot high berm of stumps and logs covered with dirt. Stumps and brush may also need to be placed along part of the road behind the berm. Contact the sale administrator for specific details of design and placement.

4.1.11 - Permits (2/12)

The Purchaser will secure any necessary permits that may be required.

5 - Operations

5.1 - Notification

5.1.1 - Pre-sale conference (10/16)

A pre-sale conference on site between the Purchaser and sale administrator is required prior to beginning any operations to determine landing and road locations. The Unit Manager or his/her representative must be contacted at least 5 days in advance to schedule the conference.

5.1.4 - Post-sale conference (10/16)

A post-sale conference on site between the Purchaser and sale administrator is required prior to the completion of active logging operations to determine clean-up and repair of landings, road edges, and the fulfillment of other contract specifications.

5.1.7 - Railroad R.O.W. (3/16)

The adjacent railroad grade is operated by Lake State Railway. Do not operate equipment or fell trees within the 100-foot wide railroad corridor. Notify Lake State Railway and MDOT when the sale is opened so that they can monitor conditions on the Sand Hill Lake access road railroad crossing. When hauling is ongoing, don't allow mud or snow to build up on the crossing boards or pack the flangeway gaps.

5.2 - Conduct of Operations

5.2.3 - Operating Restrictions

5.2.3.3 - Bark slippage restriction (3/09)

Within Payment Unit(s) #4, unless changed by written agreement, cutting and skidding are not permitted during the period of April 15 to July 15. This restriction is because of bark slippage.

5.2.3.5 - Oak wilt restriction (1/18)

Within Payment Units 1, 2, 3 & 4, unless changed by written agreement, cutting, skidding, hauling within the sale and brushing of access roads to the sale are not permitted during the period of April 15 to July 15. Operations may be allowed if specific steps are taken to prevent damaging uncut oak during the high risk period. Those steps may include completing all road brushing before April 15th and clearing a tree-length buffer along uncut oak cover before April 15th. This is necessary to reduce the spread of oak wilt. For more information, contact the Unit Manager or his/her representative.

5.2.22 - Operating Caution

5.2.22.1 - Operating caution (6/11)

It is recommended, but not required, that within Payment Unit(s) 1, 2, 3 & 4, cutting, skidding, and hauling occur during dry summer or frozen winter conditions. The reason for the recommendation is because PU 2 has a seasonal high water table, there are low ground inclusions between the retention islands in PU 1, and the haul route from the north crosses through areas of low ground.

5.2.37 - No decking areas (12/08)

No decking is allowed within 100 feet of the bog between PUs 3 & 4 or the retention islands in PU 1.

5.2.38 - No decking against live trees (2/04)

Cut products may not be decked against unmarked or designated leave trees.

5.4 - Soil Protection

5.4.1 - Rutting restriction, general (7/16)

Operations are to cease immediately if equipment and weather conditions result in rutting of roads and/or skid trails which is 12 inches or greater in depth and 50 feet in length. The Unit Manager or his/her representative may restrict hauling and/or skidding if ruts exceed the specified depth. With the Unit Manager or his/her representative's approval, the Purchaser may return to the area when the risk of rutting has decreased.

5.8 - Protection of Endangered Species

5.8.3 - Red shoulder hawk or goshawk (2/16)

In the event that an active red shoulder hawk or goshawk nest is found, the contract may be amended to protect the nest site until the nest is determined to be inactive. The value of the trees in this excluded area will be refunded or credited to the Purchaser. The nest will be buffered with a five-chain radius (eight acre) protection area, centered on the nest tree, in which there will be no cutting or new roads constructed. Avoid human disturbance, including loading and skidding, in the protection area.

An additional zone of five chains (ten chains centered on the active nest tree) will be established in which there is no management activity from March 15 to July 15. Limit biomass harvesting and chipping operations within this ten-chain zone, retain the maximum one-third of residues per the Woody Biomass Harvesting Guidelines (Michigan DNR 2010). Nests determined to be inactive will be protected with a one-chain no-harvest buffer.

6 - Safety and Fire Prevention

6.2 - Signing

6.2.1 - Road posting (10/20)

The Purchaser is responsible for posting and maintaining caution signs on the forest road haul route prior to beginning operations. The road must be posted as directed by the sale administrator to warn of logging activity and truck traffic. Signs must be removed when harvest operations are suspended or completed. The Purchaser will provide these signs.

7 - Other Conditions

7.5 - Loss

7.5.1 - Deteriorating timber (7/09)

The sale area has received damage from age-related decline in the overmature Jack Pine, Aspen & Oak. The Purchaser should harvest the wood as soon as possible. The Department of Natural Resources is held free of responsibility of any further damage or deterioration due to delay in harvesting.



TIMBER SALE MAP

This information provided by authority of Part 525, 1994 PA 451, as amended.

Forest Management Unit Grayling		County Crawford	Mapped By Charlebois	Date 09/25/2022	Page 1	of 2
Township 27N	Range 4W	Section(s) and Subdivision(s) Sec 26: SENE, E1/2SE Sec 25: SWNW, W1/2SW		Scale 1:7,920		

Cover Type

A = Aspen	H = Hemlock	N = Marsh	U = Upland Brush
B = Paper Birch	J = Jack Pine	O = Oak	UM = Upland Mixed
C = Cedar	L = Lowland Brush	P = Lowland Poplar	V = Bog or Marsh
D = Treed Bog	LM = Lowland Mixed	Q = Mixed Swamp Conifer	W = White Pine
E = Swamp Hdwoods	M = Mpl, Bch, Brch	R = Red Pine	X = Non Stocked
F = Spruce Fir	MC = Mixed Conifer	S = Black Spruce	Z = Water
G = Grass	MD = Mixed Deciduous	T = Tamarack	

Density

0 = Non Stocked	5 = Pole Timber Medium
1 = Seedling Sapling Poor	6 = Pole Timber Well
2 = Seedling Sapling Medium	7 = Saw Timber Poor
3 = Seedling Sapling Well	8 = Saw Timber Medium
4 = Pole Timber Poor	9 = Saw Timber Well

Legend

- Sale Boundary - Red
- Sale Boundary - Blue
- PU Boundary - Yellow
- ① PU #
- ▣ Retention Area - Red
- Highway - Paved
- Snowmobile Trail
- Tank Trail
- Forest Road
- Temporary Access Road
- ⋯ Nearby Timber Sale
- River
- Intermittent Stream
- ◆ Survey Corner

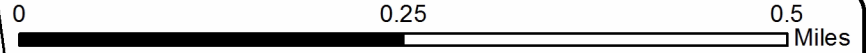

SE Comp 167
Compartment 167
67.3 Acres

PU	Acres
1	19.0
2	11.9
3	14.2
4	22.2

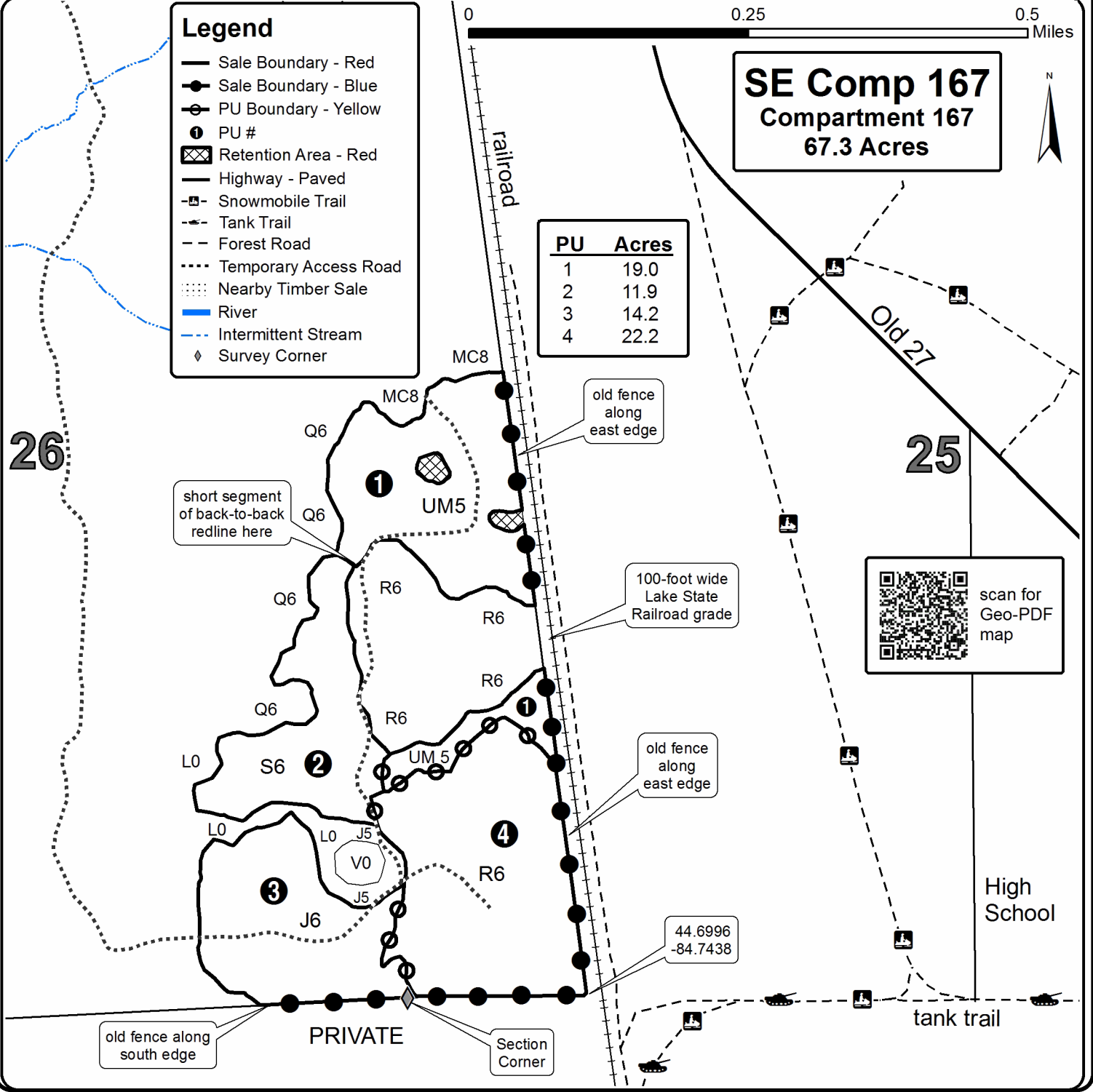



TIMBER SALE MAP

This information provided by authority of Part 525, 1994 PA 451, as amended.

Forest Management Unit Grayling		County Crawford	Mapped By Charlebois	Date 09/25/2022	Page 2	of 2
Township 27N	Range 4W	Section(s) and Subdivision(s) Sec 26: SENE, E1/2SE Sec 25: SWNW, W1/2SW		Scale 1:17,500		

Cover Type

A = Aspen	H = Hemlock	N = Marsh	U = Upland Brush
B = Paper Birch	J = Jack Pine	O = Oak	UM = Upland Mixed
C = Cedar	L = Lowland Brush	P = Lowland Poplar	V = Bog or Marsh
D = Treed Bog	LM = Lowland Mixed	Q = Mixed Swamp Conifer	W = White Pine
E = Swamp Hdwoods	M = Mpl. Bch. Brch	R = Red Pine	X = Non Stocked

Density

0 = Non Stocked	5 = Pole Timber Medium
1 = Seedling Sapling Poor	6 = Pole Timber Well
2 = Seedling Sapling Medium	7 = Saw Timber Poor
3 = Seedling Sapling Well	8 = Saw Timber Medium
4 = Pole Timber Poor	9 = Saw Timber Well

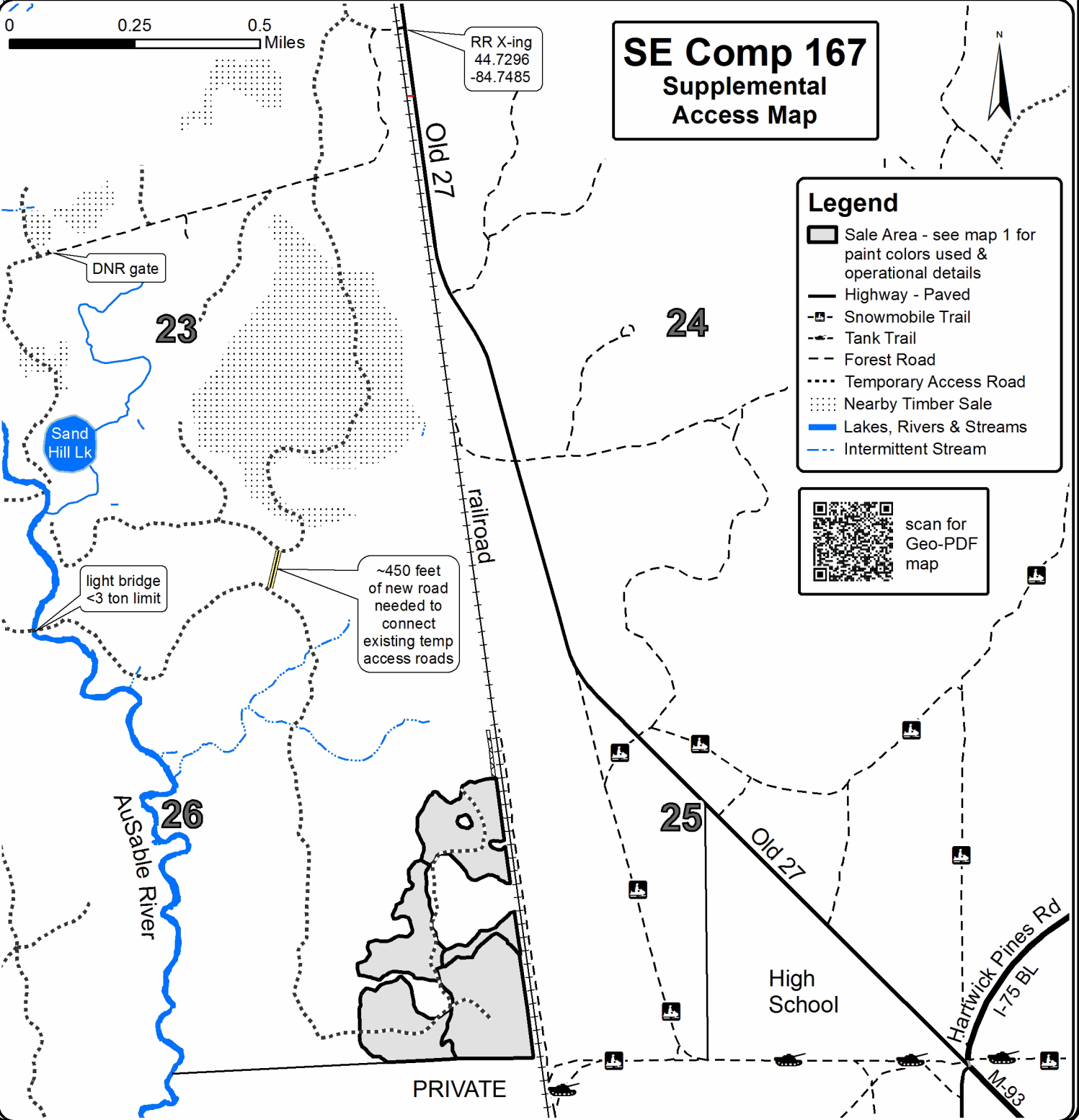

TIMBER SALE INFORMATION

Draw Down Mixed Pine (72-003-22)

T27N, R04W, SEC. 14; T27N, R04W, SEC. 22; T27N, R04W, SEC. 23.
Crawford County (Advertised Price \$100,133.75)

SALE NOTE: This sale contract will be for 3 years due to seasonal high water, sensitive soils, and challenging access.

A timber sale contract for this lump sum, sealed bid timber sale will be awarded to the responsible bidder offering the highest sealed bid price. All units of volume listed below were estimated using the Inventory Manager computer program and the new Michigan taper model. Bids must be at or above the following advertised price for each product and species:

<u>PRODUCTS & SPECIES</u>	<u>ESTIMATED UNITS*</u>	<u>ADVERTISED PRICE</u>
Sawtimber		
Black/Red (Hybrid) Oak	12.8 MBF	\$ 137.00 / MBF
Red Maple	7.0 MBF	\$ 93.00 / MBF
Red Pine	262.8 MBF	\$ 119.00 / MBF
White Pine	102.1 MBF	\$ 74.00 / MBF
Pulpwood		
Jack Pine	79 Cords	\$ 19.80 / Cord
Mixed Aspen	139 Cords	\$ 26.05 / Cord
Mixed Hardwood	225 Cords	\$ 28.85 / Cord
Mixed Oak	28 Cords	\$ 27.05 / Cord
Red Pine	987 Cords	\$ 38.70 / Cord
White Pine	250 Cords	\$ 25.10 / Cord
White Spruce	99 Cords	\$ 20.15 / Cord

* The total volume is statistically estimated within plus (+) or minus (-) 15.84 percent. There are an estimated 2,804 cords on this timber sale, plus or minus 444 cords at the 95% confidence level. The estimated units are final and not subject to adjustment. Prospective bidders are urged to examine this timber and to make their own estimates of quantity and quality.

BOND AND PAYMENT SCHEDULE:

1. A bond in the amount of \$5,007.00 to insure faithful performance of the conditions of the contract will be deposited by the successful bidder within 21 days of the sale award.
2. Cutting in any sale or unit without the required advance payment would be considered a trespass.
3. Total payment must be paid in advance or according to the following schedule :
 - (a) Ten percent (10%) of the sale value must be paid within 21 days of the sale award.
 - (b) The 10% down payment will be credited towards the first unit cut.
 - (c) Payment for each of the following units must be made before cutting begins in that unit:

PAYMENT UNIT NUMBER	PERCENT OF TOTAL SALE VALUE
01	9.9%
02	22.3%
03	44.4%
04	1.9%
05	2.8%
06	17.0%
07	1.7%
4. If no cutting takes place, the 10% down payment will not be refunded.
5. Operations on the contract issued will terminate on 06/30/2026.

SALE STATISTICS

Volumes were calculated in cubic feet using the Michigan taper model. Cubic foot volume includes all wood inside bark for the product indicated. For display purposes, cubic feet were converted to cords and MBF using a simple conversion factor, e.g. 79 cubic feet per cord and 185 cubic feet per MBF. The cubic foot volumes are precise; the cords and MBF volumes are not. Cubic foot volume cannot be directly converted to cords or boards with precision.

SALE VOLUMES

The total estimated sale volume may not equal the sum of the species/products due to the nature of statistical calculations associated with double sampling methodology.

VOLUME			STATISTICAL RANGE IN CORDS	
TOTAL CUBIC FEET	TOTAL CORDS	PERCENT ERROR	MINIMUM	MAXIMUM
221,550	2,804	15.84%	2,360	3,249

VDU VOLUMES

A VDU is a Volume Determination Unit. Volumes and their associated statistics are calculated at the VDU level and summarized to the sale level. There is often a one to one relationship between a VDU and a Payment Unit, but not always, depending on the cruise design. Refer to the VDU TO PAYMENT UNIT table.

	VOLUME			RANGE IN CORDS	
VDU	TOTAL CUBIC FEET	TOTAL CORDS	PERCENT ERROR	MINIMUM	MAXIMUM
23	22,272	282	56.45%	123	441
29	33,867	429	33.06%	287	570
30	19,489	247	61.45%	95	398
31	4,772	60	27.91%	44	77
40	8,621	109	87.48%	14	205
50	94,237	1,193	25.26%	892	1,494
74	30,554	387	39.72%	233	540
80	7,738	98	71.09%	28	168
TOTAL:	221,550	2,804		1,715	3,894

VDU TO PAYMENT UNIT

When a VDU is associated with more than one Payment Unit (PU), the VDU volumes are assigned to the PU based on acres of the VDU within the PU.

VDU	VDU ACRES	PU	PU ACRES
23	21.8	1	21.8
29	21.9	6	21.9
30	6.6	2	6.6
31	5.2	7	5.2
40	3.8	5	3.8
50	87.7	3	87.7
74	10.0	2	10.0
80	10.4	4	10.4
TOTAL:	167.4		167.4

DESCRIPTION OF TIMBER BY PAYMENT UNIT (PU)

PU	MARKET GROUP	PRODUCT	QUANTITY	UNIT	ACRES	ADVERTISE PRICE
1	Red Pine	Sawtimber	27.1	MBF	21.8	\$9,881.30
	Red Pine	Pulpwood	172	Cords		
2	Black/Red (Hybrid /Red (Hybrid) Oak	Sawtimber	12.0	MBF	16.6	\$22,370.10
	Red Maple		7.0	MBF		
	Red Pine		57.3	MBF		
	White Pine		56.7	MBF		
	Mixed Hardwood	Pulpwood	73	Cords		
	<i>Paper Birch</i>		21	Cords		
	<i>Red Maple</i>		52	Cords		
	Mixed Oak		19	Cords		
	<i>/Red (Hybrid) Oak</i>		19	Cords		
	Red Pine		86	Cords		
	White Pine		124	Cords		
	3	Red Pine	Sawtimber	141.1		
White Pine			39.9	MBF		
Jack Pine		Pulpwood	48	Cords		
<i>Jack Pine</i>		Sawtimber	4.3	MBF		
<i>Jack Pine</i>		Pulpwood	39	Cords		
Mixed Aspen			133	Cords		
<i>B. T. Aspen</i>		Sawtimber	1.7	MBF		
<i>Quaking Aspen</i>			3.1	MBF		
<i>B. T. Aspen</i>		Pulpwood	75	Cords		
<i>Quaking Aspen</i>			49	Cords		
Mixed Hardwood			72	Cords		
<i>Red Maple</i>			72	Cords		
Red Pine			403	Cords		
White Pine			102	Cords		
4	White Spruce	Pulpwood	95	Cords	10.4	\$1,914.25
	<i>Tamarack</i>	Sawtimber	2.1	MBF		
	<i>White Spruce</i>		7.5	MBF		
	<i>Tamarack</i>	Pulpwood	3	Cords		
	<i>White Spruce</i>		73	Cords		
5	Black/Red (Hybrid Northern Pin Oak	Sawtimber	0.8	MBF	3.8	\$2,766.25
	Mixed Aspen	Pulpwood	6	Cords		
	<i>Quaking Aspen</i>		6	Cords		
	Mixed Hardwood		66	Cords		
	<i>Red Maple</i>		66	Cords		
	Mixed Oak		7	Cords		
	<i>Northern Pin Oak</i>		7	Cords		
	White Pine		13	Cords		
	White Spruce		4	Cords		
<i>Black Spruce</i>		4	Cords			
6	Red Pine	Sawtimber	35.3	MBF	21.9	\$17,072.20
	White Pine		2.8	MBF		
	Red Pine	Pulpwood	324	Cords		
	White Pine		5	Cords		
7	Red Pine	Sawtimber	2.0	MBF	5.2	\$1,737.60
	White Pine		2.7	MBF		
	Jack Pine	Pulpwood	31	Cords		
	<i>Jack Pine</i>		31	Cords		
	Mixed Hardwood		14	Cords		
	<i>Red Maple</i>		14	Cords		
Mixed Oak		2	Cords			

DESCRIPTION OF TIMBER BY PAYMENT UNIT (PU), CON'T

PU	MARKET GROUP	PRODUCT	QUANTITY	UNIT	ACRES	ADVERTISE PRICE
7 con't	<i>Northern Pin Oak</i>	<i>Pulpwood</i>	2	<i>Cords</i>		
	Red Pine		2	Cords		
	White Pine		6	Cords		
TOTAL:			384.7	MBF		
TOTAL:			1,807	Cords		

Sale Specific Conditions & Requirements

Sale Name: Draw Down Mixed Pine

Sale Number: 72-003-22 Seq#: 2

1 - Sale Area

1.2 - Boundaries

1.2.1 - Painted boundaries (9/19)

The sale boundary and Payment Unit boundaries are marked and identified by blue, red and yellow paint. Exterior sale boundary lines against private property are marked with blue paint. Exterior sale boundary lines against state are marked with red paint. Interior Payment Unit boundaries are marked with yellow paint. The painted boundary line trees are not Included Timber and are to be protected, except cut all red marked aspen in Payment Unit 5, or trees marked with orange paint. Yellow painted trees designating an interior Payment Unit boundary are only to be cut when all surrounding Payment Units have been paid.

2 - Timber Specifications

2.1 - Included Timber

2.1.2 - Clearcut unit(s) w/o unmerchantable trees (8/11)

Within Payment Unit(s) 5 and 7, cut all trees which meet minimum piece specifications in 2.2 Utilization except do not cut green marked trees or northern white cedar in Payment Unit 5 and do not cut green marked trees in Payment Unit 7.

2.1.3 - Cut tree marked unit(s) (12/08)

Within Payment Unit(s) 1-3, all trees are designated for cutting when marked with orange paint above and below stump height, regardless of merchantability.

2.1.4 - Designated timber unit(s) (6/17)

Within Payment Unit(s) 4, all spruce and tamarack trees are designated for cutting which meet minimum piece specifications in 2.2 - Utilization.

2.1.8 - Designated plantation row unit(s) (12/08)

Within Payment Unit(s) 6, all trees which meet minimum piece specifications in 2.2 Utilization, within designated plantation rows are designated for cutting. In addition, all orange marked trees are included timber and are to be cut. Designated plantation rows are identified by orange paint. Rows are marked at the end and approximately every fifth tree is painted as a confidence marker.

2.2 - Utilization

2.2.4 - Skidding length (2/14)

Skidding of unlimbed tops or lengths over 17 feet is not permissible unless approved by the Unit Manager or his/her representative.

2.2.6 - Roundwood operation required (3/21)

The skidding of whole trees or tree segments with limbs attached is prohibited within Payment Unit(s) 1-6. All products must be produced as roundwood and forwarded to existing roads or landing areas in final product length.

2.2.7 - Uncut designated trees (2/04)

Liquidated damages of \$5.00 per tree will be assessed for every marked tree not cut.

3 - Payments

3.3 - Pre-measured Sales

3.3.4 - Dividing payment units (7/14)

Payment Unit(s) 3 may be divided at the request of the Purchaser and upon approval of the Unit Manager. Dividing Payment Units is a contract modification which requires a Timber Sale Contract Amendment. There will be only one division per Payment Unit.

3.4 - Damaged Timber

3.4.1 - Damaged timber (7/16)

General Condition and Requirement 3.4 Damaged Timber, defines liquidated damages for undesignated live merchantable trees which are cut or injured. In addition, extreme care should be taken to avoid damage to tree seedlings and saplings.

Within Payment Units 4, 5, and 7, if more than 25% of the tree seedlings or saplings (1/4" to 4.5" DBH) within a specified portion of the sale area are damaged, liquidated damages will be assessed at \$500 per acre for all acreage within that specified portion of the sale area that was damaged.

Operational paths may be cut cleanly through regeneration areas with prior approval of the administering forester.

3.4.3 - Special Protection Areas (8/11)

The Purchaser shall protect special protection areas from damage by the Purchaser's operations. Special protection areas are located south of Payment Unit 7, southwest of Payment Unit 6, and southeast of Payment Unit 2. These areas are labeled on the timber sale map. The Purchaser shall not cut live or dead trees within special protection areas. No operations may occur within this area. If the Purchaser's operations have cut or damaged special protection areas through carelessness, the Purchaser shall pay \$1000 as fixed, agreed and liquidated damages for each acre or part thereof cut or damaged. Such payment does not constitute ownership of the undesignated timber.

4 - Transportation

4.1 - Construction

4.1.6 - Road construction (1/09)

Construction of new roads or improvements of existing roads shall be done in such a way as to minimize the environmental and visual impacts. Merchantable trees shall be cut and utilized unless otherwise directed. Non-merchantable trees shall be severed and laid flat on the ground. Slash shall be dispersed within the sale area as directed by the sale administrator. Stumps shall be set upright, not left on edge, and be moved at least 10 feet away from the road edge. Disturbed soil shall be feathered into the woods and not left in berms or windrows.

4.1.7 - Road closure (10/11)

All new roads built into the sale must be blocked to vehicle traffic upon completion of the sale. Overgrown roads that are reopened shall be considered new roads. In general, this will require constructing a four (4') foot high berm of stumps and logs covered with earth. Temporary berms may be required if no sale activity occurs for 30 or more consecutive days. Contact the sale administrator for specific details of design and placement.

4.1.11 - Permits (2/12)

The Purchaser will secure any necessary permits that may be required.

4.4 - Access

4.4.3 - Access gate (12/08)

All access gates must be kept locked when unattended unless otherwise approved by the Unit Manager or his/her representative.

4.4.4 - Restricted access (10/05)

No operations shall occur in the area directly south of Payment Unit 7, southwest of Payment Unit 6, and southeast of Payment Unit 2. These are special protection areas and will be subject to fixed, agreed and liquidated damages in condition 3.4.3.

5 - Operations

5.1 - Notification

5.1.6 - Utility R.O.W. (4/19)

It is the responsibility of the Purchaser to obtain permission from the utility company to utilize the power line R.O.W. for operations. This includes any activity other than driving on existing roads.

5.1.7 - Railroad R.O.W. (3/16)

The adjacent railroad grade is operated by Lake State Railway. Do not operate equipment or fell trees within the 100-foot wide railroad corridor. Notify Lake State Railway and MDOT when the sale is opened so that they can monitor conditions on

the Sand Hill Lake access road railroad crossing. When hauling is ongoing, don't allow mud or snow to build up on the crossing boards or pack the flangeway gaps.

5.2 - Conduct of Operations

5.2.2 - Hazard Trees/Snags

5.2.2.1 - Den trees (10/16)

Obvious hollow and/or den trees shall be protected and left standing unless they are a safety hazard.

5.2.3 - Operating Restrictions

5.2.3.3 - Bark slippage restriction (3/09)

Within Payment Unit(s) 1-4, and 6, unless changed by written agreement, cutting and skidding are not permitted during the period of April 15 to July 15. This restriction is because of bark slippage.

5.2.3.4 - Oak wilt restriction, no exceptions (1/18)

Within Payment Unit(s) 7, cutting, skidding, hauling within the sale and brushing of access roads to the sale are not permitted during the period of April 15 to July 15. No exceptions will be granted. This is necessary to reduce the spread of oak wilt.

5.2.22 - Operating Caution

5.2.22.1 - Operating caution (6/11)

It is recommended, but not required, that within Payment Unit(s) 2-5, cutting, skidding, and hauling occur during dry summer or frozen winter conditions. The reason for the recommendation is due to pockets of saturated soil and seasonally high water table.

5.2.32 - Decking/landing restoration (9/13)

All decking and landing areas must have the surface area restored to a condition equal to or better than before. This is to ensure the proper regeneration of the stand. Wood debris, chips and "cookies" from trimmings must be removed or scattered away from landing and loading areas and may not be windrowed on the edge.

5.2.38 - No decking against live trees (2/04)

Cut products may not be decked against unmarked or designated leave trees.

5.4 - Soil Protection

5.4.1 - Rutting restriction, general (7/16)

Operations are to cease immediately if equipment and weather conditions result in rutting of roads and/or skid trails, which is 12 inches or greater in depth and 50 feet in length. The Unit Manager or his/her representative may restrict hauling and/or skidding if ruts exceed the specified depth. With the Unit Manager or his/her representative's approval, the Purchaser may return to the area when the risk of rutting has decreased.

5.4.6 - Wet area protection (5/10)

No harvesting operations, including skidding and felling, are to take place within the small bog inclusions. When harvesting occurs, there should be no disturbance to the small bog inclusions. All equipment, trees and tops should be kept out of this area. Within 100 feet of the wetlands, equipment should only be used when the soil is in a dry or frozen condition. Care must be taken by the Purchaser to identify and avoid operating in these areas of the timber sale.

5.5 - Protection of Improvements

5.5.3 - Protection of improvements detail (10/13)

The parking area near the gate on the east side of the AuSable River is to remain intact. No operations will take place within this public access point. This area is marked on the timber sale map with a parking symbol.

5.8 - Protection of Endangered Species

5.8.3 - Red shoulder hawk or goshawk (2/16)

In the event that an active red shoulder hawk or goshawk nest is found, the contract may be amended to protect the nest site until the nest is determined to be inactive. The value of the trees in this excluded area will be refunded or credited to the Purchaser. The nest will be buffered with a five-chain radius (eight acre) protection area, centered on the nest tree, in which

there will be no cutting or new roads constructed. Avoid human disturbance, including loading and skidding, in the protection area.

An additional zone of five chains (ten chains centered on the active nest tree) will be established in which there is no management activity from March 15 to July 15 (NLP). Limit biomass harvesting and chipping operations within this ten-chain zone, retain the maximum one-third of residues per the Woody Biomass Harvesting Guidelines (Michigan DNR 2010). Nests determined to be inactive will be protected with a one-chain no-harvest buffer.

5.8.6 - Protection of eagle nests (5/12)

To protect an active eagle's nest, all harvesting operations within 660 feet of an active eagle nest are limited to the period of September 1 through December 31. Harvest operations will not be permitted within 660 feet of an active eagle nest between January 1 and August 31. In addition, no operations will be allowed at any time within 330 feet of the nest. During timber sale preparation, the known active nest site was more than 660 feet from the harvest area. If a new nest is found within 660 feet of the sale area or haul route, the contract will be amended to protect the site. The nest will be buffered with a 330-foot radius protection area, centered on the nest tree, in which there will be no cutting, road construction or equipment operations allowed. The value of the trees in this excluded area will be refunded or credited to the Purchaser.

6 - Safety and Fire Prevention

6.2 - Signing

6.2.1 - Road posting (10/20)

The Purchaser is responsible for posting and maintaining caution signs on Sand Hill Road, and the Sand Hill Lake access route off of Old Hwy 27 prior to beginning operations. The road must be posted at appropriate distances from the sale area to warn of logging activity and truck traffic. Signs must be removed when harvest operations are suspended or completed. The Purchaser will provide these signs.



TIMBER SALE MAP

This information provided by authority of Part 525, 1994 PA 451, as amended.

Sale Number	Year
72-003	22

Forest Management Unit	County	Mapped By	Date	Page	of
Grayling	Crawford	Derek Nellis	09/28/2022	1	1
Township	Range	Section(s) and Subdivision(s)	Scale		
27N	04W	E1/2NE, NESE, S1/2SE Sec 14; E1/2NE Sec 22; NW, NWNE, S1/2NE, N1/2SW, SE Sec 23	1:15,840		

Cover Type				Density	
A = Aspen	H = Hemlock	N = Marsh	U = Upland Brush	0 = Non Stocked	5 = Pole Timber Medium
B = Paper Birch	J = Jack Pine	O = Oak	UM = Upland Mixed	1 = Seedling Sapling Poor	6 = Pole Timber Well
C = Cedar	L = Lowland Brush	P = Lowland Poplar	V = Bog or Marsh	2 = Seedling Sapling Medium	7 = Saw Timber Poor
D = Treed Bog	LM = Lowland Mixed	Q = Mixed Swamp Conifer	W = White Pine	3 = Seedling Sapling Well	8 = Saw Timber Medium
E = Swamp Hdwoods	M = Mpl, Bch, Brch	R = Red Pine	X = Non Stocked	4 = Pole Timber Poor	9 = Saw Timber Well
F = Spruce Fir	MC = Mixed Conifer	S = Black Spruce	Z = Water		
G = Grass	MD = Mixed Deciduous	T = Tamarack			

PU Acres

PU	Acres
1	21.8
2	16.6
3	87.7
4	10.4
5	3.8
6	21.9
7	5.2

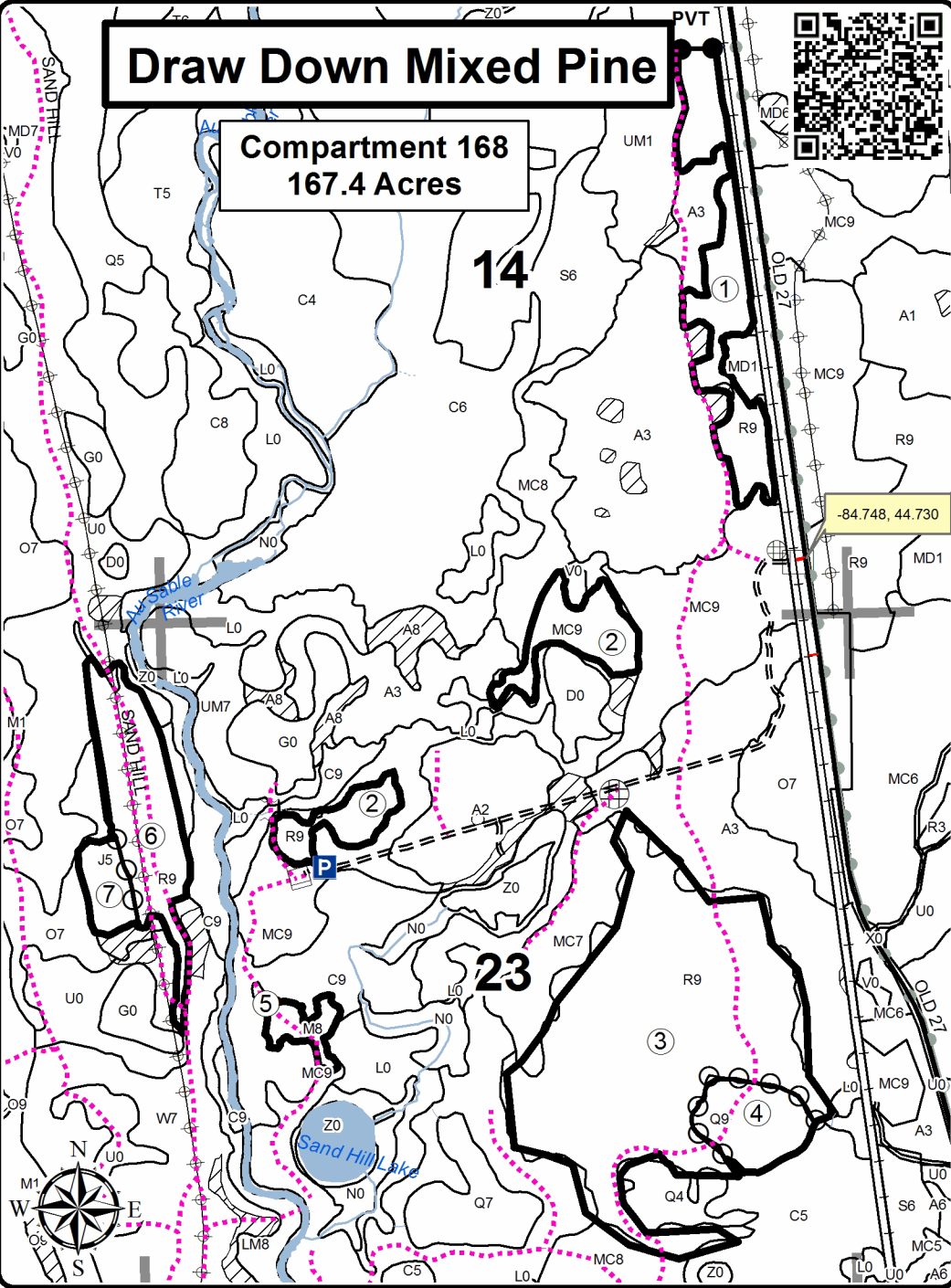

Legend

- Recreational Trails
- Gate
- Berms
- Culvert
- Secondary Forest Road
- Forest Access Route
- Paved Road
- Gravel Road
- County Road - Seasonal
- Temporary Management Access
- Parking Area
- Active Railroad
- Powerline
- 14** Section Number
- Intermittent Stream
- Lake/Pond
- Perennial River
- Lakes and Rivers All
- Retention/Special Protection Area
- Against State (Red)
- Payment Unit (Yellow)
- Private Line (Blue)
- Stand Boundaries
- Section Corners



TIMBER SALE INFORMATION

Comp 170 HDWD (72-004-22)
 T28N, R04W, SEC. 8.
 Crawford County (Advertised Price \$25,849.85)

SALE NOTE: Mixed Hardwood pulp contains beech, paper birch, oak, and iron wood.

A timber sale contract for this lump sum, sealed bid timber sale will be awarded to the responsible bidder offering the highest sealed bid price. All units of volume listed below were estimated using the Inventory Manager computer program and the new Michigan taper model. Bids must be at or above the following advertised price for each product and species:

<u>PRODUCTS & SPECIES</u>	<u>ESTIMATED UNITS*</u>	<u>ADVERTISED PRICE</u>
Sawtimber		
Beech	8.4 MBF	\$ 67.00 / MBF
Red Maple	51.9 MBF	\$ 93.00 / MBF
Red Oak	19.0 MBF	\$ 134.00 / MBF
Sugar Maple	5.4 MBF	\$ 321.00 / MBF
Pulpwood		
Mixed Hardwood	44 Cords	\$ 28.85 / Cord
Quaking Aspen	22 Cords	\$ 26.05 / Cord
Red Maple	160 Cords	\$ 28.85 / Cord
Sugar Maple	337 Cords	\$ 28.85 / Cord

* The total volume is statistically estimated within plus (+) or minus (-) 30.19 percent. There are an estimated 831 cords on this timber sale, plus or minus 251 cords at the 95% confidence level. The estimated units are final and not subject to adjustment. Prospective bidders are urged to examine this timber and to make their own estimates of quantity and quality.

BOND AND PAYMENT SCHEDULE:

1. A bond in the amount of \$1,292.00 to insure faithful performance of the conditions of the contract will be deposited by the successful bidder within 21 days of the sale award.
2. Cutting in any sale or unit without the required advance payment would be considered a trespass.
3. Total payment must be paid in advance or according to the following schedule :
 - (a) Ten percent (10%) of the sale value must be paid within 21 days of the sale award.
 - (b) The 10% down payment will be credited towards the first unit cut.
 - (c) Payment for each of the following units must be made before cutting begins in that unit:

PAYMENT UNIT NUMBER	PERCENT OF TOTAL SALE VALUE
01	16.0%
02	6.4%
03	77.6%
4. If no cutting takes place, the 10% down payment will not be refunded.
5. Operations on the contract issued will terminate on 06/30/2025.

SALE STATISTICS

Volumes were calculated in cubic feet using the Michigan taper model. Cubic foot volume includes all wood inside bark for the product indicated. For display purposes, cubic feet were converted to cords and MBF using a simple conversion factor, e.g. 79 cubic feet per cord and 185 cubic feet per MBF. The cubic foot volumes are precise; the cords and MBF volumes are not. Cubic foot volume cannot be directly converted to cords or boards with precision.

SALE VOLUMES

The total estimated sale volume may not equal the sum of the species/products due to the nature of statistical calculations associated with double sampling methodology.

VOLUME		STATISTICAL RANGE IN CORDS		
TOTAL CUBIC FEET	TOTAL CORDS	PERCENT ERROR	MINIMUM	MAXIMUM
65,620	831	30.19%	580	1,081

VDU VOLUMES

A VDU is a Volume Determination Unit. Volumes and their associated statistics are calculated at the VDU level and summarized to the sale level. There is often a one to one relationship between a VDU and a Payment Unit, but not always, depending on the cruise design. Refer to the VDU TO PAYMENT UNIT table.

VDU	VOLUME		PERCENT ERROR	RANGE IN CORDS	
	TOTAL CUBIC FEET	TOTAL CORDS		MINIMUM	MAXIMUM
376	47,503	601	24.45%	454	748
378	5,691	72	44.99%	40	104
379	12,425	157	28.88%	112	203
TOTAL:	65,620	831		606	1,055

VDU TO PAYMENT UNIT

When a VDU is associated with more than one Payment Unit (PU), the VDU volumes are assigned to the PU based on acres of the VDU within the PU.

VDU	VDU ACRES	PU	PU ACRES
376	15.8	3	15.8
378	12.9	2	12.9
379	15.7	1	15.7
TOTAL:	44.4		44.4

DESCRIPTION OF TIMBER BY PAYMENT UNIT (PU)

PU	MARKET GROUP	PRODUCT	QUANTITY	UNIT	ACRES	ADVERTISE PRICE			
1	Red Maple	Sawtimber	3.0	MBF	15.7	\$4,128.00			
	Sugar Maple		0.6	MBF					
	Mixed Hardwood	Pulpwood	21	Cords					
	<i>Ironwood</i>		21	<i>Cords</i>					
	Quaking Aspen		13	Cords					
	<i>Quaking Aspen</i>	<i>Sawtimber</i>	2.4	<i>MBF</i>					
	<i>Quaking Aspen</i>	<i>Pulpwood</i>	8	<i>Cords</i>					
	Red Maple		7	Cords					
	Sugar Maple		87	Cords					
2	Red Maple	Sawtimber	0.5	MBF	12.9	\$1,662.10			
	Red Maple	Pulpwood	3	Cords					
	Sugar Maple		53	Cords					
3	Beech	Sawtimber	8.4	MBF	15.8	\$20,059.75			
	Red Maple		48.4	MBF					
	Red Oak		19.0	MBF					
	Sugar Maple		4.8	MBF					
	Mixed Hardwood	Pulpwood	23	Cords					
	<i>Beech</i>		8	<i>Cords</i>					
	<i>Paper Birch</i>		6	<i>Cords</i>					
	<i>Red Oak</i>		9	<i>Cords</i>					
	Quaking Aspen		9	Cords					
	<i>Quaking Aspen</i>		9	<i>Cords</i>					
	Red Maple		150	Cords					
	Sugar Maple		197	Cords					
	TOTAL:			84.7			MBF		
	TOTAL:			563			Cords		

Sale Specific Conditions & Requirements

Sale Name: Comp 170 HDWD

Sale Number: 72-004-22 Seq#: 2

1 - Sale Area

1.2 - Boundaries

1.2.1 - Painted boundaries (9/19)

The sale boundary and Payment Unit boundaries are marked and identified by blue, red and yellow paint. Exterior sale boundary lines against private property are marked with blue paint. Exterior sale boundary lines against state are marked with red paint. The south boundary of Payment Unit 3 is unpainted and designated by an unnamed forest access route. Interior Payment Unit boundaries are marked with yellow paint. Retention patches are marked with red paint; no harvesting activities may occur within these areas. The painted boundary line trees are not Included Timber and are to be protected unless marked with orange paint. Yellow painted trees designating an Interior Payment Unit boundary are only to be cut when all surrounding Payment Units have been paid.

2 - Timber Specifications

2.1 - Included Timber

2.1.1 - Clearcut unit(s) with unmerchantable trees (6/14)

Within Payment Unit(s) 3, cut all trees that are two (2) inches or more at DBH except do not cut trees greater than 26" DBH. Special protection trees identified in accordance with condition 3.4.2, within clearcutting unit boundaries, are not Included Timber and are to be protected.

2.1.3 - Cut tree marked unit(s) (12/08)

Within Payment Unit(s) 1 and 2, all trees are designated for cutting when marked with orange paint above and below stump height, regardless of merchantability.

2.2 - Utilization

2.2.4 - Skidding length (2/14)

Skidding of unlimbed tops or lengths over 17 feet is not permissible unless approved by the Unit Manager or his/her representative.

2.2.7 - Uncut designated trees (2/04)

Liquidated damages of \$5.00 per tree will be assessed for every marked tree not cut.

3 - Payments

3.3 - Pre-measured Sales

3.3.4 - Dividing payment units (7/14)

Payment Unit(s) may be divided at the request of the Purchaser and upon approval of the Unit Manager. Dividing Payment Units is a contract modification which requires a Timber Sale Contract Amendment. There will be only one division per Payment Unit.

3.4 - Damaged Timber

3.4.1 - Damaged timber (7/16)

General Condition and Requirement 3.4 Damaged Timber, defines liquidated damages for undesignated live merchantable trees which are cut or injured. No damage is acceptable to undesignated live merchantable trees. Within the sale area, if more than 5% of trees (> 4.5" DBH) within a specified area of the sale are damaged, liquidated damages will be assessed for all trees damaged. Rates will be in accordance with General Condition and Requirement 3.4 Damaged Timber, or at a rate of \$100 per sawtimber tree and \$50 per pole sized tree, whichever is greater.

3.4.2 - Special Protection Trees (4/14)

The Purchaser shall not cut live or dead special protection trees within cutting units or clearings. Special protection trees are trees over 26" DBH. If the Purchaser's operations have cut or damaged special protection trees through carelessness, the Purchaser shall pay \$500 as fixed, agreed and liquidated damages for each special protection tree cut or damaged. Such

payment does not constitute ownership of the undesignated timber.

4 - Transportation

4.1 - Construction

4.1.3 - Slash and earthen piles (8/04)

Piles or windrows of earth along roads and landings that have been widened or constructed shall be leveled. Slash from road maintenance or construction, including stumps, shall be chipped, utilized or otherwise removed from the sale.

4.1.4 - Timber removed for construction (12/09)

Trees cut or damaged in the process of pre-approved road, landing or skid trail construction will be decked in an area separate from other Designated Timber and not removed until measured by the sale administrator. Payment will be made at the specified Purchase Unit Price.

4.1.6 - Road construction (1/09)

Construction of new roads or improvements of existing roads shall be done in such a way as to minimize the environmental and visual impacts. Merchantable trees shall be cut and utilized unless otherwise directed. Non-merchantable trees shall be severed and laid flat on the ground. Slash shall be chipped, utilized or otherwise removed from the sale. Stumps shall be set upright, not left on edge, and be moved at least 10 feet away from the road edge. Disturbed soil shall be feathered into the woods and not left in berms or windrows.

4.1.7 - Road closure (10/11)

All new roads built into the sale must be blocked to vehicle traffic upon completion of the sale. Overgrown roads that are reopened shall be considered new roads. In general, this will require constructing a four (4') foot high berm of stumps and logs covered with earth. Temporary berms may be required if no sale activity occurs for 30 or more consecutive days. Contact the sale administrator for specific details of design and placement.

4.1.11 - Permits (2/12)

The Purchaser will secure any necessary permits that may be required.

5 - Operations

5.1 - Notification

5.1.3 - Well heads and natural gas pipelines (11/15)

The Purchaser is responsible for contacting the pipeline company prior to operating equipment in the vicinity of well heads or natural gas pipelines.

5.2 - Conduct of Operations

5.2.2 - Hazard Trees/Snags

5.2.2.1 - Den trees (10/16)

Obvious hollow and/or den trees shall be protected and left standing unless they are a safety hazard.

5.2.3 - Operating Restrictions

5.2.3.3 - Bark slippage restriction (3/09)

Within Payment Unit(s) 1 and 2, unless changed by written agreement, cutting and skidding are not permitted during the period of April 15 to July 15. This restriction is because of bark slippage.

5.2.3.5 - Oak wilt restriction (1/18)

Within Payment Unit(s) 1, 2, and 3 unless changed by written agreement, cutting, skidding, hauling within the sale and brushing of access roads to the sale are not permitted during the period of April 15 to July 15. Operations may be allowed if specific steps are taken to prevent damaging uncut oak during the high risk period. Those steps may include completing all road brushing before April 15th and clearing a tree-length buffer along uncut oak cover before April 15th. This is necessary to reduce the spread of oak wilt. For more information, contact the Unit Manager or his/her representative.

5.2.32 - Decking/landing restoration (9/13)

All decking and landing areas must have the surface area restored to a condition equal to or better than before. This is to

ensure the proper regeneration of the stand.

5.2.38 - No decking against live trees (2/04)

Cut products may not be decked against unmarked or designated leave trees.

5.4 - Soil Protection

5.4.1 - Rutting restriction, general (7/16)

Operations are to cease immediately if equipment and weather conditions result in rutting of roads and/or skid trails which is 12 inches or greater in depth and 50 feet in length. The Unit Manager or his/her representative may restrict hauling and/or skidding if ruts exceed the specified depth. With the Unit Manager or his/her representative's approval, the Purchaser may return to the area when the risk of rutting has decreased.

5.7 - Protection of Historical Sites

5.7.2 - Potential historical site(s) (9/06)

The State Historic Preservation Office has identified the potential for a historic site within the boundary of this timber sale. Note that if the site is discovered during operations, General Condition and Requirement 5.7 - Protection of Historical Sites will apply.

6 - Safety and Fire Prevention

6.2 - Signing

6.2.1 - Road posting (10/20)

The Purchaser is responsible for posting and maintaining caution signs on access routes prior to beginning operations. The road must be posted at appropriate distances from the sale area to warn of logging activity and truck traffic. Signs must be removed when harvest operations are suspended or completed. The Purchaser will provide these signs.



TIMBER SALE MAP

This information provided by authority of Part 525, 1994 PA 451, as amended.

Forest Management Unit Grayling	County Crawford	Mapped By Derek Nellis	Date 09/27/2022	Page 1	of 1
Township 28N	Range 04W	Section(s) and Subdivision(s) NE Sec 8	Scale 1:7,920		

Cover Type				Density	
A = Aspen	H = Hemlock	N = Marsh	U = Upland Brush	0 = Non Stocked	5 = Pole Timber Medium
B = Paper Birch	J = Jack Pine	O = Oak	UM = Upland Mixed	1 = Seedling Sapling Poor	6 = Pole Timber Well
C = Cedar	L = Lowland Brush	P = Lowland Poplar	V = Bog or Marsh	2 = Seedling Sapling Medium	7 = Saw Timber Poor
D = Treed Bog	LM = Lowland Mixed	Q = Mixed Swamp Conifer	W = White Pine	3 = Seedling Sapling Well	8 = Saw Timber Medium
E = Swamp Hdwoods	M = Mpl, Bch, Brch	R = Red Pine	X = Non Stocked	4 = Pole Timber Poor	9 = Saw Timber Well
F = Spruce Fir	MC = Mixed Conifer	S = Black Spruce	Z = Water		
G = Grass	MD = Mixed Deciduous	T = Tamarack			

PU	Acres
1	15.7
2	12.9
3	15.8

Comp 170 HDWD

Compartment 170

44.4 Acres

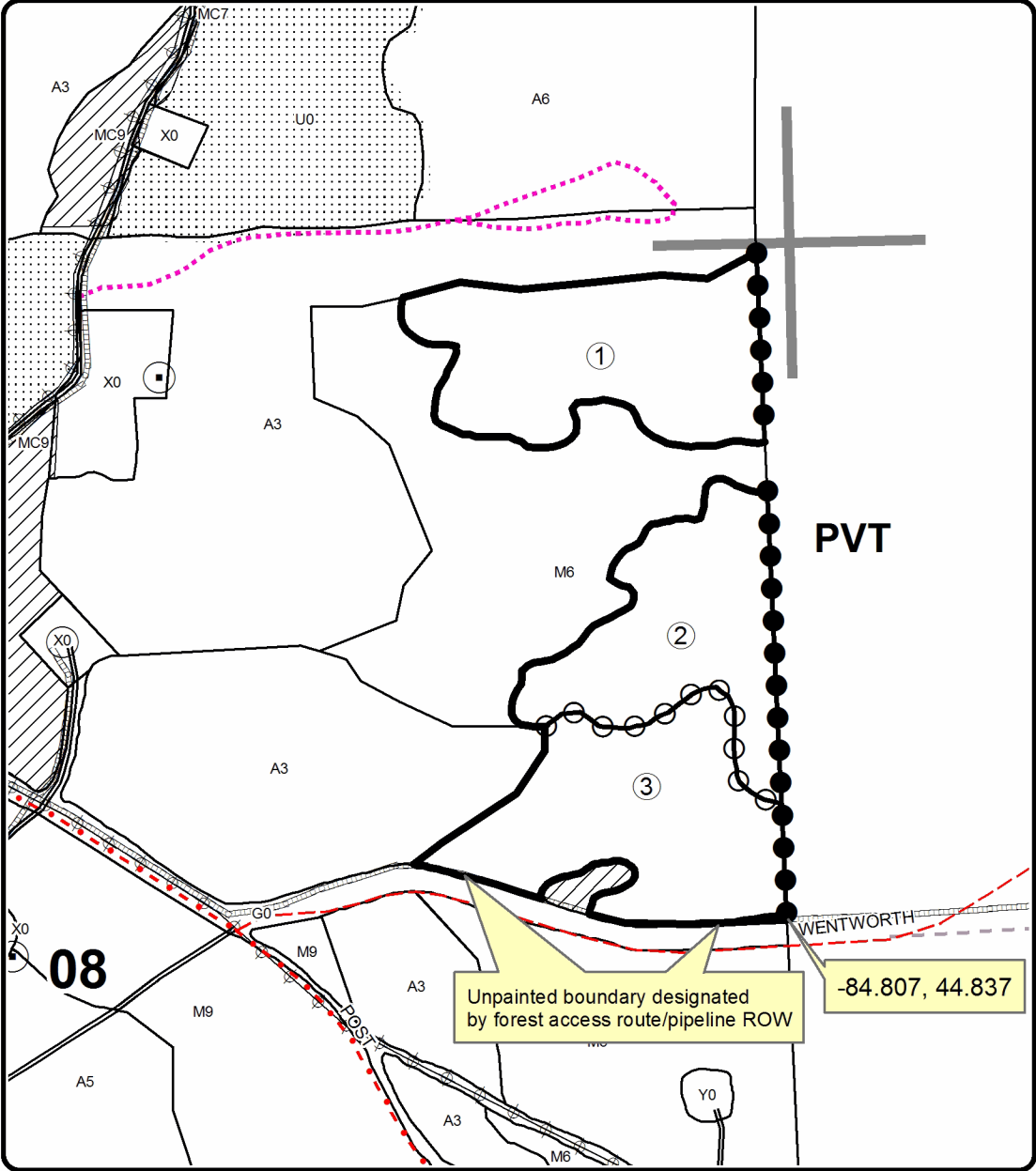
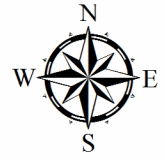

- ### Legend
- Recreational Trails
 - Oil & Gas Well Surface Locations
 - Primary Forest Road
 - Secondary Forest Road
 - Forest Access Route
 - Paved Road
 - Gravel Road
 - County Road - Seasonal
 - Private
 - Temporary Management Access
 - Pipeline
 - Powerline
 - Retention Area
 - Against State (Red)
 - Payment Unit (Yellow)
 - Private Line (Blue)
 - PVT** Private Property
 - Nearby Timber Sale
 - Section Numbers
 - Section Corners

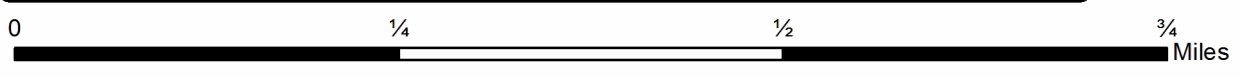

TIMBER SALE INFORMATION

Deward & Manistee (72-024-22)

T28N, R04W, SEC. 5; T28N, R04W, SEC. 6; T28N, R04W, SEC. 7; T28N, R04W, SEC. 8.
Crawford County (Advertised Price \$78,293.35)

SALE NOTE: There is a considerable amount of regen and brush that must be cut in Payment Units 3, 4 & 5 in order to facilitate subsequent RP planting. Those PUs also have extensive pipeline and wellsite interface. There is some low ground in the west side of PU 1.

A timber sale contract for this lump sum, sealed bid timber sale will be awarded to the responsible bidder offering the highest sealed bid price. All units of volume listed below were estimated using the Inventory Manager computer program and the new Michigan taper model. Bids must be at or above the following advertised price for each product and species:

<u>PRODUCTS & SPECIES</u>	<u>ESTIMATED UNITS*</u>	<u>ADVERTISED PRICE</u>
Sawtimber		
Black/Red (Hybrid) Oak	30.7 MBF	\$ 137.00 / MBF
Red Pine	270.7 MBF	\$ 119.00 / MBF
White Pine	40.2 MBF	\$ 74.00 / MBF
Pulpwood		
Black/Red (Hybrid) Oak	71 Cords	\$ 27.05 / Cord
Jack Pine	538 Cords	\$ 19.80 / Cord
Mixed Aspen	525 Cords	\$ 26.05 / Cord
Mixed Hardwood	135 Cords	\$ 28.85 / Cord
Red Pine	175 Cords	\$ 38.70 / Cord
White Pine	79 Cords	\$ 25.10 / Cord

* The total volume is statistically estimated within plus (+) or minus (-) 13.60 percent. There are an estimated 2,412 cords on this timber sale, plus or minus 328 cords at the 95% confidence level. The estimated units are final and not subject to adjustment. Prospective bidders are urged to examine this timber and to make their own estimates of quantity and quality.

BOND AND PAYMENT SCHEDULE:

1. A bond in the amount of \$3,915.00 to insure faithful performance of the conditions of the contract will be deposited by the successful bidder within 21 days of the sale award.
2. Cutting in any sale or unit without the required advance payment would be considered a trespass.
3. Total payment must be paid in advance or according to the following schedule :
 - (a) Ten percent (10%) of the sale value must be paid within 21 days of the sale award.
 - (b) The 10% down payment will be credited towards the first unit cut.
 - (c) Payment for each of the following units must be made before cutting begins in that unit:

PAYMENT UNIT NUMBER	PERCENT OF TOTAL SALE VALUE
01	8.9%
02	5.7%
03	29.2%
04	28.2%
05	28.0%

4. If no cutting takes place, the 10% down payment will not be refunded.
5. Operations on the contract issued will terminate on 06/30/2025.

SALE STATISTICS

Volumes were calculated in cubic feet using the Michigan taper model. Cubic foot volume includes all wood inside bark for the product indicated. For display purposes, cubic feet were converted to cords and MBF using a simple conversion factor, e.g. 79 cubic feet per cord and 185 cubic feet per MBF. The cubic foot volumes are precise; the cords and MBF volumes are not. Cubic foot volume cannot be directly converted to cords or boards with precision.

SALE VOLUMES

The total estimated sale volume may not equal the sum of the species/products due to the nature of statistical calculations associated with double sampling methodology.

VOLUME		STATISTICAL RANGE IN CORDS		
TOTAL CUBIC FEET	TOTAL CORDS	PERCENT ERROR	MINIMUM	MAXIMUM
190,519	2,412	13.60%	2,084	2,740

VDU VOLUMES

A VDU is a Volume Determination Unit. Volumes and their associated statistics are calculated at the VDU level and summarized to the sale level. There is often a one to one relationship between a VDU and a Payment Unit, but not always, depending on the cruise design. Refer to the VDU TO PAYMENT UNIT table.

VDU	VOLUME		PERCENT ERROR	RANGE IN CORDS	
	TOTAL CUBIC FEET	TOTAL CORDS		MINIMUM	MAXIMUM
12	19,248	244	34.56%	159	328
24	171,271	2,168	12.87%	1,889	2,447
TOTAL:	190,519	2,412		2,048	2,775

VDU TO PAYMENT UNIT

When a VDU is associated with more than one Payment Unit (PU), the VDU volumes are assigned to the PU based on acres of the VDU within the PU.

VDU	VDU ACRES	PU	PU ACRES
12	25.8	1	25.8
24	95.8	2	6.0
		3	30.7
		4	29.7
		5	29.4
TOTAL:	121.6		121.6

DESCRIPTION OF TIMBER BY PAYMENT UNIT (PU)

PU	MARKET GROUP	PRODUCT	QUANTITY	UNIT	ACRES	ADVERTISE PRICE
1	Red Pine	Sawtimber	7.4	MBF	25.8	\$6,983.05
	White Pine		1.6	MBF		
	Jack Pine	Pulpwood	2	Cords		
	Mixed Aspen		186	Cords		
	<i>B. T. Aspen</i>		96	<i>Cords</i>		
	<i>Quaking Aspen</i>		90	<i>Cords</i>		
	Mixed Hardwood		5	Cords		
	<i>Black Cherry</i>		2	<i>Cords</i>		
	<i>Red Maple</i>		3	<i>Cords</i>		
	Red Pine		13	Cords		
	White Pine		18	Cords		
2	Black/Red (Hybrid)	Sawtimber	1.9	MBF	6.0	\$4,448.05
	Red Pine		16.5	MBF		
	White Pine		2.4	MBF		
	Black/Red (Hybrid)	Pulpwood	4	Cords		
	Jack Pine		34	Cords		
	Mixed Aspen		21	Cords		
	<i>B. T. Aspen</i>		11	<i>Cords</i>		
	<i>Quaking Aspen</i>		10	<i>Cords</i>		
	Mixed Hardwood		8	Cords		
	<i>Beech</i>		1	<i>Cords</i>		
	<i>Red Maple</i>		7	<i>Cords</i>		
	Red Pine		10	Cords		
	White Pine		4	Cords		
3	Black/Red (Hybrid)	Sawtimber	9.9	MBF	30.7	\$22,856.85
	Red Pine		84.4	MBF		
	White Pine		12.4	MBF		
	Black/Red (Hybrid)	Pulpwood	23	Cords		
	Jack Pine		172	Cords		
	Mixed Aspen		109	Cords		
	<i>B. T. Aspen</i>		56	<i>Cords</i>		
	<i>Quaking Aspen</i>		53	<i>Cords</i>		
	Mixed Hardwood		41	Cords		
	<i>Beech</i>		2	<i>Cords</i>		
	<i>Black Cherry</i>		1	<i>Cords</i>		
	<i>Red Maple</i>		38	<i>Cords</i>		
	Red Pine		52	Cords		
	White Pine		19	Cords		
4	Black/Red (Hybrid)	Sawtimber	9.5	MBF	29.7	\$22,111.80
	Red Pine		81.6	MBF		
	White Pine		12.0	MBF		
	Black/Red (Hybrid)	Pulpwood	22	Cords		
	Jack Pine		166	Cords		
	Mixed Aspen		105	Cords		
	<i>B. T. Aspen</i>		54	<i>Cords</i>		
	<i>Quaking Aspen</i>		51	<i>Cords</i>		
	Mixed Hardwood		41	Cords		
	<i>Beech</i>		3	<i>Cords</i>		
	<i>Black Cherry</i>		1	<i>Cords</i>		
	<i>Red Maple</i>		37	<i>Cords</i>		
	Red Pine		50	Cords		
White Pine		19	Cords			
5	Black/Red (Hybrid)	Sawtimber	9.4	MBF	29.4	\$21,893.60
	Red Pine		80.8	MBF		
	White Pine		11.8	MBF		
	Black/Red (Hybrid)	Pulpwood	22	Cords		

DESCRIPTION OF TIMBER BY PAYMENT UNIT (PU), CON'T

PU	MARKET GROUP	PRODUCT	QUANTITY	UNIT	ACRES	ADVERTISE PRICE
5 con't	Jack Pine	Pulpwood	164	Cords		
	Mixed Aspen		104	Cords		
	<i>B. T. Aspen</i>		53	<i>Cords</i>		
	<i>Quaking Aspen</i>		51	<i>Cords</i>		
	Mixed Hardwood		40	Cords		
	<i>Beech</i>		3	<i>Cords</i>		
	<i>Black Cherry</i>		1	<i>Cords</i>		
	<i>Red Maple</i>		36	<i>Cords</i>		
	Red Pine		50	Cords		
	White Pine		19	Cords		
TOTAL:			341.6	MBF		
TOTAL:			1,523	Cords		

Sale Specific Conditions & Requirements

Sale Name: Deward & Manistee

Sale Number: 72-024-22 Seq#: 2

1 - Sale Area

1.2 - Boundaries

1.2.1 - Painted boundaries (9/19)

The sale boundary and Payment Unit boundaries are marked and identified by red and yellow paint, in addition to designated unpainted boundaries. Exterior sale boundary lines against state are marked with red paint. Interior Payment Unit boundaries are marked with yellow paint in addition to unpainted boundaries designated as Manistee River Road and Deward/Post Road. The painted boundary line trees are not Included Timber and are to be protected except cut those redline trees along road and utility corridors that meet the 2.1.1 Timber Specification. Yellow painted trees designating an interior Payment Unit boundary are only to be cut when all surrounding Payment Units have been paid. Note that there is back-to-back redline along the PU 1-2 shared border with an adjacent timbersale contract. The PU 3-4 redline that borders a recently-closed timbersale contract has some back-to-back redline and some overlap with that old redline in order to straighten out the future plantation edge.

2 - Timber Specifications

2.1 - Included Timber

2.1.1 - Clearcut unit(s) with unmerchantable trees (6/14)

Within Payment Unit(s) 1 & 2, cut all trees that are two (2) inches or more at DBH except green-marked.

Within Payment Unit(s) 3, 4 & 5, cut all woody stems that are one (1) inch or more at DBH except green-marked.

2.1.11 - Description of timber note (2/04)

Note that all aspen, maple, jack pine, black cherry & beech were cruised as pulp.

2.2 - Utilization

2.2.2 - Chipping required (2/18)

Payment Units 3, 4 & 5 must be chip harvested to facilitate subsequent planting operations. The Purchaser has the option to produce sawlogs or pulpwood bolts, but the remaining portion of the trees must be chipped and hauled, except for the required woody biomass retention. A chipping exemption may be obtained if proposed operations are determined to be suitable for planting by reforestation staff. This exemption must be granted in writing. Liquidated damages may be assessed at \$350 per acre if it is determined that slash mitigation was inadequate and mastication is needed for the DNR to conduct site preparation for planting. The requirement to retain approximately 1/6 to 1/3 of tree tops and limbs less than four inches in diameter is still applicable (G. C. & R. 2.2). That residual biomass must be spread out so that it does not hinder the planned trenching and planting.

2.2.3 - Stump heights (4/07)

Stump heights within Payment Units 3, 4 & 5 shall not exceed 6 inches for trees less than 24 inches in diameter at stump height (DSH), and 12 inches for trees 24 inches DSH and greater. This is in order to facilitate planting operations.

3 - Payments

3.3 - Pre-measured Sales

3.3.4 - Dividing payment units (7/14)

Payment Unit(s) 3, 4 & 5 may be divided at the request of the Purchaser and upon approval of the Unit Manager. Dividing Payment Units is a contract modification which requires a Timber Sale Contract Amendment. There will be only one division per Payment Unit.

3.4 - Damaged Timber

3.4.1 - Damaged timber (7/16)

General Condition and Requirement 3.4 Damaged Timber, defines liquidated damages for undesignated live merchantable trees which are cut or injured.

No damage is acceptable to undesignated live merchantable trees. Within the sale area, if more than 5% of trees (> 4.5"

DBH) within a specified area of the sale are damaged, liquidated damages will be assessed for all trees damaged. Rates will be in accordance with General Condition and Requirement 3.4 Damaged Timber or at a rate of \$100 per tree, whichever is greater.

4 - Transportation

4.1 - Construction

4.1.6 - Road construction (1/09)

Construction of new roads, landings, or improvements of existing roads shall be done in such a way as to minimize the environmental and visual impacts. Merchantable trees shall be cut and utilized unless otherwise directed. Non-merchantable trees shall be severed and laid flat on the ground. Slash shall be chipped or scattered, and not left in windrows and kept a minimum of 10 feet back from the road edge. Stumps shall be set upright, not left on edge, and be moved at least 10 feet away from the road edge. Disturbed soil shall be feathered into the woods and not left in berms or windrows.

4.1.7 - Road closure (10/11)

All new roads built into the sale must be blocked to vehicle traffic upon completion of the sale. Overgrown roads that are reopened shall be considered new roads. In general, closure will require constructing a four (4') foot high berm of stumps and logs covered with dirt. Stumps and brush may need to be placed along part of the road behind the berm. Contact the sale administrator for specific details of design and placement.

4.1.11 - Permits (2/12)

The Purchaser will secure any necessary permits that may be required.

4.4 - Access

4.4.4 - Restricted access (10/05)

Equipment operations within the Restricted Area shown on the Timbersale Map are limited to the mapped open roads. No off-road activity is permitted within this area.

5 - Operations

5.1 - Notification

5.1.1 - Pre-sale conference (10/16)

A pre-sale conference on site between the Purchaser and sale administrator is required prior to beginning any operations to determine landing and road locations. The Unit Manager or his/her representative must be contacted at least 5 days in advance to schedule the conference.

5.1.3 - Well heads and natural gas pipelines (11/15)

The Purchaser is responsible for contacting the gas or pipeline company prior to operating equipment in the vicinity of well heads or natural gas pipelines. Contact Riverside (989-705-7665), Merit (800-328-7430), and any other oilfield operating companies indicated by your MISS Dig notification. Operations may begin away from pipelines and wellsites after the Pre-Work meeting, but plan for at least ten days after the initial pipeline contacts to allow the oilfield operating companies time to assess and armor any needed pipeline crossings.

5.1.4 - Post-sale conference (10/16)

A post-sale conference on site between the Purchaser and sale administrator is required prior to the completion of active logging operations to determine clean-up and repair of landings, road edges, and the fulfillment of other contract specifications.

5.1.6 - Utility R.O.W. (4/19)

It is the responsibility of the Purchaser to obtain permission from the utility company to utilize the power line R.O.W. for operations. Contact Great Lakes Energy or Top O' Michigan Electric (800-482-7171).

5.2 - Conduct of Operations

5.2.3 - Operating Restrictions

5.2.3.5 - Oak wilt restriction (1/18)

Within Payment Units 1-5 unless changed by written agreement, cutting, skidding, hauling within the sale and brushing of access roads to the sale are not permitted during the period of April 15 to July 15. Operations may be allowed if specific steps are taken to prevent damaging uncut oak during the high risk period. Those steps may include completing all road

brushing before April 15th and clearing a tree-length buffer along uncut oak cover before April 15th. This is necessary to reduce the spread of oak wilt. For more information, contact the Unit Manager or his/her representative.

5.2.4 - Dead and Down Creation

5.2.4.2 - Dead and down creation, hare and grouse (1/14)

To improve habitat for snowshoe hare, grouse, and other species, the Purchaser is to leave two 14 inch diameter or larger log size pieces on the ground for every two acres in Payment Units 1 & 2. They should be scattered throughout the sale area except avoid leaving them within 200 feet of open roads. If possible, the logs or trees should be felled so they overlap. Note these pieces should have a minimum length of ten feet. They can be of any tree species and can be an un-merchantable piece of wood or a full tree.

5.2.22 - Operating Caution

5.2.22.1 - Operating caution (6/11)

It is recommended, but not required, that within Payment Unit(s) 1, cutting and skidding in the west end occur during dry summer or frozen winter conditions. The reason for the recommendation is because there is ground with a seasonal high water table along that edge.

5.2.29 - Shrub protection (1/20)

Do not cut or damage hawthorn, witch-hazel, dogwood or junberry in Payment Units 1 & 2. These woody-shrub plants are beneficial to various wildlife species.

5.2.38 - No decking against live trees (2/04)

Cut products may not be decked against unmarked or designated leave trees.

5.4 - Soil Protection

5.4.1 - Rutting restriction, general (7/16)

Operations are to cease immediately if equipment and weather conditions result in rutting of roads and/or skid trails which is 12 inches or greater in depth and 50 feet in length. The Unit Manager or his/her representative may restrict hauling and/or skidding if ruts exceed the specified depth. With the Unit Manager or his/her representative's approval, the Purchaser may return to the area when the risk of rutting has decreased.

6 - Safety and Fire Prevention

6.2 - Signing

6.2.1 - Road posting (10/20)

The Purchaser is responsible for posting and maintaining caution signs on Manistee River Road and Deward/Post Road prior to beginning operations. The road must be posted at appropriate distances from the sale area to warn of logging activity and truck traffic. Signs must be removed when harvest operations are suspended or completed. The Purchaser will provide these signs.

7 - Other Conditions

7.5 - Loss

7.5.1 - Deteriorating timber (7/09)

The sale area has received damage from decline in the overmature jack pine. The Purchaser should harvest the wood as soon as possible. The Department of Natural Resources is held free of responsibility of any further damage or deterioration due to delay in harvesting.



TIMBER SALE MAP

This information provided by authority of Part 525, 1994 PA 451, as amended.

Forest Management Unit Grayling	County Crawford	Mapped By Charlebois	Date 09/25/2022	Page 1	of 1
Township 28N	Range 4W	Section(s) and Subdivision(s) Sec 7: N1/2NE Sec 8: NW, NWNE	Scale 1:7,920		

Cover Type				Density	
A = Aspen	H = Hemlock	N = Marsh	U = Upland Brush	0 = Non Stocked	5 = Pole Timber Medium
B = Paper Birch	J = Jack Pine	O = Oak	UM = Upland Mixed	1 = Seedling Sapling Poor	6 = Pole Timber Well
C = Cedar	L = Lowland Brush	P = Lowland Poplar	V = Bog or Marsh	2 = Seedling Sapling Medium	7 = Saw Timber Poor
D = Treed Bog	LM = Lowland Mixed	Q = Mixed Swamp Conifer	W = White Pine	3 = Seedling Sapling Well	8 = Saw Timber Medium
E = Swamp Hdwoods	M = Mpl, Bch, Brch	R = Red Pine	X = Non Stocked	4 = Pole Timber Poor	9 = Saw Timber Well
F = Spruce Fir	MC = Mixed Conifer	S = Black Spruce	Z = Water		
G = Grass	MD = Mixed Deciduous	T = Tamarack			

PU	Acres
1	25.8
2	6.0
3	30.7
4	29.7
5	29.4

Deward & Manistee Compartment 170 121.6 Acres



scan for
Geo-PDF
map

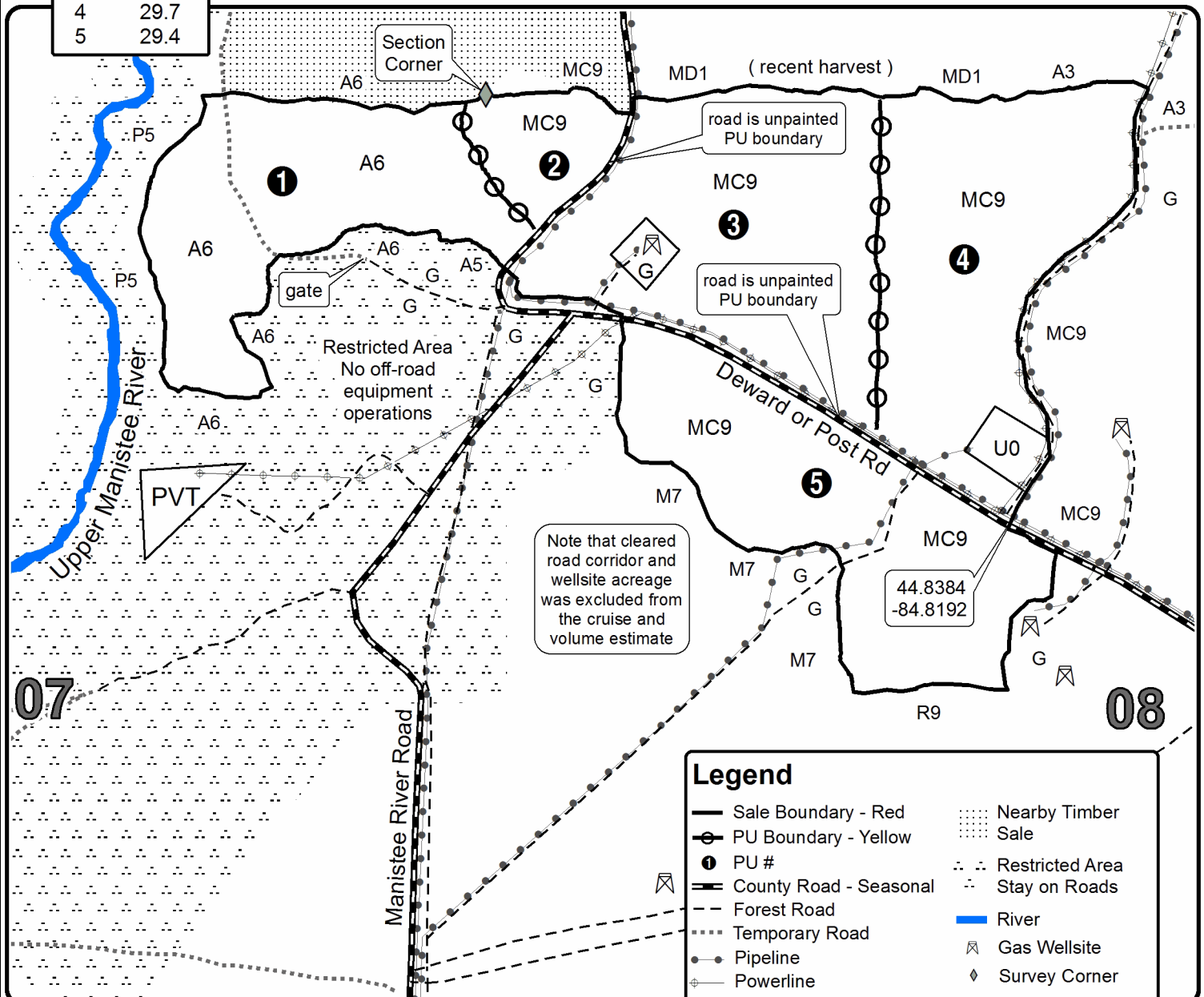

Legend	
	Sale Boundary - Red
	PU Boundary - Yellow
	PU #
	County Road - Seasonal
	Forest Road
	Temporary Road
	Pipeline
	Powerline
	Nearby Timber Sale
	Restricted Area Stay on Roads
	River
	Gas Wellsite
	Survey Corner

TIMBER SALE INFORMATION

West 167 Oak (72-027-22)

T27N, R04W, SEC. 26; T27N, R04W, SEC. 27; T27N, R04W, SEC. 34.
Crawford County (Advertised Price \$111,205.70)

SALE NOTE: The oak was heavily defoliated in spring of 2022. Dormant harvest was specified in order to give the stressed, aging oak its best shot at sprouting vigorously. The most direct access will require keying through the Sand Hill Road gate off Pollack Bridge Road. Alternate access could be established to the southwest by re-opening a berm on the Williams Tract fenceline.

A timber sale contract for this lump sum, sealed bid timber sale will be awarded to the responsible bidder offering the highest sealed bid price. All units of volume listed below were estimated using the Inventory Manager computer program and the new Michigan taper model. Bids must be at or above the following advertised price for each product and species:

<u>PRODUCTS & SPECIES</u>	<u>ESTIMATED UNITS*</u>	<u>ADVERTISED PRICE</u>
Sawtimber		
Red Maple	3.4 MBF	\$ 93.00 / MBF
Red Oak	412.1 MBF	\$ 134.00 / MBF
White Oak	64.7 MBF	\$ 85.00 / MBF
Pulpwood		
B. T. Aspen	120 Cords	\$ 26.05 / Cord
Jack Pine	9 Cords	\$ 19.80 / Cord
Misc. Species 1	204 Cords	\$ 6.50 / Cord
Mixed Oak	1,307 Cords	\$ 27.05 / Cord
Red Maple	353 Cords	\$ 28.85 / Cord

* The total volume is statistically estimated within plus (+) or minus (-) 9.04 percent. There are an estimated 3,177 cords on this timber sale, plus or minus 287 cords at the 95% confidence level. The estimated units are final and not subject to adjustment. Prospective bidders are urged to examine this timber and to make their own estimates of quantity and quality.

BOND AND PAYMENT SCHEDULE:

1. A bond in the amount of \$5,560.00 to insure faithful performance of the conditions of the contract will be deposited by the successful bidder within 21 days of the sale award.
2. Cutting in any sale or unit without the required advance payment would be considered a trespass.
3. Total payment must be paid in advance or according to the following schedule :
 - (a) Ten percent (10%) of the sale value must be paid within 21 days of the sale award.
 - (b) The 10% down payment will be credited towards the first unit cut.
 - (c) Payment for each of the following units must be made before cutting begins in that unit:

PAYMENT UNIT NUMBER	PERCENT OF TOTAL SALE VALUE
01	25.7%
02	25.8%
03	25.7%
04	22.8%
4. If no cutting takes place, the 10% down payment will not be refunded.
5. Operations on the contract issued will terminate on 06/30/2025.

SALE STATISTICS

Volumes were calculated in cubic feet using the Michigan taper model. Cubic foot volume includes all wood inside bark for the product indicated. For display purposes, cubic feet were converted to cords and MBF using a simple conversion factor, e.g. 79 cubic feet per cord and 185 cubic feet per MBF. The cubic foot volumes are precise; the cords and MBF volumes are not. Cubic foot volume cannot be directly converted to cords or boards with precision.

SALE VOLUMES

The total estimated sale volume may not equal the sum of the species/products due to the nature of statistical calculations associated with double sampling methodology.

VOLUME		STATISTICAL RANGE IN CORDS		
TOTAL CUBIC FEET	TOTAL CORDS	PERCENT ERROR	MINIMUM	MAXIMUM
251,001	3,177	9.04%	2,890	3,465

VDU VOLUMES

A VDU is a Volume Determination Unit. Volumes and their associated statistics are calculated at the VDU level and summarized to the sale level. There is often a one to one relationship between a VDU and a Payment Unit, but not always, depending on the cruise design. Refer to the VDU TO PAYMENT UNIT table.

VDU	VOLUME		PERCENT ERROR	RANGE IN CORDS	
	TOTAL CUBIC FEET	TOTAL CORDS		MINIMUM	MAXIMUM
1	133,232	1,686	13.01%	1,467	1,906
10	117,769	1,491	13.33%	1,292	1,689
TOTAL:	251,001	3,177		2,759	3,595

VDU TO PAYMENT UNIT

When a VDU is associated with more than one Payment Unit (PU), the VDU volumes are assigned to the PU based on acres of the VDU within the PU.

VDU	VDU ACRES	PU	PU ACRES
1	54.3	1	27.1
		2	27.2
10	46.4	3	24.6
		4	21.8
TOTAL:	100.7		100.7

DESCRIPTION OF TIMBER BY PAYMENT UNIT (PU)

PU	MARKET GROUP	PRODUCT	QUANTITY	UNIT	ACRES	ADVERTISE PRICE
1	Red Maple	Sawtimber	0.7	MBF	27.1	\$28,568.75
	Red Oak		104.0	MBF		
	White Oak		16.5	MBF		
	B. T. Aspen	Pulpwood	26	Cords		
	Jack Pine		4	Cords		
	Misc. Species 1		63	Cords		
	Mixed Oak		370	Cords		
	<i>Northern Pin Oak</i>		3	<i>Cords</i>		
	<i>Red Oak</i>		243	<i>Cords</i>		
	<i>White Oak</i>		124	<i>Cords</i>		
	Red Maple		69	Cords		
2	Red Maple	Sawtimber	0.8	MBF	27.2	\$28,722.35
	Red Oak		104.4	MBF		
	White Oak		16.6	MBF		
	B. T. Aspen	Pulpwood	26	Cords		
	Jack Pine		5	Cords		
	Misc. Species 1		64	Cords		
	Mixed Oak		371	Cords		
	<i>Northern Pin Oak</i>		3	<i>Cords</i>		
	<i>Red Oak</i>		244	<i>Cords</i>		
	<i>White Oak</i>		124	<i>Cords</i>		
	Red Maple		70	Cords		
3	Red Maple	Sawtimber	1.0	MBF	24.6	\$28,572.35
	Red Oak		108.0	MBF		
	White Oak		16.8	MBF		
	B. T. Aspen	Pulpwood	36	Cords		
	Misc. Species 1		41	Cords		
	Mixed Oak		300	Cords		
	<i>Red Oak</i>		171	<i>Cords</i>		
	<i>White Oak</i>		129	<i>Cords</i>		
	Red Maple		113	Cords		
4	Red Maple	Sawtimber	0.9	MBF	21.8	\$25,342.25
	Red Oak		95.7	MBF		
	White Oak		14.8	MBF		
	B. T. Aspen	Pulpwood	32	Cords		
	Misc. Species 1		36	Cords		
	Mixed Oak		266	Cords		
	<i>Red Oak</i>		151	<i>Cords</i>		
	<i>White Oak</i>		115	<i>Cords</i>		
	Red Maple		101	Cords		
TOTAL:			480.2	MBF		
TOTAL:			1,993	Cords		

Sale Specific Conditions & Requirements

Sale Name: West 167 Oak

Sale Number: 72-027-22 Seq#: 2

1 - Sale Area

1.2 - Boundaries

1.2.1 - Painted boundaries (9/19)

The sale boundary and Payment Unit boundaries are marked and identified by blue, red and yellow paint. Exterior sale boundary lines against private property are marked with blue paint. Exterior sale boundary lines against state are marked with red paint. Interior Payment Unit boundaries are marked with yellow paint. The painted boundary line trees are not Included Timber and are to be protected. Yellow painted trees designating an Interior Payment Unit boundary are only to be cut when all surrounding Payment Units have been paid. Disregard the faded red paint remnants from past adjacent harvests.

2 - Timber Specifications

2.1 - Included Timber

2.1.1 - Clearcut unit(s) with unmerchantable trees (6/14)

Within Payment Unit(s) 1-4, cut all trees that are two (2) inches or more at DBH except oak saplings and all red pine and white pine. In addition, cut all dead standing oak that is retaining at least 25% of its bark or is in a clump with live oak stems. Disregard the faded green paint remnants from past harvests.

2.1.11 - Description of timber note (2/04)

Note that miscellaneous species 1 is dead standing oak as described in 2.1.1. Note also that all aspen & jack pine were cruised as pulp.

2.2 - Utilization

2.2.3 - Stump heights (4/07)

Stump heights within the Sale Area shall not exceed 12 inches for all trees. Taller stumps may be allowed by the sale administrator on the steeper hills.

3 - Payments

3.3 - Pre-measured Sales

3.3.4 - Dividing payment units (7/14)

Payment Unit(s) may be divided at the request of the Purchaser and upon approval of the Unit Manager. Dividing Payment Units is a contract modification which requires a Timber Sale Contract Amendment. There will be only one division per Payment Unit.

3.4 - Damaged Timber

3.4.1 - Damaged timber (7/16)

General Condition and Requirement 3.4 Damaged Timber, defines liquidated damages for undesignated live merchantable trees which are cut or injured. In addition, reasonable care should be taken to avoid damage to tree seedlings and saplings.

Within the sale area, if more than 20% of the oak and pine seedlings or saplings (1/4" to 4.5" DBH) within a specified portion of the sale area are damaged, liquidated damages will be assessed at \$300 per acre for all acreage within that specified portion of the sale area that was damaged. Operational paths that are cleanly cut through regen will not be considered damaged areas.

4 - Transportation

4.1 - Construction

4.1.6 - Road construction (1/09)

Construction of new roads and landings or improvements of existing roads shall be done in such a way as to minimize the environmental and visual impacts. Merchantable trees shall be cut and utilized unless otherwise directed. Non-merchantable

trees shall be severed and laid flat on the ground. Slash shall be chipped, utilized or scattered back into the sale area, not left in piles or windrows, and be kept a minimum of 10 feet back from the road edge. Stumps shall be set upright, not left on edge, and be moved at least 10 feet away from the road edge. Disturbed soil shall be feathered into the woods and not left in berms or windrows.

4.1.7 - Road closure (10/11)

All new roads built into the sale must be blocked to vehicle traffic upon completion of the sale. Overgrown roads that are reopened shall be considered new roads. In general, closure will require constructing a four (4') foot high berm of stumps and logs covered with dirt. Stumps and brush may also need to be placed along part of the road behind the berm. Contact the sale administrator for specific details of design and placement.

4.1.11 - Permits (2/12)

The Purchaser will secure any necessary permits that may be required.

4.4 - Access

4.4.3 - Access gate (12/08)

The Sand Hill Road access gate must be locked at all times unless otherwise approved by the Unit Manager or his/her representative. This is to prevent someone other than the Purchaser from going through the gate and being locked in.

5 - Operations

5.1 - Notification

5.1.1 - Pre-sale conference (10/16)

A pre-sale conference on site between the Purchaser and sale administrator is required prior to beginning any operations to determine landing and road locations. The Unit Manager or his/her representative must be contacted at least 5 days in advance to schedule the conference. Bring a padlock to the pre-sale conference in order to daisy-chain it onto the access gate's DNR padlock.

5.1.4 - Post-sale conference (10/16)

A post-sale conference on site between the Purchaser and sale administrator is required prior to the completion of active logging operations to determine clean-up and repair of landings, road edges, and the fulfillment of other contract specifications.

5.2 - Conduct of Operations

5.2.3 - Operating Restrictions

5.2.3.5 - Oak wilt restriction (1/18)

Within Payment Units 1-4, unless changed by written agreement, cutting, skidding, hauling within the sale and brushing of access roads to the sale are not permitted during the period of April 15 to July 15. Operations may be allowed if specific steps are taken to prevent damaging uncut oak during the high risk period. Those steps may include completing all road brushing before April 15th and clearing a tree-length buffer along uncut oak cover before April 15th. This is necessary to reduce the spread of oak wilt. For more information, contact the Unit Manager or his/her representative.

5.2.3.11 - Coppice regeneration protection (4/10)

To promote oak regeneration, harvesting is limited to October 15th through May 15th. Timber harvesting in any Payment Unit must be completed before significant sprouting occurs in that Payment Unit so as to minimize damage to the new regeneration. Any post harvest operations, such as chipping, must be completed before sprouting of regeneration occurs. If it is anticipated that chipping will be delayed, then tops shall be carried to one central location or left unchipped. The Unit Manager or his/her representative may cease such operations if sprouting occurs before the operation is complete.

5.2.38 - No decking against live trees (2/04)

Cut products may not be decked against unmarked or designated leave trees.

5.4 - Soil Protection

5.4.1 - Rutting restriction, general (7/16)

Operations are to cease immediately if equipment and weather conditions result in rutting of roads and/or skid trails which is 12 inches or greater in depth and 50 feet in length. The Unit Manager or his/her representative may restrict hauling and/or skidding if ruts exceed the specified depth. With the Unit Manager or his/her representative's approval, the Purchaser may

return to the area when the risk of rutting has decreased.

5.4.2 - Skid trails (2/04)

Skid trails up and down slopes should be avoided. If however this is unavoidable, these trails will be left in a non-erodible condition using water bars, logs, and slash. Placing of slash on these skid trails while logging is ongoing may alleviate need for any further action. At the direction of the sale administrator, seed, fertilizer, and mulch may also be required.

5.5 - Protection of Improvements

5.5.3 - Protection of improvements detail (10/13)

Note that there is no obligation to protect the old fence that runs along the south edge of Payment Units 3 & 4 and within the west edge of Payment Unit 3. That fencing was installed when the land was privately-owned. Embedded wire may be encountered along the fence lines. High stumps can be left on trees with ingrown wire.

6 - Safety and Fire Prevention

6.2 - Signing

6.2.1 - Road posting (10/20)

The Purchaser is responsible for posting and maintaining caution signs on Sand Hill Road prior to beginning operations. The road must be posted at appropriate distances from the sale area to warn of logging activity and truck traffic. Signs must be removed when harvest operations are suspended or completed. The Purchaser will provide these signs.

7 - Other Conditions

7.5 - Loss

7.5.1 - Deteriorating timber (7/09)

The sale area has received damage from spongy moth defoliation in spring of 2022 that removed nearly 100% of the oak canopy. The oak was only partially re-leafed by late summer. The Purchaser should harvest the wood as soon as possible. The Department of Natural Resources is held free of responsibility of any further damage or deterioration due to delay in harvesting.



TIMBER SALE MAP

This information provided by authority of Part 525, 1994 PA 451, as amended.

Forest Management Unit Grayling	County Crawford	Mapped By Charlebois	Date 09/25/2022	Page 1	of 1
Township 27N	Range 4W	Section(s) and Subdivision(s) Sec 26: SWNW, NWSW Sec 27: E1/2	Scale 1:15,840		

Cover Type

A = Aspen	H = Hemlock	N = Marsh	U = Upland Brush
B = Paper Birch	J = Jack Pine	O = Oak	UM = Upland Mixed
C = Cedar	L = Lowland Brush	P = Lowland Poplar	V = Bog or Marsh
D = Treed Bog	LM = Lowland Mixed	Q = Mixed Swamp Conifer	W = White Pine
E = Swamp Hdwoods	M = Mpl, Bch, Brch	R = Red Pine	X = Non Stocked
F = Spruce Fir	MC = Mixed Conifer	S = Black Spruce	Z = Water

Density

0 = Non Stocked	5 = Pole Timber Medium
1 = Seedling Sapling Poor	6 = Pole Timber Well
2 = Seedling Sapling Medium	7 = Saw Timber Poor
3 = Seedling Sapling Well	8 = Saw Timber Medium
4 = Pole Timber Poor	9 = Saw Timber Well

PU	Acres
1	27.1
2	27.2
3	24.6
4	21.8

West 167 Oak
Compartment 167
100.7 Acres

Legend

- Sale Boundary - Red
- Sale Boundary - Blue
- PU Boundary - Yellow
- PU #
- County Road - Paved
- County Road - Seasonal
- Forest Road
- Temporary Access Road
- Private Road
- Powerline
- Nearby Timber Sale
- River
- Survey Corner

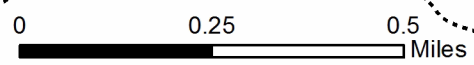
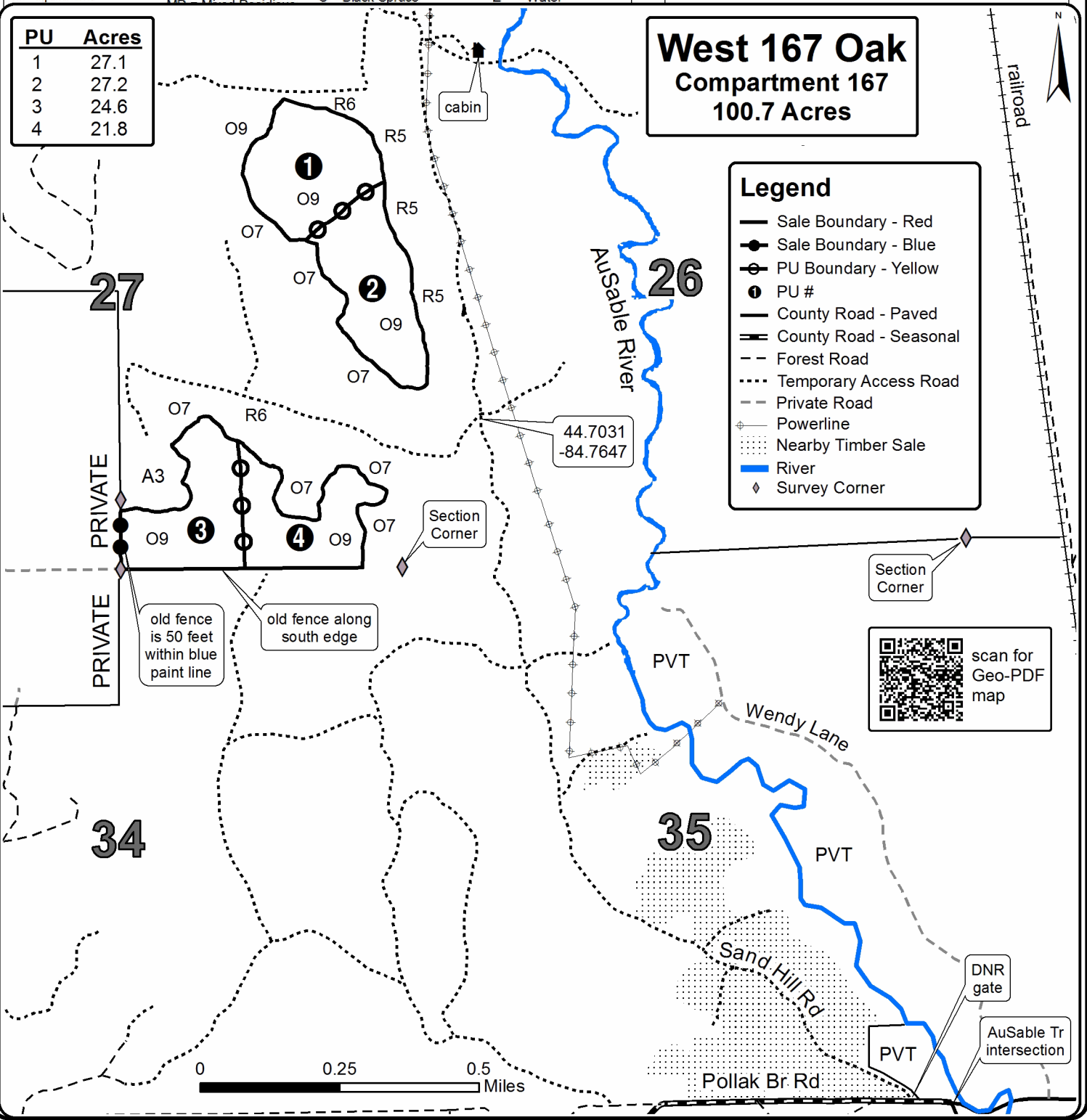

TIMBER SALE INFORMATION

White & 612 Pine (72-622-19)
 T28N, R03W, SEC. 26.
 Crawford County (Advertised Price \$5,913.75)

SALE NOTE: This harvest involves thinning a planted windbreak along White Road and CR 612, and clearcutting scotch pine that has been invading the area around the Military Medivac Landing Zone (LZ Charlie). Chipping is required to reduce the scotch pine seed source.

A recreation site such as a trail, pathway, or campground is within the sale area or the vicinity. Certain restrictions/specifications may be applicable including time restrictions.

A timber sale contract for this lump sum, sealed bid timber sale will be awarded to the responsible bidder offering the highest sealed bid price. All units of volume listed below were estimated using the T-Sale computer program and our traditional volume equations. Bids must be at or above the following advertised price for each product and species:

<u>PRODUCTS & SPECIES</u>	<u>ESTIMATED UNITS*</u>	<u>ADVERTISED PRICE</u>
Sawtimber		
Red Pine	25.0 MBF	\$ 73.00 / MBF
Pulpwood		
Jack Pine	4 Cords	\$ 12.20 / Cord
Mixed Aspen	35 Cords	\$ 16.05 / Cord
Red Pine	36 Cords	\$ 23.85 / Cord
Scotch Pine	280 Cords	\$ 9.00 / Cord
Sugar Maple	3 Cords	\$ 17.75 / Cord
White Pine	3 Cords	\$ 15.45 / Cord

* The total volume is statistically estimated within plus (+) or minus (-) 22.06 percent. There are an estimated 412 cords on this timber sale, plus or minus 91 cords at the 95% confidence level. The estimated units are final and not subject to adjustment. Prospective bidders are urged to examine this timber and to make their own estimates of quantity and quality.

BOND AND PAYMENT SCHEDULE:

- A bond in the amount of \$1,000.00 to insure faithful performance of the conditions of the contract will be deposited by the successful bidder within 21 days of the sale award.
- Cutting in any sale or unit without the required advance payment would be considered a trespass.
- Total payment must be paid in advance or according to the following schedule :
 - Ten percent (10%) of the sale value must be paid within 21 days of the sale award.
 - The 10% down payment will be credited towards the first unit cut.
 - Payment for each of the following units must be made before cutting begins in that unit:

PAYMENT UNIT NUMBER	PERCENT OF TOTAL SALE VALUE
01	71.3%
02	28.7%
- If no cutting takes place, the 10% down payment will not be refunded.
- Operations on the contract issued will terminate on 06/30/2025.

SALE STATISTICS

SALE VOLUMES

VOLUME		STATISTICAL RANGE IN CORDS		
TOTAL CUBIC FEET	TOTAL CORDS	PERCENT ERROR	MINIMUM	MAXIMUM
32,513	412	22.06%	321	502

VDU VOLUMES

A VDU is a Volume Determination Unit. Volumes and their associated statistics are calculated at the VDU level and summarized to the sale level. There is often a one to one relationship between a VDU and a Payment Unit, but not always, depending on the cruise design. Refer to the VDU TO PAYMENT UNIT table.

VDU	VOLUME		PERCENT ERROR	RANGE IN CORDS	
	TOTAL CUBIC FEET	TOTAL CORDS		MINIMUM	MAXIMUM
39	0	0	20.92%	0	0
45	0	0	45.40%	0	0
TOTAL:	0	0		0	0

VDU TO PAYMENT UNIT

When a VDU is associated with more than one Payment Unit (PU), the VDU volumes are assigned to the PU based on acres of the VDU within the PU.

VDU	VDU ACRES	PU	PU ACRES
39	9.0	1	9.0
45	34.5	2	34.5
TOTAL:	43.5		43.5

DESCRIPTION OF TIMBER BY PAYMENT UNIT (PU)

PU	MARKET GROUP	PRODUCT	QUANTITY	UNIT	ACRES	ADVERTISE PRICE
1	Red Pine	Sawtimber	25.0	MBF	9.0	\$4,215.80
	Jack Pine	Pulpwood	4	Cords		
	Mixed Aspen		6	Cords		
	<i>B. T. Aspen</i>	<i>Sawtimber</i>	<i>0.4</i>	<i>MBF</i>		
	<i>B. T. Aspen</i>	<i>Pulpwood</i>	<i>2</i>	<i>Cords</i>		
	<i>Quaking Aspen</i>		<i>3</i>	<i>Cords</i>		
	Red Pine		36	Cords		
	Scotch Pine		147	Cords		
	<i>Scotch Pine</i>	<i>Sawtimber</i>	<i>7.5</i>	<i>MBF</i>		
	<i>Scotch Pine</i>	<i>Pulpwood</i>	<i>132</i>	<i>Cords</i>		
	Sugar Maple		1	Cords		
	White Pine		3	Cords		
2	Mixed Aspen	Pulpwood	29	Cords	34.5	\$1,697.95
	<i>Quaking Aspen</i>	<i>Sawtimber</i>	<i>0.7</i>	<i>MBF</i>		
	<i>B. T. Aspen</i>	<i>Pulpwood</i>	<i>16</i>	<i>Cords</i>		
	<i>Quaking Aspen</i>		<i>12</i>	<i>Cords</i>		
	Scotch Pine		133	Cords		
	<i>Scotch Pine</i>	<i>Sawtimber</i>	<i>7.7</i>	<i>MBF</i>		
	<i>Scotch Pine</i>	<i>Pulpwood</i>	<i>118</i>	<i>Cords</i>		
Sugar Maple		2	Cords			
TOTAL:			25.0	MBF		
TOTAL:			361	Cords		

Sale Specific Conditions & Requirements

Sale Name: White & 612 Pine

Sale Number: 72-622-19 Seq#: 2

1 - Sale Area

1.2 - Boundaries

1.2.1 - Painted boundaries (1/14)

The sale boundary is marked and identified by red paint, with designated unpainted Payment Unit boundaries. Exterior sale boundary lines against state are marked with red paint. Interior Payment Unit boundaries are unpainted and designated as the covertype lines shown on the timbersale map. Payment Unit 1 is the planted pine windbreak along White Road and County Road 612. Payment Unit 2 is naturally-established scotch pine with patches of aspen. LZ Charlie is a maintained opening that is not part of either Payment Unit. The painted boundary line trees are not Included Timber and are to be protected except cut all scotch pine, jack pine and aspen boundary trees once the interior edge has been cut.

2 - Timber Specifications

2.1 - Included Timber

2.1.1 - Clearcut unit(s) with unmerchantable trees (6/14)

Within Payment Unit(s) 2, cut all scotch pine, jack pine and aspen trees that are two (2) inches or more at DBH, including dead trees of those species. Also cut all maple trees that are less than 10 inches at DBH.

2.1.3 - Cut tree marked unit(s) (12/08)

Within Payment Unit(s) 1, all trees are designated for cutting when marked with orange paint above and below stump height, regardless of merchantability. In addition, cut all scotch pine, jack pine and aspen trees that are two inches or more at DBH, including dead trees of those species.

2.2 - Utilization

2.2.2 - Chipping required (2/18)

This area must be chip harvested to meet National Guard requirements. The Purchaser has the option to produce sawlogs or pulpwood bolts, but the remaining portion of the trees must be chipped and hauled. The requirement to retain approximately 1/6 to 1/3 of tree tops and limbs less than four inches in diameter does not apply (G. C. & R. 2.2) because the area is used for Military training.

2.2.3 - Stump heights (4/07)

Stump heights within the Sale Area shall not exceed 6 inches for all trees. This is in order to facilitate military requirements.

3 - Payments

3.4 - Damaged Timber

3.4.1 - Damaged timber (7/16)

General Condition and Requirement 3.4 Damaged Timber, defines liquidated damages for undesignated live merchantable trees which are cut or injured. No damage is acceptable to undesignated live merchantable trees. Within the sale area, if more than 10% of trees (> 4.5" DBH) within a specified area of the sale are damaged, liquidated damages will be assessed for all trees damaged. Rates will be in accordance with General Condition and Requirement 3.4 Damaged Timber.

3.4.2 - Special Protection Trees (4/14)

The Purchaser shall not cut live or dead special protection trees within cutting units or clearings. Special protection trees are the black walnut and American elm trees. If the Purchaser's operations have cut or damaged special protection trees through carelessness, the Purchaser shall pay \$500 as fixed, agreed and liquidated damages for each special protection tree cut or damaged. Such payment does not constitute ownership of the undesignated timber.

4 - Transportation

4.1 - Construction

4.1.6 - Road construction (1/09)

Construction of new roads or improvements of existing roads shall be done in such a way as to minimize the environmental

and visual impacts. Merchantable trees shall be cut and utilized unless otherwise directed. Non-merchantable trees shall be severed and laid flat on the ground. Slash shall be chipped, utilized or otherwise removed from the sale. Stumps shall be set upright, not left on edge, and be moved at least 10 feet away from the road edge. Disturbed soil shall be feathered into the woods and not left in berms or windrows.

4.1.7 - Road closure (10/11)

All new roads built into the sale must be blocked to vehicle traffic upon completion of the sale. Overgrown roads that are reopened shall be considered new roads. In general, this will require constructing a four (4') foot high berm of stumps and logs covered with earth. Contact the sale administrator for specific details of design and placement.

4.1.11 - Permits (2/12)

The Purchaser will secure any necessary highway permits that may be required.

5 - Operations

5.1 - Notification

5.1.1 - Pre-sale conference (10/16)

A pre-sale conference on site between the Purchaser and sale administrator is required prior to beginning any operations to determine landing and road locations. The Unit Manager or his/her representative must be contacted at least 5 days in advance to schedule the conference.

5.1.4 - Post-sale conference (10/16)

A post-sale conference on site between the Purchaser and sale administrator is required prior to the completion of active logging operations to determine clean-up and repair of landings, road edges, and the fulfillment of other contract specifications.

5.1.5 - National Guard notification (2/15)

This sale is upon lands utilized for training by the Michigan National Guard - Camp Grayling. A minimum of five (5) business days prior to opening this sale, the producer must request that the sale administrator contact the military for information regarding training plans that may impact sale operations.

5.2 - Conduct of Operations

5.2.1 - Slash

5.2.1.10 - No slash in openings (5/10)

No brush or logging debris is to be left in the maintained wildlife opening which is indicated as "Medivac LZ Charlie" on the Timber Sale Map. The opening is used as a helicopter landing zone and bivouac area during Military training. Any damage to the opening shall be repaired according to specifications of the Unit Manager or his/her representative.

5.2.3 - Operating Restrictions

5.2.3.3 - Bark slippage restriction (3/09)

Within Payment Unit(s) 1, unless changed by written agreement, cutting and skidding are not permitted during the period of April 15 to July 15. This restriction is because of bark slippage.

5.2.3.7 - National Guard training restriction (1/09)

Operations on this contract will not be allowed during National Guard training operations. Typically, the restricted period is from May 1 to October 31. The contractor must check with the Unit Manager who will coordinate the cutting schedule with the Military. Harvest equipment and timber products may need to be removed from the sale area during the period of May 1 to October 31.

5.2.29 - Shrub protection (9/07)

Do not cut or damage apple trees, hawthorn, cherry, or juneberry. These woody-shrub plants are highly beneficial to various wildlife species.

5.2.32 - Decking/landing restoration (9/13)

All decking and landing areas must have the surface area restored to a condition equal to or better than before. This is to ensure the proper regeneration of the stand. Slash and wood chips must be removed or spread out across landing areas and may not be windrowed on the edge.

5.2.37 - No decking areas (12/08)

No decking is allowed within the maintained opening shown as "Medivac LZ Charlie" on the timbersale map without permission of the Unit Manager or his/her representative.

5.2.38 - No decking against live trees (2/04)

Cut products may not be decked against unmarked or designated leave trees.

5.4 - Soil Protection

5.4.1 - Rutting restriction, general (7/16)

Operations are to cease immediately if equipment and weather conditions result in rutting of roads and/or skid trails which is 12 inches or greater in depth and 50 feet in length. The Unit Manager or his/her representative may restrict hauling and/or skidding if ruts exceed the specified depth. With the Unit Manager or his/her representative's approval, the Purchaser may return to the area when the risk of rutting has decreased.

5.5 - Protection of Improvements

5.5.3 - Protection of improvements detail (10/13)

The following are specific protection measures for this sale. Protect the concrete parking pad on the edge of Payment Unit 1 adjacent to LZ Charlie.

7 - Other Conditions

7.10 - Certified Timber

7.10.1 - Non-certified timber (2/16)

The area encompassed by this timber sale is not certified to the standards of the Forest Stewardship Council (FSC) or the Sustainable Forestry Initiative (SFI). Forest products from this sale may not be delivered to the mill as "FSC and / or SFI certified". The lands within this sale are managed for Military training.

8 - Performance and Settlement

8.3 - Uncompleted or Terminated Contracts

8.3.1 - Completion of contract, chipping (1/16)

In addition to cutting, all chipping must be completed by the contract expiration date. If chipping has not been completed, an extension fee or damages may be charged per General Condition & Requirement 7.2 and 8.3.



TIMBER SALE MAP

This information provided by authority of Part 525, 1994 PA 451, as amended.

Forest Management Unit Grayling	County Crawford	Mapped By Charlebois	Date 08/14/2019	Page 1	of 1
Township 28N	Range 3W	Section(s) and Subdivision(s) Section 26: W1/2SW, SESW	Scale 1:7,920		

Cover Type				Density	
A = Aspen	H = Hemlock	N = Marsh	U = Upland Brush	0 = Non Stocked	5 = Pole Timber Medium
B = Paper Birch	J = Jack Pine	O = Oak	UM = Upland Mixed	1 = Seedling Sapling Poor	6 = Pole Timber Well
C = Cedar	L = Lowland Brush	P = Lowland Poplar	V = Bog or Marsh	2 = Seedling Sapling Medium	7 = Saw Timber Poor
D = Treed Bog	LM = Lowland Mixed	Q = Mixed Swamp Conifer	W = White Pine	3 = Seedling Sapling Well	8 = Saw Timber Medium
E = Swamp Hdwoods	M = Mpl, Bch, Brch	R = Red Pine	X = Non Stocked	4 = Pole Timber Poor	9 = Saw Timber Well
F = Spruce Fir	MC = Mixed Conifer	S = Black Spruce	Z = Water		
G = Grass	MD = Mixed Deciduous	T = Tamarack			

PU	Acres
1	9
2	34.5

White & 612 Pine

Compartment 241

43.5 Acres

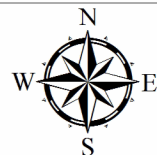

Legend

- Sale Boundary: red paint
- Payment Unit: designated unpainted covertype boundary
- 1** Payment Unit #
- Mowed Medivac Zone
- Paved Road
- Poor Dirt Road
- Compartment Boundary
- ◇ Survey Corner
- 26** Section Number
- Adjacent Residence
- Concrete Pad

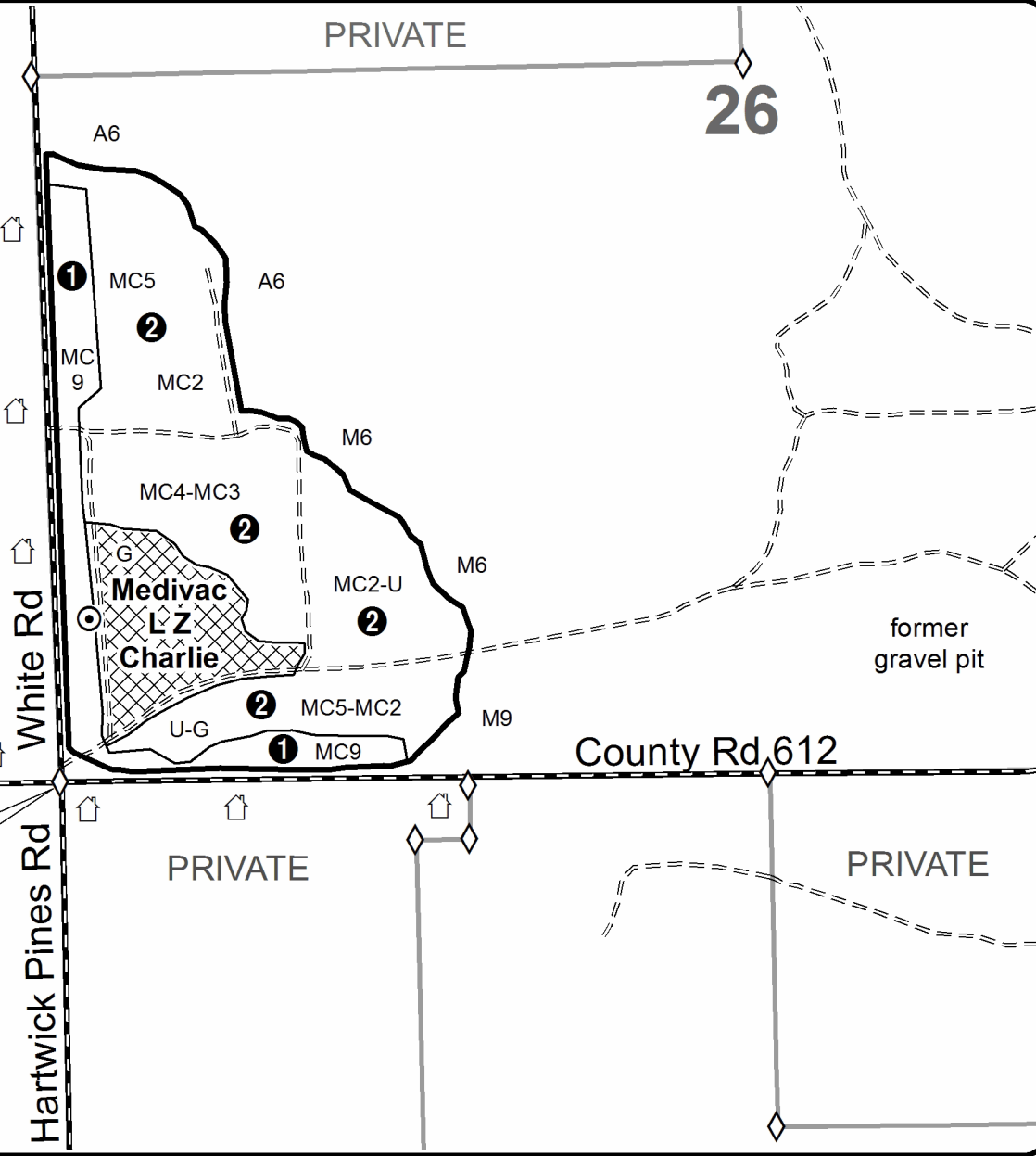

44.7854
-84.6452

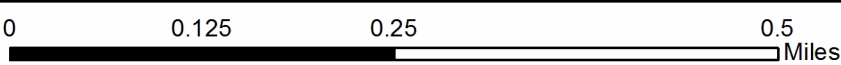

White & 612 Pine (72-622-19)
T28N, R03W, SEC. 26; Crawford COUNTY

In response to the notice of sale to be held 9:00 a.m. (local time) on April 17, 2023, I am hereby submitting my sealed bid (firm offer) for the following forest products to be cut. Bids for individual species must be at or above the advertised price. All non-responsive bid forms may be rejected.

<u>PRODUCTS & SPECIES</u>	<u>ESTIMATED VOLUME*</u>	<u>ADVERTISED PRICE</u>	<u>BID PRICE/UNIT</u>
Sawtimber			
Red Pine	25.0 MBF	\$ 73.00/MBF	\$ _____
Pulpwood			
Jack Pine	4 Cords	\$ 12.20/Cord	\$ _____
Mixed Aspen	35 Cords	\$ 16.05/Cord	\$ _____
Red Pine	36 Cords	\$ 23.85/Cord	\$ _____
Scotch Pine	280 Cords	\$ 9.00/Cord	\$ _____
Sugar Maple	3 Cords	\$ 17.75/Cord	\$ _____
White Pine	3 Cords	\$ 15.45/Cord	\$ _____

*The volumes are statistically estimated within plus (+) or minus (-) 22.06 percent at 95% confidence level. These estimated volumes are final and not subject to adjustment. Prospective bidders are urged to examine this timber and to make their own estimates of quantity and quality.

I understand that any or all bids may be rejected. All bids must be signed and all bid items must be bid or the bid form may be rejected. I also understand that consideration and awarding a contract will be based upon my past performance and ability to complete the contract based upon equipment and staffing subject to my control.

FEDERAL ID: _____ or SOCIAL SECURITY NUMBER: _____

Company or individual bidding: _____

Company representative's name: _____

Address: _____

City: _____ State: _____ Zip: _____

IF AVAILABLE, PLEASE PLACE THE PERSONALIZED LABEL FROM YOUR PROSPECTUS IN THE ABOVE BOX.

Individual or company representative's signature: _____ Date: _____

Phone number : _____ Email (optional): _____

THE WINNING BIDDER MUST COMPLETE THE VERIFICATION OF WORKER'S DISABILITY COMPENSATION ACT COMPLIANCE (ON REVERSE SIDE IF DOUBLE SIDED) WITHIN 21 DAYS OF SALE AWARD DATE



FOR DEPARTMENT USE ONLY	
Sale Number (XX - XXX - XX - XX)	
Forest Management Unit:	

TIMBER SALE VERIFICATION OF WORKER'S DISABILITY COMPENSATION ACT COMPLIANCE

As required by Act 317, P.A. 1969 (Worker's Compensation) and
Part 5 of Act 451 of 1994, as amended.

VERIFICATION OF WORKER'S DISABILITY COMPENSATION ACT COMPLIANCE

- This verification must be completed and submitted within 21 days of contract award and prior to the issuance of the timber sale contract.
- In addition, if boxes 2B or 2C are checked, then Notice of Exclusion or Certificate of Insurance must be submitted within twenty-one (21) days of the contract award and prior to the issuance of the timber sale contract.
- All information must be typed or printed except for written signatures.

Please Check Appropriate Categories:

1. My business is organized as (you **must** check one of the boxes below):
 - A. Sole Proprietorship (individual)
 - B. Partnership
 - C. Corporation
2. You **must** check one of the boxes below:
 - A. I certify my business is a sole proprietorship and it has no employees but the sole proprietor. I am not subject to the Worker's Compensation Laws.
 - B. I certify my business has satisfied its obligation to the Worker's Compensation Act through the use of an approved Notice of Exclusion (BWC-337, Rev. 5/96). I will provide a copy of the Notice of Exclusion within 21 days of the contract award. (For questions or a copy of the BWC-337, please call the Worker's Compensation Bureau at 517-322-1195).
 - C. I certify my business has a Worker's Compensation Policy. I will provide an original Certificate of Insurance within twenty-one (21) days of the contract award.
3. If you have checked item 2(A) or 2(B), you **must** indicate the number of **both** full-time and part-time employees, other than yourself, including family members and active partners (if none, you must enter "0").

_____ Full-time Employees

_____ Part-time Employees

Name of Business		Federal ID (or) Social Security No.	
Address		Telephone ()	
City	State	ZIP	

I hereby certify that the above information is true and correct. I agree to notify the Michigan DNR of any changes that occur in factors affecting my coverage during any of my present and future operations.

Signature of Owner or Authorized Representative

Title

Date

Please complete the "SEALED BID" information on the next page

Draw Down Mixed Pine (72-003-22)
T27N, R04W, SEC. 14; T27N, R04W, SEC. 22; T27N, R04W, SEC. 23; Crawford

In response to the notice of sale to be held 9:00 a.m. (local time) on April 17, 2023, I am hereby submitting my sealed bid (firm offer) for the following forest products to be cut. Bids for individual species must be at or above the advertised price. All non-responsive bid forms may be rejected.

<u>PRODUCTS & SPECIES</u>	<u>ESTIMATED VOLUME*</u>	<u>ADVERTISED PRICE</u>	<u>BID PRICE/UNIT</u>
Sawtimber			
Black/Red (Hybrid) Oak	12.8 MBF	\$ 137.00/MBF	\$ _____
Red Maple	7.0 MBF	\$ 93.00/MBF	\$ _____
Red Pine	262.8 MBF	\$ 119.00/MBF	\$ _____
White Pine	102.1 MBF	\$ 74.00/MBF	\$ _____
Pulpwood			
Jack Pine	79 Cords	\$ 19.80/Cord	\$ _____
Mixed Aspen	139 Cords	\$ 26.05/Cord	\$ _____
Mixed Hardwood	225 Cords	\$ 28.85/Cord	\$ _____
Mixed Oak	28 Cords	\$ 27.05/Cord	\$ _____
Red Pine	987 Cords	\$ 38.70/Cord	\$ _____
White Pine	250 Cords	\$ 25.10/Cord	\$ _____
White Spruce	99 Cords	\$ 20.15/Cord	\$ _____

*The volumes are statistically estimated within plus (+) or minus (-) 15.84 percent at 95% confidence level. These estimated volumes are final and not subject to adjustment. Prospective bidders are urged to examine this timber and to make their own estimates of quantity and quality.

I understand that any or all bids may be rejected. All bids must be signed and all bid items must be bid or the bid form may be rejected. I also understand that consideration and awarding a contract will be based upon my past performance and ability to complete the contract based upon equipment and staffing subject to my control.

FEDERAL ID: _____ or SOCIAL SECURITY NUMBER: _____

Company or individual bidding: _____

Company representative's name: _____

Address: _____

City: _____ State: _____ Zip: _____

IF AVAILABLE, PLEASE PLACE THE PERSONALIZED LABEL FROM YOUR PROSPECTUS IN THE ABOVE BOX.

Individual or company representative's signature: _____ Date: _____

Phone number : _____ Email (optional): _____

THE WINNING BIDDER MUST COMPLETE THE VERIFICATION OF WORKER'S DISABILITY COMPENSATION ACT COMPLIANCE (ON REVERSE SIDE IF DOUBLE SIDED) WITHIN 21 DAYS OF SALE AWARD DATE



FOR DEPARTMENT USE ONLY
Sale Number (XX - XXX - XX - XX)
Forest Management Unit:

TIMBER SALE VERIFICATION OF WORKER'S DISABILITY COMPENSATION ACT COMPLIANCE

*As required by Act 317, P.A. 1969 (Worker's Compensation) and
Part 5 of Act 451 of 1994, as amended.*

VERIFICATION OF WORKER'S DISABILITY COMPENSATION ACT COMPLIANCE

- This verification must be completed and submitted within 21 days of contract award and prior to the issuance of the timber sale contract.
- In addition, if boxes 2B or 2C are checked, then Notice of Exclusion or Certificate of Insurance must be submitted within twenty-one (21) days of the contract award and prior to the issuance of the timber sale contract.
- All information must be typed or printed except for written signatures.

Please Check Appropriate Categories:

1. My business is organized as (you **must** check one of the boxes below):
 - A. Sole Proprietorship (individual)
 - B. Partnership
 - C. Corporation
2. You **must** check one of the boxes below:
 - A. I certify my business is a sole proprietorship and it has no employees but the sole proprietor. I am not subject to the Worker's Compensation Laws.
 - B. I certify my business has satisfied its obligation to the Worker's Compensation Act through the use of an approved Notice of Exclusion (BWC-337, Rev. 5/96). I will provide a copy of the Notice of Exclusion within 21 days of the contract award. (For questions or a copy of the BWC-337, please call the Worker's Compensation Bureau at 517-322-1195).
 - C. I certify my business has a Worker's Compensation Policy. I will provide an original Certificate of Insurance within twenty-one (21) days of the contract award.
3. If you have checked item 2(A) or 2(B), you **must** indicate the number of **both** full-time and part-time employees, other than yourself, including family members and active partners (if none, you must enter "0").

_____ Full-time Employees

_____ Part-time Employees

Name of Business		Federal ID (or) Social Security No.	
Address		Telephone ()	
City	State	ZIP	

I hereby certify that the above information is true and correct. I agree to notify the Michigan DNR of any changes that occur in factors affecting my coverage during any of my present and future operations.

Signature of Owner or Authorized Representative

Title

Date

Please complete the "SEALED BID" information on the next page

West 167 Oak (72-027-22)
T27N, R04W, SEC. 26; T27N, R04W, SEC. 27; T27N, R04W, SEC. 34; Crawford

In response to the notice of sale to be held 9:00 a.m. (local time) on April 17, 2023, I am hereby submitting my sealed bid (firm offer) for the following forest products to be cut. Bids for individual species must be at or above the advertised price. All non-responsive bid forms may be rejected.

<u>PRODUCTS & SPECIES</u>	<u>ESTIMATED VOLUME*</u>	<u>ADVERTISED PRICE</u>	<u>BID PRICE/UNIT</u>
Sawtimber			
Red Maple	3.4 MBF	\$ 93.00/MBF	\$ _____
Red Oak	412.1 MBF	\$ 134.00/MBF	\$ _____
White Oak	64.7 MBF	\$ 85.00/MBF	\$ _____
Pulpwood			
B. T. Aspen	120 Cords	\$ 26.05/Cord	\$ _____
Jack Pine	9 Cords	\$ 19.80/Cord	\$ _____
Misc. Species 1	204 Cords	\$ 6.50/Cord	\$ _____
Mixed Oak	1,307 Cords	\$ 27.05/Cord	\$ _____
Red Maple	353 Cords	\$ 28.85/Cord	\$ _____

*The volumes are statistically estimated within plus (+) or minus (-) 9.04 percent at 95% confidence level. These estimated volumes are final and not subject to adjustment. Prospective bidders are urged to examine this timber and to make their own estimates of quantity and quality.

I understand that any or all bids may be rejected. All bids must be signed and all bid items must be bid or the bid form may be rejected. I also understand that consideration and awarding a contract will be based upon my past performance and ability to complete the contract based upon equipment and staffing subject to my control.

FEDERAL ID: ____ - ____ - ____ or SOCIAL SECURITY NUMBER: ____ - ____ - ____

Company or individual bidding: _____

Company representative's name: _____

Address: _____

City: _____ State: _____ Zip: _____

IF AVAILABLE, PLEASE PLACE THE PERSONALIZED LABEL FROM YOUR PROSPECTUS IN THE ABOVE BOX.

Individual or company representative's signature: _____ Date: _____

Phone number : _____ Email (optional): _____

THE WINNING BIDDER MUST COMPLETE THE VERIFICATION OF WORKER'S DISABILITY COMPENSATION ACT COMPLIANCE (ON REVERSE SIDE IF DOUBLE SIDED) WITHIN 21 DAYS OF SALE AWARD DATE



FOR DEPARTMENT USE ONLY	
Sale Number (XX - XXX - XX - XX)	
Forest Management Unit:	

TIMBER SALE VERIFICATION OF WORKER'S DISABILITY COMPENSATION ACT COMPLIANCE

As required by Act 317, P.A. 1969 (Worker's Compensation) and
Part 5 of Act 451 of 1994, as amended.

VERIFICATION OF WORKER'S DISABILITY COMPENSATION ACT COMPLIANCE

- This verification must be completed and submitted within 21 days of contract award and prior to the issuance of the timber sale contract.
- In addition, if boxes 2B or 2C are checked, then Notice of Exclusion or Certificate of Insurance must be submitted within twenty-one (21) days of the contract award and prior to the issuance of the timber sale contract.
- All information must be typed or printed except for written signatures.

Please Check Appropriate Categories:

1. My business is organized as (you **must** check one of the boxes below):
 - A. Sole Proprietorship (individual)
 - B. Partnership
 - C. Corporation
2. You **must** check one of the boxes below:
 - A. I certify my business is a sole proprietorship and it has no employees but the sole proprietor. I am not subject to the Worker's Compensation Laws.
 - B. I certify my business has satisfied its obligation to the Worker's Compensation Act through the use of an approved Notice of Exclusion (BWC-337, Rev. 5/96). I will provide a copy of the Notice of Exclusion within 21 days of the contract award. (For questions or a copy of the BWC-337, please call the Worker's Compensation Bureau at 517-322-1195).
 - C. I certify my business has a Worker's Compensation Policy. I will provide an original Certificate of Insurance within twenty-one (21) days of the contract award.
3. If you have checked item 2(A) or 2(B), you **must** indicate the number of **both** full-time and part-time employees, other than yourself, including family members and active partners (if none, you must enter "0").

_____ Full-time Employees

_____ Part-time Employees

Name of Business		Federal ID (or) Social Security No.	
Address		Telephone ()	
City	State	ZIP	

I hereby certify that the above information is true and correct. I agree to notify the Michigan DNR of any changes that occur in factors affecting my coverage during any of my present and future operations.

Signature of Owner or Authorized Representative

Title

Date

Please complete the "SEALED BID" information on the next page

SE Comp 167 (72-002-22)
T27N, R04W, SEC. 25; T27N, R04W, SEC. 26; Crawford COUNTY

In response to the notice of sale to be held 9:00 a.m. (local time) on April 17, 2023, I am hereby submitting my sealed bid (firm offer) for the following forest products to be cut. Bids for individual species must be at or above the advertised price. All non-responsive bid forms may be rejected.

<u>PRODUCTS & SPECIES</u>	<u>ESTIMATED VOLUME*</u>	<u>ADVERTISED PRICE</u>	<u>BID PRICE/UNIT</u>
Sawtimber			
Red Pine	91.3 MBF	\$ 119.00/MBF	\$ _____
White Pine	17.4 MBF	\$ 74.00/MBF	\$ _____
Pulpwood			
Black Spruce	133 Cords	\$ 20.15/Cord	\$ _____
Jack Pine	205 Cords	\$ 19.80/Cord	\$ _____
Mixed Hardwood	79 Cords	\$ 28.85/Cord	\$ _____
Northern Pin Oak	14 Cords	\$ 27.05/Cord	\$ _____
Quaking Aspen	76 Cords	\$ 26.05/Cord	\$ _____
Red Pine	314 Cords	\$ 38.70/Cord	\$ _____
White Pine	195 Cords	\$ 25.10/Cord	\$ _____

*The volumes are statistically estimated within plus (+) or minus (-) 13.94 percent at 95% confidence level. These estimated volumes are final and not subject to adjustment. Prospective bidders are urged to examine this timber and to make their own estimates of quantity and quality.

I understand that any or all bids may be rejected. All bids must be signed and all bid items must be bid or the bid form may be rejected. I also understand that consideration and awarding a contract will be based upon my past performance and ability to complete the contract based upon equipment and staffing subject to my control.

FEDERAL ID: ____ - ____ - ____ or SOCIAL SECURITY NUMBER: ____ - ____ - ____

Company or individual bidding: _____

Company representative's name: _____

Address: _____

City: _____ State: _____ Zip: _____

IF AVAILABLE, PLEASE PLACE THE PERSONALIZED LABEL FROM YOUR PROSPECTUS IN THE ABOVE BOX.

Individual or company representative's signature: _____ Date: _____

Phone number : _____ Email (optional): _____

THE WINNING BIDDER MUST COMPLETE THE VERIFICATION OF WORKER'S DISABILITY COMPENSATION ACT COMPLIANCE (ON REVERSE SIDE IF DOUBLE SIDED) WITHIN 21 DAYS OF SALE AWARD DATE



FOR DEPARTMENT USE ONLY	
Sale Number (XX - XXX - XX - XX)	
Forest Management Unit:	

TIMBER SALE VERIFICATION OF WORKER'S DISABILITY COMPENSATION ACT COMPLIANCE

As required by Act 317, P.A. 1969 (Worker's Compensation) and
Part 5 of Act 451 of 1994, as amended.

VERIFICATION OF WORKER'S DISABILITY COMPENSATION ACT COMPLIANCE

- This verification must be completed and submitted within 21 days of contract award and prior to the issuance of the timber sale contract.
- In addition, if boxes 2B or 2C are checked, then Notice of Exclusion or Certificate of Insurance must be submitted within twenty-one (21) days of the contract award and prior to the issuance of the timber sale contract.
- All information must be typed or printed except for written signatures.

Please Check Appropriate Categories:

1. My business is organized as (you **must** check one of the boxes below):
 - A. Sole Proprietorship (individual)
 - B. Partnership
 - C. Corporation
2. You **must** check one of the boxes below:
 - A. I certify my business is a sole proprietorship and it has no employees but the sole proprietor. I am not subject to the Worker's Compensation Laws.
 - B. I certify my business has satisfied its obligation to the Worker's Compensation Act through the use of an approved Notice of Exclusion (BWC-337, Rev. 5/96). I will provide a copy of the Notice of Exclusion within 21 days of the contract award. (For questions or a copy of the BWC-337, please call the Worker's Compensation Bureau at 517-322-1195).
 - C. I certify my business has a Worker's Compensation Policy. I will provide an original Certificate of Insurance within twenty-one (21) days of the contract award.
3. If you have checked item 2(A) or 2(B), you **must** indicate the number of **both** full-time and part-time employees, other than yourself, including family members and active partners (if none, you must enter "0").

_____ Full-time Employees

_____ Part-time Employees

Name of Business		Federal ID (or) Social Security No.	
Address		Telephone ()	
City	State	ZIP	

I hereby certify that the above information is true and correct. I agree to notify the Michigan DNR of any changes that occur in factors affecting my coverage during any of my present and future operations.

Signature of Owner or Authorized Representative

Title

Date

Please complete the "SEALED BID" information on the next page

Deward & Manistee (72-024-22)

T28N, R04W, SEC. 5; T28N, R04W, SEC. 6; T28N, R04W, SEC. 7; T28N, R04W,

In response to the notice of sale to be held 9:00 a.m. (local time) on April 17, 2023, I am hereby submitting my sealed bid (firm offer) for the following forest products to be cut. Bids for individual species must be at or above the advertised price. All non-responsive bid forms may be rejected.

<u>PRODUCTS & SPECIES</u>	<u>ESTIMATED VOLUME*</u>	<u>ADVERTISED PRICE</u>	<u>BID PRICE/UNIT</u>
Sawtimber			
Black/Red (Hybrid) Oak	30.7 MBF	\$ 137.00/MBF	\$ _____
Red Pine	270.7 MBF	\$ 119.00/MBF	\$ _____
White Pine	40.2 MBF	\$ 74.00/MBF	\$ _____
Pulpwood			
Black/Red (Hybrid) Oak	71 Cords	\$ 27.05/Cord	\$ _____
Jack Pine	538 Cords	\$ 19.80/Cord	\$ _____
Mixed Aspen	525 Cords	\$ 26.05/Cord	\$ _____
Mixed Hardwood	135 Cords	\$ 28.85/Cord	\$ _____
Red Pine	175 Cords	\$ 38.70/Cord	\$ _____
White Pine	79 Cords	\$ 25.10/Cord	\$ _____

*The volumes are statistically estimated within plus (+) or minus (-) 13.60 percent at 95% confidence level. These estimated volumes are final and not subject to adjustment. Prospective bidders are urged to examine this timber and to make their own estimates of quantity and quality.

I understand that any or all bids may be rejected. All bids must be signed and all bid items must be bid or the bid form may be rejected. I also understand that consideration and awarding a contract will be based upon my past performance and ability to complete the contract based upon equipment and staffing subject to my control.

FEDERAL ID: ____ - ____ - ____ or SOCIAL SECURITY NUMBER: ____ - ____ - ____

Company or individual bidding: _____

Company representative's name: _____

Address: _____

City: _____ State: _____ Zip: _____

IF AVAILABLE, PLEASE PLACE THE PERSONALIZED LABEL FROM YOUR PROSPECTUS IN THE ABOVE BOX.

Individual or company representative's signature: _____ Date: _____

Phone number : _____ Email (optional): _____

THE WINNING BIDDER MUST COMPLETE THE VERIFICATION OF WORKER'S DISABILITY COMPENSATION ACT COMPLIANCE (ON REVERSE SIDE IF DOUBLE SIDED) WITHIN 21 DAYS OF SALE AWARD DATE



FOR DEPARTMENT USE ONLY	
Sale Number (XX - XXX - XX - XX)	
Forest Management Unit:	

TIMBER SALE VERIFICATION OF WORKER'S DISABILITY COMPENSATION ACT COMPLIANCE

As required by Act 317, P.A. 1969 (Worker's Compensation) and
Part 5 of Act 451 of 1994, as amended.

VERIFICATION OF WORKER'S DISABILITY COMPENSATION ACT COMPLIANCE

- This verification must be completed and submitted within 21 days of contract award and prior to the issuance of the timber sale contract.
- In addition, if boxes 2B or 2C are checked, then Notice of Exclusion or Certificate of Insurance must be submitted within twenty-one (21) days of the contract award and prior to the issuance of the timber sale contract.
- All information must be typed or printed except for written signatures.

Please Check Appropriate Categories:

1. My business is organized as (you **must** check one of the boxes below):
 - A. Sole Proprietorship (individual)
 - B. Partnership
 - C. Corporation
2. You **must** check one of the boxes below:
 - A. I certify my business is a sole proprietorship and it has no employees but the sole proprietor. I am not subject to the Worker's Compensation Laws.
 - B. I certify my business has satisfied its obligation to the Worker's Compensation Act through the use of an approved Notice of Exclusion (BWC-337, Rev. 5/96). I will provide a copy of the Notice of Exclusion within 21 days of the contract award. (For questions or a copy of the BWC-337, please call the Worker's Compensation Bureau at 517-322-1195).
 - C. I certify my business has a Worker's Compensation Policy. I will provide an original Certificate of Insurance within twenty-one (21) days of the contract award.
3. If you have checked item 2(A) or 2(B), you **must** indicate the number of **both** full-time and part-time employees, other than yourself, including family members and active partners (if none, you must enter "0").

_____ Full-time Employees

_____ Part-time Employees

Name of Business		Federal ID (or) Social Security No.	
Address		Telephone ()	
City	State	ZIP	

I hereby certify that the above information is true and correct. I agree to notify the Michigan DNR of any changes that occur in factors affecting my coverage during any of my present and future operations.

Signature of Owner or Authorized Representative

Title

Date

Please complete the "SEALED BID" information on the next page

Comp 170 HDWD (72-004-22)
T28N, R04W, SEC. 8; Crawford COUNTY

In response to the notice of sale to be held 9:00 a.m. (local time) on April 17, 2023, I am hereby submitting my sealed bid (firm offer) for the following forest products to be cut. Bids for individual species must be at or above the advertised price. All non-responsive bid forms may be rejected.

<u>PRODUCTS & SPECIES</u>	<u>ESTIMATED VOLUME*</u>	<u>ADVERTISED PRICE</u>	<u>BID PRICE/UNIT</u>
Sawtimber			
Beech	8.4 MBF	\$ 67.00/MBF	\$ _____
Red Maple	51.9 MBF	\$ 93.00/MBF	\$ _____
Red Oak	19.0 MBF	\$ 134.00/MBF	\$ _____
Sugar Maple	5.4 MBF	\$ 321.00/MBF	\$ _____
Pulpwood			
Mixed Hardwood	44 Cords	\$ 28.85/Cord	\$ _____
Quaking Aspen	22 Cords	\$ 26.05/Cord	\$ _____
Red Maple	160 Cords	\$ 28.85/Cord	\$ _____
Sugar Maple	337 Cords	\$ 28.85/Cord	\$ _____

*The volumes are statistically estimated within plus (+) or minus (-) 30.19 percent at 95% confidence level. These estimated volumes are final and not subject to adjustment. Prospective bidders are urged to examine this timber and to make their own estimates of quantity and quality.

I understand that any or all bids may be rejected. All bids must be signed and all bid items must be bid or the bid form may be rejected. I also understand that consideration and awarding a contract will be based upon my past performance and ability to complete the contract based upon equipment and staffing subject to my control.

FEDERAL ID: _____ - _____ or SOCIAL SECURITY NUMBER: _____ - _____ - _____

Company or individual bidding: _____

Company representative's name: _____

Address: _____

City: _____ State: _____ Zip: _____

IF AVAILABLE, PLEASE PLACE THE PERSONALIZED LABEL FROM YOUR PROSPECTUS IN THE ABOVE BOX.

Individual or company representative's signature: _____ Date: _____

Phone number : _____ Email (optional): _____

THE WINNING BIDDER MUST COMPLETE THE VERIFICATION OF WORKER'S DISABILITY COMPENSATION ACT COMPLIANCE (ON REVERSE SIDE IF DOUBLE SIDED) WITHIN 21 DAYS OF SALE AWARD DATE

