



**DEPARTMENT OF NATURAL RESOURCES
STATE OF MICHIGAN
TIMBER SALE PROSPECTUS #7292**

SCHEDULED SALE DATE AND TIME: 3:00 p.m. (local time) on September 20, 2023.

LOCATION: BALDWIN OFFICE, 2468 W 24TH STREET, BALDWIN, MI 49304.

PROSPECTUS NOTE: The bidder is advised to inspect the sale area and review the location, estimated volumes, operating costs and contract terms of proposed sales. Please be aware that some landowners may request 60 days or more notice for access across their land.

Notice is hereby given that bids will be received by the Unit Manager, CADILLAC MANAGEMENT UNIT, for certain timber on the following described lands:

GNA2 Zone 7 (63-801-23) / T21N, R10W, SEC. 10, S1/2SW.
T21N, R10W, SEC. 15, N1/2NW, W1/2SW.
T21N, R10W, SEC. 18, NWNW, SESW, W1/2SE.
T21N, R10W, SEC. 19, N1/2NW, SWNW, N1/2NE, SWNE.
T21N, R10W, SEC. 9, NWSE.
T21N, R11W, SEC. 1, W1/2SW.
T21N, R11W, SEC. 11, E1/2NE, NESE.
T21N, R11W, SEC. 12, NW, SWNE, S1/2SE.
T21N, R11W, SEC. 13, NE.
T21N, R11W, SEC. 2, N1/2NW, SENW, NE, N1/2SE, SESE.
T21N, R11W, SEC. 23, N1/2SE, SESE.
T21N, R11W, SEC. 23, S1/2NW, NENE, S1/2NE, N1/2SW.
T21N, R11W, SEC. 24, W1/2SW.
T22N, R10W, SEC. 34, W1/2SW.

Wexford County, Advertised Price \$420,062.50, 436.2 Acres, Red Pine, Aspen.

SALE NOTE: The area encompassed by this timber sale is not certified to the standards of the Forest Stewardship Council (FSC) or the Sustainable Forestry Initiative (SFI). Forest products from this sale may not be delivered to the mill as "FSC and / or SFI certified". The lands within this sale belong to the National Forest system and are being managed by the State as part of a Good Neighbor Authority (GNA) agreement.

A recreation site such as a trail, pathway, or campground is within the sale area or the vicinity. Certain restrictions/specifications may be applicable including time restrictions. Access may be through private or other public land.

GNA2 Gates Road (63-802-23) / T12N, R10W, SEC. 19, N1/2SE.
T12N, R10W, SEC. 20, SWNW, N1/2SW.
T12N, R10W, SEC. 21, N1/2SW.
T12N, R11W, SEC. 23, NESE.

Newaygo County, Advertised Price \$181,456.60, 99.4 Acres, Red Pine, Hardwood.

SALE NOTE: All units of volume listed for this sale were estimated using the Inventory Manager computer program and the new Michigan taper model. This is a Good Neighbor Authority (GNA) timber sale on national forest land. This timber sale was set-up and is being advertised by the Michigan DNR for the US Forest Service. The contract will be awarded and administered by the Michigan DNR. Note the additional Sale Specific Conditions & Requirements containing the acronym 'GNA'.

Access may be through other public land.

GNA2 188th Aspen (63-805-22) / T16N, R15W, SEC. 10, NWNE.

T16N, R15W, SEC. 2 , W1/2SW.

T16N, R15W, SEC. 3 , SE.

Oceana County, Advertised Price \$237,294.55, 107.6 Acres, Aspen, Hardwood.

SALE NOTE: All units of volume listed for this sale were estimated using the Inventory Manager computer program and the new Michigan taper model.

This is a Good Neighbor Authority (GNA) timber sale on national forest land. This timber sale was set-up and is being advertised by the Michigan DNR for the US Forest Service. The contract will be awarded and administered by the Michigan DNR. Note the additional Sale Specific Conditions & Requirements containing the acronym 'GNA'.

A recreation site such as a trail, pathway, or campground is within the sale area or the vicinity. Certain restrictions/specifications may be applicable including time restrictions. Access may be through other public land.

BID INSTRUCTIONS (VER. 10/10/2022):

1. Scheduled Bid Location, Date, and Time (2/11)

Bids must be received by the Unit Manager, BALDWIN OFFICE, 2468 W 24th Street, Baldwin, MI 49304, no later than 3:00 p.m. (local time) on September 20, 2023. For further information concerning this sale, contact David Flsher at 231-745-4651 extension 6946.

2. Bidder's Qualifications (10/22)

If all or part of a timber sale was prepared by a private contractor, the contractor and that contractor's company are not permitted to bid on the timber sale. A person must be 18 years of age or older to purchase timber. Permanent employees of the Department of Natural Resources or members of their immediate household may not bid. Former employees, in the permanent or seasonal class, may not bid until 3 months after the last day of active duty. Bids will not be accepted from individuals or companies appearing on the DNR/FRD No-Bid List. This list contains the names of purchasers who previously failed to execute a contract within 21-days or who have a history of poor performance.

3. Preparation of Sealed Bids (5/16)

Bid Forms may be completed online thru Michigan DNR Timber Sale Online Bidding (OLB) at www.michigan.gov/timberbidding or by completing the hardcopy Bid Form found in the Timber Sale Prospectus. Hardcopy Bid Forms shall be manually signed in ink. Registration in OLB is considered your 'signature' for all bids submitted thru that system. Bid prices must be entered for each species and product in the Bid Price column for all material subject to bidding and all fill-in blanks must be completed. If erasures or other changes appear on the hardcopy Bid Form, each erasure or change must be initialed by the person signing the bid.

4. Submission of Sealed Bids (5/16)

Bid forms may be obtained from the Unit Manager or thru OLB. Bids may be submitted hardcopy or thru OLB. All hardcopy bids must be submitted on the bid form and in an envelope clearly identified as described in this section. NOTE: Only one bid form per bid envelope. Sealed bids must be submitted to the Unit office designated in the prospectus and must be submitted at or prior to the time established in the prospectus. The envelope should show on the outside (a) the sale name or number and (b) the date and time of bid opening, as shown in the prospectus. Bids received after the time specified in the sale prospectus are late bids and will be rejected.

It is possible for a bidder to submit multiple bids on a single sale. For example, a bid may be submitted hardcopy and a bid may be submitted thru OLB. Or, two bidders from the same company could both submit bids on the same sale. If this were to happen, the State would accept all bids received and award the contract accordingly. All bidding and contractual requirements would apply to all bids received.

5. Public Opening of Sealed Bids (7/16)

If conditions permit, the sealed bids will be publicly opened and posted at the time and place set in the prospectus.

If a bidder, present at a bid opening, has submitted bids on more than one sale, that bidder may withdraw their unopened bid envelopes or announce the withdrawal of their online bid after being declared the successful bidder on one sale.

6. Award of Contract (1/11)

Award of the contract will be made to the Bidder whose bid, conforming to the prospectus, is most advantageous to the State of Michigan on the basis of total value at rates bid for the estimated quantities. The State reserves the right to reject any bid or waive any minor irregularity in bids received. A written award mailed (or otherwise furnished) to the successful Bidder shall be deemed to result in a binding contract without further action by either party.

7. Down Payment (1/11)

The Bidder to whom award is made must make a down payment within 21 days of the sale award. The amount of the down payment will be calculated as shown in the Bond and Payment Schedule of this prospectus. Only cash may be used to meet this requirement.

8. Performance Security (1/11)

As guarantee of faithful performance, a cash bond, certificate of deposit, surety bond or irrevocable letter of credit (LOC) is required within 21 days of the sale award. The amount of the performance security is shown in the Bond and

Payment Schedule of this prospectus. If an LOC or surety is used, the coverage must extend for at least 6 months beyond the contract expiration.

9. Worker's Compensation (10/22)

Purchaser shall obtain worker's compensation insurance to cover claims under Michigan's Worker's Disability Compensation Act of 1969 or similar employee benefit act of any other state applicable to an employee. Verification of Worker's Disability Compensation Act Compliance must be completed and submitted within 21 days of contract award and prior to the issuance of the timber sale contract. In addition, if applicable, Notice of Exclusion or Certificate of Insurance must also be submitted.

10. Timber Sale Contract (10/22)

Additional conditions and requirements common to all timber sales are listed on the timber sale contract (R4031) and are available on line at www.michigan.gov/timber. Contact the Unit Manager for additional information or a sample contract. Within 21 days of the date of the award letter, the bidder must sign the contract and provide the required down payment, performance security, and verification of worker's disability compensation. The down payment and performance security shall be in accordance with the provisions of the timber sale contract, in the sums stated in this prospectus. If these actions are not taken, then the Bidder, the Bidder's corporation, and the corporation's principals may not be permitted to bid on State timber sales for a period of 3 months after the first offense, 6 months after the second offense, and 1 year after the third offense. An offense will only be counted against the Bidder for 5 years. In addition, the Bidder certifies that if awarded this contract, the Bidder will complete the timber sale contract in accordance with its terms and any modifications thereof including requirements to purchase, cut, and remove the included timber by the expiration date.

Payment Unit values in the State Forest Timber Sale Contract are calculated based on the advertised value of the Payment Unit as a percentage of the total advertised value of the contract. The advertised value of each Payment Unit is given in the Description of Timber by Payment Unit table on the Timber Sale Information page. For example, if the value of Payment Unit 1 is advertised as \$1,500 and the total Timber Sale value is advertised as \$10,000, the contract price for Payment Unit 1 will be 15% of the total bid price ($\$1,500/\$10,000 * 100$).

11. Disclaimer of Estimates and Bidder's Warranty of Inspection (10/22)

Before submitting this bid, the Bidder is advised and cautioned to inspect the sale area, review the requirements of the sale contract, and take other steps as may be reasonably necessary to ascertain the location, estimated volumes, construction estimates, and operating costs of the proposed sale. Failure to do so will not relieve the Bidder from responsibility for completing the contract.

The Bidder warrants that this bid is submitted solely on the basis of the Bidder's examination and inspection of the quality and quantity of the timber offered for sale and the Bidder's opinion of the value thereof and the costs of recovery. No reliance should be placed on the State of Michigan's estimates of timber quality, quantity or costs of recovery. Bidder further acknowledges that the State of Michigan: (i) expressly disclaims any warranty of fitness of timber for any purpose; (ii) offers this timber as is without any warranty of quality (merchantability) or quantity and (iii) expressly disclaims any warranty as to the quantity or quality of timber sold.

12. Certification and Chain-of-Custody (10/22)

Unless otherwise indicated in the contract under section 7 – Other Conditions of the Sale Specific Conditions & Requirements, the area encompassed by this timber sale is certified to the standards of the Forest Stewardship Council (FSC) - Certificate #SCS-FM/COC-00090N and the Sustainable Forestry Initiative (SFI) - Certificate #NSF-SFIS-5Y031-SF5. Forest products from this sale may be delivered to the mill as "FSC 100% and / or SFI certified" as long as the contractor hauling the forest products is chain-of-custody (COC) certified or covered under a COC certificate from the destination mill. The purchaser is responsible for maintaining COC after leaving the sale area.

13. Good Neighbor Authority (GNA) Requirements (10/22)

If the name of this timber sales contains the acronym GNA, it is authorized by the Good Neighbor Authority (GNA) and covered by various agreements between the U.S. Forest Service and the State. The timber sale occurs on federal land and the following conditions apply:

GNA contracts on US Forest Service land will not be awarded to purchasers on the Federal list of excluded parties. The System for Award Management (SAM) will be checked for active excluded parties prior to award of contract. In

addition, the Bidder to whom award is made must complete an Assurance Regarding Felony Conviction or Tax Delinquent Status for Corporate Applicants (AD-3031).

14. Good Neighbor Authority (GNA) Requirements, con't (10/22)

Bidder certifies, by signing this bid form, that to the best of Bidder's knowledge that the following representations are accurate and complete.

- a. That the Bidder and its principals are not presently debarred, suspended, proposed for debarment, declared ineligible, or voluntary excluded from timber sales (covered transactions) by any Federal department or agency.
- b. That the Bidder and its principals have not within a 3-year period preceding this bid been convicted of or had a civil judgment rendered against them for commission of fraud or a criminal offense in connection with obtaining, attempting to obtain, or performing a public (Federal, State, or local) transaction or contract under a public transaction; violation of Federal or State antitrust statutes or commission of embezzlement, theft, forgery, bribery, falsification or destruction of records, making false statements, or receiving stolen property.
- c. That the Bidder and its principals are not presently indicted for or otherwise criminally or civilly charged by a governmental entity (Federal, State, or local) with commission of any of the offenses enumerated in paragraph b of this certification.
- d. That the Bidder and its principals have not within a 3-year period preceding this bid had one or more public transactions (Federal, State, or local) terminated for breach or default of a timber or forest product contract.

Bidders that cannot certify this requirement, in whole or in part, shall submit an explanation with their bid.

SHANNON LOTT, Acting
Director

TIMBER SALE INFORMATION

GNA2 Zone 7 (63-801-23)

T21N, R10W, SEC. 10; T21N, R10W, SEC. 15; T21N, R10W, SEC. 18; T21N, R10W, SEC. 19; T21N, R10W, SEC. 9; T21N, R11W, SEC. 1; T21N, R11W, SEC. 11; T21N, R11W, SEC. 12; T21N, R11W, SEC. 13; T21N, R11W, SEC. 2; T21N, R11W, SEC. 23; T21N,

SALE NOTE: The area encompassed by this timber sale is not certified to the standards of the Forest Stewardship Council (FSC) or the Sustainable Forestry Initiative (SFI). Forest products from this sale may not be delivered to the mill as "FSC and / or SFI certified". The lands within this sale belong to the National Forest system and are being managed by the State as part of a Good Neighbor Authority (GNA) agreement.

A recreation site such as a trail, pathway, or campground is within the sale area or the vicinity. Certain restrictions/specifications may be applicable including time restrictions. Access may be through private or other public land.

A timber sale contract for this lump sum, sealed bid timber sale will be awarded to the responsible bidder offering the highest sealed bid price. All units of volume listed below were estimated using the Inventory Manager computer program and the new Michigan taper model. Bids must be at or above the following advertised price for each product and species:

| <u>PRODUCTS & SPECIES</u> | <u>ESTIMATED UNITS*</u> | <u>ADVERTISED PRICE</u> |
|-------------------------------|-------------------------|-------------------------|
| Sawtimber | | |
| Beech | 28.7 MBF | \$ 157.00 / MBF |
| Jack Pine | 12.6 MBF | \$ 26.00 / MBF |
| Mixed Aspen | 596.7 MBF | \$ 97.00 / MBF |
| Red Maple | 131.0 MBF | \$ 96.00 / MBF |
| Red Pine | 1,305.1 MBF | \$ 93.00 / MBF |
| White Pine | 6.3 MBF | \$ 87.00 / MBF |
| White Spruce | 4.2 MBF | \$ 54.00 / MBF |
| Pulpwood | | |
| Balsam Fir | 11 Cords | \$ 27.95 / Cord |
| Jack Pine | 571 Cords | \$ 15.20 / Cord |
| Mixed Aspen | 1,572 Cords | \$ 28.55 / Cord |
| Mixed Hardwood | 807 Cords | \$ 21.05 / Cord |
| Red Pine | 3,400 Cords | \$ 43.80 / Cord |
| Scotch Pine | 82 Cords | \$ 13.10 / Cord |
| White Pine | 10 Cords | \$ 22.20 / Cord |
| White Spruce | 62 Cords | \$ 25.05 / Cord |

* The total volume is statistically estimated within plus (+) or minus (-) 9.52 percent. There are an estimated 11,091 cords on this timber sale, plus or minus 1,056 cords at the 95% confidence level. The estimated units are final and not subject to adjustment. Prospective bidders are urged to examine this timber and to make their own estimates of quantity and quality.

BOND AND PAYMENT SCHEDULE:

1. A bond in the amount of \$42,006.00 to insure faithful performance of the conditions of the contract will be deposited by the successful bidder within 21 days of the sale award.
2. Cutting in any sale or unit without the required advance payment would be considered a trespass.
3. Total payment must be paid in advance or according to the following schedule :
 - (a) Ten percent (10%) of the sale value must be paid within 21 days of the sale award.
 - (b) The 10% down payment will be credited towards the first unit cut.

(c) Payment for each of the following units must be made before cutting begins in that unit:

| PAYMENT UNIT NUMBER | PERCENT OF TOTAL SALE VALUE |
|---------------------|-----------------------------|
| 01 | 2.6% |
| 02 | 7.6% |
| 03 | 11.3% |
| 04 | 10.6% |
| 05 | 9.7% |
| 06 | 0.5% |
| 07 | 2.3% |
| 08 | 7.3% |
| 09 | 0.5% |
| 10 | 5.6% |
| 11 | 4.0% |
| 12 | 12.9% |
| 13 | 2.2% |
| 14 | 4.8% |
| 15 | 2.4% |
| 16 | 5.5% |
| 17 | 5.5% |
| 18 | 4.7% |

4. If no cutting takes place, the 10% down payment will not be refunded.

5. Operations on the contract issued will terminate on 07/31/2026.

SALE STATISTICS

Volumes were calculated in cubic feet using the Michigan taper model. Cubic foot volume includes all wood inside bark for the product indicated. For display purposes, cubic feet were converted to cords and MBF using a simple conversion factor, e.g. 79 cubic feet per cord and 185 cubic feet per MBF. The cubic foot volumes are precise; the cords and MBF volumes are not. Cubic foot volume cannot be directly converted to cords or boards with precision.

SALE VOLUMES

The total estimated sale volume may not equal the sum of the species/products due to the nature of statistical calculations associated with double sampling methodology.

| VOLUME | | PERCENT ERROR | STATISTICAL RANGE IN CORDS | |
|------------------|-------------|---------------|----------------------------|---------|
| TOTAL CUBIC FEET | TOTAL CORDS | | MINIMUM | MAXIMUM |
| 876,188 | 11,091 | 9.52% | 10,035 | 12,147 |

VDU VOLUMES

A VDU is a Volume Determination Unit. Volumes and their associated statistics are calculated at the VDU level and summarized to the sale level. There is often a one to one relationship between a VDU and a Payment Unit, but not always, depending on the cruise design. Refer to the VDU TO PAYMENT UNIT table.

| VDU | VOLUME | | PERCENT ERROR | RANGE IN CORDS | |
|---------------|------------------|---------------|---------------|----------------|---------------|
| | TOTAL CUBIC FEET | TOTAL CORDS | | MINIMUM | MAXIMUM |
| 1 | 103,392 | 1,309 | 22.19% | 1,018 | 1,599 |
| 2 | 53,616 | 679 | 23.44% | 520 | 838 |
| 4 | 19,156 | 242 | 32.42% | 164 | 321 |
| 171 | 32,511 | 412 | 15.54% | 348 | 475 |
| 201 | 21,802 | 276 | 0.00% | 276 | 276 |
| 202 | 45,890 | 581 | 16.25% | 487 | 675 |
| 203 | 14,673 | 186 | 39.50% | 112 | 259 |
| 205 | 99,877 | 1,264 | 33.15% | 845 | 1,683 |
| 224 | 32,687 | 414 | 25.94% | 306 | 521 |
| 231 | 19,477 | 247 | 38.11% | 153 | 341 |
| 233 | 18,293 | 232 | 67.29% | 76 | 387 |
| 238 | 25,493 | 323 | 37.94% | 200 | 445 |
| 291 | 18,846 | 239 | 33.67% | 158 | 319 |
| 911 | 101,048 | 1,279 | 27.74% | 924 | 1,634 |
| 912 | 60,983 | 772 | 17.65% | 636 | 908 |
| 913 | 18,313 | 232 | 47.77% | 121 | 343 |
| 914 | 10,608 | 134 | 32.30% | 91 | 178 |
| 915 | 3,645 | 46 | 0.00% | 46 | 46 |
| 916 | 13,760 | 174 | 77.88% | 39 | 310 |
| 921 | 60,186 | 762 | 17.11% | 631 | 892 |
| 922 | 8,895 | 113 | 109.28% | 0 | 236 |
| 931 | 60,695 | 768 | 23.02% | 591 | 945 |
| 932 | 32,343 | 409 | 32.38% | 277 | 542 |
| TOTAL: | 876,188 | 11,091 | | 8,019 | 14,173 |

VDU TO PAYMENT UNIT

When a VDU is associated with more than one Payment Unit (PU), the VDU volumes are assigned to the PU based on acres of the VDU within the PU.

| VDU | VDU ACRES | PU | PU ACRES |
|---------------|--------------|----|--------------|
| 1 | 38.7 | 3 | 38.7 |
| 2 | 31.1 | 2 | 31.1 |
| 4 | 11.5 | 1 | 11.5 |
| 171 | 3.4 | 18 | 3.4 |
| 201 | 30.7 | 14 | 30.7 |
| 202 | 28.1 | 13 | 28.1 |
| 203 | 12.8 | 14 | 12.8 |
| 205 | 19.7 | 12 | 19.7 |
| 224 | 11.2 | 16 | 11.2 |
| 231 | 8.6 | 17 | 8.6 |
| 233 | 4.9 | 16 | 4.9 |
| 238 | 7.9 | 17 | 7.9 |
| 291 | 9.4 | 15 | 9.4 |
| 911 | 48.6 | 4 | 48.6 |
| 912 | 32.9 | 5 | 32.9 |
| 913 | 21.2 | 7 | 21.2 |
| 914 | 8.9 | 6 | 8.9 |
| 915 | 1.3 | 4 | 1.3 |
| 916 | 12.5 | 5 | 12.5 |
| 921 | 39.8 | 8 | 39.8 |
| 922 | 5.5 | 9 | 5.5 |
| 931 | 22.5 | 10 | 22.5 |
| 932 | 25.0 | 11 | 25.0 |
| TOTAL: | 436.2 | | 436.2 |

DESCRIPTION OF TIMBER BY PAYMENT UNIT (PU)

| PU | MARKET GROUP | PRODUCT | QUANTITY | UNIT | ACRES | ADVERTISE PRICE |
|------------------|----------------------|-----------|--------------|--------------|-------|-----------------|
| 1 | Red Pine | Sawtimber | 97.9 | MBF | 11.5 | \$10,830.55 |
| | Mixed Hardwood | Pulpwood | 5 | Cords | | |
| | <i>Beech</i> | | 2 | <i>Cords</i> | | |
| | <i>Red Maple</i> | | 3 | <i>Cords</i> | | |
| | Red Pine | | 37 | Cords | | |
| 2 | Red Pine | Sawtimber | 41.7 | MBF | 31.1 | \$31,750.85 |
| | Mixed Hardwood | Pulpwood | 7 | Cords | | |
| | <i>Beech</i> | | 7 | <i>Cords</i> | | |
| | Red Pine | | 633 | Cords | | |
| 3 | Mixed Aspen | Sawtimber | 299.5 | MBF | 38.7 | \$47,396.20 |
| | <i>B. T. Aspen</i> | | 228.5 | <i>MBF</i> | | |
| | <i>Quaking Aspen</i> | | 71.0 | <i>MBF</i> | | |
| | Red Maple | | 1.8 | MBF | | |
| | Mixed Aspen | Pulpwood | 520 | Cords | | |
| | <i>B. T. Aspen</i> | | 460 | <i>Cords</i> | | |
| | <i>Quaking Aspen</i> | | 60 | <i>Cords</i> | | |
| | Mixed Hardwood | | 158 | Cords | | |
| | <i>Red Maple</i> | | 149 | <i>Cords</i> | | |
| | <i>Sugar Maple</i> | | 9 | <i>Cords</i> | | |
| 4 | Mixed Aspen | Sawtimber | 119.2 | MBF | 49.9 | \$44,548.10 |
| | <i>B. T. Aspen</i> | | 59.4 | <i>MBF</i> | | |
| | <i>Quaking Aspen</i> | | 59.8 | <i>MBF</i> | | |
| | Red Maple | | 6.5 | MBF | | |
| | Red Pine | | 23.5 | MBF | | |
| | White Pine | | 3.0 | MBF | | |
| | Mixed Aspen | Pulpwood | 760 | Cords | | |
| | <i>B. T. Aspen</i> | | 141 | <i>Cords</i> | | |
| | <i>Quaking Aspen</i> | | 619 | <i>Cords</i> | | |
| | Mixed Hardwood | | 124 | Cords | | |
| | <i>Black Cherry</i> | | 18 | <i>Cords</i> | | |
| | <i>Red Maple</i> | | 106 | <i>Cords</i> | | |
| | Red Pine | | 127 | Cords | | |
| White Pine | | 2 | Cords | | | |
| 5 | Mixed Aspen | Sawtimber | 2.1 | MBF | 45.4 | \$40,568.30 |
| | <i>B. T. Aspen</i> | | 2.1 | <i>MBF</i> | | |
| | Red Pine | | 66.0 | MBF | | |
| | Mixed Aspen | Pulpwood | 16 | Cords | | |
| | <i>B. T. Aspen</i> | | 16 | <i>Cords</i> | | |
| Red Pine | | 771 | Cords | | | |
| 6 | Mixed Aspen | Sawtimber | 3.2 | MBF | 8.9 | \$2,072.70 |
| | <i>B. T. Aspen</i> | | 3.2 | <i>MBF</i> | | |
| | White Pine | | 1.2 | MBF | | |
| | Jack Pine | Pulpwood | 3 | Cords | | |
| | Mixed Aspen | | 10 | Cords | | |
| | <i>B. T. Aspen</i> | | 5 | <i>Cords</i> | | |
| | <i>Quaking Aspen</i> | | 5 | <i>Cords</i> | | |
| | Mixed Hardwood | | 12 | Cords | | |
| | <i>Black Cherry</i> | | 2 | <i>Cords</i> | | |
| <i>Red Maple</i> | | 10 | <i>Cords</i> | | | |
| Scotch Pine | | 82 | Cords | | | |
| 7 | Red Pine | Sawtimber | 37.9 | MBF | 21.2 | \$9,788.10 |
| | Red Pine | Pulpwood | 143 | Cords | | |
| 8 | Beech | Sawtimber | 6.0 | MBF | 39.8 | \$30,456.55 |
| | Jack Pine | | 11.2 | MBF | | |
| | Red Pine | | 193.5 | MBF | | |

DESCRIPTION OF TIMBER BY PAYMENT UNIT (PU), CON'T

| PU | MARKET GROUP | PRODUCT | QUANTITY | UNIT | ACRES | ADVERTISE PRICE |
|---------|--|---------------------------------------|---|--|-------|-----------------|
| 8 con't | Jack Pine Mixed Hardwood <i>Beech</i> Red Pine | Pulpwood | 24 25 25 236 | Cords Cords Cords Cords | | |
| 9 | Beech Jack Pine Mixed Aspen <i>B. T. Aspen</i> Red Maple Jack Pine Mixed Aspen <i>B. T. Aspen</i> Mixed Hardwood <i>Beech</i> <i>Red Maple</i> | Sawtimber Pulpwood | 3.1 1.4 2.1 2.1 5.3 4 11 11 20 2 18 | MBF MBF MBF <i>MBF</i> MBF Cords Cords <i>Cords</i> Cords <i>Cords</i> Cords | 5.5 | \$2,031.45 |
| 10 | Beech Mixed Aspen <i>B. T. Aspen</i> Red Maple Mixed Aspen <i>B. T. Aspen</i> Mixed Hardwood <i>Beech</i> <i>Ironwood</i> <i>Red Maple</i> | Sawtimber Pulpwood | 12.9 64.2 64.2 46.4 171 171 289 69 2 218 | MBF MBF <i>MBF</i> MBF Cords <i>Cords</i> Cords <i>Cords</i> <i>Cords</i> Cords | 22.5 | \$23,672.60 |
| 11 | Red Pine Red Pine | Sawtimber Pulpwood | 101.2 172 | MBF Cords | 25.0 | \$16,945.20 |
| 12 | Beech Red Pine Mixed Hardwood <i>Beech</i> Red Pine | Sawtimber Pulpwood | 4.4 448.6 19 19 263 | MBF MBF Cords <i>Cords</i> Cords | 19.7 | \$54,329.95 |
| 13 | Red Pine Jack Pine Red Pine | Sawtimber Pulpwood | 1.2 540 25 | MBF Cords Cords | 28.1 | \$9,414.60 |
| 14 | Red Pine Mixed Hardwood <i>Beech</i> Red Pine | Sawtimber Pulpwood | 170.6 3 3 92 | MBF Cords <i>Cords</i> Cords | 43.5 | \$19,958.55 |
| 15 | Red Pine Red Pine | Sawtimber Pulpwood | 31.2 166 | MBF Cords | 9.4 | \$10,172.40 |
| 16 | Beech Mixed Aspen <i>B. T. Aspen</i> Red Maple Balsam Fir Mixed Aspen <i>B. T. Aspen</i> Mixed Hardwood <i>Beech</i> <i>Red Maple</i> | Sawtimber Pulpwood | 2.3 106.4 106.4 71.0 11 84 84 141 12 129 | MBF MBF <i>MBF</i> MBF Cords Cords <i>Cords</i> Cords <i>Cords</i> Cords | 16.1 | \$23,171.60 |
| 17 | Red Pine White Spruce Red Pine White Spruce | Sawtimber Pulpwood | 27.9 4.2 432 62 | MBF MBF Cords Cords | 16.5 | \$23,296.20 |

DESCRIPTION OF TIMBER BY PAYMENT UNIT (PU), CON'T

| PU | MARKET GROUP | PRODUCT | QUANTITY | UNIT | ACRES | ADVERTISE PRICE |
|--------|------------------|-----------|----------|--------------|-------|-----------------|
| 18 | Red Pine | Sawtimber | 63.9 | MBF | 3.4 | \$19,658.60 |
| | White Pine | | 2.1 | MBF | | |
| | Mixed Hardwood | Pulpwood | 4 | Cords | | |
| | <i>Beech</i> | | 2 | <i>Cords</i> | | |
| | <i>Red Maple</i> | | 2 | <i>Cords</i> | | |
| | Red Pine | | 303 | Cords | | |
| | White Pine | | 8 | Cords | | |
| | TOTAL: | | | 2,084.6 | | |
| TOTAL: | | | 6,515 | Cords | | |

Sale Specific Conditions & Requirements

Sale Name: GNA2 Zone 7

Sale Number: 63-801-23 Seq#: 1

1 - Sale Area

1.2 - Boundaries

1.2.1 - Painted boundaries (9/19)

The sale boundary and Payment Unit boundaries are marked and identified by orange paint. Exterior sale boundary lines against private property are marked with orange paint. Exterior sale boundary lines against federal are marked with orange paint. Interior Payment Unit boundaries are marked with orange paint. Retention patches are marked with orange paint; no harvesting activities may occur within these areas. The painted boundary line trees are not Included Timber and are to be protected unless marked with green paint. Orange painted trees designating an interior Payment Unit boundary are only to be cut when all surrounding Payment Units have been paid.

2 - Timber Specifications

2.1 - Included Timber

2.1.1 - Clearcut unit(s) with unmerchantable trees (6/14)

Within Payment Unit(s) 1, cut all beech, red pine and, red maple trees that are two (2) inches or more at DBH.

Within Payment Unit(s) 3, cut all aspen two (2) inches or more at DBH. In addition, all other hardwood species less than eleven (11) inches at DBH are designated for cutting.

Within Payment Unit(s) 4 north of the powerline, cut all aspen two (2) inches or more at DBH. In addition, all other hardwood species less than eleven (11) inches at DBH are designated for cutting. Furthermore, all trees which meet minimum piece specifications in 2.2 Utilization, within designated plantation rows are designated for cutting. Designated plantation rows follow a take two, leave four pattern. Begin with the fifth row in from the outside of the plantation. Because of the variability of row direction, it shall be the responsibility of the producer to maintain the row sequence.

Within Payment Unit(s) 4 south of the power line, cut all trees that are two (2) inches or more at DBH, except do not cut any conifers, black cherry, or oak.

Within Payment Unit(s) 6, cut all trees which meet minimum piece specifications, except do not cut white pine twelve (12) inches or greater at DBH, or any black cherry or oak.

Within Payment Unit(s) 9, cut all trees that are two (2) inches or more at DBH, except do not cut white pine twenty-two (22) inches or greater at DBH, or any oak, black cherry, or hemlock.

Within Payment Unit(s) 10, cut all trees that are two (2) inches or more at DBH, except do not cut any conifers, oak, black cherry, yellow birch, or sugar maple.

Within Payment Unit(s) 12, cut all red pine, beech, and ironwood that are two (2) inches or more at DBH.

Within Payment Unit(s) 13, cut all trees which meet minimum piece specifications. In addition, leave 3-5 trees per acre with a preference order of: oak, cherry, white pine, all other species.

Within Payment Unit(s) 14 south of the painted division line, cut all beech, red pine, and ironwood greater than two (2) inches at DBH.

Within Payment Unit(s) 16, cut all aspen, red maple and beech that are two (2) inches or more at DBH.

Within Payment Unit(s) 18, cut all trees which meet minimum piece specifications, except do not cut white pine twenty-five (25) inches or more at DBH, or any oak or black cherry.

Furthermore, within Payment Units listed above, retain a minimum of 4 living trees per acre. If this is not met with designated retention trees, the operator shall leave designated cut trees to meet this requirement.

2.1.3 - Cut tree marked unit(s) (12/08)

Within Payment Unit(s) 2, 7, 8, 11, and Payment Unit 14 north of the painted division line, all trees are designated for cutting when marked with blue paint above and below stump height, regardless of merchantability. In addition, cut all beech and ironwood that are (2) inches or more at DBH.

Within Payment Unit(s) 5, all trees are designated for cutting when marked with blue paint above and below stump height, regardless of merchantability. In addition, cut all beech and ironwood that are (2) inches or more at DBH. Furthermore, all trees which meet minimum piece specifications in 2.2 Utilization, within designated plantation rows are designated for cutting. Designated plantation rows follow a take two, leave four pattern. Begin with the fifth row in from the outside of the plantation. Because of the variability of row direction, it shall be the responsibility of the producer to maintain the row sequence.

2.1.8 - Designated plantation row unit(s) (12/08)

Within Payment Unit(s) 15, all trees which meet minimum piece specifications in 2.2 Utilization, within designated plantation rows are designated for cutting. Designated plantation rows follow a take two, leave four pattern. Begin with the fifth row in from the outside of the plantation. Because of the variability of row direction, it shall be the responsibility of the producer to maintain the row sequence.

Within Payment Unit 17, all trees which meet minimum piece specifications in 2.2 Utilization, within designated plantation rows are designated for cutting. For red pine, designated plantation rows follow a take two, leave four pattern - Begin with the fifth row in from the outside of the plantation. For white spruce, designated plantation rows follow a take two, leave six pattern - Begin with the seventh row in from the outside of the plantation. Because of the variability of row direction, it shall be the responsibility of the producer to maintain the row sequence. In addition, cut all blue marked trees.

2.2 - Utilization

2.2.12 - GNA, cut and remove Included Timber (3/18)

Unless provided otherwise herein, the DNR agrees to sell and permit Purchaser to cut and remove Included Timber and Purchaser agrees to purchase, cut, and remove Included Timber.

3 - Payments

3.3 - Pre-measured Sales

3.3.4 - Dividing payment units (7/14)

Payment Unit(s) may be divided at the request of the Purchaser and upon approval of the Unit Manager. Dividing Payment Units is a contract modification which requires a Timber Sale Contract Amendment.

3.4 - Damaged Timber

3.4.1 - Damaged timber (7/16)

General Condition and Requirement 3.4 Damaged Timber, defines liquidated damages for undesignated live merchantable trees which are cut or injured. Within Payment Unit 12, and Payment Unit 14 south of the division line, extreme care should be taken to avoid damage to tree seedlings and saplings.

4 - Transportation

4.1 - Construction

4.1.3 - Slash and earthen piles (8/04)

Piles or windrows of earth along roads and landings that have been widened or constructed shall be leveled. Slash from road maintenance or construction, including stumps, shall be dispersed throughout the sale, chipped, utilized or otherwise removed from the sale.

4.2 - Maintenance

4.2.1 - Hauling restriction (12/08)

Hauling on the gravel road off of 25 Rd. going into Payment Unit 8 is restricted to the first 1/10th mile from 25 Rd. The

restriction is in place to protect a heritage site.

4.2.3 - Road maintenance (8/13)

The following road maintenance is required on Forest Service roads within 60 days of completion of hauling, or if no hauling occurs for 60 days, the road must be maintained and graded. This includes cleaning of drainage areas, grading, crowning and filling with gravel, if necessary. Damages will be assessed if grading/repair does not occur.

4.2.5 - Two wheel drive condition (2/04)

All existing trail roads on and adjacent to the sale area must be passable by two-wheel drive traffic for the duration of the sale.

4.4 - Access

4.4.1 - Private property access (3/11)

Permission for access across private land may be needed.

5 - Operations

5.2 - Conduct of Operations

5.2.1 - Slash

5.2.1.8 - Slash height (12/08)

No slash may exceed 24 inches in height.

5.2.2 - Hazard Trees/Snags

5.2.2.1 - Den trees (10/16)

Obvious hollow and/or den trees shall be protected and left standing unless they are a safety hazard.

5.2.3 - Operating Restrictions

5.2.3.4 - Oak wilt restriction, no exceptions (1/18)

Within Payment Units 1-18, cutting, skidding, hauling within the sale and brushing of access roads to the sale are not permitted during the period of April 15 to July 15. No exceptions will be granted. This is necessary to reduce the spread of oak wilt.

5.2.3.11 - Coppice regeneration protection (4/10)

Within Payment Unit(s) 3, 4, 9, 10, and 16, harvesting is limited to October 1 to March 31 in order to promote aspen regeneration. Any post harvest operations, such as chipping, must be completed before sprouting of regeneration occurs. If it is anticipated that chipping will be delayed, then tops shall be carried to one central location or left unchipped. The Unit Manager or his/her representative may cease such operations if sprouting occurs before the operation is complete.

Within Payment Unit(s) 1, 12, and 14, cutting, skidding, and hauling are not permitted during the period April 1 to September 30. This restriction is to protect desirable hardwood advanced regeneration.

5.2.3.14 - heterobasidion root disease (HRD) (3/21)

This plantation is at risk of infection by the root rot fungus, *Heterobasidion irregulare*. To prevent the spread of this disease, cutting operations within Payment Unit(s) 2, 4, 5, 7, 8, 11, 14, 15, and 17 are restricted to the period of January 1st through February 28th. Cutting may only occur outside this period with written permission of the Unit Manager or with the application of a preventative pesticide. Cellu-Treat and RotStop C are currently the only EPA registered products available in the United States for the control of *Heterobasidion*. Both products are a water-soluble powder that must be applied to the stump, in accordance with the product label. Dye must be added to these products to provide visible evidence of adequate coverage. Application of these pesticides requires licensing by the Michigan Department of Agriculture and Rural Development. All applicators are required to: provide to the Sale Administrator notification of application per requirements in 40 CFR 170.120; and document and provide to the Sale Administrator annually, by December 31 and prior to closure of sale, the volume of product used and acres treated.

5.2.17 - Timber Mats and Interlocking Composite Mats (5/23)

Some roads or skid trails may require extra protection such as that afforded by timber mats, interlocking composite mats, or another approved system. Approximately 200 feet of road or trail will need extra protection at locations shown on the Timber

Sale Map. If available, mats may be borrowed from the DNR. A Timber Sale Contract Amendment will be used to document the Purchaser's use of the DNR's mats. Contact the sale administrator regarding availability and pick-up. Timber mats are available from various field offices. Composite mats are only available from the Grayling field office and the Marquette ICC. The Purchaser is responsible for picking up and hauling the mats to and from the site. The composite mats will require DNR staff onsite for installation and removal. Contact the sale administrator to schedule at least 30 days before desired install/removal date. All mats must be cleaned prior to drop off. This may include, but is not limited to, power washing and brushing to remove mud and debris. A charge of \$700.00 per timber mat and \$2,000.00 per composite mat will be assessed for all damaged or non-returned mats. Damage for the crane/timber mats is defined as three or more broken cants. Damage for the composite mats is defined as cracked or broken mats.

5.2.32 - Decking/landing restoration (9/13)

All decking and landing areas must have the surface area restored to a condition equal to or better than before. This is to ensure the proper regeneration of the stand. Wood debris, chips and "cookies" from trimmings must be removed or scattered away from landing and loading areas and may not be windrowed on the edge.

5.4 - Soil Protection

5.4.1 - Rutting restriction, general (7/16)

Operations are to cease immediately if equipment and weather conditions result in rutting of roads and/or skid trails which exceed 12 inches or greater in depth and 50 feet in length. The Unit Manager or his/her representative may restrict hauling and/or skidding if ruts exceed the specified depth. With the Unit Manager or his/her representative's approval, the Purchaser may return to the area when the risk of rutting has decreased.

5.4.2 - Skid trails (2/04)

Skid trails up and down slopes should be avoided. If however this is unavoidable, these trails will be left in a non-erodible condition using water bars, logs, and slash. Placing of slash on these skid trails while logging is ongoing may alleviate need for any further action. At the direction of the sale administrator, seed, fertilizer, and mulch may also be required.

5.6 - Debris and Waste Material

5.6.2 - GNA, equipment cleaning (1/16)

(a) Areas, known by the DNR prior to timber sale advertisement, that are infested with invasive species of concern are shown on the Timber Sale Map. A current list of invasive species of concern and a map showing the extent of known infestations is available from the DNR. For purposes of this provision, "Off-Road Equipment" includes all logging and construction machinery, except for log trucks, chip vans, service vehicles, water trucks, pickup trucks, cars, and similar vehicles.

(b) Purchaser shall adhere to the following requirements with regard to cleaning "Off-Road Equipment":

(i) Prior to moving Off-Road Equipment onto the Sale Area, Purchaser shall identify the location of the equipment's most recent operation. Purchaser shall not move any Off-Road Equipment that last operated in an area infested with one or more invasive species of concern onto Sale Area without having cleaned such equipment of seeds, soil, vegetative matter, and other debris that could contain or hold seeds, and having notified the DNR, as provided in (iii). If the location of prior operation cannot be identified, then Purchaser shall assume that the location is infested with invasive species of concern.

(ii) Prior to moving Off-Road Equipment from a cutting unit that is shown on the Timber Sale Map to be infested with invasive species of concern to, or through any other area that is shown as being free of invasive species of concern, or infested with a different invasive species, Purchaser shall clean such equipment of seeds, soil, vegetative matter, and other debris that could contain or hold seeds, and shall notify the DNR, as provided in (iii).

(iii) Prior to moving any Off-Road Equipment subject to the cleaning requirements set forth above, Purchaser shall advise DNR of its cleaning measures and make the equipment available for inspection. DNR shall have 2 days, excluding weekends and State holidays, to inspect equipment after it has been made available. After satisfactory inspection or after such 2 day period, Purchaser may move the equipment as planned. Equipment shall be considered clean when a visual inspection does not disclose seeds, soil, vegetative matter, and other debris that could contain or hold seeds. Purchaser shall not be required to disassemble equipment unless so directed by the DNR after inspection.

(iv) If Purchaser desires to clean Off-Road Equipment on National Forest land, such as at the end of a project or prior to

moving to, or through an area that is free of invasive species of concern, Purchaser shall obtain prior approval from the Unit Manager or his/her representative as to the location for such cleaning and measures, if any, for controlling impacts.

(v) Unit Manager or his/her representative may order delay, interruption, or modification of this Contract pursuant to Condition & Requirement 7.3 or 7.3.4.

(c) Nothing contained in this Condition & Requirement shall be interpreted as creating any warranty on the part of the DNR that all locations of invasive species of concern have been described herein, elsewhere in this Contract, or designated on the ground. Following sale advertisement, additional locations may be described or designated, and other species may be added to the list of invasive species of concern. In such event, the Unit Manager or his/her representative may order delay, interruption, or modification of this Contract pursuant to Condition & Requirement 7.3 or 7.3.4.

(d) The parties shall promptly communicate with one another with respect to description or designation of additional locations; discovery of locations of new species or new infestation; and, addition of species to the list of invasive species of concern.

5.7 - Protection of Historical Sites

5.7.1 - Historical sites (7/12)

The Purchaser shall not cut live or dead trees or operate equipment within historical sites. Historical sites are excluded from Payment Units. The Purchaser shall protect historical sites from damage by the Purchaser's operations. If Purchaser's operations have cut or damaged historical sites through carelessness, the Purchaser shall pay \$5,000 as fixed, agreed and liquidated damages for each acre or part thereof cut or damaged.

5.8 - Protection of Endangered Species

5.8.5 - Protection of raptor nests (3/13)

All trees with raptor nests will be protected if found during harvesting operations. Notification will be made to the Unit Manager or his/her representative who will notify the Wildlife Biologist so an on-site evaluation and recommendation can be made, if necessary.

6 - Safety and Fire Prevention

6.2 - Signing

6.2.1 - Road posting (10/20)

The Purchaser is responsible for posting and maintaining caution signs on county, forest roads and snowmobile trails prior to beginning operations. The road must be posted at appropriate distances from the sale area to warn of logging activity and truck traffic. Signs must be removed when harvest operations are suspended or completed. The Purchaser will provide these signs.

7 - Other Conditions

SKIP

7.1.1 - GNA, title (7/16)

General Condition & Requirement 7.1 is inapplicable. The following applies to this contract.

All right, title, and interest in and to any Included Timber shall remain in USDA Forest Service with the State of Michigan acting on behalf of the USDA Forest Service under this GNA contract, until it has been Measured, removed from Sale Area or other authorized cutting area, and paid for, at which time title shall vest in Purchaser. Title to any Included Timber that has been Measured and paid for, but not removed from Sale Area or other authorized cutting area by Purchaser on or prior to Termination Date, shall remain in USDA Forest Service.

7.3 - Contract Modifications

7.3.4 - GNA, contract suspension and modification (5/16)

(a) The Unit Manager may, by written order, delay or interrupt authorized operations under this contract or, notwithstanding Condition & Requirement 7.3, modify this contract, in whole or in part:

(i) To prevent environmental degradation or resource damage, including, but not limited to, harm to habitat, plants, animals,

cultural resources, or cave resources;

(ii) To ensure consistency with land and resource management plans or other documents prepared pursuant to the National Environmental Policy Act of 1969, 42 USC 4321-4347;

(iii) To conduct environmental analysis, including, but not limited to, engaging in consultation pursuant to the Endangered Species Act of 1973, 16 USC 1531, et seq.; or

(iv) Upon agreement of the Forest Service, due to administrative appeal or litigation, regardless of whether the Unit Manager's order is required by a court order or this contract is named in such a proceeding.

(b) In the event of an order delaying or interrupting Purchaser's Operations under this Condition & Requirement, Purchaser's remedy shall be:

(i) a no cost contract extension,

(ii) reimbursement for Out-of-Pocket Expenses,

however, the foregoing remedies shall be available only to the extent that the Unit Manager's order was the sole and exclusive cause of the delay or interruption of Purchaser's operations.

(c) Remedies awarded to the Purchaser shall not be duplicative, and the Unit Manager shall have the right to structure remedies provided herein to avoid duplicative compensation.

(d) Purchaser agrees that this Condition & Requirement, and the remedies provided herein shall apply regardless of any finding by any court that the DNR failed to comply with any statute, regulation and/or policy in connection with awarding, advertising, or authorizing this sale, or a similar sale.

7.5 - Loss

7.5.2 - GNA, liability for loss (7/16)

If Included Timber is destroyed or damaged by an unexpected event that changes the nature of Included Timber, such as wind, flood, insects, disease, or similar cause, the Purchaser shall bear the timber value loss resulting from such destruction or damage.

Deterioration or loss of timber value due to delay or interruption under 7.3.4 - GNA, contract suspension and modification, shall be borne by the party holding title. In this event, Included Timber to which USDA Forest Service holds title, Purchaser of the State GNA contract will not be obligated to remove and pay for such timber. This Subsection shall not be construed to relieve either party of liability for negligence.

7.10 - Certified Timber

7.10.1 - Non-certified timber (2/16)

The area encompassed by this timber sale is not certified to the standards of the Forest Stewardship Council (FSC) or the Sustainable Forestry Initiative (SFI). Forest products from this sale may not be delivered to the mill as "FSC and / or SFI certified". The lands within this sale belong to the National Forest system and are being managed by the State as part of a Good Neighbor Authority (GNA) agreement.

99 - Unique

SKIP

99.1 - Unique Sale Condition (5/19)

Special consideration is given to snags because they are an important part of the habitat requirement for many species of wildlife. The logger is to leave or create at least nine (9) wildlife snags per acre in Payment Unit 12. Snags consist of leaving a dead standing tree that is not deemed a safety hazard by the Purchaser, or trees with a minimum diameter of ten (10) inches measured at a point to 4.5 feet above ground level which can be girdled the full circumference of the tree. Create snags using red pine or beech trees.



TIMBER SALE MAP

This information provided by authority of Part 525, 1994 PA 451, as amended.

| | | | | | |
|--|-------------------|--|--------------------|-----------|---------|
| Forest Management Unit Cadillac Management Unit | County Wexford | Mapped By Joel Taylor | Date 07/28/2023 | Page 1 | of 5 |
| Township 21N | Range 11W | Section(s) and Subdivision(s) S1 W1/2SW, S2 N1/2NW, SENW, NE, N1/2SE, SESE, S11 E1/2NE, NESE, and S12 NW, SWNE, S1/2SE | Scale 1:15,840 | | |

| Cover Type | | | | Density | |
|-------------------|----------------------|-------------------------|-------------------|-----------------------------|------------------------|
| A = Aspen | H = Hemlock | N = Marsh | U = Upland Brush | 0 = Non Stocked | 5 = Pole Timber Medium |
| B = Paper Birch | J = Jack Pine | O = Oak | UM = Upland Mixed | 1 = Seedling Sapling Poor | 6 = Pole Timber Well |
| C = Cedar | L = Lowland Brush | P = Lowland Poplar | V = Bog or Marsh | 2 = Seedling Sapling Medium | 7 = Saw Timber Poor |
| D = Treed Bog | LM = Lowland Mixed | Q = Mixed Swamp Conifer | W = White Pine | 3 = Seedling Sapling Well | 8 = Saw Timber Medium |
| E = Swamp Hdwoods | M = Mpl, Bch, Brch | R = Red Pine | X = Non Stocked | 4 = Pole Timber Poor | 9 = Saw Timber Well |
| F = Spruce Fir | MC = Mixed Conifer | S = Black Spruce | Z = Water | | |
| G = Grass | MD = Mixed Deciduous | T = Tamarack | | | |

| PU | Acres | PU | Acres |
|----|-------|----|-------|
| 1 | 11.5 | 4 | 49.9 |
| 2 | 31.1 | 5 | 45.4 |
| 3 | 38.7 | 6 | 8.9 |

GNA2 Zone 7

436.2 Acres

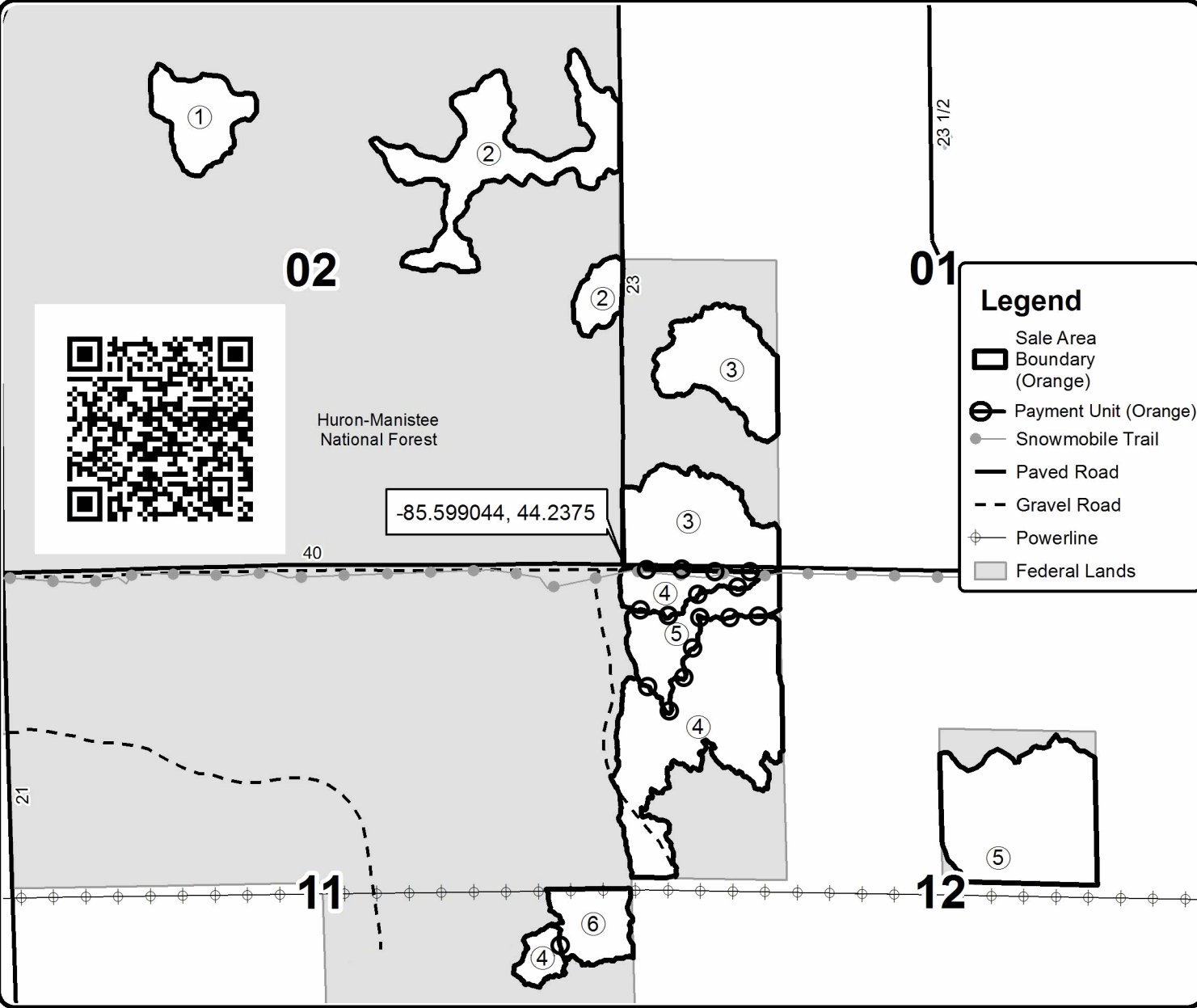

Legend

- Sale Area
- Boundary (Orange)
- Payment Unit (Orange)
- Snowmobile Trail
- Paved Road
- Gravel Road
- Powerline
- Federal Lands

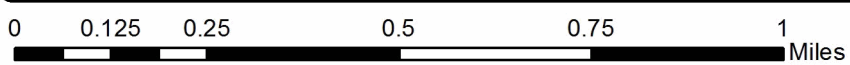



TIMBER SALE MAP

This information provided by authority of Part 525, 1994 PA 451, as amended.

| | |
|-------------|------|
| Sale Number | Year |
| 63-801-23 | 23 |

| | | | | | |
|--------------------------|-----------|---|------------|------|----|
| Forest Management Unit | County | Mapped By | Date | Page | of |
| Cadillac Management Unit | Wexford | Joel Taylor | 07/28/2023 | 2 | 5 |
| Township | Range | Section(s) and Subdivision(s) | Scale | | |
| 21N | 10W & 11W | S12 NW,SWNE,S1/2SE; S13 NE; S18 NWNW,SESW,W1/2SE; S19 N1/2NW,SWNW,N1/2NE,SWNE | 1:15,840 | | |

| Cover Type | | | | Density | |
|-------------------|----------------------|-------------------------|-------------------|-----------------------------|------------------------|
| A = Aspen | H = Hemlock | N = Marsh | U = Upland Brush | 0 = Non Stocked | 5 = Pole Timber Medium |
| B = Paper Birch | J = Jack Pine | O = Oak | UM = Upland Mixed | 1 = Seedling Sapling Poor | 6 = Pole Timber Well |
| C = Cedar | L = Lowland Brush | P = Lowland Poplar | V = Bog or Marsh | 2 = Seedling Sapling Medium | 7 = Saw Timber Poor |
| D = Treed Bog | LM = Lowland Mixed | Q = Mixed Swamp Conifer | W = White Pine | 3 = Seedling Sapling Well | 8 = Saw Timber Medium |
| E = Swamp Hdwoods | M = Mpl, Bch, Brch | R = Red Pine | X = Non Stocked | 4 = Pole Timber Poor | 9 = Saw Timber Well |
| F = Spruce Fir | MC = Mixed Conifer | S = Black Spruce | Z = Water | | |
| G = Grass | MD = Mixed Deciduous | T = Tamarack | | | |

| PU | Acres | PU | Acres |
|----|-------|----|-------|
| 7 | 21.2 | 12 | 19.7 |
| 8 | 39.8 | 13 | 28.1 |
| 9 | 5.5 | 14 | 43.5 |

GNA2 Zone 7

436.2 Acres

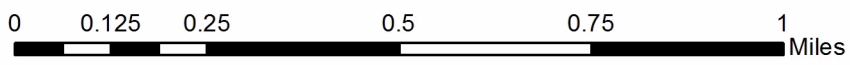
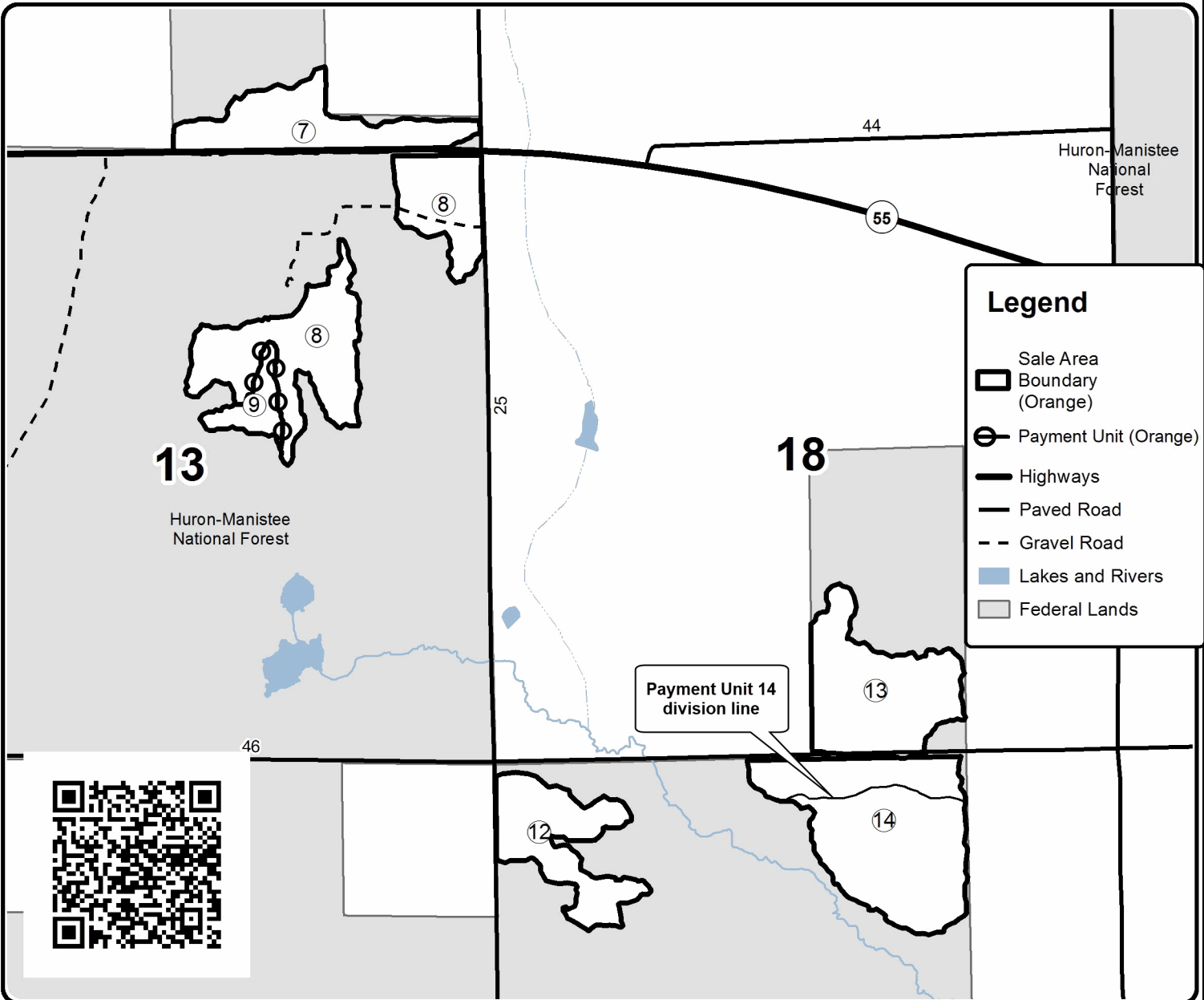



TIMBER SALE MAP

This information provided by authority of Part 525, 1994 PA 451, as amended.

| | | | | | |
|--------------------------|---------|--|------------|------|----|
| Forest Management Unit | County | Mapped By | Date | Page | of |
| Cadillac Management Unit | Wexford | Joel Taylor | 07/28/2023 | 3 | 5 |
| Township | Range | Section(s) and Subdivision(s) | Scale | | |
| 21N | 11W | S23 N1/2SE,SESE; S23 S1/2NW,NENE,S1/2NE,N1/2SW; S24 W1/2SW | 1:15,840 | | |

| Cover Type | | | | Density | |
|-------------------|----------------------|-------------------------|-------------------|-----------------------------|------------------------|
| A = Aspen | H = Hemlock | N = Marsh | U = Upland Brush | 0 = Non Stocked | 5 = Pole Timber Medium |
| B = Paper Birch | J = Jack Pine | O = Oak | UM = Upland Mixed | 1 = Seedling Sapling Poor | 6 = Pole Timber Well |
| C = Cedar | L = Lowland Brush | P = Lowland Poplar | V = Bog or Marsh | 2 = Seedling Sapling Medium | 7 = Saw Timber Poor |
| D = Treed Bog | LM = Lowland Mixed | Q = Mixed Swamp Conifer | W = White Pine | 3 = Seedling Sapling Well | 8 = Saw Timber Medium |
| E = Swamp Hdwoods | M = Mpl, Bch, Brch | R = Red Pine | X = Non Stocked | 4 = Pole Timber Poor | 9 = Saw Timber Well |
| F = Spruce Fir | MC = Mixed Conifer | S = Black Spruce | Z = Water | | |
| G = Grass | MD = Mixed Deciduous | T = Tamarack | | | |

| PU | Acres |
|----|-------|
| 10 | 22.5 |
| 11 | 25.0 |

GNA2 Zone 7

436.2 Acres

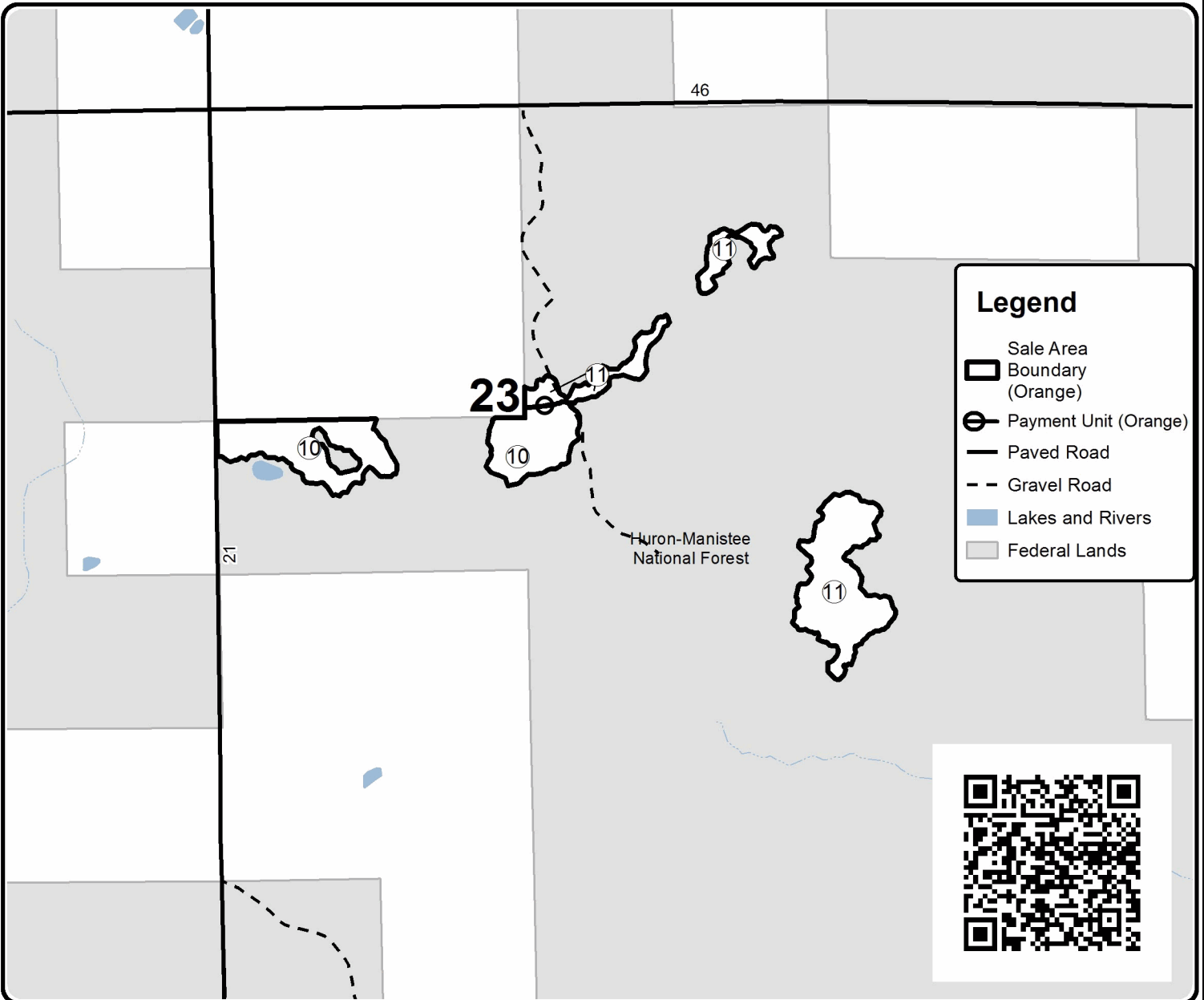

Legend

- Sale Area
- Boundary (Orange)
- Payment Unit (Orange)
- Paved Road
- Gravel Road
- Lakes and Rivers
- Federal Lands

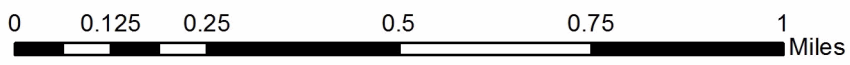



TIMBER SALE MAP

This information provided by authority of Part 525, 1994 PA 451, as amended.

| | |
|-------------|------|
| Sale Number | Year |
| 63-801-23 | 23 |

| | | | | | |
|--------------------------|---------|--|------------|------|----|
| Forest Management Unit | County | Mapped By | Date | Page | of |
| Cadillac Management Unit | Wexford | Joel Taylor | 07/28/2023 | 4 | 5 |
| Township | Range | Section(s) and Subdivision(s) | Scale | | |
| 21N | 10W | S9 NWSE; S10 S1/2SW; S15 N1/2NW,W1/2SW | 1:15,840 | | |

| Cover Type | | | | Density | |
|-------------------|----------------------|-------------------------|-------------------|-----------------------------|------------------------|
| A = Aspen | H = Hemlock | N = Marsh | U = Upland Brush | 0 = Non Stocked | 5 = Pole Timber Medium |
| B = Paper Birch | J = Jack Pine | O = Oak | UM = Upland Mixed | 1 = Seedling Sapling Poor | 6 = Pole Timber Well |
| C = Cedar | L = Lowland Brush | P = Lowland Poplar | V = Bog or Marsh | 2 = Seedling Sapling Medium | 7 = Saw Timber Poor |
| D = Treed Bog | LM = Lowland Mixed | Q = Mixed Swamp Conifer | W = White Pine | 3 = Seedling Sapling Well | 8 = Saw Timber Medium |
| E = Swamp Hdwoods | M = Mpl, Bch, Brch | R = Red Pine | X = Non Stocked | 4 = Pole Timber Poor | 9 = Saw Timber Well |
| F = Spruce Fir | MC = Mixed Conifer | S = Black Spruce | Z = Water | | |
| G = Grass | MD = Mixed Deciduous | T = Tamarack | | | |

| PU | Acres |
|----|-------|
| 16 | 16.1 |
| 17 | 16.5 |
| 18 | 3.4 |

GNA2 Zone 7

436.2 Acres

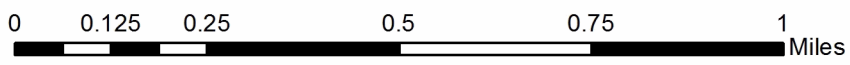
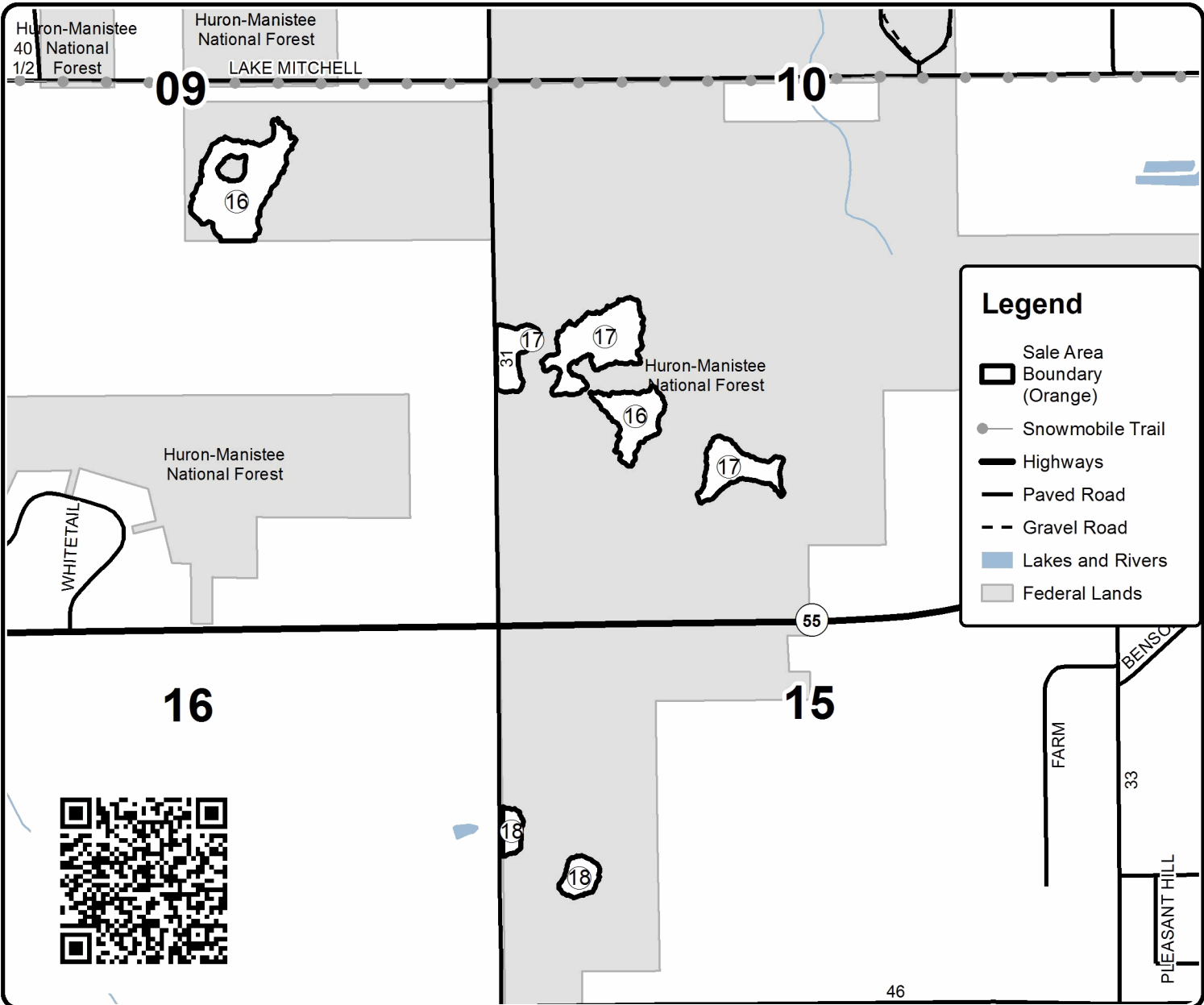



| | |
|-------------|------|
| Sale Number | Year |
| 63-801-23 | 23 |

TIMBER SALE MAP

This information provided by authority of Part 525, 1994 PA 451, as amended.

| | | | | | | |
|--------------------------|---------|-------------------------------|-------------|------------|------|----|
| Forest Management Unit | County | Mapped By | Joel Taylor | Date | Page | of |
| Cadillac Management Unit | Wexford | Cruised By | Joel Taylor | 07/28/2023 | 5 | 5 |
| Township | Range | Section(s) and Subdivision(s) | Scale | | | |
| 22N | 10W | S34 W1/2SW | 1:15,840 | | | |

Cover Type

| | | | |
|-------------------|----------------------|-------------------------|-------------------|
| A = Aspen | H = Hemlock | N = Marsh | U = Upland Brush |
| B = Paper Birch | J = Jack Pine | O = Oak | UM = Upland Mixed |
| C = Cedar | L = Lowland Brush | P = Lowland Poplar | V = Bog or Marsh |
| D = Treed Bog | LM = Lowland Mixed | Q = Mixed Swamp Conifer | W = White Pine |
| E = Swamp Hdwoods | M = Mpl, Bch, Brch | R = Red Pine | X = Non Stocked |
| F = Spruce Fir | MC = Mixed Conifer | S = Black Spruce | Z = Water |
| G = Grass | MD = Mixed Deciduous | T = Tamarack | |

Density

| | |
|-----------------------------|------------------------|
| 0 = Non Stocked | 5 = Pole Timber Medium |
| 1 = Seedling Sapling Poor | 6 = Pole Timber Well |
| 2 = Seedling Sapling Medium | 7 = Saw Timber Poor |
| 3 = Seedling Sapling Well | 8 = Saw Timber Medium |
| 4 = Pole Timber Poor | 9 = Saw Timber Well |

PU Acres
15 9.4

GNA2 Zone 7

436.2 Acres

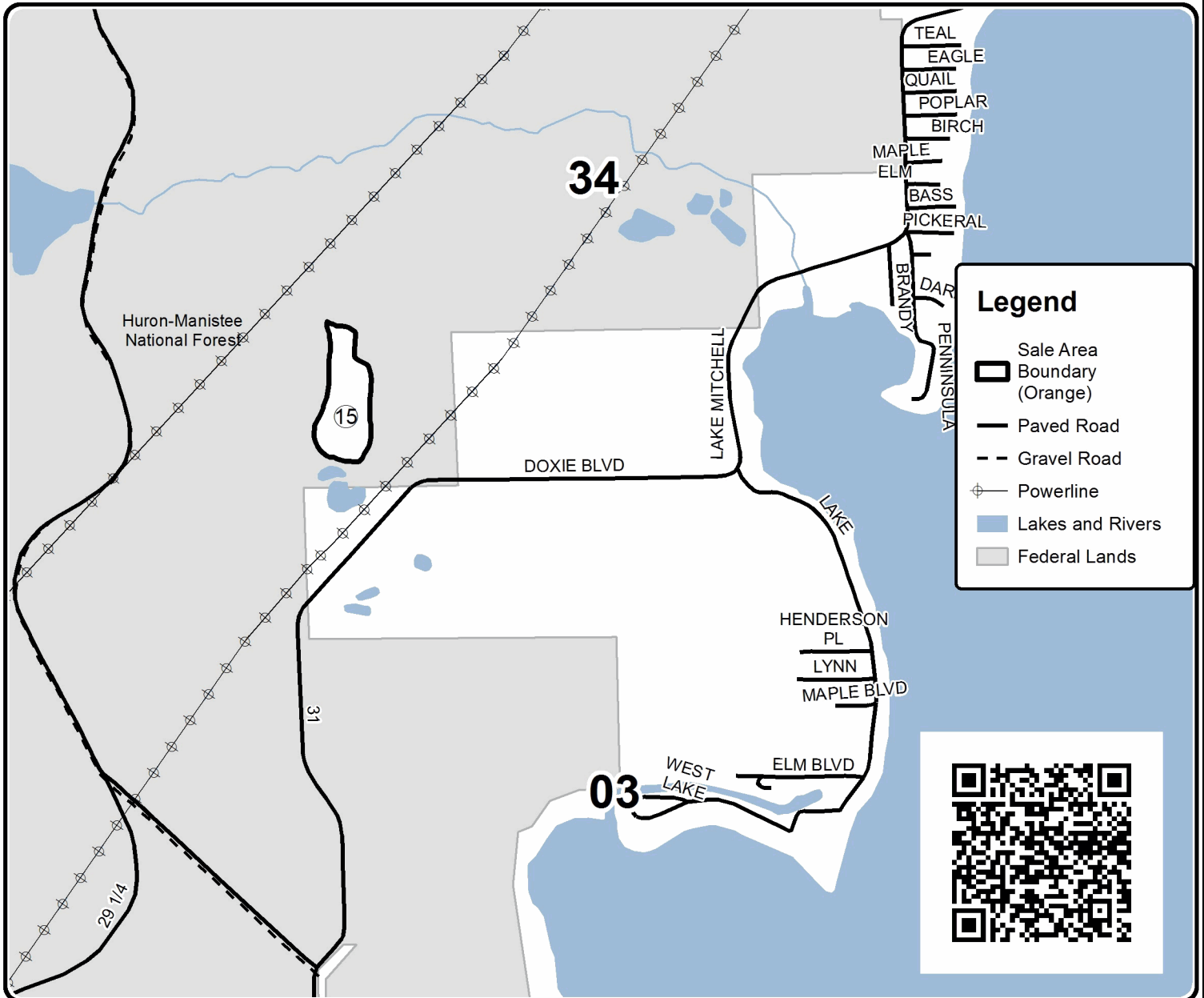

TIMBER SALE INFORMATION

GNA2 Gates Road (63-802-23)

T12N, R10W, SEC. 19; T12N, R10W, SEC. 20; T12N, R10W, SEC. 21; T12N, R11W, SEC. 23.
Newaygo County (Advertised Price \$181,456.60)

SALE NOTE: All units of volume listed for this sale were estimated using the Inventory Manager computer program and the new Michigan taper model. This is a Good Neighbor Authority (GNA) timber sale on national forest land. This timber sale was set-up and is being advertised by the Michigan DNR for the US Forest Service. The contract will be awarded and administered by the Michigan DNR. Note the additional Sale Specific Conditions & Requirements containing the acronym 'GNA'.

Access may be through other public land.

A timber sale contract for this lump sum, sealed bid timber sale will be awarded to the responsible bidder offering the highest sealed bid price. All units of volume listed below were estimated using the Inventory Manager computer program and the new Michigan taper model. Bids must be at or above the following advertised price for each product and species:

| <u>PRODUCTS & SPECIES</u> | <u>ESTIMATED UNITS*</u> | <u>ADVERTISED PRICE</u> |
|-------------------------------|-------------------------|-------------------------|
| Sawtimber | | |
| Red Pine | 452.8 MBF | \$ 98.00 / MBF |
| Pulpwood | | |
| Mixed Hardwood | 22 Cords | \$ 22.25 / Cord |
| Northern Pin Oak | 10 Cords | \$ 28.55 / Cord |
| Red Pine | 2,944 Cords | \$ 46.30 / Cord |

* The total volume is statistically estimated within plus (+) or minus (-) 13.97 percent. There are an estimated 4,917 cords on this timber sale, plus or minus 687 cords at the 95% confidence level. The estimated units are final and not subject to adjustment. Prospective bidders are urged to examine this timber and to make their own estimates of quantity and quality.

BOND AND PAYMENT SCHEDULE:

1. A bond in the amount of \$18,146.00 to insure faithful performance of the conditions of the contract will be deposited by the successful bidder within 21 days of the sale award.
2. Cutting in any sale or unit without the required advance payment would be considered a trespass.
3. Total payment must be paid in advance or according to the following schedule :
 - (a) Ten percent (10%) of the sale value must be paid within 21 days of the sale award.
 - (b) The 10% down payment will be credited towards the first unit cut.
 - (c) Payment for each of the following units must be made before cutting begins in that unit:

| PAYMENT UNIT NUMBER | PERCENT OF TOTAL SALE VALUE |
|---------------------|-----------------------------|
| 01 | 20.9% |
| 02 | 25.4% |
| 03 | 19.5% |
| 04 | 15.2% |
| 05 | 16.1% |
| 06 | 2.9% |
4. If no cutting takes place, the 10% down payment will not be refunded.
5. Operations on the contract issued will terminate on 12/31/2025.

SALE STATISTICS

Volumes were calculated in cubic feet using the Michigan taper model. Cubic foot volume includes all wood inside bark for the product indicated. For display purposes, cubic feet were converted to cords and MBF using a simple conversion factor, e.g. 79 cubic feet per cord and 185 cubic feet per MBF. The cubic foot volumes are precise; the cords and MBF volumes are not. Cubic foot volume cannot be directly converted to cords or boards with precision.

SALE VOLUMES

The total estimated sale volume may not equal the sum of the species/products due to the nature of statistical calculations associated with double sampling methodology.

| VOLUME | | STATISTICAL RANGE IN CORDS | | |
|------------------|-------------|----------------------------|---------|---------|
| TOTAL CUBIC FEET | TOTAL CORDS | PERCENT ERROR | MINIMUM | MAXIMUM |
| 388,436 | 4,917 | 13.97% | 4,230 | 5,604 |

VDU VOLUMES

A VDU is a Volume Determination Unit. Volumes and their associated statistics are calculated at the VDU level and summarized to the sale level. There is often a one to one relationship between a VDU and a Payment Unit, but not always, depending on the cruise design. Refer to the VDU TO PAYMENT UNIT table.

| VDU | VOLUME | | PERCENT ERROR | RANGE IN CORDS | |
|---------------|------------------|--------------|---------------|----------------|--------------|
| | TOTAL CUBIC FEET | TOTAL CORDS | | MINIMUM | MAXIMUM |
| 1 | 9,060 | 115 | 54.94% | 52 | 178 |
| 6 | 99,187 | 1,256 | 28.96% | 892 | 1,619 |
| 8 | 63,520 | 804 | 35.80% | 516 | 1,092 |
| 123 | 151,716 | 1,920 | 26.11% | 1,419 | 2,422 |
| 578 | 64,953 | 822 | 17.76% | 676 | 968 |
| TOTAL: | 388,436 | 4,917 | | 3,555 | 6,279 |

VDU TO PAYMENT UNIT

When a VDU is associated with more than one Payment Unit (PU), the VDU volumes are assigned to the PU based on acres of the VDU within the PU.

| VDU | VDU ACRES | PU | PU ACRES |
|---------------|-------------|----|-------------|
| 1 | 8.1 | 6 | 8.1 |
| 6 | 19.2 | 4 | 9.3 |
| | | 5 | 9.9 |
| 8 | 18.7 | 3 | 18.7 |
| 123 | 32.6 | 2 | 32.6 |
| 578 | 20.8 | 1 | 20.8 |
| TOTAL: | 99.4 | | 99.4 |

DESCRIPTION OF TIMBER BY PAYMENT UNIT (PU)

| PU | MARKET GROUP | PRODUCT | QUANTITY | UNIT | ACRES | ADVERTISE PRICE |
|---------------|--------------------|------------------|----------|--------------|-------|-----------------|
| 1 | Red Pine | Sawtimber | 10.9 | MBF | 20.8 | \$37,969.30 |
| | Red Pine | Pulpwood | 797 | Cords | | |
| 2 | Red Pine | Sawtimber | 278.6 | MBF | 32.6 | \$45,869.10 |
| | Red Pine | Pulpwood | 401 | Cords | | |
| 3 | Red Pine | Sawtimber | 69.0 | MBF | 18.7 | \$35,442.65 |
| | Mixed Hardwood | Pulpwood | 11 | Cords | | |
| | <i>Sugar Maple</i> | <i>Sawtimber</i> | 3.2 | <i>MBF</i> | | |
| | <i>Sugar Maple</i> | <i>Pulpwood</i> | 5 | <i>Cords</i> | | |
| | Northern Pin Oak | | 10 | Cords | | |
| | Red Pine | | 608 | Cords | | |
| 4 | Red Pine | Sawtimber | 45.7 | MBF | 9.3 | \$27,554.65 |
| | Mixed Hardwood | Pulpwood | 5 | Cords | | |
| | <i>Beech</i> | <i>Sawtimber</i> | 2.5 | <i>MBF</i> | | |
| | Red Pine | Pulpwood | 496 | Cords | | |
| 5 | Red Pine | Sawtimber | 48.6 | MBF | 9.9 | \$29,296.40 |
| | Mixed Hardwood | Pulpwood | 6 | Cords | | |
| | <i>Beech</i> | <i>Sawtimber</i> | 2.7 | <i>MBF</i> | | |
| | <i>Beech</i> | <i>Pulpwood</i> | 1 | <i>Cords</i> | | |
| | Red Pine | | 527 | Cords | | |
| 6 | Red Pine | Pulpwood | 115 | Cords | 8.1 | \$5,324.50 |
| TOTAL: | | | 452.8 | MBF | | |
| TOTAL: | | | 2,976 | Cords | | |

Sale Specific Conditions & Requirements

Sale Name: GNA2 Gates Road

Sale Number: 63-802-23 Seq#: 1

1 - Sale Area

1.2 - Boundaries

1.2.1 - Painted boundaries (9/19)

The sale boundary and Payment Unit boundaries are marked and identified by orange paint. Exterior sale boundary lines against private property are marked with orange paint. Exterior sale boundary lines against federal are marked with orange paint. Interior Payment Unit boundaries are marked with orange paint. The painted boundary line trees are not Included Timber and are to be protected unless marked with blue paint.

2 - Timber Specifications

2.1 - Included Timber

2.1.3 - Cut tree marked unit(s) (12/08)

Within Payment Unit(s) 1 and 6, all trees are designated for cutting when marked with blue paint above and below stump height, regardless of merchantability. In addition, cut rows are designated with blue paint.

2.1.7 - Leave tree marked unit(s) (6/14)

Within Payment Unit(s) 2-5, all trees which meet minimum piece specifications in 2.2 Utilization are designated for cutting, except do not cut trees marked with orange paint above and below stump height.

2.2 - Utilization

2.2.3 - Stump heights (4/07)

Stump heights within Payment Unit(s) 1-6 shall not exceed 12 inches for trees greater than 10 inches DBH and 4 inches for trees smaller than 10 inches DBH.

2.2.11 - Chipping restriction (9/14)

If chipping occurs on this sale, then no woody debris present on the ground at the start of the sale may be chipped. In addition, brush or chips may not be stored or stockpiled on-site for more than 30 days.

2.2.12 - GNA, cut and remove Included Timber (3/18)

Unless provided otherwise herein, the DNR agrees to sell and permit Purchaser to cut and remove Included Timber and Purchaser agrees to purchase, cut, and remove Included Timber.

4 - Transportation

4.1 - Construction

4.1.6 - Road construction (1/09)

Construction of new roads or improvements of existing roads shall be done in such a way as to minimize the environmental and visual impacts. Merchantable trees shall be cut and utilized unless otherwise directed. Non-merchantable trees shall be severed and laid flat on the ground. Slash shall be scattered, and not left in windrows and kept a minimum of 10 feet back from the road edge. Stumps shall be set upright, not left on edge, and be moved at least 10 feet away from the road edge. Disturbed soil shall be feathered into the woods and not left in berms or windrows.

4.1.7 - Road closure (10/11)

All new roads built into the sale must be blocked to vehicle traffic within 30 days of completion of hauling. Overgrown roads that are reopened shall be considered new roads. In general, this will require constructing a four (4') foot high berm of stumps and logs covered with earth. Stumps and brush must be placed along the remainder of the trail. These roads must be rendered impassable to cars and trucks. All stumps from road building and landing construction must be reserved to block any newly constructed roads upon completion of the sale. These stumps must be scattered along the road system to prohibit vehicular movement. Temporary berms may be required if no sale activity occurs for 30 or more consecutive days. Contact the sale administrator for specific details of design and placement.

4.2 - Maintenance

4.2.4 - Grading (10/16)

For completion of the sale, forest roads must be graded. In general, this will require a road grader or bull dozer to shape up the roads after forest products have been hauled off site. This includes cleaning of drainage areas, grading, crowning and filling with gravel, if necessary. The grading equipment to be used must be approved by the Unit Manager or his/her representative.

4.2.5 - Two wheel drive condition (2/04)

All existing trail roads on and adjacent to the sale area must be passable by two-wheel drive traffic for the duration of the sale.

4.4 - Access

4.4.5 - Federal property access (3/11)

Permission for access across federal land has been obtained by the DNR.

5 - Operations

5.1 - Notification

5.1.1 - Pre-sale conference (10/16)

A pre-sale conference on site between the Purchaser and sale administrator is required prior to beginning any operations to determine landing and road locations. The Unit Manager or his/her representative must be contacted at least 5 days in advance to schedule the conference.

5.1.4 - Post-sale conference (10/16)

A post-sale conference on site between the Purchaser and sale administrator is required 5 days prior to the completion of active logging operations to determine clean-up and repair of landings, road edges, and the fulfillment of other contract specifications.

5.2 - Conduct of Operations

5.2.1 - Slash

5.2.1.8 - Slash height (12/08)

No slash may exceed 24 inches in height.

5.2.1.11 - Slash for reforestation (3/21)

To facilitate restoration efforts, slash within Payment Unit 4 shall be piled in windrows along the north edge of the payment unit boundary, blocking access from the road. Stumps within specified restoration areas shall be removed during operations. These areas will be marked on the ground and the Sale Administrator will cover disposal during the pre-sale conference.

5.2.2 - Hazard Trees/Snags

5.2.2.1 - Den trees (10/16)

Obvious hollow and/or den trees shall be protected and left standing unless they are a safety hazard.

5.2.3 - Operating Restrictions

5.2.3.1 - Operating restrictions (9/11)

Within Payment Unit(s) 4, unless changed by written agreement, cutting, skidding, and hauling are limited to the period of September 1 to April 30. This restriction is for Karner blue butterfly habitat.

5.2.3.4 - Oak wilt restriction, no exceptions (1/18)

Within Payment Unit(s) 1-6 cutting, skidding, hauling within the sale and brushing of access roads to the sale are not permitted during the period of April 15 to July 15. No exceptions will be granted. This is necessary to reduce the spread of oak wilt.

5.2.3.14 - heterobasidion root disease (HRD) (3/21)

This plantation is at risk of infection by the root rot fungus, Heterobasidion irregulare. To prevent the spread of this disease, cutting operations within Payment Unit(s) 1-6 are restricted to the period of January 1st through February 28th. Cutting may only occur outside this period with written permission of the Unit Manager or with the application of a

preventative pesticide.

Cellu-Treat and RotStop C are currently the only EPA registered products available in the United States for the control of Heterobasidion. Both products are a water-soluble powder that must be applied to the stump, in accordance with the product label. Dye must be added to these products to provide visible evidence of adequate coverage. Application of these pesticides requires licensing by the Michigan Department of Agriculture and Rural Development. All applicators are required to: provide to the Sale Administrator notification of application per requirements in 40 CFR 170.120; and document and provide to the Sale Administrator annually, by December 31 and prior to closure of sale, the volume of product used and acres treated.

5.2.29 - Shrub protection (1/20)

Do not cut or damage hawthorn, witch-hazel, dogwood or juneberry. These woody-shrub plants are highly beneficial to various wildlife species.

5.2.32 - Decking/landing restoration (9/13)

All decking and landing areas must have the surface area restored to a condition equal to or better than before. This is to ensure the proper regeneration of the stand. Wood debris, chips and "cookies" from trimmings must be removed or scattered away from landing and loading areas and may not be windrowed on the edge.

5.2.38 - No decking against live trees (2/04)

Cut products may not be decked against unmarked or designated leave trees.

5.4 - Soil Protection

5.4.1 - Rutting restriction, general (7/16)

Operations are to cease immediately if equipment and weather conditions result in rutting of roads and/or skid trails which is 12 inches or greater in depth and 50 feet in length. The Unit Manager or his/her representative may restrict hauling and/or skidding if ruts exceed the specified depth. With the Unit Manager or his/her representative's approval, the Purchaser may return to the area when the risk of rutting has decreased.

5.6 - Debris and Waste Material

5.6.2 - GNA, equipment cleaning (1/16)

(a) Areas, known by the DNR prior to timber sale advertisement, that are infested with invasive species of concern are shown on the Timber Sale Map. A current list of invasive species of concern and a map showing the extent of known infestations is available from the DNR. For purposes of this provision, "Off-Road Equipment" includes all logging and construction machinery, except for log trucks, chip vans, service vehicles, water trucks, pickup trucks, cars, and similar vehicles.

(b) Purchaser shall adhere to the following requirements with regard to cleaning "Off-Road Equipment":

(i) Prior to moving Off-Road Equipment onto the Sale Area, Purchaser shall identify the location of the equipment's most recent operation. Purchaser shall not move any Off-Road Equipment that last operated in an area infested with one or more invasive species of concern onto Sale Area without having cleaned such equipment of seeds, soil, vegetative matter, and other debris that could contain or hold seeds, and having notified the DNR, as provided in (iii). If the location of prior operation cannot be identified, then Purchaser shall assume that the location is infested with invasive species of concern.

(ii) Prior to moving Off-Road Equipment from a cutting unit that is shown on the Timber Sale Map to be infested with invasive species of concern to, or through any other area that is shown as being free of invasive species of concern, or infested with a different invasive species, Purchaser shall clean such equipment of seeds, soil, vegetative matter, and other debris that could contain or hold seeds, and shall notify the DNR, as provided in (iii).

(iii) Prior to moving any Off-Road Equipment subject to the cleaning requirements set forth above, Purchaser shall advise DNR of its cleaning measures and make the equipment available for inspection. DNR shall have 2 days, excluding weekends and State holidays, to inspect equipment after it has been made available. After satisfactory inspection or after such 2 day period, Purchaser may move the equipment as planned. Equipment shall be considered clean when a visual inspection does not disclose seeds, soil, vegetative matter, and other debris that could contain or hold seeds. Purchaser shall not be required to disassemble equipment unless so directed by the DNR after inspection.

(iv) If Purchaser desires to clean Off-Road Equipment on National Forest land, such as at the end of a project or prior to moving to, or through an area that is free of invasive species of concern, Purchaser shall obtain prior approval from the Unit Manager or his/her representative as to the location for such cleaning and measures, if any, for controlling impacts.

(v) Unit Manager or his/her representative may order delay, interruption, or modification of this Contract pursuant to Condition & Requirement 7.3 or 7.3.4.

(c) Nothing contained in this Condition & Requirement shall be interpreted as creating any warranty on the part of the DNR that all locations of invasive species of concern have been described herein, elsewhere in this Contract, or designated on the ground. Following sale advertisement, additional locations may be described or designated, and other species may be added to the list of invasive species of concern. In such event, the Unit Manager or his/her representative may order delay, interruption, or modification of this Contract pursuant to Condition & Requirement 7.3 or 7.3.4.

(d) The parties shall promptly communicate with one another with respect to description or designation of additional locations; discovery of locations of new species or new infestation; and, addition of species to the list of invasive species of concern.

5.8 - Protection of Endangered Species

5.8.5 - Protection of raptor nests (3/13)

All trees with raptor nests will be protected if found during harvesting operations. Notification will be made to the Unit Manager or his/her representative who will notify the Wildlife Biologist so an on-site evaluation and recommendation can be made, if necessary.

6 - Safety and Fire Prevention

6.2 - Signing

6.2.1 - Road posting (10/20)

The Purchaser is responsible for posting and maintaining caution signs on roads adjacent to sale area prior to beginning operations. The road must be posted at appropriate distances from the sale area to warn of logging activity and truck traffic. Signs must be removed when harvest operations are suspended or completed. The Purchaser will provide these signs.

7 - Other Conditions

SKIP

7.1.1 - GNA, title (7/16)

General Condition & Requirement 7.1 is inapplicable. The following applies to this contract.

All right, title, and interest in and to any Included Timber shall remain in USDA Forest Service with the State of Michigan acting on behalf of the USDA Forest Service under this GNA contract, until it has been Measured, removed from Sale Area or other authorized cutting area, and paid for, at which time title shall vest in Purchaser. Title to any Included Timber that has been Measured and paid for, but not removed from Sale Area or other authorized cutting area by Purchaser on or prior to Termination Date, shall remain in USDA Forest Service.

7.3 - Contract Modifications

7.3.4 - GNA, contract suspension and modification (5/16)

(a) The Unit Manager may, by written order, delay or interrupt authorized operations under this contract or, notwithstanding Condition & Requirement 7.3, modify this contract, in whole or in part:

(i) To prevent environmental degradation or resource damage, including, but not limited to, harm to habitat, plants, animals, cultural resources, or cave resources;

(ii) To ensure consistency with land and resource management plans or other documents prepared pursuant to the National Environmental Policy Act of 1969, 42 USC 4321-4347;

(iii) To conduct environmental analysis, including, but not limited to, engaging in consultation pursuant to the Endangered

Species Act of 1973, 16 USC 1531, et seq.; or

(iv) Upon agreement of the Forest Service, due to administrative appeal or litigation, regardless of whether the Unit Manager's order is required by a court order or this contract is named in such a proceeding.

(b) In the event of an order delaying or interrupting Purchaser's Operations under this Condition & Requirement, Purchaser's remedy shall be:

(i) a no cost contract extension,

(ii) reimbursement for Out-of-Pocket Expenses,

however, the foregoing remedies shall be available only to the extent that the Unit Manager's order was the sole and exclusive cause of the delay or interruption of Purchaser's operations.

(c) Remedies awarded to the Purchaser shall not be duplicative, and the Unit Manager shall have the right to structure remedies provided herein to avoid duplicative compensation.

(d) Purchaser agrees that this Condition & Requirement, and the remedies provided herein shall apply regardless of any finding by any court that the DNR failed to comply with any statute, regulation and/or policy in connection with awarding, advertising, or authorizing this sale, or a similar sale.

7.5 - Loss

7.5.2 - GNA, liability for loss (7/16)

If Included Timber is destroyed or damaged by an unexpected event that changes the nature of Included Timber, such as wind, flood, insects, disease, or similar cause, the Purchaser shall bear the timber value loss resulting from such destruction or damage.

Deterioration or loss of timber value due to delay or interruption under 7.3.4 - GNA, contract suspension and modification, shall be borne by the party holding title. In this event, Included Timber to which USDA Forest Service holds title, Purchaser of the State GNA contract will not be obligated to remove and pay for such timber. This Subsection shall not be construed to relieve either party of liability for negligence.

7.10 - Certified Timber

7.10.1 - Non-certified timber (2/16)

The area encompassed by this timber sale is not certified to the standards of the Forest Stewardship Council (FSC) or the Sustainable Forestry Initiative (SFI). Forest products from this sale may not be delivered to the mill as "FSC and / or SFI certified". The lands within this sale belong to the National Forest system and are being managed by the State as part of a Good Neighbor Authority (GNA) agreement.



TIMBER SALE MAP

This information provided by authority of Part 525, 1994 PA 451, as amended.

| | | | | | | |
|------------------------------------|------------------|--|-------------------|--------------------|-----------|---------|
| Forest Management Unit Cadillac | | County Newaygo and Montcalm | Mapped By Park | Date 07/25/2023 | Page 1 | of 1 |
| Township 12N | Range 10W 11W | Section(s) and Subdivision(s) S19: N1/2SE, S20: SWNW,N1/2SW, S21: N1/2SW, S23: NESE | | Scale 1:15,840 | | |

| Cover Type | | | | Density | |
|-------------------|----------------------|-------------------------|-------------------|-----------------------------|------------------------|
| A = Aspen | H = Hemlock | N = Marsh | U = Upland Brush | 0 = Non Stocked | 5 = Pole Timber Medium |
| B = Paper Birch | J = Jack Pine | O = Oak | UM = Upland Mixed | 1 = Seedling Sapling Poor | 6 = Pole Timber Well |
| C = Cedar | L = Lowland Brush | P = Lowland Poplar | V = Bog or Marsh | 2 = Seedling Sapling Medium | 7 = Saw Timber Poor |
| D = Treed Bog | LM = Lowland Mixed | Q = Mixed Swamp Conifer | W = White Pine | 3 = Seedling Sapling Well | 8 = Saw Timber Medium |
| E = Swamp Hdwoods | M = Mpl, Bch, Brch | R = Red Pine | X = Non Stocked | 4 = Pole Timber Poor | 9 = Saw Timber Well |
| F = Spruce Fir | MC = Mixed Conifer | S = Black Spruce | Z = Water | | |
| G = Grass | MD = Mixed Deciduous | T = Tamarack | | | |

| PU | Acres | PU | Acres |
|----|-------|----|-------|
| 1 | 20.8 | 4 | 9.3 |
| 2 | 32.6 | 5 | 9.9 |
| 3 | 18.7 | 6 | 8.1 |

GNA2 Gates Road

Compartment 7921578

99.4 Acres

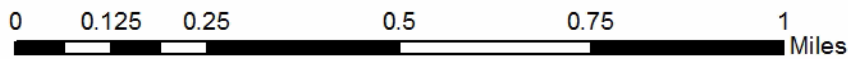
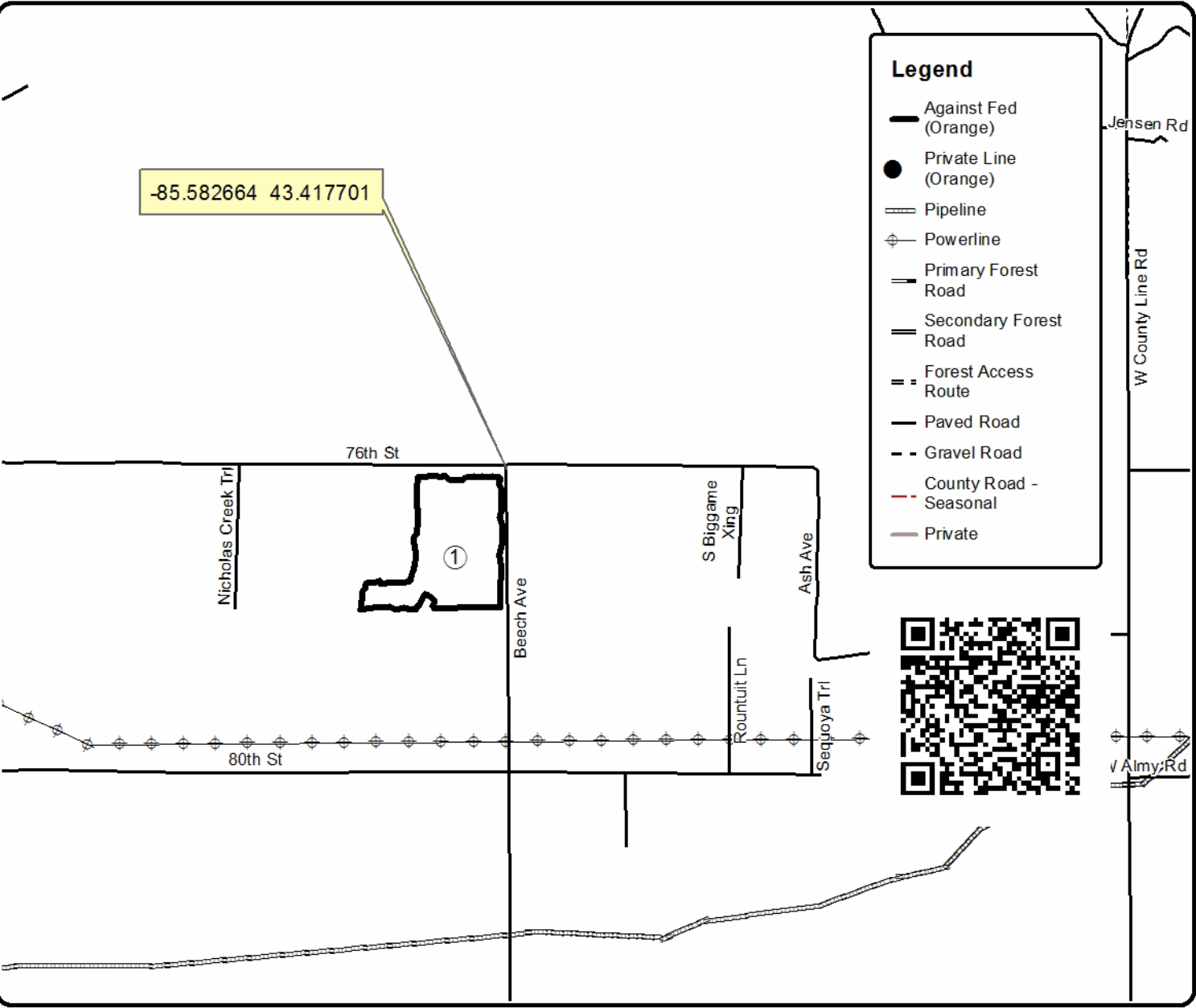



TIMBER SALE MAP

This information provided by authority of Part 525, 1994 PA 451, as amended.

| | |
|-------------|------|
| Sale Number | Year |
| 63 - 802 | 23 |

| | | | | | |
|------------------------|----------------------|---|------------|------|----|
| Forest Management Unit | County | Mapped By | Date | Page | of |
| Cadillac | Newaygo and Montcalm | Park | 07/25/2023 | 1 | 1 |
| Township | Range | Section(s) and Subdivision(s) | Scale | | |
| 12N | 10W 11W | S19: N1/2SE, S20: SWNW,N1/2SW, S21: N1/2SW, S23: NESE | 1:15,840 | | |

| Cover Type | | | | Density | |
|-------------------|----------------------|-------------------------|-------------------|-----------------------------|------------------------|
| A = Aspen | H = Hemlock | N = Marsh | U = Upland Brush | 0 = Non Stocked | 5 = Pole Timber Medium |
| B = Paper Birch | J = Jack Pine | O = Oak | UM = Upland Mixed | 1 = Seedling Sapling Poor | 6 = Pole Timber Well |
| C = Cedar | L = Lowland Brush | P = Lowland Poplar | V = Bog or Marsh | 2 = Seedling Sapling Medium | 7 = Saw Timber Poor |
| D = Treed Bog | LM = Lowland Mixed | Q = Mixed Swamp Conifer | W = White Pine | 3 = Seedling Sapling Well | 8 = Saw Timber Medium |
| E = Swamp Hdwoods | M = Mpl, Bch, Brch | R = Red Pine | X = Non Stocked | 4 = Pole Timber Poor | 9 = Saw Timber Well |
| F = Spruce Fir | MC = Mixed Conifer | S = Black Spruce | Z = Water | | |
| G = Grass | MD = Mixed Deciduous | T = Tamarack | | | |

| PU | Acres | PU | Acres |
|----|-------|----|-------|
| 1 | 20.8 | 4 | 9.3 |
| 2 | 32.6 | 5 | 9.9 |
| 3 | 18.7 | 6 | 8.1 |

GNA2 Gates Road

Compartment 7921578

99.4 Acres

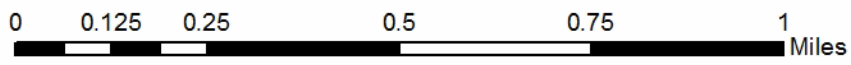
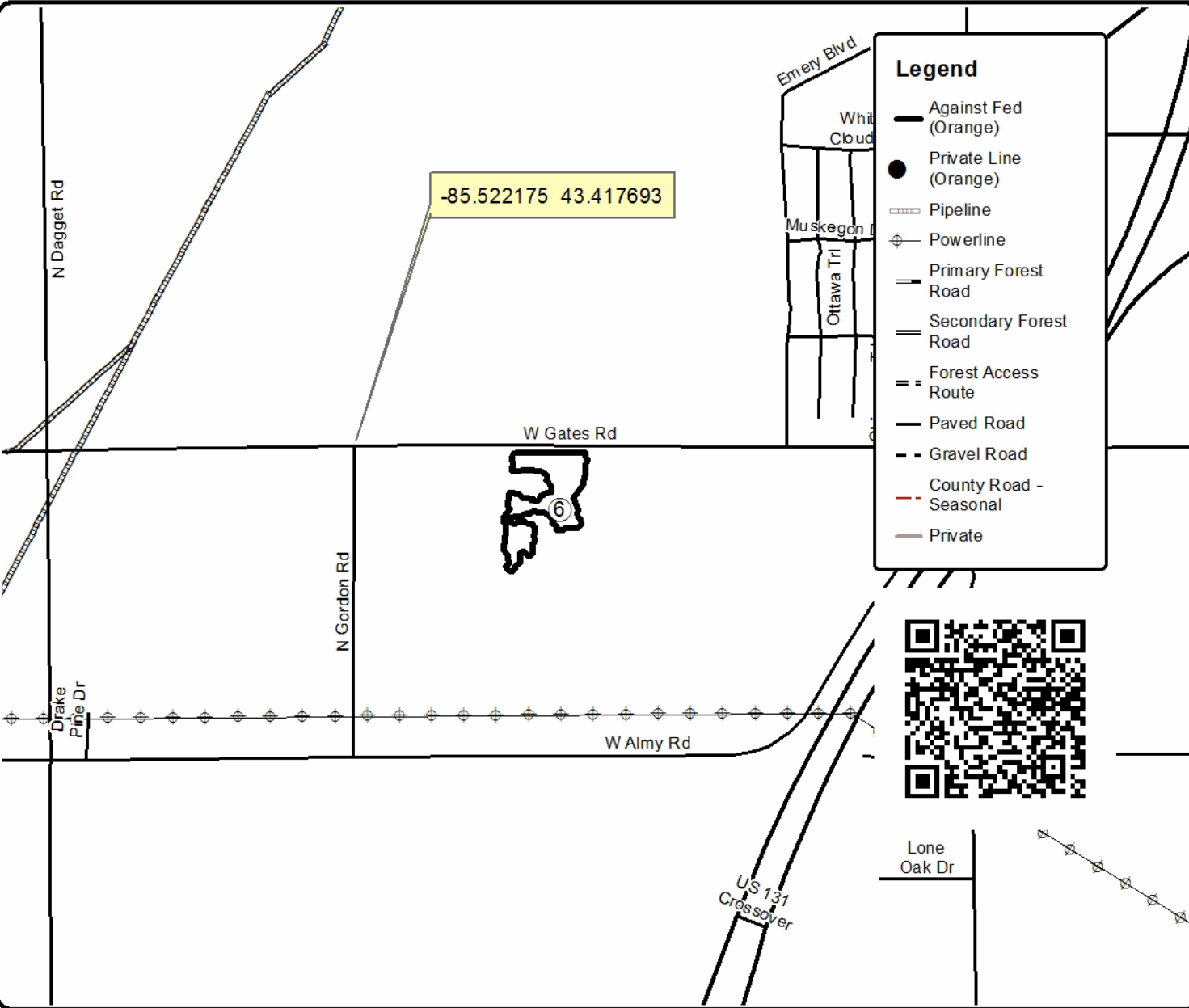



TIMBER SALE MAP

This information provided by authority of Part 525, 1994 PA 451, as amended.

| | |
|-------------|------|
| Sale Number | Year |
| 63 - 802 | 23 |

| | | | | | |
|------------------------|----------------------|---|------------|------|----|
| Forest Management Unit | County | Mapped By | Date | Page | of |
| Cadillac | Newaygo and Montcalm | Park | 07/25/2023 | 1 | 1 |
| Township | Range | Section(s) and Subdivision(s) | Scale | | |
| 12N | 10W 11W | S19: N1/2SE, S20: SWNW,N1/2SW, S21: N1/2SW, S23: NESE | 1:15,840 | | |

| Cover Type | | | | Density | |
|-------------------|----------------------|-------------------------|-------------------|-----------------------------|------------------------|
| A = Aspen | H = Hemlock | N = Marsh | U = Upland Brush | 0 = Non Stocked | 5 = Pole Timber Medium |
| B = Paper Birch | J = Jack Pine | O = Oak | UM = Upland Mixed | 1 = Seedling Sapling Poor | 6 = Pole Timber Well |
| C = Cedar | L = Lowland Brush | P = Lowland Poplar | V = Bog or Marsh | 2 = Seedling Sapling Medium | 7 = Saw Timber Poor |
| D = Treed Bog | LM = Lowland Mixed | Q = Mixed Swamp Conifer | W = White Pine | 3 = Seedling Sapling Well | 8 = Saw Timber Medium |
| E = Swamp Hdwoods | M = Mpl, Bch, Brch | R = Red Pine | X = Non Stocked | 4 = Pole Timber Poor | 9 = Saw Timber Well |
| F = Spruce Fir | MC = Mixed Conifer | S = Black Spruce | Z = Water | | |
| G = Grass | MD = Mixed Deciduous | T = Tamarack | | | |

| PU | Acres | PU | Acres |
|----|-------|----|-------|
| 1 | 20.8 | 4 | 9.3 |
| 2 | 32.6 | 5 | 9.9 |
| 3 | 18.7 | 6 | 8.1 |

GNA2 Gates Road

Compartment 7921578

99.4 Acres

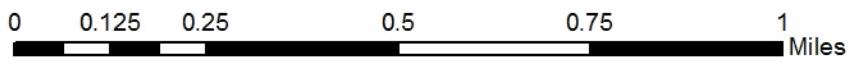
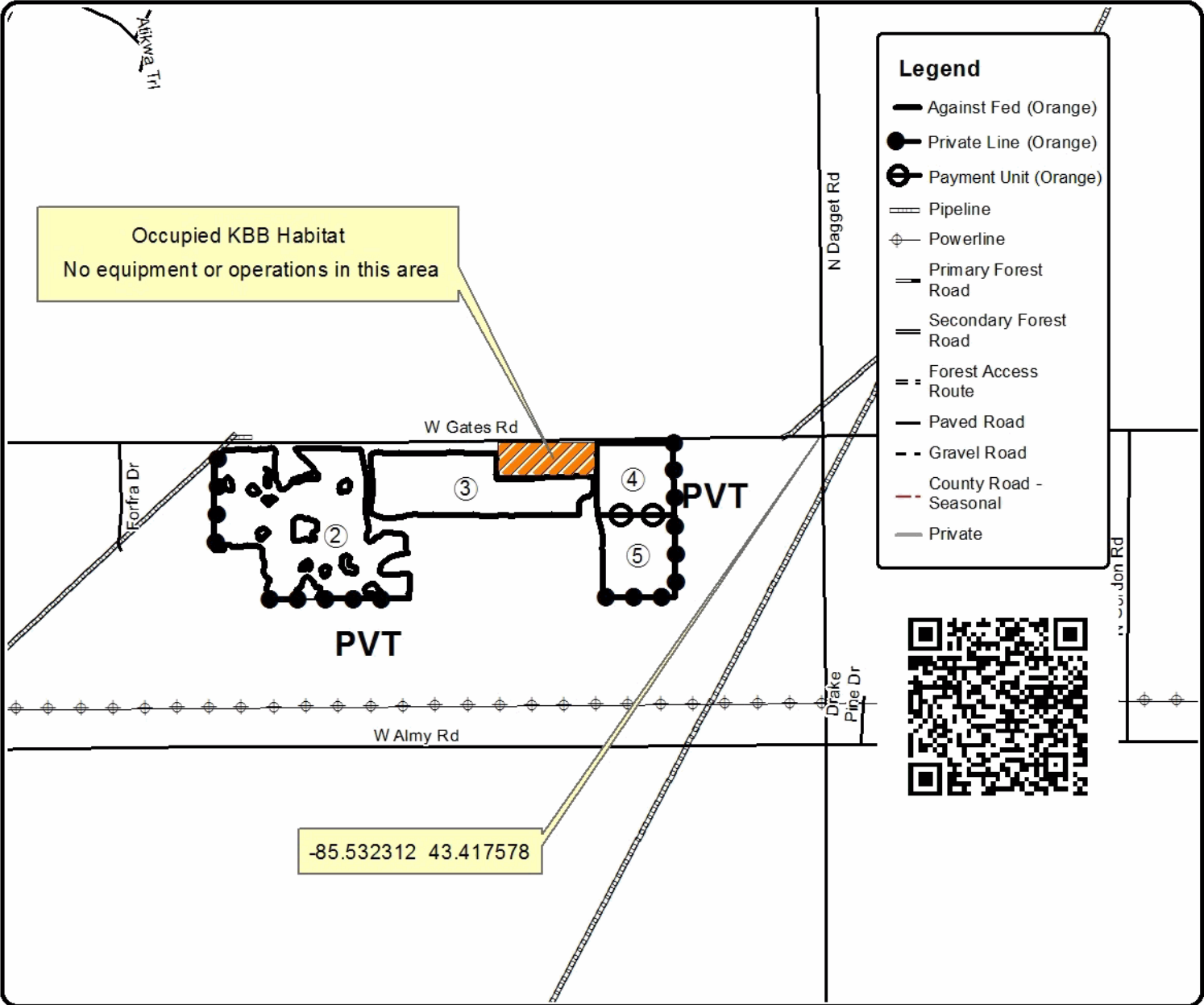

TIMBER SALE INFORMATION

GNA2 188th Aspen (63-805-22)

T16N, R15W, SEC. 10; T16N, R15W, SEC. 2; T16N, R15W, SEC. 3.
Oceana County (Advertised Price \$237,294.55)

SALE NOTE: All units of volume listed for this sale were estimated using the Inventory Manager computer program and the new Michigan taper model.

This is a Good Neighbor Authority (GNA) timber sale on national forest land. This timber sale was set-up and is being advertised by the Michigan DNR for the US Forest Service. The contract will be awarded and administered by the Michigan DNR. Note the additional Sale Specific Conditions & Requirements containing the acronym 'GNA'.

A recreation site such as a trail, pathway, or campground is within the sale area or the vicinity. Certain restrictions/specifications may be applicable including time restrictions. Access may be through other public land.

A timber sale contract for this lump sum, sealed bid timber sale will be awarded to the responsible bidder offering the highest sealed bid price. All units of volume listed below were estimated using the Inventory Manager computer program and the new Michigan taper model. Bids must be at or above the following advertised price for each product and species:

| <u>PRODUCTS & SPECIES</u> | <u>ESTIMATED UNITS*</u> | <u>ADVERTISED PRICE</u> |
|-------------------------------|-------------------------|-------------------------|
| Sawtimber | | |
| B. T. Aspen | 808.7 MBF | \$ 104.00 / MBF |
| Black Cherry | 2.8 MBF | \$ 290.00 / MBF |
| Red Maple | 121.0 MBF | \$ 103.00 / MBF |
| Red Oak | 339.6 MBF | \$ 179.00 / MBF |
| Sugar Maple | 91.4 MBF | \$ 331.00 / MBF |
| White Oak | 4.4 MBF | \$ 77.00 / MBF |
| Pulpwood | | |
| B. T. Aspen | 654 Cords | \$ 30.60 / Cord |
| Mixed Hardwood | 759 Cords | \$ 22.55 / Cord |
| Mixed Oak | 394 Cords | \$ 28.95 / Cord |

* The total volume is statistically estimated within plus (+) or minus (-) 11.91 percent. There are an estimated 4,803 cords on this timber sale, plus or minus 572 cords at the 95% confidence level. The estimated units are final and not subject to adjustment. Prospective bidders are urged to examine this timber and to make their own estimates of quantity and quality.

BOND AND PAYMENT SCHEDULE:

1. A bond in the amount of \$23,729.00 to insure faithful performance of the conditions of the contract will be deposited by the successful bidder within 21 days of the sale award.
2. Cutting in any sale or unit without the required advance payment would be considered a trespass.
3. Total payment must be paid in advance or according to the following schedule :
 - (a) Ten percent (10%) of the sale value must be paid within 21 days of the sale award.
 - (b) The remainder is due before cutting begins.
 - (c) Payment for each of the following units must be made before cutting begins in that unit:

| PAYMENT UNIT NUMBER | PERCENT OF TOTAL SALE VALUE |
|---------------------|-----------------------------|
| 01 | 100.0% |
4. If no cutting takes place, the 10% down payment will not be refunded.
5. Operations on the contract issued will terminate on 12/31/2025.

SALE STATISTICS

Volumes were calculated in cubic feet using the Michigan taper model. Cubic foot volume includes all wood inside bark for the product indicated. For display purposes, cubic feet were converted to cords and MBF using a simple conversion factor, e.g. 79 cubic feet per cord and 185 cubic feet per MBF. The cubic foot volumes are precise; the cords and MBF volumes are not. Cubic foot volume cannot be directly converted to cords or boards with precision.

SALE VOLUMES

The total estimated sale volume may not equal the sum of the species/products due to the nature of statistical calculations associated with double sampling methodology.

| VOLUME | | | STATISTICAL RANGE IN CORDS | |
|------------------|-------------|---------------|----------------------------|---------|
| TOTAL CUBIC FEET | TOTAL CORDS | PERCENT ERROR | MINIMUM | MAXIMUM |
| 379,439 | 4,803 | 11.91% | 4,231 | 5,375 |

VDU VOLUMES

A VDU is a Volume Determination Unit. Volumes and their associated statistics are calculated at the VDU level and summarized to the sale level. There is often a one to one relationship between a VDU and a Payment Unit, but not always, depending on the cruise design. Refer to the VDU TO PAYMENT UNIT table.

| | VOLUME | | | RANGE IN CORDS | |
|---------------|------------------|--------------|---------------|----------------|--------------|
| VDU | TOTAL CUBIC FEET | TOTAL CORDS | PERCENT ERROR | MINIMUM | MAXIMUM |
| 38 | 379,439 | 4,803 | 11.92% | 4,231 | 5,375 |
| TOTAL: | 379,439 | 4,803 | | 4,231 | 5,375 |

VDU TO PAYMENT UNIT

When a VDU is associated with more than one Payment Unit (PU), the VDU volumes are assigned to the PU based on acres of the VDU within the PU.

| VDU | VDU ACRES | PU | PU ACRES |
|---------------|--------------|----|--------------|
| 38 | 107.6 | 1 | 107.6 |
| TOTAL: | 107.6 | | 107.6 |

DESCRIPTION OF TIMBER BY PAYMENT UNIT (PU)

| PU | MARKET GROUP | PRODUCT | QUANTITY | UNIT | ACRES | ADVERTISE PRICE |
|---------------|--------------------------|-----------|----------|--------------|-------|-----------------|
| 1 | B. T. Aspen | Sawtimber | 808.7 | MBF | 107.6 | \$237,294.55 |
| | Black Cherry | | 2.8 | MBF | | |
| | Red Maple | | 121.0 | MBF | | |
| | Red Oak | | 339.6 | MBF | | |
| | Sugar Maple | | 91.4 | MBF | | |
| | White Oak | | 4.4 | MBF | | |
| | B. T. Aspen | | Pulpwood | 654 | | |
| | Mixed Hardwood | 759 | | Cords | | |
| | <i>Beech</i> | 43 | | <i>Cords</i> | | |
| | <i>Black Cherry</i> | 38 | | <i>Cords</i> | | |
| | <i>Red Maple</i> | 402 | | <i>Cords</i> | | |
| | <i>Sugar Maple</i> | 276 | | <i>Cords</i> | | |
| | Mixed Oak | 394 | | Cords | | |
| | <i>/Red (Hybrid) Oak</i> | 11 | | <i>Cords</i> | | |
| | <i>Red Oak</i> | 380 | | <i>Cords</i> | | |
| | <i>White Oak</i> | 3 | | <i>Cords</i> | | |
| | TOTAL: | | | 1,367.9 | | |
| TOTAL: | | | 1,807 | Cords | | |

Sale Specific Conditions & Requirements

Sale Name: GNA2 188th Aspen

Sale Number: 63-805-22 Seq#: 1

1 - Sale Area

1.2 - Boundaries

1.2.1 - Painted boundaries (9/19)

The sale boundary is marked and identified by orange paint. Exterior sale boundary lines against private property are marked with 2 slashes of orange paint. Exterior sale boundary lines against federal property are marked with 2 slashes of orange paint. The painted boundary line trees are not Included Timber and are to be protected.

2 - Timber Specifications

2.1 - Included Timber

2.1.7 - Leave tree marked unit(s) (6/14)

Within Payment Unit(s) 1, cut all deciduous trees that are four (4) inches or more at DBH, except do not cut trees marked with orange paint above and below stump height.

2.2 - Utilization

2.2.6 - Roundwood operation required (3/21)

The skidding of whole trees or tree segments with limbs attached is prohibited within Payment Unit 1. All products must be produced as roundwood and forwarded to existing roads or landing areas in final product length. Trees must be harvested with in-woods processor (feller bunching harvester will not be allowed) in order to retain existing understory.

2.2.12 - GNA, cut and remove Included Timber (3/18)

Unless provided otherwise herein, the DNR agrees to sell and permit Purchaser to cut and remove Included Timber and Purchaser agrees to purchase, cut, and remove Included Timber.

3 - Payments

3.3 - Pre-measured Sales

3.3.4 - Dividing payment units (7/14)

Payment Unit(s) 1 may be divided at the request of the Purchaser and upon approval of the Unit Manager. Dividing Payment Units is a contract modification which requires a Timber Sale Contract Amendment. Payment Units splits will only be allowed 3 times during the sale.

4 - Transportation

4.1 - Construction

4.1.3 - Slash and earthen piles (8/04)

Piles or windrows of earth along roads and landings that have been widened or constructed shall be leveled. Slash from road maintenance or construction, including stumps, shall be dispersed throughout the sale, or be chipped, utilized or otherwise removed from the sale.

4.1.6 - Road construction (1/09)

Construction of new roads or improvements of existing roads shall be done in such a way as to minimize the environmental and visual impacts. Merchantable trees shall be cut and utilized unless otherwise directed. Non-merchantable trees shall be severed and laid flat on the ground. Slash shall be scattered, and not left in windrows and kept a minimum of 10 feet back from the road edge. Stumps shall be set upright, not left on edge, and be moved at least 10 feet away from the road edge. Disturbed soil shall be feathered into the woods and not left in berms or windrows.

4.1.7 - Road closure (10/11)

All new roads built into the sale must be blocked to vehicle traffic within 30 days of completion of hauling. Overgrown roads that are reopened shall be considered new roads. In general, this will require constructing a four (4') foot high berm of stumps and logs covered with earth. Stumps and brush must be placed along the remainder of the trail. These roads must be rendered impassable to cars and trucks. All stumps from road building and landing construction must be reserved to block any

newly constructed roads upon completion of the sale. These stumps must be scattered along the road system to prohibit vehicular movement. Temporary berms may be required if no sale activity occurs for 30 or more consecutive days. Contact the sale administrator for specific details of design and placement.

4.2 - Maintenance

4.2.1 - Hauling restriction (12/08)

Hauling may be restricted on forest roads by the Unit Manager or his/her representative. The restriction may occur during spring breakup or may occur during wet weather conditions.

4.2.4 - Grading (10/16)

For completion of the sale, forest service roads must be graded. In general, this will require a road grader or bull dozer to shape up the roads after forest products have been hauled off site. This includes cleaning of drainage areas, grading, crowning and filling with gravel, if necessary. The grading equipment to be used must be approved by the Unit Manager or his/her representative.

4.2.5 - Two wheel drive condition (2/04)

All existing trail roads on and adjacent to the sale area must be passable by two-wheel drive traffic for the duration of the sale.

5 - Operations

5.1 - Notification

5.1.1 - Pre-sale conference (10/16)

A pre-sale conference on site between the Purchaser and sale administrator is required prior to beginning any operations to determine landing and road locations. The Unit Manager or his/her representative must be contacted at least 5 days in advance to schedule the conference.

5.1.4 - Post-sale conference (10/16)

A post-sale conference on site between the Purchaser and sale administrator is required 5 days prior to the completion of active logging operations to determine clean-up and repair of landings, road edges, and the fulfillment of other contract specifications.

5.2 - Conduct of Operations

5.2.1 - Slash

5.2.1.8 - Slash height (12/08)

No slash may exceed 24 inches in height.

5.2.1.11 - Slash for reforestation (3/21)

Within Payment Unit 1, chipping is prohibited. To facilitate reforestation, the Sale Area shall be left with slash evenly distributed. Bunched tops within the cutting area shall be broken up and scattered.

5.2.2 - Hazard Trees/Snags

5.2.2.1 - Den trees (10/16)

Obvious hollow and/or den trees shall be protected and left standing unless they are a safety hazard.

5.2.2.3 - Snag tree creation (2) (2/04)

Special consideration is given to snags because they are an important part of the habitat requirement for many species of wildlife. The logger is to leave or create at least nine (9) wildlife snags per acre throughout the sale area. Snags consist of leaving a dead standing tree that is not deemed a safety hazard by the Purchaser, or trees with a minimum diameter of nine (9) inches measured at a point to 4.5 feet above ground level which can be girdled the full circumference of the tree.

5.2.3 - Operating Restrictions

5.2.3.1 - Operating restrictions (9/11)

Within Payment Unit(s) 1, unless changed by written agreement, cutting, skidding, and hauling are limited to the period of October 1 to March 31. This restriction is aspen regeneration per USFS.

5.2.3.4 - Oak wilt restriction, no exceptions (1/18)

Within Payment Unit(s) 1, cutting, skidding, hauling within the sale and brushing of access roads to the sale are not permitted during the period of April 15 to July 15. No exceptions will be granted. This is necessary to reduce the spread of oak wilt.

5.2.4 - Dead and Down Creation

5.2.4.4 - Dead and down creation, grouse (6/18)

To encourage grouse and other wildlife, in Payment Unit(s) 1, leave three, 10" diameter or larger log-length (8 foot minimum) piece on the ground for every one acre. These will be evenly scattered throughout the Payment Unit. These trees will be evenly scattered throughout the Payment Unit, preferably at least two chains from any roads, two-tracks, or trails open to vehicles. This can be an unmerchantable piece or a full tree.

5.2.29 - Shrub protection (1/20)

Do not cut or damage hawthorn, witch-hazel, dogwood, sassafras or juneberry. These woody-shrub plants are highly beneficial to various wildlife species.

5.2.32 - Decking/landing restoration (9/13)

All decking and landing areas must have the surface area restored to a condition equal to or better than before. This is to ensure the proper regeneration of the stand. Wood debris, chips, and "cookies" from trimmings must be removed or scattered away from landing and loading areas and may not be windrowed on the edge.

5.2.38 - No decking against live trees (2/04)

Cut products may not be decked against unmarked or designated leave trees.

5.2.40 - Pathway protection (10/10)

The motorcycle trail and is shown on the Timber Sale Map. Do not cut trees or damage posts with pathway markers. Maintain a 20-foot-wide slash, debris, and rut free zone daily, using the pathway as the centerline. Do not run equipment down the pathway. Skidding across the trail may only occur in locations approved by the sale administrator.

5.4 - Soil Protection

5.4.1 - Rutting restriction, general (7/16)

Operations are to cease immediately if equipment and weather conditions result in rutting of roads and/or skid trails which is 12 inches or greater in depth and 50 feet in length. The Unit Manager or his/her representative may restrict hauling and/or skidding if ruts exceed the specified depth. With the Unit Manager or his/her representative's approval, the Purchaser may return to the area when the risk of rutting has decreased.

5.4.5 - Soil caution (11/04)

Skid trails up and down slopes should be avoided. Skid trails along ridges have potential for erosion and the placement of slash on these skid trails while logging is ongoing may alleviate need for any further action. At the direction of the sale administrator, seed, fertilizer, and mulch may also be required.

5.6 - Debris and Waste Material

5.6.2 - GNA, equipment cleaning (1/16)

(a) Areas, known by the DNR prior to timber sale advertisement, that are infested with invasive species of concern are shown on the Timber Sale Map. A current list of invasive species of concern and a map showing the extent of known infestations is available from the DNR. For purposes of this provision, "Off-Road Equipment" includes all logging and construction machinery, except for log trucks, chip vans, service vehicles, water trucks, pickup trucks, cars, and similar vehicles.

(b) Purchaser shall adhere to the following requirements with regard to cleaning "Off-Road Equipment":

(i) Prior to moving Off-Road Equipment onto the Sale Area, Purchaser shall identify the location of the equipment's most recent operation. Purchaser shall not move any Off-Road Equipment that last operated in an area infested with one or more invasive species of concern onto Sale Area without having cleaned such equipment of seeds, soil, vegetative matter, and other debris that could contain or hold seeds, and having notified the DNR, as provided in (iii). If the location of prior operation cannot be identified, then Purchaser shall assume that the location is infested with invasive species of concern.

(ii) Prior to moving Off-Road Equipment from a cutting unit that is shown on the Timber Sale Map to be infested with invasive species of concern to, or through any other area that is shown as being free of invasive species of concern, or infested with a different invasive species, Purchaser shall clean such equipment of seeds, soil, vegetative matter, and other debris that could contain or hold seeds, and shall notify the DNR, as provided in (iii).

(iii) Prior to moving any Off-Road Equipment subject to the cleaning requirements set forth above, Purchaser shall advise DNR of its cleaning measures and make the equipment available for inspection. DNR shall have 2 days, excluding weekends and State holidays, to inspect equipment after it has been made available. After satisfactory inspection or after such 2 day period, Purchaser may move the equipment as planned. Equipment shall be considered clean when a visual inspection does not disclose seeds, soil, vegetative matter, and other debris that could contain or hold seeds. Purchaser shall not be required to disassemble equipment unless so directed by the DNR after inspection.

(iv) If Purchaser desires to clean Off-Road Equipment on National Forest land, such as at the end of a project or prior to moving to, or through an area that is free of invasive species of concern, Purchaser shall obtain prior approval from the Unit Manager or his/her representative as to the location for such cleaning and measures, if any, for controlling impacts.

(v) Unit Manager or his/her representative may order delay, interruption, or modification of this Contract pursuant to Condition & Requirement 7.3 or 7.3.4.

(c) Nothing contained in this Condition & Requirement shall be interpreted as creating any warranty on the part of the DNR that all locations of invasive species of concern have been described herein, elsewhere in this Contract, or designated on the ground. Following sale advertisement, additional locations may be described or designated, and other species may be added to the list of invasive species of concern. In such event, the Unit Manager or his/her representative may order delay, interruption, or modification of this Contract pursuant to Condition & Requirement 7.3 or 7.3.4.

(d) The parties shall promptly communicate with one another with respect to description or designation of additional locations; discovery of locations of new species or new infestation; and, addition of species to the list of invasive species of concern.

5.8 - Protection of Endangered Species

5.8.5 - Protection of raptor nests (3/13)

All trees with raptor nests will be protected if found during harvesting operations. Notification will be made to the Unit Manager or his/her representative who will notify the Wildlife Biologist so an on-site evaluation and recommendation can be made, if necessary.

6 - Safety and Fire Prevention

6.2 - Signing

6.2.1 - Road posting (10/20)

The Purchaser is responsible for posting and maintaining caution signs on 188th Avenue and River Road prior to beginning operations. The road must be posted at appropriate distances from the Sale Area to warn of logging activity and truck traffic. Signs must be removed when harvest operations are suspended or completed. The Purchaser will provide these signs.

6.2.3 - Recreational trail posting (10/20)

The Purchaser is responsible for posting and maintaining caution signs on the motorcycle trail prior to beginning operations. The trail must be posted at appropriate distances from the Sale Area to warn of logging activity and truck traffic at both ends of the trail. Signs must be removed when harvest operations are suspended or completed. The Purchaser will provide these signs.

7 - Other Conditions

SKIP

7.1.1 - GNA, title (7/16)

General Condition & Requirement 7.1 is inapplicable. The following applies to this contract.

All right, title, and interest in and to any Included Timber shall remain in USDA Forest Service with the State of Michigan

acting on behalf of the USDA Forest Service under this GNA contract, until it has been Measured, removed from Sale Area or other authorized cutting area, and paid for, at which time title shall vest in Purchaser. Title to any Included Timber that has been Measured and paid for, but not removed from Sale Area or other authorized cutting area by Purchaser on or prior to Termination Date, shall remain in USDA Forest Service.

7.3 - Contract Modifications

7.3.4 - GNA, contract suspension and modification (5/16)

(a) The Unit Manager may, by written order, delay or interrupt authorized operations under this contract or, notwithstanding Condition & Requirement 7.3, modify this contract, in whole or in part:

(i) To prevent environmental degradation or resource damage, including, but not limited to, harm to habitat, plants, animals, cultural resources, or cave resources;

(ii) To ensure consistency with land and resource management plans or other documents prepared pursuant to the National Environmental Policy Act of 1969, 42 USC 4321-4347;

(iii) To conduct environmental analysis, including, but not limited to, engaging in consultation pursuant to the Endangered Species Act of 1973, 16 USC 1531, et seq.; or

(iv) Upon agreement of the Forest Service, due to administrative appeal or litigation, regardless of whether the Unit Manager's order is required by a court order or this contract is named in such a proceeding.

(b) In the event of an order delaying or interrupting Purchaser's Operations under this Condition & Requirement, Purchaser's remedy shall be:

(i) a no cost contract extension,

(ii) reimbursement for Out-of-Pocket Expenses,

however, the foregoing remedies shall be available only to the extent that the Unit Manager's order was the sole and exclusive cause of the delay or interruption of Purchaser's operations.

(c) Remedies awarded to the Purchaser shall not be duplicative, and the Unit Manager shall have the right to structure remedies provided herein to avoid duplicative compensation.

(d) Purchaser agrees that this Condition & Requirement, and the remedies provided herein shall apply regardless of any finding by any court that the DNR failed to comply with any statute, regulation and/or policy in connection with awarding, advertising, or authorizing this sale, or a similar sale.

7.5 - Loss

7.5.2 - GNA, liability for loss (7/16)

If Included Timber is destroyed or damaged by an unexpected event that changes the nature of Included Timber, such as wind, flood, insects, disease, or similar cause, the Purchaser shall bear the timber value loss resulting from such destruction or damage.

Deterioration or loss of timber value due to delay or interruption under 7.3.4 - GNA, contract suspension and modification, shall be borne by the party holding title. In this event, Included Timber to which USDA Forest Service holds title, Purchaser of the State GNA contract will not be obligated to remove and pay for such timber. This Subsection shall not be construed to relieve either party of liability for negligence.

7.10 - Certified Timber

7.10.1 - Non-certified timber (2/16)

The area encompassed by this timber sale is not certified to the standards of the Forest Stewardship Council (FSC) or the Sustainable Forestry Initiative (SFI). Forest products from this sale may not be delivered to the mill as "FSC and / or SFI certified". The lands within this sale belong to the National Forest system and are being managed by the State as part of a

Good Neighbor Authority (GNA) agreement.



TIMBER SALE MAP

This information provided by authority of Part 525, 1994 PA 451, as amended.

| | | | | | |
|------------------------------------|------------------|--|--------------------|-----------|---------|
| Forest Management Unit Cadillac | County Oceana | Mapped By Park | Date 07/21/2023 | Page 1 | of 1 |
| Township 15N | Range 16W | Section(s) and Subdivision(s) Sec 2: SWSW Sec 3: SE | Scale 1:15,840 | | |

| Cover Type | | | | Density | |
|-------------------|----------------------|-------------------------|-------------------|-----------------------------|------------------------|
| A = Aspen | H = Hemlock | N = Marsh | U = Upland Brush | 0 = Non Stocked | 5 = Pole Timber Medium |
| B = Paper Birch | J = Jack Pine | O = Oak | UM = Upland Mixed | 1 = Seedling Sapling Poor | 6 = Pole Timber Well |
| C = Cedar | L = Lowland Brush | P = Lowland Poplar | V = Bog or Marsh | 2 = Seedling Sapling Medium | 7 = Saw Timber Poor |
| D = Treed Bog | LM = Lowland Mixed | Q = Mixed Swamp Conifer | W = White Pine | 3 = Seedling Sapling Well | 8 = Saw Timber Medium |
| E = Swamp Hdwoods | M = Mpl, Bch, Brch | R = Red Pine | X = Non Stocked | 4 = Pole Timber Poor | 9 = Saw Timber Well |
| F = Spruce Fir | MC = Mixed Conifer | S = Black Spruce | Z = Water | | |
| G = Grass | MD = Mixed Deciduous | T = Tamarack | | | |

| PU | Acres |
|----|-------|
| 1 | 107.6 |

GNA2 188th Aspen

Compartment 7921134
107.6 Acres

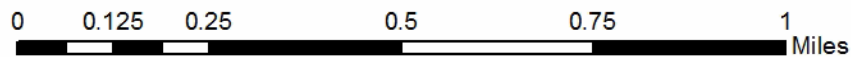
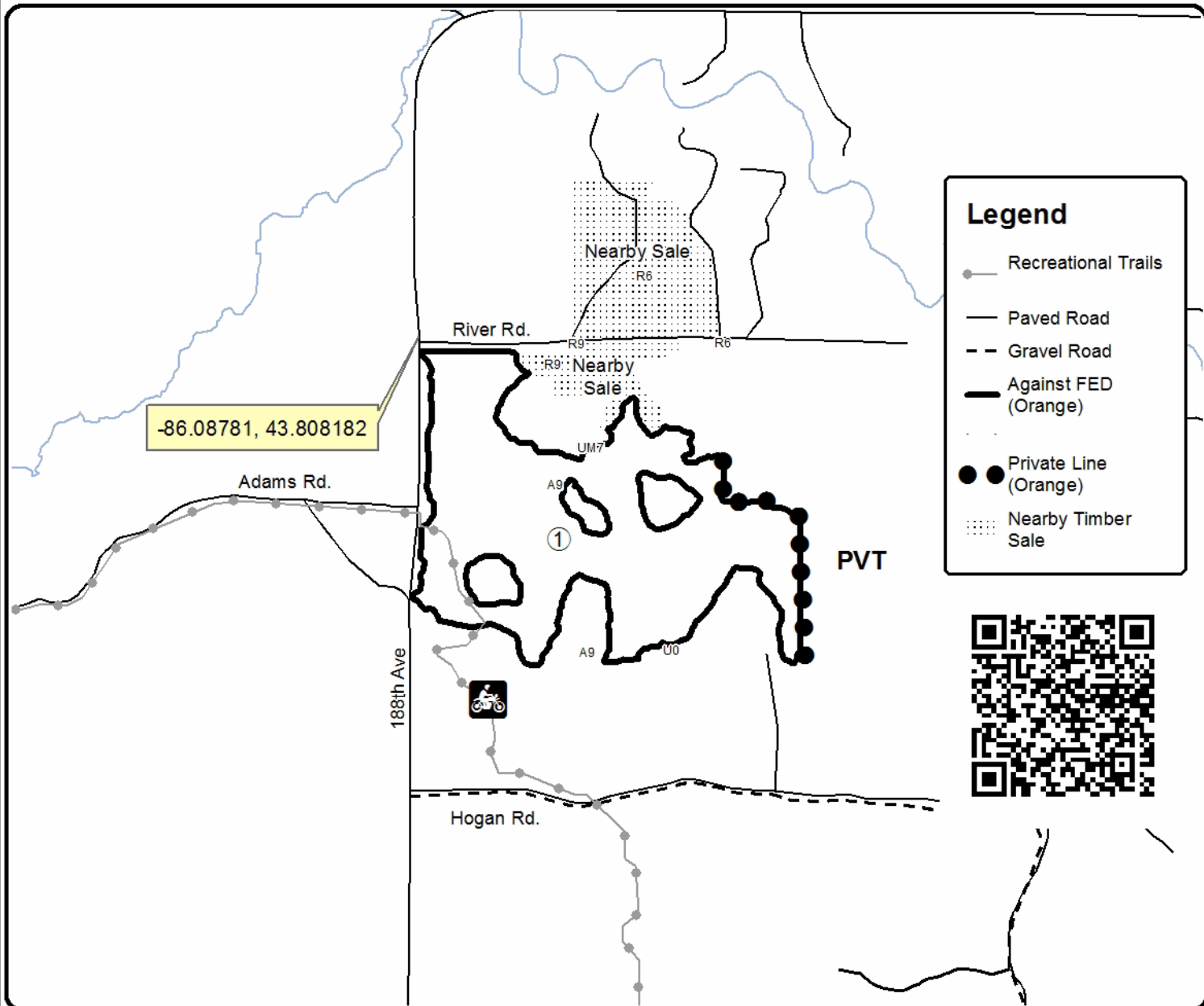
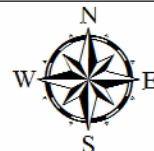

GNA2 188th Aspen (63-805-22)

T16N, R15W, SEC. 10; T16N, R15W, SEC. 2; T16N, R15W, SEC. 3; Oceana

In response to the notice of sale to be held 3:00 p.m. (local time) on September 20, 2023, I am hereby submitting my sealed bid (firm offer) for the following forest products to be cut. Bids for individual species must be at or above the advertised price. All non-responsive bid forms may be rejected.

| <u>PRODUCTS & SPECIES</u> | <u>ESTIMATED VOLUME*</u> | <u>ADVERTISED PRICE</u> | <u>BID PRICE/UNIT</u> |
|-------------------------------|--------------------------|-------------------------|-----------------------|
| Sawtimber | | | |
| B. T. Aspen | 808.7 MBF | \$ 104.00/MBF | \$ _____ |
| Black Cherry | 2.8 MBF | \$ 290.00/MBF | \$ _____ |
| Red Maple | 121.0 MBF | \$ 103.00/MBF | \$ _____ |
| Red Oak | 339.6 MBF | \$ 179.00/MBF | \$ _____ |
| Sugar Maple | 91.4 MBF | \$ 331.00/MBF | \$ _____ |
| White Oak | 4.4 MBF | \$ 77.00/MBF | \$ _____ |
| Pulpwood | | | |
| B. T. Aspen | 654 Cords | \$ 30.60/Cord | \$ _____ |
| Mixed Hardwood | 759 Cords | \$ 22.55/Cord | \$ _____ |
| Mixed Oak | 394 Cords | \$ 28.95/Cord | \$ _____ |

*The volumes are statistically estimated within plus (+) or minus (-) 11.91 percent at 95% confidence level. These estimated volumes are final and not subject to adjustment. Prospective bidders are urged to examine this timber and to make their own estimates of quantity and quality.

I understand that any or all bids may be rejected. All bids must be signed and all bid items must be bid or the bid form may be rejected. I also understand that consideration and awarding a contract will be based upon my past performance and ability to complete the contract based upon equipment and staffing subject to my control.

FEDERAL ID: ____ - ____ - ____ or SOCIAL SECURITY NUMBER: ____ - ____ - ____

Company or individual bidding: _____

Company representative's name: _____

Address: _____

City: _____ State: _____ Zip: _____

IF AVAILABLE, PLEASE PLACE THE PERSONALIZED LABEL FROM YOUR PROSPECTUS IN THE ABOVE BOX.

Individual or company representative's signature: _____ Date: _____

Phone number : _____ Email (optional): _____

THE WINNING BIDDER MUST COMPLETE THE VERIFICATION OF WORKER'S DISABILITY COMPENSATION ACT COMPLIANCE (ON REVERSE SIDE IF DOUBLE SIDED) WITHIN 21 DAYS OF SALE AWARD DATE



| FOR DEPARTMENT USE ONLY | |
|----------------------------------|--|
| Sale Number (XX - XXX - XX - XX) | |
| Forest Management Unit: | |

TIMBER SALE VERIFICATION OF WORKER'S DISABILITY COMPENSATION ACT COMPLIANCE

As required by Act 317, P.A. 1969 (Worker's Compensation) and
Part 5 of Act 451 of 1994, as amended.

VERIFICATION OF WORKER'S DISABILITY COMPENSATION ACT COMPLIANCE

- This verification must be completed and submitted within 21 days of contract award and prior to the issuance of the timber sale contract.
- In addition, if boxes 2B or 2C are checked, then Notice of Exclusion or Certificate of Insurance must be submitted within twenty-one (21) days of the contract award and prior to the issuance of the timber sale contract.
- All information must be typed or printed except for written signatures.

Please Check Appropriate Categories:

1. My business is organized as (you **must** check one of the boxes below):
 - A. Sole Proprietorship (individual)
 - B. Partnership
 - C. Corporation
2. You **must** check one of the boxes below:
 - A. I certify my business is a sole proprietorship and it has no employees but the sole proprietor. I am not subject to the Worker's Compensation Laws.
 - B. I certify my business has satisfied its obligation to the Worker's Compensation Act through the use of an approved Notice of Exclusion (BWC-337, Rev. 5/96). I will provide a copy of the Notice of Exclusion within 21 days of the contract award. (For questions or a copy of the BWC-337, please call the Worker's Compensation Bureau at 517-322-1195).
 - C. I certify my business has a Worker's Compensation Policy. I will provide an original Certificate of Insurance within twenty-one (21) days of the contract award.
3. If you have checked item 2(A) or 2(B), you **must** indicate the number of **both** full-time and part-time employees, other than yourself, including family members and active partners (if none, you must enter "0").

_____ Full-time Employees

_____ Part-time Employees

| | | | |
|------------------|-------|-------------------------------------|--|
| Name of Business | | Federal ID (or) Social Security No. | |
| Address | | Telephone () | |
| City | State | ZIP | |

I hereby certify that the above information is true and correct. I agree to notify the Michigan DNR of any changes that occur in factors affecting my coverage during any of my present and future operations.

Signature of Owner or Authorized Representative

Title

Date

Please complete the "SEALED BID" information on the next page

GNA2 Zone 7 (63-801-23)

T21N, R10W, SEC. 10; T21N, R10W, SEC. 15; T21N, R10W, SEC. 18; T21N,

In response to the notice of sale to be held 3:00 p.m. (local time) on September 20, 2023, I am hereby submitting my sealed bid (firm offer) for the following forest products to be cut. Bids for individual species must be at or above the advertised price. All non-responsive bid forms may be rejected.

| <u>PRODUCTS & SPECIES</u> | <u>ESTIMATED VOLUME*</u> | <u>ADVERTISED PRICE</u> | <u>BID PRICE/UNIT</u> |
|-------------------------------|--------------------------|-------------------------|-----------------------|
| Sawtimber | | | |
| Beech | 28.7 MBF | \$ 157.00/MBF | \$ _____ |
| Jack Pine | 12.6 MBF | \$ 26.00/MBF | \$ _____ |
| Mixed Aspen | 596.7 MBF | \$ 97.00/MBF | \$ _____ |
| Red Maple | 131.0 MBF | \$ 96.00/MBF | \$ _____ |
| Red Pine | 1,305.1 MBF | \$ 93.00/MBF | \$ _____ |
| White Pine | 6.3 MBF | \$ 87.00/MBF | \$ _____ |
| White Spruce | 4.2 MBF | \$ 54.00/MBF | \$ _____ |
| Pulpwood | | | |
| Balsam Fir | 11 Cords | \$ 27.95/Cord | \$ _____ |
| Jack Pine | 571 Cords | \$ 15.20/Cord | \$ _____ |
| Mixed Aspen | 1,572 Cords | \$ 28.55/Cord | \$ _____ |
| Mixed Hardwood | 807 Cords | \$ 21.05/Cord | \$ _____ |
| Red Pine | 3,400 Cords | \$ 43.80/Cord | \$ _____ |
| Scotch Pine | 82 Cords | \$ 13.10/Cord | \$ _____ |
| White Pine | 10 Cords | \$ 22.20/Cord | \$ _____ |
| White Spruce | 62 Cords | \$ 25.05/Cord | \$ _____ |

*The volumes are statistically estimated within plus (+) or minus (-) 9.52 percent at 95% confidence level. These estimated volumes are final and not subject to adjustment. Prospective bidders are urged to examine this timber and to make their own estimates of quantity and quality.

I understand that any or all bids may be rejected. All bids must be signed and all bid items must be bid or the bid form may be rejected. I also understand that consideration and awarding a contract will be based upon my past performance and ability to complete the contract based upon equipment and staffing subject to my control.

FEDERAL ID: ____ - ____ - ____ or SOCIAL SECURITY NUMBER: ____ - ____ - ____

Company or individual bidding: _____

Company representative's name: _____

Address: _____

City: _____ State: _____ Zip: _____

IF AVAILABLE, PLEASE PLACE THE PERSONALIZED LABEL FROM YOUR PROSPECTUS IN THE ABOVE BOX.

Individual or company representative's signature: _____ Date: _____

Phone number : _____ Email (optional): _____

THE WINNING BIDDER MUST COMPLETE THE VERIFICATION OF WORKER'S DISABILITY COMPENSATION ACT COMPLIANCE (ON REVERSE SIDE IF DOUBLE SIDED) WITHIN 21 DAYS OF SALE AWARD DATE

GNA2 Gates Road (63-802-23)

T12N, R10W, SEC. 19; T12N, R10W, SEC. 20; T12N, R10W, SEC. 21; T12N,

In response to the notice of sale to be held 3:00 p.m. (local time) on September 20, 2023, I am hereby submitting my sealed bid (firm offer) for the following forest products to be cut. Bids for individual species must be at or above the advertised price. All non-responsive bid forms may be rejected.

| <u>PRODUCTS & SPECIES</u> | <u>ESTIMATED VOLUME*</u> | <u>ADVERTISED PRICE</u> | <u>BID PRICE/UNIT</u> |
|-------------------------------|--------------------------|-------------------------|-----------------------|
| Sawtimber | | | |
| Red Pine | 452.8 MBF | \$ 98.00/MBF | \$ _____ |
| Pulpwood | | | |
| Mixed Hardwood | 22 Cords | \$ 22.25/Cord | \$ _____ |
| Northern Pin Oak | 10 Cords | \$ 28.55/Cord | \$ _____ |
| Red Pine | 2,944 Cords | \$ 46.30/Cord | \$ _____ |

*The volumes are statistically estimated within plus (+) or minus (-) 13.97 percent at 95% confidence level. These estimated volumes are final and not subject to adjustment. Prospective bidders are urged to examine this timber and to make their own estimates of quantity and quality.

I understand that any or all bids may be rejected. All bids must be signed and all bid items must be bid or the bid form may be rejected. I also understand that consideration and awarding a contract will be based upon my past performance and ability to complete the contract based upon equipment and staffing subject to my control.

FEDERAL ID: _____ or SOCIAL SECURITY NUMBER: _____

Company or individual bidding: _____

Company representative's name: _____

Address: _____

City: _____ State: _____ Zip: _____

IF AVAILABLE, PLEASE PLACE THE PERSONALIZED LABEL FROM YOUR PROSPECTUS IN THE ABOVE BOX.

Individual or company representative's signature: _____ Date: _____

Phone number : _____ Email (optional): _____

THE WINNING BIDDER MUST COMPLETE THE VERIFICATION OF WORKER'S DISABILITY COMPENSATION ACT COMPLIANCE (ON REVERSE SIDE IF DOUBLE SIDED) WITHIN 21 DAYS OF SALE AWARD DATE



TIMBER SALE VERIFICATION OF WORKER'S DISABILITY COMPENSATION ACT COMPLIANCE

As required by Act 317, P.A. 1969 (Worker's Compensation) and
Part 5 of Act 451 of 1994, as amended.

| FOR DEPARTMENT USE ONLY | |
|----------------------------------|--|
| Sale Number (XX - XXX - XX - XX) | |
| Forest Management Unit: | |

VERIFICATION OF WORKER'S DISABILITY COMPENSATION ACT COMPLIANCE

- This verification must be completed and submitted within 21 days of contract award and prior to the issuance of the timber sale contract.
- In addition, if boxes 2B or 2C are checked, then Notice of Exclusion or Certificate of Insurance must be submitted within twenty-one (21) days of the contract award and prior to the issuance of the timber sale contract.
- All information must be typed or printed except for written signatures.

Please Check Appropriate Categories:

1. My business is organized as (you **must** check one of the boxes below):
 - A. Sole Proprietorship (individual)
 - B. Partnership
 - C. Corporation
2. You **must** check one of the boxes below:
 - A. I certify my business is a sole proprietorship and it has no employees but the sole proprietor. I am not subject to the Worker's Compensation Laws.
 - B. I certify my business has satisfied its obligation to the Worker's Compensation Act through the use of an approved Notice of Exclusion (BWC-337, Rev. 5/96). I will provide a copy of the Notice of Exclusion within 21 days of the contract award. (For questions or a copy of the BWC-337, please call the Worker's Compensation Bureau at 517-322-1195).
 - C. I certify my business has a Worker's Compensation Policy. I will provide an original Certificate of Insurance within twenty-one (21) days of the contract award.
3. If you have checked item 2(A) or 2(B), you **must** indicate the number of **both** full-time and part-time employees, other than yourself, including family members and active partners (if none, you must enter "0").

_____ Full-time Employees

_____ Part-time Employees

| | | | |
|------------------|-------|-------------------------------------|--|
| Name of Business | | Federal ID (or) Social Security No. | |
| Address | | Telephone () | |
| City | State | ZIP | |

I hereby certify that the above information is true and correct. I agree to notify the Michigan DNR of any changes that occur in factors affecting my coverage during any of my present and future operations.

Signature of Owner or Authorized Representative

Title

Date

Please complete the "SEALED BID" information on the next page