



**DEPARTMENT OF NATURAL RESOURCES  
STATE OF MICHIGAN  
TIMBER SALE PROSPECTUS #7353**

SCHEDULED SALE DATE AND TIME: **2:00 p.m. (local time) on December 13, 2023.**

LOCATION: **SHINGLETON MGMT UNIT, PO BOX 67, M 28 WEST, SHINGLETON, MI 49884.**

PROSPECTUS NOTE: The bidder is advised to inspect the sale area and review the location, estimated volumes, operating costs and contract terms of proposed sales. Please be aware that some landowners may request 60 days or more notice for access across their land.

Notice is hereby given that bids will be received by the Unit Manager, SHINGLETON MANAGEMENT UNIT, for certain timber on the following described lands:

Hufflepuff Hardwoods (41-003-23) / T45N, R13W, SEC. 13, SESW.

T45N, R13W, SEC. 24, NENW,NE,E1/2SE.

Schoolcraft County, Advertised Price \$68,483.70, 117.3 Acres, Hardwood, Sugar Maple.

SALE NOTE: The county must be contacted prior to crossing or harvesting in the county road R-O-W. This applies to Payment Units 2, 4, 5 and County Road 456.

Within Payment Unit(s) 1-6, harvesting is limited to the period of October 1 to April 15 because of both deer yard restrictions and slippery bark concerns.

Trail 43 is a snowmobile trail and is shown on the Timber Sale Map. See Sale Spec 5.2.41 for restrictions.

A recreation site such as a trail, pathway, or campground is within the sale area or the vicinity. Certain restrictions/specifications may be applicable including time restrictions.

Ski Trail Hardwood 2 (41-010-23) / T42N, R17W, SEC. 26, S1/2NW,S1/2NE,N1/2SW,N1/2SE.

T42N, R17W, SEC. 26, SWSE.

T42N, R17W, SEC. 27, NW,NWNE,S1/2NE,N1/2SW,N1/2SE.

T42N, R17W, SEC. 34, W1/2NE.

Schoolcraft County, Advertised Price \$500,408.40, 424.5 Acres, Hardwood, Sugar Maple.

SALE NOTE: Road work is required on this sale. See Sale Spec 4.1.8 for details.

Within Payment Unit(s) 4, 5, and 7, harvesting is limited to the period of October 1 to December 31 to protect the ski trail, while providing deer browse.

Within Payment Unit(s) 1, 2, 3, 6, 8, and 9, harvesting is limited to the period of October 1 to April 15 to provide deer browse.

The Indian Lake Pathway is shown on the Timber Sale Map. See Sale Spec 5.2.40 for restrictions.

Snowmobile Trail 7 is shown on the Timber Sale Map. See Sale Spec 5.2.41 for details.

A recreation site such as a trail, pathway, or campground is within the sale area or the vicinity. Certain restrictions/specifications may be applicable including time restrictions.

Hope You Like Bees (41-019-23) / T42N, R17W, SEC. 26, SWNW,NWSW.

T42N, R17W, SEC. 27, N1/2NW,NE,N1/2SE.

Schoolcraft County, Advertised Price \$169,467.70, 145.3 Acres, Red Pine, Hardwood.

SALE NOTE: Road work is required on this sale. See Sale Spec 4.1.8 for details.

The Indian Lake Pathways are a network of hiking, cross country skiing, and snowshoeing trails and are shown on the Timber Sale Map. See Sale Spec 5.2.40 for restrictions.

Snowmobile Trail 7 is shown on the Timber Sale Map. See Sale Spec 5.2.41 for details.

A recreation site such as a trail, pathway, or campground is within the sale area or the vicinity. Certain restrictions/specifications may be applicable including time restrictions.

## BID INSTRUCTIONS (VER. 10/10/2022):

### 1. Scheduled Bid Location, Date, and Time (2/11)

Bids must be received by the Unit Manager, SHINGLETON OFFICE, PO Box 67 M 28 West, Shingleton, MI 49884, no later than 2:00 p.m. (local time) on December 13, 2023. For further information concerning this sale, contact Robert Burnham at 906-420-1645 extension n/a.

### 2. Bidder's Qualifications (10/22)

If all or part of a timber sale was prepared by a private contractor, the contractor and that contractor's company are not permitted to bid on the timber sale. A person must be 18 years of age or older to purchase timber. Permanent employees of the Department of Natural Resources or members of their immediate household may not bid. Former employees, in the permanent or seasonal class, may not bid until 3 months after the last day of active duty. Bids will not be accepted from individuals or companies appearing on the DNR/FRD No-Bid List. This list contains the names of purchasers who previously failed to execute a contract within 21-days or who have a history of poor performance.

### 3. Preparation of Sealed Bids (5/16)

Bid Forms may be completed online thru Michigan DNR Timber Sale Online Bidding (OLB) at [www.michigan.gov/timberbidding](http://www.michigan.gov/timberbidding) or by completing the hardcopy Bid Form found in the Timber Sale Prospectus. Hardcopy Bid Forms shall be manually signed in ink. Registration in OLB is considered your 'signature' for all bids submitted thru that system. Bid prices must be entered for each species and product in the Bid Price column for all material subject to bidding and all fill-in blanks must be completed. If erasures or other changes appear on the hardcopy Bid Form, each erasure or change must be initialed by the person signing the bid.

### 4. Submission of Sealed Bids (5/16)

Bid forms may be obtained from the Unit Manager or thru OLB. Bids may be submitted hardcopy or thru OLB. All hardcopy bids must be submitted on the bid form and in an envelope clearly identified as described in this section. NOTE: Only one bid form per bid envelope. Sealed bids must be submitted to the Unit office designated in the prospectus and must be submitted at or prior to the time established in the prospectus. The envelope should show on the outside (a) the sale name or number and (b) the date and time of bid opening, as shown in the prospectus. Bids received after the time specified in the sale prospectus are late bids and will be rejected.

It is possible for a bidder to submit multiple bids on a single sale. For example, a bid may be submitted hardcopy and a bid may be submitted thru OLB. Or, two bidders from the same company could both submit bids on the same sale. If this were to happen, the State would accept all bids received and award the contract accordingly. All bidding and contractual requirements would apply to all bids received.

### 5. Public Opening of Sealed Bids (7/16)

If conditions permit, the sealed bids will be publicly opened and posted at the time and place set in the prospectus.

If a bidder, present at a bid opening, has submitted bids on more than one sale, that bidder may withdraw their unopened bid envelopes or announce the withdrawal of their online bid after being declared the successful bidder on one sale.

### 6. Award of Contract (1/11)

Award of the contract will be made to the Bidder whose bid, conforming to the prospectus, is most advantageous to the State of Michigan on the basis of total value at rates bid for the estimated quantities. The State reserves the right to reject any bid or waive any minor irregularity in bids received. A written award mailed (or otherwise furnished) to the successful Bidder shall be deemed to result in a binding contract without further action by either party.

### 7. Down Payment (1/11)

The Bidder to whom award is made must make a down payment within 21 days of the sale award. The amount of the down payment will be calculated as shown in the Bond and Payment Schedule of this prospectus. Only cash may be used to meet this requirement.

### 8. Performance Security (1/11)

As guarantee of faithful performance, a cash bond, certificate of deposit, surety bond or irrevocable letter of credit (LOC) is required within 21 days of the sale award. The amount of the performance security is shown in the Bond and

Payment Schedule of this prospectus. If an LOC or surety is used, the coverage must extend for at least 6 months beyond the contract expiration.

#### 9. Worker's Compensation (10/22)

Purchaser shall obtain worker's compensation insurance to cover claims under Michigan's Worker's Disability Compensation Act of 1969 or similar employee benefit act of any other state applicable to an employee. Verification of Worker's Disability Compensation Act Compliance must be completed and submitted within 21 days of contract award and prior to the issuance of the timber sale contract. In addition, if applicable, Notice of Exclusion or Certificate of Insurance must also be submitted.

#### 10. Timber Sale Contract (10/22)

Additional conditions and requirements common to all timber sales are listed on the timber sale contract (R4031) and are available on line at [www.michigan.gov/timber](http://www.michigan.gov/timber). Contact the Unit Manager for additional information or a sample contract. Within 21 days of the date of the award letter, the bidder must sign the contract and provide the required down payment, performance security, and verification of worker's disability compensation. The down payment and performance security shall be in accordance with the provisions of the timber sale contract, in the sums stated in this prospectus. If these actions are not taken, then the Bidder, the Bidder's corporation, and the corporation's principals may not be permitted to bid on State timber sales for a period of 3 months after the first offense, 6 months after the second offense, and 1 year after the third offense. An offense will only be counted against the Bidder for 5 years. In addition, the Bidder certifies that if awarded this contract, the Bidder will complete the timber sale contract in accordance with its terms and any modifications thereof including requirements to purchase, cut, and remove the included timber by the expiration date.

Payment Unit values in the State Forest Timber Sale Contract are calculated based on the advertised value of the Payment Unit as a percentage of the total advertised value of the contract. The advertised value of each Payment Unit is given in the Description of Timber by Payment Unit table on the Timber Sale Information page. For example, if the value of Payment Unit 1 is advertised as \$1,500 and the total Timber Sale value is advertised as \$10,000, the contract price for Payment Unit 1 will be 15% of the total bid price ( $\$1,500/\$10,000 * 100$ ).

#### 11. Disclaimer of Estimates and Bidder's Warranty of Inspection (10/22)

Before submitting this bid, the Bidder is advised and cautioned to inspect the sale area, review the requirements of the sale contract, and take other steps as may be reasonably necessary to ascertain the location, estimated volumes, construction estimates, and operating costs of the proposed sale. Failure to do so will not relieve the Bidder from responsibility for completing the contract.

The Bidder warrants that this bid is submitted solely on the basis of the Bidder's examination and inspection of the quality and quantity of the timber offered for sale and the Bidder's opinion of the value thereof and the costs of recovery. No reliance should be placed on the State of Michigan's estimates of timber quality, quantity or costs of recovery. Bidder further acknowledges that the State of Michigan: (i) expressly disclaims any warranty of fitness of timber for any purpose; (ii) offers this timber as is without any warranty of quality (merchantability) or quantity and (iii) expressly disclaims any warranty as to the quantity or quality of timber sold.

#### 12. Certification and Chain-of-Custody (10/22)

Unless otherwise indicated in the contract under section 7 – Other Conditions of the Sale Specific Conditions & Requirements, the area encompassed by this timber sale is certified to the standards of the Forest Stewardship Council (FSC) - Certificate #SCS-FM/COC-00090N and the Sustainable Forestry Initiative (SFI) - Certificate #NSF-SFIS-5Y031-SF5. Forest products from this sale may be delivered to the mill as "FSC 100% and / or SFI certified" as long as the contractor hauling the forest products is chain-of-custody (COC) certified or covered under a COC certificate from the destination mill. The purchaser is responsible for maintaining COC after leaving the sale area.

#### 13. Good Neighbor Authority (GNA) Requirements (10/22)

If the name of this timber sales contains the acronym GNA, it is authorized by the Good Neighbor Authority (GNA) and covered by various agreements between the U.S. Forest Service and the State. The timber sale occurs on federal land and the following conditions apply:

GNA contracts on US Forest Service land will not be awarded to purchasers on the Federal list of excluded parties. The System for Award Management (SAM) will be checked for active excluded parties prior to award of contract. In

addition, the Bidder to whom award is made must complete an Assurance Regarding Felony Conviction or Tax Delinquent Status for Corporate Applicants (AD-3031).

14. Good Neighbor Authority (GNA) Requirements, con't (10/22)

Bidder certifies, by signing this bid form, that to the best of Bidder's knowledge that the following representations are accurate and complete.

- a. That the Bidder and its principals are not presently debarred, suspended, proposed for debarment, declared ineligible, or voluntary excluded from timber sales (covered transactions) by any Federal department or agency.
- b. That the Bidder and its principals have not within a 3-year period preceding this bid been convicted of or had a civil judgment rendered against them for commission of fraud or a criminal offense in connection with obtaining, attempting to obtain, or performing a public (Federal, State, or local) transaction or contract under a public transaction; violation of Federal or State antitrust statutes or commission of embezzlement, theft, forgery, bribery, falsification or destruction of records, making false statements, or receiving stolen property.
- c. That the Bidder and its principals are not presently indicted for or otherwise criminally or civilly charged by a governmental entity (Federal, State, or local) with commission of any of the offenses enumerated in paragraph b of this certification.
- d. That the Bidder and its principals have not within a 3-year period preceding this bid had one or more public transactions (Federal, State, or local) terminated for breach or default of a timber or forest product contract.

Bidders that cannot certify this requirement, in whole or in part, shall submit an explanation with their bid.

Scott Bowen  
Director



# TIMBER SALE INFORMATION

Hufflepuff Hardwoods (41-003-23)  
T45N, R13W, SEC. 13; T45N, R13W, SEC. 24.  
Schoolcraft County (Advertised Price \$68,483.70)

SALE NOTE: The county must be contacted prior to crossing or harvesting in the county road R-O-W. This applies to Payment Units 2, 4, 5 and County Road 456.

Within Payment Unit(s) 1-6, harvesting is limited to the period of October 1 to April 15 because of both deer yard restrictions and slippery bark concerns.

Trail 43 is a snowmobile trail and is shown on the Timber Sale Map. See Sale Spec 5.2.41 for restrictions.

A recreation site such as a trail, pathway, or campground is within the sale area or the vicinity. Certain restrictions/specifications may be applicable including time restrictions.

A timber sale contract for this lump sum, sealed bid timber sale will be awarded to the responsible bidder offering the highest sealed bid price. All units of volume listed below were estimated using the Inventory Manager computer program and the new Michigan taper model. Bids must be at or above the following advertised price for each product and species:

<u>PRODUCTS &amp; SPECIES</u>	<u>ESTIMATED UNITS*</u>	<u>ADVERTISED PRICE</u>
Sawtimber		
Basswood	97.9 MBF	\$ 122.00 / MBF
Black Cherry	1.1 MBF	\$ 104.00 / MBF
Red Maple	2.1 MBF	\$ 88.00 / MBF
Sugar Maple	140.8 MBF	\$ 327.00 / MBF
Pulpwood		
Black Spruce	5 Cords	\$ 19.50 / Cord
Mixed Aspen	27 Cords	\$ 30.20 / Cord
Mixed Hardwood	462 Cords	\$ 20.10 / Cord

\* The total volume is statistically estimated within plus (+) or minus (-) 12.16 percent. There are an estimated 1,133 cords on this timber sale, plus or minus 138 cords at the 95% confidence level. The estimated units are final and not subject to adjustment. Prospective bidders are urged to examine this timber and to make their own estimates of quantity and quality.

## BOND AND PAYMENT SCHEDULE:

1. A bond in the amount of \$3,424.00 to insure faithful performance of the conditions of the contract will be deposited by the successful bidder within 21 days of the sale award.
2. Cutting in any sale or unit without the required advance payment would be considered a trespass.
3. Total payment must be paid in advance or according to the following schedule:
  - (a) Ten percent (10%) of the sale value must be paid within 21 days of the sale award.
  - (b) The 10% down payment will be credited towards the first unit cut.
  - (c) Payment for each of the following units must be made before cutting begins in that unit:

<u>PAYMENT UNIT NUMBER</u>	<u>PERCENT OF TOTAL SALE VALUE</u>
01	12.1%
02	22.2%
03	18.1%
04	14.0%
05	13.5%
06	20.1%

4. If no cutting takes place, the 10% down payment will not be refunded.
5. Operations on the contract issued will terminate on 06/30/2026.

## SALE STATISTICS

Volumes were calculated in cubic feet using the Michigan taper model. Cubic foot volume includes all wood inside bark for the product indicated. For display purposes, cubic feet were converted to cords and MBF using a simple conversion factor, e.g. 79 cubic feet per cord and 185 cubic feet per MBF. The cubic foot volumes are precise; the cords and MBF volumes are not. Cubic foot volume cannot be directly converted to cords or boards with precision.

## SALE VOLUMES

The total estimated sale volume may not equal the sum of the species/products due to the nature of statistical calculations associated with double sampling methodology.

VOLUME			STATISTICAL RANGE IN CORDS	
TOTAL CUBIC FEET	TOTAL CORDS	PERCENT ERROR	MINIMUM	MAXIMUM
89,471	1,133	12.16%	995	1,270

## VDU VOLUMES

A VDU is a Volume Determination Unit. Volumes and their associated statistics are calculated at the VDU level and summarized to the sale level. There is often a one to one relationship between a VDU and a Payment Unit, but not always, depending on the cruise design. Refer to the VDU TO PAYMENT UNIT table.

	VOLUME			RANGE IN CORDS	
VDU	TOTAL CUBIC FEET	TOTAL CORDS	PERCENT ERROR	MINIMUM	MAXIMUM
1	15,552	197	33.41%	131	263
2	20,198	256	20.51%	203	308
3	14,362	182	24.60%	137	227
4	16,210	205	36.53%	130	280
5	10,280	130	40.47%	77	183
6	12,869	163	35.25%	105	220
<b>TOTAL:</b>	<b>89,471</b>	<b>1,133</b>		<b>785</b>	<b>1,481</b>

## VDU TO PAYMENT UNIT

When a VDU is associated with more than one Payment Unit (PU), the VDU volumes are assigned to the PU based on acres of the VDU within the PU.

VDU	VDU ACRES	PU	PU ACRES
1	14.6	1	14.6
2	23.3	2	23.3
3	22.9	2	0.1
		3	22.8
4	20.7	3	0.1
		4	20.6
5	21.7	3	0.1
		5	21.6
6	14.1	6	14.1
<b>TOTAL:</b>	<b>117.3</b>		<b>117.3</b>



**DESCRIPTION OF TIMBER BY PAYMENT UNIT (PU)**

PU	MARKET GROUP	PRODUCT	QUANTITY	UNIT	ACRES	ADVERTISE PRICE
1	Basswood	Sawtimber	30.2	MBF	14.6	\$8,297.20
	Sugar Maple		9.4	MBF		
	Mixed Aspen	Pulpwood	27	Cords		
	<i>Quaking Aspen</i>		27	<i>Cords</i>		
	Mixed Hardwood		36	Cords		
	<i>Basswood</i>		17	<i>Cords</i>		
	<i>Sugar Maple</i>		19	<i>Cords</i>		
2	Basswood	Sawtimber	26.7	MBF	23.4	\$15,193.20
	Sugar Maple		30.6	MBF		
	Mixed Hardwood	Pulpwood	96	Cords		
	<i>Basswood</i>		22	<i>Cords</i>		
	<i>Red Maple</i>		3	<i>Cords</i>		
	<i>Sugar Maple</i>		71	<i>Cords</i>		
3	Basswood	Sawtimber	4.5	MBF	23.0	\$12,410.40
	Red Maple		2.1	MBF		
	Sugar Maple		29.5	MBF		
	Mixed Hardwood	Pulpwood	101	Cords		
	<i>Basswood</i>		3	<i>Cords</i>		
	<i>Beech</i>		14	<i>Cords</i>		
	<i>Red Maple</i>		3	<i>Cords</i>		
	<i>Sugar Maple</i>		81	<i>Cords</i>		
4	Basswood	Sawtimber	23.2	MBF	20.6	\$9,581.30
	Sugar Maple		14.2	MBF		
	Black Spruce	Pulpwood	5	Cords		
	Mixed Hardwood		100	Cords		
	<i>Basswood</i>		31	<i>Cords</i>		
	<i>Sugar Maple</i>		69	<i>Cords</i>		
5	Black Cherry	Sawtimber	1.1	MBF	21.6	\$9,243.40
	Sugar Maple		23.0	MBF		
	Mixed Hardwood	Pulpwood	80	Cords		
	<i>Beech</i>		15	<i>Cords</i>		
	<i>Black Cherry</i>		6	<i>Cords</i>		
	<i>Ironwood</i>		2	<i>Cords</i>		
	<i>Sugar Maple</i>		57	<i>Cords</i>		
6	Basswood	Sawtimber	13.3	MBF	14.1	\$13,758.20
	Sugar Maple		34.1	MBF		
	Mixed Hardwood	Pulpwood	49	Cords		
	<i>Basswood</i>		10	<i>Cords</i>		
	<i>Sugar Maple</i>		39	<i>Cords</i>		
TOTAL:			241.9	MBF		
TOTAL:			494	Cords		

# Sale Specific Conditions & Requirements

**Sale Name: Hufflepuff Hardwoods**

**Sale Number: 41-003-23 Seq#: 1**

## 1 - Sale Area

### 1.2 - Boundaries

#### 1.2.1 - Painted boundaries (9/19)

The sale boundary and Payment Unit boundaries are marked and identified by blue, red and yellow paint. Exterior sale boundary lines against private property are marked with blue paint. Exterior sale boundary lines against state are marked with red paint. Interior Payment Unit boundaries are marked with yellow paint. The painted boundary line trees are not Included Timber and are to be protected unless marked with orange paint.

## 2 - Timber Specifications

### 2.1 - Included Timber

#### 2.1.3 - Cut tree marked unit(s) (12/08)

Within Payment Unit(s) 1-6, all trees are designated for cutting when marked with orange paint above and below stump height, regardless of merchantability.

### 2.2 - Utilization

#### 2.2.10 - No chipping tops and limbs (8/16)

Within Payment Unit(s) 1-6, chipping of limbs or tops is not permitted. Limbs and the remaining top must be left on site and scattered.

## 3 - Payments

### 3.3 - Pre-measured Sales

#### 3.3.4 - Dividing payment units (7/14)

Payment Unit(s) that are \$20,000 or greater in value may be divided at the request of the Purchaser and upon approval of the Unit Manager. Dividing Payment Units is a contract modification which requires a Timber Sale Contract Amendment.

## 4 - Transportation

### 4.1 - Construction

#### 4.1.3 - Slash and earthen piles (8/04)

Piles or windrows of earth along roads and landings that have been widened or constructed shall be leveled. Slash from road maintenance or construction, including stumps, shall be dispersed throughout the sale.

#### 4.1.4 - Timber removed for construction (3/23)

Trees cut or damaged in the process of pre-approved road, landing or skid trail construction will be decked in an area separate from other Designated Timber and not removed until measured by the sale administrator. Payment will be made at contract prices or average prices, if not on the contract.

#### 4.1.6 - Road construction (1/09)

Construction of new roads or improvements of existing roads shall be done in such a way as to minimize the environmental and visual impacts. Merchantable trees shall be cut and utilized unless otherwise directed. Non-merchantable trees shall be severed and laid flat on the ground. Slash shall be scattered, and not left in windrows and kept a minimum of 10 feet back from the road edge. Stumps shall be set upright, not left on edge, and be moved at least 10 feet away from the road edge. Disturbed soil shall be feathered into the woods and not left in berms or windrows.

#### 4.1.7 - Road closure (10/11)

All new roads built into the sale must be blocked to vehicle traffic upon completion of the sale. Overgrown roads that are reopened shall be considered new roads. In general, this will require constructing a four (4') foot high berm of stumps and logs covered with earth. Stumps and brush must be placed along the remainder of the trail. These roads must be rendered impassable to cars and trucks. All stumps from road building and landing construction must be reserved to block any newly constructed roads upon completion of the sale. These stumps must be scattered along the road system to prohibit vehicular

movement. Contact the sale administrator for specific details of design and placement.

#### 4.2 - Maintenance

##### 4.2.4 - Grading (10/16)

For completion of the sale, state forest roads must be graded. In general, this will require a road grader or bull dozer to shape up the roads after forest products have been hauled off site. This includes cleaning of drainage areas, grading, crowning and filling with gravel, if necessary. The grading equipment to be used must be approved by the Unit Manager or his/her representative.

#### 4.3 - Public Right-of-Way

##### 4.3.2 - County R-O-W (12/06)

The county must be contacted prior to crossing or harvesting in the county road R-O-W. This applies to Payment Unit 2, 4, 5 and County Road 456.

### 5 - Operations

#### 5.2 - Conduct of Operations

##### 5.2.2 - Hazard Trees/Snags

###### 5.2.2.1 - Den trees (10/16)

Obvious hollow and/or den trees shall be protected and left standing unless they are a safety hazard.

##### 5.2.3 - Operating Restrictions

###### 5.2.3.1 - Operating restrictions (9/11)

Within Payment Unit(s) 1-6, unless changed by written agreement, cutting, skidding, and hauling are limited to the period of October 1 to April 15. This restriction is because of both deer yard restrictions and slippery bark concerns.

##### 5.2.32 - Decking/landing restoration (9/13)

All decking and landing areas must have the surface area restored to a condition equal to or better than before. This is to ensure the proper regeneration of the stand. Wood debris, chips and "cookies" from trimmings must be removed or scattered away from landing and loading areas and may not be windrowed on the edge.

##### 5.2.38 - No decking against live trees (2/04)

Cut products may not be decked against unmarked or designated leave trees.

##### 5.2.41 - Snowmobile trail protection (9/11)

Trail 43 is a snowmobile trail and is shown on the Timber Sale Map. Do not cut or damage posts with orange trail markers or traffic control signs. If the trail road is to be used for hauling during the snowmobile season, then a snow covered base must be left on the trail. Maintain a 20 foot wide slash, debris, and rut free zone daily using the snowmobile trail as the centerline. No decking of forest products will be permitted along the snowmobile trail. All stumps within 20 feet of the snowmobile trail must be cut at ground level.

#### 5.8 - Protection of Endangered Species

##### 5.8.3 - Red shoulder hawk or goshawk (1) (2/16)

In the event that an active red shoulder hawk or goshawk nest is found, the contract may be amended to protect the nest site until the nest is determined to be inactive. The value of the trees in this excluded area will be refunded or credited to the Purchaser. The nest will be buffered with a five-chain radius (eight acre) protection area, centered on the nest tree, in which there will be no cutting or new roads constructed. Avoid human disturbance, including loading and skidding, in the protection area.

An additional zone of five chains (ten chains centered on the active nest tree) will be established in which there is no management activity from April 1 to July 30. Limit biomass harvesting and chipping operations within this ten-chain zone, retain the maximum one-third of residues per the Woody Biomass Harvesting Guidelines (Michigan DNR 2010). Nests determined to be inactive will be protected with a one-chain no-harvest buffer.

### 6 - Safety and Fire Prevention

## 6.2 - Signing

### 6.2.1 - Road posting (10/20)

The Purchaser is responsible for posting and maintaining caution signs on County Road 456 prior to beginning operations. The road must be posted at appropriate distances from the sale area to warn of logging activity and truck traffic. Signs must be removed when harvest operations are suspended or completed. The Purchaser will provide these signs.

### 6.2.2 - Snowmobile trail posting (10/20)

The Purchaser is responsible for posting and maintaining caution signs on Trail 43 prior to beginning operations during the snowmobile season (approximately December 1 to March 31). The trail must be posted at appropriate distances from the sale area to warn of logging activity and truck traffic. Signs must be removed when harvest operations are suspended or completed. The DNR will provide these signs.



### TIMBER SALE MAP

This information provided by authority of Part 525, 1994 PA 451, as amended.

Sale Number <b>41-003-23</b>	Date 09/15/2023	
Scale 1:15,840	Page 1	Of 1

Forest Management Unit Shingleton Mgt Unit	County Schoolcraft	Mapped By: Luoto Cruised By: Gould
---	-----------------------	---------------------------------------

Township 45N	Range 13W	Section(s) and Subdivision(s) Sec. 13 SESW; Sec. 24 NENW,NE,E1/2SE;
-----------------	--------------	---

Cover Type			
A = Aspen	J = Jack Pine	O = Oak	U = Upland Brush
B = Paper Birch	K = Rock	P = Lowland Poplar	UM = Upland Mix Forest
C = Cedar	L = Lowland Brush	Q = Mixed Swamp Conifer	V = Bog or Marsh
D = Treed Bog	LM = Lowland Mix Forest	R = Red Pine	W = White Pine
E = Swamp Hardwoods	M = Maple, Beech, Birch	S = Black Spruce	X = Non Stocked
F = Spruce/Fir	MC = Mixed Conifer	T = Tamarack	Y = Sand
G = Grass	MD = Mixed Deciduous	Z = Water	
H = Hemlock	N = Marsh		

Density	
0 = Non Stocked	5 = Pole Timber Medium
1 = Seedling Sapling Poor	6 = Pole Timber Well
2 = Seedling Sapling Medium	7 = Saw Timber Poor
3 = Seedling Sapling Well	8 = Saw Timber Medium
4 = Pole Timber Poor	9 = Saw Timber Well

PU #	Acres	PU #	Acres
1	14.6	4	20.6
2	23.4	5	21.6
3	22.9	6	14.1

## Hufflepuff Hardwoods

117.3 Acres

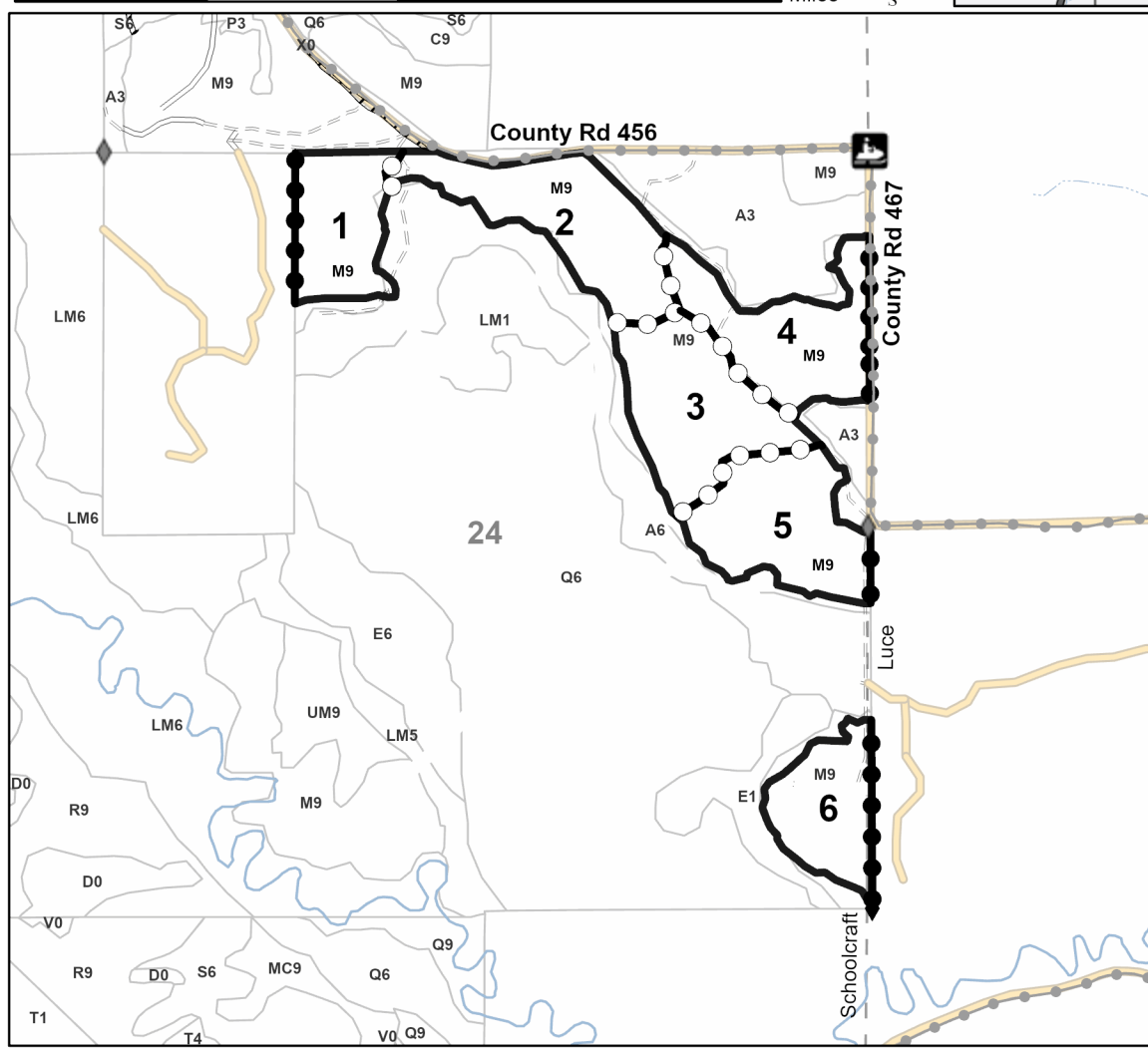
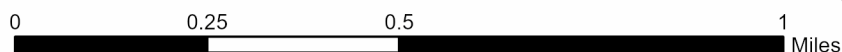
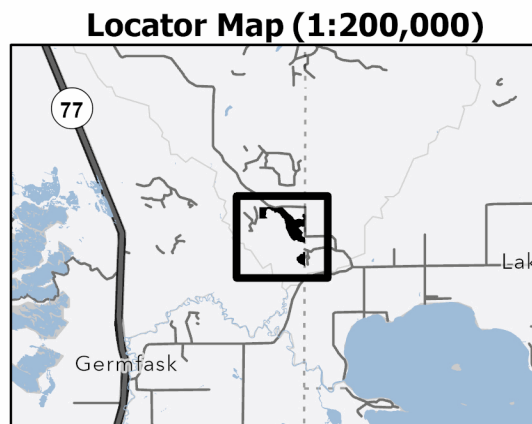

### Legend

- Sale Boundary (Red)
- Payment Unit (Yellow)
- Private Line (Blue)
- Recreational Trail
- Survey Corner
- Counties
- Intermittent Stream
- Perennial River
- Timber Sale Map Generic Lines
- Retention Areas
- Stand
- Primary Forest Road
- Secondary Forest Road
- Forest Access Route
- Administrative Access Only
- Non-DNR Road

Use QR Code to open Map in App





## TIMBER SALE INFORMATION

### Ski Trail Hardwood 2 (41-010-23)

T42N, R17W, SEC. 26; T42N, R17W, SEC. 27; T42N, R17W, SEC. 34.  
Schoolcraft County (Advertised Price \$500,408.40)

SALE NOTE: Road work is required on this sale. See Sale Spec 4.1.8 for details.

Within Payment Unit(s) 4, 5, and 7, harvesting is limited to the period of October 1 to December 31 to protect the ski trail, while providing deer browse.

Within Payment Unit(s) 1, 2, 3, 6, 8, and 9, harvesting is limited to the period of October 1 to April 15 to provide deer browse.

The Indian Lake Pathway is shown on the Timber Sale Map. See Sale Spec 5.2.40 for restrictions.

Snowmobile Trail 7 is shown on the Timber Sale Map. See Sale Spec 5.2.41 for details.

A recreation site such as a trail, pathway, or campground is within the sale area or the vicinity. Certain restrictions/specifications may be applicable including time restrictions.

A timber sale contract for this lump sum, sealed bid timber sale will be awarded to the responsible bidder offering the highest sealed bid price. All units of volume listed below were estimated using the Inventory Manager computer program and the new Michigan taper model. Bids must be at or above the following advertised price for each product and species:

<u>PRODUCTS &amp; SPECIES</u>	<u>ESTIMATED UNITS*</u>	<u>ADVERTISED PRICE</u>
Sawtimber		
Basswood	359.6 MBF	\$ 122.00 / MBF
Black Cherry	26.7 MBF	\$ 104.00 / MBF
Red Maple	245.6 MBF	\$ 88.00 / MBF
Sugar Maple	1,078.4 MBF	\$ 327.00 / MBF
Yellow Birch	54.1 MBF	\$ 111.00 / MBF
Pulpwood		
Mixed Aspen	90 Cords	\$ 30.20 / Cord
Mixed Hardwood	3,479 Cords	\$ 20.10 / Cord
N. White Cedar	6 Cords	\$ 8.00 / Cord
Red Pine	9 Cords	\$ 90.20 / Cord

\* The total volume is statistically estimated within plus (+) or minus (-) 8.77 percent. There are an estimated 7,688 cords on this timber sale, plus or minus 675 cords at the 95% confidence level. The estimated units are final and not subject to adjustment. Prospective bidders are urged to examine this timber and to make their own estimates of quantity and quality.

### **BOND AND PAYMENT SCHEDULE:**

1. A bond in the amount of \$25,020.00 to insure faithful performance of the conditions of the contract will be deposited by the successful bidder within 21 days of the sale award.
2. Cutting in any sale or unit without the required advance payment would be considered a trespass.
3. Total payment must be paid in advance or according to the following schedule :
  - (a) Ten percent (10%) of the sale value must be paid within 21 days of the sale award.
  - (b) The 10% down payment will be credited towards the first unit cut.
  - (c) Payment for each of the following units must be made before cutting begins in that unit:

PAYMENT UNIT NUMBER	PERCENT OF TOTAL SALE VALUE
01	10.7%
02	13.6%
03	9.5%
04	11.9%
05	13.0%
06	12.6%
07	10.8%
08	12.9%
09	5.0%

4. If no cutting takes place, the 10% down payment will not be refunded.
5. Operations on the contract issued will terminate on 06/30/2027.

## SALE STATISTICS

Volumes were calculated in cubic feet using the Michigan taper model. Cubic foot volume includes all wood inside bark for the product indicated. For display purposes, cubic feet were converted to cords and MBF using a simple conversion factor, e.g. 79 cubic feet per cord and 185 cubic feet per MBF. The cubic foot volumes are precise; the cords and MBF volumes are not. Cubic foot volume cannot be directly converted to cords or boards with precision.

## **SALE VOLUMES**

The total estimated sale volume may not equal the sum of the species/products due to the nature of statistical calculations associated with double sampling methodology.

VOLUME			STATISTICAL RANGE IN CORDS	
TOTAL CUBIC FEET	TOTAL CORDS	PERCENT ERROR	MINIMUM	MAXIMUM
607,345	7,688	8.77%	7,013	8,362

## **VDU VOLUMES**

A VDU is a Volume Determination Unit. Volumes and their associated statistics are calculated at the VDU level and summarized to the sale level. There is often a one to one relationship between a VDU and a Payment Unit, but not always, depending on the cruise design. Refer to the VDU TO PAYMENT UNIT table.

	VOLUME			RANGE IN CORDS	
VDU	TOTAL CUBIC FEET	TOTAL CORDS	PERCENT ERROR	MINIMUM	MAXIMUM
1	607,345	7,688	8.77%	7,013	8,362
<b>TOTAL:</b>	<b>607,345</b>	<b>7,688</b>		<b>7,013</b>	<b>8,362</b>

## **VDU TO PAYMENT UNIT**

When a VDU is associated with more than one Payment Unit (PU), the VDU volumes are assigned to the PU based on acres of the VDU within the PU.

VDU	VDU ACRES	PU	PU ACRES
1	424.5	1	45.4
		2	58.0
		3	40.1
		4	50.7
		5	55.1
		6	53.4
		7	45.9
		8	54.6
		9	21.3
<b>TOTAL:</b>	<b>424.5</b>		<b>424.5</b>



**DESCRIPTION OF TIMBER BY PAYMENT UNIT (PU)**

PU	MARKET GROUP	PRODUCT	QUANTITY	UNIT	ACRES	ADVERTISE PRICE
1	Basswood	Sawtimber	38.5	MBF	45.4	\$53,557.40
	Black Cherry		2.9	MBF		
	Red Maple		26.3	MBF		
	Sugar Maple		115.3	MBF		
	Yellow Birch		5.8	MBF		
	Mixed Aspen	Pulpwood	10	Cords		
	<i>Quaking Aspen</i>	<i>Sawtimber</i>	4.0	<i>MBF</i>		
	<i>Quaking Aspen</i>	<i>Pulpwood</i>	2	<i>Cords</i>		
	Mixed Hardwood		373	Cords		
	<i>Basswood</i>		23	<i>Cords</i>		
	<i>Beech</i>		73	<i>Cords</i>		
	<i>Black Cherry</i>		4	<i>Cords</i>		
	<i>Ironwood</i>		7	<i>Cords</i>		
	<i>Red Maple</i>		36	<i>Cords</i>		
	<i>Sugar Maple</i>		222	<i>Cords</i>		
	<i>Yellow Birch</i>		8	<i>Cords</i>		
	N. White Cedar		1	Cords		
	Red Pine		1	Cords		
	<i>Red Pine</i>	<i>Sawtimber</i>	0.4	<i>MBF</i>		
	2	Basswood	Sawtimber	49.1		
Black Cherry			3.6	MBF		
Red Maple			33.5	MBF		
Sugar Maple			147.3	MBF		
Yellow Birch			7.3	MBF		
Mixed Aspen		Pulpwood	11	Cords		
<i>Quaking Aspen</i>		<i>Sawtimber</i>	5.1	<i>MBF</i>		
<i>Quaking Aspen</i>		<i>Pulpwood</i>	1	<i>Cords</i>		
Mixed Hardwood			473	Cords		
<i>Basswood</i>			30	<i>Cords</i>		
<i>Beech</i>			93	<i>Cords</i>		
<i>Black Cherry</i>			4	<i>Cords</i>		
<i>Ironwood</i>			10	<i>Cords</i>		
<i>Red Maple</i>			45	<i>Cords</i>		
<i>Sugar Maple</i>			282	<i>Cords</i>		
<i>Yellow Birch</i>			9	<i>Cords</i>		
Red Pine			2	Cords		
<i>Red Pine</i>		<i>Sawtimber</i>	0.7	<i>MBF</i>		
<i>Red Pine</i>		<i>Pulpwood</i>	1	<i>Cords</i>		
3		Basswood	Sawtimber	34.0	MBF	40.1
	Black Cherry		2.5	MBF		
	Red Maple		23.2	MBF		
	Sugar Maple		101.9	MBF		
	Yellow Birch		5.1	MBF		
	Mixed Aspen	Pulpwood	8	Cords		
	<i>Quaking Aspen</i>	<i>Sawtimber</i>	3.6	<i>MBF</i>		
	<i>Quaking Aspen</i>	<i>Pulpwood</i>	1	<i>Cords</i>		
	Mixed Hardwood		329	Cords		
	<i>Basswood</i>		21	<i>Cords</i>		
	<i>Beech</i>		64	<i>Cords</i>		
	<i>Black Cherry</i>		3	<i>Cords</i>		
	<i>Ironwood</i>		6	<i>Cords</i>		
	<i>Red Maple</i>		32	<i>Cords</i>		
	<i>Sugar Maple</i>		196	<i>Cords</i>		
	<i>Yellow Birch</i>		7	<i>Cords</i>		
	N. White Cedar		1	Cords		
	Red Pine		1	Cords		

## DESCRIPTION OF TIMBER BY PAYMENT UNIT (PU), CON'T

PU	MARKET GROUP	PRODUCT	QUANTITY	UNIT	ACRES	ADVERTISE PRICE
3 con't	<i>Red Pine</i>	<i>Sawtimber</i>	0.4	<i>MBF</i>		
4	Basswood	Sawtimber	42.9	MBF	50.7	\$59,756.00
	Black Cherry		3.2	MBF		
	Red Maple		29.3	MBF		
	Sugar Maple		128.8	MBF		
	Yellow Birch		6.5	MBF		
	Mixed Aspen	Pulpwood	11	Cords		
	<i>Quaking Aspen</i>	<i>Sawtimber</i>	4.5	<i>MBF</i>		
	<i>Quaking Aspen</i>	<i>Pulpwood</i>	2	<i>Cords</i>		
	Mixed Hardwood		415	Cords		
	<i>Basswood</i>		26	<i>Cords</i>		
	<i>Beech</i>		81	<i>Cords</i>		
	<i>Black Cherry</i>		4	<i>Cords</i>		
	<i>Ironwood</i>		8	<i>Cords</i>		
	<i>Red Maple</i>		40	<i>Cords</i>		
	<i>Sugar Maple</i>		248	<i>Cords</i>		
	<i>Yellow Birch</i>		8	<i>Cords</i>		
	N. White Cedar		1	Cords		
	Red Pine		1	Cords		
	<i>Red Pine</i>	<i>Sawtimber</i>	0.5	<i>MBF</i>		
5	Basswood	Sawtimber	46.7	MBF	55.1	\$64,951.30
	Black Cherry		3.5	MBF		
	Red Maple		31.9	MBF		
	Sugar Maple		140.0	MBF		
	Yellow Birch		7.0	MBF		
	Mixed Aspen	Pulpwood	12	Cords		
	<i>Quaking Aspen</i>	<i>Sawtimber</i>	4.9	<i>MBF</i>		
	<i>Quaking Aspen</i>	<i>Pulpwood</i>	2	<i>Cords</i>		
	Mixed Hardwood		451	Cords		
	<i>Basswood</i>		28	<i>Cords</i>		
	<i>Beech</i>		89	<i>Cords</i>		
	<i>Black Cherry</i>		5	<i>Cords</i>		
	<i>Ironwood</i>		8	<i>Cords</i>		
	<i>Red Maple</i>		43	<i>Cords</i>		
	<i>Sugar Maple</i>		269	<i>Cords</i>		
	<i>Yellow Birch</i>		9	<i>Cords</i>		
	N. White Cedar		1	Cords		
	Red Pine		1	Cords		
	<i>Red Pine</i>	<i>Sawtimber</i>	0.5	<i>MBF</i>		
6	Basswood	Sawtimber	45.2	MBF	53.4	\$62,950.10
	Black Cherry		3.4	MBF		
	Red Maple		30.9	MBF		
	Sugar Maple		135.7	MBF		
	Yellow Birch		6.8	MBF		
	Mixed Aspen	Pulpwood	11	Cords		
	<i>Quaking Aspen</i>	<i>Sawtimber</i>	4.7	<i>MBF</i>		
	<i>Quaking Aspen</i>	<i>Pulpwood</i>	2	<i>Cords</i>		
	Mixed Hardwood		438	Cords		
	<i>Basswood</i>		28	<i>Cords</i>		
	<i>Beech</i>		86	<i>Cords</i>		
	<i>Black Cherry</i>		4	<i>Cords</i>		
	<i>Ironwood</i>		8	<i>Cords</i>		
	<i>Red Maple</i>		42	<i>Cords</i>		
	<i>Sugar Maple</i>		261	<i>Cords</i>		
	<i>Yellow Birch</i>		9	<i>Cords</i>		
	N. White Cedar		1	Cords		

## DESCRIPTION OF TIMBER BY PAYMENT UNIT (PU), CON'T

PU	MARKET GROUP	PRODUCT	QUANTITY	UNIT	ACRES	ADVERTISE PRICE
6 con't	Red Pine	Pulpwood	1	Cords		
	<i>Red Pine</i>	<i>Sawtimber</i>	0.5	<i>MBF</i>		
7	Basswood	Sawtimber	38.9	MBF	45.9	\$54,149.20
	Black Cherry		2.9	MBF		
	Red Maple		26.6	MBF		
	Sugar Maple		116.6	MBF		
	Yellow Birch		5.9	MBF		
	Mixed Aspen	Pulpwood	10	Cords		
	<i>Quaking Aspen</i>	<i>Sawtimber</i>	4.1	<i>MBF</i>		
	<i>Quaking Aspen</i>	<i>Pulpwood</i>	2	<i>Cords</i>		
	Mixed Hardwood		377	Cords		
	<i>Basswood</i>		24	<i>Cords</i>		
	<i>Beech</i>		74	<i>Cords</i>		
	<i>Black Cherry</i>		4	<i>Cords</i>		
	<i>Ironwood</i>		7	<i>Cords</i>		
	<i>Red Maple</i>		36	<i>Cords</i>		
	<i>Sugar Maple</i>		224	<i>Cords</i>		
	<i>Yellow Birch</i>		8	<i>Cords</i>		
	N. White Cedar		1	Cords		
	Red Pine		1	Cords		
	<i>Red Pine</i>	<i>Sawtimber</i>	0.4	<i>MBF</i>		
8	Basswood	Sawtimber	46.3	MBF	54.6	\$64,380.30
	Black Cherry		3.4	MBF		
	Red Maple		31.6	MBF		
	Sugar Maple		138.7	MBF		
	Yellow Birch		7.0	MBF		
	Mixed Aspen	Pulpwood	12	Cords		
	<i>Quaking Aspen</i>	<i>Sawtimber</i>	4.8	<i>MBF</i>		
	<i>Quaking Aspen</i>	<i>Pulpwood</i>	2	<i>Cords</i>		
	Mixed Hardwood		448	Cords		
	<i>Basswood</i>		28	<i>Cords</i>		
	<i>Beech</i>		88	<i>Cords</i>		
	<i>Black Cherry</i>		5	<i>Cords</i>		
	<i>Ironwood</i>		8	<i>Cords</i>		
	<i>Red Maple</i>		43	<i>Cords</i>		
	<i>Sugar Maple</i>		267	<i>Cords</i>		
	<i>Yellow Birch</i>		9	<i>Cords</i>		
	N. White Cedar		1	Cords		
	Red Pine		1	Cords		
	<i>Red Pine</i>	<i>Sawtimber</i>	0.5	<i>MBF</i>		
9	Basswood	Sawtimber	18.0	MBF	21.3	\$25,072.50
	Black Cherry		1.3	MBF		
	Red Maple		12.3	MBF		
	Sugar Maple		54.1	MBF		
	Yellow Birch		2.7	MBF		
	Mixed Aspen	Pulpwood	5	Cords		
	<i>Quaking Aspen</i>	<i>Sawtimber</i>	1.9	<i>MBF</i>		
	<i>Quaking Aspen</i>	<i>Pulpwood</i>	1	<i>Cords</i>		
	Mixed Hardwood		175	Cords		
	<i>Basswood</i>		11	<i>Cords</i>		
	<i>Beech</i>		34	<i>Cords</i>		
	<i>Black Cherry</i>		2	<i>Cords</i>		
	<i>Ironwood</i>		3	<i>Cords</i>		
	<i>Red Maple</i>		17	<i>Cords</i>		
	<i>Sugar Maple</i>		104	<i>Cords</i>		
	<i>Yellow Birch</i>		4	<i>Cords</i>		

TOTAL:	1,764.4	MBF
--------	---------	-----

TOTAL:	3,585	Cords
--------	-------	-------

## Sale Specific Conditions & Requirements

**Sale Name: Ski Trail Hardwood 2**

**Sale Number: 41-010-23 Seq#: 1**

### 1 - Sale Area

#### 1.2 - Boundaries

##### 1.2.1 - Painted boundaries (9/19)

The sale boundary and Payment Unit boundaries are marked and identified by blue, red, yellow and green paint. Exterior sale boundary lines against private property are marked with blue paint. Exterior sale boundary lines against state are marked with red paint. Regeneration gaps are marked with double sided green paint. These green painted trees are included in the gap and are to be harvested. Interior Payment Unit boundaries are marked with yellow paint. The painted boundary line trees are not Included Timber and are to be protected unless marked with orange paint.

### 2 - Timber Specifications

#### 2.1 - Included Timber

##### 2.1.4 - Designated timber unit(s) (6/17)

Within Payment Unit(s) 1 - 9, all trees marked with orange paint are designated for harvest. In addition, within Units 1, 3, 4, 6 and 8 all trees within regeneration gaps are designated for cutting. This includes all trees over 15' in height. Regeneration gaps are identified by green paint, these green boundary trees are also designated for harvest. Within Payment Unit(s) 2, 5, 7, and 9 all trees located within the green painted regeneration gaps which meet merchantability requirements in 2.2 Utilization are designated for harvest.

#### 2.2 - Utilization

##### 2.2.9 - No chipping permitted (12/08)

Within Payment Unit(s) 1-9, all wood must be removed by whole tree, tree segment, or roundwood. No chipping is permitted.

### 3 - Payments

#### 3.3 - Pre-measured Sales

##### 3.3.4 - Dividing payment units (7/14)

Payment Unit(s) 1-9 may be divided at the request of the Purchaser and upon approval of the Unit Manager. Dividing Payment Units is a contract modification which requires a Timber Sale Contract Amendment.

#### 3.4 - Damaged Timber

##### 3.4.2 - Special Protection Trees (4/14)

The Purchaser shall not cut live or dead special protection trees within cutting units or clearings. Special protection trees are hemlock and oak. If the Purchaser's operations have cut or damaged special protection trees through carelessness, the Purchaser shall pay \$100 as fixed, agreed and liquidated damages for each special protection tree cut or damaged. Such payment does not constitute ownership of the undesignated timber.

### 4 - Transportation

#### 4.1 - Construction

##### 4.1.3 - Slash and earthen piles (8/04)

Piles or windrows of earth along roads and landings that have been widened or constructed shall be leveled. Slash from road maintenance or construction, including stumps, shall be dispersed throughout the sale.

##### 4.1.6 - Road construction (1/09)

Construction of new roads or improvements of existing roads shall be done in such a way as to minimize the environmental and visual impacts. Merchantable trees shall be cut and utilized unless otherwise directed. Non-merchantable trees shall be severed and laid flat on the ground. Slash shall be scattered, and not left in windrows and kept a minimum of 10 feet back from the road edge. Stumps shall be set upright, not left on edge, and be moved at least 10 feet away from the road edge. Disturbed soil shall be feathered into the woods and not left in berms or windrows.

#### 4.1.7 - Road closure (10/11)

All new roads built into the sale must be blocked to vehicle traffic upon completion of the sale. Overgrown roads that are reopened shall be considered new roads. In general, this will require constructing a four (4') foot high berm of stumps and logs covered with earth. These roads must be rendered impassable to cars and trucks. Contact the sale administrator for specific details of design and placement.

#### 4.1.8 - Road work (1) (8/07)

The following road work is required: 500 cubic yards of 3 inch minus rock must be purchased, hauled, and spread between M149 and the sale area. Exact locations will be determined by the sale administrator. All work shall be at purchasers expense and must be completed prior to hauling. Prior to placement of rock, the road must be prepped with a bulldozer. Material must be approved by sale administrator.

### 4.2 - Maintenance

#### 4.2.4 - Grading (10/16)

For completion of the sale, state forest roads must be graded. In general, this will require a road grader or bull dozer to shape up the roads after forest products have been hauled off site. This includes cleaning of drainage areas, grading, crowning and filling with gravel, if necessary. The grading equipment to be used must be approved by the Unit Manager or his/her representative.

## 5 - Operations

### 5.2 - Conduct of Operations

#### 5.2.2 - Hazard Trees/Snags

##### 5.2.2.1 - Den trees (10/16)

Obvious hollow and/or den trees shall be protected and left standing unless they are a safety hazard.

#### 5.2.3 - Operating Restrictions

##### 5.2.3.1 - Operating restrictions (9/11)

Within Payment Unit(s) 4, 5, and 7, unless changed by written agreement, cutting, skidding, and hauling are limited to the period of October 1 to December 31. This restriction is to protect the ski trail while providing deer browse.

##### 5.2.3.2 - Operating restrictions (9/11)

Within Payment Unit(s) 1, 2, 3, 6, 8, 9, unless changed by written agreement, cutting, skidding, and hauling are limited to the period of October 1 to April 15. This restriction is to provide deer browse.

#### 5.2.32 - Decking/landing restoration (9/13)

All decking and landing areas must have the surface area restored to a condition equal to or better than before. This is to ensure the proper regeneration of the stand. Wood debris, chips and "cookies" from trimmings must be removed or scattered away from landing and loading areas and may not be windrowed on the edge.

#### 5.2.40 - Pathway protection (10/10)

The Indian Lake Pathway is shown on the Timber Sale Map. Maintain a 20-foot wide slash, debris, and rut free zone daily, using the pathway as the centerline. Do not run equipment down the pathway. Skidding across the trail may only occur in locations approved by the sale administrator.

#### 5.2.41 - Snowmobile trail protection (9/11)

Snowmobile Trail 7 is shown on the Timber Sale Map. Do not cut or damage posts with orange trail markers or traffic control signs. If the trail is used for hauling, it must be graded to the satisfaction of the Unit Manager or his/her representative prior to December 1st. If the trail road is to be used for hauling during the snowmobile season, then a snow covered base must be left on the trail. Maintain a 20 foot wide slash, debris, and rut free zone daily using the snowmobile trail as the centerline. No decking of forest products will be permitted along the snowmobile trail. All stumps within 20 feet of the snowmobile trail must be cut at ground level.

### 5.8 - Protection of Endangered Species

#### 5.8.3 - Red shoulder hawk or goshawk (1) (2/16)

In the event that an active red shoulder hawk or goshawk nest is found, the contract may be amended to protect the nest site

until the nest is determined to be inactive. The value of the trees in this excluded area will be refunded or credited to the Purchaser. The nest will be buffered with a five-chain radius (eight acre) protection area, centered on the nest tree, in which there will be no cutting or new roads constructed. Avoid human disturbance, including loading and skidding, in the protection area.

An additional zone of five chains (ten chains centered on the active nest tree) will be established in which there is no management activity from April 1 to July 30 (UP). Limit biomass harvesting and chipping operations within this ten-chain zone, retain the maximum one-third of residues per the Woody Biomass Harvesting Guidelines (Michigan DNR 2010). Nests determined to be inactive will be protected with a one-chain no-harvest buffer.

## **6 - Safety and Fire Prevention**

### **6.2 - Signing**

#### **6.2.2 - Snowmobile trail posting (10/20)**

The Purchaser is responsible for posting and maintaining caution signs on Trail 7 prior to beginning operations during the snowmobile season (approximately December 1 to March 31). The trail must be posted to warn of logging activity and truck traffic. Signs must be removed when harvest operations are suspended or completed. The Purchaser will provide these signs.

#### **6.2.3 - Recreational trail posting (10/20)**

The Purchaser is responsible for posting and maintaining caution signs on the Indian Lake Pathway prior to beginning operations. The trail must be posted at appropriate distances from the sale area approximately 350 feet from the sale area to warn of logging activity and truck traffic at both ends of the trail. Signs must be removed when harvest operations are suspended or completed. The Purchaser will provide these signs.



### TIMBER SALE MAP

This information provided by authority of Part 525, 1994 PA 451, as amended.

Sale Number  
**41-010-23**

Date  
**09/20/2023**

Forest Management Unit		County	Mapped By: Petreluis		
Shingleton Mgt Unit		Schoolcraft	Cruised By: UMLMWS		
Scale		Page		Of	
1:15,840		1		1	

Township	Range	Section(s) and Subdivision(s)			
42N	17W	NW,NWNE,S1/2NE,N1/2SW,N1/2SE; Sec. 34 W1/2NE; Sec. 26 S1/2NW,S1/2NE,N1/2SW,N1/2SE; Sec. 26 SWSE; Sec. 27			

#### Cover Type

A = Aspen	J = Jack Pine	O = Oak	U = Upland Brush
B = Paper Birch	K = Rock	P = Lowland Poplar	UM = Upland Mix Forest
C = Cedar	L = Lowland Brush	Q = Mixed Swamp Conifer	V = Bog or Marsh
D = Treed Bog	LM = Lowland Mix Forest	R = Red Pine	W = White Pine
E = Swamp Hardwoods	M = Maple, Beech, Birch	S = Black Spruce	X = Non Stocked
F = Spruce/Fir	MC = Mixed Conifer	T = Tamarack	Y = Sand
G = Grass	MD = Mixed Deciduous	Z = Water	
H = Hemlock	N = Marsh		

#### Density

0 = Non Stocked	5 = Pole Timber Medium
1 = Seedling Sapling Poor	6 = Pole Timber Well
2 = Seedling Sapling Medium	7 = Saw Timber Poor
3 = Seedling Sapling Well	8 = Saw Timber Medium
4 = Pole Timber Poor	9 = Saw Timber Well

## Ski Trail Hardwood 2

424.5 Acres

Sale Map

Gaps U1-5

Gaps U6-8

Gaps U9



#### Legend

- Payment Unit
- Stand
- Sections
- Against State (Red)
- Payment Unit (Yellow)
- Private Line (Blue)
- Recreational Trail
- Highway
- Primary Forest Road
- Secondary Forest Road
- Forest Access Route
- Administrative Access Only
- Non-DNR Road
- Survey Grade Corner

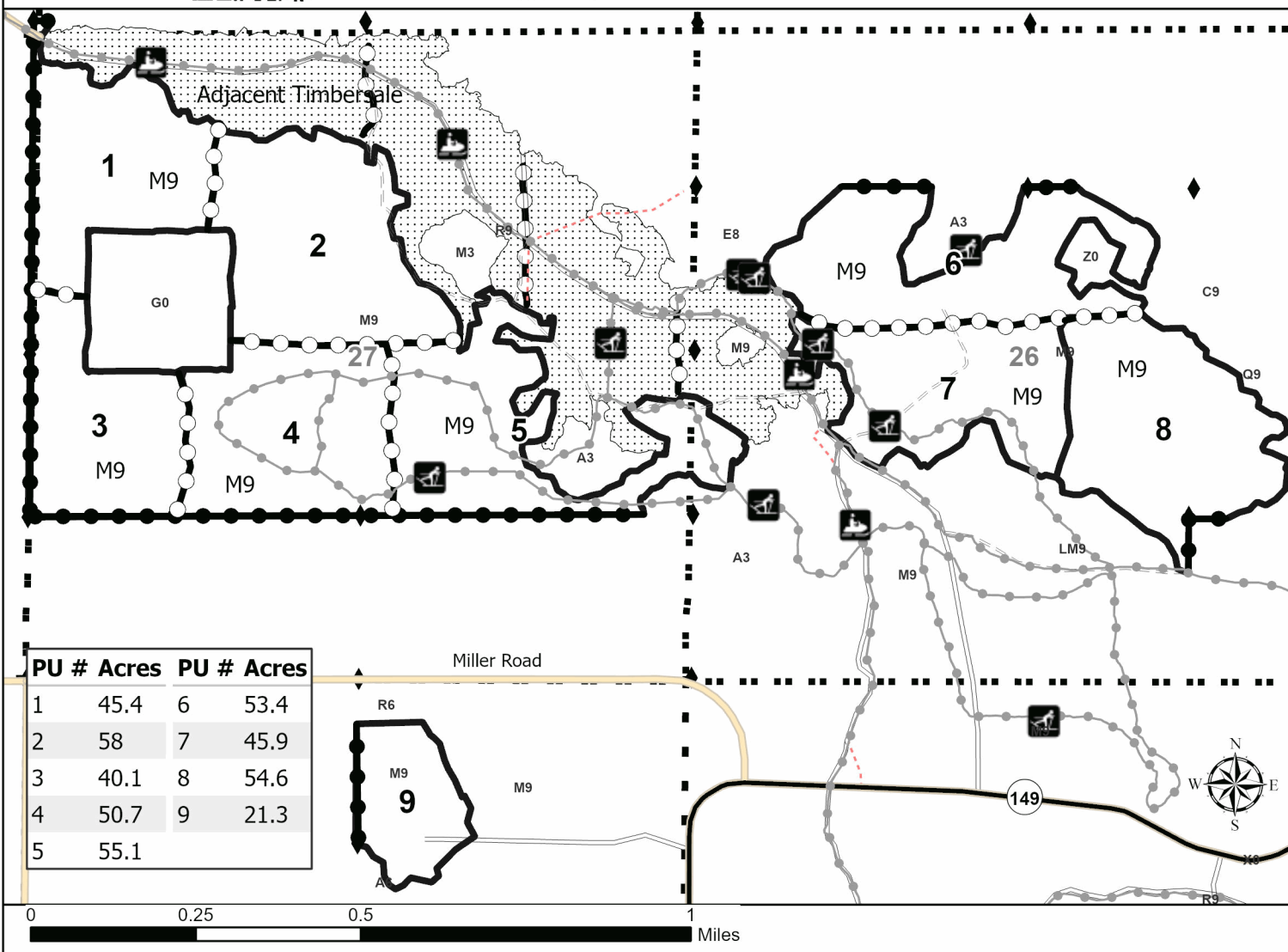

PU #	Acres	PU #	Acres
1	45.4	6	53.4
2	58	7	45.9
3	40.1	8	54.6
4	50.7	9	21.3
5	55.1		



## TIMBER SALE INFORMATION

Hope You Like Bees (41-019-23)  
 T42N, R17W, SEC. 26; T42N, R17W, SEC. 27.  
 Schoolcraft County (Advertised Price \$169,467.70)

SALE NOTE: Road work is required on this sale. See Sale Spec 4.1.8 for details.

The Indian Lake Pathways are a network of hiking, cross country skiing, and snowshoeing trails and are shown on the Timber Sale Map. See Sale Spec 5.2.40 for restrictions.

Snowmobile Trail 7 is shown on the Timber Sale Map. See Sale Spec 5.2.41 for details.

A recreation site such as a trail, pathway, or campground is within the sale area or the vicinity. Certain restrictions/specifications may be applicable including time restrictions.

A timber sale contract for this lump sum, sealed bid timber sale will be awarded to the responsible bidder offering the highest sealed bid price. All units of volume listed below were estimated using the Inventory Manager computer program and the new Michigan taper model. Bids must be at or above the following advertised price for each product and species:

<u>PRODUCTS &amp; SPECIES</u>	<u>ESTIMATED UNITS*</u>	<u>ADVERTISED PRICE</u>
Pulpwood		
Balsam Fir	20 Cords	\$ 14.05 / Cord
Mixed Aspen	29 Cords	\$ 30.20 / Cord
Mixed Hardwood	139 Cords	\$ 20.10 / Cord
Red Pine	1,835 Cords	\$ 90.20 / Cord

\* The total volume is statistically estimated within plus (+) or minus (-) 12.20 percent. There are an estimated 1,874 cords on this timber sale, plus or minus 229 cords at the 95% confidence level. The estimated units are final and not subject to adjustment. Prospective bidders are urged to examine this timber and to make their own estimates of quantity and quality.

### **BOND AND PAYMENT SCHEDULE:**

1. A bond in the amount of \$8,473.00 to insure faithful performance of the conditions of the contract will be deposited by the successful bidder within 21 days of the sale award.
2. Cutting in any sale or unit without the required advance payment would be considered a trespass.
3. Total payment must be paid in advance or according to the following schedule :
  - (a) Ten percent (10%) of the sale value must be paid within 21 days of the sale award.
  - (b) The 10% down payment will be credited towards the first unit cut.
  - (c) Payment for each of the following units must be made before cutting begins in that unit:
 

PAYMENT UNIT NUMBER	PERCENT OF TOTAL SALE VALUE
01	24.9%
02	26.5%
03	32.6%
04	16.0%
4. If no cutting takes place, the 10% down payment will not be refunded.
5. Operations on the contract issued will terminate on 12/31/2026.

### **SALE STATISTICS**

Volumes were calculated in cubic feet using the Michigan taper model. Cubic foot volume includes all wood inside bark for the product indicated. For display purposes, cubic feet were converted to cords and MBF using a simple conversion factor, e.g. 79 cubic feet per cord and 185 cubic feet per MBF. The cubic foot volumes are precise; the cords and MBF volumes are not. Cubic foot volume cannot be directly converted to cords or boards with precision.

### **SALE VOLUMES**

The total estimated sale volume may not equal the sum of the species/products due to the nature of statistical calculations associated with double sampling methodology.

VOLUME		STATISTICAL RANGE IN CORDS		
TOTAL CUBIC FEET	TOTAL CORDS	PERCENT ERROR	MINIMUM	MAXIMUM
148,063	1,874	12.20%	1,645	2,103

**VDU VOLUMES**

A VDU is a Volume Determination Unit. Volumes and their associated statistics are calculated at the VDU level and summarized to the sale level. There is often a one to one relationship between a VDU and a Payment Unit, but not always, depending on the cruise design. Refer to the VDU TO PAYMENT UNIT table.

VDU	VOLUME		PERCENT ERROR	RANGE IN CORDS	
	TOTAL CUBIC FEET	TOTAL CORDS		MINIMUM	MAXIMUM
1	148,063	1,874	12.21%	1,645	2,103
<b>TOTAL:</b>	<b>148,063</b>	<b>1,874</b>		<b>1,645</b>	<b>2,103</b>

**VDU TO PAYMENT UNIT**

When a VDU is associated with more than one Payment Unit (PU), the VDU volumes are assigned to the PU based on acres of the VDU within the PU.

VDU	VDU ACRES	PU	PU ACRES
1	145.3	1	36.1
		2	38.5
		3	47.4
		4	23.3
<b>TOTAL:</b>	<b>145.3</b>		<b>145.3</b>

**DESCRIPTION OF TIMBER BY PAYMENT UNIT (PU)**

PU	MARKET GROUP	PRODUCT	QUANTITY	UNIT	ACRES	ADVERTISE PRICE
1	Balsam Fir	Pulpwood	5	Cords	36.1	\$42,116.35
	Mixed Aspen		7	Cords		
	<i>Quaking Aspen</i>		7	<i>Cords</i>		
	Mixed Hardwood		35	Cords		
	<i>Beech</i>		2	<i>Cords</i>		
	<i>Black Cherry</i>		1	<i>Cords</i>		
	<i>Red Maple</i>		30	<i>Cords</i>		
	<i>Sugar Maple</i>		2	<i>Cords</i>		
	Red Pine		456	Cords		
2	Balsam Fir	Pulpwood	5	Cords	38.5	\$44,892.75
	Mixed Aspen		8	Cords		
	<i>Quaking Aspen</i>		8	<i>Cords</i>		
	Mixed Hardwood		37	Cords		
	<i>Beech</i>		2	<i>Cords</i>		
	<i>Black Cherry</i>		1	<i>Cords</i>		
	<i>Red Maple</i>		32	<i>Cords</i>		
	<i>Sugar Maple</i>		2	<i>Cords</i>		
	Red Pine		486	Cords		
3	Balsam Fir	Pulpwood	7	Cords	47.4	\$55,324.55
	Mixed Aspen		9	Cords		
	<i>Quaking Aspen</i>		9	<i>Cords</i>		
	Mixed Hardwood		46	Cords		
	<i>Beech</i>		3	<i>Cords</i>		
	<i>Black Cherry</i>		1	<i>Cords</i>		
	<i>Red Maple</i>		38	<i>Cords</i>		
	<i>Sugar Maple</i>		4	<i>Cords</i>		
	Red Pine		599	Cords		
4	Balsam Fir	Pulpwood	3	Cords	23.3	\$27,134.05
	Mixed Aspen		5	Cords		
	<i>Quaking Aspen</i>		5	<i>Cords</i>		
	Mixed Hardwood		21	Cords		
	<i>Beech</i>		1	<i>Cords</i>		
	<i>Red Maple</i>		19	<i>Cords</i>		
	<i>Sugar Maple</i>		1	<i>Cords</i>		
	Red Pine		294	Cords		
TOTAL:			2,023	Cords		

## Sale Specific Conditions & Requirements

**Sale Name: Hope You Like Bees**

**Sale Number: 41-019-23 Seq#: 1**

### 1 - Sale Area

#### 1.2 - Boundaries

##### 1.2.1 - Painted boundaries (9/19)

The sale boundary and Payment Unit boundaries are marked and identified by red and yellow paint. Exterior sale boundary lines against state are marked with red paint. Interior Payment Unit boundaries are marked with yellow paint. The painted boundary line trees are not Included Timber and are to be protected unless marked with orange paint.

### 2 - Timber Specifications

#### 2.1 - Included Timber

##### 2.1.3 - Cut tree marked unit(s) (12/08)

Within Payment Unit(s) 1- 4, all trees are designated for cutting when marked with orange paint above and below stump height, regardless of merchantability.

#### 2.2 - Utilization

##### 2.2.3 - Stump heights (4/07)

Stump heights within the Sale Area shall not exceed 12 inches for trees greater than 10 inches DBH and 4 inches for trees smaller than 10 inches DBH. This is in order to facilitate planting operations.

### 3 - Payments

#### 3.3 - Pre-measured Sales

##### 3.3.4 - Dividing payment units (7/14)

Payment Unit(s) may be divided at the request of the Purchaser and upon approval of the Unit Manager. Dividing Payment Units is a contract modification which requires a Timber Sale Contract Amendment.

### 4 - Transportation

#### 4.1 - Construction

##### 4.1.3 - Slash and earthen piles (8/04)

Piles or windrows of earth along roads and landings that have been widened or constructed shall be leveled. Slash from road maintenance or construction, including stumps, shall be dispersed throughout the sale.

##### 4.1.4 - Timber removed for construction (3/23)

Trees cut or damaged in the process of pre-approved road, landing or skid trail construction will be decked in an area separate from other Designated Timber and not removed until measured by the sale administrator. Payment will be made at contract prices or average prices, if not on the contract.

##### 4.1.6 - Road construction (1/09)

Construction of new roads or improvements of existing roads shall be done in such a way as to minimize the environmental and visual impacts. Merchantable trees shall be cut and utilized unless otherwise directed. Non-merchantable trees shall be severed and laid flat on the ground. Slash shall be scattered, and not left in windrows and kept a minimum of 10 feet back from the road edge. Stumps shall be set upright, not left on edge, and be moved at least 10 feet away from the road edge. Disturbed soil shall be feathered into the woods and not left in berms or windrows.

##### 4.1.7 - Road closure (10/11)

All new roads built into the sale must be blocked to vehicle traffic upon completion of the sale. Overgrown roads that are reopened shall be considered new roads. In general, this will require constructing a four (4') foot high berm of stumps and logs covered with earth. These roads must be rendered impassable to cars and trucks. Contact the sale administrator for specific details of design and placement.

##### 4.1.8 - Road work (1) (8/07)

The following road work is required. 300 cubic yards of 3 inch minus breaker run gravel must be purchased, hauled and spread between M-149 and the sale area. Exact gravel locations will be determined at the pre-sale meeting. The roadbed will need to be shaped with a bulldozed prior to placement. All work is at the purchasers expense. All work must be complete before hauling can begin.

#### 4.2 - Maintenance

##### 4.2.4 - Grading (10/16)

For completion of the sale, state forest roads must be graded. In general, this will require a road grader or bull dozer to shape up the roads after forest products have been hauled off site. This includes cleaning of drainage areas, grading, crowning and filling with gravel, if necessary. The grading equipment to be used must be approved by the Unit Manager or his/her representative.

### 5 - Operations

#### 5.2 - Conduct of Operations

##### 5.2.2 - Hazard Trees/Snags

###### 5.2.2.1 - Den trees (10/16)

Obvious hollow and/or den trees shall be protected and left standing unless they are a safety hazard.

##### 5.2.3 - Operating Restrictions

###### 5.2.3.6 - Bark beetle restriction (12/08)

In the event drought creates a high risk of pine bark beetle infestation, pine is not to be cut during the period March 1 through July 1, unless all portions of trees greater than two inches in diameter are removed from the sale area, reduced to chips, or treated to the satisfaction of the Unit Manager or his/her representative, within fifteen days of being severed from the stump. Pine log decks, pulpwood piles and treetops that are piled for chipping in the fall or winter within a 1/4 mile of susceptible sites must be removed before March 15. Residual slash must not be placed in piles or rows and must be spread over the site for quick drying. The Department of Natural Resources will exercise this specification if the risk of damage warrants.

##### 5.2.32 - Decking/landing restoration (9/13)

All decking and landing areas must have the surface area restored to a condition equal to or better than before. This is to ensure the proper regeneration of the stand. Wood debris, chips and "cookies" from trimmings must be removed or scattered away from landing and loading areas and may not be windrowed on the edge.

##### 5.2.38 - No decking against live trees (2/04)

Cut products may not be decked against unmarked or designated leave trees.

##### 5.2.40 - Pathway protection (10/10)

The Indian Lake Pathways are a network of hiking, cross country skiing, and snowshoeing trails and are shown on the Timber Sale Map. Do not cut trees or damage posts with blue pathway markers. Maintain a 20-foot wide slash, debris, and rut free zone daily, using the pathway as the centerline. Do not run equipment down the pathway.

##### 5.2.41 - Snowmobile trail protection (9/11)

Snowmobile Trail 7 is shown on the Timber Sale Map. Do not cut or damage posts with orange trail markers or traffic control signs. If the trail is used for hauling, it must be graded to the satisfaction of the Unit Manager or his/her representative prior to December 1st. The snowmobile trail may not be used for timber harvesting operations between December 1 and March 31. Maintain a 20 foot wide slash, debris, and rut free zone daily using the snowmobile trail as the centerline. All stumps within 20 feet of the snowmobile trail must be cut at ground level.

#### 5.8 - Protection of Endangered Species

##### 5.8.3 - Red shoulder hawk or goshawk (1) (2/16)

In the event that an active red shoulder hawk or goshawk nest is found, the contract may be amended to protect the nest site until the nest is determined to be inactive. The value of the trees in this excluded area will be refunded or credited to the Purchaser. The nest will be buffered with a five-chain radius (eight acre) protection area, centered on the nest tree, in which there will be no cutting or new roads constructed. Avoid human disturbance, including loading and skidding, in the protection area.

An additional zone of five chains (ten chains centered on the active nest tree) will be established in which there is no management activity from April 1 to July 30. Limit biomass harvesting and chipping operations within this ten-chain zone, retain the maximum one-third of residues per the Woody Biomass Harvesting Guidelines (Michigan DNR 2010). Nests determined to be inactive will be protected with a one-chain no-harvest buffer.

## **6 - Safety and Fire Prevention**

### 6.2 - Signing

#### 6.2.3 - Recreational trail posting (10/20)

The Purchaser is responsible for posting and maintaining caution signs on Indian Lake Pathway prior to beginning operations. The trail must be posted at appropriate distances from the sale area to warn of logging activity and truck traffic at both ends of the trail. Signs must be removed when harvest operations are suspended or completed. The Purchaser will provide these signs.



### TIMBER SALE MAP

This information provided by authority of Part 525, 1994 PA 451, as amended.

Sale Number <b>41-019-23</b>	Date 09/25/2023	
Scale 1:15,840	Page 1	Of 1

Forest Management Unit Shingleton Mgt Unit	County Schoolcraft	Mapped By: Sean Fischer Cruised By: Sean Fischer
---	-----------------------	---

Township 42N	Range 17W	Section(s) and Subdivision(s) Sec. 26 SWNW,NWSW; Sec. 27 N1/2NW,NE,N1/2SE;
-----------------	--------------	--

Cover Type			
A = Aspen	J = Jack Pine	O = Oak	U = Upland Brush
B = Paper Birch	K = Rock	P = Lowland Poplar	UM = Upland Mix Forest
C = Cedar	L = Lowland Brush	Q = Mixed Swamp Conifer	V = Bog or Marsh
D = Treed Bog	LM = Lowland Mix Forest	R = Red Pine	W = White Pine
E = Swamp Hardwoods	M = Maple, Beech, Birch	S = Black Spruce	X = Non Stocked
F = Spruce/Fir	MC = Mixed Conifer	T = Tamarack	Y = Sand
G = Grass	MD = Mixed Deciduous	Z = Water	
H = Hemlock	N = Marsh		

Density	
0 = Non Stocked	5 = Pole Timber Medium
1 = Seedling Sapling Poor	6 = Pole Timber Well
2 = Seedling Sapling Medium	7 = Saw Timber Poor
3 = Seedling Sapling Well	8 = Saw Timber Medium
4 = Pole Timber Poor	9 = Saw Timber Well

## Hope You Like Bees 145.3 Acres

PU #	Acres	Red pine pulp (cfs)	Mix HW pulp (cfs)	Mix aspen pulp (cfs)	Balsam fir Pulp (cfs)
1	36.1	456	35	7	5
2	38.5	486	37	8	7
3	47.4	599	46	9	3
4	23.3	294	21	5	5

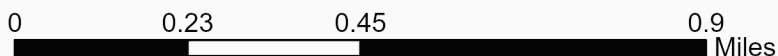

### Legend

- Recreational Trail
- Primary Forest Road
- Secondary Forest Road
- Forest Access Route
- Administrative Access Only
- Non-DNR Road
- Survey Grade Corner
- Payment Unit (Yellow)
- Payment Unit (Red)
- Nearby Timber Sale
- Stand

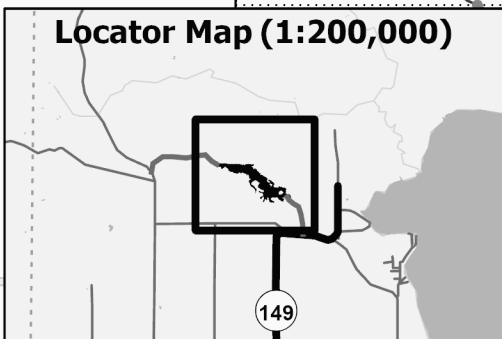
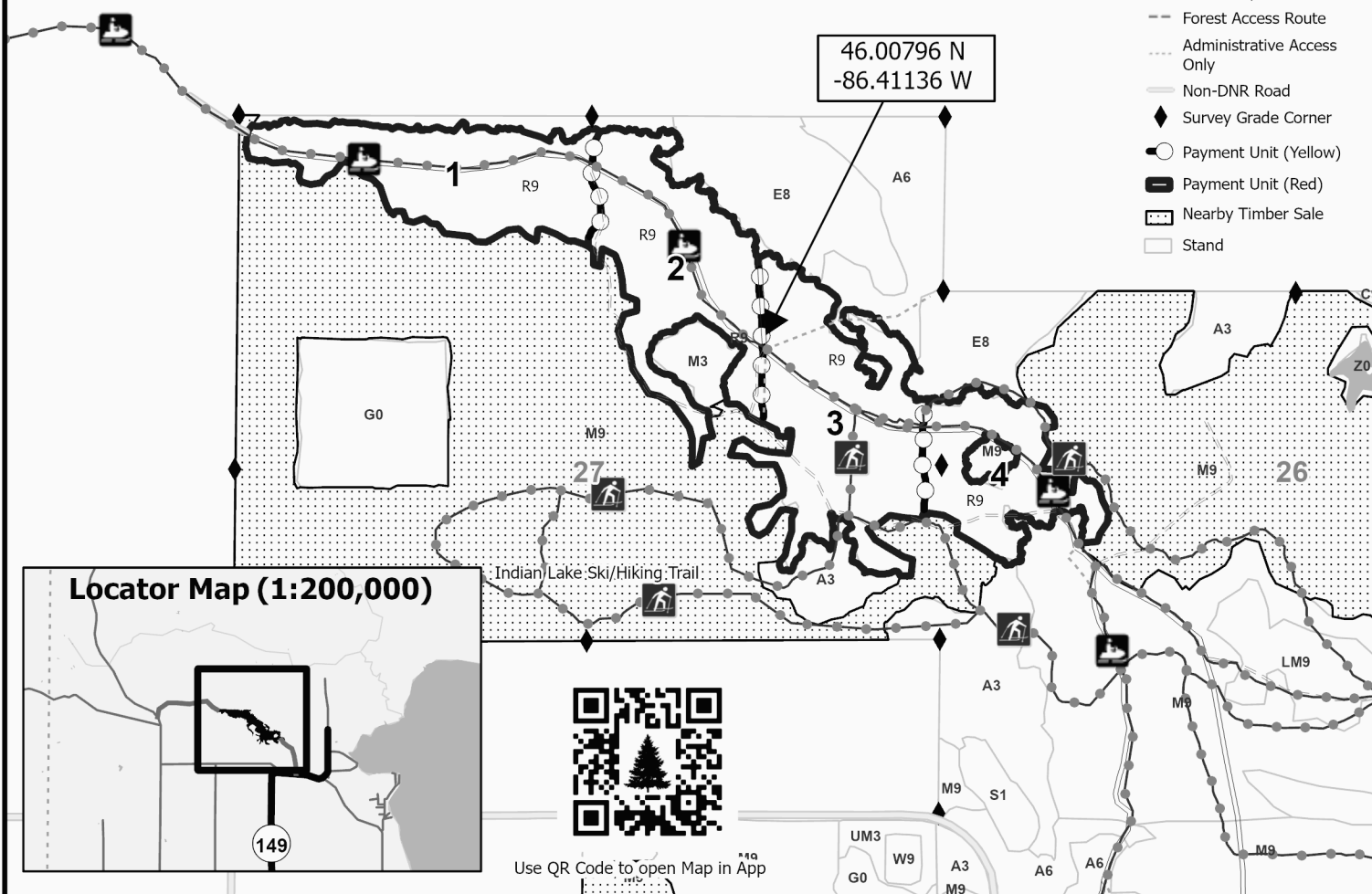

Use QR Code to open Map in App





Hufflepuff Hardwoods (41-003-23)  
T45N, R13W, SEC. 13; T45N, R13W, SEC. 24; Schoolcraft COUNTY

In response to the notice of sale to be held 2:00 p.m. (local time) on December 13, 2023, I am hereby submitting my sealed bid (firm offer) for the following forest products to be cut. Bids for individual species must be at or above the advertised price. All non-responsive bid forms may be rejected.

<u>PRODUCTS &amp; SPECIES</u>	<u>ESTIMATED VOLUME*</u>	<u>ADVERTISED PRICE</u>	<u>BID PRICE/UNIT</u>
<b>Sawtimber</b>			
Basswood	97.9 MBF	\$ 122.00/MBF	\$ _____
Black Cherry	1.1 MBF	\$ 104.00/MBF	\$ _____
Red Maple	2.1 MBF	\$ 88.00/MBF	\$ _____
Sugar Maple	140.8 MBF	\$ 327.00/MBF	\$ _____
<b>Pulpwood</b>			
Black Spruce	5 Cords	\$ 19.50/Cord	\$ _____
Mixed Aspen	27 Cords	\$ 30.20/Cord	\$ _____
Mixed Hardwood	462 Cords	\$ 20.10/Cord	\$ _____

\*The volumes are statistically estimated within plus (+) or minus (-) 12.16 percent at 95% confidence level. These estimated volumes are final and not subject to adjustment. Prospective bidders are urged to examine this timber and to make their own estimates of quantity and quality.

I understand that any or all bids may be rejected. All bids must be signed and all bid items must be bid or the bid form may be rejected. I also understand that consideration and awarding a contract will be based upon my past performance and ability to complete the contract based upon equipment and staffing subject to my control.

FEDERAL ID: \_\_\_\_\_ or SOCIAL SECURITY NUMBER: \_\_\_\_\_

Company or individual bidding: \_\_\_\_\_

Company representative's name: \_\_\_\_\_

Address: \_\_\_\_\_

City: \_\_\_\_\_ State: \_\_\_\_\_ Zip: \_\_\_\_\_

IF AVAILABLE, PLEASE PLACE THE PERSONALIZED LABEL FROM YOUR PROSPECTUS IN THE ABOVE BOX.

Individual or company representative's signature: \_\_\_\_\_ Date: \_\_\_\_\_  
Phone number : \_\_\_\_\_ Email (optional): \_\_\_\_\_

**THE WINNING BIDDER MUST COMPLETE THE VERIFICATION OF WORKER'S DISABILITY COMPENSATION ACT COMPLIANCE (ON REVERSE SIDE IF DOUBLE SIDED) WITHIN 21 DAYS OF SALE AWARD DATE**



<b>FOR DEPARTMENT USE ONLY</b>	
Sale Number (XX - XXX - XX - XX)	
Forest Management Unit:	

# TIMBER SALE VERIFICATION OF WORKER'S DISABILITY COMPENSATION ACT COMPLIANCE

As required by Act 317, P.A. 1969 (Worker's Compensation) and  
Part 5 of Act 451 of 1994, as amended.

## VERIFICATION OF WORKER'S DISABILITY COMPENSATION ACT COMPLIANCE

- This verification must be completed and submitted within 21 days of contract award and prior to the issuance of the timber sale contract.
- In addition, if boxes 2B or 2C are checked, then Notice of Exclusion or Certificate of Insurance must be submitted within twenty-one (21) days of the contract award and prior to the issuance of the timber sale contract.
- All information must be typed or printed except for written signatures.

Please Check Appropriate Categories:

1. My business is organized as (you **must** check one of the boxes below):
  - A.  Sole Proprietorship (individual)
  - B.  Partnership
  - C.  Corporation
2. You **must** check one of the boxes below:
  - A.  I certify my business is a sole proprietorship and it has no employees but the sole proprietor. I am not subject to the Worker's Compensation Laws.
  - B.  I certify my business has satisfied its obligation to the Worker's Compensation Act through the use of an approved Notice of Exclusion (BWC-337, Rev. 5/96). I will provide a copy of the Notice of Exclusion within 21 days of the contract award. (For questions or a copy of the BWC-337, please call the Worker's Compensation Bureau at 517-322-1195).
  - C.  I certify my business has a Worker's Compensation Policy. I will provide an original Certificate of Insurance within twenty-one (21) days of the contract award.
3. If you have checked item 2(A) or 2(B), you **must** indicate the number of **both** full-time and part-time employees, other than yourself, including family members and active partners (if none, you must enter "0").

\_\_\_\_\_ Full-time Employees

\_\_\_\_\_ Part-time Employees

Name of Business		Federal ID (or) Social Security No.	
Address		Telephone (       )	
City	State	ZIP	

*I hereby certify that the above information is true and correct. I agree to notify the Michigan DNR of any changes that occur in factors affecting my coverage during any of my present and future operations.*

\_\_\_\_\_  
Signature of Owner or Authorized Representative

\_\_\_\_\_  
Title

\_\_\_\_\_  
Date

Please complete the "SEALED BID" information on the next page

Ski Trail Hardwood 2 (41-010-23)  
T42N, R17W, SEC. 26; T42N, R17W, SEC. 27; T42N, R17W, SEC. 34; Schoolcraft

In response to the notice of sale to be held 2:00 p.m. (local time) on December 13, 2023, I am hereby submitting my sealed bid (firm offer) for the following forest products to be cut. Bids for individual species must be at or above the advertised price. All non-responsive bid forms may be rejected.

<u>PRODUCTS &amp; SPECIES</u>	<u>ESTIMATED VOLUME*</u>	<u>ADVERTISED PRICE</u>	<u>BID PRICE/UNIT</u>
<b>Sawtimber</b>			
Basswood	359.6 MBF	\$ 122.00/MBF	\$ _____
Black Cherry	26.7 MBF	\$ 104.00/MBF	\$ _____
Red Maple	245.6 MBF	\$ 88.00/MBF	\$ _____
Sugar Maple	1,078.4 MBF	\$ 327.00/MBF	\$ _____
Yellow Birch	54.1 MBF	\$ 111.00/MBF	\$ _____
<b>Pulpwood</b>			
Mixed Aspen	90 Cords	\$ 30.20/Cord	\$ _____
Mixed Hardwood	3,479 Cords	\$ 20.10/Cord	\$ _____
N. White Cedar	6 Cords	\$ 8.00/Cord	\$ _____
Red Pine	9 Cords	\$ 90.20/Cord	\$ _____

\*The volumes are statistically estimated within plus (+) or minus (-) 8.77 percent at 95% confidence level. These estimated volumes are final and not subject to adjustment. Prospective bidders are urged to examine this timber and to make their own estimates of quantity and quality.

I understand that any or all bids may be rejected. All bids must be signed and all bid items must be bid or the bid form may be rejected. I also understand that consideration and awarding a contract will be based upon my past performance and ability to complete the contract based upon equipment and staffing subject to my control.

FEDERAL ID: \_\_\_\_ - \_\_\_\_ - \_\_\_\_ or SOCIAL SECURITY NUMBER: \_\_\_\_ - \_\_\_\_ - \_\_\_\_

Company or individual bidding: \_\_\_\_\_

Company representative's name: \_\_\_\_\_

Address: \_\_\_\_\_

City: \_\_\_\_\_ State: \_\_\_\_\_ Zip: \_\_\_\_\_

IF AVAILABLE, PLEASE PLACE THE PERSONALIZED LABEL FROM YOUR PROSPECTUS IN THE ABOVE BOX.

Individual or company representative's signature: \_\_\_\_\_ Date: \_\_\_\_\_

Phone number : \_\_\_\_\_ Email (optional): \_\_\_\_\_

**THE WINNING BIDDER MUST COMPLETE THE VERIFICATION OF WORKER'S DISABILITY COMPENSATION ACT COMPLIANCE (ON REVERSE SIDE IF DOUBLE SIDED) WITHIN 21 DAYS OF SALE AWARD DATE**



FOR DEPARTMENT USE ONLY	
Sale Number (XX - XXX - XX - XX)	
Forest Management Unit:	

# TIMBER SALE VERIFICATION OF WORKER'S DISABILITY COMPENSATION ACT COMPLIANCE

As required by Act 317, P.A. 1969 (Worker's Compensation) and  
Part 5 of Act 451 of 1994, as amended.

## VERIFICATION OF WORKER'S DISABILITY COMPENSATION ACT COMPLIANCE

- This verification must be completed and submitted within 21 days of contract award and prior to the issuance of the timber sale contract.
- In addition, if boxes 2B or 2C are checked, then Notice of Exclusion or Certificate of Insurance must be submitted within twenty-one (21) days of the contract award and prior to the issuance of the timber sale contract.
- All information must be typed or printed except for written signatures.

Please Check Appropriate Categories:

1. My business is organized as (you **must** check one of the boxes below):
  - A.  Sole Proprietorship (individual)
  - B.  Partnership
  - C.  Corporation
2. You **must** check one of the boxes below:
  - A.  I certify my business is a sole proprietorship and it has no employees but the sole proprietor. I am not subject to the Worker's Compensation Laws.
  - B.  I certify my business has satisfied its obligation to the Worker's Compensation Act through the use of an approved Notice of Exclusion (BWC-337, Rev. 5/96). I will provide a copy of the Notice of Exclusion within 21 days of the contract award. (For questions or a copy of the BWC-337, please call the Worker's Compensation Bureau at 517-322-1195).
  - C.  I certify my business has a Worker's Compensation Policy. I will provide an original Certificate of Insurance within twenty-one (21) days of the contract award.
3. If you have checked item 2(A) or 2(B), you **must** indicate the number of **both** full-time and part-time employees, other than yourself, including family members and active partners (if none, you must enter "0").

\_\_\_\_\_ Full-time Employees

\_\_\_\_\_ Part-time Employees

Name of Business		Federal ID (or) Social Security No.	
Address		Telephone (       )	
City	State	ZIP	

*I hereby certify that the above information is true and correct. I agree to notify the Michigan DNR of any changes that occur in factors affecting my coverage during any of my present and future operations.*

\_\_\_\_\_  
Signature of Owner or Authorized Representative

\_\_\_\_\_  
Title

\_\_\_\_\_  
Date

Please complete the "SEALED BID" information on the next page

Hope You Like Bees (41-019-23)  
T42N, R17W, SEC. 26; T42N, R17W, SEC. 27; Schoolcraft COUNTY

In response to the notice of sale to be held 2:00 p.m. (local time) on December 13, 2023, I am hereby submitting my sealed bid (firm offer) for the following forest products to be cut. Bids for individual species must be at or above the advertised price. All non-responsive bid forms may be rejected.

<u>PRODUCTS &amp; SPECIES</u>	<u>ESTIMATED VOLUME*</u>	<u>ADVERTISED PRICE</u>	<u>BID PRICE/UNIT</u>
Pulpwood			
Balsam Fir	20 Cords	\$ 14.05/Cord	\$ _____
Mixed Aspen	29 Cords	\$ 30.20/Cord	\$ _____
Mixed Hardwood	139 Cords	\$ 20.10/Cord	\$ _____
Red Pine	1,835 Cords	\$ 90.20/Cord	\$ _____

\*The volumes are statistically estimated within plus (+) or minus (-) 12.20 percent at 95% confidence level. These estimated volumes are final and not subject to adjustment. Prospective bidders are urged to examine this timber and to make their own estimates of quantity and quality.

I understand that any or all bids may be rejected. All bids must be signed and all bid items must be bid or the bid form may be rejected. I also understand that consideration and awarding a contract will be based upon my past performance and ability to complete the contract based upon equipment and staffing subject to my control.

FEDERAL ID: \_\_\_ - \_\_\_ - \_\_\_ or SOCIAL SECURITY NUMBER: \_\_\_ - \_\_\_ - \_\_\_

Company or individual bidding: \_\_\_\_\_

Company representative's name: \_\_\_\_\_

Address: \_\_\_\_\_

City: \_\_\_\_\_ State: \_\_\_\_\_ Zip: \_\_\_\_\_

IF AVAILABLE, PLEASE PLACE THE PERSONALIZED LABEL FROM YOUR PROSPECTUS IN THE ABOVE BOX.

Individual or company representative's signature: \_\_\_\_\_ Date: \_\_\_\_\_

Phone number : \_\_\_\_\_ Email (optional): \_\_\_\_\_

**THE WINNING BIDDER MUST COMPLETE THE VERIFICATION OF WORKER'S DISABILITY COMPENSATION ACT COMPLIANCE (ON REVERSE SIDE IF DOUBLE SIDED) WITHIN 21 DAYS OF SALE AWARD DATE**



<b>FOR DEPARTMENT USE ONLY</b>	
Sale Number (XX - XXX - XX - XX)	
Forest Management Unit:	

# TIMBER SALE VERIFICATION OF WORKER'S DISABILITY COMPENSATION ACT COMPLIANCE

As required by Act 317, P.A. 1969 (Worker's Compensation) and  
Part 5 of Act 451 of 1994, as amended.

## VERIFICATION OF WORKER'S DISABILITY COMPENSATION ACT COMPLIANCE

- This verification must be completed and submitted within 21 days of contract award and prior to the issuance of the timber sale contract.
- In addition, if boxes 2B or 2C are checked, then Notice of Exclusion or Certificate of Insurance must be submitted within twenty-one (21) days of the contract award and prior to the issuance of the timber sale contract.
- All information must be typed or printed except for written signatures.

Please Check Appropriate Categories:

1. My business is organized as (you **must** check one of the boxes below):
  - A.  Sole Proprietorship (individual)
  - B.  Partnership
  - C.  Corporation
2. You **must** check one of the boxes below:
  - A.  I certify my business is a sole proprietorship and it has no employees but the sole proprietor. I am not subject to the Worker's Compensation Laws.
  - B.  I certify my business has satisfied its obligation to the Worker's Compensation Act through the use of an approved Notice of Exclusion (BWC-337, Rev. 5/96). I will provide a copy of the Notice of Exclusion within 21 days of the contract award. (For questions or a copy of the BWC-337, please call the Worker's Compensation Bureau at 517-322-1195).
  - C.  I certify my business has a Worker's Compensation Policy. I will provide an original Certificate of Insurance within twenty-one (21) days of the contract award.
3. If you have checked item 2(A) or 2(B), you **must** indicate the number of **both** full-time and part-time employees, other than yourself, including family members and active partners (if none, you must enter "0").

\_\_\_\_\_ Full-time Employees

\_\_\_\_\_ Part-time Employees

Name of Business		Federal ID (or) Social Security No.	
Address		Telephone (       )	
City	State	ZIP	

*I hereby certify that the above information is true and correct. I agree to notify the Michigan DNR of any changes that occur in factors affecting my coverage during any of my present and future operations.*

\_\_\_\_\_  
Signature of Owner or Authorized Representative

\_\_\_\_\_  
Title

\_\_\_\_\_  
Date

Please complete the "SEALED BID" information on the next page