



**DEPARTMENT OF NATURAL RESOURCES  
STATE OF MICHIGAN  
TIMBER SALE PROSPECTUS #7379**

**SCHEDULED SALE DATE AND TIME: 9:00 a.m. (local time) on February 13, 2024.**

**LOCATION: GAYLORD MGMT UNIT, 1732 WEST M 32, GAYLORD, MI 49735.**

**PROSPECTUS NOTE:** The bidder is advised to inspect the sale area and review the location, estimated volumes, operating costs and contract terms of proposed sales. Please be aware that some landowners may request 60 days or more notice for access across their land.

Notice is hereby given that bids will be received by the Unit Manager, GAYLORD MANAGEMENT UNIT, for certain timber on the following described lands:

Mud Lake Mix (52-008-23) / T29N, R01W, SEC. 6 , E1/2NE,NESE.

Otsego County, Advertised Price \$80,790.40, 48.5 Acres, Aspen, Red Oak.

SALE NOTE: Oak wilt restrictions apply to this sale.

Second Time Jack Pine (52-011-23) / T29N, R04W, SEC. 30, SWNW,W1/2SW.

T29N, R04W, SEC. 31, W1/2NW,NWSW.

Otsego County, Advertised Price \$13,838.75, 51.3 Acres, Jack Pine, Aspen.

SALE NOTE: Good Access, jack pine is deteriorating due to age and windthrow. No cutting restrictions.

Aspen Remix (52-021-23) / T33N, R05W, SEC. 33, W1/2SW.

Charlevoix County, Advertised Price \$38,345.30, 35.7 Acres, Aspen, Hardwood.

SALE NOTE: Straightforward sale. Oak Wilt spec with exceptions.

Camp Pellston Aspen (52-104-23) / T36N, R05W, SEC. 5 , N1/2NW,SEW,SWNE.

Emmet County, Advertised Price \$20,112.20, 42.3 Acres, Aspen, Hardwood.

SALE NOTE: Mixed aspen final harvest with retention to protect wet areas. Harvesting during winter or dry summer months is recommended.

## BID INSTRUCTIONS (VER. 10/10/2022):

### 1. Scheduled Bid Location, Date, and Time (2/11)

Bids must be received by the Unit Manager, GAYLORD OFFICE, 1732 West M 32, Gaylord, MI 49735, no later than 9:00 a.m. (local time) on February 13, 2024. For further information concerning this sale, contact Lucas Merrick at 989-732-3541 extension .

### 2. Bidder's Qualifications (10/22)

If all or part of a timber sale was prepared by a private contractor, the contractor and that contractor's company are not permitted to bid on the timber sale. A person must be 18 years of age or older to purchase timber. Permanent employees of the Department of Natural Resources or members of their immediate household may not bid. Former employees, in the permanent or seasonal class, may not bid until 3 months after the last day of active duty. Bids will not be accepted from individuals or companies appearing on the DNR/FRD No-Bid List. This list contains the names of purchasers who previously failed to execute a contract within 21-days or who have a history of poor performance.

### 3. Preparation of Sealed Bids (5/16)

Bid Forms may be completed online thru Michigan DNR Timber Sale Online Bidding (OLB) at [www.michigan.gov/timberbidding](http://www.michigan.gov/timberbidding) or by completing the hardcopy Bid Form found in the Timber Sale Prospectus . Hardcopy Bid Forms shall be manually signed in ink. Registration in OLB is considered your 'signature' for all bids submitted thru that system. Bid prices must be entered for each species and product in the Bid Price column for all material subject to bidding and all fill-in blanks must be completed. If erasures or other changes appear on the hardcopy Bid Form, each erasure or change must be initialed by the person signing the bid.

### 4. Submission of Sealed Bids (5/16)

Bid forms may be obtained from the Unit Manager or thru OLB. Bids may be submitted hardcopy or thru OLB. All hardcopy bids must be submitted on the bid form and in an envelope clearly identified as described in this section. NOTE: Only one bid form per bid envelope. Sealed bids must be submitted to the Unit office designated in the prospectus and must be submitted at or prior to the time established in the prospectus. The envelope should show on the outside (a) the sale name or number and (b) the date and time of bid opening, as shown in the prospectus. Bids received after the time specified in the sale prospectus are late bids and will be rejected.

It is possible for a bidder to submit multiple bids on a single sale. For example, a bid may be submitted hardcopy and a bid may be submitted thru OLB. Or, two bidders from the same company could both submit bids on the same sale. If this were to happen, the State would accept all bids received and award the contract accordingly. All bidding and contractual requirements would apply to all bids received.

### 5. Public Opening of Sealed Bids (7/16)

If conditions permit, the sealed bids will be publicly opened and posted at the time and place set in the prospectus.

If a bidder, present at a bid opening, has submitted bids on more than one sale, that bidder may withdraw their unopened bid envelopes or announce the withdrawal of their online bid after being declared the successful bidder on one sale.

### 6. Award of Contract (1/11)

Award of the contract will be made to the Bidder whose bid, conforming to the prospectus, is most advantageous to the State of Michigan on the basis of total value at rates bid for the estimated quantities. The State reserves the right to reject any bid or waive any minor irregularity in bids received. A written award mailed (or otherwise furnished) to the successful Bidder shall be deemed to result in a binding contract without further action by either party.

### 7. Down Payment (1/11)

The Bidder to whom award is made must make a down payment within 21 days of the sale award. The amount of the down payment will be calculated as shown in the Bond and Payment Schedule of this prospectus. Only cash may be used to meet this requirement.

### 8. Performance Security (1/11)

As guarantee of faithful performance, a cash bond, certificate of deposit, surety bond or irrevocable letter of credit (LOC) is required within 21 days of the sale award. The amount of the performance security is shown in the Bond and

Payment Schedule of this prospectus. If an LOC or surety is used, the coverage must extend for at least 6 months beyond the contract expiration.

#### 9. Worker's Compensation (10/22)

Purchaser shall obtain worker's compensation insurance to cover claims under Michigan's Worker's Disability Compensation Act of 1969 or similar employee benefit act of any other state applicable to an employee. Verification of Worker's Disability Compensation Act Compliance must be completed and submitted within 21 days of contract award and prior to the issuance of the timber sale contract. In addition, if applicable, Notice of Exclusion or Certificate of Insurance must also be submitted.

#### 10. Timber Sale Contract (10/22)

Additional conditions and requirements common to all timber sales are listed on the timber sale contract (R4031) and are available on line at [www.michigan.gov/timber](http://www.michigan.gov/timber). Contact the Unit Manager for additional information or a sample contract. Within 21 days of the date of the award letter, the bidder must sign the contract and provide the required down payment, performance security, and verification of worker's disability compensation. The down payment and performance security shall be in accordance with the provisions of the timber sale contract, in the sums stated in this prospectus. If these actions are not taken, then the Bidder, the Bidder's corporation, and the corporation's principals may not be permitted to bid on State timber sales for a period of 3 months after the first offense, 6 months after the second offense, and 1 year after the third offense. An offense will only be counted against the Bidder for 5 years. In addition, the Bidder certifies that if awarded this contract, the Bidder will complete the timber sale contract in accordance with its terms and any modifications thereof including requirements to purchase, cut, and remove the included timber by the expiration date.

Payment Unit values in the State Forest Timber Sale Contract are calculated based on the advertised value of the Payment Unit as a percentage of the total advertised value of the contract. The advertised value of each Payment Unit is given in the Description of Timber by Payment Unit table on the Timber Sale Information page. For example, if the value of Payment Unit 1 is advertised as \$1,500 and the total Timber Sale value is advertised as \$10,000, the contract price for Payment Unit 1 will be 15% of the total bid price ( $\$1,500/\$10,000 * 100$ ).

#### 11. Disclaimer of Estimates and Bidder's Warranty of Inspection (10/22)

Before submitting this bid, the Bidder is advised and cautioned to inspect the sale area, review the requirements of the sale contract, and take other steps as may be reasonably necessary to ascertain the location, estimated volumes, construction estimates, and operating costs of the proposed sale. Failure to do so will not relieve the Bidder from responsibility for completing the contract.

The Bidder warrants that this bid is submitted solely on the basis of the Bidder's examination and inspection of the quality and quantity of the timber offered for sale and the Bidder's opinion of the value thereof and the costs of recovery. No reliance should be placed on the State of Michigan's estimates of timber quality, quantity or costs of recovery. Bidder further acknowledges that the State of Michigan: (i) expressly disclaims any warranty of fitness of timber for any purpose; (ii) offers this timber as is without any warranty of quality (merchantability) or quantity and (iii) expressly disclaims any warranty as to the quantity or quality of timber sold.

#### 12. Certification and Chain-of-Custody (10/22)

Unless otherwise indicated in the contract under section 7 – Other Conditions of the Sale Specific Conditions & Requirements, the area encompassed by this timber sale is certified to the standards of the Forest Stewardship Council (FSC) - Certificate #SCS-FM/COC-00090N and the Sustainable Forestry Initiative (SFI) - Certificate #NSF-SFIS-5Y031-SF5. Forest products from this sale may be delivered to the mill as "FSC 100% and / or SFI certified" as long as the contractor hauling the forest products is chain-of-custody (COC) certified or covered under a COC certificate from the destination mill. The purchaser is responsible for maintaining COC after leaving the sale area.

#### 13. Good Neighbor Authority (GNA) Requirements (10/22)

If the name of this timber sales contains the acronym GNA, it is authorized by the Good Neighbor Authority (GNA) and covered by various agreements between the U.S. Forest Service and the State. The timber sale occurs on federal land and the following conditions apply:

GNA contracts on US Forest Service land will not be awarded to purchasers on the Federal list of excluded parties. The System for Award Management (SAM) will be checked for active excluded parties prior to award of contract. In

addition, the Bidder to whom award is made must complete an Assurance Regarding Felony Conviction or Tax Delinquent Status for Corporate Applicants (AD-3031).

14. Good Neighbor Authority (GNA) Requirements, con't (10/22)

Bidder certifies, by signing this bid form, that to the best of Bidder's knowledge that the following representations are accurate and complete.

- a. That the Bidder and its principals are not presently debarred, suspended, proposed for debarment, declared ineligible, or voluntary excluded from timber sales (covered transactions) by any Federal department or agency.
- b. That the Bidder and its principals have not within a 3-year period preceding this bid been convicted of or had a civil judgment rendered against them for commission of fraud or a criminal offense in connection with obtaining , attempting to obtain, or performing a public (Federal, State, or local) transaction or contract under a public transaction; violation of Federal or State antitrust statutes or commission of embezzlement, theft, forgery, bribery, falsification or destruction of records, making false statements, or receiving stolen property.
- c. That the Bidder and its principals are not presently indicted for or otherwise criminally or civilly charged by a governmental entity (Federal, State, or local) with commission of any of the offenses enumerated in paragraph b of this certification.
- d. That the Bidder and its principals have not within a 3-year period preceding this bid had one or more public transactions (Federal, State, or local) terminated for breach or default of a timber or forest product contract.

Bidders that cannot certify this requirement, in whole or in part, shall submit an explanation with their bid.

Scott Bowen  
Director

**TIMBER SALE INFORMATION**

Mud Lake Mix (52-008-23)  
 T29N, R01W, SEC. 6.  
 Otsego County (Advertised Price \$80,790.40)

SALE NOTE: Oak wilt restrictions apply to this sale.

A timber sale contract for this lump sum, sealed bid timber sale will be awarded to the responsible bidder offering the highest sealed bid price. All units of volume listed below were estimated using the Inventory Manager computer program and the new Michigan taper model. Bids must be at or above the following advertised price for each product and species:

| <u>PRODUCTS &amp; SPECIES</u> | <u>ESTIMATED UNITS*</u> | <u>ADVERTISED PRICE</u> |
|-------------------------------|-------------------------|-------------------------|
| Sawtimber                     |                         |                         |
| Red Oak                       | 187.5 MBF               | \$ 201.00 / MBF         |
| Pulpwood                      |                         |                         |
| Mixed Aspen                   | 1,114 Cords             | \$ 27.15 / Cord         |
| Mixed Hardwood                | 272 Cords               | \$ 23.60 / Cord         |
| Red Oak                       | 147 Cords               | \$ 43.80 / Cord         |

\* The total volume is statistically estimated within plus (+) or minus (-) 11.56 percent. There are an estimated 1,984 cords on this timber sale, plus or minus 229 cords at the 95% confidence level. The estimated units are final and not subject to adjustment. Prospective bidders are urged to examine this timber and to make their own estimates of quantity and quality.

**BOND AND PAYMENT SCHEDULE:**

- A bond in the amount of \$4,040.00 to insure faithful performance of the conditions of the contract will be deposited by the successful bidder within 21 days of the sale award.
- Cutting in any sale or unit without the required advance payment would be considered a trespass.
- Total payment must be paid in advance or according to the following schedule :
  - Ten percent (10%) of the sale value must be paid within 21 days of the sale award.
  - The 10% down payment will be credited towards the first unit cut.
  - Payment for each of the following units must be made before cutting begins in that unit:
 

| PAYMENT UNIT NUMBER | PERCENT OF TOTAL SALE VALUE |
|---------------------|-----------------------------|
| 01                  | 45.5%                       |
| 02                  | 54.5%                       |
- If no cutting takes place, the 10% down payment will not be refunded.
- Operations on the contract issued will terminate on 06/30/2027.

**SALE STATISTICS**

Volumes were calculated in cubic feet using the Michigan taper model. Cubic foot volume includes all wood inside bark for the product indicated. For display purposes, cubic feet were converted to cords and MBF using a simple conversion factor, e.g. 79 cubic feet per cord and 185 cubic feet per MBF. The cubic foot volumes are precise; the cords and MBF volumes are not. Cubic foot volume cannot be directly converted to cords or boards with precision.

**SALE VOLUMES**

The total estimated sale volume may not equal the sum of the species/products due to the nature of statistical calculations associated with double sampling methodology.

| VOLUME           |             | STATISTICAL RANGE IN CORDS |         |         |
|------------------|-------------|----------------------------|---------|---------|
| TOTAL CUBIC FEET | TOTAL CORDS | PERCENT ERROR              | MINIMUM | MAXIMUM |
| 156,705          | 1,984       | 11.56%                     | 1,754   | 2,213   |

**VDU VOLUMES**

A VDU is a Volume Determination Unit. Volumes and their associated statistics are calculated at the VDU level and summarized to the sale level. There is often a one to one relationship between a VDU and a Payment Unit, but not always, depending on the cruise design. Refer to the VDU TO PAYMENT UNIT table.

| VDU           | VOLUME           |              | PERCENT ERROR | RANGE IN CORDS |              |
|---------------|------------------|--------------|---------------|----------------|--------------|
|               | TOTAL CUBIC FEET | TOTAL CORDS  |               | MINIMUM        | MAXIMUM      |
| 21            | 93,917           | 1,189        | 10.77%        | 1,061          | 1,317        |
| 26            | 62,789           | 795          | 26.16%        | 587            | 1,003        |
| <b>TOTAL:</b> | <b>156,705</b>   | <b>1,984</b> |               | <b>1,648</b>   | <b>2,320</b> |

**VDU TO PAYMENT UNIT**

When a VDU is associated with more than one Payment Unit (PU), the VDU volumes are assigned to the PU based on acres of the VDU within the PU.

| VDU           | VDU ACRES   | PU | PU ACRES    |
|---------------|-------------|----|-------------|
| 21            | 29.7        | 1  | 29.7        |
| 26            | 18.8        | 2  | 18.8        |
| <b>TOTAL:</b> | <b>48.5</b> |    | <b>48.5</b> |

**DESCRIPTION OF TIMBER BY PAYMENT UNIT (PU)**

| PU     | MARKET GROUP         | PRODUCT          | QUANTITY | UNIT         | ACRES | ADVERTISE PRICE |
|--------|----------------------|------------------|----------|--------------|-------|-----------------|
| 1      | Red Oak              | Sawtimber        | 29.6     | MBF          | 29.7  | \$36,782.10     |
|        | Mixed Aspen          | Pulpwood         | 934      | Cords        |       |                 |
|        | <i>B. T. Aspen</i>   |                  | 644      | <i>Cords</i> |       |                 |
|        | <i>Quaking Aspen</i> |                  | 290      | <i>Cords</i> |       |                 |
|        | Mixed Hardwood       |                  | 180      | Cords        |       |                 |
|        | <i>Red Maple</i>     | <i>Sawtimber</i> | 7.0      | <i>MBF</i>   |       |                 |
|        | <i>Black Cherry</i>  | <i>Pulpwood</i>  | 4        | <i>Cords</i> |       |                 |
|        | <i>Paper Birch</i>   |                  | 5        | <i>Cords</i> |       |                 |
|        | <i>Red Maple</i>     |                  | 157      | <i>Cords</i> |       |                 |
|        | Red Oak              |                  | 28       | Cords        |       |                 |
| 2      | Red Oak              | Sawtimber        | 157.9    | MBF          | 18.8  | \$44,008.30     |
|        | Mixed Aspen          | Pulpwood         | 180      | Cords        |       |                 |
|        | <i>B. T. Aspen</i>   |                  | 159      | <i>Cords</i> |       |                 |
|        | <i>Quaking Aspen</i> |                  | 21       | <i>Cords</i> |       |                 |
|        | Mixed Hardwood       |                  | 92       | Cords        |       |                 |
|        | <i>Red Maple</i>     | <i>Sawtimber</i> | 0.9      | <i>MBF</i>   |       |                 |
|        | <i>Red Maple</i>     | <i>Pulpwood</i>  | 90       | <i>Cords</i> |       |                 |
|        | Red Oak              |                  | 119      | Cords        |       |                 |
| TOTAL: |                      |                  | 187.5    | MBF          |       |                 |
| TOTAL: |                      |                  | 1,533    | Cords        |       |                 |

# Sale Specific Conditions & Requirements

**Sale Name: Mud Lake Mix**

**Sale Number: 52-008-23 Seq#: 1**

## 1 - Sale Area

### 1.2 - Boundaries

#### 1.2.1 - Painted boundaries (9/19)

The sale boundary and Payment Unit boundaries are marked and identified by blue, red and yellow paint. Exterior sale boundary lines against private property are marked with blue paint. Exterior sale boundary lines against state are marked with red paint. Interior Payment Unit boundaries are marked with yellow paint. Retention patches are marked with red paint; no harvesting activities may occur within these areas. The painted boundary line trees are not Included Timber and are to be protected. Yellow painted trees designating an interior Payment Unit boundary are only to be cut when all surrounding Payment Units have been paid.

## 2 - Timber Specifications

### 2.1 - Included Timber

#### 2.1.1 - Clearcut unit(s) with unmerchantable trees (6/14)

Within Payment Unit(s) #1 and 2, cut all trees that are two (2) inches or more at DBH.

## 3 - Payments

### 3.3 - Pre-measured Sales

#### 3.3.4 - Dividing payment units (7/14)

Payment Unit(s) may be divided at the request of the Purchaser and upon approval of the Unit Manager. Dividing Payment Units is a contract modification which requires a Timber Sale Contract Amendment.

## 4 - Transportation

### 4.1 - Construction

#### 4.1.3 - Slash and earthen piles (8/04)

Piles or windrows of earth along roads and landings that have been widened or constructed shall be leveled. Slash from road maintenance or construction, including stumps, shall be dispersed throughout the sale.

#### 4.1.6 - Road construction (1/09)

Construction of new roads or improvements of existing roads shall be done in such a way as to minimize the environmental and visual impacts. Merchantable trees shall be cut and utilized unless otherwise directed. Non-merchantable trees shall be severed and laid flat on the ground. Slash shall be scattered, and not left in windrows and kept a minimum of 10 feet back from the road edge. Stumps shall be set upright, not left on edge, and be moved at least 10 feet away from the road edge. Disturbed soil shall be feathered into the woods and not left in berms or windrows.

#### 4.1.7 - Road closure (10/11)

All new roads built into the sale must be blocked to vehicle traffic upon completion of the sale. Overgrown roads that are reopened shall be considered new roads. In general, this will require constructing a four (4') foot high berm of stumps and logs covered with earth. Stumps and brush must be placed along the remainder of the trail. These roads must be rendered impassable to cars and trucks. All stumps from road building and landing construction must be reserved to block any newly constructed roads upon completion of the sale. These stumps must be scattered along the road system to prohibit vehicular movement. Contact the sale administrator for specific details of design and placement.

### 4.2 - Maintenance

#### 4.2.4 - Grading (10/16)

For completion of the sale, state forest roads must be graded. In general, this will require a road grader or bull dozer to shape up the roads after forest products have been hauled off site. This includes cleaning of drainage areas, grading, crowning and filling with gravel, if necessary. The grading equipment to be used must be approved by the Unit Manager or his/her representative.

## 5 - Operations

### 5.1 - Notification

#### 5.1.1 - Pre-sale conference (10/16)

A pre-sale conference on site between the Purchaser and sale administrator is required prior to beginning any operations to determine landing and road locations. The Unit Manager or his/her representative must be contacted at least 5 days in advance to schedule the conference.

#### 5.1.3 - Well heads and natural gas pipelines (11/15)

The Purchaser is responsible for contacting the gas or pipeline company and MISS DIG 30 days prior to operating equipment in the vicinity of well heads or natural gas pipelines.

#### 5.1.4 - Post-sale conference (10/16)

A post-sale conference on site between the Purchaser and sale administrator is required 5 days prior to the completion of active logging operations to determine clean-up and repair of landings, road edges, and the fulfillment of other contract specifications.

### 5.2 - Conduct of Operations

#### 5.2.1 - Slash

##### 5.2.1.11 - Slash for reforestation (3/21)

To facilitate reforestation, the Sale Area shall be left with slash evenly distributed. Bunched tops within the cutting area shall be broken up and scattered. Stumps shall be cut low to the ground. Processing sites shall not be left with a compacted layer of slash; tops from these sites shall be hauled back into the cut area and scattered.

#### 5.2.2 - Hazard Trees/Snags

##### 5.2.2.1 - Den trees (10/16)

Obvious hollow and/or den trees shall be protected and left standing unless they are a safety hazard.

#### 5.2.3 - Operating Restrictions

##### 5.2.3.5 - Oak wilt restriction (1/18)

Within Payment Unit(s) #1 and #2, unless changed by written agreement, cutting, skidding, hauling within the sale and brushing of access roads to the sale are not permitted during the period of April 15 to July 15. Operations may be allowed if specific steps are taken to prevent damaging uncut oak during the high risk period. Those steps may include completing all road brushing before April 15th and clearing a tree-length buffer along uncut oak cover before April 15th. This is necessary to reduce the spread of oak wilt. For more information, contact the Unit Manager or his/her representative.

##### 5.2.3.11 - Coppice regeneration protection (4/10)

Timber harvesting in any Payment Unit must be completed before significant aspen sprouting occurs in that Payment Unit so as to minimize damage to the new regeneration. Any post harvest operations, such as chipping, must be completed before sprouting of regeneration occurs. If it is anticipated that chipping will be delayed, then tops shall be carried to one central location or left unchipped. The Unit Manager or his/her representative may cease such operations if sprouting occurs before the operation is complete.

#### 5.2.29 - Shrub protection (1/20)

Do not cut or damage hawthorn, witch-hazel, dogwood or juneberry. These woody-shrub plants are highly beneficial to various wildlife species.

#### 5.2.32 - Decking/landing restoration (9/13)

All decking and landing areas must have the surface area restored to a condition equal to or better than before. This is to ensure the proper regeneration of the stand. Wood debris, chips and "cookies" from trimmings must be removed or scattered away from landing and loading areas and may not be windrowed on the edge.

### 5.4 - Soil Protection



#### 5.4.1 - Rutting restriction, general (7/16)

Operations are to cease immediately if equipment and weather conditions result in rutting of roads and/or skid trails which is 12 inches or greater in depth and 50 feet in length. The Unit Manager or his/her representative may restrict hauling and/or skidding if ruts exceed the specified depth. With the Unit Manager or his/her representative's approval, the Purchaser may return to the area when the risk of rutting has decreased.

#### 5.8 - Protection of Endangered Species

##### 5.8.5 - Protection of raptor nests (3/13)

All trees with raptor nests will be protected if found during harvesting operations. Notification will be made to the Unit Manager or his/her representative who will notify the Wildlife Biologist so an on-site evaluation and recommendation can be made, if necessary.

### **6 - Safety and Fire Prevention**

#### 6.2 - Signing

##### 6.2.1 - Road posting (10/20)

The Purchaser is responsible for posting and maintaining caution signs on Mud Lake Rd prior to beginning operations. The road must be posted at appropriate distances from the sale area to warn of logging activity and truck traffic. Signs must be removed when harvest operations are suspended or completed. The Purchaser will provide these signs.



# TIMBER SALE MAP

This information provided by authority of Part 525, 1994 PA 451, as amended.

|             |      |
|-------------|------|
| Sale Number | Year |
| 52 - 008    | 23   |

|                                   |                  |  |                    |           |         |
|-----------------------------------|------------------|--|--------------------|-----------|---------|
| Forest Management Unit<br>Gaylord | County<br>Otsego | Mapped By<br>Matt Foster                                 | Date<br>06/21/2023 | Page<br>1 | of<br>1 |
| Township<br>29N                   | Range<br>01W     | Section(s) and Subdivision(s)<br>Section 6: E1/2NE, NESE | Scale<br>1:15,840  |           |         |

| Cover Type        |                      |                         |                   | Density                     |                        |  |  |
|-------------------|----------------------|-------------------------|-------------------|-----------------------------|------------------------|--|--|
| A = Aspen         | H = Hemlock          | N = Marsh               | U = Upland Brush  | 0 = Non Stocked             | 5 = Pole Timber Medium |  |  |
| B = Paper Birch   | J = Jack Pine        | O = Oak                 | UM = Upland Mixed | 1 = Seedling Sapling Poor   | 6 = Pole Timber Well   |  |  |
| C = Cedar         | L = Lowland Brush    | P = Lowland Poplar      | V = Bog or Marsh  | 2 = Seedling Sapling Medium | 7 = Saw Timber Poor    |  |  |
| D = Treed Bog     | LM = Lowland Mixed   | Q = Mixed Swamp Conifer | W = White Pine    | 3 = Seedling Sapling Well   | 8 = Saw Timber Medium  |  |  |
| E = Swamp Hdwoods | M = Mpl, Bch, Brch   | R = Red Pine            | X = Non Stocked   | 4 = Pole Timber Poor        | 9 = Saw Timber Well    |  |  |
| F = Spruce Fir    | MC = Mixed Conifer   | S = Black Spruce        | Z = Water         |                             |                        |  |  |
| G = Grass         | MD = Mixed Deciduous | T = Tamarack            |                   |                             |                        |  |  |

| PU | Acres |
|----|-------|
| 1  | 29.7  |
| 2  | 18.8  |

## Mud Lake Mix Compartment 2 48.5 Acres

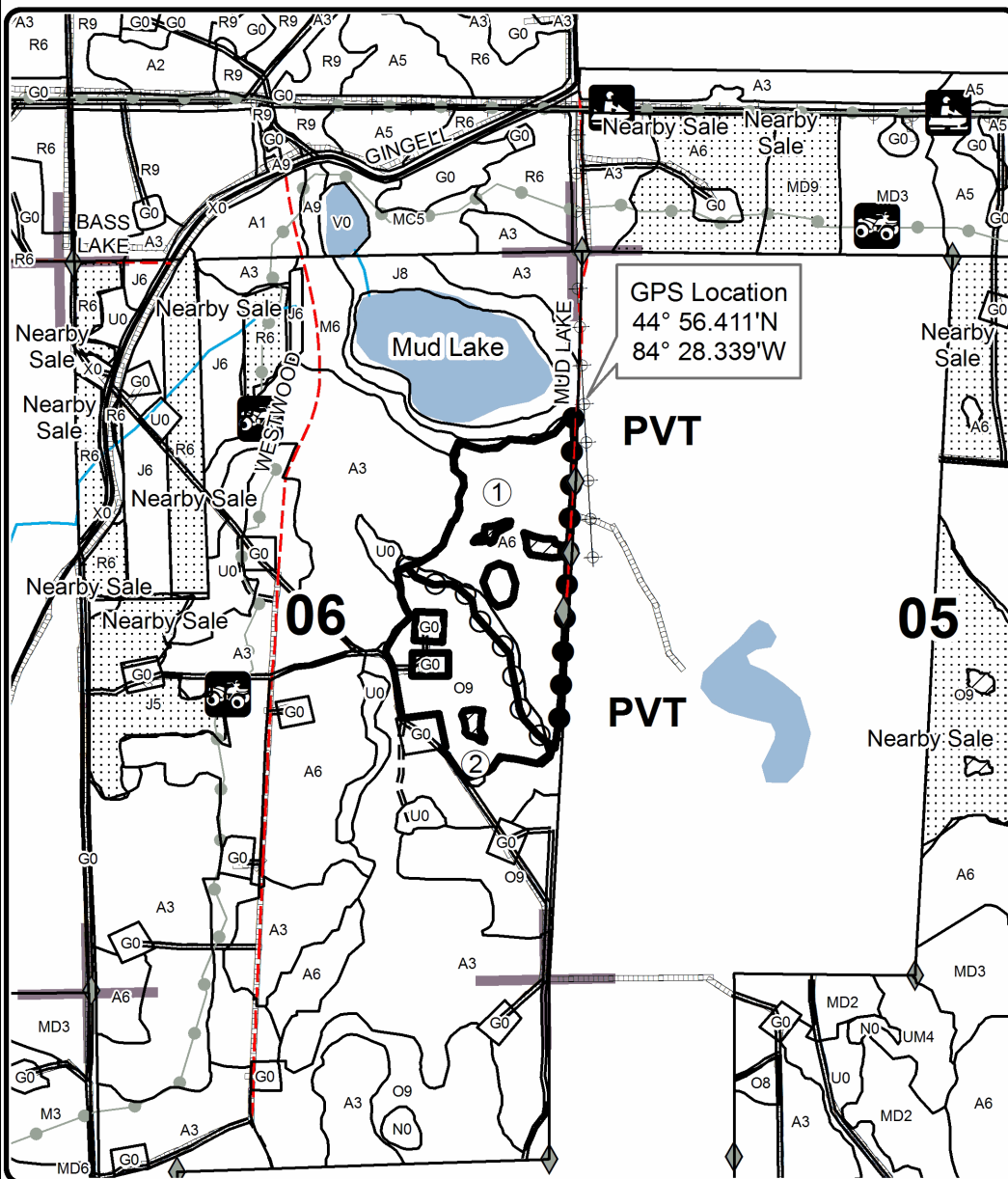
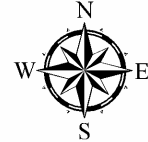

### Legend

- Sale Boundary (Red)
- Payment Unit (Yellow)
- Private Line (Blue)
- Retention Area (Red)
- Stand Boundaries
- Nearby Timber Sales
- Recreational Trail
- Field Grade Corners
- Secondary Forest Road
- Forest Access Route
- Paved Road
- Gravel Road
- County Road - Seasonal
- Perennial River
- Lakes and Rivers
- Section Corners
- Pipeline
- Powerline

### Avenza Map

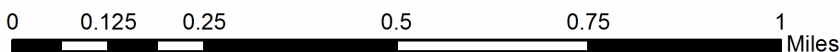

## TIMBER SALE INFORMATION

Second Time Jack Pine (52-011-23)  
 T29N, R04W, SEC. 30; T29N, R04W, SEC. 31.  
 Otsego County (Advertised Price \$13,838.75)

SALE NOTE: Good Access, jack pine is deteriorating due to age and windthrow. No cutting restrictions.

A timber sale contract for this lump sum, sealed bid timber sale will be awarded to the responsible bidder offering the highest sealed bid price. All units of volume listed below were estimated using the Inventory Manager computer program and the new Michigan taper model. Bids must be at or above the following advertised price for each product and species:

| <u>PRODUCTS &amp; SPECIES</u> | <u>ESTIMATED UNITS*</u> | <u>ADVERTISED PRICE</u> |
|-------------------------------|-------------------------|-------------------------|
| Pulpwood                      |                         |                         |
| Jack Pine                     | 788 Cords               | \$ 12.70 / Cord         |
| Quaking Aspen                 | 76 Cords                | \$ 19.15 / Cord         |
| Red Maple                     | 7 Cords                 | \$ 16.65 / Cord         |
| Red Pine                      | 36 Cords                | \$ 40.80 / Cord         |
| White Pine                    | 26 Cords                | \$ 30.40 / Cord         |

\* The total volume is statistically estimated within plus (+) or minus (-) 15.90 percent. There are an estimated 947 cords on this timber sale, plus or minus 151 cords at the 95% confidence level. The estimated units are final and not subject to adjustment. Prospective bidders are urged to examine this timber and to make their own estimates of quantity and quality.

### BOND AND PAYMENT SCHEDULE:

1. A bond in the amount of \$692.00 to insure faithful performance of the conditions of the contract will be deposited by the successful bidder within 21 days of the sale award.
2. Cutting in any sale or unit without the required advance payment would be considered a trespass.
3. Total payment must be paid in advance or according to the following schedule :
  - (a) Ten percent (10%) of the sale value must be paid within 21 days of the sale award.
  - (b) The 10% down payment will be credited towards the first unit cut.
  - (c) Payment for each of the following units must be made before cutting begins in that unit:
 

| PAYMENT UNIT NUMBER | PERCENT OF TOTAL SALE VALUE |
|---------------------|-----------------------------|
| 01                  | 26.1%                       |
| 02                  | 73.9%                       |
4. If no cutting takes place, the 10% down payment will not be refunded.
5. Operations on the contract issued will terminate on 06/30/2026.

### SALE STATISTICS

Volumes were calculated in cubic feet using the Michigan taper model. Cubic foot volume includes all wood inside bark for the product indicated. For display purposes, cubic feet were converted to cords and MBF using a simple conversion factor, e.g. 79 cubic feet per cord and 185 cubic feet per MBF. The cubic foot volumes are precise; the cords and MBF volumes are not. Cubic foot volume cannot be directly converted to cords or boards with precision.

### SALE VOLUMES

The total estimated sale volume may not equal the sum of the species/products due to the nature of statistical calculations associated with double sampling methodology.

| VOLUME           |             | STATISTICAL RANGE IN CORDS |         |         |
|------------------|-------------|----------------------------|---------|---------|
| TOTAL CUBIC FEET | TOTAL CORDS | PERCENT ERROR              | MINIMUM | MAXIMUM |
| 74,845           | 947         | 15.90%                     | 797     | 1,098   |

## VDU VOLUMES

A VDU is a Volume Determination Unit. Volumes and their associated statistics are calculated at the VDU level and summarized to the sale level. There is often a one to one relationship between a VDU and a Payment Unit, but not always, depending on the cruise design. Refer to the VDU TO PAYMENT UNIT table.

| VDU           | VOLUME           |             | PERCENT ERROR | RANGE IN CORDS |              |
|---------------|------------------|-------------|---------------|----------------|--------------|
|               | TOTAL CUBIC FEET | TOTAL CORDS |               | MINIMUM        | MAXIMUM      |
| 61            | 2,755            | 35          | 172.53%       | 0              | 95           |
| 84            | 48,892           | 619         | 18.75%        | 503            | 735          |
| 173           | 23,198           | 294         | 37.41%        | 184            | 404          |
| <b>TOTAL:</b> | <b>74,845</b>    | <b>947</b>  |               | <b>687</b>     | <b>1,233</b> |

## VDU TO PAYMENT UNIT

When a VDU is associated with more than one Payment Unit (PU), the VDU volumes are assigned to the PU based on acres of the VDU within the PU.

| VDU           | VDU ACRES   | PU | PU ACRES    |
|---------------|-------------|----|-------------|
| 61            | 2.2         | 2  | 2.2         |
| 84            | 33.4        | 2  | 33.4        |
| 173           | 15.7        | 1  | 15.7        |
| <b>TOTAL:</b> | <b>51.3</b> |    | <b>51.3</b> |

## DESCRIPTION OF TIMBER BY PAYMENT UNIT (PU)

| PU            | MARKET GROUP  | PRODUCT   | QUANTITY | UNIT  | ACRES | ADVERTISE PRICE |
|---------------|---------------|-----------|----------|-------|-------|-----------------|
| 1             | Jack Pine     | Pulpwood  | 284      | Cords | 15.7  | \$3,606.80      |
|               | Jack Pine     | Sawtimber | 26.6     | MBF   |       |                 |
|               | Jack Pine     | Pulpwood  | 231      | Cords |       |                 |
| 2             | Jack Pine     | Pulpwood  | 504      | Cords | 35.6  | \$10,212.80     |
|               | Jack Pine     | Sawtimber | 28.6     | MBF   |       |                 |
|               | Jack Pine     | Pulpwood  | 447      | Cords |       |                 |
|               | Quaking Aspen |           | 75       | Cords |       |                 |
|               | Quaking Aspen | Sawtimber | 2.7      | MBF   |       |                 |
|               | Quaking Aspen | Pulpwood  | 70       | Cords |       |                 |
|               | Red Maple     |           | 7        | Cords |       |                 |
|               | Red Maple     | Sawtimber | 0.8      | MBF   |       |                 |
|               | Red Maple     | Pulpwood  | 5        | Cords |       |                 |
|               | Red Pine      |           | 36       | Cords |       |                 |
|               | Red Pine      | Sawtimber | 8.4      | MBF   |       |                 |
|               | Red Pine      | Pulpwood  | 19       | Cords |       |                 |
|               | White Pine    |           | 26       | Cords |       |                 |
| White Pine    | Sawtimber     | 6.4       | MBF      |       |       |                 |
| White Pine    | Pulpwood      | 13        | Cords    |       |       |                 |
| <b>TOTAL:</b> |               |           | 932      | Cords |       |                 |

## Sale Specific Conditions & Requirements

Sale Name: Second Time Jack Pine

Sale Number: 52-011-23 Seq#: 1

### 1 - Sale Area

#### 1.2 - Boundaries

##### 1.2.1 - Painted boundaries (9/19)

The sale boundary and Payment Unit boundaries are marked and identified by red paint. Exterior sale boundary lines against state are marked with red paint. Retention patches are marked with red paint; no harvesting activities may occur within these areas.

### 2 - Timber Specifications

#### 2.1 - Included Timber

##### 2.1.1 - Clearcut unit(s) with unmerchantable trees (6/14)

Within Payment Unit(s), cut all trees that are two (2) inches or more at DBH. Due to the amount of damage and dieback in the Jack Pine spec 5.2.2.1 Den Trees will be waived and all standing dead trees are to be cut.

#### 2.2 - Utilization

##### 2.2.2 - Chipping required (2/18)

Payment Unit 2 must be chip harvested to facilitate subsequent planting operations. The Purchaser has the option to produce sawlogs or pulpwood bolts, but the remaining portion of the trees must be chipped and hauled. Products may be produced as roundwood and forwarded to decking areas in final product length, but the tops must be left intact and skidded to the landing for chipping in order to minimize the amount of residual slash. If market conditions limit the practicality of chipping, tops and slash must be arranged in a way that will not inhibit future planting operations, as directed by the sale administrator. A chipping exemption can be obtained if proposed operations are determined to be suitable for planting by reforestation staff. This exemption must be granted in writing. The requirement to retain approximately 1/6 to 1/3 of tree tops and limbs less than four inches in diameter is still applicable (G. C. & R. 2.2).

##### 2.2.3 - Stump heights (4/07)

Stump heights within Payment Unit(s) 2 shall not exceed 6 inches for all trees. This is in order to facilitate planting operations.

##### 2.2.4 - Skidding length (2/14)

Skidding of lengths over 17 feet is permissible as long as the timber sale administrator approves the method and machinery used. If at any point damage exceeds specification 3.4.1, all of the remaining wood must be skid in lengths less than 17 feet.

### 4 - Transportation

#### 4.1 - Construction

##### 4.1.3 - Slash and earthen piles (8/04)

Piles or windrows of earth along roads and landings that have been widened or constructed shall be leveled. Slash from road maintenance or construction, including stumps, shall be dispersed throughout the sale.

##### 4.1.6 - Road construction (1/09)

Construction of new roads or improvements of existing roads shall be done in such a way as to minimize the environmental and visual impacts. Merchantable trees shall be cut and utilized unless otherwise directed. Non-merchantable trees shall be severed and laid flat on the ground. Slash shall be scattered, and not left in windrows and kept a minimum of 10 feet back from the road edge. Stumps shall be set upright, not left on edge, and be moved at least 10 feet away from the road edge. Disturbed soil shall be feathered into the woods and not left in berms or windrows.

##### 4.1.7 - Road closure (10/11)

All new roads built into the sale must be blocked to vehicle traffic upon completion of the sale. Overgrown roads that are reopened shall be considered new roads. In general, this will require constructing a four (4') foot high berm of stumps and logs covered with earth. Stumps and brush must be placed along the remainder of the trail. These roads must be rendered impassable to cars and trucks. Contact the sale administrator for specific details of design and placement.

## 4.2 - Maintenance

### 4.2.5 - Two wheel drive condition (2/04)

All existing trail roads on and adjacent to the sale area must be passable by two-wheel drive traffic for the duration of the sale.

## 5 - Operations

### 5.1 - Notification

#### 5.1.3 - Well heads and natural gas pipelines (11/15)

The Purchaser is responsible for contacting the MISS DIG hotline 30 days prior to operating equipment in the vicinity of well heads or natural gas pipelines.

### 5.2 - Conduct of Operations

#### 5.2.1 - Slash

##### 5.2.1.8 - Slash height (12/08)

No slash or tree tops may exceed 24 inches in height.

##### 5.2.1.12 - Slash for prescribed burning (1/05)

To facilitate prescribed burning, slash shall be moved at least 25 feet inside the sale boundary in Payment Unit 1. Slash cannot be piled or placed near residual trees.

##### 5.2.1.14 - Chipping of slash (10/08)

If tops are chipped, they must be skidded to the landing separately from the bole section of the tree. Skidding of tops must be done in such a way as to minimize damage to the residual trees.

#### 5.2.3 - Operating Restrictions

##### 5.2.3.6 - Bark beetle restriction (12/08)

In the event drought creates a high risk of pine bark beetle infestation, pine is not to be cut during the period March 1 through July 1, unless all portions of trees greater than two inches in diameter are removed from the sale area, reduced to chips, or treated to the satisfaction of the Unit Manager or his/her representative, within fifteen days of being severed from the stump. Pine log decks, pulpwood piles and treetops that are piled for chipping in the fall or winter within a 1/4 mile of susceptible sites must be removed before March 15. Residual slash must not be placed in piles or rows and must be spread over the site for quick drying. The Department of Natural Resources will exercise this specification if the risk of damage warrants.

##### 5.2.32 - Decking/landing restoration (9/13)

All decking and landing areas must have the surface area restored to a condition equal to or better than before. This is to ensure the proper regeneration of the stand. Wood debris, chips and "cookies" from trimmings must be removed or scattered away from landing and loading areas and may not be windrowed on the edge.

### 5.4 - Soil Protection

#### 5.4.1 - Rutting restriction, general (7/16)

Operations are to cease immediately if equipment and weather conditions result in rutting of roads which is 12 inches or greater in depth and 50 feet in length. The Unit Manager or his/her representative may restrict hauling and/or skidding if ruts exceed the specified depth. With the Unit Manager or his/her representative's approval, the Purchaser may return to the area when the risk of rutting has decreased.

#### 5.4.6 - Wet area protection (5/10)

No harvesting operations, including skidding and felling, are to take place within the Riparian Management Buffer identified on the timber sale map. Care must be taken by the Purchaser to identify and avoid operating in these areas of the timber sale.

### 5.8 - Protection of Endangered Species

#### 5.8.5 - Protection of raptor nests (3/13)

All trees with raptor nests will be protected if found during harvesting operations. Notification will be made to the Unit

Manager or his/her representative who will notify the Wildlife Biologist so an on-site evaluation and recommendation can be made, if necessary.

## **6 - Safety and Fire Prevention**

### 6.2 - Signing

#### 6.2.1 - Road posting (10/20)

The Purchaser is responsible for posting and maintaining caution signs on all State Forest and/or County roads that are to be used as a haul route prior to beginning operations. The road must be posted at appropriate distances from the sale area to warn of logging activity and truck traffic. Signs must be removed when harvest operations are suspended or completed. The Purchaser will provide these signs.

## **7 - Other Conditions**

### 7.5 - Loss

#### 7.5.1 - Deteriorating timber (7/09)

The sale area has received damage from windthrow and over mature tree species. The Purchaser should harvest the wood as soon as possible. The Department of Natural Resources is held free of responsibility of any further damage or deterioration due to delay in harvesting.



# TIMBER SALE MAP

This information provided by authority of Part 525, 1994 PA 451, as amended.

|             |      |
|-------------|------|
| Sale Number | Year |
| 52 - 011    | 23   |

|                                   |                  |   |                    |           |         |
|-----------------------------------|------------------|---|--------------------|-----------|---------|
| Forest Management Unit<br>Gaylord | County<br>Otsego | Mapped By<br>Crew   | Date<br>08/17/2023 | Page<br>1 | of<br>1 |
| Township<br>29N                   | Range<br>04W     | Section(s) and Subdivision(s)<br>30 - SWNW,W1/2SW; 31 - W1/2NW,NWSW | Scale<br>1:15,840  |           |         |

| Cover Type        |                      |                         |                   | Density                     |                        |
|-------------------|----------------------|-------------------------|-------------------|-----------------------------|------------------------|
| A = Aspen         | H = Hemlock          | N = Marsh               | U = Upland Brush  | 0 = Non Stocked             | 5 = Pole Timber Medium |
| B = Paper Birch   | J = Jack Pine        | O = Oak                 | UM = Upland Mixed | 1 = Seedling Sapling Poor   | 6 = Pole Timber Well   |
| C = Cedar         | L = Lowland Brush    | P = Lowland Poplar      | V = Bog or Marsh  | 2 = Seedling Sapling Medium | 7 = Saw Timber Poor    |
| D = Treed Bog     | LM = Lowland Mixed   | Q = Mixed Swamp Conifer | W = White Pine    | 3 = Seedling Sapling Well   | 8 = Saw Timber Medium  |
| E = Swamp Hdwoods | M = Mpl, Bch, Brch   | R = Red Pine            | X = Non Stocked   | 4 = Pole Timber Poor        | 9 = Saw Timber Well    |
| F = Spruce Fir    | MC = Mixed Conifer   | S = Black Spruce        | Z = Water         |                             |                        |
| G = Grass         | MD = Mixed Deciduous | T = Tamarack            |                   |                             |                        |

| PU | Acres |
|----|-------|
| 1  | 35.6  |
| 2  | 15.7  |

## Second Time Jack Pine

### Compartment 022

### 51.3 Acres

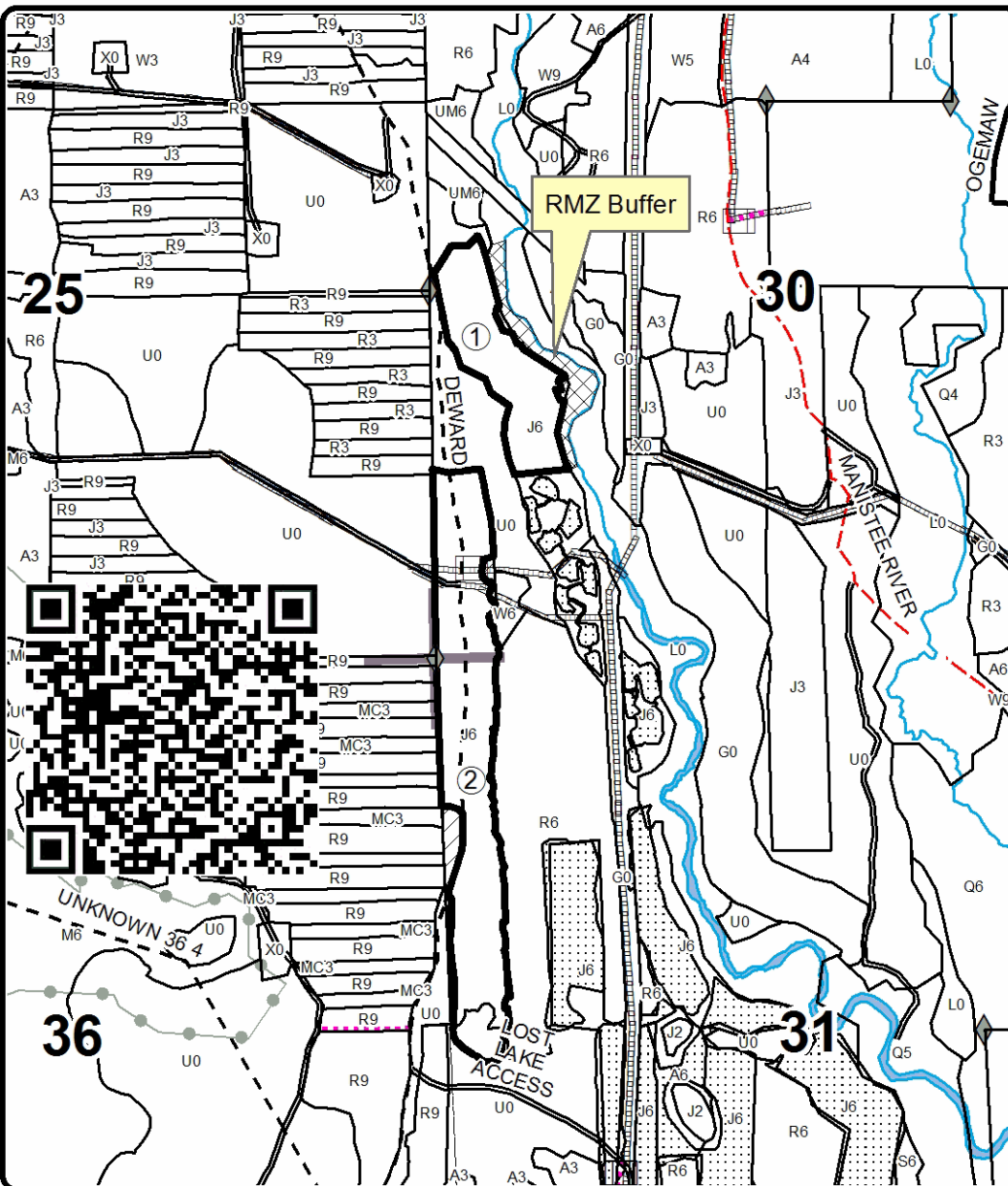
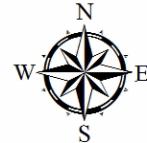

### Legend

- Against State (Red)
- Retention Area
- Pipeline
- Stand Boundaries
- Recreational Trail
- Secondary Forest Road
- Paved Road
- Gravel Road
- County Road - Seasonal
- Temporary Management Access
- Perennial River
- Lakes and Rivers
- Nearby Timber Sales
- Section Corners

Locator Map  
1:100,000

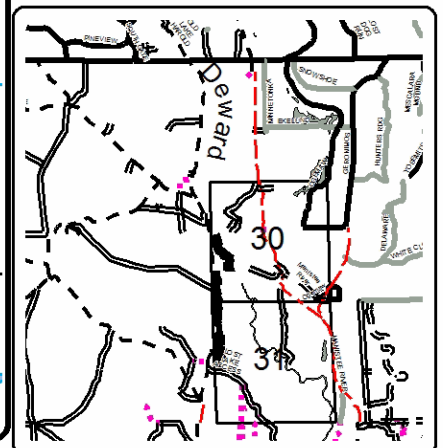



**TIMBER SALE INFORMATION**

Aspen Remix (52-021-23)  
 T33N, R05W, SEC. 33.  
 Charlevoix County (Advertised Price \$38,345.30)

SALE NOTE: Straightforward sale. Oak Wilt spec with exceptions.

A timber sale contract for this lump sum, sealed bid timber sale will be awarded to the responsible bidder offering the highest sealed bid price. All units of volume listed below were estimated using the Inventory Manager computer program and the new Michigan taper model. Bids must be at or above the following advertised price for each product and species:

| <u>PRODUCTS &amp; SPECIES</u> | <u>ESTIMATED UNITS*</u> | <u>ADVERTISED PRICE</u> |
|-------------------------------|-------------------------|-------------------------|
| Sawtimber                     |                         |                         |
| Beech                         | 21.1 MBF                | \$ 91.00 / MBF          |
| Red Maple                     | 48.3 MBF                | \$ 154.00 / MBF         |
| Pulpwood                      |                         |                         |
| Basswood                      | 22 Cords                | \$ 16.60 / Cord         |
| Mixed Aspen                   | 913 Cords               | \$ 23.95 / Cord         |
| Mixed Hardwood                | 248 Cords               | \$ 20.85 / Cord         |
| Mixed Oak                     | 41 Cords                | \$ 38.65 / Cord         |

\* The total volume is statistically estimated within plus (+) or minus (-) 20.96 percent. There are an estimated 1,342 cords on this timber sale, plus or minus 281 cords at the 95% confidence level. The estimated units are final and not subject to adjustment. Prospective bidders are urged to examine this timber and to make their own estimates of quantity and quality.

**BOND AND PAYMENT SCHEDULE:**

- A bond in the amount of \$1,917.00 to insure faithful performance of the conditions of the contract will be deposited by the successful bidder within 21 days of the sale award.
- Cutting in any sale or unit without the required advance payment would be considered a trespass.
- Total payment must be paid in advance or according to the following schedule :
  - Ten percent (10%) of the sale value must be paid within 21 days of the sale award.
  - The 10% down payment will be credited towards the first unit cut.
  - Payment for each of the following units must be made before cutting begins in that unit:
 

| PAYMENT UNIT NUMBER | PERCENT OF TOTAL SALE VALUE |
|---------------------|-----------------------------|
| 01                  | 27.5%                       |
| 02                  | 35.1%                       |
| 03                  | 37.4%                       |
- If no cutting takes place, the 10% down payment will not be refunded.
- Operations on the contract issued will terminate on 06/30/2026.

**SALE STATISTICS**

Volumes were calculated in cubic feet using the Michigan taper model. Cubic foot volume includes all wood inside bark for the product indicated. For display purposes, cubic feet were converted to cords and MBF using a simple conversion factor, e.g. 79 cubic feet per cord and 185 cubic feet per MBF. The cubic foot volumes are precise; the cords and MBF volumes are not. Cubic foot volume cannot be directly converted to cords or boards with precision.

**SALE VOLUMES**

The total estimated sale volume may not equal the sum of the species/products due to the nature of statistical calculations associated with double sampling methodology.

| VOLUME           |             | STATISTICAL RANGE IN CORDS |         |         |
|------------------|-------------|----------------------------|---------|---------|
| TOTAL CUBIC FEET | TOTAL CORDS | PERCENT ERROR              | MINIMUM | MAXIMUM |
| 106,021          | 1,342       | 20.96%                     | 1,061   | 1,623   |

## VDU VOLUMES

A VDU is a Volume Determination Unit. Volumes and their associated statistics are calculated at the VDU level and summarized to the sale level. There is often a one to one relationship between a VDU and a Payment Unit, but not always, depending on the cruise design. Refer to the VDU TO PAYMENT UNIT table.

| VDU           | VOLUME           |              | PERCENT ERROR | RANGE IN CORDS |              |
|---------------|------------------|--------------|---------------|----------------|--------------|
|               | TOTAL CUBIC FEET | TOTAL CORDS  |               | MINIMUM        | MAXIMUM      |
| 24            | 33,998           | 430          | 51.22%        | 210            | 651          |
| 26            | 72,023           | 912          | 23.51%        | 697            | 1,126        |
| <b>TOTAL:</b> | <b>106,021</b>   | <b>1,342</b> |               | <b>907</b>     | <b>1,777</b> |

## VDU TO PAYMENT UNIT

When a VDU is associated with more than one Payment Unit (PU), the VDU volumes are assigned to the PU based on acres of the VDU within the PU.

| VDU           | VDU ACRES   | PU | PU ACRES    |
|---------------|-------------|----|-------------|
| 24            | 9.8         | 2  | 0.3         |
|               |             | 3  | 9.5         |
| 26            | 25.9        | 1  | 11.6        |
|               |             | 2  | 14.3        |
| <b>TOTAL:</b> | <b>35.7</b> |    | <b>35.7</b> |

**DESCRIPTION OF TIMBER BY PAYMENT UNIT (PU)**

| PU                 | MARKET GROUP       | PRODUCT          | QUANTITY  | UNIT         | ACRES | ADVERTISE PRICE |             |      |             |
|--------------------|--------------------|------------------|-----------|--------------|-------|-----------------|-------------|------|-------------|
| 1                  | Red Maple          | Sawtimber        | 1.5       | MBF          | 11.6  | \$10,526.85     |             |      |             |
|                    | Mixed Aspen        | Pulpwood         | 386       | Cords        |       |                 |             |      |             |
|                    | <i>B. T. Aspen</i> | <i>Sawtimber</i> | 18.9      | <i>MBF</i>   |       |                 |             |      |             |
|                    | <i>B. T. Aspen</i> | <i>Pulpwood</i>  | 348       | <i>Cords</i> |       |                 |             |      |             |
|                    | Mixed Hardwood     |                  | 43        | Cords        |       |                 |             |      |             |
|                    | <i>Sugar Maple</i> | <i>Sawtimber</i> | 0.5       | <i>MBF</i>   |       |                 |             |      |             |
|                    | <i>Ironwood</i>    | <i>Pulpwood</i>  | 2         | <i>Cords</i> |       |                 |             |      |             |
|                    | <i>Red Maple</i>   |                  | 24        | <i>Cords</i> |       |                 |             |      |             |
|                    | <i>Sugar Maple</i> |                  | 16        | <i>Cords</i> |       |                 |             |      |             |
|                    | Mixed Oak          |                  | 4         | Cords        |       |                 |             |      |             |
|                    | <i>Red Oak</i>     |                  | 4         | <i>Cords</i> |       |                 |             |      |             |
|                    | 2                  | Beech            | Sawtimber | 0.6          |       |                 | MBF         | 14.6 | \$13,449.00 |
| Red Maple          |                    |                  | 3.3       | MBF          |       |                 |             |      |             |
| Mixed Aspen        |                    | Pulpwood         | 477       | Cords        |       |                 |             |      |             |
| <i>B. T. Aspen</i> |                    | <i>Sawtimber</i> | 23.6      | <i>MBF</i>   |       |                 |             |      |             |
| <i>B. T. Aspen</i> |                    | <i>Pulpwood</i>  | 430       | <i>Cords</i> |       |                 |             |      |             |
| Mixed Hardwood     |                    |                  | 59        | Cords        |       |                 |             |      |             |
| <i>Sugar Maple</i> |                    | <i>Sawtimber</i> | 0.8       | <i>MBF</i>   |       |                 |             |      |             |
| <i>Beech</i>       |                    | <i>Pulpwood</i>  | 1         | <i>Cords</i> |       |                 |             |      |             |
| <i>Ironwood</i>    |                    |                  | 3         | <i>Cords</i> |       |                 |             |      |             |
| <i>Red Maple</i>   |                    |                  | 32        | <i>Cords</i> |       |                 |             |      |             |
| <i>Sugar Maple</i> |                    |                  | 21        | <i>Cords</i> |       |                 |             |      |             |
| Mixed Oak          |                    |                  | 6         | Cords        |       |                 |             |      |             |
| <i>Red Oak</i>     |                    | <i>Sawtimber</i> | 0.2       | <i>MBF</i>   |       |                 |             |      |             |
| <i>Red Oak</i>     |                    | <i>Pulpwood</i>  | 6         | <i>Cords</i> |       |                 |             |      |             |
| 3                  |                    | Beech            | Sawtimber | 20.5         | MBF   | 9.5             | \$14,366.35 |      |             |
|                    | Red Maple          |                  | 43.5      | MBF          |       |                 |             |      |             |
|                    | Basswood           | Pulpwood         | 22        | Cords        |       |                 |             |      |             |
|                    | <i>Basswood</i>    | <i>Sawtimber</i> | 5.9       | <i>MBF</i>   |       |                 |             |      |             |
|                    | <i>Basswood</i>    | <i>Pulpwood</i>  | 10        | <i>Cords</i> |       |                 |             |      |             |
|                    | Mixed Aspen        |                  | 49        | Cords        |       |                 |             |      |             |
|                    | <i>B. T. Aspen</i> | <i>Sawtimber</i> | 5.7       | <i>MBF</i>   |       |                 |             |      |             |
|                    | <i>B. T. Aspen</i> | <i>Pulpwood</i>  | 38        | <i>Cords</i> |       |                 |             |      |             |
|                    | Mixed Hardwood     |                  | 147       | Cords        |       |                 |             |      |             |
|                    | <i>Sugar Maple</i> | <i>Sawtimber</i> | 6.5       | <i>MBF</i>   |       |                 |             |      |             |
|                    | <i>Beech</i>       | <i>Pulpwood</i>  | 46        | <i>Cords</i> |       |                 |             |      |             |
|                    | <i>Red Maple</i>   |                  | 68        | <i>Cords</i> |       |                 |             |      |             |
|                    | <i>Sugar Maple</i> |                  | 20        | <i>Cords</i> |       |                 |             |      |             |
|                    | Mixed Oak          |                  | 31        | Cords        |       |                 |             |      |             |
|                    | <i>Red Oak</i>     | <i>Sawtimber</i> | 6.4       | <i>MBF</i>   |       |                 |             |      |             |
|                    | <i>Red Oak</i>     | <i>Pulpwood</i>  | 18        | <i>Cords</i> |       |                 |             |      |             |
|                    | TOTAL:             |                  |           | 69.4         | MBF   |                 |             |      |             |
|                    | TOTAL:             |                  |           | 1,224        | Cords |                 |             |      |             |

# Sale Specific Conditions & Requirements

**Sale Name: Aspen Remix**

**Sale Number: 52-021-23 Seq#: 1**

## 1 - Sale Area

### 1.2 - Boundaries

#### 1.2.1 - Painted boundaries (9/19)

The sale boundary and Payment Unit boundaries are marked and identified by blue, red and yellow paint. Exterior sale boundary lines against private property are marked with blue paint. Exterior sale boundary lines against state are marked with red paint. Interior Payment Unit boundaries are marked with yellow paint. Retention patches are marked with red X's, no harvesting activities may occur within these areas. The painted boundary line trees are not Included Timber and are to be protected. Yellow painted trees designating an interior Payment Unit boundary are only to be cut when all surrounding Payment Units have been paid.

## 2 - Timber Specifications

### 2.1 - Included Timber

#### 2.1.1 - Clearcut unit(s) with unmerchantable trees (6/14)

Within Payment Unit(s) 1-3, cut all species or delectetrees that are two (2) inches or more at DBH.

## 3 - Payments

### 3.3 - Pre-measured Sales

#### 3.3.4 - Dividing payment units (7/14)

Payment Unit(s) may be divided at the request of the Purchaser and upon approval of the Unit Manager. Dividing Payment Units is a contract modification which requires a Timber Sale Contract Amendment. There will be only one division per Payment Unit.

## 4 - Transportation

### 4.1 - Construction

#### 4.1.6 - Road construction (1/09)

Construction of new roads or improvements of existing roads shall be done in such a way as to minimize the environmental and visual impacts. Merchantable trees shall be cut and utilized unless otherwise directed. Non-merchantable trees shall be severed and laid flat on the ground. Slash shall be scattered, and not left in windrows and kept a minimum of 10 feet back from the road edge. Stumps shall be set upright, not left on edge, and be moved at least 10 feet away from the road edge. Disturbed soil shall be feathered into the woods and not left in berms or windrows.

#### 4.1.7 - Road closure (10/11)

All new roads built into the sale must be blocked to vehicle traffic upon completion of the sale. Overgrown roads that are reopened shall be considered new roads. In general, this will require constructing a four (4') foot high berm of stumps and logs covered with earth. These roads must be rendered impassable to cars and trucks. All stumps from road building and landing construction must be reserved to block any newly constructed roads upon completion of the sale. These stumps must be scattered along the road system to prohibit vehicular movement. Contact the sale administrator for specific details of design and placement.

### 4.2 - Maintenance

#### 4.2.5 - Two wheel drive condition (2/04)

All existing trail roads on and adjacent to the sale area must be passable by two-wheel drive traffic for the duration of the sale.

## 5 - Operations

### 5.1 - Notification

#### 5.1.1 - Pre-sale conference (10/16)

A pre-sale conference on site between the Purchaser and sale administrator is required prior to beginning any operations. The Unit Manager or his/her representative must be contacted at least 5 days in advance to schedule the conference.

## 5.2 - Conduct of Operations

### 5.2.1 - Slash

#### 5.2.1.8 - Slash height (12/08)

No slash or tree tops may exceed 36 inches in height.

### 5.2.2 - Hazard Trees/Snags

#### 5.2.2.1 - Den trees (10/16)

Obvious hollow and/or den trees shall be protected and left standing unless they are a safety hazard.

### 5.2.3 - Operating Restrictions

#### 5.2.3.5 - Oak wilt restriction (1/18)

Within the Sale Area, unless changed by written agreement, cutting, skidding, hauling within the sale and brushing of access roads to the sale are not permitted during the period of April 15 to July 15. Operations may be allowed if specific steps are taken to prevent damaging uncut oak during the high risk period. Those steps may include completing all road brushing before April 15th and clearing a tree-length buffer along uncut oak cover before April 15th. This is necessary to reduce the spread of oak wilt. For more information, contact the Unit Manager or his/her representative.

#### 5.2.3.11 - Coppice regeneration protection (4/10)

Timber harvesting in any Payment Unit must be completed before significant tree sprouting occurs in that Payment Unit so as to minimize damage to the new regeneration. The Unit Manager or his/her representative may cease such operations if sprouting occurs before the operation is complete.

### 5.2.32 - Decking/landing restoration (9/13)

All decking and landing areas must have the surface area restored to a condition equal to or better than before. This is to ensure the proper regeneration of the stand. Wood debris, chips and "cookies" from trimmings must be removed or scattered away from landing and loading areas and may not be windrowed on the edge.

### 5.2.38 - No decking against live trees (2/04)

Cut products may not be decked against unmarked or designated leave trees.

## 5.4 - Soil Protection

### 5.4.1 - Rutting restriction, general (7/16)

Operations are to cease immediately if equipment and weather conditions result in rutting of roads and/or skid trails which is 12 inches or greater in depth and 50 feet in length. The Unit Manager or his/her representative may restrict hauling and/or skidding if ruts exceed the specified depth. With the Unit Manager or his/her representative's approval, the Purchaser may return to the area when the risk of rutting has decreased.

## 5.8 - Protection of Endangered Species

### 5.8.5 - Protection of raptor nests (3/13)

All trees with raptor nests will be protected if found during harvesting operations. Notification will be made to the Unit Manager or his/her representative who will notify the Wildlife Biologist so an on-site evaluation and recommendation can be made, if necessary.

## 6 - Safety and Fire Prevention

### 6.2 - Signing

#### 6.2.1 - Road posting (10/20)

The Purchaser is responsible for posting and maintaining caution signs on White Road, and any other roads involved in removing timber products (County or State Forest Roads) prior to beginning operations. The road must be posted at appropriate distances from the sale area to warn of logging activity and truck traffic. Signs must be removed when harvest operations are suspended or completed. The Purchaser will provide these signs, these signs must have high visibility and be approved by the sale administrator.





# TIMBER SALE MAP

This information provided by authority of Part 525, 1994 PA 451, as amended.

|                                   |                      |   |                    |           |         |
|-----------------------------------|----------------------|---|--------------------|-----------|---------|
| Forest Management Unit<br>Gaylord | County<br>Charlevoix | Mapped By<br>Doug Tyran                         | Date<br>09/18/2023 | Page<br>1 | of<br>1 |
| Township<br>33N                   | Range<br>05W         | Section(s) and Subdivision(s)<br>Sec. 33 W1/2SW | Scale<br>1:7,920   |           |         |

| Cover Type        |                      |                         |                   | Density                     |                        |  |  |
|-------------------|----------------------|-------------------------|-------------------|-----------------------------|------------------------|--|--|
| A = Aspen         | H = Hemlock          | N = Marsh               | U = Upland Brush  | 0 = Non Stocked             | 5 = Pole Timber Medium |  |  |
| B = Paper Birch   | J = Jack Pine        | O = Oak                 | UM = Upland Mixed | 1 = Seedling Sapling Poor   | 6 = Pole Timber Well   |  |  |
| C = Cedar         | L = Lowland Brush    | P = Lowland Poplar      | V = Bog or Marsh  | 2 = Seedling Sapling Medium | 7 = Saw Timber Poor    |  |  |
| D = Tread Bog     | LM = Lowland Mixed   | Q = Mixed Swamp Conifer | W = White Pine    | 3 = Seedling Sapling Well   | 8 = Saw Timber Medium  |  |  |
| E = Swamp Hdwoods | M = Mpl, Bch, Brch   | R = Red Pine            | X = Non Stocked   | 4 = Pole Timber Poor        | 9 = Saw Timber Well    |  |  |
| F = Spruce Fir    | MC = Mixed Conifer   | S = Black Spruce        | Z = Water         |                             |                        |  |  |
| G = Grass         | MD = Mixed Deciduous | T = Tamarack            |                   |                             |                        |  |  |

## PU Acres

|   |      |
|---|------|
| 1 | 11.6 |
| 2 | 14.6 |
| 3 | 9.5  |

## Aspen Remix

Compartment 39  
35.7 Acres

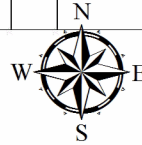

## Legend

- Sale Boundary (Red)
- Payment Unit (Yellow)
- Private Line (Blue)
- Stand Boundaries
- Retention Area (Red X's)
- Nearby Timber Sales
- Highways
- Primary Forest Road
- Secondary Forest Road
- Forest Access Route
- Paved Road
- Gravel Road

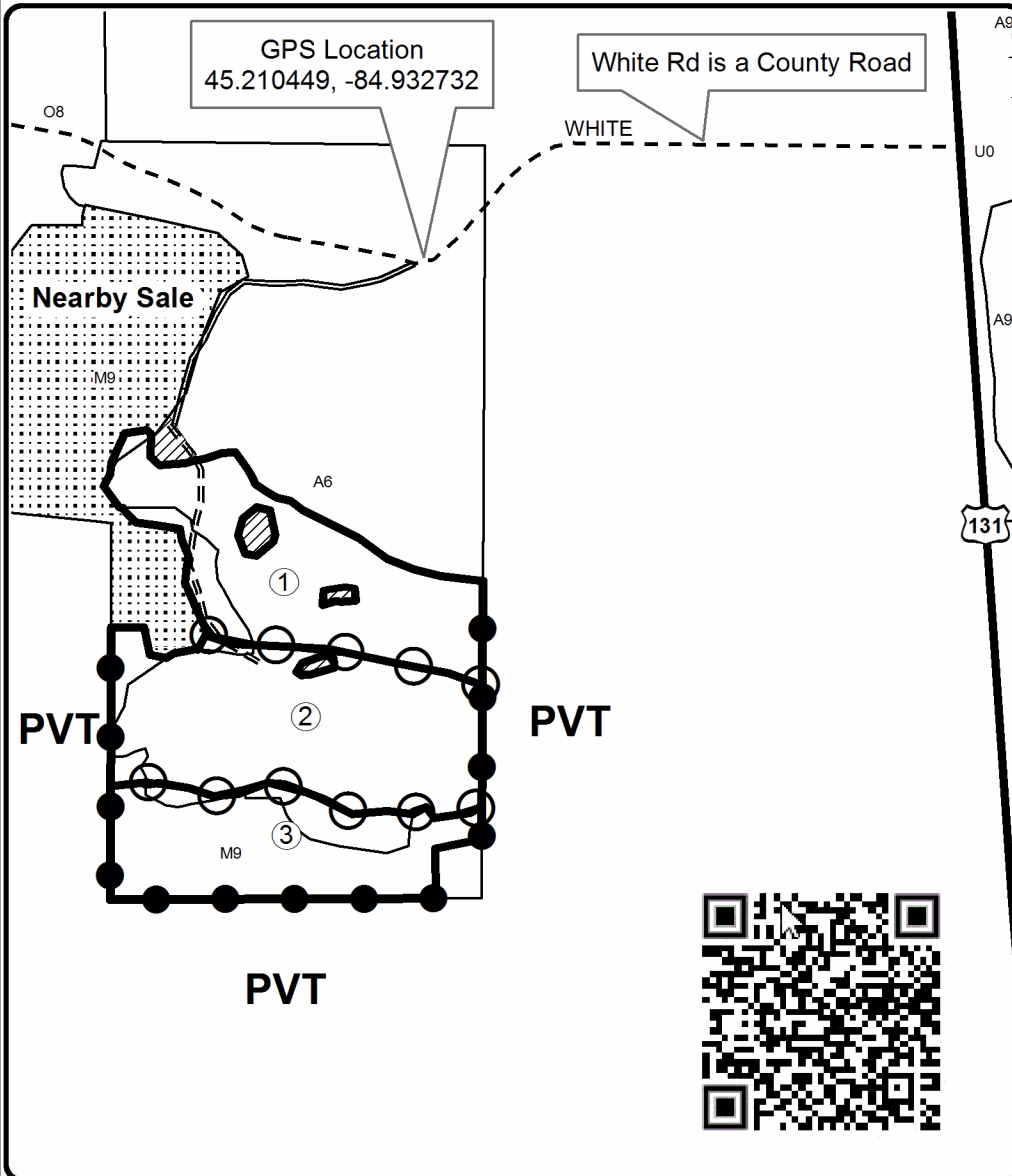

Locator Map  
1:200,000

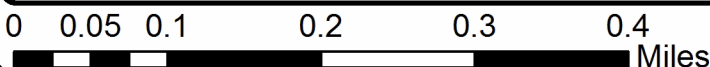
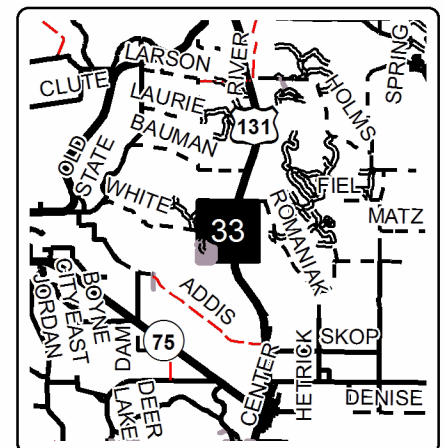





## TIMBER SALE INFORMATION

Camp Pellston Aspen (52-104-23)  
T36N, R05W, SEC. 5.  
Emmet County (Advertised Price \$20,112.20)

SALE NOTE: Mixed aspen final harvest with retention to protect wet areas. Harvesting during winter or dry summer months is recommended.

A timber sale contract for this lump sum, sealed bid timber sale will be awarded to the responsible bidder offering the highest sealed bid price. All units of volume listed below were estimated using the Inventory Manager computer program and the new Michigan taper model. Bids must be at or above the following advertised price for each product and species:

| <u>PRODUCTS &amp; SPECIES</u> | <u>ESTIMATED UNITS*</u> | <u>ADVERTISED PRICE</u> |
|-------------------------------|-------------------------|-------------------------|
| Sawtimber                     |                         |                         |
| B. T. Aspen                   | 25.0 MBF                | \$ 64.00 / MBF          |
| Quaking Aspen                 | 23.1 MBF                | \$ 64.00 / MBF          |
| Pulpwood                      |                         |                         |
| Black Cherry                  | 6 Cords                 | \$ 20.85 / Cord         |
| Mixed Aspen                   | 706 Cords               | \$ 23.95 / Cord         |

\* The total volume is statistically estimated within plus (+) or minus (-) 32.89 percent. There are an estimated 802 cords on this timber sale, plus or minus 264 cords at the 95% confidence level. The estimated units are final and not subject to adjustment. Prospective bidders are urged to examine this timber and to make their own estimates of quantity and quality.

### **BOND AND PAYMENT SCHEDULE:**

1. A bond in the amount of \$1,006.00 to insure faithful performance of the conditions of the contract will be deposited by the successful bidder within 21 days of the sale award.
2. Cutting in any sale or unit without the required advance payment would be considered a trespass.
3. Total payment must be paid in advance or according to the following schedule :
  - (a) Ten percent (10%) of the sale value must be paid within 21 days of the sale award.
  - (b) The 10% down payment will be credited towards the first unit cut.

(c) Payment for each of the following units must be made before cutting begins in that unit:

| PAYMENT UNIT NUMBER | PERCENT OF TOTAL SALE VALUE |
|---------------------|-----------------------------|
| 01                  | 63.6%                       |
| 02                  | 36.4%                       |

4. If no cutting takes place, the 10% down payment will not be refunded.
5. Operations on the contract issued will terminate on 06/30/2027.

### **SALE STATISTICS**

Volumes were calculated in cubic feet using the Michigan taper model. Cubic foot volume includes all wood inside bark for the product indicated. For display purposes, cubic feet were converted to cords and MBF using a simple conversion factor, e.g. 79 cubic feet per cord and 185 cubic feet per MBF. The cubic foot volumes are precise; the cords and MBF volumes are not. Cubic foot volume cannot be directly converted to cords or boards with precision.

### **SALE VOLUMES**

The total estimated sale volume may not equal the sum of the species/products due to the nature of statistical calculations associated with double sampling methodology.

| VOLUME           |             | STATISTICAL RANGE IN CORDS |         |         |
|------------------|-------------|----------------------------|---------|---------|
| TOTAL CUBIC FEET | TOTAL CORDS | PERCENT ERROR              | MINIMUM | MAXIMUM |
| 63,378           | 802         | 32.89%                     | 538     | 1,066   |

**VDU VOLUMES**

A VDU is a Volume Determination Unit. Volumes and their associated statistics are calculated at the VDU level and summarized to the sale level. There is often a one to one relationship between a VDU and a Payment Unit, but not always, depending on the cruise design. Refer to the VDU TO PAYMENT UNIT table.

| VDU           | VOLUME           |             | PERCENT ERROR | RANGE IN CORDS |              |
|---------------|------------------|-------------|---------------|----------------|--------------|
|               | TOTAL CUBIC FEET | TOTAL CORDS |               | MINIMUM        | MAXIMUM      |
| 18            | 39,325           | 498         | 28.71%        | 355            | 641          |
| 32            | 24,053           | 304         | 61.95%        | 116            | 493          |
| <b>TOTAL:</b> | <b>63,378</b>    | <b>802</b>  |               | <b>471</b>     | <b>1,134</b> |

**VDU TO PAYMENT UNIT**

When a VDU is associated with more than one Payment Unit (PU), the VDU volumes are assigned to the PU based on acres of the VDU within the PU.

| VDU           | VDU ACRES   | PU | PU ACRES    |
|---------------|-------------|----|-------------|
| 18            | 35.1        | 1  | 35.1        |
| 32            | 7.2         | 2  | 7.2         |
| <b>TOTAL:</b> | <b>42.3</b> |    | <b>42.3</b> |

**DESCRIPTION OF TIMBER BY PAYMENT UNIT (PU)**

| PU            | MARKET GROUP         | PRODUCT   | QUANTITY | UNIT         | ACRES | ADVERTISE PRICE |
|---------------|----------------------|-----------|----------|--------------|-------|-----------------|
| 1             | B. T. Aspen          | Sawtimber | 25.0     | MBF          | 35.1  | \$12,798.20     |
|               | Quaking Aspen        |           | 13.6     | MBF          |       |                 |
|               | Black Cherry         | Pulpwood  | 6        | Cords        |       |                 |
|               | Mixed Aspen          |           | 426      | Cords        |       |                 |
|               | <i>B. T. Aspen</i>   |           | 21       | <i>Cords</i> |       |                 |
|               | <i>Quaking Aspen</i> |           | 405      | <i>Cords</i> |       |                 |
| 2             | Quaking Aspen        | Sawtimber | 9.5      | MBF          | 7.2   | \$7,314.00      |
|               | Mixed Aspen          | Pulpwood  | 280      | Cords        |       |                 |
|               | <i>B. T. Aspen</i>   |           | 99       | <i>Cords</i> |       |                 |
|               | <i>Quaking Aspen</i> |           | 181      | <i>Cords</i> |       |                 |
| <b>TOTAL:</b> |                      |           | 48.1     | MBF          |       |                 |
| <b>TOTAL:</b> |                      |           | 712      | Cords        |       |                 |

# Sale Specific Conditions & Requirements

**Sale Name: Camp Pellston Aspen**

**Sale Number: 52-104-23 Seq#: 1**

## 1 - Sale Area

### 1.2 - Boundaries

#### 1.2.1 - Painted boundaries (9/19)

The Timber Sale boundary and Payment Unit boundaries are marked and identified by red paint. Exterior sale boundary lines adjacent to state-owned land are marked with red paint. Retention patches are marked with red paint; no harvesting activities may occur within these areas. The painted boundary line trees are not Included Timber and are to be protected, except for the painted boundary trees along Robinson and Palmer Rds. These may be felled and utilized to prevent them from eventually falling onto the roads.

## 2 - Timber Specifications

### 2.1 - Included Timber

#### 2.1.1 - Clearcut unit(s) with unmerchantable trees (6/14)

Within Payment Unit(s) 1 and 2, cut all trees that are two (2) inches or more at DBH except any incidental oak, hemlock, and apple trees, and any tree 26" at DBH and greater. Also, black cherry trees marked with a band of green paint are to remain unharvested and any tree marked with a band of pink paint are to be felled and left intact on the ground.

### 2.2 - Utilization

#### 2.2.8 - Utilization and removal (5/14)

All products meeting standards set forth in General Condition and Requirement 2.2 - Utilization must be removed from the sale area. Retain on site between 1/6 and 1/3 of the slash from harvested trees (tree tops and limbs less than four inches in diameter). This is because of biomass retention requirements.

## 3 - Payments

### 3.3 - Pre-measured Sales

#### 3.3.4 - Dividing payment units (7/14)

Payment Unit(s) 1 and 2 may be divided at the request of the Purchaser and upon approval of the Unit Manager. Dividing Payment Units is a contract modification which requires a Timber Sale Contract Amendment. There will be only one division per Payment Unit. No harvest activities may occur until the Purchaser-signed contract amendment has been received.

## 4 - Transportation

### 4.1 - Construction

#### 4.1.3 - Slash and earthen piles (8/04)

Piles or windrows of earth along roads and landings that have been widened or constructed shall be leveled. Slash from road maintenance or construction, including stumps, shall be dispersed throughout the sale, chipped, utilized or otherwise removed from the sale.

#### 4.1.6 - Road construction (1/09)

Construction of new roads or improvements of existing roads shall be done in such a way as to minimize the environmental and visual impacts. Merchantable trees shall be cut and utilized unless otherwise directed. Non-merchantable trees shall be severed and laid flat on the ground. Slash shall be scattered, and not left in windrows and kept a minimum of 10 feet back from the road edge. Stumps shall be set upright, not left on edge, and be moved at least 10 feet away from the road edge. Disturbed soil shall be feathered into the woods and not left in berms or windrows.

#### 4.1.7 - Road closure (10/11)

All new roads built into the sale must be blocked to vehicle traffic upon completion of the sale. In general, this will require constructing a four (4') foot high berm of stumps and logs covered with earth.

## 5 - Operations

## 5.1 - Notification

### 5.1.1 - Pre-sale conference (10/16)

A pre-sale conference between the Purchaser and sale administrator is required prior to beginning any operations to discuss contract specifications and to determine landing and road locations.

## 5.2 - Conduct of Operations

### 5.2.1 - Slash

#### 5.2.1.1 - Slash within sale area (9/16)

No trees are to be felled outside the sale area and all slash is to be kept at least 10 feet back from the red paint line. If sale boundary lines are along a public road or highway, then slash must be removed 50' from these lines per General Condition & Requirement 5.2.1.

### 5.2.2 - Hazard Trees/Snags

#### 5.2.2.1 - Den trees (10/16)

Obvious hollow and/or den trees shall be protected and left standing unless they are a safety hazard.

### 5.2.4 - Dead and Down Creation

#### 5.2.4.4 - Dead and down creation, grouse (6/18)

To encourage grouse and other wildlife, in Payment Unit(s) 1 and 2, cut and leave intact on the ground, any tree marked with a band of pink paint. These downed trees will function as grouse drumming logs.

### 5.2.22 - Operating Caution

#### 5.2.22.1 - Operating caution (6/11)

It is recommended, but not required, that within Payment Unit(s) 1 and 2, cutting and skidding occur during dry summer or frozen winter conditions. The reason for the recommendation is because of seasonal wet areas found within the sale boundary that could create excessive soil rutting conditions from harvest equipment.

### 5.2.29 - Shrub protection (1/20)

Do not cut or damage hawthorn, witch-hazel, dogwood or junberry. These woody-shrub plants are highly beneficial to various wildlife species.

### 5.2.32 - Decking/landing restoration (9/13)

All decking and landing areas must have the surface area restored to a condition equal to or better than before. This is to ensure the proper regeneration of the stand. Wood debris, chips and "cookies" from trimmings must be removed or scattered away from landing and loading areas and may not be windrowed on the edge. Stumps will be removed from the landing area and placed upright back into the sale area away from the landing. Piles of topsoil will need to be spread out evenly.

## 5.4 - Soil Protection

### 5.4.1 - Rutting restriction, general (7/16)

Operations are to cease immediately if equipment and weather conditions result in rutting of roads which is 12 inches or greater in depth and 50 feet in length. The Unit Manager or his/her representative may restrict hauling and/or skidding if ruts exceed the specified depth. With the Unit Manager or his/her representative's approval, the Purchaser may return to the area when the risk of rutting has decreased.

### 5.4.6 - Wet area protection (5/10)

No harvesting operations, including skidding and felling, are to take place within the vernal pond areas or drainages. When harvesting occurs, there should be no disturbance to the vernal pond depression. All equipment, trees and tops should be kept out of this area. Within 100 feet of the pond, equipment should only be used when the soil is in a dry or frozen condition. Care must be taken by the Purchaser to identify and avoid operating in these areas of the timber sale.

## 5.8 - Protection of Endangered Species

### 5.8.5 - Protection of raptor nests (3/13)

All trees with raptor nests will be protected if found during harvesting operations. Notification will be made to the Unit Manager or his/her representative who will notify the Wildlife Biologist so an on-site evaluation and recommendation can be

made, if necessary.

## **6 - Safety and Fire Prevention**

### 6.2 - Signing

#### 6.2.1 - Road posting (10/20)

The Purchaser is responsible for posting and maintaining caution signs on Robinson, Palmer, and Larks Lake Rds. prior to beginning operations. The road must be posted at appropriate distances from the sale area to warn of logging activity and truck traffic. Signs must be removed when harvest operations are suspended or completed. The Purchaser will provide these signs.



# TIMBER SALE MAP

This information provided by authority of Part 5, 1994 PA 451, as amended.

|             |         |
|-------------|---------|
| Sale Number | Year    |
| 52-104-23   | 2023    |
| Date        | Page of |
| 05/24/2023  | 1   1   |

|  |                         |  |                   |              |
|--|-------------------------|--|-------------------|--------------|
| Forest Management Unit<br><b>GAYLORD-NORTH</b> | County<br><b>EMMET</b>  | Mapped By<br><b>STACKS</b>                                     | Date              | Page of      |
| Compartment Number<br><b>52111</b>             | Township<br><b>T36N</b> | Cruised By<br><b>STACKS</b>                                    | <b>05/24/2023</b> | <b>1   1</b> |
|  | Range<br><b>R05W</b>    | Section(s) and Subdivision(s)<br><b>5 E 1/2 NW, NWNW, SWNE</b> |                   |              |

| Cover Type          |                         |                         |                        | Density                     |                        |
|---------------------|-------------------------|-------------------------|------------------------|-----------------------------|------------------------|
| A = Aspen           | J = Jack Pine           | O = Oak                 | U = Upland Brush       | 0 = Non Stocked             | 5 = Pole Timber Medium |
| B = Paper Birch     | K = Rock                | P = Lowland Poplar      | UM = Upland Mix Forest | 1 = Seedling Sapling Poor   | 6 = Pole Timber Well   |
| C = Cedar           | L = Lowland Brush       | Q = Mixed Swamp Conifer | V = Bog or Marsh       | 2 = Seedling Sapling Medium | 7 = Saw Timber Poor    |
| D = Treed Bog       | LM = Lowland Mix Forest | R = Red Pine            | W = White Pine         | 3 = Seedling Sapling Well   | 8 = Saw Timber Medium  |
| E = Swamp Hardwoods | M = Maple, Beech, Birch | S = Black Spruce        | X = Non Stocked        | 4 = Pole Timber Poor        | 9 = Saw Timber Well    |
| F = Spruce/Fir      | MC = Mixed Conifer      | T = Tamarack            | Y = Sand               |                             |                        |
| G = Grass           | MD = Mixed Deciduous    |                         | Z = Water              |                             |                        |
| H = Hemlock         | N = Marsh               |                         |                        |                             |                        |

## CAMP PELLSTON ASPEN

### EMMET COUNTY

#### 42.3 ACRES

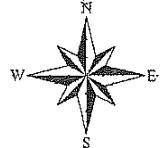

| UNIT | ACRES |
|------|-------|
| 1    | 35.1  |
| 2    | 7.2   |
|      | 42.3  |

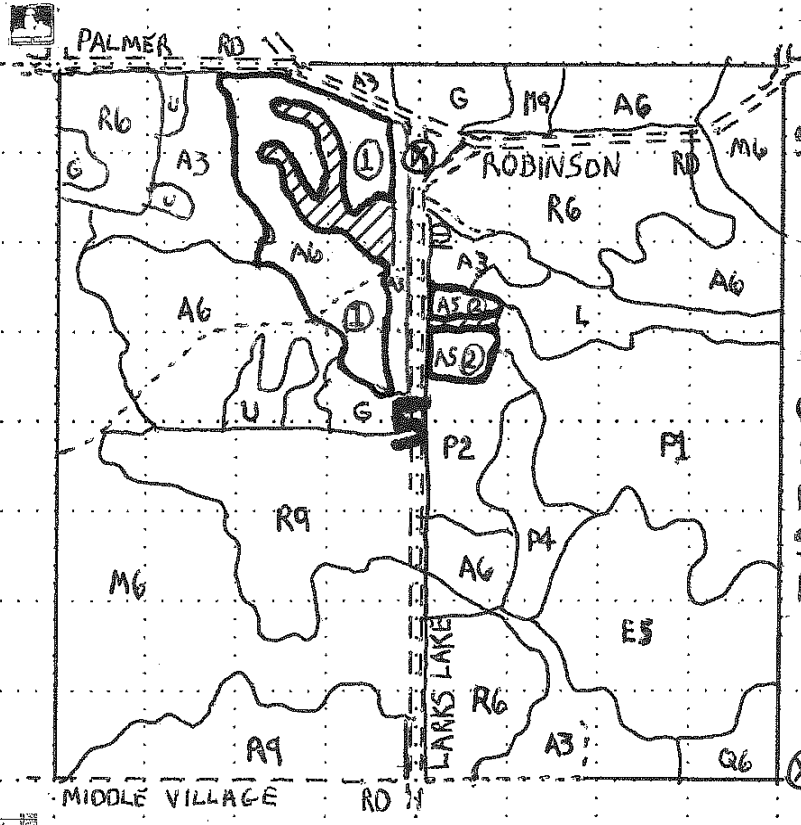

- SALE BOUNDARY: PUBLIC (RED) - ———
- PRIVATE (BLUE) - - - - -
- PAYMENT UNIT: (YELLOW) - 00000
- P.U. NUMBER - ①
- COUNTY ROAD - = = = = =
- SEASONAL C. R. - - - - -
- FOREST TRAIL ROAD - - - - -
- SNOWMOBILE TRAIL -
- RETENTION AREA -

⊗ - 64.91111  
45.549386

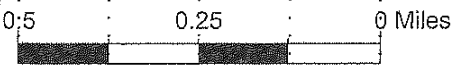
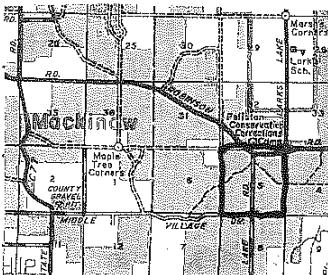

Camp Pellston Aspen (52-104-23)  
T36N, R05W, SEC. 5; Emmet COUNTY

In response to the notice of sale to be held 9:00 a.m. (local time) on February 13, 2024, I am hereby submitting my sealed bid (firm offer) for the following forest products to be cut. Bids for individual species must be at or above the advertised price. All non-responsive bid forms may be rejected.

| <u>PRODUCTS &amp; SPECIES</u> | <u>ESTIMATED VOLUME*</u> | <u>ADVERTISED PRICE</u> | <u>BID PRICE/UNIT</u> |
|-------------------------------|--------------------------|-------------------------|-----------------------|
| <b>Sawtimber</b>              |                          |                         |                       |
| B. T. Aspen                   | 25.0 MBF                 | \$ 64.00/MBF            | \$ _____              |
| Quaking Aspen                 | 23.1 MBF                 | \$ 64.00/MBF            | \$ _____              |
| <b>Pulpwood</b>               |                          |                         |                       |
| Black Cherry                  | 6 Cords                  | \$ 20.85/Cord           | \$ _____              |
| Mixed Aspen                   | 706 Cords                | \$ 23.95/Cord           | \$ _____              |

\*The volumes are statistically estimated within plus (+) or minus (-) 32.89 percent at 95% confidence level. These estimated volumes are final and not subject to adjustment. Prospective bidders are urged to examine this timber and to make their own estimates of quantity and quality.

I understand that any or all bids may be rejected. All bids must be signed and all bid items must be bid or the bid form may be rejected. I also understand that consideration and awarding a contract will be based upon my past performance and ability to complete the contract based upon equipment and staffing subject to my control.

FEDERAL ID: \_\_\_\_\_ - \_\_\_\_\_ or SOCIAL SECURITY NUMBER: \_\_\_\_\_ - \_\_\_\_\_ - \_\_\_\_\_

Company or individual bidding: \_\_\_\_\_

Company representative's name: \_\_\_\_\_

Address: \_\_\_\_\_

City: \_\_\_\_\_ State: \_\_\_\_\_ Zip: \_\_\_\_\_

IF AVAILABLE, PLEASE PLACE THE PERSONALIZED LABEL FROM YOUR PROSPECTUS IN THE ABOVE BOX.

Individual or company representative's signature: \_\_\_\_\_ Date: \_\_\_\_\_

Phone number : \_\_\_\_\_ Email (optional): \_\_\_\_\_

**THE WINNING BIDDER MUST COMPLETE THE VERIFICATION OF WORKER'S DISABILITY COMPENSATION ACT COMPLIANCE (ON REVERSE SIDE IF DOUBLE SIDED) WITHIN 21 DAYS OF SALE AWARD DATE**



# TIMBER SALE VERIFICATION OF WORKER'S DISABILITY COMPENSATION ACT COMPLIANCE

As required by Act 317, P.A. 1969 (Worker's Compensation) and  
Part 5 of Act 451 of 1994, as amended.

| FOR DEPARTMENT USE ONLY          |  |
|----------------------------------|--|
| Sale Number (XX - XXX - XX - XX) |  |
| Forest Management Unit:          |  |

## VERIFICATION OF WORKER'S DISABILITY COMPENSATION ACT COMPLIANCE

- This verification must be completed and submitted within 21 days of contract award and prior to the issuance of the timber sale contract.
- In addition, if boxes 2B or 2C are checked, then Notice of Exclusion or Certificate of Insurance must be submitted within twenty-one (21) days of the contract award and prior to the issuance of the timber sale contract.
- All information must be typed or printed except for written signatures.

Please Check Appropriate Categories:

1. My business is organized as (you **must** check one of the boxes below):
  - A.  Sole Proprietorship (individual)
  - B.  Partnership
  - C.  Corporation
2. You **must** check one of the boxes below:
  - A.  I certify my business is a sole proprietorship and it has no employees but the sole proprietor. I am not subject to the Worker's Compensation Laws.
  - B.  I certify my business has satisfied its obligation to the Worker's Compensation Act through the use of an approved Notice of Exclusion (BWC-337, Rev. 5/96). I will provide a copy of the Notice of Exclusion within 21 days of the contract award. (For questions or a copy of the BWC-337, please call the Worker's Compensation Bureau at 517-322-1195).
  - C.  I certify my business has a Worker's Compensation Policy. I will provide an original Certificate of Insurance within twenty-one (21) days of the contract award.
3. If you have checked item 2(A) or 2(B), you **must** indicate the number of **both** full-time and part-time employees, other than yourself, including family members and active partners (if none, you must enter "0").

\_\_\_\_\_ Full-time Employees

\_\_\_\_\_ Part-time Employees

|                  |       |                                     |  |
|------------------|-------|-------------------------------------|--|
| Name of Business |       | Federal ID (or) Social Security No. |  |
| Address          |       | Telephone<br>(       )              |  |
| City             | State | ZIP                                 |  |

*I hereby certify that the above information is true and correct. I agree to notify the Michigan DNR of any changes that occur in factors affecting my coverage during any of my present and future operations.*

\_\_\_\_\_  
Signature of Owner or Authorized Representative

\_\_\_\_\_  
Title

\_\_\_\_\_  
Date

Please complete the "SEALED BID" information on the next page



Mud Lake Mix (52-008-23)  
T29N, R01W, SEC. 6; Otsego COUNTY

In response to the notice of sale to be held 9:00 a.m. (local time) on February 13, 2024, I am hereby submitting my sealed bid (firm offer) for the following forest products to be cut. Bids for individual species must be at or above the advertised price. All non-responsive bid forms may be rejected.

| <u>PRODUCTS &amp; SPECIES</u> | <u>ESTIMATED VOLUME*</u> | <u>ADVERTISED PRICE</u> | <u>BID PRICE/UNIT</u> |
|-------------------------------|--------------------------|-------------------------|-----------------------|
| Sawtimber                     |                          |                         |                       |
| Red Oak                       | 187.5 MBF                | \$ 201.00/MBF           | \$ _____              |
| Pulpwood                      |                          |                         |                       |
| Mixed Aspen                   | 1,114 Cords              | \$ 27.15/Cord           | \$ _____              |
| Mixed Hardwood                | 272 Cords                | \$ 23.60/Cord           | \$ _____              |
| Red Oak                       | 147 Cords                | \$ 43.80/Cord           | \$ _____              |

\*The volumes are statistically estimated within plus (+) or minus (-) 11.56 percent at 95% confidence level. These estimated volumes are final and not subject to adjustment. Prospective bidders are urged to examine this timber and to make their own estimates of quantity and quality.

I understand that any or all bids may be rejected. All bids must be signed and all bid items must be bid or the bid form may be rejected. I also understand that consideration and awarding a contract will be based upon my past performance and ability to complete the contract based upon equipment and staffing subject to my control.

|   |
|---|
| FEDERAL ID: _____ or SOCIAL SECURITY NUMBER: _____<br>Company or individual bidding: _____<br>Company representative's name: _____<br>Address: _____<br>City: _____ State: _____ Zip: _____ |
|---|

IF AVAILABLE, PLEASE PLACE THE PERSONALIZED LABEL FROM YOUR PROSPECTUS IN THE ABOVE BOX.

Individual or company representative's signature: \_\_\_\_\_ Date: \_\_\_\_\_

Phone number : \_\_\_\_\_ Email (optional): \_\_\_\_\_

**THE WINNING BIDDER MUST COMPLETE THE VERIFICATION OF WORKER'S DISABILITY COMPENSATION ACT COMPLIANCE (ON REVERSE SIDE IF DOUBLE SIDED) WITHIN 21 DAYS OF SALE AWARD DATE**



|                                  |
|----------------------------------|
| <b>FOR DEPARTMENT USE ONLY</b>   |
| Sale Number (XX - XXX - XX - XX) |
| Forest Management Unit:          |

## TIMBER SALE VERIFICATION OF WORKER'S DISABILITY COMPENSATION ACT COMPLIANCE

*As required by Act 317, P.A. 1969 (Worker's Compensation) and  
Part 5 of Act 451 of 1994, as amended.*

### VERIFICATION OF WORKER'S DISABILITY COMPENSATION ACT COMPLIANCE

- This verification must be completed and submitted within 21 days of contract award and prior to the issuance of the timber sale contract.
- In addition, if boxes 2B or 2C are checked, then Notice of Exclusion or Certificate of Insurance must be submitted within twenty-one (21) days of the contract award and prior to the issuance of the timber sale contract.
- All information must be typed or printed except for written signatures.

Please Check Appropriate Categories:

1. My business is organized as (you **must** check one of the boxes below):
  - A.  Sole Proprietorship (individual)
  - B.  Partnership
  - C.  Corporation
  
2. You **must** check one of the boxes below:
  - A.  I certify my business is a sole proprietorship and it has no employees but the sole proprietor. I am not subject to the Worker's Compensation Laws.
  - B.  I certify my business has satisfied its obligation to the Worker's Compensation Act through the use of an approved Notice of Exclusion (BWC-337, Rev. 5/96). I will provide a copy of the Notice of Exclusion within 21 days of the contract award. (For questions or a copy of the BWC-337, please call the Worker's Compensation Bureau at 517-322-1195).
  - C.  I certify my business has a Worker's Compensation Policy. I will provide an original Certificate of Insurance within twenty-one (21) days of the contract award.
  
3. If you have checked item 2(A) or 2(B), you **must** indicate the number of **both** full-time and part-time employees, other than yourself, including family members and active partners (if none, you must enter "0").

\_\_\_\_\_ Full-time Employees

\_\_\_\_\_ Part-time Employees

|                  |       |                                     |  |
|------------------|-------|-------------------------------------|--|
| Name of Business |       | Federal ID (or) Social Security No. |  |
| Address          |       | Telephone<br>(       )              |  |
| City             | State | ZIP                                 |  |

*I hereby certify that the above information is true and correct. I agree to notify the Michigan DNR of any changes that occur in factors affecting my coverage during any of my present and future operations.*

\_\_\_\_\_  
Signature of Owner or Authorized Representative

\_\_\_\_\_  
Title

\_\_\_\_\_  
Date

**Please complete the "SEALED BID" information on the next page**

Second Time Jack Pine (52-011-23)  
T29N, R04W, SEC. 30; T29N, R04W, SEC. 31; Otsego COUNTY

In response to the notice of sale to be held 9:00 a.m. (local time) on February 13, 2024, I am hereby submitting my sealed bid (firm offer) for the following forest products to be cut. Bids for individual species must be at or above the advertised price. All non-responsive bid forms may be rejected.

| <u>PRODUCTS &amp; SPECIES</u> | <u>ESTIMATED VOLUME*</u> | <u>ADVERTISED PRICE</u> | <u>BID PRICE/UNIT</u> |
|-------------------------------|--------------------------|-------------------------|-----------------------|
| Pulpwood                      |                          |                         |                       |
| Jack Pine                     | 788 Cords                | \$ 12.70/Cord           | \$ _____              |
| Quaking Aspen                 | 76 Cords                 | \$ 19.15/Cord           | \$ _____              |
| Red Maple                     | 7 Cords                  | \$ 16.65/Cord           | \$ _____              |
| Red Pine                      | 36 Cords                 | \$ 40.80/Cord           | \$ _____              |
| White Pine                    | 26 Cords                 | \$ 30.40/Cord           | \$ _____              |

\*The volumes are statistically estimated within plus (+) or minus (-) 15.90 percent at 95% confidence level. These estimated volumes are final and not subject to adjustment. Prospective bidders are urged to examine this timber and to make their own estimates of quantity and quality.

I understand that any or all bids may be rejected. All bids must be signed and all bid items must be bid or the bid form may be rejected. I also understand that consideration and awarding a contract will be based upon my past performance and ability to complete the contract based upon equipment and staffing subject to my control .

FEDERAL ID: \_\_\_\_\_ - \_\_\_\_\_ or SOCIAL SECURITY NUMBER: \_\_\_\_\_ - \_\_\_\_\_ - \_\_\_\_\_

Company or individual bidding: \_\_\_\_\_

Company representative's name: \_\_\_\_\_

Address: \_\_\_\_\_

City: \_\_\_\_\_ State: \_\_\_\_\_ Zip: \_\_\_\_\_

IF AVAILABLE, PLEASE PLACE THE PERSONALIZED LABEL FROM YOUR PROSPECTUS IN THE ABOVE BOX.

Individual or company representative's signature: \_\_\_\_\_ Date: \_\_\_\_\_

Phone number : \_\_\_\_\_ Email (optional): \_\_\_\_\_

**THE WINNING BIDDER MUST COMPLETE THE VERIFICATION OF WORKER'S DISABILITY COMPENSATION ACT COMPLIANCE (ON REVERSE SIDE IF DOUBLE SIDED) WITHIN 21 DAYS OF SALE AWARD DATE**



|                                  |
|----------------------------------|
| <b>FOR DEPARTMENT USE ONLY</b>   |
| Sale Number (XX - XXX - XX - XX) |
| Forest Management Unit:          |

## TIMBER SALE VERIFICATION OF WORKER'S DISABILITY COMPENSATION ACT COMPLIANCE

*As required by Act 317, P.A. 1969 (Worker's Compensation) and  
Part 5 of Act 451 of 1994, as amended.*

### VERIFICATION OF WORKER'S DISABILITY COMPENSATION ACT COMPLIANCE

- This verification must be completed and submitted within 21 days of contract award and prior to the issuance of the timber sale contract.
- In addition, if boxes 2B or 2C are checked, then Notice of Exclusion or Certificate of Insurance must be submitted within twenty-one (21) days of the contract award and prior to the issuance of the timber sale contract.
- All information must be typed or printed except for written signatures.

Please Check Appropriate Categories:

1. My business is organized as (you **must** check one of the boxes below):
  - A.  Sole Proprietorship (individual)
  - B.  Partnership
  - C.  Corporation
2. You **must** check one of the boxes below:
  - A.  I certify my business is a sole proprietorship and it has no employees but the sole proprietor. I am not subject to the Worker's Compensation Laws.
  - B.  I certify my business has satisfied its obligation to the Worker's Compensation Act through the use of an approved Notice of Exclusion (BWC-337, Rev. 5/96). I will provide a copy of the Notice of Exclusion within 21 days of the contract award. (For questions or a copy of the BWC-337, please call the Worker's Compensation Bureau at 517-322-1195).
  - C.  I certify my business has a Worker's Compensation Policy. I will provide an original Certificate of Insurance within twenty-one (21) days of the contract award.
3. If you have checked item 2(A) or 2(B), you **must** indicate the number of **both** full-time and part-time employees, other than yourself, including family members and active partners (if none, you must enter "0").

\_\_\_\_\_ Full-time Employees

\_\_\_\_\_ Part-time Employees

|                  |       |                                     |  |
|------------------|-------|-------------------------------------|--|
| Name of Business |       | Federal ID (or) Social Security No. |  |
| Address          |       | Telephone<br>(       )              |  |
| City             | State | ZIP                                 |  |

*I hereby certify that the above information is true and correct. I agree to notify the Michigan DNR of any changes that occur in factors affecting my coverage during any of my present and future operations.*

\_\_\_\_\_  
Signature of Owner or Authorized Representative

\_\_\_\_\_  
Title

\_\_\_\_\_  
Date

**Please complete the "SEALED BID" information on the next page**

Aspen Remix (52-021-23)  
T33N, R05W, SEC. 33; Charlevoix COUNTY

In response to the notice of sale to be held 9:00 a.m. (local time) on February 13, 2024, I am hereby submitting my sealed bid (firm offer) for the following forest products to be cut. Bids for individual species must be at or above the advertised price. All non-responsive bid forms may be rejected.

| <u>PRODUCTS &amp; SPECIES</u> | <u>ESTIMATED VOLUME*</u> | <u>ADVERTISED PRICE</u> | <u>BID PRICE/UNIT</u> |
|-------------------------------|--------------------------|-------------------------|-----------------------|
| <b>Sawtimber</b>              |                          |                         |                       |
| Beech                         | 21.1 MBF                 | \$ 91.00/MBF            | \$ _____              |
| Red Maple                     | 48.3 MBF                 | \$ 154.00/MBF           | \$ _____              |
| <b>Pulpwood</b>               |                          |                         |                       |
| Basswood                      | 22 Cords                 | \$ 16.60/Cord           | \$ _____              |
| Mixed Aspen                   | 913 Cords                | \$ 23.95/Cord           | \$ _____              |
| Mixed Hardwood                | 248 Cords                | \$ 20.85/Cord           | \$ _____              |
| Mixed Oak                     | 41 Cords                 | \$ 38.65/Cord           | \$ _____              |

\*The volumes are statistically estimated within plus (+) or minus (-) 20.96 percent at 95% confidence level. These estimated volumes are final and not subject to adjustment. Prospective bidders are urged to examine this timber and to make their own estimates of quantity and quality.

I understand that any or all bids may be rejected. All bids must be signed and all bid items must be bid or the bid form may be rejected. I also understand that consideration and awarding a contract will be based upon my past performance and ability to complete the contract based upon equipment and staffing subject to my control.

FEDERAL ID: \_\_\_\_\_ - \_\_\_\_\_ or SOCIAL SECURITY NUMBER: \_\_\_\_\_ - \_\_\_\_\_ - \_\_\_\_\_  
 Company or individual bidding: \_\_\_\_\_  
 Company representative's name: \_\_\_\_\_  
 Address: \_\_\_\_\_  
 City: \_\_\_\_\_ State: \_\_\_\_\_ Zip: \_\_\_\_\_

IF AVAILABLE, PLEASE PLACE THE PERSONALIZED LABEL FROM YOUR PROSPECTUS IN THE ABOVE BOX.

Individual or company representative's signature: \_\_\_\_\_ Date: \_\_\_\_\_

Phone number : \_\_\_\_\_ Email (optional): \_\_\_\_\_

**THE WINNING BIDDER MUST COMPLETE THE VERIFICATION OF WORKER'S DISABILITY COMPENSATION ACT COMPLIANCE (ON REVERSE SIDE IF DOUBLE SIDED) WITHIN 21 DAYS OF SALE AWARD DATE**



| FOR DEPARTMENT USE ONLY          |  |
|----------------------------------|--|
| Sale Number (XX - XXX - XX - XX) |  |
| Forest Management Unit:          |  |

## TIMBER SALE VERIFICATION OF WORKER'S DISABILITY COMPENSATION ACT COMPLIANCE

As required by Act 317, P.A. 1969 (Worker's Compensation) and  
Part 5 of Act 451 of 1994, as amended.

### VERIFICATION OF WORKER'S DISABILITY COMPENSATION ACT COMPLIANCE

- This verification must be completed and submitted within 21 days of contract award and prior to the issuance of the timber sale contract.
- In addition, if boxes 2B or 2C are checked, then Notice of Exclusion or Certificate of Insurance must be submitted within twenty-one (21) days of the contract award and prior to the issuance of the timber sale contract.
- All information must be typed or printed except for written signatures.

Please Check Appropriate Categories:

1. My business is organized as (you **must** check one of the boxes below):
  - A.  Sole Proprietorship (individual)
  - B.  Partnership
  - C.  Corporation
2. You **must** check one of the boxes below:
  - A.  I certify my business is a sole proprietorship and it has no employees but the sole proprietor. I am not subject to the Worker's Compensation Laws.
  - B.  I certify my business has satisfied its obligation to the Worker's Compensation Act through the use of an approved Notice of Exclusion (BWC-337, Rev. 5/96). I will provide a copy of the Notice of Exclusion within 21 days of the contract award. (For questions or a copy of the BWC-337, please call the Worker's Compensation Bureau at 517-322-1195).
  - C.  I certify my business has a Worker's Compensation Policy. I will provide an original Certificate of Insurance within twenty-one (21) days of the contract award.
3. If you have checked item 2(A) or 2(B), you **must** indicate the number of **both** full-time and part-time employees, other than yourself, including family members and active partners (if none, you must enter "0").

\_\_\_\_\_ Full-time Employees

\_\_\_\_\_ Part-time Employees

|                  |       |                                     |  |
|------------------|-------|-------------------------------------|--|
| Name of Business |       | Federal ID (or) Social Security No. |  |
| Address          |       | Telephone<br>(       )              |  |
| City             | State | ZIP                                 |  |

*I hereby certify that the above information is true and correct. I agree to notify the Michigan DNR of any changes that occur in factors affecting my coverage during any of my present and future operations.*

\_\_\_\_\_  
Signature of Owner or Authorized Representative

\_\_\_\_\_  
Title

\_\_\_\_\_  
Date

Please complete the "SEALED BID" information on the next page