



**DEPARTMENT OF NATURAL RESOURCES  
STATE OF MICHIGAN  
TIMBER SALE PROSPECTUS #7381**

SCHEDULED SALE DATE AND TIME: 9:00 a.m. (local time) on March 12, 2024.

LOCATION: GAYLORD MGMT UNIT, 1732 WEST M 32, GAYLORD, MI 49735.

PROSPECTUS NOTE: The bidder is advised to inspect the sale area and review the location, estimated volumes, operating costs and contract terms of proposed sales. Please be aware that some landowners may request 60 days or more notice for access across their land.

Notice is hereby given that bids will be received by the Unit Manager, GAYLORD MANAGEMENT UNIT, for certain timber on the following described lands:

C 48 Hardwoods (52-005-23) / T31N, R05W, SEC. 20, SENW,W1/2NE,SW,NWSE.

T31N, R05W, SEC. 29, NWNW,S1/2NW.

Antrim County, Advertised Price \$135,576.70, 137.8 Acres, Hardwood, Sugar Maple.

SALE NOTE: Access will be difficult due to the hilly terrain and rec trails in the area .

A recreation site such as a trail, pathway, or campground is within the sale area or the vicinity. Certain restrictions/specifications may be applicable including time restrictions.

Hollywood Mix (52-106-23) / T35N, R01E, SEC. 22, S1/2SW.

T35N, R01E, SEC. 27, N1/2NW,SEW.

Cheboygan County, Advertised Price \$48,961.95, 59.6 Acres, Red Oak, Hardwood.

SALE NOTE: Oak wilt seasonal harvest restriction and ORV trail specs applied.

A recreation site such as a trail, pathway, or campground is within the sale area or the vicinity. Certain restrictions/specifications may be applicable including time restrictions.

Lorenzo Mix (52-113-23) / T35N, R01E, SEC. 10, N1/2NW.

T35N, R01E, SEC. 3 , SWSW.

Cheboygan County, Advertised Price \$15,850.65, 22.7 Acres, Aspen, Hardwood.

SALE NOTE: Mixed species final harvest with retention. Seasonal oak wilt restriction applied. ORV trail protection specs included. Target shooting range near Sale Area.

A recreation site such as a trail, pathway, or campground is within the sale area or the vicinity. Certain restrictions/specifications may be applicable including time restrictions.

Super Terrific Fun Time Pine (52-114-23) / T33N, R04W, SEC. 4 , NWNE.

T34N, R04W, SEC. 33, E1/2NW,N1/2NE,SENE,E1/2SW.

T34N, R04W, SEC. 33, N1/2SE,SWSE.

T34N, R04W, SEC. 34, S1/2NW,NWSW.

Charlevoix County, Advertised Price \$387,034.15, 173.7 Acres, Red Pine, Hardwood.

SALE NOTE: Payment Units 4-9 must be chip harvested (spec 2.2.2) and stump heights shall not exceed six (6) inches (spec 2.2.3). This is to facilitate subsequent planting operations. A chipping exemption can be obtained if proposed operations are determined to be suitable for planting by reforestation staff. In addition, steep/operationally challenging ground is present in certain harvest locations. Some of these locations have been approximated on the Sale Map. Access to Payment Unit 3 is best accomplished through privately owned lands (spec 4.4.1).

A recreation site such as a trail, pathway, or campground is within the sale area or the vicinity. Certain restrictions/specifications may be applicable including time restrictions. Access may be through private or other public land.

## BID INSTRUCTIONS (VER. 10/10/2022):

### 1. Scheduled Bid Location, Date, and Time (2/11)

Bids must be received by the Unit Manager, GAYLORD OFFICE, 1732 West M 32, Gaylord, MI 49735, no later than 9:00 a.m. (local time) on March 12, 2024. For further information concerning this sale, contact Lucas Merrick at 989-732-3541 extension .

### 2. Bidder's Qualifications (10/22)

If all or part of a timber sale was prepared by a private contractor, the contractor and that contractor's company are not permitted to bid on the timber sale. A person must be 18 years of age or older to purchase timber. Permanent employees of the Department of Natural Resources or members of their immediate household may not bid. Former employees, in the permanent or seasonal class, may not bid until 3 months after the last day of active duty. Bids will not be accepted from individuals or companies appearing on the DNR/FRD No-Bid List. This list contains the names of purchasers who previously failed to execute a contract within 21-days or who have a history of poor performance.

### 3. Preparation of Sealed Bids (5/16)

Bid Forms may be completed online thru Michigan DNR Timber Sale Online Bidding (OLB) at [www.michigan.gov/timberbidding](http://www.michigan.gov/timberbidding) or by completing the hardcopy Bid Form found in the Timber Sale Prospectus . Hardcopy Bid Forms shall be manually signed in ink. Registration in OLB is considered your 'signature' for all bids submitted thru that system. Bid prices must be entered for each species and product in the Bid Price column for all material subject to bidding and all fill-in blanks must be completed. If erasures or other changes appear on the hardcopy Bid Form, each erasure or change must be initialed by the person signing the bid.

### 4. Submission of Sealed Bids (5/16)

Bid forms may be obtained from the Unit Manager or thru OLB. Bids may be submitted hardcopy or thru OLB. All hardcopy bids must be submitted on the bid form and in an envelope clearly identified as described in this section. NOTE: Only one bid form per bid envelope. Sealed bids must be submitted to the Unit office designated in the prospectus and must be submitted at or prior to the time established in the prospectus. The envelope should show on the outside (a) the sale name or number and (b) the date and time of bid opening, as shown in the prospectus. Bids received after the time specified in the sale prospectus are late bids and will be rejected.

It is possible for a bidder to submit multiple bids on a single sale. For example, a bid may be submitted hardcopy and a bid may be submitted thru OLB. Or, two bidders from the same company could both submit bids on the same sale. If this were to happen, the State would accept all bids received and award the contract accordingly. All bidding and contractual requirements would apply to all bids received.

### 5. Public Opening of Sealed Bids (7/16)

If conditions permit, the sealed bids will be publicly opened and posted at the time and place set in the prospectus.

If a bidder, present at a bid opening, has submitted bids on more than one sale, that bidder may withdraw their unopened bid envelopes or announce the withdrawal of their online bid after being declared the successful bidder on one sale.

### 6. Award of Contract (1/11)

Award of the contract will be made to the Bidder whose bid, conforming to the prospectus, is most advantageous to the State of Michigan on the basis of total value at rates bid for the estimated quantities. The State reserves the right to reject any bid or waive any minor irregularity in bids received. A written award mailed (or otherwise furnished) to the successful Bidder shall be deemed to result in a binding contract without further action by either party.

### 7. Down Payment (1/11)

The Bidder to whom award is made must make a down payment within 21 days of the sale award. The amount of the down payment will be calculated as shown in the Bond and Payment Schedule of this prospectus. Only cash may be used to meet this requirement.

### 8. Performance Security (1/11)

As guarantee of faithful performance, a cash bond, certificate of deposit, surety bond or irrevocable letter of credit (LOC) is required within 21 days of the sale award. The amount of the performance security is shown in the Bond and

Payment Schedule of this prospectus. If an LOC or surety is used, the coverage must extend for at least 6 months beyond the contract expiration.

#### 9. Worker's Compensation (10/22)

Purchaser shall obtain worker's compensation insurance to cover claims under Michigan's Worker's Disability Compensation Act of 1969 or similar employee benefit act of any other state applicable to an employee. Verification of Worker's Disability Compensation Act Compliance must be completed and submitted within 21 days of contract award and prior to the issuance of the timber sale contract. In addition, if applicable, Notice of Exclusion or Certificate of Insurance must also be submitted.

#### 10. Timber Sale Contract (10/22)

Additional conditions and requirements common to all timber sales are listed on the timber sale contract (R4031) and are available on line at [www.michigan.gov/timber](http://www.michigan.gov/timber). Contact the Unit Manager for additional information or a sample contract. Within 21 days of the date of the award letter, the bidder must sign the contract and provide the required down payment, performance security, and verification of worker's disability compensation. The down payment and performance security shall be in accordance with the provisions of the timber sale contract, in the sums stated in this prospectus. If these actions are not taken, then the Bidder, the Bidder's corporation, and the corporation's principals may not be permitted to bid on State timber sales for a period of 3 months after the first offense, 6 months after the second offense, and 1 year after the third offense. An offense will only be counted against the Bidder for 5 years. In addition, the Bidder certifies that if awarded this contract, the Bidder will complete the timber sale contract in accordance with its terms and any modifications thereof including requirements to purchase, cut, and remove the included timber by the expiration date.

Payment Unit values in the State Forest Timber Sale Contract are calculated based on the advertised value of the Payment Unit as a percentage of the total advertised value of the contract. The advertised value of each Payment Unit is given in the Description of Timber by Payment Unit table on the Timber Sale Information page. For example, if the value of Payment Unit 1 is advertised as \$1,500 and the total Timber Sale value is advertised as \$10,000, the contract price for Payment Unit 1 will be 15% of the total bid price ( $\$1,500/\$10,000 * 100$ ).

#### 11. Disclaimer of Estimates and Bidder's Warranty of Inspection (10/22)

Before submitting this bid, the Bidder is advised and cautioned to inspect the sale area, review the requirements of the sale contract, and take other steps as may be reasonably necessary to ascertain the location, estimated volumes, construction estimates, and operating costs of the proposed sale. Failure to do so will not relieve the Bidder from responsibility for completing the contract.

The Bidder warrants that this bid is submitted solely on the basis of the Bidder's examination and inspection of the quality and quantity of the timber offered for sale and the Bidder's opinion of the value thereof and the costs of recovery. No reliance should be placed on the State of Michigan's estimates of timber quality, quantity or costs of recovery. Bidder further acknowledges that the State of Michigan: (i) expressly disclaims any warranty of fitness of timber for any purpose; (ii) offers this timber as is without any warranty of quality (merchantability) or quantity and (iii) expressly disclaims any warranty as to the quantity or quality of timber sold.

#### 12. Certification and Chain-of-Custody (10/22)

Unless otherwise indicated in the contract under section 7 – Other Conditions of the Sale Specific Conditions & Requirements, the area encompassed by this timber sale is certified to the standards of the Forest Stewardship Council (FSC) - Certificate #SCS-FM/COC-00090N and the Sustainable Forestry Initiative (SFI) - Certificate #NSF-SFIS-5Y031-SF5. Forest products from this sale may be delivered to the mill as "FSC 100% and / or SFI certified" as long as the contractor hauling the forest products is chain-of-custody (COC) certified or covered under a COC certificate from the destination mill. The purchaser is responsible for maintaining COC after leaving the sale area.

#### 13. Good Neighbor Authority (GNA) Requirements (10/22)

If the name of this timber sales contains the acronym GNA, it is authorized by the Good Neighbor Authority (GNA) and covered by various agreements between the U.S. Forest Service and the State. The timber sale occurs on federal land and the following conditions apply:

GNA contracts on US Forest Service land will not be awarded to purchasers on the Federal list of excluded parties. The System for Award Management (SAM) will be checked for active excluded parties prior to award of contract. In

addition, the Bidder to whom award is made must complete an Assurance Regarding Felony Conviction or Tax Delinquent Status for Corporate Applicants (AD-3031).

14. Good Neighbor Authority (GNA) Requirements, con't (10/22)

Bidder certifies, by signing this bid form, that to the best of Bidder's knowledge that the following representations are accurate and complete.

- a. That the Bidder and its principals are not presently debarred, suspended, proposed for debarment, declared ineligible, or voluntary excluded from timber sales (covered transactions) by any Federal department or agency.
- b. That the Bidder and its principals have not within a 3-year period preceding this bid been convicted of or had a civil judgment rendered against them for commission of fraud or a criminal offense in connection with obtaining , attempting to obtain, or performing a public (Federal, State, or local) transaction or contract under a public transaction; violation of Federal or State antitrust statutes or commission of embezzlement, theft, forgery, bribery, falsification or destruction of records, making false statements, or receiving stolen property.
- c. That the Bidder and its principals are not presently indicted for or otherwise criminally or civilly charged by a governmental entity (Federal, State, or local) with commission of any of the offenses enumerated in paragraph b of this certification.
- d. That the Bidder and its principals have not within a 3-year period preceding this bid had one or more public transactions (Federal, State, or local) terminated for breach or default of a timber or forest product contract.

Bidders that cannot certify this requirement, in whole or in part, shall submit an explanation with their bid.

Scott Bowen  
Director



# TIMBER SALE INFORMATION

C 48 Hardwoods (52-005-23)  
T31N, R05W, SEC. 20; T31N, R05W, SEC. 29.  
Antrim County (Advertised Price \$135,576.70)

SALE NOTE: Access will be difficult due to the hilly terrain and rec trails in the area .

A recreation site such as a trail, pathway, or campground is within the sale area or the vicinity. Certain restrictions/specifications may be applicable including time restrictions.

A timber sale contract for this lump sum, sealed bid timber sale will be awarded to the responsible bidder offering the highest sealed bid price. All units of volume listed below were estimated using the Inventory Manager computer program and the new Michigan taper model. Bids must be at or above the following advertised price for each product and species:

<u>PRODUCTS &amp; SPECIES</u>	<u>ESTIMATED UNITS*</u>	<u>ADVERTISED PRICE</u>
<b>Sawtimber</b>		
B. T. Aspen	16.3 MBF	\$ 43.00 / MBF
Basswood	331.6 MBF	\$ 61.00 / MBF
Beech	49.6 MBF	\$ 87.00 / MBF
Black Cherry	4.8 MBF	\$ 76.00 / MBF
Red Maple	327.1 MBF	\$ 123.00 / MBF
Sugar Maple	198.5 MBF	\$ 211.00 / MBF
<b>Pulpwood</b>		
B. T. Aspen	13 Cords	\$ 15.80 / Cord
Basswood	444 Cords	\$ 11.10 / Cord
Mixed Hardwood	1,556 Cords	\$ 14.60 / Cord

\* The total volume is statistically estimated within plus (+) or minus (-) 12.06 percent. There are an estimated 4,280 cords on this timber sale, plus or minus 517 cords at the 95% confidence level. The estimated units are final and not subject to adjustment. Prospective bidders are urged to examine this timber and to make their own estimates of quantity and quality.

**BOND AND PAYMENT SCHEDULE:**

1. A bond in the amount of \$6,779.00 to insure faithful performance of the conditions of the contract will be deposited by the successful bidder within 21 days of the sale award.
2. Cutting in any sale or unit without the required advance payment would be considered a trespass.
3. Total payment must be paid in advance or according to the following schedule :
  - (a) Ten percent (10%) of the sale value must be paid within 21 days of the sale award.
  - (b) The 10% down payment will be credited towards the first unit cut.
  - (c) Payment for each of the following units must be made before cutting begins in that unit:
 

PAYMENT UNIT NUMBER	PERCENT OF TOTAL SALE VALUE
01	34.5%
02	33.5%
03	32.0%
4. If no cutting takes place, the 10% down payment will not be refunded.
5. Operations on the contract issued will terminate on 06/30/2027.

**SALE STATISTICS**

Volumes were calculated in cubic feet using the Michigan taper model. Cubic foot volume includes all wood inside bark for the product indicated. For display purposes, cubic feet were converted to cords and MBF using a simple conversion factor, e.g. 79 cubic feet per cord and 185 cubic feet per MBF. The cubic foot volumes are precise; the cords and MBF volumes are not. Cubic foot volume cannot be directly converted to cords or boards with precision.

**SALE VOLUMES**

The total estimated sale volume may not equal the sum of the species/products due to the nature of statistical calculations associated with double sampling methodology.

VOLUME		STATISTICAL RANGE IN CORDS		
TOTAL CUBIC FEET	TOTAL CORDS	PERCENT ERROR	MINIMUM	MAXIMUM
338,152	4,280	12.06%	3,764	4,797

**VDU VOLUMES**

A VDU is a Volume Determination Unit. Volumes and their associated statistics are calculated at the VDU level and summarized to the sale level. There is often a one to one relationship between a VDU and a Payment Unit, but not always, depending on the cruise design. Refer to the VDU TO PAYMENT UNIT table.

VDU	VOLUME		PERCENT ERROR	RANGE IN CORDS	
	TOTAL CUBIC FEET	TOTAL CORDS		MINIMUM	MAXIMUM
11	338,152	4,280	12.07%	3,764	4,797
<b>TOTAL:</b>	<b>338,152</b>	<b>4,280</b>		<b>3,764</b>	<b>4,797</b>

**VDU TO PAYMENT UNIT**

When a VDU is associated with more than one Payment Unit (PU), the VDU volumes are assigned to the PU based on acres of the VDU within the PU.

VDU	VDU ACRES	PU	PU ACRES
11	137.8	1	47.6
		2	46.1
		3	44.1
<b>TOTAL:</b>	<b>137.8</b>		<b>137.8</b>



**DESCRIPTION OF TIMBER BY PAYMENT UNIT (PU)**

PU	MARKET GROUP	PRODUCT	QUANTITY	UNIT	ACRES	ADVERTISE PRICE
1	B. T. Aspen	Sawtimber	5.6	MBF	47.6	\$46,839.40
	Basswood		114.6	MBF		
	Beech		17.1	MBF		
	Black Cherry		1.7	MBF		
	Red Maple		113.0	MBF		
	Sugar Maple		68.6	MBF		
	B. T. Aspen	Pulpwood	5	Cords		
	Basswood		153	Cords		
	Mixed Hardwood		537	Cords		
	<i>Beech</i>		87	<i>Cords</i>		
	<i>Black Cherry</i>		4	<i>Cords</i>		
	<i>Ironwood</i>		10	<i>Cords</i>		
	<i>Red Maple</i>		193	<i>Cords</i>		
	<i>Sugar Maple</i>		243	<i>Cords</i>		
2	B. T. Aspen	Sawtimber	5.5	MBF	46.1	\$45,357.50
	Basswood		110.9	MBF		
	Beech		16.6	MBF		
	Black Cherry		1.6	MBF		
	Red Maple		109.4	MBF		
	Sugar Maple		66.4	MBF		
	B. T. Aspen	Pulpwood	4	Cords		
	Basswood		149	Cords		
	Mixed Hardwood		521	Cords		
	<i>Beech</i>		85	<i>Cords</i>		
	<i>Black Cherry</i>		4	<i>Cords</i>		
	<i>Ironwood</i>		10	<i>Cords</i>		
	<i>Red Maple</i>		187	<i>Cords</i>		
	<i>Sugar Maple</i>		235	<i>Cords</i>		
3	B. T. Aspen	Sawtimber	5.2	MBF	44.1	\$43,379.80
	Basswood		106.1	MBF		
	Beech		15.9	MBF		
	Black Cherry		1.5	MBF		
	Red Maple		104.7	MBF		
	Sugar Maple		63.5	MBF		
	B. T. Aspen	Pulpwood	4	Cords		
	Basswood		142	Cords		
	Mixed Hardwood		498	Cords		
	<i>Beech</i>		81	<i>Cords</i>		
	<i>Black Cherry</i>		4	<i>Cords</i>		
	<i>Ironwood</i>		9	<i>Cords</i>		
	<i>Red Maple</i>		179	<i>Cords</i>		
	<i>Sugar Maple</i>		225	<i>Cords</i>		
TOTAL:			927.9	MBF		
TOTAL:			2,013	Cords		

## Sale Specific Conditions & Requirements

Sale Name: C 48 Hardwoods

Sale Number: 52-005-23 Seq#: 1

### 1 - Sale Area

#### 1.2 - Boundaries

##### 1.2.1 - Painted boundaries (9/19)

The sale boundary and Payment Unit boundaries are marked and identified by teal, red and yellow paint. Exterior sale boundary lines against state are marked with red paint. Interior Payment Unit boundaries are marked with yellow paint. Regeneration gaps are marked by teal paint. The painted boundary line trees are not Included Timber and are to be protected unless marked with orange paint.

### 2 - Timber Specifications

#### 2.1 - Included Timber

##### 2.1.3 - Cut tree marked unit(s) (12/08)

Within Payment Unit(s) 1-3, all trees are designated for cutting when marked with orange paint above and below stump height, regardless of merchantability. In Regeneration Gaps marked by teal paint, all trees over 6 feet in height are to be cut.

#### 2.2 - Utilization

##### 2.2.5 - Limbed tree skidding (1/09)

The skidding of whole trees or tree segments with limbs attached is prohibited unless approved by the Unit Manager or his/her representative.

### 3 - Payments

#### 3.3 - Pre-measured Sales

##### 3.3.4 - Dividing payment units (7/14)

Payment Unit(s) may be divided at the request of the Purchaser and upon approval of the Unit Manager. Dividing Payment Units is a contract modification which requires a Timber Sale Contract Amendment. There will be only one division per Payment Unit.

#### 3.4 - Damaged Timber

##### 3.4.1 - Damaged timber (7/16)

General Condition and Requirement 3.4 Damaged Timber, defines liquidated damages for undesignated live merchantable trees which are cut or injured.

No damage is acceptable to undesignated live merchantable trees. Within the sale area, if more than 5 % of trees (> 4.5" DBH) within a specified area of the sale are damaged, liquidated damages will be assessed for all trees damaged. Rates will be in accordance with General Condition and Requirement 3.4 Damaged Timber.

### 4 - Transportation

#### 4.1 - Construction

##### 4.1.3 - Slash and earthen piles (8/04)

Piles or windrows of earth along roads and landings that have been widened or constructed shall be leveled. Slash from road maintenance or construction, including stumps, shall be dispersed throughout the sale.

##### 4.1.4 - Timber removed for construction (3/23)

Trees cut or damaged in the process of pre-approved road, landing or skid trail construction will be decked in an area separate from other Designated Timber and not removed until measured by the sale administrator. Payment will be made at contract prices or average prices, if not on the contract.

##### 4.1.6 - Road construction (1/09)

Construction of new roads or improvements of existing roads shall be done in such a way as to minimize the environmental and visual impacts. Merchantable trees shall be cut and utilized unless otherwise directed. Non-merchantable trees shall be severed and laid flat on the ground. Slash shall be scattered, and not left in windrows and kept a minimum of 10 feet back from the road edge. Stumps shall be set upright, not left on edge, and be moved at least 10 feet away from the road edge. Disturbed soil shall be feathered into the woods and not left in berms or windrows.

#### 4.1.7 - Road closure (10/11)

All new roads built into the sale must be blocked to vehicle traffic upon completion of the sale. Overgrown roads that are reopened shall be considered new roads. In general, this will require constructing a four (4') foot high berm of stumps and logs covered with earth. Stumps and brush must be placed along the remainder of the trail. Contact the sale administrator for specific details of design and placement.

### 4.2 - Maintenance

#### 4.2.5 - Two wheel drive condition (2/04)

All existing trail roads on and adjacent to the sale area must be passable by two-wheel drive traffic for the duration of the sale.

## 5 - Operations

### 5.2 - Conduct of Operations

#### 5.2.1 - Slash

##### 5.2.1.8 - Slash height (12/08)

No slash or tree tops may exceed 24 inches in height.

#### 5.2.2 - Hazard Trees/Snags

##### 5.2.2.1 - Den trees (10/16)

Obvious hollow and/or den trees shall be protected and left standing unless they are a safety hazard.

#### 5.2.3 - Operating Restrictions

##### 5.2.3.3 - Bark slippage restriction (3/09)

Within Payment Unit(s) , unless changed by written agreement, cutting and skidding are not permitted during the period of April 15 to July 15. This restriction is because of bark slippage.

#### 5.2.32 - Decking/landing restoration (9/13)

All decking and landing areas must have the surface area restored to a condition equal to or better than before. This is to ensure the proper regeneration of the stand. Wood debris, chips and "cookies" from trimmings must be removed or scattered away from landing and loading areas and may not be windrowed on the edge.

#### 5.2.38 - No decking against live trees (2/04)

Cut products may not be decked against unmarked or designated leave trees.

#### 5.2.40 - Pathway protection (10/10)

The Hiking trail is shown on the Timber Sale Map. Do not cut trees or damage posts with blue pathway markers. Maintain a 20-foot wide slash, debris, and rut free zone daily, using the pathway as the centerline. Do not run equipment down the pathway. Skidding across the trail may only occur in locations approved by the sale administrator.

#### 5.2.41 - Snowmobile trail protection (9/11)

The snowmobile trail is shown on the Timber Sale Map. Do not cut or damage posts with orange trail markers or traffic control signs. If the trail is used, it must be maintained and restored to a condition equal to or better than before the sale. The road maintenance/restoration must be done prior to December 1. If the trail is used for hauling, it must be graded to the satisfaction of the Unit Manager or his/her representative prior to December 1st. If the trail road is to be used for hauling during the snowmobile season, then a snow covered base must be left on the trail. The snowmobile trail may only be crossed at right angles. Maintain a 20 foot wide slash, debris, and rut free zone daily using the snowmobile trail as the centerline. No decking of forest products will be permitted along the snowmobile trail. All stumps within 10 feet of the snowmobile trail must be cut at ground level.

### 5.4 - Soil Protection

#### 5.4.1 - Rutting restriction, general (7/16)

Operations are to cease immediately if equipment and weather conditions result in rutting of roads and/or skid trails which is 12 inches or greater in depth and 50 feet in length. The Unit Manager or his/her representative may restrict hauling and/or skidding if ruts exceed the specified depth. With the Unit Manager or his/her representative's approval, the Purchaser may return to the area when the risk of rutting has decreased.

#### 5.4.2 - Skid trails (2/04)

Skid trails up and down slopes should be avoided. If however this is unavoidable, these trails will be left in a non-erodible condition using water bars, logs, and slash. Placing of slash on these skid trails while logging is ongoing may alleviate need for any further action. At the direction of the sale administrator, seed, fertilizer, and mulch may also be required.

### 5.8 - Protection of Endangered Species

#### 5.8.5 - Protection of raptor nests (3/13)

All trees with raptor nests will be protected if found during harvesting operations. Notification will be made to the Unit Manager or his/her representative who will notify the Wildlife Biologist so an on-site evaluation and recommendation can be made, if necessary.

## 6 - Safety and Fire Prevention

### 6.2 - Signing

#### 6.2.1 - Road posting (10/20)

The Purchaser is responsible for posting and maintaining caution signs on Jordan River Road prior to beginning operations. The road must be posted at appropriate distances from the sale area to warn of logging activity and truck traffic. Signs must be removed when harvest operations are suspended or completed. The Purchaser will provide these signs.

#### 6.2.2 - Snowmobile trail posting (10/20)

The Purchaser is responsible for posting and maintaining caution signs on the snowmobile trail prior to beginning operations during the snowmobile season (approximately December 1 to March 31). The trail must be posted at appropriate distances from the sale area to warn of logging activity and truck traffic. Signs must be removed when harvest operations are suspended or completed. The Purchaser will provide these signs.

#### 6.2.3 - Recreational trail posting (10/20)

The Purchaser is responsible for posting and maintaining caution signs on the Hiking Trail prior to beginning operations. The trail must be posted at appropriate distances from the sale area to warn of logging activity and truck traffic at both ends of the trail. Signs must be removed when harvest operations are suspended or completed. The Purchaser will provide these signs.



# TIMBER SALE MAP

This information provided by authority of Part 525, 1994 PA 451, as amended.

Sale Number	Year
52 - 005	23

Forest Management Unit Gaylord	County Antrim	Mapped By Crew	Date 07/03/2023	Page 1	of 1
Cruised By UMWLMS					

Township 31N	Range 05W	Section(s) and Subdivision(s) 20 - SENW,W1/2NE,SW,NWSE, 29 - NWNW,S1/2NW	Scale 1:15,840
-----------------	--------------	---	-------------------

### Cover Type

A = Aspen	H = Hemlock	N = Marsh	U = Upland Brush
B = Paper Birch	J = Jack Pine	O = Oak	UM = Upland Mixed
C = Cedar	L = Lowland Brush	P = Lowland Poplar	V = Bog or Marsh
D = Treed Bog	LM = Lowland Mixed	Q = Mixed Swamp Conifer	W = White Pine
E = Swamp Hdwoods	M = Mpl, Bch, Brch	R = Red Pine	X = Non Stocked
F = Spruce Fir	MC = Mixed Conifer	S = Black Spruce	Z = Water
G = Grass	MD = Mixed Deciduous	T = Tamarack	

### Density

0 = Non Stocked	5 = Pole Timber Medium
1 = Seedling Sapling Poor	6 = Pole Timber Well
2 = Seedling Sapling Medium	7 = Saw Timber Poor
3 = Seedling Sapling Well	8 = Saw Timber Medium
4 = Pole Timber Poor	9 = Saw Timber Well

PU	Acres	PU	Acres
1	47.6		
2	46.1		
3	44.1		

## C 48 Hardwoods

### Compartment 048

137.8 Acres

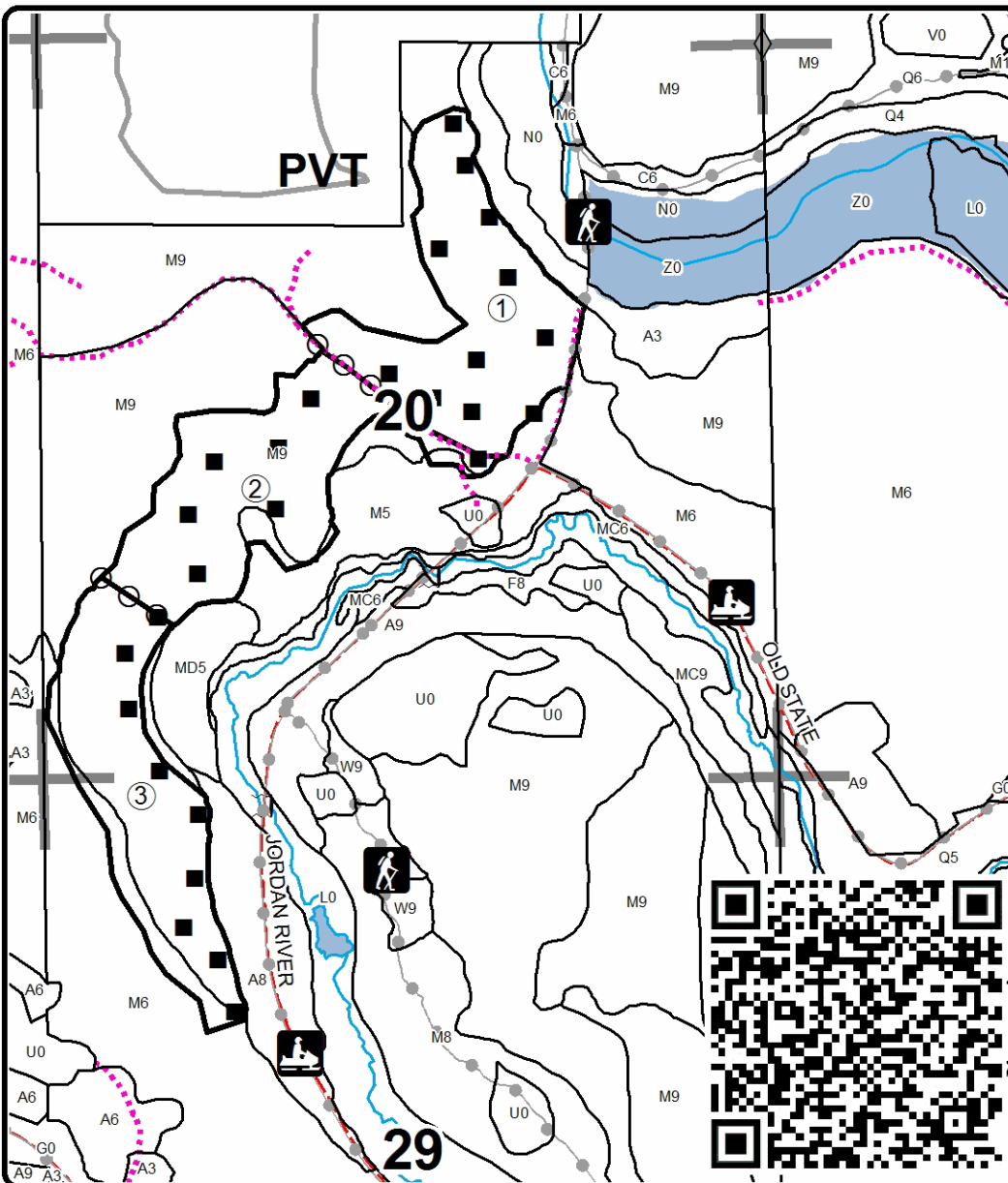
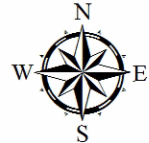

### Legend

- ○ Payment Unit (Yellow)
- ▭ Against State (Red)
- ▭ Stand Boundaries
- Regen Gaps (Teal)
- Recreational Trail
- ◇ Field Grade Corners
- - - County Road - Seasonal
- Private
- ⋯ Temporary Management Access
- Perennial River
- ▭ Lakes and Rivers
- Section Corners

### Locator Map

1:200,000

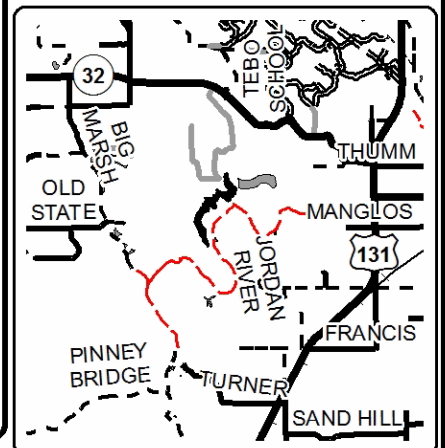



## TIMBER SALE INFORMATION

### Hollywood Mix (52-106-23)

T35N, R01E, SEC. 22; T35N, R01E, SEC. 27.  
Cheboygan County (Advertised Price \$48,961.95)

SALE NOTE: Oak wilt seasonal harvest restriction and ORV trail specs applied.

A recreation site such as a trail, pathway, or campground is within the sale area or the vicinity. Certain restrictions/specifications may be applicable including time restrictions.

A timber sale contract for this lump sum, sealed bid timber sale will be awarded to the responsible bidder offering the highest sealed bid price. All units of volume listed below were estimated using the Inventory Manager computer program and the new Michigan taper model. Bids must be at or above the following advertised price for each product and species:

<u>PRODUCTS &amp; SPECIES</u>	<u>ESTIMATED UNITS*</u>	<u>ADVERTISED PRICE</u>
<b>Sawtimber</b>		
B. T. Aspen	42.0 MBF	\$ 64.00 / MBF
Basswood	2.8 MBF	\$ 92.00 / MBF
N. White Cedar	2.7 MBF	\$ 66.00 / MBF
Paper Birch	2.6 MBF	\$ 55.00 / MBF
Quaking Aspen	8.1 MBF	\$ 64.00 / MBF
Red Maple	9.9 MBF	\$ 185.00 / MBF
Red Oak	159.1 MBF	\$ 110.00 / MBF
Red Pine	19.8 MBF	\$ 134.00 / MBF
Sugar Maple	2.5 MBF	\$ 317.00 / MBF
<b>Pulpwood</b>		
Balsam Fir	21 Cords	\$ 20.50 / Cord
Mixed Aspen	28 Cords	\$ 23.70 / Cord
Mixed Hardwood	190 Cords	\$ 21.85 / Cord
N. White Cedar	12 Cords	\$ 18.25 / Cord
Red Oak	195 Cords	\$ 39.45 / Cord
Red Pine	31 Cords	\$ 51.40 / Cord
White Pine	199 Cords	\$ 37.95 / Cord
White Spruce	5 Cords	\$ 19.15 / Cord

\* The total volume is statistically estimated within plus (+) or minus (-) 16.83 percent. There are an estimated 1,286 cords on this timber sale, plus or minus 217 cords at the 95% confidence level. The estimated units are final and not subject to adjustment. Prospective bidders are urged to examine this timber and to make their own estimates of quantity and quality.

### **BOND AND PAYMENT SCHEDULE:**

1. A bond in the amount of \$2,448.00 to insure faithful performance of the conditions of the contract will be deposited by the successful bidder within 21 days of the sale award.
2. Cutting in any sale or unit without the required advance payment would be considered a trespass.
3. Total payment must be paid in advance or according to the following schedule :
  - (a) Ten percent (10%) of the sale value must be paid within 21 days of the sale award.
  - (b) The 10% down payment will be credited towards the first unit cut.
  - (c) Payment for each of the following units must be made before cutting begins in that unit:
 

PAYMENT UNIT NUMBER	PERCENT OF TOTAL SALE VALUE
01	13.4%
02	14.5%
03	72.1%
4. If no cutting takes place, the 10% down payment will not be refunded.
5. Operations on the contract issued will terminate on 06/30/2027.

### **SALE STATISTICS**

Volumes were calculated in cubic feet using the Michigan taper model. Cubic foot volume includes all wood inside bark for the product indicated. For display purposes, cubic feet were converted to cords and MBF using a simple conversion factor, e.g. 79 cubic feet per cord and 185 cubic feet per MBF. The cubic foot volumes are precise; the cords and MBF volumes are not. Cubic foot volume cannot be directly converted to cords or boards with precision.

## SALE VOLUMES

The total estimated sale volume may not equal the sum of the species/products due to the nature of statistical calculations associated with double sampling methodology.

VOLUME			STATISTICAL RANGE IN CORDS	
TOTAL CUBIC FEET	TOTAL CORDS	PERCENT ERROR	MINIMUM	MAXIMUM
101,576	1,286	16.83%	1,069	1,502

## VDU VOLUMES

A VDU is a Volume Determination Unit. Volumes and their associated statistics are calculated at the VDU level and summarized to the sale level. There is often a one to one relationship between a VDU and a Payment Unit, but not always, depending on the cruise design. Refer to the VDU TO PAYMENT UNIT table.

	VOLUME			RANGE IN CORDS	
VDU	TOTAL CUBIC FEET	TOTAL CORDS	PERCENT ERROR	MINIMUM	MAXIMUM
76	20,409	258	44.22%	144	373
80	17,965	227	34.16%	150	305
83	63,202	800	23.90%	609	991
<b>TOTAL:</b>	<b>101,576</b>	<b>1,286</b>		<b>903</b>	<b>1,669</b>

## VDU TO PAYMENT UNIT

When a VDU is associated with more than one Payment Unit (PU), the VDU volumes are assigned to the PU based on acres of the VDU within the PU.

VDU	VDU ACRES	PU	PU ACRES
76	12.2	1	11.8
		2	0.4
80	8.5	2	8.5
83	38.9	3	38.9
<b>TOTAL:</b>	<b>59.6</b>		<b>59.6</b>



**DESCRIPTION OF TIMBER BY PAYMENT UNIT (PU)**

PU	MARKET GROUP	PRODUCT	QUANTITY	UNIT	ACRES	ADVERTISE PRICE
1	B. T. Aspen	Sawtimber	11.8	MBF	11.8	\$6,543.70
	N. White Cedar		2.6	MBF		
	Paper Birch		2.5	MBF		
	Quaking Aspen		5.9	MBF		
	Red Maple		7.6	MBF		
	Balsam Fir	Pulpwood	9	Cords		
	<i>Balsam Fir</i>		9	<i>Cords</i>		
	Mixed Aspen		8	Cords		
	<i>B. T. Aspen</i>		7	<i>Cords</i>		
	<i>Quaking Aspen</i>		1	<i>Cords</i>		
	Mixed Hardwood		142	Cords		
	<i>Paper Birch</i>		15	<i>Cords</i>		
	<i>Red Maple</i>		121	<i>Cords</i>		
	<i>Sugar Maple</i>		6	<i>Cords</i>		
	N. White Cedar		12	Cords		
2	B. T. Aspen	Sawtimber	30.2	MBF	8.9	\$7,079.45
	Basswood		2.8	MBF		
	N. White Cedar		0.1	MBF		
	Paper Birch		0.1	MBF		
	Quaking Aspen		2.2	MBF		
	Red Maple		2.3	MBF		
	Red Oak		9.7	MBF		
	Sugar Maple		2.5	MBF		
	Balsam Fir	Pulpwood	7	Cords		
	<i>Balsam Fir</i>	<i>Sawtimber</i>	1.9	<i>MBF</i>		
	<i>Balsam Fir</i>	<i>Pulpwood</i>	3	<i>Cords</i>		
	Mixed Aspen		20	Cords		
	<i>B. T. Aspen</i>		19	<i>Cords</i>		
	<i>Quaking Aspen</i>		1	<i>Cords</i>		
	Mixed Hardwood		48	Cords		
	<i>Basswood</i>		2	<i>Cords</i>		
	<i>Paper Birch</i>		1	<i>Cords</i>		
	<i>Red Maple</i>		31	<i>Cords</i>		
	<i>Sugar Maple</i>		14	<i>Cords</i>		
	Red Oak		4	Cords		
	White Pine		14	Cords		
	<i>White Pine</i>	<i>Sawtimber</i>	5.1	<i>MBF</i>		
	<i>White Pine</i>	<i>Pulpwood</i>	4	<i>Cords</i>		
White Spruce		5	Cords			
3	Red Oak	Sawtimber	149.4	MBF	38.9	\$35,338.80
	Red Pine		19.8	MBF		
	Balsam Fir	Pulpwood	5	Cords		
	<i>Balsam Fir</i>		5	<i>Cords</i>		
	Red Oak		191	Cords		
	Red Pine		31	Cords		
	White Pine		185	Cords		
	<i>White Pine</i>	<i>Sawtimber</i>	45.4	<i>MBF</i>		
<i>White Pine</i>	<i>Pulpwood</i>	94	<i>Cords</i>			
TOTAL:			249.5	MBF		
TOTAL:			681	Cords		

# Sale Specific Conditions & Requirements

**Sale Name: Hollywood Mix**

**Sale Number: 52-106-23 Seq#: 1**

## 1 - Sale Area

### 1.2 - Boundaries

#### 1.2.1 - Painted boundaries (9/19)

The sale boundaries are marked and identified by blue, red, and yellow paint. Exterior sale boundary lines adjacent to private property are marked with blue paint. Exterior sale boundary lines adjacent to state-owned land are marked with red paint. Payment Unit boundary lines are marked with yellow paint. Trees marked with yellow paint should remain standing until both adjacent payment units are paid for. Retention patches are marked with red paint; no harvesting activities may occur within these areas. The painted boundary line trees are not Included Timber and are to remain unharvested.

## 2 - Timber Specifications

### 2.1 - Included Timber

#### 2.1.1 - Clearcut unit(s) with unmerchantable trees (6/14)

Within Payment Unit(s) 1, cut all trees that are two (2) inches or more at DBH except hemlock and red oak, or any potential legacy tree 26"+ at DBH. These trees will function as single tree retention.

Within Payment Units 2 and 3, cut all trees that are two (2) inches or larger at DBH except incidental hemlock or any potential legacy tree 26"+ at DBH. These trees will function as single tree retention. Also in Unit 2, any trees marked with a band of green paint shall be felled and left intact on the ground to function as wildlife habitat trees (See spec. 5.2.4.1). These trees should be felled last, after surrounding trees have been felled and skidded to the landing area.

Also, retention areas are found within Units 1 and 3, are shown on the timber sale map, and the boundaries are marked with red paint. No harvesting equipment is to operate within their boundaries.

### 2.2 - Utilization

#### 2.2.8 - Utilization and removal (5/14)

All products meeting standards set forth in General Condition and Requirement 2.2 - Utilization must be removed from the sale area. Retain on site between 1/6 and 1/3 of the slash from harvested trees (tree tops and limbs less than four inches in diameter). This is because forest certification biomass retention requirements.

## 3 - Payments

### 3.3 - Pre-measured Sales

#### 3.3.4 - Dividing payment units (7/14)

Payment Unit(s) 1 - 3 may be divided at the request of the Purchaser and upon approval of the Unit Manager. Dividing Payment Units is a contract modification which requires a Timber Sale Contract Amendment. There will be only one division per Payment Unit. No harvest activities may take place until the producer returns the signed amendment to the Unit Manager.

## 4 - Transportation

### 4.1 - Construction

#### 4.1.3 - Slash and earthen piles (8/04)

Piles or windrows of earth along roads and landings that have been widened or constructed shall be leveled. Slash from road maintenance or construction, including stumps, shall be dispersed throughout the sale.

#### 4.1.6 - Road construction (1/09)

Construction of new roads or improvements of existing roads shall be done in such a way as to minimize the environmental and visual impacts. Merchantable trees shall be cut and utilized unless otherwise directed. Non-merchantable trees shall be severed and laid flat on the ground. Slash shall be scattered, and not left in windrows and kept a minimum of 10 feet back

from the road edge. Stumps shall be set upright, not left on edge, and be moved at least 10 feet away from the road edge. Disturbed soil shall be feathered into the woods and not left in berms or windrows.

#### 4.1.7 - Road closure (10/11)

All new roads built into the sale must be blocked to vehicle traffic upon completion of the sale. Overgrown roads that are reopened shall be considered new roads. In general, this will require constructing a four (4') foot high berm of stumps and logs covered with earth.

#### 4.1.8 - Road work (1) (8/07)

All forest trail roads and county roads within or adjacent to the timber sale should remain passable to vehicle traffic for the duration of harvest activities

### 4.3 - Public Right-of-Way

#### 4.3.2 - County R-O-W (12/06)

The county must be contacted prior to crossing or harvesting in the county road R-O-W.

## 5 - Operations

### 5.1 - Notification

#### 5.1.1 - Pre-sale conference (10/16)

A pre-sale conference between the Purchaser and sale administrator is required prior to beginning any harvest operations to discuss contract specifications and to determine landing and road locations.

### 5.2 - Conduct of Operations

#### 5.2.1 - Slash

##### 5.2.1.1 - Slash within sale area (9/16)

No trees are to be felled outside the sale area and all slash is to be kept at least 10 feet back from the red or blue paint line. If sale boundary lines are along a public road or highway, then slash must be removed 50' from these lines per General Condition & Requirement 5.2.1.

#### 5.2.2 - Hazard Trees/Snags

##### 5.2.2.1 - Den trees (10/16)

Obvious hollow and/or den trees shall be protected and left standing unless they are a safety hazard.

#### 5.2.3 - Operating Restrictions

##### 5.2.3.4 - Oak wilt restriction, no exceptions (1/18)

Within Payment Unit(s) 1 - 3, cutting, skidding, hauling within the sale and brushing of access roads to the sale are not permitted during the period of April 15 to July 15. No exceptions will be granted. This is necessary to reduce the spread of oak wilt.

#### 5.2.4 - Dead and Down Creation

##### 5.2.4.1 - Dead and down creation, marked trees (10/13)

In Unit 2, all trees marked with a band of green paint must be left until all merchantable timber has been cut and taken to the landing. At which time, they are to be cut, felled, and left on the ground. If more than one tree is marked next to another, fall them so their tops or trunks overlap. This will facilitate snowshoe hare habitat. These trees have been taken off the timber tally.

#### 5.2.29 - Shrub protection (1/20)

Do not cut or damage hawthorn, witch-hazel, dogwood or juneberry. These woody-shrub plants are highly beneficial to various wildlife species. Also, protect any areas of concentrated aspen and oak saplings from damage from harvest equipment.

#### 5.2.32 - Decking/landing restoration (9/13)

All decking and landing areas must have the surface area restored to a condition equal to or better than before. This is to ensure the proper regeneration of the stand. Wood debris, including slash and stumps, chips and "cookies" from trimmings

must be removed or scattered away from landing and loading areas and may not be windrowed on the edge. Piles of topsoil should be spread out evenly.

#### 5.2.39 - ORV trail/route protection (4/18)

The ORV trail is shown on the Timber Sale Map. Do not cut trees or damage posts with yellow ORV markers. All stumps within 5 feet of the trail must be cut flush with the ground. Maintain a 20 foot wide slash, debris, and rut free zone daily using the ORV trail or route as the centerline. Do not run equipment down the ORV trail. Skidding locations across the ORV trail should be minimized to reduce the areas of potential damage.

### 5.4 - Soil Protection

#### 5.4.1 - Rutting restriction, general (7/16)

Operations are to cease immediately if equipment and weather conditions result in rutting of roads which is 12 inches or greater in depth and 50 feet in length. The Unit Manager or his/her representative may restrict hauling and/or skidding if ruts exceed the specified depth. With the Unit Manager or his/her representative's approval, the Purchaser may return to the area when the risk of rutting has decreased.

### 5.8 - Protection of Endangered Species

#### 5.8.5 - Protection of raptor nests (3/13)

All trees with raptor nests will be protected if found during harvesting operations. Notification will be made to the Unit Manager or his/her representative who will notify the Wildlife Biologist so an on-site evaluation and recommendation can be made, if necessary.

## 6 - Safety and Fire Prevention

### 6.2 - Signing

#### 6.2.1 - Road posting (10/20)

The Purchaser is responsible for posting and maintaining caution signs on Hutchinson and Dangler roads prior to beginning operations. The road must be posted at appropriate distances from the sale area to warn of logging activity and truck traffic. Signs must be removed when harvest operations are suspended or completed. The Purchaser will provide these signs.

#### 6.2.3 - Recreational trail posting (10/20)

The Purchaser is responsible for posting and maintaining caution signs on the ORV trail prior to beginning operations. The trail must be posted at appropriate distances from the sale area to warn of logging activity and truck traffic at both ends of the trail. Signs must be removed when harvest operations are suspended or completed. The Purchaser will provide these signs.



# TIMBER SALE MAP

This information provided by authority of Part 5, 1994 PA 451, as amended.

Sale Number	Year
52-106-23	2023

Forest Management Unit <b>GAYLORD - NORTH</b>	County <b>CHEBOYGAN</b>	Mapped By <b>STACKS</b>	Date <b>07/14/23</b>	Page <b>1</b>	of <b>1</b>
Compartment Number <b>52208</b>	Township <b>T35N</b>	Range <b>ROIE</b>	Section(s) and Subdivision(s) <b>22S½ SW; 27N½ NW, SENW</b>		

Cover Type				Density	
A = Aspen	J = Jack Pine	O = Oak	U = Upland Brush	0 = Non Stocked	5 = Pole Timber Medium
B = Paper Birch	K = Rock	P = Lowland Poplar	UM = Upland Mix Forest	1 = Seedling Sapling Poor	6 = Pole Timber Well
C = Cedar	L = Lowland Brush	Q = Mixed Swamp Conifer	V = Bog or Marsh	2 = Seedling Sapling Medium	7 = Saw Timber Poor
D = Treed Bog	LM = Lowland Mix Forest	R = Red Pine	W = White Pine	3 = Seedling Sapling Well	8 = Saw Timber Medium
E = Swamp Hardwoods	M = Maple, Beech, Birch	S = Black Spruce	X = Non Stocked	4 = Pole Timber Poor	9 = Saw Timber Well
F = Spruce/Fir	MC = Mixed Conifer	T = Tamarack	Y = Sand		
G = Grass	MD = Mixed Deciduous		Z = Water		
H = Hemlock	N = Marsh				

## HOLLYWOOD MIX CHEBOYGAN COUNTY

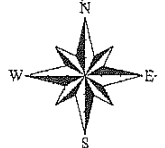

59.6 ACRES

P.U.	ACRES
1	11.8
2	8.9
3	38.9
	59.6

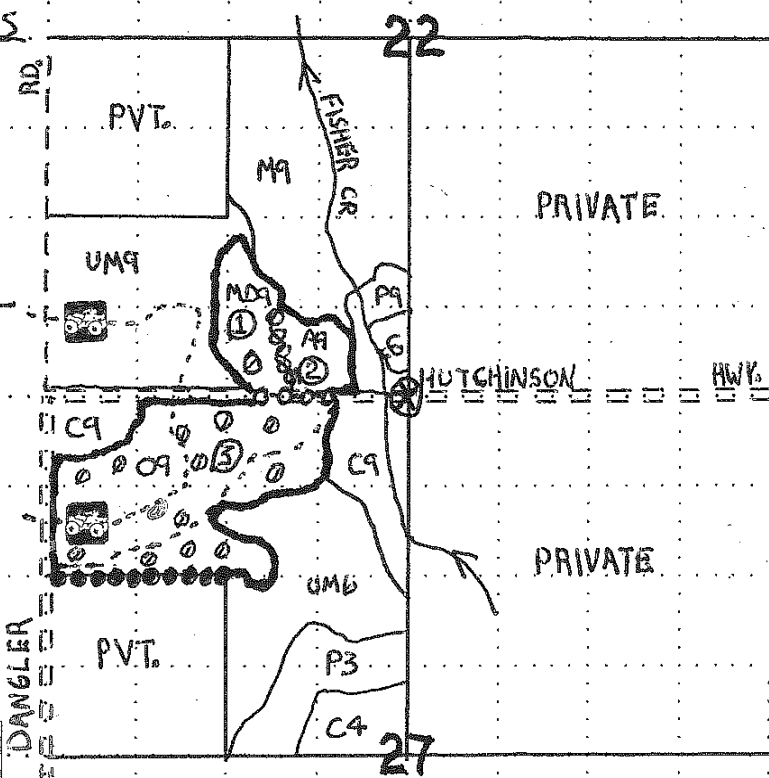

- SALE BOUNDARY:**  
**PUBLIC (RED) - - - - -**  
**PRIVATE (BLUE) - - - - -**
- PAYMENT UNIT:**  
**(YELLOW) - - - - -**
- P.U. NUMBER - ①**
- COUNTY ROAD - - - - -**
- SEASONAL C. R. - - - - -**
- FOREST TRAIL ROAD - - - - -**
- ORV TRAIL - - - - -**
- RETENTION AREA - - - - -**

⊗ -84.298311  
45.371920

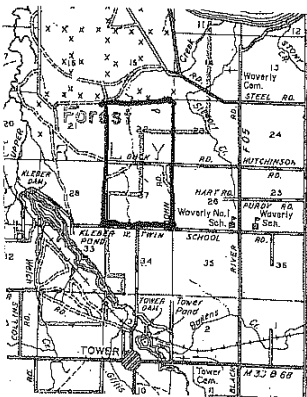

0.5 0.25 0 Miles



## TIMBER SALE INFORMATION

Lorenzo Mix (52-113-23)

T35N, R01E, SEC. 10; T35N, R01E, SEC. 3.  
Cheboygan County (Advertised Price \$15,850.65)

SALE NOTE: Mixed species final harvest with retention. Seasonal oak wilt restriction applied. ORV trail protection specs included. Target shooting range near Sale Area.

A recreation site such as a trail, pathway, or campground is within the sale area or the vicinity. Certain restrictions/specifications may be applicable including time restrictions.

A timber sale contract for this lump sum, sealed bid timber sale will be awarded to the responsible bidder offering the highest sealed bid price. All units of volume listed below were estimated using the Inventory Manager computer program and the new Michigan taper model. Bids must be at or above the following advertised price for each product and species:

<u>PRODUCTS &amp; SPECIES</u>	<u>ESTIMATED UNITS*</u>	<u>ADVERTISED PRICE</u>
<b>Sawtimber</b>		
B. T. Aspen	24.5 MBF	\$ 64.00 / MBF
Black/Red (Hybrid) Oak	7.1 MBF	\$ 140.00 / MBF
Red Maple	1.7 MBF	\$ 185.00 / MBF
Red Oak	21.7 MBF	\$ 110.00 / MBF
Red Pine	2.2 MBF	\$ 134.00 / MBF
White Oak	6.0 MBF	\$ 76.00 / MBF
White Pine	9.8 MBF	\$ 52.00 / MBF
<b>Pulpwood</b>		
B. T. Aspen	126 Cords	\$ 23.70 / Cord
Balsam Fir	4 Cords	\$ 20.50 / Cord
Jack Pine	6 Cords	\$ 15.85 / Cord
Mixed Oak	45 Cords	\$ 39.45 / Cord
Red Maple	32 Cords	\$ 21.85 / Cord
Red Oak	52 Cords	\$ 39.45 / Cord
Red Pine	23 Cords	\$ 51.40 / Cord
White Pine	12 Cords	\$ 37.95 / Cord

\* The total volume is statistically estimated within plus (+) or minus (-) 30.16 percent. There are an estimated 453 cords on this timber sale, plus or minus 137 cords at the 95% confidence level. The estimated units are final and not subject to adjustment. Prospective bidders are urged to examine this timber and to make their own estimates of quantity and quality.

### **BOND AND PAYMENT SCHEDULE:**

1. A bond in the amount of \$793.00 to insure faithful performance of the conditions of the contract will be deposited by the successful bidder within 21 days of the sale award.
2. Cutting in any sale or unit without the required advance payment would be considered a trespass.
3. Total payment must be paid in advance or according to the following schedule :
  - (a) Ten percent (10%) of the sale value must be paid within 21 days of the sale award.
  - (b) The remainder is due before cutting begins.
  - (c) Payment for each of the following units must be made before cutting begins in that unit:
 

PAYMENT UNIT NUMBER	PERCENT OF TOTAL SALE VALUE
01	100.0%
4. If no cutting takes place, the 10% down payment will not be refunded.
5. Operations on the contract issued will terminate on 06/30/2027.

### **SALE STATISTICS**

Volumes were calculated in cubic feet using the Michigan taper model. Cubic foot volume includes all wood inside bark for the product indicated. For display purposes, cubic feet were converted to cords and MBF using a simple conversion factor, e.g. 79 cubic feet per cord and 185 cubic feet per MBF. The cubic foot volumes are precise; the cords and MBF volumes are not. Cubic foot volume cannot be directly converted to cords or boards with precision.

## SALE VOLUMES

The total estimated sale volume may not equal the sum of the species/products due to the nature of statistical calculations associated with double sampling methodology.

VOLUME		STATISTICAL RANGE IN CORDS		
TOTAL CUBIC FEET	TOTAL CORDS	PERCENT ERROR	MINIMUM	MAXIMUM
35,822	453	30.16%	317	590

## VDU VOLUMES

A VDU is a Volume Determination Unit. Volumes and their associated statistics are calculated at the VDU level and summarized to the sale level. There is often a one to one relationship between a VDU and a Payment Unit, but not always, depending on the cruise design. Refer to the VDU TO PAYMENT UNIT table.

VDU	VOLUME			RANGE IN CORDS	
	TOTAL CUBIC FEET	TOTAL CORDS	PERCENT ERROR	MINIMUM	MAXIMUM
8	35,822	453	30.17%	317	590
<b>TOTAL:</b>	<b>35,822</b>	<b>453</b>		<b>317</b>	<b>590</b>

## VDU TO PAYMENT UNIT

When a VDU is associated with more than one Payment Unit (PU), the VDU volumes are assigned to the PU based on acres of the VDU within the PU.

VDU	VDU ACRES	PU	PU ACRES
8	22.7	1	22.7
<b>TOTAL:</b>	<b>22.7</b>		<b>22.7</b>

## DESCRIPTION OF TIMBER BY PAYMENT UNIT (PU)

PU	MARKET GROUP	PRODUCT	QUANTITY	UNIT	ACRES	ADVERTISE PRICE			
1	B. T. Aspen	Sawtimber	24.5	MBF	22.7	\$15,850.65			
	Black/Red (Hybrid)		7.1	MBF					
	Red Maple		1.7	MBF					
	Red Oak		21.7	MBF					
	Red Pine		2.2	MBF					
	White Oak		6.0	MBF					
	White Pine		9.8	MBF					
	B. T. Aspen		Pulpwood	126			Cords		
	Balsam Fir			4			Cords		
	Jack Pine	6		Cords					
	Mixed Oak	45		Cords					
	/Red (Hybrid) Oak	25		Cords					
	White Oak	20		Cords					
	Red Maple	32		Cords					
	Red Oak	52		Cords					
	Red Pine	23		Cords					
	White Pine	12		Cords					
	<b>TOTAL:</b>			73.0			MBF		
	<b>TOTAL:</b>			300			Cords		



# Sale Specific Conditions & Requirements

**Sale Name: Lorenzo Mix**

**Sale Number: 52-113-23 Seq#: 2**

## 1 - Sale Area

### 1.2 - Boundaries

#### 1.2.1 - Painted boundaries (9/19)

The sale boundary and Payment Unit boundaries are marked and identified by blue & red paint. Exterior sale boundary lines against private property are marked with blue paint. Exterior sale boundary lines against state are marked with red paint. Retention patches are marked with red paint; no harvesting activities may occur within these areas. The painted boundary line trees are not Included Timber and are to be protected unless marked with orange paint.

## 2 - Timber Specifications

### 2.1 - Included Timber

#### 2.1.1 - Clearcut unit(s) with unmerchantable trees (6/14)

Within Payment Unit(s) 1, cut all trees that are two (2) inches or more at DBH, except do not cut hemlock, any trees that are twenty-six (26) inches or more at DBH, or trees marked with teal paint.

### 2.2 - Utilization

#### 2.2.8 - Utilization and removal (5/14)

All products meeting standards set forth in General Condition and Requirement 2.2 - Utilization must be removed from the Sale Area. Retain on site between 1/6 and 1/3 of the slash from harvested trees (tree tops and limbs less than four inches in diameter). This is because of forest certification biomass retention requirements.

## 3 - Payments

### 3.3 - Pre-measured Sales

#### 3.3.4 - Dividing payment units (7/14)

Payment Unit(s) 1 may be divided at the request of the Purchaser and upon approval of the Unit Manager. Dividing Payment Units is a contract modification which requires a Timber Sale Contract Amendment. There will be only one division per Payment Unit. No harvest activities may take place until the producer returns the signed amendment to the Unit Manager.

## 4 - Transportation

### 4.1 - Construction

#### 4.1.3 - Slash and earthen piles (8/04)

Piles or windrows of earth along roads and landings that have been widened or constructed shall be leveled. Slash from road maintenance or construction, including stumps, shall be dispersed throughout the sale.

#### 4.1.6 - Road construction (1/09)

Construction of new roads or improvements of existing roads shall be done in such a way as to minimize the environmental and visual impacts. Merchantable trees shall be cut and utilized unless otherwise directed. Non-merchantable trees shall be severed and laid flat on the ground. Slash shall be scattered, and not left in windrows and kept a minimum of 10 feet back from the road edge. Stumps shall be set upright, not left on edge, and be moved at least 10 feet away from the road edge. Disturbed soil shall be feathered into the woods and not left in berms or windrows.

#### 4.1.7 - Road closure (10/11)

All new roads built into the sale must be blocked to vehicle traffic upon completion of the sale. In general, this will require constructing a four (4') foot high berm of stumps and logs covered with earth.

#### 4.1.8 - Road work (1) (8/07)

All forest trail & county roads within or adjacent to the harvest area should remain passable to vehicle traffic for the duration of harvest activities.

## 5 - Operations

## 5.1 - Notification

### 5.1.1 - Pre-sale conference (10/16)

A pre-sale conference between the Purchaser and sale administrator is required prior to beginning any harvest operations to discuss contract specifications and to determine landing and access road locations.

## 5.2 - Conduct of Operations

### 5.2.1 - Slash

#### 5.2.1.1 - Slash within sale area (9/16)

No trees are to be felled outside the sale area and all slash is to be kept at least 10 feet back from the red or blue paint line. If sale boundary lines are along a public road or highway, then slash must be removed 50' from these lines per General Condition & Requirement 5.2.1.

### 5.2.2 - Hazard Trees/Snags

#### 5.2.2.1 - Den trees (10/16)

Obvious hollow and/or den trees shall be protected and left standing unless they are a safety hazard.

### 5.2.3 - Operating Restrictions

#### 5.2.3.4 - Oak wilt restriction, no exceptions (1/18)

Within Payment Unit 1, cutting, skidding, hauling within the sale and brushing of access roads to the sale are not permitted during the period of April 15 to July 15. No exceptions will be granted. This is necessary to reduce the spread of oak wilt.

### 5.2.29 - Shrub protection (1/20)

Do not cut or damage hawthorn, witch-hazel, dogwood or juneberry. These woody-shrub plants are highly beneficial to various wildlife species.

### 5.2.32 - Decking/landing restoration (9/13)

All decking and landing areas must have the surface area restored to a condition equal to or better than before. This is to ensure the proper regeneration of the stand. Wood debris, chips and "cookies" from trimmings must be removed or scattered away from landing and loading areas and may not be windrowed on the edge. Piles of topsoil should be spread out evenly.

### 5.2.39 - ORV trail/route protection (4/18)

The ORV trail is shown on the Timber Sale Map. Do not cut trees or damage posts with yellow ORV markers. All stumps within 5 feet of the trail must be cut flush with the ground. Maintain a 20-foot-wide slash, debris, and rut free zone daily using the ORV trail or route as the centerline. Do not run equipment down the ORV trail or route. Skidding locations across the trail or route should be minimized to reduce the areas of potential damage.

## 5.4 - Soil Protection

### 5.4.1 - Rutting restriction, general (7/16)

Operations are to cease immediately if equipment and weather conditions result in rutting of roads which is 12 inches or greater in depth and 50 feet in length. The Unit Manager or his/her representative may restrict hauling and/or skidding if ruts exceed the specified depth. With the Unit Manager or his/her representative's approval, the Purchaser may return to the area when the risk of rutting has decreased.

## 5.8 - Protection of Endangered Species

### 5.8.5 - Protection of raptor nests (3/13)

All trees with raptor nests will be protected if found during harvesting operations. Notification will be made to the Unit Manager or his/her representative who will notify the Wildlife Biologist so an on-site evaluation and recommendation can be made, if necessary.

## 6 - Safety and Fire Prevention

### 6.2 - Signing

#### 6.2.1 - Road posting (10/20)

The Purchaser is responsible for posting and maintaining caution signs on North Black River Road, Top Trail, and all adjacent forest trail access roads prior to beginning operations. The road must be posted at appropriate distances from the Sale Area to warn of logging activity and truck traffic. Signs must be removed when harvest operations are suspended or completed. The Purchaser will provide these signs.

#### 6.2.3 - Recreational trail posting (10/20)

The Purchaser is responsible for posting and maintaining caution signs on the ORV trail prior to beginning operations. The trail must be posted at appropriate distances from the Sale Area to warn of logging activity and truck traffic at both ends of the trail. Signs must be removed when harvest operations are suspended or completed. The Purchaser will provide these signs.



# TIMBER SALE MAP

This information provided by authority of Part 5, 1994 PA 451, as amended.

Sale Number	Year
52-113-23	2023

Forest Management Unit <b>GAYLORD-NORTH</b>	County <b>CHEBOYGAN</b>	Mapped By <b>STACKS</b>	Date <b>8/28/23</b>	Page <b>1</b>	of <b>1</b>
Compartment Number <b>52208</b>	Township <b>T35N</b>	Range <b>ROIE</b>	Section(s) and Subdivision(s) <b>3.SWSW, 10 N1/2NW</b>		

Cover Type				Density	
A = Aspen	J = Jack Pine	O = Oak	U = Upland Brush	0 = Non Stocked	5 = Pole Timber Medium
B = Paper Birch	K = Rock	P = Lowland Poplar	UM = Upland Mix Forest	1 = Seedling Sapling Poor	6 = Pole Timber Well
C = Cedar	L = Lowland Brush	Q = Mixed Swamp Conifer	V = Bog or Marsh	2 = Seedling Sapling Medium	7 = Saw Timber Poor
D = Treed Bog	LM = Lowland Mix Forest	R = Red Pine	W = White Pine	3 = Seedling Sapling Well	8 = Saw Timber Medium
E = Swamp Hardwoods	M = Maple, Beech, Birch	S = Black Spruce	X = Non Stocked	4 = Pole Timber Poor	9 = Saw Timber Well
F = Spruce/Fir	MC = Mixed Conifer	T = Tamarack	Y = Sand		
G = Grass	MD = Mixed Deciduous		Z = Water		
H = Hemlock	N = Marsh				

## LORENZO MIX

## CHEBOYGAN COUNTY

### 22.7 ACRES

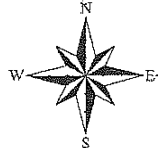

P.U.	ACRES
1	22.7

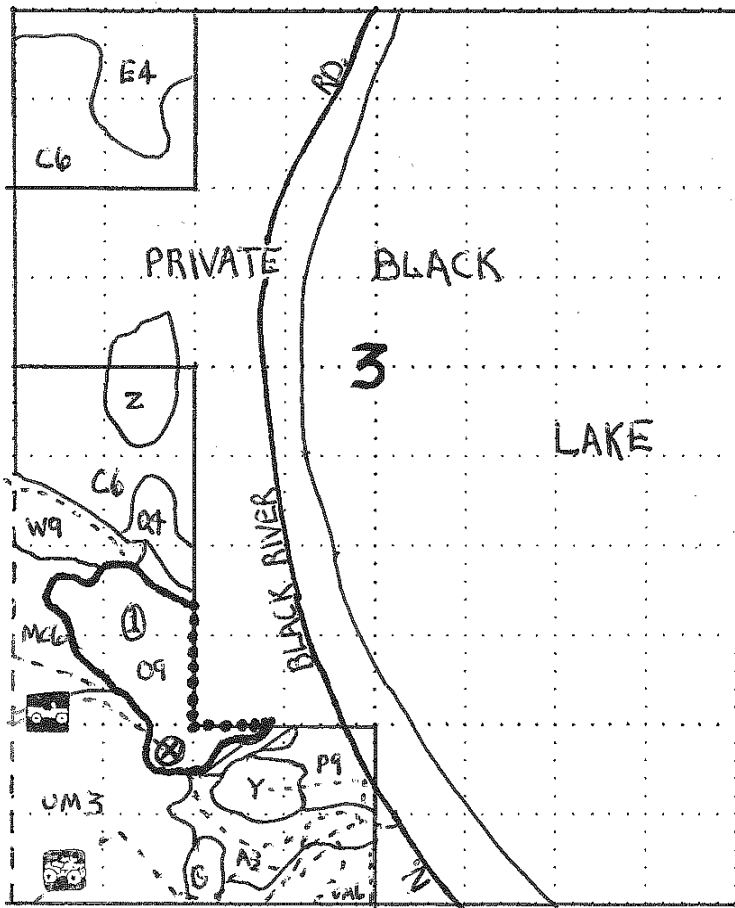

- SALE BOUNDARY:**  
**PUBLIC (RED) -** ———  
**PRIVATE (BLUE) -** ———  
**P.U. NUMBER -** ①  
**COUNTY ROAD -** ———  
**SEASONAL C. R. -** - - - -  
**FOREST TRAIL ROAD -** - - - -  
**SNOWMOBILE TRAIL -** [Icon]  
**RETENTION AREA -** [Icon]  
**ORV TRAIL -** [Icon]  
**ORV ROUTE -** [Icon]

⊗ - 84.303866  
 45.440867

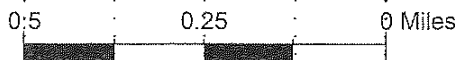
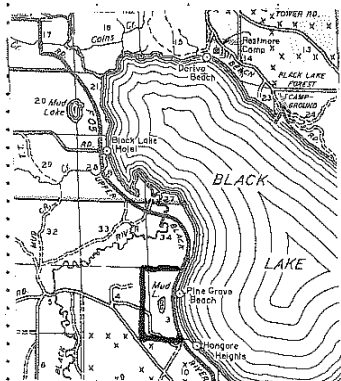

## TIMBER SALE INFORMATION

### Super Terrific Fun Time Pine (52-114-23)

T33N, R04W, SEC. 4; T34N, R04W, SEC. 33; T34N, R04W, SEC. 34.  
Charlevoix County (Advertised Price \$387,034.15)

SALE NOTE: Payment Units 4-9 must be chip harvested (spec 2.2.2) and stump heights shall not exceed six (6) inches (spec 2.2.3). This is to facilitate subsequent planting operations. A chipping exemption can be obtained if proposed operations are determined to be suitable for planting by reforestation staff. In addition, steep/operationally challenging ground is present in certain harvest locations. Some of these locations have been approximated on the Sale Map. Access to Payment Unit 3 is best accomplished through privately owned lands (spec 4.4.1).

A recreation site such as a trail, pathway, or campground is within the sale area or the vicinity. Certain restrictions/specifications may be applicable including time restrictions. Access may be through private or other public land.

A timber sale contract for this lump sum, sealed bid timber sale will be awarded to the responsible bidder offering the highest sealed bid price. All units of volume listed below were estimated using the Inventory Manager computer program and the new Michigan taper model. Bids must be at or above the following advertised price for each product and species:

<u>PRODUCTS &amp; SPECIES</u>	<u>ESTIMATED UNITS*</u>	<u>ADVERTISED PRICE</u>
Sawtimber		
Basswood	147.5 MBF	\$ 92.00 / MBF
Red Maple	20.3 MBF	\$ 185.00 / MBF
Sugar Maple	347.2 MBF	\$ 317.00 / MBF
Pulpwood		
Basswood	356 Cords	\$ 16.65 / Cord
Mixed Aspen	411 Cords	\$ 23.70 / Cord
Mixed Hardwood	1,477 Cords	\$ 21.85 / Cord
Paper Birch	17 Cords	\$ 17.50 / Cord
Red Pine	4,113 Cords	\$ 51.40 / Cord

\* The total volume is statistically estimated within plus (+) or minus (-) 7.79 percent. There are an estimated 7,350 cords on this timber sale, plus or minus 573 cords at the 95% confidence level. The estimated units are final and not subject to adjustment. Prospective bidders are urged to examine this timber and to make their own estimates of quantity and quality.

### **BOND AND PAYMENT SCHEDULE:**

1. A bond in the amount of \$19,352.00 to insure faithful performance of the conditions of the contract will be deposited by the successful bidder within 21 days of the sale award.
2. Cutting in any sale or unit without the required advance payment would be considered a trespass.
3. Total payment must be paid in advance or according to the following schedule :
  - (a) Ten percent (10%) of the sale value must be paid within 21 days of the sale award.
  - (b) The 10% down payment will be credited towards the first unit cut.
  - (c) Payment for each of the following units must be made before cutting begins in that unit:

PAYMENT UNIT NUMBER	PERCENT OF TOTAL SALE VALUE
01	7.3%
02	6.3%
03	2.4%
04	6.4%
05	4.8%
06	3.2%
07	19.9%
08	21.2%
09	22.0%
10	6.5%

4. If no cutting takes place, the 10% down payment will not be refunded.
5. Operations on the contract issued will terminate on 06/30/2027.

### **SALE STATISTICS**

Volumes were calculated in cubic feet using the Michigan taper model. Cubic foot volume includes all wood inside bark for the product indicated. For display purposes, cubic feet were converted to cords and MBF using a simple conversion factor, e.g. 79 cubic feet per cord and 185 cubic feet per MBF. The cubic foot volumes are precise; the cords and MBF volumes are not. Cubic foot volume cannot be directly converted to cords or boards with precision.

### SALE VOLUMES

The total estimated sale volume may not equal the sum of the species/products due to the nature of statistical calculations associated with double sampling methodology.

VOLUME			STATISTICAL RANGE IN CORDS	
TOTAL CUBIC FEET	TOTAL CORDS	PERCENT ERROR	MINIMUM	MAXIMUM
580,682	7,350	7.79%	6,777	7,924

### VDU VOLUMES

A VDU is a Volume Determination Unit. Volumes and their associated statistics are calculated at the VDU level and summarized to the sale level. There is often a one to one relationship between a VDU and a Payment Unit, but not always, depending on the cruise design. Refer to the VDU TO PAYMENT UNIT table.

VDU	VOLUME			RANGE IN CORDS	
	TOTAL CUBIC FEET	TOTAL CORDS	PERCENT ERROR	MINIMUM	MAXIMUM
8	98,645	1,249	20.14%	997	1,500
9	405,404	5,132	7.93%	4,725	5,539
12	46,182	585	24.86%	439	730
18	30,450	385	55.73%	171	600
<b>TOTAL:</b>	<b>580,682</b>	<b>7,350</b>		<b>6,332</b>	<b>8,369</b>

### VDU TO PAYMENT UNIT

When a VDU is associated with more than one Payment Unit (PU), the VDU volumes are assigned to the PU based on acres of the VDU within the PU.

VDU	VDU ACRES	PU	PU ACRES
8	28.8	1	0.7
		2	1.2
		4	1.2
		8	15.4
		9	10.3
9	115.2	1	11.1
		2	9.0
		3	3.9
		4	9.2
		5	7.7
		6	5.1
		7	23.9
		8	19.6
		9	25.7
12	21.6	10	21.6
18	8.1	7	8.1
<b>TOTAL:</b>	<b>173.7</b>		<b>173.7</b>

**DESCRIPTION OF TIMBER BY PAYMENT UNIT (PU)**

PU	MARKET GROUP	PRODUCT	QUANTITY	UNIT	ACRES	ADVERTISE PRICE
1	Basswood	Sawtimber	4.2	MBF	11.8	\$28,282.80
	Red Maple		1.7	MBF		
	Sugar Maple		18.2	MBF		
	Basswood	Pulpwood	11	Cords		
	Mixed Aspen		20	Cords		
	<i>Quaking Aspen</i>		20	<i>Cords</i>		
	Mixed Hardwood		79	Cords		
	<i>Beech</i>		16	<i>Cords</i>		
	<i>Ironwood</i>		1	<i>Cords</i>		
	<i>Red Maple</i>		11	<i>Cords</i>		
	<i>Sugar Maple</i>		51	<i>Cords</i>		
	Red Pine		378	Cords		
	2		Basswood	Sawtimber		
Red Maple		1.5	MBF			
Sugar Maple		17.2	MBF			
Basswood		Pulpwood	11	Cords		
Mixed Aspen			18	Cords		
<i>Quaking Aspen</i>			18	<i>Cords</i>		
Mixed Hardwood			74	Cords		
<i>Beech</i>			15	<i>Cords</i>		
<i>Ironwood</i>			1	<i>Cords</i>		
<i>Red Maple</i>			10	<i>Cords</i>		
<i>Sugar Maple</i>			48	<i>Cords</i>		
Paper Birch			1	Cords		
Red Pine			311	Cords		
3	Basswood	Sawtimber	1.1	MBF	3.9	\$9,397.65
	Red Maple		0.6	MBF		
	Sugar Maple		5.4	MBF		
	Basswood	Pulpwood	3	Cords		
	Mixed Aspen		7	Cords		
	<i>Quaking Aspen</i>		7	<i>Cords</i>		
	Mixed Hardwood		24	Cords		
	<i>Beech</i>		5	<i>Cords</i>		
	<i>Red Maple</i>		3	<i>Cords</i>		
	<i>Sugar Maple</i>		16	<i>Cords</i>		
	Red Pine		131	Cords		
4	Basswood	Sawtimber	4.6	MBF	10.4	\$24,824.65
	Red Maple		1.5	MBF		
	Sugar Maple		17.5	MBF		
	Basswood	Pulpwood	12	Cords		
	Mixed Aspen		18	Cords		
	<i>Quaking Aspen</i>		18	<i>Cords</i>		
	Mixed Hardwood		75	Cords		
	<i>Beech</i>		16	<i>Cords</i>		
	<i>Ironwood</i>		1	<i>Cords</i>		
	<i>Red Maple</i>		10	<i>Cords</i>		
	<i>Sugar Maple</i>		48	<i>Cords</i>		
	Paper Birch		1	Cords		
	Red Pine		317	Cords		
5	Basswood	Sawtimber	2.1	MBF	7.7	\$18,519.50
	Red Maple		1.1	MBF		
	Sugar Maple		10.7	MBF		
	Basswood	Pulpwood	5	Cords		
	Mixed Aspen		13	Cords		
	<i>Quaking Aspen</i>		13	<i>Cords</i>		
	Mixed Hardwood		47	Cords		

**DESCRIPTION OF TIMBER BY PAYMENT UNIT (PU), CON'T**

PU	MARKET GROUP	PRODUCT	QUANTITY	UNIT	ACRES	ADVERTISE PRICE
5 con't	<i>Beech</i>	<i>Pulpwood</i>	9	<i>Cords</i>		
	<i>Red Maple</i>		7	<i>Cords</i>		
	<i>Sugar Maple</i>		31	<i>Cords</i>		
	Red Pine		259	<i>Cords</i>		
6	Basswood	Sawtimber	1.4	MBF	5.1	\$12,255.65
	Red Maple		0.7	MBF		
	Sugar Maple		7.1	MBF		
	Basswood	Pulpwood	4	<i>Cords</i>		
	Mixed Aspen		9	<i>Cords</i>		
	<i>Quaking Aspen</i>		9	<i>Cords</i>		
	Mixed Hardwood		31	<i>Cords</i>		
	<i>Beech</i>		6	<i>Cords</i>		
	<i>Red Maple</i>		4	<i>Cords</i>		
	<i>Sugar Maple</i>		21	<i>Cords</i>		
	Red Pine		171	<i>Cords</i>		
	7	Basswood	Sawtimber	16.5		
Red Maple			3.5	MBF		
Sugar Maple			64.9	MBF		
Basswood		Pulpwood	50	<i>Cords</i>		
Mixed Aspen			163	<i>Cords</i>		
<i>B. T. Aspen</i>			123	<i>Cords</i>		
<i>Quaking Aspen</i>			40	<i>Cords</i>		
Mixed Hardwood			265	<i>Cords</i>		
<i>American Elm</i>			1	<i>Cords</i>		
<i>Beech</i>			28	<i>Cords</i>		
<i>Ironwood</i>			4	<i>Cords</i>		
<i>Red Maple</i>			25	<i>Cords</i>		
<i>Sugar Maple</i>			207	<i>Cords</i>		
Red Pine			852	<i>Cords</i>		
8		Basswood	Sawtimber	31.9	MBF	35.0
	Red Maple		4.7	MBF		
	Sugar Maple		87.6	MBF		
	Basswood	Pulpwood	80	<i>Cords</i>		
	Mixed Aspen		68	<i>Cords</i>		
	<i>Quaking Aspen</i>		68	<i>Cords</i>		
	Mixed Hardwood		371	<i>Cords</i>		
	<i>American Elm</i>		1	<i>Cords</i>		
	<i>Beech</i>		87	<i>Cords</i>		
	<i>Ironwood</i>		10	<i>Cords</i>		
	<i>Red Maple</i>		49	<i>Cords</i>		
	<i>Sugar Maple</i>		224	<i>Cords</i>		
	Paper Birch		9	<i>Cords</i>		
	Red Pine		762	<i>Cords</i>		
9	Basswood	Sawtimber	24.8	MBF	36.0	\$85,078.20
	Red Maple		5.0	MBF		
	Sugar Maple		76.1	MBF		
	Basswood	Pulpwood	63	<i>Cords</i>		
	Mixed Aspen		67	<i>Cords</i>		
	<i>Quaking Aspen</i>		67	<i>Cords</i>		
	Mixed Hardwood		325	<i>Cords</i>		
	<i>American Elm</i>		2	<i>Cords</i>		
	<i>Beech</i>		73	<i>Cords</i>		
	<i>Ironwood</i>		7	<i>Cords</i>		
	<i>Red Maple</i>		43	<i>Cords</i>		
	<i>Sugar Maple</i>		200	<i>Cords</i>		
	Paper Birch		6	<i>Cords</i>		



**DESCRIPTION OF TIMBER BY PAYMENT UNIT (PU), CON'T**

PU	MARKET GROUP	PRODUCT	QUANTITY	UNIT	ACRES	ADVERTISE PRICE
9 con't	Red Pine	Pulpwood	932	Cords		
10	Basswood	Sawtimber	56.4	MBF	21.6	\$25,337.05
	Sugar Maple		42.5	MBF		
	Basswood	Pulpwood	117	Cords		
	Mixed Aspen		28	Cords		
	<i>B. T. Aspen</i>		28	<i>Cords</i>		
	Mixed Hardwood		186	Cords		
	<i>Beech</i>		20	<i>Cords</i>		
	<i>Ironwood</i>		6	<i>Cords</i>		
	<i>Sugar Maple</i>		160	<i>Cords</i>		
TOTAL:			515.0	MBF		
TOTAL:			6,374	Cords		

## Sale Specific Conditions & Requirements

Sale Name: Super Terrific Fun Time Pine

Sale Number: 52-114-23 Seq#: 2

### 1 - Sale Area

#### 1.2 - Boundaries

##### 1.2.1 - Painted boundaries (9/19)

The sale boundary and Payment Unit boundaries are marked and identified by blue, red and yellow paint, along with a road. Exterior sale boundary lines against private property are marked with blue paint. Exterior sale boundary lines against state are marked with red paint. Interior Payment Unit boundaries are marked with yellow paint, with the exception of the Interior Payment Unit boundary between Payment Units 6 & 7, which is unpainted and identified by Welsh Road (see Timber Sale Map). One interior retention island is present within the Sale Area and is marked with red painted X's. Boundary excluded retention areas are present and are shown on the Timber Sale Map. No harvesting activities may occur within designated retention areas. The painted boundary line trees are not Included Timber and are to be protected. Yellow painted trees designating an interior Payment Unit boundary are only to be cut when all surrounding Payment Units have been paid.

### 2 - Timber Specifications

#### 2.1 - Included Timber

##### 2.1.1 - Clearcut unit(s) with unmerchantable trees (6/14)

Within Payment Unit(s) 1-9, cut all trees that are two (2) inches or more at DBH, except do not cut any yellow birch, hemlock or trees marked with green paint.

##### 2.1.5 - Overstory removal unit(s) (8/11)

Within Payment Unit(s) 10, all trees with DBH equal to or greater than 9 inches which meet minimum piece specifications in 2.2 Utilization, are designated for cutting. If a multi-stem tree has one or more stems with a DBH equal to or greater than 9 inches, then cut all stems. Conversely, if a multi-stem tree does not have any stems 9" DBH or greater, then do not cut any of the stems. Additionally, do not cut any elm.

See Sale Condition 3.4.1 - "Damaged Timber" regarding sugar maple sapling and pole timber protection within Payment Unit 10.

#### 2.2 - Utilization

##### 2.2.2 - Chipping required (2/18)

Payment Units 4-9 must be chip harvested to facilitate subsequent planting operations. The Purchaser has the option to produce sawlogs or pulpwood bolts, but the remaining portion of the trees must be chipped and hauled. If market conditions limit the practicality of chipping, tops and slash must be arranged in a way that will not inhibit future planting operations, as directed by the Sale Administrator. A chipping exemption can be obtained if proposed operations are determined to be suitable for planting by reforestation staff. The requirement to retain approximately 1/6 to 1/3 of tree tops and limbs less than four inches in diameter is still applicable (G. C. & R. 2.2).

##### 2.2.3 - Stump heights (4/07)

Stump heights within Payment Units 4-9 shall not exceed 6 inches for all trees. This is in order to facilitate planting operations.

##### 2.2.6 - Roundwood operation required (3/21)

The skidding of whole trees or tree segments with limbs attached is prohibited within Payment Unit 10. All products must be produced as roundwood and forwarded to existing roads or landing areas in final product length. Trees must be harvested with in-woods processor (feller bunching harvester will not be allowed) in order to retain existing understory.

### 3 - Payments

#### 3.3 - Pre-measured Sales

##### 3.3.4 - Dividing payment units (7/14)

Payment Unit(s) 7-9 may be divided at the request of the Purchaser and upon approval of the Unit Manager. Dividing Payment Units is a contract modification which requires a Timber Sale Contract Amendment. There will be only one division

per Payment Unit.

### 3.4 - Damaged Timber

#### 3.4.1 - Damaged timber (7/16)

General Condition and Requirement 3.4 Damaged Timber, defines liquidated damages for undesignated live merchantable trees which are cut or injured. In addition, extreme care should be taken to avoid damage to sugar maple saplings and pole timber in Payment Unit 10. As much as possible, harvesting operations should try to go around areas that are heavy with sugar maple saplings/poles, many of which are greater than 20 feet tall.

Within Payment Unit 10, if more than 20% of the sugar maple saplings and pole timber (1/4" to 8.9" DBH) within a specified portion of the Sale Area are damaged, liquidated damages will be assessed at \$500 per acre for all acreage within that specified portion of the Sale Area that was damaged. Saplings and poles cut cleanly in skid rows for operability will not be counted as damaged timber.

No damage is acceptable to undesignated live merchantable trees and designated retention areas. Within the Sale Area, if more than 5% of trees (> 4.5" DBH) within a specified area of the sale are damaged, liquidated damages will be assessed for all trees damaged. Rates will be in accordance with General Condition and Requirement 3.4 Damaged Timber.

## 4 - Transportation

### 4.1 - Construction

#### 4.1.3 - Slash and earthen piles (8/04)

Piles or windrows of earth along roads and landings that have been widened or constructed shall be leveled. Slash from road maintenance or construction, including stumps, shall be dispersed throughout the sale.

#### 4.1.4 - Timber removed for construction (3/23)

Trees cut or damaged in the process of pre-approved road, landing or skid trail construction will be decked in an area separate from other Designated Timber and not removed until measured by the sale administrator. Payment will be made at contract prices or average prices, if not on the contract.

#### 4.1.6 - Road construction (1/09)

Construction of new roads or improvements to existing roads shall be done in such a way as to minimize the environmental and visual impacts. Merchantable trees shall be cut and utilized unless otherwise directed. Non-merchantable trees shall be severed and laid flat on the ground. Slash shall be scattered, and not left in windrows and kept a minimum of 10 feet back from the road edge. Stumps shall be set upright, not left on edge, and be moved at least 10 feet away from the road edge. Disturbed soil shall be feathered into the woods and not left in berms or windrows.

#### 4.1.7 - Road closure (10/11)

New roads or overgrown roads that are reopened must be blocked to vehicle traffic within 30 days of completion of hauling. In general, this will require constructing a four (4') foot high berm of stumps and logs covered with earth. Stumps and brush must be placed along the remainder of the trail. These roads must be rendered impassable to cars and trucks. All stumps from road building and landing construction must be reserved to block any newly constructed roads upon completion of the sale. These stumps must be scattered along the road system to prohibit vehicular movement. Temporary berms may be required if no sale activity occurs for 30 or more consecutive days. Contact the Sale Administrator for specific details of design and placement.

### 4.2 - Maintenance

#### 4.2.2 - Fill material (4/07)

To maintain roads, fill material may be needed in areas where "holes" exist or may be expected to develop. This fill material should be placed before trucking begins. The Unit Manager or his/her representative must approve the type of fill material used prior to placement. In general, suitable fill material includes cobble and/or crushed rock. Fill material may not be sourced from adjacent State-owned lands.

#### 4.2.4 - Grading (10/16)

If deemed necessary by the Sale Administrator, state forest roads must be graded after hauling operations are complete. In general, this will require a road grader or bulldozer to shape up the roads after forest products have been hauled off site. The grading equipment to be used must be approved by the Unit Manager or his/her representative.

#### 4.2.5 - Two wheel drive condition (2/04)

All existing trail roads on and adjacent to the sale area must be passable by two-wheel drive traffic for the duration of the sale.

#### 4.4 - Access

##### 4.4.1 - Private property access (3/11)

Permission for access across private land is the responsibility of the Purchaser. Access to Payment Unit 3 is best accomplished through private property. Should the Purchaser desire to cross private property, a copy of the written permission from the private landowner may be required by the DNR.

### 5 - Operations

#### 5.1 - Notification

##### 5.1.1 - Pre-sale conference (10/16)

A pre-sale conference between the Purchaser and sale administrator is required prior to beginning any operations to determine landing and road locations. The Unit Manager or his/her representative must be contacted at least 5 days in advance to schedule the conference.

#### 5.2 - Conduct of Operations

##### 5.2.1 - Slash

###### 5.2.1.8 - Slash height (12/08)

No slash or tree tops may exceed 24 inches in height.

###### 5.2.1.10 - No slash in openings (5/10)

No brush or logging debris is to be left in the maintained wildlife opening which is indicated by "G0" on the Timber Sale Map. Any damage to the opening shall be repaired according to specifications of the Unit Manager or his/her representative.

##### 5.2.2 - Hazard Trees/Snags

###### 5.2.2.1 - Den trees (10/16)

Obvious hollow and/or den trees shall be protected and left standing unless they are a safety hazard.

##### 5.2.3 - Operating Restrictions

###### 5.2.3.3 - Bark slippage restriction (3/09)

Within Payment Unit(s) 10, unless changed by written agreement, cutting and skidding are not permitted during the period of April 15 to July 15. This restriction is because of bark slippage.

##### 5.2.4 - Dead and Down Creation

###### 5.2.4.3 - Dead and down creation, dead trees (6/07)

Except as provided for in General Condition and Requirement 5.2.2, no dead trees, standing or down, are to be cut, skidded, or processed.

###### 5.2.32 - Decking/landing restoration (9/13)

All decking and landing areas must have the surface area restored to a condition equal to or better than before. This is to ensure the proper regeneration of the stand. Wood debris, chips and "cookies" from trimmings must be removed or scattered away from landing and loading areas and may not be windrowed on the edge.

###### 5.2.38 - No decking against live trees (2/04)

Cut products may not be decked against unmarked or designated leave trees.

###### 5.2.39 - ORV trail/route protection (4/18)

The Tomahawk Motorcycle Trail travels through Payment Units 1, 8, & 9 and is shown on the Timber Sale Map. Do not cut or damage any carsonite posts with yellow ORV markers. Trees with yellow ORV markers shall be cut off above the markers and at least 5 feet above ground. All stumps within 5 feet of the trail must be cut flush with the ground. Maintain a 10-foot-wide slash, debris, and rut free zone daily using the ORV trail or route as the centerline. Do not run equipment down

the ORV trail or route. Skidding across the trail or route may only occur in locations approved by the Sale Administrator.

#### 5.2.40 - Pathway protection (10/10)

The North Country Pathway is a hiking trail and travels near or against portions of Payment Units 3, 4, 5, & 7. The pathway is shown on the Timber Sale Map. Do not cut or damage any carsonite posts with blue pathway markers. Trees with blue pathway markers located inside the sale boundary shall be cut off above the blue markers and at least 5 feet above ground. Maintain a 10-foot-wide slash, debris, and rut free zone daily, using the pathway as the centerline. Do not run equipment down the pathway. Skidding across the trail may only occur in locations approved by the Sale Administrator.

### 5.4 - Soil Protection

#### 5.4.1 - Rutting restriction, general (7/16)

Operations are to cease immediately if equipment and weather conditions result in rutting of roads and/or skid trails which is 12 inches or greater in depth and 25 feet in length. The Unit Manager or his/her representative may restrict hauling and/or skidding if ruts exceed the specified depth. With the Unit Manager or his/her representative's approval, the Purchaser may return to the area when the risk of rutting has decreased.

#### 5.4.2 - Skid trails (2/04)

Skid trails up and down slopes should be avoided. If however this is unavoidable, these trails will be left in a non-erodible condition using water bars, logs, and slash. Placing of slash on these skid trails while logging is ongoing may alleviate need for any further action. At the direction of the sale administrator, seed, fertilizer, and mulch may also be required.

### 5.8 - Protection of Endangered Species

#### 5.8.5 - Protection of raptor nests (3/13)

All trees with raptor nests will be protected if found during harvesting operations. Notification will be made to the Unit Manager or his/her representative who will notify the Wildlife Biologist so an on-site evaluation and recommendation can be made, if necessary.

## 6 - Safety and Fire Prevention

### 6.2 - Signing

#### 6.2.1 - Road posting (10/20)

The Purchaser is responsible for posting and maintaining caution signs on roads used for hauling prior to beginning operations. The road must be posted at appropriate distances from the Sale Area to warn of logging activity and truck traffic. Signs must be removed when harvest operations are suspended or completed. The Purchaser will provide these signs.

#### 6.2.3 - Recreational trail posting (10/20)

The Purchaser is responsible for posting and maintaining caution signs on the North Country Pathway and Tomahawk Motorcycle Trail prior to beginning operations. The trail must be posted at appropriate distances from the Sale Area to warn of logging activity and truck traffic at both ends of the trail. Signs must be removed when harvest operations are suspended or completed. The Purchaser will provide these signs.



# TIMBER SALE MAP

This information provided by authority of Part 525, 1994 PA 451, as amended.

Forest Management Unit Gaylord		County Charlevoix & Emmet	Mapped By J. St. Pierre	Date 9/11/2023	Page 1	of 1
Township 33N & 34N	Range 04W	Section(s) and Subdivision(s) 33N: Sec.4 NWNE      34N: Sec.33 E1/2NW, N1/2NE, SENE, E1/2SW Sec.33 N1/2SE,SWSE    Sec.34 S1/2NW,NWSW		Scale 1:15,840		

Cover Type				Density	
A = Aspen	H = Hemlock	N = Marsh	U = Upland Brush	0 = Non Stocked	5 = Pole Timber Medium
B = Paper Birch	J = Jack Pine	O = Oak	UM = Upland Mixed	1 = Seedling Sapling Poor	6 = Pole Timber Well
C = Cedar	L = Lowland Brush	P = Lowland Poplar	V = Bog or Marsh	2 = Seedling Sapling Medium	7 = Saw Timber Poor
D = Treed Bog	LM = Lowland Mixed	Q = Mixed Swamp Conifer	W = White Pine	3 = Seedling Sapling Well	8 = Saw Timber Medium
E = Swamp Hdwoods	M = Mpl, Bch, Brch	R = Red Pine	X = Non Stocked	4 = Pole Timber Poor	9 = Saw Timber Well
F = Spruce Fir	MC = Mixed Conifer	S = Black Spruce	Z = Water		
G = Grass	MD = Mixed Deciduous	T = Tamarack			

PU	Acres	PU	Acres	PU	Acres
1	11.8	5	7.7	9	36.0
2	10.2	6	5.1	10	21.6
3	3.9	7	32.0		
4	10.4	8	35.0		

## Super Terrific Fun Time Pine

### Compartment 216

173.7 Acres

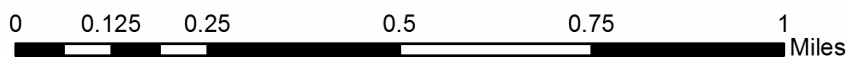
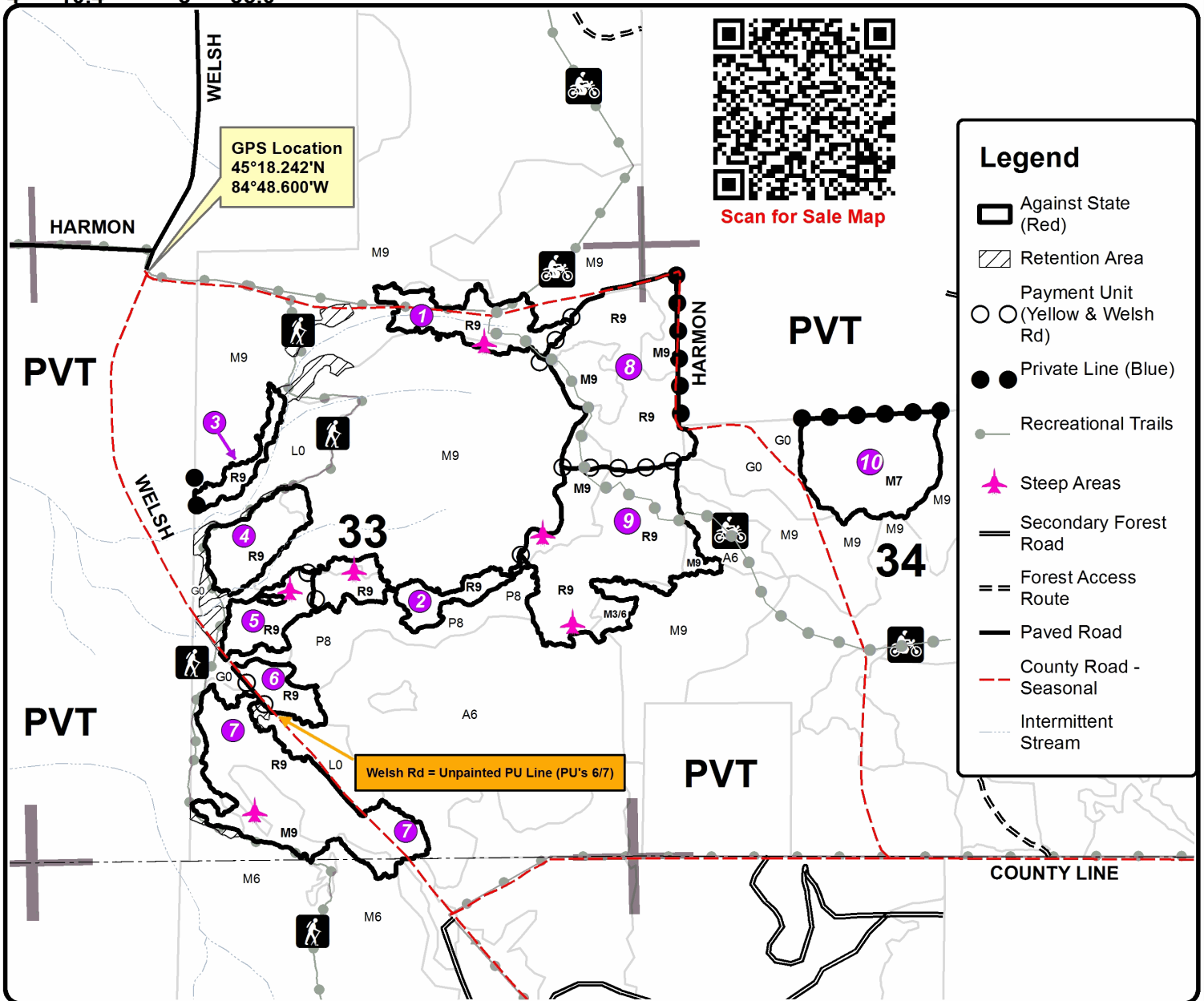
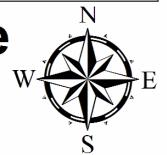

C 48 Hardwoods (52-005-23)  
T31N, R05W, SEC. 20; T31N, R05W, SEC. 29; Antrim COUNTY

In response to the notice of sale to be held 9:00 a.m. (local time) on March 12, 2024, I am hereby submitting my sealed bid ( firm offer) for the following forest products to be cut. Bids for individual species must be at or above the advertised price. All non-responsive bid forms may be rejected.

<u>PRODUCTS &amp; SPECIES</u>	<u>ESTIMATED VOLUME*</u>	<u>ADVERTISED PRICE</u>	<u>BID PRICE/UNIT</u>
<b>Sawtimber</b>			
B. T. Aspen	16.3 MBF	\$ 43.00/MBF	\$ _____
Basswood	331.6 MBF	\$ 61.00/MBF	\$ _____
Beech	49.6 MBF	\$ 87.00/MBF	\$ _____
Black Cherry	4.8 MBF	\$ 76.00/MBF	\$ _____
Red Maple	327.1 MBF	\$ 123.00/MBF	\$ _____
Sugar Maple	198.5 MBF	\$ 211.00/MBF	\$ _____
<b>Pulpwood</b>			
B. T. Aspen	13 Cords	\$ 15.80/Cord	\$ _____
Basswood	444 Cords	\$ 11.10/Cord	\$ _____
Mixed Hardwood	1,556 Cords	\$ 14.60/Cord	\$ _____

\*The volumes are statistically estimated within plus (+) or minus (-) 12.06 percent at 95% confidence level. These estimated volumes are final and not subject to adjustment. Prospective bidders are urged to examine this timber and to make their own estimates of quantity and quality.

I understand that any or all bids may be rejected. All bids must be signed and all bid items must be bid or the bid form may be rejected. I also understand that consideration and awarding a contract will be based upon my past performance and ability to complete the contract based upon equipment and staffing subject to my control.

FEDERAL ID: \_\_\_\_ - \_\_\_\_ - \_\_\_\_ or SOCIAL SECURITY NUMBER: \_\_\_\_ - \_\_\_\_ - \_\_\_\_

Company or individual bidding: \_\_\_\_\_

Company representative's name: \_\_\_\_\_

Address: \_\_\_\_\_

City: \_\_\_\_\_ State: \_\_\_\_\_ Zip: \_\_\_\_\_

IF AVAILABLE, PLEASE PLACE THE PERSONALIZED LABEL FROM YOUR PROSPECTUS IN THE ABOVE BOX.

Individual or company representative's signature: \_\_\_\_\_ Date: \_\_\_\_\_

Phone number : \_\_\_\_\_ Email (optional): \_\_\_\_\_

**THE WINNING BIDDER MUST COMPLETE THE VERIFICATION OF WORKER'S DISABILITY COMPENSATION ACT COMPLIANCE (ON REVERSE SIDE IF DOUBLE SIDED) WITHIN 21 DAYS OF SALE AWARD DATE**



# TIMBER SALE VERIFICATION OF WORKER'S DISABILITY COMPENSATION ACT COMPLIANCE

As required by Act 317, P.A. 1969 (Worker's Compensation) and  
Part 5 of Act 451 of 1994, as amended.

FOR DEPARTMENT USE ONLY	
Sale Number (XX - XXX - XX - XX)	
Forest Management Unit:	

## VERIFICATION OF WORKER'S DISABILITY COMPENSATION ACT COMPLIANCE

- This verification must be completed and submitted within 21 days of contract award and prior to the issuance of the timber sale contract.
- In addition, if boxes 2B or 2C are checked, then Notice of Exclusion or Certificate of Insurance must be submitted within twenty-one (21) days of the contract award and prior to the issuance of the timber sale contract.
- All information must be typed or printed except for written signatures.

Please Check Appropriate Categories:

1. My business is organized as (you **must** check one of the boxes below):
  - A.  Sole Proprietorship (individual)
  - B.  Partnership
  - C.  Corporation
2. You **must** check one of the boxes below:
  - A.  I certify my business is a sole proprietorship and it has no employees but the sole proprietor. I am not subject to the Worker's Compensation Laws.
  - B.  I certify my business has satisfied its obligation to the Worker's Compensation Act through the use of an approved Notice of Exclusion (BWC-337, Rev. 5/96). I will provide a copy of the Notice of Exclusion within 21 days of the contract award. (For questions or a copy of the BWC-337, please call the Worker's Compensation Bureau at 517-322-1195).
  - C.  I certify my business has a Worker's Compensation Policy. I will provide an original Certificate of Insurance within twenty-one (21) days of the contract award.
3. If you have checked item 2(A) or 2(B), you **must** indicate the number of **both** full-time and part-time employees, other than yourself, including family members and active partners (if none, you must enter "0").

\_\_\_\_\_ Full-time Employees

\_\_\_\_\_ Part-time Employees

Name of Business		Federal ID (or) Social Security No.	
Address		Telephone (       )	
City	State	ZIP	

*I hereby certify that the above information is true and correct. I agree to notify the Michigan DNR of any changes that occur in factors affecting my coverage during any of my present and future operations.*

\_\_\_\_\_  
Signature of Owner or Authorized Representative

\_\_\_\_\_  
Title

\_\_\_\_\_  
Date

Please complete the "SEALED BID" information on the next page



Hollywood Mix (52-106-23)  
T35N, R01E, SEC. 22; T35N, R01E, SEC. 27; Cheboygan COUNTY

In response to the notice of sale to be held 9:00 a.m. (local time) on March 12, 2024, I am hereby submitting my sealed bid ( firm offer) for the following forest products to be cut. Bids for individual species must be at or above the advertised price. All non-responsive bid forms may be rejected.

<u>PRODUCTS &amp; SPECIES</u>	<u>ESTIMATED VOLUME*</u>	<u>ADVERTISED PRICE</u>	<u>BID PRICE/UNIT</u>
<b>Sawtimber</b>			
B. T. Aspen	42.0 MBF	\$ 64.00/MBF	\$ _____
Basswood	2.8 MBF	\$ 92.00/MBF	\$ _____
N. White Cedar	2.7 MBF	\$ 66.00/MBF	\$ _____
Paper Birch	2.6 MBF	\$ 55.00/MBF	\$ _____
Quaking Aspen	8.1 MBF	\$ 64.00/MBF	\$ _____
Red Maple	9.9 MBF	\$ 185.00/MBF	\$ _____
Red Oak	159.1 MBF	\$ 110.00/MBF	\$ _____
Red Pine	19.8 MBF	\$ 134.00/MBF	\$ _____
Sugar Maple	2.5 MBF	\$ 317.00/MBF	\$ _____
<b>Pulpwood</b>			
Balsam Fir	21 Cords	\$ 20.50/Cord	\$ _____
Mixed Aspen	28 Cords	\$ 23.70/Cord	\$ _____
Mixed Hardwood	190 Cords	\$ 21.85/Cord	\$ _____
N. White Cedar	12 Cords	\$ 18.25/Cord	\$ _____
Red Oak	195 Cords	\$ 39.45/Cord	\$ _____
Red Pine	31 Cords	\$ 51.40/Cord	\$ _____
White Pine	199 Cords	\$ 37.95/Cord	\$ _____
White Spruce	5 Cords	\$ 19.15/Cord	\$ _____

\*The volumes are statistically estimated within plus (+) or minus (-) 16.83 percent at 95% confidence level. These estimated volumes are final and not subject to adjustment. Prospective bidders are urged to examine this timber and to make their own estimates of quantity and quality.

I understand that any or all bids may be rejected. All bids must be signed and all bid items must be bid or the bid form may be rejected. I also understand that consideration and awarding a contract will be based upon my past performance and ability to complete the contract based upon equipment and staffing subject to my control.

FEDERAL ID: \_\_\_\_\_ or SOCIAL SECURITY NUMBER: \_\_\_\_\_

Company or individual bidding: \_\_\_\_\_

Company representative's name: \_\_\_\_\_

Address: \_\_\_\_\_

City: \_\_\_\_\_ State: \_\_\_\_\_ Zip: \_\_\_\_\_

IF AVAILABLE, PLEASE PLACE THE PERSONALIZED LABEL FROM YOUR PROSPECTUS IN THE ABOVE BOX.

Individual or company representative's signature: \_\_\_\_\_ Date: \_\_\_\_\_

Phone number : \_\_\_\_\_ Email (optional): \_\_\_\_\_

**THE WINNING BIDDER MUST COMPLETE THE VERIFICATION OF WORKER'S DISABILITY COMPENSATION ACT COMPLIANCE (ON REVERSE SIDE IF DOUBLE SIDED) WITHIN 21 DAYS OF SALE AWARD DATE**



**TIMBER SALE**  
**VERIFICATION OF WORKER'S DISABILITY**  
**COMPENSATION ACT COMPLIANCE**

*As required by Act 317, P.A. 1969 (Worker's Compensation) and  
Part 5 of Act 451 of 1994, as amended.*

FOR DEPARTMENT USE ONLY	
Sale Number (XX - XXX - XX - XX)	
Forest Management Unit:	

**VERIFICATION OF WORKER'S DISABILITY COMPENSATION ACT COMPLIANCE**

- This verification must be completed and submitted within 21 days of contract award and prior to the issuance of the timber sale contract.
- In addition, if boxes 2B or 2C are checked, then Notice of Exclusion or Certificate of Insurance must be submitted within twenty-one (21) days of the contract award and prior to the issuance of the timber sale contract.
- All information must be typed or printed except for written signatures.

Please Check Appropriate Categories:

1. My business is organized as (you **must** check one of the boxes below):
  - A.  Sole Proprietorship (individual)
  - B.  Partnership
  - C.  Corporation
2. You **must** check one of the boxes below:
  - A.  I certify my business is a sole proprietorship and it has no employees but the sole proprietor. I am not subject to the Worker's Compensation Laws.
  - B.  I certify my business has satisfied its obligation to the Worker's Compensation Act through the use of an approved Notice of Exclusion (BWC-337, Rev. 5/96). I will provide a copy of the Notice of Exclusion within 21 days of the contract award. (For questions or a copy of the BWC-337, please call the Worker's Compensation Bureau at 517-322-1195).
  - C.  I certify my business has a Worker's Compensation Policy. I will provide an original Certificate of Insurance within twenty-one (21) days of the contract award.
3. If you have checked item 2(A) or 2(B), you **must** indicate the number of **both** full-time and part-time employees, other than yourself, including family members and active partners (if none, you must enter "0").

\_\_\_\_\_ Full-time Employees

\_\_\_\_\_ Part-time Employees

Name of Business		Federal ID (or) Social Security No.	
Address		Telephone (       )	
City	State	ZIP	

*I hereby certify that the above information is true and correct. I agree to notify the Michigan DNR of any changes that occur in factors affecting my coverage during any of my present and future operations.*

\_\_\_\_\_  
Signature of Owner or Authorized Representative

\_\_\_\_\_  
Title

\_\_\_\_\_  
Date

**Please complete the "SEALED BID" information on the next page**

Super Terrific Fun Time Pine (52-114-23)  
T33N, R04W, SEC. 4; T34N, R04W, SEC. 33; T34N, R04W, SEC. 34; Charlevoix

In response to the notice of sale to be held 9:00 a.m. (local time) on March 12, 2024, I am hereby submitting my sealed bid ( firm offer) for the following forest products to be cut. Bids for individual species must be at or above the advertised price. All non-responsive bid forms may be rejected.

<u>PRODUCTS &amp; SPECIES</u>	<u>ESTIMATED VOLUME*</u>	<u>ADVERTISED PRICE</u>	<u>BID PRICE/UNIT</u>
<b>Sawtimber</b>			
Basswood	147.5 MBF	\$ 92.00/MBF	\$ _____
Red Maple	20.3 MBF	\$ 185.00/MBF	\$ _____
Sugar Maple	347.2 MBF	\$ 317.00/MBF	\$ _____
<b>Pulpwood</b>			
Basswood	356 Cords	\$ 16.65/Cord	\$ _____
Mixed Aspen	411 Cords	\$ 23.70/Cord	\$ _____
Mixed Hardwood	1,477 Cords	\$ 21.85/Cord	\$ _____
Paper Birch	17 Cords	\$ 17.50/Cord	\$ _____
Red Pine	4,113 Cords	\$ 51.40/Cord	\$ _____

\*The volumes are statistically estimated within plus (+) or minus (-) 7.79 percent at 95% confidence level. These estimated volumes are final and not subject to adjustment. Prospective bidders are urged to examine this timber and to make their own estimates of quantity and quality.

I understand that any or all bids may be rejected. All bids must be signed and all bid items must be bid or the bid form may be rejected. I also understand that consideration and awarding a contract will be based upon my past performance and ability to complete the contract based upon equipment and staffing subject to my control .

FEDERAL ID: \_\_\_\_ - \_\_\_\_ - \_\_\_\_ or SOCIAL SECURITY NUMBER: \_\_\_\_ - \_\_\_\_ - \_\_\_\_

Company or individual bidding: \_\_\_\_\_

Company representative's name: \_\_\_\_\_

Address: \_\_\_\_\_

City: \_\_\_\_\_ State: \_\_\_\_\_ Zip: \_\_\_\_\_

IF AVAILABLE, PLEASE PLACE THE PERSONALIZED LABEL FROM YOUR PROSPECTUS IN THE ABOVE BOX.

Individual or company representative's signature : \_\_\_\_\_ Date: \_\_\_\_\_

Phone number : \_\_\_\_\_ Email (optional): \_\_\_\_\_

**THE WINNING BIDDER MUST COMPLETE THE VERIFICATION OF WORKER'S DISABILITY COMPENSATION ACT COMPLIANCE (ON REVERSE SIDE IF DOUBLE SIDED) WITHIN 21 DAYS OF SALE AWARD DATE**



<b>FOR DEPARTMENT USE ONLY</b>
Sale Number (XX - XXX - XX - XX)
Forest Management Unit:

## TIMBER SALE VERIFICATION OF WORKER'S DISABILITY COMPENSATION ACT COMPLIANCE

*As required by Act 317, P.A. 1969 (Worker's Compensation) and  
Part 5 of Act 451 of 1994, as amended.*

### VERIFICATION OF WORKER'S DISABILITY COMPENSATION ACT COMPLIANCE

- This verification must be completed and submitted within 21 days of contract award and prior to the issuance of the timber sale contract.
- In addition, if boxes 2B or 2C are checked, then Notice of Exclusion or Certificate of Insurance must be submitted within twenty-one (21) days of the contract award and prior to the issuance of the timber sale contract.
- All information must be typed or printed except for written signatures.

Please Check Appropriate Categories:

1. My business is organized as (you **must** check one of the boxes below):
  - A.  Sole Proprietorship (individual)
  - B.  Partnership
  - C.  Corporation
  
2. You **must** check one of the boxes below:
  - A.  I certify my business is a sole proprietorship and it has no employees but the sole proprietor. I am not subject to the Worker's Compensation Laws.
  - B.  I certify my business has satisfied its obligation to the Worker's Compensation Act through the use of an approved Notice of Exclusion (BWC-337, Rev. 5/96). I will provide a copy of the Notice of Exclusion within 21 days of the contract award. (For questions or a copy of the BWC-337, please call the Worker's Compensation Bureau at 517-322-1195).
  - C.  I certify my business has a Worker's Compensation Policy. I will provide an original Certificate of Insurance within twenty-one (21) days of the contract award.
  
3. If you have checked item 2(A) or 2(B), you **must** indicate the number of **both** full-time and part-time employees, other than yourself, including family members and active partners (if none, you must enter "0").

\_\_\_\_\_ Full-time Employees

\_\_\_\_\_ Part-time Employees

Name of Business		Federal ID (or) Social Security No.	
Address		Telephone (       )	
City	State	ZIP	

*I hereby certify that the above information is true and correct. I agree to notify the Michigan DNR of any changes that occur in factors affecting my coverage during any of my present and future operations.*

\_\_\_\_\_  
Signature of Owner or Authorized Representative

\_\_\_\_\_  
Title

\_\_\_\_\_  
Date

**Please complete the "SEALED BID" information on the next page**

Lorenzo Mix (52-113-23)  
T35N, R01E, SEC. 10; T35N, R01E, SEC. 3; Cheboygan COUNTY

In response to the notice of sale to be held 9:00 a.m. (local time) on March 12, 2024, I am hereby submitting my sealed bid ( firm offer) for the following forest products to be cut. Bids for individual species must be at or above the advertised price. All non-responsive bid forms may be rejected.

<u>PRODUCTS &amp; SPECIES</u>	<u>ESTIMATED VOLUME*</u>	<u>ADVERTISED PRICE</u>	<u>BID PRICE/UNIT</u>
<b>Sawtimber</b>			
B. T. Aspen	24.5 MBF	\$ 64.00/MBF	\$ _____
Black/Red (Hybrid) Oak	7.1 MBF	\$ 140.00/MBF	\$ _____
Red Maple	1.7 MBF	\$ 185.00/MBF	\$ _____
Red Oak	21.7 MBF	\$ 110.00/MBF	\$ _____
Red Pine	2.2 MBF	\$ 134.00/MBF	\$ _____
White Oak	6.0 MBF	\$ 76.00/MBF	\$ _____
White Pine	9.8 MBF	\$ 52.00/MBF	\$ _____
<b>Pulpwood</b>			
B. T. Aspen	126 Cords	\$ 23.70/Cord	\$ _____
Balsam Fir	4 Cords	\$ 20.50/Cord	\$ _____
Jack Pine	6 Cords	\$ 15.85/Cord	\$ _____
Mixed Oak	45 Cords	\$ 39.45/Cord	\$ _____
Red Maple	32 Cords	\$ 21.85/Cord	\$ _____
Red Oak	52 Cords	\$ 39.45/Cord	\$ _____
Red Pine	23 Cords	\$ 51.40/Cord	\$ _____
White Pine	12 Cords	\$ 37.95/Cord	\$ _____

\*The volumes are statistically estimated within plus (+) or minus (-) 30.16 percent at 95% confidence level. These estimated volumes are final and not subject to adjustment. Prospective bidders are urged to examine this timber and to make their own estimates of quantity and quality.

I understand that any or all bids may be rejected. All bids must be signed and all bid items must be bid or the bid form may be rejected. I also understand that consideration and awarding a contract will be based upon my past performance and ability to complete the contract based upon equipment and staffing subject to my control.

FEDERAL ID: \_\_\_\_ - \_\_\_\_ - \_\_\_\_ or SOCIAL SECURITY NUMBER: \_\_\_\_ - \_\_\_\_ - \_\_\_\_

Company or individual bidding: \_\_\_\_\_

Company representative's name: \_\_\_\_\_

Address: \_\_\_\_\_

City: \_\_\_\_\_ State: \_\_\_\_\_ Zip: \_\_\_\_\_

IF AVAILABLE, PLEASE PLACE THE PERSONALIZED LABEL FROM YOUR PROSPECTUS IN THE ABOVE BOX.

Individual or company representative's signature: \_\_\_\_\_ Date: \_\_\_\_\_

Phone number : \_\_\_\_\_ Email (optional): \_\_\_\_\_

**THE WINNING BIDDER MUST COMPLETE THE VERIFICATION OF WORKER'S DISABILITY COMPENSATION ACT COMPLIANCE (ON REVERSE SIDE IF DOUBLE SIDED) WITHIN 21 DAYS OF SALE AWARD DATE**



# TIMBER SALE VERIFICATION OF WORKER'S DISABILITY COMPENSATION ACT COMPLIANCE

As required by Act 317, P.A. 1969 (Worker's Compensation) and  
Part 5 of Act 451 of 1994, as amended.

FOR DEPARTMENT USE ONLY	
Sale Number (XX - XXX - XX - XX)	
Forest Management Unit:	

### VERIFICATION OF WORKER'S DISABILITY COMPENSATION ACT COMPLIANCE

- This verification must be completed and submitted within 21 days of contract award and prior to the issuance of the timber sale contract.
- In addition, if boxes 2B or 2C are checked, then Notice of Exclusion or Certificate of Insurance must be submitted within twenty-one (21) days of the contract award and prior to the issuance of the timber sale contract.
- All information must be typed or printed except for written signatures.

Please Check Appropriate Categories:

- My business is organized as (you **must** check one of the boxes below):
  - Sole Proprietorship (individual)
  - Partnership
  - Corporation
- You **must** check one of the boxes below:
  - I certify my business is a sole proprietorship and it has no employees but the sole proprietor. I am not subject to the Worker's Compensation Laws.
  - I certify my business has satisfied its obligation to the Worker's Compensation Act through the use of an approved Notice of Exclusion (BWC-337, Rev. 5/96). I will provide a copy of the Notice of Exclusion within 21 days of the contract award. (For questions or a copy of the BWC-337, please call the Worker's Compensation Bureau at 517-322-1195).
  - I certify my business has a Worker's Compensation Policy. I will provide an original Certificate of Insurance within twenty-one (21) days of the contract award.
- If you have checked item 2(A) or 2(B), you **must** indicate the number of **both** full-time and part-time employees, other than yourself, including family members and active partners (if none, you must enter "0").

\_\_\_\_\_ Full-time Employees

\_\_\_\_\_ Part-time Employees

Name of Business		Federal ID (or) Social Security No.	
Address		Telephone (       )	
City	State	ZIP	

*I hereby certify that the above information is true and correct. I agree to notify the Michigan DNR of any changes that occur in factors affecting my coverage during any of my present and future operations.*

\_\_\_\_\_  
Signature of Owner or Authorized Representative

\_\_\_\_\_  
Title

\_\_\_\_\_  
Date

Please complete the "SEALED BID" information on the next page