



**DEPARTMENT OF NATURAL RESOURCES
STATE OF MICHIGAN
TIMBER SALE PROSPECTUS #7444**

SCHEDULED SALE DATE AND TIME: 4:00 p.m. (local time) on August 22, 2024.

LOCATION: TRAVERSE CITY MGMT UNIT, 2122 M 37 SOUTH, TRAVERSE CITY, MI 49685.

PROSPECTUS NOTE: Four sales are for Kalkaska County, and one sale is for Grand Traverse County.

The bidder is advised to inspect the sale area and review the location, estimated volumes, operating costs and contract terms of proposed sales. Please be aware that some landowners may request 60 days or more notice for access across their land.

Notice is hereby given that bids will be received by the Unit Manager, TRAVERSE CITY MANAGEMENT UNIT, for certain timber on the following described lands:

Strait Row Red (61-029-24) / T25N, R11W, SEC. 35, E1/2NW,NE,NESE.
T25N, R11W, SEC. 36, W1/2NW.

Grand Traverse County, Advertised Price \$78,290.15, 77.2 Acres, Red Pine, Aspen.

15 Gallons Hardwood (61-116-24) / T27N, R05W, SEC. 10, NENW,NE.
T27N, R05W, SEC. 11, SW,W1/2SE.
T27N, R05W, SEC. 3, SESE.

Kalkaska County, Advertised Price \$160,658.75, 151.0 Acres, Hardwood, Sugar Maple.

SALE NOTE: Refer to Spec 2.2.2 Chipping is required for entire sale.

A recreation site such as a trail, pathway, or campground is within the sale area or the vicinity. Certain restrictions/specifications may be applicable including time restrictions.

Over Baited Hardwoods (61-117-24) / T27N, R05W, SEC. 11, NW,W1/2NE,NESW,NWSE.
T27N, R05W, SEC. 2, SESW.

Kalkaska County, Advertised Price \$128,105.40, 100.3 Acres, Hardwood, Sugar Maple.

SALE NOTE: 5.2.3.4 - Oak wilt restriction, no exceptions applies to entire sale area.

A recreation site such as a trail, pathway, or campground is within the sale area or the vicinity. Certain restrictions/specifications may be applicable including time restrictions.

Lone Wolf (61-119-24) / T27N, R07W, SEC. 7, SWNW,S1/2NE,N1/2SW.
T27N, R07W, SEC. 8, SWNW,NWSW.
T27N, R07W, SEC. 9, W1/2NW.

Kalkaska County, Advertised Price \$32,039.65, 54.8 Acres, Hardwood, Red Pine.

SALE NOTE: A recreation site such as a trail, pathway, or campground is within the sale area or the vicinity. Certain restrictions/specifications may be applicable including time restrictions.

Mae Mae Mix (61-123-24) / T27N, R08W, SEC. 16, SWSE.

T27N, R08W, SEC. 19, SESE.

T27N, R08W, SEC. 20, N1/2NW,SENE,W1/2NE,SWSW,E1/2SE.

T27N, R08W, SEC. 21, SWNW,NWNE,W1/2SW,S1/2SE.

T27N, R08W, SEC. 28, NWNW.

T27N, R08W, SEC. 29, N1/2NW,NENE.

T27N, R08W, SEC. 30, NENE.

Kalkaska County, Advertised Price \$101,786.70, 113.0 Acres, Hardwood, Red Pine.

SALE NOTE: A recreation site such as a trail, pathway, or campground is within the sale area or the vicinity.
Certain restrictions/specifications may be applicable including time restrictions.

BID INSTRUCTIONS (VER. 10/10/2022):

1. Scheduled Bid Location, Date, and Time (2/11)

Bids must be received by the Unit Manager, TRAVERSE CITY OFFICE, 2122 M 37 South, Traverse City, MI 49685, no later than 4:00 p.m. (local time) on August 22, 2024. For further information concerning this sale, contact Patrick Cotant at 231-649-0544.

2. Bidder's Qualifications (10/22)

If all or part of a timber sale was prepared by a private contractor, the contractor and that contractor's company are not permitted to bid on the timber sale. A person must be 18 years of age or older to purchase timber. Permanent employees of the Department of Natural Resources or members of their immediate household may not bid. Former employees, in the permanent or seasonal class, may not bid until 3 months after the last day of active duty. Bids will not be accepted from individuals or companies appearing on the DNR/FRD No-Bid List. This list contains the names of purchasers who previously failed to execute a contract within 21-days or who have a history of poor performance.

3. Preparation of Sealed Bids (5/16)

Bid Forms may be completed online thru Michigan DNR Timber Sale Online Bidding (OLB) at www.michigan.gov/timberbidding or by completing the hardcopy Bid Form found in the Timber Sale Prospectus. Hardcopy Bid Forms shall be manually signed in ink. Registration in OLB is considered your 'signature' for all bids submitted thru that system. Bid prices must be entered for each species and product in the Bid Price column for all material subject to bidding and all fill-in blanks must be completed. If erasures or other changes appear on the hardcopy Bid Form, each erasure or change must be initialed by the person signing the bid.

4. Submission of Sealed Bids (5/16)

Bid forms may be obtained from the Unit Manager or thru OLB. Bids may be submitted hardcopy or thru OLB. All hardcopy bids must be submitted on the bid form and in an envelope clearly identified as described in this section. NOTE: Only one bid form per bid envelope. Sealed bids must be submitted to the Unit office designated in the prospectus and must be submitted at or prior to the time established in the prospectus. The envelope should show on the outside (a) the sale name or number and (b) the date and time of bid opening, as shown in the prospectus. Bids received after the time specified in the sale prospectus are late bids and will be rejected.

It is possible for a bidder to submit multiple bids on a single sale. For example, a bid may be submitted hardcopy and a bid may be submitted thru OLB. Or, two bidders from the same company could both submit bids on the same sale. If this were to happen, the State would accept all bids received and award the contract accordingly. All bidding and contractual requirements would apply to all bids received.

5. Public Opening of Sealed Bids (7/16)

If conditions permit, the sealed bids will be publicly opened and posted at the time and place set in the prospectus.

If a bidder, present at a bid opening, has submitted bids on more than one sale, that bidder may withdraw their unopened bid envelopes or announce the withdrawal of their online bid after being declared the successful bidder on one sale.

6. Award of Contract (1/11)

Award of the contract will be made to the Bidder whose bid, conforming to the prospectus, is most advantageous to the State of Michigan on the basis of total value at rates bid for the estimated quantities. The State reserves the right to reject any bid or waive any minor irregularity in bids received. A written award mailed (or otherwise furnished) to the successful Bidder shall be deemed to result in a binding contract without further action by either party.

7. Down Payment (1/11)

The Bidder to whom award is made must make a down payment within 21 days of the sale award. The amount of the down payment will be calculated as shown in the Bond and Payment Schedule of this prospectus. Only cash may be used to meet this requirement.

8. Performance Security (1/11)

As guarantee of faithful performance, a cash bond, certificate of deposit, surety bond or irrevocable letter of credit (LOC) is required within 21 days of the sale award. The amount of the performance security is shown in the Bond and

Payment Schedule of this prospectus. If an LOC or surety is used, the coverage must extend for at least 6 months beyond the contract expiration.

9. Worker's Compensation (10/22)

Purchaser shall obtain worker's compensation insurance to cover claims under Michigan's Worker's Disability Compensation Act of 1969 or similar employee benefit act of any other state applicable to an employee. Verification of Worker's Disability Compensation Act Compliance must be completed and submitted within 21 days of contract award and prior to the issuance of the timber sale contract. In addition, if applicable, Notice of Exclusion or Certificate of Insurance must also be submitted.

10. Timber Sale Contract (10/22)

Additional conditions and requirements common to all timber sales are listed on the timber sale contract (R4031) and are available on line at www.michigan.gov/timber. Contact the Unit Manager for additional information or a sample contract. Within 21 days of the date of the award letter, the bidder must sign the contract and provide the required down payment, performance security, and verification of worker's disability compensation. The down payment and performance security shall be in accordance with the provisions of the timber sale contract, in the sums stated in this prospectus. If these actions are not taken, then the Bidder, the Bidder's corporation, and the corporation's principals may not be permitted to bid on State timber sales for a period of 3 months after the first offense, 6 months after the second offense, and 1 year after the third offense. An offense will only be counted against the Bidder for 5 years. In addition, the Bidder certifies that if awarded this contract, the Bidder will complete the timber sale contract in accordance with its terms and any modifications thereof including requirements to purchase, cut, and remove the included timber by the expiration date.

Payment Unit values in the State Forest Timber Sale Contract are calculated based on the advertised value of the Payment Unit as a percentage of the total advertised value of the contract. The advertised value of each Payment Unit is given in the Description of Timber by Payment Unit table on the Timber Sale Information page. For example, if the value of Payment Unit 1 is advertised as \$1,500 and the total Timber Sale value is advertised as \$10,000, the contract price for Payment Unit 1 will be 15% of the total bid price ($\$1,500/\$10,000 * 100$).

11. Disclaimer of Estimates and Bidder's Warranty of Inspection (10/22)

Before submitting this bid, the Bidder is advised and cautioned to inspect the sale area, review the requirements of the sale contract, and take other steps as may be reasonably necessary to ascertain the location, estimated volumes, construction estimates, and operating costs of the proposed sale. Failure to do so will not relieve the Bidder from responsibility for completing the contract.

The Bidder warrants that this bid is submitted solely on the basis of the Bidder's examination and inspection of the quality and quantity of the timber offered for sale and the Bidder's opinion of the value thereof and the costs of recovery. No reliance should be placed on the State of Michigan's estimates of timber quality, quantity or costs of recovery. Bidder further acknowledges that the State of Michigan: (i) expressly disclaims any warranty of fitness of timber for any purpose; (ii) offers this timber as is without any warranty of quality (merchantability) or quantity and (iii) expressly disclaims any warranty as to the quantity or quality of timber sold.

12. Certification and Chain-of-Custody (10/22)

Unless otherwise indicated in the contract under section 7 – Other Conditions of the Sale Specific Conditions & Requirements, the area encompassed by this timber sale is certified to the standards of the Forest Stewardship Council (FSC) - Certificate #SCS-FM/COC-00090N and the Sustainable Forestry Initiative (SFI) - Certificate #NSF-SFIS-5Y031-SF5. Forest products from this sale may be delivered to the mill as "FSC 100% and / or SFI certified" as long as the contractor hauling the forest products is chain-of-custody (COC) certified or covered under a COC certificate from the destination mill. The purchaser is responsible for maintaining COC after leaving the sale area.

13. Good Neighbor Authority (GNA) Requirements (10/22)

If the name of this timber sales contains the acronym GNA, it is authorized by the Good Neighbor Authority (GNA) and covered by various agreements between the U.S. Forest Service and the State. The timber sale occurs on federal land and the following conditions apply:

GNA contracts on US Forest Service land will not be awarded to purchasers on the Federal list of excluded parties. The System for Award Management (SAM) will be checked for active excluded parties prior to award of contract. In

addition, the Bidder to whom award is made must complete an Assurance Regarding Felony Conviction or Tax Delinquent Status for Corporate Applicants (AD-3031).

14. Good Neighbor Authority (GNA) Requirements, con't (10/22)

Bidder certifies, by signing this bid form, that to the best of Bidder's knowledge that the following representations are accurate and complete.

- a. That the Bidder and its principals are not presently debarred, suspended, proposed for debarment, declared ineligible, or voluntary excluded from timber sales (covered transactions) by any Federal department or agency.
- b. That the Bidder and its principals have not within a 3-year period preceding this bid been convicted of or had a civil judgment rendered against them for commission of fraud or a criminal offense in connection with obtaining , attempting to obtain, or performing a public (Federal, State, or local) transaction or contract under a public transaction; violation of Federal or State antitrust statutes or commission of embezzlement, theft, forgery, bribery, falsification or destruction of records, making false statements, or receiving stolen property.
- c. That the Bidder and its principals are not presently indicted for or otherwise criminally or civilly charged by a governmental entity (Federal, State, or local) with commission of any of the offenses enumerated in paragraph b of this certification.
- d. That the Bidder and its principals have not within a 3-year period preceding this bid had one or more public transactions (Federal, State, or local) terminated for breach or default of a timber or forest product contract.

Bidders that cannot certify this requirement, in whole or in part, shall submit an explanation with their bid.

Scott Bowen
Director

TIMBER SALE INFORMATION

Strait Row Red (61-029-24)
T25N, R11W, SEC. 35; T25N, R11W, SEC. 36.
Grand Traverse County (Advertised Price \$78,290.15)

A timber sale contract for this lump sum, sealed bid timber sale will be awarded to the responsible bidder offering the highest sealed bid price. All units of volume listed below were estimated using the Inventory Manager computer program and the new Michigan taper model. Bids must be at or above the following advertised price for each product and species:

| <u>PRODUCTS & SPECIES</u> | <u>ESTIMATED UNITS*</u> | <u>ADVERTISED PRICE</u> |
|-------------------------------|-------------------------|-------------------------|
| Sawtimber | | |
| Red Pine | 95.0 MBF | \$ 125.00 / MBF |
| Pulpwood | | |
| Mixed Hardwood | 38 Cords | \$ 20.80 / Cord |
| Quaking Aspen | 71 Cords | \$ 20.50 / Cord |
| Red Pine | 1,277 Cords | \$ 50.25 / Cord |

* The total volume is statistically estimated within plus (+) or minus (-) 12.34 percent. There are an estimated 1,608 cords on this timber sale, plus or minus 199 cords at the 95% confidence level. The estimated units are final and not subject to adjustment. Prospective bidders are urged to examine this timber and to make their own estimates of quantity and quality.

BOND AND PAYMENT SCHEDULE:

1. A bond in the amount of \$3,915.00 to insure faithful performance of the conditions of the contract will be deposited by the successful bidder within 21 days of the sale award.
2. Cutting in any sale or unit without the required advance payment would be considered a trespass.
3. Total payment must be paid in advance or according to the following schedule :
 - (a) Ten percent (10%) of the sale value must be paid within 21 days of the sale award.
 - (b) The 10% down payment will be credited towards the first unit cut.
 - (c) Payment for each of the following units must be made before cutting begins in that unit:

| PAYMENT UNIT NUMBER | PERCENT OF TOTAL SALE VALUE |
|---------------------|-----------------------------|
| 01 | 28.3% |
| 02 | 24.8% |
| 03 | 46.9% |
4. If no cutting takes place, the 10% down payment will not be refunded.
5. Operations on the contract issued will terminate on 09/30/2026.

SALE STATISTICS

Volumes were calculated in cubic feet using the Michigan taper model. Cubic foot volume includes all wood inside bark for the product indicated. For display purposes, cubic feet were converted to cords and MBF using a simple conversion factor, e.g. 79 cubic feet per cord and 185 cubic feet per MBF. The cubic foot volumes are precise; the cords and MBF volumes are not. Cubic foot volume cannot be directly converted to cords or boards with precision.

SALE VOLUMES

The total estimated sale volume may not equal the sum of the species/products due to the nature of statistical calculations associated with double sampling methodology.

| VOLUME | | | STATISTICAL RANGE IN CORDS | |
|------------------|-------------|---------------|----------------------------|---------|
| TOTAL CUBIC FEET | TOTAL CORDS | PERCENT ERROR | MINIMUM | MAXIMUM |
| 127,055 | 1,608 | 12.34% | 1,410 | 1,807 |

VDU VOLUMES

A VDU is a Volume Determination Unit. Volumes and their associated statistics are calculated at the VDU level and summarized to the sale level. There is often a one to one relationship between a VDU and a Payment Unit, but not always, depending on the cruise design. Refer to the VDU TO PAYMENT UNIT table.

| VDU | VOLUME | | PERCENT ERROR | RANGE IN CORDS | |
|---------------|------------------|--------------|---------------|----------------|--------------|
| | TOTAL CUBIC FEET | TOTAL CORDS | | MINIMUM | MAXIMUM |
| 132 | 65,110 | 824 | 13.69% | 711 | 937 |
| 146 | 61,945 | 784 | 21.38% | 617 | 952 |
| TOTAL: | 127,055 | 1,608 | | 1,328 | 1,889 |

VDU TO PAYMENT UNIT

When a VDU is associated with more than one Payment Unit (PU), the VDU volumes are assigned to the PU based on acres of the VDU within the PU.

| VDU | VDU ACRES | PU | PU ACRES |
|---------------|-------------|----|-------------|
| 132 | 47.1 | 1 | 25.1 |
| | | 2 | 22.0 |
| 146 | 30.1 | 3 | 30.1 |
| TOTAL: | 77.2 | | 77.2 |

DESCRIPTION OF TIMBER BY PAYMENT UNIT (PU)

| PU | MARKET GROUP | PRODUCT | QUANTITY | UNIT | ACRES | ADVERTISE PRICE |
|--------|--------------------|-----------|----------|--------------|-------|-----------------|
| 1 | Red Pine | Sawtimber | 10.0 | MBF | 25.1 | \$22,154.00 |
| | Red Pine | Pulpwood | 416 | Cords | | |
| 2 | Red Pine | Sawtimber | 8.7 | MBF | 22.0 | \$19,378.50 |
| | Red Pine | Pulpwood | 364 | Cords | | |
| 3 | Red Pine | Sawtimber | 76.3 | MBF | 30.1 | \$36,757.65 |
| | Mixed Hardwood | Pulpwood | 38 | Cords | | |
| | <i>Red Maple</i> | | 15 | <i>Cords</i> | | |
| | <i>Sugar Maple</i> | | 23 | <i>Cords</i> | | |
| | Quaking Aspen | | 71 | Cords | | |
| | Red Pine | | 497 | Cords | | |
| TOTAL: | | | 95.0 | MBF | | |
| TOTAL: | | | 1,386 | Cords | | |

Sale Specific Conditions & Requirements

Sale Name: Strait Row Red

Sale Number: 61-029-24 Seq#: 1

1 - Sale Area

1.2 - Boundaries

1.2.1 - Painted boundaries (9/19)

The sale boundary and Payment Unit boundaries are marked and identified by red paint and a two-track trail. Exterior sale boundaries against state are marked with red paint. Interior Payment Unit boundaries are unpainted and identified by the two-track trail between Payment Unit 1 & 2. The painted boundary line trees are not Included Timber and are to be protected unless marked with orange paint.

2 - Timber Specifications

2.1 - Included Timber

2.1.3 - Cut tree marked unit(s) (12/08)

Within Payment Unit(s) 3, all trees are designated for cutting when marked with orange paint above and below stump height, regardless of merchantability. In addition, cut all aspen, regardless of merchantability.

2.1.8 - Designated plantation row unit(s) (12/08)

Within Payment Unit(s) 1 and 2, all trees which meet minimum piece specifications in 2.2 Utilization, within designated plantation rows are designated for cutting. Designated plantation rows are every third row. Begin with the third row in from the outside of the plantation, then continue every third row. Because of the variability of row direction, it shall be the responsibility of the producer to maintain the third row sequence. In addition, cut all aspen, regardless of merchantability.

2.2 - Utilization

2.2.6 - Roundwood operation required (3/21)

The skidding of whole trees or tree segments with limbs attached is prohibited. All products must be produced as roundwood and forwarded to existing roads or landing areas in final product length.

3 - Payments

3.3 - Pre-measured Sales

3.3.4 - Dividing payment units (7/14)

Payment Unit(s) 3 may be divided at the request of the Purchaser and upon approval of the Unit Manager. Dividing Payment Units is a contract modification which requires a Timber Sale Contract Amendment. There will be only one division per Payment Unit.

4 - Transportation

4.1 - Construction

4.1.12 - No new roads (1/12)

No new roads will be permitted in any Payment Unit. All operations are limited to existing roads. Skid trails only will be allowed.

4.2 - Maintenance

4.2.5 - Two wheel drive condition (2/04)

All existing trail roads on and adjacent to the sale area must be passable by two-wheel drive traffic for the duration of the sale.

5 - Operations

5.1 - Notification

5.1.1 - Pre-sale conference (10/16)

A pre-sale conference on site between the Purchaser and sale administrator is required prior to beginning any operations in a

Payment Unit to determine landing and road locations. The Unit Manager or his/her representative must be contacted at least 3 days in advance to schedule the conference.

5.2 - Conduct of Operations

5.2.3 - Operating Restrictions

5.2.3.3 - Bark slippage restriction (3/09)

Within Payment Unit(s) 1 and 2, unless changed by written agreement, cutting and skidding are not permitted during the period of April 15 to July 15. This restriction is because of bark slippage. Operations may be allowed if specific steps are taken to prevent damage during this period.

5.2.3.13 - Heterobasidion root disease (HRD) (7/19)

This plantation is at risk of infection by the root rot fungus, Heterobasidion irregulare. To prevent the spread of this disease, cutting operations within Payment Unit(s) 1-3 are restricted to the period of January 1st through March 31st. Cutting may only occur outside this period with written permission of the Unit Manager or with the application of a preventative pesticide. Consultation with a forest health specialist will determine if cutting can occur prior to January 1 without pesticide application, dependent upon current and forecasted snow cover. Cellu-Treat and RotStop C are currently the only EPA registered products available in the United States for the control of Heterobasidion. Both products are a water-soluble powder that must be applied to the stump, in accordance with the product label. Dye must be added to these products to provide visible evidence of adequate coverage. Application of these pesticides requires licensing by the Michigan Department of Agriculture and Rural Development. All applicators are required to: provide to the Sale Administrator notification of application per requirements in 40 CFR 170.120; and document and provide to the Sale Administrator annually, by December 31 and prior to closure of sale, the volume of product used and acres treated.

5.2.20 - Equipment width (2/04)

Equipment used to remove designated rows must be capable of moving through cut rows without damaging residual trees.

Note that: The Purchaser should preview the sale, prior to purchase, to ensure equipment is proper width for Payment Units 1 & 2.

6 - Safety and Fire Prevention

6.2 - Signing

6.2.1 - Road posting (10/20)

The Purchaser is responsible for posting and maintaining caution signs on roads near landings prior to beginning operations. The road must be posted at appropriate distances from the Sale Area to warn of logging activity and truck traffic. Signs must be removed when harvest operations are suspended or completed. The Purchaser will provide these signs.



TIMBER SALE MAP

This information provided by authority of Part 525, 1994 PA 451, as amended.

Sale Number
61-029-24

Date
05/23/2024

| | | |
|------------------------|----------------|-------------------------------------|
| Forest Management Unit | County | Mapped By: Ventimiglia |
| Traverse City Mgt Unit | Grand Traverse | Cruised By: Ventimiglia/Contractors |

| | | |
|----------|------|----|
| Scale | Page | Of |
| 1:15,840 | 1 | 1 |

| | | |
|----------|-------|---|
| Township | Range | Section(s) and Subdivision(s) |
| 25N | 11W | Sec. 35 E1/2NW,NE,NESE; Sec. 36 W1/2NW; |

| Cover Type | | | |
|---------------------|-------------------------|-------------------------|------------------------|
| A = Aspen | J = Jack Pine | O = Oak | U = Upland Brush |
| B = Paper Birch | K = Rock | P = Lowland Poplar | UM = Upland Mix Forest |
| C = Cedar | L = Lowland Brush | Q = Mixed Swamp Conifer | V = Bog or Marsh |
| D = Treed Bog | LM = Lowland Mix Forest | R = Red Pine | W = White Pine |
| E = Swamp Hardwoods | M = Maple, Beech, Birch | S = Black Spruce | X = Non Stocked |
| F = Spruce/Fir | MC = Mixed Conifer | T = Tamarack | Y = Sand |
| G = Grass | MD = Mixed Deciduous | Z = Water | |
| H = Hemlock | N = Marsh | | |

| Density | |
|-----------------------------|------------------------|
| 0 = Non Stocked | 5 = Pole Timber Medium |
| 1 = Seedling Sapling Poor | 6 = Pole Timber Well |
| 2 = Seedling Sapling Medium | 7 = Saw Timber Poor |
| 3 = Seedling Sapling Well | 8 = Saw Timber Medium |
| 4 = Pole Timber Poor | 9 = Saw Timber Well |

| PU # | Acres |
|------|-------|
| 1 | 25.1 |
| 2 | 22 |
| 3 | 30.1 |

Strait Row Red

77.2 Acres

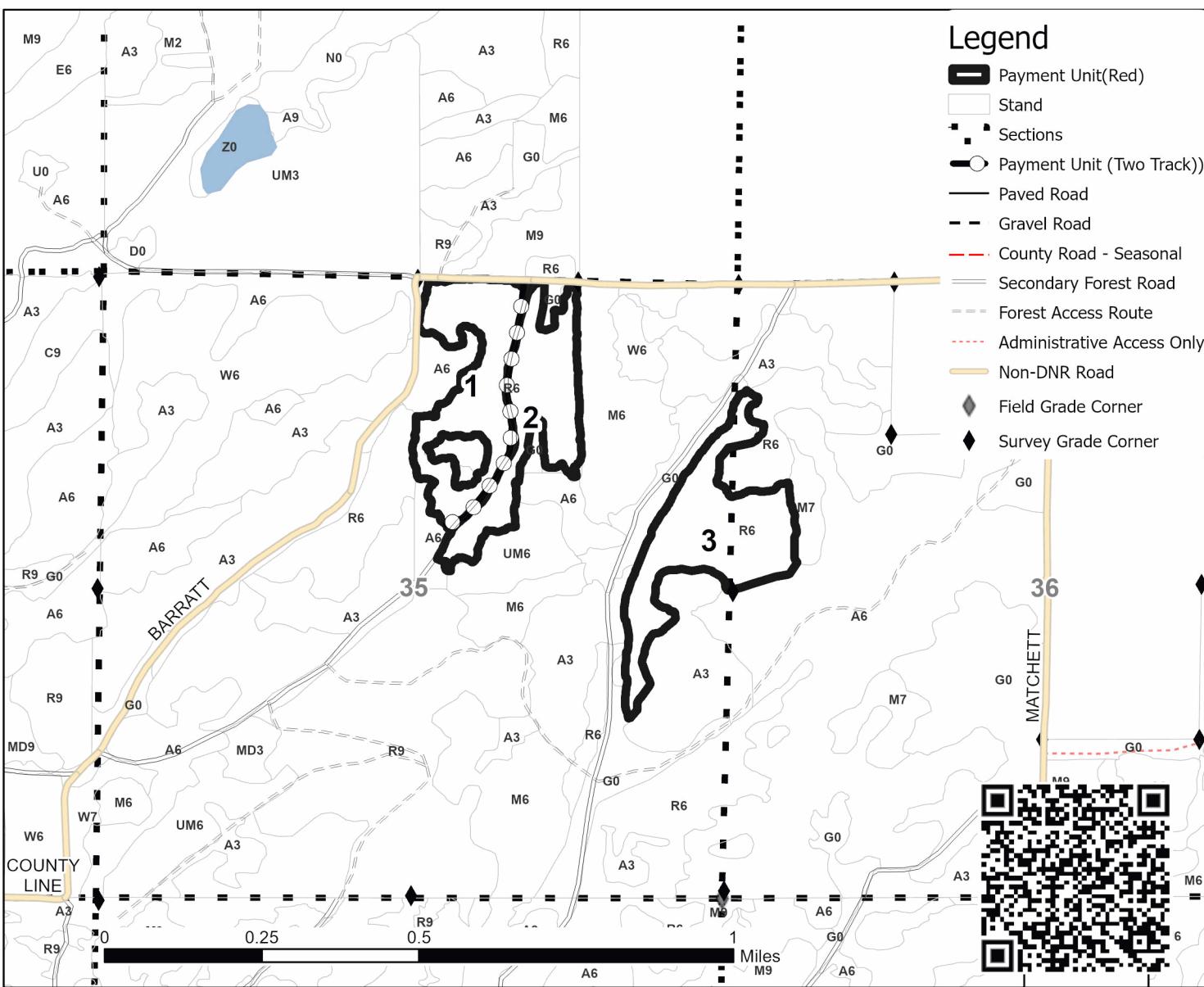

TIMBER SALE INFORMATION

15 Gallons Hardwood (61-116-24)
 T27N, R05W, SEC. 10; T27N, R05W, SEC. 11; T27N, R05W, SEC. 3.
 Kalkaska County (Advertised Price \$160,658.75)

SALE NOTE: Refer to Spec 2.2.2 Chipping is required for entire sale.

A recreation site such as a trail, pathway, or campground is within the sale area or the vicinity. Certain restrictions/specifications may be applicable including time restrictions.

A timber sale contract for this lump sum, sealed bid timber sale will be awarded to the responsible bidder offering the highest sealed bid price. All units of volume listed below were estimated using the Inventory Manager computer program and the new Michigan taper model. Bids must be at or above the following advertised price for each product and species:

| <u>PRODUCTS & SPECIES</u> | <u>ESTIMATED UNITS*</u> | <u>ADVERTISED PRICE</u> |
|-------------------------------|-------------------------|-------------------------|
| Sawtimber | | |
| Basswood | 21.6 MBF | \$ 97.00 / MBF |
| Beech | 13.0 MBF | \$ 118.00 / MBF |
| Black Cherry | 21.0 MBF | \$ 116.00 / MBF |
| Paper Birch | 1.7 MBF | \$ 37.00 / MBF |
| Red Maple | 92.2 MBF | \$ 103.00 / MBF |
| Red Oak | 11.8 MBF | \$ 119.00 / MBF |
| Sugar Maple | 466.5 MBF | \$ 235.00 / MBF |
| Yellow Birch | 3.4 MBF | \$ 71.00 / MBF |
| Pulpwood | | |
| B. T. Aspen | 21 Cords | \$ 16.40 / Cord |
| Mixed Hardwood | 2,007 Cords | \$ 16.65 / Cord |

* The total volume is statistically estimated within plus (+) or minus (-) 9.89 percent. There are an estimated 3,508 cords on this timber sale, plus or minus 347 cords at the 95% confidence level. The estimated units are final and not subject to adjustment. Prospective bidders are urged to examine this timber and to make their own estimates of quantity and quality.

BOND AND PAYMENT SCHEDULE:

1. A bond in the amount of \$8,033.00 to insure faithful performance of the conditions of the contract will be deposited by the successful bidder within 21 days of the sale award.
2. Cutting in any sale or unit without the required advance payment would be considered a trespass.
3. Total payment must be paid in advance or according to the following schedule :
 - (a) Ten percent (10%) of the sale value must be paid within 21 days of the sale award.
 - (b) The 10% down payment will be credited towards the first unit cut.
 - (c) Payment for each of the following units must be made before cutting begins in that unit:

| PAYMENT UNIT NUMBER | PERCENT OF TOTAL SALE VALUE |
|---------------------|-----------------------------|
| 01 | 13.2% |
| 02 | 17.0% |
| 03 | 21.2% |
| 04 | 21.3% |
| 05 | 27.3% |

4. If no cutting takes place, the 10% down payment will not be refunded.
5. Operations on the contract issued will terminate on 09/30/2027.

SALE STATISTICS

Volumes were calculated in cubic feet using the Michigan taper model. Cubic foot volume includes all wood inside bark for the product indicated. For display purposes, cubic feet were converted to cords and MBF using a simple conversion factor, e.g. 79 cubic feet per cord and 185 cubic feet per MBF. The cubic foot volumes are precise; the cords and MBF volumes are not. Cubic foot volume cannot be directly converted to cords or boards with precision.

SALE VOLUMES

The total estimated sale volume may not equal the sum of the species/products due to the nature of statistical calculations associated with double sampling methodology.

| VOLUME | | | STATISTICAL RANGE IN CORDS | |
|------------------|-------------|---------------|----------------------------|---------|
| TOTAL CUBIC FEET | TOTAL CORDS | PERCENT ERROR | MINIMUM | MAXIMUM |
| 277,170 | 3,508 | 9.89% | 3,161 | 3,856 |

VDU VOLUMES

A VDU is a Volume Determination Unit. Volumes and their associated statistics are calculated at the VDU level and summarized to the sale level. There is often a one to one relationship between a VDU and a Payment Unit, but not always, depending on the cruise design. Refer to the VDU TO PAYMENT UNIT table.

| | VOLUME | | | RANGE IN CORDS | |
|---------------|------------------|--------------|---------------|----------------|--------------|
| VDU | TOTAL CUBIC FEET | TOTAL CORDS | PERCENT ERROR | MINIMUM | MAXIMUM |
| 64 | 130,519 | 1,652 | 14.68% | 1,410 | 1,895 |
| 87 | 146,651 | 1,856 | 13.49% | 1,606 | 2,107 |
| TOTAL: | 277,170 | 3,508 | | 3,016 | 4,001 |

VDU TO PAYMENT UNIT

When a VDU is associated with more than one Payment Unit (PU), the VDU volumes are assigned to the PU based on acres of the VDU within the PU.

| VDU | VDU ACRES | PU | PU ACRES |
|---------------|--------------|----|--------------|
| 64 | 79.9 | 1 | 20.5 |
| | | 2 | 26.4 |
| | | 3 | 33.0 |
| 87 | 71.1 | 4 | 31.2 |
| | | 5 | 39.9 |
| TOTAL: | 151.0 | | 151.0 |

DESCRIPTION OF TIMBER BY PAYMENT UNIT (PU)

| PU | MARKET GROUP | PRODUCT | QUANTITY | UNIT | ACRES | ADVERTISE PRICE |
|---------------------|---------------------|--------------|----------|--------------|-------|-----------------|
| 1 | Basswood | Sawtimber | 1.7 | MBF | 20.5 | \$21,223.75 |
| | Beech | | 2.5 | MBF | | |
| | Black Cherry | | 3.4 | MBF | | |
| | Red Maple | | 19.2 | MBF | | |
| | Sugar Maple | | 62.9 | MBF | | |
| | Yellow Birch | | 0.9 | MBF | | |
| | Mixed Hardwood | | 213 | Cords | | |
| | <i>Basswood</i> | Pulpwood | 1 | <i>Cords</i> | | |
| | <i>Beech</i> | | 5 | <i>Cords</i> | | |
| | <i>Black Cherry</i> | | 8 | <i>Cords</i> | | |
| | <i>Ironwood</i> | | 2 | <i>Cords</i> | | |
| | <i>Red Maple</i> | | 21 | <i>Cords</i> | | |
| | <i>Sugar Maple</i> | | 175 | <i>Cords</i> | | |
| | <i>Yellow Birch</i> | | 1 | <i>Cords</i> | | |
| 2 | Basswood | Sawtimber | 2.1 | MBF | 26.4 | \$27,294.35 |
| | Beech | | 3.2 | MBF | | |
| | Black Cherry | | 4.4 | MBF | | |
| | Red Maple | | 24.7 | MBF | | |
| | Sugar Maple | | 81.0 | MBF | | |
| | Yellow Birch | | 1.1 | MBF | | |
| | Mixed Hardwood | | 273 | Cords | | |
| | <i>Basswood</i> | Pulpwood | 1 | <i>Cords</i> | | |
| | <i>Beech</i> | | 7 | <i>Cords</i> | | |
| | <i>Black Cherry</i> | | 10 | <i>Cords</i> | | |
| | <i>Ironwood</i> | | 2 | <i>Cords</i> | | |
| | <i>Red Maple</i> | | 27 | <i>Cords</i> | | |
| | <i>Sugar Maple</i> | | 225 | <i>Cords</i> | | |
| | <i>Yellow Birch</i> | | 1 | <i>Cords</i> | | |
| 3 | Basswood | Sawtimber | 2.7 | MBF | 33.0 | \$34,081.85 |
| | Beech | | 4.1 | MBF | | |
| | Black Cherry | | 5.5 | MBF | | |
| | Red Maple | | 30.8 | MBF | | |
| | Sugar Maple | | 101.2 | MBF | | |
| | Yellow Birch | | 1.4 | MBF | | |
| | Mixed Hardwood | | 339 | Cords | | |
| | <i>Basswood</i> | Pulpwood | 1 | <i>Cords</i> | | |
| | <i>Beech</i> | | 8 | <i>Cords</i> | | |
| | <i>Black Cherry</i> | | 12 | <i>Cords</i> | | |
| | <i>Ironwood</i> | | 2 | <i>Cords</i> | | |
| | <i>Red Maple</i> | | 35 | <i>Cords</i> | | |
| | <i>Sugar Maple</i> | | 281 | <i>Cords</i> | | |
| | 4 | | Basswood | Sawtimber | 6.6 | MBF |
| Beech | | 1.4 | MBF | | | |
| Black Cherry | | 3.4 | MBF | | | |
| Paper Birch | | 0.7 | MBF | | | |
| Red Maple | | 7.7 | MBF | | | |
| Red Oak | | 5.2 | MBF | | | |
| Sugar Maple | | 97.2 | MBF | | | |
| B. T. Aspen | | Pulpwood | 9 | Cords | | |
| Mixed Hardwood | | | 519 | Cords | | |
| <i>Basswood</i> | | | 3 | <i>Cords</i> | | |
| <i>Beech</i> | | | 6 | <i>Cords</i> | | |
| <i>Black Cherry</i> | | | 7 | <i>Cords</i> | | |
| <i>Ironwood</i> | | | 1 | <i>Cords</i> | | |
| <i>Red Maple</i> | | | 12 | <i>Cords</i> | | |
| <i>Red Oak</i> | 6 | <i>Cords</i> | | | | |

DESCRIPTION OF TIMBER BY PAYMENT UNIT (PU), CON'T

| PU | MARKET GROUP | PRODUCT | QUANTITY | UNIT | ACRES | ADVERTISE PRICE |
|---------|---------------------|-----------------|------------|--------------|-------|-----------------|
| 4 con't | <i>Sugar Maple</i> | <i>Pulpwood</i> | <i>484</i> | <i>Cords</i> | | |
| 5 | Basswood | Sawtimber | 8.5 | MBF | 39.9 | \$43,790.25 |
| | Beech | | 1.8 | MBF | | |
| | Black Cherry | | 4.3 | MBF | | |
| | Paper Birch | | 1.0 | MBF | | |
| | Red Maple | | 9.8 | MBF | | |
| | Red Oak | | 6.6 | MBF | | |
| | Sugar Maple | | 124.2 | MBF | | |
| | B. T. Aspen | Pulpwood | 12 | Cords | | |
| | Mixed Hardwood | | 663 | Cords | | |
| | <i>Basswood</i> | | <i>2</i> | <i>Cords</i> | | |
| | <i>Beech</i> | | <i>7</i> | <i>Cords</i> | | |
| | <i>Black Cherry</i> | | <i>9</i> | <i>Cords</i> | | |
| | <i>Ironwood</i> | | <i>2</i> | <i>Cords</i> | | |
| | <i>Paper Birch</i> | | <i>1</i> | <i>Cords</i> | | |
| | <i>Red Maple</i> | | <i>15</i> | <i>Cords</i> | | |
| | <i>Red Oak</i> | | <i>8</i> | <i>Cords</i> | | |
| | <i>Sugar Maple</i> | | <i>619</i> | <i>Cords</i> | | |
| TOTAL: | | | 631.2 | MBF | | |
| TOTAL: | | | 2,028 | Cords | | |

Sale Specific Conditions & Requirements

Sale Name: 15 Gallons Hardwood

Sale Number: 61-116-24 Seq#: 1

1 - Sale Area

1.2 - Boundaries

1.2.1 - Painted boundaries (9/19)

The sale boundary and Payment Unit boundaries are marked and identified by red and yellow paint. Exterior sale boundary lines against state are marked with red paint. Interior Payment Unit boundaries are marked with yellow paint. Retention patches are marked with red paint; no harvesting activities may occur within these areas. The painted boundary line trees are not Included Timber and are to be protected. Yellow painted trees designating an interior Payment Unit boundary are only to be cut when all surrounding Payment Units have been paid.

2 - Timber Specifications

2.1 - Included Timber

2.1.1 - Clearcut unit(s) with unmerchantable trees (6/14)

Within Payment Unit(s) 1-5, cut all trees that are one (1) inch or more at DBH.

2.2 - Utilization

2.2.2 - Chipping required (2/18)

Payment Units 1-5 must be chip harvested to facilitate subsequent planting operations. Products may be produced as roundwood and forwarded to decking areas in final product length, but the tops must be left intact and skidded to the landing for chipping in order to minimize the amount of residual slash. The requirement to retain approximately 1/6 to 1/3 of tree tops and limbs less than four inches in diameter is still applicable (G. C. & R. 2.2).

2.2.3 - Stump heights (4/07)

Stump heights within the Sale Area shall not exceed 10 inches for trees greater than 10 inches DBH and 4 inches for trees smaller than 10 inches DBH. This is in order to facilitate planting operations.

3 - Payments

3.3 - Pre-measured Sales

3.3.4 - Dividing payment units (7/14)

Payment Unit(s) greater than \$25,000 in value may be divided at the request of the Purchaser and upon approval of the Unit Manager. Dividing Payment Units is a contract modification which requires a Timber Sale Contract Amendment. There will be only one division per Payment Unit.

4 - Transportation

4.1 - Construction

4.1.3 - Slash and earthen piles (8/04)

Piles or windrows of earth along roads and landings that have been widened or constructed shall be leveled. Slash from road maintenance or construction, including stumps, shall be dispersed throughout the sale.

4.1.11 - Permits (2/12)

The Purchaser will secure any necessary county road permits that may be required.

4.1.12 - No new roads (1/12)

No new roads will be permitted in any Payment Unit. All operations are limited to existing roads. Only skid trails to the designated landing will be allowed.

4.2 - Maintenance

4.2.5 - Two wheel drive condition (2/04)

All existing trail roads on and adjacent to the sale area must be passable by two-wheel drive traffic for the duration of the

sale.

5 - Operations

5.1 - Notification

5.1.1 - Pre-sale conference (10/16)

A pre-sale conference on site between the Purchaser and sale administrator is required prior to beginning any operations to determine landing and road locations. The Unit Manager or his/her representative must be contacted at least 5 days in advance to schedule the conference.

5.2 - Conduct of Operations

5.2.32 - Decking/landing restoration (9/13)

All decking and landing areas must have the surface area restored to a condition equal to or better than before. This is to ensure the proper regeneration of the stand. Wood debris, chips and "cookies" from trimmings must be removed or scattered away from landing and loading areas and may not be windrowed on the edge.

5.2.40 - Pathway protection (10/10)

The hiking and horse trail is shown on the Timber Sale Map. Do not cut trees or damage posts with blue pathway markers. Maintain a 20-foot-wide slash, debris, and rut free zone daily, using the pathway as the centerline. Do not run equipment down the pathway. Skidding across the trail may only occur in locations approved by the Sale Administrator.

5.2.41 - Snowmobile trail protection (9/11)

Merita Ln NE is a snowmobile trail and is shown on the Timber Sale Map. Do not cut or damage posts with orange trail markers or traffic control signs. If the trail is used, it must be maintained and restored to a condition equal to or better than before the sale. The road maintenance/restoration must be done prior to December 1. If the trail is used for hauling, it must be graded to the satisfaction of the Unit Manager or his/her representative prior to December 1. If the trail road is to be used for hauling during the snowmobile season, then a snow-covered base must be left on the trail. The snowmobile trail may not be used for any timber sale operations from December 1 to March 31. The snowmobile trail may only be crossed at right angles. Maintain a 20-foot-wide slash, debris, and rut free zone daily using the snowmobile trail as the centerline. No decking of forest products will be permitted along the snowmobile trail. All stumps within 20 feet of the snowmobile trail must be cut at ground level.

5.4 - Soil Protection

5.4.1 - Rutting restriction, general (7/16)

Operations are to cease immediately if equipment and weather conditions result in rutting of roads and/or skid trails which is 12 inches or greater in depth and 50 feet in length. The Unit Manager or his/her representative may restrict hauling and/or skidding if ruts exceed the specified depth. With the Unit Manager or his/her representative's approval, the Purchaser may return to the area when the risk of rutting has decreased.

6 - Safety and Fire Prevention

6.2 - Signing

6.2.1 - Road posting (10/20)

The Purchaser is responsible for posting and maintaining caution signs on any county or state road that comes into contact with logging operations prior to beginning operations. The road must be posted at appropriate distances from the Sale Area to warn of logging activity and truck traffic. Signs must be removed when harvest operations are suspended or completed. The Purchaser will provide these signs.

6.2.2 - Snowmobile trail posting (10/20)

The Purchaser is responsible for posting and maintaining caution signs on the snowmobile trail, Merita Ln NE, prior to beginning operations during the snowmobile season (approximately December 1 to March 31). The trail must be posted at appropriate distances from the Sale Area to warn of logging activity and truck traffic. Signs must be removed when harvest operations are suspended or completed. The Purchaser will provide these signs.

6.2.3 - Recreational trail posting (10/20)

The Purchaser is responsible for posting and maintaining caution signs on the hiking and horse trail prior to beginning operations. The trail must be posted at appropriate distances from the Sale Area to warn of logging activity and truck traffic

at both ends of the trail. Signs must be removed when harvest operations are suspended or completed. The Purchaser will provide these signs.



TIMBER SALE MAP

This information provided by authority of Part 525, 1994 PA 451, as amended.

Sale Number
61-116-24

Date
04/10/2024

| | | |
|------------------------|----------|--------------------------|
| Forest Management Unit | County | Mapped By: Tom Peterson |
| Traverse City Mgt Unit | Kalkaska | Cruised By: Tom Peterson |

| | | |
|----------|------|----|
| Scale | Page | Of |
| 1:15,840 | 1 | 1 |

| | | |
|----------|-------|--|
| Township | Range | Section(s) and Subdivision(s) |
| 27N | 05W | Sec. 10 NENW,NE; Sec. 11 SW,W1/2SE; Sec. 3 SESE; |

| Cover Type | | | |
|---------------------|-------------------------|-------------------------|------------------------|
| A = Aspen | J = Jack Pine | O = Oak | U = Upland Brush |
| B = Paper Birch | K = Rock | P = Lowland Poplar | UM = Upland Mix Forest |
| C = Cedar | L = Lowland Brush | Q = Mixed Swamp Conifer | V = Bog or Marsh |
| D = Treed Bog | LM = Lowland Mix Forest | R = Red Pine | W = White Pine |
| E = Swamp Hardwoods | M = Maple, Beech, Birch | S = Black Spruce | X = Non Stocked |
| F = Spruce/Fir | MC = Mixed Conifer | T = Tamarack | Y = Sand |
| G = Grass | MD = Mixed Deciduous | Z = Water | |
| H = Hemlock | N = Marsh | | |

| Density | |
|-----------------------------|------------------------|
| 0 = Non Stocked | 5 = Pole Timber Medium |
| 1 = Seedling Sapling Poor | 6 = Pole Timber Well |
| 2 = Seedling Sapling Medium | 7 = Saw Timber Poor |
| 3 = Seedling Sapling Well | 8 = Saw Timber Medium |
| 4 = Pole Timber Poor | 9 = Saw Timber Well |

| PU # | Acres |
|------|-------|
| 1 | 20.5 |
| 2 | 26.4 |
| 3 | 33 |
| 4 | 31.2 |
| 5 | 39.9 |



15 Gallons Hardwood

151.0 Acres

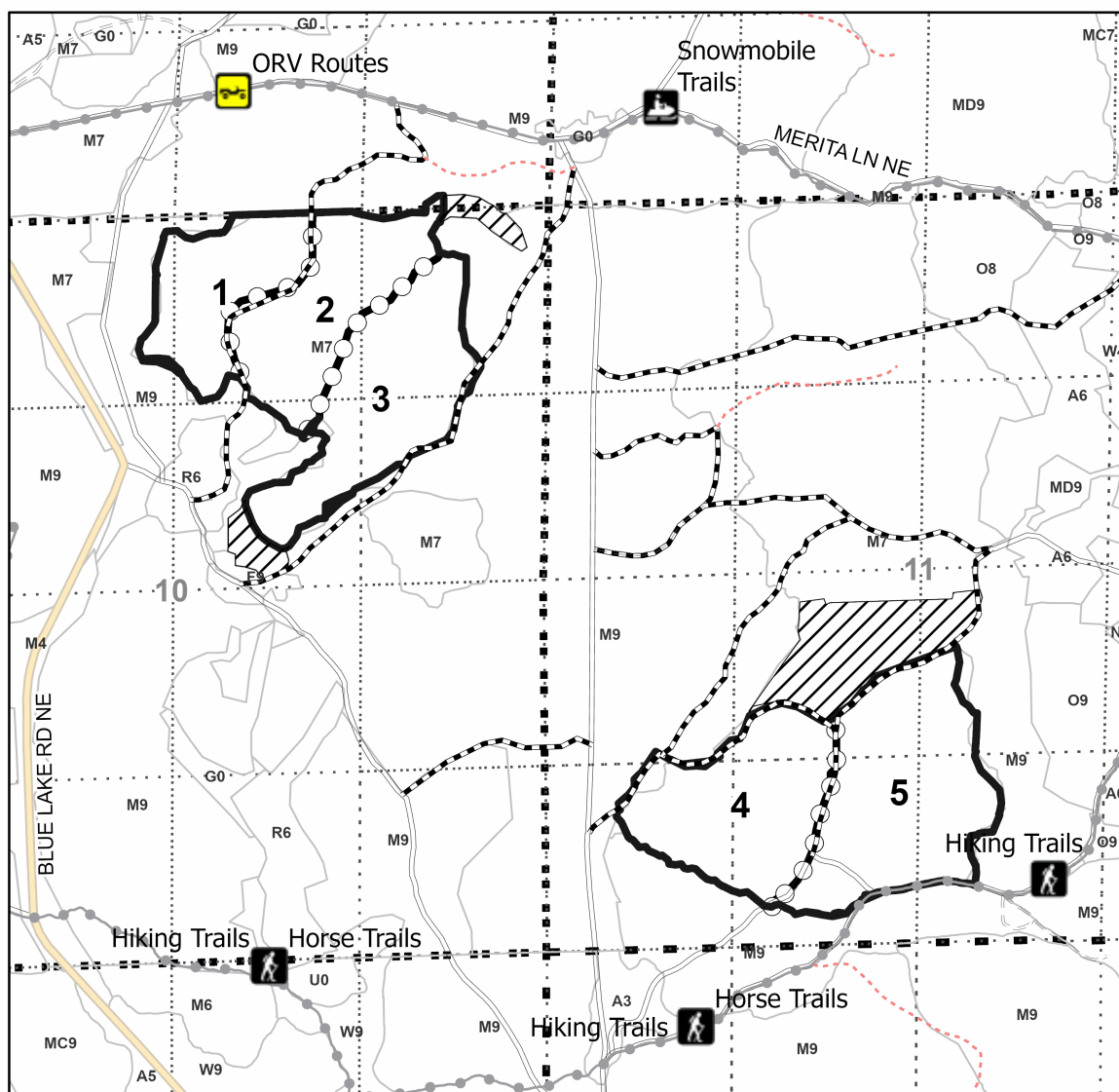
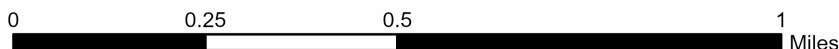

Legend

- Against State (Red)
- Payment Unit (Yellow)
- Stand
- Retention Areas
- Nearby Timber Sale
- Recreational Trail
- Primary Forest Road
- Secondary Forest Road
- Forest Access Route
- Administrative Access Only
- Non-DNR Road
- Paved Road
- Gravel Road
- County Road - Seasonal
- Private Road
- Hiking
- Equestrian
- ORV Route
- Snowmobile

Use QR Code to open Map in App



TIMBER SALE INFORMATION

Over Baited Hardwoods (61-117-24)
T27N, R05W, SEC. 11; T27N, R05W, SEC. 2.
Kalkaska County (Advertised Price \$128,105.40)

SALE NOTE: 5.2.3.4 - Oak wilt restriction, no exceptions applies to entire sale area.

A recreation site such as a trail, pathway, or campground is within the sale area or the vicinity. Certain restrictions/specifications may be applicable including time restrictions.

A timber sale contract for this lump sum, sealed bid timber sale will be awarded to the responsible bidder offering the highest sealed bid price. All units of volume listed below were estimated using the Inventory Manager computer program and the new Michigan taper model. Bids must be at or above the following advertised price for each product and species:

| <u>PRODUCTS & SPECIES</u> | <u>ESTIMATED UNITS*</u> | <u>ADVERTISED PRICE</u> |
|-------------------------------|-------------------------|-------------------------|
| Sawtimber | | |
| Beech | 6.4 MBF | \$ 148.00 / MBF |
| Black Cherry | 7.3 MBF | \$ 145.00 / MBF |
| Red Maple | 142.9 MBF | \$ 129.00 / MBF |
| Red Oak | 6.2 MBF | \$ 149.00 / MBF |
| Sugar Maple | 269.3 MBF | \$ 294.00 / MBF |
| Pulpwood | | |
| Mixed Hardwood | 1,297 Cords | \$ 20.80 / Cord |
| Red Oak | 20 Cords | \$ 29.50 / Cord |

* The total volume is statistically estimated within plus (+) or minus (-) 12.32 percent. There are an estimated 2,330 cords on this timber sale, plus or minus 287 cords at the 95% confidence level. The estimated units are final and not subject to adjustment. Prospective bidders are urged to examine this timber and to make their own estimates of quantity and quality.

BOND AND PAYMENT SCHEDULE:

1. A bond in the amount of \$6,405.00 to insure faithful performance of the conditions of the contract will be deposited by the successful bidder within 21 days of the sale award.
2. Cutting in any sale or unit without the required advance payment would be considered a trespass.
3. Total payment must be paid in advance or according to the following schedule :
 - (a) Ten percent (10%) of the sale value must be paid within 21 days of the sale award.
 - (b) The 10% down payment will be credited towards the first unit cut.
 - (c) Payment for each of the following units must be made before cutting begins in that unit:

| PAYMENT UNIT NUMBER | PERCENT OF TOTAL SALE VALUE |
|---------------------|-----------------------------|
| 01 | 26.6% |
| 02 | 40.8% |
| 03 | 32.6% |
4. If no cutting takes place, the 10% down payment will not be refunded.
5. Operations on the contract issued will terminate on 09/30/2027.

SALE STATISTICS

Volumes were calculated in cubic feet using the Michigan taper model. Cubic foot volume includes all wood inside bark for the product indicated. For display purposes, cubic feet were converted to cords and MBF using a simple conversion factor, e.g. 79 cubic feet per cord and 185 cubic feet per MBF. The cubic foot volumes are precise; the cords and MBF volumes are not. Cubic foot volume cannot be directly converted to cords or boards with precision.

SALE VOLUMES

The total estimated sale volume may not equal the sum of the species/products due to the nature of statistical calculations associated with double sampling methodology.

| VOLUME | | STATISTICAL RANGE IN CORDS | | |
|------------------|-------------|----------------------------|---------|---------|
| TOTAL CUBIC FEET | TOTAL CORDS | PERCENT ERROR | MINIMUM | MAXIMUM |
| 184,038 | 2,330 | 12.32% | 2,042 | 2,617 |

VDU VOLUMES

A VDU is a Volume Determination Unit. Volumes and their associated statistics are calculated at the VDU level and summarized to the sale level. There is often a one to one relationship between a VDU and a Payment Unit, but not always, depending on the cruise design. Refer to the VDU TO PAYMENT UNIT table.

| VDU | VOLUME | | PERCENT ERROR | RANGE IN CORDS | |
|---------------|------------------|--------------|---------------|----------------|--------------|
| | TOTAL CUBIC FEET | TOTAL CORDS | | MINIMUM | MAXIMUM |
| 187 | 184,038 | 2,330 | 12.33% | 2,042 | 2,617 |
| TOTAL: | 184,038 | 2,330 | | 2,042 | 2,617 |

VDU TO PAYMENT UNIT

When a VDU is associated with more than one Payment Unit (PU), the VDU volumes are assigned to the PU based on acres of the VDU within the PU.

| VDU | VDU ACRES | PU | PU ACRES |
|---------------|--------------|----|--------------|
| 187 | 100.3 | 1 | 26.7 |
| | | 2 | 40.9 |
| | | 3 | 32.7 |
| TOTAL: | 100.3 | | 100.3 |

DESCRIPTION OF TIMBER BY PAYMENT UNIT (PU)

| PU | MARKET GROUP | PRODUCT | QUANTITY | UNIT | ACRES | ADVERTISE PRICE |
|---------|---------------------|-----------|--------------|--------------|-------|-----------------|
| 1 | Beech | Sawtimber | 1.7 | MBF | 26.7 | \$34,085.70 |
| | Black Cherry | | 1.9 | MBF | | |
| | Red Maple | | 38.0 | MBF | | |
| | Red Oak | | 1.7 | MBF | | |
| | Sugar Maple | | 71.7 | MBF | | |
| | Mixed Hardwood | | Pulpwood | 345 | | |
| | <i>Beech</i> | 12 | | <i>Cords</i> | | |
| | <i>Black Cherry</i> | 3 | | <i>Cords</i> | | |
| | <i>Red Maple</i> | 45 | | <i>Cords</i> | | |
| | <i>Sugar Maple</i> | 285 | | <i>Cords</i> | | |
| | Red Oak | | 5 | Cords | | |
| 2 | Beech | Sawtimber | 2.6 | MBF | 40.9 | \$52,275.00 |
| | Black Cherry | | 3.0 | MBF | | |
| | Red Maple | | 58.3 | MBF | | |
| | Red Oak | | 2.5 | MBF | | |
| | Sugar Maple | | 109.8 | MBF | | |
| | Mixed Hardwood | | Pulpwood | 531 | | |
| | <i>Beech</i> | 18 | | <i>Cords</i> | | |
| | <i>Black Cherry</i> | 4 | | <i>Cords</i> | | |
| | <i>Ironwood</i> | 1 | | <i>Cords</i> | | |
| | <i>Red Maple</i> | 70 | | <i>Cords</i> | | |
| | <i>Sugar Maple</i> | 438 | <i>Cords</i> | | | |
| Red Oak | | 8 | Cords | | | |
| 3 | Beech | Sawtimber | 2.1 | MBF | 32.7 | \$41,744.70 |
| | Black Cherry | | 2.4 | MBF | | |
| | Red Maple | | 46.6 | MBF | | |
| | Red Oak | | 2.0 | MBF | | |
| | Sugar Maple | | 87.8 | MBF | | |
| | Mixed Hardwood | | Pulpwood | 421 | | |
| | <i>Beech</i> | 14 | | <i>Cords</i> | | |
| | <i>Black Cherry</i> | 3 | | <i>Cords</i> | | |
| | <i>Red Maple</i> | 55 | | <i>Cords</i> | | |
| | <i>Sugar Maple</i> | 349 | | <i>Cords</i> | | |
| | Red Oak | | 7 | Cords | | |
| TOTAL: | | | 432.1 | MBF | | |
| TOTAL: | | | 1,317 | Cords | | |

Sale Specific Conditions & Requirements

Sale Name: Over Baited Hardwoods

Sale Number: 61-117-24 Seq#: 1

1 - Sale Area

1.2 - Boundaries

1.2.1 - Painted boundaries (9/19)

The sale boundary and Payment Unit boundaries are marked and identified by red and yellow paint. Exterior sale boundary lines against state are marked with red paint. Interior Payment Unit boundaries are marked with yellow paint. Retention patches are marked with red paint; no harvesting activities may occur within these areas. The painted boundary line trees are not Included Timber and are to be protected. Yellow painted trees designating an interior Payment Unit boundary are only to be cut when all surrounding Payment Units have been paid.

2 - Timber Specifications

2.1 - Included Timber

2.1.5 - Overstory removal unit(s) (8/11)

Within Payment Unit(s) 1-3, all trees with DBH equal to or greater than 4.5 inches in DBH which meet minimum piece specifications in 2.2 Utilization, are designated for cutting, except do not cut any hemlock, basswood, yellow birch or trees marked with green.

2.2 - Utilization

2.2.3 - Stump heights (4/07)

Stump heights within the Sale Area shall not exceed 12 inches for trees greater than 12 inches at DBH and 6 inches for trees smaller than 10 inches at DBH.

2.2.6 - Roundwood operation required (3/21)

The skidding of whole trees or tree segments with limbs attached is prohibited, within Payment Unit(s) 1-3. All products must be produced as roundwood and forwarded to existing roads or landing areas in final product length. Trees must be harvested with in-woods processor (feller bunching harvester will not be allowed) in order to retain existing understory.

2.2.9 - No chipping permitted (12/08)

Within Payment Unit(s) 1-3, all wood must be removed as roundwood. No chipping will be allowed within Sale Area. Tops must be placed on sugar maple stumps to help protect stump sprouts from deer browse.

3 - Payments

3.3 - Pre-measured Sales

3.3.4 - Dividing payment units (7/14)

Payment Unit(s) 1-3, may be divided at the request of the Purchaser and upon approval of the Unit Manager. Dividing Payment Units is a contract modification which requires a Timber Sale Contract Amendment. There will be only one division per Payment Unit.

3.4 - Damaged Timber

3.4.1 - Damaged timber (7/16)

General Condition and Requirement 3.4 Damaged Timber, defines liquidated damages for undesignated live merchantable trees which are cut or injured. In addition, extreme care should be taken to avoid damage to tree seedlings and saplings.

Within the Sale Area, if more than 50% of the tree seedlings or saplings (1/4" to 4.5" DBH) within a specified portion of the Sale Area are damaged, liquidated damages will be assessed at \$500 per acre for all acreage within that specified portion of the Sale Area that was damaged.

4 - Transportation

4.1 - Construction

4.1.3 - Slash and earthen piles (8/04)

Piles or windrows of earth along roads and landings that have been widened or constructed shall be leveled. Slash from road maintenance or construction, including stumps, shall be dispersed throughout the sale.

4.1.6 - Road construction (1/09)

Construction of new roads or improvements of existing roads shall be done in such a way as to minimize the environmental and visual impacts. Merchantable trees shall be cut and utilized unless otherwise directed. Non-merchantable trees shall be severed and laid flat on the ground. Slash shall be scattered, and not left in windrows and kept a minimum of 15 feet back from the road edge. Stumps shall be set upright, not left on edge, and be moved at least 25 feet away from the road edge. Disturbed soil shall be feathered into the woods and not left in berms or windrows.

4.1.11 - Permits (2/12)

The Purchaser will secure any necessary county road permits that may be required.

4.2 - Maintenance

4.2.5 - Two wheel drive condition (2/04)

All existing trail roads on and adjacent to the sale area must be passable by two-wheel drive traffic for the duration of the sale.

5 - Operations

5.1 - Notification

5.1.1 - Pre-sale conference (10/16)

A pre-sale conference on site between the Purchaser and sale administrator is required prior to beginning any operations, to determine landing and road locations. The Unit Manager or his/her representative must be contacted at least 5 days in advance to schedule the conference.

5.2 - Conduct of Operations

5.2.1 - Slash

5.2.1.11 - Slash for reforestation (3/21)

To facilitate reforestation, within the Sale Area slash will be stacked on sugar maple stumps at least 36 inches high. This will help protect stump sprouts from being browsed by deer. In addition to slash being placed on sugar maple stumps, the stumps shall be cut low to the ground to promote stump sprouting.

5.2.3 - Operating Restrictions

5.2.3.4 - Oak wilt restriction, no exceptions (1/18)

Within Payment Unit(s) 1-3, cutting and skidding within the Sale Area and brushing of access roads to the sale are not permitted during the period of April 15 to July 15. No exceptions will be granted. This is necessary to reduce the spread of oak wilt.

5.2.32 - Decking/landing restoration (9/13)

All decking and landing areas must have the surface area restored to a condition equal to or better than before. This is to ensure the proper regeneration of the stand. Wood debris, chips and "cookies" from trimmings must be removed or scattered away from landing and loading areas and may not be windrowed on the edge.

5.2.39 - ORV trail/route protection (4/18)

The ORV trail or route and is shown on the Timber Sale Map. Do not cut trees or damage posts with yellow ORV markers. All stumps within 5 feet of the trail must be cut flush with the ground. Maintain a 20-foot-wide slash, debris, and rut free zone daily using the ORV trail or route as the centerline. Do not run equipment down the ORV trail or route. Skidding across the trail or route may only occur in locations approved by the Sale Administrator.

5.2.41 - Snowmobile trail protection (9/11)

The snowmobile trail and is shown on the Timber Sale Map. Do not cut or damage posts with orange trail markers or traffic control signs. If the trail is used, it must be maintained and restored to a condition equal to or better than before the sale. If the trail is used for hauling, it must be graded to the satisfaction of the Unit Manager or his/her representative prior to December 1. If the trail road is to be used for hauling during the snowmobile season, then a snow covered base must be left

on the trail. Maintain a 20-foot-wide slash, debris, and rut free zone daily using the snowmobile trail as the centerline. No decking of forest products will be permitted along the snowmobile trail. All stumps within 20 feet of the snowmobile trail must be cut at ground level.

5.4 - Soil Protection

5.4.1 - Rutting restriction, general (7/16)

Operations are to cease immediately if equipment and weather conditions result in rutting of roads and/or skid trails which is 12 inches or greater in depth and 50 feet in length. The Unit Manager or his/her representative may restrict hauling and/or skidding if ruts exceed the specified depth. With the Unit Manager or his/her representative's approval, the Purchaser may return to the area when the risk of rutting has decreased.

6 - Safety and Fire Prevention

6.2 - Signing

6.2.1 - Road posting (10/20)

The Purchaser is responsible for posting and maintaining caution signs on any county or state road the timber sale is affected by prior to beginning operations. The road must be posted at appropriate distances from the Sale Area to warn of logging activity and truck traffic. Signs must be removed when harvest operations are suspended or completed. The Purchaser will provide these signs.

6.2.2 - Snowmobile trail posting (10/20)

The Purchaser is responsible for posting and maintaining caution signs on snowmobile trail prior to beginning operations during the snowmobile season (approximately December 1 to March 31). The trail must be posted at appropriate distances from the Sale Area to warn of logging activity and truck traffic. Signs must be removed when harvest operations are suspended or completed. The Purchaser will provide these signs.

6.2.3 - Recreational trail posting (10/20)

The Purchaser is responsible for posting and maintaining caution signs on ORV trail prior to beginning operations. The trail must be posted at appropriate distances from the sale area to warn of logging activity and truck traffic at both ends of the trail. Signs must be removed when harvest operations are suspended or completed. The Purchaser will provide these signs.



TIMBER SALE MAP

This information provided by authority of Part 525, 1994 PA 451, as amended.

Sale Number
61-117-24

Date
04/12/2024

| | | |
|------------------------|----------|--------------------------|
| Forest Management Unit | County | Mapped By: Tom Peterson |
| Traverse City Mgt Unit | Kalkaska | Cruised By: Tom Peterson |

| | | |
|----------|------|----|
| Scale | Page | Of |
| 1:15,840 | 1 | 1 |

| | | |
|----------|-------|---|
| Township | Range | Section(s) and Subdivision(s) |
| 27N | 05W | Sec. 11 NW,W1/2NE,NESW,NWSE; Sec. 2 SESW; |

| Cover Type | | | |
|---------------------|-------------------------|-------------------------|------------------------|
| A = Aspen | J = Jack Pine | O = Oak | U = Upland Brush |
| B = Paper Birch | K = Rock | P = Lowland Poplar | UM = Upland Mix Forest |
| C = Cedar | L = Lowland Brush | Q = Mixed Swamp Conifer | V = Bog or Marsh |
| D = Treed Bog | LM = Lowland Mix Forest | R = Red Pine | W = White Pine |
| E = Swamp Hardwoods | M = Maple, Beech, Birch | S = Black Spruce | X = Non Stocked |
| F = Spruce/Fir | MC = Mixed Conifer | T = Tamarack | Y = Sand |
| G = Grass | MD = Mixed Deciduous | Z = Water | |
| H = Hemlock | N = Marsh | | |

| Density | |
|-----------------------------|------------------------|
| 0 = Non Stocked | 5 = Pole Timber Medium |
| 1 = Seedling Sapling Poor | 6 = Pole Timber Well |
| 2 = Seedling Sapling Medium | 7 = Saw Timber Poor |
| 3 = Seedling Sapling Well | 8 = Saw Timber Medium |
| 4 = Pole Timber Poor | 9 = Saw Timber Well |

| PU # | Acres |
|------|-------|
| 1 | 26.7 |
| 2 | 40.9 |
| 3 | 32.7 |

Over Baited Hardwoods

100.3 Acres

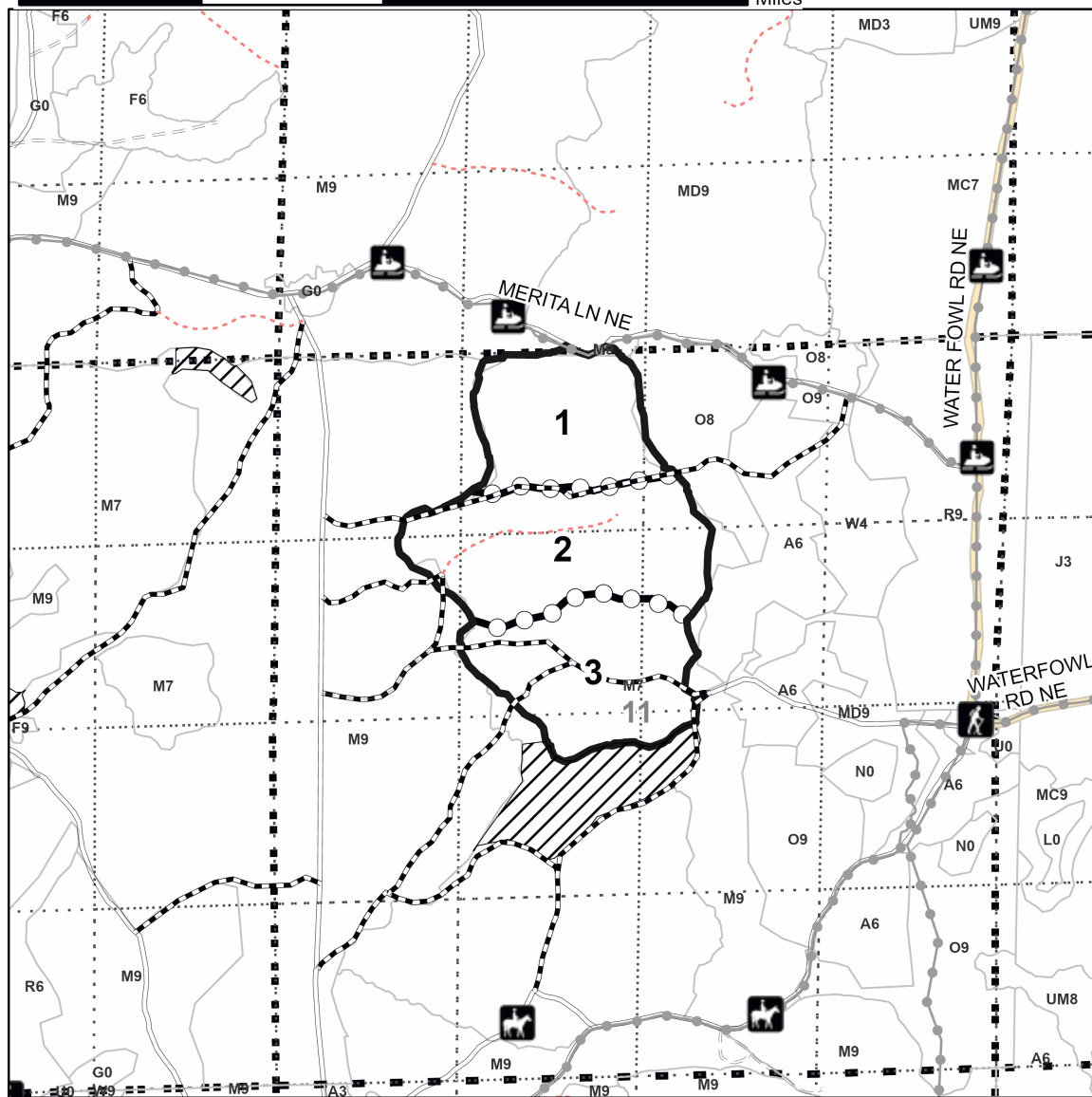
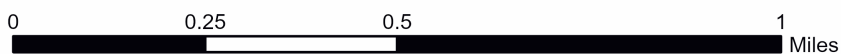

Legend

- Against State (Red)
- Payment Unit (Yellow)
- Stand
- Retention Areas
- Sections
- Recreational Trail
- County Road - Seasonal
- Primary Forest Road
- Secondary Forest Road
- Forest Access Route
- Administrative Access Only
- Non-DNR Road

Use QR Code to open Map in App



TIMBER SALE INFORMATION

Lone Wolf (61-119-24)

T27N, R07W, SEC. 7; T27N, R07W, SEC. 8; T27N, R07W, SEC. 9.
Kalkaska County (Advertised Price \$32,039.65)

SALE NOTE: A recreation site such as a trail, pathway, or campground is within the sale area or the vicinity. Certain restrictions/specifications may be applicable including time restrictions.

A timber sale contract for this lump sum, sealed bid timber sale will be awarded to the responsible bidder offering the highest sealed bid price. All units of volume listed below were estimated using the Inventory Manager computer program and the new Michigan taper model. Bids must be at or above the following advertised price for each product and species:

| <u>PRODUCTS & SPECIES</u> | <u>ESTIMATED UNITS*</u> | <u>ADVERTISED PRICE</u> |
|-------------------------------|-------------------------|-------------------------|
| Sawtimber | | |
| Red Maple | 4.4 MBF | \$ 129.00 / MBF |
| Red Oak | 19.2 MBF | \$ 149.00 / MBF |
| Red Pine | 61.1 MBF | \$ 125.00 / MBF |
| White Pine | 5.2 MBF | \$ 87.00 / MBF |
| Pulpwood | | |
| B. T. Aspen | 166 Cords | \$ 20.50 / Cord |
| Balsam Fir | 15 Cords | \$ 22.70 / Cord |
| Jack Pine | 39 Cords | \$ 20.65 / Cord |
| Mixed Hardwood | 390 Cords | \$ 20.80 / Cord |
| Red Oak | 57 Cords | \$ 29.50 / Cord |
| Red Pine | 108 Cords | \$ 50.25 / Cord |
| White Pine | 32 Cords | \$ 23.50 / Cord |

* The total volume is statistically estimated within plus (+) or minus (-) 22.25 percent. There are an estimated 1,020 cords on this timber sale, plus or minus 227 cords at the 95% confidence level. The estimated units are final and not subject to adjustment. Prospective bidders are urged to examine this timber and to make their own estimates of quantity and quality.

BOND AND PAYMENT SCHEDULE:

1. A bond in the amount of \$1,602.00 to insure faithful performance of the conditions of the contract will be deposited by the successful bidder within 21 days of the sale award.
2. Cutting in any sale or unit without the required advance payment would be considered a trespass.
3. Total payment must be paid in advance or according to the following schedule :
 - (a) Ten percent (10%) of the sale value must be paid within 21 days of the sale award.
 - (b) The 10% down payment will be credited towards the first unit cut.
 - (c) Payment for each of the following units must be made before cutting begins in that unit:

| PAYMENT UNIT NUMBER | PERCENT OF TOTAL SALE VALUE |
|---------------------|-----------------------------|
| 01 | 25.5% |
| 02 | 20.8% |
| 03 | 17.8% |
| 04 | 14.8% |
| 05 | 21.1% |

4. If no cutting takes place, the 10% down payment will not be refunded.
5. Operations on the contract issued will terminate on 09/30/2027.

SALE STATISTICS

Volumes were calculated in cubic feet using the Michigan taper model. Cubic foot volume includes all wood inside bark for the product indicated. For display purposes, cubic feet were converted to cords and MBF using a simple conversion factor, e.g. 79 cubic feet per cord and 185 cubic feet per MBF. The cubic foot volumes are precise; the cords and MBF volumes are not. Cubic foot volume cannot be directly converted to cords or boards with precision.

SALE VOLUMES

The total estimated sale volume may not equal the sum of the species/products due to the nature of statistical calculations associated with double sampling methodology.

| VOLUME | | | STATISTICAL RANGE IN CORDS | |
|------------------|-------------|---------------|----------------------------|---------|
| TOTAL CUBIC FEET | TOTAL CORDS | PERCENT ERROR | MINIMUM | MAXIMUM |
| 80,568 | 1,020 | 22.25% | 793 | 1,247 |

VDU VOLUMES

A VDU is a Volume Determination Unit. Volumes and their associated statistics are calculated at the VDU level and summarized to the sale level. There is often a one to one relationship between a VDU and a Payment Unit, but not always, depending on the cruise design. Refer to the VDU TO PAYMENT UNIT table.

| | VOLUME | | | RANGE IN CORDS | |
|---------------|------------------|--------------|---------------|----------------|--------------|
| VDU | TOTAL CUBIC FEET | TOTAL CORDS | PERCENT ERROR | MINIMUM | MAXIMUM |
| 8 | 8,639 | 109 | 94.28% | 6 | 212 |
| 12 | 12,675 | 160 | 51.72% | 77 | 243 |
| 16 | 21,368 | 270 | 41.63% | 158 | 383 |
| 31 | 17,237 | 218 | 48.32% | 113 | 324 |
| 36 | 11,694 | 148 | 53.95% | 68 | 228 |
| 42 | 8,955 | 113 | 89.71% | 12 | 215 |
| TOTAL: | 80,568 | 1,020 | | 434 | 1,606 |

VDU TO PAYMENT UNIT

When a VDU is associated with more than one Payment Unit (PU), the VDU volumes are assigned to the PU based on acres of the VDU within the PU.

| VDU | VDU ACRES | PU | PU ACRES |
|---------------|-------------|----|-------------|
| 8 | 4.3 | 1 | 4.3 |
| 12 | 9.7 | 1 | 9.7 |
| 16 | 18.8 | 2 | 18.8 |
| 31 | 7.6 | 3 | 7.6 |
| 36 | 10.7 | 5 | 10.7 |
| 42 | 3.7 | 4 | 3.7 |
| TOTAL: | 54.8 | | 54.8 |

DESCRIPTION OF TIMBER BY PAYMENT UNIT (PU)

| PU | MARKET GROUP | PRODUCT | QUANTITY | UNIT | ACRES | ADVERTISE PRICE |
|--------|---------------------|-----------|----------|--------------|-------|-----------------|
| 1 | Red Pine | Sawtimber | 28.6 | MBF | 14.0 | \$8,159.30 |
| | B. T. Aspen | Pulpwood | 51 | Cords | | |
| | Balsam Fir | | 15 | Cords | | |
| | Jack Pine | | 22 | Cords | | |
| | Mixed Hardwood | | 95 | Cords | | |
| | <i>Red Maple</i> | | 95 | <i>Cords</i> | | |
| | Red Oak | | 9 | Cords | | |
| | Red Pine | | 10 | Cords | | |
| 2 | Red Maple | Sawtimber | 4.4 | MBF | 18.8 | \$6,673.30 |
| | Red Pine | | 1.5 | MBF | | |
| | B. T. Aspen | Pulpwood | 73 | Cords | | |
| | Jack Pine | | 3 | Cords | | |
| | Mixed Hardwood | | 145 | Cords | | |
| | <i>Black Cherry</i> | | 7 | <i>Cords</i> | | |
| | <i>Red Maple</i> | | 117 | <i>Cords</i> | | |
| | <i>Sugar Maple</i> | | 21 | <i>Cords</i> | | |
| | Red Oak | | 20 | Cords | | |
| | Red Pine | | 15 | Cords | | |
| 3 | Red Oak | Sawtimber | 6.1 | MBF | 7.6 | \$5,698.65 |
| | Red Pine | | 5.9 | MBF | | |
| | B. T. Aspen | Pulpwood | 36 | Cords | | |
| | Mixed Hardwood | | 145 | Cords | | |
| | <i>Beech</i> | | 19 | <i>Cords</i> | | |
| | <i>Red Maple</i> | | 126 | <i>Cords</i> | | |
| | Red Oak | | 5 | Cords | | |
| | Red Pine | | 3 | Cords | | |
| 4 | Red Oak | Sawtimber | 13.1 | MBF | 3.7 | \$4,744.75 |
| | B. T. Aspen | Pulpwood | 6 | Cords | | |
| | Jack Pine | | 14 | Cords | | |
| | Mixed Hardwood | | 5 | Cords | | |
| | <i>Red Maple</i> | | 5 | <i>Cords</i> | | |
| | Red Oak | | 23 | Cords | | |
| | Red Pine | | 29 | Cords | | |
| | White Pine | | 6 | Cords | | |
| 5 | Red Pine | Sawtimber | 25.1 | MBF | 10.7 | \$6,763.65 |
| | White Pine | | 5.2 | MBF | | |
| | Red Pine | Pulpwood | 51 | Cords | | |
| | White Pine | | 26 | Cords | | |
| TOTAL: | | | 89.9 | MBF | | |
| TOTAL: | | | 807 | Cords | | |

Sale Specific Conditions & Requirements

Sale Name: Lone Wolf

Sale Number: 61-119-24 Seq#: 1

1 - Sale Area

1.2 - Boundaries

1.2.1 - Painted boundaries (9/19)

The sale boundary and Payment Unit boundaries are marked and identified by blue and red paint. Exterior sale boundary lines against private property are marked with blue paint. Exterior sale boundary lines against state are marked with red paint. The painted boundary line trees are not Included Timber and are to be protected.

2 - Timber Specifications

2.1 - Included Timber

2.1.1 - Clearcut unit(s) with unmerchantable trees (6/14)

Within Payment Unit(s) 1-3, cut all trees that are two (2) inches or more at DBH, except do not cut trees marked with green paint, white oak or white pine.

Within Payment Unit 4, cut all trees that are six (6) inches or more at DBH, except do not cut trees marked with green paint.

2.1.3 - Cut tree marked unit(s) (12/08)

Within Payment Unit(s) 5, all trees are designated for cutting when marked with orange paint above and below stump height, regardless of merchantability.

2.2 - Utilization

2.2.3 - Stump heights (4/07)

Stump heights within the Sale Area shall not exceed 12 inches for trees greater than 10 inches at DBH and 4 inches for trees smaller than 10 inches at DBH.

3 - Payments

3.3 - Pre-measured Sales

3.3.4 - Dividing payment units (7/14)

Payment Unit(s) may be divided at the request of the Purchaser and upon approval of the Unit Manager. Dividing Payment Units is a contract modification which requires a Timber Sale Contract Amendment. There will be only one division per Payment Unit.

4 - Transportation

4.1 - Construction

4.1.6 - Road construction (4/24)

Construction of new roads or improvements of existing roads shall be done in such a way as to minimize the environmental and visual impacts. Merchantable trees shall be cut and utilized unless otherwise directed. Non-merchantable trees shall be severed and laid flat on the ground. Slash shall be scattered, and not left in windrows and kept a minimum of 10 feet back from the road edge. Stumps shall be set upright, not left on edge, and be moved at least 10 feet away from the road edge. Disturbed soil shall be feathered into the woods and not left in berms or windrows.

4.1.11 - Permits (2/12)

The Purchaser will secure any necessary highway and stream crossing permits that may be required.

4.2 - Maintenance

4.2.5 - Two wheel drive condition (2/04)

All existing trail roads on and adjacent to the sale area must be passable by two-wheel drive traffic for the duration of the sale.

4.3 - Public Right-of-Way

4.3.1 - MDOT R-O-W (11/14)

The Michigan Department of Transportation (MDOT) must be contacted prior to harvesting timber within the MDOT right-of-way. This applies for Payment Unit 4.

4.4 - Access

4.4.2 - Alternate route on private property (2/04)

It is the Purchaser's responsibility to obtain access across private land for any routes other than the route shown on the Timber Sale Map.

5 - Operations

5.1 - Notification

5.1.1 - Pre-sale conference (10/16)

A pre-sale conference on site between the Purchaser and sale administrator is required prior to beginning any operations, to determine landing and road locations. The Unit Manager or his/her representative must be contacted at least 5 days in advance to schedule the conference.

5.1.3 - Well heads and natural gas pipelines (11/15)

The Purchaser is responsible for contacting the gas or pipeline company 30 days prior to operating equipment in the vicinity of well heads or natural gas pipelines. Written permission is required before harvest operations begin and must be submitted to the Unit Manager. This is the access route for Payment Unit 1.

5.1.4 - Post-sale conference (10/16)

A post-sale conference on site between the Purchaser and sale administrator is required 5 days prior to the completion of active logging operations to determine clean-up and repair of landings, road edges, and the fulfillment of other contract specifications.

5.2 - Conduct of Operations

5.2.1 - Slash

5.2.1.8 - Slash height (12/08)

No slash or tree tops may exceed 24 inches in height.

5.2.2 - Hazard Trees/Snags

5.2.2.1 - Den trees (10/16)

Obvious hollow and/or den trees shall be protected and left standing unless they are a safety hazard.

5.2.3 - Operating Restrictions

5.2.3.4 - Oak wilt restriction, no exceptions (1/18)

Within Payment Unit(s) 1-5, cutting, skidding, hauling within the sale and brushing of access roads to the sale are not permitted during the period of April 15 to July 15. No exceptions will be granted. This is necessary to reduce the spread of oak wilt.

5.2.3.2 - Decking/landing restoration (9/13)

All decking and landing areas must have the surface area restored to a condition equal to or better than before. This is to ensure the proper regeneration of the stand. Wood debris, chips and "cookies" from trimmings must be removed or scattered away from landing and loading areas and may not be windrowed on the edge.

5.4 - Soil Protection

5.4.1 - Rutting restriction, general (7/16)

Operations are to cease immediately if equipment and weather conditions result in rutting of roads and/or skid trails which is 12 inches or greater in depth and 50 feet in length. The Unit Manager or his/her representative may restrict hauling and/or skidding if ruts exceed the specified depth. With the Unit Manager or his/her representative's approval, the Purchaser may return to the area when the risk of rutting has decreased.

6 - Safety and Fire Prevention

6.2 - Signing

6.2.1 - Road posting (10/20)

The Purchaser is responsible for posting and maintaining caution signs on Valley Rd, Rice Rd and US 131 prior to beginning operations. The road must be posted at appropriate distances from the Sale Area to warn of logging activity and truck traffic. Signs must be removed when harvest operations are suspended or completed. The Purchaser will provide these signs.

6.2.3 - Recreational trail posting (10/20)

The Purchaser is responsible for posting and maintaining caution signs on any recreational trails utilized prior to beginning operations. The trail must be posted at appropriate distances from the Sale Area to warn of logging activity and truck traffic at both ends of the trail. Signs must be removed when harvest operations are suspended or completed. The Purchaser will provide these signs.



TIMBER SALE MAP

This information provided by authority of Part 525, 1994 PA 451, as amended.

Sale Number
61-119-24

Date
05/19/2024

| | | |
|------------------------|----------|------------------------|
| Forest Management Unit | County | Mapped By: Paul Roell |
| Traverse City Mgt Unit | Kalkaska | Cruised By: Paul Roell |

| | | |
|----------|------|----|
| Scale | Page | Of |
| 1:24,000 | 1 | 1 |

| | | |
|----------|-------|---|
| Township | Range | Section(s) and Subdivision(s) |
| 27N | 07W | Sec. 7 SWNW,S1/2NE,N1/2SW; Sec. 8 SWNW,NWSW; Sec. 9 W1/2NW; |

| Cover Type | | | |
|---------------------|-------------------------|-------------------------|------------------------|
| A = Aspen | J = Jack Pine | O = Oak | U = Upland Brush |
| B = Paper Birch | K = Rock | P = Lowland Poplar | UM = Upland Mix Forest |
| C = Cedar | L = Lowland Brush | Q = Mixed Swamp Conifer | V = Bog or Marsh |
| D = Treed Bog | LM = Lowland Mix Forest | R = Red Pine | W = White Pine |
| E = Swamp Hardwoods | M = Maple, Beech, Birch | S = Black Spruce | X = Non Stocked |
| F = Spruce/Fir | MC = Mixed Conifer | T = Tamarack | Y = Sand |
| G = Grass | MD = Mixed Deciduous | Z = Water | |
| H = Hemlock | N = Marsh | | |

| Density | |
|-----------------------------|------------------------|
| 0 = Non Stocked | 5 = Pole Timber Medium |
| 1 = Seedling Sapling Poor | 6 = Pole Timber Well |
| 2 = Seedling Sapling Medium | 7 = Saw Timber Poor |
| 3 = Seedling Sapling Well | 8 = Saw Timber Medium |
| 4 = Pole Timber Poor | 9 = Saw Timber Well |

| PU # | Acres |
|------|-------|
| 1 | 14.0 |
| 2 | 18.8 |
| 3 | 7.6 |
| 4 | 3.7 |
| 5 | 10.7 |

Lone Wolf Acres 54.8

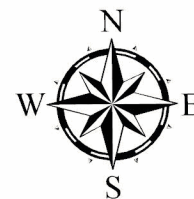

0 0.38 0.75 1.5 Miles

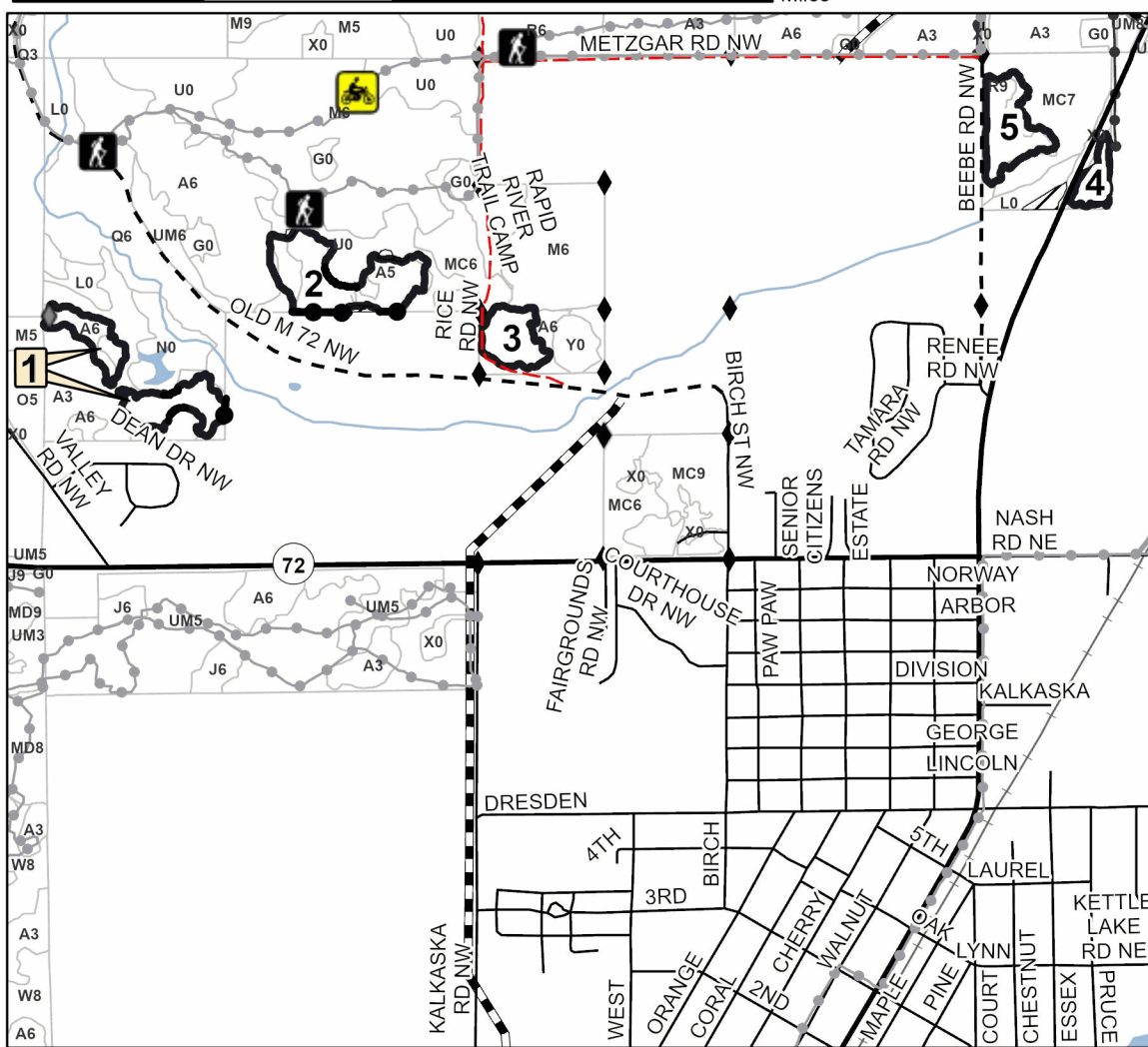

Legend

- Against State (Red)
- Private Line (Blue)
- Stand
- Retention Areas
- Recreational Trail
- Paved Road
- Gravel Road
- County Road - Seasonal
- Private Road
- Highway
- Pipeline
- Powerline
- Active Railroad
- Field Grade Corner
- Survey Grade Corner



TIMBER SALE INFORMATION

Mae Mae Mix (61-123-24)

T27N, R08W, SEC. 16; T27N, R08W, SEC. 19; T27N, R08W, SEC. 20; T27N, R08W, SEC. 21; T27N, R08W, SEC. 28; T27N, R08W, SEC. 29; T27N, R08W, SEC. 30.

SALE NOTE: A recreation site such as a trail, pathway, or campground is within the sale area or the vicinity. Certain restrictions/specifications may be applicable including time restrictions.

A timber sale contract for this lump sum, sealed bid timber sale will be awarded to the responsible bidder offering the highest sealed bid price. All units of volume listed below were estimated using the Inventory Manager computer program and the new Michigan taper model. Bids must be at or above the following advertised price for each product and species:

| <u>PRODUCTS & SPECIES</u> | <u>ESTIMATED UNITS*</u> | <u>ADVERTISED PRICE</u> |
|-------------------------------|-------------------------|-------------------------|
| Sawtimber | | |
| Basswood | 27.5 MBF | \$ 121.00 / MBF |
| Red Maple | 3.3 MBF | \$ 129.00 / MBF |
| Red Oak | 86.4 MBF | \$ 149.00 / MBF |
| Red Pine | 231.6 MBF | \$ 125.00 / MBF |
| Sugar Maple | 21.9 MBF | \$ 294.00 / MBF |
| White Pine | 67.7 MBF | \$ 87.00 / MBF |
| Pulpwood | | |
| B. T. Aspen | 242 Cords | \$ 20.50 / Cord |
| Basswood | 61 Cords | \$ 11.85 / Cord |
| Hemlock | 6 Cords | \$ 8.65 / Cord |
| Jack Pine | 13 Cords | \$ 20.65 / Cord |
| Mixed Hardwood | 527 Cords | \$ 20.80 / Cord |
| Paper Birch | 28 Cords | \$ 16.45 / Cord |
| Red Oak | 247 Cords | \$ 29.50 / Cord |
| Red Pine | 258 Cords | \$ 50.25 / Cord |
| White Pine | 264 Cords | \$ 23.50 / Cord |

* The total volume is statistically estimated within plus (+) or minus (-) 16.04 percent. There are an estimated 2,676 cords on this timber sale, plus or minus 429 cords at the 95% confidence level. The estimated units are final and not subject to adjustment. Prospective bidders are urged to examine this timber and to make their own estimates of quantity and quality.

BOND AND PAYMENT SCHEDULE:

1. A bond in the amount of \$5,089.00 to insure faithful performance of the conditions of the contract will be deposited by the successful bidder within 21 days of the sale award.
2. Cutting in any sale or unit without the required advance payment would be considered a trespass.
3. Total payment must be paid in advance or according to the following schedule :
 - (a) Ten percent (10%) of the sale value must be paid within 21 days of the sale award.
 - (b) The 10% down payment will be credited towards the first unit cut.
 - (c) Payment for each of the following units must be made before cutting begins in that unit:

| PAYMENT UNIT NUMBER | PERCENT OF TOTAL SALE VALUE |
|---------------------|-----------------------------|
| 01 | 1.4% |
| 02 | 4.5% |
| 03 | 22.2% |
| 04 | 19.1% |
| 05 | 13.2% |
| 06 | 7.0% |
| 07 | 32.6% |
4. If no cutting takes place, the 10% down payment will not be refunded.
5. Operations on the contract issued will terminate on 09/30/2027.

SALE STATISTICS

Volumes were calculated in cubic feet using the Michigan taper model. Cubic foot volume includes all wood inside bark for the product indicated. For display purposes, cubic feet were converted to cords and MBF using a simple conversion factor, e.g. 79 cubic feet per cord and 185 cubic feet per MBF. The cubic foot volumes are precise; the cords and MBF volumes are not. Cubic foot volume cannot be directly converted to cords or boards with precision.

SALE VOLUMES

The total estimated sale volume may not equal the sum of the species/products due to the nature of statistical calculations associated with double sampling methodology.

| VOLUME | | | STATISTICAL RANGE IN CORDS | |
|------------------|-------------|---------------|----------------------------|---------|
| TOTAL CUBIC FEET | TOTAL CORDS | PERCENT ERROR | MINIMUM | MAXIMUM |
| 211,413 | 2,676 | 16.04% | 2,247 | 3,106 |

VDU VOLUMES

A VDU is a Volume Determination Unit. Volumes and their associated statistics are calculated at the VDU level and summarized to the sale level. There is often a one to one relationship between a VDU and a Payment Unit, but not always, depending on the cruise design. Refer to the VDU TO PAYMENT UNIT table.

| | VOLUME | | | RANGE IN CORDS | |
|---------------|------------------|--------------|---------------|----------------|--------------|
| VDU | TOTAL CUBIC FEET | TOTAL CORDS | PERCENT ERROR | MINIMUM | MAXIMUM |
| 23 | 17,385 | 220 | 54.92% | 99 | 341 |
| 24 | 22,706 | 287 | 57.99% | 121 | 454 |
| 31 | 31,432 | 398 | 44.61% | 220 | 575 |
| 66 | 8,848 | 112 | 56.36% | 49 | 175 |
| 68 | 55,818 | 707 | 38.35% | 436 | 978 |
| 86 | 2,758 | 35 | 115.16% | 0 | 75 |
| 107 | 33,180 | 420 | 32.50% | 284 | 556 |
| 206 | 39,285 | 497 | 34.12% | 328 | 667 |
| TOTAL: | 211,413 | 2,676 | | 1,536 | 3,822 |

VDU TO PAYMENT UNIT

When a VDU is associated with more than one Payment Unit (PU), the VDU volumes are assigned to the PU based on acres of the VDU within the PU.

| VDU | VDU ACRES | PU | PU ACRES |
|---------------|--------------|----|--------------|
| 23 | 10.5 | 6 | 10.5 |
| 24 | 10.5 | 7 | 10.5 |
| 31 | 25.1 | 5 | 25.1 |
| 66 | 6.8 | 2 | 6.8 |
| 68 | 18.0 | 3 | 18.0 |
| 86 | 2.5 | 1 | 2.5 |
| 107 | 22.2 | 4 | 22.2 |
| 206 | 17.4 | 7 | 17.4 |
| TOTAL: | 113.0 | | 113.0 |

DESCRIPTION OF TIMBER BY PAYMENT UNIT (PU)

| PU | MARKET GROUP | PRODUCT | QUANTITY | UNIT | ACRES | ADVERTISE PRICE |
|------------|---------------------|-----------|----------|--------------|-------|-----------------|
| 1 | Basswood | Sawtimber | 1.4 | MBF | 2.5 | \$1,390.55 |
| | Red Oak | | 1.5 | MBF | | |
| | Sugar Maple | | 1.8 | MBF | | |
| | Basswood | Pulpwood | 5 | Cords | | |
| | Mixed Hardwood | | 14 | Cords | | |
| | <i>Beech</i> | | 2 | <i>Cords</i> | | |
| | <i>Red Maple</i> | | 8 | <i>Cords</i> | | |
| | <i>Sugar Maple</i> | | 4 | <i>Cords</i> | | |
| | Red Oak | | 4 | Cords | | |
| 2 | Red Maple | Sawtimber | 1.5 | MBF | 6.8 | \$4,597.90 |
| | Red Pine | | 2.7 | MBF | | |
| | Sugar Maple | | 8.0 | MBF | | |
| | B. T. Aspen | Pulpwood | 6 | Cords | | |
| | Mixed Hardwood | | 67 | Cords | | |
| | <i>Red Maple</i> | | 11 | <i>Cords</i> | | |
| | <i>Sugar Maple</i> | | 56 | <i>Cords</i> | | |
| | Paper Birch | | 9 | Cords | | |
| | Red Pine | | 1 | Cords | | |
| 3 | Red Pine | Sawtimber | 58.9 | MBF | 18.0 | \$22,626.50 |
| | White Pine | | 40.6 | MBF | | |
| | B. T. Aspen | | Pulpwood | 163 | | |
| | Jack Pine | 9 | | Cords | | |
| | Mixed Hardwood | 199 | | Cords | | |
| | <i>Red Maple</i> | 199 | | <i>Cords</i> | | |
| | Red Oak | 15 | | Cords | | |
| | Red Pine | 59 | | Cords | | |
| | White Pine | 28 | Cords | | | |
| 4 | Red Oak | Sawtimber | 5.5 | MBF | 22.2 | \$19,429.70 |
| | Red Pine | | 95.4 | MBF | | |
| | White Pine | | 10.3 | MBF | | |
| | Jack Pine | Pulpwood | 4 | Cords | | |
| | Red Oak | | 23 | Cords | | |
| | Red Pine | | 72 | Cords | | |
| | White Pine | | 60 | Cords | | |
| 5 | Basswood | Sawtimber | 17.7 | MBF | 25.1 | \$13,434.30 |
| | Red Oak | | 11.5 | MBF | | |
| | Red Pine | | 11.7 | MBF | | |
| | Sugar Maple | Pulpwood | 5.9 | MBF | | |
| | White Pine | | 1.9 | MBF | | |
| | Basswood | | 31 | Cords | | |
| | Hemlock | | 6 | Cords | | |
| | Mixed Hardwood | | 101 | Cords | | |
| | <i>Black Cherry</i> | | 20 | <i>Cords</i> | | |
| | <i>Ironwood</i> | | 6 | <i>Cords</i> | | |
| | <i>Red Maple</i> | | 51 | <i>Cords</i> | | |
| | <i>Sugar Maple</i> | | 24 | <i>Cords</i> | | |
| | Paper Birch | | 12 | Cords | | |
| | Red Oak | | 40 | Cords | | |
| | Red Pine | | 5 | Cords | | |
| White Pine | 88 | Cords | | | | |
| 6 | Red Maple | Sawtimber | 1.8 | MBF | 10.5 | \$7,085.25 |
| | Red Pine | | 17.1 | MBF | | |
| | Sugar Maple | | 2.8 | MBF | | |
| | B. T. Aspen | Pulpwood | 54 | Cords | | |
| | Mixed Hardwood | | 39 | Cords | | |
| | <i>Black Cherry</i> | | 5 | <i>Cords</i> | | |

DESCRIPTION OF TIMBER BY PAYMENT UNIT (PU), CON'T

| PU | MARKET GROUP | PRODUCT | QUANTITY | UNIT | ACRES | ADVERTISE PRICE | | | | |
|---------|--------------------|-----------------|----------|--------------|-------|-----------------|-------|--|--|--|
| 6 con't | <i>Red Maple</i> | <i>Pulpwood</i> | 24 | <i>Cords</i> | | | | | | |
| | <i>Sugar Maple</i> | | 10 | <i>Cords</i> | | | | | | |
| | Paper Birch | | 7 | Cords | | | | | | |
| | Red Pine | | 8 | Cords | | | | | | |
| | White Pine | | 62 | Cords | | | | | | |
| 7 | Basswood | Sawtimber | 8.4 | MBF | 27.9 | \$33,222.50 | | | | |
| | Red Oak | | 67.9 | MBF | | | | | | |
| | Red Pine | | 45.8 | MBF | | | | | | |
| | Sugar Maple | | 3.4 | MBF | | | | | | |
| | White Pine | | 14.9 | MBF | | | | | | |
| | B. T. Aspen | Pulpwood | 19 | Cords | | | | | | |
| | Basswood | | 25 | Cords | | | | | | |
| | Mixed Hardwood | | 107 | Cords | | | | | | |
| | <i>Red Maple</i> | | 37 | <i>Cords</i> | | | | | | |
| | <i>Sugar Maple</i> | | 70 | <i>Cords</i> | | | | | | |
| | Red Oak | | 165 | Cords | | | | | | |
| | Red Pine | | 113 | Cords | | | | | | |
| | White Pine | | 26 | Cords | | | | | | |
| | TOTAL: | | | 438.4 | | | MBF | | | |
| | TOTAL: | | | 1,646 | | | Cords | | | |

Sale Specific Conditions & Requirements

Sale Name: Mae Mae Mix

Sale Number: 61-123-24 Seq#: 1

1 - Sale Area

1.2 - Boundaries

1.2.1 - Painted boundaries (9/19)

The sale boundary and Payment Unit boundaries are marked and identified by blue, red and yellow paint. Exterior sale boundary lines against private property are marked with blue paint. Exterior sale boundary lines against state are marked with red paint. Interior Payment Unit boundaries are marked with yellow paint. Retention patches are marked with red paint; no harvesting activities may occur within these areas. The painted boundary line trees are not Included Timber and are to be protected. Yellow painted trees designating an interior Payment Unit boundary are only to be cut when all surrounding Payment Units have been paid.

2 - Timber Specifications

2.1 - Included Timber

2.1.1 - Clearcut unit(s) with unmerchantable trees (6/14)

Within Payment Unit(s) 1, 3, 6 and 7, cut all trees that are two (2) inches or more at DBH, with the following exceptions:

- Within Payment Unit 3, do not cut white pine under 6 inches or trees marked with green paint.
- Within Payment Unit 6, do not cut any oak.
- Within Payment Unit 7, do not cut any white oak or trees marked with green paint.

Special protection trees identified in accordance with condition 3.4.2, within clearcutting unit boundaries, are not Included Timber and are to be protected.

2.1.3 - Cut tree marked unit(s) (12/08)

Within Payment Unit(s) 2 and 5, all trees are designated for cutting when marked with orange paint above and below stump height, regardless of merchantability. In addition, cut all aspen, beech and ironwood, regardless of merchantability.

2.1.5 - Overstory removal unit(s) (8/11)

Within Payment Unit(s) 4, all trees with DBH equal to or greater than 6 inches which meet minimum piece specifications in 2.2 Utilization, are designated for cutting, except do not cut white oak.

2.2 - Utilization

2.2.3 - Stump heights (4/07)

Stump heights within the Sale Area shall not exceed 12 inches for trees greater than 10 inches at DBH and 4 inches for trees smaller than 10 inches at DBH.

3 - Payments

3.3 - Pre-measured Sales

3.3.4 - Dividing payment units (7/14)

Payment Unit(s) may be divided at the request of the Purchaser and upon approval of the Unit Manager. Dividing Payment Units is a contract modification which requires a Timber Sale Contract Amendment. There will be only one division per Payment Unit.

3.4 - Damaged Timber

3.4.2 - Special Protection Trees (4/14)

The Purchaser shall not cut live or dead special protection trees within cutting units or clearings. Special protection trees are trees with a diameter of 26 inches or greater within Payment Units 3 and 7. If the Purchaser's operations have cut or damaged special protection trees through carelessness, the Purchaser shall pay as fixed, agreed and liquidated damages for each special protection tree cut or damaged. Such payment does not constitute ownership of the undesignated timber.

4 - Transportation

4.1 - Construction

4.1.6 - Road construction (4/24)

Construction of new roads or improvements of existing roads shall be done in such a way as to minimize the environmental and visual impacts. Merchantable trees shall be cut and utilized unless otherwise directed. Non-merchantable trees shall be severed and laid flat on the ground. Slash shall be scattered, and not left in windrows and kept a minimum of 10 feet back from the road edge. Stumps shall be set upright, not left on edge, and be moved at least 10 feet away from the road edge. Disturbed soil shall be feathered into the woods and not left in berms or windrows.

4.2 - Maintenance

4.2.5 - Two wheel drive condition (2/04)

All existing trail roads on and adjacent to the sale area must be passable by two-wheel drive traffic for the duration of the sale.

5 - Operations

5.1 - Notification

5.1.1 - Pre-sale conference (10/16)

A pre-sale conference on site between the Purchaser and sale administrator is required prior to beginning any operations, to determine landing and road locations. The Unit Manager or his/her representative must be contacted at least 5 days in advance to schedule the conference.

5.1.4 - Post-sale conference (10/16)

A post-sale conference on site between the Purchaser and sale administrator is required 5 days prior to the completion of active logging operations to determine clean-up and repair of landings, road edges, and the fulfillment of other contract specifications.

5.2 - Conduct of Operations

5.2.1 - Slash

5.2.1.8 - Slash height (12/08)

No slash or tree tops may exceed 24 inches in height.

5.2.2 - Hazard Trees/Snags

5.2.2.1 - Den trees (10/16)

Obvious hollow and/or den trees shall be protected and left standing unless they are a safety hazard.

5.2.3 - Operating Restrictions

5.2.3.4 - Oak wilt restriction, no exceptions (1/18)

Within Payment Unit(s) 1-7, cutting, skidding, hauling within the sale and brushing of access roads to the sale are not permitted during the period of April 15 to July 15. No exceptions will be granted. This is necessary to reduce the spread of oak wilt.

5.2.29 - Shrub protection (1/20)

Do not cut or damage hawthorn, witch-hazel, dogwood or juneberry. These woody-shrub plants are highly beneficial to various wildlife species.

5.2.32 - Decking/landing restoration (9/13)

All decking and landing areas must have the surface area restored to a condition equal to or better than before. This is to ensure the proper regeneration of the stand. Wood debris, chips and "cookies" from trimmings must be removed or scattered away from landing and loading areas and may not be windrowed on the edge.

5.2.40 - Pathway protection (10/10)

The Shore to Shore trail is a horse/hiking trail and is shown on the Timber Sale Map. Do not cut trees or damage posts with blue pathway markers. Maintain a 20-foot-wide slash, debris, and rut free zone daily, using the pathway as the centerline. Do

not run equipment down the pathway. Skidding across the trail may only occur in locations approved by the Sale Administrator.

5.4 - Soil Protection

5.4.1 - Rutting restriction, general (7/16)

Operations are to cease immediately if equipment and weather conditions result in rutting of roads and/or skid trails which is 12 inches or greater in depth and 50 feet in length. The Unit Manager or his/her representative may restrict hauling and/or skidding if ruts exceed the specified depth. With the Unit Manager or his/her representative's approval, the Purchaser may return to the area when the risk of rutting has decreased.

6 - Safety and Fire Prevention

6.2 - Signing

6.2.1 - Road posting (10/20)

The Purchaser is responsible for posting and maintaining caution signs on Boardman River Rd, Island Lake Rd and North River Rd prior to beginning operations. The road must be posted at appropriate distances from the Sale Area to warn of logging activity and truck traffic. Signs must be removed when harvest operations are suspended or completed. The Purchaser will provide these signs.

6.2.3 - Recreational trail posting (10/20)

The Purchaser is responsible for posting and maintaining caution signs on any recreational trails utilized prior to beginning operations. The trail must be posted at appropriate distances from the Sale Area to warn of logging activity and truck traffic at both ends of the trail. Signs must be removed when harvest operations are suspended or completed. The Purchaser will provide these signs.



TIMBER SALE MAP

This information provided by authority of Part 525, 1994 PA 451, as amended.

| | |
|---------------------------------|--------------------|
| Sale Number 61-123-24 | Date 05/19/2024 |
| Scale 1:24,000 | Page 1 |
| | Of 1 |

| | | |
|--|--------------------|------------------------|
| Forest Management Unit Traverse City Mgt Unit | County Kalkaska | Mapped By: Paul Roell |
| | | Cruised By: Paul Roell |

| | | | |
|-----------------|--------------|----------------------------------|--|
| Township 27N | Range 08W | Section(s) and Subdivision(s) | SWNW,NWNE,W1/2SW,S1/2SE; Sec. 28 NWNW; Sec. 29 N1/2NW,NENE; Sec. 30 NENE; Sec. 16 SWSE; Sec. 19 SESE; Sec. 20 N1/2NW,SENW,W1/2NE,SWSW,E1/2SE; Sec. 21 |
|-----------------|--------------|----------------------------------|--|

| Cover Type | | | |
|---------------------|-------------------------|-------------------------|------------------------|
| A = Aspen | J = Jack Pine | O = Oak | U = Upland Brush |
| B = Paper Birch | K = Rock | P = Lowland Poplar | UM = Upland Mix Forest |
| C = Cedar | L = Lowland Brush | Q = Mixed Swamp Conifer | V = Bog or Marsh |
| D = Treed Bog | LM = Lowland Mix Forest | R = Red Pine | W = White Pine |
| E = Swamp Hardwoods | M = Maple, Beech, Birch | S = Black Spruce | X = Non Stocked |
| F = Spruce/Fir | MC = Mixed Conifer | T = Tamarack | Y = Sand |
| G = Grass | MD = Mixed Deciduous | | Z = Water |
| H = Hemlock | N = Marsh | | |

| Density | |
|-----------------------------|------------------------|
| 0 = Non Stocked | 5 = Pole Timber Medium |
| 1 = Seedling Sapling Poor | 6 = Pole Timber Well |
| 2 = Seedling Sapling Medium | 7 = Saw Timber Poor |
| 3 = Seedling Sapling Well | 8 = Saw Timber Medium |
| 4 = Pole Timber Poor | 9 = Saw Timber Well |

| PU # | Acres | PU # | Acres |
|------|-------|------|-------|
| 1 | 2.5 | 5 | 25.1 |
| 2 | 6.8 | 6 | 10.5 |
| 3 | 18 | 7 | 27.9 |
| 4 | 22.2 | | |

Mae Mae Mix

Acres 113

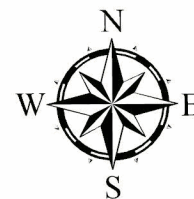

0 0.38 0.75 1.5 Miles

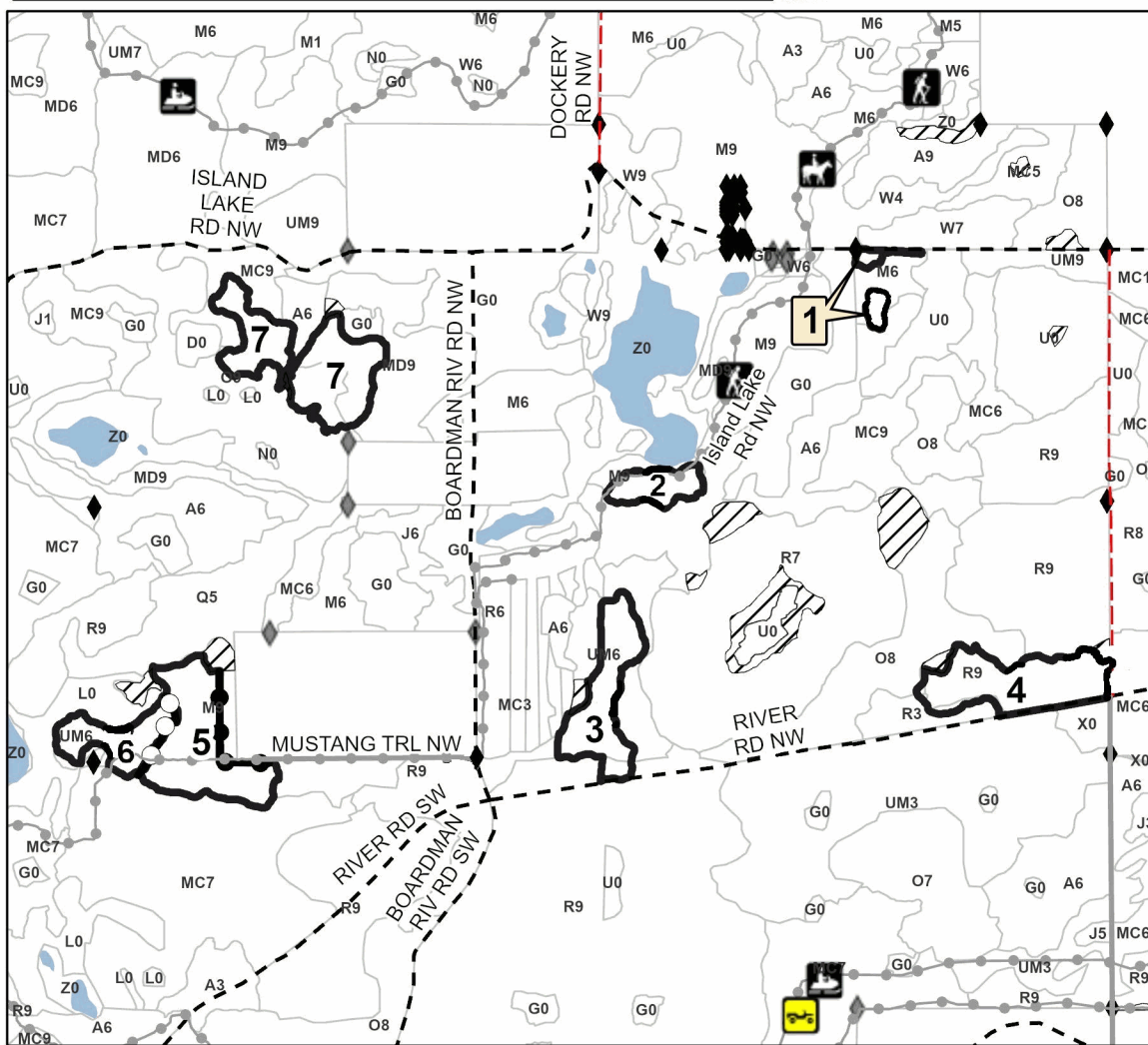

| Legend | |
|--------|------------------------|
| | Against State (Red) |
| | Payment Unit (Yellow) |
| | Private Line (Blue) |
| | Stand |
| | Retention Areas |
| | Recreational Trail |
| | Gravel Road |
| | County Road - Seasonal |
| | Private Road |
| | Field Grade Corner |
| | Survey Grade Corner |



15 Gallons Hardwood (61-116-24)
T27N, R05W, SEC. 10; T27N, R05W, SEC. 11; T27N, R05W, SEC. 3; Kalkaska

In response to the notice of sale to be held 4:00 p.m. (local time) on August 22, 2024, I am hereby submitting my sealed bid (firm offer) for the following forest products to be cut. Bids for individual species must be at or above the advertised price. All non-responsive bid forms may be rejected.

| <u>PRODUCTS & SPECIES</u> | <u>ESTIMATED VOLUME*</u> | <u>ADVERTISED PRICE</u> | <u>BID PRICE/UNIT</u> |
|-------------------------------|--------------------------|-------------------------|-----------------------|
| Sawtimber | | | |
| Basswood | 21.6 MBF | \$ 97.00/MBF | \$ _____ |
| Beech | 13.0 MBF | \$ 118.00/MBF | \$ _____ |
| Black Cherry | 21.0 MBF | \$ 116.00/MBF | \$ _____ |
| Paper Birch | 1.7 MBF | \$ 37.00/MBF | \$ _____ |
| Red Maple | 92.2 MBF | \$ 103.00/MBF | \$ _____ |
| Red Oak | 11.8 MBF | \$ 119.00/MBF | \$ _____ |
| Sugar Maple | 466.5 MBF | \$ 235.00/MBF | \$ _____ |
| Yellow Birch | 3.4 MBF | \$ 71.00/MBF | \$ _____ |
| Pulpwood | | | |
| B. T. Aspen | 21 Cords | \$ 16.40/Cord | \$ _____ |
| Mixed Hardwood | 2,007 Cords | \$ 16.65/Cord | \$ _____ |

*The volumes are statistically estimated within plus (+) or minus (-) 9.89 percent at 95% confidence level. These estimated volumes are final and not subject to adjustment. Prospective bidders are urged to examine this timber and to make their own estimates of quantity and quality.

I understand that any or all bids may be rejected. All bids must be signed and all bid items must be bid or the bid form may be rejected. I also understand that consideration and awarding a contract will be based upon my past performance and ability to complete the contract based upon equipment and staffing subject to my control.

FEDERAL ID: _____ or SOCIAL SECURITY NUMBER: _____

Company or individual bidding: _____

Company representative's name: _____

Address: _____

City: _____ State: _____ Zip: _____

IF AVAILABLE, PLEASE PLACE THE PERSONALIZED LABEL FROM YOUR PROSPECTUS IN THE ABOVE BOX.

Individual or company representative's signature: _____ Date: _____

Phone number : _____ Email (optional): _____

THE WINNING BIDDER MUST COMPLETE THE VERIFICATION OF WORKER'S DISABILITY COMPENSATION ACT COMPLIANCE (ON REVERSE SIDE IF DOUBLE SIDED) WITHIN 21 DAYS OF SALE AWARD DATE

Over Baited Hardwoods (61-117-24)
T27N, R05W, SEC. 11; T27N, R05W, SEC. 2; Kalkaska COUNTY

In response to the notice of sale to be held 4:00 p.m. (local time) on August 22, 2024, I am hereby submitting my sealed bid (firm offer) for the following forest products to be cut. Bids for individual species must be at or above the advertised price. All non-responsive bid forms may be rejected.

| <u>PRODUCTS & SPECIES</u> | <u>ESTIMATED VOLUME*</u> | <u>ADVERTISED PRICE</u> | <u>BID PRICE/UNIT</u> |
|-------------------------------|--------------------------|-------------------------|-----------------------|
| Sawtimber | | | |
| Beech | 6.4 MBF | \$ 148.00/MBF | \$ _____ |
| Black Cherry | 7.3 MBF | \$ 145.00/MBF | \$ _____ |
| Red Maple | 142.9 MBF | \$ 129.00/MBF | \$ _____ |
| Red Oak | 6.2 MBF | \$ 149.00/MBF | \$ _____ |
| Sugar Maple | 269.3 MBF | \$ 294.00/MBF | \$ _____ |
| Pulpwood | | | |
| Mixed Hardwood | 1,297 Cords | \$ 20.80/Cord | \$ _____ |
| Red Oak | 20 Cords | \$ 29.50/Cord | \$ _____ |

*The volumes are statistically estimated within plus (+) or minus (-) 12.32 percent at 95% confidence level. These estimated volumes are final and not subject to adjustment. Prospective bidders are urged to examine this timber and to make their own estimates of quantity and quality.

I understand that any or all bids may be rejected. All bids must be signed and all bid items must be bid or the bid form may be rejected. I also understand that consideration and awarding a contract will be based upon my past performance and ability to complete the contract based upon equipment and staffing subject to my control.

FEDERAL ID: _____ or SOCIAL SECURITY NUMBER: _____

Company or individual bidding: _____

Company representative's name: _____

Address: _____

City: _____ State: _____ Zip: _____

IF AVAILABLE, PLEASE PLACE THE PERSONALIZED LABEL FROM YOUR PROSPECTUS IN THE ABOVE BOX.

Individual or company representative's signature: _____ Date: _____

Phone number : _____ Email (optional): _____

THE WINNING BIDDER MUST COMPLETE THE VERIFICATION OF WORKER'S DISABILITY COMPENSATION ACT COMPLIANCE (ON REVERSE SIDE IF DOUBLE SIDED) WITHIN 21 DAYS OF SALE AWARD DATE



| |
|----------------------------------|
| FOR DEPARTMENT USE ONLY |
| Sale Number (XX - XXX - XX - XX) |
| Forest Management Unit: |

TIMBER SALE VERIFICATION OF WORKER'S DISABILITY COMPENSATION ACT COMPLIANCE

*As required by Act 317, P.A. 1969 (Worker's Compensation) and
Part 5 of Act 451 of 1994, as amended.*

VERIFICATION OF WORKER'S DISABILITY COMPENSATION ACT COMPLIANCE

- This verification must be completed and submitted within 21 days of contract award and prior to the issuance of the timber sale contract.
- In addition, if boxes 2B or 2C are checked, then Notice of Exclusion or Certificate of Insurance must be submitted within twenty-one (21) days of the contract award and prior to the issuance of the timber sale contract.
- All information must be typed or printed except for written signatures.

Please Check Appropriate Categories:

1. My business is organized as (you **must** check one of the boxes below):
 - A. Sole Proprietorship (individual)
 - B. Partnership
 - C. Corporation

2. You **must** check one of the boxes below:
 - A. I certify my business is a sole proprietorship and it has no employees but the sole proprietor. I am not subject to the Worker's Compensation Laws.
 - B. I certify my business has satisfied its obligation to the Worker's Compensation Act through the use of an approved Notice of Exclusion (BWC-337, Rev. 5/96). I will provide a copy of the Notice of Exclusion within 21 days of the contract award. (For questions or a copy of the BWC-337, please call the Worker's Compensation Bureau at 517-322-1195).
 - C. I certify my business has a Worker's Compensation Policy. I will provide an original Certificate of Insurance within twenty-one (21) days of the contract award.

3. If you have checked item 2(A) or 2(B), you **must** indicate the number of **both** full-time and part-time employees, other than yourself, including family members and active partners (if none, you must enter "0").

_____ Full-time Employees

_____ Part-time Employees

| | | | |
|------------------|-------|-------------------------------------|--|
| Name of Business | | Federal ID (or) Social Security No. | |
| Address | | Telephone () | |
| City | State | ZIP | |

I hereby certify that the above information is true and correct. I agree to notify the Michigan DNR of any changes that occur in factors affecting my coverage during any of my present and future operations.

Signature of Owner or Authorized Representative

Title

Date

Please complete the "SEALED BID" information on the next page

Mae Mae Mix (61-123-24)

T27N, R08W, SEC. 16; T27N, R08W, SEC. 19; T27N, R08W, SEC. 20; T27N,

In response to the notice of sale to be held 4:00 p.m. (local time) on August 22, 2024, I am hereby submitting my sealed bid (firm offer) for the following forest products to be cut. Bids for individual species must be at or above the advertised price. All non-responsive bid forms may be rejected.

| <u>PRODUCTS & SPECIES</u> | <u>ESTIMATED VOLUME*</u> | <u>ADVERTISED PRICE</u> | <u>BID PRICE/UNIT</u> |
|-------------------------------|--------------------------|-------------------------|-----------------------|
| Sawtimber | | | |
| Basswood | 27.5 MBF | \$ 121.00/MBF | \$ _____ |
| Red Maple | 3.3 MBF | \$ 129.00/MBF | \$ _____ |
| Red Oak | 86.4 MBF | \$ 149.00/MBF | \$ _____ |
| Red Pine | 231.6 MBF | \$ 125.00/MBF | \$ _____ |
| Sugar Maple | 21.9 MBF | \$ 294.00/MBF | \$ _____ |
| White Pine | 67.7 MBF | \$ 87.00/MBF | \$ _____ |
| Pulpwood | | | |
| B. T. Aspen | 242 Cords | \$ 20.50/Cord | \$ _____ |
| Basswood | 61 Cords | \$ 11.85/Cord | \$ _____ |
| Hemlock | 6 Cords | \$ 8.65/Cord | \$ _____ |
| Jack Pine | 13 Cords | \$ 20.65/Cord | \$ _____ |
| Mixed Hardwood | 527 Cords | \$ 20.80/Cord | \$ _____ |
| Paper Birch | 28 Cords | \$ 16.45/Cord | \$ _____ |
| Red Oak | 247 Cords | \$ 29.50/Cord | \$ _____ |
| Red Pine | 258 Cords | \$ 50.25/Cord | \$ _____ |
| White Pine | 264 Cords | \$ 23.50/Cord | \$ _____ |

*The volumes are statistically estimated within plus (+) or minus (-) 16.04 percent at 95% confidence level. These estimated volumes are final and not subject to adjustment. Prospective bidders are urged to examine this timber and to make their own estimates of quantity and quality.

I understand that any or all bids may be rejected. All bids must be signed and all bid items must be bid or the bid form may be rejected. I also understand that consideration and awarding a contract will be based upon my past performance and ability to complete the contract based upon equipment and staffing subject to my control.

FEDERAL ID: ____ - ____ - ____ or SOCIAL SECURITY NUMBER: ____ - ____ - ____

Company or individual bidding: _____

Company representative's name: _____

Address: _____

City: _____ State: _____ Zip: _____

IF AVAILABLE, PLEASE PLACE THE PERSONALIZED LABEL FROM YOUR PROSPECTUS IN THE ABOVE BOX.

Individual or company representative's signature: _____ Date: _____

Phone number : _____ Email (optional): _____

THE WINNING BIDDER MUST COMPLETE THE VERIFICATION OF WORKER'S DISABILITY COMPENSATION ACT COMPLIANCE (ON REVERSE SIDE IF DOUBLE SIDED) WITHIN 21 DAYS OF SALE AWARD DATE



TIMBER SALE VERIFICATION OF WORKER'S DISABILITY COMPENSATION ACT COMPLIANCE

As required by Act 317, P.A. 1969 (Worker's Compensation) and
Part 5 of Act 451 of 1994, as amended.

| FOR DEPARTMENT USE ONLY | |
|----------------------------------|--|
| Sale Number (XX - XXX - XX - XX) | |
| Forest Management Unit: | |

VERIFICATION OF WORKER'S DISABILITY COMPENSATION ACT COMPLIANCE

- This verification must be completed and submitted within 21 days of contract award and prior to the issuance of the timber sale contract.
- In addition, if boxes 2B or 2C are checked, then Notice of Exclusion or Certificate of Insurance must be submitted within twenty-one (21) days of the contract award and prior to the issuance of the timber sale contract.
- All information must be typed or printed except for written signatures.

Please Check Appropriate Categories:

1. My business is organized as (you **must** check one of the boxes below):
 - A. Sole Proprietorship (individual)
 - B. Partnership
 - C. Corporation
2. You **must** check one of the boxes below:
 - A. I certify my business is a sole proprietorship and it has no employees but the sole proprietor. I am not subject to the Worker's Compensation Laws.
 - B. I certify my business has satisfied its obligation to the Worker's Compensation Act through the use of an approved Notice of Exclusion (BWC-337, Rev. 5/96). I will provide a copy of the Notice of Exclusion within 21 days of the contract award. (For questions or a copy of the BWC-337, please call the Worker's Compensation Bureau at 517-322-1195).
 - C. I certify my business has a Worker's Compensation Policy. I will provide an original Certificate of Insurance within twenty-one (21) days of the contract award.
3. If you have checked item 2(A) or 2(B), you **must** indicate the number of **both** full-time and part-time employees, other than yourself, including family members and active partners (if none, you must enter "0").

_____ Full-time Employees

_____ Part-time Employees

| | | | |
|------------------|-------|-------------------------------------|--|
| Name of Business | | Federal ID (or) Social Security No. | |
| Address | | Telephone () | |
| City | State | ZIP | |

I hereby certify that the above information is true and correct. I agree to notify the Michigan DNR of any changes that occur in factors affecting my coverage during any of my present and future operations.

Signature of Owner or Authorized Representative

Title

Date

Please complete the "SEALED BID" information on the next page

Lone Wolf (61-119-24)

T27N, R07W, SEC. 7; T27N, R07W, SEC. 8; T27N, R07W, SEC. 9; Kalkaska

In response to the notice of sale to be held 4:00 p.m. (local time) on August 22, 2024, I am hereby submitting my sealed bid (firm offer) for the following forest products to be cut. Bids for individual species must be at or above the advertised price. All non-responsive bid forms may be rejected.

| <u>PRODUCTS & SPECIES</u> | <u>ESTIMATED VOLUME*</u> | <u>ADVERTISED PRICE</u> | <u>BID PRICE/UNIT</u> |
|-------------------------------|--------------------------|-------------------------|-----------------------|
| Sawtimber | | | |
| Red Maple | 4.4 MBF | \$ 129.00/MBF | \$ _____ |
| Red Oak | 19.2 MBF | \$ 149.00/MBF | \$ _____ |
| Red Pine | 61.1 MBF | \$ 125.00/MBF | \$ _____ |
| White Pine | 5.2 MBF | \$ 87.00/MBF | \$ _____ |
| Pulpwood | | | |
| B. T. Aspen | 166 Cords | \$ 20.50/Cord | \$ _____ |
| Balsam Fir | 15 Cords | \$ 22.70/Cord | \$ _____ |
| Jack Pine | 39 Cords | \$ 20.65/Cord | \$ _____ |
| Mixed Hardwood | 390 Cords | \$ 20.80/Cord | \$ _____ |
| Red Oak | 57 Cords | \$ 29.50/Cord | \$ _____ |
| Red Pine | 108 Cords | \$ 50.25/Cord | \$ _____ |
| White Pine | 32 Cords | \$ 23.50/Cord | \$ _____ |

*The volumes are statistically estimated within plus (+) or minus (-) 22.25 percent at 95% confidence level. These estimated volumes are final and not subject to adjustment. Prospective bidders are urged to examine this timber and to make their own estimates of quantity and quality.

I understand that any or all bids may be rejected. All bids must be signed and all bid items must be bid or the bid form may be rejected. I also understand that consideration and awarding a contract will be based upon my past performance and ability to complete the contract based upon equipment and staffing subject to my control.

FEDERAL ID: _____ - _____ or SOCIAL SECURITY NUMBER: _____ - _____ - _____

Company or individual bidding: _____

Company representative's name: _____

Address: _____

City: _____ State: _____ Zip: _____

IF AVAILABLE, PLEASE PLACE THE PERSONALIZED LABEL FROM YOUR PROSPECTUS IN THE ABOVE BOX.

Individual or company representative's signature: _____ Date: _____

Phone number : _____ Email (optional): _____

THE WINNING BIDDER MUST COMPLETE THE VERIFICATION OF WORKER'S DISABILITY COMPENSATION ACT COMPLIANCE (ON REVERSE SIDE IF DOUBLE SIDED) WITHIN 21 DAYS OF SALE AWARD DATE



| |
|----------------------------------|
| FOR DEPARTMENT USE ONLY |
| Sale Number (XX - XXX - XX - XX) |
| Forest Management Unit: |

TIMBER SALE VERIFICATION OF WORKER'S DISABILITY COMPENSATION ACT COMPLIANCE

*As required by Act 317, P.A. 1969 (Worker's Compensation) and
Part 5 of Act 451 of 1994, as amended.*

VERIFICATION OF WORKER'S DISABILITY COMPENSATION ACT COMPLIANCE

- This verification must be completed and submitted within 21 days of contract award and prior to the issuance of the timber sale contract.
- In addition, if boxes 2B or 2C are checked, then Notice of Exclusion or Certificate of Insurance must be submitted within twenty-one (21) days of the contract award and prior to the issuance of the timber sale contract.
- All information must be typed or printed except for written signatures.

Please Check Appropriate Categories:

1. My business is organized as (you **must** check one of the boxes below):
 - A. Sole Proprietorship (individual)
 - B. Partnership
 - C. Corporation
2. You **must** check one of the boxes below:
 - A. I certify my business is a sole proprietorship and it has no employees but the sole proprietor. I am not subject to the Worker's Compensation Laws.
 - B. I certify my business has satisfied its obligation to the Worker's Compensation Act through the use of an approved Notice of Exclusion (BWC-337, Rev. 5/96). I will provide a copy of the Notice of Exclusion within 21 days of the contract award. (For questions or a copy of the BWC-337, please call the Worker's Compensation Bureau at 517-322-1195).
 - C. I certify my business has a Worker's Compensation Policy. I will provide an original Certificate of Insurance within twenty-one (21) days of the contract award.
3. If you have checked item 2(A) or 2(B), you **must** indicate the number of **both** full-time and part-time employees, other than yourself, including family members and active partners (if none, you must enter "0").

_____ Full-time Employees

_____ Part-time Employees

| | | | |
|------------------|-------|-------------------------------------|--|
| Name of Business | | Federal ID (or) Social Security No. | |
| Address | | Telephone () | |
| City | State | ZIP | |

I hereby certify that the above information is true and correct. I agree to notify the Michigan DNR of any changes that occur in factors affecting my coverage during any of my present and future operations.

Signature of Owner or Authorized Representative

Title

Date

Please complete the "SEALED BID" information on the next page

Strait Row Red (61-029-24)
T25N, R11W, SEC. 35; T25N, R11W, SEC. 36; Grand Traverse COUNTY

In response to the notice of sale to be held 4:00 p.m. (local time) on August 22, 2024, I am hereby submitting my sealed bid (firm offer) for the following forest products to be cut. Bids for individual species must be at or above the advertised price. All non-responsive bid forms may be rejected.

| <u>PRODUCTS & SPECIES</u> | <u>ESTIMATED VOLUME*</u> | <u>ADVERTISED PRICE</u> | <u>BID PRICE/UNIT</u> |
|-------------------------------|--------------------------|-------------------------|-----------------------|
| Sawtimber | | | |
| Red Pine | 95.0 MBF | \$ 125.00/MBF | \$ _____ |
| Pulpwood | | | |
| Mixed Hardwood | 38 Cords | \$ 20.80/Cord | \$ _____ |
| Quaking Aspen | 71 Cords | \$ 20.50/Cord | \$ _____ |
| Red Pine | 1,277 Cords | \$ 50.25/Cord | \$ _____ |

*The volumes are statistically estimated within plus (+) or minus (-) 12.34 percent at 95% confidence level. These estimated volumes are final and not subject to adjustment. Prospective bidders are urged to examine this timber and to make their own estimates of quantity and quality.

I understand that any or all bids may be rejected. All bids must be signed and all bid items must be bid or the bid form may be rejected. I also understand that consideration and awarding a contract will be based upon my past performance and ability to complete the contract based upon equipment and staffing subject to my control.

FEDERAL ID: _____ - _____ or SOCIAL SECURITY NUMBER: _____ - _____ - _____
 Company or individual bidding: _____
 Company representative's name: _____
 Address: _____
 City: _____ State: _____ Zip: _____

IF AVAILABLE, PLEASE PLACE THE PERSONALIZED LABEL FROM YOUR PROSPECTUS IN THE ABOVE BOX.

Individual or company representative's signature: _____ Date: _____

Phone number : _____ Email (optional): _____

THE WINNING BIDDER MUST COMPLETE THE VERIFICATION OF WORKER'S DISABILITY COMPENSATION ACT COMPLIANCE (ON REVERSE SIDE IF DOUBLE SIDED) WITHIN 21 DAYS OF SALE AWARD DATE



| |
|----------------------------------|
| FOR DEPARTMENT USE ONLY |
| Sale Number (XX - XXX - XX - XX) |
| Forest Management Unit: |

TIMBER SALE VERIFICATION OF WORKER'S DISABILITY COMPENSATION ACT COMPLIANCE

*As required by Act 317, P.A. 1969 (Worker's Compensation) and
Part 5 of Act 451 of 1994, as amended.*

VERIFICATION OF WORKER'S DISABILITY COMPENSATION ACT COMPLIANCE

- This verification must be completed and submitted within 21 days of contract award and prior to the issuance of the timber sale contract.
- In addition, if boxes 2B or 2C are checked, then Notice of Exclusion or Certificate of Insurance must be submitted within twenty-one (21) days of the contract award and prior to the issuance of the timber sale contract.
- All information must be typed or printed except for written signatures.

Please Check Appropriate Categories:

1. My business is organized as (you **must** check one of the boxes below):
 - A. Sole Proprietorship (individual)
 - B. Partnership
 - C. Corporation
2. You **must** check one of the boxes below:
 - A. I certify my business is a sole proprietorship and it has no employees but the sole proprietor. I am not subject to the Worker's Compensation Laws.
 - B. I certify my business has satisfied its obligation to the Worker's Compensation Act through the use of an approved Notice of Exclusion (BWC-337, Rev. 5/96). I will provide a copy of the Notice of Exclusion within 21 days of the contract award. (For questions or a copy of the BWC-337, please call the Worker's Compensation Bureau at 517-322-1195).
 - C. I certify my business has a Worker's Compensation Policy. I will provide an original Certificate of Insurance within twenty-one (21) days of the contract award.
3. If you have checked item 2(A) or 2(B), you **must** indicate the number of **both** full-time and part-time employees, other than yourself, including family members and active partners (if none, you must enter "0").

_____ Full-time Employees

_____ Part-time Employees

| | | | |
|------------------|-------|-------------------------------------|--|
| Name of Business | | Federal ID (or) Social Security No. | |
| Address | | Telephone () | |
| City | State | ZIP | |

I hereby certify that the above information is true and correct. I agree to notify the Michigan DNR of any changes that occur in factors affecting my coverage during any of my present and future operations.

Signature of Owner or Authorized Representative

Title

Date

Please complete the "SEALED BID" information on the next page