

INSTITUTE FOR FISHERIES RESEARCH  
 DIVISION OF FISHERIES MICHIGAN CONSERVATION DEPT.  
 LAKE INVENTORY MAP  
**KING LAKE**  
 AREA 29.5 ACRES  
 MARGINAL SURVEY AND SOUNDINGS 3/4 /43  
 HILLSDALE COUNTY T.6,7S,R.3 W, SEC.3,34

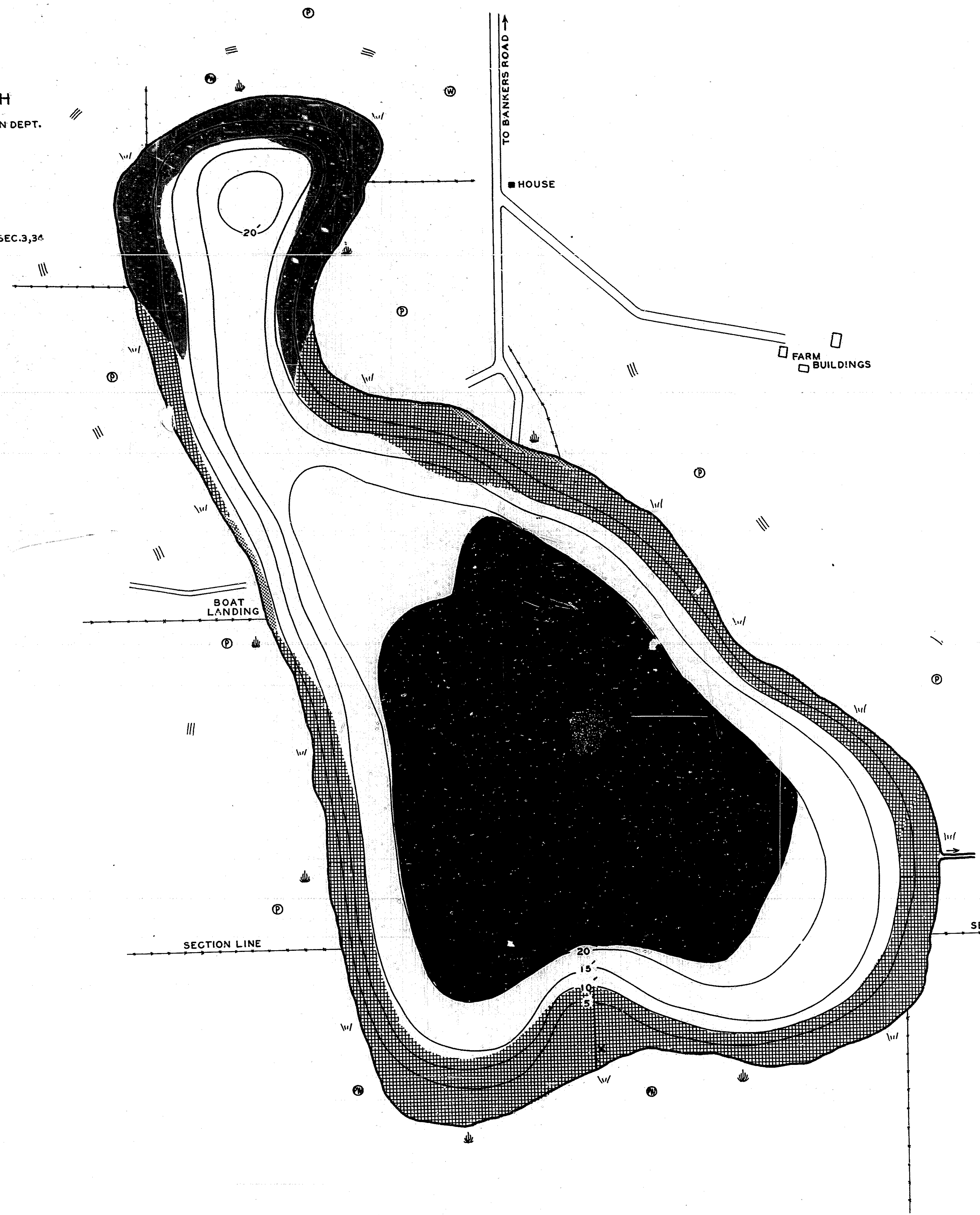

- LEGEND**
- BOTTOM**
- Sand
  - Pulpy peat
  - Pulpy peat and Marl
  - Fibrous peat
  - Fibrous peat and Marl
  - Muck
- OUTLINE & CONTOURS**
- Shoreline
  - Contours
- SHORE FEATURES**
- Road
  - Dock
  - Slope
  - Fence
  - Trash
  - Marsh
  - Brush
  - Wooded
  - Partly wooded
  - Pasture
  - Outlet

