

MICHIGAN DEPARTMENT OF NATURAL RESOURCES
JAMES LAKE

AREA 212 ACRES
 IRON COUNTY T. 44 N., R. 37 W., SECS. 14, 15, 22, 23
 SURVEY AND SOUNDINGS DEC. 20, 1971 TO JAN. 18, 1972

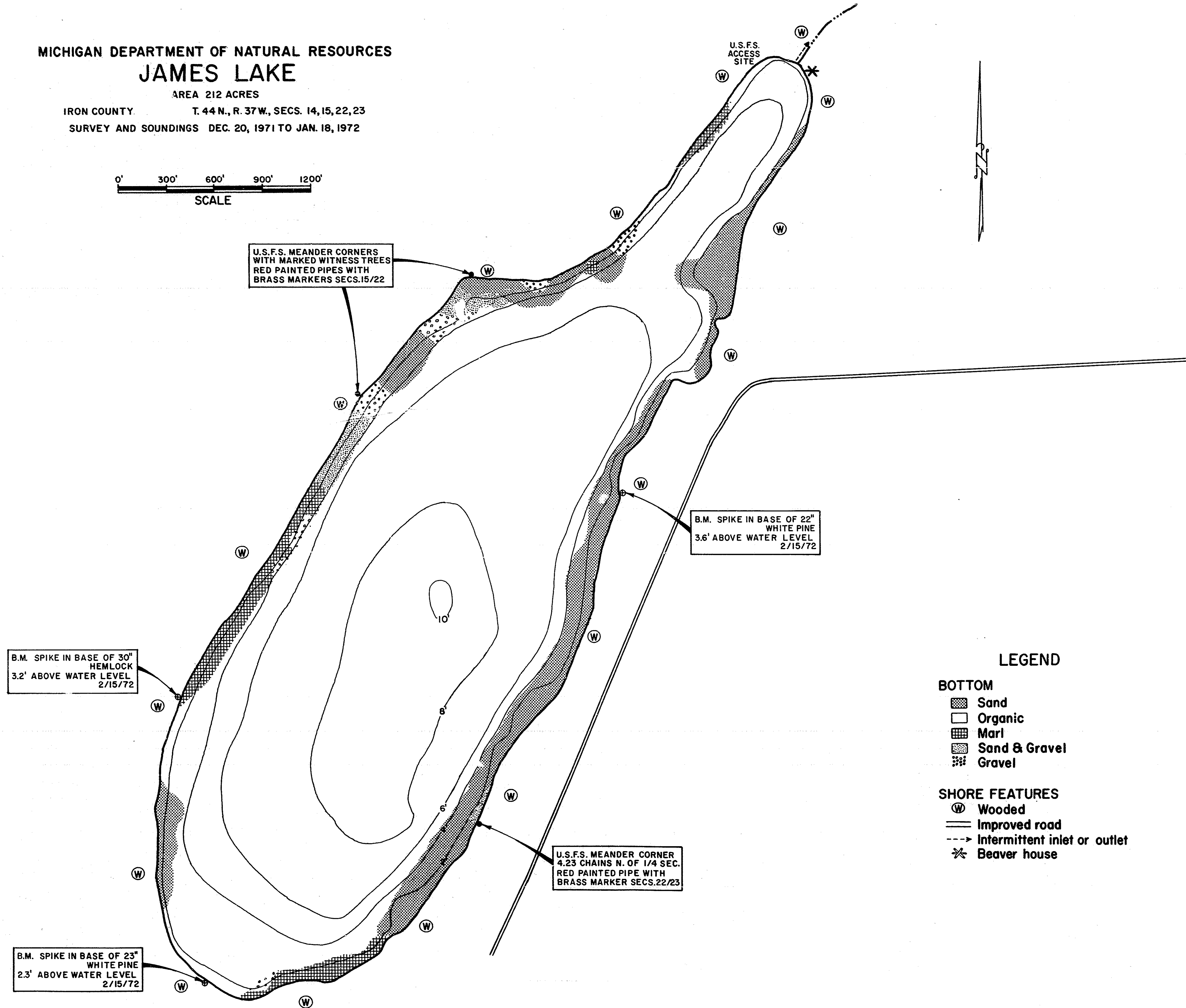
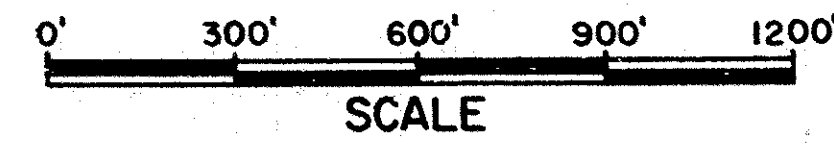

U.S.F.S. MEANDER CORNERS
 WITH MARKED WITNESS TREES
 RED PAINTED PIPES WITH
 BRASS MARKERS SECS.15/22

B.M. SPIKE IN BASE OF 22"
 WHITE PINE
 3.6' ABOVE WATER LEVEL
 2/15/72

B.M. SPIKE IN BASE OF 30"
 HEMLOCK
 3.2' ABOVE WATER LEVEL
 2/15/72

U.S.F.S. MEANDER CORNER
 4.23 CHAINS N. OF 1/4 SEC.
 RED PAINTED PIPE WITH
 BRASS MARKER SECS.22/23

B.M. SPIKE IN BASE OF 23"
 WHITE PINE
 2.3' ABOVE WATER LEVEL
 2/15/72

LEGEND

BOTTOM

- Sand
- Organic
- Marl
- Sand & Gravel
- Gravel

SHORE FEATURES

- Wooded
- Improved road
- Intermittent inlet or outlet
- Beaver house