

INSTITUTE FOR FISHERIES RESEARCH
 DIVISION OF FISHERIES MICHIGAN CONSERVATION DEPT.

LAKE INVENTORY MAP
MEAD LAKE
 AREA 20.8 ACRES

MARGINAL SURVEY AND SOUNDINGS 3/23/40

KENT COUNTY

T. 8 N., R. 11-12 W., SEC. 7, 12

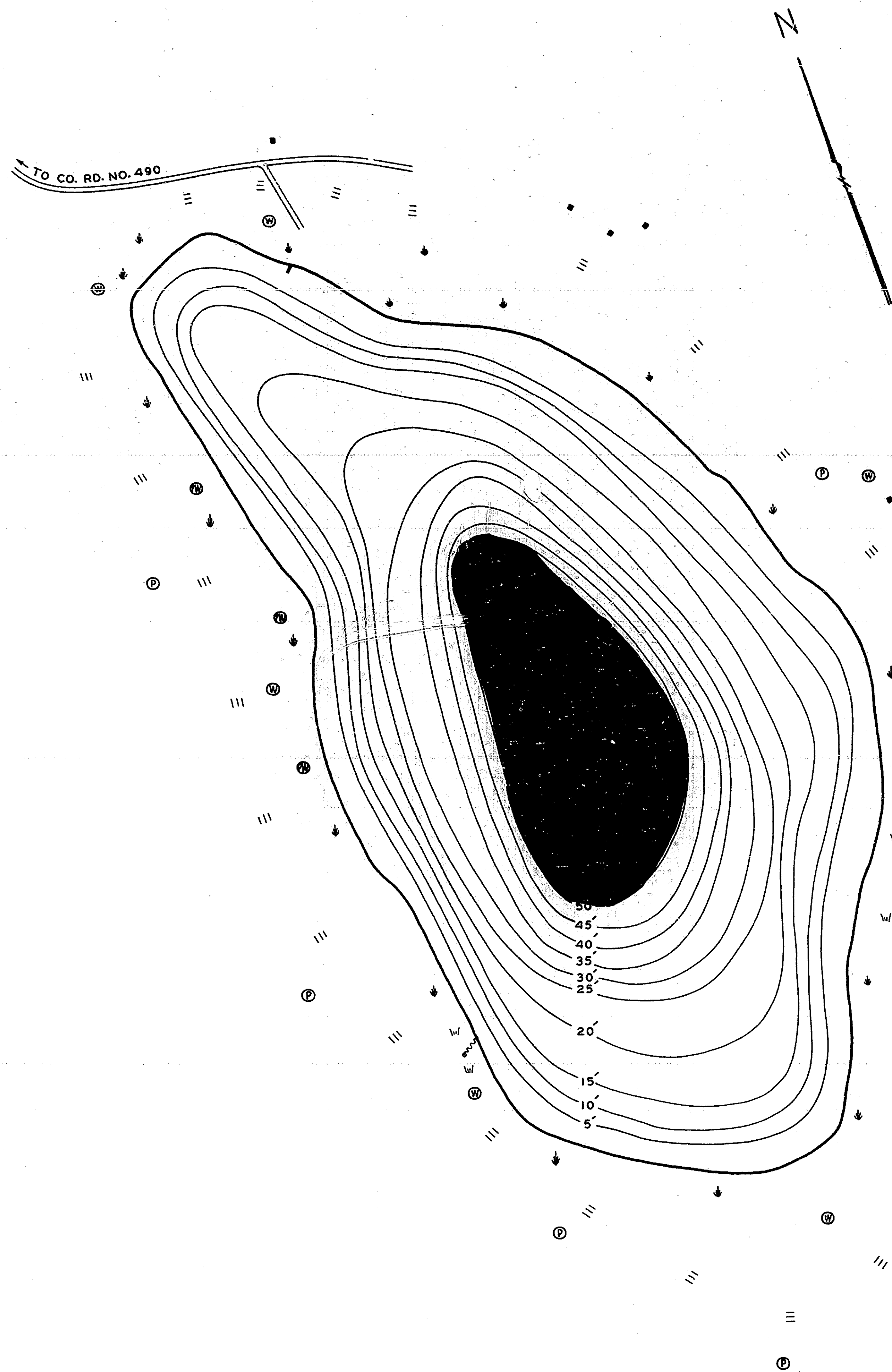

LEGEND

- BOTTOM**
- Pulpy peat
 - Muck
- OUTLINE & CONTOURS**
- Shoreline
 - Contours
- SHORE FEATURES**
- Cottage
 - ⊥ Dock
 - ⊙ Spring
 - ||| Slope
 - == Road
 - ~ Marsh
 - ↓ Brush
 - ⊙ Wooded
 - ⊙ Partly wooded
 - ⊙ Pasture

